

3483

4-679

BOOK 3483

Book "E"

SEP. 12 1921

FIELD NOTES

OF THE RESURVEY OF THE

Second Standard Parallel South through part of Range 25 East,

and of the East boundary of

Township 11 South, Range 25 East,

AND OF THE SURVEY OF

part of the Subdivision lines of

Township 11 South, Range 25 East,

Of the Gila and Salt River Base and Meridian,

In the State of Arizona,

EXECUTED BY

Guy R. Veal, and

Karl L. Siebecker,

U. S. Transitmen,

In the capacity of U. S. Surveyors, under Special Instructions dated October 6, 1919,

issued by the United States Surveyor General to govern surveys included in Group

No. 102, Arizona, which were approved by the Commissioner of the General Land

Office, October 24, 1919, and Assignment Instructions dated Nov. 4 & 18, 1919

Resurvey and Survey commenced February 28, 1920

Resurvey and Survey completed March 8, 1920

3483

3483

1A

BOOK 3483



Book "E"

Group 102 - - Arizona.

BOOK 3483

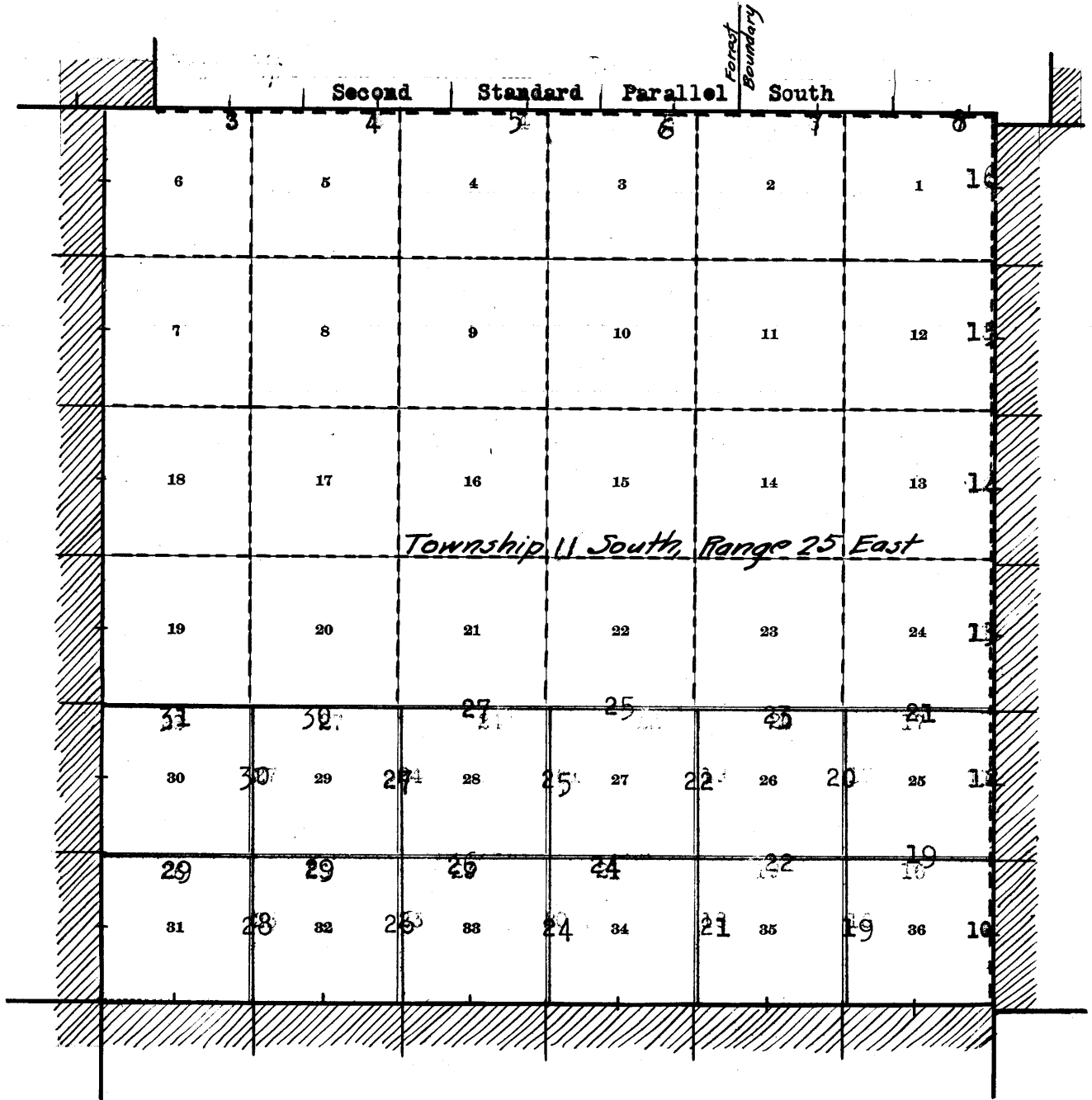
INDEX DIAGRAM.

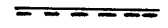
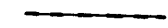

-  Lines surveyed under this Group.
-  Lines resurveyed under this Group.
-  Unsurveyed
-  Accepted surveys
-  Areas surveyed as per accepted plats on file.

Resurveys and surveys hereinafter described executed by Guy R. Veal and Karl L. Siebecker, U. S. Transitmen, on dates shown on diagram on page 1 hereof, using respectively Buff solar transit No. 9939 and Young and Sons' light mountain transit No. 8522, described with certificate of approval by the Assistant Supervisor of Surveys in Book "A".

We examine the adjustments of the transits and correct all errors; then, to test the solar apparatus, by comparing their indications, resulting from solar observations made during a.m. and p.m. hours, with a meridian determined by observations on Polaris at elongation, we proceed as follows:

Feb. 28, 1920. At our camp in sec. 13, T. 11 S., R. 25 E., G. and S. R. B. and M., lat. $32^{\circ}28\frac{1}{2}'$ N., long. $109^{\circ}43\frac{1}{2}'$ W., at 8 hrs. 57.8 m., p.m., l.m.t., by our watches, which are set to correct local mean time, we observe Polaris at western elongation, in accordance with the Manual of Instructions, and mark a point in the line thus determined by a tack driven in a stake, 5 chs. N. of our station.

Feb. 29, 1920. We lay off the azimuth of Polaris, $1^{\circ}19\frac{1}{2}'$ to the east, and mark the true meridian thus determined by a tack in a stake, firmly driven in the ground, 5 chs. N. of our station.

At 9 hrs. 0 m., a.m., l.m.t., we set off $32^{\circ}28\frac{1}{2}'$ N. on the lat. arcs; $7^{\circ}52\frac{1}{2}'$ S. on the decl. arcs; and determine a meridian with each solar, which in each case agrees with the true meridian.

At apparent noon, with the lat. arcs unchanged, we observe the sun on the meridian with each solar; the resulting decl. with each solar is $7^{\circ}50'$ S., which is the computed decl. of the sun.

At 3 hrs. 0 m., p.m., l.m.t., with the lat. arcs unchanged, we set off $7^{\circ}46\frac{1}{2}'$ S. on the decl. arcs; and determine a meridian with each solar, which in each case agrees with the true-meridian.

As all of the solar observations during the usual hours of solar work come within $1'30''$ of the true meridian, we conclude that the adjustments of the instruments are satisfactory.

Unless otherwise specified, all measurements are made with a Lufkin steel tape 5 chs. in length, compared with a Chesterman standard steel tape and found correct. The measurements are made on the slope, the vertical angles determined and the slope measurements properly reduced to true horizontal distances.

Chains

The 2nd Standard Parallel South, thru Range 24 E., was surveyed in 1875 by Theo. F. White, U. S. D. S.
 The Parallel thru Rs. 25 and 26 E. was surveyed in 1884, by J. B. McLaughlin, U. S. D. S.
 In 1903, W. H. Thorn, U. S. S. retraced the Parallel from the standard $\frac{1}{4}$ sec. cor. of sec. 35, T. 10 S., R. 24 E. to the standard cor. of secs. 34 and 35, T. 10 S., R. 25 E., and at the latter cor., set an iron post with brass cap, for Forest Reserve Bdy. Post No. 1.
 In 1913, Thomas B. Matthews, U. S. resurveyed the Parallel thru the E. $2\frac{1}{2}$ miles of R. 24 E., reestablishing the cors. with iron posts with brass caps, including the std. cor. of Ts. 10 S., Rs. 24 and 25 E.
 In 1917, Quintin Campbell, U. S. T., in connection with the subdivision of T. 11 S., R. 26 E., independently resurveyed the parallel thru R. 26 E., reestablished the standard cor. of Ts. 10 S., Rs. 25 and 26 E., and extended the Parallel West 28.41 chs. on S. bdy. of sec. 36, T. 10 S., R. 25 E. to intersection with W. bdy. of T. 11 S., R. 26 E., surveyed due North, at which point of intersection he established closing cor. of Ts. 11 S., Rs. 25 and 26 E.
 The following notes describe an independent resurvey of the Parallel from the standard cor. of Ts. 10 S., Rs. 24 and 25 E., east to a point N. of the Campbell closing cor. of Ts. 11 S., Rs. 25 and 26 E., where the NE. cor. of T. 11 S., R. 25 E. is established.

The standard cor. of Ts. 10 S., Rs. 24 and 25 E. reestablished by Thomas B. Matthews, U. S. S. in 1913 is an iron post, 3 ins. in diam., projecting 12 ins. above ground, firmly set, properly marked on brass cap, and witnessed by a mound of stone, N. of cor. No bearing trees.

Thence,
 East, on a true line, on S. bdy. of sec. 31.
 Over mountainous land, thru scattering undergrowth.
 Ascend 380 ft.

- 14.00 Spur, slopes S. Descend 290 ft., over SE. slope
- 29.00 Canyon, course S. Ascend 215 ft.
- 39.11 Fall 58 lks. S. of the original standard $\frac{1}{4}$ sec. cor. of sec. 31, which is a granite stone, 12 x 6 x 36 ins., firmly set in a mound of stone, marked "SC $\frac{1}{4}$ " on N. face, and witnessed by a mound of stone, N. of cor. No bearing trees.
- 40.00 Destroy all trace of this cor.
- 40.00 Set an iron post, 3 ft. long, 1 in. in diam., 26 ins. in the ground, for reestablished standard $\frac{1}{4}$ sec. cor. of sec. 31, with brass cap, marked

S C
~~TS~~ 31

1920

Raise a mound of stone, 2 ft. base, $1\frac{1}{2}$ ft. high, N. of cor.

- 40.30 From this cor., Hay's ranch house, brs. S. $5^{\circ} 46'$ E.
- 60.00 Four wire fence, brs. NE. and SW. Ascend 260 ft.
- 60.00 Spur, slopes SW. Descend 185 ft., over NE. slope.
- 60.20 From this point, Hays' ranch house, brs. S. $3^{\circ} 5'$ W.
- 68.00 Gulch, course SE. Descend 220 ft.
- 78.00 Canyon, course SW., with wash carrying stream of water 5 lks. wide, 3 ins. deep, course SW. from E. Thence in wash, course W.

Independent Resurvey of 2nd Std. Par. S., thru part of R. 25 E.

Chains

- 78.78 Fall 114 lks. S. of the original standard cor. of secs. 31 and 32, which is a granite stone, 8 x 10 x 14 ins., firmly set in a mound of stone, marked "SC" on N. face, 1 notch on W. edge, 5 notches on E. edge, and witnessed by a mound of stone, N. of cor. No bearing trees. Destroy all trace of this cor.
- 80.00 The true point for reestablished standard cor. of secs. 31 and 32 falls in wash, course W. from NE. Impracticable to monument the cor. at this point; therefore, set witness cor. as hereinafter described.
- Land, mountainous.
Soil, rocky, 4th rate.
No timber.
Undergrowth, cedar, juniper and cactus.

- From reestablished true point for std. cor. of secs. 31 and 32,
East, on a true line, on S. bdy. of sec. 32.
Over mountainous land, thru scattering undergrowth.
Leave bottom of canyon and wash, and ascend slightly to
- 0.96 Set an iron post, 3 ft. long, 2 ins. in diam., 27 ins. in the ground, for witness cor. to reestablished standard cor. of secs. 31 and 32, marked on brass cap

	S	:	C	
T 10 S		R 25 E		
S 31		S 32		
WC				
				1920

from which;

A juniper, 12 ins. in diam., brs. N. 18° E., 104 lks. dist., mark "WC SC T 10 S R 25 E S 32 BT."

A black oak, 10 ins. in diam., brs. N. 79° W., 46 lks. dist., mark "WC SC T 10 S R 25 E S 31 BT."

- And raise a mound of stone, 2 ft. base, 1½ ft. high, N. of cor.
Ascend 165 ft.
- 14.00 Spur, slopes SE. Descend 160 ft.
- 29.00 Draw, course SE. Ascend 160 ft.
- 38.21 Fall 128 lks. S. of the original standard ¼ sec. cor. of sec. 32, which is a granite stone, 14 x 4 x 20 ins. above ground, firmly set in a mound of stone, marked "SC¼" on N. face, and witnessed by a mound of stone, N. of cor. No bearing trees. Destroy all trace of this cor.
- 40.00 Set an iron post, 3 ft. long, 1 in. in diam., 20 ins. in the ground, deposit marked (X) stone, and raise a mound of stone around post for reestablished std. ¼ sec. cor. of sec. 32, with brass cap, marked

S	C
¼ S 32	
	1920

Ascend 155 ft.

Independent Resurvey of Second Std. Par. S., thru part of R. 25 E. 5

Chains

- 46.00 Spur, slopes SE. Descend 190 ft.
 54.00 Canyon, course S. Ascend 360 ft., over SW. slope.
 68.00 Spur, slopes SE. Descend 495 ft.
 76.84 Fall 67 lks. S. of the original standard cor. of secs. 32 and 33, which is a granite stone, 8 x 6 x 12 ins. above ground, firmly set, marked "SC" on N. face, 2 notches on W. edge, and 4 notches on E. edge, and witnessed by a mound of stone, N. of cor. No bearing trees. Destroy all trace of this cor.
 80.00 Set an iron post, 3 ft. long, 2 ins. in diam., 27 ins. in the ground, for reestablished standard cor. of secs. 32 and 33, marked on brass cap,

S : C
 T 10 S 1 | R 25 E
 S 32 | S 33
 1920

from which,

A black oak, 10 ins. in diam., brs. N. 69 $\frac{1}{2}$ ° W.,
 107 lks. dist., marked "SC T 10 S R 25 E S
 32 BT."

No other trees within limits. Raise a mound of stone, 2 ft. base, 1 $\frac{1}{2}$ ft. high, N. of cor.

Land mountainous.

Soil, rocky, 4th rate.

No timber.

Undergrowth, scrub oak, cedar and cactus.

- East, on a true line, on S. bdy. of sec. 33.
 Over mountainous land, thru scattering undergrowth.
 Descend 235 ft.
 10.50 Draw, course SE. Descend 315 ft.
 19.00 Road, brs. SE. to Hays' ranch house, and N.
 27.00 Canyon, course NE. Ascend 80 ft.
 33.00 Spur, slopes N. Descend.
 35.00 Draw, course NE. Ascend 55 ft. over NW. slope.
 38.11 Fall 26 lks. S. of the original standard $\frac{1}{4}$ sec. cor. of sec. 33, which is a granite stone, 6 x 4 x 10 ins. above ground, firmly set, marked "SC $\frac{1}{4}$ " on N. face, and witnessed by a mound of stone, N. of cor. No bearing trees. Destroy all trace of this cor.
 40.00 Set an iron post, 3 ft. long, 1 in. in diam., 27 ins. in the ground, for reestablished standard $\frac{1}{4}$ sec. cor. of sec. 33, marked on brass cap,

S C
 $\frac{1}{4}$ S 33
 1920

and raise a mound of stone, 2 ft. base, 1 $\frac{1}{2}$ ft. high, N. of cor.

6 Independent Resurvey of Second Std. Par. North, thru part of R. 25 E.

Chains

- Thence over broken land.
- Descend 25 ft.
- 48.00 Ascend 35 ft.
- 49.00 Descend 80 ft.
- 54.00 Draw, course N. Ascend 55 ft.
- 55.50 Descend 35 ft.
- 59.50 Ascend 40 ft.
- 61.35 Descend 150 ft.
- 73.00 Ascend 55 ft.
- 78.42 Fall 225 lks. S. of the original standard cor. of secs. 33 and 34, which is a granite stone, 8 x 6 x 12 ins. above ground, firmly set, marked "SC" on N. face, and 3 notches on each of E. and W. edges, and witnessed by a mound of stone, N. of cor. No bearing trees. Destroy all trace of this cor.
- 80.00 Set an iron post, 3 ft. long, 2 ins. in diam., 18 ins. in the ground, deposit marked (X) stone, and raise a mound of stone around post, for reestablished standard cor. of secs. 33 and 34, with brass cap, marked

S : C
 T 10 S | R 25 E
 S 33 | S 34

1920

Land, mountainous and broken
 Soil, rocky, 4th rate.
 No timber.
 Undergrowth, scattering cedar and scrub oak.

- East, on a true line, on S. bdy. of sec. 34.
- Over broken land, thru scattering undergrowth.
- Descend 65 ft.
- 6.00 Wash, course N. Ascend 40 ft.
- 8.00 Spur, slopes N. Descend 70 ft.
- 12.00 Draw, course N.
Ascend 105 ft.
- 18.00 Spur, slopes NE.
Descend 25 ft.
- 19.00 Draw, course NE.
Ascend 175 ft.
- 26.00 Spur, slopes NE.
Descend 110 ft.
- 30.30 Ascend 100 ft.
- 38.11 Fall 204 lks. S. of the original standard $\frac{1}{4}$ sec. cor. of Sec. 34, which is a granite stone, 10 x 12 x 14 ins. above ground, firmly set, marked "SC $\frac{1}{4}$ " on N. face, and witnessed by a mound of stone, N. of cor. No bearing trees. Destroy all trace of this cor.
- 40.00 Set an iron post, 3 ft. long, 1 in. in diam., deposit marked stone and raise mound of stone around post for reestablished standard $\frac{1}{4}$ sec. cor. of sec. 34 marked on brass cap,

Chains.

S C
1/4 S 34
1920

43.75 Descend 85 ft.
 Ascend 25 ft.
 45.70 Descend 05 ft.
 53.00 Draw, course NE. Ascend NW. slope.
 53.50 Descend 145 ft.
 63.35 Wash, course NE. Ascend 60 ft.
 69.25 Descend 75 ft.
 71.20 Ascend 65 ft.
 78.12 Fall 290 lks. S. of the original standard cor. of secs. 34 and 35, which is a granite stone 6x12x20 ins. above ground, firmly set in a mound of stone marked "SC" on N. face, 2 notches on E. edge and 4 notches on W. edge. No accessories.

At a point 6 lks. N. of this cor. is Forest Reserve Bdy. Post, established by W.H. Thorn, U.S.S. in 1903, which is an iron post, 4 ins. in diam., projecting 3 ft. above ground firmly set in mound of stone, and marked on brass cap,

USGLO COR
RESERVE

No. 1
1903

80.00 No accessories. Remove this iron pipe, and destroy all trace of the original standard cor. of secs. 34 and 35. Reset the iron Forest Boundary Post, 4 ft. long, 4 ins. in diam., 27 ins. in the ground, for reestablished Forest Boundary Post No. 1, and also for reestablished standard cor. of secs. 34 and 35, and change the markings on brass cap, to read:

USGLO COR
RESERVE SC
T10S | R25E
S34 | S35

1920
No. 1
1903

and raise a mound of stone, 2 ft. base, 1 1/2 ft. high, N. of cor.

Land, broken.
Soil, rocky and sandy, 4th rate.
No timber.
Undergrowth, cedar and scrub oak.

2.00 East, on a true line, on S. bdy. of sec. 35.
 9.80 Over rolling and broken land, thru. scattering undergrowth.
 18.00 Ascend 35 ft.
 Descend 65 ft.
 22.00 Ascend 60 ft.
 38.42 Spur, slopes N. Descend 75 ft.
 Draw, course NE. Thence over rolling land.
 Fall 30 lks. S. of the original standard 1/4 sec. cor. of sec. 35, which is a malpais stone, 6x8x12 ins. above ground, firmly set, marked "SC 1/4" on N. face, and witnessed by a mound of stone, N. of cor. No bearing trees.
 Destroy all trace of this cor.
 40.00 Set an iron post, 3 ft. long, 1 in. in diam., 12 ins. in the ground, deposit marked (x) stone, and raise a mound of stone around post, for reestablished std. 1/4 sec. cor. of sec. 35, with brass cap, marked

8 Independent resurvey of 2nd. Std. Par. S. thru part of Range 25 E.

Chains.

S C
 $\frac{1}{4}$ S 35
 1920

- 44.00 Descend 25 ft.
 Ascend 180 ft.
 57.70 Spur, slopes N. Descend 175 ft.
 68.00 Wash, course N. Thence over rolling land.
 77.75 Gulch, course NW., with stream of water, 18 ins. wide, 2 ins. deep.
 80.00 Diligent search in this vicinity failed to reveal any trace of the original standard cor. of secs. 35 and 36. Set an iron post, 3 ft. long, 2 ins. in diam., 6 ins. in the ground, deposit marked (x) stone, and raise a mound of stone around post, for reestablished std. cor. of secs. 35 and 36, with brass cap, marked

S C
 T10S R25E
 S35 S36
 1920

Land, rolling and broken.
 Soil, sandy and rocky, 4th rate.
 No timber.
 Undergrowth, cedar, scrub oak, and cactus.

- 16.50 East, on a true line, on part of S. bdy. of sec. 36.
 38.09 Over mountainous land, thru. scattering undergrowth. Ascend 290 ft. Ridge, brs. N. and S. Descend 330 ft. Fall 250 lks. S. of the original standard $\frac{1}{4}$ sec. cor. of sec. 36, which is a granite stone, 4x6x12 ins. above ground, firmly set, marked "S $\frac{1}{4}$ " on N. face, and witnessed by a mound of stone, N. of cor. No bearing trees.
 40.00 Destroy all trace of this cor. Set an iron post, 3 ft. long, 1 in. in diam., 27 ins. in the ground, for reestablished std. $\frac{1}{4}$ sec. cor. of sec. 36, marked on brass cap,

S C
 $\frac{1}{4}$ S 36
 1920

- 51.34 and raise a mound of stone, 2 ft. base, 1 $\frac{1}{2}$ ft. high, N. of cor. Descend 130 ft. Intersect N. and S. line, 8.20 chs. N. of the original closing cor. of Ts. 11 S., Rs. 25 and 26 E., hereinafter described, and altered to refer to T. 11 S., R. 26 E. only. At the point of intersection, set an iron post 3 ft. long, 3 ins. in diam., 27 ins. in the ground; for cor. of T. 11 S., R. 25 E. only (NE. cor.), marked on brass cap,

T10S R25E
 S36
 T11S
 R25E
 S1
 1920

and raise a mound of stone, 2 ft. base, 1 $\frac{1}{2}$ ft. high, SW. of cor.
 Land, mountainous.
 Soil, rocky and sandy, 4th rate.
 No timber.
 Undergrowth, cedar and scrub oak.

Dependent Resurvey of East bdy. of Township 11 South, Range 25 East. 9

Chains.

This township boundary was surveyed in 1917 by Quintin Campbell, U.S.T. in connection with the survey of T.11 S., R.26 E., establishing the cors. thereon common to Ts.11 S., Rs.25 and 26 E., setting iron posts with brass caps to monument all the cors.

No retracement or resurvey of the line is of record. Transitman Campbell also resurveyed the South bdy. of T.11 S., R.26 E., and in connection with said resurvey, reestablished the cor. of Ts.11 and 12 S., Rs.25 and 26 E. at a point 1.22 chs.S. of the original cor. of said Ts., and destroyed said original Tp.cor. This procedure was erroneous, as accepted surveys in T.12 S., R.25 E. were dependent on the position of the original Tp.cor., and the same should have been changed to refer to Ts.11 and 12 S., R.25 E. only, and the cor. of Ts.11 and 12 S., R.26 E. reestablished at 1.22 chs.S, therefrom.

Correction of this error of survey is made as follows:

The Campbell reestablished cor. of Ts.11 and 12 S., Rs.25 and 26 E. is an iron post, 3 ins. in diam., projecting 12 ins. above ground, firmly set, properly marked on brass cap, and witnessed by a mound of stone, 2 ft. base, 1 1/2 ft. high, W. of cor. No bearing trees. Change this cor. to refer to Ts.11 and 12 S., R.26 E. only, by altering markings on brass cap, to read:

T 11 S
R26E
S31
S 6
T 12 S
1917

and move mound of stone from W. to E. of cor.

At a point 1.22 chs.N. from above described cor., Set an iron post, 3 ft. long, 3 ins. in diam., 24 ins. in the ground, for reestablished cor. of Ts.11 and 12 S., R.25 E., marked on brass cap,

T11S
R25E T11S
S36 R26E
S 1 S31
T12S
1920

and raise a mound of stone, 2 ft. base, 1 1/2 ft. high, W. of cor.

Retracement for Resurvey.

From the reestablished cor. of Ts.11 and 12 S., R.26 E., hereinbefore described,

40.07

North, on retracement on W. bdy. of sec. 31 (S. 1/2). Intersect the original 1/4 sec. cor. of secs. 31 and 36, herein after described.

The true course and dist. of S. 1/2 of W. bdy. of sec. 31 are therefore, North, 40.07 chs.

Thence,

40.03

North, on retracement, on W. bdy. of sec. 31 (N. 1/2). Intersect the original cor. of secs. 25, 30, 31 and 36, herein after described.

The true course and dist. of N. 1/2 of W. bdy. of sec. 31, are therefore, North, 40.03 chs.

40.18

From the original cor. of secs. 25, 30, 31 and 36, North, on retracement on W. bdy. of sec. 30 (S. 1/2). Intersect the original 1/4 sec. cor. of secs. 25 and 30, herein after described.

The true course and distance of S. 1/2 of W. bdy. of sec. 30, are therefore North, 40.18 chs.

Thence,

10. Dependent Resurvey of E. bdy. of Township 11 South, Range 25 East.

Chains.	
40.04	North, on retracement, on W. bdy. of sec. 30 (N. $\frac{1}{2}$). Fall 1 lk. E. of the original cor. of secs. 19, 24, 25 and 30, hereinafter described. The true course and dist. of N. $\frac{1}{2}$ of W. bdy. of sec. 30, are therefore N. 0° 1' W., 40.04 chs.

40.12	From the original cor. of secs. 19, 24, 25 and 30, North, on retracement, on W. bdy. of sec. 19 (S. $\frac{1}{2}$). Intersect the original $\frac{1}{4}$ sec. cor. of secs. 19 and 24, hereinafter described. The true course and dist. of S. $\frac{1}{2}$ of W. bdy. of sec. 19, are therefore North, 40.12 chs.
	Thence, North, on retracement, on W. bdy. of sec. 19 (N. $\frac{1}{2}$).
40.10	Intersect the original cor. of secs. 13, 18, 19 and 24, hereinafter described. The true course and dist. of N. $\frac{1}{2}$ of W. bdy. of sec. 19, are therefore North, 40.10 chs.
40.08	----- From the original cor. of secs. 13, 18, 19 and 24, North, on retracement on W. bdy. of sec. 18 (S. $\frac{1}{2}$). Fall 1 lk. W. of the original $\frac{1}{4}$ sec. cor. of secs. 13 and 18, hereinafter described. The true course and dist. of S. $\frac{1}{2}$ of W. bdy. of sec. 18, are therefore N. 0° 1' E., 40.08 chs.
40.00	Thence, North, on retracement, on W. bdy. of sec. 18 (N. $\frac{1}{2}$). Fall 1 lk. E. of the original cor. of secs. 7, 12, 13 and 18, hereinafter described. The true course and dist. of N. $\frac{1}{2}$ of W. bdy. of sec. 18, are therefore N. 0° 1' W., 40.00 chs.
39.95	----- From the original cor. of secs. 7, 12, 13 and 18, North, on retracement on W. bdy. of sec. 7 (S. $\frac{1}{2}$). Fall 5 lks. W. of the original $\frac{1}{4}$ sec. cor. of secs. 7 and 12, hereinafter described. The true course and dist. of S. $\frac{1}{2}$ of W. bdy. of sec. 7 are therefore, N. 0° 4' E., 39.95 chs.
39.75	Thence, North on retracement, on W. bdy. of sec. 7 (N. $\frac{1}{2}$). Fall 6 lks. W. of the original cor. of secs. 1, 6, 7 and 12, hereinafter described. The true course and dist. of N. $\frac{1}{2}$ of W. bdy. of sec. 7 are therefore N. 0° 5' E., 39.75 chs.
40.09	----- From the original cor. of secs. 1, 6, 7 and 12, North, on retracement, on W. bdy. of sec. 6 (S. $\frac{1}{2}$). Fall 6 lks. W. of the original $\frac{1}{4}$ sec. cor. of secs. 1 and 6, hereinafter described. The true course and dist. of S. $\frac{1}{2}$ of W. bdy. of sec. 6, are therefore N. 0° 5' E., 40.09 chs.
35.99	Thence, North, on retracement, on W. bdy. of sec. 6 (N. $\frac{1}{2}$). Fall 10 lks. W. of the original closing cor. of T. 11 S., R. 25 and 26 E., on 2nd. Std. Parallel South, hereinafter described. The true course and dist. of N. $\frac{1}{2}$ of W. bdy. of sec. 6 are therefore N. 0° 10' E., 35.99 chs.

RESURVEY.

1.
From the reestablished cor. of T. 11 and 12 S., R. 25 E., hereinafter described,
North, on a true line, on E. bdy. of sec. 36.

Dependent Resurvey of E. bdy. of Township 11 South, Range 25 East.

11

Chains.

- Over mountainous land, thru. scattering undergrowth. Ascend 110 ft. along four wire fence, parallel to and E. of line.
- 16.00 Spur, slopes SW. Descend NW. slope, 80 ft.
- 23.00 Draw, course SW. Ascend over SW. slope, 135 ft.
- 32.00 Spur, slopes W. Descend NW. slope, 30 ft.
- 36.00 Draw, course W. Ascend 25 ft.
- 38.85 (40.07 chs. North from cor. of T_s. 11 and 12 S., R. 26 E.), Intersect the original $\frac{1}{4}$ sec. cor. of secs. 31 and 36, which is an iron post 1 in. in diam., firmly set in a mound of stone, properly marked on brass cap, and witnessed by a mound of stone, W. of cor., and one bearing tree, a cedar, 20 ins. in diam., bearing S. $4\frac{1}{2}^{\circ}$ W., 40 lks. dist. Change this cor. to $\frac{1}{4}$ sec. cor. of sec. 31 only, by altering the markings on brass cap, to read:

$\frac{1}{4}$
 S31
 1917

- Remove old mound of stone, W. of cor., and raise a new mound of stone, 2 ft. base, $1\frac{1}{2}$ ft. high, E. of cor. The bearing tree becomes an accessory to the reestablished $\frac{1}{4}$ sec. cor. of sec. 36, as described below. Thence, North, on true line, continuing measurement of E. bdy. of sec. 36.
- 40.00 Continue along W. side of fence, parallel to line. Set an iron post, 3 ft. long, 1 in. in diam., 10 ins. in the ground, deposit marked (x) stone, for reestablished $\frac{1}{4}$ sec. cor. of sec. 36; and raise a mound of stone around post, with brass cap, marked

$\frac{1}{4}$ S36
 1920

- from which,
 The original bearing tree, a cedar, 20 ins. in diam., brs. S. 1° W., 155 lks. dist., marked " $\frac{1}{4}$ S 36 BT."
- No other tree within limits.
- Cor. stands on spur, slopes W. Descend 20 ft.
- 44.00 Cross the fence which has paralleled the line S. of this point; Thence along $\frac{1}{4}$ E. of said fence.
- 46.00 Draw, course W. Ascend 70 ft.
- 52.00 Spur, slopes SE. Descend 10 ft.
- 53.00 Ascend 115 ft.
- 57.50 Cross the fence, which has paralleled the line S. of this point. Fence extends NE from this point.
- 78.88 (40.03 chs. North from $\frac{1}{4}$ sec. cor. of sec. 31), Intersect the original cor. of secs. 25, 30, 31 and 36, which is an iron post, 3 ins. in diam., projecting 12 ins. above ground, firmly set, properly marked on brass cap, and witnessed by a mound of stone, W. of cor. No bearing trees. Change this cor. to cor. of secs. 30 and 31 only, by altering marking on brass cap, to read:

T11S
 R26E
 S30
 S31
 1917

- Remove old mound of stone, W. of cor., and raise a new mound of stone, 2 ft. base, $1\frac{1}{2}$ ft. high, E. of cor. Thence, North, on a true line, continuing measurement of E. bdy. of sec. 36.
- 80.00 Set an iron post, 3 ft. long, 2 ins. in diam., 16 ins. in the ground, deposit marked (x) stone, and raise a mound of stone around post, for reestablished cor. of secs. 25 and 36, with brass cap, marked

12 Dependent Resurvey of East bdy. of Township 11 South, Range 25 East.

Chains.

T11S	T11S
S25	R26E
S30	S30
R25E	

1920

Land, mountainous.
 Soil, rocky, 3rd rate.
 No timber.
 Undergrowth, cedar and cactus.

North, on a true line, on E. bdy. of sec. 25.
 Over mountainous land, thru. scattering undergrowth.
 Ascend 90 ft.

- 6.00 Top of cliff, brs. E. and W. Descend 210 ft., over NE. slope.
- 16.00 Canyon, course E., with stream of water 3 lks. wide, 2 ins. deep; ascend 195 ft., over SE. slope.
- 27.00 Spur, slopes SE. Descend 170 ft.
- 30.65 Continue descent, over NE. slope.
- 39.06 (40.18 chs. North from cor. of secs. 30 and 31), Intersect

the original $\frac{1}{4}$ sec. cor. of secs. 25 and 30, which is an iron post, 1 in. in diam., projecting 10 ins. above ground, firmly set, properly marked on brass cap, and witnessed by a mound of stone, W. of cor., and two bearing trees, as follows:

A cedar, 6 ins. in diam., S. $7\frac{1}{2}^{\circ}$ W., 129 lks. dist., marked " $\frac{1}{4}$ S 25 BT."

A juniper, 12 ins. in diam., N. $29^{\circ} 20'$ E., 160 lks. dist., marked " $\frac{1}{4}$ S 30 BT."

Change this cor. to $\frac{1}{4}$ sec. cor. of sec. 30 only, by altering marking on brass cap, to read:

$\frac{1}{4}$
 |
 S30
 |
 1917

Remove old mound of stone, W. of cor., and raise a new mound of stone, 2 ft. base, $1\frac{1}{2}$ ft. high, E. of cor. The SW. bearing tree now becomes accessory to the $\frac{1}{4}$ sec. cor. of sec. 25, as hereinafter described.

Thence, N. $0^{\circ} 1'$ W., on a true line, continuing measurement of E. bdy. of sec. 25.

- 40.00 Set an iron post, 3 ft. long, 1 in. in diam., 12 ins. in the ground, deposit marked (x) stone, and raise a mound of stone around post, for reestablished $\frac{1}{4}$ sec. cor. of sec. 25 only, with brass cap, marked

$\frac{1}{4}$ S 25 |
 1920

from which,

The original bearing tree, a cedar, 6 ins. in diam., brs. S. $4\frac{3}{4}^{\circ}$ W., 223 lks. dist., marked " $\frac{1}{4}$ S 25 BT."

Continue descent.

- 41.00 Canyon, course SE., with stream of water, 3 lks. wide, 9 ins. deep, Ascend 100 ft., over SW. slope.
- 48.00 Spur, slopes SE. Descend 105 ft., over NE. slope.
- 60.00 Draw, course E. Ascend 60 ft.
- 60.10 Four wire fence, brs. E. and W.
- 62.10 Spur, slopes SE. Descend 35 ft., over NE. slope.
- 70.00 Canyon, course SE., with stream of water, 4 lks. wide, 2 ins. deep; ascend 25 ft.
- 79.10 (40.04 chs. N. $0^{\circ} 1'$ W. from $\frac{1}{4}$ sec. cor. of sec. 30), Intersect the original cor. of secs. 09, 24, 25 and 30, which is an iron post, 3 ins. in diam., projecting 12 ins. above

Dependent Resurvey of East bdy. of Township 11 South, Range 25 East. 13

Chains.

ground, firmly set, properly marked on brass cap, and witnessed by a mound of stone, W. of cor. No bearing trees.

Change this cor. to cor. of secs. 19 and 30, by altering marking on brass cap, to read:

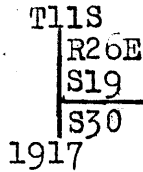

Remove old mound of stone, W. of cor., and raise a new mound of stone, 2 ft. base, 1 1/2 ft. high, E. of cor. Thence North, on true line, continuing measurement of E. bdy. of sec. 25.

80.00 Set an iron post, 3 ft. long, 2 ins. in diam., 27 ins. in the ground, for reestablished cor. of secs. 24 and 25 only, marked on brass cap,

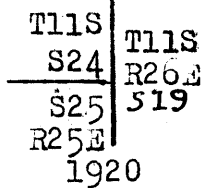

Land, mountainous.
Soil, rocky. 4th rate.
No timber.
Undergrowth, cedar, scrub oak, greasewood and cactus.

18.00 North, on a true line, on E. bdy. of sec. 24.
34.00 Over gently rolling land, through scattering undergrowth.
39.22 Low saddle, brs. E. and W. Descend 50 ft.
Draw, course E. Ascend 55 ft., over SE. slope.
(40.12 chs. North from cor. of secs. 19 and 30), Intersect the original 1/4 sec. cor. of secs. 19 and 24, which is an iron post, 1 in. in diam., projecting 10 ins. above ground, firmly set, properly marked on brass cap, and witnessed by a mound of stone, W. of cor. No bearing trees.

Change this cor. to 1/4 sec. cor. of sec. 19 only, by altering marking on brass cap, to read:

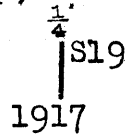

40.00 Remove old mound of stone, W. of cor., and raise a new mound of stone 2 ft. base, 1 1/2 ft. high, E. of cor.
Set an iron post, 3 ft. long, 1 in. in diam., 14 ins. in the ground, deposit marked (x) stone, and raise a mound of stone around post, for reestablished 1/4 sec. cor. of sec. 24 only, with brass cap, marked

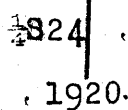

63.00 Old road, brs. E. and W.
78.00 Ascend 35 ft.
79.32 (40.10 chs. North from 1/4 sec. cor. of sec. 19), Intersect the original cor. of secs. 13, 18, 19 and 24, which is an iron post, 3 ins. in diam., projecting 12 ins. above ground, firmly set, properly marked on brass cap, witnessed by a mound of stone, W. of cor. No bearing trees.

Change this cor. to cor. of secs. 18 and 19 only, by altering the marking on brass cap, to read:

14 Dependent Resurvey of East bdy. of Township 11 South, Range 25 East.

Chains.

T11S
R26E
S18
S19

1917

Remove old mound of stone, W. of cor., and raise a new mound of stone, 2 ft. base, 1½ ft. high, E. of cor. Thence, N.0°1'E., on a true line, continuing measurement of E. bdy. of sec. 24.

80.00 Set an iron post, 3 ft. long, 2 ins. in diam., 27 ins. in the ground, for reestablished cor. of secs. 13 and 24 only, marked on brass cap,

T11S	T11S
S13	R26E
S24	S18
R25E	

1920

Dig pits, 18x18x12 ins., SW. and NW. of post, 3 ft. dist. Land, rolling and gently rolling. Soil, rocky, 4th rate. No timber. Undergrowth, cedar, scrub oak, greasewood and cactus.

N.0° 1'E., on a true line, on E. bdy. of sec. 13. Over rolling land, thru. scattering undergrowth. Ascend 45 ft. Descend 45 ft. Ascend 40 ft. Spur, slopes NE. Descend 65 ft. Gulch, course NE. Ascend 15 ft., over SE. slope. Spur, slopes NE. Descend 80 ft. (40.08 chs. N.0°1'E. from cor. of secs. 18 and 19), Intersect the original ¼ sec. cor. of secs. 13 and 18, which is an iron post, 1 in. in diam., projecting 10 ins. above ground, firmly set, properly marked on brass cap, and witnessed by a mound of stone, W. of cor., and one bearing tree, a cedar, 10 ins. in diam., N.33½°W., 27 lks. dist., properly marked. Change this cor. to ¼ sec. cor. of sec. 18 only, by altering marking on brass cap, to read:

↑
S18

1917

Remove old mound of stone, W. of cor., and raise a new mound of stone, 2 ft. base, 1½ ft. high, E. of cor. The bearing tree now becomes an accessory to the reestablished ¼ sec. cor. of sec. 13, hereinafter described. Thence, N.0°1'W., on true line, continuing measurement of E. bdy. of sec. 13.

40.00 Set an iron post, 3 ft. long, 1 in. in diam., 12 ins. in the ground, deposit marked (x) stone, and raise a mound of stone around post, for reestablished ¼ sec. cor. of sec. 13 only, with brass cap, marked

¼S13

1920

from which, The original bearing tree, a cedar, 10 ins. in diam., brs. S. 22°W., 40 lks. dist., marked "¼S 13BT." Descend 85 ft.

Chains.

49.00 Sycamore Creek, course SE., with stream of water, 4 lks. wide, 2 ins. deep, course SE. Ascend.

53.00 Road, brs. E. and SW.

59.00 Gulch, 50 lks. wide, course E. Ascend. 20 ft.

63.65 Descend 30 ft.

65:62 Ascend gradually.

79.40 (40.00 chs. N. 0° 1' W. from 1/4 sec. cor. of sec. 18, T. 11 S., R. 26 E.), Intersect the original cor. of secs. 7, 12, 13 and 18, which is an iron post, 3 ins. in diam., projecting 12 ins. above ground, firmly set, properly marked on brass cap, and witnessed by a mound of stone, W. of cor. No bearing trees.

Change this cor. to cor. of secs. 7 and 18 only, by altering marking on brass cap, to read:

T11S
R26E
S 7
S18

1917

Remove old mound of stone, W. of cor., and raise a mound of stone, 2 ft. base, 1 1/2 ft. high, E. of cor.

Thence,

N. 0° 4' E., on a true line, continuing measurement of E. bdy. of sec. 13.

80.00 Set an iron post, 3 ft. long, 2 ins. in diam., 27 ins. in the ground, for reestablished cor. of secs. 12 and 13 only, marked on brass cap,

T11S
S12
S13
R25E
S 7
1920

and raise a mound of stone, 2 ft. base, 1 1/2 ft. high, W. of cor.

Land, rolling and broken.

Soil, rocky, 4th rate.

No timber.

Undergrowth, cedar, scrub oak, greasewood and cactus.

N. 0° 4' E., on a true line, on E. bdy. of sec. 12.

Over broken land, thru. scattering undergrowth.

10.00 Leave broken land; ascend 445 ft., over mountainous SW. slope.

39.35 (39.95 chs. N. 0° 4' E., from cor. of secs. 7 and 18, T. 11 S., R. 26 E.), Intersect the original 1/4 sec. cor. of secs. 7 and 12, which is an iron post, 1 in. in diam., projecting 9 ins. above ground, firmly set, properly marked on brass cap, and witnessed by two bearing trees as follows:

A cedar, 14 ins. in diam., N. 57 1/2° W., 230 lks. dist., marked "1/4 S 12 BT."

A cedar, 12 ins. in diam., N. 27 1/2° E., 145 lks. dist., marked "1/4 S 7 BT."

Change this cor. to 1/4 sec. cor. of sec. 7 only, by altering marking on brass cap, to read:

S 7

1917

Remove old mound of stone, W. of cor., and raise a mound of stone, 2 ft. base, 1 1/2 ft. high, E. of cor. The old NW bearing tree becomes an accessory to 1/4 sec. cor. of sec. 12, as hereinafter described.

16 Dependent Resurvey of East bdy. of Township 11 South, Range 25 East.

Chains.

Thence, N.0°5'E., on a true line, continuing measurement of E. bdy. of sec. 12.

40.00 Spur, slopes SE. Set an iron post, 3 ft. long, 1 in. in diam., 14 ins. in the ground, deposit marked (x) stone, and raise a mound of stone around post, for reestablished 1/4 sec. cor. of sec. 12 only, with brass cap, marked

1/4 S 12

1920

from which,

The original bearing tree,

A cedar, 14 ins. in diam., brs. N. 73 1/4° W., 203 lks. dist., marked "1/4 S 12 BT."

Descend 390 ft., over NW. slope.

60.10 Canyon, course NE. Ascend 180 ft., over S. slope.

79.10 (39.75 chs., N. 0° 5' E. from 1/4 sec. cor. of sec. 7), Intersect the original cor. of secs. 1, 6, 7 and 12, which is an iron post, 3 ins. in diam., projecting 12 ins. above ground, firmly set, properly marked on brass cap, and witnessed by a mound of stone, W. of cor., and two bearing trees, as follows:

A cedar, 8 ins. in diam., S. 58° W., 50 lks. dist., marked "T11SR25ES12BT."

A cedar, 24 ins. in diam., N. 45° E., 280 lks. dist., marked "T11S R26ES6BT."

Change this cor. to cor. of secs. 6 and 7 only, by altering marking on brass cap, to read:

T11S
R26E
S 6
S 7
1917

Remove old mound of stone, W. of cor., and raise a new mound of stone, 2 ft. base, 1 1/2 ft. high, E. of cor.

The SW. bearing tree now becomes an accessory to the cor. of secs. 1 and 12, as hereinafter described.

Thence,

N. 0° 5' E., on a true line, continuing measurement of E. bdy. of sec. 12.

80.00 Set an iron post, 3 ft. long, 2 ins. in diam., 6 ins. in the ground, deposit marked (x) stone, and raise a mound of stone around post, for reestablished cor. of secs. 1 and 12 only, with brass cap, marked

T11S | T11S
S 1 | R26E
S 12 | S 6
R25E |
1920

from which,

The original bearing tree, a cedar, 8 ins. in diam., brs. S. 20° W., 124 lks. dist., marked "T11SR25ES12BT."

Land, broken and mountainous.

Soil, sandy and rocky, 4th rate.

No timber.

Undergrowth, cedar; scrub oak and greasewood.

N. 0° 5' E., on a true line, on E. bdy. of sec. 1.

Over broken and mountainous land, thru. scattering undergrowth.

Descend.

22.00 Canyon, course E.

8.00 Spur, slopes SE. Descend 25 ft.

9.00 Canyon, course SE., with stream of water 2 lks. wide, 2 ins. deep. Ascend 105 ft., over S. slope.

Dependent resurvey of East bdy. of Township 11 South, Range 25 East. 17

Chains.

16.00 Spur, slopes SE.; descend.
 17.00 Ascend 45 ft.
 20.00 Spur, slopes SE. Descend 115 ft., over NE. slope.
 24.00 Canyon, course SE., with stream of water, 2 lks. wide, 2 ins. deep, Ascend 265 ft., over S. slope.
 37.00 Spur, slopes E. Descend 60 ft.
 38.00 Three wire fence, brs. NE. and SW.
 39.19 (40.09 chs. N. 0° 5' E. from cor. of secs. 6 and 7), Intersect the original $\frac{1}{4}$ sec. cor. of secs. 1 and 6, which is an iron post, 1 in. in diam., projecting 24 ins. above ground, firmly set in mound of stone, properly marked on brass cap, and witnessed by two bearing trees, as follows:

A cedar, 14 ins. in diam., S. 55 $\frac{1}{2}$ ° W., 176 lks. dist., marked " $\frac{1}{4}$ S 1 BT."
 A cedar, 12 ins. in diam., S. 67 $\frac{1}{2}$ ° E., 227 lks. dist., marked " $\frac{1}{4}$ S 6 BT."

Change this cor. to $\frac{1}{4}$ sec. cor. of sec. 6 only, by altering marking on brass cap to read:

↑
 S 6
 1917

Raise a mound of stone, 2 ft. base, 1 $\frac{1}{2}$ ft. high, E. of cor. The SW. bearing tree is now an accessory to the $\frac{1}{4}$ sec. cor. of sec. 1, as hereinafter described.

Thence, N. 0° 10' E., on a true line, continuing measurement of E. bdy. of sec. 1.

40.00 Set an iron post, 3 ft. long, 1 in. in diam., 6 ins. in the ground, deposit marked (x) stone, and raise a mound of stone around post, for reestablished $\frac{1}{4}$ sec. cor. of sec. 1 only, with brass cap, marked

↑
 S 1
 1920

from which, The original bearing tree, a cedar tree, 14 ins. in diam., brs. S. 38 $\frac{1}{4}$ ° W., 232 lks. dist., marked " $\frac{1}{4}$ S 1 BT."

Ascend 15 ft.
 Descend 155 ft.

51.35 Canyon, course NE. Ascend 210 ft., over SE. slope.
 59.00 Spur, slopes NE. Descend 125 ft., over NW. slope, to
 72.00 (35.99 chs. N. 0° 10' E. from $\frac{1}{4}$ sec. cor. of sec. 6), Intersect
 75.18 the original closing cor. of T. 11 S., R. 25 and 26 E., on 2nd Std. Parallel S., which is an iron post, 3 ins. in diam., projecting 12 ins. above ground, firmly set, properly marked on brass cap, and witnessed by a mound of stone, S. of cor. No bearing trees.

Change this cor. to cor. of T. 11 S., R. 26 E. only (NW. cor.) by altering the marking on brass cap, to read:

T10S R25E
 S36
 S 6
 R26E
 T11S
 1917

Remove old mound of stone, S. of cor., and raise a new mound of stone, 2 ft. base, 1 $\frac{1}{2}$ ft. high, SE. of cor.

Thence, North, on true line, continuing measurement of E. bdy. of sec. 1.

Over mountainous land, thru. scattering undergrowth. Descend 110 ft., over N. slope, to (8.20 chs. N. from NW. cor. of T. 11 S., R. 26 E.), Intersect

83.38

18 Dependent Resurvey of East bdy. of Township 11 South, Range 25 East.

Chains.

2nd Std. Par. S., surveyed due East from std. cor. of Ts. S., Rs. 24 and 25 E., at which point establish NE. cor. of T. 11 S., R. 25 E. only, as hereinbefore described.
 Land, broken and mountainous.
 Soil, rocky, 4th rate.
 No timber.
 Undergrowth, greasewood and cedar.

Boundaries of Township 11 South, Range 25 East.
 Latitudes, Departures, and Closing Errors.

Line designated.	True bearing.	Dist.	Latitudes.		Departures.	
			N.	S.	E.	W.
South Boundary,	N. 89° 52' W.	476.46	1.11			476.46
West Boundary,	North,	482.06	482.06			
North Boundary, (2nd Std. Par. S)	East,	477.81			477.81	
East Boundary,	South,	8.20		8.20		
	S. 0° 10' W.	35.99		35.99		.10
	S. 0° 5' W.	79.84		79.84		.12
	S. 0° 4' W.	39.95		39.95		.05
	S. 0° 1' E.,	40.00		40.00	.01	.01
	S. 0° 1' W.	40.08		40.08		.01
	South,	80.22		80.22		
	S. 0° 1' E.	40.04		40.04	.01	
	South,	119.96		119.96		
Convergency,					.46	
<u>Totals,</u>			483.17	483.28	478.29	476.74
				483.17	476.74	
<u>Error in latitude,</u>					.21	
<u>Error in departure,</u>					1.55	

20. Part of Subdivision lines of Township 11 South, Range 25 East.

Chains.

40.13 Set an iron post, 3 ft. long, 1 in. in diam., 12 ins. in the ground, deposit marked (x) stone, and raise a mound of stone around post, for $\frac{1}{4}$ sec. cor., marked on brass cap,

$$\frac{1}{4} \text{ S } 25$$

$$\text{S } 36$$

$$1920$$

from which,

A cedar, 7 ins. in diam., brs. S. $32\frac{1}{2}^{\circ}$ W., 27 lks. dist., mark " $\frac{1}{4}$ S 36 BT."

No other trees within limits.

Ascend 15 ft.

41.70 Spur, slopes S. Descend 140 ft.

48.35 Gulch, 20 lks. wide, course S. Ascend 30 ft., over SE. slope.

52.25 Descend 45 ft.

60.25 Spur, slopes SW. Descend 30 ft., over W. slope.

63.05 Draw, 10 lks. wide, course SW. Thence over S. slope.

72.25 Head of draw, course SW.

80.26 The cor. of secs. 25, 26, 35 and 36.

Land, mountainous and rolling.

Soil, sandy and rocky, 4th rate.

No timber.

Undergrowth, cedar, Spanish dagger and soto.

N. $0^{\circ} 01'$ W., bet. secs. 25 and 26.

Over mountainous land, thru. scattering undergrowth.

Descend.

6.90 Gulch, 10 lks. wide, course SW. Ascend 270 ft.

23.60 Spur, slopes SW. Descend 35 ft.

28.20 Head of gulch, 10 lks. wide, course SW. Ascend 150 ft., over S. slope.

34.20 Spur, slopes SW. Descend 120 ft., to

40.00 Set an iron post, 3 ft. long, 1 in. in diam., 6 ins. in the ground, deposit marked (x) stone, and raise a mound of stone around post, for $\frac{1}{4}$ sec. cor., with brass cap, marked

$$\frac{1}{4} \text{ S } 26 \text{ S } 25$$

$$1920$$

from which,

A cedar, 23 ins. in diam., brs. N. $73\frac{1}{2}^{\circ}$ E., 95 lks. dist., mark " $\frac{1}{4}$ S 25 BT."

No other trees within limits.

45.00 Saddle of ridge, brs. NW. and SE. Ascend 65 ft.

49.90 Thence along E. slope.

52.90 Spur, slopes SE. Descend 120 ft.

71.20 Wash, 25 lks. wide, course SE., with stream of water, 4 lks. wide, 2 ins. deep; ascend 115 ft., over NW. slope.

80.00 Set an iron post, 3 ft. long, 2 ins. in diam., 4 ins. in the ground, deposit marked (x) stone, and raise a mound of stone around post, for cor. of secs. 23, 24, 25 and 26, with brass cap, marked

$$\begin{array}{|l|l|} \hline T11S & R25E \\ \hline S23 & S24 \\ \hline \end{array}$$

$$S26 \text{ S } 25$$

$$1920$$

from which,

A red oak, 8 ins. in diam., brs. N. $67\frac{1}{2}^{\circ}$ E., 162 lks. dist., mark "T11S R25E S24 BT."

A white oak, 6 ins. in diam., brs. S. $35\frac{1}{2}^{\circ}$ W., 71 lks. dist., mark "T11S R25E S26 BT."

A red oak, 12 ins. in diam., brs. N. 20° W., 240 lks. dist., mark "T11S R25E S23 BT."

No other trees within limits.

Land, mountainous.

Soil, rocky, 4th rate.

Survey of part of the Subdivision lines of Township 11 S. R. 25 E. 19

Chains.

The following notes describe the survey of the Subdivision lines of the south two tiers of secs. in this Tp. No subdivision lines have ever been surveyed in this Tp. The south boundary of the Tp. was surveyed in 1915, by Thomas B. Matthews, U.S.S., and no retracement or resurvey of said line is of record. The west boundary of the Tp. was surveyed in 1875 by Theo. F. White, U.S.D.S., and was resurveyed in 1913, by Thomas B. Matthews, U.S.S.

The original cor. of secs. 1, 2, 35 and 36, on the S. bdy. of the Tp., is an iron post, 3 ins. in diam., projecting 12 ins. above ground, firmly set, properly marked on brass cap, and witnessed by a mound of stone, W. of cor. No bearing trees.

Thence;
 N. 0° 1' W., bet. secs. 35 and 36.
 Over rolling land, thru scattering undergrowth.
 13.80 Road, brs. NE and SW.
 16.00 Wash, course SW. Ascend 80 ft.
 32.00 Spur, slopes SE. Descend 15 ft.
 36.00 Gulch, course SE. Ascend 10 ft. to
 40.00 Set an iron post, 3 ft. long, 1 in. in diam., 14 ins. in the ground, deposit marked (x) stone, and raise a mound of stone around post, for $\frac{1}{4}$ sec. cor., with brass cap, marked

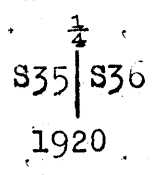

Ascend 45 ft.
 44.00 Spur, slopes SE. Descend 40 ft.
 51.50 Gulch, 10 lks. wide, course SE., with stream of water, 2 lks. wide, 2 ins. deep; ascend 130 ft.
 63.70 Spur, slopes E. Thence along E. slope.
 69.00 Spur, slopes E. Descend 45 ft.
 77.20 Wash, 10 lks. wide, course SE. Ascend 30 ft. to
 80.00 Set an iron post, 3 ft. long, 2 ins. in diam., 12 ins. in the ground, deposit marked (X) stone, and raise a mound of stone around post, for cor. of secs. 25, 26, 35 and 36, with brass cap, marked

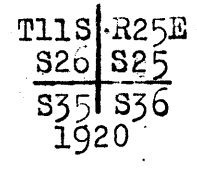

Land, rolling and mountainous.
 Soil, rocky, 3rd and 4th rate.
 No timber.
 Undergrowth, cedar and soto.
 Some bear grass.

S. 89° 52' E., on a random line, bet. secs. 25 and 36.
 40.00 Set temp. $\frac{1}{4}$ sec. cor.
 80.26 Fall 3 lks. S. of the reestablished cor. of secs. 25 and 36, on the E. bdy. of the Tp., hereinbefore described.
 Thence,
 N. 89° 53' W., on a true line, bet. secs. 25 and 36.
 Over mountainous land, thru scattering undergrowth.
 Ascend 35 ft.
 3.15 Ridge, brs. NW. and SE. Ascend.
 7.10 Spur, slopes S. Descend 135 ft., over W. slope, to
 14.35 Wash, 14 lks. wide, course SW. Descend 125 ft. to
 28.15 Wash, 20 lks. wide, course S. Ascend 35 ft.
 30.55 Road, brs. NW. and SE.
 34.35 Spur, slopes S. from NW. Ascend 125 ft. to

Part of the Subdivision lines of Township 11 South, Range 25 East. 21

Chains.

No timber.
Undergrowth, cedar, Spanish dagger and mesal.
Some bear grass.

40.00 S. 39°53' E., on a random line, bet. secs. 24 and 25.
Set temp. $\frac{1}{4}$ sec. cor.
80.40 Fall 6 lks. S. of the reestablished cor. of secs. 24 and 25,
on the E. bdy. of the Tp., hereinbefore described.

Thence,
N. 89°50' W., on a true line, bet. secs. 24 and 25.
Over mountainous land, thru. scattering undergrowth.
Ascend 430 ft., over NE. slope.
20.40 Three wire fence, brs. NW. and SE.
37.05 Spur, slopes SE. Descend 55 ft., over SW. slope, to
40.20 Set an iron post, 3 ft. long, 1 in. in diam., 16 ins. in
the ground, deposit marked (x) stone, and raise a mound
of stone around post, for $\frac{1}{4}$ sec. cor., with brass cap,
marked

$\frac{1}{4}$ S 24
S 25
1920

49.40 Descend 115 ft., over SW. slope.
Canyon, course S., with stream of water 2 lks. wide, 2 ins.
deep. Ascend 130 ft., over SE. slope.

56.40 Spur, slopes SE. Descend 80 ft.

62.40 Draw, course SE. Ascend 70 ft., over E. slope.

72.40 Spur, slopes SE. Descend 185 ft., over broken cliffs to
sec. cor.

76.40 Cliff, brs. NW. and SE.

80.40 The cor. of secs. 23, 24, 25 and 26.

Land, mountainous.

Soil, rocky, 4th rate.

No timber.

Undergrowth, scattering cedar and scrub oak.

As there is no agricultural land in this township lying
north of sec. 25, discontinue the subdivision of this
range of sections.

The original cor. of secs. 2, 3, 34 and 35, on the S. bdy. of
Tp. is an iron post, 3 ins. in diam., projecting 12 ins.
above ground, firmly set, properly marked on brass cap,
and witnessed by mound of stone, W. of cor. No bearing
trees.

Thence,

N. 0°1' W., bet. secs. 34 and 35.

Over rolling and broken land, thru. scattering undergrowth.

Ascend 50 ft., over SE. slope.

7.50 Spur, slopes SW. Descend 65 ft., over NW. slope.

19.00 Wash, 20 lks. wide, course SW. Ascend 130 ft. on spur.

33.25 Spur, slopes S. Thence along E. slope of spur.

40.00 Set an iron post, 3 ft. long, 1 in. in diam., 6 ins. in
the ground, deposit marked (x) stone, and raise a mound
of stone around post, for $\frac{1}{4}$ sec. cor., with brass cap,
marked

$\frac{1}{4}$
S34 | S35
1920

65.00 Same spur, slopes SW. Descend gradual NW. slope.

70.50 Road; brs. NW. and SE.

73.20 Gulch, 15 lks. wide, course SW. Ascend 45 ft., over S. slope, to

80.00 Set an iron post, 3 ft. long, 2 ins. in diam., 6 ins. in
the ground, deposit marked (x) stone, and raise a mound

22 Part of Subdivision lines of Township 11 South, Range 25 East.

Chains.

of stone around post, for cor. of secs. 26, 27, 34 and 35,
with brass cap, marked

T11S	R25E
S27	S26
S34	S35
1920	

Land, rolling and broken.
Soil, sandy and rocky, 3rd. and 4th rate..
No timber.
Undergrowth, cedar, scrub oak and cactus.

40.00 S. 89°52'E., on a random line, bet. secs. 26 and 35.
80.38 Set temp. $\frac{1}{4}$ sec. cor.
Intersect N. and S. line, 8 lks. S. of the cor. of secs. 25,
26, 35 and 36.
Thence,
N. 89°55'W., on a true line, bet. secs. 26 and 35.
Over mountainous land, thru. scattering undergrowth.
Descend.
4.40 Gulch, course SE. Ascend 40 ft.
10.90 Spur, slopes N. Descend 155 ft.
26.40 Wash, 20 lks. wide, course S. Ascend 135 ft., over E. slope.
36.40 Spur, slopes SE. Descend 95 ft., over W. slope.
39.45 Gulch, 10 lks. wide, course SW. Ascend 75 ft.
40.19 Set an iron post, 3 ft. long, 1 in. in diam., 22 ins. in
the ground, deposit marked (x) stone, and raise a mound
of stone around post, for $\frac{1}{4}$ sec. cor., marked on brass
cap,

$\frac{1}{4}$	S 26
	S 35
1920	

50.60 Ascend over SE. slope.
Spur, slopes SW. Descend 150 ft., over W. slope.
59.00 Gulch, course SW., with stream of water 2 lks. wide, 2 ins.
deep. Ascend 45 ft., over SE. slope.
65.50 Spur, slopes SW. Descend 80 ft., over W. slope.
72.20 Gulch, course SW. thence along S. slope.
80.38 The cor. of secs. 26, 27, 34 and 35.
Land, mountainous.
Soil, rocky, 4th rate.
No timber.
Undergrowth, cedar, scrub oak and mesal.

N. 0°1'W., bet. secs. 26 and 27.
Over mountainous land, thru. scattering undergrowth.
Ascend SE. slope, 100 ft.
4.75 Spur, slopes SW. Descend 20 ft., over NW. slope.
9.75 Head of gulch, course SW. Ascend 470 ft., over S. slope.
26.25 Spur, slopes NE. Descend 235 ft.
37.60 Head of gulch, 10 lks. wide, course E. Ascend 45 ft., over
S. slope, to
40.00 Set an iron post, 3 ft. long, 1 in. in diam., 6 ins. in the
ground, deposit marked (x) stone, and raise a mound of
stone around post, for $\frac{1}{4}$ sec. cor., with brass cap, marked

$\frac{1}{4}$	S27	S26
1920		

44.70 Ascend 120 ft.
Ridge, brs. NE. and SW. Descend 340 ft., over NW. slope.
64.25 Spur, slopes NW. Continue descent.
66.80 Gulch, 15 lks. wide, course NW. Thence along W. slope.
70.30 Wash, 30 lks. wide, water in pools, course SW. Ascend 100 ft.
over SE. slope, to

Part of Subdivision lines of Township 11 South, Range 25 East. 23

Chains.
80.00. Set an iron post, 3 ft. long, 2 ins. in diam., 6 ins. in the ground, deposit marked (x) stone, and raise a mound of stone around post, for cor. of secs. 22, 23, 26 and 27, marked on brass cap,

T11S	R25E
S22	S23
S27	S26
1920	

from which,
 A cedar, 10 ins. in diam., brs. S. 34° E., 246 lks. dist., mark "T11S R25E S26 BT."
 A cedar, 10 ins. in diam., brs. S. 80 1/2° W., 317 lks. dist., mark "T11S R25E S27 BT."
 A cedar, 8 ins. in diam., brs. N. 28° W., 91 lks. dist., mark "T11S R25E S22 BT."

No other trees within limits.
 Land, mountainous.
 Soil, rocky, 4th rate.
 No timber.
 Undergrowth, cedar, scrub oak and cactus.

40.00 S. 89° 55' E., on a random line, bet. secs. 23 and 26. Set temp. 1/4 sec. cor.
 80.44 Intersect N. and S. line, 2 lks. S. of the cor. of secs. 23, 24, 25 and 26.
 thence,
 N. 89° 56' W., on a true line, bet. secs. 23 and 26.
 Over mountainous land, thru. scattering undergrowth.
 Descend SW. slope, 75 ft.
 5.45 Canyon, course SE., with stream of water 2 lks. wide, 2 ins. deep; ascend 175 ft., over SE. slope.
 21.45 Spur, slopes S.. Descend 50 ft., over SW. slope.
 24.70 Gulch, course SE. Ascend 75 ft.
 39.45 Spur, slopes SE. Descend 40 ft. to
 40.22 Set an iron post, 3 ft. long, 1 in. in diam., 6 ins. in the ground, deposit marked (x) stone, and raise a mound of stone around post, for 1/4 sec. cor., with brass cap, marked

1/4	S 23
	S 26
1920	

from which,
 A cedar, 20 ins., in diam., brs. N. 15° E., 84 lks. dist., marked "1/4 S23 BT."
 A cedar, 10 ins. in diam., brs. S. 52° W., 47 lks. dist., mark "1/4 S26 BT."

Descend 15 ft.
 41.65 Canyon, course SE. Ascend 160 ft., over E. slope.
 46.45 Ridge, brs. NW. and SE. Descend 205 ft..
 63.45 Draw, course SW. Ascend 35 ft.
 69.45 Spur, slopes S. Descend 65 ft.
 72.45 Draw, course SW. Ascend 20 ft.
 75.75 Spur, slopes S. Descend 20 ft.
 76.95 Draw, course S. Ascend 00 ft.
 80.44 The cor. of secs. 22, 23 26 and 27.
 Land, mountainous.
 Soil, rocky, 4th rate.
 No timber.
 Undergrowth, scattering cedar and scrub oak.

As there is no agricultural land in this township lying north of sec. 26, discontinue the subdivision of this range of sections.

24 Part of the Subdivision lines of Township 11 South, Range 25 East.

Chains.

The original cor. of secs. 3, 4, 33 and 34, on the S. bdy. of Tp., is an iron post, 3 ins. in diam., projecting 12 ins. above ground, firmly set, properly marked on brass cap, and witnessed by a mound of stone, W. of cor. No bearing trees.

Thence, N. 0° 2' W., bet. secs. 33 and 34. Over mountainous land.

11.90 Spur, slopes SW. Descend 130 ft.

29.70 Thence, along W. slope.

40.00 Set an iron post, 3 ft. long, 1 in. in diam., 27 ins. in the ground, for 1/4 sec. cor., marked on brass cap,

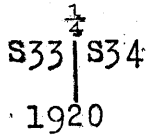

and raise a mound of stone, 2 ft. base, 1 1/2 ft. high, W. of cor.,

50.70 Wash, 15 lks. wide, course SW. Ascend 155 ft.

79.80 Four wire fence brs. E. and W.

80.00 Sour, slopes SW. Set an iron post, 3 ft. long, 2 ins. in diam., 10 ins. in the ground, deposit marked (x) stone and raise a mound of stone around post, for cor. of secs. 27, 28, 33 and 34, with brass cap, marked

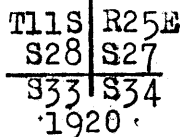

Band, mountainous and rolling. Soil, stony and gravelly, 3rd and 4th rate. No timber. No undergrowth.

40.00 S. 89° 52' E., on a random line, bet. secs. 27 and 34. Set temp. 1/4 sec. cor.

79.94 Intersect N. and S. line, 7 lks. N. of the cor. of secs. 26, 27, 34 and 35.

Thence, N. 89° 49' W., on a true line, bet. secs. 27 and 34. Over mountainous land, thru. scattering undergrowth. Descend 40 ft., over SW. slope.

8.45 Head of small wash, 5 lks. wide, course SW. Ascend SE. slope, 95 ft.

21.15 Spur, slopes SW. Descend 130 ft., over W. slope.

29.55 Gulch, 15 lks. wide, course SW. Ascend 20 ft.

34.00 End of spur, slopes SW. Descend 20 ft.

34.95 Wash, 20 lks. wide, course SE. Ascend 30 ft. to

39.97 Set an iron post, 3 ft. long, 1 in. in diam., 16 ins. in the ground, deposit marked (x) stone, and raise a mound of stone around post, for 1/4 sec. cor., with brass cap, marked

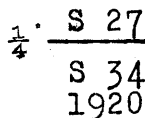

Ascend.

41.30 Spur, slopes S. Descend 45 ft.

44.85 Gulch, course SW. Ascend 30 ft.

50.20 Spur, slopes S. Descend 55 ft., over W. slope.

55.75 Gulch, 10 lks. wide, course S. Ascend 50 ft., over E. slope.

59.30 Four wire fence, brs. N. Corners S. of line, and runs W.

63.10 Spur, slopes S. Descend 90 ft., over W. slope.

71.85 Wash, 10 lks. wide, course SW. Ascend 25 ft. to

79.94 The cor. of secs. 27, 28, 33 and 34.

Part of Subdivision lines of Township 11 South, Range 25 East. 25

Chains.

Land, mountainous.
Soil, sandy and gravelly, .4th rate.
No timber.
Undergrowth; scattering cedar, scrub oak and cactus.

N.0°2'W., bet. secs. 27 and 28.
Over mountainous land, thru. scattering undergrowth.
Descend 20 ft., over NW. slope.
7.00 Wash, 10 lks. wide, course SW. Ascend SE. slope, 210 ft. to
12.00 Gulch, 10 lks. wide, course SW. Ascend.
27.70 Ridge, brs. NE. and SW. Descend 155 ft.
39.25 Wash, 50 lks. wide, course SW., with stream of water, 3 lks.
wide, 2 ins. deep, Ascend 35 ft.
40.00 Set an iron post, 3 ft. long, 1 in. in diam., 6 ins. in the
ground, deposit marked (x) stone, and raise a mound of
stone around post, for $\frac{1}{4}$ sec. cor., marked on brass cap,

1
S28 | S27
1920

from which,

A white oak, 30 ins. in diam., brs. S. 37°W., 221 lks.
dist., mark " $\frac{1}{4}$ S28 BT."

No other trees within limits.
Ascend 35 ft.
45.00 Spur, slopes SW. Descend 25 ft., over NW. slope.
51.25 Gulch, 10 lks. wide, water in pools, course SW. Ascend 30 ft.
62.00 End of spur, slopes NE. Descend 15 ft.
64.95 Head of gulch, 5 lks. wide, course SE. Ascend 75 ft.
74.85 Spur, slopes SW. Thence along W. slope.
78.85 Descend NW. slope, to
80.00 Set an iron post, 3 ft. long, 2 ins. in diam., 6 ins. in
the ground, deposit marked (x) stone, and raise a mound
of stone around post, for cor. of secs. 21, 22, 27 and 28,
with brass cap, marked

T11S R25E
S21 | S22
S28 | S27
1920

Land, rolling and mountainous.
Soil, sandy and gravelly, 4th rate.
No timber.
Undergrowth, scattering cedar and scrub oak.

S. 89°49'E., on a random line; bet. secs. 22 and 27.
40.00 Set temp. $\frac{1}{4}$ sec. cor.
79.98 Intersect N. and S. line, 2 lks. N. of the cor. of secs. 22, 23,
26 and 27.

Thence,
N. 89°48'W., on a true line, bet. secs. 22 and 27.
Over broken and mountainous land, thru. scattering under-
growth.
Ascend 75 ft., over SE. slope.
7.40 Spur, slopes SW. Descend 240 ft., over W. slope.
27.00 Gulch, 20 lks. wide, course SW. Ascend 25 ft.
33.10 Spur, slopes SW. Descend 20 ft.
35.20 Gulch, 10 lks. wide, course SW. Ascend 25 ft.
37.00 Spur, slopes SW. Descend 20 ft. to
39.99 Set an iron post 3 ft. long, 1 in. in diam., 26 ins. in the
ground, for $\frac{1}{4}$ sec. cor., marked on brass cap,

$\frac{1}{4}$ S 22
S 27
1920

26 Part of Subdivision lines of Township 11 South Range 25 East

Chains.
 from which,
 A cedar limb, 6 ins. in diam., brs. N. 16½° W., 39 lks. dist., mark "¼ S22 BT."
 A cedar, 10 ins. in diam., brs. S. 14½° E., 43 lks. dist., mark "¼ S 27 BT."
 40.60 Gulch, 20 lks. wide, course S., with stream of water, 3 lks. wide, 2 ins. deep, Ascend 105 ft., over SE. slope.
 51.45 Spur, slopes SW. Descend 75 ft.
 62.95 Head of gulch, 10 lks. wide, course SE. Ascend 75 ft.
 70.70 Spur, slopes N. Descend 130 ft.
 79.98 The cor. of secs. 21, 22, 27 and 28.
 Land, broken and mountainous.
 Soil, sandy and gravelly, 4th rate.
 No timber.
 Undergrowth, scattering cedar, soto and scrub oak.

As there is no agricultural land in this township lying north of sec. 27 discontinue the subdivision of this range of sections.

The original cor. of secs. 32 and 33, on the S. bdy. of Tp. is an iron post, 3 ins. in diam., projecting 12 ins. above ground, firmly set, properly marked on brass cap, and witnessed by a mound of stone, N. of cor. No bearing trees.

Thence,
 N. 0° 2' W., bet. secs. 32 and 33.
 Over rolling land, thru. scattering undergrowth.
 Ascend gradually, 40 ft.
 20.00 fence brs. N. and S., 60 lks. E. of line:
 36.20 Descend gradually, 35 ft.
 Wash, 10 lks. wide, course SW. Ascend 30 ft., over SE. slope to ¼ sec. cor.
 39.00 Road, brs. NE. and SW.
 40.00 Set an iron post, 3 ft. long, 1 in. in diam., 16 ins. in the ground, deposit marked (x) stone, and raise a mound of stone around post, for ¼ sec. cor., with brass cap, marked

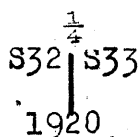

fence cors., 60 lks. E., and runs E and S. from cor.
 Ascend 80 ft.
 70.00 Spur, slopes NE. Descend 45 ft.
 80.00 Set an iron post 3 ft. long, 2 ins. in diam., 27 ins. in the ground, for cor. of secs. 28, 29, 32 and 33, marked on brass cap,

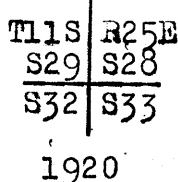

and raise a mound of stone, 2 ft. base, 1½ ft. high, W. of cor.
 Land, rolling.
 Soil, sandy, 3rd rate.
 No timber.
 Undergrowth, mesquite.

40.00 S. 89° 52' E., on a random line, bet. secs. 28 and 33.
 80.14 Set temp. ¼ sec. cor.
 Intersect N. and S1 line, 5 lks. S. of the cor. of secs. 27,

Part of Subdivision lines of Township 11 South, Range 25 East. 27

Chains 28, 33 and 34.
 Thence,
 N. 89° 54' W., on a true line, bet. secs. 28 and 33.
 Over rolling land, thru scattering undergrowth. Descend
 65 ft.
 6.55 Wash, 5 lks. wide, course S. Thence along S. slope.
 11.25 Gulch, 10 lks. wide, course S. Ascend 35 ft.
 16.75 Spur, slopes SW. Descend 25 ft.
 22.65 Gulch, 10 lks. wide, course S. Ascend 20 ft.
 18.15 Spur, slopes SW. Descend 50 ft.
 35.15 Fence, brs. N. and S.
 40.07 Set an iron post, 3 ft. long, 1 in. in diam., 27 ins. in
 the ground, for $\frac{1}{4}$ sec. cor., marked on brass cap,

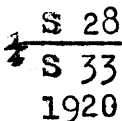

from which,
 A white oak; 12 ins. in diam., brs. N. 68 $\frac{1}{2}$ ° W.,
 129 lks. dist., mark. ~~†~~ S 28 BT."

No other tree, within limits; raise a mound of stone, 2
 ft. base, 1 $\frac{1}{2}$ ft. high, N. of cor.
 Descend.
 42.05 Wash, 30 lks. wide, course SW. Ascend 90 ft.
 47.50 Fence brs. NE. and SW.
 49.65 Road, brs. N. and S.
 65.30 Descend 135 ft.
 79.55 Head of draw, course NE. Ascend to
 80.14 The cor. of secs. 28, 29, 32 and 33.
 Land, rolling.
 Soil, sandy and gravelly, 4th rate.
 No timber.
 Undergrowth, scrub oak.
 Some grass.

 N. 0° 2' W., bet. secs. 28 and 29.
 Over rolling land, thru scattering undergrowth. Descend.
 1.10 Draw, 3 lks. wide, course NW. Ascend 60 ft.
 12.44 Ridge, brs. NW. and SE. Descend 55 ft.
 19.20 Wash, 20 lks. wide, course NW. Ascend 40 ft.
 22.20 Road, brs. NW. and SE.
 29.85 Spur, slopes SW. Descend 50 ft.
 40.00 Set an iron post, 3 ft. long, 1 in. in diam., 27 ins. in
 the ground, for $\frac{1}{4}$ sec. cor., marked on brass cap

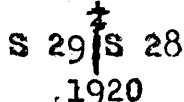

and raise a mound of stone, 2 ft. base, 1 $\frac{1}{2}$ ft. high,
 W. of cor. Continue descent.
 45.00 Wash, 20 lks. wide, course SW. Asc. 145 ft.
 51.10 Road, brs. NE. and SW.
 54.40 Same road, brs. NW. and SE.
 69.00 Spur, slopes SW. Desc.
 73.50 Head of gulch, course SW. Asc. 130 ft. to
 80.00 Set an iron post, 3 ft. long, 2 ins. in diam., 24 ins. in
 the ground, for cor. of secs. 20, 21, 28 and 29, marked
 on brass cap

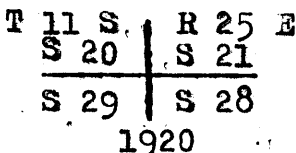

and raise a mound of stone, 2 ft. base, 1 $\frac{1}{2}$ ft. high, W.
 of cor.
 Land, rolling.
 Soil, sandy and gravelly, 4th rate.
 No timber.
 Undergrowth, cedar and mescal.

 S. 89° 54' E., on random line, bet. secs. 21 and 28.
 29.97 Offset point.
 Thence,
 South, 4.89 chs. into sec. 28
 to offset point.

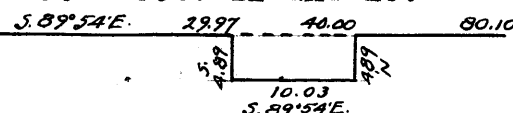

28 Part of Subdivision lines of Township 11 South, Range 25 East.

Chains Thence,
S. 89° 54' E., 10.03 chs. on offset line, in sec. 28 to offset point.
Thence,
North, 4.89 chs., returning to point on random line at
40.00 Offset point. Set temp. $\frac{1}{4}$ sec. cor.
Thence,
S. 89° 54' E., on a random line, bet. secs. 21 and 28, continuing measurement.
80.10 Intersect N. and S. line, 4 lks. N. of the cor. of secs. 21, 22, 27 and 28.
Thence,
N. 89° 52' W., on a true line, bet. secs. 21 and 28. Over rolling land, thru scattering undergrowth. Descend 80 ft.
9.25 Gulch, 10 lks. wide, course NW. Ascend.
13.90 End of spur, slopes NW. Descend 145 ft.
16.60 Mouth of gulch, course NW.
22.80 Wash, 15 lks. wide, course SW. Ascend 30 ft.
27.30 Spur, slopes SW. Descend 15 ft.
33.00 Wash, 20 lks. wide, course SW. Thence along S. slope.
37.30 Gulch, 10 lks. wide, course SE. Ascend 40 ft.
40.05 Set an iron post, 3 ft. long, 1 in. in diam., 16 ins. in the ground, deposit marked (X) stone, and raise a mound of stone around post, for $\frac{1}{4}$ sec. cor., with brass cap, marked

S 21
* S 28
1920

40.10 Offset point. To avoid cliff on sec. line, offset as follows:

South, 4.89 chs. to offset point in Sec. 28.
Thence N. 89° 52' W., 10.03 chs. on offset line in Sec. 28 to offset point

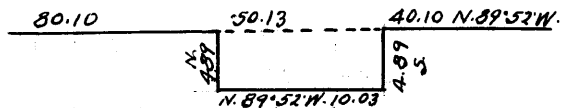

Thence North, 4.89 chs., returning to sec. line at

50.13 Offset point at base of cliff, bearing NW. and SE., facing SW.

Thence,
N. 89° 52' W., on true line, bet: secs 21 and 28, continuing measurement.

50:70 Head of draw, course SE. Asc. 45 ft.
55.70 Spur, slopes SE. Descend 95 ft.
63.20 Gulch, 10 lks. wide, course SE. Asc. 170 ft.
75.20 Spur, slopes SE. Descend 70 ft.
80.10 The cor. of secs. 20, 21, 28 and 29.

Land, rolling and mountainous.
Soil, sandy and rocky, 4th rate.
No timber.
Undergrowth, scrub cedar

As there is no agricultural land in this township, lying north of sec. 28, discontinue the subdivision of this range of secs.

The original cor. of secs. 31 and 32, on the S. bdy. of Tp. is an iron post, 3 ins. in diam., projecting 12 ins. above ground, firmly set, properly marked on brass cap, and witnessed by a mound of stone, N. of cor. No bearing trees.

Thence, N. 0° 3' W., bet. sec. 31 and 32. Over rolling land, thru scattering undergrowth.

28.10 Wash, 10 lks. wide, course SW.
35.10 Wash, 15 lks. wide, course SW.
40.00 Set an iron post, 3 ft. long, 1 in. in diam., 27 ins. in the ground, for $\frac{1}{4}$ sec. cor., marked on brass cap,

S 31 | S 32
1920

and raise a mound of stone, 2 ft. base, 1 $\frac{1}{2}$ ft. high, W. of cor.

Part of Subdivision lines of Township 11 South, Range 25 East, 29

Chains.

- 42.00 Road, brs.NE. and SW.
- 55.00 Dim road, brs.NE. and SW.
- 77.50 Wash, 30 lks.wide, course SW.
- 80.00 Set an iron post, 3 ft.long, 2 ins. in diam., 24 ins. in the ground, for cor.of secs.29,30,31 and 32, marked on brass cap,

T11S	R25E
S30	S29
S31	S32
1920	

and raise a mound of stone, 2 ft.base, 1½ ft.high,W. of cor.

Land, rolling.
Soil, sandy, 3rd rate.
No timber.
Undergrowth, mesquite.

- 40.00 S. 89°52'E., on a random line, bet. secs.29 and 32. Set temp.¼ sec.cor.
- 80.04 Intersect N. and S. line, 9 lks.N.of the cor. of secs.28,29, 32 and 33.
Thence
N. 89°48'W., on a true line, bet. secs.29 and 32.
Over rolling land, thru. scattering undergrowth.
- 10.25 Ascend 50 ft.
- 17.05 End of spur, slopes NW. Descend 105 ft.
- 27.25 Wash, 15 lks.wide, course SW. Thence over gently rolling land.
- 36.85 Road, brs.NE. and SW.
- 40.02 Set an iron post, 3 ft.long, 1 in. in diam., 27 ins. in the ground, for ¼ sec.cor., marked on brass cap,

¼ S 29
S 32
1920

and raise a mound of stone, 2 ft.base, 1½ ft.high,N. of cor.

- 77.85 Wash, 30 lks.wide, course SW.
- 80.04 The cor.of secs.29,30, 31 and 32.
Land, rolling and gently rolling.
Soil, sandy and rocky, 3rd rate.
No timber.
Undergrowth, greasewood.

- 40.00 N. 89°52'W., on a random line, bet. secs.30 and 31. Set temp.¼ sec.cor.
- 76.49 Fall 8 lks.S.of the reestablished cor.of secs.25,30,31 and 36, on the W. bdy.of the Tp., which is an iron post, 3 ins.in diam., projecting 12 ins.above ground, firmly set, properly marked on brass cap, and witnessed by 4 pits, one each NE., SE., SW. and NW.of cor., and mound of earth, W.of cor. No bearing trees.
Thence,
S. 89°49'E., on a true line bet. secs.30 and 31.
Over gently rolling land, thru. scattering undergrowth.
- 16.50 Leave gently rolling land; thence over roughly rolling land; ascend 70 ft.to
- 36.49 Set an iron post, 3 ft.long, 1 in. in diam., 12 ins.in the ground, deposit marked (x)stone, and raise a mound of stone around post, for ¼ sec.cor., with brass cap, marked

20. Part of Subdivision lines of Township 11 South, Range 25 East.

Chains..

$\frac{1}{4}$ S 30
S 31
1920

51.49 Ascend 55 ft., over W. slope.
71.50 Descend 85 ft., over SE. slope.
76.49 Thence over gently rolling land.
The cor. of secs. 29, 30, 31 and 32.
Land, gently and roughly rolling.
Soil, sandy, 4th rate.
No timber.
Undergrowth, mesquite.

5.00 N. 0° 3' W., bet. secs. 29 and 30.
35.60 Over rolling land, thru. scattering undergrowth.
40.00 Ascend 140 ft. over gradual SE. slope,
Head of gulch, 5 lks. wide, course SE. Continue ascent.
Set an iron post, 3 ft. long, 1 in. in diam., 14 ins. in
the ground, deposit marked (x) stone, and raise a mound
of stone around post, for $\frac{1}{4}$ sec. cor., with brass cap,
marked

$\frac{1}{4}$
S30 | S29
1920

42.30 Ridge, brs. NE. and SW. Descend 30 ft.
43.00 Ascend 40 ft.
48.00 Spur, slopes W. Descend 50 ft.
68.00 Gulch, 10 lks. wide, course SW. Ascend 310 ft., over S.
slope.
78.10 Point of spur, slopes SW. Descend.
80.00 Set an iron post, 3 ft. long, 2 ins. in diam., on bed rock,
supported in a mound of stone, containing a marked (x)
stone for cor. of secs. 19, 20, 29 and 30, marked on brass
cap,

T11S | R25E
S19 | S20
S30 | S29
1920

and raise a mound of stone, 2 ft. base, 1 $\frac{1}{2}$ ft. high, W.
of cor.
Land, rolling and mountainous.
Soil, rocky and gravelly, 4th rate.
No timber.
Undergrowth, cedar and mesquite.

40.00 S. 89° 48' E., on a random line, bet. secs. 20 and 29.
80.08 Set temp. $\frac{1}{4}$ sec. cor.
Intersect the cor. of secs. 20, 21, 28 and 29.
Thence,
N. 89° 48' W., on a true line, bet. secs. 20 and 29.
Over rolling and mountainous land, thru. scattering under-
growth.
8.70 Descend 145 ft., over W. slope.
9.10 Head of gulch, course S. Ascend.
13.00 Descend 95 ft.
35.10 Road, brs. N. and S.
39.78 Wash, 100 lks. wide, course SW. Ascend.
Set an iron post, 3 ft. long, 1 in. in diam., 26 ins. in the
ground, for witness cor. to $\frac{1}{4}$ sec. cor., marked on brass
cap,

WC $\frac{1}{4}$ S 20
S 29
1920

Part of Subdivision lines of Township 11 South Range 25 East 31

Chains.	and raise a mound of stone, 2 ft. base, $1\frac{1}{2}$ ft. high, N. of cor. Descend.
40.04	The true point for $\frac{1}{4}$ sec. cor. falls in wash, 10 lks. wide, course S. Ascend 135 ft.
53.30	Spur, slopes SE. Descend 100 ft.
61.00	Wash, 10 lks. wide, course S. Ascend 190 ft.
77.10	Spur, slopes SW. Descend 15 ft. to
80.08	The cor. of secs. 19, 20, 29 and 30. Land, rolling and mountainous. Soil, sandy and rocky, 3rd and 4th rate. No timber. Undergrowth, greasewood.

40.00	N. $89^{\circ}49'W.$, on a random line, bet. secs. 19 and 30. Set temp. $\frac{1}{4}$ sec. cor.
76.40	Fall 3 lks. N. of the reestablished cor. of secs. 19, 24, 25 and 30, on the W. bdy. of the Tp., which is an iron post, 3 ins. in diam., projecting 12 ins. above ground, firmly set, properly marked on brass cap, and witnessed by a mound of stone, W. of cor. No bearing trees. Thence, S. $89^{\circ}50'E.$, on a true line, bet. secs. 19 and 30. Over level land, thru. scattering undergrowth.
36.40	Set an iron post, 3 ft. long, 1 in. in diam., 26 ins. in the ground, for $\frac{1}{4}$ sec. cor., marked on brass cap, $\frac{1}{4}$ S 19 S 30 1920
50.80	and raise a mound of stone, 2 ft. base, $1\frac{1}{2}$ ft. high, N. of cor. Wash, 20 lks. wide, course SW. Leave level, and enter mountainous land. Ascend 345 ft., over W. slope, to
76.40	The cor. of secs. 19, 20, 29 and 30. Land, level and mountainous. Soil, sandy and rocky, 4th rate. No timber. Undergrowth, greasewood.

As there is no agricultural land in this township lying north of secs. 29 and 30, discontinue the subdivision of these ranges of sections.

The continued satisfactory adjustment of the solar apparatus during the survey of this township is indicated from field tests as described in Book "F."

GENERAL DESCRIPTION.

This township lies at the southern end of the Pinaleno Mountains. The unsurveyed part is extremely rough and broken. The surveyed part is also rough, particularly along the northern boundary, being traversed by numerous long ridges and spurs, ranging N. and S. in the eastern part, and NE. and SW. in the western. The approximate elevation is 4500 ft.

The soil is sandy and rocky, 3rd and 4th rate. Along the southern boundary, there is a fair growth of grass.

There is a very scattering growth of oak and cedar, heaviest

32

Chains.

in the northern part. It is of no commercial value, the trees being small and scrubby.

No evidence of minerals was found in the part surveyed; but extensive prospecting has been done in sec. 13, and it is claimed copper has been found.

There is no settler in the township, but part of the land has been fenced.

Small areas along the S. bdy. are tillable; and the entire area surveyed may be classed as fair grazing land. No other industrial possibilities are apparent.

There are washes with small springs in sections 25, 36, 26, 35, 27, 28, and 33, but these springs probably dry up in the summer, as they are all quite small.



CERTIFICATE OF UNITED STATES TRANSITMAN.

I, Karl L. Siebecker, U. S. Transitman,, hereby certify upon honor that, in pursuance of special instructions received from the U. S. Surveyor General for Group 102, Arizona, bearing date of the 6th day of October, 191⁹, I have well, faithfully, and truly in my own proper person, and in strict conformity with said instructions, the Manual of Surveying Instructions, and the laws of the United States, ^{re-} surveyed all those parts or portions of of the Second Standard Parallel South in Range 25 East, and of the East boundary of Township 11 South, Range 25 East, and surveyed all those parts or portions of the Subdivision lines of

Township 11 South, Range 25 East

of the Gila and Salt River

Base and Meridian, in the State of Arizona, which are represented in and by diagram on page 1 hereof the foregoing field notes, as having been executed by me, and under my direction; and that all the corners of resurvey and said survey have been established and perpetuated in strict accordance with the Manual of Surveying Instructions, and the special written instructions of the U. S. Surveyor General, for Group 102, Arizona,

and in the specific manner described in the field notes, and that the foregoing are the original field notes of resurvey and such survey.

Place Augusta, Mont.
Date Sept. 5th 1921

Karl L. Siebecker
U. S. Transitman

APPROVAL.

OFFICE OF THE UNITED STATES SURVEYOR GENERAL,

....., 191

The foregoing field notes of the survey of

executed by

under his special instructions dated, 191, having been critically examined, and the necessary corrections and explanations made, the said field notes, and the surveys they describe, are hereby approved.

.....
U. S. Surveyor General.

I certify that the foregoing transcript of the field notes of the above-described surveys in, has been correctly copied from the original notes on file in this office.

.....
U. S. Surveyor General.

BOOK 3483

CERTIFICATE OF UNITED STATES TRANSITMAN.

I, Guy R. Veal, U. S. Transitman, hereby certify upon honor that, in pursuance of special instructions received from the U. S. Surveyor General for Group 102, Arizona, bearing date of the 6th day of October, 1919, I have well, faithfully, and truly in my own proper person, and in strict conformity with said instructions, the Manual of Surveying Instructions, and the laws of the United States, surveyed all those parts or portions of the Subdivision lines of

Township 11 South, Range 25 East,

of the Gila and Salt River

Base and Meridian, in the State of Arizona, which are represented in and by diagram on page 1 hereof the foregoing field notes as having been executed by me, and under my direction; and that all the corners of said survey have been established and perpetuated in strict accordance with the Manual of Surveying Instructions, and the special written instructions of the U. S. Surveyor General, for Group 102, Arizona

and in the specific manner described in the field notes, and that the foregoing are the original field notes of such survey.

Place - Lawas City, Mich.
Date August 15, 1921

Guy R. Veal,
U. S. Transitman

APPROVAL.

OFFICE OF THE UNITED STATES SURVEYOR GENERAL,

Phoenix Arizona SEP 15 1921

The foregoing field notes of the re-survey of Second Standard Parallel South through part of Range 25 East, and of the East boundary of Township 11 South, Range 25 East, and of the survey of part of the Subdivision lines of Township 11 South, Range 25 East, of the Gila and Salt River Base and Meridian, in the State of Arizona,

executed by Guy R. Veal, and Karl L. Siebecker, U. S. Transitmen, under special instructions dated October 6, 1921 for Group 102 Arizona, having been critically examined, and the necessary corrections and explanations made, the said field notes, and the surveys they describe, are hereby approved.

Francis A. Frost
U. S. Surveyor General.

I certify that the foregoing transcript of the field notes of the above described surveys in has been correctly copied from the original notes on file in this office.