

3500

BOOK 3500

4-679

Book "P"

BOOK 3500

1000
1

FIELD NOTES

OF THE RESURVEY OF

the South boundary,

the East boundary,

and part of the North boundary,

AND OF THE SURVEY OF

part of the North boundary,

and the Subdivision lines of

Township 23 North, Range 30 East,

Of the Gila and Salt River Base and Meridian,

In the State of Arizona,

EXECUTED BY

Loyd E. Sechrist, and

William D. Wilson,

U. S. Transitmen,

In the capacity of U. S. Surveyor, under instructions dated Sept. 27, 1918,

issued by the United States Surveyor General to govern surveys included in

Group No. 92, Arizona, which were approved by the Commissioner of the General Land

Office, October 19, 1918, and Assignment Instructions dated June 18, 1920.
Sept 11, 1920.

Resurvey and Survey commenced July 15, 1920

Resurvey and Survey completed September 23, 1920

3500

3500

1A

Book "F"
Group 92 - - - Arizona.

BOOK 3500

INDEX DIAGRAM.

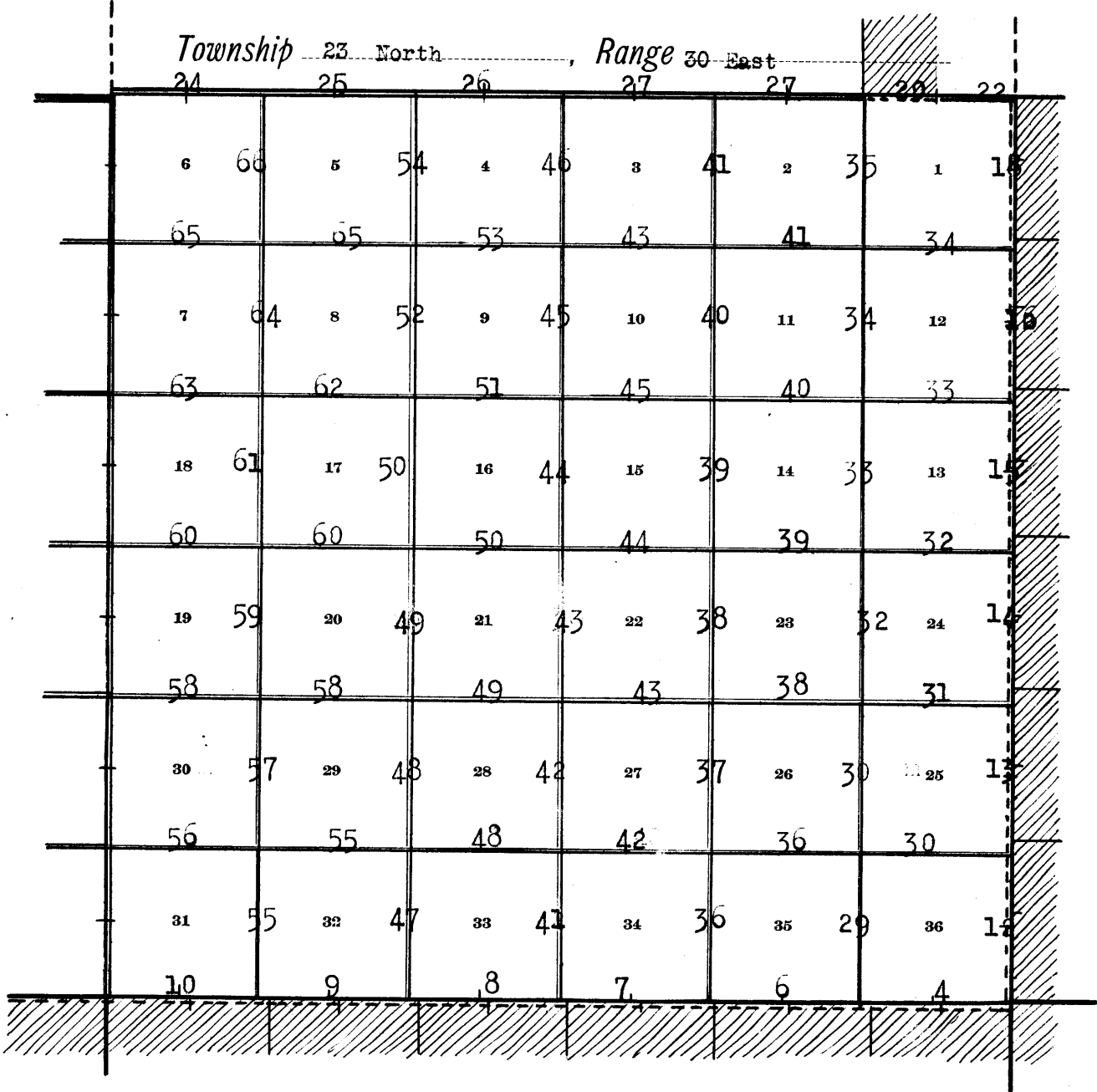

----- Lines resurveyed under this Group.

===== Lines surveyed under this Group.

----- Accepted surveys,

 Areas surveyed as per accepted plats on file.

----- Unsurveyed.

DATE DIAGRAM
 Township 23 North, Range 30 East
 Book "F"
 Group 92 - - - Arizona

See Book "E" for dates of execution of survey of this line.

| | | | | | | |
|---------------|------------------------------|-----------------------------|--------------------------|--------------------------|--------------------------|---------|
| 6 7-18-20 | 5 7-18-20 9-23-20 | 4 7-17-20 9-19-20 | 3 7-17-20 8-27-20 | 2 7-16-20 8-26-20 | 1 7-15-20 8-24-20 | 8-25-20 |
| 7 9-22-20 | 8 9-21-20 9-18-20 | 9 9-16-20 9-3;9-15-20 | 10 8-26-20 8-27-20 | 11 8-24-20 8-26-20 | 12 8-25-20 8-24-20 | 8-25-20 |
| 15 9-18-20 | 17 9-17-20 9-3;9-17-20 | 16 8-18-20 8-18-20 | 15 8-12-20 8-12-20 | 14 8-6-20 8-6-20 | 13 8-23-20 7-29-20 | 8-23-20 |
| 19 9-1-20 | 20 9-2-20 9-1-20 | 21 8-17-20 8-17-20 | 22 8-11-20 8-10-20 | 23 8-5-20 8-5-20 | 24 7-30-20 7-29-20 | 7-30-20 |
| 30 8-30-20 | 29 8-31-20 8-30-20 | 28 8-16-20 8-14-20 | 27 8-10-20 8-9-20 | 26 8-4-20 8-3-20 | 25 7-28-20 7-27-20 | 7-28-20 |
| 31 8-21-20 | 32 8-20-20 8-20-20 | 33 8-13-20 8-13-20 | 34 8-3-20 8-2-20 | 35 7-26-20 7-24-20 | 36 7-23-20 7-22-20 | 7-23-20 |
| 7-21-20 | 7-21-20 | 7-21-20 | 7-21-20 | 7-21-20 | 7-21-20 | 7-21-20 |

On the above diagram:-

Dotted red lines indicate resurveys, and red lines indicate surveys executed by Loyd E. Sechrist, U.S. Transitman, on dates shown thereon.

Blue lines indicate surveys executed by William D. Wilson, U.S. Transitman, on dates shown thereon.

Black lines indicate surveys executed by Sidney E. Blout, U.S. Cadastral Engineer, on dates shown in Book "E."

Resurveys and surveys, hereinafter described, executed on dates shown on diagram on page 1 hereof by Loyd E. Sechrist, and William D. Wilson, U. S. Transitmen, the former using a Buff "Rocky Mountain Favorite" solar transit, No. 10124, with U-shaped standards, $4\frac{1}{2}$ -inch horizontal circle, 4-inch vertical circle, and improved Smith solar attachment, the latter using same instrument and also Buff Solar Transit No. 10125, same description. All azimuth determinations are accomplished with the solar attachments, except the special observations on Polaris for meridian, upon which to test the solar attachment, as stated in the field notes.

All measurements are made with a Lufkin 5-chain steel tape, compared with a Chesterman standard steel tape and found correct; the measurements are made on the slope, the vertical angle determined and the slope measurements, properly reduced to true horizontal distances.

TEST OF INSTRUMENT NO. 10124.

The instrument was examined, tested on the meridian, established May 16, 1920, by Polaris observations, at camp in sec. 21, T. 25 N., R. 28 E., in latitude $55^{\circ} 32\frac{1}{2}'$ N., longitude $109^{\circ} 22' 09''$ W., found correct and was approved by the Assistant Supervisor of Surveys for Arizona, June 18, 1920, conditional upon further satisfactory field tests.

Preliminary to beginning the surveys under Group No. 92, examine the adjustments of the transit and correct the level and collimation errors, then to test the solar attachment, by comparing the results of observations on the sun, made during a. m., and p. m., hours with a meridian established by observations on Polaris, proceed as follows:

June 20, 1920, set instrument on the meridian, established at camp in sec. 21, T. 25 N., R. 28 E., by Polaris observation May 16th, 1920, and at 8 h. 59 m., a. m., l.m.t., set off $35^{\circ} 32\frac{1}{2}'$ N. on the lat. arc, $25^{\circ} 28'$ N. on the decl. arc and determine a meridian with the solar and mark a point thereof by a tack in the stake already set 5-chs. N.; this point falls $00\frac{1}{2}'$ E. of the meridian established by the Polaris observations.

At the same station at 3 h. 59 m. p. m., l.m.t., set off $35^{\circ} 32\frac{1}{2}'$ N. on the lat. arc, $25^{\circ} 27'$ N. on the decl. arc, and determine a meridian with the solar and mark a point thereof on the stake already set 5-chs. N., on which the solar meridian falls $01'$ W. of the meridian established by the Polaris observations.

The solar apparatus by a. m., and p. m., observations, defines positions for meridians, which agree within about one minute in azimuth with the meridian established by the Polaris observations, therefore, conclude that the instrument is in satisfactory adjustment.

TEST OF SOLAR TRANSIT NO. 10125

This instrument was examined, tested on the meridian at Phoenix, Arizona, September 7, 1920, found correct and was approved by the Assistant Supervisor of Surveys for Arizona, September 11, 1920, conditional upon satisfactory field tests.

Examine the adjustments of the transit and find them to be correct, then to test the solar apparatus, by comparing the results of a. m., and p. m., observations on the sun with a meridian, established by observations on Polaris; proceed as follows:

September 11, 1920, at camp on N. bdy. of sec. 26, T. 22 N.; R. 29 E., latitude $35^{\circ} 17'$ N., longitude $109^{\circ} 14'$ W., at 8 h. 13.1 m., p. m., l.m.t., observe Polaris at eastern elongation, making four observations, two each with telescope in direct and reversed positions, and mark the mean point in the line thus determined on a stake driven firmly in the ground 5-chs. N.

Azimuth of Polaris at eastern elongation = $1^{\circ} 22' 30''$.

September 12, 1920, lay off the azimuth of Polaris $1^{\circ} 22\frac{1}{2}'$ to the west and mark the meridian thus determined by a tack driven in a stake set firmly in the ground 5-chs. N.

At 8 h. 00 m., a.m., apparent time, September 12, 1920, set off $55^{\circ} 17'$ N. on the lat. arc, $4^{\circ} 9\frac{1}{2}'$ N. on the decl. arc, and determine a meridian with the solar at the above station and mark a point thereof on the stake already set 5-chs. N.; this mark falls 1' west of the meridian established by the Polaris observations.

At 4 h. 00 m., p. m., apparent time; set off $35^{\circ} 17'$ N. on the lat. arc, $4^{\circ} 1\frac{1}{2}'$ N. on the decl. arc, and determine a meridian with the solar and mark the direction thus determined on stake already set 5-chs. N.; this mark agrees with the meridian established by the Polaris observations.

The solar apparatus by a. m., and p. m., observations defines positions for meridians, which agree satisfactorily within $0\frac{1}{2}'$ of the meridian established by the Polaris observations, therefore, conclude that the adjustments of the instrument are satisfactory.

The magnetic bearing of the true meridian at 8 a. m. is N. $14^{\circ} 30'$ W., and the angle thus determined gives the magnetic declination $14^{\circ} 30'$ E.

4 Dependent Resurvey of South bdy. of Township 23 North, Range 30 East.

Chains.

This township boundary was surveyed by W. R. Fitzgerald, U.S.D.S. in 1882, and no retracement or resurvey of the line is of record. The following notes describe a dependent resurvey of the line, and in the retracement for such resurvey, the record of the survey is used for the bearing and length of the random line.

Retracement for Resurvey.

The cor. of Ts. 22 and 23 N., Rs. 29 and 30 E., reestablished as described in Book "E," is a sandstone 24x10x8 ins., firmly set in a mound of stone, marked "T23N R30E" on NE. face, and 6 notches on each of N., S.E., and W. edges, witnessed by a mound of stone 3 ft. base, 2 ft. high, S. of cor. No bearing trees.

Thence,
 N. 89° 57' E., on a random line, searching diligently at record intervals for the original $\frac{1}{4}$ sec. and sec. cors., setting temp. $\frac{1}{4}$ sec. and sec. cors. at such intervals, and find no trace of any cor. on the line.

470.18 Fall 4.65 chs. S. of the previously reestablished cor. of Ts. 22 and 23 N., Rs. 30 and 31 E., hereinafter described. The true bearing and length of the S. bdy. of T. 23 N., R. 30 E. are therefore, S. 89° 23' W., 470.18 chs.

To maintain the original proportion bet. the cor. intervals on the line, there will be eleven equal intervals of 39.28 $\frac{1}{2}$ chs. each on the east $5\frac{1}{2}$ miles, and one interval of 38.04 chs. on the west $\frac{1}{2}$ mile of the line, which reestablished intervals will apply only to the reestablishment of cors. relating to accepted areas south of the line. A second set of cors. is reestablished relating to new areas. North of line only at intervals of 40.00 chs., counting from the cor. of Ts. 22 and 23 N., Rs. 30 and 31 E., as described as follows:

Resurvey:

The cor. of Ts. 22 and 23 N., Rs. 30 and 31 E., reestablished by Charles L. Campbell, U.S.D.S. in 1907, is a malpais stone, 10x10x4 ins. loosely set in ground, marked with 6 notches on each of N., S.E., and W. edges, and witnessed by mound of stone, 2 ft. base, 1 $\frac{1}{2}$ ft. high, S. of cor., and 4 bearing trees as follows:

- A pinyon, 10 ins. in diam., N. 22 $\frac{1}{2}$ ° E., 142 lks. dist., marked "T23N R31E S31BT."
- A pinyon, 10 ins. in diam., S. 27° E., 82 lks. dist., marked "T22N R31E S6 BT."
- A pinyon, 6 ins. in diam., S. 77° W., 44 lks. dist., marked "T22N R30E S 1 BT."
- A pinyon, 6 ins. in diam., N. 48 $\frac{1}{2}$ ° W., 42 lks. dist., marked "T23N R30E S36 BT."

Reestablish this cor. in same place, as follows:

Set an iron post, 3 ft. long, 3 ins. in diam., 12 ins. in the ground to bed rock, supported in a mound of stone, 4 ft. base, 2 ft. high, and alongside iron post in the mound of stone, reset the old cor. stone, for reestablished cor. of Ts. 22 and 23 N., Rs. 30 and 31 E., marked on brass cap,

~~T23N~~
 R30E | R31E
 S36 | S31
 S 1 | S 6
 T22N
 1920

To which the original cor. accessories described above still apply.

Dependent Resurvey of South bdy. of Township 23 North, Range 30 East.

Chains.

- Thence, S. 89° 23' W., on a true line, on S. bdy. of sec. 30.
- Over rolling and broken land, thru dense timber and undergrowth. Asc. 11 ft., over E. slope.
- 1.40 Spur, slopes SE. Desc. 11 ft., over SW. slope.
- 4.84 Wash, 25 lks. wide, course S. Asc. 23 ft., over E. slope.
- 19.30 Stony ridge, brs. N. and S. Desc. 13 ft., over W. slope.
- 21.78 Wash, 30 lks. wide, banks 4 ft. high, course S. Asc. 17 ft., over E. slope.
- 26.45 Ridge, brs. N. and S.; thence over rough, stony land.
- 39.28½ (Proportional dist.), Set an iron post, 3 ft. long, 1 in. in diam., 26 ins. in the ground, for reestablished ¼ sec. cor. of sec. 1 only, marked on brass cap,

¼ S 1
1920

- A cedar, 20 ins. in diam., brs. S. 21° E., 42 lks. dist., mark "¼ S 1 BT."
- A pinyon, 9 ins. in diam., brs. S. 37° W., 115 lks. dist., mark "¼ S 1 BT."
- 40.00 Set an iron post, 3 ft. long, 1 in. in diam., 26 ins. in the ground for reestablished ¼ sec. cor. of sec. 30 only, marked on brass cap,

¼ S 36
1920

- A cedar, 12 ins. in diam., brs. N. 6¼° W., 33 lks. dist., mark "¼ S 36 BT."
- A cedar, 6 ins. in diam., brs. N. 64° W., 50 lks. dist., mark "¼ S 36 BT."
- 40.06 Descend 10 ft., over SW. slope.
- 44.05 East rim of canyon, 50 ft. deep, brs. N. 20° W. and S. 20° E.; desc. abruptly over sandstone ledges.
- 45.00 Bottom of canyon, with stream of clear water, 3 lks. wide, 2 ins. deep, on gravel bottom, course S. 20° E. Asc. W. wall of canyon.
- 45.40 West rim of canyon, brs. N. 20° W. and S. 20° E. Asc. 11 ft. over NE. slope.
- 48.05 Ridge, brs. NW and SE.; thence over rough, stony land.
- 58.50 East rim of canyon, 50 ft. deep, course S. 20° E.; desc. abruptly.
- 59.30 Bottom of canyon, with stream of water, 2 lks. wide, 3 ins. deep, course S. 20° E. Asc. W. wall of canyon.
- 62.23 West rim of canyon, brs. N. 20° W., and S. 20° E.; thence over rolling SE. slope, ascending very gradually.
- 78.57 (Proportional dist.), Set an iron post, 3 ft. long, 2 ins. in diam., 24 ins. in the ground for reestablished cor. of secs. 1 and 2 only, marked on brass cap,

T23N R30E
S36
S 2 | S 1
T22N
1920

- A pinyon, 8 ins. in diam., brs. S. 35¼° E., 45 lks. dist., mark "T22N R30E S1 BT."
- A pinyon, 7 ins. in diam., brs. S. 28° W., 31 lks. dist., mark "T22N R30E S2 BT."
- 80.00 Set an iron post, 3 ft. long, 2 ins. in diam., 24 ins. in the ground, for reestablished cor. of secs. 35 and 36 only, marked on brass cap,

T23N R30E
S35 | S36
S 2
T22N
1920

6 Dependent Resurvey of South bdy. of Township 23 North, Range 30 East.

Chains.

A cedar, 10 ins. in diam., brs. N. 48 1/2° E., 25 lks.
dist., mark "T23N R30E S36 BT."
A pinyon, 10 ins. in diam., brs. N. 73 1/2° W., 34 lks.
dist., mark "T23N R30E S35 BT."

Land, rolling and broken.
Soil, shallow, sandy clay loam, 3rd rate.
Timber, dense cedar, pinyon and yellow pine.
Undergrowth, dense scrub oak, cinchona, sage brush and cacti.

37.85 1/2 S. 89° 23' W., on true line, on S. bdy. of sec. 35.
Over rolling, and broken stony land, thru dense timber and
undergrowth. Asc. 55 ft., over SE. slope.
(39.28 1/2 chs. S. 89° 23' W. from cor. of secs. 1 and 2), Set
an iron post 3 ft. long, 1 in. in diam., 26 ins. in the
ground, for reestablished 1/4 sec. cor. of sec. 2 only,
marked on brass cap,

1/4 S 2
1920

40.00 A yellow pine, 16 ins. in diam., brs. S. 11° E., 76
lks. dist., mark "1/4 S 2 BT."
A yellow pine, 20 ins. in diam., brs. S. 70 1/4° W., 46
lks. dist., mark "1/4 S 2 BT."
Set an iron post, 3 ft. long, 1 in. in diam., 26 ins. in
the ground for reestablished 1/4 sec. cor. of sec. 35 only,
marked on brass cap,

1/4 S 35
1920

59.00 A yellow pine, 12 ins. in diam., brs. N. 27 1/2° E., 33
lks. dist., mark "1/4 S 35 BT."
67.20 A yellow pine, 12 ins. in diam., brs. N. 79 1/4° E., 100
lks. dist., mark "1/4 S 35 BT."
69.10 Ridge, brs. N. 30° E. and S. 30° W. Desc. 88 ft., over NW. slope.
77.14 Wash, 40 lks. wide, course S. 50° W. Asc. 9 ft., over SE. slope.
Ridge bank of wash, brs. NE. and SW.; thence over S. slope.
(78.57 chs. S. 89° 23' W. from cor. of secs. 1 and 2), Set an
iron post 3 ft. long, 2 ins. in diam., 20 ins. in the
ground to bed rock, surrounded with a mound of stone
3 ft. base, 1 ft. high, for reestablished cor. of secs.
2 and 3 only, marked on brass cap,

T22N R30E
S35
S 3 S 2
T22N
1920

80.00 A pinyon, 11 ins. in diam., brs. S. 52 1/2° E., 21 lks.
dist., mark "T22N R30E S2 BT."
A cedar, 20 ins. in diam., brs. S. 23 1/2° W., 12 lks.
dist., mark "T22N R30E S3 BT."
Set an iron post, 3 ft. long, 2 ins. in diam., 24 ins. in
the ground, for reestablished cor. of secs. 34 and 35
only, marked on brass cap,

T23N R30E
S34 S35
S 3
T22N
1920

A pinyon, 12 ins. in diam., brs. N. 81 1/4° E., 60 lks.
dist., mark "T23N R30E S35 BT."
A pinyon, 7 ins. in diam., brs. N. 15 1/4° W., 60 lks.
dist., mark "T23N R30E S34 BT."

Page 2002

Dependent Resurvey of South bdy. of Township 23 North, Range 30 East. 7

Chains.

Land, rolling and broken.
Soil, shallow, rocky clay loam, 3rd rate.
Timber, dense pinyon and cedar, and scattering yellow pine.
Undergrowth, dense sage brush, cinchona, and cacti.

- 2.70 S. 89°23'W., on true line, on S. bdy. of sec. 34. Over broken, stony land, thru. dense timber and undergrowth. Desc. 39 ft., over W. slope.
- 16.45 Ravine, 15 lks. wide, course S. 15° W. Asc. 84 ft., over SE. slope.
- 23.00 Spur, slopes S. Descend 51 ft., over W. slope.
- 25.60 Wash, 50 lks. wide, course S. 30° W. Asc. 11 ft., over SE. slope.
- 36.42½ Top of ascent on W. side of wash; thence over broken SW. slope.
- 39.28½ (39.28½ chs. S. 89°23'W., from cor. of secs. 2 and 3), Set an iron post 3 ft. long, 1 in. in diam., 3 ins. in the ground, on bed rock, supported in a mound of stone 6 ft. base, 2 ft. high for reestablished ¼ sec. cor. of sec. 3 only, marked on brass cap,

¼ S 3
1920

- A pinyon, 5 ins. in diam., brs. S. 62½° E., 113 lks. dist., mark "¼ S 3 BT."
- A pinyon, 5 ins. in diam., brs. S. 48½° W., 36 lks. dist., mark "¼ S 3 BT."
- 40.00 Set an iron post, 3 ft. long, 1 in. in diam., 4 ins. in the ground on bedrock, supported in a mound of stone 6 ft. base, 2½ ft. high, for reestablished ¼ sec. cor. of sec. 34 only, marked on brass cap,

¼ S 34
1920

- A pinyon, 10 ins. in diam., brs. N. 42° E., 40 lks. dist., mark "¼ S 34 BT."
- A pinyon, 5 ins. in diam., brs. N. 35° W., 50 lks. dist., mark "¼ S 34 BT."
- 50.60 S. rim of wide gorge, brs. NE. and SW. Desc. 210 ft., over steep, broken NW. slope.
- 60.60 Foot of steep broken NW. slope. Thence along steep N. slope. Desc. 30 ft. to cor. of secs. 33 and 34.
- 63.25 Spring of alkali water, brs. N. 1.00 ch. dist.
- 73.79 Abandoned stone house, brs. N. 1.00 ch. dist.
- 75.71 (78.57 chs. S. 89°23'W. from cor. of secs. 2 and 3), Set an iron post, 3 ft. long, 2 ins. in diam., 14 ins. in the ground on bedrock, supported in a mound of stone 4 ft. base, 2 ft. high, for reestablished cor. of secs. 3 and 4 only, marked on brass cap,

T23N R30E
S34
S 4 | S 3
T22N
1920

- A cedar, 9 ins. in diam., brs. S. 39° E., 47 lks. dist., mark "T22N R30E S3 BT."
- A cedar, 6 ins. in diam., brs. S. 8½° W., 49 lks. dist., mark "T22N R30E S4 BT."
- 80.00 Set an iron post, 3 ft. long, 2 ins. in diam., 18 ins. in the ground on bedrock, supported in a mound of stone 2 ft. base, 8 ins. high, for reestablished cor. of secs. 33 and 34 only, marked on brass cap,

8 Dependent Resurvey of South bdy. of Township 23 North, Range 30 E.

Chains.

| | |
|------|------|
| T23N | R30E |
| S33 | S34 |
| S 4 | |
| T22N | |
| 1920 | |

A cedar, 14 ins. in diam., brs. N. $60\frac{1}{2}^{\circ}$ E., 18 lks. dist., mark "T23N R30E S34 BT."

A cedar, 6 ins. in diam., brs. N. $65\frac{1}{2}^{\circ}$ W., 76 lks. dist., mark "T23N R30E S33 BT."

Land, rough and broken.

Soil, shallow, stony clay loam, 3rd and 4th rate.

Timber, dense pinyon and cedar, and scattering pine.

Undergrowth, dense sage brush, cinchona, scrub cedar and cacti.

S. $89^{\circ}23'W.$, on true line, on S. bdy. of sec. 33.

Over rolling and broken land, thru. dense timber and undergrowth. Desc. 56 ft., over NW. slope.

6.57 Wash, 75 lks. wide, 25 ft. deep, course S. $55^{\circ}W.$ in bottom of wide gorge.

10.00 Point of spur, slopes SE. Descend 11 ft. over SW. slope.

34.99 $\frac{1}{2}$ (39.28 $\frac{1}{2}$ chs. S. $89^{\circ}23'W.$ from cor. of secs. 3 and 4) The point for reestablished $\frac{1}{4}$ sec. cor. of sec. 4 only, falls in the bottom of ravine, 15 lks. wide, 4 ft. deep, course NW., where prevailing conditions would insure the destruction of the cor.; therefore, continue line and measurement and at

36.19 $\frac{1}{2}$ Set an iron post, 3 ft. long, 1 in. in diam., 26 ins. in the ground for witness cor. to reestablished $\frac{1}{4}$ sec. cor. of sec. 4 only, marked on brass cap,

| |
|---------------------|
| WC $\frac{1}{4}$ S4 |
|---------------------|

1920

A cedar, 6 ins. in diam., brs. S. $59^{\circ}E.$, 259 lks. dist., mark "WC $\frac{1}{4}$ S 4 BT."

A cedar, 18 ins. in diam., brs. S. $36\frac{1}{2}^{\circ}W.$, 336 lks. dist., mark "WC $\frac{1}{4}$ S 4 BT."

39.43 Ravine, 15 lks. wide, 4 ft. deep, course N. $30^{\circ}W.$ Ascend gradually over NE. slope.

40.00 Set an iron post, 3 ft. long, 1 in. in diam., 26 ins. in the ground for reestablished $\frac{1}{4}$ sec. cor. of sec. 33 only, marked on brass cap,

| |
|------|
| S 33 |
|------|

1920

No trees suitable for bearing trees available; dig pits, 18x18x12 ins., E. and W. of post, 3 ft. dist.

65.63 Point of spur, slopes N. Desc. over NW. slope.

69.93 Wash, 50 lks. wide, 15 ft. deep, course S. $65^{\circ}W.$; thence over rolling SW. slope.

74.28 (78.57 chs. S. $89^{\circ}23'W.$ from cor. of secs. 3 and 4), Set an iron post 3 ft. long, 2 ins. in diam., 24 ins. in the ground, for reestablished cor. of secs. 4 and 5 only, marked on brass cap,

| | |
|------|------|
| T23N | R30E |
| S33 | |
| S 5 | S 4 |
| T22N | |
| 1920 | |

A cedar, 6 ins. in diam., brs. S. $57\frac{1}{2}^{\circ}E.$, 70 lks. dist., mark "T22N R30E S4 BT."

LOCK 3000

Dependent Resurvey of South bdy. of Township 23 North, Range 30 E. 9

Chains.

80.00 A cedar, 14 ins. in diam., brs. S. 47° W., 247 lks.
 dist., mark "T22N R30E S5 BT."
 Set an iron post, 3 ft. long, 2 ins. in diam., 24 ins. in
 the ground for reestablished cor. of secs. 32 and 33,
 marked on brass cap,

| | |
|------|------|
| T23N | R30E |
| S32 | S33 |
| S 5 | |
| T22N | |
| 1920 | |

A cedar, 6 ins. in diam., brs. N. 87½° E., 139 lks.
 dist., mark "T23N R30E S33 BT."
 A cedar, 14 ins. in diam., brs. N. 54½° W., 139 lks.
 dist., mark "T23N R30E S32 BT."

Land, rolling and broken.
 Soil shallow dry, sandy clay loam, 3rd rate.
 Timber, dense cedar and pinyon.
 Undergrowth, dense sage brush, cinchona and cacti.

33.56½ S. 89° 23' W., on true line, on S. bdy. of sec. 32.
 Over rolling and broken land, thru. medium timber and
 dense undergrowth. Desc. gradually over SW slope.
 (39.28½ chs. S. 89° 23' W., from cor. of secs. 4 and 5), Set
 an iron post, 3 ft. long, 1 in. in diam., 26 ins. in the
 ground for reestablished ¼ sec. cor. of sec. 5 only,
 marked on brass cap,

| |
|-------|
| ¼ S 5 |
| 1920 |

38.69 A cedar, 14 ins. in diam., brs. S. 40° E., 24 lks.
 dist., mark "¼ S 5 BT."
 A cedar, 5 ins. in diam., brs. S. 50° W., 37 lks.
 dist., mark "¼ S 5 BT."
 40.00 Wash, 50 lks. wide, 4 ft. deep, course S. 40° W.; ascend 29
 ft., over SE slope.
 Set an iron post, 3 ft. long, 1 in. in diam., 26 ins. in
 the ground, for reestablished ¼ sec. cor. of sec. 32 only,
 marked on brass cap,

| |
|--------|
| ¼ S 32 |
| 1920 |

53.67 A cedar, 8 ins. in diam., brs. N. 35° E., 148 lks.
 dist., mark "¼ S 32 BT."
 63.83 A cedar, 6 ins. in diam., brs. N. 27° W., 204 lks.
 dist., mark "¼ S 32 BT."
 68.98 Point of spur, slopes S.; desc. 50 ft., over W. slope.
 72.85 Wash, 80 lks. wide, 6 ft. deep, course NW.
 Same wash, 100 lks. wide, 6 ft. deep, course SW.
 (78.57 chs., S. 89° 23' W., from cor. of secs. 4 and 5), Set an
 iron post 3 ft. long, 2 ins. in diam., 24 ins. in the
 ground for reestablished cor. of secs. 5 and 6 only,
 marked on brass cap,

| | |
|-----------|------|
| T23N | R30E |
| S32 | |
| S 6 S 5 | |
| T22N | |
| 1920 | |

A cedar, 12 ins. in diam., brs. S. 15½° E., 479 lks.
 dist., mark "T22N R30E S5 BT."
 A cedar, 12 ins. in diam., brs. S. 23¾° W., 329 lks.
 dist., mark "T22N R30E S6 BT."
 76.74 Same wash, 70 lks. wide, 10 ft. deep, course N. 65° W.

10 Dependent Resurvey of South bdy. of Township 23 North, Range 30 E.

| | | | | | | | | | | | | | | | |
|--------------------|---|------|------|-----|-----|-----|--|------|--|------|--|-------------------|------|--------------------|------|
| Chains. | | | | | | | | | | | | | | | |
| 80:00 | Set an iron post, 3 ft. long, 2 ins. in diam., 24 ins. in the ground, for reestablished cor. of secs. 31 and 32 only, marked on brass cap, <div style="text-align: center;"> <table border="1"> <tr> <td>T23N</td> <td>R30E</td> </tr> <tr> <td>S31</td> <td>S32</td> </tr> <tr> <td colspan="2">S 6</td> </tr> <tr> <td colspan="2">T22N</td> </tr> <tr> <td colspan="2">1920</td> </tr> </table> </div> <p>A cedar, 10 ins. in diam., brs. N. $79\frac{1}{2}^{\circ}$ E., 321 lks. dist., mark "T23N R30 E S32 BT." A pinyon, 10 ins. in diam., brs. N. $29\frac{1}{2}^{\circ}$ W., 279 lks. dist., mark "T23N R30E S31 BT." Land, rolling and broken. Soil, shallow, sandy and stony clay loam, 3rd rate. Timber, medium growth of pinyon and cedar. Undergrowth, dense sage brush, cinchona and cactus.</p> <hr/> <p>S $89^{\circ}23'$ W., on true line, on S. bdy. of sec. 31. Over rolling and broken land, thru. dense timber and undergrowth.</p> <p>3.84 Same wash crossed in preceding mile, 80 lks. wide, 10 ft. deep, course SW.</p> <p>8.54 Left bank of Defiance Creek, 20 ft. high, brs. N. and S.</p> <p>9.25 Dry bed of Defiance Creek, 40 lks. wide, course S. 20° W. Asc.</p> <p>10:04 Right bank of Defiance Creek, brs. N. 20° E. and S. 20° W. Asc. 224 ft., over broken SE. slope.</p> <p>32.13$\frac{1}{2}$ (39.28$\frac{1}{2}$ chs. S. $89^{\circ}23'$ W., from cor. of secs. 5 and 6), Set an iron post 3 ft. long, 1 in. in diam., 3 ins. in the ground on bed rock, supported in a mound of stone 6 ft. base, 2$\frac{1}{2}$ ft. high for reestablished $\frac{1}{4}$ sec. cor. of sec. 6 only, marked on brass cap, <div style="text-align: center;"> <table border="1"> <tr> <td>$\frac{1}{4}$S 6</td> </tr> <tr> <td>1920</td> </tr> </table> </div> <p>A pinyon, 6 ins. in diam., brs. S. $4\frac{1}{2}^{\circ}$ E., 27 lks. dist., mark "$\frac{1}{4}$S 6 BT." A cedar, 8 ins. in diam., brs. S. 80° W., 55 lks. dist., mark "$\frac{1}{4}$S 6 BT."</p> <p>40:00 Set an iron post 3 ft. long, 1 in. in diam., 26 ins. in the ground, for reestablished $\frac{1}{4}$ sec. cor. of sec. 31 only, marked on brass cap, <div style="text-align: center;"> <table border="1"> <tr> <td>$\frac{1}{4}$S 31</td> </tr> <tr> <td>1920</td> </tr> </table> </div> <p>A cedar, 5 ins. in diam., brs. N. $49\frac{1}{2}^{\circ}$ E., 29 lks. dist., mark "$\frac{1}{4}$S 31 BT." A cedar, 8 ins. in diam., brs. N. 74° W., 95 lks. dist., mark "$\frac{1}{4}$S 31 BT."</p> <p>54.83 Spur, slopes S. Desc. 134 ft., over stony W. slope.</p> <p>66.31 Wash, 20 lks. wide, course S. Asc. 43 ft., over broken SE. slope, to</p> <p>70.18 Intersect the reestablished cor. of Ts. 22 and 23 N., Rs. 29 and 30 E., hereinbefore described, and also, described in Book "E," of this group. Land, rolling and broken. Soil, shallow rocky clay loam, 3rd rate. Timber, dense pinyon and cedar. Undergrowth, dense sage brush, cinchona and cacti.</p> <hr/> </p></p> | T23N | R30E | S31 | S32 | S 6 | | T22N | | 1920 | | $\frac{1}{4}$ S 6 | 1920 | $\frac{1}{4}$ S 31 | 1920 |
| T23N | R30E | | | | | | | | | | | | | | |
| S31 | S32 | | | | | | | | | | | | | | |
| S 6 | | | | | | | | | | | | | | | |
| T22N | | | | | | | | | | | | | | | |
| 1920 | | | | | | | | | | | | | | | |
| $\frac{1}{4}$ S 6 | | | | | | | | | | | | | | | |
| 1920 | | | | | | | | | | | | | | | |
| $\frac{1}{4}$ S 31 | | | | | | | | | | | | | | | |
| 1920 | | | | | | | | | | | | | | | |

Dependent Resurvey of E.bdy.of Township 23 North, Range 30 East. 11

Chains.

This township boundary was surveyed by W R.Fitzgerald,U.S. D.S. in 1882. The line was surveyed in its entirety, by Charles L.Campbell,U.S.D.S. in 1907, and all cors, reestablished, as there was no trace of any of the original cors.

No subsequent retracement or resurvey of the line is of record.

Retracement for Resurvey.

From the reestablished cor.of Ts. 22 and 23 N.,Rs.30 and 31 E., hereinbefore described, North, on a random line on S. 1/2 of W.bdy.of sec.31,T.23 N., R.31 E.

39.87 Fall 5 lks.E. of the previously reestablished 1/4 sec.cor. of secs:31 and 30, hereinafter described. True bearing and length of S. 1/2 of W.bdy.of sec.31 are therefore N.0°04' W., 39.87 chs,

Thence, North, on a random line, on W.bdy.of sec.31 (N. 1/2). Fall 33 lks.E.of the previously reestablished cor.of secs. 25,30,31 and 30, hereinafter described. True bearing and length of N. 1/2 of W.bdy. of sec.31 are therefore N.0° 28'W., 40.00 chs.

40.00 North, on a random line, on W. bdy. of sec.30 (S. 1/2). Fall 26 lks.E. of the previously reestablished 1/4 sec.cor. of secs.25 and 30, hereinafter described. True bearing and length of S. 1/2 of W.bdy. of sec.30 are therefore, N.0°22'W.,, 40.00 chs.

39.97 North, on a random line, on W. bdy. of sec.30 (N. 1/2). Fall 3 lks.W. of the previously reestablished cor.of secs.19,24, 25 and 30, hereinafter described. True bearing and length of N. 1/2 of W. bdy. of sec.30 are therefore N.0° 03' E., 39.97 chs.

40.00 North, on a random line, on W.bdy.of sec.19 (S. 1/2). Fall 15 lks.E.of the previously reestablished 1/4 sec.cor. of secs.19 and 24, hereinafter described. True bearing and length of S. 1/2 of W.bdy.of sec.19 are therefore N.0°13'W.,40.00 chs.

40.13 North, on random line, on W. bdy. of sec.19 (N. 1/2). Fall 38 lks.W.of the previously reestablished cor.of secs. 13,18,19 and 24, hereinafter described. True bearing and length of N. 1/2 of W.bdy. of sec.19 are therefore N.0° 33'E., 40.13 chs.

40.22 North, on a random line on W. bdy. of sec.18 (S. 1/2). Fall 7 lks.W. of the previously reestablished 1/4 sec.cor. of secs.13 and 18, hereinafter described. True bearing and length of S. 1/2 of W. bdy. of sec.18 are therefore, N.0°00' E., 40.22 chs.

39.76 North, on a random line, on W. bdy. of sec.18 (N. 1/2). Fall 20 lks.E. of the previously reestablished cor.of secs. 7,12,13 and 18, hereinafter described. True bearing and elength of N. 1/2 of W. bdy. of sec.18 are therefore, N.0° 22'W.,39.70 chs.

39.88 North, on a random line, on W. bdy. of sec.7 (S. 1/2). Fall 7 lks.E.of the previously reestablished 1/4 sec.cor. of secs.7 and 12, hereinafter described. True bearing and length of S. 1/2 of W. bdy. of sec.7 are therefore N.0° 00' W., 39.88 chs. Thence, North, on a random line, on W. bdy. of sec.7 (N. 1/2).

12 Dependent Resurvey of E. bdy. of Township 23 North, Range 30 E.

| Chains. | Retracement for Resurvey continued. |
|---------|--|
| 40.05 | Fall 18 lks. E. of the previously reestablished cor. of secs. 1, 6, 7 and 12, hereinafter described. True bearing and length of N. $\frac{1}{2}$ of W. bdy. of sec. 7 are therefore N. $0^{\circ} 15' W.$, 40.05 chs. |
| 39.70 | North, on a random line, on W. bdy. of sec. 6 (S. $\frac{1}{2}$). Fall 24 lks. W. of the previously reestablished $\frac{1}{4}$ sec. cor. of secs. 1 and 6, hereinafter described. True bearing and length of S. $\frac{1}{2}$ of W. bdy. of sec. 6 are therefore N. $0^{\circ} 21' E.$, 39.70 chs. Thence, |
| 40.00 | North, on a random line, on W. bdy. of sec. 6 (N. $\frac{1}{2}$). Diligent search in this vicinity fails to reveal any trace of the original cor. of Tps. 23 and 24 N., Rs. 30 and 31 E.; therefore, set temp. cor. of said Tps. After retracing the N. bdy. of Tp., bet. secs. 1 and 36, find that this temp. cor. location does not produce a line defective in either alinement or measurement; therefore at same point, reestablish the township cor., as hereinafter described. True bearing and length of N. half of W. bdy. of sec. 6 are therefore North, 40.00 chs. |
| | RESURVEY: |
| | From the reestablished cor. of Tps. 22 and 23 N., Rs. 30 and 31 E., hereinbefore described, N. $0^{\circ} 04' W.$, on true line, on E. bdy. of sec. 36. Over rolling and broken stony land, thru. dense timber and undergrowth. Asc. 89 ft., over SE. slope. |
| 34.50 | Point of spur, slopes SE. Desc. 28 ft., over NE. slope. |
| 34.91 | (40.00 chs. southing from cor. of secs. 25 and 36), Set an iron post, 3 ft. long, 1 in. in diam., 20 ins. in the ground for reestablished $\frac{1}{4}$ sec. cor. of sec. 36 only, marked on brass cap, <div style="text-align: center;"> $\frac{1}{4} S 36$ 1920 </div> A pinyon, 5 ins. in diam., brs. N. $61\frac{1}{2}^{\circ} W.$, 105 lks. dist., mark " $\frac{1}{4} S 36 BT.$ " A pinyon, 10 ins. in diam., brs. S. $36\frac{1}{2}^{\circ} W.$, 29 lks. dist., mark " $\frac{1}{4} S 36 BT.$ " |
| 37.66 | Wash, 12 lks. wide, course S. $85^{\circ} E.$ Asc. 16 ft., over S. slope. |
| 39.87 | Intersect the previously reestablished $\frac{1}{4}$ sec. cor. of secs. 31 and 36, which is a sandstone, 16x12x3 ins. above ground, loosely set, marked " $\frac{1}{4}$ " on W. face, witnessed by two bearing trees as follows: A pinyon, 7 ins. in diam., N. $47\frac{1}{2}^{\circ} W.$, 51 lks. dist., marked " $\frac{1}{4} S 36 BT.$ " A pinyon, 12 ins. in diam., N. $44\frac{1}{2}^{\circ} E.$, 105 lks. dist., marked " $\frac{1}{4} S 31 BT.$ " Alongside of the old cor. stone, set an iron post, 3 ft. long, 1 in. in diam., 20 ins. in the ground, for reestablished $\frac{1}{4}$ sec. cor. of sec. 31 only, marked on brass cap, <div style="text-align: center;"> $\frac{1}{4} S 31$ 1920 </div> Obliterate marking on old NW. bearing tree, and in addition to the old NE. bearing tree, establish a new one as follows: On a pinyon, 7 ins. in diam., S. $30\frac{1}{4}^{\circ} E.$, 103 lks. dist., mark " $\frac{1}{4} S 31 BT.$ " Thence, N. $0^{\circ} 28' W.$, on true line, continuing measurement of E. bdy. of sec. 36. |
| 41.00 | Spur, slopes E. Desc. 42 ft., over N. slope. |
| 53.41 | Gulch, 5 lks. wide, course E. Asc. 29 ft., over S. slope. |
| 62.63 | Spur, slopes E. Desc. 10 ft., over N. slope. |

Dependent Resurvey of East bdy. of Township 23 North, Range 30 E. 13

Chains.

63.43 Ravine, 15 lks. wide, 5 ft. deep, course S. 85° E. Asc. 80 ft., over SW. slope.
 74.91 (80.00 chs. — northing of S. bdy. of Tp.), Set an iron post, 3 ft. long, 2 ins. in diam., 24 ins. in the ground for re-established cor. of secs. 25 and 36 only, marked on brass cap,

T23N
 R30E | R31E
 S25 |
 S30 | S31
 1920

A pinyon, 8 ins. in diam., brs. N. 55½° W., 40 lks. dist., mark "T23N R30E S25 BT.", and
 A cedar, 10 ins. in diam., brs. S. 22½° W., 44 lks. dist., mark "T23N R30E S36 BT."

Land, rolling and broken.
 Soil, shallow, rocky clay loam, 3rd rate.
 Timber, dense pinyon and cedar.
 Undergrowth, dense sage brush, cinchona and cacti.

4.96 N. 0° 28' W., on a true line on E. bdy. of sec. 25. Over rolling stony land, thru. dense timber and undergrowth. Asc. over SE. slope. (40.00 chs. N. 0° 28' W. from ¼ sec. cor. of sec. 31) Intersect the previously reestablished cor. of secs. 25, 30, 31 and 36, which is a sandstone 18x12x4 ins. above ground, loosely set, marked with 5 notches on N. edge, and 1 notch on S. edge, and witnessed by four bearing trees, as follows:

- A pinyon, 10 ins. in diam., N. 42° E., 19 lks. dist., marked "T23NR31E S30 BT."
- A pinyon, 12 ins. in diam., brs. S. 55½° E., 91 lks. dist., marked "T23N R31E S31 BT."
- A pinyon, 8 ins. in diam., S. 27½° W., 54 lks. dist., marked "T23N R30E S 36 BT."
- A pinyon, 8 ins. in diam., brs. N. 57½° W., 39 lks. dist., marked "T23N R30E S25 BT."

Alongside of the old stone cor., set an iron post 3 ft. long, 2 ins. in diam., 24 ins. in the ground, for re-established cor. of secs. 30 and 31 only, marked on brass cap,

T23N
 R30E | R31E
 S25 | S30
 S31
 1920

Destroy marking on the old NW. and SW. bearing trees. Thence, N. 0° 22' W., on true line, continuing measurement of E. bdy. of sec. 25. Asc. 30 ft., over SE. slope.

10.46 Spur, slopes SE. Desc. 80 ft., over NE. slope.
 18.16 Ravine, 50 lks. wide, course SE. Asc. 61 ft., over SW. slope.
 36.11 Spur, slopes E. Descend 57 ft., over N. slope.
 39.96 (Midpoint of E. bdy. of sec. 25), Set an iron post, 3 ft. long, 1 in. in diam., 6 ins. in the ground to bed rock, supported in a mound of stone, 4 ft. base, 2 ft. high, for reestablished ¼ sec. cor. of sec. 25 only, marked on brass cap,

¼ S 25 |
 1920

A pinyon, 6 ins. in diam., brs. N. 21¼° W., 56 lks. dist., mark "¼ S 25 BT."

14 Dependent resurvey of East bdy. of Township 23 North, Range 30 E.

Chains.

44.96 (40.00 chs. N. 0°22'W., from cor. of secs. 30 and 31), Intersect the previously reestablished $\frac{1}{4}$ sec. cor. of secs. 25 and 30, which is a sandstone outcropping 2x10x2 ft. above ground, marked with a cross (x) for exact cor. point, with " $\frac{1}{4}$ " N. of cross (x), and witnessed by two bearing trees as follows:
 A pinyon, 6 ins. in diam., brs. S. 53 $\frac{1}{4}$ °W., 63 lks. dist., mark " $\frac{1}{4}$ S 25 BT."
 A pinyon, 10 ins. in diam., S. 15 $\frac{1}{2}$ °E., 15 lks. dist., marked " $\frac{1}{4}$ S 30 BT."
 A pinyon, 18 ins. in diam., S. 45°W., 30 lks. dist., marked " $\frac{1}{4}$ S 25 BT."

Over cross (x) set an iron post, 3 ft. long, 1 in. in diam., supported in a mound of stone 6 ft. base, 2 $\frac{1}{2}$ ft. high, for reestablished $\frac{1}{4}$ sec. cor. of sec. 30 only, marked on brass cap,

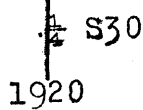

Destroy marking on old SW. bearing tree, and in addition to the old SE. bearing tree establish a new one as follows:

On a pinyon, 11 ins. in diam., N. 33 $\frac{1}{4}$ °E., 84 lks. dist., mark " $\frac{1}{4}$ S 30 BT."

Thence, N. 0°03'E., on a true line, continuing measurement of E. bdy. of sec. 25.

Asc. 104 ft., over rolling SE. slope.

79.92 Point of intersection of Subdivision line, bet. secs. 24 and 25, T. 23 N., R. 30 E., at which point closing cor. of said secs. is established as hereinafter described.
 Land, rolling and broken. Soil, shallow rocky clay, 3rd rate. Timber, dense pinyon and cedar.
 Undergrowth, dense sage brush, cinchona and cacti.

N. 0°3'E., on a true line, on E. bdy. of sec. 24.
 Over rolling land, thru. dense timber and undergrowth.
 Along rolling E. slope.

5.01 (39.97 chs. N. 0°3'E. from $\frac{1}{4}$ sec. cor. of sec. 30), Intersect the previously reestablished cor. of secs. 19, 24, 25 and 30, which is a sandstone, 18x10x8 ins. above ground, marked with 4 notches on N. edge, and 2 notches on S. edge, and witnessed by two bearing trees, as follows:

A pinyon, 12 ins. in diam., N. 50°E., 39 lks.

dist., mark "T23N R31E S19 BT."

A pinyon, 10 ins. in diam., S. 39°W., 34 lks.

dist., mark "T23N R30E S25 BT."

Alongside of the old stone cor. set an iron post, 3 ft. long, 2 ins. in diam., 18 ins. in the ground to bedrock, supported in a mound of stone 4 ft. base, 1 $\frac{1}{2}$ ft. high, for reestablished cor. of secs. 19 and 30 only, marked on brass cap,

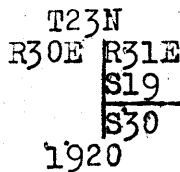

Destroy marking on old SW bearing tree, and in addition to the old NE. bearing tree, establish a new one as follows:

On a pinyon, 10 ins. in diam., S. 29 $\frac{1}{2}$ °E., 78 lks. dist., mark "T23N R31E S30 BT."

25.00 Thence, N. 0°13'W., on true line, continuing measurement of
 26.09 (E. bdy. of sec. 24, ...), set an iron post, 3 ft.
 40.04 Wash, 10 lks. wide, 2 ft. deep, course E. ...
 (Midpoint of E. bdy. of sec. 24), Set an iron post, 3 ft. long, 1 in. in diam., 26 ins. in the ground, for

Dependent Resurvey of East bdy. of Township 23 North, Range 30 East. 15

Chains.

reestablished 1/4 sec. cor. of sec. 24 only, marked on brass cap,

1/4 S24
1920

45.01

(40.00 chs. N. 0° 13' W. from cor. of secs. 19 and 30), Intersect the previously reestablished 1/4 sec. cor. of secs. 19 and 24, which is a sandstone, 6x4x8 ins. above ground, marked "1/4" on W. face, and witnessed by two bearing trees, as follows:
A pinyon, 14 ins. in diam., brs. N. 29 1/4° W., 39 lks. dist., mark "1/4 S 24 B T."
A pinyon, 10 ins. in diam., brs. S. 9 1/4° W., 53 lks. dist., mark "1/4 S 24 B T."

A pinyon, 6 ins. in diam., S. 34 1/4° E., 52 lks. dist., marked "1/4 S 19 B T."
A pinyon, 8 ins. in diam., S. 25° W., 7 lks. dist., marked "1/4 S 24 B T."
Alongside of the old stone cor., set an iron post, 3 ft. long, 1 in. in diam., 20 ins. in the ground for reestablished 1/4 sec. cor. of sec. 19 only, marked on brass cap,

1/4 S19
1920

Destroy marking on old SW. bearing tree, and establish a new bearing tree as follows:
On a pinyon, 12 ins. in diam., N. 42° E., 59 lks. dist., mark "1/4 S 19 B T."

63.61
80.08

Thence, N. 0° 33' E., on true line, continuing measurement of E. bdy. of sec. 24.
Asc. 23 ft., over S. slope.
Point of intersection of Subdivision line bet, secs. 13 and 24, T. 23 N., R. 30 E., at which point, closing cor. is established as hereinafter described.

Land, rolling and broken.
Soil, shallow rocky clay, 3rd rate.
Timber, dense pinyon and cedar.
Undergrowth, dense sage brush, cinchona and scrub oak.

.06
2.06
4.06
5.06

N. 0° 33' E., on true line, on E. bdy. of sec. 13.
Over rolling and broken stony land, thru, dense timber and undergrowth.
South bank of ravine, 100 ft. deep, brs. E. and W.
Bottom of ravine, course E.
North bank of ravine, brs. E and W.
(40.13 chs. N. 0° 33' E. from 1/4 sec. cor. of sec. 19), Intersect the previously reestablished cor. of secs. 13, 18, 19 and 24, which is a red sandstone, 30x10x14 ins., set in a mound of stone, marked with 3 notches on each of N. and S. edges, and witnessed by four bearing trees as follows:
A pinyon pine, 10 ins. in diam., N. 70° E., 37 lks. dist., marked "T23N R31E S18 B T."
A pinyon, 12 ins. in diam., S. 70° E., 45 lks. dist., marked "T23N R31E S 19 B T."
A pinyon, 6 ins. in diam., S. 2° W., 88 lks. dist., marked "T23N R30E S24 B T."
A pinyon, 6 ins. in diam., N. 7° W., 21 lks. dist., marked "T23N R30E S13 B T."
Alongside of the old stone cor., set an iron post 3 ft. long, 2 ins. in diam., 12 ins. in the ground to bed rock, supported in a mound of stone, 4 ft. base, 2 ft. high, for reestablished cor. of secs. 18 and 19 only, marked on brass cap,

16 Dependent Resurvey of East bdy. of Township 23 North, Range 30 E.

Chains.

| | |
|------|------|
| T23N | |
| R30E | R31E |
| | S18 |
| S13 | S19 |

1920

Destroy marking on old NW. and SW. bearing trees.

Thence,

N.0°6'E., on true line, continuing measurement of E. bdy. of sec. 13. Asc. 33 ft., over SE. slope.

33.51

Spur, slopes N.60°E. Desc. 110 ft., over NE. slope.

40.03

(Midpoint of E. bdy. of sec. 13). Set an iron post, 3 ft. long, 1 in. in diam., 26 ins. in the ground, for reestablished $\frac{1}{4}$ sec. cor. of sec. 13 only, marked on brass cap,

|
S 13

1920

A pinyon, 11 ins. in diam., brs. N.51 $\frac{1}{2}$ °W., 45 lks. dist., mark " $\frac{1}{4}$ S 13 BT."

A cedar, 13 ins. in diam., brs. S.49 $\frac{1}{2}$ °W., 15 lks. dist., mark " $\frac{1}{4}$ S 13 BT."

44.46

Ravine, 20 lks. wide, 4 ft. deep, course E. Asc. 42 ft. over S. slope.

45.28

(40.22 chs. N.0°6'E. from cor. of secs. 18 and 19) Intersect the previously reestablished $\frac{1}{4}$ sec. cor. of secs. 13 and 18, which is a sandstone 12x10x12 ins. above ground marked " $\frac{1}{4}$ " on W. face, and witnessed by two bearing trees, as follows:

A pinyon, 6 ins. in diam., N.63 $\frac{1}{2}$ °E., 33 lks. dist., marked " $\frac{1}{4}$ S 18 BT."

A pinyon, 4 ins. in diam., N.13 $\frac{1}{2}$ °W., 20 lks. dist., marked " $\frac{1}{4}$ S 13 BT."

Alongside of the old stone cor., set an iron post 3 ft. long, 1 in. in diam., 26 ins. in the ground, for reestablished $\frac{1}{4}$ sec. cor. of sec. 18 only, marked on brass cap,

|
S 18

1920

Destroy marking on the old NW bearing tree, and in addition to the old NE bearing tree, establish a new one as follows:

On a cedar, 12 ins. in diam., S.19 $\frac{1}{2}$ °E., 15 lks. dist., mark " $\frac{1}{4}$ S 18 BT."

Thence,

N.0°22'W. on true line, continuing measurement of E. bdy. of sec. 13.

47.31

Spur, slopes E. Descend 30 ft. over E. slope.

51.36

South rim of canyon, 110 ft. deep, brs. E. and W. Desc.

52.86

Bottom of canyon, cross ravine 20 lks. wide, course E. Asc.

54.56

North rim of canyon, brs. E. and W. Asc. 10 ft., over SE. slope.

57.43

Spur, slopes E. Desc. gradually over NE. slope, to

65.06

Desc. 217 ft., over N. slope.

75.50

Ravine, 20 lks. wide, course E. Asc. 68 ft., over S. slope.

80.06

Point of intersection of Subdivision line bet. secs. 12 and 13, T.23 N., R.30 E. at which point closing cor. of said secs. is established as hereinafter described.

Land, rough and broken.

Soil, shallow rocky loam, 3rd rate.

Timber, dense pinyon and cedar.

Undergrowth, dense sage brush and cinchona.

N.0°22'W., on true line, on E. bdy. of sec. 12.

Dependent Resurvey of East bdy. of Township 23 North, Range 30 East, 17

Chains.

Over rolling and broken land, thru. dense timber and undergrowth. Ascend over S. slope.

1.41 Spur, slopes SE. Desc: 59 ft. over NE. slope.

4.98 (39.76 chs. N. 0° 22' W. from $\frac{1}{4}$ sec. cor. of sec. 18) Intersect the previously reestablished cor. of secs. 7, 12, 13 and 18, which is a sandstone 20x13x3 ins. above ground, loosely set, marked with 2 notches on N. and 4 notches on S. edge, and witnessed by four bearing trees as follows:

- A pinyon, 9 ins. in diam., N. 59 $\frac{1}{2}$ ° E., 29 lks. dist., marked "T23N R31E S7 BT."
- A pinyon, 25 ins. in diam., S. 33 $\frac{1}{4}$ ° E., 42 lks. dist., marked "T23N R31E S 18 BT."
- A pinyon, 6 ins. in diam., S. 16 $\frac{1}{2}$ ° W., 38 lks. dist., marked "T23N R30E S13 BT."
- A pinyon, 10 ins. in diam., N. 65° W., 20 lks. dist., marked "T23N R30E S12 BT."

Alongside of the old stone cor., set an iron post, 3 ft. long, 2 ins. in diam., 24 ins. in the ground for reestablished cor. of secs. 7 and 18 only, marked on brass cap,

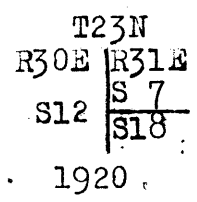

Destroy marking on old NW. and SW. bearing trees.

Thence,

39.85 N. 0° 6' W., on true line, continuing measurement of E. bdy. of sec. 12. Desc. 12 ft., over NE. slope.

40.02 Top of divide, bet. the Rio Puerco Wash, and Defiance Creek brs. N. 80° E. and S. 80° W. Desc. over NW. slope. (Midpoint of E. bdy. of sec. 12), Set an iron post, 3 ft. long, 1 in. in diam., 18 ins. in the ground to bed rock, supported in a mound of stone, 4 ft. base, 1 $\frac{1}{2}$ ft. high for reestablished $\frac{1}{4}$ sec. cor. of sec. 12 only, marked on brass cap,

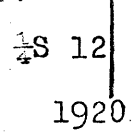

A pinyon, 7 ins. in diam., brs. N. 36 $\frac{1}{2}$ ° W., 58 lks. dist., mark " $\frac{1}{4}$ S 12 BT."

A pinyon, 10 ins. in diam., brs. S. 13 $\frac{1}{2}$ ° W., 41 lks. dist., mark " $\frac{1}{4}$ S 12 BT."

44.86 (39.88 chs. N. 0° 6' W. from cor. of secs. 7 and 18) Intersect the previously reestablished $\frac{1}{4}$ sec. cor. of secs. 7 and 12, which is a sandstone 24x12x6 ins., set in a mound of stone, marked " $\frac{1}{4}$ " on W. face, and witnessed by two bearing trees as follows:

- A pinyon, 9 ins. in diam., N. 39 $\frac{1}{2}$ ° W., 20 lks. dist., marked "S 12 BT."
- A pinyon, 9 ins. in diam., S. 29 $\frac{1}{2}$ ° E., 43 lks. dist., marked " $\frac{1}{4}$ S 7 BT."

Alongside old cor., set an iron post 3 ft. long, 1 in. in diam., 14 ins. in the ground to bed rock, supported in a mound of stone 4 $\frac{1}{2}$ ft. base, 1 $\frac{1}{2}$ ft. high for reestablished $\frac{1}{4}$ sec. cor. of sec. 7 only, marked on brass cap,

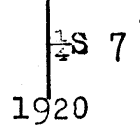

Destroy marking on old NW bearing tree, and in addition to the old SE. bearing tree, establish new one as follows:

- On a pinyon, 4 ins. in diam., N. 70 $\frac{1}{4}$ ° E., 14 lks. dist., mark " $\frac{1}{4}$ S 7 BT."

Thence,

18 Dependent Resurvey of East bdy. of Township 23 North, Range 30 E

chains.

N.0°15'W., on a true line, continuing measurement of E. bdy. of sec. 12.
 Descend 90 ft., over N. slope.
 64.72 Road from Lupton to St. Michaels, Arizona, brs. N.60°W. and S.60°E.
 68.61 Ravine, 15 lks. wide, banks 6 ft. high, course N.60°W.; thence along SW. slope; not much change in elevation.
 80.04 Point of intersection of subdivision line; bet. secs. 1 and 12, T.23 N., R.30 E., at which point closing cor. of said secs. is established as hereinafter described.
 Land, rolling and broken.
 Soil, shallow, rocky clay loam, 3rd rate.
 Timber, dense yellow pine, pinyon and cedar.
 Undergrowth, dense sage brush and cinchona.

N.0° 15'W., on true line, on E. bdy. of sec. 1.
 Over rolling and broken land, thru. timber and undergrowth.
 4.87 (40.05 chs. N.0°15'W. from $\frac{1}{4}$ sec. cor. of sec. 7) Intersect the previously reestablished cor. of secs. 1, 6, 7 and 12, which is a sandstone, 12x0x0 ins. above ground, loosely set, marked with 1 notch on N. edge, and 5 notches on S. edge, and witnessed by four bearing trees as follows:
 A yellow pine, 30 ins. in diam., N.49°E., 65 lks. dist., marked "T23N R31E S6 BT."
 A yellow pine, 14 ins. in diam., S.3 $\frac{1}{2}$ °E., 34 lks. dist., marked "T23N R31E S7 BT."
 A pinyon, 10 ins. in diam., brs. S.51 $\frac{1}{2}$ °W., 36 lks. dist., marked "T23N R30E S12BT."
 A yellow pine, 12 ins. in diam., N.88°W., 47 lks. dist., marked "T23N R30E, S1 BT."
 Alongside of the old stone cor., set an iron post 3 ft. long, 2 ins. in diam., 24 ins. in the ground, for re-established cor. of secs. 6 and 7 only, marked on brass cap,

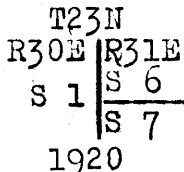

Destroy marking on old NW. and SW. bearing trees.
 Thence,
 N.0°21'E., on true line, continuing measurement of E. bdy. of sec. 1.
 Ascend gradually along W. slope.
 29.25 Ascend 338 ft., over SW. slope.
 40.00 Set an iron post, 3 ft. long, 1 in. in diam., 26 ins. in the ground, for reestablished $\frac{1}{4}$ sec. cor. of sec. 1 only, marked on brass cap,

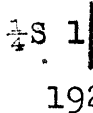

A cedar, 20 ins. in diam., brs. N.15 $\frac{1}{2}$ °W., 35 lks. dist., mark " $\frac{1}{4}$ S 1 BT."
 A pinyon, 8 ins. in diam., brs. S.40 $\frac{3}{4}$ °W., 98 lks. dist., mark " $\frac{1}{4}$ S 1 BT."
 44.57 (39.70 chs. N.0°21'E. from cor. of secs. 6 and 7) Intersect the previously reestablished $\frac{1}{4}$ sec. cor. of secs. 1 and 6, which is a sandstone, 12x10x8 ins. above ground, loosely set, marked " $\frac{1}{4}$ " on W. face, and witnessed by two bearing trees, as follows:
 A yellow pine, 12 ins. in diam., N.10°W., 60 lks. dist., marked " $\frac{1}{4}$ S 1 BT."
 A pinyon, 12 ins. in diam., N.81 $\frac{1}{2}$ °E., 33 lks. dist., marked " $\frac{1}{4}$ S 6. BT."
 Alongside the old stone cor., set an iron post, 3 ft. long, 1 in. in diam., 14 ins. in the ground to bed rock,

Dependent Resurvey of East bdy. of Township 23 North, Range 30 East. 10

Chains.

supported in a mound of stone 4 ft. base, 1 1/2 ft. high, for reestablished 1/4 sec. cor. of sec. 6, marked on brass cap,

1/4 S 6

1920

Destroy marking on old NW bearing tree, and in addition to the old NE bearing tree, establish a new one as follows:

On a pinyon, 12 ins. in diam., S. 48 1/2° E., 20 lks. dist., mark "1/4 S 6 BT."

Thence, North, on true line, continuing measurement of E. bdy. of sec. 1.

58.00 foot of sandstone cliff, 50 ft. high, brs. N. 30° W. and S. 30° E.

60.27 Top of same cliff, brs. N. 30° W. and S. 30° E.; thence over broken E. slope, with little change in elevation.

84.57 (40.00 chs. N. from 1/4 sec. cor. of sec. 6), Set an iron post, 3 ft. long, 3 ins. in diam., 20 ins. in the ground to bed rock, supported in a mound of stone 4 ft. base, 1 ft. high, for reestablished cor. of Ts. 23 and 24 N., rs. 30 and 31 E.; marked on brass cap,

| | |
|------|------|
| T24N | |
| R30E | R31E |
| S30 | S31 |
| S 1 | S 6 |
| T23N | |
| 1920 | |

A yellow pine, 12 ins. in diam., brs. N. 70 1/2° E., 49 lks. dist., mark "T24N R31E S31 BT."

A yellow pine, 12 ins. in diam., brs. S. 74° E., 122 lks. dist., mark "T23N R31E S6 BT."

A cedar, 6 ins. in diam., brs. S. 14° W., 39 lks. dist., mark "T23N R30E S1 BT."

A pinyon, 5 ins. in diam., brs. N. 81 1/2° W., 50 lks. dist., mark "T24N R30E S30 BT."

Land, rolling and broken.
Soil, shallow, sandy and stony clay loam, 3rd and 4th rate.
Timber, dense yellow pine, pinyon and cedar.
Undergrowth, dense sage brush and cinchona.

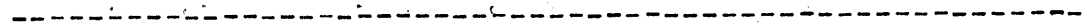

20 Dependent Resurvey of Part of North bdy. of T.23 N., R.30 E. (W. $\frac{1}{2}$ bet. secs. 1 & 36)

Chains.

The only portion of the North bdy. of T.23 N., R.30 E., which has been surveyed is that portion bet. the west halves of secs. 1 and 36, Ts. 22 and 23 N., R.30 E., this portion of the line having been surveyed by Charles L. Campbell, U.S.D.S. in 1907 at the same time that he resurveyed the E. bdy. of T.23 N., R.30 E. In Campbell's record, the E. $\frac{1}{2}$ of line bet. secs. 1 and 36 is reported as unsurveyable, and the $\frac{1}{4}$ sec. cor. of secs. 1 and 36 was established by offset West 40 chs., and North 40 chs. from the $\frac{1}{4}$ sec. cor. of secs. 1 and 6 on E. bdy. of T.23 N., R.30 E., and the W. $\frac{1}{2}$ of line bet. secs. 1 and 36 was then surveyed west 40.00 chs.

Retracement for Resurvey.

From original $\frac{1}{4}$ sec. cor. of secs. 1 and 36, hereinafter described,

- 40.10 West, on a random line, bet. secs. 1 and 36 (W. $\frac{1}{2}$).
Fall 30 lks. N. of the original cor. of secs. 1, 2, 35 and 36, hereinafter described.
True bearing and length of W. $\frac{1}{2}$ of line, bet. secs. 1 and 36 is therefore N. 89° 34' E., 40.10 chs.

Resurvey.

The original cor. of secs. 1, 2, 35 and 36 is a cross (x) on sandstone ledge 10x3x4 ft. above ground, with 1 notch E., and 5 notches W. of cross (x) with mound of stone, 2 ft. base, 1 $\frac{1}{2}$ ft. high, W. of cor.

Reestablish the cor. as follows:

Over cross (x) on ledge set an iron post 3 ft. long, 2 ins. in diam., supported in a mound of stone, 6 ft. base, 2 $\frac{1}{2}$ ft. high for reestablished cor. of secs. 1, 2, 35 and 36, marked on brass cap,

| | |
|------|-------|
| T24N | R30E. |
| S35 | S36. |
| S 2 | S 1 |
| T23N | |
| 1920 | |

- A yellow pine, 12 ins. in diam., brs. N. 58° E., 55 lks. dist., mark "T24N R30E S36 BT."
- A yellow pine, 20 ins. in diam., brs. S. 31 $\frac{1}{2}$ ° E., 45 lks. dist., mark "T23N R30E S1 BT."
- A yellow pine, 14 ins. in diam., brs. S. 24° W., 45 lks. dist., mark "T23N R30E S2 BT."
- A yellow pine, 14 ins. in diam., brs. N. 37 $\frac{1}{2}$ ° W., 54 lks. dist., mark "T24N R30E S35 BT."

Thence,

N. 89° 34' E., on true line, bet. secs. 1 and 36 (W. $\frac{1}{2}$).

Over stony, mountainous land, thru dense timber and undergrowth. Desc. 150 ft., over NE. slope.

- 7.19 Ravine, 20 lks. wide, course N.; spring of pure clear water, brs. N. 15 lks. dist. Asc. 167 ft., over W. slope.
- 11.09 Stony spur, slopes N. 20° W. Desc. 126 ft., over steep NE. slope, to
- 33.60 Foot of steep descent; thence descend gradually over broken, stony NE. slope.
- 38.87 Road from Lupton to St. Michaels, Arizona, brs. N. 15° W. and S. 15° E.
- 40.10 Intersect the original $\frac{1}{4}$ sec. cor. of secs. 1 and 36, which is a red sandstone, 16x6x6 ins. above ground, marked "1" on N. face, and witnessed by two bearing trees as follows:
- A pinyon, 10 ins. in diam., N. 55° W., 61 lks. dist., marked "1 S 36 BT."
 - A pinyon, 10 ins. in diam., S. 87 $\frac{1}{2}$ ° W., 92 lks. dist., marked "1 S 1 BT."

Dependent Resurvey of part of North bdy. of T.23 N.R.30 E. (W. 1/4 bet. Secs. 1 & 36)

Chains.

Alongside of the old stone cor., set an iron post, 3 ft. long, 1 in. in diam., 20 ins. in the ground, for reestablished 1/4 sec. cor. of secs. 1 and 36, marked on brass cap,

1/4 S 36
S 1
1920

Land, broken and mountainous.
Soil, shallow clay loam, and stony, 3rd and 4th rate.
Timber, dense pinyon and cedar, and scattering yellow pine.
Undergrowth, dense cichona, scrub oak and sage brush.



Survey of part of the

22. North bdy. of Township 23 North, Range 30 East (E. 1/2 bet. secs. 1 & 36).

Chains.

From temp. cor. of Ts, 23 and 24 N., Rs. 30 and 31 E., set at 40.00 chs. N. of the original 1/4 sec. cor. of secs. 1 and 6, on E. bdy. of Tp. 23 N., R. 30 E., as hereinbefore described, West, on random line, bet. secs. 1 and 36 (E. 1/2).

3.57 Top of cliffs, facing W. Discontinue chaining, and triangulate as described as follows, and as shown on the diagram hereon:

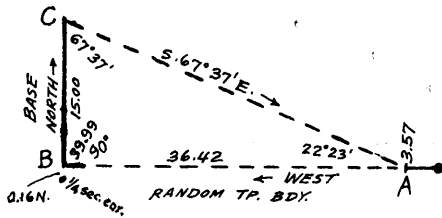

Leave flag at this point on random Tp. line indicated on diagram at "A."

Set flag at point "B" west from "A" and 16 lks. N. of 1/4 sec. cor. Vertical angle "A" to "B" = -10° 10'.

From point "B" measure a base North 15.00 chs. to point "C." Bearing of "CA" = S. 67° 37' E.

Included angles of "CAB" are 67° 37', 22° 23' and 90°, the sum of which is 180°.

"AB" = tang. 07° 37' x base or 2.42819 x 15.00 = 36.42 chs., which added to 3.57 chs. gives 39.99 chs. west from temp. Tp. cor. for point "B" at end of random Tp. line, 16 lks. N. of 1/4 sec. cor.

39.99 Fall 16 lks. N. of original 1/4 sec. cor. of secs. 1 and 36, hereinbefore described.

thence, N. 89° 46' E., on true line, bet. secs. 1 and 36 (E. 1/2). Over broken land, thru. dense timber and undergrowth. Desc. gradually over NE. slope.

3.79 Wash, 40 lks. wide, course N. 20° W. Leave timber, brs. NW. and SE. Enter level valley land, brs. N. and S.

8.80 Leave valley, brs. NW. and SE., and enter mountainous land and dense timber and undergrowth. Ascend. 700 ft., over sandstone cliffs facing west. Measurement by triangulation, to

36.42 Top of cliffs, bear N. 20° W. and S. 20° E. Asc. 18 ft. to
39.99 Intersect the reestablished cor. of Ts. 23 and 24 N., Rs. 30 and 31 E., hereinbefore described.

Land, rough, level and mountainous.
Soil, shallow clay loam and stone, 3rd and 4th rate.
Timber, scattering yellow pine and pinyon, and dense cedar.
Undergrowth, dense cinchona, scrub oak and sage brush.

Survey of part of North bdy. of Township 23 North, Range 30 W. (W 52 N)

Chains.

From the reestablished cor. of secs. 1, 2, 35 and 36, hereinbefore described,

West, on a random line, along the N. bdy. of Tp. 23 N., R. 30 E., setting temp. $\frac{1}{4}$ sec. cor. and sec. cors. at intervals of 40.00 chs.

56.30 East rim of canyon of Defiance Creek. To avoid cliffs, over which chaining is impracticable on random line, offset into sec. 2, as described as follows, and as shown on the diagram hereon:

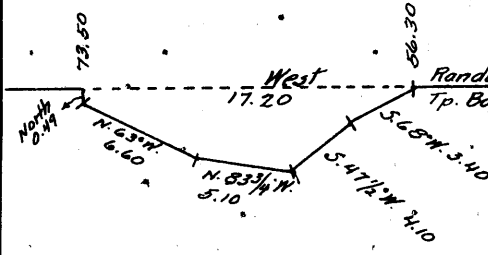

S. 68°W., 3.40 chs.
 S. 47 $\frac{1}{2}$ °W., 4.10 chs.
 N. 83 $\frac{1}{4}$ °W., 5.10 chs.
 N. 63°W., 6.00 chs.
 North, 0.49 chs. to point on random Tp. bdy., 17.20 chs. W. of offset station, or 73.50 chs. W. of sec. cor. of secs. 1, 2, 35 and 36.

73.50 Offset point on random Tp. bdy. on E. rim of canyon of Defiance Creek.

Continue line and measurement.

80.00 Set temp. cor. of secs. 2, 3, 34 and 35.

92.90 East rim of canyon of Defiance Creek. To avoid the steep broken cliffs over which chaining on random Tp. bdy. is impracticable, offset into sec. 3, as described as follows, and as shown on diagram hereon:

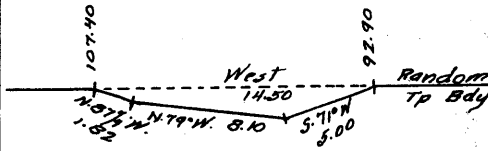

S. 71°W., 5.00 chs.
 N. 79°W., 8.10 chs.
 N. 87 $\frac{1}{2}$ °W., 1.82 chs. to point on random Tp. bdy., 14.50 chs. W. of offset point, or 107.40 chains W. of cor. of secs. 1, 2, 35 and 36.

107.40 Offset point on random Tp. bdy. on E. rim of Defiance Creek Canyon.

Continue line and measurement.

136.94 (56.94 chs. W. from temp. cor. of secs. 2, 3, 34 and 35), E. rim of canyon of Defiance Creek, Random Tp. bdy. crosses the canyon W. of this point, and chaining is impracticable; therefore, triangulate to point in bottom of canyon, as described as follows, and as shown on the diagram hereon. Leave flag at this point on random Tp. bdy. indicated on diagram at "A."

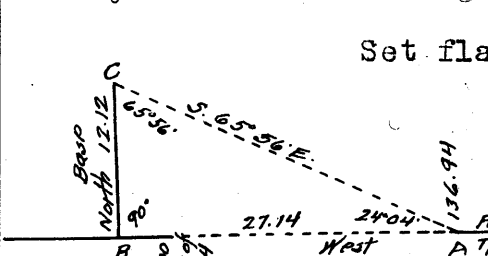

Set flag at this point on random Tp. bdy. in bottom of canyon at "B."
 Vertical angle "A" to "B" = 21°51'.
 From point "B" measure a Base North, 12.12 chs. to point "C."
 Bearing of "CA" = S. 65° 56' E.
 Included angles of "CAB" are 65° 50', 24° 04' and 90°, the sum of which is 180°.

"AB" = tang. 65° 56' x base or 2.23902 x 12.12 = 27.14 chs., which added to 136.94 chs. gives 164.08 chs. W. from cor. of secs. 1, 2, 35 and 36 for point "B" on random Tp. bdy.
 From point "B" measure East 4.08 chs. to

160.00 Set temp. cor. of secs. 3, 4, 33 and 34.

164.08 Triangulation point of triangulation described above.

171.17 Foot of steep W. wall of Defiance Creek canyon. Triangulate as described as follows, and as shown on diagram hereon:

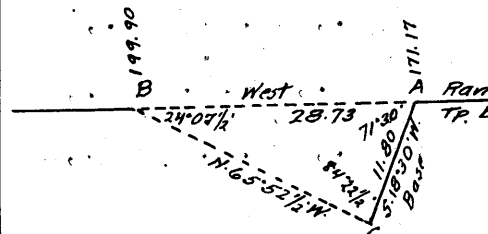

From this point on random Tp. bdy. indicated on diagram at "A", measure a base, S 18° 30' W., 11.80 chs. to point "C."

24 Part of N.bd. of Township 23 North, Range 30 E. (W. 5 m.)

Chains.

Set flag on random Tp. bdy. on W. rim of canyon at point "B." Vertical angle "A" to "B" = +19° 05'. Bearing of "CB" = N. 65° 52½' W.

Included angles of "CBA" are 84° 22½', 24° 07½' and 71° 30' the sum of which is 180°.

"AB" = sine 84° 22½' x base or .99518 x 11.80 = 28.73 chs.,
sine 24° 07½' .40873

which added to 171.17 chs. gives 199.90 chs. W. from cor. of secs. 1, 2, 35 and 36 for point "B." on random Tp. bdy.

199.90

Triangulation point on W. rim of canyon. Continue line and measurement by chaining.

200.00

Set temp. ¼ sec. cor. of secs. 4 and 33.

Continue line and measurement, setting temp. sec. and ¼ sec. cors. at intervals of 40.00 chs. until at

388.77

Intersect N. and S. line, 3.55 chs. N. of the cor. of Ts. 23 and 24 N., Rs. 29 and 30 E., established by Sidney E. Blout, U.S. Cadastral Engineer, under this group, in connection with the survey of the E. bdy. of T. 23 N., R. 29 E., as described in Book "E," which is an iron post 3 ins. in diam., 12 ins. above ground, firmly set, marked on brass cap,

T24N
R29E | R30E
S36 | S31
S 1 | S 6
T23N
1920

and witnessed by four bearing trees as follows:

A pinyon, 7 ins. in diam., N. 72½° E., 231 lks. dist., marked "T24N R30E, S31 BT."

A pinyon, 16 ins. in diam., S. 50° E., 175 lks. dist., marked "T23N R30E S6 BT."

A pinyon, 6 ins. in diam., S. 48° W., 141 lks. dist., marked "T23N R29E S1 BT."

A pinyon, 9 ins. in diam., N. 70½° W., 120 lks. dist., marked "T24N R29E S31 BT."

Change this cor. to refer to Ts. 23 and 24 N., R. 29 E. only by altering marking on brass cap, to read:

T24N
R29E | R30E
S36 |
S 1 | S 6
T23N
1920

Destroy marking on NE. and SE. bearing trees.

At point of intersection, set an iron post 3 ft. long, 3 ins. in diam., 24 ins. in the ground for cor. of Ts. 23 and 24 N., R. 30 E., only, marked on brass cap,

T24N
R29E | R30E
S36 | S31
S 5 |
T23N
1920

A pinyon, 12 ins. in diam., brs. N. 74° E., 182 lks. dist., mark "T24N R30E S31 BT."

A pinyon, 13 ins. in diam., brs. S. 70° E., 303 lks. dist., mark "T23N R30E S6 BT."

A pinyon, 12 ins. in diam., brs. N. 82½° W., 110 lks.

Chains.

dist., mark "T24N R29E S36 BT."

Thence, East, bet. secs. 6 and 31, blazing and marking true line. Over rolling land, thru. dense timber and undergrowth.

11.27
24.77
28.77

Ravine, 20 lks. wide, 3 ft. deep, course S. 85° E.
Ravine, 20 lks. wide, 4 ft. deep, course S. 50° W.
Set an iron post, 3 ft. long, 1 in. in diam., 4 ins. in the ground to bed rock, supported in a mound of stone 4 ft. base, 1 1/2 ft. high, for 1/4 sec. cor. of secs. 6 and 31, marked on brass cap,

1/4 S 31
S 6
1920

A yellow pine, 10 ins. in diam., brs. N. 41 1/4° W., 41 lks. dist., mark "S 31 BT."
A yellow pine, 20 ins. in diam., brs. S. 73 1/2° W., 77 lks. dist., mark "S 6 BT."

68.77

Set an iron post, 3 ft. long, 2 ins. in diam., 20 ins. in the ground, to bed rock, supported in a mound of stone, 4 ft. base, 1 ft. high, for cor. of secs. 5, 6, 31 and 32, marked on brass cap,

T24N | R30E
S31 | S32
S 6 | S 5
T23N
1920

A pinyon, 24 ins. in diam., brs. N. 18 1/2° E., 103 lks. dist., mark "T24N R30E S32 BT."
A pinyon, 14 ins. in diam., brs. S. 10 1/2° E., 40 lks. dist., mark "T23N R30E S5 BT."
A cedar, 10 ins. in diam., brs. S. 75 1/4° W., 20 lks. dist., mark "T23N R30E S6 BT."
A yellow pine, 13 ins. in diam., brs. N. 8 1/4° W., 98 lks. dist., mark "T24N R30E S31 BT."

Land, rolling.
Soil, shallow sandy loam, 2nd rate.
Timber, scattering yellow pine and dense pinyon, and cedar.
Undergrowth, dense sage brush.

East, on true line, bet. secs. 5 and 32. Over rolling land, thru. dense timber and undergrowth.
Set an iron post, 3 ft. long, 1 in. in diam., 20 ins. in the ground, for 1/4 sec. cor. of secs. 5 and 32, marked on brass cap,

40.00

1/4 S 32
S 5
1920

A pinyon, 6 ins. in diam., brs. N. 71° W., 45 lks. dist., mark "1/4 S 32 BT."
A pinyon, 8 ins. in diam., brs. S. 15 1/4° E., 124 lks. dist., mark "1/4 S 5 BT."

80.00

Set an iron post, 3 ft. long, 2 ins. in diam., 20 ins. in the ground, to bed rock, supported in a mound of stone, 4 ft. base, 1 ft. high, for cor. of secs. 4, 5, 32 and 33, marked on brass cap,

T24N | R30E
S32 | S33
S 5 | S 4
T23N
1920

A pinyon, 12 ins. in diam., brs. N. 58° E., 139 lks.

26 North bdy. of Township 23 North, Range 30 E. (W. 5 m.)

Chains.

- dist., mark "T24N R30E S33 BT."
- A cedar, 6 ins. in diam., brs. S. 15 1/2° E., 209 lks.
- dist., mark "T23N R30E S4 BT."
- A cedar, 12 ins. in diam., brs. S. 78° W., 203 lks.
- dist., mark "T23N R30E S5 BT."
- A cedar, 8 ins. in diam., brs. N. 57 3/4° W., 113 lks.
- dist., mark "T24N., R30E., S32 BT."

Land, rolling.
 Soil, shallow sandy and stony clay loam, 2nd and 3rd rate.
 Timber, scattering yellow pine, dense pinyon and cedar.
 Undergrowth, dense sage brush.

East, on true line, bet. secs. 4 and 33.
 Over rolling land, thru. dense timber and undergrowth; ascend gradually over SW. slope.

- 32.50 Top of SW. slope; descend over SE. slope.
- 40.00 Set an iron post, 3 ft. long, 1 in. in diam., 6 ins. in the ground, to bed rock, supported in a mound of stone 4 ft. base, 2 ft. high, for 1/4 sec. cor. of secs. 4 and 33, marked on brass cap,

S 33
 S 4
 1920

- A pinyon, 11 ins. in diam., brs. N. 64° W., 96 lks.
 dist., mark "1/4 S 33 BT."
- A pinyon, 12 ins. in diam., brs. S. 2 1/2° E., 206 lks.
 dist., mark "1/4 S 4 B. T."
- 40.10 West rim of Defiance Creek canyon, with perpendicular sandstone walls 656 ft. high, brs. N. and S. Descend into canyon. Measurement by triangulation, as hereinbefore described, to
- 68.83 Bottom of canyon at foot of cliffs, brs. N. 45° E. and S. 20° W.; thence over sandy bottom land in canyon; chain measurement of remainder of mile.
- 70.90 Right bank of Defiance Creek, 25 ft. high, brs. N. 30° E. and S. 30° W.
- 72.30 Center of Defiance Creek, with stream of clear pure water, 40 lks. wide, 4 ins. deep, over sand bottom, course S. 30° W.
- 73.70 Left bank of Defiance Creek, 25 ft. high, brs. N. 30° E. and S. 30° W. Ascend 31 ft., over NW. slope to sec. cor.
- 75.92 Triangulation point of triangulation hereinbefore described.
- 80.00 Set an iron post, 3 ft. long, 2 ins. in diam., 12 ins. in the ground to bed rock, supported in a mound of stone 4 ft. base, 1 1/2 ft. high, for cor. of secs. 3, 4, 33 and 34, marked on brass cap,

T24N | R30E
 S33 | S34

 S 4 | S 3
 T23N
 1920

- A pinyon, 6 ins. in diam., brs. N. 37 3/4° E., 32 lks.
 dist., mark "T24N R30E S34 BT."
- A pinyon, 8 ins. in diam., brs. S. 9 1/2° E., 54 lks.
 dist., mark "T23N R30E S3 BT."
- A pinyon, 7 ins. in diam., brs. S. 18 1/2° W., 50 lks.
 dist., mark "T23N R30E S4 BT."
- A pinyon, 12 ins. in diam., brs. N. 84° W., 31 lks.
 dist., mark "T24N R30E S33 BT."

Land, rolling and broken.
 Soil, sandy and stony, 2nd and 3rd rate.
 Yimber, scattering yellow pine, dense pinyon and cedar.
 Undergrowth, dense sage brush.

Chains.

East, on a true line, bet. secs. 3 and 34.
Over broken land.
Ascend 718 ft., over precipitous E. wall of canyon, over cliffs and ledges, thru. scattering timber and undergrowth:

23.06 Measurement by triangulation hereinbefore described, to East rim of Defiance Creek canyon, brs. N. 50° E. and S. 50° W.; thence over rolling stony land, thru. dense timber and undergrowth, chaining measurement.

40.00 Set an iron post, 3 ft. long, 1 in. in diam., 26 ins. in the ground for 1/4 sec. cor. of secs. 3 and 34, marked on brass cap,

1/4 S 34
S 3
1920

A pinyon, 6 ins. in diam., brs. N. 20 1/4° W., 45 lks. dist., mark "1/4 S 34 BT."

A pinyon, 5 ins. in diam., brs. S. 62 1/2° E., 12 lks. dist., mark "1/4 S 3 BT."

52.60 East rim of Defiance Creek canyon in bend, brs. N. 85° W. and S. 85° E., slopes too steep to chain; measurement by traverse into sec. 3, as hereinbefore described, to

67.10 East rim of same canyon, brs. N. 78° E. and S. 78° W. End of traverse, thence on Tp. bdy., over rolling, stony land.

80.00 Set an iron post, 3 ft. long, 2 ins. in diam., 24 ins. in the ground, for cor. of secs. 2, 3, 34 and 35, marked on brass cap,

T24N | R30E
S34 | S35
S 3 | S 2
T23N
1920

A pinyon, 7 ins. in diam., brs. N. 39° E., 65 lks. dist., mark "T24N R30E S35 BT."

A pinyon, 6 ins. in diam., brs. S. 20 1/4° E., 35 lks. dist., mark "T23N R30E S2 BT."

A pinyon, 7 ins. in diam., brs. S. 41 3/4° W., 12 lks. dist., mark "T23N R30E S3 BT."

A pinyon, 8 ins. in diam., brs. N. 36 1/2° W., 26 lks. dist., mark "T24N R30E S34 BT."

Land, rolling and broken.
Soil, sandy and stony, 3rd and 4th rate.
Timber, scattering yellow pine, dense pinyon and cedar.
Undergrowth, dense sage brush.

East, on true line, bet. secs. 2 and 35.
Over rolling land, near E. rim of Defiance Creek Canyon, which is N. of line; thru. dense timber and undergrowth.

6.50 East rim of Defiance Creek Canyon, brs. NW. and S. 60° E. Thence across bend in wall of canyon, brs. NW and NE. Measurement by offset into sec. 2, as hereinbefore described to

23.70 East rim of Defiance Creek canyon, brs. S. 70° W., and N. 70° E. End of traverse. Thence on Tp. bdy.
Ascend 17 ft., over NW. slope.

30.10 Spur, slopes NE. Desc. 461 ft., over SE. slope.

40.00 Set an iron post 3 ft. long, 1 in. in diam., 26 ins. in the ground for 1/4 sec. cor. of secs. 2 and 35, marked on brass cap,

1/4 S 35
S 2
1920

28 Part of North bdy. of Township 23 North, Range 30 E. (W. 5 m.)

Chains.

A pinyon, 10 ins. in diam., brs. N. 40° E., 23 lks. dist., mark "S 35 BT."

A pinyon, 10 ins. in diam., brs. S. 41° E., 40 lks. dist., mark "S 2 BT."

80.00 Intersect the reestablished cor. of secs. 1, 2, 35 and 36, hereinbefore described.

Land, rolling and broken.

Soil, sandy and stony, 3rd and 4th rate.

Timber, dense pinyon and cedar.

Undergrowth, dense sage brush.

Boundaries of Township 23 North, Range 30 East.
Latitudes, Departures, and Closing Errors.

| Line designated. | True bearing. | Dist. | Latitudes. | | Departures. | |
|----------------------------|---------------|--------|------------|--------|-------------|--------|
| | | | N. | S. | E. | W. |
| South boundary, | S. 89° 23' W. | 470.18 | | 5.06 | | 470.18 |
| West boundary, | North, | 483.55 | 483.55 | | | |
| North boundary, | East, | 388.77 | | | 388.77 | |
| | N. 89° 34' E. | 40.10 | .30 | | 40.10 | |
| | N. 89° 40' E. | 399.99 | .16 | | 39.99 | |
| East boundary, | South, | 40.00 | | 40.00 | | |
| | S. 0° 21' W. | 39.70 | | 39.70 | | .25 |
| | S. 0° 15' E. | 40.05 | | 40.05 | .18 | |
| | S. 0° 06' E. | 39.88 | | 39.88 | .07 | |
| | S. 0° 22' E. | 39.76 | | 39.76 | .26 | |
| | S. 0° 06' W. | 40.22 | | 40.22 | | .07 |
| | S. 0° 33' W. | 40.13 | | 40.13 | | .38 |
| | S. 0° 13' E. | 40.00 | | 40.00 | .15 | |
| | S. 0° 03' W. | 39.97 | | 39.97 | | .04 |
| | S. 0° 22' E. | 40.00 | | 40.00 | .26 | |
| S. 0° 28' E. | 40.00 | | 40.00 | .33 | | |
| S. 0° 04' E. | 39.87 | | 39.87 | .05 | | |
| Convergency, | | | | | .51 | |
| Totals, | | | 484.01 | 484.64 | 470.67 | 470.92 |
| | | | | 484.01 | | 470.67 |
| <u>Error in latitude,</u> | | | 0.63 | | | |
| <u>Error in departure,</u> | | | | | 0.25 | |

Survey of Subdivision lines of T.23 N., R. 30 E.

Chains.

Preliminary to the Subdivision of this township, survey a latitudinal Governing Section line, west from the re-established cor. of secs. 25 and 30 on E bdy. of Tp., for a distance of 400 chs., setting temp. cors. at intervals of 40.00 chs. thereon. The initial point of this line is determined from the resurvey of the South boundary of the township, and east boundary of sec. 30, and the bearing of line is computed to produce a theoretical intersection with the cor. of secs. 25, 30, 31 and 36 on W. bdy. of Tp., the unavoidable errors of field work being overcome in the line bet. secs. 30 and 31, by running west on random, and return on true line, corrected to agree with the falling of the random line.

A Meridional Governing section line is also surveyed N.0° 6' W. from the reestablished cor. of secs. 35 and 36, on S. bdy. of Tp., to intersection with the above described governing sec. line, establishing $\frac{1}{4}$ sec. cor. of secs. 35 and 36 at 40.00 chs. S.0° 6' E. from such point of intersection, and from said point of intersection, the line is surveyed N.0° 6' W. for a distance of 320.00 chs., establishing $\frac{1}{4}$ sec. and sec. cors. at intervals of 40.00 chs. thereon. The bearing of this line is determined from the resurvey of the East bdy. of the Tp., and the resurvey and survey of that portion of the North bdy. situate . of sec. 1, computed to produce a theoretical intersection with the cor. of secs. 1, 2, 35 and 36 on N. bdy. of Tp., the unavoidable errors of field work being overcome in the line bet. secs. 1 and 2, by running N.0° 6' W., on a random line bet. said secs., and return on true line corrected to agree with the falling of the random line. These two Governing Section Lines then form a basis for the survey of the remainder of the Subdivision lines as hereinafter described.

From reestablished cor. of secs. 35 and 36 on S. bdy. of Tp., N.0° 06' W., on Meridional Governing Section line, bet. secs. 35 and 36.

- 31.78 Over rolling land, thru. dense timber and undergrowth.
- 35.74 Ascend 16 ft., over SE. slope.
- Ravine, 30 lks. wide, 5 ft. deep, course S. 80° E.
- Set an iron post 3 ft. long, 1 in. in diam., 20 ins. in the ground, for $\frac{1}{4}$ sec. cor., marked on brass cap,

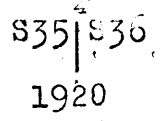

- A pinyon, 10 ins. in diam., brs. N. 26 $\frac{1}{2}$ ° E., 58 lks. dist., mark " $\frac{1}{4}$ S 36 BT."
- A pinyon, 9 ins. in diam., brs. S. 71 $\frac{1}{2}$ ° W., 63 lks. dist., mark " $\frac{1}{4}$ S 35 BT."
- 53.20 Ravine, 20 lks. wide, 3 ft. deep, course S. 80° E. Asc. 37 ft., over SW. slope, to
- 75.74 Intersect Latitudinal Governing Section line 28 lks. E. of the temp. cor. of secs. 25, 20, 35 and 36.
- At point of intersection,
- Set an iron post, 3 ft. long, 2 ins. in diam., 24 ins. in the ground, for cor. of secs. 25, 20, 35 and 36, marked on brass cap,

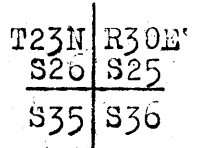

1920

chains.

- A pinyon, 8 ins. in diam., brs. N. 82 $\frac{1}{2}$ ° E., 21 lks. dist., mark "T23N R30E S25 BT."
- A cedar, 14 ins. in diam., brs. S. 27 $\frac{1}{2}$ ° E., 51 lks. dist., mark "T23N R30E S36 BT."
- A pinyon, 10 ins. in diam., brs. S. 4 $\frac{1}{2}$ ° W., 30 lks. dist., mark "T23N R30E S35 BT."
- A pinyon, 6 ins. in diam., brs. N. $\frac{1}{2}$ ° W., 55 lks. dist., mark "T23N R30E S26 BT."

Land, rolling and broken.
 Soil, sandy and stony clay loam, 2nd and 3rd rate.
 Timber, scattering yellow pine, dense pinyon and cedar.
 Undergrowth, dense sage brush and cinchona.

 From the reestablished cor. of secs. 25 and 36, on E. bdy. of Tp., hereinbefore described, West, on Latitudinal Governing Section line, bet. secs. 25 and 36.

- Over broken and rolling land, thru. dense timber and undergrowth. Desc. 10 ft., over W. slope.
- ..69 Ravine, 15 lks. wide, 3 ft. deep, course south. Ascend 5 ft. over E. slope.
- 5.50 Point of spur, slopes S. Descend 5 ft., over SW. slope.
- 9.52 Ravine, 15 lks. wide, 5 ft. deep, course S. 40° E. Asc. 24 ft. over E. slope, to
- 12.75 Top of ascent, brs. N. and S.
- 22.40 Descend 10 ft., over W. slope.
- 28.09 Ravine, 10 lks. wide, course S. 45° E. Asc. 29 ft., over E. slope.
- 33.41 Ridge, brs. N. 10° W. and S. 10° E. Desc. 59 ft., over SW. slope.
- 39.86 (Mid point), Set an iron post, 3 ft. long, 1 in. in diam., 26 ins. in the ground for $\frac{1}{4}$ sec. cor., marked on brass cap,

$\frac{1}{4}$ S 25
 S 36
 1920

- A yellow pine, 16 ins. in diam., brs. S. 85° W., 40 lks. dist., mark " $\frac{1}{4}$ S 36 BT."
- A yellow pine, 12 ins. in diam., brs. N. 4 $\frac{1}{2}$ ° W., 75 lks. dist., mark " $\frac{1}{4}$ S 25 BT."
- 45.12 Ravine; 20 lks. wide, 2 ft. deep, course S. 15° W.
- 47.12 Ravine; 15 lks. wide, 3 ft. deep, course S. 15° E.
- 50.50 Ravine, 15 lks. wide, 5 ft. deep, course S. 50° E.
- 75.42 Ravine, 15 lks. wide, 3 ft. deep, course SE. Asc. 5 ft., over SE. slope, to
- 79.72 The cor. of secs. 25, 26, 35 and 36.
 Land, rolling and broken.
 Soil, shallow rocky clay loam, 3rd rate.
 Timber, scattering yellow pine, dense pinyon and cedar.
 Undergrowth; dense cinchona and sage brush.

 N: 0° 06' W., on Meridional Governing Section line, bet. secs. 25 and 26,

- Over broken and rolling land, thru. dense timber and undergrowth. Asc. slightly over SE. slope, to
- 9.50 Ravine, 20 lks. wide, 3 ft. deep, course S. 30° E. Asc. 44 ft. over SW. slope.
- 27.13 Ridge, brs. N. 60° E. and S. 60° W. Descend 70 ft. over broken NW. slope.
- 40.00 Set an iron post, 3 ft. long, 1 in. in diam., 26 ins. in the ground, for $\frac{1}{4}$ sec. cor., marked on brass cap,

$\frac{1}{4}$
 S26 | S25
 1920

- A pinyon, 10 ins. in diam., brs. N. 46 $\frac{1}{2}$ ° W., 31 lks. dist., mark " $\frac{1}{4}$ S 26 BT."

Subdivision lines of Township 23 North, Range 30 East. 31

Chains.

59.96 A pinyon, 12 ins. in diam., brs. S. 28 1/4° E., 35 lks.
 dist., mark "1/4 S 25 BT."
 Ravine, 15 lks. wide, 6 ft. deep, course S. 20° W.
 66.26 Same ravine, 15 lks. wide, course S. 15° E. Ascend 76 ft.
 over SW. slope, to
 80.00 Set an iron post, 3 ft. long, 2 ins. in diam., 24 ins. in
 the ground, for cor. of secs. 23, 24, 25 and 26, marked
 on brass cap,

| | |
|------|------|
| T23N | R30E |
| S23 | S24 |
| S26 | S25 |

1920

A pinyon, 8 ins. in diam., brs. N. 17° E., 52 lks.
 dist., mark "T23N R30E S24 BT."
 A pinyon, 10 ins. in diam., brs. S. 12 1/4° E., 7 lks.
 dist., mark "T23N R30E S25 BT."
 A pinyon, 14 ins. in diam., brs. S. 43° W., 24 lks.
 dist., mark "T23N R30E S26 BT."
 A pinyon, 15 ins. in diam., brs. N. 50 1/2° W., 31 lks.
 dist., mark "T23N R30E S23 BT."
 Land, rolling and broken.
 Soil, shallow, sandy and stony clay loam, 3rd rate.
 Timber, dense pinyon and cedar.
 Undergrowth, dense sage brush, cinchona, algerita and
 scrub oak.

3.50 East, on true line, bet. secs. 24 and 25.
 Over broken and rolling land, thru. dense timber and
 undergrowth. Desc. 6 ft., over SE. slope.
 Ravine, 200 lks. wide, 30 ft. deep, course S. Asc. 72 ft.
 over W. slope.
 17.66 Ridge, brs. N. 30° E. and S. 30° W. Desc. 70 ft. over SE. slope.
 40.00 Set an iron post, 3 ft. long, 1 in. in diam., 14 ins.
 in the ground, to bed rock, supported in a mound of
 stone 4 ft. base, 1 1/2 ft. high, for 1/4 sec. cor., marked
 on brass cap,

| |
|----------|
| 1/4 S 24 |
| S 25 |

1920

79.58 A pinyon, 5 ins. in diam., brs. N. 7 lks. dist.,
 marked 1/4 S 24 B T."
 A pinyon, 7 ins. in diam., brs. S. 55 1/2° W., 14 lks.
 dist., mark "1/4 S 25 BT."
 Intersect E. bdy. of Tp., 5.01 chs. S. 0° 03' W. from re-
 established cor. of secs. 19 and 30; T. 23 N., R. 31 E.,
 hereinbefore described.
 At point of intersection,
 Set an iron post, 3 ft. long, 2 ins. in diam. 24 ins.
 in the ground, for closing cor. of secs. 24 and 25,
 marked on brass cap,

| | | |
|------|------|------|
| T23N | R30E | R31E |
| CC | S24 | S30 |
| | S25 | |

1920

A pinyon, 14 ins. in diam., brs. N. 68 1/4° W., 68 lks.
 dist., mark "CC T23N R30E S24 BT."
 A pinyon, 11 ins. in diam., brs. S. 79 1/2° W., 93 lks.
 dist., mark "CC T23N R30E S25 BT."
 Land, rolling and broken.
 Soil, shallow, rocky clay loam, 3rd rate.
 Timber, dense pinyon and cedar.
 Undergrowth, dense sage brush, cinchona, algerita and scrub
 oak.

32 Subdivision lines of Township 23 North, Range 30 East.

Chains.

From cor. of secs, 23, 24, 25 and 26,
N. 0° 00' W. on Meridional Governing Section Line, bet. secs.
23 and 24.

Over broken and rolling land, thru. dense timber and undergrowth. Asc. 33 ft., over SW. slope.

9.36 Point of spur, slopes SW. Desc. 48 ft., over NW. slope.

13.26 Ravine, 15 lks. wide, course S. 10° W. Asc. 111 ft., over SE slope.

28.34 Ridge, brs. N. 30° E. and S. 30° W. Desc. 40 ft., over NW. slope.

40.00 Set an iron post, 3 ft. long, 1 in. in diam., 20 ins. in the ground, for 1/4 sec. cor., marked on brass cap,

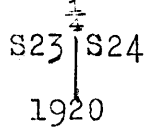

A pinyon, 9 ins. in diam., brs. S. 72° E., 21 lks. dist., mark "1/4 S 24 BT."

A pinyon, 6 ins. in diam., brs. S. 83 1/2° W., 42 lks. dist., mark "1/4 S 23 BT."

52.73 Ravine, 10 lks. wide, 3 ft. deep, course S. 45° W.; asc. 17 ft., over SE. slope, to

80.00 Set an iron post, 3 ft. long, 2 ins. in diam., 24 ins. in the ground, for cor. of secs. 13, 14, 23 and 24, marked on brass cap.

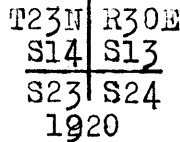

A pinyon, 11 ins. in diam., brs. N. 50 1/2° E., 41 lks. dist., mark "T23N R30E S13 BT."

A pinyon, 10 ins. in diam., brs. S. 20 1/2° E., 59 lks. dist., mark "T23N R30E S24 BT."

A pinyon, 6 ins. in diam., brs. S. 6 1/2° W., 41 lks. dist., mark "T23N R30E S23 BT."

A pinyon, 12 ins. in diam., brs. N. 27 1/2° W., 6 lks. dist., mark "T23N R30E S14 BT."

Land, rolling and broken.

Soil, shallow, rocky clay loam, 3rd rate.

Timber, dense pinyon and cedar.

Undergrowth, dense sage brush, cinchona, algerita and scrub oak.

East, on true line, bet. secs. 13 and 24.

Over rolling and broken land, thru. dense timber and undergrowth. Asc. 20 ft. over NW. slope.

7.50 Ridge, brs. NE and SW. Descend gradually over SE. slope.

40.00 Set an iron post 3 ft. long, 1 in. in diam., 20 ins. in the ground, for 1/4 sec. cor., marked on brass cap,

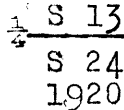

A pinyon, 9 ins. in diam., brs. N. 20° E., 16 lks. dist., marked "1/4 S 13 BT."

A pinyon, 10 ins. in diam., brs. S. 62° E., 63 lks. dist., mark "1/4 S 24 BT."

Descend 45 ft. over SE. slope.

67.69 Ravine, 20 lks. wide, course N. 85° E. Ascend 16 ft. over NW. slope, to

79.82 Intersect E. bdy. of Tp., 5.00 chs. S. 0° 35' W. from reestablished cor. of secs. 18 and 19, T. 23 N., R. 31 E. hereinbefore described.

At point of intersection, Set an iron post 3 ft. long, 2 ins. in diam., 3 ins. in the ground to bed rock,

Subdivision lines of Township 23 North, Range 30 East.

Chains.

supported in a mound of stone 5 ft. base, 2 1/2 ft. high, for closing cor. of secs. 13 and 24, marked on brass cap,

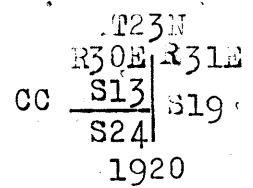

- A pinyon, 8 ins. in diam., brs. N. 32° W., 55 lks. dist., mark "CC T23N R30E S13 BT."
- A pinyon, 6 ins. in diam., brs. S. 30° W., 39 lks. dist., mark "CC T23N R30E S24 BT."

Land rolling and broken.
 Soil, shallow, sandy clay loam, 3rd and 4th rate.
 Timber, dense pinyon and cedar.
 Undergrowth, dense sage brush, cinchona, algerita and scrub oak.

From cor. of secs. 13, 14, 23 and 24, N. 0° 06' W. on Meridional Governing Section line, bet. secs. 13 and 14.

40.00

Over rolling land, thru. dense timber and undergrowth. Ascend gradually along W. slope.
 Set an iron post, 3 ft. long, 1 in. in diam., 20 ins. in the ground, for 1/4 sec. cor., marked on brass cap,

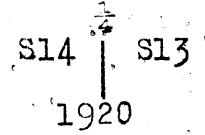

- A pinyon 10 ins., in diam., brs. N. 38 1/2° W., 87 lks. dist., mark "1/4 S 14 BT."
- A cedar, 5 ins. in diam., brs. S. 43 1/2° E., 122 lks. dist., mark "1/4 S 13 BT."

80.00

Set an iron post, 3 ft. long, 2 ins. in diam., 24 ins. in the ground, for cor. of secs. 11, 12, 13 and 14, marked on brass cap,

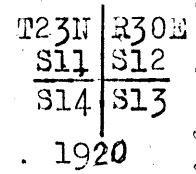

- A pinyon, 6 ins. in diam., brs. N. 27 1/2° E., 48 lks. dist., mark "T23N R30E S12 BT."
- A pinyon, 6 ins. in diam., brs. S. 22° E., 51 lks. dist., mark "T23N R30E S13 BT."
- A pinyon, 10 ins. in diam., brs. S. 6 1/2° W., 99 lks. dist., mark "T23N R30E S14 BT."
- A pinyon, 10 ins. in diam., brs. N. 44 1/2° W., 53 lks. dist., mark "T23N R30E S11 BT."

Land, rolling.
 Soil, shallow clay loam, 3rd rate.
 Timber, dense pinyon and cedar.
 Undergrowth, dense sage brush, cinchona, algerita and scrub oak.

East, on a true line, bet. secs. 12 and 13.
 Over rolling land, thru. dense timber and undergrowth.
 Set an iron post, 3 ft. long, 1 in. in diam., 20 ins. in the ground, for 1/4 sec. cor., marked on brass cap,

40.00

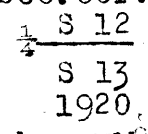

- A pinyon, 10 ins. diam., brs. N. 8° W., 8 lks. dist., mark "1/4 S12 BT."
- A pinyon, 12 ins. diam., brs. S. 36 1/4° W., 59 lks. dist., mark "1/4 S13 BT."

34 Subdivision of Township 23 North, Range 30 East.

Chains.

68.20 Descend 250 ft., over steep NE. slope, to
 79.84 Intersect E. bdy. of Tp., 4.98 chs. S. 0° 22' E., from the
 reestablished cor. of secs. 7 and 18, T. 23 N., R. 31 E.,
 hereinbefore described.
 At point of intersection, set an iron post, 3 ft. long,
 2 ins. in diam., 20 ins. in the ground, for closing
 cor. of secs. 12 and 13 marked on brass cap,

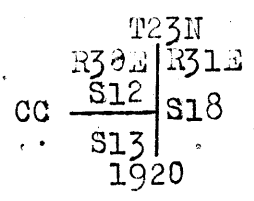

A cedar, 12 ins. in diam., brs. N. 29 1/4° W., 33 lks.
 dist., mark "CC T23N R30E S12 BT."
 A cedar, 14 ins. in diam., brs. S. 01 1/4° W., 36 lks.
 dist., mark "CC T23N R30E S13 BT."

Land, rolling and broken.
 Soil, shallow, sandy and stony clay loam, 3rd and 4th rate.
 Timber, dense pinyon and cedar.
 Undergrowth, dense sage brush, cinchona, scrub oak and
 algerita.

From cor. of secs. 11, 12, 13 and 14,
 N. 0° 06' W., on Meridional Governing Section line, bet. secs.
 11 and 12.
 Over rolling land, thru. dense timber and undergrowth.
 40.00 Set an iron post, 3 ft. long, 1 in. in diam., 12 ins. in
 the ground to bed rock, supported in a mound of stone
 4 ft. base, 2 ft. high for 1/4 sec. cor., marked on brass
 cap,

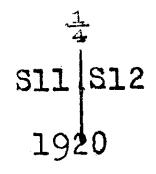

A pinyon, 10 ins. in diam., brs. S. 60 1/4° E., 19
 lks. dist., mark "S 12 BT."
 A pinyon, 9 ins. in diam., brs. S. 60° W., 16
 lks. dist., mark "S 11 BT."

80.00 Set an iron post, 3 ft. long, 2 ins. in diam., 24 ins.
 in the ground, for cor. of secs. 1, 2, 11 and 12, marked
 on brass cap,

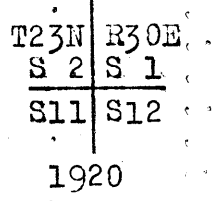

A cedar, 8 ins. in diam., brs. N. 15° E., 364 lks.
 dist., mark "T23N R30E S1 BT."
 A cedar, 7 ins. in diam., brs. S. 05° E., 480 lks.
 dist., mark "T23N R30E S12 BT."
 A pinyon, 8 ins. in diam., brs. S. 86° W., 120 lks.
 dist., mark "T23N R30E S11 BT."
 A cedar, 8 ins. in diam., brs. N. 05 1/4° W., 218 lks.
 dist., mark "T23N R30E S2 BT."

Land, rolling.
 Soil, dry, sandy and stony clay loam, 3rd rate.
 Timber, dense pinyon and cedar.
 Undergrowth, dense sage and cinchona and scrub oak.

East, on a true line, bet. secs. 1 and 12.
 Over rolling and broken land, thru. dense timber and
 undergrowth.

Subdivision of Township 23 North, Range 30 East.

Chains.

17.40 Leave rolling and broken land, and enter mountainous land. Descend 402 ft. over steep NE. slope.

40.00 Set an iron post, 3 ft. long, 1 in. in diam., 20 ins. in the ground, for 1/4 sec. cor., marked on brass cap,

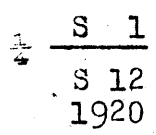

A pinyon, 7 ins. in diam., bears N. 63 1/4° W., 84 lks. dist., mark "S 1 BT."

A cedar, 12 ins. in diam., brs. S. 78 1/4° E., 5 lks. dist., mark "S 12 BT."

58.32 Foot of steep descent, brs. NW and SE. Leave mountainous land; thence along N. slope, descending gradually.

73.21 Road from Lupton to St. Michaels, Arizona, brs. N. 45° W. and S. 45° E.

74.85 Wash, 20 lks. wide, banks 5 ft. high, course N. 20° W. Asc. 15 ft. over SW. slope, to

79.72 Intersect the E. bdy. of Tp., 4.87 chs. S. 0° 15' E. from the reestablished cor. of secs. 6 and 7, T. 23 N., R. 31 E., hereinbefore described.

At point of intersection, set an iron post, 3 ft. long, 2 ins. in diam., 24 ins. in the ground, for closing cor. of secs. 1 and 12, marked on brass cap,

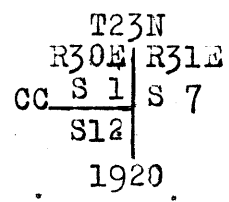

A pinyon, 12 ins. in diam., brs. N. 78 1/4° W., 43 lks. dist., mark "CC T23N R30E S1 BT."

A pinyon, 14 ins. in diam., brs. S. 37 1/2° W., 79 lks. dist., mark "CC T23N R30E S12 BT."

Land, rolling, broken and mountainous. Soil, shallow, sandy and stony clay loam, 3rd rate. Timber, dense pinyon and cedar. Undergrowth, dense sage brush, cinchona and scrub oak.

From cor. of secs. 1, 2, 11 and 12, N. 0° 06' W. on a random line, bet. secs. 1 and 2.

40.00 Set temp. 1/4 sec. cor.

84.02 Fall 10 lks. E. of the reestablished cor. of secs. 1, 2, 35 and 36 on N. bdy. of Tp., hereinbefore described.

Thence, S. 0° 10' E., on a true line, bet. secs. 1 and 2.

Over mountainous land, thru. dense timber and undergrowth. Ascend 363 ft., over steep NE. slope.

44.02 Set an iron post, 3 ft. long, 1 in. in diam., 20 ins. in the ground, for 1/4 sec. cor., marked on brass cap,

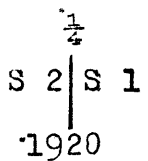

A pinyon, 14 ins. in diam., brs. N. 15° W., 36 lks. dist., mark "S 2 BT."

A pinyon, 7 ins. in diam., brs. S. 82° E., 38 lks. dist., mark "S 1 BT."

59.00 Top of steep ascent, brs. NW and SE. Leave mountainous, and enter rolling land. Desc. gradually over SW. slope, to

84.02 The cor. of secs. 1, 2, 11 and 12. Land, rolling and mountainous.

36 Subdivision lines of Township 23 North, Range 30 East.

chains.

Soil, N.60 chs., rocky; S.20 chs., sandy clay loam, 2nd and 3rd rate. Timber, dense pinyon and cedar. Undergrowth, dense sage brush, cinchona and scrub oak.

From the reestablished cor. of secs. 34 and 35 on S bdy. of Tp., hereinbefore described, N.0° 07' W., bet. secs. 34 and 35. Over rolling and broken land, thru. dense timber and undergrowth.

- 14.68 Descend 22 ft., over W. slope.
- Ravine, 20 lks. wide, 3 ft. deep, course S.15° W. Ascend 86 ft., over SE. slope.
- 26.00 Spur, slopes S. 30° W. Descend 12 ft., over NW. slope.
- 30.52 Ravine, 20 lks. wide, course S.15° W. Ascend 32 ft., over SE. slope.
- 36.60 (40.00 chs. southing from cor. of secs. 26, 27, 34 and 35), set an iron post 3 ft. long, 1 in. in diam., 14 ins. in the ground, to bed rock, supported in a mound of stone 4 ft. base, 2 ft. high, for $\frac{1}{4}$ sec. cor., marked on brass cap,

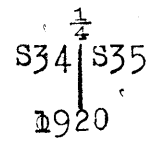

- A pinyon, 15 ins. in diam., brs. N.83° W., 36 lks. dist., mark " $\frac{1}{4}$ S34 BT."
- A pinyon, 13 ins. in diam., brs. S.55° E., 42 lks. dist., mark " $\frac{1}{4}$ S 35 BT."

- 41.19 Ridge, brs. NE. and SW. Desc. 52 ft. over NW. slope.
- 45.91 Ravine, 50 lks. wide, cut banks 2 ft. high, course S.35° W. Ascend 12 ft., over SE. slope.
- 57.71 Point of spur, slopes SE. Descend 12 ft. over NE. slope,
- 60.71 Ravine, 15 lks. wide, cut banks, 2 ft. high, course S.50° E. Ascend 51 ft., over SW. slope, to
- 76.65 Intersect Latitudinal Governing Section line, 22 lks. E. of the temp. cor. of secs. 26, 27, 34 and 35. At point of intersection, Set an iron post 3 ft. long, 2 ins. in diam., 24 ins. in the ground for cor. of secs. 26, 27, 34 and 35, marked on brass cap,

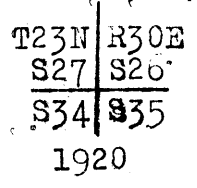

- A pinyon, 9 ins. in diam., brs. N.53° E., 64 lks. dist., mark "T23N R30E S26 BT."
- A pinyon, 9 ins. in diam., brs. S.80° E., 50 lks. dist., mark "T23N R30E S35 BT."
- A pinyon, 11 ins. in diam., brs. S.44 $\frac{1}{2}$ ° W., 67 lks. dist., mark "T23N R30E S34 BT."
- A pinyon, 8 ins. in diam., brs. N.40° W., 82 lks. dist., mark "T23N R30E S27 BT."

Land, rolling and broken. Soil, shallow, sandy and stony clay loam, 3rd and 4th rate. Timber, dense pinyon and cedar. Undergrowth, dense sage brush, cinchona and scrub oak.

From the cor. of secs. 25, 26, 35 and 36, hereinbefore described, West, on Latitudinal Governing Section Line, bet. secs. 26 and 35.

Subdivision lines of Township 23 North, Range 30 East. 37

Chains.

Over rolling and broken land, thru. dense timber and undergrowth. Ascend 20 ft., over SE. slope.
 21.60 Ridge, brs. N. 60° E. and S. 60° W. Desc. 36 ft., over NW. slope.
 40.03 (Mid-point), Set an iron post 3 ft. long, 1 in. in diam., 20 ins. in the ground to bed rock, supported in a mound of stone 4 ft. base, 1½ ft. high, for ¼ sec. cor., marked on brass cap,

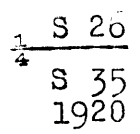

A pinyon, 11 ins. in diam., brs. N. 80° W., 11 lks. dist., mark "¼ S 26 BT."
 A pinyon, 9 ins. in diam., brs. S. 63½° W., 37 lks. dist., mark "¼ S 35 BT."
 47.32 Ravine, 20 lks. wide, with cut banks 3 ft. high, course S. 35° W. Asc. 10 ft., over SE. slope.
 52.56 Point of spur, slopes SE. Desc. 22 ft., over SW. slope.
 60.07 Ravine, 40 lks. wide, banks 5 ft. high, course S. 45° E. Ascend 11 ft. over SE. slope, to
 80.06 The cor. of secs. 26, 27, 34 and 35.
 Land, rolling and broken.
 Soil, shallow, sandy and rocky loam, 3rd rate.
 Timber, dense pinyon and cedar.
 Undergrowth, dense sage brush, algerita, cinchona and scrub oak.

N. 0° 07' W., bet. secs. 26 and 27.
 Over gently rolling land, thru. dense timber and undergrowth. Asc. gradually, over SE. slope.
 40.00 Set an iron post, 3 ft. long, 1 in. in diam., 26 ins. in the ground, for ¼ sec. cor., marked on brass cap,

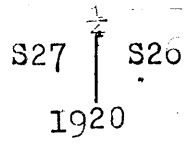

A pinyon, 9 ins. in diam., brs. N. 14½° W., 54 lks. dist., mark "¼ S 27 BT."
 A pinyon, 7 ins. in diam., brs. S. 68½° E., 52 lks. dist., mark "¼ S 26 BT."
 Continue over SE. slope.
 80.00 Set an iron post, 3 ft. long, 2 ins. in diam., 24 ins. in the ground, for cor. of secs. 22, 23, 26 and 27, marked on brass cap,

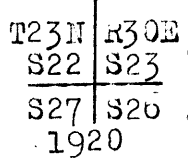

A pinyon, 14 ins. in diam., brs. N. 55½° E., 88 lks. dist., mark "T23N R30E S23 BT."
 A pinyon, 5 ins. in diam., brs. S. 33½° E., 41 lks. dist., mark "T23N R30E S26 BT."
 A pinyon, 12 ins. in diam., brs. S. 28½° W., 37 lks. dist., mark "T23N R30E S27 BT."
 A pinyon, 12 ins. in diam., brs. N. 30° W., 26 lks. dist., mark "T23N R30E S22 BT."

Land, gently rolling.
 Soil, shallow, sandy and stony clay loam, 3rd rate.
 Timber, dense pinyon and cedar.
 Undergrowth, dense sage brush, cinchona, scrub oak, and algerita brush.

38 Subdivision of Township 23 North, Range 30 East.

Chains.

- East, on a random line, bet. secs. 23 and 26.
 40.00 Set temp. $\frac{1}{4}$ sec. cor.
 80.10 Intersect N. and S. line, 5 lks. N. of the cor. of secs. 23, 24, 25 and 26.
 Thence,
 N. $89^{\circ} 58'$ W., on true line bet. secs. 23 and 26.
 Over rolling and broken land, thru. dense timber and undergrowth. Descend 27 ft., over SW. slope.
 3.05 Ravine, 15 lks. wide, banks 5 ft. high, course S. Asc. 57 ft. over E. slope.
 15.06 Spur, slopes S. Descend 51 ft. over W. slope.
 17.96 Wash, 10 lks. wide, with cut banks, 2 ft. high, course S. Ascend 37 ft., over E. slope.
 24.10 Spur; slopes S. 16° W. Desc. 29 ft., over W. slope.
 32.40 Ravine, 30 lks. wide, course S. 10° W. Asc. 16 ft., over SE. slope, to
 40.05 Set an iron post, 3 ft. long, 1 in. in diam., 14 ins. in the ground, to bed rock, supported in a mound of stone, 4 ft. base, 2 ft. high, for $\frac{1}{4}$ sec. cor., marked on brass cap,

$\frac{1}{4}$ S 23
 S 26
 1920

A pinyon, 14 ins. in diam., brs. N. $14\frac{1}{2}^{\circ}$ W., 73 lks. dist., mark " $\frac{1}{4}$ S 23 BT."

A pinyon, 10 ins. in diam., brs. S. $26\frac{1}{2}^{\circ}$ E., 10 lks. dist., mark " $\frac{1}{4}$ S 26 BT."

- Ascend very gradually over SE. slope.
 80.10 The cor. of secs. 22, 23, 26 and 27.
 Land, rolling and broken.
 Soil, shallow sandy and stony clay loam, 3rd rate.
 Timber, dense pinyon and cedar.
 Undergrowth, dense sage brush, cinchona and scrub oak.

- N. $0^{\circ} 07'$ W., bet. secs. 22 and 23.
 Over rolling land, thru. dense timber and undergrowth.
 Ascend very gradually over SE. slope.
 40.00 Set an iron post, 3 ft. long, 1 in. in diam., 26 ins. in the ground, for $\frac{1}{4}$ sec. cor., marked on brass cap,

$\frac{1}{4}$
 S22 | S23
 1920

A pinyon, 7 ins. in diam., brs. N. $72\frac{1}{2}^{\circ}$ W., 55 lks. dist., mark " $\frac{1}{4}$ S 22 BT."

A pinyon, 6 ins. in diam., brs. S. $71\frac{1}{2}^{\circ}$ E., 11 lks. dist., mark " $\frac{1}{4}$ S 23 BT."

- Ascend gradually over SE. slope.
 53.30 Ridge, brs. N. 35° E. and S. 35° W., Descend gradually, over NW. slope, to
 79.20 Ravine, 10 lks. wide, course S. 60° W. Asc. 8 ft., over SE. slope, to
 80.00 Set an iron post, 3 ft. long, 2 ins. in diam., 24 ins. in the ground, for cor. of secs. 14, 15, 22 and 23, marked on brass cap,

T23N | R30E
 S15 | S14
 S22 | S23
 1920

A pinyon, 10 ins. in diam., brs. N. $22\frac{1}{2}^{\circ}$ E., 16 lks. dist., mark "T23N R30E S14 BT."

A pinyon, 9 ins. in diam., brs. S. 40° E., 57 lks. dist., mark "T23N R30E S23 BT."

Subdivision of Township 23 North, Range 30 East. 39

Chains.

A pinyon, 8 ins. in diam., brs. S. 67 1/4° W., 93 lks. dist., mark "T23N R30E S22 BT."
A pinyon, 9 ins. in diam., brs. N. 10 1/4° W., 26 lks. dist., mark "T23N R30E S15 BT."

Land, rolling.
Soil, sandy and stony clay loam, 2nd rate.
Timber, dense pinyon and cedar.
Undergrowth, dense sage brush, cinchona and scrub oak.

- 40.00 Set temp. 1/4 sec. cor.
- 80.02 Intersect N. and S. line, 5 lks. S. of the cor. of secs. 13, 14, 23 and 24.
Thence,
West, on true line, bet. secs. 14 and 23.
Over rolling land, thru. dense timber and undergrowth.
Desc. 11 ft., over W. slope.
- 14.53 Ravine, 5 lks. wide, with cut banks 2 ft. high, course S. 40° W. Asc. 17 ft., over SE. slope.
- 28.60 Spur, slopes S. 20° W. Desc. 15 ft., over NW. slope.
- 36.03 Ravine, 10 lks. wide, with cut banks 4 ft. high, course S. 20° E. Asc. 12 ft., over SE. slope.
- 40.01 Set an iron post, 3 ft. long, 1 in. in diam., 20 ins. in the ground for 1/4 sec. cor., marked on brass cap,

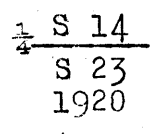

A pinyon, 9 ins. in diam., brs. N. 28° E., 6 lks. dist., mark "1/4 S 14 B T."
A pinyon, 24 ins. in diam., brs. S. 35° W., 32 lks. dist., mark "1/4 S 23 BT."

- 55.80 Asc. gradually over SE. slope.
- 80.02 Ridge, brs. NE and SW. Desc. gradually over NW. slope.
The cor. of secs. 14, 15, 22 and 23.
Land, rolling.
Soil, sandy and stony, clay loam, 3rd rate.
Timber, dense pinyon and cedar.
Undergrowth, dense sage brush, cinchona and scrub oak.

- 40.00 N. 0° 07' W., bet. secs. 14 and 15.
Over gently rolling land, thru. dense timber and undergrowth.
Ascend very gradually, over SW. slope.
Set an iron post 3 ft. long, 1 in. in diam., 26 ins. in the ground for 1/4 sec. cor., marked on brass cap,



A pinyon, 9 ins. in diam., brs. S. 46° E., 47 lks. dist., mark "1/4 S 14 B T."
A pinyon, 14 ins. in diam., brs. S. 0° W., 158 lks. dist., mark "1/4 S 15 BT."

- 80.00 Ascend very gradually over SW. slope.
Set an iron post, 3 ft. long, 2 ins. in diam., 24 ins. in the ground, for cor. of secs. 10, 11, 14 and 15, marked on brass cap,

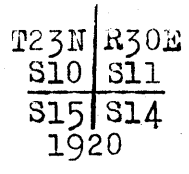

10 Subdivision of Township 23 North, Range 30 East.

Chains.

- A pinyon, 10 ins. in diam., brs. N. 46 1/2° E., 70 lks. dist., mark "T23N R30E S11 BT."
- A pinyon, 10 ins. in diam., brs. S. 33° E., 25 lks. dist., mark "T23N R30E S14 BT."
- A pinyon, 6 ins. in diam., brs. S. 54° W., 38 lks. dist., mark "T23N R30E S15 BT."
- A pinyon, 22 ins. in diam., brs. N. 60° W., 93 lks. dist., mark "T23N R30E S10 BT."

Land, gently rolling.
 Soil, sandy and stony clay loam, 2nd rate.
 Timber, dense pinyon and cedar.
 Undergrowth, dense sage brush, cinchona and scrub oak.

- East, on a random line, bet. secs. 11 and 14.
 40.00 Set temp. 1/4 sec. cor.
 79.96 Intersect N. and S. line, 5 lks. N. of the cor. of secs. 11, 12, 13 and 14.
 Thence,
 N. 89° 58' W., on a true line, bet. secs. 11 and 14.
 Over gently rolling land, thru. dense timber and undergrowth.
 Descend very gradually, over SW. slope.
 39.98 Set an iron post, 3 ft. long, 1 in. in diam., 12 ins. in the ground to bed rock, supported in a mound of stone, 4 ft. base, 2 ft. high, for 1/4 sec. cor., marked on brass cap,

1/4 S 11
 S 14
 1920

- A pinyon, 11 ins. in diam., brs. N. 88 1/2° W., 98 lks. dist., mark "1/4 S 11 BT."
 - A cedar, 18 ins. in diam., brs. S. 11° W., 40 lks. dist., mark "1/4 S 14 BT."
- Continue over gently rolling land. Desc. very gradually over SW. slope.
 79.96 The cor. of secs. 10, 11, 14 and 15.
 Land, gently rolling.
 Soil, sandy and stony clay loam, 2nd rate.
 Timber, dense pinyon and cedar.
 Undergrowth, cinchona, scrub oak, and sage brush.

- N. 0° 07' W., bet. secs. 10 and 11.
 Over gently rolling land, thru. dense timber and undergrowth. Asc. very gradually, over W. slope.
 40.00 Set an iron post, 3 ft. long, 1 in. in diam., 26 ins. in the ground, for 1/4 sec. cor., marked on brass cap,

S10 | S11
 |
 1920

- A pinyon, 9 ins. in diam., brs. N. 60 1/2° E., 28 lks. dist., mark "1/4 S 11 BT."
 - A pinyon, 10 ins. in diam., brs. S. 16° W., 32 lks. dist., mark "1/4 S 10 BT."
- Continue over gently rolling land. Asc. very gradually over W. slope.
 80.00 Set an iron post 3 ft. long, 2 ins. in diam., 8 ins. in the ground to bed rock, supported in a mound of stone 4 ft. base, 2 ft. high for cor. of secs. 2, 3, 10 and 11, marked on brass cap

T23N | R30E
 S 3 | S 2
 S10 | S11
 1920

Subdivision of Township 23 North, Range 30 East.

Chains.

A cedar, 12 ins. in diam., brs. N. 79½° E., 72 lks. dist., mark "T23N R30E S2 BT."
 A pinyon, 10 ins. in diam., brs. S. 61° E., 128 lks. dist., mark "T23N R30E S11 BT."
 A cedar, 11 ins. in diam., brs. S. 41° W., 173 lks. dist., mark "T23N R30E S10 BT."
 A cedar, 11 ins. in diam., brs. N. 34¾° W., 125 lks. dist., mark "T23N R30E S3 BT."
 Land, gently rolling. Soil, sandy & stony clay loam, 2nd rate. Timber, dense pinyon & cedar, Undergrowth, dense scrub oak, cinchona and sage brush.

S. 89° 58' E., on a random line, bet. secs. 2 and 11.
 40.00 Set temp. ¼ sec. cor.
 80.00 Intersect N. & S. line, 8 lks. N. of cor. of secs. 1, 2, 11 and 12. Thence, N. 89° 55' W., on true line, bet. secs. 2 and 11. Over gently rolling land, thru. dense timber and undergrowth. Descend very gradually over W. slope.

40.00 Set an iron post, 3 ft. long, 1 in. in diam., 12 ins. in the ground, to bed rock, supported in mound of stone, 4½ ft. base, 2 ft. high, for ¼ sec. cor., marked on brass cap,
 ¼ S 2
 S 11
 1920

A pinyon, 10 ins. in diam., brs. N. 4° E., 111 lks. dist., mark "¼ S 2 B T."
 A pinyon, 10 ins. in diam., brs. S. 68¼° E., 60 lks. dist., mark "¼ S 11 BT."

80.00 Continue over gently rolling land. Descend very gradually over W. slope. The cor. of secs. 2, 3, 10 and 11. Land, gently rolling. Soil, sandy clay loam, 2nd rate. Timber, dense pinyon and cedar. Undergrowth, dense cinchona and sage brush.

40.00 N. 0° 07' W., on a random line, bet. secs. 2 and 3. Set temp. ¼ sec. cor.
 84.00 Intersect N. bdy. of Tp., 10 lks. E. of cor. of secs. 2, 3, 34 & 35. Thence, S. 0° 11' E., on true line, bet. secs. 2 and 3. Over rolling land, thru. dense timber and undergrowth. Ascend 25 ft., over NE. slope.

16.60 Top of ascent, brs. NW and SE.; thence over gently rolling land. Desc. very gradually over W. slope.
 44.00 Set an iron post, 3 ft. long, 1 in. in diam., 20 ins. in the ground, for ¼ sec. cor., marked on brass cap,
 ¼ S 3 | S 2
 1920

A cedar, 20 ins. in diam., brs. N. 71½° E., 33 lks. dist., mark "¼ S 2 BT."
 A pinyon, 18 ins. in diam., brs. S. 69½° W., 21 lks. dist., mark "¼ S 3 BT."

84.00 Continue over gently rolling land. Desc. very gradually over W. slope. The cor. of secs. 2, 3, 10 and 11. Land, rolling. Soil, sandy clay loam, 2nd rate. Timber, dense pinyon and cedar. Undergrowth, dense sage brush and cinchona.

From the reestablished cor. of secs. 33 and 34, on S. bdy. of Tp., hereinbefore described, N. 0° 07' W., bet. secs. 33 and 34. Over rolling broken land, thru. dense timber and undergrowth. Desc. 50 ft., over N. slope.

4.31 Ravine, 15 lks. wide, with cut banks, 3 ft. high, course S. 80° W. Ascend very gradually over SW. slope, across mouth of wide gorge.

32.08 Leave rolling, and enter mountainous land. Asc. 352 ft. over steep SW. slope of N. wall of wide gorge.

37.48 (40.00 chs. southing from cor. of secs. 27, 28, 33 and 34), Set an iron post 3 ft. long, 1 in. in diam., 18 ins. in the ground to bed rock, supported in a mound of stone 3½ ft. base, 1 ft. high for ¼ sec. cor., marked on brass cap,

42 S. Division of Township 23 North, Range 30 East

Chains.

S33 | S34
1920

An oak, 4 ins. in diam., brs. N. 32° W., 30 lks.
dist., mark "1/4 S 33 BT."
A cedar, 12 ins. in diam., brs. S. 28° E., 27 lks.
dist., mark "1/4 S 34 BT."

67.62 Top of steep ascent, brs. NW. and SE. Leave mountainous land. Thence over gently rolling land; asc. very gradually over SW. slope.

77.48 Intersect Latitudinal Governing Section Line 34 lks. E. of temp. cor. of secs. 27, 28, 33 and 34. At point of intersection, Set an iron post 3 ft. long, 2 ins. in diam., 24 ins. in the ground for cor. of secs. 27, 28, 33 and 34, marked on brass cap,

T23N | R30E
S28 | S27
S33 | S34
1920

A pinyon, 9 ins. in diam., brs. N. 54 1/4° E., 99 lks.
dist., mark "T23N R30E S27 BT."
A cedar, 14 ins. in diam., brs. S. 34 1/2° E., 119 lks.
dist., mark "T23N R30E S34 BT."
A cedar, 7 ins. in diam., brs. S. 31° W., 25 lks.
dist., mark "T23N R30E S33 BT."
A cedar, 8 ins. in diam., brs. N. 29 3/4° W., 46 lks.
dist., mark "T23N R30E S28 BT."

Land, rolling, broken and mountainous.
Soil, sandy and stony, 2nd & 3rd rate, Timber, dense pinyon and cedar. Undergrowth, dense sage brush & cinchona.

From the cor. of secs. 26, 27, 34 and 35, West, on Latitudinal Governing Section Line, bet. secs. 27 and 34. Over rolling land, thru. dense timber and undergrowth. Asc. very gradually, over SE. slope.

39.94 (Mid-point) Set an iron post, 3 ft. long, 1 in. in diam., 26 ins. in the ground, for 1/4 sec. cor., marked on brass cap,

1/4 S 27
S 34
1920

A pinyon, 13 ins. in diam., brs. N. 33 3/4° E., 16 lks.
dist., mark "1/4 S 27 BT."
A pinyon, 12 ins. in diam., brs. S. 22 3/4° E., 31 lks.
dist., mark "1/4 S 34 BT."

64.30 Continue very gradual ascent, over SE. slope. Ridge, brs. N. 10° E. and S. 10° W. Desc. 33 ft. over broken W. slope, to

79.88 The cor. of secs. 27, 28, 33 and 34. Land, rolling and broken. Soil, sandy & stony clay loam, 3rd rate. Timber, dense pinyon and cedar. Undergrowth, dense cinchona and sage brush.

N. 0° 7' W., bet. secs. 27 and 28. Over rolling and broken land, thru. dense timber and undergrowth. Asc. very gradually over W. slope.

40.00 Set an iron post, 3 ft. long, 1 in. in diam., 26 ins. in the ground for 1/4 sec. cor., marked on brass cap,

S 28 | S 27
1920

A cedar, 16 ins. in diam., brs. N. 55° W., 9 lks.
dist., mark "1/4 S 28 BT."
A pinyon, 9 ins. in diam., brs. S. 36 3/4° E., 105 lks.
dist., mark "1/4 S 27 BT."

80.00 Continue very gradual ascent over W. slope. Set an iron post, 3 ft. long, 2 ins. in diam., 24 ins. in the ground, for cor. of secs. 21, 22, 27 and 28, marked on brass cap,

Chains.

| | |
|------|------|
| T23N | R30E |
| S21 | S22 |
| S28 | S27 |

1920

- A pinyon, 5 ins. in diam., brs. N. 38° E., 33 lks. dist., mark "T23N R30E S22 BT."
- A pinyon, 5 ins. in diam., brs. S. 19° W., 18 lks. dist., mark "T23N R30E S27 BT."
- A cedar, 8 ins. in diam., brs. S. 14° W., 33 lks. dist., mark "T23N R30E S28 BT."
- A pinyon, 10 ins. in diam., brs. N. 21 1/4° W., 69 lks. dist., mark "T23N R30E S21 BT."

Land, rolling and broken.
 Soil, shallow sandy & stony clay loam, 3rd rate.
 Timber, dense pinyon and cedar.
 Undergrowth, dense cinchona and sage brush.

East, on a random line, bet. secs. 22 and 27.

- 40.00 Set temp. 1/4 sec. cor.
- 79.82 Intersect N. and S. line, 5 lks. S. of the cor. of secs. 22, 23, 26 and 27.

Thence, S. 89° 58' W. on true line, bet. secs. 22 and 27.
 Over rolling land, thru dense timber and undergrowth.
 Asc. very gradually over SE. slope.

- 39.91 Set an iron post, 3 ft. long, 1 in. in diam., 26 ins. in the ground, for 1/4 sec. cor., marked on brass cap,

| | |
|-----|------|
| 1/4 | S 22 |
| | S 27 |

1920

- A pinyon, 7 ins. in diam., brs. N. 36 1/4° W., 62 lks. dist., mark "1/4 S 22 BT."
- A pinyon, 8 ins. in diam., brs. S. 14° W., 30 lks. dist., mark "1/4 S 27 BT."

Ascend very gradually over E. slope.
 Low ridge, brs. N. and S. Desc. very gradually over W. slope.
 The cor. of secs. 21, 22, 27 and 28.
 Land, rolling. Soil, sandy & stony clay loam, 2nd and 3rd rate.
 Timber, dense pinyon and cedar.
 Undergrowth, dense cinchona and sage brush.

- 47.75
- 79.82

N. 0° 07' W., bet. secs. 21 and 22.

Over rolling land, thru dense timber and undergrowth.
 Ascend very gradually over SW. slope.

- 15.00 Spur, slopes SW. Desc. 54 ft., over NW. slope, to
- 30.17 South rim of canyon, brs. E. and W., 500 lks. wide, 100 ft. deep, course W.

- 35.17 North rim of same canyon, brs. E. & W. Asc. very gradually, over SW. slope.

- 40.00 Set an iron post, 3 ft. long, 1 in. in diam., 26 ins. in the ground, for 1/4 sec. cor., marked on brass cap,

| | | |
|-----|------|------|
| 1/4 | S 21 | S 22 |
|-----|------|------|

1920

- A pinyon, 12 ins. in diam., brs. N. 55 3/4° E., 38 lks. dist., mark "1/4 S 22 BT."
- A pinyon, 10 ins. in diam., brs. N. 26 1/4° W., 40 lks. dist., mark "1/4 S 21 BT."

Continue gradual ascent over SW. slope.

- 54.00 Spur, slopes S. 60° W. Descend 12 ft., over NW. slope.
- 59.70 Rocky ravine, 10 lks. wide, course N. 80° W.
- 77.00 Ravine, 10 lks. wide, 2 ft. deep, course S. 75° W.
- 80.00 Set an iron post, 3 ft. long, 2 ins. in diam., 14 ins. in the ground to bed rock, supported in a mound of stone 4 ft. base, 1 1/2 ft. high, for cor. of secs. 15, 16, 21 and 22, marked on brass cap,

| | |
|------|------|
| T23N | R30E |
| S16 | S15 |
| S21 | S22 |

1920

- A pinyon, 10 ins. in diam., brs. N. 11° E., 131 lks. dist., mark "T23N R30E S15 BT."

44 Subdivision of Township 23 North, Range 30 East.

Chains.

- A pinyon, 9 ins. in diam., brs. S. 59 $\frac{1}{4}$ ° E., 92 lks.
dist., mark "T23N R30E S22 BT."
- A pinyon, 12 ins. in diam., brs. S. 35 $\frac{3}{4}$ ° W., 109 lks.
dist., mark "T23N R30E S21 BT."
- A pinyon, 7 ins. in diam., brs. N. 15 $\frac{1}{4}$ ° W., 92 lks.
dist., mark "T23N R30E S16 BT."

Land, rolling and broken.
Soil, shallow, sandy & stony clay loam, 2nd and 3rd rate.
Timber, dense pinyon and cedar.
Undergrowth, dense cinchona and sage brush.

- 40.00 N. 89° 58' E., on a random line, bet. secs. 15 and 22.
Set temp. $\frac{1}{4}$ sec. cor.
- 79.90 Intersect N. and S. line, 8 lks. N. of the cor. of secs. 14, 15, 22 and 23.
Thence, N. 89° 59' W., on true line, bet. secs. 15 and 22.
Over gently rolling land, thru. dense timber and undergrowth.
Descend very gradually over SW. slope.
- 39.95 Set an iron post, 3 ft. long, 1 in. in diam., 26 ins. in the ground, for $\frac{1}{4}$ sec. cor., marked on brass cap,

$\frac{1}{4}$ S 15
S 22
1920

- A pinyon, 16 ins. in diam., brs. N. 54° E., 65 lks,
dist., marked " $\frac{1}{4}$ S 15 BT."
- A pinyon, 14 ins. in diam., brs. S. 25° W., 24 lks.
dist., mark " $\frac{1}{4}$ S 22 BT."
- Continue gradual descent, over SW. slope.
- 73.60 Wash, 10 lks. wide, 2 ft. deep, course S. 75° W. Ascend slightly
over SW. slope, to
- 79.90 The cor. of secs. 15, 16, 21 and 22.
Land, gently rolling.
Soil, sandy clay loam, 2nd rate.
Timber, dense pinyon and cedar.
Undergrowth, dense cinchona, algerita and sage brush.

- 28.20 N. 0° 07' W., bet. secs. 15 and 16.
Over gently rolling land, thru. dense timber and undergrowth;
over W. slope, with little change in elevation.
- 40.00 Ravine, 10 lks. wide, 2 ft. deep, course W.
Set an iron post, 3 ft. long, 1 in. in diam., 26 ins. in the ground, for $\frac{1}{4}$ sec. cor., marked on brass cap,

S 16 | S 15
1920

- A pinyon, 9 ins. in diam., brs. S. 58 $\frac{1}{4}$ ° E., 22 lks.
dist., mark " $\frac{1}{4}$ S 15 BT."
- A pinyon, 9 ins. in diam., brs. S. 77° W., 78 lks.
dist., mark " $\frac{1}{4}$ S 16 BT."
- 80.00 Continue over W. slope, with little change in elevation.
Set an iron post, 3 ft. long, 2 ins. in diam., 24 ins. in the ground, for cor. of secs. 9, 10, 15 and 16, marked on brass cap,

T23N | R30E
S 9 | S 10
S 16 | S 15
1920

- A pinyon, 9 ins. in diam., brs. N. 57 $\frac{1}{2}$ ° E., 21 lks.
dist., mark "T23N R30E S10 BT."
- A pinyon, 7 ins. in diam., brs. S. 88 $\frac{3}{4}$ ° E., 42 lks.
dist., mark "T23N R30E S15 BT."
- A pinyon, 10 ins. in diam., brs. S. 5 $\frac{1}{2}$ ° W., 81 lks.
dist., mark "T23N R30E S16 BT."
- A pinyon, 10 ins. in diam., brs. N. 34 $\frac{1}{4}$ ° W., 52 lks.
dist., mark "T23N R30E S9 BT."

Land, gently rolling.
Soil, sandy and stony clay loam, 2nd rate.
Timber, dense pinyon and cedar.
Undergrowth, dense cinchona, sage brush and algerita.

Subdivision of Township 23 North, Range 30 East.

45

| | | | | | | | |
|---------|---|------|------|-----|-----|-----|------|
| Chains. | S. 89° 59' E., on a random line, bet. secs. 10 and 15. | | | | | | |
| 40.00 | Set temp. $\frac{1}{4}$ sec. cor. | | | | | | |
| 80.00 | Intersect the cor. of secs. 10, 11, 14 and 15. | | | | | | |
| | Thence, | | | | | | |
| | N. 89° 59' W., on a true line, bet. secs. 10 and 15. | | | | | | |
| | Over gently rolling land, thru. dense timber and undergrowth. Desc. very gradually over W. slope. | | | | | | |
| 40.00 | Set an iron post, 3 ft. long, 1 in. in diam., 20 ins. in the ground, for $\frac{1}{4}$ sec. cor., marked on brass cap, | | | | | | |
| | $\frac{1}{4}$ S 10 S 15 1920 | | | | | | |
| | A pinyon, 10 ins. in diam., brs. N. 55° W., 53 lks. dist., mark " $\frac{1}{4}$ S 10 BT." | | | | | | |
| | A pinyon, 10 ins. in diam., brs. S. 32 $\frac{1}{4}$ ° E., 18 lks. dist., mark " $\frac{1}{4}$ S 15 BT." | | | | | | |
| | Continue gradual descent, over W. slope. | | | | | | |
| 80.00 | The cor. of secs. 9, 10, 15 and 16. | | | | | | |
| | Land, gently rolling. | | | | | | |
| | Soil, shallow, sandy clay loam, 2nd rate. | | | | | | |
| | Timber, dense pinyon and cedar. | | | | | | |
| | Undergrowth, dense cinchona, algerita and sage brush. | | | | | | |
| ----- | | | | | | | |
| | N. 0° 07' W., bet. secs. 9 and 10. | | | | | | |
| | Over gently rolling land, thru. dense timber and undergrowth. Descend slightly, over NW slope, to | | | | | | |
| 4.00 | Rocky ravine, 30 lks. wide, 3 ft. deep, course S. 45° W. Asc. very gradually over W. slope. | | | | | | |
| 40.00 | Set an iron post, 3 ft. long, 1 in. in diam., 20 ins. in the ground, for $\frac{1}{4}$ sec. cor., marked on brass cap, | | | | | | |
| | $\frac{1}{4}$ S 9 S 10 1920 | | | | | | |
| | A pinyon, 8 ins. in diam., brs. N. 31° W., 71 lks. dist., mark " $\frac{1}{4}$ S 9 BT." | | | | | | |
| | A pinyon, 9 ins. in diam., brs. S. 24 $\frac{1}{4}$ ° E., 36 lks. dist., mark " $\frac{1}{4}$ S 10 BT." | | | | | | |
| | Continue over W. slope, with little change in elevation. | | | | | | |
| 80.00 | Set an iron post, 3 ft. long, 2 ins. in diam., 24 ins. in the ground, for cor. of secs. 3, 4, 9 and 10, marked on brass cap, | | | | | | |
| | <table border="1" style="margin-left: auto; margin-right: auto;"> <tbody> <tr> <td>T23N</td> <td>R30E</td> </tr> <tr> <td>S 4</td> <td>S 3</td> </tr> <tr> <td>S 9</td> <td>S 10</td> </tr> </tbody> </table> 1920 | T23N | R30E | S 4 | S 3 | S 9 | S 10 |
| T23N | R30E | | | | | | |
| S 4 | S 3 | | | | | | |
| S 9 | S 10 | | | | | | |
| | A pinyon, 14 ins. in diam., brs. N. 19 $\frac{1}{2}$ ° E., 314 lks. dist., mark "T23N R30E S3 BT." | | | | | | |
| | A pinyon, 14 ins. in diam., brs. S. 39 $\frac{1}{2}$ ° E., 171 lks. dist., mark "T23N R30E S10 BT." | | | | | | |
| | A pinyon, 16 ins. in diam., brs. S. 60° W., 72 lks. dist., mark "T23N R30E S9 BT." | | | | | | |
| | A cedar, 8 ins. in diam., brs. N. 08 $\frac{1}{4}$ ° W., 51 lks. dist., mark "T23N R30E S4 BT." | | | | | | |
| | Land, gently rolling. | | | | | | |
| | Soil, shallow, sandy loam, 2nd rate. | | | | | | |
| | Timber, dense pinyon and cedar. | | | | | | |
| | Undergrowth, dense cinchona, algerita and sage brush. | | | | | | |
| ----- | | | | | | | |
| 40.00 | S. 89° 59' E., on a random line, bet. secs. 3 and 10. | | | | | | |
| | Set temp. $\frac{1}{4}$ sec. cor. | | | | | | |

46 Subdivision of Township 23 North, Range 30 East.

Chains

30.00 Intersect N. and S. line, 12 lks. N. of the cor. of secs. 2, 3, 10 and 11.

Thence,

N. 89° 54' W., on true line, bet. secs. 3 and 10.

Over gently rolling land, thru dense timber and undergrowth. Desc. very gradually over W. slope.

40.00 Set an iron post 3 ft. long, 1 in. in diam., 26 ins. in the ground, for 1/4 sec. cor., marked on brass cap,

1/4 S 3
S 10
1920

A cedar, 6 ins. in diam., brs. N. 50 1/2° W., 31 lks. dist., mark "S 3 BT."

A pinyon, 10 ins. in diam., brs. S. 28° E., 72 lks. dist., mark "S 10 BT."

Continue very gradual descent, over W. slope.

80.00 The cor. of secs. 3, 4, 9 and 10.

Land, gently rolling.

Soil, shallow, sandy clay loam, 3rd rate.

Timber, dense pinyon and cedar.

Undergrowth, dense cinchona and sage brush.

All stadia measurements, hereinafter described, are made with fixed stadia wires with a ratio of 1:100+ as exhibited by the test described in these notes; the focal constant of the instrument is 1.3 links; the rod used is a standard Philadelphia level rod graduated to feet, and equipped with two targets, and a rod level; all readings are made with a vertical rod. August 27, 1920. Make the following test of the stadia wire interval:

Horizontal length of base = 15.00 chs.
Mean of 4 rod readings = 9.877 ft.
Vertical angle of test = 00°
K = 100.212
(c+f) = .013 chs.

N. 0° 7' W., on a random line, bet. secs. 3 and 4.

12.28 South rim of side canyon, with precipitous sides; stadia to rod point on random line on N. rim of canyon, mean of 3 rod readings 4.637 ft. Vertical angle to rod point 1° 10'

Dist. on random line ----- = 12.28 chs.

Dist. by stadia across canyon ----- = 7.05 chs.

19.33 Rod point on N. rim of side canyon.

Thence,

Continue chaining on random line.

31.30 East rim of Defiance Creek Canyon, with precipitous sides bears NE and SW. Stadia to rod point on side of spur on E. wall of canyon.

Mean of three rod readings 9.844 ft. Vertical angle to rod point - 8°.

Dist. on random line ----- = 31.30 chs.

Dist. by stadia to rod point ----- = 14.67 chs.

45.97 chs.

Dist. by return measurement ----- = 5.97 chs.

40.00

40.00 Set temp. 1/4 sec. cor.

45.97 Rod point of above described stadia measurement. Thence continue chaining on random line.

46.02 Spur on E. wall of canyon, slopes SW. Stadia to rod point on spur, on random line on E. wall of canyon. Mean of three rod readings 9.797 ft. Vertical angle to rod point - 8° 24'

Dist. on random line ----- = 46.02 chs.

Dist. by stadia to rod point on E. wall of canyon ----- = 14.58 "

60.60 "

60.60 Rod point of above described stadia measurement on spur, sloping SW.

Subdivision of Township 23 North, Range 30 East.

Chains.

From this station, stadia to rod point on random line on E. wall of canyon, on spur, sloping NW. Mean of three rod readings, 3.049 ft. Vertical angle to rod point, +6° 35'.

Dist. on random line-----= 60.00 chs.

Dist. by stadia-----= 4.04 chs.

05.24 chs.

65.24 Rod point of above described stadia measurement on spur sloping NW.

Thence,

83.78 Continue chaining on random line, and at Intersect the N. bdy. of Tp., 10 lks. E. of the cor. of secs. 3, 4, 33 and 34, hereinbefore described.

Thence,

S. 0° 11' E., on true line, bet secs. 3 and 4.

Over broken, mountainous land, over cliffs, spurs and ledges, on E. wall of canyon of Defiance Creek, thru dense timber and undergrowth. Asc. 300 ft. over NW slope.

18.54 Spur, slopes NW. Descend slightly to

23.18 Spur, slopes SW. Asc. 150 ft. to

37.76 Spur, slopes SW. Desc. 225 ft., over S. slope, to

43.78 Set an iron post, 3 ft. long, 1 in. in diam., 20 ins. in the ground for 1/4 sec. cor., marked on brass cap,

S 4 | S 3

1920 Raise a mound of stone, 2 ft.

base, 1 1/2 ft. high, W. of cor. This cor. is in a ravine,

course SW. Ascend 375 ft.; over NW slope, to

52.28 E. rim of Defiance Creek Canyon, brs. NE. and SW.. Leave canyon, and enter gently rolling land along W. slope.

64.45 N. rim of side canyon, brs. E. and W., 100 ft. deep, Thence across canyon, course W.

71.50 South rim of side canyon, brs. E. and W. Leave canyon, and enter gently rolling land, along W. slope.

83.78 The cor. of secs. 3, 4, 9 and 10.

Land, rolling, broken and mountainous.

Soil, sandy and stony, 2nd, 3rd and 4th rate.

Timber, dense pinyon and cedar.

Undergrowth, dense cinchona and sage brush.

From the reestablished cor. of secs. 32 and 33, on S. bdy. of Tp., hereinbefore described,

N. 0° 08' W., bet. secs. 32 and 33.

Over gently rolling land, thru dense timber and undergrowth. Asc. very gradually over SW. slope.

38.30 (40.00 chs. southing from cor. of secs. 28, 29, 32 and 33)

Set an iron post, 3 ft. long, 1 in. in diam., 20 ins. in the ground, for 1/4 sec. cor., marked on brass cap,

S 32 | S 33

1920

A cedar, 10 ins. in diam., brs. N. 37 1/2° E., 30 lks. dist., mark "S 33 BT."

A cedar, 16 ins. in diam., brs. S. 65 1/2° W., 32 lks. dist., mark "S 32 BT."

Continue gradual ascent over SW. slope.

51.06 Wash, 20 lks. wide, with cut banks, 3 ft. high, course SW.

78.30 Intersect Latitudinal Governing Section Line, 40 lks. E. of the temp. cor. of secs. 28, 29, 32 and 33. At point of intersection,

Set an iron post, 3 ft. long, 2 ins. in diam., 24 ins. in the ground for cor. of secs. 28, 29, 32 and 33, marked on brass cap,

T 23 N | R 30 E

S 29 | S 28

S 32 | S 33

1920

48 Subdivision of Township 23 North, Range 30 East.

Chains.

- A pinyon, 10 ins. in diam., brs. N. 73° E., 84 lks. dist., mark "T23N R30E S28 BT."
- A pinyon, 4 ins. in diam., brs. S. 45 1/4° E., 24 lks. dist., mark "T23N R30E S33 BT."
- A pinyon, 5 ins. in diam., brs. S. 43 3/4° W., 33 lks. dist., mark "T23N R30E S 32 BT."
- A pinyon, 5 ins. in diam., brs. N. 18° W., 70 lks. dist., mark "T23N R30E S29 BT."

Land, gently rolling.
Soil, shallow, sandy and rocky clay loam, 3rd rate.
Timber, dense pinyon and cedar, scattering yellow pine.
Undergrowth, dense sage brush, cinchona and cacti.

From the cor. of secs. 27, 28, 33 and 34,
West, on Latitudinal Governing Section Line, bet. secs. 28 and 33.

- Over rolling land, thru. dense timber and undergrowth. Descend 20 ft., over W. slope, to
- 4.10 Rim brs NW and SE. Leave rolling and enter mountainous land. Desc. 367 ft., over steep W. slope, to
- 16.10 Foot of steep descent, brs. N. 30° W. and S. 30° E. Leave mountainous land, and enter rolling land. Descend 60 ft., over SW. slope, to
- 39.97 Set an iron post, 3 ft. long, 1 in. in diam., 26 ins. in the ground, for 1/4 sec. cor., marked on brass cap,

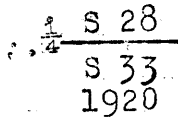

- A cedar, 14 ins. in diam., brs. N. 6° W., 192 lks. dist., mark "1/4 S 28 BT."
- A cedar, 12 ins. in diam., brs. S. 13 1/4° W., 56 lks. dist., marked "1/4 S 33 BT."

Thence over gently rolling land. Desc. very gradually, over SW. slope.

- 45.50 Wash, 20 lks. wide, 3 ft. deep, course S. 20° W. Asc. very gradually over SE. slope.
- 61.00 Long low spur, slopes SW. Desc. very gradually, over W. slope, to
- 79.94 The cor. of secs. 28, 29, 32 and 33.
Land, rolling and mountainous.
Soil, sandy and stony, 2nd and 3rd rate.
Timber, dense pinyon and cedar.
Undergrowth, dense cinchona, sage brush and cacti.

N. 0° 08' W., bet. secs. 28 and 29.

Over rolling and broken land, thru. dense timber and undergrowth. Asc. slightly over W. slope, to

- 10.50 Wash, 15 lks. wide, 3 ft. deep, course S. 65° W. Ascend slightly over SW. slope, to
- 19.00 Wash, 15 lks. wide, 2 ft. deep, course S. 20° W. Ascend 65 ft., over S. slope, to
- 40.00 Set an iron post, 3 ft. long, 1 in. in diam., 26 ins. in the ground, for 1/4 sec. cor., marked on brass cap,

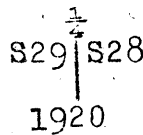

- A pinyon, 7 ins. in diam., brs. N. 75 1/4° E., 54 lks. dist., mark "1/4 S 28 BT."
- A pinyon, 7 ins. in diam., brs. S. 65° W., 40 lks. dist., mark "1/4 S 29 BT."

Ascend 40 ft., over S. slope.

- 54.00 Ridge, brs. N. 60° E. and S. 60° W. Desc. 60 ft., over broken NW slope, to
- 80.00 Set an iron post, 3 ft. long, 2 ins. in diam., 24 ins. in

Chains.

the ground for cor. of secs. 20, 21, 28 and 29, marked on brass cap,

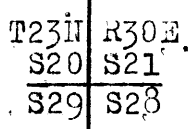

1920

A cedar, 8 ins. in diam., brs. N. 60 1/2° E., 32 lks. dist., mark "T23N R30E S21 BT."

A pinyon, 12 ins. in diam., brs. S. 27 1/2° E., 19 lks. dist., mark "T23N R30E S28 BT."

A pinyon, 11 ins. in diam., brs. S. 63 1/2° W., 122 lks. dist., mark "T23N R30E S29 BT."

A cedar, 6 ins. in diam., brs. N. 60 1/2° W., 30 lks. dist., mark "T23N R30E S20 BT."

Land, rolling and broken.
Soil, stony clay loam, 3rd rate.
Timber, dense pinyon and cedar.
Undergrowth, dense sage brush,

40.00 East, on a random line, bet. secs. 21 and 28.
Set temp. 1/4 sec. cor.

79.98 Intersect the cor. of secs. 21, 22, 27 and 28.
Thence,

West, on true line, bet. secs. 21 and 28
Over gently rolling land, thru. dense timber and undergrowth. Desc. slightly over W. slope, to

3.70 Rim, brs. N. and S. Leave rolling, and enter mountainous land. Desc. 465 ft., over steep broken W. slope.

35.00 Foot of steep descent, brs. N. and S. Leave mountainous, and enter rolling land.

39.99 Descend 90 ft., over NW. slope, to sec. cor.
Set an iron post, 3 ft. long, 1 in. in diam., 20 ins. in the ground, for 1/4 sec. cor., marked on brass cap,

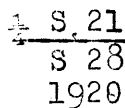

A pinyon, 6 ins. in diam., brs. N. 28 1/2° W., 25 lks. dist., mark "1/4 S 21 BT."

A pinyon, 7 ins. in diam., brs. S. 8° E., 44 lks. dist., mark "S 28 BT."

79.98 The cor. of secs. 20, 21, 28 and 29.
Land, rolling, broken and mountainous.
Soil, sandy clay loam and stone, 3rd and 4th rate.
Timber, dense pinyon, and cedar.
Undergrowth, dense cinchona and sage brush.

,50 N. 0° 08' W., bet. secs. 20 and 21.
Over broken and rolling land, thru. dense timber and undergrowth. Descend slightly to.

34.50 Ravine, 30 lks. wide, banks 5 ft. high, course W. Ascend. 150 ft. over SW. slope, to

40.00 Rim, brs. E. and W. thence over slightly rolling land.

Set an iron post, 3 ft. long, 1 in. in diam., 4 ins. in the ground, to bed rock, supported in a mound of stone, 4 1/2 ft. base, 2 ft. high, for 1/4 sec. cor., marked on brass cap,

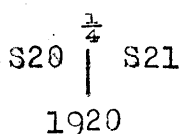

A cedar, 12 ins. in diam., brs. N. 19° E., 6 lks. dist.,

50 Subdivision of Township 23 North, Range 30 East.

Chains.

mark "S 21 BT."
 A pinyon, 7 ins. in diam., brs. S. $63\frac{1}{2}^{\circ}$ W., 25 lks.
 dist., mark "S 20 BT."
 Continue over slightly rolling land, to
 42.70 South rim of ravine, brs. N. 45° E. and S. 45° W. Desc. 100 ft.
 44.00 Bottom of ravine, 40 lks. wide, course S. 45° W. Asc. 100 ft.
 50.00 North rim of ravine, brs. N. 45° E. and S. 45° W. Enter heavily
 rolling and broken land. Asc. 230 ft., over S. slope, to
 80.00 Set an iron post 3 ft. long, 2 ins. in diam., 14 ins. in
 the ground, to bed rock, supported in a mound of stone
 4 ft. base, $1\frac{1}{2}$ ft. high, for cor. of secs. 16, 17, 20 and
 21, marked on brass cap,

| | |
|------|------|
| T23N | R30E |
| S17 | S16 |
| S20 | S21 |

1920

A pinyon, 7 ins. in diam., brs. N. 12° E., 92 lks.
 dist., mark "T23N R30E S16 BT."
 A pinyon, 6 ins. in diam., brs. S. 65° E., 31 lks.
 dist., mark "T23N R30E S21 BT."
 A pinyon, 12 ins. in diam., brs. S. 47° W., 64 lks.
 dist., mark "T23N R30E S20 BT."
 A cedar, 11 ins. in diam., brs. N. 73° W., 97 lks.
 dist., mark "T23N R30E S17 BT."
 Land, rolling and broken.
 Soil, sandy and stony clay loam, 3rd rate.
 Timber, dense pinyon and cedar.
 Undergrowth, dense cinchona, sage brush and algerita.

40.00 East, on a random line, bet. secs. 16 and 21.
 Set temp. $\frac{1}{4}$ sec. cor.
 79.96 Intersect N. and S. line, 16 lks. S. of the cor. of secs.
 15, 16, 21 and 22.
 Thence,
 S. $89^{\circ}53'$ W., on true line, bet. secs. 16 and 21.
 Over rolling and broken land, thru. dense timber and
 undergrowth. Desc. gradually over SW. slope.
 39.98 Set an iron post, 3 ft. long, 1 in. in diam., 20 ins. in
 the ground to bed rock, supported in a mound of stone
 3 ft. base, 10 ins. high, for $\frac{1}{4}$ sec. cor., marked on
 brass cap,

| |
|--------------------|
| $\frac{1}{4}$ S 16 |
| S 21 |
| 1920 |

A pinyon, 6 ins. in diam., brs. N. 44° W., 44 lks.
 dist., mark "S 16 BT."
 A pinyon, 5 ins. in diam., brs. S. $34\frac{1}{4}^{\circ}$ E., 6 lks.
 dist., mark "S 21 BT."
 Desc. 60 ft., over W. slope.
 43.15 Bottom of ravine, 300 lks. wide, with banks 50 ft. high,
 course S. 15° W. Ascend 68 ft., over SE. slope.
 49.70 Point of spur, slopes S. Desc. 60 ft., over W. slope.
 59.50 Ravine, 30 lks. wide, course S. Asc. 59 ft. over E. slope,
 to
 79.96 The cor. of secs. 16, 17, 20 and 21.
 Land, rolling and broken.
 Soil, shallow, rocky and sandy clay loam, 3rd rate.
 Timber, dense pinyon and cedar.
 Undergrowth, dense sage brush and cinchona.

N. $0^{\circ}08'$ W., bet. secs. 16 and 17.
 Over rolling land, thru. dense timber and undergrowth.
 Ascend gradually over SW. slope.

1000 0000

Subdivision of Township 23 North, Range 30 East. 51

Chains.

- 15.59 Rocky wash, 20 lks.wide, 4 ft. deep, course S.80°W.
- 35.08 Rocky wash, 200 lks.wide, 15 ft. deep, course S.45°W.
- 40.00 Set an iron post, 3 ft.long, 1 in. in diam., 20 ins. in the ground, for $\frac{1}{4}$ sec.cor., marked on brass cap,

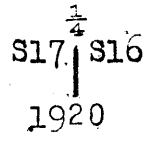

- A pinyon, 9 ins. in diam., brs.S.43 $\frac{1}{2}$ °E., 20 lks. dist., mark " $\frac{1}{4}$ S 16 BT."
- A pinyon, 6 ins. in diam., brs.S.60°W., 28 lks. dist., mark " $\frac{1}{4}$ S 17 BT."
- Continue gradual ascent, over SW.slope.
- 74.89 Wash, 10 lks.wide, 2 ft. deep, course S.60°W. Asc. over SE.slope, to
- 80.00 Set an iron post, 3 ft.long, 2 ins. in diam., 24 ins. in the ground, for cor.of secs.8,9,10 and 17, marked on brass cap,

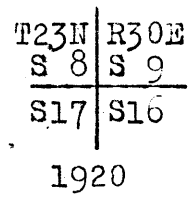

- A pinyon, 10 ins. in diam., brs.N.62 $\frac{1}{2}$ °E., 105 lks. dist., mark "T23N R30E S9 BT."
- A pinyon, 11 ins.in diam., brs.S.17°E., 60 lks. dist., mark "T23N R30E S16 BT."
- A pinyon, 14 ins. in diam., brs.S.9°W., 91 lks. dist., mark "T23N R30E S17 BT."
- A pinyon, 10 ins.in diam., brs.N.60°W., 69 lks. dist., mark "T23N R30E S8 BT."

Land, rolling.
 Soil, shallow, sandy loam, 2nd rate.
 Timber, dense pinyon and cedar.
 Undergrowth, dense cinchona and sage brush,

-
- 40.00 N.89° 53'E., on a random line, bet. secs. 9 and 10. Set temp. $\frac{1}{4}$ sec.cor.
 - 79.98 Intersect N. and S. line, 5 lks.N.of the cor. of secs. 9,10,15 and 16.
 Thence,
 S.89°55'W., on true line, bet. secs.9 and 16.
 Over rolling land, thru. dense timber and undergrowth.
 Descend gradually.
 - 8.58 Wash, 15 lks.wide, 2 ft. deep, course S. 70°W.
 - 15.88 Same wash, 10 lks.wide, 2 ft. deep, course N.70°W.
 - 26.68 Same wash, 15 lks.wide, 3 ft. deep, course S.75° W.
 - Continue gradual descent.
 - 39.99 Set an iron post, 3 ft.long, 1 in. in diam., 20 ins. in the ground, for $\frac{1}{4}$ sec.cor., marked on brass cap,

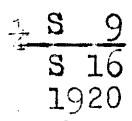

- A pinyon, 7 ins. in diam., brs.N.07 $\frac{1}{2}$ °E., 127 lks.dist., mark " $\frac{1}{4}$ S 9 BT."
- A pinyon, 6 ins.in diam., brs.S.26 $\frac{1}{2}$ °E., 90 lks.dist., mark " $\frac{1}{4}$ S 16 BT."
- Continue gradual descent.
- 73.48 Wash, 10 lks.wide, 4 ft. deep, course S.60° W. Ascend over SE.slope.
- 79.98 The cor.of secs.8,9,10 and 17.
 Land, rolling.
 Soil, shallow, sandy clay loam, 2nd and 3rd rate.

Chains.

Timber, dense pinyon and cedar.
Undergrowth, dense cinchona and sage brush.

N.0°03'W., bet. secs.8 and 9.
Over rolling land, thru. dense timber and undergrowth.
Ascend slightly over SE.slope.

4.30 Low ridge, brs.NE. and SW. Desc. very gradually, over NW slope, to

25.62 South rim of Defiance Creek Canyon, brs.E and W., with perpendicular sandstone walls 480 ft.high.

Chaining of the measurement across the S. wall of canyon being impracticable, triangulate as described as follows, and as shown on the diagram hereon:

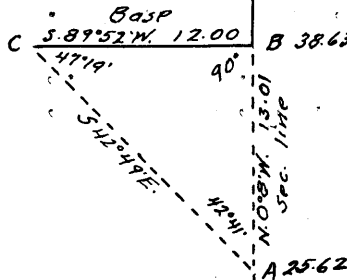

From this point on sec.line, on S.rim of canyon indicated on diagram as "A," line in flag N.0° 8'W. at foot of south wall of canyon at point "B."

Vertical angle, "A" to "B" = -29°10'.
From point "B" measure a base S.89° 52'W., 12.00 chs. to point "C."
Bearing "C" to "A" = S.42° 49' E.

Included angles of "CBA" are 47°19', 90° and 42°41', the sum of which is 180°.

"AB" = tang. 47°19' x base or 1.08432 x 12.00 = 13.01 chs., which added to 25.62 chs. gives 38.63 chs.

38.63 N.0°8'W. from sec.cor. for point "B" on sec.line. Triangulation point at foot of precipitous descent, at base of S.wall of canyon; descend 40 ft., over rolling bottom of canyon. Continue measurement by chaining.

40.00 Set an iron post 3 ft.long, 1 in. in diam., 18 ins. in the ground to bed rock, supported in a mound of stone, 4 ft.base, 1 1/4 ft.high, for 1/4 sec.cor., marked on brass cap,

S 8 | S 9
1920

A pinyon, 5 ins. in diam., brs.S.89 1/2° E., 49 lks. dist., mark "S 9 BT."

A pinyon, 4 ins. in diam., brs.S.52°W., 25 lks. dist., mark "S 8 BT."

48.55 Left bank of Defiance Creek, 30 ft.high, brs.NE and SW.

49.50 Center of Defiance Creek, with stream of pure clear water 20 lks.wide, 4 ins. deep, on gravel bottom, course SW.

51.00 Right bank of Defiance Creek, 25 ft.high, brs.NE. and SW. Asc. 10 ft. over bottom of canyon.

53.00 Foot of N.wall of canyon, brs.NE. and SW. Chaining of measurement across the N.wall of canyon being impracticable, triangulate as described as follows, and as shown on diagram hereon;

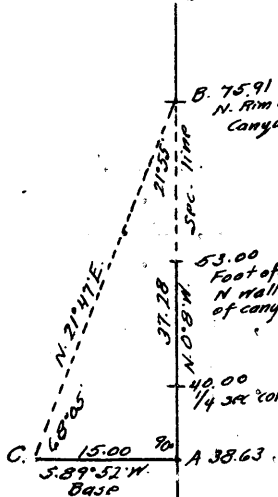

An adequate length of base being impracticable from this point on sec. line, return to 38.63 ch.station on sec.line at foot of S.wall of canyon, indicated on diagram at "A."

From "A" measure a base S.89°52'W., 15.00 chs. to point "C."

Set flag on section line at N.rim of canyon at "B."

Vertical angle from 53.00 ch.station on sec.line to point "B." = + 12°30'

Bearing of "CB" = N.21° 47' E.

Included angles of "CBA" are 68°05',

Subdivision of Township 23 North, Range 30 East.

Chains.

21°55' and 90°, the sum of which is 180°.

"AB" = tang. 68°05' x base or 2.48549 x 15.00 = 37.28 chs. which added to 38.63 chs. gives 75.91 chs. N.0°8'W., from sec. cor. for point "B" on sec. line.

58.00 Spring of pure water, brs.W. 10 chs. dist.

75.91 Triangulation point on N.rim of Defiance Creek Canyon. Rim brs.NE. and SW.

Leave broken and mountainous land, and enter slightly rolling land. Ascend gradually.

80.00 Set an iron post, 3 ft. long, 2 ins. in diam., 24 ins. in the ground, for cor. of secs. 4, 5, 8 and 9, marked on brass cap.

| | |
|------|------|
| T23N | R30E |
| S 5 | S 4 |
| S 8 | S 9 |

1920

- A cedar, 6 ins. in diam., brs. N.40°E., 11 lks. dist., mark "T23N R30E S4 BT."
- A cedar, 4 ins. in diam., brs. S.65°E., 33 lks. dist., mark "T23N R30E S9 BT."
- A cedar, 6 ins. in diam., brs. S.37°W., 43 lks. dist., marked "T23N R30E S8 BT."
- A cedar, 6 ins. in diam., brs. N.43°W., 36 lks. dist., mark "T23N R30E S5 BT."

Land, rolling, broken and mountainous.
 Soil, sandy loam and barren rock, 3rd and 4th rate.
 Timber, dense pinyon and cedar.
 Undergrowth, dense sage brush and cinchona.

3.96. N.89°55'E., on random line, bet. secs. 4 and 9. West rim of canyon of Defiance Creek, brs. NE. and SW. The line E, of this point crosses said canyon; Discontinue chaining, and triangulate as described as follows, and as shown on the diagram hereon:

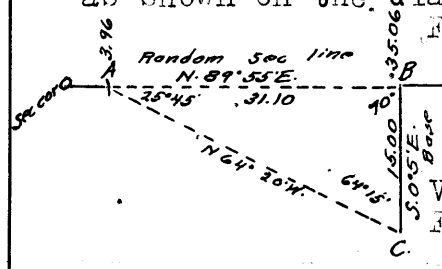

From this point on random sec. line, indicated on diagram at "A", line in a flag on random sec. line at foot of W. wall of canyon at point "B."

Vertical angle "A" to "B" = - 18°27'.
 From "B" measure a base, S.0°5'E., 15.00 chs. to "C"
 Bearing of "CA" = N.04° 20'W.

Included angles of "CAB" are 04° 15', 25° 45' and 90°, the sum of which is 180°.

"AB" = tang. 64° 15' x base or 2.07321 x 15.00 = 31.10 chs., which added to 3.96 chs. gives 35.06 chs. N.89° 55'E. from sec. cor. for point "B" on random sec. line.

35.06 Triangulation point at foot of W wall of canyon.

Continue line and measurement by chaining.

40.00 Point for temp. 1/2 sec. cor. falls in bed of Defiance Creek; therefore, at

40.88 Set temp. witness cor. to 1/2 sec. cor.

46.78 Foot of E. wall of canyon. Slope too steep and broken to chain. Triangulate to point on random line on E. rim of canyon, as described as follows, and as shown on the diagram hereon:

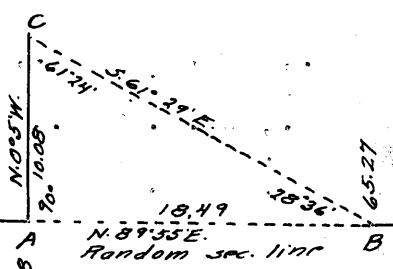

From this point on random sec. line, indicated on diagram at "A" line in flag on E. rim of canyon, N.89° 55' E., at "B."

Vertical angle "A" to "B" = + 27°25'.
 From "A", measure a base, N.0°5'W. to "C,"
 Bearing of "CB" = S.61°29' E.

54 Subdivision of Township 23 North, Range 30 East.

Chains. Included angles of "CBA" are 61°24', 28°35' and 90°, the sum of which is 180°.
 "AB" = tang. 61°24' x base or 1.83413 x 10.08 = 18.49 chs., which added to 46.78 chs. gives 65.27 chs. N.89° 55' E. from sec.cor. for point "B" on random sec.line.
 65.27 Triangulation point on E. rim of canyon.
 80.06 Intersect N. and S. line, 5 lks.N.of the cor. of secs.5, 4,9 and 10.
 Thence,
 S.89°57'W., on true line, bet. secs.4 and 9.
 Over rolling land, thru. dense timber and undergrowth.
 Descend gradually over W.slope, to
 14.79 East rim of Defiance Creek canyon with perpendicular sandstone walls, brs.NE. and SW. Desc. 633 ft. over cliffs on E.wall of canyon. Measurement by triangulation, to
 33.28 Foot of precipitous descent, brs.N. and SW. Leave E.wall of canyon; descend gradually over bottom of canyon. Continue measurement by chaining.
 39.18 Set an iron post, 3 ft.long, 1 in. in diam., 20 ins. in the ground for witness cor.to the $\frac{1}{4}$ sec.cor., marked on brass cap,

$$\begin{array}{r} \text{WC } \frac{1}{4} \text{ S } 4 \\ \quad \quad \quad \text{S } 9 \\ \quad \quad \quad 1920 \end{array}$$

 An oak, 5 ins. in diam., brs.N.49 $\frac{1}{2}$ °E., 161 lks. dist., mark "WC $\frac{1}{4}$ S 4 BT."
 An oak, 4 ins. in diam., brs. S.63° E., 100 lks. dist., mark "WC $\frac{1}{4}$ S 9 BT."
 39.72 Left bank of Defiance Creek, 40 ft.high, brs.N.15°E. and S.15°W.
 40.62 Center of Defiance Creek, with stream of clear water, 25 lks.wide, 4 ins. deep, course S. 15°W.
 41.50 Right bank of Defiance Creek, 25 ft.high, brs.N.15°E, and S.15°W.; thence over sandy land in bottom of canyon.
 45.00 Triangulation point.
 46.50 Foot of precipitous ascent, brs.NE. and SW. Leave bottom of canyon. Asc. 684 ft. over cliffs on W.wall of canyon. Measurement by triangulation, to
 76.10 West rim of canyon, brs.NE. and SW. Leave broken and mountainous land in canyon. Enter gently rolling land. Ascend slightly to
 80.06 The cor.of secs.4,5, 8 and 9.
 Land, rolling, broken and mountainous.
 Soil, sandy and stony, 3rd and 4th rate.
 Timber, dense pinyon and cedar.
 Undergrowth, dense cinchona and sage brush.

N.0°08'W., on a random line, bet. secs.4 and 5.
 40.00 Set temp. $\frac{1}{4}$ sec.cor.
 83.84 Intersect N. bdy.of Tp., 12 lks.E.of the cor.of secs.4,5, 32 and 33, hereinbefore described.
 Thence,
 S.0°13'E., on true line, bet. secs.4 and 5.
 Over rolling and broken land, thru. dense timber and undergrowth. Desc. very gradually over SW.slope.
 43.84 Set an iron post 3 ft.long, 1 in. in diam., 20 ins. in the ground, for $\frac{1}{4}$ sec.cor., marked on brass cap,

$$\begin{array}{r} \frac{1}{4} \\ \text{S } 5 \text{ S } 4 \\ \quad \quad \quad 1920 \end{array}$$

 A pinyon, 3 ins. in diam., brs.S.89 $\frac{1}{2}$ °E., 22 lks. dist., mark "S 4 BT."
 A pinyon, 5 ins. in diam., brs.S.86°W., 21 lks. dist., mark "S 5 BT."
 Continue gradual descent, over SW.slope.

Subdivision of Township 23 North, Range 30 East.

Chains.

83.84

The cor. of secs. 4, 5, 8 and 9.
Land, rolling and broken.
Soil, sandy and stony, 2nd and 3rd rate.
Timber, dense pinyon and cedar.
Undergrowth, dense cinchona and sage brush.

From the reestablished cor. of secs. 31 and 32 on S. bdy. of Tp., hereinbefore described, N.0° 09' W., bet. secs. 31 and 32:

2.80

Over rolling and broken land, thru. dense timber and undergrowth. Descend slightly to Ravine, 150 lks. wide, 6 ft. deep, course S.70°W. Asc. 57 ft. over SE. slope.

4.12

Point of spur, slopes SW. Desc. 11 ft., over NW. slope.

17.30

Ravine, 50 lks. wide, course S.50°W. Asc. 132 ft., over SE. slope.

39.07

(40.00 chs. southing from cor. of secs. 29, 30, 31 and 32), set an iron post 3 ft. long, 1 in. in diam., 26 ins. in the ground for 1/4 sec. cor., marked on brass cap,



A cedar, 12 ins. in diam., brs. N.13°E., 96 lks. dist., mark "1/4 S 32 BT."

A cedar, 24 ins. in diam., brs. S.79 1/2°W., 56 lks. dist., mark "1/4 S 31 BT"

43.50

Top of hill, brs. E and W. Desc. 69 ft., over N. slope.

55.15

Asc. 22 ft., over S. slope.

58.26

Top of hill, brs. E and W. Desc. 35 ft., over N. slope.

60.95

Ascend 95 ft., over S. slope.

72.66

Top of round hill. Desc. 40 ft., over N. slope, to

79.07

Intersect Latitudinal Governing Section Line, 32 lks. E. of the temp. cor. of secs. 29, 30, 31 and 32.

At point of intersection, set an iron post, 3 ft. long, 2 ins. in diam., 24 ins. in the ground for cor. of secs. 29, 30, 31 and 32, marked on brass cap,

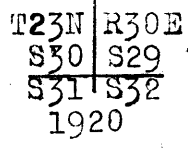

A cedar, 6 ins. in diam., brs. N.30°E., 87 lks. dist., mark "T23N R30E S29 BT."

A pinyon, 10 ins. in diam., brs. S.27 1/2°E., 61 lks. dist., mark "T23N R30E S32 BT."

A pinyon, 11 ins. in diam., brs. S.70 1/2°W., 55 lks. dist., mark "T23N R30E S31 BT."

A cedar, 12 ins. in diam., brs. N.38°W., 74 lks. dist., mark "T23N R30E S30 BT."

Land, rolling, broken and hilly.
Soil, shallow, sandy and stony clay loam, 2nd and 3rd rate.
Timber, dense pinyon and cedar.
Undergrowth, dense sage brush.

From the cor. of secs. 28, 29, 32 and 33, West, on Latitudinal Governing Section Line, bet. secs. 29 and 32.

6.65

Over rolling and broken land, thru. dense timber and undergrowth. Desc. gently over SW. slope. Wash, 15 lks. wide, 3 ft. deep, course S. Asc. 75 ft., over S. slope.

15.94

Wash, 10 lks. wide, 2 ft. deep, course S.45° E.

56 Subdivision of Township 23 North, Range 30 East.

| | |
|------------------|--|
| Chains. 40.04 | (Mid-point). Set an iron post, 3 ft. long, 1 in. in diam., 20 ins. in the ground for $\frac{1}{4}$ sec. cor., marked on brass cap, $\frac{1}{4} \begin{array}{l} S 29 \\ S 32 \\ 1920 \end{array}$ A cedar, 10 ins. in diam., brs. N. $31\frac{1}{2}^{\circ}$ W., 13 lks. dist., mark " $\frac{1}{4}$ S 29 BT." A cedar, 9 ins. in diam., brs. S. $50\frac{1}{2}^{\circ}$ W., 27 lks. dist., mark " $\frac{1}{4}$ S 32 BT." |
| 41.50 | Descend gradually over SW. slope. |
| 41.40 | Center of ravine, 300 lks. wide, 30 ft. deep, course S. Asc. 40 ft., over SE. slope. |
| 74.00 | Spur, slopes S. Descend 107 ft. over W. slope. |
| 80.08 | The cor. of secs. 29, 30, 31 and 32. Land, rolling and broken. Soil, rocky clay, 3rd rate. Timber, dense pinyon and cedar. Undergrowth, dense cinchona, algerita and sage brush. |
| ----- | |
| | West, on a random line, bet. secs. 30 and 31. Stadia from sec. cor. to point of spur; mean of 3 rod readings 0.844 ft. Vertical angle to rod point on spur + 2° . Dist. on random line----- = 00.00 chs. Dist. by stadia to rod point on spur, = <u>10.39 "</u> 10 39 " |
| 10.39 | Rod point of above described stadia measurement. Continue chaining on random line. |
| 30.86 | E. rim of Defiance Creek Canyon, brs. N. and S.; precipitous descent of 100 ft. Stadia to W. rim of canyon, mean of three rod readings, 3.897 ft., vertical angle to rod point on W. rim, $0^{\circ}00'$. Dist. on random line----- = 30.86 chs. Dist. by stadia across canyon----- = <u>5.93 "</u> 36.79 " |
| 36.79 | Rod point on W. rim of canyon. Continue chaining on random line. |
| 69.91 | Intersect W. bdy. of Tp., 10 lks. S. of the cor. of secs. 25, 30, 31 and 36, described in Book "E" of this group. Thence, S. $89^{\circ} 52'$ E., on true line, bet. secs. 30 and 31. Over broken land, thru. dense timber and undergrowth. Descend 50 ft., over E. slope. |
| 7.24 | Wash, 50 lks. wide, course N. 50° E. Asc. 10 ft. over NW. slope. |
| 11.50 | Point of spur, slopes NE. Desc. 74 ft. over NE. slope. |
| 27.91 | Ravine, 15 lks. wide, course N. 75° E. Asc. 12 ft. |
| 29.91 | Set an iron post, 3 ft. long, 1 in. in diam., 14 ins. in the ground, to bed rock, supported in a mound of stone, 4 ft. base, $1\frac{1}{2}$ ft. high, for $\frac{1}{4}$ sec. cor., marked on brass cap, $\frac{1}{4} \begin{array}{l} S 30 \\ S 31 \\ 1920 \end{array}$ A pinyon, 8 ins. in diam., brs. N. $35\frac{1}{2}^{\circ}$ E., 51 lks. dist., mark " $\frac{1}{4}$ S 30 BT." A cedar, 6 ins. in diam., brs. S. 30° W., 50 lks. dist., mark " $\frac{1}{4}$ S 31 BT." |
| 33.12 | West rim of Defiance Creek canyon, with perpendicular sandstone walls 100 ft. high. Descend. Measurement across canyon, by stadia, as hereinbefore described. |
| 35.00 | (Approximate) Bottom of canyon, cross Defiance Creek, with stream of clear water, 30 lks. wide, 5 ins. deep, course S. Asc. |

Chains.
38.55 East rim of canyon, brs. N. and S.
Ascend 60 ft., over SW. slope.
59.52 Point of spur, slopes SW. Desc. 24 ft. over SE. slope, to
69.91 The cor. of secs. 29, 30, 31 and 32.
Land, broken.
Soil, shallow, rocky clay loam, 2nd and 3rd rate.
Timber, dense pinyon and cedar.
Undergrowth, dense sage brush and cinchona.

N. 0° 09' W., bet. secs. 29 and 30.
Over broken and mountainous land, thru dense timber and
undergrowth. Asc. 212 ft., over SE. slope.
5.50 Foot of steep ascent: Stadia to rod point on line on
SE. side of ridge: Mean of three rod readings, 9.060 ft.
Vertical angle to rod point: + 6° 30'.
Dist. on line ----- = 5.50 chs.
Dist. by stadia ----- = 13.59 chs.

19.09 Rod point on line at opening in timber on SE. slope of
ridge. 19.09 "
21.88 Top of rocky ridge, brs. NE. and SW. Descend 119 ft., over
steep NW. slope.
Stadia to rod point on line at opening in timber on NW.
side of ridge; near foot: Mean of three rod readings,
10.805 ft. Vertical angle to rod point: - 6° 21'.
Dist. on line ----- = 21.88 chs.
Dist. by stadia ----- = 16.22 "

38.10 Rod point on NW. side of ridge, near foot; continue descent
over rolling NW. slope. 38.10 "
40.00 Set an iron post, 3 ft. long, 1 in. in diam., 26 ins. in
the ground, for 1/4 sec. cor., marked on brass cap,
S30 | S29
|
1920

A pinyon, 11 ins. in diam., brs. N. 54° E., 132 lks.
dist., mark "S 29 BT."
A pinyon, 12 ins. in diam., brs. N. 83 1/2° W., 27 lks.
dist., mark "S 30 BT."

54.72 East rim of Defiance Creek Canyon on perpendicular sand
stone cliff 100 ft. high, brs. NE and SW.
Stadia to rod point on line at W. rim of canyon. Mean of
three rod readings: 7.203 ft. Vertical angle to rod
point: + 2°.
Dist. on line ----- = 54.72 chs.
Dist. by stadia across canyon ----- = 10.94 "
65.66 Rod point on W. rim of canyon at top of perpendicular
sandstone cliff 100 ft. high, bearing NE and SW.;
thence over E. slope, with slight change in elevation.
80.00 Set an iron post 3 ft. long, 2 ins. in diam., 10 ins. in
the ground, supported in a mound of stone, 4 1/2 ft. base,
2 ft. high for cor. of secs. 19, 20, 29 and 30, marked on
brass cap,
T23N | R30E
S19 | S20

S30 | S29
1920

A pinyon, 8 ins. in diam., brs. N. 42° E., 142
lks. dist., mark "T23N R30E S20 BT."
A cedar, 10 ins. in diam., brs. S. 84 1/2° E., 37 lks.
dist., mark "T23N R30E S29 BT."

Chains.

A pinyon, 4 ins. in diam., brs. S. 62 $\frac{1}{2}$ °W., 43 lks. dist., mark "T23N R30E S30 BT."
 A cedar, 14 ins. in diam., brs. N. 27°W., 17 lks. dist., mark "T23N R30E S19 BT."

Land, broken and mountainous.
 Soil, stony, 3rd and 4th rate.
 Timber, dense pinyon and cedar.
 Undergrowth, dense sage brush, cinchona and algerita.

3.20 East, on a random line, bet. secs. 20 and 29.
 West rim of Defiance Creek canyon, at top of sandstone bluff, 125 ft. high, bearing N. and S., facing E.
 Stadia to rod point on random line at E. rim of canyon.
 Mean of three rod readings: 4.527 ft. Vertical angle to rod point, 0°00'.

Dist. on random line ----- = 3.20 chs.
 Dist. by stadia across canyon ----- = 6.896 chs.
 10.10 chs.

10.10 Rod point on random line on East rim of Defiance Creek canyon at top of sandstone bluff, 125 ft. high, brs. N. and S. facing W.; continue chaining on random line.

40.00 Set temp. $\frac{1}{4}$ sec. cor.

80.10 Intersect the cor. of secs. 20, 21, 28 and 29.

Thence,
 West, on true line, bet. secs. 20 and 29.
 Over rolling land, thru. scattering timber and dense undergrowth. Desc. gradually.

5.50 Wash, 30 lks. wide, 4 ft. deep, course S. 70°W.

19.10 Wash, 20 lks. wide, 4 ft. deep, course S. 65°W.

34.00 Wash, 40 lks. wide, 4 ft. deep, course S.

40.05 Set an iron post 3 ft. long, 1 in. in diam., 26 ins. in the ground, for $\frac{1}{4}$ sec. cor., marked on brass cap,

$\frac{1}{4}$ S 20
 S 29
 1920

A cedar, 8 ins. in diam., brs. N. 66°E., 179 lks. dist., mark "S 20 BT."

A pinyon, 4 ins. in diam., brs. S. 50 $\frac{1}{4}$ °E., 313 lks. dist., mark "S 29 BT."

53.20 Wash, 20 lks. wide, 2 ft. deep, course S. 15°W.

70.00 East rim of Defiance Creek canyon, with perpendicular sandstone walls, 100 ft. high. Desc. Measurement across canyon by stadia, as hereinbefore described.

73.50 (Approximate) Bottom of canyon, cross Defiance Creek, 100 lks. wide, water in pools, course S. Ascend.

76.90 West rim of canyon, brs. N. and S. Ascend slightly over E. slope, to

80.10 The cor. of secs. 19, 20, 29 and 30.

Land, rolling and broken.
 Soil, shallow, sandy and stony clay loam, 2nd and 3rd rate.
 Timber, scattering pinyon and cedar.
 Undergrowth, dense sage brush and cinchona.

40.00 N. 89°52'W., on a random line, bet. secs. 19 and 30.
 Set temp. $\frac{1}{4}$ sec. cor.

69.72 Intersect the W. bdy. of Tp. 9 lks. N. of the cor. of secs. 19, 24, 25 and 30, described in Book "E" of this group.
 Thence,

S. 89°50'E., on true line, bet. secs. 19 and 30.
 Over rolling and broken land, thru. dense timber and undergrowth. Desc. 125 ft., over gradual E. slope.

29.72 Set an iron post, 3 ft. long, 1 in. in diam., 26 ins. in the ground, for $\frac{1}{4}$ sec. cor., marked on brass cap,

Chains.

S 19
S 30
1920

69.72 A pinyon, 12 ins. in diam., brs. N. 28 1/2° E., 61 lks. dist., mark "S 19 BT."
A cedar, 11 ins. in diam., brs. S. 57 1/2° W., 39 lks. dist., mark "S 30 BT."
The cor. of secs. 19, 20, 29 and 30.
Land, rolling and broken.
Soil, sandy and stony clay loam, 2nd and 3rd rate.
Timber, dense pinyon and cedar.
Undergrowth, dense sage brush, cinchona, algerita and cacti.

3.20 N. 0° 9' W., bet. secs. 19 and 20.
Over rolling and broken land, thru. dense timber and undergrowth.
West rim of Defiance Creek Canyon, brs. N. 35° W. and S. 35° E. at top of sandstone cliffs, 100 ft. high, facing NE.
Stadia to rod point on sec. line at east rim of canyon, mean of three rod readings, 4.462 ft. Vertical angle to rod point, 0° 00'.

Dist on sec. line ----- 3.20 chs.
Dist. by stadia across canyon ----- 6.70 chs.
9.90 chs.

6.60 (Approximate) bottom of canyon. Defiance Creek, 100 lks. wide, water in pools, course S. 50° E.
9.90 Rod point on line at east rim of canyon, at top of perpendicular sandstone cliffs, 100 ft. high, bearing N. 50° W. and S. 50° E.

25.39 Continue measurement on sec. line by chaining.
Ascend very gradually over SW. slope.
Rocky ravine, 20 lks. wide, 2 ft. deep, course S. 35° W. Ascend gradually, over SE. slope.

40.00 Set an iron post, 3 ft. long, 1 in. in diam., 26 ins. in the ground, for 1/4 sec. cor., marked on brass cap,

S19 | S20
1920

65.00 A pinyon, 5 ins. in diam., brs. N. 55 1/2° E., 76 lks. dist., mark "S 20 BT."
80.00 A pinyon, 10 ins. in diam., brs. S. 45 3/4° W., 180 lks. dist., mark "S 19 BT."
Continue gradual ascent.

80.00 Ascend 109 ft., over SE. slope, to Set an iron post, 3 ft. long, 2 ins. in diam., 4 ins. in the ground to bed rock, supported in a mound of stone 6 ft. base, 2 1/2 ft. high, for cor. of secs. 17, 18, 19 and 20, marked on brass cap,

T23N | R30E
S18 | S17
S19 | S20
1920

A pinyon, 5 ins. in diam., brs. N. 71 1/2° E., 31 lks. dist., mark "T23N R30E S17 BT."
A cedar, 8 ins. in diam., brs. S. 35° E., 5 lks. dist., mark "T23N R30E S20 BT."
A pinyon, 9 ins. in diam., brs. S. 74 1/2° W., 102 lks. dist., mark "T23N R30E S19 BT."
A pinyon, 5 ins. in diam., brs. N. 27° W., 57 lks. dist., mark "T23N R30E S18 BT."
Land, rolling and broken.
Soil, shallow rocky and sandy clay loam, 3rd rate.

| Chains. | |
|---------|---|
| | Timber, dense pinyon and cedar. Undergrowth, dense cinchona, algerita and sage brush. |
| 26.40 | East, on a random line, bet. secs. 17 and 20. W. edge of ravine, brs. N. and S. Stadia to rod point on random line on E. edge of ravine, mean of rod readings, 8.580 ft. Vertical angle to rod point + 5°41'. Dist. on random line ----- = 26.40 chs. Dist. by stadia across ravine, ----- = 12.91 " 39.31 |
| 39.31 | Rod point on random line on E. edge of ravine. Continue chaining on random line. |
| 40.00 | Set temp. $\frac{1}{4}$ sec. cor. |
| 42.82 | W. edge of rocky ravine with precipitous sides, brs. NE. and SW. Stadia to rod point on random line on E. edge of ravine. Mean of three rod readings: 5.704 ft. Vertical angle to rod point: + 1°50'. Dist. on random line ----- = 42.82 chs. Dist. by stadia across ravine ----- = 8.66 " 51.48 " |
| 51.48 | Rod point on random line on E. edge of ravine, continue chaining on random line. |
| 80.20 | Intersect N. and S. line, 10 lks. N. of the cor. of secs. 16, 17, 20 and 21. Thence, N. 89°56' W., on true line, bet. secs. 17 and 20. Over broken land, thru. dense timber and undergrowth. |
| 11.80 | Ravine, 5 chs. wide, 50 ft. deep, course S. 30° W. |
| 28.90 | East edge of ravine, 90 ft. deep, brs. N. and S. Thence across ravine. Measurement by stadia. |
| 32.50 | (Approximate) Bottom of same ravine, 20 lks. wide, course S. 50° W. Ascend. |
| 36.88 | West edge of same ravine, brs. N. 50° W. and S. 50° W. Thence over broken S. slope, chaining measurement. |
| 40.10 | Set an iron post, 3 ft. long, 1 in. in diam., 4 ins. in the ground, to bed rock, supported in a mound of stone 5 ft. base, 2 $\frac{1}{2}$ ft. high for $\frac{1}{4}$ sec. cor., marked on brass cap, $\frac{1}{4}$ S 17 $\frac{1}{4}$ S 20 1920 |
| | A cedar, 30 ins. in diam., brs. N. 77° E., 87 lks. dist., mark "S 17 BT." A cedar, 11 ins. in diam., brs. S. 28° E., 99 lks. dist., mark "S 20 BT." |
| 40.89 | East edge of ravine, 135 ft. deep, brs. N. and S. Thence, across ravine. Measurement by stadia. |
| 45.00 | (Approximate) Center of bottom of same ravine, 3 chs. wide, course S. Ascend. |
| 53.80 | West edge of same ravine, brs. N. and S.; thence over roll- ing and broken S. slope, chaining measurement. |
| 60.60 | Rocky ravine, 30 lks. wide, 10 ft. deep, course S. |
| 80.20 | The cor. of secs. 17, 18, 19 and 20. Land, rolling and broken. Soil, sandy and stony clay loam, 3rd rate. Timber, dense pinyon and cedar. Undergrowth, dense algerita, cinchona and sage brush. |
| 10.90 | N. 89° 56' W., on a random line, bet. secs. 18 and 19. Foot of spur. Stadia to rod point on random line, at top of spur. Mean of three rod readings 9.030 ft. Vertical angle to rod point + 3°07'. Dist. on random line ----- = 10.90 chs. Dist. by stadia ----- = 13.68 chs. 24.58 chs. |

Subdivision of Township 23 North, Range 30 East.

Chains.
 24.58 Rod point on random line at top of rocky spur, sloping SW.; continue chaining on random line.
 25.88 Stadia to rod point at foot of spur. Mean of three rod readings: 8.402 ft. Vertical angle to rod point - 9° 05'.
 Dist. on random line ----- = 25.88 chs.
 Dist. by stadia, ----- = 12.54 chs.
 38.42 Rod point on random line at foot of spur; continue chaining on random line.
 40.00 Set temp. $\frac{1}{4}$ sec. cor.
 44.64 East rim of Defiance Creek Canyon, brs. NW. and SE.; precipitous descent.
 Stadia across canyon to rod point on random line on west rim; mean of three rod readings: 7.158 ft. Vertical angle to rod point 0° 00'.
 Dist. on random line ----- = 44.64 chs.
 Dist. by stadia ----- = 10.88 chs.
 55.52 Rod point on random line, on West rim of Defiance Creek canyon. Continue chaining on random line.
 59.30 Intersect the W. bdy. of Tp., 4 lks. N. of the cor. of secs. 13, 18, 19 and 24, described in Book "E" of this group.
 Thence,
 S. 89° 58' E., on true line, bet. secs. 18 and 19.
 Over rolling and broken land, thru. dense timber & undergrowth.
 13.90 West rim of Defiance Creek canyon at top of perpendicular sandstone wall, 125 ft. high, brs. N. 10° W. and S. 10° E.
 Descend. Measurement across canyon by stadia.
 18.50 (Approximate) Bottom of canyon; cross Defiance Creek, with stream of clear water, 150 lks. wide, 3 ins. deep, over sandy bottom, course S.
 25.40 East rim of canyon, brs. N. and S. Asc. 137 ft., over SW. slope.
 29.30 Set an iron post, 3 ft. long, 1 in. in diam., over cross (x) on bed rock, supported in a mound of stone 5 $\frac{1}{2}$ ft. base, 2 $\frac{1}{2}$ ft. high, for $\frac{1}{4}$ sec. cor., marked on brass cap,

$$\begin{array}{r} \frac{1}{4} S 18 \\ S 19 \\ 1920 \end{array}$$

 A pinyon, 7 ins. in diam., brs. N. 11 $\frac{3}{4}$ ° E., 48 lks. dist., mark " $\frac{1}{4}$ S 18 BT."
 A pinyon, 7 ins. in diam., brs. S. 2 $\frac{1}{4}$ ° E., 133 lks. dist., mark " $\frac{1}{4}$ S 19 BT."
 44.72 Spur, brs. SW. Desc. 49 ft., over SE. slope, to
 58.40 Foot of steep descent; descend gradually.
 69.30 the cor. of secs. 17, 18, 19 and 20.
 Land, rolling and broken.
 Soil, stony clay loam, 3rd rate.
 Timber, dense pinyon and cedar.
 Undergrowth, dense sage brush, algerita and cinchona.

 N. 0° 09' W., bet. secs. 17 and 18.
 Over rolling and broken land, thru. dense timber and undergrowth. Asc. 170 ft., over S. slope.
 15.62 Top of steep ascent; ascend gradually.
 40.00 Set an iron post, 3 ft. long, 1 in. in diam., 20 ins. in the ground, for $\frac{1}{4}$ sec. cor., marked on brass cap,

$$\begin{array}{r} \frac{1}{4} \\ S 18 | S 17 \\ 1920 \end{array}$$

 A cedar, 10 ins. in diam., brs. N. 62° W., 56 lks. dist., mark " $\frac{1}{4}$ S 18 BT."
 A cedar, 12 ins. in diam., brs. S. 72° E., 34 lks. dist., mark " $\frac{1}{4}$ S 17 BT."

Chains.

42.30
09.01

Spur, slopes S. 30°W. Descend very gradually over W. slope. East rim of Defiance Creek canyon, brs. NE and SW.; precipitous descent 543 ft. Discontinue chaining on sec. line, and triangulate as described as follows, and as shown on the diagram hereon;

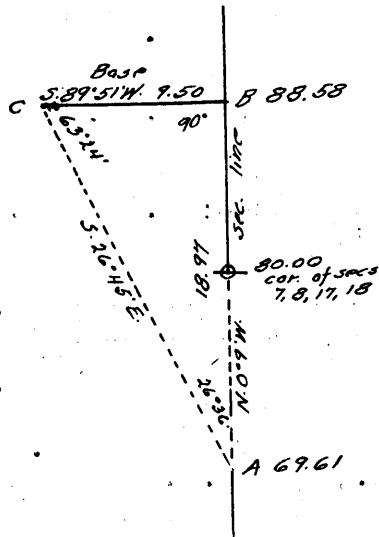

From this point on sec. line indicated on diagram at "A," line in a flag N. 0° 9' W. at base of E. wall of canyon at point "B." Vertical angle, "A" to "B" = - 23° 23'.

From point "B," measure a base, S. 39° 51' W., 9.50 chs. to point "C." Bearing "CA" = S. 26° 45' E. Included angles of "CAB" are 63° 24', 90° and 26° 30', the sum of which is 180°.

"AB" = $\text{tang. } 63^\circ 24' \times \text{Base or } 1.99695 \times 9.50 = 18.97 \text{ chs.}$, which added to 69.01 chs. gives 88.58 chs. N. 0° 9' W. from cor. of secs. 17, 18, 19 and 20 for point "B" on sec. line of 8.58 chs. N. 0° 9' W. from point for cor. of secs. 7, 8, 17 and 18.

From point "B" measure S. 0° 9' E., 8.58 chs. to point on E. wall of canyon, at

80.00 Set an iron post, 3 ft. long, 2 ins. in diam., 24 ins. in the ground, for cor. of secs. 7, 8, 17 and 18, marked on brass cap,

| | |
|------|------|
| T23N | R30E |
| S 7 | S 8 |
| S18 | S17 |

1920

- A pinyon, 5 ins. in diam., brs. N. 82½° E., 23 lks. dist., mark "T23N R30E S8 BT."
- A cedar, 8 ins. in diam., brs. S. 33° E., 47 lks. dist., mark "T23N R30E S17 BT."
- A pinyon, 5 ins. in diam., brs. S. 23½° W., 49 lks. dist., mark "T23N R30E S18 BT."
- A pinyon, 6 ins. in diam., brs. N. 84½° W., 47 lks. dist., mark "T23N R30E S7 BT."

Land, rolling and broken.
Soil, shallow, sandy and stony clay loam, 3rd and 4th rate.
Timber, dense pinyon and cedar.
Undergrowth, dense cinchona, algerita and sage brush.

S. 39° 50' E., on a random line, bet. secs. 8 and 17. The beginning of the random line passes over precipitous cliffs, facing NW. on E. wall of Defiance Creek, canyon. Chaining impracticable. Triangulate as described as follows, and as shown on the diagram hereon.

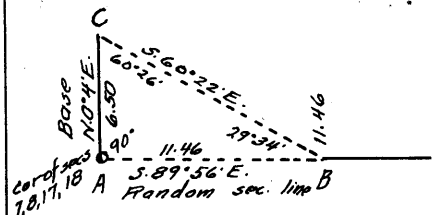

From cor. of secs. 7, 8, 17 and 18, indicated on diagram at "A," line in a flag S. 39° 50' E. on random sec. line, at E. rim of canyon at point "B."

Vertical angle "A" to "B" = + 28° 55'. From sec. cor. measure a base, N. 0° 4' E., 0.50 chs. to point "C." Bearing of "CB" = S. 60° 22' E.

Included angles of "CBA" are 60° 26', 29° 34' and 90°, the sum of which is 180°.

"AB" = $\text{tang. } 60^\circ 26' \times \text{base or } 1.76271 \times 0.50 = 11.46 \text{ chs.}$

Subdivision of Township 23 North, Range 30 East.

Chains.

11.46 Triangulation point on random line on E. rim of canyon. Continue line and measurement by chaining.
 40.00 Set temp. $\frac{1}{4}$ sec. cor.
 80.02 Intersect N. and S. line, 5 lks. S. of the cor. of secs. 8, 9, 16 and 17.
 Thence,
 N. $89^{\circ}58'W.$, on true line, bet. secs. 8 and 17.
 Over rolling and broken land, thru. dense timber and undergrowth. Asc. over SE. slope.
 6.20 Long low spur, slopes SW. Descend gradually over NW. slope.
 40.01 Set an iron post, 3 ft. long, 1 in. in diam., 26 ins. in the ground for $\frac{1}{4}$ sec. cor., marked on brass cap,

$\frac{1}{4}$ S 8
 S 17
 1920

A pinyon, 11 ins. in diam., brs. North 4 lks. dist., mark " $\frac{1}{4}$ S 8 BT."

A pinyon, 12 ins. in diam., brs. S. $87\frac{1}{2}^{\circ}W.$, 28 lks. dist., mark " $\frac{1}{4}$ S 17 BT."

68.54 East rim of Defiance Creek Canyon, brs. NE and SW. Descend 557 ft., over precipitous NW. slope of E. wall of canyon. Measurement by triangulation to
 80.02 The cor. of secs. 7, 8, 17 and 18.
 Land, rolling and broken.
 Soil, sandy and stony clay loam, 2nd and 3rd rate.
 Timber, dense pinyon and cedar.
 Undergrowth, dense cinchona and sage brush.

N. $89^{\circ}58'W.$, on a random line, bet. secs. 7 and 18.
 3.80 Left bank of Defiance Creek, brs. NE. and SW. Triangulate from this point to point on random sec. line on W. rim of canyon, as described as follows, and as shown on diagram hereon:

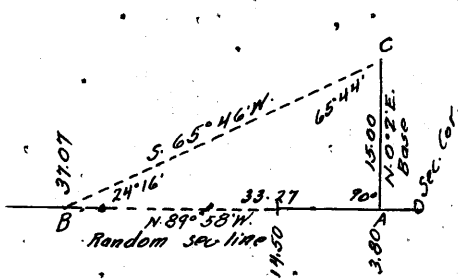

From this point on random line, indicated on diagram at "A", line in flag on random sec. line at W. rim of canyon at point "B."
 Vertical angle "A" to "B" = $+13^{\circ}20'$.

From "A" measure a Base, N. $0^{\circ}2'E.$ 15.00 chs. to point "C."
 Bearing of "CB" = S. $65^{\circ}46'W.$

Included angles of "CAB" are $65^{\circ}44'$, 90° and $24^{\circ}16'$, the sum of which is 180° .
 "AB" = tang. $65^{\circ}44'$ x Base or $2.21819 \times 15.00 = 33.27$ chs., which added to 3.80 chs. gives 37.07 chs. N. $89^{\circ}58'W.$ from sec. cor. for point "B," on random sec. line.

9.24 Center of Defiance Creek.
 13.30 Right bank of Defiance Creek.
 14.50 Foot of W. wall of canyon. Discontinue chaining.
 37.07 Triangulation point on random sec. line on W. rim of canyon. Continue line and measurement by chaining.
 40.00 Set temp. $\frac{1}{4}$ sec. cor.
 69.24 Intersect W. bdy. of Tp., 2 lks. N. of the cor. of secs. 7, 12, 13 and 18, described in Book "E" of this group.
 Thence,
 S. $89^{\circ}59'E.$, on true line, bet. secs. 7 and 18.
 Over rolling and broken land, thru. dense timber and undergrowth. Descend gradually over S. slope.
 29.24 Set an iron post, 3 ft. long, 1 in. in diam., 18 ins. in the ground, to bed rock, supported in a mound of stone 3 ft. base, 1 ft. high, for $\frac{1}{4}$ sec. cor., marked on brass cap,

$\frac{1}{4}$ S 7
 S 18
 1920

Chains.

- A pinyon, 6 ins. in diam., brs. N. 52 1/4° W., 105 lks. dist., mark "1/4 S 7 BT."
- A pinyon, 4 ins. in diam., brs. S. 11 1/2° E., 85 lks. dist., mark "1/4 S 18 BT."
- 32.17 West rim of Defiance Creek canyon, with precipitous sand stone walls, bearing NE. and SW. Desc. 524 ft. Measurement to Left bank of Defiance Creek by triangulation hereinbefore described.
- 54.74 Foot of west wall of canyon, brs. NE. and SW. Desc. gradually.
- 55.94 Right bank of Defiance Creek, 20 ft. high, brs. N. 65° E. and S. 65° W.
- 60.00 Center of Defiance Creek, with stream of clear water, 150 lks. wide, 3 ins. deep, course S. 65° W.; ascend.
- 65.44 Top of left bank of Defiance Creek, 20 ft. high, brs. N. 60° E. and S. 60° W. Ascend 15 ft., over NW. slope, to
- 69.24 The cor. of secs. 7, 8, 17 and 18.
Land, rolling, broken and mountainous.
Soil, stony clay and loose rock, 3rd and 4th rate.
Timber, dense pinyon and cedar.
Undergrowth, dense cinchona and sage brush.

N. 0° 09' W., bet. secs. 7 and 8.
Over broken and mountainous land, thru, dense timber and undergrowth.
Descend 77 ft., over NW slope, to
8.58 Base of E. wall of Defiance Creek canyon, brs. NE. and SW. Triangulate from this point to point on sec. line; on W. rim of canyon, as described as follows, and as shown on the diagram hereon.

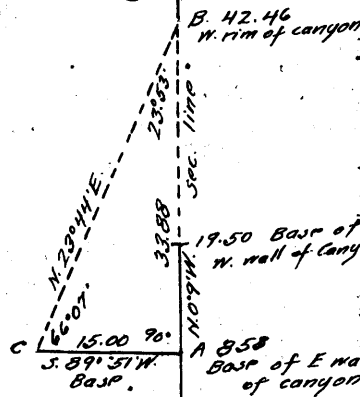

From this point on sec. line, indicated on diagram at "A", line in flag N. 0° 9' W. at point "B" on W. rim of canyon.
Vertical angle "A" to "B" = + 14° 12'.
From point "A" measure a base, S. 89° 51' W., 15.00 chs. to point "C."
Bearing of "CB" = N. 23° 44' E.
Included angles of "CBA" are 66° 07', 23° 53' and 90°, the sum of which is 180°.

- "AB" = tang. 66° 07' x Base or 2.25840 x 15.00 = 33.88 chs., which added to 8.58 chs. gives 42.46 chs. N. 0° 9' W. from sec. cor. for point "B" on sec. line on W. rim of canyon.
- From point "A," continue line and measurement by chaining, and locate the topographical features, as follows:
Over slightly rolling bottom of canyon. Descend.
- 12.20 Left bank of Defiance Creek, 20 ft. high, brs. N. 60° E. and S. 60° W.
- 14.75 Center of Defiance Creek, with stream of clear water, 300 lks. wide, 3 ins. deep, course S. 60° W., on sandy bottom.
- 17.40 Right bank of Defiance Creek, 15 ft. high, brs. N. 60° E. and S. 60° W. Ascend gradually over bottom of canyon.
- 19.50 Base of west wall of canyon, 560 ft. high, bearing NE. and SW. Discontinue chaining. Measurement to W. rim by above described triangulation.
- 40.00 The point for the 1/4 sec. cor. falls on sloping ledge of sandstone, where it is inaccessible.
- 42.46 Triangulation point on W. rim of Defiance Creek canyon. Continue line and measurement by chaining. Ascend very gradually over rolling SW. slope.
- 42.50 Set an iron post, 3 ft. long, 1 in. in diam., over cross(x) on sandstone ledge, supported in a mound of stone, 4 ft. base, 2 1/2 ft. high for witness cor. to the 1/4 sec. cor., marked on brass cap.

Subdivision of Township 23 North, Range 30 East.

Chains.

| | |
|------|---|
| 1 | 8 |
| S 7 | S |
| W | C |
| 1920 | |

80.00 A cedar, 14 ins. in diam., brs. N. 9 1/2° E., 28 lks. dist., mark "WC 1/4 S 8 BT."
 A pinyon, 6 ins. in diam., brs. S. 63° W., 69 lks. dist., mark "WC 1/4 S 7 BT."
 Continue gradual ascent over SW. slope.
 Set an iron post, 3 ft. long, 2 ins. in diam., 12 ins. in the ground to bed rock, supported in a mound of stone, 4 ft. base, 1 1/2 ft. high for cor. of secs. 5, 6, 7 and 8, marked on brass cap,

| | |
|------|------|
| T23N | R30E |
| S 6 | S 5 |
| S 7 | S 8 |
| 1920 | |

A pinyon, 12 ins. in diam., brs. N. 71° E., 128 lks. dist., mark "T23N R30E S5 BT."
 A pinyon, 14 ins. in diam., brs. S. 27° E., 21 lks. dist., mark "T23 N R30E S8 BT."
 A pinyon, 6 ins. in diam., brs. S. 69 1/2° W., 12 lks. dist., mark "T23N R30E S7 BT."
 A pinyon, 10 ins. in diam., brs. N. 37° W., 16 lks. dist., mark "T23N R30E S6 BT."
 Land, rolling, broken and mountainous.
 Soil, sandy and stony, 3rd and 4th rate.
 Timber, dense pinyon, scattering oak and cedar.
 Undergrowth, dense sage brush, cinchona and algerita.

40.00 S. 89° 58' E., on a random line, bet. secs. 5 and 8.
 80.04 Set temp. 1/4 sec. cor.
 Intersect N. and S. line, 12 lks. S. of the cor. of secs. 4, 5, 8 and 9.

Thence,
 S. 89° 57' W., on true line, bet. secs. 5 and 8.
 Over gently rolling land, thru. dense timber and undergrowth.
 Descend very gradually over SW. slope.
 40:02 Set an iron post, 3 ft. long, 1 in. in diam., 20 ins. in the ground, for 1/4 sec. cor., marked on brass cap,

| | |
|------|-----|
| 1/4 | S 5 |
| S | 8 |
| 1920 | |

A pinyon, 4 ins. in diam., brs. N. 56 1/2° W., 41 lks. dist., mark "1/4 S 5 BT."
 A pinyon, 6 ins. in diam., brs. S. 26 1/2° E., 68 lks. dist., marked "1/4 S 8 BT."

58.30 Continue gradual descent, over SW. slope.
 80.04 Wash, 30 lks. wide, 4 ft. deep, course S. 00° W.
 The cor. of secs. 5, 6, 7 and 8.
 Land, gently rolling. Soil, sandy & stony, 3rd and 4th rate.
 Timber, dense pinyon and cedar.
 Undergrowth, dense sage brush and algerita.

40.00 N. 89° 59' W., on a random line, bet. secs. 6 and 7.
 69.06 Set temp. 1/4 sec. cor.
 Intersect the W bdy. of Tp., 19 lks. S. of the cor. of secs. 1, 0, 7 and 12; described in Book "E" of this group.

Thence,
 S. 89° 50' E., on true line, bet. secs. 6 and 7.
 Over rolling and broken land, thru. dense timber and undergrowth. Descend over SE. slope.
 15.06 Ravine, 450 lks. wide, 70 ft. deep, course S. Thence over S. slope.

66 Subdivision of Township 23 North, Range 30 East.

Chains.

22.56 Ravine, 250 lks.wide, 40 ft.deep, course SW.
 29.06 Set an iron post, 3 ft.long, 1 in. in diam., 3 ins.in the ground, to bed rock, supported in a mound of stone 4 ft.base, 2½ ft.high, for ¼ sec.cor., marked on brass cap,

¼ S 6
 S 27
 1920

A pinyon, 12 ins. in diam., brs.N.53°W., 29 lks. dist., mark "¼ S 6 BT"

A pinyon, 5 ins. in diam., brs.S.5½°E., 31 lks. dist., mark "¼ S 7 BT."

64.26 Ravine, 400 lks.wide, 20 ft. deep, course S.40°W. Asc.over SW.slope, to

69.06 The cor.of secs. 5,6,7 and 8.

Land, rolling and broken.

Soil, sandy and stony, 3rd and 4th rate.

Timber, dense pinyon and cedar.

Undergrowth, dense cinchona and sage brush.

40.00 N.0°09' W., on a random line, bet. secs. 5 and 6.

83.88 Set temp.¼ sec.cor.

Intersect the N.bdy.of Tp., 15 lks.E.of the cor. of secs. 5, 6, 31 and 32. hereinbefore described.

Thence,

S.0°15'E., on a true line, bet. secs.5 and 6.

Over gently rolling land, thru. dense timber and undergrowth. Desc. very gradually, over SW.slope.

43.88 Set an iron post 3 ft.long, 1 in. in diam., 26 ins. in the ground for ¼ sec.cor., marked on brass cap,

¼ S 5
 1920

A pinyon, 6 ins. in diam., brs:N.65½°E., 53 lks. dist., mark "¼ S 5 BT."

A pinyon, 8 ins. in diam., brs.S.43½°W., 69 lks. dist., mark "¼ S 6 BT."

Continue very gradual descent, over SW.slope.

81.38 Ravine, 300 lks.wide, 20 ft. deep, course S.60° W.

83.88 The cor.of secs.5,6, 7 and 8.

Land, gently rolling.

Soil, sandy, 3rd rate.

Timber, dense pinyon and cedar.

Undergrowth, dense sage brush.

GENERAL DESCRIPTION.

This township comprises an elevated wooded mesa country, the greatest elevation being attained along the North boundary in secs.3,4, and 5, and in the vicinity of the northeast corner of the township, which is situated on an almost impassable sandstone rim rock, at an elevation of over 7000 ft.; the slope of the land is, in general, towards the south and southwest. A high ridge, which enters the township on the south boundary of sec. 34, and extends in a northerly direction across the township, forms the principal water shed for the drainage of the land in the township. To the east of this ridge, the drainage is in general in a southeasterly direction into the Rio Puerco Wash, while over the remainder of the township to the west of the ridge, the drainage is in a southerly or southwesterly

Chains.

direction into Defiance Creek, which crosses thru. the township in a southwesterly direction, in a box canyon, with perpendicular sandstone walls ranging in height from one hundred to eight hundred feet.

The land of the higher portions of the township in the vicinity of the north boundary, and of the high ridge in the east central part is generally rolling, and the soil, tho. shallow and stony can nearly all be classed as 2nd rate. The land over the remainder of the township, with the exception of secs. 28, 32 and 33, is very rough and broken, and the soil very stony, 3rd and 4th rate, in character. In secs. 28, 33, and 34, there is some nearly level land, the soil of which is a medium rich sandy loam, and is covered with a good growth of bunch grass.

The entire township is well timbered with pinyon and cedar, while in the bottom lands along Defiance Creek are found small groves of oak, and on the higher elevations are groves of yellow pine, some of the trees being quite large. Cedar, which is the predominating forest tree, is of the species known as "Juniperus Occidentalis," which thrives in shallow soil in most of the arid districts in the western states. This cedar grows very slowly, and except under the most favorable conditions does not attain any great size. The average life of this cedar is about 175 years.

No mineral deposits were found anywhere in the township during the progress of the survey.

The township is watered by three springs, one each in sec. 1, 8 and 34, and by Defiance Creek, which flows a small stream all through the year.

The only settlers on the land at the time of this survey are Navajo Indians, who are engaged in raising sheep and goats, which is the only industry being carried on in the township. These Indians' mode of living is nomadic in general, so that as a matter of fact, there are no bona fide settlers in the township at the present time.

The land in this township as a whole is best adapted to grazing purposes.

Final Test of Buff Solar Transit No. 10125.

September 25, 1920. Upon the completion of the surveys in T. 23 N., R. 30 E., place the instrument on the meridian which was established September 11, 1920, by observations on Polaris, at camp on the N. bdy. of sec. 26, T. 22 N., R. 29 E.; latitude, 35°16'N.; longitude, 109°14' W., hereinbefore described; and at 9h. 52m. a.m., l.m.t., set off 35°16'N. on the lat. arc; 0°54½'S. on the decl. arc, and determine a meridian with the solar, and mark a point thereof on stake already set 5 chs. N., on which the solar meridian falls 01' east of the meridian established by the Polaris observations.

At 3h. 52m. p.m., l.m.t., set off 35°16'N., on the lat. arc; 1°00'S. on the decl. arc, and determine a meridian with the solar, and mark a point thereof on the stake already set 5 chs. N.; this mark agrees with the meridian established by the Polaris observations. The solar apparatus by a.m. and p.m. observations defines positions for meridians, which agree within approximately 01' with the meridian established by the Polaris observations.

BOOK 800

4-680

FIELD ASSISTANTS.

to William D. Wilson, U. S. Transitman

| NAMES. | CAPACITY. |
|---|-----------|
| See certificate of Loyd E. Sechrist, U. S. Transitman | |
| | |
| | |
| | |
| | |
| | |
| | |
| | |
| | |
| | |
| | |
| | |
| | |
| | |
| | |
| | |
| | |

BOOK 3500

CERTIFICATE OF UNITED STATES TRANSITMAN.

I, William D. Wilson, U. S. Transitman, hereby certify upon honor that, in pursuance of special instructions received from the U. S. Surveyor General, for Group 92, Arizona,

bearing date of the 27th day of September, 1918, I have well, faithfully, and truly

in my own proper person, and in strict conformity with said instructions, the Manual of Surveying Instructions, and the laws of the United States, surveyed all those parts or portions of the Subdivision lines of

Township 23 North, Range 30 East,

of the Gila and Salt River

Base and Meridian, in the State of Arizona, which are represented in

and by diagram on page 1 hereof

the foregoing field notes/as having been executed by me, and under my direction; and that all the corners of said survey have been established and perpetuated in strict accordance with the Manual of Surveying Instruc-

tions, and the special written instructions of the U. S. Surveyor General, for Group 92, Arizona,

and in the specific manner described in the field notes, and that the foregoing are the original field notes of such survey.

Place Parkland, Wash.

Date Oct. 27, 1921.

William D. Wilson
U. S. Transitman

APPROVAL.

OFFICE OF THE UNITED STATES SURVEYOR GENERAL

, 191

The foregoing field notes of the survey of

executed by

under his special instructions dated, 191, having been critically examined, and the necessary corrections and explanations made, the said field notes, and the surveys they describe, are hereby approved.

U. S. Surveyor General.

I certify that the foregoing transcript of the field notes of the above-described surveys in, has been correctly copied from the original notes on file in this office.

U. S. Surveyor General.

BOOK 8500

4-680

FIELD ASSISTANTS.

to Loyd E. Sechrist, U. S. Transitman

| NAMES. | CAPACITY. |
|-------------------|--------------------|
| William D. Wilson | Head chairman |
| Leo E. Essenpreis | " " |
| Tom Graves | Rear " and Flagman |
| Douglas J. Hill | " " " Axman |
| James Clark | Flagman |
| Robin Wilcox | " |
| Allen M. Willden | Moundman |
| Joe Widener | " |
| Julian C. Herring | Axman |
| Frank Pedersin | " |
| | |
| | |
| | |
| | |
| | |
| | |
| | |
| | |
| | |

BOOK 3500

CERTIFICATE OF UNITED STATES TRANSITMAN.

I, Loyd E. Sechrist, U. S. Transitman, hereby certify upon honor that, in pursuance of special instructions received from the U. S. Surveyor General, for Group 92, Arizona, bearing date of the 27th day of September, 1918, I have well, faithfully, and truly in my own proper person, and in strict conformity with said instructions, the Manual of Surveying Instructions, and the laws of the United States, re-surveyed all those parts or portions of the South, East, and North boundaries, and surveyed all those parts or portions of the North boundary, and Subdivision lines of

Township 23 North, Range 30 East,

of the Gila and Salt River

Base and Meridian, in the State of Arizona,

and by diagram on page 1 hereof

the foregoing field notes as having been executed by me, and under my direction; and that all the corners of resurvey and said survey have been established and perpetuated in strict accordance with the Manual of Surveying Instructions,

and the special written instructions of the U. S. Surveyor General, for Group 92, Arizona,

and in the specific manner described in the field notes, and that the foregoing are the original field notes of resurvey and such survey.

Loyd E. Sechrist, U. S. Transitman, (deceased).

Phoenix, Arizona,

by

[Signature]

Assistant Supervisor of Surveys

Date November 1, 1921

APPROVAL.

OFFICE OF THE UNITED STATES SURVEYOR GENERAL,

Phoenix Arizona November 15, 1921.

The foregoing field notes of the re-survey of the South and East boundaries, and of part of of the North boundary, and of the survey of part of the North boundary and of the Subdivision lines of

Township 23 North, Range 30 East,

of the Gila and Salt River Base and Meridian,

in the State of Arizona,

executed by Loyd E. Sechrist and William D. Wilson, U. S. Transitmen,

under his special instructions dated September 27, 1918 for Group 92 Arizona having been critically examined, and the necessary corrections and explanations made, the said field notes, and the surveys they describe, are hereby approved.

[Signature]

U. S. Surveyor General.

I certify that the foregoing transcript of the field notes of the above-described surveys in

has been correctly copied from the original notes on file in this office.