

JUN 27 1920

4-679

BOOK 3512

Book "B"

# FIELD NOTES

OF THE SURVEY OF THE

East  $2\frac{1}{2}$  miles of the Seventh Standard Parallel North, ~~in~~ Range 9 West,

the East  $\frac{1}{2}$  mile of the North boundary, and a portion of the Subdivision lines of

TOWNSHIP 29 NORTH, RANGE 9 WEST,

Of the Gila and Salt River Base and Meridian,

In the State of Arizona

EXECUTED BY

Guy Redwine, U. S. Cadastral Engineer, and

Horace M. Muscott, U. S. Transitman,

In the capacity of U. S. Surveyor, under Special Instructions dated February 25, 1920,

issued by the United States Surveyor General to govern surveys included in Group

No. 106, which were approved by the Commissioner of the General Land

Office, March 8, 1920, and Assignment Instructions dated April 8, 1920

Survey commenced May 17, 1920

Survey completed June 11, 1920

3512

3512

3512

~~INDEX DIAGRAM.~~

~~Township~~ \_\_\_\_\_ ~~Range~~ \_\_\_\_\_

6	5	4	3	2	1
7	8	9	10	11	12
18	17	16	15	14	13
19	20	21	22	23	24
30	29	28	27	26	25
31	32	33	34	35	36

3512

BOOK 3512

INDEX DIAGRAM

TOWNSHIP 29 NORTH, RANGE 9 WEST.

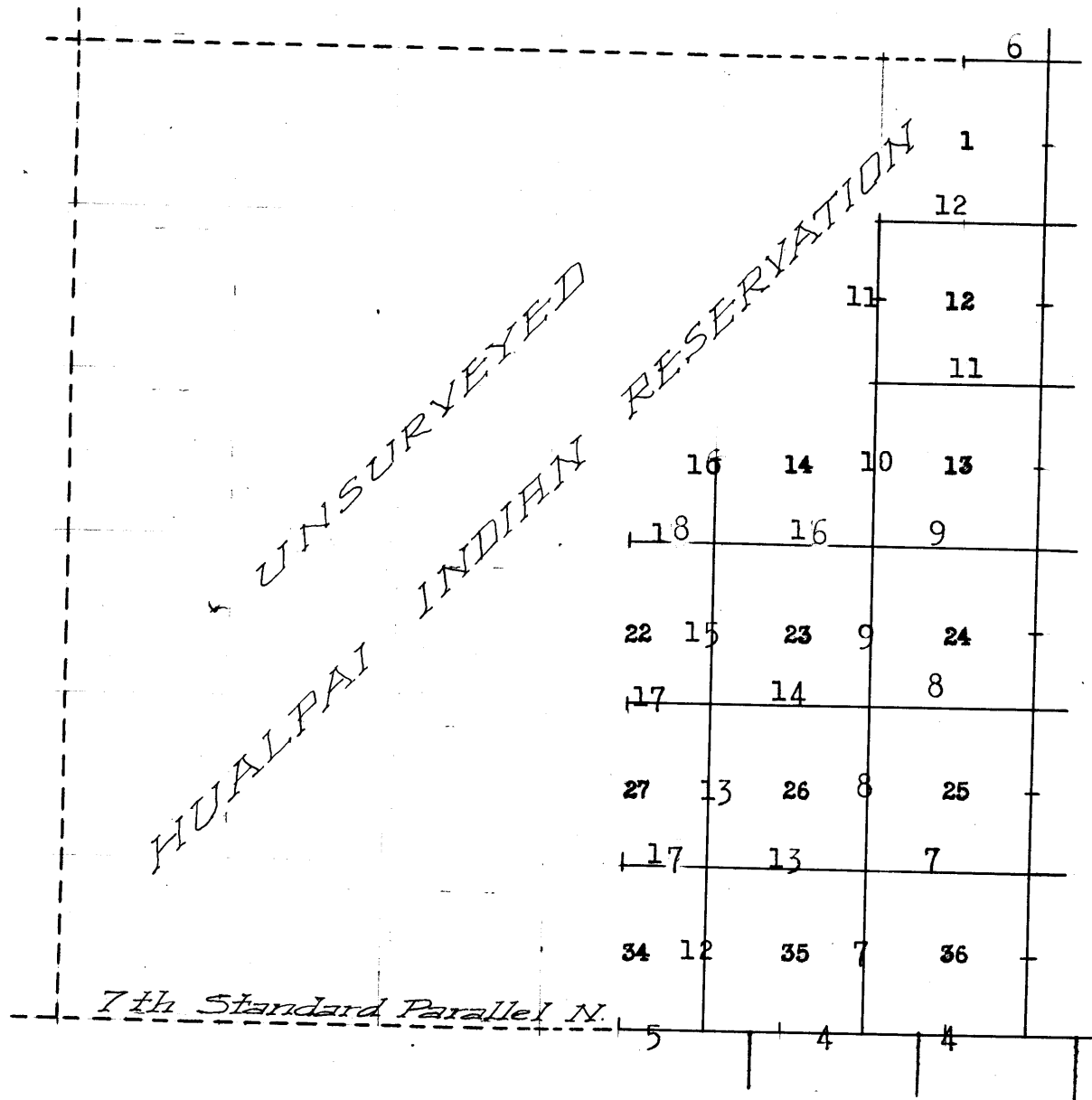

- Lines surveyed under this Group.
- Lines surveyed under current Group 107.
- - - Unsurveyed.

BOOK 3512

BOOK "B"

DATE DIAGRAM

TOWNSHIP 29 NORTH, RANGE 9 WEST.

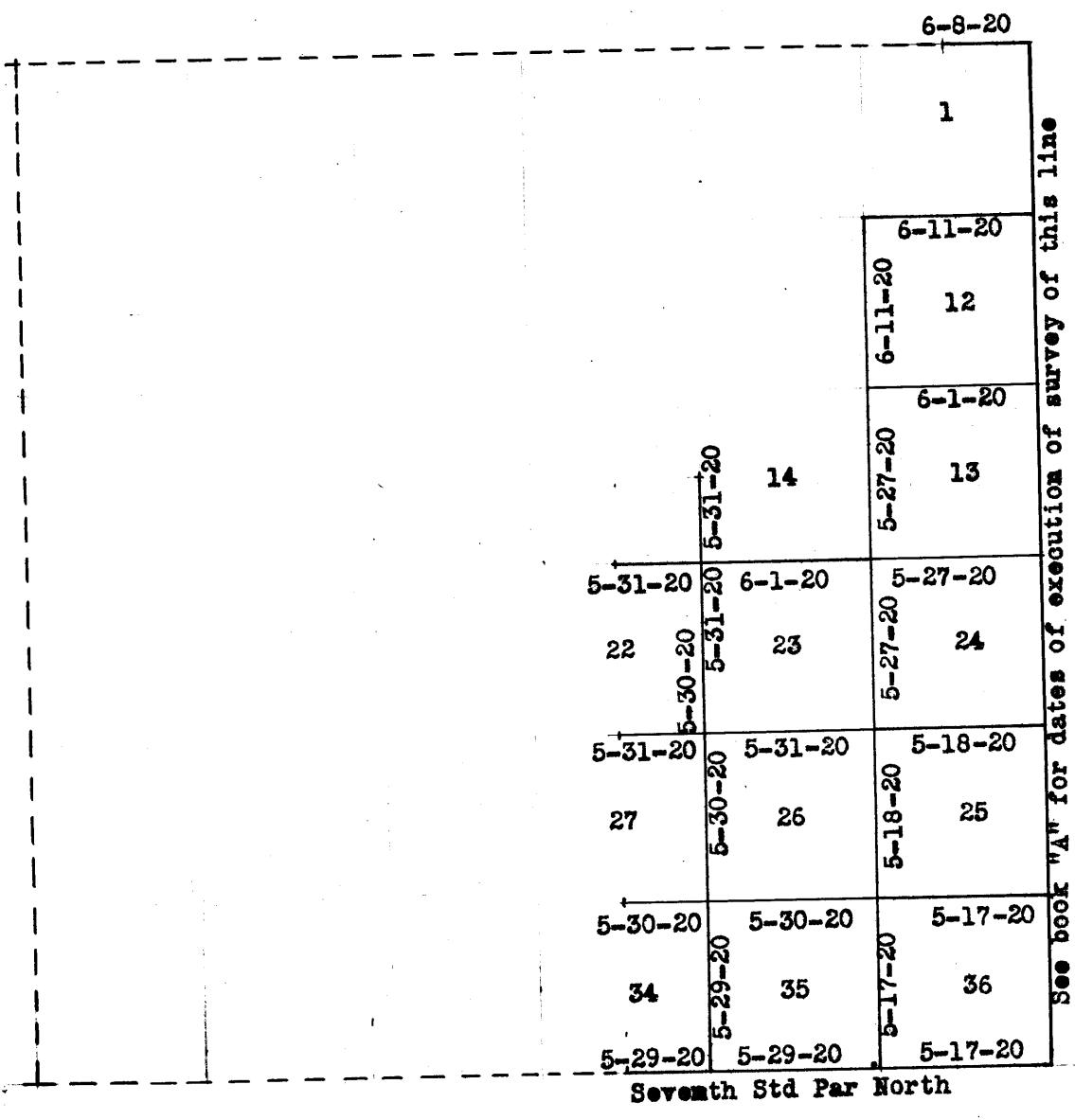

Black lines on above diagram indicate surveys executed by Guy Redwine, U. S. Cadastral Engineer, on dates shown thereon.

Red lines on above diagram indicate surveys executed by Horace M. Mascott, U. S. Transitman, on dates shown thereon.

Surveys hereinafter described, executed by Guy Redwine, U.S. Cadastral Engineer, and Horace M. Muscott, U.S. Transitman, on dates shown on diagram on page 2 hereof, using respectively, Buff solar transit No. 9208, and Young and Sons mountain transit No. 8489. Each instrument is equipped with full vertical circle, and the Smith solar attachment; unless otherwise specified all azimuth determinations are accomplished with the solar attachments.

May 15, 1920: We examine the adjustment of each instrument and correct all errors; then, to test the solar apparatus by comparing its indications from observations made during a.m. and p.m. hours with a meridian established by Polaris observation, proceed with each instrument as follows:

At camp, in SE.  $\frac{1}{4}$  of sec. 19, T. 29 N., R. 8 W., Gila and Salt River Base and Meridian, Arizona, in latitude,  $35^{\circ}53'N.$ , and longitude,  $113^{\circ}10\frac{1}{2}'W.$  at 9h. 58m. p.m., l.m.t., observe Polaris at lower culmination, making four observations, two each with the telescope in direct and reversed positions, and mark the mean point in the meridian thus determined by a tack in a peg driven firmly in the ground, 5 chs. N.

May 16, 1920. At 9h. 00m. a.m., l.m.t., set off  $35^{\circ}53'N.$ , in the lat. arc;  $19^{\circ}08\frac{1}{2}'N.$  on the decl. arc, and determine a meridian with the solar, which agrees with the true meridian.

At app. noon, with the lat. arc unchanged, observe the sun on the meridian; the resulting reading of the decl. arc is  $19^{\circ}10'N.$ , which agrees with the computed declination of the sun.

At 3h. 00m., p.m., l.m.t., with the lat. arc unchanged, set off  $19^{\circ}12'N.$  on the decl. arc, and determine a meridian with the solar, which agrees with the true meridian.

As all of the solar observations made with both instruments during the usual hours of the solar work come within  $1'30''$  of the true meridian, we conclude that the adjustments of the instruments are satisfactory.

-----

Unless otherwise specified, all measurements are made with Lufkin steel tapes, 5 chs. in length, compared with Lufkin standard steel tape,, and found correct. The measurements are made on the slope, the vertical angle determined, and the slope measurements properly reduced to the true horizontal distances.

-----

## A Survey of Seventh Standard Parallel North, Thru. part of R.9 W.

Chains.

- From the standard cor. of Ts.29 N., Rs.8 and 9 W., described in Book "A,"  
West, on S. bdy. of sec.36.  
Over mountainous land, thru. scattering undergrowth.  
Descend 23 ft., over SW. slope.
- 1.40 Gulch, course S. into Diamond Creek canyon. Asc. 186 ft., over SE. slope.
- 13.60 Descend 150 ft., over SW. slope.
- 24.30 Bottom of ravine, course SE. into Diamond Creek canyon. Ascend 154 ft., over E. slope, to
- 40.00 Set an iron post, 3 ft. long, 1 in. in diam., 20 ins. in the ground, supported in a mound of stone, for standard  $\frac{1}{4}$  sec. cor. of sec.36, marked on brass cap,
- S C  
 $\frac{1}{4}$ S 36  
1920
- and raise a mound of stone, 2 $\frac{1}{2}$  ft. base, 2 ft. high, N. of cor.  
Ascend 35 ft., over E. slope.
- 47.00 Top of hill. Enter scattering timber and dense undergrowth. Descend 60 ft. over W. slope.
- 57.60 Head of gulch, course N. Asc. 142 ft., over E. slope.
- 73.30 Descend 60 ft., over NW. slope, to
- 80.00 Set an iron post, 3 ft. long, 2 ins. in diam., on surface rock, supported in a mound of stone, for standard cor. of secs. 35 and 36, marked on brass cap,
- S C  
T29N R9 W  
S35 S36  
1920
- from which,  
A pine, 8 ins. in diam., brs. N. 49 $\frac{1}{2}$ ° E., 31 lks. dist., marked T29N R9W S36 SC BT.  
A pine, 6 ins. in diam., brs. N. 26 $\frac{1}{2}$ ° W., 32 lks. dist., marked T29N R9W S35 SC BT.
- Land, mountainous.  
Soil, rocky, 4th rate.  
Timber, scattering pine and cedar in W. 33 chs. No timber in E. 47 chs.  
Undergrowth, chamisal, sagebrush, manzanita and scrub oak, scattering and dense.  
No grass.
- 
- West, on S. bdy. of sec.35.  
Over mountainous land, thru. scattering timber and dense undergrowth.  
Ascend 220 ft., over E. slope.
- 40.00 Set an iron post, 3 ft. long, 1 in. in diam., 10 ins. in the ground to bed rock, deposit a stone marked with a cross (x) at base of post, and raise a mound of stone around post, for standard  $\frac{1}{4}$  sec. cor. of sec.35, marked on brass cap,
- S C  
 $\frac{1}{4}$ S 35  
1920
- Ascend 350 ft., over E. slope, to  
Base of perpendicular cliff, 20 ft. high, bearing N. and S. facing E. From top of cliff, ascend 90 ft. over NE. slope.
- 61.50
- 67.70 Point of spur, slopes N. Desc. 90 ft., over NW. slope.

Seventh Standard Parallel North, thru part of Range 9 West. 5

Chains.

79.60  
80.00

Bottom of ravine, course N.80°E. Ascend slightly to  
Set an iron post, 3 ft. long, 2 ins. in diam., 15 ins. in  
the ground to bed rock, supported in a mound of stone  
for standard cor. of secs. 34 and 35, marked on brass  
cap,

S C  
T29N R9 W  
S34 | S35

1920

from which,

- An oak, 5 ins. in diam., brs. N.21 $\frac{3}{4}$ °E., 58 lks. dist., marked T29N R9W S 35 S C B T.
- A pine, 5 ins. in diam., brs. N.85 $\frac{3}{4}$ °W., 80 lks. dist., marked T29N R9W S34 SC BT.

Land, mountainous.  
Soil, rocky, 4th rate.  
Timber, scattering pine and cedar.  
Undergrowth, dense chamisal, scrub oak and sagebrush.  
No grass.

-----  
West, on S. bdy. of sec. 34.  
Over mountainous land, thru. scattering timber and dense  
undergrowth.

35.00

Ascend 260 ft., over E. slope.  
Ridge, brs. N. and S. forming E. upper rim of the Colorado  
River canyon. Deep saddle, brs. S. 5 chs. dist.  
Thence over cliffs and slide rock on E. or left wall of  
the Colorado River canyon. Desc. 270 ft. over W. slope,  
to

40.00

Set an iron post, 3 ft. long, 1 in. in diam., over cross  
(x) marked on surface rock, and raise a mound of stone  
around post, for standard  $\frac{1}{4}$  sec. cor. of sec. 34,  
marked on brass cap,

S C  
 $\frac{1}{4}$ S 34  
1920

Beyond this cor. the line passes over steep broken de-  
scent into the Colorado River canyon, and continua-  
tion of survey is impracticable.

Land, mountainous.  
Soil, rocky, 4th rate.  
Timber, scattering pine and cedar.  
Undergrowth, dense scrub oak, chamisal and sagebrush.  
No grass.

-----

## 6 Survey of part of North bdy. of Township 29 North, Range 9 West.

Chains.

From the cor. of Ts. 29 and 30 N., Rs. 8 and 9 W. described in Book "A,"  
 West, on a true line, bet. secs. 1 and 36.  
 Over mountainous land, thru. dense timber and undergrowth.  
 Descend slightly across ledge in E. wall of canyon, bearing NW. and SE.

1.00 Leave ledge, and descend 190 ft., over W. slope.  
 10.50 Bottom of canyon, course NW. from S. Asc. 375 ft., over E. slope, to  
 26.00 Base of precipitous cliffs, bearing NW. and SE. facing NE. Asc. 170 ft. to  
 29.00 Top of same cliffs; ascend 35 ft. over NE. slope, to  
 31.00 E. edge of top of spur, sloping N. Thence across top of spur, along N. slope, with slight change in elevation.  
 40.00 Set an iron post, 3 ft. long, 1 in. in diam., 8 ins. in the ground, to bed rock, supported in a mound of stone, for  $\frac{1}{4}$  sec. cor., marked on brass cap,

$\frac{1}{4}$  S 36  
 S 1  
 1920

from which,

A pine, 8 ins. in diam., brs. S.  $27\frac{1}{2}^{\circ}$  E., 15 lks.  
 dist., marked  $\frac{1}{4}$  S 1 BT.

A pine, 5 ins. in diam., brs. N.  $47\frac{1}{2}^{\circ}$  W., 40 lks.  
 dist., marked  $\frac{1}{4}$  S 36 BT.

About 10 chs. W. of this cor., the precipitous descent into the Colorado River Canyon renders a continuation of the survey of this township bdy. impracticable.

Land, mountainous.

Soil, rocky, 4th rate.

Timber, dense pine, cedar and oak.

Undergrowth, dense scrub oak, sage brush and chamisal.

No grass.

---



Survey of Subdivision of part of Township 29 North Range 9 West. 7

Chains.

From the standard cor. of secs. 35 and 36, on S. bdy. of Tp. (7th. Std. Par. N.) hereinbefore described, N. 0° 01' W., bet. secs. 35 and 36.  
 Over mountainous land, thru scattering timber and dense undergrowth. Descend 35 ft., over NW. slope.  
 2.15 Ascend 80 ft., over SE. slope.  
 16.50 Descend 30 ft., over N. slope.  
 20.00 Gulch, course E. Ascend 130 ft., over S. slope, to  
 40.00 Set an iron post, 3 ft. long, 1 in. in diam., over cross (x) marked on surface rock, and raise a mound of stone around post, for 1/4 sec. cor., marked on brass cap,

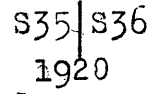

Ascend 23 ft., over S. slope.  
 44.00 Ridge, brs. E. and W. Desc. 40 ft., over N. slope.  
 54.25 Gulch, course E. Enter dense timber; asc. 150 ft., over S. slope, to  
 69.00 S. edge of top of spur, sloping E. from NW. Thence over gently rolling top of spur, ascending slightly over SE. slope, to  
 80.00 Set an iron post, 3 ft. long, 2 ins. in diam., 26 ins. in the ground, for cor. of secs. 25, 26, 35 and 36, marked on brass cap,

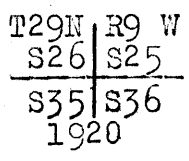

- from which,
- A pine, 7 ins. in diam., brs. N. 26 1/4° E., 95 lks. dist., marked T29N R9W S25 BT.
  - A cedar, 12 ins. in diam., brs. S. 21 1/4° E., 29 lks. dist., marked T29N R9W S36 BT.
  - A pine, 8 ins. in diam., brs. S. 20 1/2° W., 31 lks. dist., marked T29N R9W S35 BT.
  - A cedar, 12 ins. in diam., brs. N. 41 1/2° W., 51 lks. dist., marked T29N R9W S26 BT.

Land, mountainous and rolling.  
 Soil, rocky, 4th rate.  
 Timber, pine and cedar, scattering and dense.  
 Undergrowth, dense sage brush, scrub oak, chamisal and manzanita. No grass.

East, on a random line, bet. secs. 25 and 36.  
 40.00 Set temp. 1/4 sec. cor.  
 80.00 Fall 14 lks. S. of the cor. of secs. 25, 30, 31 and 36, on E. bdy. of Tp., described in Book "A."  
 Thence,  
 S. 89° 54' W., on a true line, bet. secs. 25 and 36.  
 Over rolling land, thru dense timber and undergrowth.  
 Ascend 80 ft., over SE. slope.  
 13.00 Spur, slopes S. Desc. 170 ft., over W. slope.  
 18.00 Gulch, course SE. Asc. 100 ft., over E. slope, to  
 40.00 Set an iron post, 3 ft. long, 1 in. in diam., 12 ins. in the ground, supported in a mound of stone, for 1/4 sec. cor., marked on brass cap,

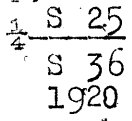

- from which,
- A pine, 8 ins. in diam., brs. N. 80 1/2° W., 36 lks. dist., marked 1/4 S 25 BT.
  - A pine, 5 ins. in diam., brs. S. 7 1/2° E., 61 lks. dist., marked 1/4 S 36 BT.

Thence over gently rolling top of spur, sloping E.  
 Ascend 155 ft., over E. slope, to  
 80.00 The cor. of secs. 25, 26, 35 and 36, on top of spur, sloping E. from NW.  
 Land, mountainous and rolling.  
 Soil, gravelly and rocky clay, 3rd and 4th rate.

## 8 Subdivision of part of Township 29 North Range 9 West

	<p>Chains.</p> <p>Timber, dense pine, cedar and oak. Undergrowth, dense chamisal, scrub oak and sagebrush.</p> <p>-----</p> <p>N. 0° 01' W., bet. secs. 25 and 26. Over rolling land, thru. dense timber and undergrowth. Descend 60 ft., over rolling NE. slope of spur.</p> <p>14.30 Gully, course NE. Thence over E. slope, descending slightly to</p> <p>22.00 Gully, course E. Leave dense, and enter scattering timber. Ascend 40 ft., over S. slope, to</p> <p>40.00 Set an iron post, 3 ft. long, 1 in. in diam., 26 ins. in the ground, for <math>\frac{1}{4}</math> sec. cor., marked on brass cap,</p> <p style="text-align: center;"> <math>\frac{1}{4}</math>  S26   S25  1920 </p> <p>from which,</p> <p style="padding-left: 40px;">A pine, 15 ins. in diam., brs. N. 34<math>\frac{3}{4}</math>° E., 108 lks. dist., marked <math>\frac{1}{4}</math> S 25 BT.</p> <p style="padding-left: 40px;">A pine, 12 ins. in diam., brs. S. 77<math>\frac{1}{2}</math>° W., 14 lks. dist., marked <math>\frac{1}{4}</math> S 26 BT.</p> <p>Ascend 80 ft., over S. slope, to</p> <p>67.00 Leave timber, changes to SE. slope, and ascend 100 ft. to</p> <p>80.00 Set an iron post, 3 ft. long, 2 ins. in diam., over cross (X) marked on surface rock, and raise a mound of stone around post, for cor. of secs. 23, 24, 25 and 26, marked on brass cap,</p> <p style="text-align: center;"> T29N   R9W  S23   S24  S26   S25  1920 </p> <p>Land, rolling. Soil, rocky, 4th rate. Timber, pine and cedar, dense and scattering in S. 67 chs.; no timber in N. 13 chs. Undergrowth, dense scrub oak, manzanita and sagebrush. No grass.</p> <p>-----</p> <p>N. 89° 54' E., on a random line, bet. secs. 24 and 25.</p> <p>40.00 Set temp. <math>\frac{1}{4}</math> sec. cor.</p> <p>80.02 Intersect the cor. of secs. 19, 24, 25 and 30, on E. bdy. of Tp., described in Book "A."</p> <p>Thence, S. 89° 54' W., on a true line, bet. secs. 24 and 25. Over rolling land, thru. scattering timber and undergrowth. Ascend 125 ft., over E. slope, to</p> <p>17.00 Change to NE. slope, and ascend 50 ft. to</p> <p>40.01 Set an iron post, 3 ft. long, 1 in. in diam., 26 ins. in the ground, for <math>\frac{1}{4}</math> sec. cor., marked on brass cap,</p> <p style="text-align: center;"> <math>\frac{1}{4}</math> S 24  S 25  1920 </p> <p>from which,</p> <p style="padding-left: 40px;">A pine, 10 ins. in diam., brs. S. 53<math>\frac{1}{2}</math>° W., 16 lks. dist., marked <math>\frac{1}{4}</math> S 25 BT.</p> <p style="padding-left: 40px;">A pine, 20 ins. in diam., brs. N. 73<math>\frac{1}{2}</math>° W., 15 lks. dist., marked <math>\frac{1}{4}</math> S 24 BT.</p> <p>Ascend 15 ft., over N. slope, to</p> <p>48.00 Leave timber, and enter dense undergrowth. Asc. 160 ft., over SE. slope, to</p> <p>80.02 The cor. of secs. 23, 24, 25 and 26. Land, rolling. Soil, rocky, 4th rate. Timber, scattering pine, cedar and oak in E. 48 chs. No timber in W. 32 chs. Undergrowth, scrub oak, manzanita and sagebrush, scattering and dense. No grass.</p> <p>-----</p> <p>N. 0° 01' W., bet. secs. 23 and 24. Over rolling land, thru. dense undergrowth. Ascend 214 ft., over SE. slope.</p> <p>20.00 Ridge, brs. NE and SW. Desc. 50 ft., over NW. slope.</p> <p>28.35 Gully, course SW. Asc. 55 ft., over S. slope.</p> <p>34.00 Rim of bench, brs. E. and W. Thence over nearly level surface of bench, bearing N. and S. Enter scattering timber.</p>
--	---

Subdivision lines of part of Township 29 North, Range 9 West. 9

Chains.  
40.00

Set an iron post, 3 ft. long, 1 in. in diam., 26 ins. in the ground, for 1/4 sec. cor., marked on brass cap,

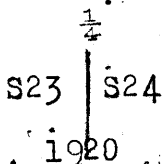

from which,

A pine, 10 ins. in diam., brs. S. 32 1/2° E., 27 lks. dist., marked 1/4 S 24 BT.

An oak, 5 ins. in diam., brs. S. 34 1/2° W., 75 lks. dist., marked 1/4 S 23 BT.

Continue over nearly level surface of bench, bearing N. and S.

64.00 Head of gully, course E.

68.40 Rim of bench, brs. NW. and SE. Leave nearly level land and bench, and enter rolling land. Desc. 60 ft., over NE. slope.

78.00 Gully, course NE. Asc. 16 ft. over SE. slope.

80.00 Set an iron post, 3 ft. long, 2 ins. in diam., 16 ins. in the ground, to bed rock, supported in a mound of stone, for cor. of secs. 13, 14, 23 and 24, marked on brass cap,

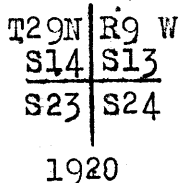

from which,

A pine, 10 ins. in diam., brs. N. 89 3/4° E., 82 lks. dist., marked T29N R9W S13 BT.

A cedar, 6 ins. in diam., brs. S. 20 1/2° E., 34 lks. dist., marked T29N R9W S24 BT.

A cedar, 5 ins. in diam., brs. S. 75 1/2° W., 155 lks. dist., marked T29N R9W S23 BT.

A pine, 10 ins. in diam., brs. N. 13° W., 77 lks. dist., marked T29N R9W S14 BT.

Land, rolling and nearly level.

Soil, gravelly clay, 3rd rate.

Timber, scattering pine, cedar and oak in N. 46 chs.

No timber in S. 34 chs.

Undergrowth, dense scrub oak, chamisal and sagebrush.

No grass.

40.00 N. 89° 54' E., on a random line, bet. secs. 13 and 24. Set temp. 1/4 sec. cor.

80.08 Fall 5 lks. N. of the cor. of secs. 13, 18, 19 and 24, on E. bdy. of Tp., described in Book "A."

Thence,

S. 89° 56' W., on a true line, bet. secs. 13 and 24.

Over rolling land, thru scattering timber and dense undergrowth. Asc. 20 ft., over E. slope.

4.70 Spur, slopes S. from NW. Desc. 55 ft., over SW. slope.

13.20 Gully, course SE. Asc. 220 ft., over NE. slope.

29.70 Ridge, brs. N. and S. Desc. 35 ft., over W. slope.

37.20 Gully, course NE. Asc. 30 ft., over SE. slope, to

40.04 Set an iron post, 3 ft. long, 1 in. in diam., 26 ins. in the ground, for 1/4 sec. cor., marked on brass cap,

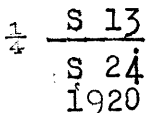

from which,

10 Subdivision of part of Township q29 North, Range 9 West.

chains.

A pine, 14 ins. in diam., brs. N. 16 $\frac{1}{2}$ ° E., 104 lks. dist., marked  $\frac{1}{4}$  S 13 BT.  
 A pine, 12 ins. in diam., brs. S. 82 $\frac{1}{2}$ ° E., 30 lks. dist., marked  $\frac{1}{4}$  S 24 BT.  
 Descend 15 ft., over SW. slope.  
 44.40 Gully, course SE. Asc. 60 ft., over NE. slope.  
 54.00 Spur, slopes N. Desc. 86 ft., over W. slope.  
 61.40 Gully, course N. Asc. 52 ft. over E. slope, to  
 65.40 Changes to NE. slope, and ascend 26 ft. to  
 69.28 Spur, slopes NE. Desc. 53 ft., over NW. slope.  
 76.33 Draw, course NE. Asc. 47 ft., over SE. slope, to  
 80.08 The cor. of secs. 13, 14, 23 and 24.  
 Land, rolling.  
 Soil, rocky, 4th rate.  
 Timber, scattering cedar and pine.  
 Undergrowth, dense scrub oak, chamisal and sagebrush.  
 No grass.

N. 0° 01' W., bet. secs. 13 and 14.  
 Over rolling land, thru. scattering timber and dense undergrowth. Asc. 30 ft., over SE. slope.  
 5.50 Spur, slopes NE. Desc. 80 ft., over N. slope.  
 17.60 Gully, course NE. Asc. 100 ft., over SE. slope.  
 27.10 Spur, slopes NE. Desc. 40 ft., over N. slope.  
 31.00 Head of gulch, course NE. Asc. 52 ft., over SE. slope, to  
 40.00 Spur, slopes NE. Set an iron post, 3 ft. long, 1 in. in diam., 16 ins. in the ground, to bed rock, supported in a mound of stone, for  $\frac{1}{4}$  sec. cor., marked on brass cap,

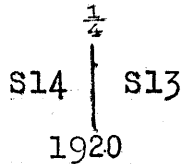

from which,  
 A pine, 8 ins. in diam., brs. N. 74 $\frac{1}{2}$ ° E., 52 lks. dist., marked  $\frac{1}{4}$  S 13 BT.  
 A pine, 8 ins. in diam., brs. S. 78° W., 68 lks. dist., marked  $\frac{1}{4}$  S 14 BT.  
 Descend 90 ft., over NW. slope.  
 50.50 Gulch, course NE. Asc. 60 ft., over SE. slope.  
 68.00 Ridge, brs. NE. and SW. Desc. 60 ft., over NW. slope.  
 73.40 Gulch, course NE. Asc. 20 ft., over SE. slope, to  
 80.00 Set an iron post, 3 ft. long, 2 ins. in diam., 24 ins. in the ground, for cor. of secs. 11, 12, 13 and 14, marked on brass cap,

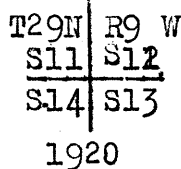

from which,  
 An oak, 5 ins. in diam., brs. N. 44 $\frac{1}{2}$ ° E., 40 lks. dist., marked T29N R9W S12 BT.  
 An oak, 5 ins. in diam., brs. S. 48 $\frac{1}{2}$ ° E., 25 lks. dist., marked T29N R9W S13 BT.  
 A pine, 10 ins. in diam., brs. S. 69 $\frac{1}{2}$ ° W., 110 lks. dist., marked T29N R9W S14 BT.  
 A pine, 14 ins. in diam., brs. N. 65° W., 71 lks. dist., marked T29N R9W S11 BT.

Land, rolling.  
 Soil, rocky, 4th rate.  
 Timber, scattering pine, cedar and oak.  
 Undergrowth, dense scrub oak, chamisal and sage brush.  
 No grass.

Subdivision of part of Township 29 North, Range 9 West, 11

Chains.

40.00 N. 89° 56' E., on a random line, bet. secs. 12 and 13.  
Set temp.  $\frac{1}{4}$  sec. cor.

80.00 Fall 9 lks. S. of the cor. of secs. 7, 12, 13 and 18, on E. bdy. of Tp., described in Book "A."  
Thence,  
S. 89° 52' W., on a true line, bet. secs. 12 and 13.  
Over rolling land, thru. scattering timber and dense undergrowth.

22.00 Asc. 100 ft., over E. slope, along top of spur.  
Junction of two spurs, sloping E. and NE. Desc. 65 ft. over NW. slope.

29.80 Gulch, course NE. Asc. 20 ft., over E. slope.

37.00 Descend slightly over N. slope, to

40.00 Set an iron post, 3 ft. long, 1 in. in diam., 20 ins. in the ground, supported in a mound of stone, for  $\frac{1}{4}$  sec. cor., marked on brass cap,

$\frac{1}{4}$  S 12  
S 13  
1920

from which,  
A yellow pine, 10 ins. in diam., brs. S. 71° E., 50 lks. dist., marked  $\frac{1}{4}$  S 13 BT.  
A yellow pine, 20 ins. in diam., brs. N. 76 $\frac{1}{2}$ ° W., 109 lks. dist., marked  $\frac{1}{4}$  S 12 BT.

40.20 Gully, course NE. Asc. 170 ft., over SE. slope.

74.13 Ridge, brs. NE. and SW. Desc. 40 ft., over NW. slope.

76.36 Gulch, course N. from SW. Asc. 45 ft. over E. slope, to

80.00 The cor. of secs. 11, 12, 13 and 14.  
Land, rolling.  
Soil, rocky clay, 4th rate.  
Timber, scattering pine and cedar.  
Undergrowth, dense scruboak; locust, chamisal and manzanita.  
No grass.

---

N. 0° 01' W., bet. secs. 11 and 12.  
Over rolling land, thru. dense timber and undergrowth.  
Descend 65 ft., over E. slope.

14.00 Gulch, course E. Asc. 70 ft., over SE. slope.

28.00 Ridge, brs. N. and SW. Thence along top of ridge, descending slightly to

40.00 Set an iron post, 3 ft. long, 1 in. in diam., 24 ins. in the ground, for  $\frac{1}{4}$  sec. cor., marked on brass cap,

$\frac{1}{4}$   
S 11 | S 12  
1920

from which,  
A pine, 10 ins. in diam., brs. S. 72 $\frac{1}{2}$ ° E., 10 lks. dist., marked  $\frac{1}{4}$  S 12 BT.  
A pine, 10 ins. in diam., brs. N. 39° W., 10 lks. dist., marked  $\frac{1}{4}$  S 11 BT.

50.00 Continue along top of ridge, descending slightly.  
Leave top of ridge, brs. N. 5° E., and S. Desc. 91 ft., over W. slope, to

60.50 Ascend 126 ft. over W. slope.

70.30 Top of same ridge, brs. N. and S. 5° E. Thence along top of ridge, descending slightly to

80.00 Set an iron post, 3 ft. long, 2 ins. in diam., 20 ins. in the ground, supported in a mound of stone, for cor. of secs. 1, 2, 11 and 12, marked on brass cap,

12 Subdivision of part of Township 29 North, Range 9 West.

Chains.

T29N	R9 W.
S 2	S 1
S11	S12
1920	

from which,  
 A pine, 5 ins. in diam., brs. N. 42 $\frac{1}{2}$ ° E., 23 lks. dist., marked T29N R9W S1 BT.  
 A cedar, 6 ins. in diam., brs. S. 37 $\frac{1}{2}$ ° E., 77 lks. dist., marked T29N R9W S12 BT.  
 A pine, 6 ins. in diam., brs. S. 43 $\frac{1}{2}$ ° W., 70 lks. dist., marked T29N R9W S11 BT.  
 A cedar, 8 ins. in diam., brs. N. 47 $\frac{1}{2}$ ° W., 22 lks. dist., marked T29N R9W S2 BT.

Land, rolling.  
 Soil, rocky, 4th rate.  
 Timber, dense pine and cedar.  
 Undergrowth, dense chamisal, scrub oak and sagebrush.  
 No grass.

40.00 N. 89° 52' E., on a random line, bet. secs. 1 and 12.  
 Set temp.  $\frac{1}{4}$  sec. cor.  
 79.92 Fall 2 lks. S. of the cor. of secs. 1, 6, 7 and 12, on E. bdy. of Tp., described in Book "A."  
 Thence,  
 S. 89° 51' W., on a true line, bet. secs. 1 and 12.  
 Over mountainous land, thru. scattering timber and dense undergrowth.  
 Descend 263 ft., over NW. slope.  
 14.00 Gulch, course NE. Asc. 150 ft., over SE. slope.  
 25.00 Ridge, brs. NE. and SW. Desc. 50 ft., over NW. slope, to  
 39.50 Gulch, course NE. Ascend slightly to  
 39.96 Set an iron post, 3 ft. long, 1 in. in diam., 15 ins. in the ground to bed rock, supported in a mound of stone, for  $\frac{1}{4}$  sec. cor., marked on brass cap,

$\frac{1}{4}$	S 1
	S 12
	1920

from which,  
 A pine, 12 ins., brs. N. 64 $\frac{1}{2}$ ° E., 20 lks. dist., marked  $\frac{1}{4}$  S 1 BT.  
 A pine, 10 ins. in diam., brs. S. 14 $\frac{1}{2}$ ° W., 15 lks. dist., marked  $\frac{1}{4}$  S 12 BT.

45.00 Ascend 90 ft., over SE. slope, to  
 Ridge, brs. NE and SW. Descend slightly over NW. slope, to  
 49.40 Ascend 40 ft.; over N. slope, to  
 65.00 Desc. 130 ft., over NW. slope.  
 71.00 Gulch, course N. Asc. 20 ft., over NE. slope, to  
 79.92 The cor. of secs. 1, 2, 11 and 12, on top of ridge, bearing N. and S.  
 Land, mountainous.  
 Soil; rocky, 4th rate.  
 Timber, pine and cedar.  
 Undergrowth, chamisal, scrub oak, sage brush and manzanita.  
 No grass.

The greater part of the line, bet. secs. 1 and 2 falls on precipitous broken slopes, on E. or left wall of the Colorado River canyon, and renders the survey of the line impracticable.

From the standard cor. of secs. 34 and 35, on S. bdy. of Tp.

Chains

(7th. Std. Par. N.), hereinbefore described,  
N. 0° 01' W., bet. secs. 34 and 35.  
Over mountainous land, thru scattering timber and dense  
undergrowth.

12.00  
17.00  
28.00  
40.00

Ascend 115 ft., over SE. slope.  
Spur, slopes NE. Desc. 46 ft., over NE. slope, to  
Thence over E. slope, descending 60 ft. to  
Ascend 235 ft., over SE. slope, to  
Set an iron post, 3 ft. long, 1 in. in diam., over cross (x)  
marked on surface rock, and raise a mound of stone around  
post, for 1/4 sec. cor., marked on brass cap,

1/4  
S34 | S35  
1920

Continue over broken, mountainous land, thru scattering  
timber, and dense undergrowth.

63.60  
80.00

Ascend 130 ft., over SE. slope, to  
Thence over E. slope, ascending 45 ft. to  
Set an iron post, 3 ft. long, 2 ins. in diam., 24 ins. in  
the ground, for cor. of secs. 26, 27, 34 and 35, marked  
on brass cap,

T29N | R9W  
S27 | S26  
S34 | S35  
1920

from which,

- A cedar, 10 ins. in diam., brs. S. 11 1/2° E., 82 lks.  
dist., marked T29N R9W S35 BT.
- A cedar, 10 ins. in diam., brs. S. 17 1/2° W., 85 lks.  
dist., marked T29N R9W S34 BT.
- A pine, 18 ins. in diam., brs. N. 31 1/2° W., 98 lks.  
dist., marked T29N R9W S27 BT.

No tree available in sec. 26. No stone available.  
Dig a pit 18x18x12 ins. NE. of cor. 3 ft. dist.  
Land, mountainous.  
Soil, gravelly and rocky clay, 3rd and 4th rate.  
Timber, scattering pine, cedar and oak.  
Undergrowth, dense chemisal, scrub oak and sage brush.  
No grass.

40.00  
80.04

East, on a random line, bet. secs. 26 and 35.  
Set temp. 1/4 sec. cor.  
Fall 3 lks. N. of the cor. of secs. 25, 26, 35 and 36.  
Thence,  
N. 89° 59' W., on a true line, bet. secs. 26 and 35.  
Over rolling land, thru dense timber and undergrowth,  
along S. slope, on gently rolling top of spur, sloping  
E. from NW.

17.00  
20.70  
32.60  
40.02

Leave top of spur, and descend 22 ft. over SW. slope.  
Gully, course SE. Asc. 55 ft., over NE. slope, to  
Asc. 73 ft., over E. slope, to  
Set an iron post, 3 ft. long, 1 in. in diam., 20 ins. in  
the ground, supported in a mound of stone, for 1/4 sec.  
cor., marked on brass cap,

1/4 S 26  
S 35  
1920

from which,

- An oak, 10 ins. in diam., brs. N. 2 1/2° W., 96 lks:  
dist., marked 1/4 S 26 BT.

14 Subdivision of part of Township 29 North, Range 9 West.

Chains.

A cedar, 10 ins. in diam., brs. S.  $14\frac{1}{2}^{\circ}$ W., 32 lks. dist., marked  $\frac{1}{4}$  S 35 BT.  
 Ascend slightly over E. slope, to  
 41.50 Point of spur, slopes NE. Desc. 20 ft., over NW. slope.  
 44.00 Head of gully, course NE. Asc. 50 ft., over NE. slope, to  
 50.30 Gulch, course NE. Leave rolling, and enter mountainous land. Asc. 250 ft., over SE. slope, to  
 74.00 Gulch, course SE. Ascend 110 ft., over E. slope, to  
 80.04 The cor. of secs. 26, 27, 34 and 35.  
 Land, rolling and mountainous.  
 Soil, rocky clay, 4th rate.  
 Timber, dense pine, cedar and oak.  
 Undergrowth, dense scrub cedar, scrub oak, sage brush and chamisal.  
 No grass.

N.  $0^{\circ}01'$  W., bet. secs. 26 and 27.  
 Over mountainous land, thru. dense timber and undergrowth.  
 Ascend slightly over E. slope, to  
 8.00 Spur, slopes NE. Desc. 71 ft. over N. slope.  
 15.50 Head of gulch, course NW. Desc. 25 ft., over W. slope, to  
 40.00 Set an iron post, 3 ft. long, 1 in. in diam., 26 ins. in the ground, for  $\frac{1}{4}$  sec. cor., marked on brass cap;

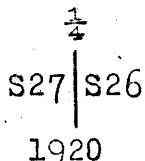

from which,  
 A pine, 10 ins. in diam., brs. N.  $42\frac{1}{2}^{\circ}$ E., 4 lks. dist., marked  $\frac{1}{4}$  S 26 BT.  
 A pine, 16 ins. in diam., brs. W., 5 lks. dist., marked  $\frac{1}{4}$  S 27 BT.  
 Desc. 170 ft., over broken NW. slope.  
 67.20 Gulch, course NE. Asc. 140 ft., over SE. slope, to  
 80.00 Set an iron post, 3 ft. long, 2 ins. in diam., 6 ins. in the ground, to bed rock, supported in a mound of stone, for cor. of secs. 22, 23, 26 and 27, marked on brass cap,

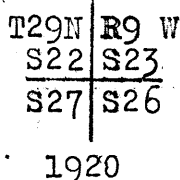

from which,  
 A pine, 10 ins. in diam., brs. N.  $82\frac{3}{4}^{\circ}$ E., 88 lks. dist., marked T29N R9W S23 BT.  
 A pine, 8 ins. in diam., brs. S.  $25^{\circ}$ E., 96 lks. dist., marked T29N R9W S26 BT.  
 A pine, 10 ins. in diam., brs. S.  $55^{\circ}$ W., 77 lks. dist., marked T29N R9W S27 BT.  
 A pine, 14 ins. in diam., brs. N.  $19\frac{1}{2}^{\circ}$ W., 63 lks. dist., marked T29N R9W S22 BT.  
 Land, mountainous.  
 Soil, rocky, 4th rate.  
 Timber, dense pine and cedar.  
 Undergrowth, dense chamisal, scrub oak and sage brush.  
 No grass.

S.  $89^{\circ}59'$  E., on a random line, bet. secs. 23 and 26.  
 40.00 Set temp.  $\frac{1}{4}$  sec. cor.  
 80.04 Fall 5 lks. S. of the cor. of secs. 23, 24, 25 and 26.  
 Thence,



Subdivision of part of Township 29 North, Range 9 West. 15

Chains.

S. 89°59'W., on a true line, bet. secs. 23 and 26.  
 Over rolling land, thru. scattering timber and dense undergrowth.  
 Ascend 220 ft., over E. slope.  
 19.30 Ridge, brs. N. and S. Leave rolling, and enter mountainous land. Desc. 100 ft., over W. slope.  
 26.80 Gulch, course N. Asc. 130 ft., over E. slope.  
 36.10 Ridge, brs. N. and S. Enter dense timber. Desc. 70 ft., over W. slope, to  
 40.02 Set an iron post, 3 ft. long, 1 in. in diam., 26 ins. in the ground, for 1/4 sec. cor., marked on brass cap,

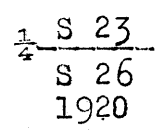

from which,  
 A yellow pine, 10 ins. in diam., brs. N. 31°E., 11 lks. dist., marked 1/4 S 23 BT.  
 A yellow pine, 10 ins. in diam., brs. S. 41 1/2°E., 13 lks. dist., marked 1/4 S 26 BT.

Desc. 40 ft., over W. slope.  
 41.50 Gulch, 10 lks. wide, course N. Asc. 115 ft., over E. slope.  
 49.50 Spur, slopes N. Desc. 55 ft., over NW. slope.  
 56.00 Ascend 25 ft., over NE. slope.  
 61.00 Spur, slopes NE. Desc. 290 ft., over NW. slope.  
 74.40 Bottom of ravine, course N. 30°W., general course NE. Asc. 165 ft., over E. slope, to  
 80.04 The cor. of secs. 22, 23, 26 and 27.  
 Land, rolling and mountainous.  
 Soil, rocky, 4th rate.  
 Timber, pine and cedar, scattering and dense.  
 Undergrowth, dense scrub cedar, chamisal and scrub oak.  
 No grass.

N. 0°01'W., bet. secs. 22 and 23.  
 Over mountainous land, thru. dense timber and undergrowth.  
 Ascend 130 ft., over SE. slope.

14.00 Ridge, brs. N. 20°E. and S. 20°W. Descend 180 ft., over NW. slope, to  
 40.00 Set an iron post, 3 ft. long, 1 in. in diam., on surface rock, supported in a mound of stone, for 1/4 sec. cor., marked on brass cap,

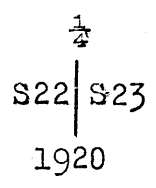

from which,  
 A pine, 10 ins. in diam., brs. S. 19 1/2°E., 13 lks. dist., marked 1/4 S 23 BT.  
 A pine, 10 ins. in diam., brs. S. 89 1/2°W., 84 lks. dist., marked 1/4 S 22 BT.

Descend 190 ft. over NW. slope.  
 47.50 Bottom of ravine, course NE. Asc. 334 ft., over SE. slope.  
 65.64 Spur, slopes NE. Desc. 170 ft., over NW. slope, to  
 80.00 Set an iron post, 3 ft. long, 2 ins. in diam., 18 ins. in the ground to bed rock, supported in a mound of stone for cor. of secs. 14, 15, 22 and 23, marked on brass cap,

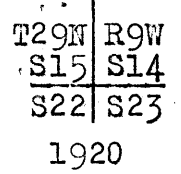

from which,

16 Subdivision of part of Township 29 North Range 9 West

Chains.

- A pine, 12 ins. in diam., brs. N. 79 $\frac{1}{4}$ ° E., 84 lks. dist., marked T29N R9W S14 BT.
- A pine, 10 ins. in diam., brs. S. 27 $\frac{1}{2}$ ° E., 46 lks. dist., marked T29N R9W S23 BT.
- A pine, 6 ins. in diam., brs. S. 6 $\frac{1}{4}$ ° W., 36 lks. dist., marked T29N R9W S22 BT.
- A pine, 8 ins. in diam., brs. N. 66° W., 9 lks. dist., marked T29N R9W S15 BT.

Land, mountainous.  
 Soil, rocky, 4th rate.  
 Timber, dense pine and cedar.  
 Undergrowth, dense chamisal, and scrub oak.  
 No grass.

- 40.00 N. 89° 59' E., on a random line, bet. secs. 14 and 23. Set temp.  $\frac{1}{4}$  sec. cor.
- 80.08 Fall 19 lks. S. of the cor. of secs. 13, 14, 23 and 24. Thence S. 89° 51' W., on a true line, bet. secs. 14 and 23. Over rolling land, thru. scattering timber and dense undergrowth. Ascend 60 ft., over E. slope.
- 10.00 E. edge of top of ridge, brs. N. and S. Thence over nearly level top of ridge:
- 15.00 W. edge of top of ridge, brs. N. and S. Leave rolling, and enter mountainous land and dense timber. Desc. 380 ft. over W. slope, to
- 40.04 Set an iron post, 3 ft. long, 1 in. in diam., 15 ins. in the ground, to bed rock, supported in a mound of stone, for  $\frac{1}{4}$  sec. cor., marked on brass cap,

$\frac{1}{4}$  S 14  
 S 23  
 1920

- from which,
- A pine, 6 ins. in diam., brs. N. 14 $\frac{1}{2}$ ° W., 66 lks. dist., marked  $\frac{1}{4}$  S 14 BT.
- A pine, 5 ins. in diam., brs. S. 18 $\frac{1}{4}$ ° W., 16 lks. dist., marked  $\frac{1}{4}$  S 23 BT.

- Descend 190 ft., over W. slope.
- 45.50 Bottom of ravine, course N. At junction of two ravines, one from the SE., and the other from the SW. Asc. 356 ft., over E. slope.
- 64.40 Spur, slopes NE. Desc. 110 ft., over NW. slope, to
- 80.08 The cor. of secs. 14, 15, 22 and 23. Land, rolling and mountainous. Soil, rocky, 4th rate. Timber, cedar, pine and oak, scattering and dense. Undergrowth, dense chamisal, scrub oak and sagebrush. No grass.

- N. 0° 01' W., bet. secs. 14 and 15. Over mountainous land, thru. dense timber and undergrowth. Descend 60 ft., over NW. slope.
- 2.90 Gulch, course NE. Ascend 130 ft., over SE. slope, to
- 11.00 Thence along E. slope, with slight change in elevation.
- 16.12 Descend 260 ft., over NW. slope.
- 25.40 Bottom of ravine, course NE. At about 5 chs. NE., the gulch, crossed at 2.90 ch. station joins this ravine from SE. Asc. 240 ft., over SE. slope, to
- 40.00 Set an iron post, 3 ft. long, 1 in. in diam., 5 ins. in the ground to bed rock, supported in a mound of stone for  $\frac{1}{4}$  sec. cor., marked on brass cap,

Chains.



from which,  
 A pine, 6 ins. in diam., brs. N. 71 $\frac{1}{2}$ ° E., 66 lks.  
 dist., marked  $\frac{1}{4}$  S 14 BT.  
 A pine, 8 ins. in diam., brs. S. 7 $\frac{1}{2}$ ° E., 20 lks.  
 dist., marked  $\frac{1}{4}$  S 15 BT.

At about 20 chs. N. of this cor., the line intersects the upper rim of the Colorado River Canyon, rendering continuation of survey impracticable. Therefore, discontinue the survey of this range of secs.

Land, mountainous.  
 Soil, rocky, 4th rate.  
 Timber, dense pine and cedar.  
 Undergrowth, dense chamisal, scrub oak and sagebrush.  
 No grass.

3.60  
 10.70  
 23.60  
 27.10  
 29.00  
 40.00

From cor. of secs. 26, 27, 34 and 35,  
 West, on a true line, bet. secs. 27 and 34.  
 Over mountainous land, thru. dense timber and undergrowth.  
 Ascend 15 ft., over E. slope.  
 Spur, slopes N. Descend 110 ft. over SW. slope.  
 Gulch, course N. near head. Ascend 46 ft., over E. slope, to  
 Thence across nearly level top of spur, sloping N.  
 Leave top of spur; descend 50 ft., over W. slope.  
 Gulch, course N. Asc. 85 ft., over E. slope, to  
 Set an iron post, 3 ft. long, 1 in. in diam., 24 ins. in  
 the ground, for  $\frac{1}{4}$  sec. cor., marked on brass cap,

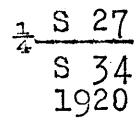

from which,  
 A yellow pine, 10 ins. diam., brs. N. 54 $\frac{1}{2}$ ° E., 21  
 lks. dist., marked  $\frac{1}{4}$  S 27 BT.  
 A yellow pine, 12 ins. in diam., brs. S. 5 $\frac{1}{2}$ ° E., 119  
 lks. dist., marked  $\frac{1}{4}$  S 34 BT.

About 20 chs. west of this cor., the line intersects the upper rim of the Colorado River canyon, rendering continuation of survey impracticable.

Land, mountainous.  
 Soil, rocky, 4th rate.  
 Timber, dense pine, cedar and oak.  
 Undergrowth, dense chamisal, locust, scrub oak, manzanita  
 and sage brush.  
 No grass.

8.40  
 27.15  
 35.90  
 40.00

From cor. of secs. 22, 23, 26 and 27,  
 West, on a true line, bet. secs. 22 and 27.  
 Over mountainous land, thru. dense timber and undergrowth.  
 Ascend 100 ft., over SE. slope.  
 Thence over nearly level top of ridge, bearing NE. and  
 SW.  
 Leave top of ridge; descend 215 ft., over NW. slope.  
 Gulch, course N. Asc. 95 ft., over E. slope, to  
 Set an iron post, 3 ft. long, 1 in. in diam., 9 ins. in  
 the ground, to bed rock, supported in a mound of  
 stone, for  $\frac{1}{4}$  sec. cor., marked on brass cap,

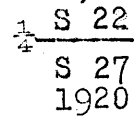

18 Subdivision of part of Township 29 North, Range 9 West.

Chains.

A pine, 10 ins. indiam., brs. N. 68° E., 58 lks. dist., marked 1/4 S 22 BT.  
A pine, 6 ins. in diam., brs. S. 34° E., 54 lks. dist., marked 1/4 S 27 BT.

About 12 chs. west of this cor., the line intersects the upper rim of the Colorado River Canyon, rendering continuation of survey impracticable.

Land, mountainous.

- Soil, rocky, 4th rate.
- Timber, dense pine, cedar, and oak.
- Undergrowth, dense chamisal, locust, scrub oak, manzanita and sage brush.
- No grass.

From cor. of secs. 14, 15, 22 and 23, West, on a true line, bet. secs. 15 and 22.

Over mountainous land, thru. scattering timber and dense undergrowth.

Descend 45 ft., over NW. slope.

2.00 Gulch, course NW. general course NE. Ascend 265 ft., over E. slope.

12.50 Spur, slopes NE. Desc. 166 ft., over W. slope.

22.60 Bottom of ravine, course NE. Ascend 150 ft., over SE. slope, to

40.00 Set an iron post, 3 ft. long, 1 in. in diam., 10 ins. in the ground to bed rock, deposit a stone marked with a cross (x) at base of post, and raise a mound of stone around post, for 1/4 sec. cor., marked on brass cap,

1/4 S 15  
S 22  
1920

About 12 chs. west of this cor., the line intersects the upper rim of the Colorado River canyon, rendering continuation of chaining impracticable.

Land, mountainous.

Soil, rocky, 4th rate.

Timber, scattering pine and cedar.

Undergrowth scrub oak, chamisal and sagebrush.

No grass.

The continued satisfactory adjustment of the solar apparatus during the survey of this township is indicated over from field tests, as described in Book No. and some

2.00

Boundaries of that portion of Township 29 North, Range 9 West, surveyed under Group No. 186.

Latitudes, Departures, and Closing Errors,

Line designated.	True bearing.	Dist.	Latitudes.		Departures.	
			N.	S.	E.	W.
South boundary, (7th. Std. Par. N.)	West,	160.00				160.00
Subdivisional boundary,	N. 0° 01' W.	240.00	240.00			
	N. 89° 51' E.	80.08	.21		80.08	.07
	N. 0° 01' W.	160.00	160.00			.05
	N. 89° 51' E.	79.92	.21		79.92	
East boundary,	South,	400.00		400.00		
Convergency,					.12	
<u>Totals.</u>			400.42	400.00	160.12	160.12
			400.00		160.12	
<u>Error in latitude,</u>			0.42			
<u>Error in departure,</u>					.00	

GENERAL DESCRIPTION.

The portion of T. 29 N., R. 9 W., surveyed as described in the foregoing field notes includes practically all of the surveyable area in said Tp. lying East of the Colorado River Canyon, the left upper rim of which extends N. and S. thru. secs. 22, 27, and 34 and NE. and SW. thru. secs. 1, 2, 11, 14 and 15.

The surface is rolling, broken and mountainous. Secs. 35 and 36, and parts of secs. 25, 26 and 34 drain into Diamond Creek canyon, course S. thru. the eastern part of T. 28 N., R. 9 W.

Secs. 13 and 24, and parts of secs. 12 and 25 drain into Prospect Valley, course NE, thru. the W. half of T. 29 N., R. 8 W.

The remainder of the surveyed area drains North, directly into Colorado River Canyon.

The soil is mostly a rocky clay, 4th rate.

The timber, consists of pine, cedar and oak in dense and scattering growths.

A dense undergrowth of sagebrush, chamisal, scrub oak, and manzanita is prevalent in all sections.

There is no grass, and no permanent running water.

There are no settlers, improvements, roads or evidence of valuable mineral deposits.

The surveyed portion of this township is in the Hualpai Indian Reservation.

4-680

BOOK 3512  
FIELD ASSISTANTS.

to Horace M. Muscott, U. S. Transitman

NAMES.	CAPACITY.
Robert R. Parsons,	1st chairman,
Francis R. Ihrie,	1st chairman,
J. B. Turner,	2nd chairman,
George Way,	cornerman,
J. S. Troy,	axman,
C. H. Hunt,	flagman.

BOOK 3512  
22

CERTIFICATE OF UNITED STATES TRANSITMAN

I, Horace M. Muscott, U. S. Transitman, hereby certify upon honor that, in pursuance of special instructions received from the U. S. Surveyor General, for Group 106, Arizona bearing date of the 25th day of February, 1920, I have well, faithfully, and truly in my own proper person, and in strict conformity with said instructions, the Manual of Surveying Instructions, and the laws of the United States, surveyed all those parts or portions of the Seventh Standard Parallel North, 6th Range 9 West, and of the North boundary, and Subdivision lines  
of Township 29 North, Range 9 West,

of the Gila and Salt River Base and Meridian, in the State of Arizona, which are represented in the foregoing field notes and by diagram on page 2 hereof as having been executed by me, and under my direction; and that all the corners of said survey have been established and perpetuated in strict accordance with the Manual of Surveying Instructions, and the special written instructions of the U. S. Surveyor General, for Group 106, Arizona and in the specific manner described in the field notes, and that the foregoing are the original field notes of such survey

Place Los Angeles, Calif  
Date July 11 1922

Horace M. Muscott  
U. S. Transitman

~~APPROVAL~~

~~OFFICE OF THE UNITED STATES SURVEYOR GENERAL,~~

~~101~~

The foregoing field notes of the survey of

executed by \_\_\_\_\_, under his special instructions dated \_\_\_\_\_, 191\_\_\_\_, having been critically examined, and the necessary corrections and explanations made, the said field notes, and the surveys they describe, are hereby approved.

\_\_\_\_\_  
U. S. Surveyor General.

I certify that the foregoing transcript of the field notes of the above-described surveys in \_\_\_\_\_, has been correctly copied from the original notes on file in this office.

\_\_\_\_\_  
U. S. Surveyor General.





24  
BOOK 3512

CERTIFICATE OF UNITED STATES CADASTRAL ENGINEER.

I, Guy Redwine, U. S. Cadastral Engineer, hereby certify upon honor that, in pursuance of special instructions received from the U. S. Surveyor General, for Group 106, Arizona bearing date of the 25th day of February, 1920, I have well, faithfully, and truly in my own proper person, and in strict conformity with said instructions, the Manual of Surveying Instructions, and the laws of the United States, surveyed all those parts or portions of the Subdivision lines of

Township 29 North, Range 9 West,

of the Gila and Salt River

Base and Meridian, in the State of Arizona, which are represented in and by diagram on page 2 hereof the foregoing field notes as having been executed by me, and under my direction; and that all the corners of said survey have been established and perpetuated in strict accordance with the Manual of Surveying Instructions, and the special written instructions of the U. S. Surveyor General, for Group 106, Arizona and in the specific manner described in the field notes, and that the foregoing are the original field notes of such survey.

Place Wheeler California  
Date June 24, 1922

Guy Redwine  
U. S. Cadastral Engineer

APPROVAL.

OFFICE OF THE UNITED STATES SURVEYOR GENERAL,

Phoenix Arizona, August 7, 1922.

The foregoing field notes of the survey of the East 2 1/2 miles of the Seventh Standard Parallel North, within Range 9 West, of the East 1/2 mile of the North boundary, and of a portion of the Subdivision lines of Township 29 North, Range 9 West,  
of the Gila and Salt River Base and Meridian,  
in the State of Arizona,

executed by Guy Redwine, U.S. Cadastral Engineer, and Horace M. Musdott, U.S. Transitman, under special instructions dated February 25, 1920 for Group 106, Arizona, having been critically examined, and the necessary corrections and explanations made, the said field notes, and the surveys they describe, are hereby approved.

Frank D. Brett  
U. S. Surveyor General.

~~I certify that the foregoing transcript of the field notes of the above described surveys in~~  
~~has been correctly copied from the original notes on file in this office.~~

~~U. S. Surveyor General.~~