

ORIG

①

4-679

BOOK 3534

NE 27. 1920

Book "G"

Indexed

FIELD NOTES

OF THE SURVEY OF THE

North boundary,

the West boundary,

and the Subdivision lines of

Township 27 North, Range 8 West,

Of the Gila and Salt River Base and Meridian,

In the State of Arizona

EXECUTED BY

Quintin Campbell, U. S. Surveyor,

James H. Finley, U. S. Transitman, and

Kenneth W. Bond, U. S. Transitman,

In the capacity of U. S. Surveyors, under Special Instructions dated February 25, 1920, issued by the United States Surveyor General to govern surveys included in Group No. 107, Arizona, which were approved by the Commissioner of the General Land Office, March 8, 1920, and Assignment Instructions dated March 19 & 29, 1920

Survey commenced April 5, 1920

Survey completed June 8, 1920

3534

3534

3534

Book "G"

Group 107 - - Arizona.

BOOK 3534

INDEX DIAGRAM.

	Township 27 North		Range 8 West				
	14	13	12	11	10	10	
8	6 58	5 47	4 39	3 31	2 23	1	
	57	57	46	38	31	22	
7	7 56	8 46	9 37	10 30	11 21	12	
	55	55	45	37	29	21	
6	18 54	17 44	16 36	15 28	14 20	13	
	53	52	44	35	28	19	
4	19 52	20 43	21 35	22 27	23 18	24	
	51	51	42	34	26	18	
3	30 50	29 41	28 33	27 25	26 17	25	
	49	49	40	32	25	16	
3	31 48	32 39	33 32	34 24	35 16	36	

==== Lines surveyed under this Group.

----- Accepted surveys.



Areas surveyed as per accepted plats on file.

13

BOOK 3534

BOOK "G"

DATE DIAGRAM

TOWNSHIP 27 NORTH, RANGE 8 WEST,

	6-8-20	5-7-20	5-7-20	5-6-20	5-6-20	5-5-20	5-5-20
6-8-20	6	5	4	3	2	1	
6-7-20	5-24-20	5-15-20	5-4-20	5-3-20	5-3-20	4-9-20	
6-4-20	7	8	9	10	11	12	
6-3-20	5-22-20	5-11-20	5-1-20	4-30-20	4-30-20	4-8-20	
6-2-20	18	17	16	15	14	13	
5-28-20	5-19-20	5-10-20	5-1-20	4-28-20	4-15-20	4-7-20	
5-20-20	19	20	21	22	23	24	
5-19-20	5-18-20	5-8-20	5-7-20	4-27-20	4-14-20	4-6-20	
5-27-20	30	29	28	27	26	25	
5-14-20	5-14-20	5-7-20	5-6-20	4-26-20	4-13-20	4-5-20	
5-26-20	31	32	33	34	35	36	

See Book "A" for dates of execution of survey of this line.

See Book "D" for dates of execution of survey of this line.

Brown lines on above diagram indicate accepted surveys.

Black lines on above diagram indicate surveys executed by Quintin Campbell, U. S. Surveyor, on dates shown thereon.

Blue lines on above diagram indicate surveys executed by James H. Finley, U. S. Transitman, on dates shown thereon.

Red lines on above diagram indicate surveys executed by Kenneth W. Bond, U. S. Transitman, on dates shown thereon.

Chains.

Surveys hereinafter described, executed on dates shown on diagram on page 1 hereof, by Quintin Campbell, U.S. Surveyor, and James H. Finley and Kenneth W. Bond, U.S. Transitmen, Campbell using Young and Sons transit, No. 8491, and Finley and Bond using Young and Sons transit N. 8477, successively. Each instrument is equipped with full vertical circle, and the Smith solar attachment; unless otherwise specified, all azimuth determinations are accomplished with the solar attachments.

PRELIMINARY FIELD TESTS OF INSTRUMENTS BY CAMPBELL
AND FINLEY.

March 29, 1920. We examine the adjustment of each instrument, and correct all errors; then, to test the solar apparatus by comparing its indications from observations made during a.m. and p.m. hours with a meridian established by Polaris observation, proceed with each instrument as follows:

In camp, near the cor. of Ts. 27 and 28 N., Rs. 7 and 8 W., Gila and Salt River Base and Meridian, Arizona, in latitude $35^{\circ}40'10''$ N.; longitude, $113^{\circ}04'41''$ W., at 6h. 59.3m. p.m., l.m.t., observe Polaris at Western elongation, making four observations, two each with the telescope in direct and reversed positions, and mark the mean point in the line thus determined, on a peg driven firmly in the ground, 6 chs. N.

Azimuth of Polaris at Western elongation = $1^{\circ}22'41''$.

March 30, 1920. Lay off the azimuth of Polaris $1^{\circ}22\frac{1}{2}'$ to the east, and mark a point in the meridian thus determined by a tack in a peg driven firmly in the ground, 6 chs. N.

At 8h. 0m., a.m., l.m.t., set off $35^{\circ}40'$ N. on the lat. arc $3^{\circ}50'$ N. on the decl. arc, and determine a meridian with the solar, which agrees with the true meridian.

At app. noon, with the lat. arc unchanged, observe the sun on the meridian; the resulting reading of the decl. arc is $3^{\circ}53\frac{1}{2}'$ N., which agrees with the computed decl. of the sun.

At 4h. 0m. p.m., l.m.t., with the lat. arc unchanged, set off $3^{\circ}58'$ N. on the decl. arc, and determine a meridian with the solar, which agrees with the true meridian.

As all of the solar observations made with both instruments during the usual hours of solar work come within $1'30''$ of the true meridian, we conclude that the adjustments of the instrument are satisfactory.

Unless otherwise specified, all measurements are made with Lallie steel tapes, 2 and 5 chs. in length, compared with a Lufkin Standard steel tape, and found correct.

The measurements are made on the slope, the vertical angle determined, & the slope measurements properly reduced to true horizontal distances.

Chains.

From the cor. of Ts. 26 and 27 N., Rs. 8 and 9 W., described in Book "D,"
 North, on true line, bet. secs. 31 and 36.
 Over mountainous land, thru. dense timber and scattering undergrowth.
 Descend 40 ft. over NW. slope.
 6.50 Gully, 50 lks. wide, course SW.
 Ascend gradually over SW. slope.
 18.00 Gully, 10 lks. wide, course SW. Continue gradual ascent over SW. slope, to
 32.30 Gully, 20 lks. wide, course SW.
 Ascend 15 ft., over SE. slope, to
 40.00 Set an iron post, 3 ft. long, 1 in. in diam., 26 ins. in the ground, for $\frac{1}{4}$ sec. cor., marked on brass cap,

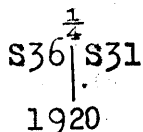

from which,

- A pine, 8 ins. in diam., brs. N. 53° E., 44 lks. dist., marked $\frac{1}{4}$ S 31 BT.
- A pine, 10 ins. in diam., brs. N. 58° W., 7 lks. dist., marked $\frac{1}{4}$ S 36 BT.

Descend slightly over E. slope, to
 42.50 Gully, 10 lks. wide, course SE.
 Ascend gradually over SE. slope, to
 46.90 Gully, 10 lks. wide, course SE.
 Ascend 30 ft., over SW. slope, to
 54.90 Same gully, 10 lks. wide, course SW.
 Ascend 60 ft., over S. slope.
 60.80 Spur, slopes SW.
 Descend 90 ft., over NW. slope.
 67.20 Gulch, 30 lks. wide, course SW.
 Ascend 180 ft., over SW. slope.
 78.00 Point of spur, slopes W.
 Descend gradually over NW. slope, to
 80.00 Set an iron post, 3 ft. long, 2 ins. in diam., 24 ins. in the ground, for cor. of secs. 25, 30, 31 and 36, marked on brass cap,

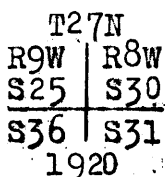

from which,

- A pine, 10 ins. in diam., brs. N. 53° E., 95 lks. dist., marked T27N R8W S30 BT.
- A pine, 8 ins. in diam., brs. S. 24 $\frac{1}{2}$ ° E., 33 lks. dist., marked T27N R8W S31 BT.
- A juniper, 10 ins. in diam., brs. S. 57° W., 92 lks. dist., marked T27N R9W S36 BT.
- A pine, 8 ins. in diam., brs. N. 55° W., 73 lks. dist., marked T27N R9W S25 BT.

Land, mountainous.
 Soil, rocky, 4th rate.
 Timber, dense juniper and pine.
 Undergrowth, scattering prickly ash and scrub oak.
 No grass.

 North, on true line, bet. secs. 25 and 30.
 Over mountainous land, thru. dense timber and scattering undergrowth.
 Descend 95 ft., over NW. slope.
 5.80 Gulch, 25 lks. wide, course W.
 Ascend 19 ft., over W. slope, to

A. West boundary of Township 27 North, Range 8 West.

Chains.

7.90 Gulch, 25 lks. wide, course SW.
Ascend 120 ft., over SW. slope.

14.60 Point of spur, slopes W. from NE.
Descend 140 ft. over NW. and W. slopes, to

30.60 Rocky gulch, 25 lks. wide, course W.
Ascend 120 ft., over SW. slope.

36.06 Point of spur, slopes W.
Descend 45 ft., over NW. slope, to

40.00 Set an iron post, 3 ft. long, 1 in. in diam., 26 ins. in
the ground, for $\frac{1}{4}$ sec. cor., marked on brass cap,

$\frac{1}{4}$
S25 | S30
1920

from which,
A pine, 14 ins. in diam., brs. N. 27° E., 63 lks.
dist., marked $\frac{1}{4}$ S 30 BT.
A pine, 8 ins. in diam., brs. S. 5 $\frac{1}{2}$ ° W., 231 lks.
dist., marked $\frac{1}{4}$ S 25 BT.

Ascend 18 ft., over SW. slope.

41.28 Descend 90 ft., over NW. slope, broken by cliffs and ledges.

52.00 Gulch, 25 lks. wide, course S. 25° W.
Ascend 210 ft., over steep broken S. slope, to

57.70 Top of cliffs, bearing E. and W. facing S.
Ascend 15 ft., over S. slope.

59.90 Descend 20 ft., over N. slope.

65.65 Gully, 25 lks. wide, course W.
Ascend 60 ft., over SW. slope, to

80.00 Set an iron post, 3 ft. long, 2 ins. in diam., 12 ins. in
the ground, to bedrock, and raise a mound of
stone around post, for cor. of secs. 19, 24, 25 and 30,
marked on brass cap,

T27N
R9W | R8W
S24 | S19
S25 | S30
1920

from which,
A juniper, 10 ins. in diam., brs. N. 57° E., 55 lks.
dist., marked T27N R8W S19 BT.
A pine, 8 ins. in diam., brs. S. 74° E., 43 lks. dist.,
marked T27N R8W S30 BT.
A pine, 16 ins. in diam., brs. S. 7° W., 45 lks.
dist., marked T27N R9W S25 BT.
A pine, 10 ins. in diam., brs. N. 75° W., 59 lks.
dist., marked T27N R9W S24 BT.

Land, mountainous.
Soil, rocky, 4th rate.
Timber, dense juniper and pine.
Undergrowth, scattering prickly ash and scrub oak.
No grass.

North, on true line, bet. secs. 19 and 24.
Over mountainous land, thru. dense timber and scattering
undergrowth.

4.43 Descend 34 ft., over NW. slope.
Gulch, 15 lks. wide, course W.
Ascend 38 ft., over SW. slope.

8.30 Descend 70 ft., over NW. slope, across cliffs and slide
rock, to

18.30 South or left rim of canyon, brs. E. and SW.

24.35 Descend 313 ft., over precipitous NW. slope, to

Chains.

24.85

Bottom of canyon, 50 lks.wide, course W.
The ascent over the N.wall of this canyon is too rough and broken to permit chaining; therefore, triangulate measurement as described as follows, and as shown on the diagram hereon:

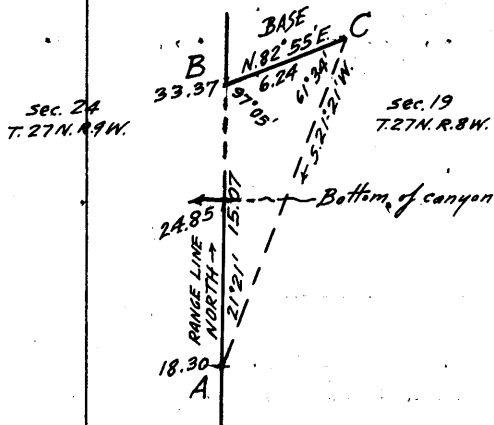

Set flag on Tp.bdy.at S.rim of canyon indicated on diagram at "A."

From point "B" on Tp.bdy. at N.rim.of canyon, measure a Base N.82°55'E., 6.24 chs.to point "C."

Bearing "C-A" = S.21°21'W.
Included angles.of triangle A-B-C are 21°21', 97°05' and 61°34', the sum of which is 180°00'.

Vertical angle from "B" to bottom of canyon is - 30°.

Triangulated measurement of "A-B" is obtained by $\frac{\text{sine } 61^{\circ}34' \times \text{Base}}{\text{sine } 21^{\circ}21'}$ or $\frac{.87937 \times 6.24}{.36406} = 15.07$ chs., which

added to 18.30 chs. gives 33.37 chs. North from cor. of secs. 19, 24, 25 and 30 for the position of triangulation point "B." at N. rim of canyon.

The triangulated measurement from bottom of canyon to the N. rim is therefore 33.37 chs. - 24.85 chs. = 8.52 chs. From bottom of canyon ascend 325 ft., over rough broken S. slope, to

33.37 Triangulation point. N. rim of canyon, brs. E. and W.

Continue line and measurement by chaining.

35.40 Ascend gradually, over S. slope, to Spur, slopes W.

Descend 65 ft., over N. slope, to

40.00 Set an iron post, 3 ft. long, 1 in. in diam., 26 ins. in the ground, for $\frac{1}{4}$ sec. cor., marked on brass cap,

$\frac{1}{4}$
S24 | S19
1920

from which,

A pine, 6 ins. in diam., brs. N.47°E., 28 lks. dist., marked $\frac{1}{4}$ S 19 BT.

A pine, 8 ins. in diam., brs. N.30 $\frac{1}{2}$ °W., 28 lks. dist., marked $\frac{1}{4}$ S 24 BT.

48.00 Descend 175 ft., over N. slope. Gulch, 25 lks.wide, course NW.

Ascend 50 ft., over SW. slope.

55.80 Point of spur, slopes W.

Descend 35 ft. over N. slope.

57.55 Gulch, 25 lks.wide, course NW.

Ascend 148 ft., over SW. slope.

63.10 Point of spur, slopes W.

Descend 200 ft., over steep NW. slope, to

72.32 Gulch, 10 lks.wide, course W.

Ascend 30 ft., over SW. slope, to

75.98 Gulch, 10 lks.wide, course SW.

Ascend 70 ft., over S. slope, to

80.00 Set an iron post, 3 ft. long, 2 ins. in diam., 24 ins. in the ground, for cor. of secs. 13, 18, 19 and 24, marked on brass cap,

T27N
R9W | R8W
S13 | S18
S24 | S19
1920

6 West boundary of Township 27 North, Range 8 West.

Chains.

- from which,
- A pine, 6 ins. in diam., brs. N. 85° E., 54 lks. dist., marked T27N R8W S18 BT.
- A pine, 6 ins. in diam., brs. S. 14° E., 35 lks. dist., marked T27N R8W S19 BT.
- A pine, 10 ins. in diam., brs. S. 25° W., 33 lks. dist., marked T27N R9W S24 BT.
- A pine, 8 ins. in diam., brs. N. 60° W., 75 lks. dist., marked T27N R9W S13 BT.

Land, mountainous.
 Soil, rocky, 4th rate.
 Timber, dense juniper and pine.
 Undergrowth, scattering scrub oak, and prickly ash.
 No grass.

North, on true line, bet. secs. 13 and 18.
 Over mountainous land, thru. dense timber and scattering undergrowth.

- Ascend slightly to
- 0.25 Point of spur, slopes W.
- Descend 17 ft., over N. slope.
- 2.08 Gulch, 10 lks. wide, course W.
- Ascend 60 ft., over SW. slope.
- 7.90 Point of spur, slopes N. 75° W.
- Descend 240 ft., over steep NW. slope.
- 18.77 Gulch, 50 lks. wide, course W.
- Ascend 255 ft., over steep SW. slope, to
- 33.76 Top of red cliff on line, 10 ft. high, 70 ft. long, bearing NW. and SE., facing SW.
- Ascend 60 ft., over S. slope, to
- 40.00 Set an iron post, 3 ft. long, 1 in. in diam., 26 ins. in the ground, for $\frac{1}{4}$ sec. cor., marked on brass cap,

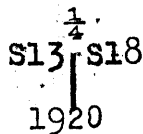

- from which,
- A pine, 12 ins. in diam., brs. N. 41° E., 46 lks. dist., marked $\frac{1}{4}$ S 18 BT.
- A pine, 10 ins. in diam., brs. N. 75° W., 27 lks. dist., marked $\frac{1}{4}$ S 13 BT.

- Ascend 12 ft., over S. slope.
 - 41.70 Ridge, brs. E. and W.
 - Descend 59 ft., over N. slope.
 - 44.04 Gulch, 25 lks. wide, course W.
 - Ascend 156 ft., over S. slope.
 - 50.40 Point of spur, slopes W.
 - Descend 60 ft., over NW. slope, to
 - 54.41 Top of cliffs, 100 ft. high, bearing E. and W. facing N., and forming the S. or left rim of a canyon, course W.
- Chaining being impracticable, triangulate the measurement across this canyon as described as follows, and as shown on the diagram hereon:

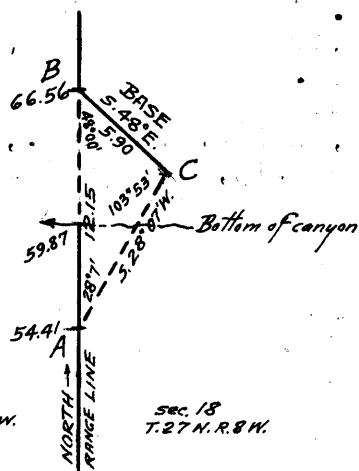

Set flag on Tp. bdy. at S. rim of canyon, indicated on diagram at "A".
 From a point on Tp. bdy. on opposite side of canyon, indicated at "B," measure a Base S. 48° E., 5.90 chs. to point "C."
 Bearing "C-A" = S. 28° 7' W.
 Included angles of triangle "A-B-C" are 28° 7', 48° 00' and 103° 53', the sum of which is 180° 00'.

Sec. 13 T27N. R. 9W.

Sec. 18 T. 27 N. R. 8 W.

Chains.

Triangulated measurement on Tp.bdy. is obtained by
 $\frac{\text{side } 103^{\circ}53' \times \text{Base}}{\text{side } 28^{\circ}7'}$ or $\frac{.97079 \times 5.90}{.47127} = 12.15 \text{ chs.},$

which, added to 54.41 chs. gives 66.56 chs. N. from the cor. of secs. 13, 18, 19 and 24 for the position of the triangulation point "B" on N. side of canyon.

Vertical angle from point "A" to bottom of canyon = - 43°
 Vertical angle from point "B" to bottom of canyon = - 39°
 Vertical angle from point "A" to point "B" = - 6°.

By computation of the above vertical angles, the position of the bottom of the canyon is determined together with the difference in elevation between the triangulation points "A" and "B", and the bottom of the canyon.

- 59.87 From 54.41 ch. station on S. rim of canyon, Descend 336 ft. over cliffs and slide rock, to Bottom of canyon, 50 lks. wide, course W.
- 66.56 Ascend 252 ft., over steep broken S. slope, to Triangulation point on top of spur, sloping W. Continue line and measurement by chaining.
- 77.46 Descend 185 ft., over steep broken N. slope. Gulch, 20 lks. wide, course W.
- 80.00 Ascend 30 ft., over SW. slope, to Set an iron post, 3 ft. long, 2 ins. in diam., 24 ins. in the ground, for cor. of secs. 7, 12, 13 and 18, marked on brass cap,

T27N
 R9W | R8W
 S12 | S 7
 S13 | S18
 1920

from which,

- A pine, 8 ins. in diam., brs. N. 80° E., 75 lks. dist., marked T27N R8W S7 BT.
- A pine, 10 ins. in diam., brs. S. 5° E., 40 lks. dist., marked T27N R8W S18 BT.
- A pine, 8 ins. in diam., brs. S. 80° W., 48 lks. dist., marked T27N R9W S13 BT.
- A pine, 6 ins. in diam., brs. N. 71° W., 33 lks. dist., marked T27N R9W S12 BT.

Land, mountainous.
 Soil, rocky, 4th rate.
 Timber, dense juniper and pine.
 Undergrowth, scattering prickly ash and scrub oak.
 No grass.

-
- 4.90 North, on true line, bet. secs. 7 and 12. Over mountainous land, thru dense timber and scattering undergrowth. Ascend 29 ft., over SW. slope. Point of spur, slopes NW.
 - 10.00 Descend 80 ft., over N. slope. Gulch, 10 lks. wide, course W.
 - 18.70 Ascend 80 ft., over SW. slope. Spur, slopes NW.
 - 27.60 Descend 170 ft., over N. slope, to Top of cliffs, 50 ft. high, bearing NW. and SE., facing NE.
 - 32.00 Descend 150 ft., over NE. slope, to Bottom of canyon, 100 lks. wide, course W.
 - 40.00 Ascend 210 ft., over SE. slope, to Set an iron post, 3 ft. long, 1 in. in diam., 26 ins. in the ground, for $\frac{1}{4}$ sec. cor., marked on brass cap,

$\frac{1}{4}$
 S12 | S 7
 1920

8 West boundary of Township 27 North, Range 8 West.

Chains.

from which,
 A pine, 10 ins. in diam., brs. S. 18° W., 98 lks.
 dist., marked $\frac{1}{2}$ S 12 BT.
 A juniper, 20 ins. in diam., brs. S. 38° E., 28 lks.
 dist., marked $\frac{1}{2}$ S 7 BT.
 Descend 135 ft., over N. slope.
 46.95 Rocky gulch, 10 lks. wide, course NW.
 Ascend gradually over W. slope, to
 52.00 Gulch, 20 lks. wide, course SW.
 Ascend slightly over SW. slope, to
 53.55 Gulch, 20 lks. wide, course SW.
 Ascend 25 ft., over SW. slope, to
 56.50 Gulch, 25 lks. wide, course S. 15° W. from N. Thence in
 bottom of gulch, ascending 98 ft., to
 63.80 Leave gulch, course S. from NE.
 Ascend 184 ft., over S. slope.
 73.10 Spur, slopes W. and SW.
 Descend 60 ft., over N. slope.
 78.60 Gulch, 20 lks. wide, course W.
 Ascend 30 ft., over SW. slope, to
 80.00 Set an iron post, 3 ft. long, 2 ins. in diam., 12 ins. in
 the ground to bed rock, and raise a mound of stone
 around post, for cor. of secs. 1, 6, 7 and 12, marked on
 brass cap,

T27N	
R9W	R8W
S 1	S 6
S12	S 7
1920	

from which,
 A pine, 8 ins. in diam., brs. N. 44° E., 64 lks.
 dist., marked T27N R9W S6 BT.
 A pine, 6 ins. in diam., brs. S. 45° E., 22 lks.
 dist., marked T27N R8W S7 BT.
 A pine, 10 ins. in diam., brs. S. 85 $\frac{1}{2}$ ° W., 47 lks.
 dist., marked T27 N. R9W S12 BT.
 A pine, 12 ins. in diam., brs. N. 22° W., 50 lks.
 dist., marked T27N R9W S1 BT.

Land, mountainous.
 Soil, rocky, 4th rate.
 Timber, dense juniper and pine.
 Undergrowth, scattering prickly ash and scrub oak.
 No grass.

North, on true line, bet. secs. 1 and 6.
 Over mountainous land, thru. dense timber and scattering
 undergrowth.
 Ascend 23 ft., over steep S. slope.
 .96 Spur, slopes W.
 Descend 22 ft., over N. slope.
 6.90 Rocky gulch, 50 lks. wide, course W.
 Ascend 60 ft., over SW. slope, to
 11.83 Rocky gulch, 25 lks. wide, course SW. Heads at foot of
 cliffs, 10 chs. NE.
 Ascend 265 ft., over steep broken SW. slope, to
 26.30 Descend 16 ft., over N. slope.
 28.20 Gulch, 25 lks. wide, course W., heads at foot of cliffs 5
 chs. E.
 Ascend 50 ft., over SW. slope, to
 32.23 Foot of steep cliffs 400 ft. high, brs. N. and SE., facing
 W.
 Thence along foot of cliffs, ascending 25 ft. to
 39.00 Continue along foot of cliffs, descending 67 ft. to
 40.00 Set an iron post, 3 ft. long, 1 in. in diam., 26 ins. in
 the ground, for $\frac{1}{4}$ sec. cor., marked on brass cap,

chains.

S 1 1/4 S 6

1920

from which,

A pine, 10 ins. in diam., brs. N. 34° E., 62 lks.
dist., marked 1/4 S 6 BT.

A pine, 10 ins. in diam., brs. S. 78° W., 58 lks.
dist., marked 1/4 S 1 BT.

A cross (x) on foot of cliffs brs. N. 62 1/2° E., 30 lks.
dist., marked X B O S 6.

Continue along foot of high perpendicular cliffs at 50 lks.
W. therefrom.

60.20 Ascend 86 ft. over steep W. slope, to
Top of cliff, 50 ft. high, facing NW. Leave foot of cliffs
E. of line, which turn to NE. at this point.

63.40 Descend 205 ft., over steep broken NW. slope.

Gulch, 50 lks. wide, course SW.

76.60 Ascend 105 ft., over S. slope.

Spur, slopes W.

80.00 Descend 100 ft., over NW. slope to Tp. cor.

Set temp. Tp. cor.

80.55 Intersect the N. bdy. of T. 27 N., R. 8 W., surveyed due
west, as hereinafter described.

At point of intersection, set an iron post 3 ft. long, 3
ins. in diam., 26 ins. in the ground, in slide-rock,
for cor. of T. 27 and 28 N., R. 8 and 9 W., marked on
brass cap,

T28N	
R9W	R8W
S36	S31
S 1 1/4 S 6	
T27N	
1920	

from which,

A pine, 10 ins. in diam., brs. N. 75° E., 154 lks.
dist., marked T28N R8W S31 BT.

A pine, 8 ins. in diam., brs. S. 8° E., 64 lks.
dist., marked T27N R8W S6 BT.

A pine, 20 ins. in diam., brs. S. 14° W., 57 lks.
dist., marked T27N R9W S1 BT.

A pine, 6 ins. in diam., brs. N. 54° W., 42 lks.
dist., marked T28N R9W S36 BT.

Land, mountainous.

Soil, gravelly and rocky, 4th rate.

Timber, dense juniper and pine.

Undergrowth, scattering prickly ash and scrub oak.

No grass.

10. Survey of North bdy. of Township 27 North, Range 8 West.

Chains.

From the cor. of Ts. 27 and 28 N., Rs. 7 and 8 W., described in Book "A,"

West, on true line, bet. secs. 1 and 36.

Over level land, thru. scattering undergrowth, in basin known as "Aubrey Flats."

1.30 Gully, 6 ft. deep, 15 lks. wide, course SW.

5.50 Gully 3 ft. deep, 18 lks. wide, course SE.

26.50 Gully 3 ft. deep, 6 lks. wide, course SE.

30.70 Road NW. and SE.

40.00 West edge of Aubrey Flats, brs. NW. and SE. Set an iron post 3 ft. long, 1 in. in diam., 26 ins. in the ground, for $\frac{1}{4}$ sec. cor., marked on brass cap,

$\frac{1}{4}$ S 36
S 1
1920

from which,

A juniper, 34 ins. in diam., brs. N. $10\frac{1}{4}^\circ$ E., 260 lks. dist., marked $\frac{1}{4}$ S 36 BT.

and dig pits, 18x18x12 ins., one each E. and W. of post, 3 ft. dist.

Leave level, and enter gently rolling land.

Ascend 85 ft., over E. slope.

48.00 Enter scattering timber, brs. N. and S.

59.90 Spur, slopes NE.

Descend 48 ft., over NW. slope.

77.35 Draw, 50 lks. wide, course NE.

Ascend 32 ft., over SE. slope, to

80.00 Set an iron post, 3 ft. long, 2 ins. in diam., 6 ins. in the ground to bed rock; deposit a stone marked with a cross (x) at base of post, and raise a mound of stone around post, for cor. of secs. 1, 2, 35 and 36, marked on brass cap,

T28N | R8 W
S35 | S36
S 2 | S 1
T27N
1920

from which,

A juniper, 12 ins. in diam., brs. N. 86° E., 136 lks. dist., marked T28N R8W S36 BT.

A pine, 36 ins. in diam., brs. S. 54° E., 284 lks. dist., marked T27N R8W S1 BT.

A pine, 24 ins. in diam., brs. S. 4° W., 190 lks. dist., marked T27N R8W S2 BT. No other trees available.

Land, E. $\frac{1}{2}$ level; W. $\frac{1}{2}$ gently rolling.

Soil, E. $\frac{1}{2}$ sandy and gravelly clay, 1st and 2nd rate; W. $\frac{1}{2}$ gravelly and rocky, 3rd rate.

Timber, scattering juniper and pine in W. 32 chs. No timber in E. 48 chs.

Undergrowth, scattering sagebrush and prickly ash in W. $\frac{1}{2}$; scattering sagebrush in E. $\frac{1}{2}$.

Good grass in E. $\frac{1}{2}$. Fair grass in W. $\frac{1}{2}$.

West, on true line, bet. secs. 2 and 35.

Over rolling land, thru. scattering timber and dense undergrowth.

Ascend 18 ft., over SE. slope.

2.30 Descend 23 ft., over SW. slope.

7.30 Ascend 40 ft., over NE. slope.

16.50 Point of spur, slopes NW.

Descend 52 ft., over W. slope.

21.40 Draw, 50 lks. wide, course N.

Ascend 25 ft., over NE. slope.

26.40 Descend 25 ft., over NW. slope.

North boundary of Township 27 North, Range 8 West. 11

Chains.

31.30 Draw, 20 lks.wide, course NE.
Ascend 68 ft., over E.slope, to
40.00 Set an iron post, 3 ft.long, 1 in. in diam., 26 ins.in the
ground, for 1/4 sec.cor., marked on brass cap,

1/4 S 35
S 2
1920

from which,
A pine, 36 ins. in diam., brs.S.63 1/4°E., 116 lks.
dist., marked 1/4 S 2 BT.
An oak, 6 ins. in diam., brs.N.35°W., 211 lks.
dist., marked 1/4 S 35 BT.

47.50 Ascend 85 ft., over NE.slope, to
Leave scattering, and enter dense timber.
Descend 30 ft., over NW.slope.

51.30 Draw, 30 lks.wide, course NE.
Ascend 45 ft., over NE.slope.

57.86 Descend 16 ft., over N.slope.

62.86 Ascend 73 ft., over NE.slope, to

76.50 Spur, slopes S.80°E.

Ascend slightly along S. slope, near top of spur.

80.00 Set an iron post, 3 ft.long, 2 ins. in diam., 24 ins.in
the ground, for cor.of secs.2,3, 34 and 35, marked on
brass cap,

T28N | R8 W
S34 | S35
S 3 | S 2
T27N
1920

from which,
A pine, 12 ins. in diam., brs.N.69°E., 76 lks.
dist., marked T28N R8W S35 BT.
A pine, 12 ins. in diam., brs.S.89°E., 71 lks.
dist., marked T27N R8W S2 BT.
A pine, 14 ins. in diam., brs.S.25 3/4°W., 57 lks.
dist., marked T27N R8W S3 BT.
A pine, 12 ins. in diam., brs.N.24 1/2°W., 33 lks.
dist., marked T28N R8W S34 BT.

Land, rolling.
Soil, sandy and gravelly clay loam, 2nd and 3rd rate.
Timber, juniper and pine, scattering in E. 47 1/2 chs.; dense
in W. 32 1/2 chs.
Undergrowth, dense sagebrush, prickly ash and scrub juniper.
Fair grass.

West, on true line, bet. secs.3 and 34.
Over roughly rolling land, thru. dense timber and under-
growth.

Ascend 27 ft., along S.slope, near top of spur in bend
of same from SW. to SE.

10.00 Top of spur, slopes NE. for about 150 lks., thence E.
Descend 33 ft., over NW.slope.

14.76 Ascend 70 ft., over NE.slope.

17.55 Road, brs.NW. and SE. At about 3 chs.NW., this road turns
to NE.

29.60 Descend 25 ft., over NW.slope.

34.60 Gully, 20 lks.wide, course NE.

Ascend 15 ft., over E.slope, to

40.00 Set an iron post, 3 ft.long, 1 in. in diam., 26 ins.in
the ground, for 1/4 sec.cor., marked on brass cap,

1/4 S 34
S 3
1920

from which,
A pine, 10 ins. in diam., brs.S.61 1/2°E., 29 lks.
dist., marked 1/4 S 3 BT.

12 North boundary of Township 27 North, Range 8 West.

Chains.

A pine, 8 ins. in diam., brs. N. 19° W., 50 lks. dist., marked $\frac{1}{4}$ S 34 BT.

Leave tolling, and enter mountainous land.

Ascend 62 ft., over E. slope.

46.50 Spur, slopes NE. from S.

Descend 33 ft., over NW. slope.

48.90 Head of gully, course N.

Ascend 75 ft., over E. slope.

59.20 Point of spur, slopes NE.

Descend 110 ft., over W. slope.

63.00 Draw, 70 lks. wide, course N., near head.

Ascend 12 ft., over NE. slope.

65.00 Descend 42 ft., over NW. slope.

71.80 Gulch, 20 lks. wide, course N. near head.

Ascend 44 ft., over NE. slope.

74.54 Descend 25 ft., over NW. slope.

76.70 Gulch, 20 lks. wide, course NE.

Ascend 25 ft., over SE. slope, to

80.00 Set an iron post 3 ft. long, 2 ins. in diam., 6 ins. in the ground, to bedrock, and raise a mound of stone around post, for cor. of secs. 3, 4, 33 and 34, marked on brass cap,

T28N R8 W.
 S33 S34
 S 4 S 3
 T27N
 1920

from which,

A pine, 15 ins. in diam., brs. N. 28° E., 17 lks. dist., marked T28N R8W S34 BT.

A pine, 18 ins. in diam., brs. S. 72 $\frac{1}{4}$ ° E., 32 lks. dist., marked T27N R8W S3 BT.

A pine, 10 ins. in diam., brs. S. 11 $\frac{3}{4}$ ° W., 36 lks. dist., marked T27N R8W S4 BT.

A pine, 18 ins. in diam., brs. N. 62° W., 52 lks. dist., marked T28N R8W S33 BT.

Land, E. $\frac{1}{2}$, roughly rolling; W. $\frac{1}{2}$ mountainous.

Soil, gravelly and rocky, 3rd rate,

Timber, dense juniper and pine,

Undergrowth, dense sagebrush, prickly ash and scrub juniper.

Fair grass.

West, on true line, bet. secs. 4 and 33.

Over mountainous land, thru. dense timber and undergrowth.

Ascend 110 ft., over SE. and E. slopes.

11.35 Spur, slopes SE.

Descend 50 ft., over SW. slope.

22.80 Head of draw, course S. Asc. 155 ft., over E. slope.

25.90 A pine, 18 ins. in diam., on line, marked with 2 notches on E. and W. faces.

35.65 Spur, slopes NE.

Descend 55 ft., over NW. slope, to

40.00 Set an iron post, 3 ft. long, 1 in. in diam., 26 ins. in the ground, for $\frac{1}{4}$ sec. cor., marked on brass cap,

$\frac{1}{4}$ S 33
 S 4
 1920

from which,

A pine, 14 ins. in diam., brs. S. 27° E., 65 lks. dist., marked $\frac{1}{4}$ S 4 BT.

A pine, 24 ins. in diam., brs. N. 452° W., 21 lks. dist., marked $\frac{1}{4}$ S 33 BT.

Descend 93 ft., over NW. slope.

43.28 Enter tall pines, brs. N. and S.

44.40 Gulch, 20 lks. wide, course N. A seep spring in bottom of this gulch, about 40 chs. N.

Ascend 64 ft., over NE. slope.

North boundary of Township 27 North Range 8 West 13

Chains.
 57.30
 60.55
 67.00
 73.28
 75.70
 80.00

6.40
 16.60
 30.00
 35.30
 40.00

45.10
 53.00
 57.00
 71.60
 76.80
 80.00

Descend 26 ft., over NW.slope.
 Draw, 30 lks.wide, course N.10°E.,
 Ascend slightly over NE.slope, to
 Draw, 70 lks.wide, course NE.
 Ascend 60 ft., over SE.slope.
 Descend 8 ft., over SW.slope.
 Gully, 10 lks.wide, course SE.
 Ascend 63 ft., over E.slope, to
 Set an iron post, 3 ft.long, 2 ins. in diam., 24 ins.in
 the ground, for cor.of secs.4,5, 32 and 33, marked on
 brass cap,

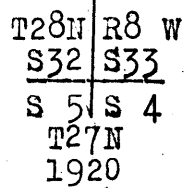

- from which,
- A pine, 8 ins.in diam., brs.N.48 $\frac{1}{2}$ °E., 90 lks.
dist., marked T28N R8W S33. BT.
 - A pine, 10 ins. in diam. brs.S.72°E., 22 lks.
dist., marked T27N R8W S4 BT.
 - A pine, 12 ins.in diam., brs. S.38 $\frac{1}{2}$ °W., 72 lks.
dist. marked T27N R8W S5 BT.
 - A pine, 8 ins. in diam. brs.N.63°W., 17 lks.
dist., marked T28N R8W S32 BT.

Land, mountainous.
 Soil, sandy, gravelly and rocky, 3rd. rate.
 Timber, dense juniper and pine.
 Undergrowth, dense scrub juniper, prickly ash and scrub
 oak.
 Fair grass.

West, on true line, bet. secs.5 and 32.
 Over mountainous land, thru. dense timber and undergrowth.
 Ascend 95 ft. over E.slope,
 Spur, slopes SE.
 Descend 130 ft., over SW. alope.
 Gulch, 20 lks.wide, course S.
 Ascend 145 ft., over E. and NE., slopes
 Point of spur, slopes NW.
 Descend 103 ft., over W.slope.
 Gulch, 10 lks. wide, course N.
 Ascend 67 ft., over NE.slope, to
 Point of spur, slopes N. Set an iron post 3 ft.long, 1
 in. in diam., 26 ins. in the ground, for $\frac{1}{4}$ sec.cor.,
 marked on brass cap,

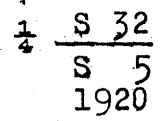

- from which,
- A pine, 26 ins. in diam., brs.N.45°E., 128 lks.
dist., marked $\frac{1}{4}$ S 32 BT.
 - A pine, 20 ins. in diam., brs.S.27°E., 73 lks.
dist., marked $\frac{1}{4}$ S 5 BT.

Descend 93 ft., over NW. slope.
 Gulch, 100 lks.wide, course NE.
 Ascend 100 ft., over E.slope.
 Point of spur, slopes SE. Thence along S.slope of same,
 near top.
 Descend 20 ft., to
 Ascend 70 ft., over S. and SE. slopes to
 Top of same spur, slopes N85°E. from S.
 Descend 50 ft., over W.slope.
 Gulch, 20 lks.wide, course N.10°W.
 Ascend 20 ft., over N.slope, to
 Set an iron post, 3 ft.long, 2 ins. in diam., 24 ins.in
 the ground, for cor.of secs.5, 6, 31 and 32, marked on

14 North boundary of Township 27 North Range 8 West.

Chains.

brass cap,

T28N	R8 W.
S31	S32
S 6	S 5
T27N	
1920	

from which,

- A pine, 12 ins. in diam., brs. N. $84\frac{1}{4}^\circ$ E., 67 lks. dist., marked T28N R8W S32 BT.
- A pine, 10 ins. in diam., brs. S. $44\frac{3}{4}^\circ$ E., 63 lks. dist., marked T27N R8W S5 BT.
- A pine, 15 ins. in diam., brs. S. 75° W., 86 lks. dist., marked T27N R8W S6 BT.
- A pine, 8 ins. in diam., brs. N. $80\frac{1}{2}^\circ$ W., 95 lks. dist., marked T28N R8W S31 BT.

Land, mountainous.

Soil, gravelly black clay, 2nd rate.

Timber, dense juniper and pine.

Undergrowth, dense prickly ash, scrub juniper and sage brush.

Fair grass.

West, on true line, bet. secs. 6 and 31.

Over mountainous land, thru. dense timber and scattering undergrowth.

2.50 Gully, 10 lks. wide, course NE.

Ascend 225 ft., over NE. slope, to $\frac{1}{4}$ sec. cor.

17.97 Enter dense undergrowth.

40.00 Set an iron post 3 ft. long, 1 in. in diam., 6 ins. in the ground to bed rock, and raise a mound of stone around post, for $\frac{1}{4}$ sec. cor., marked on brass cap,

$\frac{1}{4}$	S 31
	S 6
	1920

from which,

- A pine, 12 ins. in diam., brs. S. $32\frac{1}{4}^\circ$ E., 38 lks. dist., marked $\frac{1}{4}$ S 6 BT.
- A pine, 14 ins. in diam., brs. N. $20\frac{1}{2}^\circ$ W., 53 lks. dist., marked $\frac{1}{4}$ S 31 BT.

Ascend 10 ft., over E. slope.

43.80 Top of divide, brs. N. and S.

Descend 145 ft., over W. slope.

46.10 A pine, 14 ins. in diam., on line marked with 2 notches on E. and W. faces.

56.40 Gulch, 10 lks. wide, course SW. near head.

Descend 217 ft., over SW. slope, to

69.14 Top of high, nearly perpendicular cliffs, bearing N. and S., facing W. It being impracticable to continue chaining, triangulate the measurement to Tp. cor., as described as follows, and as shown on the diagram hereon:

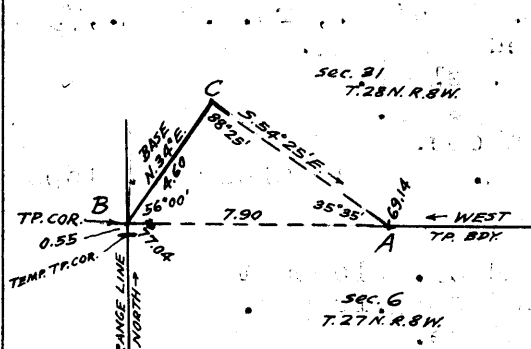

Leave flag at top of cliffs indicated on diagram at "A."

From a point "B," which is 55 lks. N. of the temp. cor. of T_s. 27 and 28 N., R_s: 8 and 9 W., the flag at "A" bears East.

From "B" measure a Base N. 34° E., 4.60 chs. to point "C."

Bearing "C-A" = S. $54^\circ 25'$ E.

Included angles of triangle "A-B-C" are $35^\circ 35'$, 56° and $88^\circ 25'$, the sum of which is $180^\circ 00'$.

North boundary of Township 27 North, Range 8 West. 15

Chains.

Triangulated measurement "A-B" is obtained by
 $\frac{\text{sine } 88^{\circ}25' \times \text{Base}}{\text{sine } 35^{\circ}35'}$ or $\frac{.99962 \times 4.60}{.58189} = 7.90$ chs., which

added to 69.14 chs., gives 77.04 chs. W. from the cor.
 of secs. 5, 6, 31 and 32 for the position of the inter-
 section of the North bdy. with the West bdy. of the Tp.,
 at which point establish the Tp. cor., as hereinbefore
 described.

The vertical angle from "B" to "A" is $+ 40^{\circ}$; therefore,
 the Tp. cor. is 437 ft. below the top of cliffs at
 69.14 ch. station,

77.04 Intersect the cor. of Ts. 27 and 28 N., Rs. 8 and 9 W., herein-
 before described.

Land, mountainous.

Soil, E. half, gravelly black clay, 2nd rate; W. $\frac{1}{2}$ gravelly
 and rocky, 3rd and 4th rate.

Timber, dense juniper and pine.

Undergrowth, prickly ash and scrub oak, dense and scat-
 tering.

Fair grass in E. $\frac{1}{2}$.

No grass in W. $\frac{1}{2}$.

16 Survey of Subdivision lines of Township 27 North Range 8 West

Chains.

From the cor. of secs. 1, 2, 35 and 36, on the S. bdy. of the Tp. described in Book "D."

N. 0° 1' W., bet. secs. 35 and 36.

Over roughly rolling land, thru. scattering timber and dense undergrowth.

Descend slightly over NW. slope.

.90 Gulch, 20 lks. wide, course N. 20° E.

Ascend 55 ft., over rocky S. slope.

27.40 Point of spur, slopes E.

Descend 90 ft., over NE. slope.

38.70 Gulch, 50 lks. wide, course SE.

Ascend 33 ft., over S. slope to 1/4 sec. cor.

39.00 Leave scattering, and enter dense timber.

40.00 Set an iron post, 3 ft. long, 1 in. in diam., 26 ins. in the ground, for 1/4 sec. cor., marked on brass cap,

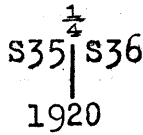

from which,

A pine, 8 ins. in diam., brs. S. 76 3/4° E., 72 lks. dist., marked 1/4 S 36 BT.

A pine, 6 ins. in diam., brs. N. 10 3/4° W., 60 lks. dist., marked 1/4 S 35 BT.

Leave roughly rolling, and enter gently rolling land.

Ascend 60 ft., over S. slope.

48.53 A juniper, 18 ins. in diam., on line, marked with 2 notches on each of N. and S. faces.

66.37 Spur, slopes SE. Leave dense, and enter scattering timber.

Descend 40 ft., over NE. slope, to

80.00 Set an iron post, 3 ft. long, 2 ins. in diam., 24 ins. in the ground, for cor. of secs. 25, 26, 35 and 36, marked on brass cap,

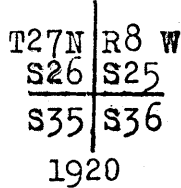

from which,

A juniper, 6 ins. in diam., brs. S. 64° E., 114 lks. dist., marked T27N R8W S36 BT.

A juniper, 5 ins. in diam., brs. S. 8 3/4° W., 111 lks. dist., marked T27N R8W S35 BT.

A juniper, 7 ins. in diam., brs. N. 66 1/2° W., 230 lks. dist., marked T27N R8W S26 BT.

and dig a pit, 18x18x12 ins., NE. of post, 3 ft. dist. Land, rolling.

Soil, gravelly and rocky, 3rd and 4th rate.

Timber, juniper and pine, scattering and dense.

Undergrowth, dense prickly ash, scrub oak, sagebrush and cacti.

No grass.

40.00 East, on a random line, bet. secs. 25 and 36.

79.90 Set temp. 1/4 sec. cor.

Fall 4 lks. N. of cor. of secs. 25, 30, 31 and 36, on E. bdy. of the Tp., described in Book "A."

Thence,

N. 89° 58' W., on a true line, bet. secs. 25 and 36.

Over gently rolling land, thru. scattering timber and undergrowth.

Ascend 68 ft. along N. slope of spur, sloping E.

20.74 Top of spur, sloping E. Thence along top of spur, ascending 55 ft. to 1/4 sec. cor.

Subdivision lines of Township 27 North, Range 8 West. 17

Chains.

30.00 Leave scattering, and enter dense timber.
39.95 Set an iron post, 3 ft. long, 1 in. in diam., 26 ins. in the ground, for 1/4 sec.cor., marked on brass cap,

1/4 S 25
S 36
1920

from which,
A pine, 6 ins. in diam., brs. N. 55 1/2° E., 87 lks. dist., marked 1/4 S 25 BT.
A pine, 6 ins. in diam., brs. S. 22 1/4° W., 72 lks. dist., marked 1/4 S 36 BT.

Continue along top of spur, sloping E.
Ascend 60 ft., to
50.00 Leave top of spur, sloping E. from NW.
Descend 15 ft., over SW. slope.
55.10 Gully, 10 lks. wide, course SE.
Ascend 20 ft., over SE. slope, to
63.70 Wash, 200 lks. wide, course SE.
Leave dense, and enter scattering timber.
Ascend 105 ft., over NE. slope, to
79.90 The cor. of secs. 25, 26, 35 and 36.
Land, rolling.
Soil, sandy and gravelly clay loam, 1st and 2nd rate.
Timber, juniper and pine, scattering and dense.
Undergrowth, scattering sagebrush.
Fair grass.

N. 0° 1' W., bet. secs. 25 and 26.
Over rolling land, thru. scattering timber and undergrowth.

5.00 Descend 23 ft., over NE. slope.
Wash, 100 lks. wide, course SE.
Leave scattering, and enter dense timber.
Ascend 32 ft., over S. slope.
16.68 Spur, slopes SE.
Descend 57 ft., over NE. slope.
31.50 Wash, 150 lks. wide, course E.
Ascend 40 ft., over S. slope.
38.20 Point of spur, slopes SE.
Descend slightly over NE. slope, to
40.00 Set an iron post, 3 ft. long, 1 in. in diam., 26 ins. in the ground, for 1/4 sec.cor., marked on brass cap,

1/4 S 26 S 25
1920

from which,
A pine, 12 ins. in diam., brs. N. 72 1/4° E., 43 lks. dist., marked 1/4 S 25 BT.
A pine, 7 ins. in diam., brs. N. 65° W., 31 lks. dist., marked 1/4 S 26 BT.

Ascend 30 ft., over SE. slope.
42.00 A pine, 6 ins. in diam., on line marked with 2 notches on each of N. and S. faces.
45.20 Spur, slopes SE.
Descend 125 ft., over NE. slope.
67.10 Wash, 100 lks. wide, course SE.
Ascend 50 ft., over S. slope, to sec. cor.
72.10 East end of open park, 8.00 chs. wide, brs. E. and W.
78.90 A juniper, 12 ins. in diam., on line marked with 2 notches on each of N. and S. faces.
80.00 Set an iron post, 3 ft. long, 2 ins. in diam., 24 ins. in the ground, for cor. of secs. 23, 24, 25 and 26, marked on brass cap,

18 Subdivision lines of Township 27 North, Range 8 West.

Chains.

T27N	R8W
S23	S24
S26	S25
1920	

from which,

A juniper, 8 ins. in diam., brs. N. $25\frac{1}{2}^{\circ}$ E., 72 lks.
dist., marked T27N R8W S24 BT.A pine, 7 ins. in diam., brs. S. 13° E., 21 lks.
dist., marked T27N R8W S25 BT.A juniper, 10 ins. in diam., brs. S. $85\frac{1}{2}^{\circ}$ W., 53 lks.
dist., marked T27N R8W S26 BT.A pine, 6 ins. in diam., brs. N. $60\frac{1}{4}^{\circ}$ W., 108 lks.
dist., marked T27N R8W S23 BT.

Land, rolling.

Soil, gravelly and rocky, 3rd and 4th rate.

Timber, juniper and pine, scattering in S. 5 chs.; dense
in remainder.

Undergrowth, scattering prickly ash and sage brush.

Fair grass.

S. $89^{\circ}58'$ E., on random line, bet. secs. 24 and 25.40.00 Set temp. $\frac{1}{4}$ sec. cor.80.08 Fall 14 lks. S. of cor. of secs. 19, 24, 25 and 30, on the E.
bdy. of the Tp., described in Book "A."

Thence,

S. $89^{\circ}56'$ W., on a true line, bet. secs. 24 and 25.Over level land, thru. scattering undergrowth, and very
scattering timber.12.00 Leave level land, and very scattering timber, brs. N. and S.
and enter gently rolling land and dense timber and un-
dergrowth.

Ascend 120 ft., over E. slope, to

40.04 Set an iron post 3 ft. long, 6 ins. in the ground to bed
rock, and raise a mound of stone around post, for $\frac{1}{4}$
sec. cor., marked on brass cap.

$\frac{1}{4}$	S 24
	S 25
	1920

from which,

A juniper, 6 ins. in diam., brs. N. 70° E., 6 lks.
dist., marked $\frac{1}{4}$ S 24 BT.A juniper, 6 ins. in diam., brs. S. $21\frac{1}{2}^{\circ}$ E., 82 lks.
dist., marked $\frac{1}{4}$ S 25 BT.Continue over gently rolling land, thru. dense timber
and undergrowth.

Ascend 85 ft., over E. and SE. slopes to sec. cor.

69.35 A juniper, 8 ins. in diam., on line, marked with 2
notches on each of E. and W. faces.

80.08 The cor. of secs. 23, 24, 25 and 26.

Land, level in E. 12 chs.; remainder, gently rolling.

Soil, sandy clay loam, 1st rate in E. 12 chs.; gravelly clay,
2nd and 3rd rate in W. 68 chs.Timber, juniper and pine, very scattering in E. 12 chs.;
dense in remainder.Undergrowth, prickly ash, scrub juniper and sagebrush,
scattering and dense.

Good grass in E. 12 chs. Fair grass in remainder.

N. $0^{\circ}1'$ W., bet. secs. 23 and 24.Over gently rolling land, thru. dense timber and under-
growth.

Ascend 27 ft., over S. slope.

5.90 Spur, slopes E. Descend 50 ft., over NE. slope.

Subdivision lines of Township 27 North, Range 8 West. 19

Chains.

- 8.72 A pine, 6 ins. in diam., on line marked with 2 notches on each of N. and S. faces.
- 20.46 Draw, 70 lks. wide, course E.
Descend slightly over E. slope, to
- 27.85 Draw, 60 lks. wide, course E.
Ascend slightly over E. slope, to $\frac{1}{4}$ sec. cor.
- 31.06 A juniper, 8 ins. in diam., on line marked with 2 notches on each of N. and S. faces.
- 40.00 Set an iron post 3 ft. long, 1 in. in diam., 20 ins. in the ground to bed rock, and raise a mound of stone around post, for $\frac{1}{4}$ sec. cor., marked on brass cap,



from which,
 A pine, 6 ins. in diam., brs. N. $46\frac{1}{2}^{\circ}$ W., 9 lks. dist., marked $\frac{1}{4}$ S 23 BT.
 A pine, 6 ins. in diam., brs. S. $13\frac{1}{4}^{\circ}$ E., 49 lks. dist., marked $\frac{1}{4}$ S 24 BT.

- 45.75 Descend 15 ft., over E. slope, to Gully, 10 lks. wide, course N. 70° E.
Ascend 15 ft., over SE. slope.
- 48.00 Descend 30 ft., over NE. slope.
- 52.08 A pine, 10 ins. in diam., on line, marked with 2 notches on each of N. and S. faces.
- 54.58 Center of draw, 5 chs. wide, course E.
Ascend 30 ft., over S. slope.
- 62.06 Descend 25 ft., over NE. slope.
- 72.85 Gully, 30 lks. wide, course NE.
Ascend 17 ft., over SE. slope.
- 75.56 Spur, slopes NE.
Descend 20 ft., over N. slope, to
- 80.00 Set an iron post, 3 ft. long, 2 ins. in diam., 24 ins. in the ground, for cor. of secs. 13, 14, 23 and 24, marked on brass cap,

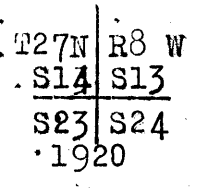

from which,
 A pine, 6 ins. in diam., brs. N. 31° E., 41 lks. dist., marked T27N R8W S13 BT.
 A juniper, 10 ins. in diam., brs. S. $18\frac{1}{2}^{\circ}$ E., 43 lks. dist., marked T27N R8W S24 BT.
 A pine, 8 ins. in diam., brs. S. $30\frac{1}{2}^{\circ}$ W., 70 lks. dist., marked T27N R8W S23 BT.
 A pine, 10 ins. in diam., brs. N. $80\frac{1}{2}^{\circ}$ W., 45 lks. dist., marked T27N R8W S14 BT.

Land, gently rolling.
 Soil, gravelly loam; 3rd rate.
 Timber, dense juniper and pine.
 Undergrowth, dense prickly ash, scrub juniper & sagerbrush.
 Fair grass.

-
- 40.00 N. $89^{\circ}56'$ E., on a random line, bet. secs. 13 and 24.
Set temp. $\frac{1}{4}$ sec. cor.
 - 80.10 Fall 4 lks. N. of the cor. of secs. 13, 18, 19 and 24, on the E. bdy. of the Tps., described in Book "A."
Thence,
S. $89^{\circ}58'$ W., on a true line, bet. secs. 13 and 24.
Over nearly level land, thru. scattering timber and undergrowth.

20 Subdivision lines of Township 27 North, Range 8 West.

Chains.

Ascend slightly over SE. slope.
 20.00 Descend slightly over S. slope.
 29.60 Wash, 20 lks. wide, course S. Leave timber, and enter dense undergrowth. Continue over nearly level land, ascending slightly over E. slope, to
 40.05 Set an iron post, 3 ft. long, 1 in. in diam., 26 ins. in the ground, for $\frac{1}{4}$ sec. cor., marked on brass cap,

$\frac{1}{4}$ S 13
 S 24
 1920

and dig pits, 18x18x12 ins., one each E. and W. of post, 3 ft. dist.
 Continue over nearly level land, thru dense undergrowth.
 Ascend slightly over E. slope.
 46.86 Road brs. N. and S.
 52.00 Leave nearly level land, and enter gently rolling land and dense timber.
 Ascend 92 ft., over E. slope, to
 75.10 Point of spur, slopes E. from S. 60° W.
 Descend 12 ft., over N. slope, to
 80.10 The cor. of secs. 13, 14, 23 and 24.
 Land, E. 52 chs. nearly level; W. 28 chs., gently rolling. Soil in E. $\frac{1}{2}$ sandy clay loam, 1st rate; in W. $\frac{1}{2}$, sandy and gravelly, 2nd rate.
 Timber, juniper and pine, scattering in E. 29 $\frac{1}{2}$ chs.; dense in W. 28 chs. No timber elsewhere.
 Undergrowth, sagebrush and scrub juniper, scattering in E. 29 $\frac{1}{2}$ chs.; dense elsewhere.
 Good grass in E. $\frac{1}{2}$; fair in W. $\frac{1}{2}$.

N. 0° 1' W., bet. secs. 13 and 14.
 Over rolling land, thru dense timber and undergrowth.
 Descend 20 ft., over N. slope.
 2.19 Gully, 5 lks. wide, course E.
 Descend 26 ft., over E. slope.
 15.00 Wash, 2 chs. wide, course SE.
 Ascend 54 ft., over S. slope.
 22.00 Point of spur, slopes SE. Leave dense and enter scattering timber and undergrowth.
 Descend 60 ft., over NE. slope, to $\frac{1}{4}$ sec. cor.
 39.47 Road, brs. E. and W.
 40.00 Set an iron post 3 ft. long, 1 in. in diam., 26 ins. in the ground, for $\frac{1}{4}$ sec. cor., marked on brass cap,

$\frac{1}{4}$
 S13 | S14
 1920

from which,
 A pine, 6 ins. in diam., brs. N. 30 $\frac{1}{4}$ ° E., 72 lks. dist., marked $\frac{1}{4}$ S 13 BT.
 and dig pits, 18x18x12 ins., one each N. and S. of post, 3 ft. dist.
 Descend slightly over NE. slope.
 42.40 Draw, 40 lks. wide, course E. for 2 chs., thence SE.
 Ascend slightly over S. slope, to
 50.00 Leave rolling, and enter mountainous land; ascend 226 ft. over S. slope.
 64.30 S. end of top of ridge, bearing N. and S.; thence along top of ridge; ascending 20 ft., to
 80.00 Bend in top of ridge, brs. W. and S. Set an iron post, 3 ft. long, 2 ins. in diam., 12 ins. in the ground, to bed rock, and raise a mound of stone around post, for cor. of secs. 11, 12, 13 and 14, marked on brass cap,

Chains.

T27N	R8 W.
S11	S12
S14	S13
1920	

from which,

- A juniper, 12 ins. in diam., brs. N. 43 $\frac{3}{4}$ ° E., 312 lks. dist., marked T27N R8W S12 BT.
- A juniper, 14 ins. in diam., brs. S. 64 $\frac{1}{4}$ ° E., 281 lks. dist., marked T27N R8W S13 BT.
- A juniper, 6 ins. in diam., brs. S. 15 $\frac{1}{2}$ ° W., 105 lks. dist., marked T27N R8W S14 BT.
- A juniper, 18 ins. in diam., brs. N. 13 $\frac{1}{2}$ ° W., 128 lks. dist., marked T27N R8W S11 BT.

Land, S. 50 chs., rolling; N. 30 chs., mountainous.
 Soil, sandy and gravelly loam, 2nd rate.
 Timber, juniper and pine, dense in S. 22 chs.; scattering elsewhere.
 Undergrowth, sagebrush, prickly ash and scrub juniper; dense in S. 22 chs.; scattering elsewhere.
 Fair grass.

40.00
79.94

N. 89° 58' E., on random line, bet. secs. 12 and 13.
 Set temp. $\frac{1}{4}$ sec. cor..
 Fall 3 lks. S. of cor. of secs. 7, 12, 13 and 18, on E. bdy. of Tp., described in Book "A."

5.00

Thence,
 S. 89° 57' W., on a true line, bet. secs. 12 and 13.
 Over nearly level land, thru. scattering timber and undergrowth.

15.00
39.97

Ascend slightly over E. slope, to
 Leave nearly level land and timber, and enter gently rolling land.
 Ascend 130 ft., over E. slope to $\frac{1}{4}$ sec. cor.
 Enter scattering timber and dense undergrowth.
 Set an iron post, 3 ft. long, 1 in. in diam., 26 ins. in the ground, for $\frac{1}{4}$ sec. cor., marked on brass cap,

$\frac{1}{4}$ S 12
S 13
1920

from which,

- A juniper, 10 ins. in diam.; brs. N. 70 $\frac{1}{2}$ ° E. 132 lks. dist., marked $\frac{1}{4}$ S 12 BT.
- A juniper, 6 ins. in diam., brs. S. 52° E., 186 lks. dist., marked $\frac{1}{4}$ S 13 BT.

79.94

Continue over gently rolling land, thru. scattering timber and dense undergrowth.
 Ascend 175 ft. over E. and NE. slopes to
 The cor. of secs. 11, 12, 13 and 14, on top of ridge, bearing W. and S.
 Land, E. 5 chs., nearly level; remainder, gently rolling.
 Soil, sandy and gravelly clay loam; 1st and 2nd rate.
 Timber, scattering juniper and pine in E. 5 chs. and W. 65 chs. None elsewhere.
 Undergrowth, sagebrush, prickly ash and scrub juniper, scattering in E. 15 chs. Dense elsewhere.
 Good grass in E. half; fair in W. half.

9.60
13.40

N. 0° 1' W., bet. secs: 11 and 12.
 Over rolling land, thru. scattering timber and dense undergrowth.
 Ascend 20 ft., over NE. slope.
 A pine; 8 ins. in diam., on line, marked with 2 notches on each of N. and S. faces.
 Descend 50 ft., over NE. slope.

22 Subdivision lines of Township 27 North, Range 8 West.

Chains.	
21.70	Draw, 70 lks.wide, course N.70°E. Leave scattering, and enter dense timber.
	Ascend 25 ft., over S.slope.
28.10	Point of spur, slopes NE.
	Descend 15 ft., over N.slope.
33.10	Gully, 20 lks.wide, course SE.
	Ascend 15 ft., over S.slope, to
40.00	Set an iron post, 3 ft.long, 1 in. in diam., 26 ins.in the ground, for $\frac{1}{4}$ sec.cor., marked on brass cap,
	$\begin{array}{c} \frac{1}{4} \\ \text{S11} \text{S12} \\ \hline 1920 \end{array}$
	from which,
	A pine, 12 ins. in diam., brs.S.5 $\frac{1}{2}$ °E., 13 lks. dist., marked $\frac{1}{4}$ S 12 BT.
	A pine, 12 ins.in diam., brs.S.12°W., 18 lks. dist., marked $\frac{1}{4}$ S 11 BT.
	Ascend 40 ft., over SE.slope.
41.06	A pine, 10 ins.in diam., on line, marked with 2 notches on each of N.and S. faces.
48.08	A juniper, 24 ins. in diam., on line, marked with 2 notches on each of N. and S. faces.
52.80	Descend 90 ft., over E.slope.
73.25	Gully, 20 lks.wide, course SE. near head.
	Ascend 30 ft., over E.slope, to
80.00	Set an iron post, 3 ft.long, 2 ins. in diam., 24 ins.in the ground, for cor.of secs. 1,2,11 and 12, marked on brass cap,
	$\begin{array}{c} \text{T27N} \text{R8 W} \\ \hline \text{S 2} \text{S 1} \\ \hline \text{S11} \text{S12} \\ \hline 1920 \end{array}$
	from which,
	A juniper, 12 ins. in diam., brs.N.52°E., 61 lks. dist., marked T27N R8W S1 BT.
	A pine, 8 ins. in diam., brs.S.17°E., 98 lks. dist., marked T27N R8W S12 BT.
	A juniper, 6 ins. in diam., brs.S.65 $\frac{1}{2}$ °W., 49 lks. dist., marked T27N R8W S11 BT.
	A pine, 6 ins. in diam., brs.N.40°W., 107 lks. dist., marked T27N R8W S2 BT.
	Land, rolling.
	Soil, gravelly and rocky clay loam, 2nd and 3rd rate.
	Timber, juniper and pine, scattering in S.22 chs.; dense elsewhere.
	Undergrowth, dense prickly ash and sagebrush.
	Fair grass.

40.00	N.89°57'E., on random line, bet. secs.1 and 12.
80.02	Set temp. $\frac{1}{4}$ sec.cor.
	Fall 2 lks.N.of cor.of secs.1,6,7 and 12 on E. bdy.of Tp., described in Book "A."
	Thence,
	S.89°58'W., on a true line, bet. secs.1 and 12.
	Over nearly level land, thru. scattering timber and undergrowth.
4.65	Shallow wash, 6 lks.wide, course NE. Leave nearly level, and enter rolling land.
	Ascend 150 ft.over E. and NE.slopes to $\frac{1}{4}$ sec.cor.
11.50	Leave scattering, and enter dense timber, brs.N.and S.
28.00	Leave timber, brs.N.and S.
32.80	Road, brs.N.and S.
35.50	Enter dense timber and undergrowth, brs.N.and S.

Chains.

- 40.01 Set an iron post, 3 ft. long, 1 in. in diam., 26 ins. in the ground, for $\frac{1}{4}$ sec. cor., marked on brass cap,

$$\frac{1}{4} \frac{S \ 1}{S \ 12}$$

1920

from which,

A pine, 20 ins. in diam., brs. N. $73\frac{1}{2}^{\circ}$ E., 81 lks. dist., marked $\frac{1}{4}$ S 1 BT.

A juniper, 6 ins. in diam., brs. S. 45° W., 25 lks. dist., marked $\frac{1}{4}$ S 12 BT.

- Ascend slightly over N. slope, to
 45.00 Descend 32 ft., over N. slope.
 55.25 Wash, 30 lks. wide, course NE.
 Ascend 110 ft., over E. slope, to
 80.02 The cor. of secs. 1, 2, 11 and 12.
 Land, E. 5 chs., nearly level; remainder rolling.
 Soil, sandy and gravelly clay loam, 1st and 2nd rate.
 Timber, juniper and pine, scattering in E. $11\frac{1}{2}$ chs.; dense elsewhere, with the exception of a small area in the E. $\frac{1}{2}$ mile devoid of timber.
 Undergrowth, sage brush and scrub juniper, scattering in E. $35\frac{1}{2}$ chs.; dense elsewhere.
 Good grass in E. $11\frac{1}{2}$ chs. Fair elsewhere.

- 40.00 N. $0^{\circ} 1' W.$, on random line, bet. secs. 1 and 2.
 Set temp. $\frac{1}{4}$ sec. cor.
 80.46 Intersect the cor. of secs. 1, 2, 35 and 36, on the N. bdy. of the Tp., hereinbefore described.
 Thence,
 S. $0^{\circ} 1' E.$, on a true line, bet. secs. 1 and 2.
 Over rolling land, thru. scattering timber and dense undergrowth.
 Descend 36 ft., over SE. slope.
 1.25 Gully, 20 lks. wide, course E.
 Ascend 85 ft., over NE. and E. slopes, to
 20.00 Descend 34 ft., over S. slope.
 22.46 Gulch, 70 lks. wide, course E.
 Descend 10 ft. over E. slope, to
 30.10 Gully, 20 lks. wide, course N. 70° E.
 Ascend 18 ft., over NE. slope, to
 35.30 Gully 20 lks. wide, course NE. Leave scattering, and enter dense timber.
 Ascend 47 ft., over NE. slope, to
 40.46 Set an iron post, 3 ft. long, 1 in. in diam., 26 ins. in the ground, for $\frac{1}{4}$ sec. cor., marked on brass cap,

$$\frac{1}{4} \frac{S \ 2 \ S \ 1}{1920}$$

from which,

A juniper, 6 ins. in diam., brs. N. 44° E., 40 lks. dist., marked $\frac{1}{4}$ S 1 BT.

A pine, 8 ins. in diam., brs. N. 40° W., 89 lks. dist., marked $\frac{1}{4}$ S 2 BT.

- Ascend slightly over E. slope, to
 46.00 Descend 37 ft., over SE. slope.
 52.30 Gully, 20 lks. wide, course SE. near head.
 Ascend 114 ft., over NE. slope, to
 80.46 The cor. of secs. 1, 2, 11 and 12.
 Land, rolling.
 Soil, gravelly clay loam, 2nd and 3rd rate.
 Timber, juniper and pine; scattering in N. 35 chs. Dense elsewhere.

24 Subdivision lines of Township 27 North, Range 8 West.

Chains.

Undergrowth, dense prickly ash, sagebrush and scrub juniper.
Fair grass.

From the cor. of secs. 2, 3, 34 and 35, on the S. bdy. of the Tp., described in Book "D," N. 0° 1' W., bet. secs. 34 and 35.

Over mountainous land, thru. dense timber and undergrowth, along top of ridge, bearing N. and S.

Descend slightly to

5.00 Leave top of ridge. Thence along E. slope of same, near top.

Descend 90 ft. to

24.55 Thence along top of same ridge, bearing N. and S. Leave dense and enter scattering timber.

Descend 30 ft. to

40.00 Set an iron post, 3 ft. long, 1 in. in diam., 3 ins. in the ground to bed rock, and raise a mound of stone around post for $\frac{1}{4}$ sec. cor., marked on brass cap,



and raise a mound of stone 2 ft. base, 1 1/2 ft. high, W. of cor.

Continue along top of ridge, bearing N. and S., thru. scattering timber and dense undergrowth.

Descend 25 ft., to

45.74 Leave top of ridge, which brs. NW. and S. Beyond this point, the sec. line, passes over steep broken NE. slope, covered with dense timber and a mass of tangled undergrowth, and chaining is impracticable; therefore triangulate measurement as described as follows, and as shown on the diagram hereon:

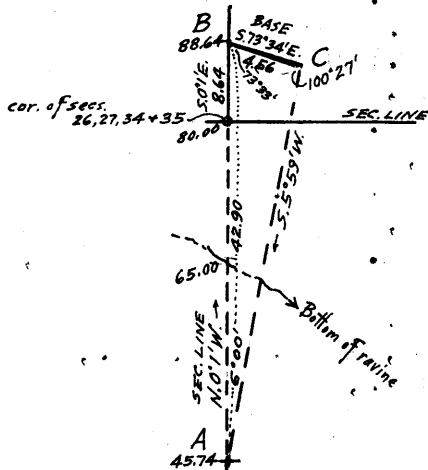

Set flag at 45.74 chs. station on sec. line, indicated on diagram at "A."

From a point ahead on sec. line indicated at "B," measure a Base S. 73° 34' E., 4.56 chs. to point "C."

Bearing "C-A" = S. 5° 59' W.

Vertical angle "B" to "A" = + 9°.

Included angles of triangle

"A-B-C" are 6° 00', 73° 33'

and 100° 27', the sum of which is 180° 00'.

Triangulated measurement on sec. line from "A" to "B" is obtained by

$$\frac{\text{sine } 100^{\circ}27' \times \text{Base}}{\text{sine } 6^{\circ}00'} \text{ or } \frac{.98341 \times 4.56}{.10453} = 42.90 \text{ chs.}$$

which, added to 45.74 chs. gives 88.64 chs. N. 0° 1' W. from the cor. of secs. 2, 3, 34 and 35, for the position of triangulation point "B," or 8.64 chs. N. 0° 1' W. from the point for cor. of secs. 26, 27, 34 and 35.

65.00 (Approximate) Bottom of ravine, course S. 75° E. about 600 ft. below 45.74 ch. station.

Ascend about 300 ft., over steep S. slope, to

72.00 (Approximate) Spur, slopes SE. Leave dense, and enter scattering timber.

Descend about 75 ft. over NE. slope to sec. cor.

From triangulation point "B," chain measurement,

S. 0° 1' E., 8.64 chs. to

80.00 Set an iron post, 3 ft. long, 2 ins. in diam., 4 ins. in

Subdivision lines of Township 27 North, Range 8 West. 25

Chains.

the ground to bedrock, and raise a mound of stone around post, for cor. of secs. 26, 27, 34 and 35, marked on brass cap,

T27N	R8 W
S27	S26
S34	S35
1920	

from which,

A juniper, 6 ins. in diam., brs. N. $61\frac{1}{2}^{\circ}$ E., 226 lks. dist., marked T27N R8W S26 BT.

A pine, 8 ins. in diam., brs. S. $87\frac{1}{2}^{\circ}$ E., 280 lks. dist., marked T27N R8W S35 BT.

A juniper, 6 ins. in diam., brs. S. 89° W., 308 lks. dist., marked T27N R8W S34 BT.

and raise a mound of stone, 2 ft. base, $1\frac{1}{2}$ ft. high, W. of cor.

Land, mountainous.

Soil, gravelly and rocky, 4th rate.

Timber, juniper and pine, dense and scattering.

Undergrowth, dense manzanita, prickly ash and scrub juniper.

No grass.

- East, on a random line, bet. secs. 26 and 35.
- 40.00 Set temp. $\frac{1}{4}$ sec. cor.
- 80.12 Fall 9 lks. N. of cor. of secs. 25, 26, 35 and 36.
- Thence,
- N. $89^{\circ}56'$ W., on a true line, bet. secs. 26 and 35.
- Over rolling land, thru. scattering timber and dense undergrowth.
- 30.00 Ascend 100 ft., over NE. slope, to Spur, slopes SE. from W. Leave rolling, and enter mountainous land.
- 40.06 Ascend 50 ft., along top of spur, to Set an iron post, 3 ft. long, 1 in. in diam., 26 ins. in the ground, for $\frac{1}{4}$ sec. cor., marked on brass cap,
- | | |
|---------------|------|
| $\frac{1}{4}$ | S 26 |
| | S 35 |
| | 1920 |
- from which,
- A juniper, 36 ins. in diam., brs. S. 28° E., 24 lks. dist., marked $\frac{1}{4}$ S 35 BT.
- and raise a mound of stone 2 ft. base, $1\frac{1}{2}$ ft. high, N. of cor.
- 45.00 Ascend slightly along top of spur, sloping E. Leave top of spur, slopes E. from SW.
- Descend 20 ft., over NW. slope.
- 50.75 Gulch, 70 lks. wide, course NE.
- Ascend 150 ft., over S. slope, to
- 75.20 Same gulch, 20 lks. wide, course SE. for 3 chs., thence E.
- Ascend 75 ft., over NE. slope, to
- 80.12 The cor. of secs. 26, 27, 34 and 35.
- Land, E. 30 chs., rolling, remainder, mountainous.
- Soil, gravelly and rocky clay loam, 3rd and 4th rate.
- Timber, scattering juniper and pine.
- Undergrowth, dense prickly ash, scrub juniper, sagebrush and cacti.
- No grass.

N. $0^{\circ}1'$ W., bet. secs. 26 and 27.

Over mountainous land, thru. scattering timber and dense undergrowth.

26 Subdivision lines of Township 27 North, Range 8 West.

Chains.

14.00 Descend 60 ft., over NE. slope.
 Gulch, 20 lks. wide, course SE.
 Leave scattering, and enter dense timber.
 Ascend 207 ft., over S. slope, to
 31.20 Descend 40 ft., over N. slope, to
 40.00 Set an iron post, 3 ft. long, 1 in. in diam., 26 ins. in
 the ground, for $\frac{1}{4}$ sec. cor., marked on brass cap,

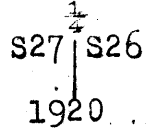

from which,
 A pine, 8 ins. in diam., brs. S. $58\frac{1}{2}^\circ$ E., 19 lks.
 dist., marked $\frac{1}{4}$ S. 26 BT.
 A pine, 8 ins. in diam., brs. S. $11\frac{1}{2}^\circ$ W., 29 lks.
 dist., marked $\frac{1}{4}$ S 27 BT.

40.35 Descend 8 ft., over NW. slope.
 Gulch, 20 lks. wide, course SW.
 Ascend 120 ft., over SE. slope.
 53.10 Ridge, brs. NE. and SW.
 Descend 190 ft., over NW. slope.
 61.32 A juniper, 12 ins. in diam., on line, marked with 2 notches
 on each of N. and S. faces.
 67.00 Gulch, 30 lks. wide, course SW.
 Ascend 35 ft., over SW. slope, to
 80.00 Set an iron post, 3 ft. long, 2 ins. in diam., 24 ins. in
 the ground, for cor. of secs. 22, 23, 26 and 27, marked
 on brass cap,

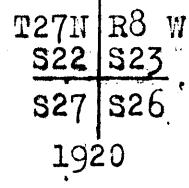

from which,
 A pine, 14 ins. in diam., brs. N. 72° E., 138
 lks. dist., marked T27N R8W S23 BT.
 A pine, 8 ins. in diam., brs. S. $87\frac{1}{2}^\circ$ E., 112
 lks. dist., marked T27N R8W S26 BT.
 A pine, 6 ins. in diam., brs. S. 86° W., 37, lks.
 dist., marked T27N R8W S27 BT.
 A juniper, 6 ins. in diam., brs. N. $89\frac{1}{2}^\circ$ W., 31
 lks. dist., marked T27N R8W S22 BT.

Land, mountainous,
 Soil, gravelly and rocky, 4th rate.
 Timber, juniper and pine, scattering in S. 14 chs.; dense
 elsewhere.
 Undergrowth, dense prickly ash, scrub juniper, manzanita
 and cacti.
 Poor grass.

40.00 S. $89^\circ 56'$ E., on a random line, bet. secs. 23 and 26.
 Set temp. $\frac{1}{4}$ sec. cor.
 80.02 Fall 4 lks. S. of the cor. of secs. 23, 24, 25 and 26.
 Thence,
 N. $89^\circ 58'$ W., on a true line, bet. secs. 23 and 26.
 Over rolling land, thru. dense timber and undergrowth.
 Ascend 65 ft., over S. slope, to
 20.10 Wash, 100 lks. wide, course SE.
 Ascend 100 ft., over SE. slope, to
 40.01 Set an iron post 3 ft. long, 1 in. in diam., 26 ins. in
 the ground, for $\frac{1}{4}$ sec. cor., marked on brass cap,

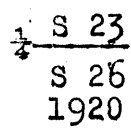

subdivision lines of Township 27 North, Range 8 West. 27

Chains.

from which,

A pine, 10 ins. in diam., brs. N. 15° W., 85 lks. dist., marked $\frac{1}{4}$ S 23 BT.

A juniper, 18 ins. in diam., brs. S. 84° E., 103 lks. dist., marked $\frac{1}{4}$ S 26 BT.

Leave rolling and enter mountainous land.

Ascend 465 ft., over E. slope.

70.25 Ridge, brs. N. and S.

Descend 86 ft., over W. slope.

76.00 Head of gulch, course N.

Ascend 10 ft., over NE. slope.

77.50 Spur, slopes NW.

Descend 22 ft., over SW. slope, to

80.02 The cor. of secs. 22, 23, 26 and 27.

Land, E. $\frac{1}{2}$, rolling; W. $\frac{1}{2}$, mountainous.

Soil, gravelly and rocky, 3rd and 4th rate.

Timber, dense juniper and pine.

Undergrowth, dense prickly ash, scrub juniper and sagebrush.

Fair grass in E. $\frac{1}{2}$. No grass in W. $\frac{1}{2}$.

N. 0° 1' W., bet. secs. 22 and 23.

Over mountainous land, thru. dense timber and undergrowth.

Ascend slightly over SW. slope, to

2.00 Spur, slopes NW.

Descend 62 ft., over NE. slope, to

7.40 Head of gulch, course NE.

Descend 200 ft., over NE. slope, to

22.60 Gulch, 20 lks. wide, course NE.

Ascend 35 ft., over SE. slope.

31.30 Descend 6 ft., over NE. slope.

33.70 Gulch, 50 lks. wide, course E. near head.

Ascend 6 ft., over SE. slope, to

35.58 A pine, 12 ins. in diam., on line, marked with 2 notches on each of N. and S. faces.

Descend 20 ft., along E. slope, to

40.00 Set an iron post, 3 ft. long, 1 in. in diam., 26 ins. in the ground, for $\frac{1}{4}$ sec. cor., marked on brass cap,

$\frac{1}{4}$
S22 | S23
1920

from which,

A pine, 9 ins. in diam., brs. N. 50° E., 27 lks. dist. from which marked $\frac{1}{4}$ S 23 BT.

A pine, 8 ins. in diam., brs. N. 41° W., 402 lks. dist., marked $\frac{1}{4}$ S 22 BT. 23 BT.

Leave mountainous, and enter rolling land.

Ascend slightly over E. slope, to

42.40 Descend 118 ft., over NE. and N. slopes, to

65.12 Draw, 50 lks. wide, course NE.

Ascend 31 ft., over SE. slope, to

72.72 Descend 6 ft., over NE. slope.

74.70 Draw, 100 lks. wide, course E.

Ascend 15 ft., over SE. slope, to

80.00 Set an iron post, 3 ft. long, 2 ins. in diam., 24 ins. in the ground, for cor. of secs. 14, 15, 22 and 23, marked on brass cap,

T27N | R8 W
S15 | S14
S22 | S23
1920

from which,

A pine, 8 ins. in diam., brs. N. 34° E., 15 lks. dist., marked T27N R8W S14 BT.

28. Subdivision lines of Township 27 North, Range 8 West.

Chains.

- A juniper, 12 ins. in diam., brs. S. 30° E., 90 lks. dist., marked T27N R8W S23 BT.
- A pine, 6 ins. in diam., brs. S. 40° W., 149 lks. dist., marked T27N R8W S22 BT.
- A juniper, 16 ins. in diam., brs. N. 70° W., 53 lks. dist., marked T27N R8W S15 BT.

Land, S. $\frac{1}{2}$, mountainous; N. $\frac{1}{2}$, rolling.
 Soil, gravelly and rocky, 4th rate.
 Timber, dense juniper and pine.
 Undergrowth, dense prickly ash and scrub juniper.
 No grass.

- 40.00 S. 89° 58' E., on random line; bet. secs. 14 and 23.
Set temp. $\frac{1}{4}$ sec. cor.
- 79.86 Fall 3 lks. N. of cor. of secs. 13, 14, 23 and 24.
Thence,
N. 89° 57' W., on a true line, bet. secs. 14 and 23.
Over rolling land, thru. dense timber and undergrowth.
Ascend 50 ft., over N. slope, to
- 13.10 Gully, 30 lks. wide, course N. 70° E.
Ascend 66 ft., over NE. slope.
- 23.20 Point of spur, slopes N.
Descend 80 ft., over W. slope, to $\frac{1}{4}$ sec. cor.
- 39.93 Leave dense, and enter scattering timber and undergrowth.
Set an iron post, 3 ft. long, 1 in. in diam., 26 ins. in the ground, for $\frac{1}{4}$ sec. cor., marked on brass cap.

$\frac{1}{4}$ S 14
 S 23
 1920

from which,

- A juniper, 6 ins. in diam., brs. S. 10° E., 82 lks. dist., marked $\frac{1}{4}$ S 23 BT.
- A juniper, 6 ins. in diam., brs. N. 10° E., 265 lks. dist., marked $\frac{1}{4}$ S 14 BT.
- Thence across nearly level bottom of draw.
- 43.20 Center of draw, 10 chs. wide, course NE.
Ascend 160 ft., over E. slope to sec. cor.
- 53.00 Enter dense timber and undergrowth.
- 79.86 The cor. of secs. 14, 15, 22 and 23.
Land, rolling.
Soil, gravelly and rocky, 3rd and 4th rate.
Timber, juniper and pine, scattering and dense.
Undergrowth, prickly ash and scrub juniper, scattering and dense.
Fair grass.

- N. 0° 1' W., bet. secs. 14 and 15.
Over rolling land, thru. dense timber and undergrowth.
Descend 20 ft., over NE. slope, to
- 4.09 Draw, 50 lks. wide, course NE. near head.
Ascend 15 ft., over E. slope.
- 9.30 Descend 72 ft., over NE. and N. slopes, to $\frac{1}{4}$ sec. cor.
- 15.00 Leave dense, and enter scattering timber.
- 40.00 Set an iron post, 3 ft. long, 1 in. in diam., 26 ins. in the ground, for $\frac{1}{4}$ sec. cor., marked on brass cap,

$\frac{1}{4}$
 S15 | S14
 1920

from which,

Subdivision lines of Township 27 North, Range 8 West. 29

Chains.

A juniper, 36 ins. in diam., brs. S. 62 $\frac{1}{2}$ ° E., 115 lks. dist., marked $\frac{1}{4}$ S 14 BT.
 A juniper, 12 ins. in diam., brs. S. 61 $\frac{1}{2}$ ° W., 70 lks., marked $\frac{1}{4}$ S 15 BT.
 Descend 20 ft., over N. slope.
 48.57 Center of draw, 5.00 chs. wide, course NE.
 Ascend 75 ft., over SE. slope, to
 80.00 Point of spur, slopes SW. from N. 75° W. Set an iron post 3 ft. long, 2 ins. in diam., 24 ins. in the ground, for cor. of secs. 10, 11, 14 and 15, marked on brass cap,

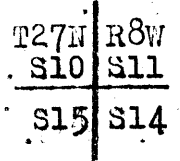

1920

from which,
 A juniper, 6 ins. in diam., brs. S. 55 $\frac{1}{2}$ ° E., 350 lks. dist., marked T27N R8W S14 BT.
 A juniper, 24 ins. in diam., brs. S. 44 $\frac{1}{2}$ ° W., 693 lks. dist., marked T27N R8W S15 BT.
 A juniper, 24 ins. in diam., brs. N. 0 $\frac{1}{2}$ ° W., 9 lks. dist., marked T27N R8W S10 BT.

and dig a pit 18x18x12 ins., NE. of post, 3 ft. dist.
 Land, rolling.
 Soil, sandy clay loam, 1st rate.
 Timber, juniper and pine, dense in S. 15 chs.; scattering elsewhere.
 Undergrowth, dense sage brush, scrub juniper and prickly ash.
 Good grass.

40.00 S. 89° 57' E., on random line, bet. secs. 11 and 14.
 Set temp. $\frac{1}{4}$ sec. cor.
 79.92 Fall 7 lks. N. of the cor. of secs. 11, 12, 13 and 14.
 Thence,
 N. 89° 54' W., on a true line, bet. secs. 11 and 14.
 Over mountainous land, thru. scattering timber and undergrowth, along top of ridge, bearing E. and W.
 Ascend 40 ft., to
 10.70 Leave top of ridge, brs. E. and NW.
 Descend 10 ft., to
 20.80 Spur, slopes SW.
 Descend 260 ft. over W. slope, to
 34.00 E. edge of bottom of draw, brs. N. and S.
 Leave mountainous, and enter rolling land.
 38.00 Center of draw, 8 chs. wide, course S.
 39.96 Set an iron post, 3 ft. long, 1 in. in diam., 26 ins. in the ground, for $\frac{1}{4}$ sec. cor., marked on brass cap,

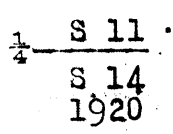

1920

from which,
 A juniper, 20 ins. in diam., brs. N. 68 $\frac{1}{2}$ ° E., 240 lks. dist., marked $\frac{1}{4}$ S 11 BT.
 A juniper, 12 ins. in diam., brs. S. 44 $\frac{1}{2}$ ° W., 496 lks. dist., marked $\frac{1}{4}$ S 14 BT.
 42.00 W. edge of bottom of draw, brs. N. and S. Leave draw.
 Ascend 120 ft., over E. slope to sec. cor.
 52.15 Road brs. N. and S.
 79.92 The cor. of secs. 10, 11, 14 and 15.
 Land, E. 34 chs., mountainous; remainder, rolling.
 Soil, sandy and gravelly, 1st and 2nd rate.
 Timber, scattering juniper and pine.
 Undergrowth, scattering scrub juniper and sagebrush.
 Fair grass in E 34 chs.; good grass in W 46 chs.

30 Subdivision lines of Township 27 North Range 8 West

Chains.

- N.0°1'W., bet. secs.10 and 11.
Over rolling land, thru. scattering timber and undergrowth.
Descend 45 ft., over NE. slope.
- 9.00 Draw, 2 chs.wide, course E.
Ascend 35 ft., over SE. slope.
- 14.00 Point of spur, slopes SE.
Descend 45 ft., over NE. slope.
- 26.10 Draw, 2 chs.wide, course SE.
Ascend 60 ft., over S. slope.
- 29.95 Point of spur, slopes SE.
Descend 25 ft., over NE. slope.
- 32.64 A juniper, 14 ins. in diam., on line, marked with 2 notches
on each of N. and S. faces.
- 38.35 Draw, 2 chs.wide, course SE.
Ascend 12 ft., over S. slope.
- 40.00 Set an iron post, 3 ft. long, 1 in. in diam., 26 ins. in
the ground, for $\frac{1}{4}$ sec. cor., marked on brass cap,

$\frac{1}{4}$
S10 | S11
1920

from which,

- A juniper, 20 ins. in diam., brs. S. 81 $\frac{1}{4}$ ° E., 388
lks. dist., marked $\frac{1}{4}$ S 11 BT.
- A juniper, 30 ins. in diam., brs. S. 35 $\frac{1}{2}$ ° W., 331
lks. dist., marked $\frac{1}{4}$ S 10 BT.
- Ascend 25 ft., over S. slope.
- 42.83 A pine, 12 ins. in diam., on line, marked with 2 notches on
each of N. and S. faces.
- 45.00 Spur, slopes S. 80° E.
Descend 34 ft., over N. slope.
- 47.50 Draw, 70 lks. wide, course E.
Ascend 20 ft., over E. slope, to
- 58.70 Draw, 80 lks. wide, course NE.
Descend slightly over NE. slope, to
- 65.00 Draw, 2 chs. wide, course NE.
Ascend 17 ft., over E. slope, to
- 70.00 Draw, 80 lks. wide, course E.
Ascend slightly over SE. slope, to
- 76.00 Draw, 100 lks. wide, course SE.
Ascend 20 ft., over SE. slope, to
- 80.00 Set an iron post, 3 ft. long, 2 ins. in diam., 24 ins. in
the ground, for cor. of secs. 2, 3, 10 and 11, marked on
brass cap,

T27N | R8 W
S 3 | S 2
S10 | S11
1920

from which,

- A pine, 8 ins. in diam., brs. N. 72 $\frac{1}{2}$ ° E., 160 lks.
dist., marked T27N R8W S2 BT.
- A juniper, 16 ins. in diam., brs. S. 85 $\frac{1}{2}$ ° E., 135 lks.
dist., marked T27N R8W S11 BT.
- A juniper, 12 ins. in diam., brs. S. 41 $\frac{1}{2}$ ° W., 165 lks.
dist., marked T27N R8W S10 BT.
- A juniper, 16 ins. in diam., brs. N. 39° W., 175 lks.
dist., marked T27N R8W S3 BT.
- Land, rolling.
Soil, sandy clay loam, 1st rate.
Timber, scattering juniper and pine.
Undergrowth, scattering scrub juniper, prickly ash and
sage brush.
Good grass.

Subdivision lines of Township 27 North, Range 8 West. 31

Chains.

S.89°54'E., on a random line, bet. secs.2 and 11.
 40.00 Set temp. $\frac{1}{4}$ sec.cor.
 80.04 Fall 14 lks.S. of cor. of secs.1,2,11 and 12.
 Thence,
 West, on true line, bet. secs.2 and 11.
 Over rolling land, thru. dense timber and undergrowth.
 Ascend 40 ft., over E. slope.
 3.20 Ridge brs. NW. and SW.
 Descend 45 ft., over W. slope.
 7.10 Head of gully, 20 lks.wide, course S.85°W.
 Ascend 25 ft., over S. slope, to
 15.80 Descend 95 ft., over SW. and W. slopes.
 32.00 Leave dense, and enter scattering timber and undergrowth.
 38.80 Center of draw, 100 lks.wide, course S.
 Ascend slightly over E. slope, to
 40.02 Set an iron post, 3 ft. long, 1 in. in diam., 26 ins. in
 the ground, for $\frac{1}{4}$ sec.cor., marked on brass cap,

$\frac{1}{4}$ S 2
 S 11
 1920

from which,

A juniper, 8 ins. in diam., brs.S.32 $\frac{1}{2}$ °E., 250
 lks. dist., marked $\frac{1}{4}$ S 11 BT.

A juniper, 30 ins. in diam., brs. N.6 $\frac{1}{2}$ °W., 433
 lks. dist., marked $\frac{1}{4}$ S 2 BT.

Ascend 90 ft., over E. and SE. slopes to sec.cor.
 50.06 Road, brs.N. and S.
 80.04 The cor. of secs.2,3,10 and 11.
 Land, rolling.
 Soil, sandy loam, 1st and 2nd rate.
 Timber, juniper and pine; dense in E. 32 chs.; scattering
 elsewhere.
 Undergrowth, prickly ash, scrub juniper and sage brush,
 dense in E. 32 chs.; scattering elsewhere.
 Fair grass.

N.0°1'W., on random line bet. secs.2 and 3.
 40.00 Set temp. $\frac{1}{4}$ sec.cor.
 80.48 Fall 8 lks.W.of cor. of secs. 2,3, 34 and 35, on N.bdy.
 of Tp., hereinbefore described.
 Thence,
 S.0°2' W., on a true line, bet. secs.2 and 3.
 Over rolling land, thru.dense timber and undergrowth.
 Descend 25 ft., over S. slope.
 4.75 Ascend 35 ft. over NE. slope.
 13.70 Ridge, brs.NW. and SE.
 Descend 125 ft., over S. and SE. slopes to $\frac{1}{4}$ sec.cor.
 27.60 Road, brs.NW. and SE.
 Leave dense, and enter scattering timber and undergrowth.
 40.48 Set an iron post.3 ft. long, 1 in. in diam., 26 ins. in
 the ground, for $\frac{1}{4}$ sec.cor., marked on brass cap,

$\frac{1}{4}$
 S 3 | S 2
 1920

and dig pits, 18x18x12 ins., one each N.and S.of post,
 3 ft. dist.
 Ascend 40 ft., over NE. slope.
 48.80 A pine, 14 ins.in diam., on line, marked with 2 notches
 on each of N. and S. faces.
 49.20 Point of spur, slopes SE.
 Descend 57 ft., over S. slope.
 53.00 Draw, 50 lks.wide, course E.
 Ascend 50 ft., over NE. and E. slopes.
 58.78 A juniper, 30 ins.in diam., on line, marked with 2

32 Subdivision lines of Township 27 North, Range 8 West.

Chains.

77.00
80.48

notches on each of N. and S. faces.
Descend 20 ft., over S. slope, to
The cor. of secs. 2, 3, 10 and 11.
Land, rolling.
Soil, sandy and gravelly loam, 2nd rate.
Timber, juniper and pine, dense in N. 27 1/2 chs.; scattering
elsewhere.
Undergrowth, prickly ash, sagebrush and scrub juniper, dense
in N. 27 1/2 chs.; scattering elsewhere.
Fair grass.

40.00

From the cor. of secs. 3, 4, 33 and 34, on the S. bdy. of the
Tp. described in Book "D,"
Over nearly level land, thru. dense timber and under-
growth.
Descend very gradually over NE. slope, to
Set an iron post, 3 ft. long, 1 in. in diam., 26 ins. in
the ground, for 1/4 sec. cor., marked on brass cap,



from which,

A juniper, 20 ins. in diam., brs. N. 69 1/2° E., 84
lks. dist., marked 1/4 S 34 BT.

A juniper, 8 ins. in diam., brs. S. 58 1/4° W., 82
lks. dist., marked 1/4 S 33 BT.

Continue over nearly level land, thru. dense timber and
undergrowth, along E. slope, with slight change in
elevation.

65.00
73.80
80.00

Leave mountainous & enter rolling land; asc. 50 ft. over SE. slope.
Spur, slopes NE. Descend 130 ft., over N. slope, to
Set an iron post, 3 ft. long, 2 ins. in diam., 24 ins. in
the ground, for cor. of secs. 27, 28, 33 and 34, marked
on brass cap,

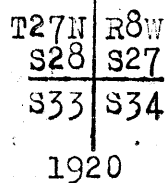

from which,

A pine, 12 ins. in diam., brs. N. 24 1/2° E., 64 lks.
dist., marked T27N R8W S27 BT.

A pine, 12 ins. in diam., brs. S. 62 1/4° E., 160 lks.
dist., marked T27N R8W S34 BT.

A pine, 12 ins. in diam., brs. S. 28 1/2° W., 50 lks.
dist., marked T27N R8W S33 BT.

A pine, 12 ins. in diam., brs. N. 30 1/2° W., 21 lks.
dist., marked T27N R8W S28 BT.

Land, S. 65 chs., nearly level; N. 15 chs., rolling.
Soil, sandy and gravelly clay loam, 1st and 2nd rate.
Timber, dense juniper and pine.
Undergrowth, dense prickly ash and scrub juniper, sage
brush and manzanita.
Fair grass.

40.00
80.04

East, on a random line, bet. secs. 27 and 34.
Set temp. 1/4 sec. cor.
Fall 3 lks. N. of cor. of secs. 26, 27, 34 and 35.
Thence,
N. 89° 59' W., on a true line, bet. secs. 27 and 34.
Over mountainous land, thru. dense timber and undergrowth.

Subdivision lines of Township 27 North, Range 8 West. 33

Chains.

- 11.00 Ascend 60 ft., over NE. slope.
Spur, slopes SE.
- 18.60 Descend 107 ft., over SW. slope.
Bottom of ravine, 50 lks. wide, course SE. Thence along steep high S. side of same.
- 40.02 Ascend 210 ft., over NE. and N. slope, to
Set an iron post, 3 ft. long, 1 in. in diam., 20 ins. in the ground to bed rock, and raise a mound of stone around post, for 1/4 sec. cor., marked on brass cap,

$\frac{1}{4}$ S 27
 S 34
 1920

from which,

- A juniper, 10 ins. in diam., brs. S. 12 3/4° E., 25 lks. dist., marked 1/4 S 34 BT.
- A pine, 8 ins. in diam., brs. N. 77 1/4° W., 45 lks. dist., marked 1/4 S 27 BT.

- 44.90 Descend 55 ft., over NW. slope.
Bottom of same ravine, 70 lks. wide, course NW. for about 3 chs., thence E.
- 48.00 Ascend 50 ft., over E. slope, to
Leave mountainous, and enter rolling land.
- 55.40 Ascend 20 ft., over E. slope.
Spur, slopes NE.
- 60.00 Descend 25 ft., over N. slope.
Ascend 50 ft., over NE. and N. slopes, to
- 80.04 The cor. of secs. 27, 28, 33 and 34.
Land, E. 48 chs., mountainous; remainder rolling.
Soil, gravelly and rocky, 2nd and 3rd rate.
Timber, dense juniper and pine.
Undergrowth, dense prickly ash, scrub juniper and scrub oak.
Fair grass.

-
- N. 0° 2' W., bet. secs. 27 and 28.
Over rolling land, thru. dense timber and undergrowth.
 - 7.00 Descend 15 ft., over N. slope.
 - 12.40 Ascend 20 ft., over SE. slope.
 - 35.00 Descend 110 ft. over E. and NE. slopes.
 - 40.00 Ascend 17 ft., over SE. slope, to
Set an iron post 3 ft. long, 1 in. in diam., 26 ins. in the ground, for 1/4 sec. cor., marked on brass cap,

$\frac{1}{4}$
 S 28 | S 27
 1920

from which,

- A juniper, 7 ins. in diam., brs. S. 61° E., 46 lks. dist., marked 1/4 S 27 BT.
- A pine, 12 ins. in diam., brs. S. 25° W., 166 lks. dist., marked 1/4 S 28 BT.

- 43.80 Leave dense, and enter scattering timber.
Ascend 10 ft., over SE. slope.
- 46.80 Descend 28 ft., over NE. slope.
Draw, 70 lks. wide, course E.
- 53.80 Ascend 45 ft., over SE. slope.
Descend 71 ft., over NE. slope, to
- 65.75 Draw, 50 lks. wide, course NE.
Descend 50 ft., over NE. slope, to
- 75.00 Draw, 100 lks. wide, course NE.
Descend slightly over NE. slope, to
- 80.00 Set an iron post 3 ft. long, 2 ins. in diam., 24 ins. in the ground, for cor. of secs. 21, 22, 27 and 28, marked

34 Subdivision lines of Township 27 North, Range 8 West.

Chains.

on brass cap,

T27N	R8W
S21	S22
S28	S27

1920

from which,

- A juniper, 6 ins. in diam., brs. N. 26° E., 140
lks. dist., marked T27N R8W S22 BT.
A pine, 30 ins. in diam., brs. S. 24 $\frac{1}{2}$ ° E., 434
lks. dist., marked T27N R8W S27 BT.
A pine, 30 ins. in diam., brs. S. 78 $\frac{1}{2}$ ° W., 290
lks. dist., marked T27N R8W S28 BT.
A pine, 12 ins. in diam., brs. N. 81 $\frac{1}{2}$ ° W., 226
lks. dist., marked T27N R8W S21 BT.

Land, rolling.

Soil, sandy, clay loam, 1st rate.

Timber, juniper and pine; dense in S. half; scattering
in N. half.Undergrowth, dense scrub juniper, prickly ash and sage
brush.

Fair grass.

- 40.00 S. 89° 59' E., on a random line, bet. secs. 22 and 27.
Set temp. $\frac{1}{4}$ sec. cor.
80.02 Fall 7 lks. N. of the cor. of secs. 22, 23, 26 and 27.
Thence,
N. 89° 56' W., on a true line, bet. secs. 22 and 27.
Over mountainous land, thru. dense timber and undergrowth.
Descend 156 ft., over SW. and W. slopes.
23.20 Gulch, 20 lks. wide, course NE.
Ascend 60 ft., over NE. slope, to
35.85 Gulch, 20 lks. wide, course NE.
Ascend 40 ft., over E. slope, to
40.01 Set an iron post, 3 ft. long, 1 in. in diam., 26 ins. in
the ground, for $\frac{1}{4}$ sec. cor., marked on brass cap,

$\frac{1}{4}$	S. 22
	S 27

1920

from which,

- A juniper, 12 ins. in diam., brs. N. 61 $\frac{1}{2}$ ° E., 20
lks. dist., marked $\frac{1}{4}$ S 22 BT.
A pine, 12 ins. in diam., brs. S. 28 $\frac{1}{2}$ ° E., 187.
lks. dist., marked $\frac{1}{4}$ S 27 BT.
Leave dense, and enter scattering timber.
Ascend 48 ft., over E. slope.
45.20 Ridge, brs. N. and S.
Descend 85 ft., over W. slope, to
54.20 Gulch, 10 lks. wide, course SW. Leave mountainous, and
enter rolling land.
Descend 65 ft., over SW. slope, to
62.00 Draw, 20 lks. wide, course NW.
Ascend 45 ft. over E. and NE. slopes to sec. cor.
63.84 Trail, brs. NW. and SE.
80.02 The cor. of secs. 21, 22, 27 and 28.
Land, E. 54 chs, mountainous; remainder, rolling.
Soil, sandy and gravelly clay loam, 1st and 3rd rate.
Timber, juniper and pine, dense in E. half; scattering
in W. half.
Undergrowth, dense scrub oak, scrub juniper and prickly
ash.
No grass in E. half; fair grass in W. half.

Subdivision lines of Township 27 North, Range 8 West. 35

Chains.

N. 0°2'W., bet. secs. 21 and 22.
 Over rolling land, thru. scattering timber and dense undergrowth.
 Descend 75 ft., over NE. and N. slopes.
 17.40 Draw, 100 lks. wide, course NW. Leave rolling land and scattering timber, and enter mountainous land and dense timber.
 Ascend 156 ft., over SW. slope.
 30.00 Descend 30 ft.
 36.10 Gulch, 20 lks. wide, course NW.
 Ascend 50 ft., over SW. slope, to
 40.00 Set an iron post, 3 ft. long, 1 in. in diam., 26 ins. in the ground, for $\frac{1}{4}$ sec. cor., marked on brass cap,

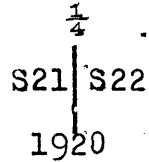

from which,
 A pine, 6 ins. in diam., brs. N. 1 $\frac{1}{2}$ ° E., 51 lks. dist., marked $\frac{1}{4}$ S 22 BT.
 A pine, 12 ins. in diam., brs. N. 4 $\frac{1}{2}$ ° W., 47 lks. dist., marked $\frac{1}{4}$ S 21 BT.

Ascend 82 ft., over SW. slope.
 52.10 NW. end of ridge, brs. NW. and SE.
 Descend 302 ft., over N. slope to sec. cor.
 66.50 Leave dense, and enter scattering timber.
 80.00 Set an iron post, 3 ft. long, 2 ins. in diam., 24 ins. in the ground, for cor. of secs. 15, 16, 21 and 22, marked on brass cap,

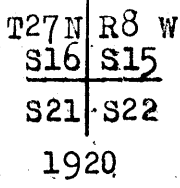

from which,
 A pine, 36 ins. in diam., brs. S. 30° E., 483 lks. dist., marked T27N R8W S22 BT.
 A pine 27 ins. in diam., brs. S. 23 $\frac{1}{2}$ ° W., 390 lks. dist., marked T27N R8W S21 BT.
 and dig pits 18x18x12 ins., one each NE., SE., SW. and NW. of post, 3 ft. dist.

Land, S. 17 $\frac{1}{2}$ chs. rolling; remainder, mountainous.
 Soil, sandy, gravelly and rocky loam, 3rd rate.
 Timber, pine and juniper, scattering in S. 17 $\frac{1}{2}$ chs. and N. 13 $\frac{1}{2}$ chs.; dense elsewhere.
 Undergrowth, dense scrub juniper, prickly ash and broom weed.
 Fair grass.

S. 89°56' E., on a random line, bet. secs. 15 and 22.
 40.00 Set temp. $\frac{1}{4}$ sec. cor.
 80.00 Intersect the cor. of secs. 14, 15, 22 and 23.
 Thence,
 N. 89°56' W., on a true line, bet. secs. 15 and 22.
 Over rolling land, thru. dense timber and undergrowth.
 Ascend 60 ft., over NE. slope.
 14.30 Leave dense, and enter scattering timber.
 Descend 65 ft., over NW. slope.
 21.50 Gully, 10 lks. wide, course NE.
 Ascend 130 ft., over NE. slope.
 37.00 Descend slightly over N. slope, to

36 Subdivision lines of Township 27 North, Range 8 West.

Chains.

40.00 Set an iron post 3 ft. long, 1 in. in diam., 26 ins. in the ground, for $\frac{1}{4}$ sec. cor., marked on brass cap,

$\frac{1}{4}$ S 15
S 22
1920

from which,

A juniper, 30 ins. in diam., brs. S. $76\frac{1}{2}^{\circ}$ E., 312 lks. dist., marked $\frac{1}{4}$ S 22 BT.

A juniper, 6 ins. in diam., brs. N. $78\frac{1}{2}^{\circ}$ W., 31 lks. dist., marked $\frac{1}{4}$ S 15 BT.

Descend 70 ft., over NW. slope.

50.30 Draw, 150 lks. wide, course N. Leave rolling and enter mountainous land.

Ascend 85 ft., over NE. slope.

59.00 Spur, slopes N.

Descend 120 ft., over W. slope.

64.40 Bottom of gulch, 100 lks. wide, course NW.

Ascend 86 ft., over NE. slope.

68.00 Descend 30 ft., over N. slope.

75.00 Ascend 20 ft., over N. slope, to

80.00 The cor. of secs. 15, 16, 21 and 22.

Land, E. 50 chs.; rolling, remainder mountainous.

Soil, sandy, gravelly and rocky, 3rd rate.

Timber, juniper and pine, dense in E. 14 chs.; scattering elsewhere.

Undergrowth, dense scrub oak, scrub juniper and sagebrush. Fair grass.

N. $0^{\circ} 2' W.$, bet. secs. 15 and 16.

Over mountainous land, thru. scattering timber and undergrowth.

Descend 50 ft., over N. slope.

6.50 Center of draw, 6 chs. wide, course E.

Ascend 29 ft. over S. slope.

14.90 Point of spur, slopes E.

Descend 22 ft., over N. slope.

24.90 Draw, 100 lks. wide, course SE.

Ascend 72 ft., over SW. slope.

29.80 Spur, slopes SE.

Descend 45 ft., over NE. slope, to

40.00 Set an iron post, 3 ft. long, 1 in. in diam., 26 ins. in the ground, for $\frac{1}{4}$ sec. cor., marked on brass cap,

$\frac{1}{4}$
S 16 | S 15
1920

from which,

A juniper, 12 ins. in diam., brs. N. 16° E., 128 lks. dist., marked $\frac{1}{4}$ S 15 BT.

A juniper, 20 ins. in diam., brs. N. $89\frac{1}{2}^{\circ}$ W., 241 lks. dist., marked $\frac{1}{4}$ S 16 BT.

Descend 44 ft., over NE. slope.

45.08 Gulch, 20 lks. wide, course SE.

Ascend 142 ft., over SW. slope.

64.00 Spur, slopes SE.

Descend 90 ft., over NE. slope.

71.85 Gulch, 30 lks. wide, course E.

Ascend 120 ft., over SW. slope, to

80.00 Point of spur, sloping SE. from N. Set an iron post, 3 ft. long, 2 ins. in diam., 10 ins. in the ground to bed-rock, deposit a stone, marked with a cross (x) at base of post, and raise a mound of stone around post, for cor. of secs. 9, 10, 15 and 16, marked on brass cap,

Subdivision lines of Township 27 North, Range 8 West. 37

Chains.

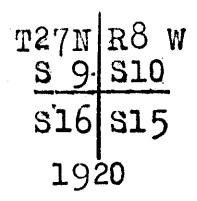

from which,
 A juniper, 24 ins. in diam., brs. N. 54 $\frac{3}{4}$ ° E., 36 lks. dist., marked T27N R8W S10 BT.
 A pine, 8 ins. in diam., brs. S. 26 $\frac{3}{4}$ ° E., 6 lks. dist., marked T27N R8W S15 BT.
 A juniper, 30 ins. in diam., brs. S. 83 $\frac{3}{4}$ ° W., 62 lks. dist., marked T27N R8W S16 BT. No other trees available.

Land, mountainous.
 Soil, sandy, gravelly and rocky, 3rd rate.
 Timber, scattering juniper and pine.
 Undergrowth, scattering scrub juniper and sagebrush.
 Fair grass.

40.00 S. 89° 56' E., on random line, bet. secs. 10 and 15.
 79.90 Set temp. $\frac{1}{4}$ sec. cor.
 Fall 5 lks. N. of cor. of secs. 10, 11, 14 and 15.
 Thence,
 N. 89° 54' W., on a true line, bet. secs. 10 and 15.
 Over rolling land, thru. scattering timber and undergrowth.
 Descend 34 ft., over SW. slope.
 20.00 Ascend 120 ft., over SE. slope, to
 39.95 Set an iron post, 3 ft. long, 1 in. in diam., 26 ins. in the ground, for $\frac{1}{4}$ sec. cor., marked on brass cap,

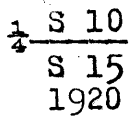

from which,
 A juniper, 10 ins. in diam., brs. S. 34 $\frac{3}{4}$ ° E., 142 lks. dist., marked $\frac{1}{4}$ S 15 BT.
 A pine, 12 ins. in diam., brs. N. 44 $\frac{3}{4}$ ° W., 135 lks. dist., marked $\frac{1}{4}$ S 10 BT.

Ascend 200 ft., over SE. slope.
 58.00 Leave rolling, and enter mountainous land.
 62.65 Spur, slopes S.
 Descend 75 ft., over W. slope.
 73.00 Gulch, 50 lks. wide, course S.
 Ascend 140 ft., over E. slope, to
 79.90 The cor. of secs. 9, 10, 15 and 16.
 Land, E. 58 chs., rolling, remainder, mountainous.
 Soil, gravelly and rocky, 3rd and 4th rate.
 Timber, scattering juniper and pine.
 Undergrowth, scattering prickly ash, scrub juniper and sagebrush.
 Fair grass.

5.00 N. 0° 2' W., bet. secs. 9 and 10.
 Over mountainous land, thru. dense timber and undergrowth.
 Along top of spur, sloping S. Ascend slightly to
 Leave top of spur, sloping S. from NW.
 Descend 17 ft., over NE. slope.
 10.00 Head of gulch, course E.
 Ascend 30 ft., over SE. slope.
 20.80 Spur, slopes NE.
 Descend 84 ft., over N. slope.
 26.70 Deep gulch, 50 lks. wide, course N. 70° E.
 Ascend 90 ft., over $\frac{1}{2}$ S. slope.
 34.00 Point of spur, slopes NE.

38 Subdivision lines of Township 27 North, Range 8 West.

Chains.

40.00 Descend 20 ft., over N. slope, to
Set an iron post, 3 ft. long, 1 in. in diam., 26 ins. in
the ground, for $\frac{1}{4}$ sec. cor., marked on brass cap,

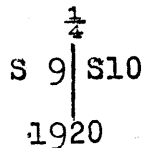

from which,

A juniper, 10 ins. in diam., brs. N. $41\frac{1}{2}^{\circ}$ E., 112
lks. dist., marked $\frac{1}{4}$ S 10 BT.

A pine, 12 ins. in diam., brs. S. $46\frac{1}{2}^{\circ}$ W., 75 lks.
dist., marked $\frac{1}{4}$ S 9 BT.

40.90 Descend 24 ft., over N. slope.
Gulch, 50 lks. wide, course S. 70° E.
Ascend 130 ft., over S. slope.

48.70 Point of spur, slopes S. 70° E.
Descend 85 ft., over NE. slope.

57.50 Gulch, 40 lks. wide, course SE.
Ascend 36 ft., over S. slope.

60.80 Descend 127 ft., over NE. slope.

71.30 Gulch, 150 lks. wide, course SE.

Ascend 102 ft., over SW. slope, to

80.00 Set an iron post, 3 ft. long, 2 ins. in diam., 8 ins. in
the ground to bed rock, and raise a mound of stone
around post, for cor. of secs. 3, 4, 9 and 10, marked
on brass cap,

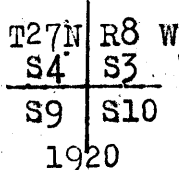

from which,

A pine, 16 ins. in diam., brs. N. $48\frac{1}{2}^{\circ}$ E., 30 lks.
dist., marked T27N R8W S3 BT.

A pine, 10 ins. in diam., brs. S. $61\frac{1}{2}^{\circ}$ E., 62 lks.
dist., marked T27N R8W S10 BT.

A pine, 10 ins. in diam., brs. S. 50° W., 23 lks.
dist., marked T27N R8W S9 BT.

A pine, 8 ins. in diam., brs. N. $76\frac{1}{2}^{\circ}$ W., 52 lks.
dist., marked T27N R8W S4 BT.

Land, mountainous.

Soil, rocky, 4th rate.

Timber, dense juniper and pine.

Undergrowth, dense prickly ash, scrub oak, scrub juniper
and broomweed.

Fair grass.

40.00 S. $89^{\circ}54'$ E., on random line, bet. secs. 3 and 10.
Set temp. $\frac{1}{4}$ sec. cor.

79.94 Fall 14 lks. S. of cor. of secs. 2, 3, 10 and 11.
Thence,

West, on true line, bet. secs. 3 and 10.

Over rolling land, thru. scattering timber and under-
growth.

2.90 Ascend 13 ft., over SE. slope.

6.00 Descend 13 ft., over SW. slope.

Draw, 2 chs. wide, course SE.

24.00 Ascend 70 ft. over SE. slope, to

Draw, 90 lks. wide, course SE.

Ascend 45 ft., over E. slope.

35.04 Spur, slopes SE. Leave scattering, and enter dense timber
and undergrowth.

Descend slightly over SW. slope, to

39.97 Set an iron post, 3 ft. long, 1 in. in diam., 26 ins. in

Subdivision lines of Township 27 North, Range 8 West. 39

Chains.

the ground, for 1/4 sec.cor., marked on brass cap,

1/4 S 3
S 10
1920

from which,

A pine, 6 ins.in diam., brs.N.45 1/2°W., 76 lks.
dist., marked 1/4 S 3 BT.

A pine, 14 ins. in diam., brs.S.33 3/4°W., 63 lks.
dist., marked 1/4 S 10 BT.

Ascend 30 ft., over S.slope, to
50.00 Leave rolling, and enter mountainous land.
Ascend 143 ft., over S. slope, to
61.00 Ascend 193 ft., over E.slope.
70.80 Spur, slopes SE.
Descend 90 ft., over SW. slope, to
79.94 The cor.of secs.3, 4, 9 and 10.
Land, E. 50 chs. rolling; remainder, mountainous.
Timber, juniper and pine, scattering in E. 35 chs.; dense
elsewhere.
Undergrowth, prickly ash, scrub oak, scrub juniper and
broomweed, scattering in E. 35 chs.; dense elsewhere.
Fair grass.
Soil, gravelly and rocky, 3rd and 4th rate.

N.0°1'E., on random line, bet. secs,3 and 4.
40.00 Set temp.1/4 sec.cor..
80.43 Fall 7 lks.W.of cor.of secs.3, 4, 33 and 34, on the N. bdy.
of the Tp., hereinbefore described.
Thence,
S.0°4'W., on a true line, bet. secs.3 and 4.
Over mountainous land, thru. dense timber and undergrowth.
Descend 77 ft., over SE.slope.
6.55 Gulch, 20 lks.wide, course NE.
Ascend 206 ft., over NW. slope.
30.70 Spur, slopes NE.
Descend 20 ft., over SE.slope, to
40.43 Set an iron post, 3 ft.long, 1 in. in diam., 26 ins.in
the ground, for 1/4 sec.cor., marked on brass cap,

1/4
S 4 S 3
1920

from which,

A pine, 24 ins.in diam., brs.N.62 1/2°E., 10 lks.
dist., marked 1/4 S 3 BT.

A juniper, 8 ins. in diam., brs.N.86 1/2°W., 100 lks.
dist., marked 1/4 S 4 BT.

Ascend 30 ft., over NE.slope.
60.50 Spur, slopes S. from NW. Thence along top of same.De-
scending slightly to
65.20 Leave top of spur, slopes SE. from N.
Descend 80 ft., over SW.slope, to
80.43 The cor.of secs.3, 4, 9 and 10.
Land, mountainous.
Soil, gravelly and rocky, 3rd and 4th rate.
Timber, dense juniper and pine.
Undergrowth, dense prickly ash, scrub juniper and scrub
oak.
Fair grass.

From the cor.of secs.4, 5, 32 and 33, on the S. bdy.of the
Tp., described in Book "D,"
Over mountainous land, thru. dense timber and undergrowth.
Descend 17 ft., over NW.slope, to

40 Subdivision lines of Township 27 North, Range 8 West.

Chains.

- 6.10 Gulch, 50 lks.wide, course W.
Descend 20 ft., over W. slope.
- 11.80 A juniper, 12 ins. in diam., on line, marked with 2 notches
on each of N. and S. faces.
- 14.30 Gulch, 25 lks.wide, course SW.
Ascend 130 ft., over S. slope.
- 28.00 Spur, slopes SW.
Descend 20 ft., over NW. slope.
- 33.10 Head of gulch, course SW.
Ascend 36 ft., over S. slope.
- 35.80 Ridge, brs. E. and W.
Descend 10 ft., over N. slope, to
- 40.00 Set an iron post, 3 ft. long, 1 in. in diam., 26 ins. in
the ground, for $\frac{1}{4}$ sec. cor., marked on brass cap,

$\frac{1}{4}$
S32 | S33
1920

from which,

- A pine, 8 ins. in diam., brs. S. $21\frac{1}{2}^{\circ}$ W., 125 lks.
dist., marked $\frac{1}{4}$ S 32 BT.
- A juniper, 12 ins. in diam., brs. S. $51\frac{1}{2}^{\circ}$ E., 56 lks.
dist., marked $\frac{1}{4}$ S 33 BT.
- 40.20 Head of gulch, 20 lks.wide, course W.
Ascend 30 ft. over S. slope.
- 45.00 Spur, slopes NW. from E.
Descend 60 ft., over N. slope.
- 52.30 Gulch, 50 lks.wide, course NW..
Ascend 70 ft., over S. slope.
- 57.60 Spur, slopes W.
Descend 110 ft., over N. slope.
- 67.00 Gulch, 50 lks.wide, course W.
Ascend 84 ft., over S. slope.
- 75.80 Spur, slopes W. from NE.
Descend 15 ft., over NW. slope, to
- 80.00 Set an iron post, 3 ft. long, 2 ins. in diam., 24 ins. in
the ground, for cor. of secs. 28, 29, 32 and 33, marked
on brass cap,

T27N | R8W
S29 | S28
S32 | S33
1920

from which,

- A juniper, 12 ins. in diam., brs. N. 24° E., 50 lks.
dist., marked T27N R8W S28 BT.
- A juniper, 30 ins. in diam., brs. S. 55° E., 110 lks.
dist., marked T27N R8W S33 BT.
- A juniper, 14 ins. in diam., brs. S. 7° W., 129 lks.
dist., marked T27N R8W S32 BT.
- A pine, 16 ins. in diam., brs. N. 67° W., 113 lks.
dist., marked T27N R8W S29 BT.
- Land, mountainous.
Soil, gravelly and rocky, 4th rate.
Timber, dense juniper and pine, and scattering cedar.
Undergrowth, dense scrub oak and prickly ash.
No grass.

- 40.00 East, on a random line, bet. secs. 28 and 33.
Set temp. $\frac{1}{4}$ sec. cor.
- 79.92 Fall 9 lks. N. of the cor. of secs. 27, 28, 33 and 34.
Thence,
N. $89^{\circ}56'$ W., on a true line, bet. secs. 28 and 33,
Over rolling land, thru. dense timber and undergrowth.
Descend 100 ft., over NW. slope, to

Subdivision lines of Township 27 North, Range 8 West. 41

Chains.
 25.00 Gulch, 50 lks.wide, course NW. Leave rolling, and enter mountainous land.
 Descend 25 ft., over N.slope, to
 30.00 Gulch, 1 ch. wide, course N.
 Ascend 30 ft., over N.slope, to
 38.50 Gulch, 20 lks.wide, course N.
 Ascend 15 ft., over N.slope, to
 39.96 Set an iron post, 3 ft.long, 1 in. in diam., 26 ins.in the ground, for $\frac{1}{4}$ sec.cor., marked on brass cap,

$\frac{1}{4}$ S 28
 S 33
 1920

from which,

A juniper, 24 ins. in diam., brs.N.66°W., 51 lks.dist., marked $\frac{1}{4}$ S 28 BT.
 A pine, 18 ins. in diam., brs.S.10°W., 38 lks.dist., marked $\frac{1}{4}$ S 33 BT.

Ascend 50 ft., over NE.slope.
 45.00 Ridge, brs.NW. and SE.
 Descend 60 ft., over SW.slope.
 51.20 Head of gulch, course SW.
 Ascend 20 ft., over S.slope.
 54.70 Spur, slopes SW.
 Descend 50 ft., over W.slope.
 61.30 Gulch, 20 lks.wide, course SW.
 Ascend 30 ft., over SE.slope.
 71.90 Spur, slopes SW.
 Descend 30 ft., over NW.slope, to
 79.92 The cor.of secs. 28, 29, 32 and 33.
 Land, E.25 chs., rolling; remainder, mountainous.
 Soil, gravelly and rocky, 4th rate.
 Timber, pine, juniper and cedar.
 Undergrowth, dense scrub oak and prickly ash.
 No grass.

N.0°3' W., bet. secs. 28 and 29.
 Over mountainous land, thru. dense timber and undergrowth.
 Descend 40 ft., over NW.slope.
 2.74 Gulch, 15 lks.wide, course W.
 Ascend 100 ft., over SW.slope, to
 23.30 Point of short spur, slopes W. Ascend 40 ft. to
 31.00 Ridge, brs.NW. and SE.
 Descend 10 ft., over NE.slope.
 32.00 Head of gulch, 20 lks.wide, course NE.
 Ascend 30 ft., over E.slope.
 37.00 .Point of small spur, slopes NE.
 Descend 20 ft., over N. slope.
 40.00 Head of gulch, course NE. Set an iron post, 3 ft.long, 1 in. in diam., 26 ins.in the ground, for $\frac{1}{4}$ sec.cor., marked on brass cap,

$\frac{1}{4}$
 S29 | S28
 1920

from which,

A pine, 16 ins. in diam., brs.S.85°E., 326 lks. dist., marked $\frac{1}{4}$ S 28 BT.
 A pine, 18 ins. in diam., brs.S.70°W., 32 lks. dist., marked $\frac{1}{4}$ S 29 BT.

Ascend 20 ft., over SE.slope.
 43.00 Spur, slopes NE.
 Descend 75 ft., over N.slope.
 48.00 Head of gulch, 25 lks.wide, course NE., Leave mountainous, and enter rolling land.

42 Subdivision lines of Township 27 North, Range 8 West.

Chains.

53.30 Ascend 30 ft., over SE. slope.
Spur, slopes NE.
70.40 Descend 100 ft., over N. slope, to
Gully, 15 lks. wide, course NE.; thence across small area
of level land, bearing NE. and SW.
75.00 Leave level land.
Ascend 24 ft., over SE. slope.
78.80 Point of small spur, slopes E.
Descend 12 ft., over NE. slope, to
80.00 Gully, 20 lks. wide, course SE.
Set an iron post 3 ft. long, 2 ins. in diam., 24 ins. in
the ground, for cor. of secs. 20, 21, 28 and 29, marked on
brass cap,

T27N	R8W
S20	S21
S29	S28

1920

from which,

A pine, 30 ins. in diam., brs. N. 75° E., 232 lks.
dist., marked T27N R8W S21 BT.
A pine, 24 ins. in diam., brs. S. 49½° E., 142 lks.
dist., marked T27N R8W S28 BT.
A pine, 14 ins. in diam., brs. S. 13° W., 53 lks.
dist., marked T27N R8W S29 BT.
A pine, 36 ins. in diam., brs. N. 81½° W., 194 lks.
dist., marked T27N R8W S20 BT.
Land, S. 48 chs., mountainous, remainder, rolling.
Soil, gravelly and rocky, 4th rate.
Timber, dense juniper and pine, and scattering cedar.
Undergrowth, dense scrub oak and prickly ash.
No grass.

40.00 S. 89° 56' E., on random line, bet. secs. 21 and 28.
Set temp. ¼ sec. cor.
79.98 Fall 5 lks. S. of the cor. of secs. 21, 22, 27 and 28.
Thence,
N. 89° 58' W., on a true line, bet. secs. 21 and 28.
Over rolling land, thru. scattering timber and dense
undergrowth.
Ascend 90 ft., over NE. and E. slopes.
15.30 Spur, slopes N.
Descend 16 ft., over NW. slope.
19.10 Draw, 75 lks. wide, course NE. Leave scattering, and enter
dense timber.
Ascend 80 ft., over NE. slope.
34.60 Spur, slopes NW.
Descend 20 ft., over W. slope, to
39.99 Set an iron post, 3 ft. long, 1 in. in diam., 26 ins. in
the ground, for ¼ sec. cor., marked on brass cap,

¼	S 21
	S 28

1920

from which,

A juniper, 12 ins. in diam., brs. N. 44° E., 94
lks. dist., marked ¼ S 21 BT.
A pine, 18 ins. in diam., brs. S. 38° W., 73 lks.
dist., marked ¼ S 28 BT.
Descend 25 ft., over W. slope.
43.90 Gully, 15 lks. wide, course N.
Ascend 15 ft., over E. slope.
50.20 Spur, slopes N.
Descend 80 ft., over W. slope, to
63.70 Enter small area of level land, brs. N. and S.

Subdivision lines of Township 27 North, Range 8 West.

Chains.

- 67.40 Wash, 10 lks.wide, course N.
 - 70.30 Wash, 10 lks.wide, course NE.
Leave level, and enter rolling land.
Ascend 46 ft., over E.slope.
 - 77.00 Point of spur, slopes SE. Desc. 15 ft., over SW.slope, to
 - 79.98 The cor. of secs. 20, 21, 28 and 29 in gully, course SE.
Land, rolling.
Soil, gravelly and rocky, 4th rate.
Timber, juniper, pine and cedar, scattering in E. 19 chs.;
dense elsewhere.
Undergrowth, dense scrub oak and prickly ash, No grass.
-
- N. 0° 3' W., bet. secs. 20 and 21.
Over mountainous land, thru. dense timber and undergrowth.
Ascend 30 ft., over SW.slope.
 - 3.00 Spur, slopes SE. Descend 50 ft., over NE.slope.
 - 6.90 Gulch, 20 lks.wide, course SE.
Ascend 70 ft., over S.slope.
 - 13.20 Spur, slopes NE. from NW.
Descend 100 ft., over N.slope.
 - 18.53 Gulch, 10 lks.wide, course E.
Ascend 60 ft., over S.slope.
 - 24.70 Spur, slopes NE.
Descend 80 ft., over N.slope.
 - 28.60 Gulch, 10 lks.wide, course E.
Ascend 30 ft., over SE.slope, to
 - 40.00 Spur, slopes NE. Set an iron post, 3 ft. long, 1 in. in diam.,
26 ins. in the ground, for $\frac{1}{4}$ sec. cor., marked on brass
cap,

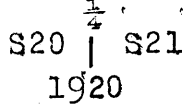

- from which,
- A pine, 12 ins. in diam., brs. S. 58° E., 22 lks.
dist., marked $\frac{1}{4}$ S 21 BT.
- A juniper, 10 ins. in diam., brs. S. 16° W., 69 lks.
dist., marked $\frac{1}{4}$ S 20 BT.

- Descend 100 ft., over N.slope.
- 47.30 Gulch, 30 lks.wide, course NE. Asc. 100 ft. over SE.slope.
- 60.00 Spur, slopes NE.
Descend 60 ft., over N.slope.
- 72.50 Head of gulch, 20 lks.wide, course E.
Ascend 20 ft., over S.slope.
- 76.00 Spur, slopes NE.
Descend slightly over NW.slope.
- 77.00 Head of gulch, 20 lks.wide, course NW. for 50 lks., thence N.
Descend 70 ft., over NW.slope, to
- 80.00 Set an iron post, 3 ft. long, 2 ins. in diam., 24 ins. in
the ground, for cor. of secs. 16, 17, 20 and 21, marked
on brass cap,

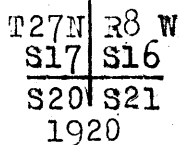

- from which,
- A pine, 20 ins. in diam., brs. N. 15 $\frac{1}{2}$ ° E., 238 lks.
dist., marked T27N R8W S16 BT.
- A juniper, 24 ins. in diam., brs. S. 46° E., 80 lks.
dist., marked T27N R8W S21 BT.
- A pine, 20 ins. in diam., brs. S. 38 $\frac{1}{2}$ ° W., 183 lks.
dist., marked T27N R8W S20 BT.
- A juniper, 30 ins. in diam., brs. N. 70° W., 185 lks.
dist., marked T27N R8W S17 BT.

Land, mountainous.
Soil, gravelly and rocky, 4th rate.
Timber, dense juniper, pine and cedar.
Undergrowth, dense scrub oak and prickly ash.
No grass.

44. Subdivision lines of Township 27 North, Range 8 West.

Chains.

- S. $89^{\circ}58'$ E., on random line, bet. secs. 16 and 21.
 40.00 Set temp. $\frac{1}{4}$ sec. cor.
 80.00 Fall 13 lks. S. of the cor. of secs. 15, 16, 21 and 22.
 Thence,
 S. $89^{\circ}56'$ W., on a true line; bet. secs. 16 and 21.
 Over mountainous land, thru. scattering timber & undergrowth.
 Ascend 17 ft., over N. slope, to
 5.00 Descend 47 ft., over NW. slope, to
 9:50 Gulch, 80 lks. wide, course N. Asc. 147 ft., over NE. slope.
 13.00 Point of spur, slopes N. Desc. 50 ft., over NW. slope.
 15:60 Gulch, 20 lks. wide, course N. Asc. 60 ft., over NE. slope.
 24.26 Center of dam, brs. N. $37^{\circ}45'$ E., 6 chs. dist.
 Descend 50 ft., over NW. slope.
 39.25 Gully, 20 lks. wide, course NE. Asc. 12 ft., over SE. slope, to
 40.00 Set an iron post 3 ft. long, 1 in. in diam., 26 ins. in the
 ground, for $\frac{1}{4}$ sec. cor., marked on brass cap,

$$\frac{1}{4} \begin{array}{l} S 16 \\ S 21 \\ 1920 \end{array}$$
 from which,
 A forked pine, 24 ins. in diam., brs. N. $62\frac{1}{2}^{\circ}$ E.,
 397 lks. dist., marked $\frac{1}{4}$ S 16 BT.
 A pine, 16 ins. in diam., brs. S. 28° W., 31
 lks. dist., marked $\frac{1}{4}$ S 21 BT.
 Leave scattering, and enter dense timber.
 Ascend 130 ft., over SE. slope.
 52.00 Point of spur, slopes S. Desc. 80 ft., over SW. slope.
 59.00 Gulch, 50 lks. wide, course SE. Asc. 190 ft., over NE. slope.
 76.50 Point of spur, slopes N. from SW. Desc. 40' ft. over NW. slope, to
 80.00 The cor. of secs. 16, 17, 20 and 21.
 Land, mountainous.
 Soil, gravelly and rocky, 4th rate.
 Timber, juniper and pine, scattering in E. $\frac{1}{2}$; dense in W. $\frac{1}{2}$.
 Undergrowth, scattering scrub oak and prickly ash. No grass.
-
- N. $0^{\circ}3'$ W., bet. secs. 16 and 17.
 Over mountainous land, thru. dense timber and scattering
 undergrowth. Descend 50 ft., over NW. slope, to
 2.50 Gulch, 20 lks. wide, course NE. Desc. 30 ft., over E. slope.
 10.15 Gulch, 10 lks. wide, course SE.
 Ascend 210 ft., over S. slope.
 37.90 Ridge, brs. W. and NE. Leave dense, and enter scattering timber.
 Descend 20 ft., over N. slope, to
 40.00 Set an iron post, 3 ft. long, 1 in. in diam., 26 ins. in the
 ground, for $\frac{1}{4}$ sec. cor., marked on brass cap,

$$\frac{1}{4} \begin{array}{l} S 17 \\ S 16 \\ 1920 \end{array}$$
 from which,
 A pine, 20 ins. in diam., brs. N. $53\frac{1}{2}^{\circ}$ E., 155 lks.
 dist., marked $\frac{1}{4}$ S 16 BT.
 A pine, 10 ins. in diam., brs. N. 22° W., 173 lks.
 dist., marked $\frac{1}{4}$ S 17 BT.
 Descend 64 ft., over NW. slope.
 44.20 Gulch, 5 lks. wide, course NW. near head.
 Ascend 23 ft.; over SW. slope.
 47.40 Point of spur, slopes NW.
 Descend 75 ft., over N. slope.
 55.40 Gulch, 100 lks. wide, course NE.
 Ascend 90 ft.; over SE. slope.
 69.40 Point of spur, slopes NE.
 Descend 100 ft.; over N. slope.
 76.15 Gulch, 20 lks. wide, course E.
 Ascend 80 ft., over S. slope, to

Subdivision lines of Township 27 North, Range 8 West. 45

Chains.

80.00 Set an iron post, 3 ft. long, 2 ins. in diam., 24 ins. in the ground, for cor. of secs. 8, 9, 16 and 17, marked on brass cap,

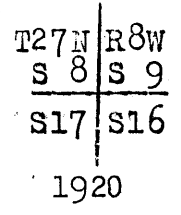

from which,
 A pine, 30 ins. in diam., brs. S. 13° E., 495 lks. dist., marked T27N R8W S16 BT.
 A pine, 28 ins. in diam., brs. S. 78 1/4° W., 366 lks. dist., marked T27N R8W S17 BT.
 A pine, 12 ins. in diam., brs. N. 15 1/4° W., 408 lks. dist., marked T27N R8W S8 BT.
 and raise a mound of stone, 2 ft. base, 1 1/2 ft. high, W. of cor.

Land, mountainous.
 Soil, gravelly and rocky, 4th rate.
 Timber, juniper and pine, dense in S. 38 chs.; scattering elsewhere.
 Undergrowth, scattering scrub oak and prickly ash.
 No grass.

40.00 N. 89° 56' E., on a random line, bet. secs. 9 and 16.
 Set temp. 1/4 sec. cor.
 80.08 Fall 3 lks. S. of the cor. of secs. 9, 10, 15 and 16, Thence,
 S. 89° 55' W., on a true line, bet. secs. 9 and 16.
 Over mountainous land, thru. scattering timber and undergrowth.
 Descend 80 ft., over SW. slope.
 9.40 Gulch, 10 lks. wide, course SE. Asc. 75 ft., over E. slope.
 14.30 Spur, slopes S. Desc. 135 ft., over W. slope.
 23.98 A pine, 4 ins. in diam., on line, marked with 2 notches on each of E. and W. faces.
 24.50 Gulch, 30 lks. wide, course SW. at this point, general course SE.
 Ascend 60 ft., over E. slope, to
 40.04 Set an iron post, 3 ft. long, 1 in. in diam., 24 ins. in the ground, for 1/4 sec. cor., marked on brass cap,

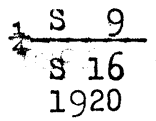

from which,
 A juniper, 8 ins. in diam., brs. N. 9 1/2° W., 90 lks. dist., marked 1/4 S 9 BT.
 A pine, 30 ins. in diam., brs. S. 9 1/2° E., 67 lks. dist., marked 1/4 S 16 BT.

Leave scattering and enter dense timber.
 Ascend 100 ft., over E. slope.
 51.08 Spur, slopes NE.
 Descend 80 ft., over NW. slope.
 62.08 Gulch, 20 lks. wide, course NE.
 Ascend 100 ft., over SE. slope.
 66.88 Point of spur, slopes SE.
 Descend 65 ft., over SW. slope.
 70.48 Gulch, 10 lks. wide, course S. near head; ascend 60 ft., over SE. and S. slopes, to
 80.08 The cor. of secs. 8, 9, 16 and 17.
 Land, mountainous.
 Soil, gravelly and rocky, 4th rate.
 Timber, juniper and pine, scattering in N. 1/4; dense in W. 1/4.

46 Subdivision lines of Township 27 North, Range 8 West.

Chains.

Undergrowth, scattering scrub oak and prickly ash.
No grass.

N. 0° 3' W., bet. secs. 8 and 9.
Over mountainous land, thru. dense timber and scattering undergrowth.

- 5.00 Ascend 70 ft., over S. slope.
Spur, slopes SE.
- 7.80 Descend 50 ft., over NE. slope.
Head of gulch, 20 lks. wide, course NE.
Ascend 22 ft., over SE. slope.
- 13.00 Spur, slopes NE.
Descend 130 ft., over N. slope.
- 21.60 Gulch, 25 lks. wide, course E.
Ascend 33 ft., over S. slope.
- 26.00 Spur, slopes E.
Descend 40 ft., over N. slope.
- 38.85 Gulch, 25 lks. wide, course SE.
Ascend 20 ft., over SW. slope, to
- 40.00 Set an iron post, 3 ft. long, 1 in. in diam., 26 ins. in the ground, for $\frac{1}{4}$ sec. cor., marked on brass cap,

$\frac{1}{4}$
 S 8 | S 9
 1920

from which,

- A pine, 16 ins. in diam., brs. N. 65° E., 38 lks. dist., marked $\frac{1}{4}$ S 9 BT.
- A pine, 24 ins. in diam., brs. S. 50° W., 41 lks. dist., marked $\frac{1}{4}$ S 8 BT.

- 58.00 Ascend 160 ft., over SW. slope.
Point of spur, slopes NW.
- 69.10 Descend 86 ft., over N. slope.
Gulch, 50 lks. wide, course N.
- 80.00 Ascend 160 ft., over SW. slope, to
Set an iron post, 3 ft. long, 2 ins. in diam., 24 ins. in the ground, for cor. of secs. 4, 5, 8 and 9, marked on brass cap,

T27N | R8 W
 S 5 | S 4
 S 8 | S 9
 1920

from which,

- A pine, 24 ins. in diam., brs. N. 40° E., 149 lks. dist., marked T27N R8W S4 BT.
- A pine, 12 ins. in diam., brs. S. 73° E., 249 lks. dist., marked T27N R8W S9 BT.
- A juniper, 28 ins. in diam., brs. S. 11° W., 270 lks. dist., marked T27N R8W S8 BT.
- A juniper, 8 ins. in diam., brs. N. 66 $\frac{1}{2}$ ° W., 150 lks. dist., marked T27N R8W S5 BT.

Land, mountainous.
Soil, gravelly and rocky, 4th rate.
Timber, dense juniper, pine and cedar.
Undergrowth, scattering scrub oak and prickly ash.
No grass.

- 40.00 N. 89° 55' E., on a random line, bet. secs. 4 and 9.
Set temp. $\frac{1}{4}$ sec. cor.
- 80.08 Fall 5 lks. N. of the cor. of secs. 3, 4, 9 and 10.
Thence,

Chains.

- S. 89° 57' W., on a true line, bet. secs. 4 and 9.
Over mountainous land, thru. dense timber and scattering undergrowth.
- 5.10 Descend 95 ft., over SW. slope, to Gulch, 80 lks. wide, course SE.
- 13.10 Ascend 52 ft., over NE. slope.
- 16.00 Descend 44 ft., over NW. slope.
- 31.60 Same gulch, 50 lks. wide, course NE.
Ascend 200 ft. over SE. slope.
- 35.45 Spur, slopes SE.
Descend 30 ft., over SW. slope, to Gulch, 20 lks. wide, course SW. near head.
- 40.04 Descend 65 ft., over SW. slope, to Set an iron post, 3 ft. long, 1 in. in diam., 26 ins. in the ground, for $\frac{1}{4}$ sec. cor., marked on brass cap,

$\frac{1}{4}$ S 4
 S 9
 1920

from which,

- A juniper, 6 ins. in diam., brs. N. 13 $\frac{1}{2}$ ° W., 165 lks. dist., marked $\frac{1}{4}$ S 4 BT.
- A juniper, 14 ins. in diam., brs. S. 89° W., 29 lks. dist., marked $\frac{1}{4}$ S 9 BT.
- 42.68 Descend 86 ft., over SW. slope.
Gulch, 20 lks. wide, course S.
- 45.64 Ascend 64 ft., over E. slope.
Point of spur, slopes SE.
- 49.86 Descend 40 ft., over SW. slope.
Gulch, 20 lks. wide, course SE. Ascend 170 ft., over E. slope.
- 64.28 Ridge, brs. NW. and S.
Descend 100 ft., over W. slope.
- 73.20 Gulch, 20 lks. wide, course SE.
Ascend 60 ft., over E. slope.
- 78.58 Spur, slopes SE.
Descend slightly over SW. slope, to
- 80.08 The cor. of secs. 4, 5, 8 and 9.
Land, mountainous.
Soil, gravelly and rocky, 4th rate.
Timber, dense juniper and pine.
Undergrowth, scattering prickly ash and scrub oak.
No grass.

-
- 40.00 N. 0° 3' E., on a random line, bet. secs. 4 and 5.
Set temp. $\frac{1}{4}$ sec. cor.
 - 80.32 Intersect the cor. of secs. 4, 5, 32 and 33, on the N. bdy. of Tp., hereinbefore described.
Thence,
S. 0° 3' W., on a true line, bet. secs. 4 and 5.
Over mountainous land, thru. dense timber and undergrowth.
 - 9.17 Descend 80 ft., over SE. slope.
Gulch, 25 lks. wide, course NE.
 - 20.62 Ascend 110 ft., over N. slope.
Point of spur, slopes NW.
 - 34.75 Descend 50 ft. over SW. slope.
Gulch, 10 lks. wide, course NW.
 - 40.00 Ascend 36 ft., over NW. slope, to Gulch, 10 lks. wide, course N, 10° W. from S.
 - 40.32 Set an iron post, 3 ft. long, 1 in. in diam., 26 ins. in the ground, for $\frac{1}{4}$ sec. cor., marked on brass cap,

$\frac{1}{4}$
 S 5 | S 4
 1920

48 Subdivision lines of Township 27 North, Range 8 West.

Chains.

from which,
 A pine, 20 ins. in diam., brs. S. 65° E., 27 lks. dist., marked $\frac{1}{4}$ S 4 BT.
 An oak, 16 ins. in diam., brs. N. 50° W., 31 lks. dist., marked $\frac{1}{4}$ S 5 BT.
 Ascend 70 ft., along bottom of gulch, to Head of gulch, 10 lks. wide, course N.
 Ascend 20 ft. over N. slope.
 46.30 Ridge, brs. NW. and SE. Thence along top of spur, sloping S.
 55.00 Descend 60 ft., to .
 78.00 Leave top of spur, slopes SE. from N.
 Descend slightly over SW. slope, to
 80.32 The cor. of secs. 4, 5, 8 and 9.
 Land, mountainous.
 Soil, sandy, gravelly and rocky, 3rd and 4th rate.
 Timber, dense juniper and pine, and scattering cedar and oak.
 Undergrowth, scattering scrub oak, prickly ash and sage brush.
 Fair grass.

From the cor. of secs. 5, 6, 31 and 32, on the S. bdy. of the Tp., described in Book "D," N. 0° 3' W., bet. secs. 31 and 32.
 Over mountainous land; thru. dense timber and undergrowth.
 Ascend 90 ft., over SW. slope, near top of spur, sloping S. at 1000 lks. E. of line.
 15.70 Spur, slopes S. from NW.
 Descend 40 ft. over NE. slope.
 24.70 Head of gulch, 20 lks. wide, course E.
 Ascend 45 ft., over SE. and E. slopes, to $\frac{1}{4}$ sec. cor.
 25.57 A juniper, 20 ins. in diam., on line, marked with 2 notches on each of N. and S. faces.
 40.00 Set an iron post, 3 ft. long, 1 in. in diam.; 26 ins. in the ground, for $\frac{1}{4}$ sec. cor., marked on brass cap,

$\frac{1}{4}$
 S31 | S32
 1920

from which,
 A pine, 8 ins. in diam., brs. S. 5 $\frac{1}{2}$ ° E., 14 lks. dist., marked $\frac{1}{4}$ S 32 BT.
 A pine, 8 ins. in diam., brs. S. 23 $\frac{1}{2}$ ° W., 11 lks. dist., marked $\frac{1}{4}$ S 31 BT.
 Descend 15 ft., over NE. slope.
 43.60 Gully, 20 lks. wide, course SE.
 Ascend 140 ft., over SE. slope, to
 80.00 Set an iron post, 3 ft. long, 2 ins. in diam., 24 ins. in the ground, for cor. of secs. 29, 30, 31 and 32, marked on brass cap,

T27N | R8W
 S30 | S29
 S31 | S32
 1920

from which,
 A juniper, 10 ins. in diam., brs. S. 28° E., 176 lks. dist., marked T27N R8W S32 BT.
 A juniper, 12 ins. in diam., brs. S. 37 $\frac{1}{2}$ ° W., 30 lks. dist., marked T27N R8W S31 BT.
 and dig pits, 18x18x12 ins., one each NE., SE., SW. and NW. of post, 3 ft. dist.

Chains.

Land, mountainous.
 Soil, gravelly and rocky, 4th rate.
 Timber, dense juniper and pine.
 Undergrowth, dense prickly ash, scrub oak and sagebrush.
 Fair grass in N. $\frac{1}{2}$.

40.00 East, on random line, bet. secs. 29 and 32.
 79.92 Set temp. $\frac{1}{4}$ sec. cor.
 Fall 7 lks. S. of the cor. of secs. 28, 29, 32 and 33.
 Thence,
 S. $89^{\circ}57'$ W. on a true line, bet. secs. 29 and 32.
 Over mountainous land, thru. dense timber and undergrowth.
 Descend 75 ft., over NW. slope.
 7.60 Gulch, 20 lks. wide, course SW.
 Ascend 40 ft., over S. and SE. slopes, to
 30.00 Spur, slopes SW.
 Descend 160 ft., over W. slope, to
 39.96 Set an iron post, 3 ft. long, 1 in. in diam., 26 ins. in
 the ground, for $\frac{1}{4}$ sec. cor., marked on brass cap,

$\frac{1}{4}$ S 29
 S 32
 1920

from which,

A pine, 20 ins. in diam., brs. N. $11\frac{1}{2}^{\circ}$ W., 56 lks.
 dist., marked $\frac{1}{4}$ S 29 BT.
 A pine, 16 ins. in diam., brs. S. $41\frac{1}{2}^{\circ}$ W., 37 lks.
 dist., marked $\frac{1}{4}$ S 32 BT.

40.30 Gulch, 25 lks. wide, course S.
 Ascend 195 ft., over E. slope.
 60.95 Spur, slopes S.
 Descend 135 ft., over W. slope.
 76.30 Gulch, 20 lks. wide, course SE.
 Ascend 30 ft., over SE. slope, to
 79.92 The cor. of secs. 29, 30, 31 and 32.

Land, mountainous.
 Soil, gravelly and rocky, 3rd and 4th rate.
 Timber, dense juniper and pine.
 Undergrowth, dense scrub oak and prickly ash.
 Fair grass in W. $\frac{1}{2}$.

40.00 West, on a random line, bet. secs. 30 and 31.
 78.20 Set temp. $\frac{1}{4}$ sec. cor.
 Intersect the cor. of secs. 25, 30, 31 and 36, on the W. bdy.
 of the Tp., hereinbefore described.
 Thence,
 East, on a true line, bet. secs. 30 and 31.
 Over mountainous land, thru. dense timber and scattering
 undergrowth.
 Ascend 135 ft., over NW. slope.
 17.50 Spur, slopes SW.
 Descend 90 ft., over SE. slope broken by cliffs.
 20.40 Gulch, 30 lks. wide, course SW.
 Ascend 90 ft. over W. slope, to
 23.50 West end of top of cliffs, bearing E. & W. facing S. Thence
 along same, with slight change in elevation.
 27.50 Leave top of cliffs, and descend 120 ft. over SE. face of
 these cliffs.
 31.10 Gulch, 30 lks. wide, course S.
 Ascend 110 ft. to $\frac{1}{4}$ sec. cor., over SW. slope, broken by cliffs
 and slide rock.
 38.20 Set an iron iron post, 3 ft. long, 1 in. in diam., 26 ins.
 in the ground, for $\frac{1}{4}$ sec. cor., marked on brass cap,

$\frac{1}{4}$ S 30
 S 31
 1920

Subdivision lines of Township 27 North, Range 8 West.

Chains.

from which,

A juniper, 8 ins. in diam., brs. N. 11° E., 40 lks.
dist., marked $\frac{1}{4}$ S 30 BT.

A juniper, 12 ins. in diam., brs. S. 2 $\frac{1}{2}$ ° E., 78 lks.
dist., marked $\frac{1}{4}$ S 31 BT.

52.20 Ascend 40 ft., over SW. and S. slopes, to
Head of gulch, 10 lks. wide, course S. 70° W.
Ascend 195 ft., over SW. slope.

69.50 Point of spur, slopes S.

78.20 Descend 112 ft., over SE. slope, to
The cor. of secs. 29, 30, 31 and 32.

Soil, gravelly and rocky, 4th rate.
Timber, dense juniper and pine.
Undergrowth, scattering prickly ash and scrub oak.
No grass.
Land, mountainous.

N. 0° 3' W., bet. secs. 29 and 30.

Over mountainous land, thru. dense timber and undergrowth.
Ascend 110 ft., over SE. slope to

13.34 Head of gulch, 20 lks. wide, course SE. for 2 chs.; thence
S. 10° E.

Ascend 200 ft., over SE. slope, to

40.00 Top of ridge, brs. NE. and SW. Set an iron post 3 ft. long,
1 in. in diam., 6 ins. in the ground to bed rock, and raise
a mound of stone around post for $\frac{1}{4}$ sec. cor., marked on
brass cap,

$\frac{1}{4}$
S30 | S29
1920

from which,

A pine, 12 ins. in diam., brs. S. 10 $\frac{1}{4}$ ° E., 9 lks.
dist., marked $\frac{1}{4}$ S 29 BT.

A pine, 10 ins. in diam., brs. S. 35 $\frac{1}{2}$ ° W., 67 lks.
dist., marked $\frac{1}{4}$ S 30 BT.

49.95 Descend 72 ft., to
Top of same ridge, brs. N. and SE. Thence along same, descend-
ing slightly to

65.00 Leave top of ridge, brs. NW. and S.

Descend 30 ft., over E. slope, to

80.00 Set an iron post, 3 ft. long, 2 ins. in diam., 6 ins. in
the ground to bed-rock, and raise a mound of stone
around post, for cor. of secs. 19, 20, 29 and 30, marked
on brass cap,

T27N | R8 W
S19 | S20
S30 | S29
1920

from which,

A pine, 8 ins. in diam., brs. N. 15° E., 46 lks.
dist., marked T27N R8W S20 BT.

A juniper, 24 ins. in diam., brs. S. 28° E., 38 lks.
dist., marked T27N R8W S29 BT.

A pine, 12 ins. in diam., brs. S. 42 $\frac{1}{4}$ ° W., 40 lks.
dist., marked T27N R8W S30 BT.

An oak, 4 ins. in diam., brs. N. 18° W., 104 lks.
dist., marked T27N R8W S19 BT.

Land, mountainous.
Soil, gravelly and rocky, 4th rate.
Timber, dense juniper and pine, and scattering oak.
Undergrowth, dense prickly ash, scrub juniper and scrub
oak.
Poor grass.

Subdivision lines of Township 27 North, Range 8 West.

Chains.

40.00
79.78

N. 89° 57' E., on a random line, bet. secs. 20 and 29.
Set temp. 1/4 sec. cor.

30.40

Fall 7 lks. S. of the cor. of secs. 20, 21, 28 and 29.
Thence,
S. 89° 54' W., on a true line, bet. secs. 20 and 29,
Over mountainous land, thru. dense timber and undergrowth.
Ascend 115 ft., over SE. and S. slopes.

39.89

Top of ascent on S. side of hill, the top of which brs. N.
about 20 chs. dist.
Descend 52 ft., over S. and SW. slopes, to
Gulch, 20 lks. wide, course SE. Set an iron post, 3 ft. long,
1 in. in diam., 18 ins. in the ground to bed rock,
and raise a mound of stone around post, for 1/4 sec. cor.,
marked on brass cap,

1/4 S 20
S 29
1920

from which,

A pine, 24 ins. in diam., brs. N. 37 1/2° W., 170 lks.
dist., marked 1/4 S 20 BT.
A pine, 24 ins. in diam., brs. S. 28 1/2° W., 75 lks.
dist., marked 1/4 S 29 BT.

47.50

Ascend 40 ft., over E. slope.
Spur, slopes SE.

49.90

Descend 15 ft., over SW. slope.
Gulch, 10 lks. wide, course SE.

66.60

Ascend 80 ft., over NE. slope.
Ridge, brs. NW. and SE. near NW. end of same.

79.50

Descend 75 ft., over SE. slope.
Gulch, 10 lks. wide, course SE.

79.78

Ascend slightly to
The cor. of secs. 19, 20, 29 and 30.
Land, mountainous.
Soil, gravelly and rocky, 4th rate.
Timber, dense juniper and pine, and scattering cedar.
Undergrowth, dense scrub oak and prickly ash.
No grass.

40.00

West, on a random line, bet. secs. 19 and 30.
Set temp. 1/4 sec. cor.

77.81

Fall 23 lks. N. of the cor. of secs. 19, 24, 25 and 30, on
the W. bdy. of the Tp., hereinbefore described.

Thence,
N. 89° 50' E., on a true line, bet. secs. 19 and 30.
Over mountainous land, thru. dense timber and scattering
undergrowth.

13.85

Ascend 56 ft., over SW. slope.
Descend 60 ft., over S. and SE. slopes.

21.90

Gulch, 100 lks. wide, course SW.
Ascend 40 ft., over SW. slope, to

37.81

Set an iron post, 3 ft. long, 1 in. in diam., 12 ins. in
the ground to bed rock, and raise a mound of stone
around post, for 1/4 sec. cor., marked on brass cap,

1/4 S 19
S 30
1920

from which,

A pine, 12 ins. in diam., brs. N. 51° E., 33 lks.
dist., marked 1/4 S 19 BT.
A cedar, 18 ins. in diam., brs. S. 52° E., 43 lks.
dist., marked 1/4 S 30 BT.

52.20

Ascend 244 ft., over SW. slope.
Ridge, brs. NW. and SE.

59.40

Descend 52 ft., over E. slope.
Gulch, 20 lks. wide, course N.

52 Subdivision lines of Township 27 North, Range 8 West.

Chains.

65.20 Ascend 46 ft., over W. slope.
 Ridge, brs. NW. and SE.
 77.81 Descend 113 ft., over E. slope, to
 The cor. of secs. 19, 20, 29 and 30.
 Land, mountainous.
 Soil, gravelly and rocky, 4th rate.
 Timber, dense juniper and pine.
 Undergrowth, scattering scrub oak, scrub juniper and prickly ash.
 No grass.

0.30 N. 0° 3' W., bet. secs. 19 and 20.
 Over mountainous land, thru. dense timber and undergrowth.
 Descend slightly over E. slope, to
 Gulch, 10 lks. wide, course SE.
 28.00 Ascend 45 ft., over E. slope, to
 40.00 Ascend 55 ft., over SE. slope, to
 Set an iron post, 3 ft. long, 1 in. in diam., 26 ins. in
 the ground, for $\frac{1}{4}$ sec. cor., marked on brass cap,

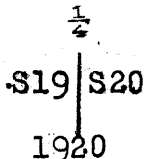

from which,
 A juniper, 10 ins. in diam., brs. S. 18 $\frac{3}{4}$ ° E., 108
 lks. dist., marked $\frac{1}{4}$ S. 20 BT.
 A pine, 8 ins. in diam., brs. S. 22° W., 41
 lks. dist., marked $\frac{1}{4}$ S. 19 BT.

64.74 Ascend 60 ft., over SE. slope, to
 Head of gulch, course S. 45° E.,
 73.70 Ascend 67 ft., over SE. slope.
 Ridge, brs. NE. and SW. At 100 lks. NE., this ridge turns
 to N.
 80.00 Descend slightly along W. slope, to
 Set an iron post, 3 ft. long, 2 ins. in diam., 24 ins. in
 the ground, for cor. of secs. 17, 18, 19 and 20, marked on
 brass cap,

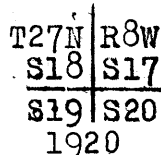

from which,
 A juniper, 8 ins. in diam., brs. N. 82 $\frac{3}{4}$ ° E., 59
 lks. dist., marked T27N R8W S17 BT.
 A pine, 6 ins. in diam., brs. S. 19° E., 49 lks.
 dist., marked T27N R8W S20 BT.
 A pine, 8 ins. in diam., brs. S. 10° W., 57 lks.
 dist., marked T27N R8W S19 BT.
 A pine, 16 ins. in diam., brs. N. 19 $\frac{3}{4}$ ° W., 74 lks.
 dist., marked T27N R8W S18 BT.

Land, mountainous.
 Soil, gravelly and rocky, 4th rate.
 Timber, dense juniper and pine.
 Undergrowth, dense prickly ash, scrub juniper and scrub oak.
 Poor grass.

40.00 N. 89° 54' E., on a random line, bet. secs. 17 and 20.
 Set temp. $\frac{1}{4}$ sec. cor.
 79.88 Intersect the cor. of secs. 16, 17, 20 and 21.
 Thence,
 S. 89° 54' W., on a true line, bet. secs. 17 and 20.

Chains.

Over mountainous land, thru. dense timber and undergrowth.
 Descend 25 ft., over NW. slope.
 .60 Gulch, 20 lks. wide, course N.
 Ascend 10 ft., over N. slope.
 4.05 Gulch, 35 lks. wide, course NE.
 Ascend 80 ft., over E. slope.
 9.00 Spur, slopes NE.
 Descend 42 ft., over NW. slope.
 12.60 Gulch, 20 lks. wide, course NE.
 Ascend 100 ft., over E. slope.
 24.20 Point of spur, slopes NE.
 Descend 70 ft., over NW. slope.
 28.14 Gulch, 20 lks. wide, course NE.
 Ascend 110 ft. over E. slope.
 35.70 Spur, slopes NE.
 Descend 40 ft., over NW. slope.
 38.00 Gulch, 20 lks. wide, course NE.
 Ascend 40 ft., over NE. slope, to
 39.94 Set an iron post, 3 ft. long, 1 in. in diam., 26 ins. in
 the ground, for $\frac{1}{4}$ sec. cor., marked on brass cap,

$\frac{1}{4}$ S 17
 S 20
 1920

from which,

- A juniper, 8 ins. in diam., brs. N. 19° W., 112 lks. dist., marked $\frac{1}{4}$ S 17 BT.
- A pine, 18 ins. in diam., brs. S. 63 $\frac{1}{2}$ ° E., 90 lks. dist., marked $\frac{1}{4}$ S 20 BT.

Ascend 70 ft., over NE. slope.
 47.38 Point of spur, slopes N.
 Descend 60 ft., over NW. slope.
 51.70 Gulch, 5 lks. wide, course NW.
 Ascend 16 ft., over NE. slope.
 54.00 Point of spur, slopes N.
 Descend 40 ft., over NW. slope.
 56.90 Gulch, 25 lks. wide, course NE.
 Ascend 290 ft., over E. slope.
 78.00 Ridge, brs. N. and S.
 Descend 10 ft. over W. slope, to
 79.88 The cor. of secs. 17, 18, 19 and 20.
 Land, mountainous.
 Soil, gravelly and rocky, 4th rate.
 Timber, dense juniper and pine, and scattering cedar.
 Undergrowth, dense prickly ash and scrub oak.
 Poor, grass.

S. 89° 50' W., on a random line, bet. secs. 18 and 19.
 140.00 Set temp. $\frac{1}{4}$ sec. cor.
 177.75 Fall 5 lks. S. of the cor. of secs. 13, 18, 19 and 24, on the
 W. bdy. of the Tp., hereinbefore described.
 Thence,
 N. 89° 52' E., on a true line, bet. secs. 18 and 19.
 Over mountainous land, thru. dense timber and scattering
 undergrowth.
 Ascend 25 ft., over S. slope, to
 3.20 Head of gulch, 10 lks. wide, course SW.
 Ascend 400 ft., over W. slope.
 25.20 Ridge, brs. N. and S.
 Descend 40 ft., over NE. slope, to
 37.75 Set an iron post, 3 ft. long, 1 in. in diam., 26 ins. in
 the ground, for $\frac{1}{4}$ sec. cor., marked on brass cap,

$\frac{1}{4}$ S 18
 S 19
 1920

from which,

54. Subdivision lines of Township 27 North, Range 8 West.

Chains.

A pine, 12 ins. in diam., brs. S. 24° E., 45 lks.
 dist., marked $\frac{1}{4}$ S 19 BT.
 A pine, 16 ins. in diam., brs. N. 35 $\frac{3}{4}$ ° W., 9 lks.
 dist., marked $\frac{1}{4}$ S 18 BT.
 Descend 70 ft., over NE slope.
 44.90 Gulch, 50 lks. wide, course N. 10° W. for 10 chs., thence W.
 Ascend 105 ft., over W. slope.
 52.34 Descend 57 ft., over NE slope.
 59.05 Head of gulch, 50 lks. wide, course NW.
 Ascend 225 ft., over W. slope, to
 77.75 The cor. of secs. 17, 18, 19 and 20.
 Land, mountainous.
 Soil, gravelly and rocky, 4th rate.
 Timber, dense juniper and pine.
 Undergrowth, scattering prickly ash, scrub juniper, scrub
 oak and sagebrush.
 No grass.

N. 0° 3' W., bet. secs. 17 and 18.
 Over mountainous land, thru. dense timber and undergrowth,
 along W. slope of ridge, bearing N. and S., near top
 of same.
 Ascend 30 ft., to
 5.97 Ridge, brs. N. and S. Thence along top of same, descending
 37 ft., to
 20.96 Leave top of ridge, brs. NE. and S.
 Descend 103 ft., over NW slope.
 27.90 Gulch, 10 lks. wide, course W.
 Ascend 105 ft., over S. slope.
 40.00 Ridge, brs. SE. and NW.
 Set an iron post, 3 ft. long, 1 in. in diam., 26 ins. in
 the ground, for $\frac{1}{4}$ sec. cor., marked on brass cap,

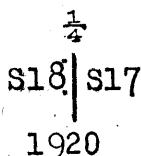

from which,
 A juniper, 8 ins. in diam., brs. N. 45° W., 33 lks.
 dist., marked $\frac{1}{4}$ S 18 BT.
 A pine, 30 ins. in diam., brs. N. 10 $\frac{1}{4}$ ° E., 470 lks.
 dist., marked $\frac{1}{4}$ S 17 BT.
 Descend 134 ft., over N. slope.
 51.30 Gulch, 10 lks. wide, course NW.
 Ascend 35 ft., over SW. slope.
 59.50 Descend 96 ft., over NW. slope.
 68.60 Same gulch, 10 lks. wide, course NE.
 Ascend 29 ft., over SE. slope.
 73.70 Descend 20 ft., over NE. slope.
 75.20 Gulch, 10 lks. wide, course SE. near head.
 Ascend 54 ft., over SE. slope, to
 80.00 Set an iron post, 3 ft. long, 2 ins. in diam., 6 ins. in
 the ground, to bedrock, deposit a stone marked with a
 cross (x) at base of post, and raise a mound of stone
 around post, for cor. of secs. 7, 8, 17 and 18, marked
 on brass cap,

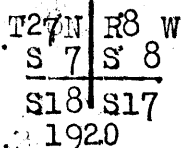

from which,
 A juniper, 14 ins. in diam., brs. S. 63 $\frac{1}{4}$ ° E., 51
 lks. dist., marked T27N R8W S17 BT.
 A pine, 14 ins. in diam., brs. S. 86° W., 283 lks.

Chains.

dist., marked T27N R8W S18 BT.
 A juniper, 6 ins. in diam., brs. N. 64° W., 197 lks.
 dist., marked T27N R8W S7 BT. No other trees available.
 Land, mountainous.
 Soil, gravelly and rocky, 4th rate.
 Timber, dense juniper and pine.
 Undergrowth, scattering prickly ash, scrub juniper and scrub oak.
 Poor grass.

40.00 N. 89° 54' E., on a random line, bet. secs. 8 and 17.
 79.96 Set temp. $\frac{1}{4}$ sec. cor.
 Fall 12 lks. N. of cor. of secs. 8, 9, 16 and 17.
 Thence,
 S. 89° 59' W., on a true line, bet. secs. 8 and 17.
 Over mountainous land, thru. scattering timber and undergrowth.
 3.40 Descend 30 ft., over SW. slope.
 Gulch, 20 lks. wide, course S.
 12.20 Ascend 80 ft., over E. slope.
 Spur, slopes S.
 19.30 Descend 60 ft., over W. slope.
 Gulch, 20 lks. wide, course S.
 25.10 Ascend 40 ft., over SE. slope.
 Point of spur, slopes S.
 27.00 Descend 15 ft., over SW. slope.
 Gulch, 20 lks. wide, course SE.
 39.98 Ascend 160 ft., over E. slope, to
 Set an iron post, 3 ft. long, 1 in. in diam., 26 ins. in the ground, for $\frac{1}{4}$ sec. cor., marked on brass cap,

$\frac{1}{4}$ $\frac{S}{S}$ $\frac{8}{17}$
 1920

from which,
 A quinine bush, 6 ins. in diam., brs. S. 66 $\frac{1}{4}$ ° W., 60 lks. dist., marked $\frac{1}{4}$ S 17 BT.
 A quinine bush, 4 ins. in diam., brs. N. 11 $\frac{1}{2}$ ° W., 78 lks. dist., marked $\frac{1}{4}$ S 8 BT.
 44.76 Ascend 40 ft., over E. slope.
 Spur, slopes NE.
 60.60 Descend 140 ft., over NW. slope, to
 Gulch, 10 lks. wide, course N.
 66.80 Ascend slightly over N. slope, to
 Gulch, 20 lks. wide, course NE.
 79.96 Ascend 150 ft., over SE. slope, to
 The cor. of secs. 7, 8, 17 and 18.
 Land, mountainous.
 Soil, gravelly and rocky, 4th rate.
 Timber, scattering juniper, pine and cedar.
 Undergrowth, scattering prickly ash, scrub oak and quinine brush.
 No grass.

40.00 S. 89° 52' E., on a random line, bet. secs. 7 and 18.
 77.32 Set temp. $\frac{1}{4}$ sec. cor.
 Fall 7 lks. N. of the cor. of secs. 7, 12, 13 and 18, on the W. bdy. of the Tp., hereinbefore described.
 Thence,
 N. 89° 49' E., on a true line, bet. secs. 7 and 18.
 Over mountainous land, thru. dense timber and scattering undergrowth.
 Ascend 760 ft., over SW. and W. slopes.

56 Subdivision lines of Township 27 North, Range 8 West.

Chains.

23.28 Ridge, brs. NW. and SE.
 Descend 170 ft., over NE. slope, to
 37.32 Set an iron post, 3 ft. long, 1 in. in diam., 26 ins. in
 the ground, for $\frac{1}{4}$ sec. cor., marked on brass cap,

$\frac{1}{4}$ S 7
 S 18
 1920

from which,
 A pine, 14 ins. in diam., brs. S. $18\frac{1}{2}^{\circ}$ E., 183 lks.
 dist., marked $\frac{1}{4}$ S 18 BT.
 A pine, 8 ins. in diam., brs. N. $6\frac{1}{2}^{\circ}$ W., 123 lks.
 dist., marked $\frac{1}{4}$ S 7 BT.

Descend 25 ft., over NE. slope.
 38.92 Gulch, 20 lks. wide, course NE.
 Ascend 54 ft., over NW. slope.
 43.70 Point of spur, slopes N.
 Descend 92 ft., over NE. slope.
 52.70 Gulch, 20 lks. wide, course NW.
 Ascend 157 ft., over W. slope.
 62.75 Ridge, brs. N. and S.
 Descend 60 ft., over E. and SE. slopes, to
 77.32 The cor. of secs. 7, 8, 17 and 18.
 Land, mountainous.
 Soil, gravelly and rocky, 4th rate.
 Timber, dense juniper and pine.
 Undergrowth, scattering manzanita, prickly ash and scrub
 oak.
 No grass.

N. $0^{\circ} 3'$ W., bet. secs. 7 and 8.
 Over mountainous land, thru. dense timber and undergrowth.
 Ascend 133 ft., over SE. slope.

19.40 Ridge, brs. NE. and SW.
 Descend 85 ft., over NW. slope, to
 40.00 Set an iron post, 3 ft. long, 1 in. in diam., 26 ins. in
 the ground, for $\frac{1}{4}$ sec. cor.; marked on brass cap,

$\frac{1}{4}$
 S 7 | S 8
 1920

from which,
 A pine, 6 ins. in diam., brs. N. 31° E., 20 lks.
 dist., marked $\frac{1}{4}$ S 8 BT.
 A juniper, 14 ins. in diam., brs. N. $72\frac{1}{2}^{\circ}$ W., 29 lks.
 dist., marked $\frac{1}{4}$ S 7 BT.

Descend 106 ft., over NW. slope.
 50.40 Ascend 130 ft., over SW. slope.
 73.20 Descend 103 ft., over NW. slope, to
 80.00 Set an iron post, 3 ft. long, 2 ins. in diam., 16 ins. in
 the ground, to bed rock, deposit a stone marked with
 a cross (x) at base of post, and raise a mound of stone
 around post, for cor. of secs. 5, 6, 7 and 8, marked on
 brass cap,

T27N | R8 W
 S 6 | S 5
 S 7 | S 8

from which,
 A pine, 30 ins. in diam., brs. S. $64\frac{1}{2}^{\circ}$ E., 57 lks.
 dist., marked T27N R8W S8 BT.

Subdivision lines of Township 27 North, Range 8 West. 57

Chains.

A pine, 26 ins. in diam., brs. S. 20 1/4° W., 106 lks. dist., marked T27N R8W S7 BT.
A pine, 12 ins. in diam., brs. N. 27 3/4° W., 165 lks. dist., marked T27N R8W S6 BT. No other trees available.

Land, mountainous.
Soil, rocky, 4th rate.
Timber, dense juniper and pine.
Undergrowth, dense scrub juniper, quinine brush and prickly ash.
No grass.

40.00 N. 89° 59' E., on a random line, bet. secs. 5 and 8.
80.00 Set temp. 1/4 sec. cor.
Fall 3 lks. S. of the cor. of secs. 4, 5, 8 and 9.
Thence,
S. 89° 58' W., on a true line, bet. secs. 5 and 7.
Over mountainous land, thru. dense timber and scattering undergrowth.
13.80 Descend 140 ft., over SW. slope.
Gulch, 25 lks. wide, course S.
22.50 Ascend 60 ft., over SE. slope, to
Head of gulch, 10 lks. wide, course SE.
26.00 Ascend 60 ft., over E. slope.
Spur, slopes SE.
31.75 Descend 70 ft., over SW. slope.
Gulch, 10 lks. wide, course SE.; junction of gulch from the
W. brs. S. 100 lks. dist.
40.00 Ascend 60 ft. over SE. slope, to
Set an iron post, 3 ft. long, 1 in. in diam., 26 ins. in
the ground, for 1/4 sec. cor., marked on brass cap,

1/4 S 5
S 8
1920

from which,
A pine, 24 ins. in diam., brs. N. 18° E., 178 lks. dist., marked 1/4 S 5 BT.
A pine, 14 ins. in diam., brs. S. 48 1/2° E., 109 lks. dist., marked 1/4 S 8 BT.

69.50 Ascend 320 ft., over SE. and E. slopes.
Ridge, brs. N. and SE.
80.00 Descend 110 ft., over W. slope, to
The cor. of secs. 5, 6, 7 and 8.
Land, mountainous.
Soil, gravelly and rocky, 4th rate.
Timber, dense juniper and pine, and scattering cedar.
Undergrowth, scattering scrub oak, prickly ash and manzanita.
No grass.

40.00 S. 89° 49' W., on random line, bet. secs. 6 and 7.
66.33 Set temp. 1/4 sec. cor.
Top of high, almost perpendicular cliffs, bearing N. and S. facing W.
It is impracticable to chain measurement beyond this point; therefore, triangulate as described as follows, and as shown on the diagram hereon:

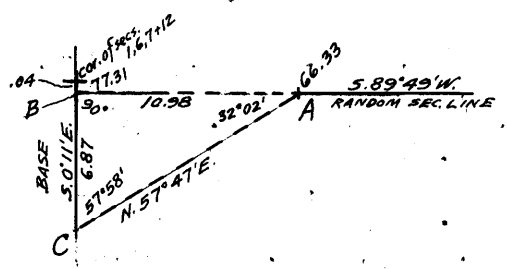

Set flag at 66.33 ch. station on random sec. line indicated on diagram at "A."
Set another flag ahead on random line at "B."
Flag "B" is on the W. bdy. of the tp. at a point

58 Subdivision lines of Township 27 North, Range 8 West.

Chains.

4 lks. S. of the cor. of secs. 1, 6, 7 and 12, of Twp. 27 N., R. 8 W., from flag "B" measure a base S. 0° 11' E., 6.87 chs. to point "C."

Vertical angle "B" to "A" = 1137° 37' 7 chs. to point "C."

Bearing "C-A" = "N. 57° 47' E. 31.57 41' E."

Included angles of triangle "A-B-C" are 32° 02', 90° 00' and 57° 58', the sum of which is 180° 00'.

Triangulated measurement on random sec. line from "A" to "B" is obtained by tang. 57° 58' x Base or 1.59826 x 6.87 = 10.98 chs., which added to 66.33 chs. gives 77.31 chs. as the total length of sec. line, bet. secs. 6 and 7.

77.31 Intersect the W. bdy. of the Tp., 4 lks. S. of the cor. of secs. 1, 6, 7 and 12, hereinbefore described. Thence, N. 39° 51' E., on true line, bet. secs. 6 and 7, triangulating measurement of 10.98 chs., as described above. Over mountainous land, thru. dense timber and scattering undergrowth.

10.98 Ascend 437 ft., over cliffs facing W. Triangulation point at top of cliffs, bearing N. and S. facing W.

Continue line and measurement by chaining. Ascend 224 ft., over W. slope.

17.16 Ridge, brs. N. and S. near S. end of same. Descend 148 ft., over E. slope.

28.45 Gulch, 20 lks. wide, course SW. Ascend 200 ft., over NW. slope, to

37.31 Set an iron post, 3 ft. long, 1 in. in diam., 26 ins. in the ground, for 1/4 sec. cor., marked on brass cap,

1/4 S 6
S 7
1920

from which,
A pine, 8 ins. in diam., brs. N. 36° E., 47 lks. dist., marked 1/4 S 6 BT.
A pine, 10 ins. in diam., brs. S. 25° W., 43 lks. dist., marked 1/4 S 7 BT.

47.11 Ascend 115 ft., over W. slope. Spur, slopes N.

55.00 Descend 64 ft., over E. slope. Gulch, 30 lks. wide, course N: 10° W.

60.60 Ascend 60 ft., over NW. slope. Spur, slopes SW.

75.80 Descend 160 ft., over SE. slope. Gulch, 100 lks. wide, course SW.

77.31 Ascend 12 ft., over W. slope, to The cor. of secs. 5, 6, 7 and 8.

Land, mountainous. Soil, gravelly and rocky, 4th rate. Timber, dense juniper and pine. Undergrowth, scattering scrub oak and prickly ash. No grass.

40.00 N. 0° 3' E., on a random line, bet. secs. 5 and 6. Set temp. 1/4 sec. cor.

80.25 Fall 2 lks. W. of cor. of secs. 5, 6, 31 and 32, on the N. bdy. of Tp., hereinbefore described.

Thence, S. 0° 4' W., on a true line, bet. secs. 5 and 6. Over mountainous land, thru. dense timber and undergrowth.

21.15 Ascend 70 ft. over N. and NE. slopes. Descend 25 ft., over SE. slope.

30.42 Gulch, 100 lks. wide, course NE. Ascend 117 ft., over NW. slope, to

40.25 Set an iron post 3 ft. long, 1 in. in diam., 26 ins. in the

Subdivision lines of Township 27 North, Range 8 West. 59

Chains.

ground, for 1/4 sec.cor., marked on brass cap,

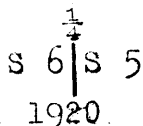

from which,

A pine, 30 ins. in diam., brs.S. 36 1/2° E., 70 lks. dist., marked 1/4 S 5 BT.

A pine, 14 ins. in diam., brs.S. 76 1/4° W., 21 lks. dist., marked 1/4 S 6 BT.

- Ascend 42 ft., over NW. slope.
- 55.30 Descend 28 ft., over W. slope.
- 60.27 Head of gulch, 20 lks. wide, course NW.
- Ascend 67 ft., over N. slope.
- 66.75 Saddle in ridge, bearing E. and W.
- Descend 32 ft., over S. slope, to
- 70.25 Head of gulch, course S.
- Descend 80 ft., along W. side of this gulch, to
- 78.75 Leave same gulch, 20 lks. wide, course W. from N.
- Ascend 5 ft., over NW. slope, to
- 80.25 The cor. of secs. 5, 6, 7 and 8.

Land, mountainous.

Soil, gravelly and rocky, 4th rate.

Timber, dense juniper and pine:

Undergrowth, dense prickly ash and scrub oak.

No grass.

The continued satisfactory adjustment of the solar apparatus during the survey of this township is indicated from field tests described in Book "C"

Boundaries of that part of T. 27 N., R. 8 W., surveyed under this Group (inside the Hualpai Indian Reservation).

Latitudes, Departures and Closing Errors.

Line designated.	True course.	Dist.	Latitudes.		Departures.	
			N.	S.	E.	W.
South boundary,	West,	418.72				418.72
West boundary,	North,	480.55	480.55			
North boundary,	East,	477.04			477.04	
East boundary,	South,	430.66		430.66		
Ely. of Hualpai Indian Reserv.	S. 50° 10' W.	69.84		44.74		53.63
	S. 50° 05' W.	7.75		4.97		5.94
Convergency,					.51	
Totals.			480.55	480.37	477.55	478.29
			480.37			477.55
Error in latitude,			0.18			
Error in departure,					0.74	

GENERAL DESCRIPTION.

The portion of this township surveyed as described in the foregoing field notes lies entirely within the Hualpai Indian Reservation.

The surface of the west half of the township is mountainous, and that of the east half varies from level to mountainous. Along the east boundary, a narrow strip is level and nearly level, which merges into gently rolling and rolling surface, then into mountainous.

The soil of the greater part of the township is gravelly and rocky, 3rd and 4th rate.

In the east range of sections, part of the NE. quarter of the township, and in the south half of the two central ranges of sections, there is considerable sandy and gravelly clay loam, 1st and 2nd rate.

The timber consists of juniper and pine, in dense and scattering growths, in about equal proportions. In the east range of sections, there are small areas devoid of timber.

The undergrowth consists of prickly ash, scrub oak, scrub juniper, sage brush and cacti in dense and scattering growths, in about equal proportions.

A good growth of grass is prevalent in part of the east range of sections, and throughout the greater part of the east half of the township is a fair growth of grass. The west half of the Township is mostly bare of grass.

There is no permanent running water, but a reservoir has been constructed in sec. 16 for periodical storage of water.

There are no indications of valuable mineral deposits. There are no settlers, and aside from the reservoir mentioned, there are no improvements.

Two roads traverse the NE. quarter of the township.

4-680

BOOK 3534

FIELD ASSISTANTS.

to James H. Finley, U. S. Transitman

NAMES.	CAPACITY.
Kenneth W. Bond,	1st chainman,
Donald Sutch,	2nd chainman,
Owen H. Hoffman,	cornerman,
Elmer Vick,	axman,
John T. Gilmore,	flagman.

CERTIFICATE OF UNITED STATES ~~TRANSITMAN~~

I, James H. Finley, U. S. Transitman, hereby certify upon honor that, in pursuance of special instructions received from the U. S. Surveyor General, for Group 107, Arizona, bearing date of the 25th day of February, 1922, I have well, faithfully, and truly in my own proper person, and in strict conformity with said instructions, the Manual of Surveying Instructions, and the laws of the United States, surveyed all those parts or portions of the Subdivision lines of Township 27 North, Range 8 West,

Base and Meridian, in the State of Arizona, which are represented in and by diagram on page 1 hereof the foregoing field notes, as having been executed by me, and under my direction; and that all the corners of said survey have been established and perpetuated in strict accordance with the Manual of Surveying Instructions, and the special written instructions of the U. S. Surveyor General, for Group 107, Arizona, and in the specific manner described in the field notes, and that the foregoing are the original field notes of such survey.

Place - Altaville, Calif.
Date Nov. 24, 1922

James H. Finley
U. S. transitman

APPROVAL.

OFFICE OF THE UNITED STATES SURVEYOR GENERAL,

....., 191

The foregoing field notes of the survey of

executed by

under his special instructions dated, 191, having been critically examined, and the necessary corrections and explanations made, the said field notes, and the surveys they describe, are hereby approved.

.....
U. S. Surveyor General.

I certify that the foregoing transcript of the field notes of the above-described surveys in, has been correctly copied from the original notes on file in this office.

.....
U. S. Surveyor General.

64 BOOK 3534

CERTIFICATE OF UNITED STATES TRANSITMAN.

I, Kenneth W. Bond, Transitman, U. S. Surveyor, hereby certify upon honor that, in pursuance of special instructions received from the U. S. Surveyor General for Group 107, Arizona, bearing date of the 25th day of February, 1920, I have well, faithfully, and truly in my own proper person, and in strict conformity with said instructions, the Manual of Surveying Instructions, and the laws of the United States, surveyed all those parts or portions of the subdivision lines and the North bdy. of T. 27 N. R 8 W.

of the Gila and Salt River, Base & Meridian, in the State of Arizona and by diagram on page 1 hereof the foregoing field notes as having been executed by me, and under my direction; and that all the corners of said survey have been established and perpetuated in strict accordance with the Manual of Surveying Instructions, and the special written instructions of the U. S. Surveyor General, for Group 107, Arizona, and in the specific manner described in the field notes, and that the foregoing are the original field notes of such survey.

Place, Denver, Colorado.

Date, February 23, 1921.

Kenneth W. Bond

U.S. Transitman.

U.S. 525252

APPROVAL.

OFFICE OF THE UNITED STATES SURVEYOR GENERAL,

191

The foregoing field notes of the survey of

executed by

under his special instructions dated, 191, having been critically examined, and the necessary corrections and explanations made, the said field notes, and the surveys they describe, are hereby approved.

U. S. Surveyor General.

I certify that the foregoing transcript of the field notes of the above-described surveys in, has been correctly copied from the original notes on file in this office.

U. S. Surveyor General.

CERTIFICATE OF UNITED STATES SURVEYOR.

I, Quintin Campbell, U. S. Surveyor, hereby certify upon honor that, in pursuance of special instructions received from the U. S. Surveyor General for Group 107, Arizona, bearing date of the 25th day of February, 1920, I have well, faithfully, and truly in my own proper person, and in strict conformity with said instructions, the Manual of Surveying Instructions, and the laws of the United States, surveyed all those parts or portions of the North and West boundaries, and Subdivision lines of

Township 27 North, Range 8 West,

of the Gila and Salt River

Base and Meridian, in the State of Arizona, which are represented in and by diagram on page 1 hereof the foregoing field notes, as having been executed by me, and under my direction; and that all the corners of said survey have been established and perpetuated in strict accordance with the Manual of Surveying Instructions, and the special written instructions of the U. S. Surveyor General, for Group 107, Arizona, and in the specific manner described in the field notes, and that the foregoing are the original field notes of such survey.

Place PHOENIX Arizona
Date March 31-1922

Quintin Campbell
U. S. Surveyor.

APPROVAL.

OFFICE OF THE UNITED STATES SURVEYOR GENERAL,

Phoenix, Arizona, February 13, 1923.

The foregoing field notes of the survey of the North and West boundaries, and Subdivision lines of

Township 27 North, Range 8 West,

of the Gila and Salt River Base and Meridian,

in the State of Arizona,

executed by Quintin Campbell, U. S. Surveyor, and James H. Finley, and Kenneth W. Bond, U. S. Transitmen, under special instructions dated Feb. 25, 1920, for Group 107, Arizona, having been critically examined, and the necessary corrections and explanations made, the said field notes, and the surveys they describe, are hereby approved.

James H. Finley
U. S. Surveyor General.

~~I certify that the foregoing transcript of the field notes of the above described surveys in~~
~~has been correctly copied from the original notes on file in this office.~~

U. S. Surveyor General.