

3541

Book "A"

4-679

BOOK 3541

MAR 25 1923

FIELD NOTES

OF THE SURVEY OF

Part (Completion) of 6th Standard Par. N., thru Range 10 West,

Part (Completion) of the West boundary, and

Part (Completion) of the Subdivision lines

of

TOWNSHIP 24 NORTH, RANGE 10 WEST,

(within the Hualpai Indian Reservation)

Of the Gila and Salt River Base and Meridian,

In the State of Arizona

EXECUTED BY

Horace M. Muscott,

U. S. Transitman

In the capacity of U. S. Surveyor, under Special Instructions dated February 26, 1920 issued by the United States Surveyor General to govern surveys included in Group No. 108, Arizona, which were approved by the Commissioner of the General Land Office, March 10, 1920, and Assignment Instructions dated August 7, 1920.

Survey commenced August 17, 1920

Survey completed August 18, 1920

3541

3541

C. G. Giff

INDEX DIAGRAM.

Township _____, Range _____

6	5	4	3	2	1
7	8	9	10	11	12
18	17	16	15	14	13
19	20	21	22	23	24
30	29	28	27	26	25
31	32	33	34	35	36

BOOK 3541

Book "A"

Township 24 North, Range 10 West

INDEX DIAGRAM.

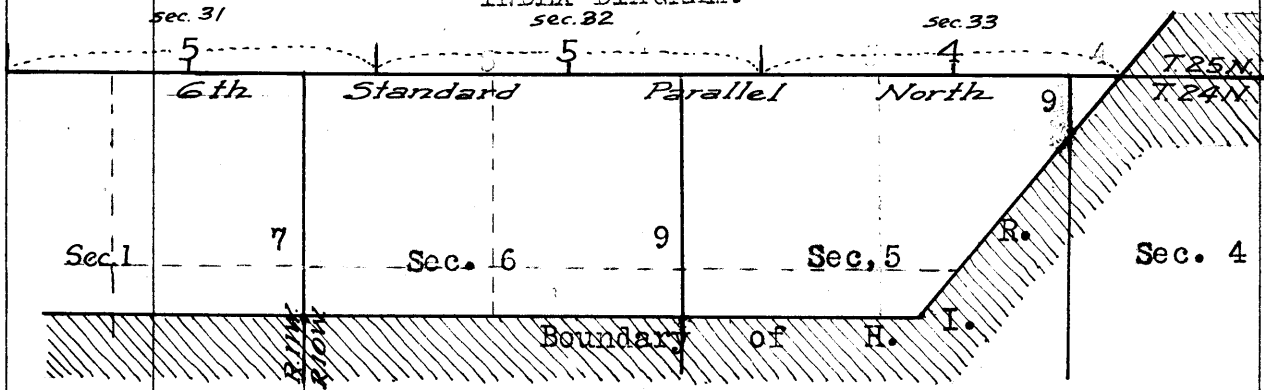

- Lines surveyed under this Group
- - - Accepted surveys.
- ▨ Areas surveyed as per accepted plats on file.

BOOK 3541

Book "A"

Group 108 - Arizona

Township 24 North, Range 10 West

DATE DIAGRAM

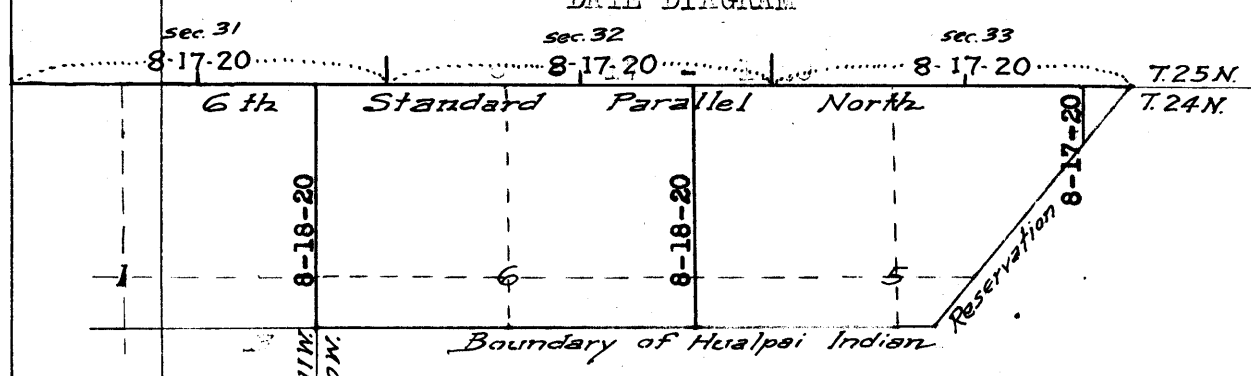

Lines surveyed by Horace M. Muscott, U. S. Transitman on dates shown on this diagram

Survey commenced August 17, 1920, and executed with a Young and Sons light mountain transit No. 8489; the instrument is equipped with a full vertical circle and the Smith solar attachment; unless otherwise specified, all azimuth determinations are accomplished with the solar attachment.

August 15, 1920. I examine the adjustments of the instrument and correct all errors; then, to test the solar apparatus, by comparing its indications resulting from observations made during a.m. and p.m. hours, with a meridian established by Polaris observations, proceed as follows:

August 17, 1920. At camp, near the NW. cor. of sec. 35, T. 25 N., R. 10 W., G. and S. R. B. and M., Arizona, lat. $35^{\circ}30\frac{1}{2}'$ N., long. $113^{\circ}19\frac{1}{2}'$ W., at 9 hrs. 0 m., a.m. l.m.t., I set off $35^{\circ}30\frac{1}{2}'$ N. on the lat. arc; $13^{\circ}23\frac{1}{2}'$ N. on the decl. arc; and determine a meridian with the solar.

At 9 hrs. 46.7 m., a.m., l.m.t., I observe Polaris at western elongation, making four observations, two each with the telescope in direct and reversed positions, and mark the mean point in the line thus determined, on a peg driven firmly in the ground, 5 chs. N.

Azimuth of Polaris at western elongation is $1^{\circ}22'49''$.

I lay off the azimuth of Polaris, $1^{\circ}23'$ to the east, and mark the meridian thus determined by a tack in a peg driven firmly in the ground, 5 chs. N.

The meridian determined by solar observation agrees with this true meridian.

At apparent noon, with the lat. arc unchanged, I observe the sun on the meridian; the resulting reading of the decl. arc is $13^{\circ}21'$ N., which agrees with the computed decl. of the sun.

At 3 hrs. 0 m., p.m., l.m.t., with the lat. arc unchanged, I set off $13^{\circ}19'$ N. on the decl. arc; and determine a meridian with the solar which I find to agree with the true meridian.

As all of the solar observations during the usual hours of solar work come within $1'30''$ of the true meridian, I conclude that the adjustments of the instrument are satisfactory.

Unless otherwise specified, all measurements are made with a Lufkin steel tape, 5 chs. in length, compared with a Lufkin standard steel tape and found correct. The measurements are made on the slope, the vertical angle determined, and the slope measurements properly reduced to true horizontal distances.

Part (Completion) of the 6th Std. Par. N., thru R. 10 W.

Chains

The boundaries of the Hualpai Indian Reservation were originally surveyed in August and September, 1900, by Albert T. Colton, U. S. D. S. No retracement or resurvey of the Indian Reservation boundary within this township is of record in this office.

That part of the 6th Standard Parallel North lying outside the Hualpai Indian Reservation was surveyed to an intersection with the Southeast Boundary of the Hualpai Indian Reservation in April, 1912, by William H. Elliott, U. S. S. No subsequent retracement or resurvey of these lines is of record in this office.

The standard closing cor. of T. 25 N., R. 10 W., on the S. E. bdy. of Hualpai Indian Reservation, is an iron post 3 ins. in diam., projecting 12 ins. above ground, properly marked on brass cap and witnessed by a mound of stone 4 ft. base, 2 ft. high E. of cor. and a cedar tree, 12 ins. dia., properly mkd., which bears N. 61° E., 218 lks. dist. According to the record this cor. is 10.58 chs. W. of the Standard cor. of secs. 33 and 34.

Thence,

West, on a true line on S. bdy. of sec. 33.

Over rolling land, thru scattering timber and undergrowth. Asc. 130 ft. over gradual NE. slope.

29.62

(40.00 chs. West of the Std. cor. of secs. 33 and 34, T. 25 N., R. 10 W.)

Set an iron post, 3 ft. long, 1 in. in diam., in a mound of stone, for standard $\frac{1}{4}$ sec. cor., marked on brass cap

S C
45 33
1920

From which

A pine, 4 ins. in diam., bears N. 35 $\frac{1}{2}$ ° E., 57 lks. dist. marked T 25 N R 10 W S 33 S-C B T.

A pine, 10 ins. in diam., bears N. 68° W., 70 lks. dist. marked T 25 N R 10 W S 33 S-C B T.

Desc. 200 ft. over NW. slope.

43.90

Canyon, course N. Asc. 145 ft. to

50.60

Spur, slopes N. 20° E. Desc. 170 ft. over NW. slope to

69.62

(80.00 chs. west of the std. cor. of secs. 33 and 34, T. 25 N., R. 10 W.)

Set an iron post, 3 ft. long, 2 ins. in diam., 10 ins. in the ground to bed rock, supported in a mound of stone, for standard cor. of secs. 32 and 33, marked on brass cap

S C
T 25 N R 10 W
S 32 | S 33
1920

From which

A pine, 4 ins. in diam., bears N. 21 $\frac{1}{2}$ ° E., 20 lks. dist. marked T 25 N R 10 W S 33 S-C B T.A pine, 8 ins. in diam., bears N. 50 $\frac{1}{2}$ ° W., 22 lks. dist. marked T 25 N R 10 W S 32 S-C B T.

Land; rolling.

Soil; rocky, 4th rate.

Timber; scrub cedar and pine.

Undergrowth; sagebrush, chamiso and cactus.

Part (Completion) of the 6th Std. Par. N., thru R. 10 W. BOOK 3541

Chains West, on S. bdy Sec. 32.
 Over rolling land, thru scattering timber and undergrowth.
 Asc. 68 ft. over NW. slope.
 17.40 Wash; 15 lks. wide; 2 ft. deep, course N. Asc. gradually.
 20.20 Wagon road, bears N. and S.
 25.00 Asc. 86 ft.
 40.00 Set an iron post, 3 ft. long, 1 in. dia., 26 ins. in the ground for standard $\frac{1}{4}$ Sec. cor. marked on brass cap

S C
 $\frac{1}{4}$ S 32
 1920

78.00 Raise a mound of stone, 3 ft. base, 2 $\frac{1}{2}$ ft. high N. of cor.
 Continue asc. 190 ft. over E. slope.
 80.00 Spur, slopes NE. Desc.
 Set an iron post, 3 ft. long, 2 ins. dia., 6 ins. in the ground to bed rock, supported in a mound of stone, for standard cor. of Secs. 31 and 32, marked on brass cap

S C
 T 25 N R 10 W
 S 31 | S 32
 1920

From which
 A cedar, 6 ins. diam., bears N. 45 $\frac{1}{2}$ ° E., 22 lks. dist. marked T 25 N R 10 W S 32 S C B T.
 A pine, 14 ins. diam., bears N. 49° W., 120 lks. dist. marked T 25 N R 10 W S 31 S C B T.
 Land; rolling.
 Soil; rocky, 4th rate.
 Timber; scrub pine and cedar.
 Undergrowth; sagebrush, chamiso and cactus.

West, on S. bdy. of Sec. 31.
 Over rolling land, thru scattering timber and undergrowth.
 Desc. 50 ft. over W. slope to
 16.50 Gulch, course N. Asc. 85 ft. over E. slope.
 24.00 Spur, bears NE., asc. 50 ft. to
 40.00 Set an iron post, 3 ft. long, 1 in. diam., in a mound of stone, for standard $\frac{1}{4}$ Sec. cor., marked on brass cap

S C
 $\frac{1}{4}$ S 31
 1920

From which
 A cedar, 6 ins. dia., bears N. 74 $\frac{3}{4}$ ° E., 221 lks. dist. marked $\frac{1}{4}$ S 31 S C B T.
 A cedar, 6 ins. diam., bears N. 60° W., 127 lks. dist. marked $\frac{1}{4}$ S 31 S C B T.

Continue descent.
 46.00 Gulch, course N. Asc. 35 ft. to
 50.00 Thence over level land.
 55.00 Desc. 25 ft.
 71.00 Road, bears NE. and SW.
 74.20 Gulch, course N. 20° E.
 80.00 Set an iron post, 3 ft. long, 3 in. in diam., 18 ins. in the ground to bed rock, supported in a mound of stone, for standard cor. of T^s. 25 N., R^s. 10 and 11 W., marked on brass cap

S C
 T 25 N
 R 11 W | R 10 W
 S 36 | S 31
 1920

Part (Completion) of the 6th Std. Par. N., thru R. 10 W.

Chains

From which

A cedar, 6 ins. diam., bears N. 65° E., 137 lks. dist.
marked T 25 N R 10 W S 31 S C B E.

A cedar, 12 ins. dia., bears N. 104° W., 66 lks.
dist. marked T 25 N R 11 W S 36 S C B T.

Land; rolling.

Soil; rocky, 4th rate.

Timber; scrub pine and cedar.

Undergrowth; chamiso, sagebrush and cactus.

Part (completion) of West bdy. of Township 24 N., Range 10 West. 7

Chains.

That part of the West bdy. of T. 24 N., R. 10 W. lying outside of the Hualpai Indian Reservation was surveyed to an intersection with the South bdy. of the Hualpai Indian Reservation in March, 1912, by J. B. Wright, U.S.S. No subsequent retracement or resurvey of this bdy. is of record in this office.

The closing cor. of Ts. 24 N., Rs. 10 and 11 W. on S. bdy. of Hualpai Indian Reservation is an iron post, 3 ins. in diam., projecting 12 ins. above ground, properly marked on brass cap and witnessed by two properly marked bearing trees, as follows:

- A pinyon, 8 ins. in diam., S. 19 $\frac{3}{4}$ ° E., 76 lks. dist.
- A cedar, 6 ins. in diam., S. 51° W., 64 lks. dist.

According to the record this closing cor. is 36.77 chs. North of the cor. of secs. 1, 6, 7 and 12.

Thence, North, bet. secs. 1 and 6.

3.23

Over rolling land, thru. scattering timber and undergrowth. (40.00 chs. North of the cor. of secs. 1, 6, 7 and 12) Set an iron post, 3 ft. long, 1 in. in diam., in a mound of stone, for $\frac{1}{4}$ sec. cor., marked on brass cap,

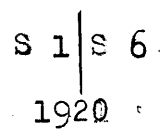

from which,

- A cedar, 18 ins. in diam., brs. N. 41 $\frac{1}{4}$ ° E., 59 lks. dist., marked $\frac{1}{4}$ S 6 BT.
- A cedar, 12 ins. in diam., brs. S. 46 $\frac{1}{2}$ ° W., 55 lks. dist., marked $\frac{1}{4}$ S 1 BT.

14.23

Descend 80 ft., over N. slope. Draw, course NE.

28.23

Ascend 80 ft., over E. slope. Descend 40 ft. to

35.91

(72.68 chs. North of the cor. of secs. 1, 6, 7 and 12), Intersect the 6th Std. Par. N., 14.57 chs. W. of the Std. cor. of secs. 31 and 32, hereinbefore described.

At point of intersection,

Set an iron post 3 ft. long, 3 ins. in diam., 15 ins. in the ground to bed rock, supported in a mound of stone, for closing cor. of Ts. 24 N., Rs. 10 and 11 W., marked on brass cap,

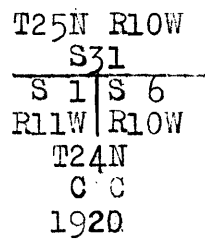

from which,

- A cedar, 6 ins. in diam., brs. S. 77° E., 38 lks. dist., marked T24N R10W S6 CC BT.
- A pine, 8 ins. in diam., brs. S. 25 $\frac{1}{4}$ ° W., 63 lks. dist., marked T24N R11W S1 CC BT.

Land, rolling.

Soil, rocky, 4th rate.

Timber, scrub pine and cedar.

Undergrowth, sagebrush, chamiso and cacti.

Boundaries of the portion of Township 24 North, Range
10 West, surveyed under Group No. 108.

Latitudes, departures and closing errors.

Line designated.	True bearing.	Dist.	Latitudes.		Departures.	
			N.	S.	E.	W.
North boundary, (6th. Std. Par. N.)	West,	164.19				164.19
West boundary,	South,	35.91		35.91		
Hualpai Indian Reservation Boundary,	East, N. 50°00'E.	121.22 56.18			121.22 43.04	
Convergency,						.01
Totals,			36.11	35.91	164.26	164.20
			35.91		164.20	
Error in latitude,			.20			
Error in departure,					.06	

ECC 3541

Survey of part (Completion) of the Subdivision Lines of
T. 24 N., R. 10 W.

Chains

The subdivision of that portion of T. 24 N., R. 10 W., lying outside the Hualpai Indian Reservation was surveyed by Jesse B. Wright, U. S. S., in March and April, 1912. No subsequent retracement or resurvey of these lines is of record in this office

The closing cor. of secs. 4 and 5 on SE. boundary of Hualpai Indian Reservation is an iron post, 2 ins. diam., projecting 12 ins. above ground, properly marked on brass cap and witnessed by two bearing trees, both properly marked, as follows:

A cedar, 6 ins. diam., S. 8° E., 79 lks. dist.

A cedar, 18 ins. diam., S. 10° W., 160 lks. dist.

According to the record, this closing cor. is 67.55 chs. N. 0° 3' W., of the cor. of secs. 4, 5, 8 and 9.

Thence

N. 0° 03' W., bet. secs. 4 and 5.

Over rolling land, thru scattering timber and undergrowth. Asc. 40 ft. over gradual S. slope.

5.05 (72.60 chs. N. 0° 3' W. of the cor. of secs. 4, 5, 8 and 9).

Intersect the 6th Std. Par. N., 5.94 chs. west of the closing cor. of T. 25 N., R. 10 W., on SE. bdy. of Hualpai Indian Reservation, hereinbefore described.

At point of intersection, set an iron post, 3 ft. long, 2 ins. in diam., over cross (X) mkd. on surface rock and raise a md. of stone around post, for closing cor. of secs. 4 and 5, marked on brass cap

T 25 N	R 10 W
S 33	
S 5	S 4
T 24 N	R 10 W
C C	
1920	

Land; rolling.

Soil; rocky, 4th. rate.

Timber; scrub pine and cedar.

Undergrowth; chamiso and sagebrush.

The closing cor. of secs. 5 and 6 on S. bdy. of Hualpai Indian Reservation is an iron post, 2 ins. in diam., projecting 12 ins. above ground, properly marked on brass cap and witnessed by two properly marked bearing trees as follows:

A pinyon, 16 ins. diam., S. 78° E., 109 lks. dist.

A cedar, 6 ins. diam., S. 62½° W., 89 lks. dist.

According to the record, this closing cor. is 36.55 chs. N. 0° 03' W. of the cor. of secs. 5, 6, 7 and 8.

Thence

N. 0° 03' W., bet. secs. 5 and 6

Over rolling land, thru scattering timber and undergrowth.

3.45 (40.00 chs. N. 0° 3' W. of the cor. of secs. 5, 6, 7 and 8.)

Set an iron post, 3 ft. long, 1 in. in diam., in a mound of stone, for ¼ sec. cor., marked on brass cap

	¼	
S 6		S 5
1920		

From which

A pine, 6 ins. in diam., bears N. 62½° E., 85 lks. dist. marked ¼ S 5 B T.

A pine, 5 ins. diam., bears S. 43° W., 77 lks. dist. marked ¼ S 6 B T.

Desc. 144 ft. over gradual NW. slope.

Survey of Part (Completion) of the Subdivision Lines of
T. 24 N., R. 10 W.

Chains
36.13

(72.68 chs. N. $0^{\circ} 3'$ W. of the cor. of secs. 5, 6, 7 and 8.)

Intersect the 6th Std. Par. N., 16.63 chs. west of the standard cor. of secs. 32 and 33, hereinbefore described.

At point of intersection, set an iron post, 3 ft. long, 2 ins. in diam., 8 ins. in the ground to bed rock, deposit a stone marked with a cross (X) at base of post and raise a md. of stone around post, for closing cor. of secs. 5 and 6, marked on brass cap

T 25 N R 10 W
S 32

S 6 S 5
T 24 N R 10 W

C. C.

1920

Land; rolling.

Soil; rocky, 4th rate.

Timber; scrub cedar and pine.

Undergrowth; chamiso, sagebrush and cactus.

GENERAL DESCRIPTION.

The portion of T. 24 N., R. 10 W., surveyed as described in the foregoing field notes lies within the Hualpai Indian Reservation. It is rolling land covered with a scattered growth of juniper and pinyon pine timber.

The soil is rocky, 4th rate.

There are no indications of mineral, no springs or streams, settlers or improvements.

The continued satisfactory adjustment of the instrument thruout the survey of this township is indicated from field tests as shown in Book "B".

4-680

BOOK 3541

FIELD ASSISTANTS.

Horace M. Muscott, U. S. Transitman.

NAMES.	CAPACITY.
Ben Mollette	1st Chainman.
Geo. Way	2nd Chainman.
Ted. Lazovich	axman and flagman.
Homer Pepper	axman and flagman.
Ed. Mitchell	moundsman.
Ben Morgan	flagman.

CERTIFICATE OF UNITED STATES TRANSITMAN.

BOOK 3541

I, Horace M. Muscott, U. S. Transitman hereby certify upon honor that, in pursuance of special instructions received from the U. S. Surveyor General, for Group 108, Arizona,

bearing date of the 26th day of February, 1920, I have well, faithfully, and truly

in my own proper person, and in strict conformity with said instructions, the Manual of Surveying Instructions, and the laws of the United States, surveyed all those parts or portions of the 6th Standard Parallel North, thru Range 10 West, West boundary, and Subdivision lines of

TOWNSHIP 24 NORTH, RANGE 10 WEST,

of the Gila and Salt

River Base and Meridian, in the State of Arizona, which are represented in

and by diagram on page 2 hereof the foregoing field notes, as having been executed by me, and under my direction; and that all the corners of said survey have been established and perpetuated in strict accordance with the Manual of Surveying Instructions, and the special written instructions of the U. S. Surveyor General, for Group 108, Arizona, and in the specific manner described in the field notes, and that the foregoing are the original field notes of such survey.

Place Los Angeles, Calif

Horace M. Muscott
U. S. Transitman

Date March 22 1923

APPROVAL.

OFFICE OF THE UNITED STATES SURVEYOR GENERAL,

Phoenix, Arizona, JUN 18 1923, 1923.

The foregoing field notes of the survey of the
Part (completion) of 6th Standard Par. N., thru Range 10 West,
Part (completion) of the West boundary, and
Part (completion) of the Subdivision lines

of

TOWNSHIP 24 NORTH, RANGE 10 WEST,

executed by Horace M. Muscott, U. S. Transitman,

under his special instructions dated February 26, 1920, for Group 108, Arizona, having been critically examined, and the necessary corrections and explanations made, the said field notes, and the surveys they describe, are hereby approved.

Frank P. Goff
U. S. Surveyor General.

I certify that the foregoing transcript of the field notes of the above described surveys in _____, has been correctly copied from the original notes on file in this office:

U. S. Surveyor General