

3542

15

*Orig*

Book "B"

4-679

MAR 21 1923

BOOK 3542

APR - 6 1921

# FIELD NOTES

OF THE SURVEY OF THE

Sixth Standard Parallel North, thru Range 11 West,

Part (Completion) of the West bdy., and

Part (Completion) of the Subdivision lines,

of

TOWNSHIP 24 NORTH, RANGE 11 WEST,  
*(within the Hualpai Indian Reservation)*  
and Retracement of

Part of the S. bdy. of the Hualpai Indian Reservation, within

TOWNSHIP 24 NORTH, RANGE 11 WEST,

Of the Gila and Salt River Base and Meridian,

In the State of Arizona.

EXECUTED BY

Horace M. Muscott, and Francis R. Ihrie,

U. S. Transitmen,  
and

Thos. D. Daley, U. S. Surveyor,

In the capacity of U. S. Surveyors, under Special Instructions dated February 26, 1920,  
issued by the United States Surveyor General to govern surveys included in Group  
No. 108, Arizona, which were approved by the Commissioner of the General Land  
Office, March 10, 1920, and Assignment Instructions dated August 7, 1920,  
April 6, 1921.

Survey commenced August 17, 1920

Survey completed April 16, 1921

3542

3542

# INDEX DIAGRAM.

Township ..... Range .....

6	5	4	3	2	1
7	8	9	10	11	12
18	17	16	15	14	13
19	20	21	22	23	24
30	29	28	27	26	25
31	32	33	34	35	36





BOOK 3542

Book "B"

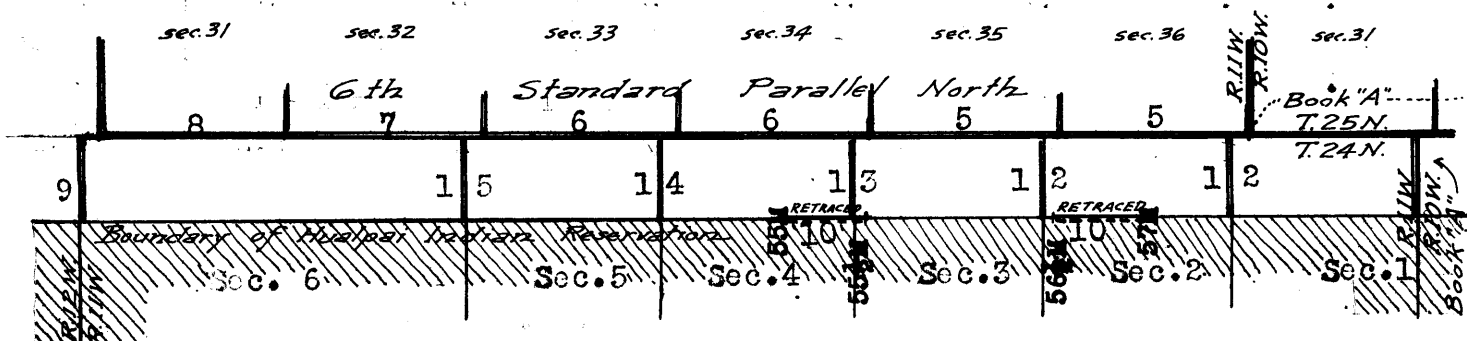
Township 24 North, Range 11 West

INDEX DIAGRAM.

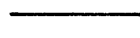

-  Surveyed under this group.
-  Retraced under this group.
-  Surveyed under Group No. 109.
-  Accepted surveys.
-  Areas surveyed as per accepted plats on file.

BOOK 3542

Book "B"

Group 108 - Arizona

Township 24 North, Range 11 West

DATE DIAGRAM

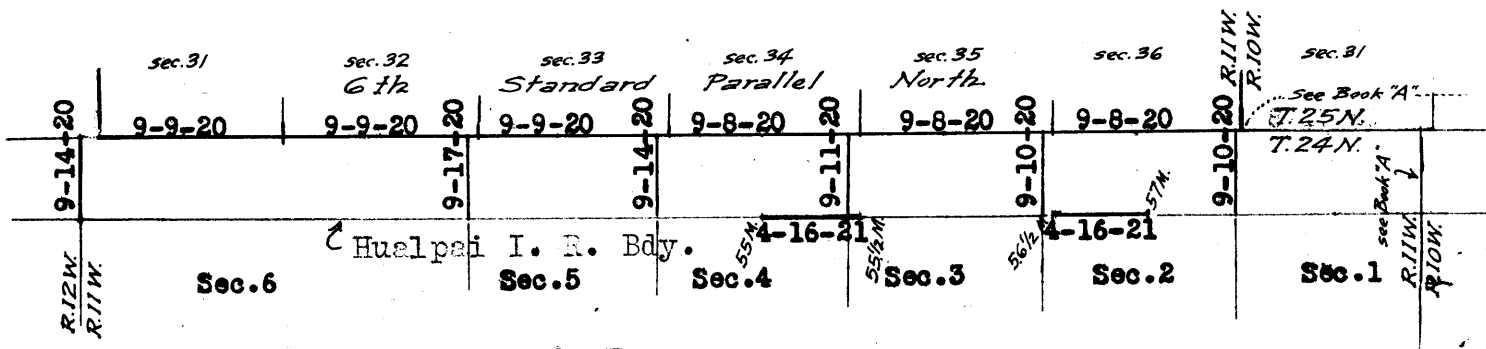

- Surveyed by Horace M. Muscott, U. S. Transitman, on dates shown on this diagram.
- Surveyed by Francis R. Ihrle, U. S. Transitman, on dates shown on this diagram.
- Retraced by Thos. D. Daley, U. S. Surveyor, on dates shown on this diagram

Surveys commenced Aug. 17, 1920 and executed with Young and Sons Light Mountain transit No. 8489 and Buff Rocky Mountain Favorite transit No. 9977; the instruments are equipped with full vertical circle and the Smith solar attachment; unless otherwise specified, all azimuth determinations are accomplished with the solar attachment.

Field test of Young and Sons light mountain transit No. 8489.

August 22, 1920. I examine the adjustments of the instrument, and correct all errors; then, to test the solar apparatus, by comparing its indications from observations made during a. m. and p. m. hours with a meridian established by Polaris observation, I proceed as follows:

In camp near the NW. cor. of sec. 35, T. 25 N., R. 10 W., G. and S. R. B. and M., Arizona, lat.  $35^{\circ} 30\frac{1}{2}'$  N., long.  $113^{\circ} 19\frac{1}{2}'$  W., at 9 hrs. 0 m., a. m., l. m. t., I set off  $35^{\circ} 30\frac{1}{2}'$  N. on the lat. arc;  $11^{\circ} 45'$  N., on the decl. arc; and determine a meridian with the solar, which agrees with the meridian established by observations on Polaris on August 17, as described in Book "A".

At apparent noon, with the lat. arc unchanged, I observe the sun on the meridian; the resulting reading of the decl. arc is  $11^{\circ} 42\frac{1}{2}'$  N., which agrees with the computed decl. of the sun.

At 3 hrs. 0 m., p. m., l. m. t., with the lat. arc unchanged, I set off  $11^{\circ} 40'$  N. on the decl. arc; and determine a meridian with the solar which agrees with the true meridian.

As all of the solar observations during the usual hours of solar work come within  $1' 30''$  of the true meridian, I conclude that the adjustments of the instrument are satisfactory.

Unless otherwise specified, all measurements are made with a 5 ch. Lufkin steel tape, compared with a Lufkin standard steel tape and found correct. The measurements are made on the slope, the vertical angle determined and the slope measurements properly reduced to true horizontal distances.

Field test of Buff Rocky Mountain Favorite transit No. 9977.

August 29, 1920. In camp near the NW. cor. of sec. 35, T. 25 N., R. 10 W., G. and S. R. B. & M., Arizona, lat.  $35^{\circ} 30\frac{1}{2}'$  N., long.  $113^{\circ} 19\frac{1}{2}'$  W., I examine the adjustments of the instrument; and correct all errors; then, to test the solar apparatus, by comparing its indications from observations made during a. m. and p. m. hours with a meridian established by Polaris observations, proceed as follows:

At 9 hrs. 0 m., a. m., l. m. t., I set off  $35^{\circ} 30\frac{1}{2}'$  N. on the lat. arc;  $9^{\circ} 19\frac{1}{2}'$  N. on the decl. arc; and determine a meridian with the solar, which agrees with the meridian established by observations on Polaris on August 17, as described in Book "A".

At apparent noon, with the lat. arc unchanged, I observe the sun on the meridian; the resulting reading of the decl. arc is  $9^{\circ} 16\frac{1}{2}'$  N., which agrees with the computed decl. of the sun.

At 3 hrs. 0 m., p. m., l. m. t., with the lat. arc unchanged I set off  $9^{\circ} 14'$  N., on the decl. arc; and de-

termine a meridian with the solar, which agrees with the true meridian.

As all of the solar observations during the usual hours of solar work come within 1' 30" of the true meridian, I conclude that the adjustments of the instrument are satisfactory.

Unless otherwise specified, all measurements are made with a 5 ch. Lufkin steel tape compared with a Lufkin standard steel tape and found correct. The measurements are made on the slope, the vertical angle determined and the slope measurements properly reduced to true horizontal distances.

Field Test of Buff Rocky Mountain Favorite Transit No. 9977 by Mr. Thos. D. Daley.

April 14, 1921, I examine the adjustments of the instrument and correct all errors; then, to test the solar apparatus, by comparing its indications from observations made during a. m. and p. m. hours with a meridian established by Polaris observation, I proceed as follows:

April 15, 1921. At camp, near the  $\frac{1}{4}$  sec. cor. of secs. 23 and 26, T. 25 N., R. 11 W., G. and S. R. B. and M., Arizona, lat.  $35^{\circ} 31\frac{1}{2}'$  N., long.  $113^{\circ} 25\frac{1}{2}'$  W., at 6 hrs. 2.1 m., a. m., l. m. t., I observe Polaris at eastern elongation, making four observations, two each with the telescope in direct and reversed positions, and mark the mean point in the line thus determined, on a peg driven firmly in the ground, 5 chs. N.

Azimuth of Polaris at eastern elongation is  $1^{\circ} 22' 18''$ .

I lay off the azimuth of Polaris,  $1^{\circ} 22\frac{1}{2}'$  to the west, and mark the meridian thus determined by a tack in a peg driven firmly in the ground, 5 chs. N.

At 9 hrs. 0 m., a. m., l. m. t., I set off  $35^{\circ} 31\frac{1}{2}'$  N., on the lat. arc;  $9^{\circ} 45'$  N. on the decl. arc; and determine a meridian with the solar, which agrees with the true meridian.

At apparent noon, with the lat. arc unchanged, I observe the sun on the meridian; the resulting reading of the decl. arc is  $9^{\circ} 47\frac{1}{2}'$  N., which agrees with the computed decl. of the sun.

At 3 hrs. 0 m., p. m., l. m. t., with the lat arc unchanged, I set off  $9^{\circ} 50\frac{1}{2}'$  N. on the decl. arc; and determine a meridian with the solar which I find to agree with the true meridian.

As all of the solar observations during the usual hours of solar work come within 1' 30" of the true meridian, I conclude that the adjustments of the instrument are satisfactory.

Unless otherwise specified, all measurements are made with a Lufkin steel tape, 5 chs, in length, compared with a Lufkin standard steel tape and found correct. The measurements are made on the slope, the vertical angles determined, and the slope measurements properly reduced to true horizontal distances.

## Sixth Standard Parallel North, thru Range 11 West.

Chains From the standard cor. of Ts. 25 N., Rs. 10 and 11 W., described in Book "A".  
West, on S. bdy. of sec. 36.  
Over rolling land, thru scattering timber and undergrowth.  
Asc. 115 ft. over E. slope, to  
30.00 Top of ascent, thence over level land to  
40.00 Set an iron post, 3 ft. long, 1 in. in diam., 4 ins. in the ground to bed rock, supported in a mound of stone for standard  $\frac{1}{4}$  sec. cor. marked on brass cap

S C  
 $\frac{1}{4}$  S 36  
1920

From which  
A cedar, 12 ins. in diam., bears N.  $19\frac{1}{2}^{\circ}$  E., 157 lks. dist. marked  $\frac{1}{4}$  S 36 S C B T.  
A cedar, 6 ins. in diam., bears N.  $37\frac{1}{4}^{\circ}$  W., 67 lks. dist. marked  $\frac{1}{4}$  S 36 S C B T.  
41.50 Spur, slopes S.  $25^{\circ}$  W. Desc. 280 ft. over W. slope.  
59.50 Ravine, course N. Thence along N. slope.  
61.50 Ravine, course N. Asc. 156 ft. over E. slope.  
80.00 Set an iron post, 3 ft. long, 2 ins. in diam., 4 ins. in the ground to bed rock, supported in a mound of stone, for standard cor. of secs. 35 and 36, marked on brass cap

S C  
T 25 N R 11 W  
S 35 | S 36  
1920

From which  
A cedar, 8 ins. diam., bears N.  $28\frac{1}{2}^{\circ}$  E., 183 lks. dist. marked T 25 N R 11 W S 36 S C B T.  
A cedar, 10 ins. in diam., bears N.  $24\frac{1}{2}^{\circ}$  W., 245 lks. dist. marked T 25 N R 11 W S 35 S C B T.  
Land; rolling.  
Soil; rocky, 4th rate.  
Timber; scrub pine and cedar.  
Undergrowth; chamiso, sagebrush and cactus.

West, on S. bdy. of sec. 35.  
Over rolling land, thru scattering timber and undergrowth  
3.50 Spur, slopes NE. Desc.  
8.00 Head of ravine, course NE. Asc. 100 ft. over E. slope to  
16.50 Spur, slopes N. from SW. Thence along N. slope, descending 15 ft.  
25.50 Asc. 105 ft.  
40.00 Set an iron post, 3 ft. long, 1 in. in diam., 16 ins. in the ground to bed rock, supported in a mound of stone, for standard  $\frac{1}{4}$  sec. cor., marked on brass cap

S C  
 $\frac{1}{4}$  S 35  
1920

From which  
A cedar, 8 ins. dia., bears N.  $45^{\circ}$  E., 28 lks. dist. marked  $\frac{1}{4}$  S 35 S C B T.  
A cedar, 6 ins. dia., bears N.  $30^{\circ}$  W., 122 lks. dist. marked  $\frac{1}{4}$  S 35 S C B T.  
Continue ascent 90 ft.  
47.00 Spur, slopes S.  $60^{\circ}$  E.  
51.00 Spur, slopes N. Desc. 145 ft. to  
58.40 Ravine, course N. Asc. 180 ft.  
74.00 Ridge, bears N.  $10^{\circ}$  E. and S.  $10^{\circ}$  E. Desc. 100 ft.  
79.70 Head of ravine, course N. Asc.  
80.00 Set an iron post, 3 ft. long, 2 ins. in diam., 24 ins. in the ground for standard cor. of secs. 34 and 35,

## Sixth Standard Parallel North, thru Range 11 West.

Chains

marked on brass cap

S C  
T 25 N R 11 W  
S 34 | S 35  
1920

From which

A cedar, 8 ins. in diam., bears N.  $74\frac{1}{2}^{\circ}$  E., 173  
lks. dist. marked T 25 N R 11 W S 35 S C B T.

A cedar, 6 ins. in diam., bears N.  $8\frac{1}{4}^{\circ}$  W., 102  
lks. dist. marked T 25 N R 11 W S 34 S C B T.

Land; rolling.

Soil; rocky, 4th rate.

Timber; scrub cedar and pine.

Undergrowth; sagebrush and chamiso.

West, on S. bdy. of sec. 34.

Over rolling land, thru scattering timber and undergrowth  
Asc. 145 ft. over E. slope.11.00 Ridge, bears N.  $20^{\circ}$  W. and S.  $20^{\circ}$  E. Desc. 630 ft. over  
steep SW. slope.40.00 Set an iron post, 3 ft. long, 1 in. in diam., 12 ins. in  
the ground to bed rock, supported in a mound of stone  
for standard  $\frac{1}{4}$  sec. cor., marked on brass cap

S C  
 $\frac{1}{4}$  S 34  
1920

From which

A cedar, 6 ins. in diam., bears N.  $10\frac{1}{2}^{\circ}$  E., 111  
lks. dist. marked  $\frac{1}{4}$  S 34 S C B T.

A cedar, 8 ins. in diam., bears N.  $10\frac{1}{2}^{\circ}$  W., 139  
lks. dist. marked  $\frac{1}{4}$  S 34 S C B T.

Desc. 175 ft. over SW. slope to cor.

59.50 Spur, slopes N.  $30^{\circ}$  W.

65.00 Spur, slopes NW.

80.00 Set an iron post, 3 ft. long, 2 ins. in diam., 24 ins.  
in the ground, for standard cor. of secs. 33 and 34,  
marked on brass cap

S C  
T 25 N R 11 W  
S 33 | S 34  
1920

From which

A cedar, 6 ins. in diam., bears N.  $58^{\circ}$  E., 243  
lks. dist. marked T 25 N R 11 W S 34 S C B T.

A cedar, 6 ins. in diam., bears N.  $59^{\circ}$  W., 267  
lks. dist. marked T 25 N R 11 W S 33 S C B T.

Land; rolling.

Soil; rocky, 4th rate.

Timber; scrub cedar and pine.

Undergrowth; sagebrush and chamiso.

West, on S. bdy. of sec. 33.

Over rolling land, thru scattering timber and undergrowth  
Desc. 70 ft. over W. slope.7.00 Draw, course N.  $60^{\circ}$  W.

10.00 Desc. 47 ft. over W. slope.

22.00 Drain, course NW. Asc. 50 ft.

40.00 Set an iron post, 3 ft. long, 1 in. in diam., 20 ins. in  
the ground to bed rock, supported in a mound of stone,  
for standard  $\frac{1}{4}$  sec. cor., marked on brass cap



## Sixth Standard Parallel North, thru Range 11 West.

Chains

S C  
 $\frac{1}{4}$  S 33  
 1920

From which

A cedar, 6 ins. in diam., bears N.  $24\frac{3}{4}^{\circ}$  E., 283 lks.  
 dist. marked  $\frac{1}{4}$  S 33 S C B T.

A cedar, 4 ins. in diam., bears N.  $67\frac{3}{4}^{\circ}$  W., 332 lks.  
 dist. marked  $\frac{1}{4}$  S 33 S C B T. Continue asc.

41.30

Spur, slopes NW. Desc. 70 ft. over W. slope.

48.45

Wash, course N. Asc. 70 ft. over SE. slope.

70.00

Ridge, bears S.  $85^{\circ}$  E. and N.  $60^{\circ}$  W. Desc. 100 ft.  
 over W. and SW. slopes to

80.00

Set an iron post, 3 ft. long, 2 ins. in diam., 20 ins. in  
 the ground to bed rock, supported in a mound of stone,  
 for standard cor. of secs. 32 and 33, marked on brass  
 cap

S C  
 T 25 N R 11 W  
 S 32 | S 33  
 1920

From which

A cedar, 10 ins. in diam., bears N.  $61\frac{3}{4}^{\circ}$  E., 83 lks.  
 dist. marked T 25 N R 11 W S 33 S C B T.

No other trees within limits.

Raise a mound of stone 2 ft. base,  $1\frac{1}{2}$  ft. high N. of cor.  
 Land; rolling.

Soil; rocky, 4th rate.

Timber; scrub cedar and pine.

Undergrowth; sagebrush and chamiso.

West, on S. bdy. of sec. 32.

Over rolling land, thru scattering undergrowth.

Desc. 30 ft. over gradual W. slope.

22.00

Wash, course N. from E. Asc. 20 ft.

25.00

Point of spur, slopes N. about 5 chs. Desc. 75 ft. to

30.00

Wash, course NW. from NE. Asc. 56 ft. to A. T. and  
 S. F. R. R. brs. N. about 5 chs. dist., on curve from  
 NE. to NW. Asc. 56 ft. to

40.00

Set an iron post, 3 ft. long, 1 in. in diam., 20 ins.  
 in the ground to bed rock, deposit a stone mkd. with  
 a cross (X) at base of post and raise a md. of stone  
 around post, for standard  $\frac{1}{4}$  sec. cor., marked on brass  
 cap

S C  
 $\frac{1}{4}$  S 32  
 1920

Asc. 15 ft.

42.00

Desc. 40 ft.

47.05

Asc. 35 ft.

70.00

Spur, slopes NW. Desc. 34 ft.

80.00

Set an iron post, 3 ft. long, 2 ins. in diam., 6 ins. in  
 the ground to bed rock, deposit a stone mkd. with a  
 cross (X) at base of post and raise a md. of stone  
 around post, for standard cor. of secs. 31 and 32,  
 marked on brass cap

S C  
 T 25 N R 11 W  
 S 31 | S 32  
 1920

Land; rolling.

Soil; 3rd rate.

Timber; none.

Undergrowth; sagebrush.

## Sixth Standard Parallel North, thru Range 11 West.

Chains West, on S. bdy. of sec. 31.  
 Over rolling land, thru scattering undergrowth.  
 Desc. 80 ft. over W. slope.  
 21.50 Telegraph line, bears NE. and SW.  
 24.75 Right of way fence brs. NE. and SW.  
 26.15 A. T. and S. F. R. R. brs. NE. to Nelson and SW. to  
 Crozier.  
 29.15 Right of way fence brs. NE. and SW.  
 32.80 Center of wash 150 lks. wide, course S. 80° W.  
 40.00 Set an iron post, 3 ft. long, 1 in. in diam., 26 ins. in  
 the ground for standard  $\frac{1}{4}$  Sec. cor., marked on brass  
 cap

S C  
 $\frac{1}{4}$  S 31  
 1920

Raise a mound of stone, 2  
 ft. base,  $1\frac{1}{2}$  ft. high N. of cor. Cor. falls on S.  
 edge of spur.  
 Asc. 50 ft.  
 57.00 Desc. 50 ft.  
 59.00 Ravine, course S. 20° E. Thence along S. slope.  
 64.50 Draw, course S. 20° W. Asc. 80 ft. to  
 77.00 Spur, slopes S.; along slope of same.  
 80.00 Set an iron post, 3 ft. long, 3 ins. in diam., 24 ins.  
 in the ground for standard cor. of Ts. 25 N., Rs. 11  
 and 12 W., marked on brass cap

S C  
 T 25 N  
 R 12 W | R 11 W  
 S 36 | S 31  
 1920

Raise a mound of stone, 2  
 ft. base,  $1\frac{1}{2}$  ft. high N. of cor. Cor. falls on S.  
 slope of spur.  
 Land; rolling.  
 Soil; 3rd rate.  
 Timber; none.  
 Undergrowth; sagebrush.  
 Good grazing.

Part (Completion) of the W. bdy. of T. 24 N., R. 11 W.

Chains

That part of the West boundary of T. 24 N., R. 11 W., lying outside the Hualpai Indian Reservation was surveyed to an intersection with the South boundary of the Hualpai Indian Reservation in Jan. 1912, by W. H. Elliott, U. S. S. No subsequent retracement or resurvey of this line is of record in this office. The boundaries of the Hualpai Indian Reservation were originally surveyed in August and September, 1900, by Albert T. Colton, U. S. D. S. No retracement or resurvey of the Indian Reservation bdy. within this township is of record in this office.

The closing cor. of Ts. 24 N., Rs. 11 and 12 W. on S. bdy. of Hualpai Indian Reservation is an iron post, 3 ins. in diam., projecting 12 ins. above ground, properly marked on brass cap and witnessed by three pits, one each on line E., W. and S. of cor. According to the record, this cor. was established on the South Bdy. of the Hualpai Indian Reservation at 36.80 chs. North of the cor. of secs. 1, 6, 7 and 12.

Thence

.08  
3.20

North, bet. secs. 1 and 6. Over rolling land. Three strand barbed wire fence bears E. and W. (40.00 chs. North of the cor. of secs. 1, 6, 7 and 12) Set an iron post, 3 ft. long, 1 in. in diam., 24 ins. in the ground in a mound of stone for 1/4 sec. cor., marked on brass cap;

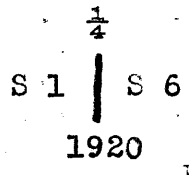

13.20  
35.48

Raise a mound of stone, 2 ft. base, 1 1/2 ft. high W. of cor. Draw, course SW. Trail bears E. and W. (72.28 chs. North from the cor. of secs. 1, 6, 7 & 12) Intersect the Sixth Standard Parallel North, 17.90 chs. west of the standard cor. of Ts. 25 N., Rs. 11 and 12 W., hereinbefore described. At point of intersection, set an iron post, 3 ins. in diam., 3 ft. long, 26 ins. in the ground for closing cor. of Ts. 24 N., Rs. 11 and 12 W., marked on brass cap

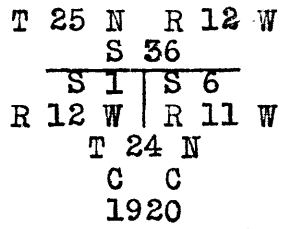

Dig pits 18 x 18 x 12 ins. corosswise on each line, E., W., and S. of post 3 ft. dist. Land; rolling. Soil; gravelly loam, 2nd rate. Timber; none. Undergrowth; cactus and sagebrush. Good grass.

Retracement of a Portion of the S. bdy. of Hualpai  
Indian Reservation.

Chains     The 55 mile cor. on S. bdy. of Hualpai Indian Reserva-  
tion is a limestone 14 x 10 x 8 ins. above ground, firm-  
ly set, properly marked, and witnessed by a mound of  
stone E. of cor.  
Thence  
East, on a retracement along S. bdy. of H. I. R.  
Over rolling land, thru scattering timber and under-  
growth.  
Asc. 500 ft. over W. slope.  
23.20     Ridge, bears N. and S. Desc. 156 ft. over NE. slope.  
38.16     Fall 18 lks. N. of the closing cor. of secs. 3 and 4,  
T. 24 N., R. 11 E., hereinafter described.  
39.49     Fall 18 lks. N. of the 55½ mile cor. on S. bdy. of H. I.  
R., which is a rock in place 36 x 24 x 10 ins. above  
ground, properly marked, witnessed by a mound of  
stone, E. of cor.  
True course and distance from 55 mile cor. to 55½  
mile cor. are therefore S. 89° 45' E., 39.49 chs.

-----

The 56½ mile cor. on S. bdy. of Hualpai Indian Reserva-  
tion is a limestone 10 x 8 x 8 ins. above ground,  
firmly set, properly marked, witnessed by a mound of  
stone, 2 ft. base, 1½ ft. high E. of cor.  
Thence  
East, on retracement, along S. bdy. of H. I. R.  
Over rolling land, thru scattering timber and undergrowth  
5.50     Ridge, bears N. and S. Desc. 30 ft. to  
13.50     Wash, course N. Asc. 23 ft. to  
18.50     Spur, slopes N. Desc. 70 ft. to  
24.80     Wash, course S. Asc. 70 ft. over W. slope to  
40.18     Fall 6 lks. N. of the 57 mile cor. on S. bdy. of Hualpai  
Indian Reservation, which is a limestone 12 x 10 x 8  
ins. above ground, properly marked, witnessed by a  
mound of stone, 3 ft. base, 2 ft. high E. of cor.  
True course and distance from 56½ mile cor. to  
57 mile cor. are therefore S. 89° 55' E., 40.18 chs.

-----

Boundaries of the Portion of Township 24 North, Range 11 West,  
 surveyed under Group 108.

Latitudes, departures and closing errors.

Line designated	True bearing	Dist- ance.	Latitudes.		Departures.	
			S.	E.	W.	
N. bdy. of Tp. (6th. Std. Par N)	West	563.33				563.33
West Bdy.	South	35.48		35.48		
South Boundary (H.I.R.Bdy)	East	284.92			284.92	
	S.89°45'E	39.49		.18	39.49	
	East	80.00			80.00	
	S.89°55'E	40.18		.06	40.18	
	East	118.78			118.78	
East Boundary	North	35.91	35.91			
Convergency						.04
Totals			35.91	35.72	563.37	563.37
Error in latitude			35.72			563.37
Error in latitude			.19			
Error in departure						.00

## Part (Completion) of the Subdivision of T. 24 N., R. 11 W.

Chains The closing cor. of secs. 1 and 2, T. 24 N., R. 11 W., on S. bdy. of Hualpai Indian Reservation is an iron post 2 ins. in diam., projecting 12 ins. above ground, firmly set, properly marked on brass cap and witnessed by two properly marked bearing trees as follows:  
 A cedar, 28 ins. in diam., S. 17° E., 436 lks. dist.  
 A cedar, 9 ins. in diam., S. 50° W., 22 lks. dist.  
 According to the record this cor. was established on the South bdy. of Hualpai Indian Reservation at 36.60 chs. N. 0° 1' W. of the cor. of secs. 1, 2, 11 and 12.  
 Thence  
 N. 0° 01' W., bet. secs. 1 and 2.  
 3.40 Over rolling land, thru scattering timber and undergrowth (40.00 chs. N. 0° 1' W. from the cor. of secs. 1, 2, 11 and 12.)  
 Set an iron post, 3 ft. long, 1 in. in diam., in a mound of stone, for  $\frac{1}{4}$  sec. cor. marked on brass cap

S 2 | S 1  
 1920

From which  
 A pine, 8 ins. in diam., bears N. 57° E., 52 lks. dist., marked  $\frac{1}{4}$  S 1 B T.  
 A pine, 8 ins. in diam., bears S. 54 $\frac{1}{2}$ ° W., 36 lks. dist. marked  $\frac{1}{4}$  S 2 B T.  
 36.08 (72.68 chs. N. 0° 1' W. from the cor. of secs. 1, 2, 11 and 12.)  
 Intersect the Sixth Standard Parallel N., 14.57 chs. W. of the standard cor. of Ts. 25 N., Rs. 10 and 11 W., described in Book "A".  
 At point of intersection, set an iron post, 3 ft. long, 2 ins. in diam., 4 ins. in the ground to bed rock, supported in a mound of stone, for closing cor. of secs. 1 and 2, marked on brass cap

T 25 N R 11 W  
 S 36  
 S 2 | S 1  
 T 24 N R 11 W  
 C C  
 1920

From which  
 A cedar, 14 ins. in diam., bears S. 46 $\frac{1}{2}$ ° E., 70 lks. dist., marked T 24 N R 11 W S 1 C C B T.  
 A cedar, 6 ins. in diam., bears S. 82 $\frac{3}{4}$ ° W., ( ) lks. dist., marked T 24 N R 11 W S 2 C C B T.  
 Land; rolling.  
 Soil; rocky, 4th rate.  
 Timber; pine and cedar.  
 Undergrowth; chamiso, sagebrush and cactus.

The closing cor. of secs. 2 and 3 on S. bdy. of Hualpai Indian Reservation is an iron post, 2 ins. in diam., projecting 12 ins. above ground, firmly set, properly marked on brass cap and witnessed by two properly marked bearing trees as follows:  
 A cedar, 6 ins. in diam., S. 30 $\frac{1}{2}$ ° E., 61 lks. dist.  
 A cedar, 12 ins. in diam., S. 55 $\frac{1}{2}$ ° W., 16 lks. dist.  
 According to the record, this cor. was established on the South Bdy. of the Hualpai Indian Reservation at 36.54 chs. N. 0° 01' W. of the cor. of secs. 2, 3, 10 and 11.  
 Thence  
 N. 0° 01' W., bet. secs. 2 and 3.

Part (Completion) of the Subdivision of T. 24 N., R. 11 W.

Chains  
3.46 Over rolling land, thru scattering timber and undergrowth (40.00 chs. N. 0° 01' W., from the cor. of secs. 2, 3, 10 and 11.)  
Set an iron post, 3 ft. long, 1 in. in diam., in a mound of stone, for  $\frac{1}{4}$  sec. cor., marked on brass cap

S 3  $\frac{1}{4}$  S 2  
1920

From which  
A cedar, 10 ins. in diam., bears N. 82 $\frac{3}{4}$ ° E., 42 lks. dist. marked  $\frac{1}{4}$  S 2 B T.  
A cedar, 12 ins. in diam., bears S. 86 $\frac{1}{2}$ ° W., 66 lks. dist., marked  $\frac{1}{4}$  S 3 B T.

Asc. 30 ft. over S. slope.  
7.76 Spur, slopes E.  
16.96 Desc. 100 ft. over N. slope to.  
25.16 Wash, course E. Asc. 110 ft. over S. slope to  
33.36 Spur, slopes E. Desc. 15 ft. to  
36.10 (72.64 chs. N. 0° 01' W., from the cor. of secs. 2, 3, 10 and 11.)  
Intersect the Sixth Standard Parallel N., 15.04 chs. W. of the standard cor. of secs. 35 and 36, hereinbefore described.  
At point of intersection, set an iron post, 3 ft. long, 2 ins. in diam., in a mound of stone, for closing cor. of secs. 2 and 3, marked on brass cap

T 25 N R 11 W  
S 35  
-----  
S 3 S 2  
T 24 N R 11 W  
C C  
1920

From which  
A cedar, 10 ins. in diam., bears S. 31° E., 106 lks. dist. marked T 24 N R 11 W S 2 C C B T.  
A pinyon, 6 ins. in diam., bears S. 72 $\frac{1}{2}$ ° W., 35 lks. dist., marked T 24 N R 11 W S 3 C C B T.

Land; slightly rolling, drains NE.  
Soil; rocky, 3d rate.  
Timber; scrub cedar and pinyon.  
Undergrowth; sagebrush, chamiso and cactus.  
Fair grass.

The closing cor. of secs. 3 and 4 on S. bdy. of Hualpai Indian Reservation is an iron post, 2 ins. in diam., projecting 12 ins. above ground, firmly set, properly marked on brass cap and witnessed by two properly marked bearing trees as follows:  
A pinyon, 9 ins. in diam., S. 75 $\frac{1}{2}$ ° E., 9 lks. dist.  
A pinyon, 20 ins. in diam., S. 54 $\frac{3}{4}$ ° W., 177 lks. dist.  
According to the record this cor. was established on the South Bdy. of the Hualpai Indian Reservation at 36.46 chs. N. 0° 2' W. of the cor. of secs. 3, 4, 9 and 10.

Thence  
N. 0° 02' W., bet. secs. 3 and 4.  
Over mountainous land, thru scattering timber and undergrowth.  
3.54 (40.00 chs. N. 0° 02' W. from the cor. of secs. 3, 4, 9 and 10).  
Set an iron post, 3 ft. long, 1 in. in diam., 6 ins. in the ground to bed rock, supported in a mound of stone, for  $\frac{1}{4}$  sec. cor., marked on brass cap

## Part (Completion) of the Subdivision of T. 24 N., R. 11 W.

Chains

$$\begin{array}{c} \frac{1}{4} \\ \text{S } 4 \text{ | S } 3 \\ \hline 1920 \end{array}$$

From which

A cedar, 14 ins. in diam., bears N.  $71\frac{1}{2}^{\circ}$  E., 122 lks. dist. marked  $\frac{1}{4}$  S 3 B T.

A pinyon, 12 ins. in diam., bears S.  $76\frac{1}{2}^{\circ}$  W., 40 lks. dist., marked  $\frac{1}{4}$  S 4 B T.

Asc. 25 ft. to

6.54 Ridge, bears SE. and NW. Desc. 320. ft. over NE. slope to  
21.54 Gulch, course NW. Asc. 330 ft. over SW. slope to  
36.18 (72.64 chs. N.  $0^{\circ} 02'$  W., from the cor. of secs. 3, 4,  
9 and 10.)

Intersect the Sixth Standard Parallel N., 15.15 chs. W. of the standard cor. of secs. 34 and 35, hereinbefore described.

At point of intersection, set an iron post, 3 ft. long, 2 ins. in diam., in a mound of stone, for closing cor. of secs. 3 and 4, marked on brass cap.

$$\begin{array}{c} \text{T } 25 \text{ N } \quad \text{R } 11 \text{ W} \\ \text{S } 34 \\ \hline \text{S } 4 \quad \text{S } 3 \\ \text{T } 24 \text{ N } \quad \text{R } 11 \text{ W} \\ \text{C } \text{ C} \\ 1920 \end{array}$$

From which

A cedar, 10 ins. in diam., bears S.  $24\frac{1}{2}^{\circ}$  E., 95 lks. dist., marked T 24 N R 11 W S 3 C C B T

A pinyon, 8 ins. in diam., bears S.  $56\frac{1}{2}^{\circ}$  W., 94 lks. dist. marked T 24 N R 11 W S 4 C C B T.

Land; mountainous, drains NW.

Soil; rocky, 3rd rate.

Timber; cedar and pinyon.

Undergrowth; sagebrush, chamiso and cactus.

Fair grass.

The closing cor. of secs. 4 and 5 on S. bdy. of Hualpai Indian Reservation is an iron post, 2 ins. in diam., projecting 12 ins. above ground, firmly set, properly marked on brass cap and witnessed by a mound of stone 2 ft. base,  $1\frac{1}{2}$  ft. high S. of cor.

According to the record, this cor. was established on the South Bdy. of the Hualpai Indian Reservation at 36.76 chs. N.  $0^{\circ} 3'$  W. of the cor. of secs. 4, 5, 8 and 9.

Thence

N.  $0^{\circ} 03'$  W., bet. secs. 4 and 5.

Over slightly rolling land, thru scattering timber and undergrowth.

3.24 (40.00 chs. N.  $0^{\circ} 03'$  W. of the cor. of secs. 4, 5, 8 and 9.)

Set an iron post, 3 ft. long, 1 in. in diam., in a mound of stone, for  $\frac{1}{4}$  Sec. cor., marked on brass cap

$$\begin{array}{c} \frac{1}{4} \\ \text{S } 5 \text{ | S } 4 \\ \hline 1920 \end{array}$$

From which

A cedar, 10 ins. in diam., bears N.  $74\frac{1}{2}^{\circ}$  E., 67 lks. dist. marked  $\frac{1}{4}$  S 4 B T.

A cedar, 8 ins. in diam., bears N.  $66\frac{1}{2}^{\circ}$  W., 90 lks. dist. marked  $\frac{1}{4}$  S 5 B T.

Desc. 70 ft. over rolling N. slope.



## Part (Completion) of the Subdivision of T. 24 N., R. 11 W.

Chains  
35.77

(72.53 chs. N. 0° 03' W. of the cor. of secs. 4, 5, 8 and 9).

Intersect the Sixth Standard Parallel N., 14.60 chs. W. of the standard cor. of secs. 33 &amp; 34, hereinbefore described.

At point of intersection, set an iron post, 3 ft. long, 2 ins. in diam., 26 ins. in the ground, for closing cor. of secs. 4 and 5, marked on brass cap

T 25 N	R 11 W
S 33	
S 5	S 4
T 24 N	R 11 W
C C	
1920	

Raise a mound of stone 2 ft. base, 1½ ft. high S. of cor. Land; slightly rolling. Drains NW.  
Soil; 3rd rate.  
Timber; scattering pinyon and dense cedar.  
Undergrowth; sagebrush, chamiso and cactus.

The closing cor. of secs. 5 and 6 on S. bdy. of Hualpai Indian Reservation is an iron post, 2 ins. in diam., projecting 12 ins. above ground, firmly set, properly marked on brass cap and witnessed by a mound of stone 2 ft. base, 1½ ft. high S. of cor.

According to the record, this cor. was established on the south bdy. of the Hualpai Indian Reservation at 36.94 chs. N. 0° 03' W. of the cor. of secs. 5, 6, 7 and 8.

Thence

N. 0° 03' W., bet. secs. 5 and 6.

3.06

Over slightly rolling land, thru scattering undergrowth. (40.00 chs. from the cor. of secs. 5, 6, 7 and 8.)

Set an iron post, 3 ft. long, 1 in. in diam., 26 ins. in the ground for ¼ sec. cor., marked on brass cap

S 6	S 5
1920	

Dig pits 18 x 18 x 12 ins.

N. and S. of post, 3 ft. dist.

Desc. 70 ft. over rolling N. slope to

33.56

Wash, course NW.

35.68

(72.62 chs. N. 0° 03' W. from the cor. of secs. 5, 6, 7 and 8.

Intersect the Sixth Standard Parallel N., 14.87 chs. W. of the standard cor. of secs. 32 and 33, hereinbefore described.

At point of intersection, set an iron post, 3 ft. long, 2 ins. in diam., 26 ins. in the ground for closing cor. of secs. 5 and 6, marked on brass cap

T 25 N	R 11 W
S 32	
S 6	S 5
T 24 N	R 11 W
C C	
1920	

Dig pits 18 x 18 x 12 ins.

crosswise on each line, E. W. and S. of cor. 3 ft. dist.

Land; slightly rolling, drains NW.

Soil; 3rd rate.

Timber; none.

Undergrowth; sagebrush, chamiso and cactus.

Good grass.

(Part (Completion) of the Subdivision of T. 24 N., R. 11 W.

Chains

The continued satisfactory adjustment of the instruments thruout the survey of this township is indicated from field tests as shown in Books "D" and "E".

---

GENERAL DESCRIPTION.

The portion of T. 24 N., R. 11 W., surveyed under this assignment as described in the preceding notes lies within the Hualpai Indian Reservation. The surface is rolling and covered with a scattering growth of juniper and pinyon timber. The soil is rocky but can be utilized for grazing.

There are no indications of mineral and no streams or springs.

The A. T. & S. F. R. R. crosses Sec. 6, running NE. and SW.

---



18  
BOOK 3542

CERTIFICATE OF UNITED STATES TRANSITMAN.

I, Francis R. Ihrie, U. S. Transitman, hereby certify upon honor that, in pursuance of special instructions received from the U. S. Surveyor General, for Group 108, Arizona, bearing date of the 26th day of February, 19 20 I have well, faithfully, and truly in my own proper person, and in strict conformity with said instructions, the Manual of Surveying Instructions, and the laws of the United States, surveyed all those parts or portions of

Subdivision lines of

TOWNSHIP 24 NORTH, RANGE 11 WEST,

of the Gila and Salt

River Base & Meridian, in the State of Arizona, which are represented in *and by diagram on page 2 hereof* the foregoing field notes *as* having been executed by me, and under my direction; and that all the corners of said survey have been established and perpetuated in strict accordance with the Manual of Surveying Instructions, and the special written instructions of the U. S. Surveyor General, for Group 108, Arizona, and in the specific manner described in the field notes, and that the foregoing are the original field notes of such survey.

Place Washington, D.C. Francis R. Ihrie  
Date April 11 1923. U. S. Transitman.

APPROVAL.

~~OFFICE OF THE UNITED STATES SURVEYOR GENERAL,~~

, 19

The foregoing field notes of the survey of

executed by under his special instructions dated , 19 , having been critically examined, and the necessary corrections and explanations made, the said field notes, and the surveys they describe, are hereby approved.

*U. S. Surveyor General.*

I certify that the foregoing transcript of the field notes of the above-described surveys in , has been correctly copied from the original notes on file in this office.

*U. S. Surveyor General.*

BOOK 3542

4-680

FIELD ASSISTANTS.

to Thos. D. Daley, U. S. Surveyor

NAMES.	CAPACITY.
A. L. Bailey	1st Chainman.
Robert A. Johnson	2nd Chainman.
Chas. O. Harris	Axman and moundman.
Ben Eaves	Axman and moundman.
Geo. Demorest.	Flagman.

BOOK 3542

MAR 28 1923

CERTIFICATE OF UNITED STATES SURVEYOR.

I, Thos. D. Daley, U. S. Surveyor, hereby certify upon honor that, in pursuance of special instructions received from the U. S. Surveyor General, for Group 108, Arizona, bearing date of the 26th day of February, 1920, I have well, faithfully, and truly in my own proper person, and in strict conformity with said instructions, the Manual of Surveying Instructions, and the laws of the United States, ~~surveyed~~ <sup>retraced</sup> all those parts or portions of the South Boundary of the Hualpai Indian Reservation within

TOWNSHIP 24 NORTH, RANGE 11 WEST,

of the Gila and Salt River Base & Meridian, in the State of Arizona, and by diagram on page 2 hereof, which are represented in the foregoing field notes as having been executed by me, and under my direction; and that all the corners of said ~~survey~~ <sup>retracement</sup> have been established and perpetuated in strict accordance with the Manual of Surveying Instructions, and the special written instructions of the U. S. Surveyor General, for Group 108, Arizona, and in the specific manner described in the field notes, and that the foregoing are the original field notes of such ~~survey~~ <sup>retracement</sup>.

Place Santa Fe, N.M.  
Date March 26, 1923.

Thomas D. Daley  
U. S. Surveyor.

APPROVAL.

OFFICE OF THE UNITED STATES SURVEYOR GENERAL,

....., 191

The foregoing field notes of the survey of .....

executed by .....

under his special instructions dated ....., 191, having been critically examined, and the necessary corrections and explanations made, the said field notes, and the surveys they describe, are hereby approved.

.....  
U. S. Surveyor General.

I certify that the foregoing transcript of the field notes of the above-described surveys in ....., has been correctly copied from the original notes on file in this office.

.....  
U. S. Surveyor General.

4-680

BOOK 3542

FIELD ASSISTANTS.

to Horace M. Muscott, U. S. Transitman

NAMES.	CAPACITY.
Ben Mollette	1st Chainman.
Geo. Way	2nd Chainman.
Homer Pepper	Flagman.
Ted Lizovich	Moundman.
Ross Dykes	1st Chainman
I. C. Perkins	Moundman
E. C. Merrill	Axman

22  
BOOK 3542

CERTIFICATE OF UNITED STATES TRANSITMAN.

I, Horace M. Muscott, U.S. Transitman, hereby certify upon honor that, in pursuance of special instructions received from the U. S. Surveyor General, for Group 108, Arizona, bearing date of the 20th day of February, 1920, I have well, faithfully, and truly in my own proper person, and in strict conformity with said instructions, the Manual of Surveying Instructions, and the laws of the United States, surveyed all those parts or portions of the Sixth Standard Parallel North, thru. Range 11 West, West boundary, and Subdivision lines of  
TOWNSHIP 24 NORTH, RANGE 11 WEST,

of the Gila and Salt River Base and Meridian, in the State of Arizona, which are represented in and by diagram on page 2 hereof the foregoing field notes as having been executed by me, and under my direction; and that all the corners of said survey have been established and perpetuated in strict accordance with the Manual of Surveying Instructions, and the special written instructions of the U. S. Surveyor General, for Group 108, Arizona, and in the specific manner described in the field notes, and that the foregoing are the original field notes of such survey.

Place Los Angeles, Calif Horace M. Muscott  
Date March 22, 1923 U.S. Transitman.

APPROVAL.

OFFICE OF THE UNITED STATES SURVEYOR GENERAL,

Phoenix, Arizona, JUN 18 1923, 1923.

The foregoing field notes of the survey of the Sixth Std. Parallel North, thru. Range 11 West, Part(completion)of the West bdy., and Part(completion)of the Subdivision lines of  
TOWNSHIP 24 NORTH, RANGE 11 WEST,  
and Retracement of

Part of the S.bdy. of the Hualapai Indian Reservation, within Township 24 North, Range 11 West, of the Gila and Salt River Base & Mer., Arizona, executed by Horace M. Muscott, and Francis R. Ihrie, U.S. Transitsmen, and Thos. D. Daley, U. S. Surveyor, under special instructions dated Feb'y. 20, 1920, for Grp. 108, Arizona, having been critically examined, and the necessary corrections and explanations made, the said field notes, and the surveys and retracements they describe, are hereby approved.

Francis R. Ihrie  
U. S. Surveyor General.

~~I certify that the foregoing transcript of the field notes of the above-described surveys in \_\_\_\_\_ has been correctly copied from the original notes on file in this office.~~

U. S. Surveyor General.