

3546

Book "F."

4-679

196
ORIG
①

BOOK 3546

FIELD NOTES

OF THE SURVEY OF THE

North boundary, and

Subdivision lines

of

TOWNSHIP 26 NORTH, RANGE 10 WEST,

(within the Hualpai Indian Reservation)

Of the Gila and Salt River Base and Meridian,

In the State of Arizona.

EXECUTED BY

Thomas D. Daley, U. S. Surveyor,

and

Horace M. Muscott, and Claude F. Warner, U.S. Transitmen,

In the capacity of U. S. Surveyors, under Special Instructions dated February 26., 1920,

issued by the United States Surveyor General to govern surveys included in Group

No. 108, Arizona, which were approved by the Commissioner of the General Land

Office, March 10., 1920, and Assignment Instructions dated August 7, 1920
Sept. 28, 1920
and April 6, 1921

Survey commenced November 10., 1920

Survey completed May 19., 1921.

3546

3546

1A

BOOK 3546

Book "F"

Group 108 - Arizona.

Township 26 North, Range 10 West.

INDEX DIAGRAM.

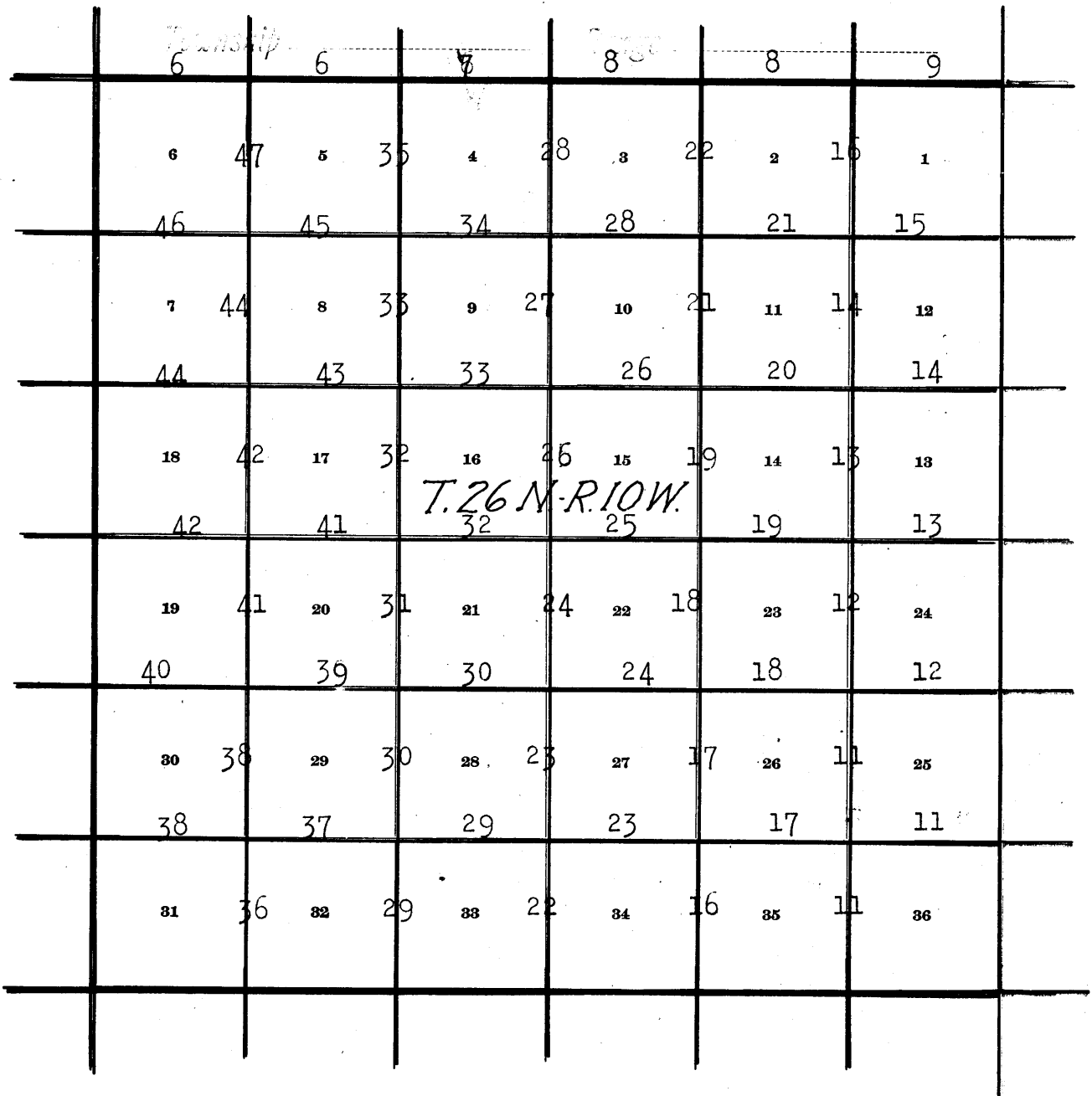

———— Lines surveyed under this group.

———— Lines surveyed under Group No. 107.

Book "F"

Group 108 - Arizona.

Township 26 North, Range 10 West.

DATE DIAGRAM.

	5-11-21	5-10-21	5-9-21	5-9-21	11-27-20	11-26-20
	6	5	4	3	2	1
5-12-21	5-13-21	5-13-21	11-27-20	11-22-20	11-20-20	
7	8	9	10	11	12	
11-23-20	11-24-20	11-26-20	11-19-20	11-17-20	11-16-20	
16	17	16	15	14	13	
11-12-20	11-12-20	11-18-20	11-18-20	11-18-20	11-17-20	
19	20	21	22	23	24	
11-11-20	11-11-20	11-13-20	11-13-20	11-16-20	11-16-20	
30	29	28	27	26	25	
11-10-20	11-10-20	11-13-20	11-15-20	11-16-20	11-16-20	
31	32	33	34	35	36	
11-10-20		11-10-20	11-13-20	11-16-20	11-16-20	

For dates of survey of this line see Book "E" of this Group.

For dates of survey of this line, see Book "F" of Group 107.

For dates of survey of this line, see Book "C" of this group.

Red lines indicate surveys executed by Horace M. Muscott, U. S. T., on dates shown thereon.

Green lines indicate surveys executed by Claude F. Warner, U. S. S., on dates shown thereon.

Blue lines indicate surveys executed by Thomas D. Daley, U. S. S. on dates shown thereon.

Survey commenced November 10, 1920, and executed with Buff Rocky Mountain Favorite transit No. 9977 and Young and Son Light Mountain transit No. 8489. Both instruments are equipped with full vertical circles and the Smith solar attachment. Unless otherwise specified, all azimuth determinations are accomplished with the solar attachment. Field test of instruments Nos. 9977 and 8489 by Mr. Warner and Mr. Muscott.

Nov. 6, 1920: We examine the adjustments of each instrument and correct all errors; then to test the solar apparatus by comparing their indications from observations made during a.m. and p.m. hours with a meridian established by Polaris observation, proceed with each instrument as follows:

Nov. 7, 1920: At camp near the $\frac{1}{4}$ sec. cor. of secs. 23 and 26, T. 25 N., R. 11 W., G. & S. R. B. & M., Arizona, lat. $35^{\circ}31\frac{1}{2}'$ N., long. $113^{\circ}25\frac{1}{2}'$ W., using the meridian established as described in Book "B".

At 9h 00m., a.m., l.m.t., we set off $35^{\circ}31\frac{1}{2}'$ N., on the lat. arcs $16^{\circ}18'$ S., on the declination arcs, and determine a meridian with each solar which agrees with the true meridian.

At app. noon, with the lat. arcs unchanged, we observe the sun on the meridian with each instrument; the resulting reading of the decl. arc in each case is $16^{\circ}20\frac{1}{2}'$ S., which agrees with the computed declinations of the sun.

At 3h 00m., p.m., l.m.t., with the lat. arcs unchanged, we set off $16^{\circ}22\frac{1}{2}'$ S., on the declination arcs and determine a meridian with each solar, which agrees with the true meridian.

As all of the solar observations during the usual hours of solar work come within $1'30''$ of the true meridian, we conclude that the adjustment of the instruments are satisfactory.

Unless otherwise specified all measurements are made with a 5 ch. Lufkin steel tape compared with a Lufkin standard steel tape and found correct. The measurements are made on the slope, the vertical angle determined, and the slope measurements properly reduced to the horizontal distances.

Field test of instruments Nos. 9977 and 8489 by Mr. Daley and Mr. Muscott.

May 6, 1921: We examine the adjustments of the instruments and correct all errors; then to test the solar apparatus by comparing its indications from observations made during a.m. and p.m. hours with a meridian established by polaris observation, proceed as follows:

May 7, 1921: In camp near the cor. of secs. 25, 26, 35 and 36, T. 27 N., R. 11 W., G. & S. R. B. & M., Arizona, lat. $35^{\circ}41'$ N., long. $113^{\circ}25'$ W., at 4 hrs. 36m., a.m., l.m.t., we observe Polaris at eastern elongation, making four observations, two each, with the telescope in direct and reversed positions, and mark the mean point in the line thus determined, on a peg driven firmly in the ground, 5 chs. North.

Azimuth of Polaris at eastern elongation - - $1^{\circ}22'37''$

At 8 hrs., 0 m., a.m., l.m.t., we lay off the azimuth of Polaris $1^{\circ}22\frac{1}{2}'$ to the west and mark the meridian thus determined by a tack in a peg driven firmly in the ground, 5 chs. North..

At 9 hrs., 0 m., a.m., l.m.t., we set off $35^{\circ}41'N.$ on the lat.arcs., $16^{\circ}48'N.$ on the decl.arcs, and determine a meridian with each solar, which agrees with the true meridian.

At apparent noon, with the lat.arcs unchanged, we observe the sun on the meridian; the resulting readings of the decl.arcs are $16^{\circ}49\frac{1}{2}'W.$, which agrees with the computed decl. of the sun.

At 3 hrs. 0 m., p.m., l.m.t., with the lat.arcs unchanged, we set off $16^{\circ}52'N.$ on the decl.arcs, and determine a meridian with each solar which agrees with the true meridian.

As all of the solar observations during the usual hours of solar work come within $1'30''$ of the true meridian, we conclude that the adjustments of the instrument are satisfactory.

Unless otherwise specified, all measurements are made with a Lufkin steel tape, 5 chs. in length, compared with a Lufkin standard steel tape and found correct. The measurements are made on the slope, the vertical angle determined, and the slope measurements properly reduced to true horizontal distances.

North Boundary of T, 26 N., R. 10 W.

Chains.

From the cor. of Ts. 26 and 27 N., Rs. 9 and 10 W., described in the field notes of current Group No. 107, West on a random line, along the N. bdy. of T. 26 N., R. 10 W., setting temp. $\frac{1}{4}$ sec. and sec. cors. at intervals of 40.00 chs. to

269.50 Precipitous cliff over which it is impossible to chain.

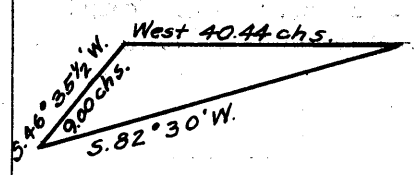

Vertical angle to flag on random line, $-19\frac{1}{2}^\circ$; auxiliary flag brs. $S.82^\circ30'W.$; from flag on random line, auxiliary flag brs. $S.46^\circ35\frac{1}{2}'W.$ 9.00 chs. dist.; all bearing checked by direct reading of the solar and all angles checked by deflection.

Dist. on random = 269.50 chs.
 Dist. by triangulation = 40.44 "
 309.94 "

309.94 Triangulation point. In order to locate temp. $\frac{1}{4}$ sec. cor. at 280.00 chs., proceed as follows: Set a flag East on random line. From auxiliary flag of last triangulation, flag on random line brs. $N.78^\circ44\frac{1}{2}'E.$; all bearings checked by direct reading of the solar, and all angles checked by deflection.

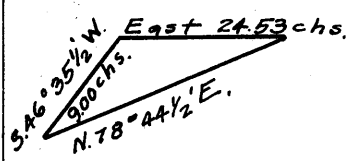

Dist. on random = 309.94 chs.
 Dist. by triangulation = 24.53 "
 285.41 " Thence East

280.00 Set temp. $\frac{1}{4}$ sec. cor. of secs. 4 and 33.

320.00 From the 309.94 ch. point, continue West on random line. Set temp. cor. of secs. 4, 5, 32, and 33.

333.13 At this point, offset South 1.40 chs., and continue West on random offset line. West 13.13 chs. West

333.13 Set back 1.40 chs. North to random line, and continue West on random line.

360.00 Set temp. $\frac{1}{4}$ sec. cor. of secs. 5 and 32. Rim rock, over which it is impossible to chain. From the 354.25 ch. point, vertical angle to flag on random line, -4° ; auxiliary flag brs. $S.81^\circ15\frac{1}{2}'W.$; from flag on random line, auxiliary flag brs. South 5.60 chs. dist.; all bearings checked by direct reading of the solar and all angles checked by deflection.

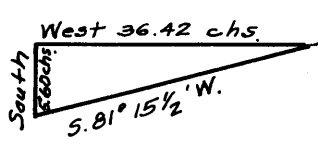

Dist. on random = 354.25 chs.
 Dist. by triangulation = 36.42 "
 390.67 "

390.67 Triangulation point. Continue West on random line, dist. by chaining.

400.00 Set temp. cor. of secs. 5, 6, 31, and 32.

421.49 Precipitous cliffs over which it is impossible to chain; vertical angle to flag on random line, -16° ; auxiliary flag brs. South 3.70 chs dist.; from flag on random line, auxiliary flag brs. $S.71^\circ45'E.$; all bearings checked by direct reading of the solar, and all angles checked by deflection.

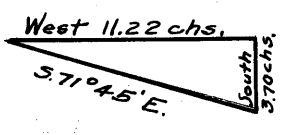

Dist. on random = 421.49 chs.
 Dist. by triangulation = 11.22 "
 432.71 "

North Boundary of T. 26 N., R. 10 W.

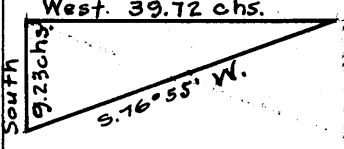
Chains.	
432.71	Triangulation point.
432.97	Top of cliffs. Set temp. witness cor. to $\frac{1}{4}$ sec. cor. of secs. 6 and 31. Vertical angle to flag on random line, -26° ; auxiliary flag brs. S. $76^\circ 55' W.$; from flag on random line; auxiliary flag brs. South 9.23 chs. dist.; all bearings checked by direct reading of the solar and all angles checked by deflection.
	
	Dist. on random = 432.97 chs. Dist. by triangulation = 39.72 " <u>472.69 "</u>
472.69	Triangulation point. Continue West on random line, measurement by chaining.
478.72	Fall 45 lks. N. of the cor. of Ts. 26 and 27 N., Rs. 10 and 11 W., described in Book "E". The falling answers to a correction of $0^\circ 3'$, or 7 lks. S. per mile, counting from the NE. cor. of the Tp. From the cor. of Ts. 26 and 27 N., Rs. 10 and 11 W., N. $89^\circ 57' E.$ on a true line, bet. secs. 6 and 31. Over mountainous land, through scattering undergrowth. Asc. 1200 ft. over series of cliffs.
6.03	Thence by triangulation, as hereinbefore described.
38.72	The true point for $\frac{1}{4}$ sec. cor. falls on cliff.
45.52	Mark cross (X) at exact cor. point, and over same set an iron post, 3 ft. long, 1 in. diam., on surface rock, supported in a mound of stone, 3 ft. base, $2\frac{1}{2}$ ft. high, for witness cor. to $\frac{1}{4}$ sec. cor., marked on brass cap
	$WC \frac{1}{4} \frac{S31}{S6}$ 1921
46.01	Asc. 220 ft. over cliffs, measurement by chaining.
57.23	Thence by triangulation as hereinbefore described.
60.30	Thence by chaining.
78.00	Spur, slopes SW. Desc. 190 ft., over NE. slope.
78.72	Wash, 15 lks. wide, course SE.
78.72	Mark cross (X) at exact cor. point, and over same set an iron post, 3 ft. long, 2 ins. diam., on surface rock, supported in a mound of stone, for cor. of secs. 5, 6, 31 and 32, marked on brass cap
	$\begin{array}{c} T27N R10W \\ S31 S32 \\ \hline S6 S5 \\ T26N \\ 1921 \end{array}$
	Land, rough mountainous. Soil, rocky, 4th rate. Timber, none. Undergrowth, black brush, Spanish dagger, cactus, and palo christi.
	N. $89^\circ 57' E.$ on a true line, bet. secs. 5 and 32. Over mountainous land, through scattering timber and undergrowth.
	Asc. 20 ft.
1.68	Spur, slopes S. Desc. 25 ft., over E. slope.
5.35	Wash, 10 lks. wide, course S. Thence over rolling land.
9.33	Thence by triangulation, as hereinbefore described.
22.00	(Approx.) Rim of canyon, brs. N. and S. Desc. about 900 ft.
35.00	(Approx.) Canyon, course S.
40.00	Mark cross (X) at exact cor. point, and over same set an iron post, 3 ft. long, 1 in. diam., on surface rock,

BOOK 8546

North Boundary of T.26 N., R.10 W.

Chains

supported in a mound of stone, for 1/4 sec. cor., marked on brass cap

1/4 S 32
S 5
1921

45.75 Asc. 300 ft. over steep W. slope forming canyon wall to Rim of canyon N. and S. Asc. slightly. Measurement by chaining to

45.90 Spur, slopes S.

51.60 Spur, slopes SE. Desc. 250 ft. to

62.70 Spur, slopes S. along S. slope.

66.87 Offset South, 1.40 chs. Thence N.89°57'E. on off set line

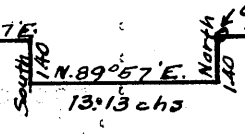

67.40 Spur, slopes S. Desc. 220 ft. to

75.70 Wash, 20 lks. wide, course SE.

78.80 Spur, slopes SE.

80.00 Offset North, 1.40 chs. to true point for cor. of secs. 4, 5, 32 and 33, where line.

Mark cross (x) exact cor. point and over same set an iron post, 3 ft. long, 2 ins. in diam., on surface rock, supported in a mound of stone, for cor. of secs. 4, 5, 32 and 33, marked on brass cap

T27N | R10W
S 32 | S 33
S 5 | S 4
T26N
1921

Land; mountainous.
Soil; rocky, 4th. rate.
Timber; scattering juniper.
Undergrowth; black brush, spanish dagger, cactus and palo verde.

N.89°57'E., on a true line bet. secs. 4 and 33.
Over mountainous land, thru scattering timber and undergrowth.

10.06 Desc. 300 ft. over SE. slope to Bottom of canyon, course SW. Asc. 450 ft. Dist. by triang.
34.59 Thence by chaining as hereinbefore described

40.00 Mark cross (x) at exact cor. point and over same set an iron post, 3 ft. long, 1 in. in diam., on surface rock, supported in a mound of stone, for 1/4 sec. cor. marked on brass cap

1/4 S 33
S 4
1921

50.50 Thence by triangulation as hereinbefore described. Top of rim rock bears N. and S. 450 ft. above 1/4 cor. Thence by chaining as hereinbefore described.

52.20 Wash, drains S.70°W.

55.25 Same wash, course W. from SE.

73.00 Same wash, course SW, Asc. 70 ft. to

79.00 Spur, slopes SW. Slight ascent to cor.

80.00 Mark cross (x) at exact cor. point and over same set an iron post, 3 ft. long, 2 ins. in diam., on surface rock, supported in a mound of stone, for cor. of secs. 3, 4, 33 and 34. marked on brass cap

T27N | R10W
S 33 | S 34
S 4 | S 3
T26N
1921

From which

A juniper, 6 ins. in diam., bears N.86 1/2°E., 72 lks. dist. marked T 27 N R 10 W S 34 B T

A juniper, 6 ins. in diam., bears N.56 1/2°W., 95 lks. dist. marked T 27 N R 10 W S 33 B T

North Boundary of T. 26 N., R. 10 W.

Chains

No other trees within limits.

Land; mountainous,

Soil; rocky, 4th rate.

Timber; scattering juniper.

Undergrowth; black brush, spanish bayonet, cactus and palo christi.

N. 89° 57' E., on a true line bet. secs. 3 and 34.

Over mountainous land, thru scattering timber and undergrowth.

- 6.10 Desc. 30 ft. over SE. slope to Wash, 10 lks. wide, course SW. Asc. 120 ft. over W. slope to
- 18.30 Spur, slopes S along S slope to
- 25.40 Spur, slopes S. Desc. 40 ft. to
- 30.00 Drain, course SE. Asc. 80 ft. to
- 38.40 Spur, slopes SW. along S slope to
- 40.00 Mark cross (x) at exact cor. point and over same set an iron post, 3 ft. long; 1 in. in diam., on surface rock, supported in a mound of stone for $\frac{1}{4}$ sec. cor., marked on brass cap

	S	34
$\frac{1}{4}$	S	3
		1921

- 43.20 Desc. 26 ft. to Drain, course S. Asc. 30 ft. to
- 48.10 Spur, slopes S along broken south slope over spurs
- 62.30 Spur, slopes SW.
- 68.00 Spur, slopes S.
- 77.00 Spur, slopes SE. Desc. 40 ft. to
- 80.00 Mark cross (x) at exact cor. point and over same set an iron post, 3 ft. long; 2 ins. in diam., on surface rock, supported in a mound of stone, for cor. of secs. 2, 3, 34 and 35, marked on brass cap

T27N	R10W
S 34	S 35
S 3	S 2
T26N	
1920	

Land; rolling and mountainous.

Soil; rocky, 4th rate.

Timber; pinyon and juniper.

Undergrowth; black brush, cactus, spanish dagger and palo christi

N. 89° 57' E., on a true line bet. secs. 2 and 35.

Over broken land, thru scattering timber and undergrowth.

Desc. 50 ft. to

- 5.50 Wash, course NE. Asc. 30 ft.
- 7.50 Small spur, slopes NE. Desc. 50 ft. to
- 20.50 Small wash, course NE along N slope to
- 24.70 Spur, slopes N. Desc. 45 ft. to
- 29.10 Wash, course N. Asc. 70 ft. to
- 34.50 Spur, slopes NE. Slight descent to
- 37.50 Small ravine, course NE.
- 40.00 Set an iron post, 3 ft. long, 1 in. in diam., 6 ins. in the ground to bed rock, supported in a mound of stone for $\frac{1}{4}$ sec. cor., marked on brass cap

$\frac{1}{4}$	S	35
	S	2
		1921

From which

A juniper, 6 ins. in diam., bears N. 70 $\frac{1}{2}$ ° E., 118 lks. dist. marked $\frac{1}{4}$ S 35 B TA juniper, 6 ins. in diam., bears S. 75 $\frac{1}{2}$ ° W., 62 lks. dist. marked $\frac{1}{4}$ S 2 B T

- 46.00 Asc. 60 ft. over NW. slope to Spur, slopes NE. Desc. 60 ft. over E. slope to
- 57.50 Head of ravine, course N. along N. slope to

North Boundary of T. 26 N., R. 10 W.

Chains
61.60
80.00

Ridge, bears SE. and NW. Desc. 150 ft. over E. slope to
Set an iron post, 5 ft. long, 2 ins. in diam., 6 ins. in
the ground to bed rock deposit stone marked cross (X)
at base of post and raise a mound of stone around post
for cor. of secs. 1, 2, 35 and 36, marked on brass cap

T 27 N R 10 W
S 35 | S 36
S 2 | S 1
T 26 N
1921

From which

A juniper, 8 ins. in diam., bears S. 55° E., 52 lks.
dist. marked T 26 N R 10 W S 1 B T.

A juniper, 10 ins. in diam., bears N. 54½° W., 2.12
chs. dist. marked T 27 N R 10 W S 35 B T.

No other trees within limits.

Land; broken.

Soil; rocky, 3d and 4th rates.

Timber; scattering scrub cedar.

Undergrowth; sagebrush, chamiso and cactus.

N. 89° 57' E., on a true line bet. secs. 1 and 36.

Over broken land, thru scattering timber and undergrowth.
Desc. 320 ft. over E. slope to

8.00 Wash, 60 lks. wide, 6 ft. deep, course NE. Asc. 250 ft.
over W. slope to

17.00 Spur, slopes N. Desc. 198 ft. to

35.70 Wash, 20 lks. wide, course NE. Asc. 120 ft. over W. slope
to

39.30 Spur, slopes N.

40.00 Mark cross (X) at exact cor. point and over same set an
iron post, 3 ft. long, 1 in. in diam., on surface
rock, supported in a mound of stone, for ¼ sec. cor.,
marked on brass cap

¼ S 36
S 1
1921

From which

A cedar, 8 ins. in diam., bears S. 18° E., 116 lks.
dist. marked ¼ S 1 B T.

No other trees within limits.

Desc. 50 ft. to

44.00 Wash, course NW. Asc. 500 ft. over W. slope to

80.00 The cor. of Ts. 26 and 27 N., Rs. 9 and 10 W. described
in field notes of current group No. 107.

Land; broken, drains N.

Soil; rocky, 3d and 4th rates.

Timber; scattering cedar.

Undergrowth; sagebrush, chamiso and cactus.

Boundaries of T. 26 N., R. 10 W.

Latitudes, departures and closing errors.

Line designated	True bearings	Dist- ance.	Latitudes		Departures	
			N.	S.	E.	W.
S. bdy. of Tp.	S.89°58'W.	479.35		.28		479.35
W. bdy. of Tp.	North	480.00	480.00			
N. bdy. of Tp.	N.89°57'E.	478.72	.42		478.72	
E. bdy. of Tp.	South	480.00		480.00		
Convergency					.52	
Totals			480.42	480.28	479.24	479.35
			480.28			479.24
Error in latitude			.14			
Error in departure					.11	

Subdivision of T. 26 N., R. 10 W.

Chains	From the cor. of secs. 1, 2, 35 and 36 on S. bdy. of Tp., described in Book "C", N.0001'W., bet. secs. 35 and 36.
40.00	Over nearly level land, thru scattering timber and undergrowth. Set an iron post, 3 ft. long, 1 in. in diam., 26 ins. in the ground for $\frac{1}{4}$ sec. cor., marked on brass cap $\begin{array}{c} \frac{1}{4} \\ \\ \text{S } 35 \text{ } \text{S } 36 \\ \\ 1920 \end{array}$
80.00	From which A cedar, 10 ins. in diam., bears N.38 $\frac{1}{2}$ °E., 105 lks. dist. marked $\frac{1}{4}$ S 36 B T A cedar, 8 ins. in diam., bears N.44°W., 98 lks. dist. marked $\frac{1}{4}$ S 35 B T Set an iron post, 3 ft. long, 2 ins. in diam., 26 ins. in the ground for cor. of secs. 25, 26, 35 and 36, marked on brass cap $\begin{array}{c} \text{T26N R10W} \\ \hline \text{S } 26 \text{ } \text{S } 25 \\ \hline \text{S } 35 \text{ } \text{S } 36 \\ 1920 \end{array}$
	From which A cedar, 14 ins. in diam., bears S.20°E., 438 lks. dist. marked T 26 N R 10 W S 36 B T No other trees within limits. Dig pits 18x18x12 ins., NE., SE., SW., and NW., of post 3 ft. dist. Land; nearly level. Soil; gravelly, 3d. rate. Timber; pine and cedar. Undergrowth; sagebrush, chamiso, cactus and spanish dagger.
40.00	N.89°58'E., on a random line bet. secs. 25 and 36.
80.08	Set temp. $\frac{1}{4}$ sec. cor. Fall 11 lks. N. of the cor. of secs. 25, 30, 31 and 36, on E. bdy. of Tp., described in field notes of current group No. 107.
20.00	Thence N.89°57'W., on a true line bet. secs. 25 and 36.
40.04	Over nearly level land, thru scattering undergrowth. Drain, course SW. Set an iron post, 3 ft. long, 1 in. in diam., 26 ins. in the ground for $\frac{1}{4}$ sec. cor., marked on brass cap $\begin{array}{c} \frac{1}{4} \text{ S } 25 \\ \hline \text{S } 36 \\ 1920 \end{array}$
80.08	From which A cedar, 10 ins. in diam., bears N.76 $\frac{1}{2}$ °E., 193 lks. dist. marked $\frac{1}{4}$ S 25 B T No other trees within limits. Dig pits, 18x18x12 ins., E. and W. of post, 3 ft. dist. The cor. of secs. 25, 26, 35 and 36. Land; nearly level, drains SW. Soil; gravelly, 3d. rate. Timber; none. Undergrowth; sagebrush and cactus.
40.00	N.0001'W., bet. secs. 25 and 26. Over nearly level land, thru dense timber and scattering undergrowth. Set an iron post, 3 ft. long, 1 in. in diam., 24 ins. in the ground for $\frac{1}{4}$ sec. cor., marked on brass cap $\begin{array}{c} \frac{1}{4} \\ \\ \text{S } 26 \text{ } \text{S } 25 \\ \\ 1920 \end{array}$
	From which A pine, 8 ins. in diam., bears N.40 $\frac{3}{4}$ °E., 63 lks. dist. marked $\frac{1}{4}$ S 25 B T

Subdivision of T. 26 N., R. 10 W.

Chains	A pine, 10 ins. in diam., bears N.46 $\frac{1}{4}$ °W., 72 lks. dist. marked $\frac{1}{4}$ S 26 B T
45.00	Desc. 40 ft. to
65.00	Foot of descent, thence over level land
80.00	Drain, course N.35°W.
	Set an iron post, 3 ft. long, 2 ins. in diam., 24 ins. in the ground for cor. of secs. 23, 24, 25 and 26, marked on brass cap
	T26N R10W S 23 S 24 ----- S 26 S 25 1920
	From which
	A cedar, 14 ins. in diam., bears N.36°E., 72 lks. dist. marked T 26 N R 10 W S 24 B T
	A cedar, 16 ins. in diam., bears S.45 $\frac{1}{4}$ °E., 299 lks. dist. marked T 26 N R 10 W S 25 B T
	A cedar, 14 ins. in diam., bears S.51 $\frac{3}{4}$ °W., 32 lks. dist. marked T 26 N R 10 W S 26 B T
	A cedar, 6 ins. in diam., bears N.35 $\frac{1}{2}$ °W., 57 lks. dist. marked T 26 N R 10 W S 23 B T
	Land; nearly level. Soil; gravelly, 3d. rate. Timber; pine and cedar. Undergrowth; sagebrush, cactus, spanish dagger and algerita. Good grass.
	----- S.89°57'E., on a random line bet. secs. 24 and 25.
40.00	Set temp. $\frac{1}{4}$ sec. cor.
80.22	Fall 28 lks. S. of the cor. of secs. 19, 24, 25 and 30, on E. bdy. of Tp., described in field notes of current Group No. 107.
	Thence S.89°51'W., on a true line bet. secs. 24 and 25. Over nearly level land, thru scattering timber and under- growth.
21.00	Small wash, course NW.
25.00	Asc. 25 ft. to
30.00	Top of asct. over level land.
40.11	Set an iron post, 3 ft. long, 1 in. in diam., 26 ins. in the ground for $\frac{1}{4}$ sec. cor., marked on brass cap
	S 24 ----- S 25 1920
	From which
	A cedar, 24 ins. in diam., bears N.3°E., 251 lks. dist. marked $\frac{1}{4}$ S 24 B T
	A cedar, 12 ins. in diam., bears S.52 $\frac{1}{2}$ °W., 107 lks. dist. marked $\frac{1}{4}$ S 25 B T
61.40	Slight desct. to
65.00	Small drain, course N.
76.50	Asc. 20 ft. to
80.22	The cor. of secs. 23, 24, 25 and 26. Land; nearly level. Soil; gravelly, 3d. rate. Timber; cedar and pinyon. Undergrowth; sagebrush, cactus and chamiso.
	----- N.0°01'W., bet. secs. 23 and 24. Over rolling land, thru scattering timber and undergrowth. Desc. 40 ft. over N. slope to
12.00	Drain, course NE.
17.90	Asc. 23 ft. to
22.90	Spur, slopes NE. Desc. 43 ft. over N. slope to
31.20	Drain, course NE. Asc. 29 ft. to
37.00	Spur, slopes NE. Desc. 15 ft. to
39.90	Head of small ravine, course NE.
40.00	Set an iron post, 3 ft. long, 1 in. in diam., 12 ins. in the ground to bed rock, supported in a mound of stone, for $\frac{1}{4}$ sec. cor., marked on brass cap

BOOK

Subdivision of T.26 N., R.10 W.,

Chains

$\frac{1}{4}$
 S 23 | S 24
 1920

From which

A cedar, 8 ins. in diam., bears N.13°E., 22 lks. dist., marked $\frac{1}{4}$ S 24 B T

A cedar, 12 ins. in diam., bears N.17°W., 67 lks. dist., marked $\frac{1}{4}$ S 23 B T

Asc. 30 ft. over S. slope to

45.00 Spur, slopes E. Desc. 23 ft. over N. slope to

50.00 Drain, course NE along E slope to

56.50 Ridge, bears NE and SW. Desc. 140 ft. to

76.50 Ravine, course NE. Asc. 34 ft. over SE. slope to

80.00 Set an iron post, 3 ft. long, 2 ins. in diam., 26 ins. in the ground for cor. of secs. 13, 14, 23 and 24 marked on brass cap

T26N | R10W
 S 14 | S 13
 S 23 | S 24
 1920

From which

A pinyon, 8 ins. in diam., bears N.67½°E., 153 lks. dist., marked T 26 N R 10 W S 13 B T

A pinyon, 6 ins. in diam., bears S.14°E., 21 lks. dist., marked T 26 N R 10 W S 24 B T

A pinyon, 7 ins. in diam., bears S.82°W., 76 lks. dist., marked T 26 N R 10 W S 23 B T

A pinyon, 6 ins. in diam., bears N.53°W., 48 lks. dist., marked T 26 N R 10 W S 14 B T

Land; rolling, drains NE.

Soil; gravelly, 3d. rate.

Timber; cedar and pinyon.

Undergrowth; sagebrush, cactus and chamiso.

40.00 N.89°51'E., on a random line bet. secs. 13 and 24.

80.38 Set temp. $\frac{1}{4}$ sec. cor.

Intersect the E. bdy. of Tp., at the cor. of secs. 13, 18, 19 and 24, described in field notes of current Group 107.

Thence S.89°51'W., on a true line bet. secs. 13 and 24.

Over rolling land, thru scattering timber and undergrowth.

Asc. 52 ft. over E. slope to

7.00 Ridge, bears N. and S. Desc. 160 ft. over rolling W. slope to

40.19 Set an iron post, 3 ft. long, 1 in. in diam., 6 ins. in the ground to bed rock, supported in a mound of stone, for $\frac{1}{4}$ sec. cor., marked on brass cap

$\frac{1}{4}$ S 13
 S 24
 1920

From which

A pinyon, 8 ins. in diam., bears N.59°W., 50 lks. dist., marked $\frac{1}{4}$ S 13 B T

A pinyon, 10 ins. in diam., bears S.14°W., 63 lks. dist., marked $\frac{1}{4}$ S 24 B T

Over S slope to

53.00 Desc. over SW. slope 45 ft. to

56.00 Small ravine, course NW. Asc. 25 ft.

61.00 Spur, slopes N. Desc. 85 ft. over SW. slope to

68.60 Wash, 40 lks. wide; 3 ft. deep, course NW. Asc. 45 ft. to

74.40 Spur, slopes N. Desc. 25 ft. to

78.90 Ravine, course NE. Asc.

80.38 The cor. of secs. 13, 14, 23 and 24.

Land; rolling, drains N.

Soil; gravelly, 3d. rate.

Timber; cedar and pinyon.

Undergrowth; sagebrush, cactus, chamiso and scrub oak.

Fair grass.

N.0°01'W., bet. secs. 13 and 14.

Over rolling land, thru dense timber and scattering undergrowth.

Subdivision of T. 26 N., R. 10 W.

1.70 Asc. 23 ft. over S. slope to
 15.30 Top of ascent. Desc. 100 ft. over N. slope to
 23.00 Small canyon, course E. Asc. 75 ft. to
 33.40 Spur, slopes E. Desc. 130 ft.
 40.00 Wash, 30 lks. wide, course NW. Asc. 130 ft.
 Set an iron post, 3 ft. long, 1 in. in diam., 10 ins. in
 the ground to bed rock, supported in a mound of stone,
 for $\frac{1}{4}$ sec. cor., marked on brass cap

$\frac{1}{4}$
 S 14 | S 13
 1920

From which

A pinyon, 1 ins. in diam., bears S. 30 $\frac{3}{4}$ ⁰E., 88 lks. dist.
 marked $\frac{1}{4}$ S 13 B T.

A cedar, 6 ins. in diam., bears S. 79 $\frac{1}{2}$ ⁰W., 4 lks. dist.,
 marked $\frac{1}{4}$ S 14 B T.

Along W slope to

41.00 Spur, slopes W. Desc. 140 ft. over N. slope to
 57.00 Wash, 25 lks. wide, course W. Asc. 264 ft. over S. slope to
 74.30 Spur, slopes W. Asc. 35 ft. to cor.
 80.00 Mark cross (x) at exact cor. point and over same set an
 iron post 3 ft. long, 2 ins. in diam., on surface rock
 supported in a mound of stone for cor. of secs.
 11, 12, 13 and 14, marked on brass cap

T26N | R10W
 S 11 | S 12
 S 14 | S 13
 1920

Land; rolling.

Soil; rocky, 4th rate.

Timber; pinyon and scrub cedar.

Undergrowth; chamiso, algerita, spanish dagger and sage
 brush.

Good grass.

40.00 N. 89⁰51'E., on a random line bet. secs. 12 and 13.
 Set temp. $\frac{1}{4}$ sec. cor.

80.32 Fall 3 lks. S. of the cor. of secs. 7, 12, 13 and 18 on
 E. bdy. of Tp., described in field notes of current
 Group No. 107.

Thence S. 89⁰50'W., on a true line bet. secs. 12 and 13.

Over rolling land, thru scattering timber and undergrowth.

.30 Wash, 15 lks. wide, course NW.

2.00 Desc. 75 ft. over NW. slope.

30.60 Canyon, 20 ft. deep, course N. Asc. 30 ft. to cor.

40.16 Set an iron post, 3 ft. long, 1 in. in diam., 6 ins. in
 the ground to bed rock, supported in a mound of stone,
 for $\frac{1}{4}$ sec. cor., marked on brass cap

$\frac{1}{4}$ S 12
 $\frac{1}{4}$ S 13
 1920

From which

A pinyon, 6 ins. in diam., bears N. 8 $\frac{1}{2}$ ⁰W., 172 lks. dist.
 marked $\frac{1}{4}$ S 12 B T

A pinyon, 6 ins. in diam., bears S. 20 $\frac{1}{2}$ ⁰E., 95 lks. dist.
 marked $\frac{1}{4}$ S 13 B T

Desc. 70 ft. to

45.90 Asc. 85 ft. to

50.72 Along N. slope to

63.77 Asc. 56 ft. to

75.30 Small spur, slopes NW. Desc. 46 ft. to

80.32 The cor. of secs. 11, 12, 13 and 14.

Land; rolling.

Soil; rocky, 4th rate.

Timber; pine and cedar.

Undergrowth; sagebrush, palo verde, algerita and spanish
 dagger.

Fair grass.

N. 0⁰01'W., bet. secs. 11 and 12.

Subdivision of T.26 N.,R.11 W.

BOOK 354

Chains Over rolling land, thru scattering timber and undergrowth.
 Asc. 23 ft. over SW. slope to
 5.00 Top of ascent. Desc. 200 ft. over N. slope to
 33.60 Ravine, course NW. Asc. 23 ft. over SW. slope to
 39.20 Spur, slopes W. Desc. 23 ft. over N. slope to
 40.00 Mark cross (x) at exact cor. point and over same set an
 iron post, 3 ft. long, 1 in. in diam., on surface rock
 in a mound of stone, for $\frac{1}{4}$ sec. cor., marked on brass cap

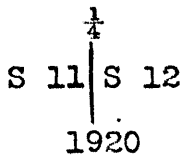

Desc. 234 ft. over NW. slope to
 53.00 Wash, 40 lks. wide, 4 ft. deep, course NE. Desc. 34 ft. to
 58.20 Same wash, course NW. along W slope to
 76.00 Asc. 20 ft. over SW slope to
 80.00 Set an iron post, 3 ft. long, 2 ins. in diam., 26 ins.
 in the ground for cor. of secs. 1, 2, 11 and 12, marked
 on brass cap

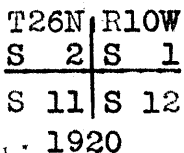

From which

- A cedar, 10 ins. in diam., bears N. $31\frac{1}{2}^{\circ}$ E., 31 lks. dist.
marked T 26 N R 10 W S 1 B T
- A cedar, 8 ins. in diam., bears S. 12° E., 35 lks. dist..
marked T 26 N R 10 W S 12 B T
- A cedar, 8 ins. in diam., bears S. 36° W., 30 lks. dist..
marked T 26 N R 10 W S 11 B T
- A cedar, 12 ins. in diam., bears N. 70° W., 51 lks. dist..
marked T 26 N R 10 W S 2 B T

Land; rolling, drains N.
 Soil; rocky, 3d. rate.
 Timber; cedar and pinyon.
 Undergrowth; sagebrush, camiso and cactus.
 Fair grass.

 N. $89^{\circ}50'$ E., on a random line bet. secs. 1 and 12.
 40.00 Set temp. $\frac{1}{4}$ sec. cor.
 80.14 Fall 12 lks. S. of the cor. of secs. 1, 6, 7 and 12 on
 E. bdy. of Tp., described in field notes of current
 group No. 107.
 Thence S. $89^{\circ}45'$ W., on a true line bet. secs. 1 and 12..
 Over rolling land, thru scattering timber and undergrowth.
 Asc. 23 ft. over E. slope to
 7.00 Ridge, bears N. and S. Desc. 230 ft. over W. slope to
 17.45 Ravine, course N. Asc. 150 ft. over E. slope to
 33.85 Ridge, bears N. and S. Desc. 13 ft. to
 37.65 Head of small ravine, course N.
 40.07 Set an iron post, 3 ft. long, 1 in. in diam., 6 ins. in
 the ground to bedrock, supported in a mound of stone,
 for $\frac{1}{4}$ sec. cor., marked on brass cap

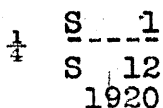

From which

- A pinyon, 6 ins. in diam., bears N. $61\frac{1}{2}^{\circ}$ W., 105 lks.
dist. marked $\frac{1}{4}$ S 1 B T
- A cedar, 8 ins. in diam., bears S. $8\frac{1}{2}^{\circ}$ E., 79 lks. dist..
marked $\frac{1}{4}$ S 12 B T

Asc. 23 ft. over E. slope
 42.00 Top of ascent.
 44.85 Desc. 230 ft. over NW. slope to
 58.25 Wash, course NW. Asc. 85 ft. over NE. slope to
 65.15 Ridge, bears SE. and NW. Desc. 284 ft. over SW. slope to
 80.14 The cor. of secs. 1, 2, 11 and 12.
 Land; rolling, drains N.

Subdivision of T. 26 N., R. 10 W.

Chains	Soil; rocky, 3d. rate. Timber; cedar and pinyon. Undergrowth; sagebrush, chamiso, cactus and scrub oak. Fair grass.

	N. 0° 01' W., on a random line bet. secs. 1 and 2.
40.00	Set temp. $\frac{1}{4}$ sec. cor.
80.45	Fall 7 lks. W. of the cor. of secs. 1, 2, 35 and 36 on N. bdy. of Tp., hereinbefore described. Thence S. 0° 02' W., on a true line bet. secs. 1 and 2. Over rolling land, thru scattering timber and undergrowth. Desc. 300 ft. over SE. slope to
18.50	Wash, 60 lks. wide, course NE. Asc. 270 ft. over NW. slope to
31.50	Spur, slopes W. Desc. 17 ft. to
33.10	Asc. 50 ft. to
40.45	Set an iron post, 3 ft. long, 1 in. in diam., in a mound of stone, for $\frac{1}{4}$ sec. cor., marked on brass cap
	$\frac{1}{4}$
	S 2 S 1
	1920
	From which
	A cedar, 8 ins. in diam., bears N. 90° E., 97 lks. dist. marked $\frac{1}{4}$ S 1 B T
	A cedar, 12 ins. in diam., bears S. 28 $\frac{1}{2}$ ° W., 165 lks. dist. marked $\frac{1}{4}$ S 2 B T
	Asc. 100 ft. over N. slope to
49.00	Spur, slopes NW. Thence over broken W. slope
68.00	Desc. 68.00 ft. over SW slope.
80.45	The cor. of secs. 1, 2, 11 and 12. Land; rolling, drains N. Soil; rocky, 3d. to 4th rates. Timber; scattering scrub cedar. Undergrowth; sagebrush and cactus. Fair grass.

	From the cor. of secs. 2, 3, 34 and 35 on S. bdy. of Tp. described in Book "C".
	N. 0° 01' W., bet. secs. 34 and 35.
	Over nearly level land, thru scattering timber and under- growth.
40.00	Set an iron post, 3 ft. long, 1 in. in diam., 24 ins. in the ground for $\frac{1}{4}$ sec. cor., marked on brass cap
	$\frac{1}{4}$
	S 34 S 35
	1920
	From which
	A cedar, 14 ins. in diam., bears N. 41 $\frac{1}{2}$ ° E., 141 lks. dist. marked $\frac{1}{4}$ S 35 B T
	A cedar, 12 ins. in diam., bears S. 75 $\frac{1}{2}$ ° W., 110 lks. dist. marked $\frac{1}{4}$ S 34 B T.
80.00	Set an iron post, 3 ft. long, 2 ins. in diam., 24 ins. in the ground for cor. of secs. 26, 27, 34 and 35, marked on brass cap
	T 26 N R 10 W S 27 S 26
	S 34 S 35
	1920
	From which
	A cedar, 20 ins. in diam., bears N. 45° E., 467 lks. dist. marked T 26 N R 10 W S 26 B T.
	A cedar, 6 ins. in diam., bears S. 2 $\frac{3}{4}$ ° E., 137 lks. dist. marked T 26 N R 10 W S 35 B T
	A cedar, 10 ins. in diam., bears S. 21 $\frac{1}{2}$ ° W., 445 lks. dist. marked T 26 N R 10 W S 34 B T
	No other trees within limits. Raise a mound of stone, 2 ft. base, 1 $\frac{1}{2}$ ft. high W. of cor.

Subdivision of T. 26 N., R. 10 W.

.Chains Land; nearly level.
Soil; loam, 2nd. rate.
Timber; pine and cedar.
Undergrowth; chamiso, cactus and spanish dagger.
Good grass.

40.00 N.89°58'E., on a random line bet. secs. 26 and 35.
Set temp. $\frac{1}{4}$ sec. cor.
79.86 Intersect N and S line, 2 lks. S of the cor. of secs.
25, 26, 35 and 36.
Thence S.89°57'W., on a true line bet. secs. 26 and 35.
Over gently rolling land, thru scattering undergrowth.
10.00 Enter scattering timber.
35.00 Desc. 25 ft. to
39.93 Set an iron post, 3 ft. long, 1 in. in diam., 26 ins. in
the ground for $\frac{1}{4}$ sec. cor., marked on brass cap.

S 26

 $\frac{1}{4}$ S 35
1920

From which

A cedar, 12 ins. in diam., bears N.35°W., 19 lks. dist.
marked $\frac{1}{4}$ S 26 B T

A cedar, 12 ins. in diam., bears S.50°E., 71 lks. dist.
marked $\frac{1}{4}$ S 35 B T

79.86 The cor. of secs. 26, 27, 35 and 36.

Land; gently rolling.
Soil; gravelly, 3d. rate.
Timber; cedar and pinyon.
Undergrowth; sagebrush, cactus and chamiso.

40.00 N.0°01'W., bet. secs. 26 and 27.
Over gently rolling land, thru scattering timber and
undergrowth.
Set an iron post, 3 ft. long, 1 in. in diam., 24 ins. in
the ground for $\frac{1}{4}$ sec. cor., marked on brass cap

$\frac{1}{4}$
S 27 | S 26
1920

From which

A cedar, 10 ins. in diam., bears S.86 $\frac{3}{4}$ °E., 97 lks. dist.
marked $\frac{1}{4}$ S 26 B T

A cedar, 6 ins. in diam., bears S.83°W., 98 lks. dist.
marked $\frac{1}{4}$ S 27 B T

55.00 Asc. 23 ft. to
60.00 Top of asct. thence over level land.
80.00 Set an iron post, 3 ft. long, 2 ins. in diam., 24 ins. in
the ground for cor. of secs. 22, 23, 26 and 27,
marked on brass cap

T26N R10W
S 22 | S 23
S 27 | S 26
1920

From which

A cedar, 8 ins. in diam., bears N.27 $\frac{1}{4}$ °E., 30 lks. dist.
marked T 26 N R 10 W S 23 B T

A cedar, 12 ins. in diam., bears S.31 $\frac{1}{2}$ °E., 80 lks. dist.
marked T 26 N R 10 W S 26 B T

A cedar, 8 ins. in diam., bears S.1°W., 90 lks. dist.
marked T 26 N R 10 W S 27 B T

Subdivision of T. 26 N., R. 10 W.

Chains

A cedar, 14 ins. in diam., bears N. 68° W., 39 lks. dist. marked T 26 N R 10 W S 22 B T.
 Land; rolling, drains N.
 Soil; loam, 2nd. rate.
 Timber; cedar and pine.
 Undergrowth; chamiso and spanish dagger.
 Good grass.

N. 89° 57' E., on a random line bet. secs. 23 and 26.

40.00

Set temp. $\frac{1}{4}$ sec. cor.

79.90

Interssect N and S line, 2 lks. S of the cor. of secs. 23, 24, 25 and 26.

Thence S. 89° 56' W., on a true line bet. secs. 23 and 26.

Over gently rolling land, thru dense timber and scattering undergrowth.

25.00

Desc. 30 ft. to

30.00

Drain, course NW.

39.95

Set an iron post, 3 ft. long, 1 in. in diam., 24 ins. in the ground for $\frac{1}{4}$ sec. cor., marked on brass cap

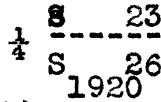

From which

A cedar, 24 ins. in diam., bears N. 46 $\frac{3}{4}$ ° E., 96 lks. dist. marked $\frac{1}{4}$ S 23 B T

A pinyon, 8 ins. in diam., bears S. 45 $\frac{3}{4}$ ° E., 118 lks. dist. marked $\frac{1}{4}$ S 26 B T

Asc. 85 ft. to

50.00

Thence over level land.

79.90

The cor. of secs. 22, 23, 26 and 27.

Land; rolling.

Soil; gravelly, 3d. rate.

Timber; dense pine and cedar.

Undergrowth; scattering chamiso, sagebrush, cactus and spanish bayonet.

Good grass.

N. 0° 01' W., bet. secs. 22 and 23.

Over rolling land, thru medium dense timber and scattering undergrowth.

25.00

Drainage changes from W. to N. Desc. gentle N. slope 20 ft. to

32.00

Foot descent over level land.

40.00

Set an iron post, 3 ft. long, 1 in. in diam., 24 ins. in the ground for $\frac{1}{4}$ sec. cor., marked on brass cap

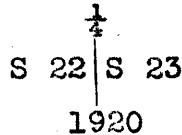

from which

A cedar, 14 ins. in diam., bears N. 40 $\frac{1}{2}$ ° E., 25 lks. dist. marked $\frac{1}{4}$ S 23 B T

A cedar, 10 ins. in diam., bears S. 31 $\frac{1}{2}$ ° W., 58 lks. dist. marked $\frac{1}{4}$ S 22 B T

60.00

Desc. 65 ft. to

72.00

Foot of desct. over level land.

80.00

Set an iron post, 3 ft. long, 2 ins. in diam., 18 ins. in the ground to bed rock, supported in a mound of stone, for cor. of secs. 14, 15, 22 and 23, marked on brass cap

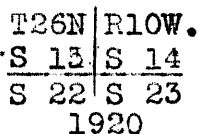

Subdivision of T. 26 N., R. 10 W.

Chains

From which
 A cedar, 14 ins. in diam., bears N.55½°E., 129 lks. dist.
 marked T 26 N R 10 W S 14 B T
 A cedar, 8 ins. in diam., bears S.82¼°E., 45 lks. dist.
 marked T 26 N R 10 W S 23 B T
 A pine, 8 ins. in diam., bears S.81°W., 48 lks. dist.
 marked T 26 N R 10 W S 22 B T
 A pine, 10 ins. in diam., bears N.67¾°W., 72 lks. dist.
 marked T 26 N R 10 W S 15 B T
 Soil; gravelly and rocky, 3d. and 4th. rates.
 Land; rolling.
 Timber; pine and cedar.
 Undergrowth; chamiso, sagebrush, cactus, spanish dagger
 and algerita..

40.00
 79.94
 13.50
 20.00
 27.00
 33.00
 39.97

 N.89°56'E., on a random line bet. secs. 14 and 23.
 Set temp. ¼ sec. cor.
 Intersect N and S line, 5 lks. N of the cor. of secs.
 13, 14, 23 and 24.
 Thence S.89°58'W., on a true line bet. secs. 14 and 23.
 Over rolling land, thru scattering timber and undergrowth.
 Asc. 75 ft. over E. slope to
 Ridge, bears N and S. Desc. 75 ft.
 Ravine, course N. Asc. 35 ft.
 Spur, slopes N. Desc. 80 ft. over W. slope to
 Ravine, course NE. Asc. 80 ft. over E. slope to
 Set an iron post, 3 ft. long, 1 in. in diam., 24 ins. in
 the ground for ¼ sec. cor., marked on brass cap

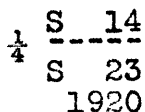

42.50
 56.40
 66.50
 79.94

From which
 A pinyon, 6 ins. in diam., bears N.57½°E., 26 lks. dist.
 marked ¼ S 14 B T
 A pinyon, 10 ins. in diam., bears S.58°W., 24 lks. dist.
 marked ¼ S 23 B T
 Asc. 60 ft. over E. slope to
 Ridge, bears N and S. Desc. 150 ft. over W. slope to
 Ravine, course NE. Asc. 50 ft. over SE. slope to
 Top of ascent.
 The cor. of secs. 14, 15, 22 and 23.
 Land; rolling, drains N.
 Soil; gravelly, 3d. rate.
 Timber; cedar and pine.
 Undergrowth; sagebrush, cactus and chamiso.
 Fair grass.

10.00
 32.44
 39.70
 40.00

 N.0°01'W., bet. secs. 14 and 15.
 Over rolling land, thru medium dense timber and scatter-
 ing undergrowth.
 Desc. 45 ft. to
 Thence over level land.
 Desc. 75 ft. to
 Wash, course N.80°W.
 Set an iron post, 3 ft. long, 1 in. in diam., 26 ins. in
 the ground for ¼ sec. cor., marked on brass cap

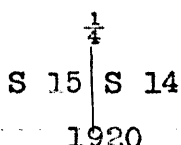

From which
 A cedar, 14 ins. in diam., bears S.81½°E., 37 lks. dist.
 marked ¼ S 14 B T

Subdivision of T. 26 N., R. 10 W.

Chains
 .49.42 A pinyon, 12 ins. in diam., bears N. 73½° W., 43 lks. dist.
 .53.80 marked ¼ S 15 B T
 .57.52 Asc. 73 ft. to
 .77.30 Desc. 50 ft.
 .80.00 Small canyon, course N. 75° W., Asc. 25 ft.
 Desc. 25 ft.
 Small canyon, course W. along W. slope to
 On spur sloping NW, set an iron post, 3 ft. long, 2 ins.
 in diam., 24 ins. in the ground for cor. of secs. 10,
 11, 14 and 15, marked on brass cap

T26N	R10W
S 10	S 11
S 15	S 14
1920	

From which
 A cedar, 6 ins. in diam., bears N. 46¼° E., 112 lks. dist.
 marked T 26 N R 10 W S 11 B T
 A cedar, 12 ins. in diam., bears S. 42¼° E., 43 lks. dist.
 marked T 26 N R 10 W S 14 B T
 A cedar, 12 ins. in diam., bears S. 27½° W., 93 lks. dist.
 marked T 26 N R 10 W S 15 B T
 A cedar 10 ins. in diam., bears N. 38¾° W., 25 lks. dist.
 marked T 26 N R 10 W S 10 B T
 Land; rolling.
 Soil; rocky 3d. to 4th. rates.
 Timber; pine and cedar.
 Undergrowth; chamiso, sagebrush, spanish bayonet and
 algerita.

 N. 89° 58' E., on a random line bet. secs. 11 and 14.
 40.00 Set temp. ¼ sec. cor.
 79.98 Intersect N and S line, 12 lks. S of the cor. of secs.
 11, 12, 13 and 14.
 Thence S. 89° 53' W., on a true line bet. secs. 11 and 14.
 Over rolling land, thru scattering timber and undergrowth.
 Desc. 325 ft. over W. slope to
 15.50 Wash, 50 lks. wide, course NW.
 19.80 Wash, 20 lks. wide, 6 ft. deep, course N. Asc. 200 ft. to
 30.50 Top of bluff, facing E. Asc. 57 ft. to
 39.99 Set an iron post, 3 ft. long, 1 in. in diam., 7 ins. in
 the ground to bed rock, supported in a mound of stone,
 for ¼ sec. cor., marked on brass cap

¼	S 11
	S 14
1920	

From which
 A pinyon, 10 ins. in diam., bears N. 65° E., 24 lks. dist.
 marked ¼ S 11 B T
 A pinyon, 6 ins. in diam., bears S. 53½° W., 90 lks. dist.
 marked ¼ S 14 B T
 Asc. 35 ft. to
 48.40 Spur, slopes N. Desc. 300 ft. over W. slope to
 59.20 Canyon, course N. Asc. 130 ft. over E. slope to
 69.00 Spur, slopes N. Desc. 40 ft. over W. slope to
 79.98 The cor. of sec. 10, 11, 14 and 15.
 Land; rolling.
 Soil; rocky, 4th. rate.
 Timber; pine and cedar.
 Undergrowth; sagebrush, palo verde, algerita and spanish
 bayonet.
 Good grass.

BOOK 204

Subdivision of T. 26 N., R. 10 W.

Chains N.0001'W., bet. secs. 10 and 11.
Over rolling land, thru scattering timber and undergrowth.
Desc. 25 ft. to
7.50 Small wash, course NE. Asc. 92 ft. over SE. slope to
23.50 Spur, slopes E. along E. slope to
40.00 Set an iron post, 3 ft. long, 1 in. in diam., 12 ins. in
the ground to bed rock, supported in a mound of stone,
for $\frac{1}{4}$ sec. cor., marked on brass cap

$\frac{1}{4}$
S 10 | S 11
1920

From which

A cedar, 6 ins. in diam., bears N.48°E., 66 lks. dist.
marked $\frac{1}{4}$ S 11 B TA cedar, 8 ins. in diam., bears N.82 $\frac{1}{2}$ °W., 60 lks. dist.
marked $\frac{1}{4}$ S 10 B T

Continue over E slope.

43.90 Desc. over NE. slope 35 ft.

46.50 Ravine, course E. Asc. 52 ft.

55.80 Spur, slopes E. Desc. 106 ft. over N. slope to

64.00 Small ravine, course E. Asc. 88 ft. over SE slope to

80.00 Set an iron post, 3 ft. long, 2 ins. in diam., 14 ins. in
the ground to bed rock, supported in a mound of stone,
for cor. of secs. 2, 3, 10 and 11, marked on brass cap

T26N | R10W
S 3 | S 2
S 10 | S 11
1920

From which

A cedar, 8 ins. in diam., bears N.57°E., 66 lks. dist.,
marked T 26 N R 10 W S 2 B TA cedar, 12 ins. in diam., bears S.68 $\frac{1}{2}$ °E., 34 lks. dist.
marked T 26 N R 10 W S 11 B TA cedar, 12 ins. in diam., bears S.8 $\frac{1}{4}$ °W., 82 lks. dist.
marked T 26 N R 10 W S 10 B TA cedar, 8 ins. in diam., bears N.51°W., 70 lks. dist.
marked T 26 N R 10 W S 3 B T

Land; rolling, drains NE.

Soil; rocky, 3d. rate.

Timber; cedar and pine.

Undergrowth; sagebrush, chamiso and cactus.

Fair grass.

N.89°53'E., on a random line bet. secs. 2 and 11.

40.00 Set temp. $\frac{1}{4}$ sec. cor.

80.14 Intersect the cor. of secs. 1, 2, 11 and 12.

Thence S.89°53'W., on a true line bet. secs. 2 and 11.

Desc: 78 ft. over W. slope

26.00 Wash, 40 lks. wide, course NW. Asc. 63 ft. to

28.95 Desc. 15 ft. to

32.60 Wash, 20 lks. wide, course NE. Asc. 70 ft. to

40.07 Set an iron post, 3 ft. long, 1 in. in diam., 6 ins. in
the ground to bed rock, supported in a mound of stone,
for $\frac{1}{4}$ sec. cor., marked on brass cap

$\frac{1}{4}$ S 2
S 11
1920

From which

A cedar, 5 ins. in diam., bears N.31°E., 58 lks. dist.
marked $\frac{1}{4}$ S 2 B TA cedar, 10 ins. in diam., bears S.16 $\frac{1}{2}$ °E., 14 lks. dist.
marked $\frac{1}{4}$ S 11 B T

40.15 Spur, slopes SE. Desc. 15 ft. to

43.35 Ravine, course SE. Asc. 286 ft. over E. slope to

Subdivision of T. 26 N., R. 10 W.

Chains	
63.45	Top of ascent over level ground to Cor.
80.14	The cor. of secs. 2, 3, 10 and 11. Land; rolling, drains N. Soil; rocky, 3d. rate. Timber; cedar and pinyon. Undergrowth; sagebrush, chamiso, and cactus. Fair grass.

40.00	N.0°01'W., on a random line bet. secs. 2 and 3. Set temp. $\frac{1}{4}$ sec. cor.
80.35	Fall 12 lks. E. of the cor. of secs. 2, 3, 34 and 35 on N. bdy. of Tp., hereinbefore described. Thence S.0°06'E., on a true line bet. secs. 2 and 3. Over rolling land, thru dense timber and scattering under- growth.
8.20	Wide draw, course NE.
40.35	Set an iron post, 3 ft. long, 1 in. in diam., 14 ins. in the ground to bed rock, supported in a mound of stone for $\frac{1}{4}$ sec. cor., marked on brass cap
$\frac{1}{4}$ S 3 S 2 1921	
	From which A juniper, 10 ins. in diam., bears N.41 $\frac{1}{2}$ °E., 46 lks. dist., marked $\frac{1}{4}$ S 2 B T A juniper, 10 ins. in diam., bears S.86°W., 108 lks. dist., marked $\frac{1}{4}$ S 3 B T
48.10	Asc. 100 ft. to
62.30	Top of ascent
80.35	The cor. of secs. 2, 3, 10 and 11. Land; rolling. Soil; loam, 2nd. rate. Timber; cedar and pine. Undergrowth; sagebrush, chamiso and cactus.

	From the cor. of secs. 3, 4, 33 and 34 on S. bdy. of Tp., described in Book "C" N.0°02'W., bet. secs. 33 and 34. Over gently rolling land, thru scattering timber and undergrowth.
15.00	Asc. 57 ft. over gradual S. slope.
25.50	Top of ascent over level land.
40.00	Set an iron post, 3 ft. long, 1 in. in diam., in a mound of stone, 3 $\frac{1}{2}$ ft. base, 2 $\frac{1}{2}$ ft. high for $\frac{1}{4}$ sec. cor. marked on brass cap
$\frac{1}{4}$ S 33 S 34 1920	
	From which A cedar, 12 ins. in diam., bears N.87°E., 125 lks. dist. marked $\frac{1}{4}$ S 34 B T A cedar, 14 ins. in diam., bears S.74°W., 78 lks. dist. marked $\frac{1}{4}$ S 33 B T
65.00	Desc. 70 ft. over gentle N. slope.
80.00	Set an iron post, 3 ft. long, 2 ins. in diam., in a mound of stone 4 ft. base, 2 ft. high for cor. of secs. 27, 28, 33 and 34, marked on brass cap

Subdivision of T. 26 N., R. 10 W.

BOOK 3543

Chains

T26N	R10W
S 28	S 27
S 33	S 34
1920	

From which

- A cedar, 12 ins. in diam., bears N.49½°E., 253 lks. dist. marked T 26 N R 10 W S 27 B T
- A cedar, 28 ins. in diam., bears S.67¼°E., 94 lks. dist. marked T 26 N R 10 W S 34 B T
- A cedar, 10 ins. in diam., bears S. 50°W., 187 lks. dist. marked T 26 N R 10 W S 33 B T
- A cedar, 16 ins. in diam., bears N.46°W., 120 lks. dist. marked T 26 N R 10 W S 28 B T

Land; gently rolling.
 Soil; gravelly, 3d. rate.
 Timber; cedar and pinyon.
 Undergrowth; sagebrush, cactus and chamiso.
 Fair grass.

N.89°58'E., on a random line bet. secs. 27 and 34.

- 40.00 Set temp. ¼ sec. cor.
- 80.04 Intersect N and S line, 2 lks. S of the cor. of secs. 26, 27, 34 and 35.

Thence S. 89°57'W., on a true line bet. secs. 27 and 34.

Over nearly level land, thru scattering timber and undergrowth.

- 40.02 Set an iron post, 3 ft. long, 1 in. in diam., 24 ins. in the ground for ¼ sec. cor., marked on brass cap

¼	S 27
¼	S 34
1920	

From which

- A cedar, 20 ins. in diam., bears N.75½°W., 372 lks. dist. marked ¼ S 27 B T

No other trees within limits.

Dig pits 18x18x12 ins. E. and W. of post 3 ft. dist.

- 65.00 Desc. 70 ft. to cor.
- 78.50 Dim road, bears S.35°E. and N.35°W.
- 80.04 The cor. of secs. 27, 28, 33 and 34.

Land; nearly level.
 Soil; gravelly.
 Timber; cedar and pinyon.
 Undergrowth; chamiso, cactus and spanish bayonet.
 Good grass.

N.0°02'W., bet. secs. 27 and 28.

Over gently rolling land, thru scattering timber and undergrowth.

- 1.00 Small drain, course SW.
- 22.10 Dim road, bears SE and NW.
- 40.00 Set an iron post, 3 ft. long, 1 in. in diam., in a mound of stone 3½ ft. base, 2½ ft. high, for ¼ sec. cor. marked on brass cap

¼	S 28	S 27
1920		

From which

- A cedar, 12 ins. in diam., bears S.51°E., 126 lks. dist. marked ¼ S 27 B T
- A cedar, 12 ins. in diam., bears S.73½°W., 130 lks. dist. marked ¼ S 28 B T

Subdivision of T. 26 N., R. 10 W.

Chains							
45.00	Desc. 52 ft. over gentle N. slope to						
54.00	Enter small valley, bears SE and NW.						
60.00	Leave valley and ascend 44 ft. over gentle S. slope.						
70.00	Top of asct. over level land.						
80.00	Set an iron post, 3 ft. long, 2 ins. in diam., 12 ins. in the ground to bed rock, supported in a mound of stone for cor. of secs. 21, 22, 27 and 28, marked on brass cap						
	<table border="1"> <tr> <td>T26N</td> <td>R10W</td> </tr> <tr> <td>S 21</td> <td>S 22</td> </tr> <tr> <td>S. 28</td> <td>S 27</td> </tr> </table> <p>1920</p>	T26N	R10W	S 21	S 22	S. 28	S 27
T26N	R10W						
S 21	S 22						
S. 28	S 27						
	From which						
	A cedar, 12 ins. in diam., bears N. 65° E., 105 lks. dist. marked T 26 N R 10 W S 22 B T						
	A cedar, 10 ins. in diam., bears S. 62½° E., 127 lks. dist. marked T 26 N R 10 W S 27 B T						
	A cedar, 8 ins. in diam., bears S. 38½° W., 45 lks. dist. marked T 26 N R 10 W S 28 B T						
	A cedar, 12 ins. in diam., bears N. 75° W., 114 lks. dist. marked T 26 N R 10 W S 21 B T						
	Land; gently rolling.						
	Soil; gravelly, 3d. rate.						
	Timber; cedar and pine.						
	Undergrowth; sagebrush, chamiso and cactus.						
	Fair grass.						

	N. 89° 57' E., on a random line bet. secs. 22 and 27.						
40.00	Set temp. ¼ sec. cor.						
80.14	Intersect N and S line, 11 lks. N of the cor. of secs. 22, 23, 26 and 27.						
	Thence N. 89° 58' W., on a true line bet. secs. 22 and 27.						
	Over nearly level land, thru medium heavy timber and undergrowth.						
40.07	Set an iron post, 3 ft. long, 1 in in diam., 8 ins. in the ground to bed rock, supported in a mound of stone for ¼ sec. cor., marked on brass cap						
	<table border="1"> <tr> <td>¼</td> <td>S 22</td> </tr> <tr> <td></td> <td>S 27</td> </tr> </table> <p>1920</p>	¼	S 22		S 27		
¼	S 22						
	S 27						
	From which						
	A cedar, 16 ins. in diam., bears N. 19¼° E., 195 lks. dist. marked ¼ S 22 B T						
	A cedar, 14 ins. in diam., bears S. 21½° E., 115 lks. dist. marked ¼ S 27 B T						
57.50	Desc. 23 ft. to						
62.50	Over level land						
80.14	The cor. of secs. 21, 22, 27 and 28.						
	Land; nearly level, drains W.						
	Soil; 3d. and 4th. rates.						
	Timber; cedar and pinyon.						
	Undergrowth; algerita, scrub oak, sagebrush and spanish gagger.						

	N. 0° 02' W., bet. secs. 21 and 22.						
	Over gently rolling land, thru scattering timber and undergrowth.						
5.00	Asc. 23 ft. to						
10.00	Top of asct. over level land.						
40.00	Set an iron post, 3 ft. long, 1 in. in diam., 26 ins. in the ground for ¼ sec. cor., marked on brass cap						

Subdivision of T. 26 N., R. 10 W.

BOOK 3546

Chains

1/4
S 21 | S 22
1920

From which

A cedar, 8 ins. in diam., bears N. 86° E., 40 lks. dist.
marked 1/4 S 22 B T

A cedar, 8 ins. in diam., bears West, 56 lks. dist.
marked 1/4 S 21 B T

54.80
65.00
75.00
80.00

Desc. 50 ft. to

Asc. 23 ft. to

Desc. 23 ft. to

Set an iron post, 3 ft. long, 2 ins. in diam., on bed
rock, supported in a mound of stone, for cor. of secs.
15, 16, 21 and 22, marked on brass cap

T26N | R10W
S 16 | S 15
S 21 | S 22
1920

From which

A cedar, 8 ins. in diam., bears N. 72 1/2° E., 46 lks. dist.
marked T 26 N R 10 W S 15 B T

A cedar, 12 ins. in diam., bears S. 49° E., 216 lks.
dist. marked T 26 N R 10 W S 22 B T

A cedar, 14 ins. in diam., bears S. 15° W., 42 lks. dist.
marked T 26 N R 10 W S 21 B T

A cedar, 10 ins. in diam., bears N. 77° W., 39 lks. dist.
marked T 26 N R 10 W S 16 B T

Land; gently rolling.

Soil; gravelly, 3rd. rate.

Timber; cedar and pinyon.

Undergrowth; sagebrush, cactus and chamiso

Fair grass.

S. 89° 58' E., on a random line bet. secs. 15 and 22.

40.00

Set temp. 1/4 sec. cor.

80.10

Intersect the cor. of secs. 14, 15, 22 and 23.

Thence N. 89° 58' W., on a true line bet. secs. 15 and 22.

Over rolling land, thru scattering timber and undergrowth.

21.00

Desc. 45 ft. over gradual W. slope to

31.00

Ravine, course NW. Asc. 25 ft. to

36.16

Desc. 40 ft. to

40.05

Set an iron post, 3 ft. long, 1 in. in diam., 26 ins. in
the ground for 1/4 sec. cor., marked on brass cap

1/4 S 15
S 22
1920

From which

A cedar, 14 ins. in diam., bears N. 88° E., 16 lks. dist.
marked 1/4 S 15 B T

A cedar, 10 ins. in diam., bears S. 34 1/2° W., 66 lks. dist.
marked 1/4 S 22 B T

Over level land.

47.10

Small ravine, course N. Asc. 20 ft. to

64.00

Desc. 80 ft. over W. slope to

71.50

Ravine, course N. Asc. 50 ft. over E. slope.

80.10

The cor. of secs. 15, 16, 21 and 22.

Land; rolling, drains N.

Soil; gravelly, 3rd. rate.

Timber; cedar and pinyon.

Undergrowth; sagebrush, cactus and chamiso.

Fair grass.

Subdivision of T. 26 N., R. 10 W.

Chains N.0°02'W., bet. secs. 15 and 16.
 Over rolling land, thru scattering timber and undergrowth.
 2.90 Desc. 100 ft. over N. slope.
 17.00 Ravine, course NE. Asc. slightly
 22.00 Small spur, slopes NE. Desc. 40 ft. to
 27.00 Ravine, course NW. Asc. 20 ft. to
 29.00 Small spur, slopes W.
 35.00 Small ravine, course W. Asc. 60 ft. over S. slope to
 40.00 Set an iron post 3 ft. long, 1 in. in diam., 26 ins. in
 the ground for $\frac{1}{4}$ sec. cor., marked on brass cap

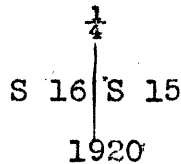

From which

A cedar, 10 ins. in diam., bears S.4°E., 13 lks. dist. marked $\frac{1}{4}$ S 15 B T

A cedar, 8 ins. in diam., bears N.70 $\frac{1}{2}$ °W., 75 lks. dist. marked $\frac{1}{4}$ S 16 B T

Asc. 30 ft. to

47.50 Spur, slopes W. Desc. 70 ft. over N. slope to

54.00 Ravine, course W. Asc. 94 ft. over S. slope to

66.00 Top of ascent. Desc. 35 ft. to

71.00 Asc. along W. slope 40 ft. to cor.

80.00 Set an iron post, 3 ft. long, 2 ins. in diam., in a mound of stone, for cor. of secs. 9, 10, 15 and 16, marked on brass cap

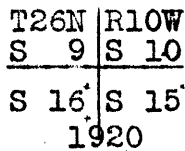

From which

A cedar, 8 ins. in diam., bears N.77°E., 53 lks. dist. marked T 26 N R 10 W S 10 B T

A cedar, 8 ins. in diam., bears S.56°E., 90 lks. dist. marked T 26 N R 10 W S 15 B T

A pinyon, 12 ins. in diam., bears S.81 $\frac{1}{2}$ °W., 27 lks. dist. marked T 26 N R 10 W S 16 B T

A cedar, 6 ins. in diam., bears N.61 $\frac{1}{2}$ °W., 67 lks. dist. marked T 26 N R 10 W S 9 B T

Land; rolling, drains W.

Soil; gravelly, 3d. rate.

Timber; cedar and pinyon.

Undergrowth; sagebrush, chamiso and cactus.

Fair grass.

40.00 S.89°58'E., on a random line bet. secs. 10 and 15.

80.00 Set temp. $\frac{1}{4}$ sec. cor.

Intersect N and S line, 12 lks. N of the cor of secs 10, 11, 14 and 15.

Thence N.89°53'W., on a true line bet. secs. 10 and 15.

Over rolling land, thru scattering timber and undergrowth.

5.00 Ravine, course N. Asc. 34 ft. to

10.00 Spur, slopes N. Desc. 150 ft. to

19.20 Wash, 20 lks. wide, 4 ft. deep, course N. Asc. 150 ft. over E. slope to

30.50 Spur, slopes N. Desc. 50 ft. over W. slope to

38.50 Ravine, course N.

40.00 Set an iron post, 3 ft. long, 1 in. dia., on bed rock, supported in a mound of stone, for $\frac{1}{4}$ sec. cor., marked on brass cap

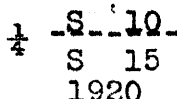

From which

Subdivision of T. 26 N., R. 10 W.

Chains A cedar, 12 ins. in diam., bears North, 36 lks. dist. marked $\frac{1}{4}$ S 10 B T
 A cedar, 8 ins. in diam., bears S. 38° W., 44 lks. dist. marked $\frac{1}{4}$ S 15 B T
 Asc. 75 ft. over E. slope to
 52.00 Ridge, bears N and S. Desc. 40 ft. over W slope to
 58.00 Head of small ravine, course NW. Asc. 23 ft. to
 65.00 Ridge, bears N and S. Desc. 23 ft.
 80.00 The cor. of secs. 9, 10, 15 and 16.
 Land; rolling, drains N.
 Soil; rocky, 3d. rate.
 Timber; cedar and pinyon.
 Undergrowth; sagebrush, chamiso and cactus.
 Fair grass.

N. 0° 02' W., bet. secs. 9 and 10.
 Over rolling land, thru scattering timber and undergrowth, along W slope to
 29.20 Desc. 180 ft. over NE slope to
 39.60 Canyon, course NW.
 40.00 Set an iron post, 3 ft. long, 1 in. in diam., on bed rock supported in a mound of stone for $\frac{1}{4}$ sec. cor., marked on brass cap

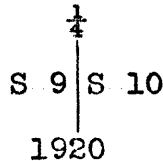

From which
 A cedar, 12 ins. in diam., bears S. 40 $\frac{3}{4}$ ° E., 136 lks. dist. marked $\frac{1}{4}$ S 10 B T
 A cedar, 12 ins. in diam., bears S. 87 $\frac{1}{2}$ ° W., 140 lks. dist. marked $\frac{1}{4}$ S 15 B T

Asc. 106 ft. to
 48.00 Spur, slopes NW.; vertical angle to flag ahead, 0°; auxiliary flag brs. N. 13° 24' W., from flag ahead, auxiliary flag brs. N. 82° 2' W., 6.80 chs.; all bearings checked by direct reading of the solar, and all angles checked by deflection.

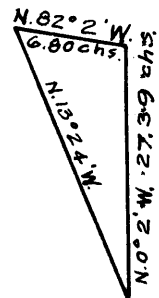

Triangulated dist. -- 27.39 chs.
 48.00 + 27.39 -- 75.39 chs.
 62.00 Approx. bottom of canyon 600 ft. deep, course NW.
 75.39 Triangulation point on N. edge of canyon. Desc. 45 ft.

80.00 Set an iron post, 3 ft. long, 2 ins. in diam., on bed rock, supported in a mound of stone, for cor. of secs. 3, 4, 9 and 10, marked on brass cap

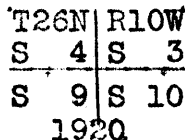

From which
 A cedar, 12 ins. in diam., bears N. 61 $\frac{1}{2}$ ° E., 142 lks. dist. marked T 26 N R 10 W D 3 B T
 A cedar, 6 ins. in diam., bears S. 41 $\frac{1}{2}$ ° E., 62 lks. dist. marked T 26 N R 10 W S 10 B T.
 A cedar, 8 ins. in diam., bears S. 6 $\frac{1}{4}$ ° W., 79 lks. dist. marked T 26 N R 10 W S 9 B T
 A cedar, 6 ins. in diam., bears N. 46 $\frac{1}{4}$ ° W., 120 lks. dist. marked T 26 N R 10 W S 4 B T
 Land; rolling and mountainous.
 Soil; rocky, drains W.
 Timber; scrub cedar and pinyon pine.
 Undergrowth; sagebrush and cactus.

Subdivision of T. 26 N., R. 10 W.

Chains S. 89°53'E., on a random line bet. secs. 3 and 10.
 40.00 Set temp. $\frac{1}{4}$ sec. cor.
 80.10 Intersect N and S line, 23 lks S of the cor of secs 2, 3, 10 and 11.
 Thence S. 89°57'W., on a true line bet. secs. 3 and 10.
 Over rolling land, thru scattering timber and undergrowth.
 40.05 Set an iron post, 3 ft. long, 1 in. in diam., 6 ins. in the ground to bed rock, supported in a mound of stone, for $\frac{1}{4}$ sec. cor., marked on brass cap

$\frac{1}{4}$ S 3
 S 10
 1920

From which
 A cedar, 10 ins. in diam., bears N. 26 $\frac{1}{2}$ °E., 57 lks. dist. marked $\frac{1}{4}$ S 3 B T
 A cedar, 12 ins. in diam., bears S. 43°E., 270 lks. dist. marked $\frac{1}{4}$ S 10 B T

Desc. 80 ft. to
 46.60 Along N. slope to
 70.00 Desc. 103 ft. to cor.
 80.10 The cor. of secs. 3, 4, 9 and 10.
 Land; rolling.
 Soil; rocky, 4th. rate.
 Timber; pinyon and cedar.
 Undergrowth; sagebrush, quinine brush, spanish bayonet, cactus, chamiso and algerita.

40.00 N. 0°07'W., on a random line bet. secs. 3 and 4.
 Set temp. $\frac{1}{4}$ sec. cor.
 80.34 Ball 9 lks. W. of the cor. of secs. 3, 4, 33 and 34 on N. bdy. of Tp., hereinbefore described.
 Thence S. 0°03'E., on a true line bet. secs. 3 and 4.
 Over rolling land, thru scattering timber and undergrowth.
 Desc. 37 ft.

3.35 Wash, 10 lks. wide, course W. Asc. 50 ft. over N. slope to
 10.35 Spur, slopes W. Desc. 83 ft.
 23.45 Wash, 25 lks. wide, course W. Asc. 64 ft.
 27.00 Spur, slopes NE. Asc. 77 ft. to
 36.50 Spur, slopes W. Desc. 37 ft. to
 40.34 Set an iron post, 3 ft. long, 1 in. in diam., in a mound of stone, for $\frac{1}{4}$ sec. cor., marked on brass cap

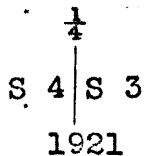

From which
 A juniper, 8 ins. in diam., bears N. 70 $\frac{3}{4}$ °E., 36 lks. dist. marked $\frac{1}{4}$ S 3 B T
 A juniper, 8 ins. in diam., bears West, 16 lks. dist. marked $\frac{1}{4}$ S 4 B T

41.35 Wash, course W. Asc. 50 ft.
 46.55 Spur, slopes W. along W slope to
 52.65 Spur, slopes SW. Desc. 135 ft. to
 64.45 Wash, 20 lks. wide, course W. Asc. 107 ft. over S. slope to
 69.35 Spur, slopes SW. Desc. 100 ft. over S. slope to
 80.15 Wash, 5 lks. wide, course SW.
 80.34 The cor. of secs. 3, 4, 9 and 10.
 Land; rolling and hilly.
 Soil; rocky, 4th. rate.
 Timber; juniper.
 Undergrowth; black brush, cactus, spanish bayonet and palo christi.

Subdivision of T. 26 N., R. 10 W.

1001 3546

Chains From the cor. of secs. 4, 5, 32 and 33 on S. bdy. of Tp.,
 described in Book "C",
 N.0°03'W., bet. secs. 32 and 33.
 Over gently rolling land, thru scattering timber and
 undergrowth.

7.50 Desc. 75 ft. over gentle NW. slope.
 32.59 Wash, course W. Asc. 44 ft. over S. slope to
 40.00 Set an iron post, 3 ft. long, 1 in. in diam., 6 ins. in
 the ground to bed rock deposit stone marked cross (x)
 at base of post and raise a mound of stone around
 post for 1/4 sec. cor., marked on brass cap

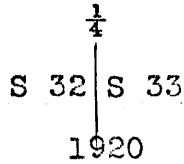

41.70 Spur, slopes W. Thence over W. slope
 60.00 Ridge, bears SE and NW. Desc. 60 ft. over NE. slope to
 76.90 Wash, course NW. Asc. 20 ft. over SW. slope to
 80.00 Set an iron post, 3 ft. long, 2 ins. in diam., 18 ins. in
 the ground to bed rock, deposit stone marked cross
 (x) at base of post and raise a mound at stone
 around post for cor. of secs. 28, 29, 32 and 33, marked
 on brass cap

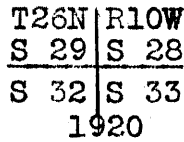

From which

- A cedar, 8 ins. in diam., bears N. 71°E., 85 lks. dist.
marked T 26 N R 10 W S 28 B T
- A cedar, 12 ins. in diam., bears S. 89 1/4°E., 66 lks. dist.
marked T 26 N R 10 W S 33 B T
- A cedar, 12 ins. in diam., bears N. 44°W., 548 lks. dist.
marked T 26 N R 10 W S 29 B T

No other trees within limits.

Land; rolling.

Soil; rocky, 4th. rate.

Timber; scattering cedar.

Undergrowth; sagebrush, chamiso and cactus.

Fair grass.

40.00 N. 89°58'E., on a random line bet. secs. 28 and 33.
 Set temp. 1/4 sec. cor.
 80.08 Intersect N and S line, 5 lks. S of the cor of secs
 27, 28, 33 and 34.
 Thence S. 89°56'W., on a true line bet. secs. 28 and 33.
 Over rolling land, thru scattering timber and undergrowth.
 12.50 Small drain, course SW. Asc. 23 ft. to
 10.00 Top of ascent, over level land
 16.00 Desc. 40 ft.
 27.20 Small ravine, course NW. Asc. 20 ft. to
 35.00 Spur, slopes NW. Desc. 47 ft. to
 40.00 Ravine, course NW.
 40.04 Set an iron post, 3 ft. long, 1 in. in diam., 14 ins. in
 the ground to bed rock, supported in a mound of stone,
 for 1/4 sec. cor., marked on brass cap

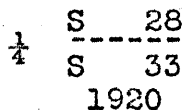

From which

- A cedar, 10 ins. in diam., bears N. 66°W., 124 lks. dist.
marked 1/4 S 28 B T
- A cedar, 8 ins. in diam., bears S. 51 1/2°E., 129 lks. dist.
marked 1/4 S 33 B T

Asc. 46 ft.

Subdivision of T. 26 N., R. 10 W.

Chains.

45.19 Desc. 35 ft. to
 49.20 Small ravine, course NW. Asc. 34 ft. to
 55.00 Desc. 30 ft. to
 62.60 Drain, course NW. Asc. 40 ft. to
 71.30 Ridge, bears SE and NW. Desc. 25 ft. to
 80.08 The cor. of secs. 28, 29, 32 and 33.
 Land; gently rolling.
 Soil; gravelly, 3d. rate.
 Timber; cedar and scattering pinyon.
 Undergrowth; sagebrush, cactus and chamiso.
 Fair grass.

N.0°03'W., bet. secs. 28 and 29.

Over nearly level land, thru scattering timber and undergrowth.

20.00 Enter rolling land. Desc. 66 ft. over gentle N. slope.

29.00 Canyon, course W. over rolling land.

35.40 Canyon, course SW about 10 chs. then W.

40.00 Set an iron post, 3 ft. long, 1 in. in diam., 18 ins. in the ground to bed rock, supported in a mound of stone, for $\frac{1}{4}$ sec. cor., marked on brass cap

↓
 S 29 | S 28

1920

From which

A cedar, 8 ins. in diam., bears N.40°E., 137 lks. dist. marked $\frac{1}{4}$ S 28 B T

A cedar, 8 ins. in diam., bears N. 63 $\frac{1}{4}$ °W., 83 lks. dist. marked $\frac{1}{4}$ S 29 B T

40.50 Canyon, course S.20°W.

76.50 Old Indian Trail and wagon road, bears SE and NW.

Desc. 20 ft. to

80.00 Set an iron post, 3 ft. long, 2 ins. in diam., 18 ins. in the ground to bed rock, supported in a mound of stone, for cor. of secs. 20, 21, 28 and 29, marked on brass cap

T26N | R 10W

S 20 | S 21

S 29 | S 28

1920

From which

A cedar, 14 ins. in diam., bears N.27 $\frac{1}{4}$ °E., 226 lks. dist. marked T 26 N R 10 W S 21 B T

A cedar, 12 ins. in diam., bears S. 49 $\frac{1}{4}$ °E., 107 lks. dist. marked T 26 N R 10 W S 28 B T

A cedar, 8 ins. in diam., bears S.16 $\frac{1}{4}$ °W., 51 lks. dist. marked T 26 N R 10 W S 29 B T

A cedar, 6 ins. in diam., bears N. 47 $\frac{1}{4}$ °W., 353 lks. dist. marked T 26 N R 10 W S 20 B T

Land; rolling, drains W.

Soil; rocky, 4th. rate.

Timber; scrub cedar and pinyon pine.

Undergrowth; algerita, sage, chamiso and spanish bayonet.

N.89°56'E., on a random line bet. secs. 21 and 28.

40.00 Set temp. $\frac{1}{4}$ sec. cor.

80.00 Intersect N and S line, 9 lks. N of the cor of secs 21, 22, 27 and 28.

Thence West, on a true line bet. secs. 21 and 28.

Over gently rolling land, thru scattering timber and undergrowth.

BOOK 3546

Subdivision of T. 26 N., R.10 W.

Chains

35.00

40.00

Drain, course SW. Asc. 37 ft. to
Set an iron post, 3 ft. long, 1 in. in diam., 16 ins. in
the ground to bed rock, supported in a mound of stone,
for $\frac{1}{4}$ sec. cor., marked on brass cap.

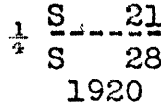

From which

A cedar, 6 ins. in diam., bears N.56°W., 99 lks. dist.
marked $\frac{1}{4}$ S 21 B T

A cedar, 12 ins. in diam., bears S.9 $\frac{1}{2}$ °E., 105 lks. dist.
marked $\frac{1}{4}$ S 28 B T

70.65

80.00

Desc. 53 ft. to
The cor. of secs. 20, 21, 28 and 29.
Land; gently rolling.
Soil; gravelly, 3d. rate.
Timber; cedar and scattering pinyon.
Undergrowth; sagebrush, cactus and chamise.
Fair grass.

N.0°03'W., bet. secs. 20 and 21.

Over gently rolling land, thru scattering timber and
undergrowth.

3.00

7.60

40.00

Drain, course SW. Asc. gentle SE. slope.
Top of ascent 38 ft. above cor. over level land.
Set an iron post, 3 ft. long, 1 in. in diam., 26 ins. in
the ground for $\frac{1}{4}$ sec. cor., marked on brass cap

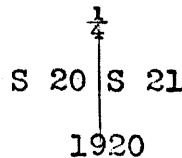

From which

A cedar, 10 ins. in diam., bears N.66°E., 46 lks. dist.
marked $\frac{1}{4}$ S 21 B T

A cedar, 10 ins. in diam., bears N.81 $\frac{1}{2}$ °W., 111 lks. dist.
marked $\frac{1}{4}$ S 20 B T

Continue over level land:

62.00

76.40

80.00

Desc. 133 ft. over gentle N. slope to
Small ravine, course W. Asc. 22 ft. over S. slope
Set an iron post, 3 ft. long, 2 ins. in diam., 16 ins. in
the ground to bed rock, supported in a mound of stone,
for cor. of secs. 16, 17, 20 and 21, marked on brass
cap.

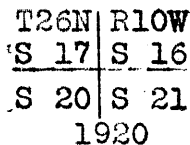

From which

A cedar, 8 ins. in diam., bears N. 62 $\frac{1}{2}$ °E., 92 lks. dist.
marked T 26 N R 10 W S 16 B T

A cedar, 8 ins. in diam., bears S. 48 $\frac{1}{2}$ °E., 150 lks. dist.
marked T 26 N R 10 W S 21 B T

A cedar, 8 ins. in diam., bears S. 39°W., 93 lks. dist.
marked T 26 N R 10 W S 20 B T

A cedar, 8 ins. in diam., bears N. 32 $\frac{1}{2}$ °W., 105 lks. dist.
marked T 26 N R 10 W S 17 B T

Land; gently rolling.
Soil; gravelly, 3d. rate.
Timber; cedar and scattering pinyon.
Undergrowth; sagebrush and cactus.
Fair grass.

Subdivision of T. 26 N., R. 10 W.

Chains East, on a random line bet. secs. 16 and 21.
 40.00 Set temp. $\frac{1}{4}$ sec. cor.
 80.10 Intersect N and S line, 19 lks. S of the cor of secs
 15, 16, 21 and 22.
 Thence S. 89° 52' W., on a true line bet. secs. 16 and 21.
 Over gently rolling land, thru scattering timber and
 undergrowth.
 5.97 Desc. 40 ft. to
 12.00 Wash, course N. Asc. E. slope 34 ft.
 16.00 Top of ascent.
 35.00 Descend. 40 ft. to
 40.05 Set an iron post, 3 ft. long, 1 in. in diam., 26 ins. in
 the ground for $\frac{1}{4}$ sec. cor., marked on brass cap

$\frac{1}{4}$ S 16
 $\frac{1}{4}$ S 21
 1920

From which

A pinyon, 10 ins. in diam., bears N. 46 $\frac{1}{2}$ ° W., 77 lks. dist.
 marked $\frac{1}{4}$ S 16 B T

A pinyon, 8 ins. in diam., bears S. 23° E., 25 lks. dist.
 marked $\frac{1}{4}$ S 21 B T

51.90 Shallow wash, 20 lks. wide, course NW.
 57.00 Drain, course N. Asc. 35 ft. to
 62.10 Desc. 35 ft. to
 75.00 Asc. 30 ft. to cor.
 80.10 The cor. of secs. 16, 17, 20 and 21.

Land; gently rolling.
 Soil; rocky, 3d. to 4th. rate.
 Timber; cedar and scattering pinyon.
 Undergrowth; sagebrush and cactus.
 Fair grass.

N. 0° 03' W., bet. secs. 16 and 17.
 Over rolling land, thru medium dense timber and undergrowth.
 Asc. 33 ft. to

11.40 Desc. 15 ft. to
 20.70 Wash, course W. over rolling land.
 40.00 Set an iron post, 3 ft. long, 1 in. in diam., 26 ins. in
 the ground for $\frac{1}{4}$ sec. cor., marked on brass cap

$\frac{1}{4}$
 S 17 S 16
 1920

From which

A cedar, 8 ins. in diam., bears N. 81° E., 64 lks. dist.
 marked $\frac{1}{4}$ S 16 B T

A cedar, 12 ins. in diam., bears S. 22 $\frac{1}{2}$ ° W., 54 lks. dist.
 marked $\frac{1}{4}$ S 17 B T

Desc. 100 ft. over N. slope to
 57.50 Ravine, course NW. Asc. 57 ft. over SW. slope to
 66.80 Spur, slopes NW. Desc. 40 ft. to
 73.66 Asc. 50 ft. to
 80.00 Mark cross (x) at exact cor. point and over same set
 an iron post, 3 ft. long, 2 ins. in diam., on surface
 rock in a mound of stone, for cor. of secs. 8, 9, 16 and
 17, marked on brass cap

T26N | R10W
 S 8 | S 9
 S 17 | S 16
 1920

Cor. stands on W. side of small round hill.
 Land; rolling, drains N.
 Soil; gravelly, 3d. rate.
 Timber; cedar and scattering pinyon.

Subdivision of T. 26' N., R. 10 W.

BOOK 3546

Chains

Undergrowth; sagebrush, cactus and chamiso.
Fair grass.

1.00

N. 89° 52' E., on a random line bet. secs. 9 and 16.
Set flag ahead on random line; auxiliary flag brs. N. 70° 49' E
from flag on random line, auxiliary flag bears N. 0° 08' W,
15.20 chs. All bearings checked by direct reading of
the solar, and all angles checked by deflection.

Dist. by triangulation -- 44.02 chs.
Dist. on random -- 1.00 chs.
Total dist. -- 45.02 chs.

45.02

Triangulation point.
Thence S. 89° 52' W., 5.02 chs. and set temp
1/4 sec. cor.

Continue N. 89° 52' E., on a random line,
measurement by chaining.

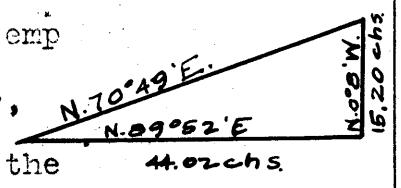

80.08

Intersect N and S line, 23 lks. N of the
cor. of secs. 9, 10, 15 and 16.

Thence N. 89° 58' W., on a true line bet. secs.
9 and 16.

Over rolling land, thru medium dense timber and under-
growth.

20.00

Desc. 60 ft. to

28.40

Foot of desc.

40.04

Mark a cross (X) on surface rock at exact cor. point and
over same, set an iron post, 3 ft. long, 1 in. in diam.,
supported in a mound of stone, for 1/4 sec. cor. marked
on brass cap

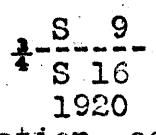

40.60

Thence by triangulation, as hereinbefore described.
East rim of canyon about 700 ft. deep, bears SE and NW.

60.00

Approx. bottom of canyon. Wash, course NW.

79.08

triangulation Pt., W. rim of canyon. Asc. grad. Dist. by
chaining.

80.08

The cor. of secs. 8, 9, 16 and 17.
Land; E. half, rolling. W. half, mountainous.
Soil: rocky, 4th. rate.
Timber; scrub cedar and pinyon.
Undergrowth: sagebrush, chamiso, algerita and spanish
bayonet.

N. 0° 03' W., bet. secs. 8 and 9.

Over nearly level land, thru scattering timber and under-
growth.

3.00

Edge of canyon, bears SE. and NW. The descent into canyon
is over five rims of perpendicular rock walls, impossible
to chain.

Set flag ahead on line; auxiliary flag brs. N. 10° 12' W. from
Cor. secs. 8, 9, 16 and 17; from flag ahead,
auxiliary flag brs. S. 89° 57' W., 8.90 chs.;
all direct bearings checked by direct
reading of the solar, and all angles
checked by deflection.

32.00

Dist. by triangulation -- 49.71 chs. of
(Approx. dist.) Wash in bottom of SE Fork of
Hells Canyon, course NW., about 800 ft.
below sec. cor.

40.00

True point for 1/4 sec. cor. falls on in-
accessible place.

49.70

Mark cross (x) at wit. cor. point and over same set an
iron post, 3 ft. long, 1 in. in diam., on bed rock,
supported in a mound of stone, 3 1/2 ft. base, 2 1/2 ft.
high for witness cor. to the 1/4 sec. cor. marked on
brass cap

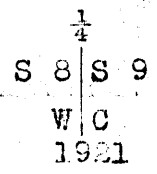
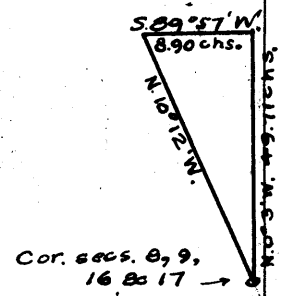

Subdivision of T. 26 N., R. 10 W.

Chains
49.71

Triangulation point at base of cliff,
75 ft. high, 600 ft. below sec. cor.

Vertical angle back to bottom of canyon -- -26½°

Vertical angle back to flag on sec. cor. -- +11°

Offset west, 3.61 chs. to avoid cliffs.

Thence N.0°03'W. on offset line.

Asc. 210 ft. over SW. slope to

54.46

Spur, slopes W.

Offset East, 3.61 chs. to true line.

Thence N.0°03'W. on true line by triangulation as follows:

Vertical angle to flag, -18½°; Auxiliary

flag brs. N.18°08'W; from flag ahead,

auxiliary flag brs. S.89°57'W., 7.50

chs. dist.; all bearings checked by

direct readings of the solar, and

all angles checked by deflection.

Dist. by triangulation == 22.97 chs.

22.97 + 54.46 = 77.43 chs.

65.48

Small canyon, course West (Approx)

77.43

Triangulation point on flat spur sloping W.

500 ft. below 54.46 point.

78.07

Top of rim rock, 70 ft. high, bears E and W. Impossible to chain.

Vertical angle to flag ahead, -43½°;

auxiliary flag bears N.61°027'E., from

flag ahead auxiliary flag brs. N.89°57'E.

10.00 chs. dist; all bearings checked

by direct reading of the solar, and all

angles checked by deflection.

Distance by triangulation = 5.43 chs.

78.07 + 5.43 = 83.50 chs.

Dist. by return meas. 3.50 chs.

80.00

80.00

Mark cross (X) at exact cor. point and over same set an

iron post, 3 ft. long, 2 ins. in diam., on bed rock,

supported in a mound of stone 3 ft. base, 2½ ft.

high, for cor. of secs. 4, 5, 8 and 9, marked on brass

cap

T26N	R10W
S 5	S 4
S 8	S 9

1921

Land; mountainous.

Soil; rocky, 4th rate.

Timber; scattering juniper and pinyon.

Undergrowth; black brush, skunk brush, spanish bayonet, and palo christi.

40.00

S.89°58'E., on a random line bet. secs. 4 and 9.

Set temp. ¼ sec. cor.

Impracticable to continue chaining on account of precipitous cliffs.

Vertical angle to flag on random line, +14°; auxiliary

flag brs. N.0°02'E., 10.00 chs. dist; from flag on random

line, auxiliary flag brs. N.74°11'W.

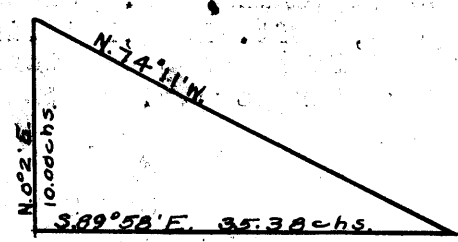
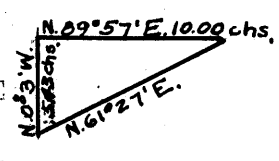
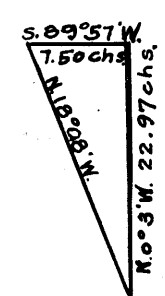
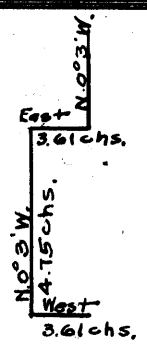

Subdivision of T. 26.N., R. 10 W.

Chains All bearings checked by direct reading of the solar, and all angles check by deflection;

Dist. on random line -- 40.00 chs.
 Dist. by triangulation -- 35.38 chs.
 Total dist. -- 75.38 chs.

75.38 Triangulation point.
 Continue S.89°58'E. on random line, dist. by chaining.

80.10 Intersect N and S line, 5 lks. N of the cor. of secs. 3, 4, 9 and 10.
 Thence N.89°56'W., on a true line bet. secs. 4 and 9.
 Over mountainous land, thru scattering timber and undergrowth.

4.72 Rim rock, bears SE. and NW.
 Thence by triangulation, as hereinbefore described.

40.05 Set an iron post, 3 ft. long, 1 in. in diam., 8 ins. in the ground to bed rock deposit stone marked with a cross (x) at base of post, and raise a mound of stone around post for 1/4 sec. cor., marked on brass cap

$$\frac{1}{4} \frac{8}{S} \frac{4}{9}$$

1921

Cor. stands on NE. side of cliff 40 ft. high.
 Thence over broken N. slope below first rim rock; measurement by chaining

75.00 Asc. 30 ft. to cor.

80.10 The cor. of secs. 4, 5, 8 and 9.
 Land; mountainous.
 Soil; rocky, 4th. rate.
 Timber; cedar and pinyon.
 Undergrowth; sagebrush, cactus and other desert varieties.

N.0°04'W., on a random line bet. secs. 4 and 5.

3.66 Set temp. point.

18.92 Rim rock, 75 ft. high. Impossible to chain farther.
 Vertical angle to flag, on random line from 3.66 ch. point + 22 1/2°; from same point, auxiliary flag brs. N.89°56'E., 10.00 chs. dist.; from flag on random line, auxiliary flag brs. S.22°14 1/2'E.; all bearings checked by direct reading of the solar, and all angles checked by deflection.

Dist. by triangulation -- 24.53 chs.
 24.53 + 3.66 -- 28.19 chs.

28.19 Triangulation point, continue N.0°04'W on random line bet. secs. 4 and 5, distance by chaining.

39.42 Set temp. point.

40.00 Set temp. 1/4 sec. cor.
 The north half mile of this line crosses the NE. fork Hell's Canyon, which is about 800 ft. deep and has sides so precipitous that it is impossible to chain across.

Subdivision of T. 26.N., R.10 W.

Chains Vertical angle to flag on random line from 39.42 ch. point is 52° ; from same point, auxiliary flag brs. N.89°56'E., 8.00 chs.; from flag on random line, auxiliary flag bears S 11°10'E., all bearings checked by direct reading of the solar and all angles checked by deflection.

Dist. on random -- 39.42 chs.
Dist. by triangulation-- 40.78 chs.
80.20

80.20 Fall 12 lks. E. of the cor. of secs. 4, 5, 32 and 33 on N. bdy. of Tp., hereinbefore described.

Thence S.0°09'E., on a true line bet. secs. 4 and 5. Over mountainous land, thru scattering undergrowth, topography approximate distance by triangulation.

4.00 Rim of canyon, bears NE and SW. Desc. 500 ft. to
14.00 Wash, in NE fork of Hells Canyon, course SW. Asc. 800 ft.
26.00 SE. wall of canyon, bears NE. and SW.
35.00 Small spur, slopes W.
40.20 Mark cross (x) at exact cor. point and over same set an iron post, 3 ft. long, 1 in. in diam., on bed rock supported in a mound of stone, for $\frac{1}{4}$ sec. cor., marked on brass cap

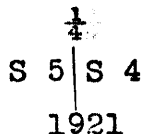

Thence by chaining

42.70 Wash, course W. Asc. 40 ft.
46.70 Spur, slopes W?
52.01 Spur, slopes W. Desc. 50 ft., dist. by triangulation.
61.28 Top of perpendicular wall, 75 ft. high. Desc. 225 ft. to
68.00 Wash, 20 lks. wide, course SW. over broken W. slope, dist. by chaining.
73.80 Wash, 50 lks. wide, in E. branch of Hell's Canyon, course W. Asc. 180 ft. to cor.
80.20 The cor. of secs. 4, 5, 8 and 9.
Land; mountainous.
Soil; rocky, 4th rate.
Timber; none.
Undergrowth; black brush, spanish bayonet, cactus, catclaw, skunk brush and ~~pale~~ christi.

From the cor. of secs. 5, 6, 31 and 32 on S. bdy. of Tp., described in Book "C", N.0°03'W., bet. secs. 31 and 32.

5.00 Over rolling land, thru scattering timber and undergrowth. Desc. 244 ft. over gradual N. slope.
40.00 Set an iron post, 3 ft. long, 1 in in diam., 24 ins. in the ground for $\frac{1}{4}$ sec. cor., marked on brass cap

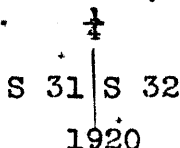

From which

A pine, 12 ins. in diam., bears S.81°E., 66 lks. dist. marked $\frac{1}{4}$ S 32 B T
A pine, 12 ins. in diam., bears S.71 $\frac{1}{2}$ °W., 54 lks. dist. marked $\frac{1}{4}$ S 31 B T

43.00 Wash, 30 lks. wide, 1 ft. deep, course W. Asc. 121 ft.
57.00 Wash, 50 ft. deep, course SW. Asc. 33 ft. to
61.44 Top of ascent over level land to

Subdivision of T. 26 N., R. 10 W.

BOOK 3540

Chains

76.50

Rim rock, 50 ft. high, bears E and W. Desc. 200 ft. over steep N. slope to

80.00

Mark cross (x) at exact cor. point and over same set an iron post, 3 ft. long, 2 ins. in diam., on bed rock supported in a mound of stone, 3 1/2 ft. base, 2 1/2 ft. high for cor. of secs. 29, 30, 31 and 32, marked on brass cap

T26N	R10W
S 30	S 29
S 31	S 32
1920	

Land; rolling, drains W.
Soil; rocky, 4th. rate.
Timber; scattering scrub cedar and pinyon.
Undergrowth; chamiso, algerita and cactus.

0.79

N.89°58'E., on a random line bet. secs. 29 and 32. Vertical angle to flag on random line, -70; auxiliary flag brs. S.67°29'E.; from flag on random line, auxiliary flag bears S.0°2'E.; 5.00 chs. dist.; all bearing checked by direct reading of the solar and all angles checked by deflection.

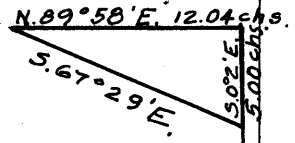

Dist. on random	--	.79 chs.
Dist. by triangulation	--	<u>12.04 chs.</u>
Total		12.83

12.83

Triangulation point. Continue N.89°58'E. on a random line, dist. by chaining

40.00

Set temp. 1/4 sec. cor.

79.94

Intersect N and S line, 2 lks. N of the cor of secs. 28; 29, 32 and 33

Thence S.89°59'W., on a true line bet. secs. 29 and 32. Over rolling land, thru scattering timber and undergrowth.

7.10

Desc. 70 ft. over SW. slope to

11.10

Ravine, course NW. Asc. 30 ft. over NE. slope to Top of ascent.

36.00

Desc. 23 ft. over W. slope to

39.97

Set an iron post, 3 ft. long, 1 in. in diam., 8 ins. in the ground to bed rock, supported in a mound of stone, for 1/4 sec. cor., marked on brass cap

1/4	S	29

	S	32
1920		

From which

A cedar, 8 ins. in diam., bears N.48°W., 97 lks. dist. marked 1/4 S 29 B T

A cedar, 6 ins. in diam., bears S.46°W., 54 lks. dist. marked 1/4 S 32 B T

Desc. 74 ft. to

44.50

Ravine, course NW.

57.00

Ravine, course SW. Asc. 23 ft. over gentle SE slope to

64.50

Spur, slopes SE.

67.11

Canyon rim NW and SE, thence by triangulation.

74.00

(Approx. dist.) Wash in canyon, course NW about 400 ft. deep.

79.15

Triang. pt. 100 ft. lower than rim. Desc. 92 ft. to cor., dist. by chaining.

79.94

The cor. of secs. 29, 30, 31 and 32.

Land; rolling.

Soil; rocky, 4th. rate.

Timber; scattering cedar and pinyon.

Undergrowth; sagebrush, cactus and chamiso.

Subdivision of T. 26 N.R. 10 W.

40:00 S. 89° 58' W., on a random line bet. secs. 30 and 31.
 Set temp. 1/4 sec. cor.
 65.46 Top of abrupt cliff over which it is impossible to chain.
 Vertical angle to flag on random line, -- 38 1/2°; auxiliary
 flag brs. N. 0° 2' W., 10.00 chs. dist.;
 from flag on random line auxiliary
 flag brs. N 54° 09' E; all bearings
 checked by direct reading of the solar,
 and all angles checked by deflection.

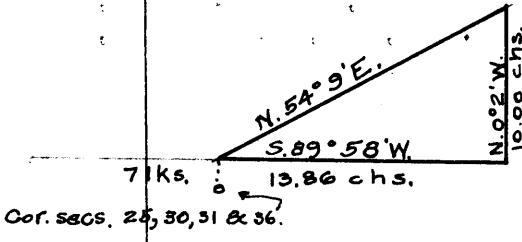

Dist. on random	--	65.46 chs.
Dist. by triangulation	--	13.86 chs.
Total dist.	--	79.32

79.32 Fall 7 lks. N. of the cor. of secs. 25, 30, 31 and 36
 on W. bdy. of Tp., described in Book "E".
 Thence 89° 55' E., on a true line bet. secs. 30 and 31.
 Over mountainous land, thru scattering undergrowth,
 dist. by triangulation.
 Asc. 720 ft. over W. slope to,
 13.86 Triang. Pt. top of bluff, bears N and S. Thence by chaining
 23.40 Asc. 320 ft. over NW. slope to
 39.32 Flat spur slopes NW. Mark cross (x) at exact cor. point
 and over same set an iron post, 3 ft. long, 1 in. in
 diam. on bed rock supported in a mound of stone, 3 1/2 ft.
 base, 2 1/2 ft. high for 1/4 sec. cor., marked on brass cap

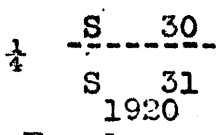

Desc. 380 ft. over E. slope
 67.30 Canyon, course N. Asc. 195 ft. over SW. slope to
 73.72 Spur, slopes NW. Desc. 90 ft. over NW. slope to
 79.32 The cor. of secs. 29, 30, 31 and 32.
 Land; mountainous.
 Soil; rocky, 4th. rate.
 Timber; none.
 Undergrowth; sagebrush and spanish dagger.

N. 0° 03' W., bet. secs. 29 and 30:
 Over broken land, thru scattering timber and undergrowth.
 On account of precipitous cliffs, forming side of canyon
 400 ft. deep, it is impossible to chain.
 Vertical angle to flag ahead, 6°; auxiliary flag bears
 N. 89° 57' E.; 10.00 chs. dist; from flag
 ahead, auxiliary flag brs. S. 16° 13' E
 All bearings checked by direct read-
 ing of the solar, and all angles
 checked by deflection:



Dist. by triangulation -- 34.50 chs.

34.50 Triangulation point. 200 ft. above sec. cor.
 34.60 Mark cross (x) at exact witness cor. point and over same
 set an iron post, 3 ft. long, 1 in. in diam., on bed
 rock, supported in a mound of stone 3 1/2 ft. base, 2 1/2
 ft. high for witness cor. to the 1/4 sec. cor., marked
 on brass cap

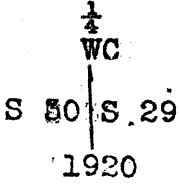

Cor. stands on point of cliff.

Subdivision of T. 26 N. R. 10 W.

Chains

34.60

Still being unable to chain on account of the precipitous cliffs, triangulate as follows:-
 Vertical angle to flag ahead, 00;
 auxiliary flag brs. N. 89° 57' E.,
 10.00 chs. dist.; from flag ahead,
 auxiliary flag brs. S. 30° 28' E.;
 all bearings checked by direct
 reading of the solar, and all
 angles checked by deflection.

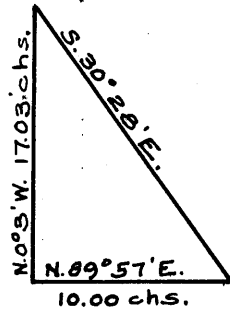

Dist. by triangulation -- 17.03 chs.
 34.60 + 17.03 -- 51.63 chs.

40.00

True point for 1/4 sec. cor. falls on precipitous cliffs.

49.60

Canyon, 100 ft. deep, 2 chs. wide, course W.

51.63

Triangulation point. Thence by chaining

63.40

Asc. 96 ft. over S. slope to Ridge, bears E. and W. Desc. 270 ft. over N. slope to

80.00

Set an iron post, 3 ft. long, 2 ins. in diam., 24 ins. in the ground for cor. of secs. 19, 20, 29 and 30, marked on brass cap

T26N	R10W
S 19	S 20
S 30	S 29
1920	

From which

A cedar, 8 ins. in diam., bears N. 52 1/2° E., 73 lks. dist. marked T 26 N R 10 W S 20 B T

A cedar, 10 ins. in diam., bears S. 28 1/2° E., 62 lks. dist. marked T 26 N R 10 W S 29 B T

A cedar, 8 ins. in diam., bears S. 45° W., 50 lks. dist. marked T 26 N R 10 W S 30 B T

A cedar, 12 ins. in diam., bears N. 26° W., 26 lks. dist. marked T 26 N R 10 W S 19 B T

Land; broken.

Soil; rocky, 4th. rate.

Timber; scattering cedar.

Undergrowth; sagebrush, cactus and chamisco.

40.00

N. 89° 59' E., on a random line bet. secs. 20 and 29.

79.92

Set temp. 1/4 sec. cor.

Intersect N and S line, 5 lks. S. of the cor. of secs. 20, 21, 28 and 29.

Thence S. 89° 57' W., on a true line bet. secs. 20 and 29.

Over nearly level land, thru scattering timber and undergrowth.

4.00

Old Indian Trail and dim road, bears SE and NW.

15.00

Asc. 52 ft. to

20.00

Top of asct.

39.96

Set an iron post, 3 ft. long, 1 in. in diam., 18 ins. in the ground to bed rock, supported in a mound of stone, for 1/4 sec. cor., marked on brass cap

1/4	S 20

	S 29
1920	

From which

A cedar, 10 ins. in diam., bears N. 55 3/4° W., 154 lks. dist. marked 1/4 S 20 B T

A cedar, 8 ins. in diam., bears S. 6° E., 85 lks. dist. marked 1/4 S 29 B T

Desc. 200 ft. over W. slope to

56.00

Small canyon, course NW. Asc. 27 ft. to

60.00

Thence along N. slope.

79.92

The cor. of secs. 19, 20, 29 and 30.

Subdivision of T. 26 N., R. 10 W.

Chains A cedar, 8 ins. in diam., bears S. 6° E., 85 lks. dist. marked $\frac{1}{4}$ S 29 B T
 Desc. 200 ft. over W. slope to
 56.00 Small canyon, course NW. Asc. 27 ft. to
 60.00 Thence along N. slope
 79.92 The cor. of secs. 19, 20, 29 and 30.
 Land; rolling.
 Soil; rocky, 4th rate.
 Timber; scrub cedar and pine.
 Undergrowth; sagebrush, algerita, spanish bayonet and chamiso.

40.00 S. 89° 55' W., on a random line bet. secs. 19 and 30.
 Set temp. $\frac{1}{4}$ sec. cor.
 69.01 Edge of precipitous cliff over which it is impossible to chain. Set flag on line below cliffs. Vertical angle to flag on random line, -29°; auxiliary flag brs. N. 0° 5' W., 5.00 chs. dist.; from flag on random line, auxiliary flag brs. N. 63° 24' E., all bearings checked by direct reading of the solar and all angles checked by deflection.

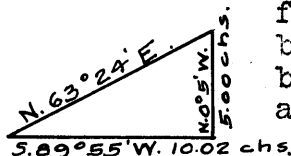

Dist. on random -- 69.01 chs.
 Dist. by triangulation -- 10.02 chs.
 Total dist. -- 79.03 chs.

79.03 Triangulation point. Continue S. 89° 58' W. on random line, dist. by chaining.
 79.24 Fall 16 lks. S. of the cor. of secs. 19, 24, 25 and 30 on W. bdy. of Tp., described in Book "E".
 Thence S. 89° 58' E., on a true line bet. secs. 19 and 30.
 Over broken land, thru scattering timber and undergrowth.
 0.21 Asc. 320 ft. over W. slope. Dist. by triangulation.
 10.23 Top of rim rock, bears N. and S. Asc. 50 ft. Dist. by chaining.
 12.24 Spur, slopes N. Desc. 30 ft. over E. slope to
 15.74 Ravine, course NW. Asc. 150 ft. over SW slope to
 26.24 Spur, slopes S. Desc. 10 ft. to
 30.44 Wash, course SW. Asc. 142 ft. over W. slope to
 37.44 Spur, slopes NW. along N. slope to
 39.24 Mark cross (x) at exact cor. point and over same set an iron post, 3 ft. long, 1 in. in diam., on bed rock, supported in a mound of stone, 3½ ft. base, 2½ ft. high, for $\frac{1}{4}$ sec. cor., marked on brass cap

$\frac{1}{4}$ S --- 19
 $\frac{1}{4}$ S 30
 1920

42.24 Drain, course NW.
 Asc. 90 ft. over SW slope.
 49.25 Ridge, bears SE and NW. Desc. 120 ft. over NE. slope to
 59.75 Drain, course NW. Asc. 140 ft. over NW. slope to
 66.25 Top of ascent. Desc. 22 ft. over NE. slope to
 79.24 The cor. of secs. 19, 20, 29 and 30.
 Land; broken, drains NW.
 Soil; rocky, 4th rate.
 Timber; scattering cedar.
 Undergrowth: sagebrush, cactus and chamiso.
 Poor grass.

Subdivision of T. 26 N., R. 10 W.

Chains N.0003'W., bet. secs. 19 and 20.
 Over mountainous land, thru scattering timber and medium heavy undergrowth.
 Desc. 90 ft. over N. slope to
 4.20 Canyon, course N.80°W. Asc. 140 ft. over SW. slope to
 11.00 Spur, slopes S. 70°W. 57 ft. asc. to
 14.20 Canyon, 100 ft. deep, course W. Asc. 65 ft.
 19.50 Spur, slopes SW.
 22.50 Canyon, 30 ft. deep, course SW.
 32.00 Flat spur, slopes S.80°W. Desc. 107 ft. to
 40.00 Set an iron post 3 ft. long, 1 in. in diam., 24 ins. in the ground for $\frac{1}{4}$ sec. cor., marked on brass cap

$\frac{1}{4}$
 S 19 | S 20
 1920

From which

A pine, 6 ins. in diam., bears N. 46 $\frac{1}{2}$ °E., 20 lks. dist. marked $\frac{1}{4}$ S 20 B T

A pine, 8 ins. in diam., bears S. 78°W., 44 lks. dist. marked $\frac{1}{4}$ S 19 B T

40.60 Canyon, 30 ft. deep, course NW. Thence along W. slope
 54.00 Canyon, 60 ft. deep, course SW. Asc. 160 ft. over SE. slope.

67.30 Top of ascent; thence along W slope.

68.30 Dim road, bears E. and W.

80.00 Set an iron post, 3 ft. long, 2 ins. in diam., 8 ins. in the ground to bed rock deposit stone marked cross (x) at base of post and raise a mound of stone around post for cor. of secs. 17, 18, 19 and 20, marked on brass cap

T26N | R10W
 S 18 | S 17
 S 19 | S 20
 1920

From which

A cedar, 10 ins. in diam., bears S. 24 $\frac{1}{2}$ °E., 30 lks. dist. marked T 26 N R 10 W S 20 B T

A pine, 12 ins. in diam., bears S. 18°W., 223 lks. dist. marked T 26 N R 10 W S 19 B T

No other trees within limits.

Land; mountainous, drains, W.

Soil; rocky, 4th rate.

Timber; scrub cedar and pinyon.

Undergrowth; sagebrush, chamiso and algerita.

40.00 N.89°57'E., on a random line bet. secs. 17 and 20.
 Set temp. $\frac{1}{4}$ sec. cor.
 80.00 Intersect N and S line 7 lks. S. of the cor of secs 16, 17, 20 and 21.
 Thence S.89°54'W., on a true line bet secs 17 and 20.
 Over rolling land, thru scattering timber and undergrowth.
 Desc. 115 ft. over W. slope to
 14.00 Canyon, 90 ft. deep, course N. over rolling land.
 40.00 Set an iron post, 3 ft. long, 1 in. in diam., 24 ins. in the ground for $\frac{1}{4}$ sec. cor., marked on brass cap

S 17
 $\frac{1}{4}$ S 20
 1920

From which

A cedar, 10 ins. in diam., bears N. 71 $\frac{3}{4}$ °W., 29 lks. dist. marked $\frac{1}{4}$ S 17 B T

A cedar, 8 ins. in diam., bears S. 83°E., 79 lks. dist. marked $\frac{1}{4}$ S 20 B T

Desc. 42 ft. to

Subdivision of T. 26 N., R. 10 W.

Chains
 46.30 Canyon, 150 ft. deep, course N.
 64.40 Dim road, bears SE. and NW.
 72.00 Dim road, bears NE. and SW..
 77.50 Desc. west slope.
 80.00 The cor. of secs. 17, 18, 19 and 20.
 Land; rolling mountainous, drains N.
 Soil; rocky, 4th rate.
 Timber; scrub cedar and pinyon pine.
 Undergrowth; sagebrush, chamiso and cactus.

40.00 N.89°58'W., on a random line bet. secs. 18 and 19.
 Set temp. ¼ sec. cor.
 73.10 Top of perpendicular cliff over which it is impossible to chain.

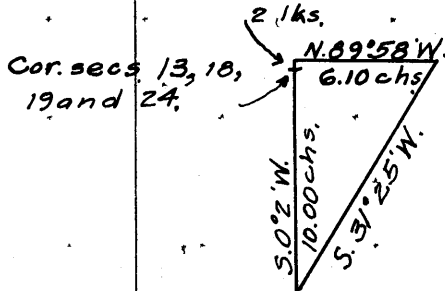

Vertical angle to flag on random line at cor. of secs. 13, 18, 19 and 24, --40°; auxiliary flag brs. S.31°25'W.; from flag ahead auxiliary flag brs. S.0°2'W., 10.00 chs. dist.; all bearings checked by direct reading of the solar, and all angles checked by deflection

Dist. on random -- 73.10 chs.
 Dist. by triangulation -- 6.10 chs.
 Total dist. -- 79.20 chs.

79.20 Fall 2 lks. N. of the cor. of secs. 13, 18, 19 and 24 on W. bdy. of Tp., described in Book "E". Thence S.89°59'E., on a true line bet. secs. 18 and 19. Over mountainous land, thru scattering timber and undergrowth, dist. by triangulation.
 Asc. 260 ft. to
 6:10 Top of cliff, bears N and S. Asc. 160 ft. dist. by chaining.
 10:70 Spur, slopes N.80°W. Desc. 125 ft. over E. slope to
 15:20 Bottom of canyon, course NW. from E. Thence follow up canyon. Asc. 170 ft. to
 31:20 Confluence of canyons from NE and SE. Asc. 200 ft. to
 39:20 Set an iron post, 3-ft. long, 1 in. in diam., 26 ins. in the ground for ¼ sec. cor. marked on brass cap

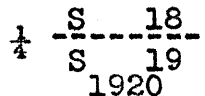

Raise a mound of stone 3½ ft. base, 2½ ft. high N. of cor. Asc. 90 ft. to
 42.00 Top of ascent. Thence over rolling spurs, Desc. 80 ft. to
 59.80 Dim road and trail, bears N and S.
 66.28 Asc. 85 ft. to
 79.20 The cor. of secs. 17, 18, 19 and 20..
 Land; mountainous, drains W.:
 Soil; rocky, 4th rate.
 Timber; scattering scrub cedar and pinyon.
 Undergrowth; sagebrush, camiso and spanish bayonet..

N.0°03'W., secs. 17 and 18.
 Over broken land, thru scattering timber and undergrowth.
 12.50 Spur, slopes W. over broken land. Desc. 40 ft.
 21.20 Desc. 400 ft. over broken NW. slope to
 40.00 Set an iron post, 3 ft. long, 1 in. in diam., 6 ins. in the ground to bed rock, supported in a mound of stone, for ¼ sec. cor., marked on brass cap

Subdivision of T. 26 N., R. 10 W.

BOOK 3842

Chains

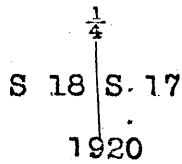

From which

A pinyon, 10 ins. in diam., bears N. 56° E., 24 lks. dist. marked 1/4 S 17 B T

A pinyon, 8 ins. in diam., bears N. 32 1/2° W., 43 lks. dist. marked 1/4 S 18 B T

Desc. 225 ft. over NW. slope to Ravine, course NE.

48.00

Spur, slopes E. Desc. 45 ft.

49.60

Ravine, course NE. Asc. 230 ft. to

54.00

Spur, slopes NE. Desc. 455 ft. over NW. slope to

69.50

Set an iron post, 3 ft. long, 2 ins. in diam., 12 ins. in the ground to bed rock deposit stone marked cross (x) at base of post; and raise a mound of stone around post for cor. of secs. 7, 8, 17, and 18, marked on brass cap

80.00



1920

Land; broken, drains N.

Soil; rocky, 4th. rate.

Timber; scattering cedar and pinyon..

Undergrowth; sagebrush, cactus and chamiso.

Poor grass.

N. 89° 54' E., on a random line bet. secs. 8 and 17. Line passes over precipitous cliff where it is impossible to chain.

Vertical angle to flag on random line = 160; auxiliary flag brs.

N. 75° 50' E.; from flag on random line, auxiliary flag brs.

N. 0° 06' W., 10.00 chs. dist., all bearings checked by direct reading of the solar and all angles checked by deflection..

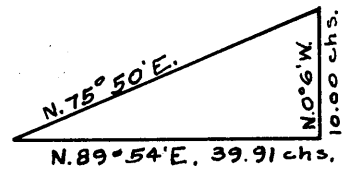

Dist. by triangulation -- 39.91 chs.

39.91 Triangulation point. Thence N. 89° 54' E. on a random line, dist. by chaining.

40.00 Set temp. 1/4 sec. cor.

64.00 W. edge of canyon across which it is impossible to chain. Set flag on random, line ahead; auxiliary flag brs.

N. 56° 40' E.; from flag on random line, auxiliary flag brs. N. 0° 06' W., 10.00 chs. dist: all bearings checked by direct reading of the solar and all angles checked by deflection.

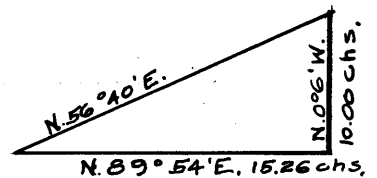

Dist on random -- 64.00 chs.

Dist. by triangulation -- 15.26 chs.

Total dist. -- 79.26 chs.

79.26 Triangulation point. Thence N. 89° 54' E. on random line, dist by chaining.

79.92 Intersect the cor. of secs. 8, 9, 16 and 17

Thence S. 89° 54' W., on a true line bet. secs. 8 and 17.

Over broken land, thru scattering timber and undergrowth E. edge of canyon bears N and S. Thence by triangulation

.66

8.20 (Approx. dist) Wash in canyon. Course N. 300 ft. below rim.

Subdivision of T. 26 N., R. 10 W.

Chains	
15.92	W. edge of canyon, bears N and S. Asc. 35 ft. dist by chaining.
19.00	Ridge, bears N and S.
23.70	Desc. 200 ft. over W. slope to
30.00	Ravine, course N. Asc. 35 ft. to
35.00	Spur, slopes N. over top of spur to
37.65	Desc. 95 ft. over NW. slope to
39.96	Set an iron post, 3 ft. long, 1 in. in diam., 6 ins. in the ground to bed rock deposit stone marked cross (x) at base of post and raise a mound of stone around post for $\frac{1}{4}$ sec. cor., marked on brass cap
	$\frac{1}{4}$ S --- 8 S 17 1920
	Desc. about 700 ft. over precipitous cliffs..
40.01	Thence by triangulation.
77.00	Wash, course NW. Asc. to
79.92	The cor. of secs. 7, 8, 17, and 18. Land; broken.. Soil; rocky, 3d. to 4th. rates.. Timber; scattering scrub cedar. Undergrowth; sagebrush, chamiso and cactus..

	N. 89° 59' W., on a random line bet. secs. 7 and 18..
40.00	Set temp. $\frac{1}{4}$ sec. cor.
79.01	Fall 4 lks. S. of the cor. of secs. 7, 12, 13 and 18, on W. bdy. of Tp., described in Book "E". Thence S. 89° 57' E., on a true line bet. secs. 7 and 18.. Over broken land, thru scattering timber and undergrowth..
12.50	Spur, slopes S. Desc. 133 ft. to
29.10	Wash, course N. Asc. 57 ft.
34.10	Small spur, slopes N. Desc. 40 ft.
39.01	Set an iron post, 3 ft. long, 1 in. in diam., 16 ins. in the ground to bed rock deposit stone marked cross (x) at base of post and raise a mound of stone around post for $\frac{1}{4}$ sec. cor., marked on brass cap
	$\frac{1}{4}$ S --- 7 S 18 1920
	Raise a mound of stone, 2 ft. base, 1 $\frac{1}{2}$ ft. high N. of cor.
39.50	Wash, course N. Asc. 322 ft. over NW. slope to 69.70
57.30	Indian Trail, bears N and S. Spring and camp ground 4 chs. N.
69.70	Spur, slopes N. Desc. 274 ft. over broken NE. slope to
79.01	The cor. of secs. 7, 8, 17 and 18. Land; broken, drains N. Soil; rocky, 3d. and 4th. rates. Timber; scattering scrub cedar and pinyon. Undergrowth; sagebrush, chamiso and cactus. Poor grass.

	N. 0° 03' W., bet. secs. 7 and 8.
	Over mountainous land, thru scattering undergrowth. Desc. 150 ft. over NE. slope to
10.00	Wash, 50 lks. wide, course N. 20° W. Thence over series of spurs and drains, bearing NW. Desc. 50 ft. to
36.20	Spur, slopes NW. Desc. 75 ft. to
40.00	Mark cross (x) at exact cor. point and over same set an iron post, 3 ft. long, 1 in. in diam., on surface rock in a mound of stone 3 ft. base, 2 $\frac{1}{2}$ ft. high, for $\frac{1}{4}$ sec. cor., marked on brass cap

Subdivision of T. 26 N., R. 10 W.

BOOK 2546

Chains

S 7 S 8

1921

Cor. stands in wash, south fork of Hells Canyon, 5 chs. wide, 50 ft. deep, course NE.

41.00 Perpendicular wall over which it is impossible to chain. in order to obtain a suitable base return to 37.60 ch.pt.

Set flag on line on extreme high point ahead, the vertical angle to which is + 17°.

Auxiliary flag brs. N. 53° 46' E., 15.60 chs.; from flag ahead; auxiliary flag

brs. S. 20° 23' E.; all bearings checked by direct reading of the solar, and all angles checked by deflection.

Dist. by triangulation -- 43.59 chs.

43.59 + 37.60 -- 81.19 chs.

Return measure -- 1.19

80.00

55.00 (Approx. dist.) Main wall of canyon, bears NE. and SW. Continue asct. over cliffs.

80.00 Set an iron post, 3 ft. long, 2 ins. in diam., 10 ins. in the ground to bed rock deposit stone marked cross (x) at base of post, and raise a mound of stone around post for cor. of secs. 5, 6, 7 and 8, marked on brass cap

T26N | R10W
S 6 | S 5

S 7 | S 8

1921

Cor. 900 ft. above 37.60 chain point.

Land; mountainous. N. half, all cliffs.

Soil; rocky, 4th rate.

Timber; none.

Undergrowth; black brush, spanish bayonet and palo christi.

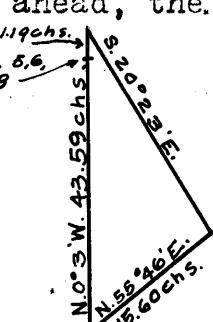

7.57 N. 89° 54' E., on a random line bet. secs. 5 and 8. Top of rim rock. Impossible to chain. Vertical angle to flag on random line, -- 38°; auxiliary flag brs. N. 53° 04' E.; from flag on random line, auxiliary flag brs. N. 0° 54' W. 12.00 chs. dist.

all bearings checked by direct reading of the solar, and all angles checked by deflection.

Dist. on random. -- 7.57 chs.

Dist. by triangulation -- 16.02 chs.

Total dist. -- 23.59 chs.

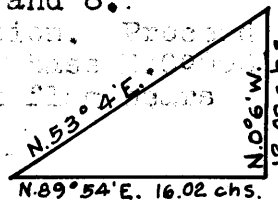

23.59 Triangulation point. Thence N. 89° 54' E. on random line, dist. by chaining.

40.00 Set temp. 1/4 sec. cor.

Thence by traverse to avoid cliff.

S. 89° 54' W. 2.42 chs.

N. 26° E. 3.82 chs.

N. 89° 54' E. 0.70 chs.

S. 68 3/4° E. 9.51 chs.

To point on random line bet. secs. 5 and 8, 48.83 chs.;

N. 89° 54' E. of the cor. of secs. 5, 6, 7 and 8. Continue

N. 89° 54' E. on random line bet. secs. 5 and 8.

69.66 Cliff, 80 ft. high on line. Traverse as follows:

N. 53 1/4° E. 1.04

East 9.45

South 0.59

To the cor. of secs 4, 5, 8 and 9 the true course and distance of the line bet. secs. 5 and 8 are therefore

Subdivision of T. 26 N., R. 10 W.

Chains

S.89°53'W., 79.94 chs.

S.89°53'W., on a true line bet. secs. 5 and 8.
Over mountainous land, thru scattering undergrowth, dist by traverse. Desc. 160 ft.

10.28 Thence by chaining on random line..

17.15 Wash, 150 lks. wide, course NW.

31.11 Thence by traverse. N. slope to

37.13 Top of asct. along N. slope to

39.97 Set an iron post, 3 ft. long, 1 in. in diam., 6 ins. in the ground to bed rock deposit stone marked cross (x) at base of post and raise a mound of stone around post for 1/4 sec. cor., marked on brass cap

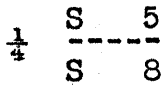

1921

Cor. stands at base of perpendicular cliff, 80 ft. high bearing SE. and NW.

Desc. 190 ft. Dist. by chaining on random line..

47.00 Top of rim rock, 70 ft. high, bears N. and S.

56.35 Wash, 8 ft. deep, course N. Asc. 650 ft. over steep E. slope to

72.47 Rim rock, bears N. and S. Asc. 180 ft. over E. slope to

79.94 The cor. of secs. 5, 6, 7 and 8.

Land: broken.

Soil: rocky, 4th. rate.

Timber: none.

Undergrowth: low desert brush.

N.89°57'W., on a random line bet. secs. 6 and 7..

1.31 On account of precipitous cliffs in advance over which it is impracticable to chain triangulate as follows:
Set flag on line ahead beyond cliffs

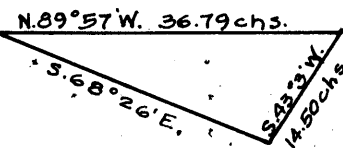

Vertical angle, to flag on random line, = 41°; auxiliary flag brs. S.43°3'W. 14.50 chs. dist.; from flag on random line, auxiliary flag brs. S.68°26'E. 36.79 chs.; all bearings checked by direct reading of the solar, and all angles checked by deflection

Dist. on random -- 1.31 chs.

Dist. by triangulation -- 36.79 "

Total dist. -- 38.10 "

38.10 Triangulation point. Thence N.89°57'W. on random line, dist. by chaining.

40.00 Set temp. 1/4 sec. cor.

78.90 Intersect the cor. of secs. 1, 6, 7 and 12 on W. bdy. of Tp. described in Book "E".

Thence S.89°57'W., on a true line bet. secs. 6 and 7..

Over mountainous land, thru scattering undergrowth..

Asc. 520 ft. over broken SW. slope to

22.36 Ridge, bears N. and S. Desc. 130 ft. to

27.00 Gulch, course N. Asc. 165 ft. to

31.40 Rim rock, 130 ft. high. Asc. 110 ft. to

34.90 N. side of high peak.

38.90 Set an iron post, 3 ft. long, 1 in. in diam., 14 ins. in the ground to bed rock deposit stone marked cross (x) at base of post and raise a mound of stone around post for 1/4 sec. cor., marked on brass cap.

Subdivision of T. 26 N., R. 10 W.

Chains

1/4 S 6
S 7
1921

Cor. stands on N. slope of high ridge.
 40.80 Thence by triangulation, descending about 600 ft. over a series of cliffs
 58.00 (Approx.) Wash course North. Asc. 420 ft.
 71.33 Thence by chaining.
 77.60 Spur, slopes NE.
 78.90 The cor. of secs. 5, 6, 7 and 8.
 Land; mountainous.
 Soil; rocky, 4th rate.
 Timber; none
 Undergrowth; low desert brush.

4.54 N.0°10'W., on a random line bet. secs. 5 and 6.
 From this point the line descends into Hells Canyon over precipitous cliffs where it is impossible to chain.
 Vertical angle to flag on random line - 35 1/2°; auxiliary flag brs. N.17°51'E; from flag on line, auxiliary flag brs. N.89°50'E. 7.30 chs. dist. all bearings checked by direct reading of the solar, and all angles checked by deflection.

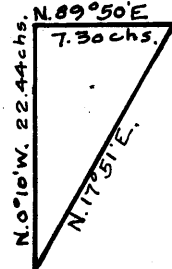

Dist. on random --- 4.54 chs.
 Dist. by triangulation -- 22.44 chs.
 Total dist. --- 26.98 chs.

26.98 Triangulation point. 1050. ft. below 4.54 ch. point.
 Thence N.0° 10' W., on a random line dist. by chaining.

40.00 Set temp. 1/4 sec. cor.
 On account of precipitous cliffs ahead, it is impracticable to continue chaining. Vertical angle to flag on random line from 26.98 ch. point is + 22 1/2°; from E. end of base above described flag on random line brs. N.80°41'W.

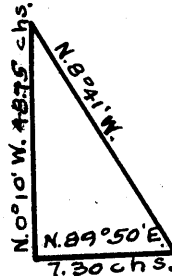

Dist. on random -- 26.98 chs.
 Dist. by triangulation -- 48.75 chs.
 Total dist. --- 75.73 chs.

75.73 Triangulation point. Thence N.0°10'W. on a random line, dist. by chaining.

80.13 Fall 21 lks. W. of the cor. of secs. 5, 6, 31 and 32. on N. bdy. of Tp., hereinbefore described.

Thence S.0°01'E., on a true line bet. secs. 5 and 6. Over precipitous land, thru low desert brush.

1.90 Wash, 15 lks. wide, course SE.

4.40 Desc. 1280 ft. over precipitous cliffs.

40.13 Mark cross (x) at exact cor. point and over same set an iron post, 3 ft. long, 1 in. in diam., in a mound of stone, 3 ft. base, 2 1/2 ft. high, for 1/4 sec. cor., marked on brass cap

1/4
S 6 | S 5
1921

46.50 Main wash of Hells Canyon, 3 chs. wide, course W.
 58.00 Foot of cliffs, bears E. and SW. Asc. 850 ft. to
 78.90 Spur, slopes NE.
 80.13 The cor. of secs. 5, 6, 31 and 32.
 Land; mountainous, all cliffs. Soil; rocky, 4th rate.
 Timber; none. Undergrowth; black brush, palo christi, etc.

Final Field Test of Instruments Nos. 9977 and 8489, used by Mr. Muscott and Mr. Warner, during 1920.

Nov. 13, 1920. We examine the adjustment of the instruments and find them satisfactory; then to test the solar apparatus by comparing their indications from observations made during a.m. and p.m. hours with a meridian established by Polaris observation, we proceed as follows:

Nov. 14, 1920. In camp in sec. 32, T. 26 N., R. 10 W., G&SRB&M., Arizona, lat. $35^{\circ}37'N$; long. $113^{\circ}20'W$, at 3 hrs. 57.3m., a.m., l.m.t., we observe Polaris at western elongation, making four observations, two each with the telescope in direct and reversed positions, and mark the mean point in the line thus determined, on a peg driven firmly in the ground 5 chs. N.

Azimuth of Polaris at western elongation $1022^{\circ}17''$

At 8 hrs. 0 m., a.m., l.m.t., we lay off the azimuth of Polaris, $1022^{\circ}\frac{1}{2}'$, to the East, and mark the meridian thus determined by a tack in a peg driven firmly in the ground, 5 chs. N.

Nov. 28, 1922, using the meridian determined as above described, at 9 hrs. 0 m., a.m., l.m.t., we set off $35^{\circ}37'N$ on the lat. arcs, $21^{\circ}18^{\frac{1}{2}}'S$, on the decl. arcs, and determine a meridian with each solar, which agrees with the true meridian.

At apparent noon with the lat. arc unchanged, we observe the sun on the meridian with each solar; the resulting reading of the decl. arc of each instrument is $21^{\circ}20^{\frac{1}{2}}'S$, which agrees with the computed decl. of the sun.

At 3 hrs. 0 m., p.m., l.m.t., with the lat. arcs unchanged, we set off $21^{\circ}21'S$, on the decl. arcs, and determine a meridian with each solar which agrees with the true meridian.

As all of the solar observations during the usual hours of solar work come within $1^{\circ}30''$ of the true meridian, we conclude that the adjustments of the instruments have been in satisfactory condition during the progress of the survey.

The continued satisfactory adjustment of the instruments used in this Tp. in 1921 is indicated from field tests as described in Book "G".

BOOK 3546

General Description.

This township is situated entirely within the Hualpai Indian Reservation. The surface ranges from nearly level in the southeastern to precipitous cliffs and canyons in the northwestern part. The drainage is to the north and west. The soil for the most part is very rocky and would all be classed as 3d. and 4th. rate, except the southeast portion, which is a gravelly loam, 2nd. rate. There is a scattering growth of juniper and pinyon timber thruout the township. No apparent indications of mineral were found. There are no permanent streams and no settlers. A spring is found in the SE $\frac{1}{4}$ of Sec. 7.

BOOK 3546

4-680

FIELD ASSISTANTS.

Claude F. Warner, U.S. Transitman

NAMES.	CAPACITY.
Julius S. Owens	1st Chainman
I.C. Perkins	2nd Chainman
L.M. Brown	Moundsman
J.J. Hayden	Flagman
G. Swanson	Flagman
W.T. Archer	Axman
G.O. Harris	Moundsman

CERTIFICATE OF UNITED STATES TRANSITMAN.

I, Claude F. Warner, U.S. Transitman, hereby certify upon honor that, in pursuance of special instructions received from the U. S. Surveyor General, for Group 103, Arizona, bearing date of the 20th day of February, 1920, I have well, faithfully, and truly in my own proper person, and in strict conformity with said instructions, the Manual of Surveying Instructions, and the laws of the United States, surveyed all those parts or portions of the

North boundary, and

Subdivision lines of

TOWNSHIP 26 NORTH, RANGE 10 WEST,

of the Gila and Salt

River Base and Meridian, in the State of Arizona, and by diagram on page 1 hereof

the foregoing field notes as having been executed by me, and under my direction; and that all the corners of said survey have been established and perpetuated in strict accordance with the Manual of Surveying Instructions, and the special written instructions of the U. S. Surveyor General, for Group 103, Arizona, and in the specific manner described in the field notes, and that the foregoing are the original field notes of such survey.

Place Helena, Mont.

Claude F. Warner U.S. Transitman

Date: Apr 11, 1923

APPROVAL:

OFFICE OF THE UNITED STATES SURVEYOR GENERAL,

191

The foregoing field notes of the survey of

executed by

under his special instructions dated, 191, having been critically examined, and the necessary corrections and explanations made, the said field notes, and the surveys they describe, are hereby approved.

U. S. Surveyor General.

I certify that the foregoing transcript of the field notes of the above-described surveys in, has been correctly copied from the original notes on file in this office.

U. S. Surveyor General.

4-680

FIELD ASSISTANTS.

to H.M.Muscott, U.S.Transitman

NAMES.	CAPACITY.
Ross Dykes	1st Chainman
E.C.Merrill	2nd Chainman
Geo.Demorest	Flagman
Ted Lizovich	Moundsman
Walter Hutchinson	Axman
F.A.Weir	Moundsman

54
BOOK 3546

CERTIFICATE OF UNITED STATES TRANSITMAN.

I, Horace M. Muscott, U. S. Transitman, hereby certify upon honor that, in pursuance of special instructions received from the U. S. Surveyor General, for Group 108, Arizona, bearing date of the 20th day of February, 1920, I have well, faithfully, and truly in my own proper person, and in strict conformity with said instructions, the Manual of Surveying Instructions, and the laws of the United States, surveyed all those parts or portions of the North boundary and Subdivision lines of TOWNSHIP 26 NORTH, RANGE 10 WEST,

of the Gila and Salt River Base and Meridian, in the State of Arizona, and by diagram on page 1 hereof which are represented in the foregoing field notes as having been executed by me, and under my direction; and that all the corners of said survey have been established and perpetuated in strict accordance with the Manual of Surveying Instructions, and the special written instructions of the U. S. Surveyor General, for Group 108, Arizona, and in the specific manner described in the field notes; and that the foregoing are the original field notes of such survey.

Place Los Angeles, Calif Horace M. Muscott
U.S. Transitman.

Date: March 22, 1923

~~APPROVAL.~~

~~OFFICE OF THE UNITED STATES SURVEYOR GENERAL,~~

The foregoing field notes of the survey of _____, 1921

executed by _____

under his special instructions dated _____, 1921, having been critically examined, and the necessary corrections and explanations made, the said field notes, and the surveys they describe, are hereby approved.

~~U. S. Surveyor General.~~

I certify that the foregoing transcript of the field notes of the above-described surveys in _____, has been correctly copied from the original notes on file in this office.

~~U. S. Surveyor General.~~

CERTIFICATE OF UNITED STATES SURVEYOR.

I, Thomas D. Daley, U. S. Surveyor, hereby certify upon honor that, in pursuance of special instructions received from the U. S. Surveyor General, for Group No. 108, Arizona, bearing date of the 20th day of February, 1920, I have well, faithfully, and truly in my own proper person, and in strict conformity with said instructions, the Manual of Surveying Instructions, and the laws of the United States, surveyed all those parts or portions of the Subdivision lines of

TOWNSHIP 26 NORTH, RANGE 10 EAST,

of the Gila and Salt River Base and Meridian, in the State of Arizona, and by diagram on page 1 hereof the foregoing field notes as having been executed by me, and under my direction; and that all the corners of said survey have been established and perpetuated in strict accordance with the Manual of Surveying Instructions, and the special written instructions of the U. S. Surveyor General, for Group 108, Arizona, and in the specific manner described in the field notes, and that the foregoing are the original field notes of such survey.

Place Santa Fe, N.M.
Date March 26, 1923.

Thomas D. Daley
U. S. Surveyor.

APPROVAL.

OFFICE OF THE UNITED STATES SURVEYOR GENERAL,

Phoenix, Arizona, JUN 18 1923.

The foregoing field notes of the survey of the

North boundary, and

Subdivision lines

of

TOWNSHIP 26 NORTH, RANGE 10 WEST,

of the Gila and Salt River Base and Meridian, in the State of Arizona,

executed by Thomas D. Daley, U.S.S., and Horace Muscott & Claude F. Warner, U.S. Transfimen,

under special instructions dated February 20, 1920, for Grp. 108, Ariz, having been critically examined, and the necessary corrections and explanations made, the said field notes, and the surveys they describe, are hereby approved.

Frank P. Frost
U. S. Surveyor General.

I certify that the foregoing transcript of the field notes of the above described surveys in, has been correctly copied from the original notes on file in this office.

U. S. Surveyor General.