

3559

Book "A"

4-679

ORIG

JUN-5 1922

BOOK 3559

# FIELD NOTES

OF THE RETRACEMENT OF

Part of the Boundary of the Hualpai Indian Reservation,

AND OF THE SURVEY OF

Part of the North Boundary (completion), and

Part of the Subdivision lines (completion)

of

TOWNSHIP 26 NORTH, RANGE 14 WEST,

Of the Gila and Salt River Base and Meridian,

In the State of Arizona,

EXECUTED BY

Quintin Campbell, U. S. Surveyor,

and

Francis R. Ihrle, U.S. Transitman,

In the capacity of U. S. Surveyors, under instructions dated February 27, 1920, issued by the United States Surveyor General to govern surveys included in Group No. 110, Ariz, which were approved by the Commissioner of the General Land Office, March 10, 1920, and Assignment Instructions dated April 2, 1921.

Retracement & Survey commenced April 12, 1921.

Retracement & Survey completed August 6, 1921.

3559

3559

1A

3559

Book "A"  
Group 110 - - Arizona.

BOOK 3559

### INDEX DIAGRAM.

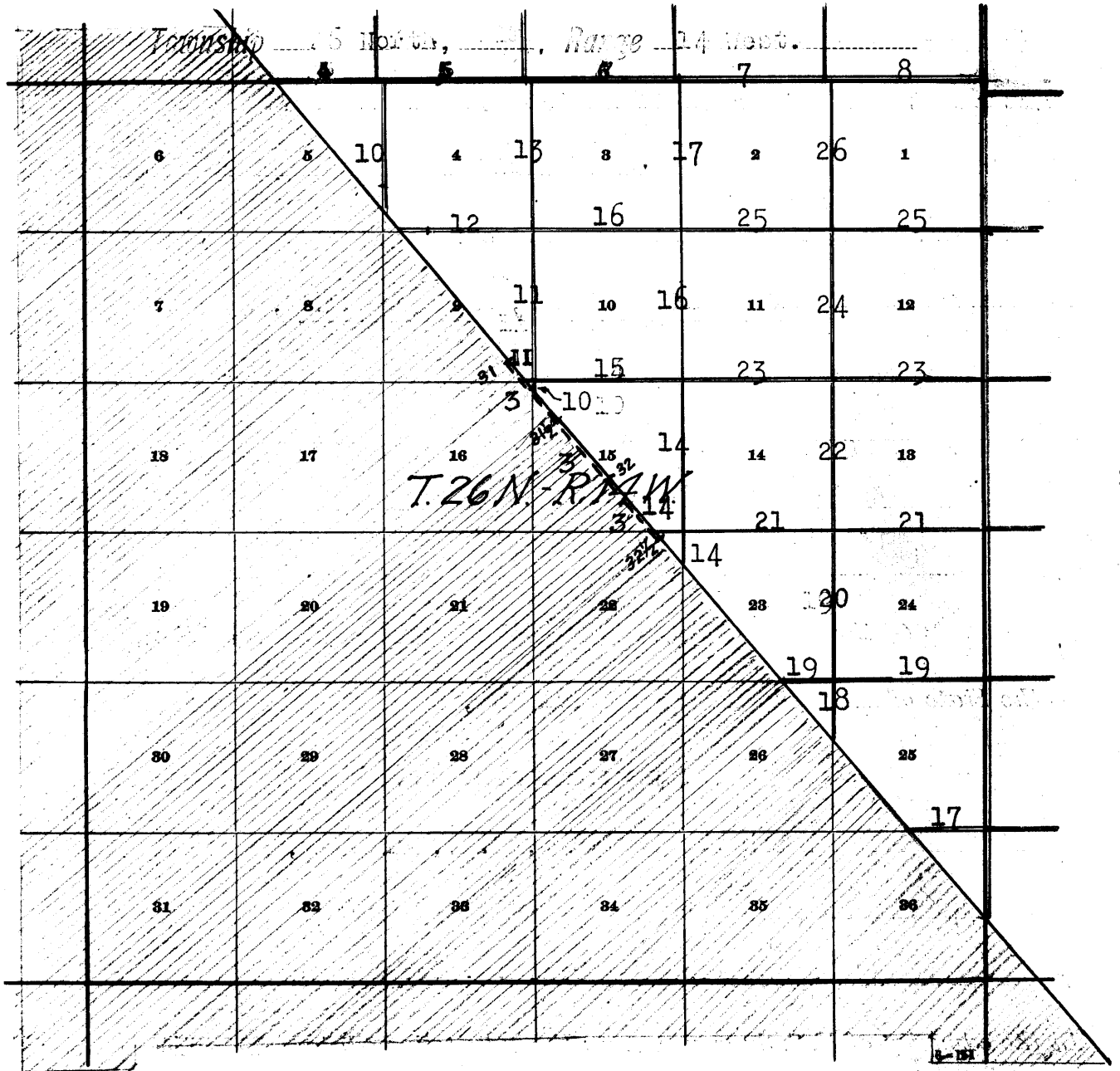

———— Lines surveyed under this group.

----- Lines retraced under this group.

———— Lines surveyed under current Group No. 109.

———— Accepted surveys.

 Areas surveyed as per accepted plats on file.

DATE DIAGRAM.

Book "A"

Group 110 - - Arizona.

Township 26 North, Range 14 West.

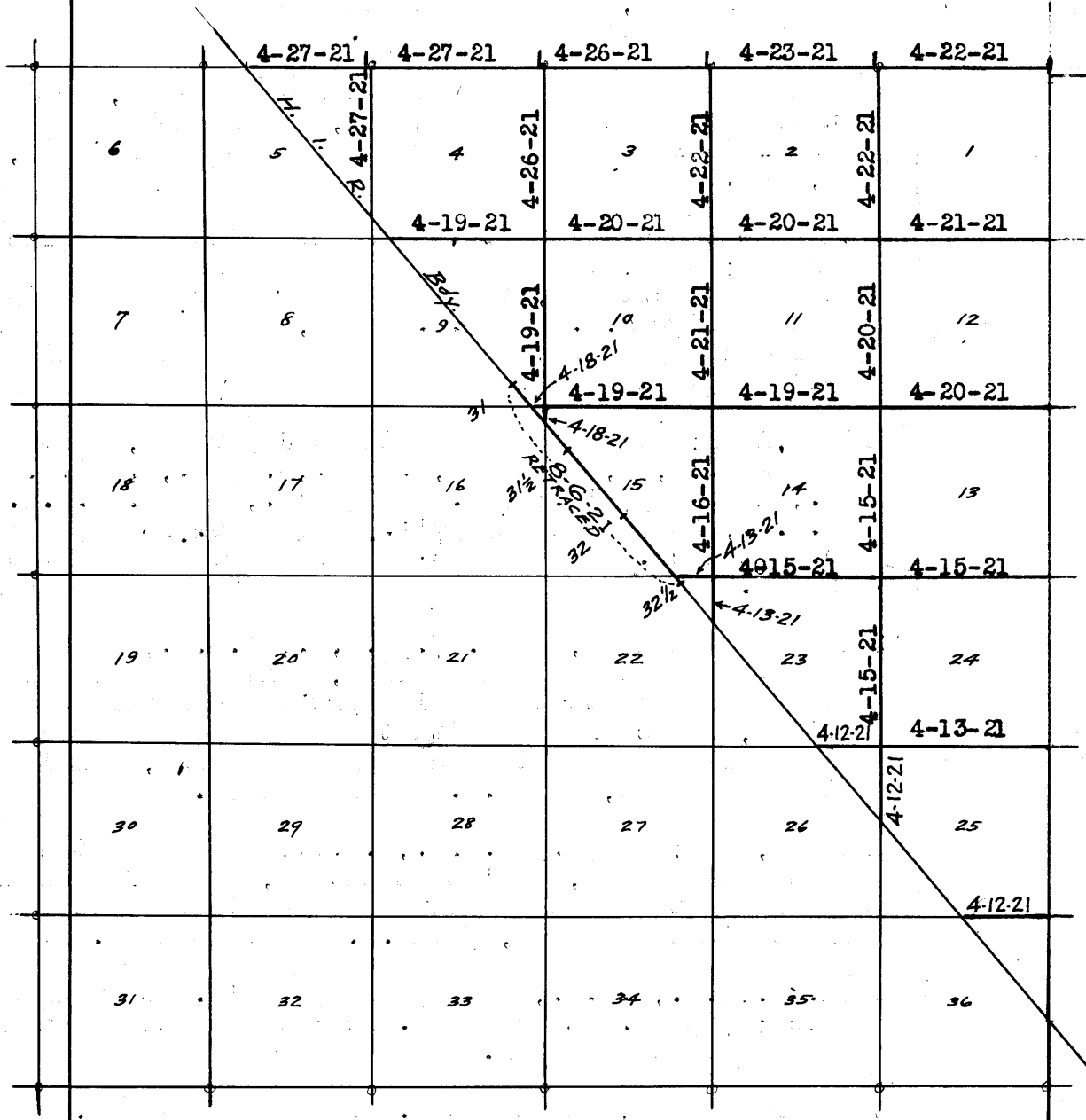

Blue lines indicate surveys by Quintin Campbell, U.S.S. on dates shown thereon.

Red lines indicate surveys and retracements by Francis R. Ihrie, U.S.T. on dates shown thereon.

Green lines indicate surveys under current Group 109.

Black lines indicate accepted surveys.

Retracements and surveys hereinafter described, executed by Quintin Campbell, U.S. Surveyor and Francis R. Thrie, U.S. Transitman, on dates shown on diagram on page 1 hereof, using respectively Young and Sons' light mountain transits Nos. 8491 and 8477. Both instruments are provided with full vertical circles and solar attachments, the verniers of which, as well as of the horizontal plates, read to single minutes. All azimuth determinations are accomplished with the solar attachments, except the special observations upon Polaris for meridian, upon which to test the solar apparatus, as stated in the field notes.

These instruments were approved for field work, conditional upon satisfactory field tests, by the Assistant Supervisor of Surveys for Arizona and California, April 2, 1921.

We examine the adjustments of the transits and correct all errors; then, to test the solar apparatus by comparing their indications, resulting from solar observations, made during a.m. and p.m. hours, with a meridian determined by observations on Polaris at elongation, we proceed as follows:

April 9, 1921: At our camp at Milkweed Springs, at the cor. of secs. 19, 20, 29 and 30, T. 26 N., R. 13 W., G. & S. R. B. & M., lat.  $35^{\circ}37\frac{1}{2}'$  N.; long.  $113^{\circ}42\frac{1}{2}'$  W., at 3h. 0m. p.m., l.m.t., we set off  $35^{\circ}37\frac{1}{2}'$  N. on the lat. arc;  $7^{\circ}39'$  N. on the decl. arc; and determine a meridian with each solar.

At the same station, at 6h. 17.5m. p.m., l.m.t., we observe Polaris at western elongation, making four observations, two each with telescope in direct and reversed positions, in accordance with the Manual of Instructions, and mark mean point by a tack in a stake, firmly driven in the ground, 5 chs. N. of our station.

April 10, 1921: At 7h. 30m. a.m., l.m.t., we lay off the azimuth of Polaris,  $1^{\circ}22'$  to the east, and mark the true meridian thus determined by a tack in a stake firmly driven in the ground, 5 chs. N. of our station.

At 8h. 0m., a.m., l.m.t., we set off  $35^{\circ}37\frac{1}{2}'$  N. on the lat. arcs;  $7^{\circ}55'$  N. on the decl. arcs; and determine a meridian with each solar.

At apparent noon, with the lat. arc on transit No. 8477 unchanged, and with  $7^{\circ}58\frac{1}{2}'$  N. set off on decl. arc of transit No. 8491, we observe the sun on the meridian. The resulting reading of decl. arc and lat. arc on transits 8477 and 8491 respectively are  $7^{\circ}58\frac{1}{2}'$  N. and  $35^{\circ}37\frac{1}{2}'$  N.

As all of the solar observations during the usual hours of solar work come within  $1'30''$  of the true meridian, we conclude that the adjustments of the solars are satisfactory.

Unless otherwise specified, all measurements are made with a Lufkin steel tape, 5 chs. in length, compared with a Chesterman standard steel tape and found correct.

The measurements are made on the slope, the vertical angles determined, and the slope measurements properly reduced to true horizontal distances.

Retracement of that part of the Hualpai Indian Reservation  
Boundary between the 31 and 32 1/2 mile cors.

Chains.

The boundaries of the Hualpai Indian Reservation were surveyed in August and September, 1900, by Albert T. Colton, U.S.D.S. Retracement of part of the Reservation boundary forming the N. bdy. of T. 26 N., R. 14 W. were made in 1917 under Group 45 by J.C. Hooper, U.S. Transitman, to justify the subdivisional closings against this line, but no retracement of the line between the 31 and 32 1/2 mile corners is of record.

The 31 mile cor. on the boundary of the Hualpai Indian Reservation is a sandstone, 6x16x9 ins. above ground, marked H.I.R. 31 M on NE., and P.L. on SW. faces, witnessed by a mound of stone S. 40° E. of cor.

From this cor.,

S. 40° E. on retracement of first half of 32 mile.

Over mountainous land, thru scattering timber and undergrowth.

Descend 30 ft.

13.39 Intersect the closing cor. of secs. 9 and 16, T. 26 N., R. 14 W., which is an iron post, 2 ins. in diam., 12 ins. above ground, properly marked, witnessed by two bearing trees.

Continue descent.

16.45 Intersect the closing cor. of secs. 15 and 16, T. 26 N., R. 14 W., which is an iron post, 2 ins. in diam., 12 ins. above ground, properly marked, witnessed by two bearing trees.

Continue descent 55 ft.

40.02 Intersect the 31 1/2 mile cor. on the boundary of the Hualpai Indian Reservation, which is a sandstone, 6x20x16 ins. above ground, marked H.I.R. 31 1/2 M on NE., P.L. on SW. faces, witnessed by a mound of stone, S. 40° E. of cor. The true course and distance of this half mile are therefore S. 40° E., 40.02 chs.

From the 31 1/2 mile cor.,

S. 40° E., on retracement of last half of 32 mile.

Over mountainous land, thru scattering timber and undergrowth.

Descend 270 ft.

39.87 Intersect the 32 mile cor. on the boundary of the Hualpai Indian Reservation, which is a sandstone, 6x10x8 ins. above ground, marked H.I.R. 32 M. on NE., and P.L. on SW. faces, witnessed by a mound of stone, S. 40° E. of cor. The true course and distance of this half mile are therefore S. 40° E., 39.87 chs.

From the 32 mile cor.,

S. 40° E., on retracement of first half of 33 mile.

Over mountainous land, thru scattering timber and undergrowth.

38.19 Intersect the closing cor. of secs. 15 and 22, T. 26 N., R. 14 W., which is an iron post, 2 ins. in diam., in a mound of stone, properly marked, witnessed by two bearing trees.

39.77 Intersect the 32 1/2 mile cor. on the boundary of the Hualpai Indian Reservation, which is a sandstone, 6x14x6 ins. above ground, marked H.I.R. 32 1/2 M. on NE. and P.L. on SW. faces, witnessed by a mound of stone, S. 40° E. of cor. The true course and distance of this half mile are therefore S. 40° E., 39.77 chs.

Land, mountainous.

Soil, rocky, 4th rate.

Timber, cedar and juniper.

Undergrowth, sagebrush and cactus, scrub oak, manzanita and mountain mahogany.

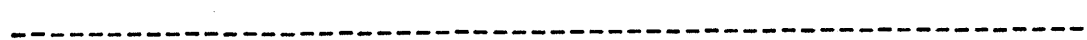

## 4 Completion of the survey of the North bdy. of T. 26 N., R. 14 W.

## Chains.

From the closing cor. of secs. 5 and 32, on the N. bdy. of T. 26 N., R. 14 W., which is an iron post, 2 ins. in diam., 12 ins. above ground, properly marked, witnessed by a mound of stone, W. of cor., and set 22.64 chs. East of the cor. of secs. 5, 6, 31 and 32, as established by S. Frank Walters, U.S. Transitman in July 1917, under Group 45.

East, on a random line, setting temp.  $\frac{1}{4}$  sec. and sec. cors. for the areas S. of line at intervals of 40.00 chs.; and at 376.94 chs., intersect the W. bdy. of T. 27 N., R. 13 W., 1.72 chs. North of the cor. of Ts. 26 and 27 N., Rs. 13 and 14 W., which is an iron post, 12 ins. above ground, properly marked, witnessed by four bearing trees.

As T. 26 N., R. 14 W. is to be subdivided from W. to E., and T. 27 N., R. 14 W. from E. to W., two sets of cors. are required on the N. bdy. of T. 26 N., R. 14 W.

I return to the closing cor. of secs. 5 and 32 on the N. bdy. of T. 26 N., R. 14 W. On the side of the post which refers to the land within the Reservation, I add the section numbers S32 and S5, and above the original date 1917, I add the year number 1921. I also efface the letters CC on the brass cap,

Thence,

East, on a true line, along the N. bdy. of sec. 5,

Over mountainous land, thru. dense timber and undergrowth. Ascend 55 ft.

16.94 (39.58 chs. East of the cor. of secs. 5, 6, 31 and 32) Set an iron post, 3 ft. long, 1 in. in diam., 26 ins. in the ground for  $\frac{1}{4}$  sec. cor., of sec. 32, T. 27 N., R. 14 W., marked on brass cap,

$\frac{1}{4}$ S 32

1921

from which,

A pinyon, 8 ins. in diam., brs. N. 20° E., 32 lks. dist., marked  $\frac{1}{4}$  S 32 BT.

A pinyon, 8 ins. in diam., brs. N. 32° W., 40 lks. dist., marked  $\frac{1}{4}$  S 32 BT.

17.36 (40.00 chs. E. of the cor. of secs. 5, 6, 31 and 32) Set an iron post, 3 ft. long, 1 in. in dia., 12 ins. in the ground, on bed rock, in a mound of stone, for  $\frac{1}{4}$  sec. cor., marked on brass cap,

$\frac{1}{4}$ S 5

1921

from which,

A pinyon, 8 ins. in diam., brs. S. 35° E., 35 lks. dist., marked  $\frac{1}{4}$  S 5 BT.

A pinyon, 6 ins. in diam., brs. South 22 lks. dist., marked  $\frac{1}{4}$  S 5 BT.

18.94 Descend 45 ft., over SE. slope.

24.34 Draw, 20 lks. wide, course NE.

Ascend NW. slope.

44.82 Spur, slopes N. Descend E. slope.

49.71 Draw, 20 lks. wide, course N. Asc. NW. slope.

56.94 (79.58 chs. East of the cor. of secs. 5, 6, 31 and 32), Set an iron post, 3 ft. long, 2 ins. in diam., 18 ins. in the ground, on solid rock, in a mound of stone, for cor. of secs. 32 and 33, T. 27 N., R. 14 W., marked on brass cap,

T27N | R14W  
S32 | S33

S 5

T26N | R14W

1921

from which,

Chains.

57.36 A juniper, 8 ins. in diam., brs. N. 30° E., 60 lks. dist., marked T27N R14W S33 BT.  
 A pinyon, 10 ins. in diam., brs. N. 1° W., 38 lks. dist., marked T27N R14W S32 BT.  
 (80.00 chs. East of the cor. of secs. 5, 6, 31 and 32)  
 Set an iron post, 3 ft. long, 2 ins. in diam., 24 ins. in the ground, for cor. of secs. 4 and 5, T. 26 N., R. 14 W., marked on brass cap,

T27N R14W  
S33  
 S 5 S 4  
 T26N R14W  
 1921

from which,  
 A juniper, 20 ins. in diam., brs. S. 87½° E., 110 lks. dist., marked T26N R14W S4 BT.  
 A juniper, 8 ins. in diam., brs. S. 85° W., 23 lks. dist., marked T26N R14W S5 BT.

Land, mountainous.  
 Soil, gravelly clay and loam, 4th rate.  
 Timber, juniper and pinyon.  
 Undergrowth, sage brush, quinine brush and scrub oak.

-----  
 East, on a true line, along the N. bdy. of sec. 4.  
 Over rolling and hilly land, thru. heavy timber and undergrowth.  
 Descend 120 ft., over SE. slope.  
 14.60 Ravine, 20 lks. wide, course NE. Thence along N. slope.  
 29.60 Ravine, 20 lks. wide, course SE. Thence along S. slope.  
 39.58 (40.00 chs. from the cor. of secs. 32 and 33, T. 27 N., R. 14 W.) Set an iron post, 3 ft. long, 1 in. in diam., 26 ins. in the ground, for ¼ sec. cor. of sec. 33, T. 27 N., R. 14 W., marked on brass cap,

¼ S 33  
 1921

from which,  
 A juniper, 10 ins. in diam., brs. N. 6° W., 28 lks. dist., marked ¼ S 33 BT.  
 A juniper, 14 ins. in diam., brs. N. 50° W., 22 lks. dist., marked ¼ S 33 BT.  
 40.00 Set an iron post, 3 ft. long, 1 in. in dia., 26 ins. in the ground, for ¼ sec. cor. of sec. 4, T. 26 N., R. 14 W., marked on brass cap,

¼ S 4  
 1921

from which,  
 A juniper, 6 ins. in diam., brs. S. 53° E., 130 lks. dist., marked ¼ S 4 BT.  
 A juniper, 8 ins. in diam., brs. S. 34° E., 105 lks. dist., marked ¼ S 4 BT.  
 79.58 Descend 30 ft., along S. slope.  
 (80.00 chs. from the cor. of secs. 32 and 33, T. 27 N., R. 14 W.) Set an iron post, 3 ft. long, 2 ins. in diam., 24 ins. in the ground, for cor. of secs. 33 and 34, T. 27 N., R. 14 W., marked on brass cap,

T27N R14W  
S33 S34  
 S 4  
 T26N R14W  
 1921

6 Completion of North bdy. of Township 26 North, Range 14 West.

Chains.

from which,

A juniper, 10 ins. diam., brs. N. 52° E., 219 lks.  
dist., marked T27N R14W S34 BT.

A juniper, 24 ins. in diam., brs. N. 30° E., 221 lks.  
dist., marked T27N R14W S34 BT.

A juniper, 10 ins. in diam., brs. N. 59° W., 133 lks.  
dist., marked T27N R14W S33 BT.

80.00 Set an iron post, 3 ft. long, 2 ins. in diam., 24 ins. in the ground, for cor. of secs. 3 and 4, T. 26 N. R. 14 W., marked on brass cap,

T27N R14W  
S34  
-----  
S 4 | S 3  
T26N R14W  
1921

from which,

A juniper, 4 ins. in diam., brs. S. 43° E., 66 lks.  
dist., marked BT.

A juniper, 14 ins. in diam., brs. S. 57° W., 93 lks.  
dist., marked T26N R14W S4 BT.

Land, rolling and hilly.

Soil, gravelly clay and loam, 4th rate.

Timber, juniper and pinyon.

Undergrowth, sagebrush, prickly ash and scrub oak.

-----  
East, on the N. bdy. of sec. 3.

Over rolling and hilly land, thru, heavy timber and undergrowth.

Descend 50 ft., over SE. slope.

9.60 Ravine, 20 lks. wide, course N. 70° E.

39.58 (40.00 chs. from the cor. of secs. 33 and 34, T. 27 N., R. 14 W.) Set an iron post 3 ft. long, 1 in. in diam., 12 ins. in the ground, in a mound of stone, for 1/4 sec. cor. of sec. 34, T. 27 N., R. 14 W., marked on brass cap,

1/4 S 34  
-----  
1921

from which,

A juniper, 12 ins. in diam., brs. N. 49 1/2° E., 69 lks. dist., marked 1/4 S 34 BT.

A juniper, 18 ins. in diam., brs. N. 10° W., 89 lks. dist., marked 1/4 S 34 BT.

40.00 Set an iron post, 3 ft. long, 1 in. in diam., 26 ins. in the ground, for 1/4 sec. cor. of sec. 3, T. 26 N., R. 14 W., marked on brass cap,

1/4 S 3  
-----  
1921

from which,

A juniper, 8 ins. in diam., brs. S. 40° E., 41 lks. dist., marked 1/4 S 3 BT.

A juniper, 20 ins. in diam., brs. S. 54° W., 30 lks. dist., marked 1/4 S 3 BT.

64.60 Head of draw, course NE.

79.58 (80.00 chs. from the cor. of secs. 33 and 34, T. 27 N., R. 14 W.)

Set an iron post, 3 ft. long, 2 ins. in diam., 24 ins. in the ground, for cor. of secs. 34 and 35, T. 27 N., R. 14 W., marked on brass cap,

T27N R14W  
S34 S35  
-----  
S 3  
T26N R14W  
1921



Completion of North bdy. of Township 26 North Range 14 West 7

Chains.

80.00 from which,  
 A juniper, 8 ins. in diam., brs.N. 18°E., 100 lks.dist., marked T27N R14W S35 BT.  
 A juniper, 18 ins.in diam., brs.N.32°W., 293 lks.dist., marked T27N R14W S34 BT.  
 Set an iron post 3 ft.long, 2 ins.in diam., 26 ins.in the ground, for cor. of secs. 2 and 3, T.26 N. R.14 W., marked on brass cap,

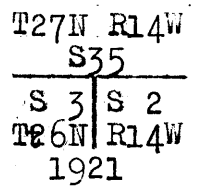

from which,  
 A juniper, 24 ins.in diam., brs.S.82°E., 188 lks.dist., marked T26N R14W S2 BT.  
 A juniper, 12 ins.in diam., brs.S.52°W., 117 lks.dist., marked T26N R14W S3 BT.  
 Land, rolling and hilly.  
 Soil, gravelly clay and loam, 4th rate.  
 Timber, juniper and pinyon.  
 Undergrowth, scrub oak, prickly ash and sagebrush.

-----  
 East, on a true line, along the N. bdy. of sec.2.  
 Over rolling and hilly land, thru. heavy timber and undergrowth.  
 Ascend 40 ft.  
 9.50 Small spur, slopes N.  
 Descend 30 ft.

39.58 (40.00 chs. East of the cor. of secs. 34 and 35, T.27 N., R.14 W.) Set an iron post, 3 ft.long, 1 in. in diam., 10 ins. in the ground in a mound of stone, for  $\frac{1}{4}$  sec. cor. of sec.35, R.27 N. R. 14 W., marked on brass cap,

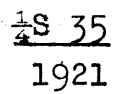

40.00 from which,  
 A juniper, 8 ins. in diam., brs.N. 35°W., 75 lks.dist., marked  $\frac{1}{4}$  S. 35 BT.  
 A pinyon, 20 ins. in diam., brs.N.11°W., 75 lks.dist., marked  $\frac{1}{4}$  S. 35 BT.  
 Set an iron post, 3 ft.long, 1 in. in diam., 10 ins. in the ground, in a mound of stone, for  $\frac{1}{4}$  sec.cor. of sec. 2, T.26 N., R.14 W., marked on brass cap,



79.58 from which,  
 A pinyon, 8 ins. in diam., brs.S.30°E., 89 lks.dist., marked  $\frac{1}{4}$  S 2 BT.  
 A pinyon, 8 ins.in diam., brs.S.46°E., 157 lks.dist., marked  $\frac{1}{4}$  S 2 BT.  
 (80.00 chs. East of the cor. of secs. 34 and 35, T.27 N. R. 14 W.,) Set an iron post, 3 ft.long, 2 ins. in diam., on solid rock, in a mound of stone, for cor. of secs. 35 and 36, T.27 W. R. 14 W., marked on brass cap,

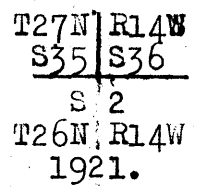

from which,

8 Completion of North bdy. of Township 26 North Range 14 West

Chains.

80.00 Set an iron post, 3 ft. long, 2 ins. in diam., 20 ins. in the ground, in a mound of stone, for cor. of secs. 1 and 2, T. 26 N., R. 14 W., marked on brass cap,  

$$\begin{array}{r} T27N \ R14W \\ \hline S36 \\ \hline S \ 2 \ | \ S \ 1 \\ T26N \ | \ R14W \\ \hline 1921 \end{array}$$

from which,  
 A pinyon, 7 ins. in diam., brs. S. 32° E., 68 lks.  
 dist., marked T26N R14W S1 BT.  
 A juniper, 30 ins. in diam., brs. S. 60° W., 39 lks.  
 dist., marked T26N R14W S2 BT.

Land, rolling and hilly.  
 Soil, gravelly clay and loam, 4th rate.  
 Timber, juniper and pinyon.  
 Undergrowth, sage brush, prickly ash and scrub oak.

25.00 East, on a true line, along the N. bdy. of sec. 1.  
 Over mountainous land, thru. heavy timber and undergrowth.  
 Ascend 80 ft. over W. slope.  
 Spur, slopes NE.  
 Descend 60 ft.

39.58 (40.00 chs. East of the cor. of secs. 35 and 36, T. 27 N., R. 14 W.) Set an iron post, 3 ft. long, 1 in. in diam., 10 ins. in the ground, on solid rock, in a mound of stone for  $\frac{1}{4}$  sec. cor. of sec. 36, T. 27 N., R. 14 W., marked on brass cap,

$$\begin{array}{r} \frac{1}{4} S \ 36 \\ \hline 1921 \end{array}$$

from which,  
 A juniper, 16 ins. in diam., brs. N. 4° E., 92 lks. dist., marked  $\frac{1}{4}$  S. 36 BT.  
 A juniper, 6 ins. in diam., brs. N. 18° W., 73 lks. dist., marked  $\frac{1}{4}$  S. 36 BT.

40.00 Set an iron post, 3 ft. long, 1 in. in diam., 20 ins. in the ground, in a mound of stone, for  $\frac{1}{4}$  sec. cor. of sec. 1, T. 26 N., R. 14 W., marked on brass cap,

$$\begin{array}{r} \frac{1}{4} S \ 1 \\ \hline 1921 \end{array}$$

from which,  
 A juniper, 6 ins. in diam., brs. S. 9° W., 77 lks. dist., marked  $\frac{1}{4}$  S 1 BT.  
 A juniper, 6 ins. in diam., brs. S. 53° W., 67 lks. dist., marked  $\frac{1}{4}$  S 1 BT.

79.58 Intersect the W. bdy. of T. 27 N., R. 13 W., 1.72 chs. N. of the cor. of Ts. 26 and 27 N., Rs. 13 and 14 W., hereinbefore described.

At the point of intersection,  
 Set an iron post, 3 ft. long, 3 ins. in diam., 26 ins. in the ground, for cor. of Ts. 26 and 27 N., R. 14 W., marked on brass cap,

$$\begin{array}{r} T27N \\ R14W \\ \hline S36 \\ \hline S \ 1 \ | \ S31 \\ T26N \\ \hline 1921 \end{array}$$

Completion of North bdy of Township 26 North Range 14 West 9

Chains.

from which,  
 A juniper, 20 ins. in diam., brs. S. 35 $\frac{1}{4}$ ° W., 257  
 lks. dist., marked T26N R14W S1 BT.  
 A juniper, 26 ins. in diam., brs. N. 54 $\frac{1}{4}$ ° W., 160  
 lks. dist., marked T27N R14W S36 BT.  
 I alter the markings on the post set under Group 109  
 for the cor. of Ts. 26 and 27 N., Rs. 13 and 14 W. to refer  
 to R. 13 W. only, and destroy the markings on the bearing  
 trees W. of line.  
 Land, mountainous.  
 Soil, gravelly clay and loam, 2nd and 3rd rate.  
 Timber, juniper and pinyon.  
 Undergrowth, sage brush and scrub oak.

-----  
 Boundaries of T. 26 N., R. 14 W., within the Hualpai  
 Indian Reservation.  
 -----

Latitudes, departures and closing errors.

Line designated.	True bearing.	Dist.	Latitudes.		Departures.	
			N.	S.	E.	W.
Hualpai Indian Reservation Bdy.	N. 40° W.	110.11	84.35			70.78
	N. 39° 39' W.	39.75	30.61			25.36
	N. 40° 17' W.	40.02	30.53			25.88
	N. 40° W.	40.00	30.64			25.71
	N. 39° 41' W.	39.56	30.44			25.26
	N. 40° W.	239.66	183.59			154.05
	N. 40° 14' W.	39.80	30.38			25.71
	N. 40° 07' W.	36.69	28.06			23.64
North boundary,	East,	376.94			376.94	
East boundary,	South,	448.65		448.65		
Convergency,					.19	
Totals,			448.60	448.65	377.13	376.39
				448.60	376.39	
Error in latitude,				.05		
Error in departure,					.74	

## 10. Completion of the survey of Subdivision lines of T.26 N., R.14 W.

Chains.

The subdivision of that part of T.26 N., R.14 W. lying south of the Hualpai Indian Reservation was executed in June and July 1917, under Group 45 by S. Frank Walters and James C. Hopper, U.S. Transitmen, who also surveyed the east boundary of said township to an intersection with the boundary of the Hualpai Indian Reservation. The completion of the east boundary was surveyed under current Group 109.

The closing cor. of secs. 4 and 5, on the Hualpai Indian Reservation boundary is an iron post, 2 ins. in diam., set in a mound of stone, properly marked, witnessed by two bearing trees and established 13.35 chs. N.0°2' W. of the cor. of secs. 4, 5, 8 and 9. On that part of the brass cap referring to the areas lying within the Hualpai Indian Reservation, I add the section numbers S4 and S5, and above the original date 1917, I add the year number 1921. I also efface the letters C on the brass cap, and on the bearing trees.

Thence,  
N.0°2'W., on a random line, bet. secs. 4 and 5.  
26.65 (40.00 chs. N.0°2'W. of the cor. of secs. 4, 5, 8 and 9).  
Set temp.  $\frac{1}{4}$  sec. cor.  
67.60 (80.95 chs. N.0°2'W. of the cor. of secs. 4, 5, 8 and 9) Fall  
16 lks. W. of the cor. of secs. 4 and 5, on the N. bdy. of  
the Tp., hereinbefore described.

Thence,  
S.0°6'W., on a true line, bet. secs. 4 and 5.  
Over rolling, mountainous land thru. heavy timber and  
undergrowth.  
Descend 70 ft.  
15.95 Draw, 10 lks. wide, course E.  
Ascend 95 ft.  
40.95 Set an iron post 3 ft. long, 1 in. in diam., 26 ins. in  
the ground, for  $\frac{1}{4}$  sec. cor., marked on brass cap,

S 5 | S 4  
1921

and raise a mound of stone, 2 ft. base, 1½ ft. high, W. of  
cor.  
Continue ascent 190 ft.  
43.55 Long ridge, brs. N.60°W. and S.60°E.  
Descend 165 ft.  
67.60 The closing cor. of secs. 4 and 5.  
Land, rolling, mountainous.  
Soil, rocky red clay and loam, 4th rate.  
Timber, juniper and pinyon.  
Undergrowth, quinine brush, scrub oak, prickly ash, manzanita and cactus.

-----  
The closing cor. of secs. 15 and 16, on the Hualpai Indian Reservation boundary is an iron post, 2 ins. in diam., set in a mound of stone, properly marked witnessed by two bearing trees and established 77.75 chs. N.0°1' W. of the cor. of secs. 15, 16, 21 and 22. On that part of the brass cap referring to the areas lying within the Hualpai Indian Reservation, I add the section numbers S15 and S16, and above the original date 1917 I add the year number 1921. I also efface the letters CC on the brass cap and on the bearing trees.

Thence,  
N.0°1'W. bet. secs. 15 and 16.  
Over mountainous land, thru. scattering timber and

Completion of Subdivision lines of T.26 N., R. 14 W. 11

Chains.

2.33 undergrowth.  
 (80.08 chs. N.0°1'W. of the cor. of secs. 15, 16, 21 and 22)  
 At a point due East of the closing cor. of secs. 9 and 16,  
 set an iron post 3 ft. long, 2 ins. in diam., 24 ins. in  
 the ground for cor. of secs. 9, 10, 15 and 16, marked on  
 brass cap,

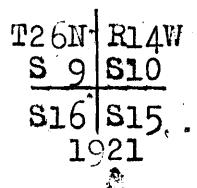

from which,  
 A juniper, 8 ins. in diam., brs. N.22°E., 127 lks.  
 dist., marked T26N R14W S10 BT.  
 A pinyon, 4 ins. in diam., brs. S.7½°E., 95 lks.  
 dist., marked BT.  
 A pinyon, 6 ins. in diam., brs. S.50½°W., 28 lks.  
 dist., marked T26N R14W S16 BT.  
 A juniper, 4 ins. in diam., brs. N.85½°W., 21 lks.  
 dist., marked BT.

Land, mountainous.  
 Soil, rocky, 4th rate.  
 Timber, pinyon and juniper.  
 Undergrowth, scrub oak and manzanita.

The closing cor. of secs. 9 and 16 on the Hualpai Indian  
 Reservation Boundary is an iron post, 2 ins. in diam.,  
 12 ins. above ground, properly marked, witnessed by two  
 bearing trees and established 78.34 chs. East of the  
 cor. of secs. 8, 9, 16 and 17. On that part of the brass  
 cap referring to the areas lying within the Hualpai  
 Indian Reservation, I add the section numbers S9 and  
 S16, and above the original date 1917 I add the year  
 number 1921. I also efface the letters CC on the  
 brass cap and on the bearing trees.

Thence,  
 East, on a true line, bet. secs. 9 and 16.  
 Over mountainous land, thru. scattering timber and under-  
 growth.

1.97 (80.31 chs. East of the cor. of secs. 8, 9, 16 and 17) The  
 cor. of secs. 9, 10, 15 and 16.

Land, mountainous..  
 Soil, rocky, 4th rate.  
 Timber, juniper and pine.  
 Undergrowth, quinine brush, scrub oak, prickly ash, manzanita  
 and cactus.

From the cor. of secs. 9, 10, 15 and 16,  
 N.0°1'W., bet. secs. 9 and 10.  
 Over rolling land, thru. heavy timber and scattering under-  
 growth.

8.00 Ascend 20 ft.  
 Low spur, slopes N.60°E.  
 Descend.  
 13.00 Draw 2 chs. wide, course NE.  
 16.00 Old road brs. N.60°E. to Meriwhitica Canyon, and S.60°W. to  
 Hackberry.  
 27.65 Four wire fence, brs. N.80°E. and S.80°W.  
 40.00 Set an iron post, 3 ft. long, 1 in. in diam., 26 ins. in  
 the ground, for ¼ sec. cor., marked on brass cap,

12 Completion of Subdivision lines of T. 26 N. R. 14 W

Chains.

S 9 1/4 S10  
1921

from which,

A juniper, 12 ins. in diam., brs. N. 13° E.,  
49 lks. dist., marked 1/4 S 10 BT.

A juniper, 14 ins. in diam., brs. S. 73 1/4° W., 82  
lks. dist., marked 1/4 S 9 BT.

Ascend 30 ft.

45.00 Descend 50 ft.

56.06 Ravine, 35 lks. wide, course S. 20° E.

Ascend 185 ft.

80.00 Set an iron post, 3 ft. long, 2 ins. in diam., 12 ins. in  
the ground, in a mound of stone, for cor. of secs., 3, 4,  
9 and 10, marked on brass cap.

T26N | R14W  
S 4 | S 3  
S 9 | S10  
1921

from which,

A juniper, 14 ins. in diam., brs. N. 77 1/4° E.,  
144 lks. dist., marked T26N R14W S3 BT.

A juniper, 14 ins. in diam., brs. S. 59 1/2° E., 311  
lks. dist., marked T26N R14W S10 BT.

A pinyon, 12 ins. in diam., brs. S. 84 1/4° W., 112  
lks. dist., marked T26N R14W S9 BT.

A juniper, 20 ins. in diam., brs. N. 87° W., 45  
lks. dist., marked T26N R14 W S4 BT.

Land, rolling.

Soil, sandy red loam, 2nd and 3rd rate.

Timber, juniper and pinyon.

Undergrowth, quinine brush, ash and scrub oak.

Fair grass.

-----  
The closing cor. of secs. 4 and 9, on the Hualpai Indian  
Reservation Boundary is an iron post, 2 ins. in diam.,  
set in a mound of stone, properly marked, witnessed  
by two bearing trees and established 11.20 chs. East  
of the cor. of secs. 4, 5, 8 and 9. On that part of the  
brass cap referring to the areas lying within the  
Hualpai Indian Reservation, I add the section numbers  
S4 and S9, and above the original date 1917 I add the  
year number 1921. I also efface the letters CC on  
the brass cap and on the bearing trees.

Thence,

28.80 East, on a random line, bet. secs. 4 and 9.  
(40.00 chs. East of the cor. of secs. 4, 5, 8 and 9) Set temp.  
1/4 sec. cor.

68.82 (80.02 chs. East of the cor. of secs. 4, 5, 8 and 9) Intersect  
N. and S. line, 18 lks. S. of the cor. of secs. 3, 4, 9  
and 10.

I return to the closing cor. of secs. 4 and 9.

Thence,

East, on a true line, bet. secs. 4 and 9.

Over level land, thru. heavy timber and scattering under-  
growth.

28.81 (40.01 chs. East of the cor. of secs. 4, 5, 8 and 9),  
Set an iron post, 3 ft. long, 1 in. in diam., 26 ins. in  
the ground for 1/4 sec. cor., marked on brass cap,

1/4 S 4  
S 9  
1921

Completion of Subdivision lines of T. 26 N., R. 14 W. 13

Chains.

and raise a mound of stone, 2 ft. base, 1 1/2 ft. high, N. of cor.

Thence, N. 89° 45' E., on a true line, bet. secs. 4 and 9, continuing measurement.

47.20 Leave level land, brs. NW. and SE. Ascend 170 ft.

68.82 The cor. of secs. 3, 4, 9 and 10. Land, level and rolling. Soil, gravelly clay and loam, 2nd rate. Timber, pinyon and juniper. Undergrowth, quinine brush, scrub oak and prickly ash.

N. 0° 6' E., on a random line, bet. secs. 3 and 4. Set temp. 1/4 sec. cor.

40.00 80.54 Fall 35 lks. E. of the cor. of secs. 3 and 4, on the N. bdy. of the Tp., hereinbefore described.

Thence, S. 0° 9' E., on a true line, bet. secs. 3 and 4. Over rolling land, thru. heavy timber and scattering undergrowth.

11.27 Descend 30 ft. Ravine, 12 lks. wide, course NE. Ascend 55 ft.

20.55 Thence over level land. Ravine, 20 lks. wide, course NE.

38.75 40.54 Set an iron post, 3 ft. long, 1 in. in diam., 14 ins. in the ground, on bed rock, in a mound of stone, for 1/4 sec. cor., marked on brass cap,

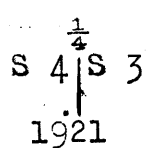

from which, A juniper, 10 ins. in diam., brs. N. 60° E., 28 lks. dist., marked 1/4 S 3 BT. A juniper, 24 ins. in diam., brs. S. 33° W., 38 lks. dist., marked 1/4 S 4 BT.

Leave level, and enter mountainous land, bearing NE and SW.

76.55 Ascend 420 ft. Spur, slopes E. Descend 65 ft.

80.54 The cor. of secs. 3, 4, 9 and 10. Land, level, rolling and mountainous. Soil, gravelly and rocky, 2nd and 4th rate. Timber, juniper and pinyon. Undergrowth, quinine brush, scrub oak, prickly ash and cactus. Fair grass.

The closing cor. of secs. 22 and 23, on the Hualpai Indian Reservation Boundary, is an iron post, 2 ins. in diam., set in a mound of stone, properly marked, witnessed by two bearing trees, and established 62.67 chs. North of the cor. of secs. 22, 23, 26 and 27. On that part of the brass cap referring to the areas lying within the Hualpai Indian Reservation, I add the section numbers S22 and S23, and above the original date 1917 I add the year number 1921. I also efface the letters CC on the brass cap, and on the bearing trees.

Thence,

## 14 Completion of Subdivision lines of T1 26 N., R. 14 W.

Chains.

North, bet. secs. 22 and 23.  
Over mountainous land, thru. heavy timber and scattering undergrowth.

14.35 Ascend 145 ft.  
Spur, slopes NE.

17.55 Descend 15 ft.  
(80.22 chs. North of the cor. of secs. 22, 23, 26 and 27)  
At a point due East of the closing cor. of secs. 15 and 22,  
Set an iron post, 3 ft. long, 2 ins. in diam., 24 ins. in  
the ground, for cor. of secs. 14, 15, 22 and 23, marked  
on brass cap

T26N	R14W
S15	S14
S22	S23

1921

from which,

A pinyon, 6 ins. in diam., brs. N. 39° E., 71  
lks. dist., marked T26N R14W S14 BT.

A pinyon, 6 ins. in diam., brs. S. 87° E., 34  
lks. dist., marked T26N R14W S23 BT.

A pinyon, 12 ins. in diam., brs. S. 80° W., 74 lks.  
dist., marked T26N R14W S22 BT.

A pinyon, 6 ins. in diam., brs. N. 66° W., 29 lks.  
dist., marked T26N R14W S15 BT.

Land, mountainous.

Soil, gravelly and rocky, 4th rate.

Timber, juniper and pinyon.

Undergrowth, manzanita and scrub oak.

The closing cor. of secs. 15 and 22, on the Hualpai Indian  
Reservation Boundary is an iron post, 2 ins. in diam.,  
set in a mound of stone, properly marked, witnessed by  
two bearing trees and established 65.54 chs. East of  
the cor. of secs. 15, 16, 21 and 22. On that part of the  
brass cap referring to the areas lying within the  
Hualpai Indian Reservation, I add the section numbers  
S15 and S22, and above the original date 1917 I add  
the year number 1921. I also efface the letters CC  
on the brass cap, and on the bearing trees.

Thence,

East, on a true line, bet. secs. 15 and 22.

Over mountainous land, thru. heavy timber and scattering  
undergrowth.

14.46 (80.00 chs. East of the cor. of secs. 15, 16, 21 and 22) The  
cor. of secs. 14, 15, 22 and 23.

Land, mountainous.

Soil, rocky, 4th rate.

Timber, juniper and pinyon.

Undergrowth, manzanita.

North, bet. secs. 14 and 15.

Over mountainous land, thru. heavy timber and scattering  
undergrowth.

Descend 465 ft., over NW. slope.

40.00 Set an iron post, 3 ft. long, 1 in. in diam., 26 ins. in  
the ground for  $\frac{1}{4}$  sec. cor., marked on brass cap,

S15	S14
-----	-----

1921



Completion of Subdivision lines of T. 26 N. R. 14 W. 15

Chains.

from which,  
 A pinyon, 12 ins. in diam., brs.S.29°E., 12 lks.dist., marked  $\frac{1}{4}$  S 14 BT.  
 A pinyon, 14 ins. in diam., brs.S.51 $\frac{1}{2}$ °W., 32 lks.dist., marked  $\frac{1}{4}$  S 15 BT.

Continue descent 140 ft.  
 64.00 Ravine, 30 lks.wide, course N.80°E. Thence over rolling land.  
 80.00 Set an iron post, 3 ft.long, 2 ins. in diam., 24 ins.in the ground, for cor.of secs.10,11,14 and 15, marked on brass cap,

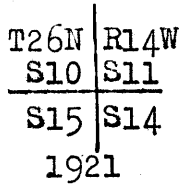

from which,  
 A juniper, 8 ins. in diam., brs.N.44°E., 25 lks.dist., marked T26N R14W S11 BT.  
 A juniper, 12 ins. in diam., brs.S.45°E., 154 lks.dist., marked T26N R14W S14 BT.  
 A juniper, 20 ins. in diam., brs.S.48°W., 133 lks.dist., marked T26N R14W S15 BT.  
 A juniper, 24 ins. in diam., brs.N.63°W., 44 lks. dist., marked T26N R14W S10 BT.

Land, mountainous and rolling.  
 Soil, gravelly, clay and loam, rocky, 4th rate.  
 Timber, pinyon and juniper.  
 Undergrowth, scrub oak and prickly ash.  
 Fair grazing.

40.00 West, on a random line, bet. secs. 10 and 15.  
 79.92 Set temp.  $\frac{1}{4}$  sec.cor.  
 Intersect N. and S. line, 9 lks.N.of the cor.of secs.9, 10,15 and 16.

Thence,  
 N.89°56'E., on a true line, bet. secs.10 and 15.  
 Over rolling land, thru. scattering undergrowth and heavy timber.  
 39.96 Set an iron post, 3 ft.long, 1 in. in diam., 10 ins.in the ground, on bed rock, in a mound of stone, for  $\frac{1}{4}$  sec.cor., marked on brass cap,

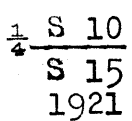

from which,  
 A juniper, 7 ins.in diam., brs.North 66 lks. dist., marked  $\frac{1}{4}$  S 10 BT.  
 A juniper, 10 ins.in diam., brs.S.14 $\frac{1}{2}$ °E., 84 lks. dist., marked  $\frac{1}{4}$  S 15 BT.

79.92 The cor.of secs. 10,11,14 and 15.  
 Land, rolling.  
 Soil, gravelly clay and loam, 2nd rate.  
 Timber, juniper and pinyon.  
 Undergrowth, scrub oak, prickly ash, sagebrush and quinine brush.

North, bet. secs. 10 and 11.  
 Over slightly rolling land, thru. heavy timber and scattering undergrowth.

Completion of

16 Subdivision lines of Township 26 North, Range 14 West.

Chains.

0.50 Ravine, 40 lks.wide, course E.  
 15.00 Enter level land, brs.E.and W.  
 17.00 Small ravine, course E.  
 23.00 Leave level land, brs.E. and W. Thence over slightly rolling land.  
 40.00 Set an iron post, 3 ft.long, 1 in.in diam.,12 ins.in the ground, in a mound of stone, for  $\frac{1}{4}$  sec.cor., marked on brass cap,

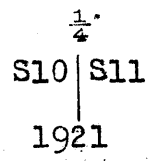

from which,  
 A juniper, 18 ins.in diam., brs.N.32°E.,43 lks.dist., marked  $\frac{1}{4}$  S 11 BT.  
 A juniper, 16 ins. in diam., brs.N.88°W.,37 lks.dist., marked  $\frac{1}{4}$  S 10 BT.

45.50 Ravine, 20 lks.wide, course NE.  
 48.50 Road brs.NE. to Meriwhitica Canyon and SW. to Hackberry.  
 51.00 Four wire fence, brs.NW. and SE.  
 80.00 Set an iron post, 3 ft.long, 2 ins.in diam., 26 ins.in the ground, for cor.of secs.2,3,10 and 11, marked on brass cap,

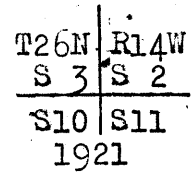

from which,  
 A juniper, 12 ins.in diam., brs.N.7 $\frac{1}{2}$ °E.,152 lks.dist., marked T26N R14W S2 BT.  
 A juniper, 24 ins.in diam., brs.S.6°E.,102 lks.dist., marked T26N R14W S11 BT.  
 A juniper,24 ins.in diam., brs.S.74 $\frac{1}{2}$ °W.,75 lks.dist., marked T26N R14W S10 BT.  
 A juniper,12 ins.in diam., brs.N.41 $\frac{1}{2}$ °W.,200 lks.dist., marked T26N R14W S3 BT.

Land, slightly rolling and level.  
 Soil, sandy and gravelly loam, 2nd rate.  
 Timber, juniper and pinyon.  
 Undergrowth, quinine brush, prickly ash, scrub oak, and cactus.

40.00 S.89°56'W., on a random line, bet. secs.3 and 10. Set temp. $\frac{1}{4}$  sec.cor.  
 80.00 Intersect N.and S. line, 30 lks. S. of the cor.of secs. 3,4,9 and 10.  
 Thence,  
 S.89°51'E., on a true line bet. secs.3 and 10.  
 Over rolling land, thru. heavy timber and scattering undergrowth.  
 Ascend 20 ft.  
 2.70 Descend 125 ft.  
 14.51 Ascend 65 ft.  
 35.65 Spur, slopes SE.  
 Descend 55 ft.  
 40.00 Set an iron post, 3 ft.long, 1 in.in diam., 24 ins.in the ground, for  $\frac{1}{4}$  sec.cor., marked on brass cap,

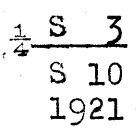

Completion of Subdivision lines of T.26 N. R. 14 W. 17

Chains.

from which,

- A juniper, 12 ins. in diam., brs. N. 72° W., 168 lks. dist., marked  $\frac{1}{4}$  S 3 BT.
- A juniper, 14 ins. in diam., brs. S. 20 $\frac{1}{2}$ ° E., 70 lks. dist., marked  $\frac{1}{4}$  S 10 BT.

Continue descent, 155 ft.  
 54.60 Leave mountainous land, brs. NW. and SE. Thence over level land.  
 80.00 The cor. of secs. 2, 3, 10 and 11.  
 Land, level, rolling and mountainous.  
 Soil, gravelly and sandy loam, 2nd rate.  
 Timber, juniper and pinyon.  
 Undergrowth, quinine brush, scrub oak and prickly ash.

40.00 N. 0° 8' W., on a random line, bet. secs. 2 and 3.  
 Set temp.  $\frac{1}{4}$  sec. cor.  
 80.41 Fall 24 lks. W. of the cor. of secs. 2 and 3, on the N. bdy. of the Tp., hereinbefore described.  
 Thence, S. 0° 2' W., on a true line, bet. secs. 2 and 3.  
 Over rolling and mountainous land, thru. heavy timbers and undergrowth.  
 Ascend 305 ft.  
 40.41 Set an iron post, 3 ft. long, 1 in. in diam., 12 ins. in the ground, on bed rock, in a mound of stone, for  $\frac{1}{4}$  sec. cor., marked on brass cap.

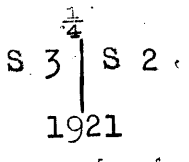

from which,

- A juniper, 8 ins. in diam., brs. S. 45° E., 77 lks. dist., marked  $\frac{1}{4}$  S 2 BT.
- A pinyon, 10 ins. in diam., brs. N. 87° W., 97 lks. dist., marked  $\frac{1}{4}$  S 3 BT.

40.90 Spur, slopes E.  
 Descend 170 ft.  
 70.40 Ravine, course E. Thence over level land.  
 80.41 The cor. of secs. 2, 3, 10 and 11.  
 Land, level, rolling and mountainous.  
 Soil, rocky clay, 2nd and 4th rate.  
 Timber, juniper and pinyon.  
 Undergrowth, quinine brush, scrub oak, prickly ash and cactus.  
 Fair grazing.

The closing cor. of secs. 25 and 36, on the Hualpai Indian Reservation Boundary is an iron post, 2 ins. in diam., set in a mound of stone, properly marked, witnessed by two bearing trees and established 39.81 chs. East of the cor. of secs. 25, 26, 35 and 36. On that part of the brass cap referring to the areas lying within the Hualpai Indian Reservation, I add the section numbers S25 and S36, and above the original date 1917 I add the year number 1921. I also efface the letters CC on the brass cap. and on the bearing trees.

0.19 Thence, East, on a random line, bet. secs. 25 and 36.  
 (40.00 chs. East of the cor. of secs. 25, 26, 35 and 36)  
 Set temp.  $\frac{1}{4}$  sec. cor.

15  
 13  
 1  
 32

## 18 Completion of Subdivision lines of T 26 N R 4 W

Chains.

- 39.66 (79.47 chs. East of the cor. of secs. 25, 26, 35 and 36) Fall  
09 lks. N. of the cor. of secs. 25, 30, 31 and 36 on  
the E. bdy. of Tp., which is an iron post, 2 ins. in  
diam.; set in a mound of stone, properly marked, wit-  
nessed by four bearing trees, as described in the field  
notes of current Group 109.  
I return to the closing cor. of secs. 25 and 36.  
Thence,  
East on a true line, bet. secs. 25 and 36.
- 0.19 (40.00 chs. East of the cor. of secs. 25, 26, 35 and 36),  
Set an iron post, 3 ft. long, 1 in. in diam., 26 ins. in  
the ground, for  $\frac{1}{4}$  sec. cor., marked on brass cap,
- $\frac{1}{4}$  S 25  
S 36  
1921
- from which,  
A juniper, 8 ins. in diam., brs. N. 65° E., 12  
lks. dist., marked  $\frac{1}{4}$  S 25 BT.  
A juniper, 24 ins. in diam., brs. S. 72° W., 226  
lks. dist., marked  $\frac{1}{4}$  S 36 BT.
- Thence,  
S. 89° 52' E., on a true line, bet. secs. 25 and 36, continuing  
measurement.  
Over rolling land, thru. heavy timber and scattering  
undergrowth.  
Descend 55 ft.
- 0.34 Fence brs. N. 40° W. and S. 40° E.  
4.00 Draw, 20 lks. wide, course NE.  
Ascend 30 ft.
- 10.89 Descend 25 ft.  
28.69 Ascend 25 ft. to cor. of secs. 25, 30, 31 and 36.  
39.66 The cor. of secs. 25, 30, 31 and 36.  
Land, rolling.  
Soil, gravelly clay, 4th rate.  
Timber, juniper and pinyon.  
Undergrowth, sage brush, scrub oak and prickly ash.
- 
- The closing cor. of secs. 25 and 26, on the Hualpai Indian  
Reservation Boundary is an iron post 2 ins. in diam.,  
set in a mound of stone, properly marked, witnessed by  
two bearing trees and established 47.36 chs. North of  
the cor. of secs. 25, 26, 35 and 36. On that part of  
the brass cap referring to the areas lying within the  
Hualpai Indian Reservation, I add the section numbers  
S25 and S26, and above the original date 1917 I add  
the year number 1921. I also efface the letters CC  
on the brass cap, and on the bearing trees.
- Thence,  
North, bet. secs. 25 and 26.  
Over mountainous land, thru. heavy timber and undergrowth.  
Ascend 125 ft.
- 0.60 Wire fence brs. N. 40° W. and S. 40° E.  
11.24 Spur, slopes SE.  
Descend 145 ft.
- 26.64 Wash, 20 lks. wide, course E.  
Ascend 25 ft.
- 32.75 (80.11 chs. North of the cor. of secs. 25, 26, 35 and 36),  
At a point due East of the closing cor. of secs. 23 and 26,  
hereinafter described, set an iron post, 3 ft. long, 2  
ins. in diam., 14 ins. in the ground, in a mound of  
stone, for cor. of secs. 23, 24, 25 and 26, marked on  
brass cap,

Completion of Subdivision lines of T. 26 N., R. 14 W. 19

Chains.

T26N	R14W
S23	S24
S26	S25

1921

- from which,
- A cedar, 10 ins. in diam., brs. N.  $87\frac{1}{4}^{\circ}$  E., 184 lks. dist., marked T26N R14W S24 BT.
- A cedar, 6 ins. in diam., brs. S.  $25\frac{1}{4}^{\circ}$  E., 68 lks. dist., marked T26N R14W S25 BT.
- A cedar, 8 ins. in diam., brs. S.  $40\frac{1}{4}^{\circ}$  W., 47 lks. dist., marked T26N R14W S26 BT.
- A cedar, 6 ins. in diam., brs. N.  $36^{\circ}$  W., 32 lks. dist., marked T26N R14W S23 BT.

Land, mountainous.  
 Soil, gravelly clay, 4th rate.  
 Timber, juniper and pinyon.  
 Undergrowth, scrub oak and prickly ash.  
 Fair grazing.

The closing cor. of secs. 23 and 26, on the Hualpai Indian Reservation Boundary is an iron post, 2 ins. in diam., set in a mound of stone, properly marked, witnessed by two bearing trees, and established 52.98 chs. East of the cor. of secs. 22, 23, 26 and 27. On that part of the brass cap referring to the areas lying within the Hualpai Indian Reservation, I add the section numbers S23 and ~~S26~~, and above the original date 1917 I add the year number 1921. I also efface the letters CC on the brass cap, and on the bearing trees.

Thence,  
 East, on a true line, bet. secs. 23 and 26, eastward.  
 Over slightly rolling land, thru. heavy timber and undergrowth.

- 0.61 Descend 80 ft.
- 12.94 Wire fence brs. N.  $40^{\circ}$  W. and S.  $40^{\circ}$  E.
- 15.47 Road brs. N. to Meriwhitica Canyon and S. to Hackberry.
- 21.47 Ascend 40 ft.
- 27.22 Descend 10 ft.
- (80.20 chs. East of the cor. of secs. 22, 23, 26 and 27),
- The cor. of secs. 23, 24, 25 and 26.
- Land, rolling.
- Soil, gravelly clay, 4th rate.
- Timber, juniper and pinyon.
- Undergrowth, scrub oak and prickly ash.

- 40.00 S.  $89^{\circ}56'$  E., on a random line, bet. secs. 24 and 25.
- 79.19 Set temp.  $\frac{1}{4}$  sec. cor.
- Fall 37 lks. N. of the cor. of secs. 19, 24, 25 and 30, on the E. bdy. of the Tp., which is an iron post, 2 ins. in diam., set in a mound of stone, properly marked, witnessed by four bearing trees.

Thence,  
 N.  $89^{\circ}40'$  W., on a true line, bet. secs. 24 and 25.  
 Over mountainous land, thru. heavy timber and scattering undergrowth.

- 0.30 Ascend.
- Ridge, brs. N. and S.
- 0.81 Descend 190 ft.
- 14.60 Wire fence, brs. NW. and SE.
- 17.20 Wire fence, brs. NE. and SW.
- Ravine, course N. from S.  $30^{\circ}$  W. Thence over rolling land.

20 Completion of Subdivision lines of T.26 N. R. 14 W.

Chains.

27.10 From this point, head of spring brs.S.1 ch. dist.  
 32.20 Road, brs.N.and S.  
 34.70 Indian house brs.North 0.40 chs.dist.  
 37.20 Ravine, 20 lks.wide, course SE.  
 39.19 Set an iron post, 3 ft.long, 1 in. in diam., 26 ins.in  
 the ground, for  $\frac{1}{4}$  sec.cor., marked on brass cap,

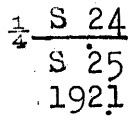

from which,  
 A pinyon, 6 ins.in diam., brs.N.34 $\frac{3}{4}$ °E., 22  
 lks.dist., marked  $\frac{1}{4}$  S 24 BT.  
 A cedar, 14 ins. in diam., brs.S. 17 $\frac{1}{4}$ ° E., 23  
 lks.dist., marked  $\frac{1}{4}$  S 25 BT.

41.15 Ravine, 20 lks.wide, course N.60°E. from W.  
 Ascend 60 ft.in ravine.  
 55.20 Leave ravine, course E. from N.60°W.  
 Ascend 140 ft.  
 58.20 Ravine, 20 lks.wide, course NE. Continue ascent.  
 79.19 The cor.of secs. 23, 24, 25 and 26.  
 Land, rolling and mountainous.  
 Soil, gravelly clay, 4th rate.  
 Timber, juniper and pinyon.  
 Undergrowth, scrub oak and prickly ash.

-----  
 North, bet. secs. 23 and 24.  
 Over mountainous and rolling land, thru. scattering un-  
 dergrowth and heavy timber.

Ascend 80 ft.  
 8.19 Spur, slopes NW.  
 Descend 65 ft.  
 14.00 Ravine, 10 lks.wide, course E.  
 16.00 Road brs. E. to Meriwhitica Canyon and W. to Hackberry.  
 26.60 Descend 20 ft.  
 28.37 Ascend 50 ft.  
 40.00 Set an iron post, 3 ft.long, 1 in. in diam., 26 ins. in  
 the ground, for  $\frac{1}{4}$  sec.cor., marked on brass cap,

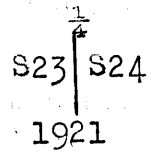

from which,  
 A pinyon, 14 ins. in diam., brs.N.87 $\frac{1}{4}$ °E., 30  
 lks.dist., marked  $\frac{1}{4}$  S 24 BT.  
 A cedar, 10 ins. in diam., brs.S.88 $\frac{1}{2}$ °W., 32  
 lks.dist., marked  $\frac{1}{4}$  S 23 BT.

Descend 50 ft.  
 46.96 Ravine, 15 lks.wide, course E.  
 Ascend 45 ft.  
 57.36 Descend 80 ft.  
 62.25 Ravine, 15 lks.wide, course E.  
 Ascend 45 ft.  
 65.86 Descend 65 ft.  
 80.00 Set an iron post, 3 ft.long, 2 ins. in diam., 24 ins.in  
 the ground, for cor.of secs.13, 14, 23 and 24, marked  
 on brass cap,

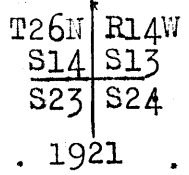

from which,

Completion of Subdivision lines of T 26 N, R 14 W 21

Chains.

- A juniper, 18 ins.in diam., brs. N.85 $\frac{1}{2}$ °E.,  
130 lks.dist., marked T26N R14W S13 BT.
- A juniper, 12 ins.in diam., brs.S.45 $\frac{1}{2}$ °E.,  
12 lks.dist., marked T26N R14W S24 BT.
- A juniper, 14 ins.in diam., brs.S.25 $\frac{1}{2}$ °W.,  
125 lks.dist., marked T26N R14W S23 BT.
- A juniper, 10 ins.in diam., brs.N.52°W.,  
88 lks.dist., marked T26N R14W S14 BT.

Land, mountainous and rolling.  
Soil, gravelly, clay and loam, 2nd rate.  
Timber, pinyon and juniper.  
Undergrowth, scrub oak and prickly ash.

- 40.00 West, on a random line, bet. secs.14 and 23.  
Set temp.  $\frac{1}{4}$  sec.cor.
- 80.00 Intersect the cor.of secs.14,15, 22 and 23.  
Thence,  
East, on a true line, bet. secs.14 and 23.  
Over mountainous land, thru. heavy timber and scattering  
undergrowth.  
Ascend 70 ft.
- 4.89 Spur, slopes NE.  
Descend 525 ft.
- 40.00 Set an iron post, 3 ft.long, 1 in. in diam., 26 ins.in  
the ground, for  $\frac{1}{4}$  sec.cor., marked on brass cap,

$\frac{1}{4}$  S 14  
S 23  
1921

- from which,  
A pinyon, 12 ins.in diam., brs.N.63°E., 49  
lks.dist., marked  $\frac{1}{4}$  S 14 BT.
- A pinyon, 8 ins. in diam., brs.S.47°W., 23  
lks.dist., marked  $\frac{1}{4}$  S 23 BT.

- 80.00 Continue descent, 180 ft.  
The cor.of secs. 13,14,23 and 24.  
Land, mountainous and rolling,  
Soil, gravelly, clay and loam, 2nd rate.  
Timber, pinyon and juniper.  
Undergrowth, scrub oak and prickly ash.

- 40.00 S.89° 40' E., on a random line, bet. secs.13 and 24.  
Set temp.  $\frac{1}{4}$  sec.cor.
- 79.45 Fall 2 lks.S.of the cor.of secs.13,18, 19 and 24, on the  
E. bdy.of the Tp., which is an iron post, 2 ins.in diam.,  
set in a mound of stone, properly marked, witnessed  
by four bearing trees, as described in the field  
notes of current Group 109.  
Thence,  
N.89°41'W., on a true line, bet. secs.13 and 24.  
Over mountainous land, thru. heavy timber and scattering  
undergrowth.  
Ascend 75 ft.
- 12.95 Spur, slopes N.20°E.  
Descend 95 ft.
- 19.65 Wash, 10 lks.wide, 8 ft.deep, course NE. Thence over level  
land,
- 31.95 Road brs.NW. to Meriwhitica Canyon, and SE. to Hackberry.
- 37.45 Ravine, course N.60°E.
- 39.45 Set an iron post 3 ft.long, 1 in. in diam., 26 ins.in the  
ground, for  $\frac{1}{4}$  sec.cor., marked on brass cap,

## 22 Completion of Subdivision lines of T. 26 B. R. 14 W.

Chains.

$$\frac{1}{4} S 13$$

$$S 24$$

$$1921$$

from which,

A pinyon, 8 ins. in diam., brs. N. 21° W., 120 lks. dist., marked  $\frac{1}{4}$  S 13 BT.A juniper, 12 ins. in diam., brs. S. 12° W., 102 lks. dist., marked  $\frac{1}{4}$  S 24 BT.

42.45 Ravine, 20 lks. wide, course S. 70° E.

Ascend 45 ft.

48.15 Descend 25 ft.

52.25 Ascend 55 ft.

65.65 Descend 50 ft.

69.45 Ravine, 10 lks. wide, course N. 60° E. Thence along S. slope.

77.45 Ravine, 10 lks. wide, course S. 80° E.

Ascend 15 ft.

79.45 The cor. of secs. 13, 14, 23 and 24.

Land, level and mountainous.

Soil, gravelly, clay and loam, 2nd rate.

Timber, pinyon and juniper.

Undergrowth, scrub oak and prickly ash.

Fair grazing.

North, bet. secs. 13 and 14.

Over rolling land, thru. heavy timber and scattering undergrowth.

Descend.

0.50 Draw, 20 lks. wide, course SE.

Ascend 65 ft.

7.52 Spur, slopes E.

Descend 40 ft.

19.50 Road brs. E. to Hackberry, and W. to Meriwhitica Canyon.

21.58 Draw, 15 lks. wide, course E.

Ascend 105 ft.

34.50 Spur, slopes E.

Descend.

40.00 Set an iron post, 3 ft. long, 1 in. in diam., 26 ins. in the ground, for  $\frac{1}{4}$  sec. cor., marked on brass cap,
$$S14 \quad \frac{1}{4} \quad S13$$

$$1921$$

from which,

A pinyon, 8 ins. in diam., brs. N. 43° E., 64 lks. dist., marked  $\frac{1}{4}$  S 13 BT.A pinyon, 12 ins. in diam., brs. S. 80° W., 57 lks. dist., marked  $\frac{1}{4}$  S 14 BT.

Descend 25 ft.

46.60 Head of draw, 12 lks. wide, course NE.

Ascend 215 ft.

68.00 Spur, slopes E.

Descend 45 ft.

80.00 Set an iron post, 3 ft. long, 2 ins. in diam., 24 ins. in the ground, for cor. of secs. 11, 12, 13 and 14, marked on brass cap,

$$T26N \quad R14W.$$

$$S11 \quad S12$$

$$S14 \quad S13$$

$$1921$$

from which,



Chains.

- A juniper, 10 ins. in diam., brs. N.  $9\frac{1}{2}^{\circ}$  E., 132 lks. dist., marked T26N R14W S12 BT.  
 A juniper, 20 ins. in diam., brs. S.  $20^{\circ}$  E., 60 lks. dist., marked T26N R14W S13 BT.  
 A juniper, 8 ins. in diam., brs. S.  $38^{\circ}$  W., 130 lks. dist., marked T26N R14W S14 BT.  
 A juniper, 10 ins. in diam., brs. N.  $35^{\circ}$  W., 5 lks. dist., marked T26N R14W S11 BT.
- Land, rolling and mountainous.  
 Soil, gravelly, clay and loam, 2nd rate.  
 Timber, pinyon and juniper.  
 Undergrowth, scrub oak and prickly ash.  
 Fair grass.
- 
- West, on random line, bet. secs. 11 and 14.  
 40.00 Set temp.  $\frac{1}{4}$  sec. cor.  
 80.26 Intersect N. and S. line, 30 lks. S. of the cor. of secs. 10, 11, 14 and 15.  
 Thence,  
 S.  $89^{\circ}47'$  E., on a true line, bet. secs. 11 and 14.  
 Over gently rolling land, thru. heavy timber and undergrowth.
- 40.00 Road brs. N.  $45^{\circ}$  E. to Meriwhitica Canyon, and S.  $45^{\circ}$  W.  
 40.13 Set an iron post, 3 ft. long, 1 in. in diam., 26 ins. in the ground, for  $\frac{1}{4}$  sec. cor., marked on brass cap,
- $\frac{1}{4}$  S 11  
 S 14  
 1921
- from which,  
 A juniper, 10 ins. in diam., brs. N.  $57\frac{1}{2}^{\circ}$  E., 123 lks. dist., marked  $\frac{1}{4}$  S 11 BT.  
 A juniper, 8 ins. in diam., brs. S.  $83^{\circ}$  W., 252 lks. dist., marked  $\frac{1}{4}$  S 14 BT.
- 50.00 Leave gently rolling land, brs. NE. and SW.  
 Ascend 105 ft.
- 80.26 The cor. of secs. 11, 12, 13 and 14.  
 Land, gently rolling and rolling.  
 Soil, gravelly clay and loam, 2nd rate,  
 Timber, juniper and pinyon.  
 Undergrowth, sagebrush, quinine brush, prickly ash and scrub oak.
- 
- S.  $89^{\circ}41'$  E., on a random line, bet. secs. 12 and 13.  
 40.00 Set temp.  $\frac{1}{4}$  sec. cor.  
 79.40 Intersect the cor. of secs. 7, 12, 13 and 18, on the E. bdy. of the Tp., which is an iron post, 2 ins. in diam., 9 in. above ground, properly marked, witnessed by four bearing trees, as described in the field notes of current Group No. 109.  
 Thence,  
 N.  $89^{\circ}41'$  W., on a true line, bet. secs. 12 and 13.  
 Over rolling and mountainous land, thru. scattering timber and undergrowth.
- Descend 50 ft.
- 4.80 Ravine, 20 lks. wide, course NE.  
 Ascend 90 ft.
- 12.30 Spur, slopes NE.  
 Descend 55 ft.
- 30.00 Ravine, 20 lks. wide, course N.  $70^{\circ}$  E.  
 Ascend.

24 Completion of Subdivision lines of T. 26 N., R. 14 W.

Chains.

38.90 Ravine, 10 lks. wide, course SE. Continue ascent,  
39.40 Set an iron post, 3 ft. long, 1 in. in diam., 26 ins. in  
the ground, for  $\frac{1}{4}$  sec. cor., marked on brass cap,

$\frac{1}{4}$  S. 12  
S 13  
1921

from which,  
A juniper, 8 ins. in diam., brs. N. 38° E., 77  
lks. dist., marked  $\frac{1}{4}$  S 12 BT.  
A juniper, 10 ins. in diam., brs. S. 13° E., 60  
lks. dist., marked  $\frac{1}{4}$  S 13 BT.

Continue ascent 250 ft.

71.40 Ridge, brs. NE. and SW.  
Descend.

79.40 The cor. of secs. 11, 12, 13 and 14.  
Land, rolling and mountainous.  
Soil, rocky and gravelly, 4th rate.  
Timber, juniper and pinyon.  
Undergrowth, sagebrush, quinine brush, scrub oak and  
prickly ash.

North, bet. secs. 11 and 12.  
Over rolling land, thru. heavy timber and scattering  
undergrowth.

Descend gradually 85 ft.

35.80 Ravine, 10 lks. wide, course N. 60° E.

38.70 Ravine, 20 lks. wide, course E.

40.00 Set an iron post, 3 ft. long, 1 in. in diam., 26 ins. in the  
ground, for  $\frac{1}{4}$  sec. cor., marked on brass cap,

S11 S12  
1921

from which,  
A juniper, 10 ins. in diam., brs. S. 40° E.  
145 lks. dist., marked  $\frac{1}{4}$  S 12 BT.  
A juniper, 10 ins. in diam., brs. S. 34° W.,  
314 lks. dist., marked  $\frac{1}{4}$  S 11 BT.

Ascend 75 ft.

70.00 Ridge, brs. NE. and SW.

Descend 30 ft.

78.35 Ravine, 10 lks. wide, course N. 60° E.

80.00 Set an iron post, 3 ft. long, 2 ins. in diam., 24 ins. in  
the ground, for cor. of secs. 1, 2, 11 and 12, marked on  
brass cap,

T26N | R14W  
S 2 | S 1  
S11 | S12  
1921

from which;  
A juniper, 24 ins. in diam., brs. N. 39 $\frac{1}{2}$ ° E., 104  
lks. dist., marked T26N R14W S1 BT.  
A juniper, 14 ins. in diam., brs. S. 74 $\frac{1}{2}$ ° E., 208  
lks. dist., marked T26N R14W S12 BT.  
A juniper, 18 ins. in diam., brs. S. 57° W., 88  
lks. dist., marked T26N R14W S11 BT.  
A juniper, 10 ins. in diam., brs. N. 24 $\frac{1}{2}$ ° W., 78  
lks. dist., marked T26N R14W S2 BT.

Land, rolling.

## 8 Completion of Subdivision lines of T.26 N., R. 14 W. 25

Chains.

Soil, gravelly clay and loam, 2nd rate.  
 Timber, pinyon and juniper.  
 Undergrowth, sagebrush and quinine brush.

- 40.00 N.  $89^{\circ}47'W.$ , on a random line, bet. secs.2 and 11.  
 Set temp.  $\frac{1}{4}$  sec.cor.  
 80.00 Intersect N. and S. line, 2 lks.S. of the cor. of secs.2,3,  
 10 and 11.  
 Thence,  
 S.  $89^{\circ}46'E.$ , on a true line, bet. secs.2 and 11.  
 Over gently rolling land, thru. heavy timber, and scat-  
 tering undergrowth.  
 35.00 Leave timber, brs.NE and SW.  
 39.45 Draw, 10 lks.wide, course N.  $55^{\circ}E.$   
 40.00 Set an iron post, 3 ft.long, 1 in. in diam., 30 ins. in  
 the ground, for  $\frac{1}{4}$  sec.cor., marked on brass cap,

$$\frac{1}{4} \frac{S \ 2}{S \ 11}$$

1921

from which,

- A juniper, 8 ins. in diam., brs.N.  $30^{\circ}W.$ , 472  
 lks.dist., marked  $\frac{1}{4}$  S 2 BT.  
 A juniper, 30 ins. in diam., brs.S.  $12^{\circ}E.$ , 180  
 lks.dist., marked  $\frac{1}{4}$  S 11 BT.  
 53.00 Wash, 20 lks.wide, course N.  $80^{\circ}E.$   
 58.00 Enter timber, brs.NE and SW.  
 Ascend 70 ft.  
 70.00 Low spur, slopes SW.  
 77.00 Road brs.NE. to Meriwhitica Canyon, and SW. to Hackberry.  
 80.00 The cor. of secs.1,2,11 and 12.  
 Land, rolling, and gently rolling.  
 Soil, gravelly and sandy loam, 2nd rate.  
 Timber, pinyon and juniper.  
 Undergrowth, quinine brush, scrub oak, sagebrush and  
 cactus.  
 Fair grazing.

- 40.00 S.  $89^{\circ}41'E.$ , on a random line, bet. secs.1 and 12.  
 Set temp.  $\frac{1}{4}$  sec.cor.  
 79.50 Intersect the E. bdy. of Tp., 5 lks.N. of the cor. of secs.  
 1,6,7 and 12, which is an iron post, 2 ins. in diam.,  
 set in a mound of stone, properly marked, witnessed  
 by four bearing trees, as described in the field notes  
 of current Group No.109.  
 Thence,  
 N.  $89^{\circ}39'W.$ , on a true line, bet. secs.1 and 12.  
 Over gently rolling land, thru. heavy timber and scatter-  
 ing undergrowth.  
 8.82 Ravine, 20 lks.wide, course NE.  
 39.50 Set an iron post, 3 ft.long, 1 in. in diam., 26 ins. in  
 the ground, for  $\frac{1}{4}$  sec.cor., marked on brass cap,

$$\frac{1}{4} \frac{S \ 1}{S \ 12}$$

1921

from which,

- A juniper, 8 ins. in diam., brs.N.  $49^{\circ}E.$ , 16 lks.  
 dist., marked  $\frac{1}{4}$  S 1 BT.  
 A juniper, 8 ins. in diam., brs.S.  $9^{\circ}E.$ , 28 lks.  
 dist., marked  $\frac{1}{4}$  S 12 BT.

## 26 Completion of Subdivision lines of T. 26 N., R. 14 W.

Chains.

- 74.50 Ravine, 10 lks. wide, course N. 60° E.  
79.50 The cor. of secs. 1, 2, 11 and 12.  
Land, gently rolling.  
Soil, gravelly, clay and loam, 2nd rate.  
Timber, juniper and pinyon.  
Undergrowth, scrub oak, prickly ash and sagebrush.
- 
- 40.00 N. 0° 2' E., on a random line, bet. secs. 1 and 2.  
Set temp.  $\frac{1}{4}$  sec. cor.  
81.12 Fall 35 lks. E. of the cor. of secs. 1 and 2, on the N. bdy. of  
the Tp., hereinbefore described.  
Thence,  
S. 0° 13' E., on a true line, bet. secs. 1 and 2.  
Over rolling land, thru. dense timber and scattering  
undergrowth.  
Ascend 105 ft.  
23.35 Flat fidge, brs. NE. and SW.  
Descend 75 ft.  
40.10 Draw, 10 lks. wide, course NE. Thence over gently rolling  
land.  
41.12 Set an iron post, 3 ft. long, 1 in. in diam., 26 ins. in  
the ground, for  $\frac{1}{4}$  sec. cor., marked on brass cap,
- $\frac{1}{4}$   
 S 2 | S 1  
 1921
- from which,  
A juniper, 6 ins. in diam., brs. S. 41° E., 107  
lks. dist., marked  $\frac{1}{4}$  S 1 BT.  
A juniper, 14 ins. in diam., brs. N. 27° W., 234  
lks. dist., marked  $\frac{1}{4}$  S 2 BT.
- 54.08 Fence brs: N. 70° E. and S. 70° W.  
63.75 Wash, 20 lks. wide, course NE.  
75.95 Road brs. NE. to Meriwhitica Canyon and SW. to Hackberry.  
81.12 The cor. of secs. 1, 2, 11 and 12.  
Land, rolling and gently rolling.  
Soil, gravelly clay and loam, 2nd rate.  
Timber, juniper and pinyon.  
Undergrowth, sage brush, quinine brush, prickly ash and  
scrub oak.

---

The continued satisfactory adjustment of the solar apparatus during the survey of this township is indicated from field tests as described in Book "B."

---

GENERAL DESCRIPTION.

That portion of T. 26 N., R. 14 W. surveyed under this Group is rolling and mountainous land, covered with a heavy growth of juniper and pinyon timber and a scattering growth of scrub oak, prickly ash and sage brush undergrowth. The general drainage is to the northeast.

A spring and Indian House are found in the southeast quarter of sec. 24. A road runs in a northerly direction from Hackberry to Meriwhitica Canyon and Clay Springs. No indications of mineral were observed.

30  
17  
8  
48

4-680

BOOK 3559

FIELD ASSISTANTS. to

Francis R. Ihrie, U. S. Transitman.

NAMES.	CAPACITY.
John M. Holland	1st Chainman
Jesse Potter	2nd Chainman
Ty White	1st Chainman
Joseph Sepule	2nd Chainman
Harry Severns	Flagman
Rudolph McCormack	Flagman
William Owens	Axeman
Max Cornforth	Moundsman
Earl Draper	Cornerman
Andrew Devine	Axeman





CERTIFICATE OF UNITED STATES SURVEYOR.

I, Quintin Campbell, U. S. Surveyor, hereby certify upon honor that, in pursuance of special instructions received from the U. S. Surveyor General, for Group 110, Arizona,

bearing date of the 27th day of February, 19 20, I have well, faithfully, and truly

in my own proper person, and in strict conformity with said instructions, the Manual of Surveying Instructions, and the laws of the United States, ~~surveyed all these parts or portions of the~~

~~Boundary of the Hualpai Indian Reservation, and surveyed all these parts or portions of the~~

~~North boundary and Subdivision lines of~~

TOWNSHIP 26 NORTH, RANGE 14 WEST,

of the Gila and Salt

River Base and Meridian, in the State of Arizona, which are represented in

the foregoing field notes <sup>and by diagram on page hereof</sup> as having been executed by me, and under my direction; and that all the corners of said survey have been established and perpetuated in strict accordance with the Manual of Surveying Instructions, and the special written instructions of the U. S. Surveyor General, for Group 110, Arizona

and in the specific manner described in the field notes, and that the foregoing are the original field notes of such ~~surveyment and survey~~.

Place Phoenix Arizona

*Quintin Campbell*  
U. S. Surveyor.

Date March 30 - 1922

APPROVAL.

OFFICE OF THE UNITED STATES SURVEYOR GENERAL,

Phoenix, Arizona JUN 30, 1923.

The foregoing field notes of the ~~retracement of part of the~~ Boundary of the Hualpai Indian Reservation, and the survey of part (completion) of the North Boundary and part (completion) of the Subdivision lines of

TOWNSHIP 26 NORTH, RANGE 14 WEST

of the Gila and Salt River Base and Meridian, in the State of Arizona.

executed by Quintin Campbell, U. S. Surveyor, and Francis R. Ihrie, U. S. Transitman

under his special instructions dated Feb. 27, 1920 for Gr. 110, Arizona, having been critically examined, and the necessary corrections and explanations made, the said field notes, and the ~~retracements and surveys~~ they describe, are hereby approved.

*Francis R. Ihrie*  
U. S. Surveyor General.

~~I certify that the foregoing transcript of the field notes of the above described surveys in~~

~~has been correctly copied from the original notes on file in this office.~~