

Book "H"
4-679

BOOK 3566

FIELD NOTES

OF THE RETRACEMENT OF
Part of the Boundary of the Hualpai Indian Reservation and

OF THE SURVEY OF

PART of EAST boundary,

Part of NORTH boundary, and

Part of Subdivision lines of

TOWNSHIP 30 NORTH, RANGE 15 WEST,

and

Part of Subdivision lines of

TOWNSHIP 31 NORTH, RANGE 15 WEST,

Of the Gila and Salt River Base and Meridian,

In the State of Arizona

EXECUTED BY

Thomas D. Daley, U.S. Surveyor,

and

William E. Hiester, U.S. Transitman,

In the capacity of U. S. Surveyors, under Special Instructions dated February 27, 1920,
issued by the United States Surveyor General to govern surveys included in Group
No. 110, Ariz., which were approved by the Commissioner of the General Land
Office, March 10, 1920, and Assignment Instructions dated June 27, 1921.

Retracement & Survey commenced July 19, 1921

Retracement & Survey completed July 29, 1921

3566

3566

3566

INDEX DIAGRAM

Book "H"

Group 110

Arizona

Townships 30 and 31 North, Range 15 West.

BOOK 3563

35

INDEX DIAGRAM.

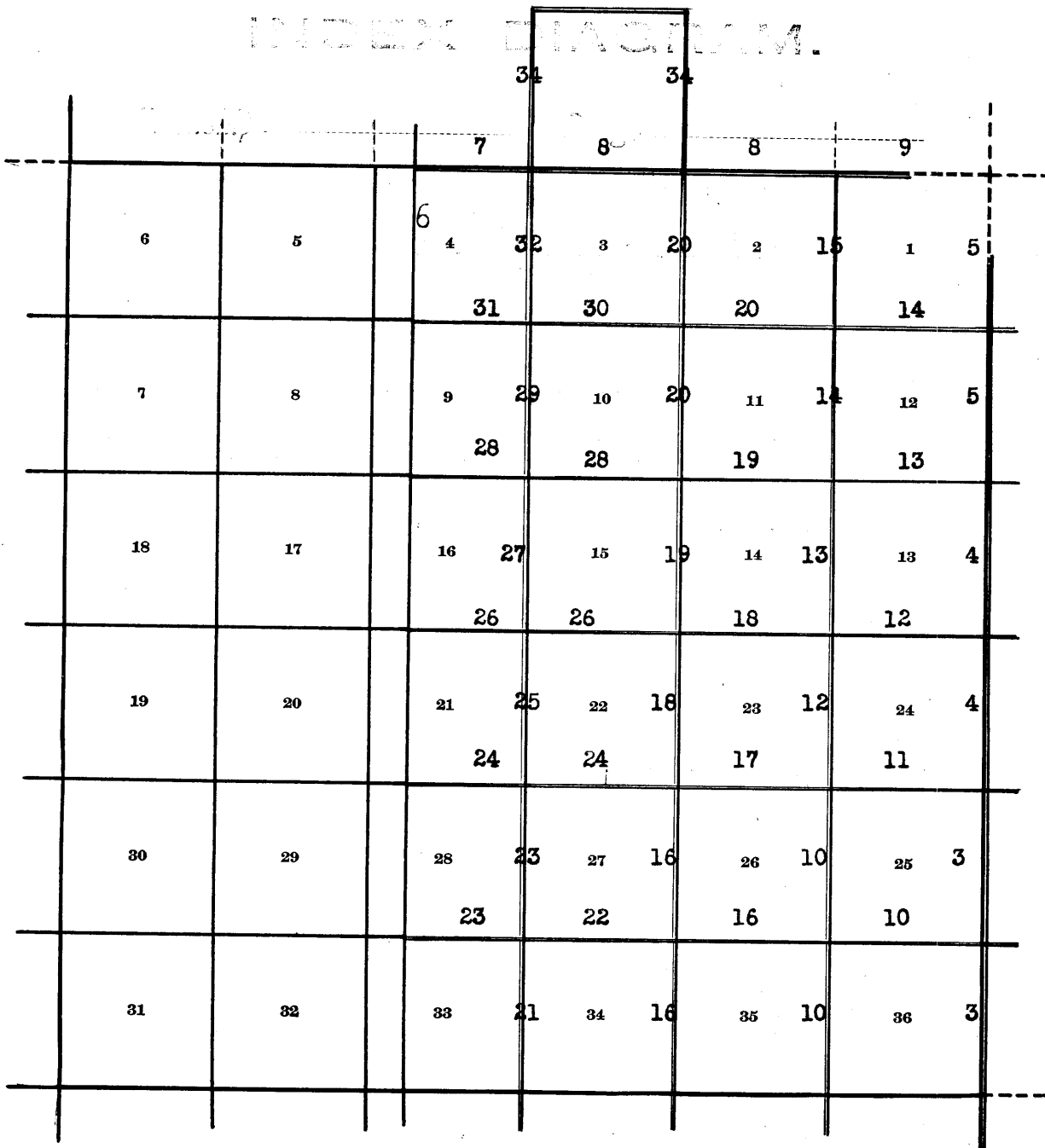

Accepted surveys.

Lines surveyed under this group.

DATE DIAGRAM

Book "H"

Group 110 Arizona

Township 30 and 31 North, Range 15 West.

					7-29-21		
			7-27-21	7-28-21		7-28	7-28
						1921	1921
6	5	7-29-21	4	3	2	1	
			7-26-21	7-26-21	7-26-21	7-27-21	7-27
7	8		9	10	11	12	
			7-26-21	7-25-21	7-26-21	7-27-21	
			7-22-21	7-25-21	7-25-21	7-22-21	
18	17		16	15	14	13	
			7-21-21	7-22-21	7-22-21	7-21-21	7-21-21
19	20		21	22	23	24	
			7-21-21	7-21-21	7-20-21	7-19-21	7-21-21
30	29		28	27	26	25	
			7-20-21	7-20-21	7-20-21	7-19-21	7-19-21
31	32		33	34	35	36	
			7-20-21	7-20-21	7-19-21	7-19-21	7-19-21

For dates of survey of this line, see Book "G" of this Group.

Red lines indicate surveys executed by Thos. D. Daley, U.S. Surveyor on dates shown thereon.

Blue lines indicate surveys executed by William E. Hiester, U.S. Transitman, on dates shown thereon.

Black lines indicate accepted surveys.

Surveys hereinafter described executed by Thos. D. Daley, U. S. Surveyor and William E. Hiester, U. S. Transitman, on dates shown on diagram on page 1 hereof, using respectively Buff solar transit No. 9977 and Young and Sons light mountain transit No. 8429. For description of instruments and certificate of approval, see Book "G".

We examine the adjustments of the transits and correct all errors; then, to test the solar apparatus, by comparing their indications, resulting from solar observations made during a.m. and p.m. hours, with a meridian determined by observations on Polaris at elongation, we proceed as follows:

July 17, 1921: at our camp near the cor. of secs. 23, 24, 25 and 26, T. 29 N., R. 15 W., G. and S.R.B. and M., lat. $35^{\circ}53'$ N., long. $113^{\circ}51\frac{1}{2}'$ W., at 9 hrs. 0 m., a.m., l.m.t., using the meridian determined as described in Book "G", we set off $35^{\circ}55'$ N. on the lat. arcs; $21^{\circ}14'$ N. on the decl. arcs; and determine a meridian with each solar which agrees with the true meridian.

At apparent noon, with the lat. arcs unchanged, we observe the sun on the meridian with each solar; the resulting decl. in each case is $21^{\circ}12\frac{1}{2}'$ N., which is the commuted decl. of the sun.

At 3 hrs. 0 m., p.m., l.m.t., with the lat. arcs unchanged, we set off $21^{\circ}11\frac{1}{2}'$ N. on the decl. arcs; and determine a meridian with each solar which agrees with the true meridian.

As all of the solar observations during the usual hours of solar work come within $1'30''$ of the true meridian, we conclude that the adjustments of the solars are satisfactory.

Unless otherwise specified, all measurements are made with a Lufkin steel tape, 5 chs. in length, compared with a Chesterman standard steel tape and found correct. The measurements are made on the slope, the vertical angles determined and the slope measurements properly reduced to true horizontal distances.

Survey of Part of the East Boundary
of T. 30 N., R. 15 W.

Chains From the cor. of Ts, 29 and 30 N., Rs. 14 and 15 W.,
described in Book "G".
North bet. secs. 31 and 36.
Over gently sloping land, through scattering undergrowth
and timber.
40.00 Set an iron post, 3 ft. long, 1 in. diam., 26 ins. in the
ground, for $\frac{1}{4}$ sec. cor., marked on brass cap

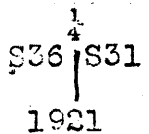

80.00 And raise a mound of stone, 2 ft. base, 1 $\frac{1}{2}$ ft. high,
W. of cor.
Set an iron post, 3 ft. long, 2 ins. diam., 12 ins. in
the ground, in a mound of stone with marked (X) stone
for cor. of secs. 25, 30, 31 and 36, marked on brass
cap

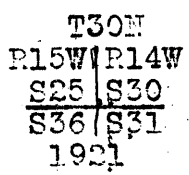

From which
A juniper, 10 ins. diam., brs. S. 43 $\frac{1}{2}$ ° W.,
442 lks. dist., marked T30N R15W S36 BT.
A juniper, 8 ins. diam., brs. N. 81° W.,
217 lks. dist., marked T30N R15 W S25 BT

No other trees within limits.
Land, gently sloping.
Soil, 2nd rate.
Timber, very scattering juniper.
Undergrowth, sagebrush, cat claw and cactus.
Fair grazing.

32.00 North bet. secs. 25 and 30.
Over level land, through scattering timber and undergrowth.
Wash, 8 lks. wide, course NE.
40.00 Set an iron post, 3 ft. long, 1 in. diam., 24 ins. in the
ground, in a mound of stone, for $\frac{1}{4}$ sec. cor., marked on
brass cap



From which
A juniper, 8 ins. diam., brs. S. 47° E.,
86 lks. dist., marked $\frac{1}{4}$ S30 BT.
A juniper, 6 ins. diam., brs. S. 23 $\frac{3}{4}$ ° W.,
158 lks. dist., marked $\frac{1}{4}$ S25 BT.

48.00 Reservoir brs. East 8 chs. dist.
80.00 Set an iron post, 3 ft. long, 2 ins. diam., on bed rock,
with cross (X) at exact cor. point, in a mound of stone,
for cor. of secs. 19, 24, 25 and 30, marked on brass
cap



From which
A juniper, 10 ins. diam., brs. S. 56° E.,
141 lks. dist., marked T30N R14W S30 BT.
A juniper, 8 ins. diam., brs. S. 23 $\frac{1}{2}$ ° W.,
60 lks. dist., marked T30N R15W S25 BT.

Survey of Part of the East Boundary
of T. 30-N., R. 15-W.

Chains	<p>No other trees within limits. Land, level. Soil, 3rd rate. Timber, juniper. Undergrowth, sagebrush, cat claw and cactus. Fair grazing.</p> <hr/> <p>North bet. secs. 19 and 24. Over level land, through scattering timber and undergrowth.</p> <p>40.00 Set an iron post, 3 ft. long, 1 in. diam., 12 ins. in the ground, in a mound of stone, for $\frac{1}{4}$ sec. cor., marked on brass cap</p> <div style="text-align: center;"> $\begin{array}{c} \frac{1}{4} \\ S19 \mid S24 \\ 1921 \end{array}$ </div> <p>From which</p> <p style="padding-left: 2em;">A juniper, 14 ins. diam., brs. N.56$\frac{1}{2}$°E., 225 lks. dist., marked $\frac{1}{4}$S24 BT.</p> <p style="padding-left: 2em;">A juniper, 10 ins. diam., brs. S.85°W., 115 lks. dist., marked $\frac{1}{4}$S19 BT.</p> <p>45.20 Wash, 12 lks. wide, course NE. Asc. 75 ft.</p> <p>80.00 Set an iron post, 3 ft. long, 2 ins. diam., 12 ins. in the ground, in a mound of stone with marked (X) stone for of secs. 13, 18, 19 and 24, marked on brass cap</p> <div style="text-align: center;"> $\begin{array}{c} T30N \\ R15W \mid R14W \\ S13 \mid S18 \\ S24 \mid S19 \\ 1921 \end{array}$ </div> <p>From which</p> <p style="padding-left: 2em;">A juniper, 10 ins. diam., brs. N.72$\frac{1}{2}$°E., 366 lks. dist., marked T30N R14W S18 BT.</p> <p style="padding-left: 2em;">A juniper, 8 ins. diam., brs. S.69$\frac{1}{2}$°E., 206 lks. dist., marked T30N R14W S19 BT.</p> <p>No other trees within limits. Land, level and rolling. Soil, 4th rate. Timber, juniper. Undergrowth, sagebrush, cat claw and cactus. Fair grazing.</p> <hr/> <p>North bet. secs. 13 and 18. Over rolling land, through scattering timber and undergrowth. Desc. 35 ft.</p> <p>10.50 Wash, 12 lks. wide, course NE. Asc. gradual slope.</p> <p>31.50 Low ridge, brs. N.30°E and S.30°W. Thence over level land.</p> <p>40.00 Set an iron post, 3 ft. long, 1 in. diam., 12 ins. in the ground, in a mound of stone, for $\frac{1}{4}$ sec. cor., marked on brass cap</p> <div style="text-align: center;"> $\begin{array}{c} \frac{1}{4} \\ S13 \mid S18 \\ 1921 \end{array}$ </div> <p>From which</p> <p style="padding-left: 2em;">A juniper, 8 ins. diam., brs. S.88$\frac{3}{4}$°E., 260 lks. dist., marked $\frac{1}{4}$S18 BT.</p> <p style="padding-left: 2em;">A juniper, 14 ins. diam., brs. N.65°W.,</p>
--------	---

Survey of Part of the East Boundary
of T: 30 N., R: 15 W.

BOOK 3566

Chains

70.00
80.00

160 lks. dist., marked $\frac{1}{2}$ S13 BT.
Continue over level land.
Asc. 35 ft.
Set an iron post, 3 ft. long, 2 ins. diam., 10 ins. in the ground, in a mound of stone with marked (X) stone for cor. of secs. 7, 12, 13 and 18, marked on brass cap

T30N
R15W | R14W
S12 | S 7
S13 | S18
1921

From which

A juniper, 8 ins. diam., brs. S. 49° W.,
428 lks. dist., marked T30N R15W S13 BT.
A juniper, 14 ins. diam., brs. N. 43 $\frac{1}{2}$ ° W.,
459 lks. dist., marked T30N R15W S12 BT.
No other trees within limits.
Land, level and rolling.
Soil, 3rd rate.
Timber, juniper.
Undergrowth, sagebrush, cat claw and cactus.
Fair grazing.

18.00
32.90
37.00
40.00

North bet. secs. 7 and 12.
Over rolling and mountainous land, through scattering timber and undergrowth.
Desc. 80 ft.
Asc. 75 ft.
Ridge, brs. NW. and SE. Desc.
Set an iron post, 3 ft. long, 1 in. diam., 12 ins. in the ground, with marked (X) stone, for $\frac{1}{2}$ sec. cor.; and raise a mound of stone around post, with brass cap marked

S12 | S 7
1921

53.20
63.50
68.00
70.00
80.00

Thence over nearly level land.
Desc. 130 ft.
Wash, 20 lks. wide, course W. Asc.
Spur, slopes SW. Desc.
Wash, 12 lks. wide, course SW. Asc. 95 ft.
Set an iron post, 3 ft. long, 2 ins. diam., 12 ins. in the ground, with marked (X) stone, for cor. of secs. 1, 6, 7 and 12, marked on brass cap

T30N
R15W | R14W
S 1 | S 6
S12 | S 7
1921

Land, level, rolling and mountainous.
Soil, 3rd rate.
Timber, juniper.
Undergrowth, sagebrush, cat claw and cactus.
Fair grazing.

North bet. secs. 1 and 6.
Over rolling land, through scattering timber and undergrowth.
Asc. 50 ft.

Survey of Part of the East Boundary
of T. 30 N., R. 15 W.

6

Chains

12.75

Thence over level land.

40.00

Set an iron post, 3 ft. long, 1 in. diam., on bed rock;
with marked (X) stone, for $\frac{1}{4}$ sec. cor.; and raise a mound
of stone around post, with brass cap marked

1
S 1 S 6
1921

At about 45.00 chs., impassable rim rock bearing NE. and
NW. prevents the continuation of the survey of this
line.

Land, rolling and level.;

Soil, 3rd rate.

Timber, juniper.

Undergrowth, sagebrush, cat claw and cactus.

Fair grazing.

Retracement for alinement of the West Boundary of the

Hualpai Indian Reservation bet. the $2\frac{1}{2}$ and

$3\frac{1}{2}$ mile cors.

The $2\frac{1}{2}$ mile cor., on the West Bdy. of the Hualpai Indian
Reservation is a cross (X) on a rock ledge, 10 ft.
high, bearing E. and W., with HIR $2\frac{1}{2}$ M East and PL
West of cross, and a mound of stone, S. of cor.

The $3\frac{1}{2}$ mile cors., on the West Bdy. of the Hualpai Indian
Reservation is a cross (X) on a rock ledge, 2 ft.
high, bearing E. and W., marked HIR $3\frac{1}{2}$ M East and PL
West of cross, and a mound of stone, S. of cor.

From the $2\frac{1}{2}$ mile cor., a flag is visible on the $3\frac{1}{2}$ mile
cor. and bears S. 00°39' W.

Survey of Part of the North Boundary
of T.30 N., R.15 W.

2500

Chains

That portion of the West Bdy. of the Hualpai Indian Reservation forming the W.Bdy. of the part of T. 30 N., R.15 W. surveyed at this time was originally surveyed in 1900 by Albert T. Colton, U.S. Deputy Surveyor. In 1916 and 1917, the survey of that part of T. 30 N., T.15 W. lying outside the Reservation was executed by E.J.Lange, U.S. Surveyor, and S. Frank Walters and D.R.Averill, U. S. Transitman, under Group 45, who established the iron post closing cors. on the Reservation Bdy., which are hereinafter described, and made such retracements of the Reservation Bdy. as were required to close their surveys.

As the true point for cor. of Ts. 30 and 31 N., Rs. 14 and 15 W. is inaccessible, and only a portion of the North Bdy. of T.30 N., R.15 W. is surveyable, we initiate the survey of this Bdy. from the cor. of secs. 3, 4, 33 and 34, established at the intersection of the line bet. secs. 3 and 4, run on the regular meridional bearing, with the N.Bdy. of T.30 N., R.15 W. produced from the closing cor. of secs. 4 and 33.

The closing cor. of secs. 4 and 33, on the N. Bdy. of Tp. and the W. Bdy. of the Hualpai Indian Reservation is an iron post, 2 ins. diam., set in a mound of stone, properly marked, witnessed by a mound of stone, W. of cor. and established 17.55 chs. East of the cor. of secs. 4, 5, 32 and 33.

Thence East on a random line, bet. secs. 4 and 33, continuing measurement.

37.55 (20.00 chs. East of the closing cor. of secs. 4 and 33, on the Hualpai Indian Reservation Bdy.) Set temp. $\frac{1}{4}$ sec. cor.

77.46 (59.91 chs. East of the original closing cor. of secs. 4 and 33, on the Hualpai Indian Reservation Bdy.) Intersect line run N.002'W. from the cor. of secs. 3 and 10, as hereinafter described, at a point 79.54 chs. N.002'W. of said cor.

At the point of intersection. Set an iron post, 3 ft. long, 2 ins. diam., 14 ins. in the ground, with marked (X) stone, for cor. of secs. 3, 4, 33 and 34; and raise a mound of stone around post, with brass cap marked

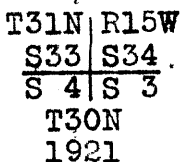

I return to the original closing cor. of secs. 4 and 33, on the W. Bdy. of the Hualpai Indian Reservation.. Thence East on a true line, bet, secs. 4 and 33, continuing measurement

24.20 Over mountainous land, through scattering undergrowth. Asc. 235 ft.

27.35 Thence along S. slope.

37.46 Desc. 170 ft.. (19.91 chs. East of the original closing cor. of secs. 4 and 33, and 40.00 chs. West of the cor. of secs. 3, 4, 33 and 34.) Set an iron post, 3 ft. long, 1 in. diam., 6 ins. in the ground, with marked (X) stone, for $\frac{1}{4}$ sec. cor.; and raise a mound of stone around post, with brass cap marked

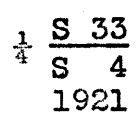

Survey of Part of the North Boundary
of T. 30 N., R. 15 W.

Chains Continue descent, 125 ft.
42.20 Wash, 30 lks. wide, 10 ft. deep, course N. Asc. 480 ft.
52.05 Spur, slopes N. Desc. 55 ft.
53.65 Asc. 125 ft.
68.30 Spur, slopes NE. Desc. 100 ft.
77.46 (59.91 chs. East of the original closing cor. of secs.
4 and 33, on the Hualpai Indian Reservation.) The cor.
of secs. 3, 4, 33 and 34.
Land, mountainous.
Soil, rocky, 4th rate.
Timber, none.
Undergrowth, scrub oak, sagebrush, cat claw and cactus.
Fair grazing.

East bet. secs. 3 and 34.
Over mountainous land, through scattering undergrowth.
Desc. 225 ft.
16.23 Wash, 30 lks. wide, 2 ft. deep, course NW. Asc. 200 ft.
28.71 Thence along S. slope.
33.20 Desc. 20 ft.
37.70 Asc. 20 ft.
40.00 Set an iron post, 3 ft. long, 1 in. diam., 6 ins. in the
ground, with marked (X) stone, for $\frac{1}{4}$ sec. cor.; and raise
a mound of stone around post, with brass cap marked

$$\frac{1}{4} \frac{S \ 34}{S \ 3}$$

1921

Continue ascent, 125 ft.
61.15 Thence along N. slope.
73.61 Desc. 40 ft.
76.21 Rim of impassable canyon, 1200 ft. deep, brs. N. and S.
Set an iron post, 3 ft. long, 2 ins. diam., 6 ins. in
the ground, with marked (X) stone, 20 X 8 X 6 ins., for
witness cor. to cor. of secs. 2, 3, 34 and 35; and raise
a mound of stone around post, with brass cap marked

T31N R15W
S34 | S35 WC
S 3 | S 2

T30N

1921

80.00 The true point for cor. of secs. 2, 3, 34 and 35 is in-
accessible.
Land, mountainous. Soil, 3rd and 4th rates.
Timber, none. Fair grazing
Undergrowth, scrub oak, sagebrush, cat claw and cactus.

East bet. secs. 2 and 35.
Over mountainous land, through scattering undergrowth.
From the witness cor. to cor. of secs. 2, 3, 34 and 35,
3.79 chs. West of the true point for cor. of secs.
2, 3, 34 and 35, set a flag ahead on line, bet. secs.
2 and 35. Measure a base from
this point, South 35.00 chs.
From the S. end of base, flag
at the witness cor. of secs. 2,
3, 34 and 35, brs. N. 60°47' W.
The three angles of the triangle
are therefore 60°47', 29°13' and
90°, the sum of which is 180°.
The distance triangulated is
given by $\tan. 60^{\circ}47' \times 35.00 =$
 $1.78807 \times 35.00 = 62.58 \text{ chs.}$

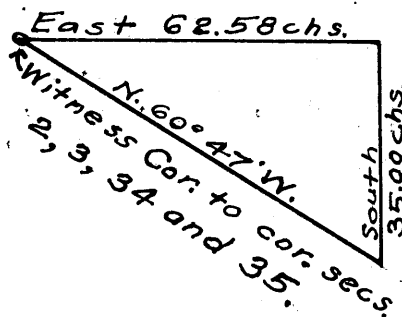

BOOK 3506

Survey of Part of the North Boundary
of T. 30 N., R. 15 W.

Chains. or 58.79 chs. East of the true point for cor. of secs. 2, 3, 34 and 35.

58.79 Rim of canyon, 800 ft. deep, brs. N. and S. The true point for $\frac{1}{4}$ sec. cor. is inaccessible. Continue East bet. secs. 2 and 35.

65.20 Head of deep ravine, course N.

80.00 Set an iron post, 3 ft. long, 2 ins. diam., 12 ins. in the ground, with marked (X) stone, for cor. of secs. 1, 2, 35 and 36; and raise a mound of stone around post, with brass cap marked

T31N R15W
 S35 | S36
 S 2 | S 1
 T30N
 1921

Land, mountainous.
 Soil, rocky, 4th rate.
 No timber.
 Undergrowth, sagebrush, cat claw and cactus.
 Fair grazing.

East bet. secs. 1 and 36.
 Over rolling land, through scattering undergrowth.
 Asc. 30 ft.
 5.00 Desc. 155 ft.
 33.50 Wash, 10 lks. wide, course N.300E. Asc.
 40.00 Set an iron post, 3 ft. long, 1 in. diam, 12 ins. in the ground, with marked (X) stone, for $\frac{1}{4}$ sec. cor.; and raise a mound of stone around post, with brass cap marked

$\frac{1}{4}$ S 36
 S. 1
 1921

Continue ascent, 40 ft.
 42.10 Knoll, Desc. 45 ft.
 47.50 Wash, 1 ch. wide, course S. Asc. 30 ft.
 58.80 Rim of impassable canyon, 600 ft. deep, brs. N. and S.
 I discontinue the survey of this line at this point.
 Land, rolling.
 Soil, rocky, 4th rate.
 Timber, none.
 Undergrowth, sagebrush, cat claw and cactus.
 Fair grazing.

Survey of Part of the Subdivision
of T. 30 N., R. 15 W.

Chains	From the cor. of secs. 1, 2, 35 and 36, on the S. bdy. of Tp., described in Book "G", N. 0° 01' W. bet. secs. 35 and 36.
40.00	Over level land, through scattering timber and undergrowth. Set an iron post, 3 ft. long, 1 in. diam., 14 ins. in the ground, in a mound of stone with marked (X) stone for $\frac{1}{4}$ sec. cor., marked on brass cap
	$\begin{array}{c} \frac{1}{4} \\ S35 S36 \\ 1921 \end{array}$
63.00	And raise a mound of stone, 2 ft. base, $1\frac{1}{2}$ ft. high, W. of cor.
75.00	Draw, course NE.
80.00	Draw, course E. Set an iron post, 3 ft. long, 2 ins. diam., 12 ins. in the ground, in a mound of stone with marked (X) stone, for cor. of secs. 25, 26, 35 and 36, marked on brass cap
	$\begin{array}{c} T30N R15W \\ S26 S25 \\ S35 S36 \\ 1921 \end{array}$
	And raise a mound of stone, 2 ft. base, $1\frac{1}{2}$ ft. high, W. of cor.
	Land, level.
	Soil, 1st rate.
	Timber, scattering juniper.
	Undergrowth, scrub oak, sagebrush, cat claw and cactus.
	Fair grazing.

40.00	East on a random line, bet. secs. 25 and 36.
79.98	Set temp. $\frac{1}{4}$ sec. cor. Fall 9 lks. N. of cor. of secs. 25, 30, 31 and 36, on the East Bdy. of the Tp., as hereinbefore described. Thence N. 89° 56' W. on a true line, bet. secs. 25 and 36. Over level land, through scattering undergrowth.
10.20	Draw, course N. 20° E.
39.99	Set an iron post, 3 ft. long, 1 in. diam., 24 ins. in the ground, for $\frac{1}{4}$ sec. cor., marked on brass cap
	$\begin{array}{c} \frac{1}{4} S 25 \\ S 36 \\ 1921 \end{array}$
	Dig pits, 18 X 18 X 12 ins., E. and W. of post, 3 ft. dist.
62.50	Draw, course NE.
79.98	The cor. of secs. 25, 26, 35 and 36. Land, level. Soil, 1st rate. No timber. Undergrowth, sagebrush, cat claw and cactus. Fair grazing.

	N. 0° 01' W. bet. secs. 25 and 26. Over rolling land, through scattering timber and undergrowth.
	Asc.
5.00	Low ridge, brs. E. and W. Desc. 55 ft.
23.35	Thence over level land.
40.00	Set an iron post, 3 ft. long, 1 in. diam., 24 ins. in the

Survey of Part of the Subdivision
of T. 30 N., R. 15 W.

BOOK 3300

Chains ground for $\frac{1}{4}$ sec. cor., marked on brass cap

$\frac{1}{4}$
S26 | S25
1921

From which
 A juniper, 15 ins. diam., brs. S. 56 $\frac{3}{4}$ °E.,
 28 lks. dist., marked $\frac{1}{4}$ S25 BT.
 A juniper, 10 ins. diam., brs. S. 22 $\frac{1}{4}$ °W.,
 42 lks. dist., marked $\frac{1}{4}$ S26 BT.

41.80 Draw, course NE.
 51.10 Draw, course E.
 62.20 Draw, course NE.
 57.60 Desc, 50 ft.
 76.70 Wash, 10 lks. wide, 1 ft. deep, course E.
 80.00 Set an iron post, 3 ft. long, 2 ins. diam., 12 ins. in the
 ground, in a mound of stone, for cor. of secs. 23, 24,
 25 and 26, marked on brass cap

T30N | R15W
 S23 | S24
 S26 | S25
 1921

From which
 A juniper, 10 ins. diam., brs. N. 63 $\frac{3}{4}$ °E.,
 262 lks. dist., marked T30N R15W S24 BT.
 A juniper, 13 ins. diam., brs. S. 20 $\frac{1}{2}$ °E.,
 145 lks. dist., marked T30N R15W S25 BT.
 A juniper, 8 ins. diam., brs. S. 27°W.,
 254 lks. dist., marked T30N R15W S26 BT.
 A juniper, 10 ins. diam., brs. N. 13 $\frac{1}{4}$ °W.,
 190 lks. dist., marked T30N R15W S23 BT.

Land, level and rolling.
 Soil, second and 3rd rates.
 Timber, juniper.
 Undergrowth, black brush, sagebrush and cactus.
 Fair grazing.

S. 89°56'E. on a random line, bet. secs. 24 and 25.
 40.00 Set temp. $\frac{1}{4}$ sec. cor.
 80.04 Fall 2 lks. S. of the cor. of secs. 19, 24, 25 and 30, on
 the E. bdy. of Tp., hereinbefore described.
 Thence N. 89°57'W. on a true line, bet. secs. 24 and 25.
 Over level land, through scattering timber and undergrowth.
 15.10 Desc. 50 ft.
 25.00 Draw, course N. Tank brs. South 12 chs. dist. Continue
 over level land.
 40.02 Set an iron post, 3 ft. long, 1 in. diam., 10 ins. in the
 ground, in a mound of stone, for $\frac{1}{4}$ sec. cor., marked on
 brass cap

$\frac{1}{4}$ S 24
 S 25
 1921

From which
 A juniper, 10 ins. diam., brs. N. 65 $\frac{1}{2}$ °W.,
 107 lks. dist., marked $\frac{1}{4}$ S24 BT.
 A juniper, 12 ins. diam., brs. S. 72°E.,
 134 lks. dist., marked $\frac{1}{4}$ S25 BT.

51.35 Desc. 65 ft.
 63.10 Wash, course N. Asc. 35 ft.
 70.20 Spur, slopes NW. Desc. 40 ft.
 75.05 Draw, 10 lks. wide, 1 ft. deep, course NW. Asc. 25 ft.
 80.04 The cor. of secs. 23, 24, 25 and 26.

Survey of Part of the Subdivision
of T. 30 N., R. 15 W.

Chains

Land, level and rolling.
Soil, 1st and 2nd rates.
Timber, juniper.
Undergrowth, black brush, sagebrush and cactus.
Fair grazing.

N. 001' W. bet. secs. 23 and 24.

Over rolling land, through scattering timber and undergrowth.

Desc. 35 ft.

- 6.50 Draw, course NE. Asc. very gradually.
28.50 Ridge, brs. E. and W. Desc. 40 ft.
37.20 Wash, 10 lks. wide, course NE. Thence over level land.
40.00 Set an iron post, 3 ft. long, 1 in. diam., on bed rock, in a mound of stone, for $\frac{1}{4}$ sec. cor., marked on brass cap

$\frac{1}{4}$
S23 | S24

1921

From which

- A juniper, 8 ins. diam., brs. S. 340E.,
74 lks. dist., marked $\frac{1}{4}$ S24 BT.
A juniper, 10 ins. diam., brs. N. 600W.,
176 lks. dist., marked $\frac{1}{4}$ S23 BT.
61.00 Wash, 12 lks. wide, course NE.
80.00 Set an iron post, 3 ft. long, 2 ins. diam., on bed rock, in a mound of stone, for cor. of secs. 13, 14, 23 and 24, marked on brass cap

T30N | R15W

S14 | S13

S23 | S24

1921

From which

- A juniper, 8 ins. diam., brs. N. 5 $\frac{1}{2}$ 0E.,
59 lks. dist., marked T30N R15W S13 BT.
A juniper, 10 ins. diam., brs. S. 490E.,
146 lks. dist., marked T30N R15W S24 BT.
A juniper, 12 ins. diam., brs. S. 270W.,
4 lks. dist., marked T30N R15W S23 BT.
A juniper, 12 ins. diam., brs. N. 560W.,
114 lks. dist., marked T30N R15W S14 BT.

Land, level and rolling.

Soil, 4th rate.

Timber, juniper.

Undergrowth, black brush, sagebrush and cactus.

Fair grazing.

S. 89° 57' E., on a random line, bet. secs. 13 and 24.

- 40.00 Set temp. $\frac{1}{4}$ sec. cor.
80.06 Fall 12 lks. S. of the cor. of secs. 13, 18, 19 and 24, on the E. bdy. of Tp., hereinbefore described. Thence S. 89° 58' W. on a true line, bet. secs. 13 and 24. Over rolling land, through scattering timber and undergrowth.

Asc.

- 0.55 Spur, slopes N. 200E. Desc. 30 ft.
22.25 Wash, 12 lks. wide, course N. 200E. Asc. 65 ft.
32.05 Spur, slopes N. Desc. 110 ft.
40.03 Set an iron post, 3 ft. long, 1 in. diam., 12 ins. in the ground, in a mound of stone with marked (X) stone for $\frac{1}{4}$ sec. cor., marked on brass cap

BOOK 810 13

Survey of Part of the Subdivision
of T. 30 N. R. 15 W.

Chains	
	$\frac{1}{4}$ <u>S 13</u> S 24 1921
	From which A juniper, 8 ins. diam., brs. N. 39°W., 203 lks. dist., marked $\frac{1}{4}$ S13 BT. No other trees within limits. Continue descent.
41.35	Draw, 10 lks. wide, course N.10°W. Asc. 50 ft.
54.55	Spur, slopes N. 20°E. Desc. 75 ft.
77.05	Wash, 20 lks. wide, course N.30°E. Asc.
80.06	The cor. of secs. 13, 14, 23 and 24. Land, rolling. Soil, 3rd rate. Timber, juniper. Undergrowth, sagebrush, black brush and cactus. Fair grazing.

	N.00°1'W. bet. secs. 13 and 14. Over rolling land, through scattering timber and under- growth. Desc. 25 ft.
2.50	Wash, course NE.
5.00	Desc. 25 ft.
9.90	Wash, 10 lks. wide, course NE.
20.00	Desc. gradual slope, 25 ft.
40.00	Set an iron post, 3 ft. long, 1 in. diam., 16 ins. in the ground, with marked (X) stone, for $\frac{1}{4}$ sec. cor.; and raise a mound of stone around post, with brass cap marked
	$\frac{1}{4}$ S14 S13 1921
	Continue gradual descent.
54.00	Wash, 10 lks. wide, course NE. Asc. 50 ft.
73.50	Desc. 85 ft.
80.00	Set an iron post, 3 ft. long, 2 ins. diam., on bed rock, with marked (X) stone, for cor. of secs. 11, 12, 13 and 14; and raise a mound of stone around post, with brass cap marked
	T30N, R15W <u>S11 S12</u> <u>S14 S13</u> 1921
	Land, rolling. Soil, 3rd rate. Timber, juniper. Undergrowth, sagebrush, black brush and cactus. Fair grazing.

	N.89°58'E. on a random line, bet. secs. 12 and 13.
40.00	Set temp. $\frac{1}{4}$ sec. cor.
79.96	Fall 9 lks. N. of the cor. of secs. 7, 12, 13, and 18, on the E. bdy. of Tp., hereinbefore described. Thence N.89°58'W. on a true line, bet. secs. 12 and 13. Over rolling hills, through scattering timber and under- growth. Desc. 30 ft.
14.30	Asc. 50 ft.
21.00	Spur, slopes S. Desc. 150 ft.

Survey of Part of the Subdivision
of T. 30 N., R. 15 W.

Chains

39.98	Set an iron post, 3 ft. long, 1 in. diam., 14 ins. in the ground, with marked (X) stone, for $\frac{1}{4}$ sec. cor.; and raise a mound of stone around post, with brass cap marked
	$\frac{1}{4} \begin{array}{c} S 12 \\ S 13 \\ 1921 \end{array}$
	Continue descent, 40 ft.
40.20	Wash, 14 lks. wide, course N.20°W. Asc. 100 ft.
51.30	Ridge, brs. N.20°W. and SE. Desc. 175 ft.
61.50	Wash, 75 lks. wide, course N.20°W. Asc. 165 ft.
73.00	Spur, slopes NE. Desc.
79.96	The cor. of secs. 11, 12, 13 and 14. Land, rolling hills. Soil, 3rd rate. Timber, juniper. Undergrowth, scrub oak, sagebrush, black brush and cactus. Fair grazing.

	N.001°W. bet. secs. 11 and 12. Over mountainous land, through scattering undergrowth. Desc.
2.00	Ravine, 5 lks. wide, 30 ft. deep, course NE. Asc. 140 ft.
11.83	Spur, slopes E. Thence over top of spur.
19.50	Desc. 100 ft.
25.16	Asc. 30 ft.
32.00	Spur, slopes NE. Desc. 45 ft.
40.00	Set an iron post, 3 ft. long, 1 in diam., 16 ins. in the ground, with marked (X) stone, for $\frac{1}{4}$ sec. cor.; and raise a mound of stone around post, with brass cap marked
	$\frac{1}{4} \begin{array}{c} S 11 \\ S 12 \\ 1921 \end{array}$
	Continue descent, 55 ft.
44.95	Asc. 110 ft.
49.80	Ridge, brs. NE. and SW. Desc. 300 ft.
78.00	Canyon, 20 lks. wide, course N.20°E. Asc.
80.00	Set an iron post, 3 ft. long, 2 ins. diam., on bed rock, with marked (X) stone, for cor. of secs. 1, 2, 11 and 12; and raise a mound of stone around post, with brass cap marked
	$\begin{array}{c} T 30 N R 15 W \\ S 2 S 1 \\ \hline S 11 S 12 \\ 1921 \end{array}$
	Land, mountainous. Soil, rocky, 4th rate. Timber, none. Undergrowth, sagebrush, black brush and cactus. Fair grazing.

	S.89°58'E. on a random line, bet. secs. 1 and 12.
40.00	Set temp. $\frac{1}{4}$ sec. cor.
80.16	Intersect the cor. of secs. 1, 6, 7 and 12, on the E. bdy. of Tp. hereinbefore described. Thence N.89°58'W. on a true line, bet. secs. 1 and 12. Over mountainous land, through scattering undergrowth. Asc. 100 ft..
14.15	Ridge, brs. NE. and SW. Desc. 220 ft.

Survey of Part of the Subdivision
of T. 30 N., R.15 W.

Chains.

28.95 Wash, 20 lks. wide, course SW. Asc. 125 ft.
40.08 Set an iron post, 3 ft. long, 1 in. diam., 16 ins. in the
ground, with marked (X) stone, for $\frac{1}{4}$ sec. cor.; and raise
a mound of stone around post, with brass cap marked

$\frac{1}{4}$ $\frac{S \ 1}{S \ 12}$
1921

Desc. 265 ft.
54.35 Rim rock, brs. NE. and SW. Continue descent.
64.85 Wash, 40 lks. wide, course NE. Asc. 125 ft.
72.45 Spur, slopes NE. Desc. 125 ft.
78.85 Wash, 12 lks. wide, course NE. Asc. 25 ft.
80.16 The cor. of secs. 1, 2, 11 and 12.
Land, mountainous.
Soil, rocky, 4th rate.
Timber, none.
Undergrowth, sagebrush, black brush and cactus..
Fair grazing.

4.95 N.001'W. on a random line, bet. secs. 1 and 2.
Impossible to chain from this point across gulch. Set a
flag ahead on line, from which
I measure a base N.89°59'E.
16.50 chs.. From E. end of base,
flag at the 4.95 ch. point brs.
S.29°14'W. The three angles of
the triangle are therefore
29°15', 90° and 60°45', the sum
of which is 180°. The distance
triangulated is given by cot.
29°15' X 16.50 = 1.78563 X 16.50
= 29.46 chs., which added to
4.95 chs., gives

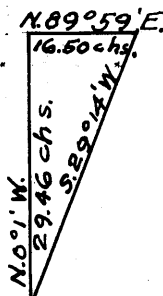

34.41 Thence continue N.001'W.
40.00 Set temp. $\frac{1}{4}$ sec. cor.
79.60 Intersect the cor. of secs. 1, 2, 35 and 36, on the N.
bdy. of Tp., hereinbefore described.
Thence S.001'E. on a true line, bet. secs. 1 and 2.
Over rolling and mountainous land, through scattering
undergrowth.
Asc. gradually.
7.35 Ridge, brs. E. and W. Desc. 60 ft.
11.20 Ravine, 60 ft. deep, course N.70°W. Asc.
19.00 Hill, brs. E. and W. Desc. 85 ft.
28.20 Ravine, 70 ft. deep, course N.70°W. Asc. 80 ft.
34.65 Desc. 45 ft.
39.60 Set an iron post, 3 ft. long, 1 in. diam., on bed rock,
with marked (X) stone, for $\frac{1}{4}$ sec. cor.; and raise a mound
of stone around post, with brass cap marked

$\frac{1}{4}$
S 2 | S 1
1921

Asc. 50 ft.
45.15 Spur, slopes S. Thence by triangulation, topography
approximate. Desc.
71.60 Wash in deep canyon, 40 lks. wide, course W. Asc.
74.65 Spur, slopes E. Thence by chaining, descending 50 ft.
79.60 The cor. of secs. 1, 2, 11 and 12.
Land, rolling and mountainous.
Soil, rocky, 4th rate.
Timber, none.
Undergrowth, black brush, sagebrush and cactus.
Fair grazing.

Survey of Part of the Subdivision
of T. 30 N., R. 15 W.

Chains From the cor. of secs. 2, 3, 34 and 35, on the S. bdy. of
Tp. described in Book "G".
N. 001' W. bet. secs. 34 and 35.
Over rolling and level land, through scattering timber and
undergrowth.
27.00 Draw, course N. 70° E. Asc. 65 ft.
34.00 Spur, slopes N. 70° E. Desc.
40.00 Set an iron post, 3 ft. long, 1 in. diam., 12 ins. in the
ground, with marked (X) stone, for $\frac{1}{4}$ sec. cor.; and raise
a mound of stone around post, with brass cap marked

$\frac{1}{4}$
S34 | S35

1921

Thence over level land.
54.00 Draw, course E. Asc. 70 ft.
80.00 Set an iron post, 3 ft. long, 2 ins. diam. 6 ins. in the
ground, in a mound of stone with marked (X) stone for
cor of secs. 26, 27, 34 and 35, marked on brass cap

T30N | R15W

S27 | S26

S34 | S35

1921

From which

A juniper, 10 ins. diam., brs. N. 63 $\frac{1}{2}$ ° E.,
112 lks. dist., marked T30N R15W S26 BT.
No other trees within limits.
Land, level and rolling.
Soil, rocky, 4th rate.
Timber, juniper.
Undergrowth, sagebrush, black brush and cat claw.
Fair grazing.
Cor. fall on spur, slopes NE.

East on a random line, bet. secs. 26 and 35.
40.00 Set temp. $\frac{1}{4}$ sec. cor.
80.00 Intersect the cor. of secs. 25, 26, 35 and 36.
Thence West on a true line bet. secs. 26 and 35.
Over level and rolling land, through scattering timber
and undergrowth.
10.00 Asc. 25 ft.
15.00 Continue over level land.
30.00 Asc. 20 ft.
40.00 Set an iron post, 3 ft. long, 1 in. diam., 14 ins. in the
ground, with marked (X) stone, for $\frac{1}{4}$ sec. cor.; and raise
a mound of stone around post, with brass cap marked

$\frac{1}{4}$ S 26

S 35

1921

Continue over level land.
58.30 Asc. 65 ft.
80.00 Spur, slopes NE. The cor of secs. 26, 27, 34 and 35.
Land, level and rolling.
Soil, 3rd rate.
Timber, juniper.
Undergrowth, sagebrush, black brush and cactus.
Fair grazing.

N. 001' W. bet. secs. 26 and 27.

Survey of Part of the Subdivision
of T. 30 N., R. 15 W.

BOOK 3558

Chains Over level land, through scattering timber and under-
growth.
15.00 Desc. 145 ft.
36.00 Draw, course NE. Continue over level land.
40.00 Set an iron post, 3 ft. long, 1 in. diam., 8 ins. in the
ground, in a mound of stone with marked (X) stone for
 $\frac{1}{4}$ sec. cor., marked on brass cap

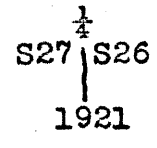

From which
A juniper, 16 ins. diam., brs. S. 61 $\frac{1}{2}$ ° E.,
234 lks. dist., marked $\frac{1}{4}$ S26 BT.
54.00 Same draw, course NW. Asc. gradual slope, 30 ft.
80.00 Set an iron post, 3 ft. long, 2 ins. diam., 6 ins. in the
ground, in a mound of stone with marked (X) stone for
for of secs. 22, 23, 26 and 27, marked on brass cap

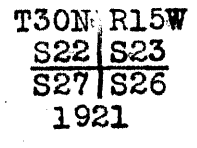

From which
A juniper, 6 ins. diam., brs. N. 77° E.,
58 lks. dist., marked T30N R15 W S23 BT.
No other trees within limits.
Land, level and rolling.
Soil, 4th rate.
Timber, juniper.
Undergrowth, sagebrush, black brush, and cactus.
Fair grazing.

40.00 East on a random line, bet. secs. 23 and 26.
Set temp. $\frac{1}{4}$ sec. cor.
80.16 Intersect the cor. of secs. 23, 24, 25 and 26.
Thence West on a true line, bet. secs. 23 and 26.
Over rolling land, through scattering timber and under-
growth.
Asc. 55 ft.
19.15 Spur, slopes, NE. Desc. 45 ft.
29.95 Ravine, 8 lks. wide, course NE. Asc. 55 ft.
39.15 Spur, slopes NE. Desc.
40.08 Set an iron post, 3 ft. long, 1 in. diam., 4 ins. in the
ground, with marked (X) stone, for $\frac{1}{4}$ sec. cor.; and
raise a mound of stone around post, with brass cap
marked

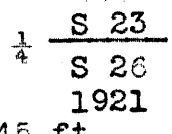

Continue descent, 45 ft.
45.65 Ravine, 6 lks. wide, course NE. Asc. 80 ft.
62.15 Ridge, brs. N. 20° E. and S. 20° W. Desc. 65 ft.
77.15 Draw, course N. 20° W. Asc.
80.16 The cor. of secs. 22, 23, 26 and 27.
Land, rolling.
Soil, rocky, 4th rate.
Timber, juniper.
Undergrowth, sagebrush, black brush and cactus.
Fair grazing.

Survey of Part of the Subdivision
of T. 30 N., R. 15 W.

Chains	N.001'W. bet. secs. 22 and 23. Over rolling land, through scattering undergrowth. Desc. 30 ft.
8.20	Thence over level land..
28.18	Asc. 50 ft.
40.00	Set an iron post, 3 ft. long, 1 in. diam., 3 ins. in the ground, with marked (X) stone, 16 X 12 X 6 ins., for $\frac{1}{4}$ sec. cor., and raise a mound of stone around post, with brass cap marked
	$\begin{array}{c} \frac{1}{4} \\ \text{S22} \text{S23} \\ \hline 1921 \end{array}$
	Desc. 60 ft.
49.95	Draw, course NW. Asc. 25 ft.
68.55	Desc. 30 ft.
73.53	Draw, course NW. Asc. 25 ft.
80.00	Set an iron post, 3 ft. long, 2 ins. diam., 6 ins. in the ground, with marked (X) stone, 8 X 8 X 4 ins., for cor. of secs. 14, 15, 22 and 23; and raise a mound of stone around post, with brass cap marked
	$\begin{array}{c} \text{T30N} \text{R15W} \\ \hline \text{S15} \text{S14} \\ \hline \text{S22} \text{S23} \\ \hline 1921. \end{array}$
	Land, rolling. Soil, rocky, 4th rate. Timber, none. Undergrowth, sagebrush, black brush and cactus. Fair grazing.

	East on a random line, bet. secs. 14 and 23.
40.00	Set temp. $\frac{1}{4}$ sec. cor.
79.94	Intersect N. and S. line, 5 lks. N. of the cor. of secs. 13, 14, 23 and 24.
	Thence N.89°58'W. on a true line, bet. secs. 14 and 23.
	Over rolling land, through scattering undergrowth..
	Asc. 75 ft.
13.00	Spur, slopes NE. Desc. 30 ft.
19.50	Ravine, 6 lks. wide, course NE. Asc. 90 ft.
30.50	Ridge, brs. N. 20°E. and S. 20°W. Desc. 35 ft.
38.00	Center of flat, 4 chs. wide, slopes N.
39.97	Set an iron post, 3 ft. long, 1 in. diam., 26 ins. in the ground, for $\frac{1}{4}$ sec. cor., marked on brass cap
	$\frac{1}{4} \frac{\text{S } 14}{\text{S } 23}$
	1921
	And raise a mound of stone, 2 ft. base, 1 $\frac{1}{2}$ ft. high, N. of cor.
	Thence over gently rolling land:
60.00	Asc. 45 ft.
70.00	Spur, slopes N. Desc. 45 ft.
79.94	The cor. of secs. 14, 15, 22 and 23.
	Land, level and rolling.
	Soil, 2nd rate.
	No timber..
	Undergrowth, sagebrush, black brush and cactus.
	Fair grazing.

Survey of Part of the Subdivision
of T. 30 N., R. 15 W,

BOOK 2506

Chains	N.001'W.bet.secs.14 and 15. Over level and rolling land, through scattering under- growth.
5.00	Desc. 25 ft.
14.91	Draw, course W. Asq. 50 ft.
25.00	Thence along W. slope.
40.00	Set an iron post, 3 ft. long, 1 in. diam., 8 ins. in the ground, with marked (X) stone, 12 X 8 X 8 ins., for $\frac{1}{4}$ sec.cor.; and raise a mound of stone around post, with brass cap marked
	$\frac{1}{4}$ S15 S14 1921
	Asc. 20 ft.
44.00	Spur, slopes W. Thence along W. slope.
59.05	Desc. 25 ft.
64.00	Thence along W. slope.
71.60	Desc. 35 ft.
80.00	Draw, course SW. Set an iron post, 3 ft. long, 2 ins. diam., 26 ins. in the ground, for cor. of secs. 10, 11, 14 and 15, marked on brass cap
	T30N R15W S10 S11 S15 S14 1921
	And raise a mound of stone, 2 ft. base, 2 $\frac{1}{2}$ ft. high, W. of cor. Land, level and rolling. Soil, rocky, 4th rate. Timber, none. Undergrowth, black brush, sagebrush and cactus. Fair grazing.

40.00	S.89°58'E. on a random line, bet. secs. 11 and 14. Set temp. $\frac{1}{4}$ sec. cor.
79.88	Intersect N. and S line, 14 lks. N. of the cor. of secs. 11, 12, 13 and 14. Thence N.89°52'W. on a true line, bet. secs. 11 and 14. Over broken hills, through scattering timber and under- growth.
	Desc.
2.70	Ravine, 10 lks. wide, course NE. Asc. 85 ft.
13.90	Ridge, brs. N. and S. Desc. 65 ft.
39.94	Set an iron post, 3 ft. long, 1 in. diam.; 26 ins. in the ground, for $\frac{1}{4}$ sec.cor., marked on brass cap
	$\frac{1}{4}$ S 11 S 14 1921
	From which A juniper, 6 ins. diam., brs. N. 79 $\frac{1}{4}$ °E., 180 lks. dist., marked $\frac{1}{4}$ S11 BT. No other trees within limits. Continue descent.
57.70	Wash, 12 lks. wide, course NE. Asc. 25 ft.
62.50	Low ridge, brs. N. and S. Desc.
79.88	The cor. of secs. 10, 11, 14 and 15. Land, rolling and broken hills. Soil, 2nd rate. Timber, juniper. Undergrowth, sagebrush, black brush and cactus.. Fair grazing.

Survey of Part of the Subdivision
of T. 30 N., R. 15 W.

Chains N.001'W. bet. secs. 10 and 11.
Over rolling hills, through scattering undergrowth.
Asc. 100 ft.
8.25 Thence over nearly level land.
39.50 Head of wash, course N.200E.
40.00 Set an iron post, 3 ft. long, 1 in. diam., 6 ins. in the
ground, with marked (X) stone, for $\frac{1}{4}$ sec. cor.; and raise
a mound of stone around post, with brass cap marked

$\frac{1}{4}$
S10 | S11
1921

47.75 Desc. 65 ft.
54.00 Wash, 6 lks. wide, course NE. Asc. 45 ft.
64.00 Spur, slopes NE. Desc. 195 ft.
76.00 Wash, 50-lks. wide, course NW. Asc. 75 ft.
80.00 Set an iron post, 3 ft. long, 2 ins. diam., 24 ins. in the
ground, for cor. of secs. 2, 3, 10 and 11, marked on
brass cap

T30N | R15W
S 3 | S 2
S10 | S11
1921

And raise a mound of stone, 2 ft. base, $1\frac{1}{2}$ ft. high, W.
of cor.
Land, rolling and level.
Soil, 4th rate.
Timber, none.
Undergrowth, sagebrush, black brush and cactus.
Fair grazing.

S.89052'E. on a random line, bet. secs. 2 and 11.
40.00 Set temp. $\frac{1}{4}$ sec. cor.
79.88 Intersect N. and S. line, 14 lks. S. of the cor. of secs.
1, 2, 11 and 12.
Thence N.89058'W. on a true line, bet. secs. 2 and 11.
Over rolling and mountainous land, through scattering
undergrowth.
Asc. 365 ft.
39.94 Set an iron post, 3 ft. long, 1 in. diam., 12 ins. in the
ground, with marked (X) stone, for $\frac{1}{4}$ sec. cor.; and raise
a mound of stone around post, with brass cap marked

$\frac{1}{4}$ S 2
S 11
1921

Continue ascent.
40.40 Ridge, brs. N. and S. Desc. 95 ft.
70.60 Asc. 50 ft.
75.95 Desc. 30 ft.
79.88 The cor. of secs. 2, 3, 10 and 11.
Land, rolling and mountainous.
Soil, rocky, 4th rate.
Timber, none.
Undergrowth, black brush, sagebrush and cactus.
Fair grazing.

N.001'W. on a random line, bet. secs. 2 and 3.
40.00 Set temp. $\frac{1}{4}$ sec. cor.
43.00 Rim of impassable canyon, brs. E. and W. Impossible
to chain from this point. I return to a point 59 lks.

Survey of Part of the Subdivision
of T. 30 N., R. 15 W.

BOOK 3085 21

Chains	<p>East of the 34.07 chs. point bet. secs. 2 and 3, whence flag at the witness cor. of secs. 2, 3, 34 and 35, which is 3.79 chs. West of the true point for cor., brs. N.50°26'W. From same point, measure a base N.64°10'E., 15.00 chs., whence flag at witness cor. brs. N.24°36'W. The three angles of the triangle are therefore 19°10', 91°14' and 69°36', the sum of which is 180°. The distance triangulated on the bearing N.5°26'W. is given by the sine proportion:</p> $\frac{X}{15.00} = \frac{\sin. 91^{\circ}14'}{\sin. 19^{\circ}10'}$ <p>log. 15.00 = 1.176091 log. sin. 91°14' = 9.999899 log. sin. 19°10' = 1.175990 log. X = 9.516294 X = 1.659696 45.68 chs. The latitude and departure of this line are 45.47 chs. and 4.33 chs. respectively. The length and falling of the theoretical random line bet. secs. 2 and 3 are therefore.</p> <p>79.54 Fall 6 lks. W. of the true point for cor. of secs. 2, 3, 34 and 35, on the N. bdy. of Tp., witnessed as hereinbefore described at 3.79 chs. W. From the true point for cor. of secs. 2, 3, 34 and 35. S.0°2'W., on a true line, bet. secs. 2 and 3. Over mountainous land, through scattering undergrowth. Along deep, impassable canyon.</p> <p>36.50 Rim of impassable canon, brs. NE. and NW. Asc. 39.54 Set an iron post, 3 ft. long, 1 in. diam., 12 ins. in the ground, with marked (X) stone, for $\frac{1}{4}$ sec. cor.; and raise a mound of stone around post, with brass cap marked</p> <p style="text-align: center;">S 3 S 2 1921</p> <p>Continue ascent.</p> <p>45.47 Spur, slopes N.64°E. Desc. 20 ft., distance by chaining. 53.46 Draw, course NE. Asc. 35 ft. 59.23 Ridge, brs. NW. and SE. Desc. 45 ft. 63.70 Thence along W. slope. 70.40 Desc. 25 ft. 79.54 The cor. of secs. 2, 3, 10 and 11. Land, rolling and mountainous. Soil, 3rd rate. No timber. Undergrowth, black brush, sagebrush and cactus. Fair grazing.</p> <hr/> <p>From the cor. of secs. 3, 4, 33 and 34, on the S. bdy. of Tp., described in Book "G". N.0°2'W. bet. secs. 33 and 34. Over level land, through scattering timber and undergrowth.</p> <p>10.00 Draw, course E. Asc. 215 ft. 30.88 Spur, slopes NE. Desc. 55 ft. 40.00 Draw, course NE. Set an iron post, 3 ft. long, 1 in. diam. 22 ins. in the ground, in a mound of stone, for $\frac{1}{4}$ sec. cor. marked on brass cap</p>	
--------	---	--

Survey of Part of the Subdivision
of T. 30 N., R. 15 W.

Chains

$$\begin{array}{c} \uparrow \\ \text{S33} \mid \text{S34} \\ \downarrow \end{array}$$

1921

From which

A juniper, 12 ins. diam., brs. S. 43°E.,
286 lks. dist., marked $\frac{1}{4}$ S34 BT.

A juniper, 14 ins. diam., brs. S. 10°W.,
351 lks. dist., marked $\frac{1}{4}$ S33 BT.

Asc. 30 ft.

45.00 Spur, slopes NE. Desc. 75 ft.

63.41 Draw, course W. Asc. 25 ft.

67.70 Spur, slopes W. Desc. 80 ft.

80.00 Set an iron post, 3 ft. long, 2 ins. diam., 6 ins. in the ground, in a mound of stone with marked (X) stone for cor. of secs. 27, 28, 33 and 34, marked on brass cap

$$\begin{array}{c} \text{T30N} \mid \text{R15W} \\ \text{S28} \mid \text{S27} \\ \text{S33} \mid \text{S34} \end{array}$$

1921

From which

A juniper, 6 ins. diam., brs. N. 57°E.,
115 lks. dist., marked T30N R15W S27 BT.

A juniper, 12 ins. diam., brs. S. 58°E.,
233 lks. dist., marked T30N R15W S34 BT.

A juniper, 12 ins. diam., brs. S. 40°W.,
209 lks. dist., marked T30N R15W S33 BT.

No other trees within limits.

Land, level, rolling and mountainous.

Soil, 2nd and 3rd rates.

Timber, juniper.

Undergrowth, sagebrush, black brush and cactus..

Fair grazing.

East on a random line, bet. secs. 27 and 34.40.00 Set temp. $\frac{1}{4}$ sec. cor.

79.98 Intersect N. and S. line, 5 lks. N. of the cor. of secs. 26, 27, 34 and 35.

Thence N. 85° 58' W. on a true line, bet. secs. 27 and 34.

Over rolling land, through scattering timber and undergrowth.

Desc. 75 ft.

9.13 Draw, course N.. Asc. 35 ft.

14.10 Point of spur slopes N. Desc. 20 ft.

23.40 Wash, course NE. Asc. 85 ft.

39.99 Set an iron post, 3 ft. long, 1 in. diam., 12 ins. in the ground, with marked (X) stone, for $\frac{1}{4}$ sec. cor.; and raise a mound of stone around post, with brass cap marked
$$\frac{1}{4} \begin{array}{c} \text{S 27} \\ \text{S 34} \end{array}$$

1921

Thence along S. slope.

60.00 Asc. 70 ft.

67.31 Spur, slopes N.. Desc. 120 ft.

79.98 The cor. of secs. 27, 28, 33 and 34.

Land, rolling.

Soil, 3rd rate.

Timber, juniper.

Undergrowth, sagebrush, black brush and cactus.

Fair grazing.

Survey of Part of the Subdivision
of T. 30 N., R. 15 W..

BOOK 3586

Chains	<p>The closing cor. of secs. 28 and 33, on the West Bdy. of the Hualpai Indian Reservation is an iron post, 2 ins. diam., set in a mound of stone, properly marked, witnessed by a mound of stone W. of cor. This cor. is established 17.90 chs. East of the cor. of secs. 28, 29, 32 and 33.</p>
20.60	<p>Thence East on a random line, bet. sec. 28 and 33. (38.50 chs. East of the cor. of secs. 28, 29, 32 and 33) Set temp. $\frac{1}{4}$ sec. cor.</p>
60.77	<p>(78.67 chs. East of the cor. of secs. 28, 29, 32 and 33) Intersect N. and S. line, 14 lks. S. of the cor. of secs. 27, 28, 33 and 34.</p>
	<p>I return to the closing cor. of secs. 28 and 33, on the Hualpai Indian Reservation Boundary.</p>
	<p>Thence East on a true line, bet. secs. 28 and 33.</p>
	<p>Over level land, through scattering timber and undergrowth.</p>
10.15	<p>Wash, course NE. Asc. 70 ft.</p>
20.77	<p>(38.67 chs. East of the cor. of secs. 28, 29, 32 and 33) Set an iron post, 3 ft. long, 1 in. diam. 10 ins. in the ground, with marked (X) stone, for $\frac{1}{4}$ sec. cor.; and raise a mound of stone around post, with brass cap marked</p>
	<p style="text-align: center;">$\frac{1}{4}$ $\frac{S\ 28}{S\ 33}$ 1921</p>
	<p>Thence N. 89° 48' E. on a true line, continuing measurement.</p>
32.50	<p>Continue ascent, 80 ft.</p>
39.75	<p>Spur, slopes N. Desc. 85 ft.</p>
52.75	<p>Draw, course S. Asc. 75 ft.</p>
59.75	<p>Spur, slopes N. Desc. 25 ft.</p>
60.77	<p>Draw, course NE. Asc.</p>
	<p>(78.67 chs. East of the cor. of secs. 28, 29, 32 and 33) The cor. of secs. 27, 28, 33 and 34. Land, level and rolling. Soil, 2nd and 3rd rates. Timber, juniper. Undergrowth, black brush, sagebrush and cactus. Fair grazing.</p>
	<p>-----</p>
	<p>N. 0° 02' W. bet. secs. 27 and 28.</p>
2.90	<p>Over level and rolling land, through scattering timber and undergrowth.</p>
10.00	<p>Draw, course NE.</p>
16.15	<p>Asc. 45 ft.</p>
30.47	<p>Spur, slopes NE. Desc. 150 ft.</p>
37.47	<p>Thence over level land.</p>
40.00	<p>Leave level land, brs. NE. and SW. Asc.</p>
	<p>Set an iron post, 3 ft. long, 1 in. diam., 4 ins. in the ground, with marked (X) stone, 16 X 12 X 3 ins., for $\frac{1}{4}$ sec. cor.; and raise a mound of stone around post, with brass cap marked</p>
	<p style="text-align: center;">$\frac{1}{4}$ S28 S27 1921</p>
	<p>Continue ascent, 20 ft.</p>

Survey of Part of the Subdivision
of T. 30 N., R.15 W,

Chains	
42.53	Spur, slopes E. Desc. 60 ft.
52.25	Thence over level land.
71.85	Draw, course NE.
80.00	Set an iron post, 3 ft. long, 2 ins. diam., 27 ins. in the ground, for cor. of secs. 21, 22, 27 and 28, marked on brass cap
	T30N R15W S21 S22 S28 S27 1921
	And raise a mound of stone, 2½ ft. base, 2 ft. high, W. of cor. Land, rolling and level. Soil, 3rd and 4th rates. Timber, juniper. Undergrowth, black brush, sagebrush and cactus. Fair grazing.

	S. 89°58'E. on a random line, bet. secs. 22 and 27.
40.00	Set temp. ¼ sec. cor.
79.92	Intersect N. and S. line 5 lks. N. of the cor. of secs. 22, 23, 26 and 27.
	Thence N. 89°56'W. on a true line, bet. secs. 22 and 27.
	Over rolling land, through scattering timber and undergrowth.
	Asc. 25 ft.
3.40	Spur, slopes NW. Desc. 70 ft.
11.70	Wash, 10 lks. wide, 10 ft. deep, course NW. Asc. 190 ft.
32.40	Spur, slopes N. 30°W. Desc. 30 ft.
39.96	Set an iron post, 3 ft. long, 1 in. diam., 10 ins. in the ground, with marked (X) stone, for ¼ sec. cor.; and raise a mound of stone around post, with brass cap marked
	¼ S 22 ¼ S 27 1921
	Continue descent, 50 ft.
60.90	Draw, course NW. Thence over level land.
74.90	Draw, course NW.
79.92	The cor. of secs. 21, 22, 27 and 28.
	Land, rolling and level.
	Soil, 2nd and 4th rates.
	Timber, juniper.
	Undergrowth, sagebrush, black brush and cactus.
	Fair grazing.

	The closing cor. of secs. 21 and 28, on the West Boundary of the Hualpai Indian Reservation is an iron post, 2 ins. diam., 10 ins. projecting above ground, properly marked, witnessed by pits and a mound of earth. This cor. is established 17.82 chs. East of the cor. of secs. 20, 21, 28 and 29.
	Thence East on a random line, bet. secs. 21 and 28.
20.68	(38.50 chs. East of the cor. of secs. 20, 21, 28 and 29)
	Set temp. ¼ sec. cor.
60.92	(78.74 chs. East of the cor. of secs. 20, 21, 28 and 29)
	Intersect the N. and S. line, 24 lks. S. of the cor.

Survey of Part of the Subdivision
of T. 30 N., R. 15 W.

Book 3166

Chains

of secs. 21, 22, 27 and 28.
 I return to the closing cor. of secs. 21 and 28, on the
 W. Bdy. of the Hualpai Indian Reservation.
 Thence East on a true line, bet. secs. 21 and 28.
 Over level land, through scattering undergrowth.
 Fence, brs. N. and S.
 Leave level land, brs. NW. and SE. Asc. 45 ft.
 (38.74 chs. East of the cor. of secs. 20, 21, 28 and 29)
 Set an iron post, 3 ft. long, 1 in. diam., 6 ins. in the
 ground, with marked (X) stone, 16 X 16 X 8 ins., for
 1/4 sec. cor.; and raise a mound of stone around post,
 with brass cap marked

0.49
11.00
20.92

1/4 S 21
 S 28
 1921

Thence N. 89° 03' 39" E. on a true line, continuing measurement.
 Continue ascent, 60 ft.
 Spur, slopes N. 20° E. Desc. 115 ft.
 Draw, course NE. Asc.
 Desc. 15 ft.
 Thence over level land.
 (78.74 chs. from the cor. of secs. 20, 21, 28 and 29)
 The cor. of secs. 21, 22, 27 and 28.
 Land, level and rolling.
 Soil, 2nd, 3rd and 4th rates.
 Timber, none.
 Undergrowth, sagebrush, scrub oak, black brush and cactus.
 Fair grazing.

33.93
45.43
47.93
50.93
60.92

N. 0° 02' W. bet. secs. 21 and 22.
 Over level land, through scattering timber and under-
 growth.
 Draw, course NW.
 Asc. 175 ft.
 Thence along W. slope.
 (Midpoint bet. th cor. of secs. 21, 22, 27 and 28 and
 the closing cor. of secs. 16 and 21, herein after de-
 scribed.) Set an iron post, 3 ft. long, 1 in. diam.,
 8 ins. in the ground, with marked (X) stone, 16 X 14 X
 8 ins.; for 1/4 sec. cor. of sec. 21; and raise a mound
 of stone around post, with brass can marked

11.00
15.00
29.80
39.78

1/4 S 21
 1921

Set an iron post, 3 ft. long, 1 in. diam., 12 ins. in the
 ground, with marked (X) stone, for 1/4 sec. cor. of sec.
 22; and raise a mound of stone around post, with brass
 cap marked

40.00

1/4 S 22
 1921

Thence along W. slope
 Spur, slopes NW. Desc. 145 ft.
 Wash, 10 lks. wide, 2 ft. deep, course SW. Asc. 75 ft.
 Ridge, brs. E. and W. Desc. 55 ft.
 The closing cor. of secs. 16 and 21, hereinafter de-
 scribed.
 Set an iron post, 3 ft. long, 2 ins. diam., 6 ins. in the
 ground, with marked (X) stone, 8 X 8 X 8 ins. for cor
 of secs. 15 and 22; and raise a mound of stone around

55.00
69.07
75.53
79.57
80.00

Survey of Prt of the Subdivision
of T. 30 N., R. 15 W.

Chains

post, with brass cap marked

	T30N
	S15
S16	S22
	R15W
	1921

Land; level and rolling.
Soil, 3rd and 4th rates.
Timber, juniper
Undergrowth, black brush, sagebrush and cactus.
Fair grazing.

40.00
79.94

S.89056'E. on a random line, bet. secs. 15 and 22.
Set temp. $\frac{1}{4}$ sec. cor.
Intersect the cor. of secs. 14, 15, 22 and 23.
Thence N.89056'W. on a true line, bet. secs. 15 and 22.
Over rolling and mountainous land, through scattering
undergrowth.

Desc. 50 ft.
3.28 Wash, 20 lks. wide, 2 ft. deep, course N. Asc. 135 ft..
17.72 Spur, slopes N. Desc. 105 ft.
27.95 Wash, 10 lks. wide, course NE. Asc. 90 ft.
39.97 Set an iron post, 3 ft. long, 1 in. diam., 8 ins. in the
ground, with marked (X) stone, for $\frac{1}{4}$ sec. cor.; and raise
a mound of stone around post, with brass cap marked

$\frac{1}{4}$	S 15
	S 22
	1921

Thence along N. slope.
41.40 Desc. 30 ft.
47.38 Wash, 10 lks. wide, 1 ft. deep, course NE. Asc. 65 ft..
59.23 Spur, slopes NE. Desc. 70 ft.
71.72 Draw, course NW. Asc. 30 ft.
79.94 The cor. of secs. 15 and 22.
Land, rolling and mountainous.
Soil, 4th rate.
Timber, none,
Undergrowth, black brush, sagebrush and cactus.
Fair grazing.

The closing cor. of secs. 16 and 21, on the West Bdy. of
the Hualpai Indian Reservation is an iron post, 2 ins.
in diam., set in a mound of stone, properly marked,
and witnessed by a mound of stone, W. of cor. This
cor. is established 17.68 chs. East of the cor. of
secs. 16, 17, 20 and 21.
Thence East on a random line, bet. secs. 16 and 21.
20.82 (38.50 chs. East of the cor. of secs. 16, 17, 20 and 21)
Set temp. $\frac{1}{4}$ sec. cor.
60.93 (78.61 chs. East of the cor. of secs. 16, 17, 20 and 21)
Intersect N. and S. line, 43 lks. S. of the cor. of
secs. 15 and 22.
At the point of intersection,
Set an iron post, 3 ft. long, 2 ins. diam., 10 ins. in the
ground, with marked (x) stone, for closing cor. of secs.

Survey of Part of the Subdivision
of T. 30 N., R. 15 W.

BOOK 5000 27

Chains	16 and 21; and raise a mound of stone around post, with brass cap marked															
	<table style="margin-left: auto; margin-right: auto;"> <tr> <td></td> <td style="text-align: center;">T30N</td> <td></td> </tr> <tr> <td style="text-align: center;">CC</td> <td style="border: 1px solid black; text-align: center;">S16</td> <td style="text-align: center;">S22</td> </tr> <tr> <td></td> <td style="border: 1px solid black; text-align: center;">S21</td> <td></td> </tr> <tr> <td></td> <td style="border: 1px solid black; text-align: center;">R15W</td> <td></td> </tr> <tr> <td></td> <td style="text-align: center;">1921</td> <td></td> </tr> </table>		T30N		CC	S16	S22		S21			R15W			1921	
	T30N															
CC	S16	S22														
	S21															
	R15W															
	1921															
	<p>I return to the original closing cor. of secs. 16 and 21, on the West Bdy. of the Hualpai Indian Reservation. Thence East on a true line, bet. secs. 16 and 21. Over mountainous land, through scattering undergrowth. Asc. 80 ft.</p>															
0.61 4.65 15.92 20.93	<p>Fence, brs. N. and S. Thence along N. slope. Desc. 25 ft. (38.61 chs. East of the cor. of secs. 16, 17, 20 and 21) Set an iron post, 3 ft. long, 1 in. diam., 10 ins. in the ground, with marked (X) stone, for $\frac{1}{4}$ sec. cor.; and raise a mound of stone around post, with brass cap marked</p>															
	<table style="margin-left: auto; margin-right: auto;"> <tr> <td style="text-align: center;">$\frac{1}{4}$</td> <td style="border: 1px solid black; text-align: center;">S 16</td> </tr> <tr> <td></td> <td style="border: 1px solid black; text-align: center;">S 21</td> </tr> <tr> <td></td> <td style="text-align: center;">1921</td> </tr> </table>	$\frac{1}{4}$	S 16		S 21		1921									
$\frac{1}{4}$	S 16															
	S 21															
	1921															
35.27 45.27 50.27 60.93	<p>Continue descent, 120 ft. Enter level land, brs. NE. and SW. Draw, course NE. Leave level land; asc. 95 ft. (78.61 chs. East of the cor. of secs. 16, 17, 20 and 21) The closing cor. of secs. 16 and 21, on the E. bdy. of sec. Land, level; rolling and mountainous. Soil, 2nd and 4th rates. Timber, none. Undergrowth, black brush, sagebrush and cactus. Fair grazing.</p>															
9.90 14.90 29.90 39.90 39.50	<p>From the cor. of secs. 15 and 22. N.002'W. along the W. bdy. of sec. 15. Over rolling land, through scattering undergrowth. Desc. 90 ft. Thence over level land. Draw, course NE. Same draw, course NW. Same draw, course N.300'E. (39.93 chs. N.002'W. of the closing cor. of secs. 16 and 21, and the midpoint between the closing cor. of secs. 16 and 21 and the closing cor. of secs. 9 and 16, hereinafter described.) Set an iron post, 3 ft. long, 1 in. diam., 12 ins. in the ground, with marked (X) stone, for $\frac{1}{4}$ sec. cor. of sec. 16; and raise a mound of stone around post, with brass cap marked</p>															
	<table style="margin-left: auto; margin-right: auto;"> <tr> <td style="text-align: center;">$\frac{1}{4}$S16</td> </tr> <tr> <td style="text-align: center;">1921</td> </tr> </table>	$\frac{1}{4}$ S16	1921													
$\frac{1}{4}$ S16																
1921																
40.00	<p>Set an iron post, 3 ft. long, 1 in. diam., 12 ins. in the ground, with marked (X) stone, for $\frac{1}{4}$ sec. cor. of sec. 15; and raise a mound of stone around post, with brass cap</p>															

Survey of Part of the Subdivision
of T. 30 N., R. 15 W.

Chains	marked
	$\frac{1}{4}$ S15 1921
42.00	Wash, course E.
50.00	Asc. 80 ft.
60.00	Thence along E. slope.
71.49	Spur, slopes NE. Desc. 85 ft.
79.43	The closing cor. of secs. 9 and 16, hereinafter described.
80.00	Set an iron post, 3 ft. long, 2 ins. diam., 6 ins. in the ground, with marked (X) stone, for cor. of secs. 10 and 15; and raise a mound of stone around post, with brass cap marked

S 9	T30N
	S10
	S15
	R15W
1921	

Land, level and rolling.
Soil, 4th rate.
No timber
Undergrowth, black brush, sagebrush and cactus.
Fair grazing.

From the cor. of secs. 10 and 15.
S. 89°56'E. on a random line, bet. secs. 10 and 15.

40.00	Set temp. $\frac{1}{4}$ sec. cor.
79.92	Intersect N. and S. line, 5 lks. S. of the cor. of secs. 10, 11, 14 and 15.
	Thence N. 89°58'W. on a true line, bet. secs. 10 and 15.
	Over rolling land, through scattering undergrowth.
12.10	Desc. 35 ft.
16.80	Wash, 15 lks. wide, 4 ft. deep, course NW. Asc. 195 ft.
31.80	Ridge, brs. N. and S. Desc. 25 ft.
35.80	Draw, course N. Asc.
39.96	Spur, slopes NW. Set an iron post, 3 ft. long, 1 in. diam. 4 ins. in the ground, with marked (X) stone, 16X12X4 ins., for $\frac{1}{4}$ sec. cor.; and raise a mound of stone around post, with brass cap marked

$\frac{1}{4}$	S 10
	S 15
	1921

Desc. 35 ft.

45.09	Draw, course N.
51.08	Draw, course NE. Asc. 30 ft.
55.85	Spur, slopes N. Desc. 135 ft.
66.97	Wash, 15 lks. wide, 2 ft. deep, course NE. Asc. 20 ft.
79.92	The cor. of secs. 10 and 15.

Land rolling.
Soil, 4th rate.
Timber, none.
Undergrowth, black brush, sagebrush and cactus.
Fair grazing.

The closing cor. of secs. 9 and 16, on the West Bdy. of the Hualpai Indian Reservation, is an iron post, 2 ins. diam., set in a mound of stone, properly marked, witnessed by a mound of stone, W. of cor., and established 17.67 chs. E. of the cor. of Secs. 8, 9, 16 and 17.

Survey of Part of the Subdivision
of T. 30 N., R. 15 W.

BOOK 300

Chains
20.83

Thence East on a random line. bet. secs. 9 and 16.
(38.50 chs. East of the cor. of secs. 8, 9, 16 and 17)
Set temp. 1/4 sec. cor.

60.85

(78.52 chs. East of the cor. of secs. 8, 9, 16 and 17)
Intersect N. and S. line, 57 lks. S. of the cor. of
cor. of secs. 10 and 15.
At the point of intersection.
Set an iron post, 3 ft. long, 2 ins. diam., 12 ins. in the
ground, with marked (X) stone, for closing cor. of secs.
9 and 16; and raise a mound of stone around post,
with brass cap marked

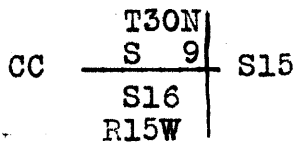

1921

I return to the original closing cor. of secs. 9 and 16.
on the West Bdy. of the Hualpai Indian Reservation.

Thence East on a true line, bet. secs. 9 and 16.
Over gently rolling land, through scattering undergrowth.
Fence, brs. N. and S.

0.05
11.88
20.85

Desc. 55 ft.
(38.52 chs. East of the cor. of secs. 8, 9, 16 and 17)
Set an iron post, 3 ft. long, 1 in. diam., 10 ins. in
the ground, with marked (X) stone, for 1/4 sec. cor.; and
raise a mound of stone around post, with brass cap
marked

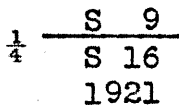

Continue descent, 40 ft.
Wash, 15 lks. wide, 1 ft. deep, course NE. Asc. 85 ft.
Spur, slopes NE. Desc. 120 ft.
Draw, course NE. Asc.
(78.52 chs. East of the cor. of secs. 8, 9, 16 and 17.)
The closing cor. of secs. 9 and 16, on the E. bdy. of
sec.

25.73
49.03
60.53
60.85

Land, rolling and gently rolling.
Soil, 4th rate.
No timber.
Undergrowth, black brush, sagebrush and cactus.
Fair grazing

From the cor. of secs. 10 and 15.
N. 0° 2' W., along the W. bdy. of sec. 10.
Over rolling and mountainous land, through scattering
undergrowth.

0.25
15.81
22.68
39.47

Desc.
Draw, course NE. Asc. 80 ft.
Spur, slopes NE. Desc. 30 ft.
Draw, course W. Asc. 25 ft.
(40.04 chs. N. 0° 2' W. of the closing cor. of secs. 9 and
16, and midpoint between the closing cor. of secs.
9 and 16 and the closing cor. of secs. 4 and 9, here-
inafter described.) Set an iron post, 3 ft. long, 1

Survey of Part of the Subdivision
of T. 30 N., R.15 W.

Chains

in.diam.12 ins.in the ground,with marked(X)stone,
for 1/4 sec.cor. of sec.9;and raise a mound of stone
around post, with brass cap marked

1/4 S 9
1921

40.00 Set an iron post, 3 ft.long,1 in.diam.,14 ins.in the
ground,with marked (X) stone, for 1/4 sec.cor.of sec.10;
and raise a mound of stone around post, with brass
cap marked

1/4 S10
1921

51.25 Cor.stands on spur, slopes NW. Desc. 120 ft.
Thence along E. slope.
56.25 Asc. 55 ft.
59.72 Desc. 185 ft.
66.66 Wash, 30 lks. wide, 3 ft. deep, course NE. Asc. 50 ft.
67.98 Desc. 30 ft.
71.48 Wash, course NE. Thence along E. slope.
79.52 The closing cor.of secs. 4 and 9,hereinafter described.
80.00 Set an iron post, 3 ft.long,2 ins. diam. 6 ins.in the
ground, with marked (X) stone, for cor. of secs. 3 and 10;
and raise a mound of stone around post with brass
cap marked

T30N
S 4 | S 3
S10
R15W
1921

Land, rolling and mountainous.
Soil, 4th rate.
Timber, none.
Undergrowth, sagebrush, black brush and cactus.
Fair grazing.

From the cor. of secs. 3 and 10.
S.89°58'E. on a random line, bet. secs. 3 and 10.
40.00 Set temp. 1/4 sec.cor.
79.92 Intersect N. and S. line, 5 lks. N. of the cor. of secs.
2, 3, 10 and 11.
Thence N.89°56'W.on a true line, bet. secs. 3 and 10.
Over rolling and mountainous land, through scattering
undergrowth.
Desc. 50 ft.
5.45 Draw, course NW. Asc. 95 ft.
15.10 Spur, slopes N. Desc.
16.40 Draw, course NW. Asc.
20.10 Spur, slopes NW. Desc. 55 ft.
27.85 Wash, course SW. Asc. 55 ft.
39.96 Set an iron post, 3 ft. long, 1 in.diam.,10 ins.in the
ground, with marked (X) stone, for 1/4 sec.cor.;and raise
a mound of stone around post, with brass cap marked

1/4 S 3
S 10
1921

Continue descent.
46.90 Draw, course N. Asc. 190 ft.
59.50 Thence along N. slope.
64.45 Desc. 160 ft.

Survey of Part of the Subdivision
of T. 30 N., R. 15 W.

31

Chains
77.10
79.92

Canyon, course N. Asc.
The cor. of secs. 3 and 10.
Land, rolling and mountainous.
Soil, 3rd and 4th rates.
No timber.
Undergrowth, black brush, sagebrush and cactus.
Fair grazing.

20.83
60.71

The closing cor. of secs. 4 and 9, on the West Bdy. of the Hualpai Indian Reservation is an iron post, 2 ins. diam., 12 ins. projecting above ground, properly marked, witnessed by a mound of stone W. of cor. This cor. is established 17.67 chs. east of the cor. of secs. 4, 5, 8 and 9.
Thence East on a random line, bet. secs. 4 and 9. (38.50 chs. East of the cor. of secs. 4, 5, 8 and 9.)
Set temp. $\frac{1}{4}$ sec. cor. (78.38 chs. East of the cor. of secs. 4, 5, 8 and 9)
Intersect N. and S. line, 48 lks. S. of the cor. of secs. 3 and 10. At the point of intersection, set an iron post, 3 ft. long, 2 ins. diam., 6 ins. in the ground, with marked (X) stone, for closing cor. of secs. 4 and 9; and raise a mound of stone around post, with brass cap marked

	T30N	
CC	S 4	S10
	S 9	
	R15W	
	1921	

4.38
10.43
20.71

I return to the original closing cor. of secs. 4 and 9, on the West Bdy. of the Hualpai Indian Reservation. Thence East on a true line, bet. secs. 4 and 9. Over rolling and mountainous land, through scattering undergrowth.
Desc.
Draw, course N. Asc. 175 ft.
Ridge, brs. N. and S. Desc. 280 ft.
(38.38 chs. East of the cor. of secs. 4, 5, 8 and 9)
Set an iron post, 3 ft. long, 1 in. diam., 12 ins. in the ground, with marked (X) stone, for $\frac{1}{4}$ sec. cor.; and raise a mound of stone around post, with brass cap marked

$\frac{1}{4}$	S 4	
	S 9	
	1921	

20.88
34.33
43.13
49.63
56.48
60.71

Continue descent.
Draw, course N. Asc. 160 ft.
Thence along S. slope.
Desc. 90 ft.
Draw, course NE. Asc. 45 ft.
Desc. 80 ft.
(78.38 chs. East of the cor. of secs. 4, 5, 8 and 9)
The closing cor. of secs. 4 and 9, on the E. Bdy. of sec.

Survey of Part of the Subdivision
of T. 30 N., R. 15 W.

Chains	<p>Land, rolling and mountainous. Soil, 4th rate. No timber. Undergrowth, black brush, sagebrush and cactus. Fair grazing.</p> <p>-----</p> <p>From the cor, of secs. 3 and 10. N.002'W. on a true line, along the W. bdy. of sec. 3. Over mountainous land, through scattering undergrowth. Desc. 25 ft.</p> <p>4.37 Wash, 30 lks. wide, 2 ft. deep, course NW. Asc. 145 ft.</p> <p>17.55 Spur, slopes W. Desc. 165 ft.</p> <p>31.86 Draw, course W. Asc. 85 ft.</p> <p>39.52 (40.00 chs. N.002'W. of the closing cor. of secs. 4 and 9) Set an iron post, 3 ft. long, 1 in. diam. 6 ins. in the ground, with marked (X) stone, for $\frac{1}{4}$ sec. cor. of sec. 4; and raise a mound of stone around post, with brass cap marked</p> <p style="text-align: center;"> $\frac{1}{4}$S 4 1921</p> <p>40.00 Set an iron post, 3 ft. long, 1 in. diam., 7 ins. in the ground, with marked (X) stone, for $\frac{1}{4}$ sec. cor. of sec. 3; and raise a mound of stone around post, with brass cap marked</p> <p style="text-align: center;"> $\frac{1}{4}$S 3 1921</p> <p>52.25 Cor. stands on spur, slopes NW. Desc. 45 ft.</p> <p>68.75 Thence along E. slope, ascending 80 ft.</p> <p>79.54 Spur, slopes NE. Desc. 85 ft.</p> <p>The cor. of secs. 3, 4, 33 and 34, on the N. bdy. of Tp. hereinbefore described.</p> <p>Land, rolling and mountainous. Soil, rocky, 4th rate. Timber, none. Undergrowth; sagebrush, black brush and cactus. Fair grazing.</p> <p>-----</p>
--------	---

Boundaries of That Portion of T. 30 N., R. 15 W.

Surveyed under this Group

Latitudes, departures and closing errors.

Line designated.	True bearing.	Dist.	Latitudes.		Departures.	
			N.	S.	E.	W.
South Boundary	West	300.88				300.88
West Boundary (Hualpai Indian Reservation Boundary)	North	320.57	320.57			
	N.007'E.	39.90	39.90		.08	
	N.009'E.	39.85	39.85		.10	
	N.0039'E.	80.00	80.00		.91	
North Boundary	East	219.91			219.91	
Subdivisional Boundary	S.001'E.	79.60		79.60	.02	
	S.89058'E.	80.16		.05	80.16	
East Boundary	South.	400.00		400.00		
Convergency					.31	
Totals			480.52	479.65	301.49	300.88
			479.65		300.88	
Error in latitude			.67			
Error in departure					.61	

General Description.

The portion of T. 30 N., R. 15 W. surveyed at this time is level, rolling and mountainous land, supporting a scattering growth of juniper timber in the southern part and black brush, sagebrush and cactus undergrowth over all the township. The soil in the flats is a sandy loam, 2nd rate, and on the hills, rocky, 3rd and 4th rates. There is considerable bunch grass and feed for stock, but no water near. The reservoir in the NE. quarter of sec. 25 was dry during the time of survey. No indications of mineral were observed.

Survey of Part of the Subdivision
of T. 31 N., R. 15 W.

34

Chains

N. 001'W. bet. secs. 34 and 35.
From the witness cor. to cor. of secs. 2, 3, 34 and 35.
on the S. bdy. of T. 31 N., R. 15 W., which is de-
scribed hereinbefore, and established 3.79 chs. W. of
the inaccessible true point for cor. of secs. 2, 3, 34
and 35, I run traverse as follows:

N. 100 W.	13.33 chs.
N. 33 $\frac{1}{2}$ W.	9.00 chs.
N. 15 $\frac{1}{2}$ E.	17.97 chs.
North	2.05 "
East	6.25 " to a point 40.00

chs. N. 001'W. of the true point for cor. of secs. 2, 3,
34 and 35, where I

40.00 Set an iron post, 3 ft. long, 1 in. diam., 10 ins. in the
ground, with marked (X) stone, for $\frac{1}{4}$ sec. cor.; and
raise a mound of stone around post, with brass cap
marked

$\frac{1}{4}$
 S34 | S35
 |
 1921

From the end of the course N. 15 $\frac{1}{2}$ E., I continue traverse
line as follows:

N. 10 E.	31.50 chs.
N. 20 W.	10.59 chs.
South	.03 chs. and
East	6.07 " to a point 80.00

chs. N. 001'W. of the true point for cor. of secs. 2, 3,
34 and 35, where I

80.00 Set an iron post, 3 ft. long, 2 ins. diam., 6 ins. in the
ground, with marked (X) stone, for cor. of secs. 26, 27,
34 and 35; and raise a mound of stone around post,
with brass cap marked

T31N | R15W
 S27 | S26
 S34 | S35
 1921

Land, mountainous and rolling.

Soil, 4th rate.

No timber.

Undergrowth, sagebrush, black brush and cactus.

Fair grazing.

From the cor. of secs. 3, 4, 33 and 34, on the S. bdy. of
T. 31 N., R. 15 W., hereinbefore described.

N. 002'W. bet. secs. 33 and 34.

Over mountainous land, through scattering undergrowth.
Desc. 175 ft.

11.45 Wash, 30 lks. wide. 1 ft. deep, course NW. Asc. 320 ft.

21.22 Top of high cliff, brs. NW. and SE. Continue ascent.

32.19 Ridge, brs. E. and W. Desc. 75 ft.

40.00 Set an iron post, 3 ft. long, 1 in. diam., 12 ins. in the
ground, with marked (X) stone, for $\frac{1}{4}$ sec. cor.; and raise
a mound of stone around post, with brass cap marked

$\frac{1}{4}$
 S33 | S34
 |
 1921

Continue descent, 60 ft.

54.18 Draw, course SE. Asc. 155 ft.

70.67 Ridge, brs. NE. and SW. Thence over level top.

80.00 Set an iron post, 3 ft. long, 2 ins. diam., 6 ins. in the

Survey of Part of the Subdivision of T. 31 N., R. 15 W, BOOK 8566

Chains ground, with marked (X) stone, 16 X 12 X 8 ins., for cor of secs. 27, 28, 33 and 34; and raise a mound of stone around post, with brass cap marked

T31N | R15W
S28 | S27
S33 | S34
1921

Land, mountainous and rolling.
Soil, 4th rate, rocky.
Timber, none.
Undergrowth, black brush, sage brush and cactus.
Fair grazing.

East on a random line, bet. secs. 27 and 34.
40.00 Set temp. $\frac{1}{4}$ sec. cor.
80.10 Intersect N. and S. line, 5 lks. N. of the cor. of secs. 27 and 34.
Thence N.89°58'W. on a true line, bet. secs. 27 and 34.
Over rolling and mountainous land, through scattering undergrowth.
Asc.
3.75 Spur, slopes NE. Desc. 25 ft.
6.95 Asc.
15.95 Desc. 55 ft.
35.50 Thence along N. slope.
40.05 Set an iron post, 3 ft. long, 1 in. diam., 24 ins. in the ground, for $\frac{1}{4}$ sec. cor., marked on brass cap

$\frac{1}{4}$ $\frac{S\ 27}{S\ 34}$
1921

And raise a mound of stone, 2 ft. base, 1 $\frac{1}{2}$ ft. high, N. of cor.
Asc. 45 ft.
46.30 Ridge, brs. N. and S. Desc. 70 ft.
62.90 Draw, course S. Asc. 125 ft.
80.10 The cor. of secs. 27, 28, 33 and 34.
Land, rolling and mountainous.
Soil, 3rd and 4th rates.
No timber.
Undergrowth, sagebrush, black brush and cactus.
Fair grazing.

Boundaries of that Portion of T. 31 N., R. 15 W.
Surveyed under this Group.

Latitudes, departures and closing errors.

Line designated.	True bearing.	Dist.	Latitudes.		Departures.	
			N.	S.	E.	W.
South Boundary	West	80.00				80.00
Subdivisional Boundary	N.0°02'W.	80.00	80.00			.05
	S.89°58'E.	80.10		.05	80.10	
	S.0°01'E.	80.00		80.00	.02	
Convergency					.02	
Totals			80.00	80.05	80.14	80.05
				80.00	80.05	
Error in latitude				.05		
Error in departure					.09	

GENERAL DESCRIPTION.

The section surveyed in T. 31 N., R. 15 W. is rolling and mountainous land, bounded on three sides by deep canyons. The soil is rocky, 4th rate, covered with a scattering growth of black brush, sagebrush and cactus. There are no settlers. No water has been developed.

The continued satisfactory adjustment of the solar apparatus during the survey of this township is indicated from field tests as described in Book "I".

4-680

BOOK 3536

FIELD ASSISTANTS. to

William E. Hiester, U. S. Transitman.

NAMES.	CAPACITY.
Robert A. Johnson.	1st Chainman.
Irving A. Jennings	2nd Chainman.
Walter Thomas	Flagman
E. J. Damron	Cornerman.
James Chamberlain	Cornerman.

BOOK 3566

CERTIFICATE OF UNITED STATES TRANSITMAN.

I, William E. Hiester, U. S. Transitman, hereby certify upon honor that, in pursuance of special instructions received from the U. S. Surveyor General, for Group 110, Arizona, bearing date of the 27th day of February, 19 20, I have well, faithfully, and truly in my own proper person, and in strict conformity with said instructions, the Manual of Surveying Instructions, and the laws of the United States, surveyed all those parts or portions of the North boundary, and Subdivision lines of TOWNSHIP 30 NORTH, RANGE 15 WEST, and surveyed all those parts or portions of the Subdivision lines of TOWNSHIP 31 NORTH, RANGE 15 WEST, of the Gila and Salt River Base and Meridian, in the State of Arizona, which are represented in and by diagram on page 1 hereof the foregoing field notes as having been executed by me, and under my direction; and that all the corners of said survey have been established and perpetuated in strict accordance with the Manual of Surveying Instructions, and the special written instructions of the U. S. Surveyor General, for Group 110, Arizona, and in the specific manner described in the field notes, and that the foregoing are the original field notes of such survey.

Place: Wolf Hole, Arizona.
 Date: June 21, 1923.

William E. Hiester
 U. S. Transitman.

~~APPROVAL.~~

~~OFFICE OF THE UNITED STATES SURVEYOR GENERAL,~~

~~10~~

~~The foregoing field notes of the survey of~~

~~executed by~~

~~under his special instructions dated~~ 19 ~~having been~~
~~critically examined, and the necessary corrections and explanations made, the said field notes, and the surveys~~
~~they describe, are hereby approved.~~

~~U. S. Surveyor General.~~

~~I certify that the foregoing transcript of the field notes of the above described surveys in~~
~~has been correctly copied from the original notes on file in this office.~~

~~U. S. Surveyor General.~~

40

BOOK 3566

CERTIFICATE OF UNITED STATES SURVEYOR.

I, Thomas D. Daley, U. S. Surveyor, hereby certify upon honor that, in pursuance of special instructions received from the U. S. Surveyor General, for Group 110, Arizona, bearing date of the 27th day of February, 1920, I have well, faithfully, and truly in my own proper person, and in strict conformity with said instructions, the Manual of Surveying Instructions, and the laws of the United States, retraced all those parts or portions of the

HUALPAI INDIAN RESERVATION BOUNDARY

and surveyed all those parts or portions of the East and North Boundaries and Subdivision Lines of

TOWNSHIP 30 NORTH, RANGE 15 WEST

of the Gila and Salt

River Base and Meridian, in the State of Arizona, which are represented in the foregoing field notes and by diagram on page 1 hereof as having been executed by me, and under my direction; and that all the corners of retracement and said survey have been established and perpetuated in strict accordance with the Manual of Surveying Instructions, and the special written instructions of the U. S. Surveyor General, for Group 110, Arizona, and in the specific manner described in the field notes, and that the foregoing are the original field notes of such retracement and survey.

Place Santa Fe, N. M.

Thomas D. Daley, U. S. Surveyor.

Date June 1, 1923.

APPROVAL.

OFFICE OF THE UNITED STATES SURVEYOR GENERAL,

Phoenix, Arizona JUN 30, 1923.

The foregoing field notes of the retracement of part of the HUALPAI INDIAN RESERVATION BOUNDARY and survey of Part of the East and North Boundaries and Part of the Subdivision Lines of TOWNSHIP 30 NORTH, RANGE 15 WEST, and Part of the Subdivision Lines of

TOWNSHIP 31 NORTH, RANGE 15 WEST,

of the Gila and Salt River Base and Meridian, in the State of Arizona, executed by Thomas D. Daley, U. S. Surveyor, and William E. Hiester, U. S. Transitman, under special instructions dated February 27, 1920, for Grp. 110, Arizona having been critically examined, and the necessary corrections and explanations made, the said field notes, and the surveys they describe, are hereby approved.

Frank O. Groth, U. S. Surveyor General.

I certify that the foregoing transcript of the field notes of the above-described surveys in, has been correctly copied from the original notes on file in this office.

U. S. Surveyor General