

3574

Book "E"

4-679

65

1

BOOK 3574

FIELD NOTES

OF THE RETRACEMENT OF

Part of the West Boundary of Township 3 South, Range 2 East

and Part of the West Boundary of Township 2 South, Range 2 East

OF THE RESURVEY OF

Part of the Subdivision Lines of

Township 2 South, Range 1 East

AND OF THE SURVEY OF

Part (South half) of the East Boundary

and Part (Completion) of the Subdivision Lines of

TOWNSHIP 2 SOUTH, RANGE 1 EAST

Of the Gila and Salt River Base and Meridian,

In the State of Arizona.

EXECUTED BY

Sidney J. Blout,

U.S. Cadastral Engineer,

In the capacity of U. S. Surveyor, under ^{Special} instructions dated May 23, 1921, issued by the United States Surveyor General to govern surveys included in Group No 116, Ariz., which were approved by the Commissioner of the General Land Office, July 6, 1921, and Assignment Instructions dated Nov. 21, 1921.

Retracement
Resurvey & Survey commenced February 16, 1922.

Retracement
Resurvey & Survey completed March 19, 1922.

3574

3574

66
1A





Book "E"

Group 116- - Arizona.

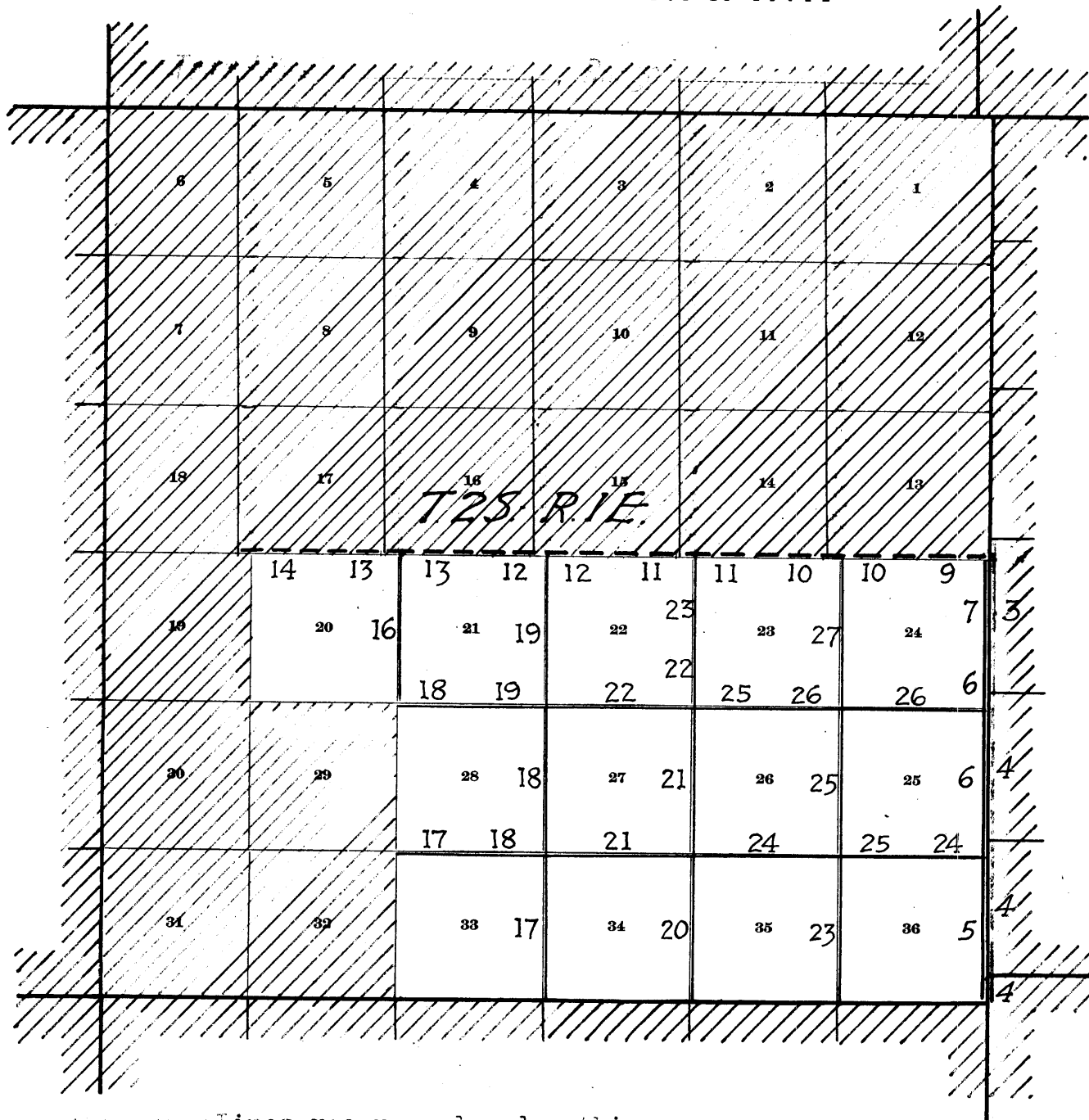
BOOK 8574

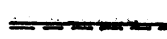
INDEX DIAGRAM.



-  Lines resurveyed under this group.
-  Lines surveyed under this group.
-  Accepted surveys.
-  Lines retraced under this group.
-  Areas surveyed as per accepted plat, on file.

BOOK 3574
15

Book "E"
Group 116 - - - Arizona.
Township 2 South, Range 1 East.

DATE DIAGRAM.

Gila and Salt River Meridian.

6	5	4	3	2	1
7	8	9	10	11	12
18	17	16	15	14	13
	2-25-22	2-27-22	3-3-22	3-9-22	3-10-22
	RESURV.	RESURV.	RESURV.	RESURV.	RESURV.
19	20	21	22	23	24
	2-25-22	2-25-22	2-28-22	3-4-22	3-6-22
		2-27-22	3-3-22	3-4-22	3-4-22
30	29	28	27	26	25
		2-21-22	2-23-22	2-24-22	3-6-22
		2-21-22	2-21-22	3-1-22	3-1-22
31	32	33	34	35	36
		2-21-22	2-23-22	2-24-22	2-24-22
		2-21-22	2-23-22	2-24-22	2-24-22

SURVEYED
2-16-22 2-17-22
1922
RETRACED

Lines retraced, resurveyed or surveyed on dates shown on above diagram, by Sidney E. Blout, U.S. Cadastral Engineer.

The retracements, resurveys, and surveys, hereinafter described, executed on dates shown on diagram on page 1 hereof, by Sidney E Blout, U.S. Cadastral Engineer, using a Buff "Rocky Mountain Favorite" solar transit, No. 9984 with U-shaped standards, $4\frac{1}{2}$ in. horizontal circle, 4 in. vertical circle, and improved Smith solar attachment.; All azimuth determinations are accomplished with the solar attachment, except the special observations on Polaris for meridian, upon which to test the solar attachment, as stated in the field notes.

The instrument was examined, tested on the meridian at the Federal Building at Phoenix Arizona, November 8, 1921, found correct, and was approved by the Assistant Supervisor of Surveys for Arizona and California, conditional upon satisfactory field tests.

February 14, 1922, At camp, near the $\frac{1}{4}$ sec. cor. bet. secs. 28 and 29, T2S., R2E. of Gila and Salt River Base and Mer. in latitude $33^{\circ}13'25''$ N., and longitude $112^{\circ}16'15''$ W. examine the adjustments of the transit and correct the level and collimation errors, then to test the solar apparatus, by comparing its indications, resulting from solar observations, made during a.m., and p.m. hours with a meridian established by observations on Polaris, proceed as follows;

At the same station, at $9^{\text{h}}52.2^{\text{m}}$ p.m., l.m.t. Feb. 14, I observe Polaris at western elongation, making four observations, two each with the telescope in direct and reversed positions and mark the mean point in the line thus determined on a peg driven firmly in the ground about 7 chs. N. of instrument.

Azimuth of Polaris at western elongation = $1^{\circ}19'27''$

February 15: I lay off the azimuth of Polaris, $1^{\circ}19\frac{1}{2}''$ to the east and mark the meridian thus determined by a tally pin driven in a stake set firmly in the ground about 7 chs. N.

Feb. 15, At $8^{\text{h}}30^{\text{m}}$ a.m., app. time; set off $33^{\circ}13\frac{1}{2}'$ N. on the lat. arc, $12^{\circ}45\frac{1}{2}'$ S. on the decl. arc and determine a meridian with the solar and mark a point thereof by a tack driven in the stake already set about 7 chs. N. on which the solar meridian falls $00\frac{1}{2}'$ E. in angular measure of the point determined by the Polaris observation.

At $3^{\text{h}}00^{\text{m}}$ p.m. app. time, with the lat. arc, unchanged, set off $12^{\circ}40'$ S. on the decl. arc and determine a meridian with the solar and mark a point thereof by a nail driven in the stake already set about 7 chs. N.; this mark falls $01'$ W. in angular measure of the mark determined by the Polaris observation.

The solar apparatus by a.m., and p.m. observations, defines positions for meridians which agree within about $01'$ with the meridian established by the Polaris observations, therefore, conclude that the adjustments of the instrument are satisfactory.

The magnetic bearing of the true meridian at 8^{h} a.m. is $N. 14^{\circ}30' W.$

All measurements are made with a Lufkin 5-chain steel tape compared with a Chesterman standard steel tape and found correct. The measurements are made on the slope the vertical angle determined, and the slope distances properly reduced to true horizontal distances.

Retracement of Part of West Boundary of T. 2 S., R. 2 E.,
and
Part of West Boundary of T. 3 S., R. 2 E.

Chains The North $2\frac{1}{2}$ miles of the range line bet. Rs. 1 and 2 E., in T. 2 S., was surveyed in 1868 by W. F. Ingalls, U. S. D. S., who established thereon $\frac{1}{4}$ sec. and sec. cors. common to the areas in Ts. 2 S., Rs. 1 and 2 E. This portion of the range line was resurveyed in November, 1911 by R. A. Farmer, U. S. Topographer, who reported all the original cors. missing and in his resurvey re-established the cors. to refer to areas in T. 2 S., R. 2 E., only. No subsequent resurvey of this part of the range line is of record. The survey of the range line through T. 3 S., and the South $3\frac{1}{2}$ miles in T. 2 S., was also executed by R. A. Farmer, U. S. Topographer in November and December, 1911, establishing all cors. thereon to refer to areas in R. 2 E., only. In January and February, 1912, R. A. Farmer surveyed the subdivision lines of the $N\frac{1}{2}$ of T. 2 S., R. 1 E., establishing closing sec., cors., $\frac{1}{4}$ sec. cors. for secs. 1 and 12 and 1-16 sec. cors. for sec. 1, on the range line, which in an indirect way constituted a resurvey of the North $2\frac{1}{2}$ miles of the E. bdy. of T. 2 S., R. 1 E., and a survey of same line East of the $S.\frac{1}{2}$ of sec. 13.

The South boundary of T. 2 S., R. 1 E., was surveyed in 1916 by W. G. Shapcott, U. S. S., who established a closing cor. for Ts. 2 and 3 S., R. 1 E., on the range line bet. Rs. 1 and 2 E., and there being no record of the establishment of cors. referring to areas in the $S.\frac{1}{2}$ of T. 2 S., R. 1 E., on said range line, the $S.\frac{1}{2}$ of East boundary of said Tp. is regarded as unsurveyed.

The following notes describe a retracement of the range line from the cor. of secs. 18 and 19, T. 2 S., R. 2 E., southerly to the closing cor. of Ts. 2 and 3 S., R. 1 E., in order to obtain the courses necessary for the execution of the survey of the $S.\frac{1}{2}$ of the East boundary of T. 2 S., R. 1 E. The notes describing said survey follow these retracement notes.

The description of corners, character of land, topographical features, etc., is omitted from the retracement notes as such data is all hereinafter described in the notes of survey of the south $\frac{1}{2}$ of the East bdy. of T. 2 S., R. 1 E.

Part of W. Bdy. of T. 2 S., R. 2 E.

The cor. of secs. 18 and 19, T. 2 S., R. 2 E., is an iron post, 1 in. in diam. projecting 10 ins. above ground, properly marked on brass cap for said secs., and witnessed by a md. of stone E. of cor. No bearing trees.

- Thence,
 South, on a random line, on W. bdy. of sec. 19 ($N.\frac{1}{2}$).
 7.95 Fall 1 lk. E. of the closing cor. of secs. 13 and 24, T. 2 S., R. 1 E., hereinafter described.
 True course and dist. of the $N.\frac{1}{2}$ of W. bdy. of sec. 19, from this C. C. to the cor. of secs. 18 and 19, are, therefore, N. $0^{\circ} 3' E.$, 7.95 chs.
 Continue line and measurement.
 39.88 Fall 3 lks. E. of the $\frac{1}{4}$ sec. cor. of sec. 19, hereinafter described.
 True course and dist. of $N.\frac{1}{2}$ of W. bdy. of sec. 19 are, therefore N. $0^{\circ} 3' E.$, 39.88 chs. Thence,
 South, on random line, on W. bdy. of sec. 19 ($S.\frac{1}{2}$)
 39.82 Fall 3 lks. E. of the cor. of secs. 19 & 30, hereinafter described.
 True course and dist. of $S.\frac{1}{2}$ of W. bdy. of sec. 19 are, therefore, N. $0^{\circ} 3' E.$, 39.82 chs.
 Thence,

Retracement of Part of West Boundary of T. 2 S., R. 2 E.,
and
Part of West Boundary of T. 3 S., R. 2 E.

Chains 20.23 South, on random line, on W. bdy. of sec. 30 (N. $\frac{1}{2}$).
Fall $1\frac{1}{2}$ lks. E. of the witness cor. to $\frac{1}{4}$ sec. cor. of sec. 30, hereinafter described.
True course of N. $\frac{1}{2}$ of W. bdy. of sec. 30, bet. this W. C. and the cor. of secs. 19 and 30 is, therefore, N. $0^{\circ} 3' E.$
This W. C. is of record as being established at 19.61 chs. North from the true cor. point.
Continue line and measurement.

39.84 (20.23 chs. + 19.61 chs.) Fall 3 lks. (computed) E. of the true point for $\frac{1}{4}$ sec. cor. of sec. 30.
True course and dist. of N. $\frac{1}{2}$ of W. bdy. of sec. 30 are, therefore N. $0^{\circ} 3' E.$, 39.84 chs.
Thence,
South, on random line, on W. bdy. of sec. 30 (S. $\frac{1}{2}$).

20.43 Fall 4 lks. E. of the witness cor. to cor. of secs. 30 and 31, hereinafter described.
True course of S. $\frac{1}{2}$ of W. bdy. of sec. 30, between this W. C. and the point for $\frac{1}{4}$ sec. cor. of sec. 30 is, therefore, N. $0^{\circ} 7' E.$
This W. C. is of record as being established at 19.67 chs. North from the true corner point.
Continue line and measurement.

40.10 (20.43 chs. + 19.67 chs.) Fall 8 lks. (computed) E. of the true point for cor. of secs. 30 and 31.
True course and dist. of S. $\frac{1}{2}$ of W. bdy. of sec. 30 are, therefore, N. $0^{\circ} 7' E.$, 40.10 chs.
Thence,
South, on random line, on W. bdy. of sec. 31 (N. $\frac{1}{2}$)
At 44.65 chs., fall 4 lks. E. of the witness cor. to $\frac{1}{4}$ sec. cor. of sec. 31, hereinafter described.
This W. C. is recorded as being established 5.30 chs. S. of the true corner point, therefore, at

39.35 (44.65 chs. - 5.30 chs.) Fall $3\frac{1}{2}$ lks. (computed) E. of the true point for $\frac{1}{4}$ sec. cor.
True course and dist. of N. $\frac{1}{2}$ of W. bdy. of sec. 31 are, therefore, N. $0^{\circ} 3' E.$, 39.35 chs.
Thence,
South, on random line, on W. bdy. of sec. 31 (S. $\frac{1}{2}$)

5.30 Fall $\frac{1}{2}$ lk. E. of the witness cor. to $\frac{1}{4}$ sec. cor. of sec. 31, hereinafter described.
Continue line and measurement.

41.03 Fall $2\frac{1}{2}$ lks. E. of the cor. of Ts. 2 and 3 S., R. 2 E., hereinafter described.
True course and dist. of S. $\frac{1}{2}$ of W. bdy. of sec. 31 are, therefore, N. $0^{\circ} 2' E.$, 41.03 chs.

Part of West Bdy. of T. 3 S., R. 2 E.

From cor. of Ts. 2 and 3 S., R. 2 E., hereinafter described.

South, on random line, on part of W. bdy. of T. 3 S., R. 2 E., between Sec. 6 thereof and sec. 36, T. 2 S., R. 1 E.

7.78 Intersect the closing cor. of Ts. 2 and 3 S., R. 1 E., hereinafter described.
True course and dist. of W. bdy. of T. 3 S., R. 2 E., between this C. C. and the cor. of Ts. 2 and 3 S., R. 2 E., are, therefore, North, 7.78 chs.

Survey of Part (S. $\frac{1}{2}$) of East Bdy. of T. 2 S., R. 1 E.

The closing cor. of Ts. 2 and 3 S., R. 1 E., is an iron post, 2 ins. in diam., projecting 3 ft. above ground, firmly set in a mound of stones, properly marked on brass cap and witnessed by a mound of stone E. of cor. No bearing trees.

Survey of Part (S. 1/2) of East Bdy. of T. 2 S., R. 1 E.

Chains This cor. is on the range line between ranges 1 and 2 E., which is also part of the Boundary of the Gila River Indian Reservation.

Thence,
North, on true line, on E. bdy. of sec. 36, along Bdy. of the G. R. I. R.
Over mountainous land, through scattering undergrowth. Descend 223 ft. over steep NE. slope to

7.78 Intersect the cor. of Ts. 2 and 3 S., R. 2 E., which is an iron post, 3 ins. in diam., projecting 10 ins. above ground, firmly set, properly marked on brass cap and witnessed by a md. of stone E. of cor. No bearing trees.

Thence,
N. 0° 2' E., on true line, continuing measurement of the E. bdy. of sec. 36, along the G. R. I. R. Bdy.
Descend 50 ft. over NE. slope.

9.08 Bottom of gulch 10 lks. wide, course NE., near head. Ascend 115 ft. over SE. slope.

13.69 Spur slopes N. 70° E. Descend 242 ft. over N. slope.

23.57 Bottom of gulch, 8 lks. wide, course E. Ascend 431 ft. over S. slope.

35.53 Spur slope E. Descend 108 ft. over steep N. slope to

38.05 Gulch, course E. Ascend 82 ft. over SE. slope to

40.00 Set an iron post, 3 ft. long, 1 in. in diam., 10 ins. in the ground to bed rock, deposit a stone marked with a cross (X) at base of post, and raise a md. of stone 3 ft. base 2 ft. high ground post, for 1/2 sec. cor. of sec. 36, only, marked on brass cap

T 2 S	36
S 36	1922

Ascend slightly over S. slope.

40.50 Point of spur slopes E. Descend 20 ft. over NE. slope to

43.51 Intersect the witness cor. to the 1/2 sec. cor. of sec. 31, T. 2 S., R. 2 E., which is an iron post, 1 in. in diam., projecting 10 ins. above ground, firmly set, properly marked on brass cap, and witnessed by a mound of stone E. of cor. No bearing trees.

Descend slightly over NE. slope to

44.80 Gully, course SE. Ascend 55 ft. over SW. slope to

48.81 (41.03 chs. N. 0° 2' E., from cor. of Ts. 2 and 3 S., R. 2 E.)

Intersect the true point for 1/2 sec. cor. of sec. 31, on precipitous SW. slope.

Thence,
N. 0° 03' E., on true line, continuing measurement of E. bdy. of sec. 36. Ascend 560 ft. over steep SW. and S. slopes

61.30 Spur slopes N. 80° E. Desc. 730 ft. over steep NW. slope.

77.00 Ascend 84 ft. over W. slope.

79.28 Spur slopes NW. Descend 48 ft. over N. slope to

80.00 Set an iron post 3 ft. long, 2 ins. in diam., 28 ins. in the ground for cor. of secs. 25 and 36, only, marked on brass cap

T 2 S	T 2 S
S 25	R 2 E
S 36	S 30
R 1 E	
1922	

Raise a mound of stone 2 ft. base, 1 1/2 ft. high W. of cor.
Land, mountainous.
Soil, rocky, 4th rate.
Timber, none.
Undergrowth, scattering cactus.
No grass.

Survey of part (S. 1/2) of East Bdy. of T. 2 S., R. 1 E.

- Chains N. 0° 03' E., on true line on E. bdy. of sec. 25 along bdy. of the Gila River Indian Reservation. Over mountainous land, through scattering undergrowth. Descend 426 ft. over steep N. slope to
- 8.16 (39.35 Chs. N. 0° 3' E., from true point for 1/4 sec. cor. of Sec. 31). Intersect true point for cor. of secs. 30 and 31, T. 2 S., R. 2 E., on precipitous N. slope. Thence,
- N. 0° 07' E., on true line, continuing measurement of E. bdy. of sec. 25. Descend 51 ft. over steep N. slope to
- 9.75 Bottom of gulch, 25 lks. wide, course N. 70° E. Ascend 70 ft. over S. slope.
- 15.66 Point of spur slopes SE. Descend 102 ft. over E. slope.
- 20.40 Ascend 208 ft. over SE. slope to
- 27.83 Fall 2 lks. W. of the witness cor. to cor. of secs. 30 and 31, T. 2 S., R. 2 E., which is an iron post, 1 in. in diam., projecting 10 ins. above ground, firmly set, properly mkd. on brass cap and witnessed by a md. of stone E. of cor. No bearing trees.
- 28.00 Spur, slopes N. 70° E. Desc. 255 ft. over N. slope.
- 39.50 Bottom of gulch, 25 lks. wide, course E. Asc. 20 ft. over S. slope to
- 40.00 Set an iron post 3 ft. long, 1 in. in diam., over cross (X) on surface rock, and raise a mound of stone 5 ft. base, 2 1/2 ft. high around post for 1/4 sec. cor. of sec. 25 only, marked on brass cap

1/4 S 25 |
1922

- Ascend 150 ft. over steep S. slope to
- 48.26 (40.10 chs. N. 0° 7' E., from true point for cor. of secs. 30 and 31) Intersect true point for 1/4 sec. cor. of sec. 30, T. 2 S., R. 2 E., on precipitous S. slope. Thence,
- N. 0° 03' E., on true line, continuing measurement of E. bdy. of sec. 25. Ascend 478 ft. over S. slope to
- 67.87 Intersect the witness cor. to the 1/4 sec. cor. of sec. 30, which is an iron post, 1 in. in diam., projecting 12 ins. above ground, firmly set, properly marked on brass cap and witnessed by a md. of stone E. of cor. No bearing trees. Ascend 95 ft. over S. slope.
- 77.00 Spur slopes E. Descend 100 ft. over NE. slope to
- 80.00 Set an iron post 3 ft. long, 2 ins. in diam., 12 ins. in the ground, deposit a stone marked with a cross (X) at base of post, and raise a mound of stone 4 ft. base, 2 ft. high around post for cor. of secs. 24. and 25, only, marked on brass cap

T 2 S | T 2 S
S 24 | R 2 E
S 25 | S 30
R 1 E |
1922

Land, mountainous.
Soil, rocky, 4th rate.
Timber, none.
Undergrowth, scattering cactus.
No grass.

N. 0° 03' E., on true line, on E. bdy. of sec. 24, along bdy. of the Gila River Indian Reservation.

ECCIN 1922

Survey of part ($S\frac{1}{2}$) of East Bdy. of T. 2 S., R. 1 E.

Chains	Over mountainous land, through scattering undergrowth. Descend 50 ft. over NE. slope to
8.10	(39.84 chs. N. $0^{\circ} 3'$ E., from true point for $\frac{1}{4}$ sec. cor. of sec. 30) Intersect the cor. of secs. 19 and 30, T. 2 S., R. 2 E., which is an iron post, 2 ins. in diam., projecting 12 ins. above ground, firmly set, properly marked on brass cap and witnessed by a md. of stone E. of cor. No bearing trees. Descend 195 ft. over NE. slope.
21.00	Gulch, course NE. Ascend 75 ft. over SE. slope.
24.60	Point of spur slopes NE. Descend 165 ft. over NE. slope.
34.25	Gulch, course NE. Ascend 50 ft. over SE. slope to
40.00	Spur slopes NE. Set an iron post 3 ft. long, 1 in. in diam., over cross (X) on surface rock, and raise a mound of stone 5 ft. base $2\frac{1}{2}$ ft. high around post for $\frac{1}{4}$ sec. cor. of sec. 24 only, marked on brass cap
	$\frac{1}{4}$ S 24 1922
43.00	Descend 120 ft. over N. slope to Gulch, course NE. Ascend 50 ft. over SE. slope to
47.92	(39.82 chs. N. $0^{\circ} 3'$ E., from cor. of secs. 19 and 30) Intersect the $\frac{1}{4}$ sec. cor. of sec. 19, T. 2 S., R. 2 E., which is an iron post, 1 in. in diam., firmly set in a mound of stone 4 ft. base, $2\frac{1}{2}$ ft. high, and properly marked on brass cap. Continue line and measurement. Descend 616 ft. over steep NE. slope to
73.50	Foot of steep descent, brs. NW. and SE. Leave mountainous and enter rolling land. Descend 30 ft. over NE. slope to
79.85	Intersect the closing cor. of secs. 13 and 24, which is an iron post, 3 ins. in diam., projecting 10 ins. above ground, firmly set, properly marked on brass cap and witnessed by a mound of stone W. of cor. No bearing trees. From this cor. the Bdy. of the Gila River Indian Reservation extends westerly and southerly. Land, S. $73\frac{1}{2}$ chs. mountainous, remainder rolling. Soil, rocky, 4th rate. Timber, none. Undergrowth, scattering greasewood and cactus. No grass.

Resurvey of part of the subdivision lines
of Township 2 South, Range 1 East.

Chains

The North half of T. 2 S., R. 1 E., lies within the Gila River Indian Reservation and the subdivision lines of this part of the township were surveyed by Robert A. Farmer, U. S. Topographer in 1912. No retracement or resurvey of any part of these lines is of record. The following notes describe a resurvey of the third latitudinal sec. line which is also part of the bdy. of the Gila River Indian Reservation.

RETRACEMENT FOR RESURVEY.

From the closing cor. of secs. 13 and 24 on E. bdy. of Tp. and angle point on bdy. of the Gila River Indian Reservation, hereinbefore described.

45.30 West, on a random line on S. bdy. of sec. 13 (E. $\frac{1}{2}$) Fall 2 lks. S. of the original $\frac{1}{4}$ sec. cor. of secs. 13 and 24, hereinafter described.

True course and dist. of E. $\frac{1}{2}$ of S. bdy. of sec. 13 are therefore N. 89° 58' W. 45.30 chs.

Thence,

39.95 West, on a random line on S. bdy. of sec. 13 (W. $\frac{1}{2}$) Fall 1 lk. S. of the original cor. of secs. 13, 14, 23 and 24, hereinafter described.

True course and dist. of W. $\frac{1}{2}$ of S. bdy. of sec. 13, are therefore N. 89° 59' W. 39.95 chs.

38.25 West, on a random line on S. bdy. of sec. 14 (E. $\frac{1}{2}$). Fall 9 lks. S. of the original witness cor. to the $\frac{1}{4}$ sec. cor. of secs. 14 and 23, hereinafter described.

This W. C. is of record as being established at 1.85 chs. E. from the true corner point therefore continue line and measurement and at

40.10 (38.25 chs. + 1.85 chs.) Fall 9 lks. (computed) S. of the original true point for $\frac{1}{4}$ sec. cor. of secs. 14 and 23.

True course and dist. of E. $\frac{1}{2}$ of S. bdy. of sec. 14, are, therefore, N. 89° 51' W., 40.10 chs.

Thence,

39.75 West, on a random line on S. bdy. of sec. 14 (W. $\frac{1}{2}$). Intersect the original cor. of secs. 14, 15, 22 and 23, hereinafter described.

True course and dist. of W. $\frac{1}{2}$ of S. bdy. of sec. 14 are, therefore, West 39.75 chs.

35.00 West, on a random line on S. bdy. of sec. 15 (E. $\frac{1}{2}$). Fall 2 lks. S. of the original witness cor. to the $\frac{1}{4}$ sec. cor. of secs. 15 and 22, hereinafter described.

This W. C. is of record as being established at 5.00 chs. E. from the true corner point, therefore, continue line and measurement and at

40.00 (35.00 chs. + 5.00 chs.) Fall 3 lks. (computed) S. of the original true point for $\frac{1}{4}$ sec. cor. of secs. 15 and 22.

True course and dist. of E. $\frac{1}{2}$ of S. bdy. of sec. 15 are, therefore, N. 89° 58' W. 40.00 chs.

Thence,

32.60 West, on a random line on S. bdy. of sec. 15 (W. $\frac{1}{2}$). Fall 3 lks. S. of the original witness cor. to cor. of secs. 15, 16, 21 and 22, hereinafter described.

This W. C. is of record as being established at 7.60 chs. E. from the true corner point, therefore, continue line and measurement and at

40.20 (32.60 chs. + 7.60 chs.) Fall 4 lks. (computed) S. of the original true point for cor. of secs. 15, 16,

Resurvey of part of the subdivision lines
of Township 2 South, Range 1 East.
RETRACEMENT FOR RESURVEY.

Chains	21 and 22. True course and dist. of W. $\frac{1}{2}$ of S. bdy. of sec. 15 are, therefore, N. $89^{\circ} 57' W.$, 40.20 chs.
35.86	West, on a random line on S. bdy. of sec. 16 (E. $\frac{1}{2}$). Fall 3 lks. S. of the original witness cor. to the $\frac{1}{4}$ sec. cor. of secs. 16 and 21, hereinafter described. This W. C. is of record as being established at 4.10 chs. E. from the true corner point, therefore, continue line and measurement and at
39.96	(35.86 + 4.10 chs.). Fall 4 lks. (computed) S. of the original true point for $\frac{1}{4}$ sec. cor. of secs. 16 and 21. True course and dist. of E. $\frac{1}{2}$ of S. bdy. of sec. 16 are, therefore, N. $89^{\circ} 57' W.$ 39.96 chs. Thence,
40.02	West, on a random line on S. bdy. of sec. 16 (W. $\frac{1}{2}$) Fall 1 lk. S. of the original cor. of secs. 16, 17, 20 and 21, hereinafter described. True course and dist. of W. $\frac{1}{2}$ of S. bdy. of sec. 16 are, therefore, N. $89^{\circ} 59' W.$, 40.02 chs.
40.08	West, on a random line on S. bdy. of sec. 17 (E. $\frac{1}{2}$). Fall 1 lk. S. of the original $\frac{1}{4}$ sec. cor. of secs. 17 and 20, hereinafter described. True course and dist. of E. $\frac{1}{2}$ of S. bdy. of sec. 17, are, therefore, N. $89^{\circ} 59' W.$, 40.08 chs. Thence,
37.38	West, on a random line on S. bdy. of sec. 17 (W. $\frac{1}{2}$) Fall 3 lks. S. of the original closing cor. of secs. 19 and 20, hereinafter described. Continue line and measurement.
40.10	Fall 4 lks. S. of the original cor. of secs. 17, 18, 19 and 20., hereinafter described. True course and dist. of W. $\frac{1}{2}$ of S. bdy. of sec. 17, are, therefore, N. $89^{\circ} 57' W.$, 40.10 chs.
<u>RESURVEY.</u>	
29.00	From the closing cor. of secs. 13 and 24, on E. bdy. of Tp., hereinbefore described. N. $89^{\circ} 58' W.$, on true line, on N. bdy. of sec. 24, along the bdy. of the Gila River Indian Reservation. Over rolling land, through very scattering timber and scattering undergrowth. Ascend 185 ft. over NE. slope to Bottom of gulch, 25 lks. wide, course N. $70^{\circ} E.$ Leave rolling and enter mountainous land.
42.40	Ascend 322 ft. over SE. slope to (40.00 chs. Easting from closing cor. of secs. 23 and 24). Set an iron post 3 ft. long, 1 in. in diam., over cross (X) on surface rock, and raise a mound of stone 4 ft. base, $2\frac{1}{2}$ ft. high around post, for $\frac{1}{4}$ sec. cor. of sec. 24 only., marked on brass cap
$\frac{1}{4}$ S 24 1922	
45.30	No trees suitable for bearing trees available. Ascend 71 ft. over steep SE. slope to Intersect the original $\frac{1}{4}$ sec. cor. of secs. 13 and 24, which is an iron post, 1 in. in diam., projecting 10 ins. above the ground, firmly set, properly marked on

Resurvey of part of the subdivision lines
of Township 2 South, Range 1 East.

Chains

brass cap; and witnessed by a mound of stone N. of cor. No bearing trees.
Alter this cor. to refer to sec. 13 only by changing the marking on the brass cap to read

G R I R
1/4 S 13
1912-22

No change in accessory is required.

Thence,

N. 89° 59' W., on true line, continuing measurement of N. bdy. of sec. 24. Ascend 25 ft. over SE. slope.
46.70 Spur, slopes N. 50° E. Descend 225 ft. over NW. slope to
78.71 Gully, course NE. Ascend 30 ft. over E. slope to
82.40 Point of intersection of the subdivision line bet. secs. 23 and 24. Closing cor. of said secs. established at this point as hereinafter described.
Land, E. 29 chs. rolling, remainder mountainous.
Soil, rocky, 4th rate.
Timber, very scattering palo verde and iron wood.
Undergrowth, scattering greasewood and cactus.
No grass.

From closing cor. of secs. 23 and 24, hereinafter described.

N. 89° 59' W., on true line, on N. bdy. of sec. 23, along S. bdy. of Gila River Indian Reservation. Over mountainous land, through very scattering timber and scattering undergrowth. Ascend 20 ft. over E. slope to
2.85 (39.95 chs. N. 89° 59' W., from 1/4 sec. cor. of sec. 13). Intersect the original cor. of secs. 13, 14, 23 and 24, which is an iron post, 1 in. in diam., projecting 12 ins. above ground, firmly set, properly marked on brass cap for said secs., and witnessed by a mound of stone N. of cor. No bearing trees.
Alter this cor. to refer to secs. 13 and 14 only, by changing marking on brass cap to read

G R I R
T 2 S R 1 E
S 14 | S 13
1912-22

No change in accessory is required.

Thence,

N. 89° 51' W., on true line continuing measurement of N. boundary of Sec. 23.
Ascend 135 ft. over E. slope
10.45 Spur, slopes NE. Desc. 73 ft. over NW. slope
19.85 Bottom of gulch 25 lks. wide, course N. 40° E. Ascend 115 ft. over gradual SE. slope to
35.22 Foot of very steep ascent, brs. NE. and SW. Ascend 150 ft. over SE. slope to
40.00 (Mid-point of N. bdy. of sec. 23). Set an iron post 3 ft. long, 1 in. in diam., over cross (X) on surface rock, and raise a mound of stone 4 ft. base, 2 1/2 ft. high, around post for 1/4 sec. cor. of sec. 23 only, marked on brass cap

1/4 S 23
1922

Ascend 52 ft. over steep SE. slope to

BOOK 237

Resurvey of part of the Subdivision lines
of Township 2 South, Range 1 East.

- Chains
41.10 Intersect the original witness cor. to $\frac{1}{4}$ sec. cor. of secs. 14 and 23, which is an iron post 3 ft. long, 1 in. in diam, projecting 10 ins. above ground, firmly set, properly marked on brass cap for said sec. and witnessed by a md. of stone N. of cor. No bearing trees. Alter this W. C. to refer to point for $\frac{1}{4}$ sec. cor. of sec. 14 only by changing the markings on the brass cap to read
- G R I R
 $\frac{1}{4}$ S 14
W C
1912-22
- No change in accessory is required. Ascend 40 ft. over SE. slope to
- 42.95 Intersect original true point for $\frac{1}{4}$ sec. cor. of secs. 14 and 23, which is now point for $\frac{1}{4}$ sec. cor. of sec. 14 only.
This point is on precipitous SE. slope, where it is impracticable to set monument.
Thence,
West, on true line, continuing measurement of N. bdy. of sec. 23. Ascend 774 ft. over SE. slope.
- 57.85 Spur, slopes N. 50° E. Desc. 280 ft. over NW. slope.
- 79.30 Bottom of gulch, 15 lks. wide, course N. 60° E.
Asc. 25 ft. over E. slope to
- 80.00 Point of intersection of the subdivision line between secs. 22 and 23. Closing cor. of said secs. established at this point as hereinafter described.
Land, mountainous.
Soil, rocky, 4th rate.
Timber, very scattering palo verde and ironwood.
Undergrowth, scattering greasewood and cactus.
No grass.
-
- From closing cor. of secs. 22 and 23.
West, on true line, on N. bdy. of sec. 22, along S. bdy. of the Gila River Indian Reservation.
Over mountainous land, through scattering undergrowth, ascend 100 ft. over E. slope to
- 2.70 (39.75 chs. W. from true point for $\frac{1}{4}$ sec. cor. of sec. 14)
Intersect the original cor. of secs. 14, 15, 22 and 23, which is an iron post, 1 in. in diam., projecting 10 ins. above ground, firmly set, properly marked on brass cap for said secs. and witnessed by a md. of stone W. of cor. No bearing trees.
Alter this cor. to refer to secs. 14 and 15 only by changing marking on brass cap to read
- G R I R
T 2 S R 1 E
S 15 | S 14
1915 - 22
- Move the md. of stone from W. to N. of cor.
Thence,
N. 89° 58' W., on true line continuing measurement of N. bdy. of sec. 22.
Ascend 606 ft. over NE. slope.
- 20.80 Main ridge of the Estrella range of mountains, bears N. 50° W., and S. 50° E. Desc. 531 ft. over steep SW. slope to
- 37.70 Intersect the original witness cor. to $\frac{1}{4}$ sec. cor. of secs. 15 and 22, which is an iron post 3 ft. long, 1 in. in diam., projecting 10 ins. above ground, firmly set, properly marked on brass cap for said secs. and

Resurvey of Part of the Subdivision Lines
of Township 2 South, Range 1 East.

Chains	witnessed by a md. of stone N. of cor. No bearing trees. Alter this cor. to refer to the point for $\frac{1}{4}$ sec. cor. of sec. 15 only by changing marking on brass cap to read
	<p>G R I R <u>$\frac{1}{4}$ S 15.</u> 1912-22.</p>
	<p>No change in accessory is required. Descend 165 ft. over steep SW. slope to 40.20 (Mid-point of N. bdy. of sec. 22). Set an iron post 3 ft. long, 1 in. in diam., over cross (X) on surface rock, and raise a mound of stone 4 ft. base, 34 ins. high around post for $\frac{1}{4}$ sec. cor. of sec. 22, only, marked on brass cap</p>
	<p><u>$\frac{1}{4}$ S 22</u> 1922</p>
	<p>42.70 (40.00 chs. N. 89° 58' W. from cor. of secs. 14 and 15). Intersect original true point for $\frac{1}{4}$ sec. cor. of secs. 15 and 22 which is now point for $\frac{1}{4}$ sec. cor. of sec. 15 only. This point falls on precipitous SW. slope where it is impracticable to establish cor. monument.</p>
	<p>Thence, N. 89° 57' W., on true line, continuing measurement of N. bdy. of sec. 22.</p>
	<p>43.50 Descend 50 ft. over SW. slope to Bottom of canyon, course SW. Ascend 491 ft. over SE. slope to</p>
	<p>75.30 Spur slopes SW. Intersect the original witness cor. to cor. of secs. 15, 16, 21 and 22, which is an iron post 3 ft. long, 1 in. in diam., projecting 10 ins. above ground, firmly set, properly marked on brass cap for said secs. and witnessed by a md. of stones W. of cor. No bearing trees.</p>
	<p>Alter this cor. to refer to point for cor. of secs. 15 and 16 only by changing marking on brass cap to read</p>
	<p>G R I R T 2 S E 1 E <u>S 16 S 15</u> W C 1912-22</p>
	<p>80.40 Move the md. of stone from W. to N. of cor. Descend 180 ft. over NW. slope to Point of intersection of the subdivision line bet. secs. 21 and 22.</p>
	<p>Closing cor. of secs. 21 and 22 established at this point as hereinafter described.</p>
	<p>Land, mountainous. Soil, rocky 4th rate. Timber, none. Undergrowth, scattering greasewood and cactus. No grass.</p>
	<p>From the closing cor. of secs. 21 and 22. N. 89° 57' W., on true line on N. bdy. of sec. 21, along bdy. of Gila River Indian Reservation. Over mountainous land, through scattering undergrowth. Descend 115 ft. over NW. slope to 2.50 (40.20 chs. N. 89° 57' W., from true point for $\frac{1}{4}$ sec. cor. of sec. 15. Intersect the original true point for cor. of secs. 15,</p>

Resurvey of part of the Subdivision Lines of Township 2 South, Range 1 East.

Chains	<p>16, 21 and 22, now point for cor. of secs. 15 and 16 only. Ascend 140 ft. over NE. slope.</p> <p>9.50 Point of spur sloping NW. Descend 1233 ft. over steep NW. slope broken by cliffs and ledges.</p> <p>35.50 Bottom of rocky canyon 25 lks. wide, course S. 50° W. Asc. 55 ft. over SE. slope to</p> <p>38.36 Intersect the original witness cor. to $\frac{1}{4}$ sec. cor. of secs. 16 and 21, which is an iron post 3 ft. long, 1 in. in diam., projecting 12 ins. above ground, firmly set, properly marked on brass cap, and witnessed by a md. of stone N. of cor. No bearing trees. Alter this cor. to refer to the true point for $\frac{1}{4}$ sec. cor. of 16 only by changing marking on brass cap to read</p> <p style="text-align: center;">G R I R $\frac{1}{4}$ S 16 1912-22</p> <p>No change in accessory is required. Asc. 10 ft. over SE. slope to</p> <p>39.98 (Mid-point of N. bdy. of sec. 21) Set an iron post 3 ft. long, 1 in. in diam. over cross (X) on surface rock and raise a mound of stone $4\frac{1}{2}$ ft. base, 34 ins. high around post, for $\frac{1}{4}$ sec. cor. of sec. 21 only, marked on brass cap</p> <p style="text-align: center;">$\frac{1}{4}$ S 21 1922</p> <p>42.46 Ascend 40 ft. over SE. slope to (39.96 chs. N. 89° 57' W., from true point for cor. of secs. 15 and 16). Intersect the original true point for $\frac{1}{4}$ sec. cor. of secs. 16 and 21, now point for $\frac{1}{4}$ sec. cor. of sec. 16 only, on steep slope and slide rock Thence, N. 89° 59' W., on true line, continuing measurement of N. bdy. of sec. 21. Ascend 10 ft. over SE. slope.</p> <p>42.95 Point of spur slopes S. Desc. 150 ft. over SW. slope.</p> <p>53.25 Bottom of canyon, 15 lks. wide, course S. Ascend 350 ft. over SE. slope broken by cliffs.</p> <p>64.20 Spur, slopes S. Descend 30 ft. over SW. slope to</p> <p>68.00 Top of cliff bears E. and W., facing S. Descend 165 ft. over face of cliff, to</p> <p>70.50 Foot of cliff brs. E. and W. Descend 46 ft. over S. slope</p> <p>75.00 Ascend 24 ft. over S. slope.</p> <p>76.60 Descend 275 ft. over steep W. slope to</p> <p>79.96 Point of intersection of subdivision line bet. secs. 20 and 21. Closing cor. of said secs. established at this point as hereinafter described.</p> <p>Land, mountainous. Soil, rocky, 4th rate. Timber, none. Undergrowth, scattering greasewood and cactus. No grass.</p> <hr/> <p>N. 89° 59' W., on true line, on N. bdy. of sec. 20, along bdy. of Gila River Indian Reservation. Over mountainous land, through very scattering timber and scattering undergrowth. Descend 70 ft. over W. slope to</p> <p>2.52 (40.02 chs. N. 89° 59' W., from true point for $\frac{1}{4}$ sec. cor. of sec. 16). Intersect the original cor. of secs. 16, 17, 20 and 21, which is an iron post, 1 in. in diam., projecting 12 ins. above ground, firmly set, properly marked on</p>
--------	---

Resurvey of part of the Subdivision lines
of Township 2 South, Range 1 East.

Chains	<p>brass cap for said secs. and witnessed by a md. of stone W. of cor. Alter this cor. to refer to secs. 16 and 17 only, by changing marking on brass cap to read</p> <p style="text-align: center;">G R I R T 2 S R 1 E <u>S 17 S 16</u> 1912-22</p> <p>Move md. of stone from W. to N. of cor. Descend 80 ft. over W. slope.</p> <p>6.02 Bottom of canyon, course S. Asc. 752 ft. over E. slope. 32.50 Spur slopes S. Desc. 125 ft. over W. slope to 39.99 (Mid-point of N. bdy. of sec. 20). Set an iron post 3 ft. long, 1 in. in diam., 4 ins. in the ground, to bed rock, deposit a stone marked with a cross (X) at base of post, and raise a mound of stone 4 ft. base $2\frac{1}{2}$ ft. high around post for $\frac{1}{4}$ sec. cor. of sec. 20, only, marked on brass cap</p> <p style="text-align: center;"><u>$\frac{1}{4}$ S 20</u> 1922</p> <p>42.60 Descend 65 ft. over W. slope to (40.08 chs. N. $89^{\circ} 59' W.$, from cor. of secs. 16 and 17) Bottom of canyon, course S. Intersect the original $\frac{1}{4}$ sec. cor. of secs. 17 and 20, which is an iron post, 3 ft. long, 1 in. in diam., projecting 12 ins. above ground, properly marked on brass cap, and witnessed by a md. of stone N. of cor. No bearing trees. Alter this cor. to refer to sec. 17 only, by changing marking on brass cap to read</p> <p style="text-align: center;">G R I R <u>$\frac{1}{4}$ S 17</u> 1912-22</p> <p>No change in accessory is required. Thence, N. $89^{\circ} 57' W.$, on true line, continuing measurement of N. bdy. of sec. 20. Ascend 170 ft. over SE. slope 59.52 Spur, slopes S. Desc. 640 ft. over W. slope to 79.98 Intersect the original closing cor. of secs. 19 and 20, which is an iron post, 2 ins. in diam., projecting 36 ins. above ground, firmly set in a md. of stone, properly marked on brass cap, and witnessed by a md. of stone S. of cor. No bearing trees. Land, mountainous. Soil, rocky, 4th rate. Timber, very scattering palo verde. Undergrowth, scattering greasewood and cactus. No grass.</p> <hr/> <p>From the closing cor. of secs. 19 and 20. N. $89^{\circ} 57' W.$, on true line, completing the resurvey of S. bdy. of sec. 17. Over mountainous land, through very scattering timber and scattering undergrowth. Descend 45 ft. over W. slope to 2.72 (40.10 chs. N. $89^{\circ} 57' W.$, from $\frac{1}{4}$ sec. cor. of sec. 17) Intersect the original cor. of secs. 17, 18, 19 and 20 which is an iron post, 1 in. in diam., projecting 12 ins. above ground, firmly set, properly marked on</p>
--------	--

BOOK 3571

Resurvey of part of the Subdivision Lines
of Township 2 South, Range 1 East.

Chains brass cap for said secs. and witnessed by a md. of stone W. of cor. No bearing trees.
Alter this cor. to refer to secs. 17 and 18, only by changing marking on brass cap to read

G H I R
T 2 S R 1 E
S 18 | S 17
1912-22

Move md. of stone from W. to N. of cor.
Land, mountainous.
Soil, rocky, 4th rate.
Timber, very scattering palo verde.
Undergrowth, scattering greasewood and cactus.
No grass.

Boundaries of that Part of T. 2 S., R. 1 E.,
Subdivided under this Group.
Latitudes, Departures and Closing Errors.

Line Designated	True course	Dist- ance	Latitudes		Departures	
			N.	S.	E.	W.
South Boundary	West	322.50				322.50
Subdivisional Boundary	N.0° 1' E.	160.00	160.00			
	N.89° 57' W.	80.00	.07			80.00
	N.0° 1' E.	79.93	79.93			
	S.89° 57' E.	37.38		.03		37.38
	S.89° 59' E.	80.10		.02		80.10
	S.89° 57' E.	80.16		.07		80.16
	S.89° 58' E.	40.00		.02		40.00
	East	39.75				39.75
	S.89° 51' E.	40.10		.10		40.10
S.89° 59' E.	39.95		.01		39.95	
S.89° 58' E.	45.30		.03		45.30	
East Boundary	S.0° 3' W.	111.59		111.59		.65
	S.0° 7' W.	40.10		40.10		.08
	S.0° 3' W.	39.35		39.35		.03
	S.0° 2' W.	41.03		41.03		.02
	South	7.78		7.78		
Convergency						.17
Totals			240.00	240.13	402.91	402.73
				240.00	402.73	
Error in latitude				0.13		
Error in departure						0.18

Survey of Part (Completion of the Subdivision Lines
of Township 2 South, Range 1 East.

Chains The subdivision lines of the North half of this township were surveyed in 1912 by R. A. Rarmer, U. S. Topographer, and secs. 19, 29, 30, 31 and 32 were surveyed by W. G. Shapcott, U. S. Surveyor, in 1916. No retracement or resurvey of any part of the subdivision lines is of record. The following notes describe the survey of the remainder of the subdivision lines of this township.

The original cor. of secs. 20, 21, 28 and 29 is an iron post, 2 ins. in diam., projecting 12 ins. above ground, firmly set, properly marked on brass cap, and witnessed by a mound of stone W. of cor. No bearing trees.

Thence,

N. 0° 01' E., on a true line, bet. secs. 20 and 21.

Over rolling land, through very scattering timber and scattering undergrowth. Ascend gradually over SW. slope.

36.50 Wash, 40 lks. wide, course S. 25° W. Continue gradual ascent over E. slope.

40.00 Set an iron post 3 ft. long, 1 in. in diam., over cross (X) marked on surface rock, and raise a mound of stone 4 ft. base, 34 ins. high, around post for $\frac{1}{4}$ sec. cor., marked on brass cap

$\frac{1}{4}$
 S 20 | S 21
 1922

No trees suitable for bearing trees within limits.

Continue over rolling land, through very scattering timber and scattering undergrowth. Ascend 34 ft. over E. slope to

44.50 Same wash, 50 lks. wide, course S. 20° E. Ascend 20 ft. over SE. slope to

48.00 Same wash, course S. 20° W. Ascend 173 ft. over SE. slope to

65.00 Same wash, 25 lks. wide, course SE. Leave rolling and enter mountainous land. Ascend 241 ft. over steep SW. and W. slopes to

80.06 Intersect S. bdy. of sec. 16, 252 lks. S. 89° 59' E., from the cor. of secs. 16 and 17, hereinbefore described. At point of intersection,

Set an iron post 3 ft. long, 2 ins. in diam., 6 ins. in the ground to bedrock, deposit a stone marked with a cross (X) at base of post and raise a mound of stone 4 ft. base, 2 ft. high around post for closing cor. of secs. 20 and 21, marked on brass cap

G R I R
 S 16
 S 20 | S 21
 T 2 S | R 1 E
 C C
 1922

No trees suitable for bearing trees within limits.

Land, mountainous.

Soil, rocky, 4th rate.

Timber, very scattering palo verde and ironwood.

Undergrowth, scattering greasewood and cactus.

No grass.

The original cor. of secs. 3, 4, 33 and 34 on S. bdy. of Tp., established by W. G. Shapcott, U. S. S. in 1916, is an iron post, 3 ins. in diam., projecting 3 ft. above ground, firmly set in a md. of stone, properly marked on brass cap and witnessed by a md. of stone W. of cor. and one ironwood bearing tree SW. of cor. 129 lks. dist.

ECON 2574

Survey of part (completion) of the Subdivision
lines of Township 2 South, Range 1 East.

17

Chains.

Thence,
N.0°02'E., bet. secs. 33 and 34.
Over level land, sloping slightly to the SW., thru. very
scattering timber and scattering undergrowth.

5.00 Wash, 20 lks.wide, course SW.

23.90 Wash, 20 lks.wide, course SW.

35.00 Leave level, and enter mountainous land.

Ascend 85 ft., over S. slope, to

40.00 Set an iron post 3 ft. long, 1 in. in diam., 10 ins. in the
ground to bed rock, deposit a stone marked with a
cross (x) at base of post, and raise a mound of stone
3½ ft. base, 1½ ft. high around post, for ¼ sec. cor.,
marked on brass cap,

¼
S33 | S34
1922

No trees suitable for bearing trees within limits.

Continue over mountainous land.

Ascend 273 ft., over S. slope.

48.00 Spur, slopes SE.

Ascend gradually over E. slope.

79.00 Bottom of gulch, 6 lks. wide, course SE.

Ascend 52 ft., over SW. slope, to

80.00 Set an iron post, 3 ft. long, 2 ins. in diam., over cross
(x) marked on surface rock, and raise a mound of stone
4 ft. base, 34 ins. high around post for cor. of secs.
27, 28, 33 and 34, marked on brass cap,

T2S | R1E
S28 | S27
S33 | S34
1922

No trees suitable for bearing trees within limits.

Land, S. 35 chs. level; N. 45 chs. mountainous.

Soil, gravelly and rocky, 3rd and 4th rate.

Timber, very scattering palo verde, mesquite and ironwood.

Undergrowth, scattering greasewood and cactus.

No grass.

West, on a random line, bet. secs. 28 and 33.

40.00 Set temp. ¼ sec. cor.

79.96 Intersect N. and S. line, 2 lks. S. of the original cor. of
secs. 28, 29, 32 and 33, which is an iron post, 2 ins.
in diam., projecting 12 ins. above ground, firmly set
marked on brass cap, and witnessed by a mound of stone
W. of cor. No bearing trees.

Thence,

S. 89° 59' E., on true line, bet. secs. 28 and 33.

Over mountainous land, thru. scattering undergrowth.

Ascend 614 ft., over NW. slope, to

39.98 Set an iron post, 3 ft. long, 1 in. in diam., 4 ins. in
the ground to bed rock, deposit a stone marked with
a cross (x) at base of post, and raise a mound of
stone 3½ ft. base, 2½ ft. high around post for ¼ sec. cor.
marked on brass cap,

¼ S 28
S 33
1922

Continue over mountainous land.

Ascend 100 ft. over NW. slope.

Survey of part (completion) of the Subdivision
lines of Township 2 South, Range 1 East.

18

Chains.

- 43.70 Spur, slopes S. 80° W.
Descend 290 ft., over S. slope.
- 58.00 Ascend 450 ft. over SW. slope.
- 70.00 Rocky spur, slopes S. 15° W.
Descend 420 ft. over E. slope.
- 79.00 Head of gulch, course SE.
Ascend 40 ft. over S. slope, to
- 79.96 The cor. of secs. 27, 28, 33 and 34.
Land, mountainous.
Soil, gravelly and rocky, 3rd and 4th rate.
Timber, none.
Undergrowth, scattering greasewood and scrub palo verde.
No grass.
-
- N. 0° 02' E., bet. secs. 27 and 28.
Over mountainous land, through scattering undergrowth.
Ascend 128 ft., over steep S. slope.
- 3.00 Spur, slopes SE.
Ascend 620 ft. over E. and SE. slopes to
- 37.00 Saddle in spur, sloping SW.
Ascend 25 ft., over W. slope, to
- 40.00 Set an iron post 3 ft. long, 1 in. in diam., 12 ins. in
the ground to bed rock, deposited a stone, marked with
a cross (x) at base of post, and raise a mound of stone
4 ft. base, 2 ft. high around post, for $\frac{1}{4}$ sec. cor., marked
on brass cap,
- $\frac{1}{4}$
S28 | S27
1922
- Continue over mountainous land.
Ascend 60 ft., over W. slope, to
- 45.20 Descend 395 ft., over NW. slope.
- 57.00 Bottom of canyon, course SW.
Ascend 135 ft., over S. slope.
- 67.00 Spur, slopes SW.
Descend 280 ft. over NW. slope.
- 78.00 Gulch, course W.
Ascend 52 ft., over S. slope, to
- 80.00 Spur, slopes W. Set an iron post, 3 ft. long, 2 ins. in
diam., 4 ins. in the ground to bed rock, deposit a stone
marked with a cross (x) at base of post, and raise a
mound of stone 4 ft. base, 2 $\frac{1}{2}$ ft. high, around post,
for cor. of secs. 21, 22, 27 and 28, marked on brass
cap,
- T2S | R1E
S21 | S22
S28 | S27
1922
- Land, mountainous.
Soil, rocky, 4th rate.
Timber, none.
Undergrowth, scattering greasewood.
No grass.
-
- N. 89° 59' W., on random line, bet. secs. 21 and 28.
Set temp. $\frac{1}{4}$ sec. cor.
- 40.00 Intersect N. and S. line, 20 lks. S. of the original cor. of
secs. 20, 21, 28 and 29, hereinbefore described.
- 79.92 Thence,
S. 89° 50' E., on true line, bet. secs. 21 and 28.
Over rolling land, thru. very scattering timber and scattering

Survey of part (completion) of the Subdivision lines
of Township 2 South, Range 1 East.

19

Chains.	
	undergrowth. Descend 25 ft., over S. and SE. slopes. Wash, 40 lks. wide, course S. 20° W. Ascend 60 ft., over SW. slope, to Foot of steep ascent, brs. NE. and SW. Ascend 240 ft., over SW. slope, to Descend 40 ft., over S. slope. Bottom of rocky gulch, 50 lks. wide, course S. 70° W. Ascend 107 ft., over NW. slope, to Set an iron post 3 ft. long, 1 in. in diam., 4 ins. in the ground to bed rock, deposit a stone marked with a cross (x) at base of post, and raise a mound of stone 4 ft. base, 2½ ft. high around post for ¼ sec. cor., marked on brass cap,
	$\frac{1}{4} \text{ S } 21$ $\text{S } 28$ 1922
	No trees suitable for bearing trees within limits. Continue over mountainous land, thru. very scattering timber and scattering undergrowth. Ascend 32 ft. over NW. slope. Spur, slopes S. 70° W. Descend 278 ft., over steep S. slope. Gulch, 50 lks. wide, course S. 60° W. near head. Ascend 90 ft. over NW. slope. Spur, slopes SW. from E.; thence on top of spur. Ascend 400 ft. to The cor. of secs. 21, 22, 27 and 28. Land, W. 21 chs., rolling; remainder, mountainous. Soil, gravelly and rocky, 3rd and 4th rate. Timber, very scattering, palo verde, mesquite and iron- wood. Undergrowth, scattering greasewood. No grass.

	N. 0° 02' E., bet. secs. 21 and 22. Over mountainous land, thru. scattering undergrowth. Descend 285 ft., over N. slope. Bottom of canyon, 45 lks. wide, course S. 60° W. Ascend 685 ft., over SE. slope, to Set an iron post, 3 ft. long, 1 in. in diam., 4 ins. in the ground to bed rock, deposit stone marked with a cross (x) at base of post, and raise a mound of stone 4 ft. base, 2½ ft. high around post, for ¼ sec. cor., marked on brass cap,
	$\frac{1}{4} \text{ S } 21 \text{ S } 22$ 1922
	Continue over mountainous land, thru. scattering under- growth. Ascend 1100 ft., over SE. slope. Spur, slopes SW. Descend 120 ft., over NW. slope, to Intersect the S. bdy. of sec. 15, identical with boundary of the Gila River Indian Indian Reservation at 250 lks. S. 89° 57' E. from the true point for cor. of secs. 15 and 16, witnessed 7.60 chs. S. 89° 57' E., as herein- before described. At point of intersection, Set an iron post, 3 ft. long, 2 ins. in diam., over cross (x), marked on surface rock, and raise a mound of stone 5 ft. base, 34 ins. high around post for closing
11.72	
21.00	
32.19	
35.72	
39.96	
41.00	
55.95	
66.00	
79.92	
17.50	
40.00	
78.00	
80.20	

20 Survey of part (completion) of the
Subdivision lines of Township 2 South, Range 1 East.

Chains.

cor. of secs. 21 and 22, marked on brass cap,

GRIR	
S 15	
S21	S22
T2S	R1E
C C	
1922	

Land, mountainous.
Soil, rocky, 4th rate.
Timber, none.
Undergrowth, scattering greasewood and cactus.
No grass.

The original cor. of secs. 2, 3, 34 and 35 on S. bdy. of Tp.
is an iron post, 3 ins. in diam., projecting 12 ins.
above ground, firmly set, properly marked on brass cap,
and witnessed by a mound of stone, W of cor.

No bearing trees.

Thence,
N. 0° 02' E., bet. secs. 34 and 35.

Over nearly level land in bottom of canyon, about 25 chs.
wide, thru. scattering undergrowth,

10.00 West edge of bottom of canyon, brs. NE and SW. Leave nearly
level, and enter mountainous land.

11.80 Ascend 500 ft., over steep broken SE. slope to $\frac{1}{4}$ sec. cor.
Granite ledge, 75-ft. high, brs. N. and S. extends N. about
115 lks.

40.00 Set an iron post 3 ft. long, 1 in. in diam., over cross (x)
marked on surface rock, and raise a mound of stone 4
ft. base, 34 ins. high around post for $\frac{1}{4}$ sec. cor., marked
on brass cap,

$\frac{1}{4}$	
S34	S35
1922	

Continue over mountainous land, thru. scattering under-
growth.

57.80 Ascend 472 ft. over SE. slope.
Bend in top of spur, slopes S. 30° W. from N. 15° W.
Descend 185 ft., over E. and NE. slopes.

73.60 Head of canyon, course S. 70° E.

80.00 Ascend 223 ft., over SE. slope, to

Set an iron post, 3 ft. long, 2 ins. in diam., over cross
(x) marked on surface rock, and raise a mound of stone
5 ft. base, 34 ins. high around post for cor. of secs.
26, 27, 34 and 35, marked on brass cap,

T2S	R1E
S27	S26
S34	S35
1922	

Land, S. 10 chs., nearly level; remainder, mountainous.
Soil, gravelly and rocky, 3rd and 4th.
Timber, none.
Undergrowth, scattering greasewood.
No grass.

40.00 West, on a random line, bet. secs. 27 and 34.
Set temp. $\frac{1}{4}$ sec. cor.

80.30 Intersect N. and S. line, 14 lks. N. of the cor. of secs.
27, 28, 33 and 34.

Thence,

COOK 3574

Survey of part (completion) of the
Subdivision lines of Township 2 South, Range 1 East. 21

Chains.

N.89°54'E., on true line, bet. secs.27 and 34.
Over mountainous land, thru. scattering undergrowth.
Ascend slightly over S.slope, to
1.53 Point of spur, sloping SE.
Descend 200 ft., over SE.slope.
13.80 Bottom of canyon, 10 lks.wide, course SW.
Ascend 300 ft., over W.slope.
25.80 Spur, slopes SW.
Descend 180 ft., over SE.slope, to
40:15 Set an iron post 3 ft.long, 1 in. in diam., over cross.
(x) marked on surface rock, and raise a mound of
stone 4 ft.base, 34 ins. high around post for 1/4 sec.cor.,
marked on brass cap,

1/4 S 27
S 34
1922

Continue over mountainous land, thru. scattering under-
growth.
Descend 110 ft., over SE.slope.
49.75 Bottom of canyon, 15 lks.wide, course SW.
Ascend 600 ft., over steep W.slope, to
69.80 Top of precipitous cliff, 150 ft. high, bearing N.and S.
facing W.
Ascend 277 ft. over NW.slope.
75.80 Spur, slopes SW.
Descend 78 ft., over SE.slope, to
80.30 The cor. of secs. 26, 27, 34 and 35.
Land, mountainous.
Soil, gravelly and rocky, 3rd and 4th rate.
Timber, none.
Undergrowth, scattering greasewood.
No grass.

N.0° 02' E., bet. secs. 26 and 27. .
Over mountainous land, thru. scattering undergrowth. .
Ascend 252 ft., over SE.slope. .
10.00 Spur, slopes SW.
Descend 417 ft., over NW.slope.
22.80 Ascend 113 ft., over W.slope.
27.50 Descend 210 ft., over NW.slope.
37.50 Bottom of canyon, 20 lks.wide, course SW.
Ascend 40 ft., over SE. slope, to
40.00 Set an iron post, 3 ft. long, 1 in. in diam., over cross
(x) marked on surface rock, and raise a mound of stone
4 ft. base, 34 ins. high around post for 1/4 sec.cor.,
marked on brass cap,

1/4
S27 | S26
1922

Continue over mountainous land, thru. scattering under-
growth.
Ascend 1260 ft. over steep broken SE. and S.slopes, to
80.00 Set an iron post, 3 ft.long, 2 ins. in diam., over cross
(x) marked on surface rock, and raise a mound of stone
4 1/2 ft. base, 34 ins. high around post, for cor. of secs.
22, 23, 26 and 27, marked on brass cap,

T2S | R1E
S22 | S23
S27 | S26
1922

Land, mountainous.

Survey of part (completion) of the
 Subdivision lines of Township 2 South, Range 1 East.

Chains.

Soil, rocky, 4th rate.
 Timber, none.
 Undergrowth, scattering scrub palo verde and mesquite.
 No grass.

 S. 89° 54' W., on a random line, bet. secs. 22 and 27.
 40.00 Set temp. $\frac{1}{4}$ sec. cor.
 80.30 Intersect N. and S. line, 3 lks. S. of the cor. of secs. 21,
 22, 27 and 28.
 Thence,
 N. 89° 55' E., on true line, bet. secs. 22 and 27.
 Over mountainous land, thru. scattering undergrowth, along
 top of spur, sloping W.
 Ascend 539 ft., to
 14.20 Leave top of spur, slopes W. from SE.
 Descend 91 ft., over NE. slope.
 19.00 Bottom of gulch, 10 lks. wide, course N.
 Ascend 590 ft., over NW. slope.
 38.30 Rocky, slopes S. 60° W.
 Descend slightly over S. slope, to
 40.15 Set an iron post, 3 ft. long, 1 in. in diam., over cross
 (x) marked on surface rock, and raise a mound of stone,
 4 ft. base, 34 ins. high around post, for $\frac{1}{4}$ sec. cor.,
 marked on brass cap,

$\frac{1}{4}$ S 22
 S 27
 1922

Continue over mountainous land, thru. scattering under-
 growth.
 Descend 80 ft., over SE. slope,
 55.00 Head of gulch, course SW.
 Ascend 750 ft., over W. slope.
 73.90 Spur, slopes S. 15° W.
 Descend 50 ft., over SE. slope, to
 80.30 The cor. of secs. 22, 23, 26 and 27.
 Land, mountainous.
 Soil, rocky, 4th rate.
 Timber, none.
 Undergrowth, scattering greasewood and scrub palo verde.
 No grass.

 N. 0° 02' E., bet. secs. 22 and 23.
 Over mountainous land, thru. scattering undergrowth.
 Ascend 140 ft., over S. slope.
 4.00 Main ridge of the Estrella Mountains, at top of cliff
 120 ft. high, bearing NW. and SE. facing NE.
 Descend 890 ft. over steep broken NE. slope, to
 40.00 Set an iron post, 3 ft. long, 1 in. in diam., 4 ins. in
 the ground to bed rock, deposit a stone marked with
 a cross (x) at base of post, and raise a mound of
 stone 4 ft. base, 2 $\frac{1}{2}$ ft. high, around post for $\frac{1}{4}$ sec.
 cor., marked on brass cap,

$\frac{1}{4}$
 S22 | S23
 1922

Continue over mountainous land, thru. scattering under-
 growth.
 Descend 60 ft., over NE. slope.
 47.00 Bottom of canyon, 10 lks. wide, course NE.

Survey of part (completion) of the Subdivision
Lines of Township 2 South, Range 1 East.

23

Chains.

Ascend 230 ft. over SE. slope, broken by cliffs and ledges.
54.00 Spur, slopes N. 50° E.
Descend 987 ft., over N. slope.
78.50 Bottom of canyon, 10 lks. wide, course NE.
Ascend 30 ft., over SE. slope, to
80.20 Intersect S. bdy. of sec. 14, identical with bdy. of the Gila River Indian Reservation, 270 lks. E. from the cor. of secs. 14 and 15, hereinbefore described.
At point of intersection,
Set an iron post, 3 ft. long, 2 ins. in diam., over cross (x) marked on surface rock, and raise a mound of stone, 4 ft. base, 34 ins. high, around post, for closing cor. of secs. 22 and 23, marked on brass cap,

G R I R
S14
S22 | S23
T2S | R1E
C | C
1922

Land, mountainous.
Soil, gravelly and rocky, 3rd and 4th rate.
Timber, none.
Undergrowth, scattering greasewood, scrub palo verde and cactus.
No grass.

The original cor. of secs. 1, 2, 35 and 36 on the S. bdy. of the Tp. is an iron post 3 ins. in diam., projecting 36 ins. above ground, firmly set in a mound of stone, properly marked on brass cap, and witnessed by a mound of stone, W. of cor. No bearing trees. ✓

Thence,
N. 0° 03' E., bet. secs. 35 and 36,
Over mountainous land, thru. scattering undergrowth.
Ascend 417 ft., over S. slope.
13.60 Spur, slopes W.
23.20 Descend 319 ft., over N. slope.
Bottom of canyon, course W.
Ascend 696 ft., over SW. slope, to
40.00 Set an iron post, 3 ft. long, 1 in. in diam., 4 ins. in the ground to bed rock, deposit a stone, marked with a cross (x) at base of post, and raise a mound of stone, 4 ft. base, 2½ ft. high around post, for ¼ sec. cor., marked on brass cap,

¼
S35 | S36
1922

Continue over mountainous land, thru. scattering undergrowth.
Ascend 140 ft., over SW. slope.
43.50 Rocky spur, slopes N. 70° W.
Descend 377 ft., over NW. slope.
60.00 Bottom of canyon, 20 lks. wide, course S. 80° W.
Ascend 341 ft., over S. slope.
73.00 Spur, slopes W.
Descend 220 ft., over N. slope.
78.75 Rocky gulch, course W.
Ascend 40 ft., over S. slope, to
80.00 Set an iron post, 3 ft. long, 2 ins. in diam., 6 ins. in the ground to bed rock, deposit a stone marked with a cross (x) at base of post, and raise a mound of stone

Survey of part (completion) of the
24. Subdivision lines of Township 2 South, Range 1 East.

Chains.

4 ft. base, 28 ins. high around post for cor. of secs.
25, 26, 35 and 36, marked on brass cap,

T2S	R1E
S26	S25
S35	S36
1922	

Land, mountainous.

Soil, rocky, 4th rate.

Timber, none.

Undergrowth, scattering greasewood and cactus.

No grass.

West, on a random line, bet. secs. 26 and 35.

40.00 Set temp. $\frac{1}{4}$ sec. cor.80.04 Intersect N. and S. line, 4 lks. N. of the cor. of secs. 26,
27, 34 and 35.

Thence,

N. $89^{\circ}58'$ E., on a true line, bet. secs. 26 and 35.

Over mountainous land, thru. scattering undergrowth.

Ascend 297 ft., over SW. slope.

13.00 Point of spur, slopes SW.

Descend 735 ft., over SE. slope, to

40.02 Set an iron post, 3 ft. long, 1 in. in diam., over cross
(x) marked on surface rock, and raise a mound of
stone, 4 ft. base, 34 ins. high, around post, for $\frac{1}{4}$
sec. cor., marked on brass cap,

$\frac{1}{4}$	S 26
	S 35
1922	

Continue over mountainous land, thru. scattering undergrowth.

Descend 302 ft., over SE. slope.

47.80 Bottom of canyon, 80 lks. wide, course SW.

Ascend 884 ft., over SW. slope, to

80.04 The cor. of secs. 25, 26, 35 and 36.

Land, mountainous.

Soil, rocky, 4th rate.

Timber, none.

Undergrowth, scattering greasewood and cactus.

No grass.

East, on a random line, bet. secs. 25 and 36.

40.00 Set temp. $\frac{1}{4}$ sec. cor.82.40 Intersect N. and S. line, 5 lks. N. of the cor. of secs.
25 and 36, on E. bdy. of the Tp., hereinbefore de-
scribed.

Thence,

N. $89^{\circ}58'$ W., on true line, bet. secs. 25 and 36.

Over mountainous land, thru. scattering undergrowth.

Ascend 25 ft., over NE. slope.

.50 Point of spur, slopes NW.

Descend 180 ft., over NW. slope.

4.63 Bottom of canyon, 40 lks. wide, course N. from SW.

Ascend 743 ft., over E. slope.

33.00 Spur, slopes NE.

Descend 25 ft., over NW. slope.

38.00 Head of gulch, course NE.

Ascend 110 ft., over E. slope, to

42.40 Set an iron post, 3 ft. long, 1 in. in diam., 10 ins. in
the ground to bed rock, deposit a stone, marked with
a cross (x) at base of post, and raise a mound of
stone, 4 ft. base, 2 ft. high around post, for $\frac{1}{4}$ sec.
cor., marked on brass cap,

Survey of part (completion) of the
Subdivision lines of Township 2 South, Range 1 East.

Chains.

$\frac{1}{4}$ S 25
S 36
1922

55.00 Continue over mountainous land, thru. scattering under-
growth.
Ascend 516 ft., over NE. slope.
Main ridge of the Estrella Mountains, brs. N. 20° W. and S.
20° E.

82.40 Descend 824 ft., over SW. slope, to
The cor. of secs. 25, 26, 35 and 36.
Land, mountainous.

Soil, rocky, 4th rate.
Timber, none.
Undergrowth, scattering greasewood and cactus.
No grass.

N. 0° 03' E., bet. secs. 25 and 26.
Over mountainous land, thru. scattering undergrowth.
Ascend 254 ft., over SW. slope.

7.65 Rocky spur, slopes W.
Descend 740 ft., over NW. slope.

39.50 Bottom of canyon, 40 lks. wide, course SW.

40.00 Ascend slightly over SE. slope, to
Set an iron post 3 ft. long, 1 in. in diam., 6 ins. in the
ground to bed rock, deposit a stone marked with a cross
(x) alongside, and raise a mound of stone $3\frac{1}{2}$ ft. base,
2 ft. high around post for $\frac{1}{4}$ sec. cor., marked on brass
cap,

$\frac{1}{4}$
S26 | S25
1922

66.79 Continue over mountainous land, thru. scattering under-
growth.
Ascend 1120 ft. over S. and SW. slopes, broken by cliffs
and ledges.

80.00 Main ridge of the Estrella Mountains, brs. NW. and SE.
Descend 460 ft., over NE. slope, to

Set an iron post 3 ft. long, 2 ins. in diam., over cross
(x) marked on surface rock, and raise a mound of stone
4 ft. base, 34 ins. high around post, for cor. of secs.
23, 24, 25 and 26, marked on brass cap,

T2S | R1E
S23 | S24
S26 | S25
1922

Land, mountainous.
Soil, rocky, 4th rate.
Timber, none.
Undergrowth, scattering greasewood and cactus.
No grass.

40.00 S. 89° 58' W., on a random line, bet. secs. 23 and 26.
Set temp. $\frac{1}{4}$ sec. cor.

80.00 Intersect N. and S. line, 20 lks. N. of the cor. of secs.
22, 23, 26 and 27.

Thence,
N. 89° 49' E., on true line, bet. secs. 23 and 26.
Over mountainous land, thru. scattering undergrowth.
Ascend 170 ft. over S. and SW. slopes.

26 Survey of part (completion) of the Subdivision
lines of Township 2 South, Range 1 East.

Chains.	
8.92	Main ridge of the Estrella Mountains, brs. NW. and SE.
40.00	Descend 525 ft. over NE. slope, to Set an iron post, 3 ft. long, 1 in. in diam. over cross (x) marked on surface rock, and raise a mound of stone 3½ ft. base, 34 ins. high around post, for ¼ sec. cor., marked on brass cap,
	$\frac{1}{4} \text{ S } 23$ $\text{S } 26$ 1922
	Continue over mountainous land, thru. scattering undergrowth.
45.00	Descend 20 ft., over NE. slope.
50.00	Ascend 70 ft., over NW. slope. Spur, slopes NE.
54.70	Descend 57 ft., over E. slope.
71.00	Ascend 473 ft., over NW. slope, to Top of cliff 200 ft. high, bearing NE. and SW. facing NW. Ascend 50 ft., over NW. slope.
74.90	Spur, slopes NE.
80.00	Descend 200 ft. over E. slope, to The cor. of secs. 23, 24, 25 and 26. Land, mountainous. Soil, rocky, 4th rate. Timber, none. Undergrowth, scattering greasewood and cactus. No grass.

40.00	S. 89° 58' E., on a random line, bet. secs. 24 and 25. Set temp. ¼ sec. cor.
82.42	Intersect N. and S. line, 10 lks. N. of the cor. of secs. 24 and 25 on E. bdy. of Tp., hereinbefore described. Thence, N. 89° 54' W., on true line, bet. secs. 24 and 25. Over mountainous land, thru. scattering undergrowth.
34.60	Ascend 1200 ft., over NE. and E. slopes. Rocky spur, slopes N. 10° E.
42.42	Descend 110 ft., over NW. slope, to. Set an iron post, 3 ft. long, 1 in. in diam., 10 ins. in the ground to bed rock, deposit a stone marked with a cross (x) at base of post, and raise a mound of stone 2½ ft. base around post for ¼ sec. cor., marked on brass cap,
	$\frac{1}{4} \text{ S } 24$ $\text{S } 25$ 1922
	Continue over mountainous land, thru. scattering undergrowth.
45.92	Descend 50 ft., over NW. slope.
52.50	Ascend 125 ft., over NE. slope. Spur, slopes N.
75.00	Descend 185 ft., over NW. slope. Head of gulch, course NE.
82.42	Ascend 113 ft. over E. slope, to The cor. of secs. 23, 24, 25 and 26. Land, mountainous. Soil, rocky, 4th rate. Timber, none. Undergrowth, scattering greasewood. No grass.

(Survey of part (completion) of the
Subdivision lines of Township 2 South, Range 1 East. 27

Chains.

N.0°03'E., bet. secs. 23 and 24.
 Over mountainous land, thru. scattering undergrowth.
 Descend 34 ft., over E. slope, to
 5.00 Spur, slopes NE.
 Descend 697 ft., over N. and NE. slopes, to
 26.15 Ascend 85 ft., over E. slope.
 31.00 Spur, slopes NE.
 Descend 280 ft., over NW. slope, to
 40.00 Set an iron post 3 ft. long, 1 in. in diam., 20 ins. in
 the ground to bed rock for 1/4 sec. cor., marked on brass
 cap,

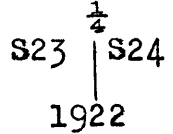

Raise a mound of stone, 3 ft. base, 2 ft. high, W. of cor.
 Continue over mountainous land, thru. scattering undergrowth.
 Descend 890 ft., over NW. slope.
 76.15 Gully, course NE.
 Ascend slightly over E. slope, to
 79.98 Intersect S. bdy. of sec. 13, identical with Bdy. of the
 Gila River Indian Reservation 285 lks. S. 89°59'E. from
 the cor. of secs. 13 and 14, hereinbefore described.
 At point of intersection,
 Set an iron post, 3 ft. long, 2 ins. in diam., 6 ins. in
 the ground to bed rock, deposit a stone marked with a
 cross (x) at base of post, and raise a mound of stone
 4 ft. base, 28 ins. high around post for closing cor.
 of secs. 23 and 24, marked on brass cap,

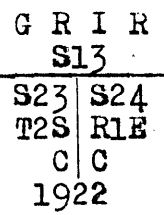

Land, mountainous.
 Soil, rocky, 4th rate.
 Timber, none.
 Undergrowth, scattering greasewood.
 No grass.

The continued satisfactory adjustment of the solar apparatus during the survey of this township is indicated from field tests described in Book "F" of this group.

GENERAL DESCRIPTION.

With the exception of part of the West half of sec. 28, and part of the South half of sec. 33, where there is a level and gently rolling surface, the portion of this township surveyed as described in the foregoing notes has a mountainous surface, being situated on the slopes of the Estrella Mountains. The main ridge of these mountains passes NW. and SE. thru. secs. 22, 26, 25 and 36, reaching an elevation of 4165 ft. above sea level.

The soil is gravelly and rocky, 3rd and 4th rate.
 There is a very scattering growth of palo verde, mesquite and ironwood timber near the foot of the mountains, but most of the area is devoid of timber.
 Most of the surface has a scattering undergrowth of greasewood, scrub palo verde and cactus.

There is no permanent running water in any of the water courses, and no springs.

There is no indication of valuable mineral deposits.

There are no settlers, roads, or improvements in this part of the township.

4-680

BOOK 3574

FIELD ASSISTANTS.

to

Sidney E. Blout, U. S. Cadastral Engineer,

NAMES.	CAPACITY.
Ben Mollette,	1st chairman,
Robert R. Parsons,	2nd chairman,
B. G. Towler,	flagman,
Louis J. Spear,	axman,
Rudolph McCormack,	cornerman.

30

BOOK 3574

CERTIFICATE OF UNITED STATES CADASTRAL ENGINEER

I, Sidney E. Blout, U.S. Cadastral Engineer hereby certify upon honor that, in pursuance of special instructions received from the U. S. Surveyor General for Group 116, Arizona, bearing date of the 23rd day of May, 1921, I have well, faithfully, and truly in my own proper person, and in strict conformity with said instructions, the Manual of Surveying Instructions, and the laws of the United States, retraced surveyed all those parts or portions of the West Bdy. of T. 3 S., R. 2 E., and the West bdy. of T. 2 S., R. 2 E., resurveyed all those parts or portions of the subdivision lines of T. 2 S., R. 1 E., and surveyed all those parts or portions of the East Boundary, and Subdivision lines of TOWNSHIP 2 SOUTH, RANGE 1 EAST

of the Gila and Salt River Base and Meridian, in the State of Arizona, which are represented in and by diagram on page 1 hereof the foregoing field notes as having been executed by me, and under my direction; and that all the corners of retracement, resurvey and said survey have been established and perpetuated in strict accordance with the Manual of Surveying Instructions, and the special written instructions of the U. S. Surveyor General, for Group 116, Arizona, and in the specific manner described in the field notes, and that the foregoing are the original field notes of such survey, retracement, resurvey and survey.

Place: Phoenix, Arizona Date: October 17, 1923 Sidney E. Blout U. S. Cadastral Engineer

APPROVAL.

OFFICE OF THE UNITED STATES SURVEYOR GENERAL,

Phoenix, Arizona, November 2, 1923

The foregoing field notes of the retracement of Part of the East Bdy. of T. 3 S., R. 2 E., and Part (South half) of the West boundary of T. 2 S., R. 2 E., and of the Resurvey of Part of the Subdivision lines of T. 2 S., R. 1 E., and of the survey of Part (South half) of the East Boundary and Part (completion) of the Subdivision lines of

TOWNSHIP 2 SOUTH, RANGE 1 EAST,

of the Gila and Salt River Base and Meridian, in the State of Arizona, executed by Sidney E. Blout, U. S. Cadastral Engineer, under his special instructions dated May 23, 1921, for Group 116, Arizona, having been critically examined, and the necessary corrections and explanations made, the said field notes, and the retracements, resurveys and surveys they describe, are hereby approved.

Signature of U. S. Surveyor General

I certify that the foregoing transcript of the field notes of the above described surveys in has been correctly copied from the original notes on file in this office.

U. S. Surveyor General.