

209  
CRP

3587

Book "C"  
4-879

ECOK 3587

# FIELD NOTES

re-  
OF THE SURVEY OF THE

First Standard Parallel South, thru Range 31 East, and

West boundary

and SURVEY of

East boundary,

North boundary, and

Subdivision lines of

TOWNSHIP 5 SOUTH, RANGE 31 EAST,

Of the Gila and Salt River Base and Meridian,

In the State of Arizona.

## EXECUTED BY

William H. Thorn, U.S. Cadastral Engineer,

and

Benjamin J. Kinsey, U.S. Transitman,

*In the capacity of U. S. Surveyors, under Special Instructions dated August 24, 1920, issued by the United States Surveyor General to govern surveys included in Group No. 111, Arizona, which were approved by the Commissioner of the General Land Office, December 18, 1920, and Assignment Instructions dated November 17, 1920*

Resurvey & Survey commenced March 8, 1921

Resurvey & Survey completed March 22, 1921

3587

3587

BOOK 3587

3587

Book "G"  
Group 111- Arizona.

INDEX DIAGRAM.

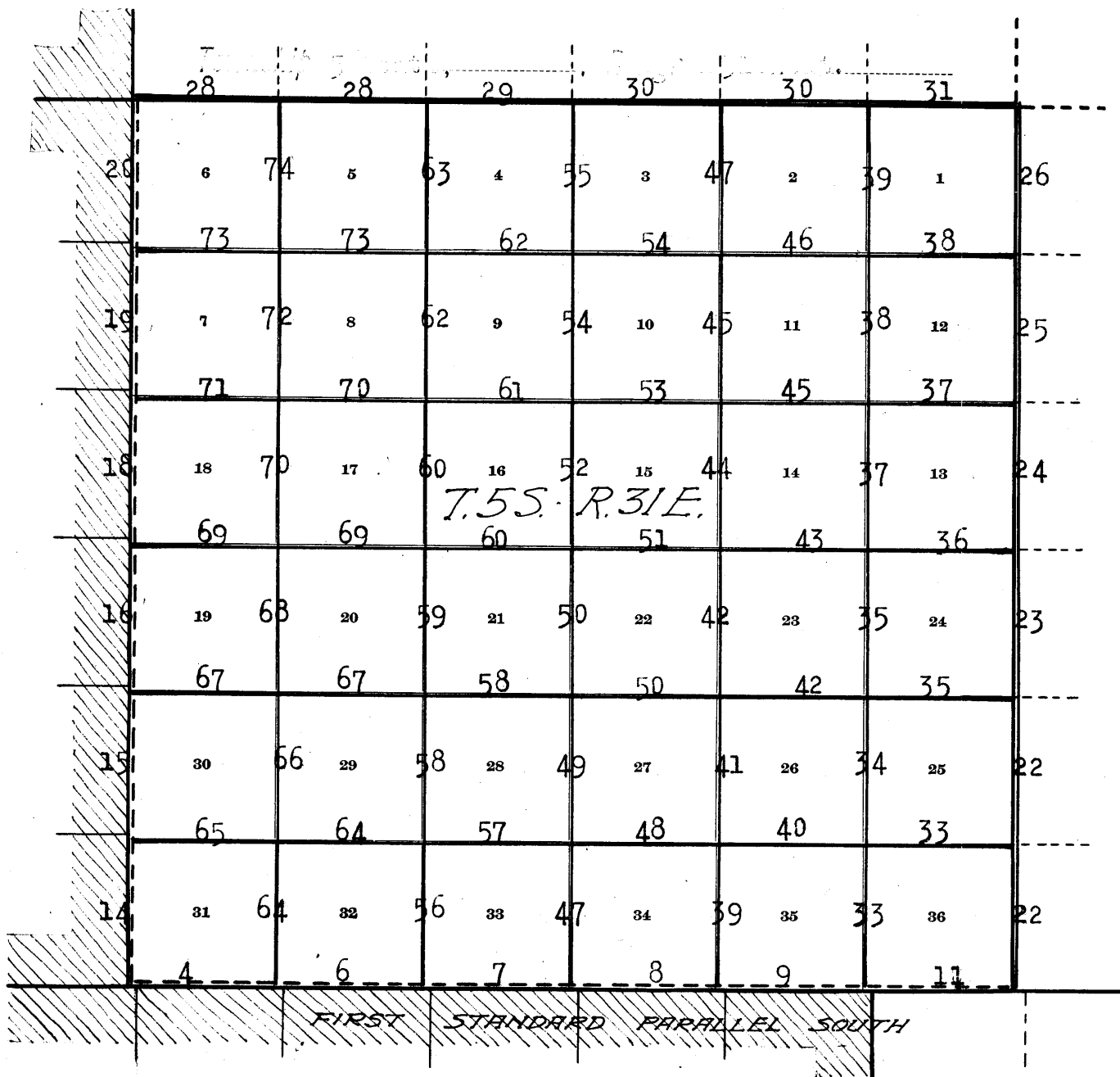

- Lines surveyed under this group.
- - - - - Lines resurveyed under this group.
- Accepted surveys.
- - - - - Unsurveyed.
- Areas surveyed as per accepted plats on file.

115

BOOK 3587

Book "G"

Group 111 - - - Arizona.

Township 5 South, Range 31 East.

DATE DIAGRAM.

	3-17-21	3-17-21	3-18-21	3-18-21	3-18-21	3-18-21
3-12-21	6 3-12-21	5 3-12-21	4 3-18-21	3 3-21-21	2 3-22-21	1 3-22-21
3-11-21	7 3-11-21	8 3-11-21	9 3-16-21	10 3-19-21	11 3-22-21	12 3-22-21
3-11-21	13 3-11-21	17 3-11-21	16 3-16-21	15 3-19-21	14 3-22-21	13 3-21-21
3-11-21	19 3-10-21	20 3-10-21	21 3-15-21	22 3-18-21	23 3-19-21	24 3-21-21
3-10-21	20 3-10-21	29 3-10-21	28 3-15-21	27 3-18-21	26 3-19-21	25 3-19-21
3-10-21	31 3-10-21	32 3-10-21	33 3-15-21	34 3-18-21	35 3-19-21	36 3-19-21
	3-8-21	3-8-21	3-8-21	3-9-21	3-9-21	3-9-21
	FIRST		STANDARD		PARALLEL SOUTH	

First Standard Parallel South.

Solid red lines on above diagram indicate surveys executed by William H. Thorn, U.S. Cadastral Engineer, on dates shown thereon.

Dotted red lines on above diagram indicate resurveys executed by William H. Thorn, U.S. Cadastral Engineer, on dates shown thereon.

Solid black lines on above diagram indicate surveys executed by Benjamin J. Kinsey, U.S. Transitman, on dates shown thereon.

Dotted black lines on above diagram indicate resurveys executed by Benjamin J. Kinsey, U.S. Transitman, on dates shown thereon.

Surveys and resurveys hereinafter described executed by William H. Thorn, U.S. Cadastral Engineer, and Benjamin J. Kinsey, U.S. Transitman, on dates shown on diagram on page 1 hereof, using respectively Young and Sons light mountain transits Nos. 8592 and 8487. Each transit is equipped with full vertical circles and the Smith solar attachment. Unless otherwise specified, all azimuth determinations are accomplished with the solar attachment.

We examine the adjustment of the transits and correct all errors; then, to test the solar apparatus, by comparing its indications, resulting from solar observations made during a.m. and p.m. hours with a meridian determined by Polaris observations, we proceed with each instrument as follows:

March 5, 1921: At camp, near the  $\frac{1}{4}$  sec. cor. of secs. 17 and 18, T. 5 S., R. 31 E., Gila and Salt River Base and Meridian, Arizona, in latitude  $32^{\circ}59\frac{1}{2}'N.$ ; longitude,  $109^{\circ}10\frac{1}{2}'W.$ , at 8h. 35.5m. p.m., l.m.t., observe Polaris at Western elongation, making four observations, two each with the telescope in direct and reversed positions, and mark the mean point in the line thus determined by a nail in a stake firmly driven in the ground, 5 chs. N.

Azimuth of Polaris at western elongation =  $1^{\circ}19'38''$ .

March 6, 1921: At 8h. 0m. a.m., l.m.t., set off the azimuth of Polaris,  $1^{\circ}19\frac{1}{2}'$  to the east, and mark the meridian thus determined by an iron pin, firmly driven in the ground, 5 chs. N.

At 9h. 0m., a.m., l.m.t., set off  $32^{\circ}59\frac{1}{2}'N.$  on the lat. arc;  $5^{\circ}40\frac{1}{2}'S.$  on the decl. arc, and determine a meridian with the solar, which agrees with the true meridian.

At apparent noon, with the lat. arc unchanged, observe the sun on the meridian; the resulting reading of the decl. arc is  $5^{\circ}37\frac{1}{2}'S.$ , which agrees with the computed decl. of the sun.

At 3h. 0m. p.m., l.m.t., with the lat. arc unchanged, set off  $5^{\circ}34\frac{1}{2}'S.$  on the decl. arc, and determine a meridian with the solar, which agrees with the true meridian.

As all of the solar observations made during the usual hours of solar work come within  $1'30''$  of the true meridian, we conclude that the adjustment of the transits is satisfactory.

Unless otherwise specified, all measurements are made with a Lufkin steel tape, 5 chs. in length, compared with a Chesterman standard steel tape, and found correct. The measurements are made on the slope, the vertical angles determined with clinometers, and the slope measurements properly reduced to true horizontal distances.

Resurvey of First Std. Parallel South, thru. Range 31 East.

Chains.

The First Standard Parallel South, thru. Range 31 East was surveyed by Theodore F. White, U.S.D.S. in February, 1882, and no retracement or resurvey of such portion of the line is of record. The subdivisional closing cors. of T.6 S., R.31 E. were established on the parallel by Daniel Drummond, U.S.D.S. in August, 1891, and the closing cor. of Ts.6 S., Rs.31 and 32 E. was established by Theo. F. White, U.S.D.S. in 1882.

Retracement for Resurvey.

- From the original standard cor. of Ts.5 S., Rs.30 and 31 E., hereinafter described, East, on random line on S. bdy. of sec.31 (W. 1/4).
- 4.95 Intersect the original closing cor. of secs.5 and 6, T.6 S., R.31 E., hereinafter described.
- Continue line and measurement.
- 40.16 Fall 12 lks.N. of the original standard 1/4 sec.cor. of sec.31, hereinafter described.
- The true course and distance of W. 1/4 of S. bdy. of sec.31 are therefore S.89°50'E., 40.16 chs.
- Thence,
- East, on random line on S. bdy. of sec.31 (E. 1/4).
- 39.95 Fall 12 lks.N. of the point of original location of the standard cor. of secs.31 and 32, hereinafter described.
- The true course and distance of E. 1/4 of S. bdy. of sec.31 are therefore S.89° 50'E., 39.95 chs.

- 
- East, on random line on S. bdy. of sec. 32 (W. 1/4).
  - 4.60 Intersect the original closing cor. of secs.4 and 5, T.6 S., R.31 E., hereinafter described.
  - Continue line and measurement.
  - 39.87 Fall 1 lk. N. of the original standard 1/4 sec.cor. of sec. 32, hereinafter described.
  - The true course and distance of W. 1/4 of S. bdy. of sec.32, are therefore S.89° 59' E., 39.87 chs.
  - Thence,
  - East, on random line on S. bdy. of sec. 32 (E. 1/4).
  - 40.05 Intersect the original standard cor. of secs.32 and 33, hereinafter described.
  - The true course and distance of E. 1/4 of S. bdy. of secs.32, are therefore East 40.05 chs.

- 
- East, on random line on S. bdy. of sec.33.
  - 4.67 Intersect the original closing cor. of secs.3 and 4, T.6 S., R.31 E., hereinafter described.
  - Continue line and measurement.
  - 40.00 Diligent search in this vicinity fails to reveal any trace of the original standard 1/4 sec.cor. Set temp. 1/4 sec. cor.
  - 80.09 Fall 23 lks.N. of the original standard cor. of secs.33 and 34, hereinafter described.
  - The true course and distance of S. bdy. of sec.33 are therefore S.89°50'E., 80.09 chs.

- 
- East, on random line on S. bdy. of sec. 34 (W. 1/4).
  - 4.42 Intersect a stone, unmarked, but probably the original closing cor. of secs. 2 and 3, T.6 S., R.31 E., hereinafter described.
  - Continue line and measurement.
  - 39.93 Fall 4 lks.N. of the original standard 1/4 sec.cor. of sec. 34, hereinafter described.
  - The true course and distance of W. 1/4 of S. bdy. of sec.34, are therefore S.89°57'E., 39.93 chs.
  - Thence,

## 4 Resurvey of First Std. Parallel S., thru. Range 31 East.

Chains.

- 39.81 East, on a random line on S. bdy. of sec. 34 (E.  $\frac{1}{2}$ ).  
Fall 5 lks. N. of the original standard cor. of secs. 34 and 35, hereinafter described.  
The true course and distance of E.  $\frac{1}{2}$  of sec. 34 are therefore S. 89° 56' E., 39.81 chs.
- 
- 5.37 East, on random line on S. bdy. of sec. 35 (W.  $\frac{1}{2}$ ).  
Fall 5 lks. N. of the original closing cor. of secs. 1 and 2, T. 6 S., R. 31 E., hereinafter described.  
Continue line and measurement.
- 39.84 Fall 20 lks. N. of the original standard  $\frac{1}{4}$  sec. cor. of sec. 35, hereinafter described.  
The true course and distance of W.  $\frac{1}{2}$  of S. bdy. of sec. 35, are therefore S. 89° 43' E., 39.84 chs.
- Thence,
- 40.02 East, on a random line on S. bdy. of sec. 35 (E.  $\frac{1}{2}$ ).  
Fall 5 lks. N. of the original standard cor. of secs. 35 and 36, hereinafter described.  
The true course and distance of E.  $\frac{1}{2}$  of S. bdy. of sec. 35 are therefore S. 89° 56' E., 40.02 chs.
- 
- 5.63 East, on random line on S. bdy. of sec. 36.  
Fall 36 lks. N. of the original closing cor. of Ts. 6 S., Rs. 31 and 32 E., hereinafter described.  
Beyond this closing cor., the land is unsurveyed on both sides of the parallel, which allows an independent resurvey of the S. bdy. of sec. 36.  
Continue line and measurement.
- 40.00 Diligent search in this vicinity fails to reveal any trace of the original standard  $\frac{1}{4}$  sec. cor. of sec. 36.
- 80.00 Set temp.  $\frac{1}{4}$  sec. cor.  
Diligent search in this vicinity fails to reveal any trace of the original standard cor. of Ts. 5 S., Rs. 31 and 32 E.  
Set temp. Tp. cor.
- 

RESURVEY.

The original standard cor. of Ts. 5 S., Rs. 30 and 31 E., is an oak post, 4 ins. square, 4 ft. long firmly set in the center of mound of stone, 4 ft. base, 3 ft. high, scribed SC TVS on N. face, SXXVI RXXX on W. face, and SXXXI RXXXI E on E. face, with 6 grooves on each of N., E. and W. faces. No bearing trees.

Reestablish this cor. as follows: Destroy the old mound, reset the old post in same place, 24 ins. in the ground, and alongside old wood post,

Set an iron post, 3 ft. long, 3 ins. in diam., 24 ins. in the ground for reestablished standard cor. of Ts. 5 S., Rs. 30 and 31 E.; marked on brass cap,

S C  
T5S  
R30E | R31E  
S36 | S31

1921

and raise a mound of stone, 5 ft. base, 4 ft. high, N. of cor.

Thence,  
S. 89° 50' E. on true line, on S. bdy. of sec. 31 (W.  $\frac{1}{2}$ ).

Resurvey of First Std. Parallel S., thru. Range 31 East. 5

Chains.

Over rolling land, thru. scattering undergrowth.  
Ascend 32 ft., over W. slope.

3.16 Spur, slopes S. 45° W.  
Descend 4 ft., over SE. slope, to

4.95 Fall 1 lk. S. of the original closing cor. of secs. 5 and 6, T. 6 S., R. 31 E., which is a malpais stone 16x10x6 ins. above ground, firmly set, marked CC on S. face, with 5 notches on E. and 1 notch on W. face, and witnessed by a mound of stone, 4 ft. base, 3 ft. high, S. of cor. No bearing trees.  
Continue line and measurement.  
Descend 68 ft., over SE. slope.

10.97 Highway, brs. N. 15° E. to Clifton and S. 15° W. to Duncan.

17.90 West, or right rim of canyon, brs. NE. and SW.  
Descend 66 ft., over SE. slope.

19.64 Wash, 50 lks. wide, course S. 15° W. in bottom of canyon.  
Ascend 177 ft., over NW. slope, to

28.30 East or left rim of canyon, brs. NE. and SW.  
Ascend 12 ft., over SW. slope.

33.30 Descend 25 ft., over SE. slope, to

40.16 Intersect the original standard  $\frac{1}{4}$  sec. cor. of sec. 31, which is a malpais rock, 12x12x8 ins. above ground, firmly set, marked SC $\frac{1}{4}$  on N. face, and witnessed by a mound of stone 4 ft. base, 3 ft. high, N. of cor. No bearing trees.  
Thence,  
S. 89° 50' W. on a true line on S. bdy. of sec. 31 (E.  $\frac{1}{2}$ ).  
Over rolling and broken land, thru. scattering undergrowth.

12.27 Descend 41 ft. over broken SE. slope.  
Wash, 30 lks. wide, course S. 20° W.  
Ascend 10 ft. over W. slope.

13.77 West bank of ravine, brs. N. 25° E. and S. 25° W.  
Descend 55 ft., over SE. slope.

15.02 Wash, 30 lks. wide, course S. 25° W. in ravine.  
Ascend 55 ft. over NW. slope.

18.77 East bank of ravine, brs. N. 25° E. and S. 25° W.  
Descend 13 ft., over SW. slope.

23.77 West bank of ravine, brs. N. 10° E. and S. 10° W.  
Descend 56 ft. over SE. slope.

25.58 Wash, 20 lks. wide, 4 ft. deep, in ravine, course S. 10° W.  
Ascend 48 ft., over W. slope.

27.57 East bank of ravine, brs. NE. and SW.  
Descend 50 ft., over SE. slope.

34.72 Center of wash, 5.00 chs. wide, course S. 45° W.  
Ascend slightly over W. slope, to

39.95 Intersect the remains of the original standard cor. of secs. 31 and 32. which is a mound of stone from which the stump of the original mesquite bearing tree, the blaze still visible, brs. S. 43° W., 186 lks. dist. No trace of the original post can be found.  
Reestablish this cor. as follows: Destroy the old mound of stone, and in the center of its position:  
Set an iron post, 3 ft. long, 2 ins. in diam., 24 ins. in the ground, for reestablished standard cor. of secs. 31 and 32, marked on brass cap,

S	C
T5 S	R31E
S31	S32

1921

and raise a mound of stone, 5 ft. base, 4 ft. high, N. of cor.

Land, rolling and broken.  
Soil, adobe and rocky volcanic formation, 2nd and 3rd rate.  
Timber, none.  
Undergrowth, scattering greasewood, catclaw, scrub mesquite, scrub cedar, rabbit brush, ocotillo and other cacti.  
Fair grass.

BOCK 3587

Resurvey of First Std. Parallel South, Rthru. Range 31 East.

Chains.

- S.  $89^{\circ}59' E.$ , on a true line, on S. bdy. of sec. 32 ( $W. \frac{1}{2}$ ).  
Over rolling and mountainous land, thru. scattering under-  
growth.
- 4.60 Ascend 10 ft., over W. slope, to  
Intersect the original closing cor. of secs. 4 and 5, T. 6 S., R. 31 E., which is a granite stone,  $8 \times 12 \times 4$  ins. above ground, firmly set, marked CC on S. face, 4 notches on E. face, and 2 notches on W. face, and witnessed by a mound of stone, 3 ft. base, 2 ft. high, W. of cor. No bearing trees.  
Reestablish this cor. as follows:  
Alongside old stone, set an iron post, 3 ft. long, 2 ins. in diam., 24 ins. in the ground, for reestablished closing cor. of secs. 4 and 5, T. 6 S., R. 31 E., marked on brass cap,
- |      |      |
|------|------|
| T5S  | R31E |
| S32  |      |
| S 5  | S 4  |
| T6S  | R31E |
| C C  |      |
| 1921 |      |
- Destroy the original mound of stone, and raise a new mound of stone, 4 ft. base, 3 ft. high, S. of cor. Thence over mountainous land, thru. scattering under-  
growth.
- 10.54 Ascend 90 ft., over W. slope.  
Point of narrow spur, slopes S.  $45^{\circ} W.$
- 15.10 Descend 75 ft., over SE. slope.  
Wash, 20 lks. wide, 2 ft. deep, in ravine, course S.  $20^{\circ} W.$
- 18.87 Ascend 85 ft., over NW. slope.  
East bank of ravine, brs. NE. and SW. Leave mountainous, and enter rolling and broken land.
- 23.87 Ascend 12 ft., over SW. slope.  
Descend 77 ft., over SE. slope.
- 35.80 Bend in wash, 30 lks. wide, course S.  $45^{\circ} W.$  from SE.  
Ascend 25 ft., over SW. slope, to
- 39.87 Intersect the original standard  $\frac{1}{4}$  sec. cor. of sec. 32, which is a mesquite post, 3 ins. square, 3 ft. long, scribed  $\frac{1}{4}$  S SC on N. face, and firmly set in the center of a mound of stone, 3 ft. base, 2 ft. high, No bearing trees.  
Reestablish this cor. as follows: Destroy old mound of stone, and reset old post in its original position 20 ins. in the ground, and alongside old wood post, set an iron post, 3 ft. long, 1 in. in diam., 24 ins. in the ground, for reestablished std.  $\frac{1}{4}$  sec. cor. of sec. 32, marked on brass cap,
- |                    |  |
|--------------------|--|
| S C                |  |
| $\frac{1}{4}$ S 32 |  |
| 1921               |  |
- and raise a mound of stone, 4 ft. base, 3 ft. high, N. of cor.
- Thence,  
East, on a true line on S. bdy. of sec. 32 ( $E. \frac{1}{2}$ ).  
Over rolling and broken land, thru. scattering undergrowth.
- 0.75 Descend 20 ft., over SE. slope.  
Same wash crossed at 35.80 ch. station in  $W. \frac{1}{2}$  of S. bdy. of sec. 32, 20 lks. wide, course S.  $40^{\circ} W.$  At 3 chs. NE., this wash is joined by another wash from E.  
Thence along broken NW. slope, nearly parallel to wash about 150 lks. N. of line.
- 40.05 Ascend 185 ft. to  
Intersect the original standard cor. of secs. 32 and 33 which is a mesquite post, 3 ins. square, 3 ft. long, scribed SC TVS RXXXIE on N. face, SXXXIII on E. face,



Recovery of First Standard Parallel South thru Range 31 east. 7

Chains.

and SXXXII on W. face, firmly set in a mound of stone, 3 ft. base, 2 ft. high, and witnessed by the original bearing tree.

A juniper, 10 ins. in diam., N. 80° W., 90 lks. dist., marked TVS RXXXI & SXXXII ST.

Reestablish this cor. as follows: Destroy old mound of stone, reset old post in same position 20 ins. in the ground, and alongside old wood post, set an iron post, 3 ft. long, 2 ins. in diam., 24 ins. in the ground, for reestablished standard cor. of secs. 32 and 33, marked on brass cap.

S	C
T58	R31E
S32	S33

1921

and raise a mound of stone, 4 ft. base, 3 ft. high, N. of cor.

Land, rolling, broken and mountainous.

Soil, adobe and rocky, volcanic formation, 2nd and 3rd rate.

Timber, none.

Undergrowth, scattering greasewood, catclaw, scrub mesquite, rabbit brush, ocotillo and other cacti.

Fair grass.

S. 89° 50' E., on a true line, on S. bdy. of sec. 33.

Over rolling and broken land, thru. scattering undergrowth. Ascend 12 ft., over broken NW. slope to closing cor.

3.70 A cedar tree, 10 ins. in diam., on line on each of E. and W. faces of which cut 2 notches.

4.67 Fall 1 lk. S. of the original closing cor. of secs. 3 and 4, T. 6 S., R. 31 E., which is a sandstone 20x14x10 ins., firmly set in a mound of stone, marked CC on S. face, and 3 notches on each of E. and W. faces, marked C C on S. face, and 3 notches on each of E. and W. faces.

No bearing trees.

Reestablish this cor. as follows: Destroy old mound of stone, reset old stone in same position, 15 ins. in the ground, and alongside stone, set an iron post 3 ft. long, 2 ins. in diam., 24 ins. in the ground, for reestablished closing cor. of secs. 3 and 4, T. 6 S., R. 31 E., marked on brass cap.

T58	R31E
S33	

S	4	S	3
T6	S	R31E	
C	C		

1921

and raise a mound of stone, 4 ft. base, 3 ft. high, S. of cor.

Continue line and measurement.

40.04 Ascend 102 ft., over NW. slope, to (Midpoint of S. bdy. of sec. 33) Set an iron post, 3 ft. long, 1 in. in diam., 24 ins. in the ground, for reestablished standard 1/2 sec. cor. of sec. 33, marked on brass cap.

S	C
T6	S
S33	

1921

and raise a mound of stone, 4 ft. base, 3 ft. high, N. of cor.

## 8 Resurvey of First Std. Parallel South, thru Range 31 East.

Chains.	Continue over rolling and broken land, thru scattering undergrowth. Ascend 10 ft., over NW. slope.										
43.00	Point of low spur, slopes N. Descend 21 ft., over NE. slope.										
45.60	Wash, 20 lks. wide, 4 ft. deep, course N. 45° W. Ascend 29 ft., over SW. slope.										
53.00	Ascend 30 ft., over W. slope.										
62.95	Descend 60 ft., over SE. slope.										
72.28	Wash, 10 lks. wide, 5 ft. deep, course S. 45° W. near head. Leave rolling, and enter mountainous land. Ascend 71 ft., over W. slope.										
75.89	Descend 53 ft., over SE. slope, to										
80.09	Intersect the original standard cor. of secs. 33 and 34, which is a mesquite post, 4 ins. square, 4 ft. long, firmly set in mound of stone, and scribed TVS RXXXIE on N. face, SXXXIII on W. face, and SXXXIV on E. face. No bearing trees. Reestablish this cor. as follows: Destroy old mound of stone, reset old post in same position, 24 ins. in the ground, and alongside same, set an iron post, 3 ft. long, 2 ins. in diam., 24 ins. in the ground, for reestablished standard cor. of secs. 33 and 34, marked on brass cap,										
	<table border="1"> <tbody> <tr> <td>S</td> <td>C</td> </tr> <tr> <td>T5S</td> <td>R31E</td> </tr> <tr> <td>S33</td> <td>S34</td> </tr> </tbody> </table> <p>1921</p>	S	C	T5S	R31E	S33	S34				
S	C										
T5S	R31E										
S33	S34										
	and raise a mound of stone, 4 ft. base, 3 ft. high, N. of cor. Land, rolling, broken and mountainous. Soil, rocky adobe, volcanic formation, 3rd rate. Timber, none. Undergrowth, scattering greasewood, catclaw, scrub mesquite, rabbit brush, ocotillo and other cacti. Fair grass.										
4.42	----- S. 89° 57' E., on a true line, on S. bdy. of sec. 34 (W 1/2). Over mountainous land, thru scattering undergrowth. Descend 10 ft., over SE. slope, to Intersect a limestone 8x5x5 ins. above ground, firmly set, unmarked and without accessories, this being the only stone on line in the vicinity of the record point for closing cor. of secs. 2 and 3, T. 6 S., R. 31 E. Accept it as marking the original closing cor. point. Reestablish this cor. as follows: Alongside old stone, set an iron post, 3 ft. long, 2 ins. in diam., 24 ins. in the ground, for reestablished closing cor. of secs. 2 and 3, T. 6 S., R. 31 E., marked on brass cap,										
	<table border="1"> <tbody> <tr> <td>T5S</td> <td>R31E</td> </tr> <tr> <td>S34</td> <td></td> </tr> <tr> <td>S 3</td> <td>S 2</td> </tr> <tr> <td>T6S</td> <td>R31E</td> </tr> <tr> <td>C</td> <td>C</td> </tr> </tbody> </table> <p>1921</p>	T5S	R31E	S34		S 3	S 2	T6S	R31E	C	C
T5S	R31E										
S34											
S 3	S 2										
T6S	R31E										
C	C										
	and raise a mound of stone, 4 ft. base, 3 ft. high, S. of cor. Continue line and measurement.										
6.60	Descend 5 ft., over SE. slope, to Wash, 40 lks. wide, 3 ft. deep, course S. 10° W. Ascend 25 ft., over SW. slope.										
8.48	Point of spur, slopes S. Descend 25 ft., over SE. slope.										
10.45	Wash, 60 lks. wide, 4 ft. deep, course S. 45° W. Dim road brs. N. 45° E. and S. 45° W.										

Chains.

- 28.53. Ascend 176 ft. over SW. slope.  
Short spur, slopes N. 45° W.  
Descend 40 ft., over NE. slope.
- 31.78 Head of gulch, course N.  
Ascend 115 ft., over W. slope, to
- 39.93 Intersect the original standard  $\frac{1}{4}$  sec. cor. of sec. 34,  
which is a limestone rock, 8x8x4 ins. above ground,  
firmly set, marked SC  $\frac{1}{4}$  on N. face, and witnessed by  
a mound of stone, 4 ft. base, 3 ft. high, N. of cor.  
No bearing trees.  
Reestablish this cor. as follows:  
Alongside old stone, set an iron post, 3 ft. long, 1 in. in  
diam., 24 ins. in the ground, for reestablished  
standard  $\frac{1}{4}$  sec. cor. of sec. 34, marked on brass cap,

S C  
 $\frac{1}{4}$ S 34

1921

- Thence,  
S. 89° 56' E., on true line, on S. bdy. of sec. 34 (E.  $\frac{1}{2}$ ).  
Over mountainous land, thru. scattering undergrowth.  
Ascend 72 ft. over W. slope.
- 6.10 Ridge, brs. N. and S.  
Descend 115 ft., over E. slope.
- 16.02 Wash, 10 lks. wide, 4 ft. deep, course S. 45° W.  
Ascend 120 ft., over NW. slope.
- 22.52 Spur, slopes S. 20° W.  
Descend 60 ft., over SE. slope.
- 28.35 Wash, 10 lks. wide, 4 ft. deep, course S. 15° W.  
Ascend 60 ft., over W. slope.
- 31.72 Spur, slopes S.  
Descend 75 ft., over SE. slope.
- 36.56 Wash, 10 lks. wide, 4 ft. deep, in ravine, course S. 10° W.  
Ascend 45 ft. over SW. slope, to
- 39.81 Short spur, slopes S. Intersect the original standard  
cor. of secs. 34 and 35, which is a mesquite post, 4  
ins. square, 4 ft. long, firmly set in a mound of stone,  
4 ft. base, 3 ft. high, scribed SC TVS RXXXI on N. face,  
SXXXIV on W. face, and SXXXV on E. face.  
No bearing trees.  
Reestablish this cor. as follows: Destroy old mound  
of stone, reset old post in same position, 24 ins.  
in the ground, and alongside same, set an iron post  
3 ft. long, 2 ins. in diam., 24 ins. in the ground, for  
reestablished standard cor. of secs. 34 and 35, marked  
on brass cap,

S | C  
T 5S | R31E  
S34 | S35

1921

and raise a mound of stone, 4 ft. base, 3 ft. high, N. of  
cor.

Land, mountainous.

Soil, adobe and rocky, volcanic formation, 2nd and 3rd rate.

Timber, none.

Undergrowth, scattering greasewood, catclaw, scrub mesquite,  
scrub cedar, ocotillo and other cacti.

Fair grass.

- S. 89° 43' E., on true line, on S. bdy. of sec. 35 (W.  $\frac{1}{2}$ ).  
Over mountainous land, thru. scattering undergrowth.
- 5.37 Descend 46 ft., over SE. slope, to  
Fall 2 lks. S. of the original closing cor. of secs. 1, and 2.

10 Resurvey of First Std. Parallel South, thru Range 31 East.

Chains.

T. 6 S., R. 31 E., which is a malpais rock, 24x10x4 ins. marked CC on S. face, 5 notches on W. face, and 1 notch on E. face, firmly set in a mound of stone 3 ft. base, 2 ft. high. No bearing trees.

Reestablish this cor. as follows: Destroy old mound of stone, reset old stone in same position, 16 ins. in the ground, and alongside same,

Set an iron post, 3 ft. long, 2 ins. in diam., 24 ins. in the ground, for reestablished closing cor. of secs. 1 and 2, T. 6 S., R. 31 E., marked on brass cap,

T5 S R31E  
S35  
S 2 | S 1  
T6S | R31E  
C | C  
1921

and raise a mound of stone, 4 ft. base, 3 ft. high, S. of cor.

Continue line and measurement.

6.73 Descend 18 ft., over SE. slope.  
Wash, 30 lks. wide, course S. 25° W.

25.24 Ascend 181 ft. over NW. slope.  
Ridge, brs. N. 45° E. and S. 45° W.  
Descend 95 ft., over SE. slope.

36.88 Wash, 10 lks. wide, 4 ft. deep, course S.  
Ascend 31 ft., over SW. slope, to

39.84 Point of spur, slopes S. Intersect the original standard 1/4 sec. cor. of sec. 35, which is a limestone 16x10x6 ins. marked SC on N. face, firmly set in mound of stone, 3 ft. base, 2 ft. high. No bearing trees. Reestablish this cor. as follows: Destroy old mound of stone, reset old stone in same position, 10 ins. in the ground, and alongside same, set an iron post, 3 ft. long, 1 in. in diam., 24 ins. in the ground, for reestablished standard sec. cor., marked on brass cap,

S C  
S 35  
1921

and raise a mound of stone, 3 ft. base, 2 ft. high, N. of cor.

Thence,

S. 89° 56' E., on true line on S. bdy. of sec. 35 (E. 1/4).  
Over mountainous land, thru. scattering undergrowth.

0.32 Descend 30 ft., over SE. slope.  
Three strand smooth wire fence, brs. N. 10° W. and S. 10° E.

6.18 Wash, 30 lks. wash, course S. 45° W.  
Ascend 30 ft., over W. slope.

8.45 Spur, slopes S. 45° W.  
Descend 28 ft., over SE. slope.

17.13 Wash, 60 lks. wide, course S. 45° W.  
Ascend 95 ft., over W. slope.

26.30 Short spur, slopes S. 45° W.  
Ascend 26 ft., over S. slope, to.

40.02 Intersect the original standard cor. of secs. 35 and 36, which is a limestone, 16x8x4 ins., firmly set in a mound of stone, 3 ft. base, 2 ft. high, marked SC TVS RXXXIE on N. face, SXXXV on W. face, and SXXXVI on E. face. No bearing trees.

Reestablish this cor. as follows: Destroy the old mound of stone, reset old stone in same position, 10 ins. in ground, and alongside same,

Set an iron post, 3 ft. long, 2 ins. in diam., 24 ins. in the ground, for reestablished standard cor. of secs. 35 and 36, marked on brass cap,

Resurvey of First Std. Parallel South, thru. Range 31 East. 11  
Chains.

S	C
T5 S	R31E
S35	S36

1921

and raise a mound of stone, 4 ft. base, 3 ft. high, N. of cor.

Land, mountainous.

Soil, adobe and rocky, volcanic formation, 2nd and 3rd rate.

Timber, none.

Undergrowth, scattering greasewood, catclaw, scrub mesquite, scrub cedar, rabbit brush, ocotillo and other cacti.

Fair grass.

-----  
East, on a true line, on S. bdy. of sec. 36.

Over mountainous land, thru. scattering undergrowth.

Ascend 40 ft., over S. slope, to

- 5.63 Fall 36 lks. N. of the original closing cor. of Ts. 6 S., Rs. 31 and 32 E., which is a mesquite post, 4 ins. square, 4 ft. long, scribed TVIS CC on S. face, RXXXIIE SVI on E. face, and RXXXIE SI on W. face, and 6 notches on each of S., E. and W. faces, firmly set in a mound of stone, 3 ft. base, 2 ft. high. No bearing trees.

Reestablish this cor. as follows: Destroy old mound of stone, reset old post in same position, 24 ins. in the ground, and alongside same, set an iron post, 3 ft. long, 2 ins. in diam., 24 ins. in the ground, for re-established closing cor. of Ts. 6 S., Rs. 31 and 32 E., marked on brass cap,

T5S	R31E
S36	

R31E	R32E
S 1	S 6

T6S

CC

1921

and raise a mound of stone, 4 ft. base, 3 ft. high, S. of cor.

Continue line and measurement.

Ascend 45 ft., over S. slope, to

- 19.44 Wash, 20 lks. wide, course S. 80° W.

Ascend 95 ft., over NW. slope.

- 27.52 Ridge, brs. N. 20° E. and S. 20° W. Saddle in same brs. NE., 7.00 chs. dist.

Descend 95 ft. over SE. slope.

- 33.50 Gulch, course S. 10° W.

Ascend 125 ft. over W. slope.

- 39.42 Spur, slopes S. 15° W.

Descend slightly over SE. slope, to

- 40.00 Set an iron post, 3 ft. long, 1 in. in diam., 24 ins. in the ground, for reestablished standard  $\frac{1}{4}$  sec. cor. of sec. 36, marked on brass cap,

S	C
$\frac{1}{4}$ S	36

1921

and raise a mound of stone, 4 ft. base, 3 ft. high, N. of cor.

Continue over mountainous land, thru. scattering undergrowth.

Descend 120 ft., over SE. slope.

- 47.78 Gulch, 20 lks. wide, course S.

Ascend 22 ft. over W. slope.

- 49.25 Low spur, slopes S. 15° W.

Descend 10 ft., over SE. slope.

12 Resurvey of First Std. Parallel South, thru. Range 31 East.

Chains.

- 50.83 Draw, course S.40°W.  
Ascend 65 ft., over NW. slope.
- 59.21 Ridge, brs. S.40°W. and N.40°E.  
Descend 80 ft. over SE. slope.
- 66.39 Three strand smooth wire fence, brs. N.70°E. and S.70°W.
- 74.26 Wash, in bottom of ravine, course S.65°W.  
Small spring brs. NE. about 2 chs. dist.  
Ascend 69 ft., over NW. slope, to
- 80.00 Set an iron post, 3 ft. long, 3 ins. in diam., 15 ins. in  
the ground to bed rock, supported by a mound of stone  
for reestablished standard cor. of Ts. 5 S., Rs. 31 and  
32 E., marked on brass cap,

S C  
T5S  
R31E | R32E  
S36 | S31

. 1921

and raised a mound of stone, 4 ft. base, 3 ft. high,  
N. of cor.  
Land, mountainous.  
Soil, rocky adobe, 3rd rate.  
Timber, none.  
Undergrowth, scattering greasewood, catclaw, scrub mesquite,  
scrub-cedar, rabbit brush, ocotillo and other cacti.  
Fair grass.

---

## Resurvey of West bdy. of Township 5 South, Range 31 East. 13

Chains.

The West boundary of T.5 S., R.31 E., was surveyed in June, 1902 by John Nash, U.S.D.S., and no retracement or resurvey of this line is of record.

Retracement for Resurvey.

All of the area to the west of this range line is surveyed, accepted and on file; and the resurvey of the line is dependent upon the courses and distances between the existing cors.; therefore, in the following notes describing the retracement of the line, the courses and distances are designated as E. boundaries of secs. in T.5 S., R.30 E. In the resurvey of the line hereinafter described,  $\frac{1}{4}$  sec. and sec. cors. referring to areas in T.5 S., R.31 E. only are established alternately at intervals of 40.00 chs. in northing, counting from the south, and the mile divisions of the range line are designated as west boundaries of the secs. in T.5 S., R.31 E. only.

40.16 From the reestablished standard cor. of T.5 S., R.30 and 31 E., hereinbefore described,  
North, on random line on E. bdy. of sec.36 (S. $\frac{1}{4}$ ).  
Fall 29 lks.W. of the original  $\frac{1}{4}$  sec.cor. of secs.31 and 36, hereinafter described.  
The true course and distance of S. $\frac{1}{4}$  of E. bdy. of sec.36, are therefore N.0° 25'E., 40.16 chs.

Thence,  
40.14 North, on random line on E. bdy. of sec.36 (N. $\frac{1}{4}$ ).  
Fall 28 lks.W. of the original cor. of secs. 25,30,31 and 36, hereinafter described.  
The true course and distance of N. $\frac{1}{4}$  of E. bdy. of sec.36, are therefore N.0° 24'E., 40.14 chs.

-----  
40.18 North, on random line on E. bdy. of sec. 25 (S. $\frac{1}{4}$ ).  
Fall 7 lks. W. of the original  $\frac{1}{4}$  sec.cor. of secs.25 and 30, hereinafter described.  
The true course and distance of S. $\frac{1}{4}$  of E. bdy. of sec.25 are therefore N.0° 6'E., 40.18 chs.

Thence,  
40.10 North, on random line, on E. bdy. of sec.25 (N. $\frac{1}{4}$ ).  
Fall 8 lks. W. of the original cor. of secs.19,24,25 and 30, hereinafter described.  
The true course and distance of N. $\frac{1}{4}$  of E. bdy. of sec.25 are therefore N.0° 7'E., 40.10 chs.

-----  
40.18 North, on random line on E. bdy. of sec.24 (S. $\frac{1}{4}$ ).  
Fall 12 lks.E. of the original  $\frac{1}{4}$  sec.cor. of secs.19 and 24, hereinafter described.  
The true course and distance of S. $\frac{1}{4}$  of E. bdy. of sec.24, are therefore N.0° 10' W., 40.18 chs.

Thence,  
40.20 North, on random line on E. bdy. of sec.24 (N. $\frac{1}{4}$ ).  
Fall 9 lks. E. of the original cor. of secs. 13,18,19 and 24, hereinafter described.  
The true course and distance of N. $\frac{1}{4}$  of E. bdy. of sec.24, are therefore N. 0° 8'W., 40.20 chs.

-----  
40.15 North, on random line on E. bdy. of sec.13. (S. $\frac{1}{4}$ ),  
Fall 9 lks.E. of original  $\frac{1}{4}$  sec.cor. of secs. 13 and 18; hereinafter described.  
The true course and distance of S. $\frac{1}{4}$  of E. bdy. of sec.13, are therefore N.0° 8'W., 40.15 chs.

BCKK 3587

## 14 Resurvey of West bdy. of Township 5 South, Range 31 East.

Chains.

- Thence,  
 North, on random line on E. bdy. of sec.13 (N.  $\frac{1}{2}$ ).  
 40.02 Fall 7 lks. E. of the original cor. of secs. 7, 12, 13 and 18, hereinafter described.  
 The true course and distance of N.  $\frac{1}{2}$  of E. bdy. of sec.13, are therefore N.  $0^{\circ} 6' W.$ , 40.02 chs.
- 
- North, on random line on E. bdy. of sec.12.  
 40.00 Diligent search in this vicinity failed to reveal any trace of the original  $\frac{1}{4}$  sec. cor. of secs. 7 and 12.  
 Set temp.  $\frac{1}{4}$  sec. cor.  
 79.32 Fall 28 lks. E. of the original cor. of secs. 1, 6, 7 and 12, hereinafter described.  
 The true course and distance of E. bdy. of sec.12 are therefore N.  $0^{\circ} 12' W.$ , 79.32 chs.
- 
- North, on random line on E. bdy. of sec.1 (S.  $\frac{1}{4}$ ).  
 40.28 Fall 7 lks. E. of the original  $\frac{1}{4}$  sec. cor. of secs. 1 and 6, hereinafter described.  
 The true course and distance of S.  $\frac{1}{4}$  of E. bdy. of sec.1, are therefore N.  $0^{\circ} 6' W.$ , 40.28 chs.
- Thence,  
 North, on random line on E. bdy. of sec.1 (N.  $\frac{1}{2}$ ).  
 40.20 Fall 7 lks. E. of the reestablished cor. of Ts. 4 and 5 S., Rs. 30 and 31 E., set by William B. Kimmel, U.S.S., in November, 1916.  
 The true course and distance of N.  $\frac{1}{2}$  of E. bdy. of sec.1 are therefore N.  $0^{\circ} 6' W.$ , 40.20 chs.

RESURVEY.

- From the reestablished standard cor. of Ts. 5 S., Rs. 30 and 31 E. hereinafter described,  
 N.  $0^{\circ} 25' E.$ , on true line on W. bdy. of sec. 31.  
 Over rolling and broken land, thru. scattering undergrowth.  
 Descend 90 ft., over NW. slope.  
 9.52 Gulch, 20 lks. wide, 1 ft. deep, course W.  
 Ascend 40 ft. over SW. slope.  
 15.69 Point of low spur, slopes W.  
 Descend 12 ft., over NW. slope.  
 17.70 Center of wash, 2 chs. wide, course SW.  
 Ascend 74 ft., over SE. slope, to  
 40.00 Set an iron post, 3 ft. long, 1 in. in diam., 26 ins. in the ground, for reestablished  $\frac{1}{4}$  sec. cor., of sec. 31 only, marked on brass cap,
- |  
 $\frac{1}{4}$ S31
- 1921
- and raise a mound of stone, 3 ft. base, 2 ft. high, E. of cor.  
 Ascend slightly over SE. slope, to  
 40.16 Intersect the original  $\frac{1}{4}$  sec. cor. of secs. 31 and 36, which is a volcanic stone 6x8x5 ins. above ground firmly set, marked  $\frac{1}{4}$  S on W. face, and witnessed by a mound of stone, 3 ft. base, 2 ft. high, W. of cor.  
 No bearing trees.  
 Reestablish this cor. as follows:  
 Alongside old stone, set an iron post, 3 ft. long, 1 in. in diam., 26 ins. in the ground, for reestablished  $\frac{1}{4}$  sec. cor. of sec. 36 only, marked on brass cap,
- |  
 $\frac{1}{4}$ S36
- 1921



Resurvey of West bdy. of Township 5 South, Range 31 East. 15

Chains.

Thence,  
 N. 0° 24' E., on a true line, continuing measurement of W.  
 bdy. of sec. 31.  
 Continue over rolling land, thru. scattering undergrowth.  
 Ascend 65 ft., over SE. slope, to  
 49.20 Road, brs. N. 30° W. to Clifton and S. 30° E. at SE. rim of  
 mesa, brs. NE. and SW. Leave rolling land and scatter-  
 ing undergrowth, and enter level land and dense un-  
 dergrowth on mesa.  
 51.00 Telephone line, brs. N. 30° W. to Clifton and S. 30° E.  
 59.60 Road brs. NE. and SW.  
 80.00 Set an iron post, 3 ft. long, 2 ins. in diam., 24 ins. in  
 the ground, for reestablished cor. of secs. 30 and 31  
 only, marked on brass cap,

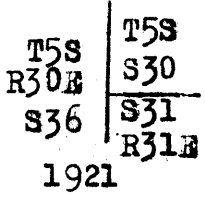

and raise a mound of stone, 3 ft. base, 2 ft. high, E.  
 of cor.  
 Land, S. 49 chs., rolling and broken. N. 31 chs., level.  
 Soil, gravelly, 4th rate.  
 Timber, none.  
 Undergrowth, scattering greasewood, catclaw, tesota, oco-  
 tillo, and other cacti in S. 49 chs. Dense greasewood  
 and scattering catclaw, tesota, ocotillo and other  
 cacti in N. 31 chs.  
 Fair grass.

N. 0° 24' E., on true line, on W. bdy. of sec. 30.  
 Over level land, thru. dense undergrowth, on mesa.  
 0.30 (40.14 chs. N. 0° 24' E. from reestablished  $\frac{1}{4}$  sec. cor. of  
 sec. 36). Intersect the original cor. of secs. 25, 30,  
 31 and 36, which is a volcanic stone, 6x8x6 ins. above  
 ground, firmly set, marked with 1 groove on S. face,  
 and 5 grooves on N. face, and witnessed by a mound of  
 stone, 3 ft. base, 2 ft. high, W. of cor. No bearing  
 trees.

Reestablish this cor. as follows:  
 Alongside old stone, set an iron post, 3 ft. long, 2 ins.  
 in diam., 24 ins. in the ground, for reestablished  
 cor. of secs. 25 and 36 only, marked on brass cap,

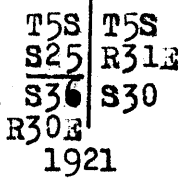

Thence,  
 N. 0° 6' E. on a true line, continuing measurement of W. bdy.  
 of sec. 30.  
 Over level land, thru. dense undergrowth on mesa.  
 19.68 Old road, brs. N. 70° E. and S. 70° W.  
 30.13 Wash, 30 lks. wide, 5 ft. deep, course SW.  
 35.23 Wire fence brs. N. 55° E. and S. 55° W.  
 40.00 Set an iron post, 3 ft. long, 1 in. in diam., 18 ins. in  
 the ground, to bed rock, supported by a mound of  
 stone, for reestablished  $\frac{1}{4}$  sec. cor. of sec. 30 only,  
 marked on brass cap,

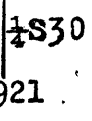

16 Resurvey of West boundary of Township 5 South, Range 31 East.

Chains.

40.48 and raise a mound of stone, 3 ft. base, 2 ft. high, E. of cor.  
 (40.18 chs. N.0°6'E. from reestablished cor. of secs. 25 and 36) Intersect the original 1/4 sec. cor. of secs. 25 and 30, which is a malpais stone 6x8x6 ins. above ground, marked 1/4 on W. face, firmly set and witnessed by a mound of stone, 3 ft. base, 2 ft. high, W. of cor. No bearing trees.  
 Reestablish this cor. as follows:  
 Alongside old stone, set an iron post, 3 ft. long, 1 in. in diam., 24 ins. in the ground, for reestablished 1/4 sec. cor. of sec. 25 only, marked on brass cap,

1/4 S 25  
 1921

Thence,  
 N.0°7'E., on true line, continuing measurement of W. bdy. of sec. 30, over level land, thru. dense undergrowth on mesa.  
 68.68 South or left rim of canyon, brs. E. and SW. Leave level land and mesa.  
 Descend 73 ft. over N. slope, to  
 70.43 South edge of bottom of canyon, brs. E. and SW. Thence across Cold Creek wash, in bottom of canyon, course SW. from above slope, to  
 76.77 North edge of bottom of canyon, brs. E. and SW. Leave bottom of canyon.  
 Ascend 74 ft., over SW slope, to  
 79.88 North or right rim of canyon, bearing N.80°E. and S.78°E. forming a point in rim of mesa and mesa.  
 Descend slightly to  
 80.00 Set an iron post, 3 ft. long, 2 ins. in diam., 8 ins. in the ground to bed rock, supported in a mound of stone for reestablished cor. of secs. 19 and 30 only, marked on brass cap;

T5S | T5S  
 R30E | S19  
 S25 | S30  
 | R31E  
 1921

and raise a mound of stone, 3 ft. base, 2 ft. high, E. of cor.  
 Land, level, except canyon walls as noted.  
 Soil, rocky and gravelly adobe, 3rd and 4th rate.  
 Timber, none.  
 Undergrowth, dense greasewood and scattering catclaw, ocotillo and other cacti.  
 Fair grass.

0.58 N.0°7'E., on true line on W. bdy. of sec. 19.  
 Over broken land, thru. dense undergrowth, along W. slope, near rim of mesa bearing NW and SE 8.1000.  
 Descend 13 ft., to  
 (40.10 chs. N.0°7'E., from the reestablished 1/4 sec. cor. of sec. 25) Intersect the original cor. of secs. 19, 24, 25 and 30, which is a volcanic rock, 8x12x8 ins. above ground, firmly set, marked with 4 grooves on N. face, and 2 grooves on S. face; and witnessed by a mound of stone 3 ft. base, 2 ft. high, W. of cor. No bearing trees.  
 Reestablish this cor. as follows:  
 Alongside old stone, set an iron post, 3 ft. long, 2 ins. in diam., 24 ins. in the ground, for reestablished cor. of secs. 24 and 25 only, marked on brass cap,

Resurvey of West boundary of Township 5 South, Range 31 East, 17

Chains.

T5S	
S24	T5S
-----	R31E
S25	S19
R30E	
1921	

This cor. is at rim of mesa, bearing N.45°W. and S.55°E. Thence, N.0°10'W., on true line, continuing measurement of W. bdy. of sec.19, over level land, thru. dense undergrowth on mesa.

- 12.86 Wash, 20 lks. wide, 10 ft. deep, course W.
- 20.50 Rim of mesa, brs. E. and W. Leave level land and mesa, and enter gently rolling land. Descend 19 ft., over N. slope.
- 22.66 Old road, brs. E. and W.
- 24.29 Wash, 20 lks. wide, 3 ft. deep, course W. Ascend 20 ft., over S. slope.
- 28.76 Low spur, slopes W. Descend 23 ft., over NW. slope.
- 35.00 Wash, course SW. Ascend 25 ft., over SE. slope.
- 36.75 Spur, slopes SW. Descend 5 ft., over NW. slope, to
- 40.00 Set an iron post, 3 ft. long, 1 in. in diam., 26 ins. in the ground, for reestablished  $\frac{1}{4}$  sec. cor. of sec.19 only, marked on brass cap,

$\frac{1}{4}$ S19

1921

and raise a mound of stone, 3 ft. base, 2 ft. high, E. of cor.

- 40.26 Descend slightly over NW. slope, to Wash, course SW. Ascend slightly over SE. slope, to
- 40.76 (40.18 chs. N.0°10'W. from reestablished cor. of secs. 24 and 25), Intersect the original  $\frac{1}{4}$  sec. cor. of secs.19 and 24, which is a volcanic stone, 8x6x6 ins. above ground, firmly set, marked  $\frac{1}{4}$  S on W. face, and witnessed by a mound of stone 3 ft. base, 2 ft. high, W. of cor.

No bearing trees.

Reestablish this cor. as follows:

Alongside old stone, set an iron post, 3 ft. long, 1 in. in diam., 24 ins. in the ground, for reestablished  $\frac{1}{4}$  sec. cor. of sec.24 only, marked on brass cap,

$\frac{1}{4}$ S24

1921

Thence, N.0° 8'W., on true line, continuing measurement of W. bdy. of sec.19.

Over gently rolling land, thru. dense undergrowth.

Descend 6 ft., over NE. slope.

- 42.94 Bend in same wash crossed at 40.26 ch. station, course SE. from NE.

Ascend 35 ft., over SE. slope.

- 45.95 Spur, slopes SW.

Descend 11 ft., over NW. slope.

- 50.95 Wash, course SW.

Ascend 51 ft., over SE. slope.

- 64.95 Low ridge, brs. NE. and SW.

Descend 23 ft., over NW. slope.

- 65.28 Road brs. E. to Fulcher's ranch and W.

- 72.18 Wash, 60 lks. wide, 4 ft. deep, course SW.

Ascend 40 ft., over SE. slope, to

- 80.00 Set an iron post, 3 ft. long, 2 ins. in diam., 26 ins. in

18 Resurvey of West boundary of Township 5 South, Range 31 East.

Chains.

the ground, for reestablished cor. of secs. 18 and 19 only, marked on brass cap,

T5S	T5S
R30E	S18
S24	S19
	R31E
1921	

and raise a mound of stone, 3 ft. base, 2 ft. high, E. of cor.

Land, level, rolling and broken.  
 Soil, adobe, rocky, 3rd and 4th rate.  
 Timber, none.  
 Undergrowth, dense greasewood and scattering catclaw, tesota, ocotillo and other cacti.  
 Fair grass.

0.96

N. 0° 8' W., on true line on W. bdy. of sec. 18.  
 Over gently rolling land, thru. dense undergrowth.  
 Ascend slightly over SE. slope, to  
 (40.20 chs. N. 0° 8' W. from reestablished  $\frac{1}{4}$  sec. cor. of sec. 24) Intersect the original cor. of secs. 13, 18, 19 and 24, which is a granite stone, 8x10x8 ins. above ground, firmly set, marked with 3 grooves on each of N. and S. faces; and witnessed by a mound of stone, 3 ft. base, 2 ft. high, W. of cor. No bearing trees.  
 Reestablish this cor. as follows:  
 Alongside old stone, set an iron post, 3 ft. long, 2 ins. in diam., 26 ins. in the ground, for reestablished cor. of secs. 13 and 24 only, marked on brass cap,

T5S	T5S
S13	R31E
S24	S18
R30E	
1921	

Thence,  
 N. 0° 8' W., on true line, continuing measurement of W. bdy. of sec. 18.

24.64

Over rolling land, thru. dense undergrowth.  
 Ascend 135 ft., over SE. slope.  
 Ridge, brs. NE. and SW.  
 Descend 16 ft., over NW. slope.

25.00

Dim road, brs. NE. and SW.

34.52

Center of wash, 100 lks. wide, 2 ft. deep, course SW.  
 Ascend 38 ft., over SE. slope, to

40.00

Set an iron post, 3 ft. long, 1 in. in diam., 26 ins. in the ground, for reestablished  $\frac{1}{4}$  sec. cor. of sec. 18 only, marked on brass cap,

$\frac{1}{4}$ S18

1921

and raise a mound of stone, 3 ft. base, 2 ft. high, E. of cor.

41.11

Ascend slightly over SE. slope, to  
 (40.15 chs. N. 0° 8' W., from reestablished cor. of secs. 13 and 24) Intersect the original  $\frac{1}{4}$  sec. cor. of secs. 13 and 18, which is a granite stone, 4x12x6 ins. above ground, firmly set, marked  $\frac{1}{4}$  on W. face, and witnessed by a mound of stone, 3 ft. base, 2 ft. high, W. of cor. No bearing trees.

## Resurvey of West boundary of Township 5 South Range 31 East. 19

Chains.

Reestablish this cor., as follows:  
 Alongside old stone, set an iron post, 3 ft. long, 1 in.  
 in diam., 26 ins. in the ground, for reestablished  
 $\frac{1}{4}$  sec. cor. of sec. 13 only, marked on brass cap,

T5S	T5S
R30E	S 7
S13	S18
	R31E

1921

Thence,  
 N. 0° 6' W., on true line, continuing measurement of W. bdy.  
 of sec. 18.  
 Ascend 63 ft., over SE. slope.  
 51.42 Ridge, brs. NE. and SW.  
 Descend 47 ft., over NW. slope.  
 59.91 Wash, 20 lks. wide, 2 ft. deep, course SW. Leave rolling  
 and enter mountainous land.  
 Ascend 156 ft., over SE. slope.  
 74.72 Ridge, brs. NE. and SW.  
 Descend 56 ft., over NW. slope, to  
 80.00 Set an iron post, 3 ft. long, 2 ins. in diam., 26 ins. in  
 the ground, for reestablished cor. of secs. 7 and 18,  
 only, marked on brass cap,

T5S	T5S
R30E	S 7
S13	S18
	R31E

1921

and raise a mound of stone, 3 ft. base, 2 ft. high, E.  
 of cor.

Land, S. 60 chs. rolling; N. 20 chs. mountainous.  
 Soil, adobe, rocky, 3rd rate.  
 Timber, none.  
 Undergrowth, dense greasewood, catclaw, tesota, ocotillo  
 and other cacti.  
 Fair grass.

N. 0° 06' W., on a true line, on W. bdy. of sec. 7.  
 Over mountainous land, thru. dense undergrowth.  
 Descend 14 ft. over NW. slope, to  
 1.13 (40.02 chs. N. 0° 6' W. from reestablished  $\frac{1}{4}$  sec. cor. of  
 sec. 13) Intersect the original cor. of secs. 7, 12, 13  
 and 18, which is a volcanic stone, 8x10x6 ins. above  
 ground, firmly set, marked with 2 grooves on N. face,  
 and 4 grooves on S. face, and witnessed by a mound  
 of stone, 3 ft. base, 2 ft. high, W. of cor. No bear-  
 ing trees.  
 Reestablish this cor. as follows:  
 Alongside old stone, set an iron post, 3 ft. long, 2 ins.  
 in diam., 24 ins. in the ground, for reestablished cor.  
 of secs. 12 and 13 only, marked on brass cap,

T5S	T5S
S12	R31E
S13	S 7
R30E	

1921

Thence,  
 N. 0° 12' W., on true line, continuing measurement of W. bdy.  
 of sec. 7.  
 Over mountainous land, thru. dense undergrowth.  
 Descend 68 ft., over NW. slope.  
 6.06 Wash, 50 lks. wide, 4 ft. deep, course SW.  
 Ascend 232 ft., over SW. slope.  
 34.61 Spur, slopes NW.

BCKK 3587

## 20 Resurvey of West bdy. of Township 5 South, Range 31 East.

Chains.

- 38.21 Descend 134 ft., over N. slope, to S. rim of canyon, brs. E. and W.  
 39.95 Descend 73 ft., over N. slope, to Wash. course W. in bottom of canyon. Thence across bottom of canyon.  
 40.00 Set an iron post, 3 ft. long, 1 in. in diam., 26 ins. in the ground, for reestablished  $\frac{1}{4}$  sec. cor. of sec. 7 only, marked on brass cap,

1/4 S 7
---------

1921

and raise a mound of stone, 3 ft. base, 2 ft. high, E. of cor.

- 40.79 Continue across bottom of canyon to (Midpoint of E. bdy. of sec. 12). Set an iron post, 3 ft. long, 1 in. in diam., 26 ins. in the ground, for reestablished  $\frac{1}{4}$  sec. cor. of sec. 12 only, marked on brass cap,

1/4 S 12
----------

1921

and raise a mound of stone, 3 ft. base, 2 ft. high, W. of cor.

Continue line and measurement of E. bdy. of sec. 12. Over mountainous land, thru. dense undergrowth. Leave bottom of canyon.

- 42.29 Ascend 80 ft., over S. slope, to N. rim of canyon, brs. E. and W.  
 53.01 Ascend 57 ft. over S. slope, to Leave mountainous, and enter rolling land.  
 66.45 Ascend 73 ft., over SW. slope. Spur, slopes SE.  
 71.00 Descend 5 ft., over E. slope.  
 80.00 Ascend 30 ft., over E. slope, to Set an iron post, 3 ft. long, 2 ins. in diam., 26 ins. in the ground for reestablished cor. of secs. 6 and 7 only, marked on brass cap,

T5S	T5S
R30E	S 6
S12	S 7
R31E	

1921

and raise a mound of stone, 3 ft. base, 2 ft. high, E. of cor.

Land, S. 53 chs., mountainous; N. 27 chs. rolling.

Soil, adobe, rocky, 3rd and 4th rate.

Timber, none.

Undergrowth, dense greasewood, catclaw, tesota, ocotillo and other cacti.

Fair grass.

- 0.45 N. 0° 12' W., on a true line, on W. bdy. of sec. 6. Over rolling land, thru. dense undergrowth. Ascend slightly over E. slope, to (79.32 chs. N. 0° 12' W. from reestablished cor. of secs. 12 and 13) Intersect the original cor. of secs. 1, 6, 7 and 12, which is a malpais stone 8x8x6 ins. above ground, firmly set, marked with 1 groove on N. and 5 grooves on S. face; and witnessed by a mound of stone, 3 ft. base, 2 ft. high, W. of cor. No bearing trees. Reestablish this cor. as follows: Alongside old stone, set an iron post, 3 ft. long, 2 ins. in diam., 24 ins. in the ground, for reestablished cor. of secs. 1 and 12 only, marked on brass cap,

BOOK 3587

Resurvey of West bdy. of Township 5 South, Range 31 East. 21

Chains.

T5S	T5S
S 1	R31E
S12	S 6
R30E	
1921	

Thence, N.0°6'W., on a true line, continuing measurement of W. bdy. of sec. 6.

Over rolling land, thru. dense undergrowth. Ascend 62 ft., over E. and SE. slopes. 15.00 Rim of mesa, brs. NE. and SW. Leave rolling, and enter nearly level land on mesa.

Ascend 18 ft. over SE. slope, to 40.00 Set an iron post, 3 ft. long, 1 in. in diam., 26 ins. in the ground, for reestablished 1/4 sec. cor. of sec. 6 only, marked on brass cap, 1/4 S 6 1921

and raise a mound of stone, 3 ft. base, 2 ft. high, E. of cor. Leave nearly level and enter level land. Continue across mesa.

40.73 (40.28 chs. N.0°6'W. from reestablished cor. of secs. 1 and 12) Intersect the original 1/4 sec. cor. of secs. 1 and 6, which is a volcanic stone, 4x8x8 ins. above ground, firmly set, marked 1/4 S on W. face, and witnessed by a mound of stone, 3 ft. base, 2 ft. high, W. of cor. No bearing trees. Reestablish this cor. as follows: Alongside old stone, set an iron post, 3 ft. long, 1 in. in diam., 26 ins. in the ground, for reestablished 1/4 sec. cor. of sec. 1 only, marked on brass cap,

1/4 S 1
1921

Continue line and measurement of W. bdy. of sec. 6. Over level land, thru. dense undergrowth on mesa. 47.23 Dim road brs. NE. and SW.

80.93 (40.20 chs. N.0°6'W., from reestablished 1/4 sec. cor. of sec. 1) Intersect the reestablished cor. of Ts. 4 and 5 S., Rs. 30 and 31 E. which is an iron post, 3 ins. in diam., projecting 14 ins. above ground, firmly set in mound of stone, properly marked on brass cap, and witnessed by a mound of stone, S. of cor. No bearing trees. Land, S. 1/2 rolling and nearly level, N. 1/2 level. Soil, adobe, rocky, 3rd and 4th rate. Timber, none. Undergrowth, dense greasewood, catclaw, tesota, ocotilla, and other cacti. Fair grass.



22 Survey of the East bdy. of Township 5 South, Range 31 East.

Chains.

- From the reestablished standard cor. of Ts. 5 S., Ra. 31 and 32 E., on 1st Standard Parallel South, hereinbefore described,  
 North, on true line, bet. secs. 31 and 36.  
 Over mountainous land, thru. scattering undergrowth.  
 Descend 45 ft., over NW. slope, to  
 1.88 Bottom of ravine, continuing stream of water, 2 lks. wide, 4 ins. deep, course W. from N. 45° E. Thence across bottom of ravine.  
 5.00 Leave bottom of ravine.  
 Ascend 240 ft., over S. slope.  
 6.37 Four strand smooth wire fence, brs. N. 70° E. and S. 70° W.  
 19.77 From this point, Jim Wright's house, corral and spring, bear E. about 30 chs. dist.  
 34.71 Ridge, brs. N. 70° E. and S. 70° W.  
 Descend 50 ft., over NW. slope, to  
 40.00 Set an iron post, 3 ft. long, 1 in. in diam., 24 ins. in the ground, for 1/4 sec. cor., marked on brass cap,

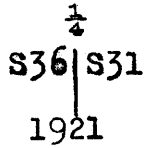

- and raise a mound of stone, 4 ft. base, 3 ft. high, W. of cor.
- Descend 8 ft., over NW. slope.  
 40.79 Gulch, course W. near head.  
 Ascend 20 ft. over SW. slope.  
 45.00 Short spur, slopes W.  
 Descend 15 ft., over NW. slope.  
 50.90 Gulch, course S. 25° E.  
 Ascend 100 ft., over SE. slope.  
 55.59 Ascend 29 ft., over E. slope.  
 60.57 Descend 12 ft., over NE. slope.  
 60.59 Three strand barb wire fence, brs. E. and W.  
 66.67 Head of canyon, course S. 75° E. Saddle in ridge brs. W. 5 chs. dist.  
 Ascend 209 ft., over S. slope, to  
 78.76 Ridge, brs. NE. and SW.  
 Ascend 11 ft., over W. slope, to  
 80.00 Set an iron post, 3 ft. long, 2 ins. in diam., 8 ins. in the ground to bed rock, supported by a mound of stone, for cor. of secs. 25, 30, 31 and 36, marked on brass cap,

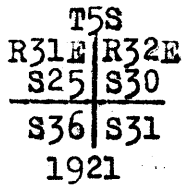

and raise a mound of stone, 4 ft. base, 3 ft. high, W. of cor.

Land, mountainous.  
 Soil, rocky, volcanic formation, 3rd rate.  
 Timber, none.  
 Undergrowth, scattering catclaw, greasewood, scrub mesquite, rabbit brush, scrub oak and scrub cedar.  
 Fair grass.

- 
- North, on true line, bet. secs. 25 and 30.  
 Over mountainous land, thru. scattering undergrowth.  
 Ascend 27 ft. over SW. slope.  
 8.88 Point of spur, slopes W.  
 Descend 385 ft., over NW. slope.  
 35.89 Wash, in bottom of canyon, course S. 40° W. near head.



## Survey of East bdy. of Township 5 South, Range 31 East. 23

Chains.

- Spring brs. NE. 2 chs. dist.  
 Ascend 57 ft. over SE. slope, to  
 40.00 Set an iron post, 3 ft. long, 1 in. in diam., 4 ins. in the  
 ground to bed rock, supported by a mound of stone  
 for  $\frac{1}{4}$  sec. cor., marked on brass cap,  

$$\begin{array}{c} \frac{1}{4} \\ \hline S25 | S30 \\ 1921 \end{array}$$
 and raise a mound of stone, 4 ft. base, 3 ft. high; W.  
 of cor.  
 Ascend 33 ft., over SE. slope.  
 44.57 Spur, slopes S. 45°W.  
 Descend 61 ft. over NW. slope.  
 50.66 Bottom of canyon, course S. 40°W. Spring brs. NE., 1.50 chs.  
 dist.  
 Ascend 248 ft., over S. slope.  
 71.16 Ridge, brs. N. 45°E. and S. 45°W. near SW. end of same.  
 Descend 45 ft., over NW. slope, to  
 80.00 Set an iron post, 3 ft. long, 2 ins. in diam., on bed rock,  
 supported by a mound of stone, for cor. of secs. 19, 24,  
 25 and 30, marked on brass cap,

$$\begin{array}{c} T5S \\ R31E | R32E \\ \hline S24 | S19 \\ \hline S25 | S30 \\ 1921 \end{array}$$

and raise a mound of stone, 4 ft. base, 3 ft. high, W.  
 of cor.  
 Land, mountainous.  
 Soil, volcanic formation, 4th rate.  
 No timber, except scattering sycamore along bottoms of  
 canyons.  
 Undergrowth, scattering catchlaw, greasewood, scrub mes-  
 quite, rabbit brush, black brush, scrub cedar and  
 cacti.  
 Fair grass.

- North, on true line, bet. secs. 19 and 24.  
 Over mountainous land, thru. scattering undergrowth.  
 Descend 70 ft., over NW. slope.  
 4.96 Gulch, course S. 30°W.  
 Ascend 70 ft. over S. slope.  
 8.35 Spur, slopes SW.  
 Descend 36 ft., over NW. slope.  
 13.82 Gulch, course S. 40°W.  
 Ascend 85 ft., over SE. slope.  
 23.08 Spur, slopes S. 45°W.  
 Descend 73 ft., over NW. slope.  
 30.39 Gulch, course S. 45°W.  
 Ascend 55 ft. over S. slope.  
 37.97 Descend 5 ft., over NW. slope, to  
 40.00 Head of gully, course W. Set an iron post, 3 ft. long, 1  
 in. in diam., 6 ins. in the ground to bed rock, sup-  
 ported by a mound of stone, for  $\frac{1}{4}$  sec. cor., marked on  
 brass cap,

$$\begin{array}{c} \frac{1}{4} \\ \hline S24 | S19 \\ 1921 \end{array}$$

and raise a mound of stone, 3 ft. base, 2 ft. high, W.  
 of cor.

BOOK 3587

24 West boundary of Township 5 South, Range 31 East.

Chains.

46.30 Ascend 76 ft., over S. slope.  
Point of spur, slopes S. 55° W.

51.28 Descend 18 ft., over NW. slope.  
Head of gulch, course S. 45° W.

58.34 Ascend 42 ft., over S. and SE. slopes.  
Spur, slopes N. 80° E. Saddle between this spur and another  
spur, sloping SW., bears N. 80° E., 4 chs. dist.

67.65 Descend 65 ft., over NE. slope.  
Gulch, course N. 15° W. near head.

71.10 Ascend 4 ft., over W. slope.  
Descend 29 ft., over NW. slope.

76.08 Ascend 18 ft., over W. slope.

79.25 Descend slightly over NW. slope, to

80.00 Head of gully, course S. 70° W., Set an iron post, 3 ft. long,  
2 ins. in diam., 15 ins. in the ground to bed rock,  
supported by a mound of stone, for cor. of secs. 13, 18,  
19 and 24, marked on brass cap,

T5S  
R31E R32E  
S13 | S18  
S24 | S19  
1921

and raise a mound of stone, 4 ft. base, 3 ft. high, W. of cor.

Land, mountainous.

Soil, very rocky, limestone formation, 3rd rate.

Timber, none.

Undergrowth, scattering catclaw, scrub oak, scrub mesquite,  
black brush, rabbit brush, buck brush and cacti.

Fair grass.

North, on true line, bet. secs. 13 and 18.  
Over mountainous land, thru. scattering undergrowth.

4.17 Ascend 75 ft., over S. slope.  
Trail, brs. N. 79° W. to Top Bar Davis ranch, and S. 70° E.  
to Duncan ranch.

8.62 Spur, slopes S. 45° W.

16.10 Descend 68 ft., over NW. slope.  
Gulch, course S. 45° W.

25.37 Ascend 175 ft. over SE. slope.  
Spur, slopes S. 50° W.

37.58 Descend 153 ft., over NW. slope.  
Cottonwood tree, 18 ins. in diam., in wash, brs. west 20  
lks. dist.

38.99 Wash, 30 lks. wide, in gulch, course S. 10° W.

40.00 Ascend 12 ft., over SE. slope, to  
Set an iron post, 3 ft. long, 1 in. in diam., 15 ins. in  
the ground to bed rock, supported by a mound of stone  
for  $\frac{1}{4}$  sec. cor., marked on brass cap,

$\frac{1}{4}$   
S13 | S18  
1921

and raise a mound of stone, 4 ft. base, 3 ft. high, W. of cor.

46.25 Ascend 36 ft., over SE. slope, to  
Same wash and gulch, course S. 10° E.

56.85 Ascend 225 ft., over S. slope.

73.52 Ascend 190 ft., over SE. slope, to  
Ridge, brs. N. 45° E. and S. 45° W.

80.00 Descend 63 ft., over NW. slope, to  
Set an iron post, 3 ft. long, 2 ins. in diam., on bed rock,  
supported by a mound of stone, for cor. of secs. 7, 12, 13  
and 18, marked on brass cap,

Survey of East bdy. of Township 5 South, Range 31 East, 25

chains.

T5S	
R31E	R32E
S 7	S12
S18	S13
1921	

and raise a mound of stone, 4 ft. base, 3 ft. high, W. of cor.

Land, mountainous. Soil, rocky, 3rd rate. No timber, except scattering walnut, live oak, cottonwood and sycamore along gulches. Undergrowth, scattering algerita, catclaw, buck brush, scrub oak, rabbit brush, scrub cedar and scrub juniper. Fair grass.

North, on true line, bet. secs. 7 and 12. Over mountainous land, thru. scattering undergrowth. Descend 205 ft., over NW. slope.

13.65  
14.75  
37.88  
40.00

Wash, 30 lks. wide, course W. Ascend 215 ft., over S. slope. Spring brs. East, 100 lks. dist. Spur, slopes W. Descend 17 ft., over N. slope, to Set an iron post, 3 ft. long, 1 in. in diam., 12 ins. in the ground to bed rock, supported by a mound of stone, for 1/4 sec. cor., marked on brass cap,

1/4	
S12	S 7
1921	

and raise a mound of stone, 4 ft. base, 3 ft. high, W. of cor.

44.73  
54.57  
61.08  
65.92  
74.37  
80.00

Descend 100 ft., over NW. slope. Gulch, course S. 55° W. Ascend 122 ft., over SE. slope. Saddle in ridge, brs. E. and W. Descend 85 ft., over N. slope. Gulch, course N. 80° W. Ascend 36 ft., over SW. slope. Point of spur, slopes W. Descend 60 ft., over NW. slope. Bottom of canyon, course S. 40° W. Ascend 53 ft. over SW. slope, to Set an iron post, 3 ft. long, 2 ins. in diam., 24 ins. in the ground, for cor. of secs. 1, 6, 7 and 12, marked on brass cap,

T5S	
R31E	R32E
S 1	S 6
S12	S 7
1921	

from which, An oak, 12 ins. in diam., brs. S. 62° E., 180 lks. dist., marked T5S R32E S7 BT.

No other trees within limits; raise a mound of stone, 4 ft. base, 3 ft. high, W. of cor.

Land, mountainous. Soil, rocky, 3rd rate, limestone and sandstone formation. No timber, except scattering walnut, sycamore and cottonwood along gulches and canyons. Undergrowth, scattering algerita, catclaw, buck brush, scrub oak, rabbit brush, scrub mesquite, scrub cedar and cacti. Fair grass.

26 Survey of East bdy. of Township 5 South, Range 31 East.

Chains.

North, on true line, bet. secs. 1 and 6.  
 Over mountainous land, thru. scattering undergrowth.  
 The south half mile of this portion of the range line  
 passes over precipitous broken slopes of Palace Peak.  
 Measurement on the range line is impracticable by  
 either chaining or triangulation; therefore, avoid the  
 impassable portion of the line, and obtain measurement  
 to the  $\frac{1}{4}$  sec. cor. by offset line, as described as fol-  
 lows, and as shown on the diagram hereon:

From the cor. of secs. 1, 6, 7 and 12, sec. 1  
 West, on offset line, 15.22 chs.  
 to offset point.

Thence,  
 North, on offset line, thru. S.  $\frac{1}{2}$  of  
 sec. 1, parallel to range line,  
 40.00 chs. to offset point.

Thence,  
 East, on offset line in sec. 1, 15.22  
 chs., returning to point on range  
 line, 40.00 chs. North from cor.  
 of secs. 1, 6, 7 and 12, at which  
 point establish the  $\frac{1}{4}$  sec. cor. of  
 secs. 1 and 6, as hereinafter  
 described.

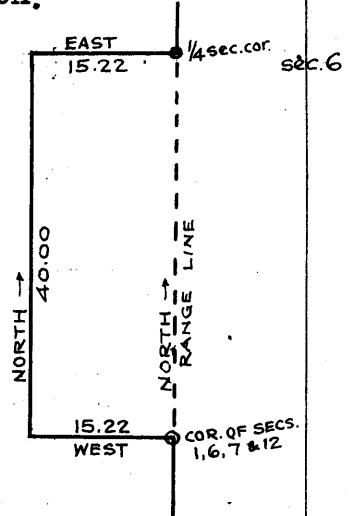

The approximate description of the topography on the  
 range line thru. S.  $\frac{1}{2}$  bet. secs. 1 and 6, is as follows:

From cor. of secs. 1, 6, 7 and 12,

20.00 Ascend about 800 ft., over SW. slope, to  
 (Approximate) Top of Palace Peak; thence, over very broken  
 W. slope.

40.00 Descend about 50 ft. to  
 Terminus of offset line described above. This point is  
 2.50 chs. west from a saddle between the N. slope of  
 Palace Peak and the SW. slope of a rocky butte to the  
 NE.

Set an iron post, 3 ft. long, 1 in. in diam., 24 ins. in  
 the ground, for  $\frac{1}{4}$  sec. cor., marked on brass cap,

$\frac{1}{4}$   
 S 1 | S 6  
 1921

and raise a mound of stone, 4 ft. base, 3 ft. high, W.  
 of cor.

Thence,  
 North, on true line, bet. secs. 1 and 6, continuing meas-  
 urement.

44.70 Ascend 113 ft. to  
 Top of cliffs, bearing NW. and SE. facing SW.

61.89 Descend 461 ft., over NW. slope.  
 Bottom of canyon, course N. 10° E.

65.36 Descend 28 ft., over E. slope, to  
 Point of spur, slopes N. & E.

72.97 Descend 175 ft., over N. slope.  
 Bottom of canyon, course W.

77.61 Ascend 70 ft., over SW. slope.  
 Point of spur, slopes W. & S.

80.00 Descend 20 ft., over NW. slope, to  
 Set an iron post, 3 ft. long, 3 ins. in diam., 24 ins. in  
 the ground, at base of large flat rock, 24x30x4 ft.,  
 for cor. of Ts. 4 and 5 S., Rs. 31 and 32 E., marked  
 on brass cap,

T4S  
 R31E | R32E  
 S36 | S31  
 S 1 | S 6  
 T5S  
 1921

Survey of East bdy. of Township 5 South, Range 31 East. 27

Chains.

from which,  
 An oak, 8 ins. in diam., brs. S.  $7\frac{1}{2}^{\circ}$  E., 210  
 lks. dist., marked T5S R32E S6 BT.  
 An oak, 10 ins. in diam., brs. S.  $11\frac{1}{2}^{\circ}$  W., 204  
 lks. dist., marked T5S R31E S1 BT.

No other trees within limits; raise a mound of stone, 4 ft. base, 3 ft. high, W. of cor.

Land, mountainous.

Soil, rocky, 4th rate.

No timber, except scattering walnut, sycamore and cotton-wood along canyons.

Undergrowth, scattering algerita, rabbit brush, manzanita, scrub oak, scrub mesquite, scrub cedar, scrub juniper, ocotillo and other cacti.

Fair grass.



## Survey of North bdy. of Township 5 South Range 31 East.

Chains.

From the cor. of Ts. 4 and 5 S., Rs. 31 and 32 E., hereinbefore described,

West, on a random line, setting temporary  $\frac{1}{4}$  sec. and sec. cors. alternately, at intervals of 40.00 chs.; and at 480.20 chs., fall 1.24 chs. S. of the reestablished cor. of Ts. 4 and 5 S., Rs. 30 and 31 E., hereinbefore described. The falling answers to a correction of  $0^{\circ} 9'$ , or 21 lks. N. per mile, counting from the NE. cor. of the Tp.; therefore, from the NW. cor. of the Tp., S.  $89^{\circ} 51' E.$ , on a true line, bet. secs. 6 and 31.

Over level land, thru, dense undergrowth, on mesa.

12.40 Dim road, brs. N. and S.

15.00 East rim of mesa, brs. N. and S. Leave level, and enter mountainous land.

Descend 140 ft., over E. slope.

27.37 Wash, 50 lks. wide, 4 ft. deep, course S.

Ascend 145 ft., over W. slope.

38.54 Ridge, brs. N. and S.

Descend 10 ft., over E. slope, to

40.20 Set an iron post, 3 ft. long, 1 in. in diam., 12 ins. in the ground to bed rock, supported by a mound of stone, for  $\frac{1}{4}$  sec. cor., marked on brass cap,

$$\begin{array}{r} \frac{1}{4} \text{ S } 31 \\ \text{S } 6 \\ 1921 \end{array}$$

and raise a mound of stone, 3 ft. base, 2 ft. high, N. of cor.

Descend 76 ft., over E. slope.

44.09 Wash, 10 lks. wide, course S.

Ascend 72 ft., over W. slope.

48.45 Spur, slopes S. From this point, Frank Davis' Ranch brs. S.  $35^{\circ} W.$  about 35 chs. dist.

Descend 166 ft., over SE. slope.

61.17 Wash, 70 lks. wide, course S.  $25^{\circ} W.$  into Buzzard's Roost Canyon. Ascend 217 ft., over NW. slope.

77.00 Ridge, brs. NE., and SW. slope.

Descend 15 ft., over E. slope, to

80.20 Set an iron post, 3 ft. long, 2 ins. in diam., 14 ins. in the ground to bed rock, supported by a mound of stone, for cor. of secs. 5, 6, 31 and 32, marked on brass cap,

$$\begin{array}{r} T4S | R31E \\ \hline S31 | S32 \\ \hline S 6 S 5 \\ T5S \\ 1921 \end{array}$$

and raise a mound of stone, 3 ft. base, 2 ft. high, W. of cor.

Land, W. 15 chs. level; remainder, mountainous.

Soil, adobe and rocky, 3rd and 4th rate.

Timber, none.

Undergrowth, dense greasewood and scattering catclaw, scrub oak, ocotillo and other cacti.

Fair grass.

S.  $89^{\circ} 51' E.$ , on true line, bet. secs. 5 and 32. Over mountainous land, thru. dense undergrowth.

Descend 35 ft., over E. slope.

3.05 Wash, 20 lks. wide, course S.

Ascend 81 ft., over W. slope.

27.00 Ridge, brs. N. and S.

Descend 125 ft. over E. slope.

34.15 Wash, 50 lks. wide, course S.

Ascend 162 ft., over W. slope, to

Survey of North bdy. of Township 5 South, Range 31 East. 29

Chains.

40.00 Set an iron post, 3 ft. long, 1 in. in diam., 26 ins. in the ground, for 1/4 sec. cor., marked on brass cap,

1/4 S 32  
S 5  
1921

and raise a mound of stone, 3 ft. base, 2 ft. high, N. of cor.

45.38 Ascend 68 ft., over W. slope. W. rim of mesa, brs. N. and S. Leave mountainous, and enter nearly level land on mesa.

65.18 Descend 20 ft., over S. slope, to E. rim of mesa, brs. NE. and SW. Leave nearly level and enter mountainous land.

75.28 Descend 170 ft. over SE. slope. Wash, 20 lks. wide, course SW.

80.00 Ascend 73 ft., over NW. slope, to Set an iron post, 3 ft. long, 2 ins. in diam., 26 ins. in the ground, for cor. of secs. 4, 5, 32 and 33, marked on brass cap,

T4S | R31E  
S32 | S33  
S 5 S 4  
T5S  
1921

and raise a mound of stone, 3 ft. base, 2 ft. high, W. of cor.

Land, mountainous, except on mesa, where it is nearly level.

Soil, rocky 4th rate.

Timber, none.

Undergrowth, dense greasewood, catclaw, scrub oak, ocotillo and other cacti. Fair grass.

S. 89° 51' E., on true line, bet. secs. 4 and 33. Over mountainous land, thru. dense undergrowth.

11.24 Ascend 152 ft., over NW. slope. Ridge, brs. NE. and SW.

18.00 Descend 30 ft., over SE. slope. Ascend 56 ft. over SW. slope.

25.05 Spur, slopes S.

40.00 Descend 348 ft. over E. slope, to Set an iron post, 3 ft. long, 1 in. in diam., 26 ins. in the ground, for 1/4 sec. cor., marked on brass cap,

1/4 S 33  
S 4  
1921

and raise a mound of stone, 3 ft. base, 2 ft. high, N. of cor.

41.15 Descend 43 ft., over E. slope. Wash, 20 lks. wide, course S. Leave mountainous, and enter rolling land.

50.70 Ascend 47 ft., over W. slope. Spur, slopes SW.

61.20 Descend 55 ft., over SE. slope.

67.75 From this point, G. Stockton's ranch house brs. South, 4.00 chs. dist. Gold Creek wash, 50 lks. wide, course SW. into Rustler's Canyon.

80.00 Ascend 65 ft., over NW. slope, to Set an iron post 3 ft. long, 2 ins. in diam., 26 ins. in the ground, for cor. of secs. 3, 4, 33 and 34, marked on brass cap,

## BOOK 3587

30 Survey of North bdy. of Township 5 South, Range 31 East.

Chains.

T4S	R31E
S33	S34
S 4	S 3
T5S	
1921	

and raise a mound of stone, 3 ft. base, 2 ft. high, W. of cor.

Land, W. 41 chs., mountainous; E. 39 chs., rolling.

Soil, rocky, 4th rate.

Timber, none.

Undergrowth, dense greasewood, catclaw, scrub oak and other cacti.

Fair grass.

S. 89° 51' E., on a true line, bet. secs. 3 and 34.

Over rolling land, thru. dense undergrowth.

Ascend 34 ft., over NW. slope.

26.84 Old road, brs. N. 80° W. and S. 80° E.

28.80 Wash, 10 lks. wide, course NW. Leave rolling, and enter mountainous land.

Ascend 110 ft., over SW. slope.

35.73 Spur, slopes NW.

Descend 15 ft., over NE. slope, to

40.00 Set an iron post, 3 ft. long, 1 in. in diam., 6 ins. in the ground to bed rock, supported by a mound of stone, for  $\frac{1}{4}$  sec. cor., marked on brass cap,

$\frac{1}{4}$	S 34
	S 3
	1921

and raise a mound of stone, 3 ft. base, 2 ft. high, N. of cor.

Ascend 185 ft., over NW. slope, to

58.75 Rim of mesa, brs. NE. and SW.

Leave mountainous, and enter gently rolling land on mesa.

Ascend 48 ft., over SW. slope to sec. cor.

65.05 Old Mule Creek stage road, brs. NE. and SW.

80.00 Set an iron post, 3 ft. long, 2 ins. in diam., 24 ins. in the ground, for cor. of secs. 2, 3, 34 and 35, marked on brass cap,

T4S	R31E
S34	S35
S 3	S 2
T5S	
1921	

and raise a mound of stone, 3 ft. base, 2 ft. high, W. of cor.

Land, rolling and mountainous.

Soil, rocky, 3rd rate.

Timber, none.

Undergrowth, dense greasewood, catclaw, scrub oak, ocotillo and other cacti.

Fair grass.

S. 89° 51' E., on true line, bet. secs. 2 and 35.

Over nearly level land, thru. dense undergrowth, on mesa.

Descend 10 ft. to

10.00 Rim of mesa, brs. NE. and SW. Leave nearly level and enter rolling land.

Descend 82 ft., over SE. slope.

20.01 Wash, 20 lks. wide, course SW.



Survey of North hdy. of Township 5 South, Range 31 East. 31

Chains.

37.15 Ascend 152 ft. over NW. slope, to Ridge, brs. NE. and SW.  
 40.00 Descend 10 ft.; over SE. slope, to Set an iron post, 3 ft. long, 1 in. in diam., 6 ins. in the ground to bed rock, supported by a mound of stone, for 1/4 sec. cor., marked on brass cap,

1/4 S 35  
 S 2  
 1921

and raise a mound of stone, 3 ft. base, 2 ft. high, N. of cor.

Continue over rolling land, thru. dense undergrowth.  
 70.04 Descend 166 ft., over SE. slope. Wash, 50 lks. wide, containing small stream of clear water, course SW. bordered by scattering timber. Leave rolling and enter mountainous land.

80.00 Ascend 98 ft., over SW. slope, to Set an iron post, 3 ft. long, 2 ins. in diam., 24 ins. in the ground, for cor. of secs. 1, 2, 35 and 36, marked on brass cap,

T4S, R31E  
 S35, S36  
 S 2 | S 1  
 T5S  
 1921

and raise a mound of stone, 3 ft. base, 2 ft. high, W. of cor.

Land, W. 10 chs., nearly level; E. 10 chs., mountainous, remainder, rolling.

Soil, rocky, 3rd rate.

No timber, except scattering cedar and juniper, along wash as noted.

Undergrowth, dense greasewood, catclaw, scrub oak, ocotillo and other cacti.

Fair grass.

S. 89° 51' E., on true line, bet. secs. 1 and 36.  
 Over mountainous land, thru. scattering undergrowth.

2.50 Ascend 40 ft., over SW. slope, to Point of spur, slopes S. 80° W.  
 16.50 Ascend 150 ft., over S. and SW. slopes. Old wire drift fence, brs. NW. and SE.  
 25.27 Same spur, slopes N. 75° W.  
 39.25 Descend 50 ft., over NE. slope. Wash, course NW.  
 40.00 Ascend slightly over SW. slope, to Set an iron post, 3 ft. long, 1 in. in diam., on bed rock, supported by a mound of stone, for 1/4 sec. cor., marked on brass cap,

1/4 S 36  
 S 1  
 1921

and raise a mound of stone, 3 ft. base, 2 ft. high, N. of cor.

53.65 Ascend 120 ft., over SW. slope.  
 55.35 Descend 15 ft., over SE. slope. Same wash, course SW. Asc. 400 ft. over NW. slope.  
 68.87 Spur, slopes SW. Desc. 167 ft., over SE. slope.  
 79.75 Gulch, course SW. Asc. slightly over NW. slope.  
 80.00 The cor. of Ts. 4 and 5 S., Rs. 31 and 32 E., hereinbefore described.  
 Land, mountainous.

BOOK 3587

32. Survey of North boundary of Township 5 South, Range 31 East.

Chains.

Soil, rocky, 3rd and 4th rate.  
 Timber, none.  
 Undergrowth, scattering greasewood, catclaw, scrub oak,  
 ocotillo and other cacti.  
 Fair grass.

-----  
 Boundaries of Township 5 South, Range 31 East.  
 -----

Latitudes, departures, and closing errors.  
 -----

Line designated.	True bearing.	Dist.	Latitudes.		Departures.	
			N.	S.	E.	W.
South boundary, (1st. Std. Par. S.)	West,	80.00				80.00
	N. 89° 56' W.	40.02	.05			40.02
	N. 89° 43' W.	39.84	.20			39.84
	N. 89° 56' W.	39.81	.05			39.81
	N. 89° 57' W.	39.93	.04			39.93
	N. 89° 50' W.	80.09	.23			80.09
	West,	40.05				40.05
	N. 89° 59' W.	39.87	.01			39.87
	N. 89° 50' W.	80.11	.23			80.11
West, boundary,	N. 0° 25' E.	40.16	40.16		.29	
	N. 0° 24' E.	40.14	40.14		.28	
	N. 0° 6' E.	40.18	40.18		.07	
	N. 0° 7' E.	40.10	40.10		.08	
	N. 0° 10' W.	40.18	40.18			.12
	N. 0° 8' W.	80.35	80.35			.18
	N. 0° 6' W.	40.02	40.02			.07
	N. 0° 12' W.	79.32	79.32			.28
N. 0° 6' W.	80.48	80.48			.14	
North boundary,	S. 89° 51' E.	480.20		1.24	480.20	
East boundary,	South,	480.00		480.00		
Convergency,					.47	
Totals,			481.74	481.24	481.39	480.51
			481.24		480.51	
Error in latitude,			0.50			
Error in departure,					0.88	

## Survey of Subdivision lines of Township 5 South, Range 31 East, 33

Chains.

- From the reestablished standard cor. of secs. 35 and 36, on S. bdy. of Tp. (1st. Std. Par. S.), hereinbefore described,  
N. 0° 1' W., bet. secs. 35 and 36.  
Over mountainous land, thru. dense undergrowth.
- 6.00 Ascend 75 ft., over S. slope.  
Ridge, brs. E. and W.
- 16.04 Descend 67 ft., over N. slope.  
Wash, 50 lks. wide, in large draw, course W.
- 23.66 Ascend 60 ft., over S. slope.  
Spur, slopes W.
- 28.33 Descend 72 ft., over N. slope.  
Wash, 30 lks. wide, course W.
- 33.57 Ascend 51 ft., over SW. slope.  
Point of spur, slopes W.
- 37.98 Descend 56 ft., over NW. slope.  
Wash, course SW.
- 40.00 Ascend 38 ft., over S. slope, to  
Set an iron post, 3 ft. long, 1 in. in diam., 26 ins. in the ground, for  $\frac{1}{4}$  sec. cor., marked on brass cap,
- $\frac{1}{4}$   
S35 | S36  
1921
- and raise a mound of stone, 3 ft. base, 2 ft. high, W. of cor.
- Ascend 130 ft., over S. slope.
- 60.74 Three strand smooth wire fence, brs. NE. and SW.
- 62.50 Ridge, brs. E. and W.
- 78.85 Descend 203 ft., over N. slope.  
Wash, 80 lks. wide, course W.
- 80.00 Road brs. E. and W. Extends to Mrs. J. G. Smith's ranch in sec. 25. Asc. 12 ft., over S. slope, to  
Set an iron post, 3 ft. long, 2 ins. in diam., 26 ins. in the ground, for cor. of secs. 25, 26, 35 and 36, marked on brass cap,
- T5S | R31E  
S26 | S25  
S35 | S36  
1921
- and raise a mound of stone, 3 ft. base, 2 ft. high, W. of cor.
- Land, mountainous.  
Soil, rocky, 3rd rate.  
Timber, none.  
Undergrowth, dense greasewood, catclaw, scrub oak, ocotillo and other cacti.  
Fair grass.
- 
- 40.00 East, on a random line, bet. secs. 25 and 36.  
Set temp.  $\frac{1}{4}$  sec. cor.
- 80.18 Fall 9 lks. N. of the cor. of secs. 25, 30, 31 and 36, on the E. bdy. of the Tp., hereinbefore described.  
Thence,  
N. 89° 56' W., on a true line, bet. secs. 25 and 36.  
Over mountainous land, thru. dense undergrowth.
- 12.65 Descend 217 ft., over NW. slope.  
Head of gully, course N.
- 20.20 Ascend 22 ft., over NE. slope.  
Ridge, brs. NW. and SE. Three strand smooth wire fence brs. N. and S.
- 23.30 Descend 65 ft. over SW. slope,  
Three strand smooth wire fence, brs. NE. and SW.

## 34 Subdivision lines of Township 5 South, Range 31 East.

Chains.

- 27.00 Thence along S. slope of ridge.  
Ascend 20 ft., to
- 40.09 Set an iron post, 3 ft. long, 1 in. in diam., 24 ins. in the ground, for  $\frac{1}{4}$  sec. cor., marked on brass cap,
- $\frac{1}{4}$  S 25  
S 36  
1921
- and raise a mound of stone, 3 ft. base, 2 ft. high, N. of cor.  
Ascend slightly over SE. slope.
- 42.70 Spur, slopes S.  
Descend 67 ft., over SW. slope, to
- 50.40 Descend 17 ft., over S. slope, to
- 55.93 Same ridge, brs. NE. and SW.  
Descend 280 ft., over NW. slope.
- 73.20 Center of wash, 5 chs. wide, course SW. for about 1.00 ch. thence W.  
Ascend 5 ft., over S. slope to sec. cor.
- 78.46 Road brs. N. 75° E. and S. 75° W. extends to Mrs. J. G. Smith's ranch in sec. 25.
- 80.18 The cor. of secs. 25, 26, 35 and 36.  
Land, mountainous.  
Soil, rocky, 4th rate.  
Timber, none.  
Undergrowth, dense greasewood, catclaw, ocotillo and other cacti.  
Fair grass.
- 
- N. 0° 1' W., bet. secs. 25 and 26.  
Over mountainous land; thru. dense undergrowth.  
Ascend 257 ft., over S. slope.
- 15.00 From this point, the ranch house of Mrs. J. G. Smith brs. E. about 17 chs. dist.
- 31.69 Ridge, brs. NE. and W.  
Ascend 36 ft., over W. slope, to
- 39.00 Short spur from ridge, slopes NW.  
Descend 22 ft., over N. slope, to
- 39.30 Wire fence brs. E. and W.
- 40.00 Set an iron post, 3 ft. long, 1 in. in diam., 18 ins. in the ground to bed rock, supported by a mound of stone for  $\frac{1}{4}$  sec. cor., marked on brass cap,
- $\frac{1}{4}$   
S26|S25  
1921
- and raise a mound of stone, 3 ft. base, 2 ft. high, W. of cor.  
This cor. is at S. rim of canyon, bearing E. and W.  
Descend 127 ft., over N. slope.
- 47.29 Wash, 40 lks. wide, in bottom of canyon, course W.  
Ascend 185 ft., over S. slope, to
- 53.70 North rim of canyon, brs. E. and W. Leave mountainous land and dense undergrowth, and enter rolling land and scattering undergrowth.  
Ascend 12 ft., over SE. slope.
- 55.70 East side of top of hill.  
Descend 55 ft., over NE. slope, to
- 80.00 Set an iron post, 3 ft. long, 2 ins. in diam., 18 ins. in the ground to bed rock; supported by a mound of stone, for cor. of secs. 23, 24, 25 and 26, marked on brass cap,

T5S | R31E  
S23 | S24  
S26 | S25  
1921

Subdivision lines of Township 5 South, Range 31 East.

Chains.

and raise a mound of stone, 3 ft. base, 2 ft. high, W. of cor.  
 Land, S. 53.70 chs., mountainous, remainder rolling.  
 Soil, rocky, 4th rate.  
 Timber, none.  
 Undergrowth, dense greasewood, catclaw, scrub oak, ocotillo and other cacti.  
 Fair grass.

---

40.00 S. 89° 56' E., on a random line, bet. secs. 24 and 25.  
 Set temp.  $\frac{1}{4}$  sec. cor.  
 80.12 Fall 9 lks. S. of the cor. of secs. 19, 24, 25 and 30, on the E. bdy. of the Tp., hereinbefore described.  
 Thence,  
 West, on true line, bet. secs. 24 and 25.  
 Over mountainous land, thru. scattering undergrowth.  
 Descend 126 ft., over NW. slope.  
 4.95 Gulch, course SW.  
 Descend 26 ft., over SW. slope, to  
 11.30 Center of wash, 100 lks. wide, in bottom of canyon, course S.  
 Ascend 446 ft., over E. slope.  
 34.10 Ridge, brs. N. and S.  
 Descend 165 ft., over W. slope, to  
 40.06 Set an iron post, 3 ft. long, 1 in. in diam., 24 ins. in the ground, for  $\frac{1}{4}$  sec. cor., marked on brass cap,  

$$\frac{1}{4} \begin{array}{l} S 24 \\ S 25 \\ 1921 \end{array}$$
 and raise a mound of stone, 3 ft. base, 2 ft. high, N. of cor.  
 Descend 270 ft., over W. slope.  
 52.10 Gulch, 20 lks. wide, course SW.  
 Ascend 100 ft., over SE. slope.  
 58.78 Ridge, brs. NE. and SW. Leave mountainous and enter rolling land.  
 Descend 145 ft., over NW. slope, to  
 75.70 Draw, course NW. Wire fence, brs. NW. and SE.  
 Ascend 12 ft., over NE. slope, to  
 80.12 The cor. of secs. 23, 24, 25 and 26.  
 Land, E. 59 chs., mountainous; remainder, rolling.  
 Soil, rocky, 4th rate.  
 Timber, none.  
 Undergrowth, scattering greasewood, ocotillo, catclaw, scrub oak and scrub cedar.  
 Fair grass.

---

N. 0° 1' W., bet. secs. 23 and 24.  
 Over rolling land, thru. scattering undergrowth.  
 Descend 30 ft., over NE. slope.  
 4.80 Wash, in draw, course NW.  
 Ascend 45 ft., over SW. slope.  
 6.00 Wire fence, brs. NW. and SE.  
 25.00 Spur, slopes NW.  
 Descend 75 ft., over E. slope, to  
 40.00 Set an iron post, 3 ft. long, 1 in. diam., 26 ins. in the ground, for  $\frac{1}{4}$  sec. cor., marked on brass cap,  

$$\frac{1}{4} \begin{array}{l} S 23 \\ S 24 \\ 1921 \end{array}$$
 and raise a mound of stone, 3 ft. base, 2 ft. high, W. of cor.

BOOK 3587

## 36 Subdivision lines of Township 5 South, Range 31 East.

Chains.

- Descend 15 ft. over N. slope.  
 40.05 Wire fence brs. NE. and SW.  
 42.39 Center of wash, 100 lks. wide, course W. Leave rolling and enter mountainous land.  
 Ascend 187 ft., over S. slope.  
 60.00 Ridge, brs. NE. and SW. Thence along W. slope.  
 Ascend 107 ft. to  
 68.80 Same ridge, brs. NW. and SE. Thence along E. slope.  
 Ascend 95 ft., to  
 80.00 Set an iron post, 3 ft. long, 2 ins. in diam., 18 ins. in the ground to bed rock, supported by a mound of stone, for cor. of secs. 13, 14, 23 and 24, marked on brass cap,

T5S	R31E
S14	S13
S23	S24
1921	

and raise a mound of stone, 3 ft. base, 2 ft. high, W. of cor.

Land, S. 42.39 chs. rolling; remainder, mountainous.

Soil, rocky, 4th rate.

Timber, none.

Undergrowth, scattering greasewood, catclaw, ocotillo and scrub cedar.

Fair grass.

- East, on a random line, bet. secs. 13 and 24.  
 40.00 Set temp.  $\frac{1}{4}$  sec. cor.  
 80.10 Intersect the cor. of secs. 13, 18, 19 and 24, on the E. bdy. of the Tp., hereinbefore described.  
 Thence,  
 West, on true line, bet. secs. 13 and 24.  
 Over mountainous land, thru. scattering undergrowth.  
 Descend 74 ft., over S. and SW. slopes, to  
 17.65 Wash, 40 lks. wide, course NW.  
 Ascend 126 ft., over NE. slope.  
 34.87 Spur, slopes N.  
 Descend 12 ft., over W. slope, to  
 36.85 Top of cliff, 50 ft. high, brs. N. and S. facing W.  
 From foot of cliff, descend 105 ft., over NW. slope, to  
 40.05 Set an iron post, 3 ft. long, 1 in. in diam., 18 ins. in the ground to bed rock, supported by a mound of stone for  $\frac{1}{4}$  sec. cor., marked on brass cap.

$\frac{1}{4}$ S 13
S 24
1921

and raise a mound of stone, 2 ft. base, 1  $\frac{1}{2}$  ft. high, N. of cor.

- 41.80 Descend 50 ft., over NW. slope.  
 Wash, 60 lks. wide, course SW.  
 Ascend 195 ft., over SE. slope.  
 58.50 Spur, slopes S.  
 Descend 190 ft., over W. slope.  
 67.30 Wash, 30 lks. wide, in canyon, course S.  
 Ascend 260 ft., over E. slope, to sec. cor.  
 68.60 Wire fence, brs. N. and S.  
 80.10 The cor. of secs. 13, 14, 23 and 24.  
 Land, mountainous.  
 Soil, rocky, 4th rate.  
 Timber, none, except scattering cedar along the washes.  
 Undergrowth, scattering greasewood, catclaw, ocotillo and other cacti. Fair grass.

BOOK 3587

## Subdivision lines of Township 5 South, Range 31 East. 37.

chains.

N. 0° 1' W., bet. secs. 13 and 14.  
 Over mountainous land, thru. dense undergrowth.  
 Descend 32 ft., over E. slope.  
 4.00 Ascend 275 ft., over E. and SE. slopes.  
 13.20 Wire fence, brs. E. and W.  
 31.77 Wire fence, brs. N. 20° E. and S. 20° W.  
 33.13 Saddle in ridge, bearing E. and W.  
 Descend 85 ft., over NW. slope, to  
 40.00 Set an iron post, 3 ft. long, 1 in. in diam., on bed rock,  
 supported by a mound of stone, for  $\frac{1}{4}$  sec. cor., marked  
 on brass cap,

$$\begin{array}{c} \frac{1}{4} \\ \text{S14} | \text{S13} \end{array}$$

1921

and raise a mound of stone, 2 ft. base, 1 $\frac{1}{2}$  ft. high,  
 W. of cor.

Descend 243 ft., over NW. slope.  
 53.52 Wire fence, brs. NW. and SE.  
 64.00 Wash, 40 lks. wide, course W.  
 Ascend 72 ft., over SW. slope.  
 66.00 House at the Lop Ear Davis ranch, brs. West about 12.00  
 chs. dist.  
 69.44 Wire fence, brs. E. and W. From this point, old corral  
 brs. West 5.00 chs. dist.  
 78.90 Ridge, brs. NW. and SE.  
 Descend slightly over NE. slope, to  
 80.00 Set an iron post, 3 ft. long, 2 ins. in diam., 26 ins. in  
 the ground, for cor. of secs. 11, 12, 13 and 14, marked  
 on brass cap,

$$\begin{array}{c} \text{T5S} | \text{R31E} \\ \text{S11} | \text{S12} \\ \text{S14} | \text{S13} \end{array}$$

1921

from which,

A cedar, 12 ins. in diam., brs. N. 24° E., 140 lks.  
 dist., marked T5S R31E S12 BT.

No other trees within limits; raise a mound of stone, 3  
 ft. base, 2 ft. high, W. of cor.

Land, mountainous.

Soil, rocky, 4th rate.

Timber, none.

Undergrowth, dense greasewood, catclaw, scrub oak, oc-  
 tillo and other cacti.

Fair grass.

East, on a random line, bet. secs. 12 and 13.  
 40.00 Set temp.  $\frac{1}{4}$  sec. cor.  
 80.24 Fall 5 lks. S. of the cor. of secs. 7, 12, 13 and 18, on  
 the E. bdy. of the Tp. hereinbefore described.  
 Thence  
 S. 89° 58' W., on true line, bet. secs. 12 and 13.  
 Over mountainous land, thru. scattering undergrowth.  
 Descend 100 ft., over NW. slope.  
 11.25 Gulch, course N. 45° W. heads about 10 chs. SE.  
 Ascend 70 ft., over NE. slope.  
 21.19 Point of spur, slopes N.  
 Descend 125 ft., over broken NW. and N. slopes, to  
 40.12 Set an iron post, 3 ft. long, 1 in. in diam., 12 ins. in  
 the ground, to bed rock, supported by a mound of  
 stone for  $\frac{1}{4}$  sec. cor., marked on brass cap,

$$\begin{array}{c} \frac{1}{4} \\ \text{S 12} \\ \text{S 13} \end{array}$$

1921

## 38 Subdivision lines of Township 5 South, Range 31 East.

Chains.

and raise a mound of stone 4 ft. base, 3 ft. high, N. of cor.  
 Descend 187 ft., over broken N. slope.  
 71.79 Ascend 21 ft., over NE. slope, to  
 80.24 The cor. of secs. 11, 12, 13 and 14.  
 Land, mountainous.  
 Soil, rocky, 3rd rate.  
 Timber, none.  
 Undergrowth, scattering scrub oak, scrub mesquite, black brush, rabbit brush, ocotillo and other cacti.  
 Fair grass.

N. 0°1'W., bet. secs. 11 and 12.  
 Over mountainous land, thru. dense undergrowth.  
 Descend 8 ft., over NE. slope.  
 8.90 Descend 69 ft., over N. slope.  
 11.38 Wash, 100 lks. wide, course W.  
 28.38 Ascend 256 ft., over SW. slope.  
 Spur, slopes W.  
 40.00 Descend 135 ft., over NW. slope, to  
 Set an iron post, 3 ft. long, 1 in. in diam., on bed rock, supported by a mound of stone, for  $\frac{1}{4}$  sec. cor., marked on brass cap,

$\frac{1}{4}$   
 S11 | S12  
 1921

and raise a mound of stone, 3 ft. base, 2 ft. high, W. of cor.  
 Descend 55 ft., over NW. slope.  
 44.42 Gulch, course W.  
 Ascend 577 ft.  
 72.46 Ridge, brs. E. and W.  
 Descend 215 ft., over NW. slope, to  
 80.00 Set an iron post, 3 ft. long, 2 ins. in diam., 24 ins. in the ground, for cor. of secs. 1, 2, 11 and 12, marked on brass cap,

T5S | R31E  
 S 2 | S 1  
 S11 | S12  
 1921

and raise a mound of stone, 3 ft. base, 2 ft. high, W. of cor.  
 Land, mountainous, NW. slope.  
 41.42 Soil, rocky, 4th. rate.  
 Timber, none.  
 Undergrowth, dense greasewood, scrub oak, catclaw, ocotillo and other cacti.  
 Fair grass.

N. 89°58'E., on a random line, bet. secs. 1 and 12.  
 40.00 Set temp.  $\frac{1}{4}$  sec. cor.  
 79.92 Fall 9 lks. N. of the cor. of secs. 1, 6, 7 and 12, on the E. bdy. of the Tp., hereinbefore described.  
 Thence,  
 N. 89°58'W., on a true line, bet. secs. 1 and 12.  
 Over mountainous land, thru. scattering undergrowth.  
 Descend 30 ft., over SW. slope.  
 4.90 Head of gulch, course S.  
 Ascend 200 ft., over SE. slope.  
 28.06 Ridge, brs. N. and S., turns to West at about 5 chs. S.  
 Descend 102 ft., over W. and NW. slopes, to  
 39.96 Set an iron post, 3 ft. long, 1 in. in diam., 24 ins. in the ground, for  $\frac{1}{4}$  sec. cor., marked on brass cap,



Subdivision lines of Township 5 South, Range 31 East. 39

Chains.

$\frac{1}{4}$  S 1  
S 12  
1921

and raise a mound of stone, 4 ft. base, 3 ft. high, N. of cor.

42.40 Descend 10 ft., over NW. slope.  
Head of canyon, course N.10°W.

70.24 Ascend 170 ft., over N.E. slope.  
Spur, slopes N.10°W.

79.92 Descend 165 ft., over NW. slope, to  
The cor. of secs. 1, 2, 11 and 12.  
Land, mountainous.  
Soil, adobe, rocky, 3rd rate.  
Timber, none.  
Undergrowth, scattering catclaw, scrub mesquite, black brush, rabbit brush and cacti.  
Fair grass.

40.00 N.0°1'W., on random line; bet. secs. 1 and 2.  
Set temp.  $\frac{1}{4}$  sec. cor.

80.27 Fall 30 lks. W. of the cor. of secs. 1, 2, 35 and 36, on the N. bdy. of the Tp., hereinbefore described.  
Thence,  
S.0°12'W., on a true line, bet. secs. 1 and 2.  
Over mountainous land, thru. scattering undergrowth.  
Descend 60 ft., over SW. slope.

3.45 Wash, in bottom of canyon, course N.80°W.  
Ascend 240 ft., over N. slope.

14.32 Ridge, brs. E. and W.  
Descend 205 ft., over S. slope.

25.00 Wash, in bottom of canyon, course W.  
Ascend 101 ft., over N. slope.

35.25 Ridge, brs. E. and W.  
Descend 65 ft., over S. slope, to

40.27 Set an iron post, 3 ft. long, 1 in. in diam., 14 ins. in the ground, to bed rock, supported by a mound of stone, for  $\frac{1}{4}$  sec. cor., marked on brass cap,

$\frac{1}{4}$   
S 2 | S 1  
1921

and raise a mound of stone, 2 ft. base, 1 $\frac{1}{2}$  ft. high, W. of cor.

45.65 Descend, 30 ft., over S. slope.  
Wash, 10 lks. wide, course W.

55.50 Ascend slightly over W. slope, to  
Wash, 50 lks. wide, 8 ft. deep, course NW.  
Ascend 113 ft., over N. slope.

62.00 Spur, slopes NW.  
Ascend 187 ft., over W. and NW. slopes, to

80.27 The cor. of secs. 1, 2, 11 and 12.  
Land, mountainous.  
Soil, rocky, 4th rate.  
Timber, none.  
Undergrowth, scattering scrub oak, greasewood, catclaw, ocotillo and ironwood.  
Fair grass.

From the standard cor. of secs. 34 and 35, on the S. bdy. of the Tp. (1st. Std. Parallel S.) hereinbefore described,  
N.0°1'W., bet. secs. 34 and 35.  
Over mountainous land, thru. scattering undergrowth.

Chains.

Along top of spur, sloping S.  
 Ascend 39 ft., to  
 3.35 Junction of spur, sloping S., with spur sloping SW. Leave  
 top of spur.  
 Ascend 47 ft., over W. slope, to  
 13.32 Head of gulch, course S. 30° W.  
 Ascend 43 ft., over SE. slope.  
 17.45 Ridge, brs. N. 45° E. and S. 45° W.  
 Descend 78 ft., over NW. slope.  
 21.89 Gulch, course S. 60° W.  
 Ascend 51 ft., over SW. slope.  
 26.32 Point of spur, slopes S. 45° W.  
 Descend 58 ft., over NW. slope.  
 27.37 Two strand barb wire fence, brs. N. 80° E. and S. 80° W.  
 32.90 Wash, 20 lks. wide, in bottom of ravine, course S. 35° W.  
 Ascend 100 ft., over SE. slope, to  
 40.00 Set an iron post, 3 ft. long, 1 in. in diam., 18 ins. in  
 the ground to bed rock, supported by a mound of stone,  
 for  $\frac{1}{4}$  sec. cor., marked on brass cap,

$\frac{1}{4}$   
 S34 | S35

1921

and raise a mound of stone, 4 ft. base, 3 ft. high, W.  
 of cor.

Ascend 28 ft., over SE. slope.  
 44.47 Ridge, brs. N. 40° E. and S. 40° W.  
 Descend 217 ft., over NW. slope.  
 61.51 Center of wash, 3 chs. wide, in bottom of ravine, course S.  
 55° W. Leave scattering, and enter dense undergrowth.  
 63.00 Road brs. N. 55° E. and S. 55° W.; extends to Mrs. J. G. Smith's  
 ranch in sec. 25.  
 Ascend 227 ft. over SE. slope, to  
 80.00 Set an iron post, 3 ft. long, 2 ins. in diam., 24 ins. in  
 the ground, for cor. of secs. 26, 27, 34 and 35, marked  
 on brass cap.

T5S | R31E  
 S27 | S26

S34 | S35

1921

and raise a mound of stone, 4 ft. base, 3 ft. high, W.  
 of cor.

Land, mountainous.

Soil, rocky volcanic and sandstone formation, 2nd rate.

Timber, none.

Undergrowth, greasewood, catclaw, scrub mesquite, black  
 brush, rabbit brush and cacti, scattering in S. 61 $\frac{1}{2}$   
 chs., dense in remainder.

Fair grass.

S. 89° 50' E., on a random line, bet. secs. 26 and 35.  
 40.00 Set temp.  $\frac{1}{4}$  sec. cor.  
 79.88 Intersect N. and S. line, 23 lks. N. of the cor. of secs. 25,  
 26, 35 and 36.  
 Thence,  
 N. 89° 40' W., on a true line, bet. secs. 26 and 35.  
 Over mountainous land, thru. very scattering timber and  
 dense undergrowth, along S. slope.  
 Ascend 45 ft.  
 8.40 Descend 75 ft., to  
 39.94 Set an iron post, 3 ft. long, 1 in. in diam., 18 ins. in  
 the ground to bed rock, supported by a mound of stone,  
 for  $\frac{1}{4}$  sec. cor., marked on brass cap,

Subdivision lines of Township 5 South, Range 31 East, 41

Chains.

$\frac{1}{4}$  S 26  
S 35  
1921

and raise a mound of stone, 3 ft. base, 2 ft. high, N. of cor.  
 Continue over mountainous land, thru. very scattering timber, and dense undergrowth, along S. slope.  
 Ascend 30 ft., to  
 71.00 Ascend 80 ft., over SE. slope, to  
 79.88 The cor. of secs. 26, 27, 34 and 35.  
 Land, mountainous.  
 Soil, rocky, 4th rate.  
 Timber, very scattering cedar.  
 Undergrowth, dense greasewood, catclaw, scrub oak, ocotillo and other cacti.  
 Fair grass.

N. 0° 1' W., bet. secs. 26 and 27.  
 Over mountainous land, thru. dense undergrowth.  
 Ascend 25 ft., over SE. slope.  
 3.48 Ridge, brs. N. 40° E. and S. 40° W. Leave dense, and enter scattering undergrowth.  
 Descend 45 ft., over NW. slope.  
 11.64 Head of gulch, course S. 30° W.  
 Ascend 47 ft.  
 15.47 Spur, slopes S. 70° W. Gate in fence, brs. West 1 ch. dist.  
 Descend 202 ft., over NW. slope.  
 16.89 Two strand barb wire fence, brs. N. 40° E. and S. 40° W.  
 30.08 Wash, course W. at S. edge of bottom of canyon. Thence across rolling bottom of canyon.  
 36.68 Center of wash, 2 chs. wide, course S. 15° W. Leave bottom of canyon.  
 Ascend 75 ft., over SE. slope, to  
 39.95 Top of bank, brs. N. 15° E. and S. 15° W.  
 40.00 Set an iron post, 3 ft. long, 1 in. in diam., 18 ins. in the ground, to bed rock, supported by a mound of stone, for  $\frac{1}{4}$  sec. cor., marked on brass cap,

$\frac{1}{4}$   
S 27 | S 26  
1921

and raise a mound of stone, 4 ft. base, 3 ft. high, W. of cor.  
 Ascend slightly over broken SE. slope, to  
 43.30 Head of short gulch, course S. 30° E.  
 Ascend 115 ft., over SW. slope.  
 53.08 Ridge, brs. N. 45° E. and S. 45° W.  
 Descend 55 ft., over NW. slope.  
 57.09 Head of gulch, course W.  
 Ascend 327, over SW. slope.  
 60.00 Point of short spur, slopes S. 75° W.  
 Descend 67 ft., over NW. slope.  
 66.43 Wash, 30 lks. wide, in gulch, course S. 45° W.  
 Ascend 87 ft., over SE. slope.  
 74.13 Ridge, brs. N. 45° E. and S. 45° W. Dim road on top of ridge, brs. N. 45° E. and S. 45° W.  
 Descend 70 ft., over NW. slope.  
 79.60 Gulch, course W. from SE. heads about 3 chs. SE. joined at this point by another gulch from NE.  
 Ascend 8 ft., over S. slope, to  
 80.00 Set an iron post, 3 ft. long, 2 ins. in diam., 22 ins. in the ground, for cor. of secs. 22, 23, 26 and 27, marked on brass cap,

## 42 Subdivision lines of Township 5 South, Range 31 East.

Chains.

T5S	R31E
S22	S23
S27	S26
1921	

and raise a mound of stone, 4 ft. base, 2½ ft. high, W. of cor.

Land, mountainous.

Soil, stony, volcanic and sandstone formation; 2nd and 3rd rate.

Timber, none.

Undergrowth, greasewood, catclaw, scrub mesquite, rabbit brush and cacti; dense in S. 3½ chs., scattering elsewhere.

Fair grass.

40.00 S. 89° 40' E., on a random line, bet. secs. 23 and 26.  
Set temp. ¼ sec. cor.  
79.68 Intersect N. and S. line, 14 lks. S. of the cor. of secs. 23, 24, 25 and 26.  
Thence,  
N. 89° 46' W., on a true line, bet. secs. 23 and 26.  
Over rolling land, thru. scattering undergrowth.  
Ascend 51 ft., over NE. slope.  
20.00 Descend 220 ft., over NW. and W. slopes, to  
39.84 Set an iron post, 3 ft. long, 1 in. in diam., 6 ins. in the ground, to bed rock, supported by a mound of stone for ¼ sec. cor., marked on brass cap,

¼	S 23
	S 26
1921	

and raise a mound of stone, 3 ft. base, 2 ft. high, N. of cor.

Continue over rolling land, thru. scattering undergrowth.

52.24 Descend 128 ft., over W. slope.  
Wash, 150 lks. wide, course S. Leave rolling, and enter mountainous land.  
Ascend 85 ft., over E. slope.  
56.73 Wire fence, brs. N. and S.  
60.00 Ridge, brs. N. and S.  
Descend 40 ft., over W. slope.  
64.96 Gulch, course SW.  
Ascend 30 ft., over SE. slope.  
73.23 Low ridge, brs. NE. and SW.  
Descend 67 ft., over NW. slope.  
79.38 Short gulch, course SW.  
Ascend slightly over S. slope, to  
79.68 The cor. of secs. 22, 23, 26 and 27.  
Land, E. 53 chs. rolling; remainder, mountainous.  
Soil, rocky, 4th rate.  
Timber, none.  
Undergrowth, scattering greasewood, catclaw, ocotillo, and other cacti.  
Fair grass.

3.42 N. 0° 1' W., bet. secs. 22 and 23.  
Over mountainous land, thru. scattering undergrowth.  
Ascend 45 ft., over S. slope.  
Point of spur, slopes SW.  
8.33 Descend 65 ft., over NW. slope.  
Gulch, course S. 45° W.  
21.14 Ascend 112 ft. over SE. slope.  
Spur, slopes S. 40° W.  
Descend 98 ft., over NW. slope.  
30.06 Wash, 20 lks. wide, 4 ft. deep, course S. 35° W.

Subdivision lines of Township 5 South, Range 31 East. 43

Chains.

40.00 Ascend 78 ft., over SE. slope, to  
Set an iron post, 3 ft. long, 1 in. in diam., 24 ins. in  
the ground, for  $\frac{1}{4}$  sec. cor., marked on brass cap,

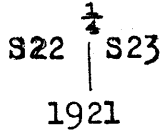

and raise a mound of stone, 3 ft. base, 2 ft. high, W.  
of cor.

54.39 Ascend 110 ft., over SE. slope.  
Spur, slopes S. 20° W.

62.74 Descend 75 ft., over NW. slope.  
Gulch, course W.

69.34 Ascend 35 ft., over SW. slope.

Point of short spur, slopes W.

70.66 Descend 18 ft., over NW. slope.

Gulch, course S. 40° W.

78.42 Ascend 46 ft., over SE. slope.

Point of short spur, slopes S. 70° W.

80.00 Descend 10 ft. over N. slope, to

Gulch, course E. Set an iron post, 3 ft. long, 2 ins.  
in diam., 24 ins. in the ground, for cor. of secs. 14, 15,  
22 and 23, marked on brass cap,

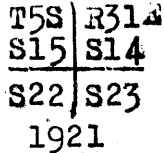

and raise a mound of stone, 4 ft. base, 3 ft. high, W.  
of cor.

Land, mountainous.

Soil, rocky, 2nd and 3rd rate.

Timber, none.

Undergrowth, scattering catclaw, greasewood, scrub mes-  
quite, buck brush, algerita, rabbit brush and cacti.

Fair grass.

40.00 S. 89° 46' E., on a random line, bet. secs. 14 and 23.  
Set temp.  $\frac{1}{4}$  sec. cor.

79.86 Intersect N. and S. line, 2 lks. S. of the cor. of secs. 13,  
14, 23 and 24.

Thence,

N. 89° 47' W., on a true line, bet. secs. 14 and 23.

Over mountainous land, thru. dense undergrowth.

13.55 Ascend 175 ft., over E. slope.

Ridge, brs. NW. and SE. A spur, slopes SW. from ridge at  
this point.

30.09 Descend 405 ft., over W. slope.

34.27 Wire fence, brs. NE. and SW.

Wash, course SW.

39.93 Ascend 23 ft., over SE. slope, to

Set an iron post, 3 ft. long, 1 in. in diam., 15 ins. in  
the ground to bed rock, supported by a mound of stone,  
for  $\frac{1}{4}$  sec. cor., marked on brass cap,

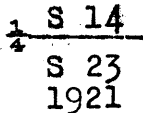

and raise a mound of stone, 3 ft. base, 2 ft. high, N.  
of cor.

49.48 Ascend 46 ft., over SE. slope, to

Thence along S. slope.

65.00 Descend 36 ft., to

BOCK 3587

## 44 Subdivision lines of Township 5 South, Range 31 East.

Chains.

65.00 Leave dense, and enter scattering undergrowth.  
Descend 143 ft., over SW. slope.

78.86 Four strand barb wire fence, brs. NW. and SE.

79.61 Wash, 10 lks. wide, course SE. from N.  
Ascend slightly over NE. slope.

79.86 The cor. of secs. 14, 15, 22 and 23.  
Land, mountainous.  
Soil, rocky, 4th rate.  
Timber, none.  
Undergrowth, greasewood, catclaw, ocotillo and other cacti,  
dense in E. 65 chs.; scattering in W. 15 chs.  
Fair grass.

N. 0° 1' W., bet. secs. 14 and 15.  
Over mountainous land, thru. scattering undergrowth.  
Ascend 75 ft., over SE. slope.

1.70 Four strand barb wire fence, brs. N. 35° W. and S. 35° E.

4.99 Bend in wash, 10 lks. wide, course S. 10° E. from N. 30° E.  
near head.

9.93 Saddle in ridge, bearing N. 25° E. and S. 25° W.  
Ascend 46 ft. along W. slope.

14.88 Ascend 379 ft., over SW. slope.

25.94 Top of ascent on W. side of rocky butte, the top of which  
brs. E. 50 lks. dist.  
Descend 336 ft., over NW. slope.

38.94 Gulch, course N. 70° W. near head.  
Ascend 50 ft., over S. slope, to

40.00 Top of shale cliff, 20 ft. high, bearing E. and W., facing  
S. Set an iron post, 3 ft. long, 1 in. in diam., on  
bed rock, supported by a mound of stone, for  $\frac{1}{4}$  sec. cor.,  
marked on brass cap,

$$\begin{array}{c} \frac{1}{4} \\ S15 | S14 \end{array}$$

1921

and raise a mound of stone, 4 ft. base, 3 ft. high, W. of  
cor.

Ascend 25 ft., over SW. slope.

41.97 Point of short spur, slopes W.  
Descend 55 ft., over NW. slope.

45.93 Gully, course N. 80° W.  
Ascend 6 ft., over SW. slope.

46.59 Point of spur, slopes W.  
Descend 50 ft., over NW. slope.

48.02 Top bar creek, course S. 45° W. in bottom of canyon. A 60  
ft. waterfall, with spring and cottonwood grove at  
foot of same, brs. NE. 2.00 chs. dist.  
Ascend 170 ft., over SE. slope.

67.57 Point of short spur, slopes E.  
Descend 12 ft., over NE. slope.

72.57 Head of gulch, course S. 35° E.  
Ascend 64 ft., over SE. slope, to

80.00 Set an iron post, 3 ft. long, 2 ins. in diam., 12 ins. in  
the ground to bed rock, supported by a mound of stone,  
for cor. of secs. 10, 11, 14 and 15, marked on brass cap,

$$\begin{array}{c} T5S | R31E \\ S10 | S11 \\ \hline S15 | S14 \end{array}$$

1921

and raise a mound of stone, 4 ft. base, 3 ft. high, W. of  
cor.

Land, mountainous.  
Soil, very rocky, 4th rate.  
Timber, none except scattering cottonwood, sycamore and

## Chains.

	oak along Lop Lar creek. Undergrowth, scattering catclaw, scrub mesquite, black brush, rabbit brush and cacti. Fair grass.
40.00	S.89° 47' E., on a random line, bet. secs.11 and 14. Set temp. $\frac{1}{4}$ sec.cor.
79.98	Intersect the cor.of secs. 11,12, 13 and 14. Thence, N.89° 47' W., on a true line, bet. secs. 11 and 14. Over mountainous land, thru. dense undergrowth. Ascend slightly over NE.slope, to Ridge, brs.NW. and SE. near NW. end of same. Descend 300 ft., over SW.slope.
1.00	Wash, course S. 15°W. in bottom of ravine, bordered by scattering timber. Leave dense, and enter scattering undergrowth. Ascend 34 ft., over SE.slope.
29.03	Spur, slopes S.20°W: Descend 65 ft., over SW.slope to $\frac{1}{4}$ sec.cor.
34.50	Four wire fence, brs.N.10°W. and S.10°E.
38.27	Set an iron post, 3 ft. long, 1 in. in diam., 12 ins. in the ground to bed rock, supported by a mound of stone for $\frac{1}{4}$ sec.cor., marked on brass cap,
39.99	
	$\frac{1}{4}$ S 11 S 14 1921
	and raise a mound of stone, 4 ft. base, 3 ft. high, N. of cor. Descend 263 ft., over SW.slope.
59.00	Trail, brs. N.80°W. and S.80°E. Extends from the Stockton Ranch in sec.10 to the Lop Lar Davis ranch in sec.14.
63.63	Gulch, course S. Ascend 62 ft., over SE.slope.
66.25	Same trail, brs.N.30°E. and S.30°W.
75.59	Point of spur, slopes S.30°W. Descend 20 ft., over SW.slope.
76.20	Same trail, brs.N.70°W. and S.70°E.
79.00	Draw, course S. from N.20°E. Ascend slightly over SE.slope, to The cor.of secs. 10,11,14 and 15.
79.98	Land, mountainous, Soil, rocky, 2nd rate. Timber, none, except scattering cottonwood and sycamore along ravine in E. half mile. Undergrowth, greasewood, rabbit brush, catclaw, scrub mesquite and cacti, dense in E. 29 chs., scattering elsewhere. Fair grass.
	N.0°1' W., bet. secs.10 and 11. Over mountainous land, thru. scattering undergrowth. Ascend 212 ft., over SE.slope.
0.40	Pack trail, brs.N.70°E. and S.70°W. Extends from the Stockton ranch in sec.10 to the Lop Lar Davis Ranch in sec.14.
8.65	Four strand barb wire fence, brs.N.20°E. and S.20°W.
19.71	Ridge, brs.N.10°E. and S.10°W. Ascend 34 ft., over W.slope, to Gulch, near head, course S.30°W.
24.07	Ascend 475 ft. over broken SW. and S.slopes, to Set an iron post, 3 ft. long, 1 in. in diam., 24 ins. in the ground, for $\frac{1}{4}$ sec.cor., marked on brass cap,
40.00	

46 Subdivision lines of Township 5 South, Range 31 East.

Chains.

$\frac{1}{4}$   
 S10 | S11  
 1921

- and raise a mound of stone, 4 ft. base, 3 ft. high, W. of cor.
- 41.42 Ascend 70 ft., over face of cliff, to Top of cliff, bearing E. and W., facing S.
- 44.45 Ascend 115 ft., to Top of cliff, 80 ft., high, bearing NW. and SE., facing SW. A gap in same brs. NW. 50 lks. dist.
- 45.40 Ascend 21 ft., over SW. slope. Top of ascent on W. side of mountain. Top of same brs. E. 1.00 ch. dist.
- 55.25 Descend 241 ft., over NW. slope. Head of gulch, course N. 5° E.
- 80.00 Descend 534 ft., over broken NE. slope, to Set an iron post, 3 ft. long, 2 ins. in diam., 24 ins. in the ground, for cor. of secs. 2, 3, 10 and 11, marked on brass cap,

T5S | R31E  
 S 3 | S 2  
 S10 | S11  
 1921

and raise a mound of stone, 4 ft. base, 3 ft. high, W. of cor.  
 Land, mountainous.  
 Soil, rocky, 3rd and 4th rate.  
 Timber, none.  
 Undergrowth, scattering catclaw, scrub mesquite, scrub oak, algerita, black brush, rabbit brush and cacti.  
 Fair grass.

- 40.00 S. 89° 47' E., on a random line, bet. secs. 2 and 11. Set temp.  $\frac{1}{4}$  sec. cor.
- 79.76 Intersect N. and S. line, 7 lks. N. of the cor. of secs. 1, 2, 11 and 12.
- Thence, N. 89° 44' W., on a true line, bet. secs. 2 and 11. Over mountainous land, thru. scattering undergrowth.
- 3.50 Descend 10 ft., over NW. slope. Gulch, course N. near head.
- 8.39 Ascend 67 ft., over E. slope. Spur, slopes N.
- 34.58 Descend 370 ft., over NW. slope. Wash, 10 lks. wide, in gulch, course N.
- 39.88 Ascend 119 ft., over E. slope, to Set an iron post, 3 ft. long, 1 in. in diam., 24 ins. in the ground, for  $\frac{1}{4}$  sec. cor., marked on brass cap,

$\frac{1}{4}$  S 2  
 S 11  
 1921

- and raise a mound of stone, 3 ft. base, 2 ft. high, N. of cor.
- 46.36 Ascend 86 ft., over E. slope. Spur, slopes N.
- 51.07 Descend 108 ft., over W. slope. Wash, 20 lks. wide in gulch, course N.
- 59.49 Ascend 192 ft., over E. slope. Spur, slopes N.
- 78.15 Descend 250 ft., over NW. slope. Wash, 15 lks. wide in gulch, course NW. from S.
- Ascend 26 ft., over NE. slope, to



## Subdivision lines of Township 5 South, Range 31 East. 47

- Chains.  
79.76 The cor. of secs. 2, 3, 10 and 11.  
Land, mountainous.  
Soil, rocky, 4th rate.  
Timber, none.  
Undergrowth, scattering greasewood, catclaw, scrub oak,  
ocotillo and other cacti.  
Fair grass.
- 
- 40.00 N. 0° 12' E., on a random line, bet. secs. 2 and 3.  
Set temp.  $\frac{1}{4}$  sec. cor.  
80.31 Fall 33 lks. E. of the cor. of secs. 2, 3, 34 and 35, on the  
N. bdy. of the Tp., hereinbefore described.  
Thence,  
S. 0° 2' E., on a true line, bet. secs. 2 and 3.  
Over gently rolling land, thru. dense undergrowth, on  
mesa.  
8.56 Descend 29 ft., over S. slope, to  
Rim of mesa, brs. NE. and SW. Leave gently rolling, and  
enter mountainous land.  
Descend 164 ft., over SE. slope.  
16.90 Bottom of canyon, course S. 45° W.  
Ascend 126 ft., over NW. slope.  
24.66 Ridge, brs. N. 55° E. and S. 55° W., near SW. end of same.  
Descend 157 ft., over SE. slope, to  
35.76 Head of gulch, course S. 30° W.  
Descend 43 ft., over SW. slope, to  
40.31 Set an iron post, 3 ft. long, 1 in. in diam., 24 ins. in  
the ground, for  $\frac{1}{4}$  sec. cor., marked on brass cap,
- $\frac{1}{4}$   
S 3 | S 2
- 1921
- and raise a mound of stone, 4 ft. base, 3 ft. high, W. of  
cor.  
43.10 Descend 33 ft., over S. slope.  
Center of wash in bottom of black Jack canyon; water in  
small holes, course S. 70° W. Good stream of water one-  
half mile up canyon, which flows a short distance, and  
then disappears in gravel.  
Leave dense and enter scattering undergrowth.  
Ascend 257 ft., over N. slope.  
55.95 Spur, slopes W. from SE.  
Descend 63 ft., over SW. slope.  
66.54 Gulch, course W.  
Ascend 46 ft., over NW. slope.  
70.48 Point of spur, slopes N. 75° W.  
Descend 162 ft., over SW. slope.
- 78.30 Wash, 15 lks. wide in gulch, course N. 35° W.  
Ascend 42 ft., over NE. slope, to  
80.31 The cor. of secs. 2, 3, 10 and 11.  
Land, N. 8 $\frac{1}{2}$  chs., gently rolling; remainder, mountainous.  
Soil, rocky, 4th rate.  
Timber, none.  
Undergrowth, scrub oak, algerita, scrub mesquite, bitter  
brush, buck brush, rabbit brush, black brush and  
cacti, dense in N. 43° chs.; scattering in remainder.  
Fair grass.
- 
- From the reestablished standard cor. of secs. 33 and  
34, on the S. bdy. of the Tp. (1st. Std. Par. S.) herein-  
before, described,  
N. 0° 2' W., bet. secs. 33 and 34.  
Over mountainous land, thru. dense undergrowth.

## 48 Subdivision lines of Township 5 South, Range 31 East.

Chains.

- 19.78 Ascend 145 ft. over SE. slope.  
Ridge brs. N.E. and SW.  
Descend 91 ft., over NW. slope.
- 24.59 Gulch, 10 lks. wide, course W.  
Ascend 85 ft., over S. slope.
- 36.52 Spur, slopes W.  
Descend 53 ft., over N. slope.
- 39.69 Gulch, 10 lks. wide, course W.  
Ascend 15 ft., over S. slope, to
- 40.00 Set an iron post, 3 ft. long, 1 in. in diam., 15 ins. in  
the ground to bed rock, supported by a mound of stone  
for  $\frac{1}{4}$  sec. cor., marked on brass cap,

$$\begin{array}{c} \frac{1}{4} \\ \hline S33 | S34 \end{array}$$

1921

and raise a mound of stone, 3 ft. base, 2 ft. high, W.  
of cor.

- 43.41 Ascend 52 ft., over S. slope.  
Spur, slopes W.  
Descend 48 ft.
- 49.75 Wash, 40 lks. wide in gulch, course W.  
Ascend 130 ft., over S. slope.
- 56.80 Ridge, brs. E. and W.  
Descend 85 ft., over N. slope.
- 61.44 Wash, 50 lks. wide in gulch, course W.  
Ascend 70 ft., over SW. slope.
- 66.54 Spur, slopes W.  
Descend 61 ft., over N. slope.
- 75.16 Wash, 20 lks. wide in gulch, course W.  
Ascend 55 ft., over S. slope.
- 79.50 Ridge, brs. E. and W.  
Descend slightly over N. slope, to
- 80.00 Set an iron post, 3 ft. long, 2 ins. in diam., 12 ins. in  
the ground to bed rock, supported by a mound of stone,  
for cor. of secs. 27, 28, 33 and 34, marked on brass  
cap,

$$\begin{array}{c} T5S | R31E \\ \hline S28 | S27 \\ \hline S33 | S34 \\ 1921 \end{array}$$

and raise a mound of stone, 3 ft. base, 2 ft. high, W.  
of cor.

Land, mountainous.  
Soil, rocky, 4th rate.  
Timber, none.  
Undergrowth, dense greasewood, catclaw, tesota, ocotillo,  
and other cacti.  
Fair grass.

- 40.00 S. 89° 56' E., on a random line, bet. secs. 27 and 34.  
Set temp.  $\frac{1}{4}$  sec. cor.
- 79.86 Intersect N. and S. line, 16 lks. S. of the cor. of secs.  
26, 27, 34 and 35.  
Thence,  
S. 89° 57' W., on a true line, bet. secs. 27 and 34.  
Over mountainous land, thru. dense undergrowth.  
Ascend 24 ft. over SE. slope.
- 8.99 Ridge, brs. N. 40° E. and S. 40° W.  
Descend 115 ft., over NW. slope.

## Subdivision lines of Township 5 South Range 31 East. 49

Chains.	
12.44	Two strand barb wire fence, brs. N. 40° E. and S. 40° W.
31.31	Draw, course N. 30° W. Ascend 12 ft., over NE. slope.
33.30	Point of spur, slopes NW. Descend 29 ft., over NW. slope, to
39.93	Set an iron post, 3 ft. long, 1 in. in diam., 24 ins. in the ground, for $\frac{1}{4}$ sec. cor., marked on brass cap,  $\frac{1}{4} \begin{array}{l} S 27 \\ S 34 \\ 1921 \end{array}$
	and raise a mound of stone, 4 ft. base, 3 ft. high, N. of cor. Descend 86 ft., over NW. slope.
49.95	Wash, 30 lks. wide, course S. 70° W. Ascend 20 ft., over SE. slope.
58.95	Descend 25 ft., along S. slope.
66.04	Ridge, brs. NE. and W. Thence over NW. and N. slopes near top of this ridge. Descend 48 ft., to
79.86	The cor. of secs. 27, 28, 33 and 34. Land, mountainous. Soil, rocky, 4th rate. Timber, none. Undergrowth, dense greasewood, catclaw, scrub mesquite, black brush, bitter brush, rabbit brush and cacti. Fair grass.
-----	
	N. 0° 2' W., bet. secs. 27 and 28. Over mountainous land, thru. dense undergrowth. Descend 120 ft., over N. slope.
10.83	Center of wash, 5 chs. wide, course W. Ascend 136 ft., over SE. slope.
27.38	Spur, slopes SW. Descend 73 ft., over NW. slope.
35.30	Wash, 100 lks. wide, course SW. Ascend 73 ft., over SE. slope.
39.16	Descend 15 ft., over NW. slope, to
40.00	Set an iron post, 3 ft. long, 1 in. in diam., 24 ins. in the ground, for $\frac{1}{4}$ sec. cor., marked on brass cap,  $s28 \begin{array}{l} \frac{1}{4} \\ s27 \\ 1921 \end{array}$
	and raise a mound of stone, 3 ft. base, 2 ft. high, W. of cor. Ascend 135 ft., over SE. slope.
51.28	Spur, slopes SW. Descend 51 ft., over NW. slope.
56.00	Ascend 12 ft., over S. slope.
60.71	Spur, slopes W. Descend 97 ft., over N. slope.
67.53	Wash, 20 lks. wide, course W. Ascend 122 ft., over S. slope.
73.00	Spur, slopes W. Descend 107 ft., over N. slope.
77.51	Wash, 10 lks. wide, course W. Ascend 60 ft., over SW. slope, to
80.00	Set an iron post, 3 ft. long, 2 ins. in diam., 20 ins. in the ground to bed rock, supported by a mound of stone for cor. of secs. 21, 22, 27 and 28, marked on brass cap,  $\begin{array}{l l} T5S & R31E \\ \hline S21 & S22 \\ \hline S28 & S27 \\ 1921 \end{array}$

## 50 Subdivision lines of Township 5 South, Range 31 East.

Chains.

Raise a mound of stone, 3 ft. base, 2 ft. high, NW. of cor.  
Steep slope to west prevents raising of mound in that  
direction.  
Land, mountainous.  
Soil, rocky, 4th rate.  
Timber, none. Undergrowth, dense greasewood, catclaw, ocotilla,  
10, and other cacti. Fair grass.

40.00 N. 89° 57' E., on a random line, bet. secs. 22 and 27.  
Set temp.  $\frac{1}{4}$  sec. cor.  
79.94 Intersect N. and S. line, 2 lks. S. of the cor. of secs. 22, 23,  
26 and 27.  
Thence,  
S. 89° 56' W., on a true line, bet. secs. 22 and 27.  
Over mountainous land, thru. scattering undergrowth.  
Descend 72 ft., over SW. slope, near bottom of gulch,  
course W.  
14.86 Gulch, course S. 35' W.  
Ascend 97 ft., over SE. slope.  
28.91 Point of spur, slopes S.  
Descend 70 ft., over SW. slope.  
32.36 Wash, 30 lks. wide, in gulch, course S. 10° E. near head.  
Ascend 85 ft., over E. slope, to  
39.97 Ridge, brs. N. and S. at this point, general bearing NE.  
and SW.  
Set an iron post, 3 ft. long, 1 in. in diam., 24 ins. in  
the ground, for  $\frac{1}{4}$  sec. cor., marked on brass cap,

$\frac{1}{4}$  S 22  
S 27  
1921

and raise a mound of stone, 4 ft. base, 3 ft. high, N. of  
cor.  
45.78 Descend 97 ft., over W. slope.  
Gulch, course S.  
Ascend 94 ft., over SE. slope.  
52.63 South end of ridge; bearing N. and S.  
Descend 68 ft., over SW. slope.  
55.98 Gulch, course S.  
Ascend 92 ft., over E. slope.  
61.09 Ridge, brs. N. and S. Leave scattering and enter dense  
undergrowth.  
69.28 Descend 160 ft., over SW. slope.  
Gulch, course S. 25° W. heads about 5 chs. NE.  
Ascend 45 ft., over SE. slope.  
73.64 Point of spur, slopes S. 50° W.  
Descend 67 ft., over SW. slope, to  
79.94 The cor. of secs. 21, 22, 27 and 28.  
Land, mountainous.  
Soil, rocky, 4th rate.  
Timber, none.  
Undergrowth, greasewood, catclaw, scrub mesquite, black  
brush, rabbit brush, and cacti, scattering in E. 61  
chs.; dense elsewhere.  
Fair grass.

0.76 N. 0° 2' W., bet. secs. 21 and 22.  
Over mountainous land, thru. dense undergrowth.  
Ascend 18 ft., over SW. slope.  
Point of spur, slopes W.  
Descend 140 ft., over NW. slope.  
11.04 Center of dry bed of Lop Bar Creek, 3 chs. wide, course  
SW. in ravine.  
Ascend 277 ft., over SE. slope, to

Subdivision lines of Township 5 South Range 31 East. 51

Chains.  
 40.00 Set an iron post, 3 ft. long, 1 in. in diam., 18 ins. in the ground to bed rock, supported by a mound of stone, for  $\frac{1}{4}$  sec. cor., marked on brass cap,

$\frac{1}{4}$   
 S21 | S22  
 1921

and raise a mound of stone, 3 ft. base, 2 ft. high, W. of cor.

51.90 Ascend 95 ft., over SE. slope.  
 Ridge, brs. NE. and SW.  
 Descend 10 ft., over NW. slope.

55.90 Head of gully, course W.  
 Ascend 30 ft., over S. slope.

60.00 Spur, slopes W. from ridge.  
 Descend 75 ft., over N. slope.

66.96 Gulch, course W.  
 Ascend 90 ft., over S. slope.

74.18 Spur, slopes SW.  
 Descend 5 ft., over NW. slope.

78.13 Head of gully, course SW.  
 Ascend 17 ft., over SE. slope, to

80.00 Set an iron post, 3 ft. long, 2 ins. in diam., 24 ins. in the ground, for cor. of secs. 15, 16, 21 and 22, marked on brass cap,

T5S | R31E  
 S16 | S15  
 S21 | S22  
 1921

and raise a mound of stone, 3 ft. base, 2 ft. high, W. of cor.

Land, mountainous.  
 Soil, rocky, 4th rate.  
 Timber, none.  
 Undergrowth, dense greasewood, catclaw, ocotillo, and other cacti.  
 Fair grass.

-----

40.00 N. 89° 56' E., on a random line, bet. secs. 15 and 22.  
 Set temp.  $\frac{1}{4}$  sec. cor.

80.06 Intersect N. and S. line, 7 lks. N. of the cor. of secs. 14, 15, 22 and 23.

Thence,  
 S. 89° 59' W., on a true line, bet. secs. 15 and 22.  
 Over mountainous land, thru. scattering undergrowth.  
 Ascend 94 ft., over E. slope;

4.77 Spur, slopes S.  
 Descend 103 ft., over W. slope.

14.65 Wash, 20 lks. wide, in gulch, course S. Heads about 10 chs. N.  
 Ascend 97 ft., over E. slope.

23.01 Ridge, brs. N. and S.  
 Descend 50 ft., over W. slope.

30.46 Draw, course S. 15° W. heads about 5 chs. N.  
 Ascend 15 ft., over SE. slope.

33.47 Spur, slopes S.  
 Descend 15 ft., over SW. slope, to

40.03 Set an iron post, 3 ft. long, 1 in. in diam., 18 ins. in the ground to bed rock, supported by a mound of stone, for  $\frac{1}{4}$  sec. cor., marked on brass cap,

$\frac{1}{4}$  S 15  
 S 22  
 1921

52 Subdivision lines of Township 5 South, Range 31 East.

Chains.

and raise a mound of stone, 4 ft. base, 3 ft. high, N. of cor.  
 Descend 116 ft., over SW. slope, to  
 46.66 Top of cliffs, 50 ft. high, bearing N. 30° E. and S. 30° W., facing W.  
 From foot of cliffs, descend 141 ft., over W. slope.  
 56.10 Dry bed of Lop Bar Creek, 40 lks. wide, in bottom of canyon, course S. 15° W. There is running water in this creek at about 30 chs. NE. Leave scattering, and enter dense undergrowth.  
 Ascend 72 ft., over SE. slope.  
 60.47 Descend 8 ft., over SW. slope.  
 62.37 Gulch, course S. 45° E.  
 Ascend 40 ft., over SE. slope, to  
 65.43 Gulch, course S. 80° E.  
 Ascend 180 ft., over NE. slope.  
 76.54 Ridge, brs. N. 40° E. and S. 30° E.  
 Descend 24 ft., over W. slope, to  
 80.06 The cor. of secs. 15, 16, 21, and 22.  
 Land, mountainous.  
 Soil, rocky, 2nd and 3rd rate.  
 Timber, none.  
 Undergrowth, greasewood, catclaw, scrub mesquite, black brush and cacti, scattering in E. 56 chs.; dense elsewhere.  
 Fair grass.

N. 0° 2' W., bet. secs. 15 and 16.  
 Over mountainous land, thru. dense undergrowth.  
 Ascend 23 ft., over SE. slope.  
 5.00 Spur, slopes SW. from E.  
 Descend 112 ft., over N. slope.  
 12.78 Wash, 10 lks. wide, in gulch, course W.  
 Ascend 95 ft., over S. slope.  
 18.86 Ridge, brs. NE. and SW.  
 Descend 130 ft., over NW. slope.  
 25.67 Wash, 20 lks. wide, in gulch, course W.  
 Ascend 85 ft. over S. slope.  
 30.50 Spur, slopes W.  
 Descend 56 ft., over N. slope.  
 33.16 Wash, 10 lks. wide in gulch, course W.  
 Ascend 90 ft., over S. slope.  
 36.87 Point of spur, slopes SW.  
 Descend 35 ft., over NW. slope, to  
 40.00 Set an iron post, 3 ft. long, 1 in. in diam., 26 ins. in the ground, for  $\frac{1}{4}$  sec. cor., marked on brass cap,

$\frac{1}{4}$   
 S16 | S15  
 1921

and raise a mound of stone, 3 ft. base, 2 ft. high, W. of cor.  
 Descend 95 ft., over NW. slope.  
 44.47 Wash, 50 lks. wide, in gulch, course SW.  
 Ascend 185 ft., over SE. slope, to  
 64.21 Saddle in ridge, brs. NE. and SW. Thence along W. slope.  
 Ascend 25 ft., to  
 70.68 Spur, slopes W.  
 Descend 55 ft., over NW. slope, to  
 80.00 Set an iron post, 3 ft. long, 2 ins. in diam., 18 ins. in the ground to bed rock, supported by a mound of stone for cor. of secs. 9, 10, 15 and 16, marked on brass cap,

T5S | R31E  
 S 9 | S10  
 S16 | S15  
 1921

Subdivision lines of Township 5 South, Range 31 East, 53.

Chains.

from which,  
 An oak, 4 ins. in diam., brs. S. 25 1/2° W., 45 lks. dist., marked BT.  
 A cedar, 6 ins. in diam., brs. N. 89 1/2° W., 313 lks. dist., marked T5S R31E S9 BT.  
 No other trees within limits; raise a mound of stone, 3 ft. base, 2 ft. high, W. of cor.  
 Land, mountainous.  
 Soil, rocky, 4th rate.  
 Timber, none.  
 Undergrowth, dense greasewood, catclaw, ocotillo and other cacti.  
 Fair grass.

40.00 N. 89° 59' E., on a random line, bet. secs. 10 and 15.  
 80.10 Set temp. 1/4 sec. cor.  
 Intersect N. and S. line, 16 lks. S. of the cor. of secs. 10, 11, 14 and 15.  
 Thence,  
 S. 89° 52' W., on a true line, bet. secs. 10 and 15.  
 Over mountainous land, thru. scattering undergrowth.  
 Ascend 5 ft., over SE. slope.  
 1.40 Pack trail, brs. N. 70° E. and S. 70° W., extends from Stockton Ranch in sec. 10 to Lop Ear Davis ranch in sec. 14.  
 3.00 Ridge, brs. N. 10° E. and S. 10° W.  
 Descend 77 ft., over NW. slope.  
 3.25 Four strand wire fence, brs. N. 20° E. and S. 20° W. Gate brs. S. 20° W., 1 ch. dist.  
 9.05 Wash, 30 lks. wide, in gulch, course S. 50° W.  
 Ascend 11 ft. over S. slope.  
 11.44 Descend 97 ft., over SW. slope.  
 22.81 Same gulch, course N. 70° W.  
 Ascend slightly over NE. slope.  
 25.83 Point of spur, slopes N.  
 Descend 35 ft., over NW. slope.  
 29.60 Same gulch, course S. 45° W.  
 Ascend 20 ft., over SE. slope.  
 30.83 Point of spur, slopes S. 30° W.  
 Descend 37 ft., over SW. slope, to  
 40.05 Set an iron post, 3 ft. long, 1 in. in diam., 24 ins. in the ground, for 1/4 sec. cor., marked on brass cap,

1/4 S 10  
 S 15  
 1921

and raise a mound of stone, 4 ft. base, 3 ft. high, N. of cor.  
 Descend 20 ft., over SW. slope.  
 41.37 Trail, brs. N. 20° W. and S. 20° E.; extends from Stockton Ranch in sec. 10 to Lop Ear Davis ranch in sec. 14.  
 41.88 Gulch, course S. 15° W. Leave scattering, and enter dense undergrowth.  
 Ascend 135 ft., over NE. slope.  
 56.94 Ridge, brs. N. and S. 60° W. At 1.00 ch. S., a short spur slopes E.  
 Descend 121 ft. over NW. slope.  
 63.91 Head of gulch, course N. 15° W.  
 Ascend 69 ft., over NE. slope, to  
 72.43 Spur, slopes N. 45° W. for about 1.00 ch., thence S. 70° W.  
 Descend slightly along SW. and S. slope, to  
 75.43 Point of same spur, slopes S. 70° W.  
 Descend 100 ft., over NW. slope to sec. cor.  
 78.85 Three strand barb wire fence, brs. N. 10° W. and S. 10° E.  
 80.10 The cor. of secs. 9, 10, 15 and 16.  
 Land, mountainous.  
 Soil, rocky, 4th rate.

## 54 Subdivision lines of Township 5 South, Range 31 East.

Chains.

Timber, none.  
Undergrowth, greasewood, catclaw, ocotillo, and other cacti; scattering in E. 42 chs.; dense elsewhere.  
Fair grass.

N. 0° 2' W., bet. secs. 9 and 10.  
Over mountainous land, thru. dense undergrowth.  
Descend 106 ft., over NW. slope.  
2.79 Wire fence, brs. NW and SE.  
9.00 Old corral, brs. W: 0.10 chs. dist.  
10.94 Wash, 50 lks. wide, course SW., containing small stream of seep water.  
Road in wash, brs. NE. to Frank Stockton's ranch, and SW.  
Ascend 185 ft., over SE. slope.  
14.50 Frank Stockton's ranch house, brs. E. about 3 chs. dist.  
16.00 Same wire fence, brs. N. 20° E. and S. 20° W.  
21.44 Point of spur, slopes E.  
Descend 42 ft., over NE. slope.  
35.00 Gulch, course E. near head.  
Ascend 40 ft., over SE. slope, to  
40.00 Set an iron post, 3 ft. long, 1 in. in diam., 26 ins. in the ground, for  $\frac{1}{4}$  sec. cor., marked on brass cap,

$\frac{1}{4}$   
S 9 | S 10  
1921

from which,

A cedar, 6 ins. in diam., brs. S. 61° E., 80 lks. dist., marked  $\frac{1}{4}$  S 10 BT.

A cedar, 10 ins. in diam., brs. S. 55° W., 198 lks. dist., marked  $\frac{1}{4}$  S 9 BT.

Ascend 105 ft., over SE. slope.  
51.85 Ridge, brs. NE. and SW.  
Descend 79 ft., over NW. slope.  
59.55 Wash, 30 lks. wide, course SW.  
Ascend 117 ft., over SE. slope.  
71.00 S. rim of mesa, brs. NE. and SW. Thence across SW. point of mesa, merging into the ridge about 5 chs. SW.  
79.00 N. rim of mesa, brs. NE. and SW.  
Descend 16 ft., over NW. slope, to  
80.00 Set an iron post, 3 ft. long, 2 ins. in diam., 26 ins. in the ground, for cor. of secs. 3, 4, 9 and 10, marked on brass cap,

T5S | R31E  
S 4 | S 3  
S 9 | S 10  
1921

and raise a mound of stone, 3 ft. base, 2 ft. high, W. of cor.

Land, mountainous.

Soil, rocky, 4th rate.

Timber, none except scattering cedar along the washes.

Undergrowth, dense greasewood, catclaw, ironwood, scrub oak, tesota, ocotillo and other cacti.

Fair grass.

N. 89° 52' E., on a random line, bet. secs. 3 and 10.  
40.00 Set temp.  $\frac{1}{4}$  sec. cor.  
80.18 Intersect N. and S. line, 2 lks. S. of the cor. of secs. 2, 3, 10 and 11.  
Thence,



Subdivision lines of Township 5 South, Range 31 East. 55

Chains.	S.89°51'W., on a true line, bet. secs.3 and 10. Over mountainous land, thru. scattering undergrowth. Ascend 12 ft., over NE. slope.
1.49	Point of spur, slopes N.20°E. Descend 17 ft., over NW. slope.
2.76	Gulch, course N.45°E. near head. Ascend 184 ft., over NE. slope.
12.89	Spur, slopes N.40°W. Leave scattering and enter dense undergrowth. Descend 350 ft., over NW. and N. slopes, to
33.12	Saddle in ridge, bearing N.70°W. and S.70°E. Head of gulch, course N., and head of another gulch, course S.40°W. Ascend 55 ft., over SE. slope, to
40.09	Set an iron post, 3 ft. long; 1 in. in diam., on bed rock, supported by a mound of stone, for 1/4 sec. cor., marked on brass cap,  <div style="text-align: center;"> <math display="block">\frac{1}{4} \begin{array}{l} S \quad 3 \\ S \quad 10 \\ 1921 \end{array}</math> </div> and raise a mound of stone, 4 ft. base, 3 ft. high, N. of cor. Ascend 130 ft., over SE. slope.
44.48	Silver City pack trail, 4 ft. wide, hrs. N.40°E., and S.40°W.
50.08	Same ridge, hrs. N.35°E. and S.35°W. Descend 58 ft., over NW. slope, to
56.00	Head of gulch, course S.45°W. Descend 110 ft., over S. slope, to
65.96	S. rim of mesa, hrs. NE. and SW. Thence across nearly level top of mesa, descending very gradually over SW. slope, to
79.30	N. rim of mesa, hrs. NE. and SW. Leave mesa. Descend 12 ft., over NW. slope, to
80.18	The cor. of secs. 3, 4, 9 and 10. Land, mountainous. Soil, rocky, 3rd rate. Timber, none. Undergrowth, catclaw, scrub oak, scrub mesquite, black brush, algerita and cacti, scattering in E. 13 chs.; dense elsewhere. Fair grass.
-----	
40.00	N. 0°2'W., on a random line, bet. secs. 3 and 4. Set temp. 1/4 sec. cor.
80.66	Fall 16 lks. W. of the cor. of secs. 3, 4, 33 and 34, on the N. bdy. of the Tp., hereinbefore described. Thence, S. 0°5'W., on a true line, bet. secs. 3 and 4. Over mountainous land, thru. dense undergrowth. Ascend 150 ft., over NW. slope. Descend 28 ft., over SW. slope.
17.35	Ascend 75 ft., over NW. slope.
20.85	Ridge, hrs. NE. and SW.
30.65	Descend 34 ft., over SE. slope.
35.65	Head of gully, course E. Ascend 57 ft., over N. slope, to
40.66	Set an iron post, 3 ft. long, 1 in. in diam., 26 ins. in the ground, for 1/4 sec. cor., marked on brass cap,  <div style="text-align: center;"> <math display="block">S \quad 4 \quad S \quad 3</math> </div> 1921

## 56 Subdivision lines of Township 5 South, Range 31 East.

Chains.

- and raise a mound of stone, 3 ft. base, 2 ft. high, W. of cor.
- 43.05 Ascend 163 ft., over N. slope, to Top of cliff, 135 ft. high, bearing E. and W. facing N. at N. edge of top of butte. Thence across top of butte.
- 44.76 Leave top of butte.
- 57.40 Descend 317 ft., over S. slope.
- 57.40 Wash, 50 lks. wide in bottom of Black Jack Canyon, course W.
- 67.15 Ascend 117 ft. over N. slope.
- 67.15 Rim of mesa, brs. E. and W. Thence across nearly level land on point of mesa.
- 71.65 Rim of mesa, brs. E. and W. Leave point of mesa.
- 78.10 Descend 56 ft., over S. slope.
- 78.10 Wash, 30 lks. wide, course SW. near head.
- 80.66 Ascend 30 ft., over NW. slope, to The cor. of secs. 3, 4, 9 and 10.
- Land, mountainous.
- Soil, rocky, 4th rate.
- Timber, none.
- Undergrowth, dense catclaw, scrub oak, scrub mesquite, black brush, algerita and cacti.
- Fair grass.

- From the reestablished standard cor. of secs. 32 and 33, on S. bdy. of Tp. (1st. Std. Par. S.) hereinbefore described,
- N. 0° 2' W., bet. secs. 32 and 33.
- Over mountainous land, thru. scattering undergrowth.
- 1.65 Descend 27 ft., over NW. slope.
- 1.65 Wash, course W.
- 5.00 Ascend 25 ft., over S. slope.
- 8.00 Descend slightly over NW. slope, to South rim of ravine, brs. E. and W.
- 12.91 Descend 63 ft., over N. slope.
- 12.91 Center of wash, 2 chs. wide in bottom of ravine, course W.
- 20.33 Ascend 65 ft., over S. slope.
- 20.33 North rim of ravine, brs. E. and W.
- 27.63 Ascend 15 ft., over rolling SW. slope, to South rim of ravine, brs. E. and W.
- 33.35 Descend 55 ft., over N. slope.
- 33.35 Wash, 40 lks. wide, in bottom of ravine, course W.
- 40.00 Ascend 48 ft., over broken SW. slope, to Set an iron post, 3 ft. long, 1 in. in diam., 18 ins. in the ground to bed rock, supported by a mound of stone, for  $\frac{1}{4}$  sec. cor., marked on brass cap.

$\frac{1}{4}$   
S32 | S33

1921

- and raise a mound of stone, 4 ft. base, 3 ft. high, W. of cor.
- 48.95 Ascend 46 ft., over broken SW. slope, to North rim of ravine, brs. E. and W.
- 51.85 Descend slightly over W. slope, to South rim of another ravine, brs. N. 75° E. and S. 75° W.
- 55.11 Descend 36 ft., over NW. slope.
- 55.11 Wash, in bottom of ravine, course S. 75° W.
- 59.23 Ascend 61 ft., over S. slope, to North rim of ravine, brs. N. 75° E. and S. 75° W. Thence over gently rolling surface of bench.
- 71.53 Ascend slightly over SW. slope, to South rim of another ravine, brs. N. 70° E. and S. 70° W. Leave bench.
- 75.05 Descend 75 ft. over NW. slope.
- 75.05 Dry bed of Lop Ear creek, 60 lks. wide, in bottom of ravine,

Subdivision lines of Township 5 South, Range 31 East. 57.

Chains.

course S.70°W. Thence across nearly level bottom of ravine.

80.00

Ascend 10 ft. to Set an iron post, 3 ft. long, 2 ins. in diam., 18 ins. in the ground to bed rock, supported by a mound of stone, for cor. of secs. 28, 29, 32 and 33, marked on brass cap,

T5S | R31E  
S29 | S28  
-----  
S32 | S33  
1921

from which,

A mesquite, 8 ins. in diam., brs. S. 12° E., 114 lks. dist., marked T5S R31E S33 BT.

A mesquite, 10 ins. in diam., brs. N. 11½° W., 145 lks. dist., marked T5S R31E S29 BT.

No other trees within limits. Raise a mound of stone, 4 ft. base, 3 ft. high, W. of cor.

Land, mountainous and rolling.

Soil, rocky, 3rd rate.

Timber, none.

Undergrowth, scattering scrub mesquite, catclaw, greasewood, rabbit brush and cacti.

Fair grass.

40.00  
80.04

S. 89° 50' E., on a random line, bet. secs. 28 and 33.

Set temp. ¼ sec. cor.

Intersect the cor. of secs. 27, 28, 33 and 34.

Thence,

N. 89° 50' W., on a true line, bet. secs. 28 and 33.

Over mountainous land, thru. dense undergrowth. Along N. slope of ridge, brs. E. and W. at about 50 lks. S. of line.

5.00

Descend 46 ft., to W. end of ridge, brs. S. 50 lks. dist.

15.00

Descend 46 ft., over NW. slope, to Leave mountainous, and enter nearly level land on bench.

40.02

Descend 40 ft., over W. slope, to Set an iron post, 3 ft. long, 1 in. in diam., 12 ins. in the ground to bed rock, supported by a mound of stone, for ¼ sec. cor., marked on brass cap,

¼ S 28  
-----  
S 33  
1921

and raise a mound of stone, 3 ft. base, 2 ft. high, N. of cor.

Continue over nearly level land on bench, thru. dense undergrowth.

67.50

Descend 28 ft., over W. slope, to South rim of ravine, brs. NE. and SW. Leave nearly level land on bench. Enter scattering undergrowth.

72.50

Descend 96 ft., over NW. slope, to Dry bed of Lop Jar Creek, 100 lks. wide, course SW. in bottom of ravine. Thence across nearly level bottom of ravine.

80.04

Ascend slightly over SE. slope, to The cor. of secs. 28, 29, 32 and 33. Land, E. 15 chs., mountainous; remainder, nearly level, with the exception of broken S. banks of ravine.

Soil, rocky, 4th rate.

Timber, none.

Undergrowth, greasewood, catclaw and cacti, dense in E. 67½ chs.; scattering elsewhere.

Fair grass.

## 58 Subdivision lines of Township 5 South, Range 31 East.

Chains.

- N.0° 2'W., bet. secs. 28 and 29.  
Over mountainous land, thru. scattering undergrowth.  
Ascend 80 ft., over SE.slope.
- 8.82 North rim of ravine, brs.N.70°E. and S.70°W. Leave ravine.  
Descend 15 ft., over NW.slope.
- 12.01 Head of gulch, course S. 45°W.  
Ascend 135 ft., over SE.slope.
- 35.60 Ridge, brs.NE and SW.  
Descend 5 ft., over NW.slope, to
- 40.00 Set an iron post, 3 ft.long, 1 in. in diam., 24 ins.in the ground, for  $\frac{1}{4}$  sec.cor., marked on brass cap,
- $$\begin{array}{c} \frac{1}{4} \\ \text{S29} \mid \text{S28} \\ \hline 1921 \end{array}$$
- and raise a mound of stone, 4 ft. base, 3 ft.high, W. of cor.
- Descend 12 ft., over NW.slope.
- 43.90 Gully, course S. 75°W. near head.  
Ascend 6 ft., over S.slope, to
- 45.00 Descend 7 ft., over NW.slope, to
- 51.00 South rim of ravine, brs.N.80°E. and S.80°W.  
Descend 55 ft., over NW.slope.
- 54.09 Wash, 20 lks.wide, course W. Thence across bottom of ravine,  
Ascend 5 ft., over SW.slope, to
- 57.86 Wash, 30 lks.wide, course S. 50°W. Leave bottom of ravine.  
Ascend 85 ft., over SW.slope, to
- 75.00 Point at SW. end of ridge, brs.E. about 3 chs.dist.  
Ascend 9 ft. over W.slope, to
- 80.00 Set an iron post, 3 ft.long, 2 ins. in diam., 24 ins.in the ground, for cor.of secs.20, 21, 28 and 29, marked on brass cap,
- $$\begin{array}{c} \text{T5S} \mid \text{R31E} \\ \text{S20} \mid \text{S21} \\ \hline \text{S29} \mid \text{S28} \\ 1921. \end{array}$$
- and raise a mound of stone, 4 ft. base, 3 ft.high, W.of cor.
- Land, rolling and mountainous.  
Soil, adobe and rocky, 2nd and 3rd rate.  
Timber, none.  
Undergrowth, scattering scrub mesquite, catclaw, greasewood black brush, rabbit brush and cacti.  
Fair grass.
- 
- S.89°50'E., on a random line, bet. secs. 21 and 28.
- 40.00 Set temp. $\frac{1}{4}$  sec.cwr.
- 80.08 Intersect N. and S. line, 9 lks.S. of the cor. of secs. 21, 22, 27 and 28.  
Thence,  
N.89°54'W., on a true line, bet. secs.21 and 28.  
Over mountainous land, thru. dense undergrowth.
- 7.49 Descend 127 ft., over steep SW. slope, to  
Gully, 10 lks.wide, course SW. near head.
- 12.46 Descend 32 ft., over SW.slope, to  
Center of dry bed of Lop Ear creek, 3 chs.wide, course SW. in bottom of ravine.
- 39.00 Ascend 140 ft., over SE.slope.  
Spur, slopes S.
- 40.04 Descend 14 ft., over W.slope, to  
Set an iron post, 3 ft. long, 1 in. in diam., 26 ins.in the ground, for  $\frac{1}{4}$  sec.cor., marked on brass cap,

Subdivision lines of Township 5 South, Range 31 East. 59

Chains.

$\frac{1}{4}$  S 21  
S 28  
1921

and raise a mound of stone, 3 ft. base, 2 ft. high, N. of cor.

- 44.38 Descend 26 ft., over W. slope.
- 49.00 Wash, 20 lks. wide, course S. near head. Ascend 66 ft., over SE. slope.
- 55.91 Ridge, brs. NE. and SW. Descend 68 ft., over NW. slope.
- 72.90 Wash, 70 lks. wide, course SW. Ascend 56 ft. over SE. slope.
- 80.08 Ridge, brs. NE. and SW. near SW. end of same. Descend 40 ft., over NW. slope, to the cor. of secs. 20, 21, 28 and 29. Land, mountainous. Soil, rocky, 4th rate. Timber, none. Undergrowth, dense greasewood and scattering catclaw, ocotillo and other cacti. Poor grass.

N. 0° 2' W., bet. secs. 20 and 21. Over mountainous land, thru. scattering undergrowth.

- 3.25 Descend 35 ft., over NW. slope. Wash, 20 lks. wide, in gulch, course S. 30° W.
- 14.73 Ascend 82 ft., over SE. slope. Low saddle in spur, sloping W.
- 19.70 Descend 35 ft. over NW. slope. Wash, 20 lks. wide, in gulch, course S. 55° W.
- 29.56 Ascend 103 ft. over SE. slope. Long spur, slopes S. 45° W.
- 34.31 Descend 40 ft., over NW. slope. Gulch, course S. 65° W.
- 40.00 Ascend 76 ft., over SE. slope, to Set an iron post, 3 ft. long, 1 in. in diam., 24 ins. in the ground, for  $\frac{1}{4}$  sec. cor., marked on brass cap,

$\frac{1}{4}$   
S20 | S21  
1921

and raise a mound of stone, 4 ft. base, 3 ft. high, W. of cor.

- 41.00 Ascend slightly over SE. slope, to Long spur, slopes S. 45° W.
- 50.91 Descend 86 ft., over NW. slope. Wash, 20 lks. wide, in gulch, course S. 45° W.
- 58.30 Ascend 74 ft., over SE. slope. Long spur, slopes S. 45° W.
- 70.52 Descend 73 ft., over NW. slope. Auto road, brs. N. 45° E. and S. 45° W.
- 73.22 Center of wash, 5 chs. wide, course S. 45° W.
- 80.00 Ascend 20 ft., over SE. slope, to Set an iron post, 3 ft. long, 2 ins. in diam., 24 ins. in the ground, for cor. of secs. 16, 17, 20 and 21, marked on brass cap,

T5S | R31E  
S17 | S16  
S20 | S21  
1921

and raise a mound of stone, 4 ft. base, 3 ft. high, W. of cor.

## 60 Subdivision lines of Township 5 South, Range 31 East.

Chains.

Land, mountainous.  
Soil, rocky, 3rd rate.  
Timber, none.  
Undergrowth, scattering greasewood, scrub mesquite, cat-  
claw, rabbit brush and cacti.  
Fair grass.

-----

40.00 S. 89° 54' E., on a random line, bet. secs. 16 and 21.  
Set temp.  $\frac{1}{4}$  sec. cor.  
79.96 Intersect N. and S. line, 2 lks. N. of the cor. of secs. 15,  
16, 21 and 22.  
Thence,  
N. 89° 53' W., on a true line, bet. secs. 16 and 21.  
Over mountainous land, thru. dense undergrowth.  
Ascend 5 ft., over SE. slope.  
3.00 Spur, slopes SW.  
8.00 Descend 57 ft., over NW. slope.  
Wash, 5 lks. wide, in gulch, course SW.  
Ascend 30 ft., over SE. slope.  
20.00 Ridge, brs. NE. and W. Thence along top of ridge.  
Descend 114 ft., to  
39.98 Set an iron post, 3 ft. long, 1 in. in diam., 18 ins. in  
the ground to bed rock, supported by a mound of stone,  
for  $\frac{1}{4}$  sec. cor., marked on brass cap,

$\frac{1}{4}$  S 16  
S 21  
1921

and raise a mound of stone, 3 ft. base, 2 ft. high, N.  
of cor.  
Continue along top of ridge, bearing E. and W.  
Ascend 24 ft.  
50.00 Descend 46 ft. to  
60.00 Leave top of ridge, brs. E. and SW.  
Descend 117 ft., over NW. slope.  
69.70 Auto road, brs. NE. to the Frank Stockton ranch, and SW.  
73.09 Center of wash, 3 chs. wide, course SW.  
Ascend 10 ft., over SE. slope, to  
79.96 The cor. of secs. 16, 17, 20 and 21.  
Land, mountainous. Soil, rocky, 4th rate.  
Timber, none.  
Undergrowth, dense greasewood and scattering scrub mes-  
quite, catclaw, rabbit brush and cacti.  
Fair grass.

-----

14.05 N. 0° 2' W., bet. secs. 16 and 17.  
Over mountainous land, thru. dense undergrowth.  
Ascend 120 ft., over SE. slope.  
19.05 Descend 12 ft., over NE. slope.  
Head of gulch, course S. 45° E.  
Ascend 133 ft., over S. slope.  
29.08 Ridge, brs. N. 45° E. and S. 45° W.  
Descend 85 ft., over NW. slope.  
36.97 Gulch, course S. 345° W., heads about 10 chs. NE.  
Ascend 52 ft., over S. slope, to  
40.00 Set an iron post, 3 ft. long, 1 in. in diam., 24 ins. in  
the ground, for  $\frac{1}{4}$  sec. cor., marked on brass cap,

$\frac{1}{4}$   
S17 | S16  
1921

and raise a mound of stone, 4 ft. base, 3 ft. high, W.  
of cor.

## Chains.

- 44.23 Ascend 38 ft., over S. slope.  
Long spur, slopes S. 45° W.  
Descend 83 ft., over NW. slope.
- 52.45 Gulch, course S. 45° W.  
Ascend 85 ft., over SE. slope.
- 58.34 Spur, slopes S. 55° W.  
Descend 126 ft., over NW. slope.
- 67.29 Wash, 30 lks. wide, in gulch, course S. 40° W.  
Ascend 140 ft., over SE. slope.
- 78.27 Spur, slopes S. 45° W.  
Descend 15 ft., over NW. slope, to
- 80.00 Set an iron post, 3 ft. long, 2 ins. in diam., 24 ins. in the ground, for cor. of secs. 8, 9, 16 and 17, marked on brass cap,

T5S	R31E
S 8	S 9
S17	S16

1921

and raise a mound of stone, 4 ft. base, 3 ft. high, W. of cor.

Land, mountainous.

Soil, rocky, 4th rate.

Timber, none.

Undergrowth, dense greasewood and scattering catclaw, rabbit brush and cacti.

Fair grass.

- 40.00 S. 89° 53' E., on a random line, bet. secs. 9 and 16.  
Set temp.  $\frac{1}{4}$  sec. cor.
- 79.94 Intersect the cor. of secs. 9, 10, 15 and 16.  
Thence  
N. 89° 53' W., on a true line, bet. secs. 9 and 16.  
Over mountainous land, thru. dense undergrowth.
- 10.66 Descend 153 ft., over NW. slope.  
Wash, 40 lks. wide, course SW. Road brs. NE. and SW. Extends to Frank Stockton's ranch in sec. 10.
- 18.30 Ascend 175 ft., over E. slope.  
Spur, slopes S.
- 23.06 Descend 72 ft., over W. slope.  
Gulch, course S.
- 39.97 Ascend 145 ft., over E. slope, to  
Set an iron post, 3 ft. long, 1 in. in diam., 26 ins. in the ground, for  $\frac{1}{4}$  sec. cor., marked on brass cap,

$\frac{1}{4}$	S 9
	S 16

1921

and raise a mound of stone, 3 ft. base, 2 ft. high, N. of cor.

- 40.00 Ridge, brs. N. and SW.  
Descend 210 ft., over NW. slope.
- 57.15 Wash, 70 lks. wide, in gulch, course SW.  
Ascend 147 ft., over SE. slope.
- 75.08 Spur, slopes SW.  
Descend 72 ft., over NW. slope, to
- 79.94 The cor. of secs. 8, 9, 16 and 17.  
Land, mountainous.  
Soil, rocky, 4th rate.  
Timber, none.  
Undergrowth, dense greasewood and scattering catclaw, teosota, ocotillo and other cacti.  
Fair grass.

Chains.	
	N. 0° 2' W., bet. secs. 8 and 9. Over mountainous land, thru. dense undergrowth. Descend 50 ft., over NW. slope.
4.33	Gulch, course S. 35° W. Ascend 102 ft., over SE. slope.
12.93	Monument on butte, brs. N. 34° 20' E.
14.57	Ridge, brs. N. 45° E. and S. 45° W. Three strand barb wire fence, brs. S. 45° W. and N. 15° E. Desc. 97 ft. over NW. slope.
20.16	Wash, course S. 40° W. from N. 10° E.; joined at this point by another wash from N. 80° E. Ascend 50 ft., over SE. slope, to
31.02	Same wash, course S. 30° E. near head. Ascend 130 ft., over SE. slope, to
40.00	Set an iron post, 3 ft. long, 1 in. in diam., 8 ins. in the ground to bed rock, supported by a mound of stone, for $\frac{1}{4}$ sec. cor., marked on brass cap,  <div style="text-align: center;"> <math display="block">\begin{array}{c} \frac{1}{4} \\ \text{S } 8 \frac{1}{4} \text{ S } 9 \\ \hline 1921 \end{array}</math> </div>
	and raise a mound of stone, 4 ft. base, 3 ft. high, W. of cor.
44.58	Ascend 25 ft., over SE. slope. Saddle in ridge, brs. N. 75° E. and S. 70° W. Monument on butte brs. S. 84° 50' E. Descend 290 ft. over N. slope.
56.67	Three strand barb wire fence, brs. N. 70° W. and S. 45° E.
61.59	Center of wash, 100 lks. wide, in bottom of Black Jack canyon, course W. near mouth of same. Trail, brs. E. and W. Ascend 233 ft., over steep broken S. slope to top of cliffs.
63.96	Corrals and spring in bottom of Fulcher Canyon, bear west about 20' chs. dist.
71.56	Top of broken cliffs, bearing E. and W. facing S. Ascend 103 ft., over S. slope.
77.07	Ridge, brs. NE. and SW., bear SW. end of same. Descend 40 ft., over NW. slope, to
80.00	Set an iron post, 3 ft. long, 2 ins. in diam., 18 ins. in the ground, to bed rock, supported by a mound of stone for cor. of secs. 4, 5, 8 and 9, marked on brass cap,  <div style="text-align: center;"> <math display="block">\begin{array}{c} \text{T5S} \mid \text{R31E} \\ \text{S } 5 \mid \text{S } 4 \\ \hline \text{S } 8 \mid \text{S } 9 \\ \hline 1921 \end{array}</math> </div>
	and raise a mound of stone, 4 ft. base, 3 ft. high, W. of cor.
	Land, mountainous. Soil, rocky, 4th rate. Timber, none. Undergrowth, dense greasewood and scattering scrub mesquite, catclaw, black brush, rabbit brush and cacti. Fair grass.
40.00	S. 89° 53' E., on a random line, bet. secs. 4 and 9. Set temp. $\frac{1}{4}$ sec. cor.
79.94	Intersect the cor. of secs. 3, 4, 9 and 10. Thence, N. 89° 53' W., on a true line, bet. secs. 4 and 9. Over mountainous land, thru. dense undergrowth. Descend 82 ft., over NW. slope.
5.16	Wash, 20 lks. wide, course SW. Ascend 67 ft., over SE. slope.



## Chains.

- 12.34 Point of spur, slopes SW.  
Descend 292 ft., over W. slope.
- 22.70 Wash, 70 lks. wide, course S. 20°W. in bottom of Black Jack canyon.
- 39.97 Ascend 194 ft., over SE. slope, to  
Set an iron post, 3 ft. long, 1 in. in diam., on bed rock, supported by a mound of stone, for  $\frac{1}{4}$  sec. cor., marked on brass cap,
- $$\begin{array}{r} \frac{1}{4} \text{ S } 4 \\ \text{S } 9 \\ 1921 \end{array}$$
- and raise a mound of stone, 3 ft. base, 2 ft. high, N. of cor.
- 42.65 Ascend 38 ft., over SE. slope, to  
Spur, slopes S. and top of cliff, 60 ft. high, bearing NW. and SE. facing W.
- 47.50 Descend 102 ft. to  
Gulch, course S.
- 77.14 Ascend 225 ft., over SE. slope.  
Ridge, brs. NE. and SW.
- 79.94 Descend 65 ft., over NW. slope, to  
The cor. of secs. 4, 5, 8 and 9.  
Land, mountainous.  
Soil, rocky, 4th rate.  
Timber, none, except scattering cedar along Black Jack canyon.  
Undergrowth, dense greasewood, scrub oak, catclaw, ocotillo and other cacti.  
Fair grass.

- 40.00 N. 0°5' E., on a random line, bet. secs. 4 and 5.  
Set temp.  $\frac{1}{4}$  sec. cor.
- 80.77 Fall 49 lks. E. of the cor. of secs. 4, 5, 32 and 33, on the N. bdy. of Tp., hereinbefore described.  
Thence,  
S. 0°16' E., on a true line, bet. secs. 4 and 5.  
Over mountainous land, thru. dense undergrowth.
- 18.86 Ascend 190 ft., over NW. slope.  
Ridge, brs. NE. and SW.
- 33.60 Descend 215 ft., over SE. slope, to  
Gulch, course E. near head.
- 35.75 Ascend 5 ft., over NE. slope.  
Descend 40 ft., over SE. slope, to
- 40.77 Set an iron post, 3 ft. long, 1 in. in diam., 18 ins. in the ground to bed rock, supported by a mound of stone, for  $\frac{1}{4}$  sec. cor., marked on brass cap,

$$\begin{array}{r} \frac{1}{4} \\ \text{S } 5 \text{ S } 4 \\ 1921 \end{array}$$

- and raise a mound of stone, 5 ft. base, 3 ft. high, W. of cor.
- 46.45 Descend 74 ft., over SE. slope, to  
Gulch, course S. 50°E.
- 55.20 Descend 80 ft. over SE. slope, to  
Center of wash, 240 lks. wide, in bottom of Fulcher canyon, course S. 45°W.
- 62.40 Ascend 165 ft., over NW. slope, to  
Top of broken cliffs, 30 ft. high, bearing N. 45°E., and S. 45°W. facing NW.
- 64.97 Ascend 10 ft., over NW. slope, to  
Point of spur, slopes S. 45°W.  
Descend 132 ft., over S. slope, to

BCCK 3587

64 Subdivision lines of Township 5 South, Range 31 East.

Chains.

71.15 Cold Creek wash in bottom of Rustler's canyon, course S. 85°W.

80.77 Ascend 176 ft., over NW. slope, to The cor. of secs. 4, 5, 8 and 9. Land, mountainous. Soil, rocky, 4th rate. No timber, except scattering cottonwood and sycamore along canyons. Undergrowth, dense scrub mesquite, catclaw, scrub oak, scrub cedar, rabbit brush, black brush and cacti. Fair grass.

From the reestablished standard cor. of secs. 31, and 32, on S. bdy. of Tp. (1st. Std. Par. S.), hereinbefore described,

5.00 N. 0°31'W., bet. secs. 31 and 32. Over rolling land, thru. scattering undergrowth. Descend slightly over W. slope, to Center of wash, 5.00 chs. wide, course SW. Ascend 105 ft., over SE. slope.

16.88 Spur, slopes SW. Descend 65 ft., over N. slope.

19.61 Wash, 20 lks. wide, course W. near head. Ascend 127 ft., over S. slope, to

40.00 Set an iron post, 3 ft. long, 1 in. in diam., 26 ins. in the ground, for 1/4 sec. cor., marked on brass cap,

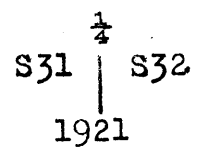

and raise a mound of stone, 3 ft. base, 2 ft. high, W. of cor.

42.50 Ascend 28 ft., over S. slope, to Rim of mesa, brs. E. and W. Thence over nearly level top of mesa. Ascend 20 ft., to

57.45 Rim of mesa, brs. NE. and SW. Leave nearly level top of mesa. Descend 62 ft., over rolling and broken NW. slope, to

69.40 Thence along W. slope. Descend 46 ft. to

76.00 Bend in wash, course SW. from NW. Ascend 9 ft., over W. slope, to

80.00 Set an iron post, 3 ft. long, 2 ins. in diam., 26 ins. in the ground, for cor. of secs. 29, 30, 31 and 32, marked on brass cap,

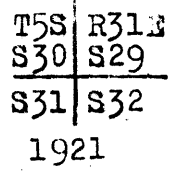

and raise a mound of stone, 3 ft. base, 2 ft. high, W. of cor.

Land, rolling, broken and nearly level. Soil, rocky, 3rd and 4th rate. Timber, none. Undergrowth, scattering greasewood, catclaw, scrub mesquite and cacti. Fair grass.

40.00 East, on a random line, bet. secs. 29 and 32. Set temp. 1/4 sec. cor. to

79.88 Intersect N. and S. line, 2 lks. N. of the cor. of secs. 28, 29, 32 and 33. Thence,

## Subdivision lines of Township 5 South, Range 31 East. 65

Chains.	N. 89° 59' W., on a true line, bet. secs. 29 and 32. Over mountainous land, thru. scattering undergrowth. Ascend 65 ft., over SE. slope.
10.92	North rim of ravine, brs. N. 70° E. and S. 70° W. Leave mountainous and enter rolling and broken land. Descend 17 ft., over SW. slope.
19.62	Wash, 30 lks. wide, course S. 45° W. Ascend 50 ft., over SE. slope.
30.88	Spur, slopes SW. Descend 28 ft., over W. slope.
37.15	Gully, course S. 45° W. Ascend 20 ft., over SE. slope, to
39.94	Set an iron post 3 ft. long, 1 in. in diam., 24 ins. in the ground, for $\frac{1}{4}$ sec. cor., marked on brass cap,  $\frac{1}{4} \begin{array}{l} S 29 \\ S 32 \\ 1921 \end{array}$ and raise a mound of stone, 4 ft. base, 3 ft. high, N. of cor. Ascend 35 ft., over SE. slope.
44.97	Rim of mesa, brs. N. 45° E. and S. 45° W. Thence, over nearly level top of mesa. Descend 20 ft., to
69.96	Rim of mesa, brs. N. and S. Leave nearly level top of mesa. Descend 95 ft., over W. slope, to
79.88	The cor. of secs. 29, 30, 31 and 32. Land, E. 11 chs. mountainous; remainder, rolling, broken and nearly level. Soil, adobe, rocky, 3rd rate. Timber, none. Undergrowth, scattering greasewood, catclaw, scrub mesquite, rabbit brush and cacti. Fair grass.
49.00	N. 89° 50' W., on a random line, bet. secs. 30 and 31. Set temp. $\frac{1}{4}$ sec. cor.
79.63	Intersect the reestablished cor. of secs. 30 and 31, on the W. bdy. of the Tp., hereinbefore described, Thence, S. 89° 50' E., on a true line, bet. secs. 30 and 31. Over level land, thru. dense undergrowth, on mesa.
12.70	Old road, brs. NE and SW.
13.65	Rim of mesa, brs. N. and S. Leave level top of mesa. Descend 70 ft., over E. slope.
16.55	Center of wash, 100 lks. wide, course S. Ascend 80 ft., over W. slope, to
22.65	Rim of mesa, brs. N. and S. Thence over nearly level top of mesa. Ascend 19 ft., over S. slope, to
29.65	Rim of mesa, brs. N. and S. Leave nearly level top of mesa. Descend 87 ft. over E. slope.
37.45	Wash, 10 lks. wide in bottom of ravine, course S. Ascend 18 ft., over W. slope, to
39.63	Set an iron post, 3 ft. long, 1 in. in diam., 26 ins. in the ground, for $\frac{1}{4}$ sec. cor., marked on brass cap,  $\frac{1}{4} \begin{array}{l} S 30 \\ S 31 \\ 1921 \end{array}$ and raise a mound of stone, 3 ft. base, 2 ft. high, N. of cor. Ascend 109 ft., over W. slope, to
47.13	Rim of mesa, brs. N. and S. Thence across gently rolling top of mesa. Descend 33 ft., over S. slope, to

66 Subdivision lines of Township 5 South Range 31 East.

Chains.  
 69.63 Rim of mesa, hrs.N. and S. Leave gently rolling land on top of mesa.  
 Descend 93 ft., over E. slope.  
 77.75 Center of wash, 100 lks. wide, in ravine, course S.  
 Ascend 12 ft., over W. slope, to  
 79.63 The cor. of secs. 29, 30, 31 and 32.  
 Land level, nearly level, rolling, broken and gently rolling.  
 Soil, rocky, 4th rate.  
 Timber, none.  
 Undergrowth, dense greasewood and scattering catclaw, ocotillo and other cacti.  
 Fair grass.

-----  
 N. 0° 3' W., bet. secs. 29 and 30.  
 Over rolling land, thru. dense undergrowth.  
 Descend 6 ft., over NW. slope.  
 4.20 Center of wash, 2 chs. wide, course SW.  
 Ascend 15 ft., over E. slope, to  
 6.90 Enter same wash, course SE. from N.  
 Ascend 10 ft., in bottom of this wash, to  
 13.20 Leave wash, course S. from NE.  
 Ascend 104 ft., over SE. slope, to  
 22.00 Rim of mesa, hrs. NE. and SW. Thence over gently rolling top of mesa.  
 Ascend 28 ft., over SW. slope, to  
 40.00 Set an iron post, 3 ft. long, 1 in. in diam., 26 ins. in the ground, for  $\frac{1}{4}$  sec. cor., marked on brass cap,

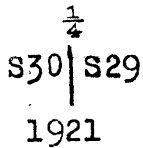

and raise a mound of stone, 3 ft. base, 2 ft. high, W. of cor.  
 Continue over gently rolling top of mesa.  
 Ascend 25 ft., over SW. slope, to  
 50.00 Rim of mesa, hrs. NE. and SW. Leave gently rolling top of mesa.  
 Descend 55 ft., over NW. slope, to  
 57.94 Center of wash, 100 lks. wide, course SW.  
 Ascend 51 ft., over S. slope.  
 64.62 Rim of mesa, hrs. NE. and SW. Thence over gently rolling land on mesa.  
 Ascend 59 ft. over SW. slope, to  
 80.00 Set an iron post, 3 ft. long, 2 ins. in diam., 26 ins. in the ground, for cor. of secs. 19, 20, 29 and 30, marked on brass cap,

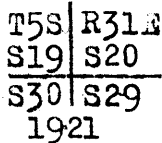

and raise a mound of stone, 3 ft. base, 2 ft. high, W. of cor.  
 Land, rolling.  
 Soil, rocky, 4th rate.  
 Timber, none.  
 Undergrowth, dense greasewood, scattering sagebrush, catclaw, ocotillo and other cacti.  
 Fair grass.

-----  
 40.00 Set an iron post on a ready line, bet. secs. 29 and 30.  
 40.00 Set top of sec. cor.

subdivision lines of Township 5 South, Range 31 East.

Chains.

40.00 S. 89° 59' E., on a random line, bet. secs. 20 and 29.  
 Set temp.  $\frac{1}{4}$  sec. cor.  
 80.00 Intersect N. and S. line, 9 lks. N. of the cor. of secs. 20,  
 21, 28 and 29.  
 Thence,  
 N. 89° 55' W., on a true line, bet. secs. 20 and 29.  
 Over rolling land, thru. scattering undergrowth.  
 Descend 46 ft., over W. slope.  
 4.95 Wash, 20 lks. wide, in gulch, course S. 30° W.  
 Ascend 30 ft., over SE. slope.  
 9.95 Descend 32 ft., over SW. slope.  
 19.92 Draw, course S.  
 Ascend 55 ft., over SE. slope.  
 26.38 Spur, slopes S. 45° W.  
 Descend 53 ft. over W. slope.  
 32.32 Wash, 20 lks. wide in ravine, course S. 45° W.  
 Ascend 34 ft., over SE. slope, to  
 40.00 Long spur, slopes S. 45° W. Set an iron post, 3 ft. long,  
 1 in. in diam., 24 ins. in the ground, for  $\frac{1}{4}$  sec. cor.,  
 marked on brass cap,

$\frac{1}{4}$  S 20  
 S 29  
 1921

and raise a mound of stone, 4 ft. base, 3 ft. high, N.  
 of cor.  
 Descend 40 ft., over W. slope, to  
 53.19 Wash, 20 lks. wide, course S. 45° W.  
 Descend 32 ft., over SW. slope, to  
 66.57 Center of wash, 100 lks. wide, in ravine, course S. 10° W.  
 Ascend 37 ft., over SE. slope, to  
 72.96 Rim of mesa, brs. NE. and SW. Thence over gently rolling  
 land on mesa.  
 Ascend slightly over S. slope, to  
 80.00 The cor. to secs. 19, 20, 29 and 30.  
 Land, rolling.  
 Soil, rocky, 4th rate.  
 Timber, none.  
 Undergrowth, scattering greasewood, scrub mesquite, cat-  
 claw, rabbit brush and cacti.  
 Fair grass.

-----  
 40.00 N. 89° 50' W., on a random line, bet. secs. 19 and 30.  
 Set temp.  $\frac{1}{4}$  sec. cor.  
 79.60 Fall 2 lks. N. of the reestablished cor. of secs. 19 and  
 30, on the W. bdy. of the Tp., hereinbefore described.  
 Thence,  
 S. 89° 51' E., on a true line, bet. secs. 19 and 30.  
 Over broken land, thru. dense undergrowth.  
 Ascend 11 ft., over W. slope.  
 1.00 Rim of mesa, brs. N. 55° W. and S. 80° W. Thence across level  
 mesa.  
 8.70 Rim of mesa and canyon, brs. NE. and SW. Leave level top  
 of mesa.  
 Descend 61 ft., over SE. slope, to  
 9.86 North or right edge of Cold Creek wash, brs. E. and SW.  
 Enter said wash, course SW. from E.  
 Ascend 20 ft., along N. side of said wash to  
 30.70 North edge of bottom of wash and canyon, brs. NE. and W.  
 Thence across Cold Creek wash, course W. from NE. and  
 across bottom of canyon.  
 Ascend 10 ft., to  
 35.80 South or left edge of bottom of canyon, brs. NE. and SW.  
 Ascend 85 ft., over NW. slope, to  
 39.43 Rim of mesa and canyon, brs. NE. and SW. Leave canyon,  
 and enter level top of mesa.  
 39.60 Set an iron post, 3 ft. long, 1 in. in diam., 26 ins. in  
 the ground, for  $\frac{1}{4}$  sec. cor., marked on brass cap,

BOOK 3587

## 68 Subdivision lines of Township 5 South, Range 31 East.

Chains.

$$\frac{1}{4} \begin{array}{c} S 19 \\ S 30 \\ 1921 \end{array}$$

- and raise a mound of stone, 3 ft. base, 2 ft. high, N. of cor,  
Continue over level mesa,  
60.00 Surface of mesa becomes gently rolling.  
Ascend 64 ft., over SW. slope, to sec. cor.  
76.70 Road brs. NE. and SW. Extends to the Frank Stockton ranch in sec. 10.  
79.60 The cor. of secs. 19, 20, 29 and 30.  
Land, level, broken and rolling.  
Soil, rocky, 4th rate.  
Timber, none.  
Undergrowth, dense greasewood and scattering catclaw, scrub mesquite, ocotillo and cacti.  
Fair grass.

- N. 0° 3' W., bet. secs. 19 and 20.  
Over gently rolling land, thru. dense undergrowth, on mesa.  
Descend 22 ft., over W. slope.  
2.20 Road brs. NE. and SW. Extends to the Frank Stockton ranch in sec. 10.  
11.90 Wash, 10 lks. wide, course SW. Leave mesa.  
Ascend 60 ft., over S. slope.  
25.00 Ridge brs. NE. and SW. near SW. end of same.  
Descend 60 ft., over NW. slope.  
37.88 Wash, 20 lks. wide in gulch, course W. Leave rolling, and enter mountainous land.  
Ascend 15 ft., over S. slope, to  
40.00 Set an iron post, 3 ft. long, 1 in. in diam., 12 ins. in the ground to bed rock, supported by a mound of stone, for  $\frac{1}{4}$  sec. cor., marked on brass cap,

$$\frac{1}{4} \begin{array}{c} S19 | S20 \\ 1921 \end{array}$$

- and raise a mound of stone, 3 ft. base, 2 ft. high, W. of cor.  
Continue over mountainous land, thru. dense undergrowth.  
Ascend 84 ft., over S. slope.  
48.51 Spur, slopes SW.  
Descend 11 ft., over NW. slope, to  
53.20 Thence over W. slope.  
Ascend 50 ft., to  
75.50 Descend 85 ft., over NW. slope, to  
80.00 Set an iron post, 3 ft. long, 2 ins. in diam., 18 ins. in the ground to bed rock, and supported by a mound of stone, for cor. of secs. 17, 18, 19 and 20, marked on brass cap,

$$\begin{array}{c} T5S | R31E \\ S18 | S17 \\ S19 | S20 \\ 1921 \end{array}$$

from which,  
A cedar, 6 ins. in diam., brs. S. 73° W., 137 lks. dist., marked T5S R31E S19 BT.  
No other trees available; therefore, raise a mound of stone, 3 ft. base, 2 ft. high, W. of cor.  
Land, S. 38 chs., rolling; remainder, mountainous.  
Soil, rocky, 4th rate.  
Timber, none.  
Undergrowth, dense greasewood and scattering catclaw,

## Subdivision lines of Township 5 South, Range 31 East.

69

Chains.

scrub mesquite, scrub cedar and cacti.  
Fair grass.

- 40;00 S. 89° 55' E., on a random line, bet. secs. 17 and 20.  
Set temp.  $\frac{1}{4}$  sec. cor.  
80.10 Intersect N. and S. line, 2 lks. S. of the cor. of secs. 16,  
17, 20 and 21.  
Thence,  
N. 89° 56' W., on a true line, bet. secs. 17 and 20.  
Over mountainous land, thru. dense undergrowth.  
Ascend 93 ft., over SE. slope, to  
12.09 Head of gully, course S. 45° E.  
Ascend 55 ft., over SE. slope, to  
18.53 Ridge, brs. NE. and SW. near SW. end of same.  
Descend 167 ft., over NW. slope.  
34.30 Center of wash, 4 chs. wide, in bottom of ravine, course  
S. 40° W.  
Ascend 12 ft., over E. slope, to  
40.05 Set an iron post, 3 ft. long, 1 in. in diam., 24 ins. in  
the ground, for  $\frac{1}{4}$  sec. cor., marked on brass cap,

$\frac{1}{4}$  S 17  
S. 20  
1921

and raise a mound of stone, 4 ft. base, 3 ft. high, N.  
of cor.

- 52.07 Ascend 95 ft., over E. slope.  
Ridge, brs. N. and S.  
80.10 Descend 210 ft. over W. and NW. slopes, to  
The cor. of secs. 17, 18, 19 and 20.  
Land, mountainous.  
Soil, rocky, 4th rate.  
Timber, none.  
Undergrowth, dense greasewood and scattering catclaw,  
scrub mesquite, rabbit brush and cacti.  
Fair grass.

- 40.00 N. 89° 51' W., on a random line, bet. secs. 18 and 19.  
Set temp.  $\frac{1}{4}$  sec. cor.  
79.72 Intersect the reestablished cor. of secs. 18 and 19, on  
the W. bdy. of the Tp., hereinbefore described,  
Thence,  
S. 89° 51' E., on a true line, bet. secs. 18 and 19.  
Over rolling land, thru. dense undergrowth.  
Descend slightly over SE. slope,  
0.60 Wash, 10 lks. wide, course S.  
Ascend 5 ft., over SW. slope.  
2.30 Point of spur, slopes S.  
Descend 10 ft., over SE. slope.  
4.10 Wash, 80 lks. wide, course SW.  
Ascend 32 ft., over NW. slope.  
21.95 Road brs. NE. to Fulcher ranch and SW.  
28.74 Spur, slopes SW.  
Descend 45 ft., over SE. slope.  
37.83 Wash, 20 lks. wide, course SW.  
Ascend 42 ft., over NW. slope, to  
39.72 Set an iron post, 3 ft. long, 1 in. in diam., 26 ins. in  
the ground, for  $\frac{1}{4}$  sec. cor., marked on brass cap,

$\frac{1}{4}$  S 18  
S 19  
1921

Chains.

and raise a mound of stone, 3 ft. base, 2 ft. high, N. of cor.  
 Ascend 52 ft., over NW. slope.  
 46.03 Spur, slopes SW.  
 Descend 30 ft., over SE. slope.  
 50.15 Wash, 10 lks. wide, course S. Leave rolling, and enter mountainous land.  
 Ascend 77 ft., over W. slope.  
 55.41 Ridge, brs. N. and S.  
 Descend 150 ft., over E. slope.  
 63.62 Old road, brs. N. and S.  
 74.76 Center of Cold Creek wash, 4 chs. wide, course S.  
 Ascend 40 ft., over NW. slope, to  
 79.72 The cor. of secs. 17, 18, 19 and 20.  
 Land, W. 50 chs. rolling; remainder, mountainous.  
 Soil, rocky, 4th rate.  
 Timber, none.  
 Undergrowth, dense greasewood and scattering catclaw, ocotillo and other cacti.  
 Fair grass.

N. 0° 3' W., bet. secs. 17 and 18.  
 Over mountainous land, thru. dense undergrowth.  
 Descend slightly over NW. slope.  
 0.10 Wash, 10 lks. wide, course W.  
 Ascend 65 ft., over SW. slope.  
 7.00 Point of spur, slopes SW.  
 Descend 73 ft., over NW. slope.  
 11.80 Ascend 23 ft., over W. slope.  
 16.80 Descend 23 ft., over NW. slope.  
 18.25 Center of Cold Creek wash, 100 lks. wide, course SW.  
 Ascend 95 ft., over SE. slope, to  $\frac{1}{4}$  sec. cor.  
 37.45 Road, brs. NE. to Fulcher ranch and SW.  
 40.00 Set an iron post, 3 ft. long, 1 in. in diam., 24 ins. in the ground, for  $\frac{1}{4}$  sec. cor., marked on brass cap,

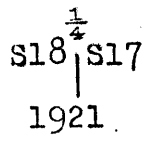

and raise a mound of stone, 3 ft. base, 2 ft. high, W. of cor.  
 Ascend 215 over E. and SE. slopes to sec. cor.  
 63.40 Wire, drift fence, brs. NW. and SE.  
 80.00 Set an iron post, 3 ft. long, 2 ins. in diam., 26 ins. in the ground, for cor. of secs. 7, 8, 17 and 18, marked on brass cap,

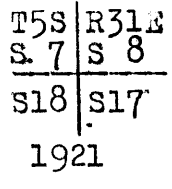

and raise a mound of stone, 3 ft. base, 2 ft. high, W. of cor.  
 Land, mountainous.  
 Soil, rocky, 4th rate.  
 Timber, none.  
 Undergrowth, dense greasewood and scattering catclaw, scrub palo verde, and cacti.  
 Fair grass.

S. 89° 56' E., on a random line, bet. secs. 8 and 17.  
 40.00 Set temp.  $\frac{1}{4}$  sec. cor.  
 80.18 Intersect N. and S. line, 5 lks. N. of the cor. of secs. 8, 9, 16 and 17.



Subdivision lines of Township 5 South, Range 31 East.

Chains.

- Thence, N. 89° 54' W., on a true line, bet. secs. 8 and 17. Over mountainous land, thru. dense undergrowth. Descend 72 ft., over NW. slope.
- 3.01 Gulch, course S. 45° W.
- 11.83 Ascend 130 ft., over SE. slope. E. edge of top of ridge. Ridge, brs. N. 20° E. and S. 20° W. Thence across nearly level top of ridge. Descend 23 ft., over SW. slope, to
- 18.82 W. edge of top of ridge, brs. N. 45° E. and S. 45° W. Three strand barb wire fence, same bearing. Leave top of ridge. Descend 230 ft., over NW. slope.
- 36.41 Wash, 30 lks. wide, in ravine, course S. 55° W.
- 40.09 Ascend 60 ft., over SE. slope, to Set an iron post, 3 ft. long, 1 in. in diam., 18 ins. in the ground to bed rock, supported by a mound of stone, for  $\frac{1}{4}$  sec. cor., marked on brass cap,

$$\begin{array}{r} \frac{1}{4} \text{ S } 8 \\ \text{S } 17 \\ 1921 \end{array}$$

- and raise a mound of stone, 4 ft. base, 3 ft. high, N. of cor.
- 45.93 Ascend 54 ft., over SE. slope. Ridge, brs. NE. and SW., near SW. end of same. Descend 210 ft., over NW. slope.
- 56.87 Wood road, brs. N. 30° W. and S. 30° E.
- 59.37 Center of Cold Creek wash, 100 lks. wide in bottom of Fulcher Canyon, course S. 30° W. Ascend 240 ft. over SE. slope, to sec. cor.
- 71.21 Fulcher's well and house bear south about 25 chs. dist.
- 80.18 The cor. of secs. 7, 8, 17 and 18. Land, mountainous. Soil, rocky, 3rd and 4th rate. No timber, except scattering sycamore trees along Fulcher canyon. Undergrowth, dense greasewood and scattering catclaw, rabbit brush, scrub mesquite and cacti. Fair grass.

- 
- 40.00 N. 89° 51' W., on a random line, bet. secs. 7 and 18. Set temp.  $\frac{1}{4}$  sec. cor.
  - 79.87 Fall 7 lks. S. of the reestablished cor. of secs. 7 and 18, on the W. bdy. of the Tp., hereinbefore described. Thence, S. 89° 48' E., on a true line, bet. secs. 7 and 18. Over mountainous land, thru. dense undergrowth. Ascend 28 ft., over NW. slope.
  - 2.97 Ridge, brs. NE. and SW. Descend 67 ft., over SE. slope.
  - 12.87 Head of wash, course SW. Ascend 61 ft. over W. slope.
  - 14.87 Point of spur, slopes S. Descend 110 ft., over SE. slope.
  - 23.84 Wash, 20 lks. wide in gulch, course SW. Ascend 100 ft., over NW. slope.
  - 33.22 Ridge, brs. NE. and SW. Descend 17 ft., over SE. slope, to
  - 39.87 Set an iron post, 3 ft. long, 1 in. in diam., 26 ins. in the ground, for  $\frac{1}{4}$  sec. cor., marked on brass cap,

$$\begin{array}{r} \frac{1}{4} \text{ S } 7 \\ \text{S } 18 \\ 1921 \end{array}$$

## 72 Subdivision lines of Township 5 South, Range 31 East.

Chains.

and raise a mound of stone, 3 ft. base, 2 ft. high, N. of cor.  
 Ascend 12 ft., over S. slope.  
 41.25 Descend 80 ft., over SE. slope.  
 52.29 Wash, 30 lks. wide, in gulch, course SW.  
 Ascend 60 ft., over NW. slope.  
 56.87 Spur, slopes SW. Old road on top of same, bearing NE. and SW.  
 Descend 30 ft., over SE. slope.  
 61.84 Wash, 20 lks. wide, in gulch, course SW.  
 Ascend 157 ft., over NW. slope.  
 70.60 Old road, brs. NE. and SW.  
 72.13 Ridge, brs. NE. and SW.  
 Descend 82 ft., over SE. slope to sec. cor.  
 74.00 Wire drift fence, brs. NE. and SW.  
 79.87 The cor. of secs. 7, 8, 17 and 18.  
 Land, mountainous.  
 Soil, rocky, 4th rate.  
 Timber, none.  
 Undergrowth, dense greasewood and scattering catclaw and cacti.  
 Fair grass.

N. 0° 3' W., bet. secs. 7 and 8.  
 Over mountainous land, thru. dense undergrowth,  
 Ascend 95 ft., over SE. slope.  
 12.84 Wire drift fence, brs. NE. and SW.  
 12.90 Old road brs. NE. and SW.  
 14.87 Ridge, brs. NE. and SW.  
 Descend 25 ft., over NW. slope.  
 21.00 Head of wash, course SW.  
 Ascend 40 ft., over S. slope.  
 27.33 Old road, brs. NE. and SW. on top of spur, sloping SW.  
 Descend 55 ft., over NW. slope.  
 35.36 Wash, 10 lks. wide in gulch, course SW.  
 Ascend 80 ft., over SE. slope, to  
 40.00 Set an iron post, 3 ft. long, 1 in. in diam., 26 ins. in the ground, for  $\frac{1}{4}$  sec. cor., marked on brass cap,

S 7 $\frac{1}{4}$  S 8

1921

and raise a mound of stone, 3 ft. base, 2 ft. high, W. of cor.  
 Ascend 18 ft., over SE. slope.  
 44.00 Rim of mesa, brs. NE. and SW. Thence over level mesa.  
 75.00 Rim of mesa, brs. NE. and SW. Leave level top of mesa.  
 Descend 17 ft., over NW. slope, to  
 80.00 Set an iron post, 3 ft. long, 2 ins. in diam., 18 ins. in the ground to bed rock, supported by a mound of stone for cor. of secs. 5, 6, 7, and 8, marked on brass cap,

T5S | R31E  
 S 6 | S 5

S 7 | S 8

1921

and raise a mound of stone, 3 ft. base, 2 ft. high, W. of cor.  
 Land, mountainous, except on mesa, where the surface is level.  
 Soil, rocky, 4th rate.  
 Timber, none.  
 Undergrowth, dense greasewood and scattering catclaw, scrub mesquite, ocotillo and other cacti.  
 Fair grass.

## Subdivision lines of Township 5 South, Range 31 East. 73

Chains.	
	S. 89°54' E., on a random line, bet. secs. 5 and 8.
40.00	Set temp. $\frac{1}{4}$ sec. cor.
80.36	Intersect the cor. of secs. 4, 5, 8 and 9.
	Thence,
	N. 89°54' W., on a true line, bet. secs. 5 and 8.
	Over mountainous land, thru. dense undergrowth.
	Descend 290 ft., over NW. slope.
6.19	Twin cedar, 10 ins. in diam., on line. Mark 2 notches on each of E. and W. faces.
16.89	Center of Cold Creek wash, 100 lks. wide, in bottom of Fulcher Canyon, course S. Small spring brs. N. about 7 chs. dist.
	Ascend 286 ft. over SE. slope.
22.16	Trail to spring, 15 chs. S. brs. N. 45° W. and S.
27.77	Old Silver City and Clifton pack trail, 6 ft. wide, brs. N. 45° E. and S. 45° W.
36.00	Rim of canyon and mesa, brs. NE. and SW. Thence over level mesa.
40.18	Set an iron post, 3 ft. long, 1 in. in diam., 10 ins. in the ground, to bed rock, supported by a mound of stone, for $\frac{1}{4}$ sec. cor., marked on brass cap,
	$\frac{1}{4} \begin{array}{r} S \ 5 \\ S \ 8 \\ 1921 \end{array}$
	and raise a mound of stone, 4 ft. base, 3 ft. high, N. of cor.
	Continue over level land on mesa.
75.00	Rim of mesa, brs. NE. and SW. Leave level top of mesa.
	Descend 21 ft., over NW. slope, to
80.36	The cor. of secs. 5, 6, 7 and 8.
	Land, E. 36 chs. and W. 5 chs. mountainous; remainder, level.
	Soil, rocky, 3rd and 4th rate.
	No timber, except scattering sycamore and cottonwood along Fulcher Canyon.
	Undergrowth, dense greasewood and scattering scrub mesquite, catclaw, black brush, scrub oak and cacti.
	Fair grass.
-----	
	N. 89°48' W., on a random line, bet. secs. 6 and 7.
40.00	Set temp. $\frac{1}{4}$ sec. cor.
80.24	Fall 2 lks. S. of the reestablished cor. of secs. 6 and 7, on the W. bdy. of Tp., hereinbefore described.
	Thence,
	S. 89°47' E., on a true line, bet. secs. 6 and 7.
	Over rolling land, thru. dense undergrowth.
	Descend 40 ft., over E. slope.
2.90	Wash, 10 lks. wide, course S. Leave rolling, and enter mountainous land.
	Ascend 48 ft., over W. slope.
7.00	Point of spur, slopes S.
	Descend 160 ft., over E. slope.
18.80	Center of wash, 100 lks. wide, course S. and old road bearing N. and S. in bottom of Buzzard Roost canyon.
	Ascend 145 ft., over W. slope.
26.00	Spur, slopes S.
	Descend 113 ft., over E. slope.
32.35	Wash, 20 lks. wide in gulch, course S. 30° W.
	Ascend 73 ft., over W. slope.
39.25	Spur, slopes SW.
	Descend slightly over SE. slope, to
40.24	Set an iron post, 3 ft. long, 1 in. in diam., 18 ins. in the ground for bed rock, supported by a mound of stone, for $\frac{1}{4}$ sec. cor., marked on brass cap,

## 74 Subdivision lines of Township 5 South, Range 31 East.

Chains.

$$\frac{1}{4} \begin{array}{r} S \ 6 \\ S \ 7 \\ \hline 1921 \end{array}$$

- and raise a mound of stone 3 ft. base, 2 ft. high, N. of cor.
- 59.85 Descend 87 ft., over SE. slope.  
Wash, 50 lks. wide in bottom of ravine, course SW.
- 80.24 Ascend 227 ft., over NW. slope, to  
The cor. of secs. 5, 6, 7 and 8.  
Land, mountainous, except the W. 3 chs.  
Soil, rocky, 4th rate.  
Timber, none.  
Undergrowth, dense greasewood, catclaw, tesota, ocotillo,  
and other cacti.  
Fair grass.
- 
- 40.00 N. 0° 16' W., on a random line, bet. secs. 5 and 6.  
Set temp.  $\frac{1}{4}$  sec. cor.
- 80.95 Intersect the cor. of secs. 5, 6, 31 and 32, on the N. bdy. of  
the Tp., hereinbefore described.  
Thence,  
S. 0° 16' E. on a true line, bet. secs. 5 and 6.  
Over mountainous land, thru. dense undergrowth.  
Descend 86 ft., over SE. slope.
- 19.45 Wash, course SW.  
Ascend 56 ft., over NW. slope.
- 36.05 Spur, slopes SW.  
Descend 59 ft., over S. slope, to
- 40.95 Set an iron post, 3 ft. long, 1 in. in diam., 6 ins. in the  
ground to bed rock, supported by a mound of stone, for  
 $\frac{1}{4}$  sec. cor., marked on brass cap,

$$\frac{1}{4} \begin{array}{r} S \ 6 \ | \ S \ 5 \\ \hline 1921 \end{array}$$

- and raise a mound of stone, 3 ft. base, 2 ft. high, W. of cor.
- 44.25 Descend 54 ft., over S. slope.  
Head of gully, course S. 20° W.
- 56.95 Descend 20 ft., over W. slope, to  
Ridge, brs. NE. and SW. near SW. end of same.
- 65.45 Descend 90 ft., over SE. slope.  
Wash, 30 lks. wide, course SW.
- 80.95 Ascend 176 ft., over NW. slope, to  
The cor. of secs. 5, 6, 7 and 8.  
Land, mountainous.  
Soil, rocky, 4th rate.  
Timber, none.  
Undergrowth, dense greasewood, catclaw, tesota, ocotillo,  
and other cacti.  
Fair grass.
- 
- The continued satisfactory adjustment of the solar apparatus during the survey of this township is indicated from field tests, as described in Book "H."
-

GENERAL DESCRIPTION.

This township is situated in Greenlee County, Arizona, about three miles west from the East bdy. of the state, and about 6 miles southeast from Clifton, the county seat. Most of the surface is mountainous, being on the southwest slope of Big Lue Mountain.

On a number of the mesas and benches, the land is level, nearly level or gently rolling.

The soil is rocky, 3rd and 4th rate, except in the SW. quarter, where part has a gravelly adobe, 2nd rate.

There is no timber, except a fringe of scattering cottonwood, sycamore, mesquite, oak and walnut along some of the larger washes in the canyons.

There are no permanent streams of running water, the water courses being dry washes, gulches and draws draining SW. into the Gila River.

A fair growth of grass is prevalent in all sections.

There is no evidence of valuable mineral deposits.

There are several permanent springs, one in sec. 5, one in sec. 8, one in sec. 14 and one in sec. 36. Near the east boundary, just outside the township, east of secs. 12 and 25, are several springs, and in sec. 15 in Lop Bar Creek, there is water in pools.

There are several settlers, G. Stockton in sec. 4, Frank Davis in sec. 6, Frank Stockton in sec. 10, Lop Bar Davis in sec. 14, J. Fulcher in sec. 17, and Mrs. J. G. Smith in sec. 25. Besides the houses, corrals, wells, and other improvements belonging to these settlers, the improvements in the township consist of several range fences extending for considerable distances, and a telephone line NW. and SE., thru. sec. 31.

Roads extend SW. from the Fulcher ranch, from the Frank Stockton ranch, and Mrs. J. G. Smith's ranch, extending southwesterly to Guthrie and Northwesterly to Clifton.

The township is now utilized entirely for grazing, which is probably the only purpose for which it is suitable.



CERTIFICATE OF UNITED STATES TRANSITMAN.

I, Benjamin J. Kinsey, U.S. Transitman, hereby certify upon honor that, in pursuance of special instructions received from the U. S. Surveyor General, for Group 111, Arizona, bearing date of the 24th day of August, 1920, I have well, faithfully, and truly in my own proper person, and in strict conformity with said instructions, the Manual of Surveying Instructions, and the laws of the United States, surveyed all those parts or portions of the West boundary, and surveyed all those parts or portions of the North boundary and Subdivision lines of

TOWNSHIP 5 SOUTH, RANGE 31 EAST,

of the Gila and Salt River Base & Meridian, in the State of Arizona, which are represented in the foregoing field notes and by diagram on page 1 hereof as having been executed by me, and under my direction; and that all the corners of resurvey & said survey have been established and perpetuated in strict accordance with the Manual of Surveying Instructions, and the special written instructions of the U. S. Surveyor General, for Group 111, Arizona, and in the specific manner described in the field notes, and that the foregoing are the original field notes of such resurvey and survey.

Place: Phoenix, Arizona
Date: May 17-1923.

Benjamin J. Kinsey
U.S. Transitman.

APPROVAL

OFFICE OF THE UNITED STATES SURVEYOR GENERAL,

19

The foregoing field notes of the survey of

executed by under his special instructions dated 19, having been critically examined, and the necessary corrections and explanations made, the said field notes, and the surveys they describe, are hereby approved.

U. S. Surveyor General.

I certify that the foregoing transcript of the field notes of the above-described surveys in, has been correctly copied from the original notes on file in this office.

U. S. Surveyor General.





CERTIFICATE OF UNITED STATES CADASTRAL ENGINEER.

I, William H. Thorn, U. S. Cadastral Eng'r, hereby certify upon honor that, in pursuance of special instructions received from the U. S. Surveyor General, for Group 111, Arizona, bearing date of the 24th day of August, 1920, I have well, faithfully, and truly in my own proper person, and in strict conformity with said instructions, the Manual of Surveying Instructions, and the laws of the United States, <sup>re-</sup> surveyed all those parts or portions of the First Standard Parallel South, thru. Range 31 East, and surveyed all those parts or portions of the East boundary, and Subdivision lines of TOWNSHIP 5 SOUTH, RANGE 31 EAST, of the Gila and Salt River Base and Meridian, in the State of Arizona, which are represented in and by diagram on page 1 hereof the foregoing field notes as having been executed by me, and under my direction; and that all the corners of resurvey & said survey have been established and perpetuated in strict accordance with the Manual of Surveying Instructions, and the special written instructions of the U. S. Surveyor General, for Group 111, Arizona, and in the specific manner described in the field notes, and that the foregoing are the original field notes of such resurvey and survey.

Place: Phoenix Arizona  
 Date: June 5 1923

*William H Thorn*

APPROVAL.

OFFICE OF THE UNITED STATES SURVEYOR GENERAL,

Phoenix, Arizona. JUN 7, 1923.

The foregoing field notes of the <sup>re-</sup> survey of the First Standard Parallel South, thru. Range 31 East, and West boundary, and Survey of the East and North boundaries, and Subdivision lines of TOWNSHIP 5 SOUTH, RANGE 31 EAST, of the Gila and Salt River Base and Meridian, in the State of Arizona,

executed by William H. Thorn, U. S. Cadastral Eng'r & Benjamin J. Kinsey, U. S. Transitman, under ~~his~~ special instructions dated August 24, 1920, for Group 111, Arizona, having been critically examined, and the necessary corrections and explanations made, the said field notes, and the <sup>re-</sup> surveys and surveys they describe, are hereby approved.

*Frank D. Frost*  
 U. S. Surveyor General.

I certify that the foregoing transcript of the field notes of the above described surveys in \_\_\_\_\_, has been correctly copied from the original notes on file in this office.

U. S. Surveyor General.