

3652

ORIG
1

Book "E"

4-679

BOOK 3652

FIELD NOTES

OF THE RETRACEMENT OF

Part of the Boundary of Baca Float No. 3, Private Land Grant,

Part of the West Boundary of T. 22 S., R. 16 E., and

Part of the Subdivision lines of Frac. T. 22 S., R. 15 E.,

RESURVEY OF

Part of the West Boundary of T. 22 S., R. 16 E., and

Part of the Subdivision lines of Frac. T. 22 S., R. 15 E., and

SURVEY OF

Part (completion) of the North Boundary,

Part (completion) of the South boundary, and

Part (completion) of the Subdivision lines of

FRACTIONAL TOWNSHIP 22 SOUTH, RANGE 15 EAST,

Of the Gila and Salt River Base and Meridian,

In the State of Arizona.

EXECUTED BY

F. W. CHAPIN,

U. S. Surveyor,

In the capacity of U. S. Surveyor, under Special Instructions dated December 16., 1921, issued by the United States Surveyor General to govern surveys included in Group No. 119, which were approved by the Commissioner of the General Land Office, February 2., 1922, and Assignment Instructions dated November 20., 1922.

Retracement,

Resurvey & Survey commenced January 5., 1922.

Retracement,

Resurvey & Survey completed January 27., 1923.

3652

1A

3652





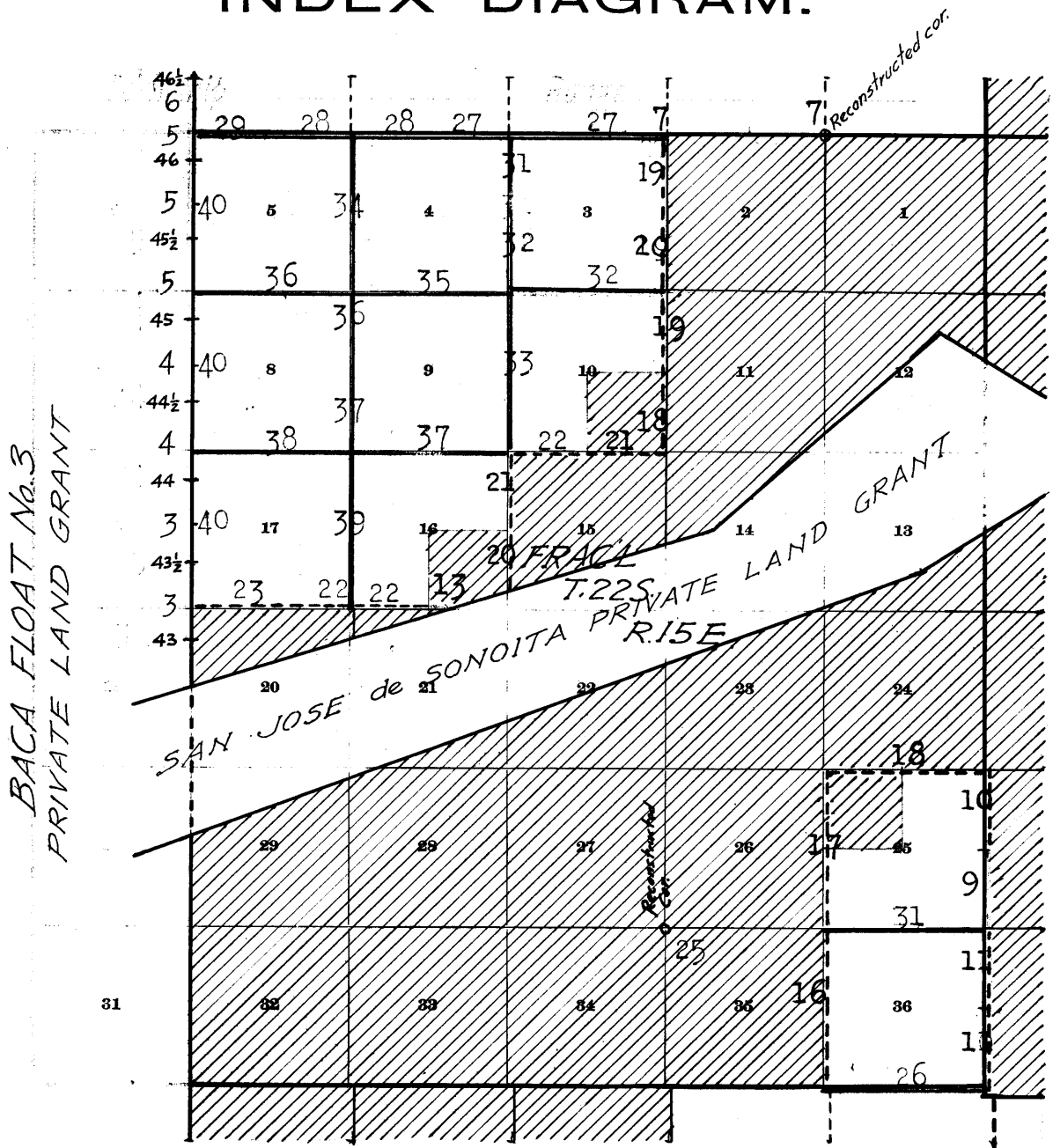

BOOK 3652

Book "E"

Group 119 - - - - Arizona.

INDEX DIAGRAM.



-  Lines surveyed under this group.
-  Lines resurveyed under this group.
-  Lines retraced under this group.
-  Accepted surveys.
-  Unsurveyed.
-  Areas surveyed as per accepted plats on file.

BOOK 3652

16

BOOK "E"

Group 119- - - - Arizona.

Frac. Township 22 South, Range 15 East.

DATE DIAGRAM.

BACA FLOAT No. 3 PRIVATE LAND GRANT

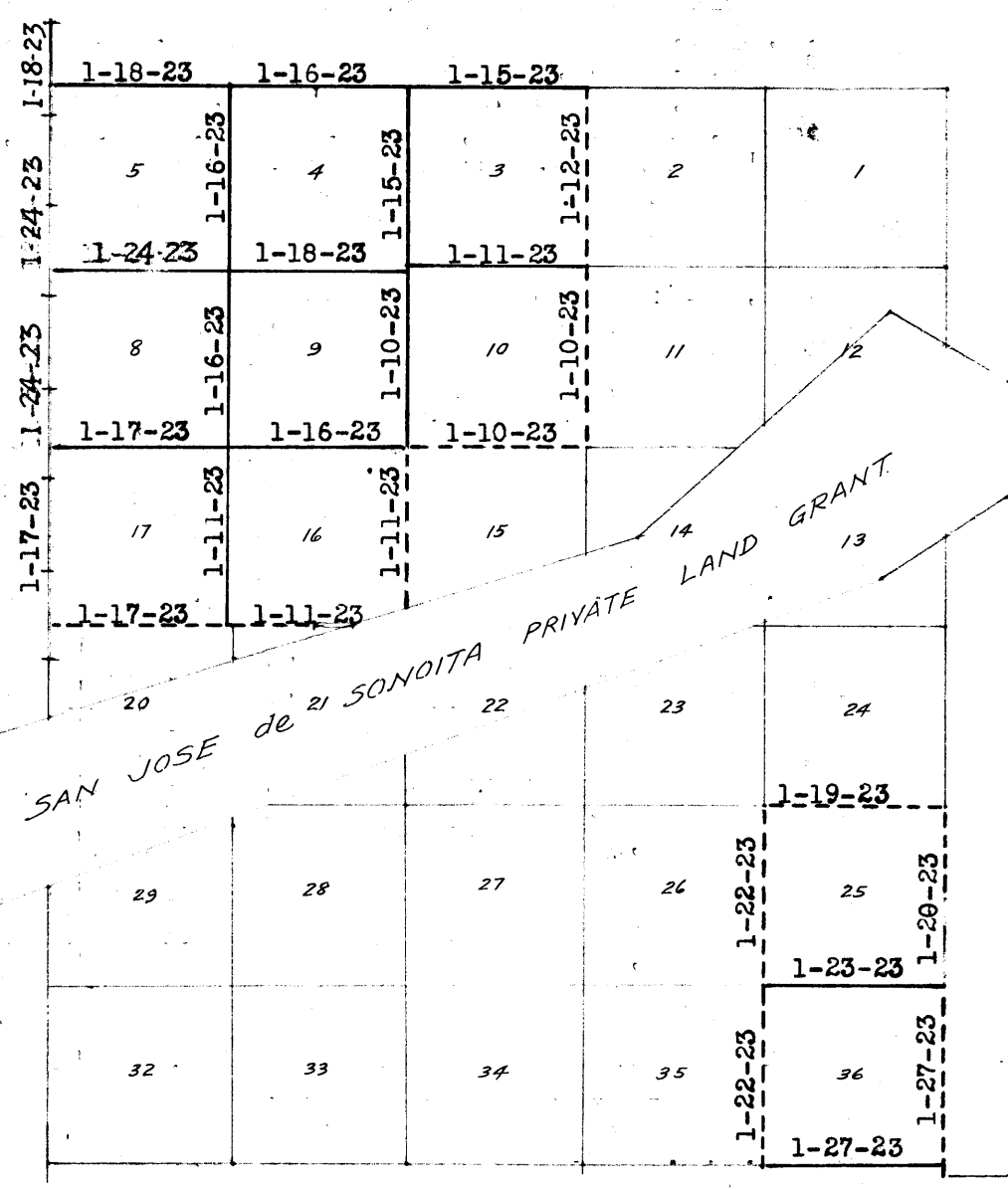

- Indicates surveys executed by F.W.Chapin, U.S.Surveyor, on dates shown thereon.
- - - - - Indicates resurveys executed by F.W.Chapin, U.S.Surveyor, on dates shown thereon.
- Indicates retracements executed by F. W.Chapin, U.S.Surveyor, on dates shown thereon.
- Indicates accepted surveys.

BOOK 3652

2

Retracements, resurveys and surveys herein described were executed on dates shown on diagram on page 1 hereof, by F. W. Chapin, U.S. Surveyor, using Buff solar transit No. 9984. The instrument is equipped with a full vertical circle and the Smith solar attachment; unless otherwise specified all azimuth determinations are accomplished with the solar attachment.

Jan. 8, 1923: Examine the adjustments of the instrument and correct all errors; then, to test the solar apparatus by comparing its indications resulting from observations made during a.m. and p.m. hours with a meridian established by direct observation upon the sun proceed as follows:

Jan. 8, 1923. In camp near the NW. cor. of sec. 15, frac. T. 22 S., R. 15 E., Gila and Salt River Base and Meridian, Arizona, in latitude $31^{\circ}31'23''$ N., and longitude $110^{\circ}48'38''$ W. of Greenwich, at 4h. 0m. p.m. app. time, set off $31'31\frac{1}{2}''$ on the lat. arc; $22^{\circ}13\frac{1}{2}'$ S. on the decl. arc, and determine a meridian with the solar, which is marked by a tree on the meridian about a mile to the north.

Jan. 9, 1923: At the same station and using the tree above mentioned for a reference mark, make a series of three altitude observations of the sun for azimuth, each with the telescope in direct and reversed positions, observing opposite limbs of the sun, and reading the horizontal deflection angles from the south point of the meridian already determined to the sun:

Observation.	Telescope.	Sun	Time by watch.	Vertical angle	Horizontal angle.
1st	Direct		10h. 4m.	$26^{\circ}20'$	$37^{\circ}16'$
3d	Reverse		10h. 7m	$26^{\circ}08'$	$37^{\circ}20'$
	Mean			$26^{\circ}14'$	$37^{\circ}18'$
2nd	Direct		10h. $4\frac{1}{2}$ m	$26^{\circ}24'$	$37^{\circ}11'$
2nd	Reverse		10h $6\frac{1}{2}$ m	$26^{\circ}04'$	$37^{\circ}25'$
	Mean,			$26^{\circ}14'$	$37^{\circ}18'$
3d	Direct		10h 5m	$26^{\circ}27'$	$37^{\circ}08'$
1st	Reverse		10h 6m	$26^{\circ}01'$	$37^{\circ}29'$
	Mean,			$26^{\circ}14'$	$37^{\circ}18\frac{1}{2}'$

Mean true bearing of solar-----N. $0^{\circ} 0' 20''$ W.
Indicated error of solar in p.m. observation -- $20''$.

At 10h. a.m. app. time with the lat. arc unchanged, set off $22^{\circ}9'S$ on the decl. arc, and determine a meridian with the solar which falls within $20''$ of the true meridian.

At app. noon with the lat. arc unchanged, observe the sun on the meridian; the resulting reading of the decl. arc is $22^{\circ}8\frac{1}{2}'$, which agrees with the computed decl. of the sun.

As all of the solar observations during the usual hours of solar work come within $30''$ of the true meridian, conclude that the adjustments of instrument are satisfactory.

Unless otherwise specified all measurements are made with a Lufkin steel tape 5 chs. in length, compared with a Lufkin standard steel tape and found correct. The measurements are made on the slope, the vertical angles determined, and the slope measurements properly reduced to true horizontal distances.

Retracement of part of Bdy. of Baca Float No. 3 (43 mile mon. to 46 1/2 mile mon.)

3

Chains.

The Baca Float No. 3 Private Land Grant includes within its boundary all of T. 22 S., R. 14 E., and parts of Ts. 21 S., Rs. 13, 14, and 15 E., Ts. 22 S., Rs. 13 and 15 E., and Ts. 23 S., Rs. 13, 14, and 15 E. The boundary of this Grant was surveyed in 1905 by Philip Contzen, U.S.D.S., beginning survey at the NE. cor. in T. 21 S., R. 15 E., thence west, 12 miles, 36.44 chs. to the N.W. cor. in T. 21 S., R. 13 E., thence S. 0° 3' 11" E., 12 miles, 36.44 chs. to S.W. cor. in T. 23 S., R. 13 E., thence East, 12 miles, 36.44 chs. to S.E. cor. in T. 23 S., R. 15 E.; thence North, 12 miles, 36.44 chs. to N.E. cor., the Initial Monument. In this survey, half mile and mile monuments were established alternately at intervals of 40 chs., counting from the N.E. cor., in continuous measurement along the North, West, South and East lines of the Grant, and monuments were established at each cor. The following notes describe a retracement of the East line of the Grant Bdy., between the 43 mile monument and the 46 1/2 mile monument. No previous retracement or resurvey of this portion of the Bdy. is of record.

The original 43 mile monument is a granite stone, 14x10x6 ins. above ground, firmly set, marked 43 M on S. face, BF No. 3, on W. face, and PL on E. face, and witnessed by a mound of stone, W. of cor., and three properly marked bearing trees as follows:

A live oak, 10 ins. in diam., S. 1/4° E., 49 lks. dist.
An oak stump, 16 ins. in diam., S. 71 1/2° E., 55 lks. dist.
An oak stump, 18 ins. in diam., N. 8° E., 30 lks. dist.

Establish a new bearing tree as follows:

A live oak, 10 ins. in diam., brs. N. 62° E., 150 lks. dist., marked 43 MBT.

Thence,

North, on random line, on 44th mile, (S. 1/2).

Over rolling land, thru scattering timber and undergrowth.

Ascend 7 ft., over S. slope.

.72 Descend 11 ft., over NE. slope.

4.56 Draw, course SE.

Ascend 61 ft., over S. slope, to

13.20 Intersect the original closing cor. of secs. 17 and 20, frac. T. 22 S., R. 15 E., established in 1905 by P. Contzen, U.S.D.S., which is a granite stone, 12x8x8 ins. above ground, firmly set, marked CC on E. face, BF No. 3 on W. face, 20 on S. face, and 17 on N. face, and witnessed by a mound of stone, E. of cor. No bearing trees.

Continue line and measurement.

Enter mountainous land.

Ascend 135 ft., over S. slope.

27.70 Spur, slopes W.

Descend 103 ft., over NW. slope.

35.57 Wash, course W.

Ascend 96 ft., over S. slope, to

40.30 Intersect the original 43 1/2 mile monument, which is a porphyry stone, 18x12x12 ins. above ground, firmly set, marked 43 1/2 M on S. face, BF No. 3 on W. face, and PL on E. face, and witnessed by a mound of stone, W. of cor.

No bearing trees.

The true course and distance of S. 1/2 of 44th mile of Grant bdy. are therefore North, 40.30 chs., and the closing cor. of secs. 17 and 20 is therefore on line.

Thence,

North, on random line, on 44th mile (N. 1/2).

Over mountainous land, thru scattering timber and undergrowth.

Ascend 48 ft., over S. slope.

3.30 Ridge, brs. E. and W.

Descend 220 ft., over N. slope.

16.56 Wash, course W. Enter nearly level land.

Ascend 24 ft., over S. slope, to

BOOK 3652

4 Retracement of part of the Bdy. of Baca Float No. 3 (43 m. mon. to 46 $\frac{1}{2}$ M. Mon).

Chains.

30.71 Enter mountainous land.
Ascend 176 ft., over S. slope, to

40.33 Fall 4 lks. E. of the original 44 mile monument, which is a porphyry stone, 8x8x8 ins. above ground; firmly set, marked 44 M on S. face, BF No. 3 on W. face, and PL on E. face, and witnessed by a mound of stone, W. of cor. No bearing trees.
The true course and dist. of N. $\frac{1}{2}$ of 44th mile of Grant Bdy. are therefore N. 0° 3' W., 40.33 chs.
Land, rolling, mountainous and nearly level.
Soil, rocky, 4th rate.
Timber, oak.
Undergrowth, ocotillo and sagebrush.

From 44 mile monument,
North, on random line, on 45th mile (S. $\frac{1}{2}$).
Over mountainous land, thru. scattering timber and undergrowth.
Ascend 60 ft., over S. slope.

2.95 Point of spur, slopes SE.
Descend 44 ft., over NE. slope, to

10.51 (77.94 chs. northing from C.C. of secs. 17 and 20)
Point of intersection with subdivision line, bet. secs. 8 and 17, Frac. T. 22 S., R. 15 E., surveyed due West, as hereinafter described.
Continue line and measurement.

29.50 Ascend 120 ft., over E. and SE. slopes.
Saddle in ridge, bearing NE. and SW.

40.32 Descend 72 ft., over NW. slope, to
Fall 8 lks. W. of the original 44 $\frac{1}{2}$ mile monument, which is a granite stone, 12x8x10 ins. above ground, firmly set in ground, and small mound of stones, and witnessed by two properly marked bearing trees, as follows:
An oak, 10 ins. in diam., N. 22 $\frac{1}{2}$ ° E., 215 lks. dist., and
An oak, 10 ins. in diam., N. 60 $\frac{1}{2}$ ° W., 142 lks. dist.
The true course and dist. of S. $\frac{1}{2}$ of 45th mile of Grant Bdy. are therefore N. 0° 7' E., 40.32 chs.
Thence,
North, on random line, on 45th mile (N. $\frac{1}{2}$).
Over rolling land, thru. scattering timber and undergrowth.
Descend 24 ft., over NW. and W. slopes.

7.10 Wash, 10 lks. wide, course W.
Ascend 45 ft., over S. slope.

16.18 Spur, slopes W.
Descend 46 ft., over N. slope.

18.80 Wash, 20 lks. wide, course W.
Ascend 50 ft., over S. slope.

22.75 Spur, slopes W.
Descend 11 ft., over N. slope.

26.25 Bottom of gully, 7 lks. wide, course W.
Ascend 102 ft., over SE. slope, to 45 mile mon.

32.39 Fence brs. E. and W.

40.33 Intersect the original 45 mile monument, which is a granite stone, 12x12x10 ins. above ground, firmly set, marked 45 M on S. face, BF No. 3 on W. face, and PL on E. face, and witnessed by four properly marked bearing trees as follows:
An oak, 6 ins. in diam., S. 27° E., 60 lks. dist.
An oak, 8 ins. in diam., N. 72° W., 61 lks. dist.,
An oak, 12 ins. in diam., S. 1° W., 144 lks. dist., and
An oak (dead) 20 ins. in diam., N. 14° E., 144 lks. dist.
The true course and dist. of the N. $\frac{1}{2}$ of the 45th mile of the Grant Bdy. are therefore North, 40.33 chs.
Land, mountainous and rolling.
Soil, rocky, 4th rate.
Timber, oak.
Undergrowth, scrub mesquite, ocotillo, cactus and sagebrush.

Retracement of part of the Bdy. of Baca Eloat No. 3 (43 M. mon, to
46 $\frac{1}{2}$ mile mon.)

5

Chains.	
	From 45 mile monument, North, on random line, on 46th mile (S. $\frac{1}{2}$). Over rolling land, thru scattering timber and undergrowth. Ascend 20 ft., over SE. slope, to
4.93	Enter mountainous land.
	Ascend 57 ft., over SE. slope, to
9.85	(79.99 chs. northing from C.C. of secs. 8 and 17) Point of intersection with subdivision lines bet. secs. 5 and 8, Fract. T. 22 S., R. 15 E., surveyed due west, as hereinafter described.
	Continue line and measurement.
	Ascend 94 ft., over SE. slope.
17.50	Point of spur, slopes E.
	Descend 40 ft., over NE. slope.
22.05	Draw, course E.
	Ascend 164 ft., over S. slope.
31.50	Ridge, brs. NW and SE.
	Descend 56 ft., over NE. slope.
39.13	Draw, course E.
	Ascend 11 ft., over S. slope, to
40.29	Fall 5 lks. E. of the original 45 $\frac{1}{2}$ mile monument, which is a granite stone, 12x8x6 ins. above ground, firmly set, marked 45 $\frac{1}{2}$ M on S. face, BF No. 3 on W. face, and PL on E. face, and witnessed by two properly marked bearing trees as follows: An oak, 12 ins. in diam., S. 11 $\frac{1}{2}$ ° E., 186 lks. dist., and An oak, 10 ins. in diam., West, 113 lks. dist. The true course and dist. of S. $\frac{1}{2}$ of the 46th mile of the Grant Bdy. are therefore, N. 0° 4' W., 40.29 chs. Thence, North, on random line, on 46th mile (N. $\frac{1}{2}$). Over mountainous land, thru scattering timber and under- growth. Ascend 10 ft., over S. slope.
1.00	Top of round hill.
	Descend 250 ft., over N. slope.
19.38	Wash, 10 lks. wide, course W. Enter gently rolling land. Ascend gradually over W. slope.
27.16	Road, Patagonia to Salero, brs. NW and SE.
38.50	Wash, 10 lks. wide, course SW.
	Ascend gradually over S. slope, to
40.44	Fall 5 lks. W. of the original 46 mile monument, which is a porphyry stone, 8x6x6 ins. above ground, firmly set, marked 46M on S. face, BF No. 3 on W. face, and PL on E. face, and witnessed by four properly marked bearing trees, as follows: An oak, 18 ins. in diam., N. 5° W., 436 lks. dist. A mesquite, 8 ins. in diam., N. 21 $\frac{1}{2}$ ° E., 170 lks. dist., An oak, 30 ins. in diam., S. $\frac{1}{2}$ ° E., 425 lks. dist., in fence bearing N. and S., and An oak, 28 ins. in diam., S. 11 $\frac{1}{2}$ ° W., 444 lks. dist. The true course and dist. of N. $\frac{1}{2}$ of the 46th mile of the Grant Bdy. are therefore N. 0° 4' E., 40.44 chs. Land, rolling and mountainous. Soil, rocky, 4th rate. Timber, oak. Undergrowth, scrub mesquite and ocotillo.

	From 46 mile monument, North, on random line, on 47th mile (S. $\frac{1}{2}$). Over mountainous land, thru scattering timber and under- growth, along W. side of fence, bearing N. and S. Ascend 92 ft., over S. slope.
6.10	Point of spur, slopes E.
	Descend 14 ft., over NE. slope to closing cor.
6.22	From this point, U.S. Mineral Monument on the Missouri pat- ented lode mining claim, brs. N. 27° 9' E. The east end cen- ter monument of said claim brs. N. 31° 25' E.
9.10	(79.98 chs. northing from C.C. of secs. 5 and 8) Point of in- tersection with the N. bdy. of fract. Tp. 22 S., R. 15 E.,

BOCK 3652

Retracement of part of the Bdy. of Baca Float No. 3, (43M. mon. to
46 M. mon.)

Chains.

surveyed due West, as hereinafter described.
Continue line and measurement, along W. side of fence bearing N. and S.
Descend 51 ft., over NE. slope.
18.65 Draw, course W.
Ascend 208 ft., over S. slope.
19.69 From this point, the U.S. Mineral Monument on the Missouri Patented lode mining claim, brs. N. $48^{\circ} 35' E.$, and the East End Center monument of said claim brs. N. $59^{\circ} 40' E.$
30.50 Ridge, brs. E. and W.
Descend 90 ft., over N. slope, to
40.05 Intersect the original $46\frac{1}{2}$ mile monument, which is a granite stone, $8 \times 8 \times 8$ ins. above ground, firmly set, marked $46\frac{1}{2}M$ on S. face, BF No. 3 on W. face, and PL on E. face, and witnessed by a mound of stone, W. of cor., and two properly marked bearing trees as follows:
An oak, 10 ins. in diam., N. $75\frac{1}{2}^{\circ} W.$, 72 lks. dist., and
An oak, 10 ins. in diam., S. $21\frac{1}{2}^{\circ} E.$, 56 lks. dist.
Land, mountainous.
Soil, rocky, 4th rate.
Timber, oak.
Undergrowth, ocotillo.

0

Chains.

The East two miles of the North bdy, of frac.T.22 S.,R.15 E. were surveyed in 1876 by Theodore F.White,U.S.D.S., and no retracement or resurvey of such portion of the Tp. bdy. is of record.

The following notes describe the reconstruction of the cor. of secs.1,2,35 and 36, and the restoration of the cor. of secs.2,3,34 and 35, as a preliminary operation to the survey of the same Tp.bdy. N.of secs.3,4, and 5.

RECONSTRUCTION OF COR.OF SECS. 1, 2,35 and.36.

The original cor.of secs.1,2,35 and 36 is a mound of earth and stone, evidently the remains of the mound recorded as having been raised around the wood post cor.monument. On top of this mound is a wood post 3 ft.long, 3 ins.in diam., marks obliterated by decay. The two record bearing trees have been cut down, but two stumps of mesquite trees remain, which bear from the center of the mound as follows:

N. 14° W., 192 lks.dist., and N.22°E., 209 lks.dist. No marks are visible on either of these stumps, but the ties agree very closely with the record; therefore, they are undoubtedly the remains of the original bearing trees, and identify this sec.cor. satisfactorily.

Reconstruct this cor. as follows:
Destroy the old mound, and in center of its position, re-set the old wood post, 12 ins.in the ground to bed rock, and alongside same, set an iron post, 3 ft.long, 2 ins. in diam., 12 ins.in the ground, deposit a stone marked with a cross (x) at base of post, and raise a mound of stone around post, for cor.of secs.1,2,35 and 36, marked on brass cap,

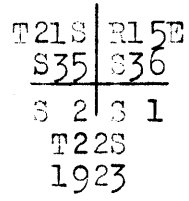

No new bearing trees available.

RESTORATION OF COR. OF SECS.2,3,34 &35.

From the remains of the original cor.of secs.1,2,35 and 36, retracement of the N. bdy.of sec.2, with diligent search at record intervals, fails to reveal any trace of either the original $\frac{1}{4}$ sec.cor. of secs.2 and 35, or the original cor.of secs.2,3,34 and 35; therefore, at 80.00 chs.West from the reconstructed cor.of secs. 1,2,35 and 36, restore the missing cor.of secs.2,3,34 and 35, as follows:

Set an iron post, 3 ft.long, 2 ins. in diam., 12 ins. in the ground to bed rock, and raise a mound of stone around post, for reestablished cor.of secs.2,3,34 and 35, marked on brass cap,

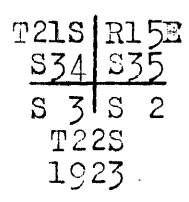

from which,
An oak, 12 ins.in diam., brs.N.42°E., 23 lks. dist., marked T21S R15E S35 BT.
An oak, 10 ins.in diam., brs.S.57 $\frac{1}{2}$ °E., 34 lks. dist., marked T22S R15E S2 BT.

BOOK 3652

Reconstruction and Restoration of sec.cors.on the North bdy.of
Frac. Township 22 South Range 15 East.

8

Chains.

An oak, 6 ins. in diam., brs. S. 77° W., 44 lks.
dist., marked T22S R15E S3 BT.
An oak, 10 ins. in diam., brs. N. 58° W+, 32 lks. dist.
marked T21S R15E S34 BT.

BOOK 3652

Retracement of Part of West Bdy. of Township 22 South, Range 16 East.

Chains	<p>The north four miles of the range line bet. Ts. 22 S., Rs. 15 and 16 E., were surveyed in 1876 by Theodore F. White, U.S.D.S. and the south two miles were surveyed in 1912 by John F. Hesse, U.S.S.</p> <p>The north 32.90 chs. bet. secs. 7 and 12, and the south 38.29 chs. bet. secs. 13 and 18, were surveyed in 1903 by Philip Contzen, U.S.D.S. The range line bet. secs. 1 and 6, and the north 32.95 chs. bet. secs. 7 and 12, were resurveyed in 1907 by John F. Hesse, U.S.S. and the range line bet. secs. 19 and 24 was resurveyed by the same surveyor in 1912.</p> <p>No other resurveys or retracements of this township are of record.</p> <p>The following notes describe a retracement bet. secs. 25 and 30 (S. $\frac{1}{2}$)</p> <p style="text-align: center;">-----</p> <p>The original $\frac{1}{4}$ sec. cor. of secs. 25 and 30 is an iron post, 1 in. diam., projecting 12 ins. above ground, firmly set in ground and mound of stone, properly marked on brass cap, and witnessed by two properly marked bearing trees as follows:</p> <p style="padding-left: 40px;">An oak, 10 ins. diam., bears S. 89$\frac{1}{2}$° E., 57 lks. dist. An oak (dead) 6 ins. diam., bears S. 10° W., 45 lks. dist.</p> <p>Thence South, on a random line bet. secs. 25 and 30 (S. $\frac{1}{2}$) Over mountainous land, through scattering timber and dense undergrowth.</p> <p>4.56 Asc. 43 ft. over NE. slope. Ridge, bears SE. and NW.</p> <p>12.95 Desc. 160 ft. over SW. slope. Wash, 15 lks. wide, course NW.</p> <p>15.00 Asc. 46 ft. over NE. slope. Desc. 176 ft. over SW. slope.</p> <p>23.53 Wash, 30 lks. wide, course W. Asc. 15 ft. over NW. slope.</p> <p>27.00 Point of spur, slopes W. Desc. 105 ft. over SW. slope.</p> <p>31.50 Wash, 25 lks. wide, course NW. Asc. 213 ft. over NE. slope. to</p> <p>39.08 Fall 5 lks. E. of the original cor. of secs. 25, 30, 31 and 36, which is an iron post, 3 ins. diam., projecting 14 ins. above ground, firmly set in the ground and mound of stone, properly marked on brass cap, and witnessed by four properly marked bearing trees as follows:</p> <p style="padding-left: 40px;">An oak, 10 ins. diam., N. 40° E., 47 lks. dist. An oak, 6 ins. diam., S. 33° E., 37 lks. dist. An oak, 8 ins. diam., S. 54° W., 57 lks. dist. An oak, 6 ins. diam., N. 19° W., 88 lks. dist.</p> <p>The true course and distance of the S. $\frac{1}{2}$ of line bet. secs. 25 and 30 are therefore S. 0° 4' W., 39.08 chs.</p> <p>Land; mountainous. Soil; rocky, 4th. rate. Timber; oak. Undergrowth; scrub oak, ocotillo and manzanita.</p>
--------	--

BOOK 3652

10

Resurvey of Part of West Bdy. of Township 22 South, Range 16 East.

Chains

Retracement for Resurvey.

Note: The west boundary of sec. 31 was retraced for alignment only, the measurement being taken from the original record.

39.96 From the original cor. of Ts. 22 and 23 S., Rs. 15 and 16 E., hereinafter described,
North, on a random line on W. bdy. of sec. 31 (S. $\frac{1}{2}$).
Fall 2 lks. E. of the original $\frac{1}{4}$ sec. cor. of secs. 31 and 36, hereinafter described.
The true course and distance of the S. $\frac{1}{2}$ of W. bdy. of sec. 31 are therefore S. $0^{\circ}2'$ E., 39.96 chs.

Thence
40.00 North, on a random line on W. bdy. of sec. 31, (N. $\frac{1}{2}$)
Intersect the original cor. of secs. 25, 30, 31 and 36, hereinafter described.
The true course and distance of N. $\frac{1}{2}$ of W. bdy. of sec. 31 are therefore South, 40.00 chs.

40.25 From the original $\frac{1}{4}$ sec. cor. of secs. 25 and 30, hereinafter described,
North, on a random line bet. secs. 25 and 30 (N. $\frac{1}{2}$)
Fall 3 lks. E. of the original cor. of secs. 19, 24, 25 and 30, hereinafter described.
The true course and distance of N. $\frac{1}{2}$ of line bet. secs. 25 and 30 are therefore S. $0^{\circ}3'$ E., 40.25 chs.

The original cor. of secs. 19, 24, 25 and 30, is a granite stone, 12 x 8 x 8 ins. above ground, firmly set, marked with 2 notches on S. edge and 4 notches on N. edge. No trace of accessories.
Reconstruct the cor. as follows:
Alongside old stone monument, set an iron post, 3 ft. long, 2 ins. diam., 14 ins. in the ground to bed rock, supported in a mound of stone, for cor. of secs. 19, 24, 25 and 30, marked on brass cap

T22S	
R15E	R16E
S 24	S 19
S 25	S 30
1923	

from which,

A cross (X) marked on granite ledge 3 ft. high, bears N. $77^{\circ}8'$ E., 29 lks. dist., mark B 0 above cross.

A cross (X) marked on granite boulder 4 x 3 x 3 ft. above ground, bears S. $59\frac{1}{2}^{\circ}$ W., 43 lks. dist. mark B 0 above cross.

Thence
S. $0^{\circ}3'$ E., on a true line bet. secs. 25 and 30 (N. $\frac{1}{2}$)
Over mountainous land, through scattering timber and dense undergrowth.
Descend 137 ft. over SW. slope.
7.30 Wash, 15 lks. wide, course NW.
Asc. 420 ft. over NE. slope to $\frac{1}{4}$ sec. cor.
16.54 Intersect NE. side line of the California patented mining claim, Mineral Survey No. 351, at a point from which Cor. No. 7, bears N. $23^{\circ}22'$ W., 179 lks. dist.
23.26 Ore tramway, bears SE. and NW.
37.83 Road, bears SE. and NW.
38.47 Intersect SW. side line of the California patented mining claim, at a point from which Cor. No. 4 bears S. $66^{\circ}38'$ W., 18 lks. dist.
Note: the above intersections to mining claim were taken from the notes of the original survey.

BOOK 3652

Resurvey of Part of the West Bdy. of Township 22 South, Range 16 East.

Chains	
40.25	The $\frac{1}{4}$ sec. cor. of secs. 25 and 30, hereinbefore described. Land; mountainous. Soil; rocky, 4th. rate. Timber; oak. Undergrowth; scrub oak, ocatillo and manzanita.
	From the original cor. of secs. 25, 30, 31 and 36, hereinbefore described, South, on a true line on W. bdy. of sec. 31 (N. $\frac{1}{2}$) (Topography on this mile approximate) Over mountainous land, through scattering timber and undergrowth.
10.50	Wash, 20 lks. wide, course NE.
23.18	Same wash, course NW.
30.63	Point of spur, slopes E.
35.00	Same wash, course NE.
38.49	(40.00 chs. northing from cor. of frac. Ts. 22 and 23 S., R. 15 E.) Set an iron post, 3 ft. long, 1 in. diam., 12 ins. in the ground to bed rock, deposit a stone marked with a cross (+) at base of post and raise a mound of stone around post for $\frac{1}{4}$ sec. cor. of sec. 36 only, marked on brass cap
	$\frac{1}{4}$ S 36 1923
40.00	Asc. over NE. slope. Intersect the original $\frac{1}{4}$ sec. cor. of secs. 31 and 36, which is an iron post, 1 in. diam., projecting 10 ins. above ground, firmly set, properly marked on brass cap, and witnessed by two properly marked bearing trees as follows: A pine, 9 ins. diam., N. 80° E., 65 lks. dist. A pine, 7 ins. diam., N. 84° W., 81 lks. dist. As this cor. now refers to sec. 31 only, I alter marks on brass cap to read as follows:
	$\frac{1}{4}$ S 31 1912
	I obliterate the markings on bearing tree in sec. 36.
	Thence S. 0° 2' E., on a true line on W. bdy. of sec. 31 (S. $\frac{1}{2}$) Over mountainous land, through scattering timber and dense undergrowth.
.50	Asc. over NE. slope. Power line, bears NE. and SW.
7.90	Top of round hill in ridge, bearing SE. and NW. Ridge turns to S. at about 5 chs. SE.
16.31	Desc. over SW. slope. Intersect the north end line of the Blue Rock No. 6, patented mining claim (Mineral Survey No. 3689) at a point from which Cor. No. 3 of said claim, bears N. 89° 42' W., 1.73 chs. Note: This tie taken from notes of the mineral survey.
34.20	Spur, slopes SW. Desc.
38.49	Point of intersection with S. bdy. of frac. T. 22 S., R. 15 E., surveyed due east as hereinafter described. Set an iron post, 3 ft. long, 3 ins. diam., 20 ins. in the ground to bed rock, deposit a stone marked with a cross (+) at base of post and raise a mound of stone around

BOOK 3652

Resurvey of Part of West Bdy. of Township 22 South, Range 15 East.

Chains post, for cor. of frac. Ts. 22 and 23 S., R.15 E., marked on brass cap

T22S		T22S
R15E		R16E
S 36		S 31
S 1		
T23S		
1923		

39.96 Continue same line and measurement.
Intersect the original cor. of Ts. 22 and 23 S., R.15 and 16 E., which is an iron post, 3 ins. diam., projecting 18 ins. above ground, firmly set in ground and mound of stone, and properly marked on brass cap for reference to said four townships, and witnessed by a mound of stone S. of cor.
As this cor. now refers to Ts. 22 and 23 S., R.16 E. only, alter the markings on brass cap to read as follows:

		T22S
T23S		R16E
R15E		S 31
S 1		S 6
		T23S
1912		

Rebuild the mound of stone, 2 ft. base, 1½ ft. high E. of cor.

Land; mountainous.
Soil; rocky, 4th. rate.
Timber; oak.
Undergrowth; scrub oak and manzanita.

Retracement of part of Subdivision lines of frac. T. 22 S. R. 15 E. 13
Chains.

The subdivision lines of this township were surveyed in 1876 by Theodore F. White, U.S.D.S. The area included within such survey conflicted with the Baca Float No. 3, and San Jose de Sonoita private land grants, but said grant being unsurveyed at the time, no segregation was made.

The San Jose de Sonoita grant was surveyed in 1903 by Philip Contzen, U.S.D.S., at which time said surveyor established closing corners on the Grant bdy. for all sec. lines and Tp. boundaries intersecting, and resurveyed the boundaries of all sections conflicting with said grant.

The Baca Float No. 3 grant was surveyed in 1905 by Philip Contzen, U.S.D.S., setting closing cors. for all sec. lines, Tp. boundaries and other grant boundaries intersecting and retracing the connecting lines to the nearest corners thereon.

The survey of the San Jose de Sonoita grant eliminated from the public land in this Tp. originally surveyed, parts of secs. 11, 12, 13, 14, 15, 16, 19, 20, 21, 22, 23, 28, 29, and 30, and the subsequent survey of the Baca Float No. 3 grant eliminated from the public land in this Tp. originally surveyed, all of secs. 19, 30 and 31, and parts of secs. 20, 29, and 32.

No other retracement or resurvey of Subdivision lines in this township is of record.

The following notes describe a retracement of that part of the sec. line bet. secs. 16 and 21, situated outside the San Jose de Sonoita grant, which line was resurveyed by P. Contzen, U.S.D.S. in 1903.

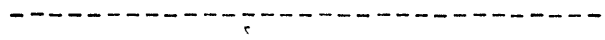

The original closing cor. of frac. secs. 16 and 21, on the bdy. of the San Jose de Sonoita Private Land Grant is a granite stone, 10x8x8 ins. above ground, firmly set, properly marked and witnessed by a mound of stone, W. of cor.

No bearing trees.

Thence,

West, on random line, bet. frac. secs. 16 and 21 (part of E. 1/2). Over mountainous land, thru scattering timber and undergrowth.

- .80 Ascend 8 ft., over SE. slope.
- Spur, slopes S.
- 8.40 Descend 164 ft., over W. slope., to Wash, 20 lks. wide, course SW.
- Ascend 128 ft., over SE. slope, to
- 16.56 Fall 2 lks. N. of the 1/4 sec. cor., reconstructed in 1903, which is a granite stone, 8x6x6 ins. above ground, firmly set, properly marked, and witnessed by a mound of stone, N. of cor. No bearing trees.

The true course and dist. of this part of the sec. line, bet. frac. secs. 16 and 21 are therefore, S. 89° 56' W., 16.56 chs.

Land, mountainous.
Soil, rocky, 4th rate.
Timber, mesquite.
Undergrowth, ocotillo.

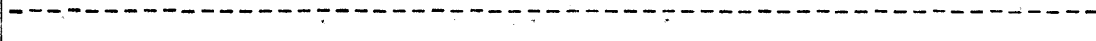

BOOK 3652

14 Resurvey of part of Subdivision lines of Frac. T.22 S., R.15 E.

Chains.

For statement regarding the previous survey, resurvey or retracement of Subdivision lines in this township, see "Retracement of part of the Subdivision lines of Frac. T.22 S., R.15 E." hereinbefore described.

The following notes describe the resurvey of those subdivision lines which bound the unsurveyed portions of the Tp. in the NW. and SE. parts, which portions are subdivided as hereinafter described under heading "Survey of part (completion) of the Subdivision lines of frac. T.22 S., R. 15 E."

Retracement for Resurvey.

From reestablished cor. of secs. 35 and 36 on S. bdy. of Tp. hereinafter described,

North, on random line, searching diligently at record intervals for the original cor. monument.

159.08 Find no trace of any cor., until at Fall 28 lks. E. of the original point of location of the cor. of secs. 23, 24, 25 and 26, determined as hereinafter described.

Thence,

79.54 S. $0^{\circ}6'E.$, on temp. line, and at (Proportional dist.) Set temp. cor. of secs. 25, 26, 35 and 36.

 From remains of original cor. of secs. 26, 27, 34 and 35, hereinafter described,

S. $89^{\circ}48'E.$, (record course) on random line, bet. secs. 26 and 35.

Diligent search in vicinity of 40.07 ch. station fails to reveal any trace of the original $\frac{1}{4}$ sec. cor.; therefore, at

80.15 (Record dist.) Set temp. cor. of secs. 25, 26, 35 and 36, which is 81 lks. S., and 2 lks. W. from the temp. cor. of same secs. set on the temp. meridional sec. line.

The point for reestablishment of the cor. of secs. 25, 26, 35 and 36 is therefore at 2 lks. W. from the temp. cor. first set, and 81 lks. N. from the second.

This reestablished point is monumented as hereinafter described, and results in true courses and distances for sec. lines dependent thereon, as follows:

Bet. secs. 25 and 26: S. $0^{\circ}5'E.$, 79.54 chs.

Bet. secs. 26 and 35: S. $89^{\circ}37'W.$, 80.15 chs.

Bet. secs. 35 and 36: S. $0^{\circ}7'E.$, 79.54 chs.

 From true point for cor. of secs. 23, 24, 25 and 26, East, on random line, bet. secs. 24 and 25.

40.00 Diligent search in this vicinity fails to reveal any trace of original $\frac{1}{4}$ sec. cor.

Set temp. $\frac{1}{4}$ sec. cor.

78.97 Fall 127 lks. N. of the cor. of secs. 19, 24, 25, and 30, on the E. bdy. of the Tp. hereinbefore described.

The true course and dist. of line bet. secs. 24 and 25 are therefore N. $89^{\circ}5'W.$, 78.98 chs.

 From the cor. of secs. 10, 11, 14 and 15, hereinafter described, North, on random line, bet. secs. 10 and 11 (S.E.).

39.72 Fall 15 lks. E. of the original $\frac{1}{4}$ sec. cor., hereinafter described.

The true course and dist. of S. $\frac{1}{2}$ of line, bet. secs. 10 and 11 are therefore, N. $0^{\circ}13'W.$, 39.72 chs.

Thence,

Resurvey of part of Subdivision lines of frac.T.22 S., R.15 E.

Chains.

Retracement for Resurvey, continued.

- 40.27 North, on random line, bet.secs.10 and 11 (N. $\frac{1}{2}$).
Fall 22 lks.E.of the original cor.of secs.2,3,10 and 11, hereinafter described.
The true course and dist. of N. $\frac{1}{2}$ of line, bet. secs.10 and 11 are therefore N.0° 19'W., 40.27 chs.
-
- 40.00 From original cor.of secs.2,3,10 and 11, hereinafter described,
North, on random line, bet. secs.2 and 3.
(Record dist.) Diligent search in this vicinity fails to reveal any trace of the original $\frac{1}{4}$ sec.cor. Set temp. $\frac{1}{4}$ sec.cor.
Continue line and measurement.
- 78.97 Fall 30 lks.E. of the reestablished cor.of secs.2,3,34 and 35 on the N.bdy.of the Tp., hereinbefore described.
The true course and dist. of line, bet.secs.2 and 3 are therefore S.0°13'E., 78.97 chs.
-
- 30.65 From the closing cor.of frac.secs.15 and 16, on the Bdy.of the San Jose de Sonoita private land grant, hereinafter described,
North, on random line, bet.frac.secs.15 and 16 (S. $\frac{1}{2}$).
Intersect the $\frac{1}{4}$ sec.cor., hereinafter described.
True course and dist.of S. $\frac{1}{2}$ of line bet.frac. secs.15 and 16 are therefore North, 30.65 chs.
Thence,
- 39.47 North, on random line, bet.frac.secs.15 and 16 (N.S).
Fall 12 lks.E.of the true point for cor.of secs.9,10,15 and 16, hereinafter described.
True course and dist.of N.half of line, bet.frac.secs. 15 and 16 are therefore N.0°10'W., 39.47 chs.
-
- 40.13 From true point for cor.of secs.9,10,15 and 16, hereinafter described,
East, on random line, bet. secs.10 and 15 (W.S).
Fall 124 lks.N.of the original $\frac{1}{4}$ sec.cor., hereinafter described.
True course and dist.of W. $\frac{1}{2}$ of line, bet. secs.10 and 15, are therefore S.88°14'W., 40.15 chs.
Thence,
- 39.80 East, on random line, bet. secs.10 and 15 (E. $\frac{1}{2}$).
Fall 18 lks.S.of the cor.of secs.10,11,14 and 15, herein- after described.
True course and dist. of E. $\frac{1}{2}$ of line, bet. secs.10 and 15 are therefore S.89°45'W., 39.80 chs.
-
- 39.30 From cor.of secs.16,17,20 and 21, hereinafter described,
East, on random line, on N.bdy.of frac.sec.21 (W.S).
Fall 2 lks.N.of the $\frac{1}{4}$ sec.cor. of frac.secs.16 and 21, hereinbefore described in notes of "Retracement of part of Subdivision lines of frac.T.22 S., R.15 E."
True course and dist. of W. $\frac{1}{2}$ of N.bdy.of frac.sec.21 are therefore, N.89°58'W., 39.30 chs.
-
- 30.00 From closing cor.of frac.secs.17 and 20, on the Bdy.of the Baca Float No.3 private land grant, hereinbefore de- scribed in notes of Retracement of part of said Bdy., East, on random line, on N.bdy.of frac.sec.20 (W. $\frac{1}{2}$).
Fall 3 lks.S.of the $\frac{1}{4}$ sec.cor., hereinafter described.
True course and dist. of W. $\frac{1}{2}$ of N. bdy.of frac.sec.20

BOOK 3652

16 Resurvey of part of Subdivision lines of frac. T. 22 S., R. 15 E.

Chains.

are therefore S. 89° 57' W., 30.00 chs.

Thence,

39.60

East, on random line, on N. bdy. of frac. sec. 20 (E. $\frac{1}{2}$).

Fall 17 lks. N. of the cor. of secs. 16, 17, 20 and 21, herein-

after described.

True course and dist. of E. $\frac{1}{2}$ of N. bdy. of frac. sec. 20 are therefore N. 89° 45' W., 39.60 chs.RESURVEY.

At the point determined, as hereinbefore described in the Retracement for Resurvey notes, reestablish the missing cor. of secs. 25, 26, 35 and 36, as follows:

Set an iron post, 3 ft. long, 2 ins. in diam., 6 ins. in the ground to bed rock, supported in a mound of stone, for reestablished cor. of secs. 25, 26, 35 and 36, marked on brass cap,

T22S	R15E
S26	S25
S35	S36
1923	

from which,

An oak, 6 ins. in diam., brs. N. 21 $\frac{1}{2}$ ° E., 71 lks. dist., marked T22S R15E S25 BT.

An oak, 14 ins. in diam., brs. S. 24° E., 46 lks. dist., marked T22S R15E S36 BT.

An oak, 6 ins. in diam., brs. S. 5° W., 37 lks. dist., marked T22S R15E S35 BT.

A granite boulder, 2 ft. x 2 ft. x 2 $\frac{1}{2}$ ft. above ground, brs. N. 9° W., 18 lks. dist., marked with a cross (X) and B0 S26 above cross.

Thence,

S. 0° 7' E., on a true line, bet. secs. 35 and 36.

Over mountainous land, thru. scattering timber and undergrowth:

Descend 35 ft., over SW. slope.

2.31 Wash, 25 lks. wide, course NW.

Ascend 334 ft., over NW. slope.

16.80 Spur, slopes W.

Descend 544 ft., over SW. and S. slopes, to

39.77 (Proportional dist.) Set an iron post, 3 ft. long, 1 in. in diam., 10 ins. in the ground to bed rock, supported in a mound of stone, for reestablished $\frac{1}{4}$ sec. cor. of secs. 35 and 36, marked on brass cap,

S35		S36
1923		

from which,

A live oak, 6 ins. in diam., brs. N. 46 $\frac{1}{2}$ ° W., 9 lks. dist., marked $\frac{1}{4}$ S 35 BT.

A granite boulder in place 3x2x2 ft. above ground brs. S. 54° E., 10 lks. dist., marked with a cross (X) and B0 S 36 above cross.

Pump house, brs. S. 13° W.

Water tank, brs. S. 17° 53' W.

Descend 243 ft., over steep S. slope.

48.24 Wash, course W. Road to 3-R mine in wash, brs. E. and W.

Ascend 465 ft., over steep N. slope.

61.00 Spur, slopes NW.

Descend 130 ft., over SW. slope.

67.50 Wash, 10 lks. wide, course NW.

Ascend 188 ft., over NE. slope:

74.00 Spur, slopes NW.

Descend 100 ft., over SW. slope.

78.00 Wash, 10 lks. wide, course W.

Resurvey of part of the Subdivision lines of frac. T. 22 S., R. 15 E. 17

Chains
79.54 Ascend 60 ft. over N. slope to
Intersect the cor. of secs. 35 and 36 on S. bdy. of Tp.,
hereinafter described.
Land; mountainous.
Soil; rocky, 4th. rate.
Timber; oak.
Undergrowth; scrub oak.

The cor. of secs. 23, 24, 25 and 26 was originally mon-
umented at the true point. Philip Contzen, U.S.D.S. in
his resurvey of part of the subdivision lines in 1903
found the original cor. monument missing, but located
the cor. point from old B.T., and as said point was in
small gully, established a witness cor. at 0.32 chs. N.
This witness cor. is a granite stone, 12 x 10 x 8 ins.
firmly set in a mound of stone, marked with 2 notches
on S. face and 4 notches on N. face, and witnessed by
four properly marked bearing trees as follows:

- An oak, 10 ins. in diam., N. 59° E., 66 lks. dist.
- A mesquite, 10 ins. in diam., S. 28 1/2° E., 149 lks. dist.
- An oak, 18 ins. in diam., S. 27° W., 163 lks. dist.
- An oak, 12 ins. in diam., N. 41° W., 55 lks. dist.

Finding no evidence of the marks W C on the cor. stone,
I chisel these marks thereon.

From true point for cor. of secs. 23, 24, 25 and 26,
S. 0° 5' E., on a true line bet. secs. 25 and 26.

Over broken ~~land~~ land, through scattering timber and
undergrowth.

- 1.00 Wash, 30 lks. wide, course NW.
- 8.30 Asc. 56 ft. over steep NE. slope.
- 10.30 Top of steep ascent. Asc. gradually.
- 18.71 Road, bears E. and W.
- Asc. 50 ft. to
- 20.00 Top of steep ascent. Asc. gradually over rolling land.
- 24.00 Wash, course E.
- 39.77 (Proportional distance) Set an iron post, 3 ft. long, 1
in. diam., 12 ins. in the ground to bed rock, supported
in a mound of stone for reestablished 1/4 sec. cor. of
secs. 25 and 26, marked on brass cap

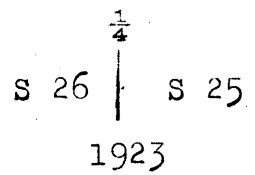

- from which,
- An oak, 12 ins. diam., bears S. 66° E., 22 lks. dist.
marked 1/4 S 25 B T
 - An oak, 8 ins. diam., bears S. 74° W., 55 lks. dist.
marked 1/4 S 26 B T

- 51.20 Asc. 260 ft. over steep NE. slope to
Precipitous cliffs beyond this point prevent chaining
on line. Offset E. 1.00 ch., then S. 0° 5' E. on offset
line. Asc. 350 ft. over precipitous NE. slope.
- 59.00 Top of ascent, then along E. slope.
- 62.00 Offset W. 1.00 ch. to true line
- Desc. 70 ft. over SE. slope.
- 67.40 Asc. 150 ft. over NE. slope.
- 73.45 Spur, bears SE. and NW.
- Desc. 155 ft. over SW. slope.
- 79.54 Intersect the reestablished cor. of secs. 25, 26, 35
and 36, hereinbefore described.
Land; mountainous.
Soil; gravelly and rocky, 3rd. and 4th. rates.
Timber; oak.
Undergrowth; scrub oak.

BOOK 3652

Resurvey of part of Subdivision lines of frac. T.22 S., R.15 E.

Chains	From the cor. of secs. 19, 24, 25 and 30 on E. bdy. of Tp., hereinbefore described, N. $89^{\circ}5'W.$, on a true line bet. secs. 24 and 25. Over mountainous land, through scattering timber and undergrowth. Desc. 230 ft. over SW. slope.								
4.53	Intersect the SE. side line of the Allis patented mining claim (Mineral Survey No. 353) at a point from which cor. No. 2, bears N. $57^{\circ}08'E.$, 10.63 chs. dist.								
10.00	W ash, 30 lks. wide, course NW. Asc. 230 ft. over NE. slope.								
13.70	Ore tramway, bears N. $29^{\circ}10'W.$ and S. $29^{\circ}10'E.$								
16.86	Road bears SE. and NW.								
19.06	Intersect SW. end line of the Allis patented mining claim at a point from which Cor. No. 5 of said claim bears N. $32^{\circ}42'W.$, 1.03 chs. dist. Note: The above ties to Allis mining claim were computed.								
22.30	Spur, slopes N. Desc. 190 ft. over NW. and W. slopes to								
39.49	(Proportional dist.) Set an iron post, 3 ft. long, 1 in. diam., 24 ins. in the ground for reestablished $\frac{1}{4}$ sec. cor. of secs. 24 and 25, marked on brass cap								
	<table style="margin-left: auto; margin-right: auto;"> <tr><td></td><td>S 24</td></tr> <tr><td>$\frac{1}{4}$</td><td>-----</td></tr> <tr><td></td><td>S 25</td></tr> <tr><td></td><td>1923</td></tr> </table>		S 24	$\frac{1}{4}$	-----		S 25		1923
	S 24								
$\frac{1}{4}$	-----								
	S 25								
	1923								
	from which, An oak, 12 ins. diam., bears N. $28\frac{1}{4}^{\circ}E.$, 96 lks. dist. marked $\frac{1}{4}$ S 24 B T An oak, 10 ins. diam., bears S. $40^{\circ}W.$, 14 lks. dist. marked $\frac{1}{4}$ S 25 B T								
45.00	Desc. 150 ft. over W. slope. Bottom of gulch, course N. Asc. 25 ft. over E. slope.								
47.00	Top of ascent. bears N. and S. Thence over rolling N. slope.								
51.40	W ash, course N.								
60.00	W ash, course N.								
62.20	Desc. gradually along N. slope.								
75.50	Desc. 72 ft. over W. slope.								
78.98	The true point for cor. of secs. 23, 24, 25 and 26, in small gully, course NW. Witness cor. 0.32 chs. N. hereinbefore described.								
	Land; mountainous and rolling. Soil; rocky and gravelly, 3rd. and 4th. rates. Timber; oak. Undergrowth; sagebrush and scrus oak.								
	The cor. of secs. 10, 11, 14 and 15, reconstructed in the original cor. position by P. Contzen, U.S.D.S. in 1903 is a granite stone, 18 x 12 x 12 ins above ground, firmly set, properly marked, and witnessed by a mound of stone W. of cor. Thence N. $0^{\circ}13'W.$, on a true line bet. secs. 10 and 11 (S. $\frac{1}{2}$) Over mountainous land, through scattering timber and undergrowth. Asc. 116 ft. over S. slope.								

Resurvey of part of Subdivision lines of frac.T.22 S.,R.15 E. 19 chains.

9.00 Spur, slopes SW. Desc.180 ft., over NW.slope, to
 19.85 Wash, 10 lks.wide, course NW.Asc.54 ft.over SW.slope.
 23.45 Point of spur, slopes SW. Desc.25 ft., over NW.slope, to
 29.50 Ascend gradually over W.slope, to
 37.00 Draw, course SW. Asc.gradually over S.slope, to
 39.72 Intersect the $\frac{1}{4}$ sec.cor.of secs.10 and 11, reconstructed by P.Contzen in 1903, which is a granite stone, 9x9x8 ins. above ground, firmly set, marked $\frac{1}{4}$ on W.face, and witnessed by accessories as follows:
 Stump of an oak, 16 ins.in diam., S.45°E., 144 lks. dist., marked BT., and
 A mesquite, 10 ins.in diam., N.20°W., 97 lks. dist., marked $\frac{1}{4}$ S 10 BT.
 The ties to this stump and tree agree with the records.
 Reconstruct this cor. as follows: Alongside old stone monument, set an iron post, 3 ft.long, 1 in.in diam., 12 ins.in the ground to bed rock, supported in a mound of stone, for $\frac{1}{4}$ sec.cor., marked on brass cap,

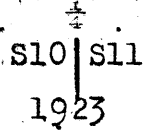

Thence,
 N.0°19'W., on true line, bet.secs.10 and 11 (N. $\frac{1}{2}$).
 Over mountainous land, thru.scattering timber and undergrowth. Asc. 50 ft., over S.slope.
 16.30 Point of spur, slopes SW.
 Descend 40 ft., over NW.slope.
 20.25 Wash, 10 lks.wide, course SW.
 Ascend 120 ft., over SE.slope.
 28.84 Spur, slopes SW.
 Descend 74 ft., over NW, slope, to
 35.70 Wash, 10 lks.wide, course SW.
 Ascend 32 ft., over S.slope, to
 40.27 Intersect the cor.of secs.2, 3, 10 and 11, reconstructed by P.Contzen, U.S.D.S. in 1903, which is a granite stone, 15x12x12 ins. above ground, firmly set, marked with 2 notches on E. face and 5 notches on S.face, and witnessed by a mound of stone, W.of cor., and two properly marked bearing trees, as follows:
 An oak, 24 ins.in diam., S.3 $\frac{1}{2}$ °E., 196 lks.dist.
 An oak, 10 ins.in diam., N.3 $\frac{1}{2}$ °W., 230 lks.dist.
 Land, mountainous.
 Soil, rocky and gravelly, 3rd rate.
 Timber, oak.
 Undergrowth, scrub mesquite and ocotillo.

From reestablished cor.of secs. 2, 3, 34 and 35, on N.bdy.of Tp., hereinbefore described,
 S, 0°13'E., on true line, bet.secs.2 and 3.
 Over mountainous land, thru.scattering timber and undergrowth. Asc.60 ft., over NE.slope.
 2.90 Spur, slopes SE. Desc.190 ft., over S.slope.
 9.70 Wash, 10 lks.wide, course SE.
 Ascend 127 ft., over NE.slope.
 21.00 Point of spur, slopes E.
 Descend 67 ft., over SE.slope.
 24.76 Wash, 10 lks.wide, course NE. near head.
 Ascend 55 ft., over N.slope.
 28.44 Ridge, brs.NE and SW. Desc.105 ft., over SE.slope.
 36.40 Wash, 10 lks.wide, course SW. Asc.55 ft., over NW.slope, to
 39.37 (Proportional dist.) Set an iron post, 3 ft.long, 1 in.in diam., 12 ins.in the ground to bed rock, deposit a stone, marked with a cross (x) at base of post, and raise a mound of stone around post, for reestablished $\frac{1}{4}$ sec.cor. of sec.2 only, marked on brass cap,

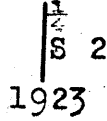

BOOK 3652

20. Resurvey of part of Subdivision lines of frac. T.22 S.R.15 E.

Chains.

No bearing trees available.
 A granite ledge, 4 ft. long, 2 ft. high, brs. N. $60\frac{1}{2}^{\circ}$ E.,
 19 lks. dist., on which mark a cross (X) and
 B0 S 2 above cross.
 Ascend 6 ft., over NW. slope, to
 40.00 Set an iron post, 3 ft. long, 1 in. in diam., 16 ins. in the
 ground to bed rock, deposit a stone, marked with a
 cross (x) at base of post; and raise a mound of stone
 around post, for reestablished $\frac{1}{4}$ sec. cor. of sec. 3 only,
 marked on brass cap,

$\frac{1}{4}$ |
 S 3

1923

No bearing trees available.
 A granite stone, 2x2x2 ft. above ground, brs. S. $66\frac{1}{2}^{\circ}$ W.
 12 lks. dist., on which mark a cross (x) and B0 S3
 above cross.
 Ascend 6 ft., over NW. slope, to
 40.77 Spur, slopes SW. Desc. 57 ft., over SE. slope, to
 43.53 Wash, 10 lks. wide, course SW. Asc. 96 ft., over NW. slope.
 49.93 Spur, slopes SW.
 Descend 162 ft., over SE. slope.
 59.75 Wash, 10 lks. wide, course SW.
 Ascend 40 ft., over NW. slope.
 62.00 Descend gradually over W. slope, to
 66.16 Saddle in spur, sloping SW.
 Descend gradually over SE. slope, to
 70.90 Descend 115 ft., over S. slope, to
 78.97 Intersect the cor. of secs. 2, 3, 10 and 11, hereinbefore de-
 scribed.
 Land, mountainous.
 Soil, gravelly and rocky, 3rd and 4th rate.
 Timber, oak.
 Undergrowth, scrub oak; scrub mesquite and ocotillo.

The closing cor. of frac. secs. 15 and 16, on the Bdy. of the
 San Jose de Sonoita private land grant, established by
 P. Contzen, U.S.D.S. in 1903 is a granite stone, 18x15x12
 ins. above ground, firmly set, marked CC on N. face, 3
 grooves on E. face, and S J D S on S. face, and witnessed
 by a mound of stone, N. of cor.

No bearing trees.

Thence,

North, on true line, bet. frac. secs. 15 and 16 (S. 2).

Over mountainous land, thru. scattering timber and under-
 growth. Asc. 75 ft., over S. slope.

3.25 Spur, slopes SW.
 Descend 25 ft., over NW. slope.
 7.00 Wash, 10 lks. wide, course SW., near head.
 Ascend 80 ft., over SW. slope.
 10.27 Ridge, brs. NW. and SE.
 Descend 185 ft., over NE. slope, to
 30.65 Intersect the $\frac{1}{4}$ sec. cor. of frac. secs. 15 and 16, recon-
 structed by P. Contzen, U.S.D.S. in 1903, which is a por-
 phyry stone, 10x8x6 ins. above ground, firmly set, marked
 $\frac{1}{4}$ on W. face, and witnessed by
 An oak, 8 ins. in diam., N. $32^{\circ}20'$ E., 180 lks.
 dist., marked $\frac{1}{4}$ S 15 BT., and
 Stump of oak, 6 ins. in diam., N. $71\frac{1}{2}^{\circ}$ W., 67 lks.
 dist., marked BT.

The ties to the tree and stump agree with record.

Reconstruct this cor. monument, as follows:

Alongside old stone, set an iron post, 3 ft. long, 1 in. in
 diam., 24 ins. in the ground, for $\frac{1}{4}$ sec. cor. of frac. secs.
 15 and 16, marked on brass cap.

Resurvey of part of Subdivision lines of frac. T.22 S. R.15 E. 21

Chairs.

$\frac{1}{4}$
 S16 | S15
 1923

- Thence,
 N.0°10'W., on true line, bet. frac. secs. 15 and 16 (N. $\frac{1}{2}$).
 Over mountainous land, thru. scattering timber and undergrowth,
- 4.10 Descend 50 ft., over NE. slope.
 Wash, 20 lks. wide, course NE.
 Ascend 55 ft., over SE. slope.
- 11.89 Spur, slopes NE.
 Descend 60 ft., over NW. slope.
- 17.08 Bend in wash, 100 lks. wide, course NW. from SW.
 Ascend 33 ft., over SW. slope.
- 19.94 Fence brs. E. and W.
- 21.04 Spur, slopes NW.
 Descend 35 ft., over NE. slope.
- 24.22 Fence brs. E. and W.
- 25.52 Center of wash, 200 lks. wide, course SE.
 Ascend gradually over SW. slope, to
- 31.42 Center of same wash, 200 lks. wide, course SW.
 Ascend gradually over SE. slope, to
- 37.72 Intersect the witness cor. to cor. of secs. 9, 10, 15 and 16, established by P. Contzen, U.S.D.S. in 1903, which is a granite stone, 8x6x6 ins. above ground, firmly set, marked with 3 notches on E. face, 4 notches on S. face, and WC on N. face, and witnessed by a mound of stone, W. of cor., and two properly marked bearing trees, as follows:
 An oak, 14 ins. in diam., N. 20° E., 25 lks. dist., and
 An oak, 30 ins. in diam., S. 26 $\frac{1}{2}$ ° E., 75 lks. dist.
 The ties to these trees agree with record.
 No trace of the record NW. bearing trees can be found.
- 39.47 Ascend gradually over SE. slope, to
 Intersect the true point for cor. of secs. 9, 10, 15 and 16 in wash 200 lks. wide, course SE. The sec. cor. was monumented at this point in 1876, but the original cor. monument was missing when P. Contzen, U.S.D.S. executed the resurvey in 1903, and said surveyor instead of making restoration at the sec. cor. point, established witness cor. at 1.75 chs. S. therefrom.
 Land, mountainous.
 Soil, gravelly and rocky, 3rd and 4th rate.
 Timber, oak and mesquite.
 Undergrowth, manzanita and ocotillo.
-
- From the cor. of secs. 10, 11, 14 and 15, hereinbefore described,
 S. 89° 45' W., on true line, bet. secs. 10 and 15 (E. $\frac{1}{2}$).
 Over mountainous land, thru. scattering timber and undergrowth.
- 12.40 Descend 26 ft., over S. slope, to
 Point of spur, slopes SW.
 Descend 222 ft., over SW. slope.
- 20.65 Wash, 100 lks. wide, course SE.
 Ascend 230 ft., over NE. slope.
- 34.22 Spur, slopes SE.
 Descend 40 ft., over SW. slope.
- 39.35 Head of wash, course NW.
 Ascend slightly over NE. slope, to
- 39.80 Intersect the $\frac{1}{4}$ sec. cor. reconstructed by P. Contzen, U.S.D.S. in 1903, which is a granite stone 8x6x6 ins. above ground, firmly set, marked $\frac{1}{4}$ on N. face, and witnessed by two properly marked bearing trees as follows:
 An oak, 10 ins. in diam., S. 49 $\frac{1}{4}$ ° E., 10 lks. dist., and
 An oak, 8 ins. in diam., N. 74° W., 122 lks. dist.
 The ties to these trees agree with the record.

BOOK 3652

82. Resurvey of part of Subdivision lines of T.22 S. R.15 E.

Chains.

Reconstruct this cor. monument as follows:

Alongside old stone, set an iron post, 3 ft. long, 1 in. in diam., 14 ins. in the ground to bed rock, and raise a mound of stone around post for $\frac{1}{4}$ sec. cor. of secs. 10 and 15, marked on brass cap,

$$\frac{1}{4} \text{ S } 10$$

$$\text{S } 15$$

1923

Thence,

S. $88^{\circ}14'$ W., on true line, bet. secs. 10 and 15 (W. $\frac{1}{2}$).

Over mountainous land, thru scattering timber and undergrowth.

- 5.32 Descend gradually over N. slope, to Point of spur, slopes NW.
 9.27 Descend 95 ft., over NW. slope.
 Wash, 20 lks. wide, course SE.
 20.50 Ascend 163 ft., over E. slope.
 Ridge, brs. N. and S.
 34.97 Descend 222 ft., over W. slope.
 Wash, 30 lks. wide, course SW.
 37.25 Ascend 22 ft., over SE. slope.
 Descend 30 ft., over SW. slope, to
 40.15 True point for cor. of secs. 9, 10, 15 and 16, in wash, 200 lks. wide, course SE. Witness cor. 1.75 chs. S. $0^{\circ}10'$ E.
 Land, mountainous.
 Soil, gravelly and rocky, 3rd and 4th rate.
 Timber, oak and mesquite.
 Undergrowth, scrub mesquite and ocotillo.

From the $\frac{1}{4}$ sec. cor. of frac. secs. 16 and 21, hereinbefore described,

N. $89^{\circ}50'$ W., on true line, on N. bdy. of frac. sec. 21 (W. $\frac{1}{2}$).

Over mountainous land, thru scattering timber and undergrowth.

- 1.40 Ascend 7 ft., over SE. slope.
 Spur, slopes SW.
 13.17 Descend 215 ft., over W. slope.
 Wash, 10 lks. wide, course SW.
 29.81 Ascend 336 ft., over SE. slope.
 Spur, slopes SW.
 39.30 Descend 292 ft., over W. slope, to
 Intersect the cor. of secs. 16, 17, 20 and 21, reconstructed by P. Contzen, U.S.D.S. in 1903, which is a granite stone, 16x12x8 ins. above ground, firmly set, marked with 4 notches on E. face, and 3 notches on S. face, and witnessed by a mound of stone W. of cor. A mesquite stump unmarked, N. $20\frac{1}{2}^{\circ}$ W., 142 lks. dist., and two properly marked bearing trees, as follows:
 A mesquite, 20 ins. in diam., N. 8° E., 108 lks. dist., and
 A mesquite, 24 ins. in diam., S. $71\frac{1}{2}^{\circ}$ W., 62 lks. dist.
 The ties to these trees agree substantially with the record.
 Alter this cor. monument to refer to frac. secs. 20 and 21 only by moving the mound of stone from W. to S. of cor., and changing the marking on the old NE. bearing tree to read "BT" only.
 No bearing tree SE. of cor. is available.
 Land, mountainous.
 Soil, rocky, 4th rate.
 Timber, mesquite.
 Undergrowth, ocotillo and scrub mesquite.

From cor. of frac. secs. 20 and 21,

N. $89^{\circ}45'$ W., on true line, on N. bdy. of frac. sec. 20 (E. $\frac{1}{2}$).

Resurvey of part of Subdivision lines of frac. T. 22 S., R. 15 E., 23

- Chains.
- Over mountainous land, thru. scattering timber and undergrowth,
 Descend 10 ft., over W. slope, to
 0.70 (40.00 chs. westing from $\frac{1}{4}$ sec. cor. of frac. secs. 16 and 21)
 Set an iron post, 3 ft. long, 2 ins. in diam., 18 ins. in the ground to bed rock, deposit a stone marked with a cross (x) at base of post, and raise a mound of stone around post, for reestablished cor. of frac. secs. 16 and 17, marked on brass cap,
- | | |
|------|------|
| T22S | R15E |
| S17 | S16 |
| S 20 | |
| 1923 | |
- Continue line and measurement.
 Descend 6 ft., over W. slope.
 1.10 Wash, 30 lks. wide, course S.
 Ascend 200 ft. over E. slope:
 2.51 Fence, brs. N. and S.
 11.08 Spur, slopes S.
 Descend 110 ft., over W. slope.
 17.40 Gulch, course S.
 Ascend 120 ft., over E. slope.
 22.80 Spur, slopes S.
 Descend 260 ft., over W. slope, to
 39.60 Intersect the $\frac{1}{4}$ sec. cor. of secs. 17 and 20, reconstructed by P. Contzen, U.S. D. S., in 1903, which is a granite stone, 10x8x6 ins. above ground, firmly set, marked $\frac{1}{4}$ on N. face, and witnessed by a mound of stone, N. of cor. No bearing trees.
 Alter this cor. monument to refer to the quarters of frac. sec. 20 only, by moving the mound of stone from N. to S. of cor.
 Thence,
 S. 89° 57' W., on a true line, on N. bdy. of frac. sec. 20 (W. $\frac{1}{2}$).
 Over mountainous land, thru. scattering timber and undergrowth.
 Descend 5 ft., over W. slope, to
 1.10 (40.00 chs. westing from reestablished cor. of secs. 16 and 17),
 Set an iron post, 3 ft. long, 1 in. in diam., 6 ins. in the ground to bed rock, deposit a stone marked with a cross (x) at base of post, and raise a mound of stone around post, for reestablished $\frac{1}{4}$ sec. cor. of frac. sec. 17 only, marked on brass cap,
- | |
|--------------------|
| $\frac{1}{4}$ S 17 |
| 1923 |
- A granite boulder, 4x3x3 ft. above ground, brs. N. 62° W., 65 lks. dist., on which mark a cross (X) and BO S17 above cross.
- Continue line and measurement.
 Descend slightly over W. slope.
 1.50 Wash, 20 lks. wide, course S.
 Ascend 46 ft., over E. slope.
 6.80 Spur, slopes S.
 Descend 16 ft., over W. slope.
 10.17 Wash, 15 lks. wide, course S.
 Ascend 20 ft., over E. slope.
 14.90 Spur, slopes S.
 Descend 37 ft., over W. slope.
 24.55 Wash, 10 lks. wide, course S.
 Ascend 40 ft., over SE. slope.
 28.20 Ascend slightly over S. slope, to
 30.00 Intersect the closing cor. of frac. secs. 17 and 20, on the Bdy. of Baca Float No. 3 private land grant, hereinbefore described, in notes of Retracement of part of the Bdy. of Baca Float No. 3.

BOOK 3652

24 Resurvey of part of Subdivision lines of frac. T.22 S. R.15 E.

Chains.

Land, mountainous.
Soil, rocky, 4th rate.
Timber, oak.
Undergrowth, ocotillo.

Resurvey of Part of Subdivision lines of frac. T.22 S., R.15 E. 25

Chains

Reconstruction of cor. of secs. 26,
27, 34 and 35.

The remains of the original cor. of secs. 26, 27, 34 and 35, consist of a mound of stone, from which an oak tree 14 ins. diam., bears N.75°W., 16 lks. dist. This tree is blazed on the side toward the mound, but no marks are visible; however the tie is in substantial agreement with that of the record to one of the three original bearing trees. No trace of the other two trees could be found. Diligent search in this vicinity fails to reveal a trace of any other cor. monument, but before accepting the mound of stone as the remains of the original cor., retrace the line between secs. 27 and 34, and at 79.40 chs. S.89°40'W., find the cor. of secs. 27, 28, 33 and 34. which was reconstructed in 1903 by P.Contzen, U.S.D.S. This retracement gives satisfactory verification of the mound of stone as remains of the original sec. cor.

Reconstruct this cor. as follows:
In center of old mound, set an iron post, 3 ft. long, 2 ins. diam., 18 ins. in the ground to bed rock, deposit a stone, marked with a cross (+) at base of post and raise a mound of stone around post, for cor. of secs. 26, 27, 34 and 35, marked on brass cap

T22S | R15E
S 27 | S 26
S 34 | S 35
1923

from which,

A forked live oak, 24 ins. diam., bears N.44°E., 92 lks. dist., marked T 22 S R 15 E S 26 B T

A live oak, 16 ins. diam., bears N.70°W., 33 lks. dist. marked T 22 S R 15 E S 27 B T

On the old blazed tree, mark T 22 S R 15 E S 27 B T

BOOK 3652

Survey of Part (Completion) of S. bdy. of frac. T.22 S., R.15 E.

Chains

The cor. of secs. 35 and 36, frac. T.22 S., R.15 E., reestablished by J.B. Wright, U.S.S. in 1913 is an iron post, 3 ins. diam., projecting 20 ins. above ground, firmly set in ground and mound of stone, properly marked on brass cap, and witnessed by a mound of stone N. of cor.

The original survey of this township bdy. established sec. and $\frac{1}{4}$ sec. cors. with a common reference to areas N. and S. of the line, but the survey of Subdivision lines in T.23 S., R.15 E., in 1913 established closing cors. along the line, and a resurvey of the line in same year reestablished the sec. and $\frac{1}{4}$ sec. cors. thereon, which referred to areas N. of the line only.

The following notes describe the survey of the S. bdy. of sec. 36, which completes the survey of the Tp. bdy. From the cor. of secs. 35 and 36, described above, East, on a true line on S. bdy. of sec. 36.

Over mountainous land, through scattering timber and dense undergrowth.

- Asc. 35 ft. over N. slope.
- 4.30 Desc. 13 ft. over NE. slope.
- 5.53 Wash, 10 lks. wide, course NW.
- Asc. 220 ft. over SW. slope.
- 13.50 Spur, slopes NW.
- Desc. 45 ft. over NE. slope.
- 18.50 Wash, 10 lks. wide, course NW.
- Asc. 233 ft. over SW. slope.
- 25.68 Spur, slopes NW.
- Desc. 190 ft. over NE. slope.
- 36.00 Wash, 10 lks. wide, course NW.
- Asc. 10 ft. over SW. slope.
- 39.30 Spur, slopes NW. Desc. 31 ft. over NE. slope to
- 40.00 Set an iron post, 3 ft. long, 1 in. diam., 14 ins. in the ground to bed rock, deposit a stone marked with a cross (+) at base of post, and raise a mound of stone around post, for $\frac{1}{4}$ sec. cor. of sec. 36 only, marked on brass cap

$\frac{1}{4}$ S 36

1923

A ledge, 6 ft. high, bears S.6°W., 22 lks. dist. on which mark a cross (+) and B O above cross.

- Desc. 86 ft. over NE. slope.
- 42.11 Intersect the W. side line of the Three R. No.7 patented mining claim (Mineral Survey No. 3689) at a point from which Cor. No. 4 of said claim bears North, 6.63 chs. Note: This tie obtained from notes of the mineral survey.
- 45.00 Wash, 10 lks. wide, course NW.
- Asc. 310 ft. over SW. slope.
- 57.00 Spur, slopes NW.
- Desc. 90 ft. over NE. slope.
- 61.70 Wash, 10 lks. wide, course NW.
- 75.00 Asc. 400 ft. over W. and NW. slopes to
- 75.00 Spur, slopes SW.
- Asc. 61 ft. over S. slope to
- 79.16 Intersect the W. bdy. of T.22 S., R.16 E., at a point 1.47 chs. N.0°2'W., from the cor. of Ts.22 and 23 S., R.16 E. hereinbefore described. Establish cor. of frac. Ts.22 and 23 S., R.15 E., as hereinbefore described.

Land; mountainous.
Soil; rocky, 3rd. and 4th. rates.
Timber; oak and pine.
Undergrowth; manzanita and scrub oak.

Survey of part (completion) of N. bdy. of frac. T. 22 S., R. 15 E. 27

Chains.

From the reestablished cor. of secs. 2, 3, 34 and 35, on N. bdy. of Tp., hereinbefore described.

West, on true line, on N. bdy. of sec. 3.

Over mountainous land, thru. scattering timber.

Ascend 254 ft., over NE. slope.

15.00 Ridge, brs. SE. and NW. U.S.M.M. No. 3777, brs. N. 48° 39' W.

Descend 304 ft., over SW. slope.

27.80 Wash, 20 lks. wide, course SE.

Ascend 110 ft., over NE. slope.

35.90 Spur, slopes SE.

Descend gradually over SW. slope, to

40.00 Set an iron post, 3 ft. long, 1 in. in diam., 4 ins. in the ground to bed rock, deposit a stone, marked with a cross (x) at base of post, and raise a mound of stone, around post, for $\frac{1}{4}$ sec. cor. of sec. 3 only, marked on brass cap.

S	3
T2S	R15E

1923

A granite ledge, 6 ft. high, brs. S. 13 $\frac{1}{2}$ ° W., 34 lks. dist., on which mark a cross (x) and B0 S3 above cross.

Descend slightly over SW. slope.

40.50 Wash, 10 lks. wide, course SE.

Ascend 156 ft., over E. slope, to

46.21 Spur, slopes N. U.S.M.M. No. 3777, brs. N. 38° 51' E.

Descend 180 ft., over W. slope, to

52.20 Wash, 20 lks. wide, course NW.

Descend 130 ft., over N. slope, to

56.80 Ascend 60 ft., over NE. slope.

58.90 Spur, slopes NW.

Descend 150 ft., over SW. slope.

69.90 Wash, 30 lks. wide, course SW. Enter rolling land.

Descend gradually over S. slope, to

73.60 Low spur, slopes SW.

Descend gradually over W. slope, to

80.00 Set an iron post, 3 ft. long, 2 ins. in diam., 12 ins. in the ground to bed rock, supported in a mound of stone, for cor. of secs. 3 and 4 only, marked on brass cap.

T21S R15E

S	4	S	3
T22S	R15E	T22S	R15E

1923

from which,

A mesquite, 6 ins. in diam., brs. S. 64° E., 159 lks. dist., marked T22S R15E S3 BT.

An oak, 24 ins. in diam., brs. S. 31° 38' W., 423 lks. dist., marked T22S R15E S4 BT.

A windmill, brs. S. 51° 22' W., about 10 chs. dist.

Land, mountainous and rolling.

Soil, rocky, 4th rate.

Timber, oak and mesquite.

Undergrowth, none.

West, on true line, on N. bdy. of sec. 4:

Over rolling land, thru. scattering timber and undergrowth.

Descend 15 ft., over W. slope.

4.00 Descend gradually over S. slope.

12.20 Ascend 18 ft., over SE. slope.

15.90 Spur, slopes SW.

Descend 42 ft., over NW. slope.

16.24 Wash, 60 lks. wide, course SW.

Ascend 45 ft., over SE. slope.

BOOK 3652

28 Survey of part (completion) of N. bdy. of frac. T. 22 S., R. 15 E.

Chains.

- 20:90 Spur, slopes SW.
Descend 37 ft., over W. slope.
31.10 Wash, 10 lks. wide, course SE.
Ascend 44 ft., over E. slope, to
40.00 Set an iron post, 3 ft. long, 1 in. in diam., 12 ins. in the
ground to bed rock, supported in a mound of stone, for
 $\frac{1}{4}$ sec. cor. of sec. 4 only, marked on brass cap,

$\frac{1}{4}$ S 4
 1923

from which,

- An oak, 15 ins. in diam., brs. S. $74^{\circ}40'$ E., 117
lks. dist., marked $\frac{1}{4}$ S 4 BT.
A forked oak, 10 ins. in diam., brs. S. 27° W., 45
lks. dist., marked $\frac{1}{4}$ S 4 BT.

- Ascend 35 ft., over E. slope.
44.06 Spur, slopes SE.
Descend 33 ft., over SW. slope.
46.80 Wash, 20 lks. wide, course SE. Enter mountainous land.
Ascend 450 ft., over NE. slope.
65.70 Ridge, brs. SE and NW.
Descend 302 ft., over SW. slope to sec. cor.
78.70 Wash, 20 lks. wide, course SW.
80.00 Set an iron post, 3 ft. long, 2 ins. in diam., 18 ins. in
the ground to bed rock, supported in a mound of
stone, for cor. of secs. 4 and 5, only, marked on brass
cap,

T21S R15E

S 5	S 4
T22S	R15E

 1923

from which,

- A mesquite, 6 ins. in diam., brs. S. $62\frac{1}{2}^{\circ}$ E., 59
lks. dist., marked T22S R15E S4 BT.
A live oak, 12 ins. in diam., brs. S. $85\frac{1}{2}^{\circ}$ W., 215
lks. dist., marked T22S R15E S5 BT.

Land, rolling and mountainous,
Soil, rocky, 3rd and 4th rate,
Timber, oak and mesquite.
Undergrowth, ocotillo.

West, on true line on N. bdy. of frac. sec. 5.

Over mountainous land, thru scattering timber and under-
growth.

- Descend 18 ft., over SW. slope.
1.60 Wash, course S.
Ascend 105 ft., over E. slope.
6.70 Point of small spur, slopes S.
Descend 20 ft., over SW. slope.
9.50 Ascend 54 ft., over E. slope.
13.20 Spur, slopes S.
Descend 205 ft., over W. slope.
28.70 Wash, 10 lks. wide, course S.
Ascend 40 ft., over E. slope.
32.80 Low spur, slopes S.
Descend 15 ft., over W. slope.
34.30 Wash, 10 lks. wide, course S.
Ascend 95 ft., over E. slope, to
40.00 Set an iron post, 3 ft. long, 1 in. in diam., on surface
rock, supported in a mound of stone, for $\frac{1}{4}$ sec. cor. of
sec. 5 only, marked on brass cap,

$\frac{1}{4}$ S 5
 1923

from which,

Survey of part (completion) of N. bdy. of frac. T. 22 S. R. 15 E. 29

Chains
47.60
58.30
65.04
67.80
67.85

A live oak, 12 ins. in diam., brs. S. 47 1/2° E., 146 lks. dist., marked 1/4 S 5 BT.
A live oak, 12 ins. in diam., brs. S. 69° W., 150 lks. dist., marked 1/4 S 5 BT.
Ascend 70 ft., over E. slope.
Ridge, brs. N. and S.
Descend 150 ft., over W. slope.
Ascend 32 ft., over NE. slope to closing cor.
Road to mine, brs. N. and S.
Fence, brs. N. and S.
Intersect the Bdy. of Baca Float No. 3 private land grant at a point 9.10 chs. N. from the 46 mile monument thereon, hereinbefore described.
At point of intersection,
Set an iron post, 3 ft. long, 3 ins. in diam., 6 ins. in the ground to bed rock, supported in a mound of stone, for closing cor. of frac. Ts. 21 and 22 S., R. 15 E., marked on brass cap,

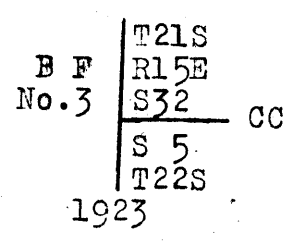

from which,
An oak, 12 ins. in diam., brs. N. 13° E., 28 lks. dist., marked T21S R15E S32 CC BT.
A rock ledge, 5 ft. wide and 3 ft. high, brs. S. 13 1/2° E., 30 lks. dist., on which mark a cross (x) and B0 S5 above cross.
Shaft of Mammoth Mine, brs. N. 53 1/2° E., 250 lks. dist.,
Land, mountainous.
Soil, rocky, 3rd and 4th rate.
Timber, oak.
Undergrowth, scrub oak and ocotillo.

Boundaries of secs. 25. and 36, frac. T. 22 S., R. 15 E.

Latitudes, Departures, and Closing Errors.

Lines designated.	True course.	Dist.	Latitudes.		Departures.	
			N.	S.	E.	W.
South bdy. of Tp.	West,	79.16				79.16
Subdivisional Boundary,	N. 0° 7' W.	79.54	79.54			.16
	N. 0° 5' W.	79.54	79.54			.12
	S. 89° 5' E.	78.98		1.26	78.97	
East Bdy. of Tp.	S. 0° 3' E.	40.25		40.25	.03	
	S. 0° 4' W.	39.08		39.08		.05
	South,	40.00		40.00		
	S. 0° 2' E.	38.49		38.49	.02	
Convergency,					.02	
Totals,			159.08	159.08	79.04	79.49
				159.08		79.04
Error in latitude,			0.00			
Error in departure,					0.45	

Boundaries of secs. 3, 4, 5, 8, 9, 10, 16 & 17, Frac. T. 22 S., R. 15 E.

Latitudes, Departures, and Closing Errors.

Lines designated.	True course.	Dist.	Latitudes.		Departures.	
			N.	S.	E.	W.
Bdy. of San Jose de Sonoita P.L.C.	S. 72° 00' W.	24.50		7.57		23.30
Subdivisional Boundary,	S. 89° 56' W.	16.56		.02		16.56
	N. 89° 58' W.	39.30	.02			39.30
	N. 89° 45' W.	39.60	.17			39.60
	S. 89° 57' W.	30.00		.03		30.00
Bdy. of Baca Float No. 3 P.L.C.	North,	27.10	27.10			
	N. 0° 3' W.	40.33	40.33			.04
	N. 0° 7' E.	40.32	40.32		.08	
	North,	40.33	40.33			
	N. 0° 4' W.	40.29	40.29			.05
N. 0° 4' E,	40.44	40.44			.05	
North,	9.10	9.10				
N. bdy. of Tp.,	East,	227.85			227.85	
Subdivisional Boundary,	S. 0° 13' E.	78.97		78.97	.30	
	S. 0° 19' E.	40.27		40.27	.22	
	S. 0° 13' E.	39.72		39.72	.15	
	S. 89° 45' W.	39.80		.17		39.80
	S. 88° 14' W.	40.15		1.24		40.13
	S. 0° 10' E.	39.47		39.47	.12	
	South,	30.65		30.65		
Convergency,					.10	
Totals,			238.10	238.11	228.87	228.78
				238.10	228.78	
Error in latitude,			0.01			
Error in departure,					0.09	

Survey of part (completion) of Subdivision lines of fract. T. 22 S., R. 15 E. 3

Chains.

From the reestablished cor. of secs. 25, 26, 35 and 36, here-
 inbefore described,
 East, on a random line, bet. secs. 25 and 36.
 40.00 Set temp. $\frac{1}{4}$ sec. cor.
 78.97 Fall 94 lks. N. of the cor. of secs. 25, 30, 31 and 36, on E.
 bdy. of Tp., hereinbefore described,
 Thence,
 N. $89^{\circ}19'$ W., on a true line, bet. secs. 25 and 36.
 Over mountainous land, thru. scattering timber and dense
 undergrowth.
 Ascend 360 ft., over NE. and E. slopes.
 19.70 Spur, slopes N.
 Descend 350 ft., over W. slope.
 30.70 Wash, in bottom of ravine, course N.
 Ascend 315 ft., over E. slope, to
 38.98 Set an iron post, 3 ft. long, 1 in. in diam., 6 ins. in the
 ground to bed rock, deposit a stone, marked with a
 cross (x) at base of post, and raise a mound of stone
 around post, for $\frac{1}{4}$ sec. cor., marked on brass cap,

$\frac{1}{4}$ S 25
 S 36
 1923

No bearing trees available.
 Ascend 37 ft., over E. slope.
 41.60 Spur, slopes N.
 Descend 390 ft., over W. slope.
 55.28 Wash, 20 lks. wide, in bottom of ravine, course N.
 Ascend 350 ft., over NE. slope.
 66.48 Ridge, brs. NW. and SE.
 Descend 210 ft., over SW. slope, to
 78.98 Intersect the reestablished cor. of secs. 25, 26, 35 and 36,
 hereinbefore described.
 Land, mountainous.
 Soil, rocky, 4th rate.
 Timber, oak.
 Undergrowth, manzanita and scrub oak.

From true point for cor. of secs. 9, 10, 15 and 16,
 N. $0^{\circ}14'$ W. (mean bearing of E. boundaries of secs. 10 and 3)
 on random line W. of secs. 10 and 3, setting temp. cors.
 at 40 ch. intervals, and at
 160.38 Fall 14 lks. W. of the cor. of secs. 3 and 4 on N. bdy. of Tp.,
 hereinbefore described.
 Thence,
 S. $0^{\circ}17'$ E., on true line, on W. bdy. of sec. 3.
 Over rolling land, thru. scattering timber.
 Descend 61 ft., over W. and SW. slopes.
 18.05 Wash, 10 lks. wide, course SW.
 Ascend 35 ft., over NW. slope.
 20.16 Point of spur, sloping SW.
 Descend 73 ft., over SW. slope.
 34.12 Wash, 100 lks. wide, course SE.
 Ascend 45 ft., over NE. slope, to
 40.00 Set an iron post, 3 ft. long, 1 in. in diam., 10 ins. in the
 ground to bed rock, supported in a mound of stone, for
 $\frac{1}{4}$ sec. cor. of secs. 3 and 4, marked on brass cap,

$\frac{1}{4}$
 S 4 | S 3
 1923

from which,
 A double oak, 10 ins. in diam., brs. N. 15° E., 83
 lks. dist., marked S 3 BT.
 An oak, 10 ins. in diam., brs. S. 9° W., 27 lks.
 dist., marked $\frac{1}{4}$ S 4 BT.
 Ascend slightly over NE. slope.

BOOK 3652

32 Survey of part (completion) of Subdivision lines of frac. T. 22 S. R. 15E

Chains.

- 41.30 Point of low spur, sloping SE.
Descend 33 ft., over S. slope.
- 47.66 Wash, 20 lks. wide, course SE.
Ascend 45 ft., over NE. slope.
- 52.40 Enter mountainous land.
Descend 90 ft., over SE. slope.
- 59.94 Wash, 100 lks. wide, course SE.
Ascend 46 ft., over NE. slope.
- 64.89 Point of spur, slopes SE.
Descend 25 ft., over S. slope.
- 73.78 Wash, 10 lks. wide, course SE.
Ascend 55 ft., over N. slope, to
- 79.03 Point of intersection with subdivision line bet. secs.
3 and 10, surveyed due West, as hereinafter described.
Set an iron post, 3 ft. long, 2 ins. in diam., 24 ins. in
the ground for cor. of secs. 3, and 10, marked on brass
cap,

	T22S
	R15E
S 4	S 3
	S 10

1923

from which,

- A mesquite, 6 ins. in diam., brs. N. $52\frac{1}{4}^{\circ}$ E., 127
lks. dist., marked T22S R15E S3 BT.
- An oak, 8 ins. in diam., brs. S. $56\frac{1}{4}^{\circ}$ E., 82 lks.
dist., marked T22S R15E S10 BT.

Land, rolling and mountainous.
Soil, rocky, 3rd and 4th rate.
Timber, oak and mesquite.
Undergrowth, none.

- From cor. of secs. 2, 3, 10 and 11, hereinbefore described,
West, on true line, bet. secs. 3 and 10.
Over mountainous land, thru scattering timber and under-
growth.
- 15.07 Descend 65 ft., over S. and SW. slopes.
Wash, 30 lks. wide, course SE.
- 23.70 Ascend 233 ft. over NE. slope.
Spur, slopes SE.
- 31.80 Descend 202 ft., over SW. slope.
Wash, 20 lks. wide, course SE.
- 39.89 Ascend 197 ft., over NE. slope, to
(Midpoint, determined after survey of this line) Set an
iron post, 3 ft. long, 1 in. in diam., 4 ins. in the
ground to bed rock, supported in a mound of stone, for
 $\frac{1}{4}$ sec. cor., of secs. 3 and 10, marked on brass cap,

	S 3
	S 10
	1923

from which,

- An oak, 10 ins. in diam., brs. S. 67° E., 10 lks.
dist., marked $\frac{1}{4}$ S 10 BT.
- An oak, 10 ins. in diam., brs. N. $42\frac{1}{2}^{\circ}$ W., 148 lks.
dist., marked $\frac{1}{4}$ S 3 BT.

- Ascend 56 ft., over NE. slope.
- 46.64 Ridge, brs. NW. and SE.
Descend 45 ft., over SW. slope.
- 49.30 Wash, 10 lks. wide, course SW.
Ascend 16 ft., over SE. slope.
- 50.76 Spur, slopes SW.
Descend 185 ft., over W. slope.
- 64.21 Wash, 10 lks. wide, course SW.
Ascend 6 ft., over SE. slope.
- 65.32 Descend 8 ft., over SW. slope.
- 70.07 Center of wash, 100 lks. wide, course SE.
Ascend 65 ft., over E. slope.

Survey of part (completion) of Subdivision lines of frac. T. 22 S. R. 15 E. 33

Chains.	
72.34	Fence brs. NE and SW.
73.62	Point of spur, sloping NE. Ascend 40 ft., over N. slope, to
79.78	Intersect the meridional sec. line at a point 79.03 chs. S. $0^{\circ}17'E.$ from cor. of secs. 3 and 4, on N. bdy. of Tp., and 81.35 chs. N. $0^{\circ}17'W.$ from true point for cor. of secs. 9, 10, 15 and 16. Establish cor. of secs. 3 and 10 at this point of intersection, as hereinbefore described. Land, mountainous. Soil, rocky, 3rd and 4th rate. Timber, oak. Undergrowth, ocotillo.

	From true point for cor. of secs. 9, 10, 15 and 16, in wash, 200 lks. wide, course SE., N. $0^{\circ}17'W.$, on true line, on W. bdy. of sec. 10. Over mountainous land, thru scattering timber and undergrowth. Ascend 31 ft., over S. slope.
1.00	Road, brs. NW and SE. Extends northwesterly to Patagonia.
3.27	Point of spur, sloping SW. Ascend 10 ft., over W. slope, to
8.00	Descend 27 ft., over NW. slope.
10.03	Center of wash, 200 lks. wide, course SW. Ascend 150 ft., over S. slope.
10.52	Road, brs. NE and SW. Extends northerly to Pete Perry's ranch, following the wash.
27.73	Point of spur, sloping SE. Descend 25 ft., over NE. slope, to
30.50	Ascend 62 ft., over E. slope, to
40.19	(Midpoint of E. bdy. of sec. 9) Set an iron post, 3 ft. long, 1 in. in diam., 6 ins. in the ground to bed rock, deposit a stone marked with a cross (x) at base of post, and raise a mound of stone around post, for $\frac{1}{4}$ sec. cor. of secs. 9 and 10, marked on brass cap, <div style="text-align: center;"> $\frac{1}{4}$ S 9 S10 1923. </div>
	from which, A mesquite, 6 ins. in diam., brs. E. 8 lks. dist., marked $\frac{1}{4}$ S 10 BT. No other bearing trees available.
44.97	Ascend 34 ft., over E. slope, to Head of wash, course SE. House of M. L. Shellenberger brs. W. about 20 chs. dist. Ascend 97 ft., over SE. slope.
48.70	Windmill at Pete Perry's ranch, brs. N. $38^{\circ}53'E.$
48.80	Point of spur, slopes E. Descend 214 ft., over NE. slope.
54.63	Fence, brs. E. and W.
57.54	Wash, 20 lks. wide, course SE. Ascend 115 ft., over SW. slope.
64.37	Spur, slopes SE. Descend 85 ft., over NE. slope, to
67.83	Wash, 10 lks. wide, course NE. near head. Descend 47 ft., over NE. slope, to
73.10	Wash, 10 lks. wide, course NE. Ascend 75 ft., over SE. slope.
76.68	Fence, brs. E. and W.
78.66	Spur, slopes NE. Descend 12 ft., over N. slope, to
80.38	(80.00 chs. S. $0^{\circ}17'E.$, from cor. of secs. 3 and 4 on N. bdy. of Tp.), Set an iron post, 3 ft. long, 2 ins. in diam., 10 ins. in the ground to bed rock, supported in a mound of stone, for cor. of secs. 4 and 9 only, marked on brass cap,

BOOK 3652

34 Survey of part (completion) of Subdivision lines of frag. T. 22 S. R. 15 E

Chains.

T22S	
R15E	
S 4	S 10
S 9	
1923	

From which,

An oak, 12 ins. in diam., brs. S. 72° W., 60 lks.

dist., marked T22S R15E S9 BT.

An oak, 6 ins. in diam., brs. N. 45° W., 82 lks.

dist., marked T22S R15E S4 BT.

Pete Perry's windmill brs. S. 37° E.Pete Perry's house brs. S. 32° 23' E.

House is due west of windmill.

Continue line and measurement.

Descend 7 ft., over N. slope, to

81.35 Intersect the cor. of secs. 3 and 10, hereinbefore described.

Land, mountainous.

Soil rocky, 3rd and 4th rate.

Timber, oak and mesquite.

Undergrowth, scrub mesquite and ocotillo:

From true point for cor. of secs. 9, 10, 15 and 16,
West, on random line, bet. secs. 9 and 16.

40.00m Set temp. $\frac{1}{4}$ sec. cor.

80.00 Set temp. cor. of secs. 8, 9, 16 and 17.

Thence,

N. 0° 17' W., on random line, W. of secs. 9 and 4, setting
temp. cors. at 40 chs. intervals, and at160.40 Fall 5 lks. E. of the cor. of secs. 4 and 5, on N. bdy. of the
Tp., hereinbefore described.

Thence,

S. 0° 18' E., on true line, bet. secs. 4 and 5.

Over mountainous land, thru. scattering timber.

Descend 50 ft., over S. slope.

3.90 Wash, 20 lks. wide, course SW.

Ascend 36 ft., over NW. slope.

7.45 Point of spur, slopes SW.

Descend 192 ft., over SW. slope.

31.65 Wash, 50 lks. wide, course SE. Enter rolling land.

Descend 10 ft., over E. slope, to

35.00 Point of spur, slopes SE.

Descend gradually over SE. slope, to

40.00 Set an iron post, 3 ft. long, 1 in. in diam., 15 ins. in the
ground to bed rock, supported in a mound of stone, for
 $\frac{1}{4}$ sec. cor., marked on brass cap,

S 5	S 4
1923	

from which,

A mesquite, 10 ins. in diam., brs. S. 19° E., 136
lks. dist., marked $\frac{1}{4}$ S 4 BT.A mesquite, 6 ins. in diam., brs. N. 10° W., 2
lks. dist., marked $\frac{1}{4}$ S 5 BT.

Continue over rolling land, thru. scattering timber.

Descend gradually over SE. slope.

45.70 Fence, brs. NE. and SW.

48.30 Descend 42 ft., over SW. slope.

51.54 Wash, 50 lks. wide, course SE.

Ascend 27 ft., over NE. slope.

57.50 Spur, slopes SE.

Descend 80 ft., over SW. slope.

70.25 Wash, 30 lk. wide, course SE.

Ascend 61 ft., over NE. slope.

72.30 Point of spur, slopes SE.

Descend 23 ft., over S. slope.

78.01 Fence brs. SE. and NW.

Surv. of part (completion) of Subdivision lines of frac. T.22 S. R.15 E. 35

Chains.

- 78.58 Road, brs. SE and NW.
 78.70 Wash, 30 lks. wide, course SE.
 Ascend 12 ft., over N. slope, to
 80.00 Set an iron post, 3 ft. long, 2 ins. in diam., 6 ins. in
 the ground to bed rock, supported in a mound of stone,
 for cor. of secs. 4, 5, 8 and 9, marked on brass cap,

T22S	R15E
S 5	S 4
S 8	S 9
1923	

from which,

- An oak, 12 ins. in diam., brs. N. 72° E., 72 lks.
 dist., marked T22S R15E S4 BT.
 An oak, 5 ins. in diam., brs. S. 5½° E., 84 lks.
 dist., marked T22S R15E S9 BT.
 An oak, 8 ins. in diam., brs. S. 27° W., 144 lks.
 dist., marked T22S R15E S8 BT.
 An oak, 12 ins. in diam., brs. N. 89½° W., 68 lks.
 dist., marked T22S R15E S5 BT.

Land, mountainous and rolling.

Soil, rocky, 3rd and 4th rate.

Timber, oak and mesquite.

Undergrowth, none.

- 40.00 East, on a random line, bet. secs. 4 and 9.
 Set temp. ¼ sec. cor.
 79.96 Intersect the cor. of secs. 4 and 9, hereinbefore described.
 Thence,
 West, on a true line, bet. secs. 4 and 9.
 Over mountainous land, thru scattering timber.
 Ascend 56 ft., over steep N. slope, to
 3.00 Top of ascent; thence across small nearly level bench.
 Descend 14 ft. to
 12.50 Leave bench.
 Descend 60 ft., over NW. slope.
 21.00 Ascend 60 ft., over NE. slope.
 26.00 Spur, slopes SE.
 Descend 63 ft., over SW. slope.
 30.50 Wash, 10 lks. wide, course S.
 Ascend 18 ft., over E. slope.
 35.00 Spur, slopes S.
 Descend 24 ft., over W. slope:
 39.70 Wash, 10 lks. wide, course S.
 Ascend slightly over E. slope, to
 39.98 Set an iron post, 3 ft. long, 1 in. in diam., 26 ins. in the
 ground for ¼ sec. cor., marked on brass cap,

¼ S	4
S	9
1923	

from which,

- An oak, 6 ins. in diam., brs. N. 33½° W., 48 lks.
 dist., marked ¼ S 4 BT.

No other bearing trees available. Raise a mound of
 stone, 2 ft. base, 1½ ft. high, N. of cor.

- Ascend 37 ft., over E. slope.
 42.00 Spur, slopes S.
 Descend 70 ft., over W. slope, to
 47.60 Ascend 25 ft., over SE. slope.
 52.00 Point of spur, slopes SW.
 Descend 65 ft., over SW. slope.
 62.40 Wash, 30 lks. wide, course SE.
 Ascend 50 ft., over NE. slope, to
 65.00 Enter rolling land.
 Ascend gradually over N. slope to sec. cor.
 69.60 Fence, brs. N. and S.
 76.00 Road, brs. SE. and NW.
 79.96 The cor. of secs. 4, 5, 8 and 9.
 Land, mountainous and rolling.

BOOK 3652

36 Surv. of part (completion) of Subdivision lines of frac. T.22 S.R.15E.

Chains.

Soil, gravelly and rocky, 3rd and 4th rate.
 Timber, oak and mesquite.
 Undergrowth, none.

- West, on true line, bet. frac. secs. 5 and 8.
 Over rolling land, thru. scattering timber.
 Ascend slightly over N. slope, to
- 1.20 Wash, 20 lks. wide, course NE.
 Ascend 50 ft., over NE. slope, to
- 18.30 Wash, 5 lks. wide, course NE.
 Ascend 40 ft., over NE. slope, to
- 24.10 Wash, 20 lks. wide, course NE. Enter mountainous land.
 Ascend 416 ft., over steep E. slope.
- 38.15 Spur, slopes N.
 Descend 12 ft., over W. slope, to
- 40.00 Set an iron post, 3 ft. long, 1 in. in diam., 26 ins. in
 the ground for $\frac{1}{4}$ sec. cor., marked on brass cap,

$$\begin{array}{r} \frac{1}{4} \text{ S } 5 \\ \text{S } 8 \\ 1923 \end{array}$$

from which,

An oak, 10 ins. in diam., brs. N. 42° E., 73 lks.
 dist., marked $\frac{1}{4}$ S 5 BT.

An oak, 10 ins. in diam., brs. S. $59\frac{1}{2}^\circ$ W., 112 lks.
 dist., marked $\frac{1}{4}$ S 8 BT.

- Ascend 35 ft., over E. slope.
- 46.40 Ridge, b'f's. N. and S.
 Descend 260 ft., over W. slope, to
- 58.10 Wash, 10 lks. wide, course NW.
 Descend 46 ft., over NW. slope, to
- 62.50 Wash, 20 lks. wide, course SW.
 Ascend 57 ft., over SE. slope, to
- 68.16 Intersect the Bdy. of Baca Float No. 3 private land grant
 at a point 9.85 chs. N. $0^\circ 4'$ W., from the 45 mile monument
 thereon, hereinbefore described.
 At point of intersection, set an iron post, 3 ft. long, 2
 ins. in diam., 10 ins. in the ground to bed rock, sup-
 ported in a mound of stone, for closing cor. of frac.
 secs. 5 and 8, marked on brass cap,

$$\begin{array}{r} \text{B F} \\ \text{No. 3} \end{array} \left| \begin{array}{l} \text{T22S} \\ \text{R15E} \\ \text{S } 5 \text{ CC} \\ \text{S } 8 \end{array} \right.$$

1923

from which,

An oak, 6 ins. in diam., brs. S. $21\frac{1}{4}^\circ$ E., 410 lks.
 dist., marked T22S R15E S8 C C B T.

No other bearing tree available.
 Land, rolling and mountainous.
 Soil, rocky, 3rd and 4th rate.
 Timber, oak.
 Undergrowth, none.

- From cor. of secs. 4, 5, 8 and 9,
 S. $0^\circ 18'$ E., bet. secs. 8 and 9.
 Over rolling land, thru. scattering timber and undergrowth.
 Ascend 26 ft., over N. slope, to
- 6.70 Enter mountainous land.
 Ascend 93 ft., over NW. slope.
- 14.76 Spur, slopes NE.
 Descend 15 ft., over SE. slope.
- 19.46 Head of wash, course NE.
 Ascend 105 ft., over NE. slope.
- 27.94 Fence brs. SE. and NW.
- 29.00 Ridge brs. SE. and NW.

Survey of part(completion)of Dubdivision lines of frac.T.22S.,R.15E.

37

Chains.

30.23 Descend 48 ft., over SW.slope to $\frac{1}{4}$ sec.cor.
 40.00 Chimney at W.end of Fred Barnett's house, brs.S.21 $\frac{1}{2}$ °W.
 Set an iron post, 3 ft.long, 1 in. in diam., 8 ins.in
 the ground to bed rock, supported in a mound of stone,
 for $\frac{1}{4}$ sec.cor., marked on brass cap,

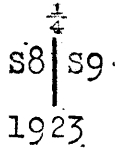

from which,
 A forked oak, 10 ins.in diam., brs.S.9°E., 418
 lks.dist., marked $\frac{1}{4}$ S 9 BT.
 An oak, 12 ins. in diam., brs.S.9°55'W., 371
 lks.dist., marked $\frac{1}{4}$ S 8 BT.
 Chimney on Fred Barnett's house, brs.S.31 $\frac{1}{2}$ °W.

49.36 Descend 50 ft., over SW.slope.
 Head of wash, course SW.
 60.14 Ascend 96 ft., over NW.slope.
 Spur, slopes SW. Fence brs.NE. and SW.
 62.60 Descend 105 ft., over SE.slope to sec.cor.
 Chimney on Fred Barnett's house, brs.N.66 $\frac{1}{2}$ ° W.
 80.00 Set an iron post, 3 ft.long, 2 ins. in diam., 12 ins. in
 the ground to bed rock, deposit a stone marked with
 a cross (x) at base of post, and raise a mound of
 stone around post, for cor.of secs.8,9,16 and 17,
 marked on brass cap,

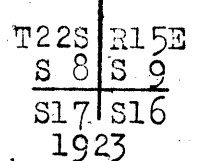

No bearing trees available.
 Land, rolling and mountainous.
 Soil, rocky, 3rd and 4th rate.
 Timber, oak.
 Undergrowth, ocotillo.

40.00 East, on a random line, bet. secs.9 and 16.
 Set temp. $\frac{1}{4}$ sec.cor.
 80.00 Fall 40 lks.N. of the true point for cor.of secs.9,10,15
 and 16, in wash, 200 lks.wide, course SE.
 Thence,
 N.89°43'W., on a true line, bet. secs.9 and 16.
 Over mountainous land, thru. scattering timber and under-
 growth.
 8.10 Ascend 80 ft., over E.slope.
 8.60 Fence, brs.SE. and NW.
 Spur, slopes SE.
 14.60 Descend 55 ft., over SW.slope.
 Wash, 20 lks.wide, course SE.
 26.15 Ascend 186 ft., over E.slope.
 Spur, slopes SE.
 32.85 Descend 36 ft., over SW.slope.
 Head of wash, course SE.
 37.45 Ascend 65 ft., over E.slope.
 Spur, slopes SE.
 40.00 Descend 28 ft., over SW.slope, to
 Set an iron post, 3 ft.long, 1 in. in diam., 24 ins.in
 the ground for $\frac{1}{4}$ sec.cor., marked on brass cap,

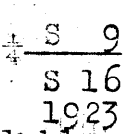

No bearing trees available.
 Raise a mound of stone, 2 ft. base, 1 $\frac{1}{2}$ ft. high, N.of
 cor.
 45.16 Descend 110 ft., over SW. slope.
 Wash, 20 lks.wide, course SE.

BOOK 3652

3 Survey of part (completion) of Subdivision lines Of frac. T.22S. R.15E.

Chains.

57.30 Ascend 165 ft., over E. slope.
Point of spur, slopes NE.
60.20 Descend 30 ft., over NW. slope.
Head of wash, course NE.
64.00 Ascend 90 ft., over E. slope.
Spur, slopes SE.
69.70 Descend 145 ft., over SW. slope.
Wash, 10 lks. wide, course SE.
80.00 Ascend 150 ft., over SE. slope, to
The cor. of secs. 8, 9, 16 and 17.
Land, mountainous.
Soil, rocky, 3rd and 4th rate.
Timber, mesquite and oak.
Undergrowth, ocotillo.

West, on a true line, bet. frac. secs. 8 and 17.
Over mountainous land, thru scattering timber and under-
growth.

3.06 Ascend 15 ft., over SE. slope.
Spur, slopes S. Fence, brs. N. and S.
9.40 Descend 116 ft., over W. slope.
Wash, 10 lks. wide, course SE. near head.
18.50 Ascend 126 ft., over SE. slope.
Spur, slopes SW.
29.26 Descend 223 ft., over NW. slope.
Wash, 20 lks. wide, course SW.
36.66 Ascend 110 ft., over SE. slope.
Point of spur, slopes S.
40.00 Descend 47 ft., over SW. slope, to
Set an iron post, 3 ft. long, 1 in. in diam., 6 ins. in
the ground to bed rock, supported in a mound of stone,
for $\frac{1}{4}$ sec. cor., marked on brass cap,

$$\begin{array}{r} \frac{1}{4} \text{ S } 8 \\ \text{S } 17 \\ 1923 \end{array}$$

from which,

An oak, 8 ins. in diam., brs. S. $64^{\circ}40'W.$, 332
lks. dist., marked $\frac{1}{4} \text{ S } 17 \text{ BT.}$
An oak, 10 ins. in diam., brs. N. $58^{\circ}1'W.$, 362
lks. dist., marked $\frac{1}{4} \text{ S } 8 \text{ BT.}$

43.75 Descend 70 ft., over SW. slope.
Wash, course SE.
56.80 Ascend 40 ft., over E. slope.
Spur, slopes S.
59.90 Descend 33 ft., over W. slope.
Wash, 10 lks. wide, course S.
68.70 Ascend 72 ft., over E. slope, to
Intersect the Bdy. of Baca Float No. 3 private land grant
at a point 10.51 chs. N. $0^{\circ}7'E.$ from the 44 mile monument
thereon, hereinbefore described.
At point of intersection, set an iron post, 3 ft. long, 2
ins. in diam., 14 ins. in the ground to bed rock, de-
posit a stone marked with a cross (x) at base of post,
and raise a mound of stone around post, for closing
cor. of frac. secs. 8 and 17, marked on brass cap,

$$\begin{array}{r} \text{B. F.} \\ \text{No. 3} \end{array} \left| \begin{array}{l} \text{T22S} \\ \text{R15E} \\ \text{S } 8 \\ \text{S17} \end{array} \right. \text{CC} \\ 1923$$

No bearing trees available.
Land, mountainous.
Soil, rocky, 3rd rate.
Timber, oak and mesquite.
Undergrowth, ocotillo.

Survey of part (completion) of Subdivision lines of frac. T.22S.R.15 E. 39

Chairs.

- From the cor. of secs. 8, 9, 16 and 17,
South, on random line, bet. frac. sec. 16 and 17.
- 40.00 Set temp. $\frac{1}{4}$ sec. cor..
- 78.20 Fall 13 lks. W. of the reestablished cor. of frac. secs. 16
and 17, hereinbefore described.
- Thence,
N. 0° 6' W., on a true line, bet. frac. secs. 16 and 17.
Over mountainous land, thru scattering timber and under-
growth.
- Ascend gradually over W. slope.
- 2.00 Descend 7 ft., over NW. slope.
- 3.20 Wash, 20 lks. wide, course SW.
- Ascend 87 ft., over S. slope.
- 8.10 Point of spur, slopes SE.
- Descend 50 ft., over NE. slope.
- 12.00 Wash, 10 lks. wide, course SE.
- Ascend 175 ft., over SW. slope.
- 28.77 Spur, slopes SE.
- Descend 27 ft., over NE. slope.
- 31.00 Wash, 10 lks. wide, course SE. near head.
- Ascend 151 ft., over S. slope.
- 36.60 Ridge, brs. E and W.
- Descend 20 ft., over N. slope, to
- 40.00 Set an iron post, 3 ft. long, 1 in. in diam., 12 ins. in
the ground to bed rock, supported in a mound of stone,
for $\frac{1}{4}$ sec. cor., marked on brass cap,



from which,
 An oak, 10 ins. in diam., brs. N. 25 $\frac{1}{2}$ ° E., 41 lks.
 dist., marked $\frac{1}{4}$ S 16 BT.
 An oak, 10 ins. in diam., brs. N. 16° W., 95 lks.
 dist., marked $\frac{1}{4}$ S 17 BT.

- 52.60 Descend 145 ft., over N. slope.
- Wash, 10 lks. wide, course NW.
- Ascend 90 ft., over SW. slope.
- 63.20 Spur, slopes SE.
- Descend 30 ft., over NE. slope.
- 65.66 Wash, 10 lks. wide, course SE. near head.
- Ascend 93 ft., over SE. slope, to
- 78.20 The cor. of secs. 8, 9, 16 and 17.
Land, mountainous.
Soil, rocky, 3rd and 4th rate.
Timber, oak and mesquite.
Undergrowth, ocotillo.

BOOK 3652

40 Establishment of $\frac{1}{4}$ sec. cors. on the Bdy. of Baca Float No. 3 private land grant, for frac. secs. 5, 8, & 17, Frac. T. 22 S., R. 15 E.

Chains.

Fractional Section 5.

At a point midway bet. the NW. and SW. cors. of frac. sec. 5, and 9.55 chs. N. $0^{\circ}4'E.$ from the $45\frac{1}{2}$ -mile mon. on the Bdy. of Baca Float No. 3 private land grant, hereinbefore described, set an iron post, 3 ft. long, 1 in. in diam., 10 ins. in the ground to bed rock, supported in a mound of stone, for $\frac{1}{4}$ sec. cor. of frac. sec. 5, marked on brass cap,

|
S 5
1923

from which,

An oak, 8 ins. in diam., brs. N. $42\frac{1}{2}^{\circ}E.$, 72 lks.
dist., marked $\frac{1}{4}$ S 5 BT.

An oak, 5 ins. in diam., brs. S. $19\frac{1}{4}^{\circ}E.$, 29 lks.
dist., marked $\frac{1}{4}$ S 5 BT.

Fractional Section 8.

At a point midway bet. the NW. and SW. cors. of frac. sec. 8, and 10.19 chs. N. from the $44\frac{1}{2}$ -mile monument on the Bdy. of Baca Float No. 3 private land grant hereinbefore described, set an iron post, 3 ft. long, 1 in. in diam., 24 ins. in the ground to bed rock, supported in a mound of stone for $\frac{1}{4}$ sec. cor. of frac. sec. 8, marked on brass cap,

|
S 8
1923

from which,

An oak, 18 ins. in diam., brs. S. $31^{\circ}E.$, 277 lks.
dist., marked $\frac{1}{4}$ S 8 BT.

An oak, 12 ins. in diam., brs. S. $14\frac{1}{2}^{\circ}E.$, 293 lks.
dist., marked $\frac{1}{4}$ S 8 BT.

Fractional Section 17:

At a point 40.00 chs. northerly from the old closing cor. of frac. secs. 17 and 20, hereinbefore described, and 12.90 chs. N. $0^{\circ}03'W.$, from the $43\frac{1}{2}$ -mile monument on the bdy. of the Baca Float No. 3 private land grant, hereinbefore described, set an iron post, 3 ft. long, 1 in. in diam., 12 ins. in the ground to bed rock, supported in a mound of stone, for $\frac{1}{4}$ sec. cor., of frac. sec. 17, marked on brass cap,

|
S 17
1923

from which,

An oak, 12 ins. in diam., brs. N. $79\frac{1}{4}^{\circ}E.$, 86 lks.
dist., marked $\frac{1}{4}$ S 17 BT.

An oak, 6 ins. in diam., brs. S. $53\frac{1}{2}^{\circ}E.$, 96 lks.
dist., marked $\frac{1}{4}$ S 17 BT.

The continued satisfactory adjustment of the instrument throughout the survey of the Tp. is indicated from a solar test made Jan. 28, 1923, as follows:

At the same station at which the solar test was made on

Jan. 9, 1923, hereinbefore described, set off $31^{\circ}31\frac{1}{2}'$ on the latitude arc, $18^{\circ}18\frac{1}{2}'$ S. on the decl. arc, and at 9h.00m.a.m., app.time, determined a meridian with the solar, which agrees with the meridian established by altitude observation upon the sun.

GENERAL DESCRIPTION.

The southeast portion of frac.T.22 S.,R.15 E., surveyed under this assignment is very rough and mountainous, ranging in elevation from about 4000 ft. above sea level to about 6000 ft. The drainage is northwest into Sonoita Creek. The northwest portion of the township surveyed under this assignment is rolling, mountainous and hilly, and ranges in elevation from about 4100 ft. above sea level to about 4800 ft. The drainage is southerly into Sonoita Creek.

The soil is very shallow and consists for the most part of disintegrated granite and sandstone.

The predominate forest species are live oak, white oak and mesquite. The oak is quite dense in portions of secs.25 and 36, but scattering on the remaining portions. The timber is utilized considerably for firewood.

Considerable prospecting for mineral has been carried on from time to time throughout both portions of the township, and the 3-R Mine in the west half of the southeast quarter of sec.36 has been developed quite extensively.

There are a few small springs, but they do not furnish sufficient water for stock purposes. Water in small quantities has also been obtained from wells.

There were several settlers on the land at the time of survey: Pete Perry in sec.10, M.L.Shellenberger in sec.9, and Fred Barnett in sec.8.

The land is all too rough for the growing of crops, but can be utilized for grazing. There would also appear to be possibilities in mining.

BOOK 3652

4-680

FIELD ASSISTANTS.

to F. W. Chapin, U.S. Surveyor.

NAMES.	CAPACITY.
Merle Brock	1st. Chainman.
Robert J. Greisiger	1st. Chainman.
B.H. Fruitt	2nd. Chainman.
Dixon L. Phillips	Flagman.
Clifton Gump	Cornerman.

CERTIFICATE OF UNITED STATES SURVEYOR.

44

I, F. W. Chapin, U. S. Surveyor, hereby certify upon honor that, in pursuance of special instructions received from the U. S. Surveyor General, for Group 119, Arizona, bearing date of the 16th day of December, 1921, I have well, faithfully, and truly in my own proper person, and in strict conformity with said instructions, the Manual of Surveying Instructions, and the laws of the United States, retraced all those parts or portions of the Boundary of Baca Float No. 3, Private Land Grant, the West bdy. of T. 22 S., R. 16 E., and Subdivision lines of frac. T. 22 S., R. 15 E., Resurveyed all those parts or portions of the West bdy. of T. 22 S., R. 16 E., and Subdivision lines of frac. T. 22 S., R. 15 E., and Surveyed all those parts or portions of the North and South boundaries, and Subdivision lines of Frac. Township 22 South, Range 15 East, of the Gila and Salt River Base and Meridian, in the State of Arizona, which are represented in the foregoing field notes and by diagram on page 1 hereof as having been executed by me, and under my direction; and that all the corners of said retracement, resurvey and survey have been established and perpetuated in strict accordance with the Manual of Surveying Instructions, and the special written instructions of the U. S. Surveyor General, for Group 119, Arizona, and in the specific manner described in the field notes, and that the foregoing are the original field notes of such retracement, resurvey and survey.

Place - Phoenix, Arizona

Date - June 30, 1923

F. W. Chapin U. S. Surveyor.

APPROVAL.

OFFICE OF THE UNITED STATES SURVEYOR GENERAL,

Phoenix, Arizona, May 14, 1925.

The foregoing field notes of the retracement of part of the boundary of Baca Float No. 3 Private Land Grant, part of the West bdy. of T. 22 S., R. 16 E., and part of the Subdivision lines of frac. T. 22 S., R. 15 E., of Resurvey of Part of the West bdy. of T. 22 S., R. 16 E., and part of the Subdivision lines of frac. T. 22 S., R. 15 E., and of the Survey of Part (completion) of the North bdy., part (completion) of the South bdy., and part (completion) of the Subdivision lines of

TOWNSHIP 22 SOUTH, RANGE 15 EAST.

of the Gila and Salt River Base and Meridian, in the State of Arizona, executed by F. W. Chapin, U. S. Surveyor,

under his special instructions dated December 16th, 1921, for Group 119, Arizona, having been critically examined, and the necessary corrections and explanations made, the said field notes, and the retracements, resurveys and surveys they describe, are hereby approved.

Charles M. Donohoe U. S. Surveyor General.

I certify that the foregoing transcript of the field notes of the above described surveys in has been correctly copied from the original notes on file in this office.