

Book "J"

4-679

BOOK 3720

FIELD NOTES

OF THE RETRACEMENT OF

Part of the Subdivision lines of Township 12 North, Range 1 East,

The Boundary of Forest Homestead No. 43, and

Part of the Boundaries of patented placer mining claims of

Mineral Surveys Nos. 1263, 1788 and 1835;

AND OF THE SURVEY OF

"RIGBY PLACER" MINING CLAIM, and"MAYER PLACER" MINING CLAIM,

situate in Sections 22 and 27 of

Township 12 North, Range 1 East,

Of the Gila and Salt River Base and Meridian,

In the State of Arizona.

EXECUTED BY

Sidney E. Blout,

U.S. Cadastral Engineer,

In the capacity of U. S. Surveyor, under Special Instructions dated Nov. 17, 1924, issued by the United States Surveyor General to govern surveys included in Group No. 129, Arizona, which were approved by the Commissioner of the General Land Office, December 6, 1924, and Assignment Instructions dated June 10, 1925.

Retracement & Survey commenced June 12, 1925.

Retracement & Survey completed June 19, 1925.

3720

3720

INDEX DIAGRAM.

Township _____, Range _____

6	5	4	3	2	1
7	8	9	10	11	12
18	17	16	15	14	13
19	20	21	22	23	24
30	29	28	27	26	25
31	32	33	34	35	36

INDEX DIAGRAM

BOOK 3720

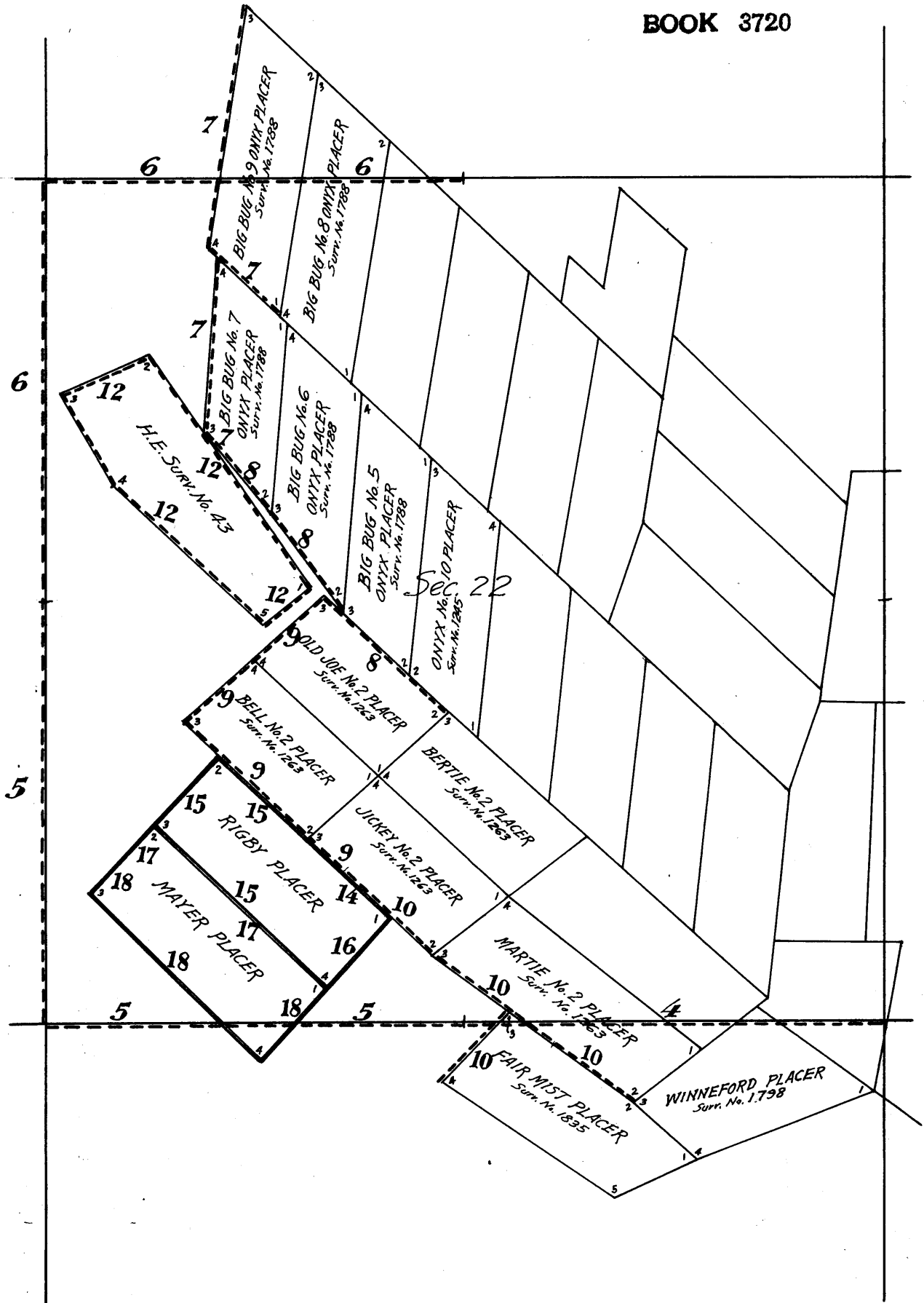

----- Retraced under this group.

————— Surveyed under this group.

————— Accepted surveys.

Book "J"

Group 129 - Arizona

Township 12 North - Range 1 East

BOOK 3720

DATE · DIAGRAM ·

1925.

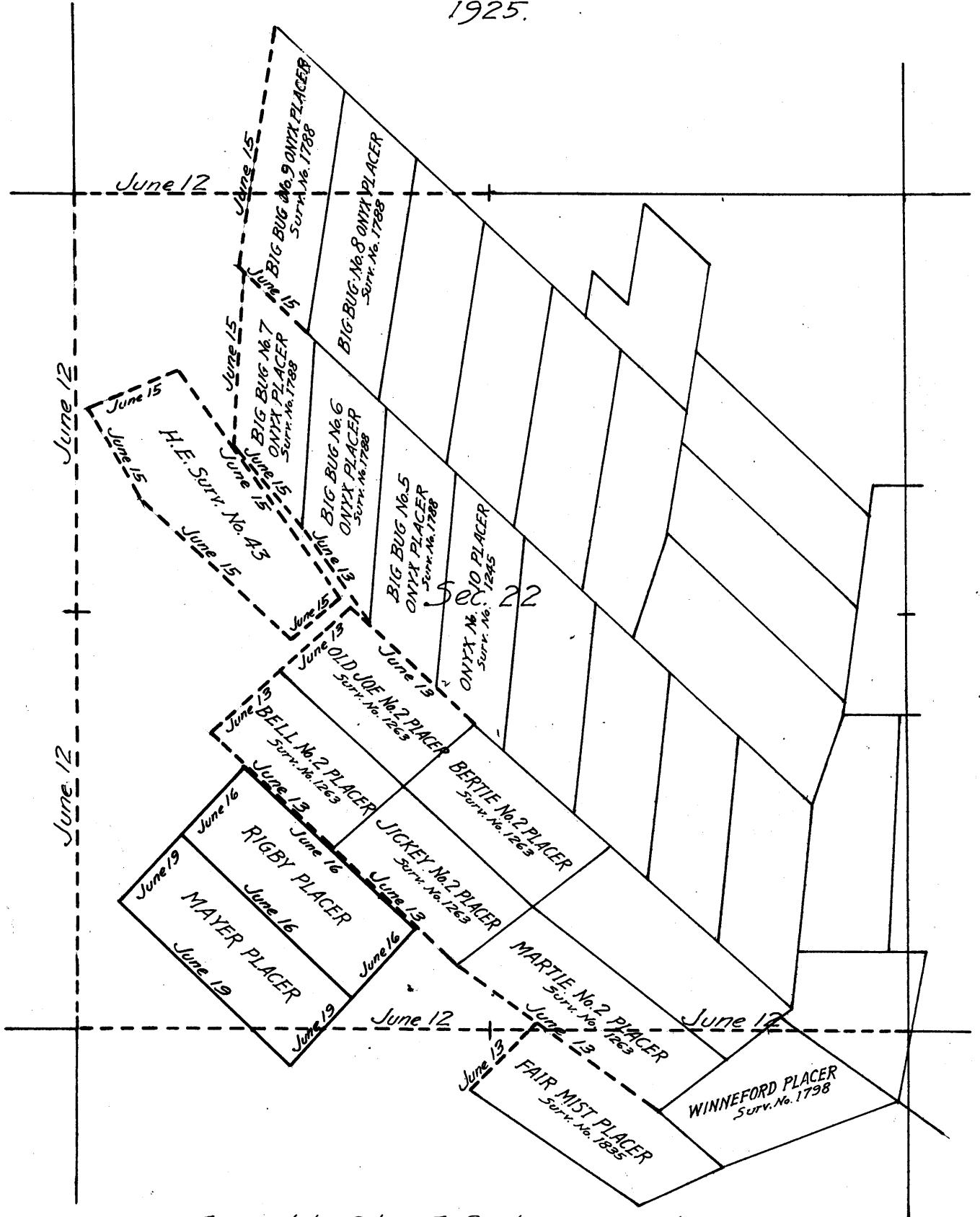

— Surveyed by Sidney E. Blout, U.S.C.E. on dates shown thereon.

- - - Retraced by Sidney E. Blout U.S.C.E. on dates shown thereon.

— Lines of accepted surveys.

Retracements and surveys, hereinafter described were executed on dates shown on diagram on page 2 hereof by Sidney E. Blout, U. S. Cadastral Engineer, using a Buff and Buff Rocky Mountain Favorite solar transit No. 16724 with U-shaped standards, $4\frac{1}{2}$ inch horizontal circle, 4 inch vertical circle, and improved Smith solar attachment. All azimuth determinations are accomplished with the solar attachment, except the special observations on Polaris, upon which to test the solar apparatus.

The instrument was examined, tested on the meridian at the Federal Building at Phoenix, Arizona, found correct, and was approved by the Assistant Supervisor of Surveys for Arizona and California, June 10, 1925, conditional upon satisfactory field tests.

PRELIMINARY FIELD TEST OF INSTRUMENT.

June 11, 1925: At the $\frac{1}{4}$ sec. cor. of secs. 22 and 27, T. 12 N., R. 1 E., latitude, $34^{\circ}24'N.$; longitude, $112^{\circ}14'44"W.$, G. and S. R. B. & M., Arizona, examine the adjustments of the transit, and find them correct; then, to test the solar apparatus by comparing its indications resulting from solar observations made during a.m. and p.m. hours with a meridian established by observations on Polaris, proceed as follows:

June 11, 1925: At same station, set off $34^{\circ}24'N.$ on the lat. arc; $23^{\circ}07'N.$ on the decl. arc, and at 4h. 00m. p.m., l.m.t., determine a meridian with the solar, and mark a point thereof on a peg driven firmly in the ground about 8 chs. N.

At same station, at 7h. 12m. p.m., by my watch, which is set by Western Union Telegraph clock to read correct local mean time, observe Polaris west of the meridian, making four observations, two each with the telescope in direct and reversed positions, and mark the mean point in the line thus determined on a stake driven firmly in the ground about 8 chs. N.

Watch time of observation, mean of four readings, 7h. 12m. p.m.

June 12, 1925: Lay off the azimuth of Polaris $0^{\circ}21'$ to the east, and mark the meridian thus determined by a nail in the peg already driven in the ground about 8 chs. N. on which the meridian falls $\frac{1}{2}'$ E. of the meridian determined by the solar in p.m. observation on June 11.

June 12: At 8h. 00m. a.m., l.m.t., set off $34^{\circ}24'N.$ on the lat. arc; $23^{\circ}09\frac{1}{2}'N.$ on the decl. arc, and determine a meridian with the solar, and mark a point thereof by a tack driven in the peg already set about 8 chs. N. This mark falls $\frac{1}{2}'$ E. of the meridian established by the Polaris observations.

As all solar observations made during the usual hours of solar work come within $1\frac{1}{2}'$ of the true meridian, conclude that the adjustments of the instrument are satisfactory.

All measurements are made with a Lufkin 5-chain steel tape, compared with a Chesterman standard steel tape and found correct. The measurements are made on the slope, the vertical angles determined with clinometer, and the slope measurements properly reduced to true horizontal distances.

4 Retracement of part of Subdivision lines of T. 12 N. R.1 E.

Chains.

The Subdivision lines of part of T. 12 N., R.1 E. were surveyed in 1911 by F. W. Rodolf, U.S.S., and a corrective survey of part of said lines in the N. tier of secs. was executed in 1913 by S.E. Blout, U.S.S.

In 1917; the N. 1/2 of line, bet. secs. 5 and 6 was retraced by U.S. Forest Service Surveyor in connection with survey of H.E.S. No. 340 in sec. 6. No other survey, retracement or resurvey of Subdivision lines in this township is of record.

The following notes describe a retracement of line bet. secs. 22 and 27, line bet. secs. 21 and 22, and W. 1/2 of line bet. secs. 15 and 22.

Between Secs. 22 and 27.

The original cor. of secs. 22, 23, 26 and 27 is an iron post, 2 ins. in diam., projecting 8 ins. above ground, firmly set, marked on brass cap,

T12N R1 E
S22 | S23
S27 | S26

1911

and witnessed by four properly marked bearing trees, one each NE., SE., SW. and NW. of cor.

Thence, N. 89° 54' W., on a random line, bet. secs. 22 and 27 (E. 2). Over level bottom land, along Big Bug Creek in town of Mayer, Arizona.

- 2.72 Wire fence, brs. E. and W.
- 10.88 Road, brs. N. and S.
- 11.85 Telephone line bears NW. and SE.
- 12.00 House on line.
- 15.74 Road, brs. NW and SE.
- 15.80 House on line.
- 17.05 Main street, in the town of Mayer, Arizona, bears N. and S.
- Meat market brs. N. 1.00 ch. dist.
- Mayer's store brs. N. 3.50 chs. dist.
- 19.85 Road, brs. NE. and SW.
- 20.95 Telephone line, bears NW. and SE.
- 21.95 P. & E. R. R. track, brs. NW. and SE.
- 23.40 Telephone line, brs. NW. and SE.
- 24.95 Road, brs. NW. and SE.
- 31.17 Fence, brs. NW. and SE.; thence in dwelling house yard.
- 32.45 Board fence, brs. NE. and SW.
House brs. S. 125 lks. dist.; leave yard.
- 34.32 Road, brs. NE. and SW.
- 36.28 Yard fence, brs. NE. and SW.
- 37.30 Heffleman's house, brs. S. 50 lks. dist.
- 37.74 Fence brs. NE. and SW.
- 38.64 Wood shed on line.
- 40.04 Fall 4 lks. S. of the original 1/4 sec. cor., which is an iron post, 1 in. in diam., projecting 14 ins. above ground, firmly set, marked on brass cap,

1/4 S 22
S 27
1911

Retracement of part of Subdivision lines of T. 12 N. R. 1 E. 5

Chains.

and witnessed by a mound of stone, N. of cor, No bearing trees.
 True course and dist. of E. $\frac{1}{4}$ of line, bet. secs. 22 and 27 are therefore, N. 89° 51' W., 40.04 chs.
 Thence,
 N. 89° 54' W., on a random line, bet. secs. 22 and 27 (W. $\frac{1}{2}$).
 Over rolling land, thru. scattering undergrowth.
 Ascend gradually over N. slope.
 2.25 Wood shed on line.
 2.40 Enter dense undergrowth, brs. NE. and SW.
 Descend about 30 ft., over NW. slope.
 17.40 Wash, 20 lks. wide, course NE. Enter mountainous land.
 Ascend 148 ft., over SE. slope, to
 40.04 Fall 4 lks. S. of the original cor. of secs. 21, 22, 27 and 28, which is an iron post, 2 ins. in diam., projecting 20 ins. above ground, firmly set in mound of stone, 4 ft. base, 1 $\frac{1}{2}$ ft. high, marked on brass cap,

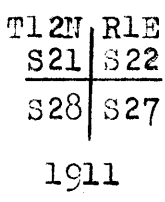

and witnessed by a mound of stone, W. of cor.
 No bearing trees.
 True course and dist. of W. $\frac{1}{4}$ of line, bet. secs. 22 and 27 are therefore, N. 89° 51' W., 40.04 chs.
 Land, level, rolling and mountainous.
 Soil, sandy and stony, 2nd and 3rd rate.
 Timber, none.
 Undergrowth, scrub oak.

N. 0° 2' W., on a random line, bet. secs. 21 and 22 (S. $\frac{1}{2}$).
 Over mountainous land, thru. dense undergrowth.
 Ascend 25 ft., over SE. slope.
 3.10 Spur, slopes E.
 Descend 33 ft., over N. slope.
 12.05 Wash, 15 lks. wide, course S. 80° E.
 Ascend 21 ft., over S. slope.
 21.50 Spur, slopes E.
 Descend 106 ft., over NE. slope, to
 39.83 Fall 1 lk. E. of the original $\frac{1}{4}$ sec. cor., which is an iron post, 1 in. in diam., projecting 18 ins. above ground, firmly set in a mound of stone, 3 ft. base, 1 ft. high, marked on brass cap,

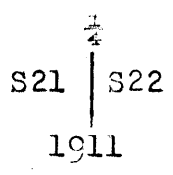

No cor. accessories.
 True course and dist. of S. $\frac{1}{2}$ of line, bet. secs. 21 and 22 are therefore, N. 0° 3' W., 39.83 chs.
 Thence,
 N. 0° 2' W., on a random line, bet. secs. 21 and 22 (N. $\frac{1}{4}$).
 Over mountainous land, thru. dense undergrowth.
 Descend 60 ft., over NE. slope.
 10.10 Ravine, 20 lks. wide, course SE.
 Ascend 23 ft., over SE. slope.
 15.10 Spur, slopes SE.

BOOK 3720

6 Retracement of part of Subdivision lines of T.12 N., R.1 E.

Chains.

- Descend gradually over NE.slope.
 19.80 P.and E.R.R. (single track) brs.NW. and SE.
 22.42 Telephone and telegraph line, brs.NW.and SE.
 32.00 Big Bug Creek, 275 lks.wide (dry), course SE. Thence over rolling land.
 Ascend gradually over SW.slope to sec.cor.
 35.90 Wire fence, brs.NW.and SE.
 36.90 Same fence, brs.E.and W.
 Fence cor.brs.W. about 150 lks.dist., from which wire fences extend E.and SE.
 40.10 Fall 2 lks.E. of the cor.of secs.15,16,21 and 22, which is an iron post, 2 ins. in diam.,projecting 18 ins. above ground, firmly set in a mound of stone, marked on brass cap,

T12N	R1E
S16	S15
S21	S22

1911

and witnessed by a mound of stone, 2 ft. base, $1\frac{1}{2}$ ft. high, W.of cor.
 True course and dist. of N. $\frac{1}{4}$ of line, bet. secs.21 and 22, are therefore, N.0°4'W., 40.10 chs.
 Land, mountainous and rolling.
 Soil, gravelly and rocky, 2nd and 3rd rate.
 Timber, none.
 Undergrowth, greasewood, catclaw and scrub oak.

- S.89°55'E., on a random line, bet.secs.15 and 22 (W. $\frac{1}{2}$).
 Over rolling land, thru. dense undergrowth.
 Ascend 40 ft., over SW.slope.
 10.30 Ravine, 4 lks.wide, 10 ft.deep, course SW.
 Ascend over SW. slope.
 17.40 Ridge, brs.NW. and SE.
 Descend over NE.slope.
 24.40 State Highway from Prescott to Phoenix, Arizona, brs.NW. and SE.
 40.07 Fall 4 lks. N.of the original $\frac{1}{4}$ sec.cor., which is an iron post, 1 in.in diam.,projecting 20 ins. above ground, firmly set in a mound of stone, 2 ft.base, $1\frac{1}{2}$ ft.high, marked on brass cap,

$\frac{1}{4}$ S 15
S 22
1911

and witnessed by a mound of stone, W.of cor. No bearing trees.
 True course and dist. of W $\frac{1}{2}$ of line, bet. secs.15 and 22 are therefore, S.89°52'E., 40.07 chs.
 Land, rolling.
 Soil, stony, 3rd rate.
 Timber, none.
 Undergrowth, catclaw and scrub oak.

Retracement of Boundaries of Patented Placer Min. Claims in T12NR1E. 7

Chains.

BIG BUG NO.9 ONYX PLACER, MINERAL SURVEY NO. 1788.

(West side line and South end line)

The NW. cor. (No.3) of this claim is a pine post, 4 ins. square, projecting 3 ft. above ground, firmly set in ground and mound of stone, and marked 3-1788 on SE. face.

Thence, S.8°32'W., on random line, on W. side line (3-4) of the claim. Over rolling land, thru. dense catclaw and scrub oak undergrowth.

10.96 State Highway from Prescott to Phoenix, Arizona, brs. NW. and SE.

15.52 Intersect Subdivision line, bet. secs. 15 and 22, at a point 17.30 chs. S.89°52'E. from cor. of secs. 15, 16, 21 and 22, hereinbefore described.

Continue line and measurement.

22.66 Fall 7 lks. S.81°28'E. from SW. cor. (No.4) of the claim, which is a pine post, 4 ins. square, projecting 3 ft. above ground, firmly set in ground and mound of stone, and marked 4-1788 on NE. face.

True course and dist. of W. side line (3-4) of the claim are therefore, S.8°42'W., 22.66 chs., and said claim line at 15.53 chs. S.8°42'W. from cor. No.3 intersects the Subdivision line, bet. secs. 15 and 22 at a point 17.25 chs., S.89°52'E. from cor. of secs. 15, 16, 21 and 22.

From SW. cor. (No.4) of the claim, S.46°55'E. on random line on South end line (1-4), of the claim.

Over rolling land, thru. dense scrub oak undergrowth.

1.04 Intersect NW. cor. (No.4) of Big Bug No.7 Onyx Placer, Mineral Survey No. 1788, hereinafter described.

Continue line and measurement.

9.08 Intersect SE. cor. (No.1) of the claim, identical with SW. cor. (No.4) of Big Bug No.8 Onyx Placer, same Mineral Survey, which is a pine post, 4 ins. square, projecting 3 ft. above ground, firmly set in ground and mound of stone, and marked 4-1788 on NE. face, and 1-1788 on NW. face.

True course and dist. of South end line (1-4) of Big Bug No.9 Onyx Placer, are therefore, S.46°55'E., 9.08 chs.

BIG BUG NO. 7 ONYX PLACER MINERAL SURVEY NO. 1788.

(West Side line and South end line)

The NW. cor. (No.4) of this claim is a pine post, 4 ins. sq., projecting 3 ft. above ground, firmly set in ground and mound of stone, and marked 4-1788 on SE. face.

Thence, S.3°10'W., on random line, on West side line (3-4) of the claim.

Over heavily rolling land, thru. dense scrub oak undergrowth.

3.24 Spur, slopes W. Descend 108 ft., over SW. slope, to

16.73 Road, brs. NW. and SE. at foot of descent. Enter gently rolling bottom land.

16.87 Fall 15 lks. N.86°50'W. from SW. cor. (No.3) of this claim, which is a pine post, 4 ins. sq., projecting 2 1/2 ft. above ground, firmly set in ground and mound of stone, and marked 3-1788 on NE. face.

True course and dist. of line 3-4 of the claim are therefore S.2°40'W., 16.87 chs.

Thence, S.36°42'E., on random line on South end line (2-3) of the claim.

Over gently rolling bottom land, along NE. side of wire fence.

8 Retracement of boundaries of pat'd. placer mining claims in T12NR1E.

Chains,		
5.00	Enter scattering oak, walnut, ash and mesquite timber and dense scrub oak undergrowth, brs. NW. and SE.	
10.54	Intersect original point of location of the SE. cor. (No. 2) of this claim, identical with SW. cor. (No. 3) of Big Bug No. 6 Placer, same Mineral Survey, determined from the record bearing and dist. to the original walnut bearing tree accessory to this cor. No trace of the post set to monument these claim cors. can be found after diligent search. True course and dist. of South end line (2-3) of Big Bug No. 7 Onyx Placer, are therefore S. 36° 42' E., 10.54 chs.	
<p>-----</p> <p><u>BIG BUG NO. 6 ONYX PLACER, MINERAL SURVEY NO. 1788.</u></p> <p><u>(South End Line.)</u></p>		
	From original point of location of SW. cor. (No. 3) of this claim, determined from bearing tree, as hereinbefore described,	
	S. 39° 46' E., on random line, on South End line (2-3) of the claim.	
	Over level sandy land, thru. oak, mesquite, walnut and ash timber and scrub oak undergrowth, along NE. side of wire fence.	
4.00	Road to Mayer, Arizona, brs. NW and SE.	
10.04	Fall 2 lks. N. 50° 14' E., from original point of location of the SE. cor. (No. 2) of this claim, identical with SW. cor. (No. 3) of Big Bug No. 5 Onyx Placer of same Mineral Survey, determined from record bearing and dist. from the two original bearing trees accessory to these claim cors.	
	No trace of the post set to monument these claim cors. can be found after diligent search.	
	True course and dist. of South end line (2-3) of Big Bug No. 6 Onyx Placer are therefore S. 39° 38' E., 10.04 chs.	
<p>-----</p> <p><u>OLD JOE NO. 2 PLACER, MINERAL SURVEY NO. 1263.</u></p> <p><u>(NE. Side Line and NW. End Line).</u></p>		
	Cor. No. 2 of Old Joe No. 2 Placer, Mineral Survey No. 1263, which is identical with cor. No. 3 of the Bertie No. 2 Placer of same Mineral Survey is a pine post, 4 ins. square, projecting 3 ft. above ground, firmly set and marked B-3-1263 on SE. face, and O. J. 2-1263 on SW. face.	
	This cor. is on the south end line (1-2) of Onyx No. 10 Placer, Mineral Survey No. 1245.	
	Thence, N. 46° 47' W., on random line on NE. side line (2-3) of the claim.	
	Over level sandy bottom land, thru. scattering walnut and oak timber and scrub oak undergrowth.	
3.50	Left bank of Big Bug Creek, 5 ft. high, brs. NW. and SE. Thence across Creek bed.	
7.00	Left bank of Big Bug Creek, 5 ft. high, brs. E. and W. Leave creek bed.	
13.87	Fall 3 lks. N. 43° 13' E. from SW. cor. (No. 3) of Big Bug No. 5 Onyx Placer, Mineral Survey No. 1788, identical with SE. cor. (No. 2) of Big Bug No. 6 Onyx Placer, same Mineral Survey, hereinbefore described.	
	Continue line and measurement.	
14.50	Enter road, brs. NW. and SE.	
16.39	Fall 4 lks. N. 43° 13' E. of the original point of location of cor. No. 3 of this claim, determined from record bearing and dist. to the original walnut bearing tree. Diligent search fails to reveal any trace of the post set to monument this claim cor.	

Retracement of Bdrs. of patented Placer mining claims in T.12 N., R.1 E. 9

Chains.

True course and dist. of NE. side line (2-3) of the Old Joe No. 2 Placer, are therefore N.46°55'W., 16.39 chs. and Cor. No. 3 of Big Bug No. 5 Onyx Placer, Mineral Survey No. 1788, identical with cor. No. 2 of Big Bug No. 6 Onyx Placer, of same Mineral Survey, is on this claim line.

From original point of location of cor. No. 3 of Old Joe No. 2 Placer,
S.48°05'W. on random line, on NW. end line (3-4) of the claim.

Over level bottom land in road.

- .15 Wire fence, brs. NW and SE. Leave road.
1.50 Left bank of Big Bug Creek, 6 ft. high, brs. NW. and SE.
Thence across dry bed of creek, course SE.
3.50 Right bank of Big Bug Creek, 20 ft. high, brs. NW. and SE.
Leave creek bed; thence over level bottom land.
9.38 Fall 1 lk. S.41°55'E. of cor. No. 4 of this claim, identical with cor. No. 4 of the Bell No. 2 Placer, of same mineral survey, which is a mound of stone with decayed end of post in center.
True course and dist. of NW. end line (3-4) of Old Joe No. 2 Placer are therefore S.48°10'W., 9.38 chs.
-

BELL NO. 2 PLACER, MINERAL SURVEY NO. 1263.

(NW. End Line and SW. Side Line).

Begin at cor. No. 4 of Bell No. 2 Placer, identical with cor. No. 4 of the Old Joe No. 2 Placer, hereinbefore described.

Thence,
S.48°05'W., on random line, on NW. end line (3-4) of the claim.

Over nearly level sandy land, thru. greasewood and scrub mesquite undergrowth.

- 9.38 Fall 1 lk. S.41°55'E. of cor. No. 3 of this claim, which is a walnut post, 4 ins. square, projecting 3 ft. above ground, firmly set in ground and mound of stone, and marked B-3-1263 on E. face.

True course and dist. of NW. end line (3-4) of Bell No. 2 Placer are therefore S.48°10'W., 9.38 chs.

Thence,
S.46°47'E., on random line on SW. side line (2-3) of the claim.

Over nearly level, sandy land, thru. greasewood, scrub oak, and catclaw undergrowth.

- 4.70 Intersect north location cor. of the Rigby Placer Mining claim, surveyed as hereinafter described.
Continue line and measurement.
16.39 Intersect cor. No. 2 of this claim, identical with cor. No. 3 of the Jickey No. 2 Placer of same mineral survey, which is an iron bolt 1 in. in diam., projecting 4 ins. above ground, firmly set.
True course and dist. of SW. side line (2-3) of Bell No. 2 Placer are therefore, S.46°47'E., 16.39 chs.
-

JICKEY NO. 2 PLACER, MINERAL SURVEY NO. 1263.

(SW. Side Line).

Begin at cor. No. 3 of Jickey No. 2 Placer, Mineral Survey No. 1263, identical with cor. No. 2 of the Bell No. 2 Placer of same Mineral Survey, hereinbefore described.

Thence,
S.47°34'E. on random line, on SW. side line (2-3) of the claim.
Over rolling land on E. slope of hills, thru. greasewood and scrub oak undergrowth.

- 3.50 House brs. W. 25 lks. dist.

10 Retracement of Bdrs. of Patented Placer Mining Claims in T12N.R1E.

Chains.

- 9.00 Road to Mayer, Arizona from Bert Jones's house, brs. N.80° W. and S.80° E.
- 11.03 Intersect the east location cor. of the Rigby Placer mining claim, surveyed as hereinafter described.
Continue line and measurement.
- 16.51 Intersect cor. No. 2 of this claim, identical with cor. No. 3 of the Martie No. 2 Placer of same Mineral Survey, which is a walnut post $3\frac{1}{2}$ ins. sq., projecting 3 ft. above ground, firmly set in ground and mound of stone, and marked J-2-1263 on N. face and M-3-1263 on E. face.
True course and dist. of SW. side line (2-3) of the Jickey No. 2 Placer are therefore, S.47° 34' E., 16.51 chs.

MARTIE NO. 2 PLACER, MINERAL SURVEY NO. 1263.
(S.W. Side Line.)

- Begin at cor. No. 3 of Martie No. 2 Placer, Mineral Survey No. 1263, identical with cor. No. 2 of the Jickey No. 2 Placer of same Mineral Survey, hereinbefore described,
Thence,
S.54° 14' E. on random line, on SW. side line (2-3) of the claim.
Over rolling land, thru. dense greasewood and scrub oak undergrowth.
Descend 20 ft., over NE. slope.
- 5.00 Ravine, 10 lks. wide, course NE.
Ascend 20 ft., over NE. slope.
- 10.20 Fall 1 lk. N.35° 46' E. from cor. No. 3 of the Fair Mist Placer, Mineral Survey No. 1835, hereinafter described.
Continue line and measurement.
- 23.89 Fall 2 lks. N.35° 46' E. from cor. No. 2 of this claim, which is identical with cor. No. 2 of Fair Mist Placer, Mineral Survey No. 1835, and cor. No. 2 of the Winneford Placer, Mineral Survey No. 1798, which is a pine post 4 ins. sq., projecting $3\frac{1}{2}$ ft. above ground, firmly set in ground, and mound of stone, and marked M-2-1263 on N. face, and W-2-1798 on E. face, and F M-2-1835 on S. face.
True course and dist. of SW. side line (2-3) of the Martie No. 2 Placer are therefore, S.54° 11' E., 23.89 chs.

FAIR MIST PLACER, MINERAL SURVEY NO. 1835.
(NW. End Line.)

- Begin at cor. No. 4 of this claim, which is a pine post 4 ins. square, projecting 3 ft. above ground, firmly set in ground and mound of stone, and marked FM-4-1835 on SE. face.
Thence,
N.45° 20' E., on random line on NW. end line (3-4) of the claim toward flag on cor. No. 3 of the claim, which is visible on such bearing.
Over heavily rolling land, thru. scrub oak undergrowth.
Descend 50 ft., over NE. slope, to
- 4.00 Foot of descent, brs. NW. and SE. Enter gently rolling land.
Descend slightly over NE. slope.
- 8.59 Intersect the Subdivision line bet. secs. 22 and 27 at a point 5.21 chs. S.89° 51' E. from the $\frac{1}{4}$ sec. cor. of said secs., hereinbefore described.
Continue line and measurement.
- 9.08 Intersect cor. No. 3 of the claim, which is an iron pipe, $1\frac{1}{2}$ ins. in diam., projecting 3 ins. above ground, firmly set on SW. side line (2-3) of Martie No. 2 placer, Min. Sur. No. 1263.
True course and dist. of NW. end line (3-4) of the Fair Mist Placer are therefore, N.45° 20' E., 9.08 chs.

Boundaries of that part of sec. 22, T.12 N., R.1 E., situated
West of patented placer mining claims, Mineral
Surveys Nos. 1788, 1263 and 1835.

Latitudes, departures, and closing errors.

Line designated.	Course.	Dist.	Latitudes.		Departures.	
			N.	S.	E.	W.
Subdivision lines,	N. 89° 51' W.	45.25	.12			45.25
	N. 0° 3' W.	39.83	39.83			.03
	N. 0° 4' W.	40.10	40.10			.05
	S. 89° 52' E.	17.25		.04	17.25	
Placer Claim Boundaries.	S. 8° 42' W.	7.13		7.05		1.08
	S. 46° 55' E.	1.04		.71	.76	
	S. 2° 40' W.	16.87		16.85		.78
	S. 36° 42' E.	10.54		8.45	6.30	
	S. 39° 38' E.	10.04		7.73	6.40	
	N. 46° 55' W.	2.52	1.72			1.84
	S. 48° 10' W.	18.76		12.51		13.98
	S. 46° 47' E.	16.39		11.22	11.94	
	S. 47° 34' E.	16.51		11.14	12.18	
	S. 54° 11' E.	10.20		5.97	8.27	
S. 45° 20' W.	0.49		.34		.35	
<u>Totals.</u>			81.77	82.01	63.10	63.36
				81.77		63.10
<u>Error in latitude.</u>			0.24			
<u>Error in departure.</u>					0.26	

BOOK 3720

12. Retracement of Bdy. of Forest Homestead Entry, Survey No. 43.

Chains.	
	Begin at cor. No. 1 of Forest Homestead Survey No. 43, which is an iron pipe $1\frac{1}{4}$ ins. in diam., driven in center of road.
	Thence N. $36^{\circ}26'$ W., on random line on line 1-2 of homestead boundary.
	Over nearly level land, thru. scrub oak and mesquite undergrowth, and scattering walnut, ash and mesquite timber.
15.00	Road to Mayer, Arizona, brs. NW. and SE.
17.93	Intersect SW. cor. No. 3 of Big Bug No. 7 Onyx Placer, Mineral Survey No. 1788, hereinbefore described.
24.86	Center of road to Mayer, Arizona, brs. N. 10° W. and S. 10° E.
26.83	Intersect cor. No. 2 of Homestead No. 43, which is a granite stone $10 \times 8 \times 12$ ins. above ground, firmly set, marked with a cross (x) on top and 2-H-E-S-43 on SW. face, and witnessed by one bearing tree SW. of cor.
	True course and dist. of line 1-2 of homestead boundary are therefore N. $36^{\circ}26'$ W., 26.83 chs.
	Thence, S. $60^{\circ}48'$ W. on random line on line 2-3 of homestead boundary.
	Over rolling stony land, thru. greasewood and scrub oak undergrowth.
	Descend 25 ft., over SW. slope.
4.50	Center of dry bed of Big Bug Creek, 300 lks. wide, course south.
9.50	Fall $00\frac{1}{2}$ lk. S. $29^{\circ}12'$ E. from cor. No. 3 of Homestead No. 43, which is a granite stone, $14 \times 12 \times 12$ ins. above ground, firmly set, marked with a cross (x) on top, and 3-H-E-S-43 on SE. face.
	True course and dist. of line 2-3 of Homestead Bdy. are therefore, S. $60^{\circ}50'$ W., 9.50 chs.
	Thence, S. $30^{\circ}31'$ E. on random line on line 3-4 of Homestead Bdy.
	Over rolling, stony land, thru. scrub oak undergrowth.
	Descend 15 ft., over SE. slope, to
1.50	Foot of descent; enter level creek bottom, brs. NE. and SW.
9.96	Fall 2 lks. N. $59^{\circ}29'$ E. from cor. No. 4 of H.E.S. No. 43, which is a schist stone $6 \times 6 \times 14$ ins. above ground, firmly set, marked with a cross (x) on top, and 4-H-E-S-43 on E. face, and witnessed by a mound of stone E. of cor.
	True course and dist. of line 3-4 of homestead boundary are therefore, S. $30^{\circ}25'$ E., 9.96 chs.
	Thence, S. $48^{\circ}04'$ E., on random line on line 4-5 of homestead boundary.
	Over rolling, stony land, thru. dense scrub oak undergrowth.
18.89	Fall 5 lks. N. $41^{\circ}56'$ E. from cor. No. 5 of Homestead No. 43, which is a schist stone $8 \times 7 \times 10$ ins. above ground, firmly set, marked with a cross (x) on top, and 5-H-E-S-43 on NE. face.
	True course and dist. of line 4-5 of homestead boundary are therefore S. $47^{\circ}54'$ E., 18.89 chs.
	Thence, N. $50^{\circ}28'$ E. on random line on line 1-5 of homestead bdy.
	Over rolling, sandy land, thru. scrub oak undergrowth.
3.25	Center of dry bed of Big Bug Creek, 350 lks. wide, course S. 40° E.
6.54	Fall 1 lk. N. $39^{\circ}32'$ W. from witness cor. to cor. No. 1 of this homestead, which is a granite stone $5 \times 6 \times 12$ ins. above ground firmly set and marked 1-H-E-S-43-WC.
6.67	Fall 1 lk. N. $39^{\circ}32'$ W. from cor. No. 1 of the homestead, the place of beginning, hereinbefore described.
	True course and dist. of line 1-5 of homestead bdy. are therefore, N. $50^{\circ}32'$ E., 6.67 chs.

Retracement of Bdy. of Forest Homestead Entry, Survey No. 43. 13

Boundaries of Forest Homestead Survey No. 43.

Latitudes, departures, and closing errors.

Line designated.	Course.	Dist.	Latitudes.		Departures.	
			N.	S.	E.	W.
1-2	N. 36° 26' W.	26.83	21.59			15.93
2-3	S. 60° 50' W.	9.50		4.63		8.30
3-4	S. 30° 25' E.	9.96		8.59	5.04	
4-5	S. 47° 54' E.	18.89		12.66	14.02	
5-1	N. 50° 32' E.	6.67	4.24		5.15	
Totals.			25.83	25.88	24.21	24.23
				25.83		24.21
Error in latitude.			0.05			
Error in departure.					0.02	

14 Segregation Survey of the "RIGBY PLACER" Mining Claim.

Chains.

RETRACEMENT FOR SURVEY.

The NE. side line of the Rigby Placer is identical with parts of the SW. side lines of Bell No. 2 Placer and Jickey No. 2 Placer, both of which were retraced, as hereinbefore described. Therefore, begin retracement of the Rigby Placer location at the North location cor. situated on the SW. side line of Bell No. 2 Placer, and retrace the NW. end line, SW. side line and SE. end line of the Rigby Placer location, as follows:

- S. 43° 09' W., on random line on NW. end line of Rigby Placer location, towards flag which is plainly visible on the West location cor.
- 8.97 Intersect W. cor. of Rigby Placer location, identical with the N. cor. of the Mayer Placer location, hereinafter described.
True course and dist. of NW. end line of the Rigby Placer location are therefore S. 43° 09' W., 8.97 chs.
- Thence, parallel to mean bearing of NE. side line of location,
S. 47° 10' E., on random line on SW. side line of Rigby Placer location, which is identical with the NE. side line of the location of the Mayer Placer.
- 22.83 Fall 12 lks. N. 42° 50' E., from South cor. of the Rigby Placer location, identical with the East cor. of the Mayer Placer location, hereinafter described.
True course and dist. of SW. side line of the Rigby Placer location are therefore, S. 46° 51 1/2' E., 22.83 chs.
- Thence,
N. 42° 26' E., on random line on SE. end line of Rigby Placer location, toward flag which is visible on the E. cor. of the Rigby Placer location.
- 9.09 Intersect E. cor. of Rigby Placer location, hereinafter described.
True course and dist. of SE. end line of Rigby Placer location are therefore, N. 42° 26' E., 9.09 chs.

Area of Rigby Placer Location, as determined from above described retracement is 20.47 acres.

SURVEY.

The East location cor. of the Rigby Placer is a pine post, 4 ins. square, projecting 8 ft. above ground, firmly set in ground and mound of stone, 3 ft. base, 2 ft. high. Alongside the pine post,
Set an iron post, 3 ft. long, 1 in. in diam., 27 ins. in the ground, for cor. No. 1 of Rigby Placer mining claim, marked on brass cap,

R
No. 1
1925

Raise a mound of stone, 2 ft. base, 1 1/2 ft. high, W. of cor. From this cor., the 1/4 sec. cor. of secs. 22 and 27, T. 12 N., R. 1 E., hereinbefore described, brs. S. 34° 07' E., 12.05 chs. dist.

- From cor. No. 1 of Rigby Placer,
N. 47° 34' W., on true line, on NE. side line of Rigby Placer, identical with part of SW. side line (2-3) of Jickey No. 2 Placer, Mineral Survey No. 1263.
Over rolling, stony land, thru. scattering scrub oak and greasewood undergrowth.
- 1.97 Road from Bert Jones's house to Mayer, Arizona, brs. N. 80°

Segregation survey of Rigby Placer Mining Claim.

15

Chains.

- W. and S. 80°E.
 7.50 House brs.W. 25 lks.dist.
 11.03 Intersect cor.No.3 of the Jickey No.2 Placer, Mineral Survey No.1263, identical with cor.No.2 of the Bell No.2 Placer of same mineral survey, hereinbefore described.
 Thence,
 N.46°47'W., on true line, on NE.side line of Rigby Placer, identical with part of SW.side line (2-3) of Bell No.2 placer, Mineral Survey No.1263, continuing measurement.
 15.00 Foundation of old smelter, brs.W. 2 chs.dist.
 22.175 Set an iron post, 3 ft.long, 1 in. in diam., with glass bottle containing names of survey party at base, 27 ins. in the ground for N.cor. (No.2) of the Rigby Placer, marked on brass cap,



1925

Note: From this cor. the N. cor. of Rigby Placer location, brs.N.46°47'W., 54½ lks.dist., which is a pine post 5x6 ins., projecting 8 ft. above ground, firmly set in ground and mound of stone, 3 ft. base, 2 ft. high.

- From cor.No.2 of Rigby Placer,
 S.43°20½'W., on true line, on NW.end line of Rigby Placer.
 Over stony, hilly land, thru. scrub oak and catclaw undergrowth.
 Ascend 114 ft., over SE.slope.
 4.50 Railroad spur track to old smelter, brs.NW. and SE.
 8.97 Set an iron post, 3 ft.long, 1 in. in diam., 27 ins. in the ground for W.cor. (No.3) of Rigby Placer, and N. cor. (No.2) of the Mayer Placer, marked on brass cap,

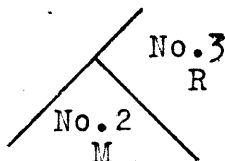

1925

Raise two mounds of stone, 2 ft.base, 1½ ft.high, one each E. and S. of cor., 3 ft.dist.

Note: From this cor. the W.location cor. of Rigby Placer, identical with the N.location cor. of the Mayer Placer, brs.N.46°51½'W., 51½ lks.dist., which is a pine post, 4 ins.square, projecting 3 ft. above ground, firmly set in ground and mound of stone, 3 ft. base, 2 ft. high.

- From cor.No.3 of Rigby Placer,
 S.46°51½'E. on true line, on SW.side line of Rigby Placer, identical with the NE side line of the Mayer Placer.
 Over stony, mountainous land, thru. dense scrub oak undergrowth.
 Ascend 20 ft., over N'slope.
 3.00 Spur, slopes SE., thence along same.
 7.00 Reservoir on line.
 7.25 Descend 140 ft., over SW.slope.
 20.75 Ravine, 10 lks.wide, course E.
 22.315 Intersect the S. location cor. of the Rigby Placer, identical with the E.location cor. of the Mayer Placer, which is a mound of stone, 3 ft. base, 2 ft.high, with decayed end of pine post in center.

16 Segregation survey of the Rigby Placer mining claim.

Chains.

Alongside of location cor., Set an iron post, 3 ft. long, 1 in. in diam., 27 ins. in the ground for S. cor. (No. 4) of Rigby Placer, and E. cor. (No. 1) of the Mayer Placer, marked on brass cap,

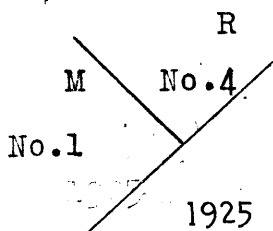

Raise two mounds of stone, 2 ft. base, 1½ ft. high, one each N. and W. of cor., 3 ft. dist.

From this cor., the ¼ sec. cor. of secs. 22 and 27, T. 12 N., R. 1 E., hereinbefore described, brs. S. 75° 40' E., 13.32 chs. dist.

From cor. No. 4 of Rigby Placer, N. 42° 26' E., on true line, on SE. end line of Rigby Placer. Over stony, hilly land, thru scrub oak and mesquite undergrowth.

- .25 Ravine, 5 lks. wide, course S. Ascend over S. slope, to
- 4.50 Rim of mesa, brs. NW. and SE., thence over rolling land on mesa.
- 9.09 Intersect E. cor. (No. 1) of Rigby Placer, the place of beginning, hereinbefore described.

AREA.

The "Rigby Placer" mining claim, surveyed as described in the foregoing notes, has an area of 20.00 acres.

Boundaries of "Rigby Placer" Mining Claim.

Latitudes, departures, and closing errors.

Line designated.	Course.	Dist.	Latitudes.		Departures.	
			N.	S.	E.	W.
1-2	N. 47° 34' W.	11.030	7.442			8.141
	N. 46° 47' W.	11.145	7.632			8.122
2-3	S. 43° 20½' W.	8.970		6.524		6.156
3-4	S. 46° 51½' E.	22.315		15.259	16.283	
4-1	N. 42° 26' E.	9.090	6.709		6.133	
<u>Totals.</u>			21.783	21.783	22.416	22.416
				21.783		22.416
<u>Error in latitude.</u>			0.000			
<u>Error in departure.</u>			0.003			

Chains.

RETRACEMENT FOR SURVEY.

The NE. side line of the "Mayer Placer" location is identical with the SW. side line of Rigby Placer location, and was retraced, as hereinbefore described; therefore, begin at the West location cor. of Rigby Placer, identical with N. location cor. of Mayer Placer, hereinbefore described, and retrace the NW. end line, SW. side line, and SE. end line of Mayer Placer, as described as follows:

8.82 S.43°09' W., on random line, on NW. end line of Mayer Placer location.
Intersect the W. cor. of Mayer Placer location, hereinafter described.
True course and dist. of NW. end line of Mayer Placer location are therefore, S.43°09'W., 8.82 chs.

22.95 Thence,
S.46° 51½'E., on random line, on SW. side line of Mayer Placer location.
Fall 22 lks. N. 43°08½'E. of South cor. of Mayer Placer location, hereinafter described.
True course and dist. of SW. side line of Mayer Placer location are therefore, S.46° 18'E., 22.95 chs.

9.04 Thence,
N.42°26'E., on random line on SE. end line of Mayer Placer location, toward flag on E. cor. of location, which is plainly visible on such bearing.
Intersect E. cor. of Mayer Placer location, identical with the S. cor. of Rigby Placer location, hereinbefore described.
True course and dist. of SE. end line of Mayer Placer location are therefore, N.42°26'E., 9.04 chs.

The area of the Mayer Placer location as determined by the above described retracement is 20.44 acres.

SURVEY.

Cor. No.1 of Mayer Placer, identical with Cor.No.4 of Rigby Placer is established alongside the E. location cor. of Mayer Placer, identical with S. location cor. of Rigby Placer, as hereinbefore described.

1.56 Thence,
N.46°51½'W., on true line, on NE. side line of Mayer Placer identical with SW. side line of Rigby Placer, Mining Claim.
Over stony, hilly land, thru. dense scrub oak and mesquite undergrowth.
Ravine, 10 lks. wide, course E.
Ascend 140 ft., over SE. slope.
15.06 Spur, slopes NE.; thence along N. slope.
15.31 Reservoir on line.
19.31 Descend 20 ft., over NW. slope, to
22.315 Intersect N. cor. (No.3) of the Mayer Placer, identical with W. cor. (No.3) of Rigby Placer, hereinbefore described.

6.20 Thence,
S.43°20½'W., on true line, on NW. end line of Mayer Placer.
Over stony, mountainous land, thru. dense scrub oak undergrowth.
Ascend 117 ft., over NE. slope.
Spur, slopes S.
Descend 55 ft., over SW. slope, to

Chains.

8.82 Set an iron post 3 ft. long, 1 in. in diam., 27 ins. in the ground for W. cor. (No. 3) of Mayer Placer, marked on brass cap,

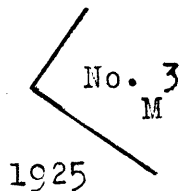

Raise a mound of stone, 2 ft. base, 1½ ft. high, E. of cor., 3 ft. dist.

Note: From this cor., the W. cor. of Mayer Placer location brs. N. 46° 18' W., 48½ lks. dist. This location cor. is a pine post, 4 ins. square, projecting 3 ft. above ground, firmly set in ground and mound of stone.

From cor. No. 3 of Mayer Placer, S. 46° 18' E., on true line on SW side line of Mayer Placer. Over stony, mountainous land, thru. scrub oak undergrowth. Ascend over SW. slope.

1.85 Iron dyke, 15 ft. high, 10 ft. wide, brs. N. 20° E. and S. 20° W. Descend 85 ft., over SE. slope.

5.25 Ravine, 6 lks. wide, course S. 70° E. Ascend 20 ft., over NE. slope.

13.00 Spur, slopes E. Descend 20 ft., over SE. slope.

17.40 Intersect Subdivision line, bet. secs. 22 and 27, T. 12 N., R. 1 E. at a point, 17.14 chs. S. 89° 51' E., from the cor. of secs. 21, 22, 27 and 28, hereinbefore described.

21.18 Ravine, 10 lks. wide, course E. Ascend 25 ft., over N. slope, to

22.465 Intersect S. location cor. of Mayer Placer, which is a pine post, 4 ins. square, projecting 3½ ft. above ground, firmly set in ground and mound of stone. Alongside, this location cor., set an iron post, 3 ft. long, 1 in. in diam., 27 ins. in the ground, for S. cor. (No. 4) of Mayer Placer, marked on brass cap,

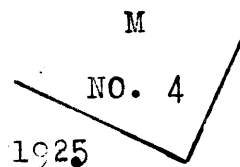

Raise a mound of stone, 2 ft. base, 1½ ft. high, N. of cor. Thence, N. 42° 26' E., on true line, on SE. end line of Mayer Placer. Over stony, mountainous land, thru. dense scrub oak undergrowth. Descend 40 ft., over N. slope.

2.40 Ravine, 10 lks. wide, course S. 80° E.

4.70 Intersect the Subdivision line bet. secs. 22 and 27, T. 12 N., R. 1 E. at a point 23.98 chs. S. 89° 51' E., from the cor. of secs. 21, 22, 27 and 28, hereinbefore described.

9.04 Intersect E. cor. (No. 1) of Mayer Placer, identical with S. cor. (No. 4) of Rigby Placer, hereinbefore described.

AREA.

The Mayer Placer Mining Claim, surveyed as described in the foregoing notes, has an area of 20.00 acres.

Boundaries of Mayer Placer Mining Claim.

Latitudes, departures, and closing errors.

Line designated.	Course.	Dist.	Latitudes.		Departures.	
			N.	S.	E.	W.
1-2	N.46°51 1/2'W.	22.315	15.259			16.283
2-3	S.43°20 1/2'W.	8.820		6.414		6.053
3-4	S.46°18'E.	22.465		15.521	16.241	
4-1	N.42°26'E.	9.040	6.672		6.099	
Totals.			21.931	21.935	22.340	22.336
				21.931	22.336	
Error in latitude,			0.004			
Error in departure,					0.004	

FINAL FIELD TEST OF INSTRUMENT.

June 19, 1925: Set up instrument on the meridian established June 11, 1925, at the 1/4 sec. cor. of secs. 22 and 27, T.12 N., R.1 E. as hereinbefore described, and at 3h.30m.p.m., l.m.t., set off 34° 24' N. on the lat. arc; 23° 26 1/2' N. on the decl. arc, and determine a meridian with the solar, and mark a point thereof on the peg already set about 8 chs. N. This mark falls 1/2' W. of the meridian established by the Polaris observation.

June 20, 1925: At same station with the lat. arc unchanged, set off 23° 27 1/2' N. on the decl. arc, and at 7h.30m.a.m., l.m.t., determine a meridian with the solar, and mark a point thereof on the peg already driven firmly in the ground about 8 chs. N. This mark falls 1/2' E. of the meridian established by the Polaris observation.

As each of the above solar observations agree within 1' of the true meridian established by Polaris observation, conclude that the instrument has retained its satisfactory adjustment during the progress of the field work herein described.

NOTICE OF LOCATION (Amended)

This Placer Mining Claim, the name of which is the RIGBY Placer Mining Claim situate on lands belonging to the United States of America, and being a form of valuable mineral deposit other than in veins or lodes of quartz or other rock in place, was entered upon and located for the purpose of exploration and purchase by The Rigby Mining and Reduction Company, of Mayer, Yavapai County, Arizona, the undersigned, on September 26, 1903.

We claim 20 acres thereof, and have marked the same on the ground as follows:- Beginning at the North East corner of the claim, about half mile Westerly from Joe Mayer's Station, at a post and monument where this notice is posted, thence South Westerly 600 feet to a post, the South East corner, thence North Westerly 1500 feet, to a post, the South West corner, thence North Easterly 600 feet to a post, the North West corner, thence South Easterly 1500 feet to a post the North East corner and place of beginning, containing 20 acres. This claim is more particularly described as follows:

The North East side line of this claim adjoins the south West side line of the placer claim known as the "Jickey" Placer Claim #2, and the "Belle" Placer claim #2, the said claims being owned and patented by Joe Mayer, and the initial monument and notice of this claim is situate about 362 feet North Westerly from the South East corner of Jickey Placer Claim #2 and adjoins the "Old Soldier" Placer Claim on the North West end of said claim, all being situate in Big Bag Mining District, Yavapai County, A. T.

This is an amended location notice of the RIGBY placer claim, located by Joe Mayer on June 23, 1902, and recorded in Book 65, page 343 on June 28, 1902, and this amended location notice is made and posted to correct errors in the description in the said original location notice.

Dated and posted on the ground this Sept. 26, 1903.
(The Rigby Mining and Reduction Co.
(Signed) -
(By T. Johns Rigby, Agent, Locators.

Witness:
H. B. Fowler,
by Jess W. Davis.

Filed and recorded in the office of the County Recorder of Yavapai County, Arizona, October 12, 1903, at 9:00 o'clock A. M. in Book 64 of Mines, at page 500.

10-18- MDO - COPY.



BOOK 3720

NOTICE OF LOCATION (Amended)

The Placer Mining Claim, the name of which is the MAYER Placer Mining Claim, situate on lands belonging to the United States of America, and being a form of valuable mineral deposit other than in veins or lodes of quartz or other rock in place, was entered upon and located for the purposes of exploration and purchase by The Rigby Mining and Reduction Company, the undersigned, on Sept. 26, 1903. We claim 20 acres thereof and have marked the same on the ground as follows:- Beginning at the North East corner of claim about half mile westerly from Joe Mayer's station at a post and monument where this notice is posted, thence South Westerly 600 feet to the South East corner, thence North Westerly 1500 feet to a post and monument the South West corner, thence North Easterly 600 feet to a point and monument the North West corner, thence South Easterly 1500 feet to a point and monument and place of beginning.

This claim is more particularly described as adjoining the "Rigby" Placer Claim on the South West and running parallel with the said claim, and is bounded on the North West by the "Gold Cup", "Gold Key" and "Gold Button" Quartz Claims, and on the North East by the "Rigby", "Jickey" and "Belle" Placer Claims, and on the East by the "Fair Mist" Placer Claim, all being situate in the Big Bug Mining District, Yavapai County, A. T.

This is an amended location notice of the "MAYER" Placer Mining Claim, located by Joe Mayer on June 23, 1902, and recorded in Book 65, page 342 on June 28, 1902, record of Mines of Yavapai County, A. T., and this amended location notice is made and posted to correct errors in the description in the said original location notice.

Dated and posted on the ground this September 26, 1903.
(The Rigby Mining and Reduction Co.
(Signed) - (by T. Johns Rigby, Agent.
(by Jess W. Davis. Locators.

Witness: H. B. Fowler.

Filed and recorded in the office of the County Recorder of Yavapai County, Arizona, October 12, 1903, at 9:00 o'clock A. M. in Book 64 of Mines, page 502.



CERTIFICATE OF UNITED STATES CADASTRAL ENGINEER.

I, Sidney E. Blout, U. S. Cadastral Engineer, hereby certify upon honor that, in pursuance of special instructions received from the U. S. Surveyor General, for Group 129, Arizona,

bearing date of the 17th day of November, 1924, I have well, faithfully, and truly

in my own proper person, and in strict conformity with said instructions, the Manual of Surveying Instruc-

tions, and the laws of the United States, retraced all those parts or portions of the Subdivision lines of T.12 N., R.1 E., the Boundary of Forest Homestead No.43, and the Boundaries of patented placer mining claims of Mineral Surveys Nos.1263,1788 & 1835;

and Surveyed all those parts or portions of the

"RIGBY PLACER" and "MAYER PLACER" MINING CLAIMS in secs.22 and 27, of

Township 12 North, Range 1 East, of the Gila and Salt River

Base and Meridian, in the State of Arizona, which are represented in

and by diagram on page 2 hereof

the foregoing field notes as having been executed by me, and under my direction; and that all the corners of said retracement

and survey have been established and perpetuated in strict accordance with the Manual of Surveying Instruc-

tions, and the special written instructions of the U. S. Surveyor General, for Group 129, Arizona,

and in the specific manner described in the field notes, and that the foregoing are the original field notes of such retracement and survey.

Place: Phoenix, Arizona.

Sidney E. Blout
U. S. Cadastral Engineer.

Date: March, 10, 1926.

APPROVAL.

OFFICE OF THE UNITED STATES Supervisor of Surveys,

Denver, Colorado, March 16, 1926.

The foregoing field notes of the retracement of

Part of the Subdivision lines of Township 12 North, Range 1 East,

The Boundary of Forest Homestead No.43, and

Part of the Boundaries of patented placer mining claims of Mineral Surveys Nos. 1263, 1788 and 1835;

and of the survey of

"RIGBY PLACER" MINING CLAIM, and

"MAYER PLACER" MINING CLAIM,

situate in secs.22 and 27 of Township 12 North, Range 1 East,

of the Gila and Salt River Base and Meridian, in the State of Arizona,

executed by Sidney E. Blout, U.S. Cadastral Engineer,

under his special instructions dated November 17, 1924 for Group 129, Arizona, having been critically examined, and the necessary corrections and explanations made, the said field notes, and the retracements and surveys they describe, are hereby approved.

Wm. M. Denson
U.S. Supervisor of Surveys.

I certify that the foregoing transcript of the field notes of the above described surveys in

has been correctly copied from the original notes on file in this office.

U. S. Surveyor General.