

BOOK 3741

FIELD NOTES

OF THE RETRACEMENT OF

Part of the Subdivision Lines of Township 16 North, Range 5 West,

AND OF THE RESURVEY OF

Part of the South Boundary,

Part of the East Boundary, and

Part of the Subdivision Lines of

TOWNSHIP 16 NORTH, RANGE 5 WEST,

Of the Gila and Salt River Base and Meridian,

In the State of Arizona

EXECUTED BY

Sidney E. Blout

U. S. Cadastral Engineer,

In the capacity of U. S. Surveyor, under Special Instructions dated February 11, 1924, issued by the United States Surveyor General to govern surveys included in Group No. 128, Arizona, which were approved by the Commissioner of the General Land Office, March 10, 1924, and Assignment Instructions dated May 1, 1924.

Retracement & resurvey commenced June 13, 1924.

Retracement & resurvey completed August 21, 1924.

3741

3741

INDEX

INDEX DIAGRAM.

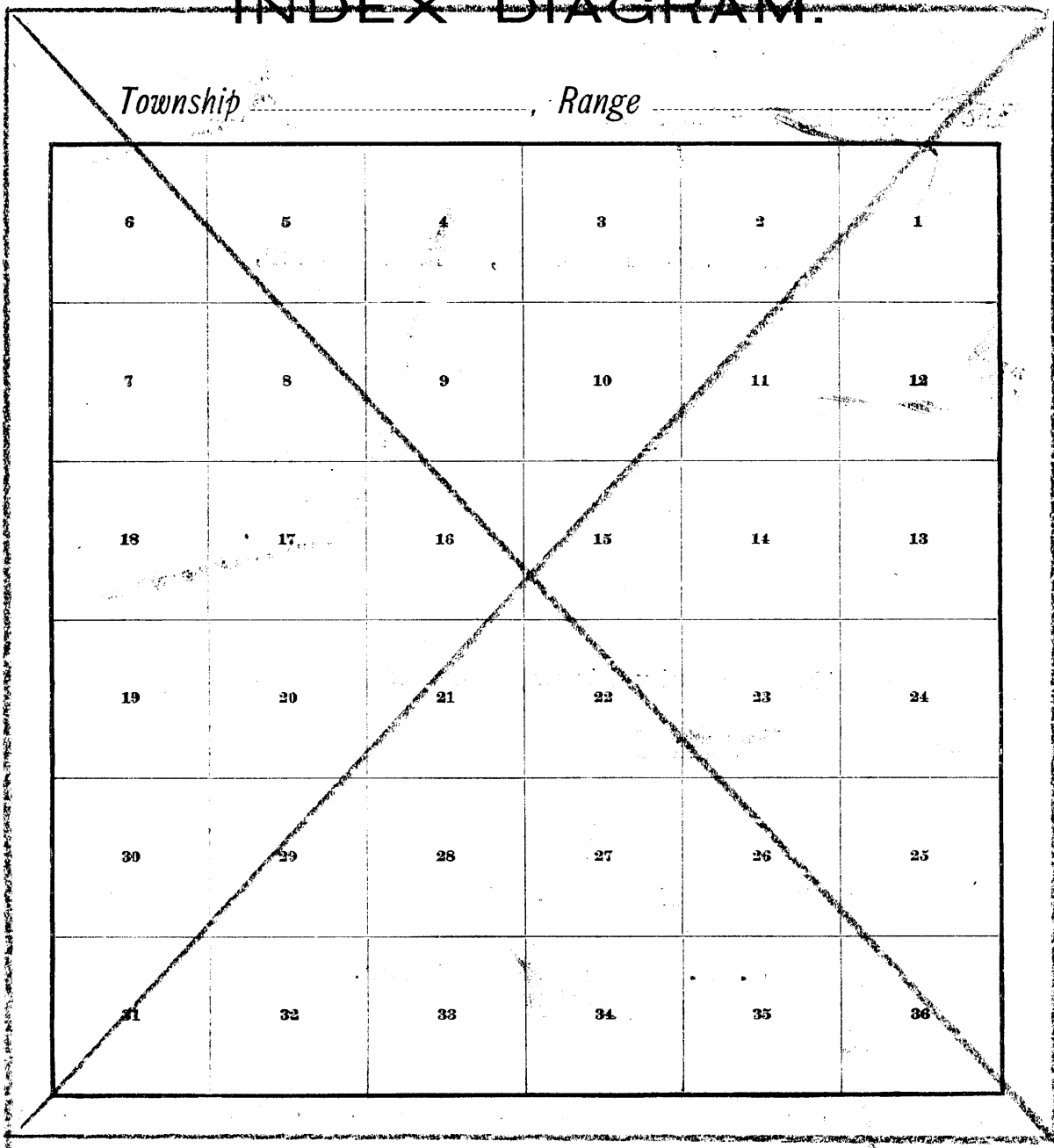

190706

190706

Book "D"
INDEX DIAGRAM

BOOK 3741

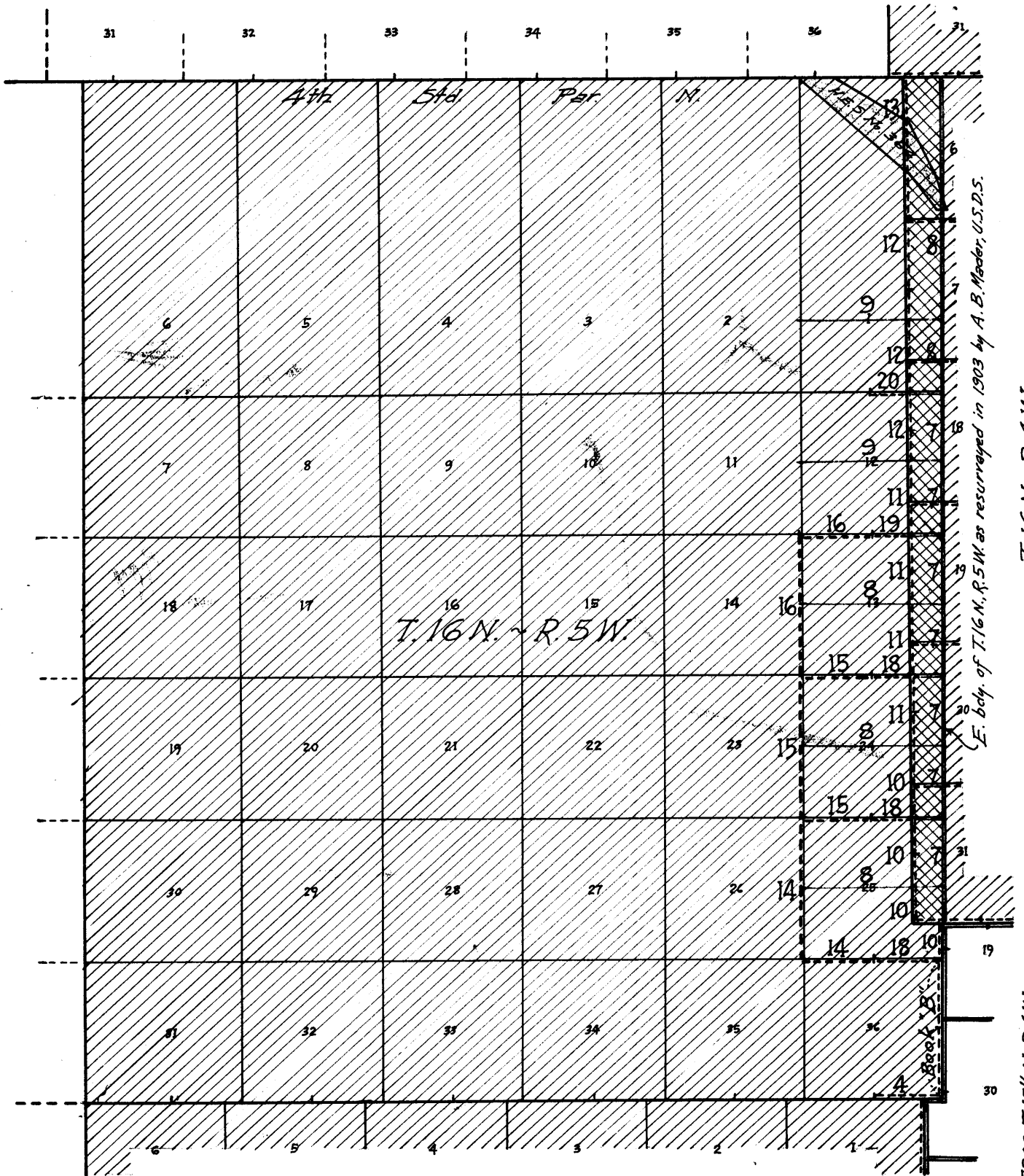

T. 16 N. - R. 4 W.

FRAC. T. 15 1/2 N. - R. 4 W.

- Surveyed under this group.
- Retraced under this group.
- Retracement for Resurvey.
- Unsurveyed.
- Forest Homestead Surveys.
- Resurveyed under this group.
- Surveyed with reference to one Tp. } This group.
- Resurveyed with reference to one Tp. }
- Accepted surveys.
- Overlap of T. 16 N., R. 5 W. (1903 survey) on T. 16 N., R. 4 W. (1871 survey) Restored to T. 16 N., R. 5 W.
- Areas surveyed as per accepted platy on file.

Latitudinal quarter sec. lines surveyed for purpose of reestablishing 1/4 sec. cors. on E. bdy. of this Tp.

• Book "D"
• DATE - DIAGRAM •
1924

BOOK 3741

	<i>Alt</i>	<i>Std.</i>	<i>Par.</i>	<i>N.</i>		Book "C"
						7-28
6	5	4	3	2	8-18	7-28
					7-29 8-18 7-29	7-28
7	8	9	10	11	8-18 12	7-29
					8-21 7-29 8-18 7-29	7-28
18	17	16 <i>T. 16 N. ~ R. 5 W.</i>	15	14	8-21 8-18 8-18	7-29
					8-21 7-30 7-30	7-29
19	20	21	22	23	8-21 8-19 24	7-30
					8-20 7-31 7-31	7-30
30	29	28	27	26	8-20 8-19 25	7-31
					8-19 8-19 8-19	7-31
31	32	33	34	35	8-20 8-20	7-31
					8-19 7-31	7-31
					6-13	Book "B"

Range line resurveyed by A. B. Mader U.S.D.S. in 1903

————— Retraced by Sidney E. Blout, U.S. Cadastral Engineer on dates shown thereon.

----- Resurveyed by S.E. Blout, U.S.C.E. on dates shown thereon.

----- Resurveyed by S.E. Blout, U.S.C.E. - Notes and dates in other books of this group.

————— Retracement for Resurvey, by S.E. Blout, U.S.C.E. on dates shown thereon.

————— Survey for Resurvey, by S.E. Blout, U.S.C.E. on dates shown thereon.

————— Accepted surveys.

Retracements and resurveys, hereinafter described, were executed on dates shown on diagram on page 2 hereof by Sidney E. Blout, U. S. Cadastral Engineer, using an A. Lietz solar transit No. 6166. The horizontal limb is provided with two double verniers, placed opposite to each other, reading to single minutes of arc, which is also the least count of the verniers of the latitude and declination arcs.

The instrument was examined, tested on the meridian at the Federal Building at Phoenix, Arizona, May 1, 1924, found correct and was approved by the Assistant Supervisor of Surveys for Arizona and California, conditional upon satisfactory field tests.

Unless otherwise specified, all azimuth determinations are accomplished with the solar attachment, except the special observations on Polaris for meridian upon which to test the solar apparatus.

All measurements are made with a Lufkin 5-chain steel tape, compared with a Chesterman standard steel tape and found correct. The measurements are made on the slope, the vertical angles determined with a clinometer and the slope measurements properly reduced to true horizontal distances.

FIELD TEST OF A. LIETZ SOLAR TRANSIT NO. 6166.

July 29, 1924. At camp at the J. W. Stewart ranch in the NE $\frac{1}{4}$ of Sec. 15; T. 16 N., R. 4 W., Gila and Salt River Base and Meridian, Arizona, in latitude 34° 46' 15" N., and longitude 112° 40 $\frac{1}{2}$ ' W., examine the adjustments of the transit and correct the level and collimation errors; then, to test the solar apparatus by comparing its indications, resulting from solar observations, made during a. m., and p. m. hours, with a meridian established by observations on Polaris; proceed as follows:

Set up instrument on the meridian established June 26, 1924, at this camp, as described in Book "C", and at 4 h. 30 m., p. m., l. m. t., set off 34° 46' N., on the lat. arc, 18° 39 $\frac{1}{2}$ ' N., on the decl. arc, and determine a meridian with the solar and mark a point thereof on the stake already set about 8 chs. N. This point falls 1 $\frac{1}{2}$ ' E. of the meridian established by the Polaris observation.

July 30, 1924. At 7 h. 0 m., a. m., l. m. t., at same station, with the lat. arc unchanged; set off 18° 31' N., on the decl. arc, and determine a meridian with the solar and mark a point thereof by a tack driven in the stake already set about 8-chs. N. This mark falls 0 $\frac{1}{2}$ ' W. of the meridian established by the Polaris observation.

Each solar observation agrees within 1 $\frac{1}{2}$ ' with the meridian established by the Polaris observation therefore conclude that the adjustments of the transit are satisfactory.

The magnetic bearing of the true meridian at 8 h. 00 m., a. m., is N. 14° 58' W.

Resurvey of Part of South Boundary of Township 16 North, Range 5 West.

Chains The south boundary of T. 16 N., R. 5 W., was surveyed due west by P. Contzen, U. S. D. S. in 1897, establishing quarter-section and section corners with common reference to areas both sides of the line, alternately at intervals of 40.00 chains. The entire line was re-surveyed due west by A. B. Mader, U. S. D. S., in 1903, reestablishing quarter-section and section corners with reference to T. 16 N., R. 5 W., only, alternately at intervals of 40.00 chains, and altering the original quarter-section and section corner monuments on the line to refer to areas S. of line, only.

No other resurvey and no retracement of this township boundary is of record.

The following notes describe a resurvey of the east half of south boundary of Sec. 36, T. 16 N., R. 5 W.

Retracement for Resurvey.

From cor. of T. 16 N., Rs. 4 and 5 W., hereinafter described.

West, on random line, on S. bdy. of Sec. 36 (E. $\frac{1}{2}$).

8.83 A point 8 lks. N. of the closing cor. of T. 15 N., Rs. 4 and 5 W., hereinafter described.

Continue line and measurement.

39.22 Fall 35 lks. N. of the quarter-section corner of Sec. 36, hereinafter described.

True course and distance of E. $\frac{1}{2}$ of S. bdy. of sec. 36 are, therefore, N. 89° 29' E., 39.22 chs., and the closing cor. of T. 15 N., Rs. 4 and 5 W., is on line.

RESURVEY

The previously reestablished quarter-section corner of Sec. 36 is a granite stone, 12 x 6 x 5 ins. above ground, firmly set, marked $\frac{1}{4}$ on N. face, and witnessed by a mound of stone N. of cor. No bearing trees. This corner monument, being a good durable stone, and properly marked and witnessed, no reconstruction or alteration of same is necessary.

Thence

N. 89° 29' E., on a true line, on S. bdy. of sec. 36 (E. $\frac{1}{2}$) Over rolling land, thru dense undergrowth. Ascend gradually over NW. slope.

18.45 Low spur, slopes NE. Descend gradually over E. slope.

29.20 Wash, 20 lks. wide, course NE. Descend slightly over NE. slope to

30.39 Intersect the closing cor. of Ts. 15 N., Rs. 4 and 5 W., which is a red granite stone, 6 x 8 x 8 ins. above ground, marked C C on S. face, 6 grooves on each of E., W. and S. faces, firmly set, and witnessed by three pits, one each E. & W., 3 ft. dist., and one S. of cor. 5 ft. dist., and a mound of earth S. of cor. No bearing trees.

Alter this cor. monument to a closing cor. of T. 15 N., R. 5 W., and Frac. T. 15 $\frac{1}{2}$ N., R. 4 W., by obliterating the grooves on the E. face of the stone.

Continue line and measurement. Descend slightly over NE. slope to

36.38 Wash, 30 lks. wide, 3 ft. deep, course N. 10° W. Asc. slightly over NW. slope to

39.22 Intersect the cor. of T. 16 N., Rs. 4 and 5 W., which is

Resurvey of Part of South Boundary of Township 16 North, Range 5 West.

Chains

a granite stone, 12 x 6 x 8 ins. above ground, firmly set, marked with 6 notches on each of E., W., and N. faces, and witnessed by a mound of stone N. of cor.

No bearing trees.

Alter this cor. monument to refer to T. 16 N., R. 5 W., only (SE. cor.) by obliterating the notches on E. face of stone, destroying the old mound of stone N. of cor., and raising a new mound of stone 2 ft. base, 1 ft. high, NW. of cor. No bearing trees available.

Land, rolling.

Soil, stony, 2nd and 3rd rate.

Timber, none.

Undergrowth, scrub oak, juniper and manzanita.

Resurvey of Part of East Boundary of Township 16 North, Range 5 West.

Chains The east boundary of T. 16 N., R. 5 W., was surveyed due north by S. W. Foreman, U. S. D. S., establishing quarter-section and section corners with common reference to areas both sides of the line, alternately thereon; at intervals of 40.00 chains, counting from the original corner of Ts. 15 and 16 N., Rs. 4 and 5 W., established by him in same year in connection with his survey of south boundary of T. 16 N., R. 4 W.

The east boundary of T. 16 N., R. 5 W., was independently resurveyed due North by A. B. Mader, U. S. D. S., in 1903, reestablishing quarter-section and section corners with a common reference to areas both sides of the line, alternately at intervals of 40.00 chains, counting from a township corner monument reconstructed by P. Contzen, U. S. D. S., in 1897, and recorded as a reestablishment of cor. of T. 16 N., Rs. 4 and 5 West. No other resurvey and no retracement of this range line is of record.

The resurveys and surveys executed under this group (Group 128, Arizona) discloses the fact that the Contzen reestablished corner of T. 16 N., Rs. 4 and 5 W., is approximately 99.00 chains S., and 16.00 chains E. of the original position of the cor. of Ts. 15 and 16 N., Rs. 4 and 5 W., and that 6.00 miles of the Mader resurveyed range line is within T. 16 N., R. 4 W., about 20.00 chains east of the original position of the west boundary thereof as determined by the resurvey of said W. boundary, described in Book "C" of this group.

The following notes describe a resurvey of the E. bdrs. of secs. 25, 24, 13, 12 and 1, of T. 16 N., R. 5 W., the resurvey of E. bdy. of Sec. 36 having been described in Book "B" of this group. This resurvey consists of the reestablishment of quarter-section corners referring to east range of sections of T. 16 N., R. 5 W., on the resurveyed W. boundary of T. 16 N., R. 4 W., described in Book "C", at those points where the latitudinal quarter-section lines of said sections run between the Mader reestablished quarter-section corners on the range line, and the original quarter-section corners on the first meridional section line of T. 16 N., R. 5 W., intersect said resurveyed west boundary of T. 16 N., R. 5 W.

The establishment of closing corners of same sections on same range line also forms part of this resurvey and the points for same are determined in a similar manner to that used for the reestablishment of the quarter-section corners, but the descriptions of said closing corners and the lines run to locate same are hereinafter described in connection with notes of "Resurvey of Part of the subdivision lines of T. 16 N., R. 5 W."

The positions of the closing corners of the east range of sections are given in these resurvey notes, and the measurements are recorded N. $0^{\circ} 47'$ W., from closing cor. to closing cor., with the exception of E. bdy. of sec. 25, where the measurement is given in northing from cor. of secs. 25 and 36, to the closing cor. of secs. 24 and 25. The south 18.60 chains of E. bdy. of sec. 25 is that portion of the Mader resurvey thereof which is outside T. 16 N., R. 4 W., and the resurveyed south and west boundaries of T. 16 N., R. 4 W., form the remainder of E. Bdy. of said sec.

Resurvey of Part of East Boundary of Township 16 North, Range 5 West.

Chains The object of this resurvey of the east boundary of T. 16 N., R. 5 W., is to eliminate that part of the Mader resurveyed range line which is within T. 16 N., R. 4 W., and restore to T. 16 N., R. 4 W., that portion of T. 16 N., R. 5 W., which overlapped by reason of said Mader resurvey.

Retracement for Resurvey

(Mader resurveyed range line)

The S. $\frac{1}{2}$ of the Mader resurveyed E. bdy. of sec. 25 was retraced in connection with survey of W. bdy. of Frac. T. 15 $\frac{1}{2}$ N., R. 4 W., as described in Book "B".

From reestablished quarter-section corner of secs. 25 and 30, hereinafter described,
 North, on random line, bet. secs. 25 and 30 (N. $\frac{1}{2}$).
 39.74 Fall 7 lks. W. of reestablished corner of secs. 19, 24, 25 and 30, hereinafter described.
 True course and dist. of N. $\frac{1}{2}$ mile bet. secs. 25 and 30 are, therefore, N. 0° 06' E., 39.74 chs.

North, on random line, bet. secs. 19 and 24 (S. $\frac{1}{2}$).
 40.28 Fall 24 lks. W. of reestablished $\frac{1}{4}$ sec. cor., hereinafter described.
 True course and dist. of S. $\frac{1}{2}$ of line, bet. secs. 19 and 24, are therefore, N. 0° 20' E., 40.28 chs.

Thence
 North, on random line, bet. secs. 19 and 24 (N. $\frac{1}{2}$).
 39.86 Fall 12 lks. W. of reestablished cor. of secs. 13, 18, 19 and 24, hereinafter described.
 True course and dist. of N. $\frac{1}{2}$ of line, bet. secs. 19 and 24, are therefore, N. 0° 10' E., 39.86 chs.

North, on random line, bet. secs. 13 and 18 (S. $\frac{1}{2}$).
 40.05 Fall 10 lks. W. of reestablished $\frac{1}{4}$ sec. cor., hereinafter described.
 True course and dist. of S. $\frac{1}{2}$ of line bet. secs. 13 and 18, are therefore, N. 0° 09' E., 40.05 chs.

Thence
 North, on random line, bet. secs. 13 and 18 (N. $\frac{1}{2}$).
 40.14 Fall 24 lks. W. of reestablished cor. of secs. 7, 12, 13 and 18, hereinafter described.
 True course and dist. of N. $\frac{1}{2}$ of line bet. secs. 13 and 18, are, therefore, N. 0° 20' E., 40.14 chs.

North, on random line, bet. secs. 7 and 12, (S. $\frac{1}{2}$).
 39.95 Fall 3 lks. W. of reestablished $\frac{1}{4}$ sec. cor., hereinafter described.
 True course and dist. of S. $\frac{1}{2}$ of line bet. secs. 7 and 12, are therefore, N. 0° 02' E., 39.95 chs.

Thence
 North, on random line, bet. secs. 7 and 12 (N. $\frac{1}{2}$).
 39.97 Fall 2 lks. W. of reestablished cor. of secs. 1, 6, 7 and 12, hereinafter described.
 True course and dist. of N. $\frac{1}{2}$ of line bet. secs. 7 and 12, are therefore; N. 0° 02' E., 39.97 chs.

Resurvey of Part of East Boundary of Township 16 North, Range 5 West.

Chains North, on random line, bet. secs. 1 and 6 ($S. \frac{1}{2}$)
 40.02 Fall 9 lks. W. of reestablished $\frac{1}{4}$ sec. cor., hereinafter
 described.
 True course and dist. of $S. \frac{1}{2}$ of line bet. secs. 1 and 6,
 are therefore, N. $0^{\circ} 08' E.$, 40.02 chs.
 Thence
 North, on random line, bet. secs. 1 and 6, ($N. \frac{1}{2}$).
 138.78 Intersect reestablished closing cor. of Tps. 16 N., Rs.
 4 and 5 W. on the 4th Std. Par. N., described in
 Book "C".
 True course and dist. of $N. \frac{1}{2}$ of line bet. secs. 1 and 6 are,
 therefore, North, 138.78 chs.

Survey of Latitudinal Quarter Section Lines.

As another preliminary process to resurvey of E. bdy. of
 T. 16 N., R. 5 W., survey the latitudinal quarter
 section lines of secs. 25, 24, 13, 12 and 1 of said
 township as described, as follows:

From original $\frac{1}{4}$ sec. cor. of secs. 25 and 26, T. 16 N.,
 R. 5 W., hereinafter described.
 East on random line, on latitudinal $\frac{1}{4}$ sec. line, of sec.
 25.
 62.87 Intersect W. bdy. of T. 16 N., R. 4 W., at a point 19.06
 chs. S. $0^{\circ} 47' E.$, of the reestablished $\frac{1}{4}$ sec. cor. of
 sec. 31.
 Set temporary quarter-section corner of sec. 25, and
 continue line and measurement.
 79.00 Fall 25 lks. S. of reestablished $\frac{1}{4}$ sec. cor. of secs. 25
 and 30 on the Mader range line, hereinafter described.
 True course and dist. of latitudinal $\frac{1}{4}$ sec. line of sec.
 25 are therefore, S. $89^{\circ} 49' W.$, 79.00 chs., and the
 true line at 16.13 chs. S. $89^{\circ} 49' W.$, will, there-
 fore, intersect the W. bdy. of T. 16 N., R. 4 W., at
 18.86 chs. S. $0^{\circ} 47' E.$, from $\frac{1}{4}$ sec. cor. of sec. 31.

From the orig. $\frac{1}{4}$ sec. cor. of secs. 23 and 24, T. 16 N.,
 R. 5 W., hereinafter described,
 East, on random line on latitudinal $\frac{1}{4}$ sec. line of sec.
 24.
 62.08 Intersect W. bdy. of T. 16 N., R. 4 W., at a point 19.27
 chs. S. $0^{\circ} 47' E.$, of reestablished $\frac{1}{4}$ sec. cor. of
 sec. 30.
 Set temp. $\frac{1}{4}$ sec. cor. of sec. 24, and continue line and
 measurement.
 79.30 Fall 25 lks. S. of reestablished $\frac{1}{4}$ sec. cor. of secs. 19
 and 24 on the Mader range line, hereinafter described.
 True course and dist. of latitudinal $\frac{1}{4}$ sec. line of sec.
 24 are, therefore, S. $89^{\circ} 49' W.$, 79.30 chs., and the
 true line at 17.22 chs. S. $89^{\circ} 49' W.$, will inter-
 sect W. bdy. of T. 16 N., R. 5 W., at 19.07 chs. S.
 $0^{\circ} 47' E.$, from $\frac{1}{4}$ sec. cor. of sec. 30.

From original $\frac{1}{4}$ sec. cor. of secs. 13 and 14, T. 16 N.,
 R. 5 W., hereinafter described.
 East on random line on latitudinal $\frac{1}{4}$ sec. line of sec. 13
 61.12 Intersect W. bdy. of T. 16 N., R. 4 W., at a point 18.97
 chs. S. $0^{\circ} 47' E.$ of reestablished $\frac{1}{4}$ sec. cor. of sec.
 19.

Resurvey of Part of East Boundary of Township 16 North, Range 5 West.

Chains Set temp. $\frac{1}{4}$ sec. cor. of sec. 13, and continue line and measurement.
 79.57 Fall 21 lks. S. of reestablished $\frac{1}{4}$ sec. cor. of secs. 13 and 18 on Mader range line hereinafter described. True course and dist. of latitudinal $\frac{1}{4}$ sec. line of sec. 13 are, therefore, S. $89^{\circ} 51' W.$, 79.57 chs., and the true line at 18.45 chs. S. $89^{\circ} 51' W.$, will, therefore, intersect the W. bdy. of T. 16 N., R. 5 W., at 18.81 chs. S. $0^{\circ} 47' E.$, from $\frac{1}{4}$ sec. cor. of sec. 19.

The orig. $\frac{1}{4}$ sec. cor. of secs. 11 and 12, T. 16 N., R. 5 W., is a malpais stone 10 x 8 x 6 ins. above ground, firmly set, marked $\frac{1}{4}$ on W. face, and witnessed by two properly marked bearing trees, one each NE. and SW. of cor.

Thence

East, on a random line, on latitudinal $\frac{1}{4}$ sec. line of sec. 12.

60.22 Intersect W. bdy. of T. 16 N., R. 4 W., at a point 18.50 chs. S. $0^{\circ} 47' E.$ of reestablished $\frac{1}{4}$ sec. cor. of sec. 18.

Set temp. $\frac{1}{4}$ sec. cor. of sec. 12 and continue line and measurement.

79.92 Fall 10 lks. N. of reestablished $\frac{1}{4}$ sec. cor. of secs. 7 and 12 on Mader range line, hereinafter described. True course and dist. of latitudinal $\frac{1}{4}$ sec. line of sec. 12, are, therefore, N. $89^{\circ} 56' W.$, 79.92 chs., and the true line at 19.70 chs. N. $89^{\circ} 56' W.$, will, therefore, intersect W. bdy. of T. 16 N.; R. 4 W., at 18.57 chs. S. $0^{\circ} 47' E.$, from $\frac{1}{4}$ sec. cor. of sec. 18.

The orig. $\frac{1}{4}$ sec. cor. of secs. 1 and 2, T. 16 N., R. 5 W., is a malpais stone 10 x 8 x 6 ins. above ground, firmly set, marked $\frac{1}{4}$ on W. face, and witnessed by two properly marked bearing trees, one each SE. and SW. of cor.

Thence

East, on a random line on latitudinal $\frac{1}{4}$ sec. line of sec. 1.

59.14 Intersect W. bdy. of T. 16 N., R. 4 W., at a point 18.70 chs., S. $0^{\circ} 47' E.$, of reestablished $\frac{1}{4}$ sec. cor. of sec. 7.

Set temp. $\frac{1}{4}$ sec. cor. of sec. 1 and continue line and measurement.

80.02 Fall 8 lks. S. of reestablished $\frac{1}{4}$ sec. cor. of secs. 1 and 6 on Mader range line, hereinafter described. True course and dist. of latitudinal $\frac{1}{4}$ sec. line of sec. 1, are therefore, S. $89^{\circ} 57' W.$, 80.02 chs., and the true line at 20.88 chs. S. $89^{\circ} 57' W.$ will, therefore, intersect W. bdy. of T. 16 N.; R. 4 W., at 18.64 chs. S. $0^{\circ} 47' E.$, from $\frac{1}{4}$ sec. cor. of sec. 7.

RESURVEY.

In the following notes, all items of topography are omitted, for the reason that the same has already been described in Books "B" and "C" of this group.

From cor. of secs. 25 and 36, T. 16 N., R. 5 W., described in Book "B" of this group.

Resurvey of Part of the East Boundary of Township 16 North, Range 5 West,

- Chains N. $0^{\circ} 8' W.$, on true line, on E. bdy. of sec. 25.
 2.33 Intersect the $\frac{1}{4}$ sec. cor. of sec. 19, Frac. T. $15\frac{1}{2} N.$, R. 4 W., described in Book "B".
 Continue line and measurement.
 18.60 Intersect the closing cor. of Frac. T. $15\frac{1}{2} N.$, R. 4 W., and T. 16 N., R. 5 W., described in Book "B".
 Thence offset 15.94 chs. N. $89^{\circ} 51' W.$, on S. bdy. of T. 16 N., R. 4 W., to
 18.64 (Northing from cor. of secs. 25 and 36) Intersect the reestablished cor. of T. 16 N., R. 4 W., (SW. cor.) described in Book "C".
 Thence
 N. $0^{\circ} 47' W.$, on true line, on W. bdy. of T. 16 N., R. 4 W., continuing measurement of northing from cor. of secs. 25 and 36.
 39.78 (Northing from cor. of secs. 25 and 36). Intersect true latitudinal $\frac{1}{4}$ sec. line of sec. 25.
 At this point of intersection set an iron post, 3 ft. long, 1 in. in diam., 27 ins. in the ground for re-established $\frac{1}{4}$ sec. cor. of sec. 25, only, marked on brass cap

$\frac{1}{4}$ S 25 |
 1924

From which

- A juniper, 5 ins. in diam., bears N. $82\frac{1}{2}^{\circ} W.$, 163 lks. dist., marked $\frac{1}{4}$ S 25 B T.
 A juniper, 8 ins. in diam., bears S. $6\frac{1}{2}^{\circ} W.$, 131 lks. dist., marked $\frac{1}{4}$ S 25 B T.
 From this cor. the Mader reestablished $\frac{1}{4}$ sec. cor. of secs. 25 and 30, which is a malpais stone 10 x 8 x 10 ins. above ground, firmly set, marked $\frac{1}{4}$ S on W. face, and witnessed by one bearing tree and a mound of stone, bears N. $89^{\circ} 49' E.$, 16.13 chs. dist.
 Obliterate marking on stone and bearing tree and scatter the mound of stone. Continue line and measurement.
 58.64 Intersect the reestablished $\frac{1}{4}$ sec. cor. of sec. 31, T. 16 N., R. 4 W., described in Book "C".
 Continue line and measurement.
 79.64 (39.86 chs. N. $0^{\circ} 47' W.$, from $\frac{1}{4}$ sec. cor. of sec. 25). Intersect subdivision line bet. secs. 24 and 25, resurveyed S. $89^{\circ} 56' E.$ Closing cor. of said secs. established here as hereinafter described.

From closing cor. of secs. 24 and 25, T. 16 N., R. 5 W., hereinafter described.

- N. $0^{\circ} 47' W.$, on true line on E. bdy. of sec. 24.
 19.00 Intersect the reestablished cor. of secs. 30 and 31, T. 16 N., R. 4 W., described in Book "C" of this group.
 Continue line and measurement.
 39.93 Intersect the latitudinal $\frac{1}{4}$ sec. line of sec. 24, surveyed thru said sec. as hereinbefore described.
 At this point of intersection, set an iron post, 3 ft. long, 1 in. in diam., 27 ins. in the ground for re-established $\frac{1}{4}$ sec. cor. of sec. 24 only, marked on brass cap.

$\frac{1}{4}$ S 24 |
 1924

From which

- A juniper, 4 ins. in diam., bears N. $43\frac{1}{2}^{\circ} W.$, 71 lks. dist., marked $\frac{1}{4}$ S 24 B T.
 A juniper, 4 ins. in diam., bears S. $76\frac{1}{4}^{\circ} W.$, 68 lks. dist., marked $\frac{1}{4}$ S 24 B T.
 From this cor. the reestablished $\frac{1}{4}$ sec. cor. of secs. 19 and 24, on the Mader range line, which is a malpais stone 10 x 8 x 4 ins. above ground, marked $\frac{1}{4}$ S on W. face, firmly set and witnessed by two properly marked bearing trees, one each NW. and SW. of cor. and a

Resurvey of Part of East Boundary of Township 16 North, Range 5 West.

Chains mound of stone W. of cor., bears N. 89° 49' E., 17.22 chs. dist.
 Obliterate the marking on the stone, and bearing trees, and scatter the mound of stone.
 Continue line and measurement.
 59.00 Intersect the reestablished 1/4 sec. cor. of sec. 30, T. 16 N., R. 4 W., described in Book "C" of this group.
 Continue line and measurement.
 79.87 (39.94 chs, N. 0° 47' W., from 1/4 sec. cor. of sec. 24).
 Intersect subdivision line, bet. secs. 13 and 24, surveyed N. 89° 58' E.
 Closing cor. of said secs. established at this point as hereinafter described.

From closing cor. of secs. 13 and 24, T. 16 N., R. 5 W., hereinafter described:
 N. 0° 47' W., on true line on E. bdy. of sec. 13.
 19.13 Intersect the reestablished cor. of secs. 19 and 30, T. 16 N., R. 4 W., described in Book "C" of this group.
 Continue line and measurement.
 40.32 Intersect the latitudinal 1/4 sec. line of sec. 13, surveyed thru said sec. as hereinbefore described.
 At this point of intersection set an iron post, 3 ft. long, 1 in. in diam., 27 ins. in the ground for reestablished 1/4 sec. cor. of sec. 13, only, marked on brass cap

1/4 S 13 |
1924

From which
 A juniper, 5 ins. in diam., bears N. 52 1/2° W., 68 lks. dist., marked 1/4 S 13 B T.
 A juniper, 4 ins. in diam., bears S. 38 1/2° W., 90 lks. dist., marked 1/4 S 13 B T.

From this cor. the reestablished 1/4 sec. cor. of secs. 13 and 18, on the Mader range line, which is a granite stone 12 x 6 x 8 ins. above ground, firmly set, marked 1/4 S on W. face, and witnessed by a mound of stone W., bears N. 89° 51' E., 18.45 chs. dist.
 Obliterate marking on the stone and scatter the mound of stone

59.13 Intersect the reestablished 1/4 sec. cor. of sec. 19, T. 16 N., R. 4 W., described in Book "C" of this group.
 Continue line and measurement.
 80.64 (40.32 chs. N. 0° 47' W., from 1/4 sec. cor. of sec. 13).
 Intersect the subdivision line, bet. secs. 12 and 13, surveyed N. 89° 50' E.
 Closing cor. of said secs. established at this point as hereinafter described.

From closing cor. of secs. 12 and 13, hereinafter described.
 N. 0° 47' W., on true line on E. bdy. of sec. 12.
 18.49 Intersect the reestablished cor. of secs. 18 and 19, T. 16 N., R. 4 W., described in Book "C" of this group.
 Continue line and measurement.
 39.92 Intersect the latitudinal 1/4 sec. line of sec. 12, surveyed thru said sec. as hereinbefore described.
 At this point of intersection, set an iron post, 3 ft. long, 1 in. in diam., 27 ins. in the ground, for reestablished 1/4 sec. cor. of sec. 12, only, marked on brass cap

Resurvey of Part of East Boundary of Township 16 North, Range 5 West.

Chains

 $\frac{1}{4}$ S 12

1924

From which

A juniper, 6 ins. in diam., bears N. $85\frac{1}{2}^{\circ}$ W., 101 lks. dist., marked $\frac{1}{4}$ S 12 B T.

A juniper, 4 ins. in diam., bears S. 50° W., 81 lks. dist., marked $\frac{1}{4}$ S 12 B T.

From this cor. the reestablished $\frac{1}{4}$ sec. cor. of secs. 7 and 12, on the Mader range line, which is a granite stone 12 x 6 x 9 ins., above ground, firmly set, marked $\frac{1}{4}$ S on W. face and witnessed by a mound of stone W., and two properly marked bearing trees, one each NW. and SW. of cor., bears S. $89^{\circ} 56'$ E., 19.70 chs. dist.

Obliterate marking on the stone and bearing trees, and scatter the mound of stone.

58.49 Intersect the reestablished $\frac{1}{4}$ sec. cor. of sec. 18, T. 16 N., R. 4 W., described in Book "C" of this group. Continue line and measurement.

79.84 (39.92 chs. N. $0^{\circ} 47'$ W., from $\frac{1}{4}$ sec. cor. of sec. 12) Intersect the subdivision line, bet. secs. 1 and 12 surveyed S. $89^{\circ} 54'$ E.

Closing cor. of said secs. established at this point as hereinafter described.

From closing cor. of secs. 1 and 12, hereinafter described.

N. $0^{\circ} 47'$ W., on true line on E. bdy. of sec. 1.

18.65 Intersect the reestablished cor. of secs. 7 and 18, T. 16 N., R. 4 W., described in Book "C" of this group. Continue line and measurement.

40.01 Intersect the latitudinal $\frac{1}{4}$ sec. line of sec. 1, surveyed thru said sec. as hereinbefore described.

At this point of intersection set an iron post, 3 ft. long, 1 in. in diam., 27 ins. in the ground, for reestablished $\frac{1}{4}$ sec. cor. of sec. 1, only, marked on brass cap

 $\frac{1}{4}$ S 1

1924

From which

A juniper, 6 ins. in diam., bears S. 67° W., 16 lks. dist., marked $\frac{1}{4}$ S 1 B T.

A juniper, 5 ins. in diam., bears S. 9° W., 19 lks. dist., marked $\frac{1}{4}$ S 1 B T.

From this cor. the reestablished cor. of secs. 1 and 6 on the Mader range line, which is a malpais stone 12 x 10 x 10 ins. above ground, firmly set, marked $\frac{1}{4}$ S on W. face, and witnessed by two properly marked bearing trees, one each W. and SE. of cor., brs. N. $89^{\circ} 57'$ E., 20.88 chs. dist.

Obliterate the marking on the stone and bearing trees. Continue line and measurement.

58.65 Intersect the reestablished $\frac{1}{4}$ sec. cor. of sec. 7, T. 16 N., R. 4 W., described in Book "C" of this group. Continue line and measurement.

98.65 Intersect the reestablished cor. of secs. 6 and 7, T. 16 N., R. 4 W., described in Book "C" of this group. Continue line and measurement.

127.76 Intersect line 1-8 of the bdy. of Forest Homestead Entry Survey No. 364 at a point 3.02 chs. N. $48^{\circ} 36'$ W., from cor. No. 8, thereof.

Resurvey of Part of East Boundary of Township 16 North, Range 5 West.

- Chains Thence across H. E. S. No. 364.
- 136.15 Intersect the witness cor. to reestablished $\frac{1}{4}$ sec. cor. of sec. 6, T. 16 N., R. 4 W., described in Book "C" of this group.
 - 138.65 Intersect true point for reestablished $\frac{1}{4}$ sec. cor. of sec. 6, T. 16 N., R. 4 W., in Humphrey's Wash, as described in Book "C" of this group.
 - 154.21 Intersect line 3-4 of the Boundary of Forest Homestead Entry Survey No. 364, at a point 9 lks. N. $57^{\circ} 32' W.$, from cor. No. 4, thereof.
 - Leave H. E. S. No. 364.
 - 179.05 (39.04 chs. N. $0^{\circ} 47' W.$, from $\frac{1}{4}$ sec. cor. of sec. 1). Intersect the reestablished closing cor. of Ts. 16 N., Rs. 4 and 5 W., on the Fourth Standard Parallel North, described in Book "C" of this group.

Boundaries of Township 16 North, Range 5 West.

Latitudes, Departures and Closing Errors.

Line designated	True course	Dist- ance.	Latitudes		Departures	
			N.	S.	E.	W.
South Boundary	S. $89^{\circ} 29' W.$	39.22		.35		39.22
	West	451.18				451.18
West Boundary	North	578.60	578.60			
North Boundary (4th St. Par. N.)	East	378.65			378.65	
	S. $89^{\circ} 49' E.$	80.22		.26	80.22	
	East	8.39			8.39	
East Boundary	S. $0^{\circ} 47' E.$	480.45		480.40	6.58	
	S. $89^{\circ} 51' E.$	15.94		.04	15.94	
	S. $0^{\circ} 8' E.$	18.60		18.60	.04	
	S. $0^{\circ} 10' W.$	40.07		40.07		.12
	S. $0^{\circ} 2' E.$	40.12		40.12	.02	
Convergency					.60	
Totals			578.60	579.84	490.44	490.52
				578.60		490.44
	Error in latitude			1.24		
	Error in departure					0.08

Retracement of Part of Subdivision Lines of T. 16 N., R. 5 W.

Chains	<p>The subdivision lines of T. 16 N., R. 5 W., were surveyed in 1903, by A. B. Mader, U. S. D. S., and no retracement or resurvey of any part of same is of record. The following notes describe a retracement of line bet. secs. 13 and 14, 23 and 24, 25 and 26, and west halves of lines between secs. 12 and 13, 13 and 24, 24 and 25, and 25 and 36.</p> <p>The original $\frac{1}{4}$ sec. cor. of secs. 25 and 36 is a granite stone 16 x 14 x 8 ins. above ground, firmly set, marked $\frac{1}{4}$ S. on N. face and witnessed by two properly marked bearing trees, one each NW. and SE. of cor.</p> <p>Thence N. $89^{\circ} 56'$ W., on random line, bet. secs. 25 and 36 ($W. \frac{1}{2}$) Over rolling land, thru dense timber and undergrowth. Desc. 90 ft. over NW. slope.</p> <p>13.10 Wash, 12 lks. wide, course NE. Asc. 195 ft. over SE. slope to sec. cor.</p> <p>35.00 Leave dense and enter scattering timber, brs. NE. and SW.</p> <p>40.04 Fall 32 lks. N. of the original cor. of secs. 25, 26, 35 and 36, which is a malpais stone 12 x 7 x 11 ins. above ground, firmly set, marked with 1 notch on each of E. and S. faces, and witnessed by four properly marked bearing trees, one each NE., SE., SW. and NW. of cor.</p> <p>True course and dist. of $W. \frac{1}{2}$ of line bet. secs. 25 and 36 are, therefore, S. $89^{\circ} 36'$ W., 40.04 chs.</p> <p>Land, rolling and mountainous. Timber, juniper and oak. Soil, stony, 2nd and 3rd rate. Undergrowth, scrub oak.</p>
	<p>N. $0^{\circ} 1'$ W., on random line, bet. secs. 25 and 26 ($S. \frac{1}{2}$) Over mountainous land, thru scattering timber and dense undergrowth. Asc. 186 ft. over SE. slope.</p> <p>9.50 Ridge, bears E. and W. Desc. 217 ft. over NW. slope.</p> <p>34.50 Wash, 10 lks. wide, course N. 10° E. Enter rolling land. Ascend gradually over SE. slope to</p> <p>40.05 Fall 5 lks. W. of the original $\frac{1}{4}$ sec. cor., which is a granite stone 9 x 7 x 6 ins. above ground, firmly set, marked $\frac{1}{4}$ S on W. face and witnessed by two properly marked bearing trees, one each SE. and SW. of cor.</p> <p>True course and dist. of $S. \frac{1}{2}$ of line bet. secs. 25 and 26, are, therefore, N. $0^{\circ} 3'$ E., 40.05 chs.</p> <p>Thence N. $0^{\circ} 1'$ W., on random line, bet. secs. 25 and 26 ($N. \frac{1}{2}$). Over rolling land, thru scattering timber and dense undergrowth. Desc. gradually over NE. slope.</p> <p>9.45 Road from Fair Oaks ranch to Prescott, Arizona, bears N. 75° E., and S. 75° W.</p> <p>15.20 Dry creek bed, 15 lks. wide, course N. 60° E. Enter mountainous land. Ascend 228 ft. over SE. slope.</p> <p>31.45 Point of spur, slopes SE. Ascend gradually over E. slope to</p> <p>39.92 Fall 5 lks. E. of the original cor. of secs. 23, 24, 25 and 26, which is a malpais stone 9 x 6 x 7 ins. above ground, firmly set, marked with 1 notch on E. face and 2 notches on S. face, and witnessed by three properly marked bearing trees, one each NE., SE., and NW. of cor. and a mound of stone W.</p> <p>True course and distance of $N. \frac{1}{2}$ of line bet. secs. 25 and 26, are therefore, N. $0^{\circ} 5'$ W., 39.92 chs.</p> <p>Land, mountainous and rolling. Soil, stony, 3rd and 4th rate. Timber, juniper and oak. Undergrowth, scrub oak.</p>

Retracement of Part of Subdivision Lines of T. 16 N., R. 5 W.

Chains N. 89° 46' E., on random line, bet. secs. 24 and 25 (W. $\frac{1}{2}$)
 Over mountainous land, thru scattering timber and under-
 growth. Descend 143 ft. over E. slope.
 10.30 Wash, 5 lks. wide, course S. 20° E. Ascend 23 ft. over
 SW. slope.
 13.50 Point of spur, slopes S. Descend 23 ft. over SE. slope.
 18.00 Wash, 5 lks. wide, course S. 15° W. Ascend 275 ft. over
 NW. slope.
 33.50 Ridge, bears N. and SE. Descend 29 ft. over NE. slope to
 39.42 Fall 3 lks. N. of the original $\frac{1}{4}$ sec. cor., which is a
 malpais stone 7 x 6 x 7 ins. above ground, firmly set,
 marked $\frac{1}{4}$ S on N. face and witnessed by two properly
 marked bearing trees, one each NW. and SE. of cor.
 True course and dist. of W. $\frac{1}{2}$ of line bet. secs. 24 and
 25, are therefore, S. 89° 48' W., 39.42 chs.
 Land, mountainous.
 Soil, stony, 3rd and 4th rate.
 Timber, cedar and juniper.
 Undergrowth, scrub oak.

From orig. cor. of secs. 23, 24, 25 and 26.
 N. 0° 1' W., on random line, bet. secs. 23 and 24 (S. $\frac{1}{2}$).
 Over mountainous land, thru dense undergrowth.
 Ascend gradually over steep E. slope to
 25.75 Descend 180 ft. over steep N. slope to
 40.02 Fall, 5 lks. W. of the original $\frac{1}{4}$ sec. cor., which is
 a granite stone 10 x 6 x 5 ins. above ground, firmly
 set, marked $\frac{1}{4}$ S on W. face and witnessed by two pro-
 perly marked bearing trees, one each NW. and SE. of
 cor.
 True course and dist. of S. $\frac{1}{2}$ of line bet. secs. 23 and
 24 are, therefore, N. 0° 3' E., 40.02 chs.
 Thence,
 N. 0° 1' W., on random line, bet. secs. 23 and 24 (N. $\frac{1}{2}$)
 Over mountainous land, thru dense undergrowth.
 Descend 125 ft. over N. slope.
 1.00 Enter scattering timber, brs. NW. and SE.
 13.00 Center of wash, 100 lks. wide, course E,
 Ascend 125 ft. over S. slope.
 23.25 Ridge, bears E. and W. Descend 225 ft. over N. slope to
 35.00 Foot of ridge, bears E. and W. Enter rolling land.
 Descend gradually over NE. slope to
 39.82 Fall 15 lks. E. of the original cor. of secs. 13, 14,
 23 and 24, which is a granite stone 12 x 8 x 6 ins.
 above ground, firmly set, marked with 1 notch on E.
 face and 3 notches on S. face and witnessed by one
 properly marked bearing tree NE. and a mound of stone
 W. of cor.
 True course and distance of N. $\frac{1}{2}$ of line bet. secs. 23
 and 24 are therefore, N. 0° 12' W., 39.82 chs.
 Land, mountainous and rolling.
 Soil, stony, 3rd and 4th rate.
 Timber, cedar and juniper.
 Undergrowth, scrub oak.

N. 89° 46' E., on random line, bet. secs. 13 and 24 (W. $\frac{1}{2}$)
 Over mountainous land, thru dense undergrowth and scat-
 tering timber. Ascend 166 ft. over SW. slope.
 10.70 Spur, slopes SW. Descend 102 ft. over SE. slope to
 15.00 Foot of descent. Leave mountainous and enter rolling
 land. Descend gradually over SE. slope.
 25.00 Leave rolling and enter mountainous land. Ascend 85 ft.
 over W. slope.
 30.10 Ridge, bears N. and S.
 Descend 97 ft. over E. slope to
 39.42 Fall 5 lks. N. of the original $\frac{1}{4}$ sec. cor., which is a

Retracement of Part of Subdivision Lines of T. 16 N., R. 5 W.

Chains malpais stone 8 x 5 x 5 ins. above ground, firmly set, marked $\frac{1}{4}$ S. on N. face and witnessed by two properly marked bearing trees, one each North and SW. of cor. True course and dist. of $W.\frac{1}{2}$ of line bet. secs. 13 and 24 are, therefore, S. 89° 48' W., 39.42 chs. Land, mountainous and rolling. Soil, stony 2nd and 3rd rate. Timber, oak and juniper. Undergrowth, scrub oak.

From original cor. of secs. 13, 14, 23 and 24. N. 0° 1' W., on random line bet. secs. 13 and 14 ($S.\frac{1}{2}$). Over rolling land, thru scattering timber and dense undergrowth. Descend slightly over NE. slope to

1.28 Ascend 34 ft. over S. slope
6.28 Spur, slopes SW. Descend 53 ft. over NW. slope.
18.90 Center of Horse Wash 125 lks. wide, course NE. Ascend 92 ft. over SE. slope
39.96 Spur, slopes E. Leave rolling and enter mountainous land. Descend slightly over N. slope to
40.08 Fall 19 lks. E. of the original $\frac{1}{4}$ sec. cor., which is a granite stone 10 x 9 x 7 ins. above ground, firmly set, marked $\frac{1}{4}$ S on W. face, and witnessed by two properly marked bearing trees, one each NE. and NW. of cor. True course and dist. of $S.\frac{1}{2}$ of line bet. secs. 13 and 14 are therefore, N. 0° 18' W., 40.08 chs. Thence N. 0° 1' W., on random line, bet. secs. 13 and 14 ($N.\frac{1}{2}$) Over mountainous land, thru scattering timber and dense undergrowth. Descend 115 ft. over N. slope to
20.30 Foot of descent, brs. E. and W. Enter rolling land. Descend gradually over NW. slope.
25.00 Leave rolling and enter mountainous land. Ascend 121 ft. over SE. slope to
40.32 Fall 2 lks. E. of the original cor. of secs. 11, 12, 13 and 14, which is a malpais stone 8 x 4 x 5 ins. above ground, firmly set, marked with 1 notch on E. face, and 4 notches on S. face, and witnessed by four properly marked bearing trees, one each NE., SE., SW., and NW. of cor. True course and dist. of $N.\frac{1}{2}$ of line bet. secs. 13 and 14 are, therefore, N. 0° 3' W., 40.32 chs. Land, rolling and mountainous. Soil, stony, 2nd and 3rd rate. Timber, cedar and juniper. Undergrowth, scrub oak.

N. 89° 58' E., on random line, bet. secs. 12 and 13 ($W.\frac{1}{2}$) Over mountainous land, thru dense timber and undergrowth. Descend gradually over rolling S. slope to
39.96 Fall 10 lks. N. of the original $\frac{1}{4}$ sec. cor., which is a malpais stone 10 x 5 x 5 ins. above ground, firmly set, marked $\frac{1}{4}$ S on N. face, and witnessed by two properly marked bearing trees, one each, NE. and SW. of cor. True course and dist. of $W.\frac{1}{2}$ of line bet. secs. 12 and 13 are, therefore, N. 89° 53' W., 39.96 chs. Land, mountainous. Soil, stony, 3rd rate. Timber, cedar and juniper. Undergrowth, scrub juniper.

Resurvey of Part of Subdivision Lines of T. 16 N., R. 5 W.

Chains The following notes describe the resurvey of the east halves of lines bet. secs. 25 and 36, 24 and 25, 13 and 24, 12 and 13, and 1 and 12 of T. 16 N., R. 5 W.

 RETRACEMENT FOR RESURVEY.

From the cor. of secs. 25 and 36, on E. bdy. of the township described in Book "B" of this group.
 N. $89^{\circ} 56'$ W., on random line, bet. secs. 25 and 36 (E. $\frac{1}{2}$)
 39.14 Fall 41 lks. N. of the original quarter-section cor.,
 hereinbefore described.

The true course and distance of E. $\frac{1}{2}$ of line bet. secs. 25 and 36 are, therefore, S. $89^{\circ} 28'$ W., 39.14 chs.

From the reestablished cor. of secs. 19, 24, 25 and 30, on the Mader range line, hereinafter described.
 S. $89^{\circ} 46'$ W., on random line, on the original subdivision line, bet. secs. 24 and 25 (E. $\frac{1}{2}$).
 39.44 Fall 21 lks. S. of the orig. $\frac{1}{4}$ sec. cor. hereinbefore described.

True course and dist. of E. $\frac{1}{2}$ of original line, bet. secs. 24 and 25, are, therefore, S. $89^{\circ} 56'$ E., 39.44 chs.

From the reestablished cor. of secs. 13, 18, 19 and 24, on the Mader range line, hereinafter described.
 S. $89^{\circ} 46'$ W., on random line, on the original subdivision line between secs. 13 and 24 (E. $\frac{1}{2}$).
 39.74 Fall 14 lks. S. of the original $\frac{1}{4}$ sec. cor., hereinbefore described.

True course and dist. of E. $\frac{1}{2}$ of original line bet. secs. 13 and 24, are, therefore, N. $89^{\circ} 58'$ E., 39.74 chs.

From the reestablished cor. of secs. 7, 12, 13 and 18, on the Mader range line, hereinafter described.
 S. $89^{\circ} 58'$ W., on random line on the original subdivision line bet. secs. 12 and 13 (E. $\frac{1}{2}$).
 39.90 Fall 9 lks. N. of the original $\frac{1}{4}$ sec. cor., hereinbefore described.

True course and dist. of E. $\frac{1}{2}$ of original line bet. secs. 12 and 13, are, therefore, N. $89^{\circ} 50'$ E., 39.90 chs.

From the reestablished cor. of secs. 1, 6, 7 and 12, on the Mader range line, hereinafter described.
 N. $89^{\circ} 59'$ W., on random line on the original subdivision line, bet. secs. 1 and 12 (E. $\frac{1}{2}$)
 39.80 Fall 6 lks. S. of the original $\frac{1}{4}$ sec. cor. hereinafter described.

True course and distance of E. $\frac{1}{2}$ of original line bet. secs. 1 and 12, are, therefore, S. $89^{\circ} 54'$ E., 39.80 chs.

 RESURVEY.

From the cor. of secs. 25 and 36, on the E. bdy. of the

Resurvey of Part of the Subdivision Lines of T. 16 N., R. 5 W.

Chains township described in Book "B" of this group.
 S. 89° 28' W., on true line, bet. secs. 25 and 36 (E. 1/2).
 Over gently rolling land, thru scattering timber and dense undergrowth.
 Ascend gradually over NE. slope to
 27.25 Wash, 10 lks. wide, in gully, 10 ft. deep, course NE.
 Enter heavily rolling land. Ascend 58 ft. over SE. slope.
 30.10 Road, bears NE. and SW.
 31.40 Spur, slopes NE. Descend 65 ft. over NW. slope to
 39.14 Intersect the original 1/4 sec. cor. of secs. 25 and 36, hereinbefore described.
 Land, gently and heavily rolling.
 Soil, stony, 2nd and 3rd rate.
 Timber, juniper and oak.
 Undergrowth, scrub oak.

 From the original 1/4 sec. cor. of secs. 24 and 25, hereinbefore described.
 S. 89° 56' E., on true line, bet. secs. 24 and 25 (E. 1/2)
 Over mountainous land, thru dense timber and undergrowth.
 Descend 89 ft. over NE. slope.
 16.70 Head of ravine, course N. Ascend 50 ft. over NW. slope to
 22.76 Intersect W. bdy. of T. 16 N., R. 4 W., at a point 19.00 chs. S. 0° 47' E., from the reestablished cor. of secs. 30 and 31, described in Book "C" of this group
 At this point of intersection, set an iron post, 3 ft. long, 2 ins. in diam., 27 ins. in the ground for closing cor. of secs. 24 and 25, marked on brass cap

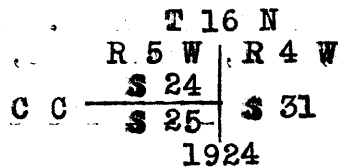

From which

A juniper, 12 ins. in diam., brs. N. 56° W., 55 lks. dist., marked T 16 N R 5 W S 24 C C B T
 A juniper, 14 ins. in diam.; brs. S. 57 1/2° W., 26 lks. dist., marked T 16 N R 5 W S 25 C C B T
 From this cor. the reestablished cor. of secs. 19, 24, 25 and 30 on the Mader range line, which is a malpais stone 12 x 10 x 10 ins. above ground, firmly set, marked with 4 notches on N. face, and 2 notches on S. face and witnessed by two properly marked bearing trees, one each NW. and SW. of cor. and a mound of stone W., bears S. 89° 56' E., 16.68 chs. dist.
 Obliterate the marking on the stone and bearing trees and scatter the md. of stones.
 Land, mountainous.
 Soil, stony, 3rd rate.
 Timber, cedar and juniper.
 Undergrowth, scrub juniper.

 From the original 1/4 sec. cor. of secs. 13 and 24, hereinbefore described.
 N: 89° 58' E., on true line, bet. secs. 13 and 24 (E. 1/2).
 Over mountainous land, thru dense timber and undergrowth.
 Desc. 51 ft. over SE. slope.
 4.55 Wash, 20 lks. wide, course NE. Ascend 89 ft. over NW. slope.
 14.60 Ridge brs. N. and S. Desc. 81 ft. over SE. slope to
 21.90 Intersect the W. bdy. of T. 16 N., R. 4 W., at a point

Resurvey of Part of Subdivision Lines of T. 16 N., R. 5 W.

Chains

19.13 chs. S. $0^{\circ} 47'$ E., from the reestablished cor. of secs. 19 and 30, described in Book "C" of this group. At this point of intersection, set an iron post, 3 ft. long, 2 ins. in diam., 27 ins. in the ground, for closing cor. of secs. 13 and 24, marked on brass cap

T 16 N		
R 5 W		R 4 W
C C	S 13	S 30
	S 24	
1924		

From which

A juniper, 12 ins. in diam., bears N. 73° W., 172 lks. dist., marked T 16 N R 5 W S 13 C C B T

A juniper, 12 ins. in diam., bears S. $72\frac{1}{2}^{\circ}$ W., 194 lks. dist., marked T 16 N R 5 W S 24 C C B T

From this cor. the reestablished cor. of secs. 13, 18, 19 and 24, on the Mader range line, which is a granite stone 14 x 9 x 6 ins., above ground, firmly set, marked with 3 notches on each of N. and S. faces, and witnessed by two properly marked bearing trees, one each NW. and SW., and a mound of stone W. of cor., bears N. $89^{\circ} 58'$ E., 17.84 chs. dist.

Obliterate the marking on the stone and bearing trees and scatter the mound of stones.

Land, mountainous.

Soil, stony, 3rd rate.

Timber, cedar and juniper.

Undergrowth, scrub oak.

From the original $\frac{1}{4}$ sec. cor. of secs. 12 and 13, hereinbefore described.

N. $89^{\circ} 50'$ E., on true line, bet. secs. 12 and 13 (E. $\frac{1}{2}$).

Over mountainous land, thru dense timber and undergrowth.

Descend gradually over S. slope to

8.00 Descend 92 ft. over SE. slope to closing cor.

9.00 Leave dense and enter scattering timber, brs. NW. and SE.

20.76 Intersect W. bdy. of T. 16 N., R. 4 W., at a point 18.49 chs. S. $0^{\circ} 47'$ E., from the reestablished cor. of secs. 18 and 19, described in Book "C" of this group. At this point of intersection, set an iron post, 3 ft. long, 2 ins. in diam., 27 ins. in the ground for closing cor. of secs. 12 and 13, marked on brass cap

T 16 N		
R 5 W		R 4 W
C C	S 12	S 19
	S 13	
1924		

From which

A juniper, 12 ins. in diam., bears N. 38° W., 68 lks. dist., marked T 16 N R 5 W S 12 C C B T

No other bearing trees available.

Raise a mound of stone 2 ft. base, $1\frac{1}{2}$ ft. high W. of cor.

From this cor. the reestablished cor. of secs. 7, 12, 13 and 18, on the Mader range line, which is a malpais stone 9 x 6 x 6 ins. above ground, firmly set, marked with 2 notches on N. face and 4 notches on S. face and witnessed by two properly marked bearing trees, one each NE. and NW., and a mound of stone W. of cor., bears N. $89^{\circ} 50'$ E., 19.14 chs. dist.

Resurvey of Part of Subdivision Lines of T. 16 N., R. 5 W.

Chains Obliterate the marking on the stone and bearing trees, and scatter the mound of stones.
Land, mountainous.
Soil, stony, 3rd rate.
Timber, cedar and juniper.
Undergrowth, scrub oak and juniper.

The orig. $\frac{1}{4}$ sec. cor. of secs. 1 and 12 is a granite stone, 8 x 6 x 5 ins. above ground, firmly set, marked $\frac{1}{4}$ S on N. face and witnessed by two properly marked bearing trees, one each NE. and SW. of cor.

Thence

S. $89^{\circ} 54'$ E., on a true line, bet. secs. 1 and 12 ($E. \frac{1}{2}$)
Over rolling land, thru scattering timber and dense undergrowth. Descend 60 ft. over E. slope to
19.56 Intersect the W. bdy. of T. 16 N., R. 4 W., at a point 18.65 chs. S. $0^{\circ} 47'$ E., from the reestablished cor. of secs. 7 and 18, described in Book "C" of this group.

At this point of intersection, set an iron post, 3 ft. long, 2 ins. in diam., 28 ins. in the ground for closing cor. of secs. 1 and 12, marked on brass cap

	T 16 N		
	R 5 W	R 4 W	
	S 1		
C C	S 12	S 18	
	1924		

From which

A juniper, 22 ins. in diam., bears N. $73\frac{3}{4}^{\circ}$ W.,
214 lks. dist., marked T 16 N R 5 W S 1 CCBT

A juniper, 7 ins. in diam., bears S. $69\frac{3}{4}^{\circ}$ W.,
278 lks. dist., marked T 16 N R 5 W S 12 CCBT

From this cor. the reestablished cor. of secs. 1, 6, 7 and 12, on the Mader range line, which is a malpais stone 10 x 5 x 5 ins. above ground, marked with 1 notch on N. face, and 5 notches on S. face and witnessed by four properly marked bearing trees, one each NE., SE., SW., and NW., bears S. $89^{\circ} 54'$ E., 20.24 chs. dist.

Obliterate the marking on the stone and bearing trees.
Land, rolling.

Soil, stony, 2nd and 3rd rate.

Timber, cedar and juniper.

Undergrowth, scrub oak and juniper:

FINAL FIELD TEST OF A. LIETZ SOLAR TRANSIT NO. 6166.

August 21, 1924, at 4 h. 0 m., p. m., l. m. t., set up instrument on the meridian on which the preliminary test was made as described on page 3 hereof, and set off $34^{\circ} 46'$ N. on the lat. arc, $11^{\circ} 59'$ N., on the decl. arc and determine a meridian with the solar and mark a point thereof by a tack driven in the stake already set about 8 chains N. This point falls 1' W. of the meridian established by the Polaris observation.

August 22, 1924, at 7 h. 0 m., a. m., l. m. t., with the lat. arc unchanged; set off $11^{\circ} 47'$ N. on the decl. arc and determine a meridian with the solar and mark a point thereof by a tack driven in the stake already set about 8 chains north. This mark falls $1\frac{1}{2}'$ east

Resurvey of Part of Subdivision Lines of T. 16 N., R. 5 W.

Chains

of the meridian established by the Polaris observation.

Since all observations made during the usual hours of solar work come within $1\frac{1}{2}'$ of the true meridian, established by Polaris observations; conclude that the instrument has remained in satisfactory adjustment thruout the time it was used in the execution of the retracements and resurveys described in the foregoing notes.

CERTIFICATE OF UNITED STATES SURVEYOR.

I, Sidney E. Blout, U.S. Cadastral Engineer, hereby certify upon honor that, in pursuance of special instructions received from the U. S. Surveyor General, for Group 128, Arizona.

bearing date of the 11th. day of February, 1924, I have well, faithfully, and truly

in my own proper person, and in strict conformity with said instructions, the Manual of Surveying Instructions, and the laws of the United States, retraced all those parts or portions of the Subdivision lines of Township 16 North, Range 5 West and

resurveyed all those parts or portions of the South and East boundaries and Subdivision lines of

Township 16 North, Range 5 West

of the Gila and Salt River

Base and Meridian, in the State of Arizona, which are represented in

and by diagram on page 2 hereof

the foregoing field notes as having been executed by me, and under my direction; and that all the corners of

retracement and resurvey said survey have been established and perpetuated in strict accordance with the Manual of Surveying Instruc-

tions, and the special written instructions of the U. S. Surveyor General, for Group 128, Arizona

and in the specific manner described in the field notes, and that the foregoing are the original field notes of such retracement and resurvey.

Place, Phoenix, Arizona
Date, July 25, 1926

Sidney E. Blout
U.S. Cadastral Engineer.

APPROVAL.

OFFICE OF THE U.S. SUPERVISOR OF SURVEYS,

Denver, Colo., December 28, 1926.

The foregoing field notes of the retracement of Part of the Subdivision lines of Township 16 North, Range 5 West, and of the resurvey of Part of the South boundary, Part of the East boundary and Part of the Subdivision lines of Township 16 South, Range 5 West of the Gila and Salt River Base and Meridian, in the State of Arizona

executed by Sidney E. Blout, U.S. Cadastral Engineer.

under his special instructions dated February 11, 1924 for Group 128, Ariz., having been critically examined, and the necessary corrections and explanations made, the said field notes, and the retracements and resurveys they describe, are hereby approved.

Walter H. Johnson
U.S. Supervisor of Surveys

I certify that the foregoing transcript of the field notes of the above described surveys in has been correctly copied from the original notes on file in this office.

U. S. Surveyor General