

BOOK 3791

FIELD NOTES

of the RETRACEMENT of

Part of the East Boundary of T. 5 N., R. 15 W.,

and of the SURVEY of the

West Boundary

and

Subdivision Lines,

of

Township 5 North, Range 15 West,

Of the Gila and Salt River Base and Meridian,

In the State of Arizona

EXECUTED BY

William H. Thorn, U. S. Cadastral Engineer.

In the capacity of U. S. Surveyor, under Special Instructions dated July 23, 1926, issued by U.S. District Cadastral Engineer to govern surveys included in Group No. 143, Arizona, which were approved by the Commissioner of the General Land Office, August 7, 1926, and Assignment Instructions dated November 1, 1926.

Survey commenced December 30, 1926.

Survey completed January 13, 1927.

3791

3791

1A

BOOK 3791

INDEX DIAGRAM.

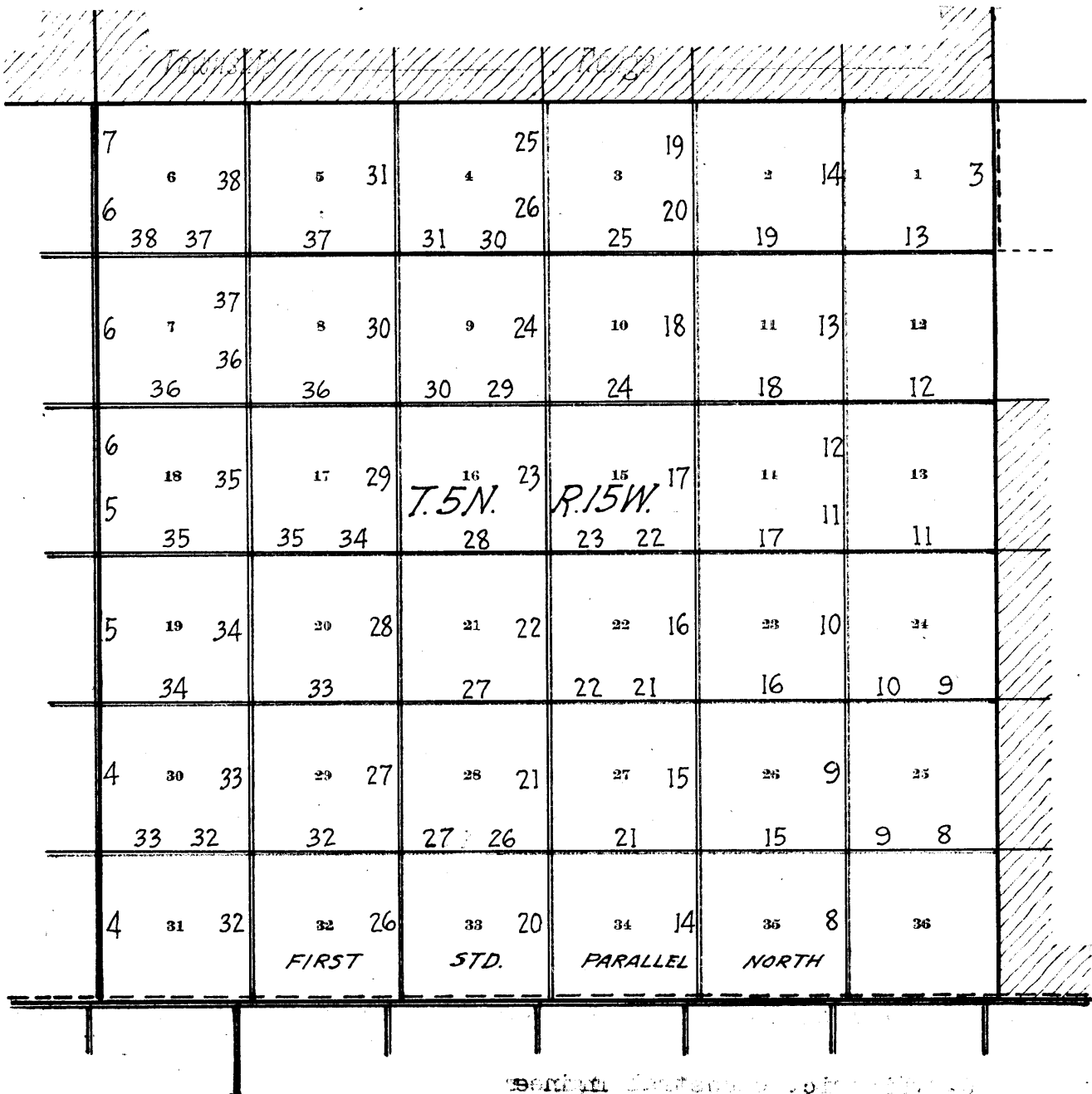

————— Surveyed under this group.

----- Retraced under this group.

----- Unsurveyed.

----- Resurveyed under this group.

————— Accepted surveys, retracements or resurveys.

Areas surveyed as per accepted plats on file.

Book "I"
 Group 143 Arizona
 Township 5 North, Range 15 West
 DATE DIAGRAM

Surveyed by Ty White, U.S.T. in 1923

12-30-26	6 1-13-27	5 1-10-27	4 1-10-27	3 1-6-27	2 1-6-27	1 1-3-27
12-30-26	7 1-10-27	8 1-10-27	9 1-7-27	10 1-6-27	11 1-4-27	12 12-31-26
12-30-26	18 1-8-27	17 1-8-27	16 1-7-27	15 1-5-27	14 1-4-27	13 12-31-26
12-30-26	19 1-8-27	20 1-8-27	21 1-7-27	22 1-5-27	23 1-4-27	24 12-31-26
12-30-26	30 1-8-27	29 1-8-27	28 1-7-27	27 1-5-27	26 1-4-27	25 12-31-26
12-30-26	31 1-8-27	32 1-7-27	33 1-5-27	34 1-4-27	35 12-31-26	36

1-3-27
 U.S.L.M.
 No. 1888

Surveyed by F. W. Rodolf, U.S.S. in 1911

*1st Standard Parallel North
 For dates of Retracement of this line see Book "G"*

Surveyed by Wm. H. Thorn, U.S. Cadastral Engineer, on dates shown thereon.

Retraced by Wm. H. Thorn, U.S.C.E., on dates shown thereon.

Accepted surveys, retracements or resurveys.

Surveys executed on dates shown on diagram on page 1 hereof by William H. Thorn, U. S. Cadastral Engineer, using Buff light mountain transit No. 18000. This instrument is equipped with solar attachment, the horizontal limb of which is provided with two double verniers placed opposite to each other reading to single minutes of arc which is also the least count of the latitude and declination arcs. Unless otherwise specified all azimuth determinations are accomplished with the solar attachment.

PRELIMINARY FIELD TEST.

Examine the adjustments of the transit, and find them correct; then, to test the solar apparatus by comparing its indications resulting from observations made during a. m. and p. m. hours with a meridian established by Polaris observation on December 25, 1926, as described in Book "G", proceed as follows:

January 2, 1927. At 9 h. 0 m., a. m., app. t., set off $33^{\circ} 39\frac{1}{2}'$ N. on the lat. arc; $22^{\circ} 56'$ S. on the decl. arc, and determine a meridian with the solar, which agrees with the true meridian.

At apparent noon make a meridian altitude observation of the sun for latitude, observing the altitude of the sun's lower limb with the telescope in direct position, reversing the transit and observing the sun's upper limb; the mean observed altitude of the sun's center

refraction	$33^{\circ} 23' 30''$
	$1' 25''$
	<hr/>
	$33^{\circ} 22' 05''$

90°	$00'$	$00''$
33°	$22'$	$05''$
<hr/>	<hr/>	<hr/>
56°	$37'$	$55''$
22°	$58'$	$26''$
<hr/>	<hr/>	<hr/>

$33^{\circ} 39' 29''$ = correct latitude of station.

At 3 h. 0 m., p. m., app. t., with the lat. arc unchanged, set off $22^{\circ} 55'$ S., on the decl. arc, and determine a meridian with the solar, which agrees with the true meridian.

As all of the solar observations made during the usual hours of solar work come within $1\frac{1}{2}'$ of the true meridian, conclude that the instruments are in satisfactory adjustment.

Unless otherwise specified all measurements were made with a Lufkin steel tape, 5.00 chains in length, compared with a Lufkin standard steel tape 1 chain in length and found correct.

All measurements herein recorded are made upon the slope the vertical angles determined with a clinometer and the slope measurement properly reduced to true horizontal distance for entry in the field notes.

Retracement of portion of East Boundary of
Township 5 North, Range 15 West.

Chains From the cor. of secs. 1, 6, 7 and 12, hereinafter de-
scribed.

North on random line between secs. 1 and 6 ($S. \frac{1}{2}$).

40.00 Fall 6 lks. E. of $\frac{1}{4}$ sec. cor., which is an iron post,
1 in. in diam., projecting 18 ins. above the ground
in small mound of stone, brass cap marked

$\frac{1}{4}$
 S 1 | S 6
 1911

Mound of stone west of cor.

True course and distance of $S. \frac{1}{2}$ of this mile are there-
fore N. $0^{\circ} 5' W.$, 40.00 chains

From this quarter-section corner U. S. L. M. No. 1888
bears East 63.74 chains distant, which is a stone
8 x 18, 18 ins. above ground, firmly set and marked
U. S. L. M. 1888 on W. face, a mound of stone 5 ft.
base, 4 ft. high brs. NE. 10 lks. dist.

A stone 14 x 24 ins., brs. S. $15^{\circ} W.$, 36 lks.
dist., marked B R U S. L. M 1888.

This monument is located on top of a conical hill and is
plainly visible for a long distance.

From quarter-section corner

North, on random line, bet. secs. 1 and 6 ($N. \frac{1}{2}$).

37.22 Fall 13 lks. E. of cor. of Ts. 5 and 6 N., Rs. 14 and 15
W., which is an iron post, 3 ins. in diam., firmly
set and properly marked on brass cap, with mound of
stone S.

True course and distance of $N. \frac{1}{2}$ of this mile are there-
fore N. $0^{\circ} 12' W.$, 37.22 chains.

Survey of West Boundary of Township 5 North, Range 15 West.

Chains From the standard corner of T. 5 N., Rs. 15 and 16 W., on First Standard Parallel North, hereinafter described.

North, on a random line on W. boundary of T. 5 N., R. 15 W., setting temporary quarter-section and section corners at intervals of 40.00 chains; and at 478.65 fall 42 lks. E. of the cor. of Ts. 5 and 6 N., Rs. 15 and 16 W., this falling answers to a correction of 7 lks. west per mile or 3'.

Return to the standard corner of T. 5 N., Rs. 15 and 16 W., on First Standard Parallel North, which is a malpais stone 12 x 12, 10 ins. above ground, firmly set marked with 6 notches on each of E., W. and N. faces, S C on N. face, and witnessed by a mound of stone N. of cor.

Thence
N. 0° 3' W., on true line, bet. secs. 31 and 36.
Over-level land, thru scattering undergrowth.
Across overflow land, course NE.

15.00 Enter gravel flat, brs. NE. and SW.
22.50 Mesquite tree 8 ins. in diam., on line, cut two notches on N. and S. faces.
29.00 Enter sandy flat.
40.00 Set an iron post, 3 ft. long, 1 in. in diam., 27 ins. in ground for $\frac{1}{4}$ sec. cor., brass cap marked

S 36	↑	S 31
1926		

Dig pits 18 x 18 x 12 ins., one each N. and S. of cor., 3 ft. dist.

72.00 Dim road, brs. NE. and SW.
80.00 Set an iron post, 3 ft. long, 2 ins. in diam., 27 ins. in ground for cor. of secs. 25, 30, 31 and 36, brass cap marked

T 5 N	
R 16 W	R 15 W
S 25	S 30
S 36	S 31
1926	

Dig pits 18 x 18 x 12 ins., one each NE., SE., SW. and NW. of cor., 3 ft. dist.
Land, level; drainage NE.
Soil, gravelly and sandy loam, 1st and 2nd rate.
Timber, none.
Undergrowth, creosote brush and scrub mesquite.

N. 0° 3' W., on true line, bet. secs. 25 and 30.
Over-level land, thru scattering undergrowth.

40.00 Set an iron post, 3 ft. long, 1 in. in diam., 27 ins. in the ground for $\frac{1}{4}$ sec. cor., brass cap marked

S 25	↑	S 30
1926		

Dig pits 18 x 18 x 12 ins., one each N. and S. of cor., 3 ft. dist.

68.00 Dim road, brs. NW. and SE.
A house brs. W. about 8.00 chs. dist.
74.00 Frame house brs. W., about 10.00 chs.
80.00 Set an iron post, 3 ft. long, 2 ins. in diam., 27 ins. in

OK 3791

Survey of West Boundary of Township 5 North, Range 15 West.

Chains ground for cor. of secs. 19, 24, 25 and 30, brass cap marked

T 5 N	
R 16 W	R 15 W
S 24	S 19
S 25	S 30
1926	

Dig pits 18 x 18 x 12 ins. one each NE., SE., SW. and NW. of cor., 3 ft. dist.

Land, level.

Soil, sandy loam, 1st rate.

Timber, none.

Undergrowth, creosote brush and scrub mesquite.

N. 0° 3' W., on true line, bet. secs. 19 and 24.

Over level land, thru scattering undergrowth.

8.00 Enter overflow land, 5.00 chs. wide, course NW.

40.00 Set an iron post, 3 ft. long, 1 in. in diam., 27 ins. in ground for $\frac{1}{4}$ sec. cor., brass cap marked

$\frac{1}{4}$	
S 24	S 19
1926	

Dig pits 18 x 18 x 12 ins., one each N. and S. of cor., 3 ft. dist.

42.00 Enter overflow land, 5.00 chs. wide, course NW.

60.00 Enter adobe flat.

80.00 Set an iron post, 3 ft. long, 2 ins. in diam., 27 ins. in ground for cor. of secs. 13, 18, 19 and 24, brass cap marked

T 5 N	
R 16 W	R 15 W
S 13	S 18
S 24	S 19
1926	

Dig pits 18 x 18 x 12 ins., one each NE., SE., SW. and NW. of cor., 3 ft. dist.

Land, level; drainage NW.

Soil, sandy loam and adobe, 1st rate.

Timber, none.

Undergrowth, creosote brush and mesquite.

N. 0° 3' W., on true line, bet. secs. 13 and 18.

Over level land, thru scattering undergrowth.

30.00 Enter mesquite thicket, 5.00 chs. wide, course NW. and SE.

40.00 Set an iron post, 3 ft. long, 1 in. in diam., 27 ins. in ground for $\frac{1}{4}$ sec. cor., brass cap marked

$\frac{1}{4}$	
S 13	S 18
1926	

Dig pits 18 x 18 x 12 ins., one each N. and S. of cor., 3 ft. dist.

Survey of West Boundary of Township 5 North, Range 15 West.

Chains

- 79.50 House bears W. 100 lks. dist.
 80.00 Set an iron post, 3 ft. long, 2 ins. in diam., 27 ins. in ground for cor. of secs. 7, 12, 13 and 18, brass cap marked

T 5 N	
R 16 W	R 15 W
S 12	S 7
S 13	S 18
1926	

Dig pits 18 x 18 x 12 ins., one each NE., SE., SW. and NW. of cor., 3 ft. dist.

Land, level.

Soil, sandy loam, 1st rate.

Timber, none.

Undergrowth, creosote brush, scrub mesquite.

N. 0° 3' W., on true line, bet. secs. 7 and 12.

Over level land, thru scattering undergrowth.

- 0.50 Road, brs. E. and W.
 40.00 Set an iron post, 3 ft. long, 1 in. in diam., 27 ins. in the ground for $\frac{1}{4}$ sec. cor., brass cap marked

$\frac{1}{4}$	
S 12	S 7
1926	

Dig pits 18 x 18 x 12 ins., one each N. and S. of cor., 3 ft. dist.

- 63.00 Gravel flat, 5.00 chs. wide, brs. NE. and SW.

- 80.00 Set an iron post, 3 ft. long, 2 ins. in diam., 27 ins. in ground for cor. of secs. 1, 6, 7 and 12, brass cap marked

T 5 N	
R 16 W	R 15 W
S 1	S 6
S 12	S 7
1926	

Dig pits 18 x 18 x 12 ins., one each NE., SE., SW. and NW. of cor., 3 ft. dist.

Land, level.

Soil, sandy and gravelly, 2nd and 3rd rate.

Timber, none.

Undergrowth, creosote brush and scrub mesquite.

N. 0° 3' W., on true line, bet. secs. 1 and 6.

Over level land, thru dense undergrowth.

- 30.00 Enter overflow land, 5.00 chs. wide, course SW.
 40.00 Set an iron post, 3 ft. long, 1 in. in diam., 27 ins. in ground for $\frac{1}{4}$ sec. cor., brass cap marked

$\frac{1}{4}$	
S 1	S 6
1926	

Survey of West Boundary of Township 5 North, Range 15 West.

Chains Dig pits 18 x 18 x 12 ins., one each N. and S. of cor.,
3 ft. dist.
78.65 Intersect the cor. of Ts. 5 and 6 N., Rs. 15 and 16 W.,
which is an iron post 3 ins. in diam., projecting 12
ins. above ground, marked on brass cap

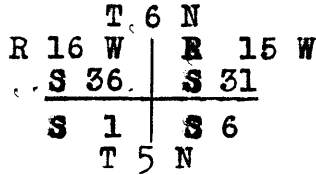

1923

and witnessed by pits, one each E., W., N., and S. of post.
Land, level.
Soil, sandy and gravelly, 2nd and 3rd rate.
Timber, none.
Undergrowth; creosote brush and scrub mesquite.

Latitudes, Departures and Closing Errors.

Line designated	True course	Dist- ance.	Latitudes		Departures	
			N.	S.	E.	W.
South Boundary (1st Std. Par. N)	S. 89° 50' W.	480.27		1.40		480.27
West Boundary	N. 0° 03' W.	478.65	478.65			.42
North Boundary	East	479.51			479.51	
East Boundary	S. 0° 12' E.	37.22		37.22	.13	
	S. 0° 05' E.	40.00		40.00	.06	
	South	400.00		400.00		
Convergency						.48
Totals			478.65	478.62	480.18	480.69
			478.62			480.18
Error in latitude			0.03			
Error in departure					0.51	

Subdivisional Lines of Township 5 North, Range 15 West.

Chains From the standard cor. of secs. 35 and 36 on the S. bdy. of T. 5 N., R. 15 W., described in Book "G".
 N. $0^{\circ} 1' W.$, on true line, bet. secs. 35 and 36.
 Over level land, thru scattering undergrowth and timber.
 25.00 Enter overflow land 5.00 chs. wide, course SW.
 30.00 Enter gravel flat.
 38.00 Enter overflow land, course SW.
 40.00 Set an iron post, 3 ft. long, 1 in. in diam., 27 ins. in ground for $\frac{1}{4}$ sec. cor., brass cap marked

$\frac{1}{4}$
S 35 S 36
1926

Dig pits 18 x 18 x 12 ins., one each N. and S. of cor., 3 ft. dist.

No bearing trees available.

42.00 Leave overflow land, course SW.
 80.00 Set an iron post, 3 ft. long, 2 ins. in diam., 27 ins. in ground for cor. of secs. 25, 26, 35 and 36, brass cap marked

T 5 N	R 15 W
S 26	S 25
S 35	S 36
1926	

From which:

Ironwood 6 ins. in diam., brs. S. $1^{\circ} E.$, 205 lks. dist. mkd. T 5 N R 15 W S 36 B T.

Ironwood 6 ins. in diam., brs. S. $34^{\circ} W.$, 209 lks. dist. mkd. T 5 N R 15 W S 35 B T.

Ironwood 6 ins. in diam., brs. N. $72^{\circ} W.$, 223 lks. dist., mkd. T 5 N R 15 W S 26 B T.

Ironwood 6 ins. in diam., brs. N. $49^{\circ} E.$, 126 lks. dist. mkd. T 5 N R 15 W S 25 B T.

Land, level.

Soil, sandy and gravelly, 3rd and 4th rate.

Timber, scattering ironwood.

Undergrowth, creosote brush and scrub mesquite.

N. $89^{\circ} 50' E.$, on random line bet. secs. 25 and 36.
 40.00 Set temp. $\frac{1}{4}$ sec. cor.
 80.16 Fall 9 lks. S. of cor. of secs. 25, 30, 31 and 36, on E. bdy. of township, which is an iron post 3 ins. in diam. projecting 12 ins. above ground, with brass cap properly marked, and witnessed by md. of earth west of cor.

Thence

S. $89^{\circ} 46' W.$, on true line, bet. secs. 25 and 36.

Over level land, thru scattering timber and undergrowth.

21.16 Wash, 10 lks. wide, course SW.

35.16 Wash, 10 lks. wide, course SW.

36.16 Old road, brs. N. and S.

40.08 Set an iron post, 3 ft. long, 1 in. in diam., 27 ins. in ground for $\frac{1}{4}$ sec. cor., brass cap marked

$\frac{1}{4}$	S 25
S 36	
1926	

From which

Ironwood, 26 ins. in diam., brs. S. $14\frac{1}{2}^{\circ} W.$, 236 lks. dist., mkd. $\frac{1}{4}$ S 36 B T.

No other trees available.

Survey of Subdivisional Lines of Township 5 North, Range 15 West.

Chains Raise a md. of stone 3 ft. base, 2 ft. high, N. of cor.
 Thence cross overflow land, drains SW.
 80.16 The cor. of secs. 25, 26, 35 and 36.
 Land, level.
 Soil; stony and gravelly, 4th rate.
 Timber, scattering ironwood.
 Undergrowth, creosote brush and cactus.

N. 0° 1' W., on true line, bet. secs. 25 and 26.
 Over level land, thru scattering timber and undergrowth.
 Cross overflow lands draining SW.
 15.70 Wash, 10 lks. wide, course SW.
 38.50 Wash, 100 lks. wide, course SW.
 40.00 Set an iron post, 3 ft. long, 1 in. in diam., 27 ins. in
 ground for $\frac{1}{4}$ sec. cor., brass cap marked

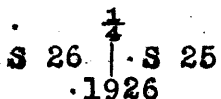

From which

Ironwood 6 ins. in diam., brs. S. 36 $\frac{1}{4}$ ° E., 107 lks.
 dist., marked $\frac{1}{4}$ S 25 B T.
 Ironwood 6 ins. in diam., brs. S. 13° W., 120 lks.
 dist., marked $\frac{1}{4}$ S 26 B T.

79.80 Drain, course SW.
 80.00 Set an iron post, 3 ft. long, 2 ins. in diam., 27 ins. in
 ground for cor. of secs. 23, 24, 25 and 26, brass
 cap marked

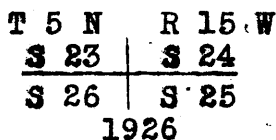

From which

Ironwood, 12 ins. in diam., brs. S. 71 $\frac{1}{2}$ ° W., 137 lks.
 dist., marked T 5 N R 15 W S 26 B T.
 Palo verde, 6 ins. in diam., brs. S. 38° E., 118 lks.
 dist., marked T 5 N R 15 W S 25 B T.
 Palo verde, 6 ins. in diam., brs. N. 52° E., 94 lks.
 dist., marked T 5 N R 15 W S 24 B T.
 No other tree available.

Raise a mound of stone, 3 ft. base, 2 ft. high W. of cor.
 Land, level.
 Soil, stony and gravelly, 3rd and 4th rate.
 Timber, scattering ironwood, and palo verde.
 Undergrowth, creosote brush, ocotillo and cholla.
 Giant cactus.

N. 89° 46' E. on random line, bet. secs. 24 and 25.
 40.00 Set temp. $\frac{1}{4}$ sec. cor.
 80.08 Fall 9 lks. S. of cor. of secs. 19, 24, 25 and 30, on
 east boundary, which is an iron post, 3 ins. in diam.
 projecting 12 ins. above ground, firmly set, and
 properly marked on brass cap; with one bearing tree
 SE. of cor. properly marked and md. of stone W.
 Thence
 S. 89° 42' W., on true line, bet. secs. 24 and 25, over level
 Thru scattering timber and undergrowth. land.

Survey of Subdivisional Lines of Township 5 North, Range 15 West.

Chains

- 6.46 Dim road, brs. NW. and SE.
 10.08 Wash, 70 lks. wide, course SW.
 18.08 Wash, 10 lks. wide, course SW.
 33.92 A. T. & S. F. R. R. track bears N. 43° 30' W., and S. 43° 30' E.
 34.20 Telegraph line brs. N. 43° 30' W., and S. 43° 30' E.
 36.78 State highway, brs. N. 43° 30' W., and S. 43° 30' E.
 40.04 Set an iron post, 3 ft. long, 1 in. in diam.; 27 ins. in ground for $\frac{1}{4}$ sec. cor., brass cap marked

$\frac{1}{4}$ $\frac{S 24}{S 25}$
 1926

From which

- Ironwood, 6 ins. in diam., brs. S. 12 $\frac{1}{2}$ ° E., 53 lks. dist., marked $\frac{1}{4}$ S 25 B T.
 No other tree available.
 Raise md. of stone 3 ft. base, 2 ft. high, N. of cor.
 42.78 Old road bears NW. and SE.
 60.08 Enter gravel flat, 5.00 chs. wide, course NE. and SW.
 70.08 Wash, 20 lks. wide, course SW.
 80.08 The cor. of secs. 23, 24, 25 and 26.
 Land, level.
 Soil, stony and gravelly, 3rd and 4th rate.
 Timber, scattering scrub ironwood and palo verde.
 Undergrowth, creosote brush, scrub catclaw and mesquite, cactus.

N. 0° 1' W., on true line, bet. secs. 23 and 24.
 Over gently rolling land, thru scattering timber and undergrowth.

- 1.30 Drain, course SW.
 14.70 Drain, course SW.
 32.00 Overflow land, 2.00 chs. wide, course SW.
 35.00 Wash, 30 lks. wide, course SW.
 37.00 Dim road, brs. NW. and SE.
 40.00 Set an iron post, 3 ft. long, 1 in. in diam., 27 ins. in ground for $\frac{1}{4}$ sec. cor., brass cap marked

S 23 $\frac{1}{4}$ S 24
 1926

- No bearing trees available.
 Raise a md. of stone, 3 ft. base, 2 ft. high, W. of cor.
 45.70 State highway, brs. N. 43° 30' W., and S. 43° 30' E.
 48.00 Telegraph line, brs. N. 43° 30' W., and S. 43° 30' E.
 48.60 A. T. & S. F. R. R. brs. N. 43° 30' W., and S. 43° 30' E.
 53.00 Drain, course SW.
 65.00 Wash, 10 lks. wide, course SW.
 75.00 Leave timber and undergrowth, brs. NE. and SW.
 80.00 Set an iron post, 3 ft. long, 2 ins. in diam., 27 ins. in ground for cor. of secs. 13, 14, 23 and 24, brass cap marked

T 5 N R 15 W
 S 14 | S 13
 S 23 | S 24
 1926

No bearing trees available.

Survey of Subdivisional Lines of Township 5 North, Range 15 West.

Chains Raise a mound of stone, 3 ft. base. 2 ft. high, W. of cor., 3 ft. dist.
Land, level and gently rolling.
Soil, stony and gravelly, 3rd and 4th rate.
Timber, scattering ironwood and palo verde.
Undergrowth, creosote brush, scrub mesquite and catclaw, ocotillo and cholla.
Giant cactus.

N. 89° 42' E., on random line, bet. secs. 13 and 24.
40.00 Set temp. $\frac{1}{4}$ sec. cor.
80.04 Fall 28 lks. N. of cor. of secs. 13, 18, 19 and 24, on the east boundary of the township, which is an iron post, 3 ins. in diam., projecting 12 ins. above ground firmly set, and properly marked on brass cap, witnessed by a mound of stone W. of cor.
Thence
S. 89° 54' W., on true line, bet. secs. 13 and 24.
Over gently rolling land, thru scattering undergrowth.
Desc. 50 ft.
2.04 Head of ravine, course SW. Asc. 50 ft.
6.04 Spur, slopes SW. Desc. 117 ft.
13.04 Ravine, course SW., thence over rolling land.
40.02 Set an iron post, 3 ft. long, 1 in. in diam., 12 ins. in ground to bed rock, deposit a stone marked cross (X) at base of post and raise md. of stone, 3 ft. base, $1\frac{1}{2}$ ft. high around post for $\frac{1}{4}$ sec. cor., brass cap marked

$\frac{1}{4}$ $\frac{\$ 13}{\$ 24}$
1926

Desc. 30 ft.
54.04 road, brs. NE. and SW., thence over rolling hills.
55.04 Wash, 150 lks. wide, course SW.
71.54 Wash, 10 lks. wide, course SW.
80.04 The cor. of secs. 13, 14, 23 and 24.
Land, hilly and rolling.
Soil, stony, 4th rate.
Timber, none.
Undergrowth, creosote brush, scrub palo verde, catclaw and mesquite.

N. 0° 1' W., on true line, bet. secs. 13 and 14.
Over rolling land, thru scattering timber and undergrowth
4.65 Road, brs. NE. and SW.
12.00 Wash, 10 lks. wide, course SW.
33.50 Enter overflow land, 5.00 chs. wide, course SW.
40.00 Set an iron post, 3 ft. long, 1 in. in diam., 26 ins. in ground for $\frac{1}{4}$ sec. cor., brass cap marked

$\frac{1}{4}$ $\frac{\$ 14}{\$ 13}$
1926

From which

Ironwood, 6 ins. in diam., brs. S. 11 $\frac{1}{2}$ ° W., 94 lks. dist., marked $\frac{1}{4}$ S 14 B T.
Palo verde 8 ins. in diam., brs. S. 57° E., 147 lks. dist., marked $\frac{1}{4}$ S 13 B T.

Survey of Subdivisional Lines of Township 5 North, Range 15 West.

- Chains. Thence over gravel flat, brs. NE. and SW.
 52.00 Enter overflow land, 2.00 chs. wide, course SW., thence over rolling land.
 79.70 Drain, course SW.
 80.00 Set an iron post, 3 ft. long, 2 ins. in diam., 27 ins. in ground for cor. of secs. 11, 12, 13 and 14, brass cap marked

T 5 N	R 15 W
<u>S 11</u>	<u>S 12</u>
S 14	S 13

1926

From which

- Ironwood, 6 ins. in diam., brs. S. $81\frac{1}{2}^{\circ}$ E., 70 lks. dist., marked T 5 N R 15 W S 13 B T.
 Ironwood, 24 ins. in diam., brs. S. $62^{\circ} 40'$ W., 232 lks. dist., marked T 5 N R 15 W S 14 B T.
 No other bearing trees available.
 Raise a md. of stone 3 ft. base, 2 ft. high, W. of cor., Land, rolling and hilly.
 Soil, stony, 4th rate.
 Timber, scattering scrub palo verde and ironwood.
 Undergrowth, creosote brush, ocotillo, cholla and scrub catclaw.
 Giant cactus.

- N. $89^{\circ} 54'$ E. on a random line, bet. secs. 12 and 13.
 40.00 Set temp. $\frac{1}{4}$ sec. cor.
 80.04 Fall 23 lks. S. of cor. of secs. 7, 12, 13 and 18, on E. bdy. of township, which is an iron post, 3 ins. in diam., projecting 12 ins. above ground, firmly set, with brass cap properly marked; one bearing tree each SE. and SW., and md. of stone W. of cor.
 Thence
 S. $89^{\circ} 44'$ W., on true line, bet. secs. 12 and 13.
 Over rolling land, thru scattering undergrowth.
 1.04 Road, in wash 10 lks. wide, course SW. Asc. 70 ft.
 9.04 Change to S. slope.
 21.04 House, brs. S. about 8.00 chs.
 26.54 House and windmill, bear S. about 4 chs.
 31.74 Mine dump brs. S., 30 lks. dist.
 34.04 Ridge, brs. NW. and SE. Mine and mill br. S. about 5.00 chs. dist. Desc. 58 ft. to
 40.02 Set an iron post, 3 ft. long, 1 in. in diam., 4 ins. in ground to bed rock, deposit stone mkd. cross (X) at base of post and raise md. of stone 4 ft. base, 2 ft. high around post for $\frac{1}{4}$ sec. cor., brass cap marked

$\frac{1}{4}$	<u>S 12</u>
	S 13

1926

- Desc. 95 ft. over SW. slope.
 55.54 Wash, 20 lks. wide, course SW. Asc. 64 ft.
 60.04 Spur, slopes N. Desc. 98 ft.
 70.04 Enter level land, brs. NE. and SW.
 80.04 The cor. of secs. 11, 12, 13 and 14.
 Land, hilly and rolling.
 Soil, stony, 4th rate.
 Timber, none.
 Undergrowth, creosote brush, ocotillo, cholla, scrub palo verde, ironwood, catclaw and mesquite.
 Giant cactus.

Survey of Subdivisional Lines of Township 5 North, Range 15 West.

Chains N. 0° 1' W., on true line, bet. secs. 11 and 12.
 Over rolling land, thru scattering undergrowth.
 8.00 Asc. 80 ft.
 9.00 Spur, slopes SW. Desc. 50 ft.
 14.00 Enter gravel flat, brs. NE. and SW.
 26.00 Enter overflow land, 2.00 chs. wide, course SW.
 40.00 Set an iron post, 3 ft. long, 1 in. in diam. 27 ins. in ground for $\frac{1}{4}$ sec. cor., brass cap marked

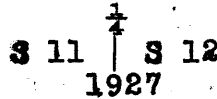

Raise md. of stone, 3 ft. base, 2 ft. high, W. of cor.
 40.60 Drain, course SW.
 60.00 Wash, 2.00 chs. wide, course SW.
 70.00 Enter rolling land.
 78.00 Placer diggings, br. E. 2.00 chs.
 80.00 Set an iron post, 3 ft. long, 2 ins. in diam., 27 ins. in ground for cor. of secs. 1, 2, 11 and 12, brass cap marked

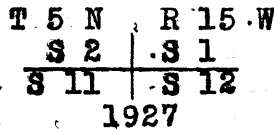

Raise md. of stone, 4 ft. base, 2 ft. high, W. of cor.
 Land, rolling.
 Soil, stony and gravelly, 3rd and 4th rate.
 Timber, none.
 Undergrowth, creosote brush, cholla, ocotillo, scrub catclaw, ironwood, mesquite and palo verde.
 Giant cactus.

N. 89° 44' E., on random line bet. secs. 1 and 12.
 40.00 Set temp. $\frac{1}{4}$ sec. cor.
 80.08 Intersect the cor. of secs. 1, 6, 7 and 12, on E. by. of township, which is an iron post, 3 ins. in diam., projecting 18 ins. above ground, in stone mound, firmly set and properly marked on brass cap, with md. of stone W. of cor.,
 Thence
 S. 89° 44' W., on true line, bet. secs. 1 and 12.
 Over rolling land, thru scattering undergrowth.
 14.08 Enter level land.
 19.78 Road, brs. NE. and SW.
 30.08 Enter overflow land, 5.00 chs. wide, course SW.
 40.04 Set an iron post, 3 ft. long, 1 in. in diam., 27 ins. in ground for $\frac{1}{4}$ sec. cor., brass cap marked

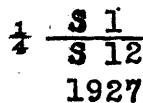

Raise md. of stone, 3 ft. base, 2 ft. high N. of cor.
 42.58 Wash, 100 lks. wide, course SW.
 53.08 Enter overflow land, 2.00 chs. wide, course SW.
 80.08 The cor. of secs. 1, 2, 11 and 12.
 Land, rolling and level.
 Soil, stony and gravelly, 3rd and 4th rate.
 Timber, none.
 Undergrowth, creosote brush, ocotillo, cholla, scrub catclaw and mesquite.
 Giant Cactus.

Survey of Subdivisional Lines of Township 5 North, Range 15 West.

Chains N. 9° 8' W. on random line, bet. secs. 1 and 2.
 40.00 Set temp. 1/4 sec. cor.
 77.60 Fall 9 lks. W. of cor. of secs. 1, 2, 35 and 36, on N. bdy. of township, set an iron post 2 ins. in diam., projecting 12 ins. above ground, firmly set, with brass cap properly marked.
 Thence
 S. 0° 4' E., on true line, bet. secs. 1 and 2.
 Over rolling land, thru scattering undergrowth.
 10.60 Wash, 10 lks. wide, course SW.
 12.40 Road, brs. NE. and SW.
 26.10 Wash, 100 lks. wide, course SW.
 30.11 Wash, 10 lks. wide, course SW.
 37.60 Set an iron post, 3 ft. long, 1 in. in diam., 27 ins. in ground for 1/4 sec. cor., brass cap marked.

$\frac{1}{4}$
 S. 2 | S 1
 1927

Raise a md. of stone, 3 ft. base, 2 ft. high, W. of cor.
 38.10 Wash, 10 lks. wide, course SW.
 56.20 Wash, 10 lks. wide, course west.
 69.10 Ravine, course SW.
 72.80 Old road, brs. NE. and SW.
 77.60 The cor. of secs. 1, 2, 11 and 12.
 Land, gently rolling.
 Soil, stony and gravelly, 3rd and 4th rate.
 Timber, none.
 Undergrowth, creosote brush, ocotillo, cholla, scrub mesquite, catclaw, palo verde and ironwood.

From the standard cor. of secs. 34 and 35, on the S. bdy. of township, described in Book "G".
 N. 0° 1' W., on true line, bet. secs. 34 and 35.
 Over level land, thru scattering undergrowth.
 16.00 Enter overflow land, 5.00 chs. wide, course SW.
 40.00 Set an iron post, 3 ft. long, 1 in. in diam., 27 ins. in ground for 1/4 sec. cor., brass cap marked

$\frac{1}{4}$
 S 34 | S 35
 1927

Dig pits 18 x 18 x 12 ins., one each N. and S. of cor., 3 ft. dist.
 45.00 Enter gravel flat, brs. NE. and SW.
 78.00 Enter overflow land, 100 lks. wide, course SW.
 80.00 Set an iron post, 3 ft. long, 2 ins. in diam., 27 ins. in ground for cor. of secs. 26, 27, 34 and 35, brass cap marked

T 5 N R 15 W
 S 27 | S 26
 S 34 | S 35
 1927

From which
 Ironwood, 14 ins. in diam., brs. S. 3° 30' W., 286 lks. dist., marked T 5 N R 15 W S 34 B T.
 Ironwood, 14 ins. in diam., brs. S. 9° E., 196 lks. dist., marked T 5 N R 15 W S 35 B T.
 No other bearing trees available.

Survey of Subdivisional Lines of Township 5 North, Range 15 West.

Chains Dig pits 18 x 18 x 12 ins., one each NE., SE., SW. and NW. of cor. 3 ft. dist.
Land, level.
Soil, gravelly, 2nd rate.
Timber, scrub ironwood and palo verde.
Undergrowth, creosote brush, ocotillo, cholla, scrub mesquite and catclaw.

N. 89° 50' E. on random line bet. secs 26. and 35.
40.00 Set temp. $\frac{1}{4}$ sec. cor.
79.92 Fall 12 lks. N. of cor. of secs. 25, 26, 35 and 36.
Thence
S. 89° 55' W., on true line, bet. secs. 26 and 35.
Over level land, thru scattering undergrowth.
32.92 Gravel flat, 3.00 chs. wide, course NE. and SW.
37.92 Enter overflow land, 5.00 chs. wide, course SW.
39.96 Set an iron post, 3 ft. long, 1 in. in diam., 27 ins. in ground for $\frac{1}{4}$ sec. cor., brass cap marked

$$\frac{1}{4} \begin{array}{r} S 26 \\ S 35 \end{array}$$

1927

Dig pits 18 x 18 x 12 ins., one each E. and W. of cor., 3 ft. dist.
41.92 Enter gravel flat, 10.00 chs. wide, brs. NE. and SW..
69.92 Enter overflow land, 5.00 chs. wide, course SW.
79.92 The cor. of secs. 26, 27, 34 and 35.
Land, level.
Soil, gravelly, 3rd rate.
Timber, none.
Undergrowth, creosote brush and scrub mesquite.

N. 0° 1' W., on true line, bet. secs. 26 and 27.
Over level land, thru scattering undergrowth.
35.00 Gravel flat, 5.00 chs. wide, brs. NE. and SW.
38.50 Drain, course SW.
40.00 Set an iron post, 3 ft. long, 1 in. in diam., 27 ins. in ground for $\frac{1}{4}$ sec. cor., brass cap marked

$$\frac{1}{4} \begin{array}{r} S 27 \\ S 26 \end{array}$$

1927

Raise md. of stone, 3 ft. base, 2 ft. high, W. of cor.
45.00 Asc. 40 ft.
49.60 Low spur, slopes west. Desc. 40 ft.
54.00 East edge of flat.
65.00 Asc. 130 ft. to
80.00 Set an iron post, 3 ft. long, 2 ins. in diam., 12 ins. in ground to bed rock, deposit stone mkd. cross (X) at base of post and raise md. of stone 4 ft. base, 2 ft. high around post for cor. of secs. 22, 23, 26 and 27, brass cap marked

$$\begin{array}{r} T 5 N \quad R 15 W \\ S 22 \quad S 23 \\ S 27 \quad S 26 \\ 1927 \end{array}$$

Survey of Subdivisional Lines of Township 5 North, Range 15 West.

Chains Land, level and rolling.
 Soil, gravelly and stony, 3rd and 4th rate.
 Timber, none.
 Undergrowth, creosote brush, cactus, scrub palo verde
 and ironwood.

N. 89° 55' E., on random line, bet. secs. 23 and 26.
 40.00 Set temp. $\frac{1}{4}$ sec. cor.

79.98 Fall 14 lks. S. of cor. of secs. 23, 24, 25 and 26.
 Thence

S. 89° 49' W., on true line, bet. secs. 23 and 26.
 Over level land, thru scattering undergrowth.

15.98 Drain, course SW.

27.98 Wash, 10 lks. wide, course SW.

39.99 Set an iron post, 3 ft. long, 1 in. in diam., 27 ins. in
 ground for $\frac{1}{4}$ sec. cor., brass cap marked

$\frac{1}{4}$ $\frac{\$ 23}{\$ 26}$
 1927

Dig pits 18 x 18 x 12 ins., one each E. and W. of cor.,
 3 ft. dist.

42.98 Wash, 20 lks. wide, course SW. Asc. 450 ft. over steep
 E. slope.

62.78 Top of malpais hill brs. NW. and SE. At this point
 raise a md. of stone 3 ft. base, 2 ft. high, on line.
 Desc. 356 ft. over steep SW. slope to

79.98 The cor. of secs. 22, 23, 26 and 27.

Land, level and mountainous.

Soil, gravelly and stony, 3rd and 4th rate.

Timber, none.

Undergrowth, creosote brush, cholla, ocotillo, scrub
 mesquite, palo verde, ironwood and catclaw.

Giant Cactus.

N. 0° 1' W., on true line, bet. secs. 22 and 23.

Over mountainous land, thru scattering undergrowth.

Asc. 46 ft.

5.00 Spur, slopes west. Desc. 108 ft.

24.50 Wash, 40 lks. wide, course SW. Thence over level land.

40.00 Set an iron post, 3 ft. long, 1 in. in diam., 27 ins. in
 ground for $\frac{1}{4}$ sec. cor., brass cap marked

$\frac{1}{4}$
 $\$ 22 \mid \$ 23$
 1927

Dig pits 18 x 18 x 12 ins., one each N. and S. of cor.,
 3 ft. dist.

50.30 Wash, 10 lks. wide, course west.

63.00 Dim road, brs. E. and W.

77.00 Wash, 10 lks. wide, course SW.

80.00 Set an iron post, 3 ft. long, 2 ins. in diam., 27 ins.
 in ground for cor. of secs. 14, 15, 22 and 23, brass
 cap marked

T 5 N R 15 W
 $\frac{\$ 15 \mid \$ 14}{\$ 22 \mid \$ 23}$
 1927

Survey of Subdivisional Lines of Township 5 North, Range 15 West.

Chains Dig pits 18 x 18 x 12 ins., one each NE., SE., SW. and NW. of cor., 3 ft. dist.
Land, level and mountainous.
Soil, gravelly and stony, 3rd and 4th rate.
Timber, none.
Undergrowth, creosote brush, cholla, ocotillo, scrub mesquite, palo verde and ironwood.

N. 89° 49' E., on random line, bet. secs. 14 and 23.
40.00 Set temp. $\frac{1}{4}$ sec. cor.
79.88 Fall 2 lks. S. of cor. of secs. 13, 14, 23 and 24.
Thence
S. 89° 48' W., on true line, bet. secs. 14 and 23.
Over level land, thru scattering undergrowth.
4.88 Drain, course SW.
9.58 Road, brs. NE. and SW.
29.48 Center of track of A. T. & S. F. R. R.; brs. N. 43° 30' W., and S. 43° 30' E.
30.38 Telegraph line, brs. N. 43° 30' W., and S. 43° 30' E.
32.28 State Highway, brs. N. 43° 30' W., and S. 43° 30' E.
36.88 Old road, brs. N. 43° 30' W., and S. 43° 30' E.
39.94 Set an iron post, 3 ft. long, 1 in. in diam., 27 ins. in ground for $\frac{1}{4}$ sec. cor., brass cap marked

$$\frac{1}{4} \frac{S 14}{S 23}$$

1927

Dig pits 18 x 18 x 12 ins., one each E. and W. of cor., 3 ft. dist.
74.88 Enter overflow land, 3.00 chs. wide, course SW.
79.88 The cor. of secs. 14, 15, 22 and 23.
Land, level.
Soil, sandy and gravelly, 3rd rate.
Timber, none.
Undergrowth, creosote brush, ocotillo, cholla, scrub mesquite, catclaw, palo verde and ironwood.

N. 0° 1' W., on true line, bet. secs. 14 and 15.
Over level land, thru scattering undergrowth.
15.00 Enter overflow land, 5.00 chs. wide, course SW.
26.50 Wash, 20 lks. wide, course SW.
30.00 Leave undergrowth, enter gravel flat, brs. NE. and SW.
40.00 Set an iron post, 3 ft. long, 1 in. in diam., 27 ins. in ground for $\frac{1}{4}$ sec. cor., brass cap marked

$$S 15 \frac{1}{4} S 14$$

1927

Raise md. of stone, 3 ft. base, 2 ft. high, W. of cor.
44.00 Wash, 10 lks. wide, course SW.
44.60 State highway, brs. N. 49° 15' W., and S. 49° 15' E.
46.80 Telegraph line, brs. N. 49° 15' W., and S. 49° 15' E.
47.30 A. T. & S. F. R. R. (center of track) brs. N. 49° 15' W. and S. 49° 15' E.
60.00 Enter overflow land, 5.00 chs. wide, course west.
70.00 Enter gravel flat, brs. NE. and SW.
80.00 Set an iron post, 3 ft. long, 2 ins. in diam., 27 ins. in ground for cor. of secs. 10, 11, 14 and 15, brass cap marked

Survey of Subdivisional Lines of Township 5 North, Range 15 West.

Chains

T 5 N	R 15 W
S 10	S 11
S 15	S 14
1927	

Raise md. of stone 3 ft. base, 2 ft. high, W. of cor.
Land, level.
Soil, stony and gravelly, 3rd rate.
Timber, none.
Undergrowth, creosote brush, cholla and ocotillo, scrub
palo verde, ironwood and mesquite.
Giant cactus.

N. 89° 48' E., on random line, bet. secs. 11 and 14.

40.00 Set temp. $\frac{1}{4}$ sec. cor.

79.90 Fall 5 lks. N. of cor. of secs. 11, 12, 13 and 14.

Thence

S. 89° 50' W., on true line, bet. secs. 11 and 14.

Over rolling land, thru scattering undergrowth.

30.00 Asc. 40 ft. to

39.95 Set an iron post, 3 ft. long, 1 in. in diam., 27 ins. in
ground for $\frac{1}{4}$ sec. cor., brass cap marked

$\frac{1}{4}$	S 11	S 14
	S 14	
1927		

Raise md. of stone, 3 ft. base, 2 ft. high, N. of cor.
Desc. 40 ft.

49.90 Drain, course SW.

57.90 Wash, 10 lks. wide, course SW.

64.90 Asc. 52 ft.

70.40 Spur, slopes SW. Desc. 63 ft.

77.90 Wash, 10 lks. wide, course SW.

79.90 The cor. of secs. 10, 11, 14 and 15.

Land, level.

Soil, stony, 4th rate.

Timber, none.

Undergrowth, creosote brush, ocotillo, cholla, scrub
mesquite and ironwood.

N. 0° 1' W., on true line, bet. secs. 10 and 11.

Over rolling land, thru scattering undergrowth.

8.50 Wash, 20 lks. wide, course SW.

17.00 Enter overflow land, 2.00 chs. wide, course SW.

40.00 Set an iron post, 3 ft. long, 1 in. in diam., 27 ins. in
ground for $\frac{1}{4}$ sec. cor., brass cap marked

S 10	$\frac{1}{4}$	S 11
1927		

Raise md. of stone, 3 ft. base, 2 ft. high, W. of cor.

57.00 Wash, 10 lks. wide, course SW.

72.00 Enter overflow land, course SW. Enter scattering timber.

76.50 Wash, 100 lks. wide, course SW.

80.00 Set an iron post, 3 ft. long, 2 ins. in diam., 27 ins.
in ground for cor. of secs. 2, 3, 10 and 11, brass
cap marked

T 5 N	R 15 W
S 3	S 2
S 10	S 11
1927	

Survey of Subdivisional Lines of Township 5 North, Range 15 West.

Chains	From which
	Ironwood, 16 ins. in diam., brs. N. $82\frac{1}{2}^{\circ}$ E., 156 lks. dist., marked T 5 N R 15 W S 2 B T.
	Ironwood, 12 ins. in diam., brs. S. 29° E., 118 lks. dist., marked T 5 N R 15 W S 11 B T.
	No other bearing tree available.
	Raise a md. of stone, 3 ft. base, 2 ft. high, W. of cor. Land, rolling and level.
	Soil, stony and gravelly, 3rd and 4th rate.
	Timber, scattering scrub ironwood and palo verde.
	Undergrowth, creosote brush, cholla, ocotillo, scrub mesquite and catclaw.

	N. $89^{\circ} 50'$ E., on random line, bet. secs. 2 and 11.
40.00	Set temp. $\frac{1}{4}$ sec. cor.
79.84	Fall 2 lks. S. of cor. of secs. 1, 2, 11 and 12.
	Thence
	S. $89^{\circ} 49'$ W., on true line, bet. secs. 2 and 11.
	Over rolling land, thru scattering undergrowth.
2.34	Wash, 10 lks. wide, course SW.
9.84	Road, brs. NE. and SW.
14.84	Leave gravel flat brs. NE. and SW. Ascend gradual NE. slope.
39.92	Set an iron post, 3 ft. long, 1 in. in diam., 18 ins. in ground to bed rock, deposit stone mkd. cross (X) at base of post and raise md. of stone 2 ft. base, 1 ft. high around post for $\frac{1}{4}$ sec. cor., brass cap marked
	$\frac{1}{4} \frac{S 2}{S 11}$ 1927
	Raise md. of stone, 3 ft. base, 2 ft. high N. of cor. Thence along gradual N. slope.
59.84	Desc. 70 ft. over W. slope.
69.54	Wash, 60 lks. wide, course SW.
79.84	The cor. of secs. 2, 3, 10 and 11.
	Land, rolling.
	Soil, stony, 4th rate.
	Timber, none.
	Undergrowth, creosote brush, cholla, ocotillo, scrub mesquite and catclaw.

	N. $0^{\circ} 4'$ W on random line bet. secs. 2 and 3.
40.00	Set temp. $\frac{1}{4}$ sec. cor.,
77.94	Fall 5 lks. E. of cor. of secs. 2, 3, 34 and 35, on N. by. of township which is an iron post, 2 ins. in diam., projecting 12 ins. above ground, firmly set and properly marked on brass cap, with one bearing tree each SE. and SW., and md. of stone W. of cor.
	Thence
	S. $0^{\circ} 6'$ E., on true line, bet. secs. 2 and 3.
	Over level land, thru scattering undergrowth.
9.94	Enter overflow land, 5.00 chs. wide, course SW.
13.44	Dim road brs. NW. and SE.
25.94	Road, brs. NE. and SW.
30.94	Wash, 10 lks. wide, course SW.
35.44	Wash, 10 lks. wide, course SW.
37.94	Set an iron post, 3 ft. long, 1 in. in diam., 27 ins. in ground for $\frac{1}{4}$ sec. cor., brass cap marked

Survey of Subdivisional Lines of Township 5 North, Range 15 West.

Chains

S 3 1/4 S 2
1927

From which
Ironwood, 6 ins. in diam., brs. N. 60° W., 31 lks.
dist., marked 1/4 S 3 B T.
Ironwood, 6 ins. in diam., brs. N. 16° E., 85 lks. dist.
marked 1/4 S 2 B T.

- 44.94 Old road, brs. NE. and SW.
- 45.24 Wash, 10 lks. wide, course SW.
- 62.94 Wash, 10 lks. wide, course SW.
- 77.94 The cor. of secs. 2, 3, 10 and 11.

Land, level.
Soil, gravelly, 3rd rate.
Timber, scattering scrub ironwood.
Undergrowth, creosote brush, ocotillo, cholla, scrub
catclaw and mesquite, and palo verde.
Giant cactus.

From the std. cor. of secs. 33 and 34, on S. bdy. of
township, described in Book "G".
N. 0° 2' W., on true line, bet. secs. 33 and 34.
Over-level land, thru clearing.

- 10.00 Leave clearing. Enter dense undergrowth and overflow
land, 5.00 chs. wide, course SW.
- 30.00 Enter overflow land, 10.00 chs. wide, course SW.
- 40.00 Set an iron post, 3 ft. long, 1 in. in diam., 27 ins. in
ground for 1/4 sec. cor., brass cap marked

S 33 1/4 S 34
1927

Dig pits 18 x 18 x 12 ins., one each N. and S. of cor.,
3 ft. dist.

- 60.00 Enter overflow land, 5.00 chs. wide, course SW.
- 72.00 Enter gravel flat 4.00 chs. wide, bears NE. and SW.
- 72.10 Dim road, brs. NW. and SE.
- 80.00 Set an iron post 3 ft. long, 2 ins. in diam., 27 ins. in
ground for cor. of secs. 27, 28, 33 and 34, brass
cap marked

T 5 N R 15 W
S 28 S 27
S 33 S 34
1927

Dig pits 18 x 18 x 12 ins. one each NE., SE., SW. and
NW. of cor., 3 ft. dist.

Land, level.
Soil, sandy loam, 1st rate.
Timber, none.
Undergrowth, creosote brush, scrub mesquite, ironwood
and palo verde.

- 40.00 N. 89° 50' E., on random line, bet. secs. 27 and 34.
Set temp. 1/4 sec. cor.
- 80.02 Fall 2 lks. N. of cor. of secs. 26, 27, 34 and 35.
Thence

Survey of Subdivisional Lines of Township 5 North, Range 15 West.

Chains S. 89° 51' W., on true line, bet. secs. 27 and 34.
Over level land, thru scattering undergrowth.
40.01 Set an iron post, 3 ft. long, 1 in. in diam., 27 ins. in
ground for $\frac{1}{4}$ sec. cor., brass cap marked

$$\frac{1}{4} \begin{array}{l} \text{S } 27 \\ \text{S } 34 \end{array}$$

1927

Dig pits 18 x 18 x 12 ins., one each E. and W. of cor.,
3 ft. dist.
49.02 Enter overflow land, 2.00 chs. wide, course SW.
68.02 Enter gravel flat, 3.00 chs. wide, brs. NE. and SW.
80.02 The cor. of secs. 27, 28, 33 and 34.
Land, level.
Soil, gravelly and sandy loam, 1st and 3rd rate.
Timber, none.
Undergrowth, creosote brush, ocotillo, cholla, scrub mes-
quite, palo verde and ironwood.

N. 0° 2' W., on true line, bet. secs. 27 and 28.
Over level land, thru scattering undergrowth.
5.00 Wash, 10 lks. wide, course SW.
40.00 Set an iron post, 3 ft. long, 1 in. in diam., 27 ins. in
ground for $\frac{1}{4}$ sec. cor., brass cap marked

$$\begin{array}{c} \frac{1}{4} \\ \text{S } 28 \quad \text{S } 27 \end{array}$$

1927

Dig pits 18 x 18 x 12 ins., one each N. and S. of cor.,
3 ft. dist.
55.00 Enter overflow land, 5.00 chs. wide, course SW.
60.00 Leave undergrowth, enter gravel flat, brs. NE. and SW.
80.00 Set an iron post, 3 ft. long, 2 ins. in diam., 27 ins. in
ground for cor. of secs. 21, 22, 27 and 28, brass
cap marked

$$\begin{array}{cc} \text{T } 5 \text{ N} & \text{R } 15 \text{ W} \\ \text{S } 21 & \text{S } 22 \\ \text{S } 28 & \text{S } 27 \end{array}$$

1927

Dig pits 18 x 18 x 12 ins., one each NE., SE., SW. and
NW. of cor., 3 ft. dist.
Land, level.
Soil, sandy loam and gravelly, 1st and 3rd rate.
Timber, none.
Undergrowth, creosote brush, scrub mesquite, catclaw,
palo verde and ironwood.

N. 89° 51' E., on random line, bet. secs. 22 and 27.
40.00 Set temp. $\frac{1}{4}$ sec. cor.
80.04 Intersect the cor. of secs. 22, 23, 26 and 27.
Thence
S. 89° 51' W., on true line, bet. secs. 22 and 27.
Over mountainous land, thru scattering undergrowth.
Desc. 131 ft.
8.04 Enter level land, brs. N. and S.
29.04 Wash, 10 lks. wide, course SW.
38.04 Asc. 46 ft. to
40.02 Set an iron post, 3 ft. long, 1 in. in diam., 6 ins. in
ground to bed rock, deposit stone marked cross (X) at
base of post and raise md. of stone 6 ft. base, 2 $\frac{1}{2}$
ft. high around post for $\frac{1}{4}$ sec. cor., brass cap marked

Survey of Subdivisional Lines of Township 5 North, Range 15 West.

Chains

$$\frac{1}{4} \begin{array}{r} \text{S } 22 \\ \text{S } 27 \\ 1927 \end{array}$$

Asc. 68 ft.
41.96 Spur slopes S. Raise md. of stone 3 ft. base, 2 ft. high on line.

Desc. 140 ft. over steep SW. slope.

46.04 Enter level land, brs. NW. and SE.

68.04 Wash, 10 lks. wide, course SW.

80.04 The cor. of secs. 21, 22, 27 and 28.

Land, mountainous and level.

Soil, stony, 4th rate.

Timber, none.

Undergrowth, creosote brush, ocotillo, cholla, scrub mesquite and palo verde.

Giant cactus.

N. 0° 2' W., on true line, bet. secs. 21 and 22.

Over rolling land, thru scattering undergrowth and timber.

10.00 Wash, 10 lks. wide, course SW.

27.00 Wash, 100 lks. wide, course SW.

29.00 Enter gravel flat, brs. NE. and SW.

40.00 Set an iron post, 3 ft. long, 1 in. in diam., 27 ins. in ground for $\frac{1}{4}$ sec. cor., brass cap marked

$$\begin{array}{ccc} & \frac{1}{4} & \\ \text{S } 21 & \uparrow & \text{S } 22 \\ & 1927 & \end{array}$$

No bearing trees available.

Dig pits 18 x 18 x 12 ins., one each N. and S. of cor., 3 ft. dist.

55.00 Wash, 10 lks. wide, course SW.

75.00 Wash, 100 lks. wide, course SW.

80.00 Set an iron post, 3 ft. long, 2 ins. in diam., 27 ins. in ground for cor. of secs. 15, 16, 21 and 22, brass cap marked

$$\begin{array}{cc|cc} \text{T } 5 \text{ N} & & \text{R } 15 \text{ W} & \\ \hline \text{S } 16 & & \text{S } 15 & \\ \hline \text{S } 21 & & \text{S } 22 & \\ & & 1927 & \end{array}$$

From which

Ironwood, 12 ins. in diam., brs. N. 61° W., 154 lks. dist., marked T 5 N R 15 W S 16 B T.

No other bearing trees available.

Dig pits 18 x 18 x 12 ins., one each NE., SE., SW. and NW. of cor., 3 ft. dist.

Land, level.

Soil, gravelly, 3rd rate.

Timber, scattering ironwood.

Undergrowth, creosote brush and scrub mesquite.

40.00 N. 89° 51' E., on random line, bet. secs. 15 and 22. Set temp. $\frac{1}{4}$ sec. cor.

80.00 Fall 7 lks. N. of cor. of secs. 14, 15, 22 and 23.

Thence

S. 89° 54' W., on true line, bet. secs. 15 and 22.

Over level land, thru scattering undergrowth.

Survey of Subdivisional Lines of Township 5 North, Range 15 West.

Chains

- 8.00 Drain, course SW.
 25.60 Wash, 20 lks. wide, course SW.
 40.00 Set an iron post, 3 ft. long, 1 in. in diam., 27 ins. in ground for $\frac{1}{4}$ sec. cor., brass cap marked

$$\frac{1}{4} \begin{array}{r} S 15 \\ S 22 \\ 1927 \end{array}$$

- Dig pits 18 x 18 x 12 ins., one each E. and W. of cor., 3 ft. dist.
 71.00 Wash, 10 lks. wide, course SW.
 80.00 The cor. of secs. 15, 16, 21 and 22.
 Land, level.
 Soil, gravelly, 3rd rate.
 Timber, none.
 Undergrowth, creosote brush, scrub mesquite, palo verde and ironwood.

- N. 0° 2' W., on true line, bet. secs. 15 and 16.
 Over-level land, thru scattering undergrowth, and timber.
 2.00 Drain, course SW.
 19.00 Enter overflow land, 4.00 chs. wide, course SW.
 29.00 Overflow land, 1 ch. wide, course SW.
 39.70 Drain, course SW.
 40.00 Set an iron post 3 ft. long, 1 in. in diam., 27 ins. in ground for $\frac{1}{4}$ sec. cor., brass cap marked

$$S 16 \frac{1}{4} S 15 \\ 1927$$

- Dig pits 18 x 18 x 12 ins., one each N. and S. of cor., 3 ft. dist.
 Clump of ironwood, brs. E. about 10.00 chs. dist.
 51.50 Drain, course SW.
 72.00 Wash, 20 lks. wide, course SW.
 80.00 Set an iron post, 3 ft. long, 2 ins. in diam., 27 ins. in ground for cor. of secs. 9, 10, 15 and 16, brass cap marked

$$\begin{array}{r} T 5 N \quad R 15 W \\ S 9 \quad S 10 \\ S 16 \quad S 15 \\ 1927 \end{array}$$

From which

- Giant cactus, 5 prongs, brs. S. 60° E., 42 lks. dist.
 No trees available.
 Dig pits 18 x 18 x 12 ins., one each NE., SE., SW. and NW. of cor., 3 ft. dist.
 Land, level.
 Soil, gravelly, 2nd and 3rd rate.
 Timber, scattering scrub ironwood and palo verde.
 Undergrowth, creosote brush, ocotillo, cholla, scrub mesquite and catclaw.
 Giant cactus.

Survey of Subdivisional Lines of Township 5 North, Range 15 West.

- Chains N. 89° 54' E., on random line, bet. secs. 10 and 15.
 40.00 Set temp. $\frac{1}{4}$ sec. cor.
 79.90 Fall 5 lks. S. of cor. of secs. 10, 11, 14 and 15.
 Thence
 S. 89° 52' W., on true line bet. secs. 10 and 15.
 Over level land, thru scattering undergrowth.
 30.90 Wash, 20 lks. wide, course SW.
 37.85 Center A. T. & S. F. R. R. brs. N. 49° 15' W., and S. 49° 15' E.
 38.35 Telegraph line, brs. N. 49° 15' W., and S. 49° 15' E.
 39.95 Set an iron post, 3 ft. long, 1 in. in diam., 27 ins. in ground for $\frac{1}{4}$ sec. cor., brass cap marked

$$\frac{1}{4} \frac{S 10}{S 15}$$

1927

- 40.90 Raise md. of stone 3 ft. base, 2 ft. high, N. of cor. State highway brs. N. 49° 15' W., and S. 49° 15' E.
 Thence over gravel flat.
 73.90 Wash, 20 lks. wide, course SW.
 79.90 The cor. of secs. 9, 10, 15 and 16.
 Land, level.
 Soil, gravelly, 3rd rate.
 Timber, none.
 Undergrowth, creosote brush, ocotillo, cholla cactus, scrub mesquite, catclaw, ironwood and palo verde.

- N. 0° 2' W., on true line, bet. secs. 9 and 10.
 Over level land, thru scattering undergrowth.
 32.80 Wash 20 lks. wide, course SW.
 33.80 State highway, brs. N. 49° 15' W., and S. 49° 15' E.
 36.00 Telegraph line, brs. N. 49° 15' W., and S. 49° 15' E.
 36.47 Center of A. T. & S. F. R. R., brs. N. 49° 15' W., and S. 49° 15' E.
 40.00 Set an iron post, 3 ft. long, 1 in. in diam., 27 ins. in ground for $\frac{1}{4}$ sec. cor., brass cap marked

$$S 9 \frac{1}{4} S 10$$

1927

- Dig pits 18 x 18 x 12 ins., one each N. and S. of cor., 3 ft. dist.
 50.00 Wash, 20 lks. wide, course SW.
 70.00 Old road, brs. NE. and SW.
 75.00 Wash, 20 lks. wide, course SW.
 76.00 Enter gravel flat, brs. NE. and SW.
 80.00 Set an iron post, 3 ft. long, 2 ins. in diam., 27 ins. in ground for cor. of secs. 3, 4, 9 and 10, brass cap marked

T 5 N R 15 W

S 4 S 3

S 9 S 10

1927

From which

- Ironwood, 8 ins. in diam, brs. S. 4° W., 130 lks. dist., marked T 5 N R 15 W S 9 B T.
 Ironwood, 12 ins. in diam., brs. N. 88° E., 326 lks. dist., marked T 5 N R 15 W S 3 B T.
 No other bearing trees available.

Survey of Subdivisional Lines of Township 5 North, Range 15 West.

Chains Dig pits 18 x 18 x 12 ins., one each NE., SE., SW. and NW. of cor. 3 ft. dist.
Land, level.
Soil, gravelly, 3rd rate.
Timber, scattering scrub ironwood.
Undergrowth, creosote brush, scrub mesquite and palo verde.

N. 89° 52' E., on random line, bet. secs. 3 and 10.
40.00 Set temp. $\frac{1}{4}$ sec. cor.
80.00 Fall 5 lks. S. of cor. of secs. 2, 3, 10 and 11.
Thence
S. 89° 50' W., on true line, bet. secs. 3 and 10.
Over level land, thru scattering undergrowth.
8.00 Wash, 10 lks. wide, course SW.
14.00 Drain, course SW.
24.80 Wash, 20 lks. wide, course SW.
28.50 Same wash, course NW.
32.50 Wash, 50 lks. wide, course SW.
40.00 Set an iron post, 3 ft. long, 1 in. in diam., 27 ins. in ground for $\frac{1}{4}$ sec. cor., brass cap marked

$\frac{1}{4}$ $\frac{\$ 3}{\$ 10}$
1927

Dig pits 18 x 18 x 12 ins., one each E. and W. of cor., 3 ft. dist.
45.00 Wash, 20 lks. wide, course SW.
60.00 Enter gravel flat, brs. NE. and SW.
62.00 Old road, brs. NE. and SW.
68.00 Wash, 2.00 chs. wide, course SW.
75.00 Wash, 10 lks. wide, course SW.
80.00 The cor. of secs. 3, 4, 9 and 10.
Land, level.
Soil, gravelly, 3rd rate.
Timber, none.
Undergrowth, creosote brush, scrub mesquite, catclaw, palo verde and ironwood.
Giant cactus.

N. 0° 7' W. on random line, bet. secs. 3 and 4.
40.00 Set temp. $\frac{1}{4}$ sec. cor.
78.00 Fall 18 lks. E. of cor. of secs. 3, 4, 33 and 34, on N. bdy. of township, which is an iron post, 2 ins. in diam., 12 ins. above ground, firmly set, with brass cap properly marked, witnessed by Bearing tree SE. of cor. and pits in each sec.
Thence
S. 0° 15' E., on true line, bet. secs. 3 and 4.
Over level land, thru scattering undergrowth.
13.00 Wash, 20 lks. wide, course SW.
36.80 Wash, 10 lks. wide, course SW.
38.00 Set an iron post, 3 ft. long, 1 in. in diam., 27 ins. in the ground for $\frac{1}{4}$ sec. cor., brass cap marked

$\frac{1}{4}$
\$ 4 | \$ 3
1927

Raise a md. of stone, 3 ft. base, 2 ft. high, W. of cor.

Survey of Subdivisional Lines of Township 5 North, Range 15 West.

Chains

- 44.50 Drain, course SW.
 55.20 Wash, 10 lks. wide, course SW.
 66.00 Drain, course SW.
 73.00 Enter gravel flat, brs. NE. and SW.
 78.00 The cor. of secs. 3, 4, 9 and 10.
 Land, level; SW. drainage.
 Soil, gravelly, 3rd rate.
 Timber, none.
 Undergrowth, creosote brush, ocotillo, cholla, scrub
 mesquite, catclaw, ironwood and palo verde.

From the standard cor. of secs. 32 and 33, on S. bdy. of
 T. 5 N., R. 15 W., described in Book "G".
 N. $0^{\circ} 2'$ W., on true line, bet. secs. 32 and 33.
 Over level land, thru dense undergrowth.

- 40.00 Set an iron post, 3 ft. long, 1 in. in diam., 27 ins. in
 ground for $\frac{1}{4}$ sec. cor., brass cap marked

S 32		S 33
	$\frac{1}{4}$	
	1927	

Dig pits 18 x 18 x 12 ins., one each N. and S. of cor.,
 3 ft. dist.

Thence across overflow land, course SW.

- 70.00 Drain, course SW.
 80.00 Set an iron post, 3 ft. long, 2 ins. in diam., 27 ins.
 in ground for cor. of secs. 28, 29, 32 and 33, brass
 cap marked

T 5 N	R 15 W
S 29	S 28
S 32	S 33
	1927

Dig pits 18 x 18 x 12 ins., one each NE., SE., SW. and
 NW. of cor., 3 ft. dist.

Land, level.

Soil, adobe, 1st rate.

Timber, none.

Undergrowth, creosote brush and scrub mesquite.

N. $89^{\circ} 50'$ E., on random line, bet. secs. 28 and 33.

- 40.00 Set temp. $\frac{1}{4}$ sec. cor.

- 80.02 Intersect the cor. of secs. 27, 28, 33 and 34.

Thence

S. $89^{\circ} 50'$ W., on true line, bet. secs. 28 and 33.

Over level land, thru scattering undergrowth and overflow
 land. Drains SW.

- 40.01 Set an iron post, 3 ft. long, 1 in. in diam., 27 ins. in
 ground for $\frac{1}{4}$ sec. cor., brass cap marked

$\frac{1}{4}$	S 28
	S 33
	1927

Dig pits 18 x 18 x 12 ins., one each E. and W. of cor.,
 3 ft. dist.

Survey of Subdivisional Lines of Township 5 North, Range 15 West.

Chains

65.02 Enter overflow land, 2.00 chs. wide, course SW.

80.02 The cor. of secs. 28, 29, 32 and 33.

Land, level.

Soil, adobe and sandy loam, 1st rate.

Timber, none.

Undergrowth, creosote brush and scrub mesquite.

N. 0° 2' W., on true line, bet. secs. 28 and 29.

Over-level land, thru scattering undergrowth.

Across overflow land, course SW.

30.00 Enter gravel flat, brs. NE. and SW.

40.00 Set an iron post, 3 ft. long, 1 in. in diam., 27 ins. in
the ground for $\frac{1}{4}$ sec. cor., brass cap marked

	$\frac{1}{4}$	
S 29		S 28
1927		

Dig pits 18 x 18 x 12 ins., one each N. and S. of cor.,
3 ft. dist.

44.00 Leave gravel flat. Enter overflow land, course SW.

60.00 Leave overflow land, course SW. Enter gravel flat, brs.
NE. and SW.80.00 Set an iron post, 3 ft. long, 2 ins. in diam., 27 ins. in
ground for cor. of secs. 20, 21, 28 and 29, brass cap
marked

T 5 N	R 15 W
S 20	S 21
S 29	S 28
1927	

Dig pits 18 x 18 x 12 ins., one each NE., SE., SW. and
NW. of cor., 3 ft. dist.

Land, level.

Soil, adobe and gravelly, 1st and 2nd rate.

Timber, none.

Undergrowth, creosote brush and scrub mesquite.

40.00 N. 89° 50' E., on random line, bet. secs. 21 and 28.
Set temp. $\frac{1}{4}$ sec. cor.

79.98 Fall 2 lks. N. of cor. of secs. 21, 22, 27 and 28.

Thence

S. 89° 51' W., on true line, bet. secs. 21 and 28.

Over level land, thru dense undergrowth.

9.98 Enter overflow land, 2.00 chs. wide, course SW.

16.98 Enter overflow land, 4.00 chs. wide, course SW.

38.98 Drain, course SW.

39.99 Set an iron post, 3 ft. long, 1 in. in diam., 27 ins. in
ground for $\frac{1}{4}$ sec. cor., brass cap marked

	$\frac{1}{4}$	S 21
		S 28
1927		

Dig pits 18 x 18 x 12 ins., one each E. and W. of cor.,
3 ft. dist.

51.48 Enter overflow land, 100 lks. wide, course SW.

57.98 Enter overflow land, 2.00 chs. wide, course SW.

62.98 Enter overflow land, 4.00 chs. wide, course SW. Thence
over gravel flat.

79.98 The cor. of secs. 20, 21, 28 and 29.

Land, level.

Soil, adobe, sandy loam and gravelly, 1st and 3rd rate.

Timber, none.

Undergrowth, creosote brush, scrub mesquite, palo verde
and ironwood, 4 to 6 ft. high.

Survey of Subdivisional Lines of Township 5 North, Range 15 West.

- Chains N. $0^{\circ} 2'$ W., on true line, bet. secs. 20 and 21.
Over level land, thru scattering undergrowth.
- 15.00 Enter scrub ironwood timber, 5.00 chs. wide, brs. E. and W.
- 40.00 Set an iron post, 3 ft. long, 1 in. in diam., 27 ins. in ground for $\frac{1}{4}$ sec. cor., brass cap marked

$$\begin{array}{c} \frac{1}{4} \\ \text{S } 20 \quad | \quad \text{S } 21 \\ 1927 \end{array}$$

- Dig pits 18 x 18 x 12 ins., one each N. and S. of cor., 3 ft. dist.
- 55.00 Enter overflow land, 5.00 chs. wide, course SW.
Thence across gravel flat.
- 80.00 Set an iron post, 3 ft. long, 2 ins. in diam., 27 ins. in ground for cor. of secs. 16, 17, 20 and 21, brass cap marked

$$\begin{array}{cc} \text{T } 5 \text{ N} & \text{R } 15 \text{ W} \\ \text{S } 17 & | \quad \text{S } 16 \\ \text{S } 20 & | \quad \text{S } 21 \\ 1927 \end{array}$$

From which

- Ironwood, 6 ins. in diam., brs. S. 88° E., 148 lks. dist., marked T 5 N R 15 W S 21 B T.
- Ironwood, 8 ins. in diam., brs. S. 1° W., 197 lks. dist., marked T 5 N R 15 W S 20 B T.
- No other bearing trees available.
- Dig pits 18 x 18 x 12 ins., one each NE., SE., SW. and NW. of cor., 3 ft. dist.
- Land, level.
- Soil, adobe and gravelly, 1st and 3rd rate.
- Timber, scattering scrub ironwood.
- Undergrowth, creosote brush and scrub mesquite.

- N. $89^{\circ} 51'$ E., on random line, bet. secs. 16 and 21.
- 40.00 Set temp. $\frac{1}{4}$ sec. cor.
- 80.06 Fall 9 lks. S. of cor. of secs. 15, 16, 21 and 22.
Thence
- S. $89^{\circ} 47'$ W., on true line, bet. secs. 16 and 21.
Over level land, thru scattering timber and undergrowth.
- 2.06 Drain, course SW.
- 5.56 Drain, course SW.
- 15.56 Drain, course SW.
- 20.06 Leave overflow land. Enter gravel flat, course SW.
- 40.03 Set an iron post, 3 ft. long, 1 in. in diam., 27 ins. in ground for $\frac{1}{4}$ sec. cor., brass cap marked

$$\begin{array}{c} \frac{1}{4} \quad \text{S } 16 \\ \quad \quad \text{S } 21 \\ 1927 \end{array}$$

From which

- Ironwood, 8 ins. in diam., brs. S. 15° E., 197 lks. dist., marked $\frac{1}{4}$ S 21 B T.
- Ironwood, 12 ins. in diam., brs. N. 71° W., 210 lks. dist., marked $\frac{1}{4}$ S 16 B T.
- 41.06 Leave gravel flat. Enter overflow land, course SW.
- 50.06 Leave overflow land, course SW.
- 62.56 Enter overflow land, 5.00 chs. wide, course SW.
- 80.06 The cor. of secs. 16, 17, 20 and 21.

Survey of Subdivisional Lines of Township 5 North, Range 15 West.

Chains Land, level.
 Soil, sandy loam and gravelly, 1st and 3rd rate.
 Timber, scattering ironwood and palo verde.
 Undergrowth, creosote brush and scrub mesquite.

N. 0° 2' W., on true line, bet. secs. 16 and 17.
 Over level land, thru scattering scrub timber and undergrowth.

- 20.00 Enter overflow land, 5.00 chs. wide, course SW.
- 30.00 Enter gravel flat, brs. NE. and SW.
- 40.00 Set an iron post, 3 ft. long, 1 in. in diam., 27 ins. in ground for $\frac{1}{4}$ sec. cor., brass cap marked

$\frac{1}{4}$
 S 17 | S 16
 1927

No bearing trees available.
 Dig pits 18 x 18 x 12 ins., one each N. and S. of cor., 3 ft. dist.

- 60.00 Drain, course SW.
- 75.00 Enter gravel flat, 5 chs. wide, brs. NE. and SW.
- 80.00 Set an iron post, 3 ft. long, 2 ins. in diam., 27 ins. in ground for cor. of secs. 8, 9, 16 and 17, brass cap marked

T 5 N R 15 W
 S 8 | S 9.
 S 17 | S 16
 1927

From which
 Ironwood, 6 ins. in diam., brs. S. 17° W., 187 lks. dist., marked T 5 N R 15 W S 17 B T.
 No other bearing tree available.
 Dig pits 18 x 18 x 12 ins., one each NE., SE., SW. and NW. of cor., 3 ft. dist.

Land, level.
 Soil, gravelly, 2nd and 3rd rate.
 Timber, scattering scrub ironwood and palo verde.
 Undergrowth, creosote brush and scrub mesquite.

- N. 89° 47' E., on random line, bet. secs. 9 and 16.
- 40.00 Set temp. $\frac{1}{4}$ sec. cor.
- 80.16 Fall 2 lks. N. of cor. of secs. 9, 10, 15 and 16.
 Thence
 S. 89° 48' W., on true line, bet. secs. 9 and 16.
 Over level land, thru scattering undergrowth.
- 8.16 Wash, 10 lks. wide, course SW.
- 33.16 Drain, course SW., thence over gravel flat.
- 40.08 Set an iron post, 3 ft. long, 1 in. in diam., 27 ins. in ground for $\frac{1}{4}$ sec. cor., brass cap marked

$\frac{1}{4}$ $\frac{S 9}{S 16}$
 1927

Dig pits 18 x 18 x 12 ins., one each E. and W. of cor., 3 ft. dist.

Survey of Subdivisional Lines of Township 5 North, Range 15 West.

Chains

- 50.16 Leave gravel flat. Enter overflow land 10.00 chs. wide, course SW.
 75.16 Enter gravel flat, brs. NE. and SW.
 80.16 The cor. of secs. 8, 9, 16 and 17.
 Land, level.
 Soil, gravelly, 2nd and 3rd rate.
 Timber, none.
 Undergrowth, creosote brush, cholla, ocotillo, scrub mesquite, ironwood and palo verde.

- N. 0° 2' W., on true line, bet. secs. 8 and 9.
 Over level land, thru scattering undergrowth, and timber.
 4.50 Dim road, brs. E. and W.
 10.00 Enter overflow land, course SW.
 15.00 Leave overflow land. Enter gravel flat, course SW.
 20.00 Leave gravel flat. Enter overflow land 5.00 chs. wide, course SW.
 40.00 Set an iron post, 3 ft. long, 1 in. in diam., 27 ins. in ground for $\frac{1}{4}$ sec. cor., brass cap marked

S 8 | S 9
 1927

From which

- Ironwood, 8 ins. in diam., brs. N. 2° W., 46 lks. dist., marked $\frac{1}{4}$ S 8 B T.
 No other bearing tree available.
 Dig pits 18 x 18 x 12 ins., one each N. and S. of cor., 3 ft. dist.
 43.00 Enter gravel flat, brs. NE. and SW.
 55.20 Road, brs. E. and W.
 57.00 Leave gravel flat. Enter overflow land, course SW.
 67.00 Leave overflow land. Enter gravel flat, brs. SW.
 80.00 Set an iron post, 3 ft. long, 2 ins. in diam., 27 ins. in ground for cor. of secs. 4, 5, 8 and 9, brass cap marked

T 5 N R 15 W
 S 5 | S 4
 S 8 | S 9
 1927

From which

- Ironwood, 8 ins. in diam., brs. S. 69° W., 120 lks. dist., marked T 5 N R 15 W S 8 B T.
 No other trees available.
 Dig pits 18 x 18 x 12 ins., one each NE., SE., SW. and NW. of cor., 3 ft. dist.
 Land, level.
 Soil, sandy and gravelly, 2nd and 3rd rate.
 Timber, scattering ironwood and palo verde.
 Undergrowth, creosote brush, ocotillo, cactus, scrub mesquite and catclaw.
 Giant cactus.

- N. 89° 48' E., on random line, bet. secs. 4 and 9.
 40.00 Set temp. $\frac{1}{4}$ sec. cor.
 80.00 Fall 5 lks. N. of cor. of secs. 3, 4, 9 and 10.
 Thence
 S. 89° 50' W., on true line, bet. secs. 4 and 9.
 Over level land, thru scattering undergrowth.
 27.00 Wash, 20 lks. wide, course SW. Thence over gravel flat brs. SW. and NE.
 40.00 Set an iron post, 3 ft. long, 1 in. in diam., 27 ins. in

Survey of Subdivisional Lines of Township 5 North, Range 15 West.

Chains the ground for $\frac{1}{4}$ sec. cor., brass cap marked

$\frac{1}{4}$ $\frac{S 4}{S 9}$

1927

Dig pits 18 x 18 x 12 ins., one each E. and W. of cor., 3 ft. dist.

48.50 Wash, 10 lks. wide, course SW.

50.22 Center A. T. & S. F. R. R., brs. N. 49° 15' W., and S. 49° 15' E.

50.80 Telegraph line, brs. N. 49° 15' W., and S. 49° 15' E.

53.20 State Highway, brs. N. 49° 15' W., and S. 49° 15' E.

58.00 Wash, 10 lks. wide, course SW.

69.00 Drain, course SW., thence over gravel flat.

80.00 The cor. of secs. 4, 5, 8 and 9.

Land, level.

Soil, sandy and gravelly, 3rd rate.

Timber, none.

Undergrowth, creosote brush, ocotillo, cholla, scrub mesquite, ironwood, palo verde and catclaw.

N. 0° 15' W. on random line, bet. secs. 4 and 5.

40.00 Set temp. $\frac{1}{4}$ sec. cor.

78.14 Fall 9 lks. E. of cor. of secs. 4, 5, 32 and 33, on N. boundary of the township, which is an iron post, 2 ins. in diam., projecting 12 ins. above ground, firmly set, properly marked on brass cap and witnessed by one pit in each sec.

Thence

S. 0° 19' E., on true line, bet. secs. 4 and 5.

Over level land, thru scattering undergrowth.

18.14 Enter overflow land, 2.00 chs. wide, course SW.

38.14 Set an iron post, 3 ft. long, 1 in. in diam., 27 ins. in ground for $\frac{1}{4}$ sec. cor., brass cap marked

$\frac{1}{4}$
S 5 | S 4
1927

Dig pits 18 x 18 x 12 ins., one each N. and S. of cor., 3 ft. dist.

39.00 Cement water tank 20 x 20 ft., 6 ft. high brs. W. about 5.00 chs. dist

46.14 McVey water tank brs. W. about 12.00 chs.

52.49 Center of A. T. & S. F. R. R., brs. N. 49° 15' W., and S. 49° 15' E.

52.54 Telegraph line, brs. N. 49° 15' W., and S. 49° 15' E.

55.14 State highway brs. N. 49° 15' W., and S. 49° 15' E.

63.14 Wash, 20 lks. wide, course SW.

77.84 Drain, course SW.

78.14 The cor. of secs. 4, 5, 8 and 9.

Land, level.

Soil, sandy and gravelly, 2nd rate.

Timber, none.

Undergrowth, creosote brush, ocotillo, cholla cactus, scrub mesquite, ironwood and palo verde.

From the standard cor. of secs. 31 and 32, on S. bdy. of township., described in Book "G".

Survey of Subdivisional Lines of Township 5 North, Range 15 West.

- Chains N. 0° 3' W., on true line bet. secs. 31 and 32.
Over level land, thru scattering undergrowth, across
overflow land, course NW.
- 19.75 Dim road, brs. NW. and SE.
- 40.00 Set an iron post, 3 ft. long, 1 in. in diam., 27 ins. in
ground for $\frac{1}{4}$ sec. cor., brass cap marked

\$ 31	$\frac{1}{4}$	\$ 32
1927		

- Dig pits 18 x 18 x 12 ins., one each N. and S. of cor.,
3 ft. dist.
- 60.00 Enter overflow land, course NW.
- 76.00 Water in holes. Leave overflow land, course NW.
- 80.00 Set an iron post, 3 ft. long, 2 ins. in diam., 27 ins.
in ground for cor. of secs. 29, 30, 31 and 32, brass
cap marked

T 5 N	R 15 W
\$ 30	\$ 29
\$ 31	\$ 32
1927	

- Dig pits 18 x 18 x 12 ins., one each NE., SE., SW. and
NW. of cor., 3 ft. dist.
- Land, level.
- Soil, adobe and sandy loam, 1st rate.
- Timber, none.
- Undergrowth, creosote brush and scrub mesquite.

- N. 89° 50' E., on random line, bet. secs. 29 and 32.
- 40.00 Set temp. $\frac{1}{4}$ sec. cor.
- 80.08 Intersect the cor. of secs. 28, 29, 32 and 33.
Thence
- S. 89° 50' W., on true line, bet. secs. 29 and 32.
Over level land, thru scattering undergrowth.
- 25.08 Enter NW. drainage.
- 35.08 Enter sandy land, brs. NW. and SE.
- 40.04 Set an iron post, 3 ft. long, 1 in. in diam., 27 ins. in
ground for $\frac{1}{4}$ sec. cor., brass cap marked

$\frac{1}{4}$	\$ 29
	\$ 32
1927	

- Dig pits 18 x 18 x 12 ins., one each E. and W. of cor.,
3 ft. dist.
- Thence over adobe flat, NW. drainage.
- 80.08 The cor. of secs. 29, 30, 31 and 32.
Land, level.
- Soil, sandy loam and adobe, 1st rate.
- Timber, none.
- Undergrowth, creosote brush and scrub mesquite.

- S. 89° 50' W., on true line, bet. secs. 30 and 31, toward
flag on objective corner which is visible.
Across overflow land, thru scattering undergrowth on
adobe flat.
- 15.00 Enter sandy flat, brs. NW. and SE.
- 25.00 Dim road, brs. NW. and SE.
- 36.00 Enter gravel flat, brs. NW. and SE.
- 40.00 Set an iron post, 3 ft. long, 1 in. in diam., 27 ins. in
ground for $\frac{1}{4}$ sec. cor., brass cap marked

Survey of Subdivisional Lines of Township 5 North, Range 15 West.

Chains.

$\frac{1}{4}$ $\frac{S 30}{S 31}$
1927

80.10 Dig pits 18 x 18 x 12 ins., one each E. and W. of cor.,
3 ft. dist. Continue over gravelly flat.
The cor. of secs. 25, 30, 31 and 36, on west boundary of
township, hereinbefore described.
Land, level.
Soil, sandy, gravelly and adobe, 1st, 2nd and 3rd rate.
Timber, none.
Undergrowth, creosote brush and scrub mesquite.

40.00 From cor. of secs. 29, 30, 31 and 32,
N. 0° 3' W., on true line, bet. secs. 29 and 30.
Over level land, thru scattering undergrowth.
NW. drainage.
Set an iron post, 3 ft. long, 1 in. in diam., 27 ins. in
ground for $\frac{1}{4}$ sec. cor., brass cap marked

S 30 \uparrow S 29
1927

70.00 Dig pits 18 x 18 x 12 ins., one each N. and S. of cor.,
3 ft. dist.
Continue across overflow land, course west.
Leave overflow land. Enter sandy land course NW.
80.00 Set an iron post, 3 ft. long, 2 ins. in diam., 27 ins.
in ground for cor. of secs. 19, 20, 29 and 30, brass
cap marked

T 5 N R 15 W
 $\frac{S 19}{S 30}$ | $\frac{S 20}{S 29}$
1927

Dig pits 18 x 18 x 12 ins., one each NE., SE., SW. and
NW. of cor., 3 ft. dist.
Land, level.
Soil, sandy loam and adobe 1st rate.
Timber, none.
Undergrowth, creosote brush and scrub mesquite.

40.00 N. 89° 50' E., on random line, bet. secs. 20 and 29.
Set temp. $\frac{1}{4}$ sec. cor.
80.08 Intersect the cor. of secs. 20, 21, 28 and 29.
Thence
S. 89° 50' W., on true line, bet. secs. 20 and 29.
Over level land, thru scattering undergrowth. Drainage
southwest.
40.04 Set an iron post, 3 ft. long, 1 in. in diam., 27 ins. in
ground for $\frac{1}{4}$ sec. cor., brass cap marked

$\frac{1}{4}$ $\frac{S 20}{S 29}$
1927

80.08 Dig pits 18 x 18 x 12 ins., one each E. and W. of cor.,
3 ft. dist.
The cor. of secs. 19, 20, 29 and 30.
Land, level.
Soil, sandy loam and adobe, 1st rate.
Timber, none.
Undergrowth, creosote brush and scrub mesquite.
S. W. Drainage.

Survey of Subdivisional Lines of Township 5 North, Range 15 West.

Chains S. 89° 50' W., on true line, bet. secs. 19 and 30,
toward flag on objective corner which is visible.
Over level land, thru scattering undergrowth on adobe
flags with westerly drainage.
20.00 Enter dense brush, brs. NW. and SE.
40.00 Set an iron post, 3 ft. long, 1 in. in diam., 27 ins. in
ground for $\frac{1}{4}$ sec. cor., brass cap marked

$$\frac{1}{4} \begin{array}{r} S 19 \\ S 30 \\ 1927 \end{array}$$

Dig pits 18 x 18 x 12 ins., one each E. and W. of cor.,
3 ft. dist. Leave dense brush, brs. NW. and SE.
60.00 Enter overflow land, 10.00 chs. wide, course NW.
80.16 The cor. of secs. 19, 24, 25 and 30, on W. bdy. of town-
ship, hereinbefore described.
Land, level.
Soil, sandy and adobe, 1st rate.
Timber, none.
Undergrowth, creosote brush and scrub mesquite.

From Cor. of secs. 19, 20, 29 and 30,
N. 0° 3' W., on true line, bet. secs. 19 and 20.
Over level land, thru a clearing 30 ft. wide, on line.
40.00 Set an iron post, 3 ft. long, 1 in. in diam., 27 ins. in
ground for $\frac{1}{4}$ sec. cor., brass cap marked

$$S 19 \begin{array}{c} \frac{1}{4} \\ | \\ S 20 \\ 1927 \end{array}$$

Dig pits 18 x 18 x 12 ins., one each N. and S. of cor.,
3 ft. dist.
80.00 Set an iron post, 3 ft. long, 2 ins. in diam., 27 ins.
in ground for cor. of secs. 17, 18, 19 and 20, brass
cap marked

$$\begin{array}{cc} T 5 N & R 15 W \\ S 18 & | & S 17 \\ S 19 & | & S 20 \\ & & 1927 \end{array}$$

Dig pits 18 x 18 x 12 ins., one each NE., SE., SW. and
NW. of cor., 3 ft. dist.
Land, level.
Soil, sandy loam, 1st rate.
Timber, none.
Undergrowth, creosote brush.

N. 89° 50' E., on random line, bet. secs. 17 and 20.
40.00 Set temp. $\frac{1}{4}$ sec. cor.
80.06 Intersect cor. of secs. 16, 17, 20 and 21.
Thence
S. 89° 50' W., on true line, bet. secs. 17 and 20.
Over level land, thru scattering undergrowth.
16.06 Gravel flat, 10.00 chs. wide, brs. NE. and SW.
40.03 Set an iron post, 3 ft. long, 1 in. in diam., 27 ins. in
ground for $\frac{1}{4}$ sec. cor., brass cap marked

$$\frac{1}{4} \begin{array}{r} S 17 \\ S 20 \\ 1927 \end{array}$$

Survey of Subdivisional Lines of Township 5 North, Range 15 West.

Chains Dig pits 18 x 18 x 12 ins., one each E. and W. of cor., 3 ft. dist.
 60.06 Overflow land, 5.00 chs. wide, course SW.
 80.06 The cor. of secs. 17, 18, 19 and 20.
 Land, level.
 Soil, sandy loam, 1st rate.
 Timber, none.
 Undergrowth, creosote brush.

S. 89° 52' W., on true line, between secs. 18 and 19, toward flag on objective corner which is visible.
 Over level land, in clearing.

5.00 House brs. N. 1.00 ch. Leave clearing, thence thru scattering undergrowth.
 40.00 Set an iron post, 3 ft. long, 1 in. in diam., 27 ins. in ground for 1/4 sec. cor., brass cap marked

1/4 S 18
 S 19
 1927

Dig pits 18 x 18 x 12 ins., one each E. and W. of cor., 3 ft. dist.
 70.00 Leave sandy land, enter adobe flat, brs. NW. and SE.
 80.16 The cor. of secs. 13, 18, 19 and 24, on west bdy. of township, hereinbefore described.
 Land, level.
 Soil, sandy loam and adobe, 1st rate.
 Timber, none.
 Undergrowth, creosote brush and scrub mesquite.

From cor. of secs. 17, 18, 19 and 20,
 N. 0° 3' W., on true line, bet. secs. 17 and 18.
 Over level land, along clearing 30 ft. wide, on line.
 West drainage.

40.00 Set an iron post, 3 ft. long, 1 in. in diam., 27 ins. in ground for 1/4 sec. cor., brass cap marked

S 18 1/4 S 17
 1927

Dig pits 18 x 18 x 12 ins., one each N. and S. of cor., 3 ft. dist.
 80.00 Set an iron post, 3 ft. long, 2 ins. in diam., 27 ins. in ground for cor. of secs. 7, 8, 17 and 18, brass cap marked

T 5 N R 15 W
 S 7 S 8
 S 18 S 17
 1927

Dig pits 18 x 18 x 12 ins., one each NE., SE., SW. and NW. of cor., 3 ft. dist.
 Land, level.
 Soil, sandy loam, 1st rate.
 Timber, none.
 Undergrowth, creosote brush.

Survey of Subdivisional Lines of Township 5 North, Range 15 West.

Chains N. 89° 50' E., on random line, bet. secs. 8 and 17.
 40.00 Set temp. 1/4 sec. cor.
 79.98 Intersect the cor. of secs. 8, 9, 16 and 17.
 Thence
 S. 89° 50' W., on true line, bet. secs. 8 and 17.
 Over level land, thru scattering undergrowth.
 9.98 Gravel flat 5.00 chs. wide, brs. NE. and SW.
 24.98 Enter overflow land, 5.00 chs. wide, course SW.
 29.98 Enter gravel flat.
 39.99 Set an iron post, 3 ft. long, 1 in. in diam., 27 ins. in
 ground for 1/4 sec. cor., brass cap marked

1/4 $\frac{S 8}{S 17}$
 1927

Dig pits 18 x 18 x 12 ins., one each E. and W. of cor.,
 3 ft. dist.
 79.98 The cor. of secs. 7, 8, 17 and 18.
 Land, level.
 Soil, sandy and gravelly, 2nd and 3rd rate.
 Timber, none.
 Undergrowth, creosote brush, scrub mesquite, palo verde
 and ironwood.
 Giant cactus.

S. 89° 51' W., on true line, between secs. 7 and 18, to-
 ward flag on objective corner which is visible.
 Over level land, thru scattering undergrowth.
 30.00 Dim road, brs. N. and S.
 38.50 House brs. N. 250 lks.
 40.00 Set an iron post, 3 ft. long, 1 in. in diam., 27 ins. in
 ground for 1/4 sec. cor., brass cap marked

1/4 $\frac{S 7}{S 18}$
 1927

Dig pits 18 x 18 x 12 ins., one each E. and W. of cor.,
 3 ft. dist. Drainage SW.
 50.00 House, brs. N. 7.50 chs. dist.
 72.00 Enter gravel flat.
 80.10 The cor. of secs. 7, 12, 13 and 18, on W. bdy. of town-
 ship, hereinbefore described.
 Land, level.
 Soil, sandy loam and gravelly, 1st and 3rd rate.
 Timber, none.
 Undergrowth, creosote brush and scrub mesquite.

From cor. of secs. 7, 8, 17 and 18,
 N. 0° 3' W., on true line, bet. secs. 7 and 8.
 Over level land, along clearing 30 ft. wide, on line.
 19.50 Road, brs. NE. and SW.
 25.00 Enter overflow land, 5.00 chs. wide, course SW.
 40.00 Set an iron post, 3 ft. long, 1 in. in diam., 27 ins. in
 ground for 1/4 sec. cor., brass cap marked

S 7 | S 8
 1/4
 1927

Survey of Subdivisional Lines of Township 5 North, Range 15 West.

Chains Dig pits 18 x 18 x 12 ins., one each N. and S. of cor.,
3 ft. dist.
46.00 Overflow land, 2.00 chs. wide, course SW.
80.00 Set an iron post, 3 ft. long, 2 ins. in diam., 27 ins. in
ground for cor. of secs. 5, 6, 7 and 8, brass cap
marked

T 5 N	R 15 W
S 6	S 5
S 7	S 8

1927

Dig pits 18 x 18 x 12 ins., one each NE., SE., SW. and
NW. of cor., 3 ft. dist.
Land, level.
Soil, sandy loam, 1st rate.
Timber, none.
Undergrowth, creosote brush.

N. 89° 50' E., on random line, bet. secs. 5 and 8.
40.00 Set temp. $\frac{1}{4}$ sec. cor.
80.10 Intersect the cor. of secs. 4, 5, 8 and 9.
Thence S. 89° 50' W., on true line, bet. secs. 5 and 8.
Over level land, thru scattering undergrowth.
0.40 Drain, course SW.
10.00 Overflow land, 2.00 chs. wide, course SW.
25.00 Enter gravel flat.
40.05 Set an iron post, 3 ft. long, 1 in. in diam., 27 ins. in
ground for $\frac{1}{4}$ sec. cor., brass cap marked

$\frac{1}{4}$	S 5
	S 8

1927

From which
Ironwood, 6 ins. in diam., brs. N. 12° 30' E., 112 lks.
dist., marked $\frac{1}{4}$ S 5 B T.
No other tree available, dig pits 18 x 18 x 12 ins.,
one each E. and W. of cor., 3 ft. dist.
63.00 Overflow land, 2.00 chs. wide, course SW.
72.00 Enter sandy flat, brs. NE. and SW.
78.30 Old road, brs. NE. and SW.
80.10 The cor. of secs. 5, 6, 7 and 8.
Land, level.
Soil, sandy and gravelly, 2nd and 3rd rate.
Timber, scattering ironwood and palo verde.
Undergrowth, creosote brush and mesquite.

S. 89° 50' W., on true line, between secs. 6 and 7, to-
ward flag on objective corner which is visible.
Over level land, thru scattering undergrowth.
20.00 Dim road, brs. N. and S.
40.00 Set an iron post, 3 ft. long, 1 in. in diam., 27 ins. in
ground for $\frac{1}{4}$ sec. cor., brass cap marked

$\frac{1}{4}$	S 6
	S 7

1927

Dig pits 18 x 18 x 12 ins., one each E. and W. of cor.,
3 ft. dist.

Survey of Subdivisional Lines of Township 5 North, Range 15 West.

Chains

- 43.00 Enter gravel flat, brs. NE. and SW.
 50.00 Enter overflow land, 5.00 chs. wide, course SW.
 52.00 House brs. N. about 15.00 chs. dist.
 79.95 Intersect the cor. of secs. 1, 6, 7 and 12, on W. bdy.

of township, hereinbefore described.

Land, level.

Soil, sandy and gravelly, 1st and 3rd rate.

Timber, none.

Undergrowth, creosote brush and mesquite.

 From cor. of secs. 5, 6, 7, and 8,
 N. 7° 19' W. on random line, bet. secs. 5 and 6.

- 40.00 Set temp. $\frac{1}{4}$ sec. cor.

- 78.35 Fall 2 lks. E. of cor. of secs. 5, 6, 31 and 32, on N.
 bdy. of township, which is an iron post, 2 ins. in
 diam., projecting 12 ins. above ground, firmly set,
 with brass cap marked

T 6 N	R 15 W
S 31	S 32
S 6	S 5
T 5 N	

1923

and witnessed by pits, one each NE, SW, SW, and NW. of
 cor. Thence

S. 0° 20' E., on true line, bet. secs. 5 and 6.

Over level land, thru scattering undergrowth.

- 8.35 Enter overflow land, 5.00 chs. wide, course SW., thence
 over gravel flat.
 38.35 Set an iron post, 3 ft. long, 1 in. in diam., 27 ins. in
 ground for $\frac{1}{4}$ sec. cor., brass cap marked

S 6	$\frac{1}{4}$	S 5
1927		

Dig pits 18 x 18 x 12 ins., one each N. and S. of cor.,
 3 ft. dist.

- 48.35 Wash, 30 lks. wide, course SW. Enter clearing 35 lks.
 wide, along line.

- 78.35 The cor. of secs. 5, 6, 7 and 8.

Land, level.

Soil, sandy and gravelly, 2nd and 3rd rate.

Timber, none.

Undergrowth, mesquite.

 The continued satisfactory adjustment of the solar
 apparatus of the instrument used in the execution of the
 surveys described in the foregoing field notes is indi-
 cated from field tests described in Book "L" of this
 group.

GENERAL DESCRIPTION.

The NE. portion of this township is mountainous and
 hilly, the south and westerly portion level, and the re-
 mainder generally rolling.

Soil is sandy loam, gravelly and stony.

Timber, scattering scrub ironwood, palo verde and mesquite.

Undergrowth, creosote brush, ocotillo, cholla cactus, scrub mesquite and catclaw.

Giant cactus. Bunch grass on the overflow lands.

The A. T. & S. F. R. R. enters the township thru Sec. 25 and leaves it thru sec. 5. The State highway parallels the railroad.

There are mineral indications in secs. 1, 12 and 13; the later section also carries a quartz mill.

There are 8 settlers in this township.

McVey pumping station for the railroad is located in the NE $\frac{1}{4}$ SE $\frac{1}{4}$, Sec. 5, and there is also a water well in sec. 13.

Mean magnetic declination 15° E.

CERTIFICATE OF U. S. CADASTRAL ENGINEER.

I, William H. Thorn, U.S. Cadastral Engineer, hereby certify upon honor that, in pursuance of special instructions received from the U.S. District Cadastral Engineer, for Group 143, Arizona, bearing date of the 23rd day of July, 1926, I have well, faithfully, and truly in my own proper person, and in strict conformity with said instructions, the Manual of Surveying Instructions, and the laws of the United States, RETRACED all those parts or portions of the East Boundary and SURVEYED all those parts or portions of the West Boundary and Subdivision Lines of Township 5 North, Range 15 West of the Gila and Salt River Base and Meridian, in the State of Arizona, which are represented in the foregoing field notes and by diagram on page 1 hereof as having been executed by me, and under my direction; and that all the corners of said retracement and survey have been established and perpetuated in strict accordance with the Manual of Surveying Instructions, and the special written instructions of the U.S. District Cadastral Engineer, for Group 143, Arizona, and in the specific manner described in the field notes, and that the foregoing are the original field notes of such retracement and survey.

Place: Phoenix, Arizona,

Date: April 16, 1927.

William H. Thorn, U.S. Cadastral Engineer.

APPROVAL.

OFFICE OF THE U.S. SUPERVISOR OF SURVEYS,

Denver, Colo., DEC. 10, 1927

The foregoing field notes of the RETRACEMENT of Part of the East Boundary and of the SURVEY of the West Boundary and Subdivision Lines of Township 5 North, Range 15 West of the Gila and Salt River Base and Meridian, in the State of Arizona executed by William H. Thorn, U.S. Cadastral Engineer

under his special instructions dated July 23, 1926 for Group 143, Arizona, having been critically examined, and the necessary corrections and explanations made, the said field notes, and the retracements and surveys they describe, are hereby approved.

U.S. Supervisor of Surveys.

I certify that the foregoing transcript of the field notes of the above-described surveys in has been correctly copied from the original notes on file in this office.

