

BOOK 3795

FIELD NOTES

OF THE RESURVEY OF

*the 4th Standard Parallel South thru Range 12 East,
and Part of the Subdivision Lines of T.20S., R.12 E.*

AND OF THE SURVEY OF

Part (completion) of the Subdivision Lines of

Township 20 South ~ Range 12 East

of the Gila and Salt River Base and Meridian,

In the State of ARIZONA

EXECUTED BY

William B. Kimmel

U.S. Cadastral Engineer

In the capacity of U. S. Surveyor..., under Special Instructions dated *September 24*, 1925,
issued by the ~~United States Surveyor General~~ *U.S. District Cadastral Engineer* to govern surveys included in Group
No. *138, Arizona*, which were approved by the Commissioner of the General Land
Office, *October 14*, 1925, and Assignment Instructions dated *November 2*, 1925.

Resurvey and Survey commenced *November 15*, 1925.

Resurvey and Survey completed *December 8*, 1925.

3795

3795





Book "A"

Group 138 - Arizona

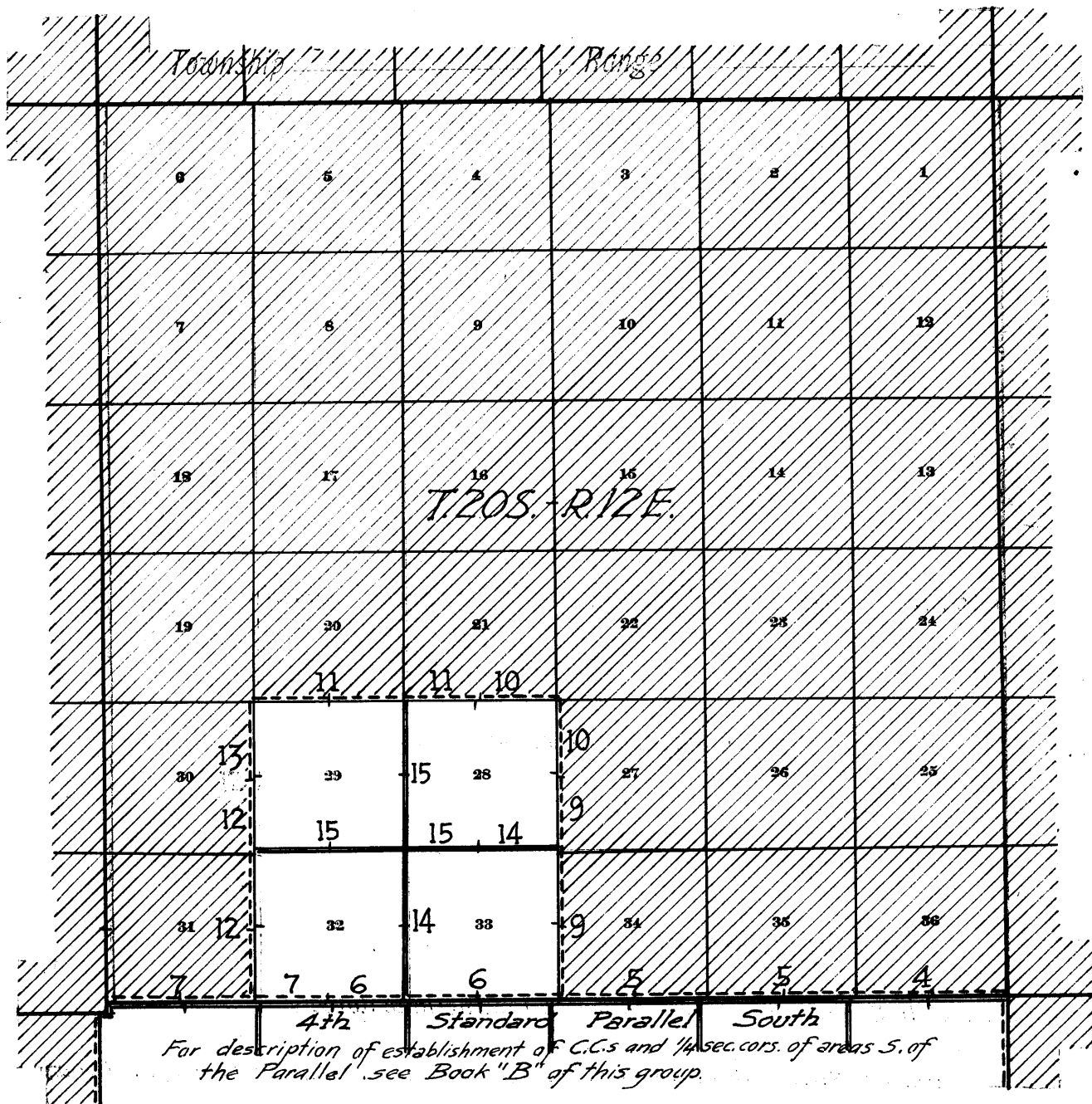
BOOK 3795

INDEX DIAGRAM.



-  Lines surveyed under this group.
-  Lines resurveyed under this group.
-  Accepted surveys, retracements or resurveys.
-  Areas surveyed as per accepted plats on file.

Resurveys and Surveys herein described were executed on dates shown on diagram on page 1, hereof, by Wm. B. Kimmel, U. S. Cadastral Engineer, using W. & L. E. Gurley transit No. 20120, equipped with a full vertical circle and the Smith Solar attachment. The horizontal limb is provided with two double verniers placed opposite to each other reading to 30" of arc. The verniers of the vertical circle and solar attachment read to 1' of arc.

Unless otherwise specified all measurements are made with Lufkin steel tape, 5 chains long, compared with a Lufkin Standard steel tape and found correct. The measurements are made on the slope, the vertical angles determined with transit or clinometer, and the slope measurements properly reduced to true horizontal distances. Unless otherwise specified, all azimuth determinations were accomplished with the solar attachment.

November 10, 1925: At the Western Union Telegraph Office, Tucson, Arizona, set watch to correct standard time, which is 24.4m fast, l.m.t.

November 11, 1925: Examine the adjustments of the transit and correct all errors; then, to test the solar apparatus, by comparing its indications, resulting from observations, made during a.m. and p.m. hours with a meridian established by Polaris observation, proceed as follows:

November 11, 1925: At camp in the SW $\frac{1}{4}$ of sec. 23, T. 21 S., R. 12 E., G. & S. R. Base and Meridian, Arizona, latitude 31° 35' N., longitude 111° 5' W., make a daylight hour angle observation on Polaris east of the meridian, one each with the telescope in direct and reversed positions, reading the horizontal deflection angle to a point of rock about 5 miles distant.

Local mean time of observation	- - - - -	5h. 26.5m.
Mean horizontal angle to rock	- - - - -	13° 27.5'
Azimuth of Polaris	- - - - -	1° 13'
True bearing, Point of rock	- - - - -	N. 12° 14.5' W.
Mean vertical angle of Polaris	- - - - -	31° 56.5'
Latitude of station	- - - - -	31° 35.5' N.

November 14, 1925, At 9h a.m., app.t., set off 31° 35 $\frac{1}{2}$ ' N. on the lat. arc; 18° 15' S. on the decl. arc; and determine a meridian with the solar, which agrees within 1' of the true meridian.

At apparent noon, with the lat. arc unchanged, observe the sun on the meridian, the resulting reading of the decl. arc is 18° 14' S. which agrees with the computed decl. of the sun. Also make a meridian observation of the sun for latitude, observing the sun's center with the transit telescope;

Observed altitude	- - - - -	40° 10' 30"
Refraction	- - - - -	1' 19"
		<hr/>
Sun's declination	- - - - -	40° 09' 11"
		18° 15' 21"
		<hr/>
Latitude (90° - 58° 24' 32")	- - -	31° 35' 28"

At 3h p.m., app.t., with the lat. arc unchanged, set off 18° 15 $\frac{1}{2}$ ' S. on the decl. arc; and determine a meridian with the solar, which agrees within 1' of the true meridian.

As all of the solar observations taken during the usual hours of solar work come within 1' of the true meridian, conclude that the adjustments of the instrument is satisfactory.

The instrument was maintained in adjustment throughout the survey.

Resurvey of 4th Standard Parallel South thru Range 12 East

chains

The 4th Standard Parallel South thru Range 12 East was surveyed by L.Wolfley, U.S.D.S. in 1885 and was independently resurveyed in 1901 by P.Contzen, U.S.D.S., reestablishing all std. sec. and $\frac{1}{4}$ sec. cors. thereon, and establishing a std. C.C. of T. 20 S., R. 12 E. at intersection of the parallel with the E. bdy. of T. 20 S., R. 11 E.

No subsequent retracement or resurvey of the parallel in R. 12 E. is of record.

The following notes describe a dependent resurvey of the S. bdrs. of secs. 31, 34, 35 & 36, and an independent resurvey of the S. bdrs. of secs. 32 & 33.

From std. cor. of Ts. 20 S., Rs. 12 & 13 E., hereinafter described,

39.96 West, on random line, on S. bdy. of sec. 36 (E. $\frac{1}{2}$)
Fall 6 lks. S. of true point for std. $\frac{1}{4}$ sec. cor. of sec. 36, determined by measuring 1.00 ch. E. from W.C. hereinafter described.
True course & dist. of E. $\frac{1}{2}$ of S. bdy. of sec. 36 are therefore N. 89° 55' W., 39.96 chs.

40.09 From true cor. point,
West, on random line, on S. bdy. of sec. 36 (W. $\frac{1}{2}$)
Fall 3 lks. N. of std. cor. of secs. 35 & 36, hereinafter described.
True course & dist. of W. $\frac{1}{2}$ of S. bdy. of sec. 36 are therefore S. 89° 57' W., 40.09 chs.

40.03 West, on random line, on S. bdy. of sec. 35 (E. $\frac{1}{2}$)
Fall 6 lks. S. of std. $\frac{1}{4}$ sec. cor. of sec. 35, hereinafter described.
True course & dist. of E. $\frac{1}{2}$ of S. bdy. of sec. 35 are therefore N. 89° 55' W., 40.03 chs.

40.07 Thence,
West, on random line, on S. bdy. of sec. 35 (W. $\frac{1}{2}$)
Intersect std. cor. of secs. 34 & 35, hereinafter described.
True course & dist. of W. $\frac{1}{2}$ of S. bdy. of sec. 35 are therefore West, 40.07 chs.

40.00 West, on random line, on S. bdy. of sec. 34 (E. $\frac{1}{2}$)
Fall 5 lks. S. of std. $\frac{1}{4}$ sec. cor. of sec. 34, hereinafter described.
True course & dist. of E. $\frac{1}{2}$ of S. bdy. of sec. 34 are therefore N. 89° 56' W., 40.00 chs.

39.86 Thence,
West, on random line, on S. bdy. of sec. 34 (W. $\frac{1}{2}$)
Fall 1 lk. S. of std. cor. of secs. 33 & 34, hereinafter described.
True course & dist. of W. $\frac{1}{2}$ of S. bdy. of sec. 34 are therefore N. 89° 59' W., 39.86 chs.

40.53 West, on random line, on S. bdrs. of secs. 33 & 32.
A point 9 lks. N. of W.C. to std. $\frac{1}{4}$ sec. cor. of sec. 33, hereinafter described. Continue line & measurement.

79.35 A point 4 lks. N. of std. cor. of secs. 32 & 33, hereinafter described. Continue line & measurement

119.49 A point 9 lks. N. of std. $\frac{1}{4}$ sec. cor. of sec. 33, hereinafter described. Continue line & measurement.

162.43 Fall 19 lks. N. of std. cor. of secs. 31 & 32, hereinafter described.
True course & dist. of the Parallel from std. cor. of secs. 33 & 34 to std. cor. of secs. 31 & 32 are therefore S. 89° 56' W., 162.43 chs.

40.17 West, on random line, on S. bdy. of sec. 31 (E. $\frac{1}{2}$)
Fall 4 lks. S. of std. $\frac{1}{4}$ sec. cor. of sec. 31, hereinafter described.
True course & dist. of E. $\frac{1}{2}$ of S. bdy. of sec. 31 are therefore N. 89° 57' W., 40.17 chs.

Thence,
West, on random line, on S. bdy. of sec. 31 (W. $\frac{1}{2}$)

4 Resurvey of 4th Standard Parallel South thru Range 12 East

chains
46.79

Fall 7 lks. S. of std. closing cor. of T. 20 S., R. 12 E. (SW. cor.), hereinafter described.
True course & dist. of W. $\frac{1}{4}$ of S. bdy. of sec. 31 are therefore N. $89^{\circ}55'W.$, 46.79 chs.

RESURVEY.

The std. cor. of Ts. 20 S., Rs. 12 & 13 E., reconstructed in original position by P. Contzen, U.S.D.S. in 1901 and which is identical with cor. of Ts. 21 S., Rs. 12 & 13 E., is a granite stone, 12x8x8 ins. above ground, firmly set, marked SC on N. face and 6 notches on each of E., W. & N. faces, and witnessed by a small mound of stone S. of cor. and one bearing tree:

a mesquite, 7 ins. diam., N. $30^{\circ}E.$, 70 lks. dist., with scribe marks faintly visible.

No trace of the record NW. bearing tree can be found. Reconstruct this cor. monument by destroying the mound of stone S. of cor. and raising a new mound of stone, 3 ft. base, 2 ft. high, N. of cor., and remarking the bearing tree SC T20S R13E S31 BT.

No other bearing tree available.

This tp. cor. is under a wire fence, bearing N. & S. Thence

N. $89^{\circ}55'W.$, on true line, on S. bdy. of sec. 36 (E. $\frac{1}{2}$)
Over rolling land, thru scattering undergrowth.

Ascend gradually over SE. slope.

2.00 Wash, 15 lks. wide, course SE.

2.60 Same wash, course NE. Asc. 70 ft. over E. slope.

22.70 Desc. 60 ft. over NW. slope.

35.50 Wash, 20 lks. wide, course NE. Asc. gradually over NE. slope.

39.96 Intersect point for std. $\frac{1}{4}$ sec. cor. of sec. 36, which falls on sloping bank of a wash, course NE.

Thence,

S. $89^{\circ}57'W.$, on true line, on S. bdy. of sec. 36 (W. $\frac{1}{2}$)
Over rolling land, thru scattering undergrowth.

Asc. gradually over E. slope to sec. cor.

1.00 Intersect the witness cor. to std. $\frac{1}{4}$ sec. cor. of sec. 36, which is a granite stone 10x6x6 ins. above ground, firmly set, marked SC $\frac{1}{4}S$ on N. face and WC on S. face, and witnessed by one bearing tree:

a mesquite, 6 ins. diam., N. $1^{\circ}00'E.$, 188 lks. dist., with scribe marks faintly visible.

No trace of the record NW. bearing tree can be found.

Reconstruct this cor. monument by raising a mound of stone, 3 ft. base, 2 ft. high, N. of cor. and remarking the bearing tree WC SC $\frac{1}{4}S36$ BT.

No other bearing tree available.

Continue line & measurement.

40.09 Intersect the previously reestablished std. cor. of secs. 35 & 36, which is an igneous stone 8x5x6 ins. above ground, firmly set, marked SC on N. face, 5 notches on W. face and 1 notch on E. face, and witnessed by a small mound of stone S. of cor. and two bearing trees:
a mesquite, 10 ins. diam., N. $10\frac{1}{4}^{\circ}E.$, 148 lks. dist., and
a mesquite, 7 ins. diam., N. $7\frac{3}{4}^{\circ}W.$, 93 lks. dist.
Scribe marks are faintly visible on both of these trees.

Reconstruct this cor. monument by destroying the mound of stone S. of cor. and raising a new mound of stone, 3 ft. base, 2 ft. high, N. of cor., remarking the NW. bearing tree SC T20S R12E S35 BT and the NE. bearing tree SC T20S R12E S36 BT.

Land, rolling.

Soil, gravelly, 3rd rate.

Timber, none.

Undergrowth, scrub mesquite, catclaw & greasewood.

chains	N.89°55'W., on true line, on S.bdy. of sec. 35 (E. $\frac{1}{2}$) Over rolling land, thru scattering undergrowth. Asc. 106 ft. over E. slope.
31.70	Ridge, brs. NE. & SW. Desc. 30 ft. over NW. slope.
37.10	Wash, 10 lks. wide, course N. Asc. 15 ft. over E. slope to
40.03	Intersect previously reestablished std. $\frac{1}{4}$ sec. cor. of sec. 35, which is an igneous stone 10x6x8 ins. above ground, firmly set, marked SC $\frac{1}{4}$ on N. face and witnessed by a small mound of stone N. of cor. and one bearing tree: a mesquite, 8 ins. diam., N. 10 $\frac{1}{2}$ ° E., 92 lks. dist., with scribe marks faintly visible. Reconstruct this cor. monument by rebuilding mound of stone 3 ft. base, 2 ft. high, N. of cor. and remarking the bearing tree SC $\frac{1}{4}$ S35 BT. No other bearing tree available.
	Thence, West, on true line, on S. bdy. of sec. 35 (W. $\frac{1}{2}$) Over rolling land, thru scattering undergrowth. Asc. slightly over E. slope.
1.30	Spur, slopes N. Desc. 40 ft. over W. slope.
7.70	Wash, 10 lks. wide, course N. Asc. gradually over NE. slope.
20.85	Wash, 20 lks. wide, course NE. Asc. 91 ft. over E. slope to
40.07	Intersect previously reestablished std. cor. of secs. 34 & 35, which is an igneous stone 12x5x10 ins. above ground, firmly set, marked SC on N. face, 4 notches on W. face & 2 notches on E. face and witnessed by a scattered mound of stone N. of cor. No bearing trees. Reconstruct this cor. monument by rebuilding the mound of stone, 3 ft. base, 2 ft. high, N. of cor. No bearing trees available.
	Land, rolling. Soil, gravelly & rocky, 3rd rate. Timber, none. Undergrowth, scrub mesquite, paloverde & catclaw.

	N. 89°56'W., on true line, on S. bdy. of sec. 34. (E. $\frac{1}{2}$) Over rolling land, thru scattering undergrowth. Asc. 10 ft. over E. slope.
2.50	Spur, slopes NE. Desc. 40 ft. over NW. slope.
26.40	Wash, 10 lks. wide, course NE. Asc. 60 ft. over E. slope to
40.00	Intersect previously reestablished std. $\frac{1}{4}$ sec. cor. of sec. 34, which is an igneous stone 12x8x10 ins. above ground, firmly set, marked SC $\frac{1}{4}$ 34 on N. face and witnessed by a small mound of stone W. of cor. No bearing trees. Reconstruct this cor. monument by destroying the old mound of stone W. of cor. and raising a new mound of stone, 3 ft. base, 2 ft. high, N. of cor. No bearing trees available.
	Thence, N. 89°59'W., on true line, on S. bdy. of sec. 34 (W. $\frac{1}{2}$) Over rolling land, thru scattering undergrowth. Asc. 30 ft. over E. slope to
5.00	Enter mountainous land, Asc. 165 ft. over E. slope.
18.90	Spur, slopes S. Top of malpais hill brs. N. about 5 chs. dist. Desc. 55 ft. over SW. slope to
23.88	Enter rolling land, Desc. 48 ft. over SW. slope
32.90	Rocky wash, 20 lks. wide, course SE. Asc. 42 ft. over E. slope.
39.86	Intersect previously reestablished std. cor. of secs. 33 & 34, which is an igneous stone 12x8x6 ins. above ground, firmly set, marked SC on N. face, and 3 notches on each of E. & W. faces, and witnessed by a scattered mound of stone N. of cor. and two bearing trees: a mesquite, 8 ins. diam., N. 58° E., 139 lks. dist. and a mesquite, 8 ins. diam., N. 3° W., 152 lks. dist. Both of these trees show faint markings. Reconstruct this cor. monument by rebuilding the mound of stone, 3 ft. base, 2 ft. high, N. of cor., remarking the NE. bearing tree SC T20S R12E S34 BT and the NW. bearing tree SC T20S R12E S33 BT.

6 Resurvey of 4th Standard Parallel South thru Range 12 East

chains	<p>Land, rolling and mountainous. Soil, gravelly and rocky, 3rd & 4th rate. Timber, none. Undergrowth, scrub mesquite, paloverde & catclaw.</p> <hr/> <p>S. 89° 56' W., on true line, on S. bdy. of sec. 33. Over rolling land, thru scattering undergrowth. Asc. 108 ft. over gradual E. slope to</p> <p>9.97 Enter mountainous land. Asc. 310 ft. over steep E. slope. 24.60 Spur, slopes SE. Desc. 375 ft. over steep W. slope. 39.50 Rocky wash, 15 lks. wide, course S. Asc. 10 ft. to 40.53 A point 4 lks. N. of W.C. to previously reestablished std. $\frac{1}{4}$ sec. cor. of sec. 33, which is a granite stone 10x10x8 ins. above ground, firmly set, properly marked & witnessed by a mound of stone N. and a properly marked mesquite bearing tree NE. of cor. Obliterate the marking on the stone and bearing tree and scatter the mound of stone. Asc. 30 ft. over E. slope to</p> <p>42.43 Set an iron post, 3 ft. long, 1 in. in diam., 3 ins. in ground to bedrock, deposit a stone marked with a cross (X) at base of post, and raise a mound of stone around post, for reestablished std. $\frac{1}{4}$ sec. cor. of sec. 33, marked on brass cap,</p> <p style="text-align: center;">SC <u>$\frac{1}{4}$ S33</u> 1925</p> <p>Asc. slightly over E. slope. 42.69 Spur, slopes S. Desc. 20 ft. over W. slope. 45.23 Wash, 10 lks. wide, course S. Asc. gradually over SE. slope to 53.55 Wash, 10 lks. wide, course SE. Asc. 460 ft. over E. slope. 54.05 A spring flowing E., brs. S. about 40 lks. dist. 79.35 A point 5 lks. S. of previously reestablished std. cor. of secs. 32 & 33, which is an igneous stone in place, exposed 24x12x4 ins. above ground, properly marked and witnessed by a mound of stone N. of cor. No bearing trees. Obliterate the marking on the stone and scatter the mound of stone.</p> <p>82.43 Set an iron post, 3 ft. long, 2 ins. in diam., 24 ins. in ground, for reestablished std. cor. of secs. 32 & 33, marked on brass cap,</p> <p style="text-align: center;">SC T20S R12E <u>S32 S33</u> 1925</p> <p>Raise a mound of stone, 3 ft. base, 2 ft. high, N. of cor.</p> <p>Land, rolling & mountainous. Soil, rocky, 4th rate. Timber, none. Undergrowth, scrub mesquite, paloverde & catclaw, & ocotillo.</p> <hr/> <p>S. 89° 56' W., on true line, on S. bdy. of sec. 32. Over mountainous land, thru scattering undergrowth. Asc. 190 ft. over E. slope.</p> <p>7.66 Wire fence, brs. N. & S. 8.50 Divide, brs. N. & S. Desc. 210 ft. over W. slope. 25.00 Wash, 10 lks. wide, course SW. Desc. 30 ft. over SW. slope. 31.62 Wash, 10 lks. wide, course SW. Asc. 30 ft. over SE. slope. 37.06 A point 5 lks. S. of previously reestablished std. $\frac{1}{4}$ sec. cor. of sec. 32, which is an igneous stone 10x5x8 ins. above ground, firmly set, properly marked and witnessed by a mound of stone N. of cor. No bearing trees. Obliterate the marking on the stone and scatter the mound of stone.</p> <p>37.90 Desc. 24 ft. over SW. slope to 40.00 Set an iron post, 3 ft. long, 1 in. in diam., 26 ins. in ground,</p>
--------	---

Resurvey of 4th Standard Parallel South thru Range 12 East

chains	for reestablished std. $\frac{1}{4}$ sec. cor. of sec. 32, marked on brass cap, <div style="text-align: center;"> SC <u>$\frac{1}{4}$ S32</u> 1925 </div> <p>Raise a mound of stone, 3 ft. base, 2 ft. high, N. of cor. Desc. 40 ft. over SW. slope.</p> <p>43.80 Wash, 10 lks. wide, course SE. Asc. 235 ft. over SE. slope.</p> <p>67.50 Spur, slopes SW. Desc. 70 ft. over W. slope.</p> <p>72.00 Ascend 70 ft. over SE. slope.</p> <p>77.80 Rocky spur, slopes SW. Desc. 72 ft. over NW. slope to</p> <p>80.00 Intersect previously reestablished std. cor. of secs. 31 & 32, which is an igneous stone in place, exposed 36x12x6 ins. above ground, marked with a cross (X) on top, SC N. of cross, 5 notches E. and 1 notch W. of cross, and witnessed by a small mound of stone N. of cor. No bearing trees.</p> <p>Reconstruct this cor. monument by rebuilding the mound of stone 3 ft. base, 2 ft. high, N. of cor. No bearing trees available.</p> <p>Land, mountainous. Soil, rocky and gravelly, 4th rate. Timber, none. Undergrowth, scrub mesquite & catclaw, & ocotillo.</p> <hr/> <p>N. 89°57' W., on true line, on S. bdy. of sec. 31 (E. $\frac{1}{4}$) Over mountainous land, thru scattering undergrowth. Desc. 340 ft. over NW. slope.</p> <p>22.07 Intersect NW. side line (2-3) of "Tumacacori No. 2" patented lode mining claim, Mineral Survey No. 3133, at a point 3.00 chs. N. 48°40' E. from Cor. No. 3 thereof and 19.67 chs. S. 48°40' W. from Cor. No. 2 thereof.</p> <p>23.00 Wash, 10 lks. wide, course N. Asc. gradually over NE. and N. slopes to</p> <p>40.17 Intersect previously reestablished std. $\frac{1}{4}$ sec. cor. of sec. 31, which is an igneous stone 16x12x6 ins. above ground, firmly set, marked SC $\frac{1}{4}$ 31 on N. face and witnessed by a small mound of stone N. of cor. No bearing trees.</p> <p>Reconstruct this cor. monument by rebuilding the mound of stone 3 ft. base, 2 ft. high, N. of cor. No bearing trees available.</p> <p>Thence, N. 89°55' W., on true line, on S. bdy. of sec. 31 (W. $\frac{1}{4}$) Over rolling land, thru scattering undergrowth, Asc. gradually over N. slope.</p> <p>3.50 Desc. 170 ft. over NW. slope.</p> <p>11.00 Wash, 5 lks. wide, course NW.</p> <p>27.40 Wash, 12 lks. wide, course N. Asc. 105 ft. over NE. slope.</p> <p>36.50 Spur, slopes N. Desc. 85 ft. over W. slope to</p> <p>46.79 Intersect std. closing cor. of T. 20 S., R. 12 E. (SW. cor.) on E. bdy. of T. 20 S., R. 11 E., which is an igneous stone 9x6x8 ins. above ground, firmly set, marked SC and 6 notches on N. face and CC and 6 notches on E. face, and witnessed by a scattered mound of stone N. of cor. No bearing trees.</p> <p>Reconstruct this cor. monument by removing remains of the mound of stone N. of cor. and raising a new mound of stone, 3 ft. base, 2 ft. high, NE. of cor. No bearing trees available.</p> <p>Land, mountainous & rolling. Soil, gravelly & rocky, 3rd & 4th rate. Timber, none. Undergrowth, scrub mesquite & ocotillo.</p> <hr/>
--------	--

8 Resurvey of Part of the Subdivision Lines of T.20 S., R.12 E.

chains	<p>The subdivision lines of T.20 S., R.12 E., with the exception of line bet. secs. 32 & 33, line bet. secs. 28 & 33, line bet. secs. 28 & 29 and line bet. secs. 29 & 32, were surveyed in 1901 by P. Contzen, U.S.D.S. and no retracement or resurvey of any part of said lines is of record.</p> <p>The following notes describe a resurvey of the W.bdrs. of secs. 27 & 34, the E.bdrs. of secs. 30 & 31, the S.bdy. of sec. 21, and the line bet. secs. 20 & 29.</p> <p style="text-align: center;">----- Retracement for Resurvey. -----</p> <p>From std. cor. of secs. 33 & 34 on S.bdy. of the Tp. (4th Std. Par. S.) hereinbefore described,</p>
40.00	North, on random line, on W.bdy. of sec. 34.
79.42	No trace of $\frac{1}{4}$ sec. cor. can be found. Set temp. $\frac{1}{4}$ sec. cor. Fall 97 lks. E. of original cor. of secs. 27, 28, 33 & 34. True course & dist. of W.bdy. of sec. 34 are therefore N.0°42'W., 79.42 chs.
40.00	North, on random line, on W.bdy. of sec. 27 (S. $\frac{1}{2}$) Fall 6 lks. E. of original $\frac{1}{4}$ sec. cor. of secs. 27 & 28. True course & dist. of S. $\frac{1}{2}$ of W.bdy. of sec. 27 are therefore N.0° 5'W., 40.00 chs.
40.14	Thence, North, on random line, on W.bdy. of sec. 27 (N. $\frac{1}{2}$) Fall 1 lk. E. of original cor. of secs. 21, 22, 27 & 28. True course & dist. of N. $\frac{1}{2}$ of W.bdy. of secs. 27 are therefore N.0° 1'W., 40.14 chs.
40.20	West, on random line, on S.bdy. of sec. 21 (E. $\frac{1}{2}$) Fall 3 lks. S. of original $\frac{1}{4}$ sec. cor. of secs. 21 & 28. True course & dist. of E. $\frac{1}{2}$ of S.bdy. of sec. 21 are therefore N.89°57'W., 40.20 chs.
40.57	Thence, West, on random line, on S.bdy. of sec. 21 (W. $\frac{1}{2}$) Fall 47 lks. S. of original cor. of secs. 20, 21, 28 & 29. True course & dist. of W. $\frac{1}{2}$ of S.bdy. of sec. 21 are therefore N.89°20'W., 40.57 chs.
40.19	West, on random line, bet. secs. 20 & 29 (E. $\frac{1}{2}$) Fall 6 lks. N. of original $\frac{1}{4}$ sec. cor. of secs. 20 & 29. True course & dist. of E. $\frac{1}{2}$ of line bet. secs. 20 & 29 are therefore S.89°55'W., 40.19 chs.
40.17	Thence, West, on random line, bet. secs. 20 & 29 (W. $\frac{1}{2}$) Fall 10 lks. N. of original cor. of secs. 19, 20, 29 & 30. True course & dist. of W. $\frac{1}{2}$ of line bet. secs. 20 & 29 are therefore S.89°51'W., 40.17 chs.
40.28	South, on random line, on E.bdy. of sec. 30 (N. $\frac{1}{2}$) Fall 2 lks. E. of original $\frac{1}{4}$ sec. cor. of secs. 29 & 30. True course & dist. of N. $\frac{1}{2}$ of E.bdy. of sec. 30 are therefore N.0° 2'E., 40.28 chs.
40.29	Thence, South, on random line, on E.bdy. of sec. 30 (S. $\frac{1}{2}$) Fall 5 lks. E. of original cor. of secs. 29, 30, 31 & 32. True course & dist. of S. $\frac{1}{2}$ of E.bdy. of sec. 30 are therefore N.0° 4'E., 40.29 chs.
40.13	South, on random line, on E.bdy. of sec. 31 (N. $\frac{1}{2}$) Fall 3 lks. E. of original $\frac{1}{4}$ sec. cor. of secs. 31 & 32. True course & dist. of N. $\frac{1}{2}$ of E.bdy. of sec. 31 are therefore N.0° 3'E., 40.13 chs.
39.19	Thence, South, on random line, on E.bdy. of sec. 31 (S. $\frac{1}{2}$) Fall 3 lks. E. of std. cor. of secs. 31 & 32 on the S.bdy. of the Tp. (4th Std. Par. S.) hereinbefore described. True course & dist. of S. $\frac{1}{2}$ of E.bdy. of sec. 31 are therefore N.0° 3'E., 39.19 chs.
	----- Resurvey. -----
	From std. cor. of secs. 33 & 34 on S.bdy. of the Tp. (4th Std.

Resurvey of Part of the Subdivision Lines of T.20 S., R.12 E.

chains Par.S.) hereinbefore described.
 N.0°42'W., on true line, on W.bdy. of sec. 34.
 Over rolling land, thru scattering undergrowth.
 Asc. gradually over E. slope to
 7.80 Wash, 10 lks. wide, course SE. Enter mountainous land.
 Asc. 310 ft. over S. slope.
 29.70 Spur, slopes E. Desc. 100 ft. over NW. slope to
 38.60 Point of rocky spur, slopes NW. Desc. 30 ft. over N. slope to
 39.71 (Midpoint) Set an iron post, 3 ft. long, 1 in. in diam., 12 ins.
 in ground to bedrock, deposit a stone marked with a cross
 (X) at base of post, and raise a mound of stone around
 post, for reestablished $\frac{1}{4}$ sec. cor. of sec. 34 only, marked
 on brass cap,

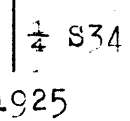

40.00 Desc. 9 ft. over N. slope to
 Set an iron post, 3 ft. long, 1 in. in diam., 16 ins. in ground
 to bedrock, deposit a stone marked with a cross (X) at
 base of post, and raise a mound of stone around post,
 for reestablished $\frac{1}{4}$ sec. cor. of sec. 33 only, marked on
 brass cap,

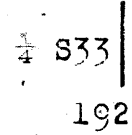

50.60 Desc. 260 ft. over N. slope.
 Wash, 10 lks. wide, course NE. Enter rolling land.
 Asc. 42 ft. over SE. slope.
 60.40 Descend 30 ft. over NE. slope to
 63.80 Wash, 10 lks. wide, course NE. Desc. gradually over NE. slope.
 79.42 Intersect original cor. of secs. 27, 28, 33 & 34 which is an
 igneous stone 12x8x8 ins. above ground, firmly set, and
 marked with 1 notch on S. face and 3 notches on E. face.
 No accessories.
 Reconstruct this cor. monument and alter same to refer to
 secs. 27 & 34 only by raising a mound of stone 3 ft.
 base, 2 ft. high, E. of cor.

Land, rolling & mountainous.
 Soil, gravelly & rocky, 3rd & 4th rate.
 Timber, none.
 Undergrowth, scrub mesquite & ocotillo.

0.58 From cor. of secs. 27 & 34,
 N.0° 5'W., on true line, on W.bdy. of sec. 27 (S. $\frac{1}{4}$)
 Over rolling land, thru scattering undergrowth.
 Desc. gradually over NE. slope to $\frac{1}{4}$ sec. cor.
 (80.00 chs. in northing from std. cor. of secs. 33 & 34) Set
 an iron post, 3 ft. long, 2 ins. in diam., 24 ins. in ground,
 for reestablished cor. of secs. 28 & 33 only, marked on
 brass cap,

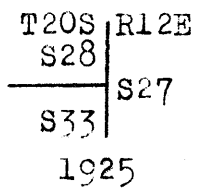

Raise a mound of stone, 3 ft. base, 2 ft. high, W. of cor.

3.30 Wash, 5 lks. wide, course NE.
 11.40 Wash, 5 lks. wide, course NE.
 21.10 Wash, 5 lks. wide, course NE.
 33.70 Wash, 10 lks. wide, course E.
 40.00 Intersect original $\frac{1}{4}$ sec. cor. of secs. 27 & 28 which is an
 igneous stone 10x8x8 ins. above ground, firmly set, marked
 $\frac{1}{4}$ 28 on W. face and 27 on E. face, and witnessed by two
 bearing trees:
 a mesquite, 10 ins. diam., N. 69 $\frac{3}{4}$ ° E., 106 lks. dist. and
 a mesquite, 8 ins. diam., S. 34 $\frac{1}{2}$ ° W., 104 lks. dist.

chains	<p>The marking is visible on both of these old trees. Reconstruct this cor.monument and alter same to refer to the quarters of sec.27 only, as follows: Obliterate marking on W.face of stone and change the marking on the E.face to read $\frac{1}{4}$ 27. Obliterate marking on the SW.bearing tree and remark the NE. bearing tree $\frac{1}{4}$ S27 BT. Raise a mound of stone, 3 ft.base, $1\frac{1}{2}$ ft.high, E.of cor. Thence, N.0° 1'W., on true line, on W.bdy.of sec.27 (N.$\frac{1}{4}$) Over rolling land, thru scattering undergrowth. Desc.54 ft.over NE. slope.</p> <p>0.58 (40.00 chs.in northing from cor.of secs.28 & 33) Set an iron post, 3 ft.long, 1 in.in diam., 12 ins.in ground to hard pan, deposit a stone marked with a cross (X) at base of post, and raise a mound of stone around post, for reestablished $\frac{1}{4}$ sec.cor.of sec.28 only, marked on brass cap,</p> <p style="text-align: center;">$\frac{1}{4}$ S28 1925</p> <p>9.90 Wash, 8 lks.wide, course E. Asc.gradually over SE.slope. 29.00 Desc. gradually over NE.slope to sec.cor. 37.60 Wash, 5 lks.wide, course NE. 40.14 Intersect original cor.of secs.21, 22, 27 & 28 which is an igneous stone 9x9x8 ins.above ground, firmly set, marked with 2 notches on S.face and 3 notches on E.face and witnessed by a small mound of stone W.of cor. No bearing trees. Reconstruct this cor.monument, retaining its original reference, by rebuilding mound of stone 3 ft.base, 2 ft.high, W.of cor.</p> <p>Land, rolling. Soil, gravelly & rocky, 3rd rate. Timber, none. Undergrowth, scrub mesquite & ocotillo.</p> <p>-----</p> <p>From cor.of secs.21, 22, 27 & 28, N.89°57'W., on true line, on S.bdy.of secs21 (E.$\frac{1}{4}$) Over rolling land, thru scattering undergrowth. Asc. gradually over NE.slope to $\frac{1}{4}$ sec.cor.</p> <p>18.20 Wash, 5 lks.wide, course NE. 32.30 Wash, 10 lks.wide, course NE. 40.20 Intersect original $\frac{1}{4}$ sec.cor.of secs.21 & 28 which is an igneous stone 10x9x8 ins.above ground, firmly set, marked $\frac{1}{4}$ 21 on N.face and $\frac{1}{4}$ 28 on S.face, and witnessed by a scattered mound of stone N.of cor. No bearing trees. Reconstruct this cor.monument and alter same to refer to quarters of sec.21 only, by obliterating marking on S.face of stone and rebuilding mound of stone 3 ft. base, 2 ft.high, N.of cor.</p> <p>Thence, N.89°20'W., on true line, on S.bdy.of sec.21 (W.$\frac{1}{4}$) Over rolling land, thru scattering undergrowth. Asc. slightly over NE.slope to</p> <p>0.57 (40.00 chs.in easting from cor.of secs.20, 21, 28 & 29) Set an iron post, 3 ft.long, 1 in.in diam., 26 ins.in ground, for reestablished $\frac{1}{4}$ sec.cor.of sec.28 only, marked on brass cap,</p> <p style="text-align: center;">$\frac{1}{4}$ S28 ----- 1925</p> <p>Raise a mound of stone, 3 ft.base, 2 ft.high, S.of cor. Asc.75 ft.over NE.slope to</p> <p>19.30 Wash, 5 lks.wide, course NE. Asc.40 ft.over NE.slope to</p>
--------	--

chains
26.60
35.60
40.57

Wash, 5 lks.wide, course N. Asc.105 ft. over E.slope.
Spur, slopes NE. Desc.40 ft. over NW.slope to
Intersect original cor.of secs.20,21,28 & 29 which is a
granite stone 10x6x6 ins.above ground, firmly set,
marked with 2 notches on S.face and 4 notches on E.
face and witnessed by a small mound of stone W.of cor.
Reconstruct this cor.monument, retaining its original ref-
erence, by rebuilding mounds of stone, 3 ft.base, 2 ft.
high, W.of cor. No bearing trees available.

Land, rolling.
Soil, gravelly & rocky, 3rd & 4th rate.
Timber, none.
Undergrowth, scrub mesquite & catclaw, & ocotillo.

8.59
11.50
22.20
37.00
40.19

S.89°55'W., on true line, bet.secs.20 & 29 (E.½)
Over rolling land, thru scattering undergrowth.
Desc.50 ft. over NW.slope.
Wash, 15 lks.wide, course NE. Asc.120 ft. over NE.slope.
Old road, brs.N. & S.
Spur, slopes NW. Desc.50 ft. over W.slope.
Wash, 10 lks.wide, course NW. Desc.gradually over NW.slope.
Intersect original ¼ sec.cor.of secs.20 & 29 which is an
igneous stone 8x8x5 ins.above ground, firmly set, marked
¼20 on N.face and ¼29 on S.face, and witnessed by a
scattered mound of stone N.of cor. and one bearing tree:
a mesquite, 8 ins.diam., S.72°E., 115 lks.dist., faintly
marked.
Reconstruct this cor.monument, retaining its original ref-
erence, by rebuilding the mound of stone 3 ft.base,
2 ft.high, N.of cor. and remarking the bearing tree
¼S29 BT. No other bearing tree available.

6.77
20.50
30.05
34.55
40.17

Thence,
S.89°51'W., on true line, bet.secs.20 & 29 (W.½)
Over rolling land, thru scattering undergrowth.
Descend gradually over NW.slope to sec.cor.
Wash, 10 lks.wide, course NW.
Wash, 5 lks.wide, course N.
Wash, 5 lks.wide, course NW.
Wash, 5 lks.wide, course NW.
Intersect original cor.of secs.19, 20, 29 & 30 which is an
igneous stone 10x8x12 ins.above ground, firmly set,
marked with 2 notches on S.face and 5 notches on E.
face and witnessed by four faintly marked bearing trees:
a mesquite, 12 ins.diam., N.58½°E., 97 lks.dist.,
a mesquite, 8 ins.diam., S.53¼°E., 262 lks.dist.,
a mesquite, 6 ins.diam., S.31½°W., 236 lks.dist. and
a mesquite, 8 ins.diam., N.60° W., 68 lks.dist.
Reconstruct this cor.monument, retaining its original ref-
erence, by renewing the marking on the bearing trees
and raising a mound of stone 3 ft.base, 2 ft.high, W.
of cor.
This cor.is under a wire fence bearing N. & S.

Land, rolling.
Soil, gravelly & rocky, 3rd & 4th rate.
Timber, none.
Undergrowth, scrub mesquite & paloverde, & ocotillo.

From std.cor.of secs.31 & 32 on S.bdy.of the Tp.(4th Std.
Par.S.) hereinbefore described, Cor.No.1 of "Tumacacori"
patented lode mining claim, Mineral Survey, No.3133, identical with Cor.No.1 of
"Tumacacori No.2" claim of same mineral survey, bears
N.12° 6'W., 6.35 chs.dist.
Cor.No.4 of "Tumacacori" and Cor.No.4 of "Tumacacori
No.2" could not be found, therefore intersection of E.
bdy.of sec.31 with SE.side line of "Tumacacori" claim
was not obtained.

12 Resurvey of Part of the Subdivision Lines of T.20 S., R.12 E.

chains	From std.cor.of secs.31 & 32,hereinbefore described, N.0° 3'E.,on true line,on E.bdy.of sec.31 (S.½) Over mountainous land,thru scattering undergrowth. Desc. 220 ft.over NW. and W. slopes.
16.85	Mine shaft brs. E. about 20 lks.dist.
19.43	Intersect NW.side line (2-3) of "Tumacacori" patented lode mining claim,Mineral Survey No.3133,at a point 12.74 chs.S.48°40'W. from Cor.No.3 thereof and 9.74 chs.N.48°49'E. from Cor.No.2 thereof. This point of intersection is on top of spur,sloping NW. Desc.140 ft.over NE.slope.
34.60	Wash,10 lks.wide,course NW. Enter rolling land. Desc.gradually over NW.slope to
39.19	Intersect original ¼ sec.cor.of secs.31 & 32 which is an igneous stone 10x8x6 ins.above ground,firmly set, marked ¼32 on E.face, ¼31 on W.face,and witnessed by a small mound of stone W.of cor. No bearing trees. Reconstruct this cor.monument and alter same to refer to the quarters of sec.31 only,by obliterating marking on E.face of stone and rebuilding mound of stone,3 ft. base,1½ ft.high,W.of cor. This cor.is alongside fence cor. from which fences extend W. & N. Thence, N.0° 3'E.,on true line,on E.bdy.of sec.31 (N.½) Over rolling land,thru scattering undergrowth,along an old fence. Desc. slightly over NW.slope to
0.81	(40.00 chs.in northing from std.cor.of secs.31 & 32) Set an iron post,3 ft.long,1 in.in diam.,12 ins.in ground to bedrock,deposit a stone marked with a cross (X) at base of post,and raise a mound of stone around post, for reestablished ¼ sec.cor.of sec.32 only,marked on brass cap, ¼ S32 1925
4.20	Desc. 100 ft.over NW.slope.
15.00	Wash, 10 lks.wide,course NW.
24.10	Wash, 30. lks.wide,course W. Asc.85 ft.over S.slope.
32.50	Spur, slopes W. Desc.40 ft.over NW.slope.
36.80	Wash, 10 lks.wide,course SW. Asc.gradually over SW.slope.
40.13	Intersect original cor.of secs.29,30,31 & 32 which is an igneous stone 12x6x8 ins.above ground,firmly set, marked with 1 notch on S.face and 5 notches on E.face and witnessed by a small mound of stone W.of cor. No bearing trees. Reconstruct this cor.monument and alter same to refer to secs.30 & 31 only, by obliterating notches on E.face of stone,marking 5 notches on N.face of stone,and rebuilding mound of stone 3 ft.base,2 ft.high,W.of cor. This cor.is alongside a fence cor. from which wire fences extend E. & N.,and lines of fence posts extend W. & S. Land, mountainous & rolling. Soil, gravelly & rocky, 3rd & 4th rate. Timber, none. Undergrowth, scrub mesquite & paloverde,& ocotillo.
0.68	From cor.of secs.30 & 31, N.0° 4'E.,on true line,on E.bdy.of sec.30 (S.½) Over rolling land,thru scattering undergrowth,along wire fence,bearing N. & S. Desc.slightly over NW.slope to (80.00 chs.in northing from std.cor.of secs.31 & 32) Set an iron post,3 ft.long,2 ins.in diam.,12 ins.in ground to hard pan,deposit a stone marked with a cross (X) at base of post,and raise a mound of stone around post, for reestablished cor.of secs.29 & 32 only,marked on brass cap,

chains

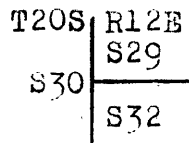

1925

Desc. slightly over NW. slope.
 2.10 Wash, 5 lks. wide, course NW. Asc. 40 ft. over SW. slope to
 11.40 Wash, 5 lks. wide, course SW. Asc. 40 ft. over S. slope.
 19.60 Spur, slopes W. Enter mountainous land.
 Desc. 75 ft. over N. slope.
 25.50 Wash, 10 lks. wide, course NW. Enter rolling land.
 Asc. 40 ft. over SW. slope.
 33.50 Desc. 37 ft. over NW. slope to
 40.29 Intersect original $\frac{1}{4}$ sec. cor. of secs. 29 & 30 which is an
 igneous stone 10x10x6 ins. above ground, firmly set,
 marked $\frac{1}{4}$ 30 on W. face, $\frac{1}{4}$ 29 on E. face and witnessed by
 a small mound of stone W. of cor. No bearing trees.
 Reconstruct this cor. monument and alter same to refer to
 the quarters of sec. 30 only, by obliterating the mark-
 ing on E. face of stone and rebuilding mound of stone
 3 ft. base, 2 ft. high, W. of cor.
 Thence,
 N. 0° 2' E., on true line, on E. bdy. of sec. 30 (N. $\frac{1}{4}$)
 Over rolling land, thru scattering undergrowth, along wire
 fence, bearing N. & S. Desc. slightly to
 0.335 (Midpoint of W. bdy. of sec. 29) Set an iron post, 3 ft. long,
 1 in. in diam., 10 ins. in ground to bedrock, against the
 W. side of a rock ledge 3 ft. high, deposit a stone mark-
 ed with a cross (X) at base of post, and raise a mound
 of stone against post & ledge, for reestablished $\frac{1}{4}$ sec.
 cor. of sec. 29 only, marked on brass cap,

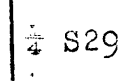

1925

Raise a mound of stone, 3 ft. base, 2 ft. high, E. of cor.
 0.35 Rocky wash, 10 lks. wide, course SW. Asc. 66 ft. over S. slope.
 5.00 Spur, slopes SW. Desc. 230 ft. over rolling & mountainous
 NW. slope to sec. cor.
 20.50 Wash, 5 lks. wide, course NW.
 38.40 Wash, 5 lks. wide, course NW.
 40.28 Intersect the cor. of secs. 19, 20.29 & 30, hereinbefore
 described.
 Land, rolling & mountainous.
 Soil, gravelly & rocky, 3rd & 4th rate.
 Timber, none.
 Undergrowth, scrub mesquite & paloverde, & ocotillo.

14 Survey of Part (completion) of Subdivision Lines of T.20 S., R.12 E.

chains	From cor. of secs. 20, 21, 28 & 29, hereinbefore described, South, on random line, setting temporary corners at intervals of 40.00 chs. and at	
160.05	Fall 65 lks. E. of std. cor. of secs. 32 & 33 on the S. bdy. of the Tp. (4th Std. Par. S.) hereinbefore described.	
	Thence	
	N. 0° 14' E., on true line, bet. secs. 32 & 33.	
	Over mountainous land, thru scattering undergrowth and very scattering timber. Desc. 46 ft. over E. slope to	
7.50	Head of gulch, course E. Asc. 150 ft. over E. slope to	
29.00	Head of gulch, course SE. Asc. 200 ft. over SE. slope.	
29.58	Wire fence, brs. E. & W.	
33.50	Divide, brs. NE. & SW. Desc. 91 ft. over NE. slope to	
40.00	Set an iron post, 3 ft. long, 1 in. in diam., 26 ins. in ground, for $\frac{1}{4}$ sec. cor. of secs. 32 & 33, marked on brass cap,	
	$\frac{1}{4}$	
	S32 S33	
	1925	
	from which	
	an oak, 10 ins. diam., brs. N. 9 $\frac{1}{2}$ ° E., 82 lks. dist., marked $\frac{1}{4}$ S33 BT	
	an oak, 4 ins. diam., brs. N. 43° W., 39 lks. dist., marked $\frac{1}{4}$ S32 BT	
	Desc. 230 ft. over NE. slope.	
52.20	Wash, 10 lks. wide, course NW. Asc. 60 ft. over W. slope to	
65.30	Wash, 10 lks. wide, course SW. Asc. 360 ft. over steep S. slope.	
75.00	Spur, slopes W. Desc. 210 ft. over steep N. slope to	
80.00	Set an iron post, 3 ft. long, 2 ins. in diam., 24 ins. in ground, for cor. of secs. 28, 29, 32 & 33, marked on brass cap,	
	T20S R12E	
	S29 S28	
	S32 S33	
	1925	
	No bearing trees available.	
	Raise a mound of stone, 3 ft. base, 2 ft. high, W. of cor.	
	Land, mountainous.	
	Soil, rocky, 4th rate.	
	Timber, oak.	
	Undergrowth, scrub mesquite, ocotillo & soto.	

40.00	N. 89° 56' E., on random line, bet. secs. 28 & 33.	
81.15	Set temp. $\frac{1}{4}$ sec. cor.	
	Fall 14 lks. N. of the cor. of secs. 28 & 33.	
	Thence	
	N. 89° 58' W., on true line, bet. secs. 28 & 33.	
	Over rolling land, thru scattering undergrowth.	
	Asc. 160 ft. over NE. slope to	
21.00	Foot of steep slope, brs. NW. & SE. Enter mountainous land.	
	Asc. 332 ft. over NE. slope to	
29.80	Rocky wash, 5 lks. wide, course NE. Asc. 165 ft. over E. slope.	
40.15	Spur, slopes N. Desc. 25 ft. over W. slope to	
41.15	Set an iron post, 3 ft. long, 1 in. in diam., 6 ins. in ground to bedrock, deposit a stone marked with a cross (X) at base of post, and raise a mound of stone around post, for $\frac{1}{4}$ sec. cor. of secs. 28 & 33, marked on brass cap,	
	$\frac{1}{4}$	
	S 28	
	S 33	
	1925	
	Desc. 40 ft. over W. slope.	
43.85	Gulch, course NE. Asc. 320 ft. over SE. slope.	

Survey of Part (completion) of Subdivision Lines of T.20 S.,R.12E.15

chains
53.85 Spur, slopes NE. Asc.400 ft.over N. & NE. slopes.
68.00 Divide, brs. NW. & SE. Desc.510 ft.over SW.slope.
78.00 Wash, 5 lks.wide,course NW.in bottom of rocky gulch.
Asc.30 ft.over NE.slope to
81.15 Intersect the cor.of secs.28,29,32 & 33.

Land, rolling & mountainous.
Soil, gravelly & rocky, 3rd & 4th rate.
Timber, none.
Undergrowth, scrub mesquite & paloverde, ocotillo & soto.

S.89°56'W. on random line,bet.secs.29 & 32.
40.00 Set temp. 1/4 sec.cor.
80.32 Fall 9 lks.S.of the cor.of secs.29 & 32.
Thence
East,on true line,bet.secs.29 & 32.
Over rolling land,thru scattering undergrowth.
Asc.25 ft.over SW. slope to
10.80 Wash, 10 lks.wide,course SW. Enter mountainous land.
Asc.180 ft.over W. slope.
27.30 Spur,slopes S. Desc.50 ft.over E. slope.
32.80 Wash, 5 lks.wide,course SE. Asc.25 ft.over SW.slope.
39.30 Spur, slopes N. Desc.20 ft.over NE.slope to
40.16 Set an iron post,3 ft.long,1 in.in diam.,10 ins.in ground
to bedrock,deposit a stone marked with a cross(X) at
base of post,and raise a mound of stone around post,
for 1/4 sec.cor.of secs.29 & 32,marked on brass cap,

S 29

S 32
1925

Desc.120 ft.over NE.slope.
52.00 Wash, 5 lks.wide,course N. Asc.55 ft.over NW.slope.
58.00 Spur, slopes N. Desc.40 ft.over NE.slope.
63.10 Wash, 5 lks.wide,course NW. Asc.315 ft.over SW.slope.
76.00 Spur, slopes NW. Asc. 40 ft.over N.slope to
80.32 Intersect the cor.of secs.28,29,32 & 33.

Land, rolling & mountainous.
Soil, rocky, 4th rate.
Timber, none.
Undergrowth, scrub mesquite & paloverde,ocotillo & soto.

N.0°14'E.,on true line,bet.secs.28 & 29.
Over mountainous land,thru scattering undergrowth.
Desc. 30 ft.over N. slope.
1.70 Wash, 5 lks.wide,in gulch,course NW. Asc.45 ft.over SW.
slope.
8.90 Divide, brs.NW. & SE. Desc. 650 ft.over NE. & N.slopes to
40.025 Set an iron post,3 ft.long,1 in.in diam.,18 ins.in ground
to bedrock,and raise a mound of stone around post,
for 1/4 sec.cor.of secs.28 & 29,marked on brass cap,

S29 | S28
1925

Raise a mound of stone,3 ft.base,2 ft.high,W.of cor.
Desc.40 ft.over N.slope.
42.80 Wash, 10 lks.wide,course NE. Desc.gradually over NE.slope.
50.80 Wash, 5 lks.wide,course E. Asc. 160 ft.over S.slope.
61.40 Top of knoll. Desc.190 ft.over NW.slope to
80.05 Intersect the cor.of secs.20,21,28 & 29.

Land, mountainous.
Soil,rocky, 4th rate. Timber, none.
Undergrowth, scrub mesquite, ocotillo & soto.

Boundaries of that Part of T.20 S.,R.12 E. subdivided under this Group.

Latitudes, Departures and Closing Errors.

Line designated	True Courses	Dist.	Latitudes		Departures	
			N.	S.	E.	W.
Subdivisional Boundary.	N. 0°42'W.	79.42	79.42			.97
	N. 0° 5'W.	40.00	40.00			.06
	N. 0° 1'W.	40.14	40.14			.01
	N.89°57'W.	40.20	40.03			40.20
	N.89°20'W.	40.57	.47			40.57
	S.89°55'W.	40.19		.06		40.19
	S.89°51'W.	40.17		.10		40.17
	S. 0° 2'W.	40.28		40.28		.02
	S. 0° 4'W.	40.29		40.29		.05
	S. 0° 3'W.	79.32		79.32		.07
South bdy. of Tp. (4th Std. Par. S.)	N.89°56'E.	162.43	.19		162.43	
Convergency						.05
Totals		160.25	160.25	160.05	162.43	162.36
			160.05		162.36	
	Error in latitude		0.20			
	Error in departure				0.07	

The continued satisfactory adjustment of the solar apparatus of the instrument used in the execution of the surveys described in the foregoing notes, is indicated from field tests of same described in Book "B" of this group.

 GENERAL DESCRIPTION.

Surface: Rolling and mountainous.
 Soil: Gravelly and rocky, 3rd and 4th rate.
 Timber: very scattering mesquite and oak.
 Undergrowth: scrub mesquite and paloverde, ocotillo and soto.
 Water: a small spring in NE $\frac{1}{4}$ NE $\frac{1}{4}$ of sec.29. No permanent flowing streams.
 Mineral: A patented lode claim in sec.32.
 Settlement: No settlers in this part of the Tp.
 Improvements: None except a few fences.
 Industry: Mining and grazing.

CERTIFICATE OF UNSTEADFAST ENGINEER.

18

I, Wm. B. Kimmel, U.S. Cadastral Engineer, hereby certify upon honor that, in pursuance of special instructions received from the U.S. District Cadastral Engineer ~~U. S. Surveyor General for~~ for Group No. 138, Arizona, bearing date of the 24th day of September, 1925, I have well, faithfully, and truly in my own proper person, and in strict conformity with said instructions, the Manual of Surveying Instructions, and the laws of the United States, ~~SURVEYED~~ ^{RESURVEYED} all those parts or portions of the 4th Standard Parallel South in Range 12 East and Subdivision Lines of Township 20 South, Range 12 East and SURVEYED all those parts or portions of the Subdivision lines of Township 20 South, Range 12 East of the Gila and Salt River Base and Meridian, in the State of Arizona, which are represented in the foregoing field notes ^{and by diagram on page 1 hereof} as having been executed by me, and under my direction; and that all the corners of said ~~resurvey~~ ^{resurvey} and survey have been established and perpetuated in strict accordance with the Manual of Surveying Instructions, and the special written instructions of the U. S. ~~Surveyor General for~~ ^{District Cadastral Engineer} for Group No. 138, Arizona, and in the specific manner described in the field notes, and that the foregoing are the original field notes of such ~~resurvey & survey~~ ^{resurvey & survey}.

Wm B. Kimmel
 U.S. Cadastral Engineer.

Phoenix, Arizona.
 May 3, 1926.

APPROVAL.

OFFICE OF THE U.S. SUPERVISOR OF SURVEYS,

Denver, Colo., December 21, 1927

The foregoing field notes of the ~~RESURVEY~~ ^{RESURVEY} of

the 4th Standard Parallel South thru R. 12 E.
and Part of the Subdivision Lines of T. 20 S., R. 12 E.
 and of the SURVEY of Part (completion) of the Subdivision Lines of Township 20 South, Range 12 East of the Gila and Salt River Base & Meridian, State of Arizona

executed by Wm B. Kimmel, U.S. Cadastral Engineer

under his special instructions dated September 24, 1925 for Group 138 Arizona, having been critically examined, and the necessary corrections and explanations made, the said field notes, and the ~~RESURVEY~~ ^{RESURVEY} and SURVEYS they describe, are hereby approved.

Wm B. Kimmel
 U.S. Supervisor of Surveys

I certify that the foregoing transcript of the field notes of the above described surveys in

has been correctly copied from the original notes on file in this office.