

Book "B" 3811

4-679

BOOK 3811

FIELD NOTES

OF THE SURVEY OF

North Ext. Golden Rule

Golden Rule

Between

and

Pinion

Lode Mining Claims

AND OF THE RESURVEY OF

Part of the Subdivision Lines of

Township 14 North, Range 1 West

Of the *Gila & Salt River Base and Meridian,*

In the State of *ARIZONA*

EXECUTED BY

Glenn F. Sawyer, U.S. Surveyor

and

Charles E. Hunter, U.S. Transitman

In the capacity of U. S. Surveyors, under Special Instructions dated *October 28, 1925,*

U.S. District Cadastral Engineer

issued by the ~~United States Surveyor General~~ to govern surveys included in Group

No. *136, Arizona,* which were approved by the Commissioner of the General Land

Office, *November 5, 1925,* and Assignment Instructions dated *February 17, 1926*

Survey and Resurvey commenced *March 2, 1926*

Survey and Resurvey completed *March 18, 1926*





3811

3811

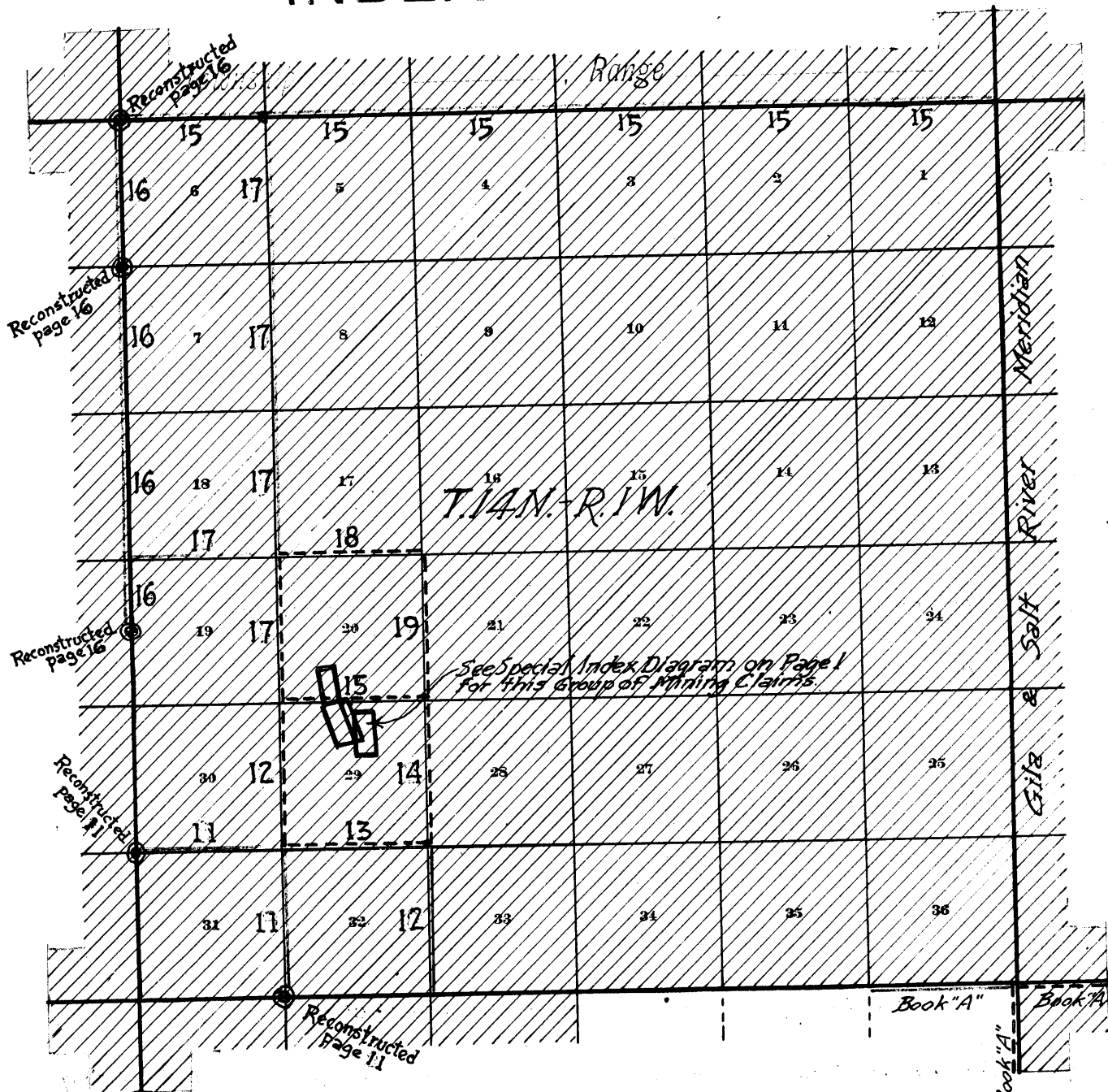
117

INDEX DIAGRAM.

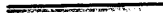

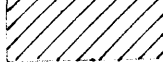
-  Surveyed under this group.
-  Resurveyed under this group.
-  Retracement for Resurvey (Intermediate missing corners not reestablished.)
-  Accepted surveys.
-  Unsurveyed.
-  Areas surveyed as per accepted plats on file.

~SPECIAL INDEX DIAGRAM FOR NOTES OF MINING CLAIMS~

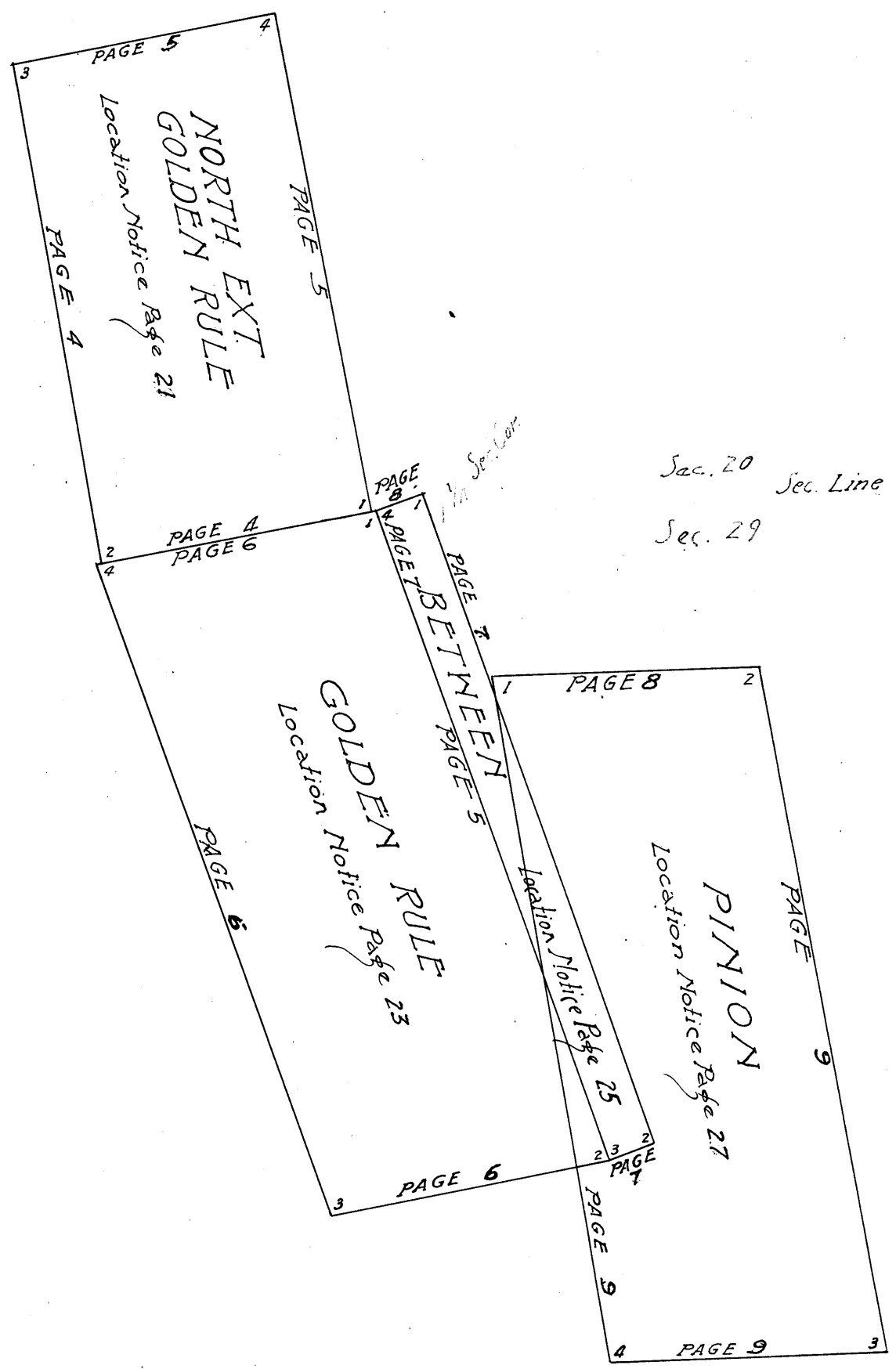

Sec. 20 Sec. Line
Sec. 29

Book "B"
 Group 136 - Arizona
 TOWNSHIP 14 NORTH, RANGE 1 WEST

DATE DIAGRAM

1926

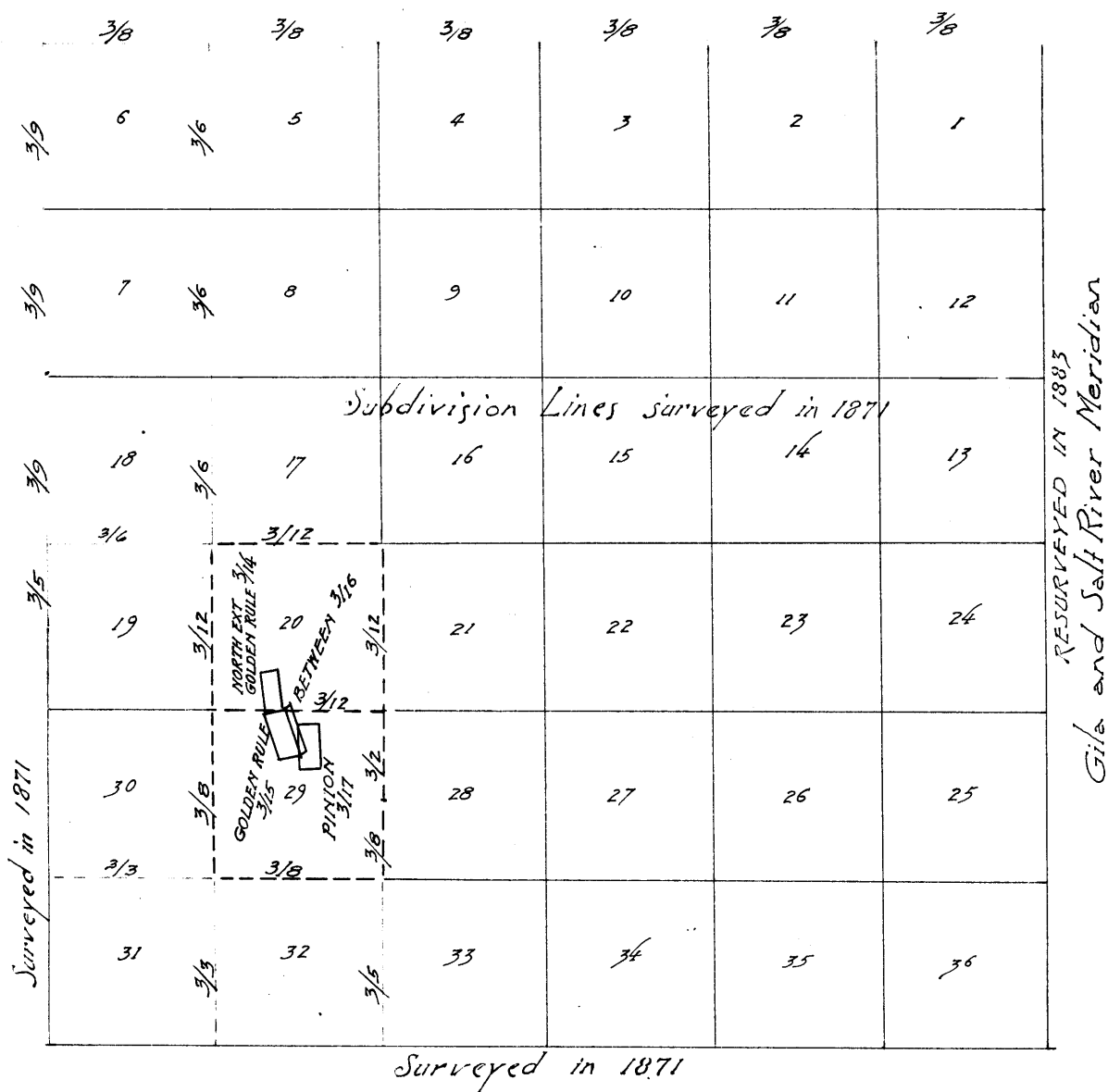

- Surveyed by Charles E. Hunter, U.S.T. on dates shown thereon
- Resurveyed by Charles E. Hunter, U.S.T. on dates shown thereon
- Resurveyed by Glenn F. Sawyer, U.S.S. on dates shown thereon
- Retracement for Resurvey by Glenn F. Sawyer, U.S.S. on dates shown thereon
- Retracement for Resurvey by Charles E. Hunter, U.S.T. on dates shown thereon
- Accepted surveys, retracements or resurveys.

Retracements, resurveys, and surveys, herein described, were executed by Glenn F. Sawyer, U. S. Surveyor and Charles E. Hunter, U. S. Transitman, on dates shown on page 2, hereof, using respectively Young and Sons transit No. 8478, and Buff and Buff transit No. 10125. Both instruments are equipped with full vertical circles and Smith solar attachments. Unless otherwise specified, all azimuth determinations are accomplished with the solar attachments.

March 2, 1926: Examine the adjustments of each instrument and correct all errors; then to test the solar apparatus by comparing their indications from observations made during a. m. and p.m. hours with a meridian established by observation on Polaris, proceed as follows:

At camp near the $\frac{1}{4}$ sec. cor. of secs. 20 and 29, T. 14 N., R. 1 W., G. & S.R.M., Arizona, in latitude $34^{\circ} 34' 27''$ N., longitude $112^{\circ} 23\frac{1}{2}'$ W., at 8 h 50 m., p.m., l.m.t., observe Polaris at western elongation, making four observations, two each with the telescope in direct and reversed positions, and mark the mean point in the line thus determined, on a peg driven firmly in the ground 8 chs. northerly.

Azimuth of Polaris at western elongation, $1^{\circ} 19' 22''$.

March 3, 1926: At 7 h 45 m., a.m., lay off the azimuth of Polaris, $1^{\circ} 19\frac{1}{2}'$ to the east and mark the meridian thus determined, by a tack in a peg, driven firmly in the ground, 8 chs. north.

At 8 h. 0 m., a.m., app. t., set off $34^{\circ} 34\frac{1}{2}'$ N. on the lat. arcs, $6^{\circ} 55'$ S. on the decl. arcs, and determine meridians with the solars. The meridian determined with the Young and Sons instrument falls 1' to the right of the true meridian; the one determined with the Buff and Buff instrument falls 1' to the left.

At app. noon, with the latitude arcs unchanged, observe the sun on the meridian; the resulting reading of the declination arc of each instrument is $6^{\circ} 52' S.$, which agrees with the computed declination of the sun.

At 4 h. 0 m., p.m., app. t., with the lat arcs unchanged, set off $6^{\circ} 47'$ S. on the decl. arcs and determine meridians with the solars. The meridian determined with the Young and Sons instrument agrees with the true meridian; the one determined with the Buff and Buff instrument falls $\frac{1}{2}'$ to the right.

As all of the solar observations during the usual hours of solar work, come within $1\frac{1}{2}'$ of the true meridian, the adjustments of the instruments are considered satisfactory.

Unless otherwise specified, all measurements are made with Lufkin steel tapes, which were compared with a standard steel tape and found correct. The measurements were made on the slope, the vertical angle determined, and the slope measurements properly reduced to true horizontal distances.

Survey of Lode Mining Claims, for segregation from
Sections 20 and 29, Township 14 North, Range 1 West.

4

Chains

North Ext. Golden Rule Mining Claim.

In retracing the location, find the location shaft and the NE., SE., SW. and NW. location corners of this claim. In surveying the claim as described in the following notes, establish the SE. and SW. corners of the claim, each 300 ft. dist. from midpoint between the SE. and SW. location corners on a line between said corners. Establish the NE. cor. identical with NE. location corner and the NW. cor. at intersection of N. end line with line between SW. cor. of claim and NW. location cor.

The SE. location cor. of this claim, is a pinyon post, 4 ins. in diam., firmly set in ground and mound of stone.

At 29 lks. S. 80° 11' W., from this location cor., set an iron post, 3 ft. long, 1 in. in diam., 16 ins. in the ground to bed rock, deposit a stone marked with a cross (X) at base of post, and raise a mound of stone 2 ft. base, 1½ ft. high, around post, for Cor. No. 1, (SE. Cor.) of NEGR. claim, marked on brass cap

COR 1
NEGR
1926

Thence

S. 80° 11' W., on S. end line (1-2) of claim, toward flag visible on SW. location cor.

4.545 (Midpoint bet. SE. and SW. location cors.) Location shaft bears N. 9° 55' W., 4.40 chs. dist.

9.09 Set an iron post, 3 ft. long, 1 in. in diam., 18 ins. in the ground to bed rock, and raise a mound of stone around post, for Cor. No. 2, (SW. cor.) of NEGR. claim, marked on brass cap

NEGR
Cor 2
1926

From which

A pinyon, 12 ins. in diam., brs. S. 42½° E., 203 lks. dist., marked 2 NEGR BT.

A pinyon, 10 ins. in diam., brs. S. 32½° E., 216 lks. dist., marked 2 NEGR BT.

The SW. location cor., which is a pinyon post, 4 ins. in diam., firmly set in ground and mound of stone, brs. S. 80° 11' W., 29 lks. dist.

N. 9° 44' W., on W. side line (2-3) of claim, toward flag visible on NW. location cor.

16.80 Set an iron post, 3 ft. long, 1 in. in diam., 4 ins. in the ground to bed rock; deposit a stone marked with a cross (X) at base of post; raise a mound of stone, 4 ft. base, 2 ft. high, around post, for cor. No. 3 (NW. cor.) of NEGR claim, marked on brass cap

NEGR
COR 3
1926

Survey of Lode Mining Claims, for segregation from Sections 20 and 29, Township 14 North, Range 1 West

Chains From which
The NW. location corner, which is a mound of stone,
brs. N. 9° 44' W., 140 lks. dist.

N. 80° 11' E., on N. end line (3-4) of claim, toward flag visible on NE. location cor.
4.49 Location shaft brs. S. 9° 55' E., 12.40 chs. dist.
8.80 Intersect NE. location cor. which is a mound of stone.
At this point, establish cor. No. 4 as follows: Remove the mound of stone, and in center of its position, Set an iron post, 3 ft. long, 1 in. in diam., 6 ins. in the ground to bed rock, deposit a stone marked with a cross (X) at base of post and raise a mound of stone, 4 ft. base, 2 ft. high, around post, for cor. No. 4 (NE. Cor.) NEGR. claim, marked on brass cap

NEGR
Cor 4
1926

S. 10° 45' E., on E. side line (4-1) of claim, toward flag visible on Cor. No. 1 of claim
16.82 Intersect cor. No. 1 (SE. Cor.) of NEGR. claim, hereinbefore described.

GOLDEN RULE MINING CLAIM.

In retracing the location find the location shaft and the NE. and NW. location corners. All other location monuments are missing. In surveying the claim as described in the following notes the bearing from the location shaft to a midpoint between the NE. and NW. location corners is taken as the course of the lode line and E. and W. side lines. The E. and W. side lines are each surveyed 300 ft. from the lode line.

At a point S. 80° 11' W., 22½ lks. dist. from the NE. location^{cor.} of this claim, which is identical with the SE. location cor. of the North Ext. Golden Rule Mining claim, hereinbefore described.

Set an iron post, 3 ft. long, 1 in. in diam., 16 ins. in the ground to bed rock, deposit a stone marked with a cross (X) at base of post, and raise a mound of stone 2 ft. base, 1 ft. high, around post, for cor. No. 1 (NE. cor.) of G. R. claim, marked on brass cap

Cor 1
G R
1926

S. 19° 36' E., on E. side line (1-2) of claim
22.73 Set an iron post, 3 ft. long, 1 in. in diam., 24 ins. in the ground, for cor. No. 2 (SE. cor.) of G. R. claim, marked on brass cap

G R
COR 2
1926

Survey of Lode Mining Claims, for segregation from Sections 20 and 29, Township 14 North, Range 1 West.

Chains Raise a mound of stone, 2 ft. base, 1½ ft. high, NW. of cor.

S. 80° 11' W., on S. end (2-3) of claim.

4.61 Location shaft, brs. N. 19° 36' W., 11.73 chs. dist.

9.22 Set an iron post, 3 ft. long, 1 in. in diam., 24 ins. in the ground; for cor. No. 3, (SW. cor.) of G. R. claim marked on brass cap.

G R
COR 3
1926

and raise a mound of stone, 2 ft. base, 1½ ft. high, NE. of cor.

N. 19° 36' W., on W. side line (3-4) of claim.

22.73 Intersect N. end line of location at 22½ lks. N. 80° 11' E., from NW. location cor., identical with SW. location cor. of N.E.G.R. claim, hereinbefore described.

At point of intersection set an iron post, 3 ft. long, 1 in. in diam., 24 ins. in the ground, for cor. No. 4, (NW. cor.) of G. R. claim, and mark on brass cap

COR 4
GR

1926

From which

A pinyon, 12 ins. in diam., brs. S. 48° 30' E., 207 lks. dist., marked 4 G R B T.

A pinyon, 10 ins. in diam., brs. S. 35° 15' E., 213 lks. dist., marked 4 G R B T

N. 80° 11' E., on the N. end line (4-1) of claim, and location.

0.065 Intersect Cor. No. 2 of North Ext. G. R., hereinbefore described.

4.61 Location shaft brs. S. 19° 36' E., 11.00 chs. dist.

9.155 Intersect Cor. No. 1 of North Ext. G. R., hereinbefore described.

9.22 Intersect cor. 1, (NE. cor.) of G. R. claim, hereinbefore described.

BETWEEN MINING CLAIM.

In retracing the location find the location shaft, but find no trace of any of the location cor. monuments. In surveying the claim as described in the following notes the W. side line is made identical with the E. side line of GOLDEN RULE, and the E. side line is surveyed parallel thereto and 100 ft. distant therefrom. The end lines are surveyed perpendicular to the side lines. The bearing from the location shaft to the mid-point of the N. end line of the claim is

Survey of Lode Mining Claims, for segregation from Sections 20 and 29, Township 14 North, Range 1 West.

Chains found to be the same as that of the side lines, therefore the lode line is parallel to the side lines, and the side lines are equidistant from the lode line. The distance from the location shaft to the mid-point of N. end line is found to agree with that given in the location notice.

At a point 1.51 chs. N. 70° 24' E., from Cor. No. 1 (NE. cor.) of Golden Rule claim.

Set an iron post, 3 ft. long, 1 in. in diam., 16 ins. in the ground, to bed rock; deposit a stone marked with a cross (X) at base of post, and raise a mound of stone, 2 ft. base, 1 1/2 ft. high, around post for Cor. No. 1 (NE. Cor.) of BETWEEN claim, marked on brass cap

COR 1
BET
1926

The reestablished 1/4 sec. cor. of secs. 20 and 29, hereinafter described brs. S. 46° 04' E., 74 lks. dist.

S. 19° 36' E., on the E. side line (1-2) of claim.
22.73 Set an iron post, 3 ft. long, 1 in. in diam., 24 ins. in the ground, for cor. No. 2, (SE. cor.) of BET. claim, and mark on brass cap

BET
COR 2
1926

From which
A pinyon, 8 ins. in diam., brs. N. 48° 30' E., 55 lks. dist., marked 2 B B T.
A pinyon, 4 ins. in diam., brs. S. 29° E., 180 lks. dist., marked 2 B B T.
A house, 30 x 10 ft., brs. N. 32° 30' E., 200 lks. dist.
A shed, 20 x 10 ft. brs. N. 75° E., 92 lks. dist.

S. 70° 24' W., on S. end line (2-3) of claim.
0.755 Location shaft brs. N. 19° 36' W., 12.13 chs. dist.
1.51 Intersect cor. No. 2 (SE. Cor.) of the Golden Rule Mining Claim, hereinbefore described, on brass cap of which additional markings are placed for cor. No. 3 (SW. cor.) of the Between Mining claim, and made to read

G R | BET
COR 2 | COR 3
1926

Raise mound of stone, 2 ft. base, 1 1/2 ft. high, NE. of cor.

N. 19° 36' W., on W. side line (3-4) of claim.
22.73 Intersect Cor. No. 1 (NE. Cor.) of the Golden Rule Mining Claim, hereinbefore described, on brass cap of which additional markings are placed for cor. No. 4 (NW. cor.) of the Between Mining Claim, and made to read

Survey of Lode Mining Claims, for segregation from Sections 20 and 29, Township 14 North, Range 1 West.

Chains

COR 1 | COR 4
G R | BET
1926

N. 70° 24' E., on N. end line (4-1) of claim
0.755 The location shaft brs. S. 19° 36' E., 10.60 chs. dist.
1.51 Intersect Cor. No. 1 (NE. cor.) of the claim, the place
of beginning.

PINION MINING CLAIM.

In retracing the location, find the location shaft, the N. E. C. Cor., and the NE. and NW. location cors. of this claim.

In surveying the claim as described in the following notes the mid-point of S. end line is established on the lode line at 100 ft. southerly from the location shaft, as per location notice, and the SE. and SW. cors. established at equal distances therefrom on a line parallel to N. end line of location.

The side lines of the claim are surveyed between the NE. and NW. location cors. and the SE. and SW. cors. of the claim. Establish the NW. cor. of the claim at a point 1500 ft. from the SW. cor. of the claim, and the NE. cor. at point of intersection of the N. end line with E. side line.

The NW. location cor. of this claim, is a pine post, 6 ins. square, firmly set in ground and mound of stone. At a point 3.57 chs. S. 10° 29' E., from this location cor., set an iron post, 3 ft. long, 1 in. in diam., 24 ins. in the ground, for cor. No. 1 (NW. cor.) of the PINION Mining Claim; marked on brass cap

COR 1
P
1926

Raise mound of stone, 2 ft. base, 1½ ft. high, SE. of cor.

The reestablished ¼ sec. cor. of secs. 20 and 29, hereinafter described, brs. N. 16° 29' W., 5.93 chs. dist.

N. 88° 55' E., on N. end line (1-2) of claim
4.60 The N. end center location corner, which is a pine post, 6 ins. square, firmly set in ground and mound of stone, brs. N. 10° 29' W., 3.57 chs. dist. Location shaft brs. S. 10° 29' E., 21.22 chs. dist.
8.92 Set an iron post, 3 ft. long, 1 in. in diam., 24 ins. in the ground, for cor. No. 2 (NE. cor.) of the PINION Mining Claim, marked on brass cap

COR 2
P
1926

Survey of Lode Mining Claims, for segregation from Sections 20 and 29, Township 14 North, Range 1 West.

Chains Raise a mound of stone, 2 ft. base, 1½ ft. high, SW. of cor. The NE. location cor. of this claim, which is a pine post 6 ins. in diam., firmly set in ground and mound of stone, brs. N. 11° 16' W., 357 lks. dist.

22.73 S. 11° 16' E., on E. side line (2-3) of claim. Set an iron post, 3 ft. long, 1 in. in diam., 18 ins. in the ground to bed rock, deposit a stone marked with a cross (X) at base of post, and raise a mound of stone, 2 ft. base, 1½ ft. high, around post, for Cor. No. 3 (SE. Cor.) of PINION CLAIM, marked on brass cap

P
COR 3
1926

4.60 S. 88° 55' W., on S. end line (3-4) of claim. The location shaft of this claim brs. N. 10° 29' W., 1.51 chs. dist.

9.20 Set an iron post, 3 ft. long, 1 in. in diam., 12 ins. in the ground to bed rock, deposit a stone marked with a cross (X) at base of post, and raise a mound of stone, 2 ft. base, 1½ ft. high, around post, for Cor. No. 4 (SW. Cor.) of PINION Claim, marked on brass cap

P
COR 4
1926

6.53 N. 10° 29' W., on W. side line (4-1) of claim, toward flag visible on NW. location cor. Intersect S. end line of Golden Rule Mining Claim, at a point 1.07 chs. S. 80° 11' W., from cor. No. 2 (SE. cor.) thereof.

13.12 Intersect W. side line of Between, and E. side line of the Golden Rule Mining Claim, at a point 6.69 chs. N. 19° 36' W., from cor. No. 2 of G. R. and Cor. No. 3 of BET.

22.68 Intersect the E. side line of the Between Mining Claim at a point 6.63 chs. S. 19° 36' E., from cor. No. 1 (NE. Cor.) thereof.

22.73 Intersect Cor. No. 1, (NW. Cor.) of PINION Claim, the place of beginning.

Chains.

RETRACEMENT FOR RESURVEY.

The cor. of secs. 5,6,31, and 32 on the S. bdy. of T14N, R1W., is an unmarked malpais stone, 6x4x6 ins. above ground, from which
 An oak stump, 10 ins. in diam., with single unidentified scribe mark, brs. S.7½°E., 17 lks. dist.,
 An oak stump, 10 ins. in diam., without visible marks, brs. N.48½°E., 37 lks. dist.
 Along side of stone, set an iron post, 3 ft. long, 1 in. in diam., 24 ins. in the ground, for the southeast corner of secs. 5,6,31, and 32, and mark on brass cap

T14N	R1W
S31	S32
S 6	S 5
T13N	
1926	

from which

A pinyon, 10 ins. in diam., brs. N.44½°E., 120 lks. dist., marked T.14N, R1W S32 BT.
 An oak, 10 ins. in diam., brs. S.31°E., 83 lks. dist., marked T13N R1W S5 BT.
 A cedar tree 12 ins. in diam., brs. S.70°W., 39 lks. dist., marked T13N R1W S6 BT.
 A pinyon, 6 ins. in diam., brs. N.33½°W., 12 lks. dist., marked T14N R1W S31 BT.
 From this cor., U.S. Geological B.M., elevation 5565 ft. brs. N.43°16'W., 39.36 chs. dist.

Thence

North, on random line bet. secs. 31-32 and 29-30, searching for cors. without success and setting temporary cors. at intervals of 40.00 chs.

157.04

Fall 98 lks. W. of the original cor. of secs. 19,20,29, and 30, hereinafter described.

The cor. of secs. 25,30,31, and 36, on the W. bdy. of T14N, R1W., is a malpais stone, 6x8x12 ins. above ground, with 1 notch on S. and 5 notches on the N. face, from which

A cedar, 18 ins. in diam., brs. N.1¾°E., 67 lks. dist., marked TX111 N R 1 W S XXX BT.

Reconstruct this cor. monument as follows:

Set an iron post, along side of stone, 3 ft. long, 2 ins. in diam., 14 ins. in the ground to bed rock, deposit a stone marked with a cross (X) at base of post, and raise a mound of stone, 2 ft. base, 1½ ft. high around post, marked on brass cap

T14N	
R2W	R1W
S25	S30
S36	S31

1926

Thence

East, on a random line bet. secs. 30-31 and 29-32, searching for cors. at record distances with out success, and setting temp. cors. 39.60 chs. and at 40.00 chs. thereafter. intervals of

79.14

Fall 7 lks. S. of the temp. cor. of secs. 29,30,31, and 32.

158.02

Fall 24 lks. S. of the cor. of secs. 28,29,32, and 33, hereinafter described.

Chains.

To further identify this cor., the line bet. secs. 32 and 33 was retraced, without finding the $\frac{1}{4}$ sec. cor. The true course and dist. of this line are S.0°2'W., 80.07 chs. which agrees very closely with the records.

RESURVEY.

The cor. of secs. 19, 20, 29, and 30, is a malpais stone, 16x12x4 ins. set in mound of stone, with 2 notches on S. face and 5 notches on E. face. Along side of stone, set an iron post, 3 ft. long, 2 ins. in diam., 27 ins. in the ground, for the reconstructed cor. of secs. 19, 20, 29, and 30, marked on brass cap

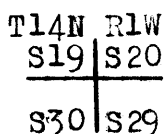

1926

No bearing trees available.
Raise a mound of stone, 3 ft. base, 2 ft. high W. of cor.

Thence S.0°58'W., on a true line bet. secs. 19 and 20. Over rolling ground, through scattering undergrowth. Desc. 60 ft. over SE. slope

12.30 Draw, course E.; asc. 195 ft. over NE. slope.
39.26 (proportional dist.) set an iron post, 3 ft. long, 1 in. in diam., 16 ins. in the ground to bed rock, for the reestablished $\frac{1}{4}$ sec. cor. of secs. 29 and 30; deposit a stone marked with a cross (X) at base of post, and raise a mound of stone around post, marked on brass cap

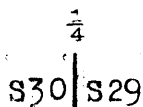

1926

No bearing trees available.

56.80 Asc. 50 ft. over N. slope.
61.80 Spur, slopes E.; desc. 29 ft. over S. slope.
69.20 Head of draw, course SE.; asc. 215 ft. over NE. slope.
Spur, slopes SE. Leave oaks. Desc. 150 ft. over stony S. slope

78.52 A point determined by double proportion between the cor. of secs. 19, 20, 29, and 30 and the cor. of secs. 5, 6, 31, and 32 on the S. bdy. and between the cor. of secs. 25, 30, 31, and 36 on the W. bdy. and the cor. of secs. 28, 29, 32, and 33. Set an iron post, 3 ft. long, 2 ins. in diam., 16 ins. in the ground to bed rock, deposit a stone marked with a cross (X) at base of post, and raise a mound of stone around post, for the reestablished cor. of secs. 29, 30, 31, and 32, marked on brass cap.

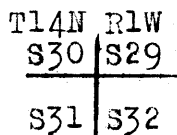

1926

No bearing trees available.
Land, rolling.
Soil, stony, 3rd rate.
Timber, oak, pinyon and juniper.
Undergrowth, oak brush.

Chains.

From the reestablished cor. of secs. 29, 30, 31, and 32.
 N.88°48'E., on a true line bet. secs. 29 and 32.
 Asc. over gradual SW. slope 70 ft.
 12.90 Spur, slopes S.; desc. 223 ft. over SE. slope
 24.40 Head of draw, course SE.; asc. 15 ft.
 24.50 Telephone line, brs. NE. and SW.
 28.60 Spur, slopes SE.; desc. 60 ft. over E. slope.
 34.60 Draw, course SE.; asc. 40 ft. over S. slope.
 39.61 (proportional dist.) set an iron post, 3 ft. long, 1 in.
 in diam., 26 ins. in the ground, for the reestablished
 $\frac{1}{4}$ sec. cor. of secs. 29 and 32, marked on brass cap

$\frac{1}{4}$ S29

S32
1926

No bearing trees available.
 Raise mound of stone, 3 ft. base, $1\frac{1}{2}$ ft. high, N. of cor.
 Thence over rolling ground.

46.34 Desc. 77 ft. over gradual SE. slope.
 49.24 Wire fence, brs. N. and S.
 59.34 Wire fence, brs. N. and S.
 65.40 Wash, 20 lks. wide, course NE.; asc. 114 ft.
 65.50 Road, brs. NE. and SW.
 79.04 Fence, cor. brs. S., 10 lks. dist.; thence fence line
 extends, S. and E.
 79.22 The cor. of secs. 28, 29, 32, and 33, which is a pine post,
 36x4x2 ins., with 1 notch on S. and 4 notches on E. fac-
 es, set in a mound of stone. Reconstruct this cor.
 monument as follows;
 Along side of post, set an iron post, 3 ft. long, 2 ins.
 in diam., 18 ins. in the ground to bed rock, for the
 cor. of secs. 28, 29, 32, and 33; deposit a stone marked
 with a cross (X) at base of post, and raise a mound of
 stone, 2 ft. base, $1\frac{1}{2}$ ft. high, around post, marked on
 brass cap

T14N R1W	
S29	S28
S32	S33

1926

from which
 A pinyon, 7 ins. in diam., brs. N.21 $\frac{1}{2}$ °E., 107 lks. dist.,
 marked T14N R1W S28 BT.
 A pinyon, 12 ins. in diam., brs. S.1 $\frac{1}{2}$ °E., 67 lks. dist.,
 marked T14N R1W S33 BT.
 No other trees were available.
 From this cor., U.S. Geological B.M., elevation 5287 ft.
 brs. S.17°12'E., 41.55 chs. dist.

Land, rolling.
 Soil, stony, 2nd rate.
 Timber, scattering pinyon.
 Undergrowth, sage brush and grass.

RETRACEMENT FOR RESURVEY

39.98 North, on random line bet. secs. 28 and 29. (S $\frac{1}{2}$)
 Fall 4 lks. E. of the $\frac{1}{4}$ sec. cor. of secs. 28 and 29.
 here in after described.
 True course and dist. of S. $\frac{1}{2}$ of line bet. secs. 28 & 29 are therefore,
 N.0°3'W., 39.98 chs.

Thence
 North, on random line bet. secs. 28 and 29 (N $\frac{1}{2}$)

Chains.

39.88 Fall 11 lks. E. of the cor. of secs. 20, 21, 28, and 29, hereinafter described.

True course and dist. of $N\frac{1}{2}$ of line bet. secs. 28 & 29 are therefore, $N.0^{\circ}9'W.$, 39.88 chs.

RESURVEY

Return to the cor. of secs. 28, 29, 32, and 33.

Thence

$N.0^{\circ}3'W.$, on true line, bet. secs. 28 and 29. ($S\frac{1}{2}$)
Over rolling land, through scattering undergrowth.
Desc. 119 ft. over NW. slope.

13.30 Wash, 20 lks. wide, course NE.; asc. 40 ft.

15.00 Road, brs. NE. and SW.

22.00 Spur, slopes E.; desc. NE. slope.

24.50 Road, brs. NW. and SE.

25.26 Draw, course E.; asc. 80 ft. over S. slope.

37.00 Spur, slopes E.; desc. 33 ft. over NW. slope.

39.98 The $\frac{1}{4}$ sec. cor. of secs. 28 and 29, which is a malpais stone, 6x8x8 ins. above ground, marked $\frac{1}{4}$ on E. face.

No bearing trees.

Reconstruct this cor. as follows; Along side of old stone, set an iron post, 3 ft. long, 1 in. in diam.; 12 ins. in the ground to bed rock, deposit a stone marked with a cross (X) at base of post, and raise a mound of stone 2 ft. base, $1\frac{1}{2}$ ft. high, around post, for $\frac{1}{4}$ sec. cor., marked on brass cap

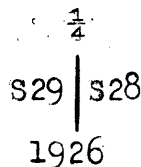

Thence

$N.0^{\circ}9'W.$, on true line, bet. secs. 28 and 29 ($N\frac{1}{2}$)
Desc. 20 ft. over NW. slope. along fence line.

1.08 Draw, course NE.; asc. 30 ft. over SE. slope.

11.88 Spur, slopes NE.; desc. 94 ft. over N. slope.

17.47 Wash, 10 lks. wide, course NE.; asc. slightly over S. slope.

32.68 Wash, 5 lks. wide, course SE.; desc. 48 ft. over N. slope.

37.70 Fence brs W.

39.88 The cor. of secs. 20, 21, 28, and 29, which is a malpais stone, 10x12x8 ins. above ground, firmly set, with 2 notches on S. and 4 notches on E. face, witnessed by a mound of stone W. Reconstruct this cor. as follows: Along side of stone, set an iron post, 3 ft. long, 2 ins. in diam., 27 ins. in the ground, for cor. of secs. 20, 21, 28, and 29, marked on brass cap

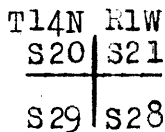

1926

No bearing trees available.

Re-build mound of stone, 3 ft. base, 2 ft. high, W. of cor.

Land, rolling.

Soil, silty loam, stony, 2nd rate.

Timber, none.

Undergrowth, grass and sage.

Resurvey of Part of the Subdivision Lines T14N, R1W.

Chains.

Thence
 From the cor. of secs. 20, 21, 28, and 29.
 West, on random line, bet. secs. 20 and 29.
 40.00 No trace of original $\frac{1}{4}$ sec. cor. Set temp. cor.
 77.68 Fall 290 lks. S. of the cor. of secs. 19, 20, 29, and 30,
 hereinbefore described.

Thence
 N. 87° 52' E., on a true line, bet. secs. 20 and 29.
 Over rolling land, through scattering undergrowth.
 Desc. 82 ft. over SE. slope.
 1.20 Wire fence, brs. south for $\frac{1}{2}$ mile.
 6.16 Wash, 5 lks. wide, course SE.
 18.90 Wash, 5 lks. wide, course S.
 24.00 Wire fence, brs. N. 89° W and S. 89° E.
 25.37 Windmill brs. S. 33° W., about 6.00 chs. dist.
 27.64 Intersect the North Ext. Golden Rule Mining Claim
 (unpatented) N. 9° 44' W., 117 lks. dist., from cor. No. 2
 of that claim.
 31.75 Wash, 5 lks. wide, course S.
 36.35 Intersect the Golden Rule Mining Claim (unpatented) S. 80°
 11' W., 50 lks. dist. from cor. No. 1 of that claim.
 36.94 Intersect the Between Mining Claim (unpatented) S. 19° 36' E.
 8 lks. dist. from cor. No. 4 of that claim.
 38.52 Leave the Between Mining Claim, (unpatented) S. 19° 36' E.
 56 lks. dist. from cor. No. 1 of that claim.
 38.87 (proportional dist.) set an iron post, 3 ft. long, 1 in.
 in diam., 16 ins. in the ground, for the reestablished
 $\frac{1}{4}$ sec. cor. of secs. 20 and 29; deposit a stone marked
 with a cross (X) at base of post; raise a mound of stone,
 3 ft. base, 2 ft. high around post, and mark on brass cap

$\frac{1}{4}$ S20

S29
1926

No bearing trees available.
 Thence along S. slope.
 47.10 Wash, 5 lks. wide, course S.
 53.50 Wash, 5 lks. wide, course S.
 61.88 Low spur, slopes S.; desc. 86 ft. over E. slope.
 77.74 The original cor. of secs. 20, 21, 28, and 29, hereinbefore
 described.

Land, rolling.
 Soil, silty loam, stony, 2nd rate.
 Timber, none.
 Undergrowth, grass and sage.

RETRACEMENT FOR RESURVEY

The cor. of Tps. 14 and 15 N., R. 1 E. & L. W., on the G. & S. R.
 Meridian is an iron post, 3 ins. in diam., 12 ins. above
 ground, with brass cap marked

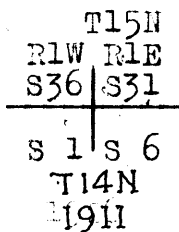

No accessory.

Thence,
 West, on a random line, on N. bdy. of T14N, R1W., search-
 ing for cors. without success at record distances and
 setting temp. cors. at intervals of 40.00 chs.
 479.24 Fall 112 lks. S. of the cor. of Tps. 14 and 15 N., Rs.
 1 and 2 W., which the original monument is missing.

Chains.

The State of Arizona has set a concrete post to perpetuate this point, which is accepted by local surveyors and settlers in all four of the contiguous townships, as the original point of the true cor. of Tps. 14 and 15 N., Rs. 1 and 2 W.; Reconstruct this cor. monument as follows: Along side of concrete post, set an iron post, 3 ft. long, 3 ins. in diam., 26 ins. in the ground, for the cor. of Tps. 14 and 15 N., Rs. 1 and 2 W., deposit a stone marked with a cross (X) at base of post, and raise a mound of stone around post, and a mark on brass cap

T15N	
R2W	R1W
836	831
S 1 S 6	
T14N	
1926	

A mound of stone is impracticable on account of field.

True course and dist. of the N. bdy. of T14N, R1W., are therefore, N.89°52'W., 479.24 chs.

Thence
From the cor. of Tps. 14 and 15 N., Rs. 1 and 2 W., hereinbefore described.

South, on a random line, bet. secs. 1 and 6.

40.00

No trace of original $\frac{1}{4}$ sec. cor.

80.15

Fall 21 lks. W. of the cor. of secs. 1, 6, 7, and 12, which is a granite stone, 16x10x6 ins. above ground, with 1 notch on the N. and 5 notches on the S. faces.

Reconstruct this cor. monument as follows: Along side of cor. set an iron post, 3 ft. long, 2 ins. in diam., 27 ins. in the ground, for cor. of secs. 1, 6, 7, and 12, marked on brass cap

T14N	
R2W	R1W
S 1	S 6
S12	S 7
1926	

No bearing trees available.

Raise a mound of stone, 3 ft. base, 2 ft. high, W. of cor.

Thence

South, on random line, searching for original cors. at record distances with out success, setting temp. points at intervals of 40.00 chs.

193.89

Fall 186 lks. E. of the $\frac{1}{4}$ sec. cor. of secs. 19 and 24, which is a granite stone, 12x10x4 ins., set in a mound of stone, marked $\frac{1}{4}$ on W. face. Reconstruct this cor. monument as follows: Along side of original stone, set an iron post, 3 ft. long, 1 in. in diam., 16 ins in the ground to bed rock, deposit a stone marked with a cross (X) at base of post, and raise a mound of stone around post, for $\frac{1}{4}$ sec. cor., marked on brass cap

$\frac{1}{4}$	
S24	S19
1926	

from which

A juniper stump, 30 ins. in diam., brs. N.40°E., 50 lks. dist. with no marks on.

Resurvey of Part of the Subdivision Lines T14N., R1W.

Chains. True course and dist. between the $\frac{1}{4}$ sec. cor. of secs. 19 and 24 and the cor. of secs. 1, 6, 7, and 12, T14N, Rs. 1 and 2 W., are therefore N.0°33'E., 193.86 chs.

At a point N.0°33'E., 38.78 chs. from the $\frac{1}{4}$ sec. cor. of secs. 19 and 24 on the W. bdy. of T14N, R1W., determined by single proportion between the $\frac{1}{4}$ sec. cor. of secs. 19 and 24 and the reconstructed cor. of secs. 1, 6, 7, and 12, T14N, R1W. and R. 2 W.

Thence
East, on a random line, bet. secs. 18-19 and 17-20, searching for cors. at record distances without success and setting temp points. 39.50, 79.50, and 119.50 chs. therefrom.

156.36 Fall 187 lks. S. of the cor. of secs. 16, 17, 20, and 21, hereinafter described.

From the original cor. of secs. 19, 20, 29, and 30, hereinbefore described.
North, on random line bet. secs. 19-20, 17-18, 7-8, and 5-6, searching cors. at record distances, without success, and setting temp. points at intervals of 40.00 chs.

80.70 Fall 131 lks. W. of the temporary cor. of secs. 17, 18, 19, and 20

315.98 Fall 281 lks. N.89°52'W. of the point for cor. of secs. 5, 6, 31, and 32 on the N. bdy. of the Tp., which was determined by single proportion between the cor. of Tps. 14 and 15 N., R1E and R1W., and the cor. of Tps. 14 and 15 N., Rs. 1 and 2 W., both cors. being hereinbefore described.

RESURVEY

From the cor. of secs. 19, 20, 29, and 30, hereinbefore described,
N.0°12'W. on a true line, bet. secs. 19 and 20.
Asc. 153 ft. over S. slope
Over rolling land, through scattering undergrowth.

.80 Wire fence, brs. E. and W.
12.86 Enter mesa land sloping to W.; thence over level land.
28.20 Wash, 10 lks. wide, course W.
39.48 (Proportional dist.) set an iron post, 3 ft. long, 1 in. in diam., 27 ins. in the ground, for the reestablished $\frac{1}{4}$ sec. cor., marked on brass cap

$\frac{1}{4}$
 S19 | S20
 1926

No bearing trees available.
Raise a mound of stone, 3 ft. base, 2 ft. high, W. of cor.
50.00 Leave mesa land; enter low hills.
51.00 Desc. 40 ft. over N. slope.
55.40 Draw, course NW.; asc. 29 ft. over S. slope.
62.90 Spur, slopes W.; desc. 29 ft. over N. slope.
70.20 Draw, course W.; asc. 76 ft. over S. slope to

Chains.

78.95

A point determined by double proportion between the cor. of secs. 19, 20, 29, and 30, and the point for cor. of secs. 5, 6, 31, and 32 on the N. bdy. of the Tp., and between the cor. of secs. 16, 17, 20, and 21 and the point for cor. of secs. 13, 18, 19, and 24 on the W. bdy. of the tp. . Set an iron post, 3 ft. long, 2 ins. in diam., 27 ins. in the ground, for the reestablished cor. of secs. 17, 18, 19, and 20, marked on brass cap

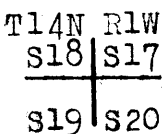

1926

No bearing trees available.
Raise a mound of stone, 3 ft. base, 2 ft. high, W. of cor.

Land, rolling
Soil, silt loam, 2nd rate.
Timber, none.
Undergrowth, grass.

18.70
38.60
39.27

N. 87° 23' E., on a true line, bet. secs. 17 and 20.
Over rolling hills, through light undergrowth.
Asc. 312 ft. over W. slope to $\frac{1}{4}$ sec. cor.

Draw, course S.
Spur, slopes SW
(proportional dist.) set an iron post, 3 ft. long, 1 in. in diam., 10 ins. in the ground to bed rock, deposit a stone marked with a cross (X) at base of post, and raise a mound of stone, 3 ft. base, 2 ft. high, around post, for reestablished $\frac{1}{4}$ sec. cor., marked on brass cap

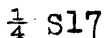

S20
1926

No bearing trees available.
Asc. 84 ft. over SW. slope.
Spur, slopes S.; desc. 46 ft. over SE. slope.

71.50
78.55

Intersect the original cor. of secs. 16, 17, 20, and 21, which was an old mound of stone with slight traces of decayed wood in the center. Accept this mound as the original cor. Remove the mound and in center of its position, set an iron post, 3 ft. long, 2 ins. in diam., 16 ins. in the ground to bed rock, deposit a stone marked with a cross (X) at base of post, and raise a mound of stone around post, for cor. of secs. 16, 17, 20, and 21, marked on brass cap

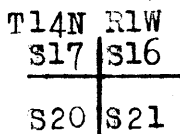

1926

No bearing trees available.
From this cor., U.S. Geological triangulation station on Bald Hill, brs. N. 48° 19' W., 23.43 chs. dist.

Land, rolling.
Soil, silt loam, 2nd and 3rd rate.
Timber, none.
Undergrowth, grass.

Chains.

RETRACEMENT FOR RESURVEY.

From the cor. of secs. 20, 21, 28, and 29, hereinbefore described.
 North, on a random line, bet. secs. 20 and 21.
 40.00 No trace of original $\frac{1}{4}$ sec. cor. Set temp. cor.
 79.62 Fall 21 lks. W. of the cor. of secs. 16, 17, 20, and 21, hereinbefore described.
 True course and dist. of this line are therefore S.0°18'W.,
 79.62 chs.

RESURVEY

From the cor. of secs. 16, 17, 20, and 21, hereinbefore described.
 S.0°18'W., on a true line, bet. secs. 20 and 21.
 Over mountainous land, through light undergrowth.
 Desc. 277 ft. over S. slope, along fence line.
 39.81 (proportional dist.) set an iron post, 3 ft. long, 1 in. in diam., 12 ins. in the ground to bed rock, deposit a stone marked with a cross (X) at base of post, and raise a mound of stone around post, for reestablished $\frac{1}{4}$ sec. cor., marked on brass cap,

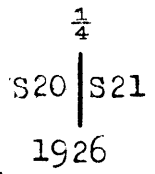

No bearing trees available.
 Thence
 Desc. 265 ft. over S. slope.
 60.00 Draw, course SE.; asc. slightly.
 70.00 Spur, slopes SE.; desc. slightly
 79.62 The cor. of secs. 20, 21, 28, and 29.

Land, mountainous.
 Soil, stony, 3rd rate.
 Timber, none.
 Undergrowth, none.

FINAL TEST OF INSTRUMENTS.

Young & Sons, No. 8478.

March 15, 1926: Set up instrument on the meridian established March 2, 1926, near the $\frac{1}{4}$ sec. cor. of secs. 20 and 29, T14N., R1W, as hereinbefore described. At 8h. 0m, a.m., app. t., set off 34°34 $\frac{1}{2}$ 'N. on the lat. arc; 2°14'S. on the decl. arc, and determine a meridian with the solar, which agrees with the true meridian.

At app. noon, with the latitude arc unchanged, observe the sun on the meridian. The resulting reading of the decl. arc is 2°11'S., which agrees with the computed decl. of the sun.

At 4h 0m p.m., app. t., with the latitude arc unchanged, set off 2°6 $\frac{1}{2}$ 'S. on the decl. arc, and determine a meridian with the solar, which falls 1' to the right of the true meridian.

As each of the above solar observations falls within 1' of the true meridian established by observation on Polaris, conclude that the instrument has retained its adjustment satisfactory during the progress of the field work.

Buff and Buff No. 10125.

March 17, 1926: Set up instrument on the meridian established March 2, 1926, near the $\frac{1}{4}$ sec. cor. of secs. 20 and 29, T.14 N., R. 1 W., as hereinbefore described. At 4h 0m p.m., app. t., set off $34^{\circ}34\frac{1}{2}'$ N. on the lat. arc; $1^{\circ}19'$ S. on the decl. arc, and determine a meridian with the solar, which falls $\frac{1}{2}'$ to the left of the true meridian.

March 18, 1926: At 8h 0m., a.m., app. t., with the lat. arc unchanged, set off $1^{\circ}3'$ S. on the decl. arc, and determine a meridian with the solar, which falls $1'$ to the right of the true meridian.

As each of the above solar observations agrees within $1'$ of the true meridian established by observation on Polaris, conclude that the instrument has retained its adjustment satisfactory during the progress of the field work.

NOTICE OF MINING LOCATION
LODE CLAIM.

TO ALL WHOM IT MAY CONCERN:

This Mining Claim, the name of which is the North Ext. Golden Rule Mining Claim, situate on lands belonging to the United States of America, and in which there are valuable mineral deposits, was entered upon and located for the purposes of exploration and purchase by E.E.Lake, F.Fay, the undersigned, on the 27 day of April, 1916.

The length of this claim is 1500 feet, and we claim 400 feet in a southerly direction and 1100 feet in a northerly direction from the center of the discovery shaft, at which this notice is posted, lengthwise of the claim, together with 300 feet in width of the surface grounds, on each side of the center of said claim. The general course of the lode deposit and premises is from the North to the South.

The claim is situated and located in the Walker Mining District, in Yavapai county, in the State of Arizona, about 6 miles in a Easterly direction from Prescott.

The surface boundaries of the claim are marked upon the ground as follows: Beginning at a point in a S. Monument direction 400 feet from the discovery shaft (at which this notice is posted) being in the center of the South end line of said claim; thence 300 feet to a monument, being the South east corner of said claim; thence 1500 feet to a monument, being at the N. east corner of said claim; thence 300 feet to a monument at the center of the North end of said claim; thence 300 feet to a monument, being at the N. west corner of said claim; thence 1500 feet to a monument at the S. west corner of said claim; thence 300 feet to the place of beginning.

All done under the provisions of Chapter Six, of Title XXXII, of the Revised Statutes of the United States, and of an Act of the General Assembly of Arizona, entitled "An Act to Revise and Codify the Laws of the Territory of Arizona," approved March 16, 1901.

Dated and posted on the ground this 27 day of April, 1916.

E. E. Lake
F. Fay.

Filed and recorded at request of F. Fay, July 26th, A.D. 1916, at 4:15 o'clock P.M., Book 100 of Mines, Page 586 Records of Yavapai county, Arizona.

(Seal) L.S. Colwell,
County Recorder.

By James W. Coyne,
Deputy Recorder.

NOTICE OF MINING LOCATION
LODE CLAIM.

TO ALL WHOM IT MAY CONCERN:

This Mining Claim, the name of which is the Golden Rule Mining Claim, situate on lands belonging to the United States of America, and in which there are valuable mineral deposits, was entered upon and located for the purposes of exploration and purchase by F. Fay and E. E. Lake the undersigned, on the 5 day of April, 1911.

The length of this claim is 1500 feet, and we claim 750 feet in a northerly direction and 750 feet in a southerly direction from the center of the discovery shaft, at which this notice is posted, lengthwise of the claim, together with 300 feet in width of the surface grounds, on each side of the center of said claim. The general course of the lode deposit and premises is from the NE. to the SW.

The claim is situated and located in the Walker Mining District, in Yavapai county, in the Territory of Arizona, about one mile in a N. direction from Albertson Ranch.

The surface boundaries of the claim are marked upon the ground as follows: Beginning at a point in a N. direction 750 feet from the discovery shaft (at which this notice is posted), being in the center of the end line of said claim; thence 300 feet to a Monument of Stone, being the N.W. corner of said claim; thence S. 1500 feet to a monument, being at the S.W. corner of said claim; thence E. 300 feet to a monument at the center of the S. end of said claim; thence E. 300 feet to a monument, being at the S.E. corner of said claim; thence N. 1500 feet to a monument at the N.E. corner of said claim; thence W. 300 feet to the place of beginning.

All done under the provisions of Chapter Six, of Title XXXII, of the Revised Statutes of the United States, and of an Act of the General Assembly of Arizona, entitled "AN Act to Revise and Codify the Laws of the Territory of Arizona," approved March 16, 1901.

Dated and posted on the ground this 5 day of April, 1911.

F. Fay
E. E. Lake.

Witness:
James Halligan.

Filed and recorded at request of E. E. Lake, April 15, A. D. 1911
at 10:34 o'clock A. M. Book 89 of Mines, page 602, Records of
Yavapai county, Arizona. J. C. Bradbury, county recorder
(Seal)

By A. C. Gilmore, Deputy Recorder.

NOTICE OF MINING LOCATION
LODE CLAIM.

TO ALL WHOM IT MAY CONCERN:

This Mining Claim, the name of which is the Between Mining Claim, situate on lands belonging to the United States of America, and in which there are valuable mineral deposits, was entered upon and located for the purposes of exploration and purchase by F. Fay & E. E. Lake, the undersigned, on the 30 day of May, 1916.

The length of this claim is 1500 feet, and we claim 700 feet in a north direction and 800 feet in a south direction from the center of the discovery shaft, at which this notice is posted, lengthwise of the claim, together with 50 feet in width of the surface grounds on each side of the center of said claim. The general course of the lode deposit and premises is from the northerly to the southerly.

The claim is situated and located in the Walker Mining District, in Yavapai county, in the State of Arizona, about 6 miles in a Easterly direction from Prescott, Arizona.

The surface boundaries of the claim are marked upon the ground as follows: Beginning at a point in a North direction 700 feet from the discovery shaft (at which this notice is posted), being in the center of the north end line of said claim; thence 50 feet to a monument monument, being the NW. corner of said claim; thence S. 1500 feet to a monument, being at the S.W. corner of said claim; thence E. 50 feet to a monument at the center of the south end of said claim; thence E. 50 feet to a monument, being at the S.E. corner of said claim; thence N. 15 feet to a monument at the N.E. corner of said claim; thence W. 50 feet to the place of beginning.

All done under the provisions of Chapter Six, of Title XXXII, of the Revised Statutes of the United States, and of an Act of the General Assembly of Arizona, entitled "An Act to Revise and Codify the Laws of the Territory of Arizona," approved March 16, 1901.

Dated and posted on the ground this 30 day of May, 1916.

F. Fay
E. E. Lake.

Filed and recorded at request of E. E. Lake, Aug. 31st, A. D. 1916, at 1:30 o'clock P. M., Book 101 of Mines, Page 34 Records of Yavapai county, Arizona.

L. S. Colwell,
(Seal) County Recorder.
By James W. Coyne,
Deputy Recorder.

NOTICE OF MINING LOCATION
LODE CLAIM.

TO ALL WHOM IT MAY CONCERN:

This Mining Claim, the name of which is the Pinion Mining Claim, situate on lands belonging to the United States of America, and in which there are valuable mineral deposits, was entered upon and located for the purpose of exploration and purchase by F.Fay and E.E.Lake, the undersigned, on the 12 day of April, 1912.

The length of this claim is 1500 feet, and we claim 1400 feet in a North direction and 100 feet in a south direction from the center of the discovery shaft, at which this notice is posted, lengthwise of the claim, together with 300 feet in width of the surface grounds, on each side of the center of said claim. The general course of the lode deposit and premises is from the N. to the S.

The claim is situated and located in the Walker Mining District, in Yavapai county, in the Territory of Arizona, about one mile in a North direction from Albertson Ranch.

The surface boundaries of the claim are marked upon the ground as follows: Beginning at a point in a south direction 100 feet from the discovery shaft (at which this notice is posted), being in the center of the " " end line of said claim; thence W. 300 feet to a Monument of Stone, being the S.W. corner of said claim; thence N. 1500 feet to a Monument, being at the N.W. corner of said claim; thence E. 300 feet to a Monument at the center of the N. end of said claim; thence E. 300 feet to a monument, being at the N.E. corner of said claim; thence S. 1500 feet to a Monument at the S.E. corner of said claim; thence W. 300 feet to the place of beginning.

All done under the provisions of Chapter Six, of Title XXXII, of the Revised Statutes of the United States, and of an Act of the General Assembly of Arizona, entitled "An Act to Revise and Codify the Laws of the Territory of Arizona," approved March 16, 1901.

Dated and posted on the ground this 12 day of April, 1912.

F.Fay
E.E.Lake.

Filed and recorded at request of E.E.Lake, May 11, A.D. 1912 at 11:20 o'clock A.M., Book 92 of Mines, page 143 Records of Yavapai County, Arizona.

(Seal) L.S.Colwell,
County Recorder.

STATE OF ARIZONA,)
County of Yavapai.) ss.

I, GRACE CHAPMAN, County Recorder in and for the County of Yavapai, State of Arizona, and custodian of the records of said office, do hereby certify that the foregoing are full, true and correct copies of Notices of Mining Location of Golden Rule, Piñon, North Ext. Golden Rule and Between lode Mining Claims, filed for record April 15, 1911, May 11, 1912, July 26th, 1916, and Aug. 31, 1916, and recorded in Books, 89, 92, 100 and 101 of Mines, at page 602, 143, 586 and 34, and of the whole thereof.

IN WITNESS WHEREOF, I have hereunto set my hand and affixed the Official Seal of my said office, in the City of Prescott, County of Yavapai, State of Arizona, this 17th day of JULY, A.D., 1925.

(S E A L)

(Signed) Grace Chapman,
County Recorder.

TRANSITMAN
CERTIFICATE OF UNITED STATES SURVEYOR

I, Charles E. Hunter, U.S. Transitman, ~~U.S. Surveyor~~, hereby certify upon honor that, in pursuance of special instructions received from the U.S. District Cadastral Engineer ~~U.S. Surveyor General~~ for for Group No. 136, Arizona bearing date of the 28th day of October, 1925, I have well, faithfully, and truly in my own proper person, and in strict conformity with said instructions, the Manual of Surveying Instructions, and the laws of the United States, surveyed all those parts or portions of the North Ext. Golden Rule, the Golden Rule, the Between, and the Pinion, lode mining claims in Secs 20 & 29, T. 14 N., R. 1 W. and resurveyed all those parts or portions of the Subdivision Lines of Township 14 North, Range 1 West of the Gila and Salt River Base and Meridian, in the State of Arizona, which are represented in the foregoing field notes and by diagram on page 2 hereof as having been executed by me, and under my direction; and that all the corners of said survey and resurvey have been established and perpetuated in strict accordance with the Manual of Surveying Instructions, and the special written instructions of the U.S. District Cadastral Engineer ~~U.S. Surveyor General~~ for for Group No. 136, Arizona and in the specific manner described in the field notes, and that the foregoing are the original field notes of such survey, and resurvey.

Place: Phoenix, Arizona.

Charles E. Hunter
U.S. Transitman, Jr.

Date: May 1, 1926.

APPROVAL

OFFICE OF THE UNITED STATES SURVEYOR GENERAL,

....., 19

The foregoing field notes of the survey of

executed by
under his special instructions dated, 19 .., having been critically examined, and the necessary corrections and explanations made, the said field notes, and the surveys they describe, are hereby approved.

.....
U. S. Surveyor General.

I certify that the foregoing transcript of the field notes of the above-described surveys in
....., has been correctly copied from the original notes on file in this office.

.....
U. S. Surveyor General.

4-680

FIELD ASSISTANTS.
TO
Glenn F. Sawyer, U.S. Surveyor

NAMES.	CAPACITY.
Ray Bell	1st Chainman
E.S. Butler	2nd Chainman
Pat Easton	Cornerman
R.L. Shackelford	Flagman

CERTIFICATE OF UNITED STATES SURVEYOR.

I, Glenn F. Sawyer, U. S. Surveyor, hereby certify upon honor that, in pursuance of special instructions received from the U.S. District Cadastral Engineer ~~U. S. Surveyor General~~ for Group No. 136, Arizona bearing date of the 28th day of October, 1925, I have well, faithfully, and truly in my own proper person, and in strict conformity with said instructions, the Manual of Surveying Instructions, and the laws of the United States, ^{re} surveyed all those parts or portions of

the Subdivision Lines of

Township 14 North, Range 1 West of the Gila & Salt River Base & Meridian, in the State of Arizona, which are represented in the foregoing field notes ^{as} having been executed by me, and under my direction; and that all the corners of said ^{re} survey have been established and perpetuated in strict accordance with the Manual of Surveying Instructions, and the special written instructions of the U.S. District Cadastral Engineer ~~U. S. Surveyor General~~ for Group No. 136, Arizona and in the specific manner described in the field notes, and that the foregoing are the original field notes of such ^{re} survey.

Place: Ontario Calif.
Date: July 25, 1927

Glenn F. Sawyer
U. S. Surveyor.

APPROVAL.

U.S. SUPERVISOR OF SURVEYS.
OFFICE OF THE ~~UNITED STATES SURVEYOR GENERAL~~

Denver, Colo., Sept. 13, 1927.

The foregoing field notes of the survey of the North Ext. Golden Rule, Golden Rule, Between, and Pinion, lode mining claims in Secs. 20 and 29, T. 14 N., R. 1 W. and of the resurvey of Part of the Subdivision lines of Township 14 North, Range 1 West of the Gila and Salt River Base and Meridian, in the State of Arizona

executed by Glenn F. Sawyer, U.S. Surveyor & Charles E. Hunter, U.S. Transitman under ~~his~~ special instructions dated October 28, 1925 for Group 136, Arizona, having been critically examined, and the necessary corrections and explanations made, the said field notes, and the surveys ~~and resurveys~~ they describe, are hereby approved.

Wm. H. Pinion
U.S. Supervisor of Surveys ~~General~~

~~I certify that the foregoing transcript of the field notes of the above described surveys~~
~~has been correctly copied from the original notes on file in this office.~~