

FIELD NOTES

OF THE SURVEY OF THE

SEVENTH STANDARD PARALLEL NORTH

thru

Part of Range 19 West

All of Range 20 West

All of Range 21 West

All of Range 22 West

and all of Fractional Range 23 West

the East Boundary

North Boundary

and Part of the West Boundary

of Fractional Township 29 North, Range 22 West

the North Boundary

and Subdivision lines of

Fractional Township 29 North, Range 23 West

and

Meanders of Left Bank of Colorado River

thru Part of

Fractional Township 29 North, Range 23 West

Of the Gila and Salt River Base and Meridian,

In the State of Arizona

EXECUTED BY

Dupree R. Averill, U.S. Surveyor

In the capacity of U. S. Surveyor, under Special Instructions dated July 15, 1929, issued by the District Cadastral Engineer to govern surveys included in Group No. 160 Arizona, which were approved by the Commissioner of the General Land Office, August 1, 1929, and Assignment Instructions dated January 29, 1930.

Survey commenced February 7, 1930.

Survey completed April 12, 1930.

3882

3882

INDEX DIAGRAM.

Township _____, Range _____

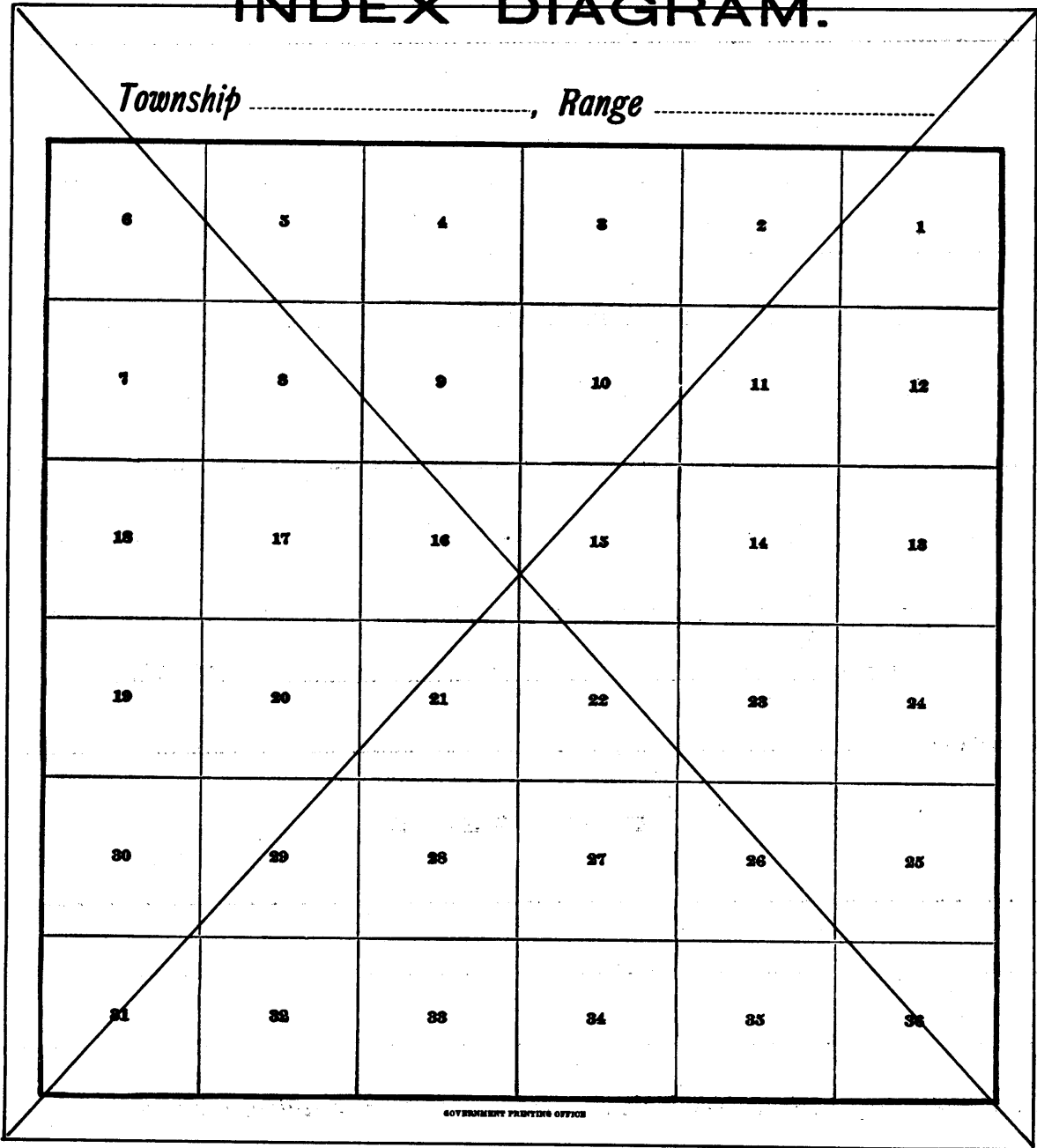

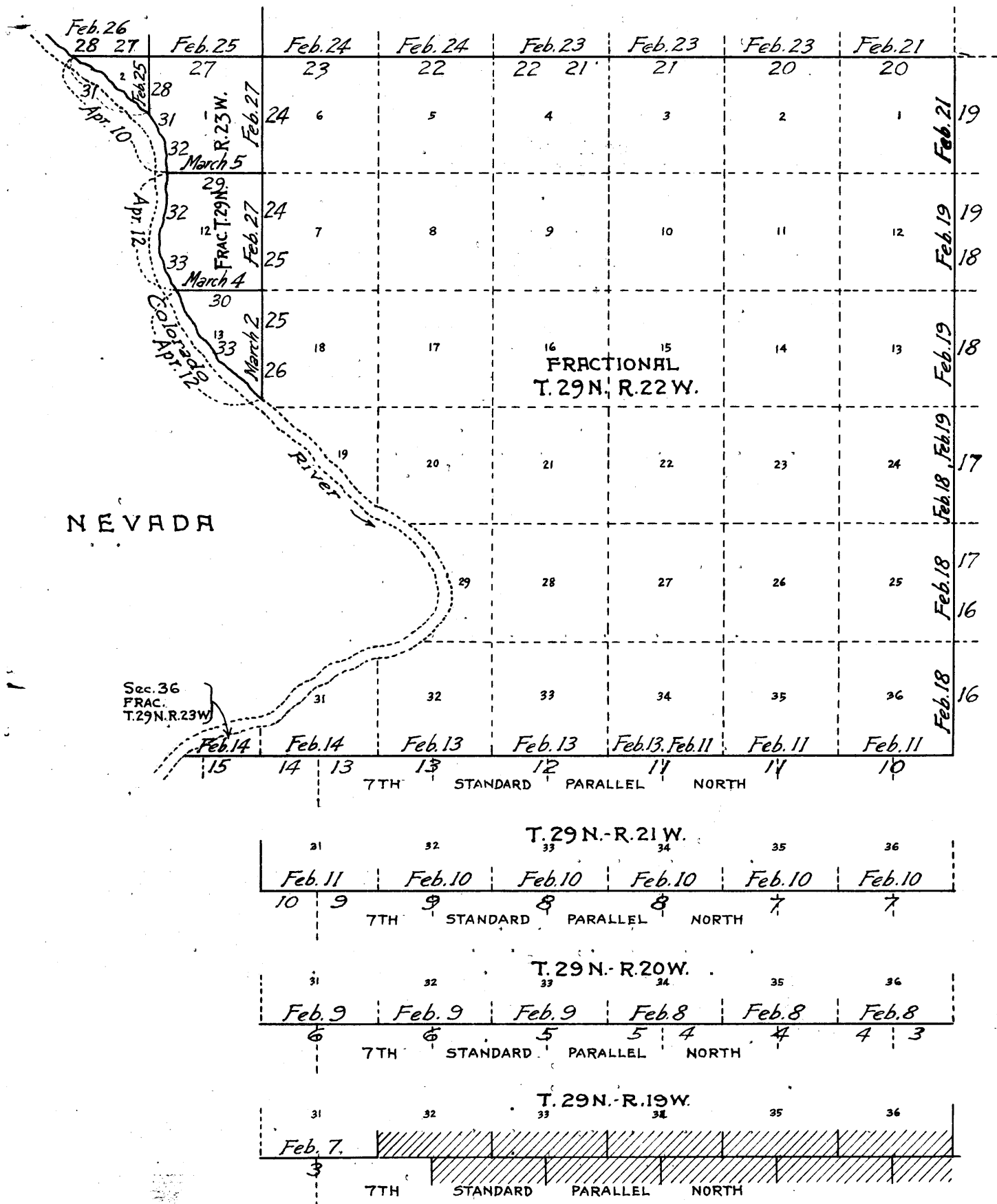

Feb. 7. / 3 Lines surveyed under Group No. 160 Ariz., by D. R. Averill, U.S. Surveyor, in 1930. Month and day shown in red. Page number of notes in green.

— Lines of accepted Arizona surveys.

- - - Unsurveyed.

 Areas of accepted surveys, as per accepted plats on file.

The surveys herein described were executed on dates shown on diagram on page 1 hereof by Dupree R. Averill, U. S. Surveyor, using Buff & Buff solar transit No. 17992, equipped with full vertical circle and the Smith solar attachment. The horizontal limb of the transit is provided with two double verniers placed opposite to each other and each reading to single minutes of arc, which is also the least count of the verniers of the latitude and declination arcs. Unless otherwise specified all azimuth determinations are accomplished with the solar attachment.

The instrument was examined, tested and approved by the District Cadastral Engineer for Arizona and California, January 29, 1930, conditional upon satisfactory field tests.

 PRELIMINARY TEST.

February 5, 1930:

At camp, near cor. of secs. 11, 12, 13 and 14, T. 27 N., R. 20 W., G. & S. R. B. & M., Arizona, latitude $35^{\circ} 44\frac{1}{2}'$ N., longitude $114^{\circ} 23\frac{1}{2}'$ W., examine the adjustments of the instrument and correct all errors, then, to test the solar apparatus by comparing its indications resulting from solar observations made during a.m. and p. m. hours with a meridian determined by Polaris observations, proceed as follows:

At 10 h. 30 m., p. m., l. m. t., observe Polaris at western elongation, making four observations, two each with the telescope in direct and reversed positions, and marking the mean point in the line thus determined by a tack in a stake driven firmly in the ground 10.00 chs. N.

Azimuth of Polaris at western elongation - $1^{\circ} 18' 49''$.

February 6, 1930:

At 7 h. 30 m., a. m., lay off the azimuth of Polaris $1^{\circ} 19'$ to the east and mark a point in the true meridian thus determined by a tack in a stake driven firmly in the ground 10.00 chs. N.

At 8 h. 0 m., a. m., app. t., set off $35^{\circ} 44\frac{1}{2}'$ N. on the lat. arc, $15^{\circ} 39\frac{1}{2}'$ S. on the decl. arc, and determine a meridian with the solar, which agrees with the true meridian.

At app. noon, with the lat. arc unchanged, observe the sun on the meridian, and obtain a reading of $15^{\circ} 38'$ S. on the decl. arc, which agrees with the computed declination of the sun.

At 4 h. 0 m., p. m., app. t., with the lat. arc unchanged, set off $15^{\circ} 33\frac{1}{2}'$ S. on the decl. arc, and determine a meridian with the solar, which agrees within 1' with the true meridian.

As all of the solar observations made during the usual hours of solar work define positions for meridian which agree within 1' with the true meridian, conclude that the instrument is in satisfactory adjustment.

Unless otherwise specified all measurements are made with a lufkin steel tape, 5 chs. in length, compared with a Lufkin standard steel tape and found correct. The measurements are made on the slope, vertical angles determined by clinometer or transit readings, and the slope measurements properly reduced to true horizontal distances for entry in the field notes.

Survey of the

7th Standard Parallel North thru Part (Completion) of R.19 W. BOOK 3882

chains

All distances on the Standard Parallel are the determination of mean measurements by two sets of chainmen.

The standard cor., of secs., 31 and 32, T.29 N., R.19 W., is an iron post, 3 ins., diam., 2 ft. above ground, firmly supported in a mound of stone, 3 ft. base, 2 ft. high, properly marked on brass cap.

Thence,

West on true line on the S., bdy., of sec., 31. Over rolling land, thru scattered undergrowth. Along gentle N. slope.

- 2.50 Drain, course NW.
- 11.00 Wash, 10 lks., wide, course NW.
- 17.50 Wash, 20 lks., wide, course NW.
- 25.45 Drain, course N.
- 39.50 Small spur, slopes N. 80° W.,
- 40.00 Set an iron post, 3 ft. long, 1 in., diam., 12 ins., in the ground, to bedrock, with marked stone (X) deposited alongside, supported in a mound of stone, 3 ft. base, 2 ft. high, for standard $\frac{1}{4}$ sec. cor., of sec. 31, marked on brass cap

SC
 $\frac{1}{4}$ S 31
 1930

- 46.00 Desc. NW. slope 70 ft.,
- Wash, 20 lks., wide, course N. 60° W.
- 65.60 Wash, 10 lks., wide, course N. 10° W., Asc., E. slope 50 ft.
- 73.00 Spur, slopes NW., Desc., SW. slope 80 ft.,
- 80.00 Set an iron post, 3 ft. long, 3 ins., diam., 30 ins., in the ground, for the standard cor., of Ts. 29 N., Rs. 19 and 20 W., marked on brass cap

SC
 T 29 N
 R 20 W | R 19 W
 S 36 | S 31
 1930

raise a mound of stone, 3 ft. base, 2 $\frac{1}{2}$ ft. high, N. of cor.

Land: rolling and broken.
Soil: rocky and gravelly, 2nd. and 3rd. rate.
Timber: none.
Undergrowth: greasewood, yucca, and cacti.

Survey of the 7th. Standard Parallel North Thru R. 20 W.,

- From std. cor. of Ts. 29 N., Rs. 19 & 20 W.,
- West on true line on the S. bdy. of sec. 36.
- Over rolling land, thru scattered undergrowth.
- Desc., NW. slope 30 ft.,
- 3.30 Wash, 50 lks., wide, course NW., Across overflow land, draining NW.
- 18.00 Asc., E. slope 50 ft.,
- 19.50 Spur, slopes N. 25° W., Desc., SW. slope 50 ft.,
- 27.00 Wash, course SW.
- 32.00 Wash, course NW.,
- 36.00 Small spur, slopes NW.
- 40.00 Set an iron post, 3 ft. long, 1 in., diam., 24 ins., in the ground, to bedrock, supported in a mound of stone, 2 ft. base, 1 ft. high, for standard $\frac{1}{4}$ sec. cor., of sec. 36, marked on brass cap

SC
 $\frac{1}{4}$ S 36
 1930

Survey of the 7th. Standard Parallel North thru R.20 W.

chains

raise a mound of stone, 3 ft. base, 2 ft. high, N. of cor.,

- 43.00 Wash, 2.00 chs., wide, course NW.
- 49.50 Small spur, slopes NW. Desc., 40 ft.,
- 55.00 over desert slope, draining NW.
- 60.95 Old road, bears NW. and SE.
- 62.50 Wash, course NW.
- 80.00 Set an iron post, 3 ft. long, 2 ins., diam., 27 ins., in the ground, for the standard cor., of secs., 35 and 36, marked on brass cap

SC
T 29 N R 20 W
S 35 | S 36

1930

raise a mound of stone, 3 ft. base, 2 ft. high N. of cor.,

Land: rolling.
Soil: rocky gravel, 3rd. rate.
Timber: none.
Undergrowth: greasewood, cacti, bayonet, yucca.

- 28.00 West on true line on the S. bdy. of sec. 35.
- 40.00 Over desert land, thru scattered undergrowth.
- 28.00 Wash, 50 lks., wide, course NW. Across overflow.
- 40.00 Set an iron post, 3 ft. long, 1 in., diam., 30 ins., in the ground, for standard cor., of sec., 35, marked on brass cap

SC
1/4 S 35

1930

raise a mound of stone, 3 ft. base, 2 ft. high, N. of cor.,

- 40.80 Wash, 20 lks., wide, course NW. Enter broken land.
- 46.00 Spur, extends NW. Desc., 30 ft.,
- 51.60 Wash, course N. 10° W., Asc., 50 ft.,
- 57.00 Spur, slopes N. 10° W., Desc., 50 ft.,
- 64.00 Wash, 30 lks., wide, course N., Asc., 50 ft.,
- 68.70 Spur, slopes N.
- 73.00 Drain, course N., Asc., 75 ft.,
- 78.50 spur, slopes N. Across shoulder of hill, along N. slope.
- 80.00 Set an iron post, 3 ft. long, 2 ins., diam., 30 ins., in the ground, for the standard cor., of secs., 34 and 35, marked on brass cap

SC
T 29 N R 20 W
S 34 | S 35

1930

raise a mound of stone, 3 ft. base, 2 ft. high, N. of cor.,

Land: desert, and rolling hills.
Soil: gravelly and rocky, 3rd. rate.
Timber: none.
Undergrowth: greasewood, cacti, bayonet, catclaw.

West on true line on the S. bdy., of sec., 34.
Over rolling and broken land, thru scattered undergrowth.

Survey of the 7th. standard Parallel North thru R.20 W.

chains

Over N. slope.
 4.00 Spur, slopes N30°W. Desc., SW.slope 130 ft.,
 16.00 Wash, course N.80°W.
 27.00 Wash, 2.00 chs.,wide, course NW.,
 36.00 Small spur, slopes N.
 37.80 Wash, course N.20°W.,
 40.00 Set an iron post,3 ft.long,1 in.,diam.,12 ins.,in the
 ground, to bedrock, supported in a mound of stone,
 2 ft.base, 2 ft.high, for the standard $\frac{1}{4}$ sec.cor., of
 sec.34, marked on brass cap

SC
 $\frac{1}{4}$ S 34

1930

raise a mound of stone,3 ft.base,2 ft.high,N.of cor.,

Asc., E. slope 50 ft.,
 43.80 Spur, slopes N.10°W.,Desc., 50 ft.,
 47.60 Draw, course NW., Asc. 50 ft.,
 50.00 Spur, slopes N.25°E.,
 53.00 Draw, course NE., Asc., E. slope 100 ft.,
 59.50 Ridge, bears N.,and S.; Desc., W. slope 75 ft.
 65.30 Gully, course N.
 66.70 Small spur, slopes N.10°W.
 71.75 Wash, course NW., Asc., NE.slope 40 ft.,
 76.75m Spur, slopes N.10°W.,Desc., 50 ft.
 80.00 Set an iron post,3 ft.long,2 ins.,diam.,on bedrock,
 with marked (X) stone deposited alongside, supported
 in a mound of stone;3 ft.base,2 $\frac{1}{2}$ ft high, for the
 standard cor.,of secs.,33,and 34, marked on brass
 cap

T 29 N R 20 W

$\frac{1}{4}$ 33 | S 34

1930

Land: rolling and hilly.
 Soil: rocky, 3rd.rate.
 Timber: none.
 Undergrowth: greasewood, cacti,^{and} catclaw.

West on true line on the S. bdy.,of sec.,33.
 Over broken land,thru scattered undergrowth.
 Desc., W. slope 20 ft.,

1.10 Small draw, course NW.
 3.50 Low divide, bears NW. and SE., Over 3. slope,
 12.50 Small spur, slopes SE.
 15:00 Divide, bears SW. and NE., Along N. slope, Asc. 30 ft.
 18.00 Desc., NW.slope 150 ft.,
 30.00 Across desert land.
 35.00 Wash, 30 lks.,wide, course NW.,
 40.00 Set an iron post,3 ft.long,1 in.,diam.,12 ins.,in the
 ground, to bedrock, with marked (X) stone deposited
 alongside, supported in a mound of stone,3 ft.base;
 2 ft.high, for the standard $\frac{1}{4}$ sec.cor., of sec.,33,
 marked on brass cap

SC
 $\frac{1}{4}$ S 33

1930

49.40 Wash, 30 lks.,wide, course NW.
 53.00 Wash, 20 lks.,wide, course NW.
 80.00 Set an iron post,3 ft.long,2 ins.,diam.,30 ins.,in the
 ground, for the standard cor.,of secs.,32 and 33.

Survey of the 7th. standard Parallel North thru R.20 W.

chains

marked on brass cap

SC
T 29 N R 20 W
S 32 | S 33

1930.

raise a mound of stone, 3 ft. base, 2 ft. high, N. of cor.,

Land: broken hills and desert.

Soil: rocky, gravelly, 2nd. and 3rd. rate.

Timber: none.

Undergrowth: greasewood, catclaw, $\frac{3}{4}$ cacti.-----
West on true line on the S. bdy., of sec., 32.

Over desert land, thru scattered undergrowth.

10.00 Wash, 30 lks., wide, course N. 25° W.

15.00 Wash, 10 lks., wide, course NW.

23.00 Wash, 10 lks., wide, course NW.

30.00 Wash, 30 lks., wide, 4 ft., deep, course N. 20° W.

40.00 Set an iron post, 3 ft. long, 1 in., diam., 30 ins., in the ground, for standard $\frac{1}{4}$ sec. cor., of sec., 32, marked on brass cap

SC

$\frac{1}{4}$ S 32

1930.

raise a mound of stone, 3 ft. base, 2 ft. high, N. of cor.,

43.00 Wash, 20 lks., wide, course N. 10° W.

45.00 Wash, 20 lks., wide, course N. 25° W.

55.00 Wash, 20 lks., wide, course N. 20° W.

60.00 Wash, 20 lks., wide, course NW.

80.00 Set an iron post, 3 ft. long, 2 ins., diam., 30 ins., in the ground, for the standard cor., of secs., 31 and 32, marked on brass cap

SC

T 29 N R 20 W
S 31 | S 32

1930

raise a mound of stone, 3 ft. base, 2 ft. high, N. of cor.

Land: desert, rolling,

Soil: gravelly, 2nd. rate.

Timber: none.

Undergrowth: greasewood, catclaw, $\frac{3}{4}$ cacti.-----
West on true line on the S. bdy. of sec., 31.

Over desert land, thru scattered undergrowth.

12.50 Wash, 10 lks., wide, course N. 20° W.

40.00 Set an iron post, 3 ft. long, 1 in., diam., 30 ins., in the ground, for standard $\frac{1}{4}$ sec. cor., marked on brass cap

SC

$\frac{1}{4}$ S 31

1930

raise a mound of stone, 3 ft. base, 1 $\frac{1}{2}$ ft. high, N. of cor.

60.00 Wash, 1.00 ch., wide, course N. 80° W.

80.00 Set an iron post, 3 ft. long, 3 ins., diam., 30 ins., in the ground, for the standard cor., of Ts. 29 N., Rs. 20 & 21 W. marked on brass cap

Survey of the 7th Standard Parallel North thru R. 21 W.

chains

SC
 T 29 N
 R 21 W | R 20 W
 S 36 | S 31

1930

raise a mound of stone, 3 ft. base, 3 ft. high, N. of cor.

Land: desert, rolling.
 Soil: gravelly, 2nd. rate.
 Timber: none. Undergrowth, greasewood, catclaw & cacti.

Survey of 7th Standard Parallel North thru R. 21 W.

From std. cor. of Ts. 29 N., Rs. 20 and 21 W.,

West on true line on the S. bdy., of sec., 36.
Over desert land, thru scattered undergrowth.

- 7.00 Wash, 20 lks., wide, course NW.
- 15.00 Wash, 50 lks., wide, course W.
- 20.00 Wash, 30 lks., wide, 4 ft. deep, from SE, course NW.
- 27.50 Wash, 1.00 ch., wide, course NW.
- 40.00 Set an iron post, 3 ft. long, 1 in., diam., 30 ins., in the ground, for standard $\frac{1}{4}$ sec. cor., of sec., 36, marked on brass cap

SC
 $\frac{1}{4}$ S 36

1930

raise a mound of stone, 3 ft. base, 1 $\frac{1}{2}$ ft. high, N. of cor.

- 53.00 Wash, 10 lks., wide, course NW.
- 75.00 Wash, 20 lks., wide, course N. 85° W.
- 80.00 Set an iron post, 3 ft. long, 2 ins., diam., 30 ins., in the ground, for the standard cor., of secs., 35 and 36, marked on brass cap

SC
 T 29 N | R 21 W
 S 35 | S 36

1930

raise a mound of stone, 3 ft. base, 2 ft. high, N. of cor.

Land: desert, rolling.
 Soil: gravelly, 2nd. rate.
 Timber: none.
 Undergrowth: greasewood, catclaw, cacti.

West on true line on the S. bdy., of sec., 35.
 Over desert land, thru scattered undergrowth.

- 32.20 Road, bears North to Colorado River and south to Chloride.
- 40.00 Set an iron post, 3 ft. long, 1 in., diam., 30 ins., in the ground, for standard $\frac{1}{4}$ sec. cor., of sec., 35, marked on brass cap

SC
 $\frac{1}{4}$ S 35

1930

raise a mound of stone, 2 ft. base, 1 $\frac{1}{2}$ ft. high, N. of cor.

- 60.00 Detrital Wash, 1.00 ch., wide, course N.
- 80.00 Set an iron post, 3 ft. long, 2 ins., diam., 30 ins., in the ground, for the standard cor., of secs., 34 and 35.

Survey of the 7th. Standard Parallel North thru R. 21 W.

chains

marked on brass cap

SC

T 29 N R 21 W

S 34 | S 35

1930

dig pits, 24 x 24 x 18 ins., N.E. and W. of cor.,

Land: desert. rolling.

Soil: gravelly clay, 2nd rate.

Timber: mesquite along Detrital Wash.

Undergrowth: greasewood, catclaw, cacti, sage.

West on true line on the S. bdy. of sec., 34.

Over desert land, thru scattered undergrowth.

29.00 Wash, 5 lks., wide, course NE.

35.00 Wash, 5 lks., wide, course NE.

40.00 Set an iron post, 3 ft. long, 1 in. diam., 30 ins., in the ground, for standard $\frac{1}{4}$ sec. cor., marked on brass cap

SC

 $\frac{1}{4}$ S 34

1930

raise a mound of stone, 3 ft. base, 1 $\frac{1}{2}$ ft. high, N. of cor.,

50.00 Wash, course NE.

55.00 Wash, 10 lks., wide, course N. 20° E.

80.00 Set an iron post, 3 ft. long, 2 ins. diam., 30 ins., in the ground, for the standard cor., of secs., 33 and 34, marked on brass cap

SC

T 29 N R 21 W

S 33 | S 34

1930

raise a mound of stone, 3 ft. base, 1 $\frac{1}{2}$ ft. high, N. of cor.,

Land: desert. rolling.

Soil: gravelly, rocky, 3rd rate.

Timber: none.

Undergrowth: greasewood, cacti.

West on true line on the S. bdy., of sec., 33.

Over desert land, thru scattered undergrowth.

0.10 Wash, 30 lks., wide, course NE.

28.60 Wash, 10 lks., wide, course NE.

40.00 Set an iron post, 3 ft. long, 1 in. diam., 30 ins., in the ground, for standard $\frac{1}{4}$ sec. cor., of sec., 33, marked on brass cap

SC

 $\frac{1}{4}$ S 33

1930

raise a mound of stone, 3 ft. base, 2 ft. high, N. of cor.,

40.25 Wash, 10 lks., wide, course NE.

66.10 Wash, 10 lks., wide, course NE.

80.00 Set an iron post, 3 ft. long, 2 ins. diam., 30 ins., in the ground, for the standard cor., of secs., 32 and 33, marked on brass cap

chains

SC
T 29 N R 21 W
S 32 | S 33

1930

raise a mound of stone, 3 ft. base, 2 ft. high, N. of cor.

Land, rolling desert.
Soil, rocky and gravelly, 2nd rate.
Timber, none.
Undergrowth, greasewood, catclaw and cacti.

West, on true line, on the S. bdy. of sec. 32.
Over desert land, thru scattered undergrowth.

- 4.00 Old road, bears N. and S.
- 10.00 Wash, course NE.
- 14.00 Wash, course NE.
- 19.50 Wash, 50 lks. wide, course N. 75° E.
- 40.00 Set an iron post, 3 ft. long, 1 in. diam., 30 ins. in the ground, for standard $\frac{1}{4}$ sec. cor. of sec. 32, marked on brass cap

SC
 $\frac{1}{4}$ S 32

1930

raise a mound of stone, 3 ft. base, 2 ft. high, N. of cor.

- 41.80 Drain, course NE.
- 46.10 Drain, course SE.
- 60.00 Drain, course S. 25° E.
- 69.00 Wash, 20 lks. wide, course N. 70° E.
- 80.00 Set an iron post, 3 ft. long, 2 ins. diam., 30 ins. in the ground, for standard cor. of secs. 31 and 32, marked on brass cap

SC
T 29 N R 21 W
S 31 | S 32

1930

raise a mound of stone, 3 ft. base, 2 ft. high, N. of cor.

Land, desert mesa.
Soil, rocky and gravelly, 2nd rate.
Timber, none.
Undergrowth, greasewood and cacti.

West, on true line, on the S. bdy. of sec. 31.
Over desert land, thru scattered undergrowth.

- 15.00 Asc. E. slope of rocky butte, 150 ft.
- 25.00 South side of top of rocky butte. Thence over broken S. slope. Desc. 75 ft.
- 38.20 Head of gully, course S.
- 40.00 Set an iron post, 3 ft. long, 1 in. diam., on bedrock, with marked (X) stone alongside, supported in a mound of stone 4 ft. base, 3 ft. high, for standard $\frac{1}{4}$ sec. cor. of sec. 31, marked on brass cap

SC
 $\frac{1}{4}$ S 31

1930

- 42.40 Asc. SE. slope 25 ft.
- 45.00 Small spur, slopes S. Wash, course S. 15° E. Over broken desert. Asc. gradually.

Survey of the 7th Standard Parallel North, thru R.21 W.

chains
 66.30 Gully, course SE. Asc. 60 ft.
 70.00 Spur, slopes NE. Asc. along N. slope 40 ft.
 75.50 Head of gully, course NE. Asc. E. slope 70 ft.
 77.70 Spur, slopes SE. from W. Asc. 40 ft. to
 80.00 Set an iron post, 3 ft. long, 3 ins. diam., on bedrock, with
 marked (X) stone alongside, supported in a mound of
 stone 5 ft. base, 3 ft. high, for std. cor. of T.29 N., R.21
 W., and Frac. T.29 N., R.22 W., marked on brass cap

SC

T 29 N

R 22 W | R 21 W

S 36 | S 31

1930

from which

U.S.M.M. No. 2948A, a schist stone 24x20x18 ins. above
 ground, marked with a cross (X) on top, and lettered
 USMM 2948 A on each of N. and E. faces, and witnessed
 by a mound of stone 15 lks. N., bears S. 5°40' W., 186.00
 chs. dist., on crest of a small spur.

Land, desert, broken and hilly.

Soil, gravelly and rocky, 2nd and 4th rate.

Timber, none.

Undergrowth, greasewood and cacti.

Survey of the 7th Standard Parallel North, thru R.22 W.

From std. cor. of T.29 N., R.21 W., and Frac. T.29 N., R.22 W.,
 West, on true line, on the S. bdy. of sec. 36.
 Over broken hilly land, thru scattered undergrowth.
 Asc. SE. slope 50 ft.
 2.00 Divide bet. Detrital and Jumbo Washes, bears N. and S.
 Desc. broken SW. slope 130 ft.
 9.00 Head of draw, course S. Asc. 17 ft.
 12.15 Spur, slopes S. Desc. 330 ft.
 26.50 Draw, course S. Asc. 30 ft.
 31.70 Spur, slopes S. 25° W. Desc. W. slope 190 ft.
 38.50 Draw, course S. Thence across desert mesa, sloping S.
 40.00 Set an iron post, 3 ft. long, 1 in. diam., 24 ins. in the
 ground to bedrock, supported in a mound of stone 2 ft.
 base, 1 ft. high, for std. $\frac{1}{4}$ sec. cor. of sec. 36, marked on
 brass cap

SC

 $\frac{1}{4}$ S 36

1930

raise a mound of stone, 3 ft. base, 2 ft. high, N. of cor.

46.00 Draw, course SW.
 48.00 Low spur, slopes SW. Thence over broken hills.
 50.50 Draw, course S.
 53.40 Spur, slopes SW. Desc. 50 ft.
 58.00 Wash, 10 ft. deep, 20 lks. wide, course SW. Asc. SE. slope 50 ft.
 62.00 Change to SW. slope. Desc. 200 ft.
 78.20 Enter draw, course W.
 79.50 Leave draw, course SW. Asc. 20 ft. to
 80.00 Set an iron post, 3 ft. long, 2 ins. diam., 10 ins. in ground
 to bedrock, with marked (X) stone deposited alongside,
 supported in a mound of stone 3 ft. base, 2 ft. high, for
 std. cor. of secs. 35 and 36, marked on brass cap

SC

T 29 N | R 22 W

S 35 | S 36

1930

Survey of the 7th. Standard Parallel North thru R.22 W. BOOK 3882

chains

Land: broken hills.
 Soil: rocky, 3rd. and 4th. rate.
 Timber: none.
 Undergrowth: greasewood, ^{and} cacti.

West on true line on the S. bdy., of sec., 35.
 Over rolling desert, thru scattered undergrowth.
 Asc. 15 ft.,
 2.50 Small spur, slopes SW. Desc., gradually 120 ft.,
 8.70 Wash, course S. 50°W.
 15.00 Enter wash, course NW.
 20.00 Leave wash, course NW.
 28.00 Low spur, slopes W. Desc., 70 ft.,
 40.00 Set an iron post, 3 ft. long, 1 in. diam., 30 ins., in the
 ground, for standard $\frac{1}{4}$ sec. cor., marked on brass cap

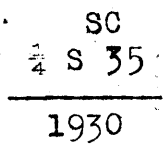

1930

raise a mound of stone, 3 ft. base, 2 ft. high, N. of cor.,

Over rolling desert, gradual descent.
 46.50 Wash, 10 lks., wide, course S.
 55.00 Wash, 40 lks., wide, course SW.
 65.00 Enter wash.
 72.00 Leave wash, course S. 55°W.
 76.50 Draw, course SW.
 80.00 Set an iron post, 3 ft. long, 2 ins., diam., 30 ins., in the
 ground, for the standard cor., of secs., 34 and 35,
 marked on brass cap

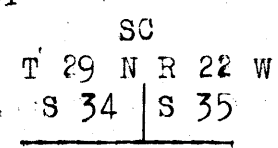

1930

raise a mound of stone, 3 ft. base, 2 ft. high, N. of cor.,

Land: rolling desert.
 Soil: gravelly and rocky, 3rd. rate.
 Timber: none.
 Undergrowth: greasewood, catclaw, ^{and} cacti.

West on true line on the S. bdy., of sec., 34.
 Over desert land, thru scattered undergrowth.
 2.90 Wash, 1.00 ch., wide, course N. 80°W.
 17.50 Wash and overflow land, drains SW.
 40.00 Set an iron post, 3 ft. long, 1 in., diam., 30 ins., in the
 ground, for standard $\frac{1}{4}$ sec. cor., marked on brass cap

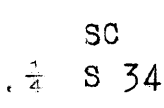

1930

raise a mound of stone, 3 ft. base, 2 ft. high, N. of cor.,

Across overflow land.
 67.00 Wash, course S. 65°W.
 71.00 Gully, course NW.
 80.00 Set an iron post, 3 ft. long, 2 ins., diam., 30 ins., in the
 ground, for the standard cor., of secs., 33 and 34,
 marked on brass cap.

Survey of the 7th. Standard Parallel North thru R. 22 W.

chains

SC
T 29 N R 22 W
S 33 | S 34

1930

raise a mound of stone, 3 ft. base, 1½ ft. high, N. of cor.
corner falls in small draw, course N. 15° W.

Land: rolling desert.

Soil: gravelly, 3rd. rate.

Timber: none.

Undergrowth: greasewood, catclaw, cacti.

West on true line on the S. bdy. of sec., 33.

Over broken desert, thru scattered undergrowth.

4.50 Gully, course N. 25° W.

5.55 Gully, course N. 25° W.

8.00 Gully, course N. 20° W.

26.00 Desc. NW. slope 60 ft.,

34.00 Draw, course NW.,

40.00 Set an iron post, 3 ft. long, 1 in. diam., 30 ins., in the
ground, for standard cor., of sec., 33, marked
on brass cap

SC

S 33

1930

raise a mound of stone, 3 ft. base, 1½ ft. high, N. of cor.

40.50 Small spur, slopes NW. Desc., W. slope 60 ft.

44.00 Enter Jumbo Wash, course N. 20° W.

44.65 Road, in wash, bears N. and S.

48.00 Leave Wash, enter mountainous land, bears N. and S.,
Asc., E. slope 300 ft.

51.70 Spur, slopes NE.

60.40 Spur, extrnds N., Desc., W. slope 170 ft.

68.20 Draw, course N.,

71.40 Enter wash, in draw, course NE.

75.00 Leave wash. Asc., SE. slope 115 ft.

80.00 Set an iron post, 3 ft. long, 2 ins. diam., 15 ins., in the
ground, to bedrock, supported in a mound of stone,
3 ft base 1½ ft. high, for the standard cor., of secs.,
32 and 33, marked on brass cap

SC

T 29 N R 22 W

S 32 | S 33

1930

raise a mound of stone, 3 ft. base, 3 ft. high, N. of cor.,

U.S. M.M. No. 2948 B, which is a cross (X) on schist
ledge, 3 x 2½ x 2½ ft., high on apex of spur on the
north side of Jumbo Wash, near the Colorado River,
further marked U.S. M.M. 2948 B and witnessed by a
cairn of stone, 3 ft. base, 2 ft. high N. 70° W., 20 lks.
dist., bears N. 8° 23' W., 82.58 chs., dist.,

Land: desert and mountains.

Soil: gravelly and rocky, 3rd. rate.

Timber: none.

Undergrowth: greasewood, cacti, catclaw.

Survey of the 7th Standard Parallel North thru R. 22 W.

chains West, on true line, on the S. bdy. of sec. 32.
 Over mountainous land, thru scattered undergrowth.
 Asc. broken SE. slope 600 ft.

7.00 Gulch, course SE.
 11.00 Spur, slopes SE.
 16.50 Gulch, course S. 60° E.
 21.60 Gulch, course S. 20° E.
 24.40 Spur, slopes S. 10° E.
 31.50 Draw, course S. 20° E.
 36.70 Spur, slopes S. 25° E.
 40.00 Set an iron post, 3 ft. long, 1 in. diam., on bedrock, with marked (X) stone deposited alongside, supported in a mound of stone 4 ft. base, 2 ft. high, for std. $\frac{1}{4}$ sec. cor. marked on brass cap

SC
 $\frac{1}{4}$ S 32

 1930

40.10 Draw, course SE. Asc. E. slope 190 ft.
 44.60 Spur ridge, slopes SE. Desc. SW. slope 90 ft.
 48.40 Gulch, course S. Asc. SE. slope 40 ft.
 51.00 Along S. slope of rocky peak.
 55.50 Head of draw, course SE. Asc. 60 ft.
 57.25 Ridge, bears SE. and N. to rocky peak. Desc. along S. slope 110 ft.
 65.62 Sharp ridge, bears N. 70° E. and S. 20° W. Set flag "A" for triangulation of part of S. bdy. of sec. 31. Desc. precipitous W. slope 350 ft.
 73.40 Gulch, course NW.
 77.00 Point of spur, slopes N. Desc. 70 ft.
 79.00 Draw, course N. Asc. 10 ft. to
 80.00 Set an iron post, 3 ft. long, 2 ins. diam., 30 ins. in the ground, for std. cor. of secs. 31 and 32, marked on brass cap

SC
 T 29 N R 22 W.
 S 31 | S 32

 1930

raise a mound of stone, 3 ft. base, 2 ft. high, N. of cor.

Land, mountainous.
 Soil, rocky, 4th rate.
 Timber, none.
 Undergrowth, greasewood and cacti.

West, on true line, on the S. bdy. of sec. 31.
 Over mountainous land, thru scattered undergrowth.
 Precipitous slopes render chaining west from sec. cor. impracticable, therefore triangulate as follows:

Set flag "B" ahead on line.
 From "B" measure a base S. 2° 47' E., 8.18 chs. to point "C".
 Bearing from "C" to flag "A" at 65.62 ch. station on S. bdy. of sec. 32 is N. 73° 22' E.
 Vertical angle "B" to std. cor. of secs. 31 & 32 is -44 $\frac{1}{2}$ °

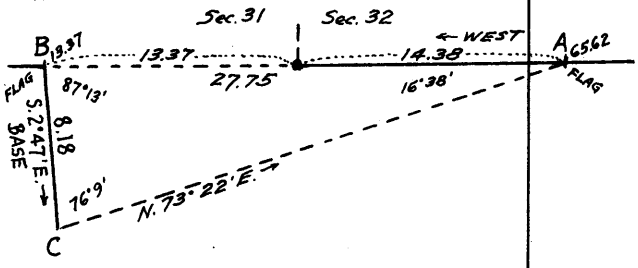

Triangulated dist. - "A" to "B" = 27.75 chs. West.
 Chained dist. - "A" to sec. cor. = 14.38 " "
 Dist. - sec. cor. to flag "B" = 13.37 chs. West.
 Ascent - sec. cor. to flag "B" = 870 ft.

Survey of the 7th Standard Parallel North thru R.22 W.

chains
13.37

Flag "B" on apex of sharp, rocky peak. Set reference flag at this point, supported in a cairn of rock, 6 ft. base, 4 ft. high.

from which

Cabin, on left bank of Colorado River, near mouth of Jumbo Wash, bears N.35°E., about 140 chs. dist.

Continue line and measurement by chaining.

Desc. 1130 ft. over precipitous W. slope.

19.60

Top of ledge, facing W., about 50 ft. high.

39.00

Gulch, course NW. Thence over broken hills.

40.00

Set an iron post, 3 ft. long, 1 in. diam., on bedrock, with marked (X) stone deposited alongside, supported in a mound of stone 5 ft. base, 3 ft. high, for std. 1/4 sec. cor. marked on brass cap

SC

1/4 S 31

1930

Thence along N. slope.

43.00

Small spur, slopes NW. Desc. W. slope 130 ft.

46.50

Draw, course N. Asc. E. slope 80 ft.

50.25

Spur, slopes N.20°E. Desc. NW slope 100 ft.

53.75

Head of draw, course N. Asc. E. slope 150 ft.

54.60

Gulch, course NE.

58.20

Gulch, course NE.

63.50

Spur, slopes N.10°E. Desc. along N. slope 80 ft.

66.00

Draw, course N.

76.00

Washed gulch, course N.

80.00

Set an iron post, 3 ft. long, 3 ins. diam., 30 ins. in the ground, for std. cor. of Frac. Ts. 29 N., Rs. 22 and 23 W., marked on brass cap

SC

T 29 N

R 23 W | R 22 W

1/4 S 36 | S 31

1930

raise a mound of stone, 3 ft. base, 2 ft. high, N. of cor.

Land, broken and mountainous.

Soil, rocky, 4th rate.

Timber, none.

Undergrowth, greasewood and cacti.

Survey of the 7th Standard Parallel North thru Frac. R. 23 W.

chains

From std. cor. of Frac. Ts. 29 N., R. 22 and 23 W.,
 hereinbefore described,
 West, on true line, on the S. bdy. of sec. 36.
 Over mountainous land, thru scattered undergrowth.
 Desc. along N. slope 100 ft.
 6.00 Draw, course N. Asc. 50 ft.
 9.00 Spur, slopes N. Desc. 150 ft.
 14.30 Draw, course N. Asc. 70 ft.
 20.00 Thence along N. slope.
 30.00 Desc. broken NW. slope 100 ft.
 35.50 Gulch, course N.
 40.00 Set an iron post, 3 ft. long, 1 in. diam., 30 ins. in the
 ground, for std. $\frac{1}{4}$ sec. cor. of sec. 36, marked on brass
 cap

SC

1/4 S 36

1930

raise a mound of stone, 3 ft. base, 2 ft. high, N. of cor.

41.00 Desc. over W. slope 200 ft.
 47.00 Thence across mouth of draw, course NW. Asc. 30 ft.
 50.70 Point of rocky spur, sloping N. Desc. 70 ft. to
 55.00 High water mark of left bank of the Colorado River,
 bearing NE. and SW.
 Set an iron post, 3 ft. long, 1 in. diam., over a cross
 (X) on surface rock, supported in a mound of stone
 5 ft. base, 3 ft. high, for std. meander cor. of sec. 36,
 marked on brass cap

SC

T29N R23W

S 36
C /

1930

Land, mountainous.
 Soil, rocky and sandy, 4th rate.
 Timber, none.
 Undergrowth, greasewood, cacti and mesquite.

Survey of the East Boundary of Frac. T.29 N., R.22 W.

chains

From std. cor. of T.29 N., R.21 W., and Frac. T.29 N., R.22 W., hereinbefore described,

North, on true line, bet. secs. 31 and 36.

Over rolling and hilly land, thru scattered undergrowth. Along E. slope.

- 1.00 Desc. NE. slope 60 ft.
- 5.70 Gully, course E. Asc. 90 ft.
- 11.30 Spur, slopes E. Desc. 50 ft.
- 21.30 Draw, course SE. Asc. 50 ft.
- 24.30 Spur, slopes N.80°E. Desc. 60 ft.
- 30.00 Draw, course E. Asc. 60 ft.
- 33.80 Spur, slopes E. Desc. over NE. slope 150 ft.
- 38.25 Wash, course E.
- 39.90 Spur, slopes NE.

40.00 Set an iron post, 3 ft. long, 1 in. diam., on bedrock, with marked (X) stone deposited alongside, supported in a mound of stone 4 ft. base, 3 ft. high, for $\frac{1}{4}$ sec. cor. of secs. 31 and 36, marked on brass cap

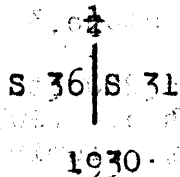

Desc. 50 ft.

- 53.90 Gully, course E. Asc. 40 ft.
- 55.30 Spur, slopes E. Desc. 60 ft.
- 66.50 Divide, between Detrital Valley and Jumbo Wash, bears N.70°E. and S.70°W. Desc. over NW. slope 40 ft.

72.00 Small spur, slopes W.

74.00 Head of gully, course W. Asc. 20 ft. to

80.00 Set an iron post, 3 ft. long, 2 ins. diam., 30 ins. in the ground, for cor. of secs. 25, 30, 31 and 36, marked on brass cap

T 29 N

R22W R21W

S 25 S 30

S 36 S 31

1930

raise a mound of stone, 3 ft. base, 2 ft. high, W. of cor.

Land, rolling and hilly.

Soil, gravelly, 2nd and 3rd rate.

Timber, none.

Undergrowth, greasewood, catclaw and cacti.

North, on true line, bet. secs. 25 and 30.

Over mountainous land, thru scattered undergrowth.

Asc. over SW. slope 60 ft.

- 5.25 Divide, bears NW. and SE. Asc. 20 ft.
- 9.20 Spur, slopes SE. Asc. 40 ft.
- 14.50 Divide, bears NE. and SW. Thence along W. slope.
- 20.00 Head of draw, course S.25°W. Asc. rocky S. slope 350 ft.
- 30.00 Top of rocky peak in divide between Detrital Valley and the Colorado River. Desc. over broken NE. slope 200 ft.

Survey of the East Boundary of Frac. T. 29 N., R. 22 W.

BOOK 3882

chains
40.00

Set an iron post, 3 ft. long, 1 in. diam., 6 ins. in the ground to bedrock, with marked (X) stone deposited alongside, supported in a mound of stone 4 ft. base, 2 ft. high, for $\frac{1}{4}$ sec. cor. of secs. 25 and 30, marked on brass cap

$$\begin{array}{c} \frac{1}{4} \\ \text{S } 25 \mid \text{S } 30 \\ 1930 \end{array}$$

Desc. over N. slope 90 ft.

50.40 Draw, course E. Asc. over broken S. slope 300 ft.

67.00 Thence along E. slope.

71.00 Spur, slopes E.

75.00 Desc. 60 ft. over NE. slope to

80.00 True point for cor. of secs. 19, 24, 25 & 30 falls on face of small sloping ledge, where it is impracticable to monument said cor., therefore establish wit. cor. at 50 lks. N., as hereinafter described.

Land, broken and mountainous.

Soil, rocky, 3rd rate.

Timber, none. Undergrowth, greasewood and cacti.

From true point for cor. of secs. 19, 24, 25 and 30, North, on true line, bet. secs. 19 and 24.

Over mountainous land, thru scattered undergrowth.

0.50 Set an iron post, 3 ft. long, 2 ins. diam., 6 ins. in the ground to bedrock, with marked (X) stone deposited alongside, supported in a mound of stone 3 ft. base, 2 ft. high, for witness cor. to cor. of secs. 19, 24, 25 & 30, marked on brass cap

$$\begin{array}{c} \text{T29N} \\ \text{R22W} \mid \text{R21W} \\ \text{S } 24 \mid \text{S } 19 \\ \text{S } 25 \mid \text{S } 30 \\ \text{WC} \end{array}$$

1930

1.00 Spur, slopes NE. Desc. over N. slope 270 ft.

13.00 Gully, course N. 20° E.

15.80 Gully, course E.

23.00 Wash, 20 lks. wide, course E. Asc. S. slope 70 ft.

28.00 Top of low gravel hill. Desc. NE. slope 100 ft. to

40.00 Set an iron post, 3 ft. long, 1 in. diam., 30 ins. in the ground, for $\frac{1}{4}$ sec. cor. of secs. 19 and 24, marked on brass cap

$$\begin{array}{c} \frac{1}{4} \\ \text{S } 24 \mid \text{S } 19 \\ 1930 \end{array}$$

raise a mound of stone, 3 ft. base, 1½ ft. high, W. of cor.

42.00 Wash, 20 lks. wide, course E.

64.00 Wash, 20 lks. wide, course E., 10 ft. deep.

74.20 Wash, 20 lks. wide, course E. Asc. S. slope 70 ft.

76.50 Low spur, slopes E. Desc. 12 ft.

79.00 Gully, course S. 80° E.

80.00 Set an iron post, 3 ft. long, 2 ins. diam., 30 ins. in the ground, for cor. of secs. 13, 18, 19 and 24, marked on brass cap

$$\begin{array}{c} \text{T29N} \\ \text{R22W} \mid \text{R21W} \\ \text{S } 13 \mid \text{S } 18 \\ \text{S } 24 \mid \text{S } 19 \end{array}$$

1930

raise a mound of stone, 3 ft. base, 2 ft. high, W. of cor.

Land, mountainous and rolling.

Soil, gravelly and rocky, 2nd and 3rd rate.

Timber, none. Undergrowth, greasewood, catclaw & cacti

Survey of the East Boundary of Frac. T.29 N., R.22 W.

- chains North, on true line, bet. secs. 13 and 18.
Over mountainous land, thru scattered undergrowth.
Ascend 15 ft.
- 1.10 Small spur, slopes E. Desc. 35 ft.
4.30 Wash, course E. Asc. 65 ft.
8.00 Spur, slopes E. Desc. NE. slope 20 ft.
10.30 Small draw, course E. Asc. 85 ft.
17.80 Spur, slopes E. Desc. 20 ft.
19.25 Draw, course E. Asc. SE. slope 250 ft.
28.75 Gulch, course S.10°E. Change to S. slope.
36.00 Spur, slopes NE. Desc. NW. slope 100 ft.
39.00 Draw, course NE.: Asc. 30 ft. over S. slope to
40.00 Set an iron post, 3 ft. long, 1 in. diam., 18 ins. in the
ground to bedrock, with a marked (X) stone deposited
alongside, supported in a mound of stone 3 ft. base,
1½ ft. high, for ¼ sec. cor. of secs. 13 & 18, marked on
brass cap

¼
S 13 | S 18
1930

- Asc. over S. slope 110 ft.
46.00 Spur, slopes NE. Desc. over NW. slope 130 ft.
57.00 Wash, 20 lks. wide, course N.80°E. Asc. 160 ft. to sec. cor.
74.10 Wash, 20 lks. wide, course S.70°E.
79.80 Gully, course S.20°E.
80.00 Set an iron post, 3 ft. long, 2 ins. diam., on bedrock,
with marked (X) stone deposited alongside, supported
in a mound of stone 5 ft. base, 3 ft. high, for cor. of
secs. 7, 12, 13 and 18, marked on brass cap

T29N
R22W | R21W
S 12 | S 7
S 13 | S 18
1930

Land, mountainous.
Soil, gravelly and rocky, 3rd rate.
Timber, none.
Undergrowth, greasewood, catclaw and cacti.

- North, on true line, bet. secs. 7 and 12.
Over mountainous land, thru scattered undergrowth.
Asc. over SW. slope 140 ft.
- 2.60 Spur, slopes S.30°E.
5.90 Spur, slopes E. Desc. over NE. slope 30 ft.
8.00 Spur, slopes N.30°E. Desc. over NW. slope 150 ft.
14.30 Wash, 10 lks. wide, course NE.
21.00 Wash, 10 lks. wide, course E. Asc. over SE. slope 130 ft.
34.00 Spur, slopes E. Desc. over N. slope 200 ft.
39.90 Draw, 50 lks. wide, course S.75°E.
40.00 Set an iron post, 3 ft. long, 1 in. diam., 6 ins. in the
ground to bedrock, with marked (X) stone deposited
alongside, supported in a mound of stone 5 ft. base,
2½ ft. high, for ¼ sec. cor. of secs. 7 and 12, marked
on brass cap

¼
S 12 | S 7
1930

Survey of the East Boundary of Frac. T. 29 N., R. 22 W.

chains
 Asc., S. slope 400 ft.,
 54.00 Spur, slopes S. 60° E., Desc., N. slope 350 ft.,
 68.00 Draw, course S. 70° E., Asc., S. slope 220 ft.,
 74.70 Spur, slopes S. 75° E., Desc., NE. slope 75 ft.,
 77.20 Gully, course E. Asc., 50 ft.,
 80.00 Set an iron post, 3 ft. long, 2 ins., diam., 6 ins., in the ground, to bedrock, with marked stone (X) deposited alongside, supported in a mound of stone, 4 ft. base, 2 1/2 ft. high, for the cor., of secs., 1, 6, 7 and 12, marked on brass cap

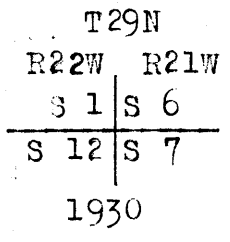

Land: broken and mountainous.
 Soil: rocky, 3rd. rate.
 Timber: none.
 Undergrowth: greasewood, catclaw, cacti.

North on true line bet. secs., 1 and 6.
 Over mountainous land, thru scattered undergrowth.
 Asc., SE. slope 150 ft.,
 1.00 Spur, slopes S. 75° E.,
 3.50 Gully, course SE.
 10.70 Spur, slopes NE., Desc., NW. slope 350 ft.,
 33.00 Wash, 20 lks. wide, course NE., Over broken desert, desc., 50 ft.,
 40.00 Set an iron post, 3 ft. long, 1 in., diam., 18 ins., in the ground, to bedrock, supported in a mound of stone, 3 ft. base, 1 1/2 ft. high, for 1/4 sec. cor., marked on brass cap.

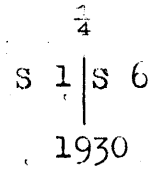

raise a mound of stone, 3 ft. base, 2 ft. high, W. of cor.,

50.00 Wash, 20 lks. wide, course E.,
 64.90 Enter overflow, course E.,
 76.00 Leave overflow, Asc., SE. slope of gravel hills, 50 ft.,
 80.00 Set an iron post, 3 ft. long, 3 ins., diam., 12 ins., in the ground, to bedrock, with marked stone (X) deposited alongside, supported in a mound of stone, 5 ft. base, 2 ft. high, for cor. of T. 29 N. & 30 N., R. 21 W., T. 30 N., R. 22 W., and frac. T. 29 N., R. 22 W., marked on brass cap

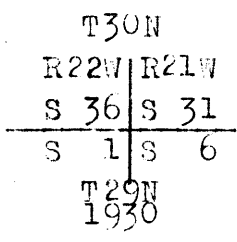

Land: mountainous and broken.
 Soil: rocky, and gravelly, 3rd. rate.
 Timber: none.
 Undergrowth: greasewood, catclaw, cacti.

Survey of the North Boundary of Frac. T.29 N., R.22 W.

chains From cor. of Ts. 29 & 30 N., R. 21 W., T. 30 N., R. 22 W. and Frac. T. 20 N., R. 22 W., hereinbefore described, West, on true line, bet. secs. 1 and 36.
 Over rolling land, thru scattered undergrowth.
 Asc., E. slope 40 ft.,
 2.00 Small spur, slopes S. Over rolling S. slope, asc., 190 ft.
 10.10 Gully, course SE.
 28.00 Enter wash, course S. 70° E.
 30.00 Leave wash, from SW.,
 40.00 Set an iron post, 3 ft. long, 1 in. diam., 18 ins., in the ground, to bedrock, with marked stone (X) deposited alongside, supported in a mound of stone, 3 ft. base, 1 1/2 ft. high, for 1/4 sec. cor., marked on brass cap

1/4 S 36
 S 1

1930

Prominent lava butte bears NE. about 10 chs., dist.,

Along S. slope.
 41.30 Gully, course SE., Asc., E. slope 125 ft.,
 46.50 Spur, slopes SE., Desc. 75 ft.,
 49.20 Draw, course SE., Asc., E. slope 225 ft.,
 56.00 Spur, slopes SE., Along S. slope, asc., 130 ft.,
 69.00 Head of draw, course S. 70° E., Asc., E. slope 230 ft.,
 76.15 Ridge, bears N., and S., Divide between Petrital Valley and Colorado River.
 Desc., W. slope 200 ft.,
 80.00 Set an iron post, 3 ft. long, 2 ins. diam., on bedrock, with marked stone (X) deposited alongside, supported in a mound of stone, 5 ft. base, 3 ft. high, for the cor. of secs., 1, 2, 35 and 36, marked on brass cap.

T30N R22W
 S 35 | S 36
 S 2 | S 1
 T29N
 1930

Land: rolling and mountainous.
 Soil: rocky, gravelly, 3rd. rate.
 Timber: none.
 Undergrowth: greasewood, catclaw, & cacti.

 West on true line bet. secs., 2 and 35.
 Over mountainous land, thru scattered undergrowth.
 Desc., NW. slope 740 ft.,
 17.60 Gulch, course N.,
 35.00 Over rolling land.
 40.00 Set an iron post, 3 ft. long, 1 in. diam., 24 ins., in the ground, to bedrock, supported in a mound of stone, 2 ft. base, 1 ft. high, for 1/2 sec. cor., marked on brass cap

1/2 S 35
 S 2

1930

raise a mound of stone, 3 ft. base, 2 ft. high, N. of cor.,

Desc., 100 ft.,
 44.70 Enter wash, 1.00 ch. wide, course S. 70° W.,
 57.30 Leave Wash, course SW. Asc., 20 ft.,
 60.00 Small spur, slopes SW., Desc., 180 ft.,
 63.00 Gully, course SW.
 80.00 Set an iron post, 3 ft. long, 2 ins. diam., 30 ins., in the ground, for the cor., of secs., 2, 3, 34 and 35, marked on brass cap

Survey of the North Boundary of Trac. T. 29. N., R. 22 W.

chains

T30N R22W	
S 34	S 35
S 3	S 2
T29N	
1930	

raise a mound of stone, 3 ft. base, 1 1/2 ft. high, W. of cor.,

Land: mountainous and rolling.
Soil: rocky and gravelly. 3rd. rate.
Timber: none.
Undergrowth: greasewood, catclaw, cacti.

West on true line bet. secs., 3 and 34.
Over rolling desert, thru scattered undergrowth.
Along N. slope of gravel hill.

- 15.00 Desc., NW. slope 120 ft.,
- 24.00 Spur, slopes S. 80° W., Desc., 150 ft.,
- 35.00 Enter desert wash, course SW.,
- 40.00 Set an iron post, 3 ft. long, 1 in. diam., 22 ins., in the ground, to rock, supported in a mound of stone, 3 ft. base, 1 ft. high, for 1/2 sec. cor., marked on brass cap

S 34	
1/4	S 3
1930	

raise a mound of stone, 3 ft. base, 2 ft. high, N. of cor.,

- 48.00 Leave overflow land, course SW.,
- 58.50 Wash, course S. 80° W.
- 69.50 Wash, 1.00 ch. wide, course SW.,
- 77.00 Spur, slopes S. 80° W.
- 80.00 Set an iron post, 3 ft. long, 2 ins. diam., 24 ins. in the ground, to bedrock, supported in a mound of stone, 2 ft. base, 1 ft. high, for the cor., of secs., 3, 4, 33 and 34, marked on brass cap

T30N R22W	
S 33	S 34
S 4	S 3
T29N	
1930	

raise a mound of stone, 3 ft. base, 1 1/2 ft. high, W. of cor.,

Land: rolling.
Soil: gravelly and rocky, 2nd. and 3rd. rate.
Timber: none.
Undergrowth: greasewood, catclaw, cacti.

West on true line bet. secs., 4 and 33.
Over rolling land, thru scattered undergrowth.
Desc., 170 ft.,

- 8.20 Wash, course SW.
- 14.80 Wash, 1.00 ch. wide, course S.
- 38.50 Gully, course SW.
- 40.00 Set an iron post, 3 ft. long, 1 in. diam., 24 ins., in the ground, to bedrock, supported in a mound of stone 2 ft. base, 1 ft. high, for 1/2 sec. cor., marked on brass cap

S 33	
1/4	S 4
1930	

raise a mound of stone, 3 ft. base, 1 1/2 ft. high, N. of cor.

Survey of the North Boundary of **Frac. T. 29. N. R. 22 W.**

chains

53.06 Over broken desert, gradual descent.
 62.00 Enter washed land, course SW.
 69.00 Leave wash.
 76.60 Wnter wash, course SW.
 78.50 Road, bears NE. and SW.,
 80.00 Leave wash, course SW., Asc., E. slope 30 ft.,
 Set an iron post, 3 ft. long, 2 ins., diam., 24 ins., in the
 ground, to bedrock, supported in a mound of stone,
 2 ft. base, 1 ft. high, for the cor., of secs., 4, 5, 32 and
 33, marked on brass cap

T30N R22W

S 32	S 33
------	------

S 5	S 4
-----	-----

T29N

1930

raise a mound of stone, 3 ft. base, 2 ft. high, W. of cor.,

Land: rolling and broken desert.
 Soil: gravelly, 2nd. and 3rd. rate.
 Timber: none.
 Undergrowth: greasewood, cacti.

West on true line bet. secs., 5 and 32.
 Over broken land, thru scattered undergrowth.
 Ascend E. slope. 100 ft.,

1.00 Rim of mesa, bears NE. and SW.
 17.50 Rim of mesa, bears NW. and SE., Desc., W. slope 350 ft.,
 28.40 Draw, course SW., Asc., E. slope 100 ft.,
 36.00 Change of slope to SE.,
 40.00 Set an iron post, 3 ft. long, 1 in., diam., 24 ins., in the
 ground, to bedrock, supported in a mound of stone;
 2 ft. base, 1 ft., high, for $\frac{1}{4}$ sec. cor., marked on brass
 cap

$\frac{1}{4}$ S 32	
S 5	

1930

raise a mound of stone, 3 ft. base, 2 ft. high, N. of cor.,

40.50 Spur, slopes S.
 Along S. slope.
 46.30 Spur, slopes S. Desc., SW. slope 125 ft.,
 51.00 Draw, course S., Asc., SE. slope 125 ft.,
 55.50 Spur, slopes S., Desc., W. slope 120 ft.,
 63.30 Draw, course S., Asc., E. slope 280 ft., along gully,
 draining east.
 77.50 Spur, slopes SE., Along S. slope.
 78.00 Spur, slopes SW. Desc., W. slope 35 ft.,
 80.00 Set an iron post, 3 ft. long, 2 ins., diam., on bedrock,
 with marked stone (X) alongside, supported in a mound
 of stone, 5 ft. base, 3 ft. high, for the cor., of secs.,
 5, 6, 31 and 32, marked on brass cap

T30N R22W

S 31	S 32
------	------

S 6	S 5
-----	-----

T29N

1930

Land: broken and mountainous.
 Soil: rocky, 3rd. rate.
 Timber: none.
 Undergrowth: greasewood, catclaw, cacti.

West on true line bet. secs., 6 and 31.

Survey of the North Boundary of Frac. T. 29 N., R. 22 W.

chains

- West on true line bet. secs. 6 and 31.
- Over rolling mountainous land, thru scattered undergrowth.
- Desc., NW. slope 220 ft.,
- 16.00 Wash, 2.00 chs., wide, course S. 10° W., Asc., SE. slope 110 ft.,
- 22.00 Spur, slopes S. 20° E., Desc. W. slope 75 ft.,
- 26.00 Wash, 2.00 chs., wide, course S. 25° E., Asc., E. slope 220 ft.,
- 37.00 Spur, slopes S. 30° E. Over S. slope, desc 25 ft.,
- 39.00 Gully, course S.
- 40.00 Set an iron post, 3 ft. long, 1 in., diam., on bedrock, with a marked stone (X) deposited alongside, supported in a mound of stone, 5 ft. base, 3 ft. high, for $\frac{1}{4}$ sec. cor., marked on brass cap

1/4	S 31
	S 6

1930

- 42.50 Spur, slopes S., Desc., W. slope 200 ft.,
- 49.50 Wash, 30 lks., wide, course S., Along broken S. slope.
- 62.00 Gully, course SE.
- 70.20 Draw, course S. 30° E.
- 72.50 Point of rocky spur, extends S.,
- 76.50 Gully, course SE. Asc., along gully from west, 50 ft.,
- 79.48 Set an iron post, 3 ft., long, 3 ins., diam., on bedrock, with a marked stone (X) deposited alongside, supported in a mound of stone, 5 ft. base, 3 ft. high, for cor. of, T. 30 N., R. 22 W., Frac. T. 30 N., R. 23 W., and Frac. T. 29 N., Rs. 22 & 23 W., marked on brass cap

T 30 N	
R 23 W	R 22 W
S 36	S 31
S 1	S 6
T 29 N	
1930	

Land: rolling and broken mountains.
 Soil: rocky, 3rd. rate.
 Timber: none.
 Undergrowth: greasewood, catclaw, cacti.

Survey of Part of the West Boundary of Frac. T. 29. N., R. 22. W.

chains From cor. of T. 30N., R. 22W., Frac. T. 30N., R. 23W., and Frac. T. 29N., R. 22 & 23W., hereinbefore described,

South on true line bet. secs., 1 and 6.
 Over mountainous land, thru scattered undergrowth.
 Asc., NE. slope 10 ft.,
 0.50 Small spur, slopes S. 70° E., Desc., 20 ft.,
 1.30 Gully, course SE. Asc., NE. slope 50 ft.,
 7.00 Spur, slopes E. Asc., 40 ft.,
 10.40 Spur, slopes E., Desc. 70 ft.,
 14.15 Gully, course E., Asc. NE. slope 120 ft.,
 20.50 Spur, slopes E. Desc. SE. slope 275 ft.,
 33.30 Gully, course N. 80° E., Asc., 50 ft.,
 35.00 Spur, slopes N. 80° E., Desc., 30 ft.,
 36.30 Gully, course S. 70° E., Asc., 40 ft.,
 37.50 Spur, slopes E., Desc., 25 ft.,
 39.65 Gully, course S. 70° E., Asc., 10 ft.,
 40.00 Set an iron post, 3 ft. long, 1 in., diam., 12 ins., in the ground, to bedrock, with marked stone (X) deposited alongside, supported in a mound of stone, 3 ft. base, 2 ft. high, for $\frac{1}{4}$ sec. cor., marked on brass cap

S 1 | S 6

1930

40.10 Gully, course E., Asc., 20 ft.,
 41.70 Spur, slopes E., Desc., S. slope 160 ft.,
 47.90 Draw, course S. 70° E., Asc., 40 ft.,
 52.00 Spur, slopes E., Desc., 70 ft.,
 54.70 Draw, course E., Asc., 50 ft.,
 56.60 Small spur, slopes E., Desc., 40 ft.,
 58.20 Gully, course E., Asc., NE. slope 140 ft.,
 64.70 Spur, slopes E., Along E. slope.
 70.15 Drain, course E., Asc., 30 ft.,
 72.10 spur, slopes SE., Along E. slope.
 75.61 Drain, course SE.
 77.00 Desc., SE slope 40 ft.,
 79.50 Gully, course SE.,
 80.00 Set an iron post, 3 ft. long, 2 ins., diam., on bedrock, with marked stone (X) deposited alongside, supported in a mound of stone, 4 ft. base, 3 ft. high, for the cor. of secs., 1, 6, 7 and 12, marked on brass cap

T 29 N
 R 23 W R 22 W

S 1 | S 6

S 12 | S 7

1930

Land: rolling and broken mountains.
 Soil: rocky and gravelly, 3rd. rate.
 Timber: none.
 Undergrowth: greasewood, catclaw, cacti.

South on true line bet. secs., 7 and 12.
 Over mountainous land, thru scattered undergrowth.
 Desc., S. slope 60 ft.,
 0.10 Gully, course SW.,
 2.50 Gully, course SE., Desc., over SE. slope 270 ft.,
 18.80 Gully, course E.,
 19.50 Small spur, slopes E., Desc., 50 ft.,
 21.50 Gully, course E.,
 24.40 Spur, slopes E., Desc., 20 ft.,
 26.00 Gully, course E., Asc., 15 ft.,
 27.90 Spur, slopes SE. Desc. 50 ft.,
 33.30 Spur, slopes SE., Desc. S. slope 70 ft.,

Survey of Part of the West Boundary of Frac. T.29 N., R.22 W.

chains
40.00

Set an iron post, 3 ft. long, 1 in. diam., 12 ins. in the ground to bedrock, with marked (X) stone deposited alongside, supported in a mound of stone 3 ft. base, 1 1/2 ft. high, for 1/4 sec. cor., marked on brass cap

S 12 | S 7

1930

- 41.20 Desc. over S. slope 30 ft.
- 41.20 Enter wash, course S. 70° W.
- 44.30 Leave wash, course W. Asc. over N. slope 40 ft.
- 47.00 Point of spur, slopes W. Desc. 40 ft.
- 49.40 Gulch, course NW.
- 51.00 Draw, course N. 10° W. Asc. over NE. slope 80 ft.
- 54.00 Spur, slopes E. Asc. 180 ft.
- 62.000 Change to N. slope.
- 64.90 Ridge, bears E. and W. Desc. over S. slope 100 ft.
- 69.70 Gully, course S. 10° W.
- 72.50 Drain, course W. Asc. over NW. slope 50 ft.
- 76.00 Rocky peak of small spur from E., breaks sharply to SE. Desc. over bluff 110 ft.
- 77.00 Foot of bluff, bears W. and SE.
- 80.00 Set an iron post, 3 ft. long, 2 ins. diam., 10 ins. in the ground to bedrock, with marked (X) stone deposited alongside, supported in a mound of stone, 4 ft. base, 2 ft. high, for cor. of secs. 7, 12, 13 and 18, marked on brass cap

T29N

R23W | R22W

S 12 | S 7

S 13 | S 18

1930

Land, mountainous.
Soil, rocky, 3rd rate.
Timber, none.
Undergrowth, greasewood, catclaw and cacti.

-
- 5.75 South, on true line, bet. secs. 13 and 18.
 - 10.90 Over mountainous land, thru scattered undergrowth. Desc. 100 ft. over S. slope along E. side of gully.
 - 10.90 Wash, 75 lks. wide, course W. Asc. over N. slope 80 ft.
 - 17.40 Spur, slopes NW. Thence along NW. slope. Asc. 40 ft.
 - 17.40 Gully, course N. 20° W. Asc. 80 ft.
 - 21.20 Spur, slopes N. 20° W. Desc. 60 ft.
 - 23.70 Gully, course N. 30° W. Asc. N. slope 230 ft., along E. side of gulch.
 - 33.25 Ridge, bears E. and W. Desc. over SW. slope 40 ft.
 - 37.60 Gully, course SW. Asc. 35 ft. over NW. slope to
 - 40.00 Set an iron post, 3 ft. long, 1 in. diam., on bedrock, with marked (X) stone deposited alongside, supported in a mound of stone 4 ft. base, 2 1/2 ft. high, for 1/4 sec. cor. of secs. 13 and 18, marked on brass cap

S 13 | S 18

1930

- 42.50 Asc. 25 ft.
- 42.50 Rocky point of spur from NE., slopes S. 20° E. Desc. over SW. slope 200 ft.
- 50.60 Head of gully, course W. Asc. 75 ft.
- 54.40 Small spur from NE., breaks sharply to the West. Desc. 20 ft. over SW. slope to

Survey of Part of the West Boundary of Frac. T. 29 N., R. 22 W.

chains
55.97

Top of cliff, bearing NW. and SE., facing SW. Discontinue chaining at this point owing to precipitous slopes ahead, and triangulate measurement of the remainder of the line as described as follows, and as illustrated by the accompanying diagram?

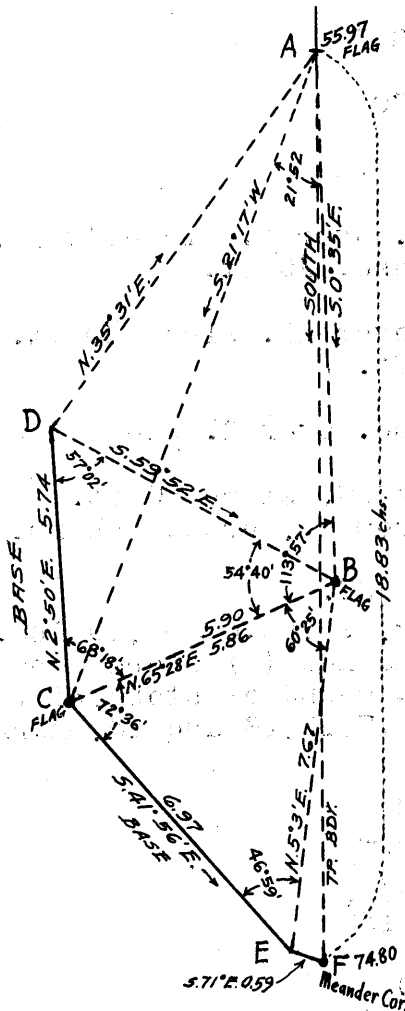

Set flag "A" at this point.
Set flag "B" on ledge of bluff S. 0° 35' E. from "A".
Set flag "C" on apex of spur, S. 21° 17' W. from "A".
From "C" measure a base N. 2° 50' W., 5.74 chs. to point "D".
From "C" measure a base S. 41° 56' E., 6.97 chs. to point "E".
Flag "A" bears N. 35° 31' E. from point "D".
Flag "B" bears N. 65° 28' E. from flag "C", S. 59° 52' E. from "D" and N. 5° 3' E. from "E".
Vertical angle "A" to "B" is -16°, and "E" to "B" is +38°.
Length of "B-C" computed on the base "C-D" is 5.90 chs., and computed on base "C-E" is 5.86 chs., the mean of which is 5.88 chs.
Length of "A-B" computed on "B-C" 5.88 chs. is 11.00 chs.
Length of "B-E" computed on "B-C" 5.88 chs. is 7.67 chs.
The latitude and departure of the triangulated traverse "A-B-E" is 18.64 chs. South, and 0.56 chs. West, respectively.

From "E" chain measurement S. 71° E. along the left bank of Colo. River, 0.59 chs. to point "F" on high water mark, theoretically due South from "A", 18.83 chs. dist.

Chained dist. on Tp. bdy. to "A" = 55.97 chs. South.
Latitude of traverse "A-B-E-F" = 18.83 " "
Dist. - sec. cor. to meander cor. (F) = 74.80 chs. South.

74.80

Point "F" at intersection of Tp. bdy. with high water mark of left bank of the Colorado River, bearing NW. and SE. Set an iron post, 3 ft. long, 1 in. diam., 14 ins. in the ground to bedrock, with a marked (X) stone deposited alongside, and raise a mound of stone around post, for meander cor. of secs. 13 and 18, marked on brass cap

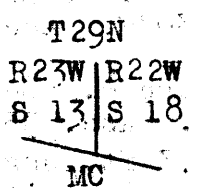

1930

from which
A boulder, 6 x 5 x 5 ft., marked with a cross (X) and lettered BO, bears N. 44 1/4° W., 131 lks. dist.
Face of cliff, marked with a cross (X) and lettered BO, bears S. 81 1/4° E., 76 lks. dist.

Land, broken and mountainous.
Soil, rocky, 3rd and 4th rate.
Timber, none.
Undergrowth, greasewood, catclaw and cacti.

Survey of the North Boundary of Fractional T.29 N., R.23 W.

chains
 From cor. of T30N, R22W., Frac. T30N, R23W., and Frac. Ts. 29N, Rs. 22 & 23W., hereinbefore described, West on true line bet. secs., 1 and 36. Over mountainous land, thru scattered undergrowth. Asc., E. slope 100 ft.,
 0.25 Leave drain, from NW.
 6.70 Saddle in ridge, bearing N.20°E. and S.20°W., Over broken N. slope.
 19.60 spur, extends N., Desc., precipitous W. slope 470 ft.,
 25.20 Gully, course N70°W., Change of slope to NW.
 31.70 Gully, course N.10°W.
 36.35 Draw, course NW.,
 39.90 Wash, 30 lks., wide, course NW.
 40.00 Set an iron post, 3 ft. long, 1 in., diam., 18 ins., in the ground, to rock, with marked stone deposited alongside, supported in a mound of stone, 3 ft. base 1½ ft. high, for ¼ sec. cor., marked on brass cap

¼	S 36
3	1

1930

45.50 Along N. slope. Asc., 90 ft., Sharp rock dyke, slopes N., Desc., W. slope 320 ft.
 56.00 Draw, course SW., Asc., SE. slope 60 ft.,
 59.00 spur, slopes SW., Desc., W. slope 190 ft.,
 68.50 Drain, course NW., Asc., NE. slope 35 ft.,
 70.50 Tip of spur, from SE., Desc., W. slope 180 ft.,
 76.75 Draw, course S., Asc., E. slope 125 ft.,
 80.00 Set an iron post, 3 ft. long, 2 ins., diam., on bedrock, at foot of bluff bearing N. and S., with a marked stone (X) deposited alongside, supported in a mound of stone, 3 ft. base, 2½ ft. high, for the cor., of secs., 1, 2, 35 and 36, marked on brass cap

T30N	R23W
S 35	S 36
S 2	S 1

T29N
1930

Land: broken and rough mountains.
 Soil: gravelly and rocky, 3rd. and 4th. rate.
 Timber: none.
 Undergrowth: cacti, greasewood, and catclaw.

West on true line bet. secs., 2 and 35. Over rough mountainous land, thru scattered undergrowth. Asc., E. slope 90 ft.,
 0.30 Top of bluff, 40 ft. high, facing E.,
 2.10 Spur, slopes SE., Asc., precipitous SE. slope 200 ft.,
 10.00 Top of bluff 50 ft. high, bears N., and NE., Spur breaks sharply to the S., Desc., precipitous W. slope 350 ft.,
 15.00 Draw, course S.20°W., Asc., E. slope 300 ft.,
 28.00 Point of sharp spur, from N., precipitous bluffs to the S.
 29.30 Desc., W. slope 400 ft.,
 34.20 Drain, course S., Over broken SW. slope.
 35.00 Small spur, slopes SW., Change to W. slope.
 39.70 Gulch, course SW., Along S. slope.
 40.00 Set an iron post, 3 ft. long, 1 in., diam., 6 ins., in the ground, to bedrock, with marked stone (X) deposited alongside, supported in a mound of stone, 3 ft. base, 2 ft. high, for ¼ sec. cor., marked on brass cap

¼	S 35
3	2

1930

42.90 Small spur, slopes SW., Desc., SW. slope 220 ft.,

Survey of the North Boundary of Fractional T.29 N., R.23 W.

chains

- 44.30 Spur, slopes SW.
- 51.30 Drain, course SW., at edge of bluff, 50 ft. high, bearing NW. and SE.,
- 53.00 Mouth of draw, from N.,
- 54.00 Asc., 20 ft., to point of spur, from N.,
- 54.30 Top of small peak at point of spur. Desc., 20 ft.,
- 54.90 Drain from N., at high water mark of left bank of Colorado River or

Set an iron post, 3 ft. long, 1 in., diam., in drain, on surface rock, with marked stone (X) deposited along side, supported in a mound of stone and concrete, 3 ft. base, 30 ins., high, for meander cor., of fractional sections 2 and 35, marked on brass cap

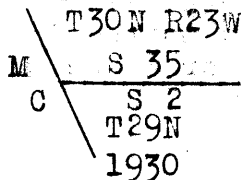

Land: rough and broken mountains.
 Soil: rocky, 4th. rate.
 Timber: none.
 Undergrowth: greasewood, catclaw.

Survey of Subdivisions of Fractional T.29 N., R.23 W.

From corner of secs. 1, 2, 35 and 36, on N. bdy of Tp., hereinbefore described, S. 0° 01' E., on true line bet. secs., 1 and 2. Over broken mountainous land, thru scattered undergrowth. Along E. slope at foot of bluff.

- 0.50 Desc., SE. slope 160 ft.,
- 5.50 Draw, 1.00 ch., wide, course SW., Asc., NW. slope 160 ft.,
- 17.10 Foot of bluff 50 ft., high, bears N. 20° E., and S. 15° W.,



Thence on traverse:

	Latitude.	Departure
	S.	W. E.
S. 15° W., 1.80 chs. =	1.74	0.47
S. 15° E., 1.80 " =	1.74	0.47
	<u>3.48 chs.</u>	<u>0.00 chs. 0.00 chs.</u>

- 20.58 Foot of bluff lies N., 50 lks., dist., bearing NW. and SE. Desc., S. slope 300 ft.,
- 30.30 Gully, course SW., Along SW. slope.
- 37.00 Wash, 20 lks., wide, course SW.,
- 39.00 High water mark of left bank of Colorado River. Set an iron post, 3 ft. long, 1 in., diam., on west slope of small ledge of rock, over a cross (X), supported in a mound of stone and concrete 4 ft. base, 30 ins., high, for meander cor., of fractional secs., 1 and 2, marked on brass cap

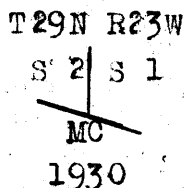

Land: rough, broken mountains.
 Soil: rocky, 3rd. rate.
 Timber: none.
 Undergrowth: greasewood, catclaw, casti.

Survey of Subdivisions of Fractional T.29 N., R.23 W.

chains From cor. of secs. 1, 6, 7 and 12, on E. bdy. of Tp., hereinbefore described,
 West, on true line, bet. secs. 1 and 12.
 Over mountainous land, thru scattered undergrowth.
 Along S. slope.

3.50 Gully, course S.60°E., Asc., E. slope 70 ft.,
 7.50 Ridge, bears N., and S., Desc., W. slope 470 ft.,
 26.00 Draw, course S.20°W., Asc., E. slope 50 ft.,
 27.50 Spur, slopes S., Desc., SW. slope 40 ft.,
 28.50 Gully, course S.10°E., Asc., E. slope 110 ft.,
 32.15 Spur, slopes S., along S. slope.
 35.00 Ridge, bears S.70°W., and NE. Along N. slope.
 37.00 Bluff, 50 ft., high, facing NE. and S.,
 37.50 Top of bluff; Asc., broken ledge 50 ft.,
 40.00 True point for $\frac{1}{4}$ sec. cor., falls on edge of bluff, an
 insecure position in which to monument the corner.
 40.08 Set an iron post, 3 ft. long, 1 in., diam., on bedrock, with
 marked stone (X) deposited alongside, supported in a
 mound of stone, 3 ft. base, 2 $\frac{1}{2}$ ft. high, for witness cor
 to $\frac{1}{4}$ sec. cor., marked on brass cap

$$\frac{1}{4} \begin{array}{l} S \ 1 \\ S \ 12 \end{array} WC.$$

1930

Across broken ledges, on N. slope of peak.

41.10 Top of sharp ledge, 30 ft. high, bearing N. and SW.,
 Desc., W. slope 210 ft.,
 47.50 Gulch, course N.20°W., Along precipitous N. slope; asc.,
 80 ft.,
 51.70 Spur, slopes N., branches to NW., Desc., 200 ft., along
 SW. slope of rocky spur...
 59.30 Gulch, course N., Asc., NE. slope 50 ft.,
 61.30 Spur, slopes N., Desc., rolling W. slope 195 ft.,
 66.17 Top of ledge, 150 ft. high, bearing NW, and SE.

Thence on traverse:

	Latitude.	Departure.
	N. S.	E. W.
S.20°W., 3.90 chs. =		3.67
N. 7°E., 3.70 " =	3.67	0.45

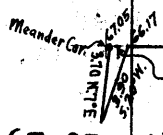

0.00chs. 0.00chs. 0.00chs. 0.88chs

to

67.05 High water mark of left bank of Colorado River at foot of bluff.
 Set an iron post, 3 ft. long, 1 in. diam., in rubble scarp,
 supported in a mound of stone 4 ft. base, 3 ft. high,
 for meander cor., of fractional secs., 1 and 12, marked
 on brass cap

$$\begin{array}{l} T29N R23W \\ M \ S \ 1 \\ C \ S \ 12 \end{array}$$

1930

from which

A cross X marked B O on base of cliff, bears N.10°E.
 71 lks., dist.,
 A cross X marked B O on base of cliff, bears S.30°E.
 19 lks., dist.,

Land: rough, mountainous.
 Soil: rocky, 4th. rate.
 Timber: none.
 Undergrowth: greasewood, catclaw, cacti.

Survey of Subdivisions of Fractional T.29 N., R.23 W.

chains

From cor of secs. 7, 12, 13 & 18, on E. bdy. of the Tp. herein before described West, on true line, bet. secs. 12 and 13. Over broken mountainous land, thru scattered undergrowth. Desc., W. slope 30 ft.,
 0.90 Gully, course S., Asc., E. slope 90 ft.,
 3.00 Spur, slopes S., Desc., W. slope 80 ft.,
 5.20 Gully, course SW., Asc., 30 ft.,
 6.40 Spur, slopes SW., Desc., 60 ft.,
 10.00 Gulch, course S., Asc., SE. slope 100 ft.,
 12.65 Spur, slopes S. Along S. slope.
 15.00 Spur, slopes S., Desc., 100 ft.,
 17.00 Canyon, course S., Asc., 100 ft.,
 18.50 Spur, slopes S., Along S. slope.
 24.50 Gully, course S., Asc., E. slope 150 ft.,
 30.30 Spur, slopes SE., Desc., 30 ft.,
 33.20 Ridge, bears NE. and SW., Along N. slope.
 34.70 Head of draw, course N.,
 36.00 Small spur, slopes N.,
 40.00 Set an iron post, 3 ft. long, 1 in. diam., on bedrock, with a marked stone (X) deposited alongside, supported in a mound of stone, 5 ft. base, 3 ft. high, for $\frac{1}{4}$ sec. cor. marked on brass cap

$\frac{1}{4}$ $\frac{S 12}{S 13}$

1930

Asc., 20 ft.,
 41.20 Spur, slopes N., Desc., W. slope 100 ft.,
 47.50 Top of bluff, 50 ft. high, bearing NW. and SE., Desc., 100 ft.,
 49.30 Head of gully, course S. Along S. slope.
 50.30 Short spur, slopes S., Desc., W. slope 260 ft.,
 56.00 Draw, course SW., Desc., along SW. slope 200 ft.,
 61.15 Highwater mark of left bank of the Colorado River, on rocky ledge. Set an iron post, 3 ft. long, 1 in. diam., on surface rock, with marked stone (X) deposited alongside, supported in a mound of stone, 5 ft. base, 3 ft. high, for meander cor., of fractional secs., 12 and 13, marked on brass cap

T29N R23W

$\frac{M}{C} \frac{S 12}{S 13}$

1930

Land: rough mountains.
 Soil: rocky, 4th. rate.
 Timber: none.
 Undergrowth: greasewood, cacti, and catclaw.

Survey of Meanders of

BOOK 3882

Left bank of Colorado River thru Part of Frac. T.29 N., R.23 W.

From the meander cor., of fractional secs., 2 and 35, on N., bdy., of Tp., hereinbefore described
 Along left margin of river at mean high water, downstream thru sec., 2.

Along broken rocky slope.

S.68°E.	0.85	chs.,	Face of bluff 20 ft., high.
N.41°E.	0.40		
East	2.70		Across mouth of draw, from the N. to face of bluff 50 ft. high.
S.34°E.	2.85		
S.70°E.	3.70		
S.58½°E.	6.25		Leave bluff, along broken rocky slope.
S.63°E.	0.60		
S.48°E.	4.40		
S.67°E.	1.50		
S.88½°E.	2.50		
S.53°E.	3.00		
S.83°E.	2.30		
S.52½°E.	1.86		
S.49°E.	3.81		
N.30°E.	0.80		
S.75°E.	2.47		To mouth of draw, from N.,
S.13°E.	1.83		
S.55°E.	0.50		
S.64°E.	1.95		
S.83°E.	1.50		To mouth of short gulch, from NE.
S.45°W.	1.60		
S.30½°E.	2.60		
S.23°E.	2.36		
S.33°E.	1.35		
S.55½°E.	1.60		
N.23°E.	3.00		To mouth of draw, from N.,
S.11°W.	3.30		
S.53°E.	5.88		
N.82°E.	1.55		
S.55½°E.	2.75		
S.33°E.	0.90		To mouth of draw, from NE.
South	0.30		
S.15°E.	1.40		
S.53°E.	3.90		
N.61°E.	1.20		To mouth of wash, from NE.
S.10°W.	0.80		
S. 5½°E.	1.60	chs.	To meander cor., of fractional secs., 1 and 2, hereinbefore described.

Land: broken and mountainous. rocky.
 Soil: rocky and sandy, 4th. rate.
 Timber: none.
 Undergrowth: scrub mesquite.

Along left margin of river at mean high water, downstream thru sec., 1.

Over rocky broken slope.

S.50°E.	1.50	chs.	
S.19°E.	1.40		To mouth of gully, from NE.
S.35°E.	2.20		
S.58°E.	2.30		To face of bluff, 30 ft. high.
S.44°E.	5.40		
S.59°E.	1.43		
N.60°E.	0.70		
S.20°E.	2.00		

Survey of Meanders of
Leftbank of Colorado River thru Part of Frad. T. 29 N., R. 23 W.

S. 30° E.	4.00 chs.	
S. 4° W.	2.56	
S. 17° E.	1.26	
S. 41° E.	2.90	
S. 14° E.	1.90	
South	3.70	To mouth of watercourse at foot of bluff, 40 ft. high.

S. 61° W.	1.50	
N. 51° W.	1.20	To face of bluff, 20 ft. high.

S. 10° W.	1.10	
S. 4° E.	1.60	Along face of bluff 50 ft. high.

S. 10° E.	5.30	
S. 16° W.	2.90	Face of bluff 100 ft. high.

S. 26½° W.	1.50	To point of rocky ledge, 10 ft. high.
------------	------	---------------------------------------

S. 23° W.	0.60	
S. 8° E.	2.10 chs.	To meander cor., of fractional secs., 1 and 12, hereinbefore described.

Land: broken and mountainous. rocky.

Soil: rocky, 4th rate.

Timber: none.

Undergrowth: none.

Along left margin of river at mean high water, downstream thru sec., 12.

Along broken rocky slope.

South	3.50 chs.	
-------	-----------	--

S. 27° E.	1.00	
-----------	------	--

S. 3° E.	4.70	
----------	------	--

S. 18° W.	3.90	
-----------	------	--

S. 14° W.	2.10	To face of bluff, 50 ft. high.
-----------	------	--------------------------------

S. 72° W.	0.20	
-----------	------	--

S. 5° W.	1.40	
----------	------	--

S. 22° W.	1.00	Along broken rocky slope.
-----------	------	---------------------------

S. 21° W.	4.60	
-----------	------	--

S. 31° E.	1.00	To mouth of draw, from E.,
-----------	------	----------------------------

S. 78° W.	0.50	
-----------	------	--

South	2.00	
-------	------	--

S. 46° W.	1.50	
-----------	------	--

S. 19° E.	0.70	
-----------	------	--

S. 53° E.	1.50	
-----------	------	--

S. 1° E.	1.80	
----------	------	--

S. 11° W.	4.40	
-----------	------	--

S. 7° W.	4.20	
----------	------	--

S. 22½° E.	1.00	
------------	------	--

S. 7° W.	2.30	
----------	------	--

S. 20½° E.	1.10	
------------	------	--

S. 22° W.	2.60	
-----------	------	--

S. 4½° W.	2.10	
-----------	------	--

S. 31° E.	1.00	
-----------	------	--

S. 33° W.	2.30	
-----------	------	--

S. 70° E.	1.00	
-----------	------	--

S. 32½° E.	2.20	
------------	------	--

S. 17° W.	2.50	
-----------	------	--

S. 5° E.	3.40	
----------	------	--

S. 15° W.	3.00	
-----------	------	--

S. 9° E.	1.20	
----------	------	--

S. 19° W.	1.12	
-----------	------	--

S. 42° E.	1.50	
-----------	------	--

S. 20° E.	1.50	
-----------	------	--

Survey of Meanders of
Left bank of Colorado River thru Part of Frac. T. 29 N., R. 23 W.

- S. 38° E. 8.10 chs.
- S. 65° E. 1.90
- S. 55° E. 1.10 chs. to mouth of draw, from E.
- S. 45° W. 1.60
- S. 37° E. 3.10
- S. 14³/₄° E. 4.04 chs. to meander cor. of fractional secs. 12 and 13, hereinbefore described.

Land, broken and mountainous.
Soil, rocky and sandy, 4th rate.
Timber, none. Undergrowth, none.

Along left margin of river at mean high water mark, downstream thru sec. 13.

Along broken, rocky slope.

- S. 85° E. 1.10 chs.
- S. 49¹/₂° E. 1.00
- S. 15° E. 1.90
- S. 65¹/₂° E. 1.80 chs. to mouth of draw, from NE.
- S. 45° W. 0.70
- S. 56³/₈° E. 5.00
- S. 80¹/₂° E. 2.30 chs. to mouth of gully, from NE.
- S. 16° E. 2.70
- S. 22¹/₂° E. 1.20
- N. 85° E. 1.70 chs. to mouth of gully, from NE.
- S. 2¹/₂° W. 0.90
- S. 40¹/₂° E. 1.20
- S. 17° E. 1.70
- S. 11° E. 1.90
- S. 45° E. 2.30
- S. 60° W. 1.00
- S. 28° W. 1.10
- S. 57¹/₄° E. 2.00
- S. 57¹/₂° E. 2.60
- S. 65¹/₂° E. 5.10
- S. 23¹/₂° E. 1.95 chs. to mouth of draw, from NE.
- S. 16° E. 2.90
- S. 5¹/₂° W. 3.60
- S. 16° E. 3.70
- S. 30° E. 4.30
- S. 32° E. 2.00
- S. 36° E. 3.70
- S. 38° E. 1.50
- S. 45¹/₂° E. 3.60 chs. to mouth of draw, from NE.
- S. 18° W. 0.90
- S. 9° W. 0.90
- S. 32° E. 2.50
- S. 63¹/₄° E. 1.80
- S. 4° W. 1.20
- S. 47° E. 7.00
- S. 2¹/₂° W. 1.90
- S. 56° E. 4.80
- S. 85° E. 1.70
- S. 44° E. 2.20
- S. 68° E. 1.10 chs. to mouth of draw, from NE.
- S. 18¹/₂° E. 1.50
- S. 40° E. 5.30
- East 1.00 ch. to mouth of gulch, from E.
- S. 45° E. 0.60
- N. 65° E. 1.40
- S. 40¹/₂° E. 2.50
- S. 44¹/₂° E. 4.20 chs. to meander cor. of fractional secs. 13 and 18, on E. bdy. of Tp., hereinbefore described.

Land, rough and broken.
Soil, rocky and sandy, 4th rate.
Timber, none. Undergrowth, scrub mesquite & greasewood.

Fractional Township 29 North, Range 23 West

The continued satisfactory adjustment of the instrument used throughout the surveys described in the foregoing notes, is indicated from preliminary and final tests of same, described in Book "B" of this group.

Boundaries of Secs.1,2,12 & 13, Frac.T.29 N.,R.23 W.,Ariz.
Latitudes, departures and closing errors.

Line designated	Course	Dist.	Latitudes		Departures		
			N.	S.	E.	W.	
East Boundary	North	234.80	234.80				
North Boundary	West	134.90				134.90	
Meanders of Left bank of Colo.Riv.	Various	Various	6.44	241.33	156.27	21.73	
Convergency						.15	
<u>Totals</u>			241.24	241.33	156.27	156.78	
				241.24		156.27	
<u>Error in latitude</u>				0.09			
<u>Error in departure</u>						0.51	

GENERAL DESCRIPTION.

Township 29 North, Range 23 West, Arizona, is made fractional by the Colorado River, the center of which is the common boundary of the States of Arizona and Nevada. The Colo. River crosses and recrosses the range line between ranges 22 and 23 West, thus causing Frac.T.29 N.,R.23 W. to be divided into two parts, one part consisting of secs.1,2,12 and 13, and the other is sec.36. Sec.36 is unsurveyed by reason of the fact that the portion of the range line east thereof, and the meanders of the left bank of the Colo.River adjoining said sec., were not surveyed under Group 160,Ariz.

The surface of secs.1,2,12 and 13, surveyed and subdivided as described in the foregoing notes, is very rough, broken and mountainous, draining southwesterly into the Colo.River, which in this vicinity flows southeasterly thru Black Canyon, with an average water width of about 6 chs.

The soil varies from tertiary gravels to an igneous rock formation, 3rd and 4th. rate.

There is no timber in this part of the Tp.

A scattered undergrowth of greasewood, cacti and catclaw is prevalent over most of the land.

There are no settlers or improvements, and no roads.

No indications of valuable minerals were observed within the boundaries of this Tp.

Except the water of the Colorado River, there is no permanent flow of water in any of the watercourses, and there are no springs.

No part of said secs. has any agricultural or grazing value.

This Tp. is adjoined on the west by unsurveyed Frac.Ts.23 and 24 S.,R.65 E.,Nevada.

CERTIFICATE OF UNITED STATES SURVEYOR

I, Dupree R. Averill, U. S. Surveyor, hereby certify upon honor that, in pursuance of special instructions received from the District Cadastral Engineer, for Group 160 Arizona bearing date of the 15th day of July, 1929, I have well, faithfully, and truly in my own proper person, and in strict conformity with said instructions, the Manual of Surveying Instructions, and the laws of the United States, surveyed all those parts or portions of the 7th Standard Parallel North in Ranges 19, 20, 21, 22 and Frac. 23 West, the East, North and West bdrs. of Frac. T. 29 N., R. 22 W., the North bdy. and Subdivision lines of Frac. T. 29 N., R. 23 W., and Meanders of Left Bank of the Colorado River in Fractional Township 29 North, Range 23 West of the Gila and Salt River Base and Meridian, in the State of Arizona, which are represented in *and by diagram on page 1 hereof* the foregoing field notes *as* having been executed by me, and under my direction; and that all the corners of said survey have been established and perpetuated in strict accordance with the Manual of Surveying Instructions, and the special written instructions of the District Cadastral Engineer, for Group 160, Ariz. and in the specific manner described in the field notes, and that the foregoing are the original field notes of such survey.

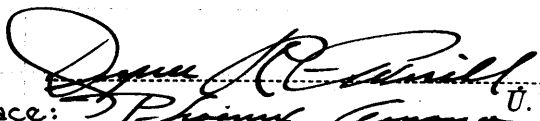
 Place: Phoenix, Arizona U. S. Surveyor.
 Date: May 15, 1930

APPROVAL

OFFICE OF U. S. SUPERVISOR OF SURVEYS,

Denver, Colo., October 10, 1930

The foregoing field notes of the survey of the 7th Standard Parallel North, thru Part of Range 19 West, and thru all of Ranges 20, 21, 22 and Frac. 23 West, the East and North bdrs, and Part of the West bdy. of Frac. T. 29 N., R. 22 W., the North bdy. and Subdivision lines of Frac. T. 29 N., R. 23 W., and the Meanders of Left Bank of the Colorado River thru part of Frac. T. 29 N., R. 23 W.

of the Gila and Salt River Base & Meridian, in the State of Arizona

executed by Dupree R. Averill, U.S. Surveyor

under his special instructions dated July 15, 1929 for Group 160, Arizona, having been critically examined, and the necessary corrections and explanations made, the said field notes, and the surveys they describe, are hereby approved.

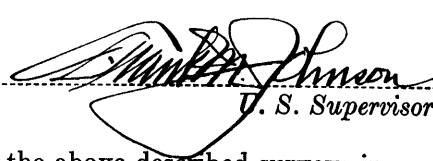
 U. S. Supervisor of Surveys.

I certify that the foregoing transcript of the field notes of the above described surveys in

, has been correctly copied from the original notes on file in this office.

U. S. Supervisor of Surveys.