

FIELD NOTES

BOOK 3903

OF THE SURVEY OF THE

Subdivision Lines of

Township 15 North, Range 7 West

Of the Gila and Salt River Base and Meridian,

In the State of Arizona

EXECUTED BY

William E. Hiester, U.S. Surveyor

and

Charles E. Hunter, U.S. Transitman

In the capacity of U. S. Surveyors, under Special Instructions dated June 24, 1929, issued by the District Cadastral Engineer to govern surveys included in Group No. 159 - Arizona, which were approved by the Commissioner of the General Land Office, July 10, 1929, and Assignment Instructions dated Jan. 2, 1930

Survey commenced March 6, 1930

Survey completed April 3, 1930

3903

3903

1A

Book "E"  
Group 159 - Arizona

BOOK 3903

INDEX DIAGRAM.

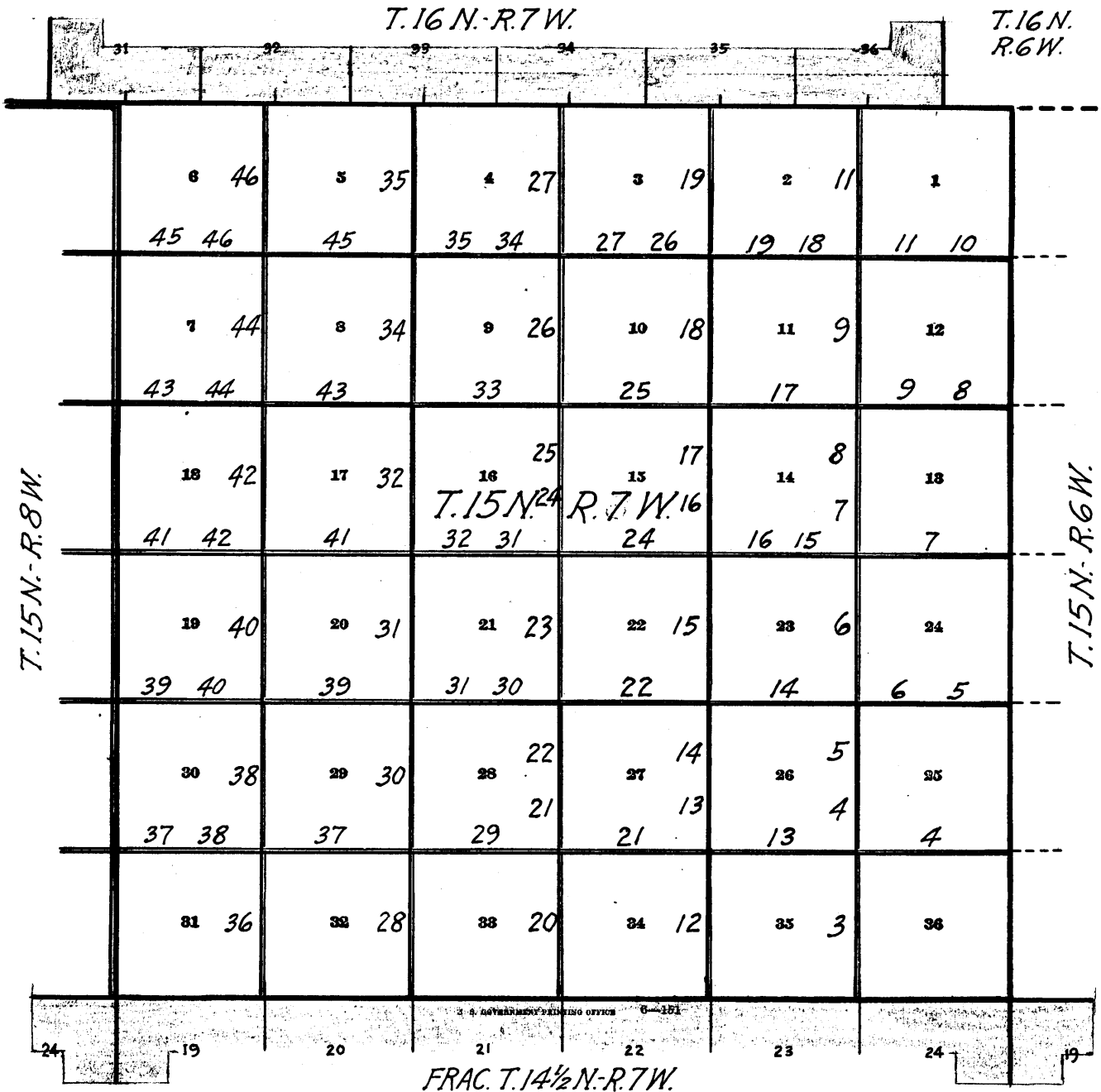

- Lines surveyed under this group.
- Accepted surveys.
- Unsurveyed.
- Areas surveyed as per accepted plats on file.

DATE-DIAGRAM-  
1930

Book "E" Group 159 Arizona  
Township 15 North- Range 7 West

*Surveyed in 1905*

6 3-24	4-3 4-3	5 3-24	4-1 4-1	4 3-24	3-22 3-22	3 3-22	3-19 3-19	2 3-22	3-20 3-20	1 3-20
7 4-2	4-2 4-2	8 3-29	3-31 3-31	9 3-31	3-21 3-21	10 3-21	3-19 3-19	11 3-11	3-20 3-20	12 3-11
13 3-25	3-29 3-29	14 3-28	3-28 3-28	15 3-27	3-21 3-12	16 3-13	3-19 3-13	17 3-18	3-11 3-11	18 3-18
19 3-24	3-25 3-25	20 3-24	3-27 3-27	21 3-22	3-12 3-12	22 3-14	3-13 3-13	23 3-14	3-11 3-11	24 3-14
29 3-21	3-24 3-24	28 3-6	3-22 3-22	27 3-6	3-8 3-8	26 3-7	3-13 3-13	25 3-7	3-10 3-10	26 3-7
31 3-6	3-6 3-6	32 3-21	3-21 3-21	33 3-8	3-8 3-8	34 3-13	3-13 3-13	35 3-10	3-10 3-10	36 3-10

*Surveyed in 1915*

*Surveyed in 1915*

*Surveyed in 1915*

*Surveyed in 1915*

Surveyed by William E. Hiester, U.S. Surveyor under this group on dates (1930) shown thereon. Notes herein.

Surveyed by Charles E. Hunter, U.S. Transitman under this group on dates (1930) shown thereon. Notes herein.

Surveyed under this group. Date diagram and notes in Book "D" of this group.

Accepted surveys.

The surveys herein described were executed on dates shown on diagram page 1 hereof, by William E. Hiester, U.S. Surveyor, and Charles E. Hunter, U.S. Transitman, using respectively Buff and Buff transit No. 19423 and Young and Sons transit No. 8584; the instruments are equipped with improved Smith solar attachments. The horizontal limbs are provided with two double verniers placed opposite each other and reading to single minutes of arc, which is also the least count of the verniers of the vertical circles, latitudes and declination arcs.

The instruments were approved, subject to the usual field tests by the District Cadastral Engineer for Arizona.

Unless otherwise specified all azimuths are determined by the solar attachments, and all measurements are made with Lallie steel tapes 5 chains in length, compared with a Lufkin standard steel tape and found correct. The measurements are made on the slope, the vertical angle determined with clinometers or transit, and the measurements properly reduced to true horizontal distances for entry in the field notes.

For preliminary and final tests of instruments on a meridian determined by Polaris, see the field notes for exteriors and subdivisions in Book "D" of this group.

---

Subdivision of T.15 N., R.7 W.

Chains

The E. and S. bdys. of T.15 N., R.7 W., was surveyed by John F. Hesse, U.S.S., in 1915, establishing cors. thereon with common reference to areas on both sides of the lines. The S. bdy. of T.16 N., R.7 W., was surveyed by A.B. Mader, U.S.D.S., in 1905, establishing cors. thereon with common reference to areas on both sides of the line. No retracement or resurvey of any part of these lines is of record. The following notes describe the subdivision of T.15 N., R.7 W.

The cor. of secs. 23, 24, 35 and 36, on S. bdy. of T.15 N., R.7 W. is an iron post, 3 ins. diam., projecting 12 ins. above ground, with brass cap marked

T15NR7W  
S35|S36  
S23|S24  
T14 1/2 N  
1915

Witnessed by a mound of stone, 3 ft. base, 2 ft. high, W. of cor.

Thence

N. 0° 1' W., bet. secs. 35 and 36.

Over mountainous land, through scattering undergrowth.

Asc. 39 ft. over SW. slope.

3.74 Top of spur, slopes SW.; desc. 179 ft. over NW. slope.

21.17 Wash, 10 lks. wide, course S. 65° W.; asc. 265 ft. over S. slope.

39:12 Top of spur, slopes S. 75° W.; desc. 31 ft. along broken W. slope.

40.00 Set an iron post, 3 ft. long, 1 in. diam., 16 ins. in the ground to bedrock, deposit a stone marked with a cross (X) at base of post, supported in a mound of stone, for 1/4 sec. cor. of secs. 35 and 36, with brass cap marked

1/4  
S35|S36  
1930

No bearing trees available.

Asc. 57 ft. over S. slope.

48.06 Top of spur, slopes W.; desc. 400 ft. over steep N. slope.

60.00 Wash, 20 lks. wide, course S. 60° W.; asc. 521 ft. over broken SE. slope.

80.00 Set an iron post, 3 ft. long, 2 ins. diam., 30 ins. in the ground, for cor. of secs. 25, 26, 35 and 36, with brass cap marked

T15NR7W  
S26|S25  
S35|S36  
1930

Raise a mound of stone, 3 ft. base, 2 1/2 ft. high, W. of cor.

Land, mountainous.

Soil, gravelly; 3rd rate.

Timber, none.

Undergrowth, scattering catclaw, cactus, yucca and grass.

Chains  
40.00  
79.92

East, on a random line, bet: secs. 25 and 36.  
Set temp  $\frac{1}{4}$  sec. cor.  
Intersect the cor. of secs. 25, 30, 31 and 36, on E. bdy. of  
Tp., which is an iron post, 3 ins. diam., projecting 30 ins.  
above ground, supported in a mound of stone, with brass  
cap marked

T15N  
R7W | R6W  
S25 | S30  
S36 | S31  
1915

Thence  
West, on a true line, bet. secs. 25 and 36.  
Over mountainous land, through scattering timber and  
undergrowth.  
Desc. 12 ft. along S. slope.  
Wash, 15 lks. wide, course S. 80° E.; asc. 303 ft. over NE. slope.  
Top of spur, slopes S. 65° E.; continue ascending 208 ft.  
Set an iron post, 3 ft. long, 1 in. diam., 28 ins. in the  
ground, for  $\frac{1}{4}$  sec. cor. of secs. 25 and 36, with brass cap  
marked

5.92  
25.12  
39.96

S25  
 $\frac{1}{4}$  ———  
S36  
1930

No bearing trees available.  
Raise a mound of stone, 3 ft. base, 2 $\frac{1}{2}$  ft. high, N. of cor.

Asc. 170 ft. over E. slope.  
Top of ridge, bears N. and S.; desc. 347 ft. over steep  
broken W. slope.  
Wash, 20 lks. wide, course S. 40° W.; asc. 349 ft. over steep E.  
slope.  
The cor. of secs. 25, 26, 35 and 36.

49.02  
66.06  
79.92

Land, mountainous.  
Soil, gravelly; 3rd rate.  
Timber, scattering juniper.  
Undergrowth, scattering catclaw, scrub oak, cactus, yucca  
and grass.

-----  
N. 0° 1' W., bet. secs. 25 and 26.  
Over mountainous land; through scattering timber and  
undergrowth.  
Asc. 10 ft. along broken SE; slope.  
Top of ascent, and head of draw, course S. 45° E.; asc. 157 ft.  
over rocky S. slope.  
Top of spur, slopes S. 75° E.; desc. 270 ft. over steep NE. slope.  
Rocky gulch, 20 lks. wide, course S. 70° E.; asc. 249 ft. over  
steep rocky SW. slope.  
Set an iron post, 3 ft. long, 1 in. diam., 12 ins. in the  
ground to bedrock, supported in a mound of stone, for  $\frac{1}{4}$   
sec. cor. of secs. 25 and 26, with brass cap marked

14.34  
18.65  
28.10  
40.00

$\frac{1}{4}$   
S26 | S25  
1930

from which

a limb of a cedar, 6 ins. diam., bears N. 5 $\frac{1}{2}$ ° E., 120 lks. dist.,  
marked  $\frac{1}{4}$  S25 BT.  
a cedar, 6 ins. diam., bears N. 72 $\frac{1}{2}$ ° W., 18 lks. dist.,  
marked  $\frac{1}{4}$  S26 BT.

Subdivision of T.15 N., R.7 W.

Chains

- 41.40 Top of spur, slopes S.45°E.; thence asc. 150 ft. along E. slope.
- 61.00 Top of rocky spur, slopes S.30°W.; desc. 85 ft. over N. slope.
- 65.80 Small basin, drains SW.; thence along rolling E. slope.
- 78.40 Short spur, slopes S.15°W.; thence along E. slope of saddle.
- 80.00 Set an iron post, 3 ft. long, 2 ins. diam., 26 ins. in the ground, for cor. of secs. 23, 24, 25 and 26, with brass cap marked

T15NR7W  
S23|S24  
S26|S25  
1930

No bearing trees available.  
Raise a mound of stone, 3 ft. base, 2½ ft. high, W. of cor.

Land, mountainous.  
Soil, rocky; 4th rate.  
Timber, scattering cedar.  
Undergrowth, scattering catclaw, scrub oak, yucca, cactus and grass.

40.00  
80.02

- East, on a random line, bet. secs. 24 and 25.
- Set temp. ¼ sec. cor.
- Fall 11 lks. S. of the cor. of secs. 19, 24, 25 and 30 on E. bdy. of Tp., which is an iron post, 3 ins. diam., projecting 12 ins. above ground, with brass cap marked

T15N  
R7W | R6W  
S24 | S19  
S25 | S30  
1915

from which

a cedar, 6 ins. diam., bears S.16¼°W., 28 lks. dist., marked T15N R7W S25 BT.  
a cedar, 12 ins. diam., bears N.16¼°W., 77 lks. dist., marked T15N R7W S24 BT.

Thence  
S.89°55'W., on a true line, bet. secs. 24 and 25.  
Over mountainous land, through scattering undergrowth.  
Asc. 22 ft. over E. slope.

- 1.30 Top of rocky spur, slopes S.10°E.; desc. 29 ft. over W. slope.
- 5.31 Drain, 5 lks. wide, course SE.; asc. 318 ft. over NE. slope.
- 32.91 End of spur, slopes SE.
- 40.01 Set an iron post, 3 ft. long, 1 in. diam., 14 ins. in the ground to bedrock, deposit a stone marked with a cross (X) at base of post, supported in a mound of stone, for ¼ sec. cor. of secs. 24 and 25, with brass cap marked

S24  
¼ ———  
S25  
1930

No bearing trees available.

- 51.27 Continue ascending over SE. slope.
- 57.30 Top of ridge, bears N. and SE.; desc. 148 ft. over W. slope.
- 65.31 Creek, 25 lks. wide, course S.; asc. 199 ft. over SE. slope.
- Top of rocky spur, slopes S.; desc. 144 ft. over SW. slope.

Chains

73.51 Thence over level land,  
 76.61 Wash, 8 lks. wide, course S.15°E.; asc. slightly over SE. slope.  
 78.50 Saddle on low spur, slopes S.15°W.; desc. 9 ft.  
 80.02 The cor. of secs. 23, 24, 25 and 26.

Land, mountainous.  
 Soil, rocky; 4th rate.  
 Timber, none.  
 Undergrowth, scattering scrub oak, mahogany, catclaw, yucca cactus and grass.

N.0°1'W., bet. secs. 23 and 24.  
 Over mountainous land, through scattering timber and undergrowth.

.20 Asc. 95 ft. over rocky S. slope.  
 5.52 Head of shallow drain, 3 lks. wide, course S.65°W.  
 11.66 Top of knoll in small basin; desc. 55 ft. over NE. slope.  
 13.85 Drain, 8 lks. wide, course S.45°E.; asc. 491 ft. over rocky SE. slope.  
 24.00 Trail, bears NE. and SW.  
 40.00 Gulch, 10 lks. wide, course S.25°E.; continue ascending.  
 Set an iron post, 3 ft. long, 1 in. diam., 16 ins. in the ground to bedrock, deposit a stone marked with a cross (X) at base of post, supported in a mound of stone, for  $\frac{1}{4}$  sec. cor. of secs. 23 and 24, with brass cap marked

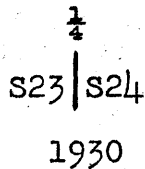

No bearing trees available.

41.40 Head of drain, 5 lks. wide, course S.35°E.  
 48.45 Top of ridge, bears N.80°E., and S.80°W.; desc. 403 ft. over N. slope.  
 59.70 Drain, 7 lks. wide, course NE.  
 65.80 Same drain, course NW.  
 70.70 Trail, bears E. and W.  
 79.40 Creek, 20 lks. wide, 6 ins. deep, course E.; asc. 8 ft. over S. slope.  
 80.00 The true point for cor. of secs. 13, 14, 23 and 24, falls in creek bed a place impracticable to set permanent mon.  
 81.00 Set an iron post, 3 ft. long, 2 ins. diam., 16 ins. in the ground to bedrock, deposit a stone marked with a cross (X) at base of post, supported in a mound of stone, for witness cor. to cor. of secs. 13, 14, 23 and 24, with brass cap marked



from which

a cedar, 8 ins. diam., bears N.83 $\frac{1}{4}$ °E., 235 lks. dist., marked WC T15N R7W S13 BT.  
 a cedar, 10 ins. diam., bears S.46°W., 134 lks. dist., marked WC T15N R7W S23 BT.

No other bearing trees available.

Land, mountainous.  
 Soil, rocky; 4th rate.  
 Timber, scattering cedar.  
 Undergrowth, scattering scrub oak, mahogany, catclaw, yucca cactus and grass.



Subdivision of T.15 N., R.7 W.

Chains From the true point for cor. of secs. 13, 14, 23 and 24.  
 N. 89° 55' E., on a random line, bet. secs. 13 and 24.  
 40.00 Set temp.  $\frac{1}{4}$  sec. cor.  
 80.00 Fall 9 lks. N. of the cor. of secs. 13, 18, 19 and 24, on E. bdy.  
 of Tp., which is an iron post, 3 ins. diam., projecting 12  
 ins. above ground, with brass cap marked

T15N  
 R7W R6W  
 S13 | S18  
 S24 | S19  
 1915

Witnessed by a mound of stone, 3 ft. base, 2  $\frac{1}{2}$  ft. high W. of  
 cor.  
 Thence  
 S. 89° 59' W., on a true line, bet. secs. 13 and 24.  
 Over mountainous land, through scattering timber and  
 undergrowth.  
 Asc. 61 ft. over E. slope.  
 2.42 Top of rocky spur, slopes SE.; desc. 34 ft. over SW. slope.  
 4.24 Drain, course SE.  
 14.66 Top of rocky spur, slopes S.; desc. 120 ft. over rocky W.  
 slope.  
 18.00 Wash, 25 lks. wide, course S.; asc. 70 ft. over SE. slope.  
 21.00 Top of rocky spur, slopes S.; desc. 350 ft. over SW. slope.  
 27.00 Creek, 60 lks. wide, course S. 45° E.; asc. 400 ft. over NE. slope.  
 40.00 Set an iron post, 3 ft. long, 1 in. diam., 14 ins. in the  
 ground to bedrock, deposit a stone marked with a cross  
 (X) at base of post, supported in a mound of stone, for  
 $\frac{1}{4}$  sec. cor. of secs. 13 and 24, with brass cap marked

S13  
 $\frac{1}{4}$  ———  
 S24  
 1930

No bearing trees available.

41.00 Top of broad spur, slopes N.; desc. 100 ft. over NW. slope.  
 55.00 Same Creek, 40 lks. wide, course NE.; asc. 100 ft. over SE.  
 slope.  
 60.00 Top of spur, slopes S.; desc. 100 ft. over SW. slope.  
 65.00 Same Creek, 50 lks. wide, course SE.; thence along N. slope.  
 78.50 Same Creek, 25 lks. wide, course NE.; asc. 10 ft. over SE. slope.  
 80.00 The true point for cor. of secs. 13, 14, 23 and 24.

Land, mountainous.  
 Soil, rocky; 4th rate.  
 Timber, scattering cedar, pinyon, sycamore and oak.  
 Undergrowth, scattering scrub oak, mahogany, catclaw, yucca,  
 cactus, laurel and grass.

From the true point for cor. of secs. 13, 14, 23 and 24.  
 N. 0° 1' W., bet. secs. 13 and 14.  
 Over mountainous land, through scattering timber and dense  
 undergrowth.  
 1.00 Witness cor. to cor. of secs. 13, 14, 23 & 24, hereinbefore described.  
 Asc. 231 ft. over S. slope.  
 12.60 Top of spurs, slopes S. 45° E. and S. 25° W.; thence along spur.  
 17.60 Top of spur, slopes S.; asc. 137 ft. over SE. slope.  
 32.40 Top of spur, slopes SE.; desc. 72 ft. over NE. slope.  
 40.00 Set an iron post, 3 ft. long, 1 in. diam., 22 ins. in the  
 ground for  $\frac{1}{4}$  sec. cor. of secs. 13 and 14, with brass cap  
 marked

$\frac{1}{4}$   
 S14 | S13  
 1930

Chains	from which
	<p>an oak, 6 ins. diam., bears N. <math>18\frac{1}{4}^{\circ}</math> E., 156 lks. dist., marked <math>\frac{1}{4}</math> S13 BT.  a mahogany, 8 ins. diam., bears N. <math>40\frac{1}{4}^{\circ}</math> W., 141 lks. dist., marked <math>\frac{1}{4}</math> S14 BT.</p>
45.59	Wash, 12 lks. wide, course S. $45^{\circ}$ E.; asc. 451 ft. over S. slope.
61.08	Rim of mesa, 20 ft. high, bears E. and W.; continue ascending
68.18	Top of ascent.; thence over rolling mesa land, through heavy timber.
80.00	Set an iron post, 3 ft. long, 2 ins. diam., 8 ins. in the ground to bedrock, supported in a mound of stone, for cor. of secs. 11, 12, 13 and 14, with brass cap marked
	T15NR7W S11 S12 S14 S13 1930
	from which
	<p>a cedar, 4 ins. diam., bears N. <math>31\frac{3}{4}^{\circ}</math> E., 110 lks. dist., marked BT only.  a cedar, 4 ins. diam., bears S. <math>27\frac{1}{2}^{\circ}</math> E., 60 lks. dist., marked BT only.  a cedar, 5 ins. diam., bears S. <math>14\frac{1}{4}^{\circ}</math> W., 104 lks. dist., marked T15N R7W S14 BT.  a cedar, 8 ins. diam., bears N. <math>36^{\circ}</math> W., 49 lks. dist., marked T15N R7W S11 BT.</p>
	Land, mountainous. Soil, rocky; 4th rate. Timber, cedar and pinyon. Undergrowth, scrub oak, catclaw, mahogany, cactus, yucca and grass.
	-----
40.00	N. $89^{\circ}59'$ E., on a random line, bet. secs. 12 and 13.
80.04	Set temp. $\frac{1}{4}$ sec. cor. Fall 19 lks. N. of the cor. of secs. 7, 12, 13 and 18, on E. bdy. of Tp., which is an iron post, 3 ins. diam., projecting 6 ins. above ground, with brass cap marked
	T15N R7W R6W S12 S 7. S13 S18 1915
	Witnessed by a mound of stone, 3 ft. base, 2 ft. high W. of cor. Thence N. $89^{\circ}53'$ W., on a true line, bet. secs. 12 and 13. Over mountainous land, through scattering timber and undergrowth. Asc. 282 ft. over SE. slope.
11.84	Top of rimrocks, 40 ft. high, bears NE. and SW.; asc. E. slope.
15.84	Rim of mesa, bears NE. and SW.; asc. 51 ft. over E. slope.
30.84	Top of ridge, bears N. and S.; desc. 35 ft. over W. slope.
40.02	Set an iron post, 3 ft. long, 1 in. diam., 20 ins. in the ground to bedrock, supported in a mound of stone, for $\frac{1}{4}$ sec. cor. of secs. 12 and 13, with brass cap marked
	S12 $\frac{1}{4}$ ——— S13 1930

Chains

from which

a pinyon pine, 9 ins. diam., bears N.  $64\frac{1}{4}^{\circ}$  W., 115 lks. dist., marked  $\frac{1}{4}$  S12 BT.  
 a cedar, 8 ins. diam., bears S.  $84\frac{1}{4}^{\circ}$  W., 168 lks. dist., marked  $\frac{1}{4}$  S13 BT.

57.29 Desc. 67 ft. over gradual NW. slope.  
 Head of drain, course N.  $30^{\circ}$  W.; asc. 84 ft. over gradual NE. slope.  
 80.04 The cor. of secs. 11, 12, 13 and 14,

Land, mountainous.  
 Soil, rocky; 4th rate.  
 Timber, scattering cedar and pinyon.  
 Undergrowth, scattering scrub oak, catclaw, mahogany, cactus, yucca, laurel and grass.

N.  $0^{\circ}1'$  W., bet. secs. 11 and 12.  
 Over rolling land, through heavy timber and scattering undergrowth.  
 To make a triangulation across deep canyon impracticable to chain, designate the above cor. point A and set a point on line on opposite side of canyon for flag B and also a point for flag C which from point A bears N.  $9^{\circ}46'$  E.; the base BC bears S.  $62^{\circ}41'$  E., 4.50 chs. dist.; all bearings checked by direct reading of the solar, and all angles checked by deflection.

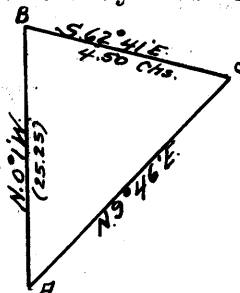

Dist. by triangulation 25.25 chs.  
 Approximate topography.

5.00 Rim of mesa, bears SE. and NW.; desc. 139 ft. over steep N. slope.  
 20.00 Wash, 10 lks. wide, 10 ft. deep, course S.  $65^{\circ}$  E.; asc. 139 ft. over steep S. slope.  
 25.25 Triangulation point B on rim of mesa, bears S.  $65^{\circ}$  E., and N.  $65^{\circ}$  W.; thence over rolling mesa land.  
 40.00 Set an iron post, 3 ft. long, 1 in. diam., 30 ins. in the ground for  $\frac{1}{4}$  sec. cor. of secs. 11 and 12, with brass cap marked

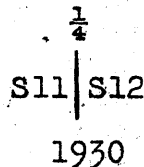

from which

a cedar, 5 ins. diam., bears N.  $57^{\circ}$  E., 13 lks. dist., marked  $\frac{1}{4}$  S12 BT.  
 a cedar, 6 ins. diam., bears S.  $82^{\circ}$  W., 55 lks. dist., marked  $\frac{1}{4}$  S11 BT.

55.00 Asc. 113 ft.  
 Top of ascent.; thence over level land.  
 70.00 Desc. 83 ft. over gradual N. slope.  
 80.00 Set an iron post, 3 ft. long, 2 ins. diam., 28 ins. in the ground, for cor. of secs. 1, 2, 11 and 12, with brass cap marked

Chains

T15NR7W

S 2 | S 1

S11 | S12

1930

from which

a cedar, 6 ins. diam., bears N.  $38\frac{3}{4}^{\circ}$  E., 47 lks. dist.,  
marked T15N R7W S1 BT.

a cedar, 6 ins. diam., bears S.  $31\frac{3}{4}^{\circ}$  E., 90 lks. dist.,  
marked T15N R7W S12 BT.

a cedar, 6 ins. diam., bears S.  $23^{\circ}$  W., 103 lks. dist.,  
marked T15N R7W S11 BT.

a cedar, 6 ins. diam., bears N.  $63^{\circ}$  W., 37 lks. dist.,  
marked T15N R7W S2 BT.

Land, rolling and level.

Soil, adobe and rocky; 3rd rate.

Timber, cedar, pinyon and oak.

Undergrowth, scattering scrub oak, mahogany, laurel, cactus  
and grass.

40.00  
80.00

S.  $89^{\circ}53'$  E., on a random line, bet. secs. 1 and 12.

Set temp.  $\frac{1}{4}$  sec. cor.

Fall 16 lks. S. of the cor. of secs. 1, 6, 7 and 12, on E. bdy.  
of Tp., which is an iron post, 3 ins. diam., projecting 14  
ins. above ground, supported in a mound of stone, with  
brass cap marked.

T15N  
R7W R6W  
S 1 | S 6  
S12 | S 7  
1915

from which

a cedar, 6 ins. diam., bears N.  $15^{\circ}$  E., 53 lks. dist.,  
marked T15N R6W S6 BT.

a pinyon pine, 10 ins. diam., bears S.  $71\frac{3}{4}^{\circ}$  W., 146 lks. dist.,  
marked T15N R7 W S12 BT.

a cedar, 8 ins. diam., bears S.  $12^{\circ}$  E., 31 lks. dist.,  
marked T15N R6W S7 BT.

a cedar, 10 ins. diam., bears N.  $80\frac{1}{2}^{\circ}$  W., 33 lks. dist.,  
marked T15N R7W S1 BT.

Thence

West, on a true line, bet. secs. 1 and 12.

Over rolling mesa land, through scattering timber and  
dense undergrowth.

Asc. 56 ft. over gradual E. slope.

40.00

Set an iron post, 3 ft. long, 1 in. diam., 4 ins. in the  
ground to bedrock, supported in a mound of stone, for  
 $\frac{1}{4}$  sec. cor. of secs. 1 and 12, with brass cap marked

S1  
 $\frac{1}{4}$  —  
S12  
1930

from which

a cedar, 6 ins. diam., bears S.  $67\frac{1}{2}^{\circ}$  E., 27 lks. dist.,  
marked  $\frac{1}{4}$  S12 BT.

a pinyon pine, 8 ins. diam., bears N.  $45\frac{1}{2}^{\circ}$  W., 75 lks. dist.,  
marked  $\frac{1}{4}$  S1 BT.

Desc. 55 ft. over gradual SW. slope.

Chains

58.50 Low spur, slopes S., desc. 89 ft. over gradual W. slope.  
 64.24 Wash, 25 lks. wide, course S.  
 66.10 Wash, 10 lks. wide, course S. 60° E., asc. 83 ft. over E. slope.  
 80.00 The cor. of secs. 1, 2, 11 and 12.

Land, rolling.  
 Soil, adobe and rocky, 3rd rate.  
 Timber, cedar and pinyon.  
 Undergrowth, scrub oak, mahogany, catclaw, cactus & grass.

N 0° 1' W., bet. secs. 1 and 2.  
 Over rolling, land, thru dense timber and scattering undergrowth.

7.20 Desc. 25 ft. over gradual NE. slope.  
 Wash, 8 lks. wide, course S. 60° E., asc. 34 ft. over gradual S. slope.  
 15.60 Top of low spur, slopes SE., desc. 44 ft. over NE. slope.  
 24.34 Wash, 8 lks. wide, course N. 70° E., asc. 96 ft. over gradual SE. slope.  
 40.00 Set an iron post, 3 ft. long, 1 in. diam., 18 ins. in the ground to bedrock, and raise a mound of stone around post, for 1/4 sec. cor., with brass cap marked

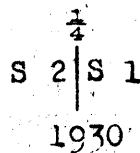

from which  
 a pinyon pine, 6 ins. diam., bears S. 79° E., 62 lks. dist., marked 1/4 S1 BT  
 a cedar, 7 ins. diam., bears S. 42 1/4° W., 61 lks. dist., marked 1/4 S2 BT

47.50 Top of spur, slopes SE., desc. 75 ft. over NE. slope.  
 56.32 Wash, 15 lks. wide, course S. 35° E., asc. 132 ft. over SW. slope.  
 70.24 Trail, bears NW. and SE.  
 79.28 Wire fence, bears NE. and SW.  
 79.68 Intersect N. bdy. of the Tp. at 4.23 chs. S. 89° 55' W. from the 1/4 sec. cor. of secs. 1 and 36, which is a malpais stone, 9x9x6 ins. above ground, firmly set, marked 1/4 on N. face, and witnessed by two properly marked cedar bearing trees; S. 43 1/2° W., 45 lks., and N. 19° E., 52 lks., dist.

Alter this cor. monument to refer to the quarters of sec. 36 only, by changing the marking on the SW. bearing tree to read "BT" only.

The cor. of secs. 1, 2, 35 and 36 is a malpais stone 10x10 x7 ins. above ground, firmly set, marked with 5 notches on W. face, 1 notch on E. face, and witnessed by four properly marked cedar bearing trees; N. 13° E. 76 lks., S. 12° E. 47 lks., S. 60 3/4° W. 196 lks., and N. 63° W. 63 lks., dist.

Alter this cor. monument to refer to secs. 35 and 36 only by changing the marking on the SE. and SW. bearing trees to read "BT" only.

At point of intersection, set an iron post, 3 ft. long, 2 ins. diam., 10 ins. in the ground to bedrock, and raise a mound of stone around post, for closing cor. of secs. 1 and 2, with brass cap marked

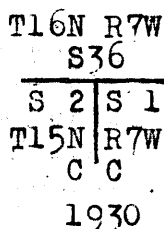

from which

Chains

a cedar, 6 ins. diam., bears S. 65 3/4° E., 171 lks.  
dist., marked T15N R7W S1 CC BT  
a cedar, 6 ins. diam., bears S. 44 3/4° W., 71 lks.  
dist., marked T15N R7W S2 CC BT

Land, rolling.  
Soil, adobe, 3rd rate.  
Timber, cedar, pinyon and oak.  
Undergrowth, scrub oak, catclaw, mahogany and grass.

The cor. of secs. 22, 23, 34 and 35, on the S. bdy. of  
T.15 N., R.7 W. is an iron post, 3 ins. diam., project-  
ing 8 ins. above ground, firmly set, with brass cap  
marked

T15N R7W  
S34 | S35  
S22 | S23  
T14N  
1915

and witnessed by a mound of stone W. of cor.

Thence

N. 0° 1' W., bet. secs. 34 and 35.  
Over mountainous land, thru scattering undergrowth.  
Desc. 174 ft. over N. slope.

11.08 Wash, 50 lks. wide, course S. 80° E., asc. 173 ft. over S. slope

19.60 Top of spur, slopes S. 45° E., desc. 22 ft. over E. slope.

40.00 Set an iron post, 3 ft. long, 1 in. diam., 10 ins. in the  
ground to bedrock, deposit a stone marked with a cross  
(X) at base of post, and raise a mound of stone around  
post, for 1/4 sec. cor., with brass cap marked

1/4  
S 34 | S 35  
1930

No bearing trees available.

44.00 Wash, 30 lks. wide, course S. 25° E., asc. 783 ft. over SW. slope

57.74 End of rocky spur, slopes W., asc. over S. slope.

78.80 Top of spur, slopes SE., thence along E. slope.

80.00 Set an iron post, 3 ft. long, 2 ins. diam., 26 ins. in the  
ground, for cor. of secs. 26, 27, 34 and 35, with brass  
cap marked

T15N R7W  
S27 | S26  
S34 | S35  
1930

No bearing trees available.

Raise a mound of stone, 3 ft. base, 2 1/2 ft. high, W. of cor.

Land, mountainous.

Soil, rocky, 4th rate.

Timber, none.

Undergrowth, catclaw, cactus, yucca and grass.

East, on random line, bet. secs. 26 and 35.

40.00 Set temp. 1/4 sec. cor.

45.48 Top of precipitous bluff; vertical angle to flag ahead  
on random line is +2 3/4°; auxiliary flag bears N. 81° 57' E.,  
from flag on random line auxiliary flag brs. N. 40° 44' W.,  
5.00 chs. dist. All bearings checked by direct reading  
of the solar, and all angles checked by deflection.

Subdivision of T.15 N., R.7 W.

Chains

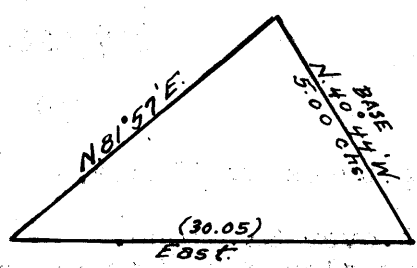

Dist. on random line	45.48 chs.
Dist. by triangulation	30.05 "
	<hr/>
	75.53 chs.
Dist. by direct meas.	4.45 "
	<hr/>
	79.98 chs.

79.98 Fall 5 lks. N. of the cor. of secs. 25, 26, 35 and 36.  
 Thence N. 89° 58' W., on a true line, bet. secs. 26 and 35.  
 Over mountainous land, through scattering timber and undergrowth.

4.38 Asc. 141 ft. over E. slope.  
 Top of spur, slopes S. 10° W.; desc. 487 ft. over steep SW. slope.

19.45 Approximate dist.; wash, 15 lks. wide, course S. 15° E.; asc. 300 ft. over E. slope.

28.88 Top of spur, slopes S. 45° E.; asc. 100 ft. over SE. slope.

34.50 Top of spur, slopes S. 15° W.; desc. 141 ft. over W. slope.

39.99 Set an iron post, 3 ft. long, 1 in. diam., 28 ins. in the ground, for 1/4 sec. cor. of secs. 26 and 35, with brass cap marked

S26  
 1/4  
 S35  
 1930

No bearing trees available.  
 Raise a mound of stone, 3 ft. base, 2 1/2 ft. high, N. of cor.

50.58 Desc. 249 ft. over rocky W. slope.

54.98 Wash, 20 lks. wide, course S. 15° W.

Creek, 2 lks. wide, in wash 20 lks. wide, course S. 45° E.

Asc. 680 ft. over NE. slope.

79.98 The cor. of secs. 26, 27, 34 and 35.

Land, mountainous.  
 Soil, rocky; 4th rate.  
 Timber, scattering cedar and pinyon.  
 Undergrowth, scattering catclaw, scrub oak, mahogany, cactus and grass.

N. 0° 1' W., bet. secs. 26 and 27.  
 Over mountainous land, through scattering timber and undergrowth.

Desc. 51 ft. along E. slope.

13.10 Top of spur, slopes E.; desc. 205 ft. over broken NE. slope.

28.42 Head of gulch, 6 lks. wide, course E.; asc. 93 ft. over SE. slope.

33.40 Top of short spur, slopes E.; desc. 54 ft. over NE. slope.

35.54 Wash, 20 lks. wide, course S. 85° E.; asc. 55 ft. over SE. slope.

40.00 Set an iron post, 3 ft. long, 1 in. diam., 4 ins. in the ground to bedrock, deposit a stone marked with a cross (X) at base of post, supported in a mound of stone, for 1/4 sec. cor. of secs. 26 and 27, with brass cap marked

Chains

$\frac{1}{4}$   
 S27 | S26  
 1930

No bearing trees available.

- 53.66 Asc. 210 ft. over SE. slope.
- 64.07 Top of spur, slopes S. 60° E.; desc. 67 ft. over NE. slope.
- 74.03 Rocky wash, 12 lks. wide, course E.; asc. 290 ft. over SE. slope.
- 80.00 Top white quartz spur, slopes E.; desc. 106 ft. over NE. slope.
- 80.00 Set an iron post, 3 ft. long, 2 ins. diam., 14 ins. in the ground to bedrock, deposit a stone marked with a cross (X) at base of post, supported in a mound of stone; for cor. of secs. 22, 23, 26 and 27, with brass cap marked

T15NR7W  
 S22 | S23  
 S27 | S26  
 1930

No bearing trees available.

Land, mountainous.  
 Soil, rocky; 4th rate.  
 Timber, scattering cedar and pinyon.  
 Undergrowth, scattering scrub oak, catclaw, mahogany, laurel, cactus and grass.

- 40.00 S. 89° 58' E., on a random line, bet. secs. 23 and 26.
- 80.10 Fall 12 lks. S. of the cor. of secs. 23, 24, 25 and 26.  
 Thence  
 S. 89° 57' W., on a true line, bet. secs. 23 and 26.  
 Over mountainous land, through scattering undergrowth.  
 Desc. 16 ft. over gradual W. slope.
- 7.30 Trail, bears N. 15° E., and S. 15° W.
- 9.14 Drain, 5 lks. wide, course S.; asc. 34 ft. over E. slope.
- 14.30 Top of small spur, slopes S.; asc. 220 ft. over SE. slope.
- 27.10 Top of spur, slopes S.; continue ascending.
- 31.50 Top of rocky spur, slopes S.; desc. 67 ft. over SW. slope.
- 38.06 Drain, 5 lks. wide, course S. 10° E.; asc. 39 ft. over E. slope.
- 40.05 Set an iron post, 3 ft. long, 1 in. diam., 26 ins. in the ground for  $\frac{1}{4}$  sec. cor. of secs. 23 and 26, with brass cap marked

S23  
 $\frac{1}{4}$  ———  
 S26  
 1930

No bearing trees available.  
 Raise a mound of stone, 3 ft. base; 2½ ft. high, N. of cor.

- 40.80 Asc. 5 ft. over E. slope.
- 44.08 Top of small spur, slopes E.; thence along S. slope.
- 51.87 Top of spur, slopes S.; desc. 56 ft. over W. slope.
- 67.30 Wash, 10 lks. wide, course S.; asc. 133 ft. over NE. slope.
- 75.40 Top of spur, slopes S.; desc. 84 ft. over SW. slope.
- 80.10 Wash, 10 lks. wide, course S. 35° E.; asc. 69 ft. over NE. slope.
- 80.10 The cor. of secs. 22, 23, 26 and 27.

Land, mountainous.  
 Soil, rocky; 4th rate.  
 Timber, none.  
 Undergrowth, scattering scrub oak, mahogany, cactus and poor grass.



Chains N.0°1'W., bet. secs. 22 and 23.  
 Over mountainous land, through scattering timber and dense undergrowth.  
 Desc. 10 ft. over NE. slope.  
 7.60 Wash, 10 lks. wide, course S.25°E.; asc. 356 ft. over rocky S. slope.  
 25.20 Top of ridge, bears N.80°W., and S.80°E.; desc. 245 ft. over broken NW. slope.  
 40.00 Set an iron post, 3 ft. long, 1 in. diam., 26 ins. in the ground, for  $\frac{1}{4}$  sec. cor. of secs. 22 and 23, with brass cap marked

$\frac{1}{4}$   
 S22 | S23  
 1930

from which

a cedar, 12 ins. diam., bears N.31°E., 370 lks. dist., marked  $\frac{1}{4}$  S23 BT.  
 a cedar, 10 ins. diam., bears S.57 $\frac{1}{2}$ °W., 314 lks. dist., marked  $\frac{1}{4}$  S22 BT.

40.30 Small drain, 5 lks. wide, course NE.; desc. 36 ft. over N. slope.  
 52.82 Same drain, 8 lks. wide, course NW.; asc. 36 ft. over SW. slope.  
 57.90 End of low spur, slopes SW.; desc. 125 ft. over NW. slope.  
 68.40 Creek, 50 lks. wide, course N.80°E.; asc. 21 ft. along end of spur.  
 75.34 Same creek, 30 lks. wide, course S.20°W.; thence along creek bed.  
 79.70 Set an iron post, 3 ft. long, 2 ins. diam., 24 ins. in the ground, for witness cor. to cor. of secs. 14, 15, 22 and 23, with brass cap marked

WC  
 T15NR7W  
 S15 | S14  
 S22 | S23  
 1930

from which

a sycamore, 12 ins. diam., bears S.79 $\frac{1}{4}$ °E., 67 lks. dist., marked WC T15N R7W S23 BT.  
 a cedar, 7 ins. diam., bears S.72°E., 72 lks. dist., marked WC T15N R7W S23 BT.  
 No other bearing trees available.

80.00 The true point for cor. of secs. 14, 15, 22 and 23 falls in creek, 50 lks. wide, a place impracticable to set permanent mon.

Land, mountainous.  
 Soil, rocky; 4th rate.  
 Timber, scattering cedar, pinyon and sycamore.  
 Undergrowth, mahogany, scrub oak, catclaw, laurel, cactus and poor grass.

-----  
 From true point for cor. of secs. 14, 15, 22 and 23.  
 N.89°57'E., on a random line, bet. secs. 14 and 23.  
 40.00 Set temp.  $\frac{1}{4}$  sec. cor.  
 80.02 Fall 6 lks. N. of the true point for cor. of secs. 13, 14, 23 and 24.  
 Thence  
 West, on a true line, bet. secs. 14 and 23.  
 Over mountainous land, through scattering timber and undergrowth.

Chains  
 5.52 Asc. 78 ft. over SE. slope.  
 10.32 Top of short spur, slopes S.; desc. 45 ft. over SW. slope.  
 10.52 Creek, 20 lks. wide, course S. 20° E.  
 12.60 Creek, 20 lks. wide, 24 ins. deep, course S. 55° E.  
 24.42 Same creek, 60 lks. wide, 24 ins. deep, course NE.; asc. 105 ft.  
 36.12 over E. slope.  
 40.01 Top of spur, slopes SE.; desc. 96 ft. over SW. slope.  
 Same creek, 60 lks. wide, 24 ins. deep, course S. 75° E.; asc.  
 29 ft. over SE. slope.  
 Set an iron post, 3 ft. long, 1 in. diam., 27 ins. in the  
 ground, for  $\frac{1}{4}$  sec. cor. of secs. 14 and 23, with brass cap  
 marked

$\frac{1}{4}$  S14  
 S23  
 1930

No bearing trees available.  
 Raise a mound of stone, 3 ft. base, 2 $\frac{1}{2}$  ft. high, N. of cor.  
 Desc. 18 ft. along N. slope.  
 42.89 Same creek, 100 lks. wide, 24 ins. deep, course NE.; asc. 69 ft.  
 over rolling E. slope.  
 50.30 Low saddle, top of spur, slopes SE.; asc. 56 ft. over SE. slope.  
 56.15 Desc. 86 ft. over SW. slope.  
 69.80 Drain, 5 lks. wide, course S. 30° E.; asc. 40 ft. over NE. slope.  
 72.50 Top of rocky spur, slopes S.; old corral bears N. 4.00 chs.  
 dist.; desc. 38 ft. over rocky W. slope.  
 79.70 Creek, 100 lks. wide, 24 ins. deep, course S.  
 80.02 The true point for cor. of secs. 14, 15, 22 and 23.

Land, mountainous.  
 Soil, rocky; 4th rate.  
 Timber, scattering cedar, pinyon and sycamore.  
 Undergrowth, scattering scrub oak, catclaw, mahogany, cactus,  
 yucca and grass.

-----  
 From true point for cor. of secs. 14, 15, 22 & 23,  
 N. 0° 1' W., bet. secs. 14 and 15.

Over mountainous land, through scattering timber and  
 undergrowth.  
 0.20 Creek, 40 lks. wide, 24 ins. deep, course SE.; asc. 281 ft. over  
 rocky S. slope.  
 4.00 Old corral, bears E. 4.00 chs. dist.  
 20.47 Wash, 6 lks. wide, course S. 20° E.  
 27.20 Same wash, 3 lks. wide, course SE.  
 33.25 Head of same wash, 3 lks. wide, course SW.; asc. 82 ft. over  
 S. slope.  
 40.00 Set an iron post, 3 ft. long, 1 in. diam., 27 ins. in the  
 ground, for  $\frac{1}{4}$  sec. cor. of secs. 14 and 15, with brass cap  
 marked

$\frac{1}{4}$   
 S15 | S14  
 1930

from which

a mahogany, 5 ins. diam., bears S. 25° W., 111 lks. dist.,  
 marked  $\frac{1}{4}$  S15 BT.  
 a cedar, 6 ins. diam., bears N. 11° W., 38 lks. dist.,  
 marked  $\frac{1}{4}$  S15 BT.

Asc. 462 ft. over over steep S. slope.  
 52.56 Top of rimrocks, 15 ft. high, bears SE. and W.  
 53.64 Top of mesa, bears E. and W.; thence over rolling mesa land.

Chains  
66.00  
80.00

Desc.37 ft.over gradual NE.slope.  
Set an iron post,3 ft.long,2 ins.diam.,28 ins.in the  
ground for cor.of secs.10,11,14 and 15,with brass cap  
marked.

T15NR7W  
S10|S11  
S15|S14  
1930

from which

a cedar,10 ins.diam.,bears N.54 $\frac{1}{4}$ °E.,143 lks.dist.,  
marked T15N R7W S11 BT.  
a cedar,8 ins.diam.,bears S.32 $\frac{3}{4}$ °E.,122 lks.dist.,  
marked T15N R7W S14 BT.  
a cedar,6 ins.diam.,bears S.30 $\frac{1}{4}$ °W.,66 lks.dist.,  
marked T15N R7W S15 BT.  
a cedar,5 ins.diam.,bears N.27 $\frac{3}{4}$ °W.,73 lks.dist.,  
marked T15N R7W S10 BT.

Land,mountainous and rolling.  
Soil,rocky;4th rate.  
Timber,scattering,cedar and pinyon.  
Undergrowth,scattering serub oak,catclaw,mahogany,cactus  
and poor grass.

40.00  
80.10

East,on a random line,bet.secs.11 and 14.  
Set temp. $\frac{1}{4}$  sec.cor.  
Fall 4 lks.S.of the cor.of secs.11,12,13 and 14.

Thence  
S.89°58'W.,on a true line,bet.secs.11 and 14.  
Over rolling mesa land,through heavy timber and scatt-  
ering undergrowth.

18.60  
40.05

Asc.70 ft.over gradual NE.slope.  
Trail,bears N.60°E. and S.60°W.  
Set an iron post,3 ft.long,1 in.diam.,26 ins.in the  
ground for  $\frac{1}{4}$  sec.cor.of secs.11 and 14,with brass cap  
marked

S11  
 $\frac{1}{4}$  ———  
S14  
1930

from which

a cedar,6 ins.diam.,bears S.23 $\frac{1}{2}$ °W.,65 lks.dist.,  
marked  $\frac{1}{4}$  S14 BT.  
a cedar,4 ins.diam.,bears N.64 $\frac{3}{4}$ °W.,59 lks.dist.,  
marked  $\frac{1}{4}$  S11 BT.

55.00  
80.10

Desc.35 ft.over gradual NW.slope.  
Bottom of draw,course NE.;asc.62 ft.over gradual NE.slope.  
The cor.of secs.10,11,14 and 15.

Land,rolling.  
Soil,adobe and rocky;4th rate.  
Timber,cedar and pinyon.  
Undergrowth,scattering scrub oak,mahogany,cactus and  
grass.

Chains N.0°1'W., bet secs.10 and 11.  
Over rolling mesa land, through scattering timber and undergrowth.  
Desc.102 ft. over gradual N. slope.  
20.32 Wash, 8 lks. wide, 4 ft. deep, course N.70°E.; asc.42 ft. over gradual SE. slope.  
33.60 Top of mesa, slopes E.; desc.87 ft. over gradual NE. slope.  
40.00 Set an iron post, 3 ft. long, 1 in. diam., 28 ins. in the ground, for  $\frac{1}{4}$  sec. cor. of secs.10 and 11, with brass cap marked

 $\frac{1}{4}$ 

S10|S11

1930.

from which

a cedar, 5 ins. diam., bears S.21 $\frac{1}{4}$ °E., 31 lks. dist., marked  $\frac{1}{4}$  S11 BT.  
a cedar, 5 ins. diam., bears S.42 $\frac{3}{4}$ °W., 25 lks. dist., marked  $\frac{1}{4}$  S10 BT.

48.50 Wash, 10 lks. wide, course E..  
51.00 Fork of same wash, 20 lks. wide, course E.; asc.90 ft. over rolling SW. slope.  
62.80 Wash, 10 lks. wide, course S.25°E.  
66.66 Trail, bears SE. and NW.  
80.00 Set an iron post, 3 ft. long, 2 ins. diam., 28 ins. in the ground, for cor. of secs.2, 3, 10 and 11, with brass cap marked

T15NR7W  
S 3|S 2  
S10|S11  
1930

from which

a pine, 6 ins. diam., bears N.12 $\frac{1}{2}$ °E., 8 $\frac{1}{4}$  lks. dist., marked T15N R7W S2 BT.  
a cedar, 18 ins. diam., bears S.15°E., 21 lks. dist., marked T15N R7W S11 BT.  
a cedar, 8 ins. diam. bears S.51°W., 59 lks. dist., marked T15N R7W S10 BT.  
a cedar, 12 ins. diam. bears N.55 $\frac{1}{2}$ °W., 43 lks. dist., marked T15N R7W S3 BT.

Land, rolling.  
Soil, adobe; 3rd rate.  
Timber, cedar and pinyon.  
Undergrowth, scattering scrub oak, mahogany, catclaw and grass.

40.00 N.89°58'E., on a random line, bet. secs.2 and 11.  
80.08 Set temp.  $\frac{1}{4}$  sec. cor.  
Fall 2 lks. N. of the cor. of secs.1, 2, 11 and 12.  
Thence  
S.89°59'W., on a true line, bet. secs.2 and 11.  
Over rolling land, through scattering timber and undergrowth.  
Asc.120 ft. over gradual NE. slope.  
40.04 Set an iron post, 3 ft. long, 1 in. diam., 11 ins in the ground to bedrock, supported in a mound of stone, for  $\frac{1}{4}$  sec. cor. of secs.2 and 11, with brass cap marked

Chains	$\frac{1}{4} \frac{S 2}{S 11}$ 1930
	from which
	a cedar, 6 ins. diam., bears N. 74 $\frac{1}{2}$ ° E., 57 lks. dist., marked $\frac{1}{4}$ S2 BT
	a pinyon pine, 8 ins. diam., bears S. 82° W., 33 lks. dist., marked $\frac{1}{4}$ S11 BT
	Asc. 35 ft. over gradual NE. slope.
54.78	Top of mesa, slopes SE., desc. 97 ft. over gradual SW. slope.
75.68	Drain, 8 lks. wide, course S. 20° E., asc. 24 ft. over gradual E. slope.
78.64	Top of low spur, slopes S. 25° E.
80.08	The cor. of secs. 2, 3, 10 and 11.
	Land, rolling.
	Soil, adobe and rocky, 4th rate.
	Timber, cedar and pinyon.
	Undergrowth, scrub oak, mahogany, cactus and grass.
-----	
	N. 0° 1' W., bet. secs. 2 and 3.
	Over rolling land, thru scattering timber and undergrowth.
	Asc. 93 ft. over gradual SW. slope.
8.60	Top of low spur, slopes S. 30° E., continue ascent.
16.10	Wash, 10 lks. wide, course S. 45° E.
40.00	Set an iron post, 3 ft. long, 1 in. diam., 20 ins. in the ground to bedrock, and raise a mound of stone around post, for $\frac{1}{4}$ sec. cor., with brass cap marked
	$\frac{1}{4} \frac{S 3}{S 2}$ 1930
	from which
	a cedar, 12 ins. diam., bears S. 16 $\frac{1}{2}$ ° E., 66 lks. dist., marked $\frac{1}{4}$ S2 BT
	a cedar, 4 ins. diam., bears S. 22° W., 79 lks. dist., marked $\frac{1}{4}$ S3 BT
50.00	Top of spur, slopes SE., desc. 95 ft. over N. slope.
61.90	Wash, 8 lks. wide, 6 ft. deep, course S. 85° E.
	Asc. 116 ft. over S. slope to
79.59	Intersect N. bdy. of the Tp. at 3.90 chs. S. 89° 55' W. from the $\frac{1}{4}$ sec. cor. of secs. 2 and 35, which is a malpais stone in place, exposed 24x18x10 ins., marked with a cross (X) on top, $\frac{1}{4}$ N. of cross, and witnessed by a mound of stone N., and one properly marked cedar bearing tree S. 38 $\frac{1}{2}$ ° W., 132 lks. dist.
	Alter this cor. monument to refer to the quarters of sec. 35 only, by changing the marking on the bearing tree to read "BT" only.
	The cor. of secs. 2, 3, 34 and 35 is a malpais stone 6x8x4 above ground, firmly set, marked with 4 notches on W. face, 2 notches on E. face, and witnessed by a mound of stone W., and two properly marked bearing trees: a wild cherry S. 24 $\frac{1}{2}$ ° E. 94 lks., and a juniper N. 39 $\frac{3}{4}$ ° W. 277 lks., dist.
	Alter this cor. monument to refer to secs. 34 and 35 only, by changing marking on the SE. bearing tree to read "BT" only, and moving the mound of stone from W. to N. of cor.
	At point of intersection, set an iron post, 3 ft. long, 2 ins. diam., 20 ins. in the ground to bedrock, and raise a mound of stone around post, for closing cor. of secs. 2 and 3, with brass cap marked

Chains

T16N R7W  
 S 35  
 S 3 | S 2  
 T15N R7W  
 C | C  
 1930

from which  
 a pinyon pine, 7 ins. diam., bears S.  $17\frac{3}{4}^{\circ}$  E., 142 lks.  
 dist., marked T15N R7W S2 CC BT  
 a cedar, 5 ins. diam., bears S.  $72\frac{3}{4}^{\circ}$  W., 53 lks. dist.,  
 marked T15N R7W S3 CC BT

Land, rolling.  
 Soil, gravelly, 3rd rate.  
 Timber, cedar, pinyon and oak.  
 Undergrowth, scrub oak, mahogany and grass.

The cor. of secs. 21, 22, 33 and 34 on the S. bdy. of T.15 N.,  
 R.7 W. is an iron post, 3 ins. diam., projecting 14 ins.  
 above ground, supported in a mound of stone, with brass  
 cap marked

T15N R7W  
 S33 | S34  
 S21 | S22  
 T14 $\frac{1}{2}$ N  
 1915

and witnessed by a mound of stone W. of cor.  
 Thence,

N.  $0^{\circ} 2' W.$ , bet. secs. 33 and 34.

Over mountainous land, thru scattering timber and under-  
 growth. Asc. 250 ft. over rocky SW. slope.

11.70 Top of long spur, slopes S.  $70^{\circ}$  E., asc. 216 ft. over S. slope.  
 24.55 Top of spur, slopes S.  $70^{\circ}$  E., desc. 86 ft. over N. slope.  
 28.12 Wash, 12 lks. wide, course E., asc. 33 ft. over E. slope.  
 30.60 Top of spur, slopes S.  $45^{\circ}$  E., desc. 36 ft. over E. slope.  
 38.40 Wash, 10 lks. wide, course S.  $45^{\circ}$  E., asc. 42 ft. over SW. slope.  
 40.00 Set an iron post, 3 ft. long, 1 in. diam., 18 ins. in the  
 ground to bedrock, deposit a stone marked with a cross  
 (X) at base of post, and raise a mound of stone around  
 post, for  $\frac{1}{4}$  sec. cor., with brass cap marked

$\frac{1}{4}$   
 S 33 | S 34  
 1930

No bearing trees available.

Asc. 274 ft. over SW. slope.

57.52 Top of spur, slopes S.  $80^{\circ}$  E., thence along rolling E. slope.  
 72.70 Wash, 8 lks. wide, course S.  $45^{\circ}$  E., asc. 122 ft. over SW. slope.  
 80.00 Set an iron post, 3 ft. long, 2 ins. diam., 26 ins. in the  
 ground, with stone marked with a cross (X) deposited at  
 base of post, for cor. of secs. 27, 28, 33 and 34, with  
 brass cap marked

T15N R7W  
 S28 | S27  
 S33 | S34  
 1930

from which  
 a pinyon pine, 8 ins. diam., bears N.  $70^{\circ}$  W., 64 lks.  
 dist., marked T15N R7W S28 BT  
 No other bearing trees available.

Land, mountainous.

Chains Soil, rocky; 4th rate.  
 Timber, scattering cedar and pinyon.  
 Undergrowth, scattering catclaw, scrub oak, cactus, yucca  
 and grass.

---

40.00 East, on a random line, bet. secs. 27 and 34.  
 Set temp.  $\frac{1}{4}$  sec. cor.  
 80.18 Fall 29 lks. S. of the cor. of secs. 26, 27, 34 and 35.  
 Thence  
 S.  $89^{\circ}48'W.$ , on a true line, bet. secs. 27 and 34.  
 Over mountainous land, through scattering timber and  
 undergrowth.  
 Asc. 28 ft. over NE. slope.  
 2.52 Top of spur, slopes S.; desc. 375 ft. over rocky SW. slope.  
 29.12 Rocky wash, 15 lks. wide, course S.  $20^{\circ}E.$ ; asc. 75 ft. over  
 NE. slope.  
 40.09 Set an iron post, 3 ft. long, 1 in. diam., on solid rock,  
 deposit a stone marked with a cross (X) at base of post,  
 supported in a mound of stone, for  $\frac{1}{4}$  sec. cor. of secs.  
 27 and 34, with brass cap marked

$\frac{1}{4}$   $\frac{S27}{S34}$   
 1930.

No bearing trees available.

Asc. 70 ft. over NE. slope.  
 44.58 Top of rocky spur, slopes S.  $10^{\circ}W.$ ; desc. 76 ft. over W. slope.  
 49.48 Wash, 10 lks. wide, course S.; asc. 52 ft. over SE. slope.  
 55.63 Top of spur, slopes S.  $20^{\circ}E.$ ; desc. 55 ft. over W. slope.  
 59.91 Rocky wash, 15 lks. wide, course S.  $10^{\circ}W.$ ; asc. 280 ft. over  
 E. slope.  
 72.68 Top of spur, slopes S.  $50^{\circ}E.$ ; desc. 67 ft. over SW. slope of  
 cliffs.  
 80.18 The cor. of secs. 27, 28, 33 and 34.

Land, mountainous.  
 Soil, rocky; 4th rate.  
 Timber, scattering cedar and pinyon.  
 Undergrowth, scattering catclaw, scrub oak, laurel, cactus  
 and poor grass.

---

N.  $0^{\circ}2'W.$ , bet. secs. 27 and 28.  
 Over mountainous land, through scattering timber and und-  
 ergrowth.  
 Asc. 22 ft. over SW. slope.  
 5.60 Top of spur, slopes S.  $70^{\circ}E.$ ; asc. 246 ft. over SE. slope.  
 40.00 Set an iron post, 3 ft. long, 1 in. diam., 16 ins. in the  
 ground to bedrock, deposit a stone marked with a cross  
 (X) at base of post, supported in a mound of stone, for  
 $\frac{1}{4}$  sec. cor. of secs. 27 and 28, with brass cap marked

$\frac{1}{4}$   
 S28 | S27  
 1930.

No bearing trees available.

Asc. 218 ft. over SE. slope.  
 49.50 Top of spur, slopes S.  $60^{\circ}E.$ ; continue ascending.  
 59.86 Top of spur, slopes N.  $75^{\circ}E.$ ; desc. 142 ft. over NE. slope.

## Chains

67.09

Head of draw, 5 lks. wide, course N.80°E.; asc. 150 ft. over broken SE. slope.

77.00

Top of short spur, slopes E.; desc. 27 ft. over NE. slope.

80.00

Set an iron post, 3 ft. long, 2 ins. diam., 6 ins. in the ground to bedrock, deposit a stone marked with a cross (X) at base of post, supported in a mound of stone, for cor. of secs. 21, 22, 27 and 28, with brass cap marked

T15NR7W  
S21|S22  
S28|S27  
1930

from which

a cedar, 9 ins. diam., bears S.82½°E., 74 lks. dist., marked T15N R7W S27 BT.

a cedar, 8 ins. diam., bears N.23°W., 229 lks. dist., marked T15N R7W S21 BT.

No other bearing trees available.

Land, mountainous.

Soil, rocky; 4th rate.

Timber, scattering cedar and pinyon.

Undergrowth, scattering scrub oak, laurel, mahogany, cactus, yucca and grass.

40.00

N.89°48'E., on a random line, bet. secs. 22 and 27.

80.04

Set temp. ¼ sec. cor.

Intersect the cor. of secs. 22, 23, 26 and 27.

Thence

S.89°48'W., on a true line, bet. secs. 22 and 27.

Over mountainous land, through scattering timber and dense undergrowth.

Asc. 135 ft. over NE. slope.

8.73

Top of spur, slopes S.; desc. 65 ft. over W. slope;

15.26

Wash, 5 lks. wide, course S.20°E.; asc. 295 ft. over SE. slope.

22.83

Culch, 8 lks. wide, course S.45°E.; continue ascending.

32.81

Top of spur, slopes S.15°E.; desc. 99 ft. over SW. slope.

40.02

Set an iron post, 3 ft. long, 1 in. diam., 30 ins. in the ground, for ¼ sec. cor. of secs. 22 and 27, with brass cap marked

S22  
¼ —  
S27  
1930

No bearing trees available.

Raise a mound of stone, 3 ft. base, 2½ ft. high, N. of cor.

Desc. 104 ft. over SW. slope.

43.13

Head of drain, 3 lks. wide, course S.

46.26

Point of spur, slopes S.

50.21

Wash, 10 lks. wide, course S.15°W.; asc. 218 ft. over SE. slope.

63.33

Top of short spur, slopes S.; desc. 50 ft. over W. slope.

65.98

Drain, 5 lks. wide, course S.10°W.; asc. 97 ft. over SE. slope.

74.99

Wash, 8 lks. wide, course S.50°E.; asc. 105 ft. over NE. slope.

80.04

The cor. of secs. 21, 22, 27 and 28.

Land, mountainous.

Soil, rocky; 4th rate.

Timber, scattering cedar and pinyon.

Undergrowth, scrub oak, mahogany, laurel, cactus and grass.



Chains

N.0°2'W., bet. secs. 21 and 22.  
 Over mountainous land, through scattering timber and dense undergrowth.  
 Desc. 50 ft. over NE. slope.  
 3.20 Drain, 5 lks. wide, course E.; asc. 106 ft. over SE. slope.  
 15.94 Top of spur, slopes E.; desc. 42 ft. over N. slope.  
 21.50 Foot of spur.; thence desc. 157 ft. over broken NW. slope.  
 40.00 Set an iron post, 3 ft. long, 1 in. diam., 16 ins. in the ground to bedrock, deposit a stone marked with a cross (X) at base of post, supported in a mound of stone, for  $\frac{1}{4}$  sec. cor. of secs. 21 and 22, with brass cap marked

$\frac{1}{4}$   
 S21 | S22  
 1930

No bearing trees available.

To make a triangulation over precipitous bluffs and dense undergrowth impracticable to chain designate the above  $\frac{1}{4}$  sec. cor. point A and set a flag B on line on opposite side of bluffs, also a flag C on opposite side of bluffs, which from point A bears N.8°31'W.; the base BC bears N.82°41'W., 6.10 chs. dist., longer base impracticable.

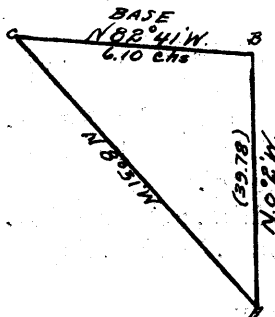

Distance across bluffs . 39.78 chs.

Approximate topography.

60.00 Desc. 217 ft. over broken NW. slope.  
 75.00 Gulch, 8 lks. wide, course N.30°E.  
 80.00 Creek, 20 lks. wide, 4 ins. deep, course E.; asc. 75 ft. over S. slope.  
 Set an iron post, 3 ft. long, 2 ins. diam., 16 ins. in the ground to bedrock, deposit a stone marked with a cross (X) at base of post, supported in a mound of stone, for cor. of secs. 15, 16, 21 and 22, with brass cap marked

T15NR7W  
 S16 | S15  
 S21 | S22  
 1930

from which

a pinyon pine, 10 ins. diam., bears S.3<sup>3</sup>/<sub>4</sub>°E., 117 lks. dist., marked T15N R7W S22 BT.  
 a cedar, 12 ins. diam., bears N.8<sup>1</sup>/<sub>2</sub>°W., 213 lks. dist., marked T15N R8W S16 BT.  
 No other bearing trees available.

Land, mountainous.  
 Soil, rocky; 4th rate.  
 Timber, scattering cedar and pinyon.  
 Undergrowth, scrub oak, mahogany, catclaw, laurel and grass.

Chains N.89°48'E., on a random line, bet. secs.15 and 22.  
 40.00 Set temp.  $\frac{1}{4}$  sec. cor.  
 80.06 Fall 2 lks. S. of the true point for cor. of secs. 14, 15,  
 22 and 23.  
 Thence  
 S.89°47'W., on a true line, bet. secs. 15 and 22.  
 Over mountainous land, through scattering timber and  
 dense undergrowth.  
 Asc. 113 ft. over NE. slope.  
 17.80 Top of broad spur, slopes N.; asc. 23 ft. along N. slope.  
 29.40 Top of broad spur, slopes N.20°W.; desc. 58 ft. over NW. slope.  
 40.03 Set an iron post, 3 ft. long, 1 in. diam., 6 ins. in the  
 ground to bedrock, supported in a mound of stone, for  
 $\frac{1}{4}$  sec. cor. of secs. 15 and 22, with brass cap marked

S15  
 $\frac{1}{4}$  ———  
 S22  
 1930

from which

a pinyon pine, 6 ins. diam., bears N.20 $\frac{1}{2}$ °E., 282 lks. dist.,  
 marked  $\frac{1}{4}$  S15 BT.  
 a cedar, 6 ins. diam., bears S.66 $\frac{1}{2}$ °W., 162 lks. dist.,  
 marked  $\frac{1}{4}$  S22 BT.

41.33 Creek, 30 lks. wide, 6 ins. deep, course N.; asc. 82 ft. over E.  
 slope.  
 50.65 Top of short spur, slopes S.; desc. 39 ft. over W, slope.  
 55.11 Creek, 25 lks. wide, 5 ins. deep, course S.; asc. 135 ft. over  
 broken SE. slope.  
 76.58 Drain, 5 lks. wide, course SE.  
 80.06 The cor. of secs. 15, 16, 21 and 22.

Land, mountainous.  
 Soil, rocky; 4th rate.  
 Timber, scattering cedar and pinyon.  
 Undergrowth, scrub oak, catclaw, mahogany, cactus and grass.

N.0°2'W., bet. secs. 15 and 16.  
 Over mountainous land, through scattering timber and  
 dense undergrowth.  
 Asc. 112 ft. along rocky SE. slope.  
 12.00 Low spur, slopes S.45°E.; desc. 81 ft. along E. slope.  
 23.20 Wash, 20 lks. wide, course E.; asc. 62 ft. over S. slope.  
 31.14 Low spur, slopes E.; desc. 87 ft. over N. slope.  
 37.40 Creek, 30 lks. wide, course S.45°E.; thence over level land.  
 40.00 Set an iron post, 3 ft. long, 1 in. diam., 26 ins. in the  
 ground for  $\frac{1}{4}$  sec. cor. of secs. 15 and 16, with brass cap  
 marked

$\frac{1}{4}$   
 S16 | S15  
 1930

from which

a pinyon pine, 12 ins. diam.; bears S.39 $\frac{1}{4}$ °E., 282 lks. dist.,  
 marked  $\frac{1}{4}$  S 15 BT.  
 a pinyon pine, 10 ins. diam., bears N.58 $\frac{3}{4}$ °W., 66 lks. dist.,  
 marked  $\frac{1}{4}$  S 16 BT.

46.00 Bend in same creek, from NW. course SW.; asc. 831 ft. over  
 steep SW. slope.

Chains  
78.50  
80.00

Top of rimrocks, 20 ft. high, bears S. 60° E. and W.  
Set an iron post, 3 ft. long, 2 ins. diam., 24 ins. in the ground, for cor. of secs. 9, 10, 15 and 16, with brass cap marked.

T15NR7W.  
S 9 | S10  
S16 | S15  
1930

from which

a cedar, 10 ins. diam., bears N. 73° E., 91 lks. dist., marked T15N R7W S10 BT.  
a cedar, 10 ins. diam., bears S. 87° E., 145 lks. dist., marked T15N R7W S15 BT.  
a cedar, 14 ins. diam., bears S. 53° W., 138 lks. dist., marked T15N R7W S16 BT.  
a cedar, 5 ins. diam., bears N. 55° W., 105 lks. dist., marked T15N R7W S9 BT.

Land, mountainous.  
Soil, rocky; 4th rate.  
Timber, scattering cedar and pinyon.  
Undergrowth, scrub oak, mahogany, catclaw, cactus, yucca and grass.

40.00  
80.04

N. 89° 47' E., on a random line, bet. secs. 10 and 15.  
Set temp.  $\frac{1}{4}$  sec. cor.  
Fall 7 lks. N. of the cor. of secs. 10, 11, 14 and 15.  
Thence  
S. 89° 50' W., on a true line, bet. secs. 10 and 15.  
Over rolling mesa land, through scattering timber and undergrowth.

40.02

Desc. 78 ft. over NW. slope.  
Set an iron post, 3 ft. long, 1 in. diam., 6 ins. in the ground to bedrock, supported in a mound of stone, for  $\frac{1}{4}$  sec. cor. of secs. 10 and 15, with brass cap marked

S10  
 $\frac{1}{4}$  ———  
S15  
1930

from which

a cedars, 5 ins. diam., bears S. 78 $\frac{1}{2}$ ° E., 35 lks. dist., marked  $\frac{1}{4}$  S15 BT.  
a cedar, 8 ins. diam., bears N. 44 $\frac{1}{4}$ ° W., 2 lks. dist., marked  $\frac{1}{4}$  S10 BT.

48.54  
70.00  
80.04

Desc. 25 ft. over NW. slope.  
Draw, course N.; asc. 124 ft. over gradual NE. slope.  
Desc. 10 ft along S. slope.  
The cor. of secs. 9, 10, 15 and 16.

Land, rolling.  
Soil, gravelly; 3rd rate.  
Timber, scattering cedar and pinyon.  
Undergrowth, scattering scrub oak, cactus, yucca and grass.

Chains	N.0°2'W., bet.secs.9 and 10. Over rolling mesa land, through scattering timber and undergrowth.
5.00	Asc.10 ft. over S. slope.
34.70	Top of low ridge bears SE. and NW.; desc.117 ft. over N. slope.
40.00	Draw, course E.; asc.17 ft. over S. slope.
	Set an iron post, 3 ft. long, 1 in. diam., 20 ins. in the ground to bedrock, supported in a mound of stone, for $\frac{1}{4}$ sec. cor. of secs.9 and 10, with brass cap marked
	$\frac{1}{4}$
	S9 S10
	1930
	from which
	a cedar, 6 ins. diam., bears S.70 $\frac{1}{4}$ °E., 86 lks. dist., marked $\frac{1}{4}$ S10 BT.
	a cedar, 6 ins. diam., bears S.85°W., 144 lks. dist., marked $\frac{1}{4}$ S9 BT.
	Asc.46 ft. over S. slope.
47.50	Top of spur, slopes E.; desc.56 ft. over NE. slope.
80.00	Set an iron post, 3 ft. long, 2 ins. diam., 26 ins. in the ground for cor. of secs.3, 4, 9 and 10, with brass cap marked
	T15NR7W
	S 4 S 3
	S 9 S10
	1930
	from which
	a cedar, 4 ins. diam., bears N.6 $\frac{1}{4}$ °E., 117 lks. dist., marked BT only.
	a cedar, 4 ins. diam., bears S.5 $\frac{1}{4}$ °E., 13 lks. dist., marked BT only.
	a cedar, 6 ins. diam., bears S.65°W., 158 lks. dist., marked T15N R7W S9 BT.
	a cedar, 6 ins. diam., bears N.87°W., 210 lks. dist., marked T15N R7W S4 BT.
	Land, rolling.
	Soil, adobe and gravelly; 3rd rate.
	Timber, scattering cedar and pinyon.
	Undergrowth, scattering scrub oak, catalaw, cactus and grass.
40.00	N.89°50'E., on a random line, bet.secs.3 and 10.
80.10	Set temp. $\frac{1}{4}$ sec. cor.
	Fall 5 lks. N. of the cor. of secs.2, 3, 10 and 11.
	Thence
	S.89°52'W., on a true line, bet.secs.3 and 10.
	Over rolling land, through scattering timber and undergrowth.
	Desc.19 ft. over W. slope.
3.75	Trail, bears SE. and NW.
4.20	Wash, 7 lks. wide, course S.; asc.100 ft. over gradual SE. slope.
28.85	Top of low spur, slopes SE.; desc.63 ft. over SW. slope.

Chains

40.05

Set an iron post, 3 ft. long, 1 in. diam., 27 ins. in the ground, for 1/4 sec. cor. of secs. 3 and 10, with brass cap marked

1/4 S 3  
S 10  
1930

from which  
a cedar, 5 ins. diam., bears N. 46 1/4° E., 58 lks. dist., marked 1/4 S3 BT  
a cedar, 12 ins. diam., bears S. 78 1/4° W., 83 lks. dist., marked 1/4 S10 BT

45.10

Desc. 29 ft. over SW. slope.  
Creek, 15 lks. wide, 6 ins. deep, course S. 45° E., asc. 183 ft. over gradual NE. slope.

80.10

The cor. of secs. 3, 4, 9 and 10.

Land, rolling.  
Soil, adobe and gravelly, 3rd rate.  
Timber, cedar and piñon.  
Undergrowth, scrub oak, mahogany, catclaw, cactus & grass.

21.12

N. 0° 2' W., bet. secs. 3 and 4.  
Over rolling land, thru scattering timber and undergrowth.  
Desc. 109 ft. over gradual NE. slope.

27.35

Creek, 8 lks. wide, course N. 75° E., asc. 178 ft. over S. slope.  
Trail, bears N. 75° E. and W.

40.00

Set an iron post, 3 ft. long, 1 in. diam., 27 ins. in the ground, for 1/4 sec. cor. of secs. 3 and 4, with brass cap marked

1/4  
S 4 | S 3  
1930

from which  
a cedar, 16 ins. diam., bears N. 74° E., 141 lks. dist., marked 1/4 S3 BT  
a cedar, 6 ins. diam., bears S. 13° W., 138 lks. dist., marked 1/4 S4 BT

49.10

Asc. 30 ft. over S. slope.  
Top of spur, slopes N. 70° E., thence along E. slope.

69.10

Spur, slopes NE., desc. 122 ft. over NE. slope

79.65

Intersect N. bdy. of the Tp. at 3.81 chs. S. 89° 55' W. from the 1/4 sec. cor. of secs. 3 and 34, which is a malpais stone 10x7x5 ins. above ground, firmly set, marked 1/4 on N. face, and witnessed by a mound of stone No. 1 cor. No bearing trees.

This cor. monument now refers to the quarters of sec. 34 only, and no physical change of same is required.

The cor. of secs. 3, 4, 33 and 34 is a part of a malpais ledge projecting 6x3x2 ft. above the surrounding surface, marked with a cross (x) on top at exact cor. point, 3 notches each E. and W. of cross, and witnessed by a mound of stone W., and two properly marked juniper bearing trees, S. 36° E. 226 lks., and N. 74 1/2° E. 241 lks. dist.

Alter this cor. monument to refer to secs. 33 and 34 only by moving mound of stone from W. to N. of cor., and changing the marking on the SE. bearing tree to read "BT" only.

At point of intersection, set an iron post, 3 ft. long, 2 ins. diam., 18 ins. in the ground, to bedrock, and raise a mound of stone around post, for closing cor. of secs. 3 and 4, with brass cap

Chains

marked

T16N R7W

S34

S 4 | S 3

T15N R7W

C | C

1930

from which

a cedar, 6 ins. diam., bears S.  $47\frac{1}{2}^{\circ}$  E., 175 lks. dist.,  
marked T15N R7W S3 CC BT

a cedar, 8 ins. diam., bears S.  $20^{\circ}$  W., 94 lks. dist.,  
marked T15N R7W S4 CC BT

Land, rolling.

Soil, gravelly, 3rd rate.

Timber, cedar and pinyon.

Undergrowth, scrub oak, catclaw, mahogany, cactus, yucca  
and grass

The cor. of secs. 20, 21, 32 and 33 on the S. bdy. of T.15 N.,  
R.7 W. is an iron post, 3 ins. diam., projecting 12 ins.  
above ground, firmly set, with brass cap marked

T15N R7W

S32 | S33

S20 | S21

T14N

1915

and witnessed by a mound of stone W. of cor.  
No bearing trees.

Thence

N.  $0^{\circ}$  2' W., bet. secs. 32 and 33.Over mountainous land, thru scattering timber and  
dense undergrowth.

Asc. 81 ft. over SE. slope.

4.15 Spur, slopes E., desc. 203 ft. over NE. slope.

12.72 Creek, 20 lks. wide, course SE., asc. 155 ft. over S. slope.

18.90 Spur, slopes SW., desc. 6 ft. over NW. slope.

23.10 Same creek, 20 lks. wide, course SW., asc. 101 ft. over  
SE. slope.

27.58 Top of spur, slopes E., desc. 54 ft. over NE. slope.

37.00 Asc. 189 ft. over SE. slope to

40.00 Set an iron post, 3 ft. long, 1 in. diam., 27 ins. in the  
ground, for  $\frac{1}{4}$  sec. cor. of secs. 32 and 33, with brass cap  
marked. $\frac{1}{4}$ 

S 32 | S 33

1930

No bearing trees available.

Raise a mound of stone, 3 ft. base, 2 $\frac{1}{2}$  ft. high, W. of cor.

Asc. 143 ft. over SE. slope.

41.55 Ravine, course SE.

50.00 Top of spur, slopes SW., desc. 25 ft. over NW. slope.

57.36 Wash, 30 lks. wide, course S.  $30^{\circ}$  W., asc. 162 ft. over SE. slope.66.76 Fence cor. bears E. 3.50 chs. dist., from which fences  
extend N. and E.

Desc. 29 ft. over NW. slope.

74.87 Draw, course E.

77.00 Same draw, course SW., asc. 93 ft. over SE. slope.

Chains  
80.00

Set an iron post, 3 ft. long, 2 ins. diam., 26 ins. in the ground, for cor. of secs. 28, 29, 32 and 33, with brass cap marked

T15NR7W  
S29 | S28  
S32 | S33  
1930

from which

- a cedar, 14 ins. diam., bears N. 40 1/2° E., 481 lks. dist., marked T15N R7W S28 BT.
- a cedar, 12 ins. diam., bears S. 35° E., 163 lks. dist., marked T15N R7W S33 BT.
- a pinyon pine, 10 ins. diam., bears S. 40° W., 117 lks. dist., marked T15N R7W S32 BT.
- a cedar, 6 ins. diam., bears N. 83 1/2° W., 163 lks. dist., marked T15N R7W S29 BT.

Land, mountainous.  
Soil, rocky; 4th rate.  
Timber, scattering cedar, pinyon and sycamore.  
Undergrowth, scrub oak, catclaw, mahogany laurel and grass.

40.00  
80.00

East, on a random line, bet. secs. 28 and 33.  
Set temp. 1/4 sec. cor.  
Fall 12 lks. S. of the cor. of secs. 27, 28, 33 and 34.  
Thence  
S. 89° 55' W., on a true line, bet. secs. 28 and 33.  
Over mountainous land, through scattering timber and dense undergrowth.  
Desc. 63 ft. over SW. slope.  
1.76 Head of drain, 6 lks. wide, course S.; asc. 343 ft. over rocky SE. slope.  
22.30 Top of spur, slopes S. 45° E.; desc. 161 ft. over rocky SW. slope.  
30.30 Top of rocky ridge, bears N. 10° E. and S. 10° W.; continue descending.  
33.70 Head of wash, 2 lks. wide, course N. 45° W.  
40.00 Set an iron post, 3 ft. long, 1 in. diam., 16 ins. in the ground to bedrock, deposit a stone marked with a cross (X) at base of post, supported in a mound of stone, for 1/4 sec. cor. of secs. 28 and 33, with brass cap marked

S28  
1/4 ———  
S33  
1930

No bearing trees available.  
Desc. 237 ft. over NW. slope.  
51.10 Wash, 10 lks. wide, course S. 60° W.  
58.00 End of small spur, slopes S. 60° W.  
60.90 Trail, bears N. 15° E. and S. 15° W.  
65.10 Wash, 10 lks. wide, course S. 15° W.; asc. 172 ft. over broken E. slope.  
70.30 Corner of fence, bears S. 100 lks. dist.  
80.00 The cor. of secs. 20, 21, 28 and 29.

Land, mountainous.  
Soil, rocky; 4th rate.  
Timber, scattering cedar and pinyon.  
Undergrowth, scrub oak, mahogany, catclaw, cactus and grass.

Chains N.0°2'W., bet. secs. 28 and 29.  
Over mountainous land, through scattering timber and dense undergrowth.  
Asc. 31 ft. over SE. slope.  
3.00 Top of ridge, bears NE. and SW.; desc. 223 ft. over NW. slope.  
21.80 Ravine, course SW.; asc. 193 ft. over SE. slope.  
33.50 Top of spur, slopes SW.; desc. 79 ft. over NW. slope.  
39.90 Set an iron post, 3 ft. long, 1 in. diam., 26 ins. in the ground for witness cor. to  $\frac{1}{4}$  sec. cor. of secs. 28 and 29, with brass cap marked

WC  
 $\frac{1}{4}$

S29 | S28

1930

No bearing trees available.

40.00 The true point for  $\frac{1}{4}$  sec. cor. of secs. 28 and 29, falls on edge of wash, a place impracticable to set permanent

mon.

40.20 Wash, 30 lks. wide, course SW.; asc. 350 ft. over SW. slope.

47.60 Thence asc. over SW. slope.

66.30 Top of spur, slopes E.; desc. 33 ft. over N. slope.

70.10 Ravine, course E.; asc. 85 ft. over S. slope.

78.50 Top of spur, slopes SW.; thence along W. slope.

80.00 Set an iron post, 3 ft. long, 2 ins. diam., 8 ins. in the ground to bedrock, deposit a stone marked with a cross (X) at base of post, supported in a mound of stone, for cor. of secs. 20, 21, 28 and 29, with brass cap marked

T15NR7W

S20 | S21

S29 | S28

1930

No bearing trees available.

Land, mountainous.

Soil, rocky; 4th rate.

Timber, scattering cedar and pinyon.

Undergrowth, scrub oak, catclaw, laurel, mahogany, cactus and grass.

40.00 N. 89°55'E., on a random line, bet. secs. 21 and 28.

Set temp.  $\frac{1}{4}$  sec. cor.

80.08 Fall 17 lks. N. of the cor. of secs. 21, 22, 27 and 28.

Thence

N. 89°58'W., on a true line, bet. secs. 21 and 28.

Over mountainous land, through scattering timber and dense undergrowth.

Asc. 323 ft. over rocky NE. slope.

15.40 Top of rocky spur, slopes SE.; thence asc. over E. slope.

33.50 Top of rocky spur, slopes S.; desc. 109 ft. over W. slope.

40.04 Set an iron post, 3 ft. long, 1 in. diam., 12 ins. in the ground to bedrock, supported in a mound of stone, for  $\frac{1}{4}$  sec. cor. of secs. 21 and 28, with brass cap marked

S21

$\frac{1}{4}$

S28

1930

from which

a pinyon pine, 12 ins. diam., bears N. 72 $\frac{1}{2}$ ° E., 270 lks. dist., marked  $\frac{1}{4}$  S21 BT.

a juniper, 6 ins. diam., bears S. 42 $\frac{3}{4}$ ° W., 101 lks. dist., marked  $\frac{1}{4}$  S28 BT.



Chains  
 61.28 Desc. 220 ft. over W. slope.  
 71.03 Ravine, course S.; desc. 34 ft. over W. slope.  
 75.88 Ravine, course S.; asc. 31 ft. over SE. slope.  
 80.08 Top of spur, slopes S.; desc. 23 ft. over W. slope.  
 The cor. of secs. 20, 21, 28 and 29.

Land, mountainous.  
 Soil, rocky; 4th rate.  
 Timber, scattering cedar and pinyon.  
 Undergrowth, scrub oak, mahogany, catclaw, cactus and grass.

-----

37.00 N. 0° 2' W., bet. secs. 20 and 21.  
 40.00 Over mountainous land, through scattering timber and dense undergrowth.  
 Asc. steep broken S. slope 521 ft.  
 Ridge, bears E. and W.; desc. 106 ft. over broken N. slope.  
 Set an iron post, 3 ft. long, 1 in. diam., 26 ins. in the ground, for  $\frac{1}{4}$  sec. cor. of secs. 20 and 21, with brass cap marked

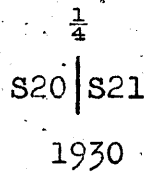

from which

a pinyon pine, 16 ins. diam., bears S. 77° E., 93 lks. dist., marked  $\frac{1}{4}$  S21 BT.  
 a pinyon pine, 21 ins. diam., bears S. 37° W., 66 lks. dist., marked  $\frac{1}{4}$  S20 BT.

74.10 Desc. 599 ft. over N. slope.  
 76.60 Gulch, course E.  
 80.00 Spur, slopes E., thence desc. NE. slope.  
 Set an iron post, 3 ft. long, 2 ins. diam., on solid rock, supported in a mound of stone, for cor. of secs. 16, 17, 20 and 21, with brass cap marked

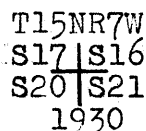

from which

a juniper, 7 ins. diam., bears N. 64° E., 97 lks. dist., marked T15N R7W S16 BT.  
 a pinyon pine, 12 ins. diam., bears S. 18° E., 231 lks. dist., marked T15N R7W S21 BT.  
 a pinyon pine, 10 ins. diam., bears S. 56 $\frac{1}{2}$ ° W., 114 lks. dist., marked T15N R7W S20 BT.  
 a pinyon pine, 12 ins. diam., bears N. 33° W., 252 lks. dist., marked T15N R7W S17 BT.

Land, mountainous.  
 Soil, rocky; 4th rate.  
 Timber, scattering juniper and pinyon.  
 Undergrowth, scrub oak, mahogany, catclaw, cactus laurel and grass.

-----

40.00 S. 89° 58' E., on a random line, bet. secs. 16 and 21.  
 79.86 Set temp.  $\frac{1}{4}$  sec. cor.  
 Fall 5 lks. S. of the cor. of secs. 15, 16, 21 and 22.  
 Thence  
 West, on a true line, bet. secs. 16 and 21.

Chains Over mountainous land, through scattering timber and dense undergrowth.  
 Desc. 35 ft. along S. slope.  
 6.40 End of spur, slopes S.  
 12.27 Shallow drain, 5 lks. wide, course S.; asc. 65 ft. over SE. slope.  
 19.80 Top of spur, slopes S.; desc. 64 ft. over SW. slope.  
 33.35 Creek, 15 lks. wide, course S. 65° E.; asc. 213 ft. over NE. slope.  
 39.93 Set an iron post, 3 ft. long, 1 in. diam., 15 ins. in the ground to bedrock, deposit a stone marked with a cross (X) at base of post, supported in a mound of stone, for 1/4 sec. cor. of secs. 16 and 21, with brass cap marked

1/4 S16  
 S21  
 1930

No bearing trees available.

Asc. 44 ft. over NE. slope.  
 42.86 End of spur slopes N.; desc. 100 ft. over W. slope.  
 44.88 Gulch, course N.; asc. 280 ft. over broken NE. slope.  
 55.66 Top of spur, slopes N.; continue ascending.  
 66.06 Top of spur, slopes N.; desc. 159 ft. over W. slope.  
 75.78 Gulch, course N.; asc. 49 ft. over NE. slope.  
 79.86 The cor. of secs. 16, 17, 20 and 21.

Land, mountainous.  
 Soil, rocky; 4th rate.  
 Timber scattering cedar and pinyon.  
 Undergrowth, scrub oak, mahogany, catclaw, cactus, laurel, and grass.

-----  
 N. 0° 2' W., bet. secs. 16 and 17.  
 Over mountainous land, through scattering timber and dense undergrowth.  
 Asc. 14 ft. along broken E. slope.  
 8.20 Desc. 92 ft. over NE. slope.  
 16.80 Wash, 20 lks. wide, course E.; asc. 155 ft. over S. slope.  
 40.00 Set an iron post, 3 ft. long, 1 in. diam., 26 ins. in the ground, for 1/4 sec. cor. of secs. 16 and 17, with brass cap marked

1/4  
 S17 | S16  
 1930

from which

a juniper, 10 ins. diam., bears S. 46 3/4° E., 217 lks. dist., marked 1/4 S16 BT.  
 a juniper, 4 ins. diam., bears N. 18° W., 202 lks. dist., marked BT only.

Asc. 37 ft. over S. slope.  
 44.60 Top of ridge, bears E. and W.; desc. 75 ft. over N. slope.  
 55.30 Ravine, course E.; asc. 66 ft. over S. slope.  
 60.30 Top of spur, slopes E.; thence along rolling E. slope.  
 66.08 Spur, slopes NE.; desc. 127 ft. over NW. slope.  
 71.07 Trail, bears E. and W.  
 71.45 Ravine, course NW.; asc. 44 ft. over S. slope.  
 76.45 Creek, 100 lks. wide, course E.; asc. 38 ft. over S. slope.  
 77.73 Trail, bears E. and W.

Chains  
79.34  
80.00

Wire fence and trail, bears E. and W.  
Set an iron post, 3 ft. long, 2 in. diam., 26 ins. in the ground for cor. of secs. 8, 9, 16 and 17, with brass cap marked.

T15NR7W  
S 8 | S 9  
S17 | S16  
1930

from which

a pinyon pine, 10 ins. diam., bears S. 22½° E., 69 lks. dist., marked T15N R7W S16 BT.  
No other bearing trees available.  
Raise a mound of stone, 3 ft. base, 2½ ft. high, W. of cor.

Land, mountainous.  
Soil, rocky; 4th rate.  
Timber, scattering juniper and pinyon.  
Undergrowth, scrub oak, mahogany, catclaw, cactus, laurel and grass.

40.00  
79.84

East, on a random line, bet. secs. 9 and 16.  
Set temp. ¼ sec. cor.  
Fall 21 lks. S. of the cor. of secs. 9, 10, 15 and 16.

Thence  
S. 89° 51' W., on a true line, bet. secs. 9 and 16.  
Over mountainous land, through scattering timber and dense undergrowth.

7.50

Along S. slope of mesa.  
Rim of mesa, bears SE. and NW.; desc. 281 ft. over broken SW. slope.

34.30  
39.92

Top of low spur, slopes SW.; thence desc. over W. slope.  
Set an iron post, 3 ft. long, 1 in. diam., 4 ins. in the ground to bedrock, deposit a stone marked with a cross (X) at base of post, supported in a mound of stone, for ¼ sec. cor. of secs. 9 and 16, with brass cap marked

S9  
¼ —  
S16  
1930

No bearing trees available.

66.99  
68.99  
76.16  
78.59  
79.84

Desc. 300 ft. over W. slope.  
Creek, course SE. Spring bears NE. about 15 chs. dist.  
Creek, 70 lks. wide, course S. 80° E.  
Same creek, course N. 80° E.; asc. 25 ft. over SE. slope.  
Wire fence, bears NE. and SW.  
The cor. of secs. 8, 9, 16 and 17.

Land, mountainous.  
Soil, rocky; 4th rate.  
Timber, scattering cedar and pinyon.  
Undergrowth, scrub oak, catclaw, mahogany, cactus and grass.

Chains N.0°2'W., bet. secs. 8 and 9.  
Over mountainous land, through scattering timber and dense undergrowth.  
Asc. 175 ft. over SE. slope.  
11.40 Top of spur, slopes E.; desc. 200 ft. over N. slope.  
19.85 Wash, 50 lks. wide, course SE.; asc. 196 ft. over SW. slope.  
40.00 Set an iron post, 3 ft. long, 1 in. diam., 10 ins. in the ground to bedrock, deposit a stone marked with a cross (X) at base of post, supported in a mound of stone, for  $\frac{1}{4}$  sec. cor. of secs. 8 and 9, with brass cap marked

 $\frac{1}{4}$ 

S8|S9

1930

No bearing trees available.

Asc. 282 ft. over N. slope.  
49.82 Wire fence, bears NE. and SW.  
55.80 Old fence on edge of mesa, bears SE. and NW.; thence over mesa land.  
72.00 Desc. 21 ft. over gradual NE. slope.  
80.00 Set an iron post, 3 ft. long, 2 ins. diam., 26 ins. in the ground, for cor. of secs. 4, 5, 8 and 9, with brass cap marked.

T15NR7W

S 5|S 4

S 8|S 9

1930

from which

a juniper, 20 ins. diam., bears N.76 $\frac{1}{4}$ °E., 149 lks. dist., marked T15N R7W S4 BT.

a juniper, 24 ins. diam., bears S.66°W., 623 lks. dist., marked T15N R7W S8 BT.

No other bearing trees available.

Raise a mound of stone, 3 ft. base, 2 $\frac{1}{2}$  ft. high, W. of cor.

Land, mountainous.

Soil, gravelly and rocky; 4th rate.

Timber, scattering cedar, juniper and pinyon.

Undergrowth, scrub oak, mahogany, catclaw, cactus and grass.

40.00 N.89°51'E., on a random line, bet. secs. 4 and 9.  
Set temp.  $\frac{1}{4}$  sec. cor.  
79.90 Fall 14 lks. S. of the cor. of secs. 3, 4, 9 and 10.  
Thence  
S.89°45'W., on a true line, bet. secs. 4 and 9.  
Over rolling land, through scattering timber and undergrowth.  
Asc. 52 ft. over NE. slope.  
12.50 Top of spur, slopes N.; desc. 35 ft. along N. slope.  
12.60 Ralph C. Anderson's house, bears N.59°W.; barn bears N.56 $\frac{1}{2}$ °W.  
32.97 Wire fence, bears N. and S.  
39.95 Set an iron post, 3 ft. long, 1 in. diam., 26 ins. in the ground, for  $\frac{1}{4}$  sec. cor. of secs. 4 and 9, with brass cap marked

 $\frac{1}{4}$  S4

S9

1930

from which

Subdivision of T.15 N., R.7 W.

Chains

a cedar, 30 ins. diam., bears S.  $3\frac{1}{2}^{\circ}$  W., 252 lks. dist., marked  $\frac{1}{4}$  S9 BT

a cedar, 8 ins. diam., bears N.  $65\frac{1}{2}^{\circ}$  W., 361 lks. dist., marked  $\frac{1}{4}$  S4 BT

Ralph C. Anderson's house bears N.  $29^{\circ}45'$  W.

Barn bears N.  $22^{\circ}45'$  W.

45.00 Asc. 140 ft. over NE. slope.

53.10 Trail, bears S.  $25^{\circ}$  E. and N.  $25^{\circ}$  W.

61.00 Top of mesa, bears S.  $45^{\circ}$  E. and N.  $45^{\circ}$  W., thence over mesa. Desc. 53 ft. over gradual SW. slope to

79.90 The cor. of secs. 4, 5, 8 and 9.

Land, rolling.

Soil, adobe, 3rd rate.

Timber, cedar and pinyon.

Undergrowth, scrub oak, catclaw, mahogany, cactus, laurel and grass.

---

N.  $0^{\circ}2'$  W., bet. secs. 4 and 5.

Over rolling mesa land, thru scattering timber and undergrowth. Asc. 64 ft. over gradual SW. slope:

1.10 Trail, bears SE. and NW.

17.96 Road, bears NW. and SE. NW. to Yolo Ranch, and SE. to Ralph C. Anderson's house.

22.00 Anderson's house bears E. about 25 chs. dist.

32.04 Trail, bears E. and W.

40.00 Set an iron post, 3 ft. long, 1 in. diam., 10 ins. in the ground to bedrock, and raise a mound of stone around post, for  $\frac{1}{4}$  sec. cor. of sec. 4 and 5, with brass cap marked

$\frac{1}{4}$

S 5 | S 4

1930

from which

a cedar, 10 ins. diam., bears N.  $30^{\circ}$  E., 117 lks. dist., marked  $\frac{1}{4}$  S4 BT

a pinyon pine, 12 ins. diam., bears N.  $60^{\circ}$  W., 87 lks. dist., marked  $\frac{1}{4}$  S5 BT

53.42 Wire fence, bears E. and W.

78.60 Road, bears NE. and SW.

79.85 Intersect N. bdy. of the Tp. at 3.92 chs. S.  $89^{\circ}55'$  W. from the  $\frac{1}{4}$  sec. cor. of secs. 4 and 33 which is a malpais stone 10x6x5 ins. above ground, firmly set, marked  $\frac{1}{4}$  on N. face, and witnessed by two properly marked bearing trees; a pinyon N.  $39\frac{1}{2}^{\circ}$  W. 11 lks., and a juniper S.  $12\frac{1}{2}^{\circ}$  E. 61 lks., dist.

Alter this cor. monument to refer to the quarters of sec. 33 only, by changing marking on the SE. bearing tree to read "BT" only.

The cor. of secs. 4, 5, 32 and 33 is a malpais stone in place, exposed 12x5x5 ins. above ground, marked with a cross (X) on top, 2 notches W. and 4 notches E., of cross, and witnessed by a mound of stone W., and three properly marked juniper bearing trees; N.  $57^{\circ}$  E. 150 lks., S.  $40\frac{1}{2}^{\circ}$  E. 87 lks., and N.  $85\frac{1}{2}^{\circ}$  W. 107 lks., dist.

Alter this cor. monument to refer to secs. 32 and 33 only by moving the mound of stone from W. to N. of cor. and changing the marking on the SE. bearing tree to read "BT" only.

At point of intersection, set an iron post, 3 ft. long, 2 ins. in diam., 26 ins. in the ground, for closing cor. of secs. 4 and 5, with brass cap marked

Chains

T16N R7W  
 S 33  
 S 5 | S 4  
 T15N R7W  
 C C  
 1930

from which

- a juniper, 12 ins. diam., bears S.  $81\frac{1}{2}^{\circ}$  E., 127 lks. dist., marked T15N R7W S4 CC BT
- a juniper, 10 ins. diam., bears S.  $65\frac{1}{2}^{\circ}$  W., 301 lks. dist., marked T15N R7W S5 CC BT

Land, rolling.  
 Soil, gravelly, 3rd rate.  
 Timber, cedar, pinyon and juniper.  
 Undergrowth, scrub oak, catclaw, mahogany, cactus & grass.

The cor. of secs. 19, 20, 31 and 32 on the S. bdy. of T.15 N., R.7 W. is an iron post, 3 ins. diam., projecting 9 ins. above ground, firmly set, with brass cap marked

T15N R7W  
 S31 | S32  
 S19 | S20  
 T14N  
 1915

- and witnessed by four bearing trees:
- a cedar, 12 ins. diam., N.  $47\frac{1}{2}^{\circ}$  E., 495 lks. dist., marked T15N R7W S32 BT
  - a cedar, 12 ins. diam., S.  $28\frac{1}{2}^{\circ}$  E., 200 lks. dist., marked T14N R7W S20 BT
  - a cedar, 12 ins. diam., S.  $23\frac{3}{4}^{\circ}$  W., 281 lks. dist., marked T14N R7W S19 BT
  - a cedar, 12 ins. diam., N.  $28\frac{3}{4}^{\circ}$  W., 80 lks. dist., marked T15N R7W S31 BT

Thence,  
 N.  $0^{\circ}$  3' W., bet. secs. 31 and 32  
 Over mountainous land, thru scattering timber and undergrowth.

- 5.20 Asc. 35 ft. over gradual S. slope.  
 Top of low divide, bears NE. and SW.  
 Asc. 141 ft. over broken SW. slope.
- 29.48 Small spur, slopes S.  $45^{\circ}$  W.
- 40.00 Set an iron post, 3 ft. long, 1 in. in diam., 10 ins. in the ground to bedrock, deposit a stone marked with a cross (X) at base of post, and raise a mound of stone around post, for  $\frac{1}{4}$  sec. cor. of secs. 31 and 32, with brass cap marked
- No bearing trees available.
- Asc. 11 ft. over SW. slope.
- 41.00 Low spur, slopes SW., desc. 51 ft. over NW. slope.
- 61.53 Drain, 5 lks. wide, course S.  $55^{\circ}$  W., asc. 116 ft. over SE. slope.
- 80.00 Set an iron post, 3 ft. long, 2 ins. diam., 15 ins. in the ground to bedrock, deposit a stone marked with a cross (X) at base of post, and raise a mound of stone around post, for cor. of secs. 29, 30, 31 and 32, with brass cap marked.

Chains

T15NR7W  
S30 | S29  
S31 | S32  
1930

No bearing trees available.

Land, mountainous.  
Soil, rocky; 4th rate.  
Timber, scattering cedar.  
Undergrowth, scattering scrub oak, catclaw, mahogany, cactus and grass.

-----

40.00 East, on a random line, bet. secs. 29 and 32.  
Set temp.  $\frac{1}{4}$  sec. cor.  
80.10 Fall 14 lks. N. of the cor. of secs. 28, 29, 32 and 33.  
Thence  
N.  $89^{\circ}54'W.$ , on a true line, bet. secs. 29 and 32.  
Over mountainous land, through scattering timber and undergrowth.  
Asc. 21 ft. over E. slope.  
1.84 Top of spur, slopes S.  $20^{\circ}W.$ ; desc. 270 ft. over NW. slope.  
15.80 Wash, 20 lks. wide, course S.; asc. 101 ft. over E. slope.  
22.80 Top of spur, slopes S.  $20^{\circ}E.$ ; desc. 87 ft. over SW. slope.  
27.60 Wash, 20 lks. wide, course N.  $60^{\circ}E.$ ; asc. 172 ft. over NE. slope.  
40.05 Set an iron post, 3 ft. long, 1 in. diam., 26 ins. in the ground for  $\frac{1}{4}$  sec. cor. of secs. 29 and 32, with brass cap marked

S29  
 $\frac{1}{4}$  —  
S32  
1930

No bearing trees available.  
Raise a mound of stone, 3 ft. base,  $2\frac{1}{2}$  ft. high, N. of cor.

Asc. 46 ft. along broken N. slope.  
49.02 Trail, bears NE. and SW.  
58.10 Top of spur, slopes S.  $65^{\circ}E.$ ; desc. 29 ft. along S. slope.  
69.40 Top of spur, slopes S.; desc. 80 ft. over rocky SW. slope.  
75.20 Wash, 10 lks. wide, course S.  $65^{\circ}E.$ ; asc. 63 ft. over gradual E. slope.  
80.10 The cor. of secs. 29, 30, 31 and 32.

Land, mountainous.  
Soil, rocky; 4th rate.  
Timber, scattering cedar and pinyon.  
Undergrowth, scattering scrub oak, catclaw, mahogany, cactus and grass.

-----

40.00 West, on a random line, bet. secs. 30 and 31.  
Set temp.  $\frac{1}{4}$  sec. cor.  
77.55 Intersect the cor. of secs. 25, 30, 31 and 36, on W. bdy. of Tp., described in book "D" of this group.  
Thence  
East, on a true line, bet. secs. 30 and 31.  
Over mountainous land, through scattering timber and dense undergrowth.  
Asc. 64 ft. over over SW. slope.  
3.88 Top of spur, slopes SE.; desc. 66 ft. over SE. slope.  
14.80 Top of spur, slopes SE. desc. 54 ft. over NE. slope.  
18.10 Creek, 5 lks. wide, course S.; asc. 24 ft. over SW. slope.  
18.84 Trail, bears SE. and NW.  
21.35 Spur, slopes S.; desc. 24 ft. over E. slope.  
24.90 Ravine, course S.; asc. 76 ft. over W. slope.  
37.29 Wash, 10 lks. wide, course S.

Chains  
37.55

Set an iron post, 3 ft. long, 1 in. diam., 16 ins. in the ground to bedrock, deposit a stone marked with a cross (X) at base of post, supported in a mound of stone, for  $\frac{1}{4}$  sec. cor. of secs. 30 and 31, with brass cap marked

S30  
 $\frac{1}{4}$   
S31  
1930

No bearing trees available.

- 37.95 Asc. 271 ft. over NW. slope.
- 50.20 Ravine, course NW.
- 56.20 Same ravine, course SW.
- 60.86 Top of ridge, bears NE. and SW.; desc. 5 ft.
- 69.15 Draw, course SW.; asc. 23 ft. over gradual NW. slope.
- 73.05 Top of spur, slopes SW.; desc. 4 ft. along S. slope.
- 77.55 Draw, course SW.; asc. 15 ft. along S. slope.
- 77.55 The cor. of secs. 29, 30, 31 and 32.

Land, mountainous.  
Soil, rocky; 4th rate.  
Timber, scattering cedar and pinyon.  
Undergrowth, scrub oak, catclaw, mahogany, cactus and grass.

N. 0° 3' W., bet. secs. 29 and 30.  
Over mountainous land, through scattering timber and dense undergrowth.

- 8.60 Asc. 30 ft. along E. slope.
- 9.57 Desc. 14 ft. over NE. slope.
- 12.78 Ravine, course SE.; asc. 19 ft. over SW. slope.
- 13.75 Top of ascent,; thence desc. 15 ft. over NW. slope.
- 14.98 Same wash, 30 lks. wide, course SW.; asc. 8 ft. over SE. slope.
- 17.48 Top of ascent.; desc. 6 ft. over NW. slope.
- 28.40 Same wash, 30 lks. wide, course SE.; asc. 70 ft. over gradual SW. slope.
- 36.01 Top of ascent,; desc. 12 ft. over NW. slope.
- 40.00 Same wash, 30 lks. wide, course SW.; asc. 40 ft. over SE. slope.
- 40.00 Set an iron post, 3 ft. long, 1 in. diam., 15 ins. in the ground to bedrock, deposit a stone marked with a cross (X) at base of post, supported in a mound of stone, for  $\frac{1}{4}$  sec. cor. of secs. 29 and 30, with brass cap marked

$\frac{1}{4}$   
S30 | S29  
1930

from which

a juniper, 8 ins. diam., bears N. 50 $\frac{1}{4}$ ° W., 82 lks. dist., marked  $\frac{1}{4}$  S30 BT.  
No other bearing tree available.

- 42.70 Asc. 617 ft. over S. slope.
- 57.64 Same wash, 20 lks. wide, course S. 30° E.
- 80.00 Top of rocky spur, slopes S.; asc. along W. slope of spur.
- 80.00 Set an iron post, 3 ft. long, 2 ins. diam., 26 ins. in the ground for cor. of secs. 19, 20, 29 and 30, with brass cap marked



Chains

T15NR7W  
S19|S20  
S30|S29  
1930

No bearing trees available.  
Raise a mound of stone, 3 ft. base, 2½ ft. high, W. of cor.

Land, mountainous.  
Soil, rocky; 4th rate.  
Timber, scattering cedar and pinyon.  
Undergrowth, scrub oak, catclaw, mahogany, cactus and grass.

S. 89°54'E., on a random line, bet. secs. 20 and 29.  
40.00 Set temp. ¼ sec. cor.  
80.08 Fall 12 lks. S. of the cor. of secs. 20, 21, 28 and 29.  
Thence  
N. 89°59'W., on a true line, bet. secs. 20 and 29.  
Over mountainous land, through dense undergrowth.  
Desc. SW. slope.  
2.30 Draw, course S.; asc. 586 ft. over steep rocky, E. slope;  
27.78 Top of N. side of high peak of mountain; desc. 225 ft. over  
SW. slope.  
40.04 Set an iron post, 3 ft. long, 1 in. diam., 26 ins. in the  
ground, for ¼ sec. cor. of secs. 20 and 29, with brass cap  
marked

S20  
¼ —  
S29  
1930

No bearing trees available.  
Raise a mound of stone, 3 ft. base, 2½ ft. high, N. of cor.  
Desc. 61 ft. over SW. slope.  
46.94 Ravine, course S.; asc. 9 ft. over E. slope.  
48.84 Top of short spur, slopes S.; desc. 15 ft.  
51.08 Head of draw, course S.; asc. 63 ft. over SE. slope.  
56.38 Top of ridge, bears NE. and S.; desc. 104 ft. over NW. slope.  
61.88 Ravine, course SW.; asc. 257 ft. over E. slope.  
79.08 Top of spur, slopes S.; desc. W. slope.  
80.08 The cor. of secs. 19, 20, 29 and 30.

Land, mountainous.  
Soil, rocky; 4th rate.  
Timber, none.  
Undergrowth, scrub oak, mahogany, catclaw, cactus and grass.

West, on a random line, bet. secs. 19 and 30.  
40.00 Set temp. ¼ sec. cor.  
77.25 Fall 3 lks. S. of the cor. of secs. 19, 24, 25 and 30, on W.  
bdy. of Tp., described in book "D" of this group.  
Thence  
S. 89°59'E., on a true line, bet. secs. 19 and 30.  
Over mountainous land, through dense undergrowth.  
1.75 Creek, 10 lks. wide, course S.; desc. 50 ft. over SW. slope.  
13.30 Ravine, course SW.; asc. 444 ft. over W. slope.  
24.25 Top of spur, slopes SW.; desc. 29 ft. over E. slope.  
37.25 Set an iron post, 3 ft. long, 1 in. diam., 8 ins. in the  
ground to bedrock, deposit a stone marked with a cross  
(X) at base of post, supported in a mound of stone, for  
¼ sec. cor. of secs. 19 and 30, with brass cap marked

Chains

S19

 $\frac{1}{4}$ 

S30

1930

No bearing trees available.

38.43 Desc. 11 ft. over E. slope.  
 Junction of washes, 30 lks. wide, from N. and NE. course S.  
 asc. 103 ft. over NW. slope.  
 45.25 Top of spur, slopes SW.; thence along S. slope.  
 52.85 Desc. 25 ft. over E. slope.  
 55.27 Ravine, course S.; asc. 341 ft. over brushy W. slope.  
 77.25 The cor. of secs. 19, 20, 29 and 30.

Land, mountainous.

Soil, rocky; 4th rate.

Timber, none.

Undergrowth, scrub oak, mahogany, catclaw, laurel, cactus  
and grass..

N. 0° 3' W., bet. secs. 19 and 20.

Over mountainous land, through scattering timber and  
undergrowth.

Asc. 19 ft. along E. slope.

0.41 Top of large granite boulder on spur, slopes SE.; desc.  
45 ft. over NE. slope.

5.40 Same spur, slopes SW.; desc. NW. slope.

12.90 Draw, course W.; asc. 455 ft. over steep SW. slope.

35.40 Top of ridge, bears SE. and NW.; desc. 116 ft. over N. slope.

40.00 Set an iron post, 3 ft. long, 1 in. diam., 15 ins. in the  
ground to bedrock, deposit a stone marked with a cross  
(X) at base of post, supported in a mound of stone, for  
 $\frac{1}{4}$  sec. cor. of secs. 19 and 20, with brass cap marked $\frac{1}{4}$ 

S19 | S20

1930

No bearing trees available.

46.67 Desc. 118 ft. over N. slope.  
 Draw, course E.; asc. 19 ft. over S. slope.  
 50.00 Top of rocky spur, slopes E.; desc. 117 ft. over N. slope.  
 57.55 Wash, 10 lks. wide, course E. asc. 138 ft. over SE. slope.  
 67.00 Top of rocky spur, slopes E.; desc. 160 ft. over N. slope.  
 76.60 Thence along rolling E. slope.  
 80.00 Set an iron post, 3 ft. long, 2 ins. diam., 24 ins. in the  
ground for cor. of secs. 17, 18, 19 and 20, with brass cap  
marked

T15NR7W

S18 | S17

S19 | S20

1930

from which

a pinyon pine, 5 ins. diam., bears N. 25° E., 33 lks. dist.,  
marked T15N R7W S17 BT.a pinyon pine, 10 ins. diam., bears S. 31° E., 220 lks. dist.,  
marked T15N R7W S20 BT.a pinyon pine, 10 ins. diam., bears S. 31° W., 150 lks. dist.,  
marked T15N R7W S19 BT.a pinyon pine, 12 ins. diam., bears N. 61½° W., 56 lks. dist.,  
marked T15N R7W S18 BT.

Chains

Land, mountainous.  
Soil, rocky; 4th rate.  
Timber, scattering juniper and pinyon.  
Undergrowth, scrub oak, mahogany, catclaw, cactus, laurel and grass.

40.00  
80.00

S. 89° 59' E., on a random line, bet. secs. 17 and 20.  
Set temp. 1/4 sec. cor.  
Fall 16 lks. S. of the cor. of secs. 16, 17, 20 and 21.

37.80  
40.00

Thence  
S. 89° 54' W., on a true line, bet. secs. 17 and 20.  
Over mountainous land, through scattering timber and dense undergrowth.  
Asc. 553 ft. over rocky E. slope.  
Top of ridge, bears N. and S.; desc. 59 ft. over W. slope.  
Set an iron post, 3 ft. long, 1 in. diam., 20 ins. in the ground to bedrock, supported in a mound of stone, for 1/4 sec. cor. of secs. 17 and 20, with brass cap marked

S17  
1/4 —  
S20  
1930

from which

a juniper, 18 ins. diam., bears N. 65° E., 27 lks. dist., marked 1/4 S17 BT.  
a juniper, 18 ins. diam., bears S. 17 3/4° W., 15 1/4 lks. dist., marked 1/4 S20 BT.

52.34  
80.00

Desc. 42 ft. over gradual W. slope.  
Wash, 20 lks. wide, course N.; asc. 66 ft. over E. slope.  
The cor. of secs. 17, 18, 19 and 20.

Land, mountainous.  
Soil, rocky; 4th rate.  
Timber, scattering cedar, pinyon and juniper.  
Undergrowth, scrub oak, mahogany, catclaw, cactus, laurel and grass.

40.00  
77.33

N. 89° 59' W., on a random line, bet. secs. 18 and 19,  
Set temp. 1/4 sec. cor.  
Fall 2 lks. S. of the cor. of secs. 13, 18, 19 and 24, on W. bdy. of tp., described in book "D" of this group.

24.48  
32.26  
34.33  
36.13  
37.33

Thence  
S. 89° 58' E., on a true line, bet. secs. 18 and 19.  
Over mountainous land, through dense undergrowth.  
Asc. 120 ft. over NW. slope.  
Top of ridge, bears NE. and SW.; desc. 32 ft. over SE. slope.  
Wash, 20 lks. wide, course SW.; asc. 23 ft. over NW. slope.  
End of short spur slopes N.  
Draw, course N.  
Set an iron post, 3 ft. long, 1 in. diam., 26 ins. in the ground, for 1/4 sec. cor. of secs. 18 and 19, with brass cap marked

S18  
1/4 —  
S19  
1930

No bearing trees available.  
Raise a mound of stone, 3 ft. base, 2 1/2 ft. high, N. of cor.

Chains Asc. 237 ft. over W. slope.  
 51.13 Top of ridge, bears N. and S.; desc. 87 ft. over E. slope.  
 55.38 Head of gulch, course NE.; asc. 100 ft. over NW. slope.  
 64.43 Top of spur, slopes NE.; desc. 203 ft. over E. slope.  
 77.33 The cor. of secs. 17, 18, 19 and 20.

Land, mountainous.  
 Soil, rocky; 4th rate.  
 Timber, none.  
 Undergrowth, scrub oak, mahogany, catclaw, cactus, laurel and grass.

N. 0° 3' W., bet. secs. 17 and 18.  
 Over mountainous land, through scattering timber and dense undergrowth.

Along broken E. slope.  
 19.40 Top of spur, slopes NE.; desc. 155 ft. over NW. slope.  
 32.00 Ravine, course NE.; asc. 54 ft. over SE. slope.  
 38.30 Point of rocks.; desc. 21 ft. over NE. slope.  
 40.00 Set an iron post, 3 ft. long, 1 in. diam., 18 ins. in the ground, supported in a mound of stone, for  $\frac{1}{4}$  sec. cor. of secs. 17 and 18, with brass cap marked

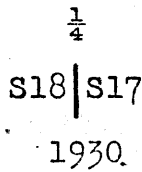

from which

a pinyon pine, 10 ins. diam., bears N. 27° E., 177 lks. dist., marked  $\frac{1}{4}$  S17 BT.  
 a pinyon pine, 10 ins. diam., bears S. 49° W., 159 lks. dist., marked  $\frac{1}{4}$  S18 BT.

47.61 Asc. 51 ft. along W. slope.  
 56.96 Top of ascent, thence desc. 163 ft. over NW. slope.  
 70.50 Ravine, course NE.; asc. 148 ft. over SE. slope.  
 80.00 Top of spur, slopes NE.; desc. 111 ft. over NW. slope.  
 Set an iron post, 3 ft. long, 2 ins. diam., 26 ins. in the ground for cor. of secs. 7, 8, 17 and 18, with brass cap marked

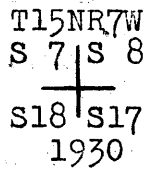

from which

a juniper 10 ins. diam., bears N. 68 $\frac{3}{4}$ ° E., 92 lks. dist., marked T15N R7W S8 BT.  
 a cedar, 4 ins. diam., bears S. 36 $\frac{1}{2}$ ° E., 94 lks. dist., marked BT. only.  
 a juniper, 10 ins. diam., bears S. 28° W., 192 lks. dist., marked T15N R7W S18 BT.  
 a pinyon pine, 8 ins. diam., bears N. 64° W., 233 lks. dist., marked T15N R7W S7 BT.

Land, mountainous.  
 Soil, rocky; 4th rate.  
 Timber, scattering cedar, pinyon and juniper.  
 Undergrowth, scrub oak, mahogany, catclaw, cactus, laurel and grass.

Chains  
40.00  
79.92

N.89°54'E., on a random line, bet. secs. 8 and 17.  
Set temp.  $\frac{1}{4}$  sec. cor.  
Fall 14 lks. N. of the cor. of secs. 8, 9, 16 and 17.  
Thence  
West, on a true line, bet. secs. 8 and 17.  
Over mountainous land, through scattering timber and  
dense undergrowth.  
Asc. 49 ft. over SE. slope.  
Top of ascent on S. side of spur; desc. 50 ft. over SW. slope.  
Wire fence, bears SE. and NW.  
Left bank of wash, course SE.; thence along wash, course E.  
Leave left bank of wash, bears NE. and SW.  
Same wash, 30 lks. wide, course SE.; asc. 23 ft. over NE. slope.  
Set an iron post, 3 ft. long, 1 in. diam., 14 ins. in the  
ground to bedrock, supported in a mound of stone, for  
 $\frac{1}{4}$  sec. cor. of secs. 8 and 17, with brass cap marked

8.07  
19.61  
25.92  
30.42  
38.42  
39.96

$\frac{1}{4}$  S8  
S17  
1930

from which.

a juniper, 12 ins. diam., bears S. 65 $\frac{3}{4}$ ° E., 146 lks. dist.,  
marked  $\frac{1}{4}$  S17 BT.  
a pinyon pine, 10 ins. diam., bears N. 61 $\frac{3}{4}$ ° W., 83 lks. dist.,  
marked  $\frac{1}{4}$  S8 BT.

48.66  
75.67  
79.92

Asc. 402 ft. over SE. slope.  
Creek, 50 lks. wide, course NE.  
Top of spur, slopes NE.; desc. 44 ft. over NW. slope.  
The cor. of secs. 7, 8, 17 and 18.

Land, mountainous.  
Soil, rocky; 4th rate.  
Timber, scattering cedar, pinyon and juniper.  
Undergrowth, scrub oak, catclaw, mahogany, laurel and grass.

40.00  
77.32

N.89°58'W., on a random line, bet. secs. 7 and 18.  
Set temp.  $\frac{1}{4}$  sec. cor.  
Fall 15 lks. N. of the cor. of secs. 7, 12, 13 and 18, on W.  
bdy. of Tp., described in book "D" of this group.

14.03

Thence  
N.89°56'E., on a true line, bet. secs. 7 and 18.  
Over mountainous land, through scattering timber and  
dense undergrowth.

26.51  
36.02  
37.32

Asc. 227 ft. along N. slope.  
Frame of old shaft, bears S. 47°35'E. 13.72 chs. dist.  
Desc. 65 ft. along N. slope.  
Trail, bears SE. and NW.; asc. 46 ft. along N. slope.  
Point of rocks; desc. 25 ft. over NE. slope.  
Set an iron post, 3 ft. long, 1 in. diam., 14 ins. in the  
ground to bedrock, supported in a mound of stone, for  
 $\frac{1}{4}$  sec. cor. of secs. 7 and 18, with brass cap marked

$\frac{1}{4}$  S7  
S18  
1930

from which

a pinyon pine, 8 ins. diam., bears S. 89 $\frac{3}{4}$ ° W., 100 lks. dist.,  
marked  $\frac{1}{4}$  S18 BT.  
a pinyon pine, 8 ins. diam., bears N. 34 $\frac{1}{4}$ ° W., 209 lks. dist.,  
marked  $\frac{1}{4}$  S7 BT.

Chains  
 39.42 Head of ravine, course NW.; asc. 25 ft. over W. slope.  
 41.62 Top of spur, slopes N.; desc. 65 ft. over NE. slope.  
 53.72 Draw, course N.; asc. 29 ft. over W. slope.  
 55.24 Trail, bears N. and S.  
 58.72 Top of spur, slopes N.; desc. 255 ft. over E. slope.  
 74.82 Ravine, course N.; asc. 28 ft. over NW. slope.  
 77.32 The cor. of secs. 7, 8, 17 and 18.

Land, mountainous.  
 Soil, rocky; 4th rate.  
 Timber, scattering cedar, pinyon and juniper.  
 Undergrowth, scrub oak, catclaw, mahogany, laurel, cactus  
 and grass.

---

N. 0° 3' W., bet. secs. 7 and 8.  
 Over mountainous land, through scattering timber and dense  
 undergrowth.  
 Desc. 57 ft. over NW. slope.  
 6.30 Ravine, course NE.; asc. 50 ft. over SE. slope.  
 12.20 Top of spur, slopes NE.; desc. 241 ft. over broken NW. slope.  
 36.27 Wire fence, bears NE. and SW.  
 39.50 Enter Bear Flat, bears E. and W.  
 40.00 Set an iron post, 3 ft. long, 1 in. diam., 8 ins. in the  
 ground to bedrock, supported in a mound of stone, for  
 $\frac{1}{4}$  sec. cor. of secs. 7 and 8, with brass cap marked

$\frac{1}{4}$   
 s7 | s8  
 1930

from which

a juniper, 32 ins. diam., bears N. 69° E., 201 lks. dist.,  
 marked  $\frac{1}{4}$  S8 BT.  
 a juniper, 4 ins. diam., bears S. 26° W., 130 lks. dist.,  
 marked BT only.

40.50 House, bears W. 3.50 chs. dist.  
 41.20 Wash, 20 lks. wide, course NE.  
 41.60 Garage, bears W. 5.00 chs. dist.  
 42.20 House, bears W. 5.00 chs. dist.  
 44.25 SE. cor. of small house on line.; desc. 58 ft.  
 47.15 Wire fence, bears E. and W.; leave Bear Flat, bears E. and W.  
 47.94 Creek, bed, 70 lks. wide, course NE.; asc. 212 ft. over rocky  
 SW. slope.  
 49.30 Trail, bears E. and W.  
 54.95 Point of rocky spur, slopes SW.; thence along W. slope.  
 59.95 Draw, course SW.; asc. SE. slope.  
 73.80 Top of ridge, bears NE. and SW.; desc. 60 ft. over NW. slope.  
 80.00 Set an iron post, 3 ft. long, 2 ins. diam., on solid rock,  
 deposit a stone marked with a cross (X) at base of post,  
 supported in a mound of stone, for cor. of secs. 5, 6, 7 and  
 8, with brass cap marked

T15NR7W  
 S 6 | S 5  
 S 7 | S 8  
 1930

from which

a juniper, 8 ins. diam., bears S. 31° E., 34 lks. dist.,  
 marked T15N R7W S8 BT.  
 a pinyon pine, 10 ins. diam., bears S. 83 $\frac{1}{2}$ ° W., 29 lks. dist.,  
 marked T15N R7W S7 BT.

Chains No other bearing trees available.  
 Land, mountainous.  
 Soil, rocky, 4th rate.  
 Timber, juniper and pinyon.  
 Undergrowth, scrub oak, catclaw, mahogany, laurel,  
 cactus and grass.

40.00 East, on random line, bet. secs. 5 and 8.  
 79.92 Set temp.  $\frac{1}{4}$  sec. cor.  
 Fall 2 lks. N. of the cor. of secs. 4, 5, 8 and 9.  
 Thence,  
 N.  $89^{\circ}59'W.$ , on true line, bet. secs. 5 and 8.  
 Over mountainous, thru scattering timber and dense  
 undergrowth.  
 Desc. 351 ft. over broken SW. slope.  
 17.10 Top of rimrocks, 30 ft. high, bearing N. and S.  
 17.12 Ralph Chapman's house bears S.  $54^{\circ}15'W.$   
 Mess hall, bears S.  $8^{\circ}30'W.$   
 SE. cor. of wood shed, bears S.  $60^{\circ}30'W.$   
 34.30 Wash, 5 lks. wide, course S.  $40^{\circ}W.$   
 39.30 Wash, 5 lks. wide, course S.  $10^{\circ}E.$   
 39.96 Set an iron post, 3 ft. long, 1 in. diam., 10 ins. in the  
 ground to bedrock, deposit a stone marked with a cross  
 (X) at base of post, and raise a mound of stone around  
 post, for  $\frac{1}{4}$  sec. cor. of secs. 5 and 8, with brass cap  
 marked

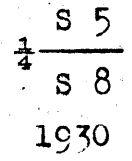

No bearing trees available.  
 42.10 Trail, bears N.  $70^{\circ}E.$  and S.  $70^{\circ}W.$ ; in saddle of spur,  
 sloping S.  $15^{\circ}W.$   
 45.20 Same trail, bears NE. and SW. to Black Pearl Mine,  
 Asc. 40 ft. over S. slope.  
 59.60 Top of low spur, slopes S.  
 65.70 Trail, bears N. and S.  
 66.10 Wash, 20 lks. wide, course S.  $30^{\circ}E.$ , asc. 151 ft. over NE. slope.  
 79.00 Top of spur, slopes S.  $35^{\circ}W.$ , desc. 6 ft. over NW. slope to  
 79.92 The cor. of secs. 5, 6, 7 and 8.

Land, mountainous.  
 Soil, rocky, 4th rate.  
 Timber, cedar and pinyon.  
 Undergrowth, scrub oak, mahogany, catclaw, laurel & grass.

40.00 S.  $89^{\circ}56'W.$ , on random line, bet. secs. 6 and 7.  
 77.16 Set temp.  $\frac{1}{4}$  sec. cor.  
 Fall 2 lks. S. of cor. of secs. 1, 6, 7 and 12 on the W.  
 bdy. of the Tp., described in Book "D" of this group,  
 Thence,  
 N.  $89^{\circ}57'E.$ , on true line, bet. secs. 6 and 7.  
 Over mountainous land, thru scattering timber and dense  
 undergrowth.  
 Asc. 380 ft. over rocky W. slope.  
 8.63 Top of rimrocks, 30 ft. high, bearing N. and S.  
 Thence over level mesa.  
 25.98 Leave mesa, bears N. and S. Desc. 136 ft. over SE. slope.  
 37.16 Set an iron post, 3 ft. long,  $\frac{3}{4}$  in. diam., 6 ins. in the  
 ground to bedrock, deposit a stone marked with a cross  
 (X) at base of post, and raise a mound of stone around  
 post, for  $\frac{1}{4}$  sec. cor. of secs. 6 and 7, with brass cap  
 marked

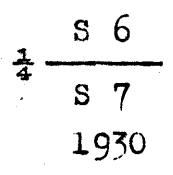

Chains

from which  
 a pinyon pine, 6 ins. diam., bears N.41°W., 33 lks. dist., marked  $\frac{1}{4}$  S6 BT  
 No other bearing trees available.

- Desc. 105 ft. over SE. slope.
- 37.63 Wash, 5 lks. wide, course N.15°E.
- 38.28 Drain, 3 lks. wide, course N.15°W., asc. 107 ft. over W. slope.
- 41.47 Location cor. of "Little Nell" mining claim bears North 46 lks. dist.
- 43.98 Top of spur, slopes SE., desc. 72 ft. over broken E. slope.
- 59.18 Top of rolling spur, slopes SE.
- 62.71 Wash, 10 lks. wide, course S.15°E.
- 65.00 Road, bears N.75°E. and S.75°W., NE. to Yolo Ranch and SW. to Black Pearl Mine.
- 67.00 Wire fence, bears N.45°E. and S.45°W.
- 67.58 Wash, 10 lks. wide, course S.30°W., asc. 71 ft. over brushy NW. slope to
- 77.16 The cor. of secs. 5, 6, 7 and 8.

Land, mountainous.  
 Soil, rocky, 4th rate.  
 Timber, cedar and pinyon.  
 Undergrowth, scrub oak, mahogany, catclaw, laurel & cactus.

No 0° 3' W., bet. secs. 5 and 6.  
 Over mountainous land, thru scattering timber and dense undergrowth.

- Desc. 40 ft. over NW. slope.
- 10.00 Draw, course SW. Fence, bears NE. and SW., asc. 185 ft. over SE. slope.
- 14.30 Road, bears NE. and SW.
- 30.00 Top of spur, slopes NE., desc. 58 ft. over NE. slope.
- 36.39 Draw, course NE., asc. over S. slope.
- 40.00 Set an iron post, 3 ft. long, 1 in. diam., 26 ins. in the ground, for  $\frac{1}{4}$  sec. cor. of secs. 5 and 6, with brass cap marked

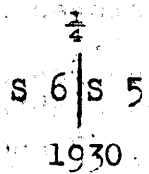

from which  
 a juniper, 8 ins. diam., bears S.40°E., 50 lks. dist., marked  $\frac{1}{4}$  S5 BT  
 a juniper, 7 ins. diam., bears S.77°W., 101 lks. dist., marked  $\frac{1}{4}$  S6 BT

- Asc. 207 ft. over SW. slope.
- 64.00 Top of ascent, slopes W., desc. 54 ft. over N. slope to
- 79.52 Intersect N. bdy. of the Tp. at 3.85 chs. S.89°55'W. from the  $\frac{1}{4}$  sec. cor. of secs. 5 and 32 which is a malpais stone 9x6x6 ins. above ground, firmly set, marked  $\frac{1}{4}$  on N. face, and witnessed by two properly marked bearing trees: a juniper S.84°E. 265 lks., and a cedar N.24 $\frac{3}{4}$ °W., 99 lks. dist.
- Alter this cor. monument to refer to the quarters of sec. 32 only by changing marking on the SE. bearing tree to read "BT" only.
- The cor. of secs. 5, 6, 31 and 32 is a malpais boulder in place, exposed 6x7x5 ft., marked with a cross (X) on top at exact cor. point, one notch W., and 5 notches E. of cross, and witnessed by a mound of stone N. No bearing trees. This cor. monument now refers to secs. 31 and 32 only, and no physical change of same is required.



Chains

At point of intersection,  
Set an iron post, 3 ft. long, 2 ins. diam., 26 ins. in the  
ground for closing cor. of secs. 5 and 6, with brass cap  
marked

- T16NR7W  
S32  
S 6 | S 5  
T15NR7W  
CC  
1930

from which

a juniper, 7 ins. diam., bears S. 55° E., 77 lks. dist.,  
marked T15N R7W S5 CC BT.  
a juniper, 8 ins. diam., bears S. 79° W., 86 lks. dist.,  
marked T15N R7W S6 CC BT.

Land, mountainous.  
Soil, rocky; 4th rate.  
Timber, scattering juniper and pinyon.  
Undergrowth, scrub oak, catclaw, mahogany, cactus, laurel  
and grass.

Boundaries of Township 15 North, Range 7 West  
Latitudes, departures and closing errors.

Line designated.	Course	Dist- ance	Latitudes		Departures	
			N.	S.	E.	W.
W.bdy.of Tp.	South.	479.40		479.40		
S.bdy.of Tp.	East.	477.42			477.42	
E.bdy.of Tp.	North.	480.00	480.00			
N.bdy.of Tp.	West S.89°55'W.	35.55 441.06		.64		35.55 441.06
Convergency						.50
Totals			480.00	480.04	477.42	477.41
				480.00	477.41	
Error in latitude-----			0.04			
Error in departure-----			0.31			

GENERAL DESCRIPTION.

The land embraced within this township is very rough and mountainous, with the exception of the northeastern portion of the township which is rolling mesa land. The soil is of granite formation, the land in the northeastern portion is covered with malpais stones, which can nearly all be classed as 3<sup>rd</sup> rate. Scattering cedar, pinyon and juniper timber are found throughout the township. The land is used for grazing purposes and is covered with dense undergrowth, scrub - oak, catclaw, mahogany, laurel, cactus and scattering nutritious grasses. Ralph C. Anderson's homestead is located in the south east quarter of sec. 4 of this township and is used for agriculture purposes. The Black Pearl Mining Co. has several mining claims and buildings in secs. 7 and 8, but there are no officially surveyed claims within the township.

-----

BOOK 3908

4-680  
(August, 1926)

**FIELD ASSISTANTS.**  
to  
Charles E. Hunter U.S. Transitman

NAMES.	CAPACITY.
John McClung	1st Chainman
McMillan Pollock	2nd Chainman
W.B. Kniskern	Flagman
J.D. Harris	Axman
Jack Reeves	Moundsman

CERTIFICATE OF UNITED STATES SURVEYOR

I, Charles E. Hunter U.S. Transitman, hereby certify upon honor that, in pursuance of special instructions received from the District Cadastral Engineer, for Group 159 Arizona bearing date of the 24th day of June, 1929, I have well, faithfully, and truly in my own proper person, and in strict conformity with said instructions, the Manual of Surveying Instructions, and the laws of the United States, surveyed all those parts or portions of

the Subdivision Lines of

Township 15 North, Range 7 West of the Gila and Salt River Base and Meridian, in the State of Arizona, which are represented in the foregoing field notes and by diagram on page 1 hereof as having been executed by me, and under my direction; and that all the corners of said survey have been established and perpetuated in strict accordance with the Manual of Surveying Instructions, and the special written instructions of the District Cadastral Engineer, for Group 159 Arizona and in the specific manner described in the field notes, and that the foregoing are the original field notes of such survey.

Place: Phoenix, Arizona

Date: May 3, 1930

Charles E. Hunter U.S. Transitman

APPROVAL

OFFICE OF U. S. SUPERVISOR OF SURVEYS,

, 19

The foregoing field notes of the survey of

executed by

under his special instructions dated, 19, having been critically examined, and the necessary corrections and explanations made, the said field notes, and the surveys they describe, are hereby approved.

U. S. Supervisor of Surveys

I certify that the foregoing transcript of the field notes of the above-described surveys in, has been correctly copied from the original notes on file in this office.

U. S. Supervisor of Surveys



CERTIFICATE OF UNITED STATES SURVEYOR

BOOK 3903

I, William E. Hiester, U. S. Surveyor, hereby certify upon honor that, in pursuance of special instructions received from the District Cadastral Engineer, for Group 159 Arizona bearing date of the 24th day of June, 1929, I have well, faithfully, and truly in my own proper person, and in strict conformity with said instructions, the Manual of Surveying Instructions, and the laws of the United States, surveyed all those parts or portions of

the Subdivision Lines of

Township 15 North, Range 7 West of the Gila and Salt River Base and Meridian, in the State of Arizona, which are represented in the foregoing field notes and by diagram on page 1 hereof as having been executed by me, and under my direction; and that all the corners of said survey have been established and perpetuated in strict accordance with the Manual of Surveying Instructions, and the special written instructions of the District Cadastral Engineer, for Group 159 Arizona and in the specific manner described in the field notes, and that the foregoing are the original field notes of such survey.

Place: San Francisco, Calif.

Date: November 24, 1930.

William E. Hiester

U. S. Surveyor.

APPROVAL

OFFICE OF U. S. SUPERVISOR OF SURVEYS,

Denver, Colo., May 18, 1931

The foregoing field notes of the survey of

the Subdivision Lines of

Township 15 North, Range 7 West

of the Gila and Salt River Base and Meridian, in the State of Arizona executed by William E. Hiester, U.S. Surveyor and Charles E. Hunter, U.S. Transitman under special instructions dated June 24, 1929 for Group 159 Arizona, having been critically examined, and the necessary corrections and explanations made, the said field notes, and the surveys they describe, are hereby approved.

U.S. Supervisor of Surveys

U. S. Supervisor of Surveys.

I certify that the foregoing transcript of the field notes of the above described surveys in

has been correctly copied from the original notes on file in this office.

U. S. Supervisor of Surveys