

BOOK 3904

FIELD NOTES

OF RESURVEY OF

Part of the East Boundary of
Township 16 North, Range 8 West

AND OF SURVEY OF

the West Boundary

and

Subdivision Lines of

Township 16 North Range 8 West

Of the Gila and Salt River Base and Meridian,

In the State of Arizona

EXECUTED BY

William E. Hiester, U.S. Surveyor

In the capacity of U. S. Surveyor, under Special Instructions dated June 24,
1929, issued by the District Cadastral Engineer to govern surveys included in Group
No. 159-Arizona, which were approved by the Commissioner of the General Land
Office, July 10, 1929, and Assignment Instructions dated Jan. 2, 1930.

Resurvey and Survey commenced March 25, 1930

Resurvey and Survey completed April 21, 1930

3904

3904

1A

Book "F"
Group 159 - Arizona.

BOOK 3904

INDEX DIAGRAM.

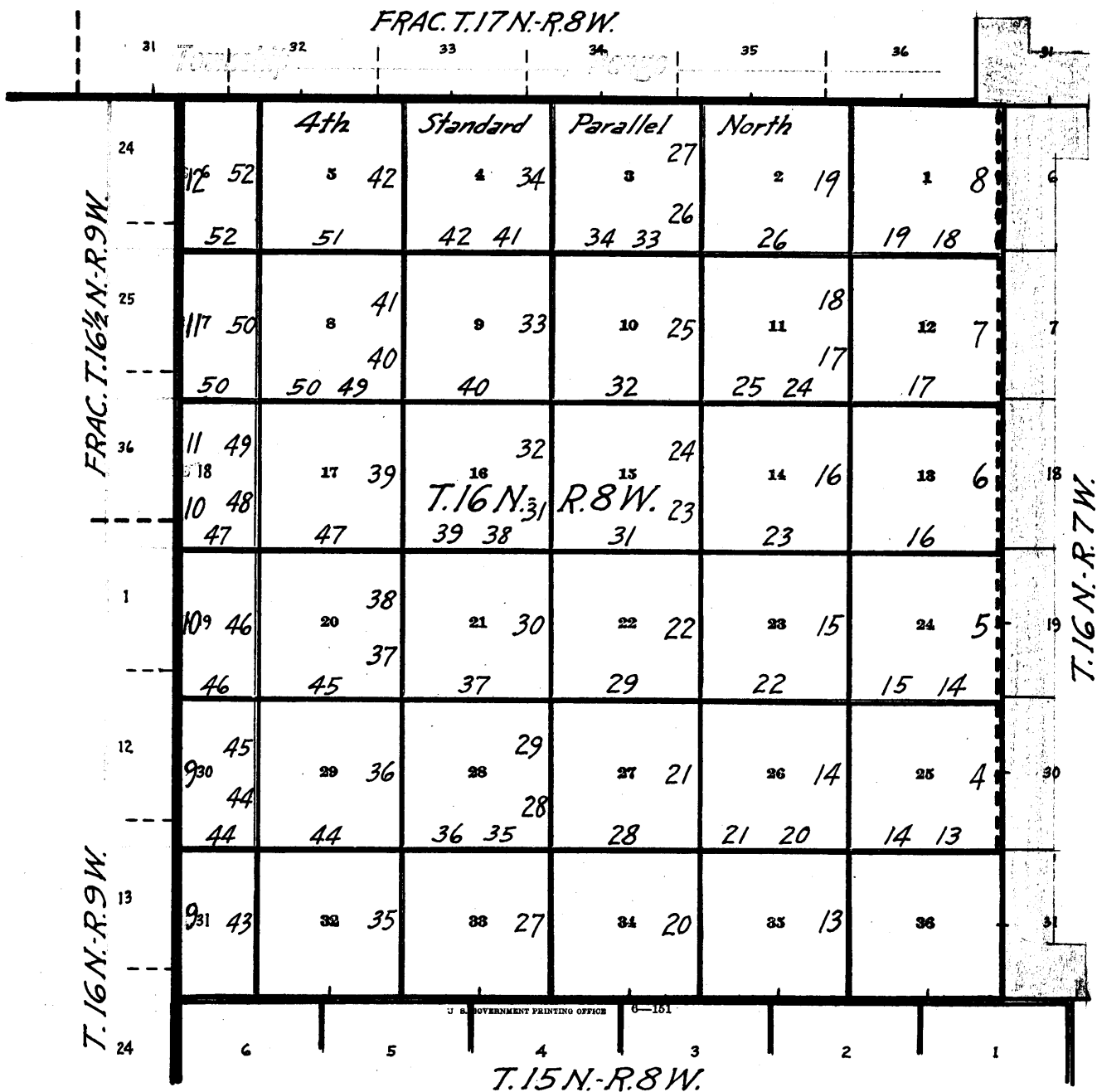

- Lines surveyed under this group.
- Lines resurveyed under this group.
- Accepted surveys.
- Unsurveyed.
- Areas surveyed as per accepted plats on file.

~DATE~DIAGRAM~
-1930-

Book "F" Group 159 Arizona
Township 16 North Range 8 West

For dates of survey see Book "C"

4th Standard Parallel North

4-11	6	4-10	5	4-12	4	4-21	3	4-15	2	4-16	1	4-19
4-11	7	4-10	8	4-12	9	4-7	10	4-15	11	3-26	12	4-19
4-9	18	4-9	17	4-8	16	4-7	15	4-15	14	3-26	13	4-19
4-4	19	4-4	20	4-5	21	4-2	22	3-28	23	3-26	24	3-29
4-4	20	4-4	29	4-3	28	4-2	27	3-28	26	3-25	25	3-29
4-4	31	4-3	32	4-2	33	3-27	34	3-28	35	3-25	36	

For dates of survey see Book "D"

— Surveved by Wm.E.Hiester,U.S.Surveyor under this group on dates (1930) shown thereon. Notes herein.

- - - Resurveved by Wm.E.Hiester,U.S.Surveyor under this group on dates (1930) shown thereon. Notes herein.

— Surveved under this group. Date diagrams and notes in other books.

— Accepted surveveys.

The surveys herein described were executed on dates shown on diagram page 1 hereof, by William E. Hiester, U.S. Surveyor, using respectively Buff transit No. 19423 and Young & Sons transit No. 8584; the instruments are equipped with improved Smith solar attachments. The horizontal limbs are provided with two double verniers placed opposite each other and reading to single minutes of arc, which is also the least count of the verniers of the vertical circles, latitude and declination arcs.

The instruments were approved, subject to the usual field tests by the District Cadastral Engineer for Arizona.

Unless otherwise specified all azimuths are determined by the solar attachments, and all measurements are made with Lallie steel tapes 5 chains in length, compared with a Lufkin steel tape and found correct. The measurements are made on the slope, the vertical angle determined with clinometers, or transit, and the slope measurements properly reduced to true horizontal distances for entry in the field notes.

For preliminary field tests of instruments on a meridian determined by observations on Polaris, see the field notes for exteriors and subdivisions in Book "D" of this group.

FINAL TESTS OF INSTRUMENTS.

For final tests of instruments Nos. 19423 and 8584, see the field notes for 4th Standard Parallel North, in Book "C" of this group.

Resurvey of Part of the East Boundary of T.16 N., R.8 W.

3

- chains The East bdy. of T.16 N., R.8 W. was surveyed due South by A.B.Mader, U.S.D.S. in 1905 in connection with his subdivision of T.16 N., R.7 W., establishing common reference corners thereon at intervals of 40 chs. counting from the closing cor. of Ts. 16 N., Rs. 7 & 8 W. on the 4th Std. Par. N.
No retracement or resurvey of any part of this township boundary is of record.
The following notes describe a resurvey of the north 5 miles of said township boundary, northerly, altering the existing cor. monuments to refer to areas east of line only, and reestablishing corners referring to areas west of line only, at intervals of 40 chs. in latitude counting from the original cor. of secs. 25, 30, 31 and 36.
- Retracement for Resurvey.

- From original cor. of secs. 25, 30, 31 and 36,
North, on random line, on W. bdy. of sec. 30 (S. $\frac{1}{2}$)
- 40.09 Intersect original $\frac{1}{4}$ sec. cor. of secs. 25 and 30.
True course and dist. of S. $\frac{1}{2}$ of W. bdy. of sec. 30
are therefore, North, 40.09 chs.
- Thence
North, on random line, on W. bdy. of sec. 30 (N. $\frac{1}{2}$)
- 40.13 Intersect original cor. of secs. 19, 24, 25 and 30.
True course and dist. of N. $\frac{1}{2}$ of W. bdy. of sec. 30
are therefore, North, 40.13 chs.
-
- North, on random line, on W. bdy. of sec. 19 (S. $\frac{1}{2}$)
- 40.06 Fall 2 lks. E. of original $\frac{1}{4}$ sec. cor. of secs. 19 and 24.
True course and dist. of S. $\frac{1}{2}$ of W. bdy. of sec. 19
are therefore, N. 0° 2' W., 40.06 chs.
- Thence
North, on random line, on W. bdy. of sec. 19 (N. $\frac{1}{2}$)
- 40.12 Intersect original cor. of secs. 13, 18, 19 and 24.
True course and dist. of N. $\frac{1}{2}$ of W. bdy. of sec. 19
are therefore, North, 40.12 chs.
-
- North, on random line, on W. bdy. of sec. 18 (S. $\frac{1}{2}$)
- 40.10 Fall 2 lks. E. of original $\frac{1}{4}$ sec. cor. of secs. 13 and 18.
True course and dist. of S. $\frac{1}{2}$ of W. bdy. of sec. 18
are therefore, N. 0° 2' W., 40.10 chs.
- Thence
North, on random line, on W. bdy. of sec. 18 (N. $\frac{1}{2}$)
- 40.11 Fall 3 lks. E. of original cor. of secs. 7, 12, 13 and 18.
True course and dist. of N. $\frac{1}{2}$ of W. bdy. of sec. 18
are therefore, N. 0° 3' W., 40.11 chs.
-
- North, on random line, on W. bdy. of sec. 7 (S. $\frac{1}{2}$)
- 40.18 Intersect original $\frac{1}{4}$ sec. cor. of secs. 7 and 12.
True course and dist. of S. $\frac{1}{2}$ of W. bdy. of sec. 7
are therefore, North, 40.18 chs.

	chains	Thence
		North, on random line, on W. bdy. of sec. 7 (N. $\frac{1}{2}$)
40.15		Intersect original cor. of secs. 1, 6, 7 and 12. True course and dist. of N. $\frac{1}{2}$ of W. bdy. of sec. 7 are therefore, North, 40.15 chs.

		North, on random line, on W. bdy. of sec. 6 (S. $\frac{1}{2}$)
40.10		Fall 2 lks. E. of original $\frac{1}{4}$ sec. cor. of secs. 1 and 6. True course and dist. of S. $\frac{1}{2}$ of W. bdy. of sec. 6 are therefore, N. 0° 2' W., 40.10 chs.
		Thence
		North, on random line, on W. bdy. of sec. 6 (N. $\frac{1}{2}$)
40.17		Fall 2 lks. E. of original closing cor. of Ts. 16 N., Rs. 7 and 8 W., on the 4th Standard Parallel North, S. of sec. 31, T. 17 N., R. 7 W. True course and dist. of N. $\frac{1}{2}$ of W. bdy. of sec. 6 are therefore, N. 0° 2' W., 40.17 chs.

		RESURVEY.

		The original cor. of secs. 25, 30, 31 and 36, Ts. 16 N., Rs. 7 and 8 W. is a malpais stone, 12x8x6 ins. above ground, firmly set, marked with 1 notch on S. face, 5 notches on N. face, and witnessed by a mound of stone W. of cor. No bearing trees.
		Thence
		North, on true line, on E. bdy. of sec. 25.
2.05		Over rolling land, thru scattering timber & undergrowth.
35.65		Drain, 8 lks. wide, course W.
		Top of mesa, bears NW. and SE.
40.00		Set an iron post, 3 ft. long, 1 in. in diam., 26 ins. in the ground, for reestablished $\frac{1}{4}$ sec. cor. of sec. 25 only, with brass cap marked
		$\frac{1}{4}$ S 25
		1930
		from which
		a cedar, 5 ins. diam., bears S. 32 $\frac{1}{2}$ ° W., 266 lks. dist., marked $\frac{1}{4}$ S 25 BT
		a cedar, 5 ins. diam., bears N. 28° W., 166 lks. dist., marked $\frac{1}{4}$ S 25 BT
40.09		Intersect the original $\frac{1}{4}$ sec. cor. of secs. 25 and 30, which is a malpais stone in place, exposed 8x6x9 ins. above ground, marked with a cross (X) on top and $\frac{1}{4}$ W. of cross, and witnessed by a mound of stone W. of cor. and one bearing tree: a juniper, 16 ins. diam., S. 79° W., 352 lks. dist., marked $\frac{1}{4}$ S 25 BT
		Alter this cor. monument to refer to the quarters of sec. 30 only, by obliterating marking on the bearing tree, moving the mound of stone from W. to E. of cor., and marking $\frac{1}{4}$ E. of the cross on the stone. No bearing trees available E. of cor.
		Continue line and measurement.
		Descend 96 ft. over NW. slope.
74.65		Shallow drain, 30 lks. wide, course S. 25° W. A small reservoir bears SW. 10 chs. dist.
80.00		Set an iron post, 3 ft. long, 2 ins. diam., 28 ins. in the

chains

ground, for reestablished cor. of secs. 24 and 25 only, with brass cap marked

T16N	
R8W	T16N
S24	S30
S25	R7W

1930

No bearing trees available.
Raise a mound of stone, 4 ft. base, 2½ ft. high, W. of cor.

Land, rolling.
Soil, sandy, 3rd rate.
Timber, cedar and pinyon.
Undergrowth, scrub oak, juniper and grass.

0.22

North, on true line, on E. bdy. of sec. 24.
Over rolling land, thru scattering timber & undergrowth.
Ascend over SE. slope.
Intersect the original cor. of secs. 19, 24, 25 and 30, which is a malpais stone, 8x12x16 ins. above ground, firmly set in ground and small mound of stone, marked with 2 notches on S. face, 4 notches on N. face, and witnessed by a mound of stone W. of cor. No bearing trees.
Alter this cor. monument to refer to secs. 19 and 30 only, by moving the mound of stone from W. to E. of cor.
No bearing trees available.

21.75

Thence
N. 0° 2' W., on true line, continuing measurement of E. bdy. of sec. 24.
Asc. 86 ft. over SE. slope.
Drain, 5 lks. wide, course S. 20° E.

40.00

Set an iron post, 3 ft. long, 1 in. diam., 30 ins. in the ground, for reestablished ¼ sec. cor. of sec. 24, with brass cap marked

¼ S24	
-------	--

1930

No bearing trees available.
Raise a mound of stone, 4 ft. base, 2½ ft. high, W. of cor.

40.28

Intersect the original ¼ sec. cor. of secs. 19 and 24, which is a malpais stone, in place, exposed 4x4x12 ins. above ground, marked with a cross (X) on top and ¼ N. of cross, and witnessed by a mound of stone W. of cor. No bearing trees.
Alter this cor. monument to refer to the quarters of sec. 19 only by marking ¼ E. of the cross on the stone and moving the mound of stone from W. to E. of cor.
No bearing trees available.

80.00

Thence
North, on true line, continuing measurement of E. bdy. of sec. 24.
Asc. 299 ft. over NE. slope.
Set an iron post, 3 ft. long, 2 ins. diam., 16 ins. in the ground to bedrock, and raise a mound of stone around post, for reestablished cor. of secs. 13 and 24, with brass cap marked

T16N	
R8W	T16N
S13	S19
S24	R7W

1930

6 Resurvey of Part of the East Boundary of T.16 N., R.8 W.

chains

from which
 a cedar, 20 ins. diam., bears S. 69° W., 188 lks. dist.,
 marked T16N R8W S24 BT
 a cedar, 12 ins. diam., bears N. 44½° W., 84 lks. dist.,
 marked T16N R8W S13 BT

Land, rolling.
 Soil, sandy, 3rd rate.
 Timber, cedar and oak.
 Undergrowth, juniper, catclaw, cactus and yucca.

- North, on true line, on E. bdy. of sec. 13.
 Over rolling land, thru scattering timber & undergrowth.
 Desc. over NE. slope.
- 0.40 Intersect the original cor. of secs. 13, 18, 19 and 24,
 which is a malpais stone 6x8x10 ins. above ground,
 firmly set, marked with 3 notches on each of N. and
 S. faces, and witnessed by a mound of stone W. of cor.
 and two bearing trees:
 a juniper, 8 ins. diam., S. 45° W., 142 lks. dist. marked
 T16N R8W S24 BT.
 a juniper, 10 ins. diam., S. 37½° E., 266 lks. dist., marked
 T16N R7W S19 BT
- Alter this cor. monument to refer to secs. 18 and 19 only
 by obliterating marking on the SW. bearing tree and
 moving the mound of stone from W. to E. of cor.
 No other bearing tree E. of line available.
- Thence
 N. 0° 2' W., on true line, continuing measurement of E. bdy.
 of sec. 13.
 Desc. 54 ft. over NE. slope.
- 8.51 Drain, 10 lks. wide, course E. Asc: 112 ft. over S. slope.
- 40.00 Set an iron post, 3 ft. long, 1 in. diam., 28 ins. in the
 ground, for reestablished cor. of sec. 13, with brass
 cap marked

¼ S13

1930

- from which
 a cedar, 20 ins. diam., bears S. 36° W., 474 lks. dist.,
 marked ¼ S13 BT
 a cedar, 10 ins. diam., bears N. 52¾° W., 283 lks. dist.,
 marked ¼ S13 BT
- 40.50 Intersect the original ¼ sec. cor. of secs. 13 and 18,
 which is a malpais stone 9x12x8 ins. above ground,
 firmly set, marked ¼ on W. face, and witnessed by a
 mound of stone W. of cor. and two bearing trees:
 a juniper, 15 ins. diam., S. 76¾° E., 323 lks. dist.,
 marked ¼ S18 BT
 a juniper, 16 ins. diam., N. 49° W., 193 lks. dist.,
 marked ¼ S13 BT
- Alter this cor. monument to refer to the quarters of sec.
 18 only, by marking ¼ on the E. face of stone,
 obliterating marking on the NW. bearing tree and
 moving the mound of stone from W. to E. of cor.
 No other bearing tree E. of line is available.
- Thence
 N. 0° 3' W., on true line, continuing measurement of E. bdy.
 of sec. 13.
 Desc. 45 ft. over gradual N. slope.
- 80.00 Set an iron post, 3 ft. long, 2 ins. diam., 28 ins. in the
 ground, for reestablished cor. of secs. 12 and 13, with
 brass cap marked

Resurvey of Part of the East Boundary of T.16 N., R.8 W.

chains

T16N	
R8W	T16N
S12	S18
S13	R7W

1930

from which

a cedar, 12 ins. diam., bears S. 27½° W., 283 lks. dist.,
 marked T16N R8W S13 BT

a cedar, 36 ins. diam., bears N. 18° W., 340 lks. dist.,
 marked T16N R8W S12 BT

Land, rolling.
 Soil, sandy, 3rd rate.
 Timber, cedar and juniper.
 Undergrowth, scrub oak, cactus, catclaw and yucca.

N. 0° 3' W., on true line, on E. bdy. of sec. 12.
 Over rolling land, thru scattering timber & undergrowth.
 Asc. gradual SE. slope.

0.61 Intersect the original cor. of secs. 7, 12, 13 and 18, which
 is a malpais stone 4x8x18 ins. above ground, firmly set,
 marked with 2 notches on N. face, 4 notches on S. face,
 and witnessed by a mound of stone W. of cor. and two
 bearing trees:
 a juniper, 16 ins. diam., S. 8¾° W., 310 lks. dist.,
 marked T16N R8W S13 BT
 a juniper, 50 ins. diam., N. 5¼° W., 270 lks. dist.,
 marked T16N R8W S12 BT

Alter this cor. monument to refer to secs. 7 and 18 only
 by moving the mound of stone from W. to E. of cor. and
 obliterating marking on the bearing trees.

Thence
 North, on true line, continuing measurement of E. bdy.
 of sec. 12.

4.60 Top of low ridge, bears NE. and SW. Desc. 33 ft. over N. slope.

40.00 Set an iron post, 3 ft. long, 1 in. diam., 28 ins. in the
 ground, for reestablished ¼ sec. cor. of sec. 12, with
 brass cap marked

¼ S12	
-------	--

1930

from which

a cedar, 9 ins. diam., bears S. 25¼° W., 273 lks. dist.,
 marked ¼ S12 BT

a cedar, 5 ins. diam., bears N. 54½° W., 419 lks. dist.,
 marked ¼ S12 BT

Continue descent over gradual N. slope.

40.79 Intersect the original ¼ sec. cor. of secs. 7 and 12, which
 is a malpais stone 4x14x8 ins. above ground, firmly set,
 marked ¼ on W. face and witnessed by a mound of stone
 W. of cor. No bearing trees.

Alter this cor. monument to refer to the quarters of sec.
 7 only by marking ¼ on E. face of stone, and moving the
 mound of stone from W. to E. of cor.

Continue line and measurement.
 Desc. 74 ft. over gradual N. slope.

49.65 Shallow drain, 15 lks. wide, course W.

80.00 Set an iron post, 3 ft. long, 2 ins. diam., 28 ins. in the
 ground, for reestablished cor. of secs. 1 and 12, with
 brass cap marked

T16N	
R8W	T16N
S1	S7
S12	R7W

1930

8 Resurvey of Part of the East Boundary of T.16 N., R.8 W.

chains

from which

a cedar, 5 ins. diam., bears S. 34° W., 221 lks. dist.,
 marked T16N R8W S12 BT

a cedar, 5 ins. diam., bears N. 45° W., 117 lks. dist.,
 marked T16N R8W S1 BT

Land, rolling.
 Soil, sandy, 3rd rate.
 Timber, cedar and juniper.
 Undergrowth, catclaw, scrub oak and yucca.

North, on true line, on E. bdy. of sec. 1
 Over rolling land, thru scattering timber & undergrowth.

0.94 Intersect the original cor. of secs. 1, 6, 7 and 12, which is
 a malpais stone 5x10x12 ins. above ground, firmly set,
 marked with 1 notch on N. face and 5 notches on S. face,
 and witnessed by a mound of stone W. of cor. and two
 bearing trees:
 a juniper, 18 ins. diam., S. 27° E., 180 lks. dist.,
 marked T16N R7W S7 BT
 a juniper, 14 ins. diam., N. 81½° W., 254 lks. dist.,
 marked T16N R8W S1 BT

Alter this cor. monument to refer to secs. 6 and 7 only by
 obliterating the marking on the NW. bearing tree and
 moving the mound of stone from W. to E. of cor.
 No other bearing tree E. of line is available.

Thence,
 N. 0° 2' W., on true line, continuing measurement of E. bdy.
 of sec. 1

107.30 Drain, 8 lks. wide, course S. 70° W.
 20.00 Wash, 20 lks. wide, course S. 30° W. Asc. 107 ft. over S. slope.
 29.40 Old trail, bears E. and W.
 40.00 Set an iron post, 3 ft. long, 1 in. diam., 5 ins. in the ground
 to bedrock, and raise a mound of stone around post, for
 reestablished ¼ sec. cor. of sec. 1, with brass cap marked

¼ S1

1930

from which

a cedar, 16 ins. diam., bears S. 11¾° W., 151 lks. dist.,
 marked ¼ S1 BT

a cedar, 12 ins. diam., bears N 73½° W., 236 lks. dist.,
 marked ¼ S1 BT

41.04 Intersect the original ¼ sec. cor. of secs. 1 and 6, which
 is a malpais stone 7x12x14 ins. above ground, firmly set,
 marked ¼ on W. face, and witnessed by two bearing trees:
 a juniper, 12 ins. diam., S. 88¼° E., 140 lks. dist.,
 marked ¼ S6 BT
 a juniper, 16 ins. diam., S. 79¼° W., 149 lks. dist.,
 marked ¼ S1 BT

Alter this cor. monument to refer to the quarters of sec.
 6 only by obliterating the marking on the SW. bearing
 tree and raising a mound of stone 3½ ft. base, 2½ ft.
 high, E. of cor. No other bearing tree E. of line is
 available.

Continue line and measurement.

81.21 Intersect the original closing cor. of Ts. 16 N., Rs. 7 and
 8 W., on the 4th Std. Par. N., which is a malpais stone
 8x12x6 ins. above ground, firmly set, marked with 6 notch-
 es on each of E. and W. faces, and CC and 6 notches on S.
 face, and witnessed by a mound of stone S. of cor.
 No bearing trees.

Land, rolling.
 Soil, sandy, 3rd rate.
 Timber, cedar and juniper.
 Undergrowth, catclaw, cactus, yucca and grass.

Survey of the West Bdy. of T.16 N., R.8 W.

Chains

From the cor. of T.15 and 16 N., R.8 W. and 15 N., R.8 W., described in book "D" of this group.

1.30
34.70
40.00

North, on a true line, along W. bdy. of sec. 31.
Over rolling land, through scattering undergrowth.
Asc. 168 ft. over rocky S. slope.
Top of rimrocks, bears E. and W.
Top of spur, slopes SW.; thence over rolling mesa land.
Set an iron post, 3 ft. long, 1 in. diam., 28 ins. in the ground, for $\frac{1}{4}$ sec. cor. of sec. 31 only, with brass cap marked

$\frac{1}{4}$ S31

1930

No bearing trees available.
Raise a mound of stone 4 ft. base, 2 $\frac{1}{2}$ ft. high, E. of cor.

65.00
80.00

Asc. 57 ft. over gradual SW. slope.
Set an iron post, 3 ft. long, 2 ins. diam., 24 ins. in the ground, for cor. of secs. 30 and 31 only, with brass cap marked

T16N
R8W
S30
S31

1930

No bearing trees available.
Raise a mound of stone, 4 ft. base, 2 $\frac{1}{2}$ ft. high, E. of cor.

Land, rolling and level.
Soil, rocky; 3rd rate.
Timber, none.
Undergrowth, scattering, scrub oak, catclaw, cactus and grass.

22.00
39.50
40.00

North, on a true line, along W. bdy. of sec. 30.
Over rolling land, through scattering undergrowth.
Asc. 45 ft. over gradual SW. slope.
Head of drain, 3 lks. wide, course SW.; asc. 73 ft. over S. slope.
Top of broad spur, slopes SW.
Set an iron post, 3 ft. long, 1 in. diam., 24 ins. in the ground, for $\frac{1}{4}$ sec. cor. of sec. 30 only, with brass cap marked

$\frac{1}{4}$ S30

1930

No bearing trees available.
Raise a mound of stone 4 ft. base, 2 $\frac{1}{2}$ ft. high E. of cor.

43.80
60.65
70.05
80.00

Desc. 156 ft. over rolling N. slope.
Drain, 5 lks. wide, course W.; thence along gradual W. slope.
Old road, bears S. 45° E., and N. 45° W.
Set an iron post, 3 ft. long, 2 ins. diam., 16 ins. in the ground to bedrock, deposit a stone marked with a cross (X) at base of post, supported in a mound of stone for cor. of secs. 19 and 30 only, with brass cap marked

T16N
R8W
S19
S30

1930

Chains	No bearing trees available. Land, rolling. Soil, rocky; 3rd rate. Timber, none. Undergrowth, scattering scrub oak, catclaw, yucca and grass.

	North, on a true line, along W. bdy. of sec. 19. Over rolling land, through scattering timber and undergrowth. Desc. 68 ft. over gradual NW. slope.
11.90	Drain, 10 lks. wide, course W.
21.30	Wash, 15 lks. wide, course S. 60° W.; thence asc. 79 ft. over SE. slope.
25.50	NW. edge of dirt dam, bears E. 50 lks. dist.
40.00	Set an iron post, 3 ft. long, 1 in. diam., 28 ins. in the ground, for $\frac{1}{4}$ sec. cor. of sec. 19 only, with brass cap marked
	$\frac{1}{4}$ S19 1930
	No bearing trees available. Raise a mound of stone 4 ft. base, 2 $\frac{1}{2}$ ft. high E. of cor.
	Asc. 29 ft. over SE. slope.
50.00	Old road, on top of ridge, bears E. and W.; desc. 108 ft. over NE. slope.
73.93	Top of cliffs 30 ft. high, bears SE. and NW.; desc. 272 ft. over NE. slope.
80.00	Set an iron post, 3 ft. long, 2 ins. diam., 30 ins. in the ground, for cor. of secs. 18 and 19 only, with brass cap marked
	T16N R8W S18 S19 1930
	from which
	a pinion pine, 16 ins. diam., bears N. 28° E., 14 lks. dist., marked T16N R8W S 18 BT.
	a pinion pine, 20 ins. diam., bears S. 16° E., 153 lks. dist., marked T16N R8W S 19 BT.
	Land, rolling. Soil, rocky; 3rd rate. Timber, scattering pinion and cedar. Undergrowth, oak, catclaw, cactus, yucca and grass.

	North, on a true line, along W. bdy. of sec. 18. Over mountainous land, through scattering timber and undergrowth. Desc. 557 ft. over NE. slope.
22.80	Conger Creek, 100 lks. wide, course W.; forks of Conger Creek, and Bull Creek bears E. about 5 chs. dist.
40.00	Asc. 350 ft. over steep S. slope. Set an iron post, 3 ft. long, 1 in. diam., 26 ins. in the ground, for $\frac{1}{4}$ sec. cor. of sec. 18 only, with brass cap marked
	$\frac{1}{4}$ S18 1930

Chains

from which

a cedar, 7 ins. diam.; bears N. 1 1/4° E., 171 lks. dist., marked 1/4 S18 BT.
No other bearing trees available.
Raise a mound of stone, 4 1/2 ft. base, 3 ft. high E. of cor.

- 49.00 Asc. 445 ft. over broken SE. slope.
- 57.20 Head of drain, 5 lks. wide, course S. 70° E.
- 58.55 Top of cliffs, 40 ft. high, bears SE. and NW.
- 69.68 Top of spur; slopes S. 55° W.; desc. 59 ft. over gradual N. slope.
- 80.00 Foot of cliff bears E. and W.; desc. 319 ft. over steep rocky NW. slope.
- Set an iron post, 3 ft. long, 2 ins. diam., 28 ins. in the ground for cor. of secs. 7 and 18 only, with brass cap marked

T16N
R8W
S7
S18
1930

from which

a pinion pine, 6 ins. diam., bears N. 54 3/4° E., 183 lks. dist., marked T16N R8W S7 BT.
a pinion pine, 3 ins. diam., bears S. 82 1/2° E., 152 lks. dist., marked T16N R8W S18 BT.

Land, mountainous.
Soil, rocky; 4th rate.
Timber, scattering, cedar and pinion.
Undergrowth, scattering catclaw, oak, yucca and cactus.

-
- 6.00 North, on a true line along W. bdy. of sec. 7.
 - 9.60 Over mountainous land, through scattering timber and undergrowth.
 - 39.50 Desc. 168 ft. over N. slope.
 - 40.00 Wash, 40 lks. wide, course N. 10° W.; Cypress Creek.
 - Asc. 503 ft. over steep SE. slope.
 - Top of spur, slopes S. 75° W.; desc. 354 ft. over steep rocky NW. slope.
 - Set an iron post, 3 ft. long, 1 in. diam., on solid rock supported in a mound of stone, for 1/4 sec. cor. of sec. 7 only, with brass cap marked

1/4 S7
1930

from which

a cedar, 16 ins. diam., bears N. 48 1/4° E., 57 lks. dist., marked 1/4 S7 BT.
a cedar, 12 ins. diam., bears S. 18 1/4° E., 87 lks. dist., marked 1/4 S7 BT.

- 75.00 Desc. 235 ft. over NW. slope.
- 80.00 Creek, 20 lks. wide, course S. 45° W.; asc. 103 ft. over steep rocky SE. slope.
- Set an iron post, 3 ft. long, 2 ins. diam., 30 ins. in the ground for cor. of secs. 6 and 7 only, with brass cap marked

T16N
R8W
S6
S7
1930

Chains

from which

a pinion pine, 5 ins. diam., bears N. $79\frac{1}{4}^\circ$ E., 83 lks. dist., marked T16N R8W S 6 BT.
 a pinion pine, 8 ins. diam., bears S. 86° E., 134 lks. dist., marked T16N R8W S7 BT.

Land, mountainous.
 Soil, rocky; 4th rate.
 Timber, scattering, pinion and cedar.
 Undergrowth, scattering scrub oak, catclaw, yucca and grass.

North, on a true line, along W. bdy. of sec. 6.
 Over mountainous land, through scattering timber and undergrowth.

6.93
 11.91
 16.21
 22.46
 25.18
 28.03
 35.31
 40.00

Asc. 164 ft. over broken SE. slope.
 Top of rocky spur, slopes E.; desc. 139 ft. over NE. slope.
 Gulch 15 lks. wide, course E.; asc. 179 ft. over S. slope.
 Top of rocky spur, slopes E.; desc. 85 ft. over NE. slope.
 Head of draw, course E.; asc. 70 ft. over SE. slope.
 Top of rocky spur, slopes E.; desc. 80 ft. over NE. slope.
 Draw, course E.; asc. 194 ft. over SE. slope.
 Top of rocky spur, slopes SE.; desc. 99 ft. along E. slope.
 Set an iron post, 3 ft. long, 1 in. diam., 30 ins. in the ground for $\frac{1}{4}$ sec. cor. of sec. 6 only, with brass cap marked

| $\frac{1}{4}$ S6
 1930

from which

a pinion pine, 8 ins. diam., bears N. $70\frac{1}{2}^\circ$ E., 15 lks. dist., marked $\frac{1}{4}$ S6 BT.
 a pinion pine, 6 ins. diam., bears S. 30° E., 41 lks. dist., marked $\frac{1}{4}$ S6 BT.

55.47
 69.75
 81.56

Wash, 10 lks. wide, course S. 30° E.; asc. 252 ft. over S. slope.
 Trail, bears N. 60° E., and S. 60° W.
 Intersect the 4th Standard Parallel North, at a point 16.21 chs. East from the standard $\frac{1}{4}$ sec. cor. of sec. 31, Frac. T17N, R.8W, described in Book "C" of this group.
 At point of intersection,
 Set an iron post, 3 ft. long, 3 ins. diam., 12 ins. in the ground to bedrock, supported in a mound of stone for closing cor. of T16N, R.8W, and Frac. T16 $\frac{1}{2}$ N, R.9W., with brass cap marked

T17NR8W
 S31
 S24 | S6
 R9W | R8W
 T16 $\frac{1}{2}$ N T16N
 C C
 1930

from which

a pinion pine, 6 ins. diam., bears S. $11\frac{1}{4}^\circ$ E., 81 lks. dist., marked T16N R8W S6 CC BT.
 a pinion pine, 12 ins. diam., bears S. 68° W., 52 lks. dist., marked T16 $\frac{1}{2}$ N R9W S24 CC BT.

Land, mountainous.
 Soil, rocky; 4th rate.
 Timber, scattering cedar and pinion.
 Undergrowth, scattering scrub oak, juniper and grass.

Chains From the cor. of secs. 35 and 36 on S. bdy. of Tp., described in book "D" of this group.

N.0°1'W., bet. secs. 35 and 36.
 Over rolling land, through scattering timber and undergrowth.
 Desc. 30 ft. over gradual N. slope.
 3.10 Head of shallow drain, seeping N.15°E.
 7.00 Same drain, 5 lks. wide, course N.40°W.
 12.80 Water pockets, in wash 40 lks. wide, course S.50°W.; asc. 55 ft. over gradual S. slope.
 28.47 Old road, bears S.45°E., and N.45°W.
 40.00 Set an iron post, 3 ft. long, 1 in. diam., 22 ins. in the ground to bedrock, supported in a mound of stone for $\frac{1}{4}$ sec. cor. of secs. 35 and 36, with brass cap marked

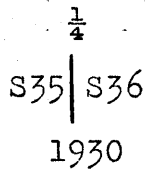

No bearing trees available.
 Raise a mound of stone, 3 ft. base, 2 $\frac{1}{2}$ ft. high, W. of cor.
 Asc. 137 ft. over gradual S. slope.
 78.70 Old road, bears N.60°E., and S.60°W.
 80.00 Set an iron post, 3 ft. long, 2 ins. diam., 28 ins. in the ground for cor. of secs. 25, 26, 35 and 36, with brass cap marked



from which

a cedar, 12 ins. diam., bears S.19°W., 378 lks. dist., marked T16N R8W S35 BT.
 No other bearing trees available.
 Raise a mound of stone, 4 ft. base, 2 $\frac{1}{2}$ ft. high W. of cor.

Land, rolling.
 Soil, rocky; 3rd rate.
 Timber, scattering cedar and pinion.
 Undergrowth, scattering cactus, yucca and grass.

40.00 East, on a random line, bet. secs. 25 and 36.
 80.00 Set temp. $\frac{1}{4}$ sec. cor.
 Fall 33 lks. S of the original cor. of secs. 25, 30, 31 and 36 on E. bdy. of Tp. hereinbefore described.
 Thence
 S.89°46'W., on a true line, bet. secs. 25 and 36.
 Over rolling land, through scattering timber and undergrowth.
 30.80 Dry wash, 20 lks. wide, course S.; asc. 52 ft. over SE. slope.
 40.00 Set an iron post, 3 ft. long, 1 in. diam., 28 ins. in the ground for $\frac{1}{4}$ sec. cor. of secs. 25 and 36, with brass cap marked

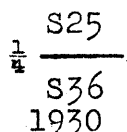

No bearing trees available.
 Raise a mound of stone, 4 ft. base, 3 ft. high, N. of cor.

Chains 80.00	<p>Asc. 99 ft. over gradual SE. slope. The cor. of secs. 25, 26, 35 and 36.</p> <p>Land, rolling. Soil, sandy; 3rd rate. Timber, scattering cedar. Undergrowth, scattering cactus, yucca and grass.</p>
35.00 40.00	<p>N. 0° 1' W., bet. secs. 25 and 26. Over rolling land, through scattering timber and undergrowth. Asc. 120 ft. over SE. slope. Top of broad spur, slopes E.; desc. 11 ft. over NE. slope. Set an iron post, 3 ft. long, 1 in. diam., 26 ins. in the ground for $\frac{1}{4}$ sec. cor. of secs. 25 and 26, with brass cap marked</p> <p style="text-align: center;">$\frac{1}{4}$ S26 S25 1930</p> <p style="text-align: right;">from which</p> <p>a cedar, 36 ins. diam., bears S. 64$\frac{1}{4}$° W., 358 lks. dist., marked $\frac{1}{4}$ S26 BT. a cedar, 5 ins. diam., bears N. 72$\frac{3}{4}$° W., 449 lks. dist., marked $\frac{1}{4}$ S26 BT. J. H. Strojost, house bears S. 35° 45' E. NW. cor. of corral, bears S. 15° E. South end of dam, bears N. 87° 45' E.</p>
80.00	<p>Desc. 29 ft. over gradual NE. slope. Set an iron post, 3 ft. long, 2 ins. diam., 28 ins. in the ground, for cor. of secs. 23, 24, 25 and 26, with brass cap marked</p> <p style="text-align: center;">T16NR8W S23 S24 S26 S25 1930</p> <p>No. bearing trees available. Raise a mound of stone, 4 ft. base, 2$\frac{1}{2}$ ft. high, W. of cor.</p> <p>Land, rolling. Soil, sandy; 3rd rate. Timber, scattering cedar. Undergrowth, scattering cactus, catclaw, yuca and grass.</p>
40.00 79.96	<p>N. 89° 46' E., on a random line, bet. secs. 24 and 25. Set temp. $\frac{1}{4}$ sec. cor. Fall 9 lks. N. of the reestablished cor. of secs. 24 and 25, on E. bdy. of Tp. hereinbefore described.</p>
14.97	<p>Thence S. 89° 50' W., on a true line, bet. secs. 24 and 25. Over rolling land, through scattering timber and undergrowth. Asc. 34 ft. over SE. slope. Bend in low spur, slopes S. 45° E.; S. end of reservoir bears S. about 30 chs. dist.</p>
35.67	<p>Desc. 23 ft. along S. slope. Rocky drain, 20 lks. wide, course S. 35° E.</p>
39.98	<p>Asc. 17 ft. over gradual NE. slope. Set an iron post, 3 ft. long, 1 in. diam., 30 ins. in the ground for $\frac{1}{4}$ sec. cor. of secs. 24 and 25, with brass cap marked</p>

Chains

$\frac{1}{4}$ S24
S25
1930

from which

a cedar, 24 ins. diam., bears S.73°E., 537 lks. dist.,
marked $\frac{1}{4}$ S25 BT.
a cedar, 24 ins. diam., bears S.62 $\frac{1}{4}$ °E., 746 lks. dist.,
marked $\frac{1}{4}$ S25 BT.

79.96 Asc. 142 ft. over E. slope.
The cor. of secs. 23, 24, 25 and 26.

Land, rolling.
Soil, sandy and rocky; 4th rates.
Timber, scattering cedar.
Undergrowth, scattering scrub oak, catclaw, yucca and grass.

15.00 N.0°1'W., bet. secs. 23 and 24.
40.00 Over rolling land; through scattering timber and under-
growth.
Low ridge, bears NE. and SW.; asc. 17 ft. along W. slope.
Set an iron post, 3 ft. long, 1 in. diam., 28 ins. in the
ground, for $\frac{1}{4}$ sec. cor. of secs. 23 and 24, with brass cap
marked

$\frac{1}{4}$
S23 | S24
1930

from which

56.00 a cedar, 6 ins. diam., bears N.66°E., 264 lks. dist.,
68.30 marked $\frac{1}{4}$ S24 BT.
No other bearing trees available.
Raise a mound of stone, 4 ft. base, 2 $\frac{1}{2}$ ft. high, W. of cor.
Asc. 45 ft. along W. slope.
Desc. 28 ft. over gradual NW. slope.
80.00 Draw, 5 lks. wide, course S.35°W., (water in holes)
Asc. 85 ft. over S. slope.
Set an iron post, 3 ft. long, 2 ins. diam., 28 ins. in the
ground, for cor. of secs. 23, 24, 25 and 26, with brass cap
marked

T16NR8W
S14 | S13
S23 | S24
1930

from which

a cedar, 10 ins. diam., bears N.68 $\frac{1}{2}$ °E., 31 lks. dist.,
marked T16N R8W S 13 BT.
a cedar, 8 ins. diam., bears S.50°E., 242 lks. dist.,
marked T16N R8W S 24 BT.
a cedar, 7 ins. diam., bears S.12°W., 147 lks. dist.,
marked T16N R8W S 23 BT.
a cedar, 12 ins. diam., bears N.77°W., 270 lks. dist.,
marked T16 N R8W S 14 BT.

Land, rolling.
Soil, rocky; 3rd rate.
Timber, scattering cedar and pinion.
Undergrowth, scattering scrub oak, cactus and grass.

Chains N.89°50'E., on a random line, bet. secs. 13 and 24.
 40.00 Set temp. $\frac{1}{4}$ sec. cor.
 80.00 Fall 2 lks. S. of the reestablished cor. of secs. 13 and 24, on E. bdy. of
 Tp. hereinbefore described.
 Thence
 S.89°49'W., on a true line, bet. secs. 13 and 24.
 Over rolling land, through scattering timber and under-
 growth.
 Asc. 36 ft. along N. slope.
 30.00 Low spur, slopes SE.
 40.00 Set an iron post, 3 ft. long, 1 in. diam., 30 ins. in the
 ground for $\frac{1}{4}$ sec. cor. of secs. 13 and 24, with brass cap
 marked

S13
 $\frac{1}{4}$
 S24
 1930

from which

a cedar, $\frac{1}{4}$ ins. diam., bears S. 3 $\frac{1}{2}$ °W., 37 lks. dist.,
 marked $\frac{1}{4}$ S24 BT.
 a cedar, $\frac{1}{4}$ ins. diam., bears N. 49 $\frac{3}{4}$ °W., 245 lks. dist.,
 marked $\frac{1}{4}$ S13 BT.

70.47 Desc. 65 ft. over W. slope.
 80.00 Wash, 20 lks. wide, course S.; asc. 45 ft. over E. slope.
 The cor. of secs. 13, 14, 23 and 24.

Land, rolling.
 Soil, sandy; 3rd rate.
 Timber, scattering cedar, pinion and scrub oak.
 Undergrowth, scattering catclaw, yucca, cactus and grass.

N.0°1'W., bet. secs. 13 and 14.
 Over rolling land, through scattering timber and under-
 growth.
 30.00 Asc. 96 ft. over SW. slope.
 Top of spur ridge, slopes SW.; thence asc 28 ft. along
 ridge.
 40.00 Set an iron post, 3 ft. long, 1 in. diam., 14 ins. in the
 ground to bedrock, supported in a mound of stone for
 $\frac{1}{4}$ sec. cor. of secs. 13 and 14, with brass cap marked

$\frac{1}{4}$
 S14 | S13
 1930

from which

a cedar, 10 ins. diam., bears N. 59 $\frac{1}{2}$ °E., 28 lks. dist.,
 marked $\frac{1}{4}$ S13 BT.
 a cedar, 30 ins. diam., bears N. 64°W., 88 lks. dist.,
 marked $\frac{1}{4}$ S14 BT.

45.00 Top of spur ridge, bears SE. and NW.; desc. 259 ft. over
 NW. slope.
 80.00 Set an iron post, 3 ft. long, 2 ins. diam., on solid rock,
 mark a cross (x) at true point for cor. supported in
 a mound of stone, for cor. of secs. 11, 12, 13 and 14, with
 brass cap marked

T16NR8W
 S11 | S12
 S14 | S13
 1930

Chains

from which

a cedar, 10 ins. diam., bears N. 9° E., 386 lks. dist., marked T16N R8W S 12 BT.
 a cedar, 6 ins. diam., bears S. 86½° E., 133 lks. dist., marked T16N R8W S 13 BT.
 a cedar, 12 ins. diam., bears S. 19½° W., 367 lks. dist., marked T16N R8W S 14 BT.
 a cedar, 12 ins. diam., bears N. 28½° W., 55 lks. dist., marked T16N R8W S 11 BT.

Land, rolling.
 Soil, sandy; 3rd rate.
 Timber, scattering cedar and pinion.
 Undergrowth, scattering scrub oak, catclaw, cactus, yucca and grass.

40.00 N. 89° 49' E., on a random line, bet. secs. 12 and 13.
 80.02 Set temp. ¼ sec. cor.
 Fall 5 lks. S. of the reestablished cor. of secs. 12 and 13 on E. bdy of Tp. hereinbefore described.

Thence S. 89° 47' W., on a true line, bet. secs. 12 and 13.
 Over rolling land, through scattering timber and undergrowth.

40.01 Desc. 46 ft. along N. slope.
 Set an iron post, 3 ft. long; 1 in. diam., 20 ins. in the ground to bedrock, supported in a mound of stone for ¼ sec. cor. of secs. 12 and 13, with brass cap marked

S12
 ¼ —
 S13
 1930

from which

a cedar, 24 ins. diam., bears N. 18¾° W., 223 lks. dist., marked ¼ S12 BT.
 a cedar, 6 ins. diam., bears N. 25° E., 236 lks. dist., marked ¼ S12 BT.

60.00 Asc. 35 ft. over gradual SE. slope.
 80.02 Top of spur, slopes S. 15° W.; desc. 136 ft. over NW. slope.
 The cor. of secs. 11, 12, 13 and 14.

Land, rolling.
 Soil, sandy; 3rd rate.
 Timber, scattering cedar and pinion.
 Undergrowth, scattering scrub oak, catclaw, yucca and cactus.

1.90 N. 0° 1' W., bet. secs. 11 and 12.
 33.90 Over rolling land, through scattering timber and undergrowth.
 Desc. 10 ft. over NW. slope.

40.00 Head of drain, 3 lks. wide, course W.; asc. 194 ft. over SW. slope.

Top of ridge, bears S. 20° E., and N. 20° W.; thence along ridge.

Set an iron post, 3 ft. long, 1 in. diam., 16 ins. in the ground to bedrock, supported in a mound of stone, for ¼ sec. cor. of secs. 11 and 12, with brass cap marked

Chains

$\frac{1}{4}$

S11 | S12

1930

from which

a cedar, 8 ins. diam., bears S. $24\frac{1}{4}^{\circ}$ E., 84 lks. dist., marked $\frac{1}{4}$ S12 BT.
a cedar, 18 ins. diam., bears S. 85° W., 149 lks. dist., marked $\frac{1}{4}$ S11 BT.

75.96
80.00

Desc. 131 ft. over NE. slope.
Trail bears N. 60° W., and SE.
Set an iron post, 3 ft. long, 2 ins. diam., 16 ins. in the ground to bedrock, supported in a mound of stone, for cor. of secs. 1, 2, 11 and 12, with brass cap marked.

T16NR8W

S 2 | S 1

S11 | S12

1930

from which

a cedar, 30 ins. diam., bears N. $17\frac{1}{4}^{\circ}$ E., 190 lks. dist., marked T16N R8W S1 BT.
a cedar, 16 ins. diam., bears S. 14° E., 85 lks. dist., marked T16N R8W S 12 BT.
a cedar, 14 ins. diam., bears S. $65\frac{1}{2}^{\circ}$ W., 183 lks. dist., marked T16N R8W S11 BT.
a cedar, 24 ins. diam., bears N. $60\frac{1}{2}^{\circ}$ W., 35 lks. dist., marked T16N R8W S2 BT.

Land, rolling.
Soil, sandy; 3rd rate.
Timber, scattering cedar and pinion.
Undergrowth, scattering cactus, scrub oak, yucca and grass.

40.00
79.98

N. $89^{\circ}47'$ E., on a random line, bet. secs. 1 and 12.
Set temp. $\frac{1}{4}$ sec. cor.
Fall 5 lks. S. of the reestablished cor. of secs. 1 and 12, on E. bdy. of Twp., hereinbefore described.

Thence
S. $89^{\circ}45'$ W., on a true line, bet. secs. 1 and 12.
Over rolling land, through scattering timber and undergrowth.

36.32
39.99

Desc. 87 ft. over gradual NW. slope.
Wash, 30 lks. wide, course S. 70° W.
Set an iron post, 3 ft. long, 1 in. diam., 20 ins. in the ground to bedrock, supported in a mound of stone for $\frac{1}{4}$ sec. cor. of secs. 1 and 12, with brass cap marked

S1

$\frac{1}{4}$

S12

1930

from which

a cedar, 6 ins. diam., bears N. $36\frac{1}{4}^{\circ}$ W., 10 lks. dist., marked $\frac{1}{4}$ S1 BT.
an oak, 10 ins. diam., bears S. $0^{\circ}15'$ W., 60 lks. dist., marked $\frac{1}{4}$ S12 BT.

43.87

Same wash, 30 lks. wide, course N. 70° W.

Chains Asc.18 ft. over NE. slope.
 48.37 Pole corral, bears N.100 lks. dist.
 51.01 Old fence line, bears N. and S.
 53.01 Trail, bears N. and S.; also old fence line, bears NE. and SW.
 56.77 Wash, 10 lks. wide, course N.30°W.; asc. 53 ft. over gradual NE. slope.
 79.98 The cor. of secs. 1, 2, 11 and 12.

Land, rolling.
 Soil, sandy and rocky; 4th rates.
 Timber, scattering cedar and pinion.
 Undergrowth, scattering oak, juniper, catclaw and grass.

N.0°1'W., bet. secs. 1 and 2.
 Over rolling land, through scattering timber and undergrowth.
 Desc. 87 ft. over NE. slope.
 8.40 Wash, 30 lks. wide, course W.; asc. 105 ft. over S. slope.
 22.20 Top of broad spur, slopes S.50°W.; desc. 96 ft. over N. slope.
 35.39 Wash, 10 lks. wide, course W.; asc. S. slope 38 ft.
 38.00 Small reservoir, bears W. about 18.00 chs. dist.
 40.00 Set an iron post, 3 ft. long, 1 in. diam., 28 ins. in the ground, for $\frac{1}{4}$ sec. cor. of secs. 1 and 2, with brass cap marked

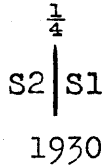

from which

a cedar, 12 ins. diam., bears N.20 $\frac{1}{2}$ °E., 61 lks. dist., marked $\frac{1}{4}$ S1 BT.
 a cedar, 18 ins. diam., bears N.22 $\frac{1}{2}$ °W., 141 lks. dist., marked $\frac{1}{4}$ S2 BT.

51.30 Desc. 18 ft. over NE. slope.
 81.54 Wash, 5 lks. wide, course S.45°E.; asc. 135 ft. over NW. slope.
 Intersect the 4th Standard Parallel North, at a point 14.28 chs. East from the standard cor. of secs. 35 and 36, Fra $\frac{1}{4}$ T.17N. R.8 W., described in book "C" of this group.
 At point of intersection,
 Set an iron post, 3 ft. long, 2 ins. diam., 24 ins. in the ground for closing cor. of secs. 1 and 2, with brass cap marked

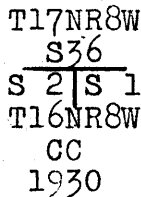

from which

a cedar, 24 ins. diam., bears S.10°E., 107 lks. dist., marked T16N R8W S1 CC BT.
 a cedar, 6 ins. diam., bears S.28°W., 38 lks. dist., marked T16N R8W S2 CC BT.

Land, rolling,
 Soil, sandy; 3rd rate.
 Timber, scattering cedar oak, pinion.
 Undergrowth, scattering juniper scrub oak, cactus, yucca and grass.

Survey of Subdivisions of T.16 N., R.8 W.

Chains From the cor. of secs. 34 and 35 on S. bdy. of Tp., described in book "D" of this group

N. 0° 1' W., bet. secs. 34 and 35.
Over level land, through scattering timber and undergrowth.

40.00 Set an iron post, 3 ft. long, 1 in. diam., 24 ins. in the ground for $\frac{1}{4}$ sec. cor. of secs. 34 and 35, with brass cap marked

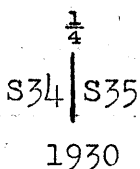

from which

a cedar, 5 ins. diam., bears N. 72 $\frac{3}{4}$ ° E., 107 lks. dist., marked $\frac{1}{4}$ S35 BT:

a cedar, 4 ins. diam., bears S. 66° W., 172 lks. dist., marked BT. only.

80.00 Set an iron post, 3 ft. long, 2 ins. diam., 28 ins. in the ground for cor. of secs. 26, 27, 34 and 35, with brass cap marked



from which

a cedar, 12 ins. diam., bears N. 18 $\frac{1}{2}$ ° E., 337 lks. dist., marked T16N R8W S26 BT.

a cedar, 30 ins. diam., bears S. 54° E., 75 lks. dist., marked T16N R8W S35 BT.

No other bearing trees available.

Deposit a stone marked with a cross (X) at base of post.

Land, level.

Soil, sandy; 2nd rate.

Timber, scattering cedar.

Undergrowth, scattering catclaw, cactus, yucca and grass.

40.00 East, on a random line, bet. secs. 26 and 35.

80.02 Set temp. $\frac{1}{4}$ sec. cor.

Fall 4 lks. S. of the cor. of secs. 25, 26, 35 and 36.

Thence

S. 89° 58' W., on a true line, bet. secs. 26 and 35.

Over rolling land, through scattering timber and undergrowth.

Desc. 52 ft. over SW. slope.

27.70 Rocky spur, slopes S.; desc. 14 ft. along S. slope.

40.01 Set an iron post, 3 ft. long, 1 in. diam., on solid rock, deposit a stone marked with a cross (X) at base of post supported in a mound of stone, for $\frac{1}{4}$ sec. cor. of secs. 26 and 35, with brass cap marked

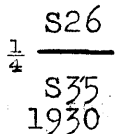

from which

<p>Chains</p> <p>45.00</p> <p>63.21</p> <p>80.02</p>	<p>a cedar, 16 ins. diam., bears S. $86\frac{1}{2}^{\circ}$W., 170 lks. dist., marked $\frac{1}{4}$ S35 BT.</p> <p>No other bearing tree available.</p> <p>Asc. 27 ft. along S. slope.</p> <p>Broad spur ridge, bears S. 30°W., and N. 30°E.</p> <p>Asc. 28 ft. along N. slope.</p> <p>Old road, bears S. 45°E., and N. 45°W.</p> <p>The cor. of secs. 26, 27, 34 and 35.</p>
<p>6.45</p> <p>40.00</p>	<p>Land, rolling.</p> <p>Soil, sandy; 3rd rate.</p> <p>Timber, scattering cedar.</p> <p>Undergrowth, scattering scrub oak, catclaw, yucca and grass.</p> <hr/> <p>N. $0^{\circ}1'$W. bet. secs. 26 and 27.</p> <p>Over rolling land, through scattering timber and undergrowth.</p> <p>Desc. 208 ft. over gradual N. slope.</p> <p>Old road, bears N. 85°W., and S. 85°E.</p> <p>Set an iron post, 3 ft. long, 1 in. diam., 24 ins. in the ground for $\frac{1}{4}$ sec. cor. of secs. 26 and 27, with brass cap marked</p>
<p>44.80</p> <p>55.50</p> <p>80.00</p>	<p style="text-align: center;">$\frac{1}{4}$</p> <p style="text-align: center;">S27 S26</p> <p style="text-align: center;">1930</p> <p style="text-align: right;">from which</p> <p>a cedar, 6 ins. diam., bears N. 39°E., 304 lks. dist., marked $\frac{1}{4}$ S26 BT.</p> <p>a cedar, 6 ins. diam., bears N. 39°W., 264 lks. dist., marked $\frac{1}{4}$ S27 BT.</p> <p>Desc. 53 ft. over N. slope.</p> <p>Draw, course W.</p> <p>Wash, 10 lks. wide, course W; asc. 50 ft. over SW. slope.</p> <p>Set an iron post, 3 ft. long, 2 ins. diam., 30 ins. in the ground for cor. of secs. 22, 23, 26 and 27, with brass cap marked</p>
	<p style="text-align: center;">T16NR8W</p> <p style="text-align: center;">S22 S23</p> <p style="text-align: center;">S27 S26</p> <p style="text-align: center;">1930</p> <p>No bearing trees available.</p> <p>Raise a mound of stone, 4 ft. base, $2\frac{1}{2}$ ft. high, W. of cor.</p> <p>Land, rolling.</p> <p>Soil, rocky; 4th rate.</p> <p>Timber, scattering cedar.</p> <p>Undergrowth, scattering scrub oak, catclaw, yucca and grass.</p>

Chains N.89°58'E., on a random line, bet. secs. 23 and 26.
 40.00 Set temp. $\frac{1}{4}$ sec. cor.
 80.06 Fall 7 lks. N. of the cor. of secs. 23, 24, 25 and 26.
 Thence
 N.89°59'W., on a true line, bet. secs. 23 and 26.
 Over rolling land, through scattering timber and under-
 growth.
 Desc. 251 ft. over gradual W. slope.
 34.55 Wash, 20 lks. wide, course S.45°W.
 40.03 Set an iron post, 3 ft. long, 1 in. diam., 28 ins. in the
 ground for $\frac{1}{4}$ sec. cor. of secs. 23 and 26, with brass cap
 marked

$\frac{1}{4}$ S23
 ———
 S26
 1930

from which

a cedar, 4 ins. diam., bears S.84°E., 69 lks. dist.,
 marked $\frac{1}{4}$ S26 BT.
 a cedar, 4 ins. diam., bears N.1°W., 29 lks. dist.,
 marked $\frac{1}{4}$ S23 BT.

Asc. 30 ft. over SE. slope.
 55.00 Low spur, slopes SW.; desc. 97 ft. over SW. slope.
 80.06 The cor. of secs. 22, 23, 26, and 27.

Land, rolling.
 Soil, rocky; 4th rate.
 Timber, scattering cedar.
 Undergrowth, scattering scrub oak, catclaw, cactus, yucca
 and grass.

 N.0°1'W., bet. secs. 22 and 23.
 Over rolling land, through scattering timber and under-
 growth.
 23.50 Desc. 127 ft. over N. slope.
 32.20 Draw, course SW., for 6 chs. dist., thence N.45°W.
 Asc. 91 ft. over S. slope.
 40.00 Set an iron post, 3 ft. long, 1 in. diam., 8 ins. in the
 ground to bedrock, deposit a stone marked with a cross
 (X) at base, of post, supported in a mound of stone for
 $\frac{1}{4}$ sec. cor. of secs. 22 and 23, with brass cap marked

$\frac{1}{4}$
 S22 | S23
 1930

No bearing trees available.

Asc. 40 ft. over S. slope.
 55.00 Low spur, slopes W.; desc. 220 ft. over NW. slope.
 69.65 Wash, 20 lks. wide, course W.; asc. 81 ft. over SW. slope.
 80.00 Set an iron post, 3 ft. long, 2 ins. diam., 7 ins. in the
 ground to bedrock, deposit a stone marked with a cross
 (X) at base of post, supported in a mound of stone for
 cor. of secs. 14, 15, 22 and 23, with brass cap marked

T16NR8W
 S15 | S14
 S22 | S23
 1930

from which

Chains	<p>a cedar, 12 ins. diam., bears S. $39\frac{3}{4}^{\circ}$ E., 114 lks. dist., marked T16N R8W S23 BT. a cedar, 12 ins. diam., bears S. $33\frac{1}{2}^{\circ}$ W., 128 lks. dist., marked T16N R8W S 22 BT. a cedar, 8 ins. diam., bears N. $25\frac{3}{4}^{\circ}$ W., 174 lks. dist., marked T16N R8W S15 BT.</p> <p>No other bearing trees available.</p> <p>Land, rolling. Soil, gravelly; 3rd rate. Timber, scattering cedar. Undergrowth, scattering scrub oak, catclaw, yucca, cactus and grass.</p>
40.00 79.98	<p>S. $89^{\circ}59'$ E., on a random line, bet. secs. 14 and 23. Set temp. $\frac{1}{4}$ sec. cor. Fall 5 lks. N. of the cor. of secs. 13, 14, 23 and 24. Thence N. $89^{\circ}57'$ W., on a true line, bet. secs. 14 and 23. Over rolling land, through scattering timber and undergrowth.</p>
17.00 37.97 39.99	<p>Desc. 233 ft. over NW. slope. Head of draw, course S. 45° W. Set an iron post, 3 ft. long, 1 in. diam., 16 ins. in the ground to bedrock, supported in a mound of stone, for $\frac{1}{4}$ sec. cor. of secs. 14 and 23, with brass cap marked</p>
79.98	<p style="text-align: center;"> $\frac{1}{4}$ <u>S14</u> S23 1930 </p> <p style="text-align: right;">from which</p> <p>a cedar, 12 ins. diam., bears S. $19\frac{3}{4}^{\circ}$ W., 171 lks. dist., marked $\frac{1}{4}$ S23 BT. a cedar, 12 ins. diam., bears N. 29° W., 155 lks. dist., marked $\frac{1}{4}$ S14 BT.</p> <p>Desc. 259 ft. over SW. slope. The cor. of secs. 14, 15, 22 and 23.</p>
7.50 19.35 21.76 27.74 32.32 40.00	<p>Land, rolling. Soil, gravelly; 3rd rate. Timber, scattering cedar. Undergrowth, scattering scrub oak, catclaw, cactus, yucca and grass.</p> <p>N. $0^{\circ}1'$ W., bet. secs. 14 and 15. Over mountainous land, through scattering timber and undergrowth. Asc. 38 ft. over SW. slope. Desc. 115 ft. over NW. slope. Wash, 25 lks. wide, course S. 65° W.; asc. 34 ft. along rolling SE. slope. Wash, 15 lks. wide, course S. 45° W. Desc. 27 ft. over NE. slope. Same wash, 10 lks. wide, course S. 20° E.; asc. 26 ft. over gradual SW. slope. Set an iron post, 3 ft. long, 1 in. diam., 30 ins. in the ground for $\frac{1}{4}$ sec. cor. of secs. 14 and 15, with brass cap marked</p>

Chains

$$\frac{1}{4}$$

S15	S14
-----	-----

1930

No bearing trees available.

Raise a mound of stone, 4 ft. base, $2\frac{1}{2}$ ft. high W. of cor.

Asc. 61 ft. over gradual SW. slope.

54.70 Head of draw, 10 lks. wide, course S. 70° W.; thence asc. 242 ft. over S. slope.

59.70 Top of rimrocks, bears E. and W.; continue ascending.

75.83 Top of spur, slopes S. 20° W.; thence over level land.

80.00 Set an iron post, 3 ft. long, 2 ins. diam., 24 ins. in the ground, deposit a stone marked with a cross (X) at base of post, for cor. of secs. 10, 11, 14 and 15, with brass cap marked

T16NR8W	
S10	S11
S15	S14
1930	

from which

a pinion pine, 6 ins. diam., bears N. $70\frac{1}{2}^{\circ}$ E., 261 lks. dist., marked T16N R8W S11 BT.a cedar, 18 ins. diam., bears S. $64\frac{1}{2}^{\circ}$ E., 200 lks. dist., marked T16N R8W S14 BT.a pinion pine, 6 ins. diam., bears N. $12\frac{3}{4}^{\circ}$ W., 250 lks. dist., marked T16N R8W S10 BT.

No other bearing tree available.

Land, mountainous.

Soil, rocky; 4th rate.

Timber, scattering cedar and pinion.

Undergrowth, scattering scrub oak, catclaw, yucca, cactus and grass.

40.00 S. $89^{\circ}57'$ E., on a random line, bet. secs. 11 and 14.80.10 Set temp. $\frac{1}{4}$ sec. cor.

Intersect the cor. of secs. 11, 12, 13 and 14.

Thence

N. $89^{\circ}57'$ W., on a true line, bet. secs. 11 and 14.

Over mountainous land, through scattering timber and undergrowth.

Desc. 147 ft. over NW. slope.

11.42 Wash, 10 lks. wide, course S. 50° W.; asc. 39 ft. over SE. slope.16.78 Top of spur, slopes S. 45° W.; desc. 186 ft. over W. slope.27.88 Wash, 20 lks. wide, course S. 15° W.; asc. 190 ft. over E. slope.39.00 Top of spur, slopes S. 15° W.40.05 Set an iron post, 3 ft. long, 1 in. diam., 28 ins. in the ground for $\frac{1}{4}$ sec. cor. of secs. 11 and 14, with brass cap marked

S11	
$\frac{1}{4}$	S14
1930	

from which

a pinion pine, 6 ins. diam., bears S. $68\frac{3}{4}^{\circ}$ W., 27 lks. dist., marked $\frac{1}{4}$ S14 BT.

Survey of Subdivisions of T.16 N., R.8 W.

Chains a cedar, 7 ins. diam., bears N. $41\frac{3}{4}$ °W., 136 lks. dist., marked $\frac{1}{4}$ S11 BT.

50.10 Desc. 166 ft. over NE. slope.

62.50 Wash, 8 lks. wide, course S. 50°W.; asc. 180 ft. over SE. slope.

73.40 Top of rimrocks, 25 ft. high, bears S. 45°E., and N. 45°W. Asc. 17 ft. over gradual SE. slope.

80.10 Top of broad spur, slopes S. 60°W.; desc. 59 ft. over W. slope.

The cor. of secs. 10, 11, 14 and 15.

Land, mountainous.
Soil, rocky; 3rd rate.
Timber, scattering cedar and pinion.
Undergrowth, scattering scrub oak, catclaw, yucca, cactus and grass.

N. 0°1'W., bet. secs. 10 and 11.
Over mountainous land, through scattering timber and undergrowth.

11.78 Desc. 109 ft. over NW. slope.
Wash. 7 lks. wide, course W.; asc. 209 ft. over gradual SW. slope.

33.70 Wash, 10 lks. wide, course W.; continue ascending.

40.00 Set an iron post, 3 ft. long, 1 in. diam., 18 ins. in the ground to bedrock, supported in a mound of stone for $\frac{1}{4}$ sec. cor. of secs. 10 and 11, with brass cap marked

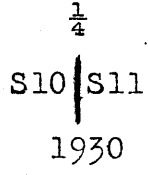

from which

a pinion pine, 6 ins. diam., bears S. 86 $\frac{1}{4}$ °E., 77 lks. dist., marked $\frac{1}{4}$ S11 BT.
a cedar, 6 ins. diam., bears N. 3°W., 464 lks. dist., marked $\frac{1}{4}$ S10 BT.

53.00 Top of rimrocks, bears SE. and NW.; thence over level land

54.40 Top of rimrocks, 20 ft. high, bears NE. and SW.; desc. 106 ft. over NW. slope.

58.61 Drain, 3 lks. wide, course W.; desc. 18 ft. along W. slope.

80.00 Set an iron post, 3 ft. long, 2 ins. diam., 26 ins. in the ground for cor. of secs. 2, 3, 10 and 11, with brass cap marked



from which

a cedar, 34 ins. diam., bears N. 61°E., 06 lks. dist., marked T16N R8W S2 BT.
a cedar, 10 ins. diam., bears S. 61°E., 19 lks. dist., marked T16N R8W S11 BT.
a cedar, 12 ins. diam., bears S. 26°W., 26 lks. dist., marked T16N R8W S10 BT.
a pinion pine, 12 ins. diam., bears N. 15 $\frac{1}{4}$ °W., 21 lks. dist., marked T16N R8W S3 BT.

Chains

Land, mountainous.
Soil, gravelly; 3rd rate.
Timber, scattering cedar and pinion.
Undergrowth, scattering scrub oak, catclaw, yucca, cactus and grass.

40.00
80.08

S. 89° 57' E., on a random line, bet. secs. 2 and 11.
Set temp. 1/4 sec. cor.
Intersect the cor. of secs. 1, 2, 11 and 12.
Thence
N. 89° 57' W., on a true line, bet. secs. 2 and 11.
Over rolling land, through scattering timber and undergrowth.
Asc. 17 ft. over NE. slope.
Stock trail, bears SE. and NW.
Top of spur, slopes N. 45° W.; desc. 195 ft. over W. slope.
Top of rimrocks, bears SE. and NW.
Wash, 40 lks. wide, course S. 20° E.; asc. 85 ft. over E. slope.
Set an iron post, 3 ft. long, 1 in. diam., 12 ins. in the ground to bedrock, supported in a mound of stone, for 1/4 sec. cor. of secs. 2 and 11, with brass cap marked

5.77
10.57
23.57
30.30
40.04

1/4 S2
S11
1930

from which
a cedar, 8 ins. diam., bears N. 61 1/2° E., 67 lks. dist., marked 1/4 S2 BT.
a pinion pine, 1 1/4 ins. diam., bears S. 34 1/2° E., 75 lks. dist., marked 1/4 S11 BT.

47.52
64.27
80.08

Asc. 27 ft. over E. slope.
Top of spur, slopes S. 20° E.; desc. 170 ft. over W. slope.
Wash, 5 lks. wide, course N. 45° W.; asc. 42 ft. over W. slope.
The cor. of secs. 2, 3, 10 and 11.

Land, rolling.
Soil, rocky; 3rd rate.
Timber, scattering cedar and pinion.
Undergrowth, scattering catclaw, scrub oak, yucca, cactus and grass.

2.20
40.00

N. 0° 1' W., bet. secs. 2 and 3.
Over mountainous land, through scattering timber and undergrowth.
Along W. slope.
Shallow wash, 10 lks. wide, course S. 35° W.; asc. 281 ft. over S. slope.
Set an iron post, 3 ft. long, 1 in. diam., 6 ins. in the ground to bedrock, supported in a mound of stone for 1/4 sec. cor. of secs. 2 and 3, with brass cap marked

1/4 S3 | S2
1930

from which
a cedar, 20 ins. diam., bears N. 18 3/4° E., 153 lks. dist., marked 1/4 S2 BT.

Chains

a cedar, 20 ins. diam., bears N. 65 1/2° W., 134 lks. dist., marked 1/4 S3 BT.

43.10
58.10
70.50
78.45
81.51

Top of low spur, slopes SE.; desc. 46 ft. over NE. slope.
Head of drain, course S. 60° E.; asc. 83 ft. over SE. slope.
Top of divide, bears N. 50° E., and S. 50° W.; desc. 39 ft. over N. slope.
Trail, bears S. 80° E., and N. 80° W.
Intersect the 4th Standard Parallel North, at a point 14.19 chs. East from the standard cor. of secs. 34 and 35, Frac. T.17 N., R.8 W., described in book "C" of this group.
At point of intersection,
Set an iron post, 3 ft. long, 2 ins. diam., 28 ins. in the ground, for closing cor. of secs. 2 and 3, with brass cap marked

T17NR8W
S35
S 3 | S 2
T16NR8W
CC
1930

from which

a cedar, 6 ins. diam. bears S. 22 1/2° E., 218 lks. dist., marked BT. only.
No other bearing tree available.
Raise a mound of stone, 4 ft. base, 2 1/2 ft. high, S. of cor.

Land, mountainous.
Soil, rocky; 4th rate.
Timber, scattering cedar and pinion.
Undergrowth, scattering scrub oak, catclaw, yucca, cactus and grass.

From the cor. of secs. 33 and 34 on S. bdy. of Tp. described in book "D" of this group,

N. 0° 2' W., bet. secs. 33 and 34.
Over rolling mesa land, through scattering timber and undergrowth.

40.00

Asc. 89 ft. over gradual SE. slope.
Set an iron post, 3 ft. long, 1 in. diam., 30 ins. in the ground, for 1/4 sec. cor. of secs. 33 and 34, with brass cap marked

1/4
S33 | S34
1930

from which

a cedar, 5 ins. diam., bears S. 38 1/2° E., 270 lks. dist., marked 1/4 S34 BT.
a cedar, 5 ins. diam., bears S. 31 1/2° W., 162 lks. dist., marked 1/4 S33 BT.

70.00
80.00

Thence over level land.
Leave level land.; asc. 28 ft. over gradual SW. slope.
Set an iron post, 3 ft. long, 2 ins. diam., 14 ins. in the ground to bedrock, supported in a mound of stone, for cor. of secs. 27, 28, 33 and 34, with brass cap marked

Chains

T16NR8W
S28 | S27
S33 | S34
1930

from which

a cedar, 5 ins. diam., bears N. 77 1/4° E., 145 lks. dist.,
marked T16N R8W S27 BT.
a cedar, 5 ins. diam., bears N. 39 1/2° W., 430 lks. dist.,
marked T16N R8W S28 BT.
No other bearing trees available.
Raise a mound of stone, 4 ft. base, 2 1/2 ft. high, W. of cor.

Land, rolling and level.
Soil, sandy; 3rd rate.
Timber, scattering cedar.
Undergrowth, scattering scrub oak, catclaw, yucca, cactus
and grass.

40.00 East, on a random line, bet. secs. 27 and 34.
Set temp. 1/4 sec. cor.
80.14 Fall 2 lks. N. of the cor. of secs. 26, 27, 34 and 35.
Thence
N. 89° 59' W., on a true line, bet. secs. 27 and 34.
Over rolling mesa land, through scattering timber and
undergrowth.
40.07 Desc. 131 ft. over gradual SW. slope.
Set an iron post, 3 ft. long, 1 in. diam., 8 ins. in the
ground to bedrock, supported in a mound of stone for
1/4 sec. cor. of secs. 27 and 34, with brass cap marked

S27
1/4 ———
S34
1930

from which

a cedar, 6 ins. diam., bears N. 56 1/2° E., 23 lks. dist.,
marked 1/4 S27 BT.
a cedar, 4 ins. diam., bears N. 75 1/2° W., 152 lks. dist.,
marked 1/4 S27 BT.

80.14 Desc. 116 ft. over SW. slope.
The cor. of secs. 27, 28, 33 and 34.
Land, rolling.
Soil, sandy; 3rd rate.
Timber, scattering cedar and pinion.
Undergrowth, scattering scrub oak, catclaw, yucca, cactus
and grass.

10.00 N. 0° 2' W., bet. secs. 27 and 28.
16.25 Over rolling mesa land, through scattering timber and
40.00 undergrowth.
Asc. 34 ft. over SW. slope.
Top of broad spur, slopes W.; desc. 45 ft. over NE. slope.
Old road, bears N. 60° W. / and S. 60° E.
Set an iron post, 3 ft. long, 1 in. diam., 16 ins. in the
ground to bedrock, supported in a mound of stone for

Chains $\frac{1}{4}$ sec. cor. of secs. 27 and 28, with brass cap marked

$\frac{1}{4}$
S28 | S27
1930

from which

a cedar, 5 ins. diam., bears S. $39\frac{1}{2}^{\circ}$ E., 62 lks. dist., marked $\frac{1}{4}$ S27 BT.
 a cedar, 5 ins. diam., bears S. 60° W., 282 lks. dist., marked $\frac{1}{4}$ S28 BT.

42.30 Desc. 158 ft. over steep NE. slope.
 63.73 Creek, 12 lks. wide, (water in holes) course N. 45° W.; asc. 131 ft. over gradual SW. slope.
 80.00 Set an iron post, 3 ft. long, 2 ins. diam., 20 ins. in the ground to bedrock, supported in a mound of stone for cor. of secs. 21, 22, 27 and 28, with brass cap marked

T16NR8W
S21 | S22
S28 | S27
1930

No bearing trees available.
 Raise a mound of stone 4 ft. base. $2\frac{1}{2}$ ft. high, W. of cor.

Land, rolling.
 Soil, sandy clay; 3rd rate.
 Timber, scattering cedar and pinion.
 Undergrowth, scattering scrub oak, catclaw, yucca, cactus and grass.

40.00 S. $89^{\circ}59'$ E., on a random line, bet. secs. 22 and 27.
 Set temp. $\frac{1}{4}$ sec. cor.
 80.20 Fall 9 lks. S. of the cor. of secs. 22, 23, 26 and 27.
 Thence
 S. $89^{\circ}57'$ W., on a true line, bet. secs. 22 and 27.
 Over rolling land, through scattering timber and undergrowth.
 40.10 Set an iron post, 3 ft. long, 1 in. diam., 24 ins. in the ground for $\frac{1}{4}$ sec. cor. of secs. 22 and 27, with brass cap marked

$\frac{1}{4}$ S22

S27
1930

No bearing trees available.
 Raise a mound of stone, 4 ft. base, $2\frac{1}{2}$ ft. high, N. of cor.

80.20 The cor. of secs. 21, 22, 27 and 28.

Land, rolling.
 Soil, sandy clay; 3rd rate.
 Timber, scattering cedar and pinion.
 Undergrowth, scattering, scrub oak, catclaw, cactus and grass.

Chains N.0°2'W., bet. secs. 21 and 22.
Over mountainous land, through scattering timber and undergrowth.
12.97 Top of precipitous bluff; 250 ft. high, impracticable to chain. To make a triangulation over bluffs and deep canyon: designate the above point flag A and set a flag B on opposite side of canyon, from flag A measure a base, N.75°14'W., 5.00 chs. dist., and set a flag C from which flag B bears N.12°14'E.; all bearings checked by direct reading of the solar, and all angles checked by deflection.

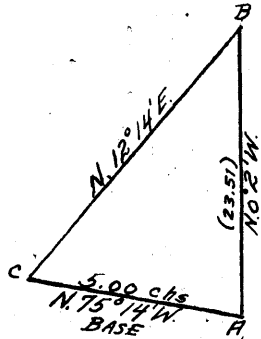

Dist. by direct meas.	12.97 chs.
Dist. by triangulation	23.51 "
	<u>36.48 chs.</u>

21.00 Approximate topography. Desc. 359 ft. over N. slope.
Creek, 35 lks. wide, course W.; asc. 359 ft. over broken SW. slope.
30.00 Point of rocky spur, slopes S.
36.48 Triangulation point B on N. side of canyon.
Desc. 37 ft. over NW. slope.
40.00 Set an iron post, 3 ft. long, 1 in. diam., 6 ins. in the ground to bedrock, deposit a stone marked with a cross (X) at base of post, supported in a mound of stone for $\frac{1}{4}$ sec. cor. of secs. 21 and 22, with brass cap marked

$\frac{1}{4}$
S21 | S22
1930

No bearing trees available.

52.50 Asc. 143 ft. over broken SW. slope.
69.84 Spur, slopes W.; continue ascending.
80.00 Top of spur, slopes N.75°W.; desc. 109 ft. over N. slope.
Set an iron post, 3 ft. long, 2 ins. diam., on solid rock, deposit a stone marked with a cross (X) at base of post, supported in a mound of stone, for cor. of secs. 15, 16, 21 and 22, with brass cap marked

T16NR8W
S16 | S15
S21 | S22
1930

from which

a cedar, 6 ins. diam., bears N.47 $\frac{3}{4}$ °E., 151 lks. dist., marked T16N R8W S15 BT.
a cedar, 12 ins. diam., bears S.16 $\frac{3}{4}$ °E., 349 lks. dist., marked T16N R8W S22 BT.
a cedar, 12 ins. diam., bears N.60 $\frac{1}{4}$ °W., 465 lks. dist., marked T16N R8W S16 BT.
No other bearing tree available.

Chains

Land, mountainous.
Soil, rocky; 4th rate.
Timber, scattering cedar and pinion.
Undergrowth, scattering scrub oak, catclaw, yucca, cactus and grass.

40.00 N. 89°57'E., on a random line, bet. secs. 15 and 22.
Set temp. 1/4 sec. cor.
80.20 Fall 9 lks. N. of the cor. of secs. 14, 15, 22 and 23.
Thence
N. 89°59'W., on a true line, bet. secs. 15 and 22.
Over mountainous land, through scattering timber and undergrowth.
Desc. 107 ft. over SW. slope.
10.14 Wash, 30 lks. wide, course S. 50°W.; asc. 168 ft. over E. slope.
24.85 Top of broad spur, slopes S.; desc. 116 ft. over gradual W. slope.
40.10 Set an iron post, 3 ft. long, 1 in. diam., 30 ins. in the ground for 1/4 sec. cor. of secs. 15 and 22, with brass cap marked

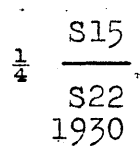

No bearing trees available.
Raise a mound of stone, 4 ft. base, 2 1/2 ft. high N. of cor.

52.10 Asc. 94 ft. over E. slope.
80.20 Top of spur, slopes S. 30°W.; desc. 163 ft. over NW. slope.
The cor. of secs. 15, 16, 21 and 22.

Land, mountainous.
Soil, rocky; 4th rate.
Timber, scattering cedar.
Undergrowth, scattering scrub oak, catclaw, yucca, cactus and grass.

N. 0°2'W., bet. secs. 15 and 16.
Over mountainous land, through scattering timber and undergrowth.
Desc. 78 ft. over NW. slope.
3.40 Wash, 10 lks. wide, course W.; asc. 197 ft. over S. slope.
21.00 Top of rimrocks, 10 ft. high, bears E. and W.; asc. 68 ft. over gradual S. slopes
36.94 Top of spur, and rimrocks, bears N. 70°E., and S. 70°W.; desc. 270 ft. over rolling NW. slope.
40.00 Set an iron post, 3 ft. long, 1 in. diam., 14 ins. in the ground to bedrock, supported in a mound of stone for 1/4 sec. cor. of secs. 15 and 16, with brass cap marked

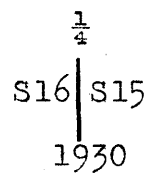

from which

a cedar, 14 ins. diam., bears N. 60 1/4°E., 257 lks. dist., marked 1/4 S15 BT.
a cedar, 8 ins. diam., bears S. 87 3/4°W., 173 lks. dist., marked 1/4 S16 BT.

Chains Desc. 270 ft. over NW. slope.
 57.00 Wash, 10 lks. wide, course W.; asc 187 ft. over S. slope.
 63.92 Top of rocky spur, slopes W.; desc. 132 ft. over NW. slope.
 78.90 Wash, 8 lks. wide, course S. 70° W.; asc. 22 ft. over S. slope.
 80.00 Set an iron post, 3 ft. long, 2 ins. diam., 12 ins. in the
 ground to bedrock, supported in a mound of stone for
 cor. of secs. 9, 10, 15 and 16, with brass cap marked

T16NR8W
 S 9 | S10
 S16 | S15
 1930

from which

a cedar, 6 ins. diam., bears N. $42\frac{3}{4}^{\circ}$ E., 140 lks. dist.,
 marked T16N R8W S10 BT.
 a cedar, 10 ins. diam., bears S. $86\frac{1}{2}^{\circ}$ E., 81 lks. dist.,
 marked T16N R8W S15 BT.
 a pinion pine, 14 ins. diam., bears S. $16\frac{1}{2}^{\circ}$ W., 171 lks. dist.,
 marked T16N R8W S16 BT.
 a cedar, 10 ins. diam., bears N. 12° W., 111 lks. dist.,
 marked T16N R8W S9 BT.

Land, mountainous.
 Soil, rocky; 4th rate.
 Timber, scattering cedar and pinion.
 Undergrowth, scattering scrub oak, catclaw, yucca, cactus
 and grass.

40.00 S. $89^{\circ}59'$ E. on a random line, bet. secs. 10 and 15.
 Set temp. $\frac{1}{4}$ sec. cor.
 80.16 Fall 5 lks. S. of the cor. of secs. 10, 11, 14 and 15.
 Thence
 S. $89^{\circ}59'$ W., on a true line, bet. secs. 10 and 15.
 Over mountainous land, through scattering timber and
 undergrowth.
 Desc. 179 ft. over W. slope.
 11.77 Wash, 25 lks. wide, course S. 70° E.; asc. 219 ft. over E. slope.
 40.08 Set an iron post, 3 ft. long, 1-in. diam., on solid rock,
 supported in a mound of stone for $\frac{1}{4}$ sec. cor. of secs.
 10 and 15, with brass cap marked

S10
 $\frac{1}{4}$ ———
 S15
 1930

from which

a cedar, 14 ins. diam., bears N. $86\frac{3}{4}^{\circ}$ E., 398 lks. dist.,
 marked $\frac{1}{4}$ S10 BT.
 a cedar, 7 ins. diam., bears S. $87\frac{1}{4}^{\circ}$ E., 301 lks. dist.,
 marked $\frac{1}{4}$ S15 BT.

40.36 Spur, slopes SE.; continue ascending 34 ft. over SE. slope.
 60.40 Top of rimrocks, bears N. and S.; desc. 289 ft. over NW
 slope.
 80.16 The cor. of secs. 9, 10, 15 and 16.

Land, mountainous.
 Soil, rocky; 4th rate.
 Timber, scattering cedar and pinion.
 Undergrowth, scattering, catclaw, yucca, cactus and grass.

Survey of Subdivisions of T.16 N., R.8 W.

Chains

N.0°2'W., bet. secs. 9 and 10.
 Over mountainous land, through scattering timber and undergrowth.
 Asc. 218 ft. over SW. slope.
 Top of spur, slopes N. 45°W.; desc. 114 ft. over NE. slope.
 Water pockets at head of wash, course NE.; asc. 82 ft. over SE. slope.
 Top of spur, slopes N.; thence along spur.
 Set an iron post, 3 ft. long, 1 in. diam., 24 ins. in the ground for $\frac{1}{4}$ sec. cor. of secs. 9 and 10, with brass cap marked

14.50
 25.44
 38.30
 40.00

$\frac{1}{4}$
 S9 | S10
 1930

from which

a pinion pine, 6 ins. diam., bears S. 51°E., 59 lks. dist., marked $\frac{1}{4}$ S10 BT.
 a pinion pine, 12 ins. diam., bears S. 15°W., 100 lks. dist., marked $\frac{1}{4}$ S9 BT.

Desc. 277 ft. over NE. slope.
 Wash, 15 lks. wide, course W.; asc. 307 ft. over SW. slope.
 Set an iron post, 3 ft. long, 2 ins. diam., 28 ins. in the ground for cor. of secs. 3, 4, 9 and 10, with brass cap marked

52.85
 80.00

T16NR8W
 S 4 | S 3
 S 9 | S10
 1930

from which

a pinion pine, 5 ins. diam., bears N. 81°E., 121 lks. dist., marked T16N R8W S3 BT.
 a cedar, 5 ins. diam., bears S. 84 $\frac{1}{2}$ °E., 280 lks. dist., marked T16N R8W S10 BT.
 a cedar, 4 ins. diam., bears S. 83°W., 130 lks. dist., marked BT only.
 a cedar, 10 ins. diam., bears N. 11 $\frac{1}{2}$ °W., 201 lks. dist., marked T16N R8W S4 BT.

Land, mountainous.
 Soil, rocky; 4 th rate.
 Timber, Scattering cedar and pinion.
 Undergrowth, scattering scrub oak, catclaw, yucca, cactus, and grass.

40.00
 80.12

N. 89°59'E., on a random line, bet. secs. 3 and 10.
 Set temp. $\frac{1}{4}$ sec. cor.
 Fall 5 lks. N. of the cor. of secs. 2, 3, 10 and 11.
 Thence
 N. 89°59'W., on a true line bet. secs 3 and 10.
 Over mountainous land through scattering timber and undergrowth.
 Wash, 20 lks. wide, course S. 15°W. Desc. over SW. slope.
 Wash, 30 lks. wide, course S. 20°E.; asc. 149 ft. over NE. slope.
 Spur, slopes S. 40°E.; continue ascending over NE. slope.
 Set an iron post, 3 ft. long, 1 in. diam., 20 ins. in the ground to bedrock, supported in a mound of stone, for $\frac{1}{4}$ sec. cor. of secs. 3 and 10, with brass cap marked

0.43
 7.32
 18.13
 40.06

Chains

$$\frac{1}{4} \frac{S3}{1930}$$

from which

a cedar, 6 ins. diam., bears N.2°E., 238 lks. dist.,
 marked $\frac{1}{4}$ S3 BT.
 a cedar, 6 ins. diam., bears S.9°E., 122 lks. dist.,
 marked $\frac{1}{4}$ S10 BT.

Asc. 16 $\frac{1}{4}$ ft. over NE. slope.
 51.43 Low spur, slopes S.45°E.; asc. 18 ft. over gradual E. slope.
 66.43 Top of rimrocks, bears SE. and NW.; desc. 343 ft. over SW.
 slope.
 80.12 The cor. of secs. 3, 4, 9 and 10.

Land, mountainous.
 Soil, rocky; 4th rate.
 Timber; scattering cedar and pinion.
 Undergrowth, scattering catclaw, scrub oak, yucca, cactus
 and grass.

N.0°2'W., bet. secs. 3 and 4.
 Over mountainous land, through scattering timber and
 undergrowth.

Asc. 16 ft. over SW. slope.
 2.00 Top of spur, slopes S.80°W.; desc. 58 ft. over NW. slope.
 8.22 Head of ravine, course N.70°W.; asc. 79 ft. over SW. slope.
 20.74 Trail, bears E. and W.; on low spur, sloping W.; desc. 216
 ft. over NW. slope.
 35.16 Draw, 5 lks. wide, course W.; asc. 98 ft. over SW. slope.
 40.00 Set an iron post 3 ft. long, 1 in. diam., 3 ins. in the
 ground to bedrock, supported in a mound of stone for
 $\frac{1}{4}$ sec. cor. of secs. 3 and 4, with brass cap marked

$$\frac{1}{4} \frac{S4 | S3}{1930}$$

from which

a cedar, 10 ins. diam., bears S.61 $\frac{1}{4}$ °W., 205 lks. dist.,
 marked $\frac{1}{4}$ S4 BT.
 a cedar, 12 ins. diam., bears S.40 $\frac{1}{2}$ °W., 246 lks. dist.,
 marked $\frac{1}{4}$ S4 BT.

50.00 Wash, 40 lks. wide, course S.45°W. (E. Fork of Bull Creek)
 Asc. 267 ft. over SE. slope.
 71.22 Trail, bears NE. and SW.; asc. 93 ft. over SE. slope.
 81.45 Intersect the 4th Standard Parallel North, at a point
 14.10 chs. East from the standard cor. of secs. 33 and 34,
 Frac. T.17N., R.8W., described in book "C" of this group.
 At point of intersection,
 Set an iron post, 3 ft. long, 2 ins. diam., 30 ins. in the
 ground, for closing cor. of secs. 3 and 4, with brass cap
 marked

T17NR8W
 $\frac{S34}{S4 | S3}$
 T16NR8W
 CC
 1930

Survey of Subdivisions of T.16 N., R.8 W.

Chains	<p style="text-align: right;">from which</p> <p>a cedar, 6 ins. diam., bears S. 34° E., 500 lks. dist., marked T16N R8W S3 CC BT. a cedar, 6 ins. diam., bears S. 14 1/4° W., 242 lks. dist., marked T16N R8W S4 CC BT.</p> <p>Land, mountainous. Soil, rocky; 4th rate. Timber, scattering cedar and pinion. Undergrowth, scattering scrub oak, catclaw, yucca, cactus and grass.</p> <hr style="border-top: 1px dashed black;"/> <p>From the cor. of secs. 32 and 33 on S. bdy. of Tp., described in book "D" of this group, N. 0° 2' W., bet. secs. 32 and 33. Over rolling land, through scattering timber and undergrowth. Asc. 30 ft. over gradual S. slope. Top of broad spur, slopes S. Set an iron post 3 ft. long, 1 in. diam., 20 ins. in the ground to bedrock, supported in a mound of stone for 1/4 sec. cor. of secs. 32 and 33, with brass cap marked</p> <div style="text-align: center;"> $\begin{array}{c} \frac{1}{4} \\ \hline S32 S33 \\ 1930 \end{array}$ </div> <p style="text-align: right;">from which</p> <p>a cedar, 8 ins. diam., bears N. 41 3/4° E., 114 lks. dist., marked 1/4 S33 BT. a cedar, 10 ins. diam., bears N. 12° W., 129 lks. dist., marked 1/4 S32 BT.</p> <p>Asc. 235 ft. over gradual NW. slope. Creek, 12 lks. wide, course W.; asc. 126 ft. over SW. slope. Set an iron post, 3 ft. long, 2 ins. diam., 4 ins. in the ground to bedrock, deposit a stone marked with a cross (X) at base of post, supported in a mound of stone for cor. of secs. 28, 29, 32 and 33, with brass cap marked</p> <div style="text-align: center;"> $\begin{array}{c} T16NR8W \\ S29 S28 \\ S32 S33 \\ 1930 \end{array}$ </div> <p>No bearing trees available. Raise a mound of stone, 4 ft. base, 2 1/2 ft. high, W. of cor.</p> <p>Land, rolling. Soil, sandy and clay; 3rd rates. Timber, scattering, cedar and pinion. Undergrowth, scattering scrub oak, catclaw, yucca, cactus and grass.</p> <hr style="border-top: 1px dashed black;"/> <p>East, on a random line, bet. secs. 28 and 33. Set temp. 1/4 sec. cor. Fall 2 lks. S. of the cor. of secs. 27, 28, 33 and 34. Thence S. 89° 59' W., on a true line, bet. secs. 28 and 33. Over rolling land, through scattering timber and undergrowth.</p>
35.00 40.00	
74.71 80.00	
40.00 80.02	

Chains. 40.01	<p>Desc. 50 ft. over gradual SW. slope. Set an iron post, 3 ft. long, 1 in. diam., 8 ins. in the ground to bedrock, supported in a mound of stone, for $\frac{1}{4}$ sec. cor. of secs. 28 and 33, with brass cap marked</p> <p style="text-align: center;"> $\frac{1}{4}$ $\frac{S28}{S33}$ 1930 </p> <p style="text-align: right;">from which</p> <p>a cedar, 10 ins. diam., bears S. $46^{\frac{3}{4}}$° E., 177 lks. dist., marked $\frac{1}{4}$ S33 BT. a cedar, 10 ins. diam., bears S. 47° W., 98 lks. dist., marked $\frac{1}{4}$ S33 BT.</p>
49.62	Desc. 63 ft. over gradual W. slope.
65.00	Wash, 10 lks. wide, course S. 25° W.; asc. 51 ft. over SE. slope.
70.00	Thence over level land,
80.02	Leave level land; desc. 81 ft. over SW. slope. The cor. of secs. 28, 29, 32 and 33. Land, rolling and level. Soil, rocky; 4th rate. Timber, scattering cedar and pinion. Undergrowth, scattering scrub oak, catclaw, mahogany, yucca, cactus and grass.

	N. 0° 2' W., bet. secs. 28 and 29. Over rolling land, through scattering timber and undergrowth. Asc. 16 ft. over SW. slope.
5.00	Top of spur, slopes NW.; desc. 28 ft. over NW. slope.
21.20	Top of broad spur, slopes SW.; desc. 33 ft. over N. slope.
40.00	Set an iron post, 3 ft. long, 1 in. diam., 28 ins. in the ground for $\frac{1}{4}$ sec. cor. of secs. 28 and 29, with brass cap marked
	$\frac{1}{4}$ S29 S28 1930
	No bearing trees available. Raise a mound of stone 4 ft. base, $2\frac{1}{2}$ ft. high W. of cor.
49.10	Drain, 3 lks. wide, course NW.; asc. 63 ft. over S. slope.
80.00	Set an iron post, 3 ft. long, 2 ins. diam., 30 ins. in the ground for cor. of secs. 20, 21, 28 and 29, with brass cap marked
	T16NR8W S20 S21 S29 S28 1930
	No bearing trees available. Raise a mound of stone, 4 ft. base, $2\frac{1}{2}$ ft. high, W. of cor.
	Land, rolling and level. Soil, sandy; 3rd rate. Timber, scattering cedar. Undergrowth, scattering catclaw, yucca, cactus and grass.

Chains
40.00
61.60

N. 89°59'E., on a random line, bet. secs. 21 and 28.
Set temp. 1/4 sec. cor.
Top of precipitous bluff; impracticable to chain. To make a triangulation over bluffs and deep canon, ∴ designate the above point A and set a flag B. on opposite side of canon, from flag A measure a base S. 23°05'E., 5.00 chs. dist., and set a flag C from which flag B bears N. 74°18'E., all bearings checked by direct reading of the solar, and all angles checked by deflection.

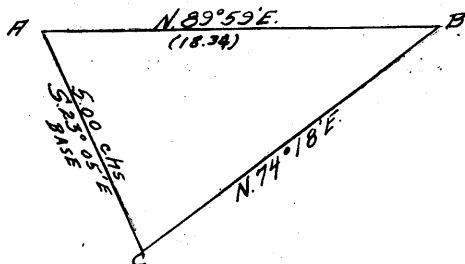

Dist. by direct meas. 61.60 chs.
Dist. by triangulation 18.34 "
79.94 chs.

79.94 Fall 12 lks. S. of the cor. of secs. 21, 22, 27 and 28.

Thence S. 89°54'W., on a true line, bet. secs. 21 and 28.
Over rolling land, through scattering timber and undergrowth.

9.09 Desc. 235 ft. over rocky SW. slope.
Approximate dist., wash, 30 lks. wide, (water in large pockets) course N. 45°W.; asc. 246 ft. over steep rocky NE. slope.

33.44 Old road, bears N. 45°W., and S. 45°E.
39.97 Set an iron post, 3 ft. long, 1 in. diam., 28 ins. in the ground for 1/4 sec. cor. of secs. 21 and 28, with brass cap marked

S21
1/4
S28
1930

No bearing trees available.
Raise a mound of stone, 4 ft. base, 2 1/2 ft. high, N. of cor.
Desc. 62 ft. over gradual SW. slope.

64.94 Low spur, slopes SW.
79.94 The cor. of secs. 20, 21, 28 and 29.

Land, rolling.
Soil, rocky; 4th rate.
Timber, scattering cedar.
Undergrowth, scattering scrub oak catclaw, cactus and grass.

N. 0°2'W., bet. secs. 20 and 21.
Over rolling land, through scattering timber & undergrowth.

20.00 Down spur, slopes W. desc. 34 ft. over gradual N. slope.
35.50 Old road, bears E. and W.
37.00 Draw, course W.; desc. 34 ft. over gradual slope.
40.00 Set an iron post, 3 ft. long, 1 in. diam., 30 ins. in the ground, for 1/4 sec. cor. of secs. 20 and 21, with brass cap marked

1/4
S20 | S21
1930

from which

Chains

a cedar, 12 ins. diam., bears N. 12 1/2° W., 449 lks. dist., marked 1/4 S20 BT.
No other bearing tree available.
Raise a mound of stone, 4 ft. base, 2 1/2 ft. high, W. of cor.

45.14

S. rim of Conger Canyon, bears E. and W.
To make a triangulation across canyon: designate the above point flag A and set a flag B on opposite side of canyon, from flag A measure a base, N. 74° 06' E., 9.10 chs. dist., and set a flag C from which flag B bears N. 15° 09' W.; all bearings checked by direct reading of the solar, and all angles checked by deflection.

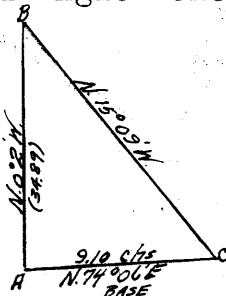

Dist. by direct meas.	45.14 chs.
Dist. by triangulation	34.89 "
	80.03 chs.
	.03 "
Dist. by return meas.	80.00 chs.

56.46

Approximate topography.; desc. 542 ft. over steep N. slope. Fall 3.20 chs. dist., E. of Conger Spring.

61.46

Conger Creek, 40 lks. wide, course W.; asc. 379 ft. over steep rocky S. slope.

80.00

Set an iron post, 3 ft. long, 2 ins. diam., 8 ins. in the ground to bedrock, deposit a stone marked with a cross (X) at base, of post, supported in a mound of stone for cor. of secs. 16, 17, 20 and 21, with brass cap marked

T16NR8W
 S17 | S16
 S20 | S21
 1930

No bearing trees available.
Head of Conger Spring, flowing about 10 ins. of water, bears S. 7° 45' W., 23.76 chs. dist.

Land, rolling.
Soil, rocky; 4th rate.
Timber, scattering cedar and pinion.
Undergrowth, scattering scrub oak, catclaw, willow, yucca cactus and grass.

40.00

N. 89° 54' E., on a random line, bet. secs. 16 and 21.

79.88

Set temp. 1/4 sec. cor. Fall 3 lks. S. of the cor. of secs. 15, 16, 21 and 22.

Thence S. 89° 53' W., on a true line, bet. secs. 16 and 21.

Over rolling land, through scattering timber and undergrowth.

36.50

Asc. 55 ft. along N. slope.

39.94

Top of broad spur, slopes N. 70° W.; thence over mesa land. Set an iron post, 3 ft. long, 1 in. diam., 20 ins. in the ground to bedrock, deposit a stone marked with a cross (X) at base of post, supported in a mound of stone for 1/4 sec. cor. of secs. 16 and 21, with brass cap marked

S16
 1/4 ———
 S21
 1930

Chains No bearing trees available.
 40.60 Wire fence, bears approx. N.10°E., and S.10 °W ..about 2
 chs. SW.of gate, on spur sloping SW.
 60.00 Desc.124 ft.along S.slope.
 77.13 Point of rocky spur, slopes S.45°W.; desc.92 ft.over SW.slope.
 79.88 The cor.of secs.16,17,20 and 21.

Land, rolling.
 Soil, rocky; 4th rate.
 Timber, scattering cedar and pinion.
 Undergrowth, scattering scrub oak, catclaw, yucca and grass.

N.0°2'W., bet.secs.16 and 17.
 Over mountainous land, through scattering timber and under-
 growth.

8.02 Asc.55 ft.over steep rocky SW.slope.
 Top of rocky spur, slopes SW.; desc.80 ft.over NW.slope.
 13.57 Top of precipitous bluffs; impracticable to chain.

To make a triangulation across bluffs and deep canyon:
 designate the above point A and set a flag B on opposite
 side of canyon, and also a flag C on opposite side of
 canyon, which from point A bears N.15°55'W., the base
 BC bears N.85°19'W., 10.94 chs.dist.; all bearings checked
 by direct reading of the solar, and all angles checked
 by deflection.

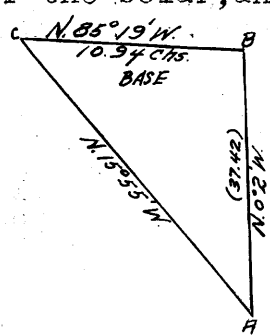

Dist.by direct meas.	13.57 chs.
Dist.by triangulation	37.42 "
	50.99 chs.
Dist.by return meas.	10.99 "
	40.00 chs.

Approximate topography.
 Desc.365 ft.over steep rocky N.slope.
 26.00 Wash, 20 lks.wide, course S.80°W.; asc.176 ft.over S.slope
 of cliffs.
 30.00 Top of cliff ; thence asc.50 ft.over S.slope.
 32.20 Top of rocky spur, slopes E.; desc.50 ft.over NE.slope.
 37.80 Head of drain, 2. lks.wide, course S.30°E.; asc.40 ft.over
 SW.slope.
 40.00 Set an iron post, 3 ft.long, 1 in.diam., 30 ins.in the
 ground, for 1/4 sec.cor.of secs.16 and 17, with brass cap
 marked

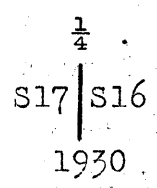

No bearing trees available.
 Raise a mound of stone, 4 ft.base, 2 1/2 ft.high, W.of cor.

Asc.204 ft.over SW.slope.
 61.87 Wash, 10 lks.wide, course S.45°W.; asc.25 ft.over SE.slope.
 71.50 Rim of mesa, bears NE.and SW.; desc.242 ft.over N.slope.
 77.25 Trail, bears S.20°E., and N.20°W.
 80.00 Set an iron post, 3 ft.long, 2 ins.diam., 4 ins.in the
 ground to bedrock, deposit a stone marked with a cross
 (X) at base of post, supported in a mound of stone, for
 cor.of secs.8,9,16 and 17, with brass cap marked

Chains

T16NR8W

S 8 | S 9

S18 | S16

1930

No bearing trees available.

Land, mountainous.

Soil, rocky; 4th rate.

Timber, scattering cedar and pinion.

Undergrowth, scattering scrub oak, cactus, yucca and grass.

40.00 N. $89^{\circ}53'E.$, on a random line, bet. secs. 9 and 16.
 Set temp. $\frac{1}{4}$ sec. cor.
 79.76 Fall 14 lks. N. of the cor. of secs. 9, 10, 15 and 16.
 Thence
 S. $89^{\circ}59'W.$, on a true line, bet. secs. 9 and 16.
 Over rolling land, through scattering timber and under-
 growth.
 Desc. 102 ft. over rocky SW. slope.
 19.33 Wash, 5 lks. wide, course S. $20^{\circ}W.$; asc. 103 ft. over SE. slope.
 31.75 Top of broad spur slopes S. $45^{\circ}W.$; desc. 34 ft. over NW.
 slope.
 39.88 Set an iron post, 3 ft. long, 1 in. diam., 30 ins. in the
 ground for $\frac{1}{4}$ sec. cor. of secs. 9 and 16, with brass cap
 marked

S9
 $\frac{1}{4}$ ———
 S16
 1930

from which

a cedar, 7 ins. diam., bears N. $62^{\circ}E.$, 404 lks. dist.,
 marked $\frac{1}{4}$ S 9 BT.

a pinion pine, 5 ins. diam., bears S. $47^{\circ}W.$, 388 lks. dist.,
 marked $\frac{1}{4}$ S16 BT.

51.55 Desc. 70 ft. over NW. slope.
 Wash, 5 lks. wide, course S. $20^{\circ}W.$; asc. 104 ft. over SW. slope.
 65.23 Top of spur, slopes SW.; desc. 321 ft. over broken W. slope.
 73.85 Draw, course N. $60^{\circ}W.$; asc. 71 ft. over NE. slope.
 79.76 The cor. of secs. 8, 9, 16 and 17.

Land, rolling.

Soil, rocky; 4th rate.

Timber, scattering cedar and pinion.

Undergrowth, scattering catclaw, scrub oak, yucca and grass.

N. $0^{\circ}2'W.$, bet. secs. 8 and 9.
 Over mountainous land, through scattering timber and
 undergrowth.
 Desc. 169 ft. over steep N. slope.
 6.30 Wash, 10 lks. wide, course N. $70^{\circ}W.$; asc. 48 ft. over S. slope.
 7.30 Low spur, slopes S. $70^{\circ}W.$; desc. 71 ft. over NW. slope.
 11.35 Bull Creek, 50 lks. wide, 3 ins. water, course S. $45^{\circ}W.$; asc.
 477 ft. over broken SE. slope.
 11.60 Stock trail, bears N. $45^{\circ}E.$, and S. $45^{\circ}W.$
 25.60 Spur, slopes SE.; continue ascending
 31.02 Top of asc.; thence desc. 60 ft. over NE. slope.
 40.00 Set an iron post, 3 ft. long, 1 in. diam., 24 ins. in the
 ground for $\frac{1}{4}$ sec. cor. of secs. 8 and 9, with brass cap
 marked

Chains

s8 | s9

1930

from which

a cedar, 16 ins. diam., bears N.36°E., 154 lks. dist., marked 1/4 S9 BT.
a pinion pine, 14 ins. diam., bears N.8°W., 205 lks. dist., marked 1/4 S8 BT.

40.20
43.82
80.00

Head of draw, course SE.; asc. 97 ft. over SW. slope.
Top of spur, slopes S.20°W.; asc. 424 ft. over SW. slope.
Set an iron post, 3 ft. long, 2 ins. diam., 6 ins. in the ground to bedrock, supported in a mound of stone for cor. of secs. 4, 5, 8 and 9, with brass cap marked

T16NR8W
S 5 | S 4
S 8 | S 9
1930

from which

a pinion pine, 10 ins. diam., bears N.28°E., 18 lks. dist., marked T16N R8W S4 BT.
a pinion pine, 12 ins. diam., bears S.36 1/4°E., 27 lks. dist., marked T16N R8W S9 BT.
a pinion pine, 9 ins. diam., bears S.33 1/2°W., 42 lks. dist., marked T16N R8W S8 BT.
a cedar, 24 ins. diam., bears N.51°W., 119 lks. dist., marked T16N R8W S5 BT.

Land, mountainous.
Soil, rocky; 4th rate.
Timber, scattering cedar and pinion.
Undergrowth, scattering scrub oak, mahogany, juniper and grass.

15.70

N.89°59'E., on a random line, bet. secs. 4 and 9.
Top of precipitous bluffs; impracticable to chain, vertical angle to flag on random line, -12° auxiliary flag bears S.82°24'E., from flag on random line the auxiliary flag bears S.18°34'E., 5.00 chs. dist.; all bearings checked by direct reading of the solar, and all angles checked by deflection.

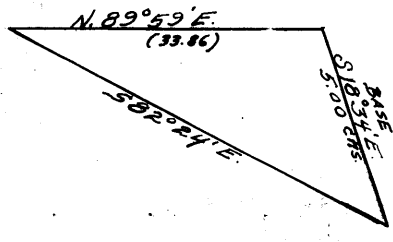

Dist. by direct meas.	15.70 chs.
Dist. by triangulation	33.86 "
	<hr/>
	49.56 chs.
Dist. by return meas.	9.56 "
	<hr/>
	40.00 chs.

40.00
79.84

Set temp. 1/4 sec. cor.
Fall 9 lks. N. of the cor. of secs. 3, 4, 9 and 10.
Thence
N.89°57'W., on a true line, bet. secs. 4 and 9.
Over mountainous land, through scattering timber and undergrowth.

Chains Desc. 103 ft. over SW. slope.
 9.86 Low saddle in divide, bears N. 75° E. & S. 75° W. asc. 90 ft. over SE. slope.
 15.36 Top of spur, slopes S. 45° W. SE. cor. of Hill's house bears
 15.36 N. 25° W. Desc. 546 ft. over steep W. slope.
 30.28 Low saddle on spur, slopes S. 65° W.; SE. cor. of Hill's house
 34.68 SE. cor. of Hill's house bears N. 18 1/4° E.
 38.85 Bull Creek, 40 lks. wide, 4 ins. of water, course S.; asc. 34
 ft. over E. slope.
 39.92 Set an iron post, 3 ft. long, 1 in. diam., 28 ins. in the
 ground at foot of cliff 140 ft. high, for 1/4 sec. cor. of
 secs. 4. and 9, with brass cap marked

S4
 1/4
 S9
 1930

from which

an oak, 12 ins. diam., bears North, 57 lks. dist.,
 marked 1/4 S4 BT.
 a pinion pine, 6 ins. diam., bears S. 2 1/4° E. 46 lks. dist.,
 marked 1/4 S9 BT.
 Asc. 170 ft. over E. slope of cliff.
 43.00 Rocky spur, slopes S. 20° E.; thence along S. slope.
 49.00 Wash, 15 lks. wide, course S. 55° E.; asc. 361 ft. over broken
 NE. slope.
 61.14 Asc. 97 ft. over E. slope.
 76.34 Top of spurs, slopes S. 70° E., and S. 10° W.; thence along spur.
 79.84 The cor. of secs. 4, 5, 8 and 9.
 Land, mountainous.
 Soil, rocky; 4th rate.
 Timber, scattering cedar and pinion;
 Undergrowth, scattering scrub oak, catclaw, mahogany and
 grass.

N. 0° 2' W., bet. secs. 4 and 5.

Over mountainous land, through scattering timber and undergrowth.

2.00 Top of spurs, slopes S. 50° W., and S. 60° E.; desc. 188 ft. over N. slope.

33.55 Wash, 10 lks. wide, course N. 60° E.; asc. 112 ft. over SE. slope.

40.00 Set an iron post, 3 ft. long, 1 in. diam., on solid rock, supported in a mound of stone, for 1/4 sec. cor. of secs. 4 and 5, with brass cap marked

1/4
 S5 | S4
 1930

from which

a pinion pine, 7 ins. diam., bears N. 57 1/2° E., 17 lks. dist.,
 marked 1/4 S4 BT.
 a pinion pine, 6 ins. diam., bears S. 50 3/4° W., 21 lks. dist.,
 marked 1/4 S5 BT.

43.70 Top of spur, slopes N. 45° E.

44.80 Desc. 112 ft. over N. slope.

49.24 Wash, 10 lks. wide, course N. 60° E.; asc. 75 ft. over SE. slope.

54.61 Top of spur, slopes E.; desc. 63 ft. over NE. slope.

58.38 Wash, 15 lks. wide, course S. 45° E.; asc. 245 ft. over S. slope.

73.96 Top of spur, slopes S. 45° E.; desc. 157 ft. over N. slope.

81.35 Intersect the 4th Standard Parallel North, at a point
 14.24 chs. East. from the standard cor. of secs. 32 and 33,
 Frac. T. 17 N. R. 8 W., described in book "C" of this group.

Chains

At point of intersection,
Set an iron post, 3 ft. long, 2 ins. diam., 30 ins. in the
ground for closing cor. of secs. 4 and 5, with brass cap
marked

T17NR8W
S33
S 5 | S 4
T16NR8W
CC
1930

from which

a pinion pine, 6 ins. diam., bears S. 74 1/2° E., 22 lks. dist.,
marked T16N R8W S4 CC BT.
a pinion pine, 7 ins. diam., bears S. 19° W., 51 lks. dist.,
marked T16N R8W S5 CC BT.

Land, mountainous.
Soil, rocky; 4th rate.
Timber, scattering cedar, pinion and oak.
Undergrowth, scattering mahogany, scrub oak, catclaw and
grass.

From the cor. of secs. 31, and 32 on S. bdy. of Tp., described
in book "D" of this group,

N. 0° 3' W., bet. secs. 31 and 32.
Over mountainous land, through scattering timber and under-
growth.

7.07 Desc. 74 ft. over rocky NE. slope.
Creek, 20 lks. wide, (water in holes) course W.; asc. 251 ft.
along W. slope.
11.17 Thence asc. over S. slope.
29.88 Top of spur, slopes S. 80° W.; thence over level land.
32.88 Desc. 43 ft. over NW. slope.
39.70 Short spur, slopes N. 45° W.; desc. 14 ft. over N. slope.
40.00 Set an iron post, 3 ft. long 1 in. diam., 14 ins. in the
ground to bedrock, deposit a stone marked with a cross
(X) at base of post, supported in a mound of stone, for
1/4 sec. cor. of secs. 31 and 32, with brass cap marked

1/4
S31 | S32
1930

No bearing trees available.

43.72 Desc. 112 ft. over N. slope.
Wash, 15 lks. wide, course SW.; asc. 235 ft. over rocky SE. slope.
59.60 Top of rocky mesa, bears E. and W.; asc. 40 ft. over SE. slope.
80.00 Set an iron post, 3 ft. long, 2 ins. diam., 12 ins. in the
ground to bedrock, deposit a stone marked with a cross
(X) at base of post, supported in a mound of stone for
cor. of secs. 29, 30, 31 and 32, with brass cap marked

T16NR8W
S30 | S29
S31 | S32
1930

from which

a cedar, 10 ins. diam., bears S. 1 1/2° E., 85 1/4 lks. dist.,
marked T16N R8W S32 BT.

Chains	No other bearing trees available. Land, mountainous. Soil, rocky; 4th rate. Timber, scattering cedar and pinion. Undergrowth, scattering scrub oak, catclaw, mahogany and grass.
40.00	East, on a random line, bet. secs. 29 and 32. Set temp. $\frac{1}{4}$ sec. cor.
80.02	Intersect the cor. of secs. 28, 29, 32 and 33. Thence West, on a true line, bet. secs. 29 and 32. Over mountainous land, through scattering timber and undergrowth. Desc. 110 ft. over SW. slope.
10.17	Drain, 15 lks wide, course S. Asc. 66 ft. over SE. slope.
20.00	Top of spur, slopes S. 30° W.; Desc. 56 ft. over NW. slope.
39.74	Draw, of course S. 20° W.; desc. 50 ft. over SW. slope.
40.01	Set an iron post, 3 ft. long, 1 in. diam., 18 ins. in the ground to bedrock, supported in a mound of stone for $\frac{1}{4}$ sec. cor. of secs. 29 and 32, with brass cap marked
	$\begin{array}{r} S29 \\ \frac{1}{4} \\ \hline S32 \\ 1930 \end{array}$
	from which
	a cedar, 8 ins. diam., bears S. $48\frac{1}{2}^{\circ}$ E., 68 lks. dist., marked $\frac{1}{4}$ S32 BT.
	a cedar, 14 ins. diam., bears N. 36° W., 382 lks. dist., marked $\frac{1}{4}$ S29 BT.
50.00	Asc. 73 ft. over E. slope.
80.02	Thence over level mesa land. The cor. of secs. 29, 30, 31 and 32. Land, level and mountainous. Soil, rocky; 4th rate. Timber, scattering cedar. Undergrowth, scattering scrub oak and grass.
38.30	West, on a random line, bet. secs. 30 and 31. Intersect the cor. of secs. 30 and 31, on W. bdy. of Tp. hereinbefore described. Thence East, on a true line, bet. secs. 30 and 31 Over rolling land, through scattering timber and undergrowth.
38.30	The cor. of secs. 29, 30, 31 and 32. Land, rolling. Soil, rocky; 4th rate. Timber, scattering cedar. Undergrowth, scattering grass.
31.47	N. $0^{\circ} 3' W.$, bet. secs. 29 and 30. Over rolling land through scattering timber and undergrowth.
40.00	Asc. 84 ft. over S. slope. Top of spur, slopes SW.; desc. 88 ft. over N. slope. Set an iron post, 3 ft. long, 1 in. diam., 24 ins. in the ground for $\frac{1}{4}$ sec. cor. of secs. 29 and 30, with brass cap marked

Chains	$\frac{1}{4}$ S30 S29 1930
	No bearing trees available. Raise a mound of stone, 4 ft. base, 2 $\frac{1}{2}$ ft. high W. of cor.
44.00	Drain, 5 lks. wide, course W.; asc. 156 ft. over rolling S. slope.
75.74	Top of broad spur, slopes W.; desc. 20 ft. over gradual NW. slope.
80.00	Set an iron post, 3 ft. long, 2 ins. diam., 4 ins. in the ground to bedrock, deposit a stone marked with a cross (X) at base of post, supported in a mound of stone for cor. of secs. 19, 20, 29 and 30, with brass cap marked
	T16NR8W S19 S20 S30 S29 1930
	from which
	a cedar, 12 ins. diam., bears N. 77° E., 605 lks. dist., marked T16N R8W S20 BT. a cedar, 6 ins. diam., bears S. 89° E., 379 lks. dist., marked T16N R8W S29 BT. No other bearing trees available.
	Land, rolling. Soil, rocky; 4th rate. Timber, scattering cedar. Undergrowth, scrub oak, catclaw, mahogany and grass.

	East, on a random line, bet. secs. 20 and 29. Set temp. $\frac{1}{4}$ sec. cor.
40.00	Fall 11 lks. S. of the cor. of secs. 20, 21, 28 and 29.
80.10	Thence S. 89° 55' W., on a true line, bet. secs. 20 and 29. Over rolling mesa land through scattering timber and undergrowth.
10.10	Top of broad mesa.; desc. 28 ft. over gradual NW. slope.
25.10	Head of drain, course NW.; asc. 51 ft. over NE. slope.
40.05	Set an iron post, 3 ft. long, 1 in. diam., 20 ins. in the ground to bedrock, deposit a stone marked with a cross (X) at base of post, supported in a mound of stone, for $\frac{1}{4}$ sec. cor. of secs. 20 and 29, with brass cap marked
	$\frac{1}{4}$ S20 <hr style="width: 50px; margin: auto;"/> S29 1930
	from which
	a cedar, 10 ins. diam., bears N. 19 $\frac{1}{4}$ ° E., 173 lks. dist., marked $\frac{1}{4}$ S20 BT. No other bearing tree available.
	Asc. 41 ft. over NE. slope. Top of spur, slopes NW.; desc. 40 ft. over gradual NW. slope.
65.10	The cor. of secs. 19, 20, 29 and 30.
80.10	Land, rolling. Soil, rocky; 4th rate. Timber, scattering cedar. Undergrowth, scattering cactus, yucca and grass.

Chains
38.24 West, on a random line, bet. secs. 19 and 30.
Fall 5 lks. S. of the cor. of secs. 19 and 30, on W. bdy. of
Tp. hereinbefore described.
Thence
S. 89° 56' E., on a true line, bet. secs. 19 and 30.
Over rolling land, through scattering undergrowth.
Asc. 208 ft. over W. slope.
38.24 The cor. of secs. 19, 20, 29 and 30.

Land, rolling.
Soil, rocky; 4th rate.
Timber, none.
Undergrowth, scattering cactus, yucca and grass.

40.00 N. 0° 3' W., bet. secs. 19 and 20.
Over rolling mesa land, through scattering undergrowth.
Desc. 179 ft. over gradual NW. slope.
Set an iron post, 3 ft. long, 1 in. diam., 30 ins. in the
ground, for $\frac{1}{4}$ sec. cor. of secs. 19 and 20, with brass cap
marked

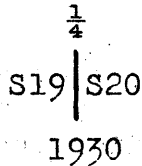

No bearing trees available.
Raise a mound of stone, 4 ft. base, 2 1/2 ft. high W. of cor.
Desc. 11 ft. over NW. slope.
45.30 Wash, 20 lks. wide, course S. 45° W.; asc. 41 ft. over S. slope.
58.05 Old road, bears E. and W.
64.80 Rim of mesa, bears E. and W.; desc. 477 ft. over N. slope.
80.00 Set an iron post, 3 ft. long, 2 ins. diam., 26 ins. in the
ground for cor. of secs. 17, 18, 19 and 20, with brass cap
marked

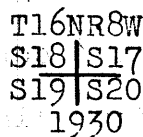

No bearing trees available.
Raise a mound of stone, 4 ft. base, 2 1/2 ft. high, W. of cor.
Land, rolling and mountainous.
Soil, rocky; 4th rate.
Timber, none.
Undergrowth, scattering scrub oak, cactus, yucca and grass.

39.02 N. 89° 55' E., on a random line, bet. secs. 17 and 20.
Set temp. point for future reference.
40.00 Set temp. $\frac{1}{4}$ sec. cor.
From 39.02 ch. point top of precipitous bluff; vertical
angle to flag on random line + 8° auxiliary flag bears
S. 49° 38' E.; from flag on random line, the auxiliary flag
bears S. 0° 1' W., 34.92 chs. dist.; all bearings checked by
direct reading of the solar, and all angles checked by
deflection.

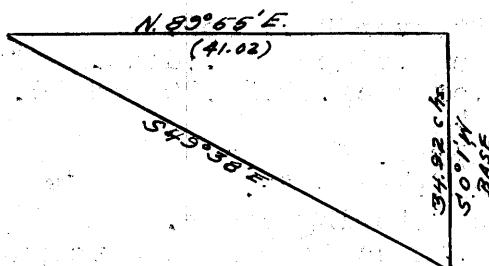

Chains

N.0°3'W., bet. secs. 17 and 18.
 Over mountainous land, through scattering timber and undergrowth.
 To make a triangulation over bluffs, impracticable to chain: designate the above cor. point A and set a point on line at top of bluffs for flag B vertical angle 14° also set a point for flag C on top of bluffs; which from point A bears N.13°47'E.; the base BC bears N.78°51'E., 8.48 chs. dist.; all bearings checked by direct reading of the solar and all angles checked by deflection.

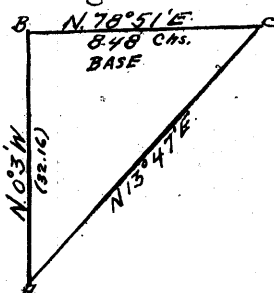

Dist. by triangulation 32.16 chs.
 Desc. 224 ft. over N. slope.

- 9.50 Approximate topography, Conger Creek, 40 lks. wide, 6 ins. deep, course W.; asc. 743 ft. over S. slope of cliffs.
- 32.16 Set temp. point for future reference on rocky spur, slopes W. at W. end of mesa.
 Desc. 43 ft. over NW. slope.
- 34.13 Set an iron post, 3 ft. long, 1 in. diam., 14 ins. in the ground to bedrock, deposit a stone marked with a cross (X) at base of post, supported in a mound of stone, for the witness cor. to 1/4 sec. cor. of secs. 17 and 18, with brass cap marked

WC
 1/4
 S18 | S17
 1930

No bearing trees available.

- 40.00 The true point for 1/4 sec. cor. of secs. 17 and 18, falls on N. face of cliffs, a place impracticable to set permanent mon.
 To make a triangulation across Bull Canyon, impracticable to chain: designate the 32.16 ch. point as flag A and set a point for flag B on opposite side of canyon, vertical angle -13 3/4° from flag A measure a base N.78°47'E., 8.48 chs. dist., and set a flag C from which flag B bears N.11°37'W.; all bearings checked by direct reading of the solar, and all angles checked by deflection.

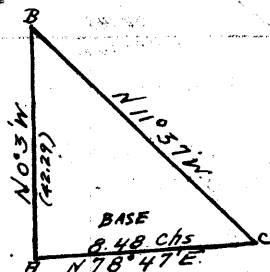

Dist. on true line	32.16 chs.
Dist. by triangulation	42.29 "
	74.45 chs.
Dist. by direct meas.	5.55 "
	80.00 chs.

- 55.42 Approximate topography; desc. 891 ft. over NW. slope.
 Bull Creek, 60 lks. wide, course S.45°W.; asc. 844 ft. over S. slope of cliffs.

Chains
74.43
79.32
80.00

Top of spur, slopes S.60°W. Desc. 86 ft. to
Top of cliffs, bearing NE. and SW. facing NW. desc.; 120 ft. over NW. slope. to
Set an iron post, 3 ft. long, 2 ins. diam., 2 ins. in the ground to bedrock, deposit a stone marked with a cross (X) at base of post, supported in a mound of stone, for cor. of secs. 7, 8, 17 and 18, with brass cap marked

T16NR8W
S 7 | S 8
S18 | S17
1930

No bearing trees available.

Land, mountainous.
Soil, rocky; 4th rate.
Timber, scattering cedar and pinion.
Undergrowth, scattering scrub oak, catclaw, juniper and grass.

40.00

N. 89°56'E., on a random line, bet. secs. 8 and 17.
Set temp. 1/4 sec. cor.
To make a triangulation across Bull Canyon, impracticable to chain; designate the above cor. flag A and set a point for flag B on opposite side of canyon, vertical angle -1° from flag A. measure a base N. 5°38'E., 5.22 chs. dist., and set a flag C from which flag B bears S. 82°20'E.; all bearings checked by direct reading of the solar, and all angles checked by deflection.

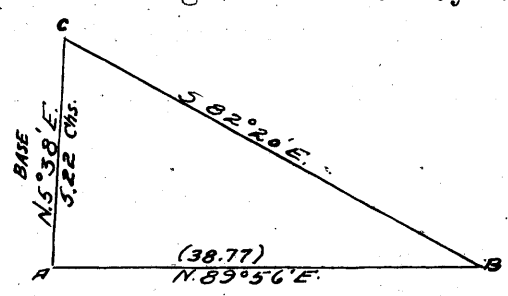

Dist. on random line	40.00 chs.
Dist. by triangulation	38.77 "
	<hr/>
	78.77 chs.
Dist. by direct meas	1.27 "
	<hr/>
	80.04 chs.

80.04

Fall 7 lks. N. of the cor. of secs. 8, 9, 16 and 17.
Thence

S. 89°59'W., on a true line, bet. secs. 8 and 17.
Over mountainous land, through scattering timber and undergrowth.; asc. 18 ft. over NE. slope.

1.41

Approximate topography; top of spur, slopes N.; desc. 352 ft. over broken NW. slope.

20.04

Bull Creek, 60 lks. wide, 3 ins. deep, course S. 55°W.; asc. 451 ft. over broken SE. slope.

36.04

Head of gulch, 5 lks. wide, course S. 15°E.

40.02

Set an iron post, 3 ft. long, 1 in. diam., 16 ins. in the ground to bedrock, supported in a mound of stone for 1/4 sec. cor. of secs. 8 and 17, with brass cap marked

S8
1/4
S17
1930

from which

a pinion pine, 9 ins. diam., bears N. 68°E., 139 lks. dist., marked 1/4 S8 BT.

Chains	a cedar, 6 ins. diam., bears S. $29\frac{1}{4}^{\circ}$ W., 59 lks. dist., marked $\frac{1}{4}$ S17 BT.
	Asc. $1\frac{1}{4}$ ft. over SE. slope.
41.51	Top of rimrocks, bears NE. and SW.
46.14	Top of spur, slopes S. 60° W.; thence over rolling mesa land.
71.83	Top of rimrocks, bears NE. and SW.; leave mesa; desc. 150 ft. over NW. slope. to sec. cor.
80.00	Cliff, 50 ft. high, faces NW.
80.04	The cor. of secs. 7, 8, 17 and 18.
	Land, mountainous. Soil, rocky; 4th rate. Timber, scattering cedar and pinion. Undergrowth, scattering scrub oak, mahogany, catclaw, yucca and grass.

38.13	N. $89^{\circ}56'$ W., on a random line, bet. secs. 7 and 18. Fall 10 lks. N. of the cor. of secs. 7 and 18 on W. bdy. of Tp. hereinbefore described. Thence N. $89^{\circ}55'$ E., on a true line, bet. secs. 7 and 18. Over mountainous land, through scattering timber and dense undergrowth.
37.80	Asc. $3\frac{3}{4}$ ft. over broken NW. slope.
38.13	Foot of cliff 50 ft. high, faces NW. The cor. of secs. 7, 8, 17 and 18.
	Land, mountainous. Soil, rocky; 4th rate. Timber, scattering cedar and pinion. Undergrowth, mahogany, catclaw, juniper, oak and grass.

	N. $0^{\circ}3'$ W., bet. secs. 7 and 8. Over mountainous land, through scattering timber and undergrowth.
6.50	Desc. 205 ft. over NW. slope.
11.70	Wash, 25 lks. wide, course W.; asc. 261 ft. over S. slope.
13.91	Top of cliff 30 ft. high, faces S.; continue ascending.
22.84	Top of spur, slopes S. 80° W.; desc. 163 ft. over N. slope.
27.36	Draw, 3 lks. wide, course W.; asc. 49 ft. over S. slope.
30.46	Top of spur, slopes W.; desc. $13\frac{1}{4}$ ft. over broken NW. slope.
40.00	Point of spur, slopes W. Set an iron post, 3 ft. long, 1 in. diam., 20 ins. in the ground to bedrock, supported in a mound of stone, for $\frac{1}{4}$ sec. cor. of secs. 7 and 8, with brass cap marked
	$\frac{1}{4}$ S7 S8
	1930
	from which
	a pinion pine, 9 ins. diam., bears N. $72\frac{3}{4}^{\circ}$ E., 31 lks. dist., marked $\frac{1}{4}$ S8 BT.
	a pinion pine, 8 ins. diam., bears S. $47\frac{1}{4}^{\circ}$ W., 140 lks. dist., marked $\frac{1}{4}$ S7 BT.
41.55	Cypress Creek, 20 lks. wide, course S. 30° W. Asc. 552 ft. over steep SE. slope.
72.00	Top of spur, slopes E.; desc. $4\frac{1}{4}$ ft. over NE. slope.
80.00	Set an iron post, 3 ft. long, 2 ins. diam., 26 ins. in the ground, for cor. of secs. 5, 6, 7 and 8, with brass cap marked

Chains

T16NR8W
S 6 | S 5
S 7 | S 8
1930

from which

a pinion pine, 6 ins. diam., bears N.22°E., 16 lks. dist., marked T16N R8W S5 BT.
a pinion pine, 9 ins. diam., bears S.81°E., 06 lks. dist., marked T16N R8W S8 BT.
a pinion pine, 6 ins. diam., bears S.28°W., 13 lks. dist., marked T16N R8W S7 BT.
a pinion pine, 6 ins. diam., bears N.8° W., 22 lks. dist., marked T16N R8W S6 BT.

Land, mountainous.
Soil, rocky; 4th rate.
Timber, scattering, cedar and pinion.
Undergrowth, scattering, mahogany, catclaw, juniper and oak.

40.00 N.89°59'E., on a random line, bet. secs. 5 and 8.
Set temp. 1/4 sec. cor.
80.06 Fall 7 lks. S. of the cor. of secs. 4, 5, 8 and 9.
Thence
S.89°56'W., on a true line, bet. secs. 5 and 8.
Over mountainous land, through heavy timber and scattering undergrowth.
Desc. 62 ft. over SW. slope.
2.60 Low spur, slopes S.50°W.; continue descending.
11.00 Top of rimrocks, bears N.20°E., and S.20°W.; desc. 398 ft. over steep rocky W. slope.
29.32 Wash, 10 lks. wide, course S.45°W., to forks of washes.
30.02 Point of spur, slopes S.
30.80 Wash, 10 lks. wide, course S.15°E.; asc. 104 ft. over E. slope.
34.31 Top of rocky spur ridge, slopes S.; desc. 90 ft. over SW. slope.
40.03 Set an iron post, 3 ft. long, 1 in. diam., 28 ins. in the ground, for 1/4 sec. cor. of secs. 5 and 8, with brass cap marked

S5
1/4 ———
S8
1930

from which

a pinion pine, 10 ins. diam., bears S.29 1/4°W., 96 lks. dist., marked 1/4 S8 BT.
a pinion pine, 10 ins. diam., bears N.21 3/4°W., 59 lks. dist., marked 1/4 S5 BT.
Asc. 321 ft. over rocky E. slope.
54.34 Top of rocky spur, slopes S.; desc. 381 ft. over W. slope of cliffs.
66.00 Cypress Creek, 15 lks. wide, course S.10°W.; asc. 370 ft. over E. slope.
80.06 The cor. of secs. 5, 6, 7 and 8.

Land, mountainous.
Soil, rocky; 4th rate.
Timber, cedar, pinion and oak.
Undergrowth, scattering juniper, oak, catclaw, mahogany and grass.

Chains
 38.10 S.89°55'W., on a random line, bet. secs. 6 and 7.
 Fall 10 lks. N. of the cor. of secs. 6 and 7, on W. bdy. of Tp.
 hereinbefore described.
 Thence
 N.89°46'E., on a true line, bet. secs. 6 and 7.
 Over mountainous land, through heavy timber and scatter-
 ing undergrowth.
 Desc. 113 ft. over SE. slope.
 5.00 Wash, 20 lks. wide, course S.45°W.; asc. 355 ft. over broken
 NW. slope.
 36.20 Top of ridge, bears N.45°E., and S.45°W.; desc. 43 ft. over
 SE. slope.
 38.10 The cor. of secs. 5, 6, 7 and 8.

Land, mountainous.
 Soil, rocky; 4th rate.
 Timber, cedar, pinion and oak.
 Undergrowth, scattering, scrub oak, juniper and grass.

 N.0°3'W., bet. secs. 5 and 6.
 Over mountainous land, through scattering timber and
 dense undergrowth.
 Asc. 33 ft. over SE. slope.
 1.23 Top of ridge, bears N. and S.45°W.; asc. 40 ft. along top
 of ridge.
 13.25 Asc. 114 ft. over S. slope of ridge.
 39.00 Top of spur, slopes N.; asc SW. slope.
 40.00 Set an iron post, 3 ft. long, 1 in. diam., 6 ins. in the
 ground to bedrock, supported in a mound of stone for
 1/4 sec. cor. of secs. 5 and 6, with brass cap marked

1/4
 S6 | S5
 1930

from which

a pinion pine, 9 ins. diam., bears N.6°E., 78 lks. dist.,
 marked 1/4 S5 BT.
 a pinion pine, 11 ins. diam., bears N.16 1/2°W., 122 lks. dist.,
 marked 1/4 S6 BT.
 Asc. 172 Ft. over SW. slope.
 61.56 Top of spur, slopes S.80°W.; desc. 116 ft. along NW. slope.
 73.12 Wash. 10 lks. wide, course S.45°W.; asc. 169 ft. over SE. slope.
 81.21 Intersect the 4th Standard Parallel North, at a point
 14.10 chs. East from the standard cor. of secs. 31 and 32,
 T17N R.8 W., described in book "C" of this group.
 At point of intersection,
 Set an iron post, 3 ft. long, 2 ins. diam., 12 ins. in the
 ground to bedrock, supported in a mound of stone, for
 the closing cor. of secs. 5 and 6, with brass cap marked

T17NR8W
 S32
 S 6 | S 5
 T16NR8W
 CC
 1930

from which

a pinion pine, 8 ins. diam., bears S.16 1/2°E., 39 lks. dist.,
 marked T16N R8W S5 CC BT.
 a pinion pine, 6 ins. diam., bears S.64 1/2°W., 21 lks. dist.,
 marked T16N R8W S6 CC BT.

Land, mountainous.
 Soil, rocky; 4th rate.
 Timber, cedar and pinion.
 Undergrowth, scattering mahogany, scrub oak and juniper.

Boundaries of Township 16 North, Range, 8 West

Latitudes, departures and closing errors.							
Line designated	Course	Dist- ance	Latitudes		Departures		
			N.	S.	E.	W.	
W.bdy.Tp.	South	481.56		481.56			
S.bdy.Tp.	East.	438.37			438.37		
E.bdy.Tp.	North	160.22	160.22				
	N.0°2'W.	40.06	40.06				.02
	North	40.12	40.12				
	N.0°2'W.	40.10	40.10				.02
	N.0°3'W	40.11	40.11				.03
	North	80.33	80.33				.05
	N.0°2'W.	80.27	80.27				
N.bdy.Tp. (4th Std.Par.N.)	West	438.04					438.04
Convergency							.50
Totals			481.21	481.56	438.57	438.66	
				481.21		438.57	
Error in latitude	-----		0.00	0.35	-----		
Error in departure	-----					0.09	

GENERAL DESCRIPTION.

The land embraced within the south and east portions of this township is rolling mesa land; the northwest portion of the township is very rough and mountainous. Bull and Conger Creeks, traverse through the township leaving same near the $\frac{1}{4}$ sec.cor.of sec.18 on the W.bdy. of the township. Conger Spring, flowing about 10 ins. of pure mountain water is located in sec.20 near the $\frac{1}{4}$ sec.cor.of secs.20 and 21.

The soil is sandy and clay, covered mostly with malpais stones, which can nearly all be classed 3rd rate. Scattering cedar and pinion timber are found within the southeastern portion of the township, the NW. portion of the township is covered with a heavy growth of cedar and pinion timber.

The land is used for grazing purposes and is covered throughout the township with nutritious grasses with scattering scrub oak, mahogany, catclaw, cactus and yucca. J.H.Strotjost's homestead is located in the south port- of this township.

No indications of mineral are found.

5600OK 3904

CERTIFICATE OF UNITED STATES SURVEYOR

I, William E. Hiester, U. S. Surveyor, hereby certify upon honor that, in pursuance of special instructions received from the District Cadastral Engineer, for Group 159 Arizona bearing date of the 24th day of June, 1929, I have well, faithfully, and truly in my own proper person, and in strict conformity with said instructions, the Manual of Surveying Instructions, and the laws of the United States, ~~resurveyed~~ resurveyed all those parts or portions of the East Boundary of Township 16 North, Range 8 West and surveyed all those parts or portions of the West Boundary and Subdivision Lines of Township 16 North Range 8 West of the Gila and Salt River Base and Meridian, in the State of Arizona, which are represented in and by diagram on page 1 hereof the foregoing field notes as having been executed by me, and under my direction; and that all the corners of said resurvey and survey have been established and perpetuated in strict accordance with the Manual of Surveying Instructions, and the special written instructions of the District Cadastral Engineer, for Group 159 Arizona and in the specific manner described in the field notes, and that the foregoing are the original field notes of such ~~resurvey~~ resurvey and survey.

Place: San Francisco, Calif.
 Date: November 24, 1930.

William E. Hiester
 U. S. Surveyor.

APPROVAL

OFFICE OF U. S. SUPERVISOR OF SURVEYS,

Denver, Colo., May 18, 1931

The foregoing field notes of the ~~resurvey~~ resurvey of Part of the East Boundary of Township 16 North Range 8 West and of the survey of the West Boundary and Subdivision Lines of Township 16 North Range 8 West of the Gila and Salt River Base and Meridian, in the State of Arizona executed by William E. Hiester, U. S. Surveyor under the special instructions dated June 24, 1929 for Group 159 Arizona, having been critically examined, and the necessary corrections and explanations made, the said field notes, and the ~~resurveys~~ resurveys and surveys they describe, are hereby approved.

William M. Denson
 U. S. Supervisor of Surveys.

~~I certify that the foregoing transcript of the field notes of the above described~~
~~has been correctly copied from the original notes~~

~~U. S. Supervisor of Surveys.~~