

FIELD NOTES

OF RESURVEY OF

Part of the Subdivision Lines

of

Township 31 North - Range 1 East

Of the Gila and Salt River Base and Meridian,

In the State of *ARIZONA*

EXECUTED BY

Sidney E. Blout, U.S. Cadastral Engineer

In the capacity of U. S. Surveyor..., under Special Instructions dated *January 31, 1928*..., issued by the District Cadastral Engineer to govern surveys included in Group No. *145 Arizona*..., which were approved by the Commissioner of the General Land Office, *February 16, 1928*..., and Assignment Instructions dated, 1928...

ReSurvey commenced *October 5*..., 1928.

ReSurvey completed *November 19*..., 1928.

3907

3907

Book "I"
Group 145- Arizona

BOOK 2907

INDEX DIAGRAM.

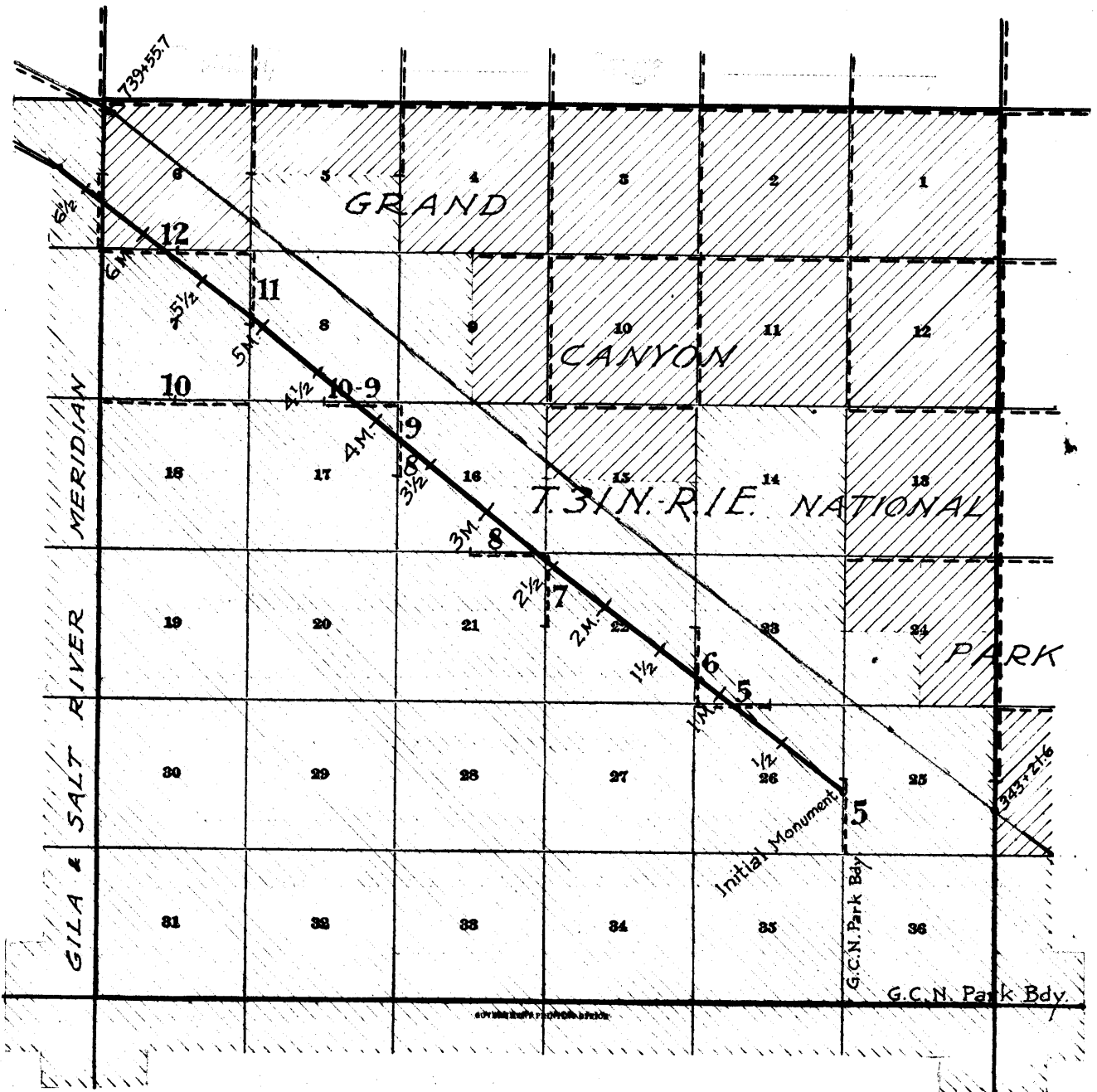

———— Grand Canyon National Park Bdy. surveyed under this group. Notes in Book "H."

----- Tp. bdrs. and Subdivision lines resurveyed under this group.

———— Supai Road. (Center line as stated in 1925 by U.S. Bureau of Public Roads.)

----- Supai Road Survey Retraced under this group. Notes in Book "H."

———— Accepted, surveyed Tp. bdrs. and Subdivision Lines.

----- Unsurveyed Tp. bdrs. and Subdivision Lines.

 Areas shown on accepted plats, which are bounded by surveyed lines.

 Areas shown on accepted plats, which are bounded by protracted lines.

Book "I"
 Group 145 Arizona
 Township 31 North, Range 1 East
 DATE DIAGRAM
 1928

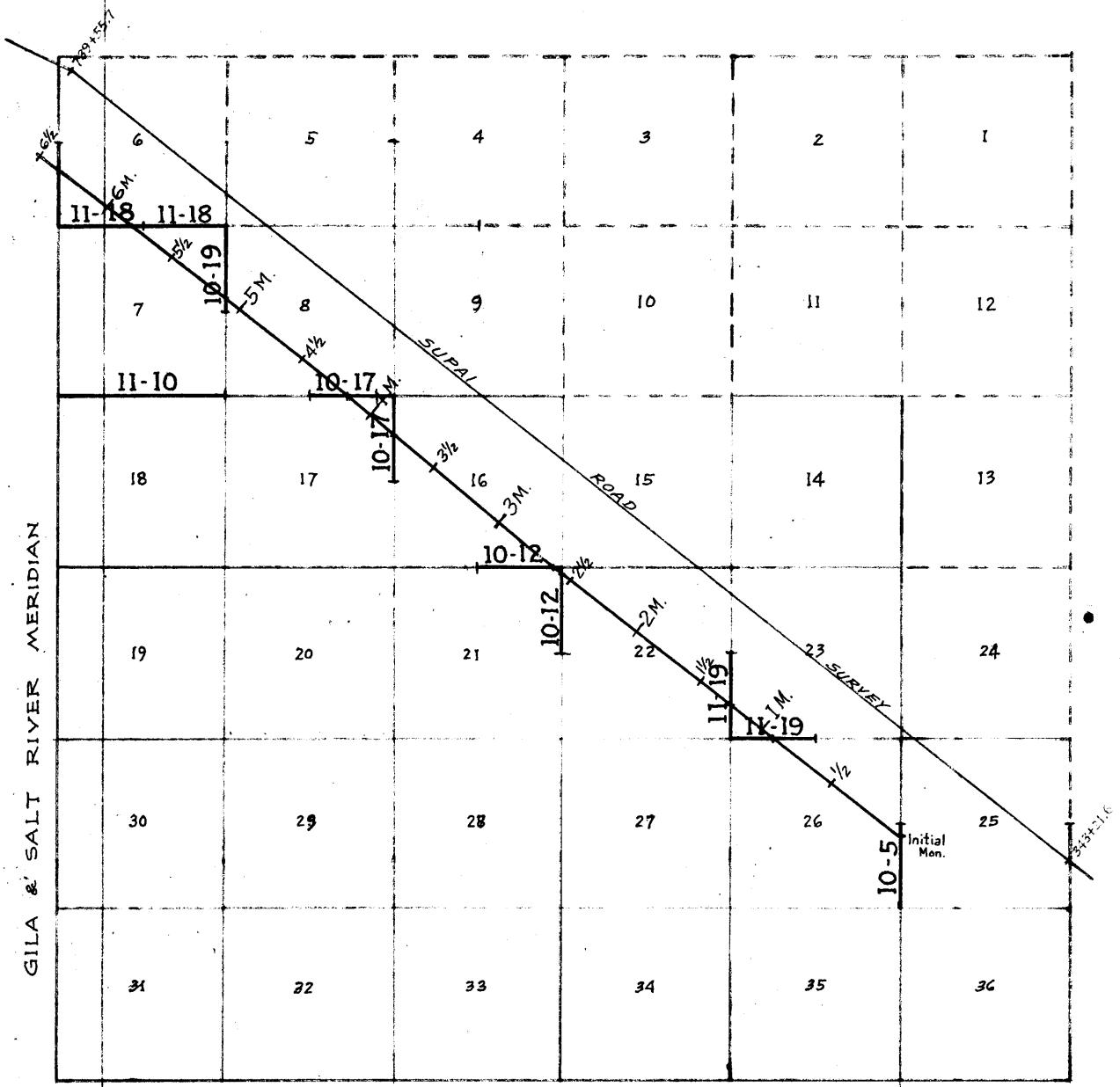

- Resurveyed by Sidney E. Blout, U.S. Cadastral Engineer, on dates shown thereon.
- Resurv. by S.E. Blout, U.S.C.E., Notes and date diagram in Book "J" of this group.
- Grand Canyon National Park Bdy. Surv. by S.E. Blout, U.S.C.E. Notes and Dates in Book "H" of this group.
- Supai Road. (Center line as staked in 1925 by Bureau of Public Roads.)
- Accepted surveyed lines.
- - - - - Unsurveyed lines.

Resurvey of Part of the Subdivision lines
of Township 31 North., Range 1 East.

Chains

The resurveys hereinafter described were executed on dates shown on diagram on page 1 hereof, by Sidney E Blout, U.S. Cadastral Engineer using a Buff "Rocky Mountain Favorite" solar transit No. 9940 with U-shaped standards. $4\frac{1}{2}$ inch horizontal circle, 4 inch vertical circle, and improved Smith solar attachment.

The instrument was examined, tested on the true meridian at the Federal Building at Phoenix Arizona, found correct, and was approved by the District Cadastral Engineer for Arizona and California September 28, 1928, conditional upon satisfactory field tests.; All azimuth determinations are accomplished with the solar attachment, except the special observations on Polaris and the sun for meridian, upon which to test the solar apparatus as stated in the field notes.

All measurements are made with a Lallie 5-chain steel tape compared with a Chesterman standard steel tape and found correct. The measurements are made on the slope, the vertical angles determined with a clinometer, and the slope measurements properly reduced to true horizontal distances for entry in the field notes.

TEST OF BUFF SOLAR TRANSIT NO. 9940.

October 3, 1928, at camp near the $\frac{1}{4}$ sec. cor. of secs. 23 and 24, T. 31 N., R. 2 E. of the Gila and Salt River Base and Meridian, Arizona, latitude $36^{\circ}03'N$ and longitude $112^{\circ}08'12"W$, examine the adjustments of the instrument and find no errors, then, to test the solar apparatus by comparing its indications, resulting from solar observations made during a.m., and p.m. hours with a meridian established by observations on Polaris; proceed as follows;

October 4, 1928, Set up instrument on the meridian established last evening and described in Book "H" of the survey of the Grand Canyon National Park boundary, and at $8^h 00^m$ a.m. app. time set off $36^{\circ}3'N$ on the lat. arc, $4^{\circ}23'S$ on the decl. arc and determine a meridian with the solar which falls $1'E$ of the meridian established by the Polaris observations.

At apparent noon with the lat. arc unchanged observe the sun on the meridian and obtain a reading of $4^{\circ}27\frac{1}{2}'S$ on the decl. arc which agrees closely with the computed declination of the sun for this hour.

At $4^h 00^m$ p.m., app. time with the lat arc unchanged, set off $4^{\circ}30\frac{1}{2}'S$ on the decl. arc and determine a meridian with the solar. This meridian falls $1\frac{1}{2}' W$ of the meridian established by the Polaris observations.

As all the solar observations, made during the usual hours of solar work come within $1\frac{1}{2}'$ of the true meridian established by the Polaris observations, conclude that the adjustments of the instrument are satisfactory.

Resurvey of Part of the Subdivision lines
of Township 31 North., Range 1 East.

LOOK 8307

Chains

The Subdivision lines of Township 31 North., Range 1 East were surveyed in 1900 by F.B. Jacobs, U.S. Surveyor and no subsequent retracement or resurvey of same is of record.

The following notes describe a resurvey of part of the subdivision lines of this township closing on the boundary of the Grand Canyon National Park and the establishment of the closing corners at the several points of intersection therewith.

In the retracement for the resurvey the record bearings of the Jacobs survey are used for the randoms.

Retracement for Resurvey.

Begin at the $\frac{1}{4}$ sec. cor. of secs. 25 and 26, T31N., R1E., G.&S.R.B.&M. Ariz., latitude $36^{\circ}02'30''N.$ and longitude $112^{\circ}14'50''W.$ hereinafter described.

Thence
40.05 S $0^{\circ}1'E.$ on a random line bet. secs. 25 and 26 (S $\frac{1}{4}$)
Fall 4 lks. W. of the orig. cor. of secs. 25, 26, 35, and 36 hereinafter described.
True course and dist. of S $\frac{1}{4}$ of line bet. secs. 25 and 26 are therefore, $N0^{\circ}2'E.$, 40.05 chs.

40.04 From the cor. of secs. 22, 23, 26, and 27, hereinafter described,
S $89^{\circ}59'E.$ (record bearing) on a random line bet. secs. 23 and 26 (W $\frac{1}{4}$)
Intersect the orig. $\frac{1}{4}$ sec. cor. hereinafter described
True course and dist. of W. $\frac{1}{4}$ of line bet. secs. 23 and 26 are therefore, $N89^{\circ}59'W.$ 40.04 chs.

40.05 From the cor. of secs. 22, 23, 26, and 27,
N $0^{\circ}1'W.$ (record bearing) on a random line bet. secs. 22 and 23 (S $\frac{1}{4}$)
Fall 12 lks. W. of the orig. $\frac{1}{4}$ sec. cor. hereinafter described.
True course and dist. of S. $\frac{1}{4}$ of line bet. secs. 22 and 23 are therefore, $N0^{\circ}9'E.$ 40.05 chs.

40.00 From the cor. of secs. 15, 16, 21, and 22, hereinafter described,
S $0^{\circ}1'E.$ (record bearing) on a random line bet. secs. 21 and 22. (W $\frac{1}{4}$)
Intersect the $\frac{1}{4}$ sec. cor. hereinafter described.
True course and dist. of N $\frac{1}{4}$ of line bet. secs. 21 and 22 are therefore, $N0^{\circ}1'W.$ 40.00 chs.

Resurvey of Part of the Subdivision lines
of Township 31 North., Range 1 East.

Chains	<p>From cor. of secs. 15, 15, 21, and 22, West (record bearing) on a random line bet. secs. 16 and 21. ($E\frac{1}{2}$)</p> <p>40.07 Intersect the $\frac{1}{4}$ sec. cor. hereinafter described. True course and dist. of the $E\frac{1}{2}$ of line bet. secs. 16 and 21 are therefore, West 40.07 chs.</p> <p>-----</p> <p>From the cor. of secs. 8, 9, 16, and 17 hereinafter described, S $0^{\circ}2'E$. (record bearing) on a random line bet. secs. 16 and 17. ($N\frac{1}{2}$)</p> <p>40.13 Fall 5 lks. W. of the orig. $\frac{1}{4}$ sec. cor. hereinafter described. True course and dist. of $N\frac{1}{4}$ of line bet. secs. 16 and 17 are therefore, N $0^{\circ}6'W$. 40.13 chs.</p> <p>-----</p> <p>From the cor. of secs. 8, 9, 16, and 17, N $89^{\circ}53'W$. (record bearing) on a random line bet. secs. 8 and 17. ($E\frac{1}{2}$)</p> <p>40.22 Fall 13 lks. S. of the $\frac{1}{4}$ sec. cor. hereinafter described True course and dist. of $E\frac{1}{2}$ of line bet. secs. 8 and 17 are therefore, N $89^{\circ}42'W$. 40.22 chs.</p> <p>-----</p> <p>From the cor. of secs. 5, 6, 7, and 8, hereinafter described, S $0^{\circ}3'E$. (record bearing) on a random line bet. secs. 7 and 8, ($N\frac{1}{2}$)</p> <p>39.91 Fall 5 lks. W. of the $\frac{1}{4}$ sec. cor. hereinafter described. True course and dist. of $N\frac{1}{2}$ of line bet. secs. 7 and 8 are therefore, N $0^{\circ}7'W$. 39.91 chs.</p> <p>-----</p> <p>From cor. of secs. 5, 6, 7, and 8, N $89^{\circ}34'W$. (record bearing) on a random line bet. secs. 6 and 7 ($E\frac{1}{2}$)</p> <p>40.03 Fall 70 lks. S. of the $\frac{1}{4}$ sec. cor., hereinafter described. True course and dist. of $E\frac{1}{2}$ of line bet. secs. 6 and 7 are therefore, N $88^{\circ}34'W$, 40.04 chs.</p> <p>Thence N $89^{\circ}34'W$. (record bearing) on a random line bet. secs. 6 and 7 ($W\frac{1}{2}$)</p> <p>38.85 Intersect W. bdy. of Tp. (Gila and Salt River Meridian) 66 lks. S. of the cor. of secs. 1, 6, 7, and 12, hereinafter described. True course and dist. of $W\frac{1}{2}$ of line bet. secs. 6 and 7 are therefore, N $88^{\circ}36'W$, 38.86 chs.</p> <p>-----</p> <p>From the cor. of secs. 7, 8, 17, and 18, hereinafter described, N $89^{\circ}35'W$. (record bearing) on a random line bet. secs. 7 and 18. ($E\frac{1}{2}$)</p> <p>40.00 Fall 36 lks. S. of the $\frac{1}{4}$ sec. cor., hereinafter described True course and dist. of $E\frac{1}{2}$ of line bet. secs. 7 and 18 are therefore, N $89^{\circ}04'W$, 40.00 chs.</p> <p>Thence</p>
--------	--

Resurvey of Part of the Subdivision lines

of Township 31 North., Range 1 E.

Book 1007

Chains

39.02 N 89°35'W. (record bearing) on a random line bet. secs. 7 and 18. (W $\frac{1}{2}$)
 Intersect the W. bdy. of Tp., (Gila and Salt River Meridian) 41 lks. S. of the cor. of secs. 7, 12, 13, and 18,
 True course and dist. of (W $\frac{1}{2}$) of line bet. secs. 7 and 18 are therefore, N. 88°59'W. 39.03 chs.

RESURVEY

From the cor. of secs. 25, 26, 35, and 36, T31N., R1E., which is a limestone 16x8x, 6 ins. above ground, firmly set, properly marked, and witnessed by four properly marked bearing trees, one each NE, SE, SW, and NW. of cor.

N 0°2'E. on true line bet. secs. 25 and 26, (S $\frac{1}{2}$)
 Over rolling sandy land thru scattering timber and undergrowth.
 3.25 Road from Grand Canyon Arizona to the Supai Indian Reservation bears N70°E. and S70°W.
 6.00 Enter heavy timber bears E. and W.
 34.71 Point of intersection of that portion of the Grand Canyon National Park Bdy. surveyed parallel to, and at a uniform distance S45°W. 40.00 chs. from the Supai Road Survey as staked and mapped by the Bureau of Public Roads in 1925. Initial Monument of Park Bdy. survey established at said point of intersection as described in Book "H"
 40.05 Continue line and measurement and at Intersect the $\frac{1}{2}$ sec. cor. of secs. 25 and 26. which is a limestone 14x4x, 7 ins. above ground, firmly set, properly marked and witnessed by two bearing trees.

Land, rolling.
 Soil, sandy and stony 3 rd. rate.
 Timber, juniper cedar, and pinion.
 Undergrowth, sagebrush and scrub cedar.

From the $\frac{1}{2}$ sec. cor. of secs. 23 and 26, T31N., R1E., which is a limestone 10x4x, 8 ins. above ground firmly set, properly marked, and witnessed by two properly marked bearing trees,

N 89°59'W. on true line bet. secs. 23 and 26 (W $\frac{1}{2}$)
 Over rolling sandy land, thru, heavy timber and brush undergrowth, in Grand Canyon National Park
 17.87 Intersect the Grand Canyon National Park Bdy. surveyed parallel to and 40.00 chs. S45°W. from the Supai Road Survey, as described in Book "H" of this Group.
 This intersection is at the 73.50 chain station of the 1st. mile of said Park Bdy. 33.50 chs. N51°50'W. from the $\frac{1}{2}$ mile monument thereon and 6.50 chs. S51°50'E. from the 1 mile mon.
 At this point of intersection, Set an iron post 3 ft. long, 2 ins. in diam. 26 ins. in the ground for closing cor. of secs. 23 and 26, marked on brass cap

Resurvey of Part of the Subdivision lines
of Township 31 North., Range 1 E.

Chains.

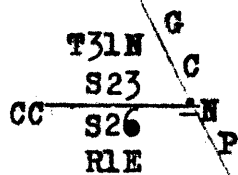

1928

from which

A juniper 6 ins. in diam. bears N61°W.60 lks. dist.,
marked T31N.,R1E.S23 CC BT.

A juniper 6 ins. in diam. bears S43½°W.66 lks. dist.,
marked T31N.,R1E. S26 CC BT.

Leave Grand Canyon National Park

Continue line and measurement.

40.04

Intersect the cor. of secs. 22, 23, 26, and 27, which is
a limestone 18x4x, 12 ins. above ground, firmly
set, properly marked, and witnessed by four
properly marked bearing trees, one each NE., SE.
SW., and NW. of cor.

Land, rolling.

Soil, sandy and stony 3 rd. rate.

Timber, cedar, pinion, and juniper.

Undergrowth, sagebrush, and scrubcedar and juniper.

From the cor. of secs. 22, 23, 26, and 27,

N 0°9'E. on true line bet. secs. 22 and 23 (S½)

Over rolling mesa land, thru heavy timber and brush under-
growth.

17.35

Intersect that part of the Bdy. of the Grand Canyon
National Park surveyed parallel to and 40.00 chs.
S45°W. from the Supai Road Survey, as described in
Book "H" of this Group.

This intersection is at the 21.63 chain station
of the 2nd. mile of said Park Bdy., 21.63 chs.

N51°50'W. from the 1 Mile monument and 18.37 chs.

S51°50'E. from the 1½ mile monument

At this point of intersection, Set an iron post
3 ft. long 2 ins. in diam. 26 ins. in the ground

for closing cor. of secs. 22 and 23 marked on brass
cap

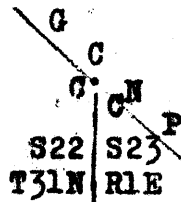

1928

from which

A juniper 8 ins. in diam. bears S4½°E. 341 lks. dist.,
marked T31N.,R1E.,S23 CC BT.

A juniper 26 ins. in diam. bears S47½°W. 237 lks. dist.,
marked T31N.,R1E.,S22 CC BT.

Enter Grand Canyon National Park

Continue line and measurement.

40.05

Intersect the ¼ sec. cor. of secs. 22 and 23, which is a

Resurvey of Part of the Subdivision lines
of Township 31 North., Range 1 East.

BOOK 8507

Chains

limestone 10x6x12 ins. above ground, firmly set,
properly marked, and witnessed by two properly
marked bearing trees.

Land, rolling.
Soil, stony 3 rd. rate.
Timber, cedar, pinion, and juniper.
Undergrowth, sagebrush and scrub juniper and cedar.

From the $\frac{1}{2}$ sec. cor. of secs. 21 and 22, T31N., R1E., which
is a limestone 12x6x10 ins. above ground,
firmly set, properly marked, and witnessed by
two properly marked bearing trees

N 0°1'W., on true line bet. secs. 21 and 22 (N $\frac{1}{2}$)
Over rolling stony land, thru heavy timber and brush
undergrowth.

39.83

Intersect that part of the Bdy. of the Grand Canyon National
Park surveyed parallel to and 40.00 chs.
S45°W. from the Supai Road Survey, as described
in Book "H" of this Group.

This intersection is at the 43.52 chain station of the
3rd. mile of said Park Bdy., 3.52 chs. N51°50'W.
from the 2 $\frac{1}{2}$ Mile monument and 36.48 chs. S51°50'E.
from the 3 Mile monument.

At this point of intersection, Set an iron post 3 ft. long
2 ins. in diam. 18 ins. in the ground to
bedrock supported in a mound of stone for
closing cor. of secs. 21 and 22., marked on
brass cap

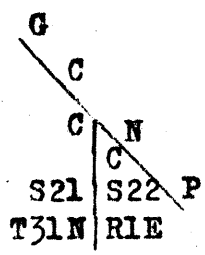

1928

from which

- A pinion 8 ins. in diam. bears S4°E. 49 lks. dist.,
marked T31N., R1E., S22 CC BT.
- A pinion 6 ins. in diam. bears S65°W. 63 lks. dist.,
marked T31N., R1E., S21 CC BT.

Enter Grand Canyon National Park.
Continue line and measurement.

40.00

Intersect the cor. of secs. 15, 16, 21, and 22. which is
a limestone 8x6x10 ins. above ground firmly
set, properly marked, and witnessed by four
properly marked bearing trees, one each NE.,
SE., SW., and NW. of cor.

Land, rolling.
Soil, stony 3 rd. rate.
Timber, cedar, pinion, and juniper.
Undergrowth, sagebrush, and scrub cedar.

Resurvey of Part of the Subdivision lines
of Township 31 North., Range 1 East.

Chains

From the cor. of secs.15,16,21,and 22,

West on true line bet. secs.16 and 21 (E.½)
Over rolling stony land thru.heavy timber and under-
growth in Grand Canyon National Park.

0.22

Intersect that part of the Bdy.of the Grand Canyon
National Park,surveyed parallel to and 40.00
chs. S45°W.from the Supai Road Survey,as
described in Book "H" of this Group.
This intersection is at the 43.80 chain station
of the 3rd.mile of said Park Bdy. 3.80 chs.
N51°50'W.from the 2½ mile monument and 36.20
chs. S51°50'E.from the 3 Mile monument.
At this point of intersection, Set an iron post 3 ft.
long 2 ins. in diam.12 ins. in the ground to
bedrock,supported in a mound of stone for
closing cor. of secs. 16 and 21.,marked on
brass cap

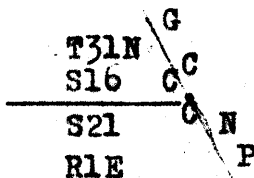

1928

from which

A juniper 6 ins. in diam. bears N87½°W.53 lks. dist.,
marked T31N.,R1E.,S16 CC BT.
A pinion 6 ins. in diam. bears S61½°W.62 lks. dist.,
marked T31N.,R1E.,S21 CC BT.

40.07

Leave Grand Canyon National Park.
Intersect the ¼ sec. cor. of secs.16 and 21,which is
a limestone 8x6x,8 ins. above ground,firmly
set,properly marked,and witnessed by two
bearing trees properly marked.

Land,rolling mesa.
Soil,stonny 3 rd. rate.
Timber,cedar,pinion,and juniper.
Undergrowth,sagebrush,and scrub cedar and juniper.

From the ¼ sec. cor. of secs.16 and 17,T31N.,T1E.,
which is a limestone 20x10x10 ins.above
ground,firmly set,properly marked,and
witnessed by two properly marked bearing
trees,

23.03

N 0°6'W. on true line bet. secs.16 and 17 (N½)
Over rolling stony land, thru.heavy timber and brush
undergrowth.
Intersect that part of the Bdy.of the Grand Canyon
National Park surveyed parallel to and
40.00 chs.S45°W.from the Supai Road Survey
as described in Book "H" of this Group.
This intersection is at the 65.38 chain station of the
4th. mile of said Park Bdy.,25.38 chs.
N51°50'W.from the 3½ Mile monument and 14.62
chs.S51°50'E.from the 4 Mile monument.
At this point of intersection, Set an iron post 3 ft. 10
long,2 ins. in diam.24 ins. in the ground
for closing cor. of secs.16 and 17.,marked on
brass cap

Resurvey of Part of the subdivision lines

BOOK 2807

of Township 31 North., Range 1 East.

Chains

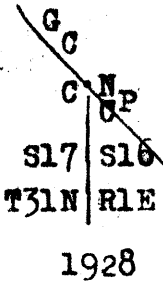

from which

A pinion 20 ins. in diam. bears $S13\frac{1}{2}^{\circ}E$. 111 lks. dist.,
 marked T31N., R1E., S16 CC BT.
 A juniper 16 ins. in diam. bears $S24^{\circ}W$. 54 lks. dist.,
 marked T31N., R1E., S17 CC BT.

Enter Grand Canyon National Park.
 Continue line and measurement.

40.13

(17.10 chs. $N0^{\circ}0'W$. from closing cor. of secs. 16 and 17)
 Intersect the cor. of secs. 8, 9, 16, and 17, which is
 a limestone $7x6x12$ ins. above ground, firmly
 set, properly marked, and witnessed by four bearing
 trees properly marked, one each NE., SE., SW., and
 NW. of cor.

Land, rolling.
 Soil, stony 3 rd. and 4 th. rate.
 Timber, cedar, pinion, and juniper.
 Undergrowth, sagebrush, and scrub cedar and juniper.

From cor. of secs. 8, 9, 16, and 17,

$N 89^{\circ}42'W$. on true line bet. secs. 8 and 17 ($E\frac{1}{2}$)
 Over rolling stony land thru. heavy timber and brush
 undergrowth in Grand Canyon National Park.

21.81

Intersect that part of the Bdy. of the Grand Canyon
 National Park surveyed parallel to and 40.00 chs.
 $S45^{\circ}W$. from the Supai Road Survey, as described
 in Book "H" of this Group.

This intersection is at station on said Park Bdy. 13.21
 chs. $N51^{\circ}50'W$. of the 4 Mile monument and 26.79
 chs. $S51^{\circ}50'E$. of the $4\frac{1}{2}$ Mile monument. on said Bdy.

At this point of intersection, Set an iron post 3 ft.
 long, 2 ins. in diam. 20 ins. in the ground to
 bedrock, supported in a mound of stone for closing
 cor. of secs. 8 and 17 marked on brass cap

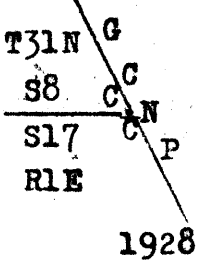

from which

A juniper 10 ins. in diam. bears $N75\frac{1}{2}^{\circ}W$. 19 lks. dist.,
 marked T31N., R1E., S8 CC BT

A juniper 8 ins. in diam. bears $S41^{\circ}W$. 80 lks. dist.,
 marked T31N., R1E., S17 CC BT.

Leave Grand Canyon National Park.

Resurvey of Part of the Subdivision lines
of Township 31 North., Range 1 East.

Chains

32.50 Forest Service Telephone line from Grand Canyon Arizona to the Supai Indian School, bears NW. and SE.

40.22 (18.41 chs. N89°42'W. from closing cor. of secs. 8 and 17) Intersect the $\frac{1}{2}$ sec. cor. of secs. 8 and 17, which is a limestone 12x6x, 10 ins. above ground firmly set, properly marked, and witnessed by two bearing trees properly marked.

Land, rolling.
Soil, stony 3 rd. and 4 th. rate.
Timber, cedar, pinion, and juniper.
Undergrowth, sagebrush and scrub cedar and juniper

From the cor. of secs. 7, 8, 17, and 18., which is a limestone 10x6x, 6 ins. above ground, firmly set, properly marked, and witnessed by four bearing trees all properly marked.,

N 89°04'W. on true line bet. secs. 7 and 18. ($E\frac{1}{2}$)
Over rolling stony land, slopes W. thru heavy timber and brush undergrowth.

37.00 Leave timber bears NW. and SE.
Enter draw course NW.

39.25 Leave draw and enter scattering timber bears NW. and SE.

40.00 Intersect the $\frac{1}{2}$ sec. cor. which is a limestone 12x8x, 12 ins. firmly set in a mound of stone, properly marked and witnessed by two bearing trees

Thence
N 88°59'W. on true line bet. secs. 7 and 18. ($W\frac{1}{2}$)
Over rolling stony mesa land thru scattering timber and undergrowth.

7.50 Leave timber bears NE. and SW.
Enter valley covered with heavy sagebrush, drains SW.

18.20 Old road from Grand Canyon Arizona to the Havasupai Indian Reservation bears NW. and SE.

18.40 Leave valley bears NE. and SW.
Enter rolling stony land slopes SE.
Ascend gradually thru scattering timber bears NE. and SW.

32.00 Enter heavy timber bears N. and S.

39.03 Intersect the cor. of secs. 7, 12, 13, and 18 on W. bdy. of Tp (Gila and Salt River Meridian), which is a limestone 8x6x3 ins. above ground poorly set and dimly marked with 2 notches on N. and 4 notches on S. edges. No corner accessories.
Reconstruct this cor. as follows;
Alongside of old stone monument, Set an iron post 3 ft. long 2 ins. in diam. 26 ins. in the ground for cor. of secs. 7, 12, 13, and 18, Ts. 31 N., Rs. 1 E. and 1 W., marked on brass cap.

T31N	
R1W	R1E
S12	S7

S13	S18

1928

from which

A juniper 16 ins. in diam. bears N61 $\frac{1}{2}$ °E. 65 lks. dist.,
marked T31N., R1E., S7 BT.

A juniper 8 ins. in diam. bears S25 $\frac{1}{4}$ °E. 142 lks. dist.,

Resurvey of Part of the subdivision lines
of Township 31 North., Range 1 East.

BOOK 3907

Chains

marked T31N., R1E., S18 BT.
A juniper 12 ins. in diam. bears S58 $\frac{1}{2}$ °W. 101 lks. dist.,
marked T31N., R1W., S13 BT.
A juniper 12 ins. in diam. bears N41 $\frac{1}{2}$ °W. 76 lks. dist.,
marked T31N., R1W., S12 BT.

Land, level and rolling.
Soil, sandy, and stony 2nd, 3rd, and 4th. rate.
Timber, cedar, pinion, and juniper.
Undergrowth, sagebrush, and scrub cedar and juniper

From the $\frac{1}{4}$ sec. cor. of secs. 7 and 8, T31N., R1E., which
is a limestone 12x4x, 10 ins. above ground,
firmly set, properly marked, and witnessed by
two bearing trees which are properly marked,

N 0°7'W. on true line bet. secs. 7 and 8 (N $\frac{1}{2}$)
Over rolling stony land thru heavy timber and brush
undergrowth.

5.99

Intersect that part of the Bdy. of the Grand Canyon
National Park surveyed parallel to and 40.00
chs. S45°W. from the Supai Road Survey as descri-
bed in Book "H" of this Group.
This intersection is at station on said Park Bdy. 7.98 chs.
N51°50'W. of the 5 Mile monument and 32.02 chs.
S51°50'E. of the 5 $\frac{1}{2}$ Mile monument on said Bdy.
At this point of intersection, Set an iron post 3 ft. long
2 ins. in diam., 8 ins. in the ground to bedrock,
supported in a mound of stone for closing cor.
of secs. 7 and 8., marked on brass cap

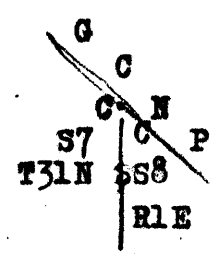

1928

from which

A juniper 12 ins. in diam. bears S25°E. 149 lks. dist.,
marked T31N., R1E., S8 CC BT.
A pinion 12 ins. in diam. bears S13 $\frac{1}{2}$ °W. 86 lks. dist.,
marked T31N., R1E., S7 CC BT.

Enter Grand Canyon National Park.
Continue line and measurement.

6.25

Draw course SW.
Ascend SE. slope over rolling stony mesa land.

39.91

(33.92 chs. N0°7'W. from closing cor. of secs. 7 and 8.)
Intersect the cor. of secs. 5, 6, 7, and 8., which is a
limestone 14x8x, 6 ins. above ground, firmly set,
properly marked, and witnessed by four bearing
trees each properly marked.

Land, rolling.
Soil, stony 3 rd. and 4 th. rate.
Timber, cedar, pinion, and juniper.
Undergrowth, sagebrush and scrub cedar and juniper.

Resurvey of Part of the subdivision lines
of Township 31 North., Range 1 East.

Chains
From the cor. of secs. 5, 6, 7, and 8,
N 88°34'W on true line bet. secs. 6 and 7 (E $\frac{1}{2}$)
Over rolling stony land thru heavy timber and brush
undergrowth.
15.00 Descend 20 ft. over W. slope.
15.64 Draw course SE.
Ascend 20 ft. over E. slope
17.04 Top of ascent on W. bank of draw, thence
Over rolling land.
40.04 Intersect the $\frac{1}{4}$ sec. cor., which is a limestone 20x7x6 ins
set in a mound of stone properly marked, and
witnessed by two bearing trees

Thence
N 89°36'W. on true line bet. secs. 6 and 7 (W $\frac{1}{2}$)
Over rolling stony land thru scattering timber and brush
undergrowth.
4.12 Intersect that part of the Bdy. of the Grand Canyon
National Park surveyed parallel to and 40.00 chs.
S45°W. from the Supai Road Survey, as described
in Book "H" of this Group.
This intersection is at the 64.37 chain station of the
6th. mile of said Park Bdy., 24.37 chs. N51°50'W.
from the 5 $\frac{1}{2}$ Mile monument and 15.63 chs. S51°50'E
from the 6 Mile monument.
At this point of intersection, Set an iron post 3 ft. long
2 ins. in diam. 14 ins. in the ground to bedrock
supported in a mound of stone for closing corner
of secs. 6 and 7., marked on brass cap

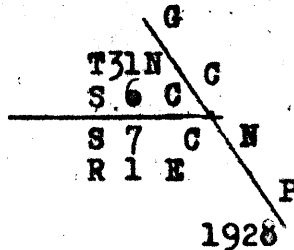

from which

A juniper 8 ins. in diam. bears N71 $\frac{1}{2}$ °W. 52 lks. dist.,
marked T31N., R1E., S6 CC BT.
A juniper 14 ins. in diam. bears S59 $\frac{1}{2}$ °W. 31 lks. dist.,
marked T31N., R1E., S7 CC BT.

Leave Grand Canyon National Park.

Continue line and measurement.

5.50 Leave scattering timber bears NE. and SW.
Enter heavy timber.

38.86 Intersect the cor. of secs. 1, 6, 7, and 12 on W. hdy. of Tp.
(Gila and Salt River Meridian) which is a
limestone 10x8x10 ins. above ground, dimly
marked with 1 notch on N. and 5 notches on S.
edges. No corner accessories.; The bearing
trees described as corner accessories in the
record have their markings obliterated.
Reconstruct this cor. as follows; Alongside of the old
stone monument, Set an iron post 3 ft. long,
2 ins. in diam. 26 ins. in the ground to bedrock
for cor. of secs. 1, 6, 7 and 12, T31N., R1E. and 1W.,
marked on brass cap, or similar, in T31N.,
R1E., S6, marked on limestone

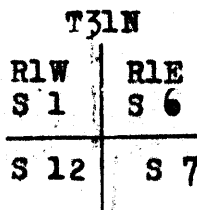

1928

from which

Resurvey of Part of the Subdivision lines
of Township 31 North., Range 1 East.

13

BOOK 8907

Chains

- A pinion 14 ins. in diam. bears $N45\frac{1}{2}^{\circ}E.$ 93 lks. dist.,
marked T31N., R1E., S6 BT.
A juniper 6 ins. in diam. bears $S61\frac{1}{2}^{\circ}E.$ 43 lks. dist.,
marked T31N., R1E., S7 BT.
A juniper 8 ins. in diam. bears $S57^{\circ}W.$ 54 lks. dist.,
marked T31N., R1W., S12 BT.
A pinion 8 ins. in diam. bears $N49\frac{1}{2}^{\circ}W.$ 43 lks. dist.,
marked T31N., R1W., S1 BT.

Land, rolling.
Soil, stony 3 rd. and 4 th. rate.
Timber, cedar, pinion, and juniper.
Undergrowth, sagebrush, scrub cedar, and juniper.

The continued satisfactory adjustment of the instrument used in the execution of the resurveys described in the foregoing notes is indicated from the final field tests of said instrument, described in Book "H" of this group.

CERTIFICATE OF UNITED STATES SURVEYOR.

BOOK 1507

I, Sidney E. Blout U.S. Cadastral Engineer, hereby certify upon honor that, in pursuance of special instructions received from the District Cadastral Engineer, for Group 145, Arizona bearing date of the 31st day of January, 1928, I have well, faithfully, and truly in my own proper person, and in strict conformity with said instructions, the Manual of Surveying Instructions, and the laws of the United States, resurveyed all those parts or portions of

the Subdivision Lines of

Township 31 North, Range 1 East of the Gila and Salt River Base and Meridian, in the State of Arizona, which are represented in the foregoing field notes and by diagram on page 1 hereof as having been executed by me, and under my direction; and that all the corners of said resurvey have been established and perpetuated in strict accordance with the Manual of Surveying Instructions, and the special written instructions of the District Cadastral Engineer, for Group 145, Ariz. and in the specific manner described in the field notes, and that the foregoing are the original field notes of such resurvey.

Place: Phoenix, Arizona.

Date: April 3, 1929.

Sidney E. Blout U.S. Cadastral Engineer.

APPROVAL.

OFFICE OF U. S. SUPERVISOR OF SURVEYS,

Denver, Colo., April 20, 1929.

The foregoing field notes of the resurvey of

Part of the Subdivision Lines of

Township 31 North, Range 1 East

of the Gila and Salt River Base and Meridian, State of Arizona

executed by Sidney E. Blout, U.S. Cadastral Engineer

under his special instructions dated January 31, 1928, for Group 145, Ariz., having been critically examined, and the necessary corrections and explanations made, the said field notes, and the resurveys they describe, are hereby approved.

U. S. Supervisor of Surveys.

I certify that the foregoing transcript of the field notes of the above described surveys in

has been correctly copied from the original notes on file in this office.

U. S. Supervisor of Surveys.