

FIELD NOTES

OF THE SURVEY OF THE

FIRST STANDARD PARALLEL NORTH THRU PART OF R. 21 E.

SOUTH BOUNDARY

WEST BOUNDARY

AND

SUBDIVISION LINES OF

FRACTIONAL TOWNSHIP 4 1/2 NORTH, RANGE 22 EAST

Of the Gila and Salt River Base and Meridian,

In the State of Arizona
All within the Fort Apache Indian Reservation

EXECUTED BY

William E. Hiester

U.S. Surveyor

In the capacity of U. S. Surveyor..., under Special Instructions dated October 16,
1930, issued by the District Cadastral Engineer to govern surveys included in Group
No. 165 Arizona, which were approved by the Commissioner of the General Land
Office, March 26, 1931, and Assignment Instructions dated March 31, 1931.

Survey commenced June 11, 1931

Survey completed July 16, 1931

3934

3934

INDEX DIAGRAM.

Township _____, Range _____

6	5	4	3	2	1
7	8	9	10	11	12
18	17	16	15	14	13
19	20	21	22	23	24
30	29	28	27	26	25
31	32	33	34	35	36

Book "C"

Group 165 Arizona

Frac. Township 4 North, Range 22 East
in the Fort Apache Indian Reservation

INDEX DIAGRAM

BOOK 3934

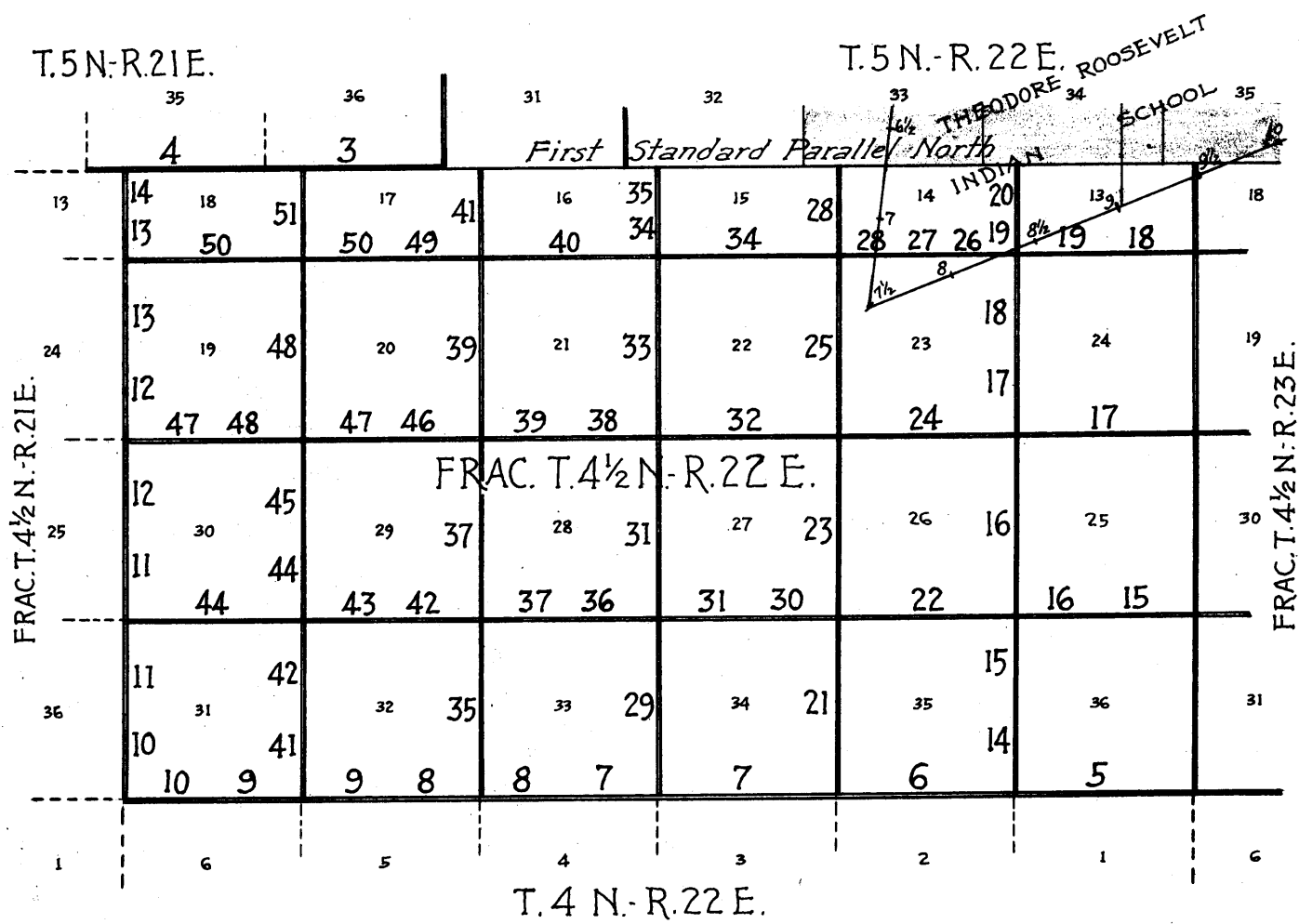

————— Surveyed under this group.

————— Accepted, surveyed lines.

----- Unsurveyed.

 Areas surveyed as per accepted plats on file.

Book "C"

Group 165 Arizona

Frac. Township 4 $\frac{1}{2}$ North, Range 22 East

DATE DIAGRAM

(1931)

BOOK 3934

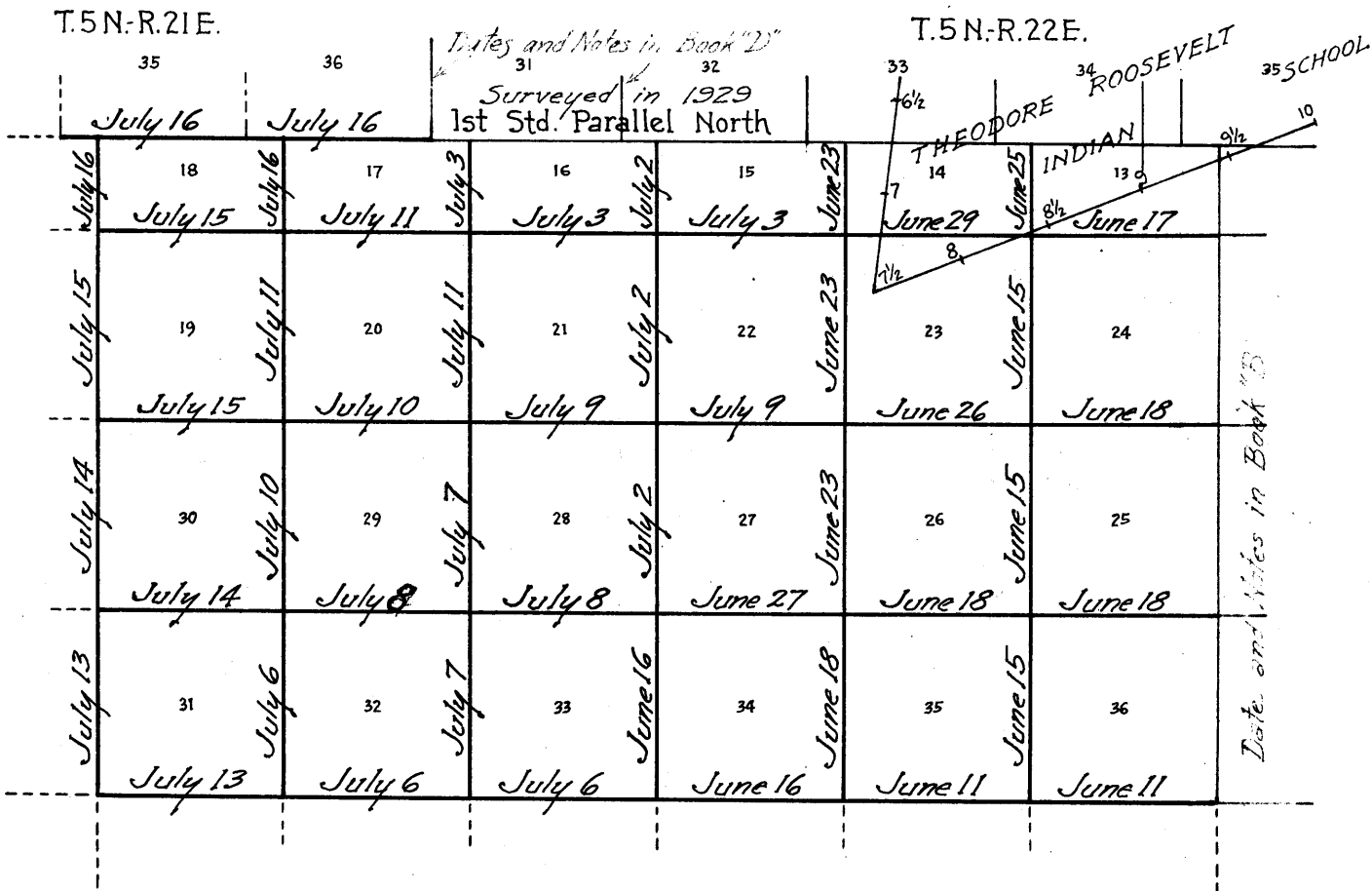

Surveyed under this group by Wm. E. Hiester, U.S. Surveyor, on dates (1931) shown thereon, and as described in the notes herein.

Surveyed under this group by Wm. E. Hiester, U.S. Surveyor, on dates shown on diagrams in Books "B" and "D" of this group.

Accepted, surveyed lines.

Unsurveyed.

Chains. Survey commenced June 11, 1931, and executed with Buff and Buff transit No. 19423, with Smith solar attachment. The horizontal limb is provided with two double verniers placed opposite to each other and reading to single minutes of arc; which is also the least count of the verniers of the latitude and declination arcs.
 For preliminary test, see final test of the instrument on a meridian determined by observation on Polaris, in the field notes of exteriors and subdivisions of T.4½ N., R. 23 E., in book "B" of this group.

Beginning at the standard cor. of Tps. 5 N., Rs. 21 and 22 E., which is an iron post, 3 ins. diam., 12 ins. above ground, and in a mound of stone to top, mkd. and witnessed as described in the official record.

West, with the establishment of the first standard parallel north, along the S. bdy. of sec. 36, T. 5 N., R. 21 E.

Over mountainous land, through scattering timber and undergrowth.

Ascend 320 ft. over E. slope.

10.30 Spur, slopes SE.; continue along S. slope.

33.00 Same spur, slopes NE.; continue along N. slope.

40.00 Set an iron post, 3 ft. long, 1 in. diam., 26 ins. in the ground, for standard ¼ sec. cor. with brass cap marked

S C
 ¼ S 36

1931

from which

A juniper, 10 ins. diam., bears N. 46½° E., 61 lks. dist., mkd. ¼ S 36 S C B T.

A white oak, 10 ins. diam., bears N. 67¾° W., 30 lks. dist., mkd. ¼ S 36 S C B T.

Descend 99 ft. over NW. slope.

55.00 Low pass, bears SE. and NW.; asc. 118 ft. over SE. slope.

65.13 Mound of stone on rocky point, 4 ft. base, 5 ft. high, bears S. 27 lks. dist.

76.26 Trail, bears SE. and NW.

79.00 Ridge, bears N. and S.; desc. 17 ft. over SW. slope.

80.00 Set an iron post, 3 ft. long, 2 ins. diam., 26 ins. in the ground, for standard cor. of secs. 35 and 36, with brass cap marked.

S C
 T5N | R21E
 S35 | S36

1931

from which

A juniper, 6 ins. diam., bears N. 40° E., 19¼ lks. dist., mkd. T 5 N R 21 E S 36 S C B T.

A cedar, 5 ins. diam., bears N. 35¾° W., 18¾ lks. dist., mkd. T 5 N R 21 E S 35 S C B T.

Chains.	Land, mountainous. Soil, rocky; 4th rate. Timber, pine, fir, cedar, pinon, oak and juniper; undergrowth, scrub oak, manzanita, mahogany chamisal and grass.									
	West, along the S. bdy. of sec. 35. Over mountainous land, through scattering timber and dense undergrowth. Descend 75 ft. over NW. slope.									
7.00	Draw, course SW.									
16.95	Head of draw, course SW.; asc. 47 ft. over SE. slope.									
20;00	Cross low ridge, bears N. and S.; continue ascending.									
29.20	Rocky peak of ridge; desc. 80 ft. over W. slope.									
35.00	Continue descending over NW. slope.									
40.00	Set an iron post, 3 ft. long, .1 in. diam., 23 ins. in the ground to bedrock, and in a mound of stone to top, for standard $\frac{1}{4}$ sec. cor. with brass cap marked.									
	<table border="0"> <tr><td></td><td>S</td><td>C</td></tr> <tr><td></td><td>$\frac{1}{4}$</td><td>S 35</td></tr> </table>		S	C		$\frac{1}{4}$	S 35			
	S	C								
	$\frac{1}{4}$	S 35								
	1931									
	from which									
	A cedar, 10 ins. diam., bears N. $20\frac{1}{4}^{\circ}$ E., 54 lks. dist., mkd. $\frac{1}{4}$ S 35 S C B T.									
	A juniper, 6 ins. diam., bears N. $31\frac{1}{4}^{\circ}$ W., 72 lks. dist., mkd. $\frac{1}{4}$ S 35 S C B T.									
	Descend 450 ft. over broken NW. slope.									
80.00	Set an iron post, 3 ft. long, 2 ins. diam., 14 ins. in the ground to bedrock, and in a mound of stone to top, for standard cor. of secs. 34 and 35, with brass cap marked.									
	<table border="0"> <tr><td></td><td>S</td><td>C</td></tr> <tr><td></td><td>T 5 N</td><td>R 21 E</td></tr> <tr><td></td><td>S 34</td><td>S 35</td></tr> </table>		S	C		T 5 N	R 21 E		S 34	S 35
	S	C								
	T 5 N	R 21 E								
	S 34	S 35								
	1931									
	from which									
	A cedar, 6 ins. diam., bears N. 43° E., 103 lks. dist., mkd. T 5 N R 21 E S 35 S C B T.									
	A cedar, 6 ins. diam., bears N. 18° W., 87 lks. dist., mkd. T 5 N R 21 E S 34 S C B T.									
	Land, mountainous. Soil, rocky; 4th rate. Timber, pine, fir, cedar, pinon, oak and juniper; undergrowth, scrub oak, manzanita, mahogany, chamisal and grass.									

SOUTH BOUNDARY OF FRAC. T.4 1/2 N., R.22 E.

BOOK 3934

Chains June 15, 1931; at 7h 20m a.m., app.t., set off 33°46 1/2' N., on the lat.arc; 23°18' N., on the decl.arc; and orient the instrument with the solar; the line of sight agrees with meridian established by Polaris observation June 13, 1931, described in book "B".

At 4h 15m p.m., app.t., set off 33°46 1/2' N., on the lat.arc; 23°19' N., on the decl.arc; and repeat the test of the solar; the line of sight agrees with the meridian established by Polaris observation.

Commence at the cor. of Tps. 4 and 4 1/2 N., Rs. 22 and 23 E., described in Book "B" of this group.

Thence,

West, bet. secs. 1 and 36.

Over rolling mesa land, through scattering timber and undergrowth.

Ascend 40 ft. over rocky NE. slope.

15.00 Spur, slopes N.; desc. 52 ft. over NW. slope.

31.00 Head of draw, course N.; asc. 49 ft. over NE. slope.

40.00 Set an iron post, 3 ft. long, 1 in. diam., 26 ins. in the ground, for 1/4 sec. cor. with brass cap marked

S 36
 1/4
 S 1
 1931

from which

A white oak, 10 ins. diam., bears S. 62° E., 19 lks. dist., mkd. 1/4 S 1 B T.

A white oak, 8 ins. diam., bears N. 34° W., 61 lks. dist., mkd. 1/4 S 36 B T.

Ascend 9 ft. over NE. slope.

42.00 Continue along N. slope.

76.70 Point of spur, slopes N.; desc. 31 ft. over NW. slope.

80.00 Set an iron post, 3 ft. long, 2 ins. diam., 18 ins. in the ground to bedrock, and in a mound of stone, to top, for cor. of secs. 1, 2, 35 and 36, with brass cap marked.

T 4 1/2 N R 22 E
 S 35 | S 36
 S 2 | S 1
 T 4 N
 1931

from which

A cedar, 36 ins. diam., bears N. 63 1/2° E., 52 lks. dist., mkd. T 4 1/2 N R 22 E S 36 B T.

A pinon, 10 ins. diam., bears S. 55 1/2° E., 48 lks. dist., mkd. T 4 N R 22 E S 1 B T.

A juniper, 10 ins. diam., bears S. 48 1/4° W., 28 lks. dist., mkd. T 4 N R 22 E S 2 B T.

A white oak, 10 ins. diam., bears N. 35 1/2° W., 38 lks. dist., mkd. T 4 1/2 N R 22 E S 35 B T.

SOUTH BOUNDARY OF T.4 $\frac{1}{2}$ N., R.22 E.

Chains Land, rolling.
 Soil, sandy loam and clay covered with volcanic stones; 2nd and 3rd rates.
 Timber, scattering pine, juniper, pinon and oak; undergrowth, scrub oak and grass.

West, bet. secs. 2 and 35.
 Over rolling mesa land, through scattering timber and undergrowth.

Descend 115 ft. over NW. slope.
 22.50 Draw, course S. 30° W.; asc. 42 ft. over SE. slope.

40.00 Set an iron post, 3 ft. long, 1 in. diam., 26 ins. in the ground, for $\frac{1}{4}$ sec. cor. with brass cap marked.

S 35
 $\frac{1}{4}$ ———
 S 2
 1931

from which

A juniper, 6 ins. diam., bears N. 1° E., 48 lks. dist., mkd.
 $\frac{1}{4}$ S 35 B T.

A juniper, 6 ins. diam., bears S. 25° E., 22 lks. dist., mkd.
 $\frac{1}{4}$ S 2 B T.

Descend 125 ft. over SW. slope.
 43.50 Rock ledge, bears SE. and NW.
 50.76 Wire fence, bears N. 70° E., and S. 70° W.
 69.00 Rocky wash, 75 lks. wide, course S.; asc. 86 ft. over E. slope.

80.00 Set an iron post, 3 ft. long, 2 ins. diam., 10 ins. in the ground to bedrock, and in a mound of stone to top, for cor. of secs. 2, 3, 34 and 35, with brass cap marked.

T 4 $\frac{1}{2}$ N R 22 E
 S 34 | S 35
 S 3 | S 2
 T 4 N
 1931

from which

A yellow pine, 10 ins. diam., bears N. 39° E., 201 lks. dist., mkd. T 4 $\frac{1}{2}$ N R 22 E S 35 B T.

A juniper, 10 ins. diam., bears S. 28 $\frac{1}{2}$ ° E., 30 lks. dist., mkd. T 4 N R 22 E S 2 B T.

A white oak, 18 ins. diam., bears S. 17 $\frac{3}{4}$ ° W., 137 lks. dist., mkd. T 4 N R 22 E S 3 B T.

A juniper, 14 ins. diam., bears N. 71° W., 98 lks. dist., mkd. T 4 $\frac{1}{2}$ N R 22 E S 34 B T.

Land rolling.
 Soil, sandy loam and clay, covered with volcanic stones; 2nd and 3rd rates.
 Timber, scattering pine, oak, pinon and juniper; undergrowth
 Scrub oak and grass.

Chains West, bet. secs. 3 and 34.

Over rolling land, through scattering timber and undergrowth.

Ascend 45. ft. over E. slope.

25.00 Spur, slopes S.; desc. 45 ft. over W. slope.

29.90 Wire fence, bears N. and S.

40.00 Set an iron post, 3 ft. long, 1 in. diam., 12 ins. in the ground to bedrock, and in a mound of stone to top, for 1/4 sec. cor. with brass cap marked.

1/4 S 34
S 3
1931

from which

A cedar, 8 ins. diam., bears S. 44° W., 54 lks. dist., mkd. 1/4 S 3 B T.

A juniper, 10 ins. diam., bears N. 40 3/4° W., 34 lks. dist., mkd. 1/4 S 34 B T.

Continue descending 23 ft. over W. slope.

50.00 Draw, course SE.; asc. 50 ft. over NE. slope.

75.00 Low spur, slopes S.; desc. 11 ft. over W. slope.

80.00 Set an iron post, 3 ft. long, 2 ins. diam., 20 ins. in the ground to bedrock, and in a mound of stone to top, for cor. of secs. 3, 4, 33 and 34, with brass cap marked.

T 4 1/2 N R 22 E
S 33 | S 34
S 4 | S 3
T 4 N
1931

from which

A white oak, 8 ins. diam., bears N. 61 1/2° E., 14 lks. dist., mkd. T 4 1/2 N R 22 E S 34 B T.

A cedar, 10 ins. diam., bears S. 47 1/2° E., 111 lks. dist., mkd. T 4 N R 22 E S 3 B T.

A pinon, 6 ins. diam., bears S. 4 1/4° W., 69 lks. dist., mkd. T 4 N R 22 E S 4 B T.

A juniper, 5 ins. diam., bears N. 49° W., 17 lks. dist., mkd. T 4 1/2 N R 22 E S 33 B T.

Land, rolling.

Soil, sandy loam and clay covered with volcanic stones; 2nd and 3rd rates.

Timber, pine, oak, cedar, pinon and juniper; undergrowth, scrub oak and grass.

West, bet. secs. 4 and 33.

Over rolling land, through scattering timber and undergrowth.

Descend 92 ft. over W. slope.

Chains.	
17.35	Draw, course SW.; asc. 11 ft. over SE. slope.
20.00	Spur, slopes S.; desc. 39 ft. over SW. slope.
40.00	Set an iron post, 3 ft. long, 1 in. diam., 14 ins. in the ground to bedrock, and in a mound of stone to top, for $\frac{1}{4}$ sec. cor. with brass cap marked.
	$\begin{array}{r} S\ 33 \\ \frac{1}{4} \\ \hline S\ 4 \\ 1931 \end{array}$
	from which
	A juniper, 48 ins. diam., bears N.46°E., 105 lks. dist., mkd. $\frac{1}{4}$ S 33 B T.
	A juniper, 6 ins. diam., bears S.1 $\frac{1}{4}$ °W., 75 lks. dist., mkd. $\frac{1}{4}$ S 4 B T.
	Ascend 40 ft. over E. slope.
80.00	Set an iron post, 3 ft. long, 2 ins. diam., 26 ins. in the ground, for cor. of secs. 4, 5, 32 and 33, with brass cap marked.
	$\begin{array}{r} T4\frac{1}{2}N\ R22E \\ S32\ S33 \\ S\ 5\ S\ 4 \\ T4N \\ 1931 \end{array}$
	from which
	A juniper, 24 ins. diam., bears N.76°E., 108 lks. dist., mkd. T 4 $\frac{1}{2}$ N R 22 E S 33 B T.
	A juniper, 14 ins. diam., bears S.15°E., 139 lks. dist., mkd. T 4 N R 22 E S 4 B T.
	A white oak, 14 ins. diam., bears S.23 $\frac{1}{2}$ °W., 54 lks. dist., mkd. T 4 N R 22 E S 5 B T.
	A white oak, 12 ins. diam., bears N.38°W., 51 lks. dist., mkd. T 4 $\frac{1}{2}$ N R 22 E S 32 B T.
	Land, rolling. Soil, sandy loam and clay, covered with volcanic stones; 2nd and 3rd rates. Timber, scattering pine, pinon, cedar and oak; undergrowth, scrub oak and grass.
	West, bet. secs. 5 and 32.
	Over rolling land, through scattering timber and undergrowth.
	Ascend 23 ft. over E. slope.
10.00	Spur, slopes S.; desc. 126 ft. over SW. slope.
29.00	Low ridge, bears NE. and SW.; continue descending 36 ft.
36.70	Head of draw, course NW.; asc. 10 ft. over NE. slope.
40.00	Set an iron post, 3 ft. long 1 in. diam., 28 ins. in the ground, for $\frac{1}{4}$ sec. cor. with brass cap marked.

Chains.

S	32
1/4	—
S	5
	1931

from which

A juniper, 14 ins. diam., bears N. 53 3/4° W., 200 lks. dist., mkd. 1/4 S 32 B T.

A juniper, 12 ins. diam., bears S. 20° W., 59 lks. dist., mkd. 1/4 S 5 B T.

Ascend 63 ft. over NE. slope.

59.00 Spur, slopes N.; desc. 276 ft. over NW. slope.

71.10 Ravine, course SW.

75.40 Spur, slopes S.; continue descending over SW. slope.

80.00 Set an iron post, 3 ft. long, 2 ins. diam., 28 ins. in the ground, for cor. of secs. 5, 6, 31 and 32, with brass cap marked.

T	4 1/2	N	R	22	E
S	31		S	32	
S	6		S	5	
		T	4 1/2		
					1931

from which

A white oak, 8 ins. diam., bears N. 11 1/4° E., 48 lks. dist., mkd. T 4 1/2 N R 22 E S 32 B T.

A white oak, 6 ins. diam., bears S. 40 1/2° E., 78 lks. dist., mkd. T 4 N R 22 E S 5 B T.

A white oak, 6 ins. diam., bears S. 57 1/4° W., 29 lks. dist., mkd. T 4 N R 22 E S 6 B T.

A pinon, 5 ins. diam., bears N. 47° W., 49 lks. dist., mkd. T. 4 1/2 N R 22 E S 31 B T.

Land, rolling.
Spil, clay and rocky; 2nd and 3rd rates.
Timber, scattering pine, oak, pinon and juniper; undergrowth scrub oak and grass.

West, bet. secs. 6 and 31.

Over mountainous land, through scattering timber and dense undergrowth.

Descend 365 ft. over SW. slope.

3.31 Trail, bears SE. and NW.

22.69 Gulch, course NE.; asc. 63 ft. over SE. slope.

26.20 Spur, slopes NE.; desc. 62 ft. over NW. slope.

32.80 Wash, 30 lks. wide, course N.; asc. 61 ft. over E. slope.

40.00 Set an iron post, 3 ft. long, 1 in. diam., 26 ins. in the ground, for 1/4 sec. cor. with brass cap marked.

SOUTH BOUNDARY OF T.4½ N.,R.22 E.

Chains.

S 31
 $\frac{1}{4}$ ———
 S 6
 1931

from which

A black oak, 6 ins.diam., bears S.21½°W., 30 lks.dist.,
 mkd. $\frac{1}{4}$ S 6 B T.

A white oak, 8 ins.diam., bears N.14¼°W., 45 lks.dist.,
 mkd. $\frac{1}{4}$ S 31 B T.

Ascend 17 ft. over broken NE. slope.

60.00 Spur, slopes N.; desc. 95 ft. over NW. slope.

66.00 Ravine, course NW.; asc. 65 ft. over NE. slope.

78.07 Set an iron post, 3 ft. long, 3 ins.diam., 20 ins. in the
 ground to bedrock, and in a mound of stone to top, for
 cor. of Tps. 4 and 4½ N., Rs. 21 and 22 E., with brass cap
 marked.

T 4½ N
 R 21 E R 22 E
 S 36 | S 31
 S 1 | S 6
 T 4 N
 1931

from which

A white oak, 6 ins.diam., bears N.40³/₄°E., 78 lks.dist.,
 mkd. T 4½ N R 22 E S 31 B T.

A juniper, 10 ins.diam., bears S.79¼°E., 45 lks.dist.,
 mkd. T 4 N R 22 E S 6 B T.

A juniper, 6 ins.diam., bears S.47½°W., 47 lks.dist., mkd.
 T 4 N R 21 E S 1 B T.

A juniper, 12 ins.diam., bears N.56½°W., 49 lks.dist.,
 mkd. T 4½ N R 21 E S 36 B T.

Land mountainous.
 Soil, rocky; 3rd rate.
 Timber scattering pine, juniper, pinon oak and hackberry;
 undergrowth scrub oak, willow and grass.

WEST BOUNDARY OF T.4½ N.,R.22 E.

Beginning at the cor. of Tps. 4 and 4½ N., Rs. 21 and 22 E.,
 hereinbefore described, thence,
 North, bet. secs. 31 and 36.

Over mountainous land, through scattering timber and dense
 undergrowth.

Descend 354 ft. over steep brushy N. slope.

0.56 Trail, bears NE. and SW.

14.68 Wash, 100 lks. wide, course W.; asc. 577 ft. over SW. slope.

40.00 Set an iron post, 3 ft. long, 1 in.diam., 20 ins. in the
 ground to bedrock, and in a mound of stone to top, for
 $\frac{1}{4}$ sec. cor. with brass cap marked

Chains	$\frac{1}{4}$ S36 S31 1931 from which A pinon, 6 ins. diam., bears S. 43 $\frac{3}{4}$ ° E., 25 lks. dist., mkd. $\frac{1}{4}$ S 31 B T. A pinon, 12 ins. diam., bears N. 67° W., 69 lks. dist., mkd. $\frac{1}{4}$ S 36 B T. Ascend 76 ft. over SW. slope. 43.90 Ridge, bears E. and W.; desc. 578 ft. over N. slope. 80.00 Set an iron post, 3 ft. long, 2 ins. diam., 26 ins. in the ground, for cor. of secs. 25, 30, 31 and 36, with brass cap marked. T 4 $\frac{1}{2}$ N R21E R22E S25 S30 S36 S31 1931 from which A juniper, 5 ins. diam., bears N. 26 $\frac{1}{2}$ ° E., 117 lks. dist., mkd. T 4 $\frac{1}{2}$ N R 22 E S 30 B T. A juniper, 4 ins. diam., bears S. 16° E., 159 lks. dist., mkd. T 4 $\frac{1}{2}$ N R 22 E S 31 B T. A juniper, 3 ins. diam., bears S. 37 $\frac{1}{2}$ ° W., 115 lks. dist., mkd. BT only. A juniper, 4 ins. diam., bears N. 21 $\frac{1}{4}$ ° W., 244 lks. dist., mkd. T 4 $\frac{1}{2}$ N R 21 E S 25 B T. Land, mountainous. Soil, rocky; 4th rate. Timber, scattering pine, juniper oak and hackberry; undergrowth, scrub oak, maple, manzanita and grass. <hr/> North, bet. secs. 25 and 30. Over mountainous land, through scattering timber and undergrowth. Descend 114 ft. over gradual N. slope. 15.00 Corral, bears W. about 7.00 chs. dist. 27.00 Top of rim rocks, 50 ft. high, bears NE. and SW.; desc. 188 ft. over N. slope. 35.00 Left bank of White River, course SW. 36.71 Right bank of White River.; asc. 48 ft. over SE. slope. 40.00 Set an iron post, 3 ft. long, 1 in. diam., 26 ins. in the ground, for $\frac{1}{4}$ sec. cor. with brass cap marked $\frac{1}{4}$ S25 S30 1931 from which
--------	--

Chains
 A cedar, 14 ins. diam., bears N. 31³/₄° E., 55 lks. dist., mkd. ¹/₄ S 30 B T.
 A cedar, 20 ins. diam., bears S. 42° W., 66 lks. dist., mkd. ¹/₄ S 25 B T.
 Ascend 188 ft. over SE. slope.
 40.97 Top of cliff, 30 ft. high, bears NE. and SW.
 42.00 Trail, bears E. and W.
 51.31 Trail, bears E. and W.
 54.90 Red spur, slopes SE.; desc. 40 ft. over NE. slope.
 58.76 Ravine, course SE.; asc. 301 ft. over SW. slope.
 80.00 Set an iron post, 3 ft. long, 2 ins. diam., 12 ins. in the ground to bedrock, and in a mound of stone to top, for cor. of secs. 19, 24, 25 and 30, with brass cap marked.

T 4½ N	
R 21 E	R 22 E
S 24	S 19
S 25	S 30
1931	

from which

A pinon, 6 ins. diam., bears N. 42° E., 18 lks. dist., mkd. T 4½ N R 22 E S 19 B T.
 A pinon, 10 ins. diam., bears S. 23° E., 135 lks. dist., mkd. T 4½ N R 22 E S 30 B T.
 A cedar, 14 ins. diam., bears S. 51° W., 19 lks. dist., mkd. T 4½ N R 21 E S 25 B T.
 A cedar, 5 ins. diam., bears N. 30½° W., 47 lks. dist., mkd. T 4½ N R 21 E S 24 B T.

Land, mountainous.
 Soil, rocky; 4th rate.
 Timber, scattering pine, cedar, oak, pinon and hackberry; undergrowth, scrub oak and grass.

North, bet. secs. 19 and 24.

Over mountainous land, through scattering timber and undergrowth.

Ascend 215 ft. along E. slope.

10.70 Head of ravine, course SE.; continue ascending.
 12.00 Head of ravine, course SE.
 29.00 Ridge, bears NE. and SW.; desc. 113 ft. over NW. slope.
 40.00 Set an iron post, 3 ft. long, 1 in. diam., 28 ins. in the ground for ¹/₄ sec. cor. with brass cap marked.

¹ / ₄	
S 24	S 19
1931	

from which

Chains

A pinon, 8 ins.diam., bears S.65°E., 13 lks.dist., mkd.
¼ S19 B T.

A cedar, 12 ins.diam., bears S.80½°W., 33 lks.dist., mkd.
¼ S 24 B T.

Descend 10 ft. over NW.slope.

41.00 Wash, 20 lks.wide, course SW.; asc. 193 ft. over SW.slope.

47.70 Same wash, course SE.; asc. SW.slope.

56.00 Spur, slopes W.

59.14 Same wash, course SW.; continue ascending.

63.00 Low saddle on ridge, bears E. and W.; desc. 51 ft. over NE.slope.

67.35 Ravine, course NW.; asc. 63 ft. over SW.slope.

70.30 Spur, slopes W.; desc. 20 ft. over N.slope.

71.25 Wash, 20 lks.wide, course W.; asc. 171 ft. over SW.slope.

80.00 Set an iron post, 3 ft. long, 2 ins.diam., 28 ins. in the ground, for cor. of secs. 13, 18, 19. and 24, with brass cap marked.

T4½N
R21E R22E
S13 | S18
S24 | S19
1931

from which

A pinon, 6 ins.diam., bears N.58°E., 64 lks.dist., mkd.
T 4½ N R 22 E S 18 B T.

A pinon, 10 ins.diam., bears S.50¼°E., 103 lks.dist., mkd.
T 4½ N R 22 E S 19 B T.

A cedar, 14 ins.diam., bears S.64½°W., 90 lks.dist., mkd.
T 4½ N R 21 E S 24 B T.

A cedar, 6 ins.diam., bears N.64½°W., 47 lks.dist., mkd.
T 4½ N R 21 E S 13 B T.

Land, mountainous.
Soil, rocky; 4th rate.
Timber, pine, fir, cedar, pinon and juniper; undergrowth, scrub oak, manzanita, and grass.

North, bet. secs. 13. and 18.

Over mountainous land, through scattering timber and undergrowth.

Ascend 15 ft. over SW.slope.

1.00 Ridge, bears E. and W.; desc. 240 ft. over N.slope.

14.60 Wash. 20 lks.wide, course W.; asc. 63 ft. over SW.slope.

19.50 Spur, slopes W.; desc. 12 ft. over NW.slope.

25.44 Rocky ravine, course SW.; asc. 139 ft. over SE.slope, formation of red clay and lava rocks.

Chains.
 30.87 Spur, slopes W.; desc. 59 ft. over NW. slope.
 38.67 Intersect the First Standard Parallel North.
 Set an iron post, 3 ft. long, 3 ins. diam., 26 ins. in the ground, for closing cor. of Tps. 4½ N., Rs. 21 and 22 E., with brass cap marked.

T5NR21E	
S 35	
S13	S18
R21E	R22E
T4½N	
CC	
1931	

from which

A pinon, 6 ins. diam., bears S. 50° E., 36 lks. dist., mkd. T 4½ N R 22 E S 18 C C B T.

A pinon, 5 ins. diam., bears S. 67½° W., 38 lks. dist., mkd. T 4½ N R 21 E S 13 C C B T.

From point of intersection the standard cor. of secs. 34 and 35, T. 5 N., R. 21 E., hereinbefore described, bears West, 15.85 chs. dist.

From the same point the standard ¼ sec. cor. of sec. 35, T. 5 N., R. 21 E., hereinbefore described, bears East, 24.15 chs. dist.

Land, mountainous.
 Soil, sandy, clay and rocky; 3rd and 4th rates.
 Timber, scattering juniper, pine, fir, pinon and oak; undergrowth scrub oak, manzanita, mahogany and grass.

SUBDIVISIONS OF T.4½ N.,R.22 E.

Commence the subdivisional survey at the cor. of secs. 1, 2, 35 and 36, on the S. bdy. of the Tp., hereinbefore described, Thence,

N. 0° 1' W., bet. secs. 35 and 36.

Over rolling land, through scattering timber and undergrowth.

Descend 176 ft. over N. slope.

16.24 Wire fence, bears N. 70° E., and S. 70° W.

33.00 Wash, 10 lks. wide, course NW.

36.87 Wash, 50 lks. wide, course SW.; asc. 32. ft. over SE. slope.

40.00 Set an iron post, 3 ft. long, 1 in. diam., 26 ins. in the ground, for ¼ sec. cor. with brass cap marked.

¼	
S35	S36
1931	

from which

A yellow pine, 6 ins. diam., bears S. 87½° E., 98 lks. dist., mkd. ¼ S 36 B T.

A yellow pine, 36 ins. diam., bears N. 19° W., 30 lks. dist., mkd. ¼ S 35 B T.

Chains
 60.00 Draw, course SE.; asc. 69 ft. over S. slope.
 75.00 Spur, slopes SW.
 80.00 Set an iron post, 3 ft. long, 2 ins. diam., 26 ins. in the ground, for cor. of secs. 25, 26, 35 and 36, with brass cap marked:

T 4½ N R 22 E
 S 26 | S 25
 S 35 | S 36
 1931

from which

A juniper, 36 ins. diam., bears N. 65½° E., 29 lks. dist., mkd. T 4½ N R 22 E S 25 B T.

A white oak, 14 ins. diam., bears S. 34½° E., 133 lks. dist., mkd. T 4½ N R 22 E S 36 B T.

A white oak, 14 ins. diam., bears S. 74½° W., 72 lks. dist., mkd. T 4½ N R 22 E S 35 B T.

A juniper, 6 ins. diam., bears N. 39° W., 176 lks. dist., mkd. T 4½ N R 22 E S 26 B T.

Land, rolling.

Soil, sandy loam and clay covered with volcanic stones; 2nd and 3rd rates.

Timber, scattering, pine, pinon, juniper and oak; undergrowth, Scrub oak, mahogany and grass.

East, on a random line, bet. secs. 25 and 36

40.00 Set temp. ¼ sec. cor.

80.08 Intersect E. bdy. of the Tp. at the cor. of secs. 25, 30, 31 and 36, described in Book "B" of this group

Thence

West on a true line, bet. secs. 25 and 36.

Over rolling land, through scattering timber and undergrowth.

Ascend 17 ft. over SE. slope.

10.00 Spur, slopes SW.; desc. 93 ft. along SW. slope.

36.00 Leave scattering timber; enter prairie land.

40.04 Set an iron post, 3 ft. long, 1 in. diam., 28 ins. in the ground, for ¼ sec. cor. with brass cap marked.

S 25

S 36
1931

from which

A juniper, 16 ins. diam., bears N. 36¾° E., 45¼ lks. dist., mkd. S 25 B T.

A white oak, 16 ins. diam., bears S. 83° E., 411 lks. dist., mkd. S 36 B T.

65.00 Leave prairie, enter scattering timber.

Chains	Ascend 28 ft. over gradual SE. slope.
76.00	Spur, slopes S.; desc. 29 ft. over W. slope.
80.08	The cor. of secs. 25, 26, 35 and 36. Land, rolling. Soil, clay covered with volcanic stones; 3 rd rate. Timber, scattering pine, cedar, pinon, oak and juniper; undergrowth, mahogany, manzanita, scrub oak, chamisal and grass.
	N. 0° 1' W., bet. secs. 25 and 26. Over rolling land, through scattering timber and undergrowth. Ascend 90 ft. along W. slope.
24.30	Ridge, bears NE. and SW.
25.50	Top of rim rocks, 30 ft. high, bears NE. and SW.; desc. 175 ft. over NW. slope.
40.00	Set an iron post, 3 ft. long, 1 in. diam., 26 ins. in the ground, for $\frac{1}{4}$ sec. cor. with brass cap marked. $\frac{1}{4}$ S26 S25 1931 from which A pinon, 10 ins. diam., bears S. 35 $\frac{1}{2}$ ° E., 167 lks. dist., mkd. $\frac{1}{4}$ S 25 B T. A yellow pine, 20 ins. diam., bears S. 32 $\frac{1}{2}$ ° W., 198 lks. dist., mkd. $\frac{1}{4}$ S 26 B T. Descend 262 ft. over NW. slope.
61.40	Spur, slopes NW.; continue descending over N. slope.
74.30	Trail, bears NE. and SW.
78.90	Drain, course NW.
80.00	Set an iron post, 3 ft. long, 2 ins. diam., 26 ins. in the ground, for cor. of secs. 23, 24, 25 and 26, with brass cap marked. T 4 $\frac{1}{2}$ N R 22 E. S23 S24 S26 S25 1931 from which A pinon, 8 ins. diam., bears N. 54 $\frac{3}{4}$ ° E., 51 lks. dist., mkd. T 4 $\frac{1}{2}$ N R 22 E S 24 B T. A pinon, 6 ins. diam., bears S. 74 $\frac{1}{2}$ ° E., 35 lks. dist., mkd. T 4 $\frac{1}{2}$ N R 22 E S 25 B T. A cedar, 14 ins. diam., bears S. 49 $\frac{1}{4}$ ° W., 55 lks. dist., mkd. T 4 $\frac{1}{2}$ N R 22 E S 26 B T. A pinon, 8 ins. diam., bears N. 41 $\frac{1}{4}$ ° W., 29 lks. dist., mkd. T 4 $\frac{1}{2}$ N R 22 E S 23 B T. Land, rolling. Soil, rocky; 3 rd rate. Timber, pine, juniper, oak and pinon; undergrowth, scrub oak, mahogany and grass.

Chains . East, on a random line, bet. secs. 24 and 25.

40.00 Set temp. $\frac{1}{4}$ sec. cor.

80.29 Intersect E. bdy. of Tp. 26 lks. S. of the cor. of secs. 19, 24, 25 and 30, described in Book "B" of this group

Thence

S. 89° 49' W., on a true line, bet. secs. 24 and 25.

Over rolling land, through scattering timber and undergrowth.

25.00 Descend 33 ft. over gradual W. slope.

39.50 Set an iron post, 3 ft. long, 1 in. diam., 16 ins. in the ground to bedrock, and in a mound of stone to top, for witness $\frac{1}{4}$ sec. cor. with brass cap marked

$$\begin{array}{r} \text{WC } \frac{1}{4} \text{ S } 24 \\ \hline \text{S } 25 \\ 1931 \end{array}$$

from which

A juniper, 36 ins. diam., bears S. 52 $\frac{1}{2}$ ° E., 33 lks. dist., mkd. W C $\frac{1}{4}$ S 25 B T.

A pinon, 16 ins. diam., bears N. 26 $\frac{1}{2}$ ° W., 20 lks. dist., mkd. W C $\frac{1}{4}$ S 24 B T.

39.95 Top of rim rock, 50 ft. high, bears NE. and SW.

40.15 True point for $\frac{1}{4}$ sec. cor. falls on W. face of rim rocks.

Descend 437 ft. over broken W. slope, through scattering timber and dense undergrowth.

80.29 The cor. of secs. 23, 24, 25 and 26.

Land, rolling and mountainous.
Soil, sandy loam and clay, covered with volcanic stones; 2nd and 3rd rates.
Timber, pine, fir, cedar, pinon and oak; undergrowth scrub oak, mahogany, manzanita, willow and bear grass.

N. 0° 1' W., bet. secs. 23 and 24.

Over mountainous land, through scattering timber and dense undergrowth.

Descend 68 ft. over broken NW. slope.

22.80 Low spur, slopes NW.; desc. 107 ft. over NE. slope.

37.20 Ravine, course NE.; asc. 9 ft. over SW. slope.

38.50 Spur, slopes NW.; desc. 12 ft. over NE. slope.

40.00 Set an iron post, 3 ft. long, 1 in. diam., 26 ins. in the ground, for $\frac{1}{4}$ sec. cor. with brass cap marked.

$$\begin{array}{r} \frac{1}{4} \\ \text{S } 23 \mid \text{S } 24 \\ 1931 \end{array}$$

from which

Chains	A pinon, 5 ins. diam., bears S.20°E., 117 lks. dist., mkd. $\frac{1}{4}$ S 24 B T.								
	A pinon, 5 ins. diam., bears S.14°W., 157 lks. dist., mkd. $\frac{1}{4}$ S 23 B T.								
	Descend 7 ft. over NE. slope.								
40.40	Wash, 10 lks. wide, course N.80°W.; asc. 55 ft. over SW. slope.								
46.00	Spur, slopes W.; desc. 63 ft. over NW. slope.								
51.00	Head of ravine, course W.; asc. 61 ft. over SW. slope.								
56.40	Spur, slopes W.; desc. 207 ft. over NW. slope.								
69.48	Ravine, course W.; asc. 10 ft. over SW. slope.								
73.60	Spur, slopes NW.; desc. 52 ft. over NE. slope.								
80.00	Set an iron post, 3 ft. long, 2 ins. diam., 26 ins. in the ground, for cor. of secs. 13, 14, 23 and 24, with brass cap marked								
	<table border="1"> <tr><td>T4$\frac{1}{2}$N</td><td>R22E</td></tr> <tr><td>S14</td><td>S13</td></tr> <tr><td>S23</td><td>S24</td></tr> <tr><td colspan="2">1931</td></tr> </table>	T4 $\frac{1}{2}$ N	R22E	S14	S13	S23	S24	1931	
T4 $\frac{1}{2}$ N	R22E								
S14	S13								
S23	S24								
1931									
	from which								
	A pinon, 6 ins. diam., bears N.43 $\frac{3}{4}$ °E., 68 lks. dist., mkd. T 4 $\frac{1}{2}$ N R 22 E S 13 B T.								
	A pinon, 3 ins. diam., bears S.55°E., 158 lks. dist., mkd. B T only.								
	A cedar, 8 ins. diam., bears S.48 $\frac{3}{4}$ °W., 51 lks. dist., mkd. T 4 $\frac{1}{2}$ N R 22 E S 23 B T.								
	A cedar, 10 ins. diam., bears N.33°W., 130 lks. dist., mkd. T 4 $\frac{1}{2}$ N R 22 E S 14 B T.								
	Land, mountainous. Soil, rocky; 4th rate. Timber, scattering pine, fir, cedar, pinon and oak; undergrowth, scrub oak, manzanita, mahogany, willow and bear grass.								
	N.89°49'E., on a random line, bet. secs. 13 and 24.								
40.00	Set temp. $\frac{1}{4}$ sec. cor.								
80.15	Intersect E. bdy. of Tp. 16 lks. N. of the cor. of secs. 13, 18, 19 and 24, described in Book "B" of this group.								
	Thence								
	S.89°56'W., on a true line, bet. secs. 13 and 24.								
	Over mountainous land, through heavy timber and undergrowth.								
	Descend 47 ft. over NW. slope.								
2.08	Ravine, course N.; asc. 30 ft. over E. slope.								
5.20	Spur, slopes N.; also trail, bears SE. and NW.								
9.20	Old road, bears SE. and NW.								

Chains	
10.95	Ravine, course N.; asc. 41 ft. over NE. slope.
16.20	Spur, slopes N.; desc. 43 ft. over NW. slope.
19.29	Ravine, course N. 10° E.; asc. 94 ft. over E. slope.
24.00	Old road, bears N. and S.
24.70	Spur, slopes N. desc. 181 ft. over NW. slope.
30.80	Wash, 30 lks. wide, course N. 80° W.; asc. 3 ft.
35.30	Spur, slopes NW.; desc. 70 ft. over SW. slope.
40.07	Set an iron post, 3 ft. long, 1 in. diam., 20 ins. in the ground to bedrock and on a mound of stone to top, for ¼ sec. cor. with brass cap marked.
	$\begin{array}{r} S\ 13 \\ \frac{1}{4} \\ S\ 24 \\ 1931 \end{array}$
	from which
	A pinon, 8 ins. diam., bears N. 46½° E., 31 lks. dist., mkd. ¼ S 13 B T.
	A pinon, 10 ins. diam., bears S. 8° W., 72 lks. dist., mkd. ¼ S 24 B T.
	Descend 19 ft. over SW. slope.
40.85	Ravine, course N.; asc. 176 ft. over E. slope.
46.80	Spur, slopes N.; desc. 56 ft. over W. slope.
69.40	Ravine, course N.; asc. 22 ft. over NE. slope.
73.30	Spur, slopes N.; desc. 39 ft. over broken NW. slope.
80.15	The cor. of secs. 13, 14, 23 and 24.
	Land, mountainous. Soil, rocky; 4th rate. Timber, pine, fir, cedar, pinon, oak, and juniper; undergrowth, scrub oak, manzanita, mahogany, chamisal and bear grass.
	N. 0° 1' W., bet. secs. 13 and 14.
	Over mountainous land, through heavy timber and scattering undergrowth.
1.73	Intersect boundary of Theodore Roosevelt Indian School.
	Set an iron post, 3 ft. long, 2 ins. diam., 26 ins. in the ground, for closing cor. of secs. 13 and 14, with brass cap marked.
	$\begin{array}{r} T\ R\ I\ S \\ S14\ S13 \\ \hline S14\ S13 \\ T4\frac{1}{2}\ N\ R22\ E \\ C\ C \\ 1931 \end{array}$
	from which

Chains.

A pinon, 6 ins. diam., bears S. 57 $\frac{1}{2}$ ^o E., 131 lks. dist., mkd.
T. 4 $\frac{1}{2}$ N R 22 E S. 13 C C B T.

A pinon, 6 ins. diam., bears S. 32 $\frac{3}{4}$ ^o W., 50 lks. dist., mkd.
T. 4 $\frac{1}{2}$ N R 22 E S 14 C C B T.

From point of intersection the 8 $\frac{1}{2}$ mile mon. of T.R.I.S. bdy. bears N. 68 $^{\circ}$ 34' E., 10.75 chs. dist., an iron post, 1 in. diam., 12 ins. above ground, mkd. and witnessed as described in the official record.

additionally mark this mon. to read

8 $\frac{1}{2}$ M.
TRIS
S 13
T4 $\frac{1}{2}$ NR22E
1929-31

From the same point the witness cor. to 8 mile point of T.R.I.S. bdy. bears S. 68 $^{\circ}$ 34' W., 29.75 chs. dist., an iron post, 2 ins. diam., 10 ins. above ground, mkd. and witnessed as described in the official record.

additionally mark this mon. to read

8 M
WC TRIS
S 23
T4 $\frac{1}{2}$ NR22E
1929-31

2.66 Old road, bears SE. and NW.; on spur, slopes NW.; desc. 416 ft. over NE. slope.

17.00 Old road, bears SE. and NW.

33.00 Bridge across wash, 30 lks. wide, course N. 80 $^{\circ}$ W.; also telephone line and road, bearing NE. and SW.

33.65 Wire fence, bears NE. and SW.; asc. 38 ft. over SE. slope.

37.40 Low ridge, bears NE. and SW.

38.77 Intersect First Standard Parallel North.

Set an iron post, 3 ft. long, 2 ins. diam., 26 ins. in the ground, for closing cor. of secs. 13 and 14, with brass cap marked.

T5NR22E
S 34
S14 | S13
T4 $\frac{1}{2}$ N | R22E
C C
1931

from which

A pinon, 4 ins. diam., bears S. 4 $\frac{1}{2}$ ^o E., 64 lks. dist., mkd.
T. 4 $\frac{1}{2}$ N R 22 E S 13 C C B T.

A white oak, 6 ins. diam., bears S. 41^o W., 30 lks. dist., mkd.
T. 4 $\frac{1}{2}$ N R 22 E S 14 C C B T.

From point of intersection the standard cor. of secs. 33 and 34, T. 5 N., R. 22 E., bears West, 13.68 chs. dist., an iron post, 2 ins. diam., 12 ins. above ground, mkd. and witnessed as described in the official record.

Chains From the same point, the standard $\frac{1}{4}$ sec. cor. on S. bdy. of sec. 34, T.5 N., R.22 E., bears East, 26.32 chs. dist., an iron post, 1 in. diam., 12 ins. above ground, mkd. and witnessed as described in the official record.

Land, mountainous.
Soil, rocky; 4th rate.
Timber, pine, fir, cedar, pinon and juniper; undergrowth, scrub oak, manzanita, mahogany, second growth juniper and bear grass.

From the cor. of secs. 2, 3, 34 and 35 on the S. bdy. of the Tp., hereinbefore described;

N.0°1'W., bet. secs. 34 and 35.

Over rolling mesa land, through scattering timber and undergrowth.

Descend 70 ft. over NE. slope.

17.74 Draw, course E.; asc. 52 ft. over S. slope.

25.00 Spur, slopes SE.; desc. 23 ft. over NE. slope.

32.80 Draw, course SE.; asc. 37 ft. over S. slope.

33.70 Trail, bears N.70°E. and S.70°W.

40.00 Set an iron post, 3 ft. long, 1 in. diam., 12 ins. in the ground to bedrock, and in a mound of stone to top, for $\frac{1}{4}$ sec. cor. with brass cap marked.

$\frac{1}{4}$
S34 | S35
1931

from which

A pinon, 10 ins. diam., bears N.60 $\frac{1}{2}$ °E., 46 lks. dist., mkd. $\frac{1}{4}$ S 35 B T.

A yellow pine, 20 ins. diam., bears N.48°W., 60 lks. dist., mkd. $\frac{1}{4}$ S 34 B T.

Ascend 84 ft. over S. slope.

48.40 Low spur, slopes SE.; continue along SE. slope.

68.75 Wire fence, bears SE. and W.

69.10 Leave mesa, bears SE. and NW.; desc. 321 ft. over steep N. slope, through heavy timber and scattering undergrowth.

76.66 Trail, bears E. and W.

80.00 Set an iron post, 3 ft. long, 2 ins. diam., 30 ins. in the ground, for cor. of secs. 26, 27, 34 and 35, with brass cap marked.

T4 $\frac{1}{2}$ N R22E
S27 | S26
S34 | S35
1931

from which

- Chains
- A cedar, 14 ins.diam., bears N.10 $\frac{1}{2}$ °E., 37 lks.dist., mkd.
T 4 $\frac{1}{2}$ N R 22 E S 26 B T.
- A yellow pine, 6 ins.diam., bears S.18 $\frac{1}{2}$ °E., 57 lks.dist.,
mkd. T 4 $\frac{1}{2}$ N R 22 E S 35 B T.
- A white oak, 6 ins.diam., bears S.28 $\frac{3}{4}$ °W., 132 lks.dist.,
mkd. T 4 $\frac{1}{2}$ N R 22 E S 34 B T.
- A pinon, 5 ins.diam., bears N.2; $\frac{1}{2}$ °W., 47 lks.dist., mkd.
T 4 $\frac{1}{2}$ N R 22 E S 27 B T.

Land, rolling and mountainous.
Soil, clay and rocky; 2nd and 3rd rates.
Timber pine, pinon, cedar, juniper and oak; undergrowth, scrub
oak, bear grass, cactus and grass.

East, on a random line, bet. secs. 26 and 35.

40.00 Set temp. $\frac{1}{4}$ sec. cor.

80.04 Intersect N. and S. line, 4 lks. S. of the cor. of secs. 25, 26,
35 and 36.

Thence

S. 89° 58' W., on a true line, bet. secs. 26 and 35.

Over rolling mesa land, through scattering timber and under-
growth.

Ascend 115 ft. over SE. slope.

35.39 Leave mesa, bears NE. and SW.; desc. 112 ft. over brushy NW.
slope.

39.90 Foot of rimrocks, 20 ft. high, bears N. and S.

40.02 Set an iron post, 3 ft. long, 1 in. diam., 26 ins. in the
ground, for $\frac{1}{4}$ sec. cor. with brass cap marked.

S 26

$\frac{1}{4}$ —

S 35

1931

from which

An oak, 6 ins.diam., bears S. 41° W., 129 lks. dist., mkd.
 $\frac{1}{4}$ S 35 B T.

An oak, 5 ins.diam., bears N. 20 $\frac{1}{4}$ ° W., 40 lks. dist., mkd. $\frac{1}{4}$
S 26 B T.

Descend 184 ft. over brushy NW. slope.

58.00 Wash, 10 lks. wide, course NW.

60.64 Trail, bears NE. and SW.; continue descending along broken
N. slope.

63.00 Ascend 75 ft. over NE. slope.

77.54 Head of draw, course NE.; continue ascending.

80.04 The cor. of secs. 26, 27, 34 and 35.

Land, rolling and mountainous.
Soil, clay and rocky; 2nd and 3rd rates.
Timber, pine, oak, juniper, pinon and cedar; undergrowth, scrub
oak, mahoganr and bear grass.

Chains	N.0°1'W., bet. secs. 26 and 27.
	Over mountainous land, through scattering timber and dense undergrowth.
	Descend 103 ft. over NE. slope.
13.60	Trail, bears SE. and NW.
19.10	Ravine, course NE.; asc. 19 ft. over SW. slope.
20.65	Spur, slopes NW.; desc. 169 ft. over N. slope.
40.00	Set an iron post, 3 ft. long, 1 in. diam., 26 ins. in the ground, for 1/4 sec. cor. with brass cap marked.
	1/4 S27 S26 1931
	from which
	A pinon, 6 ins. diam., bears N. 62° E., 52 lks. dist., mkd. 1/4 S 26 B T.
	A pinon, 8 ins. diam., bears S. 18 1/2° W., 32 lks. dist., mkd. 1/4 S 27 B T.
	Descend 77 ft. over N. slope.
51.50	Ravine, course W.; asc. 9 ft. over SW. slope.
54.20	Spur, slopes W.; desc. 179 ft. over NW. slope.
56.70	Same ravine, course NE.; asc. 11 ft. over SE. slope.
57.70	Point of spur, slopes E.; desc. 129 ft. over SE. slope.
65.36	Same ravine, course NW.
68.60	Same ravine, course NE.
69.70	Same ravine, course NW.
74.70	Bend in ravine, course NW. from SW.
76.40	Same ravine, course NE.
80.00	Set an iron post, 3 ft. long, 2 ins. diam., 26 ins. in the ground, for cor. of secs. 22, 23, 26 and 27, with brass cap marked.
	T 4 1/2 N R 22 E S22 S23 S27 S26 1931
	from which
	A pinon, 10 ins. diam., bears N. 38° E., 94 lks. dist., mkd. T 4 1/2 N R 22 E S 23 B T.
	A pinon, 8 ins. diam., bears S. 30 3/4° E., 31 lks. dist., mkd. T 4 1/2 N R 22 E S 26 B T.
	A cedar, 6 ins. diam., bears S. 69 3/4° W., 20 lks. dist., mkd. T 4 1/2 N R 22 E S 27 B T.
	A pinon, 10 ins. diam., bears N. 9° W., 71 lks. dist., mkd. T 4 1/2 N R 22 E S 22 B T.

Chains.	Land, mountainous. Soil, rocky; 4th rate. Timber, pine, cedar, pinon, oak and juniper; undergrowth, scrub oak, mahogany, manzanita and bear grass.
	N. 89° 58' E., on a random line, bet. secs. 23 and 26.
40.00	Set temp. $\frac{1}{4}$ sec. cor.
79.88	Intersect N. and S. line, 24 lks. N. of the cor. of secs. 23, 24, 25 and 26.
	Thence
	N. 89° 52' W., on a true line, bet. secs. 23 and 26.
	Over mountainous land, through scattering timber and undergrowth.
	Descend 235 ft. over broken NW. slope.
23.90	Wash, 20 lks. wide, course SW.; asc. 12 ft. over NE. slope.
26.40	Same wash, course NW.; asc. NE. slope.
32.25	Ravine, course NW.
34.30	Low spur, slopes NW.; desc. SW. slope.
38.47	Gulch, course NW.
39.75	Point of spur, slopes N.
39.94	Set an iron post, 3 ft. long, 1 in. diam., 26 ins in the ground, for $\frac{1}{4}$ sec. cor. with brass cap marked.
	$\begin{array}{r} \frac{1}{4} \text{ S } 23 \\ \hline \text{S } 26 \\ 1931 \end{array}$
	from which
	A fir, 12 ins. diam., bears N. 7° E., 24 lks. dist., mkd. $\frac{1}{4}$ S 23 B T.
	A fir, 10 ins. diam., bears S. 34 $\frac{3}{4}$ ° W., 48 lks. dist., mkd. $\frac{1}{4}$ S 26 B T.
	Descend 27. ft. over SW. slope.
42.00	Bend in same gulch, course N. from NE.
43.60	Continue along N. slope.
53.80	Descend 73 ft. over W. slope.
59.20	Ravine, course N.; asc. 81 ft. over E. slope.
68.80	Spur, slopes N.; desc. 159 ft. over broken N. slope.
75.48	Wash, 20 lks. wide course NW.; asc. 32 ft. over NE. slope.
77.30	Spur, slopes N.; desc. 47 ft. over W. slope.
78.85	Gulch, 50 lks. wide, course N.; asc. 24 ft. over NE. slope.
79.88	The cor. of secs. 22, 23, 26 and 27.
	Land, mountainous.

Chains.	Soil, clay and rocky; 2nd and 3rd rates. Timber, pine, fir, cedar, oak, pinon and juniper; undergrowth, scrub oak, mahogany, manzanita, willow and bear grass.
	N.0°1'W., bet. secs. 22 and 23. Over mountainous land, through scattering timber and dense undergrowth. Descend 127 ft. over NE. slope.
13.94	Wash, 20 lks. wide, course NW.; asc. 56 ft. over SW. slope.
23.20	Spur, slopes W.; desc. 8 ft. over N. slope.
24.20	Trail, bears E. and W.
29.80	Ravine, course W.; asc. 45 ft. over S. slope.
33.20	Spur, slopes W.; desc. 104 ft. over N. slope.
39.35	Road, bears SE. and NW.
40.00	Set an iron post, 3 ft. long, 1 in. diam., 26 ins. in the ground, for $\frac{1}{4}$ sec. cor. with brass cap marked.
	$\frac{1}{4}$ S22 S23 1931 from which A pinon, 5 ins. diam., bears S. 35 $\frac{1}{2}$ ° E., 109 lks. dist., mkd. $\frac{1}{4}$ S 23 B T. A cedar, 8 ins. diam., bears S. 66 $\frac{3}{4}$ ° W., 135 lks. dist., mkd. $\frac{1}{4}$ S 22 B T. Descend 69 ft. over NE. slope.
64.24	Road, bears E. and W.; leave mountainous land, continue over level land.
64.58	Fence, bears E. and W.; enter cultivated field.
68.24	Fence, bears E. and W.; enter apple orchard.
71.94	Fence, bears E. and W.; leave apple orchard.; NW. cor. of garage bears E. 2 lks. dist.
72.67	NW. cor. of house, bears S. 53 $\frac{1}{2}$ ° E. 164 lks. dist. NE. cor. of Cannon Day School, bears S. 39° 35' E., 318 lks. dist. Well and windmill, bears S. 27° 15' E., 192 lks. dist. Pipe at water tank, bears S. 20° 52' E., 174 lks. dist. SE. cor. of barn, bears N. 84 $\frac{1}{2}$ ° W., 47 lks. dist.
72.91	NW. cor. of barn, on line.; desc. 20 ft. over N. slope into river bottom.
73.09	Fence, bears E. and W.
77.37	Fence, bears E. and W.
77.66	Left bank of White River, course SW.
79.16	Right bank of channel of White River, course SW.
80.00	True point for cor. of secs. 14, 15, 22 and 23, falls on river sandbar, subject to overflow.

Chains Land, mountainous and level.
Soil, sandy loam and rocky; 1st and 3rd rates.
Timber, pine, fir, cedar, pinon and oak; undergrowth, scrub oak, manzanita, mahogany, second growth juniper and grass.

Thence From true point for cor. of secs. 14, 15, 22 and 23,
S. 89° 52' E., on a random line, bet. secs. 14 and 23.

40.00 Set temp. ¼ sec. cor.

80.06 Intersect N. and S. line, 16 lks. S. of the cor. of secs. 13, 14, 23 and 24.

Thence

N. 89° 59' W., on a true line, bet. secs. 14 and 23.

Over mountainous land, through scattering timber and dense undergrowth.

Descend 82 ft. over NW. slope.

4.42 Intersect boundary of Theodore Roosevelt Indian School.

Set an iron post, 3 ft. long, 2 ins. diam., 26 ins. in the ground for closing cor. of secs. 14 and 23, with brass cap marked.

	S14	/	S14	C
TRIS	<hr style="width: 100%;"/>			
	S23	/	S23	C
	T4½		N R 22 E	
			1931	

from which

A pinon, 10 ins. diam., bears N. 77° E., 56 lks. dist., mkd.
T 4½ N R 22 E S 14 C C B T.

An oak, 10 ins. diam., bears S. 27° E., 34 lks. dist., mkd.
T 4½ N R 22 E S 23 C C B T.

From point of intersection the 8½ mile mon. of T.R.I.S. bdy. bears N. 68° 34' E., 15.50 chs. dist.; hereinbefore described.

From the same point the witness cor. to 8 mile point of T.R.I.S. bdy. bears S. 68° 34' W., 25.00 chs. dist.; hereinbefore described.

6.04 Ravine, course, NW.; asc. 37 ft. over NE. slope,

11.65 Spur, slopes. NW.; desc. 367 ft. over broken W. slope.

18.85 Top of red sandstone bluff, 100 ft. high, bears N. and SW.

21.65 House, bears N. 79° 45' W.

29.65 Irrigation ditch, course SW.

30.37 Road, bears NE. and SW.

30.72 Wire fence, bears NE. and SW.; enter cultivated land.

36.42 Wire fence, bears N. 17½° W., and S. 17½° E.

40.03 Set an iron post, 3 ft. long, 1 in. diam., 28 ins. in the ground, for ¼ sec. cor. with brass cap marked.

Chains.

S 14
1/4
S 23
1931

from which

A double walnut, 10 ins. diam., bears S. 47° W., 92 lks. dist. mkd. 1/4 S 23 B T.

A walnut, 20 ins. diam., bears N. 85° W., 451 lks. dist., mkd. 1/4 S 14 B T.

House, bears N. 39° E., 830 lks. dist.

House, bears S. 61° 45' W., 1080 lks. dist.

Continue over level cultivated land.

40.96 Wire fence, bears N. and S.

44.86 Wire fence, bears NE. and SW.

47.54 Wire fence, bears NE. and SW.

50.44 Wire fence, bears NE. and SW.

50.66 Telephone line, bears NE. and SW.

51.54 House, bears N. 10° 06' E.

54.86 Wire fence, bears SE. and NW.

61.36 Wire fence, bears NE. and SW.

61.54 Intersect W. bdy. of the Theodore Roosevelt Indian School.

Set an iron post, 3 ft. long, 2 ins. diam., 30 ins. in the ground, for closing cor. of secs. 14 and 23, with brass cap marked.

C S14 / S14
C S23 / S23
T 4 1/2 NR 22 E
1931

from which

A cottonwood, 5 ins. diam., bears S. 79 3/4° W., 379 lks. dist. mkd. T 4 1/2 N R 22 E S 23 C C B T.

A cottonwood, 5 ins. diam., bears N. 57 1/2° W., 199 lks. dist., mkd. T 4 1/2 N R 22 E S 14 C C B T.

From point of intersection the 7 mile cor. on W. bdy. of TRIS; bears N. 7° 15' E., 16.20 chs. dist., an iron post, 2 ins. diam., 12 ins. above ground, mkd. and witnessed as described in the official record.

It additionally mark this cor.

T 4 1/2 N / 7M
S 14 / TRIS
R 22 E
1929

From the same point the 7 1/2 mile cor. on W. bdy. of TRIS, bears S. 7° 15' W., 23.80 chs. dist., an iron post, 3 ins. diam., 12 ins. above ground, mkd. and witnessed as described in the official record.

SUBDIVISIONS OF T.4 $\frac{1}{2}$ N., R.22 E.

Chains. additionally mark this mon. to read

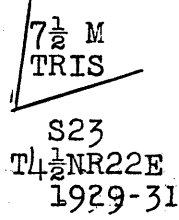

- 69.06 Road, bears NE. and SW.
- 74.66 Swinging bridge, across White River, bears N. 70 lks. dist.
- 75.76 Left bank of White River, course SW.
- 78.76 Right bank of channel of White River, course SW.
- 80.06 The true point for cor. of secs. 14, 15, 22 and 23.

Land, level and mountainous.
 Soil, sandy loam and gravelly; 1st and 2nd rates.
 Timber, pine, fir, cedar, pinon, walnut, cottonwood, juniper, and
 apple; undergrowth, manzanita, mahogany, scrub oak and grass.

From true point for cor. of secs. 14, 15, 22 and 23,
 N. 0° 1' W., bet. secs. 14 and 15.

Over level sandbar, subject to overflow in ber.

- 2.00 Leave sandbar, bear E. and W. Enter rolling land and scattering timber.
- 3.00 Set an iron post, 3 ft. long, 2 ins. diam., 26 ins. in the ground, for witness cor. of secs. 14, 15, 22 and 23, with brass cap marked.



A cedar, 3 ins. diam., bears N. 93 $\frac{3}{4}$ ° E., 110 lks. dist., mkd.
 W C T 4 $\frac{1}{2}$ N R 22 E S 14 B T.

A black walnut, 18 ins. diam., bears S. 44° E., 98 lks. dist.,
 mkd. W C T 4 $\frac{1}{2}$ N R 22 E S 14 B T.

A cedar, 3 ins. diam., bears N. 27° W., 310 lks. dist., mkd.
 W C B T only.

An alder, 5 ins. diam., bears S. 84° W., 355 lks. dist., mkd.
 W C T 4 $\frac{1}{2}$ N R 22 E S 15 B T.

Ascend 140 ft. over S. slope.

- 11.30 Top of rim rocks. 20. ft. high, bears E. and W.; continue over level mesa land.
- 15.72 Road, bears NE. and SW.
- 38.73 Intersect the First Standard Parallel North.

Set an iron post, 3 ft. long, 2 ins. diam., 28 ins. in the ground, for closing cor. of secs. 14 and 15, with brass cap marked

Chains.

T5NR22E
S 33
S15 | S14
T4 1/2 N | R22E
C C
1931

raise a mound of stone, 3 ft. base, 2 ft. high, S. of cor.

From point of intersection the standard cor. of secs. 32 and 33, T.5 N., R.22 E., bears West, 13.63 chs. dist., an iron post, 2 ins. diam., 12 ins. above ground, mkd. and witnessed as described in the official record.

From the same point the closing cor. of sec. 33, T.5 N., R.22 E., on T.R. 1, S boundary, bears East, 23.47 chs. dist., an iron post, 1 in. diam., 12 ins. above ground, mkd. and witnessed as described in the official record.

additionally mark this mon. to read

T5NR22E / S33
C S 33 / TRIS
C S14 / S14
T4 1/2 NR22E
1929-31

Land, level and rolling.
Soil, sandy loam covered with volcanic stones; 1st and 2nd rates.
Timber, scattering apple; undergrowth, grass.

From the cor. of secs. 3, 4, 33 and 34, on S. bdy. of Tp., hereinbefore described, N. 0° 2' W., bet. secs. 33 and 34.

Over rolling mesa land, through scattering timber and undergrowth.

Descend 39 ft. over NW. slope.

26.00 Draw, course SW.

40.00 Set an iron post, 3 ft. long, 1 in. diam., 26 ins. in the ground, for 1/4 sec. cor. with brass cap marked.

1/4
S33 | S34
1931

from which

A juniper, 10 ins. diam., bears S. 35° E., 95 lks. dist., mkd. 1/4 S 34 B T.

A juniper, 24 ins. diam., bears N. 73° W., 130 lks. dist., mkd. 1/4 S 33 B T.

Ascend 68 ft. over gradual S. slope.

68.60 Rim of mesa, bears E. and W.; desc. 189 ft. over N. slope.

80.00 Set an iron post, 3 ft. long, 2 ins. diam., 18 ins. in the ground to bedrock, and in a mound of stone to top, for cor. of secs. 27, 28, 33 and 34, with brass cap marked.

SUBDIVISIONS OF T. 4 1/2 N., R. 22 E.

Chains.

T 4 1/2 N R 22 E
 S 28 | S 27
 S 33 | S 34
 1931

from which

A yellow pine, 5 ins. diam., bears N. 44 1/2° E., 07 lks. dist., mkd. T. 4 1/2 N R. 22 E S. 27 B. T.

An oak, 4 ins. diam. bears S. 18 1/4° E., 17 lks. dist., mkd. T 4 1/2 N R 22 E S 34 B T.

An oak, 10 ins. diam., bears S. 84 1/2° W., 38 lks. dist., mkd. T 4 1/2 N R 22 E S 33 B T.

A pinon, 12 ins. diam., bears N. 68 1/2° W., 67 lks. dist., mkd. T 4 1/2 N R 22 E S 28 B T.

Land, rolling,
 Soil, clay and rocky; 2nd and 3rd rates.
 Timber, scattering pine, oak, pinon, juniper and cedar; undergrowth, scrub oak, mahogany, bear grass and cactus.

East, on a random line, bet. secs. 27 and 34.

40.00 Set temp. 1/4 sec. cor.

80.12 Intersect N. and S. line, 4 lks. N. of the cor. of secs. 26, 27 34 and 35.

Thence

N. 89° 58' W., on a true line, bet. secs. 27 and 34.

Over mountainous land, through scattering timber and dense undergrowth.

Ascend 10 ft. over NE. slope.

4.60 Spur, slopes NW.; desc. 25 ft. over SW. slope.

11.30 Draw, course NW.; asc. 28 ft. over NE. slope.

18.30 Spur, slopes NW.; continue along S. slope.

24.00 Descend 49 ft. over NW. slope.

30.00 Draw, course NE.; asc. 16 ft. over SE. slope.

32.50 Spur, slopes NE.; desc. 9 ft. along N. slope.

38.30 Trail, bears NE. and SW.

40.06 Set an iron post, 3 ft. long, 1 in. diam., 26 ins. in the ground, for 1/4 sec. cor. with brass cap marked.

S 27
 1/4
 S 34
 1931

from which

A double juniper, 14 ins. diam., bears N. 71 1/2° E., 66 lks. dist., mkd. 1/4 S 27 B T.

A juniper, 10 ins. diam., bears S. 18 3/4° E., 46 lks. dist., mkd. 1/4 S 34 B T.

Chains. Descend 11 ft. along N. slope.
 50.00 Spur, slopes N.; desc. 20 ft. over SW. slope.
 53.00 Draw, course NW.; asc. 58 ft. over NE. slope.
 75.50 Trail, bears SE. and NW.
 80.12 The cor. of secs. 27, 28, 33 and 34.
 Land, mountainous.
 Soil, rocky; 4th rate.
 Timber, scattering pine, fir, pinon, oak, juniper and cedar;
 undergrowth, maple, willow, mahogany, manzanita and grass.

N. 0° 2' W., bet. secs. 27 and 28.

Over mountainous land, through scattering timber and dense undergrowth.

Descend 395 ft. over NE. slope.

2.60 Trail, bears E. and W.
 10.30 ledge, 5 ft. high, bears E. and W.; desc. N. slope.
 24.08 Continue descending over NW. slope.
 40.00 Set an iron post, 3 ft. long, 1 in. diam., 26 ins. in the ground, for ¼ sec. cor. with brass cap marked

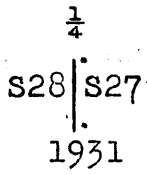

from which

A pinon, 5 ins. diam., bears S. 22½° E., 39 lks. dist., mkd. ¼ S 27 B T.

A cedar, 6 ins. diam., bears S. 66½° W., 25 lks. dist., mkd. ¼ S 28 B T.

Descend 17 ft. over NW. slope.

43.00 Draw, course NE.; asc. 8 ft. over SE. slope.
 47.00 Top of ascent.; desc. 377 ft. over NE. slope.

80.00 Set an iron post, 3 ft. long, 2 ins. diam., 12 ins. in the ground to bedrock, and in a mound of stone to top, for cor. of secs. 21, 22, 27 and 28, with brass cap marked.

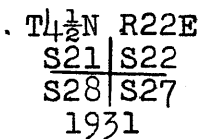

from which

A pinon, 8 ins. diam., bears N. 25° E., 46 lks. dist., mkd. T 4½ N R 22 E S 22 B T.

A cedar, 12 ins. diam., bears S. 66° E., 28 lks. dist., mkd. T 4½ N R 22 E S 27 B T.

A pinon, 12 ins. diam., bears S. 42¾° W., 53 lks. dist., mkd. T 4½ N R 22 E S 28 B T.

Chains.	A cedar, 14 ins. diam., bears N.25°W., 34 lks. dist., mkd. T 4 $\frac{1}{2}$ N R 22 E S 21 B T.
	Land, mountainous. Soil, rocky; 4th rate. Timber, scattering pine, pinon, juniper, oak and cedar; undergrowth, scrub oak, mahogany and grass.
	S.89°58'E., on a random line, bet. secs. 22 and 27.
40.00	Set temp. $\frac{1}{4}$ sec. cor.
80.09	Intersect N. and S. line 9 lks. N. of the cor. of secs. 22, 23, 26 and 27.
	Thence
	N.89°54'W., on a true line, bet. secs. 22 and 27.
	Over mountainous land, through scattering timber and dense undergrowth.
	Ascend 99 ft. over NE. slope.
4.40	Spur, slopes N.; desc. 27 ft. over W. slope.
7.70	Small draw, course N.; asc. 60 ft. over E. slope.
12.20	Spur, slopes N.; desc. 29 ft. over NW. slope.
15.30	Trail, bears N. and S.
17.00	Spur, slopes NW.; desc. 95 ft. over SW. slope.
22.44	Ravine, course N.10°W.; asc. 17 ft. over NE. slope.
23.90	Spur, slopes N.; desc. 102 ft. over W. slope.
28.21	Ravine, course NW.; asc. 72 ft. over NE. slope.
40.04	Set an iron post, 3 ft. long, 1 in. diam., 26 ins. in the ground, for $\frac{1}{4}$ sec. cor. with brass cap marked.
	$\begin{array}{r} S\ 22 \\ \frac{1}{4} \\ \hline S\ 27 \\ 1931 \end{array}$
	from which
	A pinon, 10 ins. diam., bears N.12 $\frac{1}{4}$ °E., 24 lks. dist., mkd. $\frac{1}{4}$ S 22 B T.
	A pinon, 10 ins. diam., bears S.27 $\frac{1}{2}$ °W., 63 lks. dist., mkd. $\frac{1}{4}$ S 27 B T.
	Ascend 21 ft. over NE. slope.
46.00	Top of ascent.; descend 181 ft. over NW. slope.
50.09	Trail, bears SE. and NW.
61.35	Gulch, course N.; asc. 85 ft. over NE. slope.
67.50	Spur, slopes N.; desc. 130 ft. over NW. slope.
72.13	Gulch, 20 lks. wide, course N.; asc. 155 ft. over E. slope.
80.09	The cor. of secs. 21, 22, 27 and 28.

Chains. Land, mountainous.
 Soil, clay and rocky; 2nd and 3rd rates.
 Timber, scattering pine, fir, cedar, pinon, oak and juniper;
 undergrowth, manzanita, mahogany, willow and grass.

N.0°2'W., bet. secs. 21 and 22.

Over mountainous land, through scattering timber and dense undergrowth.

Descend 311 ft. over NE. slope.

27.77 Wash, 20 lks. wide, 3 ft. deep, course NE.

36.00 Wire fence, bears NE. and SW.

38.14 Wire fence, bears E. and W.; leave mountainous land; enter river bottom.

35.94 Set an iron post, 3 ft. long, 1 in. diam., 26 ins. in the ground, for witness $\frac{1}{4}$ sec. cor. with brass cap marked.

WC
 $\frac{1}{4}$

S21 | S22

1931

from which

A cottonwood, 14 ins. diam., bears N.56°E., 440 lks. dist., mkd. W C $\frac{1}{4}$ S 22 B T.

A cottonwood, 72 ins. diam., bears N.43 $\frac{3}{4}$ °W., 230 lks. dist., mkd. W C $\frac{1}{4}$ S 21 B T.

Descend 35 ft. over gradual slope.

39.80 Left bank of White River channel, course SW.

40.00 True point for $\frac{1}{4}$ sec. cor. falls in bed of White River channel.

41.10 Right bank of White River channel, course SW.

49.00 Leave river bottom, course SW.; asc. 79 ft. over S. slope.

50.13 Wire fence, bears NE. and SW., on spur, sloping SW.

51.30 Ravine, course SW.; continue ascending over SE. slope.

53.50 Top of rim rocks, 20 ft. high, bears E. and W.; continue over level mesa land.

80.00 Set an iron post, 3 ft. long, 2 ins. diam., 26 ins. in the ground, for cor. of secs. 15, 16, 21 and 22, with brass cap marked.

T4 $\frac{1}{2}$ N R22E

S16 | S15

S21 | S22

1931

dig pits

18x18x12 ins. NE. SE. SW. and NW. of post, 3 ft. dist.

Chains	Land, level and mountainous. Soil, sandy loam and gravelly; 1st and 2nd rates. Timber, scattering pine, fir, cedar, oak, pinon and juniper; undergrowth, manzanita, mahogany, second growth juniper, willow and grass.
	S. 89°54'E., on a random line, bet. secs. 15 and 22.
40.00	Set temp. $\frac{1}{4}$ sec. cor.
79.94	Intersect N. and S. line, at the true point for cor. of secs. 14, 15, 22 and 23.
	Thence
	N. 89°54'W., on a true line, bet. secs. 15 and 22.
	Over sandbar on N. side of White River, subject to under- overflow.
	Descend 18 ft. to river level.
.24	Wire fence, bears NE. and SW.
7.20	Wire fence, bears SE. and NW. Enter scattering timber and undergrowth.
12.00	White River, 100 lks. wide, course NW. toward river.
19.00	White River, 100 lks. wide, course SW.
20.00	Leave river bottom, asc. 119 ft. over SE. slope.
27.00	Top of rim rocks, 20 ft. high, bears NE. and SW.; continue over rolling prairie land.
27.20	House bears S. about 15 chs. dist.
39.97	Set an iron post, 3 ft. long, 1 in. diam., 26 ins. in the ground, for $\frac{1}{4}$ sec. cor. with brass cap marked.
	S 15 $\frac{1}{4}$ ——— S 22 1931
	raise a mound
	of stone, 3 ft. base, 2 ft. high, N. of cor.
40.08	Road, bears N. and S.
50.00	House, bears S. about 7 chs. dist..
79.94	The cor. of secs. 15, 16, 21 and 22.
	Land, mountainous and level. Soil, sandy loam and rocky; 1st and 4th rates. Timber, scattering pine, cedar, pinon, cottonwood, walnut and oak; undergrowth scrub oak, and grass.
	N. 0°2'W., bet. secs. 15 and 16.
	Over rolling mesa land.
	Ascend 39 ft. over gradual S. slope.
3.30	Road, bears NE. and SW.

Chains.
38.54

Intersect First Standard Parallel North.

Set an iron post, 3 ft. long, 2 ins. diam., 26 ins. in the ground, for closing cor. of secs. 15 and 16, with brass cap marked.

T5NR22E	
S 32	
S16	S15
T4½N	R22E
C	C
1931	

raise a mound of stone, s ft. base, 2 ft. high, S. of cor.

From point of intersection the standard cor. of secs. 31 and 32, T.5 N., R.22 E., bears West, 13.68 chs. dist., an iron post, 2 ins. diam., 10 ins. above ground, mkd. and witnessed as described in the official record.

From the same point the standard ¼ sec. cor. of sec. 32, T. 5 N., R.22 E., bears East, 26.32 chs. dist., an iron post, 1 in. diam., 12 ins. above ground, mkd. and witnessed as described in the official record.

Land, rolling and level.
Soil, sandy loam and rocky; 1st and 3rd rates.
Timber, none; undergrowth grass.

From the cor. of secs. 4, 5, 32 and 33, on S. bdy. of Tp. hereinbefore described, N. 0° 2' W., bet. secs. 32 and 33.

Over rolling mesa land, through scattering timber and undergrowth.

Ascend 62 ft. over SE. slope.

12.43 Top of ascent.; desc. 41 ft. over N. slope.

37.40 Ascend gradual S. slope.

40.00 Set an iron post, 3 ft. long, 1 in. diam., 26 ins. in the ground, for ¼ sec. cor. with brass cap marked.

¼	
S32	S33
1931	

from which

An oak, 12 ins. diam., bears N. 60½° E., 106 lks. dist., mkd. ¼ S 33 B T.

A juniper, 18 ins. diam., bears S. 23° W., 210 lks. dist., mkd. ¼ S 32 B T.

Ascend 20 ft. over gradual S. slope.

48.00 Top of rim rocks, 20 ft. high, bears E. and W.; desc. 335 ft. over N. slope of mountainous land.

77.60 Enter small meadow, bears NE. and SW.

80.00 Set an iron post, 3 ft. long, 2 ins. diam., 26 ins. in the ground, for cor. of secs. 28, 29, 32 and 33, with brass cap marked.

Chains

T 4½ N R 22 E
 S 29 | S 28
 S 32 | S 33
 1931

from which

A juniper, 5 ins. diam., bears N. 19½° E., 157 lks. dist., mkd.
 T 4½ N R 22 E S 28 B T.

A juniper, 14 ins. diam., bears S. 68¼° E., 113 lks. dist.,
 mkd. T 4½ N R 22 E S 33 B T.

A juniper, 14 ins. diam., bears S. 72¼° W., 73 lks. dist., mkd.
 T 4½ N R 22 E S 32 B T.

A juniper, 6 ins. diam., bears N. 47° W., 203 lks. dist., mkd.
 T 4½ N R 22 E S 29 B T.

Land, level and mountainous.
 Soil, sandy loam and rocky; 1st and 2nd rates.
 Timber, scattering, piñe, cedar, pinon, fir, oak and juniper;
 undergrowth, scrub oak and grass.

East, on a random line, bet. secs. 28 and 33.

40.00 Set temp. ¼ sec. cor.

79.91 Intersect N. and S. line, 8 lks. S. of the cor. of secs. 27, 28,
 33 and 34.

Thence

S. 89° 57' W., on a true line, bet. secs. 28 and 33.

Over mountainous land, through scattering timber and dense
 undergrowth.

Ascend 37 ft. over rocky NE. slope.

11.00 Spur, slopes NW.; desc. 40 ft. over SW. slope.

11.20 Ravine, course NW.; asc. 43 ft. over broken N. slope.

35.10 Top of ascent.; desc. 31 ft. over NW. slope.

39.95 Set an iron post, 3 ft. long, 1 in. diam., 20 ins. in the
 ground to bedrock, and in a mound of stone to top, for
 ¼ sec. cor. with brass cap marked.

S 28
 ¼ ———
 S 33
 1931

from which

A yellow pine, 24 ins. diam., bears N. 0° 30' W., 97 lks. dist.
 mkd. ¼ S 28 B T.

An oak, 4 ins. diam., bears S. 74½° E., 45 lks. dist., mkd. ¼
 S 33 B T.

Ascend 173 ft. over NE. slope.

44.40 Top of rim rocks, 20 ft. high, bears SE. and NW.; continue
 over level mesa land.

Chains.
 47.30 Top of rim rock, 50 ft. high, bears NE. and SW.; desc. 426 ft. over broken NW. slope.
 75.00 Enter meadow, bears N. and S.
 79.91 The cor. of secs. 28, 29, 32 and 33a
 Land, mountainous and level.
 Soil, rocky; 4th rate.
 Timber, scattering pine, fir, pinon, cedar, oak and juniper; undergrowth, scrub oak, manzanita, willow and grass.

N. 0° 2' W., bet. secs. 28 and 29.

Over mountainous land, through scattering timber and dense undergrowth.

Ascend 35 ft. over SW. slope.

4.00 Trail, bears NE. and SW.

8.00 Leave meadow, bears E. and W.; enter scattering timber.

18.20 Spur, slopes NW.; desc. 82 ft. over N. slope.

26.40 Ravine, course NE.; asc. 12 ft. over SE. slope.

27.90 Top of ascent.; desc. 44 ft. over NE. slope.

32.24 Same ravine, course NW.; asc. 15 ft. over SW. slope.

35.30 Spur, slopes W.; desc. 18 ft. over NW. slope.

39.20 Continue descending over NE. slope.

40.00 Set an iron post, 3 ft. long, 1 in. diam., 26 ins. in the ground, for $\frac{1}{4}$ sec. cor. with brass cap marked.

$\frac{1}{4}$

S29 | S28

1931

from which

A pinon, 10 ins. diam., bears S. 48 $\frac{1}{4}$ ° E., 18 lks. dist., mkd. $\frac{1}{4}$ S 28 B T.

An oak, 6 ins. diam., bears N. 65° W., 56 lks. dist., mkd. $\frac{1}{4}$ S 29 B T.

Descend 204 ft. over broken NW. slope.

51.50 Ravine, course NW.; asc. 19 ft. over SW. slope.

53.50 Spur, slopes W.; desc. 471 ft. over N. slope.

60.00 Ravine, course NW.; continue descending over NW. slope.

76.52 Wash, 20 lks. wide, course NW.

80.00 Set an iron post, 3 ft. long, 2 ins. diam., 20 ins. in the ground, to bedrock, and in a mound of stone to top, for cor. of secs. 20, 21, 28 and 29, with brass cap marked.

Chains.

T 4 $\frac{1}{2}$ N R 22 E
 S 20 | S 21
 S 29 | S 28
 1931

from which

A cedar, 14 ins. diam., bears N. 65° E., 49 lks. dist., mkd.
 T 4 $\frac{1}{2}$ N R 22 E S 21 B T.

A cedar, 10 ins. diam., bears S. 60 $\frac{1}{2}$ ° E., 48 lks. dist., mkd.
 T 4 $\frac{1}{2}$ N R 22 E S 28 B T.

A cedar, 10 ins. diam., bears S. 72 $\frac{3}{4}$ ° W., 14 lks. dist.,
 mkd. T 4 $\frac{1}{2}$ N R 22 E S 29 B T.

A cedar, 10 ins. diam., bears N. 81 $\frac{3}{4}$ ° W., 34 lks. dist.,
 mkd. T 4 $\frac{1}{2}$ N R 22 E S 20 B T.

Land, mountainous.
 Soil, rocky; 4th rate.
 Timber, scattering pine, fir, cedar, pinon, oak and juniper;
 undergrowth, manzanita, mahogany, willow and grass.

N. 89° 57' E., on a random line, bet. secs. 21 and 28.

40.00 Set temp. $\frac{1}{4}$ sec. cor.

79.90 Intersect N. and S. line, 6 lks. N. of the cor. of secs. 21, 22,
 27 and 28.

Thence

West, on a true line, bet. secs. 21 and 28.

Over mountainous land, through scattering timber and dense
 undergrowth.

Ascend 20 ft. over NE. slope.

2.20 Spur, slopes N.; desc. 150 ft. over NW. slope.

8.50 Gulch, course N.; asc. 179 ft. over NE. slope.

22.40 Spur, slopes N.; desc. 242 ft. over NW. slope.

39.95 Set an iron post, 3 ft. long, 1 in. diam., 26 ins. in the
 ground, for $\frac{1}{4}$ sec. cor. with brass cap marked.

S 21
 $\frac{1}{4}$ ———
 S 28
 1931

from which

A cedar, 12 ins. diam., bears S. 53° E., 41 lks. dist., mkd.
 $\frac{1}{4}$ S 28 BT.

A cedar, 6 ins. diam., bears N. 63 $\frac{1}{2}$ ° W., 36 lks. dist., mkd.
 $\frac{1}{4}$ S 21 BT.

45.00 Descend 173 ft. over NW. slope.
 Gulch, course NW.; asc. over NE. slope.

46.84 Wire fence, bears NE. and SW.

53.12 Wire fence, bears SE. and NW.

56.00 Left bank of White River, course SW.

Chains.

58.00 Right bank of White River, course SW.; continue along N. channel of river.

68.00 Left bank of White River, course NW.; asc. 135 ft. over NE. slope.

74.40 Spur, slopes N.; desc. 51 ft. over NW. slope.

79.90 The cor. of secs. 20, 21, 28 and 29.

Land, mountainous.

Soil, clay and rocky; 3rd and 4th rates.

Timber, scattering pine, fir, cedar, oak, pinon, cottonwood, oak, walnut and juniper; undergrowth, mahogany, scrub oak, willow and grass.

N. 0° 2' W., bet. secs. 20 and 21.

Over mountainous land, through scattering timber and undergrowth.

Descend 92 ft. over NW. slope.

3.50 Left bank of White River, course SW.

4.50 Right bank of White River, course SW.; asc. 299 ft. over S. slope.

7.57 Top of rim rocks, 50 ft. high, bears E. and NW.; continue over gradual S. slope.

9.50 Wire fence, bears S. 20° E., and N. 20° W.

21.45 Wire fence, bears NE. and SW.

23.15 Road, bears NE. and SW.

40.00 Set an iron post, 3 ft. long, 1 in. diam., 26 ins. in the ground, for $\frac{1}{4}$ sec. cor. with brass cap marked.

$\frac{1}{4}$

S20 | S21

1931

from which

A cedar, 5 ins. diam., bears S. 51° E., 71 lks. dist., mkd. $\frac{1}{4}$ S 21 B T.

A cedar, 16 ins. diam., bears N. 74 $\frac{1}{2}$ ° W., 88 lks. dist., mkd. $\frac{1}{4}$ S 20 B T.

Ascend 47 ft. over SE. slope.

58.40 Top of ascent.; descend 60 ft. over NE. slope.

68.40 Ravine, course S. 50° E.; asc. 162 ft. over S. slope.

80.00 Set an iron post, 3 ft. long, 2 ins. diam., on solid rock, mkd. X, and in a mound of stone to top, for cor. of secs. 16, 17 20 and 21, with brass cap marked

T4 $\frac{1}{2}$ N R22E

S17 | S16

S20 | S21

1931

from which

Chains. A pinon, 12 ins. diam., bears N. 39½° E., 249 lks. dist., mkd.
 T 4½ N R 22 E S 16 B T.
 A pinon, 5 ins. diam., bears S. 53½° E., 153 lks. dist., mkd.
 T 4½ N R 22 E S 21 B T.
 A pinon, 3 ins. diam., bears S. 20° W., 51 lks. dist., mkd.
 B T only.
 A pinon, 10 ins. diam., bears N. 76½° W., 74 lks. dist., mkd.
 T 4½ N R 22 E S 17 B T.

Land, mountainous.
 Soil, gravelly and rocky; 4th rates.
 Timber, scattering cedar, pinon, oak and juniper; undergrowth,
 scrub oak, mahogany and grass.

East, on a random line, bet. secs. 16 and 21.

40.00 Set temp. ¼ sec. cor.
 79.98 Intersect N. and S. line, 2 lks. N. of the cor. of secs. 15, 16,
 21 and 22.

Thence

N. 89° 59' W., on a true line, bet. secs. 16 and 21.

Over rolling prairie land.

10.00 Road, bears NE. and SW.
 12.70 Wash, 100 lks. wide, course S.; asc. 51 ft. over SE. slope.
 39.99 Set an iron post, 3 ft. long, 1 in. diam., 26 ins. in the
 ground, for ¼ sec. cor. with brass cap marked.

S 16
 ¼
 S 21
 1931

from which

A cedar, 8 ins. diam., bears N. 68¼° E., 113 lks. dist., mkd.
 ¼ S 16 B T.
 A cedar, 4 ins. diam., bears S. 43¾° W., 29 lks. dist., mkd.
 ¼ S 21 B T.

Descend 9 ft.

43.80 Wash, 15 lks. wide, course S.; asc. 86 ft. over SE. slope.
 64.60 Spur, slopes S.; desc. 25 ft. over W. slope.
 66.40 Ravine, course S.; asc. 31 ft. over E. slope.
 69.60 Spur, slopes S.; desc. 26 ft. over W. slope.
 71.70 Wash, 20 lks. wide, course S.; asc. 193 ft. over E. slope.
 79.98 The cor. of secs. 16, 17, 20 and 21.

Land, rolling.
 Timber, scattering pinon, cedar, oak and juniper; undergrowth,
 Scrub oak, and grass.
 Soil, sandy loam and gravelly; 1st and 3rd rates.

Chains. N.0°2'W., bet.secs.16 and 17.
 Over mountainous land, through, scattering timber and undergrowth.
 Descend 131 ft.along E.slope..

1.35 Continue descending over NE.slope.
 9.33 Ravine, course SE.; asc.88 ft.over SW.slope.
 11.20 Spur, slopes SE.; desc.along E.slope.
 15.52 Wash, 30 lks.wide, course SE.; asc.8 ft.over SW.slope.
 38.59 Intersect First Standard Parallel North.

Set an iron post, 3 ft.long, 2 ins.diam., 20 ins.in the ground to bedrock, and in a mound of stone to top, for closing cor.of secs.16 and 17, with brass cap marked.

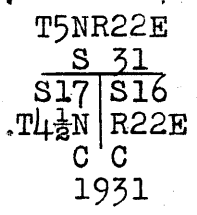

from which

A pinon, 6 ins.diam., bears S.30³/₄°E., 49 lks.dist., mkd.
 T 4 1/2 N R 22 E S 16 C C B T.

A pinon, 10 ins.diam., bears S.75°W., 54 lks.dist., mkd.
 T 4 1/2 N R 22 E S 17 C C B T.

From point of intersection, the standard cor.of Tps.5 N., Rs.21 and 22 E., bears West, 13.71 chs.dist., an iron post, 3 ins.diam., 12 ins.above ground in mound of stone to top, mkd.and witnessed as described in the official record.

From the same point, the standard 1/4 sec.cor.of sec.31, T.5 N., R.22 E., bears East, 26.29 chs.dist., an iron post, 1 in.diam., 12 ins.above ground, mkd.and witnessed as described in the official record.

Land, mountainous.
 Soil, rocky; 4th rate.
 Timber, scattering, pinon, cedar, oak and juniper; undergrowth, scrub oak, mahogany and manzanita.

From the cor.of secs.5, 6, 31 and 32, on S.bdy.of Tp. hereinbefore described,
 N.0°3'W., bet.secs.31 and 32.

Over mountainous land, through scattering timber and dense undergrowth.

Ascend 25 ft.over SW.slope.

1.60 Spur, slopes SW.; desc.82 ft.over NW.slope.
 18.70 Foot of descent.; asc.173 ft.over SW.slope.
 23.50 Top of rim rocks, 75 ft.high, bears SE.and NW.; continue over rolling mesa land.
 30.00 Top of rim rocks, 30 ft.high, bears NE.and SW.; desc.100 ft. over NW.slope.
 31.00 Wash, 20 lks.wide, course W.; asc.100 ft.over S.slope.

Chains.	
32.00	Top of rim rocks, bears SE. and NW.; continue over gradual S. slope. 46 ft.
40.00	Set an iron post, 3 ft. long, 1 in. diam., 26 ins. in the ground, for $\frac{1}{4}$ sec. cor. with brass cap marked.
	$\frac{1}{4}$
	S31 S32
	1931
	from which
	A juniper, 8 ins. diam., bears N. 82 $\frac{1}{4}$ ° E., 61 lks. dist., mkd. $\frac{1}{4}$ S. 32 B T.
	A juniper, 20 ins. diam., bears N. 73 $\frac{1}{2}$ ° W., 145 lks. dist., mkd. $\frac{1}{4}$ S. 31 B T.
56.00	Top of rim rocks, bears E. and W.; leave mesa; desc. 422 ft. over N. slope.
80.00	Set an iron post, 3 ft. long, 2 ins. diam., 26 ins. in the ground, for cor. of secs. 29, 30, 31 and 32, with brass cap marked.
	T4 $\frac{1}{2}$ N R22E S30 S29 S31 S32 1931
	from which
	A pinon, 6 ins. diam., bears N. 77° E., 13 lks. dist., mkd. T 4 $\frac{1}{2}$ N R 22 E S 29 B T.
	A pinon, 6 ins. diam., bears S. 20° E., 05 lks. dist., mkd. T 4 $\frac{1}{2}$ N R 22 E S 32 B T.
	A cedar, 12 ins. diam., bears S. 44 $\frac{3}{4}$ ° W., 47 lks. dist., mkd. T 4 $\frac{1}{2}$ N R 22 E S 31 B T.
	A pinon, 10 ins. diam., bears N. 36 $\frac{1}{2}$ ° W., 76 lks. dist., mkd. T 4 $\frac{1}{2}$ N R 22 E S 30 B T.
	Land, rolling and mountainous. Soil, clay and stony; 2nd and 3rd rates. Timber, scattering pine, cedar, pinon, fir, oak and juniper; undergrowth, scrub oak, manzanita, mahogany, willow and grass.
	East, on a random line, bet. secs. 29 and 32.
40.00	Set temp. $\frac{1}{4}$ sec. cor.
80.04	Intersect N. and S. line, 13 lks. N. of the cor. of secs. 28, 29 32 and 33.
	Thence
	N. 89° 54' W., on a true line, bet. secs. 29 and 32.
	Over mountainous land, through heavy timber and undergrowth.
	Descend 148 ft. over meadow land.
1.90	Trail, bears NE. and SW.

Chains.	
4.00	Leave meadow; enter heavy timber, bears NE. and SW.
5.20	Wash, 10 lks. wide, course SW.
14.00	Leave timber, bears NE. and SW.; enter prairie land.
19.00	Leave prairie; enter heavy timber, bears N. and S.; continue descending over NW. slope.
27.40	Draw, course N.
29.70	Wash, 20 lks. wide, course NW.; asc. 2 ft. along N. slope.
34.60	Spur, slopes NW.; desc. 51 ft. over SW. slope.
38.83	Ravine, course NW.; asc. along broken NE. slope.
40.02	Set an iron post, 3 ft. long, 1 in. diam., 26 ins. in the ground, for $\frac{1}{4}$ sec. cor. with brass cap marked.
	$\begin{array}{r} S\ 29 \\ \hline \frac{1}{4} \\ S\ 32 \\ 1931 \end{array}$
	from which
	A cedar, 8 ins. diam., bears N. 15 $\frac{1}{2}$ $^{\circ}$ E., 30 lks. dist., mkd. $\frac{1}{4}$ S 29 B T.
	A pinon, 8 ins. diam., bears S. 3 $^{\circ}$ E., 38 lks. dist., mkd. $\frac{1}{4}$ S 32 B T.
	Ascend 24 ft. over NE. slope.
40.30	Low spur, slopes NW.; desc. 29 ft. over SW. slope.
40.60	Wash, 20 lks. wide, course NW.; asc. 29 ft. over NE. slope.
44.20	Spur, slopes NW.; desc. 11 ft. over W. slope.
46.95	Ravine, course NW.; asc. 39 ft. over NE. slope.
55.63	Trail, bears SE. and NW.
62.90	Spur, slopes N.; desc. 154 ft. over NW. slope.
69.90	Head of ravine, course NW.; asc. 33 ft. over NE. slope.
75.45	Descend 29 ft. along N. slope.
80.04	The cor. of secs. 29, 30, 31 and 32.
	Land, mountainous. Soil, sandy and rocky; 3rd and 4th rates. Timber, scattering pine, fir, cedar, pinon, oak and juniper; undergrowth, scrub oak, manzanita, willow, mahogany and bear grass.
	West, on a random line, bet. secs. 30 and 31.
40.00	Set temp. $\frac{1}{4}$ sec. cor.
77.93	Intersect W. bdy. of Tp. 3 lks. N. of the cor. of secs. 25, 30, 31 and 36, hereinbefore described.
	Thence

Chains.	N.89°59'E., on a true line, bet. secs. 30 and 31. Over mountainous land, through scattering timber and undergrowth. Ascend 205 ft. over gradual NW. slope.
37.93	Set an iron post, 3 ft. long, 1 in. diam., 20 ins. in the ground to bedrock, and in a mound of stone to top, for $\frac{1}{4}$ sec. cor. with brass cap marked. $\begin{array}{r} S\ 30 \\ \frac{1}{4} \\ \hline S\ 31 \\ 1931 \end{array}$ <p style="text-align: right;">from which</p> <p>A yellow pine, 10 ins. diam., bears S.55$\frac{1}{2}$°W., 87 lks. dist., mkd. $\frac{1}{4}$ S 31 B T.</p> <p>A juniper, 36 ins. diam., bears N.60$\frac{3}{4}$°W., 74 lks. dist., mkd. $\frac{1}{4}$ S 30 B T.</p>
38.93	Wash, 10 lks. wide, course N.; asc. 60 ft. over W. slope.
43.00	Spur, slopes NW.; desc. 13 ft. over NE. slope.
44.13	Ravine, course N.; asc. 30 ft. over NW. slope.
46.40	Spur, slopes N.; desc. 72 ft. over NE. slope.
51.73	Ravine, course N.; asc. 243 ft. over NW. slope.
66.00	Continue along broken N. slope.
77.93	The cor. of secs. 29, 30, 31 and 32. Land, mountainous. Soil, rocky; 4th rate. Timber, scattering pine, fir, cedar, oak, pinon and juniper; undergrowth, mahogany and scrub oak.
	N.0°3'W., bet. secs. 29 and 30. Over mountainous land, through scattering timber and dense undergrowth. Descend 257 ft. over NE. slope.
8.00	Gulch, course NW.
13.80	Wash, 20 lks. wide, course NW.; asc. 69 ft. over SW. slope.
16.40	Top of ascent; desc. 112 ft. over NW. slope.
23.00	Spur, slopes NW.; continue descending over N. slope.
27.40	Wash, 10 lks. wide, course NW.; asc. 11 ft. over SW. slope.
32.40	Spur, slopes NW.; desc. 38 ft. over N. slope.
36.00	Draw, course NW.; asc. 21 ft. over SW. slope.
38.90	Spur, slopes NW.; desc. 12 ft. over NE. slope.
39.90	Drain, course NW.

Chains.
40.00

Set an iron post, 3 ft. long, 1 in. diam., 12 ins. in the ground to bedrock, and in a mound of stone to top, for $\frac{1}{4}$ sec. cor. with brass cap marked.

$$\frac{1}{4}$$

$$S30 | S29$$

1931

from which

A cedar, 4 ins. diam., bears N. $69\frac{1}{4}^{\circ}$ E., 30 lks. dist., mkd. $\frac{1}{4}$ S 29 B T.

A double pinon, 10 ins. diam., bears S. $11\frac{1}{4}^{\circ}$ W., 45 lks. dist., mkd. $\frac{1}{4}$ S 30 B T.

Ascend 36 ft. over SW. slope.

48.80 Spur, slopes W.; desc. 157 ft. over NW. slope.

58.64 Trail, bears NE. and SW.

65.90 Draw, course W.; asc. 34 ft. over S. slope.

69.10 Spur, slopes W.; desc. 80. ft. over N. slope.

80.00 Set an iron post, 3 ft. long, 2. ins. diam., on solid rock, mkd. X, and in a mound of stone to top, for cor. of secs. 19, 20, 29 and 30, with brass cap marked.

$$T4\frac{1}{2}N R22E$$

$$S19 | S20$$

$$S30 | S29$$

$$1931.$$

from which

A cedar, 10 ins. diam., bears N. 87° E., 219 lks. dist., mkd. T $4\frac{1}{2}$ N. R 22 E S. 20 B. T.

A cedar, 12 ins. diam., bears S. $68\frac{3}{4}^{\circ}$ E., 85 lks. dist., mkd. T $4\frac{1}{2}$ N. R. 22 E S. 29 B T.

A cedar, 5 ins. diam., bears S. $51\frac{1}{2}^{\circ}$ W., 65 lks. dist., mkd. T $4\frac{1}{2}$ N R 22. E S 30 B T.

A cedar, 10 ins. diam., bears N. 68° W., 35 lks. dist., mkd. T $4\frac{1}{2}$ N R 22 E S 19 B T.

Land, mountainous.

Soil, rocky; 4th rate.

Timber, scattering pine, fir, cedar, pimon, oak and juniper; undergrowth, mahogany, manzanita, chamisal and grass.

S. $89^{\circ}54'$ E., on a random line, bet. secs. 20 and 29.

In order to determine the distance across White River Canyon by triangulation, use the cor. of secs. 19, 20, 29 and 30 as point. A and set flags B and C on line, also flag D, which bears N. $80^{\circ}42'$ E., from flag B on random line the auxiliary flag bears N. $20^{\circ}32'$ E., 4.73 chs. dist.; from flag C on random line, the auxiliary flag bears N. $57^{\circ}05'$ W.; all bearings checked by direct reading of the solar, and all angles checked by deflection.

Chains.

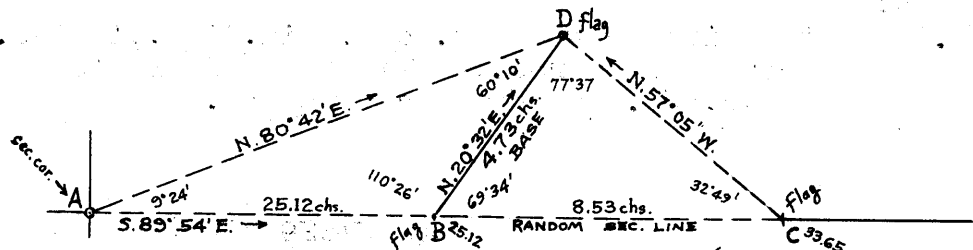

Dist. by double triangulation 33.65 chs.

- 40.00 Set temp. ¼ sec. cor.
- 79.93 Intersect N. and S. line, 9 lks. S. of the cor. of secs. 20, 21, 28 and 29.
Thence
N. 89° 58' W., on a true line, bet. secs. 20 and 29.
Over rolling land, through scattering timber and undergrowth.
Descend 68 ft. over NW. slope.
- 4.25 Rocky ravine, course NW.; asc. 12 ft. over NE. slope.
- 5.50 Spur, slopes N.; desc. 38. ft. over NW. slope.
- 7.36 Wire fence, bears NE. and SW.
- 8.06 Left bank of White River, course SW.
- 9.06 Right bank of White River, course SW.; asc. 128 ft. over E. slope.
- 15.10 Wire fence, bears NE. and SW.
- 16.36 Wash, 30 lks. wide, course S. 15° E.
- 25.60 Top of rim rocks. 20 ft. high, bears NE. and W.; continue along S. slope.
- 32.20 Leave rim rocks, bears E. and SW.; continue over level mesa land.
- 39.96 Set an iron post, 3 ft. long, 1 in. diam., 26 ins. in the ground, for ¼ sec. cor. with brass cap marked.

S 20
—
¼
S 29
1931

from which

A cedar, 1¼ ins. diam., bears S. 55° W., 7¼ lks. dist., mkd. ¼ S 29 B T.

A cedar, 6 ins. diam., bears N. 44½° W., 16 lks. dist., mkd. ¼ S 20 B T.
- 46.28 Rim of White River Canyon, bears N. and S.
- 48.53 Approximate center of White River, 100 lks. wide, course N.
- 50.11 Rim of White River Canyon, 100 ft. high, bears N. and S.; continue over level mesa land.
- 59.81 Rim of White River Canyon, 100 ft. high, bears NE. and SW.

Chains

62.81 (Approximate dist.) to Left bank of White River, course NW. from NE.; ascend 100 ft. over NE. slope.

79.50 Top of rim rocks, bears SE. and NW..

79.93 The cor. of secs. 19, 20, 29 and 30..

Land, rolling.
Soil, sandy loam and rocky; 1st and 4th rates.
Timber, scattering, cedar, oak, pinon, cottonwood and hackberry; undergrowth scrub oak and grass.

S. 89° 59' W., on a random line, bet. secs. 19 and 30.

2.73 Top of precipitous bluff along White River; vertical angle to flag on random line 0°; auxiliary flag bears S. 67° 37' W., from flag on random line the auxiliary flag bears S. 1° 03' W., 200 lks. dist.; all bearings checked by direct reading of the solar, and all angles checked by deflection.

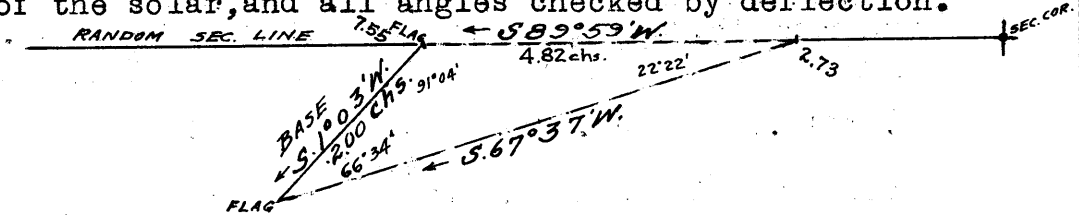

Dist. on random line	2.73 chs.
Dist. by triangulation	4.82 chs.

40.00 Set temp. 1/4 sec. cor.

77.83 Intersect W. bdy. of Tp. 9 lks. N. of the cor. of secs. 19, 24, 25 and 30, hereinbefore described,

Thence

N. 89° 55' E., on a true line, bet. secs. 19 and 30.

Over mountainous land, through scattering timber and dense undergrowth.

Descend 172 ft. over broken SE. slope.

10.20 Ravine, course SE.; asc. 70 ft. over SW. slope.

17.50 Spur, slopes S.; desc. 151 ft. over E. slope.

33.60 Ravine, course SE.; asc. 27 ft. over SW. slope.

36.06 Spur, slopes S.; desc. 14 ft. over E. slope.

37.83 Set an iron post, 3 ft. long, 1 in. diam., 26 ins. in the ground, for 1/4 sec. cor. with brass cap marked.

	S 19
1/4	-----
	S 30
	1931

from which

A cedar, 1 1/4 ins. diam., bears N. 72 1/2° E., 10 lks. dist., mkd. 1/4 S 19 B T.

A cedar, 8 ins. diam., bears S. 47 1/4° W., 61 lks. dist., mkd. 1/4 S 30 B T.

Chains.	Descend 47 ft. over E. slope.
41.33	Wash, 20 lks. wide, course S.; asc. 66 ft. over SW. slope.
44.10	Spur, slopes SE.; desc. 62 ft. over E. slope.
57.31	Trail, bears NE. and SW.
70.11	Rim of White River Canyon, 100 ft. high, bears N. and S.
72.20	(Approximate dist.) to Center of White River, 100 lks. wide, course S.
74.93	Rim of White River Canyon, 100 ft. high, bears N. and S.; continue over level land.
77.83	The cor. of secs. 19, 20, 29 and 30.
	Land, mountainous. Soil, rocky; 4th rate. Timber, scattering pine, fir, oak, pinon, cedar, and pinon; undergrowth, mahogany, scrub oak, willow and grass.
	N. 0° 3' W., bet. secs. 19 and 20.
	Over mountainous land, through scattering timber and undergrowth.
0.10	Rim of White River Canyon, 75 ft. high, bears E. and W.; desc. 165 ft. over N. slope.
7.40	Left bank of White River, course W.
8.40	Right bank of White River, course W.; asc. 123 ft. over S. slope.
9.50	Rim of White River Canyon, bears E. and W.; asc. 25 ft. along W. slope.
16.60	Trail, bears E. and W.
18.60	Wash, 30 lks. wide, course SW.; asc. 45 ft. over SE. slope.
26.00	Same wash, course SE.; asc. 141 ft. over SW. slope.
39.00	Ravine, course SE.; continue ascending over S. slope.
40.00	Set an iron post, 3 ft. long, 1 in. diam., 26 ins. in the ground, for $\frac{1}{4}$ sec. cor. with brass cap marked.
	$\frac{1}{4}$
	S19 S20
	1931
	from which
	A pinon, 6 ins. diam., bears N. 56° E., 37 lks. dist., mkd. $\frac{1}{4}$ S 20 B T.
	A pinon, 10 ins. diam., bears S. 76 $\frac{1}{4}$ ° W., 75 lks. dist., mkd. $\frac{1}{4}$ $\frac{1}{4}$ S 19 B T.
	Ascend 173 ft. over S. slope.
49.80	Top of ascent.; desc. 37 ft. over NW. slope.
58.80	Gulch, course SW.; asc. 369 ft. over SE. slope.

Chains.

80.00. Set an iron post, 3 ft. long, 2 ins. diam., 30 ins. in the ground in slide rock, for cor. of secs. 17, 18, 19 and 20, with brass cap marked.

T 4½ N R 22 E
S 18 | S 17
S 19 | S 20
1931

from which

A pinon, 10 ins. diam., bears N. 64³/₄° E., 71 lks. dist., mkd. T 4½ N R 22 E S 17 B T.

A pinon, 8 ins. diam., bears S. 57° E., 245 lks. dist., mkd. T 4½ N R 22 E S 20 B T.

A pinon, 5 ins. diam., bears S. 23½° W., 102 lks. dist., mkd. T 4½ N R 22 E S 19 B T.

A juniper, 14 ins. diam., bears N. 71½° W., 170 lks. dist., mkd. T 4½ N R 22 E S 18 B T.

Land, mountainous.
Soil, rocky; 4th rate.
Timber, scattering pine, fir, cedar, oak, pinon and juniper; undergrowth, mahogany, manzanita, scrub oak, willow and grass.

S. 89° 58' E., on a random line, bet. secs. 17 and 20.

40.00 Set temp. ¼ sec. cor.

80.06 Intersect N. and S. line, 19 lks. S. of the cor. of secs. 16, 17, 20 and 21.

Thence

S. 89° 54' W., on a true line, bet. secs. 17 and 20.

Over mountainous land, through scattering timber and undergrowth.

Ascend 331 ft. over E. slope.

2.60 Spur, slopes SE.; continue ascending over SE. slope.

27.00 Spur, slopes SE.; desc. 23 ft. over SW. slope.

40.03 Set an iron post, 3 ft. long, 1 in. diam., 20 ins. in the ground to bedrock and in a mound of stone to top, for ¼ sec. cor. with brass cap marked.

S 17
¼ S 20
1931

from which

A juniper, 8 ins. diam., bears N. 30¼° E., 75 lks. dist., mkd. ¼ S 17 B T.

A cedar, 10 ins. diam., bears S. 30½° E., 113 lks. dist., mkd. ¼ S 20 B T.

Descend 46 ft. over NW. slope.

49.10 Ravine, course SE.; asc. 75 ft. over E. slope.

56.70 High rocky spur, slopes S.; desc. 214 ft. over W. slope.

Chains.	
67.08	Wash, 40 lks. wide, course S.; asc. 129 ft. over E. slope.
80.06	The cor. of secs. 17, 18, 19 and 20.
	Land, mountainous. Soil, rocky; 4th rate. Timber, scattering pine, fir, cedar, oak, pinon and juniper; undergrowth, scrub oak, chamisal, mahogany and grass.
	S. 89°55' W., on a random line, bet. secs. 18 and 19.
40.00	Set temp. ¼ sec. cor.
77.73	Intersect W. bdy. of the Tp. 6 lks. S. of the cor. of secs. 13, 18, 19 and 24, hereinbefore described,
	Thence
	N. 89°57' E., on a true line, bet. secs. 18 and 19.
	Over mountainous land, through scattering timber and undergrowth.
	Ascend 117 ft. over SW. slope.
5.00	Ridge, bears NW. and SW.; desc. 95 ft. over NE. slope.
10.00	Same ridge, bears N. and SW.; desc. E. slope.
13.34	Head of ravine, course SE.; asc. 42 ft. over SW. slope.
15.40	Spur, slopes SE.; desc. 226 ft. over NE. slope.
35.40	Enter wash, 50 lks. wide, course E.
37.50	Leave wash, course SE.
37.73	Set an iron post, 3 ft. long, 1 in. diam., 28 ins. in the ground, for ¼ sec. cor. with brass cap marked.
	$\begin{array}{r} S\ 18 \\ \frac{1}{4} \text{---} \\ S\ 19 \\ 1931 \end{array}$
	from which
	A pinon, 6 ins. diam., bears S. 14° W., ¼ lks. dist., mkd. ¼ S 19 B T.
	A pinon, 12 ins. diam., bears N. 51° W., 9¼ lks. dist., mkd. ¼ S 18 B T.
38.03	Wash, 20 lks. wide, course S.; asc. 75 ft. over SW. slope.
42.13	Spur, slopes S.; continue along S. slope.
43.23	Ravine, course S.
46.13	Trail, bears SE. and NW.
47.54	Spur, slopes S.; desc. 138 ft. over E. slope.
55.26	Wash, 20 lks. wide, course S.; asc. 361 ft. over steep SW. slope.
69.03	Spur, slopes S.; high rocky peak bears N. 200 lks. dist.; desc. 195 ft. over SE. slope.
77.73.	The cor. of secs. 17, 18, 19 and 20.

Chains. Land,mountainous.
 Soil,rocky;4th rate.
 Timber,scattering pine,fir,cedar,oak,pinon and juniper;
 undergrowth,mahogany,manzanita,scrub oak,and bear grass.

N.0°3'W.,bet.secs.17 and 18.

Over mountainous land,through scattering timber and under-
 growth.

Ascend 180 ft.over rocky SE.slope.

10.20 Top of ascent.;continue along E.slope.

13.22 Wash,10 lks.wide,course SE.;asc.261 ft.over broken SE.
 slope.

18.20 Thence ascend S.slope of spur.

29.37 High rocky peak,bears S.19°11'W.,about 30 chs.dist.

38.72 Intersect First Standard Parallel North.

Set an iron post,3 ft.long, 2 ins.diam.,10 ins.in the
 ground to bedrock,and in a mound of stone to top,for
 closing cor.of secs.17 and 18,with brass cap marked.

T5NR21E	
S 36	
S18	S17
T4½N	R22E
C	C
1931	

from which

An oak,10 ins.diam.,bears S.54¼°E.,11 lks.dist.,mkd.
 T 4½ N R 22 E S 17 C C B T.

A juniper,8 ins.diam.,bears S.16½°W.,61 lks.dist.,mkd.
 T 4½ N R 22 E S 18 C C B T.

From point of intersection the standard cor.of secs.35
 and 36,T.5 N.,R.21 E.,bears West,13.49 chs.dist.,herein-
 before described.

From the same point the standard ¼ sec.cor.of sec.36,T.
 5 N.,R.21 E.,bears East,26.51 chs.dist.;hereinbefore
 described.

Land,mountainous.
 Soil,rocky;4th rate.
 Timber,scattering pine,oak,pinon,fir,juniper and cedar;
 undergrowth,manzanita,mahogany,scrub oak,chamisal and
 grass.

FINAL TEST OF SOLAR ATTACHMENT.

July 19,1931,on the meridian established by observation
 on Polaris,June 13,1931,as described in book "B" of this
 group, at 8h 20m a.m.,app.t., set off 33°46½' N.,on the
 lat.arc;20°58'N.,on the decl.arc;and orient the instrument
 with the solar;the line of sight agrees with the meridian
 established by Polaris observation.

At 4h 15m p.m.,app.t., set off 33°46½' N.,on the lat.
 arc;20°54½'N.,on the decl.arc;and repeat the test of the
 solar;the line of sight agrees with the meridian established
 by Polaris observation.

GENERAL DESCRIPTION.

The land embraced within the S. portion of this township is rolling mesa land. The general elevation is about 6000 ft. above sea level. The soil is sandy loam and clay, covered with volcanic stones 1st and 4th rates. The timber is scattering pine, fir, cedar, pinon and oak; scattering scrub oak, mahogany and bear grass, is found in this portion of the township. The central portion of the township is rough mountainous land, the soil is sandy loam and rocky; 1st and 4th rates; scattering pine, fir, cedar, pinon, oak and juniper, the undergrowth is dense mahogany, scrub oak, manzanita chamisal, maple and willow. The northeastern portion of the township is rolling mesa land. White River traverses through the central part of the township; entering the township near the closing cor. of secs. 13 and 14, and leaving the township near the $\frac{1}{4}$ sec. cor. of secs. 25 and 30 on the W. bdy. of the township. Cannon Day School Farm lies in the NE. quarter of sec. 22 and the NW. quarter of sec. 23. The land along White River, in secs. 13, 14, 15, 21, 22 and 23 is used for agricultural purposes; cottonwood, black walnut and fruit trees are found along the river bottom. The township is generally used for grazing purposes.

CERTIFICATE OF UNITED STATES SURVEYOR

I, William E. Hiester, U. S. Surveyor, hereby certify upon honor that, in pursuance of special instructions received from the District Cadastral Engineer, for Group 165 Arizona bearing date of the 16th day of October, 1930, I have well, faithfully, and truly in my own proper person, and in strict conformity with said instructions, the Manual of Surveying Instructions, and the laws of the United States, surveyed all those parts or portions of the First Standard Parallel North in Range 21 East
the South Boundary
West Boundary
and Subdivision Lines of
Fractional Township 4 1/2 North, Range 22 East of the Gila and Salt River Base and Meridian, in the State of Arizona, which are represented in the foregoing field notes as having been executed by me, and under my direction; and that all the corners of said survey have been established and perpetuated in strict accordance with the Manual of Surveying Instructions, and the special written instructions of the District Cadastral Engineer, for Group 165 Arizona and in the specific manner described in the field notes, and that the foregoing are the original field notes of such survey.

Place: Phoenix, Arizona.

Date: November 16, 1931.

William E. Hiester

U. S. Surveyor.

APPROVAL

OFFICE OF U. S. SUPERVISOR OF SURVEYS,

Denver, Colo., May 25, 1932.

The foregoing field notes of the survey of the First Standard Parallel North thru Part of Range 21 East
the South Boundary, West Boundary and
Subdivision Lines of
Fractional Township 4 1/2 North, Range 22 East
of the Gila and Salt River Base and Meridian, in the State of Arizona
executed by William E. Hiester U.S. Surveyor
under his special instructions dated Oct. 16, 1930 for Group 165 Arizona, having been critically examined, and the necessary corrections and explanations made, the said field notes, and the surveys they describe, are hereby approved.

Samuel A. Johnson

U. S. Supervisor of Surveys.

~~I certify that the foregoing transcript of the field notes of the above described surveys in~~
~~has been correctly copied from the original notes on file in this office.~~

~~U. S. Supervisor of Surveys.~~