

BOOK 3937

FIELD NOTES

OF THE SURVEY OF THE

R U B Y

lode mining claim

for Segregation from

Section 5 of

Township 4 North, Range 12 West

Of the Gila and Salt River Base and Meridian,

In the State of Arizona.

EXECUTED BY

Francis E. Joy, U.S. Cadastral Engineer.

In the capacity of U. S. Surveyor..., under Special Instructions dated November 3, 1930, issued by the District Cadastral Engineer to govern surveys included in Group No. 166 Arizona, which were approved by the Commissioner of the General Land Office November 15, 1930, and Assignment Instructions dated January 2, 1931.

Survey commenced February 2, 1931.

Survey completed February 2, 1931.

3937

3937

INDEX DIAGRAM.

Township 4 NORTH, Range 12 WEST

		² 2			
6	5	4	3	2	1
7	8	9	10	11	12
18	17	16	15	14	13
19	20	21	22	23	24
30	29	28	27	26	25
31	32	33	34	35	36

Book "C"

Group 166 Arizona

BOOK 3937

INDEX-DIAGRAM.

T.5N.-R.12W.
Sec.33

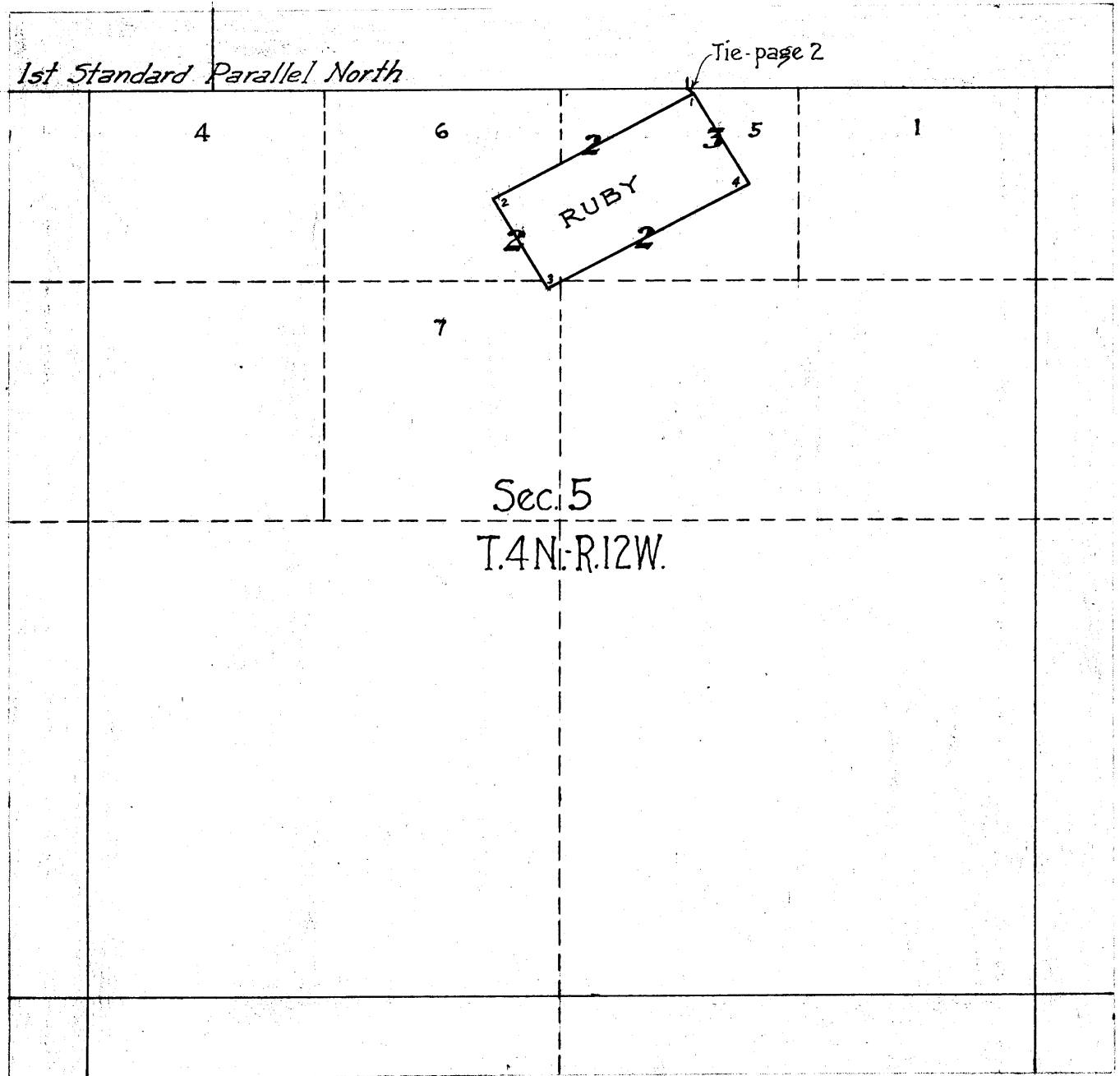

————— Surveyed under this group. Notes herein.

————— Accepted, surveyed lines.

Areas surveyed as per accepted plats on file.

Chains.

The segregation survey of the Ruby mining claim, in Sec. 5, T. 4 N., R. 12 W., Gila and Salt River B. & M., was executed with a light mountain solar transit made by Buff & Buff, Serial No. 16724, constructed in accordance with the standard specifications of the General Land Office. The horizontal circle has a diameter of $4\frac{1}{2}$ ins., with two double opposite verniers reading to single minutes; the vertical circle has a diameter of 4 ins., with one double vernier reading to single minutes. The instrument is equipped with the improved Smith solar attachment; radius of latitude arc $2\frac{1}{2}$ ins., and of declination arc $3\frac{1}{2}$ ins., each with verniers reading to single minutes. The instrument was in good condition, and having been placed in satisfactory adjustment prior to beginning the survey, and tested and found free from appreciable error, was approved by the district cadastral engineer on January 2, 1931. I examine all the instrumental adjustments before making the field tests hereinafter recorded.

The direction of all of the lines were determined by solar transit method. The measurements were made with a Lallie steel tape, 5 chs. in length, graduated every link for the first 100 lks. and thereafter at intervals of 10 lks. The tape was tested by comparison with a Keuffel & Esser standard and found correct. The measurements were made on the slope and the vertical angle of each interval was ascertained by a clinometer in good adjustment; the horizontal equivalents are entered in the field note record.

January 11, 1931, in camp near the center of the SW $\frac{1}{4}$ of sec. 33, T. 5 N., R. 12 W., latitude $33^{\circ}43\frac{1}{2}'$ N., longitude $113^{\circ}31\frac{1}{2}'$ W., at 3h. 0m. a.m., set off $33^{\circ}43\frac{1}{2}'$ N. on the lat. arc; $21^{\circ}49'$ S. on the decl. arc; and determine a meridian with the solar, whence a giant cactus, about $1\frac{1}{2}$ miles dist., bears N. $0^{\circ}08'$ E.

At 5h 08m 45s p.m., l.m.t., or 5h 42m 51s p.m., by watch which reads correct 105th meridian time as determined by comparison with a Western Union clock, make an hour angle observation on Polaris, east of the meridian, three each with the telescope in direct and reversed positions, reading the vertical angle, and the horizontal deflection angle from the cactus in the direction N-E to Polaris.

Mean horizontal angle cactus to Polaris	0° 14' 20"
Azimuth of Polaris	22' 05"
True bearing to cactus	N. 0° 7' 45" E.
Mean observed vertical angle	34° 46' 00"
Reduced latitude	33° 43' 40" N.

January 12, every hour from 8 a. m. to 11 a. m. and at 1:30 p.m. to 4 p.m., make proper settings on the arcs of the solar attachment and ascertain that the resulting orientation of the instrument, when compared with the meridian established by Polaris observation, has a maximum error of less than $1\frac{1}{2}'$.

At this time was unable to identify the location corners of the Ruby mining claim. Therefore on February 2 return with the present claimant and survey said claim. The solar attachment was further tested January 30 on the office meridian at Phoenix and found to be in satisfactory adjustment.

SEGREGATION SURVEY OF THE RUBY MINING CLAIM.

Chains.

Metes-and-bounds survey of a tract of land known as the Ruby mining claim, classified as mineral bearing but not covered by mineral patent survey, in sec. 5, T. 4 N., R. 12 W., G. & S.R., B. & M.

At a position for cor. No. 1 as pointed out by claimant, Set an iron post, 3 ft. long, 1 in. diam., 26 ins. in the ground; for cor. No. 1 of the Ruby mining claim, with brass cap mkd.

T4N R12W
S5
1
R
1931

from which
A palo verde, 8 ins. diam., bears S. 54° 30' W., 13 lks. dist., mkd. AP1 R BT.
A mesquite, 5 ins. diam., bears S. 82° 45' W., 18 lks. dist., mkd. AP S5 BT.
The standard $\frac{1}{4}$ sec. cor. on the S. bdy. of sec. 33, T. 5 N., R. 12 W., bears N. 53° 15' W., 39 lks. dist.; an iron post, 1 in. diam., 10 ins. above the ground, firmly set, marked and witnessed as described in the official record.
The discovery monument, a mound of stone, 3 ft. base, $1\frac{1}{2}$ ft. high, bears S. 45° 50' W., 9.27 chs. dist.

Thence

S. 62° 23' W., along line 1-2 Ruby mining claim.
Over level land through dense mesquite.

.50 Wire fence, bears NW. and SE.
11.90 Middle of Centennial Wash, 60 lks. wide, course SE.
19.02 Leave mesquite and ascend 40 ft. over NE. slope.
Cor. No. 2 and the NW. location corner, which is a pine post, 4 ins. sq., 4 ft. long, set in a mound of stone.

At point for cor.

Set an iron post, 3 ft. long, 1 in. diam., 12 ins. in the ground to bedrock, with a granite stone, 5 x 8 x 10 ins., mkd. X, deposited at base, and in a mound of stone to top, for cor. No. 2 of the Ruby mining claim, with brass cap mkd.

T4N R12W
S5
2
R
1931

Thence

S. 32° 15' E., along line 2-3 Ruby mining claim.
Ascend 178 ft over stony N. slope.

2.80 A tunnel, facing N. and 65 ft. deep, bears E. 30 lks. dist.
5.80 Top of hill, bears E. and W., descend 52 ft. over rocky S. slope.

9.12 Set an iron post, 3 ft. long, 1 in. diam., 8 ins. in the ground to bedrock, with a granite stone, 6 x 7 x 9 ins., mkd. X, deposited at base, and in a mound of stone to top, for cor. No. 3 of the Ruby mining claim, with brass cap mkd.

R
3
S5
T4N R12W
1931

Thence

N. 62° 23' E., along line 3-4 Ruby mining claim.
Over broken rocky S. slope.

9.30 Head of a ravine, course S. 20° E.
12.00 Spur, slopes S.; descend 140 ft. over rocky E. slope.
16.31 Set an iron post, 3 ft. long, 1 in. diam., 12 ins. in the ground to bedrock. with a granite stone, 5 x 6 x 8 ins., mkd. X, deposited at base, and in a mound of stone to top, for witness cor. to cor. No. 4 of the Ruby mining claim, with brass cap mkd.

SEGREGATION SURVEY OF THE RUBY MINING CLAIM.

200 8 888

Chains.

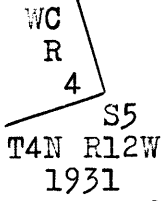

- No trace of location cor. found.
- 17.50 Enter Centennial Wash, course SE.
- 19.02 True point for cor. No. 4 of the Ruby mining claim falls in wash.
- Thence
- N. 32° 15' W., along line 4-1 Ruby mining claim.
- Over level land in Centennial Wash.
- 3.40 Leave Centennial Wash, course SE.; enter dense mesquite.
- 5.65 Wire fence, bears NW. and SE.
- 9.12 Cor. No. 1 of the Ruby mining claim and place of beginning.

GENERAL DESCRIPTION.

The Ruby mining claim, for the most part, lies on a rough and rocky hill. The hill breaks on the NE. face very rapidly over a series of cliffs, at the base of which is found the Centennial Wash.

That portion lying north and east of the wash is level and appears to be overflowed at times.

The improvements consist of a tunnel near the west end line, facing north, and about 65 ft. long. The discovery monument is alongside a shaft, 4 x 6 by 10 ft. deep, and just to the west of the monument are two tunnels, each about 30 ft. long, on a level with and facing the wash.

February 2, 1931.

48
5

NOTICE OF MINING LOCATION
LODE CLAIM

2716

BOOK 3987

TO ALL WHOM IT MAY CONCERN:

This Mining Claim, the name of which is the RUBY Mining Claim, situate on lands belonging to the United States of America, and in which there are valuable mineral deposits, was entered upon and located for the purpose of exploration and purchase by Chas. W. Barnett, J. Louis Bardet and Murrell P. Williams the undersigned, on the 9 day of May, 1911

The length of this claim is 1500 feet, and we claim 1200 feet, in a S. Westernly direction and 300 feet in a N. Eastly direction from the center of the discovery shaft, at which this notice is posted, lengthwise of the claim, together with 300 feet in width of the surface grounds, on each side of the center of said claim. The general course of the lode deposit and premises is from the Southwest to the Northeast

The claim is situated and located in the Elliot Mining District, in Yuma County, in the Territory of Arizona, about 1/4 mile in a Southernly direction from Reed Ranch This claim is an old abandoned claim formerly known as "Saritoga" Mining Claim

The surface boundaries of the claim are marked upon the ground as follows: Beginning at Amonument of stone at a point in a N. Eastly direction 300 feet from the discovery shaft (at which this notice is posted), being in the center of the N. East end line of said claim; thence 300 feet to a monument of stone, being the N. West corner of said claim; thence Southwestly 1500 feet to a monument of stone, being at the Southwesterly corner of said claim; thence S. Eastly 300 feet to a monument of stone at the center of the S. West end of said claim; thence S. Easterly 300 feet to a monument of stone, being at the S. East corner of said claim; thence N. Easterly 1500 feet to a monument of stone at the N. East corner of said claim; thence N. Westerly 300 feet to the place of beginning.

All done under the provisions of Chapter Six of Title XXXII, of the Revised Statutes of the United States and of an Act of the General Assembly of Arizona, entitled "An Act to Revise and Codify the Laws of the Territory of Arizona", approved March 16, 1901.

Dated and posted on the grounds this 9th day of May, 1911.

Chas W. Barnett
J. Louis Bardet
Murrell P. Williams

STATE OF ARIZONA)

ss

COUNTY OF YUMA)

I, A. K. Ketcherside, County Recorder in and for the County and State aforesaid, do hereby certify that the foregoing copy is a full true and correct copy of that certain Location Notice of the "Ruby" Mining Claim, which was dated May 9th 1911 and was recorded Jun. 29, 1911, in Book 8 of Mines at Page 423.

IN WITNESS WHEREOF I have hereunto set my hand and affixed my official seal at my office in Yuma County, Arizona, this 12th day of August A. D. 1929.

A. K. Ketcherside
County Recorder.

(SEAL)

4-680
(August, 1928)

FIELD ASSISTANTS.
to
Francis E. Joy, U.S. Cadastral Engineer

NAMES.	CAPACITY.
James Shine	Chainman.
Cal Davis	Chainman.

BOOK 3937

CERTIFICATE OF UNITED STATES SURVEYOR.

I, Francis E. Joy U.S. Cadastral Engineer, hereby certify upon honor that, in pursuance of special instructions received from the District Cadastral Engineer, for Group 166, Arizona bearing date of the 3rd day of November, 1930, I have well, faithfully, and truly in my own proper person, and in strict conformity with said instructions, the Manual of Surveying Instructions, and the laws of the United States, surveyed all those parts or portions of

the RUBY lode mining claim

for segregation from

Section 5 of

Township 4 North, Range 12 West of the Gila and Salt

River Base and Meridian, in the State of Arizona, which are represented in the foregoing field notes as having been executed by me, and under my direction; and that all the corners of said survey have been established and perpetuated in strict accordance with the Manual of Surveying Instructions, and the special written instructions of the District Cadastral Engineer, for Group 166, Arizona and in the specific manner described in the field notes, and that the foregoing are the original field notes of such survey.

San Francisco, California,
September 29, 1931.

Francis E. Joy
U.S. Cadastral Engineer. ~~U.S. Cadastral Engineer~~

APPROVAL.

OFFICE OF U. S. SUPERVISOR OF SURVEYS,

Denver, Colo., July 6, 1932.

The foregoing field notes of the survey of

the RUBY lode mining claim

for segregation from

Section 5 of

Township 4 North, Range 12 West

of the Gila and Salt River Base and Meridian, in the State of Arizona

executed by Francis E. Joy, U.S. Cadastral Engineer

under his special instructions dated November 3, 1930 for Group 166, Arizona, having been critically examined, and the necessary corrections and explanations made, the said field notes, and the surveys they describe, are hereby approved.

Wm. H. Johnson
U. S. Supervisor of Surveys.

~~I certify that the foregoing transcript of the field notes of the above described surveys in~~

~~, has been correctly copied from the original notes on file in this office.~~

~~U. S. Supervisor of Surveys.~~