

FIELD NOTES

OF THE RESURVEY OF

BOUNDARIES OF FORT HUACHUCA MILITARY RESERVATION

in Ts. 21 S., Rs. 19 and 20 E., and in T. 22 S., R. 20 E.,

and of

the Resurvey of a Portion of the Subdivisional Lines of said Townships,
Resurvey of Part of South Bdy. of T. 21 S., R. 19 E.

and

Retracement of Panama Nos. 1, 2 & 3 unsurveyed Mineral Locations

in Sec. 31, T. 21 S., R. 19 E. & Sec. 6, T. 22 S., R. 19 E.

Of the Gila and Salt River Meridian,

In the State of Arizona

EXECUTED BY

William E. Hiester

In the capacity of U. S. Surveyor, under Special Instructions dated January 7, 1932, issued by the District Cadastral Engineer to govern surveys included in Group No. 174, which were approved by the Commissioner of the General Land Office, January 23, 1932, and Assignment Instructions dated February 8, 1932

Survey commenced February 10, 1932

Survey completed February 25, 1932

3950

3950

INDEX DIAGRAM.

Township , *Range*

6	5	4	3	2	1
7	8	9	10	11	12
13	17	16	15	14	13
19	20	21	22	23	24
30	29	28	27	26	25
31	32	33	34	35	36

INDEX DIAGRAM

BOOK 3950

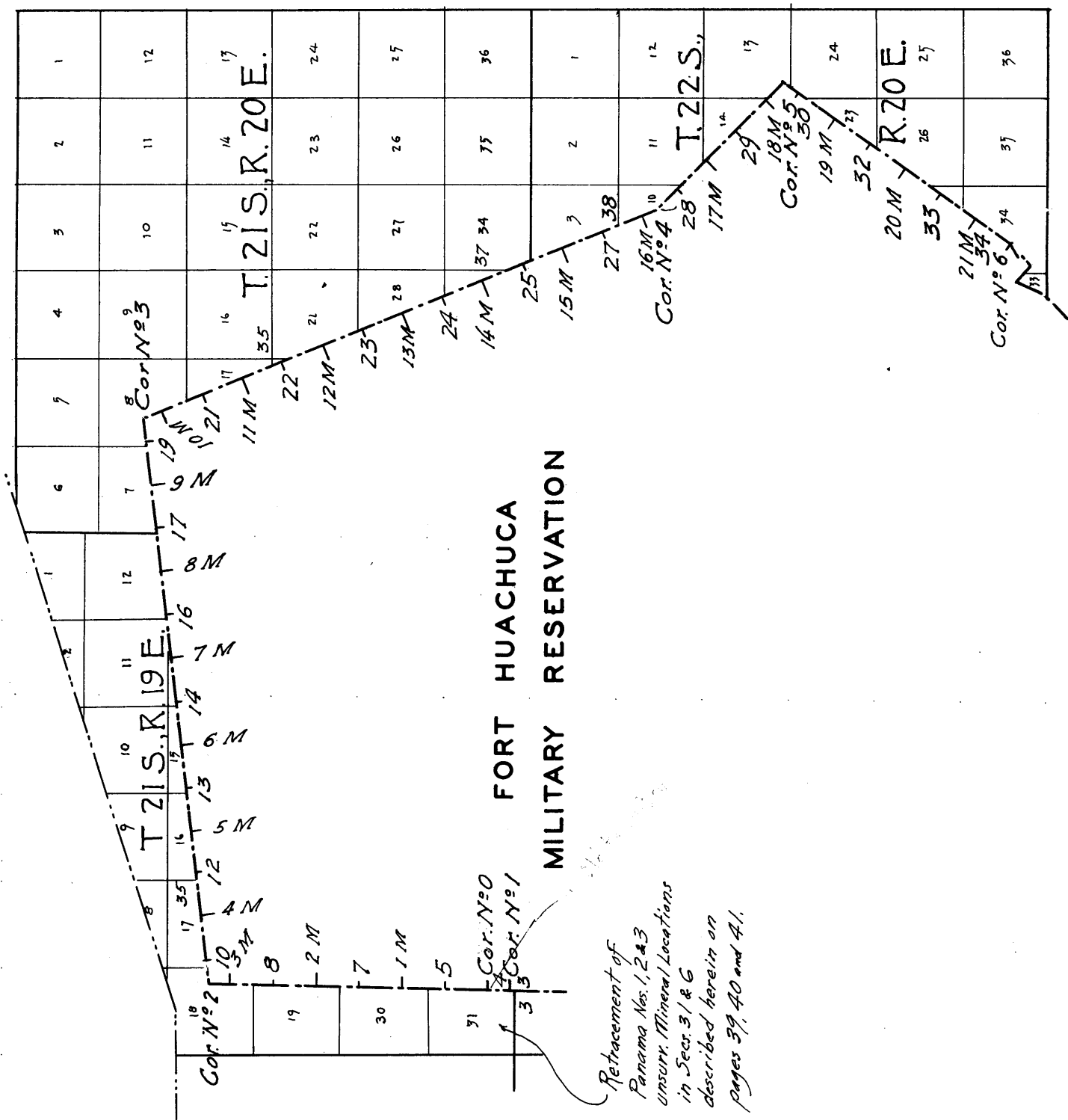

*Retracement of
Panama Nos. 1, 2 & 3
insurre. Mineral Locations
in Secs. 31 & 6
described herein on
pages 39, 40 and 41.*

The survey was executed with a light mountain transit made by Buff & Buff, Serial No. 19423, constructed in accordance with the standard specifications of the General Land Office. The horizontal circle has a diameter of $4\frac{1}{2}$ ins., with two double opposite verniers reading to single minutes; the vertical circle has a diameter of 4 ins. with one double vernier reading to single minutes. The instrument is equipped with the improved Smith solar attachment; radius of latitude arc $2\frac{1}{8}$ ins. and of the declination arc $3\frac{1}{8}$ ins., each with verniers reading to single minutes. The instrument was in good condition, and having been placed in satisfactory adjustment prior to beginning the survey, and tested and found free from appreciable error, was approved by the District Cadastral Engineer on Nov. 15, 1931. I examine all the instrumental adjustments before making the field tests hereinafter recorded.

The direction of all lines were determined by the solar transit method. The measurements were made with a Lallie steel tape 5 chs. in length, graduated every link for the first 100 lks., and the balance at intervals of 10 lks. The tape was tested by comparison with a Lufkin standard and found correct. The measurements were made on the slope and the vertical angle of each interval was ascertained by clinometer in good adjustment; the horizontal equivalents are entered in the field record.

The data furnished with the special instructions gives the geographic position for corner No. 0, Fort Huachuca Military Reservation, T. 21 S., R. 19 E., as follows; latitude $31^{\circ} 33' 33''$ N., and longitude $110^{\circ} 27' 00''$ W.

February 10, 1932, in camp near corner No. 1 Fort Huachuca Military Reservation, T. 21 S., R. 19 E., G. & S.R. Meridian, at 10h 13.4 m. ^ml.m.t., or 10h 35.8 m p.m., by my watch which reads correct 105th meridian time as determined by radio, I observe Polaris at western elongation, making two sights each with the telescope in direct and reversed positions, and place a tack at the mean point, on a peg driven firmly in the ground 10 chs. N.

February 11, 1932, after sunrise, I lay off the azimuth of Polaris $1^{\circ} 14' 17''$ and make a meridian mark on a second peg to the east of the mean point in the line determined by the observation.

In order to verify the latitude of this station and the reading of my watch, I make a meridian observation of the sun, first setting on the lower limb and noting the transit of the west limb, then, after reversal of the instrument, setting on the upper limb and noting the transit of the east limb as follows:

Mean observed altitude,.....	44°14'16"
Reduced latitude,.....	31°33'36"
Mean watch time of observation,.....	12h36m11s
Watch fast of l.m.t.,.....	21m48s
Same by reference to radio and calculated difference in longitude,.....	21m48s

Every 30 min. from 7 to 10:30 a.m., and from 1:30 to 5 p.m., I make proper settings on the arcs of the solar attachment and ascertain that the resulting orientation of the instrument when compared with a meridian established by Polaris observation has a maximum error of less than $1' 30''$.

I repeat the tests of the arcs daily by noon observations and verify the meridional indications at frequent intervals throughout the survey.

2 RESURVEY OF THE BOUNDARIES OF FORT HUACHUCA MILITARY RESERVATION
FROM CORNER NO. 1 to CORNER NO. 6.

Chains The survey of the boundaries of Fort Huachuca Military Reservation was originally executed under military order dated May 24, 1883, monuments established thereon being numbered from 1 to 6 consecutively.

In 1909 Jesse B. Wright, U. S. Deputy Surveyor, made a resurvey of a portion of said boundary from corner No. 1 to corner No. 3, establishing mile and half-mile corners thereon, and subdivided fractional T. 21 S., R. 19 E., closing his surveys on the N. and W. boundaries of the reservation. Subsequent investigation disclosed that Deputy Wright erred in his identification of corner No. 1 which was actually established upon the apex of a conical butte about a quarter of a mile to the south of his designated point.

In 1909 Philip Contzen, U. S. Deputy Surveyor, subdivided fractional Tps. 21 and 22 S., R. 20 E., and closed his survey on the reservation boundary, but established no mile and half-mile corners.

The following notes describe a resurvey of the boundaries of Fort Huachuca Military Reservation, from corner No. 1 to corner No. 6, reestablishing and establishing mile and half-mile corners, and reestablishing the closing corners of fractional Tps. 21 and 22 S., Rs. 19 and 20 E.

Beginning at corner No. 1 on conical butte, T. 21 S., R. 19 E.,

N. 2° 06' E., on a random line, along W. bdy. of F.H.M.R.

- 22.42 Intersect cor. No. 1, established by Deputy Wright in 1909.
- 62.55 Fall 2 lks. N. 87° 53' W. of ½ mile cor.
- 102.56 Fall 1 lk. N. 87° 53' W. of 1 mile cor.
- 142.68 Fall 2 lks. N. 87° 53' W. of 1½ mile cor.
- 182.76 Fall 3 lks. N. 87° 53' W. of 2 mile cor.
- 222.88 Fall 3 lks. S. 87° 53' E. of 2½ mile cor.
- 262.93 Fall 2 lks. N. 87° 53' W. of 3 mile cor.
- 281.25 Intersect the orig. cor. No. 2.

Thence from cor. No. 2:.....

N. 82° 34' E.; on a random line, along N. bdy. of F.H.M.R.

- 22.11 Fall 8 lks. S. 7° 26' E. of 3½ mile cor.
- 62.35 Fall 12 lks. S. 7° 26' E. of 4 mile cor.
- 102.43 Fall 15 lks. S. 7° 26' E. of 4½ mile cor.
- 142.56 Fall 15 lks. S. 7° 26' E. of 5 mile cor.
- 182.16 Fall 15 lks. S. 7° 26' E. of 5½ mile cor.
- 222.36 Fall 16 lks. S. 7° 26' E. of 6 mile cor.
- 262.53 Fall 14 lks. S. 7° 26' E. of 6½ mile cor.
- 302.70 Fall 16 lks. S. 7° 26' E. of 7 mile cor.
- 342.97 Fall 21 lks. S. 7° 26' E. of 7½ mile cor.
- 382.90 Fall 14 lks. S. 7° 26' E. of 8 mile cor.

FROM CORNER No.1 TO CORNER No.6

BOOK 3950

Chains.
423.04 Fall 21 lks.S.7° 26' E. of 8 $\frac{1}{2}$ mile cor.
461.11 Fall 23 lks.S.7° 26' E. of 9 mile cor.
503.39 Fall 23 lks.S.7° 26' E. of 9 $\frac{1}{2}$ mile cor.
523.61 Fall 23 lks.S.7° 26' E. of orig. cor. No. 3.

Thence from cor.No.3

S.21°24'E., on a random line, along the E.bdy.of F.H.M.R.

512.20 Point from which orig.cor.No.4 bears S.68°36'W., 15 lks. dist.

Thence from cor.No.4

S.43°36'E., on a random line, along the E.bdy.of F.H.M.R.

171.54 Point from which orig.cor.No.5 bears N.46°24'E., 10 lks. dist.

Thence from cor.No.5

S.34°30'W., on a random line, along the E.bdy.of F.H.M.R.

254.80 Point from which orig.cor.No.6 bears S.55°30'E., 44 lks. dist.

RESURVEY OF A PORTION OF THE SOUTH BOUNDARY
OF T.21 S., R.19 E.

Beginning at the $\frac{1}{4}$ sec.cor.of secs.6 and 31, on S. bdy. of T.21 S., R.19 E.

East, on a random line, bet.secs.6 and 31.

39.75 Fall 3 lks.N.of the cor.of secs.5, 6, 31 and 32, which is a pine post, 4 ins.sq.standing 12 ins.above the top of a mound of stone, mkd.and witnessed as described in the official record.I destroy all evidence of this cor.

Retracement having been made bet.secs.5 and 32, I destroy all evidence of the closing cor.bet.secs.5 and 32, Tps. 21 and 22 S., R.19 E.

No trace of the closing cor.bet.secs.31 and 32 T.21 S., R.19 E., is found.

I return to the $\frac{1}{4}$ sec.cor.of secs.6 and 31, T.21 and 22 S., R.19 E., which is a limestone 24x15x6 ins.firmly set, mkd.and witnessed as described in the official record.

Thence

S.89°57'E., on a true line, along S.bdy.sec.31.

Over mountainous land, through scattering oak.

Chains. Ascend 39 ft. over W. slope.

3.00 Spur, slopes N.; desc. 84 ft. over NE. slope.

8.25 Wash, 20 lks. wide, course NW.; asc. 136 ft. over SW. slope.

15.61 Intersect bdy. of F.H.M.R., on crest of ridge, at a point S. $1^{\circ}14'$ W., 1.89 chs. dist., from cor. No. 1

Set an iron post, 3 ft. long, 3 ins. diam., 20 ins. in the ground to bedrock, and in a mound of stone to top, for closing cor. of frac. T.21 S., R.19 E., with brass cap mkd.

T21S
R19E
S31 | FHMR
CC |
PL |
1932

from which

A black oak, 7 ins. diam., bears N. $43\frac{1}{2}^{\circ}$ W., 276 lks. dist., mkd. T 21 S R 19 E S 31 CC BT.

A black oak, 6 ins. diam., bears N. $14\frac{3}{4}^{\circ}$ W., 231 lks. dist., mkd. T 21 S R 19 E S 31 CC BT.

Land, mountainous.
Soil, rocky 3rd rate.
Timber, scattering oak; undergrowth, scrub oak.

RESURVEY OF THE BOUNDARIES OF FORT HUACHUCA MILITARY
RESERVATION FROM CORNER No. 1 TO CORNER No. 6

Beginning at cor. No. 1 on conical butte, on W. bdy. of F.H.M. R., T.21 S., R.19 E., which is a pine post, 4x4 ins. standing 24 ins. above the top of a mound of stone, 5 ft. base, 3 ft. high, mkd. and witnessed as described in the official record.

At point for cor.

Set an iron post, 3 ft. long, 3 ins. diam., 16 ins. in the ground to bedrock, with the original pine post deposited alongside, and in a mound of stone to top, for corner number 1 on the bdy. of F.H.M.R., with brass cap marked.

T21S | AP1
S31 | FHMR
R19E |
1932

from which

A black oak, 6 ins. diam., bears N. 44° E., 78 lks. dist., mkd. AP 1 FHMR BT.

A black oak, 10 ins. diam., bears S. $47\frac{3}{4}^{\circ}$ E., 64 lks. dist., mkd. AP 1 FHMR BT.

A bench mark of the U.S. Geological Survey, published elevation 5,185 ft. above sea level, bears N. $86^{\circ}43'$ W., 31.22 chs. dist.; a brass tablet seated in a granite ledge, conforming to the record.

Old Baldy, bears N. $67^{\circ}46'$ W.

SE. cor. of Pratt's house, bears N. $80^{\circ}39'$ W.

Chains	<p>Manilla Mining Co's shaft, bears S. $84^{\circ}43'E$.</p> <p>SE. corner of concrete ore bin, bears S. $85^{\circ}37'E$.</p> <p>N. $2^{\circ}06'E$, on a true line, along W. bdy. of F.H.M.R.</p> <p>Over mountainous land, through heavy oak.; desc. 215 ft. over N. slope.</p> <p>12.05 Wash, 10 lks. wide, course NW.; asc. 27 ft. over SW. slope.</p> <p>12.60 Top of low spur, slopes W.; also old tin house bears W. 150 lks. dist.</p> <p>Descend 16 ft. over gradual N. slope.</p> <p>17.00 Leave heavy oak, bears E. and W.; continue through scattering oak.</p> <p>22.42 Intersect cor. No. 1 established by Deputy Wright in 1909, which is a mound of stone 2 ft. base, 1 ft. high.</p> <p>The designation of this cor. is now changed from cor. No. 1 to corner number 0.</p> <p>At true point for cor.</p> <p>Set an iron post, 3 ft. long, 3 ins. diam., 28 ins. in the ground, in original stone mound, for Cor. No. 0; on W. bdy. of F.H.M.R., with brass cap mkd.</p> <table border="0" style="margin-left: auto; margin-right: auto;"> <tr> <td style="padding-right: 5px;">T21S</td> <td style="border-left: 1px solid black; padding-left: 5px;">AP 0</td> </tr> <tr> <td>S31</td> <td style="border-left: 1px solid black; padding-left: 5px;">FHMR</td> </tr> <tr> <td>R19E</td> <td style="border-left: 1px solid black; padding-left: 5px;"></td> </tr> <tr> <td colspan="2" style="text-align: center;">1932</td> </tr> </table> <p style="text-align: right;">from which</p> <p>Original bearing trees.</p> <p>A catclaw, 6 ins. diam., bears S. $49^{\circ}E$, 53 lks. dist., marks legible lll No. 1 FHMR BT. I remark this tree AP 0 FHMR BT.</p> <p>A pin oak, 6 ins. diam., bears S. $65\frac{1}{2}^{\circ}W$, 57 lks. dist., marks legible, T 21 S R COR No. 1 BT. I remark this tree AP S31 BT.</p> <p>New bearing tree.</p> <p>A black oak, 5 ins. diam., bears N. $63\frac{1}{2}^{\circ}E$, 260 lks. dist., mkd. AP 0 FHMR BT.</p> <p>A galvanized iron post, 6 ins. sq. 4 ft. above ground, on line bet. Cochise and Pima Counties, Arizona, marked Cochise on E. & Pima on W. bears S. $72^{\circ}W$, 4.20 chs. dist.</p> <p>Old Baldy, bears S. $68^{\circ}22'W$.</p> <p>Land, level and mountainous. Soil, sandy loam, 1st rate. Timber, oak and catclaw; undergrowth scrub oak.</p>	T21S	AP 0	S31	FHMR	R19E		1932	
T21S	AP 0								
S31	FHMR								
R19E									
1932									
.65	<p>N. $2^{\circ}08'E$, on a true line, along W. bdy. of F.H.M.R.</p> <p>Over rolling prairie land, through scattering oak.</p> <p>Graded road, bears E. to Fort Huachuca and W. to Elgin, Arizona.</p>								

RESURVEY OF THE BOUNDARIES OF FORT HUACHUCA MILITARY RESERVATION

FROM CORNER No.1 TO CORNER No.6

Chains
 1.30 Fence, bears E. and W.; desc. 71 ft. over gradual N. slope.
 13.95 Wash, 15 lks. wide, course NW.; asc. 14 ft. over SW. slope.
 16.75 Telephone line, bears E. and W.
 18.00 Top of low spur, slopes W.; desc. 73 ft. over gradual N. slope.
 23.30 Drain, course NE.
 31.57 Ravine, 24 ft. deep, course NW.
 38.82 Wash, 20 lks. wide, course NE.; asc. 9 ft. over SE. slope.
 40.13 Intersect $\frac{1}{2}$ mile cor. on W. bdy. of F.H.M.R., which is a pine post, 4 ins. sq. standing firmly 12 ins. above the top of a mound of stone, marked $\frac{1}{2}$ M on S. FHMR on E., T21 S R 19 E S 31 on W. face.

At true point for cor.

Set an iron post, 3 ft. long, 1 in. diam., 27 ins. in the ground, with the original post deposited alongside, for $\frac{1}{2}$ mile cor. of F.H.M.R., with brass cap mkd.

T21S | $\frac{1}{2}$ M
 S31 | FHMR
 R19E |
 1932

from which

Original bearing tree.

A black oak, 10 ins. diam., bears $S. 57^{\frac{3}{4}}/4^{\circ} E.$, 47 lks. dist., surface scar on the tree. I do not uncover the marks.

No trace of the original SW. bearing tree.

New bearing tree.

A black oak, 10 ins. diam., bears $N. 76^{\frac{3}{4}}/4^{\circ} E.$, 35 lks. dist., mkd. $\frac{1}{2}$ M FHMR BT.

 N. $2^{\circ} 05' E.$, on a true line, along W. bdy. of F.H.M.R.

9.40 Same wash, 20 lks. wide, course N.; continue along wash.

11.90 Leave wash, course NW.; asc. 42 ft. over SW. slope.

15.81 Intersect the closing cor. of secs. 30 and 31, T. 21 S., R. 19 E., which is a granite stone, 14x10x6 ins. marked 1 notch on S. 5 notches on N and CC on W. faces. with mound of stone W.

At true point for cor.

Set an iron post, 3 ft. long, 2 ins. diam., 28 ins. in the ground, with the original stone deposited at the base, for closing cor. of secs. 30 and 31, T. 21 S., R. 19 E., with brass cap mkd.

T21S
 C S30 | FHMR
 C S31 |
 R19E |
 1932

Chains.	from which												
	<p>Original bearing trees.</p> <p>A black oak, 10 ins. diam., bears S. $67\frac{3}{4}^{\circ}$ W., 65 lks. dist., surface scar on the tree. I do not uncover the marks.</p> <p>A black oak, 24 ins. diam., bears N. $70\frac{1}{2}^{\circ}$ W., 173 lks. dist., surface scar on the tree. I do not uncover the marks.</p>												
15.82	Fence, bears E. and W.												
24.10	Corner of fences on reservation bdy. bears NE. and SE.; continue along fence.												
30.80	Spur, slopes NW.; desc. 26 ft. over NE. slope.												
40.01	<p>Intersect 1 mile cor. on W. bdy. of F.H.M.R., which is a pine post, $3\frac{1}{4}$ ins. mkd. 1 M on S. FHMR on E. T 21 S R 19 E S 30 on W. face, standing 24 ins. above the top of a mound of stone.</p> <p>At true point for cor.</p> <p>Set an iron post, 3 ft. long, 3 ins. diam., 27 ins. in the ground, with the original post deposited alongside, for 1 mile cor. of F.H.M.R., with brass cap mkd.</p> <table style="margin-left: auto; margin-right: auto;"> <tr> <td>T21S</td> <td> </td> <td>1M</td> </tr> <tr> <td>S30</td> <td> </td> <td>FHMR</td> </tr> <tr> <td>R19E</td> <td> </td> <td></td> </tr> <tr> <td></td> <td></td> <td>1932</td> </tr> </table> <p>raise a mound of stone, 3 ft. base, 2 ft. high, E. of cor.</p> <p>Land, rolling. Soil, sandy loam and clay; 2nd rates. Timber, scattering oak. Undergrowth, scattering catclaw.</p>	T21S		1M	S30		FHMR	R19E					1932
T21S		1M											
S30		FHMR											
R19E													
		1932											
	<p>N. $2^{\circ}07'E.$, on a true line, along W. bdy. of F.H.M.R.</p> <p>Over rolling prairie land.</p>												
40.12	<p>Intersect $1\frac{1}{2}$ mile cor. on W. bdy. of F.H.M.R., which is a pine post, $3\frac{1}{4}$ ins. mkd. $1\frac{1}{2}$ M on S. FHMR on E. T 21 S R 19 E S 30 on W. face, standing 12 ins. above the top of a mound of stone.</p> <p>At true point for cor.</p> <p>Set an iron post, 3 ft. long, 1 in. diam., 27 ins. in the ground, with the original post deposited alongside, for $1\frac{1}{2}$ mile cor. of F.H.M.R., with brass cap mkd.</p> <table style="margin-left: auto; margin-right: auto;"> <tr> <td>T21S</td> <td> </td> <td>$1\frac{1}{2}$M</td> </tr> <tr> <td>S30</td> <td> </td> <td>FHMR</td> </tr> <tr> <td>R19E</td> <td> </td> <td></td> </tr> <tr> <td></td> <td></td> <td>1932</td> </tr> </table> <p>raise a mound of stone, 3 ft. base, 2 ft. high, E. of cor.</p> <p>-----</p> <p>N. $2^{\circ}07'E.$, on a true line, along W. bdy. of F.H.M.R.</p>	T21S		$1\frac{1}{2}$ M	S30		FHMR	R19E					1932
T21S		$1\frac{1}{2}$ M											
S30		FHMR											
R19E													
		1932											
4.50	Low spur, slopes NE.; desc. 109 ft. over SE. slope.												

8 RESURVEY OF THE BOUNDARIES OF FORT HUACHUCA MILITARY RESERVATION
FROM CORNER No.1 TO CORNER No.6

Chains																
9.95	Wash, 30 lks. wide, course NE.; asc. 20 ft. over SE. slope.															
15.91	Intersect the closing cor. of secs. 19 and 30, T. 21 S., R. 19 E., which is a quartzite stone, 24x10x10 ins. mkd. 2 notches on S. 4 notches on N. and CC on W. face, with mound of stone W.															
	At true point for cor.															
	Set an iron post, 3 ft. long, 2 ins. diam., 27 ins. in the ground, with the original stone deposited at the base, for closing cor. of secs. 19 and 30, T. 21 S., R. 19 E., with brass cap mkd.															
	<table border="0"> <tr> <td></td> <td>T21S</td> <td></td> </tr> <tr> <td>C</td> <td>S19</td> <td>FHMR</td> </tr> <tr> <td>C</td> <td>S30</td> <td></td> </tr> <tr> <td></td> <td>R19E</td> <td></td> </tr> <tr> <td></td> <td>1932</td> <td></td> </tr> </table>		T21S		C	S19	FHMR	C	S30			R19E			1932	
	T21S															
C	S19	FHMR														
C	S30															
	R19E															
	1932															
	raise a mound of stone, 3 ft. base, 2 ft. high W. of cor.															
	Descend 34 ft. over NE. slope.															
22.10	Draw, course NE.; asc. 52 ft. over SE. slope.															
35.00	Top of ascent; desc. 6 ft. over gradual N. slope.															
40.08	Intersect 2 mile cor. on W. bdy. of F.H.M.R., which is a pine post, 3 x 4 ins. mkd. 2M on S. FHMR on E. T 21 S R 19 E S 19 on W. face, set in mound of stone.															
	At true point for cor.															
	Set an iron post, 3 ft. long, 3 ins. diam., 27 ins. in the ground, with the original post deposited alongside, for 2 mile cor. of F.H.M.R., with brass cap mkd.															
	<table border="0"> <tr> <td></td> <td>T21S</td> <td>2 M</td> </tr> <tr> <td></td> <td>S19</td> <td>FHMR</td> </tr> <tr> <td></td> <td>R19E</td> <td></td> </tr> <tr> <td></td> <td>1932</td> <td></td> </tr> </table>		T21S	2 M		S19	FHMR		R19E			1932				
	T21S	2 M														
	S19	FHMR														
	R19E															
	1932															
	raise a mound of stone, 3 ft. base, 2 ft. high, E. of cor.															
	Land, rolling. Soil, clay, 2nd rate. Timber, none; undergrowth, scattering catclaw.															
	N. 2° 01' E., on a true line, along W. bdy. of F.H.M.R. Over rolling prairie land.															
4.28	Ravine, course NE.; asc. 39 ft. over SE. slope.															
7.70	Spur slopes E.; desc. 102 ft. over NE. slope.															
15.10	Continue along top of spur.															
21.40	Wash, 50 lks. wide, course E.; asc. 20 ft. over SE. slope.															
28.76	Ravine, course E. asc. 20 ft. over SE. slope.															
35.00	Top of ascent; desc. 40 ft. over NE. slope.															
40.12	Intersect 2½ mile cor. on W. bdy. of F.H.M.R., which is a															

FROM CORNER No.1 TO CORNER No.6

BOOK 3950

Chains	<p>pine post, 3x4 ins. mkd. 2$\frac{1}{2}$ M on S. FHMR. on E. T 21 S R 19 E S 19 on W. face, set in a mound of stone.</p> <p>At true point for cor.</p> <p>Set an iron post, 3 ft. long, 1 in. diam., 27 ins. in the ground, with the original post deposited alongside, for 2$\frac{1}{2}$ mile cor. of F.H.M.R., with brass cap mkd.</p> <div style="text-align: center;"> <table border="0"> <tr><td>T21S</td><td> </td><td>2$\frac{1}{2}$M</td></tr> <tr><td>S19</td><td> </td><td>FHMR</td></tr> <tr><td>R19E</td><td> </td><td></td></tr> <tr><td colspan="3">1932</td></tr> </table> </div> <p style="text-align: right;">from which</p> <p>A mesquite 10 ins. diam., bears N. 34$\frac{1}{2}$$^{\circ}$E., 176 lks. dist., mkd. 2$\frac{1}{2}$M FHMR BT.</p> <p>A mesquite 10 ins. diam., bears S. 65$\frac{1}{2}$$^{\circ}$E., 305 lks. dist., mkd. 2$\frac{1}{2}$M FHMR BT.</p> <p style="text-align: center;">-----</p> <p>N. 2$^{\circ}$10'E., on a true line, along W. bdy of F.H.M.R.</p> <p>Over small valley.</p> <p>4.24 Wash, 50 lks. wide, 3 ft. deep, course W.</p> <p>7.27 Cor. of fence, bears N.S and W.</p> <p>14.00 Leave valley, bears SE. and NW.; asc. 23 ft. over gradual S. slope.</p> <p>16.01 Intersect the closing cor. of secs. 18 and 19, T. 21 S., R. 19 E., which is a pine post 3x4 ins. mkd. FHMR on E. S 18 on N. S 19 on S. CC T 21 S R 19 E on W. face, with mound of stone W.</p> <p>At true point for cor.</p> <p>Set an iron post, 3 ft. long, 2 ins. diam., 27 ins. in the ground, with the original post deposited alongside, for closing cor. of secs. 18 and 19, T. 21 S., R. 19 E., with brass cap mkd.</p> <div style="text-align: center;"> <table border="0"> <tr><td>T21S</td><td> </td><td></td></tr> <tr><td>C S18</td><td> </td><td>FHMR</td></tr> <tr><td>C S19</td><td> </td><td></td></tr> <tr><td>R19E</td><td> </td><td></td></tr> <tr><td colspan="3">1932</td></tr> </table> </div> <p style="text-align: right;">raise a mound of</p> <p>stone, 3 ft. base, 2 ft. high, W. of cor.</p> <p>17.32 Road, bears E. and W.</p> <p>32.55 Old road, bears E. and W.</p> <p>33.30 Cor. of fences, bears N.S and W.</p> <p>40.05 Intersect 3 mile cor. on W. bdy. of F.H.M.R., which is a pine post, 3x4 ins. mkd. 3 M on S. FHMR on E. T 21 S R 19 E S 18 on W. face, set in a mound of stone.</p> <p>At true point for cor.</p> <p>Set an iron post, 3 ft. long, 3 ins. diam., 27 ins. in the ground, with the original post deposited alongside, for 3 mile cor. of F.H.M.R., with brass cap mkd.</p>	T21S		2 $\frac{1}{2}$ M	S19		FHMR	R19E			1932			T21S			C S18		FHMR	C S19			R19E			1932		
T21S		2 $\frac{1}{2}$ M																										
S19		FHMR																										
R19E																												
1932																												
T21S																												
C S18		FHMR																										
C S19																												
R19E																												
1932																												

10 RESURVEY OF THE BOUNDARIES OF FORT HUACHUCA MILITARY RESERVATION

FROM CORNER No.1 TO CORNER No.6

Chains

T21S | .3M
S18 | FHMR.
R19E |
.1932

from which

A mesquite, 4 ins.diam., bears N. $31\frac{1}{4}^{\circ}$ E., 262 lks. dist.,
mkd. 3M FHMR BT.

A mesquite 7 ins.diam., bears S. $25\frac{1}{4}^{\circ}$ E., 101 lks. dist.,
mkd. 3M FHMR BT.

Land, rolling.

Soil, sandy loam 1st rate; and clay 2nd rate.

No timber; undergrowth grass.

N. $2^{\circ}04'$ E., on a true line along W. bdy. of F.H.M.R.

Over rolling prairie land.; desc. 6 ft. over N. slope.

2.90 Wash, 30 lks. wide, course NW.; asc. 29 ft. over SW. slope.

18.32 Intersect cor. No. 2 which is a pine post, 4 ins. sq. mkd.
Fort Huachuca on N. and S. faces, USMR on E. and W. faces,
with the original oak post, 4 ins. sq. mks. illegible,
deposited at the base, set in a mound of stone.

At true point for cor.

Set an iron post, 3 ft. long, 3 ins. diam., 27 ins. in the
ground, with the original posts deposited alongside,
for corner No. 2 with brass cap mkd.

T21S R19E
S18

AP2
FHMR

1932

raise a mound of
stone, 5 ft. base, 3 ft. high SE. of cor.

Old Baldy, bears N. $75^{\circ}29'$ W.NE. cor. of house, bears S. $41^{\circ}55'$ W., about $\frac{3}{4}$ mile dist.NE. cor. of shed, bears S. $39^{\circ}55'$ W. " " " "NE. cor. of barn, bears S. $42\frac{1}{2}^{\circ}$ W. " " " "Windmill, bears N. $36^{\circ}48'$ W., about $\frac{1}{2}$ mile dist.

N. $82^{\circ}21'$ E., on a true line along N. bdy. of F.H.M.R.

6.20 Wash, 20 lks. wide, course NW.; asc. 20 ft. over SW. slope.

14.56 Intersect the closing cor. of secs. 17 and 18, T. 21 S., R.
19 E., which is a pine post, 3 x 4 ins. mkd. S 17 on E. S 18
on W. CC T 21 S R 19 E on N. face, with mound of stone on
the N.

At true point for cor.

Set an iron post, 3 ft. long, 2 ins. diam., 27 ins. in the
ground, with the original post deposited alongside,
for closing cor. of secs. 17 and 18, T. 21 S., R. 19 E., with

Chains

brass cap mkd.

T21S R19E

C | C

S18 | S17

FHMR

1932

raise a mound of

stone, 3 ft. base, 2 ft. high N. of cor.

22.11

Intersect $3\frac{1}{2}$ mile cor. on N. bdy. of F.H.M.R., which is a pine post, 3×4 ins. mkd. FHMR on S. T 21 S R 19 E S 17 on N. face, standing 12 ins. above the top of a mound of stone, 3 ft. base 2 ft. high.

At true point for cor.

Set an iron post, 3 ft. long, 1 in. diam., 27 ins. in the ground, with the original post deposited alongside, for $3\frac{1}{2}$ mile cor. of F.H.M.R., with brass cap mkd.

T21SR19E

S 17

$3\frac{1}{2}$ M

FHMR

1932

raise a mound of

stone, 3 ft. base, 2 ft. high, S. of cor.

N. $82^{\circ} 31' E.$, on a true line, along N. bdy. of F.H.M.R.

Descend 73 ft. over E. slope.

6.76 Ravine, course N.; asc. 66 ft. over W. slope.

12.90 Spur, slopes N.; desc, 69 ft. over E. slope.

19.90 Wash, 20 lks. wide, course N.; asc. 69 ft. over W. slope.

26.90 Low ridge, bears N. and S.; desc. 144 ft. over E. slope.

34.94 Draw, course NE.; asc. 22 ft. over NW. slope.

38.23 Spur, slopes N.; desc. 14 ft. over E. slope.

40.24 Intersect 4 mile cor. on N. bdy. of F.H.M.R., which is a pine post, 3×4 ins. mkd. 4 M on W. FHMR on S. T 21 S R 19 E S 17 on N. face, standing firmly 18 ins. above the top of a mound of stone, 3 ft. base, 1 ft. high.

At true point for cor.

Set an iron post, 3 ft. long, 3 ins. diam., 27 ins. in the ground, with the original post deposited alongside, for 4 mile cor. of F.H.M.R., with brass cap mkd.

T21SR19E

S 17

4 M

FHMR

1932

raise a mound of

stone, 3 ft. base, 2 ft. high, S. of cor.

Land, rolling.

Soil, sandy and clay, 2nd rates.

No timber, undergrowth grass.

RESURVEY OF THE BOUNDARIES OF FORT HUACHUCA MILITARY RESERVATION

FROM CORNER No.1 TO CORNER No.6

Chains. N.82°31'E., on a true line, along N.bdy. of F.H.M.R.
 Over rolling prairie land.; desc. 29 ft. over E. slope.
 2.77 Wash, 20 lks. wide, course N.; asc. 50 ft. over E. slope.
 11.70 Spur, slopes N.; desc. 44 ft. over E. slope.
 17.30 Ravine, course N.; asc. 45 ft. over W. slope.
 24.70 Ridge, bears N. and S.; desc. 36 ft. over E. slope.
 29.30 Draw, course N.; asc. 37 ft. over W. slope.
 36.43 Road, bears NE. and SW.
 40.08 Intersect $4\frac{1}{2}$ mile cor. on N. bdy. of F.H.M.R., which is a
 pine post 3x4 ins. mkd. $4\frac{1}{2}$ M on W. FHMR on S.T 21 S R 19 E
 S 16 on N. face, standing firmly 12 ins. above the top of
 a mound of stone, 3 ft. base, 1 ft. high.

At true point for cor.

Set an iron post, 3 ft. long, 1 in. diam., 27 ins. in the
 ground, with the original post deposited alongside,
 for $4\frac{1}{2}$ mile cor. of F.H.M.R., with brass cap mkd.

T21SR19E
 S 16
 $4\frac{1}{2}$ M
 FHMR
 1932

raise a mound of
 stone, 3 ft. base, 2 ft. high, S. of cor.

N.82°34'E., on a true line, along N.bdy. of F.H.M.R.

Descend 108 ft. over E. slope. along reservation fence.

16.20 Wash, 20 lks. wide, course N.20°W.; asc. 75 ft. over W. slope.

22.94 Ridge, bears N. and S.; desc. 64 ft. over E. slope.

28.90 Wash 15 lks. wide, 3 ft. deep, course N.; asc. 72 ft. over W.
 slope.

36.30 Spur, slopes N.; desc. 42 ft. over E. slope.

40.13 Intersect 5 mile cor. on N. bdy. of F.H.M.R., which is a
 pine post, 3x4 ins. mkd. 5 M on W. FHMR on S.T 21 S R 19 E
 S 16 on N. faces, standing firmly 12 ins. above the top of
 a mound of stone, 2 ft. base, 1 ft. high.

At true point for cor.

Set an iron post, 3 ft. long, 3 ins. diam., 27 ins. in the
 ground, with the original post deposited alongside,
 for 5 mile cor. of F.H.M.R., with brass cap mkd.

T21SR19E
 S 16
 5 M
 FHMR
 1932

from which

A mesquite, 10 ins. diam., bears S.81 $\frac{3}{4}$ °E., 158 lks. dist.,
 mkd. 5M FHMR BT.

Chains. No other bearing tree available. raise a mound of stone, 3 ft. base, 2 ft. high, S. of cor.

Land, rolling. Soil, sandy loam, 1st rate; and clay 2nd rate. No timber; undergrowth grass and catclaw.

1.50 N. 82° 34' E., on a true line, along N. bdy. of F. H. M. R. Over rolling land.; desc. 17 ft. over E. slope.

16.70 Wash, 10 lks. wide, 4 ft. deep, course N.; asc. 69 ft. over W. slope.

29.06 Spur, slopes N.; desc. 96 ft. over E. slope.

30.00 Wash, 15 lks. wide, course N.; asc. 37 ft. over W. slope.

33.82 Spur, slopes N.; desc. 34 ft. over E. slope.

33.82 Intersect the closing cor. of secs. 15 and 16, T. 21 S., R. 19 E., which is a sandstone, 10x8x5 ins. mkd. OC T 21 S on N. F H M R on S. 3 grooves on E. edge, with mound of stone N. At true point for cor. Set an iron post, 3 ft. long, 2 ins. diam., 27 ins. in the ground, with the original stone deposited at the base, for closing cor. of secs. 15 and 16, T. 21 S., R. 19 E., with brass cap mkd.

T21S R19E
C | C
S16 | S15
FHMR
1932

raise a mound of stone, 3 ft. base, 2 ft. high, N. of cor.

39.60 Intersect 5 1/2 mile cor. on N. bdy. of F. H. M. R., which is a quartzite stone, 8x6x5 ins. mkd. 5 1/2 M on W. F H M R on S. faces, with mound of stone W. At true point for cor. Set an iron post, 3 ft. long, 1 in. diam., 27 ins. in the ground, with the original stone deposited at the base, for 5 1/2 mile cor. of F. H. M. R., with brass cap mkd.

T21SR19E
S 15
5 1/2 M
FHMR
1932

raise a mound of stone, 3 ft. base, 3 ft. high, S. of cor.

N. 82° 33' E., on a true line, along N. bdy. of F. H. M. R. Ascend 47 ft. over W. slope.

7.00 Spur, slopes N.; desc. 94 ft. over E. slope.

Chains	
18.15	Wash, 20 lks. wide, course NE.; asc. 45 ft. over NW. slope.
25.50	Spur, slopes N.; desc. 69 ft. over E. slope.
32.70	Wash, 30 lks. wide, course N.; asc. 48 ft. over W. slope.
40.20	Intersect 6 mile cor. on N. bdy. of F.H.M.R., which is a pine post, 3x4 ins. mkd. 6 M on W. F H M R on S. T 21 S R 19 E S 15 on N. faces, standing firmly 24 ins. above the top of a mound of stone 2 ft. base, $\frac{1}{2}$ ft. high. At true point for cor. Set an iron post, 3 ft. long, 3 ins. diam., 27 ins. in the ground, with the original post deposited alongside, for 6 mile cor. of F.H.M.R., with brass cap mkd. $\begin{array}{r} T21S R19E \\ S 15 \\ 6 M \\ F H M R \\ 1932 \end{array}$ raise a mound of stone, 3 ft. base, 2 ft. high, S. of cor. Land, rolling. Soil, clay. 2nd; rate. No timber; undergrowth scattering catclaw and grass.
	N. 82° 36' E., on a true line, along N. bdy. of F.H.M.R. Over rolling land; asc. 41 ft. over E. slope.
10.60	Ridge, bears N. and S.; desc. 71 ft. over E. slope.
23.72	Wash, 10 lks. wide, course N.; asc. 63 ft. over W. slope.
32.40	Spur, slopes N.; desc. 9 ft. over E. slope.
34.44	Intersect the closing cor. of secs. 14 and 15, T. 21 S., R. 19 E., which is a quartzite stone, 10x5x4 ins. mkd. CC on N. F H M R on S. and 2 grooves on E. edges, with mound of stone N. At true point for cor. Set an iron post, 3 ft. long, 2 ins. diam., 27 ins. in the ground, with the original stone deposited at the base, for closing cor. of secs. 14 and 15, T. 21 S., R. 19 E., with brass cap mkd. $\begin{array}{r} T21S R19E \\ C C \\ S15 S14 \\ F H M R \\ 1932 \end{array}$ raise a mound of stone, 3 ft. base, 2 ft. high, N. of cor.
40.17	Intersect $6\frac{1}{2}$ mile cor. on N. bdy. of F.H.M.R., which is a pine post, 3x4 ins. mkd. $6\frac{1}{2}$ M on W. F H M R on S. T 21 S R 19 E S 14 on N faces, standing firmly 18 ins. above the top of a mound of stone, 2 ft. base 1 ft. high. At true point for cor.

Chains. Set an iron post, 3 ft. long, 1 in. diam., 27 ins. in the ground, with the original post deposited alongside, for 6 1/2 mile cor. of F.H.M.R., with brass cap mkd.

T21SR19E
~~S 11~~
~~6 1/2 M~~
 FHMR
 1932

raise a mound of stone, 3 ft. base, 2 ft. high, S. of cor.

N. 82° 32' E., on a true line, along N. bdy. of F.H.M.R.

Descend 18 ft. over E. slope.

2.00 Draw, course NE.; asc. 8 ft. over NW. slope.

5.45 Road, bears N. and S. on spur slopes N.; desc. 46 ft. over E. slope.

16.30 Draw, 100 lks. wide, course NE.; asc. 22 ft. over NW. slope.

25.60 Ridge, bears N. and S.; desc. 26 ft. over E. slope.

28.15 Intersect the closing cor. of secs. 11 and 14, T. 21 S., R. 19 E. which is a quartzite stone, 14x12x10 ins. mkd. CC on W. F H M R on S. and 1 groove on E. face, with mound of stone N.

At true point for cor.

Set an iron post, 3 ft. long, 2 ins. diam., 27 ins. in the ground, with the original stone deposited at the base, for closing cor. of secs. 11 and 14, T. 21 S., R. 19 E., with brass cap mkd.

T21SR19E
 C S11
 C S14 / FHMR
 1932

raise a mound of stone, 3 ft. base, 2 ft. high, W. of cor.

38.74 Wash, 25 lks. wide, 2 ft. deep, course NE.; asc. 8 ft. over NW. slope.

40.17 Intersect 7 mile cor. on N. bdy. of F.H.M.R., which is a pine post, 3x4 ins. mkd. 7 M on W. F H M R on S. and T 21 S R 19 E S 11 on N. faces, standing firmly 18 ins. above the top of a mound of stone, 2 ft. base, 1 ft. high.

At true point for cor.

Set an iron post, 3 ft. long, 3 ins. diam., 27 ins. in the ground, with the original post deposited alongside, for 7 mile cor. of F.H.M.R., with brass cap mkd.

T21SR19E
~~S 11~~
 7 M
 FHMR
 1932

from which

16 RESURVEY OF THE BOUNDARIES OF FORT HUACHUCA MILITARY RESERVATION FROM CORNER No.1 TO CORNER No.6

Chains

Original bearing trees... A mesquite, 16 ins. diam., bears S. 68° W., 313 lks. dist., mkd. 7M FHMR BT.

A mesquite 8 ins. diam., bears N. 7 1/4° W., 89 lks. dist., I do not uncover the marks.

New bearing tree.

A mesquite, 5 ins. diam., bears S. 36 3/4° W., 117 lks. dist., mkd. 7M. FHMR BT.

Land, rolling. Soil, sandy loam and clay; 2nd rates. Timber, scattering mesquite; undergrowth catclaw and grass.

N. 82° 30' E., on a true line, along the N. bdy. of F.H.M.R.

Over rolling land; asc. 28 ft. over W. slope.

13.74 Corner of fence, bears E.W and N.

35.28 Intersect the closing cor. of secs. 11 and 12, T. 21 S., R. 19 E., which is a quartzite stone, 12x8x8 ins. mkd. CC. T 21 S on N.F H M R on S. and 1 groove on E. edge, with mound of stone N.

At true point for cor. Set an iron post, 3 ft. long, 2 ins. diam., 27 ins. in the ground, with the original stone deposited at the base, for closing cor. of secs. 11 and 12, T. 21 S., R. 19 E., with brass cap mkd.

T21S1R19E C C S11 S12 FHMR 1932

raise a mound of stone, 3 ft. base, 2 ft. high, N. of cor.

40.27 Intersect the 7 1/2 mile cor. on N. bdy. of F.H.M.R., which is a pine post, 3x4 ins. mkd, 7 1/2 M on W. F H M R on S. T 21 S R 19 E S 12 on N. faces, standing firmly 16 ins. above the top of a mound of stone, 2 ft. base, 1 ft. high.

At true point for cor.

Set an iron post, 3 ft. long, 1 in. diam., 27 ins. in the ground, with the original post deposited alongside, for 7 1/2 mile cor. of F.H.M.R., with brass cap mkd.

T21SR19E S 12 7 1/2 M FHMR 1932

raise a mound of stone, 3 ft. base, 2 ft. high, S. of cor.

N. 82° 40' E., on a true line, along the N. bdy. of F.H.M.R.

Descend 21 ft. over SE. slope.

Chains.	
2.60	Ravine, course NE.; asc. 35 ft. over NW. slope.
6.00	Spur, slopes NE.; desc. 98 ft. over SE. slope.
19.60	Old road, bears N. and S.; also gate in reservation fence.
20.70	Enter wash, course N. 80° E.
22.30	Leave wash, course NE.
24.60	Top of ascent; continue over rolling land.
39.93	Intersect 8 mile cor. on N. bdy. of F.H.M.R., which is a pine post, 3x4 ins. mkd. 8 M on W. F H M R on S. T 21 S R 19 E S 12 on N. face, standing firmly 12 ins. above the top of a mound of stone, 3 ft. base, 1 ft. high.
	At true point for cor.
	Set an iron post, 3 ft. long, 3 ins. diam., 27 ins. in the ground, with the original post deposited alongside, for 8 mile cor. of F.H.M.R., with brass cap mkd.
	T21SR19E S 12 8 M FHMR 1932
	from which
	A mesquite, 6 ins. diam., bears S. 81½° E., 113 lks. dist., mkd. 8 M FHMR BT.
	A mesquite, 6 ins. diam., bears S. 22¼° W., 108 lks. dist., mkd. 8 M FHMR BT.
	Land, rolling. Soil, sandy clay, 3rd rate and stony, 4th rate. Timber, mesquite; undergrowth scattering catclaw.
	N. 82° 28' E., on a true line, along N. bdy. of F.H.M.R.
	Over rolling land.
2.20	Ravine, course N.; asc. 6 ft. over W. slope.
10.00	Ridge, bears NE. and SW.; desc. 32 ft. over SE. slope.
21.00	Bend in wash, from SW. to SE.; asc. 21 ft. over SW. slope.
22.60	Top of ascent.
35.36	Wire fence bears N.
35.66	Intersect the closing cor. of secs. 7 & 12, Tps. 21 S., Rs. 19 & 20 E., which is a granite stone, 10x10x10 ins. mkd. CC on N. 7 on E. 12 on W. and F H M R on S. faces, with mound of stone, N.
	At true point for cor.
	Set an iron post, 3 ft. long, 3 ins. diam., 27 ins. in the ground, with the original stone deposited at the base, for closing cor. of secs. 7 and 12, Tps. 21 S., Rs. 19 and 20 E., with brass cap mkd.

18 RESURVEY OF THE BOUNDARIES OF FORT HUACHUCA MILITARY RESERVATION FROM CORNER No.1 TO CORNER No.6

Chains.

T21S
R19E R20E
C C
S12 S 7
FHMR
1932

from which

A mesquite, 6 ins. diam., bears N. 34 3/4° E., 126 lks. dist., mkd. T 21 S R 20 E S 7 CC BT.

A mesquite, 4 ins. diam., bears N. 9 1/4° W., 103 lks. dist., mkd. T 21 S R 19 E S 12 CC BT.

39.43 Wash, 30 lks. wide, 3 ft. deep, course NE.

40.14 Intersect 8 1/2 mile cor. on N. bdy. of F.H.M.R., which is a pine post, 3x4 ins. mkd. 8 1/2 M on W. F H M R on S., and T 21 S R 20 E S 7 on N. face, standing firmly 12 ins. above the top of a mound of stone, 2 ft. base, 1 ft. high.

At true point for cor.

Set an iron post, 3 ft. long, 1 in. diam., 27 ins. in the ground, with the original post deposited alongside, for 8 1/2 mile cor. of F.H.M.R., with brass cap mkd.

T21SR20E
S 7
8 1/2 M
FHMR
1932

from which

Original bearing trees.

A mesquite 4 ins. diam., bears S. 23 1/2° E., 19 lks. dist., mkd. FHMR 8 1/2 M BT.

A mesquite 10 ins. diam., bears S. 62 1/2° W., 23 lks. dist., marks legible FHMR 8 1/2 M BT.

A mesquite stump, 10 ins. diam., bears N. 11 1/4° E., 27 lks. dist., marks legible BT.

No trace of the original NW. bearing tree.

N. 82° 32' E., on a true line, along the N. bdy. of F.H.M.R. Ascend 71 ft. over NW. slope.

22.50 Ridge, bears NE. and SW.; desc. 23 ft. over E. slope.

28.00 Road, bears N. and S., at gate in reservation fence.

33.95 Corner of fences, bears E. W and N.

38.07 Intersect 9 mile cor. on N. bdy. of F.H.M.R., which is a pine post, 3x4 ins. mkd. 9 M on W. F H M R on S. and T 21 S R 20 E S 7 on N faces, standing firmly 24 ins. above the top of a mound of stone, 3 ft. base, 1 ft. high.

At true point for cor.

Set an iron post, 3 ft. long, 3 ins. diam., 27 ins. in the ground, with the original post deposited alongside, for 9 mile cor. of F.H.M.R., with brass cap mkd.

Chains. T21SR20E
 S 7
 9 M
 FHMR
 1932

raise a mound of
 stone, 3 ft. base, 2 ft. high, S. of cor.

Land, rolling.
 Soil, sandy clay, 2nd rate, and stony 4th rate.
 Timber, scattering mequite; undergrowth scattering cat-
 claw and grass.

N. 82° 34' E., on a true line, along N. bdy. of F.H.M.R.
 Over rolling land, desc. 32 ft. over E. slope.

13.30 Wash, 20 lks. wide, 4 ft. deep, course NE.; asc. 36 ft. over NW.
 slope.

20.10 Road, bears N. and S.; asc. 36 ft. over W. slope.

25.00 Spur, slopes N.; desc. 43 ft. over E. slope.

34.76 Corner of fence, bears N and W.

36.37 Intersect the closing cor. of secs. 7 and 8, T. 21 S., R. 20
 E., which is a granite stone, 16x10x8 ins. mkd. 7 on W. 8
 on E. F H M R on S. and CC on N. faces. with a mound of
 stone N.

At true point for cor.

Set an iron post, 3 ft. long, 2 ins. diam., 27 ins. in the
 ground, with the original stone deposited at the base,
 for closing cor. of secs. 7 and 8, T. 21 S., R. 20 E., with
 brass cap mkd.

T21S R20E
 C | C
 S 7 | S 8
 FHMR
 1932

raise a mound of
 stone, 3 ft. base, 2 ft. high, N. of cor.

38.70 Wash, 10 lks. wide, 2 ft. deep, course N.; asc. 23 ft. over W.
 slope.

42.28 Intersect 9 1/2 mile cor. on N. bdy. of F.H.M.R., which is a
 pine post, 3x4 ins. mkd. 9 1/2 M on W. F H M R on S. and T 21
 S R 20 E S 8 on N. faces, standing in a mound of stone,
 2 ft. base, 1 ft. high.

At true point for cor.

Set an iron post, 3 ft. long, 1 in. diam., 27 ins. in the
 ground, with the original post, deposited alongside,
 for 9 1/2 mile cor. of F.H.M.R., with brass cap mkd.

T21SR20E
 S 8
 9 1/2 M
 FHMR
 1932

raise a mound of
 stone, 3 ft. base, 2 ft. high, S. of cor.

Chains.	Continue line and measurement. Descend 15 ft. over NE. slope.
43.18	Ravine, course NW.; asc. 32 ft. over SW. slope.
48.68	Spur, slopes N.; desc. 58 ft. over E. slope.
55.48	Wash, 30 lks. wide, course N.; asc. 68 ft. over W. slope.
56.51	Road, bears N. and S.
57.28	Corner of fences, bears N. 50 lks. dist.
62.50	Intersect cor. No 3 on bdy. of F.H.M.R., which is a pine post, 4x4 ins. mkd. U S M R on NE. and SW. faces, Fort Huachuca on SE. and NW. faces, standing 12 ins. above the top of a mound of stone, 4 ft. base, 2½ ft. high. At true point for cor. Set an iron post, 3 ft. long, 3 ins. diam., 27 ins. in the ground, with the original post, deposited alongside, for corner No. 3 of F.H.M.R., with brass cap mkd. T21SR20E S 8 AP3 FHMR 1932 from which Old Baldy, bears N. 80° W. Highest peak on Huachuca Mts. bears S. 7½° E. E. face of cliff on Mustang Mts. bears N. 47° 33' W. Joseph Mc Cray's, Windmill, bears S. 36° 52' E. W. end of Radio Tower, bears S. 18° 14' W., Tower No. 1. E. end of Radio Tower, bears S. 17° 20' W., Tower No. 2. raise a mound of stone, 3 ft. base, 2½ ft. high SW. of cor. Land, rolling. Soil, sandy clay, 3rd rate. Timber, scattering mesquite; undergrowth scattering cat-claw and grass.
	S. 21° 23' E., on a true line, along E. bdy. of F.H.M.R. Over rolling land, through scattering mesquite.
4.00	Fence, bears NE. and SW.
4.80	SW. cor. of adobe house, bears E. 1 lk. dist.
5.64	Telephone line, bears NE. and SW.
6.21	SW. cor. of Joseph Mc Cray's house, bears N. 16° W., 61 lks. dist.
6.86	Fence, bears E. and W.

- Chains.
 7.80 SW.cor.of adobe house,bears S.79 $\frac{1}{4}$ °E.,32 lks.dist.
 10.00 Windmill,bears S.89°36'E.,336 lks.dist.
 10.30 Graded road,to Fort Huachuca,bears S.9°W.,to Fairbanks N.9°E.
 12.78 Wire fence,bears N.and S.
 19.78 Set an iron post,3 ft.long,3 ins.diam.,27 ins.in the ground,for 10 mile cor.of F.H.M.R.,with brass cap mkd.

10M T21S
 FHMR S 8
 R20E
 1932

from which

A mesquite 4 ins.diam.,bears S.58 $\frac{1}{4}$ °W.,219 lks.dist., mkd.10M FHMR BT.

A mesquite 4 ins.diam.,bears S.81°W.,35 lks.dist., mkd.10M FHMR BT.

Old Baldy,bears N.79°37'W.

Windmill,bears N.1°15'W.

Highest point on Huachuca Mts.bears S.7°20'E.

Land,rolling.
 Soil,sandy clay,2 nd rate.
 No timber;undergrowth,scattering mesquite and catclaw.

S.21°23'E.,on a true line,along E.bdy.of F.H.M.R.

Over rolling land,asc.15 ft.over gradual N.slope.

17.71 Wire fence,bears E.and W.

18.90 Ravine,course E.

24.73 Intersect the closing cor.of secs. 8 and 17,T.21 S.,R. 20 E.,which is a granite stone,8x6x5 ins.mkd. 8 on N. 17 on S.H M R on W.and CC on E.faces,with mound of stone E.of cor.

At true point for cor.

Set an iron post,3 ft.long,2 ins.diam.,27 ins.in the ground,with the original stone deposited at the base, for closing cor.of secs.8 and 17,T.21 S.,R.20 E.,with brass cap mkd.

T21S
 S 8 C
 FHMR S17 C
 R20E
 1932

raise a mound of

stone,3 ft.base,2 ft.high E.of cor.

Continue along fence.bears E and SE.

22 RESURVEY OF THE BOUNDARIES OF FORT HUACHUCA MILITARY RESERVATION
FROM CORNER No.1 TO CORNER No.6

Chains	Ascend 6 ft. over gradual N. slope.
33.00	Ridge, bears N. and S.; desc. 23 ft. over gradual S. slope.
39.14	Wash, 20 lks. wide, course E.; asc. 10 ft. over N. slope.
40.00	Set an iron post, 3 ft. long, 1 in. diam., 27 ins. in the ground, for $10\frac{1}{2}$ mile cor. of F.H.M.R., with brass cap mkd. <div style="text-align: center;"> $10\frac{1}{2}M$ / T21S FHMR / S17 R20E 1932 </div> <p style="text-align: right;">from which</p> <p>A mesquite, 8 ins. diam., bears N. $45^{\circ}W.$, 90 lks. dist., mkd. $10\frac{1}{2}M$ FHMR BT.</p> <p>Raise a mound of stone, 3 ft. base, 2 ft. high SW. of cor.</p> <p>Ascend 30 ft.</p>
67.00	Road, bears NE. and SW.
76.70	Wash, 20 lks. wide, course NE.
80.00	Set an iron post, 3 ft. long, 3 ins. diam., 27 ins. in the ground, for 11 mile cor. of F.H.M.R., with brass cap mkd. <div style="text-align: center;"> $11M$ / T21S FHMR / S17 R20E 1932 </div> <p style="text-align: right;">from which</p> <p>A mesquite, 10 ins. diam., bears N. $60\frac{1}{2}^{\circ}W.$, 237 lks. dist., mkd. 11M FHMR BT.</p> <p>A mesquite 10 ins. diam., bears N. $89\frac{3}{4}^{\circ}W.$, 243 lks. dist. mkd. 11M FHMR BT.</p> <p>Land, rolling. Soil sandy and clay, 2nd rate. Timber, mesquite; undergrowth scattering catclaw.</p>
	S. $21^{\circ}23'E.$, on a true line, along E. bdy. of F.H.M.R. Over rolling land, asc. 21 ft. over gradual N. slope.
31.00	Wire fence, bears E. and W.
32.30	Graded road, bears NW. to Tombstone and SE. to Garden Canyon.
40.00	Set an iron post, 3 ft. long, 1 in. diam., 27 ins. in the ground, for $11\frac{1}{2}$ mile cor. of F.H.M.R., with brass cap mkd. <div style="text-align: center;"> $11\frac{1}{2}M$ / T21S FHMR / S20 R20E 1932 </div> <p style="text-align: right;">raise a mound of stone, 3 ft. base, 2 ft. high, SW. of cor.</p>
58.06	Rocky wash, 20 lks. wide, course NE.; asc. 25 ft. over NW. slope.

Chains.
80.00

Set an iron post, 3 ft. long, 3 ins. diam., 27 ins. in the ground, for 12 mile cor. of F.H.M.R., with brass cap mkd.

12M T21S
FHMR S21
R20E
1932

raise a mound of stone, 3 ft. base, 2 ft. high, SW. of cor.

Land, rolling.

Soil sandy and clay, 2 nd rate.

Timber, scattering mesquite; undergrowth, scattering cat-claw.

S. 21° 23' E., on a true line, along E. bdy. of F.H.M.R.

Over rolling land.

11.50 Draw, course NE.

35.80 Ravine, course NE.

37.28 Intersect the closing cor. of secs. 21 and 28, T. 21 S., R. 20 E., which is a granite stone, 8x6x6 ins. mkd. 21 on N. 28 on S. and F.H.M.R. on W. face, with mound of stone E.

At true point for cor.

Set an iron post, 3 ft. long, 2 ins. diam., 27 ins. in the ground, with the original stone deposited at base, for closing cor. of secs. 21 and 28, T. 21 S., R. 20 E., with brass cap mkd.

T21S
FHMR S21 C
S28 C
R20E
1932

raise a mound of stone, 3 ft. base, 2 ft. high, E. of cor.

40.00 Set an iron post, 3 ft. long, 1 in. diam., 27 ins. in the ground, for 12½ mile cor. of F.H.M.R., with brass cap mkd.

12½M T21S
FHMR S28
R20E
1932

from which

A mesquite, 4 ins. diam., bears S. 5½° W., 266 lks. dist., mkd. 12½ M FHMR BT.

A mesquite, 5 ins. diam., bears S. 26° W., 356 lks. dist., mkd. 12½ M FHMR BT.

W. end of Radio Tower, bears S. 51° 50' W., Tower No. 1.

E. end of Radio Tower, bears S. 50° 58' W., Tower No. 2.

Windmill, bears N. 64° 48' W., about 1 mile dist.

House with red roof, at Fort Huachuca, bears S. 50° 03' W.

24 RESURVEY OF THE BOUNDARIES OF FORT HUACHUCA MILITARY RESERVATION
FROM CORNER No. TO CORNER No.6

Chains.	
56.50	Shallow wash, 10 lks. wide, course NE.; asc. 36 ft. over NW. slope.
60.00	Spur, slopes NE.; desc. 12 ft. over SE. slope.
63.40	Draw, 50 lks. wide, course NE.; asc. 18 ft.
67.40	Spur, slopes NE.; desc. 25 ft.
71.70	Wash, 10 lks. wide, course NE.; asc. 22 ft.
80.00	Set an iron post, 3 ft. long, 3 ins. diam., 27 ins. in the ground, for 13 mile cor. of F.H.M.R., with brass cap mkd.
	13M T21S FHMR S28 R20E 1932
	raise a mound of
	stone, 3 ft. base, 2 ft. high, SW. of cor.
	Land, rolling.
	Soil sandy and clay, 2nd rate.
	No timber; undergrowth scattering catclaw.
	S. 21° 23' E., on a true line, along E. bdy. of F.H.M.R.
	Over rolling land, asc. 23 ft. over NW. slope.
3.00	Short spur, slopes NE.
8.00	Draw, 3 chs. wide, course NE.; asc. 29 ft. over NW. slope.
28.00	Spur, slopes NE.
33.00	Enter low land.
40.00	Set an iron post, 3 ft. long, 1 in. diam., 27 ins. in the ground, for 13½ mile cor. of F.H.M.R., with brass cap mkd.
	13½M T21S FHMR S28 R20E 1932
	from which
	A mesquite, 8 ins. diam., bears S. 45¼° W., 35 lks. dist., mkd. 13½ M FHMR BT.
	A mesquite, 6 ins. diam., bears N. 42¼° W., 104 lks. dist., mkd. 13½ M FHMR BT.
41.90	Wash, 50 lks. wide, course NE.; asc. 9 ft.
43.34	Intersect the closing cor. of secs. 28 and 33, T. 21 S., R. 20 E., which is a granite stone, 12x10x8 ins. mkd. 28 on N. 33 on S.H M R on W. and CC on E. face with mound of stone E.
	At true point for cor.
	Set an iron post, 3 ft. long, 2 ins. diam., 27 ins. in the ground, with the original stone deposited at the base, for closing cor. of secs. 28 and 33, T. 21 S., R. 20 E., with brass cap mkd.

FROM CORNER No.1 TO CORNER No.6

BOOK 3950

Chains

T21S
 FHMR \ S28 C
 S33 C
 R20E
 1932

from which

A mesquite, 3 ins. diam., bears N. $11\frac{3}{4}^{\circ}$ E., 81 lks. dist.,
mkd. BT.

A mesquite, 4 ins. diam., bears N. $8\frac{1}{2}^{\circ}$ W., 287 lks. dist.,
mkd. T 21 S R 20 E S 28 CC BT.

80.00

Set an iron post, 3 ft. long, 3 ins. diam., 27 ins. in the
ground, for $\frac{1}{4}$ mile cor. of F.H.M.R., with brass cap mkd.

14M T21S
 FHMR \ S33
 R20E
 1932

raise a mound of
stone, 3 ft. base, 2 ft. high, SW. of cor.

W. end of Radio Tower, bears S. $79^{\circ}38'$ W., Tower No. 1.

E. end of Radio Tower, bears S. $79^{\circ}26'$ W., Tower No. 2.

House with red roof at Fort Huachuca, bears S. $75^{\circ}34'$ W.

Flag Pole at Target Range, bears S. $28^{\circ}11'$ W.

Land, rolling.

Soil, sandy and clay, 2nd rate.

No timber; undergrowth, scattering mesquite and catclaw.

S. $21^{\circ}23'$ E., on a true line, along E. bdy. of F.H.M.R.

Over rolling land.; asc. 9 ft.

1.60

Draw, course NE.

19.90

Road, bears N. and S.

26.30

Enter wash, bears NE. and SW.

26.70

Creek, 10 lks. wide, course E.

30.00

Road in wash, bears SE. and NW.

30.37

Creek, 15 lks. wide, course NE.

30.50

Leave wash, course NE.

32.20

Windmill, bears N. $49\frac{1}{4}^{\circ}$ E., 58 lks. dist.

32.23

Wire fence, bears E. and W.

40.00

Set an iron post, 3 ft. long, 1 in. diam., 27 ins. in the
ground, for $\frac{1}{4}$ mile cor. of F.H.M.R., with brass cap mkd.

14 $\frac{1}{2}$ M T21S
 FHMR \ S34
 R20E
 1932

from which

26 RESURVEY OF THE BOUNDARIES OF FORT HUACHUCA MILITARY RESERVATION
FROM CORNER No.1 TO CORNER No.6

Chains.	A mesquite, 6 ins.diam., bears S.41 ³ / ₄ °W., 214 lks.dist., mkd. 14 ¹ / ₂ M FHMR BT.
	A mesquite, 7 ins.diam., bears S.74 ³ / ₄ °W., 507 lks.dist., mkd. 14 ¹ / ₂ M FHMR BT.
	NW.corner of Garden Canyon Store and Post Office, bears N.46 ¹ / ₄ °E., 358 lks.dist.
46.10	Telephone line, bears N.and S.
49.58	Intersect the closing cor.of secs.3 and 34, Tps.21 and 22 S.R.20 E., which is a sandstone, 12x6x6 ins.mkd. CC on E. FHMR on W.34 on N.and 3 on S.face, with mound of stone E. At true point for cor. Set an iron post, 3 ft.long, 3 ins.diam., 27 ins.in the ground, with the original stone deposited at the base, for closing cor.of secs.3 and 34, Tps.21 and 22 S., R. 20 E., with brass cap mkd.
	<pre> T21S R20E S34 C FHMR / S 3 C T22S 1932 </pre>
	from which
	NW.corner of El Paso and Southwestern Ry, Depot, bears S.22°23'E., 173 lks.dist.
	NE.corner of Airport Depot, bears S.12°13'W., 678 lks. dist.
	W.end of Radio Tower, bears N.89°38'W., Tower No. 1.
50.18	Fence, bears E.and W.
51.70	El Paso and Southwestern Ry. track, bears N.71°02'E., and S.73°02'W.
51.95	Side track of El Paso and Southwestern Ry.bears NE.and SW.
55.14	Graded road, bears SW.to Fort Huachuca, and NE.to Garden Canyon.
57.32	Fence, bears E.and W., cor.of fence bears W.30 lks.dist., thence SE.
71.54	Fence, bears E.and W.
71.70	House bears E. 200 lks.dist.
79.00	House bears E. about 200 lks.dist.
80.00	Set an iron post, 3 ft.long, 3 ins.diam., 27 ins.in the ground, for 15-mile cor.of F.H.M.R., with brass cap mkd.
	<pre> 15M T22S FHMR / S 3 R20E 1932 </pre>
	raise a mound of stone, 3 ft.base, 2 ft.high SW.of cor.

Chains. . . SW. corner of house, bears N. 56° 25' E., 189 lks. dist.
 SW. cor. of adobe house, bears N. 9° 56' E., 7.37 chs. dist.
 E. end of Radio Tower, bears N. 83° 34' W., Tower No. 2.
 W. end of Radio Tower, bears N. 83° 40' W., Tower No. 1.
 Flag Pole at Target Range, bears S. 46° 45' W.

Land, rolling.
 Soil, sandy and clay, 2nd rate.
 Timber none; undergrowth scattering grass.

S. 21° 23' E., on a true line, along E. bdy. of F.H.M.R.

Over rolling land.

1.30 Wire fence, bears E. and W.
 17.00 House, bears E. about 150 lks. dist.
 22.50 House, bears E. about 150 lks. dist.
 26.60 House, bears E. 150 ;ks. dist.
 29.00 House, bears E. 100 lks. dist.
 40.00 Set an iron post, 3 ft. long, 1 in. diam., 27 ins. in the ground, for 15½ mile cor. of F.H.M.R., with brass cap mkd.

15½M T22S
 FHMR S3
 R20E
 1932

raise a mound of stone, 3 ft. base, 2 ft. high SW. of cor.

W. end of Radio Tower, bears N. 76° 45' W.

E. end of Radio Tower, bears N. 76° 30' W.

Flag Pole at Target Range, bears S. 57° 44' W.

SW. cor. of house, bears N. 17° 39' W.

63.10 Sandy wash, 70 lks. wide, course NE.

80.00 Set an iron post, 3 ft. long, 3 ins. diam., 27 ins. in the ground, for 16 mile cor. of F.H.M.R., with brass cap mkd.

16M T22S
 FHMR S10
 R20E
 1932

raise a mound of stone, 3 ft. base, 2 ft. high SW. of cor.

Land, rolling.
 Soil, sandy and clay, 2nd rate.
 No timber; undergrowth grass.

FROM CORNER No.1 TO CORNER No.6

Chains. S.21°23'E., on a true line, along E.bdy. of F.H.M.R.
 Over rolling land, asc. 12 ft. over gradual N. slope.

12.42 Intersect cor. No. 4 on E.bdy. of F.H.M.R., which is a pine post, 4x4 ins. mkd. U S M R on SE. and NW. faces, Fort Huachuca on NE and SW. faces, and 4 on top of post, standing firmly 24 ins. above the top of a mound of stone 4 ft. base, 2 ft. high.

At true point for cor.
 Set an iron post, 3 ft. long, 3 ins. diam., 27 ins. in the ground, with the original post deposited alongside, for angle point No. 4 of F.H.M.R., with brass cap mkd.

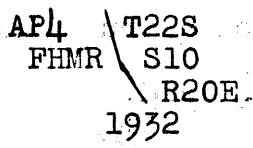

raise a mound of stone, 3 ft. base, 2 ft. high, SW. of cor.
 W. end of Radio Tower, bears N. 69° 12' W., Tower No. 1.
 E. end of Radio Tower, bears N. 68° 50' W., Tower No. 2.
 Old Baldy, bears N. 70° 53' W.

Thence from angle point No. 4
 S. 43° 38' E., on a true line, along E. bdy. of F.H.M.R.

27.58 Set an iron post, 3 ft. long, 1 in. diam., 27 ins. in the ground, for 16 1/2 mile cor. of F.H.M.R., with brass cap mkd.

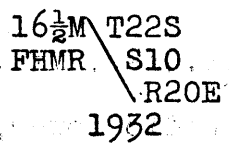

raise a mound of stone, 3 ft. base, 2 ft. high, SW. of cor.

40.78 Intersect the closing cor. of secs. 10 and 11, T. 22 S., R. 20 E., which is a granite stone, 8x6x6 ins. mkd. CC on N. 11 on E. 10 on W. and F H M R on W. face, with mound of stone N.

At true point for cor.
 Set an iron post, 3 ft. long, 2 ins. diam., 27 ins. in the ground, with the original stone deposited at the base, for closing cor. of secs. 10 and 11, T. 22 S., R. 20 E., with brass cap mkd.

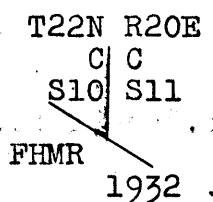

raise a mound of stone, 3 ft. base, 2 ft. high, N. of cor.

63.88 Intersect the closing cor. of secs. 11 and 14, T. 22 S., R. 20 E., which is a granite stone, 10x10x6 ins. mkd. CC on E. 11 on N. 14 on S. and FHMR on W. face., with mound of stone E. of cor.

Chains.	At true point for cor. soil
	Set an iron post, 3 ft. long, 2 ins. diam., 27 ins. in the ground with the original stone deposited at the base, for closing cor. of secs. 11 and 14, T. 22 S., R. 20 E., with brass cap mkd.
	$\begin{array}{r} \text{FHMR} \quad \text{T22SR20E} \\ \quad \quad \quad \text{S 11 C} \\ \quad \quad \quad \text{S 14 C} \\ \quad \quad \quad 1932 \end{array}$
	raise a mound of stone, 3 ft. base, 2 ft. high, E. of cor.
65.58	Wire fence, bears NE. and SW.
67.58	Set an iron post, 3 ft. long, 3 ins. diam., 27 ins. in the ground, for 17 mile cor. of F.H.M.R., with brass cap mkd.
	$\begin{array}{r} \text{FHMR} \quad \text{T22S} \\ \quad \quad \quad \text{S 14} \\ \quad \quad \quad \text{R 20E} \\ \quad \quad \quad 1932 \end{array}$
	raise a mound of stone, 3 ft. base, 2 ft. high, SW. of cor.
	Highest peak of Huachuca Mts. bears S. 7° 30' W.
	Land, rolling. Soil, sandy and clay, 2nd rate. No timber; undergrowth, grass.
	S. 43° 38' E., on a true line, along E. bdy. of F.H.M.R.
	Over rolling land.
2.90	Wash, 10 lks. wide, course E.; asc. 26 ft. over gradual N. slope.
40.00	Set an iron post, 3 ft. long, 1 in. diam., 27 ins. in the ground, for 17½ mile cor. of F.H.M.R., with brass cap mkd.
	$\begin{array}{r} \text{FHMR} \quad \text{T22S} \\ \quad \quad \quad \text{S 14} \\ \quad \quad \quad \text{R 20E} \\ \quad \quad \quad 1932 \end{array}$
	raise a mound of stone, 3 ft. base, 2 ft. high, SW. of cor.
45.80	Wash, 50 lks. wide, course NE.; asc. 31 ft.
65.36	Road, bears E. and W.
80.00	Set an iron post, 3 ft. long, 3 ins. diam., 27 ins. in the ground, for 18 mile cor. of F.H.M.R., with brass cap mkd.
	$\begin{array}{r} \text{FHMR} \quad \text{T22S} \\ \quad \quad \quad \text{S 14} \\ \quad \quad \quad \text{R 20E} \\ \quad \quad \quad 1932 \end{array}$
	raise a mound of stone, 3 ft. base, 2 ft. high SW. of cor.
	Land, rolling. Soil, sandy and clay, 2nd rate. No timber; undergrowth, grass.

30 RESURVEY OF THE BOUNDARIES OF FORT HUACHUCA MILITARY RESERVATION FROM CORNER No.1 TO CORNER No.6

Chains. S.43°38'E., on a true line along E.bdy.of F.H.M.R. Over rolling land.

4.63 Intersect the closing cor.of secs.13 and 14,T.22 S.,R.20 E.,which is a granite stone 18x12x8 ins.mkd.CC on N.13 on E.14 on W.and H M R on S. faces,with mound of stone N.

At true point for cor.

Set an iron post,3 ft.long,2 ins.diam.,27 ins.in the ground,with the original stone deposited at the base, for closing cor.of secs.13 and 14,T.22 S.,R.20 E.,with brass cap mkd.

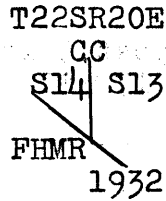

raise a mound of stone,3 ft.base,2 ft.high,N.of cor.

23.96 Intersect cor.No.5 of F.H.M.R.,which is a pine post,4x4 ins.mkd. U S M R on SE.and NW.faces,Fort Huachuca on NE.and SW.faces,and 5 on top of post,standing firmly 24 ins.above the top of a mound of stone,4 ft.base,2 ft. high.

At true point for cor.

Set an iron post,3 ft.long,3 ins.diam.,20 ins.in the ground to bedrock,and in a mound of stone to top,with the original post,deposited alongside, for corner No.5 of F.H.M.R.,with brass cap mkd.



from which

W.end of Radio Tower,bears N.60°24'W., Tower No. 1.

E.end of Radio Tower,bears N.60°04'W., Tower No. 2.

Highest point on Huachuca Mts.bears S.15°45'W.

Butte,bears S.43°41'E.

Thence from Cor. No. 5,

S.34°24'W.,on a true line,along E.bdy.of F.H.M.R.

2.89 Intersect the closing cor.of secs.13 and 24,T.22 S.,R.20 E.,which is a granite stone,24x12x12 ins.mkd.CC on E. 13 on N.24 on S.and H M R on W.faces,set in a mound of stone,2 ft.base,1 ft.high.

At true point for cor.

Set an iron post,3 ft.long,2 ins.diam.,27 ins.in the ground,with the original stone deposited at the base, for closing cor.of secs.13 and 24,T.22 S.,R.20 E.,with brass cap mkd.

Chains.

T22S
FHMR / S13 C
S24 C
R20E
1932

raise a mound of stone, 3 ft. base, 2 ft. high, E. of cor.

16.04

Set an iron post, 3 ft. long, 1 in. diam., 27 ins. in the ground, for 18 1/2 mile cor. of F.H.M.R., with brass cap mkd.

18 1/2 M
FHMR / S24
T22SR20E
1932

raise a mound of stone, 3 ft. base, 2 ft. high, NW. of cor.

17.76

Intersect the closing cor. of secs. 23 and 24, T.22 S., R.20 E., which is granite stone, 18x10x6 ins. mkd. H M R on N. and CC on S. faces, set in a mound of stone, 2 ft. base, 1 ft. high.

At. true point for cor.

Set an iron post, 3 ft. long, 2 ins. diam., 27 ins. in the the ground, with the original stone deposited at the base, for closing cor. of secs, 23 and 24, T.22 S., R.20 E., with brass cap mkd.

FHMR
S23 | S24
C | C
T22SR20E
1932

raise a mound of stone, 3 ft. base, 2 ft. high, S. of cor.

34.94

Wire fence, bears N. and S. corner of fence bears S. about 50 lks. dist., thence SW.

50.24

Cross fence, bears NE. and SW.

56.04

Set an iron post, 3 ft. long, 3 ins. diam., 27 ins. in the ground, for 19 mile cor of F.H.M.R., with brass cap mkd.

19M
FHMR / S23
T22SR20E
1932

raise a mound of stone, 3 ft. base, 2 ft. high, NW. of cor.

Land, rolling.
Soil, sandy and clay 2nd rate.
No timber; undergrowth, grass.

32 RESURVEY OF THE BOUNDARIES OF FORT HUACHUCA MILITARY RESERVATION
FROM CORNER No.1 TO CORNER No.6

Chains. S. $34^{\circ}24'W.$, on a true line, along the E. bdy. of F.H.M.R.
Over rolling land, asc. 35 ft. over gradual E. slope.

22.80 Draw, course SE; cross same fence, bears NE. and SW.

40.00 Set an iron post, 3 ft. long, 1 in. diam., 27 ins. in the ground, for $19\frac{1}{2}$ mile cor. of F.H.M.R., with brass cap mkd.

19 $\frac{1}{2}$ M
FHMR /
S23
T22SR20E
1932

raise a mound of
stone, 3 ft. base, 2 ft. high, NW. of cor.

44.82 Intersect the closing cor. of secs. 23 and 26, T.22 S., R.20 E., which is a pine post, 3x4 ins. badly decayed, set in a mound of stone, 2 ft. base, 1 ft. high.

At true point for cor.

Set an iron post, 3 ft. long, 2 ins. diam., 27 ins. in the ground, with the remains of post, deposited alongside, for closing cor. of secs. 23 and 26, T.22 S., R.20 E., with brass cap mkd.

T22S
FHMR / S23 C
S26 C
R20E
1932

from which

A willow, 16 ins. diam., bears S. $37^{\circ}E.$, 368 lks. dist., mkd. T 22 S R 20 E S 26 CC BT.

A mesquite 8 ins. diam., bears N. $61\frac{1}{2}^{\circ}E.$, 278 lks. dist., mkd. T 22 S R 20 E S 23 CC BT.

45.80 Creek, 10 lks. wide, course E.

49.20 Road, bears E. and W.

49.40 Wire fence, bears E. and W.

70.30 Wire fence, bears E. and W.

80.00 Set an iron post, 3 ft. long, 3 ins. diam., 27 ins. in the ground, for 20 mile cor. of F.H.M.R., with brass cap mkd.

20M
FHMR /
S26
T22SR20E
1932

raise a mound of
stone, 3 ft. base, 2 ft. high, NW. of cor.

Land, rolling.
Soil, sandy and clay, 2nd rate.
Timber, mesquite, willow and cottonwood; undergrowth grass.

Chains S. $34^{\circ}24'$ W., on a true line, along E. bdy. of F.H.M.R.
 Over rolling land, asc. 89 ft. over gradual NE. slope.

16.70 Old road, bears N. and S.

23.60 Intersect the closing cor. of secs. 26 and 27, T.22 S., R. 20 E., which is a granite stone, 8x6x6 ins. mkd. 26 on E. 27 on W. CC on S. and H M R on N. faces, with mound of stone S.

At true point for cor.

Set an iron post, 3 ft. long, 2 ins. diam., 27 ins. in the ground with the original stone deposited at the base, for closing cor. of secs. 26 and 27, T.22 S. R. 20 E., with brass cap mkd.

FHMR
~~S26~~
 S27
 C | C
 T22SR20E
 1932.

raise a mound of stone, 3 ft. base, 2 ft. high, S. of cor.

40.00 Set an iron post, 3 ft. long, 1 in. diam., 27 ins. in the ground for $20\frac{1}{2}$ mile cor. of F.H.M.R., with brass cap mkd.

$20\frac{1}{2}$ M
 FHMR
~~S27~~
 T22SR20E
 1932

raise a mound of stone, 3 ft. base, 2 ft. high, NW. of cor.

58.00 Cross, fence, bears NE. and SW.

61.38 Intersect the closing cor. of secs. 27 and 34, T.22 S., R. 20 E., which is a granite stone, 18x10x7 ins. mkd. 27 on N. 34 on S. H M R on W. and CC on E. faces, set in a mound of stone, 2 ft. base 1 ft. high.

At true point for cor.

Set an iron post, 3 ft. long, 2 ins. diam., 27 ins. in the ground, with the original stone deposited at the base, for closing cor. of secs. 27 and 34, T.22 S., R. 20 E., with brass cap mkd.

T22S
 FHMR
~~S27 C~~
~~S34 C~~
 R20E
 1932

raise a mound of stone, 3 ft. base, 2 ft. high, E. of cor.

74.40 Wash, 20 lks. wide, course NE.

80.00 Set an iron post, 3 ft. long, 3 ins. diam., 27 ins. in the ground, for 21 mile cor. of F.H.M.R., with brass cap mkd.

34 RESURVEY OF THE BOUNDARIES OF FORT HUACHUCA MILITARY RESERVATION
FROM CORNER No.1 TO CORNER No.6

Chains.

21M
FHMR
S34
T22SR20E
1932

raise a mound of stone, 3 ft. base, 2 ft. high, NW. of cor.

Land, rolling.

Soil sandy and clay, 2nd rate.

No timber; undergrowth, scattering catclaw.

S. 34° 24' W., on a true line along E. bdy. of F.H.M.R.

Over rolling land.; asc. 11 ft. over gradual NE. slope.

5.20 Road, bears NE. and S.

16.00 Road, bears NE. and S.

23.30 Ravine, course N.

30.00 Creek, 3 lks. wide, course N.; asc. steep NE. slope, 205 ft.

38.76 Intersect cor. No. 6 on E. bdy. of F.H.M.R., which is a pine post, 4x4 ins. mkd. U.S.M.R. on SE. and NW. faces, Fort Huachuca on NE. and SW. faces, standing firmly 12 ins. above the top of a mound of stone, 4 ft. base, 2 ft. high.

At true point for cor.

Set an iron post, 3 ft. long, 3 ins. diam., 12 ins. in the ground to bedrock, with the original post deposited alongside for corner No. 6 with brass cap mkd.

FHMR
AP6
S34
T22SR20E
1932

from which

A black oak, 10 ins. diam., bears S. 60³/₄° W., 103 lks. dist., mkd. AP 6 FHMR BT.

A black oak, 11 ins. diam., bears N. 59¹/₂° W., 92 lks. dist., mkd. AP 6 FHMR BT.

No other bearing trees available.

W. end of Radio Tower, bears N. 31° 50' W.

E. end of Radio Tower, bears N. 31° 17' W.

SW. cor. of house, bears N. 82° 45' E., about 25 chs. dist.

Land, rolling.

Soil, sandy and clay, 2nd rate.

Timber, scattering oak; undergrowth scattering mesquite.

Chains

Beginning at the cor.of secs.8,9,16 and 17,T.21 S.,R.19 E.,which is a granite stone,15x10x6 ins.above ground,firmly set,marked and witnessed as described in the official record.

S.0°1'W., on a true line,bet.secs.16 and 17.
Along fence.

- 25.36 No trace of the original closing cor.
- 26.30 Fence cor., fences bear E., W., and N.
- 26.43 Intersect the N.bdy.of F.H.M.R.

Set an iron post,3 ft.long,2 ins.diam.,27 ins.in the ground,for closing cor.of frac.secs.16 and 17,T.21 S.,R.19 E.,with brass cap mkd.

T21S R19E
C | C.
S17 | S16

FHMR
1932

raise a mound of stone,3 ft.base,2 ft.high,N.of cor.

From this point the ¼ mile cor.on N.bdy.of F.H.M.R., bears S.82°31'W.,33.20 chs.dist.,hereinbefore described.

From the same point,the ¼ mile cor.on N.bdy.of F.H.M.R.,bears N.82°31'E.,6.88 chs.dist.,hereinbefore described.

RESURVEY OF A PORTION OF THE SUBDIVISIONS
OF T.21 S.,R.20 E.

Beginning at the ¼ sec.cor.of secs.16 and 17,T.21 S.,R.20 E.,which is a granite stone,8x6x6 ins.above ground firmly set,marked and witnessed as described in the official record.

S.0°2'E.,on a random line,bet.secs.16 and 17.

- 40.00 No trace of the orig.cor.of secs.16,17,20 and 21.
- Set temp.cor.

Thence

S.0°2'E.,on a random line,bet.secs.20 and 21.

- 17.24 Fall ¼ lks.W.of the orig.closing cor.of secs.20 and 21.

From the ¼ sec.cor.of secs.16 and 21,which is a granite stone,12x8x8 ins.above ground,firmly set,marked and witnessed as described in the official record.

West,on a random line,bet.secs.16 and 21.

- 40.23 Fall 10 lks.S.of temp.cor. of secs.16,17,20 and 21.

- Chains. Thence from temp.cor.
West, on a random line, bet. secs.17 and 20.
- 6.68 No trace of the closing cor.of frac.secs.17 and 20.
Set temp.cor.
- At a point determined by single proportion bet.the $\frac{1}{4}$ sec.
cor.of secs.16 and 17 and the closing cor.of secs.20
and 21, and record distance in departure from the $\frac{1}{4}$ sec.
cor.of secs.16 and 21.T.21 S.,R.20 E.
- Set a granite stone,18x10x7 ins.15 ins.in the ground,for
cor.of secs.16,17,20 and 21,T.21 S.,R.20 E.,marked 3
grooves on S.and 4 grooves on E.faces,dig pits 18x18
x12 ins.in each sec.3 ft.dist.
- Thence
S.0°36'W.,on a true line,bet.secs.20 and 21.
Over level land,through scattering mesquite.
- 17.14 Intersect the closing cor.of frac.secs.20 and 21,which
is a pine post,3x4 ins.marks illegible,standing 18 ins.
above ground.
- 17.31 Intersect the E.bdy.of F.H.M.R.
- Set an iron post,3 ft.long,2 ins.diam.,27 ins.in the
ground,for closing cor.of frac.secs.20 and 21,T.21 S.,
R.20 E.,with brass cap mkd.
-
- raise a mound of
stone,3 ft.base,2 ft.high,N.of cor.
- From this point the $1\frac{1}{2}$ mile cor.on E.bdy.of F.H.M.R.,
bears N.21°23'W.,9.51 chs.dist.,hereinbefore described.
- From the same point the 12 mile cor.on E.bdy.of F.H.M.
R.bears S.21°23'E.,30.49 chs.dist.,hereinbefore
described.
- Land,level.
Soil,sandy and clay,2 nd rate.
Timber,none;undergrowth,scattering mesquite.
-
- From the cor.of secs.16,17,20 and 21.
West on a true line,bet.secs.17 and 20.
Over level land,through scattering mesquite.
- 6.96 Intersect the E.bdy.of F.H.M.R.
- Set an iron post,3 ft.long,2 ins.diam.,27 ins.in the
ground,for closing cor.of frac.secs.17 and 20,T.21 S.,
R.20 E.,with brass cap mkd.

Chains.

T21S
 FHMR \ S17 C
 S20 C
 R20E
 1932

raise a mound of
 stone, 3 ft. base, 2 ft. high, E. of cor.

From this point the 11 mile cor. on E. bdy. of F.H.M.R., bears N.21°23'W., 30.92 chs. dist., hereinbefore described.

From the same point the 11½ mile cor. on E. bdy. of F.H.M.R. bears S.21°23'E., 9.08 chs. dist., hereinbefore described.

Land, level.

Soil, sandy and clay, 2nd rate.

No timber; undergrowth, scattering mesquite.

From the ¼ sec. cor. of secs. 33 and 34, which is a red-wood post, 3x4 ins. standing firmly 12 ins. above the top of ground, marked and witnessed as described in the official record.

S.0°2'E., on a true line, bet. secs. 33 and 34.

21.48 No trace of the closing cor. of frac. secs. 33 and 34.

21.79 Intersect the E. bdy. of F.H.M.R., at a point S. 21° 23' E. 29.94 chs. from the 14 M. Cor.

The true point for closing cor. of frac. secs. 33 and 34, falls in sand wash, 400 lks. wide, a place impracticable to set permanent cor.

At a point N.0°2'W., 5.19 chs. dist., from the true point for cor.

Set an iron post, 3 ft. long, 2 ins. diam., 27 ins. in the ground, for witness cor. to closing cor. of frac. secs. 33 and 34, T.21 S., R.20 E., with brass cap mkd.

T21S R20E
 C C
 S33 | S34
 W C
 FHMR
 1932

from which

A Willow, 12 ins. diam., bears S.89¼°E., 219 lks. dist., mkd. WC T 21 S R 20 E S 34 CC B T.

A mesquite, 6 ins. diam., bears N.11°W., 136 lks. dist., mkd. WC T 21 S R 20 E S 33 CC B T.

RESURVEY OF A PORTION OF THE SUBDIVISIONS
 OF T.22 S., R.20 E.

Beginning at the ¼ sec. cor. of secs. 3 and 10, T.22 S., R. 20 E., which is a granite stone, 10x10x6 ins. above ground, marked and witnessed as described in the official record.

Chains Thence

West, on a random and true line, bet. secs. 3 and 10.

1.30 No trace of the orig. closing cor.

1.33 Intersect the E. bdy. of F.H.M.R., at a point 15.96 chs.
S. $21^{\circ} 23'$ E. of the $15\frac{1}{2}$ M. Cor.Set an iron post, 3 ft. long, 2 ins. diam., 27 ins. in the
ground, for closing cor. of frac. secs. 3 and 10, T.22 S.,
R.20 E., with brass cap mkd.

	T22S
	S3 C
FHMR	S10 C
	R20E
	1932

raise a mound of
stone, 3 ft. base, 2 ft. high, E. of cor.

FINAL TEST OF SOLAR ATTACHMENT.

February 24, 1932, at cor. No. 3 of Fort Huachuca Military Reservation, in sec. 8 T.21 S., R.20 E., I observe Polaris at western elongation, making two sights with the telescope in direct and reversed positions, and place a tack at the mean point, on a peg driven firmly in the ground 10 chs. N.

February 25, 1932, after sunrise, I lay off the azimuth of Polaris $1^{\circ} 14' 17''$ and make a meridian mark on a second peg to the east of the mean point in the line determined by the observation.

At 7h 30m a.m., app.t., I set off $31^{\circ} 37' 06''$ N., on the lat. arc; $9^{\circ} 21' 14''$ S., on the decl. arc; and orient the instrument with the solar; the line of sight agrees with the meridian established by Polaris observation.

At 4h 30m p.m. app.t., I set off $31^{\circ} 37' 06''$ N., on the lat. arc; $9^{\circ} 12' 37''$ S., on the decl. arc; and repeat the tests of the solar; the line of sight agrees with the meridian established by Polaris observation.

GENERAL DESCRIPTION.

The land embraced within the boundaries of Fort Huachuca Military Reservation, is sandy and clay, the west and north portions of the reservation is covered with volcanic stones. The general elevation is about 6000 ft. above sea level; the summit of Huachuca Mountains in the south portion is about 2000 ft. higher. The north, west and east portions of the reservation is rolling prairie land. The south portion is rough mountainous land, covered with heavy pine, fir, oak and cedar timber. Small groves of oak are found in the southwestern portion of the reservation; scattering mesquite and catclaw are found in the north and eastern portion of the reservation.

Fort Huachuca is located near the central part of the reservation, a good graded road, traverses northeasterly from the Fort, leaving the reservation near the 10 mile corner on the east boundary. The El Paso and Southwestern Ry. enters the reservation at Garden Canyon, Arizona, near the $14\frac{1}{2}$ mile corner. A fairly good fence traverses along a portion of the reservation.

The Panama Mine is located about a quarter of a mile easterly from angle point No. 1. An ungraded road traverses from Fort Huachuca along the Huachuca Mountains, leaving the reservation at angle point 0.

Retracement of Panama Nos. 1, 2 and 3 Lodes. Unsurveyed
Mineral Locations.

Chains.	Beginning at the NE. cor. of Panama No.1 lode, which is pine post, 3 ft. long, 4 ins. square, mkd. NE COR PAN No.1 on SW. face, loosely set in a mound of stone, 4 ft. base, 2 ft. high.
	Thence N. 65° 08' W.
	Along N. end line of Panama No.1 lode.
.68	Mound of stone, 2 ft. base, 1 ft. high, bears S.22°30'W. 09 lks. dist., stones unmarked.
5.00	Intersect mound of stone 3 ft. base, 1 ft. high, stones unmarked.
	Thence N. 63° 34' W.
1.95	Intersect NW. cor. of Panama No.1 lode, identical with NE. cor. of Panama No.2 lode, which is a lath, mkd. NE COR PAN No.2, firmly set in a mound of stone, 3 ft. base, 2 ft. high.
	Thence N.64° 47' W.
	Along N. end line of Panama No.2 lode.
2.57	Lath, unmarked, 2 ft. long, loosely set in a mound of stone, 3 ft. base, 2 ft. high, bears S.22°32'W., 12 lks. dist.
5.30	Intersect N. end center of Panama No.2 lode, which is a mound of stone, 3 ft. base, 2 ft. high, stones unmarked.
	Thence N. 64° 53' W.
	Along N. end line of Panama No. 2 lode.
4.56	Intersect NW. cor. of Panama No.2 lode, identical with NE. cor. of Panama No.3 lode, which is a mound of stone, 3 ft. base, 2 ft. high, stones unmarked.
	Thence N. 64° 53' W.
	Along N. end line of Panama No.3 lode.
4.55	Intersect N. end center of Panama No.3 lode, which is a mound of stone, 2 ft. base, 2 ft. high, stones unmarked.
	Thence N. 64° 53' W.
	Along N. end line of Panama No.3 lode.
4.54	No trace of the NW. cor. of Panama No. 3 lode. Set temp. cor.
	Thence S. 24° 26' W.
	Along W. side line. of Panama No.3 lode.
2.50	Intersect the W. bdy. of Fort Huachuca Military Reservation at a point S. 2° 06' W., 3.65 chs. dist., from cor. No.0 hereinbefore described.
8.98	Mound of stone 2 ft. base, 1 ft. high, bears S.65°30'E. 18 lks. dist., stones unmarked.

Retracement of Panama Nos. 1, 2 and 3 Lodes. Unsurveyed
Mineral Locations.

Chains. 20.71	Location notice of C.L. Oremen, Black Hawk, dated July 1, 1928, bears N.67°45'W., 1.15 chs. dist., which is a mound of stone 3 ft. base, 2 ft. high.
24.27	Intersect SW. cor. of Panama No.3 lode, which is a mound of stone, 3 ft. base, 2 ft. high., stones unmarked. Thence S. 64° 57' E. Along S. end line of Panama No. 3 lode.
2.05	Intersect the S. bdy. of Fort Huachuca Military Reservation at a point S.89° 57' E., 9.19 chs. dist., from the $\frac{1}{4}$ sec. cor. of sec. 31. on the S. bdy. of T.21 S., R. 19 E., hereinbefore described.
4.43	Intersect S. end center of Panama No. 3 lode, which is a mound of stone, 3 ft. base, 1 $\frac{1}{2}$ ft. high. stones unmarked. Thence S. 65° 10' E. Along S. end line of Panama No.3 lode.
4.87	Intersect SE. cor. of Panama No. 3 lode, identical with SW. cor. of Panama No.2 lode, which is a pine stake, painted white, 2 ins. square, standing firmly 4 ins. above the top of a mound of stone, 3 ft. base, 1 $\frac{1}{2}$ ft. high, mkd. SE COR PAN No. 3 From this cor. the NE. cor. of Panama No. 3 lode identical with NW. cor. of Panama No.2 lode, bears N. 23° 51' E., 24.22 chs. dist. Thence S. 65° 02' E. Along S. end line of Panama No.2 lode.
3.20	Intersect the S. end center of Panama No.2 lode, which is a pine stake, 2 ins. square, standing firmly 4 ins. above the top of a mound of stone, 2 ft. base, 1 $\frac{1}{2}$ ft. high, mkd. S END C PAN No.2 Thence S. 65° 03' E. Along S. end line of Panama No. 2 lode.
6.09	Intersect SE. cor. of Panama No.2 lode, identical with SW. cor. of Panama No. 1 lode, which is a pine stake, 2 ins. square, standing firmly 4 ins. above the top of a mound of stone, 3 ft. base, 1 $\frac{1}{2}$ ft. high, mkd. SE No.2 SW No.1. From this cor. the NE. cor. of Panama No.2 lode, identical with the NW. cor. of Panama No.1 lode, bears N. 25° 12' E., 24.24 chs. dist. Also from the SE. cor. of Panama No.2 lode, location monument of Manila No.2 lode, posted by Alice McFaddin, May 8, 1926, bears N. 47° 20' E. 57 lks. dist., which is a mound of stone 3 ft. base, 3 ft. high. Thence S. 64° 57' E. Along S. end line of Panama No.1 lode.
4.55	Intersect S. end center of Panama No. 1 lode, which is a pine stake, 2 ins. square, standing firmly 4 ins. above the top of a mound of stone, 2 ft. base, 1 $\frac{1}{2}$ ft. high, mkd. SUR CENTER END PAN No.1

Retracement of Panama Nos. 1, 2 and 3 Lodes, Unsurveyed Mineral Locations.

BOOK 3550

Chains.

Thence S. 64° 27' E.

Along S. end line of Panama No. 1 lode.

4.54 Intersect SE. cor. of Panama No.1 lode. which is an oak post. unmarked, 4 ins. square, standing 1 ft. above the top of a mound of stone. 3 ft. base. 2 ft. high.

Thence N. 20° 14' E.

Along E. side line of Panama No.1 lode.

13.83 Mound of stone. 3 ft. base, 2 ft. high, bears E. 97 lks. dist.

24.33 The NE. cor. of Panama No.1 lode. and place of beginning.

4-680
(August, 1926)

FIELD ASSISTANTS.

NAMES.	CAPACITY.
John B. McClung	1st Chainman
Cal Davis	2nd Chainman
Ivan Dial	Moundsman
Cecil Emmons	Axman
Jay P. Hester	Flagman

64
43

BOOK 3950

CERTIFICATE OF UNITED STATES SURVEYOR

I, William E. Hiester, U. S. Surveyor, hereby certify upon honor that, in pursuance of special instructions received from the District Cadastral Engineer for Arizona bearing date of the 7th day of January, 1932, I have well, faithfully, and truly in my own proper person, and in strict conformity with said instructions, the Manual of Surveying Instructions, and the laws of the United States, ^{re} surveyed all those parts or portions of the boundaries of Fort Huachuca Military Reservation in Ts. 21 S., Rs. 19 & 20 E., and in T. 22 S., R. 20 E., and resurveyed a portion of the subdivisional lines of said townships of the Gila and Salt River Meridian, in the State of Arizona, which are represented in the foregoing field notes as having been executed by me, and under my direction; and that all the corners of said survey have been established and perpetuated in strict accordance with the Manual of Surveying Instructions, and the special written instructions of the District Cadastral Engineer for Arizona and in the specific manner described in the field notes, and that the foregoing are the original field notes of such survey.

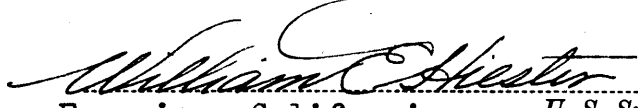

 San Francisco, California. U. S. Surveyor.
 June 1, 1932.

APPROVAL

OFFICE OF U. S. SUPERVISOR OF SURVEYS,
 Denver, Colorado, JAN 27 1933, 19

The foregoing field notes of the ^{re} survey of the boundaries of Fort Huachuca Military Reservation in Ts. 21 S., Rs. 19 & 20 E., and in T. 22 S., R. 20 E., and of the resurvey of a portion of the subdivisional lines of said townships, of the Gila and Salt River Meridian, in the State of Arizona,

executed by William E. Hiester, U. S. Surveyor, under his special instructions dated January 7, 1932, having been critically examined, and the necessary corrections and explanations made, the said field notes, and the surveys they describe, are hereby approved.

 U. S. Supervisor of Surveys.

I certify that the foregoing transcript of the field notes of the above described surveys in _____, has been correctly copied from the original notes on file in this office.

U. S. Supervisor of Surveys.