

# FIELD NOTES

OF THE RESURVEY OF

A portion of the North and West boundaries and subdivisions

AND SURVEY OF

The Casa Blanca Canal and related Storm Channel boundaries,

Township 4 South, Range 5 East.

3951

Of the Gila and Salt River Meridian,

In the State of Arizona

EXECUTED BY

Francis E. Joy

Cadastral Engineer

In the capacity of U. S. Surveyor, under Special Instructions dated February 15, 1932, issued by the District Cadastral Engineer to govern surveys included in Group No. 175, which were approved by the Commissioner of the General Land Office, Feb. 25, 1932, and Assignment Instructions dated March 2, 1932.

3951

Survey commenced March 12, 1932

Survey completed March 27, 1932.

66  
1A

BOOK 3951

# INDEX DIAGRAM.

Township 4 South, Range 5 East

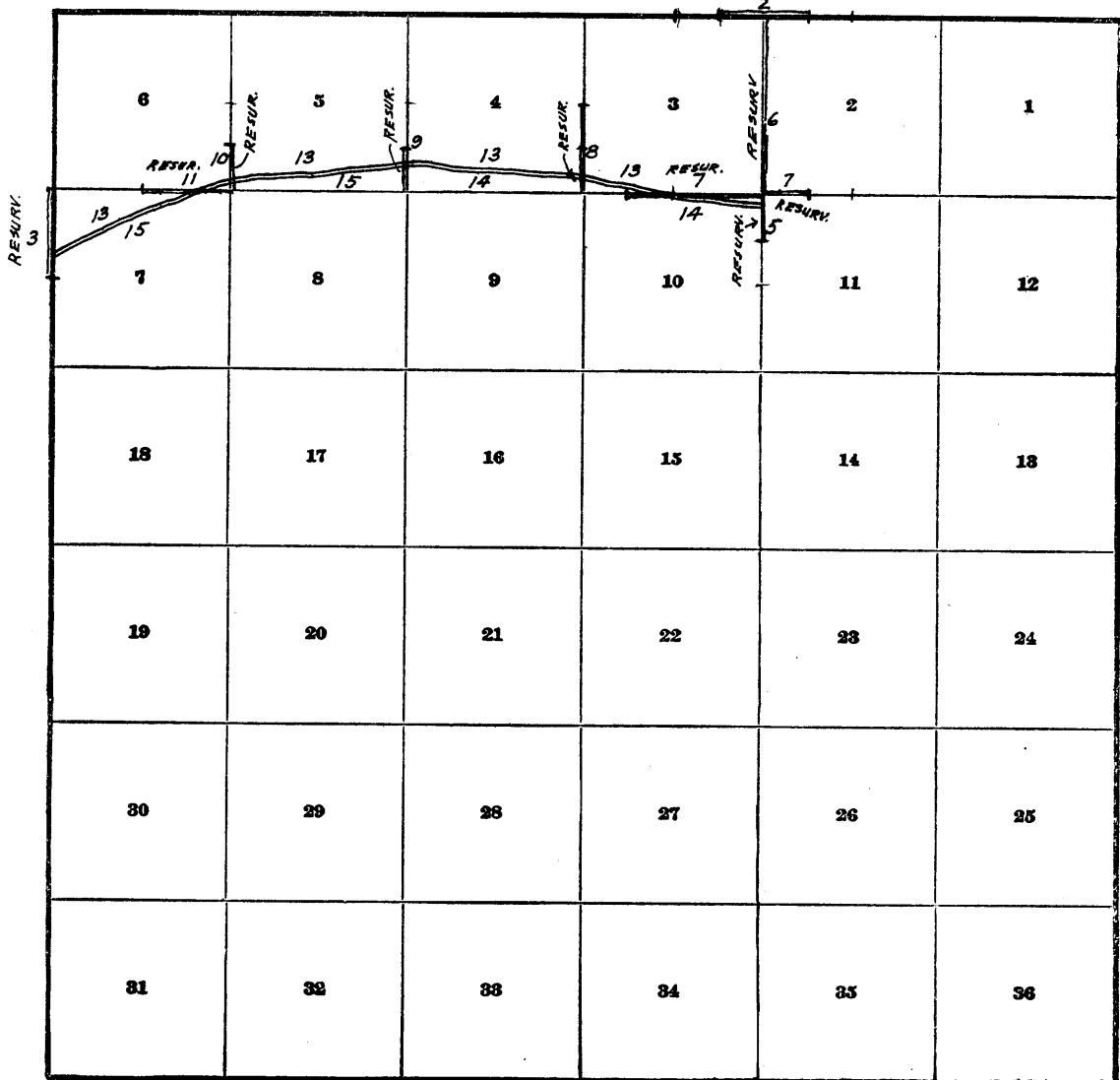

Chains.

The survey of the Casa Blanca Canal, storm channel and the necessary resurveys in township 4 south, range 5 east, Gila and Salt River Meridian, was executed with a light mountain transit made by Buff & Buff, Serial No. 16723, constructed in accordance with the standard specifications of the General Land Office. The horizontal circle has a diameter of 4½ ins., with two double opposite verniers reading to single minutes; the vertical circle has a diameter of 4 ins., with one double vernier reading to single minutes. The instrument is equipped with the improved Smith solar attachment, radius of the latitude arc 2½ ins., and of declination arc 3½ ins., each with verniers reading to single minutes. The instrument was in good condition, and having been placed in satisfactory adjustment prior to beginning the survey, and tested and found free from appreciable error, was approved by the district cadastral engineer on March 2, 1932. I examined all the instrumental adjustments before making the field tests hereinafter recorded.

The directions of all the lines were determined by solar transit method. The measurements were made with a Lallie steel tape, 5 chs. in length, graduated every link for the first 100 lks., and thereafter at intervals of 10 lks. The tape was tested by comparison with a Lufkin standard and found correct. The measurements were made on the slope, and the vertical angle of each interval was ascertained by a clinometer in good adjustment; the horizontal equivalents were determined for entry in the field note record.

The data furnished with the special instructions gives the geographic position for the NW. cor. of the Tp., as follows: latitude 33° 07' N., and longitude 111° 54' W.

March 12, 1932, in camp at the ¼ sec. cor. on N. bdy. of sec. 6, T. 4 S., R. 5 E., at 6h 17m p.m., l.m.t. by my watch, which reads correct local mean time for the longitude of my station, determined from a Western Union clock recording 105th meridian time, I make an hour angle observation on Polaris west of the meridian, making four observations, two each with the telescope in direct and reversed positions, reading the vertical angle and the horizontal deflection angle from a telephone pole about 1 mile north, in the direction E - N to Polaris.

Local mean time of obsn. - - - - -	6h 17m p.m.
Mean horizontal angle, pole to star -	6° 32' 40" E-N
Azimuth of Polaris - - - - -	1° 06' 24" W.
True bearing of pole - - - - -	N. 5° 26' 16" E.
Mean observed vertical angle - - - -	33° 40' 30"
Reduced latitude - - - - -	33° 08' 25" N.

March 13, every hour from 7 to 11 a.m. and from 1 to 5 p.m., I make proper settings on the arcs of the solar attachment and ascertain that the resulting orientation of the instrument, when compared with the meridian established by Polaris observation, has a maximum error of less than 1' 30".

I repeat the tests of the arcs daily by noon observation, and verify the meridional indications at frequent intervals throughout the survey.

## Resurvey of a portion of the N. bdy. of T. 4 S., R. 5 E.

## Chains

The following field notes describe the traverse of a line paralleling the north bank of the Casa Blanca Canal at a distance of twenty-five feet and the traverse of a line paralleling the south bank of the related storm channel at a distance of one hundred feet, the intersections of said traverse lines with the boundaries of the sections involved and the necessary resurveys of the boundaries of said sections.

The exteriors and subdivisions of T. 4 S., R. 5 E., were surveyed by G. P. Harrington, U. S. Surveyor in 1911.

Beginning at the E. 1/16 sec. cor. bet. secs. 3 and 34 on the N. bdy. of T. 4 S., R. 5 E.

East, on a random line bet. secs. 3 and 34.

20.00 No trace found of the cor. of secs. 2, 3, 34 and 35. Set temp. cor.

Thence

East, on a random line bet. secs. 2 and 35.

19.96 Intersect the W. 1/16 sec. cor., which is an iron post, 1 in. diam., 10 ins. above ground, firmly set, marked and witnessed as described in the official record.

Thence

West, on a true line bet. secs. 2 and 35.

Over level land.

18.80 Waste water ditch, 30 lks. wide, course N.

19.74 Set an iron post, 3 ft. long, 2 ins. diam., 30 ins. in the ground, for witness cor. to cor. of secs. 2, 3, 34 and 35, with brass cap mkd.

W	C
T3S	R5E
S34	S35
S3	S2
T4S	
1932	

from which

A cross (X) on NW. end of abutment of bridge, bears S. 58° 15' E., 41 lks. dist., mkd. WC BXO S2

A cross (X) on SE. face of cement wing of ditch headgate bears N. 45° 30' W., 40 lks. dist.

The head of a copper bolt, 1 3/4 ins. diam., set flush with the top of cement of SW. wing from headgate, bears N. 85° 00' W., 52 1/2 lks. dist., mkd. 1226.23

19.98 True point for cor. of secs. 2, 3, 34 and 35 falls in irrigation ditch, 15 lks. wide, course NW. from S.

Land, level.

Soil, light sandy loam; 1st rate.

No timber; undergrowth, scattering mesquite.

Resurvey of a portion of the N. bdy. of T. 4 S., R. 5 E.

BOOK 8051

Chains.

Thence from the true point for cor. of secs. 2, 3, 34 and 35.

West, on a true line bet. secs. 3 and 34.

Over level land, through scattering mesquite.

19.98

The E. 1/16 sec. cor., which is an iron post, 1 in. diam. 10 ins. above ground, firmly set, marked and witnessed as described in the official record.

Land, level.

Soil, light sandy loam; 1st rate.

No timber; undergrowth, scattering mesquite.

Resurvey of a portion of the W. bdy. of T. 4 S., R. 5 E.

I commence at the cor. of secs. 1, 6, 7 and 12 on the W. bdy. of the Tp., which is an iron post, 1 in. diam., the top of which is 4 ins. below the surface, with brass cap off and alongside marked as described in the official record. Alongside of post

Set an iron post, 3 ft. long, 2 ins. diam., 40 ins. in the ground, with original brass cap deposited alongside, for cor. of secs. 1, 6, 7 and 12, with brass cap mkd.

T 4 S  
R4E | R5E  
S1 | S6  
S12 | S7

1932

A flag at the objective cor. being visible, I run

South, on a true line bet. secs. 7 and 12.

Over level land and along road.

20.00

Intersect the N. 1/16 sec. cor., which is an iron post, 1 in. diam., the top of which is 4 ins. below surface, with brass cap broken and marks nearly obliterated. Alongside of post

Set an iron post, 3 ft. long, 1 in. diam., 40 ins. in the ground, with a glass bottle deposited at base, for N. 1/16 sec. cor., with brass cap mkd.

N 1/16  
S12 | S7

1932

24.17

Intersect the N. bdy. of the Casa Blanca Canal.

Set an iron post, 3 ft. long, 2 ins. diam., 42 ins. in the ground, with a glass bottle deposited at base, for closing cor. of secs. 7 and 12, with brass cap mkd.

C C  
T4S  
R4E | R5E  
S12 | S7

C B C  
1932

Resurvey of a portion of the W. bdy. of T. 4 S., R. 5 E.

Chains.	
25.10	Casa Blanca Canal, 30 lks. wide, course S. 61° 15' W.
25.80	Leave road, bears N. 61° 15' E. along top of levee.
26.50	Storm channel, 50 lks. wide, course S. 61° 15' W. Enter undergrowth.
28.68	Intersect the S. bdy. of the storm channel, Set an iron post, 3 ft. long, 2 ins. diam., 32 ins. in the ground, with a glass bottle deposited at base, for closing cor. of secs. 7 and 12, with brass cap mkd.
30.00	An iron pipe, 1½ ins. diam., 6 ins. above ground. Allotment corner.
35.00	An iron pipe, 1½ ins. diam., 8 ins. above ground. Allotment corner.
40.00	The ¼ sec. cor., which is an iron post, 1 in. diam., 8 ins. above the ground, firmly set, marked and witnessed as described in the official record. Renew the pits, 18 x 18 x 12 ins., N. and S. of post, 3 ft. dist.
	Land, level. Soil, light and sandy loam; 1st rate. No timber; undergrowth, creosote brush.

Resurvey of a part of the Subdivisions of T. 4 S., R. 5 E.

	I commence at the N. 1/16 sec. cor. bet. secs. 10 and 11. Thence North, on a random line bet. secs. 10 and 11.
20.00	No trace found of the cor. of secs. 2, 3, 10 and 11. Set temp. cor. Thence North, on a random line bet. secs. 2 and 3.
20.00	No trace found of the S. 1/16 sec. cor. Set temp.
40.00	No trace found of the ¼ sec. cor. Set temp.
60.00	No trace found of the N. 1/16 sec. cor. Set temp.
79.91	Intersect N. bdy. of Tp., 15 lks. W. of the true point for cor. of secs. 2, 3, 34 and 35.
	From the W. 1/16 sec. cor. bet. secs. 2 and 11. West, on a random line bet. secs. 2 and 11
20.02	Intersect the temp. cor. of secs. 2, 3, 10 and 11. Thence

## Resurvey of a part of the Subdivisions of T. 4 S., R. 5 E.

BOOK 8551

## Chains.

- West, on a random line bet. secs. 3 and 10.
- 20.00 No trace found of the E. 1/16 sec. cor. Set temp.
- 39.89 Intersect N. and S. line , 7 lks. S. of the  $\frac{1}{4}$  sec. cor.
- 
- Returning to the N. 1/16 sec. cor. bet. secs. 10 and 11, which is an iron post, 1 in. diam., 8 ins. above ground, firmly set, marked and witnessed as described in the official record.
- N. 0° 02' E., on a true line bet. secs. 10 and 11.
- Over level land, through scattering creosote brush.
- 11.72 Intersect the S. bdy. of the storm channel.
- Set an iron post, 3 ft. long, 2 ins. diam., 32 ins. in the ground, with a sandstone, 4 x 3 x 2 ins., mkd. X, deposited at base, for closing cor. of secs. 10 and 11, with brass cap mkd.
- C B C

S10	S11
T4S	R5E
C	C
1932	
- 12.10 Road, bears E. and W.
- 13.40 Storm channel, 50 lks. wide, course N. 80° W.
- 14.40 Casa Blanca Canal, course N. 80° W.
- 14.70 Headgate for an irrigation ditch, course N. Thence in ditch.
- 15.41 Intersect the N. bdy. of the Casa Blanca Canal. The true point for closing cor. falls in ditch. Therefore at a point, N. 79° 10' W., 45 lks. dist.
- Set an iron post, 3 ft. long, 2 ins. diam., 32 ins. in the ground, with a piece of concrete, 10 x 6 x 4 ins., mkd. X, deposited at base, for witness cor. to closing cor. of secs. 10 and 11, with brass cap mkd.
- W C

C	C
T4S	R5E
S10	S11
C B C	
1932	
- 20.00 At the proportional distance the true point for the cor. of secs. 2, 3, 10 and 11 falls in irrigation ditch, 10 lks. wide, course N. At points N. 45° E., S. 45° E., S. 45° W. and N. 45° W., 45 lks. dist.
- Set iron posts, 3 ft. long, 2 ins. diam., 28 ins. in the ground, with glass bottles, NE., SW. and NW., and with a piece of concrete, 10 x 8 x 6 ins., mkd. X, SE, deposited at base, for witness cors. to cor. of secs. 2, 3, 10 11, with brass caps mkd.

## Resurvey of a part of the Subdivisions of T. 4 S., R. 5 E.

Chains.

W C	
T4S	R5E
S3	S2
S10	S11

1932

A bridge in road, bearing N. and S. passes over true point for cor.

Land, level.

Soil, sandy loam; 1st rate.

No timber; undergrowth, creosote brush.

Thence from the true point for cor. of secs. 2, 3, 10 and 11.

N.  $0^{\circ}06'$  E., on a true line bet. secs. 2 and 3.

Over level land and in an irrigation ditch, 10 lks. wide in bottom, course N.

20.00

At the proportional distance the true point for the S.  $1/16$  sec. cor. falls in irrigation ditch, course N. At points E. and W., 25 lks. dist.

Set iron posts, 3 ft. long, 1 in. diam., 28 ins. in the ground, with pieces of concrete, 8 x 6 x 4 ins., mkd. X, deposited at base, for witness cors. to the S.  $1/16$  sec. cor., with brass caps mkd.

W C	
S $1/16$	
S3	S2
1932	

40.00

At the proportional distance the true point for the  $\frac{1}{4}$  sec. cor. falls in irrigation ditch, course N. At points E and W., 25 lks. dist.

Set iron posts, 3 ft. long, 1 in. diam., 28 ins. in the ground, with pieces of concrete, 8 x 6 x 3 ins., mkd. X, deposited at base, for witness  $\frac{1}{4}$  sec. cors., with brass caps mkd.

W C	
$\frac{1}{4}$	
S3	S2
1932	

60.00

At the proportional distance the true point for the N.  $1/16$  sec. cor. falls in irrigation ditch, course N. At points E. and W., 25 lks. dist.

Set iron posts, 3 ft. long, 1 in. diam., 28 ins. in the ground, with washed stones, 6 x 5 x 3 ins., mkd. X, deposited at base, for witness cors. to the N.  $1/16$  sec. cor., with brass caps mkd.

W C	
N $1/16$	
S3	S2
1932	



Resurvey of a part of the Subdivisions of T. 4 S., R. 5 E.

BOOK 3851

- Chains.  
79.40 Road and bridge over ditch, bears E. and W.
- 79.91 The true point for cor. of secs. 2, 3, 34 and 35, on the N. bdy. of the Tp., hereinbefore described.  
  
Land, level.  
Soil, light sandy loam; 1st rate.  
No timber; undergrowth, creosote brush and mesquite.

---

- The W. 1/16 sec. cor. bet. secs. 2 and 11 is an iron post, 1 in. diam., with 5 ins. of the post and brass cap lying loose alongside, marked and witnessed as described in the official record. Alongside of post
- Set an iron post, 3 ft. long, 1 in. diam., 28 ins. in the ground, with the original brass cap deposited at base, for W. 1/16 sec. cor., with brass cap mkd.

$$\begin{matrix} 1 & S2 \\ W16 & S11 \end{matrix}$$

1932

- 18 x 18 x 12 ins., E. and W. of post, 3 ft. dist. renew the pits,
- Thence
- West, on a true line bet. secs. 2 and 11.
- Over level land.
- 19.00 Waste water ditch, 30 lks. wide, course N.
- 20.01 The true point for cor. of secs. 2, 3, 10 and 11.  
  
Land, level.  
Soil, light sandy loam; 1st rate.  
No timber; undergrowth, scattering mesquite.

---

- From the true point for cor. of secs. 2, 3, 10 and 11.  
N. 89° 54' W., on a true line bet. secs. 3 and 10.  
Over level land, through scattering mesquite.
- 8.30 Irrigation ditch, 10 lks. wide, course N. 60° W.
- 13.90 Telephone line, bears N. 70° W. and S. 70° E.
- 14.70 Road, bears N. 70° W. and S. 70° E.
- 19.95 At the proportional distance  
  
Set an iron post, 3 ft. long, 1 in. diam., 40 ins. in the ground, with a granite stone, 10 x 6 x 6 ins., mkd. X, deposited at base, for E. 1/16 sec. cor., with brass cap mkd.

$$\begin{matrix} 1 & S3 \\ E16 & S10 \end{matrix}$$

1932

- Corner falls in N. edge of road.
- 20.20 Road, bears N. 80° W. and S. 80° E.
- 20.34 Intersect the N. bdy. of the Casa Blanca Canal.

## Resurvey of a part of the Subdivisions of T. 4 S., R. 5 E.

## Chains.

Set an iron post, 3 ft. long, 2 ins. diam., 40 ins. in the ground, with a granite stone, 10 x 6 x 6 ins., mkd. X, deposited at base, for closing cor. of secs. 3 and 10, with brass cap mkd.

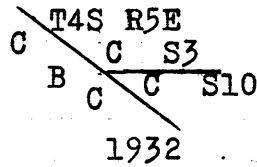

This cor. is in the S. side of road.

- 24.30 To Casa Blanca Canal, 30 lks. wide, course N. 79° W.  
 26.20 Road, along top of levee, bears N. 79° W and S. 79° E.  
 28.30 Storm channel, 50 lks. wide, course N. 79° W.  
 39.90 The  $\frac{1}{4}$  sec. cor., which is an iron post, 1 in. diam., 8 ins. above ground, firmly set, marked and witnessed as described in the official record.  
 A flag at the W. 1/16 sec. cor., bears N. 89° 54' W., therefore I continue alignment and measurement.  
 54.14 Intersect the S. bdy. of the storm channel.

Set an iron post, 3 ft. long, 2 ins. diam., 30 ins. in the ground, with a glass bottle deposited at base, for closing cor. of secs. 3 and 10, with brass cap mkd.

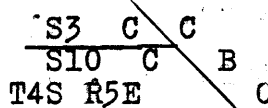

1932

- 59.85 The W. 1/16 sec. cor., which is an iron post, 1 in. diam., 6 ins. above ground, firmly set, marked and witnessed as described in the official record.

Land, level.  
 Soil, light sandy loam; 1st rate.  
 No timber; undergrowth, creosote brush.

From the cor. of secs. 3, 4, 9 and 10.

N. 0° 08' W., on a random line bet. secs. 3 and 4.

- 20.00 No trace found of the S. 1/16 sec. cor. Set temp.

- 40.00 Intersect the  $\frac{1}{4}$  sec. cor., which is an iron post, 1 in. diam., 2 ins. above ground, firmly set, marked and witnessed as described in the official record.

Thence

S. 0° 08' E., on a true line bet. secs. 3 and 4.

Over level land through brush.

- 5.00 An iron pipe,  $1\frac{1}{4}$  ins. diam., 8 ins. above ground. Allotment corner.  
 15.00 An iron pipe,  $1\frac{1}{4}$  ins. diam., 8 ins. above ground. Allotment corner.

Resurvey of a part of the Subdivisions of T. 4 S., R. 5 E.

BOOK 3951

Chains.									
20.00	Set an iron post, 3 ft. long, 1 in. diam., 28 ins. in the ground, with a glass bottle deposited at base, for S. 1/16 sec. cor., with brass cap mkd.								
	<p style="text-align: center;">S 1/16</p> <table style="margin-left: auto; margin-right: auto;"> <tr> <td style="border-right: 1px solid black; padding: 0 5px;">S4</td> <td style="padding: 0 5px;">S3</td> </tr> </table> <p style="text-align: center;">1932</p>	S4	S3						
S4	S3								
25.50	An old road, bears E. and W.								
30.00	An iron pipe, 1 1/4 ins. diam., 4 ins. above ground. Allotment corner.								
30.57	Intersect the N. bdy. of the Casa Blanca Canal.								
	Set an iron post, 3 ft. long, 2 ins. diam., 38 ins. in the ground, with a glass bottle deposited at base, for closing cor. of secs. 3 and 4, with brass cap mkd.								
	<table style="margin-left: auto; margin-right: auto;"> <tr> <td style="border-right: 1px solid black; padding: 0 5px;">C C</td> <td style="padding: 0 5px;">R5E</td> </tr> <tr> <td style="border-right: 1px solid black; padding: 0 5px;">T4S</td> <td style="padding: 0 5px;">S3</td> </tr> <tr> <td style="border-right: 1px solid black; padding: 0 5px;">S4</td> <td style="padding: 0 5px;">S3</td> </tr> </table> <p style="text-align: center;">C B C 1932</p>	C C	R5E	T4S	S3	S4	S3		
C C	R5E								
T4S	S3								
S4	S3								
	This corner is in N. edge of road.								
30.70	Road, parallel to Casa Blanca Canal.								
31.40	Casa Blanca Canal; 30 lks. wide, course N. 77° 45' W.								
32.10	Road, along top of levee, parallel to Casa Blanca Canal.								
32.70	Storm channel, 50 lks. wide, course N. 77° 45' W.								
34.54	Intersect the S. bdy. of the storm channel.								
	Set an iron post, 3 ft. long, 2 ins. diam., 30 ins. in the ground, with a glass bottle deposited at base, for closing cor. of secs. 3 and 4, with brass cap mkd.								
	<table style="margin-left: auto; margin-right: auto;"> <tr> <td style="border-right: 1px solid black; padding: 0 5px;">C B C</td> <td style="padding: 0 5px;"></td> </tr> <tr> <td style="border-right: 1px solid black; padding: 0 5px;">S4</td> <td style="padding: 0 5px;">S3</td> </tr> <tr> <td style="border-right: 1px solid black; padding: 0 5px;">T4S</td> <td style="padding: 0 5px;">R5E</td> </tr> <tr> <td style="border-right: 1px solid black; padding: 0 5px;">C C</td> <td style="padding: 0 5px;"></td> </tr> </table> <p style="text-align: center;">1932</p>	C B C		S4	S3	T4S	R5E	C C	
C B C									
S4	S3								
T4S	R5E								
C C									
40.00	The cor. of secs. 3, 4, 9 and 10, which is an iron post, 1 in. diam., 8 ins. above ground, firmly set, marked and witnessed as described in the official record. Renew the pits, 18 x 18 x 12 ins., in each sec., 3 ft. dist.								
	Land, level. Soil, light sandy loam; 1st rate. No timber; undergrowth, mesquite and creosote brush.								
	The cor. of secs. 4, 5, 8 and 9 is an iron post, 1 in. diam., 6 ins. above ground, firmly set, marked and witnessed as described in the official record.								
	A flag at the objective corner is visible, therefore N. 0° 04' W., on a true line bet. secs. 4 and 5.								
	Over level land through undergrowth.								

## Resurvey of a part of the Subdivisions of T. 4 S., R. 5 E.

Chains.																						
5.00	An iron pipe, $1\frac{1}{4}$ ins. diam., 8 ins. above ground. Allotment corner.																					
10.00	An iron pipe, $1\frac{1}{4}$ ins. diam., 8 ins. above ground. Allotment corner.																					
12.83	Intersect the S. bdy. of the storm channel.  Set an iron post, 3 ft. long, 2 ins. diam., 30 ins. in the ground, with a glass bottle deposited at base, for closing cor. of secs. 4 and 5, with brass cap mkd.																					
	<table style="margin-left: auto; margin-right: auto;"> <tr><td>C</td><td>B</td><td>C</td></tr> <tr><td colspan="3"><hr/></td></tr> <tr><td>S5</td><td> </td><td>S4</td></tr> <tr><td>T4S</td><td> </td><td>R5E</td></tr> <tr><td>C</td><td> </td><td>C</td></tr> <tr><td colspan="3"><hr/></td></tr> <tr><td colspan="3">1932</td></tr> </table>	C	B	C	<hr/>			S5		S4	T4S		R5E	C		C	<hr/>			1932		
C	B	C																				
<hr/>																						
S5		S4																				
T4S		R5E																				
C		C																				
<hr/>																						
1932																						
14.70	Storm channel, 50 lks. wide, course S. 88° W.																					
15.25	Road along top of levee, parallel to Casa Blanca Canal.																					
15.80	Casa Blanca Canal, 30 lks. wide, course S. 88° W.																					
16.20	Road, parallel to Casa Blanca Canal. Thence along E. side of a lateral ditch.																					
16.63	Intersect the N. bdy. of the Casa Blanca Canal.  Set an iron post, 3 ft. long, 2 ins. diam., 32 ins. in the ground, with a glass bottle deposited at base, for closing cor. of secs. 4 and 5, with brass cap mkd.																					
	<table style="margin-left: auto; margin-right: auto;"> <tr><td>C</td><td>C</td></tr> <tr><td>T4S</td><td> </td><td>R5E</td></tr> <tr><td>S5</td><td> </td><td>S4</td></tr> <tr><td colspan="3"><hr/></td></tr> <tr><td colspan="3">C B C</td></tr> <tr><td colspan="3">1932</td></tr> </table>	C	C	T4S		R5E	S5		S4	<hr/>			C B C			1932						
C	C																					
T4S		R5E																				
S5		S4																				
<hr/>																						
C B C																						
1932																						
20.00	The S. $1/16$ sec. cor., which is an iron post, 1 in. diam., 2 ft. below surface of ditch bank. The brass cap has been broken off. Alongside of post  Set an iron post, 3 ft. long, 1 in. diam., 28 ins. in the ground, 2 ft. below surface of ditch bank, for S. $1/16$ sec. cor., with brass cap mkd.																					
	<table style="margin-left: auto; margin-right: auto;"> <tr><td>S</td><td><math>1/16</math></td></tr> <tr><td>S5</td><td> </td><td>S4</td></tr> <tr><td colspan="3"><hr/></td></tr> <tr><td colspan="3">1932</td></tr> </table> <p>Land, level. Soil, light sandy loam; 1st rate. No timber; undergrowth, creosote brush.</p> <hr/> <p>From the cor. of secs. 5, 6, 7 and 8.  N. 0° 03' W., on a random line bet. secs. 5 and 6.</p> <p>20.00 Intersect the S. <math>1/16</math> sec. cor., which is an iron post, 1 in. diam., the top of which is 4 ins. below the surface, firmly set, marked as described in the official record.</p> <p>Thence  S. 0° 03' E., on a true line bet. secs. 5 and 6.</p>	S	$1/16$	S5		S4	<hr/>			1932												
S	$1/16$																					
S5		S4																				
<hr/>																						
1932																						

Resurvey of a part of the Subdivisions of T. 4 S., R. 5 E. 2951

Chains.

Over level cultivated land.

15.44 Set an iron post, 3 ft. long, 2 ins. diam., 32 ins. in the ground, with a glass bottle deposited at base, for witness cor. to the closing cor. of secs. 5 and 6, with brass cap mkd.

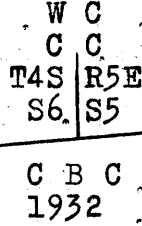

15.58 Intersect the N. bdy. of the Casa Blanca Canal.

The true point for the closing cor. of secs. 5 and 6 falls in an irrigation ditch, 8 lks. wide, course S. 80° W.

Leave cultivated land.

15.80 Road, parallel to the Casa Blanca Canal.

16.50 Casa Blanca Canal, 30 lks. wide, course S. 78° 30' W.

17.20 Road along top of levee, parallel to Casa Blanca Canal.

17.70 Storm canal, 50 lks. wide, course S. 78° 30' W.

19.62 Intersect the S. bdy. of the storm channel.

Set an iron post, 3 ft. long, 2 ins. diam., 30 ins. in the ground, with a lava rock, 6 x 4 x 2 ins., mkd. X, deposited at base, for closing cor. of secs. 5 and 6, with brass cap mkd.

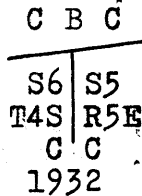

20.00 The cor. of secs. 5, 6, 7 and 8, which is an iron post, 1 in. diam., 10 ins. above ground, firmly set, marked and witnessed as described in the official record.

Land, level.  
Soil, light sandy loam; 1st rate.  
No timber; Creosote brush S. of storm channel.

A flag at the objective corner in sight, therefore N. 89° 53' W., on a true line bet. secs. 6 and 7.  
Over level land through undergrowth.

1.91 Intersect the S. bdy. of the storm channel.

Set an iron post, 3 ft. long, 2 ins. diam., 30 ins. in the ground, with a granite stone, 7 x 5 x 4 ins., mkd. X, deposited at base, for closing cor. of secs. 6 and 7, with brass cap mkd.

Resurvey of a part of the Subdivisions of T. 4 S., R. 5 E.

Chains

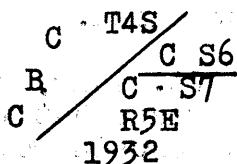

- 10.20 Storm channel, 50 lks. wide, course S. 78° 30' W.
- 14.40 Road along top of levee, parallel to Casa Blanca Canal.
- 15.70 Casa Blanca Canal, 30 lks. wide, course S. 78° 30' W.
- 20.00 The E. 1/16 sec. cor., which is an iron post, 1 in. diam., 3 ins. below surface, marked as described in the official record.
- 20.90 Road, parallel to the Casa Blanca Canal.
- 21.72 Intersect the N. bdy. of the Casa Blanca Canal.

Set an iron post, 3 ft. long, 2 ins. diam., 34 ins. in the ground, with a glass bottle deposited at base, for closing cor. of secs. 6 and 7, with brass cap mkd.

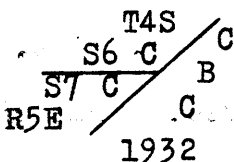

This corner is in the east bank of an irrigation ditch, 10 lks. wide, course S. 78° 30' W.

- 22.50 Enter cultivated land, parallel to Casa Blanca Canal.
- 40.00 The 1/4 sec. cor., which is an iron post, 1 in. diam., 3 ins. below the surface, marked as described in the official record.

Land, level.  
 Soil, light sandy loam; 1st rate.  
 No timber; undergrowth, creosote brush E. of storm channel.

N. bdy. of the Casa Blanca Canal, T. 4 S.; R. 5 E.

BOOK 3851

Chains.

I commence the survey of the north boundary of the Casa Blanca Canal at the closing cor. of secs. 7 and 12 on the W. bdy. of T. 4 S., R. 5 E., hereinbefore described, maintaining the uniform distance of 25 ft. (right angle width) from the outer toe of the N. bank of the canal.

Thence with traverse in sec. 7.

Over level land along edge of cultivation.

N. 61° 15' E., 6.24 chs.  
 N. 65° 10' E., 44.87 " .  
 N. 78° 35' E., 11.43 " . To the closing cor. of secs.  
 6 and 7.

Land, level.

Soil, light sandy loam; 1st rate.

No timber.

Thence in sec. 6.

Over level land along edge of cultivation.

N. 78° 35' E., 22.17 chs. To the true point for the closing cor. of secs. 5 and 6.

Land, level.

Soil, light sandy loam; 1st rate.

No timber.

Thence in sec. 5.

Over level land along edge of cultivation,

N. 78° 35' E., 14.08 chs.  
 N. 80° 08' E., 51.33 " .  
 N. 88° 07' E., 15.68 " . To the closing cor. of secs.  
 4 and 5.

Land, level.

Soil, light sandy loam; 1st rate.

No timber.

Thence in sec. 4.

Over level land.

N. 88° 07' E., 22.01 chs.  
 S. 85° 30' E., 22.49 chs.  
 S. 81° 15' E., 29.23 chs.  
 S. 77° 40' E., 6.92 chs. To the closing cor. bet. secs.  
 3 and 4.

Land, level.

Soil, sandy loam; 1st rate.

No timber.

Thence in sec. 3.

Over level land.

S. 77° 40' E., 29.08 chs.  
 S. 88° 12' E., 20.58 " .  
 S. 75° 30' E., 10.86 " . To the closing cor. bet. secs.  
 3 and 10.

Land, level.

Soil, light sandy loam; 1st rate.

No timber.

N. bdy. of the Casa Blanca Canal, T. 4 S., R. 5 E.

Chains.

Thence in sec. 10.

Over level land.

S. 75° 30' E., 11.64 chs.

S. 79° 10' E., 9.26 " . At 8.81 chs. the witness cor.  
to the cor. of secs. 10 and 11.  
To the true point for the closing  
cor. of secs. 10 and 11.

Land, level.

Soil, light sandy loam; 1st rate.

No timber.

S. bdy. of the Casa Blanca Canal Storm Channel,  
T. 4 S., R. 5 E.

I commence the survey of the south boundary of the Casa Blanca Canal Storm Channel at the closing cor. of secs. 10 and 11, T. 4 S., R. 5 E., hereinbefore described, maintaining the uniform distance of 100 ft. (right angle width) from the S. bank of said channel.

Thence with traverse in sec. 10.

Over level land, through undergrowth.

N. 80° 00' W., 12.55 chs.

N. 75° 12' W., 19.60 " .

N. 87° 55' W., 20.55 " .

N. 77° 49' W., 2.41 " . To the closing cor. of secs.  
3 and 10.

Land, level.

Soil, light sandy loam; 1st rate.

No timber; undergrowth, creosote brush.

Thence in sec. 3.

Over level land, through undergrowth.

N. 77° 49' W., 26.25 chs. To the closing cor. of secs.  
3 and 4.

Land, level.

Soil, light sandy loam; 1st rate.

No timber; undergrowth, creosote brush.

Thence in sec. 4.

Over level land, through undergrowth.

N. 77° 49' W., 6.38 chs.

N. 80° 58' W., 30.34 " .

N. 85° 32' W., 23.03 " .

S. 88° 08' W., 20.90 " . To the closing cor. of secs.  
4 and 5.

Land, level.

Soil, light sandy loam; 1st rate.

No timber; undergrowth, creosote brush.



S. bdy. of the Casa Blanca Canal Storm Channel,  
T. 4 S., R. 5 E.

BOOK 3951

Chains.

Thence in sec. 5.

Over level land, through undergrowth.

S. 88° 08' W., 13.92 chs.

S. 80° 20' W., 46.99 " .

S. 78° 42' W., 20.14 " . To the closing cor. of secs.  
5 and 6.

Land, level.

Soil, light sandy loam; 1st rate.

No timber; undergrowth, creosote brush.

Thence in sec. 6.

Over level land, through undergrowth.

S. 78° 42' W., 1.95 chs. To the closing cor. of secs.  
6 and 7.

Land, level.

Soil, light sandy loam; 1st rate.

No timber.

Thence in sec. 7.

Over level land, through undergrowth.

S. 78° 42' W., 29.66 chs.

S. 65° 30' W., 44.07 " .

S. 61° 10' W., 9.20 " . To the closing cor. of secs.  
7 and 12 on the W. bdy. of T.  
4 S., R. 5 E., hereinbefore  
described.

Land, level.

Soil, light sandy loam; 1st rate.

No timber; undergrowth, creosote brush.

## FINAL TEST OF SOLAR ATTACHMENT.

March 27: At the  $\frac{1}{4}$  sec. cor. on the N. bdy. of sec. 6,  
T. 4 S., R. 5 E., at 9h 00m a.m., app.t., I set off 33°  
08' N., on the lat. arc; 2° 43' N., on the decl. arc; and  
orient the instrument with the solar; the line of sight  
agrees with the meridian established by Polaris observa-  
tion.

At 3h 00m p.m., app.t., I set off 33° 08' N., on the  
lat. arc; 2° 49' N., on the decl. arc; and repeat the  
test of the solar; the line of sight agrees with the me-  
ridian established by Polaris observation.

March 27, 1932.

## GENERAL DESCRIPTION.

The area through which the Casa Blanca Canal and its  
related storm channel pass, is level land.

The soil is a light sandy loam and where not cleared  
is covered with a rather heavy growth of creosote brush.

That portion of secs. 5, 6, and 7 on the north side  
of the canal, at the present time, is being cleared,  
ploughed and leveled preparatory to intense cultivation.



84  
17

BOOK 3951

# CERTIFICATE OF UNITED STATES SURVEYOR

Cadastral Engineer

I, Francis M. Joy, U. S. ~~Surveyor~~, hereby certify upon honor that, in pursuance of special instructions received from the District Cadastral Engineer for Arizona

bearing date of the 15th day of February, 1932, I have well, faithfully, and truly in my own proper person, and in strict conformity with said instructions, the Manual of Surveying Instructions, and the laws of the United States, resurveyed a portion of the North and West boundaries and subdivisions, and surveyed the Casa Blanca Canal and related Storm Channel boundaries, Township 4 South, Range 5 East,

of the Gila and Salt River Meridian, in the State of Arizona, which are represented in the foregoing field notes as having been executed by me, and under my direction; and that all the corners of said survey have been established and perpetuated in strict accordance with the Manual of Surveying Instructions, and the special written instructions of the District Cadastral Engineer for Arizona and in the specific manner described in the field notes, and that the foregoing are the original field notes of such survey.

Glendale, California,  
August 15, 1932.

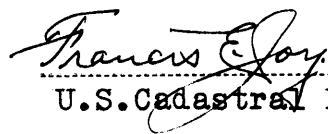
  
U.S. Cadastral Engineer. ~~U.S. Cadastral Engineer~~

## APPROVAL

OFFICE OF U. S. SUPERVISOR OF SURVEYS,

**DENVER, COLORADO** DEC 19 1932, 19

The foregoing field notes of the resurvey of a portion of the North and West boundaries and subdivisions, and survey of the Casa Blanca Canal and related Storm Channel boundaries, in Township 4 South, Range 5 East of the Gila and Salt River Meridian in the State of Arizona,

executed by Francis M. Joy, U. S. Cadastral Engineer under his special instructions dated February 15, 1932, having been critically examined, and the necessary corrections and explanations made, the said field notes, and the surveys they describe, are hereby approved.

  
U. S. Supervisor of Surveys.

I certify that the foregoing transcript of the field notes of the above-described surveys in \_\_\_\_\_, has been correctly copied from the original notes on file in this office.

U. S. Supervisor of Surveys.