

4071

129

Original
4-879

Book A

BOOK 4071

FIELD NOTES

OF THE SURVEY OF THE

Resurvey of the W. Bdy. of T. 14 N., R. 4 E., a Portion of the
 W. Bdy. of T. 13 N., R. 4 E., a Portion of the N. Bdy. of T. 13 N.,
 R. 3 E., and a Portion of the N. Bdy. of T. 13 N., R. 2 E.; and of
 the Survey of the N. and W. Bdrs. of T. 14 N., R. 3 E., the W. Bdy.
 of Frac. T. 14 $\frac{1}{2}$ N., R. 3 E., and the N. Bdy. of Frac. T. 14 N.,
 R. 2 $\frac{1}{2}$ E.,

Of the Gila and Salt River Meridian,

In the State of Arizona

EXECUTED BY

Theodore Vander Meer, U.S. Transitman.

In the capacity of U. S. Surveyor, under Special Instructions dated July 20th,
 1933, issued by the District Cadastral Engineer to govern surveys included in Group
 No. 184, which were approved by the Commissioner of the General Land
 Office, Sept. 5th, 1933, and Assignment Instructions dated Aug. 1st, 1933
 and Sept. 30th, 1933.

Survey commenced August 5th, 1933

Survey completed November 23rd, 1933.

4071

4071

INDEX DIAGRAM.*Township* , *Range*

6	5	4	3	2	1
7	8	9	10	11	12
18	17	16	15	14	13
19	20	21	22	23	24
30	29	28	27	26	25
31	32	33	34	35	36

INDEX DIAGRAM

BOOK 4071

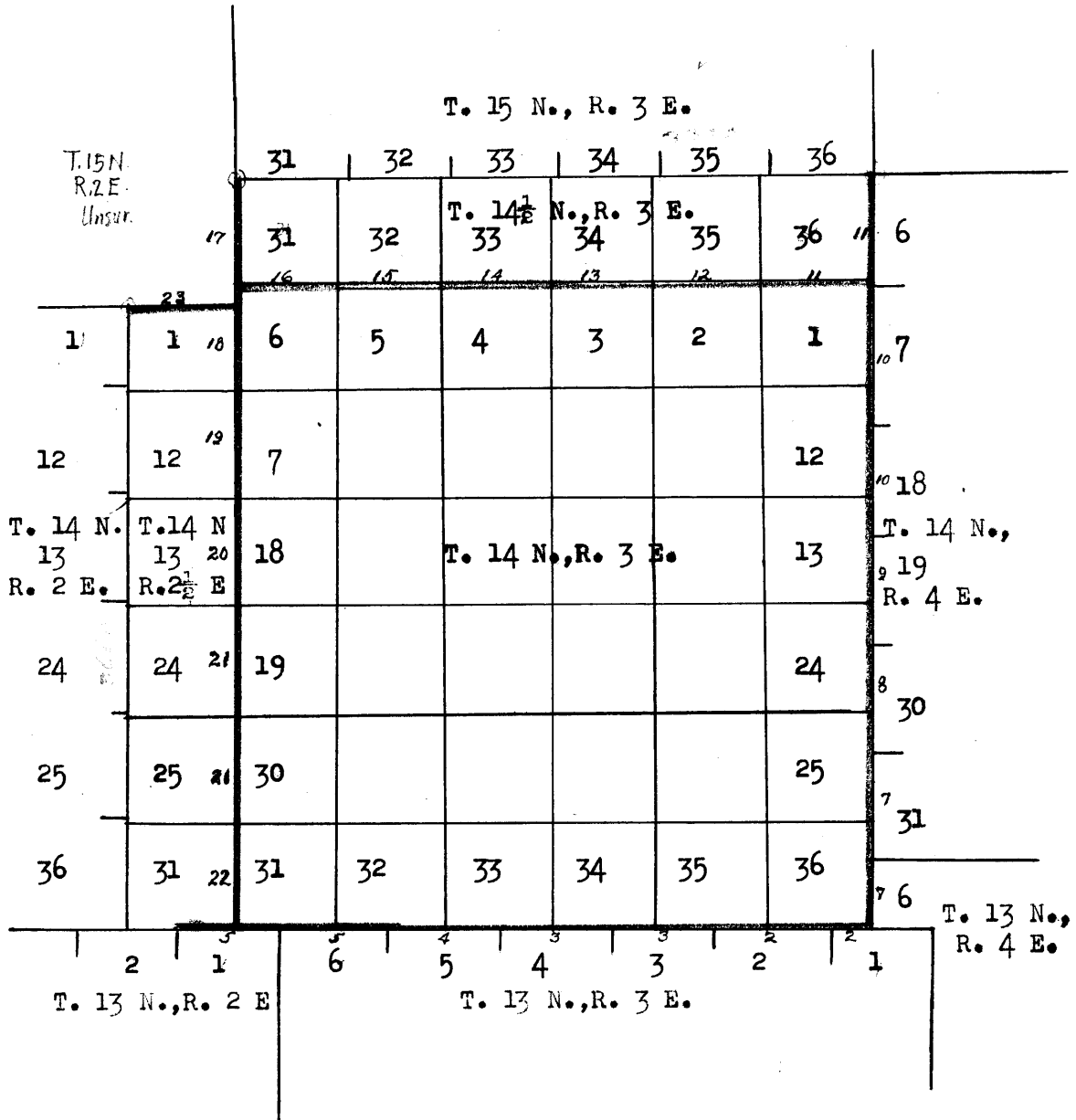

Resurvey of a Portion of the N. bdy. of
T. 13 N., R. 3 E.

BOOK 4071

The survey of township 13 north, range 3 east, was executed with a light mountain solar transit made by Buff and Buff Co., Serial No. 9977, constructed in accordance with the standard specifications of the General Land Office. The horizontal circle has a diameter of $4\frac{1}{2}$ inches, with two double verniers reading to single minutes; the vertical circle has a diameter of 4 ins., with one double vernier reading to single minutes; the telescope has fixed stadia wires; ratio 1:132, with a focal constant of 1.2 lks. The instrument is equipped with the improved Smith solar attachment; radius of latitude arc $3\frac{1}{2}$ ins., and of declination arc 3 ins., each with verniers reading to single minutes. The instrument was in good condition, and having been placed in satisfactory adjustment prior to the beginning of the survey, and tested and found free from appreciable error, was approved by the district cadastral engineer on August 1, 1933. All the instrumental adjustments were examined before making the field tests herein-after recorded.

The directions of the lines were determined by solar transit method. The measurements were made with a Lallie steel tape, five chains in length, graduated every link for the first 100 links, the balance at intervals of ten links. The tape was tested by comparison with a Lufkin standard tape and found correct. The measurements were made on the slope, and the vertical angle of each interval was read with a clinometer in good adjustment; the horizontal equivalents are entered in the field note record. Some of the distances were determined by triangulation as shown in the record.

The data furnished with the special instructions gives the geographical position of the SE. cor. of T. 14 N., R. 3 E. as follows: latitude $34^{\circ} 32' 38''$ N., longitude $111^{\circ} 58' 45''$ W.

August 4, 1933, in camp at Powell Spring in the SE $\frac{1}{4}$ of sec. 19, T. 14 N., R. 3 E., at 10h 44.4 m p. m., l. m. t., I observe Polaris at eastern elongation, making two sights each with the telescope in direct and reversed positions and mark the mean point with a tack in a stake driven firmly in the ground about 5 chains S.

August 5, 1933, after sunrise, I set off the azimuth of Polaris, $1^{\circ} 17'$ to the E., and read the true bearing of a point about $1\frac{1}{2}$ miles distant, which bearing is $S.40^{\circ}57'E$. I check this bearing with the angle from the peg to the point, which by repetition is $42^{\circ} 14'$. At 30 minute intervals from 7:30 to 10 a. m., and from 1:30 to 5 p. m., I make the proper settings on the arcs of the solar attachment and ascertain that the resulting orientation of the instrument, when compared with the meridian established by Polaris observation, has a maximum error of less than $1' 30''$.

I repeat the tests of the arcs daily by noon observations and verify the meridional indications at frequent intervals throughout the survey.

The N. Bdy. of T. 13 N., R. 3 E., and the E. 4 miles of the N. bdy. of T. 13 N., R. 2 E., were surveyed by C. B. Foster, Deputy Surveyor, in 1876.

The N. bdy. of T. 13 N., R. 3 E. was resurveyed in 1928, by B. J. Kinsey, U. S. Surveyor. The N. bdy. of sec. 2, of T. 13 N., R. 2 E., was resurveyed in 1923, by Ty White, U. S. Transitman.

Resurvey of a Portion of the N. Bdy. of
T. 13 N., R. 3 E.

Chains.

No other resurveys of these lines are of record.

For topography of the N. bdy. of T. 13 N., R. 3 E., see the field notes of such boundaries as resurveyed by B. J. Kinsey, U. S. Surveyor, in 1928.

Beginning at the closing cor. of T. 13 N., R. 4 E. and T. 14 N., R. 3 E., on the N. bdy. of sec. 1, T. 13 N., R. 3 E., which is an iron post, 3 ins. diam., firmly set, mkd. and witnessed as described in the official record.

N. 88° 22' W., on a random and true line, along the N. bdy. of sec. 1.

28.06 The cor. of secs. 1 and 2, which is an iron post, 2 ins. diam., 2 ins. above a mound of stone, set, marked and witnessed as described in the official record.

Thence,

N. 88° 54' W., on a random and true line along the N. bdy. of sec. 2.

11.95 A point 40.00 chs. in departure from the SE. cor. of sec. 36.

Set an iron post, 3 ft. long, 1 in. diam., 10 ins. in the ground to bedrock, supported in a mound of stone to top, with a lava stone mkd. X deposited at the base, for $\frac{1}{4}$ sec. cor. of sec. 36, only, T. 14 N., with brass cap mkd.

$\frac{1}{4}$ S36

1933

No suitable bearing trees available.

42.22 The $\frac{1}{4}$ sec. cor. of sec. 2 only, which is an iron post, 1 in. diam., 3 ins. above a mound, firmly set, marked and witnessed as described in the official record.

51.96 A point 80.00 chs. in departure from the SE. cor. of sec. 36.

Set an iron post, 3 ft. long, 2 ins. diam., 8 ins. in the ground to bedrock, with a stone mkd X, deposited at the base, in a mound of stone to top, for the cor. of secs. 35 and 36 only, of T. 14 N., with brass cap mkd.

T14NR3E

S35 | S36

S 2

T13NR3E

1933

from which,

A cedar, 8 ins. diam., bears N. 7° E., 24 lks. dist., mkd. T 14 N R 3 E S 36 B T

A cedar, 10 ins. diam., bears N. 75° W., 101 lks. dist., mkd. T 14 N R 3 E S 35 B T

84.44 The cor. of secs. 2 and 3, which is an iron post, 2 ins. diam., in mound of stone to top, firmly set, marked and witnessed as described in the official record.

Resurvey of a Portion of the N. Bdy. of
T. 13 N., R 3 E.

BOOK 4071

Chains	
	<p>Thence, N. 88° 54' W., on a random line along the N. bdy. of sec. 3.</p>
41.23	Intersect the $\frac{1}{4}$ sec. cor. of sec. 3 only.
83.25	Intersect the cor. of secs. 3 and 4 only.
	Return to the cor. of secs. 2 and 3.
	<p>Thence, N. 88° 54' W., on true line along the N. bdy. of sec. 3.</p>
7.53	A point 40.00 chs. in departure from the SE. cor. of sec. 35.
	<p>Set an iron post, 3 ft. long, 1 in. diam., 18 ins. in the ground to bedrock, with a lava stone, mkd. X, deposited at the base, in mound of stone to top, for $\frac{1}{4}$ sec. cor. of sec. 35 only, of T. 14 N., with brass cap mkd.</p>
	$\frac{1}{4}$ S35 <hr style="width: 50px; margin: auto;"/> 1933
	No suitable bearing trees available.
41.23	The $\frac{1}{4}$ sec. cor. of sec. 3 only, which is an iron post, 1 in. diam., 12 ins. above ground, set, marked and witnessed as described in the official record.
47.54	A point 80.00 chs. in departure from the SE. cor. of sec. 35.
	<p>Set an iron post, 3 ft. long, 2 ins. diam., 18 ins. in the ground to bedrock, with a stone marked X at base of post, in a mound of stone to top, for the cor. of secs. 34 and 35 only, of T. 14 N., with brass cap mkd.</p>
	T14NR3E S34 S35 <hr style="width: 50px; margin: auto;"/> S 3 T13NR3E 19 33
	No suitable bearing trees available.
83.25	The cor. of secs. 3 and 4 only, which is an iron post, in mound of stone to top, set, marked and witnessed as described in the official record.

	<p>Thence, N. 88° 14' W., on random and true line along the N. bdy. of sec. 4,</p>
4.30	A point 40.00 chs. in departure from the SE. cor. of sec. 34.
	<p>Set an iron post, 3 ft. long, 1 in. diam., 28 ins. in the ground, for the $\frac{1}{4}$ sec. cor. of sec. 34 only, of T. 14 N., with brass cap mkd.</p>
	$\frac{1}{4}$ S 34 <hr style="width: 50px; margin: auto;"/> 1933

Resurvey of a Portion of the N. Bdy. of
T. 13 N., R. 3 E.

Chains.

- of stone, 3 ft. base, 3 ft. high, N. of corner. raise a mound
- 42.76 The $\frac{1}{4}$ sec. cor. of sec. 4 only, which is an iron post, 1 in. diam., 3 ins. above a mound of stone, firmly set, marked and witnessed as described in the official record.
- 44.32 A point 80.00 chs. in departure from the SE. cor. of sec. 34.
Set an iron post, 3 ft. long, 2 ins. diam., 20 ins. in the ground to bedrock, with a lava stone mkd. X at the base of post, and in mound of stone to top, for cor. of secs. 33 and 34 only, of T. 14 N., with brass cap mkd.
- T14NR3E
S33 | S34
S 4
T13NR3E
1933
- No bearing trees available.
- 84.34 A point 40.00 chs. in departure from the SE. cor. of sec. 33.
Set an iron post, 3 ft. long, 1 in. diam., 20 ins. in the ground, to bedrock, with a lava stone mkd. X at base of post, and in mound of stone to top, for $\frac{1}{4}$ sec. cor. of sec. 33 only, of T. 14 N., with brass cap mkd.
- $\frac{1}{4}$ S33
1933
- No suitable bearing trees available.
- 85.52 The cor. of secs. 4 and 5, which is an iron post, 2 ins. diam., 10 ins. above ground, set, marked and witnessed as described in the official record.
-
- Thence,
N. 89° 16' W., on random and true line along the N. bdy. of sec. 5.
- 38.83 A point 80.00 chs. in departure from the SE. cor. of sec. 33.
Set an iron post, 3 ft. long, 2 ins. diam., 28 ins. in the ground, for the cor. of secs. 32 and 33 only, of T. 14 N., with brass cap mkd.
- T14NR3E
S32 | S33
S 5
T13NR3E
19 33
- No bearing trees available.
Raise a mound of stone, 2 ft. base, 1 $\frac{1}{2}$ ft. high, N. of corner.
- 41.11 The $\frac{1}{4}$ sec. cor. of sec. 5 only, which is an iron post, 1 in. diam., 10 ins. above ground, firmly set, marked and witnessed as described in the official record.
- 78.83 A point 40.00 chs. in departure from the SE. cor. of sec. 32.

Resurvey of a Portion of the N. Bdy. of
T. 13 N., R. 3 E.

ECON 4071

Chains.

Set an iron post, 3 ft. long, 1 in. diam., 28 ins. in the ground, for the $\frac{1}{4}$ sec. cor. of sec. 32 only, of T. 14 N., with brass cap mkd.

$\frac{1}{4}$ S 32
1933

raise a mound
of stone, 3 ft. base, 2 ft. high, N. of corner.

82.22

The cor. of secs. 5 and 6 only, which is an iron post, 2 ins. diam., 10 ins. above ground, firmly set, marked and witnessed as described in the official record.

Thence,

S. 86° 38' W., on random and true line along the N. bdy. of sec. 6.

36.67

A point 80.00 chs. in departure from the SE. cor. of sec. 32.

Set an iron post, 3 ft. long, 2 ins. diam., 20 ins. in the ground to bedrock, with a stone mkd. X at base of post, and in mound of stone to top, for the cor. of secs. 31 and 32 only, of T. 14 N., with brass cap mkd.

T14NR3E
S31 S32
S 6
T13NR3E
19 33

No bearing trees available.

39.67

The $\frac{1}{4}$ sec. cor. of sec. 6 only, which is an iron post, 1 in. diam., 10 ins. above ground, firmly set, marked and witnessed as described in the official record.

76.74

A point 40.00 chs. in departure from the SE. cor. of sec. 31.

Set an iron post, 3 ft. long, 1 in. diam., 10 ins. in the ground to bedrock, with a stone mkd. X at base of post, and in a mound of stone to top, for the $\frac{1}{4}$ sec. cor. of sec. 31, only, of T. 14 N., with brass cap mkd.

$\frac{1}{4}$ S 31
1933

No bearing trees available.

79.00

The cor. of Tps. 13 N., Rs. 2 and 3 E., which is an iron post, 3 ins. diam., 10 ins. above ground, firmly set, marked and witnessed as described in the official record.

Resurvey of a Portion of the N. Bdy. of
T. 13 N., R. 2 E.

West, on a random line along the N. bdy. of sec. 1.

40.00

No trace of the $\frac{1}{4}$ sec. cor. of sec. 1 could be found after diligent search.

82.00

A point 3.22 chs. N. of the cor. of secs. 1 and 2.

Return to the cor. of T. 13 N., Rs. 2 and 3 E.

Resurvey of a Portion of the N. Bdy. of
T. 13 N., R. 2 E.

Chains.							
	Thence, S. 87° 45' W., on true line along the N. bdy. of sec. 1. Desc. W. slope, 45 ft.						
6.00	Base of hill, thence along gentle S. slope.						
8.60	Small wash, course S.						
15.90	Small wash, course S.						
23.80	Wire fence, bears NE. and SW.						
25.00	Short spur, slopes S., descend W. slope 40 ft.						
29.50	Wash, 30 lks. wide, course S., asc. gradual SE. slope, 30 ft.						
31.60	Highway, bears N. and S.						
35.86	At this point, which is S. of the cor. of Tps. 14 and 14½ N., R. 3 E., hereinafter described, Set an iron post, 3 ft. long, 3 ins. diam., 28 ins. in the ground, for the cor. of Tps. 14 N., Rs. 2½ and 3 E., with brass cap mkd.						
	<table border="1"> <tr><td>T14N</td></tr> <tr><td>R2½E R3E</td></tr> <tr><td>S36 S31</td></tr> <tr><td>S S 1</td></tr> <tr><td>T13NR2E</td></tr> <tr><td>1933</td></tr> </table>	T14N	R2½E R3E	S36 S31	S S 1	T13NR2E	1933
T14N							
R2½E R3E							
S36 S31							
S S 1							
T13NR2E							
1933							
	raise a mound of stone, 2 ft. base, 1½ ft. high, N. of corner.						
41.03	Set an iron post, 3 ft. long, 1 in. diam., 28 ins. in the ground, for ¼ sec. cor. of sec. 1 only, with brass cap mkd.						
	<table border="1"> <tr><td>¼ S 1</td></tr> <tr><td>1933</td></tr> </table>	¼ S 1	1933				
¼ S 1							
1933							
	raise a mound of stone, 2 ft. base, 1½ ft. high, S. of corner. Over gentle S. slope.						
41.40	Sandy draw, course S., ascend SE. slope 125 ft.						
56.30	Spur, slopes S., descend SW. slope 35 ft.						
58.50	Draw, course S., ascend SE. slope 25 ft.						
61.40	Spur, slopes S. 20° W., descend W. slope, 100 ft.						
66.60	Gulch, course S., ascend SE. slope 40 ft.						
69.30	Short spur, slopes S., descend SW. slope 45 ft.						
73.80	Drain, course S., ascend SE. slope 40 ft.						
75.90	A point 40.00 chs. in departure from the SE. cor. of sec. 36, T. 14 N., R. 2½ E. Set an iron post, 3 ft. long, 1 in. diam., 18 ins. in the						

Resurvey of a Portion of the N. Bdy. of
T. 13 N., R. 2 E.

BOOK 4071

Chains

ground to bedrock, and in mound of stone to top, for the $\frac{1}{4}$ sec. cor. of sec. 36, T. 14 N., R. 2 $\frac{1}{2}$ E., only, with brass cap mkd.

 $\frac{1}{4}$ S 36

1933

raise a mound of stone, 2 ft. base, 1 $\frac{1}{2}$ ft. high, N. of corner.

76.20 U. S. G. S. Bench Mark, elev. 4776 ft., bears S., 12.96 chs. dist.; an iron post, 4 ins. diam., 14 ins. above ground, firmly set.

77.70 Spur, slopes S.; descend.

82.06 The cor. of secs. 1 and 2, which is an iron post, 2 ins. diam., 5 ins. above a mound of stone, firmly set, marked and witnessed as described in the official record.

Resurvey of a Portion of the W. Bdy. of
T. 13 N., R. 4 E.

The W. bdy. of sec. 6, T. 13 N., R. 4 E., was surveyed by L. R. Hanson, U. S. Transitman, in 1928. Corners set by Hanson refer to areas E. of the line only. For topography on this line see field notes of survey by Hanson in 1928. Beginning at the closing cor. of T. 13 N., R. 4 E. and T. 14 N., R. 3 E., on the N. bdy. of sec. 1, T. 13 N., R. 3 E., hereinbefore described.

North, on a random and true line along the W. bdy. of sec. 6, T. 13 N., R. 4 E.

14.70 The $\frac{1}{4}$ sec. cor. of sec. 6, which is an iron post, 1 in. diam., firmly set, marked and witnessed as described in the official record.

40.00 Set an iron post, 3 ft. long, 1 in. diam., 16 ins. in the ground to bedrock, with a lava stone mkd. X, at base of post, and in mound of stone to top, for the $\frac{1}{4}$ -sec. cor. of sec. 36, T. 14 N., R. 3 E., only, with brass cap mkd.

S36

1933

No suitable bearing trees available.

56.30 The cor. of Tps. 13 and 14 N., R. 4 E., which is an iron post, 3 ins. diam., firmly set, marked and witnessed as described in the official record.

Resurvey of the W. Bdy. of T. 14 N., R. 4 E.

The N. mile of the W. bdy. of T. 14 N., R. 4 E., was surveyed by the U. S. Forest Service in 1915. The S. five miles of the W. bdy. of T. 14 N., R. 4 E. were surveyed by C. E. Hunter, U. S. Transitman, in 1927. In these surveys corners were set referring to areas E. of the line only. For topography on this line see field notes of the surveys by Hunter in 1927, and Forest Service in 1915. From the cor. of Tps. 13 and 14 N., R. 4 E., hereinbefore described.

Resurvey of the W. Bdy. of T. 14 N., R. 4 E.

Chains.

North, on random and true line along, the W. bdy. of sec. 31.

23.70 Set an iron post, 3 ft. long, 2 ins. diam., 20 ins. in the ground to bedrock, with a mound of stone to top, for the cor. of secs. 25 and 36, T. 14 N., R. 3 E., only, with brass cap mkd.

T14N	
R3E	T14N
S25	R4E
S36	S31
1933	

from which

A scrub cedar, 10 ins. diam., bears S. $42\frac{1}{2}^{\circ}$ W., 61 lks. dist., mkd. T 14 N R 3 E S 36 B T.

A scrub cedar, 10 ins. diam., bears N. 80° W., 60 lks. dist., mkd. T 14 N R 3 E S 25 B T.

40.00 The $\frac{1}{4}$ sec. cor. of sec. 31, only, which is an iron post, 1 in. diam., firmly set, marked and witnessed as described in the official record.

63.70 Set an iron post, 3 ft. long, 1 in. diam., 18 ins. in the ground, to bedrock, with a lava stone mkd. X at the base of post, and in mound of stone to top, for $\frac{1}{4}$ sec. cor. of sec. 25, T. 14 N., R. 3 E., only, with brass cap mkd.

S25	
1933	

No suitable bearing trees available.

Corner stands on rim of mesa facing N.

80.00 The cor. of secs. 30 and 31, which is an iron post, 2 ins. diam., firmly set, marked and witnessed as described in the official record.

Thence,

North, on random and true line along, the W. bdy. of sec. 30.

23.70 Set an iron post, 3 ft. long, 2 ins. diam., 28 ins. in the ground, for the cor. of secs. 24 and 25, T. 14 N., R. 3 E., only, with brass cap mkd.

T14N	
R3E	T14N
S24	S30
S25	R4E
1933	

from which

An alligator juniper, 8 ins. diam., bears S. $80\frac{1}{2}^{\circ}$ W., 58 lks. dist., mkd. T 14 N R 3 E S 25 B T.

A sycamore, 6 ins. diam., bears N. $23\frac{1}{2}^{\circ}$ W., 129 lks. dist., mkd. T 14 N R 3 E S 24 B T.

40.00 The $\frac{1}{4}$ sec. cor. of sec. 30, only, which is an iron post, 1 in. diam., firmly set, marked and witnessed as described in the official record.

Resurvey of the W. Bdy. of T. 14 N., R. 4 E.

4071

Chains.

63.70 Set an iron post, 3 ft. long, 1 in. diam., 24 ins. in the ground, for the $\frac{1}{4}$ sec. cor. of sec. 24, T. 14 N., R. 3 E., only, with brass cap mkd.

$\frac{1}{4}$
 S24
 1933

raise a mound
of stone, 3 ft. base, 2 ft. high, W. of corner.

80.00 The cor. of secs. 19 and 30, T. 14 N., R. 4 E., which is an iron post, 2 ins. diam., firmly set, marked and witnessed as described in the official record.

Thence,

North, on random and true line along the W. bdy. of sec. 19.

23.70 Set an iron post, 3 ft. long, 2 ins. diam., 26 ins. in the ground, for the cor. of secs. 13 and 24, T. 14 N., R. 3 E., only, with brass cap mkd.

T14N
 R3E | T14N
 S13 | S19
 S24 | R4E
 1933

from which,

A scrub cedar, 12 ins. diam., bears S. 37° W., 42 lks. dist., mkd. T 14 N R 3 E S 24 B T.

A pinon, 5 ins. diam., bears N. 8° W., 46 lks. dist., mkd. T 14 N R 3 E S 13 B T.

40.00 The $\frac{1}{4}$ sec. cor. of sec. 19 only, which is an iron post, 1 in. diam., firmly set, marked and witnessed as described in the official record.

63.70 Set an iron post, 3 ft. long, 1 in. diam., 30 ins. in the ground, for the $\frac{1}{4}$ sec. cor. of sec. 13, T. 14 N., R. 3 E., only, with brass cap mkd.

$\frac{1}{4}$
 S13
 1933

from which,

A scrub cedar, 4 ins. diam., bears S. 31° W., 12 lks. dist., mkd. B T.

A scrub cedar, 10 ins. diam., bears N. 82° W., 60 lks. dist., mkd. $\frac{1}{4}$ S 13 B T.

80.00 The cor. of secs. 18 and 19, which is an iron post, 2 ins. diam., firmly set, marked and witnessed as described in the official record.

Thence,

Resurvey of the W. Bdy. of T. 14 N., R. 4 E.

Chains.

North, on random and true line along the W. bdy. of sec. 18.

23.70 Set an iron post, 3 ft. long, 2 ins. diam., 12 ins. in the ground to bedrock, with a stone mkd. X at the base of post, and in mound of stone to top, for cor. of secs. 12 and 13, T. 14 N., R. 3 E., only, with brass cap mkd.

T14N	
R3E	T14N
S12	S18
S13	R4E

1933

No suitable bearing trees available.

40.00 The $\frac{1}{4}$ sec. cor. of sec. 18 only, which is an iron post, 1 in diam., firmly set, marked and witnessed as described in the official record.

63.70 Set an iron post, 3 ft. long, 1 in. diam., 18 ins. in the ground to bedrock, with a stone mkd X, at base of post, and in a mound of stone to top, for $\frac{1}{4}$ sec. cor. of sec. 12, T. 14 N., R. 3 E., only, with brass cap mkd.

$\frac{1}{4}$	
S12	

1933

No suitable bearing trees available.

80.00 The cor. of secs. 7 and 18, which is an iron post, 2 ins. diam., firmly set, marked and witnessed as described in the official record.

Thence,

North, on random and true line along the W. bdy. of sec. 7.

23.70 Set an iron post, 3 ft. long, 2 ins. diam., 16 ins. in the ground to bedrock, with a stone mkd. X at base of post, and in mound of stone to top, for the cor. of secs. 1 and 12, only, of T. 14 N., R. 3 E., with brass cap mkd.

T14N	
R3E	T14N
S 1	S 7
S12	R4E

1933

No suitable bearing trees available.

40.00 The $\frac{1}{4}$ sec. cor. of sec. 7 only, which is an iron post, 1 in diam., firmly set, marked and witnessed as described in the official record.

63.70 Set an iron post, 3 ft. long, 1 in. diam., 30 ins. in the ground, for the $\frac{1}{4}$ sec. cor. of sec. 1, T. 14 N., R. 3 E., only, with brass cap mkd.

$\frac{1}{4}$	
S1	

1933

of stone, 2 ft. base, $1\frac{1}{2}$ ft. high, W. of corner. raise a mound

Resurvey of the W. Bdy. of T. 14 N., R. 4 E.

Chains

101.38 The cor. of secs. 6 and 7, only, which is an iron post, 2 ins. diam., firmly set, marked and witnessed as described in the official record.

Thence,

2.32 North, on random and true line along the W. bdy. of sec. 6. A point 80.00 chs. N. of the SE. cor. of sec. 1.
Set an iron post, 3 ft. long, 3 ins. diam., 28 ins. in the ground, for the cor. of Tps. 14 and 14½ N., R. 3 E., only, with brass cap mkd.

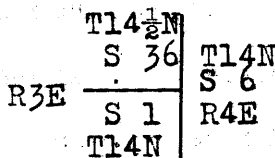

1933

raise a mound of stone, 4 ft. base, 3 ft. high, W. of corner.

40.00 The ¼ sec. cor. of sec. 6 only, which is an iron post, 1 in. diam., firmly set, marked and witnessed as described in the official record.

Thence,

N. 3° 54' E., along the W. bdy. of sec. 6.

2.32 A point 40.00 chs. in latitude from the SE. cor. of sec. 36, T. 14½ N., R. 3 E.

Set an iron post, 3 ft. long, 1 in. diam., 27 ins. in the ground, for the ¼ sec. cor. of sec. 36, T. 14½ N., R. 3 E., only, with brass cap mkd.

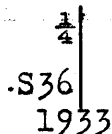

raise a mound of stone, 3 ft. base, 2 ft. high, W. of corner.

38.71 The cor. of Tps. 14½ and 15 N., R. 3 E., and Tps. 14 and 15 N., R. 4 E., which is an iron post, 3 ins. diam.; firmly set, marked and witnessed as described in the official record.

Survey of the N. Bdy. of T. 14 N., R. 3 E.

Beginning at the cor. of Tps. 14 and 14½ N., R. 3 E., hereinbefore described.

West, bet. secs. 1 and 36.

Over rolling valley land, sloping NW.

1.10 Wash, 30 lks. wide, course NE., ascend gradually over rolling SE. slope.

3.10 Road, bears NE. and SW.

19.30 Wash, 20 lks. wide, course SE.

Survey of the N. Bdy. of T. 14 N., R. 3 E.

Chains.	
40.00	Set an iron post, 3 ft. long, 1 in. diam., 28 ins. in the ground, for the $\frac{1}{4}$ sec. cor., with brass cap mkd.
	$\frac{1}{4}$ S 36 S 1 1933
	raise a mound of stone, 3 ft. base, 1 $\frac{1}{2}$ ft. high, N. of corner.
43.20	Drain, 15 lks. wide, course SE.
49.00	Drain, 10 lks. wide, course SE.
53.00	Leave valley; ascend E. slope 110 ft.
58.50	Rim of bench, bears NE. and SW.
68.70	Drain, course N. 70° E.
80.00	Set an iron post, 3 ft. long, 2 ins. diam., 20 ins. in the ground to bedrock, and in a mound of stone to top, for the cor. of secs. 1, 2, 35 and 36, with brass cap mkd.
	T14 $\frac{1}{2}$ MR3E S35 S36 S 2 S 1 T14N 1933
	raise a mound of stone, 3 ft. base, 2 ft. high, W. of corner.
	Land, rolling. Soil, 2nd and 3rd rate. Timber, scrub cedar, mesquite; undergrowth, cats claw, cactus and scrub oak.

	West, bet. secs. 2 and 35.
2.70	Drain, course N. 80° E.; asc. 80 ft. over SE. slope.
15.00	Flat spur, slopes NE.; over N. slope.
19.70	Old road, bears NE. and SW.
23.60	Drain, course N. 60° E.
40.00	Set an iron post, 3 ft. long, 1 in. diam., 24 ins. in the ground, for the $\frac{1}{4}$ sec. cor., with brass cap mkd.
	$\frac{1}{4}$ S 35 S 2 1933.
	raise a mound of stone, 2 ft. base, 1 $\frac{1}{2}$ ft. high, N. of corner.
49.90	Gulch, 6 lks. wide, course N. 60° E.; ascend SE. slope 60 ft.
64.00	Spur, slopes N. 70° E.; over N. slope.
80.00	Set an iron post, 3 ft. long, 2 ins. diam., 24 ins. in the ground, for the cor. of secs. 2, 3, 34 and 35, with brass cap mkd.

Survey of the N. Bdy. of T. 14 N., R. 3 E.

BOOK 4071

Chains.	
	T14 $\frac{1}{2}$ NR3E S34 S35 S 3 S 2 T14N 1933
	raise a mound of stone, 2 ft. base, 1 $\frac{1}{2}$ ft. high, W. of corner.
	Land, rolling. Soil, 2nd and 3rd rate. Timber, scrub cedar, mesquite; undergrowth, cats claw, cactus, scrub oak.
	West, between secs. 3 and 34.
	Over rolling land, sloping NE.
2.40	Small spur, slopes SE.
4.70	Drain, course N., across valley.
14.50	Wash, 25 lks. wide, course NE.
21.00	Spur, slopes NE.
24.30	Wash, 15 lks. wide, course NE.
30.50	Wash, 10 lks. wide, course NE.
34.20	Spur, slopes NE.
37.40	Drain, course NE.
40.00	Set an iron post, 3 ft. long, 1 in. diam., 10 ins. in the ground to bedrock, with a stone, 4 x 4 x 6 ins., mkd. X, deposited at the base, and in a mound of stone to top. for $\frac{1}{4}$ sec. cor., with brass cap mkd.
	S 34 $\frac{1}{4}$ S 3 1933
	Thence through dense brush.
46.70	Small draw, drains NE.; small stream of water.
49.90	Drain, course NE.
55.80	Spur, slopes NE.
62.50	Gulch, course NE.; spring bears S., 30 lks. dist.
67.00	Gulch, course N. 60° E.
72.20	Gulch, course N. 70° E.; asc. SE. slope.
74.70	Road, bears NE. and SW.
80.00	Set an iron post, 3 ft. long, 2 ins. diam., 28 ins. in the ground, for the cor. of secs. 3, 4, 33 and 34, with brass cap mkd.
	T14 $\frac{1}{2}$ NR3E S33 S34 S 4 S 3 T14N 1933

Survey of the N. Bdy. of T. 14 N., R. 3 E.

Chains.

raise a mound
of stone, 2 ft. base, $1\frac{1}{2}$ ft. high, W. of corner.

Land, rolling mountains.

Soil, adobe; 2nd and 3rd rates.

Timber, scrub oak, juniper, pinon; undergrowth, cats claw, manzanita.

West, between secs. 4 and 33.

Ascend SE. slope 95 ft.

6.70 Spur, slopes NE.; descend NW. slope 100 ft.

12.50 Gulch, course NE.; along N. slope.

19.35 Wire fence, bears NW. and SE.

35.00 Descend 40 ft.

38.50 Small canyon, course NE.; ascend SE. slope 50 ft.

40.00 Set an iron post, 3 ft. long, 1 in. diam., 18 ins. in the ground to bedrock; with a stone mkd. X at base of post, and in mound of stone to top, for $\frac{1}{4}$ sec. cor., with brass cap mkd.

S 33
 $\frac{1}{4}$ S 4
1933

Ascend SE. slope 85 ft.

45.00 Point of short spur, slopes SE.

46.50 Gulch, course SE.

48.00 Same gulch, course NE.; ascend SE. slope 60 ft.

51.00 Spur, slopes NE.; along N. slope.

71.50 Gulch, course NE.; ascend E. slope 205 ft.

80.00 Set an iron post, 3 ft. long, 2 ins. diam., 24 ins. in the ground, for the cor. of secs. 4, 5, 32 and 33, with brass cap mkd.

T14 $\frac{1}{2}$ NR3E
S32|S33
S 5 | S 4
T14N
1933

from which,

A juniper, 12 ins. diam., bears N. 58° E., 196 lks.
dist., mkd. T 14 $\frac{1}{2}$ N R 3 E S 33 B T.

An oak, 5 ins. diam., bears S. 84° 45' E., 91 lks.
dist., mkd. T 14 N R 3 E S 4 B T.

A black oak, 8 ins. diam., bears S. 76° 45' W., 65 lks.
dist., mkd. T 14 N R 3 E S 5 B T.

A black oak, 8 ins. diam., bears N. 66° 30' W., 89 lks.
dist., mkd. T 14 $\frac{1}{2}$ N R 3 E S 32 B T.

Survey of the N. Bdy. of T. 14 N., R. 3 E.

BOOK 4071

Chains.

Raise a mound of stone, 2 ft. base, $1\frac{1}{2}$ ft. high, W. of corner.

Land, rolling mountainous.

Soil, adobe, 2nd and 3rd rate.

Timber, scrub oak, juniper, pinon; undergrowth, cats claw, manzanita.

West, between secs. 5 and 32.

Ascend E. slope 500 ft.

26.10 Spur, slopes N.; descend W. slope 90 ft.

36.00 Gulch, course N.; along N. slope.

40.00 Set an iron post, 3 ft. long, 1 in. diam., 30 ins. in the ground, for the $\frac{1}{4}$ sec. cor., with brass cap mkd.

$\frac{1}{4}$ $\frac{S}{S}$ $\frac{32}{5}$
 1933

raise a mound

of stone, 2 ft. base, $1\frac{1}{2}$ ft. high, N. of corner.

Ascend NE. slope 250 ft.

48.00 Spur, slopes N. 20° E.; descend NW. slope.

52.20 Gulch, course N.; ascend E. slope 615 ft.

68.50 Short spur, slopes SE.

73.10 Wire fence, bears NW. and SE.; trail along fence.

80.00 Set an iron post, 3 ft. long, 2 ins. diam., 30 ins. in the ground, for the cor. of secs. 5, 6, 31 and 32, with brass cap mkd.

T14 $\frac{1}{2}$ NR3E
S31 | S32
 S 6 | S 5
 T14N
 1933

from which,

A pinon, 6 ins. diam., bears N. 51° E., 84 lks. dist., mkd. T 14 $\frac{1}{2}$ N R 3 E S 32 B T.

An alligator cedar, 10 ins. diam., bears S. 54° 30' E., 86 lks. dist., mkd. T 14 N R 3 E S 5 B T.

A pinon, 5 ins. diam., bears S. 22° W., 18 lks. dist., mkd. T.14 N R 3 E S 6 B T.

An alligator cedar, 8 ins. diam., bears N. 25° W., 11 lks. dist., mkd. T 14 $\frac{1}{2}$ N R 3 E S 31 B T.

Land, mountainous.

Soil, adobe, 3rd rate.

Timber, juniper, pinon, black oak; undergrowth, cactus, manzanita.

Survey of the N. Bdy. of T. 14 N., R. 3 E.

Chains.

West, between secs. 6 and 31.

Ascend E. slope 20 ft., through scattering timber.

1.90 Ridge, bears NW. and SE.; descend SW. slope 215 ft.

10.20 Head of draw, course SW.; continue descent 135 ft.

19.00 Gulch, course SW.; continue descent 90 ft.

28.50 Gulch, course S.; ascend E. slope 90 ft.

32.30 Trail, course N. 20° W. and S. 20° E.

34.70 Spur, slopes S. 20° E.; descend W. slope 70 ft.

40.00 Set an iron post, 3 ft. long, 1 in. diam., 22 ins. in the ground to bedrock, with a stone mkd. X at base of post, and in a mound of stone to top, for $\frac{1}{4}$ sec. cor., with brass cap mkd.

$\frac{1}{4}$ S 31
 $\frac{1}{4}$ S 6
 1933

42.40 Head of short gulch, course SW.; over S. slope.

47.20 Short spur, slopes SW.; descend W. slope 50 ft.

49.70 Rocky gulch, course SW.; ascend SE. slope 210 ft.

57.00 Spur, slopes S.; descend W. slope.

65.00 Gulch, course SE.; ascend E. slope 180 ft.

73.50 Ridge, bears N. and S.; descend W. slope 70 ft.

78.00 A point S. of the SW. cor. of T. 15 N., R. 3 E., herein-after described.

Set an iron post, 3 ft. long, 3 ins. diam., 30 ins. in the ground, for cor. of Tps. 14 and 14 $\frac{1}{2}$ N., R. 3 E., with brass cap mkd.

S36 | T14 $\frac{1}{2}$ NR3E
 | S31
 | S 6
 | T14N
 | 1933

from which,

A juniper, 8 ins. diam., bears S. 69° 30' E., 29 lks. dist., mkd. T 14 N R. 3 E S. 6 B T.

A juniper, 6 ins. diam., bears S. 13° E., 40 lks. dist., mkd. T. 14 N R 3 E S 6 B T.

Land, mountainous.
 Soil, adobe, 3rd rate.
 Timber, juniper, pinon, black oak; undergrowth, cactus, manzanita.

Survey of the W. Bdy. of T. 14 $\frac{1}{2}$ N., R. 3 E.

BOOK 4071

Chains	North, on a random line along the W. bdy. of sec. 31.
40.00	Set temp. $\frac{1}{4}$ sec. cor.
76.78	Intersect the SW. cor. of T. 15 N., R. 3 E.; which is an iron post, 3 ins. diam., in a mound of stone, firmly set, marked and witnessed as described in the official record. This cor. now refers to T. 14 $\frac{1}{2}$ N.
	Alter the markings on the brass cap to read as follows;
	T15N R2E R3E S31 T14 $\frac{1}{2}$ N S31 R3E 1933 1917
	Thence,
	South, on a true line along the W. bdy. of sec. 31.
	Ascend 490 ft. over NE. slope.
8.48	Head of drain, course NE.
21.30	Head of drain, course NE.
25.30	Short spur, slopes NE.; descend SE. slope 50 ft.
30.40	Short drain, course E.; ascend NE. slope 400 ft.
36.78	Set an iron post, 3 ft. long, 1 in. diam., 18 ins. in the ground to bedrock, with a stone mkd. X at the base of post, and in mound of stone to top, for the $\frac{1}{4}$ sec. cor. of sec. 31, with brass cap mkd..
	$\frac{1}{4}$. S31 1933
39.60	Head of gulch, course NE.; over brushy E. slope.
51.30	Ridge, bears E. and W.; descend SE. slope.
52.43	Wire fence, bears E. and W.
58.00	Head of drain, course E.; ascend 15 ft.
64.80	Ridge, bears S. 30° E. and N. 30° W.; descend SW. slope 145 ft.
76.78	The cor. of Tps. 14 and 14 $\frac{1}{2}$ N., R. 3 E.
	Land, mountainous. Soil, adobe, 3rd rate. Timber, scattering juniper, pinon, black oak; undergrowth, cactus, manzanita.

Survey of the W. Bdy. of T. 14 N., R. 3 E.	
	South, on a random line along the W. bdy. of T. 14 N., R. 3 E., setting temp. cors. at intervals of 40.00 and 80.00 chains.
400.50	Intersect the sectional correction line, run W. from the

Survey of the W. Bdy. of T. 14 N., R. 3 E.

Chains

- cor. of secs. 25 and 36, on the E. bdy. of the Tp. Set temp. cor.
- 479.44 The cor. of Tps. 14 N., Rs. $2\frac{1}{2}$ and 3 E., on the N. bdy. of sec. 1, T. 13 N., R. 2 E.
Return to the cor. of Tps. 14 and $14\frac{1}{2}$ N., R. 3 E.
Thence,
South, on a true line along the W. bdy. of sec. 6.
Descend SW. slope 125 ft.
- 13.20 Short gulch, course S. 60° W.
- 16.62 A point E. of the NE. cor. of T. 14 N., R. 2 E., hereinafter described.
Set an iron post, 3 ft. long, 3 ins. diam., 30 ins. in the ground, for the cor. of T. 14 N., R. $2\frac{1}{2}$ E., only, with brass cap mkd.
- | | | |
|--------------------|-------|--|
| | T14N | |
| T14N | R3E | |
| R $2\frac{1}{2}$ E | S 6 | |
| S 1 | | |
| | .1933 | |
- raise a mound of stone, 2 ft. base, $1\frac{1}{2}$ ft. high, SW. of corner.
Thence, between secs. 1 and 6.
- 17.40 Short drain, course S. 80° W.; ascend NW. slope 35 ft.
- 23.50 Short spur, slopes W.; descend SW. slope 160 ft.
- 39.90 Trail, bears NW. and SE..
- 40.50 Set an iron post, 3 ft. long, 1 in. diam., 20 ins. in the ground to bedrock, with a stone mkd. X at the base of post, and in mound of stone to top, for the $\frac{1}{4}$ sec. cor., with brass cap mkd.
- | | | |
|-----|---------------|--|
| | $\frac{1}{4}$ | |
| S 1 | S 6 | |
| | 19 33 | |
- Descend SW. slope 70 ft.
- 46.00 Short spur, slopes S. 70° W.; descend S. slope 35 ft.
- 51.10 Short gulch, course S. 70° W.; ascend NW. slope 80 ft.
- 62.80 Divide ridge, bears N. 20° E. and S.; along top of ridge.
- 75.20 Leave ridge, bears SW.; descend SE. slope 105 ft.
- 80.50 Set an iron post, 3 ft. long, 2 ins. diam., 30 ins. in the ground, for the cor. of secs. 1, 6, 7 and 12, with brass cap mkd.

	T14N	
R $2\frac{1}{2}$ E	R3E	
S 1	S 6	
S12	S 7	
	1933	

Survey of the W. Bdy. of T. 14 N., R. 3 E.

BOOK 4071

Chains.

of stone, 2 ft. base, 1 1/2 ft. high, W. of corner. raise a mound

Land, mountainous.

Soil, adobe; 3rd rate.

Timber, oak, juniper, pinon; undergrowth, scrub oak, cats claw, manzanita, blue brush.

South, between secs. 7 and 12.

- .30 Head of draw, course SE.
- 1.80 Wire fence, bears E. and W.
- 6.50 Head of gulch, course E. for about 5 chains, thence S. 20° E.; ascend NE. slope 160 ft.
- 18.47 Short spur, slopes E., descend SE. slope 325 ft.
- 33.90 Wash, 25 lks. wide, course S. 20° W.; over W. slope.
- 38.90 Short spur, slopes W.
- 40.00 Set an iron post, 3 ft. long, 1 in. diam., 30 ins. in the ground, for the sec. cor., with brass cap mkd.

$\frac{1}{4}$
 S12 | S 7
 1933

of stone, 2 ft. base, 1 1/2 ft. high, W. of corner. raise a mound

Through dense oak and pine timber.

- 49.20 Short spur, slopes SW.; descend S. slope 65 ft.
- 61.50 Wash, 25 lks. wide, course SE.; over E. slope.
- 68.40 Slope changes to SE.
- 79.50 Wash, 15 lks. wide, course E.; also trail, bears E. and W.
- 80.00 Set an iron post, 3 ft. long, 2 ins. diam., 26 ins. in the ground, for the cor. of secs. 7, 12, 13 and 18, with brass cap mkd.

T14N
 R2 1/2 E | R3E
 S12 | S 7
 S13 | S18
 1933

from which,

A black oak, 12 ins. diam., bears N. 81 1/4° E., 93 lks. dist., mkd. T 14 N R 3 E S 7 B T

A black oak, 10 ins. diam., bears S. 39° E., 30 lks. dist., mkd. T 14 N R 3 E S 18 B T.

A black pine, 8 ins. diam., bears S. 79° W., 40 lks. dist., mkd. T 14 N R 2 1/2 E S 13 B T.

A black oak, 18 ins. diam., bears N. 38° W., 28 lks. dist., mkd. T 14 N R 2 1/2 E S 12 B T.

Survey of the W. Bdy. of T. 14 N., R. 3 E.

Chains.

Land, mountainous.
Soil, adobe, 3rd rate.
Timber, oak, juniper, pine; undergrowth, scrub oak, cats
claw, manzanita, blue brush.

South, between secs. 13 and 18.

Ascend NE. slope 420 ft., through timber and dense under-
growth.

19.50 Shallow sandy wash, course N. 70° E.

31.50 Drain, course N. 70° E.

40.00 Set an iron post, 3 ft. long, 1 in. diam., 30 ins. in the
ground, for the $\frac{1}{4}$ sec. cor., with brass cap mkd.

1
S13 | S18
1933

of stone, 2 ft. base, 1 $\frac{1}{2}$ ft. high, W. of corner. raise a mound

Continue ascent of NE. slope, 320 ft.

49.20 Drain, course N. 70° E.; low pass bears N. 75° E., 12.00
chs. dist.

60.80 Top of hill; across bench.

65.85 Leave bench; descend S. slope 370 ft.

80.00 Set an iron post, 3 ft. long, 2 ins. diam., 22 ins. in the
ground to bedrock, with a stone mkd. X at base of post,
in a mound of stone to top, for the cor. of secs. 13, 18,
19 and 24, with brass cap mkd.

T14N
R2 $\frac{1}{2}$ E | R3E
S13 | S18
S24 | S19
1933

Land, mountainous.
Soil, adobe, 3rd rate.
Timber, oak, juniper, pine; undergrowth, scrub oak, cats
claw, manzanita, blue brush.

South, between secs. 19 and 24.

Descend S. slope 300 ft.

7.80 Wire fence, bears NW. and SE.

19.30 Gulch, course SE.

20.30 Same gulch, course S. 20° W.

21.60 Same gulch, course SE.

33.50 Gulch, small stream of water, course SE.

33.90 Wire fence, bears NW. and SE.; ascend NW. slope.

Survey of the W. Bdy. of T. 14 N., R. 3 E.

BOOK 4071

Chains

- 34.70 Point of spur, slopes NE.
- 36.30 Rocky gulch, small stream of water, course SE.; ascend N. slope 65 ft.
- 40.00 Set an iron post, 3 ft. long, 1 in. diam., 18 ins. in the ground, to bedrock, with a stone mkd. X at the base of post, and in mound of stone to top, for $\frac{1}{4}$ sec. cor., with brass cap mkd.

$\frac{1}{4}$
 S24 | S19
 1933

- 41.50 Broken spur, slopes NE.; along E. slope.
- 53.80 Sandy drain, course E.; ascend gentle NE. slope 40 ft.
- 65.00 Low spur, slopes S. 60° E.; descend S. slope 30 ft.
- 69.00 Slope changes to SE.
- 76.50 Drain, course E.
- 80.00 Set an iron post, 3 ft. long, 2 ins. diam., 20 ins. in the ground to bedrock, with a stone mkd. X deposited at the base, and in mound of stone to top, for the cor. of secs. 19, 24, 25 and 30, with brass cap mkd.

T14N
 R2 $\frac{1}{2}$ E R3E
 S24 | S19
 S25 | S30
 1933

Land, mountainous.
 Soil, adobe, 3rd rate.
 Timber, oak, juniper, pine; undergrowth, scrub oak, cats claw, manzanita, blue brush.

South, between secs. 25 and 30.

Over gently rolling E. slope, through dense brush.

- 4.40 Low divide, bears NW. and SE.; descend SW. slope 135 ft.
- 6.50 Wire fence, bears N. 58° W. and S. 58° E.
- 17.00 Head of gulch, course S. 20° E.; along E. slope.
- 20.60 Wire fence, bears NE. and SW.
- 27.60 Gulch, course S. 70° E.; ascend N. slope 115 ft.
 Note: No Cors. of Sur. No. 1555 could be found.
- 37.80 Short spur, slopes E.; descend.
- 40.00 Set an iron post, 3 ft. long, 1 in. diam., 20 ins. in the ground to bedrock, with a stone mkd. X deposited at the base, and in mound of stone to top, for the $\frac{1}{4}$ sec. cor., with brass cap mkd.

$\frac{1}{4}$
 S25 | S30
 1933

Chains.

Ascend 60 ft. over general E. slope.

46.70 Short spur, slopes E.

A mine cabin bears S. 37° 35' E.

A mine cabin bears S. 29° 40' E.; descend S. slope 240 ft.

51.50 A point 1.65 chs. E. of U. S. L. M. No. 1555, which is a cross (x) on top of small cliff, marked and witnessed as described in the official record.

58.10 Gulch, 10 lks. wide, course S. 60° E.; ascend N. slope 115 ft.

65.40 Spur, slopes SE.; a mine cabin bears S. 47° 45' E.; a mine cabin bears S. 38° E.; descend.

78.40 Old road, bears E. and W.

78.70 Sandy gulch, course S. 70° E.

80.00 Set an iron post, 3 ft. long, 2 ins. diam., 30 ins. in the ground, for the cor. of secs. 25, 30, 31 and 36, with brass cap mkd.

T14N	
R2 ¹ / ₂ E	R3E
S25	S30
S36	S31
1933	

raise a mound of stone, 2 ft. base, 1¹/₂ ft. high, W. of corner.

Land, mountainous.

Soil, adobe, 3rd rate.

Timber, oak, juniper, pine; undergrowth, scrub oak, cats claw, manzanita, blue brush.

South, between secs. 31 and 36.

Ascend N. slope 115 ft., through dense undergrowth.

8.00 Short spur, slopes E.; descend SE. slope 65 ft.

29.50 Short gulch, course E.; ascend NE. slope 40 ft.

31.00 Along top of spur, slopes S.; descend 45 ft.

40.00 Set an iron post, 3 ft. long, 1 in. diam., 26 ins. in the ground, for the ¹/₄ sec. cor., with brass cap mkd.

S36	S31
1933	

raise a mound of stone, 2 ft. base, 1¹/₂ ft. high, W. of corner.

Two cabins bear S. 25° E., 25.00 chs. dist.; a cabin bears S. 25° E., 35 chs. dist.

Descend S. slope 125 ft.

49.00 Base of hill, over gently rolling land.

Survey of the W. Bdy. of T. 14 N., R. 3 E.

BOOK 407

Chains.	
78.94	The cor. of Tps. 14 N., Rs. 2½ and 3 E., hereinbefore described.
	Land, mountainous and rolling. Soil, adobe, 3rd rate. Timber, oak, juniper, pine; undergrowth, scrub oak, cats claw, manzanita, blue brush.
	Survey of the N. Bdy. of T. 14 N., R. 2½ E.
	From the NE. cor. of T. 14 N., R. 2½ E., on the W. bdy. of sec. 6, T. 14 N., R. 3 E.
	West, on a true line bet. secs. 1 and 36.
	Descend W. slope 80 ft., through scattering juniper and dense brush.
2.50	Trail, bears N. 20° W. and S. 20° E.
4.50	Draw, course SW.; descend SW. slope 30 ft.
10.00	Gulch, course S.; ascend E. slope 105 ft.
15.10	Short spur, slopes S.; descend SW. slope 65 ft.
19.90	Gulch, course SE.; ascend E. slope 270 ft.
33.50	Ridge, bears N. and S.
34.20	Wire fence, bears N. and S.; descend NW. slope 175 ft.
40.00	Set an iron post, 3 ft. long, 1 in. diam., 30 ins. in the ground, for the ¼ sec. cor., with brass cap mkd.
	$\frac{1}{4} \begin{array}{r} S 36 \\ S 1 \\ 1933 \end{array}$
	raise a mound of stone, 2 ft. base, 1½ ft. high, N. of corner.
	Descend W. slope 140 ft.
44.35	Gulch, course SW.; thence over S. slope.
53.20	Draw, course S.
56.80	Short spur, slopes S.; descend SW. slope 40 ft.
60.30	Gulch, course S.; ascend SE. slope 60 ft.
66.30	Spur, slopes S.; descend W. slope 250 ft.
75.50	Gulch, course S. 20° W.; ascend E. slope 205 ft.
82.50	Short spur, slopes S.
83.28	Intersect the NE. cor. of T. 14 N., R. 2 E., which is an iron post, 3 ins. diam., set, marked and witnessed as described in the official record.
	Land, mountainous. Soil, adobe, 3rd rate. Timber, oak, juniper, pine; undergrowth, scrub oak, cats claw, manzanita, blue brush.

4-680
(August, 1926)

FIELD ASSISTANTS.
to

Theodore Vander Meer, U.S. Transitman

NAMES.	CAPACITY.
Ben Mollette	First Chainman
Walter Grayum	Second Chainman
Claude A. Mulkey	Second Chainman
Joseph T. Bell	Flagman
Tom J. Kulyas	Flagman
Wm. Shafer	Moundsman
Robert R. Riesgo	Moundsman
Shamus O'Brien	Axman
Raymond S. Davis	Axman
Charles Foster	Axman

158
26
BOOK 4071

CERTIFICATE OF UNITED STATES SURVEYOR

I, Theodore Vander Meer, U.S. Transitman, hereby certify upon honor that, in pursuance of special instructions received from the District Cadastral Engineer for Arizona bearing date of the 20th day of July, 1933, I have well, faithfully, and truly in my own proper person, and in strict conformity with said instructions, the Manual of Surveying Instructions, and the laws of the United States, dependently resurveyed the W. bdy. of T. 14 N., R. 4 E., a portion of the W. bdy. of T. 13 N., R. 4 E., a portion of the N. bdy. of T. 13 N., R. 3 E., and a portion of the N. bdy. of T. 13 N., R. 2 E.; and surveyed the N. and W. bdrs. of T. 14 N., R. 3 E., the W. bdy. of frac. T. 14 1/2 N., R. 3 E., and the N. bdy. of frac. T. 14 N., R. 2 1/2 E., of the Gila and Salt River Meridian, in the State of Arizona, which are represented in the foregoing field notes as having been executed by me, and under my direction; and that all the corners of said survey and resurvey have been established and perpetuated in strict accordance with the Manual of Surveying Instructions, and the special written instructions of the District Cadastral Engineer for Arizona and in the specific manner described in the field notes, and that the foregoing are the original field notes of such survey and resurvey.

Glendale, Calif.,
May 28, 1934

Theodore Vander Meer
U.S. Transitman

APPROVAL

OFFICE OF U. S. SUPERVISOR OF SURVEYS,

Denver, Colorado, April 23, 1935.

The foregoing field notes of the resurvey of the W. bdy. of T. 14 N., R. 4 E., a portion of the W. bdy. of T. 13 N., R. 4 E., a portion of the N. bdy. of T. 13 N., R. 3 E., and a portion of the N. bdy. of T. 13 N., R. 2 E.; and of the survey of the N. and W. bdrs. of T. 14 N., R. 3 E., the W. bdy. of frac. T. 14 1/2 N., R. 3 E., and the N. bdy. of frac. T. 14 N., R. 2 1/2 E., of the Gila and Salt River Meridian, in the State of Arizona.

executed by Theodore Vander Meer, U. S. Transitman, under his special instructions dated July 20th, 1933, having been critically examined, and the necessary corrections and explanations made, the said field notes, and the surveys and resurveys they describe, are hereby approved.

Walter S. Dunning
U. S. Supervisor of Surveys.

I certify that the foregoing transcript of the field notes of the above described surveys in _____, has been correctly copied from the original notes on file in _____

U. S. Supervisor of Surveys