

4-679
(April 1933)

BOOK 4072

Book B.

FIELD NOTES

OF THE SURVEY OF THE

subdivisional lines of T. 14 N., R. 3 E.,

4072

Of the Gila and Salt Meridian,

In the State of Arizona

EXECUTED BY

Theodore Vander Meer, U.S. Transitman,

4072

Under special instructions dated July 20, 1933, which provided for the surveys included under Group No. 184, bearing the approval of the Commissioner of the General Land Office under date of September 5, 1933, and assignment instructions dated August 1, 1933 and September 30, 1933.

Survey commenced August 10, 1933.

Survey completed December 5, 1933.

10

BOOK 4072

INDEX DIAGRAM.

Township 14 North, Range 3 East

6 51	52 5 50	38 4 37	28 8 27	19 2 18	8 1 8
7 48	49 8 48	36 9 35	26 10 25	17 11 16	7 12 6
18 46	47 17 45	35 16 33	24 15 23	15 14 14	5 18 4
19 43	44 20 43	32 21 31	22 22 22	12 28 12	4 24 3
30 41	42 29 40	31 28 30	21 27 20	11 26 10	2 25 2
31	39 32	29 28	19 34	9 35	1 36

Chains.

The subdivisional survey of this township was executed with a light mountain transit made by Buff and Buff Co., Serial No. 9977. For description and test of instrument see the field notes of the exteriors of T. 14 N., Rs. 2 $\frac{1}{2}$ and 3 E., and T. 14 $\frac{1}{2}$ N., R. 3 E., surveyed and resurveyed under this group.

From the cor. of secs. 25 and 36, on the E. bdy. of the Tp.

West, on a random line bet. secs. 25 and 36.

40.00 Set temp. $\frac{1}{4}$ sec. cor.

80.00 Set temp. cor. of secs. 25, 26, 35 and 36.

Thence

S. 0° 01' E. on a random line bet. secs. 35 and 36.

40.00 Set temp. $\frac{1}{4}$ sec. cor.

78.42 Intersect S. bdy. of the Tp. 14 lks. W. of the cor. of secs. 35 and 36, described in the field notes of the N. bdy. of T. 13 N., R. 3 E., resurveyed under this group. Thence, from cor.,

N. 0° 01' W., on true line bet. secs. 35 and 36.

Descend N. slope 50 ft.

2.30 Gulch, course E.; ascend S. slope.

16.70 Spur, slopes SE.; descend NE. slope.

26.10 Gulch, course SE.; ascend S. slope.

34.80 Trail, bears E. and W.

38.42 Set an iron post, 3 ft. long, 1 ins. diam., 20 ins. in the ground, in a mound of stone to top, for $\frac{1}{4}$ sec. cor. with brass cap marked

S 35 $\frac{1}{4}$ S 36
1933

No suitable bearing trees available.

44.00 Spur, slopes S. 60° E.; over E. slope.

55.00 Descend NE. slope 300 ft.

78.42 Set an iron post, 3 ft. long, 2 ins. diam., 16 ins. in the ground to bedrock, and in a mound of stone to top, for cor. of secs. 25, 26, 35 and 36, with brass cap marked

T 14 N R 3 E
S 26 | S 25
S 35 | S 36
1933

from which

A cedar, 6 ins. diam., bears S. 4° E., 44 lks. dist., mkd. T 14 N R 3 E S 36 B T.

No other suitable bearing trees.

Land, mountainous.

Soil, adobe, 3rd rate.

Timber, oak, juniper and pinon; undergrowth, scrub oak, manzanita and cateclaw.

Subdivision of T. 14 N., R. 3 E.

Chains.

From the cor. of secs. 25 and 36, on the E. bdy of the Tp., described in the field notes of the W. bdy. of T. 14 N., R. 4 E., resurveyed under this group.

West on sectional correction line bet. secs. 25 and 36.

Descend SW. slope 200 ft. through scrub cedar.

15.20 Canyon, course N. 20° W.; ascend E. slope 385 ft.

35.00 Top of flat hill, slopes N.; along N. slope.

39.93 Set an iron post, 3 ft. long, 1 in. diam., 28 ins. in the ground, for 1/4 sec. cor., with brass cap marked

1/4 S 25
S 36

from which

A cedar, 6 ins. diam., bears S. 47 1/2° E., 88 lks. dist., mkd. 1/4 S 36 B T.

A cedar, 4 ins. diam., bears N. 74 1/2° E., 82 lks. dist., mkd. B T.

Descend NW. slope.

61.00 Gulch, course NE.; junction of gulches from S. and S. 85° W., bears SW., 60 lks. dist.; ascend SE. slope.

79.86 The cor. of secs. 25, 26, 35 and 36.

Land mountainous.

Soil, adobe, 3rd rate.

Timber, oak, juniper and pinon; undergrowth, scrub oak, manzanita and catclaw.

N. 0° 01' W., bet. secs. 25 and 26.

Descend N. slope 360 ft.

11.50 Canyon, course N. 70° E.; ascend S. slope 280 ft.

23.00 Spur, slopes E.; descend NE. slope 160 ft.

31.30 Gulch, course S. 65° E.; ascend S. slope 70 ft.

36.50 Spur, slopes SE.; over E. slope.

40.00 Set an iron post, 3 ft. long, 1 in. diam., 15 ins. in the ground to bedrock, in a mound of stone to top, for 1/4 sec. cor., with brass cap marked.

1/4 S 26 | S 25
1933

No suitable bearing trees available.

41.60 Descend NE. slope 140 ft.

55.50 Head of gulch, course N. 25° E.

73.00 Gulch, course N. 70° E., 12 chs., thence N. 20° E.

Subdivision of T.14 N., R. 3 E.

BOOK 4072

Chains	Ascend SE. slope 50 ft.
74.00	Center of a sycamore thicket about 4 chs. diam.
77.20	Short spur, slopes E.; over E. slope.
80.00	Set an iron post, 3 ft. long, 2 ins. diam., 30 ins. in the ground, for cor. of secs. 23, 24, 25 and 26, with brass cap mkd.
	T 14 N R 3 E S 23 S 24 S 26 S 25 1933
	raise a mound
	of stone, 2 ft. base, 1½ ft. high, W. of cor.
	Land, mountainous. Soil, adobe, 3rd rate. Timber, scattering; undergrowth, same.

	East, on a random line bet. secs. 24 and 25.
40.00	Set a temp. sec. cor.
80.30	Intersect E. bdy. of Tp., 14 lks. N. of the cor. of secs. 24 and 25, described in the field notes of the W. bdy. of T.14 N., R.4 E., resurveyed under this group.
	Thence
	N.89°54'W., on true line bet. secs. 24 and 25.
	Descend along gentle N. slope, through scattering timber and dense undergrowth.
4.00	Wash, course N.70°E., water in pools; ascend SE. slope, 74 ft.
10.65	Spur, slopes S.; descend SW. slope 70 ft.
13.40	Wash, course S. 25 °E.; ascend NE. slope 90 ft.
21.30	Spur, slopes S.70°E.; over S. slope.
24.70	Descend SW. slope 40 ft.
35.30	Wash, course S. 70° E.; ascend E. slope 130 ft.
40.15	Set an iron post, 3 ft. long, 1 in. diam., 28 ins. in the ground, for ¼ sec. cor., with brass cap mkd.
	¼ S 24 S 25 1933
	raise a mound
	of stone, 2 ft. base, 1½ ft. high, N. of cor.
46.00	Low spur, slopes N.; over N. slope.
49.40	Swale, course NW.; ascend E. slope 40 ft.
52.20	Spur, slopes N.; descend W. slope 30 ft.
54.40	Wash, course NW.
57.40	Spur, slopes N. 30° W.; descend NW. slope 200 ft.
74.20	Wash, course NE.; ascend E. slope 85 ft.
80.30	The cor. of secs. 23, 24, 25 and 26.
	Land, mountainous. Soil, adobe, 3rd rate.

Subdivision of T.14 N., R. 3 E.

Timber, oak, juniper and pinon; undergrowth, scrub oak, manzanita and catclaw.

N.0°01'W., bet. secs. 23 and 24.

Descend 130 ft. over NE. slope of spur.

- 5.00 Ravine, course NE; ascend 30 ft.
 9.50 Spur, slopes NE.; descend 300 ft. along W. slope.
 33.00 Draw, course W.; ascend SW. slope 100 ft.
 37.00 Short spur, slopes NW.; descend N. slope 200 ft.
 40.00 Set an iron post, 3 ft. long, 1 in. diam., 18 ins. in the ground to bedrock, with a stone marked X, at base of post, and in a mound of stone to top, for $\frac{1}{2}$ section cor., with brass cap mkd.

S 23 | S 24
 1933

No bearing trees available.

- 44.50 Right bank of Cherry Creek, course E.
 47.40 Left bank of Cherry Creek; ascend S. slope 50 ft.
 50.20 Spur, slopes SE.; along E. slope.
 52.90 Descend NE. slope 40 ft.
 54.60 Wash, course S.20°E.; ascend SW. slope.
 59.60 Spur, slopes S.20°E.
 67.70 Wash, course S.10°W.
 69.90 Wash, course S.10°E., up wash along W. slope.
 80.00 Set an iron post, 3 ft. long, 2 ins. diam., 27 ins. in the ground, for cor. of secs. 13, 14, 23 and 24, with brass cap mkd.

T14N R3E
 S 14 | S 13
 S 23 | S 24
 1933

of stone, 2 ft. base, $1\frac{1}{2}$ ft. high, W. of cor. raise a mound

Land, mountainous.

Soil, adobe, 3rd rate.

Timber, oak, juniper and pinon; undergrowth, scrub oak, manzanita and catclaw.

S.89°54'E., on a random line bet. secs. 13 and 24.

- 40.00 Set temp. $\frac{1}{4}$ sec. cor.
 80.26 Intersect E. bdy of Tp., 7 lks. S. of the cor. of secs. 13 and 24, described in the field notes of the W. bdy. of T.14 N., R.4 E., resurveyed under this group.
 Thence
 N.89°57'W., on true line bet. secs. 13 and 24.
 Descend SW. slope 65 ft.

Subdivision of T. 14 N., R. 3 E.

BOOK 4672

Chains.	
3.70	Draw, course SE.; ascend NE. slope 50 ft.
9.00	Spur, slopes SE.; descend SW. slope 80 ft.
15.90	Draw, course SE.; ascend NE. slope 160 ft.
23.60	Spur, slopes SE.; along broken S. slope, ascend 45 ft.
40.13	Set an iron post, 3 ft. long, 1 in. diam., 27 ins. in the ground, for $\frac{1}{4}$ sec. cor., with brass cap marked.
	$\frac{1}{4}$ S 13 S 24 1933
	raise a mound of stone, 2 ft. base, $1\frac{1}{2}$ ft. high, N. of cor.
47.80	Draw, course SE.; ascend NE. slope 185 ft.
72.20	Highway, at curve, bears NE. to Camp Verde and SW. to Cherry.
74.00	Head of spur, slopes SE.; along S. slope.
77.20	Head of spur, slopes S.; descend W. slope.
78.10	Highway, bears N. and S.
80.26	The cor. of secs. 13, 14, 23 and 24.
	Land, mountainous. Soil, adobe, 3rd rate. Timber, oak, juniper and pinon; undergrowth, scrub oak, manzanita and catclaw.
	N. 0° 01' W. bet. secs. 13 and 14
	Ascend S. slope 155 ft. through scattering brush.
4.60	Highway, bears E. and W.
6.15	Ridge, bears E. and W.; descend N. slope 145 ft.
12.80	Gulch, course E.; ascend S. slope 140 ft.
21.35	Spur, slopes E.; descend N. slope 180 ft.
27.10	Gulch, course N. 60° E.; ascend SE. slope 70 ft.
34.50	Short spur, slopes E.; descend N. slope 60 ft.
39.50	Head of draw, course E.; ascend SE. slope 55 ft.
40.00	Set an iron post, 3 ft. long, 1 in. diam., 16 ins. in the ground to bedrock, with a stone marked X at base of post, and in a mound of stone to top, for $\frac{1}{4}$ sec. cor., with brass cap marked
	$\frac{1}{4}$ S 14 S 13 1933
	No bearing trees available.
46.20	Spur, slopes N. 20° E.; descend W. slope 240 ft.

Subdivision of T. 14 N., R. 3 E.

Chains.	
71.60	Gulch, course NE.; ascend SE. slope 50 ft.
78.10	Spur, slopes NE.; descend NW. slope 25 ft.
80.00	Set an iron post, 3 ft. long, 2 ins. diam., 28 ins. in the ground, for cor. of secs. 11, 12, 13 and 14, with brass cap marked
	T 14 N R 3 E S 11 S 12 S 14 S 13 1933
	raise a mound
	of stone, 2 ft. base, 1½ ft. high, W. of cor.
	Land, mountainous.
	Soil, adobe, 3rd rate.
	Timber, scattering oak, juniper and pinon; undergrowth, scrub oak, blue brush, manzanite and cactus.
	S. 89° 57' E., on a random line bet. secs. 12 and 13.
40.00	Set temp. ¼ sec. cor.
80.34	Intersect E. bdy. of Tp. 3 lks. S. of the cor. of secs. 12 and 13, described in the field notes of the W. bdy. of T. 14 N., R. 4. E., resurveyed under this group. Thence
	N. 89° 58' W., on true line bet. secs. 12 and 13.
	Ascend 25 ft. along N. slope, through brush.
1.70	Gulch, course NE.
15.80	Head of gulch, course NE.; ascend E. slope 45 ft.
17.80	Spur, slopes NE.; along N. slope.
24.00	Spur, slopes NE.; descend W. slope 50 ft.
27.00	Wash, 25 lks. wide, course N. 30° E.; ascend E. slope 40 ft.
29.30	Short spur, slopes N.; descend NW. slope 30 ft.
39.90	Gulch, course N. 80° E.; ascend SE. slope 155 ft.
40.17	Set an iron post, 3 ft. long, 1 in. diam., 22 ins. in the ground to bedrock, in a mound of stone to top, for ¼ sec. cor., with brass cap marked
	¼ S 12 S 13 1933
	raise a mound
	of stone, 2 ft. base, 1½ ft. high, N. of cor.
50.80	Spur, slopes N. 75° E.; descend NW. slope 80 ft.
61.20	Gulch, course NE.; ascend SE. slope 110 ft.
68.40	Spur, slopes NE.; descend NW slope 85 ft.
74.20	Gulch, course NE.; ascend SE. slope 70 ft.
78.60	Spur, slopes NE.; descend NW. slope 25 ft.

Subdivision of T. 14 N., R. 3 E.

BOOK 4072

Chains
80.34

The cor. of secs. 11, 12, 13 and 14.

Land, mountainous.,
Soil, adobe, 3rd rate.
Timber, scattering oak, juniper and pinon; undergrowth,
scrub oak, blue brush, manzanita and cactus.

N. 0°01' W., bet. secs. 11 and 12.

Descend NW. slope 50 ft. through scattering juniper and
brush.

4.00 Gulch, course NE.

5.20 Gulch, course N. 70° E.; ascend S. slope 95 ft.

11.50 Spur, slopes NE.; descend NW. slope 50 ft.

19.40 Gulch, course NE. ; ascend SE. slope 35 ft.

25.40 Spur, slopes NE.; descend NE. slope.

33.50 Gulch, course NE.

35.00 Same gulch, course NE.

38.70 Wash, 25 lks. wide, course NE.

40.00 Set an iron post, 3 ft. long, 1 in. diam., 28 ins. in the
ground, for $\frac{1}{4}$ sec. cor., with brass cap marked

S 11 | S 12
1933

raise a mound
of stone, 2 ft. base, 1½ ft. high, W. of cor.

Ascend SE. slope 15 ft.

41.75 Short spur, slopes NE.; descend NE. slope.

46.80 Wash, 20 lks. wide, course NE.

51.90 Shallow wash, 20 lks. wide, course E.; ascend S. slope.

56.60 Point of spur, slopes E.; descend NW. slope 30 ft.

59.20 Drain, course E.; ascend SE. slope 35 ft.

63.00 Spur, slopes N. 70° E.; descend NW. slope 30 ft.

66.20 Gulch, course N. 70° E.; ascend SE. slope 40 ft.

72.80 Spur, slopes N. 60° E.; over broken NE. slope.

75.50 Drain, course NE.

80.00 Set an iron post, 3 ft. long, 2 ins. diam., 28 ins. in
the ground, for cor. of secs. 1, 2, 11 and 12; with brass
cap marked

T 14 N R 3 E
S 2 | S 1
S 11 | S 12
1933

raise a mound
of stone, 2 ft. base, 1½ ft. high, W. of cor.

Subdivision of T. 14 N., R. 3 E.

Chains Land, mountainous.
Soil, adobe, 3rd rate,
Timber, scattering oak, juniper and pinon; undergrowth,
scrub oak, blue brush, manzanita and cactus.

S. 89° 58' E. on a random line bet. secs. 1 and 12.

40.00 Set temp. $\frac{1}{4}$ sec. cor.

80.00 Intersect E. bdy. of Tp. 46 lks. S. of the cor. of secs. 1 and 12, described in the field notes of the W. bdy. of T. 14 N., R. 4 E., resurveyed under this group. Thence.

S. 89° 42' W., on true line bet. secs. 1 and 12.

Descend broken SW. slope 85 ft.

6.70 Enter flat.

17.40 Old road, bears NE. and SW.

19.20 Wash, 50 lks. wide, banks 3 ft. high, course NE.; ascend SE. slope 75 ft.

27.00 Along N. slope.

40.00 Set an iron post, 3 ft. long, 1 in. diam., 28 ins. in the ground, for $\frac{1}{4}$ sec. cor., with brass cap marked

S 1

4

S 12

1933

raise a mound of stone, 2 ft. base, 1 $\frac{1}{2}$ ft. high, N. of cor.

49.00 Broken spur, slopes N. 85° E.; descend NW. slope 40 ft.

53.00 Low hill, bears S., 3 chs. dist.

57.10 Gulch, course NE.

76.50 Drain, course NE.

80.00 The cor. of secs. 1, 2, 11 and 12.

Land, mountainous.
Soil, adobe, 3rd rate.
Timber, scattering oak, juniper and pinon; undergrowth,
scrub oak, blue brush, manzanita and cactus.

N. 0° 01' W., on a random line bet. secs. 1 and 2.

40.00 Set temp. $\frac{1}{4}$ sec. cor.

80.48 Intersect N. bdy. of the Tp. 5 lks. W. of the cor. of secs. 1, 2, 35 and 36, described in the field notes of the N. bdy. of this Tp., surveyed under this group. Thence

S. 0° 01' W., on true line bet. secs. 1 and 2.

Ascend gradual N. slope.

13.70 Edge of bench, descend SE. slope 85 ft.

23.00 Rocky wash, 20 lks. wide, course N. 70° E.

Subdivision of T. 14 N., R. 3 E.

BOOK 4072

Chains	
37.20	Drain, course N. 70° E.; ascend N. slope 65 ft.
40.48	Set an iron post, 3 ft. long, 1 in. diam., 30 ins. in the ground, for $\frac{1}{4}$ sec. cor., with brass cap marked
	$\frac{1}{4}$ S 2 S 1 1933
	from which
	A pinon, 10 ins. diam., bears N. 48° E., 1.85 chs. dist., mkd. $\frac{1}{4}$ S 1 B T.
	A cedar, 8 ins. diam., bears N. 8 $\frac{3}{4}$ ° W., 2.25 chs. dist.
43.10	Top of flat spur, slopes NE.
50.00	Descend SE. slope 45 ft.
57.50	Shallow wash, 20 lks. wide, course NE.; also a road bears NE. and SW.; ascend N. slope 55 ft.
60.70	Spur, slopes N. 70° E.; old road bears NE. and S., along road.
64.40	Same road, bears NE.
65.30	Draw, course NE.; ascend N. slope 15 ft.
67.30	Short spur, slopes NE.; descend SE. slope 55 ft.
72.50	Deep gulch, course E.
78.50	Draw, course N. 75° E.
79.60	Short spur, slopes E.; descend S. slope 15 ft.
80.48	The cor. of secs. 1, 2, 11 and 12.
	Land mountainous. Soil, adobe, 3rd rate. Timber, scattering oak, juniper and pinon; undergrowth, scrub oak, blue brush, manzanita and cactus.
	From the cor. of secs. 25, 26, 35 and 36.
	West, on a random line bet. secs. 26 and 35.
40.00	Set temp. $\frac{1}{4}$ sec. cor.
80.00	Set temp. cor. of secs. 26, 27, 34 and 35.
	Thence
	S. 0° 01' E., on a random line bet. secs. 34 and 35.
40.00	Set temp. $\frac{1}{4}$ sec. cor.
76.93	Intersect S. bdy. of the Tp. 34 lks. W. of the cor. of secs. 34 and 35, described in the field notes of the N. bdy. of T. 13 N., R. 3 E., resurveyed under this group.
	Thence
	N. 0° 01' W., on true line bet. secs. 34 and 35.
	Along E. slope, ascend 125 ft.
9.30	Descend NE. slope 150 ft.
20.30	Wash, course S. 25° E.; ascend SW. slope 250 ft.

Subdivision of T. 14 N., R. 3 E.

Chains
35.50

Trail, bears NW. to ranger station and SE.

36.93

Set an iron post, 3 ft. long, 1 in. diam. 15 ins. in the ground to bedrock, with a stone marked X at base of post, and in a mound of stone to top, for $\frac{1}{4}$ sec. cor., with brass cap marked

$\frac{1}{4}$
S 34 | S 35
1933

39.00

Trail, bears SE. to ranger station and NW.

46.30

Spur, slopes SE.

49.90

Trail, bears NE. and SW.

54.70

Spur, slopes W. and SW.; along NW. slope.

64.20

Swale, course W.

68.60

Spur, slopes W.

69.90-

Descend NW. slope 60 ft.

76.93

Set an iron post, 3 ft. long, 2 ins. diam., 25 ins. in the ground, for cor. of secs. 26, 27, 34 and 35, with brass cap marked

T 14 N R 3 E
S 27 | S 26
S 34 | S 35
1933

raise a mound of stone, 4 ft. base, 3 ft. high, W. of cor.

Land, mountainous.

Soil, adobe, 3rd rate.

Timber, oak, juniper and pinon; undergrowth, scrub oak, manzanita and catclaw.

From the cor. of secs. 25, 26, 35 and 36.

West, on a sectional correction line bet. secs. 26 and 35.

Ascend E. slope 70 ft. through scattering scrub cedar and scrub oak.

8.40

Spur, slopes NE.; along N. slope, ascend 75 ft.

18.20

Descend NW. slope 125 ft.

31.00

Gulch, course NE.; ascend SE. slope 180 ft.

39.83

Set an iron post, 3 ft. long, 1 in. diam., 28 ins. in the ground, for $\frac{1}{4}$ sec. cor., with brass cap marked

$\frac{1}{4}$ S 26
S 35
1933

raise a mound of stone, 2 ft. base, 1 $\frac{1}{2}$ ft. high, N. of cor.

62.50

Flat ridge, bears NE. and SW; descend W. slope 10 ft.

79.66

The cor. of secs. 26, 27, 34 and 35.

Subdivision of T. 14 N., R 3 E.

BOOK 4072

Chains

Land, mountainous.
Soil, adobe, 3rd rate.
Timber, oak, juniper and pinon; undergrowth, scrub oak, manzanita and catclaw.

N. 0° 01' W., bet. secs. 26 and 27.

Over rolling malpais mesa, through small timber and brush
Descend 140 ft. along N. slope.

38.20

Rocky wash, course W.; turns SW. about 2 chs. dist.; ascend 8 ft. over S. slope.

40.00

Set an iron post, 3 ft. long, 1 in. diam., 26 ins. in the ground, for $\frac{1}{4}$ sec. cor., with brass cap marked

S 27 $\frac{1}{4}$ S 26
1933

from which

A scrub cedar, 10 ins. diam., bears S 46° E., 30 lks. dist., mkd. $\frac{1}{4}$ S 26 B T.

A scrub cedar, 6 ins. diam., bears N. 80° W., 122 lks. dist., mkd. $\frac{1}{4}$ S 27 B T.

Raise a mound of stone, 2 ft. base, 1 $\frac{1}{2}$ ft. high, W. of cor.

Ascend S. slope 107 ft.

49.00

Ridge divide, bears E. and S. 70° W.; spur slopes NW.; descend 43 ft.

53.40

A scrub cedar, 10 ins. diam. on line, marked with three notches on N. and S. sides.

53.89

In order to determine the distance over precipitous cliffs by triangulation, I use this station as point "A", and set a flag "B" on line N. 0° 01' W. From point "A" a flag "C" bears N. 51° 49' E., 16.33 chs. dist. From point "B" flag at "C" bears S. 37° 01' E.; all bearings checked by direct reading of the solar, and all angles checked by deflection. Vertical angle. -21 $\frac{1}{4}$ °.

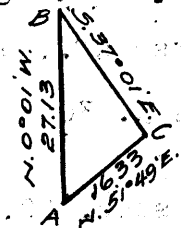

Dist. on line 53.89 chs.
Dist. by triangulation 27.13

Dist. by return measurement ~~81.02~~ chs.
1.02 chs.

80.00 chs.

80.00

Set an iron post, 3 ft. long, 2 ins. diam., 28 ins. in the ground, for cor. of secs. 22, 23, 26 and 27, with brass cap marked

T 14 N R 3 E.
S 22 | S 23
S 27 | S 26
1933

raise a mound of stone, 2 ft. base, 1 $\frac{1}{2}$ ft. high, W. of cor.

Subdivision of T. 14 N., R. 3 E.

Chains	Land, mountainous. Soil, adobe, 3rd rate. Timber, oak, juniper and pinon; undergrowth, scrub oak, manzanita and catclaw.
40.00	East, on a random line bet. secs. 23 and 26. Set temp. $\frac{1}{4}$ sec. cor.
79.98	Intersect N. and S. line 5 lks. S. of the cor. of secs. 23, 24, 25 and 26. Thence S. $89^{\circ} 58'$ W., on true line bet. secs. 23 and 26.
4.00	Over mountainous land, through scattering scrub cedar and pinon and dense undergrowth. Ascend 180 ft. over E slope. Spur, slopes N.; descend 45 ft. over NW. slope.
7.80	Ravine, course NE.; ascend 180 ft. over SE. slope.
17.00	Spur, slopes NE.; descend 20 ft. over NW. slope.
22.00	Ravine, course NE.; ascend SE. slope 130 ft.
27.50	Spur, slopes NE.; descend N. slope 30 ft.
34.00	Ravine, course NE.; ascend E. slope 210 ft.
39.99	Set an iron post, 3 ft. long, 1 in. diam., 27 ins. in the ground, for $\frac{1}{4}$ sec. cor., with brass cap marked
	$\begin{array}{r} \frac{1}{4} \text{ S } 23 \\ \hline \text{S } 26 \\ 1933 \end{array}$
	raise a mound of stone 3 ft. base, 2 ft. high, N. of cor.
42.00	Ascend 50 ft. over E. slope. Spur, slopes N.; descend 70 ft. over NW. slope.
53.00	Ravine, course N.
56.00	Ravine, course NE.; ascend 30 ft. along N. slope.
66.30	Spur, slopes N. 30° W.; descend 280 ft. over general W. slope.
79.98	The cor. of secs. 22, 23, 26 and 27.
	Land, mountainous. Soil, granite loam, 3rd rate. Timber, scrub cedar and pinon; undergrowth, oak, manzanita mahogany and catclaw.
	N. $0^{\circ} 01'$ W., bet. secs. 22 and 23.
	Over mountainous land, through scattering scrub cedar and dense undergrowth.
	Over W. slope.
	In order to determine the distance over precipitous cliffs by triangulation, I set a flag "B" on line

Subdivision of T. 14 N., R. 3 E.

BOOK 4012

Chains

N. 0° 01' W., and use the same base line as that used in the previous triangulation. From point "B" the flag at "C" bears S. 12° 46' E.; all bearings checked by direct reading of the solar, and all angles checked by deflection. Vertical angle, 0°.

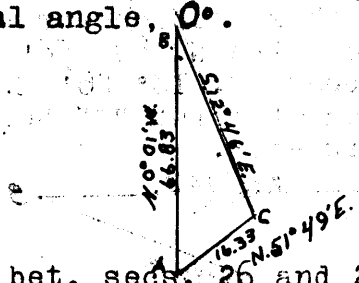

Dist. on line bet. secs. 26 and 27.	53.89 chs.
Dist. by triangulation	66.83
	<u>120.72 chs.</u>
Dist. by return measurement	0.72 chs.
	<u>120.00 chs.</u>

point for 1/4 sec. cor. of secs. 22 and 23.

The following distances are approximate, to the 1/4 sec. cor.

- 0.90 Spur, slopes NW.; descend 140 ft. over N. slope.
- 4.80 Ravine, course NW.; ascend 130 ft. over S. slope.
- 12.00 Spur, slopes NW.; descend 350 ft. over N. slope.
- 26.00 Cherry Creek, water 1 lk. wide, in channel 30 lks. wide, course E.; ascend 100 ft. over S. slope.
- 29.00 Spur, slopes SE.; ascend 20 ft. over E. slope.
- 31.50 Ravine, course S.; ascend 280 ft. over E. slope.
- 40.00 Set an iron post, 3 ft. long, 1 in. diam., 26 ins. in the ground, for 1/4 sec. cor., with brass cap marked

1/4
S 22 1/2 S 23
1933

raise a mound of stone, 3 ft. base, 2 ft. high, W. of cor.

Ascend 140 ft. over S. slope.

- 45.00 Spur, slopes SE.; along E. slope.
- 49.70 Spur, slopes E.; descend 190 ft. over broken NE. slope.
- 79.10 Wash, 20 lks. wide, course SE.; over flat.
- 80.00 Set an iron post, 3 ft. long, 2 ins. diam., 28 ins. in the ground, for cor. of secs. 14, 15, 22 and 23, with brass cap marked

T. 14 N. R. 3 E
S 15 | S 14
S 22 | S 23
1933

raise a mound of stone, 3 ft. base, 2 ft. high, W. of cor.

Land, mountainous and rolling.
Soil, granite loam, 2nd and 3rd rates.
Timber, scrub cedar, walnut, cherry, cottonwood in creek bottom; undergrowth, oak, manzanita, mahogany, catclaw.

Subdivision T. 14 N., R. 3 E.

Chains N. 89° 58' E., on a random line bet. secs. 14 and 23.

40.00 Set temp. $\frac{1}{4}$ sec. cor.

42.33 To determine the dist. over precipitous land by triangulation, I use this station for point "A", and set a flag at point "B" on line N. 89° 58' E. From point "A", a flag at point "C" bears S. 18° 26' E., 5.00 chs. dist. From point "B", flag at point "C" bears S. 80° 59' W. Vertical angle at "A" is $-4\frac{3}{4}^{\circ}$.

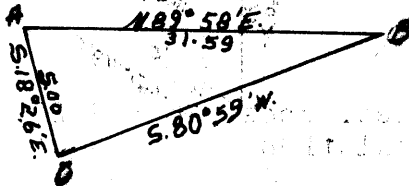

Dist. on line 42.33 chs.

Dist. by triangulation 31.59

73.92

80.02 Intersect N. and S. line 5 lks. N. of the cor. of secs. 13, 14, 23 and 24.

Thence

West, on true line bet. secs. 14 and 23.

Over mountainous land, through scattering scrub cedar and medium undergrowth.

Ascend 96 ft. over SE. slope.

4.90 Highway, on curve, bears SW. to Cherry and NE. to Camp Verde.; ascend SE. slope 30 ft.

6.10 Spur, slopes S.; Sutchliffe cabin, in Cherry Creek, bears S. 12° 15' W., about 35 chs. dist.; A mine building bears S. 44° W., about 25 chs. dist.; descend S. slope 10 ft.

12.40 Highway, bears SE. to Camp Verde and NW. to Cherry.; descend W. slope 350 ft.

17.00 Large mine dump, bears N. and S.; shaft and falling derrick bear N., 10 lks. dist.

18.50 Ravine, course S. 20° E.; ascend E. slope 400 ft.

30.00 Spur, slopes SE.; desc. S. slope 30 ft.

33.00 Short ravine, course SE.; ascend E. slope 60 ft.

36.67 Highway, bears N. to Camp Verde and S. 20° E. to Cherry.; ascend E. slope 75 ft.

40.01 Set an iron post, 3 ft. long, 1 in. diam., 27 ins. in the ground, for $\frac{1}{4}$ sec. cor., with brass cap marked.

S 14

$\frac{1}{4}$ S 23

1933

raise a mound of stone, 3 ft. base, 2 ft. high, N. of cor.

Ascend NE. slope 200 ft.

48.70 Top of hill, bears S.; 2 chs. dist.; descend NW. slope 25 ft.

51.90 Head of drain, course N.; ascend E. slope 185 ft.

Subdivision of T. 14 N., R. 3 E.

BOOK 4072

Chains 53.65	Unused road, bears NE. and SW.
54.47	U. S. G. S. bench mark; elevation 4817 ft., bear South, 2.28 chs. dist.; a brass plate set in exposed bedrock.
61.90	Ridge, bears NW. and SE., slopes SE.; top of hill bears North, 3.00 chs. dist.; descend NW. slope 180 ft.
73.00	Highway, bears NW. to Cherry and SE. to Camp Verde.
79.80	Wash, 30 lks. wide, 4 ft. deep, course S.
80.02	The cor. of secs. 14, 15, 22 and 23. Land; mountainous. Soil; granite loam, rocky, 3rd rate. Timber, scrub cedar, pinon; undergrowth, oak, catclaw, manzanita and mahogany.
	N. 0° 01' W., bet. secs. 14 and 15.
1.20	Wash, 20 lks. wide, course SE.; ascend SW. slope 125 ft. through dense underbrush.
5.50	Highway, bears NW. to Cherry and SE. to Camp Verde.
9.85	Wire fence, bears N. 65° W. and S. 65° E.
12.30	Spur slopes E.; low saddle in spur bears W. about 5 chs. dist.; along W. slope.
16.00	Spur, slopes NW.; descend N. slope 280 ft.
31.70	Wash, 25 lks. wide, course NE.
37.80	Shaft, 80 ft. deep, bears West, 40 lks. dist.
39.40	Wash, 25 lks. wide, course E.; ascend S. slope 25 ft.
40.00	Set an iron post, 3 ft. long, 1 in. diam., 18 ins. in the ground to bedrock, with a stone, mkd. X, deposited at the base, and in a mound of stone to top, for $\frac{1}{4}$ sec. cor., with brass cap mkd. S 15 ¹ / ₄ S 14 1933
41.20	Short spur, slopes E.; descend N. slope 20 ft.
42.70	Short gulch, course E.; ascend S. slope 190 ft.
43.70	Tunnel on line; Steiner's cabin W. about 5 chs. dist.
51.30	Spur, slopes E.; over E. slope.
58.00	Spur, slope NE.; descend NE. slope 25 ft.
63.80	Head of gulch, course NE.; over E. slope.
69.20	Drain. course E.
74.80	Short gulch, course SE.; ascend SE. slope 75 ft.
80.00	Set an iron post, 3 ft. long, 2 ins. diam., 12 ins. in the ground to bedrock, with a stone, mkd. X, deposited at the base, and in a mound of stone to top, for cor. of secs. 10, 11, 14 and 15, with brass cap mkd.

Subdivision of T. 14 N., R. 3 E.

Chains

T 14 N R 3 E

S 10 | S 11

S 15 | S 14

1933

From this cor., cor. No. 1, Sur. No. 1227 Gulch mining claim, bears N. 79° 35' W., 48.07 chs. dist.; a stake 1 x 2 ins., mkd. G No 1 set in a mound of stone by a local surveyor. This cor. undoubtedly occupies the position of the original cor. No other cors. of this claim could be found.

Land, mountainous.
Soil, adobe, 3rd rate.
Timber, scattering oak, juniper and pinon; undergrowth, scrub oak, blue brush, manzanita and cactus.

East, on a random line bet. secs. 11 and 14.

40.00	Set temp. $\frac{1}{4}$ sec. cor.
80.48	Intersect N. and S. line 16 lks. S. of the cor. of secs. 11, 12, 13 and 14.
	Thence
	S. 89° 53' W., on a true line bet. secs. 11 and 14.
	Descend NW. slope 25 ft.
2.20	Gulch, course NE.; ascend SE. slope 60 ft.
4.80	Spur, slopes NE.; descend NW. slope 25 ft.
7.50	Gulch, course NE.; ascend E. slope 35 ft.
9.25	Spur, slopes NE.; descend NW. slope 85 ft.
14.30	Gulch, 15 lks. wide, course NE.; ascend SE. slope 95 ft.
26.00	Spur, slopes N. 75° E.; over N. slope
32.00	Gulch, course NE.; ascend E. slope 90 ft.
40.24	Set an iron post, 3 ft. long, 1 in. diam., 28 ins. in the ground, for $\frac{1}{4}$ sec. cor., with brass cap mkd.
	S 11 S 14 1933
	raise a mound
	of stone, 3 ft. base, 2 ft. high, N. of cor.
41.00	Spur, slopes NE.; high masonry wall, S. end of which bears N. 38° 15' W., N. end of same bears N. 34° 20' W., about $\frac{1}{4}$ mile dist.; wall extends N. and S.; descend NW. slope 130 ft.
46.40	Gulch, course N. 20° E.; ascend E. slope 55 ft.
49.60	Short spur, slopes NE.; descend broken NW. slope 70 ft.
52.80	Wire fence, bears N. 15° W. and S. 15° E.
61.30	Gulch, course NE.; ascend SE. slope 350 ft.
75.80	Spur, slopes SE.; ascend NE. slope 50 ft.
80.48	The cor. of secs. 10, 11, 14 and 15.

Subdivision of T. 14 N., R. 3 E.

BOOK 4072

Chains.	<p>Land, mountainous. Soil, adobe, 3rd rate. Timber, scattering oak, juniper and pinon; undergrowth, scrub oak, blue brush, manzanita and cactus.</p>
	<p>N. 0° 01' W., bet. secs. 10 and 11. Ascend SE. slope 15 ft.</p>
1.50	Spur, slopes N. 10° E. 12 chs. thence E.; along W. slope.
12.00	Spur, slopes N. 30° W.; descend NE. slope 325 ft.
26.00	Gulch, small stream of water, course NE.; ascend SE. slope 40 ft.
29.40	Old road, bears NW. and SE.
34.50	Spur, slopes NE.; descend N. slope 30 ft.
39.50	Gulch, course NE.; ascend SE. slope 10 ft.
40.00	Set an iron post, 3 ft. long, 1 in. diam., 24 ins. in the ground, for $\frac{1}{4}$ sec. cor., with brass cap mkd.
	$\begin{array}{c} \frac{1}{4} \\ \text{S } 10 \text{ S } 11 \\ 1933 \end{array}$
	<p style="text-align: right;">raise a mound of stone, 3 ft. base, 2 ft. high, W. of cor.</p> <p>Ascend S. slope 10 ft.</p>
40.50	Spur, slopes N. 70° E.; descend N. slope 35 ft.
42.50	Gulch, small stream of water, course N. 70° E.
44.29	Cor. No. 1 of the Etta mill site, mineral survey No. 833 B. bears West, 10.44 chs. dist.; a porphyry stone, 10 x 6 x 14 ins. above ground, dimly marked. From this cor., cor. No. 5 of the Etta mining claim, mineral survey No. 833 A. bears N. 86° 54' W., 29.95 chs. dist.; a stone, properly marked and well set.
54.90	Spur, slopes N. 70° E.; descend N. slope 130 ft.
61.10	Road in wash, 50 lks. wide, course NE.; ascend SE. slope 65 ft.
69.40	Spur, slopes NE.; descend NE. slope 70 ft.
71.00	Fence, bears NW. and SE.; old road, bears NE. and SW.
79.00	Small gulch, course NE.
80.00	Set an iron post, 3 ft. long, 2 ins. diam., 26 ins. in the ground, for cor. of secs. 2, 3, 10 and 11, with brass cap mkd.
	$\begin{array}{c} \text{T } 14 \text{ N } \text{R } 3 \text{ E} \\ \text{S } 3 \text{ S } 2 \\ \text{S } 10 \text{ S } 11 \\ 1933 \end{array}$
	<p style="text-align: right;">from which</p> <p>A pinon 6 ins. diam., bears N. 22° 00' E., 105 lks. dist., mkd. T 14 N R 3 E S 2 B T.</p> <p>A pinon, 6 ins. diam., bear S. 67° 30' E., 88 lks.</p>

Subdivision of T. 14 N., R. 3 E.

Chains.

dist., mkd. T 14 N R 3 E S 11 B T.

Raise a mound
of stone, 3 ft. base, 2 ft. high, W. of cor.

Land, mountainous.

Soil, adobe, 3rd rate.

Timber, scattering oak, pinon and juniper; undergrowth,
scrub oak, blue brush, manzanita and catclaw.

N. 89° 53' E., on a random line bet. secs. 2 and 11.

40.00 Set temp. $\frac{1}{4}$ sec. cor.80.44 Intersect N. and S. line 12 lks. S. of the cor. of secs.
1, 2, 11 and 12.

Thence

S. 89° 48' W., on a true line bet. secs. 2 and 11.

Over rolling land, ascend gradual E. slope.

15.44 Top of ascent; descend NW. slope 25 ft.

22.24 Gulch, course NE.; ascend gradual E. slope.

40.22 Set an iron post, 3 ft. long, 1 in. diam., 18 ins. in the
ground to bedrock, and in a mound of stone to top, for
 $\frac{1}{4}$ sec. cor., with brass cap mkd.
$$\frac{1}{4} \frac{S 2}{S 11}$$
 1933.

40.84 Road, bears NE. and SW.

46.44 Top of ascent; descend gradual W. slope.

50.34 Road in wash, 20 lks. wide, course N. 70° E.

53.74 Old road, bears NE. and SW.

58.94 Flat spur, slopes N. 60° E.; descend NW. slope 35 ft.

72.44 Spur, slopes NE.; descend gradual W. slope.

79.74 Small gulch, course NE.

80.44 The cor. of secs. 2, 3, 10 and 11.

Land, rolling.

Soil, 2nd and 3rd rate.

Timber, scrub cedar and mesquite; undergrowth, catclaw,
cactus and scrub oak.

N. 0° 01' W., on a random line bet. secs. 2 and 3.

40.00 Set temp. $\frac{1}{4}$ sec. cor.80.76 Intersect N. bdy. of the Tp., 46 lks W. of the cor. of
secs. 2, 3, 34 and 35, described in the field notes of the
N. bdy. of this tp., surveyed under this group.

Thence

Subdivision of T. 14 N., R. 3 E.

BOOK 4072

Chains	S. 0° 19' W., on true line bet. secs. 2 and 3. Over rolling land, descend gradual SE. slope.
10.75	Gulch, course E.
12.75	Short spur, slopes NE.; descend SE. slope.
14.55	Short gulch, course NE.; over gentle NE. slope.
28.45	Old road, bears NE. and SW.
39.25	Gulch, course E.
40.76	Set an iron post, 3 ft. long, 1 in. diam., 30 ins. in the ground, for $\frac{1}{4}$ sec. cor., with brass cap marked. $\frac{1}{4}$ S 3 S 2 1933 raise a mound
	of stone, 3 ft. base, 2 ft. high, W. of cor.
62.85	Gulch, course E.
70.75	Short flat spur, slopes NE.; descend gradual SE. slope.
74.35	Gulch, course NE.
80.76	The cor. of secs. 2, 3, 10, 11. Land, rolling. Soil, 2nd and 3rd rate. Timber, scrub cedar and mesquite; undergrowth, catclaw, cactus and scrub oak.
	From the cor. of secs. 26, 27, 34 and 35. West, on a random line bet. secs. 27 and 34.
40.00	Set temp. $\frac{1}{4}$ sec. cor.
80.00	Set temp. cor. of secs. 27, 28, 33 and 34. Thence
	S. 0° 02' E., on a random line bet. secs. 33 and 34.
40.00	Set temp. $\frac{1}{4}$ sec. cor.
75.03	Intersect S. bdy. of the Tp. 6 lks. E. of the cor. of secs. 33 and 34, described in the field notes of the N. bdy. of T. 13 N., R. 3 E., resurveyed under this group. Thence
	N. 0° 02' W., on true line bet. secs. 33 and 34. Ascend SW. slope 140 ft. through scattering scrub oak.
1.70	Hillside drain, course SW.
8.00	Short spur, slopes SW.; over W. slope;
13.20	Short spur, slopes W.; descend over W. slope 70 ft.
18.10	Hillside drain, course W.
22.75	Gulch, course SW.

Subdivision of T. 14 N., R. 3 E.

Chains	
31.20	Hillside drain, course W.
35.03	Set an iron post, 3 ft. long, 1 in. diam., 6 ins. in the ground to bedrock, in a mound of stone to top, for $\frac{1}{4}$ sec. cor., with brass cap marked.
	$\frac{1}{4}$ S 33 S 34 1933
	No bearing trees available.
37.50	Enter gulch, course SW.; up gulch.
38.90	Leave gulch, course from NW.
41.00	Short gulch, course SE., joins main gulch 1 ch. SE.; ascend S. slope 480 ft.
47.80	Old road, bears E. and W.
75.03	Set an iron post, 3 ft. long, 2 ins. diam., 15 ins. in the ground to bedrock, in a mound of stone to top, for cor. of secs. 27, 28, 33 and 34, with brass cap marked
	T. 14 N. R. 3 E. S 28 S 27 S 33 S 34 1933
	No bearing trees available.
	The cor. stands under a 4 wire fence near cor.; fence bears N. 68° E. and S. 89° W.
	Land, rolling mountainous. Soil, granite loam, 3rd rate. Timber, scrub cedar; undergrowth, oak, catelaw, and mahogany.
	From the cor. of secs. 26, 27, 34 and 35:
	West, on sectional correction line bet. secs. 27 and 34.
	Over rolling land, through scattering scrub cedar and undergrowth, descend 375 ft. over W. slope.
17.90	Gulch, course SW., soon S.; ascend SE. slope 190 ft.
27.50	Over bench, bears NE. and SW.
37.20	Cor. of wire fence bearing irregularly N. and W, bears N. about 60 lks. dist.
40.03	Set an iron post, 3 ft. long, 1 in. diam., 16 ins. in the ground, with a lava stone marked X at base of post, and in a mound of stone to top, for $\frac{1}{4}$ sec. cor., with brass cap marked
	$\frac{1}{4}$ S 27 S 34 1933
	No suitable bearing trees available.
	Cor. stands on ridge, bears S. 80° W. and NE.
41.20	Leave bench, bears NE. and SW.; descend W. slope 75 ft.

Subdivision of T. 14 N., R. 3 E.

BOOK 40

Chains	
46.80	Head of ravine, course N.; low saddle in ridge bears S. 30 lks. dist.; ascend E. slope 390 ft.
68.50	Top of hill bears N. and S.; descend W. slope 283 ft.
80.06	The cor. of secs. 27, 28, 33 and 34. Land, rolling and mountainous. Soil, adobe loam, 3rd rate. Timber, scrub cedar; undergrowth, oak and catclaw.
	N. 0° 02' W., bet. secs. 27 and 28. Over rolling mountainous land, through scattering scrub cedar and dense undergrowth.
0.04	4 wire fence, bears S. 89° W. and N. 68° E.; descend broken NW. slope 460 ft.
30.20	A wire fence, bears NE. and SW.
40.00	Set an iron post, 3 ft. long, 1 in. diam., 20 ins. in the ground, with a stone marked X at base of post, and in a mound of stone to top, for $\frac{1}{4}$ sec. cor., with brass cap marked. $\begin{array}{r} \frac{1}{4} \\ S\ 28\ S\ 27 \\ 1933 \end{array}$ No bearing trees available. Descend NW. slope 20 ft.
43.40	Wash, 30 lks. wide, course NE.; over rolling land,
69.00	Drain, course E.
73.60	Spur, slopes SE.
78.00	Drain, course E.
79.70	Low spur, slopes E.
80.00	Set an iron post, 3 ft. long, 2 ins. diam., 27 ins. in the ground, for cor. of secs. 21, 22, 27 and 28, with brass cap marked. $\begin{array}{r} T\ 14\ N\ R\ 3\ E \\ S\ 21\ S\ 22 \\ S\ 28\ S\ 27 \\ 1933 \end{array}$ raise a mound of stone, 3 ft. base, 2 ft. high, W. of cor. Land, rolling mountainous and rolling. Soil, granite loam, 2nd and 3rd rate. Timber, scrub cedar; undergrowth, oak, catclaw and manzanita.
	East, on a random line bet. secs. 22 and 27.
40.00	Set temp. $\frac{1}{4}$ sec. cor.
80.04	Intersect N. and S. line 4 lks. N. of the cor. of secs. 22, 23, 26, and 27. Thence

Subdivision of T. 14 N., R. 3 E.

Chains	
	N. 89° 58' W., on true line bet. secs. 22 and 27.
	Over rolling mountainous land, through scattering scrub cedar and dense undergrowth.
	Descend W. slope 180 ft.
7.50	Cherry Creek, dry, course NE.; ascend 35 ft.
10.50	Spur, slopes S.; descend 30 ft.
14.00	Cherry Creek, 1 lk. wide, in wash 30 lks. wide, course SE.; ascend E. slope 160 ft.
25.00	Spur, slopes N.; descend NW. slope 50 ft.
30.50	Short ravine, course N.; ascend E. slope 80 ft.
33.20	Spur, slopes N.; descend W. slope 70 ft.
36.20	Short ravine, course N.; descend W. slope 35 ft.
39.20	Spur, slopes N.; descend W. slope 35 ft.
40.02	Set an iron post, 3 ft. long, 1 in. diam., 28 ins. in the ground, for $\frac{1}{4}$ sec. cor., with brass cap marked
	$\begin{array}{r} S\ 22 \\ \hline S\ 27 \\ 1933 \end{array}$
	of stone, 3 ft. base, 2 ft. high, N. of cor. raise a mound
	Descend W. slope 40 ft.
41.50	Short ravine, course N.; ascend E. slope 80 ft.
46.20	Spur, slopes N.; descend NW. slope 150 ft.
57.40	Wash, 20 lks. wide, water 1 lk. wide, course NE.; ascend gentle E. slope 150 ft.
58.50	4 wire fence, bears NE. and SW.
61.50	Drain, course SE.
80.04	The cor. of secs. 21, 22, 27 and 28.
	Land, mountainous and rolling. Soil, granite loam, 2nd rate. Timber, scrub cedar, walnut etc. in wash bottoms; undergrowth, oak, manzanita, mahogany and catclaw.
	N. 0° 02' W., bet. secs. 21 and 22.
	Over rolling land, through scattering scrub cedar and dense undergrowth.
	Ascend general SE. slope 120 ft.
26.70	Trail, bears S. 10° W. and N. 10° W.
29.00	Ridge, bears E. and W.; descend N. slope 140 ft.
40.00	Set an iron post, 3 ft. long, 1 in. diam., 28 ins. in the ground, for $\frac{1}{4}$ sec. cor., with brass cap marked.

Subdivision of T. 14 N., R. 3 E.

BOOK 4072

Chains	
	$\frac{1}{4}$ S 21 S 22 1933
	Raise a mound of stone, 3 ft. base, 2 ft. high, W. of cor.
	Descend 45 ft. over NE. slope.
45.50	Intersect the S. bdy. of H. E. S. No. 478. From point of intersection cor. No. 4 of H. E. S. No. 478 bears N. 89° 05' E., 10.58 chs. dist.; a granite stone, 8 x 10 x 4 ins. above ground, marked and witnessed as described in the official record.
47.70	Wire fence, bears E. and W.
48.80	Cherry Creek wash, 140 lks. wide, dry, course E.; ascend S. slope 120 ft. to highway.
53.20	Fence, bears E. and W.
63.03	Fence, bears E. and W.
63.45	Intersect the N. bdy. of H. E. S. No. 478. From point of intersection cor. No. 2 of H. E. S. No. 478 bears N. 89° 50' W., 5.71 chs. dist.; a granite stone, 10 x 8 x 12 ins. above ground, firmly set, a portion of the rock has been broken off and lost, only the figures 478 remaining.
65.70	Highway, on curve, bears E. to Camp Verde and W. to Cherry; Ascend 127 ft. over general S. slope.
77.70	Spur, slopes SW.; descend NW. slope 20 ft.
80.00	Set an iron post, 3 ft. long, 2 ins. diam., 18 ins. in the ground to bedrock, with a stone marked X at base of post, and in a mound of stone to top, for cor. of secs. 15, 16, 21 and 22, with brass cap marked.
	$\begin{array}{r} T\ 14\ N\ R\ 3\ E \\ \hline S\ 16\ S\ 15 \\ \hline S\ 21\ S\ 22 \\ 1933 \end{array}$
	No suitable bearing trees available.
	Land, rolling. Soil, granite loam, 2nd and 3rd rates. Timber, scrub cedar, walnut, etc. in bottom; undergrowth, oak, manzanita and catclaw.
	S. 89° 58' E., on a random line bet. secs. 15 and 22.
40.00	Set temp. $\frac{1}{4}$ sec. cor.
79.78	Intersect N. and S. line 39 lks. S. of the cor. of secs. 14, 15, 22 and 23.
	Thence
	S. 89° 45' W., on true line bet. secs. 15 and 22.
	Over rolling mountainous land, through scattering scrub cedar and medium undergrowth.
	Ascend SE. slope 120 ft.

Subdivision of T. 14 N., R. 3 E.

Chains

- 10.45 Mineral monument No. 1707 bears S. 1° 25' W., 26.93 chs. dist.; a granite stone in place, marked M M No. 1707 on E. face, projecting 16 x 20 x 24 ins. above ground, witnessed by a mound of stone E. of stone.
- 10.54 Highway, bears N. to Camp Verde and S. to Cherry; ascend E. slope 390 ft.
- 26.90- Spur, slopes S., top of hill bears N. 1 ch. dist.; descend SW. slope 90 ft.
- 34.00 Ravine, course S.; ascend SE. slope 20 ft.
- 36.70 Spur, slopes S.; descend SW. slope 47 ft.
- 39.89 Set an iron post, 3 ft. long, 1 in. diam., 18 ins. in the ground to bedrock, with a stone marked X at base of post, and in a mound of stone to top, for $\frac{1}{4}$ sec. cor. with brass cap marked
- S 15
 $\frac{1}{4}$
S 22
1933
- No suitable bearing trees available.
- Descend SW. slope 65 ft.
- 44.70 Ravine, course SE.; ascend E. slope 70 ft.
- 49.70 Spur, slopes SW.; descend NW. slope 130 ft.
- 54.90 Wash, 15 lks. wide, course S.; ascend E. slope 35 ft.
- 64.10 Spur, slopes S.; descend SW. slope 20 ft.
- 67.00 Drain, course SE.; ascend E. slope 70 ft.
- 74.00 Spur, slopes SW.; descend NW. slope 60 ft.
- 79.78 The cor. of secs. 15, 16, 21 and 22.
- Land, mountainous.
Soil, granite loam, 3rd rate.
Timber, scrub cedar; undergrowth, oak, catclaw and manzanita.

N. 0° 02' W., bet. secs. 15 and 16.

Over rolling and mountainous land, through scattering scrub cedar and medium undergrowth.

Along W. slope, ascend 70 ft.

- 6.70 Wash, 20 lks. wide, course S. 20° W.
- 10.40 Enter wash, 25 lks. wide, course SW. from N.; up wash.
- 15.30 Leave wash, course from NE.; ascend S. slope 342 ft.
- 35.90 Spur, slopes E.; along E. slope, descend 20 ft.
- 40.00 Set an iron post, 3 ft. long, 1 in. diam., 18 ins. in the ground to bedrock, with a stone marked X at base of post, and in a mound of stone to top, for $\frac{1}{4}$ sec. cor., with brass cap marked

Subdivision of T. 14 N., R. 3 E.

BOOK 4072

Chains

$$\begin{array}{c} \frac{1}{4} \\ \text{S } 16 \mid \text{S } 15 \\ 1933 \end{array}$$

No bearing trees available.

45.00 Head of wash, course SE.; ascend SW. slope 75 ft.

60.00 Wash, course SW.

76.30 Wire fence, bears NW. and SE.

80.00 Set an iron post, 3 ft. long, 2 ins. diam., 22 ins. in the ground with a stone, mkd. X, deposited at the base, and in a mound of stone to top, for cor. of secs. 9, 10, 15 and 16, with brass cap marked

$$\begin{array}{c} \text{T } 14 \text{ N } R \text{ 3 } E \\ \text{S } 9 \mid \text{S } 10 \\ \hline \text{S } 16 \mid \text{S } 15 \end{array}$$

1933

No bearing trees available.

From this cor., cor. No. 1, Sur. No. 3001, Bugler, bears S. $47^{\circ} 46'$ W: 13.88 chs. dist.; a rock 12 x 12 x 4 ins. above ground, dimly marked, and witnessed as described in the official record. No other cors. of the mining claim could be found.

Land, rolling and mountainous.
Soil, granite loam; 3rd rate.
Timber, scrub cedar; undergrowth, oak, catclaw and manzanita.

40.00 N. $89^{\circ} 45'$ E., on a random line bet. secs. 10 and 15.
Set temp. $\frac{1}{4}$ sec. cor.

79.86 Intersect N. and S. line, 9 lks. N. of the cor. of secs. 10, 11, 14 and 15.

Thence

S. $89^{\circ} 49'$ W., on a true line bet. secs. 10 and 15.

Over rolling mountainous land, through scattering scrub cedar and medium undergrowth.

.36 Spur. slopes NE.; descend NW. slope 130 ft.

6.86 Gulch, course NE.; ascend E. slope 205 ft.

19.16 Draw, course NE.

25.36 Spur. slopes NE.; descend NW. slope 140 ft.

39.16 Enter gulch, course N. 60° E.; up gulch, ascend 420 ft.39.93 Set an iron post, 3 ft. long, 1 in. diam., 12 ins. in the ground to bedrock, with a stone, mkd. X, deposited at the base, and in a mound of stone to top, for $\frac{1}{4}$ sec. cor., with brass cap mkd.

Subdivision of T. 14 N., R. 3 E.

Chains

1/4 S 10
S 15
1933

No bearing trees available.

The tie to cor. No. 1, Sur. No 1227, Gulch mining claim, is recorded from the cor. of secs. 10, 11, 14 and 15.

53.66 Leave gulch, from SW.; ascend SE. slope.

58.76 Spur, slopes NE.; descend NW. slope 135 ft.

66.76 Short gulch, course N.

69.86 Gulch, course NE.; ascend NE. slope 130 ft.

71.93 A granite stone, 12 x 12 x 16 ins. above a mound of stone bears South, 81 lks. dist.; mkd. T N N 11.

79.86 The cor. of secs. 9, 10, 15 and 16.

Land, rolling mountainous.
Soil, granite loam; 3rd rate.
Timber, scrub cedar; undergrowth, oak, catclaw and manzanita.

N. 0° 02' W., bet. secs. 9 and 10.

Descend 130 ft. over NE. slope, through scattering undergrowth.

17.70 Wash, course E.; Over rolling E. slope.

Note: no cor. Sur. No 940, Ida Mining Claim, could be found.

28.60 Wash, course E.

35.30 Wash, course E.

39.90 Spur, slopes E.

40.00 Set an iron post, 3 ft. long, 1 in. diam., 15 ins. in the ground to bedrock, with a stone, mkd. X, deposited at the base, and in a mound of stone to top, for 1/4 sec. cor., with brass cap mkd.

1/4 S 9 | S 10
1933

No bearing trees available.

70.00 Wash, course E.

75.00 Spur, slopes E.

80.00 Set an iron post, 3 ft. long, 2 ins. diam., 15 ins. in the ground to bedrock; with a stone, mkd. X, deposited at the base, and in a mound of stone to top, for cor. of secs. 3, 4, 9 and 10, with brass cap mkd.

T 14 N R 3 E
S 4 | S 3
S 9 | S 10
1933

No bearing trees available

Subdivision of T. 14 N., R. 3 E.

EOCK 4072

Chains	Land, rolling. Soil, granite loam; 3rd rate. Timber, scrub cedar; undergrowth, oak, catclaw and manzanita.
40.00	N. 89° 49' E., on a random line bet. secs 3 and 10.
79.56	Set temp. $\frac{1}{4}$ sec. cor.
	Intersect N. and S. line 44 lks. N. of the cor. of secs. 2, 3, 10 and 11.
	Thence
	N. 89° 52' W., on a true line bet. secs. 3 and 10.
	Over rolling land, through scattering timber and undergrowth. Ascend E. slope 100 ft.
6.00	Low spur, slopes NE.; along N. slope, descend 100 ft.
6.50	Wire fence, bears N. 30° W. and S. 30° E.
12.20	Gulch, course NE.
29.30-	Old road, bears NE. and SW.; ascend E. slope 100 ft.
31.60	Spur, slopes NE.; descend NW. slope 200 ft.
39.78	Set an iron post, 3 ft. long, 1 in. diam., 22 ins. in the ground to bedrock, with a stone, mkd. X, deposited at the base, and in a mound of stone to top, for $\frac{1}{4}$ sec. cor., with brass cap mkd.
	$\begin{array}{r} S\ 3 \\ \hline S\ 10 \\ 1933 \end{array}$
	No bearing trees available.
43.05	Cor. No. 4 Sur. No. 941 Gold Ring mining claim, bears S. 16.15 chs. dist.; a stone marked G R IV set in a mound of stone.
44.90	Road, bears NW. and SE.
47.00	Wash, 25 lks. wide, course N. 60° E.; ascend NE. slope 60 ft.
52.20	Water pipe line, bears NE. and SW.
53.84	Cor. No. 3, Sur. No. 943, Gold King mining claim, not patented, bears S. 4.50 chs. dist.; a stone 16x14x12 ins. above ground, dimly marked G K 3.
57.70	Spur, slopes N. 60° E.; a house, bears S. 20° E., about 15.00 chs. dist.; along N. slope descend 30 ft.
72.50	Cor. No. 5, Sur. No. 598, Conger mining claim, bears N. 5.80 chs. dist.; a stone, 12x8x10 ins. above ground, marked C No 5. No other cors. of the claim could be found.
79.56	The cor. of secs. 3, 4, 9, 10.
	Land, mountainous rolling. Soil, granite loam; 3rd rate Timber, scrub cedar; undergrowth, oak, catclaw and manzanita.

Subdivision of T. 14 N., R. 3 E.

Chains	
	N. 0° 02' W., on a random line bet. secs. 3 and 4.
40.00	Set temp. $\frac{1}{4}$ sec. cor.
80.40	Intersect the N. bdy. of the Tp. 7 lks. W. of the cor. of secs. 3, 4, 33 and 34, described in the field notes of the N. bdy. of this township surveyed under this group.
	Thence
	S. 0° 01' W., on a true line bet. secs. 3 and 4.
	Over rolling mountainous land, through scattering timber and undergrowth.
2.20	Gulch, course N. 70° E.; ascend N. slope 180 ft.
11.90	Spur, slopes N. 80° E.; along E. slope.
13.00	House, bears W. about 10 chs. dist.
20.90	Wire fence, bears NW. and SE.
25.40	Gulch, course N. 70° E.; ascend N. slope 130 ft.
32.40	Spur, slopes N. 70° E.; descend S. slope 70 ft.
39.40	Drain, course E.; over E. slope.
40.40	Set an iron post, 3 ft. long, 1 in. diam., 25 ins. in the ground, for $\frac{1}{4}$ sec. cor.; with brass cap mkd.
	$\frac{1}{4}$ S 4 S 3
	1933
	raise a mound
	of stone, 3 ft. base, 2 ft. high, W. of cor.
44.40	Gulch, course NE.; ascend N. slope 280 ft.
56.40	Spur, slopes N. 70° E.; descend SW. slope 130 ft.
65.20	Gulch, course NE.; ascend N. slope 195 ft.
75.10	Spur, slopes N. 50° E.; trail along top of spur; descend SW. slope 40 ft.
79.00	Gulch, course N. 60° E.; ascend N. slope 40 ft.
80.40	The cor. of secs. 3, 4, 9 and 10
	Land, mountainous.
	Soil, granite loam; 3rd rate.
	Timber, oak, juniper and pinon; undergrowth, scrub oak, manzanita, blue brush, and catclaw

Subdivision of T. 14 N., R. 3 E.

BOOK 4072

Chains	
	From the cor. of secs. 27, 28, 33 and 34.
	West, on a random line bet. secs. 28 and 33.
40.00	Set temp. $\frac{1}{4}$ sec. cor.
80.00	Set temp. cor. of secs. 28, 29, 32 and 33
	Thence
	S. $0^{\circ} 02'$ E., on a random line bet. secs. 32, and 33.
40.00	Set temp. $\frac{1}{4}$ sec. cor.
73.20	A point 10 lks. E. of the cor. of secs. 32 and 33, on the S. bdy. of the Tp, described in the field notes of the N. bdy. of T. 13 N., R. 3 E., resurveyed under this group.
	Thence
	N. $0^{\circ} 02'$ W., on true line bet. secs. 32 and 33.
	Over rolling land, through scattering scrub cedar and medium undergrowth.
	Along E. slope, ascend 160 ft.
3.40	Road, bears W. to Dewey and E.
6.40	Secondary road, bears NE. and SW.
10.00	The Johnson Wash Ranger Station bears E. about 22 chs. dist.
12.70	Shallow wash, 20 lks. wide, course S. 20° E.
22.00	Drain, course SE.
28.00	Drain, course SE.
33.20	Set an iron post, 3 ft. long, 1 in. diam., 27 ins. in the ground, for $\frac{1}{4}$ sec. cor., with brass cap marked
	$s \ 32 \frac{1}{4} \ s \ 33$ 1933
	from which
	A scrub cedar, 12 ins. diam., bears N. 25° E., 46 lks. dist., mkd. $\frac{1}{4}$ S 33 B T.
	A scrub cedar, 12 ins. diam., bears N. $46\frac{1}{2}^{\circ}$ W., 156 lks. dist., mkd. $\frac{1}{4}$ S 32 B T.
	Ascend S. slope 202 ft.
46.60	Slopes E.; descend NE. slope 58 ft.
56.60	Short ravine, course E.; ascend SE. slope 45 ft.
62.50	Short spur, slopes SE.; the ore bin of the Arizona-Comstock mine bears E. about 7 chs. dist; descend NE. slope 70 ft.
66.50	Drain, course SE.; ascend S. slope 20 ft.
68.00	Short spur, slopes E.
69.40	Short ravine, course SE.; ascend gradually.
72.10	4 wire fence,, bears E. and W.

Subdivision of T. 14 N., R. 3 E.

Chains
73.20

Set an iron post, 3 ft. long, 2 ins. diam., 27 ins. in the ground, for cor. of secs. 28, 29, 32 and 33., with brass cap mkd.

T. 14 N R 3 E

S 29 | S 28.

S 32 | S 33

1933

from which

A scrub cedar, 10 ins. diam., bears N. 80½° E., 81 lks. dist., mkd. T 14 N R 3 E S 28 B T.

No other suitable trees available,
Raise a mound of stone, 3 ft. base, 2 ft. high, W. of cor.
Land, rolling.
Soil, granite loam, 2nd rate.
Timber, scrub cedar and juniper; undergrowth, oak and catclaw.

From the cor. of secs. 27, 28, 33 and 34.

West, on sectional correction line bet. secs. 28 and 33.

Over rolling mountainous land, through scattering scrub cedar and dense undergrowth.

Descend W. slope 390 ft.

18.50 Gulch, course SW.; ascend SE. slope 35 ft.

20.50 4 wire fence, bears NE., joins E. and W. fence 15 lks. SW.

21.70 Spur, slopes SW.; descend NW. slope 60 ft.

32.20 Short spur, slopes N.; descend W. slope 80 ft.

40.00 Road to Logan mine, unused, bears NE.

40.05 Set an iron post, 3 ft. long, 1 in. diam., 20 ins. in the ground to bedrock, with a stone marked X at base of post, and in a mound of stone to top, for ¼ sec. cor., with brass cap mkd.

S 28

¼ S 33

1933

A cattle guard in E. and W. fence bears SW. 1 ch. dist.

40.10 Wash, 15 lks. wide, course SW.; over broken S. slope.

48.20 Short ravine; course SW.

54.70 Short ravine; course SE.

57.40 Short spur, slopes S.

63.10 Short spur, slopes S.; descend along S. slope.

73.80 Wire fence, bears NW., joins E. and W. fence 15 lks. SE.

77.20 Pipe line, 3 ins. diam., bears NW. and SE.

77.40 Rocky wash, 15 lks. wide, course SE.; ascend 20 ft.

Subdivision of T. 14 N., R. 3 E.

BOOK 4072

Chains 80.10	<p>The cor. of secs. 28, 29, 32 and 33,</p> <p>Land, rolling and rolling mountainous. Soil, granite loam, 3rd rate. Timber, scrub cedar and juniper; undergrowth, oak, manzanita, catclaw and mahogany.</p>
	<p>N. 0° 02' W., bet. secs. 28 and 29.</p> <p>Over mountainous land, through scattering scrub cedar and medium undergrowth.</p> <p>Along E. slope, descend 10 ft.</p>
3.50	Rocky wash, 15 lks. wide, course SE.; ascend 25 ft.
5.80	Pipe line, 3 ins. diam., bears NW. and SE.; ascend SW. slope 630 ft.
38.00	Short spur, slopes SW.; descend W. slope 15 ft.
40.00	<p>Set an iron post, 3 ft. long, 1 in. diam., 16 ins. in the ground to bedrock, with a stone marked X at base of post, and in a mound of stone to top, for $\frac{1}{4}$ sec. cor., with brass cap marked</p> <p style="text-align: center;"> $\frac{1}{4}$ S 29 S 28 1933 </p> <p>No suitable witness available.</p>
40.20	Short ravine, course W.; ascend SW. slope 284 ft.
62.50	A corral in a pass bears W. about 9 chs. dist. This point is on the poorly defined edge of a malpais mesa bearing SE. and NE.; descend NW. slope 310 ft.
80.00	<p>Set an iron post, 3 ft. long, 2 ins. diam., 16 ins. in the ground to bedrock, with a stone marked X at base of post, and in a mound of stone to top, for cor. of 20, 21, 28 and 29, with brass cap mkd.</p> <p style="text-align: center;"> T 14 N R 3 E S 20 S 21 S 29 S 28 1933 </p> <p>No suitable witness available.</p> <p>Land, mountainous. Soil, adobe loam, 3rd rate. Timber, scrub cedar and oak; undergrowth, oak, manzanita, catclaw and buckthorn.</p>
	<p>East, on a random line bet. secs. 21 and 28.</p>
40.00	Set temp. $\frac{1}{4}$ sec. cor.
80.08	<p>Intersect N. and S. line 4 lks. N. of the cor. of secs. 21, 22, 27 and 28.</p> <p>Thence</p> <p>N. 89° 58' W., on true line bet. secs. 21 and 28.</p> <p>Over rolling land, through scattering scrub cedar and medium undergrowth.</p>

Subdivision of T. 14 N., R. 3 E.

Chains	
	Ascend general E. slope 470 ft.
6.50	Trail, an old road, bears S. to Logan mine and N. to Cherry.
40.04	Set an iron post, 3 ft. long, 1 in. diam., 14 ins. in the ground to bedrock, with a stone marked X at base of post, and in a mound of stone to top, for $\frac{1}{4}$ sec. cor., with brass cap marked
	S 21 $\frac{1}{4}$ S 28 1933
	No suitable bearing trees available,
	Ascend E. slope 350 ft.,
45.85	Gallows frame of Logan mine bears S. $37^{\circ} 37'$ E. about 35 chs. dist.
51.80	Over malpais mesa, bears NE. and S.
63.80	Wire fence bears N. and S.
66.70	Leave mesa, bears NE. and SW.; descend 261 ft. over general NW. slope.
70.60	Enter thicket of oak timber.
72.70	Leave same.
80.08	The cor. of secs. 20, 21, 28 and 29.
	Land, rolling mountainous and mesa. Soil, adobe, 3rd rate. Timber, oak and scrub cedar; undergrowth, oak and catclaw.
	N. $0^{\circ} 02'$ W. bet. secs. 20 and 21.
	Over rolling mountainous land, through scattering scrub cedar and dense undergrowth.
	Descend NW. slope 165 ft.
14.10	Wash, 15 lks. wide, course NE.; along E. slope.
18.30	Trail, bears NE. and SW.
30.20	Spur, slopes NE.; hill bears N. 65° E., 4 chs. dist.; descend NE. slope 155 ft.
30.80	Same trail, bears NW. to Cherry and SE.
36.20	Ravine, course NE.
40.00	Set an iron post, 3 ft. long, 1 in. diam., 20 ins. in the ground, to bedrock, with a stone marked X at base of post, and in a mound of stone to top, for $\frac{1}{4}$ sec. cor., with brass cap marked
	$\frac{1}{4}$ S 20 S 21 1933
	from which
	An alligator juniper, 30 ins. diam., bears N. 47° E. 47 lks. dist., mkd. $\frac{1}{4}$ S 21 B T.

Subdivision of T. 14 N., R. 3 E.

BOOK 4072

Chains

Descend E. slope 40 ft.

50.00 Slope changes to N.; descend 135 ft.

60.70 Enter wash, S. fork of Cherry Creek, dry, course E.

62.80 Leave wash.

63.05 Wire fence, bears E. and W.; ascend S. slope 40 ft.

67.40 Spur, slopes SE.; descend gradually.

68.70 Enter chicken yard, bears N. and S.

72.81 Intersect line 3-4 of H. E. S. No. 474, at a point from which cor. No. 4 bears S. 77° 29' W., 938 chs. dist.; a granite stone, 6x8x12 ins. above ground, firmly set, marked and witnessed as described in the official record.

73.70 Road, bears E. and W.; through orchard.

80.00 The true point for cor. of secs. 16, 17, 20 and 21 falls in orchard. For witness cor. sec. line bet. secs. 16 & 17.

Land, rolling.

Soil, granite loam; 2nd rate.

Timber, oak, juniper and scrub cedar; undergrowth, oak, catclaw and manzanita.

S. 89° 58' E. on a random line bet. secs. 16 and 21.

40.00 Set temp. 1/4 sec. cor.

80.20 Intersect N. and S. line 23 lks. S. of the cor. of secs. 15, 16, 21 and 22.

Thence

S. 89° 52' W., on a true line bet. secs. 16 and 21.

Over rolling broken land, through scattering scrub cedar and medium undergrowth.

Descend slightly over W. slope.

3.50 Wash, 30 lks. wide, course SW.

5.70 Low spur, slopes S.

9.30 Wash, 15 lks. wide, course S.; ascend E. slope 45 ft.

29.90 Spur, slopes S.; descend 20 ft.

35.00 Wash, 10 lks. wide, course S.; ascend E. slope 40 ft.

40.10 Set an iron post, 3 ft. long, 1 in. diam., 16 ins. in the ground to bedrock, with a stone, mkd. X, deposited at the base, and in a mound of stone to top, for 1/4 sec. cor., with brass cap mkd.

1/4 S. 16
S. 21
1933

No suitable witness available.

Ascend E. slope 20 ft.

Subdivision of T. 14 N., R. 3 E.

Chains

- 41.30 Spur, slopes S.; descend SW. slope 50 ft.
 - 48.90 Wash, 20 lks. wide, course S. 25° W.
 - 52.00 Fence, bears N. and S.
 - 57.34 Intersect line 4-1, Sur. No. 2277, Saint Louis mining claim, at a point from which cor. No. 1, bears S. 18° 18' W., 8.38 chs. dist.; a granite stone, 6x12x12 ins. above ground, firmly set, marked and witnessed as described in the official record.
 - 60.70 Wash, 30 lks. wide, course S.
 - 64.80 Highway, bears SE. to Camp Verde and N. 88° W. to Cherry.
 - 66.93 Intersect line 2-3, Sur. No. 2277, Saint Louis mining claim, at a point from which cor. No. 2 of the mining claim bears S. 18° 18' W., 5.34 chs. dist.; a granite stone, 10x14x12 ins. above ground, firmly set, marked and witnessed as described in the official record.
 - 68.99 The Cherry school, bears N. about 1½ chs. dist.
The Cherry store, bears S. about 1½ chs. dist.
 - 79.06 Intersect line 7-1, H. E. S. No. 474. at a point from which cor. No. 7 bears N. 40° 39' W., 2087 chs. dist.; a black oak, 14 ins. diam., marked and witnessed as described in the official record.
 - 79.00 Cherry Creek wash, dry, 40 lks. wide, course SE.
 - 79.60 Fence, bears NW. and SE., enter orchard.
 - 80.20 The true point for cor. of secs. 16, 17, 20 and 21.

Land, rolling,
Soil, granite loam, 2nd rate.
Timber, scrub cedar and oak; undergrowth, oak and catclaw.

 - N. 0° 02' W., bet. secs. 16 and 17.

Through apple orchard.
 - 0.50 Set an iron post, 3 ft. long, 2 ins. diam., 30 ins. in the ground, for witness cor. of secs. 16, 17, 20 and 21, with brass cap mkd.
- T 14 N R 3 E
 S 17 | S 16
 S 20 | S 21
 W C
 1933
- from which
- A cottonwood, 20 ins. diam., bears N. 85° 30' E., 19 lks. dist., mkd. W C T 14 N R 3 E S 16 B T.
 - A walnut, 24 ins. diam., bears S. 49° 45' E., 246 lks. dist., mkd. W C T 14 N R 3 E S 21 B T.
 - A cherry, 6 ins. diam., bears N. 34° 45' E., 154 lks. dist., mkd. W C T 14 N R 3 E S 16 B T.

Subdivision of T. 14 N., R. 3 E.

BOOK 4072

Chains

A cottonwood, 16 ins. diam., bears N. 38° 00' W., 19 lks. dist., mkd. W C T 14 N R 3 E S 17 B T.

- 0.70 Leave orchard, bears E. and W.
- 1.10 Highway, bears W. to Dewey and E. to Camp Verde.
- 1.30 Cherry Creek wash, dry, 30 lks. wide, course S. Over rolling land, through scattering scrub cedar and oak and medium underbrush.
- 1.33 Intersect line 7-1, H.E.S. No. 474, at a point from which cor., No. 7 bears N. 40° 39' W., 112 lks. dist.
- 5.00 Short spur, slopes SW.; descend N. slope 15 ft.
- 12.00 Short ravine, course SW.; ascend S. slope 60 ft.
- 20.00 Low hill on short spur, slopes SW.; descend NW. slope
- 22.90 Wire fence, bears NW. and SE.; a house bears W. about 16 chs. dist.
- 38.30 Wash, 20 lks. wide, course SW.; ascend S. slope.
- 40.00 Set an iron post, 3 ft. long, 1 in. diam., 30 ins. in the ground, for $\frac{1}{4}$ sec. cor., with brass cap marked

$\frac{1}{4}$
 S 17 | S 16
 1933

from which

An oak, 7 ins. diam., bears N. 63° E., 17 lks. dist., marked $\frac{1}{4}$ S 16 B T.

An oak, 12 ins. diam., bears S. 35° W., 61 lks. dist., marked $\frac{1}{4}$ S 17 B T.

Ascend rolling SW. slope.

- 80.00 Set an iron post, 3 ft. long, 2 ins. diam., 28 ins. in ground, for cor. of secs. 8, 9, 16 and 17, with brass cap marked

T 14 N R 3 E
 S 8 | S 9
 S 17 | S 16
 1933

Raise a mound of stone, 3 ft. base, 2 ft. high, W. of cor.

Land, rolling.
Soil, granite loam, 2nd rate.
Timber, scrub cedar and oak; undergrowth, oak and catclaw.

N. 89° 52' E. on a random line bet. secs. 9 and 16.

- 40.00 Set $\frac{1}{4}$ sec. cor.
- 80.20 Intersect N. and S. line 45 lks. N. of the cor. of secs. 9, 10, 15 and 16.

Subdivision of T. 14 N., R. 3 E.

Chains	
	Thence
-	N. 89° 49' W. on true line bet. secs. 9 and 16.
	Over rolling land, through scattering oak and juniper, and undergrowth.
	Ascend E. slope.
2.80	Wire fence, bears NW. and SE., on top of ridge, bears NW. and SE.; descend W. slope.
27.60	Wash, course SW.
32.80	Road, bears N. and S.; a mine bears N. about 30 chs. dist.
40.10	Set an iron post, 3 ft. long, 1 in. diam., 28 ins. in the ground, for $\frac{1}{4}$ sec. cor., with brass cap marked
	$\begin{array}{r} S\ 9 \\ \hline \frac{1}{4} \\ S\ 16 \\ 1933 \end{array}$
	Raise a mound of stone, 3 ft. base, 2 ft. high, N. of cor.
63.40	Road, bears NW. and SE.
74.20	Wash, course S.
78.20	Drain, course SW.
80.20	The cor. of secs. 8, 9, 16 and 17.
	Land, rolling.
	Soil, granite loam, 2nd rate.
	Timber, oak, juniper and scrub cedar; undergrowth, oak, catclaw and manzanita.
	N. 0° 02' W. bet. secs. 8 and 9.
	Ascend S; slope 15 ft. through scattering timber and dense undergrowth.
2.50	Short spur, slopes SW.
4.00	Head of drain, course W.; ascend S. slope 25 ft.
5.70	Short spur, slopes W.; descend N. slope 40 ft.
8.00	Gulch, course S. 70° W.; ascend S. slope 75 ft.
12.75	Cor. No. 1, Sur. No. 3003, Independence mining claim, bears E., 7.30 chs. dist.; a granite stone in place; 8x10x12 ins. above ground, marked and witnessed as described in the official record.
14.00	Short spur, slopes SW.; descend NW. slope 15 ft.
17.70	Drain, course W.; ascend 15 ft.
19.90	Short spur, slopes S. 70° W.; descend. 20 ft.
25.00	Head of gulch, course SW.; ascend S. slope, 90 ft.
30.00	Short spur, slopes SW. over W. slope.

Subdivision of T. 14 N., R. 3 E.

BOOK 4072

Chains

40.00

Set an iron post, 3 ft. long 1 in. diam., 28 ins. in the ground, for $\frac{1}{4}$ sec. cor., with brass cap marked

S 8 $\frac{1}{4}$ S 9
1933

Raise a mound of stone, 3 ft. base, 2 ft. high, W. of cor.

43.30

Drain, course SW.

55.00

Gulch, course SW.; ascend S. slope 100 ft.

60.30

Spur, slopes S. 60° W.; descend NW. slope 40 ft.

71.10

Gulch, course SW.; ascend SW. slope 210 ft.

80.00

Set an iron post, 3 ft. long, 2 ins. diam., 30 ins. in the ground, for cor. of secs. 4, 5, 8 and 9, with brass cap mkd.

T 14 N R 3 E
S 5 | S 4
S 8 | S 9
1933

Raise a mound of stone, 3 ft. base, 2 ft. high, W. of cor.

Land, rolling.
Soil, granite loam, 2nd rate.
Timber, oak, juniper and scrub cedar; undergrowth, oak, catclaw and manzanita.

8.93

S. 89° 49' E. on a random line bet. secs. 4 and 9.

To determine the distance over cliffs by triangulation, I use this station for point "A", and set a flag at point "B" on line S. 89° 49' E. From point "A", a flag at point "C" bears S. 46° 32' E., 7.20 chs. dist. From point "B" point "C" bears S. 80° 35' W. Vertical angle at point "A" is -7°.

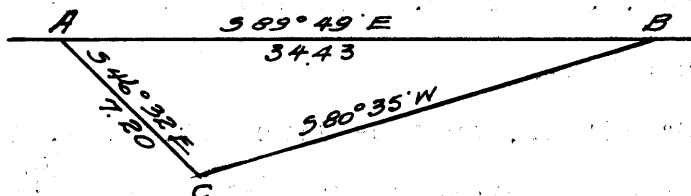

Dist. on line	8.93 chs.
Dist. by triangulation	<u>34.43</u>
	43.36
By return measurement	<u>3.36</u>
	40.00

40.00

Set temp. $\frac{1}{4}$ sec. cor.

80.04

Intersect N. and S. line 12 lks. N. of the cor. of secs. 3, 4, 9, 10.

Thence

N. 89° 44' W., on true line bet. secs. 4 and 9.

Along N. slope through scattering timber and brush.

2.04

Head of gulch, course NE.; ascend SE. slope 220 ft.

Subdivision of T. 14 N., R. 3 E.

Chains	
6.90	Trail, bears NE. and SW.
7.40	Spur, slopes NW.; descend 80 ft.
14.00	Head of draw, course NE.; ascend E. slope 405 ft.
26.00	Spur, slopes NE.; along N. slope.
36.70	Spur, slopes N.; a mound of stone bears N. 57° W., about 35 chs. dist.; descend 80 ft.
40.02	Set an iron post, 3 ft. long, 1 in. diam., 28 ins. in the ground, for $\frac{1}{4}$ sec. cor., with brass cap marked
	S 4 $\frac{1}{4}$
	S 9 1933
	Raise a mound of stone, 3 ft. base, 2 ft. high, N. of cor.
43.00	Gulch, course N.; ascend NE. slope 350 ft.
67.50	Limestone cliff, 20 ft. high, faces NE.; fence bears NW. and SE.
71.20	Ridge, bears NW. and SE.; descend SW. slope 175 ft.
80.04	The cor. of secs. 4, 5, 8 and 9.
	Land, rough mountainous. Soil, 3rd and 4th rate. Timber, oak and juniper; undergrowth, scrub oak, blue brush and manzanita.
	N. 0° 02' W., on a random line bet. secs. 4 and 5.
40.00	Set temp. $\frac{1}{4}$ sec. cor.
80.50	Intersect N. bdy. of the Tp. 33 lks. W. of the cor. of secs. 4, 5, 32 and 33, described in the field notes of the N. bdy. of the Tp. surveyed under this group.
	Thence
	S. 0° 12' W., on true line bet. secs. 4 and 5.
	Descend SE. slope 20 ft., through scattering timber and brush.
1.60	Short gulch, course N. 70° E.; ascend NE. slope 145 ft.
9.00	Spur, slopes N. 70° E.; over E. slope.
14.90	Gulch, course N. 70° E.
21.40	Gulch, course NE.
38.60	Canyon, course NE.; ascend NW. slope 425 ft.
40.50	Set an iron post, 3 ft. long, 1 in. diam., 22 ins. in the ground to bedrock, with a stone marked X at base of post, and in a mound of stone to top, for $\frac{1}{4}$ sec. cor., with brass cap marked
	$\frac{1}{4}$ S 5 S 4 1933

Subdivision of T. 14 N., R. 3 E.

BOOK 4072

Chains	
47.28	U. S. L. M. No. 1767 bears E. 7.40 chs. dist.; a granite stone, 12x12x18 ins. above ground, firmly set, marked U. S. L. M. No. 1767 on E. face, and witnessed as described in the official record.
51.50	Spur, slopes NE.; descend SE. slope 50 ft.
56.30	Head of gulch, course NE.; ascend NE. slope 300 ft.
67.00	Spur, slopes N. 20° W.; ascend NW. slope 55 ft.
71.70	Wire fence, bears NW. and SE.
74.50	Ridge, bears N. 60° W. and S. 60° E.; trail on top of ridge; descend SW. slope 55 ft.
80150	The cor. of secs. 4, 5, 8 and 9. Land, mountainous. Soil, adobe 3rd rate. Timber, oak and juniper; undergrowth, scrub oak, blue brush and manzanita.
	From the cor. of secs. 28, 29, 32 and 33.
	West, on a random line bet. secs. 29 and 32.
40.00	Set temp. $\frac{1}{4}$ sec. cor.
80.00	Set temp. cor. of secs. 29, 30, 31 and 32.
	Thence
	S. 0° 03' E., on a random line bet. secs. 31 and 32.
40.00	Set temp. $\frac{1}{4}$ sec. cor.
74.84	A point 22 lks. W. of the cor. of secs. 31 and 32, on the S. bdy. of the Tp. described in the field notes of the N. bdy. of T. 13 N. R. 3 E, resurveyed under this group.
	Thence
	N. 0° 03' W., on true line bet. secs. 31 and 32.
	Over rolling and broken land, through scattering scrub cedar and medium undergrowth.
	Ascend broken SW. slope 212 ft.
27.90	Low ridge, bears E. and W.; Ascend E. slope 15 ft.
34.84	Set an iron post, 3 ft. long, 1 in. diam., 18 ins. in the ground to bedrock, with a stone marked X at base of post, and in a mound of stone to top, for $\frac{1}{4}$ sec. cor., with brass cap mkd.
	$\frac{1}{4}$ S 31 S 32 1933
	No suitable witness available.
	A house at Wymoza mine bears S. 67 $\frac{1}{2}$ ° E., about $\frac{1}{2}$ mile dist.; a large water tank near house. Cor. stands on a short spur, slopes E; descend 55 ft. over NE. slope.

Subdivision of T. 14 N., R. 3 E.

Chains																									
45.00	Wash, 20 lks. wide, course E.; ascend SW. slope 150 ft.																								
55.50	Spur, slopes E.; descend E. slope 20 ft.																								
61.10	Short ravine, course SE.; ascend 35 ft.																								
67.20	Ravine, course SE.; ascend S. slope 130 ft.																								
74.84	Set an iron post, 3 ft. long, 2 ins. diam., 27 ins. in the ground, for cor. of secs. 29, 30, 31 and 32, with brass cap marked																								
	<table border="0"> <tr><td>T</td><td>14</td><td>N</td><td>R</td><td>3</td><td>E</td></tr> <tr><td>S</td><td>30</td><td>S</td><td>29</td><td></td><td></td></tr> <tr><td>S</td><td>31</td><td>S</td><td>32</td><td></td><td></td></tr> <tr><td></td><td></td><td></td><td></td><td>1933</td><td></td></tr> </table>	T	14	N	R	3	E	S	30	S	29			S	31	S	32							1933	
T	14	N	R	3	E																				
S	30	S	29																						
S	31	S	32																						
				1933																					
	Raise a mound of stone, 3 ft. base, 2 ft. high, W. of cor.																								
	Land, rolling.																								
	Soil, granite loam, 2nd and 3rd rates.																								
	Timber, scrub cedar; undergrowth, oak and catclaw.																								
	From the cor. of secs. 28, 29, 32 and 33.																								
	West, on sectional correction line bet. secs. 29 and 32.																								
	Over rolling mountainous land, through scattering scrub cedar and dense undergrowth.																								
	Ascend E. and NE. slope 272 ft.																								
24.40	Ridge, bears N. and S.; descend 25 ft.																								
27.40	Ravine, course S.; ascend 35 ft.																								
30.80	Spur, slopes S.; descend SW. slope 50 ft.																								
38.00	Ravine, course S.; ascend E. slope 15 ft.																								
39.89	Set an iron post, 3 ft. long, 1 in. diam., 18 ins. in the ground to bedrock, with a stone marked X at base of post, and in a mound of stone to top, for $\frac{1}{4}$ sec. cor., with brass cap mkd.																								
	<table border="0"> <tr><td>S</td><td>29</td></tr> <tr><td>S</td><td>32</td></tr> <tr><td></td><td>1933</td></tr> </table>	S	29	S	32		1933																		
S	29																								
S	32																								
	1933																								
	No suitable witness available.																								
	Ascend NE. slope 165 ft.																								
48.70	4 wire fence, bears NW. and E.																								
55.20	Ridge, bears NE. and S.; descend SW. slope 50 ft.																								
61.80	Ravine, course S.; ascend 20 ft.																								
64.80	Spur, slopes S.																								
68.20	Ravine, course S.																								
70.30	Spur, slopes SE.																								
72.50	Ravine, course S.; ascend E. slope 80 ft.																								
76.80	Spur, slopes S.; descend 25 ft.																								
78.70	Drain, course S.; ascend 15 ft.																								

Subdivision of T. 14 N., R. 3 E.

BOOK 4072

Chains

79.70 Spur, slopes S.

79.78 The cor. of secs. 29, 30, 31 and 32.

Land, rolling mountainous.
Soil, granite loam; 3rd rate.
Timber, scrub oak; undergrowth, oak, manzanita and catclaw.

West, on sectional correction line bet. secs. 30 and 31.

Over rolling land, through scattering scrub cedar and medium undergrowth.

Descend SW. slope 48 ft.

4.30 Ravine, course SE.; ascend 60 ft. over E. slope.

16.00 Ridge, bears NE. and S.; descend NW. slope 300 ft.

36.20 Wash, 15 lks. wide, course S. 20° W.; over S. slope.

40.00 Set an iron post, 3 ft. long, 1 in. diam., 18 ins. in the ground to bedrock, with a stone, mkd. X, deposited at the base, and in a mound of stone to top, for $\frac{1}{4}$ sec. cor., with brass cap mkd.

$$\frac{1}{4} \begin{array}{r} S 30 \\ \hline S 31 \\ 1933 \end{array}$$

No suitable witness available.

48.20 Low spur, slopes SW.; descend 30 ft.

53.40 Highway, bears S. to Dewey and N. to Cherry.

54.80 Hackberry Wash, 30 lks. wide, course S. 30° E.; ascend general E. slope 130 ft.

65.00 Drain, course SE.; along SE. slope.

77.94 The cor. of secs. 25, 30, 31 and 36, described in the field notes of the W. bdy. of the Tp, surveyed under this group.

Land, mountainous.
Soil, adobe, 3rd rate.
Timber, oak, juniper and pinon; undergrowth, scrub oak, manzanita, blue brush and catclaw.

Subdivision of T. 14 N., R. 3 E.

Chains

From the cor. of secs. 29, 30, 31 and 32.

N. 0° 03' W., bet. secs. 29 and 30.

Over rolling mountainous land, through scattering scrub cedar, pinon, oak, and dense undergrowth, Over top of small spur, ascend S. slope 90 ft.

- 2.70 A cabin, bears S. 43° 30' W., about 60.00 chs. dist.
A cabin, bears S. 44° 30' W., about 60.00 chs. dist.
A cabin, bears S. 46° 30' W., about 30.00 chs. dist.
- 11.00 Spur, slopes SW.; along W. slope of spur ascend 30 ft.
- 11.25 Four wire fence, bears E. and W., a corner of the fence, bears W., 60 lks. dist.
- 11.80 Fence, bears N. 18° 50' E. and SW.
- 18.30 Wash, 10 lks. wide, course SW.; ascend SE. slope 120 ft.
- 21.80 Wire fence, bears N. 56° 30' W. and S. 56° 30' E.
- 36.50 Ridge, bears SW. and E.; descend NW. slope 50 ft.
- 40.00 Set an iron post, 3 ft. long, 1 in. diam., 27 ins. in the ground, for $\frac{1}{4}$ sec. cor., with brass cap mkd.

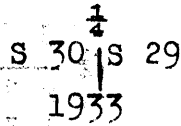

Raise a mound of stone, 3 ft. base, 2 ft. high, W. of cor.
Descend gradually over NW. slope.

- 57.30 Wash, 30 lks. wide, course NE.; over rolling E. slope.
- 71.50 Spur, slopes NE.; descend NW. slope 105 ft. through oak and pine timber.
- 79.00 Small wash, course NE.; along E. slope.
- 80.00 Set an iron post, 3 ft. long, 2 ins. diam., 20 ins. in the ground to bedrock, and in a mound of stone to top, for cor. of secs. 19; 20, 29 and 30; with brass cap mkd.

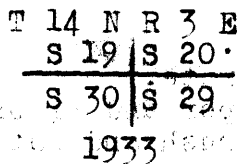

from which

- A pine, 10 ins. diam., bears N. 81° 00' E., 9 lks. dist., mkd. T 14 N R 3 E S 20 B T.
- A pine, 12 ins. diam., bears S. 74° 00' E., 135 lks. dist., mkd. T 14 N R 3 E S 29 B T.
- A pine, 12 ins. diam., bears S. 31° 30' W., 109 lks. dist., mkd. T 14 N R 3 E S 30 B T.
- A blackjack oak, 10 ins. diam., bears N. 15° 00' W., 82 lks. dist., mkd. T 14 N R 3 E S 19 B T.

Land, rolling,
Soil, granite loam; 2nd rate.
Timber, cedar, oak and pine; undergrowth, oak and catclaw.

Subdivision of T. 14 N., R. 3 E.

BOOK 4072

Chains	East, on a random line bet. secs. 20 and 29.
40.00	Set temp. $\frac{1}{4}$ sec. cor.
79.92	Intersect N. and S. line 12 lks. S. of the cor. of secs. 20, 21, 28, and 29.
	Thence
	S. 89° 55' W., on true line bet. secs. 20 and 29.
	Over rolling mountainous land, through scattering scrub cedar and medium undergrowth.
	Descend NW. slope 60 ft.
3.00	Trail, bears N. and S.
6.00	Ravine, course N.; ascend E. slope 300 ft.
19.00	Over rolling top of malpais mesa, bears N. and S.
23.00	Leave top of mesa, bears N. and S., descend W. slope 420 ft.
39.96	Set an iron post, 3 ft. long, 1 in. diam., 18 ins. in the ground to bedrock, with a stone marked X at base of post, and in a mound of stone to top, for $\frac{1}{4}$ sec. cor., with brass cap marked
	$\frac{1}{4} \begin{array}{l} S 20 \\ S 29 \\ 1933 \end{array}$
	No suitable witness available.
	Descend NW. slope 90 ft.
43.00	Enter scattering pine and oak timber.
48.20	4 wire fence, bears N. and S.
50.30	Wash, 20 lks. wide, course N. 20° W.; ascend NE. slope 65 ft.
62.00	Spur; slopes N.; descend general W. slope 120 ft.
73.30	Wash, 20 lks. wide, course N.; over rolling land,
79.30	Small wash, course N.
79.92	The cor. of secs. 19, 20, 29 and 30.
	Land, rolling. Soil, adobe and granite loam, 3rd rate. Timber, oak, pine, juniper and scrub cedar; undergrowth oak, manzanita, catclaw and mahogany.
	West, on a random line bet. secs. 19 and 30.
40.00	Set temp. $\frac{1}{4}$ sec. cor.
77.92	Intersect W. bdy. of the Tp. 26 lks. N. of the cor. of secs. 19, 24, 25 and 30, described in the field notes of the W. bdy. of the Tp. surveyed under this group.
	Thence
	N. 89° 49' E., on true line bet. secs. 19 and 30

Subdivision of T. 14 N., R. 3 E.

Chains

Over gently rolling E. slope along drain, general course E.; through dense underbrush, descend 140 ft.

37.92 Set an iron post, 3 ft. long, 1 in. diam., 30 ins. in the ground, for $\frac{1}{4}$ sec. cor., with brass cap marked

S 19
 $\frac{1}{4}$ —————
S 30
1933

from which

A black oak, 8 ins. diam., bears N. 30° E., 21 lks. dist., mkd. $\frac{1}{4}$ S 19 B T.

A juniper, 10 ins. diam., bears S. 51 $\frac{1}{2}$ ° E., 138 lks. dist., mkd. $\frac{1}{4}$ S 30 B T.

39.20 Highway, bears NE. and SW.

46.00 Drain turns SE.; over S. slope.

50.40 Wash, 6 lks. wide, course N.; over broken N. slope.

77.92 The cor. of secs. 19, 20, 29 and 30.

Land, rolling,
Soil, adobe and granite loam, 2nd and 3rd rate.
Timber, oak, pine, juniper and scrub oak; undergrowth,
oak, manzanita, catclaw and mahogany.

N. 0° 03' W., bet. secs. 19 and 20.

Over rolling land, through moderate oak, pine and scrub cedar timber, and medium undergrowth.

Descend E. slope 60 ft.

8.50 Wash, 10 lks. wide, course NW.

10.50 Same wash, course NE.; descend general E. slope 60 ft.

23.10 Drain, course NE.

32.90 S. fork of Cherry Creek, dry wash, 30 lks. wide, course E.; ascend steep S. slope 40 ft.

34.50 Over low short spur, slopes N.

38.00 Descend N. slope 30 ft.

39.90 Drain, course E.

40.00 Set an iron post, 3 ft. long, 1 in. diam., 28 ins. in the ground, with deposit of copper auto license plate, for $\frac{1}{4}$ sec. cor., with brass cap marked

$\frac{1}{4}$
S 19 | S 20
1933

from which

A blackjack oak, 10 ins. diam., bears S. 52° E., 47 lks. dist., mkd. $\frac{1}{4}$ S 20 B T.

A pine, 10 ins. diam., bears N. 64 $\frac{1}{2}$ ° W., 125 lks, dist., mkd. $\frac{1}{4}$ S 19 B T.

Ascend rolling E. slope 100 ft. to sec. cor.

Subdivision of T. 14 N., R. 3 E.

BOOK 4072

Chains	
44.70	Highway, bears E. to Cherry and W. to Dewey.
45.20	Drain, course E.
46.60	Short branch road to Midway Park, bears NW.
66.00	Enter very scattering timber, bears E. and W.
67.00	Wash, 15 lks. wide, course E.
80.00	Set an iron post, 3 ft. long, 2 ins. diam., 27 ins. in the ground, for cor. of secs. 17, 18, 19 and 20, with brass cap marked.
	T 14 N R 3 E S 18 S 17 S 19 S 20 1933
	from which
	A juniper 12 ins. diam., bears N. 54° 45' E., 205 lks. dist., mkd., T 14 N R 3 E S 17 B T. A black oak, 6 ins. diam., bears N. 84° E., 91 lks. dist., mkd., T 14 N R 3 E S 20 B T. A black oak, 8 ins. diam., bears S. 89° W., 63 lks. dist., mkd., T 14 N R 3 E S 19 B T. A black oak, 8 ins. diam., bears N. 58° W., 97 lks. dist., mkd. T 14 N R 3 E S 18 B T.
	Land, rolling, Soil, granite loam, 2nd rate. Timber, pine, oak and scrub cedar; undergrowth, oak, catclaw, manzanita and mahogany.
	N. 89° 55' E., on a random line bet. secs. 17 and 20.
40:00	Set temp. $\frac{1}{4}$ sec. cor.
50.00	To avoid fences and houses on line, traverse as follows; S. 76° 45' E., 14.44 chs. N. 78° 15' E., 16.45 chs., to the true point for cor. of secs. 16, 17, 20 and 21. Computed into terms of the random line, at
80:16	Intersect the true point for cor. of secs. 16, 17, 20 and 21. Thence, S. 89° 55' W., on true line bet. secs. 17 and 20. Over rolling land, through scattering oak, cherry and scrub cedar timber and medium undergrowth.
26.97	Intersect line 3-4 of H. E. S. No. 475 at a point from which cor. No. 4 bears N. 5° 17' W., 10.27 chs. dist.; a granite boulder in place, 4 ft. diam., marked and witnessed as described in the official record. Highway, bears NW. to Dewey and SE. to Cherry.
27.40	Wire fence along highway, bears NW. and SE.; ascend NE. slope 65 ft.
32.40	Wire fence, bears N. and S.
38.80	Short spur, slopes N; descend W. slope 20 ft.

Subdivision of T.14 N., R 3 E.

Chains 40.08	<p>Set an iron post, 3 ft. long, 1 in. diam., 24 ins. in the ground to bedrock, in a small mound of stone, for $\frac{1}{4}$ sec. cor., with brass cap marked</p> <p style="text-align: center;"> $\frac{1}{4} \begin{array}{r} S 17 \\ \hline S 20 \\ 1933 \end{array}$ </p> <p style="text-align: right;">from which</p> <p>A juniper, 6 ins. diam., bears S. 48° W., 24 lks. dist., mkd., $\frac{1}{4}$ S 20 B T.</p> <p>A cherry, 6 ins. diam., bears N. 60° W., 35 lks. dist., mkd. $\frac{1}{4}$ S 17 B T.</p> <p>Descend NW. slope 8 ft.</p>
42.40	Wash, near head, 20 lks. wide, course N. 70° E.
43.40	Highway, bears N. 70° E. to Cherry and S. 70° W. to Dewey; ascend general SE. slope to cor.
63.10	Road, bears N., to General mine, and S.
80.16	The cor. of secs. 17, 18, 19 and 20.
	Land, rolling.
	Soil, granite loam, 2nd rate.
	Timber, oak, cherry, alligator juniper and scrub cedar; undergrowth, oak, manzanita and catclaw.
	S. 89° 49' W., on a random line bet. secs. 18 and 19.
40.00	Set temp. $\frac{1}{4}$ sec. cor.
77.73	Intersect the W. bdy. of the Tp. 9 lks. N. of the cor. of secs. 13, 18, 19 and 24, described in the field notes of the W. bdy. of the Tp. surveyed under this group.
	Thence
	N. 89° 45' E., on true line bet. secs. 18 and 19.
	Over rolling mountainous land, through medium underbrush,
	Ascend SW. slope 40 ft.
7.70	Broad spur, slopes SE.; descend SE. slope 465 ft.
37.73	Set an iron post, 3 ft. long, 1 in. diam., 14 ins. in the ground to bedrock, with a stone marked X at base of post, and in a mound of stone to top, for $\frac{1}{4}$ sec. cor., with brass cap marked
	$\frac{1}{4} \begin{array}{r} S 18 \\ \hline S 19 \\ 1933 \end{array}$
	No suitable witnesses.
38.90	Short gulch, course SE.; ascend SW. slope 25 ft.
42.20	Short spur, slopes SE.; descend E. slope 105 ft.
52.60	Shallow wash, 20 lks. wide, course S. 20° E.; ascend SW. slope 40 ft.

Subdivision of T. 14 N., R. 3 E.

BOOK 4072

Chains	
60.60	Short spur, slopes S. ; descend gradual E. slope 65 ft.
65.50	Drain, course SE.; ascend gradually.
77.73	The cor. of secs. 17, 18, 19 and 20. Land, rolling mountainous. Soil, granite loam, 2nd rate. Timber, pine, oak and scrub cedar; undergrowth, oak, catelaw, manzanita and mahogany.
	N. 0° 03' W., bet. secs. 17 and 18. Over rolling land, through scattering scrub cedar and dense undergrowth. Ascend E. and SE. slopes 160 ft. to cor.
36.30	Drain, course S. 70° E.
40.00	Set an iron post, 3 ft. long, 1 in. diam., 18 ins. in the ground to bedrock, with a stone marked X at base of post, and in a mound of stone to top, for $\frac{1}{4}$ sec. cor., with brass cap marked
	$\begin{array}{r} \frac{1}{4} \\ S\ 18\ S\ 17 \\ 1933 \end{array}$
	Mill of Gold Bullion mine bears N. 52° E. Descend NE, slope 40 ft.
43.90	Drain, course E.
45.50	Drain, course E.; ascend SE. slope 70 ft.
63.40	Mill of Gold Bullion mine bears S. 88° 30' E.
63.50	Slope changes: descend N. slope 243 ft.
68.00	Enter moderate oak, pine and cherry timber.
80.00	Set an iron post, 3 ft. long, 2 ins. diam., 27 ins. in the ground, for cor. of secs. 7, 8, 17 and 18, with brass cap marked
	$\begin{array}{r} T\ 14\ N\ R\ 3\ E \\ S\ 7\ S\ 8 \\ \hline S\ 18\ S\ 17 \\ 1933 \end{array}$
	<p style="text-align: right;">from which</p> <p>An oak, 10 ins. diam., bears N. 41° E., 93 lks. dist. mkd., T 14 N R 3 E S 8 B T. A cherry, 20 ins. diam., bears S. 64½° E., 86 lks. dist., mkd. T 14 N R 3 E S 17 B T. A walnut, 14 ins. diam., bears S. 46½° W., 74 lks. dist., mkd. T 14 N R 3 E S 18 B T. An oak, 10 ins. diam., bears N. 34° W., 91 lks. dist., mkd. T 14 N. R 3 E S 7 B T.</p>
	Land, rolling. Soil, granite loam, 2nd rate. Timber, oak, pine, scrub cedar, walnut and cherry; undergrowth, oak, manzanita catelaw and mahogany.

Subdivision of T. 14 N., R. 3 E.

Chains

- 0.00 N. 89° 55' E., on a random line bet. secs. 8 and 17.
- 40.00 Set temp. $\frac{1}{4}$ sec. cor.
- 80.06 Intersect N. and S. line 16 lks. N. of the cor. of secs. 8, 9, 16, and 17.
- Thence
- N. 89° 58' W., on true line bet. secs. 8 and 17.
- Over rolling land, through scattering oak and juniper timber, and dense undergrowth.
- Descend SE. slope 20 ft.
- 7.90 Old road, bears N. and S.
- 8.60 Wash, 25 lks. wide, course S. ; ascend E. slope 25 ft.
- 11.50 Spur, slopes S. 30° E.; over S. slope.
- 19.20 Gulch, course SE.; ascend E. slope 30 ft.
- 25.50 Spur, slopes SE.; over S. slope.
- 30.00 Drain, course SE.
- 32.60 Drain, course SE.; ascend gradual SE. slope.
- 40.03 Set an iron post, 3 ft. long, 1 in. diam., 20 ins. in the ground to bedrock, with a stone marked X at base of post, and in a mound of stone to top, for $\frac{1}{4}$ sec. cor., with brass cap marked
- S 8

S 17
1933
- No witnesses available.
- 52.50 Spur, slopes S.; descend SW. slope 50 ft.
- 64.00 Wash, 35 lks. wide, course S. 20° E.; through oak and pinon timber.
- 64.50 Road, bears N. and S.; over S. slope
- 69.70 Wire fence, bears NW. and SE.
- 76.00 Wash, course SE.
- 80.06 The cor. of secs. 7, 8, 17 and 18.
- Land, rolling.
Soil, granite loam, 2nd rate.
Timber, pine, oak and scrub cedar; undergrowth, oak, cat-claw, manzanita and mahogany.
-
- S. 89° 45' W., on a random line bet. sec. 7 and 18.
- 40.00 Set temp. $\frac{1}{4}$ sec. cor.
- 77.78 Intersect the W. bdy. of the Tp. 35 lks. S. of the cor. of secs. 7, 12, 13 and 18, described in the field notes of the W. bdy. of the Tp. surveyed under this group.
- Thence

Subdivision of T. 14 N., R. 3 E.

BOOK 4072

Chains	East, on true line bet. secs. 7 and 18.
	Ascend NW. slope 15 ft. over rolling mountainous land,
5.00	Point of short spur, slopes NE.; descend NE. slope 25 ft. through scattering timber and medium undergrowth.
8.30	Wash, 20 lks. wide, course SE.; over broken S. slope.
10.90	Shallow sandy wash, course SE.
11.00	Road, bears N. 70° W. and S. 70° E.
18.50	Drain, course SE.
25.00	Wash, 15 lks. wide, course SE.
33.70	Drain, course SE.; ascend SW. slope 135 ft.
36.30	Leave timber.
37.78	Set an iron post, 3 ft. long, 1 in. diam., 27 ins. in the ground, for $\frac{1}{4}$ sec. cor., with brass cap marked
	$\begin{array}{r} S \quad 7 \\ \hline S \quad 18 \\ 1933 \end{array}$
	Raise a mound of stone, 3 ft. base, 2 ft. high, N. of cor.
	Ascend SW. slope 50 ft.
45.80	Broad short spur, slopes S.; descend SE. slope 260 ft.
57.30	Enter timber.
65.40	Drain, course SE.; ascend SW. slope 10 ft.
67.00	Short spur, slopes SE.; descend SE. slope 20 ft.
68.20	Wash, 5 lks. wide, course S.; ascend 10 ft.
69.80	Short spur, slopes SE.; descend SE. slope 75 ft.
76.90	Short wash, course S.
77.78	The cor. of secs. 7, 8, 17 and 18.
	Land, rolling mountainous.
	Soil, granite loam, 2nd rate.
	Timber, oak, juniper and pinon; undergrowth, oak, scrub cedar, manzanita and mahogany.
	N. 0° 03' W., bet. secs. 7 and 8.
	Through wash, course S. 70° E.
0.40	Leave wash,; ascend SE. slope 55 ft. through pine and oak timber; and scattering undergrowth.
10.40	Sandy draw, course SE.
10.50	Wire fence, bears NW. and SE.
16.20	Short spur, slopes E.; over broken E. slope
20.00	Drain, course SE.
25.30	Drain, course S. 70° E.

Subdivision of T. 14 N., R. 3 E.

Chains	
32.90	Short spur, slopes E.; descend N. slope 20 ft.
35.70	Wash, 15 lks. wide, course S. 60° E.; ascend SE. slope 20 ft.
40.00	Set an iron post, 3 ft. long, 1 in. diam., 28 ins. in the ground, for $\frac{1}{4}$ sec. cor., with brass cap marked <div style="text-align: center;"> $\begin{array}{c} \frac{1}{4} \\ S \ 7 \ \ S \ 8 \\ 1933 \end{array}$ </div> <p style="text-align: right;">from which</p> <p>Blackjack oak, 4 ins. diam., bears S. 77$\frac{1}{2}$° W., 79 lks. dist., mkd. $\frac{1}{4}$ S 7 B T. A juniper, 8 ins. diam., bears N. 57$\frac{1}{2}$° E., 188 lks. dist., mkd. $\frac{1}{4}$ S 8 B T.</p> <p>Over E. slope, through scattering timber and dense undergrowth.</p>
48.65	Intersect line 3-4, Sur. No. 3103, Dearborn mining claim, at a point from which cor. No. 3 of the Dearborn and No. 4 of the Black Hawk Annex No. (1) bears S. 78° 47' E., 6.25 chs. dist.; a lava stone, 26x6x10 ins. not set, on the N. side of a mound of stone, mkd. 3 D-3103-4 B H A 1.
50.30	Short spur, slopes E.; descend NE. slope 30 ft.
52.80	Drain, course E.; over E. slope.
62.90	Wash, 80 lks. wide, course SE.; old road in wash,; over SW. slope.
71.50	Drain, course SW.
78.40	Drain, course S. 60° W.
80.00	Set an iron post, 3 ft. long, 2 ins. diam., 30 ins. in the ground, for cor. of secs. 5, 6, 7 and 8, with brass cap marked <div style="text-align: center;"> $\begin{array}{c} T \ 14 \ N \ R \ 3 \ E \\ S \ 6 \ \ S \ 5 \\ \hline S \ 7 \ \ S \ 8 \\ 1933 \end{array}$ </div> <p>Raise a mound of stone 3 ft. base, 2 ft. high, W. of cor.</p> <p>Land, mountainous. Soil, adobe, 2nd and 3rd rate. Timber, oak, walnut, ash, pine and juniper; undergrowth, scrub oak, manzanita and bluebrush.</p>
	S. 89° 58' E., on a random line bet. secs. 5 and 8.
40.00	Set temp. $\frac{1}{4}$ sec. cor.
80.10	Intersect the cor. of secs. 4, 5, 8 and 9. Thence N. 89° 58' W., on true line bet. secs. 5 and 8. Descend SW. slope 225 ft. through dense undergrowth.
13.10	Wash, 8 lks. wide, course S. 15° W.; ascend SE. slope 175 ft.
20.90	Intersect line 4-1, Sur. No. 3103, Marthens J. mining claim,

Subdivision of T. 14 N., R. 3 E.

BOOK 4072

Chains	
	at a point from which cor. No. 4 of the Marthena J. and cor. No. 2 of the Catherine M., bears S. 24° 45' W., 1.26 chs. dist.; a granite stone, 6x7x18 ins. above ground, in a mound of stone, marked and witnessed as described in the official record.
28.10	Head of gulch, course SE; ascend E. slope 290 ft.
38.34	Spur, slopes S.; descend W. slope 45 ft.
40.05	Set an iron post, 3 ft. long, 1 in. diam., 30 ins. in the ground, for $\frac{1}{4}$ sec. cor., with brass cap mkd.
	S 5 $\frac{1}{4}$ ——— S. 8 1933
	Raise a mound of stone, 3 ft. base, 2 ft. high, N. of cor.
	Descend SW. slope 360 ft.
65.00	Gulch, course SW.; over broken S. slope.
74.50	Gulch, course S.
80.10	The cor. of secs. 5, 6, 7 and 8. Land, mountainous. Soil, adobe; 2nd and 3rd rates. Timber, oak, walnut, ash, pine and juniper; undergrowth, scrub oak, manzanita and blue brush.
	West, on a random line bet. secs. 6 and 7.
40.00	Set temp. $\frac{1}{4}$ sec. cor.
77.74	Intersect the W. bdy. of the Tp. at the cor. of secs. 1, 6, 7 and 12, described in the field notes of the W. bdy. of the Tp. surveyed under this group. Thence.
	East, on a true line bet. secs. 6 and 7.
	Descend E. slope 80 ft. through scattering timber and dense brush.
2.24	Gulch, course S.; ascend SW. slope 270 ft.
21.94	Cor. No. 2 Sur. No. 3002, Red Cloud mining claim, bears N. 10.98 chs. dist.; a granite stone, 6x6x12 ins. above ground, marked and witnessed as described in the official record.
31.14	Spur, slopes S.; descend SE. slope 140 ft.
37.74	Set an iron post, 3 ft. long, 1 in. diam., 28 ins. in the ground, for $\frac{1}{4}$ sec. cor., with brass cap mkd.
	$\frac{1}{4}$ S 6 S 7 1933
	Raise a mound of stone, 3 ft. base, 2 ft. high, N. of cor.
	Thence along S. slope.
43.74	Spur, slopes SE.; descend E. slope 100 ft.

Subdivision of T. 14 N., R. 3 E.

Chains	
49.74	Short ravine, course SE.; thence along S. slope.
56.74	Spur, slopes S.; descend NE. slope 180 ft.
63.74	Cherry Wash, dry, 40 lks. wide, course SE.; ascend 35 ft.
67.14	Spur, slopes S.
69.32	Intersect line 4-1, Sur. No. 3103, Clark No. 2 mining claim at a point from which cor. No. 1 bears N. 21° 14' E., 15.56 chs. dist.; a stone, 16x8x4 ins. above ground, mkd. and witnessed as described in the official record.
70.14	Wash, 10 lks. wide, course S.; ascend SW. slope 35 ft.
70.24	Road, bears N. and S.
74.94	Spur, slopes SW.; descend 20 ft.
76.24	Draw, course S. 20° W.
77.74	The cor. of secs. 5, 6, 7 and 8.
	Land, mountainous. Soil, adobe; 2nd and 3rd rates. Timber, oak, walnut, ash, pine and juniper; undergrowth, scrub oak, manzanita and blue brush.
	N. 0° 03' W., on a random line bet. secs. 5 and 6.
40.00	Set temp. $\frac{1}{4}$ sec. cor.
80.41	Intersect the N. bdy. of the Tp. 37 lks. W. of the cor. of secs. 5, 6, 31 and 32, described in the field notes of the N. bdy. of the Tp. surveyed under this group.
	Thence
	S. 0° 13' W., on a true line bet. secs. 5 and 6.
	Over E. slope through scattering timber.
3.40	Ridge, bears NW. and SE.; descend SW. slope 95 ft.
14.90	Spur, slopes SW.; descend S. slope 150 ft.
40.41	Set an iron post, 3 ft. long, 1 in. diam., 30 ins. in the ground, for $\frac{1}{4}$ sec. cor., with brass cap mkd.
	S 6 $\frac{1}{2}$ S 5 1933
	Raise a mound of stone, 3 ft. base, 2 ft. high, W. of cor.
43.80	Gulch, course SW.
49.75	A point 3 lks. E. of the cor. No. 1, Sur. No. 2291, Leg Horn mining claim, and cor. No. 1, Sur. no 3007, Falls mining claim, a granite rock, 8x8x8 ins. above ground, marked 2291 on top, LF and LH on E. face. Mound of stone E. of cor. No other cors of these claims, nor of sur. no. 939, can be found.
60.90	Draw, course SW.
64.00	Mineral Monument No. 2, bears E. 1.70 chs. dist.; a rotted post in a mound of stone.

Subdivision of T. 14 N., R. 3 E.

BOOK 4072

Chains

- 66.46 Intersect line 1-2, Sur. No. 3103, Clark No. 2 mining claim, at a point from which cor. No. 1 bears N. 78° 47' W., 283 chs. dist.; hereinbefore described.
- 72.61 Draw, course SW.
- 80.41 The cor. of secs. 5, 6, 7 and 8.
- Land, rolling and mountainous.
Soil, above, 2nd and 3rd rate.
Timber, oak, walnut, ash, pine and juniper; undergrowth, scrub oak, manzanita and blue brush.

FINAL TEST OF THE SOLAR ATTACHMENT

Dec. 9, 1933, on the meridian described in the field notes of the boundaries of this Tp., surveyed and resurveyed under this group, at 8h a.m., app.t., I set off 34° 35' N. on the lat. arc; 22° 53' S. on the decl. arc; and orient the instrument with the solar; the line of sight agrees with the meridian established by Polaris observation.

At 4h p.m., app.t., I set off 34° 35' N. on the lat. arc; 22° 53' S. on the decl. arc; and repeat the test of the solar; the line of sight agrees with the meridian established by Polaris observation.

December 9, 1934.

GENERAL DESCRIPTION

T. 14 N., R. 3 E. lies about 30 miles S.E. of the city of Prescott, Arizona, across the highway from Dewey to Clarkdale, Camp Verde and points north. Nearly every point in the township is within a mile of some secondary road.

The divide between the Verde and Agua Fria rivers follows approximately along the south and west boundaries of the township. Land along the divide is rolling in character; the most rugged portion is the east central; the northeast portion next. Cherry Creek heads in the northwest part of the township, runs south of west and drains about half of the area.

About 100 people live in the township, most of them in and near the town of Cherry, held there by mining interests and the equable climate. There are some small farms and the heavy undergrowth attracts cattle growers.

The base rock formation is a pre-cambrian granite overlaid in the south with a volcanic capping and in the north with limestone. The granite carries many small veins of gold-bearing ore; the occasional rich pockets have induced much prospecting. Three moderate sized reduction plants were observed, none in operation; two smaller ones in sec. 10 were working. There are several abandoned workings.

There is a moderate amount of pine, cherry and oak timber.

4-680
(August, 1926)

FIELD ASSISTANTS.

to
Theodore Vander Meer, U.S. Transitman

NAMES.	CAPACITY.
Ben Mollette	First Chainman
Shamus O'Brien	First Chainman
Raymond B. Davis	Second Chainman
Walter Grayum	Second Chainman
Claude A. Mulkey	Second Chainman
Joseph T. Bell	Flagman
Tom J. Kulyas	Flagman
Robert R. Riesgo	Moundsman
Wm. Shafer	Moundsman
Shamus O'Brien	Axman
Raymond S. Davis	Axman
Charles Foster	Axman

5212
BOOK 4072

CERTIFICATE OF UNITED STATES SURVEYOR

I, Theodore Vander Meer, U.S. Transitman, hereby certify upon honor that, in pursuance of special instructions received from the District Cadastral Engineer for Group 184, Arizona, bearing date of the 20th day of July, 1933, I have well, faithfully, and truly in my own proper person, and in strict conformity with said instructions, the Manual of Surveying Instructions, and the laws of the United States, surveyed all those parts or portions of the Subdivisional lines of

Township 14 North, Range 3 East

of the Gila and Salt River Base and Meridian, in the State of Arizona, which are represented in the foregoing field notes as having been executed by me, and under my direction; and that all the corners of said survey have been established and perpetuated in strict accordance with the Manual of Surveying Instructions, and the special written instructions of the District Cadastral Engineer for Group 184, Arizona, and in the specific manner described in the field notes, and that the foregoing are the original field notes of such survey.

Glendale, Calif., Theodore Vander Meer
May 28, 1934
U.S. Transitman

APPROVAL

OFFICE OF U. S. SUPERVISOR OF SURVEYS,

Denver, Colorado, April 23, 1935.

The foregoing field notes of the survey of the subdivisional lines of

Township 14 North, Range 3 East

of the Gila and Salt River Base and Meridian, in the State of Arizona.

executed by Theodore Vander Meer, U.S. Transitman

under his special instructions dated July 20, 1933, 19 , having been critically examined, and the necessary corrections and explanations made, the said field notes, and the surveys they describe, are hereby approved.

Charles J. Johnson
U. S. Supervisor of Surveys

~~I certify that the foregoing transcript of the field notes of the above described surveys in _____, has been correctly copied from the original notes on file in this office.~~

~~U. S. Supervisor of Surveys.~~