

4098

ORIGINAL

177

Book "A"

4-679  
(April 1933)

BOOK 4098

4098

# FIELD NOTES

OF THE SURVEY OF THE

BOUNDARY OF THE

YAVAPAI INDIAN RESERVATION

WITHIN THE WHIPPLE BARRACKS MILITARY RESERVATION

AND SECS. 27, 28, 33 & 34 (by projected sub. lines into W.B.M.R.)

OF

Township No. 14 North, Range No. 2 West

Of the Gila and Salt River Base and Meridian,

In the State of

ARIZONA

Created by the act of June 7, 1935, (Public No. 117, 74th Congress)

EXECUTED BY

Benjamin J. Kinsey

U.S. Surveyor

Under special instructions dated September 23, 1935, which provided

for the surveys included under Group No. 206, Arizona, bearing the approval of the

Commissioner of the General Land Office under date of October 5, 1935

and assignment instructions dated November 21, 1935

Survey commenced December 12, 1935

Survey completed December 14, 1935

4098

# INDEX DIAGRAM.

*Township* \_\_\_\_\_, *Range* \_\_\_\_\_

<b>6</b>	<b>5</b>	<b>4</b>	<b>3</b>	<b>2</b>	<b>1</b>
<b>7</b>	<b>8</b>	<b>9</b>	<b>10</b>	<b>11</b>	<b>12</b>
<b>18</b>	<b>17</b>	<b>16</b>	<b>15</b>	<b>14</b>	<b>13</b>
<b>19</b>	<b>20</b>	<b>21</b>	<b>22</b>	<b>23</b>	<b>24</b>
<b>30</b>	<b>29</b>	<b>28</b>	<b>27</b>	<b>26</b>	<b>25</b>
<b>31</b>	<b>32</b>	<b>33</b>	<b>34</b>	<b>35</b>	<b>36</b>

1A

Book "A"  
Group 206 - Arizona  
INDEX-DIAGRAM

BOOK 4098

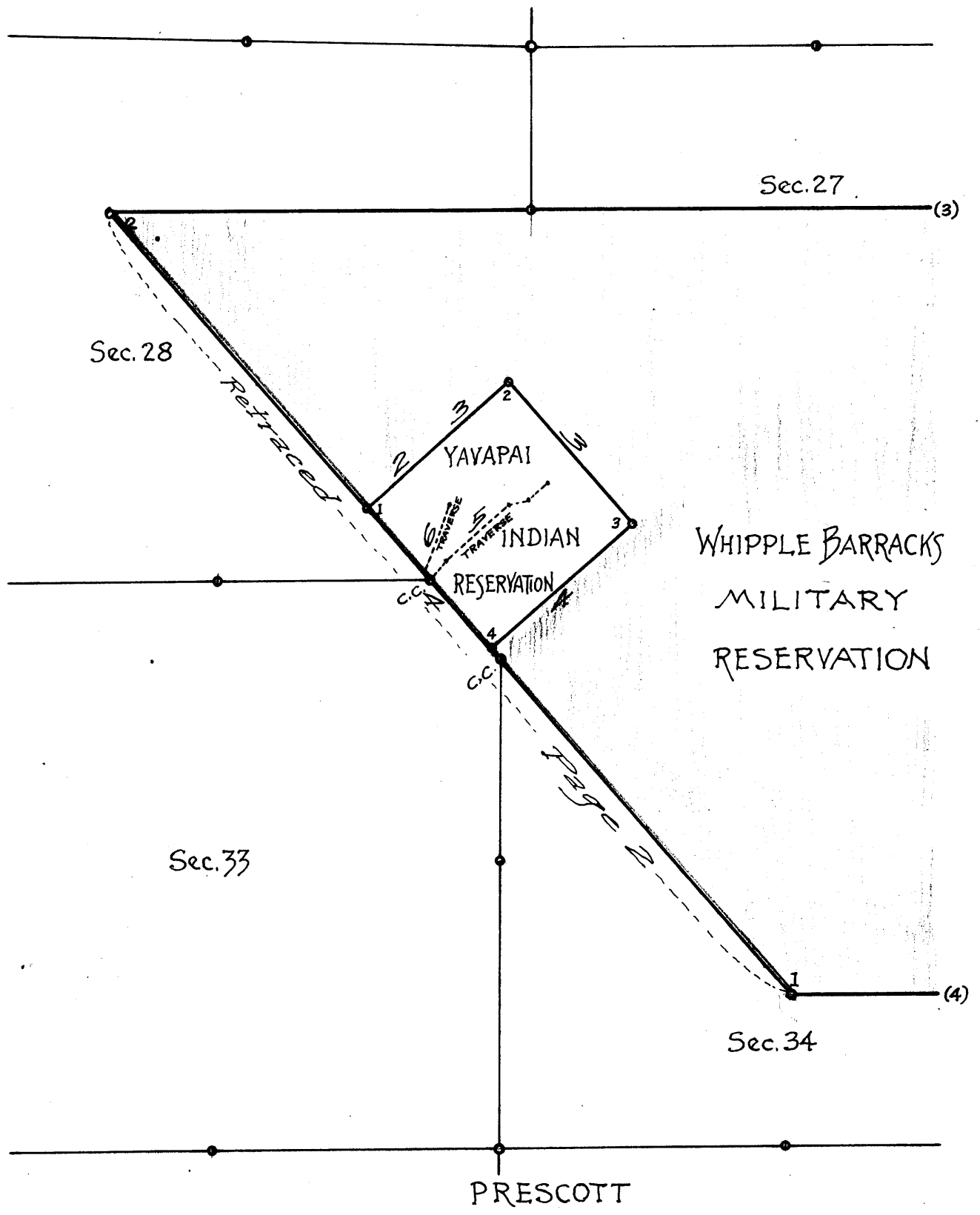

## Boundary of YAVAPAI INDIAN RESERVATION

18

chains

The survey herein described was executed by Benjamin J. Kinsey, U.S. Surveyor, using a Buff transit No. 18,000. Said instrument is equipped with the Smith solar attachment, and otherwise conforms to the standard requirements of the General Land Office.

-----  
 Preliminary Field Test of Instrument.  
 -----

December 12, 1935; at station on line 1-2 of the boundary of Whipple Barracks Military Reservation, at the closing cor. of secs. 28 and 33, T.14 N., R.2 W., G. & S.R. B. & M., Arizona, latitude  $34^{\circ}33'N.$ , longitude  $112^{\circ}28'W.$ , examine the adjustments of the transit and find no errors then, to test the working of the solar apparatus, proceed as follows:

At 2h. 17m., p.m., l.m.t., observe Polaris at eastern elongation, making four observations, two each with the telescope in direct and reversed positions, and marking the mean point in the line thus determined by a tack in top of a peg driven firmly in the ground 5 chs. northerly.

Azimuth of Polaris at eastern elongation =  $1^{\circ}15'17''$

Lay off the azimuth of Polaris  $1^{\circ}15'$  to the west, and mark the meridian thus determined by a tack in top of a peg driven firmly in the ground 5 chs. N.

By deflection from the true meridian, the bearing of the line 1-2 of the boundary of the Whipple Barracks Military Reservation is found to be  $N.41^{\circ}50'W.$ , which agrees with the official record, therefore conclude that the instrument is in satisfactory adjustment.

All azimuths of the following described lines of survey are determined by deflection, initiated from the meridian determined from the above described Polaris observation.

All measurements are made with a Lallie steel tape, 5 chs. in length, compared with a Lufkin standard tape and found correct. The measurements are made on the slope, the vertical angle determined and slope measurements are properly reduced to horizontal equivalents for entry in the field notes.

-----  
 The following notes describe a survey of the boundary of the YAVAPAI INDIAN RESERVATION, created by the act of June 7, 1935, (Public No. 117, 74th Congress). A portion of this boundary is identical with a part of line 1-2 of the boundary of Whipple Barracks Military Reservation, in secs. 28 and 33, T.14 N., R.2 W., G. & S.R. B. & M., Ariz., and the entire area embraced within said Indian Reservation is taken from said Military Reservation. The boundary of the Military Reservation was surveyed in 1875 by C.B. Foster, U.S.D.S., and resurveyed in 1927 by S.E. Blout, U.S.C.E., who also resurveyed the connecting subdivision lines of T.14 N., R.2 W. and reestablished the closing cors. on the Military Reservation boundary. No subsequent retracement or resurvey is of record.

-----  
 Retracement for Survey.  
 -----

Begin at Corner No. 1 (SW. cor.) of the Whipple Barracks Military Reservation, which is an iron post, 3 ins. diam., firmly set, projecting 10 ins. above ground, with brass cap properly marked as described in the official record.

## Survey of Boundary of YAVAPAI INDIAN RESERVATION

2

- chains
- Thence,
- N.41°50'W., on random line, on line 1-2 of boundary of Whipple Barracks Military Reservation.
- 62.38 Intersect the closing cor. of secs. 33 and 34, T.14 N., R.2 W., which is an iron post, 2 ins. diam., projecting 12 ins. above ground, firmly set, with brass cap marked and witnessed as described in the official record.
- 63.595 Set temporary Cor.No.4 (S.cor.) of Yavapai Indian Reservation.
- 76.93 Intersect the closing cor. of secs. 28 and 33, T.14 N., R.2 W., which is an iron post, 2 ins. diam., projecting 12 ins. above ground, firmly set, with brass cap marked and witnessed as described in the official record.
- 90.265 Set temporary Cor.No.1 (W.cor.) of Yavapai Indian Reservation.
- 145.44 Intersect Cor.No.2 (NW.cor.) of Whipple Barracks Military Reservation, which is an iron post, 3 ins. diam., projecting 12 ins. above ground, firmly set, with brass cap marked and witnessed as described in the official record.

True course and dist. of line 1-2 of boundary of Whipple Barracks Military Reservation are therefore; N.41°50'W., 145.44 chs., which agrees with the official record of the resurvey thereof, executed in 1927, and the subdivisional closing cors. are found thereon at record distances from Cor.No.1 of W.B.M.R. The temporary Cors. Nos. 1 and 4 of the Yavapai Indian Reservation set thereon equidistant ( 13.335 chs.) from the closing cor. of secs. 28 and 33, are therefore at the proper points for the establishment of the permanent corners.

-----  
SURVEY.  
-----

At temp. Cor.No.1 (W.cor.) of Yavapai Indian Reservation, on line 1-2 of boundary of Whipple Barracks Military Reservation 13.335 chs. N.41°50'W. from closing cor. of secs. 28 and 33, T.14 N., R.2 W., set an iron post, 3 ft. long, 3 ins. diam., 14 ins. in the ground to bedrock, with a stone 3x3x2 ins. marked with a cross (X) deposited at base, and in a mound of stone to top, for Corner No.1 (W.cor.) of the Yavapai Indian Reservation, with brass cap marked

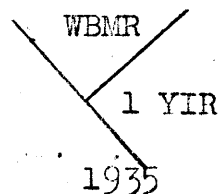

- Thence,
- N.48°10'E., on true line, on line 1-2 of boundary of the Yavapai Indian Reservation.
- Ascend gradually over S. slope.
- 1.60 Spur, slopes SE. Wire fence, 4 strand, bears E. and W. Desc: 32 ft. over NE. slope.
- 2.70 Wash, 10 lks. wide, course E.; asc. 133 ft. over S. slope.
- 12.80 A point from which, Stone house of the Indian chief bears S.24°E.

## Survey of Boundary of YAVAPAI INDIAN RESERVATION

BOOK 4098

3

- chains  
Chimney of clubhouse bears S.  $27\frac{1}{2}^{\circ}$  E.
- 15.30 Rocky ridge, bears E. and W. A granite quarry bears E., 50 lks. dist.; desc. 50 ft. over rolling N. slope.
- 19.25 Telephone line, bears N. and S.
- 24.10 Old road, bears N. and S.
- 26.67 Set an iron post, 3 ft. long, 3 ins. diam., 10 ins. in the ground to bedrock, with a stone 4x4x3 ins. marked with a cross (X) deposited at base, and in a mound of stone to top, for Corner No. 2 ( N.cor. ) of the Yavapai Indian Reservation; with brass cap marked

WBMR



1935

Thence,

S.  $41^{\circ}50'$  E., on true line, on line 2-3 of boundary of the Yavapai Indian Reservation.

Descend 114 ft. over rolling N. slope.

- 0.10 Power line, bears N. and S.
- 9.85 Low spur, slopes N.; from which,  
House ( E ) bears S.  $8^{\circ}$  W.,  
House ( F ) bears S.  $9^{\circ}$  W.,  
House ( G ) bears S.  $1^{\circ}$  W.,  
House ( H ) bears S.  $22^{\circ}$  W.,  
Garage bears S.  $32^{\circ}$  W.
- 14.50 Trail, bears N. and S.; leads to a spring in a large wash about 8 chs. N.
- 16.00 Wash, 10 lks. wide, course NE.; asc. gradual NW. slope.
- 22.10 Spur, slopes N.; desc. 36 ft. over NE. slope.
- 25.26 Trail, bears E. and W.
- 26.67 Set an iron post, 3 ft. long, 3 ins. diam., over a cross (X) cut in exposed rock ledge, and in a mound of stone to top, for Corner No. 3 ( E.cor. ) of the Yavapai Indian Reservation, with brass cap marked

WBMR



1935

-----

From temp. Cor. No. 4 ( S.cor. ) of the Yavapai Indian Reservation; on line 1-2 of bdy. of Whipple Barracks Military Reservation,

N.  $48^{\circ}10'$  E., on random line, on line 3-4 of the boundary of the Yavapai Indian Reservation.

- 26.67 Intersect Cor. No. 3 ( E.cor. ) of Yavapai Indian Reservation.

Thence,

## Survey of Boundary of YAVAPAI INDIAN RESERVATION

4

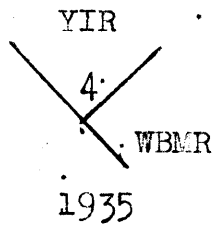
chains	S.48°10'W., on true line, on line 3-4 of boundary of the Yavapai Indian Reservation.
	Ascend 120 ft. over N. slope.
9.00	Ridge, bears N.20°W., and S.20°E.; desc. 88 ft. over SW. slope to
19.20	Wash, 5 lks. wide, course NW.; desc. slightly over NW. slope.
20.60	Wash, 10 lks. wide, course S.30°W.
23.60	Power line, bears N.0°10'W. and S.0°10'E.
25.67	Intersect temp. Cor.No.4 (S.cor.) of the Yavapai Indian Reservation, on line 1-2 of boundary of Whipple Barracks Military Reservation at a point 1.215 chs. N.41°50'W. from C.C. of secs.33 and 34, T.14 N., R.2 W., and 13.335 chs. S.41°50'E. from C.C. of secs.28 and 33,  At this point, set an iron post, 3 ft. long, 3 ins. diam., 18 ins. in the ground to bedrock, with a stone 5x5x4 ins. marked with a cross (X) deposited at base, and in a mound of stone to top, for Corner No.4 (S.cor.) of the Yavapai Indian Reservation, with brass cap marked
	
	Thence,
	N.41°50'W., on true line, on line 4-1 of boundary of the Yavapai Indian Reservation, identical with part of the line 1-2 of bdy. of Whipple Barracks Military Reserv.
	Over mountainous land, through scattering timber and undergrowth. Ascend 40 ft. over S. slope.
5.27	Spur, slopes SW. From this point, house of Rev. Wellington, Presbyterian minister, bears N. about 20 lks. dist. Descend gradually over NW. slope.
6.75	A point from which church bears S., 80 lks. dist.
7.20	A point from which house bears N. about 100 lks. dist.
7.90	Road, bears N.30°W. and S.30°E.
10.30	Wash, 6 lks. wide, course SW.; asc. gradually over S. slope.
11.65	Telephone line, bears N. and S.
13.335	(Midpoint of line 4-1 of bdy. of Y.I.R.) Intersect closing cor. of secs. 28 and 33, T.14 N., R.2 W., hereinbefore described. Asc. gradually over S. slope, along NE. side of wire fence.
25.67	Intersect Corner No.1 (W.cor.) of the Yavapai Indian Reservation, hereinbefore described, the place of beginning.
	The Yavapai Indian Reservation, within the boundary thereof surveyed as described in the foregoing field notes, contains an area of 71.13 acres.

## YAVAPAI INDIAN RESERVATION

BOOK 4098

## Traverse Line, to locate Improvements within Reservation.

5

chains	<p>From the closing cor. of secs. 28 and 33, T.14 N., R.2 W., at midpoint of line 4-1 of the bdy. of the Yavapai Indian Reservation, hereinbefore described, the following bearings to improvements were obtained:</p> <p>House ( A ) bears N.24°W.  House ( B ) bears N. 7°E.  House ( C ) bears S.72°E.  House ( D ) bears N.68°E.</p> <p>Thence, from said closing cor.,  N.39°25'E., on traverse line, within Yavapai Ind. Reserv.</p> <p>2.50 Wash, 10 lks. wide, course SE.</p> <p>2.80 Telephone line, bears N.10°E. and S.10°W.</p> <p>3.30 Traverse point at junction of roads, bearing N.50°E., S.87°W. and S.30°E., from which</p> <p>House ( A ) bears N.75°W.  House ( B ) bears N. 6°W.  House ( C ) bears S.25°W.  House ( D ) bears S.68°E.</p> <p>Thence, from traverse point,  N.48°00'E., on traverse line, within Yavapai Ind. Reserv.</p> <p>1.40 Road, bears NE. and S.20°W.</p> <p>4.50 A point from which the stone house of the Indian chief bears South 100 lks. dist.</p> <p>6.50 Road fork, NE. and NW. from SW.</p> <p>11.86 Traverse point, under power line bearing N.1°W. &amp; S.1°E.  From this point,  House ( E ) bears S.72°E.</p> <p>Thence, from traverse point,  N.73°25'E., on traverse line, within Yavapai Indian Res.</p> <p>2.26 Traverse point, on rocky ridge, bearing NW. and SE.  From this point,  The stone house of Indian chief bears S.46°W.  Chimney on clubhouse bears S.37°W.  Garage bears N.12°E.  House ( E ) bears S.52°E.  House ( F ) bears N.80°E.  House ( G ) bears N.70°E.  House ( H ) bears N.29°E.</p> <p>Thence, from traverse point,  N.48°00'E., on traverse line, within Yavapai Ind. Reserv.</p> <p>3.30 Traverse point at terminus of traverse, from which,  House ( F ) bears S.16°E.  House ( G ) bears S.70°E.  House ( H ) bears North.  Garage bears N.55°W.</p>
--------	---



## YAVAPAI INDIAN RESERVATION.

## 6 Traverse line to locate Improvements within the Reservation.

chains	From a point on line 4-1 of bdy. of Yavapai Indian Reservation 80 lks. N.41°50'W. from the closing cor. of secs. 28 and 33, T.14 N., R.2 W.,
	N.19°40'E., on traverse line, within the Yavapai Indian Reservation, toward flag visible at well.
2.00	Road, bears E. and W. From this point, House ( A ) bears N.70°W. about 2 chs. dist.
5.00	Wash, 15 lks. wide, course SE.
6.10	Low spur, slopes W.
9.00	Wash, 10 lks. wide, course SW.
9.05	Road, bears E. and W.
10.72	Terminus of traverse line, at well, about 6 ft. deep, with 3 ft. of water. From this point, House ( B ) bears West, about 1½ chs. dist.

## GENERAL DESCRIPTION.

The surface is mountainous and rolling, draining southerly and easterly into Granite Creek, about one half mile distant.

The soil is decomposed granite, 3rd and 4th rate.

Timber is principally oak, with a thin scattering growth of yellow pine.

The undergrowth consists of oakbrush, catclaw and cacti.

The well, hereinbefore described, furnishes most of the water required by the Indians on the Reservation, though a spring, outside the Reservation to the N. also adds to the general supply.

The inhabitants, about thirty in number, are Yavapai Indians, which tribe, according to the resident chief, is a branch of the Apache tribe.

A number of the houses, recently constructed, are built of stone, the remainder are of frame and sheet iron, or tin.

A church, Presbyterian, is situated just outside the SW. line of the Reservation bdy., but the minister thereof has a house just inside the same line of the reservation bdy.

Roads within the reservation connect with a road outside extending southerly to Prescott, slightly over a mile distant.

BOOK 4098

4-680  
(August, 1926)

**FIELD ASSISTANTS.**  
to Benjamin J. Kinsey, U.S. Surveyor  
in the execution of the survey described in the foregoing field notes.

NAMES.	CAPACITY.
Donald Gifford	1st Chainman
H.R. Ruddell	2nd Chainman

8

CERTIFICATE OF UNITED STATES SURVEYOR

I, Benjamin J. Kinsey, U. S. Surveyor, hereby certify upon honor that, in pursuance of special instructions received from the District Cadastral Engineer for Arizona bearing date of the 23rd day of September, 1935, I have well, faithfully, and truly in my own proper person, and in strict conformity with said instructions, the Manual of Surveying Instructions, and the laws of the United States, surveyed all those parts or portions of the Boundary of the YAVAPAI INDIAN RESERVATION within the Whipple Barracks Military Reservation in Secs. 27, 28, 33 & 34 (projected portions in the W.B.M.R.) of Township No. 14 North, Range No. 2 West of the Gila and Salt River Base and Meridian, in the State of Arizona, which are represented in the foregoing field notes as having been executed by me, and under my direction; and that all the corners of said survey have been established and perpetuated in strict accordance with the Manual of Surveying Instructions, and the special written instructions of the District Cadastral Engineer for Arizona and in the specific manner described in the field notes, and that the foregoing are the original field notes of such survey.

Phoenix, Arizona

June 24, 1936

Benjamin J. Kinsey

U. S. Surveyor.

APPROVAL

OFFICE OF U. S. SUPERVISOR OF SURVEYS,

Denver, Colo., June 29, 1936

The foregoing field notes of the survey of the Boundary of the YAVAPAI INDIAN RESERVATION WITHIN the Whipple Barracks Military Reservation in Secs. 27, 28, 33 & 34 (projected portions within W.B.M.R.) Township No. 14 North, Range No. 2 West of the Gila and Salt River Base and Meridian, in the State of Arizona executed by Benjamin J. Kinsey, U.S. Surveyor under his special instructions dated September 23, 1935, for Group 200, Ariz., having been critically examined, and the necessary corrections and explanations made, the said field notes, and the surveys they describe, are hereby approved.

[Signature]

U. S. Supervisor of Surveys.

I certify that the foregoing transcript of the field notes of the above described surveys in, has been correctly copied from the original notes on file in this office.

U. S. Supervisor of Surveys.