



# INDEX DIAGRAM.

Township \_\_\_\_\_, Range \_\_\_\_\_

6	5	4	3	2	1
7	8	9	10	11	12
18	17	16	15	14	13
19	20	21	22	23	24
30	29	28	27	26	25
31	32	33	34	35	36

INDEX DIAGRAM

BOOK 4129

Township 38 North, Range 3 East.

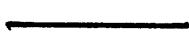
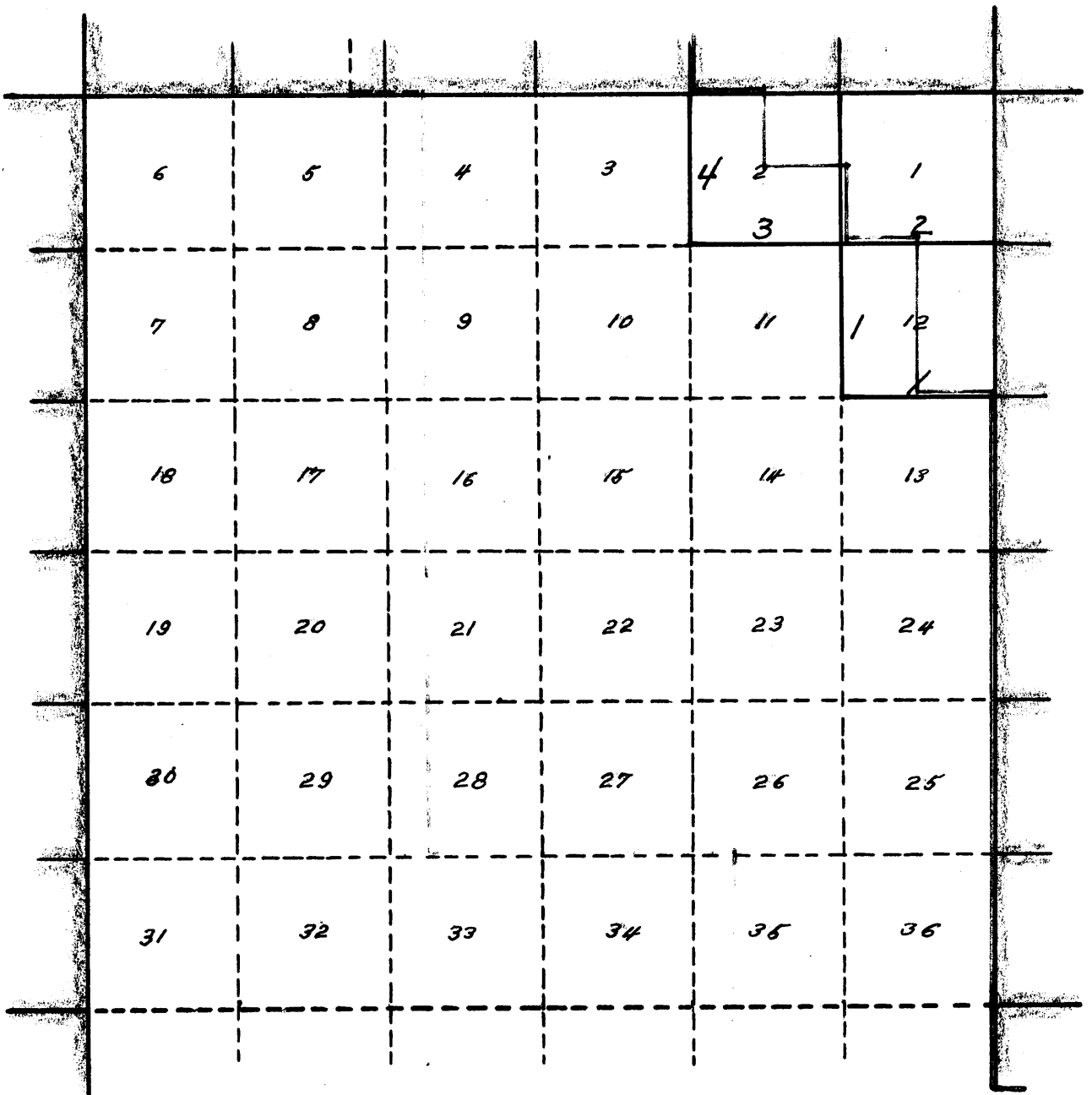

Accepted surveys.



Lines surveyed under this group.

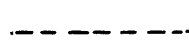

Unsurveyed lines.

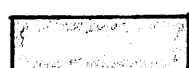

Areas surveyed as per accepted plats on file.

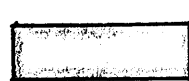

Areas surveyed under current group 181.



Boundary of Kaibab National Forest.



Boundary of Grand Canyon National Game Preserve.

## Subdivisions of T. 38 N., R. 3 E.

1.3

## Chains

The survey of subdivisions in T. 38 N., R. 3 E. was executed with a Buff transit No. 18000. For description and test of instrument, description of other equipment and method of survey, see field notes of T. 41 N., R. 2 E., surveyed under this group.

The witness corner of secs. 7, 12, 13 and 18, on the E. bdy. of the township is an iron post 2 ins. diam., projecting 12 ins. above ground, with brass cap mkd. and witnessed as described in the official record.

The true point for cor. of secs. 7, 12, 13 and 18 bears North 1.10 chs. dist. from witness corner.

From the true point for cor. of secs. 7, 12, 13 and 18.

West on true line bet. secs. 12 and 13.

Over rolling land through scattering undergrowth, ascend gradually.

34.70 Shallow wash, 10 lks. wide, course NE.; continue ascent.

40.00 Set an iron post 3 ft. long, 1 in. diam., 10 ins. in the ground to bedrock, with a stone 3 x 2 x 1 ins. mkd. X deposited at base of post, and in a mound of stone to top, for  $\frac{1}{4}$  sec. cor. with brass cap mkd.

$\frac{1}{4}$  S 12  
S 13

1936

No trees available.

40.25 Four strand barb wire fence, bears N. 30° W. and S. 30° E.; ascend 185 ft. over E. slope.

65.00 Spur, slopes NE.; descend slight NW. slope.

70.00 Rocky wash 10 lks. wide, course NE.

Ascend 160 ft. over E. slope.

80.00 Set an iron post 3 ft. long, 2 ins. diam., 18 ins. in the ground to bedrock, with a stone 2 x 2 x 3 ins. mkd. X deposited at base of post, and in a mound of stone to top, for cor. of secs. 11, 12, 13 and 14, with brass cap mkd.

T38N R3E  
S 11 | S 12  
S 14 | S 13

1936

Land, E $\frac{1}{2}$  level, W $\frac{1}{2}$  mountainous.

Soil, sandy, 3d rate and rocky, 4th rate.

Timber none; undergrowth, russian thistle and grass.

-----  
N. 0° 01' W. bet. secs. 11 and 12. over mountainous land, descend 80 ft. over NE. slope.

4.20 Wash, 20 lks. wide, course NE., ascend 68 ft. over SE. slope.

9.35 Spur slopes E., descend 170 ft. over N. slope.

39.58 Wash 30 lks. wide, course E., ascend 20 ft.

2.

Subdivision of T. 38 N., R. 3 E.

Chains  
40.00

Top of spur slopes E.

Set an iron post, 3 ft. long, 1 in. diam., 4 ins. in the ground to bedrock, with a stone 3 x 3 x 1 ins. marked X deposited at base of post, and in a mound of stone to top, for 1/4 sec. cor. with brass cap mkd.



Descend 30 ft. over N. slope.

42.20 Wash 10 lks. wide, 4 ft. deep, course E.; ascend SE. slope 35 ft.

45.00 Spur, slopes E.; descend NE. slope 35 ft.

55.00 Wash, 10 lks. wide, course SE.; thence over gently rolling land.

66.25 Wash, 25 lks. wide, course E.

75.00 Wire fence, bears NW. and SE.

78.60 Wash, 40 lks. wide, course E.

80.00 Set an iron post, 3 ft. long, 2 ins. diam., 8 ins. in the ground to bedrock, with a stone 5 x 3 x 1 ins. mkd. X deposited at base of post, and in a mound of stone to top, for cor. of secs. 1, 2, 11 and 12, with brass cap mkd.

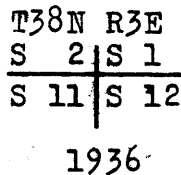

Land, rolling and mountainous.  
Soil, stony, 3d rate.  
Timber, none.  
Undergrowth, russian thistle and grass

-----  
East on a random line bet. secs. 1 and 12.

40.00 Set temp. 1/4 sec. cor.

80.00 Intersect E. bdy. of Tp. 14 lks. S. of the cor. of secs. 1, 6, 7 and 12, an iron post 2 ins. diam., projecting 12 ins. above ground, with brass cap mkd. and witnessed as described in the official record.

Thence

S. 89° 54' W. on true line bet. secs. 1 and 12, over nearly level land through scattering undergrowth.

40.00 Set an iron post, 3 ft. long, 1 in. diam., 20 ins. in the ground to bedrock, with a stone 5 x 3 x 1 ins. mkd. X deposited at base of post, and in a mound of stone to top, for 1/4 sec. cor., with brass cap mkd.

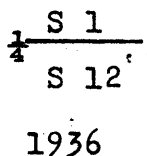

Chains	
58.90	Old road, bears NW, and SE.
80.00	The cor. of secs. 1, 2, 11 and 12. Land, nearly level. Soil, stony, 3d rate. Timber, none. Undergrowth, russian thistle and grass.
-----	
	N. 0° 01' W. on a random line bet. secs. 1 and 2.
40.00	Set temp. $\frac{1}{4}$ sec. cor.
80.04	A point 12 lks. W. of the cor. of secs. 1, 2, 35 and 36, on the N. bdy. of the Tp.; an iron post 2 ins. diam., projecting 12 ins. above ground, with brass cap mkd. and witnessed as described in the official record.
	Thence
	S. 0° 04' W. on true line bet. secs. 1 and 2, over gently rolling land through scattering undergrowth.
6.85	U. S. highway No. 89 bears NW. and SE.
26.50	Wash, 10 lks. wide, course NE.
40.04	Set an iron post, 3 ft. long, 1 in. diam., 26 ins. in the ground for $\frac{1}{4}$ sec. cor. with brass cap mkd.
	$\frac{1}{4}$ S 2   S 1 1936
	raise a mound
	of stone, 2 ft. base, $1\frac{1}{2}$ ft. high W. of cor.
46.10	Old road, bears NW. and SE.
80.04	The cor. of secs. 1, 2, 11 and 12. Land, rolling. Soil, stony, 3d rate, 2 ft. to bedrock. Timber none. Undergrowth, russian thistle and grass.
-----	
	West on true line bet. secs. 2 and 11.
	Over rolling land, through scattering undergrowth.
4.70	wire fence, bears NW. and SE.
7.50	Wash, 10 lks. wide, course SE.
13.70	Same wash, course NE. from W.; up same.
18.70	Leave wash, course NE.; over mountainous land, ascend 155 ft. over SE. slope.
40.00	Top of spur, slopes NE. Set an iron post, 3 ft. long, 1 in. diam., 8 ins. in the ground to bedrock, with a stone 4 x 4 x 1 ins. mkd. X deposited at base of post, and in a mound of stone to top, for $\frac{1}{4}$ sec. cor., with brass cap mkd.

Subdivision of T. 38 N., R. 3 E.

4.

Chains

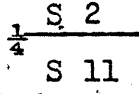

1936

Ascend NE. slope 300 ft.

80.00 Set an iron post, 3 ft. long, 2 ins. diam., 28 ins. in the ground, for cor. of secs. 2, 3, 10 and 11, with brass cap mkd.

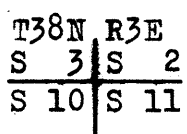

1936

of stone 2 ft. base, 1 1/2 ft. high w. of cor. raise a mound

Land, rolling and mountainous.  
Soil, stony 3d rate.  
Timber, none.  
Undergrowth, russian thistle and grass.

N. 0° 01' W. on a random line bet. secs. 2 and 3.

40.00 Set temp. 1/4 sec. cor.

80.12 Intersect N. bdy. of Tp. at the cor. of secs. 2, 3, 34 and 35; an iron post 2 ins. diam., firmly set and marked and witnessed as described in the official record.

Thence

S. 0° 01' E. on true line bet. secs. 2 and 3.

Over mountainous land, through scattering cedar and underbrush.

Ascend 50 ft. over N. slope.

4.00 Spur, slopes NE.; thence along E. slope.

19.00 Spur, slopes SE. descend 65 ft. over SE. slope.

23.60 Draw, 20 lks. wide, course SE., ascend 75 ft.

26.10 Fence, bears SE. and W.

28.60 Spur, slopes E.; descend SE. slope 135 ft.

39.10 Draw, 10 lks. wide, course NE. Ascend NE. slope 160 ft.

40.12 Set an iron post, 3 ft. long, 1 in. diam., on bedrock, and in a mound of stone to top, for 1/4 sec. cor., with brass cap mkd.

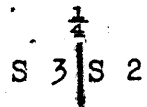

1936

from which

A scrub cedar, 10 ins. diam., bears N. 33 1/2° E., 122 lks. dist., mkd. 1/4 S-2 BT

## Subdivision of T. 38 N., R. 3 E.

5.

## Chains

- A scrub cedar, 10 ins. diam., bears S. 37° W., 156 lks. dist., mkd.  $\frac{1}{4}$  S 3 BT
- 48.10 Spur, slopes NE.; descend SE. slope, 15 ft.
- 52.60 Draw, 10 lks. wide, course NE., ascend NE. slope 20 ft.
- 55.00 Spur, slopes NE.; descend SE. slope 68 ft.
- 58.30 Wash, 20 lks. wide, course E.; ascend NE. slope 90 ft.
- 69.00 Spur, slopes E.; descend 30 ft.
- 72.00 Wash, 10 lks. wide, course NE. ascend N. slope 40 ft.
- 80.12 The cor. of secs. 2, 3, 10 and 11.

Land, mountainous.  
Soil, rocky, 3d rate.  
Timber, scattering cedar.  
Undergrowth, sagebrush, russian thistle and grass.

-----

FINAL TEST

Nov. 22, 1936; At camp in sec. 36, T.40 N., R.4 E., at 9h. 0m. a.m. app. t., set off 36° 49' N. on the lat. arc 20° 10' S. on the decl. arc, and orient the instrument with the solar; the line of sight agrees with the meridian determined by Polaris observation.

At 3h. 0m. p.m. app. t., with the lat. arc unchanged, set off 20° 13' S. on the decl. arc, and repeat the test of the instrument; the line of sight agrees with the meridian determined by Polaris observation.

-----

GENERAL DESCRIPTION

The land in the portion of the Tp. surveyed under this group, varies from nearly level in the NE. part to mountainous toward the SW.

The elevation is about 6000 ft. above sea level.

The general direction of the drainage is to the NE. There is no running water.

The soil is gravelly and rocky, 3d rate.

There is a scattering growth of scrub cedar, useful only for fuel purposes.

U. S. Highway No. 89 crosses sec. 1 in a NW. and SE. direction.

There are no settlers and no indications of valuable minerals.

-----





CERTIFICATE OF UNITED STATES SURVEYOR

BOOK 4129

I, Benjamin J. Kinsey, U.S. Surveyor, HEREBY CERTIFY upon honor that, in pursuance of special instructions bearing date of the 30th day of July, 1936, received from the district cadastral engineer for Arizona, with assignment instructions dated August 12, 1936, I have surveyed a portion of the subdivisional lines of Township 38 North, Range 3 East,

of the Gila and Salt River Meridian, in the State of Arizona, which are represented in the foregoing field notes as having been executed by me and under my direction; and that said survey has been made in strict conformity with said instructions, the Manual of Instructions for the Survey of the Public Lands of the United States, and in the specific manner described in the foregoing field notes.

138NR8W Arizona.  
May 23, 1937.

Benjamin J. Kinsey  
U.S. Surveyor

CERTIFICATE OF APPROVAL

OFFICE OF U.S. SUPERVISOR OF SURVEYS,

Denver, Colorado, June 21, 1937.

The foregoing field notes of the survey of a portion of the subdivisional lines of Township 38 North, Range 3 East, of the Gila and Salt River Meridian, in the State of Arizona,

executed by Benjamin J. Kinsey, U.S. Surveyor, under special instructions dated July 30, 1936, and assignment instructions dated August 12, 1936, having been critically examined, and the necessary corrections made prior to their certification by the engineer, the said field notes, and the survey therein described, are hereby approved.

U.S. Supervisor of Surveys.

CERTIFICATE OF TRANSCRIPT

I certify that the foregoing transcript of the field notes of the above described surveys in, is a true copy of the original field notes on file in the public survey office.

U.S. Supervisor of Surveys.