

4143

91
1

Original

4-679
(April 1933)

BOOK 4143

Book D.

FIELD NOTES

of the

resurvey of a portion of the East boundary of Luis Maria Baca Float
No. 5, and of the survey of subdivisional lines, completing the survey
of Fractional Township 17 North, Range 7 West,

Of the Gila and Salt River Meridian,

In the State of Arizona

EXECUTED BY

F. Wayne Forrest

Public Land Surveyor

General Land Office,

Under special instructions dated July 19, 1937, which provided
for the surveys included under Group No. 220, bearing the approval of the
Commissioner of the General Land Office under date of July 30, 1937
and assignment instructions dated July 26, 1937.

Survey commenced August 19, 1937.

Survey completed August 23, 1937.

4143

4143

INDEX DIAGRAM.

Township _____, *Range* _____

6	5	4	3	2	1
7	8	9	10	11	12
18	17	16	15	14	13
19	20	21	22	23	24
30	29	28	27	26	25
31	32	33	34	35	36

BOOK 4143

I N D E X . D I A G R A M

Township 17 North, Range 7 West.

T. 18 N., T. 18 N., R. 6 W.
R. 7 W.

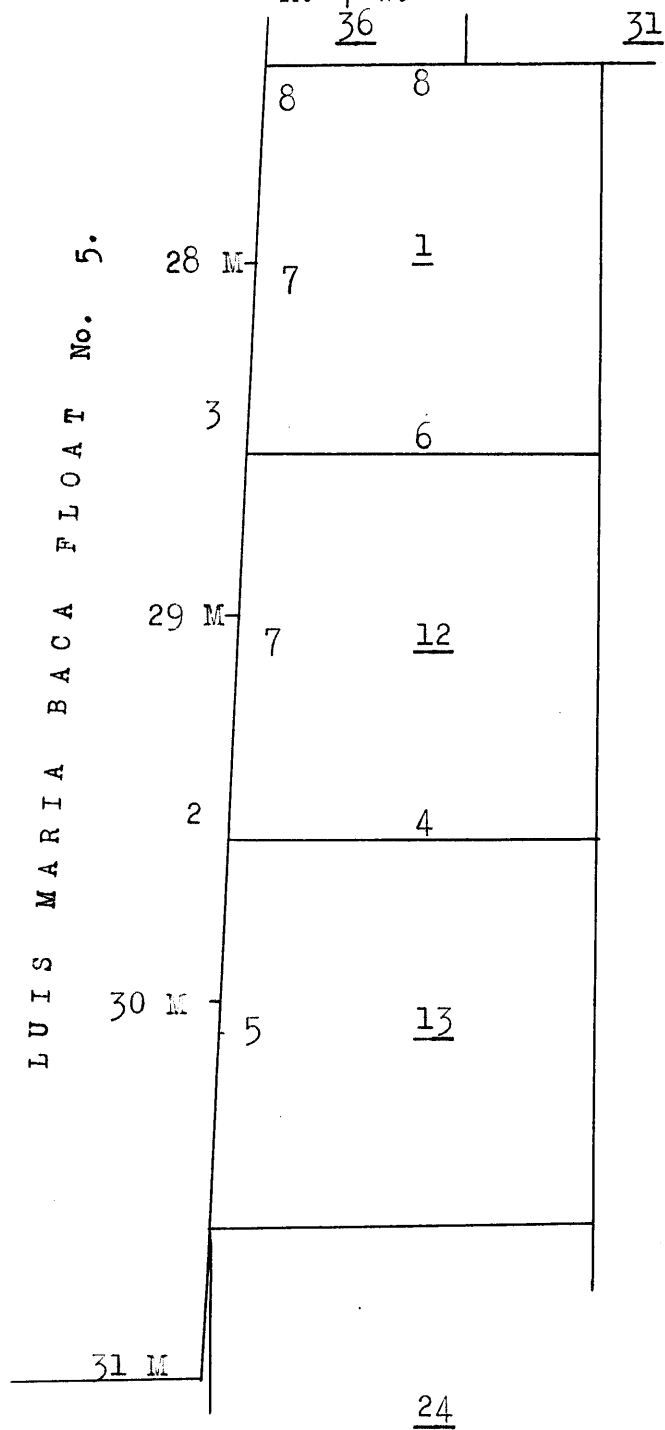

Chains

Test of Instrument.

This survey was executed with Buff solar transit No. 18,002, model of 1926. It is equipped with a full vertical circle and a Smith solar attachment and was approved by the District Cadastral Engineer, on July 26, 1937, conditional upon satisfactory field tests. All of the instrumental adjustments were examined before the field tests, hereinafter described, were made.

The directions of the lines were determined by the solar transit method, the measurements were made with a Lallie steel tape, 5 chs. in length, graduated every link for the first 100 lks., and the balance at intervals of 10 lks. The tape was tested by comparison with a Lufkin standard and found correct. The measurements were made on the slope, and the vertical angle of each interval was ascertained by a clinometer, in good adjustment; the horizontal equivalents are entered in the field note record.

The data given with the special instructions gives the geographic position for the cor. of Tps. 18 N., Rs. 6 and 7 W., on the N. bdy. of sec. 1, T. 17 N., R. 7 W., as follows: latitude $34^{\circ} 53' 44''$ N., longitude $112^{\circ} 57' 03''$ W.

The solar attachment was tested at the beginning of the survey on a meridian established by an observation of Polaris. The data for the establishment of this meridian is given in the field notes of the fourth standard parallel north, thru ranges 5 and 6 W., resurveyed under this group.

August 10, 1937: Every 30 mins. during the usual hours of solar work, the proper settings were made on the arcs of the solar attachment. The resulting orientation of the instrument, when compared with the meridian established by Polaris observation, had a maximum error of less than $1' 30''$.

The test of the solar was repeated at frequent intervals, and the transit maintained in good adjustment, throughout the survey.

Resurvey of a Portion of the E. Bdy. of the Luis Maria Baca Float No. 5.

The E. bdy. of the Luis Maria Baca Float No. 5 was surveyed by C. B. Foster, Deputy Surveyor, in 1877, in 1905 the 31st mile was retraced by A. B. Mader, Deputy Surveyor, and the 28th mile was resurveyed by B. Mollette, Transitman, in 1934.

From the 30th mile cor. on the E. bdy. of the Luis Maria Baca Float No. 5.

North, on a random line on the 30th and 29th miles of the E. bdy. of the Luis Maria Baca Float No. 5.

79.72

A point 4.04 chs. W. of the 29th mile cor.

159.55

A point 6.78 chs. W. of the 28th mile cor.

BOOK 4143

Resurvey of a Portion of the E. Bdy. of the Luis Maria
Baca Float No. 5.

Chains

Return to the 30th mile cor. on the E. bdy. of the Luis Maria Baca Float No. 5, which is a lava stone, 26x14x10 ins., set in a mound of stone, 3 ft. base, 1 ft. high, mkd. 30 M L B V on the W. face.

At point for cor., with the original stone set alongside.

Set an iron post, 3 ft. long, 2 ins. diam., 12 ins. in the ground to bedrock, and in a mound of stone, 4 ft. base, 2 ft. high, for the 30th mile cor. on the E. bdy. of the Luis Maria Baca Float No. 5, with brass cap mkd.

LMBF		T17N
30 M		R7W
No. 5		S 13
1937		

from which

Original bearing trees:

A yellow pine, 24 ins. diam., bears S. 9° W., 34 lks. dist., mkd. L B V 30 M B T.

A juniper, 10 ins. diam., bears S. 76 $\frac{3}{4}$ ° W., 152 lks. dist., mkd. L M B F NO. 5 30 M B T.

A juniper, 14 ins. diam., bears N. 12 $\frac{3}{4}$ ° W., 84 lks. dist., mkd. L M B F NO. 5 30 M B T.

Thence N. 2° 54' E., on true line on the 30th mile of the E. bdy. of the Luis Maria Baca Float No. 5.

Desc. 107 ft. over a NE. slope, thru timber and undergrowth.

8.37 Rocky wash, 8 ft. wide, course E.; asc. 80 ft. over a S. slope.

15.55 Slope changes to E.

19.85 Desc. 113 ft. over a NE. slope.

34.50 Thence over rolling land.

36.00 Small wash, course SE.

41.92 Wash, 8 ft. wide, course SE.; asc. 88 ft. over a gentle S. slope.

54.38 Slope changes to SE.

64.30 Thence along an E. slope.

67.20 Desc. 60 ft. over a NE. slope.

78.50 Wash, 10 ft. wide, course SE.; asc. 20 ft. over a S. slope.

79.82 The 29th mile cor. on the E. bdy. of the Luis Maria Baca Float No. 5, which is a granite stone, 20x12 ins., 10 ins. above ground, mkd. B L V 29 M, on the S. face.

At point for cor., with the original stone set alongside.

Resurvey of a Portion of the E. Bdy. of the Luis Maria
Baca Float No. 5.

BOOK 4143

Chains

Set an iron post, 3 ft. long, 3 ins. diam., 8 ins. in the ground to bedrock, and in a mound of stone to top, for the 29th mile cor. on the E. bdy. of the Luis Maria Baca Float No. 5, with brass cap mkd.

LMBF		T17N
29 M		R7W
No. 5		S 12
		1937

from which

Original bearing trees:

A yellow pine, 30 ins. diam., bears S. $35\frac{1}{2}^{\circ}$ E., 77 lks. dist., properly mkd., markings destroyed.

A yellow pine, 24 ins. diam., bears S. $28\frac{1}{2}^{\circ}$ W., 24 lks. dist., blazed only.

New bearing trees:

A yellow pine, 6 ins. diam., bears S. $83\frac{1}{4}^{\circ}$ W., 63 lks. dist., mkd. L M B F NO. 5 29 M B T.

A juniper, 4 ins. diam., bears N. $84\frac{1}{4}^{\circ}$ W., 20 lks. dist., mkd. L M B F NO. 5 29 M B T.

Land, rolling mountainous. ²⁹

Soil, sandy loam and rocky, 3d rate.

Timber, yellow pine, juniper and oak; undergrowth, scrub oak, and mountain laurel.

N. $1^{\circ} 58'$ E., on true line on the 29th mile of the E. bdy. of the Luis Maria Baca Float No. 5.

Asc. 82 ft. over a S. slope, thru timber and undergrowth.

11.60 Spur, slopes SE.; desc. 91 ft. over a NE. slope.

22.30 Unimproved road, bears NW. and SE.; thence over rolling land.

44.70 Asc. 40 ft. over a S. slope.

54.05 End of ascent; desc. 23 ft. over a N. slope.

60.45 Wash, 10 ft. wide, course SE.; asc. 60 ft. over a S. slope.

76.60 Desc. 20 ft. over a NW. slope.

79.88 The 28th mile cor. on the E. bdy. of the Luis Maria Baca Float No. 5, which is an iron post, 2 ins. diam., 21 ins. above ground, and in a mound of stone to top, with brass cap mkd.

LMBF		
No. 5		
28 M		
		1934

Resurvey of a Portion of the E. Bdy. of the Luis Maria
Baca Float No. 5.

Chains

I additionally mark the brass cap to read as follows:

LMBF		T17N
No. 5		R7W
		S 1
28 M		
		1937
		1934

from which

Original bearing trees:

A yellow pine, 42 ins. diam., bears N. $12\frac{1}{2}^{\circ}$ E., 50 lks. dist., marks plainly legible.A pinon, 10 ins. diam., bears S. $14\frac{1}{2}^{\circ}$ W., 80 lks. dist., mkd. L M B F NO. 5 28 M B T.A yellow pine, 42 ins. diam., bears N. $51\frac{1}{2}^{\circ}$ W., 128 lks. dist., mkd. L M B F NO. 5 28 M B T.

Land, rolling.

Soil, sandy loam and rocky, 3d rate.

Timber, yellow pine, juniper and oak; undergrowth, scattering scrub oak.

A Portion of the Subdivisional Lines Completing the
Subdivision of Fractional T. 17 N., R. 7 W.

From the cor. of secs. 7, 12, 13 and 18, described in the field notes of the W. bdy. of T. 17 N., R. 6 W., surveyed under this group.

West, bet. secs. 12 and 13.

Asc. 18 ft. over rolling land, thru timber and scattering undergrowth.

31.90 Desc. 145 ft. over a SW. slope.

40.00 Set an iron post, 3 ft. long, 1 in. diam., 6 ins. in the ground to bedrock, and in a mound of stone to top, for $\frac{1}{4}$ sec. cor., with brass cap mkd.

S 12
$\frac{1}{4}$ S 13
1937

from which

A juniper fork, 16 ins. diam., bears S. 66° W., 95 lks. dist., mkd. $\frac{1}{4}$ S 13 B T.A juniper fork, 10 ins. diam., bears N. $20\frac{1}{2}^{\circ}$ W., 137 lks. dist., mkd. $\frac{1}{4}$ S 12 B T.

Desc. 170 ft. over a rocky SW. slope.

50.40 A U. S. Geological Survey monument bears N., 49.63 chs. dist., an iron post, 3 ins. diam., 12 ins. above ground, with brass cap mkd.

A Portion of the Subdivisional Lines Completing the
Subdivision of Fractional T. 17 N., R. 7 W.

4143

Chains

ELEVATION

ABOVE	SEA
6244	FEET
DATUM PRSCT	

- 57.10 Pine Creek, 10 ft. wide, course SW.; thence over rolling land.
- 58.00 Unimproved road, bears SE. from T.
- 71.04 A four strand barbed wire fence, bears N. and S.
- 76.22 Intersect the E. bdy. of the Luis Maria Baca Float No. 5.
Set an iron post, 3 ft. long, 2 ins. diam., 28 ins. in the ground, for closing cor. of secs. 12 and 13, with brass cap mkd.

	LM	T17N	
	BF	S 12	CC
No. 5		S 13	
		R 7W	
		1937	

from which

A yellow pine, 14 ins. diam., bears N. $50\frac{1}{4}^{\circ}$ E., 2.70 lks. dist., mkd. T 17 N R 7 W S 12 C C B T.

An oak, 24 ins. diam., bears S. $46\frac{3}{4}^{\circ}$ E., 189 lks. dist., mkd. T 17 N R 7 W S 13 C C B T.

From point of intersection the 30th mile cor. on the E. bdy. of the Luis Maria Baca Float No. 5, heretofore described, bears S. $2^{\circ} 54'$ W., 34.56 chs. dist.

From the same point the 29th mile cor. on the E. bdy. of the Luis Maria Baca Float No. 5, heretofore described, bears N. $2^{\circ} 54'$ E., 45.26 chs. dist.

Land, rolling mountainous.

Soil, sandy loam and rocky, 3d rate.

Timber, yellow pine, oak and juniper; undergrowth, scattering scrub oak.

At midpoint on the W. bdy. of sec. 13.

Set an iron post, 3 ft. long, 1 in. diam., 12 ins. in the ground to bedrock, and in a mound of stone to top, for $\frac{1}{4}$ sec. cor., with brass cap mkd.

	$\frac{1}{4}$
	S 13
	1937

from which

A yellow pine, 4 ins. diam., bears N. 33° E., 132 lks. dist., mkd. $\frac{1}{4}$ S 13 B T.

A yellow pine, 12 ins. diam., bears S. $46\frac{1}{4}^{\circ}$ E., 156 lks. dist., mkd. $\frac{1}{4}$ S 13 B T.

A Portion of the Subdivisional Lines Completing the
Subdivision of Fractional T. 17 N., R. 7 W.

Chains

From this cor., the 30th mile cor. on the E. bdy. of the Luis Maria Baca Float No. 5, heretofore described, bears N. 2° 24' E., 5.56 chs. dist.

The closing cor. of secs. 13 and 24, T. 17 N., R. 7 W., on the E. bdy. of the Luis Maria Baca Float No. 5, bears S. 2° 24' W., 40.10 chs. dist., a malpais stone, 9x6 ins., 7 ins. above ground, mkd. and witnessed as described in the official record.

From the cor. of secs. 1, 6, 7 and 12, described in the field notes of the W. bdy. of T. 17 N., R. 6 W., surveyed under this group.

West, bet. secs. 1 and 12.

Desc. 55 ft. over a W. slope, thru timber and scattering undergrowth.

7.85 Wash, 8 ft. wide, course SW.; asc. 50 ft. over an E. slope.

25.45 Desc. 60 ft. over a W. slope.

40.00 Set an iron post, 3 ft. long, 1 in. diam., 18 ins. in the ground to bedrock, and in a mound of stone to top, for $\frac{1}{4}$ sec. cor., with brass cap mkd.

S 1
—
S 12
1937

from which

A juniper, 4 ins. diam., bears N. 2 $\frac{1}{2}$ ° E., 31 lks. dist., mkd. $\frac{1}{4}$ S 1 B T.

A yellow pine, 24 ins. diam., bears S. 64 $\frac{1}{2}$ ° W., 91 lks. dist., mkd. $\frac{1}{4}$ S 12 B T.

Desc. 40 ft. over a W. slope.

49.00 Small wash, course S.; thence over rolling land.

61.60 Pine Creek, 8 ft. wide, course SW.

72.63 Intersect the E. bdy. of the Luis Maria Baca Float No. 5.

Set an iron post, 3 ft. long, 2 ins. diam., 27 ins. in the ground, for closing cor. of secs. 1 and 12, with brass cap mkd.

T17N
LM | S 1
BF | — CC
No. 5 | S 12
R7W
1937

from which

A juniper fork, 24 ins. diam., bears N. 57 $\frac{1}{2}$ ° E., 140 lks. dist., mkd. T 17 N R 7 W S 1 C C B T.

A yellow pine, 8 ins. diam., bears S. 74 $\frac{1}{2}$ ° E., 102 lks. dist., mkd. T 17 N R 7 W S 12 C C B T.

101

148

A Portion of the Subdivisional Lines Completing the
Subdivision of Fractional T. 17 N., R. 7 W.

From point of intersection the 29th mile cor. on the E. bdy. of the Luis Maria Baca Float No. 5, heretofore described, bears S. $1^{\circ} 58'$ W., 34.77 chs. dist.

From the same point the 28th mile cor. on the E. bdy. of the Luis Maria Baca Float No. 5, heretofore described, bears N. $1^{\circ} 58'$ E., 45.11 chs. dist.

Land, rolling mountainous.
Soil, sandy loam and rocky, 3d rate.
Timber, yellow pine, juniper and oak; undergrowth, scattering scrub oak.

At midpoint on the W. bdy. of sec. 12.

Set an iron post, 3 ft. long, 1 in. diam., 24 ins. in the ground to bedrock, and in a mound of stone to top, for $\frac{1}{4}$ sec. cor., with brass cap mkd.

|
 $\frac{1}{4}$

| S 12

1937

from which

A juniper, 6 ins. diam., bears N. $31\frac{3}{4}^{\circ}$ E., 49 lks. dist., mkd. $\frac{1}{4}$ S 12 B T.

A juniper fork, 8 ins. diam., bears S. $36\frac{1}{2}^{\circ}$ E., 69 lks. dist., mkd. $\frac{1}{4}$ S 12 B T.

From this cor. the 29th mile cor. on the E. bdy. of the Luis Maria Baca Float No. 5, heretofore described, bears N. $2^{\circ} 54'$ E., 5.23 chs. dist.

At a point 40.00 chs. in northing from the closing cor. of secs. 1 and 12, on the E. bdy. of the Luis Maria Baca Float No. 5.

Set an iron post, 3 ft. long, 1 in. diam., 26 ins. in the ground, and in a mound of stone to top, for $\frac{1}{4}$ sec. cor., with brass cap mkd.

|
 $\frac{1}{4}$

| S 1

1937

from which

A juniper, 34 ins. diam., bears N. $40\frac{3}{4}^{\circ}$ E., 98 lks. dist., mkd. $\frac{1}{4}$ S 1 B T.

A juniper fork, 12 ins. diam., bears S. $36\frac{1}{4}^{\circ}$ E., 77 lks. dist., mkd. $\frac{1}{4}$ S 1 B T.

From this cor. the 28th mile cor. on the E. bdy. of the Luis Maria Baca Float No. 5, heretofore described, bears N. $1^{\circ} 58'$ E., 5.09 chs. dist.

A Portion of the Subdivisional Lines Completing the
Subdivision of Fractional T. 17 N., R. 7 W.

At a point 80.00 chs. in northing from the closing cor. of secs. 1 and 12, on the E. bdy. of the Luis Maria Baca Float No. 5.

Set an iron post, 3 ft. long, 1 in. diam., 28 ins. in the ground, for 1 mile cor., with brass cap mkd.

| 4 S 1
1937

From this cor. the closing cor. of frac. Tps. 17 and 18 N., Rs. 7 W., bears N. $1^{\circ} 27'$ E., 5.19 chs. dist., an iron post, 3 ins. diam., 20 ins. above ground, and in a mound of stone to top, *mkd.* and witnessed as described in the official record.

The 28th mile cor. on the E. bdy. of the Luis Maria Baca Float No. 5, heretofore described, bears S. $1^{\circ} 27'$ W., 34.93 chs. dist.

At a point 40.00 chs. west of the closing cor. of Tps. 17 N., Rs. 6 and 7 W., described in the field notes of the W. bdy. of T. 17 N., R. 6 W., surveyed under this group.

Set an iron post, 3 ft. ong, 1 in. diam., 12 ins. in the ground to bedrock, and in a mound of stone to top, for $\frac{1}{4}$ sec. cor., with brass cap mkd.

$\frac{1}{4}$ S 1
1937

from which

A yellow pine, 12 ins. diam., bears S. $21\frac{1}{2}^{\circ}$ E., 60 lks. dist., mkd. $\frac{1}{4}$ S 1 B T.

An oak, 4 ins. diam., bears S. $68\frac{1}{2}^{\circ}$ W., 30 lks. dist., mkd. $\frac{1}{4}$ S 1 B T.

From this cor. the cor. of Tps. 18 N., Rs. 6 and 7 W., bears E., 12.42 chs. dist., an iron post, 3 ins. diam., 9 ins. above ground, mkd. and witnessed as described in the official record.

The $\frac{1}{4}$ sec. cor. on the S. bdy. of frac. sec. 36, T. 18 N., R. 7 W., bears W. 27.58 chs. dist., an iron post, 1 in. diam., 10 ins. above ground, mkd. and witnessed as described in the official record.

A Portion of the Subdivisional Lines Completing the
Subdivision of Fractional T. 17 N., R. 7 W.

FINAL TEST OF SOLAR ATTACHMENT

August 29, 1937: In camp in the NE. $\frac{1}{4}$ of sec. 3, T. 16 N., R. 6 W., 9 a.m., app. time; I set off $34^{\circ} 48'$ N., on the lat. arc; $9^{\circ} 22'$ N. on the decl. arc; and orient the instrument with the solar; the line of sight agrees with the meridian established by Polaris observation.

At app. noon, with the latitude arc unchanged, I observe the sun on the meridian; the resulting reading of the declination arc is $9^{\circ} 19'$ N., which agrees with the computed declination.

At 3 p.m., app. time, I set off $34^{\circ} 48'$ N. on the lat. arc; $9^{\circ} 16'$ N. on the decl. arc; and repeat the test of the solar; the line of sight agrees with the meridian established by Polaris observation.

The area included within this survey is mostly rolling mountainous. The elevation varies between about 6000 to 7000 feet above sea level. A broken, high mesa lies in the northern part of sec. 1. The soil is mostly sandy loam and rocky, with a clay subsoil. The timber is mostly yellow pine and juniper with some oak and pinon; there is some scrub oak undergrowth.

Pine Creek drains the area, entering near the cor. of secs. 1, 6, 7 and 12 and running SW. to S. throughout the area. It has no running water.

The area lies wholly within the Prescott National Forest. An unimproved road from Hill's ranch enters the area on the westerly part of the S. bdy. of sec. 13 and runs N. to NW., leaving the area on the northerly part of the W. bdy. of sec. 12.

There are no settlers in the area. The chief industry is cattle grazing. A good wire fence runs irregularly along the E. bdy. of the Luis Maria Baca Float No. 5.

There is no evidence of mineral deposits in the area.

The average of a considerable number of readings over all parts of the area gives a value of $16^{\circ} 00'$ E. for the mean magnetic variation.

4-680
(Revised May 1934)

1007 4143

FIELD ASSISTANTS

NAMES	CAPACITY
Clark Blevins	Principal Assistant.
Herbert Qualls	Chainman.
John W. Henry	Flagman.
Pascal Austin	Moundsman.
J. D. Harris	Axman.
Paul Teeter, Jr.	Axman.

ECCK 4143

CERTIFICATE OF ~~UNITED STATES~~ SURVEYOR

I, F. Wayne Forrest, Public Land Surveyor, ~~General Land Office~~, HEREBY CERTIFY upon honor that, in pursuance of special instructions bearing date of the 19th day of July, 1937 received from the district cadastral engineer for Arizona, with assignment instructions dated July 26, 1937, I have ^{re}surveyed a portion of the East boundary of Luis Maria Baca Float No. 5, and surveyed subdivisional lines, completing the survey of Fractional Township 17 North, Range 7 West,

River
of the Gila and Salt Meridian, in the State of Arizona, which are represented in the foregoing field notes as having been executed by me and under my direction; and that said and resurvey survey has been made in strict conformity with said instructions, the Manual of Instructions for the Survey of the Public Lands of the United States, and in the specific manner described in the foregoing field notes.

Glendale, California.
November 10, 1937.

F. Wayne Forrest
Public Land Surveyor

CERTIFICATE OF APPROVAL

OFFICE OF ~~U.S.~~ SUPERVISOR OF SURVEYS,

Denver, Colorado, March 14, 1938.

The foregoing field notes of the ^{re}survey of a portion of the East boundary of Luis Maria Baca Float No. 5, and surveyed subdivisional lines, completing the survey of Fractional Township 17 North, Range 7 West, of the Gila and Salt River Meridian, in the State of Arizona,

executed by F. Wayne Forrest, Public Land Surveyor, General Land Office, under special instructions dated July 19, 1937, and assignment instructions dated July 26, 1937, having been critically examined, and

the necessary corrections made prior to their certification by the engineer, the said field notes, and the survey and resurvey therein described, are hereby approved.

[Signature]
U.S. Supervisor of Surveys.

~~CERTIFICATE OF TRANSCRIPT~~

~~I certify that the foregoing transcript of the field notes of the above described surveys in _____, is a true copy of the original field notes on file in the public survey office.~~

U.S. Supervisor of Surveys.