

UNITED STATES  
DEPARTMENT OF THE INTERIOR  
GENERAL LAND OFFICE

BOOK 4221

Book A.

# FIELD NOTES

OF THE RETRACEMENT OF THE

Abandoned "Riecker" South Boundary of the San Carlos Indian Reservation  
and Portions of Exteriors and Subdivisional lines of

T. 5 S., Rs. 18,19,20,21 and 22 E., and T. 6 S., Rs. 16,17,18 and 22 E.

Of the Gila and Salt River Meridian,

In the State of Arizona

**EXECUTED BY**

Ty White, Surveyor, and

Raymond F. Moss, Public Land Surveyor

General Land Office

Under special instructions dated March 1, 1939, which provided  
for the surveys included under Group No. 226, bearing the approval of the  
Commissioner of the General Land Office under date of April 6, 1939  
and assignment instructions dated April 11, 1939.

Survey commenced April 13, 1939.

Survey completed June 9, 1939.

4221

4221

# INDEX DIAGRAM.

*Township* -----, *Range* -----

6	5	4	3	2	1
7	8	9	10	11	12
18	17	16	15	14	13
19	20	21	22	23	24
30	29	28	27	26	25
31	32	33	34	35	36

1A

T. 5 S., R. 19 E.  
Unsurveyed

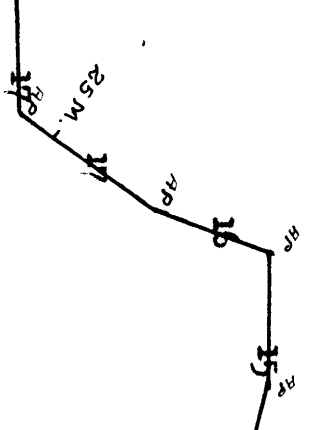

T. 5 S., R. 20 E.

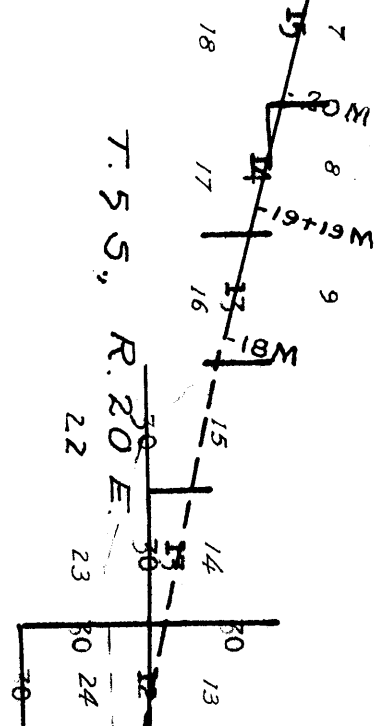

T. 5 S., R. 21 E.

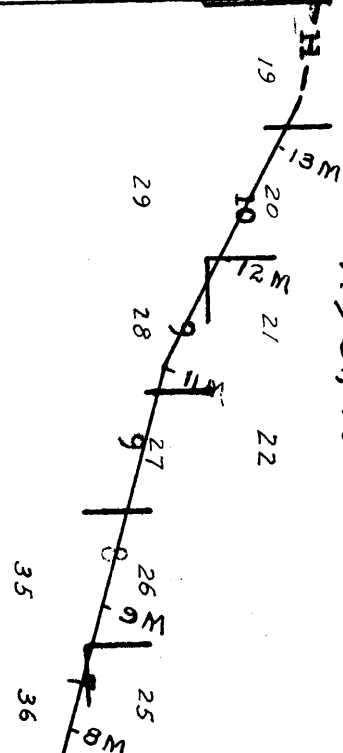

T. 5 S., R. 22 E.

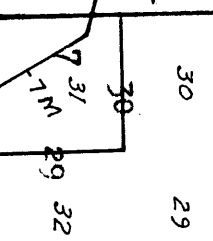

T. 6 S., R. 22 E.

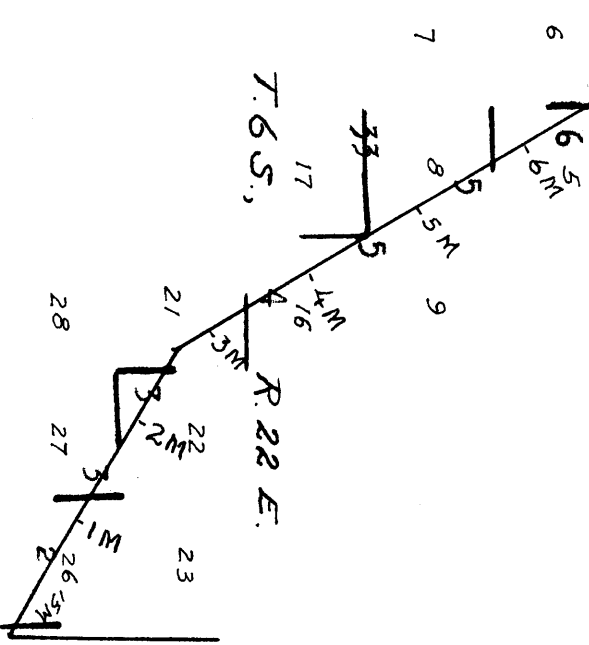

BOOK 4221

INDEX DIAGRAM # 7

B. DONOMO "TRUCKEE" SOUTH BOUND RR  
of  
S. N. C. RAILS INDIAN RESERVATION

Page numbers in type.



The retracements hereinafter described were executed by Ty White, Surveyor, and R. F. Moss, Public Land Surveyor, using respectively, Buff solar transit No. 18,002 and Gurley solar transit No. 371,537, both property of the General Land Office. The instruments are equipped with the improved Smith solar attachment, which is used in determining the directions of all lines. They were approved, conditional upon satisfactory field tests, by the district cadastral engineer on April 11, 1939. They were examined and found free from appreciable error before making the tests hereinafter recorded.

Measurements were made with Lufkin and Dietzen steel tapes, 5 chs. in length, graduated every link for the first 100 lks. and every 10 lks. on the remainder. The tapes were tested by comparison with a Lufkin standard and found correct. The measurements were made on the slope and the vertical angle of each slope determined with a clinometer in good adjustment; distances shown in the field note record are the horizontal equivalents.

The data furnished with the special instructions gives the geographic position for the SE. cor. of T. 5 S., R. 19 E., as follows: latitude 32° 56' 40" N.; longitude 110° 20' 36" W.

April 13, 1939, in camp in sec. 25, T. 6 S., R. 22 E., latitude 32° 52' 1/2" N., longitude 110° 02' 1/4" W., at 6h 33 1/2m p.m., 105th meridian standard time, we observe Polaris at western elongation, making two observations each with the telescope in direct and reversed positions, reading the horizontal angle easterly from the star to a skyline point about 2 miles distance..

Mean horizontal angle -----	1° 13' 30"
Azimuth of Polaris at western elong.-----	1° 13' 12"
True bearing of point-----	N.0° 00' 18"E.

April 14, 1939, at every 30 minutes during the usual hours of solar work, we orient the instruments on the meridian with the proper settings on the arcs of the solar attachments, and ascertain that the resulting orientations, when compared with the Polaris meridian, have a maximum error of less than 1' 30".

April 23, 1939, we make a noon observation on the sun for time and latitude at camp at the Goodwin Ranch near center of sec. 27, T. 5 S., R. 21 E., first setting on the sun's lower limb and noting the transit of the west limb, then, after reversal of the instrument, setting on the upper limb and noting the transit of the east limb.

Mean observed altitude-----	69° 27' 23"
Mean watch time of observation -----	12h 19m 06s
Reduced latitude -----	32° 58' 30"N.
Reduced watch slow of l.m.t.-----	04s

We repeat the tests of the arcs almost daily by noon observation and verify the meridional indications of the solar attachments at frequent intervals during the period of the survey.

## Chains

The S. bdy. of the San Carlos Indian Reservation (Originally White Mountain) was surveyed in 1883 by P. Riecker, U.S.D.S. This S. bdy. was initiated at a point due south of the flagstaff at the camp Goodwin Military Reservation at a distance of .15 miles from the Gila River. Its course then paralleled (approximately) the Gila River until it reached a point 15 miles due south of a point 10 miles up the left bank of said river from its confluence with the San Pedro River.

No retracements of this bdy. are of record.

As this bdy. has since been abandoned the corners described in the following notes are not remonumented or rehabilitated.

The following notes describe a retracement of the whole of the abandoned "Riecker" S. bdy. with intersections of all section lines crossed.

The Riecker SE. cor. of the San Carlos Indian Reservation, designated the 15 mile cor., is an unmarked granite stone, 6 x 4 x 4 ins. above ground, set in a small mound of stone, from which

A mesquite, 10 ins. diam., bears S.  $79\frac{1}{4}^{\circ}$  E., 27 lks. dist., marks identifiable but. not legible.

A mesquite stump, 10 ins. diam., bears N.  $55\frac{1}{4}^{\circ}$  W., 100 lks. dist., no marks.

This cor. is further identified by ties to the Riecker and Walker 14 mile corners.

The C. E. Walker SE. cor. of the San Carlos Indian Reservation bears S.  $62^{\circ} 36'$  E., 4.64 chs. dist., a quartzite stone, 12 x 10 x 4 ins. above ground, mkd. EBSOR 15M on top, with two mesquite stumps at record position of the two bearing trees of record.

Thence, ( from Riecker cor. )

N.  $57^{\circ} 57'$  W., on 1st mile.

Asc. 50 ft. over gentle NE. slope; through scattering mesquite and undergrowth.

- 4.56 Intersect the line bet. secs. 25 and 26, T. 6 S., R. 22 E., at a point 4.03 chs. N.  $0^{\circ} 03'$  W. of the cor. of secs. 25, 26, 35 and 36, and at 35.93 chs. S.  $0^{\circ} 03'$  E. of the  $\frac{1}{4}$  sec. cor. of secs. 25 and 26, both iron posts with brass caps mkd. as described in the official record.
- 4.62 Fence, bears N. and S.
- 20.10 Dry wash, 60 lks. wide, course N.  $60^{\circ}$  E.
- 24.10 Dim road, bears NE. and SW.
- 31.70 Dry wash, 20 lks. wide, course NE.; continue over gentle NE. slope.
- 49.20 Dry wash, 40 lks. wide, course N.  $60^{\circ}$  E.
- 68.80 Dry wash, 60 lks. wide, course N.  $60^{\circ}$  E.
- 80.80 The 1-mile cor., an unmarked stone in a small mound of stone.

Retracement of abandoned "Riecker" S. Bdy. of  
San Carlos Indian Reservation

## Chains

Land, gently rolling.  
Soil, sandy, 2nd and 3rd rates.  
Timber, mesquite; undergrowth, catclaw, greasewood, cacti.

-----  
N.57°48'W., on 2nd mile.

Over gently rolling land; through scattering mesquite and scattering undergrowth.

- 5.70 Dry wash, 50 lks. wide, course NE.
- 18.56 Intersect the line bet. secs. 26 and 27, T.6 S., R.22 E., at a point 14.41 chs. N.0°03'W. of the  $\frac{1}{4}$  sec. cor. and 25.54 chs. S.0°03'E. of the cor. of secs. 22, 23, 26 and 27, both General Land Office iron posts, mkd. on brass caps and witnessed as described in the official record.
- 21.10 Dry wash, 40 lks. wide, course N.60°E.
- 29.60 Dry wash, 60 lks. wide, course N.60°E.
- 43.80 Dim road, bears NE. and SW.
- 61.80 Low ridge, bears N.30°E. and S.30°W.; desc. 35 ft. over NW. slope.
- 63.10 Fence, bears E. and W.
- 66.53 Intersect the line bet. secs. 22 and 27, T.6 S., R.22 E., at a point 43 lks. N.89°54'W. of the  $\frac{1}{4}$  sec. cor. and 39.74 chs. S.89°54'E. of the cor. of secs. 21, 22, 27 and 28, both General Land Office iron posts, mkd. on brass caps and witnessed as described in the official record.
- 67.00 Dry wash, 40 lks. wide, course N.15°E.; asc. 25 ft.
- 71.50 Spur, slopes N.30°E.; desc. 20 ft.
- 77.40 Dry wash, 50 lks. wide, course NE.; asc. 15 ft.
- 81.02 The 2-mile cor., an unmarked granite stone, 16 x 12 x 9 ins. above ground, set in a small mound of stone, from which

A mesquite, 10 ins. diam., bears N.73°W., 103 lks. dist., illegible marks.

Land, rolling.  
Soil, sandy, 2nd rate.  
Timber, mesquite; undergrowth, catclaw, greasewood, cacti.

-----  
N.57°46'W., on 3rd mile.

Asc. 25 ft. over SE. slope; through scattering mesquite and desert growth.

- 3.40 Spur, slopes N.30°E.; desc. 25 ft.
- 13.10 Dry wash, 30 lks. wide, course NE.; asc. 20 ft.
- 19.60 A narrow spur, slopes N.30°E., desc. 20 ft.
- 25.50 Dry wash, 40 lks. wide, course N.30°W.; asc. 15 ft.

Retracement of abandoned "Riecker" S. Bdy. of  
San Carlos Indian Reservation

ECC

Chains	(3rd mile)
29.90	Low spur, slopes N.30°E.; desc. 15 ft.
32.42	Intersect the line bet. secs. 21 and 22, T.6 S., R.22 E., at a point 14.92 chs. S.0°04'E. of the $\frac{1}{4}$ sec. cor. and 25.01 chs. N.0°04'W. of the cor. of secs. 21,22,27 and 28, both General Land Office iron posts, mkd. on brass caps and witnessed as described in the official record.
37.00	The original Angle Point, a granite stone, 10 x 8 x 6 ins. above ground, firmly set in a small mound of stone, no identifiable marks.
	Thence, N.30°19'W., with renewed distance, on 3rd mile. Desc. 7 ft. over NW. slope.
0.40	Dry wash, 10 lks. wide, course N.30°E.; asc. 25 ft.
5.60	Ridge, bears N.30°E. and S.30°W.; desc. 100 ft. over NW. slope.
18.60	Dim road, bears NW. and SE.
22.40	Dry wash, 50 lks. wide, course N.30°W., from S.60°E.; asc. slightly.
35.18	The 3-mile cor., an unmarked stone in a small mound of stone. Land, rolling. Soil, sandy, 3rd rate. Timber, mesquite; undergrowth, catclaw, greasewood, cacti.
	----- N.30°26'W., on 4th mile. Over points of low spurs sloping SW.; through scattering mesquite and desert growth.
22.00	Dry wash, 2 chs. wide, course NE.; asc. 7 ft.
25.64	Intersect the line bet. secs. 16 and 21, T.6 S., R.22 E., at a point 6.17 chs. S.89°53'E. of the witness $\frac{1}{4}$ sec. cor. and 34.50 chs. N.89°53'W. of the cor. of secs. 15,16,21 and 22, both General Land Office iron posts, mkd. on brass caps and witnessed as described in the official record.
34.00	Road, bears NE. and SW.
45.20	Leave bottom land, bears NE. and SW.; asc. 70 ft.
45.00	Spur, slopes N.30°E.; desc. 80 ft. over NW. slope.
48.00	Dry wash, 70 lks. wide, course N.30°E.; asc. 105 ft.
64.00	Ridge, bears NE. and SW.; desc. 80 ft. over NW. slope.
74.00	Dry wash, 40 lks. wide, course NW.; asc. 15 ft.
79.72	The 4-mile cor., a granite rock, 10 x 8 x 6 ins. above ground, no identifiable marks, witnessed by a small mound of stone to NE. Land, rolling. Soil, sandy, 3rd rate. Timber, mesquite; undergrowth, greasewood, catclaw, cacti.
	-----



Retracement of abandoned "Riecker" S. Bdy. of  
San Carlos Indian Reservation

Chains	5th Mile
	N.30°26'W., on 5th mile.
	Over gently rolling land; through scattering mesquite and desert growth.
5.00	Spur, slopes NE.; desc. 35 ft.
12.50	Dry wash, 40 lks. wide, course NE.; asc. 120 ft.
32.90	Rocky spur, slopes E.; desc. 20 ft.
36.68	Intersect the line bet. secs. 16 and 17, T.6 S., R.22 E., at a point 38.255 chs. N.0°10'W. of the $\frac{1}{4}$ sec. cor., and 1.775 chs. S.0°10'E. of the cor. of secs. 8,9,16 and 17, both General Land Office iron posts, mkd. on brass caps and witnessed as described in the official record.
38.15	Ravine, 10 lks. wide, 8 ft. deep, course E.
38.74	Intersect the line bet. secs. 8 and 17, T.6 S., R.22 E., at a point 38.72 chs. N.89°56'E. of the $\frac{1}{4}$ sec. cor., and 1.04 chs. S.89°56'W. of the cor. of secs. 8,9,16 and 17, both General Land Office iron posts, mkd. on brass caps and witnessed as described in the official record.
	Asc. 360 ft. over SE. slope.
57.55	Fence, bears NE. and SW.
58.50	Spur, slopes N.60°E.; desc. 75 ft. over NW. slope.
67.80	Ravine, 15 lks. wide, course E.; asc. 465 ft. over SE. slope.
84.54	The 5-mile cor., a granite stone, 15 x 15 x 3 ins. above ground, mkd. -M S C with other illegible marks, from which  A juniper, 3 ins. diam., bears S.41°W., 67 lks. dist., illigible marks.  A mound of stone, 4 ft. base, 3 ft. high, bears SE., 3 ft. dist.  Land, rolling and mountainous. Soil, sandy, 3rd rate and rocky, 4th rate. Timber, mesquite and juniper; undergrowth, catclaw, cacti, greasewood and pala negra.
	-----
	N.30°09'W., on 6th mile.
	Over mountainous land; through scattering juniper and mesquite timber and scattering undergrowth.
0.10	Leave top of spur, slopes N.60°E.; desc. 550 ft. over NE. slope.
32.00	Ravine, 10 lks. wide, course E.; asc. 90 ft.
39.60	Spur, slopes N.60°E.; desc. 165 ft. over NE. slope.
47.21	Intersect the line bet. secs. 5 and 8, T.6 S., R.22 E., at a point 7.77 chs. S.89°53'W. of the $\frac{1}{4}$ sec. cor., and 32.38 chs. N.89°53'E. of the cor. of secs. 5,6,7 and 8, both General Land Office iron posts, with brass caps mkd. as described in the official record and witnessed as described in the official record.

Retracement of abandoned "Riecker" S. bdy. of  
San Carlos Indian Reservation

Chains	6th mile.
	Desc. 40 ft. over NE. slope.
52.20	Ravine, 15 lks. wide, course E.; asc. 95 ft. over SE. slope.
58.50	Spur, slopes N.60°E.; desc. 140 ft. over NW. slope.
71.03	The 6-mile cor., an unmarked granite stone, 10 x 8 x 4 ins. above ground, firmly set, witnessed by a mound of stone to SE.
	Land, mountainous. Soil, rocky, 4th rate. Timber, mesquite and juniper; undergrowth, catclaw, scrub oak, cacti and pala negra.
-----	
	N.30°06'W., on 7th mile.
	Desc. 75 ft. over NW. slope; through scattering juniper and mesquite timber and scattering undergrowth.
4.30	Ravine, 20 lks. wide, course N.20°E.; asc. 90 ft.
13.80	Spur, slopes NW.; desc. 210 ft. over NE. slope.
24.80	Ravine, 70 lks. wide, 30 ft. deep, course N.20°E.; asc. 220 ft. over SE. slope.
37.50	Spur, slopes N.30°E.; desc. 25 ft.
41.12	Intersect the line bet. secs. 5 and 6, T.6 S., R.22 E., at a point 16.17 chs. N.0°09'W. of the $\frac{1}{4}$ sec. cor., and 19.93 chs. S.0°09'E. of the closing cor. of secs. 5 and 6, both General Land Office iron posts, mkd. on brass caps, and witnessed as described in the official record.
	Desc. 70 ft. over NE. slope.
42.90	Ravine, 50 lks. wide, course N.70°E.; asc. 135 ft.
50.80	Spur, slopes N.15°E.; desc. 255 ft. over NE. slope.
64.12	Intersect the 1st Stan. Par., S., S. bdy. of T.5 S., R.22 E., at a point 2.00 chs. N.89°55'E. of the stan. $\frac{1}{4}$ sec. cor. of sec. 31 and 38.16 chs. S.89°55'W. of the stan. cor. of secs. 31 and 32. The stan. $\frac{1}{4}$ sec. cor. is a granite stone, 10 x 8 x 4 ins. above ground, mkd. SC on N. face, witnessed by a mound of stone N. The stan. cor. of secs. 31 and 32 is a granite stone, 10 x 6 x 6 ins. above ground, mkd. and witnessed as described in the official record. From stan. $\frac{1}{4}$ sec. cor. the closing cor. of secs. 5 and 6, T.6 S., R.22 E., hereinbefore described, bears N.89°55'E., 13.50 chs. dist.
65.20	Dry wash, 30 lks. wide, course N.; asc. 75 ft.
74.40	Spur, slopes N.20°E.; desc. 125 ft.
80.70	Dry wash, 40 lks. wide, course N.15°E.; asc. 130 ft.
90.43	The 7-mile cor., a granite stone, 10 x 8 x 6 ins. above ground, firmly set, mkd. WC, witnessed by a mound of stone, 4 $\frac{1}{2}$ ft. base, 3 ft. high, to NW.
	Land, mountainous. Soil, rocky, 4th rate. Timber, mesquite and juniper; undergrowth, catclaw, oak and cacti.
-----	

Retracement of Abandoned "Riecker" S. Bdy. of  
San Carlos Indian Reservation

Chains	8th Mile
	N.30°06'W., on 8th mile.
	Asc. slightly over SE. slope; through scattering juniper and mesquite timber and scattering undergrowth.
4.60	Top of flat spur, slopes N.60°E.; desc. 190 ft. over NW. slope.
15.50	Dry wash, 30 lks. wide, course NE.; asc. 180 ft. over SE. slope.
24.50	Spur, slopes N.; desc. 150 ft. over NW. slope.
39.33	The original Angle Point, a granite stone, 18 x 10 x 6 ins. above ground, firmly set, mkd. SB S C, witnessed by a mound of stone, 3½ ft. base, 3 ft. high, to S.
	Thence,
	N.74°06'W., with renewed distance, on 8th mile.
	Desc. slightly.
9.75	Intersect the line bet. secs. 31 and 36, E. bdy. of T.5 S., R.21 E., at a point 19.27 chs. N.0°14'W. of the ¼ sec.cor., which is a granite stone, 8 x 8 x 6 ins. above ground, firmly set and mkd. and witnessed as described in the official record. The cor. of secs. 25,30,31 and 36 bears N.0°14'W., 21.08 chs. dist. from point of intersection, a General Land Office iron post, set, mkd. on brass cap and witnessed as described in the official record.
	Desc. 100 ft. over increasing NW. slope.
28.20	Dry wash, 30 lks. wide, course N.; asc. 45 ft.
31.70	Spur, slopes N.; desc. 65 ft. over NW. slope.
35.30	Road, bears NE. and SW.
39.20	Black Rock Creek, 5 lks. wide, 2 ins. deep, in wash, 60 lks. wide, course N.20°E.; asc. 35 ft.
42.37	The 8-mile cor., a granite stone, 12 x 10 x 8 ins. above ground, firmly set, with illegible marks, witnessed by a mound of stone, 3 ft. base by 1½ ft. high, to NW.
	Land, rolling and mountainous. Soil, rocky, 3rd and 4th rates. Timber, mesquite and juniper with ash and sycamore in creek bottom; undergrowth, catclaw, oak and cacti.
-----	
	N.73°39'W., on 9th mile.
	Asc. 250 ft. over E. slope; through scattering juniper and mesquite timber and scattering undergrowth.
22.10	Spur, slopes S.30°E.; desc. 165 ft. over SW. slope.
33.70	Dry wash, 30 lks. wide, course S. for 2 chs. to junction.
35.40	Road, bears N. and S.
38.40	Dry wash, 50 lks. wide, course S.20°E.; asc. 80 ft. over E. slope.

Retracement of abandoned "Riecker" S. Bdy. of  
San Carlos Indian Reservation

Chains	(9th Mile)
42.04	Intersect the line bet. secs. 25 and 36, T.5 S., R.21 E., at a point 31.49 chs. S.89°45'W. of the $\frac{1}{4}$ sec. cor. and 8.68 chs. N.89°45'E. of the cor. of secs. 25,26,35 and 36, both General Land Office iron posts, mkd. on brass caps and witnessed as described in the official record.  Asc. 130 ft. over E. slope.
50.20	Spur, slopes S.20°E.; desc. 50 ft.
51.09	Intersect the line bet. secs. 25 and 26, T.5 S., R.21 E., at a point 37.47 chs. S.0°06'E. of the $\frac{1}{4}$ sec. cor. and 2.57 chs. N.0°06'W. of the cor. of secs. 25,26,35 and 36, both General Land Office iron posts, set, mkd. on brass caps and witnessed as described in the official record.
54.20	Small ravine, course S.; asc. 65 ft. over SE. slope.
57.10	Spur, slopes S.10°E.; desc. 45 ft. over SW. slope.
66.60	Ravine, 20 lks. wide, course SW.; asc. 210 ft.
71.30	Fence, bears NW. and SE.
76.77	The 9-mile cor., a granite stone, 20 x 3 x 3 ins. above ground, firmly set, mkd. SB S C, from which  A juniper stump, 12 ins. diam., bears N.63 $\frac{1}{4}$ °W., 96 lks. dist., mkd. S B S C B.  A mound of stone, 3 ft. base by 2 ft. high, bears NW., 4 lks. dist.  Cor. stands on divide bet. Goodwin Wash and Black Rock Creek, bears SW. and N.30°E.  Land, rolling and mountainous. Soil, rocky, 4th rate. Timber, juniper and mesquite; undergrowth, catclaw, oak and cacti.
-----	
	N.73°11'W., on 10th mile.
	Desc. 260 ft. over NW. slope; through scattering juniper and mesquite timber and scattering undergrowth.
4.60	Fence, bears SW. and NE.
26.50	Dry wash, 40 lks. wide, course N.75°W.; continue descent of NW. slope for 135 ft.
46.40	Dry wash, 90 lks. wide, course N.; asc. 45 ft.
54.00	Spur, slopes N.; desc. 65 ft. over NW. slope.
57.10	Dry wash, 10 lks. wide, course N.
57.88	Intersect the line bet. secs. 26 and 27, T.5 S., R.21 E., at a point 13.25 chs. S.0°06'E. of the $\frac{1}{4}$ sec. cor. and 26.56 chs. N.0°06'W. of the cor. of secs. 26,27,34 and 35, both General Land Office iron posts, set, mkd. on brass caps and witnessed as described in the official record.  Asc. 120 ft. over NE. slope.

Retracement of Abandoned "Biecker" S. Bdy. of  
San Carlos Indian Reservation

Chains	(10th Mile)
65.80	Spur, slopes N.20°W.; desc. 155 ft. over NW. slope.
76.20	Dry wash, 80 lks. wide, course NW.; desc. slowly.
80.00	Diligent search fails to reveal the 10-mile cor. With continued distance on 11th mile. Desc. 75 ft. over NW. slope.
84.70	Fence, bears NW. and SE.
94.40	Dry wash, 60 lks. wide, course NW.; continue descent 25 ft.
105.20	Fence, bears N. and S.
105.90	Dry wash, 80 lks. wide, course NW.; asc. 15 ft.
110.30	Toe of spur, slopes N.; desc. 20 ft.
111.30	Enter Goodwin Wash, course NE.
115.40	Leave same; fence along edge of wash; over bottom land.
128.00	Leave bottom land, bears NE. and SW.; asc. 15 ft.
131.00	Fence, bears NE. and SW.
133.65	The original Angle point, a granite stone, 3 ft. by 2 ft. by 10 ins. above ground, unmarked witnessed by a mound of stone, 4 ft. base by 3 ft. high, to E.  Cor. stands in small wash, course S.  Thence, N.63°10'W., on 11th mile, with renewed distance. Asc. 50 ft. over SE. slope.
8.57	Intersect the line bet. secs. 27 and 28, T.5 S., R.21 E., at a point 12.29 chs. N.0°07'W. of the $\frac{1}{4}$ sec. cor. and 27.69 chs. S.0°07'E. of the cor. of secs. 21, 22, 27 and 28, both General Land Office iron posts, set, mkd. on brass caps and witnessed as described in the official record.
9.80	Spur, slopes S.; desc. 50 ft. over W. slope.
12.60	Dry wash, 90 lks. wide, course S.; asc. 75 ft. over E. slope.
19.40	Spur, slopes S.20°E.; desc. 25 ft.
21.64	The 11-mile cor., a granite stone, 16 x 12 x 10 ins., with illegible marks, displaced from original position, witnessed by a mound of stone, 4 ft. base by 2 ft. high, to S.  Land, rolling. Soil, sandy, 3rd rate. Timber, juniper and mesquite; undergrowth, catclaw, cacti.
	N.62°31'W., on 12th mile.  Asc. 205 ft. over rolling S. slope; through scattering juniper and mesquite timber and scattering undergrowth.

Retracement of Abandoned "Riecker" S. Bdy. of  
San Carlos Indian Reservation

BOOK 4221

Chains	(12th Mile)
35.80	Spur, slopes S.20°W.; desc. 90 ft. over SW. slope.
47.20	Intersect the line bet. secs. 21 and 28, T.5 S., R.21 E., at a point 13.52 chs. West of the $\frac{1}{4}$ sec. cor., and 26.60 chs. East of the cor. of secs. 20, 21, 28 and 29, both General Land Office iron posts, set, mkd. on brass caps and witnessed as described in the official record.  Desc. 35 ft. over SW. slope.
51.00	Dry wash, 20 lks. wide, course S.30°E.; asc. 40 ft.
57.00	Spur, slopes S.30°E.; desc. 120 ft. over NW. slope.
63.90	Dry wash, 30 lks. wide, course S.20°E.; asc. 135 ft. over SE. slope.
72.70	Spur, slopes S.; desc. 85 ft. over W. slope.
75.40	Ravine, 8 lks. wide, course S.; asc. 70 ft.
77.22	Intersect the line bet. secs. 20 and 21, T.5 S., R.21 E., at a point 26.23 chs. S.0°10'E. of the $\frac{1}{4}$ sec. cor. and 13.82 chs. N.0°10'W. of the cor. of secs. 20, 21, 28 and 29, both General Land Office iron posts, set, mkd. on brass caps and witnessed as described in the official record.
80.40	Over top of spur, slopes S.
80.47	The 12-mile cor., a granite stone, 12 x 8 x 6 ins. above ground, firmly set, unmarked, witnessed by a mound of stone now scattered around cor.  Land, rolling. Soil, rocky, 4th rate. Timber, mesquite and juniper. Undergrowth, catclaw, cacti.  -----  N.62°50'W., on 13th mile.  Desc. 130 ft. over SW. slope; through scattering juniper and mesquite timber and scattering undergrowth.
9.50	Enter bottom land of Goodwin Wash, bears NW. and SE.
12.00	Mouth of branch wash, 50 lks. wide, from N.
13.50	Leave bottom land, bears E. and W.; asc. 245 ft. over general SE. slope.
33.70	Spur, slopes S.; desc. 45 ft.
39.40	Rocky ravine, course S.; asc. 390 ft. over SE. slope.
57.70	Top of hill; desc. 195 ft.
75.00	Drain, 4 lks. wide, course S.; asc. 105 ft. over SE. slope.
80.10	Spur, slopes S.
81.30	The 13-mile cor., a granite stone, 10 x 8 x 6 ins. above ground, firmly set, mkd. SB SC M13 on S. face, witnessed by a mound of stone, 3 ft. base, 2 ft. high, to W.  Land, rolling and mountainous. Soil, rocky, 4th rate. Timber, juniper and mesquite with cottonwood and sycamore in bottoms; undergrowth, catclaw and cacti.  -----

Retracement of Abandoned " Riecker " S. Bdy. of  
San Carlos Indian Reservation

11

Chains	( 14th Mile )
	N. 62°56'W., on 14th mile.
	Desc. 300 ft. over SW. slope; through scattering juniper and mesquite timber and scattering undergrowth.
5.40	Intersect the line bet. secs. 19 and 20, T. 5 S., R. 21 E. at a point 14.69 chs. N.0°12'W. of the $\frac{1}{4}$ sec. cor., and 25.24 chs. S.0°12'E. of the cor. of secs. 17,18,19 and 20, both General Land Office iron posts, set, mkd. on brass caps and witnessed as described in the official record.
11.30	Goodwin wash, 60 lks. wide, with stream, 5 lks. wide, 4 ins. deep, in center, course S.30°E.; asc. 145 ft.
16.50	Spur, slopes N.30°E.; desc. 35 ft.
21.80	Drain, 5 lks. wide, course N.30°E.; asc. 40 ft.
25.76	The original Angle Point, a ledge of granite stone, 10 x 3 x 3 ft. above ground, with illegible marks, witnessed by a mound of stone, 3 ft. base, by 2 ft. high, to S.
	-----
	Thence, with preliminary retracement,
	S.88°46'W.,
54.93	Fail to find 14-mile cor. Set temp. cor.
134.93	Fail to find 15-mile cor.
135.21	Set temp. 15- mile cor.
195.70	Fail to find Angle Point recorded at this distance. Set temp. point at a point 17 $\frac{1}{2}$ lks. N.1°14'W.
	Thence, from temp. point,
	N.74°38'W.,
19.23	Fail to find 16-mile cor. Set temp. cor.
85.88	Set temp cor. No trace of 17-mile cor. at a point N:74°38'W. 13.35 chs. dist.
	Thence on traverse,
	N.38°00'W.,
1.89	Set temp. cor. Thence
	N.44°10'W.,
55.23	The 18-mile cor., hereinafter described.
	-----
	Returning to the Angle Point on 14th mile.
	Thence
	N.79°21'W.; on direct line to the 18th mile cor.
	Asc. 170 ft. over NE. slope; through scattering juniper and mesquite timber and scattering undergrowth.
13.80	Spur, slopes N.; desc. 100 ft. over NW. slope.
20.60	Wash, 20 lks. wide, trickle of water in center, course N.60°E.; asc. 425 ft. over SE. slope.
43.50	Spur, slopes S.; desc. 100 ft. over SW. slope.

Retracement of Abandoned "Riecker" S. Bdy. of  
San Carlos Indian Reservation.

Chains	
56.90	Wash, 20 lks. wide, course S.60°E., trickle of water in center; asc. 65 ft.
58.80	End of spur, slopes N.; desc. 35 ft.
61.50	Dry wash, 20 lks. wide, course NE.
62.64	Intersect the line bet. secs. 19 and 24, on E. bdy. of T. 5 S., R. 20 E., at a point 35.72 chs. North of the $\frac{1}{4}$ sec. cor. and 4.33 chs. South of the cor. of secs. 13, 18, 19 and 24, both General Land Office iron posts, set, mkd. on brass caps and witnessed as described in the official record.
	Leave mesquite and enter increasing oak and pinon timber and heavier undergrowth. Asc. 40 ft. over SE. slope.
62.67	Fence, bears N. and S., soon S.45°E.
64.20	End of spur, slopes S.; desc. 25 ft.
66.60	Enter wash, 20 lks. wide, course SE., from N.80°W.
75.10	A small ravine enters from SW.
80.00	Leave wash, from N.60°W.; asc. 260 ft. over NE. slope.
87.96	Intersect the line bet. secs. 13 and 24, T. 5 S., R. 20 E., at a point 15.31 chs. S.89°14'E. of the $\frac{1}{4}$ sec. cor., and 24.89 chs. N.89°14'W. of the cor. of secs. 13, 18, 19 and 24, both General Land Office iron posts, set, mkd. on brass caps and witnessed as described in the official record.
88.20	Spur, slopes N.; desc. 55 ft. over NW. slope.
93.70	Ravine, 8 lks. wide, course N.; asc. 435 ft. over NE. slope.
112.80	Spur, slopes N.30°E.; desc. 10 ft.
117.00	Ravine, 8 lks. wide, course N.30°E.; asc. 335 ft. over NE. slope.
129.50	Spur, slopes N.30°W.; desc. 295 ft. over NW. slope.
136.00	Creek, 10 lks. wide, 2 ins. deep, course N.20°E.; asc. 200 ft. over SE. slope.
144.21	Intersect the line bet. secs. 13 and 14, T. 5 S., R. 20 E., at a point 30.06 chs. S.0°09'W. of the $\frac{1}{4}$ sec. cor., and 10.00 chs. N.0°09'E. of the cor. of secs. 13, 14, 23 and 24, both General Land Office iron posts, set, mkd. on brass caps and witnessed as described in the official record.
	Desc. 320 ft. over SE. slope.
152.80	Spur, slopes S.; desc. 100 ft. over SW. slope.
159.40	Ravine, course S.; asc. 460 ft. over SE. slope.
176.80	Spur, slopes S.; desc. 25 ft.
181.30	Head of ravine, course S.; asc. 45 ft.
186.10	Spur, slopes S.20°E.; desc. 25 ft.
189.50	Small ravine, course S.; asc. 120 ft. over SE. slope,
195.50	Spur-ridge, bears N.60°E. and S.60°W.; desc. 435 ft. over NW. slope.



Retracement of Abandoned "Riecker" S. Bdy. of  
San Carlos Indian Reservation

Chains	
212.80	Ravine, 10 lks. wide, course N.30°W.; asc. 55 ft.
217.90	Spur, slopes N.; desc. 95 ft.
222.10	Ravine, 8 lks. wide, course N.; asc. 85 ft.
224.40	Spur, slopes N.; desc. 40 ft. over NW. slope.
225.48	Intersect the line bet. secs. 14 and 15, T.5 S., R.20 E., at a point 14.80 chs. S.0°27'E. of the $\frac{1}{4}$ sec. cor. and 25.24 chs. N.0°27'W. of the cor. of secs. 14,15,22 and 23, both General Land Office iron posts, set, mkd. on brass caps and witnessed as described in the official record.
226.50	Ravine, 6 lks. wide, course N.; asc. 415 ft. over NE.slope.
240.20	A high spur, slopes N.20°W.; desc. 780 ft. over NW. slope.
267.50	Ravine, 8 lks. wide, course N.20°E.; asc. 90 ft.
272.40	Spur, slopes N.; desc. 245 ft. over NW. slope.
283.30	Goodwin Creek, 4 lks. wide, 4 ins. deep, in wash, 20 lks. wide, course N.30°E.; asc. 240 ft. over NE. slope.
288.70	Spur, slopes S.; desc. 150 ft. over SW. slope.
296.20	Ravine, 10 lks. wide, course S.30°E.; asc. 230 ft. over NE. slope.
306.60	Spur, slopes S.30°E.; desc. slightly.
307.22	Intersect the line bet. secs. 15 and 16, T.5 S., R.20 E., at a point 58 lks. N.0°09'W. of the $\frac{1}{4}$ sec. cor. and 39.50 chs. S.0°09'E. of the cor. of secs. 9,10,15 and 16, both General Land Office iron posts, set, mkd. on brass caps and witnessed as described in the official record.  Desc. 15 ft. over gentle SW. slope.
314.40	Ravine, 8 lks. wide, course SE.; asc. 255 ft. over NE. slope.
323.81	The 18-mile cor., a granite stone in place, 3 x 2 x 2 ft. above ground, illegible marks, witnessed by a mound of stone, 4 $\frac{1}{2}$ ft. square by 2 $\frac{1}{2}$ ft. high.  Cor. stands on a spur, slopes S.  Land, mountainous. Soil, rocky, rth rate. Timber, juniper, oak, pinon, sycamore with mesquite on E. $\frac{3}{4}$ mile; undergrowth, oak, squawbrush, buckbrush, manzanita, catclaw, cacti.
-----	
	N.73°56'W., on 19th mile.  Desc. 280 ft. over broken W. slope; through medium growth of oak, juniper and pinon timber and dense undergrowth.
19.60	Ravine, course S.30°W.; asc. 130 ft.
36.30	Spur, slopes S.; desc. 95 ft.
43.20	Ravine, course S.20°E.; asc. 160 ft.
56.00	Spur, slopes S.60°E.; continue ascent 110 ft.

BCCO. 1001 Retracement of Abandoned "Riecker" S. Bdy. of  
San Carlos Indian Reservation

## Chains

- 66.66 Intersect the line bet. secs. 16 and 17, T.5 S., R.20 E., at a point 21.98 chs. N.0°07'W. of the  $\frac{1}{4}$  sec. cor., and 17.96 chs. S.0°07'E. of the cor. of secs. 8,9,16 and 17, both General Land Office iron posts, set, mkd. on brass caps and witnessed as described in the official record.
- 68.20 Spur, slopes S.; desc. 85 ft. along S. slope.
- 76.50 Ravine, course S.; asc. 170 ft. over SE. slope.
- 79.20 Trail, bears NW. and SE.
- 80.00 Fail to find any evidence of 19-mile cor. Continue measurement on 20th mile.
- 84.10 Ridge, bears E. and W.; a saddle bears 8 chs. E.; continue ascent 155 ft. over NE. slope.
- 94.30 Over top of ridge, divide of Turnbull Mts., bears N. and S.
- 94.37 The 19-mile + 19-ch. cor., a porphyry stone, 16 x 8 x 4 ins. above ground, mkd. SB SC M19+19ch on S. face, set in the E. edge of a mound of stone, 4 ft. base by 2 $\frac{1}{2}$  ft. high.
- Land, mountainous.  
Soil, rocky, 4th rate.  
Timber, juniper, oak, pinon, sycamore; undergrowth, oak, buckbrush, manzanita, squawbrush, cacti.
- 
- N.73°36'W., on remainder of 20th mile.
- Desc. 355 ft. over W. slope; through medium growth of oak, juniper, pinon and sycamore timber and medium undergrowth.
- 14.30 Dry wash, 5 lks. wide, course S.; asc. 17 ft.
- 17.40 Spur, slopes W.; desc. 110 ft. over NW. slope.
- 26.00 Ravine, 5 lks. wide, course N.; asc. 15 ft.
- 27.80 Spur, slopes NW.; desc. 310 ft. over NW. slope.
- 35.79 Intersect the line bet. secs. 8 and 17, T.5 S., R.20 E., at a point 20.71 chs. S.89°50'W. of the  $\frac{1}{4}$  sec. cor., and 19.26 chs. N.89°50'E. of the cor. of secs. 7,8,17 and 18, both General Land Office iron posts, set, mkd. on brass caps and witnessed as described in the official record.
- 49.80 Dry wash, 15 lks. wide, course SW.; asc. 60 ft.
- 54.00 Spur, slopes S.60°W.; desc. 55 ft.
- 55.77 Fence, bears N. and S.
- 55.80 Intersect the line bet. secs. 7 and 8, T.5 S., R.20 E., at a point 34.40 chs. S.0°14'W. of the  $\frac{1}{4}$  sec. cor. and 5.75 chs. N.0°14'E. of the cor. of secs. 7,8,17 and 18, both General Land Office iron posts, set, mkd. on brass caps and witnessed as described in the official record.
- 56.84 The 20-mile cor., a granite stone, 10 x 8 x 5 ins. above ground, firmly set, dim, illegible marks, witnessed by a scattered mound of stone to NW.

Retracement of Abandoned "Riecker" S. Bdy. of  
San Carlos Indian Reservation

15

Chains	Land, mountainous. Soil, rocky, 4th rate. Timber, juniper, pinon, oak, sycamore; undergrowth, oak, mahogany and manzanita.
-----	
	N.74°23'W., on 21st and 22nd miles.
	Desc. 180 ft. over NW. slope; through medium growth of oak, pinon and juniper timber and medium undergrowth.
7.20	Deer Creek, small stream in channel, 20 lks. wide, course S.60°E., soon S.; asc. 185 ft. over NE. slope.
16.40	Spur, slopes S.; desc. 55 ft. over SW. slope.
20.80	Ravine, 8 lks. wide, course S.; asc. 170 ft. over SE. slope.
28.90	Spur, slopes SW.; desc. 280 ft.
50.20	Ravine, 20 lks. wide, course S.60°W.; asc. 20 ft.
53.50	Spur, slopes SW.; desc. 75 ft.
56.00	Ravine, 10 lks. wide, course S.; asc. 140 ft.
65.40	Spur, slopes S.20°E.; desc. 135 ft. over SW. slope.
70.40	Ravine, 8 lks. wide, course S.; asc. 55 ft.
76.80	Spur, slopes S.30°W.; desc. 65 ft.
80.00	Fail to find the 21-mile cor.; continue measurement on 22nd mile.
81.00	Abandoned road, bears NW. and SE.
83.10	Dry wash, 20 lks. wide, course S.30°E.; asc. 520 ft. over broken SE. slope, to Angle Point.
89.11	Intersect the W. bdy. of sec. 7, W. bdy. of T. 5 S., R. 20 E., at a point 9.91 chs. South of the $\frac{1}{4}$ sec. cor. of sec. 7 only, and 30.18 chs. North of the cor. of secs. 7 and 18, only, both General Land Office iron posts, set, mkd. on brass caps and witnessed as described in the official record.
126.86	The Angle Point on 22nd mile, a porphyry stone, 28 x 18 x 14 ins. above ground, no identifiable marks, witnessed by a mound of stone, 3 ft. base, $1\frac{1}{2}$ ft. high, to E.  Cor. stands on a spur, slopes SE.  Land, mountainous. Soil, rocky, 4th rate. Timber, juniper, oak and pinon; undergrowth, squaw brush, oak and mountain mahogany.
-----	
	N.88°29'W., on 22nd, 23rd and 24th miles.
	Asc. 330 ft. over broken SE. slope; through medium growth of oak, pinon and juniper timber and medium undergrowth.
1.70	Fence, bears N.30°E. and S.30°W.
24.03	Fail to find the 22-mile cor.; continue distance on 23rd mile.  Asc. 640 ft. over broken SE. slope.

Retracement of Abandoned "Riecker" S. Bdy. of  
San Carlos Indian Reservation

BOOK 4221

Chains	
25.30	A narrow, rocky spur, slopes S.30°E.; desc. 110 ft.
30.00	Change to SW. slope; asc. 35 ft.
37.00	Ridge, bears N. and S.; desc. along N. slope of high spur, slopes N.80°W.
86.01	The Angle Point on 24th mile, a malpais stone, 14 x 10 x 10 ins., no identifiable marks, firmly set, witnessed by a mound of stone, 4 ft. base, 3 ft. high, to NW. Further search at relative distances west and east of this monument fails to reveal any evidence of the 23-mile cor., and its relation to following boundary cors. hereinafter described substantiates its acceptance as the Angle Point.  Cor. stands on a high spur, slopes NW.  Land, mountainous. Soil, rocky, 4th rate. Timber, oak, juniper, pinon; undergrowth, squaw brush, oak and mountain mahogany.
	-----
	S.20°20'W., on 24th and 25th miles.  Desc. 1090 ft. over broken SW. slope; through scattering oak, pinon and juniper timber and medium undergrowth.
14.30	Trail, bears E. and W.
34.50	Dry wash, 20 lks. wide, course S.70°W.; asc. 290 ft. over NW. slope.
50.63	Fail to find the 24-mile cor.; with continued measurement on 25th mile.
54.40	A rocky point on Duke's Peak, bears E., 50 lks. dist.; desc. 350 ft. over SE. slope.
67.50	Dry wash, 20 lks. wide, course S.80°W.
68.04	The Angle Point on 25th mile, a porphyry stone, 16 x 12 x 8 ins., no identifiable marks, witnessed by a mound of stone, 3 ft. base by 2 ft. high, to W.  Land, mountainous. Soil, rocky, 4th rate. Timber, juniper, oak, pinon, mesquite; undergrowth, oak, squaw brush, catclaw and cacti.
	-----
	S.34°54'W., on 25th mile.  Asc. 60 ft. over NW. slope; through scattering mesquite, pinon, oak and juniper timber and medium undergrowth.
6.60	Spur, slopes E.; desc. 115 ft. over SW. slope.
14.60	Ravine, 4 lks. wide, course W.; asc. 65 ft. over NW. slope.
18.90	Spur, slopes E. for 1 ch.; desc. 265 ft. over SW. slope.
26.00	Spur, slopes SW.
33.40	Dry wash, 20 lks. wide, course W.; asc. 200 ft. over NW. slope.

Retracement of Abandoned "Riecker" S. Bdy. of  
San Carlos Indian Reservation

## Chains

46.90 Ridge, bears NE. and SW.; desc. 215 ft. over SE. slope.

48.80 Trail, bears NE. and SW.

50.50 Fence, bears NE. and SW.

72.88 The 25-mile cor., a malpais stone, 8 x 8 x 4 ins. above ground, firmly set, with illegible marks, witnessed by a mound of stone, 4 ft. base by 1½ ft. high, to W.

Land, rolling and mountainous.

Soil, rocky, 4th rate.

Timber, juniper, oak, pinon, mesquite; undergrowth, oak, squaw brush, catclaw, cacti.

-----  
S.35°16'W., on 26th mile.

Desc. 45 ft. over rolling SE. slope; through scattering juniper and mesquite timber and scattering undergrowth.

18.80 Old trail, bears SE. and NW.; desc. 105 ft.

24.80 Fence, bears SE. and NW.

17.90 Dry wash, 20 lks. wide, course W.; asc. 140 ft. over N. slope.

40.10 The Angle Point on 26th mile, a malpais stone, 16 x 8 x 6 ins. above ground, firmly set, only S of marks legible, witnessed by a mound of stone, 3 ft. base, 2 ft. high, to W.

Land, rolling and mountainous.

Soil, rocky, 4th rate.

Timber, juniper and pinon; undergrowth, oak, catclaw, cacti, squaw brush.

-----  
N.88°31'W., on 26th and 27th miles.

Desc. 225 ft. along N. slope; through scattering juniper and mesquite timber and scattering undergrowth.

27.00 (approx.) Telegraph Wash, 20 lks. wide, course S.80°W.; asc. 50 ft.

37.45 Fail, to find the 26-mile cor.; with continued distance on 27th mile.

38.50 Spur, slopes SW.; desc. 80 ft. over SW. slope.

42.00 Ravine, 15 lks. wide, course S.; asc. 75 ft.

47.20 Spur, slopes S.; desc. 95 ft. over SW. slope.

52.20 Ravine, 10 lks. wide, course S.; asc. 105 ft. over SE. slope.

58.00 Spur, slopes S.30°E.; desc. 35 ft.

62.00 Ravine, near head, course S.30°E.; asc. 110 ft.

68.50 Spur, slopes SW.; desc. 185 ft. over NW. slope.

75.60 Ravine, near head, course SW.; asc. 115 ft.

Retracement of Abandoned "Riecker" S. Bdy. of  
San Carlos Indian Reservation

BOOK 4221

Chains	
82.50	Spur, slopes SW.; along S. slope.
90.00	Spur, slopes S.80°W.; desc. 100 ft. over NW. slope.
97.95	The Angle Point on 27th mile, a malpais stone, 9 x 6 x 5 ins. above ground, firmly set, no identifiable marks, witnessed by a scattered mound of stone to NW.
	Land, rolling and mountainous. Soil, rocky, 4th rate. Timber, juniper and mesquite; undergrowth, oak, catclaw, squaw brush and cacti.
-----	
	N.59°23'W., on remainder of 27th mile.
	Desc. 95 ft. over NW. slope; through scattering mesquite and juniper timber and scattering undergrowth.
3.80	Ravine, 10 lks. wide, course W.; asc. 90 ft. over SE. slope.
13.50	Spur, slopes S.30°W.; desc. 95 ft. over NW. slope.
19.80	Dry wash, 20 lks. wide, course S.; asc. 60 ft. over SE. slope.
24.39	The 27-mile cor., a malpais stone, 10 x 6 x 6 ins. above ground, firmly set, no identifiable marks, witnessed by a scattered mound of stone to NW.
	Land, rolling. Soil, rocky, 4th rate. Timber, juniper and mesquite; undergrowth, oak, catclaw, squaw brush and cacti.
-----	
	N.60°16'W., on 28th mile.
	Asc. 135 ft. over SE. slope; through scattering juniper, mesquite, oak and pinon timber and scattering undergrowth.
10.30	Spur, slopes NE.; desc. 60 ft. over NW. slope.
15.60	Ravine, near head, course NE.; asc. 205 ft. over SE. slope.
31.90	Ridge, bears N.60°E. and S.60°W.; desc. 45 ft.
37.40	Ravine, near head, course NW.; asc. 95 ft.
45.80	Spur, slopes NE.; desc. 295 ft. over NW. slope.
58.10	Dry wash, 15 lks. wide, course N.; asc. 40 ft.
61.30	Spring, bears N., 2.30 chs. dist.; corral at spring. Asc. 50 ft.
69.70	Ravine, 8 lks. wide, course NE.; , soon N.; asc. 100 ft. over E. slope.
81.97	The 28-mile cor., a malpais stone, firmly set, 10 x 9 x 8 ins. above ground, no identifiable marks, witnessed by a mound of stone, 3½ ft. base by 2½ ft. high, to N.
	Land, rolling and mountainous. Soil, rocky, 4th rate.

Retracement of Abandoned "Riecker" S. Bdy. of  
San Carlos Indian Reservation

19

Chains	Timber, juniper, mesquite, oak, pinon; undergrowth, oak, catclaw, squaw brush and cacti.
	N.60°12'W., on 29th mile.
	Asc. 15 ft. over E. slope; through scattering juniper, oak and pinon timber and scattering undergrowth.
5.81	The witness Angle Point on 29th mile, a cross (X) on rock in place, 14 x 4 x 3 ft. above ground, with additional marks SB SC, witnessed by a mound of stone, 3 ft. by 2 ft. on S. side of marks.
	Cor. stands in saddle of spur, slopes N.20°E., from S.
7.33	The true point for Angle Point.
	Thence,
	S.60°07'W., on remainder of 29th mile, with renewed distance.
	Desc. 60 ft. over SW. slope.
3.90	Ravine, 10 lks. wide, course N.60°W.; asc. 145 ft. over NE. slope.
11.50	Short spur, slopes S.; desc. 30 ft. over W. slope.
19.00	Dry wash, 15 lks. wide, course N.30°E.; asc. 105 ft.
35.40	Top of ascent; over S. slope.
42.00	Ravine, 10 lks. wide, course E.; asc. 105 ft.
50.60	Saddle in ridge. Ridge bears N. and S.; desc. 130 ft.
67.20	Dry wash, 15 lks. wide, course S.; asc. 60 ft.
71.70	Fence, bears N. and S.
73.05	The 29-mile cor., a porphyry stone, 12 x 10 x 5 ins., mkd. SB SC M29, set in a mound of stone, 3 ft. base by 1 ft. high.
	Land, rolling and mountainous.
	Soil, rocky, 4th rate.
	Timber, juniper, pinon, oak; undergrowth, oak, catclaw, cacti and squaw brush.
	S.61°24'W., on 30th mile.
	Asc. 15 ft. over gentle SE. slope; through scattering oak, pinon and juniper timber and scattering undergrowth.
4.50	Spur, slopes S.30°E.; desc. 135 ft. over SW. slope.
7.98	Intersect the line bet. secs. 19 and 24, E. bdy. of T. 5 S. R. 18 E., at a point 24.42 chs. North of the $\frac{1}{4}$ sec. cor. and 15.89 chs. South of the cor. of secs. 13, 18, 19 and 24, both General Land Office iron posts, set, mkd. on brass caps and witnessed as described in the official record.
14.80	Ravine, near head, course E.; asc. 40 ft.

Retracement of Abandoned "Riecker" S. Bdy. of  
San Carlos Indian Reservation

Chains	
31.60	Dry wash, 20 lks. wide, course S.; asc. 250 ft.
54.40	Spur, slopes S.; desc. 300 ft. over SW. slope.
72.76	The Angle Point on 30th mile, also W. C for 30-mile cor., a volcanic stone, 10 x 10 x 4 ins. above ground, firmly set, unidentifiable marks, witnessed by a mound of stone, 3 ft. base, by 1½ ft. high, to N. of cor.
	Land, rolling and mountainous. Soil, rocky, 4th rate. Timber, juniper, pinon and oak; undergrowth, oak, catclaw and cacti.
-----	
	N.81°05'W., on 30th and 31st miles.
	Desc. slightly over SW. slope; through very scattering oak, juniper and pinon timber and scattering undergrowth.
0.35	Dry wash, 10 lks. wide, course S.; asc. 115 ft.
6.71	Point for 30-mile cor.; continue chaining on 31st mile.
18.00	Ridge, bears N. and S.; desc. 285 ft. over SW. slope.
23.00	Fence, bears N. and S.
23.41	Intersect the line bet. secs. 23 and 24, T. 5 S., R. 18 E. at a point 2.87 chs. S.0°01'E. of the ¼ sec. cor., and 37.09 chs. N.0°01'W. of the cor. of secs. 23, 24, 25 and 26, both General Land Office iron posts, set, mkd. on brass caps and witnessed as described in the official record.
42.50	Dry wash, 15 lks. wide, course S.; asc. 130 ft.
50.40	Spur, slopes S.; desc. 70 ft.
54.00	Ravine, 5 lks. wide, course S.; asc. 95 ft.
61.70	Spur, slopes S.; desc. 260 ft. over SW. slope.
72.32	The Angle Point on 31st mile, a porphyry stone, 12 x 12 x 8 ins. above ground, firmly set, faint illegible marks, witnessed by a mound of stone, 2 ft. base, by 2 ft. high, to NW.
	Thence,
	S.49°51'W., on remainder of 31st mile, with renewed distance.
	Desc. 45 ft. over SW. slope.
2.10	Dry wash, 20 lks. wide, course N.60°W.; asc. 205 ft.
11.00	Spur, slopes N.60°W.; desc. 15 ft.
12.71	The 31-mile cor., a porphyry stone, 24 x 16 x 8 ins. above ground, firmly set, dim. partly legible marks, from which Stamp hole of fallen dead oak; bears S.20°W., 23 lks. dist., marks rotted out. An oak, 20 ins. diam., bears N.72°W.; 162 lks. dist., marks rotted out.



Retracement of Abandoned "Riecker" S. Bdy. of  
San Carlos Indian Reservation

21

Chains	
	<p>Cor. is also witnessed by a mound of stone, 3 ft. base, 2 ft. high, to W.</p> <p>Land, mountainous. Soil, rocky, 4th rate. Timber, juniper, pinon and oak; undergrowth, oak, catclaw and cacti.</p> <p>-----</p> <p>S.50°18'W., on 32nd mile.</p> <p>Desc. 165 ft. over W. slope; through scattering juniper and oak timber and scattering undergrowth.</p>
3.00	Fence, bears NW. and SE.
10.70	Ravine, 10 lks. wide, course NW.; asc. 135 ft.
23.00	Ridge, bears NW. and SE.; desc. 230 ft.
28.35	Intersect the line bet. secs. 22 and 23, T.5 S., R.18 E., at a point 21.44 chs. S.0°02'E. of the $\frac{1}{4}$ sec. cor., and 18.56 chs. N.0°02'W. of the cor. of secs. 22, 23, 26 and 27, both General Land Office iron posts, set, mkd. on brass caps and witnessed as described in the official record.
57.43	Intersect the line bet. secs. 22 and 27, T.5 S., R.18 E., at a point 17.62 chs. N.89°59'E. of the $\frac{1}{4}$ sec. cor., and 22.38 chs. S.89°59'W. of the cor. of secs. 22, 23, 26 and 27, both General Land Office iron posts, set, mkd. on brass caps and witnessed as described in the official record.
	Desc. 55 ft. over W. slope.
68.80	Dry wash, 20 lks. wide, course W.; asc. 155 ft.
78.00	Spur, slopes N.; desc. 55 ft.
84.15	The 32-mile cor., a stone in place, 2 x 2 x 1 $\frac{1}{2}$ ft. above ground, unmarked, witnessed by a mound of stone, 3 ft. base by 3 ft. high, to NE. This is undoubtedly the original cor. Land, mountainous. Soil, rocky, 4th rate. Timber, juniper, pinon, oak; undergrowth, oak, catclaw and cacti.
	-----
	S.51°16'W., on 33rd mile.
	Desc. 25 ft. over NW. slope; through scattering juniper and oak timber and scattering undergrowth.
4.20	Small ravine, course N.; asc. 240 ft. over NE. slope.
16.50	Ridge, bears S.60°W. and N.60°E.; low saddle bears 5 chs. NE.; desc. 195 ft. over SW. slope.
44.80	Ravine, 10 lks. wide, course N.60°W.; asc. 80 ft.
47.53	Intersect the line bet. secs. 27 and 28, T.5 S., R.18 E., at a point 6.82 chs. S.0°05'E. of the $\frac{1}{4}$ sec. cor., and 32.23 chs. N.0°05'W. of the cor. of secs. 27, 28, 33 and 34, both General Land Office iron posts, set, mkd. on brass caps and witnessed as described in the official record.
48.50	Spur, slopes N.; desc. 15 ft.

Retracement of Abandoned "Riecker" S. Bdy. of  
San Carlos Indian Reservation

Chains	
52.00	Ravine, near head, course N.; asc. 330 ft.
71.50	Spur, slopes N.20°E.; desc. 135 ft. over NW. slope.
78.00	The magnetic declination at this point is 14½°E.
83.78	The 33-mile cor., a porphyry stone, 10 x 10 x 10 ins., mkd. 33, dislodged from position, witnessed by a mound of stone, 3 ft. base, 2 ft. high, to W.
	Land, rolling and mountainous. Soil, rocky, 4th rate. Timber, juniper, pinon, oak; undergrowth, oak, catclaw and cacti.
	-----
	S.58°31'W., on 34th mile.
	Desc. 140 ft. over SW. slope; through scattering juniper and oak timber and scattering undergrowth.
5.40	Ravine, 10 lks. wide, course NW.; asc. 210 ft. over NE. slope.
20.53	Intersect the line bet. secs. 28 and 33, T.5 S., R.18 E., at a point 5.91 chs. N.89°59'W. of the ¼ sec. cor., and 34.02 chs. S.89°59'E. of the cor. of secs. 28, 29, 32 and 33, both General Land Office iron posts, set, mkd. on brass caps and witnessed as described in the official record.
25.30	Spur, slopes NW.; desc. 485 ft. over SW. slope.
60.10	Fence, bears N. and S.
60.42	Intersect the line bet. secs. 32 and 33, T.5 S., R.18 E., at a point 19.12 chs. North of the ¼ sec. cor., and 20.80 chs. South of the cor. of secs. 28, 29, 32 and 33, both General Land Office iron posts, set, mkd. on brass caps and witnessed as described in the official record.
66.45	A search at this point and at a point 13.55 chs. N.67°05'E. of the 34-mile cor. fails to locate the Angle Point on 34th mile.
67.60	Ravine, 8 lks. wide, course W.; asc. 90 ft.
78.60	Spur, slopes NW.; asc. 23 ft.
82.62	The 34-mile cor., a porphyry stone, 12 x 10 x 12 ins. above ground, firmly set, no identifiable marks, witnessed by a mound of stone, 3 ft. base by 1½ ft. high, to NW.
	Land, rolling. Soil, rocky, 4th rate. Timber, juniper and oak; undergrowth, oak, catclaw, cacti.
	-----
	S.68°40'W., on 35th mile.
	Desc. 115 ft. over NW. slope; through scattering juniper and oak timber and scattering undergrowth.
12.00	Dry wash, 15 lks. wide, course S.30°W.; asc. 120 ft.
18.50	Spur, slopes S.; desc. 215 ft.

Retracement of Abandoned "Riecker" S. Bdy. of  
San Carlos Indian Reservation

Chains	
45.50	Dry wash, 40 lks. wide, course W.; asc. 110 ft.
54.00	Top of ascent; desc. 85 ft. over NW. slope.
55.80	Ravine, 8 lks. wide, course N.; asc. 75 ft.
62.60	Spur, slopes N.30°W.; desc. 75 ft.
63.60	Small ravine, course N.; asc. 45 ft. along N. side of spur which slopes W.
65.60	Intersect the line bet. secs. 31 and 32, T.5 S., R.18 E., at a point 16.20 chs. S.0°06'E. of the $\frac{1}{4}$ sec. cor., and 23.78 chs. N.0°06'W. of the stan. cor. of secs. 31 and 32, both General Land Office iron posts, set, mkd. on brass caps and witnessed as described in the official record.
81.37	The 35-mile cor., a malpais stone, 9 x 8 x 6 ins. above ground, firmly set, mkd. SB SC, witnessed by a scattered mound of stone to NE.
	Land, rolling and mountainous. Soil, rocky, 4th rate. Timber, juniper, oak, pinon; undergrowth, oak, catclaw and cacti.
-----	
	S.65°38'W., on 36th mile.
	Asc. 60 ft. over NE. slope; through scattering juniper and pinon timber and scattering undergrowth.
6.00	Spur, slopes NW., soon W.; desc. 205 ft.
23.00	Dry wash, 15 lks. wide, course W., soon SW.; asc. 10 ft.
27.00	Spur, near end, slopes N.; desc. 25 ft.
30.50	Same wash, course SW.; asc. 140 ft.
43.50	Narrow, rocky spur, slopes SW.; desc. 200 ft.
43.92	Intersect the 1st Stan. Par., S., S. bdy. of T.5 S., R.18 E., at a point 14.73 chs. S.89°55'W. of the stan. $\frac{1}{4}$ sec. cor. of sec. 31 and 25.20 chs. N.89°55'E. of the stan. cor. of Ts. 5 S., Rs. 17 and 18 E.; both General Land Office iron posts, set, mkd. on brass caps and witnessed as described in the official record.
51.00	Dry wash, 30 lks. wide, course SW.; asc. 175 ft.
67.00	Narrow, rocky spur, slopes SW.; desc. 185 ft.
73.39	Intersect the line bet. secs. 1 and 6, W. bdy. of T.6 S., R.18 E., at a point 21.10 chs. North of the true point for $\frac{1}{4}$ sec. cor. of sec. 6, only, 26.41 chs. North of the true point for $\frac{1}{4}$ sec. cor. of sec. 1, only, and 12.13 chs. South of the closing cor. of secs. 1 and 6, all monuments being iron posts of General Land Office, set, mkd. on brass caps and witnessed as described in the official record.
81.00	Dry wash, 20 lks. wide, course S.30°W.
82.07	The 36-mile cor., a mound of stone, 3 ft. base by 1 $\frac{1}{2}$ ft. high, built on a solid rock ledge. No marks could be found.
	Land, mountainous. Soil, rocky, 4th rate.

Retracement of Abandoned "Riecker" S. Bdy. of  
San Carlos Indian Reservation

Chains	
	Timber, juniper and pinon; undergrowth, oak, catclaw and cacti.
	-----
	S.77°17'W., on 37th mile.
	Asc. 100 ft. over SE. slope; through scattering juniper timber and scattering undergrowth.
9.00	Spur, slopes S.; desc. 190 ft.
14.20	Dry wash, 20 lks. wide, course S.; asc. 45 ft.
19.00	Toe of spur, slopes SE.; asc. 235 ft.
39.93	The Angle Point on 37th mile, a porphyry stone, 10 x 8 x 8 ins. above ground, firmly set, mkd. SB SC, witnessed by a mound of stone, 3 ft. base by 1½ ft. high, to NE.
	Cor. stands on a spur, ridge, slopes S.
	Thence,
	S.76°41'W., on remainder of 37th mile, with renewed distance.
	Desc. 125 ft. over NW. slope; through scattering juniper timber and scattering undergrowth.
13.20	Road, bears S. to ranch house and NW. to Winkelman.
15.70	Dry wash, 20 lks. wide, course SE.; asc. 170 ft.
33.87	Intersect the line bet. secs. 1 and 2, T.6 S., R.17 E., at a point 6.48 chs. N.0°04'W. of the ¼ sec. cor., and 32.04 chs. S.0°04'E. of the closing cor. of secs. 1 and 2, both General Land Office iron posts, set, mkd. on brass caps and witnessed as described in the official record.
37.11	The 37-mile cor., a limestone rock, 8 x 6 x 5 ins. above ground, firmly set, mkd. 37, witnessed by a scattered mound of stone to NW.
	Land, rolling and mountainous.
	Soil, rocky, 4th rate.
	Timber, juniper; undergrowth, oak, catclaw, cacti.
	-----
	S.76°21'W., on 38th mile.
	Asc. 165 ft. over NE. slope; through scattering undergrowth.
21.00	Spur-ridge, bears NW. and SE., dim wagon road on top.
36.00	An eroded gully, 5 lks. wide, course S.; asc. 55 ft.
50.00	Spur, slopes SE.; desc. 25 ft.
53.00	A gully, 5 lks. wide, 3 ft. deep, course SE.; asc. 100 ft.
79.61	Intersect the line bet. secs. 2 and 3, T.6 S., R.17 E., at a point 12.75 chs. S.0°01'E. of the ¼ sec. cor., and 27.09 chs. N.0°01'W. of the cor. of secs. 2, 3, 10 and 11, both General Land Office iron posts, set, mkd. on brass caps and witnessed as described in the official record.

Retracement of Abandoned "Riecker" S. Bdy. of  
San Carlos Indian Reservation

25

## Chains

80.94 The 38-mile cor., a malpais stone, 8 x 8 x 4 ins. above ground, firmly set, mkd. SB C, witnessed by a mound of stone, 2 ft. base by 1½ ft. high, to N.

Land, rolling and broken.  
Soil, rocky, 4th rate.  
No timber; undergrowth, catclaw and cacti.

-----  
S.75°48'W., on 39th mile.

Asc. 55 ft. over NE. slope; through scattering undergrowth.

15.00 A broad spur, slopes S.30°E.; desc. 70 ft.

26.00 A small ravine, course S.; asc. 115 ft.

65.00 Top of ascent; desc. 15 ft.

73.00 A small ravine, course S.; asc. 30 ft.

81.40 Intersect the line bet. secs. 3 and 4, T.6 S., R.17 E., at a point 33.02 chs. South of the ¼ sec. cor., and 7.00 chs. North of the cor. of secs. 3,4,9 and 10, both General Land Office iron posts, set, mkd. on brass caps and witnessed as described in the official record.

81.71 The 39-mile cor., a scattered mound of stone, none marked.

Land, rolling.  
Soil, rocky, 4th rate.  
Timber, none; undergrowth, catclaw and cacti.

-----  
S.76°04'W., on 40th mile.

Asc. 365 ft. over increasing SE. slope; through scattering undergrowth.

28.33 Intersect the line bet. secs. 4 and 9, T.6 S., R.17 E., at a point 12.15 chs. S.89°50'E. of the ¼ sec. cor., and 27.82 chs. N.89°50'W. of the cor. of secs. 3,4,9 and 10, both General Land Office iron posts, set, mkd. on brass caps and witnessed as described in the official record.

32.00 A spur-ridge, bears N. and S.; desc. 215 ft.

51.00 Ravine, 8 lks. wide, course N.; asc. 275 ft.

72.00 Spur, slopes N.; desc. 30 ft.

81.44 The 40-mile cor., a mound of stone, 4 ft. base by 3 ft. high; no marked stone found.

Land, rolling.  
Soil, rocky, 4th rate.  
Timber, a few junipers; undergrowth, oak, catclaw, cacti.

-----  
S.76°12'W., on 41st mile.

Desc. 210 ft. over NW. slope; through scattering small junipers and undergrowth.

Retracement of Abandoned "Riecker" S. Bdy. of  
San Carlos Indian Reservation

BRON (22)

Chains	
0.46	Intersect the line bet. secs. 8 and 9, T.6 S., R.17 E., at a point 26.97 chs. N.0°02'W. of the $\frac{1}{4}$ sec. cor. and 13.07 chs. S.0°02'E. of the cor. of secs. 4,5,8 and 9, both General Land Office iron posts, set, mkd. on brass caps and witnessed as described in the official record.
7.60	Ravine, 8 lks. wide, course N.; asc. 250 ft. over NE.slope.
26.00	Spur-ridge, slopes N.; desc. 290 ft. over NW. slope.
41.50	Ravine, 10 lks. wide, course N.20°W.; asc. 290 ft.
65.33	The Angle Point on 41st mile, a malpais stone, 16 x 12 x 6 ins. above ground, firmly set, mkd. SB SC, other illegible marks, witnessed by a mound of stone, 4 ft. base by 3 ft. high, to N. of cor. A juniper, 24 ins. diam., bears S.48 $\frac{3}{4}$ °W., 6.09 chs. dist., mkd. S B S C B T. Land, rolling and mountainous. Soil, rocky, 4th rate. Timber, juniper; undergrowth, oak, catclaw, cacti.
-----	
	S.51°32'W., on 41st (remainder) and 42nd miles.
	Asc. 50 ft. over NE. slope; through scattering juniper and palo verde timber and scattering undergrowth.
7.50	Main ridge, bears N.20°W. and S.20°E.; desc. 680 ft. over rugged SW. slope.
21.64	Intersect the line bet. secs. 7 and 8, T.6 S., R.17 E., at a point 1.70 chs. S.0°08'W. of the $\frac{1}{4}$ sec. cor. and 38.25 chs. N.0°08'E. of the cor. of secs. 7,8,17 and 18, both General Land Office iron posts, set, mkd. on brass caps and witnessed as described in the official record.
28.00	Ravine, 10 lks. wide, course W.; asc. slightly.
31.00	Spur, slopes W.; desc. 150 ft.
34.51	Fail to find the 41-mile cor.; with continued distance on 42nd mile.
38.00	Ravine, course W.; asc. 15 ft.
49.00	Spur, slopes W.; desc. 75 ft.
52.50	Ravine, course W.; asc. 145 ft.
63.00	Spur, slopes W.; desc. 310 ft.
83.26	Intersect the line bet. secs. 7 and 18, T.6 S., R.17 E., at a point 8.13 chs. West of the $\frac{1}{4}$ sec. cor. and 34.39 chs. East of the closing cor. of secs. 7 and 18, both General Land Office iron posts, set, mkd. on brass caps and witnessed as described in the official record.  Desc. 150 ft. over SW. slope.
86.00	Ravine, course N.30°W.; desc. 140 ft.
100.00	Spur, slopes W.; desc. 120 ft.
114.89	The 42-mile cor., a sandstone in place, 3 x 3 x 1 $\frac{1}{2}$ ft. above ground, mkd. SB SC M42, witnessed by a scattered mound of stone to NW.

Retracement of Abandoned "Riecker" S. Bdy. of  
San Carlos Indian Reservation

Chains

Land, mountainous.  
Soil, rocky, 4th rate.  
Timber, palo verde; undergrowth, catclaw, cacti, greasewood.

-----  
S.51°12'W., on 43rd mile.

Desc. 60 ft. over SW. slope; through scattering desert growth.

- 4.80 Ravine, near head, course W.; asc. 120 ft.
- 11.44 Intersect the W. bdy. of T.6 S., R.17 E., at a point 13.21 chs. N.1°37'W. of the  $\frac{1}{4}$  sec. cor. of sec. 18, only, and 26.79 chs. S.1°37'E. of the closing cor. of secs. 7 and 18, both General Land Office iron posts, set, mkd. on brass caps and witnessed as described in the official record.
- 13.00 Spur, slopes N.; desc. 190 ft.
- 23.00 Ravine, near head, course S.65°W.; asc. 40 ft.
- 31.50 Top of ascent; peak bears about 4 chs. S.; desc. 340 ft.
- 59.50 Dry wash, 15 lks. wide, course W.; asc. 60 ft.
- 64.00 Spur, slopes W.; desc. 125 ft.
- 84.20 The 43-mile cor., a sandstone, 8 x 6 by 12 ins. above ground, firmly set, mkd. SB SC M43, from which
- A palo verde, 10 ins. diam., bears N.20°E., 28 lks. dist., mkd. SB SC M43.
- A mound of stone, 3 ft. base, 2 $\frac{1}{2}$  ft. high, bears W., 4 lks. dist.
- Land, rolling and mountainous.  
Soil, rocky, 4th rate.  
Timber, palo verde; undergrowth, catclaw, greasewood and cacti.
- S.51°47'W., on 44th mile.
- Over bottom land; through desert growth.
- 6.30 Main channel of wash, 2 chs. wide, course W.
- 14.17 Intersect the line bet. secs. 13 and 24, T.6 S., R.16 E., at a point 69.24 chs. S.89°59'W. of the cor. of secs. 13 and 24, only, a General Land Office iron post, set, mkd. on brass cap and witnessed as described in the official record. From point of intersection the cor. of secs. 13, 14, 23 and 24 bears S.89°59'W., 10.21 chs. dist., a sandstone, 16 x 12 x 10 ins. above ground, firmly set, mkd. and witnessed as described in the official record. The witness mound W. of mkd. stone has fallen and we re-build it to a size of 3 ft. base and 3 ft. high.
- 19.50 Leave wash bottom land, bears E. and W.; asc. 80 ft. over NW. slope.

Retracement of Abandoned "Riecker" S. Bdy. of  
San Carlos Indian Reservation

## Chains

- 27.17 The cor. of secs. 13, 14, 23 and 24, T.6 S., R.16 E., here-  
inbefore described, bears N.0°02'W., 8.05 chs. dist. The  
cor. of secs. 25, 26, 35 and 36, hereinafter described, bears  
S.0°02'E., 150.76 chs. dist.; intervening corners could not  
be found.
- 27.60 Spur, slopes NW.; desc. 170 ft.
- 62.00 A deeply-eroded ravine, 20 lks. wide, course W.; asc. 60 ft.
- 72.50 Spur, slopes W.; desc. 55 ft.
- 79.00 Dry wash, 10 lks. wide, course W.; asc. 35 ft.
- 82.75 The 44-mile cor., a malpais stone, 10 x 9 x 6 ins. above  
ground, firmly set, mkd. SB SC M44, witnessed by a scat-  
tered mound of stone to NW.
- Land, rolling.  
Soil, rocky, 4th rate.  
Timber, palo verde; undergrowth, catclaw, cacti, greasewood.
- 
- S.48°17'W., on 45th mile.
- Asc. 20 ft. over NW. slope; through scattering desert  
growth.
- 8.40 Spur ridge, bears E. and W.; desc. 100 ft.
- 22.00 A deeply-eroded ravine, 10 lks. wide, course W.; asc. 60  
ft. over NW. slope.
- 34.00 Spur, slopes W.; desc. 120 ft.
- 49.01 Intersect the line bet. secs. 22 and 23, T.6 S., R.16 E.,  
at a point 4.40 chs. N.0°17'E. of the cor. of secs. 22, 23,  
26 and 27, which is a malpais stone, 14 x 12 x 8 ins. above  
ground, mkd. with 2 notches on each of E. and S. edges,  
witnessed by a mound of stone to N. The cor. of secs. 14,  
15, 22 and 23, bears N.0°17'E., 75.15 chs. dist. The  $\frac{1}{4}$   
sec. cor. of secs. 22 and 23 could not be found.
- 55.79 Intersect the line bet. secs. 22 and 27, T.6 S., R.16 E.,  
at a point 5.02 chs. S.88°44'W. of the cor. of secs. 22,  
23, 26 and 27, hereinafter described, and 71.95 chs. N.88°  
44'E. of the cor. of secs. 21, 22, 27 and 28, the remains of  
a mesquite post, 3 ins. square by 2 ft. long, no marks re-  
maining, lying on an old mound of stone, 2 ft. base by 1  
ft. high, from which
- A dead and fallen palo verde, 10 ins. diam., bears  
N.75°W., 12 lks. dist., only unmarked part of blaze  
remaining.
- A palo verde stump, 12 ins. diam., bears N.11°E., 92  
lks. dist., small unmarked part of blaze remaining.
- No evidence of the original SE. tree remains.
- 62.00 Dry wash, 30 lks. wide, course W.; asc. 65 ft.
- 77.00 Spur, slopes W.; desc. 20 ft. over SW. slope.
- 81.18 The 45-mile cor., a malpais stone, 8 x 8 x 4 ins. above  
ground, firmly set, with dim marks, witnessed by a scat-



Retracement of Abandoned "Riecker" S. Bdy. of  
San Carlos Indian Reservation

29

Chains	tered mound of stone, NW. of cor.  Land, rolling. Soil, rocky, much gypsum, 4th rate. Timber, palo verde; undergrowth, catclaw, cacti, greasewood.
	-----
	S. 42° 53' W., on 46th mile. Desc. 95 ft. over SW. slope; through scattering desert growth.
16.00	Dry wash, 80 lks. wide, in arroyo, 40 ft. deep, course W.; asc. 45 ft.
28.00	Spur, slopes W.; desc. 85 ft.
55.00	A deep ravine, 8 lks. wide, course W.; asc. 55 ft.
62.00	Spur, slopes W.; desc. 35 ft.
75.03	The abandoned SW. cor. of the San Carlos Indian Reservation, the 15-mile cor. (from N.), a stone in place, 30 x 20 x 20 ins. above ground, mkd. SB SC M15, from which  A palo verde, 8 ins. diam., bears S. 11½° E., 157 lks. dist., marks rotted away.  A palo verde, 9 ins. diam., bears N. 76° W., 163 lks. dist., marks rotted away.  There is a scattered mound of stone adjoining cor. to N.  The cor. of secs. 27, 28, 33 and 34, bears S. 0° 12' W., 7.92 chs. dist., an old mound of stone, none marked, but, from similarity to other old corners, undoubtedly the original sec. cor.  Land, rolling. Soil, rocky, 4th rate, much gypsum. Timber, palo verde; undergrowth, greasewood, catclaw, cacti.
	-----
	RETRACEMENT OF PART OF SUBDIVISION LINES IN T. 5 S., R. 22 E.
	-----
	The subdivisions of T. 5 S., R. 22 E., were surveyed by P. Contzen U.S.D.S. in 1900. No retracements or resurveys are of record.  From the stan. cor. of secs. 31 and 32, on the S. bdy. of the twp., hereinbefore described.  N. 0° 07' W., bet. secs. 31 and 32.
40.43	The original ¼ sec. cor., a granite stone, 12 x 8 x 6 ins. above ground, mkd. 32 on E. and 31 on W. faces, witnessed by a mound of stone to W.  Thence,  N. 0° 07' W., bet. secs. 31 and 32 (N. ½).
40.08	The original cor. of secs. 29, 30, 31 and 32, an old mound of stone, none marked.  Thence,  N. 89° 56' W., bet. secs. 30 and 31.

Chains	
40.00	Fail to find $\frac{1}{4}$ sec. cor.
80.34	The cor. of secs. 25, 30, 31 and 36, on the W. bdy. of the twp., hereinbefore described.
-----	
ADDITIONAL RETRACEMENTS OF E. BDY. AND SUBDIVISIONS OF T. 5 S., R. 20 E.	
<p>The E. bdy. and subdivisions of T. 5 S., R. 20 E., were surveyed in 1929 by W. E. Hiester and Theodore VanderMeer. The corners connected by the following courses and distances are all General Land Office iron posts, set, mkd. on brass caps and witnessed as described in the official record.</p> <p>The S. <math>\frac{1}{2}</math> of line bet. secs. 19 and 24, E. bdy. of T. 5 S., R. 20 E., bears North, 40.25 chs. dist.</p> <p>E. <math>\frac{1}{2}</math> of line bet. secs. 24 and 25 bears S. 89° 34' W., 40.27 chs. dist.; W. <math>\frac{1}{2}</math> of same bears N. 89° 43' W., 39.92 chs. dist.</p> <p>S. <math>\frac{1}{2}</math> of line bet. secs. 23 and 24 bears N. 0° 11' E., 39.88 chs. dist.; N. <math>\frac{1}{2}</math> of same bears N. 0° 23' W., 41.09 chs. dist.</p> <p>W. <math>\frac{1}{2}</math> of line bet. secs. 13 and 24 bears N. 89° 43' W., 39.96 chs. dist.</p> <p>N. <math>\frac{1}{2}</math> of line bet. secs. 13 and 14 bears North, 39.64 chs. dist.</p> <p>E. <math>\frac{1}{2}</math> of line bet. secs. 14 and 23 bears S. 89° 33' W., 39.89 chs. dist.; W. <math>\frac{1}{2}</math> of same bears S. 89° 55' W., 39.86 chs. dist.</p> <p>E. <math>\frac{1}{2}</math> of line bet. secs. 15 and 22 bears S. 89° 47' W., 40.11 chs. dist.; W. <math>\frac{1}{2}</math> of same bears S. 89° 51' W., 40.12 chs. dist.</p>	
-----	
RETRACEMENT OF PART OF SUBDIVISIONS OF T. 6 S., R. 16 E.	
<p>The subdivisions of T. 6 S., R. 16 E., were surveyed in 1877 by J. L. Harris, U.S.D.S. No retracements or re-surveys are of record.</p> <p>The cor. of secs. 25, 26, 35 and 36 is an igneous stone, 8 x 6 x 8 ins. above ground, mkd. with one groove on E. face, no other marks visible; witnessed by a small mound of stone to N.</p> <p>Thence,</p> <p>N. 0° 02' W., on retracement bet. secs. 25/26 and 23/24.</p>	
40.00	Fail to find $\frac{1}{4}$ sec. cor.; set temp. $\frac{1}{4}$ sec. cor.
80.00	Fail to find cor.; set temp. cor. of secs. 23, 24, 25 and 26.
120.00	Fail to find $\frac{1}{4}$ sec. cor.; set temp. $\frac{1}{4}$ sec. cor.
158.81	The cor. of secs. 13, 14, 23 and 24, hereinbefore described.
-----	
	North, on retracement bet. secs. 13/14, 11/12 and 1/2.
40.00	Fail to find $\frac{1}{4}$ sec. cor.; set temp. $\frac{1}{4}$ sec. cor.

## RETRACEMENT OF PART OF SUBDIVISIONS OF T. 6 S., R. 16 E.

31

Chains	
80.00	Fail to find cor; set temp. cor. of secs. 11,12,13 and 14.
120.00	Fail to find $\frac{1}{4}$ sec. cor.; set temp. $\frac{1}{4}$ sec. cor.
160.00	Fail to find cor.; set temp. cor. of secs. 1,2,11 and 12.
200.00	Fail to find $\frac{1}{4}$ sec. cor.; set temp. $\frac{1}{4}$ sec. cor.
239.34	Intersect the 1st Stan. Par., S., at a point 2.52 chs. S. $89^{\circ} 56'$ W. of the stan. cor. of secs. 35 and 36, S. bdy. of T. 5 S., R. 16 E., which is a limestone, 10 x 8 x 6 ins. above ground, firmly set and mkd. and witnessed as described in the official record. From intersection the stan. $\frac{1}{4}$ sec. cor. of sec. 35 bears S. $89^{\circ} 56'$ W., 36.97 chs. dist., a stone, 10 x 8 x 8 ins. above ground, firmly set and mkd. and witnessed as described in the official record.
240.15	Record distance; fail to find the closing cor. of secs. 1 and 2.

-----

From the cor. of secs. 25,26,35 and 36, hereinbefore described.

S.  $89^{\circ} 55'$  W., bet. secs. 26 and 35.

39.98 The  $\frac{1}{4}$  sec. cor., an old mound of stone with none of the original wooden post remaining.

Thence,

S.  $89^{\circ} 58'$  W., bet. secs. 26 and 35 (W.  $\frac{1}{2}$ ).

39.98 The cor. of secs. 26,27, 34 and 35, a volcanic stone, 10 x 8 x 6 ins. above ground, mkd. and witnessed as described in the official record.

-----

N.  $0^{\circ} 16'$  W., on retracement bet. secs. 26 and 27.

40.00 Fail to find  $\frac{1}{4}$  sec. cor.

79.67 The cor. of secs. 22,23,26 and 27, hereinbefore described.

-----

N.  $89^{\circ} 48'$  E., on retracement bet. secs. 23/26 and 24/25.

40.00 Fail to find  $\frac{1}{4}$  sec. cor.

80.27 Intersect the temp. cor. of secs. 23,24,25 and 26.

120.00 Fail to find  $\frac{1}{4}$  sec. cor.

160.00 Intersect the cor. of secs. 19,24,25 and 30, on the E. bdy. of the twp., a General Land Office iron post, set, mkd. on brass cap. and witnessed as described in the official record.

-----

From the cor. of secs. 13,14,23 and 24, hereinbefore described,

N.  $89^{\circ} 56'$  W., on retracement bet. secs. 14 and 23.

Chains	
40.00	Fail to find $\frac{1}{4}$ sec. cor.
79.85	The cor. of secs. 14, 15, 22 and 23, a malpais stone, .16 x 12 x 10 ins. above ground, mkd. and witnessed as described in the official record.
	-----
	From the cor. of secs. 12 and 13, only, on the E. bdy. of T. 6 S., R. 16 E., which is an iron post, firmly set, mkd. and witnessed as described in the official record.
	West, on retracement bet. secs. 12/13 and 11/14.
40.00	Fail to find $\frac{1}{4}$ sec. cor.; set temp. $\frac{1}{4}$ sec. cor.
77.28	The temp. cor. of secs. 11, 12, 13 and 14 bears North, 25 lks. dist.
120.00	Fail to find $\frac{1}{4}$ sec. cor.; set temp. $\frac{1}{4}$ sec. cor.
157.72	Fail 48 lks. N. of the cor. of secs. 10, 11, 14 and 15, which is a malpais stone, 14 x 10 x 6 ins. above ground, mkd. with 4 notches on S. and 2 notches on E. edges. Both bearing trees of record are gone.
	-----
	From the cor. of secs. 26, 27, 34 and 35, hereinbefore described,
	S. 89° 45' W., on retracement bet. secs. 27 and 34.
40.00	Fail to find $\frac{1}{4}$ sec. cor.
75.54	The cor. of secs. 27, 28, 33 and 34, hereinbefore described.
	-----
	N. 1° 21' W., on retracement bet. secs. 27 and 28.
40.00	Fail to find $\frac{1}{4}$ sec. cor.
78.21	The cor. of secs. 21, 22, 27 and 28, hereinbefore described.
	-----
	N. 0° 40' W., bet. secs. 21 and 22.
40.00	The $\frac{1}{4}$ sec. cor., a malpais stone, 10 x 6 x 6 ins. above ground, mkd. $\frac{1}{4}$ on top, from which
	A mesquite stump, bears S. 65 $\frac{1}{2}$ ° W., 22 lks. dist.
	A mound of stone, 2 ft. base by 1 ft. high, adjoins cor. to N.
	Thence,
	N. 0° 25' W., bet. secs. 21 and 22 (N. $\frac{1}{2}$ ).
41.24	The cor. of secs. 15, 16, 21 and 22, a pipe, 4 ins. diam., projecting 5 ins. above ground, set in a mound of stone. No evidence of the original cor. remains.
	-----
	N. 89° 54' E., on retracement bet. secs. 15 and 22.
40.00	Fail to find $\frac{1}{4}$ sec. cor.
77.98	The cor. of secs. 14, 15, 22 and 23, hereinbefore described.

## RETRACEMENT OF PART OF SUBDIVISION OF T. 6 S., R. 22 E.

## Chains

The subdivisions of T. 6 S., R. 22 E., were surveyed in 1924 by G. F. Sawyer, U.S.S. No retracements or re-surveys are of record.

The  $\frac{1}{4}$  sec. cor. of secs. 8 and 17 is an iron post, 1 in. in diam., firmly set, with brass cap mkd. and witnessed as described in the official record.

Thence

N.89°48'W., on retracement bet. secs. 8 and 17.

40.31

The cor. of secs. 7,8,17 and 18, which is an iron post, 2 ins. in diam., firmly set, with brass cap mkd. and witnessed as described in the official record.

## FINAL TEST OF SOLAR ATTACHMENT

June 8, 1939, in camp in sec. 23, T. 6 S., R. 16 E., latitude 32°53'40" N., longitude 110°41'17" W., at 2h 33.9 m p.m., l.m.t., we observe Polaris at western elongation; making two observations each with the telescope in direct and reversed positions, reading the horizontal angle easterly from the star to a well defined point on the skyline 3 miles north.

Mean horizontal angle----- 1° 13' 45"  
Azimuth, Polaris at western elongation ----- 1° 13' 27"  
True bearing of point -----N.0° 00' 18"E.

June 9, 1939, at every 30 minutes during the usual hours of solar work, we orient the instruments on the meridian with the proper settings on the arcs of the solar attachments, and ascertain that the resulting orientations; when compared with the Polaris meridian, leave a maximum error of less than 1'30".

## GENERAL DESCRIPTION

The Riecker line runs parallel to the meanders of the Gila River at a distance of 15 miles to the south of same. The retracement of this line starts in the SW.  $\frac{1}{4}$  of sec. 25, T. 6 S., R. 22 E., and runs northwesterly over rolling desert land for approximately 5 miles, then begins the ascent of the northeast slope of the Santa Teresa mountains, entering the Crook National Forest at the line between sections 19 and 20, T. 5 S., R. 21 E., crossing the divide of the Santa Teresa mountains at the 19+ 19 M. corner in section 17, T. 5 S., R. 20 E., leaving the Crook National Forest at the line bet. sections 7 and 8, T. 5 S., R. 20 E. Thence across Deer Creek which drains to the SW. and ascend over a high ridge at Stanley Butte which bears SW. and N. then following along the head of a series of washes, draining to the NW., crossing a low ridge in approximate section 18, T. 5 S., R. 19 E., then descending over a broken S. slope, the drainage being furnished by a series of small canyons and washes which drain into Aravaipa Creek., leaving the mountainous land and entering rolling land in section 13, T. 6 S., R. 16 E.

The line retraced terminates at the 15 M. cor. in section 27, T. 6 S., R. 16 E., and is approximately 45 miles in length. The elevation along the line varies from approximately 2700 ft. on the desert to 6000 ft. above sea level at the divide of the Santa Teresa mountains.

The soil is gravelly and rocky, 3rd and 4th rate. There is clear running water in Goodwin wash and Deer Creek, and a fine spring is located in approximate section

17, T. 5 S., R. 19 E. between the 27 and 28 M. corners. Stock grazing is engaged in along the entire line.

There is a scattered growth of oak, juniper, pinyon and pine timber on the higher mountains, and mesquite and catclaw on the desert land.

Undergrowth is of oak brush and manzanita.

The only mining activity observed along the line was in approximate section 13, T. 5 S., R. 19 E.

4-680  
(Revised May 1934)

UNITED STATES  
DEPARTMENT OF THE INTERIOR  
GENERAL LAND OFFICE

FIELD ASSISTANTS

NAMES	CAPACITY
Charles F. Bobo, Jr.	Principal Assistant
Donald Gifford	Principal Assistant
Van N. Kilgore	Chainman
Owen Longest	Chainman
London Bates	Flagman
Vermont Shaw	Flagman
Frank M. Stivers	Moundsman
Ray Sears	Moundsman
Leroy Lewis	Axeman
Paschal Austin	Axeman

BOOK 421

CERTIFICATE OF SURVEYOR

We, Ty White, Surveyor, and Raymond F. Moss, Public Land Surveyor, General Land Office, HEREBY CERTIFY upon honor that, in pursuance of special instructions bearing date of the 1st day of March, 1939 received from the district cadastral engineer for Arizona, with assignment instructions dated April 11, 1939, we have retraced all those parts or portions of the abandoned "Riecker" S. Bdy. of the San Carlos Indian Reservation and a portion of the boundaries or subdivisional lines of T. 5 S., Rs. 18, 19, 20 and 21 and 22 E., and T. 6 S., Rs. 16, 17, 18 and 22 E. of the Gila and Salt River Meridian, in the State of Arizona, which are represented in the foregoing field notes as having been executed by me and under my direction; and that said retracement survey has been made in strict conformity with said instructions, the Manual of Instructions for the Survey of the Public Lands of the United States, and in the specific manner described in the foregoing field notes.

Glendale, California, Nov. 7, 1940.  
 Phoenix, Arizona, Nov. 8, 1940.

*Ty White*  
 Surveyor  
*Raymond F. Moss*  
 Public Land Surveyor

General Land Office

CERTIFICATE OF APPROVAL

OFFICE OF SUPERVISOR OF SURVEYS,  
 Denver, Colorado, February 4, 1941.

The foregoing field notes of the survey of the retracement of the abandoned "Riecker" S. Bdy. of the San Carlos Indian Reservation and portions of boundaries and subdivisional lines of T. 5 S., Rs. 18, 19, 20, 21 and 22 E., and T. 6 S., Rs. 16, 17, 18 and 22 E., of the Gila and Salt River Meridian, Arizona, executed by Ty White, Surveyor, and Raymond F. Moss, Public Land Surveyor, General Land Office, under special instructions dated March 1, 1939, and assignment instructions dated April 11, 1939, having been critically examined, and the necessary corrections made prior to their certification by the engineer, the said field notes, and the retracement notes, and the survey therein described, are hereby approved.

*Donald A. Johnson*  
 Supervisor of Surveys.

CERTIFICATE OF TRANSCRIPT

~~I certify that the foregoing transcript of the field notes of the above described surveys in \_\_\_\_\_ is a true copy of the original field notes on file in the public survey office.~~

\_\_\_\_\_  
 Supervisor of Surveys.