

UNITED STATES
DEPARTMENT OF THE INTERIOR
GENERAL LAND OFFICE

BOOK 4244

FIELD NOTES

OF SURVEY OF

FIRST STANDARD PARALLEL SOUTH

THRU RANGES 1 and 2 WEST

Of the Gila and Salt River Meridian,

In the State of Arizona

EXECUTED BY

Horace M. Muscott

Public Land Surveyor

Under special instructions dated December 1, 1937, which provided
for the surveys included under Group No. 197 Arizona, bearing the approval of the
Commissioner of the General Land Office under date of January 14, 1938
and assignment instructions dated February 3, 1938

Survey commenced February 4, 1938

Survey completed February 12, 1938

4244

4244

INDEX DIAGRAM.

Township _____, *Range* _____

6	5	4	3	2	1
7	8	9	10	11	12
18	17	16	15	14	13
19	20	21	22	23	24
30	29	28	27	26	25
31	32	33	34	35	36

Book "A"
GROUP 197 - ARIZONA
INDEX-DIAGRAM.

BOOK 4244

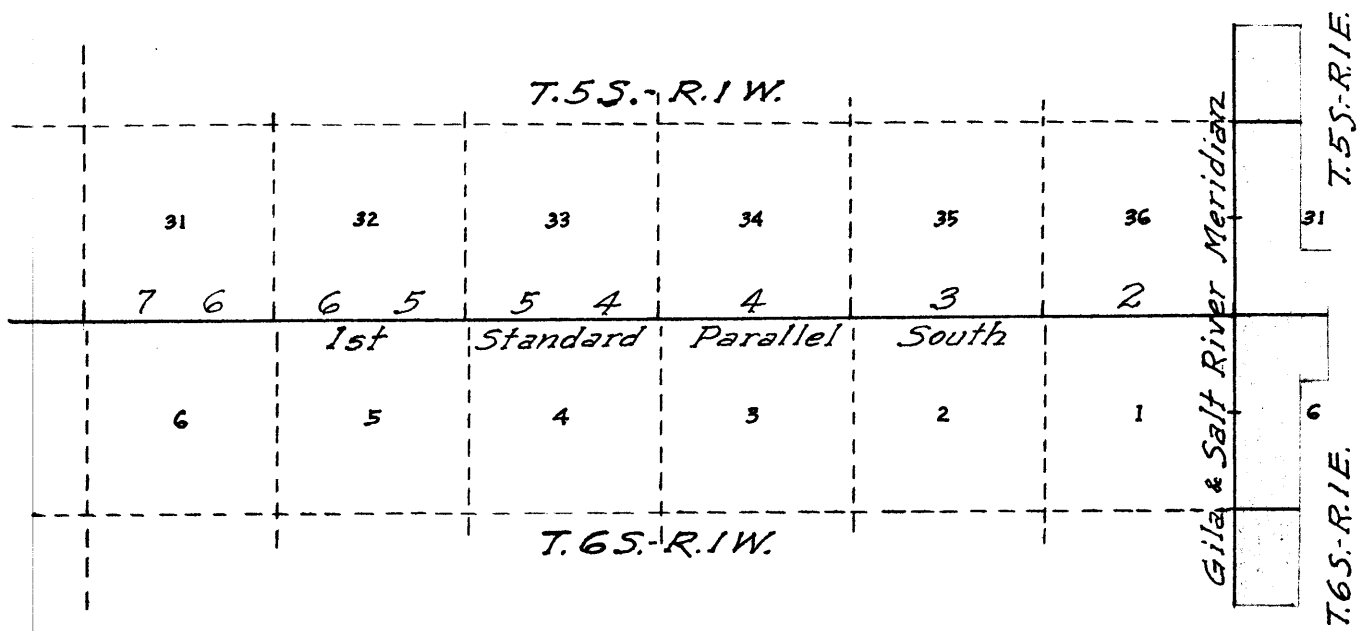

BOOK 4244

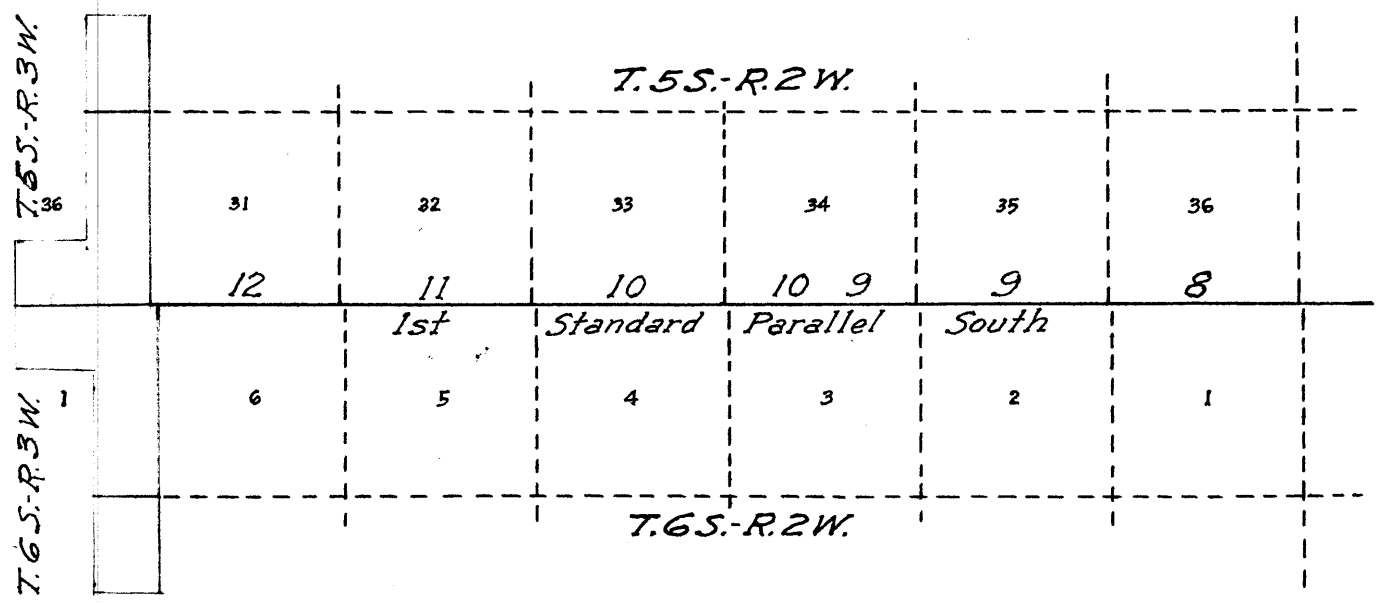

- Lines of accepted surveys.
- Lines surveyed under this group. Notes herein.
- - - - Lines to be surveyed under this group.
- Lines surveyed under current group No. 198.
- Areas surveyed as per accepted plats on file.
- Areas surveyed under current group No. 198.

The survey of First Standard Parallel South thru Ranges 1 and 2 West, described herein, was executed by Horace M. Muscott, Public Land Surveyor, using Buff and Buff transit No. 16723. This instrument is equipped with improved Smith solar attachment, and otherwise conforms to the standard specifications of the General Land Office. The transit was examined by the District Cadastral Engineer for Arizona and California prior to the beginning of the surveys of this group, and was approved conditional upon satisfactory results of field tests of same.

All measurements were made with a Lallie steel tape, 5 chs. in length, graduated every link for the first 100 lks., and the remainder at intervals of 10 lks. The tape was tested by comparison with a Lufkin standard tape and found to be correct. The measurements were made on the slope, the vertical angle of each interval determined with a clinometer in good adjustment and the horizontal equivalents entered in the field notes.

PRELIMINARY FIELD TEST OF INSTRUMENT.

Jan. 16; 1938: at camp in SE $\frac{1}{4}$ of sec. 36, T. 5 S., R. 4 W. Gila and Salt River Meridian, Arizona, in latitude 32° 57' N., longitude 112° 37' W., at 11h. 54.2 m. p.m., 1.m. t., observe Polaris at western elongation, making six observations, three each with the telescope in direct and reversed positions, and mark the mean point in the line thus determined, on a wood frame, firmly erected 5 chs. N.

Azimuth of Polaris at western elongation = 1° 13' 14".

Jan. 17, 1938: at 7h. 30m., a.m., lay off the azimuth of Polaris 1° 13' to the east and mark the true meridian thus determined by a nail in a stake driven firmly in the ground 5 chs. N.

Feb. 3, 1938: at same station, at 9h. 00m., a.m., app.t., set off 32° 57' N. on the lat. arc; 16° 32 $\frac{1}{2}$ ' S. on the decl. arc; and determine a meridian with the solar, which agrees with the true meridian.

At app. noon, with the lat. arc unchanged, observe the sun on the meridian and obtain a reading of 16° 30 $\frac{1}{2}$ ' S. on the decl. arc; which agrees with the computed declination of the sun.

At 3h. 00m., p.m., app.t., with the lat. arc unchanged, set off 16° 28' S. on the decl. arc, and determine a meridian with the solar, which agrees with the true meridian:

As all of the solar observations made during the usual hours of solar work come within 1' 30" of the true meridian, conclude that this instrument is in satisfactory adjustment on this date, prior to beginning the surveys herein described.

Survey: First Standard Parallel South, thru Range 1 West.

2.

Chains	
	<p>The cor. of Ts. 5 and 6 S., Rs. 1 E. and 1 W., on the Gila and Salt River Meridian, which was reestablished in 1914 in connection with an independent resurvey of the Meridian, is an iron post, 3 ins. in diam., projecting 8 ins. above ground, firmly set, marked on brass cap and witnessed, as described in the official record, except that the giant cactus NW. of cor. is now dead, fallen and decayed.</p> <p>Thence</p> <p>West on S. bdy. of sec. 36.</p> <p>Over nearly level land, thru scattering timber and undergrowth.</p>
15.00	Foot of slope bears NE. and SW. Leave nearly level and enter mountainous land. Asc. 70 ft. over broken SE. slope.
17.94	Spur, slopes NE.; desc. 71 ft. over NW. slope to
23.90	Thence over broken N. slope, ascending 22 ft. to
29.22	Bottom of ravine 5 lks. wide, course NE.; asc. 119 ft. over SE. slope to
40.00	Set an iron post, 3 ft. long, 1 in. in diam., over a cross (X) chiseled on exposed bedrock, and in a mound of stone to top, for standard $\frac{1}{4}$ sec. cor. of sec. 36, with brass cap marked
	SC <u>$\frac{1}{4}$ S 36</u> 1938
	No bearing trees available.
	Ascend 163 ft. over SE. slope.
45.90	Spur, slopes S. about 3 chs. to saddle; desc. 121 ft. over SW. slope.
53.66	Bottom of ravine, 10 lks. wide, course S.; asc. 128 ft. over SE. slope.
59.41	Spur, slopes SW.; desc. 216 ft. over NW. slope to
76.54	Foot of slope bears NE. and SW. Leave mountainous and enter nearly level land. Desc. 16 ft. over gradual NW. slope to
80.00	Set an iron post, 3 ft. long, 2 ins. in diam., 14 ins. in the ground to bedrock and in a mound of stone to top, for standard cor. of secs. 35 and 36, with brass cap marked
	SC T5S RLW <u>S35 S36</u> 1938
	from which
	A paloverde, 6 ins. diam., bears N. $43\frac{3}{4}^{\circ}$ E., 52 lks. dist., marked T5S RLW S36 SC BT.
	A paloverde, 8 ins. diam., bears N. 61° W., 42 lks. dist., marked T5S RLW S35 SC BT.

Survey: First Standard Parallel South, thru Range 1 West.

BOOK 404

3.

Chains

Land, nearly level and mountainous.
Soil, rocky, 4th rate.
Timber, paloverde and ironwood.
Undergrowth, sagebrush and greasewood.

West on S. bdy. of sec. 35.

Over nearly level land, thru scattering timber and undergrowth.

22.50 Thence across a series of small washes, course N.

32.50 Leave washes, and continue over nearly level land. Asc. gradually over NE. slope to

40.00 Set an iron post, 3 ft. long, 1 in. in diam., 28 ins. in the ground, for standard $\frac{1}{4}$ sec. cor., of sec. 35 with brass cap marked

SC
 $\frac{1}{4}$ S 35

1938

from which

A paloverde, 6 ins. diam., bears N. $67\frac{1}{2}^{\circ}$ E., 177 lks. dist., marked $\frac{1}{4}$ S35 SC BT.

A paloverde, 10 ins. diam., bears N. $29\frac{1}{4}^{\circ}$ W., 118 lks. dist., marked $\frac{1}{4}$ S35 SC BT.

Thence over gently rolling land, ascending gradually over NE. slope.

50.00 Wash 15 lks. wide, course NE.

72.60 Wash 10 lks. wide, course NE.

76.29 Foot of slope bears NE. and SW. Leave gently rolling and enter mountainous land. Asc. 28 ft. over E. slope to

80.00 Set an iron post, 3 ft. long, 2 ins. in diam., 14 ins. in the ground to bedrock and in a mound of stone to top, for standard cor. of secs. 34 and 35, with brass cap marked

SC
T5S | R1W
S34 | S35

1938

from which

A paloverde, 8 ins. diam., bears N. $23\frac{1}{2}^{\circ}$ E., 127 lks. dist., marked T5S R1W S35 SC BT.

A paloverde, 8 ins. diam., bears N. $81\frac{3}{4}^{\circ}$ W., 142 lks. dist., marked T5S R1W S34 SC BT.

Land, nearly level, gently rolling and mountainous.
Soil, rocky, 4th rate.
Timber, paloverde and ironwood.
Undergrowth, cactus, sage brush and greasewood.

Survey: First Standard Parallel South, thru Range 1 West.

4.

Chains	<p>West on S. bdy. of sec. 34,</p> <p>Over mountainous land, thru scattering timber and undergrowth.</p> <p>Asc. 472 ft. over broken E. slope.</p> <p>25.85 Spur, slopes N. 15°E.; desc. 347 ft. over NW. slope.</p> <p>35.77 Bottom of canyon, 20 lks. wide, course N. 10°E.; asc. 151 ft. over E. slope to</p> <p>40.00 Set an iron post, 3 ft. long, 1 in. in diam., over a cross (X) chiseled on exposed bedrock and in a mound of stone to top, for standard $\frac{1}{4}$ sec. cor. of sec. 34, with brass cap marked</p> <p style="text-align: center;">S C <u>$\frac{1}{4}$ S 34</u></p> <p style="text-align: center;">1938</p> <p>No bearing trees available.</p> <p>Asc. 118 ft. over steep E. slope to</p> <p>42.98 Spur, slopes N. 10°E.; desc. 202 ft. over W. slope.</p> <p>51.73 Swale, drains N.; asc. 54 ft. over NE. slope.</p> <p>57.72 Spur, slopes NW.; desc. 166 ft. over W. slope to</p> <p>63.42 Wash, 20 lks. wide, course N. 10°E. Thence across bottom of canyon ascending gradually to</p> <p>71.38 Wash 10 lks. wide, course NE.; Leave bottom of canyon. Asc. 120 ft. over SE. slope to</p> <p>78.89 Thence along broken S. slope, descending 11 ft. to</p> <p>80.00 Set an iron post, 3 ft. long, 2 ins. in diam., 6 ins. in the ground to bedrock and in a mound of stone to top, for standard cor. of secs. 33 and 34, with brass cap marked</p> <p style="text-align: center;">S C T 5 S R 1 W <u>S 33 S 34</u></p> <p style="text-align: center;">1938</p> <p style="text-align: right;">from which</p> <p>A paloverde, 6 ins. diam., bears N. 37° E., 18 lks. dist., marked T5S R1W S34 SC BT.</p> <p>A paloverde, 8 ins. diam., bears N. 76$\frac{1}{2}$°W., 44 lks. dist., marked T5S R1W S33 SC BT.</p> <p>Land, mountainous. Soil, rocky, 4th rate. Timber, paloverde and ironwood. Undergrowth, sagebrush, greasewood and cactus.</p>
7.87	<p>West on S. bdy. of sec. 33,</p> <p>Over mountainous land thru scattering timber and undergrowth. Asc. 35 ft. over S. and SE. slopes to</p> <p>Ascend 379 ft. over steep E. slope.</p>

Survey: First Standard Parallel South, thru Range 1 West.

5.

Chains

- 17.12 Spur, slopes N. 20°E.; desc. 153 ft. over NW. slope.
 21.38 Bottom of ravine, 5 lks. wide, course generally N., asc. 232 ft. over steep NE. slope.
 31.05 Ridge, bears N. and S., turning to SE. at 2 chs. S. of this point; desc. 374 ft. over steep W. slope to
 40.00 Set an iron post, 3 ft. long, 1 in. in diam., 14 ins. in the ground to bedrock and in a mound of stone to top, for standard $\frac{1}{4}$ sec. cor. of sec. 33, with brass cap marked

S C
 $\frac{1}{4}$ S 33

1938

from which

A paloverde, 6 ins. diam., bears N. 57 $\frac{1}{2}$ °E., 74 lks. dist., marked $\frac{1}{4}$ S33 SC BT.

A paloverde, 6 ins. diam., bears N. 73 $\frac{3}{4}$ °W., 77 lks. dist., marked $\frac{1}{4}$ S33 SC BT.

Desc. 257 ft. over W. slope to

- 54.44 Foot of slope, bears N. and S. Leave mountainous and enter rolling land. Desc. 38 ft. over gradual W. slope.
 63.62 Wash, 80 lks. wide, course N. 10° E.; asc. 16 ft. over E. slope to
 64.60 Top of bank, bears N. 10° E. and S. 10° W. Asc. gradually over NE. and N. slopes to
 80.00 Set an iron post, 3 ft. long, 2 ins. in diam., 28 ins. in the ground, for standard cor. of secs. 32 and 33, with brass cap marked

S C
 T 5 S | R 1 W
 S 32 | S 33

1938

from which

A paloverde, 8 ins. diam., bears N. 46 $\frac{1}{4}$ ° E., 49 lks. dist., marked T5S R1W S33 SC BT.

A paloverde, 6 ins. diam., bears N. 49 $\frac{1}{2}$ °W., 207 lks. dist., marked T5S R1W S32 SC BT.

Land, mountainous and rolling.

Soil, rocky, 4th rate.

Timber, paloverde and ironwood.

Undergrowth, sagebrush, greasewood and cactus.

West on S. bdy. of sec. 32,

Over rolling land, thru scattering timber and undergrowth.

Asc. gradually over N. slope.

- 6.30 Wash, 30 lks. wide, course N. 70°E. Asc. gradually over S. slope.

- 8.80 Asc. 74 ft. over SE. slope.

Survey: First Standard Parallel South thru Range 1 West.

6.

Chains							
28.77	Foot of slope, bears N. and S. Leave rolling and enter mountainous land. Asc. 276 ft. over steep E. slope.						
39.09	Point of spur, slopes SE. Asc. slightly over steep S. slope to						
40.00	Set an iron post, 3 ft. long, 1 in. in diam., 8 ins. in the ground to bedrock and in a mound of stone to top, for standard $\frac{1}{4}$ sec. cor. of sec. 32, with brass cap marked						
	<table style="margin-left: auto; margin-right: auto;"> <tr><td>S</td><td>C</td></tr> <tr><td>$\frac{1}{4}$</td><td>S32</td></tr> </table>	S	C	$\frac{1}{4}$	S32		
S	C						
$\frac{1}{4}$	S32						
	1938						
	from which						
	A paloverde, 6 ins. diam., bears N. $0^{\circ} 30' E.$, 69 lks. dist., marked $\frac{1}{4}$ S32 SC BT.						
	A paloverde, 6 ins. diam., bears N. $36\frac{1}{2}^{\circ} W.$, 148 lks. dist., marked $\frac{1}{4}$ S32 SC BT.						
	Asc. 115 ft. over S. slope to						
55.70	Bottom of gulch, 5 lks. wide, course SE. Asc. 340 ft. over steep E. slope.						
63.31	Asc. 297 ft. over steep NE. slope.						
74.17	Ridge, bears N. and S.; desc. 174 ft. over steep W. slope to						
80.00	Set an iron post, 3 ft. long, 2 ins. in diam., 14 ins. in the ground to bedrock and in a mound of stone to top, for standard cor. of secs. 31 and 32 with brass cap marked						
	<table style="margin-left: auto; margin-right: auto;"> <tr><td>S</td><td>C</td></tr> <tr><td>T 5 S</td><td>R 1 W</td></tr> <tr><td>S 31</td><td>S 32</td></tr> </table>	S	C	T 5 S	R 1 W	S 31	S 32
S	C						
T 5 S	R 1 W						
S 31	S 32						
	1938						
	from which						
	A paloverde, 6 ins. diam., bears N. $29\frac{1}{2}^{\circ} E.$, 100 lks. dist., marked T5S R1W S32 SC BT.						
	A paloverde, 6 ins. diam., bears N. $36\frac{1}{2}^{\circ} W.$, 13 lks. dist., marked T5S R1W S31 SC BT.						
	Land, rolling and mountainous.						
	Soil, rocky, 4th rate.						
	Timber, paloverde and ironwood.						
	Undergrowth, sagebrush, cactus and greasewood.						
	West on S. bdy. of sec. 31,						
	Over mountainous land, thru scattering timber and undergrowth.						
	Desc. 225 ft. over NW. slope.						
8.73	Bottom of gulch, 5 lks. wide, course SW. Desc. 200 ft. over broken S. slope.						
26.32	Asc. 80 ft. over SE. slope.						

Survey: First Standard Parallel South, thru Range 1 West.

7.

Chains	
36.74	Asc. 19 ft. over S. slope to
40.00	Set an iron post, 3 ft. long, 1 in. in diam., on exposed bedrock and in a mound of stone to top, for standard $\frac{1}{4}$ sec. cor. of sec. 31, with brass cap marked
	$\begin{array}{c} \cdot \text{ S C} \\ \cdot \frac{1}{4} \text{ S } 31 \\ \cdot \end{array}$
	1938
	from which
	A paloverde, 6 ins. diam., bears N. $18\frac{1}{4}^{\circ}$ E., 31 lks. dist., marked $\frac{1}{4}$ S31 SC BT.
	A paloverde, 8 ins. diam., bears N. $54\frac{1}{2}^{\circ}$ E., 39 lks. dist., marked $\frac{1}{4}$ S31 SC BT.
	Asc. slightly over S. slope.
41.50	Desc. 395 ft. over steep SW. slope.
57.46	Wash, 20 lks. wide, course S.; asc. 100 ft. over E. slope.
61.90	Spur, slopes S.; desc. 125 ft. over steep W. slope to
69.13	Wash, 80 lks. wide, course S. 50° W. Leave mountainous and enter nearly level land in small valley. Asc. gradually over SE. slope to
80.00	Set an iron post, 3 ft. long, 3 ins. in diam., 28 ins. in the ground, for standard cor. of Ts. 5 S., Rs. 1 and 2 W., with brass cap marked
	$\begin{array}{c} \cdot \text{ S C} \\ \cdot \text{ T } 5 \text{ S} \\ \cdot \text{ R } 2 \text{ W} \mid \text{ R } 1 \text{ W} \\ \cdot \text{ S } 36 \mid \text{ S } 31 \\ \cdot \end{array}$
	1938
	from which
	An ironwood, 6 ins. diam., bears N. $75\frac{1}{4}^{\circ}$ E., 222 lks. dist., marked T5S R1W S31 SC BT.
	An ironwood, 6 ins. diam., bears N. $38\frac{3}{4}^{\circ}$ W., 336 lks. dist., marked T5S R2W S36 SC BT.
	Land, mountainous and nearly level.
	Soil, rocky, 4th rate.
	Timber, paloverde and ironwood.
	Undergrowth, sagebrush, greasewood and cactus.

Survey: First Standard Parallel South, thru Range 2 West.

Chains

From the standard cor. of T₅ S., R_s. 1 and 2 W.,, hereinbefore described.

West on S. bdy. of sec. 36.

Over nearly level land in small valley, thru scattering timber and undergrowth.

Asc. gradually over SE. slope.

11.00 Foot of slope, bears NE. and SW. Leave valley and enter mountainous land. Asc. 236 ft. over SE. slope.

24.31 Spur, slopes S.; desc. 300 ft. over steep SW. slope to

35.15 Foot of slope, bears NE. and SW. Leave mountainous and enter nearly level and gently rolling land in valley.

38.95 Wash, 80 lks. wide, course SW. Continue across valley.

40.00 Set an iron post, 3 ft. long, 1 in. in diam., 28 ins. in the ground, for standard 1/4 sec. cor. of sec. 36, with brass cap marked

S C
1/4 S 36

1938

from which

An ironwood limb, 5 ins. diam., bears N. 43 1/2° E., 155 lks. dist., marked 1/4 S 36 SC BT.

A paloverde, 6 ins. diam., bears N. 55 1/2° E., 123 lks. dist., marked 1/4 S 36 SC BT.

Continue over nearly level and gently rolling land, in valley.

45.30 Wash, 15 lks. wide, course SW.

55.10 Wash, 40 lks. wide, course S. from NE., at mouth of wash from NW. Asc. slightly over E. slope to

57.00 Foot of slope, bears NW. and S. Leave valley and enter mountainous land. Asc. 414 ft. over E. slope.

73.00 Fork of spurs, sloping SE. and SW., from N. Desc. 301 ft. over steep W. slope to

80.00 Set an iron post, 3 ft. long, 2 ins. in diam., on exposed bedrock and in a mound of stone to top, for standard cor. of secs. 35 and 36, with brass cap marked

S C
T 5 S | R 2 W
S 35 | S 36

1938

from which

A paloverde, 6 ins. diam., bears N. 26 1/4° E., 91 lks. dist., marked T5S R2W S36 SC BT.

A paloverde, 8 ins. diam., bears N. 69 3/4° W., 93 lks. dist., marked T5S R2W S35 SC BT.

Land, nearly level, gently rolling and mountainous. Soil, rocky, 4th rate.

Timber, paloverde and ironwood.

Undergrowth, cactus, sagebrush and greasewood.

Survey: First Standard Parallel South, thru Range 2 West.

9.

Chains	<p>West on S. bdy. of sec. 35,</p> <p>Over mountainous land, thru scattering timber and undergrowth.</p> <p>Desc. 190 ft. over SW. slope.</p> <p>9.54 Asc. 39 ft. over broken S. slope.</p> <p>23.82 Asc. 256 ft. over steep SE. slope.</p> <p>33.39 Spur, slopes SW.; desc. 198 ft. over steep NW. slope to</p> <p>40.00 Set an iron post, 3 ft. long, 1 in. in diam., 6 ins. in the ground to bedrock and in a mound of stone to top, for standard $\frac{1}{4}$ sec. cor. of sec. 35, with brass cap marked</p> <p style="text-align: center;"> S C <u>$\frac{1}{4}$ S 35</u> 1938 </p> <p style="text-align: right;">from which</p> <p>A paloverde, 4 ins. diam., bears N. $63\frac{1}{2}^{\circ}$E., 42 lks. dist., marked $\frac{1}{4}$ S35 SC BT.</p> <p>A paloverde, 6 ins. diam., bears N. $46\frac{1}{2}^{\circ}$W., 68 lks. dist., marked $\frac{1}{4}$ S35 SC BT.</p> <p>Desc. 192 ft. over NW. slope.</p> <p>50.96 Wash, 40 lks. wide, course SW. Leave mountainous and enter nearly level land.</p> <p>80.00 Set an iron post, 3 ft. long, 2 ins. in diam., 28 ins. in the ground, for standard cor. of secs. 34 and 35, with brass cap marked</p> <p style="text-align: center;"> S C T 5 S R 2 W <u>S 34 S 35</u> 1938 </p> <p style="text-align: right;">from which</p> <p>An ironwood, 10 ins. diam., bears N. $12\frac{3}{4}^{\circ}$E., 104 lks. dist., marked T5S R2W S35 SC BT.</p> <p>A paloverde, 8 ins. diam., bears N. 52°W., 170 lks. dist., marked T5S R2W S34 SC BT.</p> <p>Land, mountainous and nearly level. Soil, rocky, 4th rate. Timber, paloverde and ironwood. Undergrowth, sagebrush, cactus and greasewood.</p> <hr/> <p>West on S. bdy. of sec. 34,</p> <p>Over nearly level land, thru scattering timber and undergrowth.</p> <p>4.50 Foot of slope, bears NE. and SW. Enter gently rolling land. Asc. 13 ft. over SE. slope.</p> <p>5.48 Point of spur, slopes SW. Desc. 29 ft. over W. slope to</p> <p>10.45 Thence over nearly level land.</p>
--------	---

Chains

40.00

Set an iron post, 3 ft. long, 1 in. in diam., 28 ins. in the ground, for standard $\frac{1}{4}$ sec. cor. of sec. 34, with brass cap marked

S C
 $\frac{1}{4}$ S 34

1938

from which

An ironwood limb, 4 ins. diam., bears N. $55\frac{3}{4}^{\circ}$ E., 71 lks. dist., marked $\frac{1}{4}$ S34 SC BT.

An ironwood limb, 4 ins. diam., bears N. $22\frac{1}{2}^{\circ}$ W.; 164 lks. dist., marked $\frac{1}{4}$ S34 SC BT.

Continue over nearly level land, thru scattering timber and undergrowth.

80.00

Set an iron post, 3 ft. long, 2 ins. in diam., 28 ins. in the ground, for standard cor. of secs. 33 and 34, with brass cap marked

S C
T 5 S | R 2 W
S 33 | S 34

1938

from which

An ironwood limb, 4 ins. diam.; bears N. $25\frac{3}{4}^{\circ}$ E., 53 lks. dist., marked T5S R2W S34 SC BT.

An ironwood limb, 6 ins. diam., bears N. 49° W., 169 lks. dist., marked T5S R2W S33 SC BT.

Land, nearly level and gently rolling.

Soil, gravelly, 3rd rate.

Timber, paloverde and ironwood.

Undergrowth, cactus, sagebrush and greasewood.

West on S. bdy. of sec. 33,

Over nearly level land, thru scattering timber and undergrowth.

35.00

From this point the NW. end of a small granite butte bearing NW. and SE. about 15 chs. long, 5 chs. wide, and 100 ft. high, bears S. about 5 chs. dist.

40.00

Set an iron post, 3 ft. long, 1 in. in diam., 28 ins. in the ground; for standard $\frac{1}{4}$ sec. cor. of sec. 33, with brass cap marked

S C
 $\frac{1}{4}$ S 33

1938

from which

An ironwood, 6 ins. diam., bears N. $35\frac{1}{2}^{\circ}$ E., 187 lks. dist., marked $\frac{1}{4}$ S33 SC BT.

A paloverde, 6 ins. diam., bears N. $35\frac{1}{4}^{\circ}$ W., 326 lks. dist., marked $\frac{1}{4}$ S33 SC BT.

Continue over nearly level land, thru scattering timber and undergrowth.

Survey: First Standard Parallel South, thru Range 2 West.

11

Chains

80.00 Set an iron post, 3 ft. long, 2 ins. in diam., 28 ins. in the ground, for standard cor. of secs. 32 and 33, with brass cap marked

S C	
T 5 S	R 2 W
<u>S 32</u>	<u>S 33</u>

1938

from which

An ironwood limb, 4 ins. diam., bears N. $63\frac{1}{2}^{\circ}$ E., 229 lks. dist., marked T5S R2W S33 SC BT.

An ironwood limb, 4 ins. diam., bears N. $69\frac{1}{2}^{\circ}$ W., 54 lks. dist., marked T5S R2W S32 SC BT.

Land, nearly level.
Soil, gravelly, 3rd rate.
Timber, paloverde and ironwood.
Undergrowth, greasewood, sagebrush and cactus.

West on S. bdy. of sec. 32,

Over nearly level land, thru scattering timber and undergrowth.

35.00 Wash 30 lks. wide, course NW.

40.00 Set an iron post, 3 ft. long, 1 in. in diam., 28 ins. in the ground, for standard $\frac{1}{4}$ sec. cor. of sec. 32, with brass cap marked

S C	
<u>$\frac{1}{4}$ S 32</u>	

1938

from which

An ironwood, 10 ins. diam., bears N. $30\frac{1}{2}^{\circ}$ E., 195 lks. dist., marked $\frac{1}{4}$ S32 SC BT.

A paloverde, 10 ins. diam., bears N. 28° W., 399 lks. dist., marked $\frac{1}{4}$ S32 SC BT.

Continue over nearly level land, thru scattering timber and undergrowth.

80.00 Set an iron post, 3 ft. long, 2 ins. in diam., 28 ins. in the ground, for standard cor. of secs. 31 and 32, with brass cap marked

S C	
T 5 S	R 2 W
<u>S 31</u>	<u>S 32</u>

1938

from which

A paloverde, 8 ins. diam., bears N. $34\frac{1}{2}^{\circ}$ E., 360 lks. dist., marked T5S R2W S32 SC BT.

A paloverde, 10 ins. diam., bears N. $47\frac{1}{2}^{\circ}$ W., 299 lks. dist., marked T5S R2W S31 SC BT.

Land, nearly level.
Soil, gravelly, 3rd rate.
Timber, paloverde and ironwood.
Undergrowth, greasewood, sagebrush and cactus.

Survey: First Standard Parallel South, thru Range 2 West.

12

Chains

West on S. bdy. of sec. 31,

Over nearly level land, thru scattering timber and undergrowth.

40.00

Set an iron post, 3 ft. long, 1 in. in diam., 28 ins. in the ground, for standard $\frac{1}{4}$ sec. cor. of sec. 31, with brass cap marked

S C
 $\frac{1}{4}$ S 31

1938

from which

A paloverde, 10 ins. diam., bears N. 48° E., 502 lks. dist., marked $\frac{1}{4}$ S31 SC BT.

A paloverde, 8 ins. diam., bears N. $26\frac{3}{4}^{\circ}$ W., 121 lks. dist., marked $\frac{1}{4}$ S31 SC BT.

Continue over nearly level land, thru scattering timber and undergrowth.

80.00

Set an iron post, 3 ft. long, 3 ins. in diam., 28 ins. in the ground, for standard cor. of Ts. 5 S., Rs. 2 and 3 W., with brass cap marked

S C
T 5 S
R 3 W | R 2 W
S. 36 | S 31

1938

from which

An ironwood, 6 ins. diam., bears N. $12\frac{1}{2}^{\circ}$ E., 400 lks. dist., marked T5S R2W S31 SC BT.

An ironwood, 4 ins. diam., bears N. $45\frac{3}{4}^{\circ}$ W., 498 lks. dist., marked T5S R3W S36 SC BT.

Land, nearly level.

Soil, gravelly, 3rd rate.

Timber, paloverde and ironwood.

Undergrowth, sagebrush, cactus, and greasewood.

FINAL FIELD TEST OF INSTRUMENT.

February 13, 1938: at camp in $SE\frac{1}{4}$ of sec. 36, T. 5 S., R. 4 W., Gila and Salt River Meridian, Arizona, latitude $32^{\circ}57'N.$, longitude $112^{\circ}37'W.$, examine the adjustments of Buff and Buff transit No. 16723, and find no errors, then, to test the solar apparatus of same by comparing its indications with the true meridian established at this station by Polaris observation Jan. 16 and 17, 1938, as hereinbefore described, proceed as follows:

At 9h. 00m., a.m., app.t., set off $32^{\circ}57'N.$ on the latitude arc; $13^{\circ}23\frac{1}{2}'S.$ on the declination arc; and determine a meridian with the solar, which agrees with the true meridian.

At app. noon, with the latitude arc unchanged, observe the sun on the meridian, and obtain a reading of $13^{\circ}21'S.$ on the declination arc, which agrees with the computed declination of the sun.

At 3h. 00m., p.m., app.t., with the latitude arc unchanged; set off $13^{\circ}18\frac{1}{2}'S.$ on the declination arc, and determine a meridian with the solar, which agrees with the true meridian.

As all of the solar observations made during the usual hours of solar work come within $1'30''$ of the true meridian, conclude that this instrument is in satisfactory adjustment on this date, and has remained in such condition throughout the surveys described in the foregoing field notes.

GENERAL DESCRIPTION.

The First Standard Parallel South thru Ranges 1 and 2 West, surveyed as described in the foregoing field notes is located in the Gila River drainage basin, the eastern end of the line being 30 miles south from the junction of the Salt and Gila Rivers, and the western end 12 miles east from the town of Gila Bend, Arizona. The land in Range 1 West is mainly mountainous, the line crossing spurs and ridges of the Maricopa Mountains, which have a general NW.-SE. bearing. The summit of this range, with an elevation of about 2150 feet above sea level, is crossed on S. bdy. of sec. 32, T. 5 S., R. 1 W., and the mountainous surface extends for about $1\frac{1}{2}$ miles into Range 2 West. At the eastern and western ends of the Parallel in Range 1 West, there are small areas of nearly level surface, and the S. bdy. of sec. 35 is nearly level and gently rolling. The foot of the mountains is reached in the $W\frac{1}{2}$ of S. bdy. of sec. 35, T. 5 S., R. 2 W., and west from that point the line crosses nearly level land, elevation about 1400 feet above sea level. There are also small areas of nearly level and gently rolling land on S. bdy. of sec. 36, T. 5 S., R. 2 W., in narrow valleys within the mountains. The soil of the mountainous land is rocky, 4th rate, and to the west of the mountains the soil is gravelly, 3rd rate.

Thru Ranges 1 and 2 West there is a scattering growth of paloverde and ironwood timber, and scattering undergrowth of cactus, sagebrush and greasewood.

The land is devoid of any natural or developed water supply, and owing to this arid condition there are no settlers in this vicinity. There are no indications of any valuable mineral deposits near the Parallel. No roads or trails cross the line in Ranges 1 and 2 West, and there are no improvements.

The Southern Pacific railroad with an unimproved road alongside crosses Ts. 5 S., Rs. 1 and 2 W., with an ENE and WSW bearing, and paved State highway No. 84 from Gila Bend to Casa Grande is about 4 miles south from the west end of this portion of the Parallel and 7 miles south from the east end.

Townships 5 and 6 South, Ranges 1 and 2 West are to be surveyed under this group. The Parallel thru Range 3 West is to be surveyed under current Group No. 198, and the townships north and south thereof are to be subdivided under said Group.

72
15

BOOK 4244

CERTIFICATE OF SURVEYOR

I, Horace M. Muscott, Public Land Surveyor, HEREBY CERTIFY upon honor that, in
pursuance of special instructions bearing date of the 1st day of December, 1937
received from the district cadastral engineer for Arizona, with assignment
instructions dated February 3, 1938, I have surveyed
the FIRST STANDARD PARALLEL SOUTH
THRU RANGES 1 and 2 WEST

of the Gila and Salt River Meridian, in the State of Arizona, which are
represented in the foregoing field notes as having been executed by me and under my direction; and that said
survey has been made in strict conformity with said instructions, the Manual of Instructions for the Survey
of the Public Lands of the United States, and in the specific manner described in the foregoing field notes.

PHOENIX, ARIZONA

Horace M. Muscott
Public Land Surveyor

January 22, 1940

CERTIFICATE OF APPROVAL

OFFICE OF SUPERVISOR OF SURVEYS,
Denver, Colo., APR 14 1942, 1942

The foregoing field notes of the survey of
the FIRST STANDARD PARALLEL SOUTH
thru RANGES 1 and 2 WEST
of the Gila and Salt River Meridian, in the State of Arizona
executed by Horace M. Muscott, Public Land Surveyor,
under special instructions dated December 1, 1937, for Group 197, Arizona, and assignment
instructions dated February 3, 1938, having been critically examined, and
the necessary corrections made prior to their certification by the engineer, the said field notes, and the survey
therein described, are hereby approved.

Quentin J. Cannon
Supervisor of Surveys.

~~CERTIFICATE OF TRANSCRIPT~~

~~I certify that the foregoing transcript of the field notes of the above described surveys in~~
~~is a true copy of the original field notes on file in the public survey office.~~

~~Supervisor of Surveys.~~