

Original

UNITED STATES
DEPARTMENT OF THE INTERIOR
BUREAU OF LAND MANAGEMENT

4349

FIELD NOTES

of the

RETRACEMENT

of Part of the

Subdivision of Townships 4, 5, and 6 South, Range 16 East,

First Standard Parallel South, along South Boundary of

Township 5 South, Range 16 East,

North Boundary of Township 5 South, Range 16 East,

and

Part of the Abandoned South Boundary of the San Carlos Indian Reservation

Of the Gila and Salt River Meridian,

In the State of Arizona.

EXECUTED BY

Dupree R. Averill,

G. Marvin Litz

Under special instructions dated July 3, 1946, which provided

for the surveys included under Group No. 249, bearing the approval of the

Director of the Bureau of Land Management under date of August 5, 1946

and assignment instructions dated August 28, 1946.

Survey commenced September 16, 1946.

Survey completed October 14, 1946.

4349

4349

INDEX DIAGRAM

BOOK 4349

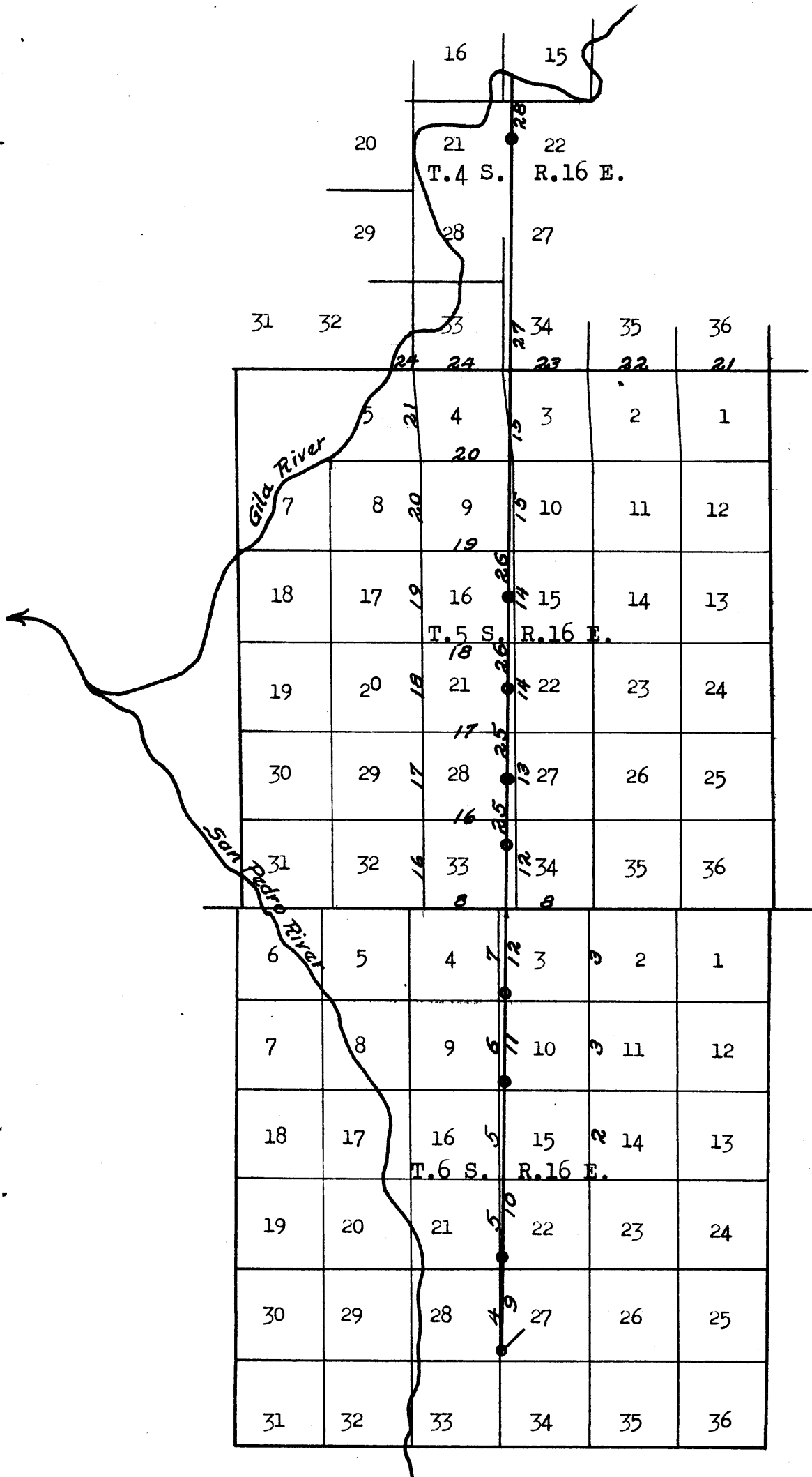

The surveys herein noted were executed with Buff and Buff transits Nos. 24849 and 26591, and Gurley transit No. 371537, equipped with Smith solar attachments, constructed in accordance with the standard specifications of the Bureau of Land Management. The instruments were placed in satisfactory adjustment prior to beginning the survey, and tested and found to be free from appreciable error.

The bearings of all lines were determined by direct observation upon the sun for azimuth, supplemented by observations with the solar units. Measurements were made with steel tapes, 5 chains in length, graduated every link for the first 100 links, and the balance at intervals of 10 links. The tapes were first tested with a Lufkin Standard 1 chain tape and found correct. The measurements were made on the slope, the vertical angle of each interval was ascertained by a clinometer in good adjustment, and the true horizontal equivalents are entered in the field note record.

The data presented with the special instructions indicates the geographical position of the northeast corner of T.5 S., R.16 E., G. & S.R. M. as follows:

Latitude: 33° 01' 46"N. Longitude: 110° 39' 20"W.

September 14, 1946; at observing station situated near the center of section 23, T.5 S., R.15 E., G. & S.R.M. Arizona, at 6h. 17m. 40s., p.m., l.m.t., make an observation on Polaris, making four sights each with the telescope in direct and reversed positions, noting the deflection angle to a reference mark 6 miles distant:

Mean horizontal angle to Polaris	17°22'08"
Mean vertical angle to Polaris	32°30'52"
Reduced bearing to reference mark	N.16°20'44" W.
Reduced latitude	32°58'36" N.

The solar units were tested upon the meridian determined by Polaris observation, and maintained in good adjustment throughout the survey.

.....

The following surveys were executed to determine the position of the abandoned South Boundary of the San Carlos Indian Reservation, from the 15 mile monument North to the Gila River (surveyed by Paul Riecker, U. S. Deputy Surveyor, in 1883), in relationship to the Public Land surveys. The lands within that part of the San Carlos Reservation ceded by the Indians to the United States by the Act of June 10, 1896 (29 Stat. 358), were withdrawn by Departmental Orders of March 30, 1931. and September 19, 1934.

The State of Arizona has applied for certain lands in Section 9, T.6 S., R.16 E., as indemnity school land selection.

Retracement of the 'Riecker' line, and intersections thereof with the lines of the public land surveys through which it passes are herein noted. No lost corners were re-established, nor were any of the existing original corners remonumented. The retracement data are thoroughly verified, and only the true line positions are given herein.

Retracement of Subdivisional Lines, T.6 S., R.16 E.

Chains

Subdivisional surveys in Ts. 5 & 6 S., R.16 E., were executed by J. L. Harris in 1877, at which time he also surveyed the 1st. Standard Parallel South. This line was resurveyed by Philip Contzgen in 1904. Harris surveyed the north boundary of T.5 S., R.16 E., west to the Gila River in section 5. In 1911, Wm. H. Elliott, U. S. Surveyor, failing to find any corner monuments of the Harris survey, resurveyed the fractional north boundary of T.5 S., R.16 E. due west to the Gila River, and completed the survey of this boundary by a direct line to the corner of Ts. 4 & 5 S., Rs. 15 & 16 E., in connection with fragmentary subdivisional surveys in T.4 S., R.16 E.

Retracement of part of the abandoned (Riecker) south boundary of the San Carlos Indian Reservation, and the boundaries of the involved sections in T.6 S., R.16 E. was executed by Ty White, Cadastral Engineer, in 1939.

The cor. of secs. 14, 15, 22 and 23, is marked by the original monument; a malpais stone, firmly set, 10 x 10 x 10 ins. above ground, marked with 3 notches on the S. and 2 notches on the E. edges, and witnessed by a mound of stone 3 ft. base, 1½ ft. high, to the N.

N.0°21'W., bet. secs. 14 and 15.

Over broken mesa land, through scattered timber and undergrowth. Desc. 80 ft. over N. slope.

- 7.00 Wash, 10 lks. wide, course N.70°W. Asc. 80 ft. over S. slope.
- 12.50 Flat spur, slopes W. Desc. 50 ft.
- 18.00 Wash, 20 lks. wide, course W. Asc. 105 ft. over S. slope.
- 24.00 Spur, slopes W. Desc. 100 ft. over N. slope.
- 36.70 Wash, 100 lks. wide, course W. Asc. 40 ft.
- 39.40 The ¼ sec. cor. of secs. 14 and 15, marked by the original monument, a volcanic stone, firmly set, 10 x 10 x 10 ins. above ground, illegibly marked on top face, and witnessed by a mound of stone 2 ft. base, 1 ft. high, to the N.
- N.0°36'W., beginning new measurement.
- Over rolling land, ascend gradually.
- 14.40 Old road, bears N.70°E. and S.70°W.
- 20.00 Short spur, slopes SW. Desc. 30 ft.
- 22.40 Wash, 20 lks. wide, course S.60°W. Asc. 100 ft. over SE. slope.
- 32.00 Spur, slopes SW. Desc. 80 ft. over NW. slope.
- 39.20 Road, bears N.70°E. and S.70°W.
- 39.70 The cor. of secs. 10, 11, 14 and 15, marked by the original monument, a malpais stone, firmly set, 12 x 10 x 4 ins. above ground, marked with 4 notches on the S. and 2 notches on the E. faces, and witnessed by a mound of stone 2 ft. base, 1 ft. high, to the W.

No evidence remains of the original bearing trees.

Retracement of Subdivisional Lines, T.6 S., R.16 E.

Chains	
	<p>Land, broken and rolling. Soil, rocky, 3rd. rate. Scattered paloverde, catsclaw, mesquite, greasewood and cactus.</p> <p>-----</p> <p>N.0°42'W., bet. secs. 10 and 11.</p> <p>Desc. 15 ft. over NW. slope, through scattered undergrowth.</p> <p>5.60 Wash, 10 lks. wide, course W.</p> <p>17.50 Desc. 30 ft. over N. slope.</p> <p>17.85 Wash, 40 lks. wide, course W. Asc. 30 ft. over S. slope.</p> <p>34.50 Drain, course S.70°W.</p> <p>39.90 The $\frac{1}{4}$ sec. cor. of secs. 10 and 11, marked by the original monument, a granite stone, firmly set, 12 x 10 x 8 ins. above ground, marked $\frac{1}{4}$ on top face, and witnessed by a mound of stone 2$\frac{1}{2}$ ft. base, 1$\frac{1}{2}$ ft. high, to the N.</p> <p>N.0°44'W., beginning new measurement. Ascend gradually.</p> <p>10.40 Wash, 20 lks. wide, course S.70°W. Asc. 90 ft. over S. slope.</p> <p>39.60 Spur, slopes W.</p> <p>39.80 The cor. of secs. 2, 3, 10 and 11, marked by the original monument, a volcanic stone, firmly set, 12 x 10 x 10 ins. above ground, marked with 5 grooves on the S. and 2 grooves on the E. faces, and witnessed by a mound of stone, 2$\frac{1}{2}$ ft. base, 1$\frac{1}{2}$ ft. high, to the N.</p> <p>No evidence remains of the original bearing tree.</p> <p>Land, rolling. Soil, rocky, 3rd. rate. Scattered paloverde, catsclaw, mesquite, greasewood and cactus.</p> <p>-----</p> <p>N.0°28'W., bet. secs. 2 and 3.</p> <p>Over broken land, through scattered undergrowth. Desc. 60 ft. over N. slope.</p> <p>3.05 Wash, 10 lks. wide, course W. Asc. 45 ft.</p> <p>12.00 Over nearly level bench land.</p> <p>20.00 Desc. 40 ft. over gradual NW. slope.</p> <p>35.40 Wash, 90 lks. wide, course W. Asc. 20 ft.</p> <p>39.78 The $\frac{1}{4}$ sec. cor. of secs. 2 and 3, marked by the original monument, a granite stone, firmly set, 14 x 10 x 6 ins. above ground, marked $\frac{1}{4}$ on top face, and witnessed by a mound of stone 2 ft. base, 1 ft. high, to the N.</p> <p>An original bearing tree, a paloverde, 5 ins. diam., blazed but without visible marks, bears S.35°E., 43 lks. dist.</p> <p>N.0°21'W., beginning new measurement.</p> <p>Over nearly level land.</p>

Retracement of Subdivisional Lines, T.6 S., R.16 E.

Chains	
10.00	Asc. 75 ft. over gradual S. slope.
34.50	Spur, slopes W. Continue along gradual W. slope.
36.80	Head of drain, course NW.
39.80	The original closing cor. of secs. 2 and 3, marked by a malpais stone, firmly set, 20 x 16 x 16 ins. above ground, marked with 2 notches on the E. and 4 notches on the W. faces, and witnessed by a mound of stone 2 ft. base, 1 ft. high, to the S.
	No evidence of original bearing tree remains.
40.28	Intersect the 1st. standard parallel south at a point S.89°57'W., 5.24 chs. dist., from the standard cor. of secs. 34 and 35, described on page 9.
	Land, slightly rolling. Soil, rocky, 2nd. and 3rd. rate. Scattered paloverde, catsclaw, mesquite, greasewood and cactus.

	The cor. of secs. 27, 28, 33 and 34 is evidenced by the original mound of stone; a wooden post, 4 ft. high, 4 ins. square, firmly set in this mound of stone marks the N.W., corner of the placer claim 'Benjamin Franklin No.2'.
	Corner is situated on a short spur, sloping W.
	N.1°23'W., bet. secs. 27 and 28.
	Over broken mesa, through scattered timber and undergrowth. Desc. 20 ft. over N. slope.
1.30	Gully, course W. Asc. 25 ft.
2.40	Small spur, slopes W.
3.40	Wash, 5 lks. wide, course SW. Asc. 80 ft. over SW. slope.
19.50	Desc. 45 ft. over N. slope.
21.60	Wash, 10 lks. wide, course S.70°W. Asc. 130 ft. over S. slope.
33.50	Spur, slopes S.70°W. Desc. 130 ft. over N. slope.
39.50	Wash, 50 lks. wide, course W. Asc. 150 ft. over S. slope.
40.00	Record distance. No evidence of original $\frac{1}{4}$ sec. cor.
52.50	Spur, slopes W. Desc. 120 ft.
78.13	Four strand barbed wire fencing, extends W. and S.73 $\frac{3}{4}$ °E.
78.18	The cor. of secs. 21, 22, 27 and 28, marked by a squared mesquite stake, badly weathered, without visible lettering, supported in a dilapidated mound of stone, 2 ft. base, 1 ft. high.
	No evidence remains of the original bearing trees.
	The cor. of secs. 22, 23, 26 and 27 bears N.88°44'E., 76.97 chs. dist., a malpais stone, firmly set, 14 x 12 x 8 ins. above ground, marked with 2 notches on the E. and S. edges, and witnessed by a mound of stone 2 $\frac{1}{2}$ ft. base, 1 ft. high, to the N.

Retracement of Subdivisional Lines, T.6 S., R.16 E.

Chains

Land, rolling and broken.
Soil, rocky, 2nd. and 3rd. rate.
Scattered paloverde, catsclaw, greasewood and cactus.

N.0°40'W., bet. secs. 21 and 22.

Over rolling N. slope, through scattered undergrowth.

- 9.00 Low spur, slopes W. Desc. 60 ft.
- 21.00 Wash, 50 lks. wide, course S.60°W. Asc. 100 ft. over S. slope.
- 31.00 Spur, slopes W. Road, bears SE. and W. Desc. 70 ft.
- 39.98 The $\frac{1}{4}$ sec. cor. of secs. 21 and 22, marked by the original monument, a malpais stone, firmly set, 10 x 8 x 6 ins. above ground, marked $\frac{1}{4}$ on the top face, and witnessed by a mound of stone 2 ft. base, 1 ft. high, to the N.
- No evidence of the original bearing trees.
- N.0°25'W., beginning new measurement. Desc. 35 ft.
- 8.25 Wash, 20 lks. wide; course W. Asc. 70 ft.
- 19.00 Spur, slopes W. Desc. 70 ft.
- 26.50 Wash, 10 lks. wide, course W. Asc. 75 ft.
- 29.00 Spur, slopes W. Desc. 70 ft.
- 35.00 Wash, 10 lks. wide, course W. Asc. 50 ft.
- 37.50 Spur, slopes W. Desc. slightly.
- 41.20 The cor. of secs. 15, 16, 21 and 22, locally perpetuated by an iron post, 3 ins. diam., 4 ft. above mound of stone, 3 ft. base, 1 ft. high.
- The cor. of secs. 14, 15, 22 and 23 bears N.89°54'E., 77.98 chs. dist.
- Land, rolling.
Soil, rocky, 2nd. and 3rd. rate.
Scattered paloverde, mesquite, greasewood and cactus.
- N.0°25'W., bet. secs. 15 and 16.
- Over rolling land, through scattered undergrowth. Desc. 40 ft.
- 6.50 Wash, 10 lks. wide, course S.60°W. Asc. 150 ft.
- 15.00 Old road, bears NE. and SW.
- 33.00 Spur, slopes S.70°W. Desc. 150 ft. over N. slope.
- 40.00 Record distance. No evidence of original $\frac{1}{4}$ sec. cor.
- 47.00 Wash, 10 lks. wide, course W. Asc. 75 ft.
- 67.00 Road, bears E. and W.
- 77.60 The cor. of secs. 9, 10, 15 and 16, marked by the original monument, a conglomerate stone, firmly set, 10 x 6 x 6

Retracement of Subdivisional Lines, T.6 S., R.16 E.

Chains

ins. above ground, and in a mound of stone 3 ft. base, 1 ft. high, marked with 4 notches on the S. and 3 notches on the E. edges.

No evidence of the original bearing tree remains.

A four strand barbed wire fence; extends E. and W.

Land, rolling.
Soil, rocky, 2nd. and 3rd. rate.
Scattered paloverde, catsclaw, greasewood and cactus.

N.88°43'E., bet. secs. 10 and 15.

Over slightly rolling land, through scattered undergrowth. Along wire fencing.

4.68 Corner of four strand barbed wire fencing, extending N. and W. bears South, 5 lks. dist.

18.30 Drain, course SW.

40.10 Record distance. No evidence of original $\frac{1}{4}$ sec. cor. Asc. 60 ft. over gradual NW. slope.

77.92 The cor. of secs. 10, 11, 14 and 15.

Land, gently sloping mesa, draining W.
Soil, rocky, 2nd. and 3rd. rate.
Scattered paloverde, catsclaw, greasewood and cactus.

From the cor. of secs. 9, 10, 15 and 16.
N.0°20'W., bet. secs. 9 and 10.

Over mesa land, through scattered timber.

11.50 Flat spur, slopes W. Desc. 100 ft. over N. slope.

20.30 Wash, 50 lks. wide, course W. Asc. 50 ft.

40.08 The $\frac{1}{4}$ sec. cor. of secs. 9 and 10, marked by the original monument, a malpais stone, firmly set, 14 x 12 x 8 ins. above ground, marked $\frac{1}{4}$ on the top face.

Corner is situated in a small swale, draining SW.

N.0°18'W., beginning new measurement.

8.20 Spur, slopes S.70°W., Desc. 95 ft. over N. slope.

16.50 Wash, 40 lks. wide, course S.50°W., Asc. 100 ft. over SE. slope.

39.56 The cor. of secs. 3, 4, 9 and 10, marked by the original monument, a malpais stone, firmly set, 12 x 10 x 8 ins. above ground, marked with 5 notches on the S. and 3 notches on the E. edges, and witnessed by a mound of stone 3 ft. base, 1 $\frac{1}{2}$ ft. high, to the N.

No evidence of the original bearing trees.

Land, broken and rolling mesa.
Soil, rocky, 3rd. rate.
Scattered palo verde, mesquite, catsclaw, greasewood and cactus.

Retracement of Subdivisional Lines, T.6 S., R.16 E.

Chains	N.88°33'E., bet. secs. 3 and 10. Over rolling mesa land, through scattered timber. Desc. 35 ft. over S. slope.
7.50	Swale, drains SW. Asc. 90 ft. over NW. slope.
30.00	Spur, slopes SW. Desc. 20 ft.
33.00	Wash, 5 lks. wide, course SW. Asc. 40 ft.
37.00	Spur, slopes SW. Desc. 10 ft.
40.11	Record distance; no evidence of original cor. monument. Continue descent 25 ft.
45.00	Wash, 15 lks. wide, course SW. Asc. 130 ft. over NW. slope.
77.38	The cor. of secs. 2, 3, 10 and 11. Land, rolling mesa. Soil, rocky, 3rd. rate. Scattered paloverde, catsclaw, greasewood and cactus.

	From the cor. of secs. 3, 4, 9 and 10. N.0°34'W., bet. secs. 3 and 4. Over broken mesa, through scattered palo verde and undergrowth.
15.50	Arroyo, 50 lks. wide, 50 ft. deep, from NE., course W.
40.00	Record distance; no evidence of original corner monument.
45.00	Desc. 170 ft. over broken N. slope.
59.50	Wash, 50 lks. wide, in draw, course S.70°W. Asc. 130 ft. over S. slope.
64.00	Change of slope to SE., Asc. 80 ft.
76.00	Change of slope to NE., Desc. 40 ft.
81.44	The original closing corner monument of secs. 3 and 4, marked by a volcanic stone 20 x 16 x 10 ins., supported in a mound of stone 3 ft. base, 1 ft. high, marked with 3 notches on the E. and W. faces, with illegible marks on S. face, and witnessed by a mound of stone 3 ft. base, 2 ft. high, to the S.
81.92	Intersect the 1st. standard parallel south at a point S.89°57'W., 8.55 chs. dist., from the standard corner of secs. 33 and 34. Land, broken mesa. Soil, rocky, 3rd. rate. Scattered paloverde, mesquite, catsclaw, greasewood and cactus.

Retracement of a Portion of the 1st. Standard Parallel
South, through R.16 E.

Chains	
	<p>The standard corner of secs. 32 and 33, T.5 S., R.16 E., is marked by the 1904 resurvey monument, a malpais stone, firmly set, 14 x 10 x 4 ins. above ground, marked with 4 notches on the E. and 2 notches on the W. face, S C on the N. face, and witnessed by a mound of stone 2 ft. base, 1 ft. high, to the N.</p> <p>N.89°57'E., on the S. bdy. of sec. 33.</p> <p>Over rolling land, through scattered timber and undergrowth. Asc. 100 ft. over NW. slope.</p>
13.20	Short spur, slopes N. Desc. 60 ft. over NE. slope.
28.70	Wash, 20 lks. wide, course N. Asc. 55 ft. over NW. slope.
39.84	<p>The standard $\frac{1}{4}$ sec. cor. of sec. 33, marked by the 1904 resurvey monument; a lava stone, firmly set, 12 x 8 x 6 ins. above ground, marked SC $\frac{1}{4}$ on the N. face, and witnessed by a mound of stone 3 ft. base, 2 ft. high, to the N.</p> <p>N.89°57'E., beginning new measurement.</p> <p>Asc. 50 ft. over NW. slope.</p>
4.00	Spur, slopes N. Desc. 20 ft. over SE. slope.
8.80	Head of drain, course S. Asc. 35 ft.
13.50	Short, low divide, slopes NW. Desc. 95 ft. over NE. slope.
31.35	<p>Point for closing cor. of secs. 3 and 4, T.6 S., R.16 E.</p> <p>Desc. 55 ft. over NE. slope.</p>
34.40	Narrow gulch, course S.20°E. Asc. 30 ft.
35.90	Sharp gravel spur, slopes S.20°E. Desc. 35 ft.
36.80	Narrow gulch, course S.10°E. Asc. 50 ft.
39.40	Gravel spur, extending S.15°E., rises to sharp rocky peak, 4 chs. distant.
39.90	<p>The standard cor. of secs. 33 and 34, marked by the 1904 resurvey monument, a pink lava stone, firmly set, 8 x 6 x 5 ins. above ground, marked with 3 grooves on the E. and W. faces, and SC on the N. face, witnessed by a mound of stone 3 ft. base, 1½ ft. high, to the N.</p> <p>Land, rolling and broken mesa. Soil, rocky, 3rd. rate. Scattered paloverde, catsclaw, greasewood and cactus.</p> <p>-----</p> <p>East, on the S. bdy. of sec. 34.</p> <p>Over broken land, through scattered timber. Desc. 55 ft. over E. slope.</p>
3.00	Wash, 30 lks. wide, in box canyon, course S.30°E. Asc. 65 ft.
6.50	Desc. 50 ft.
10.00	Gulch, course S.60°W. Asc. 100 ft.
18.00	Spur, slopes S. Desc. 120 ft. over E. slope.

Retracement of a Portion of the 1st. Standard Parallel
South, through R.16 E.

Chains

- 27.00 Enter wash, 50 lks. wide, in draw, from E., course S.
- 31.00 Leave wash, course W. from NW. Asc. 75 ft. over SW. slope.
- 34.80 The standard $\frac{1}{4}$ sec. cor. of sec. 34, marked by the 1904 resurvey monument, a granite stone, firmly set, 14 x 10 x 8 ins. above ground, marked SC $\frac{1}{4}$ on the N. face, and witnessed by a mound of stone 2 ft. base, 1 ft. high, to the N.
- N.89°57'E., beginning new measurement.
- Asc. 40 ft. over W. slope.
- 7.50 Spur, slopes SW. Desc. 50 ft. over SE. slope.
- 14.00 North side of wash, in draw, from SE., course SW. Asc. 55 ft.
- 18.00 Short spur, slopes SW. Desc. slightly.
- 23.00 Same wash, 10 lks. wide, course S.70°W. Asc. 20 ft.
- 24.00 Point of spur from S. Desc. 15 ft.
- 30.50 Same wash, 5 lks. wide, course NW. Asc. 60 ft. over SW. slope.
- 34.44 Point for closing cor. of secs. 2 and 3, T.6 S., R.16 E. Continue ascent 40 ft.
- 38.60 Spur, slopes N. Desc. 15 ft.
- 39.68 The standard cor. of secs. 34 and 35, T.5 S., R.16 E., marked by the 1904 resurvey monument, a volcanic stone, firmly set, 14 x 8 x 8 ins. above ground, marked with 2 grooves on the E., 4 grooves on the W. and SC on the N. faces, and witnessed by a mound of stone 3 ft. base, $1\frac{1}{2}$ ft. high, to the N.
- Land, broken and rolling.
Soil, rocky, 3rd. rate.
Scattered paloverde, catsclaw, greasewood and cactus.

Abandoned S. Boundary of San Carlos Indian Reservation
T.6 S., R.16 E.

Retracement of the survey of the boundary of the San Carlos Indian Reservation executed by Paul Riecker, U.S. Deputy Surveyor, in 1883.

The 15 mile monument is marked by a red granite stone, firmly set, 26 x 16 x 10 ins. above ground, marked SBSC 15M on the S. face, and witnessed by a mound of stone 3 ft. base, 2 ft. high, to the N.

No evidence remains of the original bearing trees.

The corner of secs. 27, 28, 33 and 34, bears S.0°12'W. 7.93 chs. distant.

N.1°09'W., on old boundary, in sec. 27.

Abandoned S. Boundary of San Carlos Indian Reservation

T.6 S., R.16 E.

Chains	
	Over rolling mesa land, through scattered timber and undergrowth.
	Asc. 35 ft. over SW. slope.
11.70	Low spur, slopes W. Desc. 45 ft.
13.80	Wash, 10 lks. wide, course S.70°W. Asc. 130 ft. over S. slope.
25.50	Spur, slopes S.70°W. Desc. 130 ft.
31.60	Wash, 50 lks. wide, course W. Asc. 150 ft.
45.00	Spur, slopes W. Desc. 125 ft. over NW. slope.
70.05	Four strand barbed wire fence, bears N.73 $\frac{3}{4}$ °W. and S.73 $\frac{3}{4}$ °E.
70.24	Intersect line bet. secs. 22 and 27 at a point N.88°44'E. 0.51 chs. dist. from the cor. of secs. 21, 22, 27 and 28, and S.88°44'W. 76.46 chs. dist. from the cor. of secs. 22, 23, 26 and 27.
77.28	The 14 mile witness monument, a sandstone, firmly set, 10 x 8 x 6 ins. above ground; marked SBSC M14 WC on the W. face, and witnessed by a mound of stone 3 ft. base, 2 ft. high, to the E.
	Land, rolling mesa. Soil, rocky, 2nd. and 3rd. rate. Scattered paloverde, catsclaw, mesquite, greasewood and cactus.

	N.0°18'W., on old boundary, in section 22.
	Over rolling land, through scattered timber. Desc. 60 ft. over gradual N. slope.
10.00	Record distance from 14 mile witness monument.
14.50	Wash, 50 lks. wide, course SW. Asc. 100 ft. over S. slope.
23.40	Road, bears NW. and SE.
23.50	Spur, slopes W. Desc. 110 ft.
41.10	Wash, 20 lks. wide, course W. Asc. 75 ft.
52.00	Spur, slopes W. Desc. 70 ft.
59.30	Wash, 10 lks. wide, course W. Asc. 60 ft.
62.00	Spur, slopes W. Desc. 70 ft.
68.00	Wash, 10 lks. wide, course W. Asc. 50 ft.
70.50	Spur, slopes W. Desc. 60 ft.
74.14	Intersect line bet. secs. 15 and 22 at a point N.89°54'E. 0.74 chs. dist. from the cor. of secs. 15, 16, 21 and 22, and S.89°54'W., 77.24 chs. dist. from the cor. of secs. 14, 15, 22 and 23.
	Thence in sec. 15, continuing measurement.
80.50	Wash, 50 lks. wide, course SW. Asc. 150 ft. over SE. slope.

Abandoned S. Boundary of San Carlos Indian Reservation

T.6 S., R.16 E.

Chains	
89.90	Road, bears NE. and SW.
90.00	Record distance; no evidence of 13 mile monument.
107.50	Spur, slopes SW. Desc. 150 ft. over N. slope.
121.20	Wash, 10 lks. wide, course W. Asc. 80 ft.
141.50	Road, bears W. and SE.
151.72	Intersect line bet. secs. 10 and 15 at a point N.88°43'E. 0.88 chs. dist. from the cor. of secs. 9, 10, 15 and 16, and S.88°43'W., 77.04 chs. dist. from the cor. of secs. 10, 11, 14 and 15. A four strand barbed wire fence bears E. and W. Thence in sec. 10, continuing measurement.
159.44	The 12 mile monument, a volcanic stone, firmly set, 14 x 10 x 8 ins. above ground, marked SBSC M12 on the W. face, and witnessed by a mound of stone 3 ft. base, 1½ ft. high, to the E. No evidence remains of the original bearing trees. Land, rolling and broken mesa. Soil, rocky, 2nd. and 3rd. rate. Scattered paloverde, mesquite, catsclaw, greasewood and cactus. ----- N.1°59'E., on old boundary, in sec. 10. Over rolling land, through scattered timber. Asc. 15 ft.
4.00	Small spur, slopes W. Desc. 100 ft. over N. slope.
12.60	Wash, 50 lks. wide, course W. Asc. 65 ft.
16.00	Over bench land.
34.00	Asc. 60 ft. over gradual S. slope.
43.00	Spur, slopes SW. Desc. 95 ft.
51.00	Wash, 40 lks. wide, course SW. Asc. 110 ft. over gradual S. slope.
72.07	Intersect line bet. secs. 3 and 10 at a point N.88°33'E. 3.77 chs. dist. from the cor. of secs. 3, 4, 9 and 10, and S.88°33'W. 73.61 chs. dist. from the cor. of secs. 2, 3, 10 and 11. Thence in sec. 3, continuing measurement.
74.54	The 11 mile monument, a conglomerate sandstone, firmly set, 16 x 8 x 8 ins. above ground, marked SBSC M1, very faintly, on W. face, and witnessed by a mound of stone 3 ft. base, 1½ ft. high, to the E. The bearing tree of record, a palo verde, 9 ins. diam., with unmarked blaze, is dead and fallen; the original position is now indeterminable. Land, rolling mesa. Soil, rocky, 2nd. and 3rd. rate. Scattered paloverde, catsclaw, greasewood and cactus.

Abandoned S. Boundary of San Carlos Indian Reservation

T.6 S., R.16 E.

Chains

	N.0°18'W., on old boundary, in sec. 3. Over rolling and broken mesa, through scattered timber.
18.50	Wash, 50 lks. wide, in draw, course SW.
58.00	Wash, 50 lks. wide, in box canyon about 100 ft. deep, course S.80°W.
63.00	Point of short spur, from NW. Over broken E. slope.
77.00	Gully, course SE. Asc. SW. slope. 30 ft.
79.36	Intersect 1st. standard parallel south at a point S.89° 57'W., 4.32 chs. dist. from the standard cor. of secs. 33 and 34, T.5 S., R.16 E. Thence in sec. 33, continuing measurement.
80.00	Record distance; no evidence of 10 mile monument along this entire line.
80.50	Sharp gravel spur, slopes S.20°E. Asc. 170 ft. over E. slope, along W. side of ravine, draining S. and SE.
125.00	Low spur, slopes S.15°W. Continue gradual ascent over SW. slope.
133.32	The 9 mile monument, a volcanic stone, firmly set, 10 x 7 x 5 ins. above ground, marked SBSC M on the E. face, and witnessed by a mound of stone 2 ft. base, 1½ ft. high, to the N. This monument is on top of spur, sloping S.30°W. from W. slope of low divide bearing NE. and SW. about 4 chs. to the E. A concrete dam, about 30 ft. long, 10 ft. high, impounding a small body of water, bears N.26°W. 4 chains distant. Land, broken and rolling mesa. Soil, rocky, 2nd. and 3rd. rate. Scattered paloverde, catsclaw, mesquite, greasewood and cactus.
----- Retracement of Subdivisional Lines, T.5 S., R.16 E. -----	
	From the standard cor. of secs. 33 and 34. N.1°24'E., bet. secs. 33 and 34. Over broken land, through scattered undergrowth. Along E. slope, near top of small spur, sloping S.20°E.
3.50	Desc. 40 ft. over NE. slope.
6.20	Gulch, course S.20°E.
12.00	Enter wash, 10 lks. wide, course SE.
16.50	Leave wash, from NE. Asc. 55 ft. over SE. slope.
21.00	Small spur, slopes SW.

Retracement of Subdivisional Lines, T.5 S., R.16 E.

Chains	
26.50	Gully, course S.20°W. Asc. 80 ft. over SE. slope.
34.00	Small spur, slopes SW.
40.00	Record distance; no evidence of $\frac{1}{4}$ sec. cor.
43.00	Gully, course S.20°W. Asc. 90 ft. over SE. slope.
58.00	Low ridge, slopes S.20°W. A concrete dam, about 30 ft. long, 10 ft. high, across gulch, bears West 7.80 chs. dist. Continue over broken W. slope.
64.00	Gully, course W.
69.00	Gully, course SW. turning sharply to the S. about 2 chs.W. Asc. 30 ft.
77.50	Spur, slopes SW. Desc. 20 ft. over N. slope.
79.38	The cor. of secs. 27, 28, 33 and 34, marked by the original monument, a granite stone, firmly set, 12 x 10 x 8 ins. above ground, marked with 1 groove on the S. and 3 grooves on the E. faces, and witnessed by a mound of stone 3 ft. base, $1\frac{1}{2}$ ft. high, to the N. Land, broken mesa. Soil, rocky, 3rd. rate. Scattered paloverde, greasewood and cactus.

	N.0°25'W. bet. secs. 27 and 28. Over broken land, through scattered undergrowth. Desc. 30 ft. over N. slope.
2.00	Wash, 20 lks. wide, course SW. Asc. 70 ft. over S. slope.
7.50	Spur, slopes S.30°W. Desc. 50 ft.
17.50	Gully, course SW. Asc. 15 ft.
19.00	Road, bears NE. to Smith Ranch, and W. to State Highway No.77, 2.75 miles distant. Road is in saddle of spur, extending to W. and SW. Desc. 20 ft.
21.00	Wash, 25 lks. wide, from NE. course W. Asc. 75 ft.
27.50	Spur, slopes S.70°W. Desc. 60 ft.
37.00	Wash, 15 lks. wide, course S.70°W. Asc. 20 ft. over S. slope.
40.02	The $\frac{1}{4}$ sec. cor., of secs. 27 and 28, marked by the original monument, a granite stone, firmly set, 12 x 9 x 8 ins. above ground, marked $\frac{1}{4}$ on the top face, and witnessed by a mound of stone 2 ft. base, 1 ft. high, to the N. N.0°32'W., beginning new measurement. Asc. 30 ft. over S. slope.

Retracement of Subdivisional Lines, T.5 S., R.16 E.

Chains

- 3.00 Spur, slopes S.70°W. Desc. 90 ft. over NW. slope.
- 24.00 Wash, 20 lks. wide, course S.70°W.
- 26.00 Small spur, slopes W. Over broken land, draining W.
- 38.00 Small spur, slopes SW. Desc. 20 ft.
- 40.02 The cor. of secs. 21, 22, 27 and 28, marked by the original monument, a granite stone, firmly set, 12 x 8 x 8 ins. above ground, marked with 2 notches on the S. and 3 notches on the E. edges, and witnessed by a mound of stone, 3 ft. base, 1½ ft. high, to the N.

Land, broken and rolling.
 Soil, rocky, 3rd. rate.
 Scattered paloverde, catsclaw, greasewood, cactus and ocotillo.

 No evidence of the Harris survey was found beyond this point. The following courses are based upon technical positions for corners determined by proportionate measurements from control points in four cardinal directions.

 N.1°41'W. bet. secs. 21 and 22.

Over broken and rolling land, through scattered undergrowth.

Desc. 25 ft. over N. slope.

- 1.00 Wash, 50 lks. wide, in shallow draw, course SW. Asc. 100 ft.
- 19.00 Spur, slopes S.70°W. Desc. 65 ft.
- 32.00 Wash, 15 lks. wide, course W. Asc. gradually over S. slope.
- 50.00 Low spur, slopes W.
- 69.00 Old road, washed out, and unused, bears E. and W.
- 70.00 Wash, 10 lks. wide, course W. Asc. gradually.
- 79.84 Point for cor. of secs. 15, 16, 21 and 22.

The cor. of secs. 13 and 24, on the E. bdy. of the Tp., bears N.89°52'E., 233.85 chs. dist., marked by an iron post, 2 ins. diam., firmly set and marked as described in the 1932 resurvey record.

Land, rolling.
 Soil, gravelly and rocky, 2nd. and 3rd. rate.
 Scattered paloverde, catsclaw, greasewood, cactus and ocotillo.

 N.0°13'W., bet. secs. 15 and 16.

Over rolling land, through scattered undergrowth. Asc. gradually over SW. slope.

- 10.00 Road, bears NE. and SW.

Retracement of Subdivisional Lines, T.5 S., R.16 E.

Chains

10.50 Wash, 10 lks. wide, course W. Enter low hills, ascend gradually.

30.00 Low divide, bears E. and NW. Change of slope to E.

40.00 Desc. 150 ft. over broken NE. slope.

71.00 Draw, course N.30°W. Over W. slope.

79.80 Point for cor. of secs. 9, 10, 15 and 16.

The cor. of secs. 12 and 13, on the E. bdy. of the Tp. bears N.89°55'E., 233.87 chs. dist., marked by an iron post, 2 ins. diam., firmly set and marked as described in the 1932 resurvey record.

Land, rolling and broken.
Soil, rocky, 3rd. rate.
Scattered paloverde, catsclaw, greasewood, cactus and ocotilla.

N.0°50'W. bet. secs. 9 and 10.

Over broken land, through scattered undergrowth. Asc. 25 ft. along SW. slope.

6.50 Short spur, slopes W. Desc. 250 ft. over broken N. slope.

40.50 Wash, 50 lks. wide, in box canyon, course E., near confluence with Ash Creek.

Asc. 60 ft. over precipitous S. slope.

42.00 Over bluff point of spur, from W.

48.00 Desc. 80 ft.

52.00 Ash Creek, small flow of water, in draw, 3 chs. wide, course W. Asc. 400 ft. over S. slope.

69.00 Apex of small spur from N-

71.00 Old mine trail, unused, bears irregularly NE and SW. Continue ascent 50 ft. along W. slope.

79.81 Point for cor. of secs. 3, 4, 9 and 10.

The cor. of secs. 1 and 12, on the E. bdy. of the Tp., bears N.89°58'E., 234.67 chs. dist., marked by an iron post, 2 ins. diam., firmly set and marked as described in the 1932 resurvey record.

Land, broken and mountainous.
Soil, rocky, 3rd. rate.
Scattered paloverde, catsclaw, greasewood, cactus; some cottonwood trees along margin of Ask Creek.

N.7°35'W. bet. secs. 3 and 4.

Over mountainous land, through scattered undergrowth. Asc. 380 ft. over broken S. slope.

27.30 Ridge, bears E. and W. Desc. 400 ft. over rolling N. slope.

75.00 Wash, 20 lks. wide, in shallow draw, course NW. Over S. slope.

BOOK 643
Retracement of Subdivisional Lines, T.5 S., R.16 E.

Chains

- 80.70 The cor. of secs. 3, 4, 33 and 34, marked by the 1911 resurvey monument, a granite stone, firmly set, 14 x 10 x 8 ins. above ground, marked with 3 grooves on the E. and W. faces, and witnessed by a mound of stone, 2½ ft. base, 1½ ft. high, to the W.
- Land, broken and rolling mountains.
Soil, rocky, 3rd. rate.
Scattered greasewood, cactus and ocotillo.
-
- From the standard cor. of secs. 32 and 33, on S. bdy. of Tp.
- N.0°09'E., bet. secs. 32 and 33.
- Over mesa land, through scattered timber.
- 11.00 Wash, 40 lks. wide, course W.
- 17.80 Wash, 25 lks. wide, course W.
- 26.00 Wash, 10 lks. wide, course SW.
- 37.00 Low spur, slopes SW.
- 39.00 Wash, 30 lks. wide, course SW.
- 40.00 Record dist., No evidence of ¼ sec. cor.
- 60.75 Road, bears E. to Smith Ranch, and W. to State Highway No. 77, on low spur, sloping W.
- 76.00 Small spur, slopes SW. Desc. 30 ft.
- 79.56 Point for cor. of secs. 28, 29, 32 and 33, determined by proportionate measurements.
- The cor. of secs. 29, 30, 31 and 32 bears S.89°55'W., 81.01 chs. dist., marked by the remains of the original monument, a rotted stake in a mound of stone 2 ft. base, 1 ft. high; no evidence remains of the original bearing trees.
- Land, slightly broken and rolling mesa.
Soil, gravelly and rocky, 2nd. and 3rd. rate.
Scattered paloverde, mesquite, catsclaw, greasewood, cactus and ocotillo.
-
- S.89°59'E., bet. secs. 28 and 33.
- Over rolling mesa, through scattered undergrowth.
- Asc. 70 ft.
- 7.50 Low spur, slopes S.70°W. Continue gradual ascent 60 ft.
- 40.66 Proportionate distance; no evidence of ¼ sec. cor.
- 41.10 Wash, 10 lks. wide, course S.60°W. Asc. 35 ft.
- 45.00 Spur, slopes SW. Road, bears NE. and SW.
- 48:25 Wash, 10 lks. wide, course S.

Retracement of Subdivisional Lines, T.5 S., R.16 E.

Chains

- 52.00 Spur, slopes SW. Continue ascent over broken land.
- 68.70 Spur, slopes SW. Desc. 50 ft.
- 72.00 Shallow draw, course SW. Asc. 50 ft.
- 76.00 Spur, slopes SW. Desc. 45 ft.
- 78.75 Wash, 20 lks. wide, in gulch, course S.30°W. Asc. 45 ft.
- 81.32 The cor. of secs. 27, 28, 33 and 34.
- Land, rolling mesa.
Soil, rocky, 2nd. and 3rd. rate.
Scattered paloverde, catsclaw, greasewood, cactus and ocotillo.
-
- From point for cor. of secs. 28, 29, 32 and 33.
N.0°29'E., bet. secs. 28 and 29.
Over broken and rolling mesa, through scattered timber.
- 0.50 Swale, drains SW.
- 23.20 Wash, 30 lks. wide, course W.
- 39.78 Proportionate distance; no evidence of $\frac{1}{4}$ sec. cor.
- 55.00 Wash, 50 lks. wide, in shallow draw, course SW.
- 79.15 Old road, unused, bears E. and W.
- 79.56 The cor. of secs. 20, 21, 28 and 29, marked by the original monument, a granite stone, firmly set, 12 x 8 x 5 ins. above ground, marked with 2 grooves on the S. and 4 grooves on the E. faces, and witnessed by a mound of stone, 3 ft. base, $1\frac{1}{2}$ ft. high, to the N.
- Land, broken and rolling mesa.
Soil, gravelly and rocky, 2nd. rate.
Scattered paloverde, mesquite, greasewood and cactus.
-
- N.89°44'E., bet. secs. 21 and 28.
Over rolling mesa, through scattered timber.
- 0.50 Old road, bears NE. and SW.
- 19.50 Small spur, slopes SW.
- 40.08 Record distance; no evidence of $\frac{1}{4}$ sec. cor.
- 42.50 Spur, slopes SW.
- 48.50 Wash, 15 lks. wide, course SW.
- 56.25 Same wash, course NW.
- 59.00 Same wash, course S.
- 72.00 Small spur, slopes S. Desc. 50 ft.
- 77.25 Wash, 50 lks. wide, in shallow draw, course SW. Asc. 25 ft. over NW. slope, S. bank of draw.

Retracement of Subdivisional Lines, T.5 S., R.16 E.

Chains	
80.02	The cor. of secs. 21, 22, 27 and 28.
	Land, rolling mesa. Soil, gravelly and rocky, 2nd. and 3rd. rate. Scattered paloverde, greasewood, cactus and ocotilla.

	From the cor. of secs. 20, 21, 28 and 29.
	N.0°22'W., bet. secs. 20 and 21.
	Over mesa land, through scattered undergrowth.
39.00	Wash, 50 lks. wide, course SW.
40.00	Record distance; no evidence of $\frac{1}{4}$ sec. cor.
	Asc. 30 ft.
43.30	Road, bears N.80°E. and SW.
47.00	Small spur, slopes SW. Continue ascent 200 ft. over SW. slope.
47.85	Lone palm tree, near Piper Spring, bears S.65 $\frac{1}{4}$ °E. about 15 chs. dist.
60.00	Spur, slopes W. Desc. 165 ft.
71.50	Wash, 20 lks. wide, course N.80°W. Asc. 80 ft.
78.00	Spur, slopes W. Desc. 20 ft.
80.12	The cor. of secs. 16, 17, 20 and 21, marked by the original monument, a granite stone, 15 x 12 x 10 ins. above ground, firmly set, marked with 3 notches on the S. and 4 notches on the E. edges, and witnessed by a mound of stone, 2 ft. base, 1 ft. high, to the N.
	Land, slightly rolling and hilly. Soil, rocky, 2nd. and 3rd. rate. Scattered paloverde, catsclaw, greasewood, cactus and ocotilla.

	S.89°58'E., bet. secs. 16 and 21.
	Over rolling hills, through scattered undergrowth.
	Asc. 50 ft. over NW. slope.
4.50	Spur, slopes SW. Desc. 60 ft.
18.65	Wash, 15 lks. wide, course SW. Asc. 75 ft.
39.00	Spur, slopes S. Desc. 55 ft.
53.25	Wash, 10 lks. wide, course S. Asc. 30 ft.
59.85	Small spur, slopes S.
	A U.S. Geological Survey Bench Mark bears S.31°45'W. 19.40 chs. dist., an iron post, 3 ins. diam., firmly set, 10 ins. above ground, with brass cap marked ELEVATION 2418 FEET DATUM PHNX.
	Desc. 25 ft.

Retracement of Subdivisional Lines, T.5 S., R.16 E.

Chains	
65.35	Road, bears NE. and SW., in wash, 30 lks. wide, course SW. Asc. gradually.
78.04	Point for cor. of secs. 15, 16, 21 and 22. Land, rolling hills. Soil, rocky, 3rd. rate. Scattered paloverde, mesquite, catsclaw, greasewood, cactus and ocotillo.

	From the cor. of secs. 16, 17, 20 and 21.
	North, bet. secs. 16 and 17.
	Desc. 50 ft. over NW. slope.
5.00	Wash, 5 lks. wide, course W. Over rolling land, along slight west slope.
40.40	The $\frac{1}{4}$ sec. cor. of secs. 16 and 17, marked by the original monument, a granite stone, firmly set, 15 x 12 x 5 ins. above ground, marked $\frac{1}{4}$ on top face, and witnessed by a mound of stone 3 ft. base, 2 ft. high, to the N.
	N.0°16'W., beginning new measurement.
4.00	Low divide, bears E. and W. Asc. 150 ft. over SE. slope.
6.85	Old road, abandoned, bears NE. and SW.
33.00	Spur, slopes NE. Desc. 140 ft. over NW. slope.
40.09	The cor. of secs. 8, 9, 16 and 17, marked by the original monument, a granite stone, firmly set, 20 x 16 x 12 ins. above ground, marked with 4 notches on the S. and E. edges, and witnessed by a mound of stone, 3 ft. base, 1 $\frac{1}{2}$ ft. high, to the N.
	Land, rolling and mountainous. Soil, rocky, 3rd. rate. Scattered paloverde, catsclaw, greasewood and cactus.

	S.89°30'E., bet. secs. 9 and 16.
	Asc. 10 ft. over N. slope.
9.00	Spur, slopes NE. Desc. 150 ft. over E. slope.
29.00	Old road, abandoned, bears NE. and SW.
32.30	Wash, 20 lks. wide, in draw, course N. Asc. 160 ft. over gradual W. slope.
39.40	Drain, course NW.
56.25	Wash, 10 lks. wide, course NW.
64.00	Spur, slopes N.30°W. Desc. 65 ft. over NE. slope.
73.80	Wash, 20 lks. wide, course N.30°W. Asc. slightly.
78.08	Point for cor. of secs. 9, 10, 15 and 16. Land, rolling hills. Soil, rocky, 3rd. rate. Scattered paloverde, catsclaw, greasewood and cactus.

Retracement of Subdivisional Lines, T.5 S., R.16 E.

Chains

From the cor. of secs. 8, 9, 16 and 17.

N.0°52'W., bet. secs. 8 and 9.

Over mountainous land, through scattered undergrowth.
Desc. 95 ft. over NE. slope.

- 5.10 Drain, course N.20°W. Continue descent 80 ft.
- 13.75 Same drain, 10 lks. wide, course E. Asc. 90 ft. over SW. slope.
- 21.75 Spur, slopes E. Desc. 155 ft. over N. slope.
- 26.00 Wash, 20 lks. wide, course NE. Asc. 30 ft.
- 28.26 Spur, slopes E. Desc. 55 ft.
- 34.40 Wash, 15 lks. wide, course E. Asc. 80 ft.
- 39.50 The $\frac{1}{4}$ sec. cor. of secs. 8 and 9, marked by the original monument, a granite stone, firmly set, 12 x 10 x 8 ins. above ground, marked $\frac{1}{4}$ on W. face, and witnessed by a mound of stone, 3 ft. base, 1 $\frac{1}{2}$ ft. high, to the N.
- N.1°21'W., beginning new measurement.
- Asc. 120 ft. over SE. slope.
- 18.50 Apex of spur, from SW. Desc. 300 ft. over N. slope.
- 36.00 Ash Creek canyon, dry, 2 chs. wide, in bend, from SE., course S.70°W., soon turns NW.
- 38.50 Asc. 80 ft. over precipitous S. slope.
- 39.56 The cor. of secs. 4, 5, 8 and 9, marked by the original monument, a granite stone, 14 x 12 x 10 ins. firmly set, marked with 5 notches on the S. and 4 notches on the E. edges, and witnessed by a mound of stone, 2 $\frac{1}{2}$ ft. base, 1 $\frac{1}{2}$ ft. high, to the N.
- Land, mountainous.
Soil, rocky, 4th. rate.
Scattered paloverde, catsclaw, mesquite, greasewood and cactus.
-
- N.89°48'E., bet. secs. 4 and 9.
- Over broken mountainous land, through scattered undergrowth. Along precipitous S. slope.
- 1.50 Gulch, course S. Asc. 250 ft. over SW. slope.
- 26.00 Rocky, spur, slopes S.20°W. Desc. 150 ft.
- 39.00 Draw, course S.20°W., Asc. 200 ft. over W. slope.
- 48.00 Spur, slopes SW. Over broken S. slope.
- 76.00 Gulch, course S.30°W. Asc. 100 ft. over W. slope.
- 78.35 Point for cor. of secs. 3, 4, 9 and 10.
- Land, broken mountains.
Soil, rocky, 3rd. and 4th. rate.
Scattered paloverde, greasewood and cactus.

Retracement of Subdivisional Lines, T.5 S., R.16 E.

4349

Chains

From the cor. of secs. 4, 5, 8 and 9.

N.8°22'W., bet. secs. 4 and 5.

Over mountainous land, through scattered undergrowth. Asc. 40 ft. over broken S. slope.

- 1.20 Short spur, slopes S.20°W. Continue ascent 150 ft. over broken SW. slope.
- 20.00 Spur, slopes W. Desc. 200 ft. over NW. slope.
- 39.50 Draw, course S.60°W. Asc. 250 ft. over S. slope.
- 50.00 Spur, slopes SW. Continue over precipitous W. slope.
- 65.00 Change of slope to NW. Desc. 200 ft.
- 81.77 Point for cor. of secs. 4, 5, 32 and 33, on the N. bdy. of the Tp., determined from the 1911 resurvey record.

Land, broken and precipitous mountains.
Soil, rocky, 4th. rate.
Scattered greasewood and cactus.

Retracement of Part of the North Boundary, T.5 S., R.16 E.

The cor. of Ts.4 and 5 S., Rs.16 and 17 E., is an iron post, 3 ins. diam., firmly set, marked and witnessed as described in the 1932 resurvey record.

N.89°56'W., bet. secs. 1 and 36.

Over slightly rolling land, through scattered undergrowth.

- 3.30 Wash, 10 lks. wide, course N.10°W.
- 6.30 Road, bears NE. and SW. Asc. 80 ft. over gradually increasing E. slope.
- 22.50 Wash, 10 lks. wide, in gully, course S.70°E. Asc. 350 ft. over E. slope.
- 37.50 S. slope of peak, on divide, bearing N.30°W. and S.20°E., about 12 chs. distant from low saddle to the S. Desc. 20 ft. along S. slope.
- 40.10 The $\frac{1}{4}$ sec. cor. of secs. 1 and 36, marked by the 1911 resurvey monument, a granite stone, firmly set, 9 x 6 x 5 ins. above ground, marked $\frac{1}{4}$ on the N. face, and witnessed by a mound of stone, 3 ft. base, 1 $\frac{1}{2}$ ft. high, to the N.
- N.89°20'W., beginning new measurement.
- Desc. 25 ft. over SW. slope.
- 3.75 Spur, slopes S.80°W. Desc. 180 ft. over NW. slope.
- 15.00 Apex of same spur, from SE., slopes SW. Desc. W. slope 190 ft.
- 21.80 Gully, course SW. Continue descent 100 ft. over gradual SW. slope.
- 30.25 Wash, 40 lks. wide, in draw, course NW. Roadway follows along wash.

Retracement of Part of the North Boundary, T.5 S., R.16 E.

Chains	Asc. bluff bank, 40 ft.
36.00	Small sharp spur, extends N. Desc. 50 ft.
38.00	Short gully, course N.
39.50	Enter draw, course NE.
40.05	Point for cor. of secs. 1, 2, 35 and 36, at proportionate measurement. No evidence of corner monument.
	Land, mountainous. Soil, rocky, 3rd. and 4th. rate. Scattered mesquite, greasewood and cactus.

	N.89°20'W., bet. secs. 2 and 35.
	Over mountainous land, through scattered undergrowth. Across wash, course NE.
1.00	Road, in wash, bears NE. and SW.
2.00	Asc. 250 ft. over SE. slope.
16.03	Intersect line 3-4, Pittsburg mining claim, Mineral Survey No. 2182, N.3°42'W., 6.38 chs. dist., from witness cor. monument, to cor. No.3, which is a sandstone, firmly set, 10 x 9 x 3 ins. above ground, marked + WC on top, and P3 on E. face; and S.3°42'E., 2.08 chs. dist. from cor. No. 4, marked by a granite stone, firmly set, 8 x 7 x 4 ins. above ground, marked + on top, 2182 on NW. face, and P4 on SW. face.
18.00	Gully, course S.20°W. Asc. 160 ft. over SE. slope.
29.00	Ridge, bears NE. and SW. Desc. 150 ft. over precipitous NW. slope.
37.50	Gulch, course NW.
38.75	Gulch, course N.30°E. Asc. 25 ft.
40.05	The $\frac{1}{4}$ sec. cor. of secs. 2 and 35, marked by the 1911 resurvey monument, a granite stone, firmly set, 6 x 4 x 4 ins. above ground, marked $\frac{1}{4}$ on the N. face. As no witness monument was originally established, raise a mound of stone, 3 ft. base, 2 ft. high, N. of corner stone, 3 ft. distant.
	Cor. No. 2, of Pittsburg mining claim, Mineral Survey No. 2182, bears S.12°36'E., 9.03 chs. dist., a fractured porphyry stone, firmly set, 10 x 8 x 5 ins. above ground, marked + on top, P1 on the E. face.
	No evidence of Cor. No. 1 of Pittsburg mining claim could be found.
	N.89°30'W., beginning new measurement.
	Asc. 80 ft. over E. slope.
4.00	Saddle, in spur, bearing N. Desc. 80 ft. over NW. slope.
11.62	Intersect line 1-2, Big Rock lode mining claim, Mineral Survey No. 2182, N.3°27'W., 4.73 chs. dist. from cor. No. 2, which is marked by a granite stone, firmly set, 10 x 6 x 5 ins. above ground, marked + on top, BR 2 on the E. face, 2182 on the N. face; and S.3°27'E., 4.26 chs. dist.

Retracement of Part of the North Boundary, T.5 S., R.16 E.

Chains	
	from cor. No. 1, marked by a porphyry stone, firmly set, 16 x 12 x 4 ins. above ground, marked + on top, 1 BR on the E. face.
	Continue descent 120 ft.
18.50	Ravine, course N. Asc. 200 ft. over NE. slope.
35.00	Continue ascent 50 ft. over gradual slope, changing from E. to SE.
38.27	Intersect line 1-2 of the Trenton and Golden Gate lode mining claims, Mineral Survey No. 2180, N.21°15'W., 5.41 chs. dist. from cor. No. 2, which is marked by a porphyry stone, 10 x 8 x 8 ins. above ground, firmly set, marked 2 GG 2180 on NW. face; and S.21°15'E., 3.67 chs. dist. from point for cor. No. 1, determined from the original reference monuments.
40.18	Point for cor. of secs. 2, 3, 34 and 35, determined from the 1911 resurvey record of ties to extant mineral survey monuments.
	U.S.L.M. No. 2180 bears N.67°26'W., 7.71 chs. dist., a wooden post, 6 ins. square, extending 4 ft. above a loose mound of stone 8 ft. base, 3½ ft. high; the top of the post is broken jaggedly. A rock in place, 3 x 2 x 1 ft. marked B+R USLM 2180, bears N.3¼°W., 27 lks. dist.
	Land, mountainous. Soil, rocky, 3rd. and 4th. rate. Scattered greasewood, cactus and paloverde.

	S.88°50'W., bet. secs. 3 and 34.
	Over mountainous land, through scattered undergrowth.
	Asc. 105 ft. over SE. slope, along ridge, bearing NW. and SE.
10.00	Change of slope to SW. Flat spur, slopes S. Desc. 75 ft.
18.00	Head of draw, course S. Continue over broken S. slope.
21.33	Cor. No. 4, Golden Gate, identical with cor. No. 1, Golden Chariot lode mining claims, Mineral Survey No.2180, bears South 1.64 chs. dist., marked by a granite stone, firmly set, 16 x 9 x 6 ins. above ground, marked + on top, 4 GC on the S. face, 4 GG on the E. face, and referenced as described in the official record.
30.00	Divide, bears N.85°E. and S.70°W. Desc. 160 ft. over NW. slope.
40.00	No evidence of ¼ sec. cor. Continue along N. slope.
47.00	Desc. 60 ft.
49.50	Draw, course NW. Asc. 100 ft. over E. slope.
60.00	Spur, slopes N. Desc. 120 ft. over NW. slope.
64.00	Draw, course NW. Asc. 100 ft.
74.00	Divide, on steep NW. slope, bears NW. and SE. Desc. 200 ft. over W. slope.

Retracement of Part of the North Boundary, T.5 S., R.16 E.

Chains

- 85.00 The cor. of secs. 3, 4, 33 and 34, marked by the 1911 resurvey monument, a granite stone, firmly set, 14 x 10 x 8 ins. above ground, marked with 3 grooves on the E. and W. faces, and witnessed by a mound of stone 2½ ft. base, 1½ ft. high, to the W.
- Land, rough mountains.
Soil, rocky, 3rd. and 4th. rate.
Scattered greasewood and cactus.
-
- N.89°22'W., bet. secs. 4 and 33.
- Over mountainous land, through scattered undergrowth.
- Desc. 70 ft. over W. slope.
- 2.75 Drain, course S.30°W. Asc. 100 ft. over rolling SE. slope.
- 29.00 Spur, slopes S. Continue ascent 110 ft.
- 30.00 Spur, slopes S. Desc. 210 ft. over W. slope.
- 36.75 Gulch, course S.20°W. Asc. 50 ft.
- 40.00 Record distance, no evidence of ¼ sec. cor.
- Asc. 180 ft.
- 55.00 High point of ridge, extends SW. Desc. 400 ft. over W. slope.
- 71.00 Small spur, slopes SW. Desc. 300 ft. over precipitous W. slope.
- 79.76 Point for cor. of secs. 4, 5, 32 and 33, determined by proportionate measurement.
- Land, rough mountains.
Soil, rocky, 3rd. and 4th. rate.
Scattered greasewood and cactus.
-
- N.89°22'W., bet. secs. 5 and 32.
- Over mountainous land, through scattered undergrowth.
- Desc. 20 ft.
- 0.50 Rocky gulch, course S.80°W.
- 3.00 Point of rocky spur, from NE. Desc. 70 ft.
- 6.00 Foot of mountain, bears N. and S. Desc. 40 ft. over gradual slope, in bottom of Gila River canyon, through dense mesquite.
- 11.90 The cor. for frac. secs. 5 and 32, established by Wm. H. Elliott in 1911, determined from the original bearing tree
- A mesquite, 24 ins. diam., bears S.81°E., 109 lks. dist., marked T4S R16E S5 BT
- Land, mountainous.
Soil, rocky, and loam, 4th. and 2nd. rate.
Scattered greasewood and cactus; heavy growth of mesquite in river bottom.

Abandoned S. Boundary of San Carlos Indian Reservation

T.5 S., R.16 E.

Chains	
	From the 9 mile monument, described on page 12.
	N.0°20'W., on old boundary, in sec. 33.
	Over broken mesa land, through scattered undergrowth. Desc. along W. slope.
5.00	Short gulch, course W.
9.50	Gully, course S.20°W.
15.00	Small spur, slopes SW.
25.40	Intersect line bet. secs. 28 and 33, N.89°59'W., 6.72 chs. dist. from the cor. of secs. 27, 28, 33 and 34, and S.89°59'E., 74.60 chs. dist. from point for cor. of secs. 28, 29, 32 and 33.
	Thence in sec. 28, continuing measurement.
37.00	Gully, course SW. Asc. over SE. slope.
43.00	Road, bears E. and SW., on spur, sloping S.70°W. Desc. 40 ft. over N. slope.
46.00	Wash, 25 lks. wide, course S.80°W.
50.00	Spur, slopes SW.
59.00	Wash, 15 lks. wide, course SW. Asc. 40 ft.
63.70	The 8 mile monument, a limestone, firmly set, 14 x 9 x 7 ins. above ground, marked SBSC M8 on the E. face, and witnessed by a mound of stone, 3 ft. base, 1½ ft. high, to the W.
	Land, broken and rolling. Soil, rocky and gravelly, 3rd. rate. Scattered paloverde, catsclaw, greasewood and cactus.

	N.0°14'E., on old boundary, in sec. 28.
	Over broken mesa land, through scattered undergrowth.
3.50	Spur, slopes SW.
25.00	Wash, 20 lks. wide, course SW.
38.25	Wash, 50 lks. wide, in shallow draw, course SW.
41.71	Intersect line bet. secs. 21 and 28, S.89°44'W., 6.11 chs. dist. from the cor. of secs. 21, 22, 27 and 28, and N.89°44'E., 73.91 chs. dist. from the cor. of secs. 20, 21, 28 and 29.
	Thence in sec. 21, continuing measurement.
74.00	Wash, 20 lks. wide, course W.
80.04	The 7 mile monument, a granite stone, firmly set, 16 x 6 x 6 ins. above ground, marked SBSC M7 on the W. face, and witnessed by a mound of stone 3 ft. base, 1½ ft. high to the N.
	Land, broken and rolling. Soil, rocky, 3rd. rate. Scattered paloverde, catsclaw, greasewood, ocotilla and cactus.

Abandoned S. Boundary of San Carlos Indian Reservation

T.5 S., R.16 E.

Chains	
	N.0°18'E., on old boundary, in sec. 21. Over rolling land, through scattered undergrowth.
30.40	Old roadway, abandoned, bears E. and W.
31.40	Wash, 10 lks. wide, course W.
41.50	Intersect line bet. secs. 16 and 21, N.89°58'W., 3.38 chs. dist. from point for cor. of secs. 15, 16, 21 and 22, and S.89°58'E., 74.66 chs. dist. from the cor. of secs. 16, 17, 20 and 21. Thence in sec. 16, continuing measurement.
47.00	Road, bears NE. and SW. Asc. gradually, over hilly land, draining SW.
72.00	Asc. 80 ft. over SE. slope.
82.46	The 6 mile monument, a granite stone, unmarked, 14 x 9 x 6 ins., lightly set upright in S. edge of mound of stone, 3 ft. base, 1½ ft. high. Monument is situated on E. slope of conical hill about 150 ft. high. Land, slightly rolling, and hilly. Soil, gravelly and rocky, 3rd. rate. Scattered paloverde, greasewood and cactus.

	N.0°17'E., on old boundary, in sec. 16. Over mountainous land, through scattered undergrowth. Desc. 140 ft. over an increasing NE. slope.
10.50	Gully, 20 lks. wide, 30 ft. deep, course NE. Continue descent 150 ft.
35.00	Draw, course N.20°W.
38.86	Intersect line bet. secs. 9 and 16, N.89°30'W., 2.67 chs. dist. from point for cor. of secs. 9, 10, 15 and 16, and S.89°30'E., 75.41 chs. dist., from the cor. of secs. 8, 9, 16 and 17. Thence in sec. 9, continuing measurement.
44.00	Asc. 25 ft.
46.50	Small spur, slopes W. Over broken hills.
54.00	Desc. 240 ft. over broken N. slope.
79.50	Enter wash, in small box canyon, course E., near confluence with Ash Creek.
80.00	Record distance. No evidence of 5 mile monument.
81.50	Leave wash; asc. 65 ft. over bluff slope.
84.00	Small spur, slopes E. Continue along rolling E. slope.
88.50	Desc. 80 ft. over bluffs, facing N.
90.00	Enter Ash Creek canyon, course W., from SE.

Abandoned S. Boundary of San Carlos Indian Reservation

T.5.S., R.16 E.

BOOK 4649

Chains	
92.00	Ash Creek, 5 lks. wide, 1 in. deep, course S.70°W.
93.00	Asc. 400 ft. over S. slope.
107.00	Shoulder of spur, from NE. Continue over broken W. slope.
109.00	Old trail, nears NE. and SW.
118.64	Intersect line bet. secs. 4 and 9, S.89°48'W., 1.13 chs. dist. from point for cor. of secs. 3, 4, 9 and 10, and N.89°48'E., 77.22 chs. dist., from the cor. of secs. 4, 5, 8 and 9.
	Thence in sec. 4, continuing measurement.
124.00	Enter gulch, course S.15°W.
126.83	Intersect line bet. secs. 3 and 4, N.7°35'W., 8.26 chs. dist. from point for cor. of secs. 3, 4, 9 and 10, and S.7°35'E., 72.44 chs. dist. from the cor. of secs. 3, 4, 33 and 34, on the N. bdy. of the Tp.
	Thence in sec. 3, continuing measurement.
	Asc. 420 ft. over S. slope.
140.00	Leave gulch, course S. from NE, near head.
146.00	Ridge, bears E. and W. Desc. 130 ft. over NW., slope.
153.00	Ravine, 10 lks. wide, course N.30°E. Desc. 80 ft.
160.00	Record distance. No evidence of 4 mile monument.
	Continue descent 170 ft. over rolling NE. slope.
182.50	Wash, 15 lks. wide, in shallow draw, course NW. Asc. 200 ft. over SW. slope.
198.83	Intersect N. bdy. of the Tp., N.88°50'E., 9.91 chs. dist. from the cor. of secs. 3, 4, 33 and 34, and S.88°50'W., 75.09 chs. dist. from point for cor. of secs. 2, 3, 34 and 35.
	Thence in sec. 34, T.4 S., R.16 E., continuing line and measurement.
	Along W. slope.
200.00	Divide, bears SE. and NW. Desc. 250 ft. over N. slope.
210.00	Gully, course NE. Continue descent 150 ft. over NE. slope.
222.00	Change of slope to SE. Asc. 230 ft.
236.50	Top of rocky hill; low divide bears S.20°W., about 15 chs. dist., spur slopes to W. and spur extends NE. Desc. 70 ft. over N. slope.
239.23	The $\frac{1}{4}$ sec. cor. of secs. 33 and 34, bears West 9.94 chs. dist.; marked by the original monument, an iron post, 1 in diam. firmly set, 28 ins. above ground and in a small mound of stone, marked as described in the 1911 survey record.
240.00	Record distance. No evidence of 3 mile monument.
	Desc. 300 ft. over NW. slope.
260.00	Change to rolling N. slope, desc. gradually.

Abandoned S. Boundary of San Carlos Indian Reservation

T.4.S., R.16 E.

Chains	
279.00	Knoll, about 50 ft. high, the terminus of a low spur from SE., breaking sharply N. into Deer Creek.
279.23	No evidence of the cor. of secs. 27, 28, 33 and 34 could be found at a point record distance North of the $\frac{1}{4}$ sec. cor. of secs. 33 and 34. Desc. 75 ft. over precipitous N. slope.
282.50	Deer Creek Canyon, dry wash, 3 chs. wide, course W: Asc. 250 ft. over an increasing S. slope.
319.37	The $\frac{1}{4}$ sec. cor. of secs. 27 and 28 bears West, 10.56 chs. dist., an iron post, 1 in. diam., firmly set, 18 ins. above ground, marked and witnessed as described in the 1911 survey record. Continue ascent 210 ft.
320.00	Record Distance, No evidence of .2 mile monument.
326.60	Ridge, bears N.75°W. and S.75°E. Desc. 300 ft. over NE. slope.
342.00	Draw, course N.60°W. Asc. 400 ft. over SW. slope.
374.00	E. slope of ridge, bearing NW. and SE.
385.50	Ravine, course E. Asc. 200 ft. over SE. slope.
407.70	The 1 mile witness monument, a malpais stone, in place, 26 x 16 x 16 ins. above ground, marked SBSC WC M1, and witnessed by a cairn of stone, 3 ft. base, 4 ft. high, to the W. This monument is situated in small saddle near end of ridge, from SW., spur breaks sharply to the NE. Land, rolling and mountainous. Soil, rocky, 3rd. and 4th. rate. Scattered paloverde, catsclaw, mesquite, greasewood, cactus and ocotillo.

	North, on record bearing, from 1 mile witness monument. Desc. 450 ft. over N. slope.
20.00	Gully, course NE. Desc. 60 ft. over NE. slope.
29:50	Small spur, slopes NE. Change of slope to NW.
31.40	Intersect line bet. secs. 15 and 22 S.89°56'E., 11.02 chs. dist. from the cor. of secs. 15, 16, 21 and 22; an iron post, 2 ins. diam., firmly set, marked and witnessed as described in the 1911 survey record. From point of intersection the cor. of secs. 14, 15, 21 and 22 bears S.89°56'E., 69.73 chs. dist.; a point S.0°01'E. 3.56 chs. dist. from the original witness monument; an iron post, 2 ins. diam., firmly set, 14 ins. above ground, marked as described in the 1911 survey record. There is no evidence of the $\frac{1}{4}$ sec. cor. monument for secs. 15 and 22.

Abandoned S. Boundary of San Carlos Indian Reservation

T.4 S., R.16 E.

Chains

North, on record bearing, in sec. 15, continuing measurement.

Desc. 200 ft. over NW. slope.

41.00 Small spur, slopes N.W., Desc. 140 ft. over N. slope.

53.00 Foot of mountain, enter Gila River bottom, course W.

Across bottom land, through dense mesquite and undergrowth.

63.00 Left margin of Gila River, 150 lks. wide, 10 ins. deep, course W.

No evidence of the Initial Monument could be found any where along this line.

70.50 Top of bluff bank, 40 ft. high, of Gila River bottom, extends W., apex of gravel spur from N, Asc. along spur.

72.80 Record distance from 1 mile witness monument; a point far removed in latitude from the descriptive record and beyond the confines of the Gila River.

The record point for the Initial Monument is noted as South 2.36 chs. dist. from the S. bank of the Gila River.

Land, mountainous.

Soil, rocky, 4th and 3rd. rate.

Scattered greasewood and cactus; mesquite and cottonwood along river bottom.

(31)

CERTIFICATE OF SURVEYOR

We, Dupree R. Averill
and G. Marvin Litz

HEREBY CERTIFY upon honor that, in

pursuance of special instructions bearing date of the 3rd day of July, 1946,
received from the district cadastral engineer for Arizona-Region 2,
instructions dated August 28, 1946, we have retraced part of the subdivision
of Ts. 4, 5 and 6 S., R.16 E., part of the First Standard Parallel South,
along the south boundary of T.5 S., R.16 E., part of the north boundary
of T.5 S., R.16 E., and part of the Abandoned South Boundary of the San
Carlos Indian Reservation,
of the Gila and Salt River Meridian, in the State of Arizona, which are
represented in the foregoing field notes as having been executed by me and under my direction; and that said
survey has been made in strict conformity with said instructions, the Manual of Instructions for the Survey
of the Public Lands of the United States, and in the specific manner described in the foregoing field notes.

Glendale, California.

April 21, 1947.

Dupree R. Averill
Cadastral Engineer.
G. Marvin Litz
Cadastral Engineer,

CERTIFICATE OF APPROVAL

Office of Chief Cadastral Engineer,
Denver, Colorado

SEP 16 1947

19

The foregoing field notes of the retracement of part of the subdivision of Ts.
4, 5 and 6 S., R.16 E., part of the First Standard Parallel South, along
the S. boundary of T.5 S., R.16 E., part of the N. boundary of T.5 S.,
R.16 E., and part of the Abandoned S. Boundary of the San Carlos Indian
Reservation
executed by Dupree R. Averill
and G. Marvin Litz
under special instructions dated July 3, 1946, and assignment
instructions dated August 28, 1946, having been critically examined, and
the necessary corrections made prior to their certification by the engineer, the said field notes, and the survey
therein described, are hereby approved.

Earl G. Harrington
Acting Assistant Chief Cadastral Engineer.

CERTIFICATE OF TRANSCRIPT

~~I certify that the foregoing transcript of the field notes of the above-described surveys in Ts. 4, 5 and
6 S., G. & S. R. M., is a true copy of the original field notes on file in the public survey office.~~