

Original

UNITED STATES
DEPARTMENT OF THE INTERIOR
BUREAU OF LAND MANAGEMENT

49
4379
RECEIVED
U. S. LAND OFFICE
Phoenix, Arizona

JUL 6 - 1951

FIELD NOTES

OF THE

Resurvey of a Portion of the Boundaries

and

The Limited Subdivision

of

Sections 20, 21, 22, 26 and 27

Township 3 North, Range 3 East

Of the Gila and Salt River Meridian,

In the State of Arizona

EXECUTED BY

Ty White, Cadastral Engineer

Under special instructions dated January 21, 1948, which provided
and Sept. 26, 1949

for the surveys included under Group No. 256, approved January 29, 1948
and Oct. 4, 1949,

and assignment instructions dated January 30, 1948

Survey commenced February 6, 1948

Survey completed March 24, 1948

4379

4379

4379

50
17

DEPT. OF THE INTERIOR

INDEX DIAGRAM

Township 3 North, Range 3 East

6	5	4	3	2	1
7	8	9	10	11	12
18	17	16	15	14	13
	4	7	15		
19	5 20 2	9 21	22 17 19	15 23	24
	2		16		
30	29	28	27 29	26 26 35	25
			27		
31	32	33	34	35	36

BOOK 4379

INDEX DIAGRAM

T. 3 N., R. 3 E.

BOOK 4379

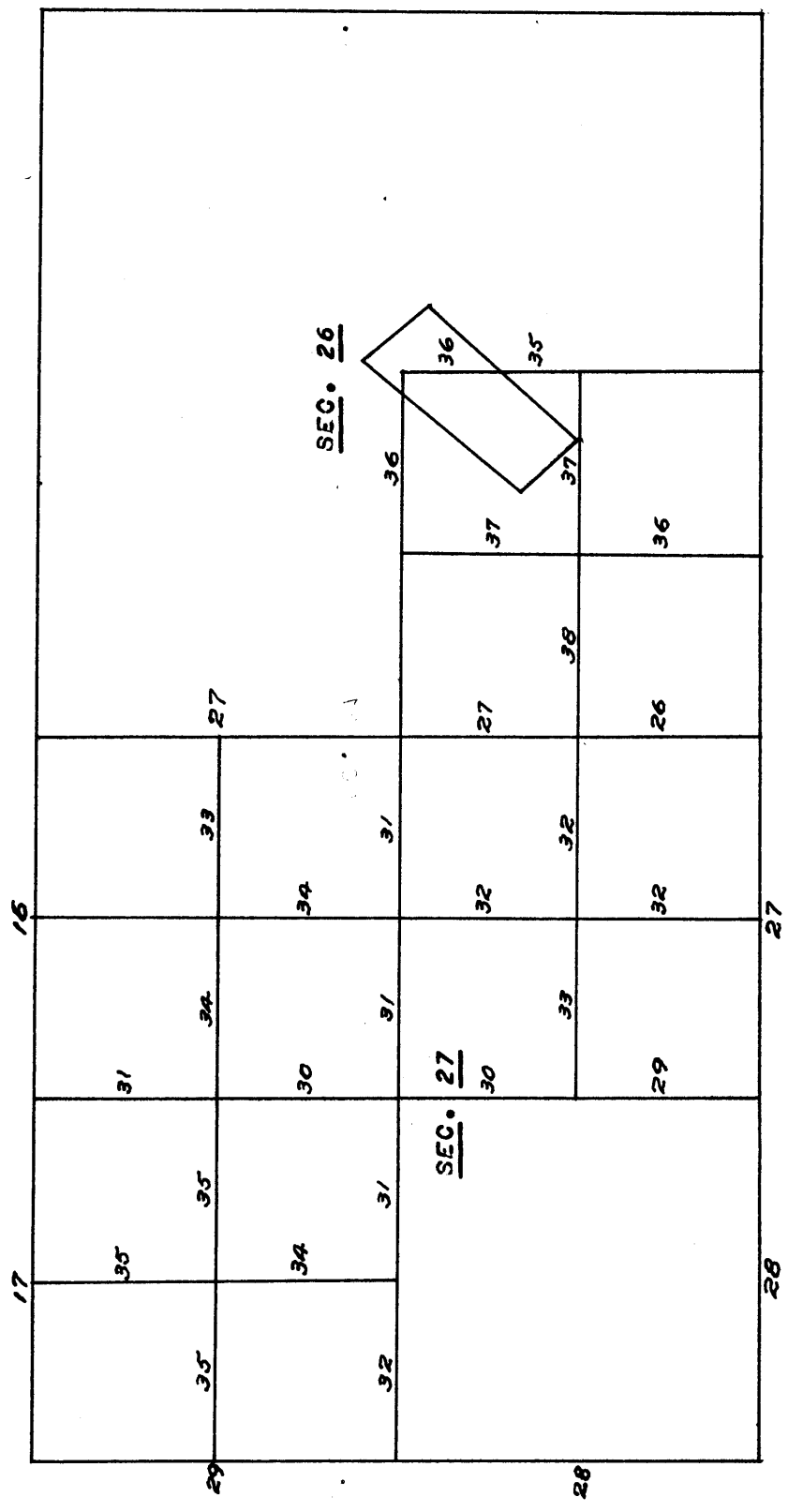

INDEX DIAGRAM BOOK 4870

T. 3 N., R. 3 E.

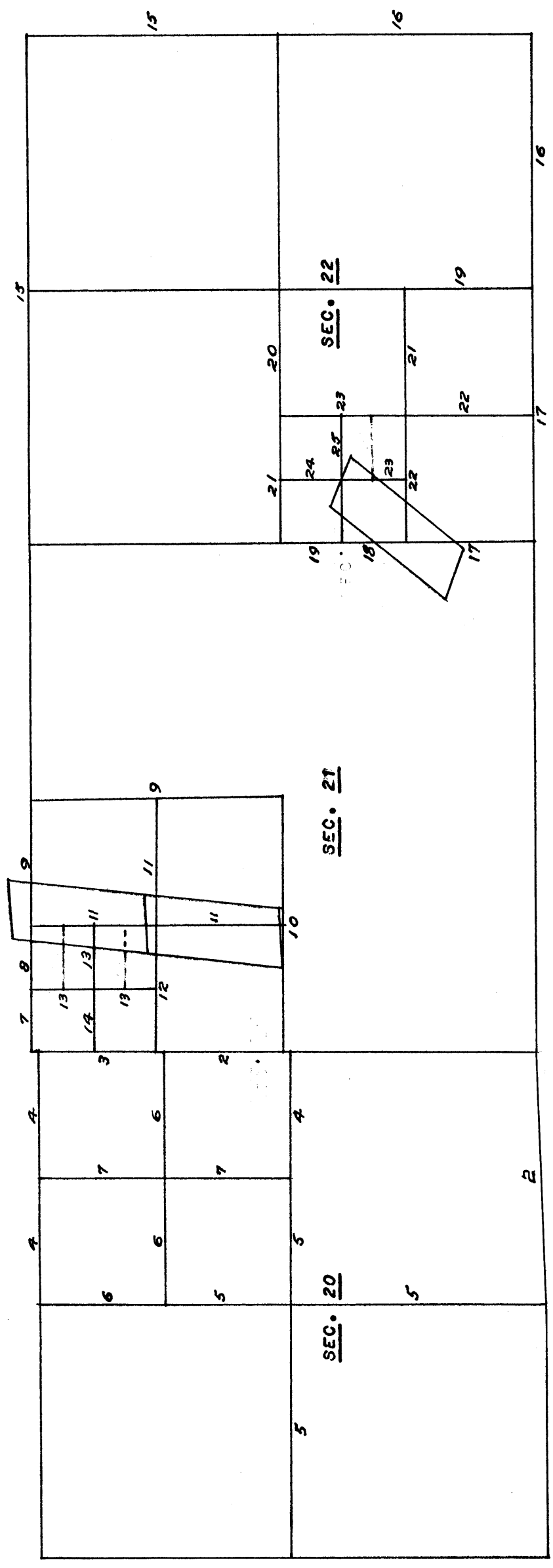

T. 3 N., R. 3 E.

INDEX

T. 3 N., R. 3 E.

The survey herein described was executed for the purpose of providing a basis for the location of small tracts on the ground for sale or lease. A resurvey of some of the section lines was made in addition to the limited subdivision of sections.

A portion of the involved section lines were surveyed by J. H. Martineau in 1894. In 1912, the remaining subdivisional lines were surveyed by Sidney E. Blout, who also resurveyed contiguous lines around section 20. Additional resurveys were made by Blout in 1925 in connection with the segregation of the Santa Rosa lode in sec. 22; by Francis E. Joy in 1933, in connection with the segregation surveys in sections 26 and 29 and by Roger F. Wilson in 1937, in connection with segregations in sec. 21. The center lines of sec. 21 were surveyed by Wilson at that time. A partial subdivision of sec. 26 was made by F. Wayne Forrest in 1943.

The survey was made with a Buff light mountain solar transit, serial No. 16724, constructed in accordance with the standard specifications of the Bureau of Land Management. The instrument was in good condition, and having been placed in satisfactory adjustment prior to the beginning of the survey, was tested and found free from appreciable error.

All azimuths in this record were determined by solar transit method. The measurements were made with a narrow steel tape, 5 chains in length, graduated every link for the first 100 links and the remainder at intervals of 10 links. The tape was tested by comparison with a 1 chain standard steel tape and found correct. The measurements were made on the slope and the vertical angle of each interval was ascertained by a clinometer in good adjustment; the horizontal equivalents only are entered in this field note record.

February 7, 1948, at camp near the $\frac{1}{2}$ sec. cor. of secs. 9 and 16, T. 3 N., R. 3 E., G. & S. R. Meridian, Arizona, in approximate latitude $33^{\circ} 36' 30''$ N. and longitude $112^{\circ} 03' 18''$ W. as determined from data given with the special instructions, elevation approximately 1,400 ft., at 5h 37.0m p.m. l.m.t., I make an hour angle observation of Polaris west of the meridian for azimuth and latitude, making four observations, two each with the telescope in direct and reversed positions, observing simultaneously the vertical angle to Polaris and the horizontal angle from a well defined point on the skyline approximately 3 miles N., W. to Polaris. My watch reads correct Mountain Standard Time as checked by radio time signals.

Mean watch time of observation	6h 05m 12s
Watch fast of l.m.t.	0h 28m 12s
Mean horizontal deflection angle	$0^{\circ} 20' 54''$
Azimuth of Polaris	$0^{\circ} 17' 54''$
True bearing of reference point	N. $0^{\circ} 03' 00''$ E.
Mean observed vertical angle	$34^{\circ} 34' 11.5''$
Reduced latitude	$33^{\circ} 36' 19.3''$ N.

February 8, 1948, at half hour intervals from 8 to 10:30 a.m. and 1:30 to 4 p.m., I make orientation tests of Buff solar transit No. 16724, including tests by noon observation. The tests give a maximum error in orientation of less than $1' 30''$.

The geographic position for the cor. of secs. 16 and 21, T. 3 N., R. 3 E. as computed from data furnished with the special instructions is as follows:

Latitude $33^{\circ} 35' 37''$ N. Longitude $112^{\circ} 03' 50''$ W.

The mean observed magnetic declination is 14° E.

Chains

The north half of sec. 29 and the south half of sec. 20, T. 3 N., R. 3 E. were returned as surveyed on the plat approved January 28, 1895. Both plat and field notes show a common corner of secs. 20, 21, 28 and 29 and a common 1/4 sec. cor. of secs. 20 and 21.

The plat approved July 27, 1914 shows a closing corner of secs. 20 and 29 established by Sidney E. Blout, 96 lks. southerly from the sec. cor. which was altered to refer to secs. 21 and 28 only, thus causing an overlap between secs. 20 and 29. It was deemed advisable to correct this condition in connection with the current survey.

The closing corner of secs. 20 and 29 is monumented with an iron post, 2 ft. long, 1 in. diam., set 24 ins. in the ground and in a concrete block 10 ins. sq., with brass cap mkd. as described in the official record. There was no evidence of the mound of stone. I destroy all evidence of this corner.

There is no remaining evidence of the cor. of secs. 21 and 28 only.

At a point 96 lks. N. 0° 24' E. of the ^{point of destroyed} closing corner of secs. 20 and 29.

Set an iron post, 3 ft. long, 2 ins. diam., 12 ins. in the ground to bedrock, and in a mound of stone to top, with brass cap mkd.

T 3 N R 3 E
S 20 | S 21
S 29 | S 28
1950

Bury a malpais stone, 8x6x6 ins., mkd. X alongside the iron post.

Thence

S. 88° 40' W., on true line bet. secs. 20 and 29 as based on the Joy resurvey of 1933 to which reference may be made for topographic items.

39.69 The 1/4 sec. cor. of secs. 20 and 29.

Resurvey of a portion of the boundaries of section 20,
T. 3 N., R. 3 E.

At a point on the E. bdy. of sec. 20.

Set an iron post, 3 ft. long, 1 in. diam., 26 ins. in the ground for 1/4 sec. cor. of sec. 20, with brass cap mkd.

1/4 S 20 |
1948

raise a mound of stone, 3 ft. base, 2 ft. high, W. of cor.

Thence

N. 0° 26' W., along the W. bdy. of sec. 21.

0.86 The 1/4 sec. cor. of sec. 21, marked by an iron post, 1 in. diam., firmly set, mkd. and witnessed as described in the official record.

2.41 Graded road, bears NW. and SE.

Resurvey of a Portion of the Boundaries of Section 20,
T. 3 N., R. 3 E.

Chains	
3.70	Shallow wash, drains E.
6.85	Wash, 30 lks. wide, 6 ft. deep course S. 20° E.; asc. 96 ft. over a SW. slope.
9.998	Point for the SN 1/64 sec. cor. of sec. 20. Set a redwood stake, 2x3 ins., 2½ ft. long, 22 ins. in the ground for SN 1/64 sec. cor. of sec. 20, mkd. 1/64 on W. face. Raise a mound of stone, 3 ft. base, 2½ ft. high, W. of cor.
10.833	Point for the SN 1/64 sec. cor. of sec. 21. Set a redwood stake, 2x3 ins., 2½ ft. long, 22 ins. in the ground, mkd. 1/64 on E. face. Raise a mound of stone, 3 ft. base, 2½ ft. high, E. of cor.
14.93	Saddle in the top of a ridge, bears E. and W.; desc. 111 ft. over a NW. slope.
19.995	Point for the N 1/16 sec. cor. of sec. 20. Set an iron post, 3 ft. long, 1 in. diam., 12 ins. in the ground to bedrock, and in a mound of stone to top, with brass cap mkd. N 1/16 S 20 1948 Bury a lava stone, 8x8x3 ins., mkd. X alongside iron post.
20.805	Point for the N 1/16 sec. cor. of sec. 21. Set an iron post, 3 ft. long, 1 in. diam., 26 ins. in the ground, with brass cap mkd. N 1/16 S 21 1948 raise a mound of stone, 3 ft. base, 2½ ft. high, E. of cor.
25.791	Point for the SNN 1/256 sec. cor. of sec. 21. Set a redwood stake, 2x3 ins., 2½ ft. long, 22 ins. in the ground, mkd. 1/256 on E. face. Raise a mound of stone, 3 ft. base, 2½ ft. high, E. of cor.
30.777	Point for the NN 1/64 sec. cor. of sec. 21. Set an iron post, 3 ft. long, 1 in. diam., 6 ins. in the ground to bedrock, and in a mound of stone to top, with brass cap mkd. NN 1/64 S 21 1948 Bury a lava stone, 6x8x2 ins., mkd. X alongside the iron post.
35.763	Point for the NNN 1/256 sec. cor. of sec. 21. Set a redwood stake, 2x3 ins., 2½ ft. long, 22 ins. in the ground, mkd. 1/256 on E. face. Raise a mound of stone, 3 ft. base, 2½ ft. high, E. of cor.
39.990	Point for the closing corner of secs. 17 and 20, at proportionate distance: there is no remaining evidence of the original corner.

Resurvey of a Portion of the Boundaries of Section 20,
T. 3 N., R. 3 E.

Chains

Bury a malpais stone, 10x10x12 ins., 12 ins. below the surface of the road, mkd. X.

from which

An iron post, 3 ft. long, 1 in. diam., set 26 ins. in the ground, for a reference monument, bears N. 45° E. 70.7 lks. dist., with brass cap mkd. R M 1948 and an arrow pointing to the true corner.

An iron post, 3 ft. long, 1 in. diam., set 26 ins. in the ground for a reference monument, bears S. 45° W. 70.7 lks. dist., with brass cap mkd. T 3 N R 3 E S 20 R M 1948 and an arrow pointing to the true corner.

40.750 The corner of secs. 16 and 21, marked by an iron post, 2 ins. diam., firmly set, mkd. and witnessed as described in the official record.

From the $\frac{1}{4}$ sec. cor. of sec. 20, mkd. by an iron post, 1 in. diam., firmly set, mkd. and witnessed as described in the official record.

EAST, on true line, along the N. bdy. of sec. 20.

6.40 Road, bears N. and S.

7.80 Wash, 30 lks. wide, 8 ft. deep, course N.; asc. 60 ft. over a W. slope.

10.10 Old road, bears NE. and SW.

16.10 Point of a spur, slopes abruptly N.; desc. 47 ft. over a NE. slope.

19.35 Point for the E. 1/16 sec. cor. of sec. 20.

Set an iron post, 3 ft. long, 1 in. diam., 6 ins. in the ground to bedrock, and in a mound of stone to top, with brass cap mkd.

E 1/16 S 20
1948

Bury a stone, 6x6x4 ins., mkd. X alongside the iron post.

19.40 Top of low spur, slopes N.

22.15 Wash, 20 lks. wide, 4 ft. deep, course N.

24.35 Wash, 20 lks. wide, 4 ft. deep, course N.; asc. 35 ft. over a W. slope.

27.70 Top of low spur, slopes N.

30.30 Shallow wash, course N.

32.30 Point of a low spur, slopes N.

35.50 Wash, 15 lks. wide, 3 ft. deep, course N.

38.55 Center of a graded road, bears N. and S.

38.70 The closing corner of secs. 17 and 20.

Subdivision of Section 20, T. 3 N., R. 3 E.

From the $\frac{1}{4}$ sec. cor. on the E. bdy. of sec. 20.

N. 89° 58' W., on the E. and W. center line of sec. 20.

Subdivision of Section 20, T. 3 N., R. 3 E.

Chains

- Ascend 76 ft. over a broken SE. slope.
- 3.80 Ravine, course S.; asc. 135 ft. over an E. slope.
- 9.60 Ridge, bears N. and S.; desc. 96 ft. over a W. slope.
- 9.795 Point for the CEE 1/64 sec. cor. of sec. 20.
Set a redwood stake, 2x3 ins., 2½ ft. long, 20 ins. in the ground, mkd. 1/64 on N. face. Raise a mound of stone, 3 ft. base, 2½ ft. high, N. of cor.
- 14.15 Ravine, course NW.
- 16.65 Wash, 30 lks. wide, 8 ft. deep, course N.
- 18.30 Shallow wash, course N.
- 19.59 Point for the CE 1/16 sec. cor. of sec. 20.
Set an iron post, 3 ft. long, 1 in. diam., 20 ins. in the ground to bedrock, and in a mound of stone to top, with brass cap mkd.
- C — E 1/16 — C
S 20
1948
- raise a mound of stone, 3 ft. base, 2 ft. high, N. of cor.
- 20.60 Wash, 30 lks. wide, 6 ft. deep, course NE.; asc. 227 ft. over an E. slope.
- 29.385 Point for the CWE 1/64 sec. cor. of sec. 20.
Set a redwood stake, 2x3 ins., 2½ ft. long, 20 ins. in the ground, mkd. 1/64 on N. face. Raise a mound of stone, 3 ft. base, 2 ft. high, N. of cor.
- 31.90 Spur, slopes NW.; desc. 238 ft. over W. slope.
- 39.18 Point for the C ¼ sec. cor. of sec. 20.
Set an iron post, 3 ft. long, 1 in. diam., 24 ins. in the ground, with brass cap mkd.
- C ¼ S 20
1948
- raise a mound of stone, 3 ft. base, 2½ ft. high, W. of cor.
- From the C ¼ sec. cor. of sec. 20, the ¼ sec. cor. of secs. 19 and 20, bears N. 89° 58' W., 39.77 chs. dist. and is monumented with an iron post, 1 in. diam., firmly set, mkd. and witnessed as described in the official record.
From the same point, the ¼ sec. cor. of secs. 20 and 29, bears S. 0° 12' W., 40.004 chs. dist. and is monumented with an iron post, 1 in. diam., firmly set, mkd. and witnessed as described in the official record.

- From the C ¼ sec. cor. of sec. 20.
N. 0° 12' E., on the N. and S. center line of sec. 20.
Ascend 19 ft. over a SW. slope.
- 7.30 Spur, slopes NW.; desc. 137 ft. over the NE. slope of spur.
- 9.999 Point for the GSN 1/64 sec. cor. of sec. 20.
Set a redwood stake, 2x3 ins., 2½ ft. long, 22 ins. in the ground, mkd. 1/64 on E. face. Raise a mound of stone, 3 ft. base, 2½ ft. high, E. of cor.

Subdivision of Section 20, T. 3 N., R. 3 E.

Chains
 17.00 Foot of steep descent of spur, bears NE. and SW.; thence over rolling land; desc. 50 ft. over a general NW. slope.
 19.998 Point for the CN 1/16 sec. cor. of sec. 20.
 Set an iron post, 3 ft. long, 1 in. diam., 12 ins. in the ground to bedrock, and in a mound of stone to top, with brass cap mkd.

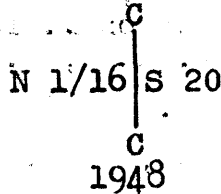

22.00 Road, bears E. and W. 1.00 ch. to intersection with road from NE.
 22.60 Road, bears NE. and SW.
 26.25 Wash, 40 lks. wide, 8 ft. deep, course N. 60° W.
 32.20 Wash, 40 lks. wide, 10 ft. deep, course NW.
 36.80 Wash, 20 lks. wide, 5 ft. deep, course NW.
 39.996 The 1/4 sec. cor. of sec. 20.

 From the N 1/16 sec. cor. of sec. 20.
 WEST, on the E. and W. center line of the NE 1/4 of sec. 20.
 Descend 33 ft. over a W. slope.

4.70 Graded road, bears N. and S.
 5.40 Foot of descent; ascend 168 ft. over NE. slope.
 9.73 Point for the CENE 1/64 sec. cor. of sec. 20.
 Set a redwood stake, 2x3 ins., 2 1/2 ft. long, 20 ins. in the ground, mkd. 1/64 on N. face. Raise a mound of stone, 3 ft. base, 2 ft. high, N. of cor.
 13.65 Ridge, bears N. and S.; desc. 205 ft. over a SW. slope.
 19.46 Point for the NE 1/16 sec. cor. of sec. 20.
 Set an iron post, 3 ft. long, 1 in. diam., 12 ins. in the ground to bedrock, and in a mound of stone to top, with brass cap mkd.

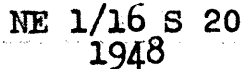

Bury a lava stone, 8x8x3 ins., mkd. X alongside the iron post.
 24.00 Foot of steep descent of spur, bears NW. and SE., thence over rolling land; desc. 26 ft. over general NW. slope.
 29.205 Point for the CWNE 1/64 sec. cor. of sec. 20.
 Set a redwood stake, 2x3 ins., 2 1/2 ft. long, 12 ins. in the ground to bedrock, and in a mound of stone to top, mkd. 1/64 on N. face. Raise a mound of stone, 3 ft. base, 2 ft. high, N. of cor.

Subdivision of Section 20, T. 3 N., R. 3 E.

Chains

30.75 Shallow wash, course N. 60° W.

31.25 Road, bears N. and S.

33.75 Road, bears NW. and SE.

34.05 Wash, 10 lks. wide, 3 ft. deep, course N.

38.95 The CN 1/16 sec. cor. of sec. 20.

From the CE 1/16 sec. cor. of sec. 20N. 0° 08' W., on the N. and S. center line of the NE. $\frac{1}{4}$ of sec. 20.

Descend 83 ft. over a NW. slope.

1.10 Wash, 30 lks. wide, 6 ft. deep, course NE.

3.50 Old road, bears NW. and SE.

5.25 Wash, 30 lks. wide, 4 ft. deep, course NW.

6.45 Wash, 30 lks. wide, 6 ft. deep, course NW.

9.987 Point for the CSNE 1/64 sec. cor. of sec. 20.

Set a redwood stake, 2x3 ins. 2 $\frac{1}{2}$ ft. long, 6 ins. in the ground to bedrock, and in a mound of stone to top, mkd. 1/64 on W. face.

14.20 Road, bears NW. and SE.

16.50 Foot of descent; ascend 177 ft. over a NW. slope.

19.975 The NE. 1/16 sec. cor. of sec. 20.

From the NE 1/16 sec. cor. of sec. 20, the E 1/16 sec. cor. of sec. 20, bears N. 0° 08' W., 19.985 chs. dist.-----
Resurvey of a Portion of the Boundaries of Section 21,
T. 3 N., R. 3 E.

From the cor. of secs. 16 and 21.

S. 89° 19' E.; on true line, bet. secs. 16 and 21.

Ascend 20 ft. over a gradual NW. slope.

5.00 Top of ascent; descend gradual E. slope.

5.068 Point for the WWW 1/256 sec. cor. of secs. 16 and 21.

Set a redwood stake, 2x3 ins., 2 $\frac{1}{2}$ ft. long, 22 ins. in the ground, mkd. 1/256 on N. face. Raise a mound of stone, 3 ft. base, 2 $\frac{1}{2}$ ft. high, N. of cor.

8.00 Draw, drains N.; asc. 57 ft. over a W. slope.

10.135 Point for the WW 1/64 sec. cor. of secs. 16 and 21.

Resurvey of a Portion of the Boundaries of Section 21,
T. 3 N., R. 3 E.

Chains	Set an iron post, 3 ft. long, 1 in. diam., 24 ins. in the ground, with brass cap mkd.
	<p style="text-align: center;">S 16 WW 1/64 S 21 1948</p>
	raise a mound of stone, 3 ft. base, 2 ft. high, N. of cor.
13.50	Spur, slopes N.; desc. 48 ft. over an E. slope;
17.50	Wash, 10 lks. wide, 2 ft. deep, course N.
17.905	Intersect line 2-3 of the Last Chance No. 2 mining claim, (a metes-and-bounds survey of land classified as mineral bearing).
	Point for the closing corner of secs. 16 and 21. Set an iron post, 3 ft. long, 1 in. diam., 26 ins. in the ground, with brass cap mkd.
	<p style="text-align: center;">S 16 CC ——— S 21 1948</p>
	raise a mound of stone, 3 ft. base, 2½ ft. high, W. of cor.
	From this point, Cor. No. 2, of the Last Chance No. 2 mining claim, bears N. 6° 43' E., 3.23 chs. dist. and is monumented with an iron post, 1 in. diam., firmly set, mkd. and witnessed as described in the official record.
	From the same point, Cor. No. 3, bears S. 6° 43' W., 18.55 chs. dist., and is monumented with an iron post, 1 in. diam., firmly set, mkd. and witnessed as described in the official record.
	Ascend 15 ft. over a gradual W. slope.
20.27	Point for the W 1/16 sec. cor. of secs. 16 and 21.
	Set an iron post, 3 ft. long, 1 in. diam., 14 ins. in the ground to bedrock, and in a mound of stone to top, with brass cap mkd.
	<p style="text-align: center;">S 16 W 1/16 ——— S 21 1948</p>
22.75	Foot of steep ascent; asc. 241 ft. over a W. slope.
27.055	Intersect line 4-1 of the Last Chance No. 2 mining claim.
	Point for the closing corner of secs. 16 and 21 falls at an inaccessible point on a cliff, 15 ft. high, facing W., where a monument cannot be established.
	From this point, Cor. No. 1, bears N. 6° 43' E., 3.965 chs. dist., and is monumented with an iron post, 1 in. diam., firmly set, mkd. and witnessed as described in the official record.
	From the same point, Cor. No. 4, bears S. 6° 43' W., 17.815 chs. dist., and is monumented with an iron post, 1 in. diam., firmly set in the ground, mkd. and witnessed as described in the official record.

Resurvey of a Portion of the Boundaries of Section 21,
T. 3 N., R. 3 E.

Chains
27.155 Point for the witness closing ~~XXXXXXXXXX~~ cor. of secs. 16
and 21.

Set an iron post, 3 ft. long, 1 in. diam., on solid sur-
face rock, and in a mound of stone, 5 ft. base, to top,
with brass cap mkd.

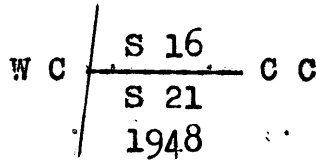

27.55 Ridge, bears N. 20° W. and S. 20° E.; desc. 198 ft. over a
steep E. slope.

30.405 Point for the EW 1/64 sec. cor. of secs. 16 and 21.

Set a redwood stake, 2x3 ins., 2½ ft. long, 18 ins. in the
ground, mkd. 1/64 on N. face. Raise a mound of stone, 3
ft. base, 2½ ft. high, N. of cor.

35.00 Foot of steep descent, bears N. and S.; desc. 30 ft. over
a gradual NE. slope.

40.54 The ¼ sec. cor. of secs. 16 and 21, which is monumented
with an iron post, 1 in. diam., firmly set, mkd. and
witnessed as described in the official record.

Subdivision of the NW. ¼ of Section 21, T. 3 N., R. 3 E.

From the C ¼ sec. cor. of sec. 21, which is monumented
with an iron post, 1 in. diam., firmly set, mkd. and
witnessed as described in the official record.

N. 0° 05' E., on the N. and S. center line of sec. 21.

Ascend 75 ft. over a gradual SE. slope.

4.35 Wash, 10 lks. wide, 3 ft. deep, course SE.

9.55 Shallow wash, course SE.

19.79 Point for the CN 1/16 sec. cor. of sec. 21.

Set an iron post, 3 ft. long, 1 in. diam., 12 ins. in the
ground to bedrock, and in a mound of stone to top, with
brass cap mkd.

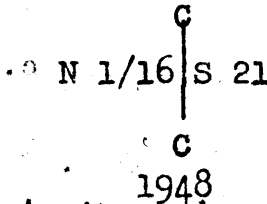

Bury a lava stone, 8x8x4 ins., mkd. X alongside the iron
post.

Ascend steeply 133 ft. over a SE. slope.

29.685 Point for the CNN 1/64 sec. cor. of sec. 21.

Set a redwood stake, 2x3 ins., 2½ ft. long, 18 ins. in the
ground, mkd. 1/64 on W. face. Raise a mound of stone, 3
ft. base, 2½ ft. high, W. of cor.

Subdivision of the NW. $\frac{1}{4}$ of Section 21, T. 3 N., R. 3 E.

Chains	
30.25	Spur, slopes E.; asc. 123 ft. over a N. slope.
36.80	Wash, 40 lks. wide, 12 ft. deep, course N. 10° E. from SW.
39.58	The $\frac{1}{4}$ sec. cor. of secs. 16 and 21.

	From the C $\frac{1}{4}$ sec. cor. of sec. 21
	N. 89° 43' W., on the E. and W. center line of sec. 21.
	Ascend 40 ft. over a gradual SE. slope.
1.20	Wash, 30 lks. wide, 6 ft. deep, course SE.
8.10	Wash, 25 lks. wide, 8 ft. deep, course SE.; asc. 87 ft. over a steep E. slope.
13.00	Spur, slopes S.; desc. 38 ft. over a W. slope.
14.80	Shallow wash, course S.; asc. 101 ft. over an E. slope.
18.15	Spur, slopes S.; desc. 76 ft. over a W. slope.
20.08	Point for the CW $\frac{1}{16}$ sec. cor. of sec. 21.
	Set an iron post, 3 ft. long, 1 in. diam., 27 ins. in the ground, with brass cap mkd.
	.W $\frac{1}{16}$ C ————— C
	S 21 1948
	A local corner, which is monumented with an iron pipe, 1 in. diam., 3 ins. above ground, bears EAST, 1.5 lks. dist.
	Raise a mound of stone, 3 ft. base, 2 $\frac{1}{2}$ ft. high, N. of cor.
20.40	Wash, 20 lks. wide, 4 ft. deep, course S.; asc. 46 ft. over an E. slope.
22.45	Spur, slopes S.; desc. 95 ft. over a steep W. slope.
26.35	Shallow wash, course S.; thence, over rolling land.
27.281	Cor. No. 1 of the Last Chance # 1 mining claim, which is monumented with an iron post, 1 in. diam., firmly set, mkd. and witnessed as described in the official record.
30.12	Point for the CWW $\frac{1}{64}$ sec. cor. of sec. 21.
	Set a redwood stake, 2x3 ins., 2 $\frac{1}{2}$ ft. long, 18 ins. in the ground, mkd. $\frac{1}{64}$ on N. face. Raise a mound of stone, 3 ft. base, 2 $\frac{1}{2}$ ft. high, N. of cor.
34.00	Wash, 20 lks. wide; 4 ft. deep, course S.
35.45	Wash, 30 lks. wide, 8 ft. deep, course SE.
39.35	Graded road, bears N. 20° W. and S. 20° E.
40.16	The $\frac{1}{4}$ sec. cor. of sec. 21.

Subdivision of the NW. $\frac{1}{4}$ of Section 21, T. 3 N., R. 3 E.

1948 4878

- Chains From the C W $\frac{1}{16}$ sec. cor. of sec. 21.
- N. $0^{\circ} 10'$ W., on the N. and S. center line of the NW. $\frac{1}{4}$ of sec. 21.
- Ascend 82 ft. along a W. slope.
- 8.75 Saddle in a ridge, bears E. and W.; desc. 64 ft. along an E. slope.
- 9.932 Point for the C S NW $\frac{1}{64}$ sec. cor. of sec. 21.
- Set a redwood stake, 2x3 ins., $2\frac{1}{2}$ ft. long, 20 ins. in the ground, mkd. $\frac{1}{64}$ on W. face. Raise a mound of stone, 3 ft. base, $2\frac{1}{2}$ ft. high, W. of cor.
- 19.864 Point for the NW $\frac{1}{16}$ sec. cor. of sec. 21.
- Set an iron post, 3 ft. long, 1 in. diam., 24 ins. in the ground, with brass cap mkd.
- NW $\frac{1}{16}$ S 21
1948
- raise a mound of stone, 3 ft. base, $2\frac{1}{2}$ ft. high, W. of cor.
- 24.00 Shallow wash, course N. 20° W.; thence along a W. slope.
- 24.838 Point for the C S N NW $\frac{1}{256}$ sec. cor. of sec. 21. (corner not monumented).
- 29.812 Point for the C N NW $\frac{1}{64}$ sec. cor. of sec. 21.
- Set an iron post, 3 ft. long, 1 in. diam., 22 ins. in the ground, with brass cap mkd.
- S 21
C-N-NW
 $\frac{1}{64}$
1948
- Raise a mound of stone, 3 ft. base, $2\frac{1}{2}$ ft. high, W. of cor.
- 34.786 Point for the C N N NW $\frac{1}{256}$ sec. cor. of sec. 21. (corner not monumented).
- 39.76 The W. $\frac{1}{16}$ sec. cor. of secs. 16 and 21.
-
- From the C N $\frac{1}{16}$ sec. cor. of sec. 21.
- N. $89^{\circ} 32'$ W., on the E. and W. center line of the NW $\frac{1}{4}$ sec. 21.
- Ascend 74 ft. over SE. slope.
- 1.00 Spur, slopes SE.
- 4.65 Wash, 30 lks. wide, 8 ft. deep, course SE.; asc. 247 ft. over NE. slope.
- 10.073 The point for the C E NW $\frac{1}{64}$ sec. cor. of sec. 21.
- Set a redwood stake, 2x3 ins. $2\frac{1}{2}$ ft. long, 20 ins. in the ground, mkd. $\frac{1}{64}$ on N. face. Raise a mound of stone, 3 ft. base, $2\frac{1}{2}$ ft. high, S. of cor. (The steep slope of the spur makes it impracticable to build the monument to the N).

64

Chains
10.15 Spur, slopes SE.; continue ascent along a S. slope.
12.20 Ridge, bears N. and S.; desc. 204 ft. over steep W. slope.
15.766 Intersect line 2-3 of the Last Chance # 1 mining claim
(a metes-and-bounds survey of land classified as mineral
bearing).

Point for the closing corner of lots 10 and 11 of sec. 21.
Set an iron post, 3 ft. long, 1 in. diam., 16 ins. in the
ground to bedrock, and in a mound of stone to top, with
brass cap mkd.

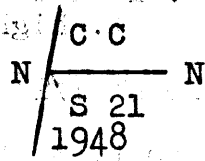

From this point, Cor. No. 3 of the Last Chance # 1 mining
claim, bears N. 6° 45' E., 2.163 chs. dist., and is
monumented with an iron post, 1 in. diam., firmly set
in a mound of stone, mkd. and witnessed as described in
the official record.

From the same point, Cor. No. 2, bears S. 6° 45' W.,
19.307 chs. dist., and is monumented with an iron post,
1 in. diam., firmly set, mkd. and witnessed as described
in the official record.

18.90 Wash, 20 lks. wide, 4 ft. deep, course NW.; asc. 135 ft.
20.146 The NW 1/16 sec. cor. of sec. 21.

24.907 Intersect line 4-1 of the Last Chance #. 1 mining claim.
Point for the closing corner of lots 10 and 11 of sec. 21.
Set an iron post, 3 ft. long, 1 in. diam., 6 ins. in the
ground to bedrock, and in a mound of stone to top, with
brass cap mkd.

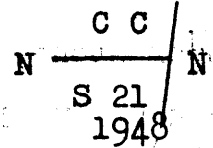

From this point, Cor. No. 4 of the Last Chance # 1 mining
claim, bears N. 6° 43' E., 1.455 chs. dist., and is
monumented with an iron post, 1 in. diam., firmly set in
a mound of stone, mkd. and witnessed as described in the
official record. This cor. is identical with Cor. No. 3
of the Last Chance No. 2 mining claim.

From the same point, Cor. No. 1 of the Last Chance # 1
mining claim, bears S. 6° 43' W., 20.015 chs. dist.

25.30 Spur, slopes N.; desc. 107 ft. over W. slope.
29.30 Shallow wash, course NW.; asc. 42 ft. over E. slope.
30.235 Point for the CW NW 1/64 sec. cor. of sec. 21.

Set an iron post, 3 ft. long, 1 in. diam., 20 ins. in the
ground to bedrock, and in a mound of stone to top, with
brass cap mkd.

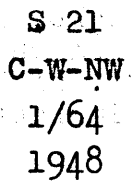

Subdivision of the NW $\frac{1}{4}$ of Section 21, T.3 N., R.3 E.

BOOK 4379

- Chains
- 32.10 Spur, slopes N.; desc. 142 ft. over NW. slope.
 - 35.279 Point for the CWW NW $\frac{1}{256}$ sec. cor. of sec. 21.
Set a redwood stake, 2 x 3 ins., 2 $\frac{1}{2}$ ft. long, 10 ins. in the ground to bedrock, and in a mound of stone to top, mkd. $\frac{1}{256}$ on N. face.
 - 40.324 The N. $\frac{1}{16}$ sec. cor. of sec. 21.

 Subdivision of the NW $\frac{1}{4}$ NW $\frac{1}{4}$ Section 21, T.3 N., R.3 E.

- From the CW NW $\frac{1}{64}$ sec. cor. of sec. 21, N.0°18'W., on N. and S. center line of the NW $\frac{1}{4}$ NW $\frac{1}{4}$ sec. 21. Desc. over a gentle NW. slope.
- 4.984 Point for the CS NW NW $\frac{1}{256}$ sec. cor. of sec. 21.
Set a redwood stake, 2 x 3 ins. 2 $\frac{1}{2}$ ft. long, 14 ins. in the ground, mkd. $\frac{1}{256}$ on W. face. Raise a mound of stone, 3 ft. base, 2 ft. high, W. of cor.
- 9.968 Point for the NW NW $\frac{1}{64}$ sec. cor. of sec. 21.
Set an iron post, 3 ft. long, 1 in. diam., 27 ins. in the ground, with brass cap mkd.

S 21
 NW-NW
 $\frac{1}{64}$
 1948

- Raise a mound of stone, 3 ft. base, 2 $\frac{1}{2}$ ft. high W. of cor.
- 14.95 Point for the CN NW NW $\frac{1}{256}$ sec. cor. of sec. 21.
Set a redwood stake, 2 x 3 ins., 2 $\frac{1}{2}$ ft. long, 14 ins. in the ground to bedrock, and in a mound of stone, 6 ins. high, mkd. $\frac{1}{256}$ on W. face. Raise a mound of stone, 3 ft. base, 2 ft. high, W. of cor.

- 19.932 The W W $\frac{1}{64}$ sec. cor. of secs. 16 and 21.

 From the CN NW $\frac{1}{64}$ sec. cor. of sec. 21, N.89°26'W., on the E. and W. center line of the NW $\frac{1}{4}$ NW $\frac{1}{4}$ of sec. 21.

- 1.85 Wash, 20 lks. wide, 4 ft. deep, course N.30°W.; asc. 84 ft. over E. slope.

Subdivision of the NW $\frac{1}{4}$ NW $\frac{1}{4}$ of Section 21, T.3 N., R.3 E.

Chains
3.56

Intersect line 2-3 of the Last Chance No. 2 mining claim, a metes-and-bounds survey of land classified as mineral bearing.

Point for the closing cor.

Set an iron post, 3 ft. long, 1 in. diam., 14 ins. in the ground to bedrock, and in a mound of stone to top, with brass cap mkd.

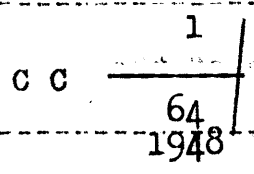

From point of intersection, Cor. No.2 of the Last Chance No.2 mining claim, bears N.6°43'E.; 13.226 chs. dist.

From the same point, Cor. No. 3, bears S.6°43'W., 8.554 chs. dist.

At a point N.6°43'E., 5.00 chs. dist., at intersection with the E. and W. center line of NE $\frac{1}{4}$ NW $\frac{1}{4}$ NW $\frac{1}{4}$ of sec. 21,

Set a redwood stake, 2 x 3 ins., 20 ins. in the ground, and raised a mound of stone W. of stake.

At a point, S.6°43'W., 5.004 chs, dist., at intersection with the E. and W. center line of the SE $\frac{1}{4}$ NW $\frac{1}{4}$ NW $\frac{1}{4}$ of sec. 21, set a redwood stake, 2 x 3 ins. 2½ ft. long, in a mound of stone, on surface rock.

6.50 Spur, slopes N.; desc. 136 ft. over NW. slope.

10.10 The NW NW 1/64 sec. cor. of sec. 21.

15.15 Point for the CW NW NW 1/256 sec. cor. of sec. 21.

Set a redwood stake, 2 x 3 ins. 2½ ft. long, 16 ins. in the ground to bedrock, and in a mound of stone, 6 ins. high, mkd. 1/256 on N. face.

Raise a mound of stone, 3 ft. base, 2 ft. high, N. of cor.

20.20 The NN 1/64 sec. cor. of sec. 21.

Resurvey of a Portion of the Boundaries of Section 22,
T. 3 N., R. 3 E.

BOOK 4879

Chains

From the cor. of secs. 15, 16, 21 and 22, which is monumented with an iron post, 2 ins. diam., firmly set, mkd., and witnessed as described in the official record..

N. 88° 19' E., on true line, bet. secs. 15 and 22.

Over broken and hilly land. Desc. 29 ft. over a NE. slope.

5.60 Wash, 20 lks. wide, 6 ft. deep, course SE.;

10.30 Wash, 40 lks. wide, 8 ft. deep, course S. 30° W. ; asc. 41 ft. over a W. slope.

13.15 Spur, slopes S.; desc. 48 ft. over an E. slope.

21.50 Wash, 30 lks. wide, 6 ft. deep, course S. 20° W.; asc. 55 ft. over a W. slope.

31.40 Point of a spur, slopes N.; desc. 46 ft. over an E. slope.

39.13 The $\frac{1}{4}$ sec. cor. of secs. 15 and 22, mkd. by a malpais stone, 12x10x3 ins., firmly set in the ground, mkd. $\frac{1}{4}$ on N. face.

At the corner point

Set an iron post, 3 ft. long, 1 in. diam., 26 ins. in the ground, with brass cap mkd.

S 15

$\frac{1}{4}$

S 22

1948

raise a mound of stone, 3 ft. base, 2 $\frac{1}{2}$ ft. high, N. of cor. and bury the original corner stone alongside the iron post.

S. 89° 39' E., beginning new measurement.

7.70 Center of a paved highway, bears N. to Cave Creek and SW. to Sunnyslope. Thence along the center of a graded and gravel surfaced road over nearly level land.

40.48 The cor. of secs. 14, 15, 22 and 23, mkd. by a granite stone, 12x10x6 ins., set flush with the surface of the road, mkd. X on top. This corner is a local reestablishment from which subdivisions in the town of Cactus have been initiated and is accepted by local engineers as marking the position of the original corner.

From the corner

An iron post, 3 ft. long, 1 in. diam.; set 27 ins. in the ground, for a reference monument, bears N. 45° E., 70.7 lks. dist., with brass cap mkd. T 3 N R 3 E S 14 R M 1948 and an arrow pointing to the true corner.

An iron post, 3 ft. long, 1 in. diam.; set 27 ins. in the ground, for a reference monument, bears S. 45° W., 70.7 lks. dist., with brass cap mkd. T 3 N R 3 E S 22 R M 1948 and an arrow pointing to the true corner.

S. 0° 07' W., bet. secs. 22 and 23:

68
-378b

ECOR 4379

Resurvey of a Portion of the Boundaries of Section 22,
T. 3 N., R. 3 E.

Chains	Over gently rolling land..
32.80	Road, bears NW. and SE.
40.03	The $\frac{1}{4}$ sec. cor. of secs. 22 and 23, mkd. with a granite stone, 10x4x6 ins., firmly set in the ground, mkd. $\frac{1}{4}$ on W. face.
	At the corner point
	Set an iron post, 3 ft. long, 1 in. diam., 27 ins. in the ground, with brass cap. mkd.
	$\begin{array}{c} \uparrow \\ S\ 22 \mid S\ 23 \\ \downarrow \\ 1948 \end{array}$
	raise a mound of stone, 3 ft. base, 2 $\frac{1}{2}$ ft. high, W. of cor. and bury the original corner stone alongside the iron post.

	S. 0° 08' W., beginning new measurement.
26.85	Wash, 20 lks. wide, 4 ft. deep, course E.
40.05	The cor. of secs. 22, 23, 26 and 27, mkd. by an iron post, 2 ins. diam., firmly set in the ground, mkd. and witnessed as described in the official record.

	N. 89° 52' W., on true line, bet. secs. 22 and 27.
	Over gently rolling land.
0.38	Road, bears N. and S.
17.60	Road, bears NE. and SW.
19.915	Point for the E. 1/16 sec. cor. of secs. 22 and 27.
	Set an iron post, 3 ft. long, 1 in. diam., 8 ins. in the ground, to bedrock, and in a mound of stone to top, with brass cap mkd.
	$\begin{array}{c} S\ 22 \\ E\ 1/16 \text{-----} \\ S\ 27 \\ 1948 \end{array}$
	Bury a lava stone 8x4x4 ins., mkd. X alongside the iron post.
31.80	Wash, 20 lks. wide, 4 ft. deep, course NE.
39.83	The $\frac{1}{4}$ sec. cor. of secs. 22 and 27, mkd. by an iron post, 1 in. diam., firmly set, mkd. and witnessed as described in the official record.

	N. 89° 50' W., beginning new measurement.
1.70	Wash, 30 lks. wide, 4 ft. deep, course NE.
2.20	Foot of steep ascent, bears NW. and SE.; asc. 393 ft. over an E. slope.

Resurvey of a Portion of the Boundaries of Section 22,
T. 3 N., R. 3 E.

BOOK 4079

- | Chains | |
|--------|--|
| 9.958 | Point for the EW. 1/64 sec. cor. of secs. 22 and 27.
Set a redwood stake, 2x3 ins., 2½ ft. long, 20 ins. in the ground, mkd. 1/64 on N. face. Raise a mound of stone, 3 ft. base, 2½ ft. high, N. of cor. |
| 15.20 | Top of a ridge, bears N. and S.; desc. 507 ft. over a steep W. slope. |
| 19.915 | Point for the W. 1/16 sec. cor. of secs. 22 and 27.
Set an iron post, 3 ft. long, 1 in. diam., 18 ins. in the ground to bedrock, and in a mound of stone to top, with brass cap mkd.

<div style="text-align: center;"> S 22
 W 1/16 —————
 S 27
 1948 </div> Bury a lava stone mkd. X alongside the iron post.
From the corner
A local corner, bears WEST, 12 lks. dist. |
| 29.873 | Point for the W W 1/64 sec. cor. of secs. 22 and 27.
Set a redwood post, 2x3 ins., 2½ ft. long, 20 ins. in the ground, mkd. 1/64 on N. face. Raise a mound of stone, 3 ft. base, 2½ ft. high, N. of cor. |
| 39.83 | The cor. of secs. 21, 22, 27 and 28, mkd. by an iron post, 2 ins. diam., firmly set, mkd. and witnessed as described in the official record. |
| ----- | |
| | N. 0° 14' E., on true line bet. secs. 21 and 22.
Over rolling land.
Ascend 10 ft. along W. slope of a small hill. |
| 2.00 | Top of ascent; desc. 35 ft. over NW. slope, |
| 9.60 | Wash, 25 lks. wide, 4 ft. deep, course NW. |
| 9.902 | Point for the SS 1/64 sec. cor. of secs. 21 and 22.
Set a redwood stake, 2x3 ins., 2½ ft. long, 20 ins. in the ground, mkd. 1/64 on W. face, from which

A local corner, mkd. by an iron pipe, 1 in. diam., 3 ins. above ground, bears SOUTH, 0.6 lk. dist.

Raise a mound of stone, 3 ft. base, 2½ ft. high, W. of cor. |
| 10.90 | Wash, 20 lks. wide, 4 ft. deep, course W. |
| 11.934 | Intersect line 1-2 of the Santa Rosa lode mining claim, (a metes-and-bounds survey of land classified as mineral bearing).

Point for the closing corner of secs. 21 and 22.
Set a redwood stake, 2x3 ins., 2½ ft. long, 20 ins. in the ground, mkd. C C S 21-22. Raise a mound of stone, 3 ft. base, 2½ ft. high, S. of cor. |

copy

Resurvey of a Portion of the Boundaries of Section 22,
T. 3 N., R. 3 E.

- Chains From this point Cor. No. 1 of the Santa Rosa lode mining claim, bears S. 39° 23' W., 1.175 chs. dist., and is monumented with an iron post, 1 in. diam., firmly set, mkd, and witnessed as described in the official record.
- From the same point, Cor. No. 2, bears N. 39° 23' E., 21.54 chs. dist., and is monumented with an iron post, 1 in. diam., firmly set, mkd. and witnessed as described in the official record.
- 14.50 Wash, 30 lks. wide, 4 ft. deep, course W.
- 15.70 Wash, 40 lks. wide, 6 ft. deep, course NW.
- 19.804 Point for the S 1/16 sec. cor. of secs. 21 and 22.
- Set an iron post, 3 ft. long, 1 in. diam., 27 ins. in the ground, with brass cap mkd.
- S 1/16
S 21 | S 22
1948
- from which
- A local corner, which is monumented with an iron pipe, 1 in. diam., 3 ins. above ground, bears SOUTH, 0.4 lk. dist.
- A road at this point prevents establishment of accessaries.
- 20.00 Road, bears E. to a garage and W. to Cave Creek-Sunnyslope Highway.
-
- 24.692 Intersect line 3-4 of the Santa Rosa lode mining claim, (a metes-and-bounds survey of land classified as mineral bearing).
- From point of intersection, Cor. No. 3 of the Santa Rosa lode mining claim, bears N. 39° 33' E., 8.740 chs. dist. and is monumented with an iron post, 1 in. diam., firmly set, mkd. and witnessed as described in the official record.
- From the same point, Cor. No. 4, bears S. 39° 33' W., 13.980 chs. dist. and is monumented with an iron post, 1 in. diam., firmly set, mkd. and witnessed as described in the official record.
- 28.15 Shallow wash, course W.
- 29.706 Point for the NS 1/64 sec. cor. of secs. 21 and 22.
- Set an iron post, 3 ft. long, 1 in. diam., 27 ins. in the ground, with brass cap mkd.
- N, S
1/64
S 21 | S 22
1948
- raise a mound of stone, 3 ft. base, 2½ ft. high, W. of cor.
- 31.10 Wash, 20 lks. wide, 4 ft. deep, course SW.

Resurvey of a Portion of the Boundaries of Section 22,
T. 3 N., R. 3 E.

Chains	
33.70	Recross wash, in bend, course SE. from NE.
35.95	Center of paved highway, bears NE. to Cave Creek and S. 20° W. to Sunnyslope.
39.608	The $\frac{1}{4}$ sec. cor. of secs. 21 and 22 which is monumented with an iron post, 1 in. diam., firmly set in a mound of stone, mkd. and witnessed as described in the official record.

Subdivision of Section 22, T. 3 N., R. 3 E.	

	From the $\frac{1}{4}$ sec. cor. of secs. 22 and 27.
	N. 0° 18' W., on the N. and S. center line of sec. 22.
	Over rolling land.
0.75	Shallow wash, course E.
4.25	Shallow wash, course NE.
6.45	Shallow wash, course NE.
9.963	Point for the CSS $\frac{1}{64}$ sec. cor. of sec. 22. Set a redwood stake, 2x3 ins., 2 $\frac{1}{2}$ ft. long, 20 ins. in the ground, mkd. $\frac{1}{64}$ on W. face. Raise a mound of stone, 3 ft. base, 2 $\frac{1}{2}$ ft. high, W. of cor.
12.95	Shallow wash, course SE. Begin ascent of mountain; asc. 66 ft. over a S. slope.
18.50	Point of a spur; slopes SW.; continue ascent of 36 ft along a W. slope.
19.786	A local corner, mkd. by an iron pipe, 1 in. diam., set in a mound of stone.
19.926	Point for the C S $\frac{1}{16}$ sec. cor. of sec. 22 Set an iron post, 3 ft. long, 1 in. diam., 26 ins. in the ground, with brass cap mkd. <div style="text-align: center;"> <p style="text-align: center;">C S 1/16 S 22 C 1948</p> </div> raise a mound of stone, 3 ft. base, 2 $\frac{1}{2}$ ft. High, W. of cor.
22.25	Slope changes; asc. 209 ft. along an E. slope.
29.889	Point for the CNS $\frac{1}{64}$ sec. cor. of sec. 22. Set a redwood stake, 2x3 ins., 2 $\frac{1}{2}$ ft. long, 20 ins. in the ground, mkd. $\frac{1}{64}$ on W. face. Raise a mound of stone, 3 ft. base, 2 $\frac{1}{2}$ ft. high, W. of cor.
34.50	High spur, slopes S. 20° W.; desc. 179 ft. over a steep NW. slope.
38.35	Spur, slopes N. 40° W., from S. 20° E.

Subdivision of Section 22, T. 3 N., R. 3 E.

Chains
39.852

Point, for the $\frac{1}{4}$ sec. cor. of sec. 22, at intersection with the E. and W. center line, and has been monumented by a local engineer with an iron post, 1 in. diam., firmly set, protruding 6 ins. above a mound of stone, 2 ft. base, 1 ft. high, with brass cap mkd.

16/13 COR

Additionally mark the brass cap to read as follows

16/13 COR

C $\frac{1}{4}$

S 22

1948

from which

A point on top of a ledge of rock, 6 ft. wide, 4 ft. high, bears S. $36^{\circ} 07' W.$, 56.4 lks. dist., mkd.
B + O.

A point on top of a rock outcropping, 6 ft. wide, 10 ft. high; bears N. $81^{\circ} 27' E.$, 11.7 lks. dist., mkd.
B + O.

From this corner the $\frac{1}{4}$ sec. cor. of secs. 22 and 23, bears N. $89^{\circ} 54' E.$, 40.17 chs. dist.

From the same corner the $\frac{1}{4}$ sec. cor. of secs. 15 and 22, bears N. $0^{\circ} 18' W.$, 40.405 chs. dist.

S. $89^{\circ} 54' W.$, on E. and W. center line of sec. 22.

Ascend 37 ft. over a NE. slope.

4.30 Spur, slopes N. from SE.; desc. 199 ft. over a steep W. slope.

9.865 Point for the C E W $\frac{1}{64}$ sec. cor. of sec. 22.

Set a redwood stake, 2x3 ins., 2 $\frac{1}{2}$ ft. long, 20 ins. in the ground, mkd. $\frac{1}{64}$ on N. face. Raise a mound of stone, 3 ft. base, 2 $\frac{1}{2}$ ft. high, N. of cor.

12.00 Foot of steep descent of mountain, bears N. and S.; desc. 51 ft. over a gradual W. slope.

17.05 Wash, 20 lks. wide, 6 ft. deep, course NW.

19.73 Point for the C W $\frac{1}{16}$ sec. cor. of sec. 22.

Set an iron post, 3 ft. long, 1 in. diam., 27 ins. in the ground, with brass cap mkd.

W $\frac{1}{16}$

C $\frac{1}{16}$ C

S 22

1948

Subdivision of Section 22, T. 3 N., R. 3 E.

1948 4879

Chains

from which

A local corner, bears SOUTH, 0.2 lk. dist., an iron post, 1 in. diam., 9 ins. above ground.

Raise a mound of stone, 3 ft. base, 2½ ft. high, N. of cor.

23.45 Wash, 30 lks. wide, 6 ft. deep, course SW.

24.663 Point for the CEWW 1/256 sec. cor. of sec. 22.

Set a redwood stake, 2x3 ins., 2½ ft. long, 20 ins. in the ground, mkd. 1/256 on N. face. Raise a mound of stone, 3 ft. base, 2½ ft. high, N. of cor.

29.595 Point for the CWV 1/64 sec. cor. of sec. 22.

Set an iron post, 3 ft. long, 1 in. diam., 27 ins. in the ground, with brass cap mkd.

S 22

C-W-W

1/64

1948

from which

A local corner, bears NORTH, 0.2 lk. dist., an iron post, 1 in. diam., 12 ins. above ground.

Raise a mound of stone, 3 ft. base, 2½ ft. high, N. of cor.

33.55 Shallow wash, course SW.

34.56 Power line, bears NE. and SW.

35.86 Center of paved highway, bears NE. and SW.

36.86 Telephone line, bears NE. and SW.

38.00 Road, bears NW. and SE.

39.46 The ¼ sec. cor. of secs. 21 and 22.

From the CS. 1/16 sec. cor. of sec. 22.

N. 89° 58' W., on the E. and W. center line of the SW. ¼ of sec. 22.

Descend 155 ft. over a steep W. slope of a spur.

5.60 Trail, bears N. 70° W. and SE.

9.00 Foot of steep descent, bears N. and S., thence over rolling land with a general NW. slope.

9.913 Point for the CE SW 1/64 sec. cor. of sec. 22.

Set a redwood stake, 2x3 ins., 2½ ft. long, 20 ins. in the ground, mkd. 1/64 on N. face, from which a local corner:

An iron post, 1 in. diam., 12 ins. above ground, bears SOUTH, 13 lks. dist.

Raise a mound of stone, 3 ft. base, 2½ ft. high, N. of cor.

Subdivision of Section 22, T. 3 N., R. 3 E.

Chains	
12.80	Wash, 20 lks. wide, 4 ft. deep, course NW.
19.826	Point for the SW 1/16 sec. cor. of sec. 22. Set an iron post, 3 ft. long, 1 in. diam., 18 ins. in the ground to bedrock, and in a mound of stone to top, with brass cap mkd. SW 1/16 S 22. 1948 Bury a lava stone, mkd. X alongside the iron post.
20.80	Low spur, slopes N.; desc. 70 ft. over a W. slope.
24.782	Point for the CEW SW 1/256 sec. cor. of sec. 22. Set a redwood stake, 2x3 ins., 2½ ft. long, 20 ins. in the ground, mkd. 1/256 on N. face. Raise a mound of stone, 3 ft. base, 2½ ft. high, N. of cor.
27.20	Wash, 20 lks. wide, 4 ft. deep, course NW.
29.738	Point for the CW SW 1/64 sec. cor. of sec. 22. Set an iron post, 3 ft. long, 1 in. diam., 27 ins. in the ground, with brass cap mkd. S 22 C-W-SW 1/64 1948 raise a mound of stone, 3 ft. base, 2½ ft. high, N. of cor.
33.233	Intersect line 1-2 of the Santa Rosa lode mining claim, (a metes-and-bounds survey of land classified as mineral bearing) Point for the closing corner of lots 14 and 4 of sec. 22. Set a redwood stake, 2x3 ins., 2½ ft. long, 20 ins. in the ground, mkd. CC-L-2-4 on E. face. From this point Cor. No. 1 of the Santa Rosa lode mining claim, bears S. 39° 23' W., 11.374 chs. dist., and is monumented with an iron post, 1 in. diam., firmly set, marked and witnessed as described in the official record. From the same point Cor. No. 2, bears N. 39° 23' E., 11.341 chs. dist., and is monumented with an iron post, 1 in. diam., firmly set, marked and witnessed as described in the official record.
33.90	Wash, 20 lks. wide, 6 ft. deep, course SW.
35.90	Wash, 50 lks. wide, 6 ft. deep, course S.
39.65	The S. 1/16 sec. cor. of secs. 21 and 22. ----- From the W. 1/16 sec. cor. of secs. 22 and 27. N. 0° 03' W., on the N. and S. center line of the SW. ¼ of sec. 22. Descend 238 ft. over the NW. slope of a mountain.

Subdivision of Section 22, T. 3 N., R. 3 E.

4379

Chains	
9.935	Point for the C S SW 1/64 sec. cor. of sec. 22. Set a redwood stake, 2x3 ins. 2½ ft. long, 20 ins. in the ground, mkd. 1/64 on W. face, from which a local corner: An iron post, 1 in. diam., 10 ins. above ground, bears SOUTH, 0.3 lk. dist. Raise a mound of stone, 3 ft. base, 2½ ft. high, W. of cor.
18.30	Top of spur, slopes N. 20° W.; continue descent along an E. slope.
19.87	The SW 1/16 sec. cor. of sec. 22.
22.00	Foot of the descent of the mountain, thence over rolling land with a general W. slope.
24.835	Point for the CSN SW 1/256 sec. cor. of sec. 22. Set a redwood stake, 2x3 ins., 2½ ft. long, 20 ins. in the ground, mkd. 1/256 on W. face. Raise a mound of stone, 3 ft. base, 2½ ft. high, W. of cor.
25.75	Wash, 30 lks. wide, 6 ft. deep, course W.
27.25	Wash, 50 lks. wide, 12 ft. deep, course W.
29.80	Point for the C N SW 1/64 sec. cor. of sec. 22. Set an iron post, 3 ft. long, 1 in. diam., 27 ins. in the ground, with brass cap mkd. S 22 C-N-SW 1/64 1948 raise a mound of stone, 3 ft. base, 2½ ft. high, W. of cor.
31.80	Wash, 25 lks. wide, 6 ft. deep, course W.
33.80	Wash, 25 lks. wide, 4 ft. deep, course W.
34.765	Point for the CNN SW 1/256 sec. cor. of sec. 22. Set a redwood stake, 2x3 ins., 2½ ft. long, 20 ins. in the ground, mkd. 1/256 on W. face. Raise a mound of stone, 3 ft. base, 2½ ft. high, W. of cor.
39.73	The CW 1/16 sec. cor. of sec. 22.
	From the CW SW 1/64 sec. cor. of sec. 22. N. 0° 04' E., on the N. and S. center line of the NW¼ SW¼ of sec. 22. Over rolling land.
0.25	Wash, 30 lks. wide, 4 ft. deep, course W.
2.65	Wash, 20 lks. wide, 4 ft. deep, course W.
4.287	Intersect line 1-2 of the Santa Rosa lode mining claim, (a metes-and-bounds survey of land classified as mineral

BOOK 4873

Subdivision of Section 22, T. 3 N., R. 3 E.

Chains	
	bearing).
	Point for the closing corner of lots 4 and 13 of sec. 22.
	Set a redwood stake, 2x3 ins. 2½ ft. long, 20 ins. in the ground, mkd. CC L-4-5 on S. face.
	From this point, Cor. No. 2 of the Santa Rosa lode mining claim, bears N. 39° 23' E., 5.798 chs. dist.
	From the same point, Cor. No. 1, bears S. 39° 23' W., 16.917 chs. dist.
4.35	Shallow wash, course W.
4.959	Point for the CS NW SW 1/256 sec. cor. of sec. 22.
	Set a redwood stake, 2x3 ins., 2½ ft. long, 20 ins. in the ground, mkd. 1/256 on W. face. Raise a mound of stone, 3 ft. base, 2½ ft. high, W. of cor.
8.25	Wash, 20 lks. wide, 6 ft. deep, course W.
9.918	Point for the NW SW 1/64 sec. cor. of sec. 22.
	Set an iron post, 3 ft. long, 1 in. diam., 27 ins. in the ground, with brass cap mkd.
	S 22
	NW-SW
	1/64
	1948
	raise a mound of stone, 3 ft. base, 2½ ft. high, W. of cor.
10.082	Intersect line 2-3 of the Santa Rosa lode mining claim, (a metes-and-bounds survey of land classified as mineral bearing).
	Point for the closing corner of lots 3 and 12 of sec. 22.
	Set a redwood stake, 2x3 ins., 2½ ft. long, 20 ins. in the ground, mkd. CC L-1-3 on N. face.
	From this point Cor. No. 2, bears S. 70° 17' E., 3.896 chs. dist.
	From the same point Cor. No. 3, bears N. 70° 17' W., 4.594 chs. dist., and is monumented with an iron post, 1 in. diam., firmly set in a mound of stone, marked and witnessed as described in the official record.
12.25	Wash, 40 lks. wide, 10 ft. deep, course SW.
14.875	Point for the CN NW SW 1/256 sec. cor. of sec. 22.
	Set a redwood stake, 2x3 ins., 2½ ft. long, 20 ins. in the ground, mkd. 1/256 on W. face. A road W. of the corner prevents the establishment of accessories. Bury a brown purex bottle alongside the wooden stake.
16.25	Road, bears NE. and SW.
19.832	The CWW 1/64 sec. cor. of sec. 22.

Subdivision of Section 22, T. 3 N., R. 3 E.

DOCP 4378

Chains	<p>From the CN SW 1/64 sec. cor. of sec. 22, S. 89°59'W., on the E. and W. center line of the NW$\frac{1}{4}$ SW$\frac{1}{4}$ of sec. 22.</p> <p>Over rolling land, descending gradually over general W. slope.</p> <p>0.45 Wash, 40 lks. wide; 4 ft. deep, course NW.</p> <p>4.30 Wash, 40 lks. wide, 12 ft. deep, course NW.</p> <p>4.945 Point for the CE NW SW 1/256 sec. cor. of sec: 22.</p> <p>Set a redwood stake, 2 x 3 ins., 2$\frac{1}{2}$ ft. long, 20 ins. in the ground, mkd. 1/256 on N. face. Raise a mound of stone, 3 ft. base, 2$\frac{1}{2}$ ft. high N. of cor.</p> <p>9.429 Intersect line 2-3, of the Santa Rosa lode mining claim, a metes-and-bounds survey of land classified as mineral bearing.</p> <p>Point for closing cor.</p> <p>Set a redwood stake, 2 x 3 ins., 2$\frac{1}{2}$ ft. long, 20 ins. in the ground.</p> <p>From this point, Cor. No. 2 of the Santa Rosa lode mining claim, bears S.70°17'E., 3.408 chs. dist.</p> <p>From the same point, Cor. No. 3, bears N.70°17'W., 5.082 chs. dist.</p> <p>9.89 The NW SW 1/64 sec. cor. of sec. 22.</p> <p>10.90 Wash, 40 lks. wide, 10 ft. deep, course SW.</p> <p>11.90 Road; bears NE. and SW.; foot of ascent, bears NE. and SW. Asc. 32 ft. over E. slope.</p> <p>15.30 Ridge, bears NE. and SW.; desc. 32 ft. over W. slope.</p> <p>15.657 Intersect line 3-4, of the Santa Rosa lode mining claim, a metes-and-bounds survey of land, classified, as mineral bearing.</p> <p>From point of intersection, Cor. No. 3 of the Santa Rosa lode mining claim, bears N.39°33'E., 2.241 chs. dist.</p> <p>From the same point, Cor. No. 4, bears S.39°33'W., 20.479 chs. dist., and is monumented with an iron post, 1 in. diam., firmly set, mkd. and witnessed as described in the official record.</p> <p>19.782 The N S 1/64 sec. cor. of secs. 21 and 22.</p>
--------	--

78

4-878b

BOOK 4379

Resurvey of a Portion of the Boundaries of
Section 27, T.3 N., R.3 E.

Chains	<p>The cor. of secs. 26, 27, 34 and 35, is monumented with an iron post, 2 ins. diam., firmly set, marked and witnessed as described in the official record, from which</p> <p>Cor. No. 1 of Mineral Survey No. 4111, Eureka lode patented mining claim, bears N.29°56'W., 7.398 chs. dist.</p> <p>Thence</p> <p>N.0°39'E., on true line bet. secs. 26 and 27.</p> <p>Over rolling and broken land; desc. 50 ft. over N. slope.</p> <p>11.00 Wash, 20 lks. wide, 6 ft. deep, course SE.</p> <p>20.065 The S. 1/16 sec. cor. of secs. 26 and 27, which is monumented with an iron post, 1 in. diam., firmly set, mkd. and witnessed as described in the official record.</p> <p>22.25 Shallow wash, course NE.</p> <p>27.00 Wash, 40 lks. wide, 10 ft. deep, course SE.</p> <p>28.85 Road, bears NW. and E.</p> <p>30.097 Point for the NS 1/64 sec. cor. of secs. 26 and 27.</p> <p>Set a redwood stake, 2 x 3 ins., 2½ ft. long, 22 ins. in the ground, mkd. 1/64 on W. face. Raise a mound of stone, 3 ft. base, 2½ ft. high, W. of cor.</p> <p>40.13 The ¼ sec. cor. of secs. 26 and 27, which is monumented with an iron post, 1 in. diam., firmly set, mkd. and witnessed as described in the official record.</p> <p>-----</p> <p>N.1°55'E., beginning new measurement.</p> <p>Over gently rolling land.</p> <p>3.20 Wash, 20 lks. wide, 6 ft. deep, course S.60°E.</p> <p>10.32 Point for the SN 1/64 sec. cor. of secs. 26 and 27.</p> <p>Set a redwood stake, 2 x 3 ins. 2½ ft. long, 20 ins. in the ground, mkd. 1/64 on W. face. Raise a mound of stone, 3 ft. base, 2½ ft. high, W. of cor.</p> <p>20.64 Point for the N. 1/16 sec. cor. of secs. 26 and 27.</p> <p>Set an iron post, 3 ft. long, 1 in. diam., 26 ins. in the ground, with brass cap mkd.</p>
--------	---

Resurvey of a Portion of the Boundaries of Section 27,
T. 3 N., R. 3 E.

Chains	
	N 1/16 S 26 S 27 ----- 1948
26.60	raise a mound of stone, 3 ft. base, 2½ ft. high, W. of cor. Point of a spur, slopes E.
34.90	Road, bears N. 10° W. and SE.
41.28	The cor. of secs. 22, 23, 26 and 27, which is monumented with an iron post, 2 ins. diam., firmly set, marked and witnessed as described in the official record.

	From the cor. of secs. 26, 27, 34 and 35, N. 89° 06' W., on true line, bet. secs. 27 and 34. Over mountainous land; ascend 30 ft. over a NE. slope.
2.00	Slope changes; continue ascent of 179 ft. over a SE. slope.
13.80	Spur, slopes S.; desc. 248 ft. over a SW. slope.
20.37	Point for the E 1/16 sec. cor. of secs. 27 and 34. Set an iron post, 3 ft. long, 1 in. diam., 26 ins. in the ground, with brass cap mkd.
	S 27 E 1/16 ----- S 34 1948
30.00	raise a mound of stone, 3 ft. base, 2½ ft. high, N. of cor. Foot of steep descent, bears NW. and SE., thence over rolling land with a general SW. slope.
32.85	Wash, 30 lks. wide, 6 ft. deep, course S.
33.90	Road, bears N. and S.
36.00	Road, bears N. and S.
39.40	Wash, 60 lks. wide, 12 ft. deep, course S.
40.74	The ¼ sec. cor. of secs. 27 and 34, and is monumented with a lava stone, 16x12x3 ins., firmly set in the ground, mkd. ¼ on N. face At the corner point Set an iron post, 3 ft. long, 1 in. diam., 27 ins. in the ground, with brass cap mkd.
	S 27 ¼ ----- S 34 1948
	raise a mound of stone, 3 ft. base, 2½ ft. high, N. of cor. and bury the original corner stone alongside the iron post.

80
4-878b

28
ECCY

Resurvey of a Portion of the Boundaries of Section 27,
T. 3 N., R. 3 E.

Chains	
	From this corner, Cor. No. 1 of Survey No. 4111, Eureka No. 1 lode patented mining claim, bears S. 57° 32' E., 12.98 chs. dist.

	N. 88° 59' W., beginning new measurement.
	Continue over rolling land.
2.45	Wash, 30 lks. wide, 4 ft. deep, course S.
4.70	Wash, 30 lks. wide, 10 ft. deep, course SE.
14.35	Foot of steep ascent, bears N. and S.; asc. 272 ft. over an E. slope.
24.90	Ridge, bears N. and SW.; desc. 183 ft. over a steep NW. slope.
39.07	The cor. of secs. 27, 28, 33 and 34, marked by a malpais stone, 36x12x4 ins., firmly set in a mound of stone, 3 ft. base, 2 ft. high, mkd. SE 28 on NW. and SW 27 on NE. faces. The original corner stone could not be found. Subdivisions in the town of Sunnyslope have been initiated from this corner and it is accepted by local engineers as marking the position of the original corner.
	At the point for corner.
	Set an iron post, 3 ft. long, 2 ins. diam., 18 ins. in the ground to bedrock, and in a mound of stone to top, with brass cap mkd.
	T 3 N R 3 E S 28 S 27 S 33 S 34 1948
	Bury the corner stone alongside the iron post.

	N. 2° 07' E., on true line, bet. secs. 27 and 28.
	Over mountainous and rolling land; desc. 110 ft. over a NW. slope.
10.00	Foot of steep descent, bears NE. and SW.; thence over rolling land.
11.65	Wash, 30 lks. wide, 4 ft. deep, course NW.
16.00	Low ridge, bears SE. and NW.
21.70	Wash, 40 lks. wide, 4 ft. deep, course W.
22.30	Wash, 20 lks. wide, 4 ft. deep, course W.
37.30	Wash, 40 lks. wide, 3 ft. deep, course W.
39.12	The ¼ sec. cor. of secs. 27 and 28, mkd. by an iron pipe, 2 ins. diam., 8 ins. above ground. This pipe is located at the intersection of center lines of streets from N. and W. of a subdivision of the town of Sunnyslope and is accepted by local engineers as marking the position of the original corner.

Resurvey of a Portion of the Boundaries of Section 27,
T. 3 N., R. 3 E.

BOOK 4379

Chains

At the corner point.

Bury a lava stone, 12x8x8 ins.; 12 ins. below the surface of the street, mkd. X.

from which

An iron post, 3 ft. long, 1 in. diam., set 24 ins. in the ground for a reference monument, bears N. 45° E., 70.7 lks. dist., with brass cap mkd. $\frac{1}{4}$ S 27 R M 1948 and an arrow pointing to the true corner.

An iron post, 3 ft. long, 1 in. diam., set 24 ins. in the ground for a reference monument, bears S. 45° E., 70.7 lks. dist., with brass cap mkd. $\frac{1}{4}$ S 27 R M 1948 and an arrow pointing to the true corner.

Reset the iron pipe on top of X mkd. on corner stone.

N. 0° 48' E., beginning new measurement.

Along the center line of a street.

- 7.60 Wash, 30 lks. wide, 6 ft. deep, course W.
- 10.30 Leave the street at the intersection of the center line of a street from the W.
- 12.05 A local corner, mkd. by an iron post, 1 in. diam., 8 ins. above ground, with brass cap mkd. $\frac{16}{3}$ COR.
- 13.80 Wash, 20 lks. wide, 6 ft. deep, course W.
- 20.60 Point for the N $\frac{1}{16}$ sec. cor. of secs. 27 and 28.
- Set an iron post, 3 ft. long, 1 in. diam., 12 ins. in the ground to bedrock, and in a mound of stone to top, with brass cap mkd.
- N $\frac{1}{16}$
S 28 | S 27
1948
- 28.75 Wash, 20 lks, wide, 3 ft. deep, course W.
- 29.85 Road, bears E. and W.
- 30.90 Point for the NN $\frac{1}{64}$ sec. cor. of secs. 27 and 28.
- Set a redwood stake, 2x3 ins., 2½ ft. long, 20 ins. in the ground, mkd. $\frac{1}{64}$ on W. face. Raise a mound of stone, 3 ft. base, 2½ ft. high, W. of corner.
- 38.05 Wash, 40 lks. wide, 6 ft. deep, course W.
- 41.20 The cor. of secs. 21, 22, 27 and 28.

Subdivision of Section 27, T. 3 N., R. 3 E.

From the $\frac{1}{4}$ sec. cor. of secs. 27 and 34.

Chains	<p>N. 1° 58' E., on the N. and S. center line of sec. 27. Over rolling land.</p> <p>9.10 Wash, 30 lks. wide, 10 ft. deep, course SW.</p> <p>11.60 Foot of steep ascent; asc. 414 ft. over the SW. slope of mountain.</p> <p>19.837 Point for the C S 1/16 sec. cor. of sec. 27. Set an iron post, 3 ft. long, 1 in. diam., 18 ins. in the ground to bedrock, and in a mound of stone to top, with brass cap mkd.</p> <div style="text-align: center;"> </div> <p>raise a mound of stone, 3 ft. base, 2½ ft. high, W. of cor.</p> <p>29.755 Point for the CNS 1/64 sec. cor. of sec. 27. Set a redwood stake, 2x3 ins., 2½ ft. long, 20 ins. in the ground, mkd. 1/64 on W. face. Raise a mound of stone, 3 ft. base, 2½ ft. high, W. of cor.</p> <p>34.20 Ridge, bears E. and W.; desc. 254 ft. over a N. slope.</p> <p>39.674 Point for the C ¼ sec. cor. of sec. 27. Set an iron post, 3 ft. long, 1 in. diam., 26 ins. in the ground, with brass cap mkd.</p> <div style="text-align: center;"> </div> <p>from which</p> <p style="padding-left: 40px;">A local corner, mkd. by an iron pipe, 1 in. diam., 6 ins. above ground, bears EAST, 5 lks. dist.</p> <p style="padding-left: 40px;">Raise a mound of stone, 3 ft. base, 2½ ft. high, W. of cor.</p> <p>Ascend 278 ft. over a broken W. slope.</p> <p>48.90 Point of a spur, slopes W.</p> <p>49.975 Point for the CSN 1/64 sec. cor. of sec. 27. Set a redwood stake, 2x3 ins., 2½ ft. long, on top of an X mkd. on solid surface rock, and in a mound of stone to top, mkd. 1/64 on W. face, from which</p> <p style="padding-left: 40px;">A rock outcrop, bears EAST, 10 lks. dist., mkd. B X O.</p> <p>51.70 Point of a spur, slopes W.</p> <p>59.60 Ridge, bears E. and W.; desc. 262 ft. over a broken NE. slope.</p> <p>60.277 Point for the CN 1/16 sec. cor. of sec. 27. Set an iron post, 3 ft. long; 1 in. diam., 4 ins. in the ground to bedrock, and in a mound of stone to top, with</p>
--------	--

Subdivision of Section 27, T. 3 N., R. 3 E.

BOOK 4078

Chains

brass cap mkd.

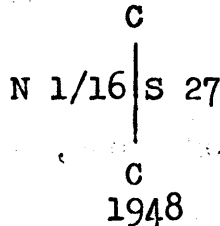
80.88 The $\frac{1}{4}$ sec. cor. of secs. 22 and 27.-----
From the $\frac{1}{4}$ sec. cor. of secs. 26 and 27.N. $89^{\circ} 46'$ W., on the E. and W. center line of sec. 27.

Over rolling land; asc. 85 ft. over a gradual SE. slope.

9.962 Point for the CEE $1/64$ sec. cor. of sec. 27.Set a redwood stake, 2x3 ins., $2\frac{1}{2}$ ft. long, 20 ins. in the ground, mkd. $1/64$ on N. face. Raise a mound of stone, 3 ft. base, $2\frac{1}{2}$ ft. high, N. of cor.

.17.85 Foot of steep ascent; asc. 305 ft. over an E. slope,

19.925 Point for the CE $1/16$ sec. cor. of sec. 27.

Set an iron post, 3 ft. long, 1 in. diam., 12 ins. in the ground to bedrock, and in a mound of stone to top, with brass cap mkd.

E $1/16$

C ————— C

S 27

1948'

raise a mound of stone, 3 ft. base, 3 ft. high, NW. of cor.

24.75 Spur, slopes N.

29.887 Point for the CWE $1/64$ sec. cor. of sec. 27.Set a redwood stake, 2x3 ins., $2\frac{1}{2}$ ft. long, 20 ins. in the ground, mkd. $1/64$ on N. face. Raise a mound of stone, 3 ft. base, $2\frac{1}{2}$ ft. high, N. of cor.

34.15 Ridge, bears N. and S.; desc. 183 ft. over a W. slope.

39.85 The C $\frac{1}{4}$ sec. cor. of sec. 27.

Continue descent across a small steep ravine, course NW.; thence along a N. slope.

47.50 Begin steep descent of 219 ft. over a NW. slope.

57.25 Wash, 30 lks. wide, 6 ft. deep, course SW.; thence over rolling land; descend gradually 79 ft. over a general W. slope.

59.348 Point for the CW $1/16$ sec. cor. of sec. 27.

Set an iron post, 3 ft. long, 1 in. diam., 26 ins. in the ground, with brass cap mkd.

Subdivision of Section 27, T. 3 N., R. 3 E.

Chains	
	W 1/16 C ————— C S 27 1948
	raise a mound of stone, 3 ft. base, 2½ ft. high, N. of cor.
75.95	Wash, 30 lks. wide, 5 ft. deep, course SW.
76.95	Road, bears NE. and SW.
78.845	The ¼ sec. cor. of secs. 27 and 28.

	From the E. 1/16 sec. cor. of secs. 27 and 34.
	N. 1° 18' E., on the N. and S. center line of the SE. ¼ of sec. 27.
	Over mountainous land
	Ascend 280 ft. over a steep S. slope.
7.15	Spur, slopes SW.; desc. 190 ft. over a steep NW. slope.
19.948	Point for the SE 1/16 sec. cor. of sec. 27.
	Set an iron post, 3 ft. long, 1 in. diam., 6 ins. in the ground to bedrock, and in a mound of stone to top, with brass cap mkd.
	SE 1/16 S 27 1948
	Bury a lava stone, 10x6x2 ins. mkd. X alongside the iron post.
20.10	Ridge, bears NW. and SE.; desc. 77 ft. over a NE. slope.
26.40	Shallow wash, course NE.; foot of steep descent of mountain thence over heavily rolling and broken land.
27.80	Wash; 30 lks. wide, 4 ft. deep, course E.
29.925	Point for the CN SE 1/64 sec. cor. of sec. 27.
	Set a redwood stake, 2x3 ins., 2½ ft. long, 16 ins. in the ground, mkd. 1/64 on W. face. Raise a mound of stone, 3 ft. base, 2½ ft. high, W. of cor.
35.50	Wash, 40 lks. wide; 10 ft. deep, course E.
37.20	Road, bears E. and W.
39.902	The CE 1/16 sec. cor. of sec. 27.

	From the S 1/16 sec. cor. of secs. 26 and 27.
	N. 89° 29' W., on the E. and W. center line of the SE. ¼ of sec. 27.
	Over hilly and broken land.
	Ascend 196 ft. over a general NE. slope.

Subdivision of Section 27, T. 3 N., R. 3 E.

BOOK 400

Chains	
3.50	Wash, 20 lks. wide, 4 ft. deep, course NE.
10.08	Point for the CE SE 1/64 sec. cor. of sec. 27. Set a redwood stake, 2x3 ins., 2½ ft. long, 18 ins. in the ground, mkd. 1/64 on N. face. Raise a mound of stone, 3 ft. base, 2½ ft. high, N. of cor.
17.50	Spur, slopes NE.; desc. 26 ft. along a N. slope.
19.50	Ridge, bears N. 80° W. from S. 40° E.; desc. 138 ft. over a SW. slope.
20.16	The SE 1/16 sec. cor. of sec. 27.
24.75	Trail, bears NE. and SW.
26.25	Wash, 10 lks. wide, 4 ft. deep, course SW.
27.35	Wash, 10 lks. wide, 4 ft. deep, course S.; asc. 48 ft. over a SE. slope.
30.10	Spur, slopes S.; thence over a broken S. slope.
30.23	Point for the CW SE 1/64 sec. cor. of sec. 27. Set a redwood stake, 2x3 ins., 2½ ft. long, 20 ins. in the ground, mkd. 1/64 on N. face. Raise a mound of stone, 4 ft. base, 3 ft. high, N. of cor.
31.75	Wash, 40 lks. wide, 10 ft. deep, course S.
35.00	Wash, 20 lks. wide, 6 ft. deep, course S.
37.75	Wash, 30 lks. wide, 6 ft. deep, course SE.; asc. 57 ft. over an E. slope.
40.30	The CS 1/16 sec. cor. of sec. 27.

	From the N. 1/16 sec. cor. of secs. 26 and 27. N. 89° 48' W., on the E. and W. center line of the NE. ¼ of sec. 27. Over rolling land; asc. 41 ft. over a gradual SE. slope.
9.50	Shallow wash, course SE.
9.959	Point for the CE NE 1/64 sec. cor. of sec. 27. Set a redwood stake, 2x3 ins., 2½ ft. long, 20 ins. in the ground, mkd. 1/64 on N. face. Raise a mound of stone, 3 ft. base, 2½ ft. high, N. of cor.
13.50	Foot of steep ascent, bears N. and S.; asc. 273 ft. over a SE. slope.
19.918	Point for the NE 1/16 sec. cor. of sec. 27. Set an iron post, 3 ft. long, 1 in. diam., 24 ins. in the ground, with brass cap mkd.
	NE 1/16 S 27 1948 raise a mound of stone, 4 ft. base, 3 ft. high, W. of cor.

86
-878b

BOOK 4370

Subdivision of Section 27, T. 3 N., R. 3 E.

Chains	
25.60	Spur, slopes N. 60° E.; thence over a broken N. slope.
29.872	Point for the CW NE 1/64 sec. cor. of sec. 27. Set a redwood stake, 2x3 ins., 2½ ft. long, 20 ins. in the ground, mkd. 1/64 on N. face, Raise a mound of stone, 3 ft. base, 2½ ft. high, N. of cor.
39.826	The CN 1/16 sec. cor. of sec. 27.

	From the CE 1/16 sec. cor. of sec. 27. N. 2° 0' E., on the N. and S. center line of the NE ¼ of sec. 27. Over rolling and hilly land. Ascend 26 ft. over a S. slope.
2.56	Spur, slopes E.; desc. 25 ft. over a N. slope.
4.56	Wash, 20 lks. wide, 4 ft. deep, course SE.
10.318	Point for the CS NE 1/64 sec. cor. of sec. 27. Set a redwood stake, 2x3 ins., 2½ ft. long, 18 ins. in the ground, mkd. 1/64 on W. face, Raise a mound of stone, 3 ft. base, 2½ ft. high, W. of cor.
13.25	Shallow wash, course E.; asc. 112 ft. over a SE. slope.
19.50	Spur, slopes NE.
20.636	The NE 1/16 sec. cor. of sec. 27. From this corner, the E 1/16 sec. cor. of secs. 22 and 27, bears N. 2° 0' E., 20.624 chs. dist.

	From the CW 1/16 sec. cor. of sec. 27. N. 1° 20' E., on the N. and S. center line of the NW ¼ of sec. 27. Over rolling land. Ascend gradually over a general W. slope.
4.25	Wash, 30 lks. wide, 10 ft. deep, course NW.
11.00	Wash, 30 lks. wide, 15 ft. deep, course W.
14.10	Wash, 50 lks. wide, 15 ft. deep, course SW.
17.00	Leave rolling land, enter mountainous land, bears NE. and SW.; asc. 220 ft. over a SE. slope.
20.61	Point for the NW 1/16 sec. cor. of sec. 27. Set an iron post, 3 ft. long, 1 in. diam., 26 ins. in the ground, with brass cap mkd. NW 1/16 S 27 1948 raise a mound of stone, 3 ft. base, 2½ ft. high, W. of cor.

Subdivision of Section 27, T. 3 N., R. 3 E.

L. 1011 1073

Chains	
23.50	Spur, slopes SW.; thence over a broken W. slope.
30.907	Point for the CN NW 1/64 sec. cor. of sec. 27.
	Set a redwood stake, 2x3 ins., 2½ ft. long, 12 ins. in the ground to bedrock, and in a mound of stone to top, mkd. 1/64 on W. face. Bury a lava stone mkd. X alongside the wooden stake.
36.85	High spur, slopes W.; desc. 156 ft. over a N. slope.
41.204	The W 1/16 sec. cor. of secs. 22 and 27.

	From the CN 1/16 sec. cor. of sec. 27.
	N. 89° 47' W.; on the E. and W. center line of the NW. ¼ of sec. 27.
	Over mountainous land.
	Ascend 20 ft. over a NE. slope.
0.80	Ridge, bears NW. and SE.; desc. 477 ft. over a broken S. slope.
11.00	Spur, slopes SW.
19.694	The NW 1/16 sec. cor. of sec. 27.
21.00	Spur, slopes SW.
28:00	Foot of the mountain; thence over rolling land with a general NW. slope.
29.547	Point for the CW NW 1/64 sec. cor. of sec. 27.
	Set a redwood stake, 2x3 ins., 2½ ft. long; 22 ins. in the ground, mkd. 1/64 on N. face. Raise a mound of stone, 3 ft. base, 2½ ft. high, N. of cor.
32.80	Point of a low spur, slopes N.
39.40	The N 1/16 sec. cor. of secs. 27 and 28.

	Subdivision of the SW. ¼ of Section 26, T. 3 N., R. 3 E.

	The CS 1/16 sec. cor. of sec. 26 is monumented with an iron post, 1 in. diam., firmly set, marked and witnessed as described in the official record.
	Thence
	N. 1° 28' W., on the N. and S. center line of sec. 26.
	Over rolling land:
0.60	Shallow wash, course SE.
0.90	Power line, bears E. and W.
10.26	Intersect line 3-4 of the Mercury mining claim, (a metes-and-bounds survey of land classified as mineral bearing).
	From point of intersection Cor. No. 3 of the Mercury mining claim, bears N. 42° 57' E., 10.86 chs. dist. and

Subdivision of the SW. 1/4 of Section 26, T. 3 N., R. 3 E.

Chains	is marked by an iron post, 1 in. diam., firmly set, mkd. and witnessed as described in the official record.
	From the same point, Cor. No. 4, bears S. 42° 57' W., 11.86 chs. dist., and is marked by an iron post, 1 in. diam., firmly set, marked and witnessed as described in the official record.
10.61	Point for the CNS 1/64 sec. cor. of sec. 26. Set a redwood stake, 2x3 ins., 2 1/2 ft. long, 14 ins. in the ground to bedrock, and in a mound of stone to top, mkd. 1/64 on W. face. Raise a mound of stone, 3 ft. base, 2 1/2 ft. high, W. of cor.
12.05	Graded road, bears E. and W.
20.90	Unimproved road, bears NW. and SE.
21.22	The C 1/4 sec. cor. of sec. 26, which is marked by an iron post, 1 in. diam., firmly set, marked and witnessed as described in the official record.

	S. 88° 02' W., on the E. and W. center line of sec. 26. Over rolling land.
1.82	Intersect line 1-2 of the Mercury mining claim, (a metes-and-bounds survey of land classified as mineral bearing). From point of intersection, Cor. No. 1 of the Mercury mining claim, bears S. 42° 32' W., 16.88 chs. dist., and is marked by an iron post, 1 in. diam., firmly set, mkd. and witnessed as described in the official record. From the same point, Cor. No. 2, bears N. 42° 32' E., 5.86 chs. dist., and is marked by an iron post, 1 in. diam., firmly set, marked and witnessed as described in the official record.
9.90	Unimproved road, bears N. and S.
10.69	Point for the CEW 1/64 sec. cor. of sec. 26. Set a redwood stake, 2x3 ins., 2 1/2 ft. long, 20 ins. in the ground, mkd. 1/64 on N. face. Raise a mound of stone, 3 ft. base, 2 1/2 ft. high, N. of cor.
21.38	The CW 1/16 sec. cor. of sec. 26, which is monumented with an iron post, 1 in. diam., firmly set, marked and witnessed as described in the official record.

	From the W. 1/16 sec. cor. of secs. 26 and 35, which is monumented with an iron post, 1 in. diam., firmly set, marked and witnessed as described in the official record.
	N. 0° 27' W., on the N. and S, center line of the SW. 1/4 of sec. 26.
	Over broken and hilly land.
5.10	Wash, 50 lks. wide, 15 ft. deep, course SW.
7.55	Power line, bears NE. and SW.
10.31	Point for the CS SW 1/64 sec. cor. of sec. 26.

Subdivision of the SW. $\frac{1}{4}$ of Section 26, T. 3 N., R. 3 E.

BOOK 4073

Chains	
	Set a redwood stake, 2x3 ins., 2 $\frac{1}{2}$ ft. long, 22 ins. in the ground, mkd. 1/64 on W. face. Raise a mound of stone, 3 ft. base, 2 $\frac{1}{2}$ ft. high W. of cor.
12.50	Wash, 40 lks. wide, 13 ft. deep, course E.; then SE.
15.15	Graded road, bears NE. and SW.
19.25	Wash, 10 lks. wide, 3 ft. deep, course E.
20.62	Point for the SW 1/16 sec. cor. of sec. 26. Set an iron post, 3 ft. long, 1 in. diam., 24 ins. in the ground, with brass cap mkd. SW 1/16 S 26 1948 from which A local corner, marked by an iron pipe, $\frac{3}{4}$ in. diam., 6 ins. above ground, bears WEST, 1 lk. dist. Raise a mound of stone, 3 ft. base, 2 ft. high, W. of cor. Thence over rolling land.
22.25	Unimproved road, bears E. and W.
26.75	Wash, 20 lks. wide, 3 ft. deep, course SE.
29.30	Unimproved road, bears E. and W.
30.934	Point for the CN SW 1/64 sec. cor. of sec. 26. Set a redwood stake, 2x3 ins., 2 $\frac{1}{2}$ ft. long, 22 ins. in the ground, mkd. 1/64 on W. face. Raise a mound of stone, 3 ft. base, 2 $\frac{1}{2}$ ft. high, W. of cor.
41.248	The CW 1/16 sec. cor. of sec. 26. ----- From the CS 1/16 sec. cor. of sec. 26. S. 89° 39' W., on the E. and W. center line of the SW $\frac{1}{4}$ of sec. 26. Over rolling land.
10.87	Point for the CE SW 1/64 sec. cor. of sec. 26. Set a redwood stake, 2x3 ins., 2 $\frac{1}{2}$ ft. long, 20 ins. in the ground, mkd. 1/64 on N. face. Raise a mound of stone, 3 ft. base, 2 $\frac{1}{2}$ ft. high, N. of cor. From this cor. a local corner, marked by an iron pipe, $\frac{3}{4}$ in. diam., 6 ins. above ground, bears WEST, 2 lks. dist.
14.55	Ravine, course S.
15.71	Power line, bears N. 20° E. and S. 20° W.
18.75	Graded road, bears N. and S.
21.74	The SW 1/16 sec. cor. of sec. 26.
28.75	Wash, 75 lks. wide, 20 ft. deep, course S. 30° E.

BOOK 4379

Subdivision of the SW. 1/4 of Section 26, T. 3 N., R. 3 E.

Chains
32.627

Point for the CW SW 1/64 sec. cor. of sec. 26.

Set a redwood stake, 2x3 ins., 2 1/2 ft. long, 20 ins. in the ground, mkd. 1/64 on N. face. Raise a mound of stone, 3 ft. base, 2 1/2 ft. high, N. of cor.

43.514

The S 1/16 sec. cor. of secs. 26 and 27.

Final Test of Solar Attachment.

March 24, 1948, in camp near the 1/4 sec. cor. of secs. 9 and 16, T. 3 N., R. 3 E. on the meridian established February 7, 1948, bet. the hours of 7:30 to 10:30 a.m., and 1:30 to 5:00 p.m., I make the proper settings on the arcs of the solar attachment; the resulting orientation of the instrument, when compared with the meridian established by Polaris observation, has a maximum error of less than 1' 30".

91
39

UNITED STATES
DEPARTMENT OF THE INTERIOR
GENERAL LAND OFFICE

BOOK 2370

FIELD ASSISTANTS

NAMES	CAPACITY
Clarence E. Bilbray Charles W. Shadle	Engineering Aid. Truckdriver and Chainman.
Robert D. Stevens	Principal Assistant.
Wesley H. Shadle	Field Assistant.
Dale H. Shadle	" "
Theodore Cole	" "

12
40
BOOK 4379

CERTIFICATE OF SURVEYOR

I, Ty White, Cadastral Engineer, HEREBY CERTIFY upon honor that, in pursuance of special instructions bearing date of the 21st day of January, 1948, received from the ~~district~~ ^{regional} cadastral engineer for Arizona, with assignment instructions dated January 30, 1948, I have ~~surveyed~~ ^{resurveyed} a portion of the boundaries of sections 20, 21, 22, 26 and 27, and surveyed the subdivision-of-section lines of sections 20, 22, and 27, and a portion of sections 21 and 26 of Township 3 North, Range 3 East of the Gila & Salt River Meridian, in the State of Arizona, which are represented in the foregoing field notes as having been executed by me and under my direction; and that said ~~survey~~ ^{resurvey} and ~~survey~~ has been made in strict conformity with said instructions, the Manual of Instructions for the Survey of the Public Lands of the United States, and in the specific manner described in the foregoing field notes.

Phoenix, Arizona
June 18, 1948

Ty White
Cadastral Engineer

CERTIFICATE OF APPROVAL
Bureau of Land Management,

~~Office of Supervisor of Surveys,~~
Washington, D.C. JUN 29 1951, 19

The foregoing field notes of the ~~survey of~~ ^{resurvey} of a portion of the boundaries of sections 20, 21, 22, 26 and 27 and the survey of the subdivision-of-section lines of sections 20, 22, and 27, and a portion of sections 21 and 26 of Township 3 North, Range 3 East of the Gila and Salt River Meridian executed by Ty White, Cadastral Engineer, under special instructions dated January 21, 1948, and assignment instructions dated January 30, 1948, having been critically examined, and the necessary corrections made prior to their certification by the engineer, the said field notes, and the survey therein described, are hereby approved.

Earl G. Harrington
Chief, Division of ~~Cadastral Engineering~~ ^{Supervisor of Surveys}

CERTIFICATE OF TRANSCRIPT

I ~~certify~~ that the foregoing transcript of the field notes of the above described surveys in _____, is a true copy of the original field notes on file in the public survey office.

~~Supervisor of Surveys.~~