

Form 9180-6
(April 1965)
(formerly 4-679)

UNITED STATES
DEPARTMENT OF THE INTERIOR
BUREAU OF LAND MANAGEMENT

FIELD NOTES

OF THE

SURVEY OF TRACTS NO. 38 AND NO. 39

IN UNSURVEYED

TOWNSHIP 1 NORTH, RANGE 14 EAST

Lined area for field notes.

Of the GILA AND SALT RIVER Meridian,

In the State of ARIZONA

EXECUTED BY

RAY HARPIN CADASTRAL SURVEYOR

Under special instructions dated May 19, 19 71, which provided for the surveys included under Group Number 531, approved May 27, 1971, and assignment instructions dated May 19, 19 71.

Survey commenced May 24, 19 71

Survey completed June 3, 19 71

INDEX DIAGRAM

Township _____, Range _____,

6	5	4	3	2	1
7	8	9	10	11	12
18	17	16	15	14	13
19	20	21	22	23	24
30	29	28	27	26	25
31	32	33	34	35	36

INDEX DIAGRAM

Unsurveyed Township 1 North, Range 14 East

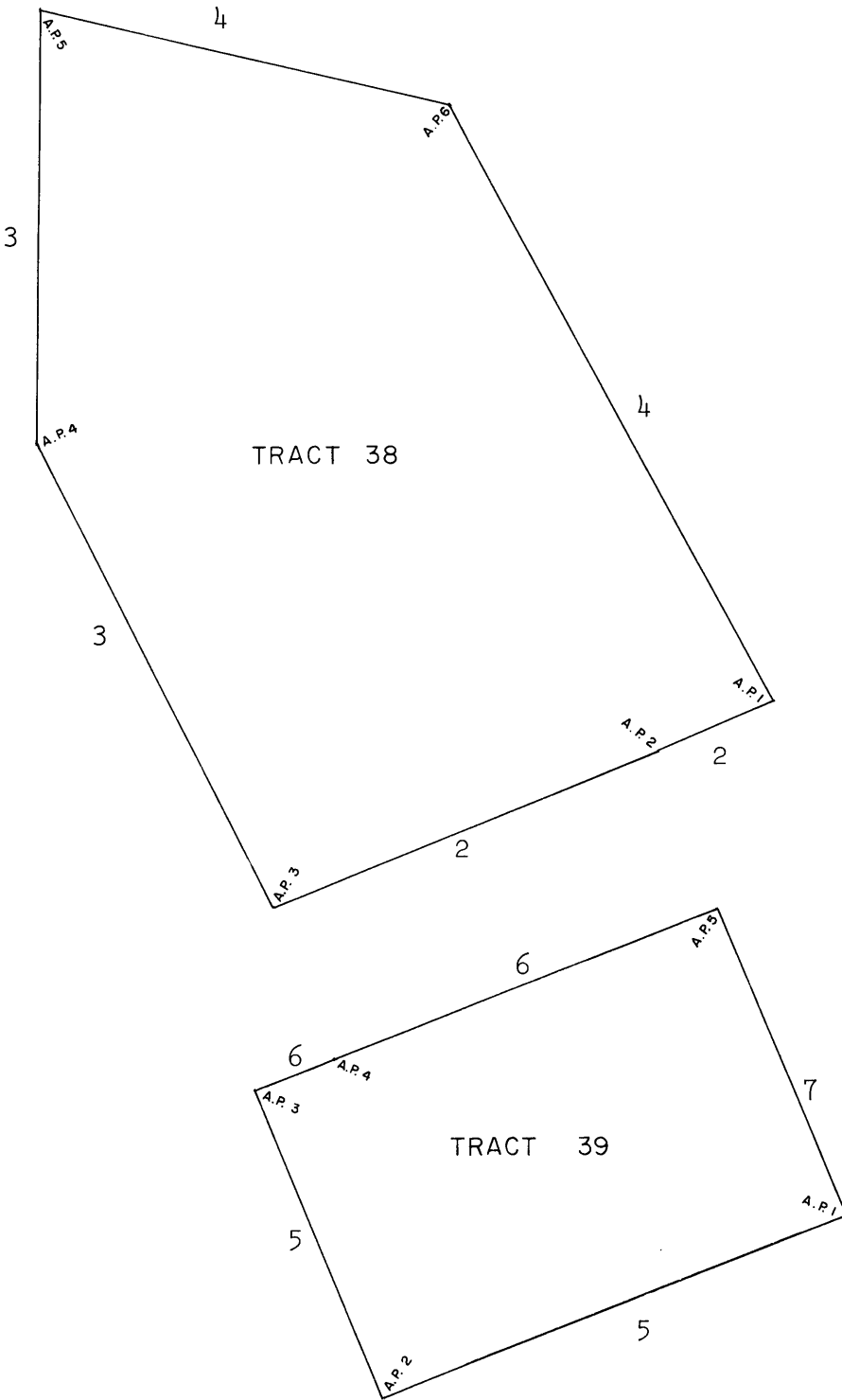

Township 1 North, Range 14 East
Gila and Salt River Meridian, Arizona

CHAINS

The following field notes are those of the (metes-and-bounds) survey of Tracts No. 38 and No. 39 in unsurveyed Township 1 North, Range 14 East, Gila and Salt River Meridian, Arizona.

The survey was executed in accordance with the specifications as set forth in the Manual of Surveying Instructions, 1947, and the special instructions dated May 19, 1971.

The directions of all lines of this survey were determined by direct altitude observation on the sun, for azimuth and carried forward by normal transit traverse. Distances are expressed in chains, reduced to horizontal equivalents.

The data furnished with the special instructions give the geographic position of the corner of sections 7 and 18 (on the west boundary) Township 1 North, Range 15 East, as: Latitude 33° 26.2' N., and Longitude 110° 52.5' W., mean magnetic declination 14° East.

Memorandum

The corner positions of this metes-and-bounds survey of Tracts No. 38 and No. 39, in unsurveyed Township 1 North, Range 14 East, are harmoniously accepted by the Cities Service Company, Miami Copper Operations, the applicant for the land exchange, and the U. S. Department of Agriculture, Forest Service, the grantor.

The cor. of secs. 7 and 18 (on the west boundary) Tp. 1 N., R. 15 E., which is monumented with an iron post, 2 ins. in diam., firmly set, projecting 12 ins. above the ground, as described in the official record of the survey of a portion of the west boundary of Tp. 1 N., R. 15 E., executed by William B. Kimmel, U. S. Cadastral Engineer, in November 1923, and approved March 17, 1926, and accepted July 6, 1926; with regulation brass cap mkd.

T1N
S 7
S 18
R15E

1923

substantiated by:

The remains of a mound of stone, east of the corner, rebuild same, 3 ft. base, 3 ft. high.

Survey of Tract No. 38 in Unsurveyed
Township 1 North, Range 14 East
Gila and Salt River Meridian, Arizona

Corner No. 1, Mineral Survey No. 3250 of Limestone Lode, which is monumented with a wood post, 2 ft. long, 4 ins. square, scribed 1L 3250, firmly set 10 ins. in the ground, and in a small mound of stone.

Survey of Tract No. 38 in Unsurveyed
Township 1 North, Range 14 East
Gila and Salt River Meridian, Arizona

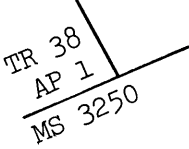
CHAINS		
	<p>At the corner point</p> <p>Set an iron post, 30 ins. long, 2½ ins. in diam., 22 ins. in the ground, with brass cap mkd.</p> <div style="text-align: center;">  <p>1971</p> </div> <p>deposit the wood post monument alongside the iron post, and raise a mound of stone, 4 ft. base, 2 ft. high, SW. of the corner.</p> <p>from which</p> <p style="padding-left: 40px;">A stone-in-place, 6x4x4 ft. above the ground, bears S. 78° 00' E., 76 lks. dist., mkd. B+0.</p> <p style="padding-left: 40px;">A stone-in-place, 4x4x3 ft. above the ground, bears S. 16° 25' E., 47 lks. dist., mkd. B+0.</p>	
<p>7.01</p>	<p>The point for Angle Point No. 1 of Tract No. 38.</p> <p>Set an iron post, 30 ins. long, 2½ ins. in diam., 12 ins. in the ground, and in a mound of stone, 3 ft. base, to top, with brass cap mkd.</p> <div style="text-align: center;">  <p>1971</p> </div> <p>from which</p> <p style="padding-left: 40px;">A juniper, 4 ins. in diam., bears S. 56° 30' W., 86 lks. dist., scribed X BT.</p> <p>This corner point is located on line 4-1 (the northern boundary) of Mineral Survey No. 3250, Limestone Lode.</p> <p>From this corner point Corner No. 1 of Mineral Survey No. 3250, Limestone Lode, bears N. 67° 04' 07" E., 15.42 chs. distance.</p> <p>From the above corner point the corner of secs. 7 and 18 (on the west boundary) Tp. 1 N., R. 15 E., heretofore described, bears S. 45° 39' 05" E., 97.524 chs. distance.</p> <hr style="width: 20%; margin: 10px auto;"/> <p>S. 67° 04' 07" W., on line 1-2, and along line 4-1 of Mineral Survey No. 3250, Limestone Lode.</p> <p>Corner No. 4, Limestone Lode and identical with Corner No. 1, Sycamore Lode, of Mineral Survey No. 3250, which is monumented with a wood post, 3 ft. long, 4 ins. square, scribed 4L 3250 on the NE. and 1S on the SW., firmly set 18 ins. in the ground.</p> <p>At the corner point</p>	

Survey of Tract No. 38 in Unsurveyed
Township 1 North, Range 14 East
Gila and Salt River Meridian, Arizona

CHAINS

Set an iron post, 30 ins. long, $2\frac{1}{2}$ ins. in diam., 18 ins. in the ground, and in a mound of stone, with brass cap mkd.

TR 38
AP 2
COR 1S | COR 4L
MS 3250

1971

deposit the wood post monument alongside the iron post.

from which

The southern face of cliff, bears N. $10^{\circ} 49'$ E., 218 lks. dist., mkd. B+0.

This corner point is designated as Angle Point No. 2, Tract No. 38.

S. $68^{\circ} 49' 02''$ W. on line 2-3, and along line 4-1 of Mineral Survey No. 3250, Sycamore Lode.

22.734 Corner No. 4, Mineral Survey No. 3250, Sycamore Lode, which is monumented with a wood post, 48 ins. long, 4 ins. square, scribed 4S 3250 on the E., firmly set 18 ins. in the ground.

At the corner point

Set an iron post, 30 ins. long, $2\frac{1}{2}$ ins. in diam., 16 ins. in the ground, and in a mound of stone, 4 ft. base, to top, with brass cap mkd.

TR 38
AP 3
COR 4S
MS 3250

1971

deposit the wood post monument alongside the iron post, and raise a mound of stone, 4 ft. base, 3 ft. high.

from which

A stone-in-place, 4x4x3 ft. above the ground, bears S. $72^{\circ} 00'$ W., 21 lks. dist., mkd. B+0.

A stone-in-place, 4x4x4 ft. above the ground, bears S. $72^{\circ} 00'$ W., 49 lks. dist., mkd. B+0.

This corner point is designated as Angle Point No. 3, Tract No. 38.

N. $27^{\circ} 18' 48''$ W., on line 3-4, along the western boundary of Tract No. 38.

28.637 The point for Angle Point No. 4.



Survey of Tract No. 38 in Unsurveyed
Township 1 North, Range 14 East
Gila and Salt River Meridian, Arizona

CHAINS	
	<p>Set an iron post, 30 ins. long, 2½ ins. in diam., 6 ins. in the ground, over a cross (+) chiseled on bedrock, and in a mound of stone, 4 ft. base, to top, with brass cap mkd.</p> <div data-bbox="852 510 958 739" style="text-align: center;"> </div> <p>from which</p> <p>A stone-in-place, 3x2x2 ft. above the ground, bears S. 35° 39' W., 33 lks. dist., mkd. B+0.</p> <p>A stone-in-place, 15x8x5 ft. above the ground, bears N. 76° 30' W., 27 lks. dist., mkd. B+0.</p> <hr style="width: 20%; margin: auto;"/> <p>N. 0° 29' 38" E., on line 4-5, continue along the western boundary of Tract No. 38.</p>
23.258	<p>The point for Angle Point No. 5.</p> <p>Set an iron post, 30 ins. long, 2½ ins. in diam., 12 ins. in the ground, and in a mound of stone, 4 ft. base, to top, with brass cap mkd.</p> <div data-bbox="885 1397 1006 1572" style="text-align: center;"> </div> <p>from which</p> <p>A stone-in-place, 3x2½x2 ft. above the ground, bears S. 82° 00' W., 5 lks. dist., mkd. B+0.</p> <hr style="width: 20%; margin: auto;"/> <p>S. 77° 06' 31" E., on line 5-6, along the northern boundary of Tract No. 38.</p>
23.261	<p>The point for Angle Point No. 6.</p> <p>Set an iron post, 30 ins. long, 2½ ins. in diam., 6 ins. in the ground, over a cross (+) chiseled on bedrock, and in a mound of stone, 3 ft. base, to top, with brass cap mkd.</p> <div data-bbox="868 2150 1015 2325" style="text-align: center;"> </div> <p>from which</p> <p>A stone-in-place, 4x3x2 ft. above the ground, bears S. 51° E., 6 lks. dist., mkd. B+0.</p>

Survey of Tract No. 38 in Unsurveyed
Township 1 North, Range 14 East
Gila and Salt River Meridian, Arizona

CHAINS		
37.17	<p>A stone-in-place, 6x5x3 ft. above the ground, bears N. 30° W., 49 lks. dist., mkd. B+0.</p> <hr/> <p>S. 28° 49' 21" E., on line 6-1, along the eastern boundary of Tract No. 38.</p> <p>Angle Point No. 1, the place of beginning.</p>	
	<p>Survey of Tract No. 39 in Unsurveyed Township 1 North, Range 14 East Gila and Salt River Meridian, Arizona</p>	
1.687	<p>Beginning at Corner No. 3, High Ball Lode and identical with Corner No. 6, Taft Lode, Mineral Survey No. 3250, which is monumented with a wood post, 24 ins. long, 4 ins. square, scribed 341B 3250 on the NE., firmly set 18 ins. in the ground.</p> <p>At the corner point</p> <p>Set an iron post, 30 ins. long, 2½ ins. in diam., 10 ins. in the ground, and in a mound of stone, 3 ft. base, to top, with brass cap mkd.</p> <div style="text-align: center;"> <p>TR 39 / MS 3250 AP 1 / COR 3HB COR 6T MS 3250</p> <p>1971</p> </div> <p>deposit the wood post monument alongside the iron post.</p> <p>from which</p> <p>A juniper, 4 ins. in diam., bears S. 63¼° E., 38 lks. dist., scribed X BT.</p> <p>This corner point is designated as Angle Point No. 1, Tract No. 39.</p> <p>From the above corner point the corner of secs. 7 and 18 (on the west boundary) Tp. 1 N., R. 15 E., heretofore described, bears S. 58° 26' 48" E., 76.99 chs. distance.</p> <hr/> <p>S. 68° 49' 02" W., on line 1-2, and along line 6-5 of Mineral Survey No. 3250, Taft Lode.</p> <p>Corner No. 5, Taft Lode and identical with Corner No. 1, Copper Wedge Lode, Mineral Survey No. 3250, which is monumented with a wood post, 4 ins. square, scribed 5T 3250 on the NE. and HCW on the SW., firmly set, projecting 2 ft. above the surface of the ground. I did not re-monument this corner point.</p> <p>(thence, continue on line 1-2, and along line 1-4 of Mineral Survey No. 3250, Copper Wedge Lode.)</p>	

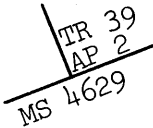
Survey of Tract No. 39 in Unsurveyed
Township 1 North, Range 14 East
Gila and Salt River Meridian, Arizona

CHAINS	
24.40	<p>The point for Corner No. 4, Mineral Survey No. 3250, Copper Wedge Lode and identical with Corner No. 4, Mineral Survey 4629, Wedge Lode, determined at record distance; there is no evidence of the original corner. I did not remonument this corner point.</p> <p>(thence, continue on line 1-2, and along line 4-3 of Mineral Survey No. 4629, Wedge Lode.)</p>
27.344	<p>The point for Angle Point No. 2, Tract No. 39.</p> <p>Set an iron post, 30 ins. long, 2½ ins. in diam., over a cross (+) chiseled on bedrock, and in a mound of stone, 4 ft. base, to top, with brass cap mkd.</p> <div style="text-align: center;">  <p>1971</p> </div> <p>This corner point is located on line 3-4 of Mineral Survey No. 4629, Wedge Lode.</p> <hr style="width: 20%; margin: 10px auto;"/> <p>N. 22° 49' 43" W., on line 2-3.</p>
18.20	<p>The point for Angle Point No. 3.</p> <p>Set an iron post, 30 ins. long, 2½ ins. in diam., 16 ins. in the ground, and in a mound of stone, 3 ft. base, to top, with brass cap mkd.</p> <div style="text-align: center;">  <p>1971</p> </div> <p>from which</p> <p style="padding-left: 40px;">A stone-in-place, 5x3x2 ft. above the ground, bears S. 51° W., 12 lks. dist., mkd. B+0.</p> <p style="padding-left: 40px;">A stone-in-place, 4x3x3 ft. above the ground, bears N. 45° W., 9 lks. dist., mkd. B+0.</p> <hr style="width: 20%; margin: 10px auto;"/> <p>N. 68° 49' 02" E., on line 3-4.</p>
4.609	<p>Corner No. 3, Mineral Survey No. 3250, Sycamore Lode, which is monumented with a wood post, 24 ins. long, 4 ins. square, scribed 6S 6260 on the NW. and 141 on the SE.</p> <p>At the corner point</p> <p>Set an iron post, 30 ins. long, 2½ ins. in diam., 16 ins. in the ground, and in a mound of stone, 4 ft. base, to top, with brass cap mkd.</p>

Survey of Tract No. 39 in Unsurveyed
Township 1 North, Range 14 East
Gila and Salt River Meridian, Arizona

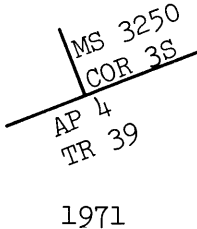
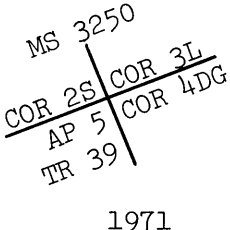
CHAINS		
	<p style="text-align: center;">  </p> <p>deposit the wood post monument alongside the iron post. from which</p> <p style="padding-left: 40px;">The eastern face of cliff, bears N. 60° W., 51 lks. dist., mkd. B+0.</p> <p>This corner point is designated as Angle Point No. 4, Tract No. 39.</p>	
22.735	<p style="text-align: center;"> <hr/> </p> <p>N. 68° 49' 02" E., on line 4-5, and along line 3-2 of Mineral Survey No. 3250, Sycamore Lode.</p> <p>Corner No. 2, Sycamore Lode, identical with Corner No. 3, Limestone Lode, and identical with Corner No. 4, Dolly Gray Lode, Mineral Survey No. 3250, which is marked with a drill stem, 1 in. in diam., firmly set, projecting 3 ins. above the surface of the ground.</p> <p>At the corner point</p> <p>Set an iron post, 30 ins. long, 2½ ins. in diam., 18 ins. in the ground, over the above drill stem, and in a mound of stone, ¾ ft. base, to top, with brass cap mkd.</p> <p style="text-align: center;">  </p>	
9.10	<p style="text-align: center;"> <hr/> </p> <p>S. 22° 49' 43" E., on line 5-1, and along line 4-3 of Mineral Survey No. 3250, Dolly Gray Lode.</p> <p>The point for Corner No. 3, Dolly Gray Lode and identical with Corner No. 4, High Ball Lode, Mineral Survey No. 3250, determined at proportionate distance; there is no evidence of the original corner. I did not remonument this corner point.</p> <p>(thence, continue on line 5-1, and along line 4-3 of Mineral Survey No. 3250, High Ball Lode.)</p>	
18.20	<p>Angle Point No. 1, the place of beginning.</p>	

Township 1 North, Range 14 East
 Gila and Salt River Meridian, Arizona

CHAINS	General Description
	<p>The land within this metes-and-bounds survey is rough and broken; the soil is rocky; timber consists of pal-overde, catclaw acacia, and juniper; cacti family, saguaro, jumping cholla, buckhorn cholla, and prickly pear; undergrowth, ocotillo, yucca, brush, and grass.</p>

Form 9180-8
(March 1969)

UNITED STATES
DEPARTMENT OF THE INTERIOR
BUREAU OF LAND MANAGEMENT

FIELD ASSISTANTS

NAMES	CAPACITY
Johnnie R. Mendez	Cadastral Surveyor
Everett E. Gorgen	Surveying Aid
Richard G. Foutch	Surveying Aid
Arthur J. Saiz	Surveying Aid
Michael F. Nolting	Surveying Aid

CERTIFICATE OF SURVEY

(I ~~We~~), Ray Harpin, HEREBY CERTIFY upon honor that, in pursuance of special instructions bearing date of the 19th day of May, 1971, (I ~~We~~) have surveyed (the metes-and-bounds survey) Tracts No. 38 and No. 39 in unsurveyed Township 1 North, Range 14 East

of the Gila and Salt River Meridian, in the State of Arizona, which are represented in the foregoing field notes as having been executed by (me), (we) and under (my) (our) direction; and that said survey has been made in strict conformity with said special instructions, the Manual of Instructions for the Survey of the Public Lands of the United States, and in specific manner described in the foregoing field notes.

August 13, 1971 (Date) Ray Harpin (Cadastral Surveyor)

CERTIFICATE OF APPROVAL

SUBMITTED FOR APPROVAL Date AUG 20 1971

BUREAU OF LAND MANAGEMENT Washington, D.C.

The foregoing field notes of the survey of Tracts No. 38 and No. 39 in unsurveyed Township 1 North, Range 14 East, Gila and Salt River Meridian, Arizona

executed by Ray Harpin

having been critically examined and found correct, are hereby approved.

FEB 15 1973 (Date) Clark L. Lanning (Chief, Division of Cadastral Survey)

CERTIFICATE OF TRANSCRIPT

I CERTIFY That the foregoing transcript of the field notes of the above-described surveys in, is a true copy of the original field notes.

(Date) (Chief, Division of Cadastral Survey) GPO 849-626