

UNITED STATES
DEPARTMENT OF THE INTERIOR
BUREAU OF LAND MANAGEMENT

FIELD NOTES

OF THE

DEPENDENT RESURVEY OF A PORTION OF TRACT 1

AND THE SURVEY OF PARCELS 1 THROUGH 4,

WITHIN SECTION 35

TOWNSHIP 16 SOUTH, RANGE 22 EAST

Of the SAN BERNARDINO Meridian,

In the State of ARIZONA

EXECUTED BY

RAY HARPIN

SUPERVISORY CADASTRAL SURVEYOR

Under special instructions dated January 7, 19 72, which provided for the surveys
Supplemental Special Instructions April 10 1972
included under Group Number 543, approved January 20, 1972,

and assignment instructions dated January 7, 19 72.

Survey commenced April 26, 19 72

Survey completed May 1, 19 72

1A

INDEX DIAGRAM

Township 16 South, Range 22 East,

6	5	4	3	2	1
7	8	9	10	11	12
18	17	16	15	14	13
19	20	21	22	23	24
30	29	28	27	26	25
31	32	33	34	35	36

Tract 1 . . . pp. 2 - 3
Parcel 1 . . . pp. 3 - 8
Parcel 2 . . . pp. 8 - 9
Parcel 3 . . . pp. 9 - 10
Parcel 4 . . . pp. 10 - 12

Township 16 South, Range 22 East
San Bernardino Meridian, Arizona

CHAINS

The following field notes are those of the dependent re-survey of a portion of Tract 1 and the survey of Parcels 1 through 4 within section 35, Township 16 South, Range 22 East, San Bernardino Meridian, Arizona.

Earlier pertinent surveys are tabulated as follows:

<u>Lines Surveyed</u>	<u>By Whom</u>	<u>Date</u>
S. Boundary	H. Poole	1855
Subd. Lines (Sec. 35)	J. LaCroze	1856
Fort Yuma Military Reserve	A. F. Waldemar Lt. Hamilton Lt. Philo Schultz	Unknown Unknown Unknown
Quartermaster's Depot (Within Sec. 35)	Unknown	Unknown
Tract No. 1 (Within Quartermaster's Depot)	Sidney E. Blout	1912

The Bureau of Sport Fisheries and Wildlife made a survey of a portion of the area involved in the Group for their own use in 1971. Their corner monuments were used for control in the survey of Parcels 1 through 4 in every instance where they were identified.

Parcels 1 through 4 are situated in section 35 within an area known as "Quartermaster's Depot", U. S. Military Reservation. The southerly boundaries of Parcels 2, 3, and 4 are identical with a portion of the northerly boundary of Tract 1. It was necessary to reconstruct a portion of the boundaries of Tract 1 to properly locate these parcels. Parcel 1 is established for a road right-of-way parallel to the center line of the Yuma Valley Railroad track.

The survey was executed in accordance with the specifications set forth in the Manual of Surveying Instructions, 1947, the Special Instructions dated January 7, 1972, and Supplemental Special Instructions dated April 10, 1972.

The directions of all lines were determined by AM and PM observations of the sun and refer to the true meridian. The lines were carried forward by transit methods.

The geographic position of the point of intersection of the west right-of-way line of Second Avenue with the north right-of-way line of First Street, Yuma, Arizona, as scaled from U. S. Geological Survey quadrangle "Yuma East", is:

Latitude: 32° 43.5' N.
Longitude: 114° 37.3' W.

The observed mean magnetic declination is 14° East.

Dependent Resurvey of a Portion
of Tract 1 within Section 35,
Township 16 South, Range 22 East
San Bernardino Meridian, Arizona

CHAINS	<p>Reestablishment of the Survey Executed by Sidney E. Blout, U. S. Surveyor, in 1912.</p> <hr/>
	<p>Beginning at Cor. 4 of Tract 1, determined on the E. right-of-way line of Second Avenue and at record distance (250 ft.) N. of the N. right-of-way line of First Street in the city of Yuma, Arizona. This point is accepted as the best available evidence of the position of the original corner.</p> <p>Set an iron post, 30 ins. long, 2½ ins. diam., 26 ins. in the ground, with brass cap mkd.</p> <div style="text-align: center;"> <p>T16S R22E</p> <p>┆</p> <p>— COR 4</p> <p>TR 1</p> <p>1972</p> </div> <p>from which</p> <p style="padding-left: 40px;">A power line pole bears S. 8° 53' W., 12 lks. dist.,</p> <p style="padding-left: 40px;">Set a steel fence post, 5 ft. long, alongside the corner.</p> <p>S. 89° 53' 15" W., on line 4 - 5 of Tract 1.</p> <p>Crossing Second Avenue.</p>
1.212	<p>Intersect the W. right-of-way line of Second Avenue. This point is designated Cor. 2 of Parcel 2, hereinafter described.</p> <p>Continue along the northerly boundary of Tract 1.</p>
5.757	<p>Point for Cor. 1 of Parcel 2, identical with Cor. 2 of Parcel 3, determined at the intersection of line 4 - 5 of Tract 1 with a lot line projecting S. through Tract 1, hereinafter described.</p>
7.272	<p>Intersect a reinforcing steel rod, ¾ in. diam., firmly set with 4 ins. projecting above the ground, on the projection of a lot line to the S. This point is designated Cor. 1 of Parcel 3, identical with Cor. 3 of Parcel 4, hereinafter described.</p> <p>Continue along the northerly boundary of Tract 1.</p>
8.939	<p>Cor. 5 of Tract 1, which is monumented with a reinforcing steel rod, ¾ in. diam., firmly set with 6 ins. projecting above the ground. This point is accepted as the best available evidence of the position of the original corner and is designated Cor. 2 of Parcel 4, hereinafter described.</p> <hr/> <p>S. 27° 21' 30" W., on line 5-6 of Tract 1.</p>
3.585	<p>Intersect the E. right-of-way line of Fourth Avenue, identical with U. S. Highway No. 80, at a concrete cylinder, 3 ins. diam., firmly set with 6 ins. projecting above the ground. This point is designated Cor. 1 of Parcel 4, hereinafter described.</p>

Dependent Resurvey of a Portion
of Tract 1 within Section 35,
Township 16 South, Range 22 East
San Bernardino Meridian, Arizona

CHAINS		
4.270	<p>Cor. 6 of Tract 1, which is marked with a cross chiseled in surface of road at the junction of Fourth Avenue and First Street. This point is accepted as the best available evidence of the position of the original corner.</p> <hr/> <p>N. 89° 53' 15" E., on line 6 - 1 of Tract 1, along the N. right-of-way line of First Street.</p>	
3.636	<p>Intersect an iron pipe, 1½ ins. diam., set flush with the surface of the ground, on a lot line projecting N. 0° 06' 45" W.</p> <p>from which</p> <p>Cor. 1 of Parcel 3, identical with Cor. 3 of Parcel 4, bears N. 0° 06' 45" W., 3.788 chs. dist., hereinafter described.</p>	
5.151	<p>Intersect the S. end of a concrete partition, 6 ins. wide, 6 ins. high, projecting N. 0° 06' 45" W. along a lot line.</p> <p>from which</p> <p>Cor. 1 of Parcel 2, identical with Cor. 2 of Parcel 3, bears N. 0° 06' 45" W., 3.788 chs. dist., hereinafter described.</p>	
9.696	<p>Point of intersection of the W. right-of-way line of Second Avenue and the N. right-of-way line of First Street.</p> <p>from which</p> <p>Cor. 2 of Parcel 2 bears N. 0° 06' 45" W., 3.788 chs. dist., hereinafter described.</p> <p>Cor. 3 of Parcel 2, identical with Cor. 6 of Parcel 1, bears N. 0° 06' 45" W., 4.194 chs. dist., hereinafter described.</p> <p>Cor. 7 of Parcel 1 bears N. 0° 06' 45" W., 4.830 chs. dist., hereinafter described.</p>	
<p>Survey of Parcel 1 within Section 35 Township 16 South, Range 22 East San Bernardino Meridian, Arizona</p>		
<p>Beginning at the true point for Cor. 1 of Parcel 1, identical with Cor. 6 of Parcel 4, determined at the intersection of the E. right-of-way line of Fourth Avenue with a line 55 ft. southerly from and normal to the center line of the Yuma Valley Railroad track. Point falls in a chain link fence in dense oleander shrubs, impractical to monument.</p> <p>from which</p> <p>Cor. 1 of Parcel 4 bears S. 0° 06' 45" E., 4.267 chs. dist., hereinafter described.</p> <p>The selected point for the witness cor. bears S. 76° 53' 57" E., 0.061 chs. dist.</p>		

Survey of Parcel 1 within Section 35
Township 16 South, Range 22 East
San Bernardino Meridian, Arizona

CHAINS

At the selected point

Set an iron post, 30 ins. long, 2½ ins. diam., flush with the surface of the ground, with brass cap mkd.

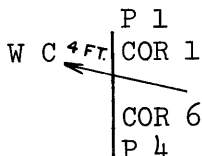

1972

Set a steel fence post, 5 ft. long, alongside the witness corner.

Thence, southeasterly along the arc of a circular curve to the left, 55 ft. southerly from and parallel to the center line of the Yuma Valley Railroad track.

Curve data:

- Δ - 14° 16' 45"
- R - 13.467 chs.
- L - 3.356 chs.
- D - 6° 26' 46"
- T - 1.687 chs.
- LC - S. 76° 53' 57" E., 3.347 chs.

3.356 Point designated for Cor. 2 of Parcel 1, identical with Cor. 5 of Parcel 4, determined at the point of the common tangent of a compound curve.

Set an iron post, 30 ins. long, 2½ ins. diam., 28 ins. in the ground, with brass cap mkd.

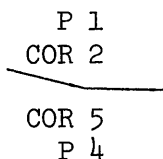

1972

Thence, continue southeasterly along the arc of a circular curve to the left, parallel to the center line of the Yuma Valley Railroad track.

Curve data:

- Δ - 2° 57' 55"
- R - 27.235 chs.
- L - 1.410 chs.
- D - 3° 11' 15"
- LC - N. 85° 31' 18" W., 1.409 chs.

0.064 On the curve; point for Cor. 3 of Parcel 1, identical with Cor. 5 of Parcel 3 and Cor. 4 of Parcel 4, determined at the intersection of this curve with the projection of a lot line to the S.

Set an iron post, 30 ins. long, 2½ ins. diam., flush with the surface of the ground, with brass cap mkd.

Survey of Parcel 1 within Section 35
Township 16 South, Range 22 East
San Bernardino Meridian, Arizona

CHAINS

P 1
COR 3

COR 4 | COR 5
P 4 | P 3

1972

NOTE: The short chord from Cor. 2 to Cor. 3 of Parcel 1 is S. 83° 45' 30" E., 0.064 chs. dist.

Continue measurement along the curve.

1.410 Point for Cor. 4 of Parcel 1, identical with Cor. 4 of Parcel 3, determined at the point of tangent.

Set an iron post, 30 ins. long, 2½ ins. diam., 28 ins. in the ground, with brass cap mkd.

P 1
COR 4

COR 4
P 3

1972

NOTE: The short chord from Cor. 3 to Cor. 4 of Parcel 1 is S. 85° 35' 18" E., 1.345 chs. dist.

S. 87° 00' 15" E., continuing parallel to the center line of the Yuma Valley Railroad track.

0.170 Point for Cor. 3 of Parcel 3, identical with Cor. 5 of Parcel 2, hereinafter described.

2.007 Point for Cor. 5 of Parcel 1, identical with Cor. 4 of Parcel 2, determined at a point of curve.

Set an iron post, 30 ins. long, 2½ ins. diam., flush with the surface of the ground, with brass cap mkd.

P 1
COR 5

COR 4
P 2

1972

Thence, easterly along the arc of a circular curve to the left, continuing parallel to the center line of the Yuma Valley Railroad track.

Curve data:

Δ - 20° 17' 38"
R - 7.760 chs.
L - 2.748 chs.
D - 11° 11' 14"
T - 1.389 chs.
LC - N. 82° 50' 56" E., 2.734 chs.

Survey of Parcel 1 within Section 35
Township 16 South, Range 22 East
San Bernardino Meridian, Arizona

CHAINS

2.748 Point for Cor. 6 of Parcel 1, identical with Cor. 3 of Parcel 2, on the W. right-of-way line of Second Avenue.

Set an iron post, 30 ins. long, 2½ ins. diam., flush with the surface of the ground, with brass cap mkd.

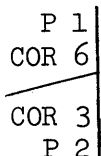

1972

N. 0° 06' 45" W., along the extension of the W. right-of-way line of Second Avenue.

0.636 Point for Cor. 7 of Parcel 1, determined at the intersection of the extension of the W. right-of-way line of Second Ave. with a line parallel to and 15 ft. southerly (normal) from the center line of the Yuma Valley Railroad track, on a curve.

Set an iron post, 30 ins. long, 2½ ins. diam., flush with the surface of the ground, with brass cap mkd.

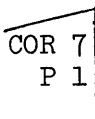

1972

Thence, southwesterly along the arc of a circular curve to the right, parallel to the center line of the Yuma Valley Railroad track.

Curve data:

- Δ - 21° 46' 30"
- R - 7.154 chs.
- L - 2.719 chs.
- D - 12° 08' 05"
- T - 1.376 chs.
- LC - S. 82° 06' 30" W., 2.703 chs.

2.719 Point for Cor. 8 of Parcel 1, determined at the point of tangent.

Set an iron post, 30 ins. long, 2½ ins. diam., flush with the surface of the ground, with brass cap mkd.



1972

N. 87° 00' 15" W., continuing parallel to the center line of the Yuma Valley Railroad track.

2.007 Point for Cor. 9 of Parcel 1, determined at a point of curve.

Survey of Parcel 1 within Section 35
Township 16 South, Range 22 East
San Bernardino Meridian, Arizona

CHAINS

Set an iron post, 30 ins. long, 2½ ins. diam., flush with the surface of the ground, with brass cap mkd.

COR 9

P 1

1972

Thence, northwesterly along the arc of a circular curve to the right, parallel to the center line of the Yuma Valley Railroad track.

Curve data:

Δ - 2° 57' 55"
R - 26.629 chs.
L - 1.378 chs.
D - 3° 15' 04"
T - 0.689 chs.
LC - N. 85° 31' 18" W., 1.378 chs.

- 1.378 Intersect a brass tablet set in a concrete cylinder, 3 ins. diam., projecting 6 ins. above the surface of the ground, established by the Bureau of Sport Fisheries and Wildlife, at the point of the common tangent of a compound curve. This point is designated Cor. 10 of Parcel 1. The brass tablet is mkd.

NO 3

BDY

US

BSF&W

1971

Thence, continue northwesterly along the arc of a circular curve to the right, parallel to the center line of the Yuma Valley Railroad track.

Curve data:

Δ - 15° 17' 00"
R - 12.861 chs.
L - 3.431 chs.
D - 6° 45' 00"
T - 1.726 chs.
LC - N. 76° 23' 50" W., 3.420 chs.

- 1.751 On the curve, intersect a concrete cylinder 3 ins. diam., projecting 6 ins. above the ground, established by the Bureau of Sport Fisheries and Wildlife, with a brass tablet cemented in the top, mkd.

NO 4

BDY

US

BSF&W

1971

Survey of Parcel 1 within Section 35
Township 16 South, Range 22 East
San Bernardino Meridian, Arizona

CHAINS

3.408 Intersect a brass tablet set in a concrete cylinder, 3 ins. diam., projecting 6 ins. above the surface of the ground, established by the Bureau of Sport Fisheries and Wildlife. This monument is designated the witness cor. for Cor. 11 of Tract 1. The brass tablet is mkd.

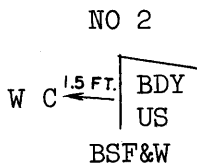

1971

3.431 Point for the true point for Cor. 11 of Parcel 1, on the E. right-of-way line of Fourth Avenue and in a chain link fence, impractical to monument.

The short chord from the true point to the witness cor. for Cor. 11 of Parcel 1 is S. 72° 29' 44" E., 0.023 chs.

S. 0° 06' 45" E., along the E. right-of-way line of Fourth Avenue.

0.648 The true point for Cor. 1 of Parcel 1, identical with Cor. 6 of Parcel 4, the point of beginning.

Parcel 1 contains 0.57 acres.

Survey of Parcel 2 within Section 35
Township 16 South, Range 22 East
San Bernardino Meridian, Arizona

Beginning at the point for Cor. 1 of Parcel 2, identical with Cor. 2 of Parcel 3, determined at the intersection of line 4 - 5 of Tract 1 with a lot line projecting S. through Tract 1, falls in a mound of earth, not monumented from which

Cor. 5 of Tract 1 bears S. 89° 53' 15" W., 3.182 chs. dist.

N. 89° 53' 15" E., between Parcel 2 and Tract 1.

4.545 Point for Cor. 2 of Parcel 2, at the intersection of line 4 - 5 of Tract 1 with the W. right-of-way line of Second Avenue.

Set an iron post, 30 ins. long, 2½ ins. diam., 29 ins. in the ground, with brass cap mkd.

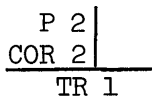

1972

Set a steel fence post, 5 ft. long, alongside the corner.

N. 0° 06' 45" W., along the W. right-of-way line of Second Avenue.

Survey of Parcel 2 within Section 35
Township 16 South, Range 22 East
San Bernardino Meridian, Arizona

<p>CHAINS</p> <p>0.406</p>	<p>Cor. 3 of Parcel 2, identical with Cor. 6 of Parcel 1, hereinbefore described.</p> <hr/> <p>Thence, southwesterly along the arc of a circular curve to the right, between Parcels 1 and 2.</p> <p>Curve data:</p> <p style="margin-left: 40px;"> Δ - 20° 17' 38" R - 7.760 chs. L - 2.748 chs. D - 11° 11' 14" T - 1.389 chs. LC - S. 82° 50' 56" W., 2.734 chs. </p>								
<p>2.748</p>	<p>Cor. 4 of Parcel 2, identical with Cor. 5 of Parcel 1, hereinbefore described.</p> <hr/> <p>N. 87° 00' 15" W., continuing between Parcels 1 and 2.</p>								
<p>1.837</p>	<p>Point for Cor. 5 of Parcel 2, identical with Cor. 3 of Parcel 3, determined on the projection of a lot line to the S. and on the S. boundary of Parcel 1.</p> <p>Set an iron post, 30 ins. long, 2½ ins. diam., 29 ins. in the ground, with brass cap mkd.</p> <div style="text-align: center; margin: 10px 0;"> <table style="border-collapse: collapse; margin: auto;"> <tr> <td colspan="2" style="border-bottom: 1px solid black;">P 1</td> </tr> <tr> <td style="border-right: 1px solid black; padding: 0 5px;">COR 3</td> <td style="padding: 0 5px;">COR 5</td> </tr> <tr> <td style="border-right: 1px solid black; padding: 0 5px;">P 3</td> <td style="padding: 0 5px;">P 2</td> </tr> </table> <p>1972</p> </div> <p>Set a steel fence post, 5 ft. long, alongside the corner.</p> <hr/> <p>S. 0° 06' 45" E., on the projection of a lot line to the S.</p>	P 1		COR 3	COR 5	P 3	P 2		
P 1									
COR 3	COR 5								
P 3	P 2								
<p>0.171</p>	<p>Cor. 1 of Parcel 2, identical with Cor. 2 of Parcel 3, the point of beginning.</p> <p>Parcel 2 contains 0.06 acres.</p>								
<p>Survey of Parcel 3 within Section 35 Township 16 South, Range 22 East San Bernardino Meridian, Arizona</p>									
<p>Beginning at Cor. 1 of Parcel 3, identical with Cor. 3 of Parcel 4, which is monumented with a reinforcing steel rod, ¾ in. diam., firmly set with 4 ins. projecting above the surface of the ground, at the intersection of line 4 - 5 of Tract 1 with a lot line projecting S.</p> <p>At the corner point</p> <p>Set an iron post, 30 ins. long, 2½ ins. diam., 26 ins. in the ground, over the steel rod, with brass cap mkd.</p> <div style="text-align: center; margin: 10px 0;"> <table style="border-collapse: collapse; margin: auto;"> <tr> <td style="border-right: 1px solid black; padding: 0 5px;">P 4</td> <td style="padding: 0 5px;">P 3</td> </tr> <tr> <td style="border-right: 1px solid black; padding: 0 5px;">COR 3</td> <td style="padding: 0 5px;">COR 1</td> </tr> <tr> <td colspan="2" style="padding: 0 5px;">TR 1</td> </tr> <tr> <td colspan="2" style="padding: 0 5px;">1972</td> </tr> </table> </div>		P 4	P 3	COR 3	COR 1	TR 1		1972	
P 4	P 3								
COR 3	COR 1								
TR 1									
1972									

Survey of Parcel 3 within Section 35
Township 16 South, Range 22 East
San Bernardino Meridian, Arizona

CHAINS	
	<p>from which</p> <p style="padding-left: 40px;">Cor. 5 of Tract 1 bears S. 89° 53' 15" W., 1.667 chs. dist.</p> <p>N. 89° 53' 15" E., between Parcel 3 and Tract 1.</p>
1.515	<p>The point for Cor. 2 of Parcel 3, identical with Cor. 1 of Parcel 2, hereinbefore described.</p> <hr style="width: 20%; margin: 10px auto;"/> <p>N. 0° 06' 45" W., between Parcels 2 and 3.</p>
0.171	<p>Cor. 3 of Parcel 3, identical with Cor. 5 of Parcel 2, on the S. boundary of Parcel 1, hereinbefore described.</p> <hr style="width: 20%; margin: 10px auto;"/> <p>N. 87° 00' 15" W., between Parcels 1 and 3.</p>
0.170	<p>Cor. 4 of Parcel 3, identical with Cor. 4 of Parcel 1, hereinbefore described.</p> <hr style="width: 20%; margin: 10px auto;"/> <p>Thence, northwesterly along a segment of the arc of a circular curve to the right, continuing between Parcels 1 and 3.</p> <p style="padding-left: 40px;">Curve data:</p> <p style="padding-left: 80px;">Δ - 2° 57' 55"</p> <p style="padding-left: 80px;">R - 27.235 chs.</p> <p style="padding-left: 80px;">L - 1.410 chs.</p> <p style="padding-left: 80px;">D - 3° 11' 15"</p> <p style="padding-left: 80px;">C - N. 85° 35' 18" W., 1.345 chs.</p>
1.346	<p>Cor. 5 of Parcel 3, identical with Cor. 3 of Parcel 1 and Cor. 4 of Parcel 4, hereinbefore described.</p> <p>NOTE: The short chord from Cor. 4 to Cor. 5 of Parcel 3, is N. 85° 35' 18" W., 1.345 chs.</p> <hr style="width: 20%; margin: 10px auto;"/> <p>S. 0° 06' 45" E., between Parcels 3 and 4.</p>
0.312	<p>Cor. 1 of Parcel 3, identical with Cor. 3 of Parcel 4, the point of beginning.</p> <p>Parcel 3 contains 0.03 acres.</p>

Survey of Parcel 4 within Section 35
Township 16 South, Range 22 East
San Bernardino Meridian, Arizona

Beginning at Cor. 1 of Parcel 4, at the intersection of line 5 - 6 of Tract 1 with the E. right-of-way line of Fourth Avenue, monumented with a brass tablet set in a concrete cylinder, 3 ins. diam., projecting 6 ins. above the surface of the ground, mkd.



NO 1
BDY
US

BSF&W

1971

Survey of Parcel 4 within Section 35
Township 16 South, Range 22 East
San Bernardino Meridian, Arizona

CHAINS	
	<p>N. 27° 21' 30" E., between Parcel 4 and Tract 1.</p>
3.585	<p>Cor. 2 of Parcel 4, identical with Cor. 5 of Tract 1, which is monumented with a reinforcing steel rod, 3/4 in. diam., firmly set with 6 ins. projecting above the ground.</p>
	<p>At the corner point</p>
	<p>Set an iron post, 30 ins. long, 2½ ins. diam., 22 ins. in the ground, over the steel rod, with brass cap mkd.</p>
	<p style="text-align: center;"> T16S R22E COR 2 P 4 / COR 5 TR 1 </p>
	<p style="text-align: center;">1972</p>
	<p>Corner is situated in a chain link fence bearing E. and W.</p>
	<p>N. 89° 53' 15" E., between Parcel 4 and Tract 1.</p>
1.667	<p>Cor. 3 of Parcel 4, identical with Cor. 1 of Parcel 3, hereinbefore described.</p>
	<p>N. 0° 06' 45" W., between Parcels 3 and 4.</p>
0.312	<p>Cor. 4 of Parcel 4, identical with Cor. 3 of Parcel 1 and Cor. 5 of Parcel 3, hereinbefore described.</p>
	<p>Thence, northwesterly along a segment of the arc of a circular curve to the right, between Parcels 1 and 4.</p>
	<p>Curve data:</p>
	<p style="padding-left: 40px;">Δ - 2° 57' 55"</p>
	<p style="padding-left: 40px;">R - 27.235 chs.</p>
	<p style="padding-left: 40px;">L - 1.410 chs.</p>
	<p style="padding-left: 40px;">D - 3° 11' 15"</p>
	<p style="padding-left: 40px;">C - N. 83° 45' 30" W., 0.064 chs.</p>
0.064	<p>Cor. 5 of Parcel 4, identical with Cor. 2 of Parcel 1, hereinbefore described.</p>
	<p>Thence, northwesterly along the arc of a circular curve to the right, continuing between Parcels 1 and 4.</p>
	<p>Curve data:</p>
	<p style="padding-left: 40px;">Δ - 14° 16' 45"</p>
	<p style="padding-left: 40px;">R - 13.467 chs.</p>
	<p style="padding-left: 40px;">L - 3.356 chs.</p>
	<p style="padding-left: 40px;">D - 6° 26' 46"</p>
	<p style="padding-left: 40px;">LC - N. 76° 53' 57" W., 3.347 chs.</p>
3.356	<p>The true point for Cor. 6 of Parcel 4, identical with Cor. 1 of Parcel 1, hereinbefore described.</p>
	<p>S. 0° 06' 45" E., along the E. right-of-way line of Fourth Avenue.</p>

Survey of Parcel 4 within Section 35
 Township 16 South, Range 22 East
 San Bernardino Meridian, Arizona

<p>CHAINS 4.267</p>	<p>Cor. 1 of Parcel 4, the point of beginning. Parcel 4 contains 0.47 acres.</p>
	<p style="text-align: center;">General Description</p> <p>Parcels 1 through 4 are situated within the city limits of Yuma, Arizona.</p> <p>The terrain is nearly level and barren with only patches of palo verde and oleander shrubs in the western portion of the area.</p>

Form 9180-8
(March 1969)

UNITED STATES
DEPARTMENT OF THE INTERIOR
BUREAU OF LAND MANAGEMENT

FIELD ASSISTANTS

NAMES	CAPACITY
Lucious L. Burns	Surveying Aid
Victor E. Templeton	Surveying Aid
Caleb C. Costin	Surveying Aid

14

CERTIFICATE OF SURVEY

(I) ~~(We)~~, Ray Harpin

, HEREBY

CERTIFY upon honor that, in pursuance of special instructions bearing date of the 7th day of January, 1972, ~~(by We)~~ Supplemental Special Instructions 10th April 1972, I have dependently resurveyed a portion of Tract 1 and surveyed Parcels 1 through 4 within section 35, Township 16 South, Range 22 East

of the San Bernardino Meridian, in the State of Arizona, which are represented in the foregoing field notes as having been executed by (me), ~~(us)~~ and under (my) ~~(our)~~ direction; and that said survey has been made in strict conformity with said special instructions, the Manual of Instructions for the Survey of the Public Lands of the United States, and in specific manner described in the foregoing field notes.

October 31, 1972
(Date)

Ray Harpin
Ray Harpin (Cadastral Surveyor)

(Date)

(Cadastral Surveyor)

CERTIFICATE OF APPROVAL

SUBMITTED FOR APPROVAL
Date DEC 7 1973

BUREAU OF LAND MANAGEMENT
Washington, D.C.

The foregoing field notes of the dependent resurvey of a portion of Tract 1 and the survey of Parcels 1 through 4 within section 35, Township 16 South, Range 22 East, San Bernardino Meridian, Arizona

executed by Ray Harpin, Supervisory Cadastral Surveyor having been critically examined and found correct, are hereby approved.

APR 2 1974
(Date)

Clark F. Lumm
(Chief, Division of Cadastral Survey)

CERTIFICATE OF TRANSCRIPT

I CERTIFY That the foregoing transcript of the field notes of the above-described surveys in _____, is a true copy of the original field notes.

(Date)

(Chief, Division of Cadastral Survey) BRQ 849-626