

Form 9180-6  
(April 1974)

UNITED STATES  
DEPARTMENT OF THE INTERIOR  
BUREAU OF LAND MANAGEMENT

FIELD NOTES

Of the Dependent Resurvey of a Portion

of the East and North Boundaries

Dependent Resurvey of the Northwest Boundary

of the Camp Verde Military Reservation

Dependent Resurvey of a Portion

of the Subdivisional Lines

Survey of Subdivisions in Sections

3, 4, 12, 13, 14, 16 and 23

Survey of Lot 7, Section 12

Resurvey of the 1892 Meanders of the Left Bank of the

Verde River and Meander of the Present Left Bank of the

Verde River through Sections 12 and 13

Township 14 North, Range 4 East

Of the Gila and Salt River Meridian,

In the State of Arizona

EXECUTED BY

Harry K. Smith

Cadastral Surveyor

Supplemental Instructions - May 31, 1974 June 4, 1974  
Under special instructions dated December 4, 1972, approved December 4, 1972,

\_\_\_\_\_, which provided for the surveys included under U.S. Survey/Group  
Number 553, Arizona, and assignment instructions dated December 4, 1972.

Survey commenced December 7, 1972

Survey completed December 19, 1974

1A

BOOK 5096

INDEX DIAGRAM

Township 14 North, Range 4 East

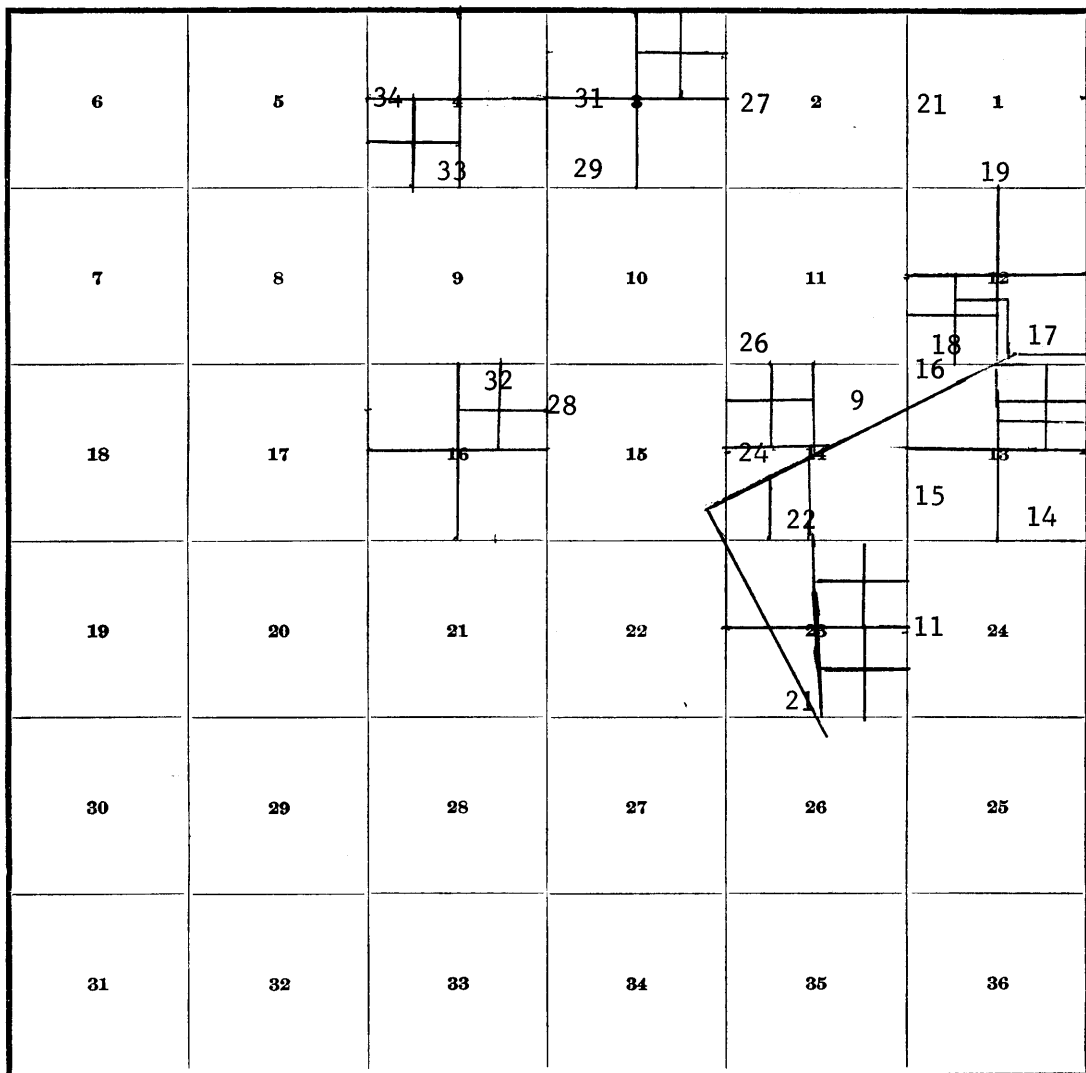

- Subdivision of Section 3, page 36.
- Subdivision of Section 4, page 39.
- Subdivision of Section 12, page 42.
- Subdivision of Section 13, page 47.
- Subdivision of Section 14, page 51.
- Subdivision of Section 16, page 56.
- Subdivision of Section 23, page 59.
- Metes and Bounds Survey, Lot 7, page 63.
- Original Meanders, Sections 12 and 13, page 65.
- Present Meanders, Sections 12 and 13, page 66.

Dependent Resurvey of  
T. 14 N., R. 4 E., G. & S. R. M., Arizona

## CHAINS

The history of surveys of Township 14 North, Range 4 East, Gila and Salt River Meridian, Arizona is as follows:

The boundaries of the Camp Verde Military Reservation were established prior to the extension of the rectangular surveys into the township. The northwest boundary of the reservation was retraced and a portion of the subdivisional lines outside the Military Reservation were surveyed by C. Burton Foster in 1877. The north and west boundaries of the Military Reservation were resurveyed and the area within the Military Reservation subdivided by Daniel Drummond in 1892 who also surveyed the meanders of the Verde River within the abandoned Camp Verde Military Reservation the same year. The remainder of the township was subdivided by Sydney E. Blout and Charles E. Hunter in 1927. A portion of the north boundary of the Camp Verde Military Reservation was resurveyed by Sydney E. Blout and Charles E. Hunter in 1927 and a portion retraced by Horace M. Muscott, Claude F. Warner and Frank Motech in 1938. The north boundary of T. 14 N., R. 4 E., was surveyed by C. Burton Foster in 1877 and partially resurveyed by Sydney E. Blout in 1917. A portion of the south boundary was surveyed by Daniel Drummond in 1892, a portion by William H. Richards Jr. in 1916 and a portion by Sydney E. Blout and Charles E. Hunter in 1927. The west five miles of the south boundary were resurveyed by Leroy R. Hanson in 1928. The north two miles of the east boundary were surveyed by C. Burton Foster in 1877; the south four miles were surveyed by Daniel Drummond in 1892, and the north three miles were resurveyed by Horace M. Muscott, Claude F. Warner and Frank Motech in 1938. The north one mile of the west boundary was surveyed by C. Burton Foster in 1877; the south five miles by Sydney E. Blout and Charles E. Hunter in 1927. All of the west boundary was resurveyed by Theodore Vander Meer in 1933. A portion of the subdivisional lines were resurveyed by Sydney E. Blout and Charles E. Hunter in 1927 and a portion retraced by the U. S. Forest Service in 1915 in connection with Homestead Entry Survey No's. 329 and 330. A portion of the subdivisional lines and a portion of the north boundary of the abandoned Camp Verde Military Reservation were resurveyed and sections 11 and 14 were partially subdivided by Vern E. Lane in 1959. Certain corners were remonumented by Boyd S. Owens in 1964. A portion of the east boundary was resurveyed by Leonard Murphy in 1972.

The following field notes are those of the dependent resurvey of a portion of the east and north boundaries, the northwest boundary of the Camp Verde Military Reservation (abandoned), and a portion of the subdivisional lines; a survey of subdivisions in sections 3, 4, 12, 13, 14, 16 and 23, a metes and bounds survey of lot 7 in section 12, and resurvey of the 1892 meanders of the left bank of the Verde River in sections 12 and 13 and meanders of the present left bank of the Verde River through sections 12 and 13, Township 14 North, Range 4 East, Gila and Salt River Meridian, Arizona.

Dependent Resurvey of  
T. 14 N., R. 4 E., G. & S. R. M., Arizona

CHAINS

The surveys were executed in accordance with the specifications set forth in the Manual of Surveying Instructions, 1947, the Special Instructions for Group No. 553, Arizona, dated December 4, 1972 and the Supplemental Special Instructions dated May 31, 1974.

Preliminary to the resurvey, the lines of the original survey were retraced and search was made for all corners and other calls of the record. Identified corners were remonumented in their original positions; lost corners were restored and monumented at proportionate positions based on the original record. The retracement data were verified and only the true line field notes are given herein.

The direction of lines were determined by means of angular deflections from azimuths obtained from triangulation station WYE located in section 35, Township 14 North, Range 4 East.

The geographic position of the southeast corner of section 23, as scaled from the U.S.G.S. quadrangle map, "Middle Verde, Ariz.," prepared in 1969, is as follows:

Latitude 34° 35' N. Longitude 111° 53' 18" W.

The mean magnetic declination is 14° 15' E.

Dependent Resurvey of a Portion of the West Bdy. of  
T. 14 N., R. 5 E., Gila and Salt River Meridian, Arizona

(Restoring the resurvey executed by Leonard W. Murphy  
in 1972)

From the cor. of secs. 7, 12; 13 and 18, T. 14 N., Rs. 4 and 5 E., monumented with an iron post, 2½ ins. diam., projecting 6 ins. above ground, with brass cap mkd.

T 14 N	
R 4 E	R 5 E
S 12	S 7
S 13	S 18
1964	
1972	

Mound of stone, 4 ft. base, 2½ ft. high, W of the cor.

S. 1°49' W., between secs. 13 and 18.

Over rolling land through moderate undergrowth and scattered cedar and palo-verde.

1.20 Road, paved, bears W and E, curving N.

6.00 Wash; 40 lks. wide, 1 ft. deep, drains N. 80° W.

Dependent Resurvey of a Portion of the West Bdy. of  
T. 14 N., R. 5 E., Gila and Salt River Meridian, Arizona

CHAINS	
20.65	Wash, 20 lks. wide, 4 ft. deep, drains SW.
20.725	The N. 1/16 sec. cor. of secs. 13 and 18, monumented by an iron post, 2½ ins. diam., projecting 8 ins. above ground, encircled by a mound of stone, 3½ ft. base to top, with brass cap mkd.
	<p style="text-align: center;">T 14 N R 4 E R 5 E N 1/16 S 13 S 18 1972</p>
	S. 1°49' W., beginning new measurement.
	Over rolling land.
10.335	Point for the S-N 1/64 sec. cor. of secs. 13 and 18.
	Set an iron post, 28 ins. long, 2½ ins. diam., 22 ins. in the ground, with brass cap mkd.
	<p style="text-align: center;">T 14 N R 4 E R 5 E S-N 1/64 S 13 S 18 1973</p>
	from which
	A re-bar, ½ inch diam., bears S. 6° W., 16 lks. dist.
	A re-bar, ½ inch diam., bears S. 60° W., 30.5 lks. dist.
	Raise a mound of stone, 2½ ft. base, 2 ft. high, W of the cor.
10.87	Fence, bears E and W.
11.60	Ridge, bears E and W.
18.10	Fence, wire, bears N. 35° E. and S. 35° W.
20.67	The ¼ sec. cor. of secs. 13 and 18, monumented by a 2½ inch iron post, projecting 6 ins. above ground, with brass cap mkd.
	<p style="text-align: center;">T 14 N R 4 E R 5 E ¼ S 13 S 18 1972</p>
	from which
	An iron post, 2½ ins. diam., projecting 5 ins. above ground, bears S. 46½° W. 50 lks. dist. with brass cap mkd. RM ¼ S13 33 ft. 1972, and an arrow pointing to the corner.

Dependent Resurvey of a Portion of the West Bdy. of  
T. 14 N., R. 5 E., Gila and Salt River Meridian, Arizona

CHAINS

An iron post, 2½ ins. diam., projecting 5 ins. above ground, bears N. 43½° W. 50 lks. dist. with brass cap mkd. RM ¼ S13 33 ft. 1972, and an arrow pointing to the corner.

Mound of stone, 3 ft. base, 1 ft. high, W of the cor.

Dependent Resurvey of a Portion of the North Boundary of  
T. 14 N., R. 4 E., Gila and Salt River Meridian, Arizona

(Restoring the survey executed by C. Burton Foster  
in 1877)

Beginning at the cor. of Tps. 14 and 15 N., R. 4 E., monumented by a limestone, 27 x 19 x 12 ins., mkd. with 6 grooves on the N. and S. faces, firmly set 8 ins. in the ground.

At the cor. point.

Set an iron post, 28 ins. long, 2½ ins. diam., 8 ins. in the ground, encircled by a mound of stone, 4 ft. base to top, with brass cap mkd.

T 15 N		T 15 N
R 4 E		R 5 E
S 36		S 31
S 1		
T 14 N		
		1974

Deposit the original cor. stone alongside the iron post.  
from the cor.

The cor. of Tps. 14 and 15 N., R. 5 E., bears South, 3.57 chs. dist., monumented by an iron post, 3 ins. diam., firmly set in a mound of stone, 3 ft. base, 2 ft. high, brass cap mkd.

T 15 N		
S 31		
S 6		R 5 E
T 14 N		
		1918

Remark the brass cap to read

T 14 N		T 15 N
R 4 E		R 5 E
S 1		S 31
		S 6
		1974
		1918

N. 88°43' W., bet. secs. 1 and 36.

Ascend over rolling land.

27.10 N. side of bluff, desc. over general W. slope.

Dependent Resurvey of a Portion of the North Boundary of  
T. 14 N., R. 4 E., Gila and Salt River Meridian, Arizona

CHAINS	
36.40	Draw, drains NW.
40.20	Fence, bears S. 62° E. and N. 62° W.
40.83	The ¼ sec. cor. of secs. 1 and 36, monumented by a limestone, 22 x 18 x 10 ins., firmly set 6 ins. in the ground with a mound of stone, 2 ft. base, 1 ft. high, E. No visible mks. on the stone.
	At the cor. point
	Set an iron post, 28 ins. long, 2½ ins. diam., 8 ins. in the ground, encircled by a mound of stone, 3 ft. base to top, with brass cap mkd.
	<p style="text-align: center;">T 15 N R 4 E  <math>\frac{1}{4}</math> <math>\frac{S 36}{S 1}</math>                      T 14 N                      1974</p>
	N. 89°47' W., beginning new measurement.
	Descend over gentle NW. slope.
13.80	Descend over steep NW. slope.
28.20	Grandpa Wash, 1 ch. wide, 3 ft. deep, drains S, curving W.
36.20	Fence, bears N. 75° E. and S. 75° W.
38.46	The cor. of secs. 1, 2, 35 and 36, monumented by an iron post, 2½ ins. diam., firmly set in a mound of stone, 4 ft. base, 2 ft. high, brass cap mkd.
	<p style="text-align: center;">T 15 N R 4 E  <math>\frac{S 35   S 36}{S 2   S 1}</math>                      T 14 N                      1964</p>
	Land, rolling and broken. Soil, sandy loam and rocky with limestone outcrops. Timber, scattered juniper, palo-verde and mesquite. Undergrowth, creosote brush, oakbrush and cacti.
	Beginning at the cor. of secs. 2, 3, 34 and 35 on the north boundary of the Tp., monumented by an iron post, 2½ ins. diam., projecting 8 ins. above ground, with brass cap mkd.
	<p style="text-align: center;">T 15 N R 4 E  <math>\frac{S 34   S 35}{S 3   S 2}</math>                      T 14 N                      1964</p>
	Mound of stone, 2½ ft. base, 1½ ft. high, W of the cor.

Dependent Resurvey of a Portion of the North Boundary of  
T. 14 N., R. 4 E., Gila and Salt River Meridian, Arizona

CHAINS	
	N. 89°14' W., between secs. 3 and 34. Over nearly level land, through moderate creosote brush.
10.80	Road, gravel, bears N. 12° E. and S. 12° W., thence through heavy creosote brush.
17.90	Fence, bears N. 10° E. and S. 10° W.
19.60	Wash, 15 lks. wide, 1 ft. deep, drains S. 10° E.
19.84	The E. 1/16 sec. cor. of secs. 3 and 34, monumented by a ½ inch re-bar, projecting 3 inches above ground. This re-bar is accepted as the cor.  At the cor. point  Set an iron post, 28 ins. long, 2½ ins. diam., 22 ins. in the ground, over the ½ inch re-bar, brass cap mkd.  <div style="text-align: center;">           T 15 N R 4 E            E 1/16 <math>\frac{S\ 34}{S\ 3}</math>            T 14 N            1972         </div>
	Raise a mound of stone, 3 ft. base, 2 ft. high, N of the cor.  Cor. is located approximately 180 lks. S of an E-W barbed wire fence.
37.30	Road, graded, bears S and N 50 lks., thence W.
37.80	Telephone line, bears S. 50° E. and N. 50° W.
39.67	The ¼ sec. cor. of secs. 3 and 34, monumented by an iron post, 2½ inches in diam., projecting 6 inches above ground, brass cap mkd.  <div style="text-align: center;">           T 15 N R 4 E            ¼ <math>\frac{S\ 34}{S\ 3}</math>            T 14 N            1964         </div>
	Mound of stone, 2 ft. base, 1 ft. high, N of the cor.  <hr style="width: 20%; margin: auto;"/>
	N. 89°15' W., beginning new measurement.  Continue over nearly level land, through heavy creosote brush.
4.00	Leave creosote brush.
28.10	Power line, bears S and westerly along sec. line.
35.50	Power line, extension bears S.
35.90	Road, graded, bears N and S.



Dependent Resurvey of a Portion of the North Boundary of  
T. 14 N., R. 4 E., Gila and Salt River Meridian, Arizona

CHAINS	
39.76	<p>The cor. of secs. 3, 4, 33 and 34, monumented by an iron post, 2½ ins. diam., projecting 6 ins. above ground, with brass cap mkd.</p> <p style="text-align: center;">T 15 N R 4 E S 33   S 34 S 4   S 3 T 14 N 1964</p> <p>Mound of stone, 1½ ft. base, 1 ft. high, W of the cor.</p> <p>The cor. is located 3 lks. N of a power line which bears E and W.</p> <p>Land, nearly level. Soil, sandy loam. No. timber; undergrowth, moderate to heavy creosote on E 44.00 chs.</p>
	<p>N. 89°15' W., between secs. 4 and 33.</p>
	<p>Over nearly level open land.</p>
	<p>Continue along E-W power line.</p>
13.30	<p>Road, graded, bears N and S.</p>
13.70	<p>Cor. of barbed wire fences extending S and W along sec. line.</p>
17.60	<p>Intersect the cors. of fence and power line; both bear E and S.</p>
19.60	<p>Road, track, bears N and S.</p>
20.20	<p>Fence, bears N and S; thence across cultivated field.</p>
23.50	<p>Power line, bears S. 35° E. and N. 35° W.</p>
28.30	<p>Fence, bears S. 30° E. and N. 30° W.; leave cultivated field.</p>
30.00	<p>Approximate dist. to trailer house on line.</p>
32.60	<p>O.K. Irrigation Ditch, 25 lks. wide, 4 ft. deep, course SE.</p>
34.15	<p>Concrete lined ditch, 5 lks. wide, 1½ ft. deep, course SW.</p>
34.60	<p>Fence, bears NE and SW.</p>
39.91	<p>The ¼ sec. cor. of secs. 4 and 33, monumented by a 1 inch hollow pipe, projecting 3 inches above ground. A 4½ ft. long wooden post is alongside of the pipe. This is accepted as the best remaining evidence of the original cor. position. Not remonumented.</p>
	<p>N. 89°15' W., beginning new measurement.</p>
	<p>Continue over nearly level open land.</p>

Dependent Resurvey of a Portion of the North Boundary of  
T. 14 N., R. 4 E., Gila and Salt River Meridian, Arizona

CHAINS	
0.10	Fence, bears NE and SW.
4.10	Fence, bears NE and SW.
4.65	Fence, bears S. 25° E. and N. 25° W.; enter river bottom land through moderate undergrowth and timber.
7.50	Left bank of the Verde River, bears N and S, curving SE.
9.50	Right bank of the Verde River. Enter moderate to heavy willows.
19.955	Point for the W. 1/16 sec. cor. of secs. 4 and 33. Set an iron post, 28 ins. long, 2½ ins. in diam., 24 ins. in the ground, with brass cap mkd.  <div style="text-align: center;">           T 15 N R 4 E            W 1/16 <math>\frac{S\ 33}{S\ 4}</math>            T 14 N            1972         </div> Set a mesquite post, 5 ft. long, 3 ins. diam., on the N side of the cor.
21.10	Barbed wire fence, bears N and S, leave heavy willows, ascend steep E-N-E slope through moderate undergrowth and juniper.
27.10	End of ascent; thence over nearly level mesa.
39.91	The cor. of secs. 4, 5, 32 and 33, monumented by an iron post, 2½ ins. diam., projecting 6 ins. above ground, with brass cap mkd.  <div style="text-align: center;">           T 15 N R 4 E            S 32   S 33            S 5   S 4            T 14 N            1964         </div> Mound of stone, 3 ft. base, 1½ ft. high, W of the cor.  Land, level on E.60 chs - Mesa on remainder. Soil, sandy and decomposed limestone. Timber, scattered juniper on W. 20.00 chs. Undergrowth, willows, mesquite and creosote brush on W ½ mile.
	N. 87°41' W., bet. secs. 5 and 32.  Over rolling land through medium timber and undergrowth.
30.10	Wash, 10 lks. wide, 1 ft. deep, drains S.
32.50	Draw, drains S. 40° E.
34.70	Spur, slopes S. 10° E.

Dependent Resurvey of a Portion of the North Boundary of  
T. 14 N., R. 4 E., Gila and Salt River Meridian, Arizona

CHAINS	
38.70	Wash, 20 lks. wide, 4 ft. deep, drains S. 15° W.
40.29	The ¼ sec. cor. of secs. 5 and 32, monumented by an iron post, 2½ ins. diam., projecting 5 ins. above ground, brass cap mkd.
<p>T 15 N R 4 E  <math>\frac{1}{4}</math> <math>\frac{S 32}{S 5}</math>                      T 14 N                      1964</p>	
Mound of stone, 3 ft. base, 1½ ft. high, N of the cor.	
<hr/>	
N. 87°40' W., beginning new measurement.	
Over rolling land.	
12.30	Fence, bears SE and NW.
13.00	Wash, 30 lks. wide, 1 ft. deep, drains S. 15° E.
14.30	State Highway No. 279, bears SE and NW.
16.10	Fence, bears SE and NW.
21.30	Old paved highway, bears SE and NW.
37.50	Wash, 5 lks. wide, 1 ft. deep, drains N.
40.38	The cor. of secs. 5, 6; 31 and 32, monumented by an iron post, 2½ ins. diam., firmly set, projecting 10 ins. above ground, with brass cap mkd.
<p>T 15 N R 4 E  <math>\frac{S 31}{S 6}   \frac{S 32}{S 5}</math>                      T 14 N                      1964</p>	
Mound of stone, 3 ft. base, 1½ ft. high, W of the cor.	
<p>Land, rolling.                      Soil, clay loam and rocky.                      Timber, scattered juniper, palo-verde and mesquite.                      Undergrowth, creosote brush, grass and cacti.</p>	
<p>Dependent Resurvey of the NW Boundary of the                      Camp Verde Military Reservation (abandoned),                      T. 14 N., R. 4 E., G. &amp; S. R. M., Arizona</p>	
<p>(Restoring the resurvey executed by Vern E. Lane                      in 1959)</p>	
<p>Beginning at Cor. No. 2 being the NW cor. of the abandon-                      ed Camp Verde Military Reservation, monumented with a                      granite stone, 12 x 12 x 12 ins. above ground firmly set                      and mkd. C V M R No. 2 on the SE face.</p>	

Dependent Resurvey of the NW Boundary of the  
Camp Verde Military Reservation (abandoned),  
T. 14 N., R. 4 E., G. & S. R. M., Arizona

CHAINS	
	Mound of stone, 2 ft. base, 1 ft. high, SW of the cor. N. 62°29' E., along the NW boundary of the abandoned Camp Verde Military Reservation.
	Over rolling land, through moderate undergrowth.
3.10	Road, track, bears S. 60° E. and N. 60° W.
8.67	Fence, bears SE and NW.
8.69	Intersect the closing cor. of secs. 14 and 15, hereinafter described.
9.35	Road, gravel, bears SE and NW.
10.30	State Highway No. 279, bears S. 50° E. and N. 50° W.
11.90	Fence, bears S. 50° E. and N. 50° W.
32.00	Fence, bears N. 87° E. and S. 87° W.
32.90	Fence, bears N. 5° E. and S. 5° W.
43.80	Spur, slopes E.
46.00	Road, graded, bears N. 70° W. and N. 62° E.
50.00	Intersection of roads, bearing N. 62° E., S. 62° W. and S. 15° E., continue along road bearing irregularly N. 62° E.
55.73	Intersect the closing cor. on the N and S centerline of sec. 14, hereinafter described.
59.60	Power line, bears S. 20° E. and N. 20° W.
68.20	Telephone line, bears N. 10° E. and S. 10° W.
78.50	Road ends.
79.00	Irrigation ditch, 5 lks. wide, 3 ft. deep, course S.
80.70	Power line, bears S. 30° E. and N. 30° W.
85.90	Graded road, bears N. 80° E. and S. 62° W.
87.97	Proportionate point for the meander cor. set on the right bank of the Verde River in 1892; there is no remaining evidence of this cor. Not monumented.
91.00	Woods Irrigation Ditch, 30 lks. wide, course N. 75° E.
95.00	Enter Verde River, course N. 60° E.
101.44	True point for the closing cor. of secs. 13 and 14, falls in the Verde River. The witness cor. is hereinafter described.
115.00	Leave river, thence along S side.
135.00	Right bank of the Verde River, bears S. 70° E. and N. 70° W., 2 to 6 ft. high.

Dependent Resurvey of the NW Boundary of the  
Camp Verde Military Reservation (abandoned),  
T. 14 N., R. 4 E., G. & S. R. M., Arizona

CHAINS	
139.87	Intersect the true point for the closing cor. of secs. 12 and 13, on line closing from the East, hereinafter described.
140.07	Left bank of the Verde River, bears S. 76°41' E. and N. 76°41' W.; point for the meander cor. of secs. 12 and 13.
	Set an iron post, 28 ins. long, 2½ ins. diam., 24 ins. in the ground, with brass cap mkd.
	Raise a mound of stone, 3 ft. base, 1½ ft. high, NE of the cor.
142.575	Intersect the closing cor. of secs. 12 and 13, on line closing from the West, hereinafter described.
146.41	Proportionate point for the meander cor. set on the left bank of the Verde River in 1892; there is no remaining evidence of this cor. Not monumented.
147.16	Road, track, bears S. 20° E. and N. 20° W.
151.90	Fence cor. bears NW 10 lks. dist., fences extend N. 62° E. and S. 80° W.; thence leave river bottom.
152.10	Eureka Irrigation Ditch, 10 lks. wide, 3 ft. deep, course SE.
154.53	Cor. No. 3 of the boundary of the abandoned Camp Verde Military Reservation, monumented by a mound of stone, 3 ft. base, 1 ft. high.
	The cor. is located 5.5 lks. S of a fence cor., fences extend S. 62° W. and N. 15° W.
<p>Dependent Resurvey of a Portion of the Subdivisional Lines T. 14 N., R. 4 E., Gila and Salt River Meridian, Arizona</p>	
<p>(Restoring the resurvey executed by Daniel Drummond in 1892)</p>	
<p>From the cor. of secs. 23, 24, 25 and 26, monumented by an iron post, 2½ ins. diam., projecting 8 ins. above ground, with brass cap mkd.</p>	
	Mound of stone, 3½ ft. base, 1 ft. high, W of the cor.

Dependent Resurvey of a Portion of the Subdivisional Lines  
T. 14 N., R. 4 E., G. & S. R. M., Arizona

CHAINS	
	N. 1°45' E., between secs. 23 and 24. Over gently rolling land, through moderate undergrowth.
3.30	Spur, slopes N. 80° E.
7.40	Spur, slopes East.
14.40	Spur, slopes S. 75° E.
18.70	Old paved highway, bears S. 75° E. and N. 75° W.
20.015	Cor. of fences extending N. 55° E. and N. 55° W.
20.025	The S. 1/16 sec. cor. of secs. 23 and 24, monumented by a sandstone, 14 x 14 x 12 ins., firmly set with 6 ins. projecting above ground, mkd. with a cross on top.  At the cor. point  Set an iron post, 28 ins. long, 2½ ins. diam., 22 ins. in the ground, encircled by a mound of stone, 2 ft. base, to top, with brass cap mkd.  T 14 N R 4 E S 1/16 S 23 S 24 1973  Bury the marked stone alongside the iron post.
22.00	Wash, 30 lks. wide, 6 ins. deep, drains N. 55° E.
29.15	Cor. of fences extending N. 10° E. and SE.
30.80	Wire fence, bears N. 75° E. and S. 75° W.
33.20	State Highway No. 279, bears S. 20° E. and N. 20° W.
36.90	Wire fence, bears S. 20° E. and N. 20° W.
38.50	Road, track, bears S. 65° W. and N. 65° E.
40.03	The ¼ sec. cor. of secs. 23 and 24, monumented by an iron post, 2½ ins. diam., projecting 4 ins. above ground, brass cap mkd.  T 14 N R 4 E S ¼ S 23 S 24 1964  N. 1°46' E., beginning new measurement.
0.06	Wire fence, bears S. 88° E. and N. 88° W.
0.35	Road, graded, bears S. 80° E. and N. 80° W.
4.30	Wash, 80 lks. wide, 20 ft. deep, drains E.

Dependent Resurvey of a Portion of the Subdivisional Lines,  
T. 14 N., R. 4 E., G. & S. R. M., Arizona

CHAINS									
6.10	Curve in track road, bears N. 80° E. and N. 5° W.								
15.20	Road, track, bears SE and NW.								
16.80	Wire fence, bears E and W for 2 lks. to cor.; thence bears N.								
19.70	Road, track, bears N. 85° E. and S. 85° W.								
20.015	Point for the N. 1/16 sec. cor. of secs. 23 and 24; not monumented.								
	Cor. falls at the cor. of a fence, which is a steel post projecting 4 ft. above ground in a base of concrete.								
23.25	Wire fence, bears E and W.								
29.70	Wire fence, bears E and W.								
31.30	Wire fence, bears E and W.								
31.40	Power line, bears N. 80° E. and S. 80° W.								
31.80	Intersection of graded roads, bears E, W and N.								
39.85	Intersection of graded roads, bears E, W and S.								
40.03	The cor. of secs. 13, 14, 23 and 24, monumented by a 1 inch iron pipe, projecting 1 inch above ground. This position is harmoniously related to existing original corners, and is accepted as the best existing evidence of the position of the original cor.								
	At the cor. point								
	Set an iron post, 28 ins. long, 2½ ins. diam., 24 ins. in the ground, and in a collar of stone, brass cap mkd.								
	<table border="0" style="margin-left: auto; margin-right: auto;"> <tr> <td>T 14 N</td> <td>R 4 E</td> </tr> <tr> <td>S 14</td> <td>S 13</td> </tr> <tr> <td>S 23</td> <td>S 24</td> </tr> <tr> <td colspan="2" style="text-align: center;">1973</td> </tr> </table>	T 14 N	R 4 E	S 14	S 13	S 23	S 24	1973	
T 14 N	R 4 E								
S 14	S 13								
S 23	S 24								
1973									
	Raise a mound of stone, 2 ft. base, 1½ ft. high, N of the cor.								
	The cor. is located at the S end of a fence extending N and W; 25 lks. W of a graded road which bears N and S, and 20 lks. N of graded road intersection, roads bear E, W and S.								
	Deposit the iron pipe inside the iron post.								
	Land, gently rolling.								
	Soil, sandy loam.								
	Timber, none.								

Dependent Resurvey of a Portion of the Subdivisional Lines,  
T. 14 N., R. 4 E., G. & S. R. M., Arizona

CHAINS	
	<p>From the cor. of secs. 13, 18, 19 and 24 on the E bdy. of the Tp., monumented by an iron post, 2½ ins. diam., projecting 4 ins. above ground, with brass cap mkd.</p> <div style="text-align: center;"> <p>T 14 N R 4 E R 5 E <u>S 13   S 18</u> <u>S 24   S 19</u> 1964 1971</p> </div> <p>Mound of stone, 1½ ft. base, 1 ft. high, N of the cor.</p> <p>A ¾ inch open end pipe beside cor., and a 8 x 8 inch wooden post projecting 4 ft. above ground is 5 lks. N of the cor.</p> <p>N. 89°59' W., between secs. 13 and 24.</p> <p>Over nearly level land through moderate undergrowth.</p>
0.45	Paved road, bears SE, gravel road bears NW.
10.50	Track road, bears N. 20° E. and S. 20° W.
10.80	Wire fence, bears N. 20° E. and S. 20° W.
14.10	U. S. Interstate Highway No. 17, bears N. 20° E. and S. 20° W.
14.80	Wash, 10 lks. wide, 2 ft. deep, drains SW.
15.75	Wire fence, bears N. 20° E. and S. 20° W.
20.15	Road, gravel, bears N. 5° E. and S. 5° W.
20.50	Power line, bears N. 5° E. and S. 5° W.
26.40	Eureka Irrigation Ditch, course S.
32.00	Graded road, bears N. 20° E. and S. 20° W.
36.51	Point for the orig. meander cor. and witness ¼ sec. cor. of secs. 13 and 24, at proportionate dist.; there is no remaining evidence of the original cor., not monumented.
37.85	Left bank of the Verde River, bears N. 15°53' E. and S. 25° W., banks 2 to 12 ft. high.
39.35	Right bank of the Verde River.
40.125	Point for the ¼ sec. cor. of secs. 13 and 24, at proportionate dist.; not monumented.
45.00	Old river channel drains S. 20° W.
48.40	Old river channel drains S. 10° W.
49.40	Wire fence, bears N. 25° E. and S. 25° W.



Dependent Resurvey of a Portion of the Subdivisional Lines,  
T. 14 N., R. 4 E., G. & S. R. M., Arizona

CHAINS	
55.27	Point for the orig. meander cor. of secs. 13 and 24, on the right bank of the Verde River, at proportionate dist.; there is no remaining evidence of the original cor.; not monumented.
65.00	Woods Irrigation Ditch, 15 lks. wide, course S. 50° W.
66.15	Power line, bears N. 30° E. and S. 30° W.
68.20	Curve in graded road, bears N. 25° E. and West.
80.00	Road, graded, bears N and S.
80.25	The cor. of secs. 13, 14, 23 and 24.
	Land, gently rolling. Soil, sandy loam. Timber, none.
	(Restoring the resurvey executed by Daniel Drummond in 1892)
	_____
	From the cor. of secs. 13, 14, 23 and 24.
	N. 1°43' E., bet. secs. 13 and 14.
	Over level land, along a N-S fence.
14.60	Fence extends W.
19.80	Fence extends W.
19.90	Road, graded, bears E and W.
20.10	Fence, extends N. 70° W.
22.90	Fence, extends N. 80° W.
26.50	Fence extends W.
30.10	Fence, extends S. 70° W.
40.21	The ½ sec. cor. of secs. 13 and 14, monumented with a granite stone, 8 x 8 x 4 ins. projecting above ground, mkd. with a cross on top. This position is harmoniously related to existing original corners, and is accepted as the best available evidence of the original corner position; not remonumented.
	_____
	N. 1°48' E., on the record bearing, beginning new measurement.
	Over nearly level land, along a N-S fence.
.60	Fence extends W.
12.90	Fence extends W.
17.70	Intersect fence cor.; fences extend N. 60° E. and south- erly, along the sec. line.

Dependent Resurvey of a Portion of the Subdivisional Lines,  
T. 14 N., R. 4 E., G. & S. R. M., Arizona

CHAINS											
17.90	Road, graded, bears N. 70° E. and S. 70° W.										
17.965	Proportionate point for the meander cor. set on the right bank of the Verde River in 1892; there is no remaining evidence of the cor. Not monumented.										
18.00	Rower line, bears N. 70° E. and S. 70° W.										
19.40	Woods Irrigation Ditch, 30 lks. wide, course N. 75° E., thence over river bottom land.										
19.70	Road, track, bears N. 75° E. and S. 75° W.										
21.00	Right bank of the Verde River, bears N. 75° E. and S. 75° W.										
21.41	Intersect the boundary of the abandoned Camp Verde Military Reservation at the true point for the closing cor. of secs. 13 and 14, for inside the reservation. This point falls in the Verde River, not monumented.  From this point, Cor. No. 3 of the abandoned Camp Verde Military Reservation bears N. 62°29' E., 53.87 chs. dist., previously described.										
(Restoring the survey executed by C. Burton Foster in 1877 and the resurvey executed by Vern E. Lane in 1959)											
From the cor. of secs. 11, 12, 13 and 14, monumented by an iron post, 2½ ins. diam., set 16 ins. below the surface of the ground, brass cap mkd.											
<table style="margin: auto;"> <tr> <td>T 14 N</td> <td>R 4 E</td> </tr> <tr> <td>S 11   S 12</td> <td></td> </tr> <tr> <td>S 14   S 13</td> <td></td> </tr> <tr> <td colspan="2">1959</td> </tr> </table>		T 14 N	R 4 E	S 11   S 12		S 14   S 13		1959			
T 14 N	R 4 E										
S 11   S 12											
S 14   S 13											
1959											
S. 0°01' W., bet. secs. 13 and 14. Over cultivated land.											
11.00	Eureka Irrigation Ditch, course N. 70° E.										
19.44	The witness N. 1/16 sec. cor. of secs. 13 and 14, which also functions as the witness closing cor. of secs. 13 and 14 on the bdy. of the abandoned Camp Verde Military Reservation, monumented by an iron post, 2½ ins. diam., firmly set, projecting 8 ins. above ground, brass cap mkd.										
<table style="margin: auto;"> <tr> <td>N 1/16</td> <td></td> </tr> <tr> <td>S 14   S 13</td> <td></td> </tr> <tr> <td colspan="2" style="text-align: center;">↓</td> </tr> <tr> <td colspan="2" style="text-align: center;">W C</td> </tr> <tr> <td colspan="2" style="text-align: center;">1959</td> </tr> </table>		N 1/16		S 14   S 13		↓		W C		1959	
N 1/16											
S 14   S 13											
↓											
W C											
1959											
Add the date 1973 to the brass cap.  Raise a mound of stone, 2 ft. base, 1½ ft. high, W of the cor.  Set a steel fence post, 2 ft. S of the cor.											

Dependent Resurvey of a Portion of the Subdivisional Lines,  
T. 14 N., R. 4 E., G. & S. R. M., Arizona

CHAINS	
	Enter Verde River bottom.
19.80	Left bank of the Verde River, bears N. 50° E. and S. 50° W., bank 4 ft. high.
20.24	True point for the N. 1/16 sec. cor. of secs. 13 and 14, falls in the Verde River.
21.45	Intersect the boundary of the abandoned Camp Verde Military Reservation at the true point for the closing cor. of secs. 13 and 14, for outside the reservation. This point falls in the Verde River.
	From this point, Cor. No. 3 of the abandoned Camp Verde Military Reservation bears N. 62°29' E., 53.09 chs. dist., previously described.
	(Restoring the survey executed by Daniel Drummond in 1892)
	From the cor. of secs. 7, 12, 13 and 18 on the E. boundary of the Tp., heretofore described.
	S. 88°04' W., bet. secs. 12 and 13.
	Over rolling land, through moderate creosote brush, scattered cedar and palo-verde.
5.20	Spur, slopes SW.
11.00	Spur, slopes S.
19.985	Point for the E. 1/16 sec. cor. of secs. 12 and 13.
	Set an iron post, 28 ins. long, 2½ ins. diam., 22 ins. in the ground, with brass cap mkd.
	T 14 N R 4 E E. 1/16 $\frac{S 12}{S 13}$ 1973
	from which
	A cedar, 6 ins. diam., bears N. 44 3/4° E., 87 lks. dist., mkd. E 1/16 S12 BT.
	A limestone boulder, 2 x 2 x 2½ ft. above ground, bears S. 2° W., 93.5 lks. dist., mkd. X B O on E face.
	Raise a mound of stone, 3 ft. base, 2½ ft. high, N of the cor.
22.80	Fence, bears S. 55° W. and NE.
25.70	Spur, slopes S. 20° W.
28.40	Spur, slopes S.
30.40	Eureka Irrigation Ditch, 10 lks. wide, 3 ft. deep, course S. 50° E.; enter river bottom through heavy weeds, scattered cottonwood and willows.

Dependent Resurvey of a Portion of the Subdivisional Lines,  
T. 14 N., R. 4 E., G. & S. R. M., Arizona

CHAINS	
37.55	Road, track, bears SE and NW.
39.97	<p>Proportionate point for the <math>\frac{1}{4}</math> sec. cor. of secs. 12 and 13, identical with the orig. meander cor. of secs. 12 and 13; there is no remaining evidence of the original cor.</p> <p>Set an iron post, 28 ins. long, <math>2\frac{1}{2}</math> ins. diam., 24 ins. in the ground, with brass cap mkd.</p>
	<p style="text-align: center;">T 14 N R 4 E  <math>\frac{1}{4}</math> <math>\frac{S 12}{S 13}</math>                      1973</p>
	<p>from which</p> <p style="padding-left: 40px;">A cottonwood, 20 ins. diam., bears N. <math>14\frac{3}{4}^{\circ}</math> E., 247 lks. dist., mkd. <math>\frac{1}{4}</math> S12 BT.</p> <p style="padding-left: 40px;">A cottonwood, 18 ins. diam., bears S. <math>45\frac{1}{2}^{\circ}</math> E., 80 lks. dist., mkd. <math>\frac{1}{4}</math> S13 BT.</p>
45.47	<p>Raise a mound of stone, 3 ft. base, <math>1\frac{1}{2}</math> ft. high, N of the cor.</p> <p>Point for the meander cor. of secs. 12 and 13 on the present left bank of the Verde River, bears S. <math>76^{\circ}23'</math> E. and N. <math>76^{\circ}41'</math> W. This cor. also functions as the witness closing cor. of secs. 12 and 13.</p> <p>Set an iron post, 28 ins. long, <math>2\frac{1}{2}</math> ins. diam., 20 ins. in the ground, with brass cap mkd.</p>
	<p style="text-align: center;">W C                      T 14 N R 4 E  <math>\frac{S 12}{S 13}</math> C                      MC                      1973</p>
	<p>Raise a mound of stone, 3 ft. base, <math>1\frac{1}{2}</math> ft. high, E of the cor.</p>
45.97	<p>True point for the closing cor. of secs. 12 and 13 on the boundary of the abandoned Camp Verde Military Reservation falls in the Verde River. Not monumented.</p> <p>from the true point for the closing cor.</p> <p style="padding-left: 40px;">The meander cor. set on the present left bank of the Verde River and on the boundary of the abandoned Camp Verde Military Reservation, bears N. <math>62^{\circ}29'</math> E., 20 lks. dist., heretofore described.</p> <p style="padding-left: 40px;">Cor. No. 3 of the abandoned Camp Verde Military Reservation, bears N. <math>62^{\circ}29'</math> E., 14.66 chs. dist., heretofore described.</p>
	<p style="text-align: center;">(Restoring the survey executed by C. Burton Foster in 1877 and the resurvey executed by Vern E. Lane in 1959).</p> <hr/> <p>From the cor. of secs. 11, 12, 13 and 14, heretofore described.</p> <p>S. <math>86^{\circ}08'</math> E., bet. secs. 12 and 13.</p>

Dependent Resurvey of a Portion of the Subdivisional Lines,  
T. 14 N., R. 4 E., G. & S. R., M., Arizona

CHAINS	
	Over level cultivated land.
6.20	Fence, bears S. 5° E. and N. 5° W.; enter housing sub-division.
6.80	Power line, bears S. 5° E. and N. 5° W.; irrigation ditch 5 lks. wide, course S.
8.30	Road, graded, bears S. 5° E. and N. 5° W.
15.00	Road, graded, bears N. 70° E. and S. 70° W.
18.20	Road, graded, bears N. 15° E. and S. 15° W.
19.73	Point for the W. 1/16 sec., cor. of secs. 12 and 13, at proportionate dist., based on the distances shown on the official 1877 survey plat; not monumented.
22.00	Eureka Irrigation Ditch, 10 lks. wide, course N. 65° E., as scaled from the U.S.G.S. quadrangle Middle Verde, Arizona, 1969.
29.50	Fence, bears N and S; enter open field.
30.60	Fence, bears N. 65° E. and S. 65° W.; enter brushy river bottom land.
36.50	The closing cor. of secs. 12 and 13 on the boundary of the abandoned Camp Verde Military Reservation, monumented with an iron post, 2½ ins. diam., projecting 4 ins. above ground, with brass cap mkd.
	<p>T 14 N R 4 E  C S 12  C S 13  1959</p>
	Mound of stone, 3 ft. base, 2 ft. high, W of the cor.
	From this point, Cor. No. 3 of the abandoned Camp Verde Military Reservation, bears N. 62°29' E., 11.955 chs. dist., previously described.
	<p>(Restoring the survey executed by C. Burton Foster  in 1877)</p>
	From the cor. of secs. 1 and 12 only on the E. bdy. of the township, monumented with an iron post, 2 ins. diam., projecting 8 ins. above ground, encircled by a mound of stone 2 ft. base, 6 ins. high, with brass cap mkd.
	<p>T 14 N   T 14 N  S 1   S 6  S 12    R 4 E R 5 E  1938</p>
	from which
	<p>A dead juniper, 14 ins. diam., bears S. 12½° W.,  409 lks. dist., mkd. T14N R4E S12 BT.</p>

Dependent Resurvey of a Portion of the Subdivisional Lines,  
T. 14 N., R. 4 E., G. & S. R. M., Arizona

CHAINS	
	<p>A dead juniper, 5 ins. diam., bears N. 12 3/4° W., 243 lks. dist., mkd. T14N R4E S1 BT.</p> <p>S. 89°06' W., bet. secs. 1 and 12.</p> <p>Over gently rolling land, through creosote brush, palo-verde and cedar.</p>
19.70	Spur, slopes N. 30° W.
27.20	Spur, slopes NW.
30.70	Spur, slopes N.
34.90	Spur, slopes N. 55° E.
38.75	<p>Point for the 1/4 sec. cor. of secs. 1 and 12 at proportionate dist.; there is no remaining evidence of the original cor.</p> <p>Set an iron post, 28 ins. long, 2 1/2 ins. diam., 12 ins. in the ground to bedrock, encircled by a mound of stone, 4 ft. base, to top, with brass cap mkd.</p> <p style="text-align: center;">T. 14 N R 4 E 1/4 S 1 S 12 1973</p> <p>from which</p> <p>A palo-verde, 4 ins. diam., bears S. 23 1/2° W., 145 lks. dist., mkd. X BT.</p> <p>Limestone outcrop, 24 x 3 ft. above ground, bears N. 52 1/2° E., 62 lks. dist., mkd. X B O in 5 inch letters.</p> <p>Cor. is located 22 lks. E of a small rock ledge.</p>
47.10	Spur, slopes N. 75° W.
65.80	Telephone line, bears SE and NW.
69.80	Road, paved, bears SE and NW.
77.50	<p>The cor. of secs. 1, 2, 11 and 12, monumented with an iron post, 2 1/2 ins. diam., projecting 7 ins. above ground, encircled by a mound of stone, 2 ft. base, to top, with brass cap mkd.</p> <p style="text-align: center;">T 14 N R 4 E S 2   S 1 S 11   S 12 1959</p> <p>Mound of stone, 3 ft. base, 1 ft. high, W of the cor.</p> <p>Land, rolling. Soil, decomposed limestone. Timber, scattered cedar and palo-verde. Undergrowth, creosote brush.</p>

Dependent Resurvey of a Portion of the Subdivisional Lines,  
T. 14 N., R. 4 E., G. & S. R. M., Arizona

CHAINS	
	N. 1°11' W., bet. secs. 1 and 2. Over rolling land, through widely scattered junipers.
2.10	Wash, 30 lks. wide, 6 ft. deep, drains SW.
8.30	Cattle guard in paved road, bears S. 40° E. and N. 40° W.
10.50	Telephone line, bears S. 58° E. and N. 58° W.
13.30	Fence, bears E and W.
19.85	Fence, bears S. 70° E. and N. 70° W.
21.30	Ascend steep S. slope.
25.70	Top of ascent, bears NW and E.
43.63	Point for the $\frac{1}{4}$ sec. cor. of secs. 1 and 2 at proportionate dist.; there is no remaining evidence of the original cor.  Set an iron post, 28 ins. long, $2\frac{1}{2}$ ins. diam., on broken limestone, and in a mound of stone, 4 ft. base, to top, with brass cap mkd.  T 14 N R 4 E $\frac{1}{4}$ S 2   S 1 1974  The cor. is located 2.51 chs. West of a fence bearing N. 4° E. and S. 4° W.
50.50	Mesa rim, bears SE and irregularly N.
75.40	Descend over steep N. slope.
85.70	Grandpa Wash, 1.00 ch. wide, 3 ft. deep, drains W.
86.75	Fence, bears S. 55° E., 40 lks. dist., thence N. 75° E.
86.94	The cor. of secs. 1, 2, 35 and 36 on the N. bdy. of the Tp., heretofore described.  Land, rolling and broken. Soil, sandy loam and rocky with limestone outcrops. Timber, widely scattered juniper, palo-verde and mesquite. Undergrowth, creosote brush, grass and cacti.
	(Restoring the resurvey executed by Daniel Drummond in 1892)
	From the cor. of secs. 23, 24, 25 and 26.  S. 88°46' W., bet. secs. 23 and 26.  Over rolling land, through moderate undergrowth.

Dependent Resurvey of a Portion of the Subdivisional Lines,  
T. 14 N., R. 4 E., G. & S. R. M., Arizona

CHAINS	
11.00	Small mesa.
20.015	Point for the E. 1/16 sec. cor. of secs. 23 and 26.
	Set an iron post, 28 ins. long, 2½ ins. diam., 22 ins. in the ground, with brass cap mkd.
	<p style="text-align: center;">T 14 N R 4 E . E 1/16 <math>\frac{S\ 23}{S\ 26}</math> 1973</p>
	Raise a mound of stone, 2 ft. base, 1½ ft. high, N of the cor.
21.80	Wash, 20 lks. wide, 3 ft. deep, drains N. 30° E.
23.10	Wash, 15 lks. wide, 4 ft. deep, drains N. 40° E.
33.30	Spur, slopes N. 50° E.
35.00	Road, track, bears N. 50° E. and S. 50° W.
40.03	The ¼ sec. cor. of secs. 23 and 26, monumented with an iron post, 2½ ins. diam., projecting 8 ins. above ground, with brass cap mkd.
	<p style="text-align: center;">T 14 N R 4 E ¼ <math>\frac{S\ 23}{S\ 26}</math> 1964</p>
	Mound of stone, 2 ft. base, 1 ft. high, W of the cor.
	From this cor., a copper weld, bears N. 4°20'30" E., 14.24 chs. dist., set flush with ground, encircled by a mound of stone, 2 ft. base, 5 ins. high, cap mkd.
	C-V-4
	A H D
	From the cor. of secs. 13, 14, 23 and 24.
	West, bet. secs. 14 and 23.
	Along the S. side of a fence line and N. side of a graded road.
20.22	The E. 1/16 sec. cor. of secs. 14 and 23, monumented with a local iron pipe, 1 in. diam., projecting 1 in. above ground. Accepted as the cor.
	At the cor. point
	Set an iron post, 28 ins. long, 2½ ins. diam., 24 ins. in the ground, over the local iron pipe, encircled by a mound of stone, 1 ft. base to top, with brass cap mkd.



Dependent Resurvey of a Portion of the Subdivisional Lines,  
T. 14 N., R. 4 E., G. & S. R. M., Arizona

CHAINS	
	<p style="text-align: center;">T 14 N. R 4 E E 1/16 <math>\frac{S 14}{S 23}</math> 1973</p> <p>from which</p> <p style="text-align: center;">An open end iron pipe, 2½ ins. diam., 4 ft. long, in E. end of cattle guard, bears N. 25° W., 55 lks. dist.</p> <p>The cor. is located at a cor. of fences extending N and E, also 26 lks. N of E-W graded road.</p>
20.40	Road, graded, bears N and S.
27.90	Road, graded, bears S. 50° E., curving E and N. 50° W.
31.90	Wash, 60 lks. wide, 3 ft. deep, drains S. 35° E.
34.80	Old paved highway, bears S. 25° E. and N. 25° W.
38.90	Road, track, bears S. 50° E. and N. 50° W.
40.47	The ¼ sec. cor. of secs. 14 and 23, monumented with an iron post, 2½ ins. diam., projecting 6 ins. above ground, with brass cap mkd.
	<p style="text-align: center;">T 14 N R 4 E ¼ <math>\frac{S 14}{S 23}</math> • 1964</p> <p>Mound of stone, 3 ft. base, 1 ft. high, N of the cor.</p> <hr style="width: 20%; margin: 10px auto;"/> <p>S. 89°54' W., beginning new measurement.</p> <p>Over gently rolling land.</p>
0.73	Fence, wire, bears S. 65° E. and N. 65° W.
4.00	State Highway No. 279, bears S. 65° E. and N. 65° W.
7.60	Fence, wire, bears S. 65° E. and N. 65° W.
20.08	The W. 1/16 sec. cor. of secs. 14 and 23, monumented with a local iron pipe, 1 in. diam., projecting 1 ft. above ground, encircled by a mound of stone, 1½ ft. base to top. Accepted as the cor.
	<p>At the cor. point</p> <p>Set an iron post, 28 ins. long, 2½ ins. diam., 22 ins. in the ground, with brass cap mkd.</p> <p style="text-align: center;">T 14 N R 4 E W 1/16 <math>\frac{S 14}{S 23}</math> 1973</p>

Dependent Resurvey of a Portion of the Subdivisional Lines,  
T. 14 N., R. 4 E., G. & S. R. M., Arizona

CHAINS						
	<p>Deposit the local cor. beside the iron post.</p> <p>Raise a mound of stone, 3½ ft. base, 1½ ft. high, N of the cor.</p>					
26.10	Wash, 15 lks. wide, 2 ft. deep, drains N, curving easterly.					
40.18	<p>The cor. of secs. 14, 15, 22 and 23, monumented with an iron post, 2 ins. diam., projecting 1 ft. above ground, encircled by a mound of stone, with brass cap mkd.</p> <div style="text-align: center;"> <p>T 14 N R 4 E</p> <table border="1" style="margin: auto;"> <tr> <td>S 15</td> <td>S 14</td> </tr> <tr> <td>S 22</td> <td>S 23</td> </tr> </table> <p>1927</p> </div> <p>Land, rolling. Soil, decomposed limestone. Timber, none. Undergrowth, creosote brush and scrub oak.</p> <hr/> <p>(Restoring the resurvey executed by Sidney E. Blout and Charles E. Hunter in 1927, and Vern E. Lane in 1959)</p> <hr/> <p>N. 2°51' E., bet. secs. 14 and 15.</p> <p>Over rolling land, through moderate undergrowth.</p>	S 15	S 14	S 22	S 23	
S 15	S 14					
S 22	S 23					
16.20	Road, track, bears N. 60° E. and S. 60° W.					
19.27	Fence, bears SE and NW.					
19.30	Intersect the closing cor. of secs. 14 and 15 on the boundary of the abandoned Camp Verde Military Reservation, monumented with an iron post, 2 ins. diam., projecting 1 ft. above ground, with brass cap mkd.					
	<div style="text-align: center;"> <p>C C.</p> <p>T 14 N R 4 E</p> <table border="1" style="margin: auto;"> <tr> <td>S 15</td> <td>S 14</td> </tr> </table> <p>C V M R</p> <p>1927</p> </div> <p>From this cor., Cor. No. 2 of the abandoned Camp Verde Military Reservation, bears S. 62°29' W., 8,69 chs. dist., heretofore described.</p>	S 15	S 14			
S 15	S 14					
20.00	Road, gravel, bears S. 50° E. and N. 50° W.					
20.06	<p>Point for the S. 1/16 sec. cor. for sec. 14 only, at proportionate dist., based on the distances shown on the official 1893 survey plat.</p> <p>Set an iron post, 28 ins. long, 2½ ins. diam., 6 ins. below the earth's surface, with brass cap mkd.</p>					

Dependent Resurvey of a Portion of the Subdivisional Lines,  
T. 14 N., R. 4 E., G. & S. R. M., Arizona

CHAINS

T 14 N R 4 E  
| S 1/16  
| S 14  
1973

from which

A highway marker, bears N. 3°06' E., 304.5 lks. dist., monumented with a brass cap, 2½ ins. diam., set in a base of concrete, 5 ins. diam., projecting 1 inch above ground, with brass cap mkd.

S T A  
239 + 75.0  
1967

The cor. is located in a gravel driveway, bears NE and SW to a truck weighing station.

21.20 State Highway No. 279, bears S. 50° E. and N. 50° W.

23.10 Fence, bears SE and NW.

30.35 Fence, bears S. 85° E. and N. 85° W.

34.20 Road, graded, bears N. 75° E. and S. 75° W.

44.57 The ¼ sec. cor. of secs. 14 and 15, monumented with an iron post, 1 inch diam., projecting 14 ins. above ground, with brass cap mkd.

¼  
S 15 | S 14  
1927

N. 2°52' E., beginning new measurement.

Over rolling land, through moderate undergrowth.

0.70 Road, track, bears NE and SW.

17.60 Wash, in large draw, 160 lks. wide, 2 ft. deep, drains N. 60° E.

20.50 Spur, slopes NE.

22.30 Point for the N. 1/16 sec. cor. of secs. 14 and 15. Not monumented.

31.10 Road, track, bears N. 70° E. and S. 70° W.

32.40 Spur, slopes NE.

44.60 The cor. of secs. 10, 11, 14 and 15, monumented with an iron post, 2 ins. diam., projecting 1 ft. above ground, brass cap mkd.

T 14 N R 4 E  
S 10 | S 11  
S 15 | S 14  
1927

Mound of stone, 3 ft. base, 1½ ft. high, W of the cor.

Dependent Resurvey of a Portion of the Subdivisional Lines,  
T. 14 N., R. 4 E., G. & S. R. M., Arizona

CHAINS	
	<p>Land, level. Soil, sandy loam. Timber, none. Undergrowth, catclaw, and mesquite brush.</p> <hr/> <p>(Restoring the survey executed by C. Burton Foster in 1877 and the resurvey executed by Vern E. Lane in 1959)</p> <hr/> <p>From the <math>\frac{1}{4}</math> sec. cor. of secs. 11 and 14, monumented with an iron post, <math>2\frac{1}{2}</math> ins. diam., set flush with the ground, with brass cap mkd.</p> <p style="text-align: center;">T 14 N R 4 E <math>\frac{1}{4}</math> <math>\frac{S 11}{S 14}</math> 1959</p> <p>N. <math>86^{\circ}02'</math> W., bet. secs. 11 and 14.</p> <p>Over level open land.</p> <p>5.10 Enter moderate timber and undergrowth.</p> <p>5.90 Eureka Irrigation Ditch, 10 lks. wide, 3 ft. deep, course S.</p> <p>8.30 Road, track, bears S, <math>20^{\circ}</math> E. and N. <math>20^{\circ}</math> W.</p> <p>17.10 Left bank of the Verde River, bears S. <math>40^{\circ}</math> E. and N. <math>40^{\circ}</math> W., banks 2 to 8 ft. high.</p> <p>18.40 Right bank of Verde River.</p> <p>19.745 Point for the W. <math>\frac{1}{16}</math> sec. cor. of secs. 11 and 14.</p> <p>Set an iron post, 28 ins. long, <math>2\frac{1}{2}</math> ins. diam., 22 ins. in the ground, with brass cap mkd.</p> <p style="text-align: center;">T 14 N R 4 E W <math>\frac{1}{16}</math> <math>\frac{S 11}{S 14}</math> 1973</p> <p>from which</p> <p style="text-align: center;">A mesquite, 12 ins. diam., bears S. <math>10^{\circ}</math> E., 18 lks. dist., mkd. W <math>\frac{1}{16}</math> S14 BT.</p> <p>Raise a mound of stone, <math>2\frac{1}{2}</math> ft. base, 2 ft. high, N of the cor.</p> <p>21.20 Wash, 70 lks. wide, 4 ft. deep, drains S. <math>20^{\circ}</math> E.</p> <p>22.30 Wash, 50 lks. wide, 5 ft. deep, drains S. <math>50^{\circ}</math> E.</p> <p>24.70 Spur, slopes N.</p> <p>27.60 Spur, slopes NE.</p>

Dependent Resurvey of a Portion of the Subdivisional Lines,  
T. 14 N., R. 4 E., G. & S. R. M., Arizona

CHAINS	
39.49	<p>The cor. of secs. 10, 11, 14 and 15.</p> <hr/> <p>(Restoring the survey executed by C. Burton Foster in 1877)</p> <hr/> <p>From the cor. of secs. 2, 3, 10 and 11, monumented by an iron post, 2½ ins. diam., projecting 2 ins. above ground, with brass cap mkd.</p> <p style="text-align: center;">T 14 N R 4 E S 3   S 2 S 10   S 11 1959</p> <p>Mound of stone, 2 ft. base, 1 ft. high, W of the cor. N. 0°04' E., between secs. 2 and 3.</p> <p>Over nearly level land, through moderate undergrowth.</p> <p>1.90 Fence, bears N. 70° E. and S. 70° W., thence across open field.</p> <p>12.80 Power line, bears SE and NW.</p> <p>13.80 Fence, bears E and W; thence through moderate undergrowth and timber.</p> <p>15.70 Fence, bears S. 53° E. and N. 53° W.; enter open area.</p> <p>18.90 Fence, bears S. 68° E. and N. 68° W.; enter Verde River bottom land, with timber and scattered undergrowth.</p> <p>27.00 Right bank of Verde River, bears N. 80° E. and S. 80° W.</p> <p>29.00 Left bank of Verde River.</p> <p>29.20 Fence, bears N. 80° E. and S. 80° W.; thence across open level land.</p> <p>31.50 Fence, bears E and W.</p> <p>32.65 Fence, bears E and W.</p> <p>41.93 The ¼ sec. cor. of secs. 2 and 3, monumented by a metal fence post, located on N. edge of a ditch, 4 lks. wide, course N. 75° E. This is accepted as the best remaining evidence of the orig. cor. position. Not remonumented.</p> <hr/> <p>N. 0°04' E., beginning new measurement.</p> <p>Continue over nearly level open land.</p> <p>0.30 Fence, bears S. 85° E. and N. 85° W.</p> <p>7.00 O.K. Irrigation Ditch, 10 lks. wide, 5 ft. deep, course irregularly S. 50° E.</p>

Dependent Resurvey of a Portion of the Subdivisional Lines,  
T. 14 N., R. 4 E., G. & S. R. M., Arizona

CHAINS	
8.50	Power line, bears S. 65° E. and N. 65° W.
8.90	Intersect the SE cor. of a wood frame barn, long side bears S. 47° E. and N. 47° W.
10.90	Fence, bears S. 47° E. and N. 47° W.
11.70	Road, graded, bears S. 47° E. and N. 47° W.
12.30	Cor. of fences, bears N. 47° W. and N along sec. line.
15.70	Telephone line, bears S. 55° E. and N. 55° W.
21.23	The N. 1/16 sec. cor. of secs. 2 and 3, monumented by an open end iron pipe, 1/2 in. diam., set in concrete, projecting 2 inches above ground. Cor. is located 0.4 lks. E of fence cor. Fences bear southerly and westerly. Raised a mound of stone, 2 1/2 ft. base, 1 1/2 ft. high, SW of the cor. Accepted as the cor. Not remonumented.
23.85	Intersect a 1/2 inch re-bar projecting 2 ins. above ground.
38.25	Wash, 20 lks. wide, 5 ft. deep, drains S. 75° W.
42.32	The cor. of secs. 2, 3, 34 and 35 on the N. bdy. of the Tp., heretofore described.  Land, nearly level. Soil, decomposed limestone. Timber, none. Undergrowth, creosote brush.
(Restoring the 1927 survey by Sidney E. Blout and Charles E. Hunter)	
From the 1/4 sec. cor. of sec. 16 only on the E. bdy. of the sec., monumented with an iron post, 1 inch diam., projecting 10 ins. above ground, with brass cap mkd.	
$\begin{array}{c} \frac{1}{4}   \\ S 16   \\ 1927 \end{array}$	
Mound of stone, 2 ft. base, 1 ft. high, W of the cor.	
N. 0°01' W., along the E. boundary of sec. 16.	
Over rolling land, through moderate undergrowth.	
6.80	Road, graded, bears N. 65° E. and S. 65° W.
12.035	The 1/4 sec. cor. of sec. 15 only, monumented with an iron post, 1 inch diam., projecting 4 ins. above ground, with brass cap mkd.
$\begin{array}{c} \frac{1}{4}   \\   S 15 \\ 1927 \end{array}$	

Dependent Resurvey of a Portion of the Subdivisional Lines,  
T. 14 N., R. 4 E., G. & S. R. M., Arizona

CHAINS	
	Mound of stone, 2 ft. base, 6 ins. high, E of the cor.
	Cor. is located in a fence line which bears S. 85° E. and N. 85° W. for 4 lks., thence N. 74° W.
14.70	Road, track, bears N. 30° E. and S. 30° W.
14.90	Fence, bears N. 24° E. and S. 24° W.
19.975	Point for the N. 1/16 sec. cor. of sec. 16 only.
	Set an iron post, 28 ins. long, 2½ ins. diam., 18 ins. in the ground, with brass cap mkd.
	<div style="text-align: center;">           T 14 N              N 1/16              S 16              R 4 E              1973         </div>
	Raise a mound of stone, 2½ ft. base, 2 ft. high, W of the cor.
27.00	Descend into Cherry Creek bottom through heavy undergrowth and scattered timber.
30.20	Fence, bears NE and SW.
38.50	Cherry Creek, 130 lks. wide, drains N. 40° E.
51.99	The cor. of secs. 9, 10, 15 and 16, monumented with an iron post, 2 ins. diam., 5 ins. above ground, with brass cap mkd.
	<div style="text-align: center;">           T 14 N R 4 E            S 9   S 10            S 16   S 15            1927         </div>
	Cor. is located in Cherry Creek bottom land.
	Land, rolling.
	Soil, sandy loam.
	Timber, scattered willows.
	Undergrowth, oak brush, catclaw and greasewood.
	(Restoring the survey executed by C. Burton Foster in 1877)
	From the ¼ sec. cor. of secs. 3 and 10, monumented by an iron post, 2½ ins. diam., set flush with the ground, with brass cap mkd.
	<div style="text-align: center;">           T 14 N R 4 E            S 3            ¼ S 10            1959         </div>
	Raise a mound of stone, 2½ ft. base, 1½ ft. high, N of the cor.

Dependent Resurvey of a Portion of the Subdivisional Lines,  
T. 14 N., R. 4 E., G. & S. R. M., Arizona

CHAINS	
	<p>from which</p> <p>The center of a stock pond, 3.60 chs. in diam., bears N. 37° W., 2.50 chs. dist.</p> <p>The SW cor. of a wood frame feed shed, bears N. 85°50' W., 19.90 chs. dist.</p> <p>The chimney of a log cabin, bears N. 72°19' W., 19.38 chs. dist.</p> <p>N. 86°56' W., between secs. 3 and 10.</p> <p>Over nearly level land.</p>
0.27	Fence, 27 lks. N of fence cor., with fences extending E, W and northerly, thence westerly enclosing stock pond.
3.90	Fence, 16 lks. N of fence cor., with fences extending E, W and North, thence easterly enclosing stock pond.
5.40	Fence, 17 lks. N of fence cor., with fences extending N and E.
14.15	Road, track, bears S. 18° E. and N. 18° W.
15.70	Cor. of a barbed wire fence extending N and W along sec. line.
16.50	Road, track, bears S. 7° E. and N. 7° W.
18.80	Road, track, bears N. 4° E. and S. 4° E., curving East.
19.80	Cor. of a barbed wire fence extending E and N. 5° W.
20.11	An iron pipe, 2 inches in diam., projecting 3 inches above ground, no mks., bears North 0.6 lks. dist.
21.50	Center of Cherry Creek, 275 lks. wide, 8 ft. deep, course N. 5° W.
23.20	The remains of a barbed wire fence extending W along sec. line, bears South 38 lks. dist.
23.85	Fence, 38 lks. N of fence cor., fences extending N, E and W.
24.50	Wash, drains NE.
28.40	Road, track, bears N. 55° E. and S. 15° W.
31.15	Wash, 170 lks. wide, 15 ft. deep, drains N. 7° E.
33.00	Fence, bears N. 38° E. and S. 38° W. for 54 lks., thence S. 73° W.
35.95	Power line, bears N. 75° E. and S. 75° W. for 257 lks., thence W.



Dependent Resurvey of a Portion of the Subdivisional Lines,  
T. 14 N., R. 4 E., G. & S. R. M., Arizona

CHAINS	
40.41	<p>The cor. of secs. 3, 4, 9 and 10, monumented with an open end iron pipe, 3 ins. diam., projecting 12 ins. above ground, accepted as the best remaining evidence of the orig. cor. position, not remonumented.</p> <p>from which</p> <p style="padding-left: 40px;">A bench mark, bears S. 2°02' E., 21.02 chs. dist., monumented by a brass cap in a base of concrete, 8 x 8 x 10 ins., with brass cap mkd.</p> <p style="text-align: center;">Elev. 3205.870 x 30 ----- 1933</p> <p>The ¼ sec. cor. of secs. 9 and 10, bears S. 0°25' W., 40.01 chs. dist., monumented by a limestone, firmly set projecting 3 ins. above ground, mkd. ¼ on SE face, located at a fence cor., fences extend N and S. 85° E.</p> <p>Land, level. Soil, sandy loam. No timber, scant undergrowth.</p>
	<p>N. 0°31' E., between secs. 3 and 4.</p>
	<p>Over cultivated field.</p>
10.20	<p>Leave field, bears E and W, thence enter Verde River bottom through moderate timber and undergrowth.</p>
13.10	<p>Fence, bears E and W.</p>
14.20	<p>Fence, bears S. 25° E. and N. 25° W.</p>
15.20	<p>Fence, bears N. 65° E. and S. 65° W.</p>
24.50	<p>Dry channel, drains S. 43° E.</p>
30.00	<p>Right bank of the Verde River, bears S. 35° E. and N. 35° W., banks 2 to 6 ft. high.</p>
32.00	<p>Left bank of Verde River.</p>
38.20	<p>Road, track, bears N. 65° E. and S. 65° W., curving West.</p>
38.60	<p>Fence, bears S. 75° E. and N. 75° W.</p>
38.70	<p>O.K. Irrigation Ditch, 15 lks. wide, 5 ft. deep, course S. 75° E., enter open nearly level land.</p>
40.77	<p>The ¼ sec. cor. of secs. 3 and 4, monumented by a ½ inch re-bar, set flush with the ground located at S. edge of track road which bears irregularly N. 70° W and E. This is accepted as the best remaining evidence of the orig. cor. position. Not remonumented.</p>
	<p style="text-align: center;">-----</p> <p>N. 0°31' E., beginning new measurement.</p>
	<p>Continue over nearly level open land.</p>

Dependent Resurvey of a Portion of the Subdivisional Lines,  
T. 14 N., R. 4 E., G. & S. R. M., Arizona

CHAINS	
7.50	Power line, bears E and N. 35° W.
12.50	Fence, bears S. 64° W. and N. 64° E. for 58 lks. to a fence cor.; fences extend S. 8° E. and N. 8° W. Enter moderate brush.
16.45	Track road, bears irregularly E and W.
20.70	Fence, bears W and E for 25 lks. to fence cor. which extends S. 8° E.
20.80	Track road and power line, bears E and W.
21.20	Concrete lined ditch, bears E and W, curving N.
22.85	Fence, bears S. 82° E. and N. 82° W.
24.80	Fence, bears E and W.
26.20	Fence, bears irregularly E and W.
26.70	Fence, bears E and W.
29.00	Fence, bears E and W, thence over open level land.
33.70	Remains of barbed wire fence, bears E and W.
34.10	Road, graded, bears E, curving N and W.
40.94	Power line, bears E and W.
40.97	The cor. of secs. 3, 4, 33 and 34 on the N. bdy. of the Tp., heretofore described.
	Land, nearly level. Soil, sandy loam. No timber; undergrowth, moderate creosote brush in N central portion.
	(Restoring the survey executed by Sidney E. Blout and Charles E. Hunter in 1927)
	From the cor. of secs. 9, 10, 15 and 16.
	N. 87°54' W., along the N. boundary of sec. 16.
	Over Cherry Creek bottom, through heavy undergrowth and scattered willows.
2.00	Ascend out of Cherry Creek bottom land, thence over gently rolling land, through moderate undergrowth.
23.20	Fence, bears S and N, 2 lks. to cor. of fence extending W and S, thence along E-W fenceline.
24.48	Point for the E. 1/16 sec. cor. of sec. 16 only.  Set an iron post, 28 ins. long, 2½ ins. diam., 22 ins. in the ground, with brass cap mkd.

Dependent Resurvey of a Portion of the Subdivisional Lines,  
T. 14 N., R. 4 E., G. & S. R. M., Arizona

CHAINS	
	<p style="text-align: center;"> <u>E 1/16</u>            S 16            T 14 N R 4 E            1973         </p> <p>Raise a mound of stone, 2½ ft. base, 1½ ft. high, S of the cor.</p> <p>Cor. is located 3 lks. S of an E-W fence.</p>
40.01	<p>The ¼ sec. cor. of sec. 9 only, monumented with an iron post, 1 inch diam., encircled by a mound of stone, 4 ft. base, 2 ft. high, with brass cap mkd.</p> <p style="text-align: center;"> <u>¼ S 9</u>            1927         </p> <p>The cor. is located in an E-W fence.</p>
44.49	<p>The ¼ sec. cor. of sec. 16 only, monumented with an iron post, 1 inch diam., projecting 1 ft. above ground, with brass cap mkd.</p> <p style="text-align: center;"> <u>¼ S 16</u>            1927         </p> <p>Mound of stone, 3 ft. base, 8 ins. high, S of the cor.</p> <p>The cor. is located 1 lk. N of an E-W fence.</p>
	<p style="text-align: center;">(Restoring the survey executed by C. Burton Foster in 1877)</p> <hr/> <p>From the cor. of secs. 3, 4, 9 and 10.</p> <p>N. 88°56' W., between secs. 4 and 9.</p> <p>Over nearly level open land, along track road bearing W, and 50 lks. N of E-W power line.</p>
9.00	Road, track, bears E and W; leave power line, bearing S to a well.
26.50	Road, track, bears N and S, curving E.
27.35	Barbed wire fence, bears N and S, curving E.
30.00	Old paved highway, bears N. 15° W., curving W and S. 15° E., curving E.
30.30	Ascend E. slope.
32.35	Spur, slopes N, thence over rolling land, through scattered undergrowth.
39.05	Wash, 60 lks. wide, 4 ft. deep, drains N. 20° E.

Dependent Resurvey of a Portion of the Subdivisional Lines,  
T. 14 N., R. 4 E., G. & S. R. M., Arizona

CHAINS	
40.41	<p>The <math>\frac{1}{4}</math> sec. cor. of secs. 4 and 9, monumented by an iron post, <math>2\frac{1}{2}</math> ins. diam., projecting 8 ins. above ground, brass cap mkd.</p> <p style="text-align: center;">T 14 N R 4 E <math>\frac{1}{4}</math> <math>\frac{S}{S}</math> <math>\frac{4}{9}</math> 1964</p> <p>Mound of stone, 2 ft. base, 1 ft. high, N of the cor.</p> <p>The cor. is located 6 lks. South of a fence cor.; fences bear S and W.</p> <hr style="width: 20%; margin: 10px auto;"/>
	<p>N. <math>88^{\circ}01'</math> W., beginning new measurement.</p>
6.10	<p>Road, track, bears irregularly NE and SW.</p>
10.90	<p>Draw, drains NE.</p>
16.50	<p>Fence, bears S. <math>40^{\circ}</math> E. and N. <math>40^{\circ}</math> W., also wash, 20 lks. wide, 3 ft. deep, drains NE.</p>
18.50	<p>State Highway No. 279, bears S. <math>41^{\circ}30'</math> E. and N. <math>41^{\circ}30'</math> W.</p>
20.17	<p>Point for the W. <math>\frac{1}{16}</math> sec. cor. of secs. 4 and 9.</p> <p>Set an iron post, 28 ins. long, <math>2\frac{1}{2}</math> ins. diam., 26 ins. in the ground, with brass cap mkd.</p> <p style="text-align: center;">T 14 N R 4 E W <math>\frac{1}{16}</math> <math>\frac{S}{S}</math> <math>\frac{4}{9}</math> 1972</p>
	<p>Raise a mound of stone, <math>2\frac{1}{2}</math> ft. base, <math>1\frac{1}{2}</math> ft. high, N of the cor.</p>
20.60	<p>Fence, bears S. <math>40^{\circ}</math> E. and N. <math>40^{\circ}</math> W.</p>
40.34	<p>The cor. of secs. 4, 5, 8 and 9, monumented by an iron post, 2 ins. diam., projecting 24 ins. above ground, brass cap mkd.</p> <p style="text-align: center;">T 14 N R 4 E <math>\frac{S}{S}</math> <math>\frac{5}{8}</math>   <math>\frac{S}{S}</math> <math>\frac{4}{9}</math> 1927</p> <p>Land, rolling. Soil, sandy loam. Timber, none. Undergrowth, scattered oak brush and cacti.</p> <hr style="width: 100%;"/>
	<p>N. <math>1^{\circ}08'</math> E., between secs. 4 and 5.</p>
	<p>Over rolling land, through light undergrowth and cedar.</p>

Dependent Resurvey of a Portion of the Subdivisional Lines,  
T. 14 N., R. 4 E., G. & S. R. M., Arizona

CHAINS	
10.95	Wash, 75 lks. wide, 5 ft. deep, drains S. 80° E.
18.90	Wash, 50 lks. wide, 6 ft. deep, drains E.
20.16	Point for the S. 1/16 sec. cor. of secs. 4 and 5.
	Set an iron post, 28 ins. long, 2½ ins. diam., 24 ins. in the ground, with brass cap mkd.
	<p style="text-align: center;">T 14 N R 4 E S 1/16 S 5   S 4 1972</p>
	Raise a mound of stone, 2½ ft. base, 1½ ft. high, W of the cor.
	The cor. is located 39 lks. East of a fence which bears N and S.
20.70	Fence, bears SE and NW.
22.90	State Highway No. 279, bears SE and NW.
25.20	Fence, bears SE and NW.
35.45	Hayfield Draw, 100 lks. wide, 8 ft. deep, drains N. 75° E.
38.65	Old paved highway, bears S. 72° E. and N. 72° W.
39.60	Fence, bears N. 75° E. and S. 75° W.
39.62	Point selected for the witness ¼ sec. cor. of secs. 4 and 5.
	Set an iron post, 28 ins. long, 2½ ins. diam., 24 ins. in the ground, brass cap mkd.
	<p style="text-align: center;">T 14 N R 4 E ¼ S 5   S 4 W C 1972</p>
	Raise a mound of stone, 2½ ft. base, 1½ ft. high, W of the cor.
40.32	True point for the ¼ sec. cor. of secs. 4 and 5, monumented by a ½ inch re-bar projecting 2 ins. above ground, in a gully draining E, impractical to remonument. This position is harmoniously related to existing original corners, and is accepted as the best existing evidence of the position of the original cor.
	N. 1°08' E., beginning new measurement.
5.50	Wash, 50 lks. wide, 12 ft. deep, drains E; asc. over rolling land.

Dependent Resurvey of a Portion of the Subdivisional Lines,  
T. 14 N., R. 4 E., G. & S. R. M., Arizona

CHAINS	
24.40	Rim of mesa, bears N. 10° E. and SW.
40.32	The cor. of secs. 4, 5, 32 and 33 on the N. bdy. of the Tp., heretofore described.
	Land, gently rolling. Soil, sandy loam. Timber, scattered cedars; undergrowth, scattered creosote brush.
Survey of Partial Subdivision of Sec. 3, T. 14 N., R. 4 E., Gila and Salt River Meridian, Arizona	
	From the ¼ sec. cor. of secs. 3 and 10.
	N. 0°15' E., along the N and S centerline of sec. 3.
	Over gently rolling land, through moderate mesquite brush.
6.80	A metal pipe line, 8 ins. diam., bears N. 15° E. and S. 15° W.
11.25	Fence, bears N. 72° E. and S. 72° W.; descend into Verde River bottom.
13.70	Right bank of the Verde River, bears N. 70° E. and S. 70° W.
15.40	Left bank of the Verde River.
21.70	Fence, bears N. 40° E. and S. 40° W. for 50 lks., thence W; thence across cultivated field.
26.00	Fence, bears N. 78° E. and S. 78° W.
41.55	Fence, bears N. 80° E. and S. 80° W.
41.74	Point for the C¼ sec. cor. of sec. 3, at the intersection with the E and W centerline of sec. 3. Not monumented.
53.50	Leave cultivated field; O.K. Ditch, 20 lks. wide, 4 ft. deep, course N. 65° E. for 120 lks., thence E.
62.56	Point for the C-N 1/16 sec. cor. of sec. 3. Not monumented.
	from which
	A local iron pipe, 1 inch in diam., projecting 4 ins. above ground, bears N. 1°14'43" E., 37 lks. dist.
63.80	Fence, bears E and W.
64.15	Road, graded, bears E and W.
67.85	Road, graded, bears E and W.

Survey of Partial Subdivision of Sec. 3,  
T. 14 N., R. 4 E., G. & S. R. M., Arizona

CHAINS	
71.00	Fence, bears E and W.
72.15	Road, track, bears S. 70° E. and N. 70° W.
74.15	Road, graded, bears E and W.
80.30	Road, graded, bears E and W.
83.40	The ½ sec. cor. of secs. 3 and 34, on the N. bdy. of the Tp., heretofore described.
From the ½ sec. cor. of secs. 2 and 3.	
N. 88°16' W., along the E and W centerline of sec. 3.	
Over open level land.	
0.23	Fence, cor., with fences extending N and S. 80° W.
4.15	Fence, bears S. 60° E. and N. 60° W.
8.65	Fence, bears N and S.
13.35	Fence, bears N and S.
18.70	Concrete lined ditch, 4 lks. wide, 14 ins. deep, course S. 8° W.
18.75	Fence, bears N. 8° E. and S. 8° W.
18.90	Lane, bears N. 8° E. and S. 8° W.
19.05	Fence, bears N. 8° E. and S. 8° W.
19.91	The point for the C-E 1/16 sec. cor. of sec. 3. Not monumented.
23.70	Fence, bears N and S.
28.80	Fence, bears N. 5° E. and S. 5° W.
36.80	Fence, bears N. 80° E. and S. 80° W.
38.40	Fence, bears N and S.
38.60	Road, graded, bears N and S.
38.80	Fence, and power line, bears N and S.
39.82	Point for the C½ sec. cor. of sec. 3.
53.20	Concrete ditch, 5 lks. wide, 3 ft. deep, course S.
53.30	Fence, bears N and S, enter cultivated field.
53.50	Road, track, bears N and S.
55.60	Fence, bears S. 32° E. and N. 32° W.
62.30	Fence, bears N. 60° E. and S. 60° W.
62.50	Road, track, bears N. 60° E. and S. 60° W.

Survey of Partial Subdivision of Sec. 3,  
T. 14 N., R. 4 E., G. & S. R. M., Arizona

CHAINS	
72.50	O.K. Irrigation Ditch, 15 lks. wide, 3 ft. deep, course N. 42° E., leave cultivated field.
74.20	Silo trench, 30 lks. wide, 12 ft. deep.
75.20	Fence, bears N. 50° E. and S. 65° W.
75.40	Road, track, bears N. 50° E. and S. 65° W.
78.85	Fence, bears S. 8° E. and N. 8° W.
79.82	The ¼ sec. cor. of secs. 3 and 4.
Subdivision, NE¼, Section 3	
From the point for the C-E 1/16 sec. cor. of sec. 3. N. 0°10' E., along the N and S centerline of the NE¼ of Sec. 3.	
Over open level land.	
0.84	Fence, bears S. 65° E. and N. 65° W.
10.60	Fence, bears E and N. 60° W.
10.80	O.K. Irrigation Ditch, 20 lks. wide, 4 ft. deep, course E.
11.50	Fence, bears S. 80° E. and N. 80° W.
13.55	Fence and power line, bears E and W.
21.02	Point for the NE 1/16 sec. cor. of sec. 3 at intersection with the E and W centerline of the NE¼ of sec. 3.
Set an iron post, 28 ins. long, 2½ ins. diam., 27 ins. in the ground, brass cap mkd.	
T 14 N. R 4 E NE 1/16 + S 3 1972	
Raise a mound of stone, 3 ft. base, 2 ft. high, W of the cor.	
21.55	Fence, bears S. 65° E. and N. 65° W.
21.90	Road, graded, bears S. 65° E. and N. 65° W.
22.20	Enter heavy creosote brush.
29.30	Telephone line, bears S. 53° E. and N. 53° W.
32.70	Fence, bears N. 10° E. and S. 10° W.
41.99	The E. 1/16 sec. cor. of secs. 3 and 34, on the N. bdy. of the Tp.
From the N. 1/16 sec. cor. of secs. 2 and 3.	



Survey of Partial Subdivision of Sec. 3,  
T. 14 N., R. 4 E., G. & S. R. M., Arizona

CHAINS	
	N. 88°52'30" W., along the E and W centerline of the NE $\frac{1}{4}$ of sec. 3.
	Over nearly level land along fence bearing westerly.
7.90	Telephone line, bears S. 55° E. and N. 55° W.
10.00	Fence cor., fence bears southerly and easterly.
16.25	Road, gravel, bears N. 15° E. and S. 15° W.
17.60	Graded road, bears S. 65° E. and N. 65° W.
18.35	Fence, bears S. 65° E. and N. 65° W.
19.865	The NE 1/16 sec. cor. of sec. 3.
20.55	Fence, bears N. 5° E. and S. 5° W.
20.70	Track road, bears N. 5° E. and S. 5° W.
20.90	Fence, bears N. 5° E. and S. 5° W.
37.95	Fence, bears N and S.
38.10	Road, graded, bears N and S.
38.30	Fence, bears N and S.
39.725	Point for the C-N 1/16 sec. cor. of sec. 3.
<p>Survey of Partial Subdivision of Sec. 4, T. 14 N., R. 4 E., Gila and Salt River Meridian, Arizona</p>	
	From the $\frac{1}{4}$ sec. cor. of secs. 4 and 9.
	N. 0°48'30" E., along the N and S centerline of sec. 4.
	Over gently rolling land, through scattered undergrowth.
9.10	Wash, drains East.
12.80	Old paved highway, bears SE and NW; enter heavy undergrowth.
14.60	Road, track, bears E, curving N and W.
20.435	Point for the C-S 1/16 sec. cor. of sec. 4.
	Set an iron post, 28 ins. long, 2 $\frac{1}{2}$ ins. diam., 24 ins. in the ground, with brass cap mkd.
	<p>T 14 N R 4 E C S 1/16   S 4 C 1972</p>
	Raise a mound of stone, 2 ft. base, 1 ft. high, W of the cor.

Survey of Partial Subdivision of Sec. 4,  
T. 14 N., R. 4 E., G. & S. R. M., Arizona

CHAINS		
	The cor. is located in a fence line which bears SE and NW.	
40.87	Point for the $C\frac{1}{4}$ sec. cor. of sec. 4 at the intersection with the E and W centerline of sec. 4. Not monumented.  from which  A bench mark, bears N. $6^{\circ}35'$ W., 5.46 chs. dist., monumented by an iron post, 3 ins. in diam., projecting 26 ins. above ground, brass cap mkd.	
	Elevation Above Sea 3183 feet Datum Prsct.	
48.10	Wire fence, bears N. $60^{\circ}$ E. and S. $60^{\circ}$ W.	
52.75	Center of wash, 5.80 chs. wide, 12 ft. deep, drains N. $15^{\circ}$ E.	
56.35	Fence, bears SE and NW, enter Verde River bottom.	
66.35	Right bank of the Verde River, bears S. $60^{\circ}$ E., curving S and N. $60^{\circ}$ W., banks 2 to 6 ft. high.	
68.35	Left bank of Verde River, thence over open field.	
81.50	The $\frac{1}{4}$ sec. cor. of secs. 4 and 33, on the N. bdy. of the Tp., heretofore described.	
	From the $\frac{1}{4}$ sec. cor. of secs. 3 and 4.  N. $88^{\circ}46'30''$ W., along the E and W centerline of sec. 4.  Over open level land.	
4.80	O.K. Irrigation Ditch, 20 lks. wide, 5 ft. deep, course S. $55^{\circ}$ E., enter Verde River bottom through willows and undergrowth.	
5.00	Fence, bears S. $55^{\circ}$ E. and N. $55^{\circ}$ W.	
7.30	Left bank of the Verde River, bears S. $40^{\circ}$ E. and N. $40^{\circ}$ W., banks 2 to 8 ft. high.	
10.30	Right bank of the Verde River.	
40.16	Point for the $C\frac{1}{4}$ sec. cor. of sec. 4.	
50.55	Fence, bears N. $62^{\circ}$ E. and S. $62^{\circ}$ W.	
52.40	Wash, 1 chain wide, 8 ft. deep, drains N. $30^{\circ}$ E.	
60.19	Point for the C-W $1/16$ sec. cor. of sec. 4.	

Survey of Partial Subdivision of Sec. 4,  
T. 14 N., R. 4 E., G. & S. R. M., Arizona

CHAINS	
	<p>Set an iron post, 28 ins. long, 2½ ins. diam., 24 ins. in the ground, with brass cap mkd.</p> <p style="text-align: center;">T 14 N R 4 E C <math>\frac{W 1/16}{S 4}</math> C 1972</p> <p>Raise a mound of stone, 3 ft. base, 1½ ft. high, N of the cor.</p>
61.20	Road, track, bears NE and SW.
67.00	Road, track, bears N. 35° E. and S. 35° W.
72.35	Hayfield Draw, 2 chs. wide, 8 ft. deep, drains N. 40° E.
78.00	Fence, bears N. 75° E. and S. 75° W.
80.22	True point for the ¼ sec. cor. of secs. 4 and 5.
	<p>Subdivision, SW¼, Sec. 4</p> <hr/> <p>From the W. 1/16 sec. cor. of secs. 4 and 9.</p> <p>N. 0°58'30" E., along the N and S centerline of the SW¼ of sec. 4.</p> <p>Over gently rolling land, through light undergrowth.</p>
1.56	State Highway No. 279, bears S. 41°30' E. and N. 41°30' W.
2.06	Fence, bears S. 41°30' E. and N. 41°30' W.
20.29	Point for the SW 1/16 sec. cor. of sec. 4 at intersection with the E and W centerline of the SW¼ of sec. 4.
	<p>Set an iron post, 28 ins. long, 2½ ins. diam., 24 ins. in the ground, with brass cap mkd.</p> <p style="text-align: center;">T 14 N R 4 E SW 1/16 S 4 1972</p> <p>Raise a mound of stone, 3 ft. base, 1½ ft. high, W of the cor.</p>
30.60	Old paved highway, bears S. 41° E. and N. 41° W.; also a wash under road, drains N. 60° E.
40.59	The C-W 1/16 sec. cor. of sec. 4.
	<p>From the C-S 1/16 sec. cor. of sec. 4.</p> <p>N. 88°24' W., along the E and W centerline of the SW¼ of sec. 4.</p>

Survey of Partial Subdivision of Sec. 4,  
T. 14 N., R. 4 E., G. & S. R. M., Arizona

CHAINS	
8.50	Old paved highway, bears S. 41° E. and N. 41° W.
20.10	The SW 1/16 sec. cor. of sec. 4.
31.40	Center of wash, 2 chs. wide, 10 ft. deep, drains N.
35.40	Fence, bears SE and NW.
37.35	State Highway No. 279, bears SE and NW.
39.45	Fence, bears SE and NW.
40.19	The S. 1/16 sec. cor. of secs. 4 and 5.
<p>Survey of Partial Subdivision of Sec. 12, T. 14 N., R. 4 E., G. &amp; S. R. M., Arizona</p>	
<p>From the ¼ sec. cor. of secs. 1 and 12.</p>	
<p>S. 1°06' W., along the N and S centerline of sec. 12.</p>	
<p>Over rolling land, through scattering undergrowth, cedar and palo-verde.</p>	
12.00	Descend steep S slope.
19.80	Base of steep S slope.
26.20	Telephone line, bears SE and NW.
32.00	Road, paved, bears SE and NW.
35.60	Road, paved, bears S. 70° E., and N. 70° W.
39.80	Road, track, bears SE and NW.
41.38	<p>The ¼ sec. cor. of sec. 12, monumented with a local re-bar, ½ in. diam., projecting 1 in. above ground.</p>
<p>At the corner point</p>	
<p>Set an iron post, 28 ins. long, 2½ ins. diam., 24 ins. in the ground, with brass cap mkd.</p>	
<p>T 14 N R 4 E ¼ S 12 1973</p>	
<p>Raise a mound of stone, 3 ft. base, 1½ ft. high, W of the cor.</p>	
<p>Reset the re-bar alongside the iron post.</p>	
<p>_____</p> <p>S. 1°01'30" W., beginning new measurement.</p>	
1.90	Road, graded, bears N. 40° E. and S. 40° W.
7.40	Wash, 20 lks. wide, 2 ft. deep, drains S. 30° W.
9.20	<p>Limestone ledge, 6 ft. high, bears N. 60° E. and S. 60° W.</p>

Survey of Partial Subdivision of Sec. 12,  
T. 14 N., R. 4 E., G. & S. R. M., Arizona

CHAINS

13.315 Point for the 1/1024 sec. cor. of sec. 12, identical with cor. No. 2, Lot 7, at proportionate dist., based on the distances shown on the official 1877 survey plat.

Set an iron post, 28 ins. long, 2½ ins. diam., 22 ins. in the ground, encircled by a mound of stone, 2 ft. base to top, with brass cap mkd.

T 14 N R 4 E  
1/1024  
-----  
Lot 7  
S 12 |  
Cor 2  
1973

Raise a mound of stone, 2½ ft. base, 1 ft. high, W. of the cor.

18.70 Fence, bears S. 85° E. and N. 85° W.

21.20 Road, track, bears irregularly E. and W.

21.305 Point for the C-S 1/16 sec. cor. of sec. 12, at proportionate dist., based on the distances shown on the official 1877 survey plat.

Set an iron post, 28 ins. long, 2½ ins. diam., 12 ins. in the ground to bedrock, encircled by a mound of stone, 3 ft. base to top, with brass cap mkd.

T 14 N R 4 E  
C  
S 1/16 | S 12  
C  
1973

from which

A cedar, 4 ins. diam., bears N. 86° W., 181 lks. dist., mkd. CS 1/16 S12 BT.

A limestone bedrock outcrop, even with the general surface, bears S. 56°45' E., 31.5 lks. dist., mkd. X B O.

Deposit broken clear glass at base of the iron post.

22.80 Wash, 10 lks. wide, 1 ft. deep, drains S. 50° W.

28.00 Ridge, bears E and W.

32.60 Power line, bears E and W.

34.60 Eureka Irrigation Ditch, 10 lks. wide, 3 ft. deep, course S. 75° E.; thence over river bottom land, through dense weeds and moderate willows and cottonwoods.

39.00 Road, track, bears S. 15° E. and N. 15° W.

40.725 Intersect the NW bdy. of the abandoned Camp Verde Military Reservation at the point for the closing cor. for outside the reservation. This cor. also functions as Cor. No. 1, Lot 7.

Survey of Partial Subdivision of Sec. 12,  
T. 14 N., R. 4 E., G. & S. R. M., Arizona

CHAINS

Set an iron post, 28 ins. long, 2½ ins. diam., 24 ins. in the ground, with brass cap mkd.

T 14 N R 4 E

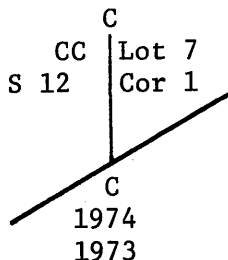

Raise a mound of broken chunks of concrete, 3 ft. base, 2 ft. high N of the cor.

From this point Cor. No. 3 of the abandoned Camp Verde Military Reservation, bears N. 62°29' E., 7.855 chs. dist., previously described.

From the ¼ sec. cor. of sec. 12 only, on the E. bdy. of the Tp., monumented with an iron post, 1 inch diam., 2 ft. above ground, encircled by a mound of stone, 3½ ft. base to top, with brass cap mkd.

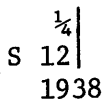

N. 89°32' W., along the E and W centerline of sec. 12.

Over rolling land, through scattered cedar, creosote brush and oak brush.

- 3.80 Descend over general W. slope.
  - 15.20 End of descent.
  - 23.50 Telephone line, bears SE and NW.
  - 30.20 Road, paved, bears NW and SE.
  - 34.60 Wash, 20 lks. wide, 2 ft. deep, drains SW.
  - 38.30 Road, graded, bears N. 40° E. and S. 40° W.
  - 39.10 Road, track, bears S and N, curving NW.
  - 39.55 The ¼ sec. cor. of sec. 12.
  - 59.21 The C-W 1/16 sec. cor. of sec. 12, monumented with an iron pipe, ¾ in. diam., projecting 1½ ft. above ground. Accepted as the cor.
- Set an iron post, 28 ins. long, 2½ ins. diam., 6 ins. in the ground to bedrock, encircled by a mound of stone, 2½ ft. base, to top, with brass cap mkd.

Survey of Partial Subdivision of Sec. 12,  
T. 14 N., R. 4 E., G. & S. R. M., Arizona

CHAINS		
	<p>T 14 N R 4 E C <math>\frac{W 1/16}{S 12}</math> C 1973</p>	
	Reset the iron pipe, alongside the iron post.	
	The cor. is located 2 lks. W of a cor. of fences extending S. 10° E. and W.	
68.30	Small knoll.	
72.90	Wash, 40 lks. wide, 15 ft. deep, drains S. 25° W.	
74.20	Fence cor., fences extend E and S. 25° W.	
74.70	Road, paved, bears N. 40° E. and S. 40° W.	
75.70	Fence cor., fences extend S. 50° W. and W.	
78.88	The $\frac{1}{4}$ sec. cor. of secs. 11 and 12, monumented with an iron post, 2½ ins. diam., projecting 4 ins. above ground, with brass cap mkd.	
	<p>T 14 N R 4 E <math>\frac{1}{4}</math> S 11   S 12 1959</p>	
	The cor. is located 2 lks. S of the cor. of fences extending NE and W.	
	<p>Subdivision, SW<math>\frac{1}{4}</math>, Sec. 12</p>	
	From the point for the W. 1/16 sec. cor. of secs. 12 and 13.	
	N. 1°59' E., along the N and S centerline of the SW $\frac{1}{4}$ of sec. 12.	
	Over level open land.	
10.20	Fence, bears SE and NW.	
14.60	Fence, bears N. 50° E., and S. 50° W.	
14.80	Road, graded, bears N. 75° E. and S. 75° W.	
15.70	Power line, bears S. 80° E. and N. 80° W.	
16.70	Enter heavy undergrowth.	
18.70	Road, track, bears S. 40° E. and N. 40° W.	
20.00	N. edge of heavy undergrowth, bears E and W; thence through scattered undergrowth.	

Survey of Partial Subdivision of Sec. 12,  
T. 14 N., R. 4 E., G. & S. R. M., Arizona

CHAINS	
20.855	<p>Point for the SW 1/16 sec. cor. of sec. 12, at intersection with the E and W centerline of the SW<math>\frac{1}{4}</math> of sec. 12.</p> <p>Set an iron post, 28 ins. long, 2<math>\frac{1}{2}</math> ins. diam., 20 ins. in the ground, with brass cap mkd.</p> <p style="text-align: center;">T 14 N R 4 E SW 1/16 S 12 1973</p> <p>from which</p> <p style="padding-left: 40px;">A mesquite, 4 ins. diam., bears N. 80°45' E., 43.5 lks. dist., mkd. SW 1/16 S12 BT.</p> <p style="padding-left: 40px;">A fence cor., bears N. 76°15' E., 17 lks. dist.; fences extend northerly, southeasterly, southerly, 100 lks. dist. to terminus, and westerly.</p> <p>Raise a mound of stone, 3 ft. base, 1<math>\frac{1}{2}</math> ft. high W of the cor.</p>
20.90	Fence, bears westerly and easterly 17 lks. to fence cor.
26.90	Wash, 10 lks. wide, 3 ft. deep, drains S. 20° E.
28.35	Same wash, 15 lks. wide, 3 ft. deep, drains S. 20° W. from N. 80° E.
28.645	True point for the 1/1024 sec. cor. of sec. 12, falls on the N. edge of the same wash, impractical to monument.
29.145	<p>Point selected for the witness 1/1024 sec. cor. of sec. 12.</p> <p>Set an iron post, 28 ins. long, 2<math>\frac{1}{2}</math> ins. diam., 20 ins. in the ground, with brass cap mkd.</p> <p style="text-align: center;">W C T 14 N R 4 E ↓ 1/1024 1974</p> <p>Raise a mound of stone, 3 ft. base, 1 ft. high, W of the cor.</p>
41.63	<p>The C-W 1/16 sec. cor. of sec. 12.</p> <hr style="width: 20%; margin: 10px auto;"/> <p>From the C-S 1/16 sec. cor. of sec. 12.</p> <p>N. 87°59'30" W., along the E and W centerline of the SW<math>\frac{1}{4}</math> of sec. 12.</p>
1.40	Road, track bears N. 80° E. and S. 80° W.
7.20	Wash, 15 lks. wide, 2 ft. deep, drains S. 15° E.
10.70	Road, graded, bears S. 5° E. and N. 5° W.



Survey of Partial Subdivision of Sec. 12,  
T. 14 N., R. 4 E., G. & S. R. M., Arizona

CHAINS	
13.00	Road, track, bears N. 20° E. and S. 20° W.
15.90	Fence, bears N. 13° E. and S. 13° W.
16.20	Road, graded, bears N. 13° E. and S. 13° W.
19.86	Fence, bears southeasterly and northwesterly 4 lks. to a fence cor.; fences extend northerly, southeasterly and southerly.
19.87	Fence, bears southerly, 100 lks. to terminus, and northerly 4 lks. to previously described fence cor.
20.04	The SW 1/16 sec. cor. of sec. 12.
32.50	Power line, bears N. 10° E. and S. 10° W.
33.10	O.K. Irrigation Ditch, 25 lks. wide, course S. 75° E.
33.50	Fence, bears S. 40° E. and N. 40° W.
33.70	Fence, bears N and S, thence across field.
39.74	The S. 1/16 sec. cor. of secs. 11 and 12, monumented with an iron post, 2½ ins. diam., 18 ins. below the surface, with brass cap mkd.
	S 1/16 S 11 S 12 1959
	from which
	A cross (X) in top of concrete headgate, bears N. 69°48' W., 11.2 lks. dist.
	No remaining evidence of the other reference monument.
	<hr style="width: 20%; margin: auto;"/> From the 1/1024 sec. cor. on the N-S centerline of sec. 12, identical with Cor. No. 2, Lot 7, previously described.
	N. 88°35'45" W.
7.80	Wash, 30 lks. wide, 10 ft. deep, drains S. 15° W.
9.50	Road, graded, bears N. 30° E. and S. 30° W. for 60 lks. to a junction, with roads curving S. 25° W. and S. 60° W.
19.60	Wash, drains S. 80° W., curving southerly.
19.68	Fence, bears N and S.
19.90	The true point for the 1/1024 sec. cor. on the N-S centerline of the SW¼ sec. 12.
	<hr/> Survey of Partial Subdivision of Sec. 13, T. 14 N., R. 4 E., Gila and Salt River Meridian, Arizona
	From the point for the ¼ sec. cor. of secs. 13 and 24. N. 1°46' E., along the N. and S centerline of sec. 13.
	Over open gravel bar along W. side of Verde River.

Survey of Partial Subdivision of Sec. 13,  
T. 14 N., R. 4 E., G. & S. R. M., Arizona

CHAINS	
12.20	Enter heavy undergrowth and moderate cottonwoods.
19.10	Fence, bears N. 40° E. and S. 40° W., enter open fields.
20.00	Fence, bears E and W.
21.90	Fence, bears E and W.
23.80	Fence, bears S. 85° E. and N. 85° W.
24.50	Fence, bears E and W.
25.60	Fence, bears E and W.
27.50	Fence, bears E and W.
33.30	Road, track, bears E and W.
35.10	Fence, bears S. 80° E. and N. 80° W.
36.90	Fence, bears E and W.
37.80	Fence, bears N. 30° E. and S. 30° W.
38.50	Woods Irrigation Ditch, 30 lks. wide, course S. 35° W.
40.07	Point for the C¼ sec. cor. of sec. 13, at the intersection with the E and W centerline of sec. 13. Not monumented.
50.045	Point for the C-S-N 1/64 sec. cor. of sec. 13, not monumented.
50.10	Fence, bears S. 20° E. and N. 20° W.
53.20	Fence, bears E and W.
56.20	Woods Irrigation Ditch, 25 lks. wide, course SE.
57.10	Road, track, bears N. 75° E. and S. 75° W.
58.60	Irrigation ditch, 40 lks. wide, course S. 80° E.
60.00	Road, track, bears S. 60° E. and N. 60° W.
60.02	Point for the CN 1/16 sec. cor. of sec. 13. Not monumented.
75.40	Right bank of the Verde River, bears S. 70° E. and N. 70° W., banks 2 to 6 ft. high.
78.40	Left bank of the Verde River, bears S. 68°16' E. and N. 68°16' W.
79.97	The ¼ sec. cor. of secs. 12 and 13.
	<p>From the ¼ sec. cor. of secs. 13 and 18, on the E. bdy. of the Tp. N. 89°48' W., along the E and W centerline of sec. 13. Over rolling land, through scattered mesquite and cedar.</p>
1.05	Fence, bears N. 35° E. and S. 35° W.
12.50	Road, paved, bears N. 5° E. and S. 5° W.
19.915	Point for the C-E 1/16 sec. cor. of sec. 13. Not monumented.
27.60	Descend into river bottom, through moderate cottonwoods.

Survey of Partial Subdivision of Sec. 13,  
T. 14 N., R. 4 E., G. & S. R. M., Arizona

CHAINS	
28.60	Eureka Irrigation Ditch, 10 lks. wide, course S. 5° E.
32.975	Left bank of the Verde River bears N. 27°55' E. and S. 27°55' W.
35.80	Right bank of the Verde River.
35.90	Fence, bears N and S.
39.00	Woods Irrigation Ditch, 15 lks. wide, course S. 30° W.
39.83	Point for the C $\frac{1}{4}$ sec. cor. of sec. 13.
43.00	Road, graded, bears NE and SW.
58.40	Pond, about 2.00 chs. diam., bears South, 1.45 chs. dist.
65.30	Power line, bears N and S.
72.30	Power line, bears N and S. 30° W.
79.97	The $\frac{1}{4}$ sec. cor. of secs. 13 and 14.
<p>Subdivision, NE<math>\frac{1}{4}</math>, Sec. 13</p> <hr/> <p>From the point for the C-E 1/16 sec. cor. of sec. 13. N. 1°47' E., along the N and S centerline of the NE<math>\frac{1}{4}</math> of sec. 13.</p> <p>Over rolling land, through scattered mesquite brush.</p>	
7.10	Wash, 15 lks. wide, 3 ft. deep, drains S. 70° W.
9.80	Fence, bears E and W.
10.155	Point for the C-S-NE 1/64 sec. cor. of sec. 13. Set an iron post, 28 ins. long, 2 $\frac{1}{2}$ ins. diam., 24 ins. in the ground, with brass cap mkd.
<p>T 14 N R 4 E C S NE 1/64 S 13 1973</p>	
	Raise a mound of stone, 2 ft. base, 2 ft. high, W of the cor.
14.00	Spur, slopes S. 75° W.
18.20	Track road on ridge, bears E and W.
20.31	Point for the NE 1/16 sec. cor. of sec. 13 at intersection with the E and W centerline of the NE $\frac{1}{4}$ of sec. 13. Not monumented.
23.00	Spur, slopes W.
26.30	Spur, slopes W.
30.00	Spur, slopes W.
32.10	Track road on ridge, bears S. 60° E. and N. 60° W., descend NE slope.
35.00	Wash, 30 lks. wide, 1 ft. deep, drains N. 35° W., thence through heavy creosote brush.

Survey of Partial Subdivision of Sec. 13,  
T. 14 N., R. 4 E., G. & S. R. M., Arizona

CHAINS	
40.66	The E. 1/16 sec. cor. of secs. 12 and 13.
	<hr/> From the N. 1/16 sec. cor. of secs. 13 and 18 on the E. boundary of the Tp. S. 89°10' W., along the E and W centerline of the NE $\frac{1}{4}$ of sec. 13. Over rolling land, through scattered mesquite brush, palo-verde and cedar.
0.20	Wash, 20 lks. wide, 4 ft. deep, drains S. 60° W., curving southerly.
7.00	Road, paved, bears N. 30° E. and S. 30° W.
17.40	Spur, slopes N.
19.935	Point for the NE 1/16 sec. cor. of sec. 13.
24.50	Track road on spur, bears S. 10° E. and N. 10° W., spur slopes N. 10° W.
26.90	Eureka Irrigation Ditch, 10 lks. wide, course S. 25° W.
28.20	Left bank of Verde River, bears S. 13°29' W. and N. 13°29' E.
30.80	Right bank of the Verde River.
39.895	Point for the C-N 1/16 sec. cor. of sec. 13.
	<hr/> From the S-N 1/64 sec. cor. of secs. 13 and 18 on the E. boundary of the Tp. S. 89°42'30" W., along the E and W centerline of the SE $\frac{1}{4}$ of the NE $\frac{1}{4}$ of sec. 13.
11.10	Road, paved, bears N. 20° E. and S. 20° W.
13.40	Wash, 40 lks. wide, 8 ft. deep, drains S. 50° W. curving westerly.
16.10	Wash, 40 lks. wide, 8 ft. deep, drains S, curving SW.
19.96	The C-S-NE 1/64 sec. cor. of sec. 13.
	<hr/> S. 89°40'30" W., beginning new measurement on the E and W centerline of the SW $\frac{1}{4}$ of the NE $\frac{1}{4}$ of sec. 13.
8.60	Eureka Irrigation Ditch, 10 lks. wide, 2 ft. deep, course S. 5° W.
9.105	Point for the special meander corner on the adjusted record meander line of the left bank of the Verde River, bears N. 1°59' E. and S. 1°59' W.
	Set an iron post, 28 ins. long, 2½ ins. diam., 22 ins. in the ground, with brass cap mkd.

Survey of Partial Subdivision of Sec. 13,  
T. 14 N., R. 4 E., G. & S. R. M., Arizona

CHAINS

T 14 N R 4 E

SMC |  $\frac{S}{13}$

1973

Raise a mound of stone, 3 ft. base, 2 ft. high, E of the cor.

from which

The point for the C-S-N 1/64 sec. cor. of sec. 13,  
bears S. 89°40'30" W., 10.83 chs. dist.

Thence N. 77°22' W. on a line normal to the present left bank of the Verde River, over land subject to overflow.

0.70 Point for the special meander cor. on the present left bank of the Verde River, bears N. 12°38' E. and S. 12°38' W.

Set an iron post, 28 ins. long, 2½ ins. diam., 24 ins. in the ground, in a collar of stone, 2½ ft. base to top, brass cap mkd.

SMC /  $\frac{S}{13}$   
1973

Survey of Partial Subdivision of Sec. 14,  
T. 14 N., R. 4 E., Gila and Salt River Meridian, Arizona

From the ¼ sec. cor. of secs. 14 and 23.

N. 1°43' E., along the N and S centerline of sec. 14, parallel to the S½ mile of the E bdy. of same sec.

Over rolling land, through medium undergrowth.

- 1.40 Road, track, bears SE and NW.
- 2.10 Wash, 30 lks. wide, 2 ft. deep, drains S, 55° E.
- 4.90 Old paved highway, bears S. 65° E. and N. 65° W.
- 7.60 Fence, bears S. 75° E. and N. 75° W.
- 17.60 Road, graded, bears E and W.
- 19.97 Point for the C-S 1/16 sec. cor. of sec. 14, at proportionate dist., based on the distances shown on the official 1893 survey plat; not monumented.
- 25.90 Wash, 25 lks. wide, 6 ft. deep, drains N. 30° W.
- 27.10 Road, graded, bears S. 20° E. and N. 20° W.
- 27.30 Fence, bears S. 20° E. and N. 20° W.
- 28.50 Fence, bears S. 50° E. and N. 50° W.
- 28.70 Dike, 4 ft. high, 10 lks. wide, bears S. 55° E. and N. 55° W., enter dense mesquite brush.
- 40.20 Fence, bears N. 62° E. and S. 62° W.; thence through medium undergrowth.

Survey of Partial Subdivision of Sec. 14,  
T. 14 N., R. 4 E., G. & S. R. M., Arizona

CHAINS	
40.265	<p>Point for the closing cor. of sec. 14 on the bdy. of the abandoned Camp Verde Military Reservation, for inside the reservation. This position is in a graded gravel road, bearing N. 62° E. and S. 62° W.; not monumented.</p>
	<p>From this point, Cor. No. 2 of the abandoned Camp Verde Military Reservation Boundary, bears S. 62°29' W., 54.27 chs. dist., heretofore described.</p>
	<hr/> <p>(Restoring the survey executed by Vern E. Lane in 1959)</p> <hr/>
	<p>From the ¼ sec. cor. of secs. 11 and 14.</p>
	<p>S. 1°26' W., along the N and S centerline of sec. 14.</p>
	<p>Over open level land.</p>
7.20	<p>Enter cottonwoods, willows and heavy undergrowth.</p>
7.50	<p>Eureka Irrigation Ditch, 10 lks. wide, course S. 50° E.</p>
9.00	<p>Road, track, bears S. 50° E. and N. 50° W.</p>
20.29	<p>The C-N 1/16 sec. cor. of sec. 14, monumented with an iron post, 2½ ins. diam., 18 ins. below the surface of the ground, brass cap mkd.</p>
	<p>C N 1/16   S 14 C 1959</p>
	<p>Reset the iron post with 8 ins. projecting above ground, encircled by a mound of stone, 2 ft. base to top of cor.</p>
	<p>from which a new bearing tree</p>
	<p>A cottonwood, 24 ins. diam., bears N. 61° W., 52 lks. dist. mkd. CN 1/16 S14 BT.</p>
	<p>Add the marks 1973 to the brass cap.</p>
	<hr/>
	<p>S. 1°27'30" W., beginning new measurement.</p>
4.00	<p>Left bank of the Verde River, bears S. 50° E. and N. 50° W., banks 2 to 6 ft. high.</p>
5.70	<p>Right bank of the Verde River.</p>
6.00	<p>Fence, bears S. 65° E. and N. 65° W.</p>
10.00	<p>Power line, bears S. 55° E. and N. 55° W.</p>
12.30	<p>Power line, bears S. 20° E. and N. 20° W.</p>
12.90	<p>Wash, 50 lks. wide, 5 ft. deep, drains N. 30° E., curving N.</p>
15.00	<p>Road, track, bears irregularly E and W.</p>

Survey of Partial Subdivision of Sec. 14,  
T. 14 N., R. 4 E., G. & S. R. M., Arizona

CHAINS	
17.80	Curve in track road, road bears E and S. 30° W., curving S.
18.10	Fence cor., fence extends E and South along sec. line.
19.22	Fence line ends.
20.29	The C <sup>1</sup> / <sub>4</sub> sec. cor. of sec. 14, monumented with an iron post, 2½ ins. diam., 1 inch below the surface of the ground, brass cap mkd.
	C <sup>1</sup> / <sub>4</sub> S 14 1959
	from which new accessories
	A power pole, bears N. 2¼° E., 211 lks. dist.
	A well pipe, 8 ins. diam., projecting 10 ins. above ground, bears N. 66¼° W., 173 lks. dist.
	Add the marks 1973 on the brass cap.
	_____
	S. 1°23' W., beginning new measurement.
	Over level open land.
4.775	Intersect the closing cor. of sec. 14, on the NW boundary of the abandoned Camp Verde Military Reservation, for outside the reservation, monumented with an iron post, 2½ ins. diam., 12 ins. below the surface and near the center of a gravel road bearing N. 62° E. and S. 62° W., brass cap mkd.
	from which new accessories
	X on an iron pipe, 15 ins. diam., bears S. 20° E., 138 lks. dist. mkd. X B O 1973.
	A steel fence post, bears S. 7° E., 20 lks. dist.
	From this closing cor., Cor. No. 2 of the abandoned Camp Verde Military Reservation, bears S. 62°29' W., 55.73 chs. dist., heretofore described.
	Add the marks 1973 to the brass cap.
	_____
	From the ¼ sec. cor. of secs. 14 and 15.
	N. 88°14' E., along the E and W centerline of sec. 14.
	Over rolling land, through moderate undergrowth.
19.80	Point selected for the witness C-W 1/16 sec. cor. of sec. 14.
	Set an iron post, 28 ins. long, 2½ ins. diam., 24 ins. in the ground, with brass cap mkd.

Survey of Partial Subdivision of Sec. 14,  
T. 14 N., R. 4 E., G. & S. R. M., Arizona

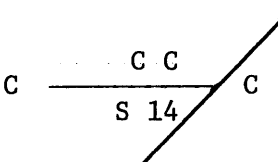
CHAINS	
	<p style="text-align: center;">                     W C                      T 14 N R 4 E                      C <math>\frac{W 1/16}{S 14}</math> → C                      1973                 </p>
	<p>Raise a mound of stone, 3 ft. base, 2 ft. high, N of the cor.</p>
20.30	<p>True point for the C-W 1/16 sec. cor. of sec. 14 falls in a wash draining S. 85° E. from irregularly S. 70° W., impractical to monument.</p>
21.40	<p>Fence, bears N and S.</p>
21.50	<p>Wash, 20 lks. wide, 1 ft. deep, drains N. 10° W., curving easterly, from irregularly W.</p>
36.90	<p>Road, track, bears N. 25° E. and S. 25° W.</p>
40.60	<p>The C<math>\frac{1}{4}</math> sec. cor. of sec. 14.</p>
	<hr/> <p>S. 86°06' E., parallel to the E and W centerline of the NE<math>\frac{1}{4}</math>, beginning new measurement.</p>
8.02	<p>Point for the closing cor. of sec. 14 on the boundary of the abandoned Camp Verde Military Reservation, for outside the reservation.</p> <p>Set an iron post, 28 ins. long, 2<math>\frac{1}{2}</math> ins. diam., 6 ins. below the earth's surface, with brass cap mkd.</p>
	<p style="text-align: center;">  </p> <p style="text-align: center;">1975</p>
	<p>from which</p> <p style="padding-left: 40px;">A telephone pole, bears N. 67°20' E., 223.5 lks. dist., with aluminum tag attached, mkd. 1947 - 3078</p> <p style="padding-left: 40px;">A power pole, bears S. 57°36' W., 274.5 lks. dist., with aluminum tag attached, mkd. PS 16383</p> <p>The cor. is S. 28° E., 13 lks. dist. from the center of a graded gravel road, 36 lks. wide, bearing N. 62° E. and S. 62° W.</p> <p>From this closing cor., Cor. No. 2 of the abandoned Camp Verde Military Reservation, bears S. 62°29' W., 64.88 chs. dist., heretofore described.</p>
	<hr/> <p style="text-align: center;">Subdivision, SW<math>\frac{1}{4}</math>, Sec. 14</p> <hr/>
	<p>From the W. 1/16 sec. cor. of secs. 14 and 23.</p> <p>N. 1°43' E., along the N and S centerline of the SW<math>\frac{1}{4}</math> of sec. 14, parallel to the S<math>\frac{1}{2}</math> mile of the E bdy. of the sec.</p> <p>Over rolling land, through moderate undergrowth.</p>



Survey of Partial Subdivision of Sec. 14,  
T. 14 N., R. 4 E., G. & S. R. M., Arizona

## CHAINS

- 0.65 Wash, 25 lks. wide, 3 ft. deep, drains E, curving NE.  
 3.00 Ditch, 30 lks. wide, 8 ft. deep, drains S. 50° E.  
 4.30 Small ridge, bears N. 65° E. and S. 65° W.  
 6.00 Fence, bears S. 55° E. and N. 55° W.  
 7.70 State Highway No. 279, bears S. 60° E. and N. 60° W.  
 9.40 Fence, bears S. 60° E. and N. 60° W.  
 12.40 Old paved highway, bears N. 75° E. and S. 75° W.  
 14.40 Road, graded, bears N. 55° E. and S. 55° W.  
 22.60 Wash, 15 lks. wide, 1 ft. deep, drains easterly.  
 29.69 Point for the closing cor. of sec. 14 on the boundary of the abandoned Camp Verde Military Reservation, for inside the reservation.  
 Set an iron post, 28 ins. long, 2½ ins. diam., 24 ins. in the ground, with brass cap mkd.

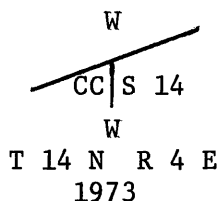

Raise a mound of stone, 4 ft. base, 2 ft. high, S. of the cor.

from which

Two local iron pipes, ½ inch and 1½ ins. diam., set flush with the ground, bear N. 62°29' E., 55 lks. dist., encircled by a mound of stone, 2 ft. base, 4 ins. high.

From the closing cor., Cor. No. 2 of the abandoned Camp Verde Military Reservation Boundary, bears S. 62°29' W., 31.26 chs. dist., previously described.

Subdivision, NW¼, Section 14

From the true point for the C-W 1/16 sec. cor. of sec. 14. N. 2°10'30" E., along the N and S centerline of the NW¼ of sec. 14.

Over rolling land, through moderate undergrowth.

- 4.10 Remains of down fence line, bears N. 75° E. and S. 75° W.  
 4.50 Spur, slopes NE.  
 11.50 Spur, slopes N. 40° E.  
 21.20 Road, track, bears N. 85° E. and S. 80° W.  
 21.26 Point for the NW 1/16 sec. cor. of sec. 14 at intersection with the E and W centerline of the NW¼ of sec. 14.  
 Set an iron post, 28 ins. long, 2½ ins. diam., 21 ins. in the ground, with brass cap mkd.

Survey of Partial Subdivision of Sec. 14,  
T. 14 N., R. 4 E., G. & S. R. M., Arizona

CHAINS	
	T 14 N R 4 E NW 1/16 S 14 1973
	Raise a mound of stone, 2½ ft. base, 2 ft. high, W of the cor.
28.40	Wash, 180 lks. wide, 3 ft. deep, drains N. 40° E.
31.60	Wash, 100 lks. wide, 2 ft. deep, drains E.
36.40	Fence, bears S. 4° E. and N. 4° W.
41.70	Wash, 30 lks. wide, 3 ft. deep, drains N. 80° E.
42.545	The W. 1/16 sec. cor. of secs. 11 and 14.
	<hr/> From the C-N 1/16 sec. cor. of sec. 14. N. 88°57' W., along the E and W centerline of the NW¼ of sec. 14. Across river bottom through heavy weeds and moderate cottonwood trees.
4.80	Left bank of the Verde River, bears SE and NW, banks 2 to 8 ft. high.
7.30	Right bank of river, ascend out of river bottom.
16.70	Fence, bears S. 60° E. and N. 60° W.
17.70	Fence, bears N. 85° E. and S. 85° W.
19.20	Road, track, bears N. 75° E. and S. 75° W.
19.40	Fence, bears S. 5° E. and N. 5° W.
20.005	The NW 1/16 sec. cor. of sec. 14.
34.20	Wash, 80 lks. wide, 6 ft. deep, drains N, curving NE.
40.00	Point for the N. 1/16 sec. cor. of secs. 14 and 15.
	<hr/> Survey of Partial Subdivision of Sec. 16, T. 14 N., R. 4 E., Gila and Salt River Meridian, Arizona
	From the ¼ sec. cor. of secs. 16 and 21, monumented by an iron post, 1 in. diam., projecting 12 ins. above ground, with brass cap mkd.
	$\frac{1}{4} \frac{S 16}{S 21}$ 1927
	from which an original bearing tree
	A palo-verde, 8 ins. diam., bears S. 65° E., 93 lks. dist., marked with an overgrown blaze. (Record: S. 55½° E., 97 lks.)
	Mound of stone, 2 ft. base, 1 ft. high, N of the cor.
	N. 0°04'30" E., along the N and S centerline of sec. 16.
	Over rolling land, through moderate undergrowth and scattered cedar.
12.00	Power line, bears S. 35° E. and N. 35° W.

Survey of Partial Subdivision of Sec. 16,  
T. 14 N., R. 4 E., G. & S. R. M., Arizona

CHAINS	
15.40	Wash, 30 lks. wide, 6 ins. deep, drains N. 80° E.
21.20	Road, graded, bears N. 82° E. and S. 82° W.
24.00	Descend into Cherry Creek bottom, through heavy undergrowth.
37.70	Cherry Creek, 280 lks. wide, 1 ft. deep, drains N. 60° E.
38.80	Ascend SE slope, out of Cherry Creek bottom, thence through moderate undergrowth.
40.025	Point for the C $\frac{1}{4}$ sec. cor. of sec. 16, at the intersection with the E and W centerline of sec. 16.  Set an iron post, 28 ins. long, 2 $\frac{1}{2}$ ins. diam., 20 ins. in the ground, with brass cap mkd.  <div style="text-align: center;">                     T 14 N R 4 E                      C<math>\frac{1}{4}</math> S 16                      1973                 </div> Raise a mound of stone, 2 $\frac{1}{2}$ ft. base, 2 ft. high, W of the cor.  The cor. is located 30 lks. from the top of a SE slope.
60.00	Point for the C-N 1/16 sec. cor. of sec. 16.  Set an iron post, 28 ins. long, 2 $\frac{1}{2}$ ins. diam., 10 ins. in the ground to bedrock, encircled by a mound of stone, 3 ft. base to top, with brass cap mkd.  <div style="text-align: center;">                     T 14 N R 4 E                      C                      N 1/16   S 16                      C                      1973                 </div> from which  <div style="text-align: center;">                     A palo-verde, 12 ins. diam., bears S. 84° E., 125 lks. dist. mkd. CN 1/16 S16 BT.                 </div>
93.535	The N $\frac{1}{4}$ sec. cor. of sec. 16 only. <hr/> From the E $\frac{1}{4}$ sec. cor. of sec. 16 only. N. 89°52' W., along the E and W centerline of sec. 16. Over rolling land, through moderate undergrowth.
9.40	Road, graded, bears N. 55° E. and S. 55° W.
11.00	Descend into Cherry Creek bottom through heavy undergrowth.
22.80	Road, track, bears NE and SW.
24.565	Point for the C-E 1/16 sec. cor. of sec. 16. Not monumented.
39.50	Cherry Creek, 170 lks. wide, 3 ft. deep, drains NE.
43.50	Ascend out of Cherry Creek bottom, thence over rolling land, through moderate to heavy undergrowth.
44.545	The C $\frac{1}{4}$ sec. cor. of sec. 16.

Survey of Partial Subdivision of Sec. 16,  
T. 14 N., R. 4 E., G. & S. R. M., Arizona

CHAINS	
66.40	Power line, bears S. 30° E. and N. 30° W.
84.46	The ¼ sec. cor. of secs. 16 and 17, monumented with an iron post, 1 in. diam., projecting 16 ins. above ground, with brass cap mkd.
$\frac{1}{4}$ S 17   S 16 1927	
<hr/> Subdivision, NE¼, Section 16 <hr/>	
From the point for the C-E 1/16 sec. cor. of sec. 16. N. 0°05' E., along the N and S centerline of the NE¼ of sec. 16.	
Across Cherry Creek bottom through heavy undergrowth and scattered willows.	
9.00	Cherry Creek, 120 lks. wide, 3 ft. deep, drains N. 70° E.
16.00	Leave creek bottom and heavy undergrowth, ascend SE slope.
19.40	Top of ascent, thence across level land.
19.995	Point for the NE 1/16 sec. cor. of sec. 16 at intersection with the E and W centerline of the NE¼ of sec. 16.
Set an iron post, 28 ins. long, 2½ ins. diam., 10 ins. in the ground to bedrock, encircled by a mound of stone, 3 ft. base to top, with brass cap mkd.	
T 14 N R 4 E NE 1/16 S 16 1973	
from which	
The cor. of a fence, bears N. 66° E., 110 lks. dist., with fences extending N. 5° E. and S. 65° E.	
47.90	Remains of fallen fence, bears S. 35° E. and N. 35° W.
52.855	The E. 1/16 sec. cor. of sec. 16 only.
<hr/> From the N. 1/16 sec. cor. of sec. 16 only, on the E. bdy. of the sec.	
N. 89°52'30" W., along the E and W centerline of the NE¼ of sec. 16.	
Over level land.	
1.60	Descend W. slope to Cherry Creek bottom.
4.60	End of descent, thence across Cherry Creek bottom, through heavy undergrowth and willows.

Survey of Partial Subdivision of Sec. 16,  
T. 14 N., R. 4 E., G. & S. R. M., Arizona

CHAINS

- 7.60 Fence, bears N. 35° E. and S. 35° W.
- 11.40 Cherry Creek, 100 lks. wide, 2 ft. deep, drains N. 30° E.
- 16.70 Leave heavy undergrowth and willows.
- 22.20 Fence, bears S. 65° E. and N. 65° W., ascend SE slope out of Cherry Creek bottom.
- 24.10 Top of ascent, thence across level land, through heavy undergrowth.
- 24.515 The NE 1/16 sec. cor. of sec. 16.
- 44.51 The C-N 1/16 sec. cor. of sec. 16.

---

Survey of Partial Subdivision of Sec. 23,  
T. 14 N., R. 4 E., Gila and Salt River Meridian, Arizona

---

- From the ¼ sec. cor. of secs. 23 and 26.  
N. 1°25' E., along the N and S centerline of sec. 23.  
Over rolling land, through light undergrowth.
- 20.275 Point for the C-S 1/16 sec. cor. of sec. 23.  
Set an iron post, 28 ins. long, 2½ ins. diam., 18 ins. in the ground, encircled by a mound of stone, 4 ft. base to top, with brass cap mkd.

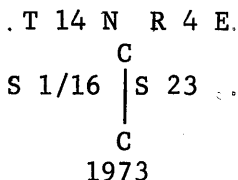

- 27.80 Grief Hill Wash, 15 lks. wide, 5 ft. deep, drains N. 80° E.
- 40.55 The C½ sec. cor. of sec. 23, monumented by a local re-bar, ½ inch diam., 24 ins. long, encircled by a small mound of stone.  
At the cor. point  
Set an iron post, 28 ins. long, 2½ ins. diam., 22 ins. in the ground, over the local re-bar, with brass cap mkd.

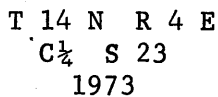

- Raise a mound of stone, 2½ ft. base, 2 ft. high, W of the cor.
- 
- N. 1°25' E., beginning new measurement.

Survey of Partial Subdivision of Sec. 23,  
T. 14 N., R. 4 E., G. & S. R. M., Arizona

CHAINS		
	Over rolling land, through moderate undergrowth.	
20.18	Point for the C-N 1/16 sec. cor. of sec. 23.  Set an iron post, 28 ins. long, 2½ ins. diam., 12 ins. in the ground to bedrock, encircled by a mound of stone, 4 ft. base to top, with brass cap mkd.  <div style="text-align: center;">                     T 14 N R 4 E                            C                      N 1/16   S 23                            C                            1973                 </div>	
	from which  A cedar, 6 ins. diam., bears N. 72° E., 75 lks. dist., mkd. CN 1/16 S23 BT.	
	The cor. is located on a steep N slope.	
23.30	Wash, 80 lks. wide, 4 ft. deep, drains N. 55° E.	
36.60	Fence, bears S. 60° E. and N. 60° W.	
38.35	State Highway No. 279, bears S. 65° E. and N. 65° W.	
39.95	Fence, bears S. 65° E. and N. 65° W.	
40.36	The ¼ sec. cor. of secs. 14 and 23,	
	From the ¼ sec. cor. of secs. 23 and 24.  S. 89°32'30" W., along the E and W centerline of sec. 23.  Over rolling land, through moderate undergrowth.	
1.50	Fence, bears S. 20° E. and N. 20° W.	
3.20	State Highway No. 279, bears S. 20° E. and N. 20° W.	
4.80	Fence, bears S. 25° E. and N. 25° W.	
10.40	Fence, bears S. 20° E. and N. 20° W.	
11.00	Old paved highway, bears N and S.	
16.00	Grief Hill Wash, 150 lks. wide, 2 ft. deep, drains N. 80° E.	
20.125	Point for the C-E 1/16 sec. cor. of sec. 23.  Set an iron post, 28 ins. long, 2½ ins. diam., 22 ins. in the ground, with brass cap mkd.  <div style="text-align: center;">                     T 14 N R 4 E                      C <u>E 1/16</u> C                            S 23                            1973                 </div>	

Survey of Partial Subdivision of Sec. 23,  
T. 14 N., R. 4 E., G. & S. R. M., Arizona

CHAINS

from which

A local re-bar,  $\frac{1}{2}$  inch in diam., bears N.  $81^{\circ}02'$  E.,  
07.7 lks. dist.

Raise a mound of stone,  $2\frac{1}{2}$  ft. base,  $1\frac{1}{2}$  ft. high, N of  
the iron post.

40.25 The  $C\frac{1}{4}$  sec. cor. of sec. 23.

S.  $89^{\circ}32'$  W., beginning new measurement.

21.825 Point for the closing cor. of sec. 23 on the boundary of  
the abandoned Camp Verde Military Reservation. Not  
monumented.

From this point, Cor. No. 2 of the boundary of the aban-  
doned Camp Verde Military Reservation, bears N.  $23^{\circ}24'$   
W., 60.71 chs. dist., previously described.

33.50 South end of a small rock wall for soil erosion preven-  
tion bears N.  $40^{\circ}$  W.

39.185 The  $\frac{1}{4}$  sec. cor. of sec. 23 only, monumented with an iron  
post, 1 in. diam., projecting 16 ins. above ground,  
encircled by a mound of stone,  $2\frac{1}{2}$  ft. base, 1 ft. high,  
with brass cap mkd.

$\frac{1}{4}$   
| S 23  
1927

Subdivision, NE  $\frac{1}{4}$ , Section 23

From the C-E 1/16 sec. cor. of sec. 23.

N.  $1^{\circ}35'30''$  E., along the N and S centerline of the NE  $\frac{1}{4}$   
of sec. 23.

Over rolling land, through moderate undergrowth.

7.80 Spur, slopes N.  $80^{\circ}$  E.

14.70 Spur, slopes E.

18.00 Old paved highway, bears S.  $65^{\circ}$  E. and N.  $65^{\circ}$  W.

20.125 Point for the NE 1/16 sec. cor. of sec. 23 at intersec-  
tion with the E and W centerline of the NE  $\frac{1}{4}$  of sec. 23.

Set an iron post, 28 ins. long,  $2\frac{1}{2}$  ins. diam., 22 ins.  
in the ground, with brass cap mkd.

T 14 N R 4 E  
NE 1/16 S 23  
1973

Raise a mound of stone,  $2\frac{1}{2}$  ft. base,  $1\frac{1}{2}$  ft. high, W of  
the cor.

Survey of Partial Subdivision of Sec. 23,  
T. 14 N., R. 4 E., G. & S. R. M., Arizona

CHAINS	
20.90	Fence, bears SE and NW.
23.00	State Highway No. 279, bears SE and NW.
25.30	Fence, bears SE and NW.
27.00	Wash, 40 lks. wide, 1 ft. deep, drains S. 40° E.
39.90	Road, graded, bears E and W.
40.23	The E. 1/16 sec. cor. of secs. 14 and 23.
	<hr/> From the point for the N. 1/16 sec. cor. of secs. 23 and 24.
	S. 89°46' W., along the E and W centerline of the NE¼ of sec. 23.
	Over rolling land, through moderate undergrowth.
2.30	Road, track, bears N. 60° E. and S. 60° W.
6.80	Road, track, bears S. 15° E. and N. 15° W.
10.90	Road, track, on a small ridge, bears S. 50° E. and N. 50° W.
12.10	Wash, 30 lks. wide, 2 ft. deep, drains S. 50° E.
15.10	Fence, bears S. 50° E. and N. 50° W.
17.10	State Highway No. 279, bears S. 35° E. and N. 35° W.
19.30	Fence, bears SE and NW.
20.18	The NE 1/16 sec. cor. of sec. 23.
26.60	Old paved highway, bears S. 70° E. and N. 70° W.
40.355	The C-N 1/16 sec. cor. of sec. 23.
	<hr/> Subdivision, SE¼, Section 23
	<hr/> From the E. 1/16 sec. cor. of secs. 23 and 26.
	N. 1°33' E., along the N and S centerline of the SE¼ of sec. 23.
	Over rolling land, through moderate undergrowth.
2.60	Wash, 80 lks. wide, 1 ft. deep, drains N. 30° E.
11.70	Road, track, bears N. 70° E. and S. 70° W.
20.15	Point for the SE 1/16 sec. cor. of sec. 23, at the intersection with the E and W centerline of the SE¼ of sec. 23.



Survey of Partial Subdivision of Sec. 23,  
T. 14 N., R. 4 E., G. & S. R. M., Arizona

## CHAINS

Set an iron post, 28 ins. long, 2½ ins. diam., 18 ins. in the ground, encircled by a mound of stone, 2 ft. base to top, with brass cap mkd.

T 14 N R 4 E  
SE 1/16 S 23  
1973

from which

A local 1 in. pipe, bears N. 3°25'30" E., 122.5 lks. dist.

A local ¼ inch re-bar, bears S. 4°09' E., 52.5 lks. dist.

Raise a mound of stone, 3 ft. base, 2 ft. high, W of the cor.

36.20 Road, track, bears N. 80° E. and S. 80° W.

38.90 Grief Hill Wash, 100 lks. wide, 3 ft. deep, drains N. 80° E.

40.28 The C-E 1/16 sec. cor. of sec. 23.

From the S: 1/16 sec. cor. of secs. 23 and 24.

S. 89°08' W., along the E and W centerline of the SE¼ of sec. 23.

Over rolling land, through moderate undergrowth.

2.40 Fence, bears S. 15° E. and N. 15° W.

3.30 Old paved highway, bears S: 60° E. and N. 15° W.

5.50 Wash, 40 lks. wide, 1 ft. deep, drains N. 80° E.

7.20 Road, track, bears N. 40° E. and S. 40° W.

12.60 Ascend E. slope.

20.08 The SE 1/16 sec. cor. of sec. 23.

24.50 Top of ascent, thence over rolling land.

40.13 The C-S 1/16 sec. cor. of sec. 23.

Metes and Bounds Survey  
Lot 7, Section 12, Township 14 North, Range 4 East,  
Gila and Salt River Meridian, Arizona

From the cor. No. 1 of Lot 7, identical with the closing cor. on the NW boundary of the abandoned Camp Verde Military Reservation, previously described.

Metes and Bounds Survey,  
 Lot 7, Section 12, T. 14 N., R. 4 E., G. & S. R. M., Arizona

CHAINS	
	<p>N. 1°01'30" E., on line 1-2 of Lot 7, along the N and S centerline of sec. 12.</p> <p>Topography previously described.</p>
19.42	The C-S 1/16 sec. cor. of sec. 12, previously described.
27.41	The 1/1024 sec. cor. of sec. 12, identical with cor. 2, Lot 7, previously described.
<hr/>	
	<p>S. 88°35'45" E., on line 2-3 on the N. bdy. of Lot 7.</p>
1.82	<p>Point for cor. No. 3, Lot 7.</p> <p>Set an iron post, 28 ins. long, 2½ ins. diam., 3 ins. in the ground to limestone bedrock, and in a mound of stone, 4 ft. base to top, with brass cap mkd.</p> <div style="text-align: center;"> <p>T 14 N R 4 E</p> <p>    S 12</p> <p>    Lot 7</p> <p>    Cor 3</p> <p>        1974</p> </div> <p>Deposit broken glass at the base of the iron post.</p>
<hr/>	
	<p>S, 1°01'30" W., on line 3-4 on the E. bdy. of Lot 7, sec. 12.</p>
5.40	Fence, bears S. 85° E. and N. 85° W.
7.90	E. end of track road, bears westerly.
8.00	Wash, 10 lks. wide, 1 ft. deep, drains S. 50° W.
14.70	Ridge, bears E and W.
19.20	Power line, bears E and W.
22.30	Eureka Irrigation Ditch, 10 lks. wide, 3 ft. deep, course S. 75° E.
25.40	Fence, bears N. 87° E. and S. 87° W.
26.41	<p>Intersect the NW boundary of the abandoned Camp Verde Military Reservation, point for the closing corner, identical with cor. No. 4, Lot 7.</p> <p>Set an iron post, 28 ins. long, 2½ ins. diam., 22 ins. in the ground, with brass cap mkd.</p> <div style="text-align: center;"> <p>T 14 N R 4 E</p> <p>    CC</p> <p>    Lot 7</p> <p>    Cor 4</p> <p>        S 12</p> <p>        1974</p> </div>
<hr/>	
	<p>S. 62°29' W., on line 4-1 on the S. bdy. of Lot 7.</p>

Metes and Bounds Survey,  
Lot 7, Section 12, T. 14 N., R. 4 E., G. & S. R. M., Arizona

CHAINS	
1.58	Road, track, bears S. 20° E. and N. 20° W.
2.07	Cor. No. 1, Lot 7, identical with the closing cor. on the NW bdy. of the abandoned Camp Verde Military Reservation, and point of beginning.
<p>Resurvey of the Meanders of the Left Bank of the Verde River in Sections 12 and 13, Township 14 North, Range 4 East, Gila and Salt River Meridian, Arizona</p>	
<p>(Restoring the survey executed by Daniel Drummond in 1892)</p>	
<p>Beginning at the proportionate point for the meander cor. on the left bank of the Verde River and on the boundary of the abandoned Camp Verde Military Reservation.</p>	
<p>from which</p>	
<p>Cor. No. 3 of the boundary of the abandoned Camp Verde Military Reservation, bears N. 62°29' E., 8.12 chs. dist., heretofore described.</p>	
<p>Thence downstream with the adjusted record meanders of the left bank of the Verde River in sec. 12.</p>	
S. 55°59" W., .73 chs.	
S. 18°17' E., 2.54 chs.	The meander cor. of secs. 12 and 13 identical with the ¼ sec. cor., heretofore described.
<p>Thence in sec. 13.</p>	
S. 18°49' E., 3.49 chs.	
S. 82°24' E., 13.00 chs.	
S. 7°02' E., 5.59 chs.	
S. 19°02' W., 12.27 chs.	
S. 6°15' W., 6.98 chs.	
S. 1°59' W., 7.98 chs.	At 76 lks. dist. on this course, the special meander cor. on the E and W center-line of the SW¼ of the NE¼ of sec. 13.
S. 0°01' E., 9.98 chs.	
S. 14°31' W., 33.92 chs.	The point for the meander cor. identical with the witness ¼ sec. cor. of secs. 13 and 24, heretofore described.

Survey of the Meanders of the Present Left Bank of the Verde River in Sections 12 and 13, T. 14 N., R. 4 E., G. & S. R. M., Arizona

CHAINS	
	<p>Survey of the Meanders of the Present Left Bank of the Verde River in Sections 12 and 13, Township 14 North, Range 4 East, Gila and Salt River Meridian, Arizona</p>
	<p>From the meander cor. of secs. 12 and 13, on the present left bank of the Verde River and on the boundary of the abandoned Camp Verde Military Reservation, heretofore described.</p> <p>Thence with meanders of the present left bank of the Verde River in sec. 12, downstream, along a sandy bank, 3 ft. high, through heavy undergrowth.</p> <p>S. 76°41' E., .33 chs.      The meander cor. of secs. 12 and 13 on the present left bank of the Verde River, identical with the witness closing cor. of secs. 12 and 13, heretofore described.</p>
	<p>Thence, in sec. 13, along a well defined bank, 3 to 8 ft. high, through scattered cottonwoods and heavy undergrowth.</p> <p>S. 76°23' E., 5.36 chs. .</p> <p>S. 68°16' E., 4.99 chs.      At 0.25 chs. dist. on this course, intersect the N-S centerline of sec. 13.</p> <p>S. 68°52' E., 5.47 chs.      At 0.75 chs. on this course, a bladed road, bears S. 5° E., crossing the Verde River, and N. 5° W., curving westerly.</p> <p>S. 42°42' E., 3.27 chs.</p> <p>S. 12°52' E., 1.56 chs.</p> <p>S. 39°14' E., 3.06 chs.</p> <p>S. 19°04' W., 8.27 chs.      At beginning of this course, bank changes to a limestone bank, 5 to 10 ft. high. At 6.00 chs. on this course, bank changes to a cut bank, 4. to 10 ft. high.</p> <p>S. 13°29' W., 3.91 chs.      At 0.39 chs. on this course, intersect the E-W centerline of the NE¼ of sec. 13.</p> <p>S. 8°44' W., 5.70 chs.</p> <p>S. 12°38' W., 2.11 chs.      At 0.88 chs. on this course, the SMC on the present left bank of the Verde River, heretofore described, thence with a traverse of the present left bank of the Verde River, for informational purposes only.</p>

Survey of the Meanders of the Present Left Bank of the Verde River  
in Section 13, T. 14 N., R. 4 E., G. & S. R. M., Arizona

CHAINS	
S. 14°31' W., 5.53 chs.	At 4.00 chs. on this course, an unimproved road, bears N and S.
S. 27°55' W., 6.41 chs.	Along a gravel bank, 1 to 4 ft. high. At 4.12 chs. on this course, intersect the E-W centerline of sec. 13.
S. 7°17' W., 5.35 chs.	Along a well defined bank, 5 to 12 ft. high.
S. 8°40' W., 8.37 chs.	
S. 7°53' W., 4.70 chs.	
S. 6°28' E., 4.40 chs.	
S. 7°53' W., 11.79 chs.	
S. 15°53' W., 3.86 chs.	At end of this course, intersect the sec. line bet. secs. 13 and 24 on the right bank of the Verde River.
GENERAL DESCRIPTION	
<p>The land encompassed in this survey is located about three miles NW of the town of Camp Verde, Arizona. The south part of Section 3, Northeast part of Section 4, North and center part of Section 13, and Northeast part of Section 14 are drained by the Verde River, which drains Southeasterly. The remainder is drained by Cherry Creek and small tributaries, which drain Northeasterly. The land varies from rolling to nearly level, ranging from 3,120 feet to 3,368 feet above sea level. Much of the land along the river bottom is under irrigation.</p> <p>Access is by way of U. S. Highway No. 79, which crosses the Southeast part of Section 13; Highway No. 279, crosses the Southwest part of Section 14 and 4. An asphalt road crosses the Northeast part of Section 12 and the East side of Section 13. There are numerous unimproved or lightly gravelled roads throughout the area resurveyed.</p> <p>Land along the Verde River is covered with scattered to dense growth of cottonwoods. Portions of the land is covered with mesquite, catclaw, creosote brush and willows. The remainder is naturally open or has been cleared.</p> <p>A Residential subdivision is being developed in the Northeast <math>\frac{1}{4}</math> of Section 3, Southwest <math>\frac{1}{4}</math> of Section 12, all but the Northeast <math>\frac{1}{4}</math> of Section 13, the Southeast <math>\frac{1}{4}</math> of Section 14 and the Northeast <math>\frac{1}{4}</math> of Section 23.</p>	

68

Form 9180-8  
(March 1969)

UNITED STATES  
DEPARTMENT OF THE INTERIOR  
BUREAU OF LAND MANAGEMENT

FIELD ASSISTANTS

NAMES	CAPACITY
Paul L. Reeves	Surveying Technician
Rex D. Krusell	Survey Aid
Kenneth Weir	Survey Aid
Ronald A. McCally	Survey Aid
Kurt A. Merkle	Survey Aid
George T. Cummings	Survey Aid
John P. Bennett III	Survey Aid
David M. Conrad	Survey Aid
Bruce M. Casketta	Survey Aid

69

CERTIFICATE OF SURVEY

(I) ~~(We)~~ Harry K. Smith, Cadastral Surveyor, HEREBY  
 and Supplemental Instructions 31st  
 CERTIFY upon honor that, in pursuance of special instructions bearing date of the 4th day  
 May 1974  
 of December, 19 72, (I) ~~(We)~~ have made a dependent resurvey of a portion  
 of the East and North boundaries, the Northwest boundary of the abandoned  
 Camp Verde Military Reservation and a portion of the subdivisional lines  
 and surveyed a portion of the subdivisions in sections 3, 4, 12, 13, 14,  
 16 and 23; made a metes and bounds survey of lot 7 in sec. 12, resurveyed  
 the 1892 meanders of the left bank of the Verde River in secs. 12 and 13  
 and meandered the present left bank of the Verde River through secs. 12  
 and 13, T. 14 N., R. 4 E.,  
 of the Gila and Salt River Meridian, in the State of Arizona, which  
 are represented in the foregoing field notes as having been executed by (me), ~~(us)~~ and under (my)  
~~(our)~~ direction; and that said survey has been made in strict conformity with said special instruc-  
 tions, the Manual of Instructions for the Survey of the Public Lands of the United States, and in  
 specific manner described in the foregoing field notes.

March 7, 1975  
 (Date)

*Harry K. Smith*  
 (Cadastral Surveyor)

(Date)

(Cadastral Surveyor)

CERTIFICATE OF APPROVAL

SUBMITTED FOR APPROVAL

Date MAR 13 1975

BUREAU OF LAND MANAGEMENT  
 Washington, D.C.

The foregoing field notes of the dependent resurvey of a portion of the East and North  
 boundaries, the Northwest boundary of the abandoned Camp Verde Military Reser-  
 vation and a portion of the subdivisional lines and the survey of a portion  
 of the subdivisions in sections 3, 4, 12, 13, 14, 16 and 23; a metes and bounds  
 survey of lot 7 in sec. 12, the resurvey of the 1892 meanders of the left bank  
 of the Verde River in sec. 12 and 13 and the meanders of the present left bank  
 of the Verde River through secs. 12 and 13, T. 14 N., R. 4 E., Gila and Salt  
 River Meridian, Arizona,  
 executed by Harry K. Smith, Cadastral Surveyor

having been critically examined and found correct, are hereby approved.

OCT 15 1975  
 (Date)

*Bernard W. Johnson*  
 (Chief, Division of Cadastral Survey)

CERTIFICATE OF TRANSCRIPT

I CERTIFY That the foregoing transcript of the field notes of the above-described surveys in  
 , is a true copy of the original field notes.

(Date)

(Chief, Division of Cadastral Survey) GPO 849 - 626