

UNITED STATES
DEPARTMENT OF THE INTERIOR
BUREAU OF LAND MANAGEMENT

FIELD NOTES

OF THE

METES-AND-BOUNDS SURVEY OF PARCEL NO. 1

IN

SECTION 2,

TOWNSHIP 14 NORTH, RANGE 5 EAST

Multiple horizontal lines for handwritten notes.

Of the GILA AND SALT RIVER Meridian,

In the State of ARIZONA

EXECUTED BY

Terrence O. Nickerson, Cadastral Surveyor

Horizontal lines for signature and name.

Under special instructions dated June 25, 1976, approved June 29, 1976,

_____, which provided for the surveys included under U.S. Survey/Group
Number 586, and assignment instructions dated July 19, 1976.

Survey commenced July 20, 1976

Survey completed July 23, 1976

1A

BOOK 5051

INDEX DIAGRAM

Township 14 North, Range 5 East

6	5	4	3	2	1
7	8	9	10	11	12
18	17	16	15	14	13
19	20	21	22	23	24
30	29	28	27	26	25
31	32	33	34	35	36

Survey of Parcel No. 1 begins on page 3

T. 14 N., R. 5 E., Gila and Salt River Meridian, Arizona

CHAINS

The following field notes are those of the metes-and-bounds survey of Parcel No. 1 in section 2, Township 14 North, Range 5 East, Gila and Salt River Meridian, Arizona.

The history of surveys pertaining to section 2 is:

The north boundary, portions of the east and west boundaries, and a portion of the subdivisional lines were surveyed by C. Burton Foster, U.S. Deputy Surveyor, in 1877, as shown on the official plat of survey approved December 27, 1877. A completion survey of the township and the remonumentation of the corner of sections 1, 2, 35, and 36 on the north boundary were executed by H. M. Muscott, Surveyor, Claude F. Warner, Transitman, and Frank Motoh, Public Land Surveyor, in 1938, as shown on the official plat of survey approved March 4, 1940. In 1964, the corner of sections 2, 3, 34, and 35 on the north boundary of the township, was remonumented by Boyd S. Owens, Cadastral Surveyor, as described in the field notes approved July 6, 1965.

Parcel No. 1 is land acquired in 1967 by the United States of America in trust for the Yavapai-Apache Indian Community. Surveys executed by private surveyors on adjacent lands relate to this survey. In 1966, Robert M. Williams, Jr., Arizona Registered Land Surveyor, surveyed a portion of the boundaries of Parcel No. 1, shown on his plat of survey of Beaver Creek Unit Three subdivision, approved November 7, 1966 by the Yavapai County Board of Supervisors and recorded in Book 12 of Maps and Plats, page 23. In 1967, Cadmus L. G. Goss, Arizona Registered Land Surveyor No. 5096, surveyed the boundaries of Parcel No. 1, shown on his plat of survey of Lake Montezuma Hills subdivision, approved October 2, 1967 by same Board of Supervisors and recorded in Book 12 of Maps and Plats, page 95.

The survey was executed in accordance with the specifications as set forth in the Manual of Surveying Instructions, 1973, and the Special Instructions for Group No. 586, dated June 25, 1976.

The direction of the lines of this survey was determined by altitude observations on the sun. The lines were carried forward by sustained angulation, being supplemented by other altitude observations on the sun taken throughout the course of the survey. All distances were measured with a Hewlett-Packard Electronic Distance Measuring instrument, Model 3805-A.

The geographic position of Angle Point No. 1 of Parcel No. 1, as scaled from the U.S. Geological Survey quadrangle map, "LAKE MONTEZUMA, ARIZ.", 1969, 7½ minute series, is as follows:

Latitude: 34° 37.9' N. Longitude: 111° 46.8' W.

The mean magnetic declination is 14½° E.

Metes-and-Bounds Survey of Parcel No. 1 in Section 2,
T. 14 N., R. 5 E., Gila and Salt River Meridian, Arizona

Beginning at a witness point on the section line bet. secs. 1 and 2, determined at the record distance from the cor. of secs. 1, 2, 35, and 36, on the N. bdy. of the Tp., described in the Special Warranty Deed for Parcel No. 1 and shown on the recorded plat of Beaver Creek Unit Three

Metes-and-Bounds Survey of Parcel No. 1, Sec. 2,
T. 14 N., R. 5 E., Gila and Salt River Mer., Arizona

CHAINS

subdivision. There is no remaining evidence of the lot cor. previously established at this point.

Set an iron post, 28 ins. long, 2½ ins. diam., 12 ins. in the ground, to bedrock, and in a mound of stone, 4 ft. base, to top, with brass cap mkd.

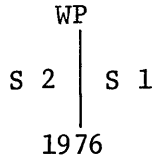

Cor. falls in the channel of Wet Beaver Creek, 1 ch. wide, course S. 82° W.

From the witness point, the cor. of secs. 1, 2, 35, and 36, on the N. bdy. of the Tp., bears N. 0° 31' 30" E., 9.318 chs. dist., an iron post, 2 ins. diam., firmly set, 1 in. below the ground's surface. The brass cap has been bladed off. The stem of a brass tablet is found cemented in the center of the iron post. This corner remonumented by Muscott, Warner, and Motoh in 1938 is harmoniously related to adjacent section corners, nearby corners of Lake Montezuma Hills subdivision and has long been known to adjacent landowners and used by local surveyors.

At the corner point

Set an iron post, 28 ins. long, 2½ ins. diam., 24 ins. in the ground, with brass cap mkd.

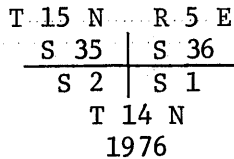

Deposit old iron post alongside new iron post.

Cor. falls on westerly edge of Montezuma Avenue, paved, 40 lks. wide, bears N. 40° W. and S. 50° E., on a curve.

From this same witness point, the SW. cor. of Lot 9, Beaver Creek Unit Three subdivision bears S. 0° 31' 30" W., 2.116 chs. dist., monumented with an iron rod, ½ in. diam., firmly set, protruding 1 in. above the ground. This lot cor. is shown on the recorded survey plats as being on the section line bet. secs. 1 and 2.

A retracement of adjacent lot lines of Lake Montezuma Hills and Beaver Creek Unit Three subdivisions identifies a bearing rotation of 1° 28' 47" to the right is needed to rectify the record bearing to the true meridian. The bearings of the Special Warranty Deed, dated September 20, 1967, recorded in Book 470, pages 130-131, of the Yavapai County records, are therefore rotated accordingly.

S. 85° 34' 55" W., on record tie line to Angle Point No. 1 of Parcel No. 1.

Along Wet Beaver Creek, course S. 82° W.

0.442 Point for Angle Point No. 1 of Parcel No. 1 and true point of beginning, determined at adjusted record bearing and record distance from the cor. of secs. 1, 2, 35, and 36, on the N. bdy. of the Tp.

Metes-and-Bounds Survey of Parcel No. 1, Sec. 2,
T. 14 N., R. 5 E., Gila and Salt River Mer., Arizona

CHAINS

Cor. point falls on emplaced basalt boulder, 4 x 3 x 2 ft. above ground, not suitable for permanent monument. Chisel X at point for the cor.

S. 85° 34' 55" W., along line 1-2 of Parcel No. 1.

0.046 Point selected for a witness cor. to Angle Point No. 1 of Parcel No. 1.

Set an iron post, 28 ins. long, 2½ ins. diam., 6 ins. in the ground, to solid river bottom, in a mound of stone, 4 ft. base, to top, with brass cap mkd.

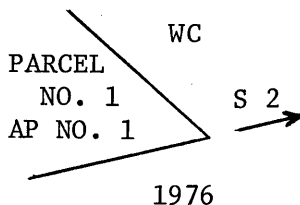

6.417 Point for Angle Point No. 2 of Parcel No. 1, as determined at adjusted record bearing and record dist. from Angle Point No. 1 of Parcel No. 1; there is no remaining evidence of the lot cor. set by Cadmus L. G. Goss during his 1967 survey of Lake Montezuma Hills subdivision.

Set an iron post, 28 ins. long, 2½ ins. diam., 23 ins. in the ground, in a collar of stone, 3 ft. base, to top, with brass cap mkd.

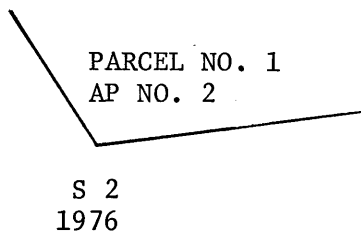

N. 44° 14' 16" W., along line 2-3 of Parcel No. 1.

Asc. over SE. slope through scattering cottonwood timber and dense undergrowth.

4.912 Point for Angle Point No. 3 of Parcel No. 1, as determined at adjusted record bearing and record dist. from Angle Point No. 2 of Parcel No. 1; there is no remaining evidence of the lot cor. set by Cadmus L. G. Goss during his 1967 survey of Lake Montezuma Hills subdivision.

Set an iron post, 28 ins. long, 2½ ins. diam., 23 ins. in the ground, in a rock collar, 2½ ft. base, to top, with brass cap mkd.

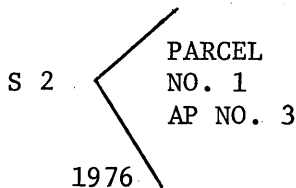

N. 32° 27' 13" E., along line 3-4 of Parcel No. 1.

Over nearly level land, through light undergrowth.

Metes-and-Bounds Survey of Parcel No. 1, Sec. 2,
T. 14 N., R. 5 E., Gila and Salt River Mer., Arizona

CHAINS

3.386 Point for Angle Point No. 4 of Parcel No. 1, as determined at adjusted record bearing and record dist., from Angle Point No. 3 of Parcel No. 1; there is no remaining evidence of the lot cor. set by Cadmus L. G. Goss during his 1967 survey of Lake Montezuma Hills subdivision.

Set an iron post, 28 ins. long, 2½ ins. diam., 22 ins. in the ground, in a rock collar, 2½ ft. base, to top, with brass cap mkd.

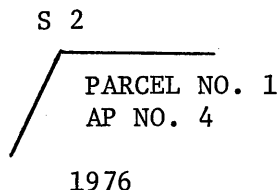

S. 88° 48' 50" E., along line 4-5 of Parcel No. 1.

Over nearly level land, through dense undergrowth.

2.00 Dirt road, 15 lks. wide, bears N. and S.

3.046 Point for Angle Point No. 5 of Parcel No. 1, as determined at adjusted record bearing and record dist., from Angle Point No. 4 of Parcel No. 1; there is no remaining evidence of the lot cor. set by Cadmus L. G. Goss during his 1967 survey of Lake Montezuma Hills subdivision.

Set an iron post, 28 ins. long, 2½ ins. diam., 16 ins. in the ground, to solid bedrock, in a mound of stone, 3 ft. base, to top, with brass cap mkd.

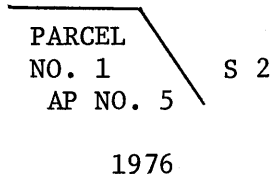

S. 40° 27' 15" E., along line 5-1 of Parcel No. 1.

Over nearly level land, through dense undergrowth.

3.80 Dirt road, 20 lks. wide, bears N. 69° E. and S. 69° W.

4.80 Enter creek bottom land, edge bears N. 80° E. and S. 80° W.

7.648 Angle Point No. 1 of Parcel No. 1, hereinbefore described, and true point of beginning.

GENERAL DESCRIPTION

The area surveyed is situated about 1 mile E. of Rimrock, Arizona. The average elevation is 3,450 ft. above sea level, with very little change in elevation. The soil varies from silt along Wet Beaver Creek to sandy loam. The timber consists mainly of cottonwood and aspen. The undergrowth consists of mesquite, small cottonwood and aspen, willows and reeds.

T. 14 N., R. 5 E., Gila and Salt River Mer., Arizona

CHAINS

No mineral deposits of value were noted. Drainage to the area is provided by Wet Beaver Creek which drains westerly. Access to the area is provided by paved roads of the adjacent Lake Montezuma Hills subdivision which has numerous dwellings.

The average of a number of readings gives a mean magnetic declination of $14\frac{1}{2}^{\circ}$ E., with no noticeable difference due to local attraction.

	CHAINS		
--	--------	--	--

CERTIFICATE OF SURVEY

(I) ~~(We)~~, Terrence O. Nickerson, Cadastral Surveyor, HEREBY CERTIFY upon honor that, in pursuance of special instructions bearing date of the 25th day of June, 19 76, (I) ~~(We)~~ have surveyed by metes and bounds Parcel No. 1 in section 2, T. 14 N., R. 5 E.,

of the Gila and Salt River Meridian, in the State of Arizona, which are represented in the foregoing field notes as having been executed by (me), ~~(us)~~ and under (my) ~~(our)~~ direction; and that said survey has been made in strict conformity with said special instructions, the Manual of Instructions for the Survey of the Public Lands of the United States, and in specific manner described in the foregoing field notes.

2/1/77 (Date) Terrence O. Nickerson (Cadastral Surveyor)

____ (Date) _____ (Cadastral Surveyor)

CERTIFICATE OF APPROVAL

BUREAU OF LAND MANAGEMENT
Washington, D.C.

The foregoing field notes of the metes-and-bounds survey of Parcel No. 1 in section 2, T. 14 N., R. 5 E., Gila and Salt River Meridian, Arizona,

executed by Terrence O. Nickerson, Cadastral Surveyor, having been critically examined and found correct, are hereby approved.

FEB 17 1978 (Date) [Signature] Acting (Chief, Division of Cadastral Survey)

CERTIFICATE OF TRANSCRIPT

I CERTIFY That the foregoing transcript of the field notes of the above-described surveys in _____, is a true copy of the original field notes.

____ (Date) _____ (Chief, Division of Cadastral Survey) GPO 849 - 626