

ORIGINAL

1

BOOK 5277

UNITED STATES
DEPARTMENT OF THE INTERIOR
BUREAU OF LAND MANAGEMENT

FIELD NOTES
OF THE

DEPENDENT RESURVEY OF PORTIONS OF THE SOUTH AND WEST BOUNDARIES OF THE

SAN RAFAEL DEL VALLE LAND GRANT AND PORTIONS OF THE SUBDIVISIONAL LINES;

THE SURVEY OF SUBDIVISIONS IN SECTIONS 16 AND 21,

AND THE METES-AND-BOUNDS SURVEYS,

OF LOT 5, SECTION 16, AND PARCELS A AND B, SECTION 21,

AND IN THE SAN RAFAEL DEL VALLE LAND GRANT

TOWNSHIP 23 SOUTH, RANGE 22 EAST

Of the Gila and Salt River Meridian,
In the State of Arizona

EXECUTED BY

William P. Carpender, Cadastral Surveyor

Under special instructions dated January 13, 1987, approved January 13, 1987
and supplemental special instructions each dated and approved May 15, 1987, July 22,
1987, and January 21, 1988, which provided for the surveys included under Group
Number 688 and assignment instructions dated May 15, 1987.

Survey commenced July 27, 1987

Survey completed February 2, 1988

2
BOOK 5277
INDEX DIAGRAM

TOWNSHIP 23 SOUTH, RANGE 22 EAST,

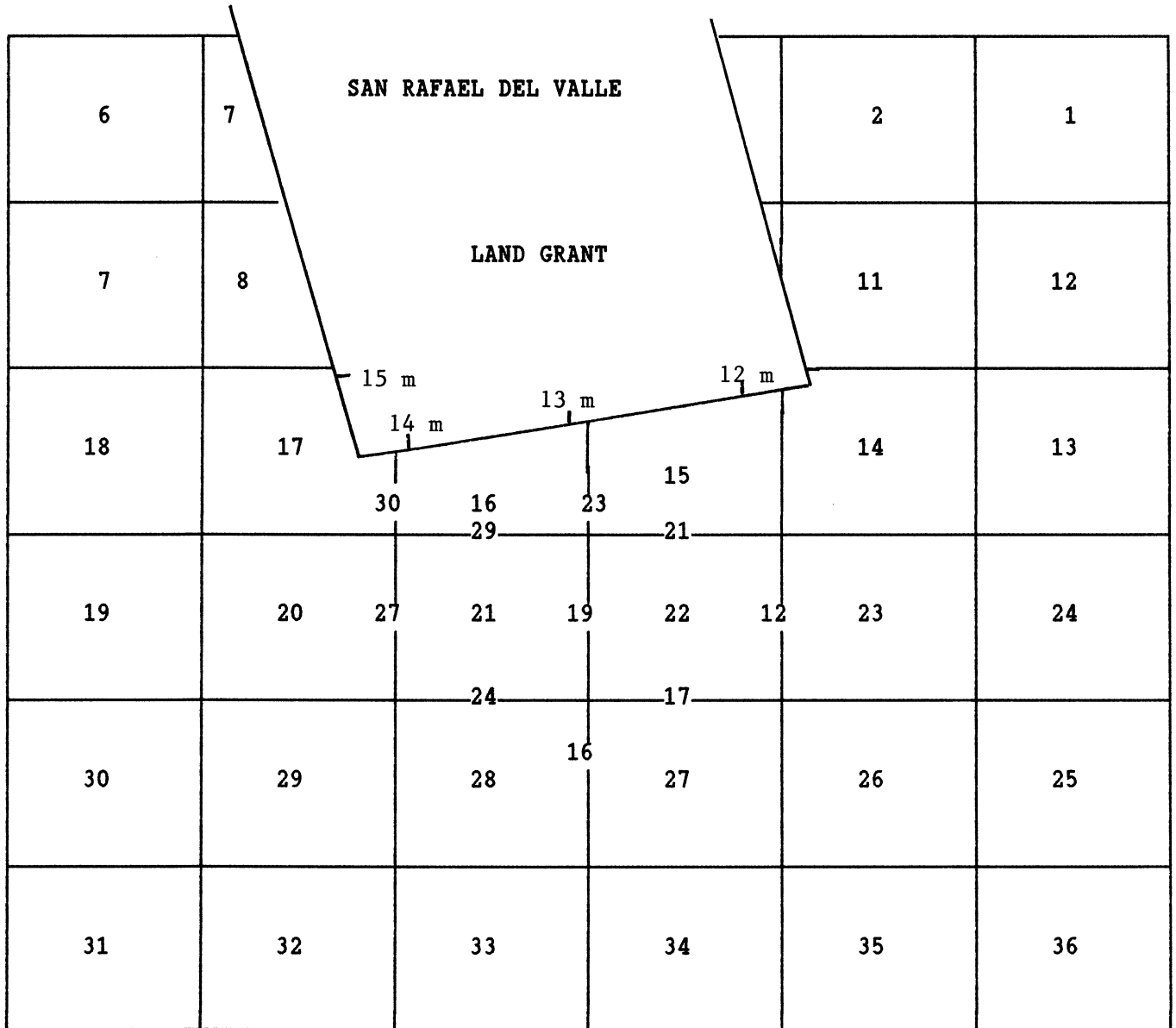

San Rafael del Valle Land Grant-Portions of S. and W. Bdy

13th Mile.....pp. 4-7
 14th Mile.....pp. 7-9
 15th Mile.....pp. 9-12
Subdivision of Sections
 Section 16.....pg. 31
 Section 21.....pp. 36-38
Metes-and-Bounds Survey
 SRDV Land Grant.....pp. 34-35
 Lot 5, Section 16 pp. 32-34
 Parcel A, Section 21.....pp. 38-40
 Parcel B, Section 21.....pp. 41-42

T 23 S, R 22 E, Gila and Salt River Meridian, Arizona

CHAINS

The following field notes are those of the dependent resurvey of portions of the south and west boundaries of the San Rafael del Valle Land Grant and portions of the subdivisional lines; the survey of subdivisions in sections 16 and 21, and the metes-and-bounds surveys, of lot 5, section 16, parcels A and B, section 21 and in the San Rafael del Valle Land Grant, Township 23 South, Range 22 East, Gila and Salt River Meridian, Arizona.

The San Rafael del Valle Land Grant was preliminarily surveyed in 1879 by S.M. Allis. The subdivisional lines of T 23 S, R 22 E, were surveyed in 1901, by Philip Contzen, and the San Rafael del Valle Land Grant, as surveyed by S.M. Allis, was not segregated. The San Rafael del Valle Land Grant was surveyed in 1902 by Philip Contzen, who also resurveyed portions of the section lines and set closing corners on the Land Grant at the intersection with the section lines. The survey of the Land Grant by Contzen resulted in the plat approved September 10, 1902, which made fractional those sections invaded by the Land Grant.

The survey was executed in accordance with the specifications as set forth in the Manual of Surveying Instructions, 1973, the Special Instructions dated January 13, 1987, and Supplemental Special Instructions dated May 15, 1987, July 22, 1987, and January 21, 1988, for Group No. 688, Arizona.

The directions of all lines were determined by hour angle observations on the sun, confirmed by U.S. Coast and Geodetic Survey horizontal control data, and refer to the true meridian. Lines of the survey without benefit of mathematical closure were verified by double measurement. Distances and angles were measured with a Zeiss Elta 46 Total Station Instrument.

Prior to restoration of any corners, all necessary lines of the previous surveys were retraced and diligent search was made for any evidence of the original monuments and other calls of the official record. Identified corners were remonumented in their original positions. In some instances, corners had been either perpetuated or reestablished by private land surveyors. These positions were accepted whenever they represented the best available evidence of the original corner position. Lost corners were reestablished at proportionate positions based on the official record, but not until exhausting every reasonable possibility of finding direct evidence of the control of each corner. The retracement data were thoroughly verified and only the true line field notes are given herein.

T 23 S, R 22 E, Gila and Salt River Meridian, Arizona

<p>CHAINS</p>	<p>The geographic position of the southeast corner of section 22, as determined from a tie made to U.S. Coast and Geodetic Survey triangulation station "HEREFORD", located in the SW quarter of section 6, Township 23 South, Range 22 East, is as follows:</p> <p>NAD 27 Latitude: 31°24'32.29" N Longitude: 110°05'15.68" W</p> <p>The mean magnetic declination as shown on HEREFORD, ARIZ. quadrangle map, published by U.S. Geological Survey in 1983 is 12° E.</p> <hr/> <p style="text-align: center;">Dependent Resurvey of a Portion of the S Bdy., San Rafael del Valle Land Grant, T 23 S, R 22 E, Gila and Salt River Mer., Arizona</p> <hr/> <p style="text-align: center;">Reestablishment of the Survey Executed by Philip Contzen, Deputy Surveyor, in 1902</p> <hr/> <p>Beginning at the 12 mile cor., monumented with a granite stone, 18 x 16 x 12 ins., firmly set, 9 ins. in the ground, mkd. SRDV on N, illegible marks on the S and W.</p> <p>At the cor. point</p> <p>Set a stainless steel post, 28 ins. long, 2 1/2 ins. diam., 22 ins. in the ground, over a steel fence post driven into the ground, and in a mound of stone, 4 ft. base, to top, with brass cap mkd.</p> <div style="text-align: center; margin: 20px 0;"> <p>T23S R22E SRDV 12M</p> <hr style="width: 10%; margin: 0 auto;"/> <p>S15 1987</p> </div> <p>from which</p> <p style="text-align: center;">A local reference monument, an open ended iron pipe, 2 1/2 ins. diam., firmly set, projecting 5 ins. above ground, with a 2 x 2 ins. wood hub inside, with a washer mkd. RCE 5896, bears N 76 1/2° E, 15 lks. dist.</p>
---------------	--

Dependent Resurvey, Portion of the S Bdy., SRDV Land Grant
T 23 S, R 22 E, Gila and Salt River Mer., Arizona

CHAINS	
	<p>A local reference monument, an open ended iron pipe, 2 1/2 ins. diam., firmly set, projecting 5 ins. above ground, with a 2 x 2 ins. wood hub inside, with a washer mkd. RCE 5896, bears S 76 1/2° W, 15 lks. dist.</p> <p>Deposit a magnet in a 1 x 1 x 2 5/8 in. white colored plastic case beneath the stainless steel post.</p> <p>Deposit the original stone alongside the stainless steel post.</p> <p>Set a steel fence post alongside the cor.</p> <p>The cor. is located S, 1 lk. from a fence, bears N 76 1/2° E and S 76 1/2° W.</p> <p>S 76° 33' W, on the 13th mile of the San Rafael del Valle Land Grant.</p> <p>Desc. over broken, rolling land, along a fence, through moderate creosote, mesquite, and catclaw brush.</p>
33.70	Southern Pacific Railroad bears S 20° E and N 20° W.
35.80	Hereford Road, asphalt surfaced, 30 lks. wide, bears S 20° E and N 20° W. Desc. gradually over cultivated land.
40.16	Point for the 12 1/2 mile cor. at proportionate distance; there is no remaining evidence of the original corner.
	<p>Set a stainless steel post, 28 ins. long, 2 1/2 ins. diam., 24 ins. in the ground, and in a mound of stone, 4 ft. base, to top, with brass cap mkd.</p>
	<p>SRDV 12 1/2 M</p> <hr style="width: 10%; margin: auto;"/> <p>T23S R22E S15 1987</p>

Dependent Resurvey, Portion of the S Bdy., SRDV Land Grant
T 23 S, R 22 E, Gila and Salt River Mer., Arizona

CHAINS	
	<p>Deposit a magnet in a 1 x 1 x 2 5/8 in. white colored plastic case beneath the stainless steel post.</p> <p>Set a steel fence post alongside the cor.</p> <p>The cor. is located N, 4 lks. dist. from a fence, bears N 76 1/2° E and S 76 1/2° W.</p> <p>Continue measurement over cultivated land.</p>
60.10	Leave cultivated land, enter riparian area.
67.60	San Pedro River, 150 lks. wide, course N 45° W.
75.70	Leave riparian area, asc. gradually.
80.25	<p>The closing cor. of secs. 15 and 16, monumented with a rebar, 5/8 in. diam., 15 ins. long, firmly set, flush with the ground, and in a collar of stone, 1 1/2 ft. diam., with an aluminum cap, 1 1/2 ins. diam., mkd. CC 15 16 LS 1047. This cor. was established by Tony A. Blanton, Registered Land Surveyor No. 1047, Arizona, in 1967, and is accepted as a careful and faithful reestablishment of the position of the original corner. This closing cor. now is also identical with AP 1, lot 5, sec. 16.</p> <p>At the cor. point</p> <p>Set a stainless steel post, 28 ins. long, 2 1/2 ins. diam., 25 ins. in the ground, with brass cap mkd.</p> <div style="text-align: center;"> <p>SRDV</p> <hr style="width: 50px; margin: 0 auto;"/> <p>S16 S15</p> <p>T23S R22E</p> <p> C C</p> <p> 1987</p> </div> <p>from which</p> <p style="margin-left: 40px;">A local monument, a rebar, 1/2 in. diam., set flush with the ground, with a yellow plastic cap, mkd. LS 5015, bears S 35° W, 1.28 chs. dist.</p>

Dependent Resurvey, Portion of the S Bdy., SRDV Land Grant
T 23 S, R 22 E, Gila and Salt River Mer., Arizona

CHAINS	
	<p>A fence corner, with fences extending N, E, and S, bears S 39 1/2° W, 99 lks. dist.</p> <p>Deposit a magnet in a 1 x 1 x 2 5/8 in. white colored plastic case beneath the stainless steel post.</p> <p>Deposit the rebar inside the stainless steel post.</p> <p>Set a steel fence post alongside the cor.</p> <hr/> <p>S 76°32' W, beginning new measurement.</p>
0.07	<p>Point for the 13 mile cor., at proportionate distance; there is no remaining evidence of the original cor.</p> <p>Set a stainless steel post, 28 ins. long, 2 1/2 ins. diam., 23 ins. in the ground, with brass cap mkd.</p> <p style="text-align: center;">SRDV 13 M <hr style="width: 10%; margin: auto;"/>T23S R22E S16 1987</p> <p>Deposit a magnet in a 1 x 1 x 2 5/8 in. white colored plastic case beneath the stainless steel post.</p> <p>Set a steel fence post alongside the cor.</p> <hr/> <p>S 76°32' W, on the 14th mile of the San Rafael del Valle Land Grant, beginning new measurement.</p> <p>Asc. gradually over nearly level land.</p>
0.50	Point for AP 2, lot 5, sec. 16, hereinafter described.
0.94	Dirt road, 20 lks. wide, bears S 20° E and N 20° W.

Dependent Resurvey, Portion of the S Bdy., SRDV Land Grant
 T 23 S, R 22 E, Gila and Salt River Mer., Arizona

CHAINS	
25.20	Begin steeper ascent.
29.90	Top of ascent.
32.60	Wash, 45 lks. wide, 8 ft. deep, drains S.
40.16	Point for the 13 1/2 mile cor., at proportionate distance. The original monument, a sandstone, 18 x 10 x 7 ins., mkd. SRVD, PL, and 13 1/2 M, was found lying loose on the ground.
	Set a stainless steel post, 28 ins. long, 2 1/2 ins. diam., 22 ins. in the ground, with brass cap mkd.
	SRDV 13 1/2 M <hr style="width: 20%; margin: auto;"/> T23S R22E S16 1987
	Deposit a magnet in a 1 x 1 x 2 5/8 in. white colored plastic case beneath the stainless steel post.
	Bury the original stone alongside the stainless steel post.
	Set a steel fence post alongside the cor.
	Continue measurement over nearly level land.
41.20	Point for the 1/4 sec. cor. of sec. 16 only, hereinafter described.
	Continue measurement over nearly level, cultivated land.
80.32	Point for the 14th mile cor., at proportionate distance; there is no remaining evidence of the original cor.
	Set a stainless steel post, 28 ins. long, 2 1/2 ins. diam., 25 ins. in the ground, with brass cap mkd.

Dependent Resurvey, Portion of the S Bdy., SRDV Land Grant
 T 23 S, R 22 E, Gila and Salt River Mer., Arizona

CHAINS	SRDV 14 M <hr style="width: 20%; margin: auto;"/> T23S R22E S16 1987
	Deposit a magnet in a 1 x 1 x 2 5/8 in. white colored plastic case beneath the stainless steel post. Set a steel fence post alongside the cor.
	<hr/> S 76°32' W, on the 15th mile of the San Rafael del Valle Land Grant, beginning new measurement. Asc. gradually over nearly level land.
2.17	The closing cor. of secs. 16 and 17, monumented with a rebar, 5/8 in. diam., 15 ins. long, set 1 in. below the surface of Palominas Road, with a yellow plastic cap mkd. LS 9086, set by Gordon W. Ray, Registered Land Surveyor No. 9086, Arizona, in 1980, over another rebar, 1/2 in. diam., 12 ins. long, 16 ins. below the surface, set by persons unknown. This position is harmoniously related to existing original cors., has long been recognized as the cor. by adjacent landowners, and is accepted as the best available evidence of the original corner position. At the cor. point Set a stainless steel post, 28 ins. long, 2 1/2 ins. diam., 32 ins. in the ground, with brass cap mkd.
	SRDV <hr style="width: 20%; margin: auto;"/> S17 S16 T23S R22E C C 1987

Dependent Resurvey, Portion of the S Bdy., SRDV Land Grant
T 23 S, R 22 E, Gila and Salt River Mer., Arizona

CHAINS	
	<p>from which</p> <p>An aluminum post, 3/4 ins. diam., 36 ins. long, set 30 ins. in the ground, for a reference monument, bears N 23 1/2° E, 69.2 ft. dist., with aluminum cap mkd. RM T23S R22E CC S16 69.2 FT. TO COR 1987 and an arrow pointing to the cor. Set a steel fence post alongside the RM. The RM is located E, 1 1/2 lks. dist., from a fence, bears N and S.</p> <p>An aluminum post, 3/4 ins. diam., 36 ins. long, set 30 ins. in the ground, for a reference monument, bears N 24 1/4° W, 90.6 ft. dist., with aluminum cap mkd. RM T23S R22E CC S17 90.6 FT. TO COR 1987 and an arrow pointing to cor. Set a steel fence post alongside the RM. The RM is located W, 1 1/2 lks. from a fence, bears N and S.</p> <p>Deposit a magnet in a 1 x 1 x 2 5/8 in. white colored plastic case beneath the stainless steel post.</p> <p>Deposit both rebars inside the stainless steel post.</p> <p>The cor. is located E, 9 lks. dist. from the center of Palominas Road, chip seal surfaced, 38 lks. wide, bears N and S.</p> <hr/> <p>S 76°30' W, beginning new measurement.</p> <p>Over gently rolling, cultivated land.</p> <p>27.46 Point for angle cor. 3, at proportionate distance; there is no remaining evidence of the original cor.</p> <p>Set a stainless steel post, 28 ins. long, 2 1/2 ins. diam., 22 ins. in the ground, with brass cap mkd.</p> <div style="text-align: center;"> <p>SRDV S17 COR 3 T23S R22E 1987</p> </div>

Dependent Resurvey, Portion of the S Bdy., SRDV Land Grant
T 23 S, R 22 E, Gila and Salt River Mer., Arizona

CHAINS	<p>from which</p> <p style="padding-left: 40px;">A cottonwood, 7 ins. diam., bears N 82 1/4° W, 7.65 chs. dist., mkd. SRDV-3 BT.</p> <p>Deposit a magnet in a 1 x 1 x 2 5/8 in. white colored plastic case beneath the stainless steel post.</p> <p>Set a steel fence post alongside the cor.</p> <hr/> <p style="text-align: center;">Dependent Resurvey, Portion of the W Bdy., SRDV Land Grant, T 23 S, R 22 E, Gila and Salt River Mer., Arizona</p> <hr/> <p style="text-align: center;">Reestablishment of the Survey Executed by Philip Contzen, Deputy Surveyor, in 1902</p> <hr/> <p>From angle cor. 3.</p> <p>N 13°30' W, beginning new measurement, continuing on the 15th mile.</p> <p>Over gently rolling, cultivated land.</p> <p>10.46 Point for the 14 1/2 mile cor. at proportionate distance; there is no remaining evidence of the original cor.</p> <p>Set a stainless steel post, 28 ins. long, 2 1/2 ins. diam., 20 ins. in the ground to bedrock, and in a mound of stone, 3 ft. base, to top, with brass cap mkd.</p> <div style="text-align: center; margin: 10px 0;"> <p>SRDV</p> <p>S17 \ 14 1/2 M</p> <p>T23S</p> <p>R22E</p> <p>1987</p> </div> <p>Deposit a magnet in a 1 x 1 x 2 5/8 in. white colored plastic case beneath the stainless steel post.</p> <p>Set a steel fence post alongside the cor.</p> <p>Continue measurement over cultivated land.</p>
--------	---

Dependent Resurvey, Portion of the W Bdy., SRDV Land Grant,
T 23 S, R 22 E, Gila and Salt River Mer., Arizona

<p>CHAINS</p> <p>50.55</p>	<p>The 15th mile cor., monumented with a granite stone, 12 x 11 x 8 ins., firmly set, projecting 6 ins. above ground, mkd. 15 M on the N face, SRDV on the E face, and PL on the W face.</p> <p>At the cor. point</p> <p>Set a stainless steel post, 28 ins. long, 2 1/2 ins. diam., 22 ins. in the ground, with brass cap mkd.</p> <div style="text-align: center; margin: 10px 0;"> <table style="border: none; margin: auto;"> <tr> <td style="padding-right: 5px;">S17</td> <td style="padding-right: 10px;">SRDV</td> </tr> <tr> <td style="padding-right: 5px;">T23S</td> <td style="padding-right: 10px;">15 M</td> </tr> <tr> <td style="padding-right: 5px;">R22E</td> <td style="padding-right: 10px;"></td> </tr> <tr> <td></td> <td style="padding-right: 10px;">1987</td> </tr> </table> </div> <p>from which</p> <p style="margin-left: 40px;">A local reference monument, an open ended iron pipe, 1/2 ins. diam., firmly set, projecting 5 ins. above ground, with a 2 x 2 ins. wood hub inside, with a washer mkd. RCE 5896, bears N, 3 lks. dist.</p> <p style="margin-left: 40px;">A local reference monument, an open ended iron pipe, 2 1/2 ins. diam., firmly set, projecting 5 ins. above ground, with a 2 x 2 ins. wood hub inside, with a washer mkd. RCE 5896, bears S, 3 lks. dist.</p> <p>Deposit a magnet in a 1 x 1 x 2 5/8 in. white colored plastic case beneath the stainless steel post.</p> <p>Deposit the original stone alongside the stainless steel post.</p> <p>Set a steel fence post alongside the cor.</p> <p>The cor. is located W, 3 lks. dist. from a fence, bears N and S; and W, 26 lks. dist. from a track road, 15 lks. wide, bears N and S.</p> <p>From this cor., U.S. Coast & Geodetic Survey triangulation station "HEREFORD, 1938", bears N 42°52'18" W, (forward bearing) 154.327 chs. dist., monumented with a bronze disk, 3 1/2 ins. diam., firmly set in a concrete block, 12 x 12 ins., projecting 6 ins. above the ground, mkd. HEREFORD 1938 ASA 262 and a triangle. Two steel fence posts are set alongside the triangulation station. The reference marks and the azimuth mark are in good condition, mkd. as described in the published data of the U.S. Coast and Geodetic Survey.</p> <hr style="width: 60%; margin-left: 0;"/>	S17	SRDV	T23S	15 M	R22E			1987
S17	SRDV								
T23S	15 M								
R22E									
	1987								

Dependent Resurvey of a Portion of the Subdivisional Lines,
T 23 S, R 22 E, Gila and Salt River Meridian, Arizona

CHAINS

Reestablishment of the Survey Executed by
Philip Contzen, Deputy Surveyor, in 1901

From the cor. of secs. 22, 23, 26, and 27, monumented with a redwood post, 4 ins. square, 35 ins. long, firmly set, projecting 16 ins. above the ground, with faint, illegible scribe marks visible.

At the cor. point

Set a stainless steel post, 28 ins. long, 2 1/2 ins. diam., 22 ins. in the ground, with brass cap mkd.

T23S R22E	
S22	S23
S27	S26
1987	

from which

A local reference monument, an open ended iron pipe, 2 1/2 ins. diam., firmly set, projecting 3 ins. above ground, with a 2 x 2 ins. wood hub inside, with a washer mkd. RCE 5896, bears N, 15 lks. dist.

A local reference monument, an open ended iron pipe, 2 1/2 ins. diam., firmly set, projecting 3 ins. above ground, with a 2 x 2 ins. wood hub inside, with a washer mkd. RCE 5896, bears W, 15 lks. dist.

Deposit a magnet in a 1 x 1 x 2 5/8 in. white colored plastic case beneath the stainless steel post.

Deposit the original post alongside the stainless steel post.

A steel fence post is set alongside the cor.

From this cor., U.S. Coast and Geodetic triangulation station "HEREFORD, 1938", hereinbefore described, bears N 48°33'35" W, (forward bearing) 405.648 chs. dist.

Dependent Resurvey of a Portion of the Subdivisional Lines,
T 23 S, R 22 E, Gila and Salt River Mer., Arizona

<p>CHAINS</p> <p>40.09</p> <p>39.10</p>	<p>N 0°06' E, bet. secs. 22 and 23.</p> <p>Over rolling land, through moderate creosote, mesquite, and catclaw brush.</p> <p>The 1/4 sec. cor. of secs. 22 and 23, monumented with a redwood post, 4 ins. square, 30 ins. long, firmly set, projecting 18 ins. above ground, with no scribe marks visible.</p> <p>At the cor. point</p> <p>Set a stainless steel post, 28 ins. long, 2 1/2 ins. diam., 25 ins. in the ground, with brass cap mkd.</p> <p style="text-align: center;">T23S R22E 1/4 S22 S23 1987</p> <p>from which</p> <p>A local reference monument, an open ended iron pipe, 2 1/2 ins. diam., firmly set, projecting 3 ins. above ground, with a 2 x 2 ins. wood hub inside, with a washer mkd. RCE 5896, bears N, 15 lks. dist.</p> <p>A local reference monument, an open ended iron pipe, 2 1/2 ins. diam., firmly set, projecting 3 ins. above ground, with a 2 x 2 ins. wood hub inside, with a washer mkd. RCE 5896, bears S, 15 lks. dist.</p> <p>Deposit a magnet in a 1 x 1 x 2 5/8 in. white colored plastic case beneath the stainless steel post.</p> <p>Deposit the original post alongside the stainless steel post.</p> <p>A steel fence post is set alongside the cor.</p> <hr style="width: 20%; margin: 10px auto;"/> <p>N 0°03' E, beginning new measurement.</p> <p>Top of low spur, slopes NW, desc. 15 ft. over steep NE slope.</p>
---	---

Dependent Resurvey of a Portion of the Subdivisional Lines,
T 23 S, R 22 E, Gila and Salt River Mer., Arizona

CHAINS	<p>40.12 The cor. of secs. 14, 15, 22 and 23, monumented with a redwood post, 4 ins. square, 24 ins. long, firmly set, projecting 18 ins. above ground, with no scribe marks visible.</p> <p>At the cor. point</p> <p>Set a stainless steel post, 28 ins. long, 2 1/2 ins. diam., 26 ins. in the ground, over a steel fence post driven into the ground, with brass cap mkd.</p> <div style="text-align: center; margin: 20px 0;"> <table style="margin: auto; border-collapse: collapse;"> <tr> <td colspan="2">T23S R22E</td> </tr> <tr> <td style="border-right: 1px solid black; padding: 0 5px;">S15</td> <td style="padding: 0 5px;">S14</td> </tr> <tr> <td style="border-right: 1px solid black; padding: 0 5px;">S22</td> <td style="padding: 0 5px;">S23</td> </tr> <tr> <td colspan="2" style="text-align: center; padding: 0 5px;">1987</td> </tr> </table> </div> <p>from which</p> <ul style="list-style-type: none"> <li style="margin-bottom: 10px;">A local reference monument, an open end iron pipe, 2 1/2 ins. diam., firmly set, projecting 3 ins. above ground, with a 2 x 2 ins. wood hub inside, with a washer mkd. RCE 5896, bears N, 16 1/2 lks. dist. <li style="margin-bottom: 10px;">A local reference monument, an open end iron pipe, 2 1/2 ins. diam., firmly set, projecting 6 ins. above ground, with a 2 x 2 ins. wood hub inside, with a washer mkd. RCE 5896, bears E, 16 1/2 lks. dist. <li style="margin-bottom: 10px;">A local reference monument, an open end iron pipe, 2 1/2 ins. diam., firmly set, projecting 4 ins. above ground, with a 2 x 2 ins. wood hub inside, with a washer mkd. RCE 5896, bears S, 14 1/2 lks. dist. <li style="margin-bottom: 10px;">A local reference monument, an open end iron pipe, 2 1/2 ins. diam., firmly set, projecting 6 ins. above ground, with a 2 x 2 ins. wood hub inside, with a washer mkd. RCE 5896, bears W, 15 lks. dist. <p>Deposit a magnet in a 1 x 1 x 2 5/8 in. white colored plastic case beneath the stainless steel post.</p> <p>Deposit the original post alongside the stainless steel post.</p> <p>A steel fence post is set alongside the cor.</p> <hr style="width: 60%; margin-left: 0;"/>	T23S R22E		S15	S14	S22	S23	1987	
T23S R22E									
S15	S14								
S22	S23								
1987									

Dependent Resurvey of a Portion of the Subdivisional Lines,
T 23 S, R 22 E, Gila and Salt River Mer., Arizona

CHAINS	<p>From the 1/4 sec. cor. of secs. 27 and 28, monumented with an iron water pipe, 1 in. diam. (3/4 in. inside diam.), projecting 3 ins. above ground level, firmly set in concrete immediately adjacent to an angle iron fence cor., with a plumber's cap, set by Mr. David Pitman and Mr. Haskell Williams, in 1964. Mr. Clarence S. Wilcox, Registered Land Surveyor No. 17565, Arizona, furnished copies of an affidavit and a memorandum, included in and made a part of the group file, attesting to the cor. position, which is accepted as a careful and faithful perpetuation of the position of the original corner.</p> <p>At the cor. point</p> <p>Set a brass tablet, 3 1/2 ins. diam., with a stem 3 ins. long, driven firmly into the iron water pipe, which is cut off 1 1/2 ins. above the concrete. The brass tablet is notched to clear the fence cor., and is mkd.</p> <div style="text-align: center;"> <p>T23S R22E 1/4 S28 S27 1987</p> </div> <p>The cor. is located between the angle iron fence cor., and a wood fence cor., fences extend N, E, S, and W.</p> <p>N 0°06' E, bet. secs. 27 and 28.</p> <p>Over nearly level, cultivated land, along a fence.</p>
40.08	<p>Point for the cor. of secs. 21, 22, 27, and 28, at proportionate dist.; there is no remaining evidence of the original cor.</p> <p>Set a stainless steel post, 28 ins. long, 2 1/2 ins. diam., 25 ins. in the ground, with brass cap mkd.</p> <div style="text-align: center;"> <p>T23S R22E S21 S22 S28 S27 1987</p> </div>

Dependent Resurvey of a Portion of the Subdivisional Lines,
T 23 S, R 22 E, Gila and Salt River Mer., Arizona

CHAINS	
	<p>from which</p> <p>A local monument, an open end iron pipe, 1 1/2 ins. diam., projecting 6 ins. above ground, bears S 51 1/2° W, 8.2 lks. dist., set by Clarence S. Wilcox, Registered Civil Engineer No. 1270, Arizona, in 1964. This position was reestablished using improper procedures and is not utilized in the course of this resurvey.</p> <p>and from which new bearing trees</p> <p>A cottonwood, 78 ins. diam., bears N 27 3/4° E, 2.52 chs. dist., mkd. T23S R22E S22 BT.</p> <p>A cottonwood, 66 ins. diam., bears N 35° W, 1.64 chs. dist., mkd. T23S R22E S21 BT.</p> <p>A fence cor. bears N 52 1/4° W, 36 lks. dist., fences extend E, S, and W.</p> <p>Deposit a magnet in a 1 x 1 x 2 5/8 in. white colored plastic case beneath the stainless steel post.</p> <p>Set a steel fence post alongside the cor.</p> <p>From this cor., a well bears N 46°09' W, 27.94 chs. dist.</p> <hr/> <p>From the cor. of secs. 22, 23, 26, and 27.</p> <p>N 89°51' W, bet. secs. 22 and 27.</p> <p>Desc. gradually, over rolling land.</p> <p>7.00 Southern Pacific Railroad bears S 30° E and N 30° W.</p> <p>9.60 Hereford Road, asphalt surfaced, 30 lks. wide, bears S 30° E and N 30° W.</p> <p>40.26 The 1/4 sec. cor. of secs. 22 and 27, monumented with a redwood post, 4 ins. square, 30 ins. long, firmly set, projecting 24 ins. above ground, mkd. 1/4 S22 on E side, no other scribe marks legible.</p>

Dependent Resurvey of a Portion the Subdivisional Lines,
T 23 S, R 22 E, Gila and Salt River Mer., Arizona

CHAINS	
	At the cor. point
	Set a stainless steel post, 28 ins. long, 2 1/2 ins. diam., 22 ins. in the ground, with brass cap mkd.
	T23S R22E
	1/4 $\frac{S22}{S27}$
	1987
	from which
	A local reference monument, an open end iron pipe,
	2 1/2 ins. diam., firmly set, projecting 3 ins. above
	ground, with a 2 x 2 ins. wood hub inside, with a washer
	mkd. RCE 5896, bears N, 15 lks. dist.
	A local reference monument, an open end iron pipe,
	2 1/2 ins. diam., firmly set, projecting 3 ins. above
	ground, with a 2 x 2 ins. wood hub inside, with a washer
	mkd. RCE 5896, bears E, 15 lks. dist.
	A local reference monument, an open end iron pipe,
	2 1/2 ins. diam., firmly set, projecting 3 ins. above
	ground, with a 2 x 2 ins. wood hub inside, with a washer
	mkd. RCE 5896, bears W, 15 lks. dist.
	Deposit a magnet in a 1 x 1 x 2 5/8 in. white colored plastic
	case beneath the stainless steel post.
	Deposit the original post alongside the stainless steel post.
	Set a steel fence post alongside the cor.
	The cor. is located in a fence, bears E and W, and under a power
	pole line, bears N and S.
	S 89°55' W, beginning new measurement.
	Continue gradual descent.
37.20	San Pedro River, 180 lks. wide, course N 60° E., asc. gradually.
40.29	The cor. of secs. 21, 22, 27, and 28.

Dependent Resurvey of a Portion the Subdivisional Lines,
T 23 S, R 22 E, Gila and Salt River Mer., Arizona

CHAINS	
	<p>N 0°09' E, bet. secs. 21 and 22. Over nearly level land, along the E edge of a cultivated field.</p>
0.22	Fence, bears E and W.
37.00	San Pedro River, course N 35° W.
40.08	<p>Point for the 1/4 sec. cor. of secs. 21 and 22, at proportionate distance; there is no remaining evidence of the original cor. Set a stainless steel post, 28 ins. long, 2 1/2 ins. diam., 22 ins. in the ground, over a steel fence post driven into the ground, with brass cap mkd.</p>
	<p style="text-align: center;">T23S R22E 1/4 S21 S22 1987</p>
	from which
	<p>A local monument, a rebar, 5/8 in. diam., 20 ins. below ground, with the remains of a corroded aluminum cap attached, bears S 45° W, 6 1/2 lks. dist., set by Tony A. Blanton, Registered Land Surveyor No. 1047, Arizona, in 1967. This position was reestablished using improper procedures and is not utilized in the course of this resurvey.</p>
	<p>A witness corner to the local monument, monumented with a rebar 5/8 in. diam., firmly set, flush with the ground, bears S 88 3/4° E, 1.84 chs. dist., with an aluminum cap, 1 1/2 ins. diam., mkd. LS 1047 1/4 21 22 123.4 and an arrow. The witness cor. is located adjacent to a cor. of fences extending N and E, a steel fence post is set alongside.</p>
	and from which new bearing trees
	<p>A willow, 7 ins. diam., bears S 44 3/4° E, 75 lks. dist., mkd. 1/4 S22 BT</p>

Dependent Resurvey of a Portion the Subdivisional Lines,
T 23 S, R 22 E, Gila and Salt River Mer., Arizona

CHAINS	<p>A cottonwood, 10 ins. diam., bears N 17 1/2° W, 1.12 chs. dist., mkd. 1/4 S21 BT</p> <p>Deposit a magnet in a 1 x 1 x 2 5/8 in. white colored plastic case beneath the stainless steel post.</p> <p>Set a steel fence post alongside the cor.</p> <p>The cor. is located E, 1 ch. dist., from the San Pedro River, 30 lks. wide, course N 15° W.</p> <p>53.00 San Pedro River, course N 30° E.</p> <p>60.12 Point for the N 1/16 sec. cor. of secs. 21 and 22.</p> <p>Set a stainless steel post, 28 ins. long, 2 1/2 ins. diam., 22 ins. in the ground, with brass cap mkd.</p> <p style="text-align: center;">T23S R22E N1/16 S21 S22 1987</p> <p>Deposit a magnet in a 1 x 1 x 2 5/8 in. white colored plastic case beneath the stainless steel post.</p> <p>Set a steel fence post alongside the cor.</p> <p>The cor. is located W, 3 lks. dist. from a fence, bears N and S.</p> <p>80.16 Point for the cor. of secs. 15, 16, 21, and 22, at proportionate dist.; there is no remaining evidence of the original cor.</p> <p>Set a stainless steel post, 28 ins. long, 2 1/2 ins. diam., 22 ins. in the ground, with brass cap mkd.</p> <p style="text-align: center;">T23S R22E S16 S15 S21 S22 1987</p> <p>from which</p>
--------	---

Dependent Resurvey of a Portion the Subdivisional Lines,
T 23 S, R 22 E, Gila and Salt River Mer., Arizona

CHAINS	
	<p>A local monument, a rebar, 5/8 in. diam., firmly set, flush with the ground, bears S 6° W, 2.2 lks. dist., with an aluminum cap, 1 1/2 ins. diam., marked LS 1047 15 16 21 22, set by Tony A. Blanton, Registered Land Surveyor No. 1047, Arizona, in 1967. This position was reestablished using improper procedures and is not utilized in the course of this resurvey.</p> <p>A fence cor. bears S 6° W, 3 lks. dist., fences extend E,S, and W.</p> <p>Deposit a magnet in a 1 x 1 x 2 5/8 in. white colored plastic case beneath the stainless steel post.</p> <p>Raise a mound of stone, 2 1/2 ft. base, 1 1/2 ft. high, W of cor.</p> <hr/> <p>From the cor. of secs. 14, 15, 22, and 23.</p> <p>N 89°59' W, bet. secs. 15 and 22.</p> <p>Desc. gradually over rolling land.</p>
23.05	<p>A local property cor. bears S, 0.3 lk. dist., monumented with a rebar, 1/2 in. diam., firmly set, flush with the ground, with an aluminum cap, 1 1/2 ins. diam., mkd. SPRR 3 20, and with a tag mkd. RCE 5896, set by Scott G. Ladd, Registered Civil Engineer No. 5896, Arizona, in 1979. The alignment of this position was determined by using unacceptable control and is not utilized in the course of this survey.</p>
24.60	<p>Southern Pacific Railroad bears S 5° E, and N 5° W.</p>
26.095	<p>A local property cor. bears S, 0.8 lk. dist., monumented with a rebar, 1/2 in. diam., firmly set, flush with the ground, with an aluminum cap, 1 1/2 ins. diam., mkd. RESID 15 RESID 22 SPRR, and with a tag mkd. RCE 5896, set by Scott G. Ladd, Registered Civil Engineer No. 5896, Arizona, in 1979. The alignment of this position was determined by using unacceptable control and is not utilized in the course of this survey.</p>

Dependent Resurvey of a Portion the Subdivisional Lines,
T 23 S, R 22 E, Gila and Salt River Mer., Arizona

CHAINS	
33.40	<p>A local property cor. bears S, 0.8 lk. dist., monumented with a rebar, 1/2 in. diam., firmly set, flush with the ground, with an aluminum cap, 1 1/2 ins. diam., mkd. 15 RESID 22 RESID, set by Scott G. Ladd, Registered Civil Engineer No. 5896, Arizona, in 1979. The alignment of this position was determined by using unacceptable control and is not utilized in the course of this survey.</p>
34.25	<p>Hereford Road, asphalt surfaced, 30 lks. wide, bears S 15° E, and N 15° W</p>
34.98	<p>A local property cor. bears S, 0.7 lk. dist., monumented with a rebar, 1/2 in. diam., firmly set, flush with the ground, with an aluminum cap, 1 1/2 ins. diam., mkd. 7, and with a tag mkd. RCE 5896, set by Scott G. Ladd, Registered Civil Engineer No. 5896, Arizona, in 1981. The alignment of this position was determined by using unacceptable control and is not utilized in the course of this survey.</p>
	<p>Continue gradual descent over cultivated land.</p>
40.22	<p>Point for the 1/4 sec. cor. of secs. 15 and 22, at proportionate dist.; there is no remaining evidence of the original cor.</p> <p>Set a stainless steel post, 28 ins. long, 2 1/2 ins. diam., 22 ins. in the ground, with brass cap mkd.</p>
	<p style="text-align: center;">T23S R22E 1/4 $\frac{S15}{S22}$ 1987</p>
	<p>from which</p>
	<p>A local monument, a rebar, 5/8 in. diam., 17 ins. long, laying horizontally 10 ins. below the ground, bears S 65° W, 1 lk. dist., position disturbed during fence construction, with aluminum cap, 1 1/2 ins. diam., mkd. LS 1047 1/4 15 22, set by Tony A. Blanton, Registered Land Surveyor No. 1047, Arizona, in 1967.</p>
	<p>A cor. of fences extending N, E, S, and W, bears S 70° W, 6 lks. dist.</p>

Dependent Resurvey of a Portion the Subdivisional Lines,
T 23 S, R 22 E, Gila and Salt River Mer., Arizona

CHAINS	
	Deposit a magnet in a 1 x 1 x 2 5/8 in. white colored plastic case beneath the stainless steel post.
	Set a steel fence post alongside the cor.
71.30	San Pedro River, 100 lks. wide, course N 30° E., asc. gradually.
80.44	The cor. of secs. 15, 16, 21, and 22.
	N 0°01' W, bet. secs. 15 and 16.
	Over nearly level, cultivated land.
38.865	A local reference monument, an open ended iron pipe, 2 1/2 ins. diam., firmly set, projecting 4 ins. above ground, with a 2 x 2 ins. wood hub inside, with a washer mkd. RCE 5896.
38.945	Point for AP 4, lot 5, sec. 16, hereinafter described.
40.08	True point for the 1/4 sec. cor. of secs. 15 and 16, at proportionate distance; there is no remaining evidence of the original cor. The cor. point falls in a pond, not suitable for monumentation.
	from which
	<p>A local witness cor., bears N 1/2° E, 31 lks. dist., monumented with a rebar, 5/8 in. diam., firmly set, flush with the ground, with an aluminum cap 1 1/2 ins. diam., mkd. LS 1047 1/4 15 16 20. and an arrow, set by Tony A. Blanton, Registered Land Surveyor No. 1047, Arizona, in 1967. This monument witnesses a position that was reestablished using improper procedures and is not utilized in the course of this resurvey. A local reference monument, an open ended iron pipe, 2 1/2 ins. diam., firmly set, projecting 3 ins. above ground, with a 2 x 2 ins. wood hub inside, is set alongside the rebar.</p>
	<p>A cor. of fences bears S 23° W, 1.22 chs. dist., fences extend N and E.</p>

Dependent Resurvey of a Portion the Subdivisional Lines,
T 23 S, R 22 E, Gila and Salt River Mer., Arizona

CHAINS	
	<p>From this point, the point selected for the witness corner to the 1/4 sec. cor. of secs. 15 and 16, bears S 17 1/2° W, 1.035 chs. dist.</p> <p>Set a stainless steel post, 28 ins. long, 2 1/2 ins. diam., 24 ins. in the ground, with brass cap mkd.</p> <div style="text-align: center;"> <p>W C T23S R22E 1/4 S16 S15 1987</p>  </div> <p>Deposit a magnet in a 1 x 1 x 2 5/8 in. white colored plastic case beneath the stainless steel post.</p> <p>Set a steel fence post alongside the witness cor.</p> <p>The witness cor. is located on the SW cor. of the dike of the pond.</p> <hr style="width: 20%; margin: 10px auto;"/>
<p>0.30</p>	<p>North, beginning new measurement.</p> <p>Leave pond, continue over nearly level land, through an orchard.</p>
<p>10.70</p>	<p>Fence, bears E and W for 63 lks. to a fence cor. from which fences extend N, S and E; leave orchard.</p>
<p>11.47</p>	<p>The closing cor. of secs. 15 and 16, on the S bdy, of the San Rafael del Valle Land Grant, hereinbefore described.</p> <p>From this cor., the 13 mile cor. of the San Rafael del Valle Land Grant, bears S 76°32' W, 7 lks. dist. hereinbefore described.</p> <hr/>
<p>0.29</p>	<p>From the cor. of secs. 21, 22, 27, and 28.</p> <p>S 89°55' W, bet. secs. 21 and 28.</p> <p>Over nearly level land, along a fence, bears E and W.</p> <p>Fence, bears N and S.</p>

Dependent Resurvey of a Portion the Subdivisional Lines,
T 23 S, R 22 E, Gila and Salt River Mer., Arizona

CHAINS	
40.25	<p>The 1/4 sec. cor. of secs. 21 and 28, monumented with the remnants of a redwood post, 4 ins. square, 12 ins. long, 12 ins. below the ground, with a rebar, 5/8 in. diam., 12 ins. long driven into the center of the post, set by Richard D. Riddell, Registered Land Surveyor No. 5015, Arizona, in 1963.</p> <p>At the cor. point</p> <p>Set a stainless steel post, 28 ins. long, 2 1/2 ins. diam., 40 ins. in the ground, with brass cap mkd.</p> <p style="text-align: center;">T23S R22E 1/4 <u>S21</u> <u>S28</u> 1987</p> <p>from which</p> <p>An aluminum post, 3/4 ins. diam., 36 ins. long, set 32 ins. in the ground, for a reference monument, bears N 1/2° E, 50.0 ft. dist., with aluminum cap mkd. RM T23S R22E 1/4 S21 50.0 FT. TO COR 1987 and an arrow pointing to the cor. Set a steel fence post alongside the RM. The RM is located in a fence, bears N and S.</p> <p>An aluminum post, 3/4 ins. diam., 36 ins. long, set 32 ins. in the ground, for a reference monument, bears N 85 3/4° E, 50.0 ft. dist., with aluminum cap mkd. RM T23S R22E 1/4 S21 50.0 FT. TO COR 1987 and an arrow pointing to the cor. Set a steel fence post alongside the RM. The RM is located in a fence, bears E and W..</p> <p>A fence cor. bears S 44 1/4° E, 72 lks. dist., fences extend S and E.</p> <p>A fence cor. bears S 1 1/4° W, 88 lks. dist., fences extend S and W.</p> <p>A power pole bears S 5 1/4° W, 85 lks. dist., power lines extend N, S, and W.</p> <p>A fence cor. bears N 5° W, 31 lks. dist., fences extend N, E, and W.</p>

Dependent Resurvey of a Portion the Subdivisional Lines,
T 23 S, R 22 E, Gila and Salt River Mer., Arizona

CHAINS	<p>Deposit a magnet in a 1 x 1 x 2 5/8 in. white colored plastic case beneath the stainless steel post.</p> <p>Deposit the original post alongside the stainless steel post.</p> <p>Deposit the rebar inside the stainless steel post.</p> <p>The cor. is located N, 23 lks. dist. from the N edge of Water Road, graded dirt surfaced, 100 lks. wide, bears E and W, and aligns with the W edge of Williams Road, dirt surfaced, 40 lks. wide, extends S.</p> <hr style="width: 20%; margin: 10px auto;"/> <p>S 89°59' W, beginning new measurement.</p> <p>Asc. gradually, over gently rolling land, along the N edge of Water Road.</p>								
40.12	<p>The cor. of secs. 20, 21, 28, and 29, monumented with a fragment of redwood found 48 ins. below the present road surface.</p> <p>At the cor. point</p> <p>Set a stainless steel post, 28 ins. long, 2 1/2 ins. diam., 31 ins. in the ground, with brass cap mkd.</p> <div style="text-align: center; margin: 10px 0;"> <table style="margin: 0 auto; border-collapse: collapse;"> <tr> <td colspan="2">T23S R22E</td> </tr> <tr> <td style="border-right: 1px solid black; padding: 2px 5px;">S20</td> <td style="padding: 2px 5px;">S21</td> </tr> <tr> <td style="border-right: 1px solid black; padding: 2px 5px;">S29</td> <td style="padding: 2px 5px;">S28</td> </tr> <tr> <td colspan="2" style="text-align: center; padding: 2px 5px;">1987</td> </tr> </table> </div> <p>from which</p> <p style="margin-left: 40px;">A local monument, a rebar, 1/2 in. diam., set flush with the ground, bears S 43° E, 21 lks. dist., with an illegible plastic cap. This monument was set by persons unknown, and is not utilized in the course of this survey.</p> <p style="margin-left: 40px;">A local monument, a rebar, 5/8 in. diam., set flush with the ground, bears S 63 3/4° W, 13 lks. dist. This monument was set by persons unknown, and is not utilized in the course of this survey.</p> <p style="margin-left: 40px;">A magnet in a 1 x 1 x 2 5/8 in. pink colored plastic case, buried 18 ins. below ground, for a reference monument bears N 29 1/2° E, 1.28 chs. dist.</p>	T23S R22E		S20	S21	S29	S28	1987	
T23S R22E									
S20	S21								
S29	S28								
1987									

Dependent Resurvey of a Portion the Subdivisional Lines,
T 23 S, R 22 E, Gila and Salt River Mer., Arizona

CHAINS	
	<p>A magnet in a 1 x 1 x 2 5/8 in. blue colored plastic case, buried 24 ins. below ground, for a reference monument bears S 52° E, 1.45 chs. dist.</p> <p>An aluminum post, 3/4 in. diam., 36 ins. long, set 30 ins. in the ground, for a reference monument, bears S 52 1/4° W, 80.2 ft. dist., with aluminum cap mkd. RM T23S R22E S29 80.2 FT. TO COR 1987 and an arrow pointing to the cor. Set a steel fence post alongside the RM. The RM is located N, 1 lk. dist. from a fence, bears E and W.</p> <p>An aluminum post, 3/4 in. diam., 36 ins. long, set 30 ins. in the ground, for a reference monument, bears N 18° W, 93.3 ft. dist., with aluminum cap mkd. RM T23S R22E S20 93.3 FT. TO COR 1987 and an arrow pointing to the cor. Set a steel fence post alongside the RM. The RM is located W, 1 lk. dist. from a fence, bears N and S.</p> <p>The intersection of Palominas Road, bears N and S, and Water Road, extends E, bears S 3 3/4° E, 55 lks. dist.</p> <p>Deposit a magnet in a 1 x 1 x 2 5/8 in. white colored plastic case beneath the stainless steel post.</p> <p>The cor. is located W, 5 lks. dist., from the center of Palominas Road, chip seal surfaced, 36 lks. wide, bears N and S.</p> <hr/> <p>N 0°09' E, bet. secs. 20 and 21.</p> <p>Over nearly level land, along Palominas Road.</p>
40.07	<p>Point for the 1/4 sec. cor. of secs. 20 and 21, at proportionate dist.; there is no remaining evidence of the original cor.</p> <p>Set a stainless steel post, 28 ins. long, 2 1/2 ins. diam., 32 ins. in the ground, with brass cap mkd.</p>

Dependent Resurvey of a Portion the Subdivisional Lines,
T 23 S, R 22 E, Gila and Salt River Mer., Arizona

CHAINS	<p style="text-align: center;">T23S R22E 1/4 S20 S21 1987</p> <p>from which</p> <p style="padding-left: 40px;">An aluminum post, 3/4 in. diam., 36 ins. long, set 30 ins. in the ground, for a reference monument, bears S 76 1/4° E, 38.1 ft. dist., with aluminum cap mkd. RM T23S R22E 1/4 S21 38.1 FT. TO COR 1987 and an arrow pointing to the cor.</p> <p style="padding-left: 40px;">An aluminum post, 3/4 in. diam., 36 ins. long, set 30 ins. in the ground, for a reference monument, bears S 27° W, 73.3 ft. dist., with aluminum cap mkd. RM T23S R22E 1/4 S20 73.3 FT. TO COR 1987 and an arrow pointing to the cor.</p> <p>Deposit a magnet in a 1 x 1 x 2 5/8 in. white colored plastic case beneath the stainless steel post.</p> <p>The cor. is located E, 2 lks. dist. from the center of Palominas Road.</p> <p>80.14 The cor. of secs. 16, 17, 20, and 21, monumented with a rebar, 1/2 in. diam., 12 ins. long, firmly set, 8 ins. below the road surface, set by persons unknown. This position is harmoniously related to existing original cors., has long been recognized as the cor. by adjacent landowners, and is accepted as the best available evidence of the original corner position.</p> <p>Set a stainless steel post, 28 ins. long, 2 1/2 ins. diam., 32 ins. in the ground, with brass cap mkd.</p> <p style="text-align: center;">T23S R22E S17 S16 S20 S21 1987</p>
--------	--

Dependent Resurvey of a Portion the Subdivisional Lines,
T 23 S, R 22 E, Gila and Salt River Mer., Arizona

CHAINS	<p>from which</p> <p>A magnet in a 1 x 1 x 2 5/8 in. pink colored plastic case, buried 24 ins. below ground, for a reference monument, bears N 39 1/2° E, 1.045 chs. dist.</p> <p>A magnet in a 1 x 1 x 2 5/8 in. blue colored plastic case, buried 24 ins. below ground, for a reference monument, bears S 27 1/4° E, 1.145 chs. dist.</p> <p>A magnet in a 1 x 1 x 2 5/8 in. grey colored plastic case, buried 24 ins. below ground, for a reference monument, bears S 23 3/4° W, 1.50 chs. dist.</p> <p>A magnet in a 1 x 1 x 2 5/8 in. orange colored plastic case, buried 18 ins. below ground, for a reference monument bears, N 30° W, 1.38 chs. dist.</p> <p>Deposit a magnet in a 1 x 1 x 2 5/8 in. white colored plastic case beneath the stainless steel post.</p> <p>Deposit the rebar inside the stainless steel post.</p> <p>The cor. is located on the E edge of the chip seal surface of Palominas Road.</p> <hr/> <p>From the cor. of secs. 15, 16, 21, and 22.</p> <p>S 89°56' W, bet. secs. 16 and 21.</p> <p>Over nearly level, cultivated land, along a fence, bears E and W.</p> <p>20.09 Point for the E 1/16 sec. cor. of secs. 16 and 21.</p> <p>Set a stainless steel post, 28 ins. long, 2 1/2 ins. diam., 22 ins. in the ground, with brass cap mkd.</p> <p style="text-align: center;">T23S R22E E 1/16 <u>S16</u> S21 1987</p>
--------	--

Dependent Resurvey of a Portion the Subdivisional Lines,
T 23 S, R 22 E, Gila and Salt River Mer., Arizona

CHAINS	
	<p>Deposit a magnet in a 1 x 1 x 2 5/8 in. white colored plastic case beneath the stainless steel post.</p> <p>Set a steel fence post alongside the cor.</p> <p>The cor. is located S, 3 lks. dist. from a fence, bears E and W.</p> <p>From this cor., a well bears S 14°23' E, 13.12 chs. dist.</p>
31.84	<p>Point for cor. 2, Parcel A, identical with cor. 1, Parcel B, hereinafter described.</p> <p>Leave cultivated area, enter mesquite and creosote brush, ascending along a fence, bears E and W.</p>
40.18	<p>Point for the 1/4 sec. cor. of secs. 16 and 21, at proportionate distance; there is no remaining evidence of the original cor.</p> <p>Set a stainless steel post, 28 ins. long, 2 1/2 ins. diam., 22 ins. in the ground, with brass cap mkd.</p> <p style="text-align: center;">T23S R22E 1/4 $\frac{S16}{S21}$ 1987</p> <p>Deposit a magnet in a 1 x 1 x 2 5/8 in. white colored plastic case beneath the stainless steel post.</p> <p>Set a steel fence post alongside the cor.</p> <p>The cor. is located E, 1 lk. dist. from a fence cor., fences extend N, E, and S.</p> <p>End ascent, continue over nearly level land.</p>
80.36	<p>The cor. of secs. 16, 17, 20, and 21.</p> <hr/> <p>N 0°03' E, bet. secs. 16 and 17.</p> <p>Over nearly level land, along Palominas Road.</p>

Dependent Resurvey of a Portion the Subdivisional Lines,
T 23 S, R 22 E, Gila and Salt River Mer., Arizona

CHAINS	
32.43	<p>The closing cor. of secs. 16 and 17, hereinbefore described.</p> <p>From this cor., the 14th mile cor. of the San Rafael del Valle Land Grant, hereinbefore described, bears N 76°32' E, 2.17 chs. dist.</p> <hr/> <p style="text-align: center;">Survey of Subdivisions in Section 16, T 23 S, R 22 E, Gila and Salt River Mer., Arizona</p> <hr/> <p>From the 1/4 sec. cor. of secs. 16 and 21.</p> <p>N 0°01' E, on a mean bearing, on the N and S center line of sec. 16.</p> <p>Over nearly level land, through moderate mesquite and creosote brush.</p>
41.99	<p>Point for the 1/4 sec. cor. of sec. 16 only, at intersection with the S bdy. of the San Rafael del Valle Land Grant.</p> <p>Set a stainless steel post, 28 ins. long, 2 1/2 ins. diam., 23 ins. in the ground, with brass cap mkd.</p> <p style="text-align: center;">SRDV 1/4 S16 T23S R22E 1987</p> <p>Deposit a magnet in a 1 x 1 x 2 5/8 in. white colored plastic case beneath the stainless steel post.</p> <p>Set a steel fence post alongside the cor.</p> <p>The cor. is located on the E edge of a cultivated field.</p> <p>From this cor., the 13 1/2 mile cor. on the S bdy. of the San Rafael del Valle Land Grant bears N 76°32' E, 1.04 chs. dist., hereinbefore described.</p> <p>From this same cor., a well bears S 6°28' W, 5.59 chs. dist.</p> <hr/>

Metes-and-Bounds Survey of Lot 5, Section 16,
T 23 S, R 22 E, Gila and Salt River Mer., Arizona

CHAINS									
	<p>From AP 1, lot 5, sec. 16, identical with the closing cor. of secs. 15 and 16, hereinbefore described.</p>								
	<p>S 76°32' W, on line 1-2, lot 5, sec. 16, identical with a portion of the S bdy. of the San Rafael del Valle Land Grant.</p>								
0.07	<p>The 13th mile cor. on the S bdy. of the San Rafael del Valle Land Grant, hereinbefore described.</p>								
0.57	<p>Point for AP 2, lot 5, sec. 16.</p>								
	<p>Set a stainless steel post, 28 ins. long, 2 1/2 ins. diam., 25 ins. in the ground, with brass cap mkd.</p>								
	<div style="text-align: center;"> <p style="margin: 0;">SRDV</p> <table style="margin: 0 auto; border-collapse: collapse;"> <tr> <td style="border-right: 1px solid black; padding: 2px;">T23S</td> <td style="padding: 2px;">AP 2</td> </tr> <tr> <td style="border-right: 1px solid black; padding: 2px;">R22E</td> <td style="padding: 2px;">LOT 5</td> </tr> <tr> <td style="border-right: 1px solid black; padding: 2px;">S 16</td> <td style="padding: 2px;">S 16</td> </tr> <tr> <td colspan="2" style="text-align: center; padding: 2px;">1988</td> </tr> </table> </div>	T23S	AP 2	R22E	LOT 5	S 16	S 16	1988	
T23S	AP 2								
R22E	LOT 5								
S 16	S 16								
1988									
	<p>Deposit a magnet in a 1 x 1 x 2 5/8 in. white colored plastic case beneath the stainless steel post.</p>								
	<p>The cor. is located in a fence bearing N and S; and 40 lks. E of a dirt road, 20 lks. wide, bearing S 12° E and N 38° W.</p>								
	<hr style="width: 20%; margin: 0 auto;"/> <p>Thence S 0°18' E, on line 2-3, lot 5, sec. 16, along a fence.</p>								
10.51	<p>Gatepost.</p>								
10.63	<p>Dirt road through gate, 25 lks. wide, bears E and curves to N and S.</p>								
10.76	<p>Gatepost.</p>								
12.48	<p>Point for AP 3, lot 5, sec. 16.</p>								
	<p>Set a stainless steel post, 28 ins. long, 2 1/2 ins. diam., 25 ins. in the ground, with brass cap mkd.</p>								
	<div style="text-align: center;"> <p style="margin: 0;">T23S R22E</p> <table style="margin: 0 auto; border-collapse: collapse;"> <tr> <td style="border-right: 1px solid black; padding: 2px;">S 16</td> <td style="padding: 2px;">LOT 5</td> </tr> <tr> <td style="border-right: 1px solid black; padding: 2px;"></td> <td style="padding: 2px;">S 16</td> </tr> <tr> <td style="border-right: 1px solid black; padding: 2px;"></td> <td style="padding: 2px;">AP 3</td> </tr> <tr> <td colspan="2" style="text-align: center; padding: 2px;">1988</td> </tr> </table> </div>	S 16	LOT 5		S 16		AP 3	1988	
S 16	LOT 5								
	S 16								
	AP 3								
1988									

Metes-and-Bounds Survey of Lot 5, Section 16,
T 23 S, R 22 E, Gila and Salt River Mer., Arizona

CHAINS	<p>Deposit a magnet in a 1 x 1 x 2 5/8 in. white colored plastic case beneath the stainless steel post.</p> <p>The cor. is located alongside a cor. of fences extending N and E; and 15 lks. E of a dirt road bearing N and curving E; and 10 lks. N of the same road</p> <hr style="width: 20%; margin: 10px auto;"/> <p>Thence N 89°20' E, on line 3-4, lot 5, sec. 16, along a fence.</p>								
0.49	<p>Point for AP 4, lot 5, sec. 16.</p> <p style="padding-left: 40px;">Set a stainless steel post, 28 ins. long, 2 1/2 ins. diam., 26 ins. in the ground, with brass cap mkd.</p> <div style="text-align: center; margin: 10px 0;"> <p>T23S R22E</p> <table style="margin: auto; border-collapse: collapse;"> <tr> <td style="border-right: 1px solid black; padding: 2px 5px;">S 16</td> <td style="padding: 2px 5px;"></td> </tr> <tr> <td style="border-right: 1px solid black; padding: 2px 5px;">LOT 5</td> <td style="padding: 2px 5px;"></td> </tr> <tr> <td style="border-right: 1px solid black; padding: 2px 5px;">AP 4</td> <td style="padding: 2px 5px;"></td> </tr> <tr> <td style="border-right: 1px solid black; padding: 2px 5px;">S 16</td> <td style="padding: 2px 5px;">S 15</td> </tr> </table> <p>1988</p> </div> <p>Deposit a magnet in a 1 x 1 x 2 5/8 in. white colored plastic case beneath the stainless steel post.</p> <p>The cor. is located in a fence bearing E and W; and 10 lks. N of a dirt road, 20 lks. wide, bears E and W.</p> <hr style="width: 20%; margin: 10px auto;"/> <p>Thence N 0°01' W, on line 4-5, lot 5, sec. 16, identical with a portion of the line bet. secs. 15 and 16.</p>	S 16		LOT 5		AP 4		S 16	S 15
S 16									
LOT 5									
AP 4									
S 16	S 15								
0.15	<p>Enter pond.</p>								
1.135	<p>Point for AP 5, lot 5, sec. 16, identical with the true point for the 1/4 sec. cor of secs. 15 and 16.</p> <hr style="width: 20%; margin: 10px auto;"/> <p>Thence North, on line 5-1, lot 5, sec. 16, identical with a portion of the line bet. secs. 15 and 16.</p>								
0.20	<p>Leave pond.</p>								

Metes-and-Bounds Survey of Lot 5, Section 16,
T 23 S, R 22 E, Gila and Salt River Mer., Arizona

CHAINS	
1.85	Dirt road, 25 lks. wide, bears E and W.
10.70	Fence, bears E and W; a gate extends W.
11.47	AP 1, lot 5, sec. 16, identical with the closing cor. of secs. 15 and 16, on the S bdy. of the San Rafael del Valle Land Grant.
<hr/> <p>Metes-and-Bounds Survey In the San Rafael del Valle Land Grant, T 23 S, R 22 E, Gila and Salt River Mer., Arizona</p> <hr/>	
<p>NOTE: This line represents the current boundary of land acquired for the San Pedro Riparian Management Area (SPRMA).</p>	
<hr/> <p>From the 1/4 sec. cor. of sec. 16 only, T 23 S, R 22 E, on the S bdy. of the San Rafael del Valle Land Grant.</p>	
<p>N 0°01' E, on the prolongation of the N and S center line of sec. 16.</p>	
18.42	<p>Point for a witness point, intervisible between cors. along line.</p> <p>Set an aluminum post, 3/4 in. diam., 36 ins. long, 30 ins. in the ground, with aluminum cap mkd.</p>
<p>Set a steel fence post alongside the cor.</p>	
41.44	<p>Point for a witness point, at intersection with the fence S of Hereford Road.</p> <p>Set a stainless steel post, 28 ins. long, 2 1/2 ins. diam., 22 ins. in the ground, with brass cap mkd.</p>

Metes-and-Bounds Survey
 In the San Rafael del Valle Land Grant,
 T 23 S, R 22 E, Gila and Salt River Mer., Arizona

CHAINS	
	<div style="text-align: center;"> <p>WP SRV SPRMA 1987</p> </div> <p>Deposit a magnet in a 1 x 1 x 2 5/8 in. white colored plastic case beneath the stainless steel post.</p> <p>Set a steel fence post alongside the cor.</p> <p>The cor. is located in a fence, bears S 75° E and N 75° W.</p>
43.12	<p>Point for a witness point, at intersection with the center of Hereford Road.</p> <p>Set a stainless steel post, 28 ins. long, 2 1/2 ins. diam., 31 ins. in the ground, with brass cap mkd.</p> <div style="text-align: center;"> <p>WP SRV SPRMA 1987</p> </div> <p>from which</p> <p>A U.S. Coast and Geodetic Survey Bench Mark bears N 73 1/2° W, 6.14 chs. dist., monumented with a standard brass disk, firmly set in a cement block 8 x 8 ins., 8 ins. above the ground, mkd. G 261 ASA 94 1945, a steel fence post is set alongside the Bench Mark.</p> <p>Deposit a magnet in a 1 x 1 x 2 5/8 in. white colored plastic case beneath the stainless steel post.</p> <p>The cor. is located in the center of Hereford Road, asphalt surfaced, 44 lks. wide, bears S 75° E and N 75° W.</p> <hr/>

Survey of Subdivisions in Section 21,
T 23 S, R 22 E, Gila and Salt River Mer., Arizona

CHAINS	
	<p>From the 1/4 sec. cor. of secs. 21 and 28.</p>
	<p>N 0°12' E, on the N and S center line of sec. 21.</p>
40.10	<p>Point for the center 1/4 sec. cor. of sec. 21, at intersection with the E and W center line of section 21.</p>
	<p>Set a stainless steel post, 28 ins. long, 2 1/2 ins. diam., 23 ins. in the ground, with brass cap mkd.</p>
	<p style="text-align: center;">T23S R22E</p>
	<p style="text-align: center;">C 1/4 S21</p>
	<p style="text-align: center;">1987</p>
	<p>Deposit a magnet in a 1 x 1 x 2 5/8 in. white colored plastic case beneath the stainless steel post.</p>
	<p>Set a steel fence post alongside the cor.</p>
	<p>From this cor., a well bears S 11°09' E, 80 1/2 lks. dist.</p>
60.14	<p>Point for the center N 1/16 sec. cor. of sec. 21, identical with cor. 6, Parcel A.</p>
	<p>Set a stainless steel post, 28 ins. long, 2 1/2 ins. diam., 22 ins. in the ground, with brass cap mkd.</p>
	<p style="text-align: center;">T23S R22E</p>
	<p style="text-align: center;">C</p>
	<p style="text-align: center;">N 1/16 S21</p>
	<p style="text-align: center;">C</p>
	<p style="text-align: center;">1987</p>
	<p>Deposit a magnet in a 1 x 1 x 2 5/8 in. white colored plastic case beneath the stainless steel post.</p>
	<p>Set a steel fence post alongside the cor.</p>
	<p>The cor. is located W, 1 lk. dist. from a fence, bears N and S.</p>
72.78	<p>Point for cor. 5, Parcel A, identical with cor. 3, Parcel B, hereinafter described.</p>

Survey of Subdivisions in Section 21,
T 23 S, R 22 E, Gila and Salt River Mer., Arizona

CHAINS	
80.18	The 1/4 sec. cor. of secs. 16 and 21.
	From the 1/4 sec. cor. of secs. 21 and 22.
	S 89°57' W, on the E and W center line of sec. 21.
20.105	Point for the center E 1/16 sec. cor. of sec. 21.
	Set a stainless steel post, 28 ins. long, 2 1/2 ins. diam., 22 ins. in the ground, with brass cap mkd.
	<p style="text-align: center;">T23S R22E E 1/16 C-----C S21 1987</p>
	Deposit a magnet in a 1 x 1 x 2 5/8 in. white colored plastic case beneath the stainless steel post.
	Set a steel fence post alongside the cor.
	The cor. is located N, 40 lks. dist. from a fence, bears E and W.
	From this cor., a well bears N 75°51' W, 9.86 chs. dist.
40.21	The center 1/4 sec. cor. of sec. 21.
80.36	The 1/4 sec. cor of secs. 20 and 21.
	<p style="text-align: center;">NE 1/4 of Section 21.</p> <hr style="width: 20%; margin: auto;"/>
	From the center E 1/16 sec. cor of sec. 21.
	N 0°10' E, on the N and S center line of the NE 1/4 of sec. 21.
20.04	Point for the NE 1/16 sec. cor. of sec. 21, at intersection with the E and W center line of the NE 1/4 of sec. 21.

Survey of Subdivisions in Section 21,
T 23 S, R 22 E, Gila and Salt River Mer., Arizona

CHAINS	
	<p>Set a stainless steel post, 28 ins. long, 2 1/2 ins. diam., 23 ins. in the ground, with brass cap mkd.</p> <p style="text-align: center;">T23S R22E NE 1/16 S21 1987</p> <p>Deposit a magnet in a 1 x 1 x 2 5/8 in. white colored plastic case beneath the stainless steel post.</p> <p>Set a steel fence post alongside the cor.</p>
40.08	<p>The E 1/16 sec. cor. of secs. 16 and 21.</p> <hr style="width: 20%; margin: 10px auto;"/> <p>From the N 1/16 sec. cor. of secs. 21 and 22.</p> <p>S 89°56' W, on the E and W center line of the NE 1/4 of sec. 21.</p>
20.10	<p>The NE 1/16 sec. cor. of sec. 21, identical with cor. 7, Parcel A.</p>
40.20	<p>The center N 1/16 sec. cor. of sec. 21, identical with cor. 6, Parcel A.</p>
	<hr/> <p>Metes-and-Bounds Survey of Parcel A, Sec. 21, T 23 S, R 22 E, Gila and Salt River Mer., Arizona</p> <hr/>
	<p>From cor. 1, Parcel A, identical with the E 1/16 sec. cor. of secs., 16 and 21.</p> <p>S 89°56' W, on line 1-2, Parcel A, identical with a portion of the line between secs. 16 and 21.</p>
11.75	<p>Point for cor. 2, Parcel A, identical with cor. 1, Parcel B.</p> <p>Set a stainless steel post, 28 ins. long, 2 1/2 ins. diam., 24 ins. in the ground, with brass cap mkd.</p> <p style="text-align: center;">T23S R22E S16 COR 1 COR 2 PARCEL B PARCEL A S21 1987</p>

Metes-and-Bounds Survey of Parcel A, Sec. 21,
T 23 S, R 22 E, Gila and Salt River Mer., Arizona

CHAINS	<p>Deposit a magnet in a 1 x 1 x 2 5/8 in. white colored plastic case beneath the stainless steel post.</p> <p>Set a steel fence post alongside the cor.</p> <p>The cor. is located S, 1 1/2 lks. dist., from a fence, bears E and W.</p> <hr style="width: 20%; margin: 10px auto;"/> <p>Thence S 0°12' W, on line 2-3, Parcel A.</p>
5.87	<p>Point for cor. 3, Parcel A, identical with cor. 5, Parcel B.</p> <p>Set a stainless steel post, 28 ins. long, 2 1/2 ins. diam., 22 ins. in the ground, with brass cap mkd.</p> <div style="text-align: center; margin: 10px 0;"> <p>T23S R22E S21 COR 5 COR 3 PARCEL B PARCEL A 1987</p> </div> <p>Deposit a magnet in a 1 x 1 x 2 5/8 in. white colored plastic case beneath the stainless steel post.</p> <p>Set a steel fence post alongside the cor.</p> <p>The cor. is located W, 3 lks. dist., from a fence cor., fences extend E and S.</p> <hr style="width: 20%; margin: 10px auto;"/> <p>Thence S 45°04' W, on line 3-4, Parcel A.</p>
2.17	<p>Point for cor. 4, Parcel A, identical with cor. 4, Parcel B.</p> <p>Set a stainless steel post, 28 ins. long, 2 1/2 ins. diam., 23 ins. in the ground, with brass cap mkd.</p> <div style="text-align: center; margin: 10px 0;"> <p>T23S R22E S21 COR 4 PARCEL B / COR 4 PARCEL A 1987</p> </div>

Metes-and-Bounds Survey of Parcel A, Sec. 21,
T 23 S, R 22 E, Gila and Salt River Mer., Arizona

CHAINS	
	<p>Deposit a magnet in a 1 x 1 x 2 5/8 in. white colored plastic case beneath the stainless steel post.</p> <p>Set a steel fence post alongside the cor.</p> <hr/> <p>Thence S 89°56' W, on line 4-5, Parcel A.</p>
6.81	<p>Point for cor. 5, Parcel A, identical with cor. 3, Parcel B.</p> <p>Set a stainless steel post, 28 ins. long, 2 1/2 ins. diam., 22 ins. in the ground, with brass cap mkd.</p> <div style="text-align: center;"> <p>T23S R22E</p> <p>C</p> <p> </p> <p>COR 3</p> <p><u>PARCEL B</u></p> <p>S21 COR 5</p> <p> PARCEL A</p> <p>C</p> <p>1987</p> </div> <p>Deposit a magnet in a 1 x 1 x 2 5/8 in. white colored plastic case beneath the stainless steel post.</p> <p>Set a steel fence post alongside the cor.</p> <p>The cor. is located E, 2 lks. dist., from a fence, bears N and S.</p> <hr/> <p>Thence S 0°12' W, on line 5-6, Parcel A, identical with a portion of the N and S center line of sec. 21.</p>
12.64	<p>Cor. 6, Parcel A, identical with the center N 1/16 sec. cor. of sec. 21.</p> <hr/> <p>Thence N 89°56' E, on line 6-7, Parcel A, identical with a portion of the E and W center line of the NE 1/4 of sec. 21.</p>
20.10	<p>Cor. 7, Parcel A, identical with the NE 1/16 sec. cor. of sec. 21.</p> <hr/>

Metes-and-Bounds Survey of Parcel A, Sec. 21,
T 23 S, R 22 E, Gila and Salt River Mer., Arizona

CHAINS	<p>Thence N 0°10' E, on line 7-1, Parcel A, identical with a portion of the N and S center line of the NE 1/4 of sec. 21.</p>
20.04	<p>Cor. 1, Parcel A, identical with the E 1/16 sec. cor of sec. 21.</p> <hr/> <p style="text-align: center;">Metes-and-Bounds Survey of Parcel B, Sec. 21, T 23 S, R 22 E, Gila and Salt River Mer., Arizona</p> <hr/> <p>From cor. 1, Parcel B, identical with cor. 2, Parcel A.</p> <p>S 89°56' W, on line 1-2, Parcel B, identical with a portion of the line bet. secs. 16 and 21.</p>
8.34	<p>Cor. 2, Parcel B, identical with the 1/4 sec. cor. of secs. 16 and 21.</p> <hr/> <p>Thence S 0°12' W, on line 2-3, Parcel B, identical with a portion of the N and S center line of sec. 21.</p>
7.40	<p>Cor. 3, Parcel B, identical with cor. 5, Parcel A.</p> <hr/> <p>Thence N 89°56' E, on line 3-4, Parcel B, identical with line 5-4, Parcel A.</p>
6.81	<p>Cor. 4, Parcel B, identical with cor. 4, Parcel A.</p> <hr/> <p>Thence N 45°04' E, on line 4-5, Parcel B, identical with line 4-3, Parcel A.</p>
2.17	<p>Cor. 5, Parcel B, identical with cor. 3, Parcel A.</p> <hr/> <p>Thence N 0°12' E, on line 5-1, Parcel B, identical with line 3-2, Parcel A.</p>
5.87	<p>Cor. 1, Parcel B, identical with cor. 2, Parcel A.</p> <hr/>

T 23 S, R 22 E, Gila and Salt River Mer., Arizona

CHAINS

GENERAL DESCRIPTION

The area surveyed is about 2 miles north of Palominas, about 13 1/2 air miles southeast of Sierra Vista, and about 12 air miles west of Bisbee, Arizona. Access is provided by Arizona State Highway 92, Hereford Road, Palominas Road, and other dirt and gravel roads.

The elevation ranges from about 4,200 to 4,300 feet above sea level. The terrain drains into the San Pedro River, which flows northerly, in the westerly portions of sections 15 and 22. Sections 16, 21, and the westerly one-half of section 22 are gently rolling pasture or cultivated land, sloping gently into the River. The easterly one-half of section 22 is broken and rolling range land, covered with a moderate growth of mesquite, creosote, and catclaw brush, mixed with native grasses. A dense riparian growth is found along the San Pedro River channel, including large, prominent cottonwood trees.

Residences are sparsely scattered throughout the area surveyed. The area south of the south boundary of section 21 is more densely populated. Several large wells are located near the cultivated lands.

The mean magnetic declination is 12° E, as shown on HEREFORD, ARIZ. quadrangle map, published by U.S. Geological Survey in 1983.

UNITED STATES
 DEPARTMENT OF THE INTERIOR
 BUREAU OF LAND MANAGEMENT

FIELD ASSISTANTS

NAMES	CAPACITY
Robert D. Begley	Land Surveyor (In training)
Luke B. Granger	Surveying Technician
Donald L. Brewer	Surveying Technician
Cheryl A. Baier	Surveying Technician
Wilmer F. Beyl	Surveying Aid
William T. Stafford	Surveying Aid

CERTIFICATE OF SURVEY

I, William P. Carpender, Cadastral Surveyor, HEREBY CERTIFY upon honor that, in pursuance of special instructions bearing date of the 13th day of January, 1987, and supplemental special instructions dated May 15, 1987, July 22, 1987 and January 21, 1988, have dependently resurveyed portions of the south and west boundaries of the San Rafael del Valle Land Grant and portions of the subdivisional lines; surveyed subdivisions in sections 16 and 21, and the metes-and-bounds surveys of lot 5, section 16, Parcels A and B, section 21 and in the San Rafael del Valle Land Grant, of Township 23 South, Range 22 East, of the Gila and Salt River Meridian, in the state of Arizona which are represented in the foregoing field notes as having been executed by me and under my direction; and that said survey has been made in strict conformity with said special instructions, the Manual of Instructions for the Survey of the Public Lands of the United States, and in specific manner described in the foregoing field notes.

SEPT. 27, 1988
(Date)

William P. Carpender
(Cadastral Surveyor)

(Date)

(Cadastral Surveyor)

CERTIFICATE OF APPROVAL

BUREAU OF LAND MANAGEMENT
Arizona State Office
Phoenix, Arizona

The foregoing field notes of the dependent resurvey of portions of the south and west boundaries of the San Rafael del Valle Land Grant and portions of the subdivisional lines; the survey of subdivisions in sections 16 and 21, and the metes-and-bounds surveys of lot 5, section 16, parcels A and B, section 21 and in the San Rafael del Valle Land Grant, of Township 23 South, Range 22 East, Gila and Salt River Meridian, executed by William P. Carpender, Cadastral Surveyor, having been critically examined and found correct, are hereby approved.

OCT 03 1988
(Date)

James P. Healey
(Chief Cadastral Surveyor of Arizona)

~~CERTIFICATE OF TRANSCRIPT~~

~~I Certify that the foregoing transcript of the field notes of the above-described surveys in T 23 S, R 22 E, Gila and Salt River Meridian, Arizona is a true copy of the original field notes.~~

~~(Date)~~

~~(Chief Cadastral Surveyor of Arizona)~~