

ORIGINAL

**UNITED STATES
DEPARTMENT OF THE INTERIOR
BUREAU OF LAND MANAGEMENT**

FIELD NOTES

OF THE

DEPENDENT RESURVEY OF A PORTION OF THE HOPI-NAVAJO PARTITION LINE,

SEGMENT "D",

THE SURVEY OF A PORTION OF THE SOUTH BOUNDARY,

THE SURVEY OF THE EAST AND NORTH BOUNDARIES,

A PORTION OF THE SUBDIVISIONAL LINES,

AND THE SUBDIVISION OF CERTAIN SECTIONS

TOWNSHIP 35 NORTH, RANGE 15 EAST,

OF THE GILA AND SALT RIVER MERIDIAN,

IN THE STATE OF ARIZONA.

EXECUTED BY

Fabian Yazzie, Cadastral Surveyor

Blas J. Urena, Cadastral Surveyor

Under Special Instructions dated June 12, 2014, approved June 12, 2014, which provided for the surveys included under Group No. 1133, and assignment instructions dated June 12, 2014 and May 11, 2015.

Survey commenced July 1, 2014

Survey completed June 6, 2015

INDEX DIAGRAM

TOWNSHIP 35 NORTH RANGE 15 EAST
GILA & SALT RIVER MERIDIAN, ARIZONA

33	32	31	30	29	28	27
6	84 5	71 4	61 3	52 2	42 1	26
83	83	71	60	50	41	
7	82 8	70 9	59 10	49 11	40 12	25
81	80	69	58	48	39	
18	79 17	67 16	57 15	47 14	38 13	24
78	77	66	56	46	38	
19	76 20	65 21	55 22	46 23	37 24	23
75	75	65	55	45	36	
30	74 29	64 28	54 27	44 26	35 25	22
73	72	63	53	43	35	
31	32	62 33	52 34	42 35	34 36	21
			20 19	18	17	16

Portion of the Hopi-Navajo
 Partition Line, Segment "D" Pages 4-16
 Subdivision of Section 1 Pages 84-86
 Subdivision of Section 2 Pages 86-89
 Subdivision of Section 9 Pages 89-90
 Subdivision of Section 10 Pages 90-91
 Subdivision of Section 11 Pages 91-93
 Subdivision of Section 16 Pages 93-95
 Subdivision of Section 17 Pages 95-96
 Subdivision of Section 18 Pages 96-98
 Subdivision of Section 19 Pages 98-99

**Dependent Resurvey of a Portion of
the Hopi-Navajo Partition Line, Segment "D",
T. 35 N., R. 15 E., Gila and Salt River Meridian, Arizona**

CHAINS

The following field notes describe the dependent resurvey of a portion of the Hopi-Navajo Partition Line, Segment "D", the survey of a portion of the south boundary, the survey of the east and north boundaries, a portion of the subdivisional lines, and the subdivision of certain sections, Township 35 North, Range 15 East, Gila and Salt River Meridian, Arizona.

The history of surveys pertaining to this survey is as follows:

Kenneth A. Krenke, Harry S. Pierce, Shirley B. Hjellum, and Jerry L. Wahl, Cadastral Surveyors, surveyed the Hopi-Navajo Partition Line, Segment "D", in 1981. Fabian Yazzie, Cadastral Surveyor, resurveyed portions of the Hopi-Navajo Partition Line, Segment "D", in Township 35 North, Range 14 East, and surveyed a portion of the east boundary of Township 35 North, Range 14 East, and established the corner of Townships 34 and 35 North, Ranges 14 and 15 East, in 2014.

The survey was executed in accordance with the specifications as set forth in the Manual of Instructions for the Survey of the Public Lands of the United States, 2009, and the Special Instructions dated June 12, 2014, for Group Number 1133, Arizona.

The true meridian direction and length of all lines were determined by real time kinematic Global Navigation Satellite System observations using Trimble Navigation R8-3 and R8-4 model receivers.

Preliminary to the resurvey, the lines of the prior surveys were retraced and search was made for all corners and other calls of record. Identified corners were remonumented in their original positions. Lost corners were reestablished and remonumented at proportionate positions based on the official record. The retracement data were thoroughly verified and only the true line field notes are given herein.

Geodetic control was derived from Global Navigation Satellite System (GNSS) static observations post processed by National Geodetic Survey, Online Positioning User Service (OPUS), utilizing Continuously Operating Reference Stations DL1882 AZFL NAU FLAGSTAFF CORS, AI8805 FRED FREDONIA CORS, DK8419 AZPG CITY OF PAGE CORS. The NAD 83 (CORS2011)(EPOCH: 2010.0000), geographic position of the corner of Townships 34 and 35 North, Ranges 15 and 16 East, is as follows:

Latitude: 36°23'22.512" N. Longitude: 110°40'05.868" W.

The geographic position of the corner of Townships 35 and 36 North, Ranges 14 and 15 East, is as follows:

Latitude: 36°28'35.685" N. Longitude: 110°46'33.204" W.

The mean magnetic declination is 10 1/2 ° E.

Dependent Resurvey of a Portion of
the Hopi-Navajo Partition Line, Segment "D",
T. 35 N., R. 15 E., Gila and Salt River Meridian, Arizona

CHAINS

Restoring the survey executed by
Kenneth A. Krenke, Harry S. Pierce, Shirley B. Hjellum,
and Jerry L. Wahl, in 1981

Beginning at the cor. for AP D-202, on the Hopi-Navajo Partition Line, Segment "D", monumented with an iron post, 2 1/2 ins. diam., firmly set, projecting 16 ins. above ground, with brass cap mkd. HOPI NAVAJO AP D-202 1979.

from which the original bearing trees

A juniper, 27 ins. diam., bears S. 28° E., 77 lks. dist., with scribe marks AP D-202 NIR BT visible on partially open blaze. (Record: 81 lks., which equal the slope dist.)

A juniper, 20 ins. diam., bears S. 36° W., 83.5 lks. dist., with scribe marks AP D-202 HIR BT visible on partially open blaze.

Reset the iron post, 28 ins. long, 27 ins. in the ground.

Deposit a magnet, in a white plastic case, at the base of the iron post.

Add the marks 2015 to the brass cap.

The cor. is located in a barbed wire fence, 5 strand, bears S. 2° E. and N. 2° W.

N. 2°09' W., along the line AP D-202 to AP D-203 of the Hopi-Navajo Partition Line, Segment "D".

Over rolling terrain.

0.56 Point for the witness point of secs. 4 and 33, determined, East, from the Tp. cor. of Tps. 34 and 35 N., Rs. 14 and 15 E., hereinafter described, at intersection of the Hopi-Navajo Partition Line, Segment "D" and the S. bdy. of the Tp.

Set a stainless steel post, 28 ins. long, 2 1/2 ins. diam., 27 ins. in the ground, with brass cap mkd.

Dependent Resurvey of a Portion of
the Hopi-Navajo Partition Line, Segment "D",
T. 35 N., R. 15 E., Gila and Salt River Meridian, Arizona

CHAINS

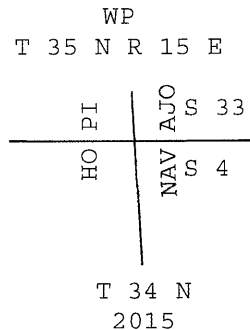

Deposit a magnet, in a white plastic case, at the base of the stainless steel post.

Witness point is located in a barbed wire fence, 5 strand, bears S. 2° E. and N. 2° W., and 18 lks. S. from a top of finger ridge, 20 ft. wide, 50 ft. high, bears N. 85° E. and N. 75° W.

From this witness point, the Tp. cor. of Tps. 34 and 35 N., Rs. 14 and 15 E., bears West, 236.52 chs. dist., monumented with a stainless steel post, 2 1/2 ins. diam., firmly set, projecting 2 ins. above ground, with brass cap mkd. T35N R14E R15E S36 S31 S1 S6 T34N 2014. With a steel fence post nearby.

11.705

The cor. for AP D-203, on the Hopi-Navajo Partition Line, Segment "D", monumented with an iron post, 2 1/2 ins. diam., firmly set, projecting 2 ins. above ground, with brass cap mkd. NAVAJO HOPI AP D-203 1979.

from which the original bearing trees

A piñon, 17 ins. diam., bears N. 41° E., 78.5 lks. dist., with scribe marks AP D-203 NIR BT visible on partially open blaze.

A juniper, 16 ins. diam., bears S. 70° W., 1.49 chs. dist., with scribe marks AP D-203 HIR BT visible on partially open blaze. (Record: 18 ins. diam.).

Add the marks 2015 to the brass cap.

The cor. is located 0.8 lk. N. 72° W. from a fence corner, barbed wire, 5 strand, with fences extending S. 2° E. and S. 87° W.

S. 87°06' W., along line AP D-203 to AP D-204 of the Hopi-Navajo Partition Line, Segment "D".

Over rolling terrain.

Dependent Resurvey of a Portion of
the Hopi-Navajo Partition Line, Segment "D",
T. 35 N., R. 15 E., Gila and Salt River Meridian, Arizona

CHAINS																									
40.00	<p>The cor. for AP D-204, on the Hopi-Navajo Partition Line, Segment "D", monumented with an iron post, 2 1/2 ins. diam., firmly set, projecting 6 ins. above ground, with brass cap mkd. NAVAJO AP D-204 HOPI 1979.</p> <p>from which the original bearing trees</p> <p style="padding-left: 40px;">A juniper, 17 ins. diam., bears N. 15° E., 45.5 lks. dist., with scribe marks AP D-205 NIR BT visible on partially open blaze. (Record: 18 ins. diam., 45 lks., mkd. AP D-204 NIR BT)</p> <p style="padding-left: 40px;">A juniper, 6 ins. diam., bears S. 4° E., 25 lks. dist., with scribe marks AP D-204 HIR BT visible on partially open blaze. (Record: 24.5 lks.)</p> <p>Add the marks 2015 to the brass cap.</p> <p>The cor. is located in a barbed wire fence, bears N. 87° E. and S. 87° W.</p> <hr style="width: 20%; margin: 10px auto;"/> <p>S. 87°04' W., along line AP D-204 to AP D-205 of the Hopi-Navajo Partition Line, Segment "D".</p> <p>Over rolling terrain.</p>																								
36.205	<p>Point for the witness point of secs. 32 and 33, determined, N. 0°03' W., from a point 160 chs. East from the Tp. cor. of Tps. 34 and 35 N., Rs. 14 and 15 E., at intersection with the Hopi-Navajo Partition Line, Segment "D".</p> <p>Set a stainless steel post, 28 ins. long, 2 1/2 ins. diam., 26 ins. in the ground, with brass cap mkd.</p> <div style="text-align: center; margin: 10px 0;"> <table style="border-collapse: collapse; margin: 0 auto;"> <tr><td colspan="4">WP</td></tr> <tr><td>T 35 N</td><td></td><td>R 15 E</td><td></td></tr> <tr><td>S 32</td><td> </td><td>S 33</td><td></td></tr> <tr><td>NAV</td><td> </td><td>AJO</td><td></td></tr> <tr><td colspan="2">-----</td><td colspan="2">-----</td></tr> <tr><td>HO</td><td> </td><td>PI</td><td></td></tr> </table> <p>2015</p> </div> <p>Deposit a magnet, in a white plastic case, at the base of the stainless steel post.</p> <p>The cor. is located 1 lk. S. of a barbed wire fence, 5 strand, bears N. 87° E. and S. 87° W.</p>	WP				T 35 N		R 15 E		S 32		S 33		NAV		AJO		-----		-----		HO		PI	
WP																									
T 35 N		R 15 E																							
S 32		S 33																							
NAV		AJO																							
-----		-----																							
HO		PI																							
37.735	<p>The cor. for AP D-205, on the Hopi-Navajo Partition Line, Segment "D", monumented with an iron post, 2 1/2 ins. diam., firmly set, projecting 14 ins. above ground, in a mound of stone, 3 ft. base, 1/2 ft. high, with brass cap mkd. NAVAJO AP D-205 HOPI 1979.</p>																								

Dependent Resurvey of a Portion of
the Hopi-Navajo Partition Line, Segment "D",
T. 35 N., R. 15 E., Gila and Salt River Meridian, Arizona

CHAINS	
	<p>from which the original bearing trees</p> <p style="padding-left: 40px;">A juniper, 20 ins. diam., bears N. 15° E., 77.5 lks. dist., with scribe marks AP D-205 NIR BT visible on partially open blaze.</p> <p style="padding-left: 40px;">A juniper, 13 ins. diam., bears S. 75° W., 58 lks. dist., with scribe marks AP D-205 HIR BT visible on partially open blaze. (Record: 20 ins. diam.)</p> <p>Rebuilt the mound of stone, 3 ft. base, to top of brass cap.</p> <p>Add the marks 2015 to the brass cap.</p> <p>The cor. is located at the terminus of a barbed wire fence, 5 strand, bears N. 7° W.</p> <hr style="width: 20%; margin: 10px auto;"/> <p>N. 7°02' W., along line AP D-205 to AP D-206 of the Hopi-Navajo Partition Line, Segment "D".</p> <p>Over rolling terrain.</p>
18.10	<p>The cor. for AP D-206, on the Hopi-Navajo Partition Line, Segment "D", monumented with an iron post, 2 1/2 ins. diam., firmly set, projecting 3 ins. above ground, with brass cap mkd. NAVAJO AP D-206 HOPI 1979.</p> <p>from which the original bearing trees</p> <p style="padding-left: 40px;">A juniper, 13 ins. diam., bears N. 35° E., 43 lks. dist., with scribe marks AP D-206 NIR BT visible on partially open blaze.</p> <p style="padding-left: 40px;">A juniper, 20 ins. diam., bears S. 45° W., 37 lks. dist., with scribe marks AP D-206 HIR BT visible on partially open blaze.</p> <p>Add the marks 2015 to the brass cap.</p> <p>The cor. is located in a fence corner, barbed wire fence, 5 strand, with fences extending S. 7° E. and N. 53° W.</p> <hr style="width: 20%; margin: 10px auto;"/> <p>N. 53°26' W., along line AP D-206 to AP D-207 of the Hopi-Navajo Partition Line, Segment "D".</p> <p>Over rolling terrain.</p>
40.41	<p>The cor. for AP D-207, on the Hopi-Navajo Partition Line, Segment "D", monumented with an iron post, 2 1/2 ins. diam., firmly set, projecting 4 ins. above ground, with brass cap mkd. NAVAJO AP D-207 HOPI 19.</p>

Dependent Resurvey of a Portion of
the Hopi-Navajo Partition Line, Segment "D",
T. 35 N., R. 15 E., Gila and Salt River Meridian, Arizona

CHAINS	
	<p>from which the original bearing trees</p> <p style="padding-left: 40px;">A forked juniper, 13 ins. diam., bears N. 48 1/2° E., 54.5 lks. dist., with scribe marks AP D-207 NIR BT visible on partially open blaze. (Record: N. 50° E., 55 lks.)</p> <p style="padding-left: 40px;">A forked juniper, 16 ins. diam., bears S. 1/2° E., 24 lks. dist., with scribe marks AP D-207 HIR BT visible on partially open blaze. (Record: South, 23.5 lks.)</p> <p>Add the marks 2015 to the brass cap.</p> <hr style="width: 20%; margin: 10px auto;"/> <p>N. 53°42' W., along line AP D-207 to AP D-208 of the Hopi-Navajo Partition Line, Segment "D".</p> <p>Over rolling terrain.</p>
9.20	<p>The cor. for AP D-208, on the Hopi-Navajo Partition Line, Segment "D", monumented with an iron post, 2 1/2 ins. diam., firmly set, projecting 9 ins. above ground, with brass cap mkd. AP D-208 NAVAJO HOPI 1979.</p> <p>from which the original bearing trees</p> <p style="padding-left: 40px;">The root crown of a piñon, bears N. 51 1/2° E., 1.32 chs. dist., with a dead and downed piñon alongside, 8 ins. diam., with scribe marks AP D-208 NIR BT visible on partially open blaze. (Record: N. 38° E., 87 lks.)</p> <p style="padding-left: 40px;">A piñon, 7 ins. diam., bears S. 10 3/4° W., 86 lks. dist., with scribe marks AP D208 HIR BT visible on partially open blaze. (Record: S. 28° W., 112 lks.)</p> <p>Add the marks 2015 to the brass cap.</p> <hr style="width: 20%; margin: 10px auto;"/> <p>N. 2°59' W., along line AP D-208 to AP D-209 of the Hopi-Navajo Partition Line, Segment "D".</p> <p>Over rolling terrain.</p>
12.82	<p>The cor. for AP D-209, on the Hopi-Navajo Partition Line, Segment "D", monumented with an iron post, 2 1/2 ins. diam., firmly set, projecting 8 ins. above ground, with brass cap mkd. NAVAJO HOPI AP D-209 1979.</p> <p>from which the original bearing trees</p> <p style="padding-left: 40px;">A forked juniper, 11 ins. diam., bears S. 85 1/2° E., 1.015 chs. dist., with scribe marks AP D-209 NIR BT visible on partially open blaze. (Record: S. 81° E., 102 lks.)</p>

Dependent Resurvey of a Portion of
the Hopi-Navajo Partition Line, Segment "D",
T. 35 N., R. 15 E., Gila and Salt River Meridian, Arizona

<p>CHAINS</p>	<p>A piñon, 8 ins. diam., bears N. 42 3/4° W., 68 lks. dist., with scribe marks AP D-209 HIR BT visible on partially open blaze. (Record: N. 40° W., 67.5 lks.)</p> <p>Add the marks 2015 to brass cap.</p> <p>The brass cap is oriented to the E. and not the N.</p> <p>The cor. is located 3.03 lks. E. of a barbed wire fence, 5 strand, bears S. 2° E. and N. 20° W.</p> <hr/> <p>N. 17°25' W., along line AP D-209 to AP D-210 of the Hopi-Navajo Partition Line, Segment "D".</p> <p>Over rolling terrain.</p> <p>13.12 Point for the witness point of secs. 29 and 32, determined, East, from the cor. of secs. 25, 30, 31, and 36 of Tp. 35 N., Rs. 14 and 15 E., at intersection with the Hopi-Navajo Partition Line, Segment "D".</p> <p>Set a stainless steel post, 28 ins. long, 2 1/2 ins. diam., 25 ins. in the ground, with brass cap mkd.</p> <div data-bbox="730 1050 1023 1365" data-label="Diagram"> </div> <p>Deposit a magnet, in a white plastic case, at the base of the stainless steel post.</p> <p>The cor. is located 1.8 lks. E. of a barbed wire fence, 5 strand, bears S. 20° E. and N. 20° W.</p> <p>From this witness point, the cor. of secs. 25, 30, 31, and 36 of Tp. 35 N., Rs. 14 and 15 E., bears West, 111.77 chs. dist., monumented with a stainless steel post, 2 1/2 ins. diam., firmly set, projecting 3 ins. above ground, with brass cap mkd. T35N R14E R15E S25 S30 S36 S31 2014. With a steel fence post nearby.</p> <p>13.255 The cor. for AP D-210, on the Hopi-Navajo Partition Line, Segment "D", monumented with an iron post, 2 1/2 ins. diam., firmly set, projecting 7 ins. above ground, in concrete cylinder, 12 ins. diam., with brass cap mkd. AP D-210 NAVAJO HOPI 1979. With a steel fence post alongside the cor.</p>
---------------	---

Dependent Resurvey of a Portion of
the Hopi-Navajo Partition Line, Segment "D",
T. 35 N., R. 15 E., Gila and Salt River Meridian, Arizona

CHAINS	
	<p>from which the original bearing trees</p> <p style="padding-left: 40px;">A juniper, 9 ins. diam., bears S. 75° E., 56.5 lks. dist., with scribe marks AP D-210 NIR BT visible on partially open blaze.</p> <p style="padding-left: 40px;">A juniper, 16 ins. diam., bears S. 70° W., 18 lks. dist., with scribe marks AP D-210 HIR BT visible on partially open blaze. (Record: 17.5 lks.)</p> <p>Add the marks 2014 to the brass cap.</p> <p>The cor. is located alongside of a barbed wire fence, 5 strand, bears S. 12° E. and N. 12° W.</p> <hr style="width: 20%; margin: 10px auto;"/> <p>N. 7°06' W., along line AP D-210 to AP D-211 of the Hopi-Navajo Partition Line, Segment "D".</p> <p>Over rolling terrain.</p>
4.37	<p>The cor. for AP D-211, on the Hopi-Navajo Partition Line, Segment "D", monumented with an iron post, 2 1/2 ins. diam., firmly set, projecting 5 ins. above ground, with brass cap mkd. AP D- 211 HOPI NAVAJO 1979. With a steel fence post nearby.</p> <p>from which the original bearing trees</p> <p style="padding-left: 40px;">A juniper, 11 ins. diam., bears N. 80° E., 49 lks. dist., with scribe marks AP D-211 NIR BT visible on partially open blaze. (Record: piñon)</p> <p style="padding-left: 40px;">A juniper, 20 ins. diam., bears S. 7° W., 78 lks. dist., mkd. AP D-211 HIR BT. (Record: S. 10° W.)</p> <p>Add the marks 2014 to the brass cap.</p> <p>The cor. is located alongside of a barbed wire fence, 5 strand, bears S. 5° E. and N. 5° W.</p> <hr style="width: 20%; margin: 10px auto;"/> <p>N. 21°59' E., along line AP D-211 to AP D-212 of the Hopi-Navajo Partition Line, Segment "D".</p> <p>Over rolling terrain.</p>
5.18	<p>The cor. for AP D-212, on the Hopi-Navajo Partition Line, Segment "D", monumented with an iron post, 2 1/2 ins. diam., firmly set, projecting 20 ins. above ground, in a mound of stone, 3 ft. base, 1 ft. high, with brass cap mkd. AP D-212 HOPI NAVAJO 1979. With a steel fence post alongside the cor.</p>

Dependent Resurvey of a Portion of
the Hopi-Navajo Partition Line, Segment "D",
T. 35 N., R. 15 E., Gila and Salt River Meridian, Arizona

CHAINS	
	<p>from which the remaining original bearing tree</p> <p style="padding-left: 40px;">A piñon, 9 ins. diam., bears N. 70° W., 40 lks. dist., with scribe marks AP D 212 HIR BT visible on partially open blaze. (Record: N. 75° W.)</p> <p>Add the marks 2014 to the brass cap.</p> <p>The cor. is located 4 lks. W. of a barbed wire fence, 5 strand, bears N. 30° E. and S. 23° W.</p> <hr style="width: 20%; margin: 10px auto;"/> <p>N. 30°09' E., along line AP D-212 to AP D-213 of the Hopi-Navajo Partition Line, Segment "D".</p> <p>Over rolling terrain.</p>
12.57	<p>The cor. for AP D-213, on the Hopi-Navajo Partition Line, Segment "D", monumented with an iron post, 2 1/2 ins. diam., firmly set, projecting 5 ins. above ground, with brass cap mkd. NAVAJO AP D-213 HOPI 1979. With a steel fence post alongside the cor.</p> <p>from which the original bearing trees</p> <p style="padding-left: 40px;">A juniper, 12 ins. diam., bears S. 17° E., 63.5 lks. dist., with scribe marks AP D-213 NIR BT visible on partially open blaze. (Record: S. 18° E.)</p> <p style="padding-left: 40px;">A juniper, 7 ins. diam., bears S. 64° W., 28 lks. dist., with scribe marks AP D-213 HIR BT visible on partially open blaze. (Record: S. 65° W., 28.5 lks.)</p> <p>Add the marks 2014 to the brass cap.</p> <p>The cor. is located alongside of a fence corner, wooden and barbed wire fence, 5 strand, bears S. 29° W. and N. 32° W.</p> <hr style="width: 20%; margin: 10px auto;"/> <p>N. 32°39' W., along line AP D-213 to AP D-214 of the Hopi-Navajo Partition Line, Segment "D".</p> <p>Over rolling terrain.</p>
16.76	<p>The cor. for AP D-214, on the Hopi-Navajo Partition Line, Segment "D", determined from the original bearing tree</p> <p style="padding-left: 40px;">A juniper, 19 ins. diam., bears S. 12° E., 40.5 lks. dist., with scribe marks AP D-214 HIR BT visible on partially open blaze.</p> <p>At the corner point</p>

Dependent Resurvey of a Portion of
the Hopi-Navajo Partition Line, Segment "D",
T. 35 N., R. 15 E., Gila and Salt River Meridian, Arizona

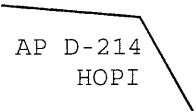
CHAINS	
	<p>Set a stainless steel post, 28 ins. long, 2 1/2 ins. diam., 23 ins. in the ground, with brass cap mkd.</p> <div style="text-align: center;"> <p>T 35 N R 15 E S 29 NAVAJO</p>  <p>AP D-214 HOPI</p> <p>2014</p> </div> <p>Deposit a magnet, in a white plastic case, at the base of the stainless steel post.</p> <p>The cor. is located 2 lks. W. of a barbed wire fence, 5 strand, bears S. 32° E. and N. 32° W.</p> <hr/> <p>N. 86°13' W., along line AP D-214 to AP D-215 of the Hopi-Navajo Partition Line, Segment "D".</p> <p>Over rolling terrain.</p>
5.74	<p>The cor. for AP D-215, on the Hopi-Navajo Partition Line, Segment "D", monumented with an iron post, 2 1/2 ins. diam., firmly set, projecting 12 ins. above ground, in a mound of stone, 3 1/2 ft. base, to top of brass cap mkd. NAVAJO AP D-215 HOPI 1979.</p> <p>from which the original bearing tree</p> <p style="padding-left: 40px;">A juniper, 18 ins. diam., bears S. 12 1/4° E., 66 lks. dist., with scribe marks AP D 215 HIR BT visible on partially open blaze. (Record: S. 8° E.)</p> <p>Add the marks 2014 to the brass cap.</p> <p>There is no fence identifying the boundary.</p> <hr/> <p>S. 74°41' W., along line AP D-215 to AP D-216 of the Hopi-Navajo Partition Line, Segment "D".</p>
24.28	<p>The cor. for AP D-216, on the Hopi-Navajo Partition Line, Segment "D", determined at record distance from the original bearing tree and an embedded collar of stone, 4 ft. diam.</p> <p style="padding-left: 40px;">A piñon, 8 ins. diam., bears S. 22 3/4° W., 90.5 lks. dist., with scribe marks AP D 216 HIR BT visible on partially open blaze. (Record: S. 28° W.)</p> <p>At the corner point</p>

Dependent Resurvey of a Portion of
the Hopi-Navajo Partition Line, Segment "D",
T. 35 N., R. 15 E., Gila and Salt River Meridian, Arizona

CHAINS

Set a stainless steel post, 28 ins. long, 2 1/2 ins. diam., 27 ins. in the ground, with brass cap mkd.

T 35 N R 15 E
NAVAJO
AP D-216
S29

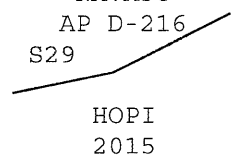

HOPI
2015

Deposit a magnet, in a white plastic case, at the base of the stainless steel post.

Raise a mound of stone, 3 ft. base, 2 1/2 ft. high, 1 lk. North of cor.

There is no fence identifying the boundary.

S. 76°23' W., along line AP D-216 to AP D-217 of the Hopi-Navajo Partition Line, Segment "D".

Over rolling terrain.

1.40 Point for the witness point of secs. 29 and 30, determined, N. 0°03' W., from a point 80 chs. East from the Tp. cor. of Tps. 34 and 35 N., Rs. 14 and 15 E., at intersection with the Hopi-Navajo Partition Line, Segment "D".

Set a stainless steel post, 28 ins. long, 2 1/2 ins. diam., 28 ins. in the ground, with brass cap mkd.

WP
T 35 N R 15 E
S 30 S 29
NAV AJO

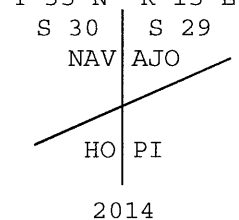

HO PI
2014

Deposit a magnet, in a white plastic case, at the base of the stainless steel post.

Raise a mound of stone, 3 ft. base, 2 1/2 ft. high, 1 lk. North of cor.

The cor. is located 15 lks. E. of a drainage, 2 ft. wide, 1 ft. deep, drains N. 6° W., the E. bank, bears N. 18° E. and S. 18° W.

Dependent Resurvey of a Portion of
the Hopi-Navajo Partition Line, Segment "D",
T. 35 N., R. 15 E., Gila and Salt River Meridian, Arizona

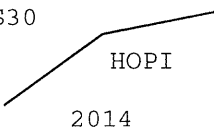
CHAINS	
8.40	<p>The cor. for AP D-217, on the Hopi-Navajo Partition Line, Segment "D", monumented with a drill hole, 1 in. diam., 1 in. deep, with cement at the bottom of the drill hole and part of the stem from the aluminum tablet in the drill hole, in sandstone ridge top.</p> <p>from which the original bearing tree</p> <p style="padding-left: 40px;">A piñon, 5 ins. diam., bears S. 38° E., 19 lks. dist., with scribe marks visible but no legible on partially open blaze. (Record: S. 30° E.)</p> <p>At the corner point, re-drill existing drill hole to 8 ins. deep.</p> <p>Set a brass tablet, 3 1/2 ins. diam., 2 3/8 ins. stem, cemented in a drill hole, in solid sandstone rock, with top mkd.</p> <div style="text-align: center;"> <p>T 35 N R 15 E NAVAJO AP D-217 S30</p>  <p>HOPI</p> <p>2014</p> </div> <p>Deposit a magnet, in a white plastic case, at the base of the brass tablet.</p> <p>The cor. is located 1.5 lks. S. of a sandstone rim, 18 ft. high, bears N. 68° E. and S. 60° W.</p> <p>Unable to locate the steel fence post.</p> <p>There is no fence identifying the boundary.</p> <hr style="width: 20%; margin: 10px auto;"/> <p>S. 56°40' W., along line AP D-217 to AP D-218 of the Hopi-Navajo Partition Line, Segment "D".</p> <p>Over rolling terrain.</p>
15.43	<p>The cor. for AP D-218, on the Hopi-Navajo Partition Line, Segment "D", monumented with an aluminum tablet, 3 1/4 ins. diam., firmly set, flush on top of a sandstone cliff, mkd. NAVAJO AP D-218 HOPI 1979.</p> <p>from which the original bearing tree</p> <p style="padding-left: 40px;">The root crown, size indeterminate, bears S. 49° E., 44 lks. dist., alongside of which is laying a dead piñon, 11 ins. diam., with scribe marks AP D-218 HIR BT visible on partially open blaze. (Record: 45 lks.)</p> <p>Add the marks 2014 to the aluminum tablet.</p>

Dependent Resurvey of a Portion of
 the Hopi-Navajo Partition Line, Segment "D",
 T. 35 N., R. 15 E., Gila and Salt River Meridian, Arizona

CHAINS

The cor. is located on top of a sandstone cliff, 25 ft. high, bears N. 58° E. and S. 58° W.

Unable to locate the steel fence post.

There is no fence identifying the boundary.

S. 54°41' W., along line AP D-218 to AP D-219 of the Hopi-Navajo Partition Line, Segment "D".

Over rolling terrain.

30.70

True point for the witness point of secs. 30 and 31, determined, East, 35.14 chs., from the cor. of secs. 25, 30, 31, and 36 of Tp. 35 N., Rs. 14 and 15 E., at intersection with the Hopi-Navajo Partition Line, Segment "D".

Corner point falls on a NW cliff face of a sandstone boulder, 12 x 8 x 8 ft., bears N. 80° E. and S. 80° W., where it is impracticable to establish a permanent monument.

From this true point, the point selected for a witness corner to the witness point of secs. 30 and 31, bears West, 10 lks. dist., on the section line between secs. 30 and 31 of the Tp.

Set a brass tablet, 3 1/4 ins. diam., 2 5/8 ins. stem, cemented in a drill hole, on top of a dense sandstone boulder, 7 x 4 x 4 ft., with top mkd.

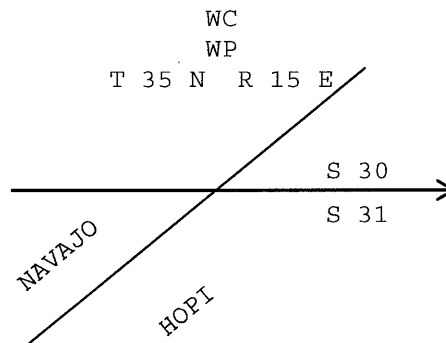

Deposit a magnet, without the plastic case, at the base of the brass tablet.

From this witness cor., Kai Si Kato Spring, a cement water meter box, 20 x 12 ins., projecting 8 ins. above ground and situated in the center of a lush patch of vegetation, 50 x 25 ft., bears N. 39°49' W., 25.50 chs. dist.

**Dependent Resurvey of a Portion of
the Hopi-Navajo Partition Line, Segment "D",
T. 35 N., R. 15 E., Gila and Salt River Meridian, Arizona**

CHAINS

This witness corner is located 1.10 chs. W. of the top of a sandstone cliff, 25 ft. high, bears N. 63° E. and S. 56° W., and 33 ft. below the top of the cliff.

35.45

The cor. for AP D-219, on the Hopi-Navajo Partition Line, Segment "D", monumented with an aluminum tablet, 3 1/4 ins. diam., firmly set, flush with the surface of a sandstone ridge top, mkd. NAVAJO AP D-219 HOPI 2014 1979.

from which the original steel fence post

A broken steel fence post, firmly set, in sandstone ridge top, bears N. 85° E., 6 lks. dist. (Record: N. 89° E.)

and the original bearing tree

A forked juniper, 8 ins. diam., bears S. 58° E., 65 lks. dist., with scribe marks AP D-219 HIR BT visible on partially open blaze. (Record: 64.5 lks.)

**Survey of a Portion of the South Boundary,
T. 35 N., R. 15 E., Gila and Salt River Meridian, Arizona**

From the cor. of Tps. 34 and 35 N., Rs. 15 and 16 E., determined East, 480.00 chs., from the cor. of Tps. 34 and 35 N., Rs. 14 and 15 E.

Set a stainless steel post, 28 ins. long, 2 1/2 ins. diam., 22 ins. in the ground, with brass cap mkd.

T 35 N	
R 15 E	R 16 E
S 36	S 31
S 1	S 6
T 34 N	

2015

Deposit a magnet, in a white plastic case, at the base of the stainless steel post.

Raise a mound of stone, 3 1/2 ft. base, 3 ft. high, 1 lk. West of cor., South was impracticable due to a juniper tree.

The cor. is located on a NE face of a finger ridge, bears N. 5° E. and S. 70° E., and 7.5 lks. S. of a drainage, 2 ft. wide, drains N. 55° E.

Survey of a Portion of the South Boundary,
T. 35 N., R. 15 E., Gila and Salt River Meridian, Arizona

CHAINS	<p>West, bet. secs. 1 and 36, on the S. bdy. of the Tp.</p> <p>Over mountainous terrain.</p>
40.00	<p>Point for the 1/4 sec. cor. of secs. 1 and 36.</p> <p>Set a stainless steel post, 28 ins. long, 2 1/2 ins. diam., 24 ins. in the ground, with brass cap mkd.</p> <div style="text-align: center; margin: 10px 0;"> <p>T 35 N R 15 E</p> <p> S 36</p> <p> 1/4 ———</p> <p> S 1</p> <p> T 34 N</p> <p> 2015</p> </div> <p>Deposit a magnet, in a white plastic case, at the base of the stainless steel post.</p> <p>from which</p> <p style="margin-left: 40px;">A stainless steel post, 28 ins. long, 2 1/2 ins. diam., set 12 ins. in the ground to bedrock, in a supporting mound of stone, 4 ft. base, to top of brass cap, for a reference monument, bears N. 45°01' E., 55.0 ft. dist. with brass cap mkd. RM T35N R15E 55.0 FT TO COR 1/4 S36 2015 and an arrow pointing to the cor. Deposit a magnet, in a white plastic case, at the base of the stainless steel post.</p> <p style="margin-left: 40px;">A stainless steel post, 28 ins. long, 2 1/2 ins. diam., set 24 ins. in the ground for a reference monument, bears S. 45°01' W., 30.0 ft. dist. with brass cap mkd. RM T34N R15E 30.0 FT TO COR 1/4 S1 2015 and an arrow pointing to the cor. Deposit a magnet, in a white plastic case, at the base of the stainless steel post. Raise a mound of stone, 4 ft. base, 2 1/2 ft. high, 1 lk. North of the reference monument.</p> <p>The cor. is located in a mountain drainage, 6 ft. wide, 2 ft. deep, drains N. 20° W., and at the base of a 5 ft. high waterfall.</p>
80.00	<p>Point for the cor. of secs. 1, 2, 35, and 36.</p> <p>Set a stainless steel post, 28 ins. long, 2 1/2 ins. diam., 23 ins. in the ground, with brass cap mkd.</p> <div style="text-align: center; margin: 10px 0;"> <p>T 35 N R 15 E</p> <p> S 35 S 36</p> <p> S 2 S 1</p> <p> T 34 N</p> <p> 2015</p> </div>

Survey of a Portion of the South Boundary,
T. 35 N., R. 15 E., Gila and Salt River Meridian, Arizona

CHAINS	
	<p>Deposit a magnet, in a white plastic case, at the base of the stainless steel post.</p> <p>Raise a mound of stone, 4 ft. base, 2 ft. high, 1 lk. North of cor.</p> <p>Land, mountainous. Soil, sandy loam and sandstone. Timber, juniper and piñon. Undergrowth, sage, Mormon tea, cliff rose, and black brush.</p> <hr/> <p>West, bet. secs. 2 and 35.</p> <p>Over mountainous terrain.</p>
40.00	<p>Point for the 1/4 sec. cor. of secs. 2 and 35.</p> <p>Set a stainless steel post, 28 ins. long, 2 1/2 ins. diam., 26 ins. in the ground, with brass cap mkd.</p> <p style="text-align: center;">T 35 N R 15 E S 35 1/4 ——— S 2 T 34 N</p> <p style="text-align: center;">2015</p> <p>Deposit a magnet, in a white plastic case, at the base of the stainless steel post.</p> <p>Raise a mound of stone, 2 1/2 ft. base, 1 1/2 ft. high, 1 lk. South of cor.</p>
80.00	<p>Point for the cor. of secs. 2, 3, 34, and 35.</p> <p>Set a stainless steel post, 28 ins. long, 2 1/2 ins. diam., 27 ins. in the ground, with brass cap mkd.</p> <p style="text-align: center;">T 35 N R 15 E S 34 S 35 S 3 S 2 T 34 N</p> <p style="text-align: center;">2015</p> <p>Deposit a magnet, in a white plastic case, at the base of the stainless steel post.</p> <p>Set a steel fence post nearby.</p>

Survey of a Portion of the South Boundary,
T. 35 N., R. 15 E., Gila and Salt River Meridian, Arizona

CHAINS	
	<p>Land, mountainous to rolling. Soil, sandy loam and rocky. Timber, scattered juniper and piñon. Undergrowth, sage, Mormon tea, native grasses, yucca, and cliff rose.</p> <hr/> <p>West, bet. secs. 3 and 34.</p> <p>Over rolling terrain.</p>
40.00	<p>Point for the 1/4 sec. cor. of secs. 3 and 34.</p> <p>Set a stainless steel post, 28 ins. long, 2 1/2 ins. diam., 24 ins. in the ground, with brass cap mkd.</p> <div style="text-align: center;"> <p>T 35 N R 15 E S 34 1/4 ——— S 3 T 34 N</p> <p>2015</p> </div> <p>Deposit a magnet, in a white plastic case, at the base of the stainless steel post.</p>
68.35	<p>BIA Route 6620, a bladed dirt road, 20 ft. wide, bears N. and S. 25° E.</p>
80.00	<p>Point for the cor. of secs. 3, 4, 33, and 34.</p> <p>Set a stainless steel post, 28 ins. long, 2 1/2 ins. diam., 26 ins. in the ground, with brass cap mkd.</p> <div style="text-align: center;"> <p>T 35 N R 15 E S 33 S 34 S 4 S 3 T 34 N</p> <p>2015</p> </div> <p>Deposit a magnet, in a white plastic case, at the base of the stainless steel post.</p> <p>Land, rolling. Soil, sandy loam. Timber, scattered juniper and piñon. Undergrowth, sage, native grasses, cliff rose, and yucca.</p> <hr/>

**Survey of a Portion of the South Boundary,
T. 35 N., R. 15 E., Gila and Salt River Meridian, Arizona**

CHAINS	<p>West, bet. secs. 4 and 33.</p> <p>Over rolling terrain.</p>
3.48	<p>Cor. for the witness point of secs. 4 and 33, on the S. bdy. of the Tp., at intersection with the Hopi-Navajo Partition Line, Segment "D", hereinbefore described.</p> <p>From this cor. point, AP D-202, on the Hopi-Navajo Partition Line, Segment "D", hereinbefore described, bears S. 2°09' E., 56 lks. dist.</p> <p>From this same cor. point, AP D-203, on the Hopi-Navajo Partition Line, Segment "D", hereinbefore described, bears N. 2°09' W., 11.145 chs. dist.</p> <hr/> <p style="text-align: center;">Survey of the East Boundary, T. 35 N., R. 15 E., Gila and Salt River Meridian, Arizona</p> <hr/> <p>From the cor. of Tps. 34 and 35 N., Rs. 15 and 16 E., hereinbefore described.</p> <p>North, bet. secs. 31 and 36, on the E. bdy. of the Tp.</p> <p>Over mountainous terrain.</p>
40.00	<p>Point for the 1/4 sec. cor. of secs. 31 and 36.</p> <p>Set a stainless steel post, 28 ins. long, 2 1/2 ins. diam., 24 ins. in the ground, with brass cap mkd.</p> <div style="text-align: center;"> <p>T 35 N</p> <p>R 15 E R 16 E</p> <p>1/4</p> <p> </p> <p>S 36 S 31</p> <p>2015</p> </div> <p>Deposit a magnet, in a white plastic case, at the base of the stainless steel post.</p> <p>Raise a mound of stone, 3 ft. base, 2 1/2 ft. high, 1 lk. West of cor.</p> <p>The cor. is located 38 lks. E. of a top of a finger ridge, 40 ft. high, bears N. 20° E. and S. 45° W.</p>
80.00	<p>Point for the cor. of secs. 25, 30, 31, and 36.</p>

Survey of the East Boundary,
T. 35 N., R. 15 E., Gila and Salt River Meridian, Arizona

CHAINS											
	<p>Set a stainless steel post, 28 ins. long, 2 1/2 ins. diam., 26 ins. in the ground, with brass cap mkd.</p> <div style="text-align: center;"> <table style="margin: auto;"> <tr><td colspan="2">T 35 N</td></tr> <tr><td>R 15 E</td><td>R 16 E</td></tr> <tr><td>S 25</td><td>S 30</td></tr> <tr><td colspan="2"><hr style="width: 50%; margin: 0 auto;"/></td></tr> <tr><td>S 36</td><td>S 31</td></tr> </table> <p>2015</p> </div> <p>Deposit a magnet, in a white plastic case, at the base of the stainless steel post.</p> <p>Set a steel fence post nearby.</p> <p>Land, mountainous to rolling. Soil, sandy loam and sandstone. Timber, scattered juniper and piñon. Undergrowth, sage, Mormon tea, and cliff rose.</p> <hr/> <p>North, bet. secs. 25 and 30.</p> <p>Over rolling terrain.</p>	T 35 N		R 15 E	R 16 E	S 25	S 30	<hr style="width: 50%; margin: 0 auto;"/>		S 36	S 31
T 35 N											
R 15 E	R 16 E										
S 25	S 30										
<hr style="width: 50%; margin: 0 auto;"/>											
S 36	S 31										
40.00	<p>Point for the 1/4 sec. cor. of secs. 25 and 30.</p> <p>Set a stainless steel post, 28 ins. long, 2 1/2 ins. diam., 25 ins. in the ground, with brass cap mkd.</p> <div style="text-align: center;"> <table style="margin: auto;"> <tr><td colspan="2">T 35 N</td></tr> <tr><td>R 15 E</td><td>R 16 E</td></tr> <tr><td colspan="2">1/4</td></tr> <tr><td>S 25</td><td>S 30</td></tr> </table> <p>2015</p> </div> <p>Deposit a magnet, in a white plastic case, at the base of the stainless steel post.</p> <p>Set a steel fence post nearby.</p>	T 35 N		R 15 E	R 16 E	1/4		S 25	S 30		
T 35 N											
R 15 E	R 16 E										
1/4											
S 25	S 30										
80.00	<p>Point for the cor. of secs. 19, 24, 25, and 30.</p> <p>Set a stainless steel post, 28 ins. long, 2 1/2 ins. diam., 27 ins. in the ground, with brass cap mkd.</p>										

Survey of the East Boundary,
T. 35 N., R. 15 E., Gila and Salt River Meridian, Arizona

CHAINS											
	<table style="margin: auto;"> <tr><td colspan="2">T 35 N</td></tr> <tr><td>R 15 E</td><td>R 16 E</td></tr> <tr><td>S 24</td><td>S 19</td></tr> <tr><td colspan="2"><hr/></td></tr> <tr><td>S 25</td><td>S 30</td></tr> </table>	T 35 N		R 15 E	R 16 E	S 24	S 19	<hr/>		S 25	S 30
T 35 N											
R 15 E	R 16 E										
S 24	S 19										
<hr/>											
S 25	S 30										
	2015										
	Deposit a magnet, in a white plastic case, at the base of the stainless steel post.										
	Set a steel fence post nearby.										
	The cor. is located on a steep northwesterly facing slope, 1 ch. S., and 50 ft. above from a wash, 15 ft. wide, drains NE.										
	Land, rolling. Soil, sandy loam and clay. Timber, scattered juniper and piñon. Undergrowth, sage and service berry.										
	<hr/>										
	North, bet. secs. 19 and 24.										
	Over rolling to mountainous terrain.										
40.00	Point for the 1/4 sec. cor. of secs. 19 and 24.										
	Set a stainless steel post, 28 ins. long, 2 1/2 ins. diam., 25 ins. in the ground, with brass cap mkd.										
	<table style="margin: auto;"> <tr><td colspan="2">T 35 N</td></tr> <tr><td>R 15 E</td><td>R 16 E</td></tr> <tr><td colspan="2">1/4</td></tr> <tr><td>S 24</td><td>S 19</td></tr> </table>	T 35 N		R 15 E	R 16 E	1/4		S 24	S 19		
T 35 N											
R 15 E	R 16 E										
1/4											
S 24	S 19										
	2015										
	Deposit a magnet, in a white plastic case, at the base of the stainless steel post.										
	Set a steel fence post nearby.										
49.47	BIA Route 40, a bladed dirt road, 20 ft. wide, bears N. 70° E. and S. 75° W.										
80.00	Point for the cor. of secs. 13, 18, 19, and 24.										
	Set a stainless steel post, 28 ins. long, 2 1/2 ins. diam., 26 ins. in the ground, with brass cap mkd.										

Survey of the East Boundary,
T. 35 N., R. 15 E., Gila and Salt River Meridian, Arizona

CHAINS											
	<table style="margin: auto;"> <tr><td colspan="2">T 35 N</td></tr> <tr><td>R 15 E</td><td>R 16 E</td></tr> <tr><td>S 13</td><td>S 18</td></tr> <tr><td colspan="2" style="border-top: 1px solid black;"></td></tr> <tr><td>S 24</td><td>S 19</td></tr> </table> <p style="text-align: center;">2015</p> <p>Deposit a magnet, in a white plastic case, at the base of the stainless steel post.</p> <p>Set a steel fence post nearby.</p> <p>Land, mountainous to rolling. Soil, sandy loam and sandstone. Timber, juniper and piñon. Undergrowth, sage and salt brush.</p> <hr/> <p>North, bet. secs. 13 and 18.</p> <p>Over rolling to mountainous terrain.</p>	T 35 N		R 15 E	R 16 E	S 13	S 18			S 24	S 19
T 35 N											
R 15 E	R 16 E										
S 13	S 18										
S 24	S 19										
40.00	<p>Point for the 1/4 sec. cor. of secs. 13 and 18.</p> <p>Set a stainless steel post, 28 ins. long, 2 1/2 ins. diam., 22 ins. in the ground, with brass cap mkd.</p>										
	<table style="margin: auto;"> <tr><td colspan="2">T 35 N</td></tr> <tr><td>R 15 E</td><td>R 16 E</td></tr> <tr><td colspan="2" style="text-align: center;">1/4</td></tr> <tr><td colspan="2" style="text-align: center;"> </td></tr> <tr><td>S 13</td><td>S 18</td></tr> </table> <p style="text-align: center;">2015</p> <p>Deposit a magnet, in a white plastic case, at the base of the stainless steel post.</p> <p>Set a steel fence post nearby.</p>	T 35 N		R 15 E	R 16 E	1/4				S 13	S 18
T 35 N											
R 15 E	R 16 E										
1/4											
S 13	S 18										
80.00	<p>Point for the cor. of secs. 7, 12, 13, and 18.</p> <p>Set a stainless steel post, 28 ins. long, 2 1/2 ins. diam., 27 ins. in the ground, with brass cap mkd.</p>										
	<table style="margin: auto;"> <tr><td colspan="2">T 35 N</td></tr> <tr><td>R 15 E</td><td>R 16 E</td></tr> <tr><td>S 12</td><td>S 7</td></tr> <tr><td colspan="2" style="border-top: 1px solid black;"></td></tr> <tr><td>S 13</td><td>S 18</td></tr> </table> <p style="text-align: center;">2015</p>	T 35 N		R 15 E	R 16 E	S 12	S 7			S 13	S 18
T 35 N											
R 15 E	R 16 E										
S 12	S 7										
S 13	S 18										

Survey of the East Boundary,
T. 35 N., R. 15 E., Gila and Salt River Meridian, Arizona

CHAINS	
	<p>Deposit a magnet, in a white plastic case, at the base of the stainless steel post.</p> <p>Set a steel fence post nearby.</p> <p>The cor. is located on an easterly facing slope.</p> <p>Land, mountainous to rolling and broken. Soil, silty sand and sandstone. Timber, juniper and piñon. Undergrowth, Mormon tea, black brush, cliff rose, and indian rain brush.</p> <hr/> <p>North, bet. secs. 7 and 12.</p> <p>Over rolling and broken terrain.</p>
40.00	<p>Point for the 1/4 sec. cor. of secs. 7 and 12.</p> <p>Set a stainless steel post, 28 ins. long, 2 1/2 ins. diam., 25 ins. in the ground, with brass cap mkd.</p> <div style="text-align: center;"> <p>T 35 N</p> <p>R 15 E R 16 E</p> <p> 1/4</p> <p> </p> <p>S 12 S 7</p> <p> 2015</p> </div> <p>Deposit a magnet, in a white plastic case, at the base of the stainless steel post.</p> <p>Set a steel fence post nearby.</p> <p>The cor. is located on a moderately steep slope facing N. 30° W., with boulder strewn, scattered junipers and basket brush.</p>
80.00	<p>Point for the cor. of secs. 1, 6, 7, and 12.</p> <p>Set a stainless steel post, 28 ins. long, 2 1/2 ins. diam., 26 ins. in the ground, with brass cap mkd.</p> <div style="text-align: center;"> <p>T 35 N</p> <p>R 15 E R 16 E</p> <p> S 1 S 6</p> <p>----- -----</p> <p> S 12 S 7</p> <p> 2015</p> </div> <p>Deposit a magnet, in a white plastic case, at the base of the stainless steel post.</p>

Survey of the East Boundary,
T. 35 N., R. 15 E., Gila and Salt River Meridian, Arizona

CHAINS	
	<p>Set a steel fence post nearby.</p> <p>The cor. is located on top of a low ridge, 20 ft. wide, bears SE and NW.</p> <p>Land, rolling and broken to rolling with sandy ridges. Soil, silty sand and rocky. Timber, scattered juniper and piñon. Undergrowth, Mormon tea, cliff rose, yucca, bitter brush, native grasses, and salt brush.</p> <hr style="width: 80%; margin: 10px auto;"/> <p>North, bet. secs. 1 and 6.</p> <p>Over rolling to nearly level terrain.</p>
34.87	Underground water line, bears N. 51° E. and S. 51° W.
40.00	<p>Point for the 1/4 sec. cor. of secs. 1 and 6.</p> <p>Set a stainless steel post, 28 ins. long, 2 1/2 ins. diam., 27 ins. in the ground, with brass cap mkd.</p> <div style="text-align: center; margin: 10px 0;"> <p>T 35 N</p> <p>R 15 E R 16 E</p> <p> 1/4</p> <p> </p> <p>S 1 S 6</p> <p> 2015</p> </div> <p>Deposit a magnet, in a white plastic case, at the base of the stainless steel post.</p> <p>Set a steel fence post nearby.</p>
48.46	Power line, 5 strand, bears N. 62° E. and S. 62° W.
48.61	S. right-of-way fence of U.S. Highway 160, woven and barbed wire fence, parallels highway.
50.29	U.S. Highway 160, an asphalt surfaced road, 36 ft. wide, bears N. 62° E. and S. 62° W.
53.71	N. right-of-way fence of U.S. Highway 160 and S. right-of-way fence of Black Mesa and Lake Powell Railroad, woven and barbed wire fence, parallels railroad.
55.45	Black Mesa and Lake Powell Railroad, bears N. 63° E. and S. 63° W.
56.61	N. right-of-way fence of Black Mesa and Lake Powell Railroad, woven and barbed wire fence, parallels railroad.

**Survey of the East Boundary,
T. 35 N., R. 15 E., Gila and Salt River Meridian, Arizona**

CHAINS											
80.00	<p>Point for the cor. of Tps. 35 and 36 N., Rs. 15 and 16 E.</p> <p>Set a stainless steel post, 28 ins. long, 2 1/2 ins. diam., 24 ins. in the ground, with brass cap mkd.</p> <div style="text-align: center;"> <table style="border-collapse: collapse; margin: auto;"> <tr><td colspan="2">T 36 N</td></tr> <tr><td style="border-right: 1px solid black; padding: 0 5px;">R 15 E</td><td style="padding: 0 5px;">R 16 E</td></tr> <tr><td style="border-right: 1px solid black; padding: 0 5px;">S 36</td><td style="padding: 0 5px;">S 31</td></tr> <tr style="border-top: 1px solid black;"><td style="border-right: 1px solid black; padding: 0 5px;">S 1</td><td style="padding: 0 5px;">S 6</td></tr> <tr><td colspan="2">T 35 N</td></tr> </table> </div> <p style="text-align: center;">2015</p> <p>Deposit a magnet, in a white plastic case, at the base of the stainless steel post.</p> <p>Set a steel fence post nearby.</p> <p>Land, gently rolling to nearly level. Soil, sandy loam. Timber, scattered juniper. Undergrowth, Mormon tea, rabbit brush, black brush, cholla, native grasses, and salt brush.</p> <hr/> <p style="text-align: center;">Survey of the North Boundary, T. 35 N., R. 15 E., Gila and Salt River Meridian, Arizona</p> <hr/> <p>From the cor. of Tps. 35 and 36 N., Rs. 15 and 16 E., hereinbefore described.</p> <p>West, bet. secs. 1 and 36, on the N. bdy. of the Tp.</p> <p>Over nearly level to gently rolling terrain.</p>	T 36 N		R 15 E	R 16 E	S 36	S 31	S 1	S 6	T 35 N	
T 36 N											
R 15 E	R 16 E										
S 36	S 31										
S 1	S 6										
T 35 N											
40.00	<p>Point for the 1/4 sec. cor. of secs. 1 and 36.</p> <p>Set a stainless steel post, 28 ins. long, 2 1/2 ins. diam., 25 ins. in the ground, with brass cap mkd.</p> <div style="text-align: center;"> <table style="border-collapse: collapse; margin: auto;"> <tr><td>T 36 N</td><td>R 15 E</td></tr> <tr><td colspan="2" style="text-align: center;">S 36</td></tr> <tr><td colspan="2" style="text-align: center;">1/4 ———</td></tr> <tr><td colspan="2" style="text-align: center;">S 1</td></tr> <tr><td colspan="2">T 35 N</td></tr> </table> </div> <p style="text-align: center;">2014</p> <p>Deposit a magnet, in a white plastic case, at the base of the stainless steel post.</p>	T 36 N	R 15 E	S 36		1/4 ———		S 1		T 35 N	
T 36 N	R 15 E										
S 36											
1/4 ———											
S 1											
T 35 N											

Survey of the North Boundary,
T. 35 N., R. 15 E., Gila and Salt River Meridian, Arizona

CHAINS									
	Set a steel fence post nearby.								
43.91	Trail road, 8 ft. wide, bears S. 23° E. and N. 23° W.								
46.08	Graded road, 20 ft. wide, bears S. 54° E. and N. 54° W.								
60.40	Questar Southern Trails Pipeline Co., underground gas pipeline, bears N. 59° E. and S. 59° W.								
76.62	Trail road, 8 ft. wide, bears N. 52° E. and S. 52° W.								
80.00	Point for the cor. of secs. 1, 2, 35, and 36.								
	Set a stainless steel post, 28 ins. long, 2 1/2 ins. diam., 25 ins. in the ground, with brass cap mkd.								
	<table style="margin: auto; border-collapse: collapse;"> <tr> <td style="padding: 0 10px;">T 36 N</td> <td style="padding: 0 10px;">R 15 E</td> </tr> <tr> <td style="padding: 0 10px; border-right: 1px solid black;">S 35</td> <td style="padding: 0 10px;">S 36</td> </tr> <tr> <td style="padding: 0 10px; border-right: 1px solid black;">S 2</td> <td style="padding: 0 10px;">S 1</td> </tr> <tr> <td colspan="2" style="padding: 0 10px;">T 35 N</td> </tr> </table>	T 36 N	R 15 E	S 35	S 36	S 2	S 1	T 35 N	
T 36 N	R 15 E								
S 35	S 36								
S 2	S 1								
T 35 N									
	2014								
	Deposit a magnet, in a white plastic case, at the base of the stainless steel post.								
	Set a steel fence post nearby.								
	The cor. is located 1.60 chs. S. 58° E. from the intersection of two trail roads, 8 ft. wide, with roads extending N. 72° E., S. 31° E., S. 62° W. and N. 34° W., and 2.16 chs. N. 14° W. from the intersection of two others trail roads, 8 ft. wide, with roads extending N. 54° E., S. 33° E., S. 54° W. and N. 33° W.								
	Land, gently rolling. Soil, sandy loam. Timber, none. Undergrowth, native grasses.								
	West, bet. secs. 2 and 35.								
	Over gently rolling terrain.								
0.84	Trail road, 8 ft. wide, bears S. 31° E. and N. 31° W.								
1.97	Trail road, 8 ft. wide, bears N. 16° E. and S. 24° W.								
3.00	Trail road, 8 ft. wide, bears N. 62° E. and S. 72° W.								
8.75	Power line, 4 strand, bears N. 68° E. and S. 68° W.								

**Survey of the North Boundary,
T. 35 N., R. 15 E., Gila and Salt River Meridian, Arizona**

CHAINS	
27.15	Graded road, 27 ft. wide, bears N. 52° E. and S. 52° W.
40.00	<p>Point of the 1/4 sec. cor. of secs. 2 and 35.</p> <p>Set a stainless steel post, 28 ins. long, 2 1/2 ins. diam., 24 ins. in the ground, with brass cap mkd.</p> <p style="text-align: center;">T 36 N R 15 E S 35 1/4 ——— S 2 T 35 N</p> <p style="text-align: center;">2014</p> <p>Deposit a magnet, in a white plastic case, at the base of the stainless steel post.</p> <p>Set a steel fence post nearby.</p> <p>From this cor. point, the northeast corner of a barbed wire fence, 2 strand, with fences extending S. 38° W. and N. 55° W., enclosing a 2 story wood-frame house, bears S. 20°35' E., 2.08 chs. dist.</p> <p>From this same cor. point, the northeast corner of the eave of the 2 story wood-frame house, 40 x 24 ft., bears S. 35°53' W., 3.76 chs. dist.</p> <p>From this same cor. point, the southeast corner of the eave of the same house, bears S. 34°53' W., 4.37 chs. dist.</p> <p>From this same cor. point, the southeast corner of the same barbed wire fence, 2 strand, with fences extending N. 38° E. and N. 38° W., bears S. 20°12' W., 5.90 chs. dist.</p> <p>From this same cor. point, the southwest corner of the eave of the same house, bears S. 39°42' W., 4.43 chs. dist.</p> <p>From this same cor. point, the northwest corner of the eave of the same house, bears S. 41°25' W., 3.82 chs. dist.</p> <p>From this same cor. point, the southwest corner of the same barbed wire fence, 2 strand, with fences extending S. 38° E. and N. 37° W., bears S. 49°42' W., 5.90 chs. dist.</p> <p>From this same cor. point, the northwest corner of the same barbed wire fence, 2 strand, with fences extending S. 55° E. and S. 37° W., bears S. 83°21' W., 1.77 chs. dist.</p>
63.06	E. right-of-way fence of Arizona State Route 98, barbed wire fence, 5 strand, parallels highway.

Survey of the North Boundary,
T. 35 N., R. 15 E., Gila and Salt River Meridian, Arizona

CHAINS											
64.67	Arizona State Route 98, an asphalt surfaced road, 36 ft. wide, bears S. 24° E. and N. 24° W.										
66.35	W. right-of-way fence of Arizona State Route 98, barbed wire fence, 5 strand, parallels highway.										
80.00	<p>Point for the cor. of secs. 2, 3, 34, and 35.</p> <p>Set a stainless steel post, 28 ins. long, 2 1/2 ins. diam., 24 ins. in the ground, with brass cap mkd.</p> <div style="text-align: center; margin: 10px 0;"> <table style="margin: auto; border-collapse: collapse;"> <tr> <td style="padding: 0 10px;">T 36 N</td> <td style="padding: 0 10px;">R 15 E</td> </tr> <tr> <td style="padding: 0 10px;">S 34</td> <td style="padding: 0 10px;">S 35</td> </tr> <tr> <td style="padding: 0 10px;">S 3</td> <td style="padding: 0 10px;">S 2</td> </tr> <tr> <td colspan="2" style="padding: 0 10px;">T 35 N</td> </tr> </table> </div> <p style="text-align: center; margin: 10px 0;">2014</p> <p>Deposit a magnet, in a white plastic case, at the base of the stainless steel post.</p> <p>Set a steel fence post nearby.</p> <p>Land, gently rolling. Soil, sandy loam. Timber, none. Undergrowth, sage and native grasses.</p> <hr style="width: 80%; margin: 20px auto;"/> <p>West, bet. secs. 3 and 34.</p> <p>Over gently rolling terrain.</p>	T 36 N	R 15 E	S 34	S 35	S 3	S 2	T 35 N			
T 36 N	R 15 E										
S 34	S 35										
S 3	S 2										
T 35 N											
40.00	<p>Point to the 1/4 sec. cor. of sec. 3 and 34.</p> <p>Set a stainless steel post, 28 ins. long, 2 1/2 ins. diam., 23 ins. in the ground, with brass cap mkd.</p> <div style="text-align: center; margin: 10px 0;"> <table style="margin: auto; border-collapse: collapse;"> <tr> <td style="padding: 0 10px;">T 36 N</td> <td style="padding: 0 10px;">R 15 E</td> </tr> <tr> <td style="padding: 0 10px;">S 34</td> <td></td> </tr> <tr> <td style="padding: 0 10px;">1/4</td> <td style="padding: 0 10px;">—</td> </tr> <tr> <td style="padding: 0 10px;">S 3</td> <td></td> </tr> <tr> <td colspan="2" style="padding: 0 10px;">T 35 N</td> </tr> </table> </div> <p style="text-align: center; margin: 10px 0;">2014</p> <p>Deposit a magnet, in a white plastic case, at the base of the stainless steel post.</p> <p>Set a steel fence post nearby.</p>	T 36 N	R 15 E	S 34		1/4	—	S 3		T 35 N	
T 36 N	R 15 E										
S 34											
1/4	—										
S 3											
T 35 N											
63.54	Power line, 2 strand, bears N. 28° E. and S. 28° W.										

Survey of the North Boundary,
T. 35 N., R. 15 E., Gila and Salt River Meridian, Arizona

CHAINS											
78.07	Trail road, 8 ft. wide, bears N. 68° E. and S. 68° W.										
80.00	Point for cor. of secs. 3, 4, 33, and 34. Set a stainless steel post, 28 ins. long, 2 1/2 ins. diam., 25 ins. in the ground, with brass cap mkd. <div style="text-align: center;"> <table style="margin: auto;"> <tr><td>T 36 N</td><td>R 15 E</td></tr> <tr><td>S 33</td><td>S 34</td></tr> <tr><td>S 4</td><td>S 3</td></tr> <tr><td colspan="2">T 35 N</td></tr> </table> <p>2014</p> </div> Deposit a magnet, in a white plastic case, at the base of the stainless steel post. Set a steel fence post nearby. Land, gently rolling. Soil, sandy loam and sandstone. Timber, none. Undergrowth, native grasses. <hr/> West, bet. secs. 4 and 33. Over gently rolling terrain.	T 36 N	R 15 E	S 33	S 34	S 4	S 3	T 35 N			
T 36 N	R 15 E										
S 33	S 34										
S 4	S 3										
T 35 N											
40.00	Point to the 1/4 sec. cor. of sec. 4 and 33. Set a stainless steel post, 28 ins. long, 2 1/2 ins. diam., 24 ins. in the ground, with brass cap mkd. <div style="text-align: center;"> <table style="margin: auto;"> <tr><td>T 36 N</td><td>R 15 E</td></tr> <tr><td>S 33</td><td></td></tr> <tr><td>1/4</td><td>—</td></tr> <tr><td>S 4</td><td></td></tr> <tr><td colspan="2">T 35 N</td></tr> </table> <p>2014</p> </div> Deposit a magnet, in a white plastic case, at the base of the stainless steel post. Set a steel fence post nearby.	T 36 N	R 15 E	S 33		1/4	—	S 4		T 35 N	
T 36 N	R 15 E										
S 33											
1/4	—										
S 4											
T 35 N											
80.00	Point for the cor. of secs. 4, 5, 32, and 33. Set a stainless steel post, 28 ins. long, 2 1/2 ins. diam., 24 ins. in the ground, with brass cap mkd.										

Survey of the North Boundary,
T. 35 N., R. 15 E., Gila and Salt River Meridian, Arizona

CHAINS					
	<p>T 36 N R 15 E <table style="margin: auto; border-collapse: collapse;"> <tr> <td style="border-right: 1px solid black; padding: 2px 10px;">S 32</td> <td style="padding: 2px 10px;">S 33</td> </tr> <tr> <td style="border-right: 1px solid black; padding: 2px 10px;">S 5</td> <td style="padding: 2px 10px;">S 4</td> </tr> </table> <p>T 35 N</p> <p>2014</p> <p>Deposit a magnet, in a white plastic case, at the base of the stainless steel post.</p> <p>Set a steel fence post nearby.</p> <p>The cor. is located on left bank of Shonto Wash, in a sandstone rock outcrop.</p> <p>Land, gently rolling. Soil, sandy loam and sandstone. Timber, none. Undergrowth, sage, yucca, rabbit brush, and native grasses.</p> <hr style="width: 80%; margin: 10px auto;"/> <p>West, bet. secs. 5 and 32.</p> <p>Over gently rolling to rolling terrain.</p> </p>	S 32	S 33	S 5	S 4
S 32	S 33				
S 5	S 4				
2.84	Shonto Wash, 8 ft. wide, 4 ft. deep, drains S. 14° W.				
40.00	<p>Point for the 1/4 sec. cor. of secs. 5 and 32.</p> <p>Set a stainless steel post, 28 ins. long, 2 1/2 ins. diam., 22 ins. in the ground, with brass cap mkd.</p> <p style="text-align: center;"> T 36 N R 15 E S 32 1/4 ——— S 5 T 35 N </p> <p style="text-align: center;">2014</p> <p>Deposit a magnet, in a white plastic case, at the base of the stainless steel post.</p> <p>Set a steel fence post nearby.</p>				
80.00	<p>Point for the cor. of secs. 5, 6, 31, and 32.</p> <p>Set a stainless steel post, 28 ins. long, 2 1/2 ins. diam., 24 ins. in the ground, with brass cap mkd.</p>				

**Survey of the North Boundary,
T. 35 N., R. 15 E., Gila and Salt River Meridian, Arizona**

CHAINS	
	T 36 N R 15 E S 31 S 32 S 6 S 5 T 35 N 2014
	Deposit a magnet, in a white plastic case, at the base of the stainless steel post. Set a steel fence post nearby. Land, gently rolling to rolling to gently rolling. Soil, sandy loam and sandstone bedrock. Timber, none. Undergrowth, sage, Mormon tea, cholla, and native grasses.
	<hr/> West, bet. secs. 6 and 31. Over gently rolling terrain.
40.00	Point for the 1/4 sec. cor. of secs. 6 and 31. Set a stainless steel post, 28 ins. long, 2 1/2 ins. diam., 25 ins. in the ground, with brass cap mkd.
	T 36 N R 15 E S 31 1/4 ——— S 6 T 35 N 2014
	Deposit a magnet, in a white plastic case, at the base of the stainless steel post. The cor. is located, 91 lks. N. 22° W. from a "Y" intersection of trails roads, 8 ft. wide, S. 34° E., N. 34° W., and N. 48° W.
40.20	Trail road, 8 ft. wide, bears S. 32° E. and N. 32° W.
40.56	Trail road, 8 ft. wide, bears S. 45° E. and N. 45° W.
79.46	The cor. of Tps. 35 and 36 N., Rs. 14 and 15 E., monumented with a stainless steel post, 2 1/2 ins. diam., firmly set, projecting 5 ins. above ground, with brass cap mkd. T36N R14E R15E S36 S31 S1 S6 T35N 2014. With a steel fence post nearby. Land, gently rolling to nearly level. Soil, sandy loam and sandstone bedrock outcrops. Timber, none. Undergrowth, Mormon tea, cholla, and native grasses.

Survey of a Portion of the Subdivisional Lines,
T. 35 N., R. 15 E., Gila and Salt River Meridian, Arizona

CHAINS	
	<p>From the cor. of secs. 1, 2, 35, and 36, on the S. bdy. of the Tp., hereinbefore described.</p> <p>N. 0°01' W., bet. secs. 35 and 36.</p> <p>Over mountainous terrain.</p>
40.00	<p>Point for the 1/4 sec. cor. of secs. 35 and 36.</p> <p>Set a brass tablet, 3 1/2 ins. diam., 2 3/4 ins. stem, cemented in a drill hole, in hard sandstone boulder, 17 x 8 ft., projecting 4 ft. above ground, with top mkd.</p> <p style="text-align: center;">T 35 N R 15 E 1/4 S 35 S 36</p> <p style="text-align: center;">2015</p> <p>Deposit a magnet, without a plastic case, at the base of the brass tablet.</p> <p>The cor. is located on top of a sandstone boulder, 17 ft. long, 8 ft. wide, projecting 4 ft. above ground, the long side bears N. 25° E. and S. 25° W.</p>
80.00	<p>Point for the cor. of secs. 25, 26, 35, and 36.</p> <p>Set a stainless steel post, 28 ins. long, 2 1/2 ins. diam., 24 ins. in the ground, with brass cap mkd.</p> <p style="text-align: center;">T 35 N R 15 E S 26 S 25 S 35 S 36</p> <p style="text-align: center;">2015</p> <p>Deposit a magnet, in a white plastic case, at the base of the stainless steel post.</p> <p>Set a steel fence post nearby.</p> <p>Land, mountainous. Soil, sandy loam, sandstone, and sparse coal. Timber, juniper and piñon. Undergrowth, cliff rose, service berry, and Mormon tea.</p> <hr/> <p>From the cor. of secs. 25, 30, 31, and 36, on the E. bdy. of the Tp., hereinbefore described.</p> <p>West, bet. secs. 25 and 36.</p>

Survey of a Portion of the Subdivisional Lines,
T. 35 N., R. 15 E., Gila and Salt River Meridian, Arizona

CHAINS	
	Over rolling to mountainous terrain.
40.00	Point for the 1/4 sec, cor. of secs. 25 and 36. Set a stainless steel post, 28 ins. long, 2 1/2 ins. diam., 26 ins. in the ground, with brass cap mkd. <div style="text-align: center;"> T 35 N R 15 E S 25 1/4 ——— S 36 2015 </div>
	Deposit a magnet, in a white plastic case, at the base of the stainless steel post.
	Set a steel fence post nearby.
80.00	The cor. of secs. 25, 26, 35, and 36. Land, mountainous. Soil, sandy loam, sandstone, and sparse coal. Timber, juniper and piñon. Undergrowth, black brush, Mormon tea, cliff rose, service berry, and sage.
	————— N. 0°01' W., bet. secs. 25 and 26.
	Over mountainous to rolling to nearly level terrain.
40.00	Point for the 1/4 sec. cor. of secs. 25 and 26. Set a stainless steel post, 28 ins. long, 2 1/2 ins. diam., 11 ins. in the ground to bedrock, in a supporting mound of stone, 4 ft. base, to top, with brass cap mkd. <div style="text-align: center;"> T 35 N R 15 E 1/4 S 26 S 25 2015 </div>
	Deposit a magnet, in a white plastic case, at the base of the stainless steel post.
	Set a steel fence post nearby.

Survey of a Portion of the Subdivisional Lines,
T. 35 N., R. 15 E., Gila and Salt River Meridian, Arizona

CHAINS									
80.00	<p>The cor. is located 1.10 chs. N. of a mountain drainage, 7 ft. wide, 2 ft. deep, drains N. 82° E.</p> <p>Point for the cor. of secs. 23, 24, 25, and 26.</p> <p>Set a stainless steel post, 28 ins. long, 2 1/2 ins. diam., 17 ins. in the ground, in a mound of stone, 4 ft. base, to top, with brass cap mkd.</p> <div style="text-align: center;"> <table style="margin: auto;"> <tr> <td>T 35 N</td> <td>R 15 E</td> </tr> <tr> <td style="border-right: 1px solid black;">S 23</td> <td>S 24</td> </tr> <tr> <td style="border-right: 1px solid black;">S 26</td> <td>S 25</td> </tr> </table> <p>2015</p> </div> <p>Deposit a magnet, in a white plastic case, at the base of the stainless steel post.</p> <p>The cor. is located on top of a mesa, 1.84 chs., E. of the rim of the mesa, 30 ft. high, bears N. 15° E. and S. 15° W.</p> <p>Land, mountainous to rolling to nearly level. Soil, silty sand and flat rock bellow surface. Timber, scattered juniper and piñon. Undergrowth, cliff rose, Mormon tea, and sage.</p> <hr/> <p>From the cor. of secs. 19, 24, 25, and 36, on the E. bdy. of the Tp., hereinbefore described.</p> <p>West, bet. secs. 24 and 25.</p> <p>Over rolling terrain.</p>	T 35 N	R 15 E	S 23	S 24	S 26	S 25		
T 35 N	R 15 E								
S 23	S 24								
S 26	S 25								
40.00	<p>Point for the 1/4 sec. cor. of secs. 24 and 25.</p> <p>Set a stainless steel post, 28 ins. long, 2 1/2 ins. diam., 27 ins. in the ground, with brass cap mkd.</p> <div style="text-align: center;"> <table style="margin: auto;"> <tr> <td>T 35 N</td> <td>R 15 E</td> </tr> <tr> <td></td> <td>S 24</td> </tr> <tr> <td>1/4</td> <td style="border-top: 1px solid black;">_____</td> </tr> <tr> <td></td> <td>S 25</td> </tr> </table> <p>2015</p> </div> <p>Deposit a magnet, in a white plastic case, at the base of the stainless steel post.</p> <p>Set a steel fence post nearby.</p> <p>The cor. is located on a northerly facing sandy ridge.</p>	T 35 N	R 15 E		S 24	1/4	_____		S 25
T 35 N	R 15 E								
	S 24								
1/4	_____								
	S 25								

Survey of a Portion of the Subdivisional Lines,
T. 35 N., R. 15 E., Gila and Salt River Meridian, Arizona

CHAINS	
80.00	<p>The cor. of secs. 23, 24, 25, and 26.</p> <p>Land, rolling to nearly level. Soil, sandy loam. Timber, scattered juniper and piñon. Undergrowth, service berry, cliff rose, Mormon tea, and sage.</p> <hr/> <p>N. 0°01' W., bet. secs. 23 and 24.</p> <p>Over nearly level to rolling to mountainous terrain.</p>
40.00	<p>Point for the 1/4 cor. of secs. 23 and 24.</p> <p>Set a stainless steel post, 28 ins. long, 2 1/2 ins. diam., 27 ins. in the ground, with brass cap mkd.</p> <div style="text-align: center;"> <p>T 35 N R 15 E 1/4 S 23 S 24</p> <p>2015</p> </div> <p>Deposit a magnet, in a white plastic case, at the base of the stainless steel post.</p> <p>Set a steel fence post nearby.</p> <p>The cor. is located on a northerly facing sandy ridge, 27 lks., W. of a wash, 8 ft. deep, drains southerly.</p>
71.19	<p>BIA Route 40, a bladed dirt road, 20 ft. wide, bears N. 59° E. and S. 60° W.</p>
80.00	<p>Point for the cor. of secs. 13, 14, 23, and 24.</p> <p>Set a stainless steel post, 28 ins. long, 2 1/2 ins. diam., 21 ins. in the ground to bedrock, with brass cap mkd.</p> <div style="text-align: center;"> <p>T 35 N R 15 E S 14 S 13 S 23 S 24</p> <p>2015</p> </div> <p>Deposit a magnet, in a white plastic case, at the base of the stainless steel post.</p> <p>The cor. is located 41 lks. N. of the base of a sandstone cliff, 35 ft. high, bears N. 50° E. and W., and 74 lks. W. of the same sandstone cliff, 50 ft. high, bears N. 25° E. and S. 30° W.</p>

Survey of a Portion of the Subdivisional Lines,
T. 35 N., R. 15 E., Gila and Salt River Meridian, Arizona

CHAINS	
	<p>Land, mountainous. Soil, sandy loam and sandstone. Timber, scattered juniper and piñon. Undergrowth, service berry, cliff rose, Mormon tea, and sage.</p> <hr/> <p>From the cor. of secs. 13, 18, 19, and 24, on the E. bdy. of the Tp., hereinbefore described.</p> <p>West, bet. secs. 13 and 24.</p> <p>Over mountainous terrain.</p>
40.00	<p>Point for the 1/4 sec. cor. of secs. 13 and 24.</p> <p>Set a stainless steel post, 28 ins. long, 2 1/2 ins. diam., 26 ins. in the ground, with brass cap mkd.</p> <div style="text-align: center;"> <p>T 35 N R 15 E S 13 1/4 ——— S 24</p> <p>2015</p> </div> <p>Deposit a magnet, in a white plastic case, at the base of the stainless steel post.</p> <p>Set a steel fence post nearby.</p>
50.06	<p>BIA Route 40, a bladed dirt road, 20 ft. wide, bears N. 27° E. and S. 28° W.</p>
73.63	<p>BIA Route 40, a bladed dirt road, 20 ft. wide, bears N. 42° E. and S. 39° W.</p>
80.00	<p>The cor. of secs. 13, 14, 23, and 24.</p> <p>Land, mountainous. Soil, sandy loam and sandstone. Timber, juniper and piñon. Undergrowth, salt brush and Mormon tea.</p> <hr/> <p>N. 0°01' W., bet. secs. 13 and 14.</p> <p>Over mountainous terrain.</p>
40.00	<p>Point for the 1/4 sec. cor. of secs. 13 and 14.</p> <p>Set a stainless steel post, 28 ins. long, 2 1/2 ins. diam., 24 ins. in the ground, with brass cap mkd.</p>

Survey of a Portion of the Subdivisional Lines,
T. 35 N., R. 15 E., Gila and Salt River Meridian, Arizona

CHAINS	
	T 35 N R 15 E 1/4 S 14 S 13 2015
	Deposit a magnet, in a white plastic case, at the base of the stainless steel post. Set a steel fence post nearby.
80.00	Point for the cor. of secs. 11, 12, 13, and 14. Set a stainless steel post, 28 ins. long, 2 1/2 ins. diam., 26 ins. in the ground, with brass cap mkd. <div style="text-align: center;"> T 35 N R 15 E S 11 S 12 ----- S 14 S 13 </div> 2015 Deposit a magnet, in a white plastic case, at the base of the stainless steel post. Set a steel fence post nearby. Land, mountainous to rolling. Soil, sandy loam and sandstone. Timber, scattered juniper and piñon. Undergrowth, cliff rose, Mormon tea, yucca, and sage.
	<hr/> From the cor. of secs. 7, 12, 13, and 18, on the E. bdy. of the Tp., hereinbefore described. West, bet. secs. 12 and 13. Over rolling to mountainous terrain.
40.00	Point for the 1/4 sec. cor. of secs. 12 and 13. Set a stainless steel post, 28 ins. long, 2 1/2 ins. diam., 25 ins. in the ground, with brass cap mkd. <div style="text-align: center;"> T 35 N R 15 E S 12 1/4 ——— S 13 </div> 2015

Survey of a Portion of the Subdivisional Lines,
T. 35 N., R. 15 E., Gila and Salt River Meridian, Arizona

CHAINS	
	<p>Deposit a magnet, in a white plastic case, at the base of the stainless steel post.</p> <p>Set a steel fence post nearby.</p> <p>From this cor. point, the undeveloped Pat Williams Spring, 25 x 10 ft., bears S. 75°43' W., 8.15 chs. dist.</p>
80.00	<p>The cor. of secs. 11, 12, 13, and 14.</p> <p>Land, mountainous to rolling. Soil, sandy loam and sandstone. Timber, juniper and piñon. Undergrowth, cliff rose, yucca, and sage.</p>
	<hr/> <p>N. 0°01' W., bet. secs. 11 and 12.</p> <p>Over gently rolling terrain.</p>
40.00	<p>Point for the 1/4 sec. cor. of secs. 11 and 12.</p> <p>Set a stainless steel post, 28 ins. long, 2 1/2 ins. diam., 26 ins. in the ground, with brass cap mkd.</p> <p style="text-align: center;">T 35 N R 15 E 1/4 S 11 S 12 2015</p>
44.84	<p>Deposit a magnet, in a white plastic case, at the base of the stainless steel post.</p> <p>Set a steel fence post nearby.</p> <p>Underground water line, bears S. 77° E. and N. 77° W.</p>
80.00	<p>Point for the cor. of secs. 1, 2, 11, and 12.</p> <p>Set a stainless steel post, 28 ins. long, 2 1/2 ins. diam., 27 ins. in the ground, with brass cap mkd.</p> <p style="text-align: center;">T 35 N R 15 E S 2 S 1 S 11 S 12 2015</p> <p>Deposit a magnet, in a white plastic case, at the base of the stainless steel post.</p>

Survey of a Portion of the Subdivisional Lines,
T. 35 N., R. 15 E., Gila and Salt River Meridian, Arizona

CHAINS	
	<p>Set a steel fence post nearby.</p> <p>Land, nearly level. Soil, sandy loam. Timber, juniper. Undergrowth, salt brush, rabbit brush, and cholla.</p> <hr/> <p>From the cor. of secs. 1, 6, 7, and 12, on the E. bdy. of the Tp., hereinbefore described.</p> <p>West, bet. secs. 1 and 12.</p> <p>Over nearly level terrain.</p>
24.87	Underground water line, bears N. 17° E. and S. 17° W.
40.00	Point for the 1/4 sec. cor. of secs. 1 and 12.
	Set a stainless steel post, 28 ins. long, 2 1/2 ins. diam., 27 ins. in the ground, with brass cap mkd.
	<p>T 35 N R 15 E</p> <p>S 1</p> <p>1/4 ———</p> <p>S 12</p> <p>2015</p>
	Deposit a magnet, in a white plastic case, at the base of the stainless steel post.
	Set a steel fence post nearby.
80.00	The cor. of secs. 1, 2, 11, and 12.
	<p>Land, nearly level. Soil, sandy loam. Timber, juniper. Undergrowth, rabbit brush, black brush, cholla, and yucca.</p> <hr/> <p>N. 0°01' W., bet. secs. 1 and 2.</p> <p>Over nearly level terrain.</p>
6.74	Power line, 5 strand, bears N. 62° E. and S. 62° W.
6.93	S. right-of-way fence of U.S. Highway 160, woven and barbed wire fence, parallels highway.
8.63	U.S. Highway 160, an asphalt surfaced road, 36 ft. wide, bears N. 62° E. and S. 62° W.

Survey of a Portion of the Subdivisional Lines,
T. 35 N., R. 15 E., Gila and Salt River Meridian, Arizona

CHAINS	
12.04	N. right-of-way fence of U.S. Highway 160 and S. right-of-way fence of Black Mesa and Lake Powell Railroad, woven and barbed wire fence, parallels railroad.
13.75	Black Mesa and Lake Powell Railroad, bears N. 62° E. and S. 62° W.
15.59	N. right-of-way fence of Black Mesa and Lake Powell Railroad, woven and barbed wire fence, parallels railroad.
20.89	Power line, 4 strand, bears N. 66° E. and S. 66° W.
40.00	Point for the 1/4 sec. cor. of secs. 1 and 2. Set a stainless steel post, 28 ins. long, 2 1/2 ins. diam., 26 ins. in the ground, with brass cap mkd. <div style="text-align: center;"> T 35 N R 15 E 1/4 S 2 S 1 2015 </div> Deposit a magnet, in a white plastic case, at the base of the stainless steel post. Set a steel fence post nearby.
43.55	Power line, 5 strand, bears S. 27° E. and N. 27° W.
68.35	Questar Southern Trails Pipeline Co., underground gas pipeline, bears N. 59° E. and S. 59° W.
77.52	Trail road, 8 ft. wide, bears N. 54° E. and S. 54° W.
78.72	Trail road, 8 ft. wide, bears S. 33° E. and N. 33° W.
80.00	The cor. of secs. 1, 2, 35, and 36, on the N. bdy. of the Tp., hereinbefore described. Land, nearly level. Soil, sandy loam. Timber, scattered juniper. Undergrowth, rabbit brush, black brush, and cholla. <hr/> From the cor. of secs. 2, 3, 34, and 35, on the S. bdy. of the Tp., hereinbefore described. N. 0°01' W., bet. secs. 34 and 35. Over mountainous terrain.

Survey of a Portion of the Subdivisional Lines,
T. 35 N., R. 15 E., Gila and Salt River Meridian, Arizona

CHAINS							
40.00	<p>Point for the 1/4 sec. cor. of secs. 34 and 35.</p> <p>Set a stainless steel post, 28 ins. long, 2 1/2 ins. diam., 26 ins. in the ground, with brass cap mkd.</p> <div style="text-align: center;"> <table style="margin: auto;"> <tr><td>T 35 N</td><td>R 15 E</td></tr> <tr><td colspan="2" style="text-align: center;">1/4</td></tr> <tr><td>S 34</td><td> S 35</td></tr> </table> <p>2015</p> </div> <p>Deposit a magnet, in a white plastic case, at the base of the stainless steel post.</p> <p>Set a steel fence post nearby.</p> <p>The cor. is located on top of a finger ridge, 20 ft. wide, 45 ft. high, bears S. 50° E. and N. 80° W.</p>	T 35 N	R 15 E	1/4		S 34	S 35
T 35 N	R 15 E						
1/4							
S 34	S 35						
80.00	<p>Point for the cor. of secs. 26, 27, 34, and 35.</p> <p>Set a stainless steel post, 28 ins. long, 2 1/2 ins. diam., 24 ins. in the ground, with brass cap mkd.</p> <div style="text-align: center;"> <table style="margin: auto;"> <tr><td>T 35 N</td><td>R 15 E</td></tr> <tr><td>S 27</td><td> S 26</td></tr> <tr><td>S 34</td><td> S 35</td></tr> </table> <p>2015</p> </div> <p>Deposit a magnet, in a white plastic case, at the base of the stainless steel post.</p> <p>Set a steel fence post nearby.</p> <p>The cor. is located on an E. facing slope, bears N. and S.</p> <p>Land, mountainous. Soil, sandy loam and sandstone. Timber, juniper and piñon. Undergrowth, sage, cliff rose, Mormon tea, yucca, and salt brush.</p> <hr/> <p>From the cor. of secs. 25, 26, 35, 36.</p> <p>West, bet. secs. 26 and 35.</p> <p>Over rolling to mountainous terrain.</p>	T 35 N	R 15 E	S 27	S 26	S 34	S 35
T 35 N	R 15 E						
S 27	S 26						
S 34	S 35						
40.00	<p>Point for the 1/4 sec. cor. of secs. 26 and 35.</p>						

Survey of a Portion of the Subdivisional Lines,
T. 35 N., R. 15 E., Gila and Salt River Meridian, Arizona

CHAINS	
80.00	<p>Set a stainless steel post, 28 ins. long, 2 1/2 ins. diam., 23 ins. in the ground, with brass cap mkd.</p> <p style="text-align: center;">T 35 N R 15 E S 26 1/4 ——— S 35</p> <p style="text-align: center;">2015</p> <p>Deposit a magnet, in a white plastic case, at the base of the stainless steel post.</p> <p>Set a steel fence post nearby.</p> <p>The cor. is located, 71 lks. S. of a mountain drainage, 8 ft. wide, 2 ft. deep, drains N. 55° W.</p> <p>The cor. of secs. 26, 27, 34, and 35.</p> <p>Land, mountainous. Soil, sandy loam and sandstone. Timber, juniper and piñon. Undergrowth, sage, salt brush, and Mormon tea.</p>
40.00	<p>N. 0°01' W., bet. secs. 26 and 27.</p> <p>Over mountainous to rolling terrain.</p> <p>Point for the 1/4 sec. cor. of secs. 26 and 27.</p> <p>Set a stainless steel post, 28 ins. long, 2 1/2 ins. diam., 25 ins. in the ground, with brass cap mkd.</p> <p style="text-align: center;">T 35 N R 15 E 1/4 S 27 S 26</p> <p style="text-align: center;">2015</p> <p>Deposit a magnet, in a white plastic case, at the base of the stainless steel post.</p> <p>The cor. is located, S. of the SW face of a sandstone boulder, 16 x 12 x 10 ft., on top of a mesa, at the easterly edge of a hill of sandstone boulders, 50 ft. high.</p>
78.03	<p>BIA Route 40, a bladed dirt road, 20 ft. wide, bears S. 86° E. and N. 84° W.</p>
80.00	<p>Point for the cor. of secs. 22, 23, 46, and 27.</p>

Survey of a Portion of the Subdivisional Lines,
T. 35 N., R. 15 E., Gila and Salt River Meridian, Arizona

CHAINS									
	<p>Set a stainless steel post, 28 ins. long, 2 1/2 ins. diam., 12 ins. in the ground, in a mound of stone, 2 ft. base, to top, with brass cap mkd.</p> <div style="text-align: center;"> <table border="1"> <tr> <td>T 35 N</td> <td>R 15 E</td> </tr> <tr> <td>S 22</td> <td>S 23</td> </tr> <tr> <td>S 27</td> <td>S 26</td> </tr> </table> <p>2015</p> </div> <p>Deposit a magnet, in a white plastic case, at the base of the stainless steel post.</p> <p>Land, rolling. Soil, sandy loam and rocky. Timber, scattered juniper and piñon. Undergrowth, cliff rose, sage, and Mormon tea.</p> <hr/>	T 35 N	R 15 E	S 22	S 23	S 27	S 26		
T 35 N	R 15 E								
S 22	S 23								
S 27	S 26								
40.00	<p>From the cor. of secs. 23, 24, 25, and 26.</p> <p>West, bet. secs. 23 and 26.</p> <p>Over mountainous to rolling terrain.</p> <p>Point for the 1/4 sec. cor. of secs. 23 and 26.</p> <p>Set a stainless steel post, 28 ins. long, 2 1/2 ins. diam., 28 ins. in the ground, with brass cap mkd.</p> <div style="text-align: center;"> <table border="1"> <tr> <td>T 35 N</td> <td>R 15 E</td> </tr> <tr> <td>S 23</td> <td></td> </tr> <tr> <td>1/4</td> <td>—</td> </tr> <tr> <td>S 26</td> <td></td> </tr> </table> <p>2015</p> </div> <p>Deposit a magnet, in a white plastic case, at the base of the stainless steel post.</p> <p>The cor. is located, on a NW facing slope.</p>	T 35 N	R 15 E	S 23		1/4	—	S 26	
T 35 N	R 15 E								
S 23									
1/4	—								
S 26									
48.78	<p>BIA Route 40, a bladed dirt road, 20 ft. wide, bears N. 32° E. and S. 49° W.</p>								
69.93	<p>BIA Route 40, a bladed dirt road, 20 ft. wide, bears S. 81° E. and S. 84° W.</p>								
80.00	<p>The cor. of secs. 22, 23, 26, and 27.</p> <p>Land, rolling. Soil, sandy loam. Timber, scattered juniper and piñon. Undergrowth, cliff rose, native grasses, sage, yucca, and Mormon tea.</p> <hr/>								

Survey of a Portion of the Subdivisional Lines,
T. 35 N., R. 15 E., Gila and Salt River Meridian, Arizona

CHAINS	
	N. 0°01' W., bet. secs. 22 and 23. Over rolling terrain.
40.00	Point for the 1/4 sec. cor. of secs. 22 and 23. Set a stainless steel post, 28 ins. long, 2 1/2 ins. diam., 27 ins. in the ground, with brass cap mkd. <div style="text-align: center;"> T 35 N R 15 E 1/4 S 22 S 23 2015 </div>
	Deposit a magnet, in a white plastic case, at the base of the stainless steel post.
80.00	Point for the cor. of secs. 14, 15, 22, and 23. Set a stainless steel post, 28 ins. long, 2 1/2 ins. diam., 24 ins. in the ground, with brass cap mkd. <div style="text-align: center;"> T 35 N R 15 E S 15 S 14 S 22 S 23 2015 </div>
	Deposit a magnet, in a white plastic case, at the base of the stainless steel post.
	The cor. is located, on a 38° southwesterly facing slope, 1 ch. E. from a wash, drains S., and 51 lks. W. of a ridge, bears S. 34° E. and N. 10° W.
	Land, rolling. Soil, sandy loam. Timber, scattered juniper and piñon. Undergrowth, cliff rose, yucca, Mormon tea, and native grasses.
	From the cor. of secs. 13, 14, 23, and 24. West, bet. secs. 14 and 23. Over rolling terrain.
40.00	Point for the 1/4 sec. cor. of secs. 14 and 23. Set a stainless steel post, 28 ins. long, 2 1/2 ins. diam., 23 ins. in the ground, with brass cap mkd.

Survey of a Portion of the Subdivisional Lines,
T. 35 N., R. 15 E., Gila and Salt River Meridian, Arizona

CHAINS	
	T 35 N R 15 E S 14 1/4 ——— S 23 2015
	Deposit a magnet, in a white plastic case, at the base of the stainless steel post. Set a steel fence post nearby.
80.00	The cor. of secs. 14, 15, 22, and 23. Land, rolling. Soil, sandy loam and sandstone. Timber, juniper and piñon. Undergrowth, cliff rose and sage.
	N. 0°01' W., bet. secs. 14 and 15. Over rolling terrain.
40.00	Point for the 1/4 sec. cor. of secs. 14 and 15. Set a stainless steel post, 28 ins. long, 2 1/2 ins. diam., 25 ins. in the ground, with brass cap mkd.
	T 35 N R 15 E 1/4 S 15 S 14 2015
	Deposit a magnet, in a white plastic case, at the base of the stainless steel post. Set a steel fence post nearby.
80.00	Point for the cor. of secs. 10, 11, 14, and 15. Set a stainless steel post, 28 ins. long, 2 1/2 ins. diam., 24 ins. in the ground, with brass cap mkd.
	T 35 N R 15 E S 10 S 11 S 15 S 14 2015

Survey of a Portion of the Subdivisional Lines,
T. 35 N., R. 15 E., Gila and Salt River Meridian, Arizona

CHAINS	
	<p>Deposit a magnet, in a white plastic case, at the base of the stainless steel post.</p> <p>Set a steel fence post nearby.</p> <p>The cor. is located, on a gentile westerly facing slope.</p> <p>Land, rolling. Soil, sandy loam and sandstone outcrops. Timber, scattered juniper. Undergrowth, Salt brush, cholla, yucca, cactus, and native grasses.</p> <hr/> <p>From the cor. of secs. 11, 12, 13, and 14.</p> <p>West, bet. secs. 11 and 14.</p> <p>Over gently rolling terrain.</p>
40.00	<p>Point for the 1/4 sec. cor. of secs. 11 and 14.</p> <p>Set a stainless steel post, 28 ins. long, 2 1/2 ins. diam., 26 ins. in the ground, with brass cap mkd.</p> <p style="text-align: center;">T 35 N R 15 E S 11 1/4 ——— S 14</p> <p style="text-align: center;">2015</p>
80.00	<p>Deposit a magnet, in a white plastic case, at the base of the stainless steel post.</p> <p>Set a steel fence post nearby.</p> <p>The cor. of secs. 10, 11, 14, and 15.</p> <p>Land, gently rolling. Soil, sandy loam. Timber, none. Undergrowth, salt brush and rabbit brush.</p> <hr/>
	<p>N. 0°01' W., bet. secs. 10 and 11.</p> <p>Over nearly level terrain.</p>
4.83	<p>Underground water line, bears N. 24° E. and S. 24° W.</p>
38.41	<p>Power line, 5 strand, bears N. 64° E. and S. 64° W.</p>

Survey of a Portion of the Subdivisional Lines,
T. 35 N., R. 15 E., Gila and Salt River Meridian, Arizona

CHAINS	
40.00	<p>Point for the 1/4 sec. cor. of secs. 10 and 11.</p> <p>Set a stainless steel post, 28 ins. long, 2 1/2 ins. diam., 27 ins. in the ground, with brass cap mkd.</p> <div style="text-align: center;"> <p>T 35 N R 15 E</p> <p>1/4</p> <p>S 10 S 11</p> <p>2015</p> </div> <p>Deposit a magnet, in a white plastic case, at the base of the stainless steel post.</p> <p>The cor. is located, on the easterly face of a low berm, 6 ft. high.</p>
45.24	S. right-of-way fence of U.S. Highway 160, barbed wire fence, 5 strand, parallels highway.
46.92	U.S. Highway 160, an asphalt surfaced road, 36 ft. wide, bears N. 62° E. and S. 62° W.
50.32	N. right-of-way fence of U.S. Highway 160 and S. right-of-way fence of Black Mesa and Lake Powell Railroad, woven and barbed wire fence, parallels railroad.
52.02	Black Mesa and Lake Powell Railroad, bears N. 63° E. and S. 63° W.
53.22	N. right-of-way fence of Black Mesa and Lake Powell Railroad, woven and barbed wire fence, parallels railroad.
80.00	<p>Point for the cor. of secs. 2, 3, 10, and 11.</p> <p>Set a stainless steel post, 28 ins. long, 2 1/2 ins. diam., 26 ins. in the ground, with brass cap mkd.</p> <div style="text-align: center;"> <p>T 35 N R 15 E</p> <p>S 3 S 2</p> <hr style="width: 50%; margin: 0 auto;"/> <p>S 10 S 11</p> <p>2015</p> </div> <p>Deposit a magnet, in a white plastic case, at the base of the stainless steel post.</p> <p>Set a steel fence post nearby.</p> <p>Land, gently rolling to nearly level. Soil, sandy clay. Timber, sparse juniper. Undergrowth, black brush, cholla, yucca, and tumble weed.</p> <hr style="width: 80%; margin-left: 0;"/>

Survey of a Portion of the Subdivisional Lines,
T. 35 N., R. 15 E., Gila and Salt River Meridian, Arizona

CHAINS	
	From the cor. of secs. 1, 2, 11, and 12.
	West, bet. secs. 2 and 11.
	Over nearly level terrain.
12.94	Power line, 5 strand, bears N. 62° E. and S. 62° W.
13.30	S. right-of-way fence of U.S. Highway 160, woven barbed wire fence, parallels highway.
16.51	U.S. Highway 160, an asphalt surfaced road, 36 ft. wide, bears N. 62° E. and S. 62° W.
22.99	N. right-of-way fence of U.S. Highway 160 and S. right-of-way fence of Black Mesa and Lake Powell Railroad, woven and barbed wire fence, parallels railroad.
26.36	Black Mesa and Lake Powell Railroad, bears N. 63° E. and S. 63° W.
26.86	E. right-of-way fence of Arizona State Route 98, barbed wire fence, 5 strand, parallels highway.
28.48	Arizona State Route 98, asphalt surfaced, 36 ft. wide, bears S. 24° E. and N. 24° W.
30.13	W. right-of-way fence of Arizona State Route 98, woven barbed wire fence, parallels highway.
40.00	Point for the 1/4 sec. cor. of secs. 2 and 11.
	Set a stainless steel post, 28 ins. long, 2 1/2 ins. diam., 27 ins. in the ground, with brass cap mkd.
	T 35 N R 15 E S 2 1/4 ——— S 11
	2015
	Deposit a magnet, in a white plastic case, at the base of the stainless steel post.
	Set a steel fence post nearby.
	From this cor. point, the designated Point of Beginning, southwest corner of Shonto NHA project No. AZ12-96, as shown in PAIKI plat titled "BOUNDARY SURVEY PLAT OF SHONTO NHA PROJECT NO. AZ12-96 AS BUILT SUB-DIVISION TRACT - 5.569 ACRES SHONTO, NAVAJO COUNTY, ARIZONA", dated 11/10/07, on file at Navajo Housing Authority, Division of Construction Services, Planning Department, Fort Defiance, Arizona, was not recovered.

Survey of a Portion of the Subdivisional Lines,
T. 35 N., R. 15 E., Gila and Salt River Meridian, Arizona

CHAINS	
	<p>From this same cor. point, the designated northwest corner of the same NHA project, monumented with a rebar, 1/2 in. diam., bears N. 31°37' E., 15.21 chs. dist.</p> <p>From this same cor. point, the corner of the same NHA project, with record bearing of N. 64°54'53" E., and 150.00 ft. dist. from the northwest corner, monumented with a 1/2 in. rebar, 1 in. below the surface of the ground, bears N. 35°52' E., 17.14 chs. dist.</p> <p>From this same cor. point, the corner of the same NHA project, with record bearing of N. 25°05'47" W., and 100.00 ft. dist. from the above described cor., monumented with a 1/2 in. rebar, 1 in. below the surface of the ground, bears N. 31°41' E., 17.94 chs. dist.</p> <p>From this same cor. point, the corner of the same NHA project, with record bearing of N. 64°54'13" E., and 275.00 ft. dist. from the above described cor., was not recovered.</p> <p>From this same cor. point, the corner of the same NHA project, with record bearing of S. 25°05'47" E., and 50.00 ft. dist. from the above described cor., monumented with a rebar, 1/2 in. diam., 5 ins. below the surface of the ground, with a plastic yellow cap, bears N. 39°42' E., 21.18 chs. dist.</p> <p>From this cor. point, the designated northeast corner of the same NHA project, monumented with a rebar, 1/2 in. diam., projecting 1 in. above the ground, with an aluminum cap, 2 ins. diam., mkd. NHA AZ RLS 46197, bears N. 41°23' E., 22.55 chs. dist.</p> <p>From this same cor. point, the designated southeast corner of the same NHA project, monumented with a rebar, 1/2 in. diam., firmly set, 11 ins. below the surface of the ground, with a plastic yellow cap, 1 in. diam., mkd. RLS 9624, bears N. 58°51' E., 20.71 chs. dist.</p>
80.00	<p>The cor. of secs. 2, 3, 10, and 11.</p> <p>Land, nearly level. Soil, sandy loam. Timber, none. Undergrowth, black brush, salt brush, and tumble weed.</p> <hr/> <p>N. 0°01' W., bet. secs. 2 and 3.</p> <p>Over nearly level terrain.</p>
20.83	<p>Questar Southern Trails Pipeline Co., underground gas pipeline, bears N. 60° E. and S. 60° W.</p>
39.19	<p>Underground water line, bears S. 41° E. and N. 41° W.</p>

Survey of a Portion of the Subdivisional Lines,
T. 35 N., R. 15 E., Gila and Salt River Meridian, Arizona

CHAINS	
40.00	<p>Point for the 1/4 sec. cor. of secs. 2 and 3.</p> <p>Set a stainless steel post, 28 ins. long, 2 1/2 ins. diam., 25 ins. in the ground, with brass cap mkd.</p> <p style="text-align: center;">T 35 N R 15 E 1/4 S 3 S 2 2015</p> <p>Deposit a magnet, in a white plastic case, at the base of the stainless steel post.</p> <p>Set a steel fence post nearby.</p>
80.00	<p>The cor. of secs. 2, 3, 34, and 35, on the N. bdy. of the Tp., hereinbefore described.</p> <p>Land, nearly level. Soil, sandy loam. Timber, none. Undergrowth, black brush, rabbit brush, and tumble weed.</p> <hr/> <p>From the cor. of secs. 3, 4, 33, and 34, on the S. bdy. of the Tp., hereinbefore described.</p> <p>N. 0°02' W., bet. secs. 33 and 34.</p> <p>Over rolling terrain.</p>
11.26	<p>BIA Route 6620, a bladed dirt road, 20 ft. wide, bears S. 60° E. and N. 25° W.</p>
40.00	<p>Point for the 1/4 sec. cor. of secs. 33 and 34.</p> <p>Set a stainless steel post, 28 ins. long, 2 1/2 ins. diam., 25 ins. in the ground, in a collar of stone, 2 ft. base, with brass cap mkd.</p> <p style="text-align: center;">T 35 N R 15 E 1/4 S 33 S 34 2015</p> <p>Deposit a magnet, in a white plastic case, at the base of the stainless steel post.</p>
80.00	<p>Point for the cor. of secs. 27, 28, 33, and 34.</p>

Survey of a Portion of the Subdivisional Lines,
T. 35 N., R. 15 E., Gila and Salt River Meridian, Arizona

CHAINS									
	<p>Set a stainless steel post, 28 ins. long, 2 1/2 ins. diam., 18 ins. in the ground, in a mound of stone, 3 ft. base, to top of brass cap mkd.</p> <div style="text-align: center;"> <table style="border-collapse: collapse; margin: auto;"> <tr> <td style="padding: 0 10px;">T 35 N</td> <td style="border-left: 1px solid black; padding: 0 10px;">R 15 E</td> </tr> <tr> <td style="padding: 0 10px;">S 28</td> <td style="border-left: 1px solid black; padding: 0 10px;">S 27</td> </tr> <tr> <td style="border-top: 1px solid black; padding: 0 10px;">S 33</td> <td style="border-left: 1px solid black; border-top: 1px solid black; padding: 0 10px;">S 34</td> </tr> </table> <p>2015</p> </div> <p>Deposit a magnet, in a white plastic case, at the base of the stainless steel post.</p> <p>The cor. is located, on a steep easterly facing slope, in broken country.</p> <p>Land, rolling and broken. Soil, silty sand and rocky. Timber, juniper and piñon. Undergrowth, sage, Mormon tea, cliff rose, and service berry.</p> <hr/> <p>From the cor. of secs. 26, 27, 34, and 35.</p> <p>West, bet. secs. 27 and 34.</p> <p>Over mountainous terrain.</p>	T 35 N	R 15 E	S 28	S 27	S 33	S 34		
T 35 N	R 15 E								
S 28	S 27								
S 33	S 34								
40.00	<p>Point for the 1/4 sec. cor. of secs. 27 and 34.</p> <p>Set a stainless steel post, 28 ins. long, 2 1/2 ins. diam., 23 ins. in the ground, with brass cap mkd.</p> <div style="text-align: center;"> <table style="border-collapse: collapse; margin: auto;"> <tr> <td style="padding: 0 10px;">T 35 N</td> <td style="border-left: 1px solid black; padding: 0 10px;">R 15 E</td> </tr> <tr> <td style="padding: 0 10px;"></td> <td style="border-left: 1px solid black; padding: 0 10px;">S 27</td> </tr> <tr> <td style="padding: 0 10px;">1/4</td> <td style="border-left: 1px solid black; padding: 0 10px;">—</td> </tr> <tr> <td style="padding: 0 10px;"></td> <td style="border-left: 1px solid black; padding: 0 10px;">S 34</td> </tr> </table> <p>2015</p> </div> <p>Deposit a magnet, in a white plastic case, at the base of the stainless steel post.</p> <p>Set a steel fence post nearby.</p>	T 35 N	R 15 E		S 27	1/4	—		S 34
T 35 N	R 15 E								
	S 27								
1/4	—								
	S 34								
80.00	<p>The cor. of secs. 27, 28, 33, and 34.</p> <p>Land, mountainous. Soil, sandy loam and sandstone. Timber, juniper and piñon. Undergrowth, sage, Mormon tea, salt brush, yucca, and native grasses.</p> <hr/>								

Survey of a Portion of the Subdivisional Lines,
T. 35 N., R. 15 E., Gila and Salt River Meridian, Arizona

CHAINS	
	N. 0°02' W., bet. secs. 27 and 28. Over mountainous to rolling terrain.
40.00	Point for the 1/4 sec. cor. of secs. 27 and 28. Set a stainless steel post, 28 ins. long, 2 1/2 ins. diam., 27 ins. in the ground, with brass cap mkd. <div style="text-align: center;"> T 35 N R 15 E 1/4 S 28 S 27 2015 </div>
80.00	Point for the cor. of secs. 21, 22, 27, and 28. Set a stainless steel post, 28 ins. long, 2 1/2 ins. diam., 26 ins. in the ground, with brass cap mkd. <div style="text-align: center;"> T 35 N R 15 E S 21 S 22 --- --- S 28 S 27 2015 </div>
	Deposit a magnet, in a white plastic case, at the base of the stainless steel post.
	Land, rolling. Soil, sandy loam. Timber, scattered juniper and piñon. Undergrowth, cliff rose, sage, Mormon tea, and cactus.
	From the cor. of secs. 22, 23, 26, and 27. West, bet. secs. 22 and 27. Over mountainous to rolling terrain.
19.55	BIA Route 40, a bladed dirt road, 20 ft. wide, bears S. 60° E. and N. 60° W.
26.74	BIA Route 40, a bladed dirt road, 20 ft. wide, bears N. 43° E. and S. 43° W.
40.00	Point for the 1/4 sec. cor. of secs. 22 and 27.

Survey of a Portion of the Subdivisional Lines,
T. 35 N., R. 15 E., Gila and Salt River Meridian, Arizona

CHAINS	
	<p>Set a stainless steel post, 28 ins. long, 2 1/2 ins. diam., 28 ins. in the ground, with brass cap mkd.</p> <p style="text-align: center;">T 35 N R 15 E S 22 1/4 ——— S 27</p> <p style="text-align: center;">2015</p> <p>Deposit a magnet, in a white plastic case, at the base of the stainless steel post.</p>
49.77	BIA Route 6620, a bladed dirt road, 25 ft. wide, bears N. 7° E. and S. 5° W.
68.30	BIA Route 6620, a bladed dirt road, 25 ft. wide, bears S. 30° E. and N. 31° W.
80.00	The cor. of secs. 21, 22, 27, and 28.
	<p>Land, rolling. Soil, sandy loam. Timber, scattered juniper and piñon. Undergrowth, cliff rose, sage, and Mormon tea.</p> <hr/> <p>N. 0°02' W., bet. secs. 21 and 22.</p> <p>Over rolling to gently rolling terrain.</p>
4.01	BIA Route 6620, a bladed dirt road, 25 ft. wide, bears N. 77° E. and S. 71° W.
40.00	Point for the 1/4 sec. cor. of secs. 21 and 22.
	<p>Set a stainless steel post, 28 ins. long, 2 1/2 ins. diam., 26 ins. in the ground, with brass cap mkd.</p> <p style="text-align: center;">T 35 N R 15 E 1/4 S 21 S 22</p> <p style="text-align: center;">2015</p> <p>Deposit a magnet, in a white plastic case, at the base of the stainless steel post.</p> <p>Set a steel fence post nearby.</p> <p>The cor. is located, 66 lks. E. of a trail road, 8 ft. wide, bears N. 2° E. and S. 4° E.</p>

Survey of a Portion of the Subdivisional Lines,
T. 35 N., R. 15 E., Gila and Salt River Meridian, Arizona

CHAINS									
54.26	BIA Route 6620, a bladed dirt road, 30 ft. wide, bears S. 34° E. and N. 22° W.								
80.00	<p>Point for the cor. of secs. 15, 16, 21, and 22.</p> <p>Set a stainless steel post, 28 ins. long, 2 1/2 ins. diam., 26 ins. in the ground, with brass cap mkd.</p> <div style="text-align: center;"> <table style="margin: auto;"> <tr> <td>T 35 N</td> <td>R 15 E</td> </tr> <tr> <td>S 16</td> <td>S 15</td> </tr> <tr> <td>S 21</td> <td>S 22</td> </tr> </table> <p>2015</p> </div> <p>Deposit a magnet, in a white plastic case, at the base of the stainless steel post.</p> <p>Set a steel fence post nearby.</p> <p>Land, gently rolling. Soil, sandy loam. Timber, juniper. Undergrowth, salt brush, black brush, Mormon tea, cholla, and yucca.</p> <hr/> <p>From the cor. of secs. 14, 15, 22, and 23.</p> <p>West. bet. secs. 15 and 22.</p> <p>Over rolling to gently rolling terrain.</p>	T 35 N	R 15 E	S 16	S 15	S 21	S 22		
T 35 N	R 15 E								
S 16	S 15								
S 21	S 22								
40.00	<p>Point for the 1/4 sec. cor. of secs. 15 and 22.</p> <p>Set a stainless steel post, 28 ins. long, 2 1/2 ins. diam., 27 ins. in the ground, with brass cap mkd.</p> <div style="text-align: center;"> <table style="margin: auto;"> <tr> <td>T 35 N</td> <td>R 15 E</td> </tr> <tr> <td></td> <td>S 15</td> </tr> <tr> <td>1/4</td> <td>—</td> </tr> <tr> <td></td> <td>S 22</td> </tr> </table> <p>2015</p> </div> <p>Deposit a magnet, in a white plastic case, at the base of the stainless steel post.</p> <p>Set a steel fence post nearby.</p>	T 35 N	R 15 E		S 15	1/4	—		S 22
T 35 N	R 15 E								
	S 15								
1/4	—								
	S 22								
40.34	Trail road, 8 ft. wide, bears S. 45° E. and N. 45° W.								
80.00	The cor. of secs. 15, 16, 21, and 22.								

Survey of a Portion of the Subdivisional Lines,
T. 35 N., R. 15 E., Gila and Salt River Meridian, Arizona

CHAINS	
	<p>Land, gently rolling. Soil, sandy loam. Timber, juniper. Undergrowth, sage, Mormon tea, yucca, cholla, and native grasses.</p> <hr/> <p>N. 0°02' W., bet. secs. 15 and 16.</p> <p>Over gently rolling to rolling terrain.</p>
39.27	Bladed dirt road, 12 ft. wide, bears S. 55° E. and N. 48° W.
39.76	Trail road, 8 ft. wide, bears S. 47° E. and N. 47° W.
40.00	Point for the 1/4 sec. cor. of secs. 15 and 16.
	<p>Set a stainless steel post, 28 ins. long, 2 1/2 ins. diam., 26 ins. in the ground, with brass cap mkd.</p> <p style="text-align: center;">T 35 N R 15 E 1/4 S 16 S 15</p> <p style="text-align: center;">2014</p> <p>Deposit a magnet, in a white plastic case, at the base of the stainless steel post.</p> <p>Set a steel fence post nearby.</p>
40.46	Bladed dirt road, 17 ft. wide, bears S. 54° E. and N. 54° W.
54.77	Underground water line, bears N. 64° E. and S. 64° W.
80.00	Point for the cor. of secs. 9, 10, 15, and 16.
	<p>Set a stainless steel post, 28 ins. long, 2 1/2 ins. diam., 26 ins. in the ground, with brass cap mkd.</p> <p style="text-align: center;">T 35 N R 15 E S 9 S 10 S 16 S 15</p> <p style="text-align: center;">2015</p> <p>Deposit a magnet, in a white plastic case, at the base of the stainless steel post.</p> <p>Set a steel fence post nearby.</p>

Survey of a Portion of the Subdivisional Lines,
T. 35 N., R. 15 E., Gila and Salt River Meridian, Arizona

CHAINS	
	<p>From this cor. point, National Geodetic Survey station "F 512 1983", PID GP0430, a vertical, first order, class II station, monumented with a stainless steel rod, access to the rod is through a 5 ins. diam., NGS logo lid, flush with the surface of the ground, NGS logo lid mkd. F 512 1983, bears S. 77°58' W., 11.635 chs. dist.</p> <p>From this same cor. point, United State Geological Survey triangulation station "KELLY 1970", PID GP0431, a horizontal, second order, and vertical, first order, class II station, monumented with a brass tablet, 3 1/2 ins. diam., firmly set, in concrete cylinder, 10 ins. diam., flush with the surface of the ground, encircled in a collar of stone, mkd. U.S. DEPARTMENT OF THE INTERIOR GEOLOGICAL SURVEY ELEV. FT ABOVE SEA KELLY 1970, bears S. 69°59 3/4' W., 21.287 chs. dist.</p> <p>From this United State Geological Survey triangulation station, the reference mark No. 1, monumented with a brass tablet, 3 1/2 ins. diam., firmly set, in concrete cylinder, 10 ins. diam., flush with the surface of the ground, mkd. U.S. DEPARTMENT OF THE INTERIOR GEOLOGICAL SURVEY KELLY RM No. 1 1970, bears S. 59° 52' E., 64 lks. dist. (12.886 meters)</p> <p>Land, rolling. Soil, sandy loam. Timber, scattered juniper and piñon. Undergrowth, native grasses, yucca, and rabbit brush.</p> <hr/> <p>From the cor. of secs. 10, 11, 14, and 15.</p> <p>West, bet. secs. 10 and 15.</p> <p>Over rolling terrain.</p>
3.29	Underground water line, bears N. 36° E. and S. 36° W.
40.00	<p>Point for the 1/4 sec. cor. of secs. 10 and 15.</p> <p>Set a stainless steel post, 28 ins. long, 2 1/2 ins. diam., 27 ins. in the ground, with brass cap mkd.</p> <p style="text-align: center;">T 35 N R 15 E S 10 1/4 ——— S 15</p> <p style="text-align: center;">2015</p> <p>Deposit a magnet, in a white plastic case, at the base of the stainless steel post.</p>

Survey of a Portion of the Subdivisional Lines,
T. 35 N., R. 15 E., Gila and Salt River Meridian, Arizona

CHAINS	
	Set a steel fence post nearby.
	The cor. is located, on a northeasterly facing gentle slope.
80.00	The cor. of secs. 9, 10, 15, and 16.
	Land, rolling. Soil, sandy loam. Timber, juniper and piñon. Undergrowth, native grasses and yucca.
	<hr/>
	N. 0°02' W., bet. secs. 9 and 10.
	Over rolling to gently rolling terrain.
0.07	Power line, 5 strand, bears N. 64° E. and S. 64° W.
3.49	S. right-of-way fence of U.S. Highway 160, barbed wire fence, 5 strand, parallels highway.
5.19	U.S. Highway 160, an asphalt surfaced road, 36 ft. wide, bears N. 62° E. and S. 62° W.
8.60	N. right-of-way fence of U.S. Highway 160 and S. right-of-way fence of Black Mesa and Lake Powell Railroad, woven and barbed wire fence, bears N. 63° E. and S. 63° W.
11.58	Black Mesa and Lake Powell Railroad, bears N. 64° E. and S. 64° W.
12.50	N. right-of-way fence of Black Mesa and Lake Powell Railroad, woven and barbed wire fence, parallels railroad.
40.00	Point for the 1/4 sec. cor. of secs. 9 and 10.
	Set a stainless steel post, 28 ins. long, 2 1/2 ins. diam., 27 ins. in the ground, with brass cap mkd.
	T 35 N R 15 E 1/4 S 9 S 10 2015
	Deposit a magnet, in a white plastic case, at the base of the stainless steel post.
	Set a steel fence post nearby.
	The cor. is located, 50 lks. N. from a trail road, 8 ft. wide, bears S. 19° E. and N. 31° W., and 27 lks. E. from the same trail road.

Survey of a Portion of the Subdivisional Lines,
T. 35 N., R. 15 E., Gila and Salt River Meridian, Arizona

CHAINS							
55.67	<p>Questar Southern Trails Pipeline Co., underground gas pipeline, bears N. 61° E. and S. 61° W.</p>						
80.00	<p>Point for the cor. of secs. 3, 4, 9, and 10.</p> <p>Set a stainless steel post, 28 ins. long, 2 1/2 ins. diam., 25 ins. in the ground, with brass cap mkd.</p> <div style="text-align: center;"> <table style="margin: auto;"> <tr> <td>T 35 N</td> <td>R 15 E</td> </tr> <tr> <td style="border-right: 1px solid black;">S 4</td> <td>S 3</td> </tr> <tr> <td style="border-right: 1px solid black;">S 9</td> <td>S 10</td> </tr> </table> <p>2015</p> </div> <p>Deposit a magnet, in a white plastic case, at the base of the stainless steel post.</p> <p>Set a steel fence post nearby.</p> <p>Land, nearly level. Soil, sandy loam. Timber, sparse juniper. Undergrowth, black brush, rabbit brush, cholla, and native grasses.</p> <hr/> <p>From the cor. of secs. 2, 3, 10, and 11.</p> <p>West, bet. secs. 3 and 10.</p> <p>Over nearly level terrain.</p>	T 35 N	R 15 E	S 4	S 3	S 9	S 10
T 35 N	R 15 E						
S 4	S 3						
S 9	S 10						
37.10	<p>Questar Southern Trails Pipeline Co., underground gas pipeline, bears N. 60° E. and S. 60° W.</p>						
40.00	<p>Point for the 1/4 sec. cor. of secs. 3 and 10.</p> <p>Set a stainless steel post, 28 ins. long, 2 1/2 ins. diam., 26 ins. in the ground, with brass cap mkd.</p> <div style="text-align: center;"> <table style="margin: auto;"> <tr> <td>T 35 N</td> <td>R 15 E</td> </tr> <tr> <td></td> <td style="border-bottom: 1px solid black;">S 3</td> </tr> <tr> <td>1/4</td> <td style="border-bottom: 1px solid black;">S 10</td> </tr> </table> <p>2015</p> </div> <p>Deposit a magnet, in a white plastic case, at the base of the stainless steel post.</p> <p>Set a steel fence post nearby.</p>	T 35 N	R 15 E		S 3	1/4	S 10
T 35 N	R 15 E						
	S 3						
1/4	S 10						
80.00	<p>The cor. of secs. 3, 4, 9, and 10.</p>						

Survey of a Portion of the Subdivisional Lines,
T. 35 N., R. 15 E., Gila and Salt River Meridian, Arizona

CHAINS	
	<p>Land, nearly level. Soil, sandy loam. Timber, sparse juniper. Undergrowth, rabbit brush, salt brush, black brush, and cholla.</p> <hr/> <p>N. 0°02' W., bet. secs. 3 and 4.</p> <p>Over nearly level terrain.</p>
40.00	<p>Point for the 1/4 sec. cor. of secs. 3 and 4.</p> <p>Set a stainless steel post, 28 ins. long, 2 1/2 ins. diam., 27 ins. in the ground, with brass cap mkd.</p> <div style="text-align: center;"> <p>T 35 N R 15 E 1/4 S 4 S 3</p> <p>2015</p> </div> <p>Deposit a magnet, in a white plastic case, at the base of the stainless steel post.</p> <p>Set a steel fence post nearby.</p>
53.89	<p>Power line, 2 strand, bears N. 36° E. and S. 36° W.</p>
59.34	<p>Base of the southerly bank of Klethla Valley Wash cliff, 20 ft. high, bears N. 51° E. and S. 25° W.</p>
70.63	<p>Klethla Valley Wash, 20 ft. wide, 2 ft. deep, drains S. 72° W.</p>
71.80	<p>Top of northerly bank of Klethla Valley Wash, 15 ft. high, bears N. 55° E. and S. 55° W.</p>
79.25	<p>Trail road, 8 ft. wide, bears N. 68° E. and S. 68° W.</p>
80.00	<p>The cor. of secs. 3, 4, 33, and 34, on the N. bdy. of the Tp., hereinbefore described.</p> <p>Land, nearly level to gently rolling. Soil, sandy loam. Timber, none. Undergrowth, native grasses, rabbit brush, cholla, black brush, and salt brush.</p> <hr/> <p>From the cor. of the witness point of secs. 32 and 33, at intersection with the Hopi-Navajo Partition Line, Segment "D", hereinbefore described.</p>

Survey of a Portion of the Subdivisional Lines,
T. 35 N., R. 15 E., Gila and Salt River Meridian, Arizona

CHAINS	
	<p>From this cor. point, AP D-204, on the Hopi-Navajo Partition Line, Segment "D", hereinbefore described, bears N. 87°04' E., 36.205 chs. dist.</p> <p>From this same cor. point, AP D-205, on the Hopi-Navajo Partition Line, Segment "D", hereinbefore described, bears S. 87° 04' E., 1.53 chs. dist.</p> <p>N. 0°03' W., bet. secs. 32 and 33.</p> <p>Over mountainous terrain.</p>
32.73	<p>Point for the 1/4 sec. cor. of secs. 32 and 33.</p> <p>Set a stainless steel post, 28 ins. long, 2 1/2 ins. diam., 24 ins. in the ground, with brass cap mkd.</p> <p style="text-align: center;">T 35 N R 15 E 1/4 S 32 S 33 2015</p> <p>from which</p> <p style="padding-left: 40px;">A stainless steel post, 28 ins. long, 2 1/2 ins. diam., set 26 ins. in the ground for a reference monument, bears N. 45°01' E., 33.0 ft. dist. with brass cap mkd. RM T35N R15E 33.0 FT TO COR 1/4 S33 2015 and an arrow pointing to the cor. Deposit a magnet, in a white plastic case, at the base of the stainless steel post, set a steel fence post nearby.</p> <p>Deposit a magnet, in a white plastic case, at the base of the stainless steel post.</p> <p>Set a steel fence post nearby.</p> <p>Raise a diversion mound of stone, 4 ft. base, 1 ft. high, on upstream side of the stainless steel post.</p> <p>The cor. is located, in a mountain drainage, 6 ft. wide, 1 ft. deep, drains N. 60° W.</p>
72.73	<p>Point for the cor. of secs. 28, 29, 32, and 33.</p> <p>Set a stainless steel post, 28 ins. long, 2 1/2 ins. diam., 26 ins. in the ground, with brass cap mkd.</p>

Survey of a Portion of the Subdivisional Lines,
T. 35 N., R. 15 E., Gila and Salt River Meridian, Arizona

CHAINS									
	<table style="margin: auto;"> <tr> <td>T 35 N</td> <td>R 15 E</td> </tr> <tr> <td>S 29</td> <td>S 28</td> </tr> <tr> <td>S 32</td> <td>S 33</td> </tr> </table>	T 35 N	R 15 E	S 29	S 28	S 32	S 33		
T 35 N	R 15 E								
S 29	S 28								
S 32	S 33								
	2015								
	<p>Deposit a magnet, in a white plastic case, at the base of the stainless steel post.</p> <p>Set a steel fence post nearby.</p> <p>The cor. is located, on the right bank of a mountain drainage, 20 ft. wide, 2 ft. deep, bears N. 25° E. and S. 25° W.</p> <p>Land, mountainous. Soil, sandy loam, sandstone, and coal. Timber, juniper and piñon. Undergrowth, Mormon tea, sage, salt brush, cliff rose, and yucca.</p> <hr/> <p>From the cor. of secs. 27, 28, 33, and 34.</p> <p>West, bet. secs. 28 and 33.</p> <p>Over mountainous terrain.</p>								
32.54	BIA Route 6620, a bladed dirt road, 25 ft. wide, bears S. 5° W. and N. 3° W.								
40.00	<p>Point for the 1/4 sec. cor. of secs. 28 and 33.</p> <p>Set a stainless steel post, 28 ins. long, 2 1/2 ins. diam., 25 ins. in the ground, with brass cap mkd.</p>								
	<table style="margin: auto;"> <tr> <td>T 35 N</td> <td>R 15 E</td> </tr> <tr> <td></td> <td>S 28</td> </tr> <tr> <td>1/4</td> <td>_____</td> </tr> <tr> <td></td> <td>S 33</td> </tr> </table>	T 35 N	R 15 E		S 28	1/4	_____		S 33
T 35 N	R 15 E								
	S 28								
1/4	_____								
	S 33								
	2015								
	<p>Deposit a magnet, in a white plastic case, at the base of the stainless steel post.</p> <p>Set a steel fence post nearby.</p> <p>The cor. is located, 23 lks. S. from a top of finger ridge, 20 ft. high, bears S. 65° E. and S. 85° W.</p>								
80.00	The cor. of secs. 28, 29, 32, and 33.								

Survey of a Portion of the Subdivisional Lines,
T. 35 N., R. 15 E., Gila and Salt River Meridian, Arizona

CHAINS	
	<p>Land, mountainous. Soil, sandy loam and sandstone. Timber, juniper and piñon. Undergrowth, Mormon tea, sage, salt brush, cliff rose, and yucca.</p> <hr/>
	<p>N. 0°03' W., bet. secs. 28 and 29.</p> <p>Over mountainous terrain.</p>
40.00	<p>Point for the 1/4 sec. cor. of secs. 28 and 29.</p> <p>Set a stainless steel post, 28 ins. long, 2 1/2 ins. diam., 25 ins. in the ground, with brass cap mkd.</p> <div style="text-align: center;"> <p>T 35 N R 15 E 1/4 S 29 S 28</p> <p>2015</p> </div> <p>Deposit a magnet, in a white plastic case, at the base of the stainless steel post.</p> <p>Set a steel fence post nearby.</p>
80.00	<p>Point for the cor. of secs. 20, 21, 28, and 29.</p> <p>Set a stainless steel post, 28 ins. long, 2 1/2 ins. diam., 21 ins. in the ground, in a mound of stone, 2 1/2 ft. base, to top, with brass cap mkd.</p> <div style="text-align: center;"> <p>T 35 N R 15 E S 20 S 21 S 29 S 28</p> <p>2015</p> </div> <p>Deposit a magnet, in a white plastic case, at the base of the stainless steel post.</p> <p>The cor. is located, on a WSW facing slope, bears S. 15° E. and N. 15° W., and is approximately 30 vertical ft. above the base of the slope.</p> <p>Land, mountainous. Soil, sandy loam, sandstone, and coal. Timber, juniper and piñon. Undergrowth, sage, salt brush, Mormon tea, yucca, prickly pear, cholla, and rabbit brush.</p> <hr/>

Survey of a Portion of the Subdivisional Lines,
T. 35 N., R. 15 E., Gila and Salt River Meridian, Arizona

CHAINS	
	<p>From the cor. of secs. 21, 22, 27, and 28.</p> <p>West, bet. secs. 21 and 28.</p> <p>Over mountainous terrain.</p>
8.07	BIA Route 6620, a bladed dirt road, 25 ft. wide, bears N. 41° E. and S. 1° E.
40.00	<p>Point for the 1/4 sec. cor. of secs. 21 and 28.</p> <p>Set a stainless steel post, 28 ins. long, 2 1/2 ins. diam., 24 ins. in the ground, with brass cap mkd.</p> <div style="text-align: center;"> <p>T 35 N R 15 E</p> <p>S 21</p> <p>1/4 ———</p> <p>S 28</p> <p>2015</p> </div> <p>Deposit a magnet, in a white plastic case, at the base of the stainless steel post.</p> <p>From this cor. point, the undeveloped Willow Spring, 15 x 10 ft., bears N. 18°54' E., 21.74 chs. dist.</p>
80.00	<p>The cor. of secs. 20, 21, 28, and 29.</p> <p>Land, mountainous.</p> <p>Soil, sandy loam and sandstone.</p> <p>Timber, juniper and piñon.</p> <p>Undergrowth, sage, yucca, cliff rose, and rabbit brush.</p> <hr/> <p>N. 0°03' W., bet. secs. 20 and 21.</p> <p>Over mountainous to rolling to gently rolling terrain.</p>
40.00	<p>Point for the 1/4 sec. cor. of secs. 20 and 21.</p> <p>Set a stainless steel post, 28 ins. long, 2 1/2 ins. diam., 27 ins. in the ground, with brass cap mkd.</p> <div style="text-align: center;"> <p>T 35 N R 15 E</p> <p>1/4</p> <p>S 20 S 21</p> <p>2015</p> </div> <p>Deposit a magnet, in a white plastic case, at the base of the stainless steel post.</p>

Survey of a Portion of the Subdivisional Lines,
T. 35 N., R. 15 E., Gila and Salt River Meridian, Arizona

CHAINS									
	Set a steel fence post nearby.								
71.69	Underground water line, bears N. 47° E. and S. 47° W.								
80.00	Point for the cor. of secs. 16, 17, 20, and 21. Set a stainless steel post, 28 ins. long, 2 1/2 ins. diam., 27 ins. in the ground, with brass cap mkd.								
	<table style="margin-left: auto; margin-right: auto;"> <tr> <td>T 35 N</td> <td>R 15 E</td> </tr> <tr> <td>S 17</td> <td>S 16</td> </tr> <tr> <td>S 20</td> <td>S 21</td> </tr> </table>	T 35 N	R 15 E	S 17	S 16	S 20	S 21		
T 35 N	R 15 E								
S 17	S 16								
S 20	S 21								
	2015								
	Deposit a magnet, in a white plastic case, at the base of the stainless steel post.								
	Set a steel fence post nearby.								
	Land, gently rolling. Soil, sandy loam. Timber, juniper. Undergrowth, sage, black brush, yucca, Mormon tea, cholla, native grasses, and salt brush.								
	<hr/>								
	From the cor. of secs. 15, 16, 21, and 22.								
	West, bet. secs. 16 and 21.								
	Over gently rolling terrain.								
1.87	BIA Route 6620, a bladed dirt road, 35 ft. wide, bears S. 10° E. and N. 10° W.								
40.00	Point for the 1/4 sec. cor. of secs. 16 and 21. Set a stainless steel post, 28 ins. long, 2 1/2 ins. diam., 27 ins. in the ground, with brass cap mkd.								
	<table style="margin-left: auto; margin-right: auto;"> <tr> <td>T 35 N</td> <td>R 15 E</td> </tr> <tr> <td></td> <td>S 16</td> </tr> <tr> <td>1/4</td> <td>_____</td> </tr> <tr> <td></td> <td>S 21</td> </tr> </table>	T 35 N	R 15 E		S 16	1/4	_____		S 21
T 35 N	R 15 E								
	S 16								
1/4	_____								
	S 21								
	2015								
	Deposit a magnet, in a white plastic case, at the base of the stainless steel post.								
	Set a steel fence post nearby.								

Survey of a Portion of the Subdivisional Lines,
T. 35 N., R. 15 E., Gila and Salt River Meridian, Arizona

CHAINS	
70.95	Underground water line, bears N. 47° E. and S. 47° W.
80.00	The cor. of secs. 16, 17, 20, and 21. Land, gently rolling. Soil, sandy loam. Timber, juniper. Undergrowth, sage, cholla, Mormon tea, yucca, and native grasses.
	N. 0°03' W., bet. secs. 16 and 17. Over gently rolling to rolling terrain.
40.00	Point for the 1/4 sec. cor. of secs. 16 and 17. Set a stainless steel post, 28 ins. long, 2 1/2 ins. diam., 26 ins. in the ground, with brass cap mkd. <div style="text-align: center;"> T 35 N R 15 E 1/4 S 17 S 16 2015 </div>
	Deposit a magnet, in a white plastic case, at the base of the stainless steel post. Set a steel fence post nearby.
42.81	Power line, 5 strand, bears N. 76° E. and S. 76° W.
42.99	S. right-of-way fence of U.S. Highway 160, barbed wire fence, 5 strand, bears N. 75° E. and S. 75° W.
44.54	U.S. Highway 160, an asphalt surfaced road, 36 ft. wide, bears N. 70° E. and S. 78° W.
47.92	N. right-of-way fence of U.S. Highway 160 and S. right-of-way fence of Black Mesa and Lake Powell Railroad, woven and barbed wire fence, parallels railroad.
51.05	Black Mesa and Lake Powell Railroad, bears N. 74° E. and S. 74° W.
52.23	N. right-of-way fence of Black Mesa and Lake Powell Railroad, woven and barbed wire fence, bears N. 67° E. and S. 75° W.
80.00	Point for the cor. of secs. 8, 9, 16, and 17. Set a stainless steel post, 28 ins. long, 2 1/2 ins. diam., 27 ins. in the ground, with brass cap mkd.

Survey of a Portion of the Subdivisional Lines,
T. 35 N., R. 15 E., Gila and Salt River Meridian, Arizona

CHAINS	<table border="1" style="margin: auto;"> <tr> <td colspan="2">T 35 N</td> <td colspan="2">R 15 E</td> </tr> <tr> <td style="border-right: 1px solid black;">S 8</td> <td style="border-right: 1px solid black;"></td> <td style="border-right: 1px solid black;">S 9</td> <td></td> </tr> <tr> <td style="border-right: 1px solid black;">S 17</td> <td style="border-right: 1px solid black;"></td> <td style="border-right: 1px solid black;">S 16</td> <td></td> </tr> </table>	T 35 N		R 15 E		S 8		S 9		S 17		S 16	
T 35 N		R 15 E											
S 8		S 9											
S 17		S 16											
	2015												
	Deposit a magnet, in a white plastic case, at the base of the stainless steel post.												
	Set a steel fence post nearby.												
	Land, gently rolling to rolling. Soil, sandy loam. Timber, scattered juniper. Undergrowth, black brush, yucca, native grasses, and sage.												
	<hr/>												
	From the cor. of secs. 9, 10, 15, and 16.												
	West, bet. secs. 9 and 16.												
	Over gently rolling to rolling terrain.												
0.14	Power line, 5 strand, bears N. 64° E. and S. 64° W.												
6.69	S. right-of-way fence of U.S. Highway 160, barbed wire fence, 5 strand, parallels highway.												
9.90	U.S. Highway 160, an asphalt surfaced road, 36 ft. wide, bears N. 62° E. and S. 62° W.												
16.47	N. right-of-way fence of U.S. Highway 160 and S. right-of-way fence of Black Mesa and Lake Powell Railroad, woven and barbed wire fence, parallels highway.												
	From this point, a right-of way monument, bears N. 62° 08' E., 1.87 chs. dist., monumented with a brass cap, 3 1/2 ins. diam., set flush in a concrete cylinder, 6 ins. diam., firmly set, projecting 2 ins. above ground, with no markings on the brass cap, with an angle liner, with no markings, 2.7 lks. S. 62° W. of brass cap.												
17.15	Power line, 4 strand, bears S. 2° E. and N. 2° W.												
23.03	Black Mesa and Lake Powell Railroad, bears N. 63° E. and S. 63° W.												
28.33	N. right-of-way fence of Black Mesa and Lake Powell Railroad, woven and barbed wire fence, bears N. 65° E. and S. 65° W.												
40.00	Point for the 1/4 sec. cor. of secs. 9 and 16.												

Survey of a Portion of the Subdivisional Lines,
T. 35 N., R. 15 E., Gila and Salt River Meridian, Arizona

CHAINS	
	<p>Set a stainless steel post, 28 ins. long, 2 1/2 ins. diam., 27 ins. in the ground, with brass cap mkd.</p> <p style="text-align: center;">T 35 N R 15 E S 9 1/4 ——— S 16</p> <p style="text-align: center;">2015</p> <p>Deposit a magnet, in a white plastic case, at the base of the stainless steel post.</p> <p>Set a steel fence post nearby.</p> <p>The cor. is located, on a southwesterly facing slope.</p>
80.00	<p>The cor. of secs. 8, 9, 16, and 17.</p> <p>Land, rolling. Soil, silty sand. Timber, scattered juniper and piñon. Undergrowth, scattered native grasses.</p> <hr/>
8.35	<p>N. 0°03' W., bet. secs. 8 and 9.</p> <p>Over gently rolling terrain.</p> <p>Questar Southern Trails Pipeline Co., underground gas pipeline, bears N. 53° E. and S. 53° W.</p> <p>From this point, the southwest corner of a fence, enclosing a sub-station on the Questar Southern Trails Pipeline Co., underground gas pipeline, bears N. 55°06' E., 3.185 chs. dist.</p> <p>From this same point, the northwest corner of the same fence, bears N. 50°48' E. 3.21 chs. dist.</p> <p>From this same point, the northeast corner of the same fence, bears N. 51°11' E. 3.515 chs. dist.</p> <p>From this same point, southeast corner of the same fence, bears N. 55°14' E. 3.49 chs. dist.</p>
40.00	<p>Point for the 1/4 sec. cor. of secs. 8 and 9.</p> <p>Set a stainless steel post, 28 ins. long, 2 1/2 ins. diam., 25 ins. in sandstone, with brass cap mkd.</p>

Survey of a Portion of the Subdivisional Lines,
T. 35 N., R. 15 E., Gila and Salt River Meridian, Arizona

CHAINS	
	<p style="text-align: center;">T 35 N R 15 E 1/4 S 8 S 9 2015</p> <p>Deposit a magnet, in a white plastic case, at the base of the stainless steel post.</p> <p>Set a steel fence post nearby.</p> <p>The cor. is located, 50 lks. E. of the top of the right bank of a wash, 20 ft. high, bears S. 10° W. and N. 5° W., and 91 lks. E. of the same wash, 12 ft. wide, 20 ft. deep, drains N.</p>
80.00	<p>Point for the cor. of secs. 4, 5, 8, and 9.</p> <p>Set a stainless steel post, 28 ins. long, 2 1/2 ins. diam., 24 ins. in the ground, with brass cap mkd.</p>
	<p style="text-align: center;">T 35 N R 15 E S 5 S 4 S 8 S 9 2015</p> <p>Deposit a magnet, in a white plastic case, at the base of the stainless steel post.</p> <p>Deposit a sardine can at the base of the stainless steel post.</p> <p>Set a steel fence post nearby.</p> <p>Land, nearly level. Soil, sandy loam. Timber, scattered and sparse juniper. Undergrowth, rabbit brush, native grasses, yucca, cholla, salt brush, and tumble weed.</p>
	<hr/> <p>From the cor. of secs. 3, 4, 9, and 10.</p> <p>West, bet. secs. 4 and 9.</p> <p>Over gently rolling terrain.</p>
27.76	<p>Power line, 4 strand, bears S. 30° E. and N. 30° W.</p>
40.00	<p>Point for the 1/4 sec. cor. of secs. 4 and 9.</p> <p>Set a stainless steel post, 28 ins. long, 2 1/2 ins. diam., 26 ins. in the ground, with brass cap mkd.</p>

Survey of a Portion of the Subdivisional Lines,
T. 35 N., R. 15 E., Gila and Salt River Meridian, Arizona

CHAINS	
	T 35 N R 15 E S 4 1/4 ——— S 9 2015
	Deposit a magnet, in a white plastic case, at the base of the stainless steel post. Set a steel fence post nearby. From this cor. point, a water well, 10 ins. case, bears N. 2°49' W., 27.27 chs. dist. From this water well, the northeast corner a fence enclosure, bears S. 43°49' E., 30.3 lks. dist. From this same water well, the southeast corner of the same fence enclosure, bears S. 4°09' E., 74.4 lks. dist. From this same water well, the southwest corner of the same fence enclosure, bears S. 31°55' W., 71.5 lks. dist. From this same water well, the northwest corner of the same fence enclosure, bears S. 68°58' W., 26 lks. dist.
80.00	The cor. of secs. 4, 5, 8, and 9. Land, nearly level. Soil, sandy loam. Timber, sparse juniper. Undergrowth, rabbit brush and native grasses.
	<hr/> N. 0°03' W., bet. secs. 4 and 5. Over nearly level to gently rolling to rolling terrain.
23.91	Klethla Valley Wash, 120 ft. wide, 2 ft. deep, drains N. 50° W.
40.00	Point for the 1/4 sec. cor. of secs. 4 and 5. Set a stainless steel post, 28 ins. long, 2 1/2 ins. diam., 26 ins. in the ground, with brass cap mkd.
	T 35 N R 15 E 1/4 S 5 S 4 2015

Survey of a Portion of the Subdivisional Lines,
T. 35 N., R. 15 E., Gila and Salt River Meridian, Arizona

CHAINS	
	<p>Deposit a magnet, in a white plastic case, at the base of the stainless steel post.</p> <p>Set a steel fence post nearby.</p>
80.00	<p>The cor. of secs. 4, 5, 32, and 33, on the N. bdy. of the Tp., hereinbefore described.</p> <p>Land, rolling. Soil, sandy loam. Timber, none. Undergrowth, black brush, native grasses, rabbit brush, and yucca.</p> <hr/> <p>From the cor. of secs. 28, 29, 32, and 33.</p> <p>West, bet. secs. 29 and 32.</p> <p>Over mountainous terrain.</p>
40.00	<p>Point for the 1/4 sec. cor. of secs. 29 and 32.</p> <p>Set a stainless steel post, 28 ins. long, 2 1/2 ins. diam., 24 ins. in the ground, with brass cap mkd.</p> <div style="text-align: center;"> <p>T 35 N R 15 E</p> <p>S 29</p> <p>1/4 ———</p> <p>S 32</p> <p>2015</p> </div>
48.14	<p>Deposit a magnet, in a white plastic case, at the base of the stainless steel post.</p> <p>Set a steel fence post nearby.</p> <p>The cor. of the witness point of secs. 29 and 32, at intersection with the Hopi-Navajo Partition Line, Segment "D", hereinbefore described.</p> <p>From this cor. point, AP D-209, on the Hopi-Navajo Partition Line, Segment "D", hereinbefore described, bears S. 17°25' E., 13.12 chs. dist.</p> <p>From this same cor. point, AP D-210, on the Hopi-Navajo Partition Line, Segment "D", hereinbefore described, bears N. 17° 25' W., 13.5 lks. dist.</p> <p>Land, mountainous. Soil, sandy loam and sandstone. Timber, juniper and piñon. Undergrowth, cliff rose, sage, Mormon tea, yucca, and prickly pear.</p> <hr/>

Survey of a Portion of the Subdivisional Lines,
T. 35 N., R. 15 E., Gila and Salt River Meridian, Arizona

CHAINS	
	<p>From the true point for the witness point of secs. 30 and 31, at intersection with the Hopi-Navajo Partition Line, Segment "D", hereinbefore described.</p> <p>From this true point, AP D-218, on the Hopi-Navajo Partition Line, Segment "D", hereinbefore described, bears N. 54°41' E., 30.70 chs. dist.</p> <p>From this same true point, AP D-219, on the Hopi-Navajo Partition Line, Segment "D", hereinbefore described, bears S. 54°41' W., 4.75 chs. dist.</p> <p>West, bet. secs. 30 and 31.</p> <p>Over mountainous terrain.</p>
0.10	<p>The witness corner to the witness point of secs. 30 and 31, at intersection with the Hopi-Navajo Partition Line, Segment "D", hereinbefore described.</p>
35.14	<p>The cor. of secs. 25, 30, 31, and 36, on the W. bdy. of the Tp., hereinbefore described.</p> <p>Land, mountainous. Soil, sandy loam and sandstone. Timber, juniper and piñon. Undergrowth, cliff rose, sage, and Mormon tea.</p> <hr/> <p>From the cor. of the witness point of secs. 29 and 30, at intersection with the Hopi-Navajo Partition Line, Segment "D", hereinbefore described.</p> <p>From this cor. point, AP D-216, on the Hopi-Navajo Partition Line, Segment "D", hereinbefore described, bears N. 76° 23' E., 1.40 chs. dist.</p> <p>From this same cor. point, AP D-217, on the Hopi-Navajo Partition Line, Segment "D", hereinbefore described, bears S. 76° 23' W., 7.00 chs. dist.</p> <p>N. 0°03' W., bet. secs. 29 and 30.</p> <p>Over mountainous terrain.</p>
12.12	<p>Point for the 1/4 secs. cor. of secs. 29 and 30.</p> <p>Set a stainless steel post, 28 ins. long, 2 1/2 ins. diam., 27 ins. in the ground, with brass cap mkd.</p>

Survey of a Portion of the Subdivisional Lines,
T. 35 N., R. 15 E., Gila and Salt River Meridian, Arizona

CHAINS	
	T 35 N R 15 E 1/4 S 30 S 29 2015
	Deposit a magnet, in a white plastic case, at the base of the stainless steel post. The cor. is located, on a northeasterly facing slope.
52.12	Point for the cor. of secs. 19, 20, 29, and 30. Set a stainless steel post, 28 ins. long, 2 1/2 ins. diam., 28 ins. in the ground, with brass cap mkd.
	T 35 N R 15 E S 19 S 20 S 30 S 29 2015
	Deposit a magnet, in a white plastic case, at the base of the stainless steel post. Set a steel fence post nearby. Land, mountainous to rolling. Soil, sandy loam. Timber, juniper and piñon. Undergrowth, sage, cholla, yucca, Mormon tea, and cactus.
	<hr/> From the cor. of secs. 20, 21, 28, and 29. West, bet. secs. 20 and 29. Over mountainous to rolling terrain.
40.00	Point for the 1/4 sec. cor. of secs. 20 and 29. Set a stainless steel post, 28 ins. long, 2 1/2 ins. diam., 24 ins. in the ground, with brass cap mkd.
	T 35 N R 15 E S 20 1/4 ——— S 29 2015

Survey of a Portion of the Subdivisional Lines,
T. 35 N., R. 15 E., Gila and Salt River Meridian, Arizona

CHAINS	
	<p>Deposit a magnet, in a white plastic case, at the base of the stainless steel post.</p> <p>From this cor. point, a water tank, 26 ft. diam., bears N. 4 1/4° W., 8.70 chs. dist.</p> <p>The cor. is located on a steep northwesterly facing slope, 15 ft. above the bottom of a wash, bears E. and W., and 23 lks. S. of the same wash.</p>
78.66	Barbed wire fence, 5 strand, bears S. 33° E. and N. 33° W., leave District 2, Shonto Chapter, and enter District 3, Tonalea Chapter.
80.00	<p>The cor. of secs. 19, 20, 29, and 30.</p> <p>Land, rolling and broken. Soil, sandy loam. Timber, scattered juniper and piñon. Undergrowth, sage and yucca.</p> <hr/> <p>West, bet. secs. 19 and 30.</p> <p>Over rolling to gently rolling terrain.</p>
40.00	<p>Point for the 1/4 sec. cor. of secs. 19 and 30.</p> <p>Set a stainless steel post, 28 ins. long, 2 1/2 ins. diam., 27 ins. in the ground, with brass cap mkd.</p> <div style="text-align: center;"> <p>T 35 N R 15 E</p> <p>S 19</p> <p>1/4 ———</p> <p>S 30</p> <p>2015</p> </div> <p>Deposit a magnet, in a white plastic case, at the base of the stainless steel post.</p> <p>From this cor. point, a steel water tank, 12 ft. high, 24 ft. diam., 40,000 gallon capacity, bears S. 47° 45' W., 43.23 chs. dist.</p>
79.82	<p>The cor. of secs. 19, 24, 25, and 30, on the W. bdy. of the Tp., monumented with a stainless steel post, 2 1/2 ins. diam. firmly set, projecting 3 ins. above ground, with brass cap mkd. T35N R14E R15E S24 S19 S25 S30 2014. With a steel fence post nearby.</p> <p>This cor. is located on the N. edge of an ATV two track road, bears N. 60° E. and S. 60° W., and 33 lks. S. 60° W. from a four-way intersection of two ATV two track roads, extending N. 65° E., S. 25° E., S. 60° W. and N. 20° W.</p>

Survey of a Portion of the Subdivisional Lines,
T. 35 N., R. 15 E., Gila and Salt River Meridian, Arizona

CHAINS	
	<p>Land, rolling to gently rolling. Soil, sandy loam. Timber, scattered juniper and piñon. Undergrowth, native grasses, Mormon tea, yucca, and cholla.</p> <hr/> <p>From the cor. of secs. 19, 20, 29, and 30. N. 0°03' W., bet. secs. 19 and 20. Over rolling to gently rolling terrain.</p>
2.10	Barbed wire fence, 5 strand, bears S. 33° E. and N. 33° W., leave District 3, Tonalea Chapter, and enter District 2, Shonto Chapter.
40.00	<p>Point for the 1/4 sec. cor. of secs. 19 and 20. Set a stainless steel post, 28 ins. long, 2 1/2 ins. diam., 28 ins. in the ground, with brass cap mkd.</p> <div style="text-align: center;"> <p>T 35 N R 15 E 1/4 S 19 S 20 2015</p> </div> <p>Deposit a magnet, in a white plastic case, at the base of the stainless steel post. Set a steel fence post nearby.</p>
49.05	Underground water line, bears N. 89° E. and S. 89° W.
80.00	<p>Point for the cor. of secs. 17, 18, 19, and 20. Set a stainless steel post, 28 ins. long, 2 1/2 ins. diam., 27 ins. in the ground, with brass cap mkd.</p> <div style="text-align: center;"> <p>T 35 N R 15 E S 18 S 17 S 19 S 20 2015</p> </div> <p>Deposit a magnet, in a white plastic case, at the base of the stainless steel post. Set a steel fence post nearby.</p> <p>Land, gently rolling. Soil, sandy loam. Timber, scattered juniper. Undergrowth, yucca, Mormon tea, buffalo grasses, native grasses, and cholla.</p> <hr/>

Survey of a Portion of the Subdivisional Lines,
T. 35 N., R. 15 E., Gila and Salt River Meridian, Arizona

CHAINS	
	<p>From the cor. of secs. 16, 17, 20, and 21.</p> <p>West, bet. secs. 17 and 20.</p> <p>Over gently rolling and slightly broken terrain.</p>
40.00	<p>Point for the 1/4 sec. cor. of secs. 17 and 20.</p> <p>Set a stainless steel post, 28 ins. long, 2 1/2 ins. diam., 28 ins. in the ground, with brass cap mkd.</p> <p style="text-align: center;">T 35 N R 15 E S 17 1/4 ——— S 20</p> <p style="text-align: center;">2015</p> <p>Deposit a magnet, in a white plastic case, at the base of the stainless steel post.</p> <p>Set a steel fence post nearby.</p>
80.00	<p>The cor. of secs. 17, 18, 19, and 20.</p> <p>Land, gently rolling. Soil, sandy loam. Timber, juniper and piñon. Undergrowth, native grasses, yucca, sage, and cholla.</p> <hr/> <p>West, bet. secs. 18 and 19.</p> <p>Over gently rolling terrain.</p>
27.47	<p>Power line, 5 strand, bears N. 65° E. and S. 65° W.</p>
40.00	<p>Point for the 1/4 sec. cor. of secs. 18 and 19.</p> <p>Set a stainless steel post, 28 ins. long, 2 1/2 ins. diam., 27 ins. in the ground, with brass cap mkd.</p> <p style="text-align: center;">T 35 N R 15 E S 18 1/4 ——— S 19</p> <p style="text-align: center;">2015</p> <p>Deposit a magnet, in a white plastic case, at the base of the stainless steel post.</p>

Survey of a Portion of the Subdivisional Lines,
T. 35 N., R. 15 E., Gila and Salt River Meridian, Arizona

CHAINS	
	Set a steel fence post nearby.
43.68	S. right-of-way fence of U.S. Highway 160, barbed wire fence, 4 strand, parallels highway. From this point, a right-of way monument, bears S. 64° W., 42 lks. dist., monumented with a brass cap, 3 1/2 ins. diam., set flush in a concrete cylinder, 33 ins. long, 6 ins. diam., laying loose on the surface of the ground and along the right-of-way fence, with no markings on the brass cap.
47.20	U.S. Highway 160, an asphalt surfaced road, 48 ft. wide, bears N. 64° E. and S. 64° W.
49.67	Leave District 2, Shonto Chapter, and enter District 3, Tonalea Chapter.
54.04	N. right-of-way fence of U.S. Highway 160 and S. right-of-way fence of Black Mesa and Lake Powell Railroad, woven and barbed wire fence, parallels railroad.
57.51	Black Mesa and Lake Powell Railroad, bears N. 64° E. and S. 64° W.
60.45	N. right-of-way fence of Black Mesa and Lake Powell Railroad, woven and barbed wire fence, parallels railroad.
72.27	Questar Southern Trails Pipeline Co., underground gas pipeline, bears N. 66° E. and S. 66° W.
79.73	The cor. of secs. 13, 18, 19, and 24, on the W. bdy. of the Tp., monumented with a stainless steel post, 2 1/2 ins. diam. firmly set, projecting 3 ins. above ground, with brass cap mkd. T35N R14E R15E S13 S18 S24 S19 2014. With a steel fence post nearby. Land, gently rolling. Soil, sandy loam. Timber, sparse juniper. Undergrowth, native grasses, yucca, Mormon tea, and cholla.
	From the cor. of secs. 17, 18, 19, and 20. N. 0°03' W., bet. secs. 17 and 18. Over gently rolling terrain.
12.62	Power line, 5 strand, bears N. 65° E. and S. 65° W.
21.44	S. right-of-way fence of U.S. Highway 160, barbed wire fence, 4 strand, parallels highway.

Survey of a Portion of the Subdivisional Lines,
T. 35 N., R. 15 E., Gila and Salt River Meridian, Arizona

CHAINS							
23.00	U.S. Highway 160, an asphalt surfaced road, 36 ft. wide, bears N. 64° E. and S. 64° W.						
26.67	N. right-of-way fence of U.S. Highway 160 and S. right-of-way fence of Black Mesa and Lake Powell Railroad, woven and barbed wire fence, bears N. 74° E. and S. 74° W.						
28.07	Black Mesa and Lake Powell Railroad, bears N. 64° E. and S. 64° W.						
29.16	N. right-of-way fence of Black Mesa and Lake Powell Railroad, woven and barbed wire fence, parallels railroad.						
34.40	Questar Southern Trails Pipeline Co., underground gas pipeline, bears N. 62° E. and S. 62° W.						
40.00	Point for the 1/4 sec. cor. of secs. 17 and 18. Set a stainless steel post, 28 ins. long, 2 1/2 ins. diam., 27 ins. in the ground, with brass cap mkd. <div style="text-align: center;"> <table style="margin: auto;"> <tr><td>T 35 N</td><td>R 15 E</td></tr> <tr><td></td><td>1/4</td></tr> <tr><td>S 18</td><td> S 17</td></tr> </table> <p>2015</p> </div>	T 35 N	R 15 E		1/4	S 18	S 17
T 35 N	R 15 E						
	1/4						
S 18	S 17						
80.00	Point for the cor. of secs. 7, 8, 17, and 18. Set a stainless steel post, 28 ins. long, 2 1/2 ins. diam., 21 ins. in the ground, in sandstone drill hole, with brass cap mkd. <div style="text-align: center;"> <table style="margin: auto;"> <tr><td>T 35 N</td><td>R 15 E</td></tr> <tr><td>S 7</td><td> S 8</td></tr> <tr><td>S 18</td><td> S 17</td></tr> </table> <p>2015</p> </div>	T 35 N	R 15 E	S 7	S 8	S 18	S 17
T 35 N	R 15 E						
S 7	S 8						
S 18	S 17						
	Deposit a magnet, in a white plastic case, at the base of the stainless steel post. Set a steel fence post nearby. Deposit a magnet, in a white plastic case, at the base of the stainless steel post. Land, gently rolling. Soil, sandy loam and exposed large blankets of sandstone. Timber, scattered juniper. Undergrowth, native grasses, cholla, and yucca.						

Survey of a Portion of the Subdivisional Lines,
T. 35 N., R. 15 E., Gila and Salt River Meridian, Arizona

CHAINS	
	<p>From the cor. of secs. 8, 9, 16, and 17.</p> <p>West, bet. secs. 8 and 17.</p> <p>Over gently rolling terrain.</p>
11.15	Questar Southern Trails Pipeline Co., underground gas pipeline, bears N. 53° E. and S. 53° W.
38.11	Graded road, 25 ft. wide, bears S. 10° E. and N. 15° W.
40.00	<p>Point for the 1/4 sec. cor. of secs. 8 and 17.</p> <p>Set a stainless steel post, 28 ins. long, 2 1/2 ins. diam., 24 ins. in the ground, with brass cap mkd.</p> <div style="text-align: center;"> <p>T 35 N R 15 E</p> <p>S 8</p> <p>1/4 ———</p> <p>S 17</p> <p>2015</p> </div> <p>Deposit a magnet, in a white plastic case, at the base of the stainless steel post.</p> <p>Set a steel fence post nearby.</p> <p>The cor. is located, 1.15 chs. S. 81° W. from the intersection of 2, two track roads, 8 ft. wide, bears N. 1° E., S. 3° E. and S. 59° W.</p>
80.00	<p>The cor. of secs. 7, 8, 17, and 18.</p> <p>Land, gently rolling.</p> <p>Soil, sandy loam and exposed blankets of sandstone.</p> <p>Timber, scattered juniper.</p> <p>Undergrowth, native grasses, rabbit brush, cholla, yucca and Mormon tea.</p> <hr/> <p>West, bet. secs. 7 and 18.</p> <p>Over gently rolling terrain.</p>
40.00	<p>Point for the 1/4 sec. cor. of secs. 7 and 18.</p> <p>Set a stainless steel post, 28 ins. long, 2 1/2 ins. diam., 27 ins. in the ground, with brass cap mkd.</p>

Survey of a Portion of the Subdivisional Lines,
T. 35 N., R. 15 E., Gila and Salt River Meridian, Arizona

CHAINS	
79.64	<p style="text-align: center;">T 35 N R 15 E S 7 1/4 ——— S 18</p> <p style="text-align: center;">2015</p> <p>Deposit a magnet, in a white plastic case, at the base of the stainless steel post.</p> <p>Set a steel fence post nearby.</p> <p>The cor. is located, 1.55 chs. S. of a wash, 6 ft. wide, 1 ft. deep, drains S. 85° W.</p> <p>The cor. of secs. 7, 12, 13, and 18, on the W. bdy. of the Tp., monumented with a stainless steel post, 2 1/2 ins. diam. firmly set, projecting 4 ins. above ground, with brass cap mkd. T35N R14E R15E S12 S7 S13 S18 2014. With a steel fence post nearby.</p> <p>Land, gently rolling. Soil, sandy loam. Timber, sparse juniper. Undergrowth, native grasses, rabbit brush, yucca, and black brush.</p>
40.00	<hr/> <p>From the cor. of secs. 7, 8, 17, and 18.</p> <p>N. 0°03' W., bet. secs. 7 and 8.</p> <p>Over rolling to gently rolling terrain.</p> <p>Point for the 1/4 sec. cor. of secs. 7 and 8.</p> <p>Set a stainless steel post, 28 ins. long, 2 1/2 ins. diam., 27 ins. in the ground, with brass cap mkd.</p>
66.45	<p style="text-align: center;">T 35 N R 15 E 1/4 S 7 S 8</p> <p style="text-align: center;">2015</p> <p>Deposit a magnet, in a white plastic case, at the base of the stainless steel post.</p> <p>Set a steel fence post nearby.</p> <p>The cor. is located, on the westerly edge of a sandstone blanket, 500 x 300 ft., bears S. 20° E. and N. 20° W.</p> <p>Shonto Wash, 20 ft. wide, 3 ft. deep, drains N. 55° W.</p>

Survey of a Portion of the Subdivisional Lines,
T. 35 N., R. 15 E., Gila and Salt River Meridian, Arizona

CHAINS							
80.00	<p>Point for the cor. of secs. 5, 6, 7, and 8.</p> <p>Set a stainless steel post, 28 ins. long, 2 1/2 ins. diam., 24 ins. in the ground, in sandstone, with brass cap mkd.</p> <table style="margin-left: auto; margin-right: auto; border-collapse: collapse;"> <tr> <td style="padding: 0 10px;">T 35 N</td> <td style="padding: 0 10px;">R 15 E</td> </tr> <tr> <td style="border-right: 1px solid black; padding: 0 5px;">S 6</td> <td style="padding: 0 5px;">S 5</td> </tr> <tr> <td style="border-right: 1px solid black; padding: 0 5px;">S 7</td> <td style="padding: 0 5px;">S 8</td> </tr> </table> <p style="text-align: center;">2015</p> <p>Deposit a magnet, in a white plastic case, at the base of the stainless steel post.</p> <p>Land, gently rolling. Soil, sandy loam and large blankets of exposed sandstone. Timber, sparse juniper. Undergrowth, salt brush, yucca, native grasses, and rabbit brush.</p> <hr/> <p>From the cor. of secs. 4, 5, 8, and 9.</p> <p>West, bet. secs. 5 and 8.</p> <p>Over gently rolling terrain.</p>	T 35 N	R 15 E	S 6	S 5	S 7	S 8
T 35 N	R 15 E						
S 6	S 5						
S 7	S 8						
40.00	<p>Point for the 1/4 cor. of secs. 5 and 8.</p> <p>Set a stainless steel post, 28 ins. long, 2 1/2 ins. diam., 26 ins. in the ground, with brass cap mkd.</p> <table style="margin-left: auto; margin-right: auto; border-collapse: collapse;"> <tr> <td style="padding: 0 10px;">T 35 N</td> <td style="padding: 0 10px;">R 15 E</td> </tr> <tr> <td style="padding: 0 5px;">S 5</td> <td style="padding: 0 5px;">S 8</td> </tr> <tr> <td style="padding: 0 5px;">1/4</td> <td style="border-top: 1px solid black; padding: 0 5px;">S 8</td> </tr> </table> <p style="text-align: center;">2015</p> <p>Deposit a magnet, in a white plastic case, at the base of the stainless steel post.</p>	T 35 N	R 15 E	S 5	S 8	1/4	S 8
T 35 N	R 15 E						
S 5	S 8						
1/4	S 8						
47.33	Klethla Valley Wash, 70 ft. wide, 2 ft. deep, drains S. 45° E.						
68.97	Bladed dirt road, 14 ft. wide, bears S. 43° E. and N. 38° W.						
80.00	<p>The cor. of secs. 5, 6, 7, and 8.</p> <p>Land, gently rolling. Soil, sandy loam. Timber, sparse juniper. Undergrowth, rabbit brush and native grasses.</p> <hr/>						

Survey of a Portion of the Subdivisional Lines,
T. 35 N., R. 15 E., Gila and Salt River Meridian, Arizona

CHAINS	
	West, bet. secs. 6 and 7.
	Over gently rolling terrain.
40.00	Point for the 1/4 sec. cor. of secs. 6 and 7.
	Set a stainless steel post, 28 ins. long, 2 1/2 ins. diam., 22 ins. in the ground, in sandstone drill hole, with brass cap mkd.
	T 35 N R 15 E S 6 1/4 ——— S 7 2015
	Deposit a magnet, in a white plastic case, at the base of the stainless steel post.
79.55	The cor. of secs. 1, 6, 7, and 12, on the W. bdy. of the Tp., monumented with a stainless steel post, 2 1/2 ins. diam. firmly set, projecting 4 ins. above ground, with brass cap mkd. T35N R14E R15E S1 S6 S12 S7 2014. With a steel fence post nearby.
	Land, gently rolling. Soil, sandy loam and sandstone. Timber, none. Undergrowth, native grasses, yucca, and black brush.
	From the cor. of secs. 5, 6, 7, and 8.
	N. 0°04' W., bet. secs. 5 and 6.
	Over gently rolling terrain.
21.50	Trail road, 8 ft. wide, bears S. 11° E. and N. 30° W.
40.00	Point for the 1/4 sec. cor. of secs. 5 and 6.
	Set a stainless steel post, 28 ins. long, 2 1/2 ins. diam., 24 ins. in the ground, with brass cap mkd.
	T 35 N R 15 E 1/4 S 6 S 5 2015
	Deposit a magnet, in a white plastic case, at the base of the stainless steel post.
	Set a steel fence post nearby.

**Survey of a Portion of the Subdivisional Lines,
T. 35 N., R. 15 E., Gila and Salt River Meridian, Arizona**

CHAINS	
80.00	<p>The cor. of secs. 5, 6, 31, and 32, on the N. bdy. of the Tp., hereinbefore described.</p> <p>Land, gently rolling. Soil, sandy loam and large blankets of exposed sandstone. Timber, none. Undergrowth, rabbit brush, native grasses, Mormon tea, and yucca.</p> <hr/> <p style="text-align: center;">Subdivision of Section 1, T. 35 N., R. 15 E., Gila and Salt River Meridian, Arizona</p> <hr/> <p>From the 1/4 sec. cor. of secs. 1 and 12. North, on the N. and S. center line of sec. 1. Over nearly level terrain.</p>
27.60	Power line, 5 strand, bears N. 62° E. and S. 62° W.
27.78	<p>S. right-of-way fence of U.S. Highway 160, woven and barbed wire fence, parallels highway.</p> <p>From this point, a right-of way monument, bears N. 60°45' E., 15.2 lks. dist., monumented with a brass cap, 3 1/4 ins. diam., set flush in a concrete cylinder, 6 ins. diam., firmly set, projecting 3 1/2 ins. above ground, with no markings on the brass cap, with an angle liner, with no markings, 2.8 lks. S. 62° W. of brass cap.</p>
29.49	U.S. Highway 160, an asphalt surfaced road, 36 ft. wide, bears N. 62° E. and S. 62° W.
32.89	<p>N. right-of-way fence of U.S. Highway 160 and S. right-of-way fence of Black Mesa and Lake Powell Railroad, woven and barbed wire fence, parallels railroad.</p> <p>From this point, a right-of way monument, bears S. 60°46' W., 2.222 chs. dist., monumented with a brass cap, 3 1/4 ins. diam., set flush in a concrete cylinder, 6 ins. diam., firmly set, projecting 1 in. above ground, with no markings on the brass cap, with an angle liner, with no markings, 2.8 lks. S. 62° W. of brass cap.</p>
34.59	Black Mesa and Lake Powell Railroad, bears N. 63° E. and S. 63° W.
35.86	N. right-of-way fence of Black Mesa and Lake Powell Railroad, woven and barbed wire fence, bears N. 64° E. and S. 64° W.
40.00	<p>Point for the center 1/4 sec. cor. of sec. 1, at intersection with the E. and W. center line.</p> <p>Set a stainless steel post, 28 ins. long, 2 1/2 ins. diam., 26 ins. in the ground, with brass cap mkd.</p>

Subdivision of Section 1,
T. 35 N., R. 15 E., Gila and Salt River Meridian, Arizona

CHAINS	
	T 35 N R 15 E C 1/4 S 1 2015
	Deposit a magnet, in a white plastic case, at the base of the stainless steel post.
	Set a steel fence post nearby.
80.00	The 1/4 sec. cor. of secs. 1 and 36, on the N. bdy. of the Tp. Land, nearly level. Soil, sandy loam. Timber, scattered juniper. Undergrowth, black brush, rabbit brush, cholla, and native grasses.
	<hr/>
	From the 1/4 sec. cor. of secs. 1 and 6, on the E. bdy. of the Tp. West, on the E. and W. center line of sec. 1. Over nearly level terrain.
16.24	Power line, 5 strand, bears N. 62° E. and S. 62° W.
16.54	S. right-of-way fence of U.S. Highway 160, woven and barbed wire fence, parallels highway.
19.80	U.S. Highway 160, an asphalt surfaced road, 36 ft. wide, bears N. 62° E. and S. 62° W.
26.37	N. right-of-way fence of U.S. Highway 160 and S. right-of-way fence of Black Mesa and Lake Powell Railroad, woven and barbed wire fence, parallels railroad.
29.62	Black Mesa and Lake Powell Railroad, bears N. 62° E. and S. 62° W.
31.66	N. right-of-way fence of Black Mesa and Lake Powell Railroad, woven and barbed wire fence, bears N. 63° E. and S. 63° W.
40.00	The center 1/4 sec. cor. of sec. 1.
78.22	Power line, 5 strand, bears S. 27° E. and N. 62° W.
80.00	The 1/4 sec. cor. of secs. 1 and 2. Land, nearly level. Soil, sandy loam. Timber, scattered juniper. Undergrowth, black brush, rabbit brush, cholla, and native grasses.
	<hr/>

Subdivision of Section 2,
T. 35 N., R. 15 E., Gila and Salt River Meridian, Arizona

CHAINS	
	From the 1/4 sec. cor. of secs. 2 and 11.
	N. 0°01' W., on the N. and S. center line of sec. 2.
	Over nearly level terrain.
4.85	Power line, 2 strand, bears S. 86° E. and N. 86° W.
12.95	From this point, the designated northwest corner of Shonto NHA Project No. AZ12-96 Subdivision, hereinbefore described, bears E. 7.98 chs. dist.
21.80	W. right-of-way fence of Arizona State Route 98, barbed wire fence, 5 strand, parallels highway.
25.52	Arizona State Route 98, an asphalt surfaced road, 36 ft. wide, bears S. 24° E. and N. 24° W.
29.07	E. right-of-way fence of Arizona State Route 98, barbed wire fence, 5 strand, parallels highway.
32.36	Woven fence, bears S. 23° E. and N. 23° W., enter water treatment area.
36.03	Woven fence, bears N. 66° E. and S. 66° W., leave water treatment area.
40.00	Point for the center 1/4 sec. cor. of sec. 2, at intersection with the E. and W. center line.
	Set a stainless steel post, 28 ins. long, 2 1/2 ins. diam., 24 ins. in the ground, with brass cap mkd.
	T 35 N R 15 E C 1/4.S 2
	. 2014
	Deposit a magnet, in a white plastic case, at the base of the stainless steel post.
	Set a steel fence post nearby.
	From this cor. point, the northeast fence corner of the water treatment area, woven fences, bears S. 75°33' E., 5.77 chs. dist.
	From this same cor. point, the southeast fence corner of the same fence, bears S. 50°58' E., 10.10 chs. dist.
	From this same cor. point, an angle point on the same fence, bears S. 23°29' E., 9.04 chs. dist.
	From this same cor. point, an angle point on the same fence, bears S. 22°54' E., 7.14 chs. dist.
	From this same cor. point, the southwest fence corner of the same fence, bears S. 0°36' E., 7.82 chs. dist.

Subdivision of Section 2,
T. 35 N., R. 15 E., Gila and Salt River Meridian, Arizona

CHAINS	
	From this same cor. point, the northwest fence corner of the same fence, bears, S. 16°13' W., 4.75 chs. dist.
44.40	Questar Southern Trails Pipeline Co., underground gas pipeline, bears N. 59° E. and S. 59° W.
76.95	The northeast corner of eave of a 2 story house, 40 x 24 ft., bears W. 2.21 chs. dist., long side bears N. 29° E. and S. 29° W.
77.11	Enter fenced property, barbed wire, 2 strand, bears N. 38° E. and S. 38° W.
78.57	Leave fenced property, barbed wire, 2 strand, bears S. 55° E. and N. 55° W.,
80.00	The 1/4 sec. cor. of secs. 2 and 35, on the N. bdy. of the Tp. Land, nearly level. Soil, sandy loam. Timber, none. Undergrowth, native grasses, cactus, and grease wood.
	From the 1/4 sec. cor. of secs. 1 and 2. West, on the E. and W. center line of sec. 2. Over nearly level terrain.
40.00	The center 1/4 sec. cor. of sec. 2.
44.95	E. right-of-way fence of Arizona State Route 98, woven and barbed wire fence, parallels highway. From this point, a right-of-way monument, bears N. 22°07' E., 46.6 lks. dist., monumented with a brass cap, 3 1/4 ins. diam., set flush in a concrete cylinder, 6 ins. diam., firmly set, projecting 6 ins. above ground, mkd. B.I.A ROADS . 1968.
46.56	Arizona State Route 98, an asphalt surfaced road, 36 ft. wide, bears S. 24° E. and N. 24° W.
47.38	Questar Southern Trails Pipeline Co., underground gas pipeline, bears N. 59° E. and S. 59° W.
48.23	W. right-of-way fence of Arizona State Route 98, woven and barbed wire fence, parallels highway. From this point, a right-of-way monument, bears S. 23°00' E., 88.6 lks. dist., monumented with a brass cap, 3 1/4 ins. diam., set flush in a concrete cylinder, 6 ins. diam., firmly set, projecting 3 ins. above ground, mkd. B.I.A ROADS . 1968.
80.00	The 1/4 sec. cor. of secs. 2 and 3.

Subdivision of Section 2,
T. 35 N., R. 15 E., Gila and Salt River Meridian, Arizona

CHAINS	
	<p>Land, nearly level. Soil, sandy loam. Timber, none. Undergrowth, native grasses, cactus, and grease wood.</p> <hr/> <p style="text-align: center;">Subdivision of Section 9, T. 35 N., R. 15 E., Gila and Salt River Meridian, Arizona</p> <hr/> <p>From the 1/4 sec. cor. of secs. 9 and 16. N. 0°02' W., on the N. and S. center line of sec. 9. Over rolling to gently rolling terrain.</p>
33.06	Questar Southern Trails Pipeline Co., underground gas pipeline, bears N. 60° E. and S. 60° W.
40.00	Point for the center 1/4 sec. cor. of sec. 9, at intersection with the E. and W. center line. Set a stainless steel post, 28 ins. long, 2 1/2 ins. diam., 27 ins. in the ground, with brass cap mkd. T 35 N R 15 E C 1/4 S 9 2015
80.00	Deposit a magnet, in a white plastic case, at the base of the stainless steel post. The 1/4 sec. cor. of secs. 4 and 9. Land, gently rolling. Soil, sandy loam and large exposed blankets of sandstone. Timber, juniper. Undergrowth, rabbit brush, yucca, and native grasses.
	<hr/> <p>From the 1/4 sec. cor. of secs. 9 and 10. West, on the E. and W. center line of sec. 9. Over gently rolling terrain.</p>
18.66	Power line, 4 strand, bears S. 2° E. and N. 2° W.
27.90	Questar Southern Trails Pipeline Co., underground gas pipeline, bears N. 60° E. and S. 60° W.
40.00	The center 1/4 sec. cor. of sec. 9.

Subdivision of Section 9,
T. 35 N., R. 15 E., Gila and Salt River Meridian, Arizona

CHAINS	
80.00	<p>The 1/4 sec. cor. of secs. 8 and 9.</p> <p>Land, gently rolling. Soil, sandy loam and large exposed blankets of sandstone. Timber, juniper. Undergrowth, rabbit brush, yucca, and native grasses.</p> <hr/> <p style="text-align: center;">Subdivision of Section 10, T. 35 N., R. 15 E., Gila and Salt River Meridian, Arizona</p> <hr/> <p>From the 1/4 sec. cor. of secs. 10 and 15.</p> <p>N. 0°02' W., on the N. and S. center line of sec. 10.</p> <p>Over gently rolling to nearly level terrain.</p>
19.27	Power line, 5 strand, bears N. 64° E. and S. 64° W.
24.40	S. right-of-way fence of U.S. Highway 160, barbed wire fence, 5 strand, parallels highway.
26.07	U.S. Highway 160, an asphalt surfaced road, 36 ft. wide, bears N. 62° E. and S. 62° W.
29.46	N. right-of-way fence of U.S. Highway 160 and S. right-of-way fence of Black Mesa and Lake Powell Railroad, woven and barbed wire fence, parallels highway.
31.16	Black Mesa and Lake Powell Railroad, bears N. 63° E. and S. 63° W.
32.13	N. right-of-way fence of Black Mesa and Lake Powell Railroad, woven and barbed wire fence, parallels railroad.
40.00	<p>Point for the center 1/4 sec. cor. of sec. 10, at intersection with the E. and W. center line.</p> <p>Set a stainless steel post, 28 ins. long, 2 1/2 ins. diam., 25 ins. in the ground, with brass cap mkd.</p> <p style="text-align: center;">T 35 N R 15 E C 1/4 S 10</p> <p style="text-align: center;">2015</p> <p>Deposit a magnet, in a white plastic case, at the base of the stainless steel post.</p> <p>Deposit an empty aluminum Trader Joe's sardine can, at the base of the stainless steel post.</p>

Subdivision of Section 10,
T. 35 N., R. 15 E., Gila and Salt River Meridian, Arizona

CHAINS	
	Set a steel fence post nearby.
78.33	Questar Southern Trails Pipeline Co., underground gas pipeline, bears N. 60° E. and S. 60° W.
80.00	The 1/4 sec. cor. of secs. 3 and 10. Land, gently rolling to nearly level. Soil, sandy loam. Timber, sparse juniper. Undergrowth, rabbit brush, cholla, and yucca.
	From the 1/4 sec. cor. of secs. 10 and 11. West, on the E. and W. center line of sec. 10. Over gently rolling to nearly level terrain.
12.58	S. right-of-way fence of U.S. Highway 160, barbed wire fence, 4 strand, parallels highway.
13.29	U.S. Highway 160, an asphalt surfaced road, 36 ft. wide, bears N. 62° E. and S. 62° W.
19.77	N. right-of-way fence of U.S. Highway 160 and S. right-of-way fence of Black Mesa and Lake Powell Railroad, woven and barbed wire fence, parallels highway.
23.06	Black Mesa and Lake Powell Railroad, bears N. 62° E. and S. 62° W.
25.51	N. right-of-way fence of Black Mesa and Lake Powell Railroad, woven and barbed wire fence, parallels railroad.
40.00	The center 1/4 sec. cor. of sec. 10.
80.00	The 1/4 sec. cor. of secs. 9 and 10. Land, gently rolling to nearly level. Soil, sandy loam. Timber, sparse juniper. Undergrowth, rabbit brush, cholla, and yucca.
<p>Subdivision of Section 11, T. 35 N., R. 15 E., Gila and Salt River Meridian, Arizona</p>	
	From the 1/4 sec. cor. of secs. 11 and 14. N. 0°01' W., on the N. and S. center line of sec. 11. Over gently rolling to nearly level terrain.

Subdivision of Section 11,
T. 35 N., R. 15 E., Gila and Salt River Meridian, Arizona

CHAINS	
39.33	Underground water line, bears N. 83° E. and S. 83° W.
39.63	Bladed dirt road, 12 ft. wide, bears N. 76° E. and S. 76° W.
39.93	Power line, single phase, bears N. 35° E. and S. 35° W.
40.00	Point for the 1/4 sec. cor. of sec. 11, at intersection with the E. and W. center line. Set a stainless steel post, 28 ins. long, 2 1/2 ins. diam., 27 ins. in the ground, with brass cap mkd. T 35 N R 15 E C 1/4 S 11 2015 Deposit a magnet, in a white plastic case, at the base of the stainless steel post. Set a steel fence post nearby. The cor. is located, 13.6 lks. N. of the northerly edge of a bladed dirt road, 12 ft. wide, bears N. 82° E. and S. 82° W., and N. 43° E. 65 lks. of the intersection of 2 bladed roads, 12 ft. wide, bears N. 3° E., N. 82° E., S. 2° E. and S. 82° W.
65.90	Power line, 5 strand, bears N. 62° E. and S. 62° W.
66.08	S. right-of-way fence of U.S. Highway 160, woven and barbed wire fence, bears N. 63° E. and S. 63° W.
67.77	U.S. Highway 160, an asphalt surfaced road, 36 ft. wide, bears N. 62° E. and S. 62° W.
71.18	N. right-of-way fence of U.S. Highway 160 and S. right-of-way fence of Black Mesa and Lake Powell Railroad, woven and barbed wire fence, parallels railroad.
72.89	Black Mesa and Lake Powell Railroad, bears N. 63° E. and S. 63° W.
73.76	N. right-of-way fence of Black Mesa and Lake Powell Railroad, woven and barbed wire fence, parallels railroad.
80.00	The 1/4 sec. cor. of secs. 2 and 11. Land, gently rolling to nearly level. Soil, sandy loam. Timber, none. Undergrowth, scattered yucca and tumble weed.

Subdivision of Section 11,
T. 35 N., R. 15 E., Gila and Salt River Meridian, Arizona

CHAINS	
	<p>From the 1/4 sec. cor. of secs. 11 and 12.</p> <p>West, on the E. and W. center line of sec. 11.</p> <p>Over gently rolling to nearly level terrain.</p>
34.30	Underground water line, bears N. 83° E. and S. 83° W.
39.95	Power line, 5 strand, bears N. 35° E. and S. 35° W.
40.00	The center 1/4 sec. cor. of sec. 11.
76.80	Power line, 5 strand, bears N. 64° E. and S. 64° W.
80.00	The 1/4 sec. cor. of secs. 10 and 11.
	<p>Land, gently rolling to nearly level.</p> <p>Soil, sandy loam.</p> <p>Timber, sparse cottonwood.</p> <p>Undergrowth, scattered yucca and tumble weed.</p>
<hr/> <p>Subdivision of Section 16, T. 35 N., R. 15 E., Gila and Salt River Meridian, Arizona</p> <hr/>	
	<p>From the 1/4 sec. cor. of secs. 16 and 21.</p> <p>N. 0°02' W., on the N. and S. center line of sec. 16.</p> <p>Over gently rolling terrain.</p>
23.58	Underground water line, bears N. 55° E. and S. 55° W.
31.46	BIA Route 6620, a bladed dirt road, 35 ft. wide, bears S. 55° E. and N. 55° W.
40.00	Point for the center 1/4 sec. cor. of sec. 16, at intersection with the E. and W. center line.
	<p>Set a stainless steel post, 28 ins. long, 2 1/2 ins. diam., 26 ins. in the ground, with brass cap mkd.</p>
	<p>T 35 N R 15 E C 1/4.S 16</p> <p>2014</p>
	<p>Deposit a magnet, in a white plastic case, at the base of the stainless steel post.</p> <p>Set a steel fence post nearby.</p>

Subdivision of Section 16,
T. 35 N., R. 15 E., Gila and Salt River Meridian, Arizona

CHAINS	
60.87	Power line, 5 strand, bears N. 64° E. and S. 64° W.
62.61	S. right-of-way fence of U.S. Highway 160, barbed wire fence, 5 strand, parallels highway.
64.31	U.S. Highway 160, an asphalt surfaced road, 36 ft. wide, bears N. 62° E. and S. 62° W.
67.31	N. right-of-way fence of U.S. Highway 160 and S. right-of-way fence of Black Mesa and Lake Powell Railroad, woven and barbed wire fence, bears N. 86° E. and S. 86° W.
69.92	Woven and barbed wire fence, bears S. 76° E. and N. 76° W.
71.15	Black Mesa and Lake Powell Railroad, bears N. 63° E. and S. 63° W.
72.56	N. right-of-way fence of Black Mesa and Lake Powell Railroad, woven and barbed wire fence, N. 61° E. and S. 61° W.
80.00	The 1/4 sec. cor. of secs. 9 and 16. Land, gently rolling. Soil, sandy loam. Timber, juniper. Undergrowth, cactus and native grasses.
	From the 1/4 sec. cor. of secs. 15 and 16. West, on the E. and W. center line of sec. 16. Over gently rolling terrain.
0.25	Trail road, 8 ft. wide, bears S. 47° E. and N. 50° W.
0.82	Bladed dirt road, 12 ft. wide, bears S. 48° E. and N. 61° W.
17.34	Underground waterline, bears N. 43° E. and S. 43° W.
40.00	The center 1/4 sec. cor. of sec. 16.
52.66	BIA Route 6620, a bladed dirt road, 35 ft. wide, bears S. 56° E. and N. 56° W.
80.00	The 1/4 sec. cor. of secs. 16 and 17. Land, gently rolling. Soil, sandy loam. Timber, juniper. Undergrowth, cactus and native grasses.

Subdivision of Section 17,
T. 35 N., R. 15 E., Gila and Salt River Meridian, Arizona

CHAINS	
	From the 1/4 sec. cor. of secs. 17 and 20.
	N. 0°03' W., on the N. and S. center line of sec. 17.
	Over nearly level terrain.
32.87	Power line, 5 strand, bears N. 76° E. and S. 76° W.
39.65	S. right-of-way fence of U.S. Highway 160, barbed wire fence, 5 strand, bears N. 77° E. and S. 77° W.
40.00	Point for the center 1/4 sec. cor. of sec. 17, at intersection with the E. and W. center line.
	Set a stainless steel post, 28 ins. long, 2 1/2 ins. diam., 26 ins. in the ground, with brass cap mkd.
	T 35 N R 15 E C 1/4 S 17
	2015
	Deposit a magnet, in a white plastic case, at the base of the stainless steel post.
	Set a steel fence post nearby.
41.18	U.S. Highway 160, an asphalt surfaced road, 36 ft. wide, bears N. 82° E. and S. 73° W.
44.27	N. right-of-way fence of U.S. Highway 160 and S. right-of-way fence of Black Mesa and Lake Powell Railroad, woven and barbed wire fence, parallels railroad.
46.75	Black Mesa and Lake Powell Railroad, bears N. 75° E. and S. 75° W.
47.54	N. right-of-way fence of Black Mesa and Lake Powell Railroad, woven and barbed wire fence, parallels railroad.
58.53	Questar Southern Trails Pipeline Co., underground gas pipeline, bears N. 53° E. and S. 53° W.
80.00	The 1/4 sec. cor. of secs. 8 and 17.
	Land, nearly level. Soil, sandy loam. Timber, scattered juniper. Undergrowth, native grasses, tumble weed, and Mormon tea.
	From the 1/4 sec. cor. of secs. 16 and 17.
	West, on the E. and W. center line of sec. 17.

**Subdivision of Section 17,
T. 35 N., R. 15 E., Gila and Salt River Meridian, Arizona**

CHAINS	
	Over nearly level terrain.
11.29	Power line, 5 strand, bears N. 76° E. and S. 76° W.
38.37	S. right-of-way fence of U.S. Highway 160, barbed wire fence, 5 strand, bears N. 78° E. and S. 78° W.
40.00	The center 1/4 sec. cor. of sec. 17.
44.27	U.S. Highway 160, an asphalt surfaced road, 36 ft. wide, bears N. 76° E. and S. 68° W.
52.08	N. right-of-way fence of U.S. Highway 160 and S. right-of-way fence of Black Mesa and Lake Powell Railroad, woven and barbed wire fence, parallels railroad.
55.54	Black Mesa and Lake Powell Railroad, bears N. 64° E. and S. 64° W.
57.38	N. right-of-way fence of Black Mesa and Lake Powell Railroad, woven and barbed wire fence, parallels railroad.
69.58	Questar Southern Trails Pipeline Co., underground gas pipeline, bears N. 62° E. and S. 62° W.
80.00	The 1/4 sec. cor. of secs. 17 and 18.
	Land, nearly level. Soil, sandy loam. Timber, scattered juniper. Undergrowth, native grasses, tumble weed, and Mormon tea.
<hr/> Subdivision of Section 18, T. 35 N., R. 15 E., Gila and Salt River Meridian, Arizona <hr/>	
	From the 1/4 sec. cor. of secs. 18 and 19.
	N. 0°04' W., on the N. and S. center line of sec. 18.
	Over gently rolling terrain.
1.81	S. right-of-way fence of U.S. Highway 160, barbed wire fence, 5 strand, parallels highway.
3.51	U.S. Highway 160, an asphalt surfaced road, 48 ft. wide, bears N. 64° E. and S. 64° W.
6.85	N. right-of-way fence of U.S. Highway 160 and S. right-of-way fence of Black Mesa and Lake Powell Railroad, woven and barbed wire fence, parallels railroad.

Subdivision of Section 18,
T. 35 N., R. 15 E., Gila and Salt River Meridian, Arizona

CHAINS	
8.55	Black Mesa and Lake Powell Railroad, bears N. 64° E. and S. 64° W.
10.47	N. right-of-way fence of Black Mesa and Lake Powell Railroad, woven and barbed wire fence, parallels railroad.
14.57	Questar Southern Trails Pipeline Co., underground gas pipeline, bears N. 68° E. and S. 66° W.
40.00	Point for the center 1/4 sec. cor. of sec. 18, at intersection with the E. and W. center line. Set a stainless steel post, 28 ins. long, 2 1/2 ins. diam., 27 ins. in the ground, with brass cap mkd. T 35 N R 15 E C 1/4 S 18 2015
80.00	Deposit a magnet, in a white plastic case, at the base of the stainless steel post. Set a steel fence post nearby. The 1/4 sec. cor. of secs. 7 and 18. Land, gently rolling. Soil, sandy loam and large exposed blankets of sandstone. Timber, scattered juniper. Undergrowth, native grasses, cholla, and yucca. <hr/>
40.00	From the 1/4 sec. cor. of secs. 17 and 18. West, on the E. and W. center line of sec. 18. Over gently rolling terrain.
75.19	The center 1/4 sec. cor. of sec. 18.
79.69	Barbed wire fence, 5 strand, bears S. 33° E. and N. 33° W., leave District 2, Shonto Chapter, and enter District 3, Tonalea Chapter. The 1/4 sec. cor. of secs. 13 and 18, on the W. bdy. of the Tp., monumented with a stainless steel post, 2 1/2 ins. diam., firmly set, projecting 4 ins. above the ground, with brass cap mkd. T35N R14E R15E 1/4 S13 S18 2014. With a steel fence post nearby. Land, gently rolling. Soil, sandy loam and large exposed blankets of sandstone. Timber, scattered juniper. Undergrowth, native grasses, cholla, and yucca. <hr/>

Subdivision of Section 19,
T. 35 N., R. 15 E., Gila and Salt River Meridian, Arizona

CHAINS	
	<p>From the 1/4 sec. cor. of secs. 19 and 30.</p> <p>N. 0°04' W., on the N. and S. center line of sec. 19.</p> <p>Over gently rolling terrain.</p>
40.00	<p>Point for the center 1/4 sec. cor. of sec. 19, at intersection with the E. and W. center line.</p> <p>Set a stainless steel post, 28 ins. long, 2 1/2 ins. diam., 27 ins. in the ground, with brass cap mkd.</p> <p style="text-align: center;">T 35 N R 15 E C 1/4 S 19</p> <p style="text-align: center;">2015</p> <p>Deposit a magnet, in a white plastic case, at the base of the stainless steel post.</p>
46.69	Underground water line, bears N. 83° E. and S. 83° W.
64.84	Barbed wire fence, 5 strand, bears S. 33° E. and N. 33° W., leave District 3, Tonalea Chapter, and enter District 2, Shonto Chapter.
74.24	Power line, 5 strand, bears N. 65° E. and S. 65° W.
80.00	<p>The 1/4 sec. cor. of secs. 18 and 19.</p> <p>Land, gently rolling. Soil, sandy loam. Timber, scattered juniper. Undergrowth, yucca, Mormon tea, and native grasses.</p> <hr/> <p>From the 1/4 sec. cor. of secs. 19 and 20.</p> <p>West, on the E. and W. center line of sec. 19.</p> <p>Over gently rolling terrain.</p>
24.16	Barbed wire fence, 5 strand, bears S. 33° E. and N. 33° W., leave District 2, Shonto Chapter, and enter District 3, Tonalea Chapter.
40.00	The center 1/4 sec. cor. of sec. 19.
79.78	<p>The 1/4 sec. cor. of secs. 19 and 24, on the W. bdy. of the Tp., monumented with a stainless steel post, 2 1/2 ins. diam., firmly set, projecting 4 ins. above the ground, with brass cap mkd. T35N R14E R15E 1/4 S24 S29 2014. With a steel fence post nearby.</p> <p>The cor. is located 65 lks. N. of a barbed wire fence, 3 strand, bears S. 50° E. and N. 50° W.</p>

Subdivision of Section 19,
T. 35 N., R. 15 E., Gila and Salt River Meridian, Arizona

CHAINS

Land, gently rolling.
Soil, sandy loam.
Timber, scattered juniper.
Undergrowth, yucca, Mormon tea, and native grasses.

GENERAL DESCRIPTION

The area surveyed and resurveyed is within the Navajo Indian Reservation and is approximated 15.5 miles northeast of the community of Tonalea. Shonto Navajo Housing Authority Sub-division, is located in the southeast quarter of section 2, near Arizona State Route 98, small housing clusters and single home units are scattered throughout the township.

The terrain varies from mountainous in the southern portion with the remaining terrain rolling to gently rolling to nearly level. The elevation ranges from about 5,900 to 7,000 ft. above sea level.

Access to the area surveyed and resurveyed is provided by U.S. Highway 160, Arizona State Route 98, BIA Routes 40 and 6620. Further access to the township is provided by several bladed dirt roads and a series of trail roads. ATV's were required to access some of the areas within the township.

The Black Mesa and Lake Powell Railroad, which supplies coal to the Navajo Generating Station, near Page, Arizona, run northeasterly and southwesterly, entering the township in section 19 and leaving the township in section 1. The Questar Southern Trails Pipeline Co. has underground gas pipelines which also run northeasterly and southeasterly, entering the township in section 19 and leaving the township in section 1.

The mean magnetic declination of 10 1/2° E. was derived from the United States Geological Survey computer program GEOMAG, utilizing the World Magnetic Model for the dates of survey.
