

ORIGINAL

**UNITED STATES
DEPARTMENT OF THE INTERIOR
BUREAU OF LAND MANAGEMENT**

FIELD NOTES

OF THE

DEPENDENT RESURVEY OF A

PORTION OF THE EAST BOUNDARY,

A PORTION OF THE SUBDIVISIONAL LINES,

AND

PORTIONS OF PATENTED MINERAL SURVEYS

IN SECTIONS 1, 2, 11 AND 12,

AND

A METES-AND-BOUNDS SURVEY OF TRACT 37,

TOWNSHIP 2 SOUTH, RANGE 12 EAST,

OF THE GILA AND SALT RIVER MERIDIAN,

IN THE STATE OF ARIZONA.

EXECUTED BY

Blas J. Urena, Cadastral Surveyor

Under Special Instructions dated March 28, 2017, approved March 28, 2017, which provided for the surveys included under Group No. 1168, and assignment instructions dated March 28, 2017.

Survey commenced May 4, 2017

Survey completed August 17, 2017

INDEX DIAGRAM

**TOWNSHIP 2 SOUTH RANGE 12 EAST
GILA AND SALT RIVER MERIDIAN, ARIZONA**

6	5	4	3	2	1
				12	5
				10	4
					7
7	8	9	10	11	12
					4
18	17	16	15	14	13
19	20	21	22	23	24
30	29	28	27	26	25
31	32	33	34	35	36

Dependent Resurvey of Portions of M.S. No. 2836Pages 15-17
 Dependent Resurvey of Portions of M.S. No. 2837Pages 17-19
 Dependent Resurvey of Portions of M.S. No. 2838Pages 19-23
 Dependent Resurvey of Portions of M.S. No. 3581Pages 23-26
 Metes-and-Bounds Survey of Tract 37Pages 26-28

T. 2 S., R. 12 E., Gila and Salt River Meridian, Arizona

CHAINS

The following field notes describe the dependent resurvey of portion of the east boundary, a portion of the subdivisional lines, and portions of patented mineral surveys in sections 1, 2, 11, and 12, and a metes-and-bounds survey of Tract 37, Township 2 South, Range 12 East, Gila and Salt River Meridian, Arizona.

The history of surveys pertaining to this survey is as follows:

Alexander B. Titus, Compassman, United States Deputy Surveyor, surveyed the South, East and West boundaries, and portions of the subdivisional lines, Township 1 South, Range 13 East, in 1906, (Books 1850 and 1851). Jacobs Curry and Francis B. Jacobs, United States Deputy Surveyors, surveyed the boundaries and subdivided Township 2 South, Range 12 East, in 1911, (Books 2227 and 2228). William B. Kimmel and Roy J. Gill, United States Surveyors, resurveyed the East boundary, Townships 2 South, Range 12 East, and subdivided Township 2 South, Range 13 East, in 1921, (Book 3392). John F. Hesse, United States Mineral Surveyor, surveyed Mineral Survey Numbers 2836, 2837, and 2838, in 1910. Edward L. Haff, United States Mineral Surveyor, surveyed Mineral Survey Number 3581, in 1919. Benjamin J. Kinsey, United States Surveyor, and Theodore Vander Meer, United States Transitman, resurveyed a portion of the South boundary, Township 1 South, Range 12 East, in 1925, (Book 3710). Jimmie D. Crume, Mineral Surveyor, surveyed Mineral Survey Number 4898, in 2012.

The survey was executed in accordance with the specifications as set forth in the Manual of Surveying Instructions, (2009), and the Special Instructions dated March 28, 2017 for Group Number 1168, Arizona.

The true meridian direction and length of all lines were determined by static or real time kinematic Global Navigation Satellite System observations using Trimble Navigation R8-3 model receivers.

Preliminary to the resurvey, the lines of the prior surveys were retraced and search was made for all corners and other calls of record. Identified corners were remonumented in their original positions. Lost corners were reestablished and remonumented at proportionate positions based on the official record. The retracement data were thoroughly verified and only the true line field notes are given herein.

The "ROCKART decals 10-456" referred to in these notes are marked "PROPERTY BOUNDARY (USFS logo) National Forest LAND BEHIND THIS SIGN". The "ROCKART decals 20-127" are marked "(BLM logo) LAND SURVEY MONUMENT Please Do Not Disturb This monument was located as part of an official land survey. It helps define land ownership lines. (Cadastral Survey logo) For further information contact your local BLM office".

T. 2 S., R. 12 E., Gila and Salt River Meridian, Arizona

CHAINS

Geodetic control was derived from Global Navigation Satellite System (GNSS) static observations post processed by National Geodetic Survey, Online Positioning User Service (OPUS), utilizing Continuously Operating Reference Stations DL3063 AZTP TEMPE CORS ARP, DN6063 AZST SAN TAN PARK CORS ARP, DN4496 AZUP USERY MOUNTAIN PK CORS ARP. The NAD 83(2011) (EPOCH:2010.0000), geographic position of the corner number 2, Mineral Survey Number 3581, Grand, is as follows:

Latitude: 33°16'05.834" N. Longitude: 111°03'48.039" W.

The NAD 83(2011)(EPOCH:2010.0000), geographic position of angle point 1, section 36, on the South boundary of Township 1 South, Range 12 East, is as follows:

Latitude: 33°17'33.256" N. Longitude: 111°05'06.085" W.

The mean magnetic declination is 10° E.

**Dependent Resurvey of a Portion of the East boundary,
T. 2 N., R. 12 E., Gila and Salt River Meridian, Arizona**

Restoring the survey executed by
Jacobs Curry and Francis B. Jacobs, in 1911
and the resurvey executed by
William B. Kimmel and Roy J. Gill, in 1921

Beginning at the 1/4 sec. cor. of sec. 12 only, on the E. bdy. of the Tp., monumented with a volcanic stone, 12 x 8 ins., firmly set, projecting 6 ins. above ground, mkd. 1/4 on W. face, witnessed by a mound of stone, 3 ft. base, 3 ft. high, 1.5 ft. W. of cor.

Rebuild the mound of stone, 4 1/2 ft. base, 3 1/2 ft. high.

N. 0°06' E., on the E. bdy. of sec. 12.

Over rough mountainous terrain.

39.90

The cor. of secs 1 and 12 only, on the E. bdy. of the Tp., monumented with a volcanic boulder in place, 4 x 3 ft., projecting 3 1/2 ft. on W. face, mkd. with + on top, and 1 grove N. and 5 groves S. of the + mark, witnessed by a mound of stone, 3 ft. base, 3 1/2 ft. high, 2 ft. N. of + mark.

Set a carsonite post, enclosed in a mound of stone, with attached ROCKART decals 10-456 and 20-127, SE of cor.

N. 0°03' E., on the E. bdy. of sec. 1, identical with the E. Bdy. of Tract 37.

Dependent Resurvey of a Portion of the East boundary,
T. 2 S., R. 12 E., Gila and Salt River Meridian, Arizona

CHAINS	
	<p>Over very mountainous terrain.</p> <p>Set a carsonite post, enclosed in a mound of stone, with attached ROCKART decal 10-456, at approximately 75 lks. along the line.</p> <p>Thence continuing to set carsonite posts, enclosed in mounds of stone, with attached ROCKART decal 10-456, at intervals of approximately 2.8 chs. along the line.</p>
5.608	<p>The closing cor. of secs. 6 and 7, T. 2 S., R 13 E., on the E. bdy. of sec. 1, T. 2 S., R. 12 E., monumented with an iron post, 2 ins. diam., firmly set, on top of a boulder in place, 12 x 7 ft. projecting 2 1/2 ft. on W. face, in a supporting mound of stone, 4 1/2 ft. base, 3 ft. high, with brass cap, mkd. T2S R12E S1 T2S R13E S6 C S7 C 2017 1917, witnessed by a mound of stone, 3 1/2 ft. base, 2 ft. high, 2.6 ft. E. of cor., and a carsonite post, enclosed in a mound of stone, with attached ROCKART decals 10-456 and 20-127, SE of cor.</p> <p>From this point, the amended original closing cor. of secs. 6 and 7, T. 2 S., R 13 E., bears S. 89°57' E., 1.7 lks. dist., as described in the field notes of T. 2 S., R. 13 E., executed concurrently under this same group.</p>
39.48	<p>The 1/4 sec. cor. of sec. 1 only, on the E. bdy. of the Tp. monumented with a volcanic stone, 30 x 12 ins., firmly set, projecting 2 ins. above ground, mkd. 1/4 on W. face, witnessed by a scattered mound of stone.</p> <p>Rebuild the mound of stone, 2 1/2 ft. base, 1 1/2 ft. high, W. of cor.</p> <p>Set a steel sign post, in the mound of stone.</p> <hr/> <p>N. 1°05' E., beginning new measurement.</p>
39.674	<p>Point for the closing cor. of Tps. 2 S., Rs. 12 and 13 E., at intersection with the S. bdy. of sec. 32, T. 1 S., R. 13 E.</p> <p>At the cor. point</p> <p>Set a stainless steel post, 28 ins. long, 2 1/2 ins. diam., 14 ins. in the ground, to bedrock, in a mound of stone, 4 ft. base, to top, with brass cap mkd.</p> <p style="text-align: center;"> T 1 S R 13 E S 32 <hr/> S 1 S 6 T 2 S C C 2017 </p>

Dependent Resurvey of a Portion of the East boundary,
T. 2 S., R. 12 E., Gila and Salt River Meridian, Arizona

CHAINS

Deposit a magnet, in a white plastic case, at the base of the stainless steel post.

from which

A point on a rock outcrop, 20 x 10 ft., bears N. 85°08' E., 25.6 lks. dist., mkd. X BO, S. of a boulder 15 x 8 ft., projecting 12 ft.

A point on a rock outcrop, 10 x 5 ft., projecting 1 ft. on W. face, bears S. 18°17' W., 31.4 lks. dist., mkd. X BO.

From this cor. point, the amended original closing cor. of Tps. 2 S., Rs. 12 and 13 E., bears N. 1°05' E., 13.3 lks. dist., monumented with a trachite stone, 16 x 6 ins. firmly set, projecting 18 ins. above ground, in a scattered mound of stone, mkd CC on S. face, and with 6 grooves on E., S. and W. faces, witnessed by a mound of stone, 2 ft. base, 1 1/2 ft. high, 1 1/2 ft. S. of mkd. stone.

Add the marks AM to top of the marked stone.

Enclose the marked stone in a collar of stones, utilizing the stones of the scattered mound of stone.

From this same cor. point, the cor. of secs. 32 and 33 only, on the S. bdy. of T. 1 S., R. 13 E., bears N. 89°55' E., 35.764 chs. dist., monumented with a + cut on rock outcrop, with 4 grooves on E. and 2 grooves W. of +, witnessed by a mound of stone, 3 ft. base, 2 ft. high, 2 ft. N. of +.

from which the remaining original bearing tree

A decayed and down tree, 4 ins. diam., bears S. 64°29' W., 1.386 chs. dist., with illegible scribe marks visible, on open blaze. (Record: S. 59°40' W., 1.38 chs.)

and from which the bearing tree established by Evert D. Bunger, in 2010, according to the results of survey recorded in Fee No. 2011-004480, on file at Pinal County Recorder's Office.

A pine, 6 ins. diam., bears N. 64°38' E., 43.3 lks. (28.6 ft.) dist., with no marks visible.

and from which a new bearing object

A point on a rock outcrop, 10 x 10 ft., projecting 2 ft. on the E. side, bears S. 43°06' W., 24.9 lks. dist., mkd. BO +.

Dependent Resurvey of a Portion of the East boundary,
T. 2 S., R. 12 E., Gila and Salt River Meridian, Arizona

CHAINS

From this same point, the 1/4 sec. cor. of sec. 32 only, on the S. bdy. of T. 1 S., R. 13 E., bears S. 89°55' W., 4.346 chs. dist., as described in the field notes of T. 1 S., R. 13 E., executed concurrently under this same group.

Dependent Resurvey of a Portion of the Subdivisional Lines,
T. 2 S., R. 12 E., Gila and Salt River Meridian, Arizona

Restoring the survey executed by
Jacobs Curry and Francis B. Jacobs, in 1911

From the cor. of secs. 1 and 12 only, on the E. bdy. of the Tp., hereinbefore described.

N. 88°07' W., bet. secs. 1 and 12, identical with the S. bdy. of Tract 37.

Over very mountainous and broken terrain.

Set a carsonite post, enclosed in a mound of stone, with attached ROCKART decal 10-456, at approximately 75 lks. along the line.

Thence continuing to set carsonite posts, enclosed in mounds of stone, with attached ROCKART decal 10-456, at intervals of approximately 4 chs. along the line.

28.131 Point for AP 3A, sec. 1, of the metes-and-bounds survey of Tract 37, T. 2 S., R. 12 E.

Set a rebar, 24 ins. long, 5/8 in. diam., 18 ins. in the ground, in a collar of stone, with brass cap, 2 ins. diam., mkd.

BLM CADASTRAL
T 2 S R 12 E

AP3A \ S 1

S 12

2017

Raise a mound of stone, 3 ft. base, 2 ft. high, SE of cor.

Set carsonite post, enclosed in a mound of stones, with attached ROCKART decals 10-456 and 20-127, SW of cor.

Thence depart Tract 37, and continuing bet. secs. 1 and 12.

Dependent Resurvey of a Portion of the Subdivisional Lines,
T. 2 S., R. 12 E., Gila and Salt River Meridian, Arizona

CHAINS	
39.17	<p>The 1/4 sec. cor. of secs. 1 and 12, determined from cor. No. 2, Touch Not No. 3, M. S. 2838, having a record tie of N. 48°31' W., 237.93 ft. (3.605 chs.) dist., utilizing a rotated bearing of N. 48°20' W., and the record dist. The determined location falls on inaccessible, precipitous broken walls near Apache Leap Cliffs. Not searched for.</p> <hr/> <p>S. 89°47' W., beginning new measurement.</p>
10.805	<p>Intersect line 2-3, Hillside, M. S. 2838, not monumented.</p> <p>From this point of intersection, cor. No. 3, Hillside, identical with cor. No. 1, Touch Not No. 3, cor. No. 2, Touch Not, M. S. 2838, bears S. 52°06' E., 6.115 chs. dist., monumented with a wood post, 4 ft. long, 4 ins. sq. firmly set, in a mound of stone, 3 1/2 ft. base, 1 1/2 ft. high, with 3 aluminum tags, and a portion of an aluminum tag, mkd. "S. E. COR. HILLSIDE", "R" on the N. face, and "N. E. COR. TOUCH NOT", "N. W. COR. TOUCH NOT NO. 3" on S. face.</p> <p>From this same point of intersection, cor. No. 2, Hillside, M. S. 2838, bears N. 52°06' W., 16.154 chs. dist., monumented with a wood post, 4 ft. long, 4 ins. sq. in a mound of stone, 3 ft. base, 1 1/2 ft. high, with an aluminum tag, mkd. "N. W. COR. CONNECTING LINK" on S. face.</p> <p>from which</p> <p style="padding-left: 40px;">A wood post, 4 ft. long, 4 ins. sq. firmly set, in a mound of stone, 2 1/2 ft. base, 1 1/2 ft. high for a reference monument, bears N. 81°45' E., 2.35 ft. dist., with an aluminum tag, mkd. "S. END C. APACHE LEAP".</p> <p>Thence across patented lands.</p>
21.08	<p>True point for AP 1, sec. 1, at intersection with line 2-3, Skiberean, M. S. 2837, identical with line 4-1, Hillside, M. S. 2838, falls on a the S. face of a boulder in place, 4 x 4 ft., projecting 2 ft. above ground, on S. face, and in a wash, 10 ft. wide, 8 ft. deep, drains S., where it is impracticable to establish a permanent monument.</p> <p>Set a carsonite post, enclosed in a mound of stone, with attached ROCKART decal 10-456, SW of the true point location.</p> <p>From this true point of intersection, the point selected for a witness cor. bears N. 70°11' W., 25.1 lks. dist.</p> <p>Set a rebar, 24 ins. long, 5/8 in. diam., 17 ins. in the ground, to bedrock, in a mound of stone, 1 1/2 ft. base, to top, with brass cap, 2 ins. diam., mkd.</p>

Dependent Resurvey of a Portion of the Subdivisional Lines,
T. 2 S., R. 12 E., Gila and Salt River Meridian, Arizona

CHAINS

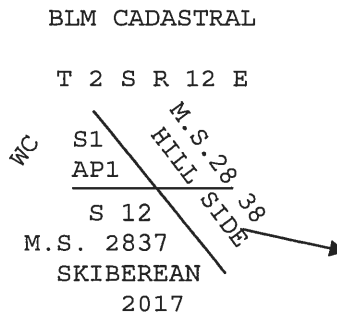

Raise a mound of stone, 2 1/2 ft. base, 1 1/2 ft. high, W. of cor.

Set a carsonite post, enclosed in a mound of stone, with attached ROCKART decal 20-127, near the cor.

The witness cor. is located on top of the right bank of the wash.

From this same true point of intersection, cor. No. 3, Skiberean, M. S. 2837, identical with cor. No. 4, Hillside, cor. No. 1, Touch Not, and cor. No. 2, Monte Carlo, M. S. 2838, bears S. 55°03' E., 8.374 chs. dist., monumented with a decayed wood post, in mound of stone, with 4 aluminum tags, mkd. "N. W. COR. TOUCH NOT", "N. E. COR. MONTE CARLO", "S. W. COR. HILLSIDE", and "S. E. COR. SKIBEREAN".

At the corner point, at the center of the mound of stone.

Set a limestone, 12 x 10 x 10 ins., 4 ins. in the ground, in a collar of stone, mkd. with a + cut, on top, directly over a 60d nail, set 4 ins. below the surface of the ground, with a brass washer, 1 1/2 ins. diam., mkd. BLM 2017.

Raise a mound of stone, 2 1/2 ft. base, 1 1/2 ft. high, 2 ft. W. of cor.

Set a carsonite post, enclosed in a mound of stone, with attached ROCKART decals 10-456 and 20-127, NE of cor.

From this same true point of intersection, cor. No. 2, Skiberean, M. S. 2837, identical with cor. No. 1, Hillside, M. S. 2838, bears N. 55°03' W., 14.751 chs. dist., monumented with a mound of stone, 2 ft. base, with a wood post, 4 ft. long, 4 ins. sq. laying loose on the surface of the ground, +/- 15 ft. E. of mound of stone, with aluminum tags missing.

Reset the wood post, at the center of the mound of stone, rebuild mound to, 3 1/2 ft. base, 1 1/2 ft. high.

Continuing to set carsonite posts, enclosed in mounds of stone, with attached ROCKART decal 10-456, at intervals of 4 chains +/- along the line.

Dependent Resurvey of a Portion of the Subdivisional Lines,
T. 2 S., R. 12 E., Gila and Salt River Meridian, Arizona

CHAINS	
32.72	<p>Intersect line 4-1, Skiberean, identical with line 2-3, Selma, M. S. 2837. Not monumented.</p> <p>From this point of intersection, cor. No. 4, Skiberean, identical with cor. No. 3, Selma, M. S. 2837, cor. No. 1, Monte Carlo, M. S. 2838, bears S. 53°15' E., 10.981 chs. dist., monumented with a small mound of stone, with a wood post, 4 ft. long, 4 ins. sq., laying loose on the surface of the ground, with 4 marked aluminum tags attached.</p> <p>Reset the wood post, at the center of the mound of stone, rebuild the mound to, 2 1/2 ft. diam., 1 ft. high, with the aluminum tags, mkd. "S. E. COR. SELMA", "S. W. COR. SKIBEREAN" facing NW and "N. W. COR. MONTE CARLO", "N. E. COR. COPPER BELL" facing SE.</p> <p>from which</p> <p style="padding-left: 40px;">A "PK" nail, 2 ins. long, mkd. P . K, on the SW face of a rock outcrop, +/- 50 x 10 ft., for a reference monument, bears N. 47°05' E., 41.70 ft. dist., with brass washer, 1 1/2 ins. diam., mkd. BLM 2017.</p> <p>From this same point of intersection, cor. No. 1, Skiberean, identical with cor. No. 2, Selma, M. S. 2837, bears N. 53°15' W., 11.763 chs. dist., monumented with a scattered mound of stone, with a wood post, 4 ft. long, 4 ins. sq. laying loose on the surface of the ground, with an aluminum tag, mkd. "N.E. COR. SELMA" on one face, and +/- 10 ft. S. of the mound of stone.</p> <p>Reset the wood post, at the center of the mound of stone, rebuild mound to, 2 1/2 ft. base, 1 ft. high.</p> <p>This cor. is located on a S. facing steep slope.</p> <p>from which</p> <p style="padding-left: 40px;">A "PK" nail, 2 1/2 ins. long, flush, on a rock outcrop, 4 x 4 ft., for a reference monument bears N. 5°14' W., 8.47 ft. dist., mkd. P . K.</p>
39.40	<p>The cor. of secs. 1, 2, 11, and 12, monumented with a limestone stone, 18 x 14 x 6 ins., firmly set, projecting 12 ins. above ground, with no marks visible, witnessed by a scattered mound of stone, 4 ft. W. of cor. Within patented lands.</p> <p>Set a carsonite post, enclosed in a mound of stones, with attached ROCKART decals 10-456 and 20-127, near the cor.</p> <p>The cor. falls on a westerly facing steep slope.</p> <hr/> <p>N. 0°27' W., bet. secs. 1 and 2, within patented lands.</p> <p>Over very mountainous terrain.</p>

Dependent Resurvey of a Portion of the Subdivisional Lines,
T. 2 S., R. 12 E., Gila and Salt River Meridian, Arizona

CHAINS	
5.042	<p>Intersect line 2-3, Selma, identical with line 4-1, Skiberean, M. S. 2837. Not monumented.</p> <p>From this point of intersection, cor. No. 4, Skiberean, identical with cor. No. 3, Selma, M. S. 2837, cor. No. 1, Monte Carlo, M. S. 2838, bears S. 53°15' E., 19.366 chs. dist., hereinbefore described.</p> <p>From this same point of intersection, cor. No. 1, Skiberean, identical with cor. No. 2, Selma, M. S. 2837, bears N. 53°15' W., 3.378 chs. dist., hereinbefore described.</p>
7.499	<p>Intersect line 1-2, Skiberean, M. S. 2837. Not monumented.</p> <p>From this point of intersection, cor. No. 2, Skiberean, M. S. 2837, identical with cor. No. 1, Hillside, M. S. 2838, bears N. 80°48' E., 6.364 chs. dist., hereinbefore described.</p> <p>From this same point of intersection, cor. No. 1, Skiberean, identical with cor. No. 2, Selma, M. S. 2837, bears S. 80°48' W., 2.722 chs. dist., hereinbefore described.</p> <p>Thence depart patented lands.</p>
10.364	<p>Intersect line 4-1, Panic, M. S. 2836. Not monumented.</p> <p>From this point of intersection, cor. No. 4, Panic, M. S. 2836, bears S. 37°57' E., 3.230 chs. dist., monumented with a scattered mound of stone, with a wood post, 4 ft. long, 4 ins. sq., laying loose on top of the mound of stone.</p> <p>Reset the wood post, at the center of the mound of stone, rebuild mound to, 3 ft. base, 1 1/2 ft. high.</p> <p>from which</p> <p style="padding-left: 40px;">A wood post, 4 ft. long, 4 ins. sq., firmly set, in a mound of stone, 4 ft. base, 1 1/2 ft. high, for a reference monument, bears S. 76°52' W., 11.20 ft. dist.</p> <p>From this same point of intersection, cor. No. 1, Panic, M. S. 2836, bears N. 37°57' W., 19.461 chs. dist., monumented with a wood post, 4 ft. long, 4 ins. sq., loosely set, in a scattered mound of stone, with an aluminum tag, mkd. "N. W. COR. PANIC" on SE face, and a decayed wood post, 4 ft. long, loose on top of the mound of stone.</p> <p>Reset the wood post, at the center of the mound of stone, rebuild mound to, 3 1/2 ft. base, 2 ft. high.</p> <p>Thence across patented lands.</p>
23.408	<p>Intersect line 2-3, Panic, M. S. 2836. Not monumented.</p>

Dependent Resurvey of a Portion of the Subdivisional Lines,
T. 2 S., R. 12 E., Gila and Salt River Meridian, Arizona

CHAINS	
	<p>From this point of intersection, cor. No. 3, M. S. 2836, Panic, bears S. 38°00' E., 17.995 chs. dist., monumented with a scattered mound of stone, with a wood post, 4 ft. long, 4 ins. sq., laying loose on top of the mound of stone, with an aluminum tag, mkd. "S. E. COR. PANIC" on one face.</p> <p>Reset the wood post, at the center of the mound of stone, rebuild mound to, 3 ft. base, 2 ft. high, with the aluminum tag facing NW.</p> <p>from which</p> <p style="padding-left: 40px;">A scattered mound of stone, with a wood post, 4 ft. long, 4 ins. sq., laying on top of the mound of stone, bears S. 85°' W., 11 ft.</p> <p>From this same point of intersection, cor. No. 2, Panic, M. S. 2836, bears N. 38°00' W., 4.758 chs. dist., monumented with a scattered mound of stone, with a wood post, 4 ft. long, 4 ins. sq., laying loose on top of the mound of stone, with 2 aluminum tags, mkd. "N. E. COR. PANIC", "N. W. COR. APACHE LEAP" on the same face.</p> <p>Reset the wood post, at the center of the mound of stone, rebuild mound to, 4 ft. base, 2 1/2 ft. high, with the aluminum tags facing SE.</p> <p>from which</p> <p style="padding-left: 40px;">A galvanized nail, 1/2 in. diam., firmly set, projecting 3 ins. above the surface of the ground, for a reference monument, bears S. 46°09' E., 7.27 ft. dist.</p> <p>Thence depart patented lands.</p>
39.263	<p>The 1/4 sec. cor. of secs. 1 and 2, monumented with a trachite stone, 14 x 8 ins., firmly set, projecting 14 ins. above ground, in a scattered mound of stone, mkd. 1/4 on W. face, witnessed by a scattered mound of stone, W. of cor.</p> <p>Rebuild the mound of stone, 3 ft. base, 2 ft. high, W. of cor.</p> <hr style="width: 20%; margin: 10px auto;"/> <p>N. 0°44' E., beginning new measurement.</p>
38.885	<p>The original closing cor. of secs. 1 and 2, at intersection with the S. bdy. of sec. 36, T. 1 S., R. 12 E., determined from the cor. of Tps. 1 S., Rs. 12 and 13 E., as per the official plat, approved Nov. 23, 1911, having a record dist. of 13.24 chs., utilizing the measured bearing bet. the cor. of Tps. 1 S., Rs. 12 and 13 E., and AP 1, sec. 36, on the S. bdy. of T. 1 S., R. 12 E., and the record dist. The determined location falls on inaccessible, precipitous broken walls near Apache Leap Cliffs. Not searched for.</p>

Dependent Resurvey of a Portion of the Subdivisional Lines,
T. 2 S., R. 12 E., Gila and Salt River Meridian, Arizona

CHAINS

From this true point of intersection, the cor. of Tps. 1 S., Rs. 12 and 13 E., bears S. 89°49' E., 13.24 chs. dist., monumented with a granite stone, 8 x 8 ins., firmly set, projecting 24 ins. above ground, marked with 6 notches on each edge, R 12 E on the W. face and + on top, witnessed by a mound of stone, 5 ft. base, 3 ft. high, 1.5 ft. N. of cor.

From this same true point of intersection, AP 1, sec. 36, on the S. bdy. of T. 1 S., R. 12 E., bears N. 89°49' W., 26.86 chs. dist., monumented with an iron post, 1 in. diam., firmly set, projecting 14 ins. above ground, in a collar of stone, with brass cap, mkd. T1S R12E S36 AP1 1924, witnessed by a scattered mound of stone, NW of cor.

Add the marks 2017 to the brass cap.

Rebuild the collar of stone, utilizing the scattered mound of stone.

From this AP 1, sec. 36, on the S. bdy. of T. 1 S., R. 12 E., the 1/4 sec. cor. of sec. 36 only, on the S. bdy. of T. 1 S., R. 12 E., bears N. 88°03' W., 25.3 lks. dist., monumented with an iron post, 1 in. diam., firmly set, projecting 18 ins. above ground, with brass cap, mkd.

1/4 S 36

1924

Remark the brass cap to read

T 1 S R 12 E

1/4 S 36

2017

1924

Enclose the iron post, in a mound of stone, 3 1/2 ft. base, to top of brass cap.

From the cor. of secs. 1, 2, 11, and 12.

N. 89°56' W., bet. secs. 2 and 11, within patented lands.

Over very mountainous terrain.

4.179

Point for AP 1, sec. 2, at intersection with line 4-1, Selma, M. S. 2837.

Dependent Resurvey of a Portion of the Subdivisional Lines,
T. 2 S., R. 12 E., Gila and Salt River Meridian, Arizona

CHAINS

Set a rebar, 24 ins. long, 5/8 in. diam., 14 ins. in the ground, to bedrock, in a mound of stone, 3 ft. base, to top, with brass cap, 2 ins. diam., mkd.

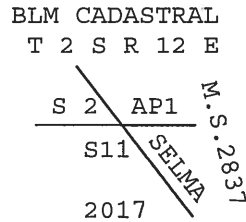

Set a carsonite post, enclosed in a mound of stone, with attached ROCKART decals 10-456 and 20-127, near the cor.

From this point of intersection, cor. No. 4, Selma, M. S. 2837, bears S. 53°19' E., 13.345 chs. dist., monumented with a decayed wood post, 3 ft. long, 4 x 3 ins., in a scattered mound of stone, with an aluminum tag, mkd. "S. E. COR. CONNECTING LINK NO. 4", witnessed by a mound of stone, 2 ft. base, 1 ft. high, NE of post.

At the corner point

Set a limestone, 12 x 9 x 8 ins., 4 ins. in the ground, in a collar of stone, mkd. with an L cut on top, directly over a 60d nail, set 4 ins. below the surface of the ground, with a brass washer, 1 1/2 ins. diam., mkd. BLM 2017.

Rebuild the mound of stone, 3 ft. base, 2 ft. high, NE of cor.

Detach the aluminum tag from the decayed wood post and place next to the marked stone, place the decayed wood post near the mound of stone.

from which a bearing rock of unknown origin

A quartz stone in place, 2 x 1 1/2 ft., projecting 3 ft., above ground, bears N. 78°57' W., 64 lks. dist., mkd. "+ B R" on NW face near the top, and "2-3043" on the SE face.

From this same point of intersection, cor. No. 1, Selma, M. S. 2837, bears N. 53°19' W., 9.402 chs. dist., monumented with a scattered mound of stone, with a decayed wood post, 2 ft. long, 4 x 1 in., loose on the surface of the ground, with an aluminum tag, mkd. "N. E. COR. CONNECTING LINK NO. 4" on one face, +/- 10 ft. SE of the mound of stone.

At the corner point, at the center of the mound of stone.

Set a quartz stone, 14 x 12 x 4 ins., 6 ins. in the ground, in a collar of stone, mkd. with a + cut, on top, directly over a 60d nail, set 6 ins. below the surface of the ground, with a brass washer, 1 1/2 ins. diam., mkd. BLM 2017.

Dependent Resurvey of a Portion of the Subdivisional Lines,
T. 2 S., R. 12 E., Gila and Salt River Meridian, Arizona

<p>CHAINS</p> <p>40.769</p> <p>9.053</p> <p>4.758</p>	<p>Raise a mound of stone, 3 ft. base, 2 ft. high, N. of cor.</p> <p>Lay the decayed wood post, nearby.</p> <p>This cor. is located on a SE facing slope.</p> <p>Thence depart patented lands.</p> <p>The 1/4 sec. cor. of secs. 2 and 11, monumented with a limestone, 12 x 6 ins. firmly set, projecting 10 ins. above ground, mkd. 1/4 on N. face, witnessed by a scattered mound of stone, N. of cor.</p> <p>Rebuild the mound of stone, 3 ft. base, 2 1/2 ft. high, N. of cor. from which</p> <p style="padding-left: 40px;">A decayed wood post, in a mound of stone, 3 ft. base, 2 ft. high, bears N. 75°31' W., 152.2 ft. dist., with an aluminum tag, mkd. "S. W. COR. SAN JUAN".</p> <hr/> <p style="text-align: center;">Dependent Resurvey of Portions of Mineral Survey No. 2836, in Secs. 1 and 2, T. 2 S., R. 12 E., Gila and Salt River Meridian, Arizona</p> <hr/> <p style="text-align: center;">Restoring the survey executed by John F. Hesse, in 1910</p> <hr/> <p style="text-align: center;">Panic Lode</p> <p>From cor. No. 1, Panic, M. S. 2836, hereinbefore described.</p> <p>N. 80°48' E., on line 1-2, Panic, M. S. 2836, Panic, within sec. 2.</p> <p>Cor. No. 2, Panic, M. S. 2836, hereinbefore described.</p> <hr/> <p>S. 38°00' E., on line 2-3, Panic, M. S. 2836.</p> <p>Intersect the sec. line bet. secs. 1 and 2, hereinbefore described.</p> <p>From this point of intersection, the cor. of secs. 1, 2, 11, and 12, bears S. 0°27' E., 23.408 chs. dist., hereinbefore described.</p> <p>From this same point of intersection, the 1/4 sec. cor. of secs. 1 and 2, bears N. 0°27' W., 15.855 chs. dist., hereinbefore described.</p> <p>Thence within sec. 1.</p>
---	--

Dependent Resurvey of Portions of Mineral Survey No. 2836,
in Secs. 1 and 2,
T. 2 S., R. 12 E., Gila and Salt River Meridian, Arizona

CHAINS	
22.727	<p>Intersect line 1-2, Hillside, M. S. 2838. Not monumented.</p> <p>From this point of intersection, cor. No. 2, Hillside, M. S. 2838, bears N. 81°05' E., 5.030 chs. dist., hereinbefore described.</p> <p>From this same point of intersection, cor. No. 1, Hillside, M. S. 2838, bears S. 81°05' W., 4.710 chs. dist., hereinbefore described.</p>
22.753	<p>Cor. No. 3, Panic, M. S. 2836, hereinbefore described.</p> <hr/> <p>S. 81°05' W., on line 3-4, Panic, M. S. 2836.</p>
4.700	<p>Intersect line 2-3, Skiberean, M. S. 2837, identical with line 4-1, M. S. 2838, Hillside. Not monumented.</p> <p>From this point of intersection, cor. No. 3, Skiberean, M. S. 2837, identical with cor. No. 4, Hillside, cor. No. 1, Touch Not, and cor. No. 2, Monte Carlo, M. S. 2838, bears S. 55°03' E., 23.093 chs. dist., hereinbefore described.</p> <p>From this same point of intersection, cor. No. 2, Skiberean, M. S. 2837, identical with cor. No. 1, Hillside, M. S. 2838, bears N. 55°03' W., 3.2 lks. dist., hereinbefore described.</p>
9.097	<p>Cor. No. 4, M. S. 2836, Panic, on line 1-2, Skiberean, M. S. 2837, hereinbefore described.</p> <p>From this cor., cor. No. 2, Skiberean, M. S. 2837, identical with cor. No. 1, Hillside, M. S. 2838, bears N. 80°48' E., 4.374 chs. dist., hereinbefore described.</p> <p>From this same cor., cor. No. 1, Skiberean, M. S. 2837, identical with cor. No. 2, Selma, M. S. 2837, bears S. 80°48' W., 4.712 chs. dist., hereinbefore described.</p> <p>From this same cor., the cor. of secs. 1, 2, 11, and 12, bears S. 13°42' W., 8.045 chs. dist., hereinbefore described.</p> <hr/> <p>N. 37°57' W., on line 4-1, M. S. 2836, Panic.</p>
3.230	<p>Intersect the sec. line bet. secs. 1 and 2, hereinbefore described.</p> <p>From this point of intersection, the cor. of secs. 1, 2, 11, and 12, bears S. 0°27' E., 10.364 chs. dist., hereinbefore described.</p> <p>From this same point of intersection, the 1/4 sec. cor. of secs. 1 and 2, bears N. 0°27' W., 28.899 chs. dist., hereinbefore described.</p> <p>Thence within sec. 2.</p>

Dependent Resurvey of Portions of Mineral Survey No. 2836,
in Secs. 1 and 2,
T. 2 S., R. 12 E., Gila and Salt River Meridian, Arizona

CHAINS	
22.691	Cor. No. 1, Panic, M. S. 2836, the point of beginning.
	<hr/> <p style="text-align: center;">Dependent Resurvey of portions of Mineral Survey No. 2837, In Secs. 1, 2, 11, and 12, T. 2 S., R. 12 E., Gila and Salt River Meridian, Arizona</p> <hr/>
	<p style="text-align: center;">Restoring the survey executed by John F. Hesse, in 1910</p> <hr/>
	<p style="text-align: center;">Selma Lode</p>
	From cor. No. 1, Selma, M. S. 2837, hereinbefore described.
	N. 80°52' E., on line 1-2, Selma, M. S. 2837, within sec. 2.
9.088	Cor. No. 2, Selma, identical with cor. No. 1, Skiberean, M. S. 2837, hereinbefore described.
	From this cor. point, the cor. of secs. 1, 2, 11, and 12, bears S. 21°15' E., 7.579 chs. dist., hereinbefore described.
	<hr/> <p>S. 53°15' E., on line 2-3, Selma, identical with line 4-1, Skiberean, M. S. 2837.</p>
3.378	Intersect the sec. line bet. secs. 1 and 2, hereinbefore described.
	From this point of intersection, the cor. of secs. 1, 2, 11, and 12, bears S. 0°27' E., 5.042 chs. dist., hereinbefore described.
	From this same point of intersection, the 1/4 sec. cor. of secs. 1 and 2, bears N. 0°27' W., 34.221 chs. dist., hereinbefore described.
	Thence within sec. 1.
11.763	Intersect the sec. line bet. secs. 1 and 12, hereinbefore described.
	From this point of intersection, the 1/4 sec. cor. of secs. 1 and 12, bears N. 89°47' E., 32.72 chs. dist., hereinbefore described.
	From this same point of intersection, the cor. of secs. 1, 2, 11, and 12, bears S. 89°47' W., 6.680 chs. dist., hereinbefore described.
	Thence within sec. 12.

Dependent Resurvey of Portions of Mineral Survey No. 2837,
in Secs. 1, 2, 11 and 12,
T. 2 S., R. 12 E., Gila and Salt River Meridian, Arizona

CHAINS	
22.744	Cor. No. 3, Selma, identical with cor. No. 4, Skiberean, M. S. 2837, and cor. No. 1, Monte Carlo, M. S. 2838, hereinbefore described.
	S. 80°59' W., on line 3-4, Selma, M. S. 2837.
9.065	Cor. No. 4, Selma, M. S. 2837, hereinbefore described.
	N. 53°19' W., on line 4-1, Selma, M. S. 2837, within sec. 12 and thence within sec. 11.
13.345	AP 1, sec. 2, at intersection with the sec. line bet. secs. 2 and 11, hereinbefore described.
	From this AP 1, sec. 2, the cor. of secs. 1, 2, 11, and 12, bears S. 89°56' E., 4.179 chs. dist., hereinbefore described.
	From this same AP 1, sec. 2, the 1/4 sec. cor. of secs. 2 and 11, bears N. 89°56' W., 36.59 chs. dist., hereinbefore described.
	Thence within sec. 2.
22.747	Cor. No. 1, Selma, M. S. 2837, the point of beginning.
	Skiberean Lode
	From cor. No. 1, Skiberean, identical with cor. No. 2, Selma, M. S. 2837, hereinbefore described.
	N. 80°48' E., on line 1-2, Skiberean, M. S. 2837, within sec. 2.
2.722	Intersect the sec. line bet. secs. 1 and 2, hereinbefore described.
	From this point of intersection, the cor. of secs. 1, 2, 11, and 12, bears S. 0°27' E., 7.499 chs. dist., hereinbefore described.
	From this same point of intersection, the 1/4 sec. cor. of secs. 1 and 2, bears N. 0°27' W., 31.764 chs. dist., hereinbefore described.
	Thence within sec. 1.
4.712	Cor. No. 4, Panic, M. S. 2836, hereinbefore described.
9.086	Cor. No. 2, Skiberean, M. S. 2837, identical with cor. No. 1, Hillside, M. S. 2838, hereinbefore described.
	S. 55°03' E., on line 2-3, Skiberean, M. S. 2837, identical with line 4-1, Hillside, M. S. 2838.

**Dependent Resurvey of Portions of Mineral Survey No. 2837,
in Secs. 1, 2, 11 and 12,
T. 2 S., R. 12 E., Gila and Salt River Meridian, Arizona**

CHAINS	
0.032	<p>Intersect line 3-4, Panic, M. S. 2836, hereinbefore described.</p> <p>From this point of intersection, cor. No. 3, Panic, M. S. 2836, bears N. 81°05' E., 4.700 chs. dist., hereinbefore described.</p> <p>From this same point of intersection, cor. No. 4, Panic, M. S. 2836, bears S. 81°05' W., 4.397 chs. dist., hereinbefore described.</p>
14.751	<p>AP 1, sec. 1, at intersection with the sec. line bet. secs. 1 and 12, hereinbefore described.</p> <p>From this AP 1, sec. 1, the 1/4 sec. cor. of secs. 1 and 12, bears N. 89°47' E., 21.08 chs. dist., hereinbefore described.</p> <p>From this same AP 1, sec. 1, the cor. of secs. 1, 2, 11, and 12, bears S. 89°47' W., 18.32 chs. dist., hereinbefore described.</p> <p>Thence within sec. 12.</p> <p>Set carsonite posts, enclosed in mounds of stone, with attached ROCKART decal 10-456, at intervals of 4 chains +/-.</p>
23.125	<p>Cor. No. 3, Skiberean, M. S. 2837, identical with cor. No. 4, Hillside, cor. No. 1, Touch Not, and cor. No. 2, Monte Carlo, M. S. 2838, hereinbefore described.</p> <hr style="width: 20%; margin: 10px auto;"/> <p>S. 79°24' W., on line 3-4, Skiberean, M. S. 2837, identical with line 1-2, Monte Carlo, M. S. 2838.</p>
9.871	<p>Cor. No. 4, Skiberean, identical with cor. No. 3, Selma, M. S. 2837, and cor. No. 1, Monte Carlo, M. S. 2838, hereinbefore described.</p> <hr style="width: 60%; margin: 10px auto;"/> <p style="text-align: center;">Dependent Resurvey of Portions of Mineral Survey No. 2838, in Secs. 1 and 12, T. 2 S., R. 12 E., Gila and Salt River Meridian, Arizona</p> <hr style="width: 60%; margin: 10px auto;"/> <p style="text-align: center;">Restoring the survey executed by John F. Hesse, in 1910</p> <hr style="width: 60%; margin: 10px auto;"/> <p style="text-align: center;">Hillside Lode</p> <p>From cor. No. 1, Hillside, M. S. 2838, identical with cor. No. 2, Skiberean, M. S. 2837, hereinbefore described.</p> <p>N. 81°05' E., on line 1-2, Hillside, M. S. 2838, within sec. 1.</p>
4.710	<p>Intersect line 2-3, Panic, M. S. 2836, hereinbefore described.</p>

Dependent Resurvey of Portions of Mineral Survey No. 3581,
in Sec. 12,
T. 2 S., R. 12 E., Gila and Salt River Meridian, Arizona

CHAINS	
	<p>From this point of intersection, cor. No. 3, Panic, M. S. 2836, bears S. 38°00' E., 2.6 lks. dist., hereinbefore described.</p>
	<p>From this same point of intersection, cor. No. 2, Panic, M. S. 2836, bears N. 38°00' W., 22.727 chs. dist., hereinbefore described.</p>
9.740	<p>Cor. No. 2, Hillside, M. S. 2838, hereinbefore described.</p> <hr/>
	<p>S. 52°06' E., on line 2-3, Hillside, M. S. 2838.</p>
16.154	<p>Intersect the sec. line bet. secs. 1 and 12, hereinbefore described.</p>
	<p>From this point of intersection, the 1/4 sec. cor. of secs. 1 and 12, bears N. 89°47' E., 10.805 chs. dist., hereinbefore described.</p>
	<p>From this same point of intersection, the cor. of secs. 1, 2, 11, and 12, bears S. 89°47' W., 28.595 chs. dist., hereinbefore described.</p> <p>Thence within sec. 12.</p>
22.269	<p>Cor. No. 3, Hillside, identical with cor. No.1, Touch Not No. 3, and cor. No. 2, Touch Not, M. S. 2838, hereinbefore described.</p> <hr/>
	<p>S. 82°33' W., on line 3-4, Hillside, identical with line 1-2, Touch Not, M. S. 2838.</p>
8.310	<p>Cor. No. 4, Hillside, identical with cor. No. 1, Touch Not, cor. No. 2, Monte Carlo, M. S. 2838, and cor. No. 3, Skiberean, M. S. 2837, hereinbefore described.</p> <hr/>
	<p style="text-align: center;">Touch Not Lode</p>
	<p>From cor. No. 2, Touch Not, identical with cor. No. 3, Hillside, and cor. No. 1, Touch Not No. 3, M. S. 2838, hereinbefore described. Within sec. 12.</p>
	<p>S. 15°38' E., on line 2-3, Touch Not, identical with line 4-1, Touch Not No. 3, M. S. 2838.</p>
22.697	<p>Cor. No. 3, Touch Not, identical with cor. No. 4, Touch Not No. 3, and cor. No. 2, Rawhide, M. S. 2838, determined at proportionate dist., bet. cor. No. 3, Touch Not. No. 3, M. S. 2838, hereinafter described, and cor. No. 4, Touch Not, identical with cor. No. 1, Rawhide, cor. No. 2, Belmont, and cor. No. 3, Monte Carlo, M. S. 2838, hereinafter described. The determined location falls on inaccessible, precipitous broken walls near Apache Leap Cliffs. Not searched for.</p> <hr/>

Dependent Resurvey of Portions of Mineral Survey No. 3581,
in Sec. 12,
T. 2 S., R. 12 E., Gila and Salt River Meridian, Arizona

CHAINS	
	S. 80°46' W., on line 3-4, Touch Not, identical with line 1-2, Rawhide, M. S. 2838.
8.989	<p>Cor. No. 4, Touch Not, identical with cor. No. 1, Rawhide, cor. No. 2, Belmont, and cor. No. 3, Monte Carlo, M. S. 2838, monumented with a wood post, 4 ft. long, 4 ins. sq., firmly set, in a mound of stone, 4 ft. base, 2 ft. high, with 4 aluminum tags, mkd. "S. E. COR. MONTE CARLO", "S. W. COR. TOUCH NOT", on SE face and "N. E. COR. BELMONT", "N. W. COR. RAWHIDE" on the NW face.</p> <p>Set a carsonite post, enclosed in a mound of stone, with attached ROCKART decals 10-456 and 20-127, NE of cor.</p> <hr/> <p>N. 13°52' W., on line 4-1, Touch Not, identical with line 2-3, Monte Carlo, M. S. 2838.</p> <p>Set carsonite posts, enclosed in mounds of stone, with attached ROCKART decal 10-456, at intervals of 4 chains +/-.</p>
22.886	<p>Cor. No. 1, Touch Not, identical with cor. No. 2, Monte Carlo, M. S. 2838, cor. No. 3, Skiberean, M. S. 2837, and cor. No. 4, Hillside, M. S. 2838 .Within sec. 12.</p> <hr/> <p style="text-align: center;">Touch Not No. 3 Lode</p> <p>From cor. No. 1, Touch Not No. 3, identical with cor. No. 2, Touch Not, and cor. No. 3, Hillside, M. S. 2838, hereinbefore described. Within sec. 12.</p> <p>N. 80°50' E., on line 1-2, Touch Not No. 3, M. S. 2838.</p>
8.784	<p>Cor. No. 2, Touch Not. No. 3, M. S. 2838, monumented with a wood post, 3 ft. long, 4 ins. sq., firmly set, in a mound of stone, 2 1/2 ft. base, 1 ft. high, with 4 aluminum tags, mkd. "S. W. COR. DACITE NO. 1", "S. E. COR. CONNECTING LINK", on N. face and "N. E. COR. TOUCH NOT NO. 3", "N. W. COR. DACITE NO. 4" on S. face.</p> <p>from which</p> <p style="padding-left: 40px;">A rock outcrop, 8 x 2 ft., projecting 4 ft. on S. face, bears S. 89°19' E., 10 lks. dist., mkd. TN N 3 + CL - 3 2838 / 2838, on top.</p> <p>From this cor. point, the 1/4 sec. cor. of secs. 1 and 12, bears N. 48°20' W., 3.605 chs. dist., hereinbefore described.</p> <hr/> <p>S. 16°09' E., on line 2-3, Touch Not. No. 3 M. S. 2838.</p>

Dependent Resurvey of Portions of Mineral Survey No. 3581,
in Sec. 12,
T. 2 S., R. 12 E., Gila and Salt River Meridian, Arizona

CHAINS	
22.712	<p>Cor. No. 3, Touch Not No. 3, M. S. 2838, monumented with a wood post, 4 ft. long, 4 ins. sq., loosely set, and leaning SE, in a mound of stone, 3 ft. base, 1 ft. high, with 4 aluminum tags, mkd. "N. E. COR. TOUCH NOT NO. 2", "N. W. COR. DACITE NO. 7" on the NE face and "S. W. COR. DACITE NO. 4", "S. E. COR. TOUCH NOT NO 3" on the SW face.</p> <p>Plumb up the wood post, and rebuild the mound of stone, 4 ft. base, 2 ft. high.</p> <hr/> <p>S. 80°46' W., on line 3-4, Touch Not No. 3, M. S. 2838.</p>
8.989	<p>Cor. No. 4, Touch Not No. 3, identical with cor. No. 2, Rawhide, and cor. No. 3, Touch Not, M. S. 2838, hereinbefore described.</p> <hr/> <p style="text-align: center;">Rawhide Lode</p> <p>From cor. No. 2, Rawhide, identical with cor. No. 3, Touch Not and cor. No. 4, Touch Not No. 3, M. S. 2838, hereinbefore described. Within sec. 12.</p> <p>S. 34°16' E., on line 2-3, Rawhide, M. S. 2838.</p>
22.868	<p>Cor. No. 3, Rawhide, M. S. 2838, monumented with a scattered mound of stone, with a partially decayed wood post, 4 ft. long, nearby, with 2 aluminum tags, mkd. "S. E. COR. RAWHIDE" on one face and "S. W. COR. TOUCH NOT NO. 2" on another face.</p> <p>Reset the wood post, at the center of the mound of stone, rebuild mound to, 3 ft. base, 2 ft. high.</p> <p>from which the bearing rocks of unknown origin</p> <p style="padding-left: 40px;">A rock outcrop, 4 x 4 ft., projecting 5 ft., on the W. face, bears N. 73°50' E., 20.5 lks. dist., mkd. "+ B R" on the W. face.</p> <p style="padding-left: 40px;">A rock outcrop, 3 x 2 ft., projecting 3 ft., on the N. face, bears S. 27°36' E., 17 lks. dist., mkd. "+ B R" on the N. face.</p> <hr/> <p>S. 80°55' W., on line 3-4, Rawhide, M. S. 2838, identical with a portion of line 4-1, Pacific No. 32, and a portion of line 2-3, Pacific No. 13, M. S. 3581.</p>
4.778	<p>S. end center, Rawhide, M. S. 2838, identical with cor. No. 4, Pacific No. 32, and cor. No. 3, Pacific No. 13, M. S. 3581, monumented with a scattered mound of stone, 3 ft. base, with a wood post, 4 ft. long, 4 ins. sq., laying nearby, with an aluminum tag, mkd. "S. END C. RAWHIDE" on one face.</p>

Dependent Resurvey of Portions of Mineral Survey No. 3581,
in Sec. 12,
T. 2 S., R. 12 E., Gila and Salt River Meridian, Arizona

CHAINS	
	<p>Reset the wood post, at the center of the mound of stone, rebuild mound to, 4 ft. base, 2 ft. high, with the aluminum tag facing N.</p> <p>Set a carsonite post, enclosed in a mound of stone, with attached ROCKART decals 10-456 and 20-127, NE of cor.</p> <p>Set a carsonite post, enclosed in a mound of stone, with attached ROCKART decal 10-456, at approximately 2.25 chs. along the line.</p>
9.312	<p>Cor. No. 4, Rawhide, identical with cor. No. 3, Belmont, M. S. 2838, monumented with a wood post, 4 ft. long, 4 ins. sq., loosely set, in a mound of stone, 2 1/2 ft. base, 1 1/2 ft. high, with 2 aluminum tags, mkd. "S. W. COR. RAWHIDE" and "S. E. COR. BELMONT" on the N. face.</p> <p>Rebuild the mound of stone, 3 1/2 ft. base, 2 1/2 ft. high.</p> <p>Set a carsonite post, enclosed in a mound of stone, with attached ROCKART decals 10-456 and 20-127, NE of cor.</p>
	<hr/> <p>N. 33°33' W., on line 4-1, Rawhide, identical with line 2-3, Belmont M. S. 2838.</p> <p>Set carsonite posts, enclosed in mounds of stone, with attached ROCKART decal 10-456, at intervals of 4 chains +/-.</p>
22.712	<p>Cor. No. 1, Rawhide, identical with cor. No. 2, Belmont, cor. No. 3, Monte Carlo, and cor. No. 4, M. Touch Not, M. S. 2838. Within sec. 12.</p>
	<hr/> <p style="text-align: center;">Dependent Resurvey of Portions of Mineral Survey No. 3581, in Sec. 12, T. 2 S., R. 12 E., Gila and Salt River Meridian, Arizona</p> <hr/>
	<p style="text-align: center;">Restoring the survey executed by Edward L. Haff, in 1919</p> <hr/>
	<p style="text-align: center;">Pacific No. 32 Lode</p> <p>From cor. No. 1, M. S. 3581, Pacific No. 32, monumented with a stone, 12 x 6 ins., firmly set, projecting 14 ins. above ground, mkd. "+" on top and "P 32 - 1 - 3581" on the W. face, witnessed by a scattered mound of stone, NE of cor.</p> <p>Rebuild the mound of stone, 3 ft. base, 2 1/2 ft. high, 1 ft. NE of + mark.</p> <p>from which</p>

Dependent Resurvey of Portions of Mineral Survey No. 3581,
in Sec. 12,
T. 2 S., R. 12 E., Gila and Salt River Meridian, Arizona

CHAINS	
	<p>A wood post, 3 ft. long, 4 ins. sq., firmly set, in a mound of stone, 4 ft. base, 2 ft. high, for a reference monument, bears N. 81°32' E., 32.89 ft. dist.</p> <p>A wood post, 4 ft. long, 4 ins. sq., firmly set, in a mound of stone, 4 ft. base, 2 ft. high, for a reference monument, bears S. 81°10' W., 23.60 ft. dist. with an aluminum tag, mkd. "N. W. COR. DACITE NO. 12", found loose and laying nearby. Attach aluminum tag to the top of the post.</p> <p>From this cor., the 1/4 sec. cor. of sec. 12 only, on the E. bdy. of the Tp., bears N. 86°24' E., 8.351 chs. dist., hereinbefore described.</p> <p>S. 14°19' E., on line 1-2, M. S. 3581, Pacific No. 32.</p>
8.450	<p>Cor. No. 2, Pacific No. 32, identical with cor. No. 1, Grand, M. S. 3581, monumented with a stone, 14 x 15 ins., firmly set, projecting 24 ins. above ground, in a mound of stone, 3 ft. base, 1 ft. high, mkd. "+ G - 1 P 32 - 2" on top and " 581" on the W. face. Witnessed by a mound of stone, 3 ft. base, 2 ft. high, 3 ft. NE of + mark.</p> <p>From this cor. point, the 1/4 sec. cor. of sec. 12 only, on the E. bdy. of the Tp., bears N. 35°38'15" E., 10.719 chs. dist., hereinbefore described.</p> <hr/> <p>S. 80°55' W., on line 2-3, Pacific No. 32, identical with line 4-1, Grand, M. S. 3581.</p>
22.740	<p>Cor. No. 3, Pacific No. 32, identical with cor. No. 4, Grand, cor. No. 3, Pacific No. 19, and cor. No. 4, Pacific No. 13, M. S. 3581, monumented with a stone, 14 x 10 ins., firmly set, projecting 12 ins. above ground, mkd. "+" on top, "P 13 - 4 - P 32 - 3 - 3581" on the N. face, "G - 4 - 3581" on the E. face, and "P 19 - 3" on the W. face.</p> <p>Witnessed by a mound of stone, 2 ft. base, 1 1/2 ft. high, 1.7 ft. E. of + mark.</p> <p>Rebuild the mound of stone, 3 ft. base, 2 ft. high.</p> <p>Set a carsonite post, enclosed in a mound of stone, with attached ROCKART decals 10-456 and 20-127, near the cor.</p> <hr/> <p>N. 14°17' W., on line 3-4, Pacific No. 32, identical with line 3-4, Pacific No. 13, M. S. 3581.</p> <p>Set carsonite posts, enclosed in mounds of stone, with attached ROCKART decal 10-456, at intervals of 4 chains +/-.</p>

Dependent Resurvey of Portions of Mineral Survey No. 3581,
in Sec. 12,
T. 2 S., R. 12 E., Gila and Salt River Meridian, Arizona

CHAINS	
8.450	Cor. No. 4, Pacific No. 32, identical with cor. No. 3, Pacific No. 13, M. S. 3581, and the S. end center, Rawhide, M. S. 2838, hereinbefore described.
	<hr/> N. 80°55' E., on line 4-1, Pacific No. 32, M. S. 3581, identical with a portion of line 3-4, Rawhide, M. S. 2838, hereinbefore described.
4.778	Cor. No. 3, Rawhide, M. S. 2838, hereinbefore described.
13.301	Cor. No. 3, Touch Not No. 2 (unpatented), M. S. 2838, monumented with a mound of stone, 3 ft. base, 1 ft. high, with a wood post, 4 ft. long, 4 ins. sq., loose on top of the mound of stone.
	Reset the wood post, at the center of the mound of stone, rebuild mound to, 3 ft. base, 2 ft. high.
	from which
	<p style="padding-left: 40px;">A stone, 4 x 2 ft. firmly set, projecting 6 ins. above ground, on the N. side, for a reference monument, bears S. 40°52' E., 1.92 ft. dist. mkd. "+ T N NO 2 - 3 2838" on top.</p>
22.735	Cor. No. 1, Pacific No. 32, M. S. 3581, the point of beginning.
	<hr/> Grand Lode
	From cor. No. 1, Grand, identical with cor. No. 2, Pacific No. 32, M. S. 3581, hereinbefore described.
	S. 14°18' E., on line 1-2, Grand, M. S. 3581.
6.119	Cor. No. 2, Grand, identical with cor. No. 1, Pacific No. 25, M. S. 3581, monumented with a stone, 8 x 6 ins. firmly set, projecting 16 ins. above ground, mkd. "+" on top, "G - 2" on the N. face, and "P 25 - 1 - 3581" on the S. face, witnessed by a mound of stone, 3 ft. base, 1 1/2 ft. high, E. of cor.
	From this cor. point, the 1/4 sec. cor. of sec. 12 only, on the E. bdy. of the Tp., bears N. 17°54'50" E., 15.387 chs. dist., hereinbefore described.
	<hr/> S. 80°55' W., on line 2-3, Grand, identical with line 4-1, Pacific No. 25, M. S. 3581.
	Thence along the westerly facing, steep and broken slope of Apache Leap Cliffs, where it is impracticable to post the entire line.
	Set a carsonite post, enclosed in a mound of stone, with attached ROCKART decal 10-456, at approximately 20.8 chs. along the line.

Dependent Resurvey of Portions of Mineral Survey No. 3581,
in Sec. 12,
T. 2 S., R. 12 E., Gila and Salt River Meridian, Arizona

CHAINS	
22.724	<p>Cor. No. 3, Grand, identical with cor. No. 4, Pacific No. 25, cor. No. 3, Pacific No. 7, and cor. No. 4, Pacific No. 19, M. S. 3581, monumented with a stone, 16 x 14 ins. firmly set, projecting 5 ins. on the S. side, mkd. "P 19 - 4 G - 3 X P 25 - 4 P 7 - 3" on top, and part of a mound of stone, 5 ft. base, 4 ft. high.</p> <p>Relocate the mound of stone, 5 ft. base, 3 ft. high, 1 ft. SW of X mark.</p> <p>Set a carsonite post, enclosed in a mound of stone, with attached ROCKART decals 10-456 and 20-127, NE of cor.</p> <p>The cor. is located on a S. facing steep slope.</p> <hr/> <p>N. 14°28' W., on line 3-4, Grand, identical with line 3-4, Pacific No. 19, M. S. 3581.</p> <p>Set a carsonite post, enclosed in a mound of stone, with attached ROCKART decal 10-456, at approximately 3 chs. along the line.</p>
6.121	<p>Cor. No. 4, Grand, identical cor. No. 3, Pacific No. 19, cor. No. 4, Pacific No. 13, and cor. No. 3, Pacific No. 32, M. S. 3581, hereinbefore described.</p> <hr/> <p style="text-align: center;">Metes-and-Bounds Survey of Tract 37, T. 2 S., R. 12 E., Gila and Salt River Meridian, Arizona</p> <hr/> <p style="text-align: center;">In sec. 1</p> <p>From AP 1A, sec. 1, Tract 37, identical with AP 2, sec. 31, of the metes-and-bounds survey of Tract 48, on the S. bdy. of T. 1 S., R. 13 E., monumented with a stainless steel post, 2 1/2 ins. diam., firmly set, projecting 20 ins. above ground, in a mound of stone, 4 ft. base, to top, with brass cap mkd. T1S R13E AP 2 S 31 AP 1A S1 T2S R12E 2017, with a carsonite post, enclosed in a mound of stone, with attached ROCKART decals 10-456 and 20-127, SW of cor.</p> <p>From this cor. point, the cor. of secs. 31 and 32 only, on the S. bdy. of T. 1 S., R. 13 E., bears S. 89°57' E., 14.021 chs. dist., monumented with a granite stone, 12 x 6 ins. firmly set, projecting 9 ins. above ground, in a collar of stone, mkd. with 5 grooves on the E. face and 1 groove on the W. face, witnessed by a mound of stone, 3 1/2 ft. base, 2 ft. high, E. of cor.</p> <p>The cor. is located on a N. facing slope.</p> <p>from which</p>

Metes-and-Bounds Survey of Tract 37,
T. 2 S., R. 12 E., Gila and Salt River Meridian, Arizona

CHAINS	
	<p>A "PK" nail, mkd. P . K, firmly set, flush on a rock outcrop 10 x 8 ft., for a reference monument, bears S. 3°12' W., 19.0 ft. dist., with brass washer, 1 1/2 ins. diam., mkd. BLM 2017.</p> <p>From this same cor. point, the cor. of Tp. 1 S., Rs. 12 and 13 E., bears N. 89°57' W., 6.638 chs. dist., hereinbefore described.</p> <p>S. 0°43' W, on line 1A-2A, along the W. bdy. of Tract 37.</p> <p>Over rough, mountainous and broken terrain.</p> <p>Set carsonite posts, enclosed in mounds of stone, with attached ROCKART decal 10-456, at intervals of 4 chains +/-.</p>
28.202	<p>Point for AP 2A, sec. 1, Tract 37.</p> <p>Set a stainless steel post, 28 ins. long, 2 1/2 ins. diam., 8 ins. in the ground, to bedrock, in a mound of stone, 3 ft. base, to top, with brass cap mkd.</p> <div data-bbox="808 913 1019 1123" style="text-align: center;"> <p>T 2 S R 12 E</p> <p>AP 2A S1</p> <p>2017</p> </div> <p>Deposit a magnet, in a white plastic case, at the base of the stainless steel post.</p> <hr style="width: 30%; margin: 10px auto;"/> <p>S. 31°30' E, on line 2A-3A, along the W. bdy. of Tract 37.</p> <p>Set a carsonite post, enclosed in a mound of stone, with attached ROCKART decal 10-456, at approximately 2.9 chs. along the line.</p>
5.934	<p>Point selected for a witness point.</p> <p>Set a rebar, 24 ins. long, 5/8 in. diam., 8 ins. in the ground, in a mound of stone, 3 ft. base, to top, with brass cap, 2 ins. diam., mkd.</p> <div data-bbox="815 1606 1026 1843" style="text-align: center;"> <p>BLM CADASTRAL WP</p> <p>T 2 S R 12 E</p> <p>S 1</p> <p>2017</p> </div>

**Metes-and-Bounds Survey of Tract 37,
T. 2 S., R. 12 E., Gila and Salt River Meridian, Arizona**

CHAINS	
	<p>Set a carsonite post, enclosed in a mound of stone, with attached ROCKART decals 10-456 and 20-127, near the cor.</p> <p>Set carsonite posts, enclosed in mounds of stone, with attached ROCKART decal 10-456, at intervals of 4 chains +/-.</p>
47.463	<p>Point selected for a witness point.</p> <p>Set a rebar, 24 ins. long, 5/8 in. diam., 10 ins. in the ground, in a mound of stone, 3 ft. base, to top, with brass cap, 2 ins. diam., mkd.</p> <div style="text-align: center;"> <p>BLM CADASTRAL WP T 2 S R 12 E S 1 2017</p> </div> <p>Set a carsonite post, enclosed in a mound of stone, with attached ROCKART decals 10-456 and 20-127, near the cor.</p> <p>Set carsonite posts, enclosed in mounds of stone, with attached ROCKART decal 10-456, at intervals of 4 chains +/-.</p>
58.779	<p>AP 3A, sec. 1, Tract 37, on the sec. line bet. secs. 1 and 12, hereinbefore described.</p> <hr/> <p style="text-align: center;">GENERAL DESCRIPTION</p> <hr/> <p>The lines surveyed and resurveyed within T. 2 S., R. 12 E. are located approximately 1.7 miles SE of Superior, Arizona. The terrain is extremely rugged, broken and mountainous, with portions of Apache Leap Cliffs situated in secs. 1 and 12. The elevation ranges from 3330 to 4710 feet above sea level. The soil is mostly rocky. There are patented mineral surveys in secs. 1, 2, 11, and 12.</p> <p>Access to the area surveyed and resurveyed, east of Apache Leap Cliffs is provided by U. S. Highway No. 60, Magma Mine Road, and U. S. Forest Service Route No. 315. Access west of Apache Leap Cliffs is provided by U. S. Highway No. 60, Arizona State Route No. 177, and Apache Leap Road.</p> <p>The mean magnetic declination of 10° E. was derived from the United States Geological Survey computer program GEOMAG, utilizing the World Magnetic Model for Epoch 2015 for the dates of survey.</p> <hr/>

CERTIFICATE OF SURVEY

I, Blas J. Urena, Cadastral Surveyor, HEREBY CERTIFY upon honor, that in pursuance of special instructions bearing date of the 28th day of March, 2017, I have dependently resurveyed a portion of the east boundary, a portion of the subdivisional lines, and portions of patented mineral surveys in sections 1, 2, 11, and 12, and performed a metes-and-bounds survey of Tract 37, T. 2 S., R. 12 E., of the Gila and Salt River Meridian, in the State of Arizona, which are represented in the foregoing field notes as having been executed by me and under my direction. Said survey has been made in strict conformity with said special instructions, the Manual of Surveying Instructions, (2009), and in specific manner described in the foregoing field notes.

6/25/2018
(Date)

Blas J. Urena
(Cadastral Surveyor)

CERTIFICATE OF APPROVAL

BUREAU OF LAND MANAGEMENT
Phoenix, Arizona

The foregoing field notes of the dependent resurvey of a portion of the east boundary, a portion of the subdivisional lines, and portions of patented mineral surveys in sections 1, 2, 11, and 12, and a metes-and-bounds survey of Tract 37, T. 2 S., R. 12 E., Gila and Salt River Meridian, in the State of Arizona, executed by Blas J. Urena, Cadastral Surveyor, having been critically examined and found correct, are hereby approved.

6/28/2018
(Date)

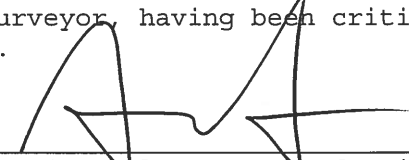
(Chief Cadastral Surveyor of Arizona)

~~CERTIFICATE OF TRANSCRIPT~~

~~I CERTIFY That the foregoing transcript of the field notes of the above described surveys in T. 2 S., R. 12 E., Gila and Salt River Meridian, Arizona, is a true copy of the original field notes.~~

~~_____
(Date)~~

~~_____
(Chief Cadastral Surveyor of Arizona)~~