

**GENERAL LAND OFFICE**  
**PRIMER**  
**OF**  
**INSTRUCTIVE INFORMATION**  
**RELATIVE TO**  
**LEGAL SUBDIVISIONS AND PLATS**  
**OF**  
**PUBLIC LAND SURVEYS**

Prepared under direction of  
I.P. Berthrong  
Chief of Drafting Div.

T.O.W

*Publication Printed circa 1921*

Reproduced by the U.S. Department of the Interior, Bureau of Land Management,  
Eastern States

THEORETICAL  
 TOWNSHIP DIAGRAM  
 SHOWING  
 METHOD OF NUMBERING SECTIONS  
 WITH ADJOINING SECTIONS

36 <i>80Ch</i>	31	32	33	34	35	36	31 <i>80Ch.</i>
<i>1 Mile</i> <i>6 Miles - 480 Chains</i>							
1	6	5	4	3	2	1	6
12	7	8	9	10	11	12	7
13 <i>480 Chains</i>	18	17	16	15	14	13	18
24 <i>6 Miles</i>	19	20	21	22	23	24	19
25	30	29	28	27	26	25	30
36	31	32	33	34	35	36	31
1	6	5	4	3	2	1	6

# SECTION DIAGRAM SHOWING SMALL SUBDIVISIONS

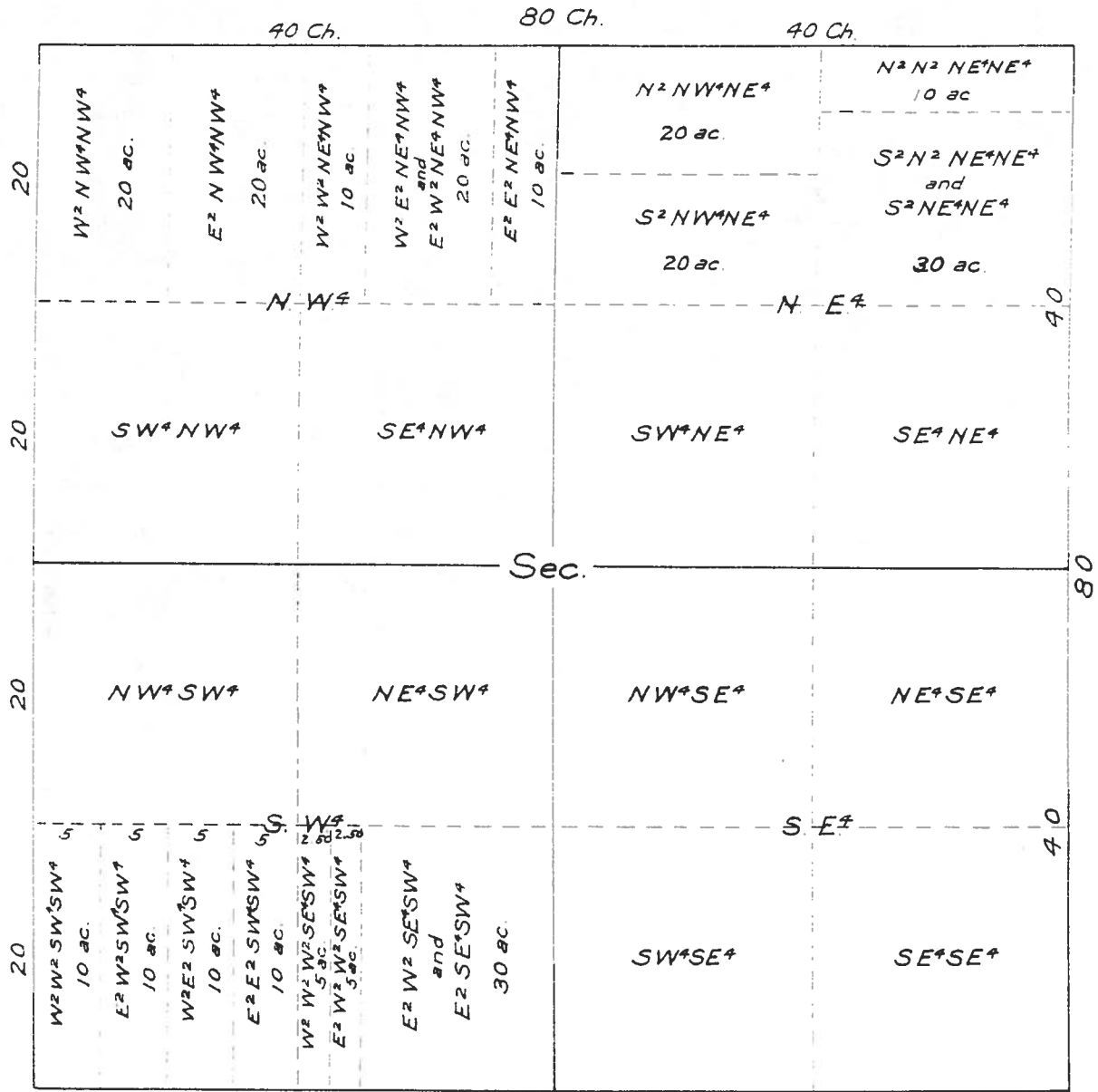

L.V.S.

## *UNITS OF MEASURE*

---

### *UNITS OF LINEAR MEASURE*

<i>1 Mile</i>	<i>equals</i>	<i>5280</i>	<i>feet</i>
<i>1 "</i>	<i>"</i>	<i>80</i>	<i>chains</i>
<i>1 Chain</i>	<i>"</i>	<i>100</i>	<i>links</i>
<i>1 "</i>	<i>"</i>	<i>66</i>	<i>feet</i>
<i>1 Link</i>	<i>"</i>	<i>7.92</i>	<i>inches</i>
<i>1 Rod, Pole or</i>			
<i>Perch</i>	<i>equals</i>	<i>16½</i>	<i>feet</i>

---

### *UNITS OF AREA*

<i>1 Acre</i>	<i>equals</i>	<i>10</i>	<i>sq. chains</i>
<i>1 "</i>	<i>"</i>	<i>43560</i>	<i>feet</i>
<i>1 Sq. Mile</i>	<i>equals</i>	<i>640</i>	<i>acres</i>

---

*A theoretical Township is six miles square, containing thirty six sections, one mile square, of 640 acres each.*

*Area of a theoretical township 23040 acres.*

*FOR CAREFUL CONSIDERATION AND OBSERVANCE.*

---

*The following must be observed in examining the records in the Drafting Division.*

*First, examine the card index for township plats and diagrams, so that you may be sure that the plat necessary for your case is in the files; it is possible that the plat desired has been withdrawn.*

*In withdrawing a plat or plat book, leave a receipt card for same, giving the township and range number or the number of volume, the number of your room, the date withdrawn, and sign your name.*

*Plats must not be retained for a longer period than is absolutely necessary for their use.*

*In returning plats to the files, it is absolutely necessary that the same be returned to their proper place—loose plats are filed in order, first by range number and then by township number.*

*Use the greatest care in handling of records—do not fold the plats; in many cases it would be impossible to restore or replace a plat if damaged, destroyed, or lost.*

*Do not make any notations on face of plat.*

*William Spry*  
Commissioner

175

8

(WILLIAM SPRY COMMISSIONED 03/22/1921)