

MS. G. N.
00101

LOT NO. 3 of A. and B.

Field Notes

of the survey of the

Madras
Mining & Mill-site claims,
Globe,

Situate in _____ mining district.

County of Pinal and in Sec. 18, Tp. 14,

Range 16E, of the Gila and Salt River Meridian,

ARIZONA.

Claimed by The Harkin Mining Company,

Survey executed by A. G. Puddleton, D. S.,

Under instructions dated November 2, 1877.

Survey commenced November 30, 1877.

Survey completed November 30, 1877.

PRELIMINARY OATHS FOR SURVEYS OF MINING CLAIMS AND MILL-SITES.

WE F. Tarbell and F. Hatch

do solemnly swear that we will faithfully execute the duties of Chain Carriers; that we will level the chain upon uneven ground, and plumb the tally pins, whether by sticking or dropping the same; that we will report the true distance to all notable objects, and the true length of all lines that we assist in measuring, to the best of our skill and ability.

F. Tarbell
F. Hatch

Sworn to and subscribed before me this 10th day
of November, 1877

Geo. Scott
Notary Public
In and for Pinal County
Ariz. Terr.

I, A. G. Penellton
do solemnly swear that I will well and truly perform the duties of
U.S. Dept. Surveyor according
to instructions given me, and to the best of my skill and ability.

A. G. Penellton

Sworn to and subscribed before me this 10th day
of November, 1877

Geo. Scott
Notary Public
In and for Pinal County
Ariz. Terr.

Field Notes of the Cadmus Mill-
site Surveyed Nov. 30th 1877

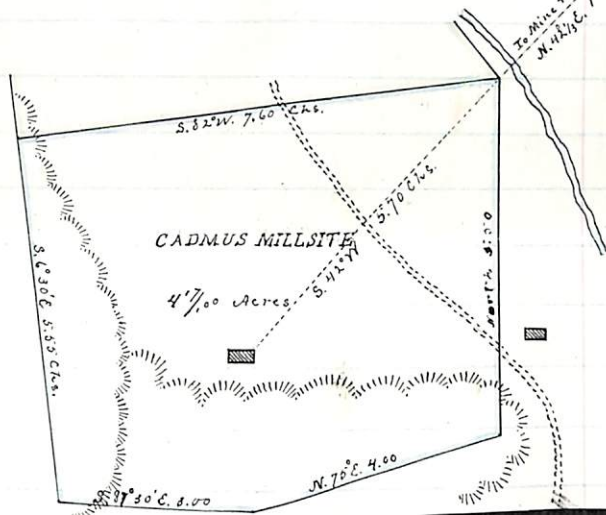

Field Notes of the Cadmus Millsite
Globe District A.T.

Surveyed Nov. 30th 1877

Commencing at a monument situated in the bottom on the north side of a leaning Sierrone tree about 18 ins through at the but and a few feet West of Pinal Creek, said monument being a round stake 4 ins in diameter 3 ft. high set in a mound of stones marked N. E. cor Cadmus Millsite

Thence S. 82° W 7.60 chains to a monument situated on the eastern slope of the hill, said monument being a round stake about 4 ins. in diameter set in a mound of stones about two ft. high marked N. W. cor of Cadmus Millsite

Thence S. 63° E. 3.85 chains to a monument situated on a flat on a hill, said monument being a stake about three inches square set in a mound of stones and marked S. W. cor. Cadmus Millsite

Thence S. 87° 30' E 3.00 chains to a monument said monument being a stake 3 x 3 ins 2 1/2 ft high set in a mound of stones 2 ft high and marked South cor Cadmus Millsite

Thence N. 75° E. 4.00 chains to a monument situated on the point of a hill at the north end of Globe City and about 150 ft. West of the road leading to the Wheat fields, said monument being a stake about 3 x 3 ins high set in a mound of stones and marked S. E. cor Cadmus Millsite

Thence North 5.50 chains to the point of beginning

Thence S 42° W. 5.70 chains to the cor of the building said building being a shop to be used in connection with the Haskin Co's smelter the machinery for which is on the ground but not put up.

Further N. E. cor. to the North corner of the Cadmus Copper mine and U.S. Mineral Monument is N 42 1/2 E 10250.5 feet

The variation is 13° 20' East of North as obtained by obs. on Polaris. Lines run on true bearings

This Millsite is situated at the North end of Globe city

A. G. Penellton

U.S. Dept. Int. Mineral Land

Field Notes of the Cadmus Copper Mine
 Globe District A.T.
 Surveyed Nov 30th 1877

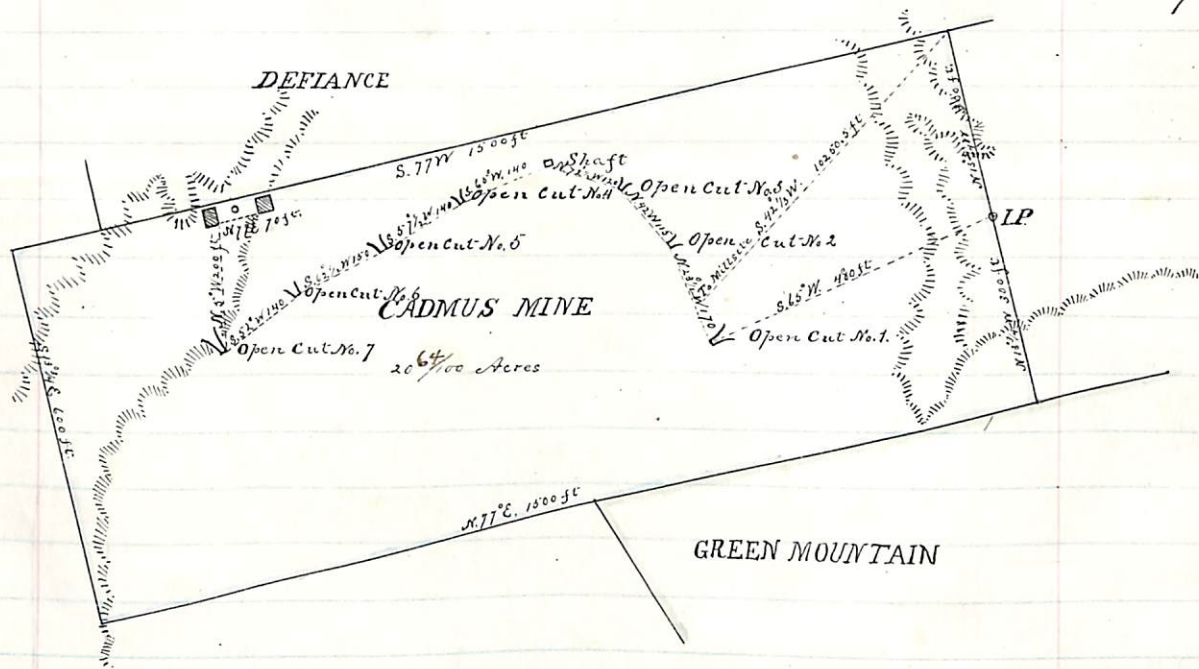

Field Notes of the Cadmus Copper Mine
Globe District A.T.

Surveyed Nov. 30th 1877

Commencing at a monument of stone about (2) two feet high on the East end of the Claim on which was posted the notice of Location and being the Initial point of the Claim

Thence N. $13^{\circ}34'W$ 300 ft to a monument on the North East side of a Gulch, said monument being a Cedar post 6x6 ins. $3\frac{1}{2}$ ft long set in a mound of stone 2 ft high and marked on the North and East sides U.S. Mineral Monument and on the South and West sides Cadmus North Cor.

Thence $S77^{\circ}W$ 1500 feet to a monument on the N.E. slope of a hill, said monument being a Cedar post 6x6 ins. $3\frac{1}{2}$ ft long set in a mound of stone 2 ft. high and marked on the South and East sides Cadmus West Cor.

Thence $S13^{\circ}34'E$ 300 ft to a monument in the bottom of what is known as Munson's Gulch, said monument being a mound of stone about 3 ft. high not marked,

Thence $S13^{\circ}34'E$ 300 ft. to a monument at the foot of a stone slide, said monument being a Cedar post 6x6 ins. $3\frac{1}{2}$ ft. high set in a mound of stones 2 ft. high and marked on the North and East sides Cadmus South Cor.

Thence N. $77^{\circ}E$. 1500 ft. to a monument on the ^{North} slope of a hill, said monument being a Cedar post ^{6x6 ins}, $3\frac{1}{2}$ ft long set in a mound of stone 2 ft high and marked on the North and West sides Cadmus East Cor.

Thence N. $13^{\circ}34'W$. 300 ft. to the point of beginning
Thence from the Initial point $S.65^{\circ}W$. 480 ft to Open Cut No. 1.

Thence N. $23^{\circ}1/2'W$. 170 ft to Open Cut No. 2.

Thence N. $42^{\circ}W$ 115 ft to Open Cut No. 3.

Thence N. $72^{\circ}1/2'W$ 120 ft to the Shaft.

Thence $S.65^{\circ}W$ 140 ft to Open Cut No. 4.

Thence $S.57^{\circ}1/2'W$ 140 ft to Open Cut No 5

Thence $S.62^{\circ}1/2'W$ 150 ft to Open Cut No 6

Thence $S.52^{\circ}W$ 140 ft to Open Cut No 7

Thence N. $5^{\circ}W$ 200 ft to Dwelling house

Thence N. $77^{\circ}E$. 70 ft to Blacksmith shop

A Well 30 ft deep is situated half way between the house and shop as shown on the plat.

The following angles and distances were taken from the North Corner and Mineral Monument

to the Willow Spring is $N. 58^{\circ} W. 610.5$ ft.

From the North Cor. and Mineral monument to the top of Iron Capad mountain bears $N. 13^{\circ} \frac{1}{2} E.$

From the West Cor. the top of Iron Capad Mt. bears $N. 29^{\circ} E.$

The highest point of mountain looking up the main gulch bears $N. 60^{\circ} E.$

The highest southern peak of Pinal Mts. bears $S. 3^{\circ} \frac{1}{2} W.$

From the North cor. and Mineral monument to the North cor. of Millerite is $S 42^{\circ} \frac{1}{8} W$ distant 10250.5 ft.

From the North Cor. and Mineral Monument to the North cor. of the Green Mountain Copper mine is $S. 66^{\circ} E.$ distant 998 ft.

The variation is $13^{\circ} 20'$ East of North as obtained by observation on Polaris. The lines are run on true bearings.

Open cut No 1 is 25 ft from the mouth to the back which is 15 ft deep the entire cut being about six feet wide in one ~~the~~ entire distance.

Open cut No. 2 is about 9 ft long 7 ft. high or deep and 5 ft wide in Copper ore and hard quartz rock

Open cut No. 3 is 6 ft long 5 ft deep and 5 ft wide

The shaft is 35 ft deep and 7×5 ft in Copper ore and hard quartz rock all the way

Open cut No 4 is nearly a prospect hole and worth about \$50.00 likewise No 5 and 6.

Open cut No 7 is 40 ft long 30 ft deep and 6 ft wide in hard rock with Copper ore in the face

The relative positions of the cuts are shown on the plan, the lens being taken on the upper side in each case.

There are no trees of any size or importance in the vicinity of the claim

The claim is situated about 2 miles east of Globe city on the South side of the Munsion Gulch the surrounding country being granite hills, there being no names given to any of them it is impossible to give any clear description.

A. G. Pendleton

U.S. Dept. Sur. Mineral Land

FINAL OATHS FOR SURVEYS OF MINING CLAIMS AND MILL-SITES.

A list of the names of individuals employed to assist in running, measuring, or marking the lines and corners described in the foregoing field-notes of the survey of Cadmus Copper Mine

and Mill Site

located in Globe Mining mining district

Pinal County, Arizona, showing the respective capacities in which they acted.

F. Farbell Chainman.

H. Hatch Chainman.

_____ Axeman.

_____ Flagman.

We hereby certify that we assisted A. G. Rendleton

U. S. Deputy surveyor, in surveying the Cadmus Copper Mine

and Mill Site

claimed by the Harkin Mining Company

located in Globe mining

district, Pinal County, and in Township No. _____ Range No. _____

of the Gila and Salt River base and meridian, Arizona, and that said Survey has been in all respects, to the best of our knowledge and belief, well and faithfully executed, and the boundary monuments planted according to the instructions furnished by the Surveyor-General.

F. Farbell Chainman.

H. Hatch Chainman.

_____ Axeman.

_____ Flagman.

SWORN to and subscribed before me this 30th day
of November 1877

Geo. Scott
Notary Public

I, A. G. Rendleton U. S. Deputy Surveyor do solemnly swear that, in pursuance of instruc-

tions from John Wasson, U. S. Surveyor-General for Arizona, bearing date the 2^d day of November 1877

I have well, faithfully and truly, in my own proper person, and in strict conformity with the instructions furnished by the Surveyor-

General and the laws of the United States, surveyed all those portions of Cadmus Copper

Mine and Mill Site

claimed by the Harkin Mining Company

located in Globe mining

district, Pinal County, and in Township No. _____ Range No. _____

of the Gila and Salt River base and meridian, Arizona, as are represented in the foregoing field-notes as having been surveyed under my directions; and I do further solemnly swear that all the corners of said surveys have been established and perpetuated in strict accordance with the instructions furnished me, and that the foregoing are the true and original field-notes of such surveys.

A. G. Rendleton
Deputy Surveyor.

SWORN to and subscribed before me this 30th day
of November 1877

Geo. Scott
Notary Public

"Cadmus Mine"

Notice is hereby given that, the undersigned, have this the 25th day of September A.D. 1876, located and claim Fifteen hundred linear feet on this lode or deposit of Copper bearing rock in place, described and bounded as follows to wit: Commencing at this monument of stone, as the initial point and center of the East boundary and running 300 feet Northerly to a monument of stone being the N.E. Corner. Thence 1500 feet Westerly to a monument of stone being the N.W. Corner. Thence 300 feet in a Southerly Course to a monument of stone being the Center monument of the South West boundary Thence 300 feet in a Southerly Course to a monument of stone being the S.W. Corner, Thence 1500 feet in a Easterly Course to a monument of stone being the S.E. Corner, Thence 300 feet to the place of beginning. This mine is situated about two miles South East from Globe City and two hundred yards South from Minors Camp near a Cotton wood tree in a Gulch Globe District Pinal County Arizona

Witness

A. R. Hammond, John Coal

John W. Read

Filed and Recorded at request of

A. B. Hammond at 10 o'clock A.M. October
23^d. A. D. 1876.

Jos. J. Devine,
Recorder

Territory of Arizona }
County of Pinal } J. Jos. J. Devine, County
Recorder and for said County, do hereby
certify that the foregoing is a full, true and
correct copy of notes of Location of the
"Cadenas Mine" as the same appears of record in
my office, in Book 1 of Mines, Page 324.

Witness my hand and seal of
office this first day of November
A. D. 1877.

Jos. J. Devine, Recorder
By J. A. Apperson, Deputy

Cadmus Copper Mine
 Notice. As hereby given that I the un-
 dersigned have this the 25th day of
 September A. D. 1876 locate and
 claim fifteen hundred ^{square} feet on
 this lode or deposit of copper bearing
 rock in place, described and bound-
 ed as follows, "to wit" Commencing at
 this monument of stones as the in-
 itial point and center of the East
 boundary and running 300 feet
 Northerly to a monument of stones
 being the N. E. corner, Thence 1500 feet
 Westerly to a monument of stones
 being the N. W. corner, Thence 300 feet
 Southerly course to a monument
 of stones being the center monument
 of the South West boundary; Thence
 300 feet Southerly to a monument of
 stones, being the S. W. corner of claim.
 Thence 1500 feet Easterly course to a
 monument of stones, being S. E. corner.
 Thence 300 feet to the place of beginning.
 This mine is situated about two
 miles North East from Globe City
 and two hundred yards South
 from Munson's Camp near a
 Cottonwood tree in a gulch.
 Globe District Pinal County
 Arizona

Witness } John W. Read
G. R. Hammond }
John Cool }
Filed for Records September 25th
A. C. 1876. G. R. Hammond
Recorder

District Recorders Office Globe Mining Dis-
trict October 26th A. C. 1877. I hereby
certify that the foregoing is a true copy
of the Cadmus Copper Mine Notice Re-
corded in the Records of of Globe
Mining District

Geo. Scott
Dist Recorder

Abstract

Cadmus Copper
Mine

Smeltersite No. 6.

Noted is hereby given that the Huskin Mining Co. of California have this day under the laws governing such locations, located and claim five acres of land and water right in connection with Smeltersite No. 6. said Smeltersite being connected with the Pan Mining claim, both of which are situated in Pinal County, Territory of Arizona, and more fully described as follows, to wit:

Field Notes of Smeltersite No. 6.

Globe District Arizona

Surveyed May 5th 1877.

Commencing at the N.E. Cor. monument of Millsite No. 5. situated on the top of a hill at the N. end of Globe City and about 150 ft. W. of the road leading to the Wheatfields thence South 5.50 Chs. to a monument and stake, situated in the bottom on the North side of a Sycamore tree, thence S. 82° W. 7.60 chains to a monument and stake situated on the Eastern slope of the hill, thence S. 6° 30' E. 5.50 chains to a monument and stake situated on a flat on the hill, thence S. 87° 30' E. 3.00 chains, to a monument and stake being also the N.W. Cor of Millsite No. 5. thence N. 75° E. 4.00 chains

to the point of beginning. This Smelter-
site is for the smelting use of the "Pew"
Mining Claim

A. G. Pundleton

U. S. Dept. Surveyor

Filed & Recorded at request of J. W. Hackett
at 10 o'clock A.M. May 24th A. D. 1877

Jno. J. Devine,
Recorder.

Territory of Arizona }
County of Pinal } J. Jno. J. Devine,
County Recorder of said County, do
hereby certify that the above and
foregoing is a true copy from the
records of my office Book 1 of Misc-
ellaneous Records. Page 104.

Witness my hand and
official seal this first
day of November
A. D. 1877

Jno. J. Devine, Recorder
By J. W. Apperson
Deputy

AFFIDAVIT OF FIVE HUNDRED DOLLARS IMPROVEMENTS.

We, *F. Tarbell* and *F. Hatch*
of lawful age, being first duly sworn according to law, depose and say that we are acquainted with
the *Cadmus Copper Mine and Mill*
Site ~~mining claim~~, situate in *Eslobe*
_____ Mining District, *Pinal* County, Arizona
Territory, for which *the Harkin* ~~and~~ *Minning Company*
have made application for survey prior to application for patent under the provisions of the Act of
Congress approved May 10, 1872, and that the labor done and improvements made thereon by the
applicants and *the* grantors exceed Five Hundred Dollars in value, and further that we are
not personally interested in said mine.

F. Tarbell
F. Hatch

TERRITORY OF ARIZONA, }
County of *Pinal* } SS.

SWORN AND SUBSCRIBED before me this

day of *November*, 187*7*

Geo. Scott
Notary Public
In and for *Pinal* County
Ariz. Terr.

Globe Mining District
 Pinal County Arizona Territory
 A. J. Epley Pros. of Newland

Sworn first duly
 sworn deposes and says that they are
 residents of this Territory and of the U. S.,
 and further that they are well acquainted
 with the two Mill Sites Nos Six and
 Seven and know and believe
 that neither of them are of a Mineral
 Character - and that the said Mill
 Sites are now occupied by the "Hastin
 Mining Company" and one (No Six)
 is for the "Cadmus" Copper Mine and
 one (No Seven) is for the "Green Mountain"
 Mine - and further saith not.

A. J. Epley J. J. Newland

Subscribed and Sworn to
 before me this 8th day of November
 A. D. 1877.

Geo. Scott

Notary Public

In and for Pinal County A. T.

U. S. Surveyor General's Office.
Tucson, A. S., Dec. 17, 1877.

The foregoing field-notes of the survey of the Adams Mining and Mill-site claims, situated in the Globe Mining district, Pinal County, Arizona, claimed by the Hackin Mining Company, surveys executed by A. J. Pendleton, D. S., under instructions from this office, having been critically examined and the necessary corrections and alterations made, the said field-notes and the survey they describe are hereby approved.

John Mason,
Surveyor General.

UNITED STATES DEPARTMENT OF THE INTERIOR 9605 (952)
BUREAU OF LAND MANAGEMENT Gen. No. 101
ARIZONA STATE OFFICE

NOTICE OF CANCELLATION OF MINERAL SURVEY

The Cadmus lode, General Number 101, located in section 13, Township 1 North, Range 15 East and section 18, Township 1 North, Range 15 1/2 East, Gila and Salt River Meridian, Arizona, is hereby canceled.

This claim has not been filed with the Arizona State Office, Bureau of Land Management, in accordance with Section 314, 90 STAT. 2769, (43 U.S.C. 1744).

This cancellation was necessitated to clear the record.

The Mineral Survey Plat should be noted as follows:

"Cadmus lode, Gen. No. 101 was canceled March 30, 1999, by memo 9605 (952) Gen. No. 101, which is now a part of the original field notes."

March 30, 1999
Date



Chief Cadastral Surveyor of Arizona

UNITED STATES DEPARTMENT OF THE INTERIOR 9605 (952)
BUREAU OF LAND MANAGEMENT Gen. No. 102
ARIZONA STATE OFFICE

NOTICE OF CANCELLATION OF MINERAL SURVEY

The Cadmus mill site, General Number 102, located in section 26, Township 1 North, Range 15 East, Gila and Salt River Meridian, Arizona, is hereby canceled.

This claim has not been filed with the Arizona State Office, Bureau of Land Management, in accordance with Section 314, 90 STAT. 2769, (43 U.S.C. 1744).

This cancellation was necessitated to clear the record.

The Mineral Survey Plat should be noted as follows:

"Cadmus mill site, Gen. No. 102 was canceled March 30, 1999, by memo 9605 (952) Gen. No. 102, which is now a part of the original field notes."

March 30, 1999
Date

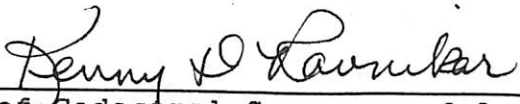

Chief Cadastral Surveyor of Arizona