

M
S

-
G
N

0

0

1

1

4

LOT NO. 40.

Field Notes

of the survey of the

Globe Ledge
Mining Claim

Situate in Globe mining district,

County of Pinal and in Sec. , Tp. ,

Range , of the Gila and Salt River Meridian,

ARIZONA.

Claimed by B. W. Reagan

Survey executed by A. G. Pendleton D. S.,

Under instructions dated July 13, 1878.

Survey commenced July 16, 1878.

Survey completed July 16, 1878.

PRELIMINARY OATHS FOR SURVEYS OF MINING CLAIMS AND MILL-SITES.

WE G. H. Hall and Lindsay Lewis
do solemnly swear that we will faithfully execute the duties of Chain Carriers;
that we will level the chain upon uneven ground, and plumb the tally pins,
whether by sticking or dropping the same; that we will report the true distance
to all notable objects, and the true length of all lines that we assist in measur-
ing, to the best of our skill and ability.

G. H. Hall

Lindsay Lewis

Sworn to and subscribed before me this Sixteenth day
of July, 1878

Wm. J. Deane
Clerk Dist Court Oriskany Co
N. Y.

I, _____
do solemnly swear that I will well and truly perform the duties of _____
_____ according
to instructions given me, and to the best of my skill and ability.

Sworn to and subscribed before me this _____ day
of _____, 187 _____

Field Notes of the
Globe Ledge Mine
Surveyed July 16, 1878

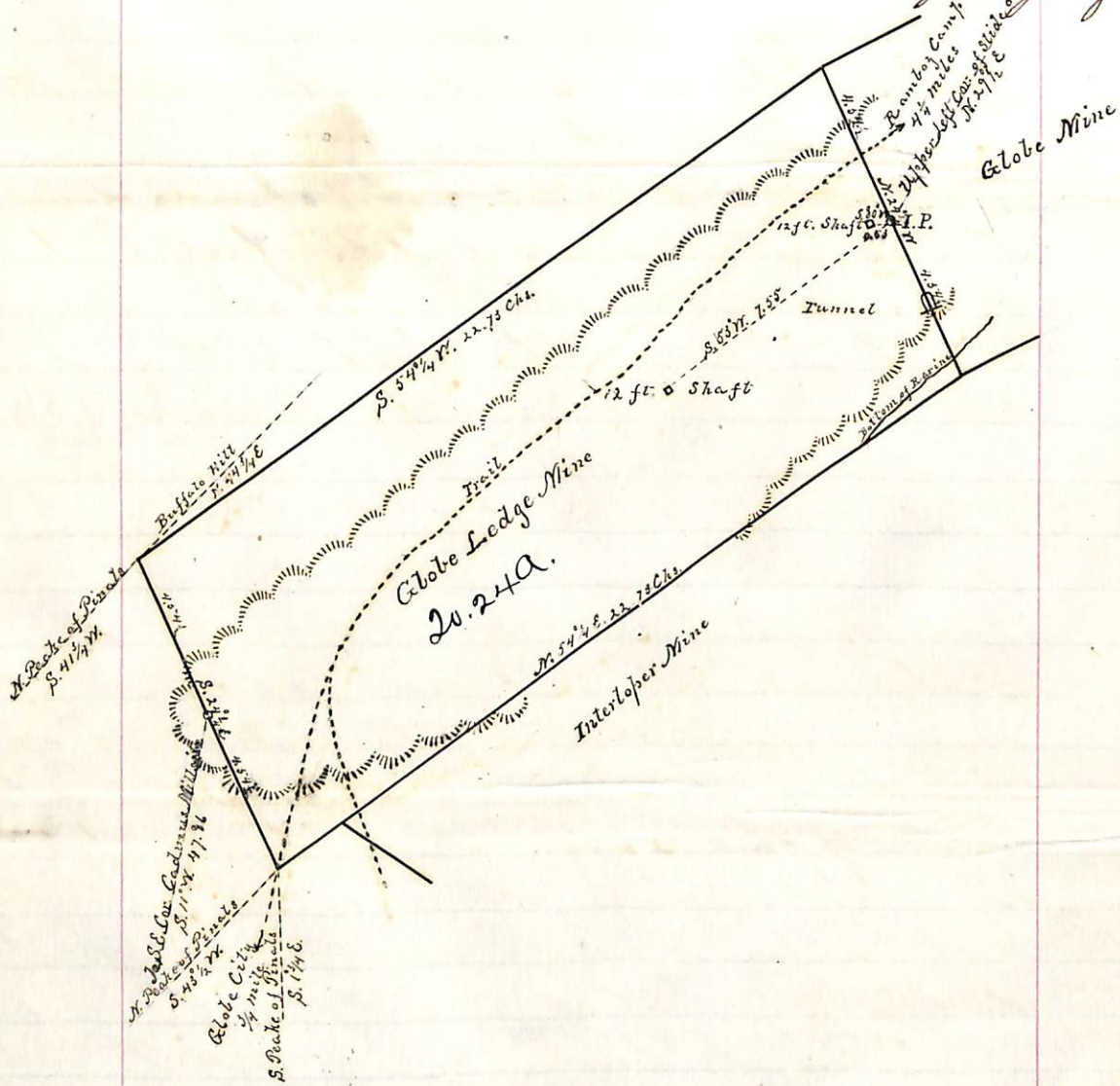

Commencing at a monument about three feet high built of copper ore and situated on the top of the Globe Hill on a large mass of Iron & Copper Crossings being the Initial Point of the Globe Ledge and Globe Mining Claims, said monument being situated about one mile north of Globe City Final Co. A. T.

Thence $N. 24^{\circ} 1/4' W. 4.54 \frac{1}{2}$ Chs. va. $13^{\circ} 20' E.$ to a monument of stones and earth about three and one half feet high marked S. L. 1 and S. 4. said monument is situated on the North West slope of the Globe Hill about 100 yards from the bend in the Rambog trail and is the North ^{East} corner of this survey and the West ^{well} corner of the Globe Mining Claim.

Thence $S. 54^{\circ} 1/4' W. 22.73$ Chs. va. $13^{\circ} 20' E.$ to a monument of stones about four feet high marked S. L. 2 said monument is situated on the North West ^{North} slope of the Globe Hill and is the West ^{North} corner

run to the South East corner monument
of the Cadmus Mill site S. 11° W. 47.86 Chains

From the Initial Point to the mouth of
the Tunnel is S. 24 $\frac{1}{4}$ ° E. 2.10 Chains, the Tunnel
is run on the line between the Globe Ledge
and the Globe mine and was done in
connection with both claims it is 100 feet
long and worth \$1200.00

From the Initial Point to Shaft No 1 S. 80° W.
0.53 Chains, the shaft is 12 feet deep and
cost ~~worth~~ \$100.00.

From the Initial Point to shaft No 2 S. 53° W.
7.55 Chains, the shaft is 12 feet deep and
cost ~~worth~~ \$100.00

The formation is Limestone and Granite and
the claim is in rolling hills, the ore is princi-
pally Copper & Iron.

The variation of the needle is 13° 20' East
of North as determined by observation of Polaris

The Lines are run on true bearings

Area = 26.24 Acs.

A. G. Pendleton
Dept. U.S. Min. Surveyor

FINAL OATHS FOR SURVEYS OF MINING CLAIMS AND MILL-SITES.

A list of the names of individuals employed to assist in running, measuring, or marking the lines and corners described in the foregoing field-notes of the survey of The Globe Ledge

Mining Claim

located in Globe mining district
Pinal County, Arizona, showing the respective capacities in which they acted.

G. W. Hall Chainman.

Lindsey Lewis Chainman.

_____ Axeman.

_____ Flagman.

We hereby certify that we assisted A. G. Bendleton

U. S. Deputy surveyor, in surveying The Globe Ledge

Mining Claim

claimed by B. M. Kragan

located in Globe mining district, Pinal County, and in Township No. _____ Range No. _____

of the Gila and Salt River base and meridian, Arizona, and that said Survey has been in all respects, to the best of our knowledge and belief, well and faithfully executed, and the boundary monuments planted according to the instructions furnished by the Surveyor-General.

G. W. Hall Chainman.

Lindsey Lewis Chainman.

_____ Axeman.

_____ Flagman.

SWORN to and subscribed before me this 14th day
of July 1878

G. A. Swasey
Notary Public

I, A. G. Bendleton U. S. Deputy Surveyor do solemnly swear that, in pursuance of instruc-

tions from John Wasson, U. S. Surveyor-General for Arizona, bearing date the 13 day of July 1878

I have well, faithfully and truly, in my own proper person, and in strict conformity with the instructions furnished by the Surveyor-

General and the laws of the United States, surveyed all those portions of The Globe Ledge

Mining Claim

claimed by B. M. Kragan

located in Globe mining district, Pinal County, and in Township No. _____ Range No. _____

of the Gila and Salt River base and meridian, Arizona, as are represented in the foregoing field-notes as having been surveyed under my directions; and I do further solemnly swear that all the corners of said surveys have been established and perpetuated in strict accordance with the instructions furnished me, and that the foregoing are the true and original field-notes of such surveys.

A. G. Bendleton
Deputy Surveyor.

SWORN to and subscribed before me this 14th day
of July 1878

G. A. Swasey
Notary Public

AFFIDAVIT OF FIVE HUNDRED DOLLARS IMPROVEMENTS.

We, J. J. Newland and W. H. Woodson
of lawful age, being first duly sworn according to law, depose and say that we are acquainted with
the Globe Ledge
_____ mining claim, situate in Globe
_____ Mining District, Pinal County, Arizona
Territory, for which B. M. Reagan and _____
has made application for survey prior to application for patent under the provisions of the Act of
Congress approved May 10, 1872, and that the labor done and improvements made thereon by the
applicant and his grantors exceed Five Hundred Dollars in value, and further that we are
not personally interested in said mine.

J. J. Newland
W. H. Woodson

TERRITORY OF ARIZONA. }
County of Pinal } SS.

SWORN AND SUBSCRIBED before me this Twenty 20th

day of July, 1878

G. A. Smasey
Notary Public



Notice

I the undersigned having purchased the interests of Mrs Folsom, P. King, W. Welch, W. H. Sampson, B. Edwards & J. Rely, of us and to the "Globe Ledge," consisting of 1500 linear feet by 600 feet in width the said Mrs Folsom et al. having located said "Globe Ledge" claim on the 9th day of September 1873. and in consequence of having purchased the interests of the said Mrs Folsom et al. I do now make a new location, covering the same ground under the same name, to wit: "Globe Ledge" mine, this I do to more fully comply with the Mining Act of Congress of May 10, 1872.

Notice of Location.

Notice is hereby given that the undersigned in compliance with the requirements of the Mining Act of Congress, approved May 10, 1872, has this day located and claims 1500 linear feet along the course of this lead, lode or vein of mineral bearing quartz, and 300 feet in width on each side of the middle of said lead lode or vein, situated in the Globe Mining District, Pinal County, Arizona, and more particularly described as follows, to wit: Commencing at this monument of stones being the center of the N.E. end of claim and upon which this notice is posted, thence N.W. 300 feet to a monument of stones, thence S.W. 1500 feet

to a monument of stone, thence S. E. 300 feet
 to a monument of stone, being the Center
 of the S. W. end of claim, thence S. E. 300
 feet to a monument of stone, thence N. W. 300
 feet to a monument of stone and place
 of beginning. This claim joins the Globe
 mine on the S. W. end and is distant
 from Globe City about one mile in a
 northerly direction, and shall be known
 as the "Globe Ledge" mine.

Located May 30th 1878.

D. W. Reagan

Filed and Recorded at request of D. W. Reagan
 June 8. 1878. at 4 o'clock P. M.

Jos. J. Deorn, Recorder
 By J. A. Apperson, Deputy

Territory of Arizona }
 County of Pinal } J. Jos. J. Deorn, County
 Recorder and for said County. hereby
 certify that the foregoing is a true and
 correct copy of the Notes of Location of the
 "Globe Ledge" mine, in Globe Mining District,
 in said County, as the same appears of record in
 my office in Book 3 of Mines, Page 14.

Witness my hand and official
 seal at Phoenix, this 9th day
 of July A. D. 1878.

Jos. J. Deorn, Recorder
 By J. A. Apperson, Deputy

U. S. Surveyor General's Office,
Tucson, Arizona, August 3, 1878.

The foregoing field-notes of the survey of the Globe Sedge Mining claim, situated in Globe Mining District, Pinal County, Arizona, and claimed by B. W. Redgan, survey executed by A. G. Pendleton, D. S., under instructions from this office, having been critically examined and the necessary corrections and alterations made, the said field-notes and the survey they describe are hereby approved.

John H. Mason
Surveyor General.