

**MS - GN**

**0**

**0**

**1**

**9**

**0**



LOT NO. 55.

## Field Notes

of the survey of the

Red Top  
Mining claim.

Situate in Tombstone mining district,

County of Pima and in Sec. \_\_\_\_\_, Tp. 208,

Range 22<sup>E</sup>, of the Gila and Salt River Meridian,

**ARIZONA.**

Claimed by The Merinae Silver  
Mining Company.

Survey executed by A. J. Mitchell D. S.,

Under instructions dated July 5. 1880

Survey commenced July 7. 1880

Survey completed July 7. 1880



PRELIMINARY OATHS FOR SURVEYS OF MINING CLAIMS AND MILL SITES.

WE, W. Dolerhi and .....

do solemnly swear that we will faithfully execute the duties of Chain Carriers; that we will level the chain upon uneven ground, and plumb the tally pins, whether by sticking or dropping the same; that we will report the true distance to all notable objects, and the true lengths of all lines that we assist in measuring, to the best of our skill and ability.

William Dolerhi

SWORN AND SUBSCRIBED before me this 7th .....

day of July 1880

A. J. Mitchell  
Notary Public

I, W. W. Ham .....

do solemnly swear that I will well and truly perform the duties of Assessor .....

..... according to instructions given me, and to the best of my skill and ability.

W. W. Ham

SWORN AND SUBSCRIBED before me this 7th .....

day of July 1880

A. J. Mitchell  
Notary Public



Field Notes of Survey of Red Top Mining Claim Tombstone Dist

11.36 1/4 I start at Initial monument marked A on flat, and run thence S. 20° 17' W. var 11° 03' E by obs. to Polaris to a monument of stones, being the centre of south end of claim at which place I plant post 4 x 4. 5 feet long with monument of stones and mark thereon R. T. M. C. No 1 from this point U. S. M. M. No 2 bears S. 88° 48' E var 11° 03' E 121.68 ch

45 1/2 From No 1. I run S. 69° 43' E, <sup>var 11° 03' E</sup> along south end of claim and north end of valley mining claim and set post 4 x 4.5 feet long with monument of stones and mark thereon R. T. M. C. No 2 the S. E. cor thence I run N 20° 17' E var 11° 03' E

300 Shaft 60 feet deep bears N. 69° 43' W distance 2.00 ch at

800 valley running W. N. W, at

1200 slight hill and at

227 1/2 I planted post 4 x 4 five feet long with monument of stones and marked thereon R. T. M. C. No 3 the N. E. cor

45 1/2 Thence I run N 69° 43' W, <sup>var 11° 03' E</sup> along N end of claim and at

I plant post 4 x 4 5 feet long with monument of stones and mark thereon R. T. M. C. No 4. This is the N centre end of claim

Thence I run on same course N 69° 43' W var. 11° 03' E continues along N end of claim and at

45 1/2 I plant post 4 x 4 5 feet long with monument of stones and mark thereon R. T. M. C. No 5. the N. W. corner

500 Thence I run S. 20° 17' W var 11° 03' E along W. side of claim and at valley course N. W and at



4

# Field Notes of Survey of Red Top. Continued

- and at  
14.00 valley course N.W. and at  
22.72½ I plant post 4 x 4 5 feet long  
with monument of stones and  
mark thereon R. T. M. C. No 6.  
The S.W. corner  
Thence run S. 69° 43' E var 11.03' E  
along south line of Red Top and  
N. E. d. line of The Valley claim  
and at 44  
454½ close on south center of claim  
enclosing an area of 20.66 acres  
This point bears S. 34° 36' E from  
N. E. cor of Merrimac claim  
(designated as lot No ) distance  
18.63 ch. The point referred to in  
location notice

The above mine is situated  
in Tombstone Hills and has  
improvements thereon consisting  
of shaft 6 x 5. 60 feet deep. value  
of same amounting to over  
\$500<sup>00</sup>/<sub>100</sub>.

Surveyed this 7<sup>th</sup> day of July 1880

A. J. Mitchell  
U.S.M.S.



FINAL OATHS FOR SURVEYS OF MINING CLAIMS AND MILL-SITES.

A LIST of the names of individuals employed to assist in running, measuring, or marking the lines and corners described in the foregoing field-notes of the survey of The Red Top.

Mining Claim  
located in Tombstone Mining District, Pima County, Arizona, showing the respective capacities in which they acted.

W. Polerhi Chainman.  
Chainman.  
W. W. Ham Axeman.  
Flagman.

WE hereby certify that we assisted A. J. Mitchell U. S. Deputy Surveyor, in surveying The Red Top - Mining Claim

claimed by Merrime Mining Company located in Tombstone Mining District, Pima County, and in Township No. \_\_\_\_\_ Range No. \_\_\_\_\_ of the Gila and Salt River base and meridian, Arizona, and that said Survey has been in all respects, to the best of our knowledge and belief, well and faithfully executed, and the boundary monuments planted according to the instructions furnished by the Surveyor General.

William Polerhi Chainman.  
Chainman.  
W. W. Ham Axeman.  
Flagman.

SWORN TO AND SUBSCRIBED before me this 7<sup>th</sup> day of July 1880

A. J. Mitchell  
Notary Public

I, A. J. Mitchell U. S. Deputy Surveyor do solemnly swear that, in pursuance of instructions from John Wasson, U. S. Surveyor-General for Arizona, bearing date the 5<sup>th</sup> day of July 1880, I have well, faithfully and truly, in my own proper person, and in strict conformity with the instructions furnished by the Surveyor-General and the laws of the United States, surveyed all those portions of land known as The Red Top Mining Claim claimed by The Merrime Mining Co located in Tombstone Mining District, Pima County, and in Township No. \_\_\_\_\_ Range No. \_\_\_\_\_ of the Gila and Salt River base and meridian, Arizona, as are represented in the foregoing field-notes as having been surveyed under my directions; and I do further solemnly swear that all the corners of said surveys have been established and perpetuated in strict accordance with the instructions furnished me, and that the foregoing are the true and original field-notes of such surveys.

A. J. Mitchell Deputy Surveyor.

SWORN TO AND SUBSCRIBED before me this 8<sup>th</sup> day of July 1880

W. A. Harwood  
Notary Public



# Red Top Mine

Supplementary Notice, notice is hereby given that whereas on June 18th 1878 James P. Whalen did locate and claim this the Red Top claim and whereas the Merrimac Silver Mining Co. has succeeded to the interest of said original locator in said claim therefore the said mining Co. through W.K. Meade its duly Authorized Agent in order to comply with the regulations of the Genl Land Office and of the Surveyor Generals office of Arizona, regarding Cords necessary to enable said Company to obtain an official survey, of said "Red Top" Claim, does so amend.

the Original location notice, as to refer a corner of the Red Top Claim to a corner of the Merrimac Claim, Tombstone District, said claim having been officially surveyed for patent as follows, to-wit:

I the undersigned do locate and claim from this the initial monument 750 feet in a south westerly direction, and 750 feet in a north easterly direction, and three hundred feet on each side of this ledge, lode or vein of mineral bearing quartz, with



all dips spurs, angles and variations  
the same to be known as the Red 8  
Dip mine, this claim is about  $\frac{1}{4}$  of  
a mile East of the "uncle Sam" mine  
and about one mile west of the  
lucky Cuss mine, and situate  
in Tombstone District, Pima  
County Arizona Territory, the  
South Center Corner of this  
claim, being South 35 East distance  
18, Chains and 33 L.K.S. from the  
North East Corner of the Merriman  
Claim before referred to this notice  
agrees exactly with the Original  
Location the record of which  
is found in Book 6, Records of  
Mines Page 433, County Recorders  
Office Pima County Arizona  
with the addition of the exact  
reference to a permanent mon-  
ument, required.

Merriman Silver Mining Company

By W. K. Meade, Agent.

Filed and recorded at request  
of W. K. Meade, July 3<sup>rd</sup> A.D.  
1880. at 1 P. M.

S. M. Carpenter

County Recorder

By J. H. Harrison Deputy



3

Territory of Arizona  
County of Pima

J. Sidney W. Carpenter  
County Recorder in and for  
the County of Pima do hereby  
Certify that the above and  
foregoing is a full true and  
correct copy of what purports  
to be the Original Notice of  
Location of the "Red Top" Mine,  
as appears of Record now in  
my office in Book I. Record of  
Mines pages 272<sup>nd</sup> and 273.

In witness whereof I have  
hereunto set my hand and  
affixed my Official Seal  
this 3rd day of July AD 1880

J. Sidney W. Carpenter  
County Recorder  
Pima Co., Ariz.



W. F. Meade being first duly sworn according to law deposes and says I am well acquainted with the "Red Top" Mining Claim situated in Tombstone Mining District Arizona. And I have this day visited said claim and in the examination of surface ground I find that the croppings of a mineral ledge is plainly visible at the initial monument and the initial monument is built on said croppings and the direction of the ledge is as nearly as can be traced exactly pointing in the center of the claim.

W. F. Meade

Subscribed and sworn to }  
before me this 31<sup>st</sup>  
day of Jan'y 1882. }

B. C. Frigley

Notary Public

Cochise County

A. J.





Jerome L. Word being first duly sworn according to law deposes and says.

I am well acquainted with the Red Top Mining Claim situated in Tombstone Mining district Arizona, and I have this day visited said claim and in the examination of surface ground I find that the cropping of a mineral ledge is plainly visible at the initial monument and the initial monument is built upon said cropping, and the direction of the ledge is as nearly as can be traced exactly pointing in the center of the claim.

Subscribed <sup>at</sup> Tombstone Jerome L. Word

to before me this 21<sup>st</sup> day of July 1882

B. C. Mingley  
Notary Public  
Cochise County  
A. T.





# Red Top Mining Claim

## Tombstone Dis' A.T.

12

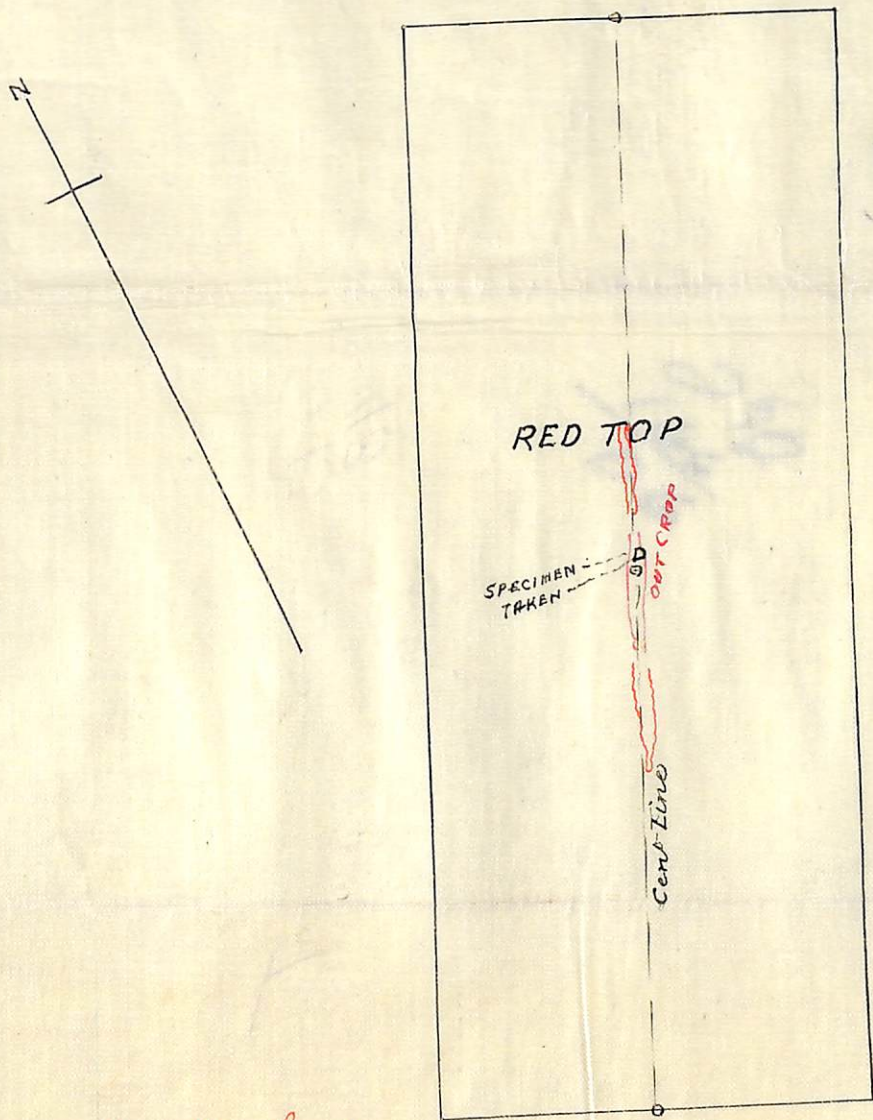

I hereby certify that the above tracing correctly represents the Croppings and Lodge, as they appear on the surface of the Red Top Mining Claim.

H. B. Maxson

U.S. Dep. Min. Surveyor

Tombstone, A.T.,  
Feb. 4, 1882

~~The Croppings are at the initial monument and said initial monument is built right upon croppings as shown in sketch and specimen D was that day taken from point marked above~~  
 Jan 19<sup>th</sup> 1882  
 J. Mitchell  
 U.S. Dep. Min.



U. S. Surveyor General's Office.  
Dresser, A. D., July 22, 1880.

The foregoing field-notes of the survey of the Red Top mining claim, situated in Daulton mining district, Pima County, Arizona, claimed by the Mermaid Silver Mining Company; survey executed by A. J. Mitchell, U. S., under instructions from this office having been critically examined and the necessary corrections and alterations made, the said field-notes and the survey they describe are hereby approved.

John Masson,  
Surveyor General.