

M
S

.
G
N

0

0

2

1

1

LOT NO. 54

Field Notes

of the survey of the

Silver Plume
Mining Claim

Situate in Pemberton mining district,

County of Pima and in Sec. _____, Tp. 20 S,

Range 22 E, of the Gila and Salt River Meridian,

ARIZONA.

Claimed by W. A. Rafferty
H. P. Perrine

et. al.

Survey executed by Henry G. Howe D. S.,

Under instructions dated July 16, 1880

Survey commenced August 3, 1880

Survey completed August 4, 1880.

PRELIMINARY OATHS FOR SURVEYS OF MINING CLAIMS AND MILL SITES.

WE, Belden F. Culver, and W. T. Porter,

do solemnly swear that we will faithfully execute the duties of Chain Carriers; that we will level the chain upon uneven ground, and plumb the tally pins, whether by sticking or dropping the same; that we will report the true distance to all notable objects, and the true lengths of all lines that we assist in measuring, to the best of our skill and ability.

Belden F. Culver
W. T. Porter

SWORN AND SUBSCRIBED before me this 3rd

day of August 1880.

W. A. Harwood
Notary Public

I, H. G. Howe, U. S. Deputy Surveyor,

do solemnly swear that I will well and truly perform the duties of Surveyor, in surveying the Silver Plume Mining Claim according to instructions given me, and to the best of my skill and ability.

H. G. Howe

SWORN AND SUBSCRIBED before me this 3rd

day of August 1880,

W. A. Harwood
Notary Public



Field Notes of the Survey

of the Silver Plume Mining Claim
 Situated in Tombstone Mining District, Pima
 County, and one mile south of the Contentions
 Hoisting works, and laying on the west slope
 of Military Hill.

Surveyed by.

L. A. G. Howe,

United States Deputy Surveyor
 of Mineral Lands.

August 31st 1880.

Belden F. Culver,

W. E. Porter,

John B. Bessman, Chainmen
 and Flagman.

Variation, $11^{\circ}05' E$ by observation of Polaris.
 I commence at the Initial Monument, set
 stake 5 ft long 3×4 inches in monument of stones
 5 ft at base and $3\frac{1}{2}$ ft high. Stake marked S.P.
 M.C. Initial Monument.

from which,

U.S. Mineral Monument No 2, bears

distant: 4074 ft.

$N 13^{\circ}5' W$

Shaft 25 ft deep 4×5 feet bears

$S 35^{\circ}30' E$ 157 ft. distant.

Open cut 5 feet deep 2 feet wide 10 ft long (East & West) bears

$S 2^{\circ}0' W$ 186 ft. distant.

Thence.

$N 41^{\circ}0' E$ 124 ft. Shaft 12 ft deep 4×5 feet on right of line at right angles,
 var. $11^{\circ}05' E$. 24 ft distant.

141 ft. Shaft 8 ft deep 4×6 ft on right of line at right angles,
 and 24 ft. distant.

210 ft. to foot of ridge and gulch drains $N 15^{\circ} W$.

288 ft. to N. End Center of Claim, set Stake 5 feet long 3×4 "
 inches in monument of stone 5 feet at base and
 $3\frac{1}{2}$ ft. high stake marked S.P. M.C. No 2. N. End
 center.

Thence, along N. end line of claim.

$N 70^{\circ}10' W$ 33 ft. to foot of Hill and gulch drains North.

35 ft to foot of Hill.

198 ft. to top of ridge bears North and South,

248. ft. to N. West corner of claim. set Stake 5 ft long 3x4 inches in monument of Stone 5 ft at base and 3 1/2 ft high. Stake marked S.P.M.C. No. 3. North West corner.

Thence, along side line of claim.

3 21° 15' W 1151 ft. to gulch drains N 35° W.

va. 11° 05' E. 1228. ft. to South West corner set stake 5 ft long 3x4 inches in monument of Stone 5 ft in diameter and 3 1/2 ft high. Stake marked S.P.M.C. No 4. S. West Corner.

Thence, along South end line of claim.

370° 10' E 70. ft. to gulch drains N. West.

va. 11° 05' E. 248. ft. to South center end. set Stake 5 ft long 3x4 inches in monument of stones 5 ft at base and 3 1/2 ft high. stake marked S.P.M.C. No. 5. South end center.

Thence, Continuing along same line.

370° 10' E 218 ft. to S. East corner set Stake 5 ft long 3x4 inches in monument of stones, 5 ft at base and 3 1/2 ft high. Stake marked S.P.M.C. No 6. South East corner.

Thence, along E. side line of claim.

N 21° 15' E 264. ft to top of Bluff.

va. 11° 05' E. 1228. ft to N East corner and set Stake 5 ft long 3x4 inches in monument of Stone 5 ft at base and 3 1/2 ft high. Stake marked S.P.M.C. No 7. N. East Corner.

Thence,

N 70° 10' W 218 ft. to North center end monument. Stake marked S.P.M.C. No 2.

From South center end monument. (Monument No 5) cut and incline 6 ft wide 5 ft high and 55 ft deep. bears.

N 43° 15' E 136 ft. Distant.

Containing 13.13 acres.

General Description.

The Silver Plume Mining Claim located one mile south of the Contention Hoisting works and on the West Slope of what is known as Military Hill. The claim is partially cut up by small gulches. The east side of claim lays up on the rough hill side which ~~is~~ ^{Slopes} West. This claim is traversed by heavy iron capped quartz ledges. The formation is Limestone and Porphyry. The samples of ore are taken from the shafts near the North end of claim.

The Silver
 as follows,
 West by
 by the
 Side Wheel
 And I have
 this claim
 at a fair
 Dollars.

Plume Mining Claim is bounded
 on the North by the Emerald on the
 the Hidden Treasure, on the South
 Rattling Boy, and on the East by the
 and Maubun Mining Claims.
 I hereby certify that the work done upon
 in sinking shafts and inclines
 valuation is over One thousand

most respectfully,
 H. G. Howe,
 U.S. Deputy Mineral
 Surveyor.

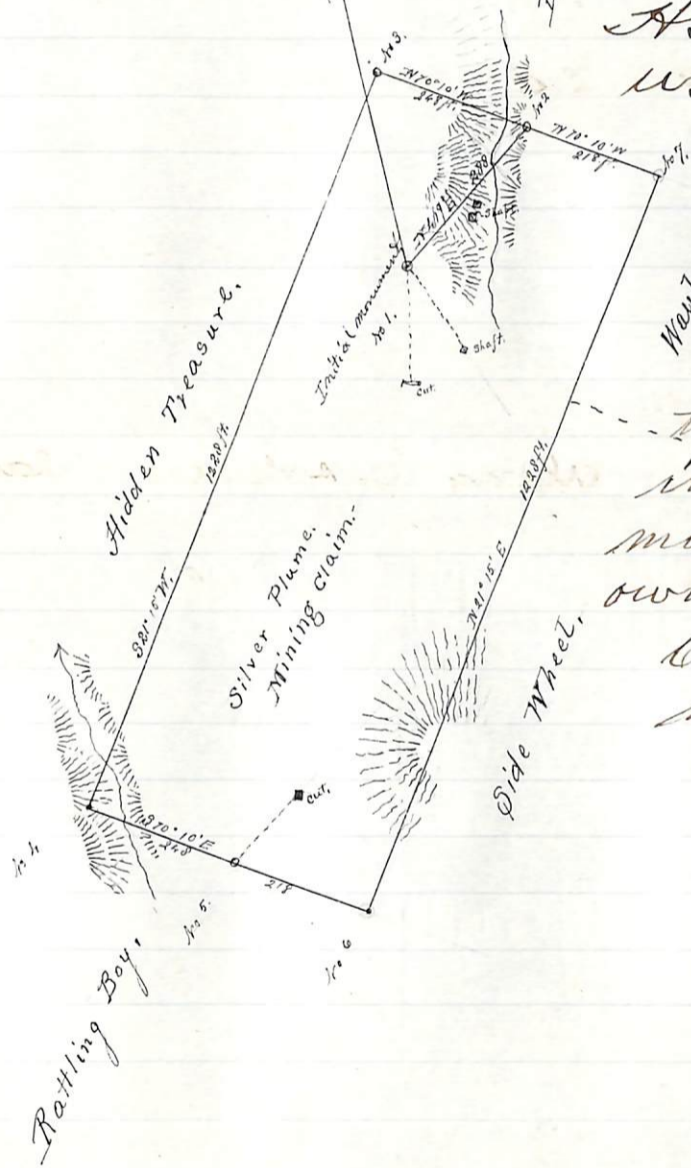

And I further certify
 that all the above
 improvements were
 made by the claimants
 owning the above
 Claim.
 most respectfully,
 H. G. Howe,
 U.S. Deputy Mineral
 Surveyor.

FINAL OATHS FOR SURVEYS OF MINING CLAIMS ~~and~~ MILL SITES.

A LIST of the names of individuals employed to assist in running, measuring, or marking the lines and corners described in the foregoing field-notes of the survey of *The Silver Plume Mining Claim* located in *Tombstone* Mining District, *Pima* County, Arizona, showing the respective capacities in which they acted.

Belden F Culver Chairman.
W. J. Porter. Chairman.
Jul Bausman. Axeman.
Flagman.

WE hereby certify that we assisted *A. G. Howe* U. S. Deputy Surveyor, in surveying *the Silver Plume Mining Claim* claimed by *W. A. Rafferty, A. P. Perrine, J. M. Whitside et al.* located in *Tombstone* Mining District, *Pima* County, and in Township No. _____ Range No. _____ of the Gila and Salt River base and meridian, Arizona, and that said Survey has been in all respects, to the best of our knowledge and belief, well and faithfully executed, and the boundary monuments planted according to the instructions furnished by the Surveyor General.

Belden F Culver Chairman.
W. J. Porter. Chairman.
Jul Bausman. Axeman.
Flagman.

SWORN TO AND SUBSCRIBED before me this *5th* day of *August*, 1880.

W. A. Hayward
Notary Public

I, *A. G. Howe*, U. S. Deputy Surveyor, do solemnly swear that, in pursuance of instructions from *John Wasson*, U. S. Surveyor-General for Arizona, bearing date the *16th* day of *July* 1880, I have well, faithfully and truly, in my own proper person, and in strict conformity with the instructions furnished by the Surveyor-General and the laws of the United States, surveyed all those portions of *of the Silver Plume Mining Claim* claimed by *W. A. Rafferty, A. P. Perrine, J. M. Whitside et al.* located in *Tombstone* Mining District, *Pima* County, Arizona, as are represented in the foregoing field-notes as having been surveyed under my directions; and I do further solemnly swear that all the corners of said surveys have been established and perpetuated in strict accordance with the instructions furnished me, and that the foregoing are the true and original field notes of such surveys.

A. G. Howe, Deputy Surveyor.

SWORN TO AND SUBSCRIBED before me this *5th* day of *August*, 1880.

W. A. Hayward
Notary Public



AFFIDAVIT OF FIVE HUNDRED DOLLARS IMPROVEMENTS.

We, H. G. Rollins and Belden F. Culver
of lawful age, being first duly sworn according to law, depose and say that we are acquainted with
the Work done on the Silver Plume
_____ mining claim, situate in Tombstone,
_____ Mining District, Pima County, Arizona
Territory, for which W. A. Rafferty and A. P. Perrine et al.
has made application for survey prior to application for patent under the provisions of the Act of
Congress approved May 10, 1872, and that the labor done and improvements made thereon by the
applicant^s and their grantor^s exceed Five Hundred Dollars in value, and further that we are
not personally interested in said mine.

H. G. Rollins.
Belden F. Culver

TERRITORY OF ARIZONA, }
County of Pima } SS.

SWORN AND SUBSCRIBED before me this 7th
day of August 1880

W. A. Harwood
Notary Public:

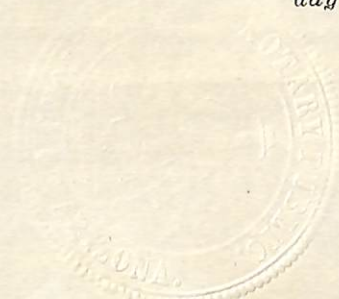

Notice.

The undersigned, present owners of the mine located and known as the Silver Plume mine situated in Tombstone District Pima County Arizona Territory located April 24 1878 a copy of a notice of which location was recorded in Book "C."

Records of Mines of Pima County page three hundred and seventy-six (376) and filed for record June 22nd 1878 to which reference is hereby made for greater certainty, being desirous of obtaining a patent for said mine, and as a preliminary step thereto wishing to have an official survey made thereof by a Deputy United States Mineral Surveyor; and the original notice of said location not being sufficiently definite by reference to some natural object or permanent monument as would identify the claim, this notice is now made to be placed upon said mine and recorded, in order to supply in the record of said mining

9

claim said deficiency of description.

The said Silver Plume mining claim is described as follows; Commencing at a monument of stones, on the North end of claim, marked as the North end center monument, the bearings thence to shaft of Anchor mine being North $21^{\circ} 12'$ West; and thence to a monument on the Lucky Cuss hill commonly called the Edwards monument, North $27^{\circ} 26'$ West, and which point is distant from said monument about thirty-nine hundred feet; thence from said North end center monument South $9^{\circ} 54'$ West, twelve hundred and twenty-nine feet to the South end center monument of stones, whence the bearings to top of Ajax hill is South $32^{\circ} 30'$ West. Then commencing at said North end center monument; thence North $81^{\circ} 8'$ West two hundred and forty-eight (248) feet to a monument of stones; thence South $9^{\circ} 54'$ West twelve hundred and twenty nine feet

to a monument of stones; thence South $81^{\circ} 8'$ East two hundred and forty eight (248) feet to said South end center monument; thence in same direction two hundred and eighteen (218) feet to a monument of stones; thence North $9^{\circ} 54'$ East twelve hundred and twenty-nine feet to a monument of stones; thence North $81^{\circ} 8'$ West two hundred and Eighteen (218) feet to the place of beginning.

This notice is placed upon said Silver Plume mine this eighth day of May 1880.

Witness:	{ W. A. Rafferty H. P. Perrine M. A. Clapp W. A. Payne Jr. S. M. Whitside C. H. Campbell Robert Hanna R. C. Lightburn }	four tenths
		two tenths
		one tenth
		one tenth
		one tenth
		one tenth

Endorsed
 Silver Plume.
 Tombstone.
 May 8th, 1880.

Filed and recorded at request
of W. A. Rafferty, May 12th A.D. 1880 at
8-AM in Book "K." Record Mines
Pages 259, 260 & 261.

J. O. Carpenter, County Recorder
By W. A. M. Dermott, Deputy.

County of Arizona
County of Pima } S.S.

J. O. Carpenter County

Recorder in and for said Pima County do
hereby ^{certify} that the above and foregoing is
a full true and correct copy of the
notice of location of the
mine before described "Silver Plume
Mine" as appears from the Records of
my office.

was used

was used

In witness whereof I have here-
unto set my hand and affixed
my official seal at office in
Tucson said Pima County on
this the Seventeenth day of
May A.D. 1880



J. O. Carpenter County Recorder
By W. A. M. Dermott
Deputy

The words "certify" on
11th line and "notice of
location of the" between
the 12th and 13th lines on
this page were interlined
by me before delivery
J. O. Carpenter Recorder
By W. A. M. Dermott Deputy

U. S. Surveyor General,
Tucson, A. T., Sept 7, 1880.

The foregoing field-notes of
the survey of the Silver Plume
mining-claim, situated in
Tombstone mining district,
Pima County, Arizona, claimed
by W. A. Rafferty, S. P. Rennie
et al.; survey executed by
Henry G. Heave, U. S., under
instructions from this office
having been critically
examined and the necessary
corrections and alterations
made, the said field-notes
and the survey they describe
are hereby approved.

John H. Mason.
Surveyor General.

Certified Copy of
Notice of Location
of the Silver Plume
Mine
