

M
S
-

0

0

4

0

6

LOT NO. 56

Survey No 406

Field Notes

of the survey of the

Centennial

Mining Claim

Globe

Situate in _____ mining district,

County of Gila and in Sec. 14, Tp 16E

Range _____, of the Gila and Salt River Meridian.

Arizona.

Claimed by the Centennial Silver Mining Company

Survey executed by A. G. Rendelton D. S.

Under instructions dated August 14th 1882

Survey commenced August 19th 1882

Survey completed August 19th 1882

PRELIMINARY OATHS

FOR SURVEYS OF MINING CLAIMS AND MILL SITES.



WE, G. D. Barclay and James Lewis

do solemnly swear that we will faithfully execute the duties of Chain Carriers: that we will level the chain upon uneven ground, and plumb the tally pins, whether by sticking or dropping the same; that we will report the true distance to all notable objects, and the true length of all lines that we assist in measuring, to the best of our skill and ability.

G. D. Barclay
James Lewis

SWORN to and subscribed before me, this 19 day

of Aug., 1882

P. P. Miller
Notary Public



I, Geo. Crum

do solemnly swear that I will well and truly perform the duties of Flagman
according to instructions given me,
and to the best of my skill and ability.

Geo. Crum

SWORN to and subscribed before me this 19 day

of Aug., 1882

P. P. Miller
Notary Public



Field Notes of
survey of

The Centennial Mining Claim

situated in

Globe Mining District
Gila County
Arizona

Surveyed under instructions
from U. S. Surveyor General
J. W. Robbins, bearing date of
August 14th 1882

Survey commenced Aug. 19th 1882
Survey completed Aug 19th 1882

A. G. Penclleton
U. S. Dep. Min. Surveyor

There being no U.S. Mineral Monument nearer than about three miles of this claim a new and substantial one was erected consisting of a Pine Post 7 feet long 2 feet in the ground 6x6 inches square (sawed) marked U. S. M. M. No 8 Globe Dist. surrounded by a mound of stones 2 feet high situated on the point of a hill just north of the Centennial Mine and from whence corner No 4 of the Centennial Mine bears S. 28° 53' E. 61.4 feet, a Cedar Tree six inches in diameter bears S. 55° 40' E. 60 feet Black Peak bears S 12° 29' W. South Peak of Pinal Mountains bears S. 6° 32' W. Apache Peak N. 13° 00' E. Quartzite hill bears N. 54° 25' E.

Field Notes of the Centennial Mine

feet

Begin at the N. E. end center the point being marked by a monument of stones 2 feet high from whence Quartzite Hill bears N 61° 07' E and Mount Turnbull bears S. 47° 46' E.

Thence S. 41° 28' E.
Var. 13° 34' E.

300 down the hill to the East corner the point being marked by an Iron pin 15 inches long drive in the ground in the middle of the road leading from the mine

Thence S. 69° 32' W
Var. 13° 34' E.

1500 over a hill and across ^{road} the "Kam-boz" gulch to a monument situated

feet on the N.E. slope of a hill said monument consists of a Cedar post 4 feet long 1 foot in the ground 4 inches in diameter marked C.II surrounded by a mound of stones 18 inches high

Thence N. $41^{\circ}28'W.$

Var $13^{\circ}34'E.$

300 to a monument of stones 2 feet high not marked being the S.W. end center of the claim

Thence N. $41^{\circ}28'W.$ (same course)

Var. $13^{\circ}34'E.$

300 to a monument said monument consists of a Cedar Post $3\frac{1}{2}$ feet long 1 foot in the ground marked C.III surrounded by a mound of stones 2 feet high.

Thence N $69^{\circ}32'E$

Var. $13^{\circ}34'E$

1500 crossing "Ramboz" gulch on hill a gulch running past the main shaft to a monument situated on a hill said monument consists of a Pine post 4 feet long 1 foot in the ground 6x6 inches square marked C.IV surrounded by a mound of stones 18 inches high

Thence S. $41^{\circ}28'E$

Var. $13^{\circ}34'E$

300 down the hill to the place of beginning

Containing 19.28 Acres

From Corner No II U. S. Mineral Monument No 8 of Globe District bears N. $28^{\circ}53'W.$ 61.4 feet

From Corner No 1 Iron Pin shaft
 No 1 bears N. $80^{\circ}45'W$. 450 feet
 Shaft No 2 bears N. $71^{\circ}43'W$. 401 feet
 From shaft No 1 the mouth of the main
 tunnel bears $S69^{\circ}W$ 15 feet
 From the S.W. End Centre monument
 the mouth of a tunnel bears $N24^{\circ}50'E$ 344 ft.
 a shaft bears $S16^{\circ}35'W$. 36 feet

The work consists of
 Shaft No 1, 200 feet deep cost \$2000.00
 Shaft No 2, 150 feet deep cost 1500.00
 Drifts to the amount of 890 ft. cost 8900.00
 A Tunnel 180 feet long cost 1000.00
 A Tunnel 40 feet long cost 300.00
 Total \$13700.00

I certify that the above described
 work was done by the claimants
 and their grantors and expenses
 \$500.00 in value

The Formation is gneiss
 The Variation of the Magnetic Needle
 as determined by Solar Compass is
 $13^{\circ}34'$ East of North.

The lines are all run on true
 bearings by solar compass

A. G. Pendleton
 U. S. Dep. Min. Surveyor

FINAL OATHS FOR SURVEYS OF MINING CLAIMS & MILL SITES.

A LIST of names of individuals employed to assist in running, measuring, or marking the lines and corners described in the foregoing field-notes of the survey of the Centennial Silver Mine located in Globe Mining district, Gila County, Arizona, showing the respective capacities in which they acted.

G.D. Barclay Chairman.
James Lewis Chainman.
Geo. Munro Axeman.
Geo. Munro Flagman.

WE hereby certify that we assisted A.G. Pendleton U. S. Deputy Surveyor, in surveying the Centennial Mine claimed by the Centennial Silver Mining Company located in Globe Mining District, Gila County, and in township No. _____ Range No. _____ of the Gila and Salt River base and meridian, Arizona, and that said Survey has been in all respects, to the best of our knowledge and belief, well and faithfully executed, and the boundary monuments planted according to the instructions furnished by the Surveyor General.

G.D. Barclay Chairman.
James Lewis Chainman.
Geo. Munro Axeman.
Geo. Munro Flagman.

SWORN TO AND SUBSCRIBED before me this 24th day of August 1882

R. Miller
Notary Public

I, A.G. Pendleton U. S. Deputy Surveyor, do solemnly swear that, in pursuance of instructions from the U. S. Surveyor-General for Arizona, bearing date the 14 day of August 1882, I have well, faithfully and truly, in my own proper person, and in strict conformity with the instructions furnished by the Surveyor-General and the laws of the United States, surveyed all those portions of The Centennial Mine claimed by the Centennial Silver Mining Co. located in Globe Mining District, Gila County, Arizona, as are represented in the foregoing field-notes as having been surveyed under my directions; and I do further solemnly swear that all the corners of said surveys have been established and perpetuated in strict accordance with the instructions furnished me, and that the foregoing are the true and original field notes of such surveys.

A.G. Pendleton Deputy Surveyor.

SWORN TO AND SUBSCRIBED before me this 24th day of August 1882

R. Miller
Notary Public

AFFIDAVIT OF FIVE HUNDRED DOLLARS IMPROVEMENTS.

We, James Lewis and N. A. Clark
of lawful age, being first duly sworn according to law, depose and say that we are acquainted with the
Centennial
mining claim, situated in
Globe Mining District, Gila County, Arizona
Territory, for which The Centennial Silver Mining Co.
has made application for survey prior to application for patent under the provisions of the Act of
Congress approved May 10, 1872, and that the labor done and improvements made thereon by the appli-
cant and its grantors exceed Five Hundred Dollars in value, and further that we are not per-
sonally interested in said mine.

James Lewis
N. A. Clark.

TERRITORY OF ARIZONA,
County of Gila } SS.

SWORN to and subscribed before me, this 24th day
of August 1882

R. Miller
Notary Public

Notice is hereby given that Centennial Silver Mining Company a Corporation organized and existing under and by virtue of the laws of the State of New York, in compliance with the requirements of the Mining Act of Congress approved May 10, 1872 and all acts of Congress Amendatory Therof, having duly located, under the laws of the United States the Mining Claim, hereinafter described, and being in the actual possession of the same, having further complied with all the laws of the United States, of the Territory of Arizona, and of the Globe Mining District hereby files this its Amended Notice of Location; locating and claiming 1500 linear feet along the course of this lead lode or vein of mineral bearing quartz, and three hundred feet in width on each side of the middle of said lead lode or vein, situate in the Globe Mining District Gila County Arizona and more particularly described as follows, to wit; Commencing at this monument of stones, being the North east end center monument of the claim as described in the original notice of location, and being the original North east end center monument of the claim - running thence S. $41^{\circ} 28'$ East 300 feet to a monument of stones; thence S. $69^{\circ} 32'$ west 1500 feet to a monu-

ment of stones; thence N. $41^{\circ} 28'$ West 300 feet
 to a monument of stones; thence N. 41°
 $28'$ West 300 feet to a monument of stones;
 thence N. $69^{\circ} 32'$ East 1500 feet to a monu-
 ment of stones; thence S. $41^{\circ} 28'$ E. 300 feet
 & a monument of stones being the place
 of beginning - From the N.E. end
 center monument, Mount Turnbull
 bears south $47^{\circ} 46'$ East and Quartzite
 Hill N. $61^{\circ} 07'$ East. - This claim is situ-
 ated about six miles N.W.E. from Globe
 City - and about one half a mile from
 "Ramboz" camp and shall be known as
 the Centennial Mining Claim -

This amended notice of location is made
 for purposes of a more particular de-
 scription of said Centennial Claim -

Located this July 31st 1882 -

The Centennial Silver Mining
 } Company - a corporation -
 H. G. Bond President -

Witnesses: } Charles B. Colton Secretary -
 G. C. Munro }
 A. G. Pendleton }

Recorded at request of G. C. Munro. at 1 o'clock
 P.M. July 31st 1882.

R. B. Miller Recorder -

Territory of Arizona }
 County of Gila

J. P. Miller County
 Recorder in and for Gila County Territory
 of Arizona, do hereby certify that the
 above and foregoing is a full true
 and correct copy of the amended
 Notice of Location of the "Centennial"
 Mining Claim as the same appears
 of Record in my Office, in Book 1
 Records of Mines at page 535 - Records
 of Gila County A.T.

Witness my hand and seal
 this 1st day of August A.D. 1882.

J. P. Miller
 County Recorder

12



of the
Centennial Mine
 GLOBE DISTRICT ARIZONA,
 Surveyed by
A. G. Pendleton,
 U.S. Dep. Min. Sur.
 Aug. 19. 1882
 Scale 200ft = 1 inch

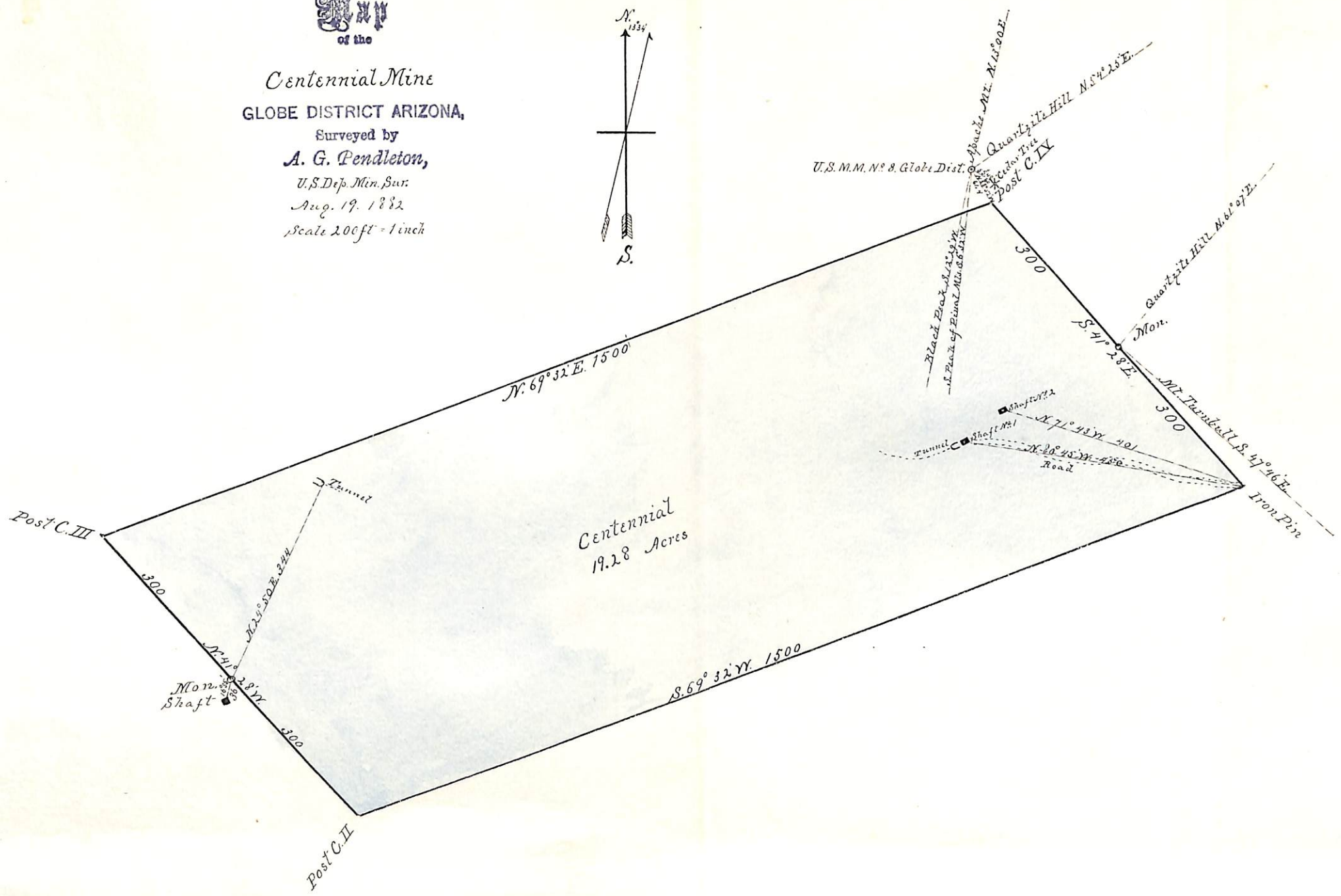
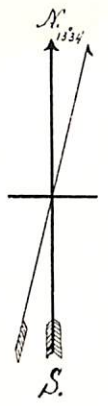

Central copy
of
Central manuscript
Manuscript No. 1000



U. S. Surveyor General's Office,

Tucson, Arizona, September 7th 1882

The foregoing field notes of the survey of the Centennial
Mining Claim situate in
the Globe Mining District, Gila
County, Arizona, claimed by the Centennial Silver
Mining Company
survey executed by A G Pendleton Deputy
Surveyor, under instructions from this office, having been critically examined
and the necessary corrections and alterations made, the said field notes and
the survey they describe are hereby approved.

J. W. Robinson

Surveyor General.