

M.S.

0

0

4

2

3

LOT NO. 52

Survey No 433

Field Notes

of the survey of the

Blue Dick

Mine

Situate in Assayumpu mining district,

County of Yavapai and in Sec. 4, Tp 12 N

Range 2 W, of the Gila and Salt River Meridian.

Arizona.

Claimed by Gilbert Clements

Survey executed by Frank S Ingalls U S D. S.

Under instructions dated August 14 188

Survey commenced September 21 188

Survey completed September 21 188

PRELIMINARY OATHS

FOR SURVEYS OF MINING CLAIMS AND MILL SITES.

WE, J. B. Gregory and Charles Dressler
do solemnly swear that we will faithfully execute the duties of Chain Carriers: that we will level the chain upon uneven ground, and plumb the tally pins, whether by sticking or dropping the same; that we will report the true distance to all notable objects, and the true length of all lines that we assist in measuring, to the best of our skill and ability.

James B Gregory
Chas L Dressler.

SWORN to and subscribed before me, this 20th day
of September, 1882

J. Weal
Notary Public

I, J. C. Burge
do solemnly swear that I will well and truly perform the duties of
Affiant according to instructions given me,
and to the best of my skill and ability.

J. C. Burge

SWORN to and subscribed before me this 20th day
of September, 1882

J. Weal
Notary Public.



Field notes of survey of the

Blue Nick mining claim.

Situated in Hassayampa mining district Yavapai County Arizona

Survey commenced September 21, 1882.

Survey completed. September 21, 1882.

Initial point: monument of location.

Center monument at northern end of claim situate on middle of outcroppings of vein and bearing notice of location.

Magnetic variation as obtained by direct observation of the Sun with Burt's Solar Transit. $13^{\circ}57' E$.

Beginning at the initial monument a pine post 4x4 inches 5 feet long in mound of stone on top of ridge at the center of northern end of claim. Marked B.D.N. 1. And from which shaft No. 1. 4x6 feet 28 feet deep bears $S42^{\circ}E$ 114 feet distant. And shaft No. 2. 4x6 feet 29 feet deep bears $S45^{\circ}E$ 203 feet distant. and shaft No. 3. 4x6 feet 24 feet deep bears $S37^{\circ}E$ 328 feet distant. And the East end of upper crosscut bears $S39^{\circ}E$ 373 feet distant. And the East end of lower tunnel bears $S54^{\circ}E$ 432 feet distant. And run thence as follows.

Variation $13^{\circ}57' E$.

$S.66^{\circ}21' W$ 300 feet to N.W. corner of claim to an oak post 4x5 inches 4 feet long in stone mound. Marked B.D.N. 2. N.W. Thence ascending along western slope of ridge.

$S.23^{\circ}39' E$ 1300 feet cross ridge. Corner N and S and descend.

1500 feet to S.W. corner of claim to a pine post 4x4 inches 4 feet long in stone mound. Marked B.D.N. 3. S.W.

and from which the S. E. Corner of the Buzzard Mining claim bears S. 52° E. 137 feet distant, thence descending.

N 66° 21' E 130 feet cross gulch 15 feet wide course S 40° E and ascend.

300 feet to a pine post 4x4 inches 4 feet long in stone mound marked B. D. N° 4. being the centre of S. End of claim. thence.

N 66° 21' E 300 feet to S. E. Corner of claim to a pine post 4x4 inches 4 feet long in stone mound. marked B. D. N° 5. thence ascending along E slope of ridge

N 28° 39' W 1500 feet to N. W. Corner of claim to a spruce post 4x4 inches 5 feet long in stone mound. marked B. D. N° 6. N. E. and from which United States Mineral Monument No 2, Cassayampa Mining district Bears. S 88° 21' E. 1280 feet distant, thence ascending

S 66° 21' W 300 feet to place of beginning.
Area of claim: 20 ⁶⁶/₁₀₀ acres.

The improvements made upon this claim by the claimant and his grantors. consists of. Shaft No. 1. 4x6 feet 28 feet deep. Shaft No 2. 4x6 feet. 29 feet deep and shaft No 3. 4x6 feet 24 feet deep. Upper crosscut. of 20 feet. Upper tunnel running from western end of crosscut to connect shafts 3 and 2. now in a distance of 130 feet. Also a lower tunnel 140 feet in length. These improvements represent in the aggregate an expenditure of \$4000.

This claim is situated on a spur which runs nearly south from the Cassayampa Mountain. and distant therefrom about 1 1/2 miles. Just north

of the Northern end of this claim there are two canyons, one running to the East, the other to the West, in both of which there is pine and spruce timber. No other timber is to be found in the near vicinity.

The formation is Borphyr - the result principally smelting ore, and assays return an average of \$90 per ton.

Frank J. Ingalls
 U. S. Geol. Min. Surveyor.

FINAL OATHS FOR SURVEYS OF MINING CLAIMS & MILL SITES.

A LIST of names of individuals employed to assist in running, measuring, or marking the lines and corners described in the foregoing field-notes of the survey of

The Blue Dick Mine located in Massayampa Mining district, Yavapai County, Arizona, showing the respective capacities in which they acted.

J. D. Gregory Chainman. Charles Dressler Chainman. J. C. Bunge Axeman. Flagman.

WE hereby certify that we assisted U. S. Deputy Surveyor, in surveying

F. J. Ingalls The Blue Dick Mine

claimed by Gilbert Clements located in Massayampa Mining District, Yavapai County, and in township No. Range No. of the Gila and Salt River base and meridian, Arizona, and that said Survey has been in all respects, to the best of our knowledge and belief, well and faithfully executed, and the boundary monuments planted according to the instructions furnished by the Surveyor General.

James B. Bunge Chainman. Chas. L. Dressler Chainman. J. C. Bunge Axeman. Flagman.

SWORN TO AND SUBSCRIBED before me this 23rd day of September 1882

Notary Public

I, F. J. Ingalls U. S. Deputy Surveyor, do solemnly swear that in pursuance of instructions from the U. S. Surveyor-General for Arizona, bearing date the 14th day of August 1882, I have well, faithfully and truly, in my own proper person, and in strict conformity with the instructions furnished by the Surveyor-General and the laws of the United States, surveyed all those portions of the Blue Dick Mine

claimed by Gilbert Clements located in Massayampa Mining District, Yavapai County, Arizona, as are represented in the foregoing field-notes as having been surveyed under my directions; and I do further solemnly swear that all the corners of said surveys have been established and perpetuated in strict accordance with the instructions furnished me, and that the foregoing are the true and original field notes of such surveys.

F. J. Ingalls Deputy Surveyor.

SWORN TO AND SUBSCRIBED before me this 25th day of September 1882

Notary Public



AFFIDAVIT OF FIVE HUNDRED DOLLARS IMPROVEMENTS.

We, *J. J. Thomas* and *W. A. Chie*

of lawful age, being first duly sworn according to law, depose and say that we are acquainted with the

Blue Dick

mining claim, situated in *Kassayampa*

Mining District, *Yavapai* County, Arizona

Territory, for which *Gilbert Clements* has

~~not~~ made application for survey prior to application for patent under the provisions of the Act of Congress approved May 10, 1872, and that the labor done and improvements made thereon by the applicant and his grantors exceed Five Hundred Dollars in value, and further that we are not personally interested in said mine.

J. J. Thomas
W. A. Chie

TERRITORY OF ARIZONA,
County of *Yavapai* } SS.

SWORN to and subscribed before me, this *23rd* day

of *September* 188*2*

J. W. [Signature]
Notary Public.

Notice of Location.

Know all men by these presents:

That the undersigned, have this day located fifteen hundred (1500) linear feet of this vein or lode, bearing precious metals, with all dips, spurs, angles and variations, with surface ground three hundred (300) feet on each side of the centre of vein, with all mineral deposits contained therein, and all timber growing within the limits of said claim, and all water ^{and} water privileges thereon or appurtenant thereto, under and according to the provisions of the mining laws of the United States, under which it is located.

This claim commences at this Monument ^{and} notice placed upon the ledge, and runs fifteen hundred (1500) feet in a southerly direction along the ledge.

The exterior boundaries are as follows, viz:

Commencing at this Monument ^{and} notice, and running three

hundred {300} feet in an easterly
 direction to monument of stone,
 at N. E. corner of claim; thence in
 a southerly direction parallel
 with the ledge fifteen hundred
 {1500} feet to monument at S. E.
 corner of claim; thence at right
 angles across the ledge in a westerly
 direction six hundred {600} feet to
 monument at S. W. corner of claim;
 thence parallel with the ledge in a
 northerly direction fifteen hundred
 {1500} feet to monument at N. W.
 corner of claim; thence at right
 angles across the ledge in an easterly
 direction three hundred {300} feet
 to monument upon the ledge ^{and}
 place of beginning.

This ledge may be more generally
 described as situated about one
 thousand yards from the Dasoris
 mine North West the same
 from Coy ^{and} Craigs Cabin South
 about fourteen miles South
 of Prescott about three hundred
 yards from the Buzzard mine North
 in Hesseampi Mining District

Yavapai County, Arizona Territory
 shall be known as the Blue Dick
 Mining Claim.

Dated on the ground this
 25th of October day of 1881.

Ed. S. Ward 750 feet
 John McDonald 375 feet
 Nelson Gabel 375 feet

{ Endorsed }

Filed and recorded at
 request of John McDonald October
 26th A.D. 1881, at 3 o'clock P.M.
 in Book No 12 of Mines, pages
 117-118. Records of Yavapai County
 Arizona.

William Wilkerson
 County Recorder
 By S. S. Bechtel
 Deputy.

I, William Wilkerson, Recorder of
 the County of Yavapai, Territory of Arizona
 do hereby certify that the foregoing is
 a full true and correct copy of the
 Notice of Location of the Blue Dick Mine
 as appears of record in this office.
 In witness whereof I have hereunto set
 my hand and Seal this 10th day of August
 A.D. 1882.

William Wilkerson
 County Recorder

- Copy of -
Notice of Location
of
Blue Dick Mine

1850
By D. J. Proctor
Deputy

Plat of the Blue Dick mine Massayampa Mining district,

Surveyed September 21st 1882 by J. A. Ingalls U.S. Dep. Mineral Surveyor under instructions from the Surveyor General of Arizona Dated August 14th 1882.

Copied of
Notice of

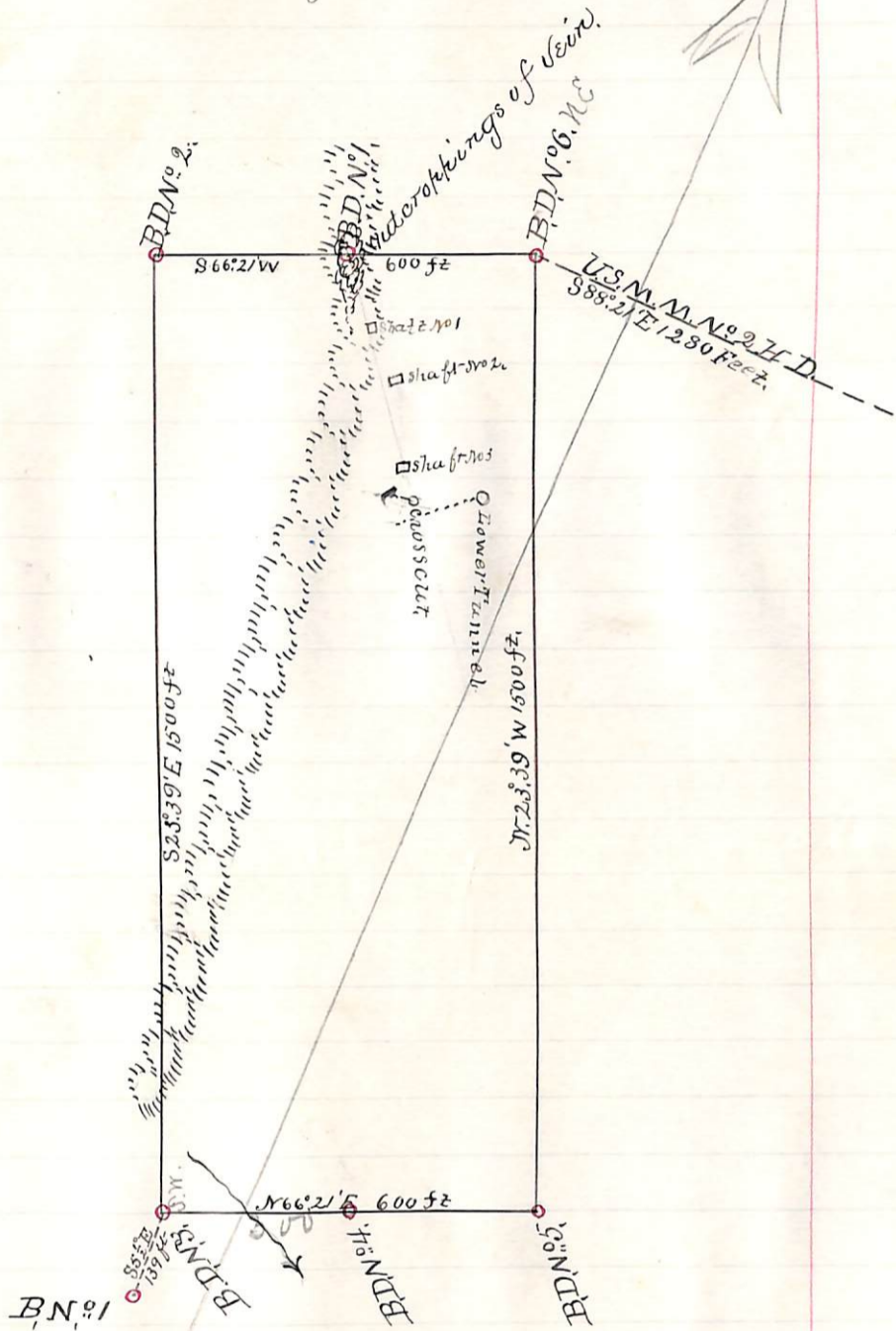

Scale 300 feet to an inch.

U. S. Surveyor General's Office.

Tucson, Arizona, October, 20. 1882.

The foregoing field notes of the survey of the Blue Dick Mine
 Mining claim situate in
 the Hassayampa Mining District, Yavapai
 County, Arizona, claimed by
Gilbert Clements
 survey executed by Frank S. Dugall Deputy
 Surveyor, under instructions from this office, having been critically examined
 and the necessary corrections and alterations made, the said field notes and
 the survey they describe are hereby approved.

J. W. Robinson

Surveyor General.

shaft^{No 1} 4x6 ft 28 ft deep

No 2 4x6 " 29 " "

No 3 4x6 " 24 " "

Crosscut 20 " long

Sum 130 "

Copy