

**M
S
-**

0

0

5

0

7

LOT NO. 38

SURVEY NO. 507

Field Notes

of the survey of the

"Eller"

Mining Claim

Situate in Dos-Labegas mining district.

County of Cochise and in Sec _____, Tp 14 S

Range 28 E, of the Gila and Salt River Meridian.

ARIZONA.

Claimed by Selden J. Wright & H. W. Reese

Survey executed by Solow M. Ellis U.S. D. S.

Under instructions dated May 11th 1883

Survey commenced " 13" 1883

Survey completed " " 1883

PRELIMINARY OATHS

FOR SURVEYS OF MINING CLAIMS AND MILL SITES.

WE, James Hutton and Frank Williams

do solemnly swear that we will faithfully execute the duties of Chain Carriers: that we will level the chain upon uneven ground, and plumb the tally pins, whether by sticking or dropping the same; that we will report the true distance to all notable objects, and the true length of all lines that we assist in measuring, to the best of our skill and ability.

James Hutton
Frank Williams

SWORN to and subscribed before me, this 13th day

of May, 1883

Solon Mc Allis
Notary Public Pine Co U.S.

I, William A Wood

do solemnly swear that I will well and truly perform the duties of Flagman
according to instructions given me,

and to the best of my skill and ability.

William A. Wood

SWORN to and subscribed before me this 13th day

of May, 1883

Solon Mc Allis
Notary Public Pine Co U.S.

Field Notes
Of the Survey of the

ELIEN MINING
CLAIM

Dos Cabezas Mining District.

Coahuila Co. A.T.

Survey made May 13, 1883
By Order of Surveyor General

J. W. Robbins

Dated May 11, 1883

By
Solon M. Allis,

U. S. Deputy Mineral Surveyor.

Fields Notes of Survey of the "Elle" Mining Claim Dos Cabezas Mining Dist Cochise Co. A. T.

Commencing at the Initial Monument at West End of claim when I found notice of Location posted I set a pins post 2x4" sq 5ft long marked E.I. 2 ft in the ground. and built a monument of stones 2 1/2 ft high around it

From which U.S. Mineral Monument No 2 Dos Cabezas Mining Dist bears N 77° 18' E dist 1515 ft.

Var 12° 30' E by Obs on Polaris

An oak tree 10" dia marked E.I. bears S 29° 31' W. dist 25 ft.

Thence Iron

S 33° 30' W

Var 12° 30' E

300 feet Along West End boundary of claim This also the East End boundary of the Neville Mining claim

To S.W. Cor of claim when I set a pins post 2x4" sq 5ft long. marked E.II. set 2 ft in the ground and built a monument of stones around it - from which shaft No 1 bears (N.W. Cor) N 74° E dist 565 ft.

A Cyprus Stump, marked E.II. bears N 64° 30' E dist 45 ft

Thence Iron S 75° 15' E

Var 12° 30' E

1400 feet Along South Side boundary of claim

To gulch running S.W.

1500 feet To S.E. Cor of claim when I set a pins post 2x4" sq 5ft long marked E.III. set 2 ft in the ground and built a monument of stones around it 2 1/2 ft high.

From which an oak tree marked E.III bears N 72° 30' E - dist 12 ft. dia of tree 12"

U.S. Mineral Monument

Field Notes of Survey of the Ellen
Mining Claim Dos Cabezas Mining
Dist Cochise Co. A.T.

No 2 Dos Cabezas Mining Dist bears
N 18° 25' E dist 728 ft
Thence ran N 33° 30' E
Var 12° 30' E

Feet Along East End boundary line of claim
60 To N.W. cor of Sonnet Mining Claim Lot No 37
300 To East center Monument of Ellen Mining
claim this line being also N.W. End
boundary line of the Sonnet mining claim Lot No 37
When I set a pin post 2x4" ~~2~~ 2 ft
in the ground 5 ft long marked E.IV.
and built a monument of stones 2 1/2 ft
high around it from which

U.S. Mineral Mon No 2 bears.
N 8° 45' E dist 440 ft.
Thence ran

Continuation of this line
N 38° 30' E
Var 12° 30' E

60 To N.W. center end monument & initial of
the Sonnet mining claim - Lot No 37

300 To N.E. cor of Ellen claim when I set
a pin post 2x4" ~~2~~ 5 ft long marked
E.V. 2 ft in the ground and built a
monument of stones 2 1/2 ft high around it
From which

U.S. Mineral Monument No 2
bears N 29° 04' W dist 220 ft.
N.W. cor Monument of Sonnet Mining Claim Lot No 37
bears N 33° 30' E dist 60 ft.
Thence I ran

N 75° 15' W
Var 12° 30' E

1500 Along N.E. side boundary of claim to N.W.
cor of same when I set a pin post 2x4" ~~2~~
5 ft long marked ELLER. VI. set 2 ft in
the ground on steep side hill 15 ft from
bottom of gulch - and built a monument

Field Notes of Survey of the Eller Mining
Claim Dos Cabezas Mining Dist A.T.
Cochise Co

of Stones 2 1/2 ft high around it
from which a cypress stump 2 ft in dia
marked E.V.T. bears N 29° 30' E dist 16 ft.
Thence Iran

S 33° 30' W

Var 12° 30' E

Feet
300

Along the West End boundary line of
claim thence also the East End
boundary line of the Nevill Mining
Claim. Or place of beginning.

This Claim contains 19.42 acres
and is bounded on the East by
the Summit and on the West by
the Nevill Mining Claims.

General Description

This claim lies on west slope of
a high ridge heading woods canyon
about 2 miles north of Telegraph
Road leading from Dos Cabezas to
Fort Bowie - and about 5 1/2 miles westward
from Fort Bowie - Cochise Co A.T.

I hereby Certify that the Improvements
made by Claimants and Grantors consist
of one Shaft 4x6 220 ft deep
One crosscut at 75 ft level 4x6 30 ft long
One drift at same level 4x6 130 ft long
One crosscut at 200 ft 4x6 40 ft ^{1/2} South
One do " do " 4x6 127 ft " North
One drift " do " 4x6 137 ft " East
In all 684 ft of 4x4 work

One Hoisting Works & Engine Costing \$3000.

Used 2x4 posts as no other available.

Solon M. Allis
U.S. Dep Min Surveyor.

FINAL OATHS FOR SURVEYS OF MINING CLAIMS & MILL SITES.

A LIST of names of individuals employed to assist in running, measuring, or marking the lines and corners described in the foregoing field-notes of the survey of The Eller

Mining Claim
located in Des Cabezas Mining district, Cochise
County, Arizona, showing the respective capacities in which they acted.

James Hatton Chainman.
Frank Williams Chainman.
William H Wood Axeman.
William H Wood Flagman.

WE hereby certify that we assisted Solon M. Allis
U. S. Deputy Surveyor, in surveying The Eller - Mining Claim

claimed by Richard J. Wright & H. W. Rogers
located in Des Cabezas Mining District, Cochise County,
and in township No. _____ Range No. _____ of the Gila and Salt River base and meridian,
Arizona, and that said Survey has been in all respects to the best of our knowledge and belief, well and
faithfully executed, and the boundary monuments planted according to the instructions furnished by the
Surveyor General.

James Hatton Chainman.
Frank Williams Chainman.
William H Wood Axeman.
William H Wood Flagman.

SWORN TO AND SUBSCRIBED before me this 14th day

of May 1883

Solon M. Allis
Notary Public Pima Co. A.T.

I, Solon M. Allis U. S. Deputy Surveyor, do solemnly swear that, in pur-
suance of instructions from the U. S. Surveyor-General for Arizona, bearing date the 11th day of
May 1883, I have well, faithfully and truly, in my own proper person, and in
strict conformity with the instructions furnished by the Surveyor-General and the laws of the United
States, surveyed all those portions of The Eller - Mining Claim

claimed by Richard J. Wright & H. W. Rogers
located in Des Cabezas Mining District, Cochise County,
Arizona, as are represented in the foregoing field-notes as having been surveyed under my directions; and
I do further solemnly swear that all the corners of said surveys have been established and perpetuated in
strict accordance with the instructions furnished me, and that the foregoing are the true and original field
notes of such surveys.

Solon M. Allis Deputy Surveyor.

SWORN TO AND SUBSCRIBED before me this 17th day

of May 1883

C. W. Clann
Notary Public,
Pima County,
Arizona.

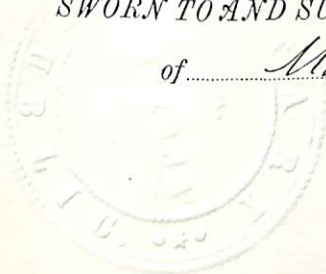

AFFIDAVIT OF FIVE HUNDRED DOLLARS IMPROVEMENTS.

Mr. *William H Wood* and *James Hatton*

of lawful age, being first duly sworn according to law, depose and say that we are acquainted with the

Eller

mining claim, situated in

Dos Cabezas Mining District, *Coconino* County, Arizona

Territory, for which *Selden J. Wright* and *J. W. Reese*

have made application for survey prior to application for patent under the provisions of the Act of Congress approved May 10, 1872, and that the labor done and improvements made thereon by the applicant and — grantor exceed Five Hundred Dollars in value, and further that we are not personally interested in said mine.

William H. Wood
James Hatton

TERRITORY OF ARIZONA,
County of *Coconino*

} SS.

SWORN to and subscribed before me, this *14th* day

of *May* 188*3*

Solon M. Allis
Notary Public Pima Co. A. T.

TERRITORY OF ARIZONA, } ss.
County of Pima.

I, Chas. R. Drake, County Recorder in and for the County of Pima, do hereby certify that the above and foregoing is a full true and correct copy of the Locution Notice of the Eller Mine

as appears of Record now in my Office in Book I Pages 71 and 72

IN WITNESS WHEREOF, I have hereunto set my hand and affixed my official seal, at my office in Tucson, this 11th day of May A. D. 1883

Chas R Drake
County Recorder,



Eller Mine

We the undersigned New Day locate
 their lode lide or mineral barren rock
 and all of its depth Spores Angels and
 disposed we alsoe claim 300 feet on
 each side of the medal of the lide and
 we claim 1000 feet South-Eastaly and
 500 feet North-westaly from their main
 mine or Recovery should their lide
 shal be known as the Eller lide, February
 7th 1879.

J S Bassett

J S Meader

Filed and recorded at request of

Supplemental Location Notice "Eller"¹¹
Mine Notice. The undersigned present
owners of the Mine located and known
as the "Eller" Mine situated in the
Dos Cabezas Mining District Cochise
County Territory of Arizona located
February 7th 1879. A copy of a
Notice of which location was
recorded in Book I records of
Mining Pines County A.T. page 71
to which reference is hereby made
for greater certainty being desirous
of obtaining a patent for said Mine
and as a preliminary step thereto
wishing to have an official survey
made thereof by a deputy United
States Mineral Surveyor and the
Original notice of said location not
being sufficiently definite by
reference to some natural object or
permanent monument as would
identify the claim do now make
this notice to be placed upon said
mine and recorded in order to supply
^{up} the records of said mining claim said
error of description. The said "Eller"
Mining Claim is described as follows
Commencing at this monument of
stones at the west center end of claim
in which is placed a pine post 2x4
inches square and 4 feet long
marked "No 1 W Cent Eller MC"

Certified Copy.

Location Noted

"Eller"

Miner

B. 1. pp. 245.
Rec of mines

Red Mountain

from which the point of Discovery
 near shaft bears S $75\frac{1}{2}^{\circ}$ E 400 feet.
 more or less. thence S $31\frac{1}{4}^{\circ}$ W 300 feet to
 mount of stones & post No 2 thence
 S. 76° E. 1500 feet. to point of stones &
 post No 3. thence $31\frac{1}{4}^{\circ}$ E 300 feet. to mount
 of stones and post No 4 in the east
 center end. of claim and in the
 west end line of the "Somet" claim
 from which the wood Canon peak
 bears N 15° W. about one mile
 thence $31\frac{1}{4}^{\circ}$ E 300 feet to mount of stones
 and post No 5 thence N 76° W 1500 feet
 to mount of stones & post No 6
 thence S $31\frac{1}{4}^{\circ}$ W 300 to the point of
 beginning.

situated in a branch of wood
 Canon about $5\frac{1}{2}$ miles north
 westerly from Camp Bowie
 and about 2000 feet north east
 of wood Canon Spring and
 about $2\frac{1}{2}$ miles north of the Pteleg
 raph road which leads from
 Camp Bowie to the town of
 Dos Cabezas.

This notice is placed on
 the said mine by the common
 wealth. Consolidated Mining
 Co. of Arizona. by their agent
 situated at N. A. Nevills Owners of
 by C. H. Parent said mine.
 Recorded at request of N. A. Nevills

July 8. 1881. 9. am.

A. H. Jones
County Recorder.

Territory of Arizona,)
County of Cochise.) ss.

I, A. H. JONES, County Recorder in and for the County
of Cochise, do hereby certify that the above and foregoing is a full, true and
correct copy of An Instrument

as appears of record now in my office in Book 2, Page 245
Records of mines

I **N** **W** **I** **T** **N** **E** **S** **S** **W** **H** **E** **R** **E** **O** **N**, I have hereunto set my
hand, and affixed my official seal, at my office in
Tombstone this 10 day of May A. D. 1882
A. H. Jones
County Recorder.

From post III Eller - Oak marked E.M. bears N72°30'E dist 12 ft 12" dia
 From post I " " F.I. " S29°30'W dist 25 ft 10" dia
 From post VI " " Cyprus " E.M. " N29°30'E " 16 ft 4" dia
 From post II " " F.I. " S76°30'E " 45 ft 18" dia

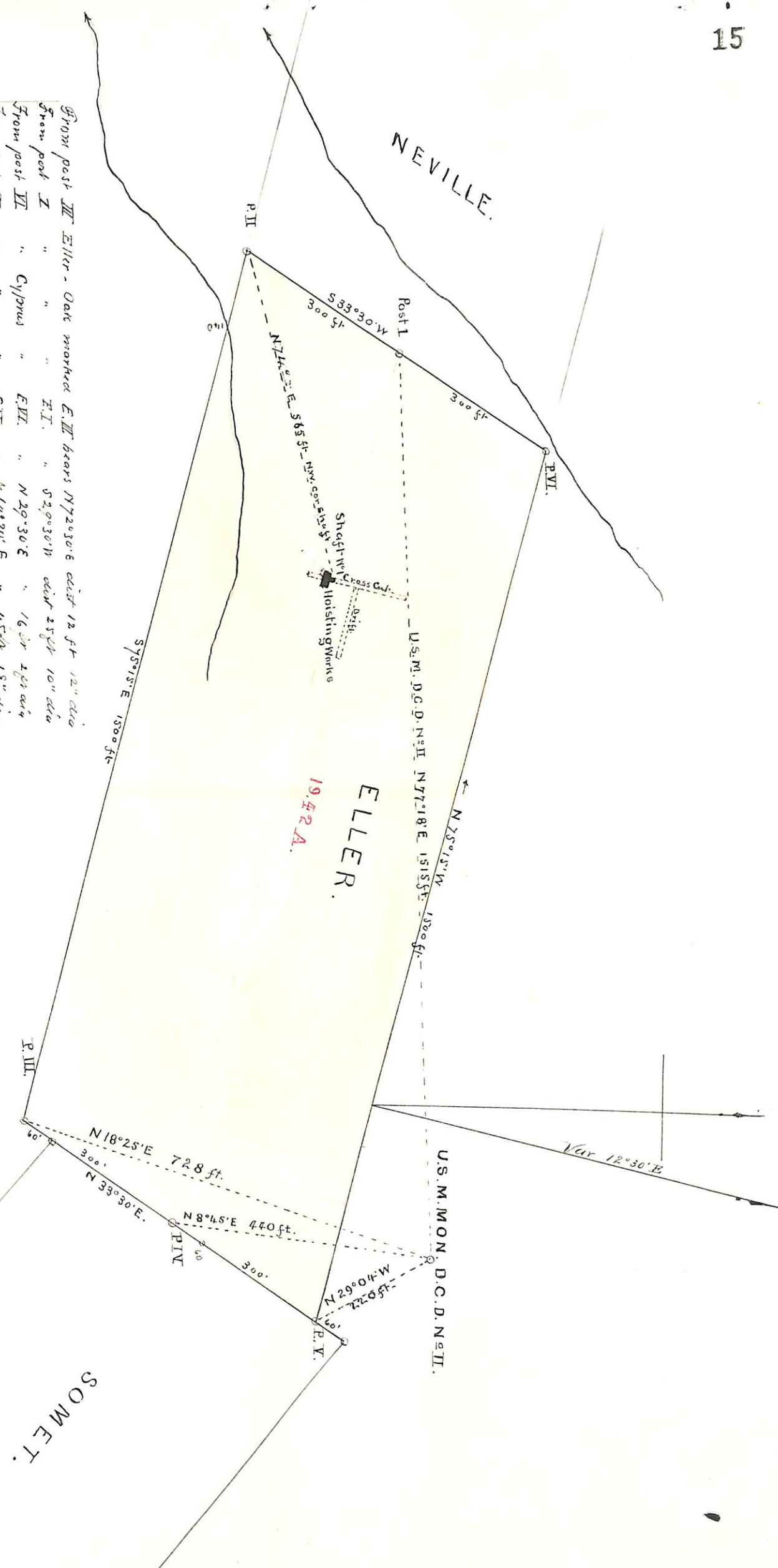

U. S. Surveyor General's Office.

Tucson, Arizona, June 16th 1883

The foregoing field notes of the survey of the "Coller"

Mining Claim situate in

the Pos Lobezas Mining District, Cochise

County, Arizona, claimed by Selden J. Wright &

H. W. Reese

survey executed by Solon M. Allis Deputy

Surveyor, under instructions from this office, having been critically examined and the necessary corrections and alterations made, the said field notes and the survey they describe are hereby approved.

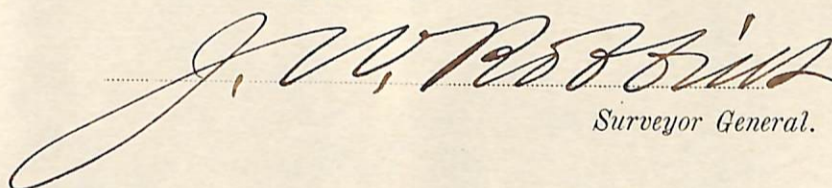

Surveyor General.

UNITED STATES DEPARTMENT OF THE INTERIOR 9605 (956)
BUREAU OF LAND MANAGEMENT M.S. 507
ARIZONA STATE OFFICE

NOTICE OF CANCELLATION OF MINERAL SURVEY

The ELLER (LOT 38) lode, Mineral Survey No. 507, located in section 29, Township 14 South, Range 28 East, Gila and Salt River Meridian, Arizona, is hereby canceled.

This claim has not been filed with the Arizona State Office, Bureau of Land Management, in accordance with Section 314, 90 STAT. 2769, (43 U.S.C. 1744).

This cancellation was necessitated to clear the record.

The Mineral Survey Plat should be noted as follows:

"ELLER (LOT 38) lode, M.S. 507, was canceled January 25, 2016, by memo 9605 (956) M.S. 507, which is now a part of the original field notes."

January 25, 2016
Date

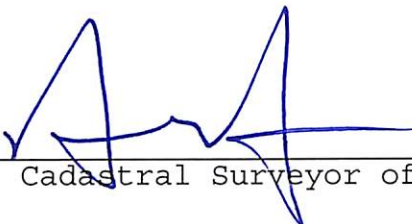

Chief Cadastral Surveyor of Arizona