

M  
S  
-

0

0

7

0

0



# POOR QUALITY

The following pages are scanned at the best possible quality setting. The original pages are of poor quality and this is the best possible reproduction.



LOTS NO. *U.R. A. & B.*SURVEYS NO. *700 & 701.*

## Field Notes

of the survey of the

*Paymaster**mining and mill-site Claims*Situate in *Patagonia* Mining districtCounty of *Pima* and in Sec. *1*, Twp *23 S*Range *16 E*, of the Gila and Salt River Meridian.

ARIZONA.

Claimed by *R. R. Richardson*Surveys executed by *G. J. Roskrug* D. S.Under instructions dated *July 31<sup>st</sup>* 1885Surveys commenced *August 11<sup>th</sup>* 1885Surveys completed *5<sup>th</sup>* 1885



# PRELIMINARY OATHS,

FOR SURVEYS OF MINING CLAIMS AND MILL-SITES.

*W. William F. Kitt*

do solemnly swear that I will faithfully execute the duties of Chain Carriers; that I will level the chain upon uneven ground, and plumb the tally pins, whether by sticking or dropping the same; that I will report the true distance to all notable objects, and the true length of all lines that I assist in measuring, to the best of our skill and ability.

*William F. Kitt*

SWORN to and subscribed before me, this 3<sup>rd</sup> day of August 1885

*George Roskrug*  
a notary public in and for  
Terra Co. A. T.

I, .....

do solemnly swear that I will well and truly perform the duties of .....  
..... according to instructions given me,  
to the best of my skill and ability.

SWORN to and subscribed before, me this..... day  
of ..... 188.....



Field Notes

of the Survey of the  
Paymaster Mining Claim  
in the "Patagonia" Mining  
District, Pima Co Arizona  
Claimed by R.R. Richardson.

Surveyed by  
George J. Roskrue  
U. S. Deputy Min. Surv.  
Under instructions from the  
Surveyor General, of date  
31<sup>st</sup> July 1885.

Survey commenced 4<sup>th</sup> Aug 1885  
" completed 4<sup>th</sup> Aug 1885



Feet

Description of Survey.

Beginning at the Initial mon. mentioned in location notice and marking the North West corner of claim, where I set a post 4 feet long 4 x 4 inches, 1 1/2 feet in the ground, and surrounded same with mound of stones - Post marked P. M. C. S. M. No 1.

Oak tree 15 ins dia, and marked P. M. C. S. M. No 1 bears S 69° W 19 feet

Oak tree 6 ins dia, and marked P. M. C. S. M. No 1 bears N 62 1/2° W 46 ft.

Oak tree 6 ins dia, and marked P. M. C. S. M. No 1 bears N 38° W 76 ft.

Oak tree 6 ins dia and marked P. M. C. S. M. No 1 bears N 50° E 72 ft

Thence S 64° 44' E  
Var 12° 35' East.

Line runs down side hill over granite boulders.

200 To location monument, where I set a post 4 x 4 ins 4 ft long 1 1/2 ft in ground and surrounded same with mound of stones - Post marked P. M. C. No 11.

Oak tree 20 ins dia and marked P. M. C. No 11 bears S 78° W 54 ft.

Oak tree 8 ins dia and marked P. M. C. No 11 bears S 83° W 97 ft.

Oak tree 12 ins dia and marked P. M. C. No 11 bears N 38° W 61 ft.

Oak tree 12 ins dia and marked P. M. C. No 11 bears N 4 3/4° E 83 ft.

Post in mound of stones, for the S.W. cor of the Guajolote Mining Claim Lot No 37 and marked G. No 11 bears S 64° 44' E 10 ft distant.

Thence S 64° 44' E (same course)  
Var 12° 35' East

000 Leave side hill at cor and enter



Feet  
300

Guajolote Flat -  
To a monument on the ledge  
marking northerly end center of  
claim, where I set a post 4x4  
ins 4 ft long, 1½ ft in ground  
and surrounded same with  
mound of stones. Post marked  
P. M. C. N. Ct. ~~1~~  
Oak tree 24 ins dia and marked P. M. C.  
N. Ct. B. J. bears S. 37° E 14 ft  
Oak tree 18 ins dia and marked P. M. C.  
N. Ct. B. J. bears S. 66° E 45 feet -  
Oak tree 12 ins dia and marked P. M. C.  
N. Ct. B. J. bears N 82° E 72 feet -  
Oak tree 18 ins dia and marked P. M.  
C. N. Ct. B. J. bears N. 73° E 46 feet -  
Thence S 64° 44' E (same course)  
Var 12° 35' East

5105 Post set in mound of stone  
for the S. E. cor of the Guajolote  
mining claim, <sup>Lot 37</sup> post marked  
G. N. IV.

600 To location mon, where I set a  
post 4x4 ins 4 ft long 1½ ft in  
ground and surrounded same  
with mound of stone, post  
marked P. M. C. N. Ct. III.

Post N. Ct. III of the Paymaster mill  
site claim bears N 85° 35' E 11,963  
ft distant -

N. Ct. II. S. M. M. Patagonia mining Dist:  
bears S 73° 39' E 1913 feet -

Oak 24 ins dia and marked P. M. C.  
N. Ct. III. B. J. bears N 71° W, 31 ft -

Oak 12 ins dia and marked P. M. C.  
N. Ct. III. B. J. bears N 46° E 67 ft -

Oak 10 ins dia and marked P. M. C.  
N. Ct. III. B. J. bears N 52½° E 71 ft -

Oak 15 ins dia and marked P. M. C.  
N. Ct. III. B. J. bears S 23½° E 51 ft -



Feet Thence S  $25^{\circ} 16' W$   
 Var  $12^{\circ} 35'$  East

1500 To location monument where  
 I set a post  $4 \times 4$  ins  $4$  ft long  
 $1\frac{1}{2}$  ft in ground and surrounded  
 same with mound of stone -  
 Post marked P. M. C. No. 14.  
 Oak Tree 20 ins. dia. and marked P. M. C.  
 No. 14 B. J. bears N  $50\frac{1}{2}^{\circ} W$  18 feet -  
 Oak Tree 10 ins. dia. and marked P. M. C.  
 No. 14. B. J. bears N  $48^{\circ} E$  21 feet -  
 Oak Tree 8 ins. dia. and marked P. M. C.  
 No. 14. B. J. bears S  $75^{\circ} E$  30 feet -  
 Oak Tree 15 ins. dia. and marked P. M. C.  
 No. 14. B. J. bears S  $36\frac{1}{2}^{\circ} W$  33 feet.

Thence N  $64^{\circ} 44' W$   
 Var  $12^{\circ} 35'$  East

300 To a monument on the ledge  
 marking the Southernly end  
 center of claim, where I set a  
 a post  $4 \times 4$  ins  $4$  ft long  $1\frac{1}{2}$  ft  
 in ground and surrounded  
 same with mound of stone.  
 Post marked P. M. C. S. C.  
 Oak Tree 15 ins. dia. and marked P. M. C.  
 S. C. B. J. bears N  $60^{\circ} W$  4 feet -  
 Oak Tree 6 ins. dia. and marked P. M. C.  
 S. C. B. J. bears S  $27^{\circ} W$  42 feet -  
 Oak Tree 10 ins. dia. and marked P. M. C.  
 S. C. B. J. bears S.  $60^{\circ} W$  35 feet -  
 Oak Tree 10 ins. dia. and marked P.  
 M. C. S. C. B. J. bears N  $26\frac{1}{2}^{\circ} E$  20 feet -

Thence N  $64^{\circ} 44' W$  (same course)  
 Var  $12^{\circ} 35'$  East

600 To location monument where  
 I set a post  $4 \times 4$  ins  $4$  ft long  
 $1\frac{1}{2}$  ft in ground and surrounded  
 same with mound of stone.  
 Post marked P. M. C. No. 15.  
 Oak Tree 12 ins. dia. and marked P. M. C.  
 No. 15. B. J. bears N  $58\frac{1}{2}^{\circ} W$  19 feet -  
 Oak Tree 12 ins. dia. and marked P. M. C.  
 No. 15. B. J. bears N  $58\frac{1}{2}^{\circ} W$  29 feet -



- Feet- Oak tree 10 ins. dia, and marked P.M. @  
N.V. B. J. bears N 34° W 38 feet -
- Oak tree 6 ins. dia, and marked P.M.  
C. N.V. B. J. bears N 6 1/2° W 90 feet.
- Thence N 25° 16' E
- Var 12° 35' East
- 1100 Line runs along East slope of  
rocky granite hill -
- 1500 To monument and post P.M.C.  
S. M. N. 1. place of beginning.

Area

Total area of Claim 20 <sup>66</sup>/<sub>100</sub> acres.

Location

This claim is located in the  
Patagonia mountains, Pima  
County A. T. in what is  
known as the Guajolote  
Flat, it is the 1<sup>st</sup> Extension  
South of the "Guajolote"  
mining claim, and lies  
about 14,000 feet West from  
the Old mowry Smelting  
Works, a place well known  
in Southern Arizona -  
Land Unsurveyed.

Improvements

made upon this claim by  
claimants or grantors consist  
of a shaft 4' x 6' 18 ft deep, S 25°  
16' W 42 ft from Post P.M. C. N. E.  
a shaft 4' x 6' 10 ft deep S 25° 16' W 145  
ft from post P.M. C. N. E.  
a shaft 4' x 6' 13 ft deep S 25° 16' W  
283 ft from post P.M. C. N. E.  
a cut 12' x 4' x 3' ft deep S 25° 16' W 314  
ft from post P.M. C. N. E.  
a shaft 6' x 6' x 3 ft deep S 25° 16' W 350  
ft from post P.M. C. N. E.  
a shaft 7' x 6' 20' 4 ft deep S 25° 16' W 395  
ft from post P.M. C. N. E.



a shaft 6x6x12 ft deep S 25° 16' W 1300  
ft from post P. M. C. N. E.

and I hereby certify that  
the value of said improvements  
exceeds the sum of five hundred  
dollars -

There have been no improvements  
made by other parties on this  
claim -

Instruments used, a Young  
and Sons Transit, and a  
steel tape -

Var and courses taken  
by observation on Polaris -

George Proskrug

U.S. Deputy mine Sur<sup>?</sup>

Judson A. J.

Sept 1<sup>st</sup> 1885



AFFIDAVIT OF FIVE HUNDRED DOLLARS IMPROVEMENTS.

*Me*, William F. Kitt

of lawful age, being first duly sworn according to law, depose and say that <sup>I am</sup> ~~we are~~ acquainted with the

Paymaster mining claim, situate in Patagonia Mining District, Pima County, Arizona Territory, for which RR Richardson

has made application for survey prior to application for patent under the provisions of the Act of Congress approved May 10, 1872, and that the labor done and improvements made thereon by the applicant and ~~his~~ grantor ~~s~~ exceed Five Hundred Dollars in value, and further that <sup>I am</sup> ~~we are~~ not personally interested in said mine.

William F. Kitt

TERRITORY OF ARIZONA,

County of Pima } SS.

SWORN AND SUBSCRIBED before me, this 8<sup>th</sup>

day of August 1885.

George J. Roskruse

Notary Public in and for Pima County, A.T.



AFFIDAVIT OF FIVE HUNDRED DOLLARS IMPROVEMENTS.

*W. F. A. Lamont*

of lawful age, being first duly sworn according to law, depose and say that <sup>I am</sup> ~~we are~~ acquainted with the

*Paymaster* mining claim, situate in *Patagonia*  
*Mountains* Mining District, *Pima* County, Arizona  
Territory, for which *R. Richardson*

has made application for survey prior to application for patent under the provisions of the Act of  
Congress approved May 10, 1872, and that the labor done and improvements made thereon by the appli-  
cant and <sup>I am</sup> ~~we are~~ his grantor exceed Five Hundred Dollars in value, and further that ~~we are~~ not per-  
sonally interested in said mine.

*F. A. Lamont*

TERRITORY OF ARIZONA,

County of *Pima* } SS.

SWORN AND SUBSCRIBED before me, this *19<sup>th</sup>*

day of *Sept* 188*5*.

*A. Balchman*

*Justice of the Peace*  
*Precinct no 15*



TERRITORY OF ARIZONA,

County of Pima.

} ss.

I, *A. B. STAMPSON*, County Recorder in and for the County of Pima, do hereby

certify that the above and foregoing is a full true and correct copy of the *Donation*

Notice of the *Claim*

as appears of Record now in my Office in Book *B Grants of Mines* Page *598*.

IN WITNESS WHEREOF, I have hereunto set my hand and

affixed my official seal, at my office in Tucson this *24*

day of *July* A. D. 188*5*.

*A B Stampson*

County Recorder.





(Paymaster Claim.)

Mining Notice. - Under and by virtue of the mining laws of the United States of America, we the undersigned do locate and claim fifteen hundred feet of this vein or lode of gold and silver bearing rock, and three hundred feet on each side thereof, said claim being known as the Paymaster claim, situate in the County of Pima, Territory of Arizona, and more particularly described as follows, to-wit: Commencing at this monument of stone, and running thence two hundred feet in an easterly direction to a monument of stone; thence in same direction four (4) hundred feet to another monument of stone, thence running in a Southerly direction fifteen hundred feet to a stone monument, thence running in a westerly direction six hundred feet to a monument of stone, thence fifteen hundred feet in a northerly direction to place of beginning. Said claim being the first Southern Extension on the "Gualota" claim in Patagonia Mountains in said County and Territory. This March 13<sup>th</sup> 1877.

Charles Conwell

Charles A. Paige

A. Linn Locators

Filed and recorded at request of B. Goodrich April 24, 1877 at  
12 o'clock M.

J. W. Carpenter, County Recorder  
By J. A. Apperson, Deputy







Field Notes

of the Survey of the  
Paymaster  
mill site claim  
in the Patagonia Mining  
District, Pima Co. Arizona.

Claimed by—

R. R. Richardson.

in connection with the  
"Paymaster" Mining Claim

Surveyed by George Prokrug

U. S. Deputy Min<sup>g</sup> Sur<sup>r</sup>

Under instructions from the  
 Surveyor General, of date  
31<sup>st</sup> July 1885.

Survey commenced 5<sup>th</sup> Aug. 1885  
 ' completed 5<sup>th</sup> Aug. 1885



## Description of Survey

Feet Beginning at the Initial mon.  
mentioned in location notice  
and marking the easterly  
corner of claim, where I set  
a post 4 x 4 ins 4 ft long  
1 1/2 ft in ground, and surrounded  
same with mound of stones.  
Post marked P. M. S. J. M. n<sup>o</sup> 1  
oak tree 18 ins, dia, and marked P. M.  
S. J. M. n<sup>o</sup> 1. B. J. bears N 7° E 80 feet.  
oak tree 4 ins, dia, and marked P. M. S. J.  
M. n<sup>o</sup> 1. B. J. bears N 7° W. 54 feet.  
oak tree 15 ins, dia, and marked P. M. S.  
J. M. n<sup>o</sup> 1. B. J. bears S 85° W. 118 feet.  
oak tree 6 ins, dia, and marked P. M. S.  
J. M. n<sup>o</sup> 1. B. J. bears S 25 1/2° E 50 feet.  
Spring of Water bears S 71° W. 119 feet.  
House bears S 83 1/2° W. - 220 feet -

Thence S 31° 45' W

Var 12° 35' East

40 Wire fence bears S 6° W. W.  
45 To center of gulch bears N. W. & S. E.  
144 To road bears N. W. and S. E.  
300 To center of gulch bears N. W. & S. E.  
330 To location monument where I set  
a post 4 x 4 ins. 4 ft long 1 1/2 ft  
in ground and surrounded  
same with mound of stones.  
Post marked P. M. S. n<sup>o</sup> 11.  
oak tree 8 ins, dia, and marked P. M. S.  
n<sup>o</sup> 11. B. J. bears N 21° W. 48 feet  
oak tree 20 ins, dia, and marked  
P. M. S. n<sup>o</sup> 11. B. J. bears N 14 1/2° W 90 ft.  
oak tree 15 ins, dia, and marked  
P. M. S. n<sup>o</sup> 11. B. J. bears S 51° E 70 feet.

Thence N 45° 30' W

Var 12° 35' East

360 To center of Mowrey Gulch bears  
N and S.  
580 To location monument where I set  
a post 4 x 4 ins 4 ft long 1 1/2 ft in



Feet ground and surrounded same with mound of stones -  
 Post marked P. M. S. n<sup>o</sup> III.  
 Post marked P. M. E. n<sup>o</sup> III. (also n. e. cor.) of the Paymaster Mining <sup>lot 42. A.</sup>  
 claim, <sup>lot 42. A.</sup> bears S 85° 36' W 11,963 feet.  
 U. S. M. M. n<sup>o</sup> 11, Patagonia Mining District bears S 81° 47' W 10,197 feet.  
 No other bearings available -  
 Thence N 31° 45' E.

290 road from Lanoria to Harshaw bears N W 1/2 S E.  
 330 To location monument where I set a post 4 x 4 ins 4 ft long 1 1/2 ft in ground and surrounded same with mound of stones.  
 Post marked P. M. S. n<sup>o</sup> IV.  
 Oak tree 4 ins. dia. and marked P. M. S. n<sup>o</sup> IV. B. J. bears N 48° E. 58 feet.  
 Post marked W. E. E. M. S. n<sup>o</sup> III. being the S. E. cor of the Western Extension Enterprise Mill Site Claim Lot n<sup>o</sup> 38 B. bears N 70° E 618 feet.  
 No other bearings available -  
 Thence S 45° 30' E

Var 12° 35' East -  
 106 To center of Mowry Gulch bears N and S.  
 493 To cor of fence (of wire) bears N. E. and S. E.  
 580 To monument and post P. M. S. J. M. n<sup>o</sup> 1. place of beginning -

#### Area

Total area of Claim 4.27 acres.

#### Location

This claim is located in the Patagonia mountains, Pima Co. A. T. about 1200 feet S. W. from the old Mowry Smelter and on the road from Harshaw to Lanoria - on unsurveyed land -



## Improvements

Upon this claim consist of an Adobe House 14 x 21 feet, some wire fencing enclosing pasture and water troughs at spring for use of cattle.

Improvements ~~not~~ are not made by claimant.

Instruments used, a Young and Sons Transit and steel tape.

Run and courses taken by observation on Polaris.

George J. Roskrue

U. S. Deputy Minr. Sur<sup>g</sup>

Tucson Sept<sup>r</sup> 1885 -  
Arizona.



Improvements



# NON-MINERAL AFFIDAVIT.

TERRITORY OF ARIZONA, )

County of Pima ) ss.

James Aubrey <sup>and</sup> of said County and Territory, being first duly sworn, ~~each~~ for himself ~~and not one for the other~~, deposes and says that he is well acquainted with the land of the Paymaster mill-site claim situated in the Patagonia mountains

Gila and Salt River Meridian, in the County of Pima and Territory of Arizona, claimed by R. R. Richardson applicant for United States patent therefor; that he is well acquainted with the character of said described

land included within the boundary lines as officially surveyed by G. Roskrug United States Deputy Surveyor, having frequently passed over the same; that his knowledge of such land is such as to enable him to testify understandingly with regard thereto; that there is not to his knowledge within the limits thereof any vein or lode of quartz or other rock in place bearing gold, silver, cinnabar, lead, tin or copper or any deposit of coal; that there is not within the limits of said land, within his knowledge, any placer, cement, gravel or other valuable mineral deposits; that no portion of said land is claimed under the local customs or rules of miners or otherwise; that no portion of said land is worked for minerals during any part of the year by any person or persons; that said land is essentially non-mineral land, and that there is within the boundaries of said claim improvements, to-wit: one adobe house 14 x 21, some wire fencing enclosing pasture and water troughs at spring for use of cattle and that he has no interest whatever in said described mill-site claim.

James Aubrey

SUBSCRIBED AND SWORN to before me this 19<sup>th</sup> day of

October A. D. 1885; and I hereby certify that the foregoing affidavit was read to the said James Aubrey and

he previous to their <sup>names</sup> being subscribed thereto, and

that deponents are reputable persons to whose affidavits full faith and credit should be given.

A. Baldwin  
Justice of the Peace



# NON-MINERAL AFFIDAVIT.

TERRITORY OF ARIZONA, )  
County of Pima ) ss.

F. A. Lamont ~~and~~ of said County and Territory, being first duly sworn, ~~each~~ for himself ~~and not one for the other~~, deposes and says that he is well acquainted with the land of the Paymaster mill-site claim situated in the Patagonia mountains Gila and Salt River Meridian, in the County of Pima and Territory of Arizona, claimed by R. R. Richardson applicant for United States patent therefor; that he is well acquainted with the character of said described land included within the boundary lines as officially surveyed by Geo. Groskrup United States Deputy Surveyor, having frequently passed over the same; that his knowledge of such land is such as to enable him to testify understandingly with regard thereto; that there is not to his knowledge within the limits thereof any vein or lode of quartz or other rock in place bearing gold, silver, cinnabar, lead, tin or copper or any deposit of coal; that there is not within the limits of said land, within his knowledge, any placer, cement, gravel or other valuable mineral deposits; that no portion of said land is claimed under the local customs or rules of miners or otherwise; that no portion of said land is worked for minerals during any part of the year by any person or persons; that said land is essentially non-mineral land, and that there is within the boundaries of said claim improvements, to-wit: One adobe House <sup>14x21 feet</sup> some wire fencing enclosing pasture and water troughs at Spring for use of cattle. and that he has no interest whatever in said described mill-site claim.

F. A. Lamont

SUBSCRIBED AND SWORN to before me this 19<sup>th</sup> day of Sept A. D. 1885; and I hereby certify that the foregoing affidavit was read to the said F. A. Lamont ~~and~~

previous to their names being subscribed thereto, and that deponent <sup>is a</sup> ~~an~~ reputable person; to whose affidavit full faith and credit should be given.

A. Baldwin  
Justice of the Peace  
District No 15-



Location of Millsite.

Under and by virtue of the laws of the U. S. A. we the undersigned do locate and claim five acres of land, together with all the water and timber thereon for a millsite for the purpose of working the Paymaster mine. This millsite is situated in the Patagonia Mountains in Pima County A. T. about four hundred yards from the Cowry works in a westerly direction and about three miles Easterly of the Paymaster Mine and further described to wit: Commencing at this monument of stone (situated about sixty yards Easterly of a flowing spring of water) thence running in a South westerly direction twenty rods to a monument of stone, thence running North westerly forty rods to a monument of stone, thence North Easterly twenty rods to a monument of stones, thence South Easterly forty rods to place of beginning.

April 2<sup>d</sup> 1877.

A. Linn

C. A. Paige

Charles Conwell

Filed and recorded at request of C. A. Paige  
June 22. 1877 at 25 min. past 10 o'clock A. M.

S. W. Carpenter, County Recorder,

By J. A. Apperson, Deputy



TERRITORY OF ARIZONA, }  
County of Pima. } ss.

I, A. B. SAMPSON, County Recorder in and for the County of Pima, do hereby certify that the above and foregoing is a full true and correct copy of the Location Notice of the Paymaster Millsite.

as appears of Record now in my Office in Book 1 Land Claims Pages 419 + 420

IN WITNESS WHEREOF, I have hereunto set my hand and affixed my official seal, at my office in Tucson this 24<sup>th</sup> day of July A. D. 1885.

A. B. Sampson  
County Recorder.



[Faded, illegible text and markings on the reverse side of the document, including a vertical line and circular punch holes.]







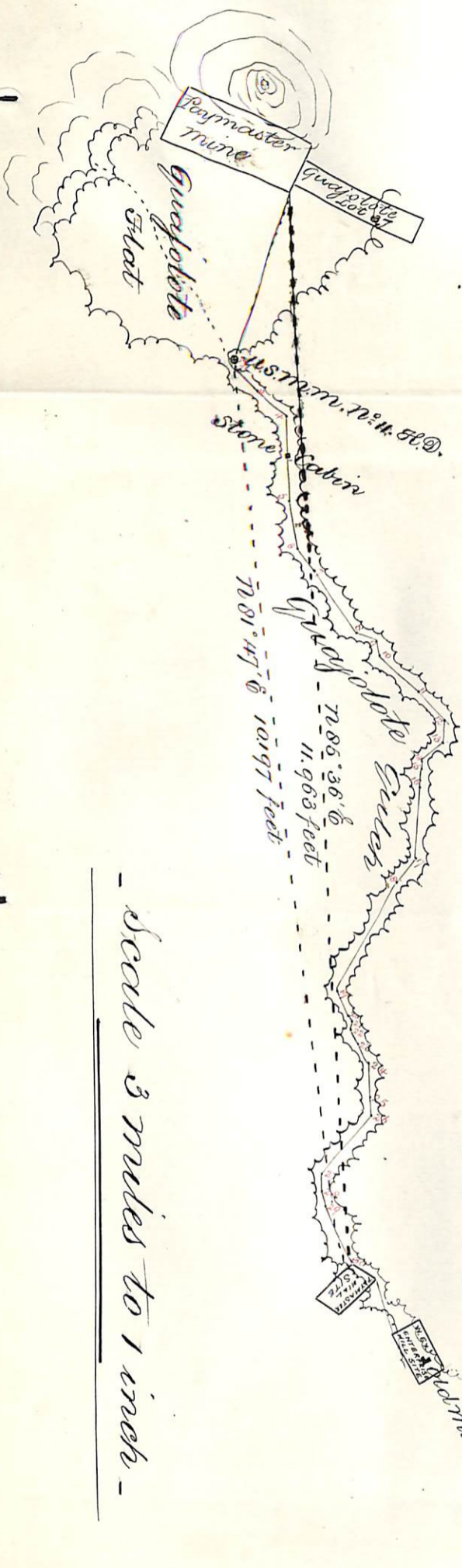

Sketch  
showing  
Traverse and direct lines  
connecting  
"Paymaster" mine with mill site.

Patagonia Mining District  
Pima County, Arizona.

Surveyed by  
George H. Shookridge  
U.S. Dep't of Sur.  
August 6<sup>th</sup> 1885.

Var 12° 35' East

Commencing at Post No. 111 of the Paymaster  
mine and run thence

573° 39' E 1913 ft to U.S.M.M. No. 11 District

Thence N 79° E	70 ft	to a point.	2
" N 48° E	355 "	" " "	3
" N 37° 15' E	430 "	" " "	4
" N 87° E	940 "	" " "	5
" N 80° E	540 "	" " "	6
" N 55° E	300 "	" " "	7
" N 56° E	860 "	" " "	8
" N 20° E	260 "	" " "	9
" N 76° 30' E	180 "	" " "	10
" N 37° 30' E	590 "	" " "	11
" N 43° E	452 "	" " "	12
" S 82° E	255 "	" " "	13
" S 42° E	325 "	" " "	14
" N 82° E	82 "	" " "	15
" S 83° 30' E	200 "	" " "	16
" S 88° 30' E	800 "	" " "	17
" S 47° 30' E	380 "	" " "	18
" S 62° E	1400 "	" " "	19
" N 66° E	300 "	" " "	20
" N 52° E	70 "	" " "	21
" S 79° E	89 "	" " "	22
" N 66° 30' E	190 "	" " "	23
" N 56° E	258 "	" " "	24
" N 85° E	380 "	" " "	25
" N 83° E	200 "	" " "	26
" S 50° E	860 "	" " "	27
" N 88° E	205 "	" " "	28
" N 76° E	183 "	" " "	29
" N 66° 15' E	710 "	" " "	30 the post

111 of the "Paymaster" mill site claim.

Scale 3 miles to 1 inch



FINAL OATHS FOR SURVEYS OF MINING CLAIMS AND MILL SITES.

A LIST of names of individuals employed to assist in running, measuring, or marking the lines and corners described in the foregoing field-notes of the survey of the Paymaster mining claim and Paymaster mill site located in Patagonia Mining district Pima County, Arizona, showing the respective capacities in which they acted.

William F. Kitt Chainman
Chainman
Axeman.
Flagman.

I hereby certify that I assisted George Roskrug U. S. Deputy Surveyor, in surveying the Paymaster mining claim and Paymaster mill site claimed by R. R. Richardson located in Patagonia Mining District Pima County, Arizona, and that said survey has been in all respects, to the best of our knowledge and belief, well and faithfully executed, and the boundary monuments planted according to the instructions furnished by the Surveyor General.

William F. Kitt Chainman.
Chainman.
Axeman.
Flagman.

SWORN TO AND SUBSCRIBED before me this 1st day of September 1885

George Roskrug
notary public in and
for Pima Co. A. T.

I, George Roskrug U. S. Deputy Surveyor, do solemnly swear that, in pursuance of instructions from the U. S. Surveyor-General for Arizona, bearing date the 31st day of July 1885, I have well, faithfully and truly, in my own proper person, and in strict conformity with the instructions furnished by the Surveyor-General and the laws of the United States, surveyed all those portions of the Paymaster mining claim and the Paymaster mill site claimed by R. R. Richardson located in Patagonia Mining District, Pima County, Arizona, as are represented in the foregoing field-notes as having been surveyed under my directions; and I do further solemnly swear that all the corners of said surveys have been established and perpetuated in strict accordance with the instructions furnished me, and that the foregoing are the true and original field-notes of such surveys,

George Roskrug Deputy Surveyor.

SWORN TO AND SUBSCRIBED before me this 4th day of September 1885

John Gardiner
notary public in and for
Pima County. A. T.



U. S. Surveyor General's Office.

Tucson, Arizona, November 2<sup>nd</sup> 1885.

The foregoing field notes of the survey of the Paymaster  
 Mining & millsite claims situate in  
 the Patagonia Mining District, Pima  
 County, Arizona, claimed by R. R. Richardson

survey executed by George J. Rosteruge Deputy  
 Surveyor, under instructions from this office, having been critically examined  
 and the necessary corrections and alterations made, the said field notes and  
 the survey they describe are hereby approved.

Royal A. Johnson  
 Surveyor General.